



US010500001B2

(12) **United States Patent**
Yu et al.

(10) **Patent No.:** **US 10,500,001 B2**
(45) **Date of Patent:** ***Dec. 10, 2019**

(54) **SURGICAL ROBOTICS SYSTEM**

(71) Applicant: **Auris Health, Inc.**, Redwood City, CA (US)

(72) Inventors: **Alan Yu**, Union City, CA (US); **Frederic H. Moll**, San Francisco, CA (US); **Benjamin Richter**, San Leandro, CA (US); **Mark H. Olson**, San Carlos, CA (US); **Jason Gonzalez**, San Francisco, CA (US); **Kyle Andrew Tucker**, San Francisco, CA (US); **Paxton Maeder-York**, San Francisco, CA (US); **Gregory T. Schulte**, Oakland, CA (US)

(73) Assignee: **Auris Health, Inc.**, Redwood City, CA (US)

(*) Notice: Subject to any disclaimer, the term of this patent is extended or adjusted under 35 U.S.C. 154(b) by 260 days.

This patent is subject to a terminal disclaimer.

(21) Appl. No.: **15/453,798**

(22) Filed: **Mar. 8, 2017**

(65) **Prior Publication Data**

US 2017/0172673 A1 Jun. 22, 2017

Related U.S. Application Data

(63) Continuation of application No. 15/154,762, filed on May 13, 2016, now Pat. No. 9,622,827.
(Continued)

(51) **Int. Cl.**
A61B 34/30 (2016.01)
A61B 34/35 (2016.01)
(Continued)

(52) **U.S. Cl.**

CPC **A61B 34/30** (2016.02); **A61B 1/00149** (2013.01); **A61B 34/35** (2016.02);
(Continued)

(58) **Field of Classification Search**

CPC **A61B 34/30**; **A61B 34/35**; **A61B 34/70**; **A61B 2034/301**; **A61B 2034/302**;
(Continued)

(56) **References Cited**

U.S. PATENT DOCUMENTS

4,878,494 A 11/1989 Phillips et al.
5,013,018 A 5/1991 Sicek
(Continued)

FOREIGN PATENT DOCUMENTS

JP 2012-005557 1/2012
KR 101448201 10/2014
(Continued)

OTHER PUBLICATIONS

PCT Invitation to Pay Additional Fees, PCT Application No. PCT/US16/32505, dated Jul. 19, 2016, 2 pp.
(Continued)

Primary Examiner — Tuan V Nguyen

(74) *Attorney, Agent, or Firm* — Knobbe, Martens Olson & Bear LLP

(57) **ABSTRACT**

A surgical robotics system with robotic arms is configurable to perform a variety of surgical procedures. The surgical robotics system includes a table, column, base, and robotic arms that are either column-mounted, rail-mounted, or mounted on a separate unit. In a column-mounted configuration, the column includes column rings that translate vertically and rotate about the column. The robotic arms are attached to the column rings. In a rail-mounted configuration, the base includes base rails that translate along the base. The robotic arms are attached to the base rails. In both
(Continued)

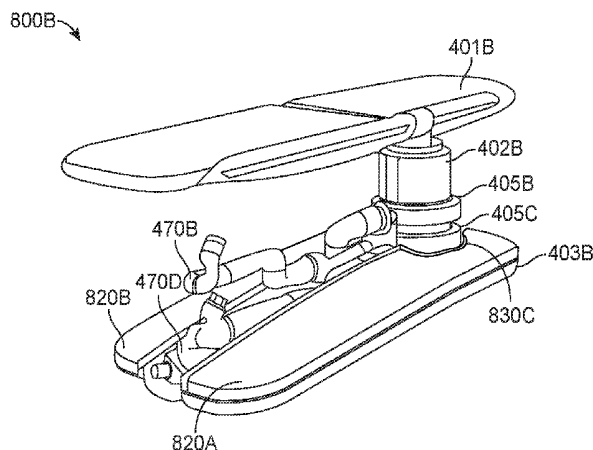

configurations, the robotic arms move independently from each other and include a multiple arm segments. Each arm segment provides an additional degree of freedom to the robotic arm. Thus, the surgical robotics system may position the robotic arms into numerous configurations to access different parts of a patient's body.

30 Claims, 30 Drawing Sheets

Related U.S. Application Data

- (60) Provisional application No. 62/162,486, filed on May 15, 2015, provisional application No. 62/162,467, filed on May 15, 2015, provisional application No. 62/193,604, filed on Jul. 17, 2015, provisional application No. 62/201,518, filed on Aug. 5, 2015, provisional application No. 62/203,530, filed on Aug. 11, 2015, provisional application No. 62/235,394, filed on Sep. 30, 2015.

(51) **Int. Cl.**

A61B 34/00 (2016.01)
A61G 7/005 (2006.01)
A61G 7/008 (2006.01)
A61G 7/015 (2006.01)
A61G 7/075 (2006.01)
A61G 13/02 (2006.01)
A61B 1/00 (2006.01)
A61G 13/04 (2006.01)
A61G 13/06 (2006.01)
A61G 13/08 (2006.01)
A61G 13/10 (2006.01)
A61G 13/12 (2006.01)

(52) **U.S. Cl.**

CPC *A61B 34/70* (2016.02); *A61G 7/005* (2013.01); *A61G 7/008* (2013.01); *A61G 7/015* (2013.01); *A61G 7/0755* (2013.01); *A61G 13/02* (2013.01); *A61G 13/04* (2013.01); *A61G 13/06* (2013.01); *A61G 13/08* (2013.01); *A61G 13/102* (2013.01); *A61G 13/1245* (2013.01); *A61B 2034/301* (2016.02); *A61B 2034/302* (2016.02); *Y10S 901/02* (2013.01); *Y10S 901/27* (2013.01); *Y10S 901/28* (2013.01)

(58) **Field of Classification Search**

CPC *A61B 2034/303*; *A61B 2034/304*; *A61B 2034/305*; *A61B 2034/306*
 See application file for complete search history.

(56) **References Cited**

U.S. PATENT DOCUMENTS

5,160,106 A 11/1992 Monick
 5,555,897 A 9/1996 Lathrop, Jr. et al.
 5,571,072 A 11/1996 Kronner
 5,762,458 A 6/1998 Wang et al.
 5,814,038 A 9/1998 Jensen et al.
 5,926,875 A 7/1999 Okamoto et al.
 5,944,476 A 8/1999 Bacchi et al.
 6,170,102 B1 1/2001 Kreuzer
 6,202,230 B1 3/2001 Borders
 6,620,174 B2 9/2003 Jensen et al.
 6,676,669 B2 1/2004 Charles et al.
 6,804,581 B2 10/2004 Wang
 7,025,761 B2 4/2006 Wang et al.
 7,074,179 B2 7/2006 Wang et al.

7,607,440 B2 10/2009 Coste-Maniere et al.
 7,695,481 B2 4/2010 Wang et al.
 7,763,015 B2 7/2010 Cooper et al.
 7,789,874 B2 9/2010 Yu et al.
 7,850,642 B2 12/2010 Moll et al.
 7,963,288 B2 6/2011 Rosenberg et al.
 7,972,298 B2 7/2011 Wallace et al.
 7,974,681 B2 7/2011 Wallace et al.
 7,976,539 B2 7/2011 Hlavka et al.
 7,979,157 B2 7/2011 Anvari
 7,996,110 B2 8/2011 Lipow et al.
 8,005,537 B2 8/2011 Hlavka et al.
 8,021,326 B2 9/2011 Moll et al.
 8,052,636 B2 11/2011 Moll et al.
 8,108,069 B2 1/2012 Stahler et al.
 8,142,420 B2 3/2012 Schena
 8,146,874 B2 4/2012 Yu
 8,172,747 B2 5/2012 Wallace et al.
 8,190,238 B2 5/2012 Moll et al.
 8,230,863 B2 7/2012 Ravikumar et al.
 8,257,303 B2 9/2012 Moll et al.
 8,311,626 B2 11/2012 Hlavka et al.
 8,343,096 B2 1/2013 Kirschenman et al.
 8,348,931 B2 1/2013 Cooper et al.
 8,394,054 B2 3/2013 Wallace et al.
 8,400,094 B2 3/2013 Schena
 8,409,136 B2 4/2013 Wallace et al.
 8,409,172 B2 4/2013 Moll et al.
 8,414,598 B2 4/2013 Brock et al.
 8,425,404 B2 4/2013 Wilson et al.
 8,469,945 B2 6/2013 Schena
 8,498,691 B2 7/2013 Moll et al.
 8,506,556 B2 8/2013 Schena
 8,512,353 B2 8/2013 Rosielle et al.
 8,515,576 B2 8/2013 Lipow et al.
 8,617,102 B2 12/2013 Moll et al.
 8,641,698 B2 2/2014 Sanchez et al.
 8,801,661 B2 8/2014 Moll et al.
 8,911,429 B2 12/2014 Olds et al.
 8,926,603 B2 1/2015 Hlavka et al.
 8,960,622 B2 2/2015 von Pechmann et al.
 8,968,333 B2 3/2015 Yu et al.
 8,974,408 B2 3/2015 Wallace et al.
 9,023,060 B2 5/2015 Cooper et al.
 9,259,281 B2 2/2016 Griffiths et al.
 9,314,306 B2 4/2016 Yu
 9,326,822 B2 5/2016 Lewis et al.
 9,358,076 B2 6/2016 Moll et al.
 9,408,669 B2 8/2016 Kokish et al.
 9,452,018 B2 9/2016 Yu
 9,457,168 B2 10/2016 Moll et al.
 9,504,604 B2 11/2016 Alvarez
 9,554,865 B2 1/2017 Olds et al.
 9,561,083 B2 2/2017 Yu et al.
 9,566,201 B2 2/2017 Yu
 9,615,889 B2 4/2017 Jensen
 9,622,827 B2 4/2017 Yu et al.
 9,629,682 B2 4/2017 Wallace et al.
 9,636,184 B2 5/2017 Lee et al.
 9,713,499 B2 7/2017 Bar et al.
 9,713,509 B2 7/2017 Schuh et al.
 9,727,963 B2 8/2017 Mintz et al.
 9,737,371 B2 8/2017 Romo et al.
 9,737,373 B2 8/2017 Schuh
 9,744,335 B2 8/2017 Jiang
 9,763,741 B2 9/2017 Alvarez et al.
 9,788,910 B2 10/2017 Schuh
 9,795,454 B2 10/2017 Seeber et al.
 9,818,681 B2 11/2017 Machida
 9,820,819 B2 11/2017 Olson
 9,844,412 B2 12/2017 Bogusky et al.
 9,850,924 B2 12/2017 Vogtherr et al.
 9,867,635 B2 1/2018 Alvarez et al.
 9,907,458 B2 3/2018 Schena
 9,918,681 B2 3/2018 Wallace et al.
 9,999,476 B2 6/2018 Griffiths et al.
 10,016,900 B1 7/2018 Meyer et al.
 10,022,192 B1 7/2018 Ummalaneni
 10,136,959 B2 11/2018 Mintz et al.

(56)

References Cited

U.S. PATENT DOCUMENTS

10,145,747	B1	12/2018	Lin et al.	
10,159,532	B1	12/2018	Ummalaneni et al.	
10,231,793	B2	3/2019	Romo	
10,244,926	B2	4/2019	Noonan et al.	
2002/0162926	A1	11/2002	Nguyen	
2002/0165524	A1	11/2002	Sanchez et al.	
2002/0170116	A1	11/2002	Borders	
2003/0191455	A1	10/2003	Sanchez et al.	
2004/0243147	A1	12/2004	Lipow	
2004/0261179	A1	12/2004	Blumenkranz	
2005/0222554	A1 *	10/2005	Wallace	A61B 5/042 606/1
2006/0069383	A1	3/2006	Bogaerts	
2006/0200026	A1	9/2006	Wallace et al.	
2008/0027464	A1	1/2008	Moll et al.	
2008/0039867	A1	2/2008	Feussner	
2008/0082109	A1	4/2008	Moll et al.	
2008/0167750	A1	7/2008	Stahler	
2008/0195081	A1	8/2008	Moll et al.	
2008/0218770	A1	9/2008	Moll et al.	
2009/0036900	A1	2/2009	Moll	
2009/0062602	A1	3/2009	Rosenberg et al.	
2010/0185211	A1	7/2010	Herman	
2010/0204713	A1	8/2010	Ruiz	
2010/0286712	A1	11/2010	Won et al.	
2010/0308195	A1 *	12/2010	Yu	A61B 90/50 248/349.1
2011/0238083	A1	9/2011	Moll et al.	
2011/0270273	A1	11/2011	Moll et al.	
2012/0136372	A1	5/2012	Amat Girbau et al.	
2012/0191079	A1	7/2012	Moll et al.	
2012/0191083	A1	7/2012	Moll et al.	
2012/0191086	A1	7/2012	Moll et al.	
2012/0253332	A1	10/2012	Moll	
2012/0266379	A1	10/2012	Hushek	
2012/0296161	A1	11/2012	Wallace et al.	
2013/0190741	A1	7/2013	Moll et al.	
2013/0255425	A1	10/2013	Schena	
2013/0338679	A1	12/2013	Rosielle et al.	
2014/0142591	A1	5/2014	Alvarez et al.	
2014/0180309	A1	6/2014	Seeber et al.	
2014/0188132	A1	7/2014	Kang	
2014/0249546	A1	9/2014	Shvartsberg et al.	
2014/0309649	A1	10/2014	Alvarez et al.	
2014/0316436	A1	10/2014	Bar et al.	
2014/0357984	A1	12/2014	Wallace et al.	
2014/0364870	A1	12/2014	Alvarez et al.	
2014/0379000	A1	12/2014	Romo et al.	
2015/0038981	A1	2/2015	Kilroy et al.	
2015/0051592	A1	2/2015	Kintz	
2015/0101442	A1	4/2015	Romo	
2015/0119638	A1	4/2015	Yu et al.	
2015/0164594	A1	6/2015	Romo et al.	
2015/0164596	A1	6/2015	Romo	
2015/0335389	A1	11/2015	Greenberg	
2015/0335480	A1	11/2015	Alvarez et al.	
2016/0001038	A1	1/2016	Romo et al.	
2016/0157942	A1 *	6/2016	Gombert	B25J 9/1666 606/130
2016/0270865	A1	9/2016	Landey et al.	
2016/0279394	A1	9/2016	Moll et al.	
2016/0287279	A1	10/2016	Bovay et al.	
2016/0296294	A1	10/2016	Moll et al.	
2016/0346052	A1	12/2016	Rosielle et al.	
2016/0374541	A1	12/2016	Agrawal et al.	
2017/0007337	A1	1/2017	Dan	

2017/0065364	A1	3/2017	Schuh et al.	
2017/0065365	A1	3/2017	Schuh	
2017/0071692	A1	3/2017	Taylor et al.	
2017/0071693	A1	3/2017	Taylor et al.	
2017/0086929	A1	3/2017	Moll et al.	
2017/0100199	A1	4/2017	Yu et al.	
2017/0119411	A1	5/2017	Shah	
2017/0119412	A1	5/2017	Noonan et al.	
2017/0119413	A1	5/2017	Romo	
2017/0119481	A1	5/2017	Romo et al.	
2017/0135771	A1	5/2017	Auld et al.	
2017/0165011	A1	6/2017	Bovay et al.	
2017/0172673	A1	6/2017	Yu et al.	
2017/0202627	A1	7/2017	Sramek et al.	
2017/0209073	A1	7/2017	Sramek et al.	
2017/0209217	A1	7/2017	Jensen	
2017/0215976	A1	8/2017	Nowlin et al.	
2017/0215978	A1	8/2017	Wallace et al.	
2017/0290631	A1	10/2017	Lee et al.	
2017/0304021	A1	10/2017	Hathaway	
2017/0325906	A1	11/2017	Piecuch et al.	
2017/0333679	A1	11/2017	Jiang	
2017/0340353	A1	11/2017	Ahluwalia et al.	
2017/0340396	A1	11/2017	Romo et al.	
2017/0365055	A1	12/2017	Mintz et al.	
2017/0367782	A1	12/2017	Schuh et al.	
2018/0025666	A1	1/2018	Ho et al.	
2018/0055583	A1	3/2018	Schuh et al.	
2018/0078439	A1	3/2018	Cagle et al.	
2018/0078440	A1	3/2018	Koenig et al.	
2018/0079090	A1	3/2018	Koenig et al.	
2018/0177556	A1	6/2018	Noonan et al.	
2018/0214011	A1	8/2018	Graetzel et al.	
2018/0221038	A1	8/2018	Noonan et al.	
2018/0221039	A1	8/2018	Shah	
2018/0250083	A1	9/2018	Schuh et al.	
2018/0271616	A1	9/2018	Schuh et al.	
2018/0279852	A1	10/2018	Rafii-Tari et al.	
2018/0280660	A1	10/2018	Landey et al.	
2018/0289243	A1	10/2018	Landey et al.	
2018/0289431	A1	10/2018	Draper et al.	
2018/0325499	A1	11/2018	Landey et al.	
2018/0333044	A1	11/2018	Jenkins	
2018/0360435	A1	12/2018	Romo	
2019/0000559	A1	1/2019	Berman et al.	
2019/0000560	A1	1/2019	Berman et al.	
2019/0000566	A1	1/2019	Graetzel et al.	
2019/0000568	A1	1/2019	Connolly et al.	
2019/0000576	A1	1/2019	Mintz et al.	
2019/0083183	A1	3/2019	Moll et al.	
2019/0105776	A1	4/2019	Ho et al.	
2019/0105785	A1	4/2019	Meyer	
2019/0107454	A1	4/2019	Lin	
2019/0110839	A1	4/2019	Rafii-Tari et al.	
2019/0110843	A1	4/2019	Ummalaneni et al.	

FOREIGN PATENT DOCUMENTS

WO	WO 10/068005	6/2010
WO	WO 15/010788	1/2015

OTHER PUBLICATIONS

PCT International Search Report and Written Opinion, PCT Application No. PCT/US16/32505, dated Sep. 23, 2016, 15 pp.
United States Office Action, U.S. Appl. No. 15/154,762, dated Oct. 18, 2016, 7 pp.

* cited by examiner

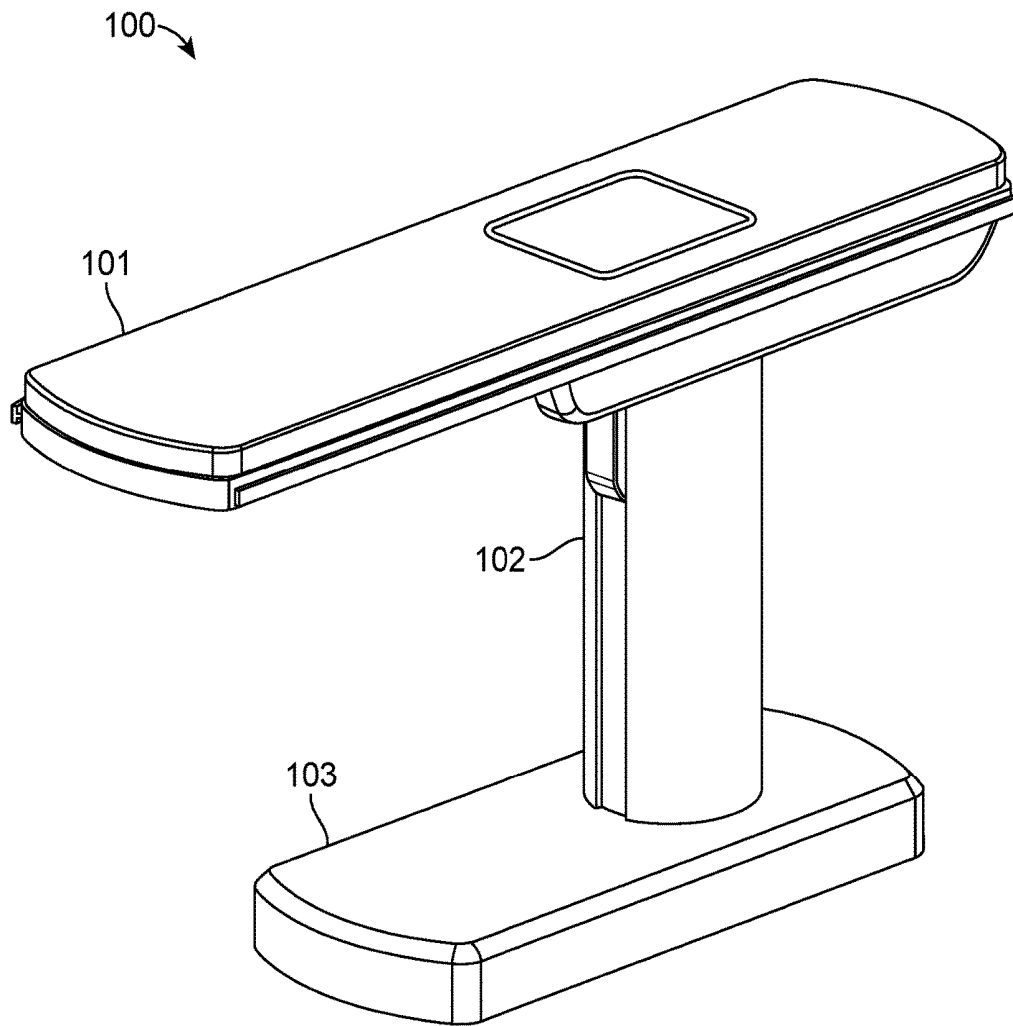

FIG. 1

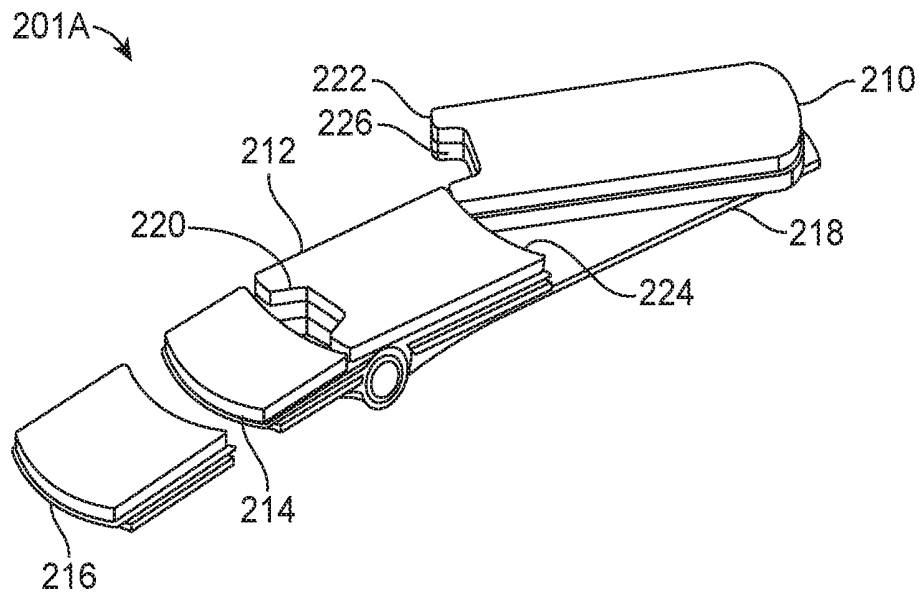

FIG. 2A

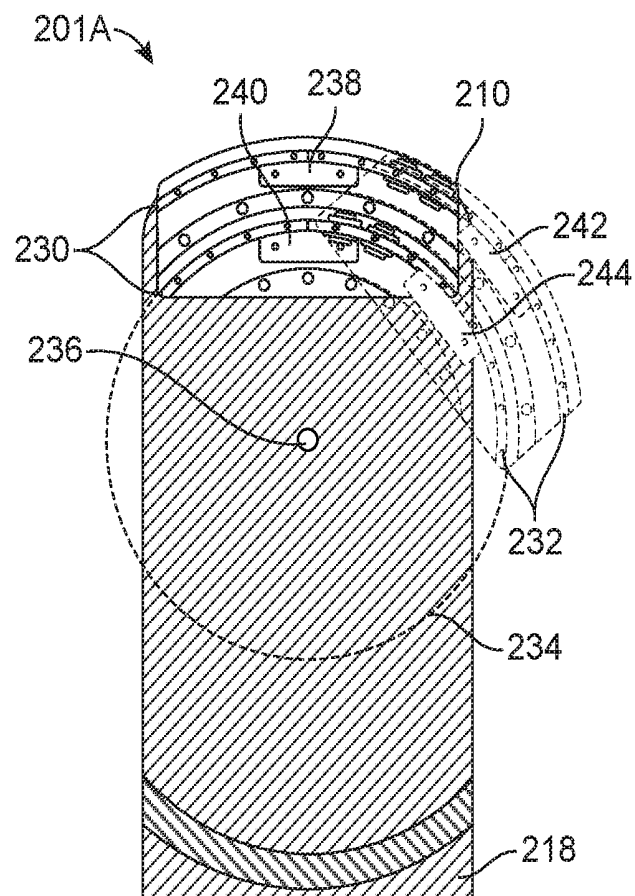

FIG. 2B

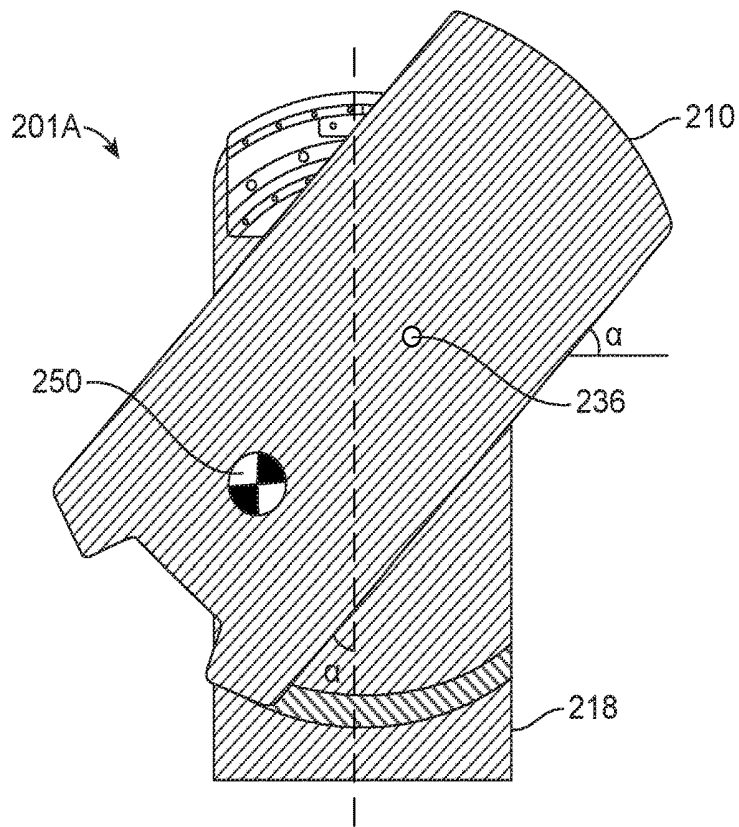

FIG. 2C

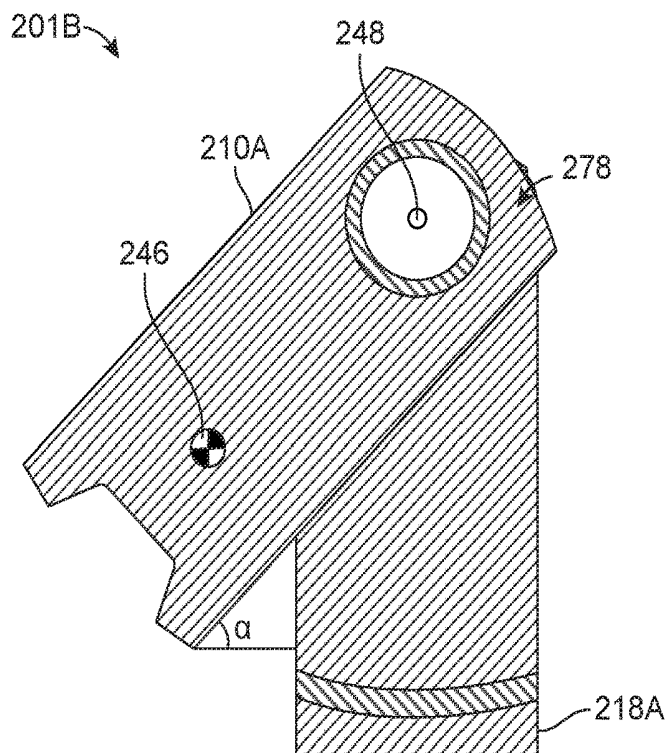

FIG. 2D

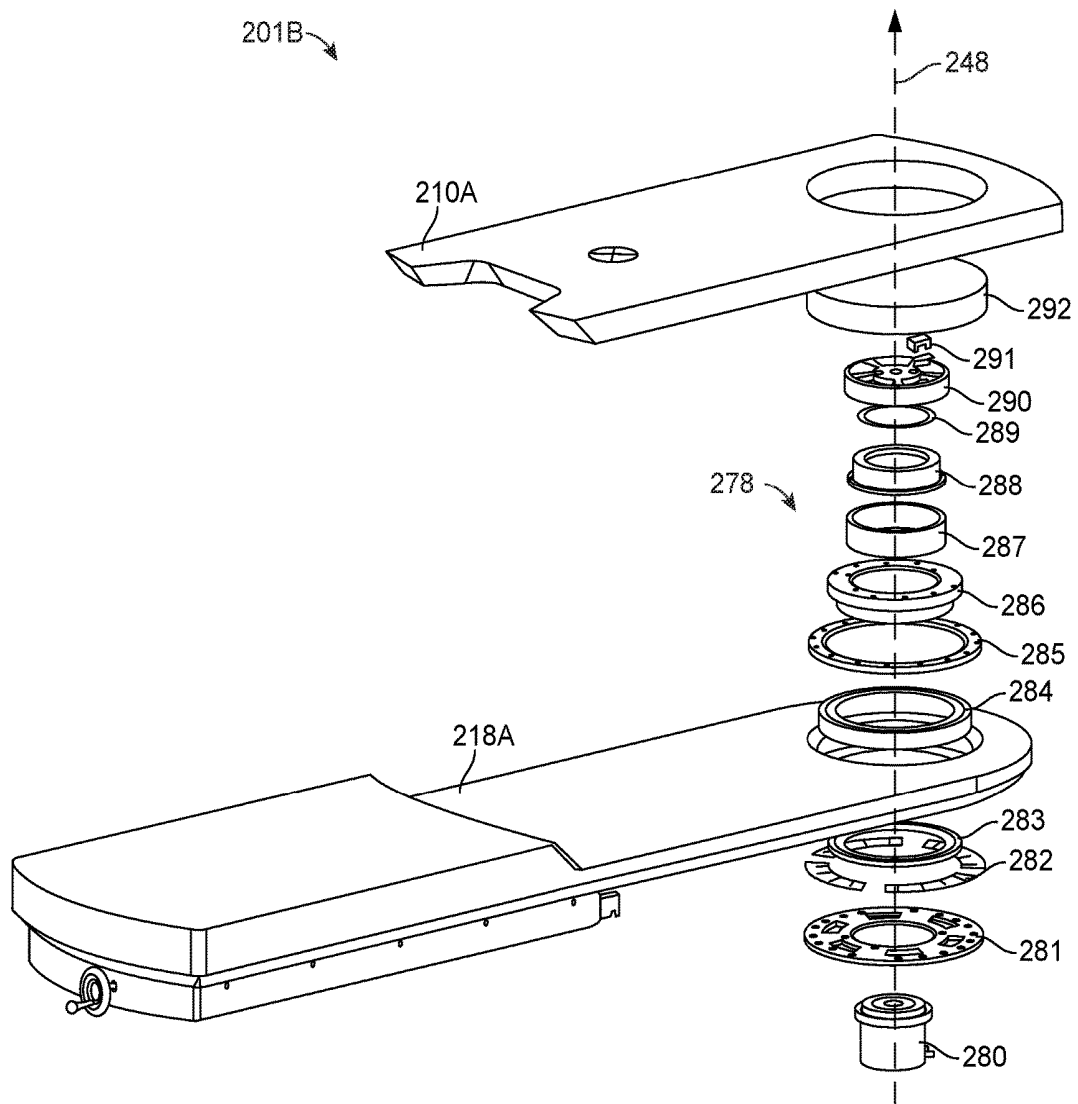

FIG. 2E

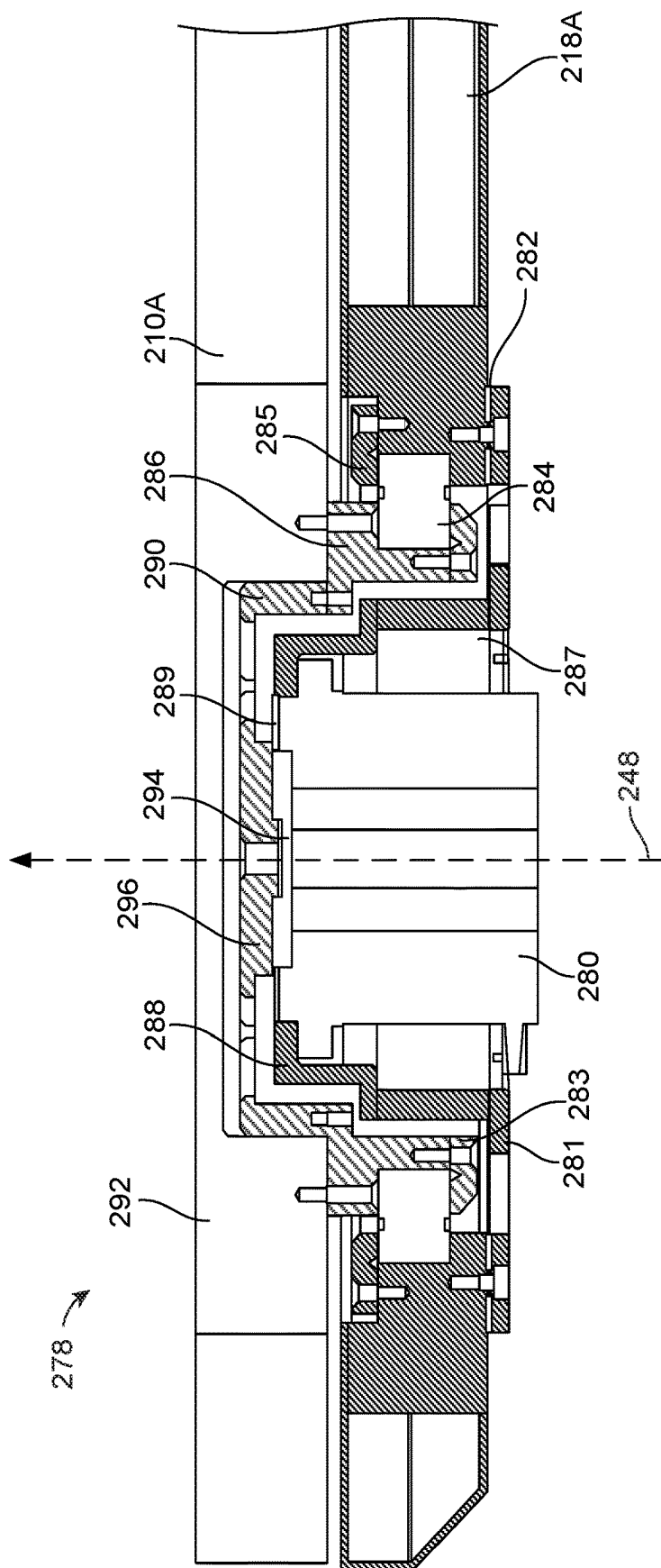

FIG. 2F

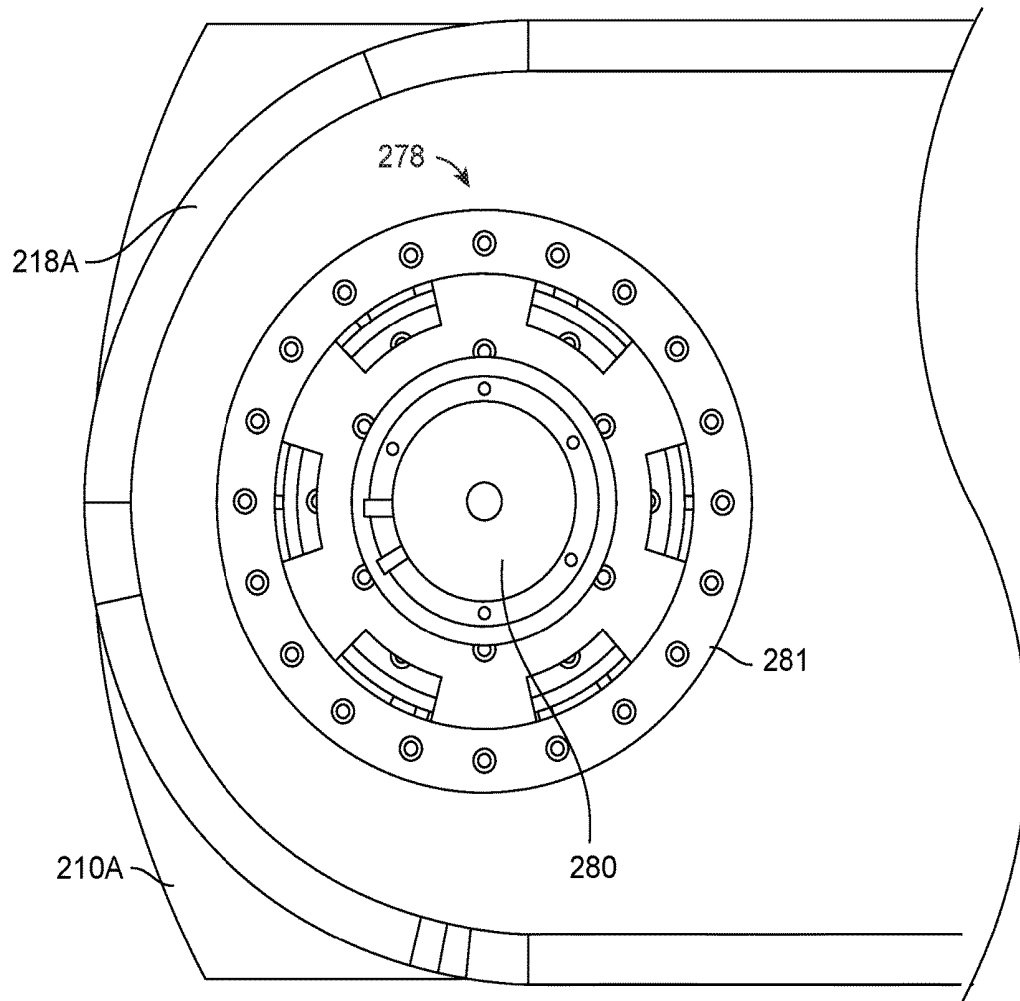

FIG. 2G

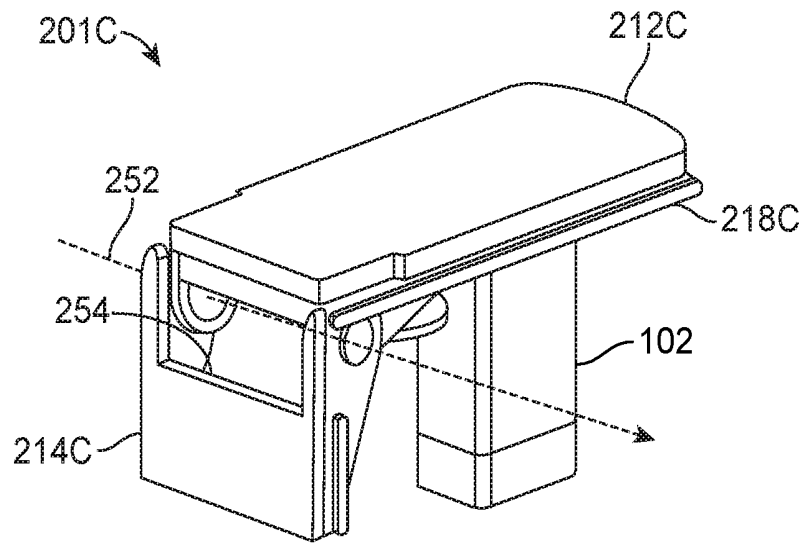

FIG. 2H

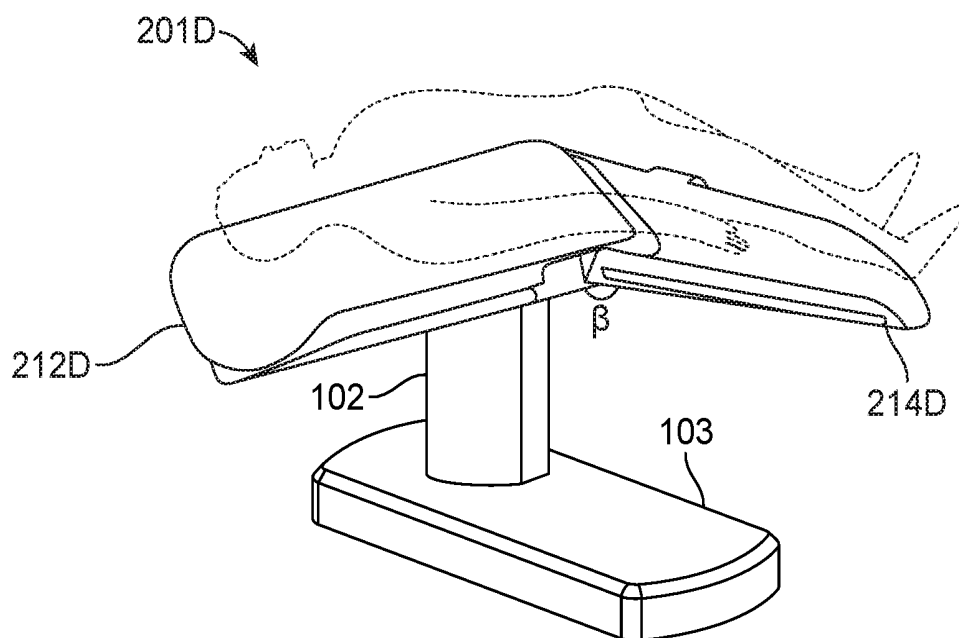

FIG. 2I

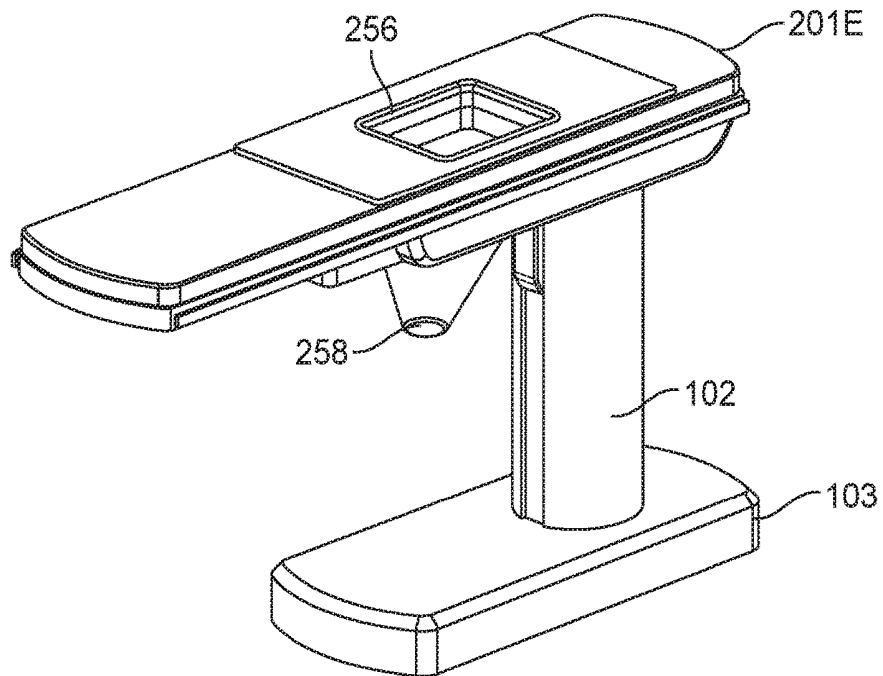

FIG. 2J

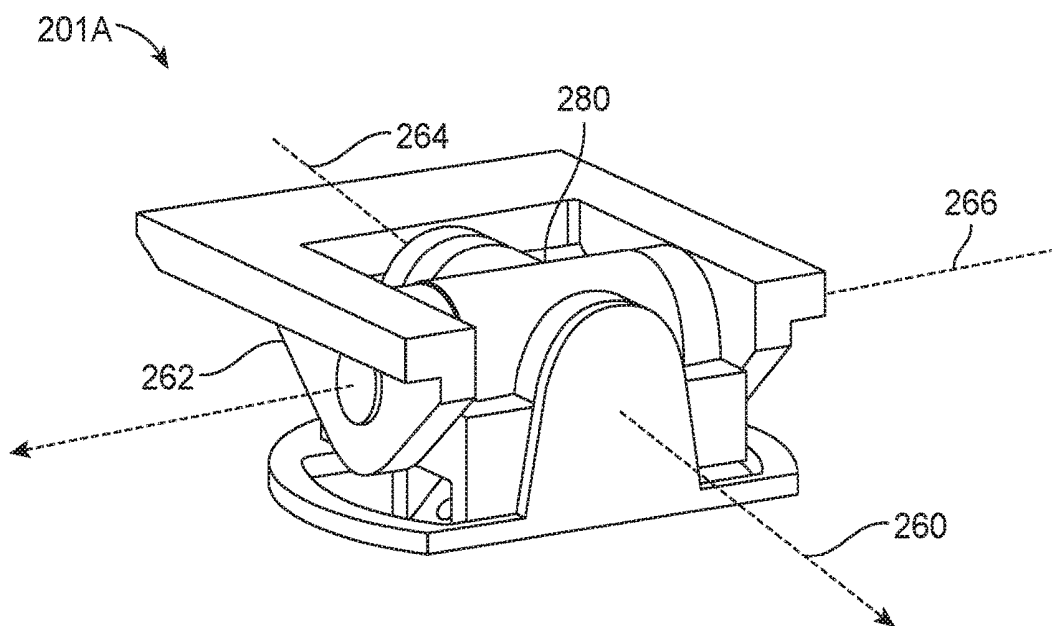

FIG. 2K

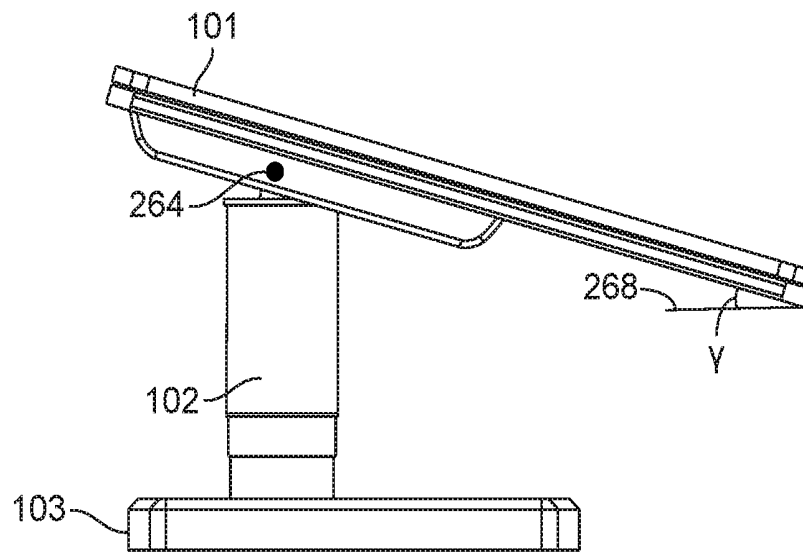

FIG. 2L

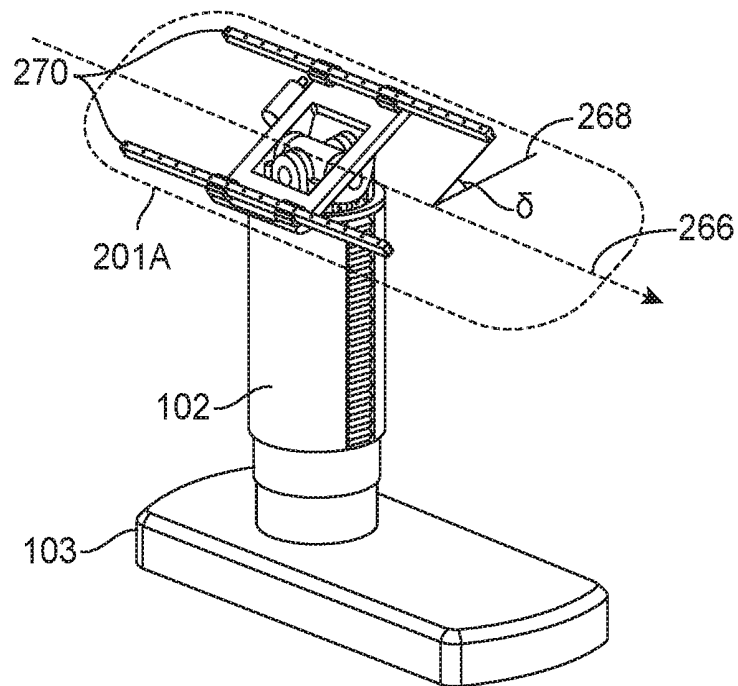

FIG. 2M

FIG. 3B

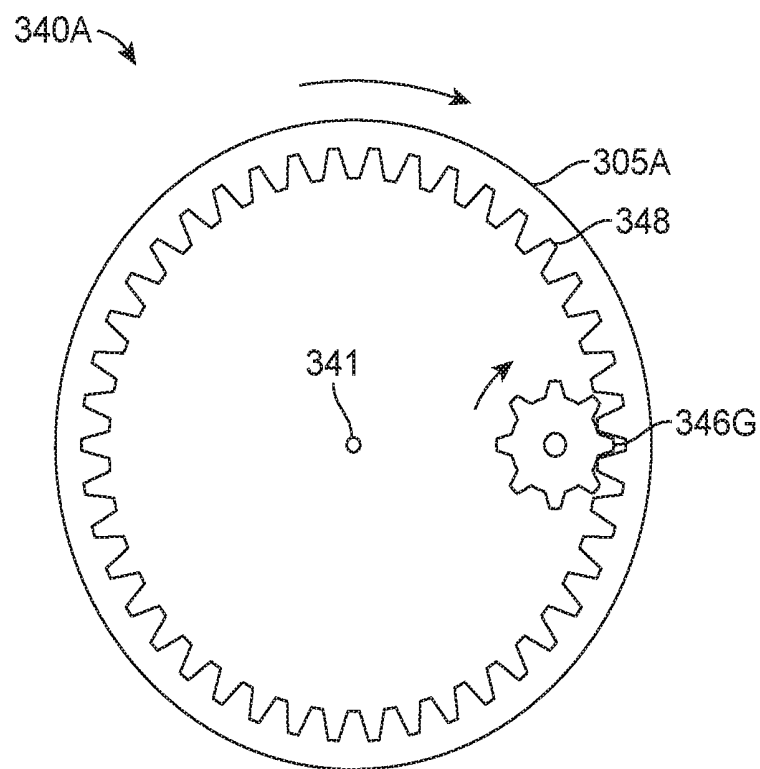

FIG. 3C

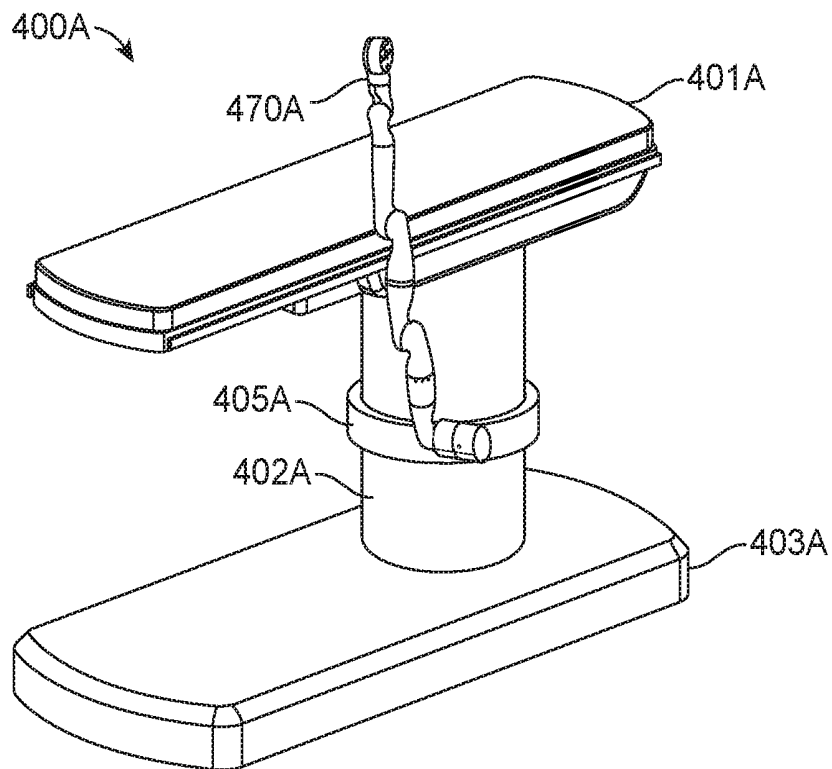

FIG. 4A

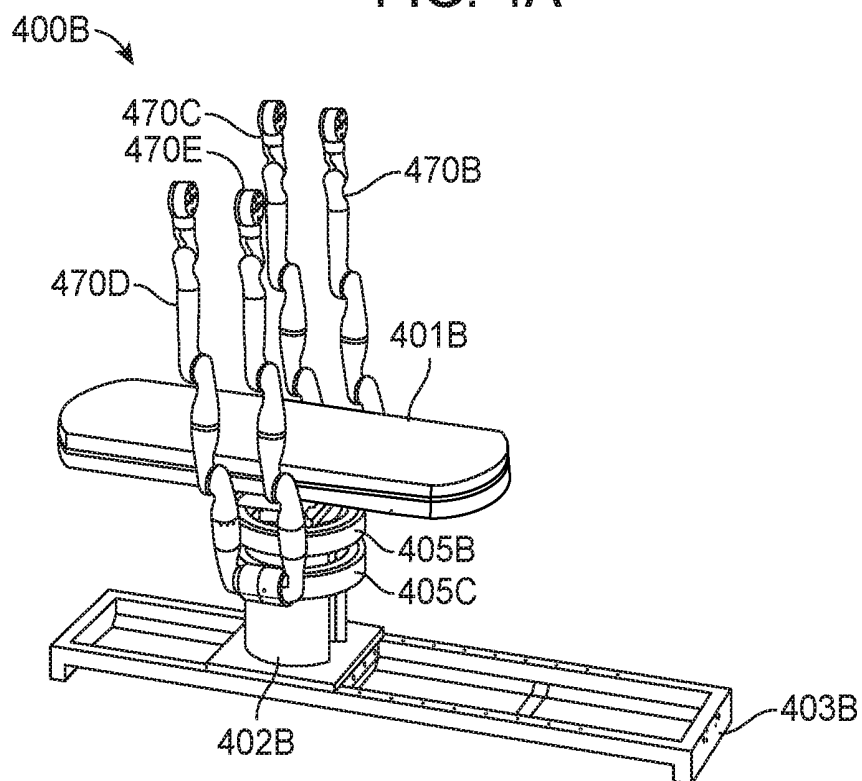

FIG. 4B

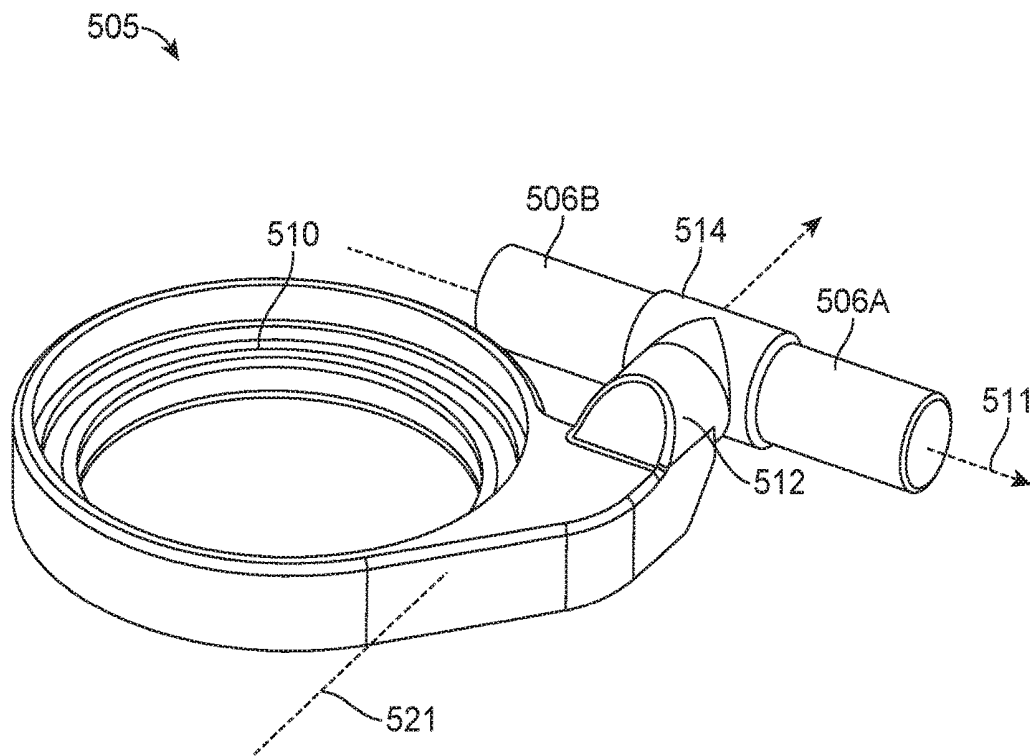

FIG. 5A

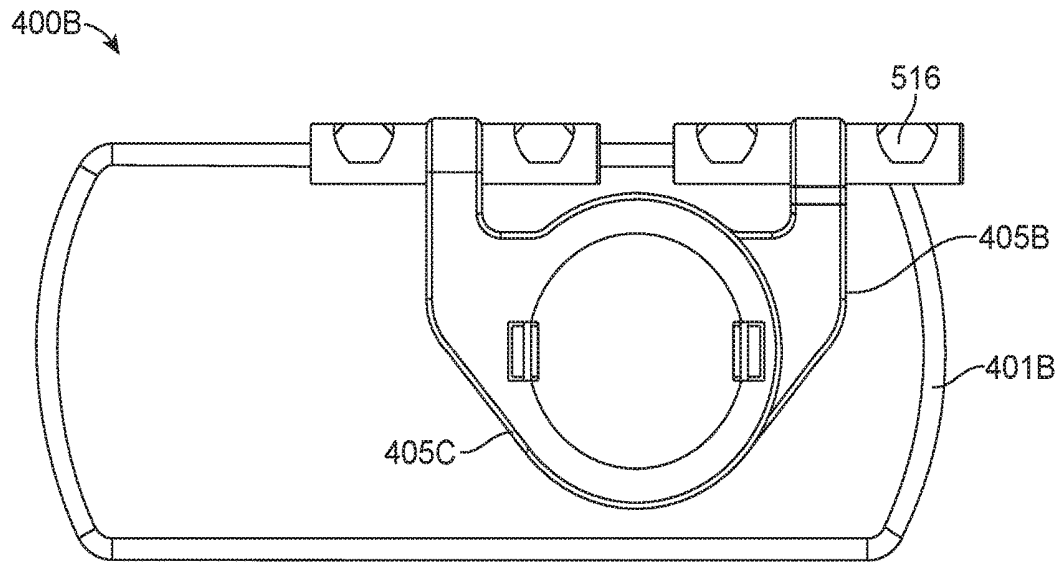

FIG. 5B

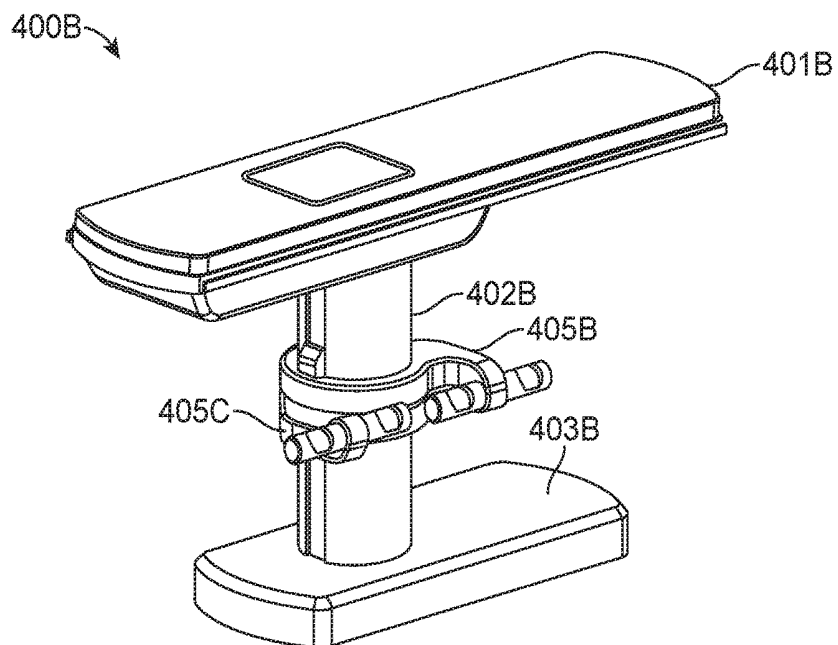

FIG. 5C

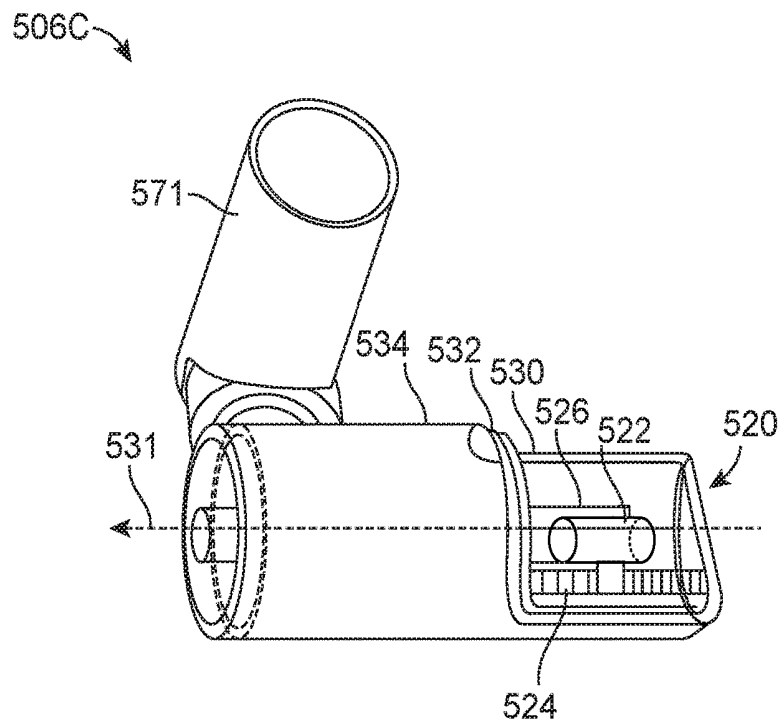

FIG. 5D

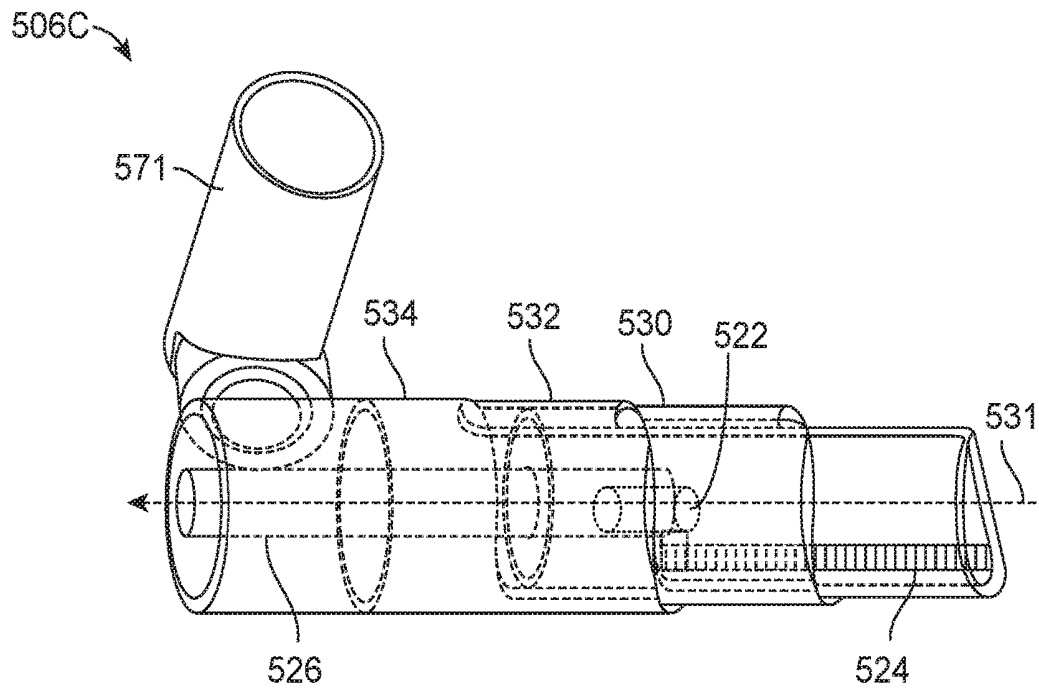

FIG. 5E

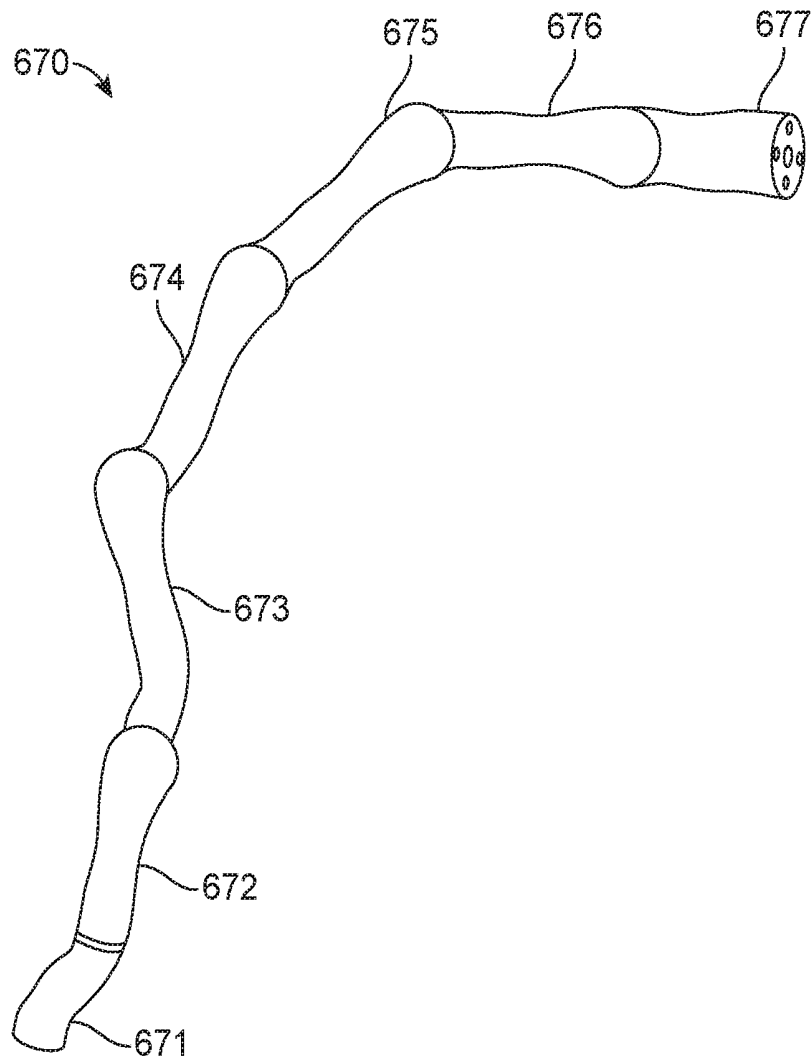

FIG. 6A

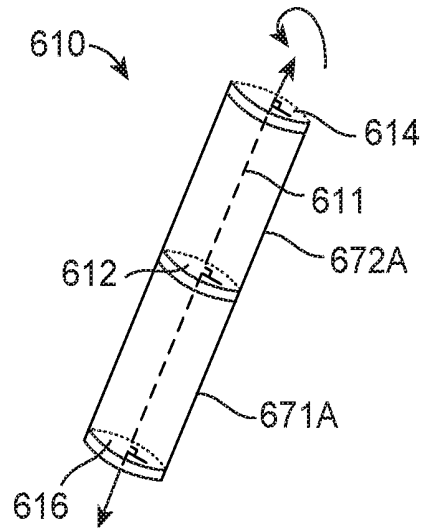

FIG. 6B

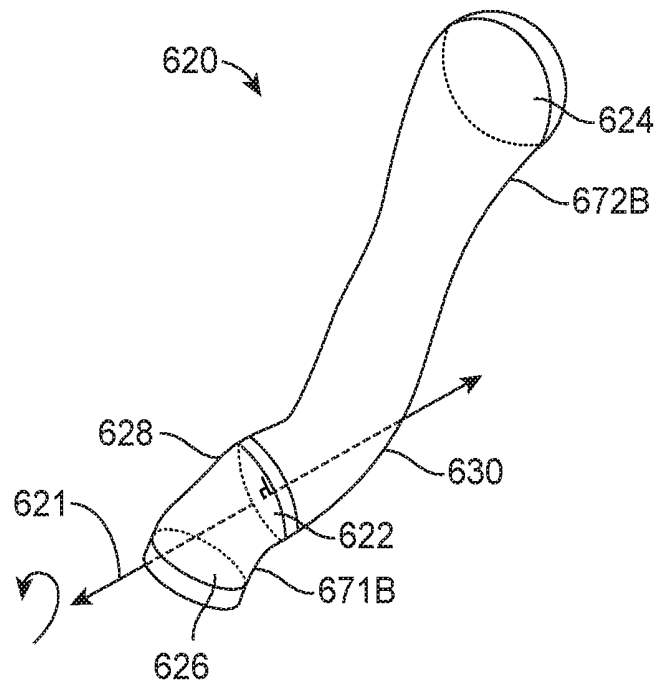

FIG. 6C

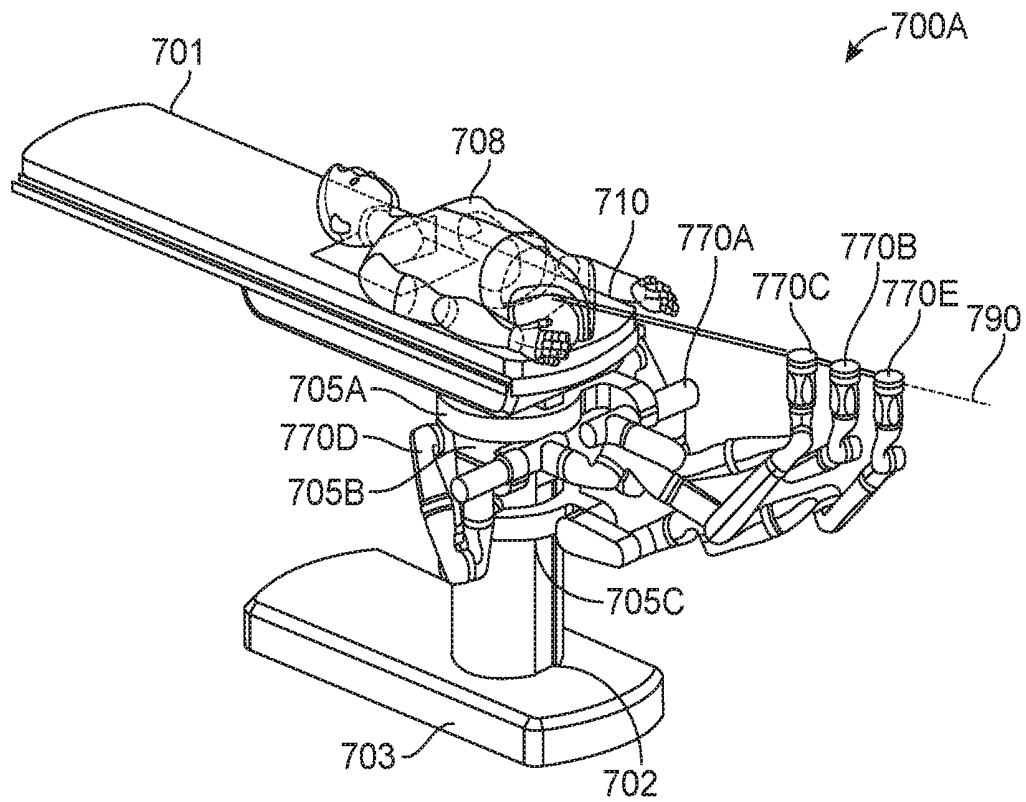

FIG. 7A

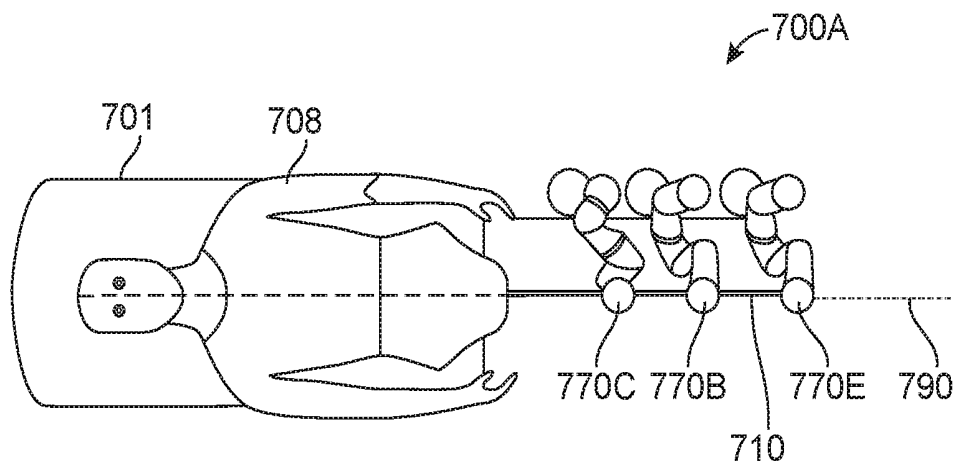

FIG. 7B

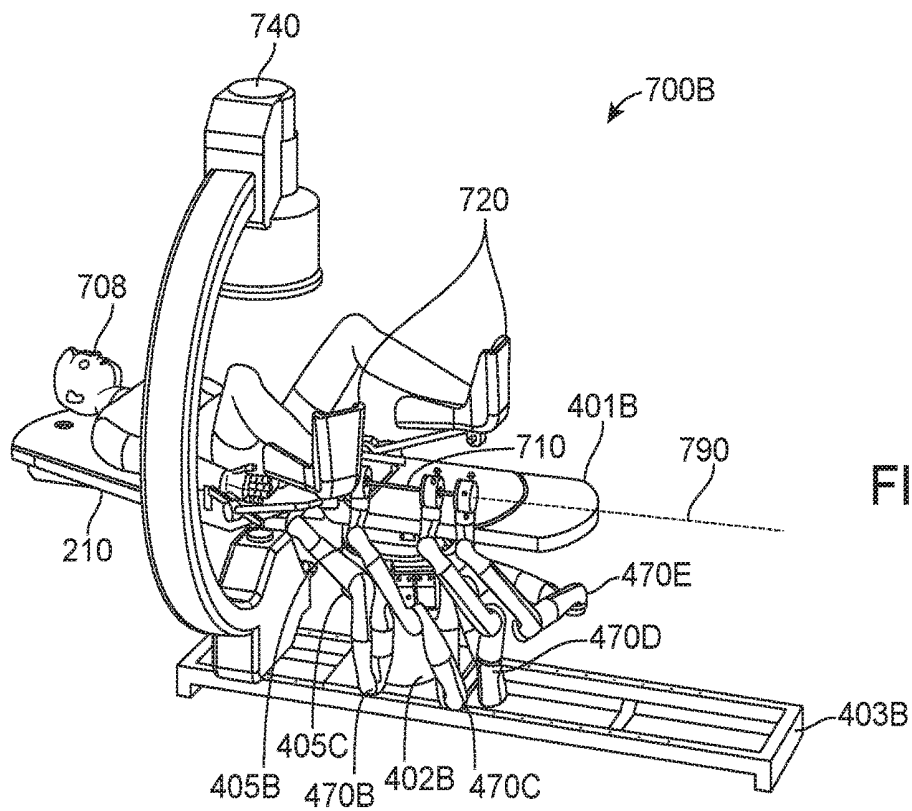

FIG. 7C

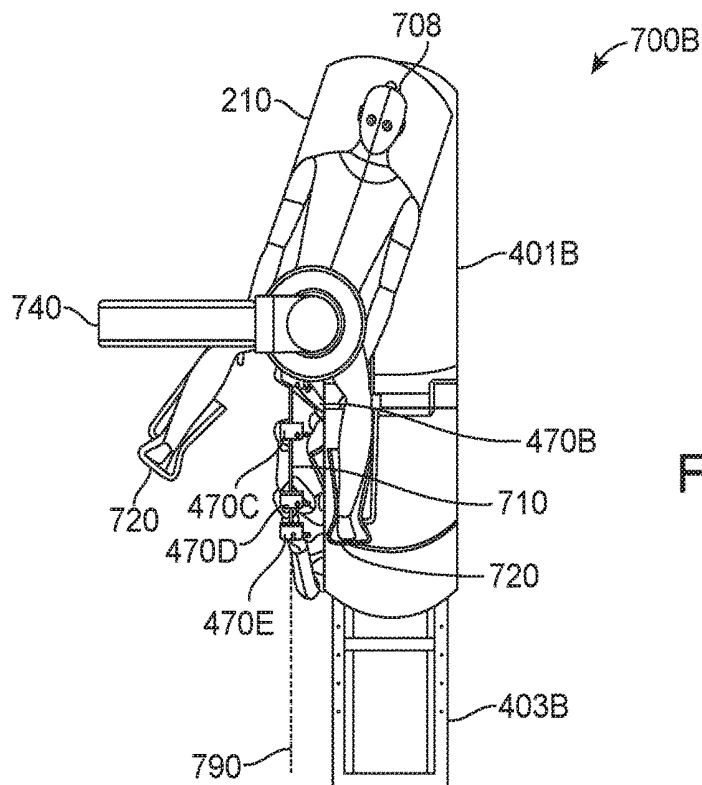

FIG. 7D

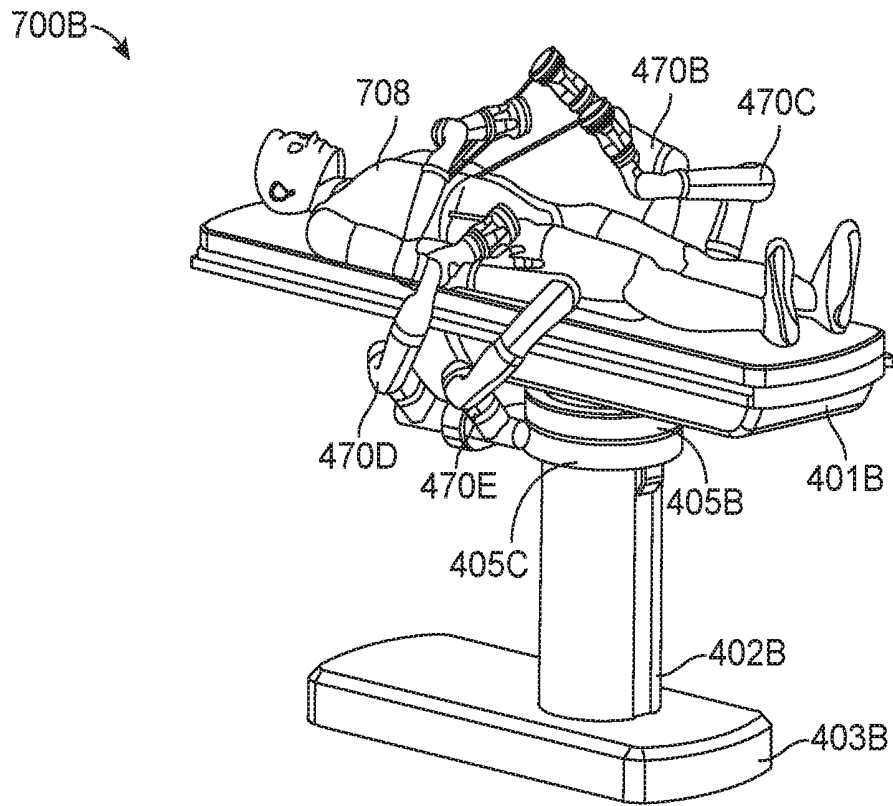

FIG. 7E

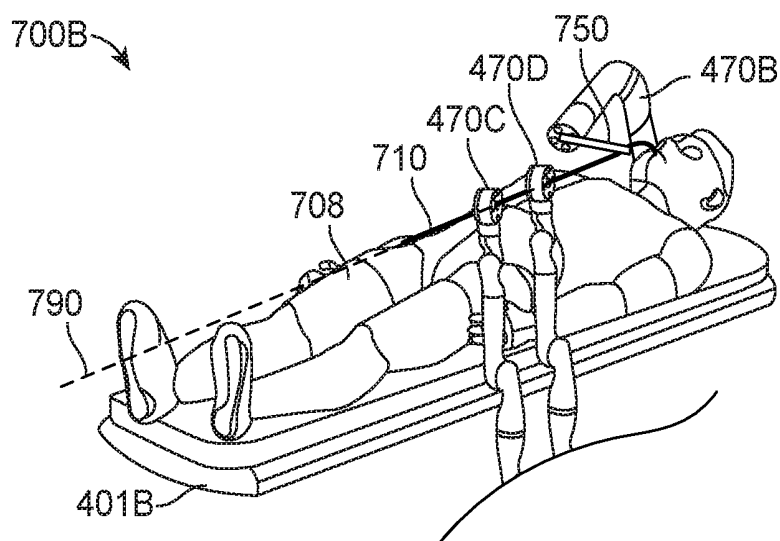

FIG. 7F

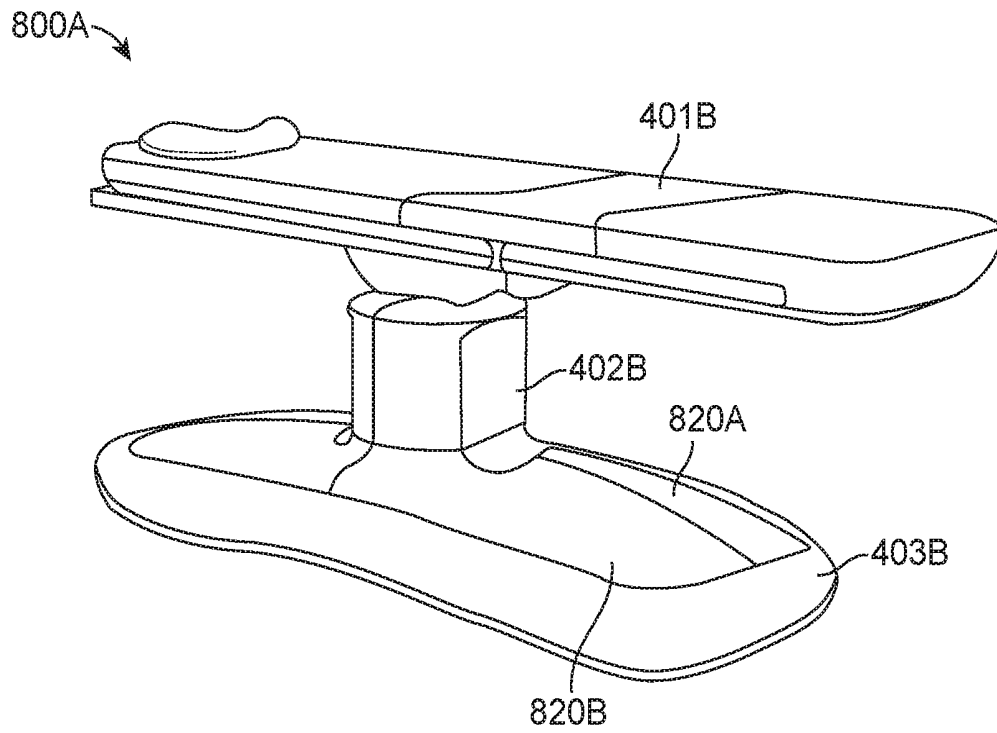

FIG. 8A

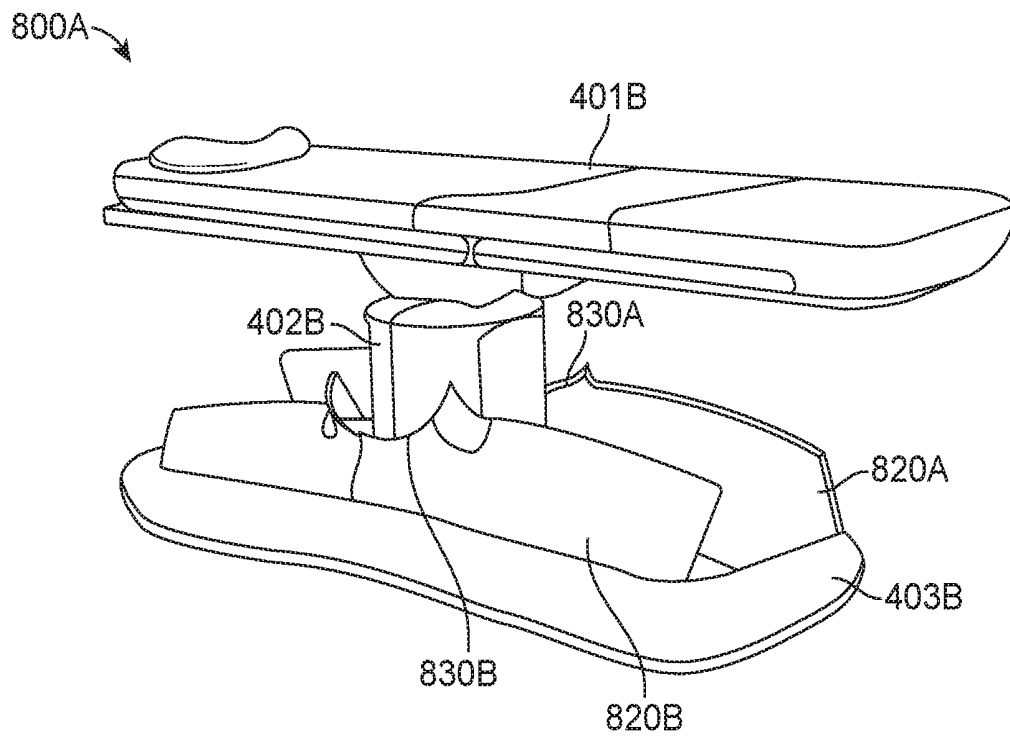

FIG. 8B

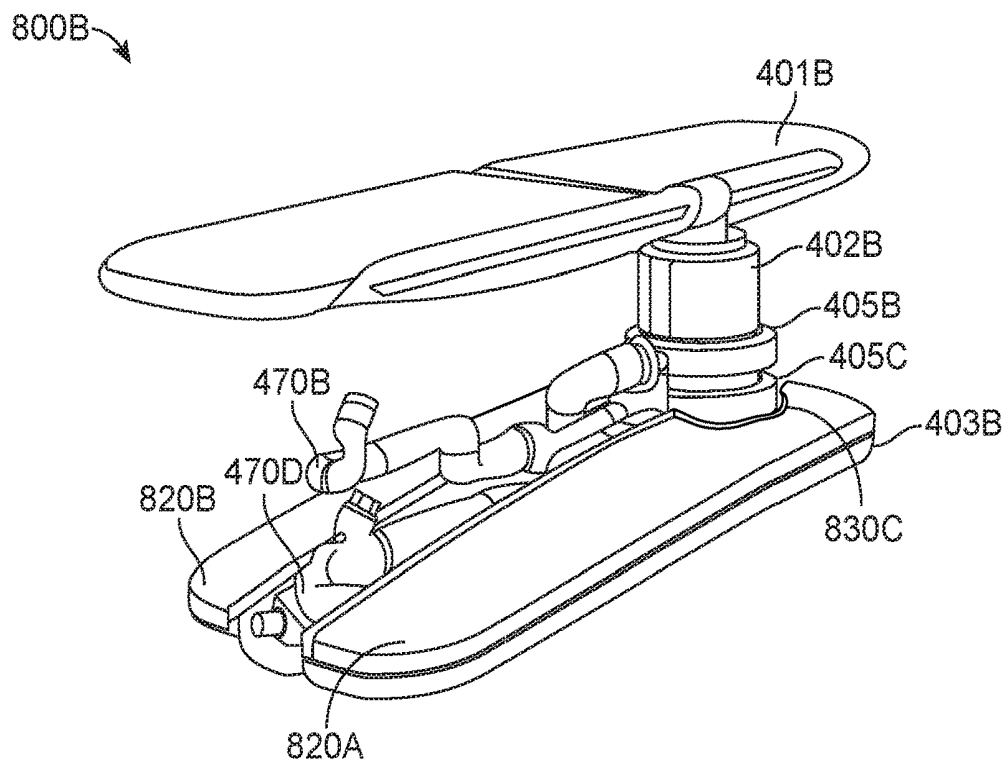

FIG. 8C

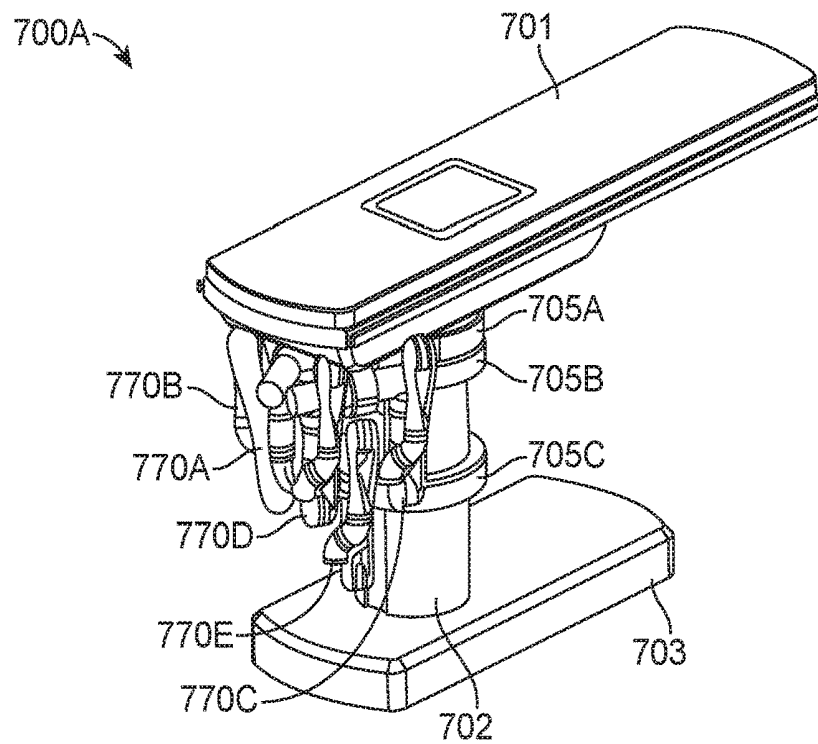

FIG. 8D

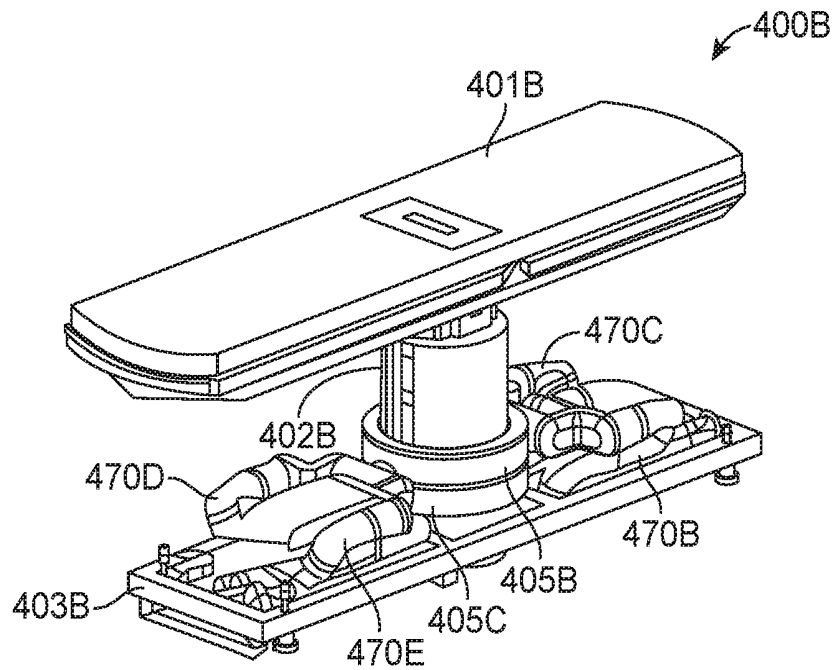

FIG. 8E

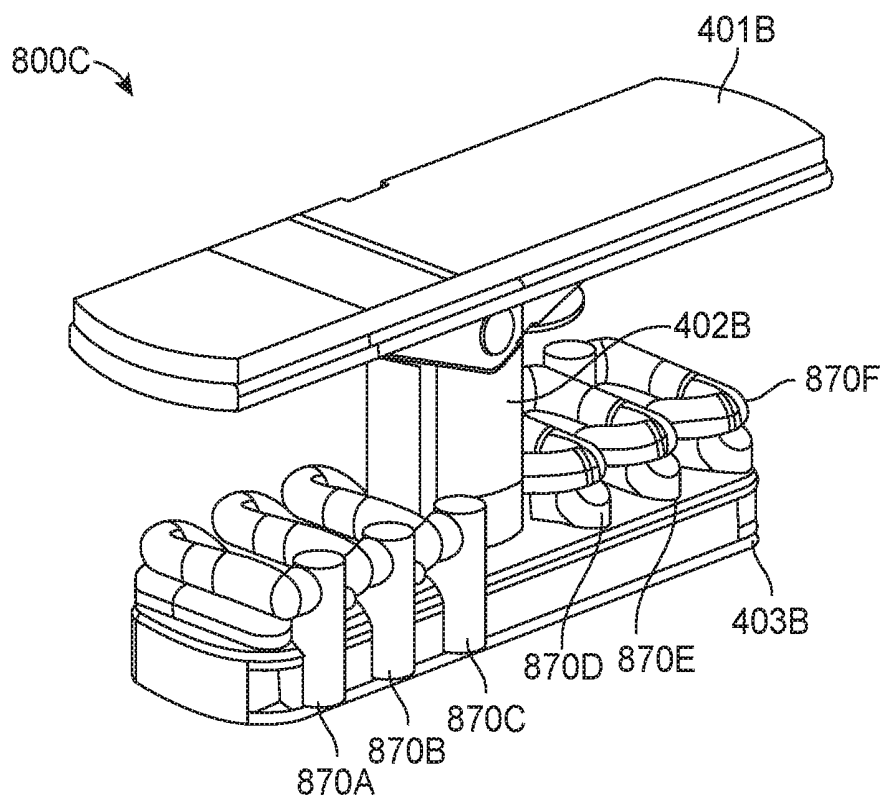

FIG. 8F

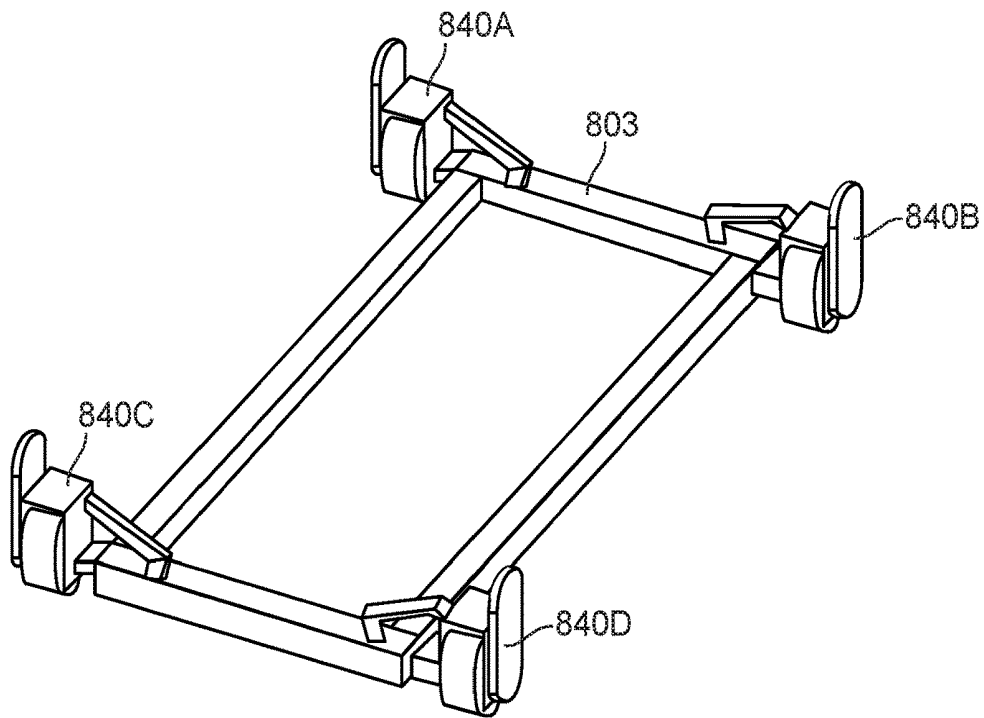

FIG. 8G

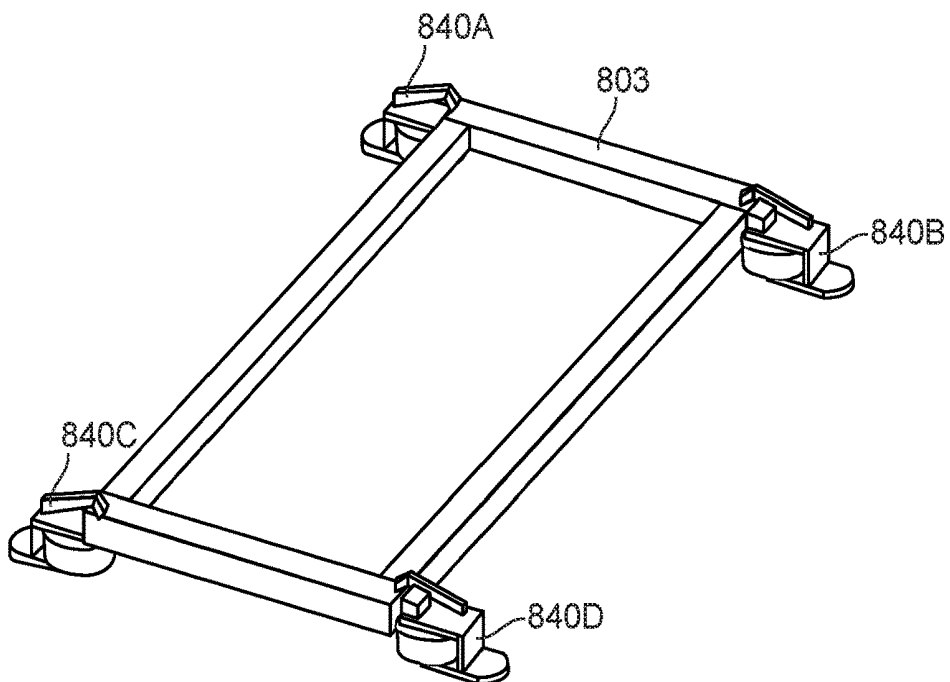

FIG. 8H

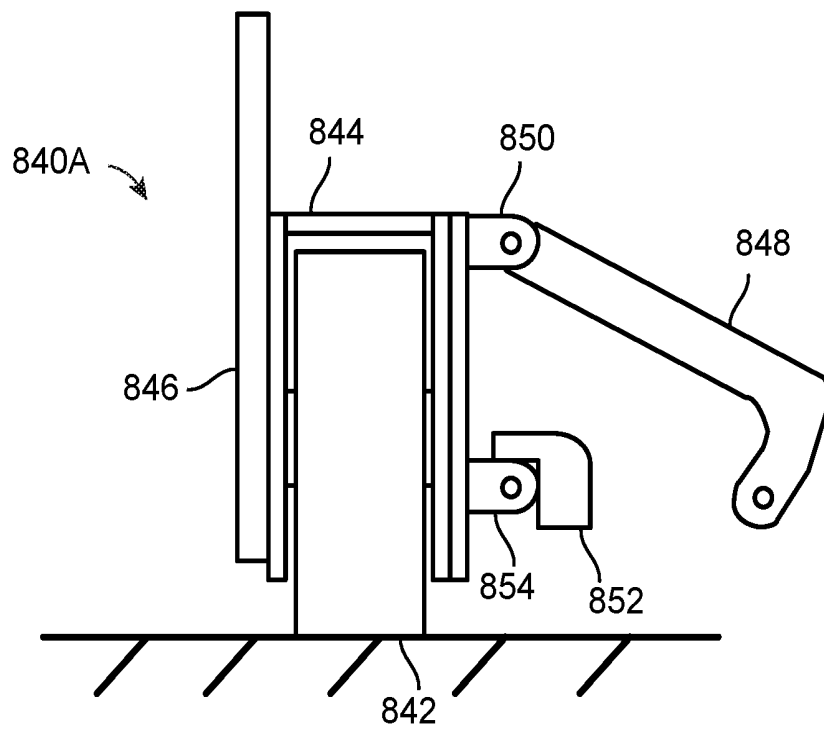

FIG. 8I

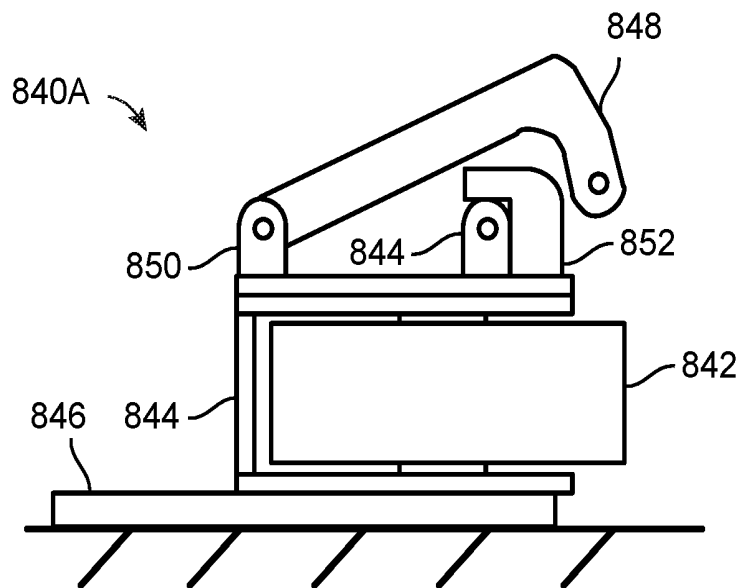

FIG. 8J

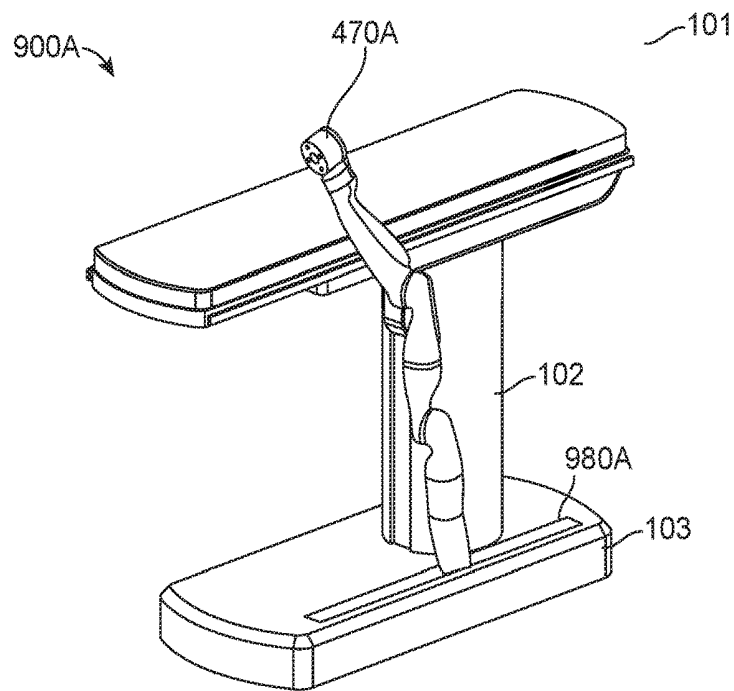

FIG. 9A

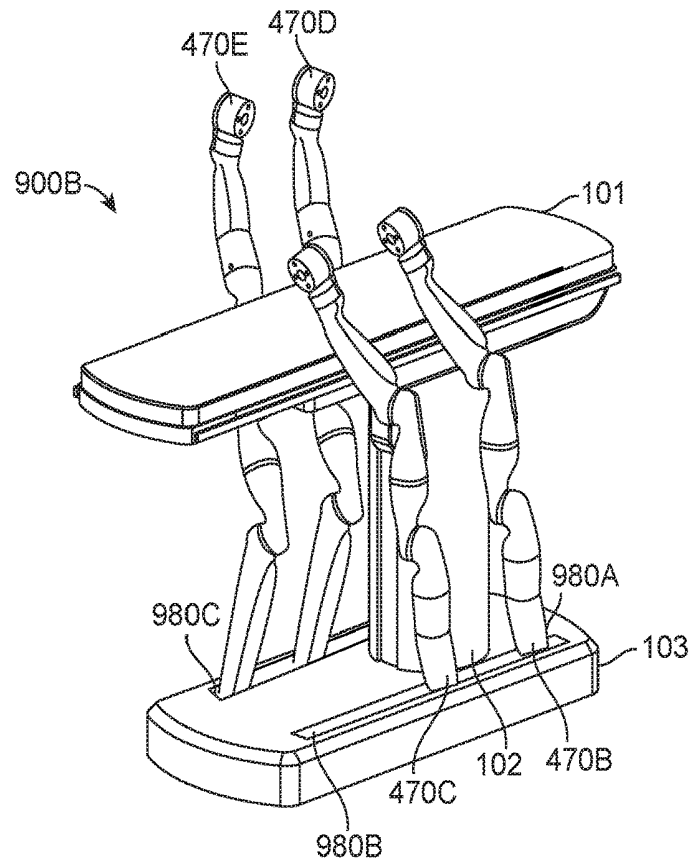
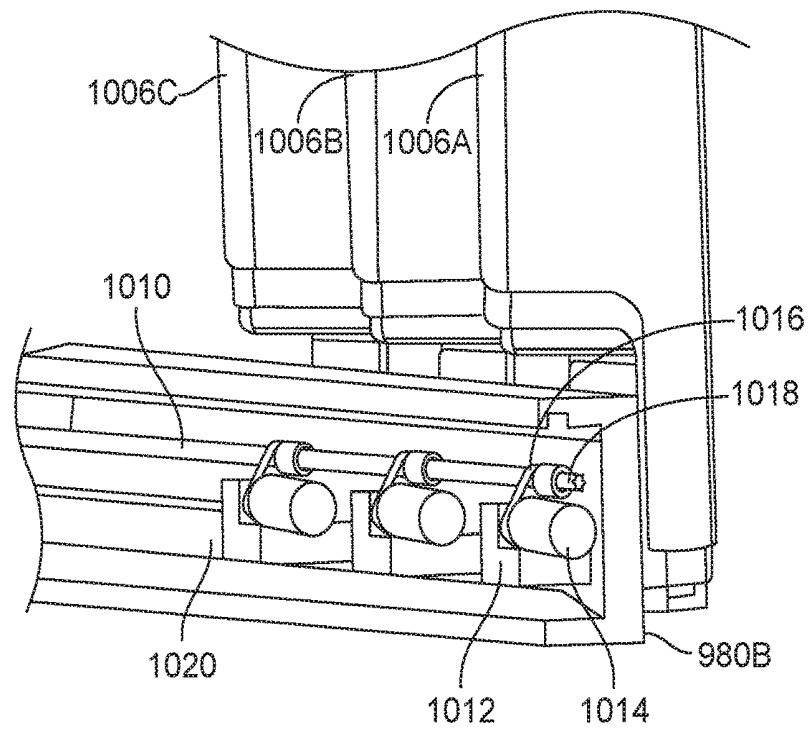
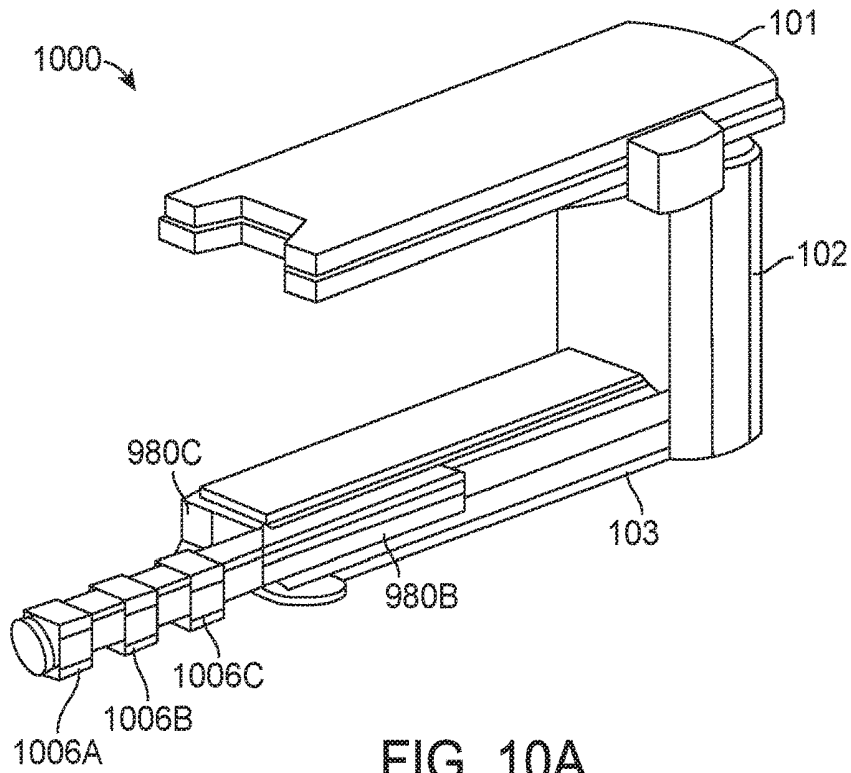

FIG. 9B



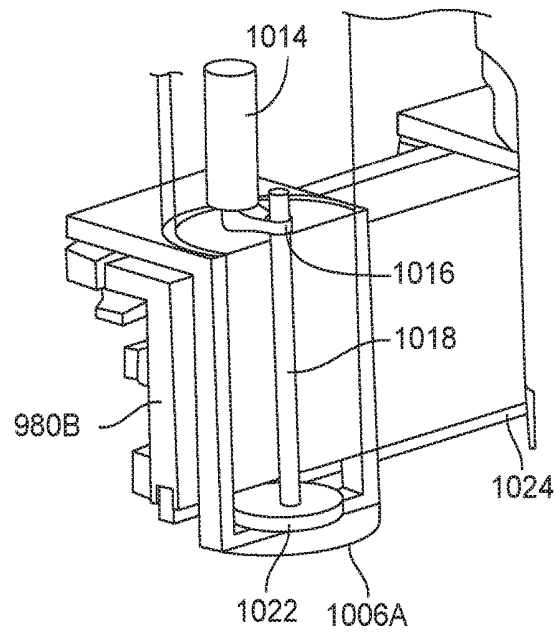

FIG. 10C

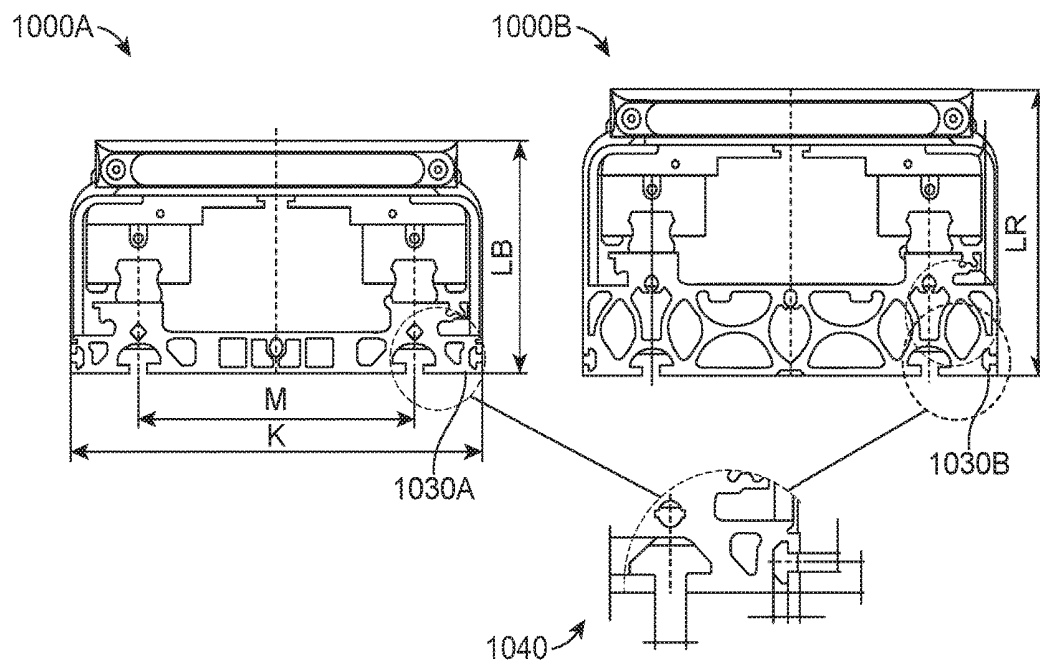
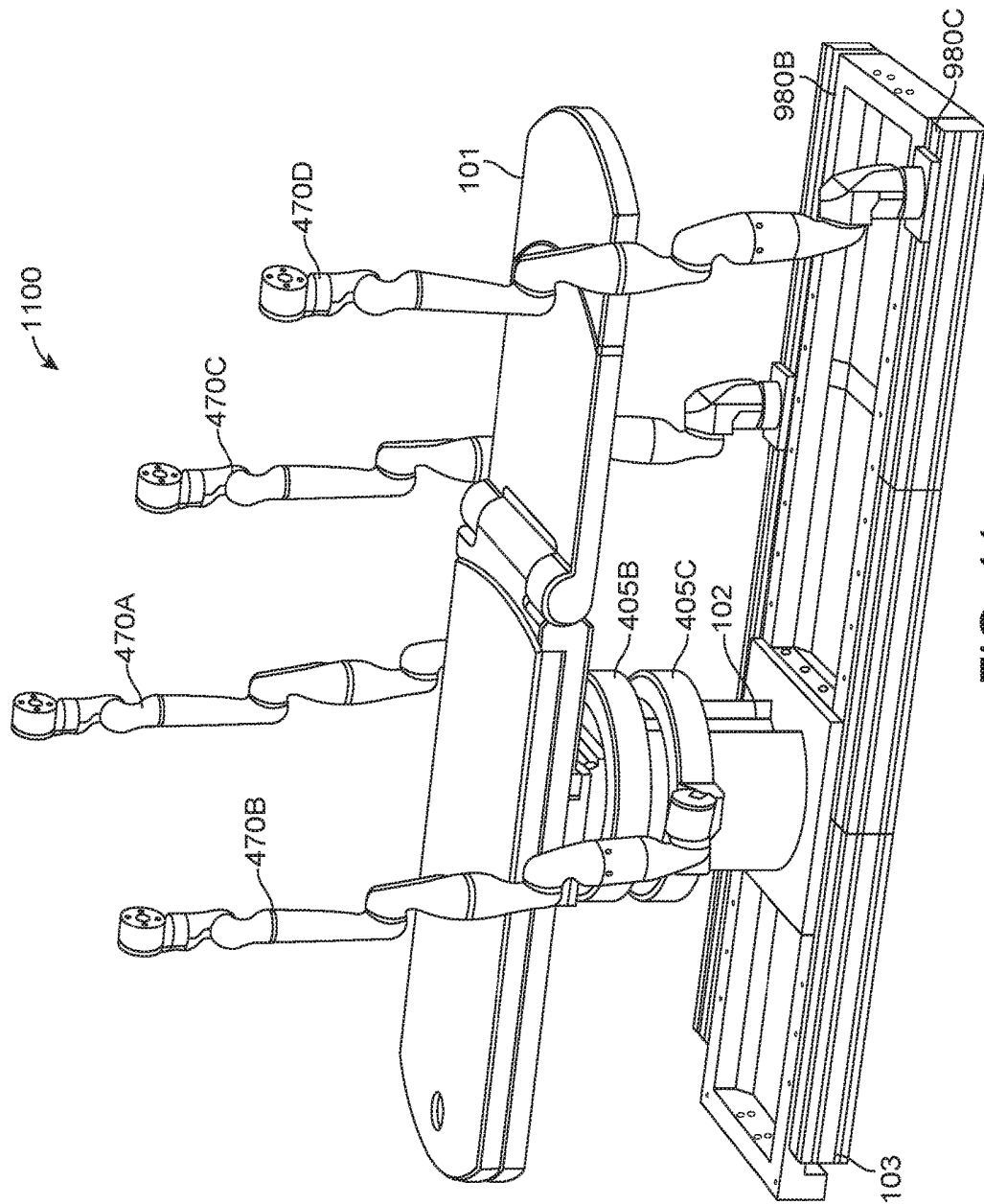

FIG. 10D



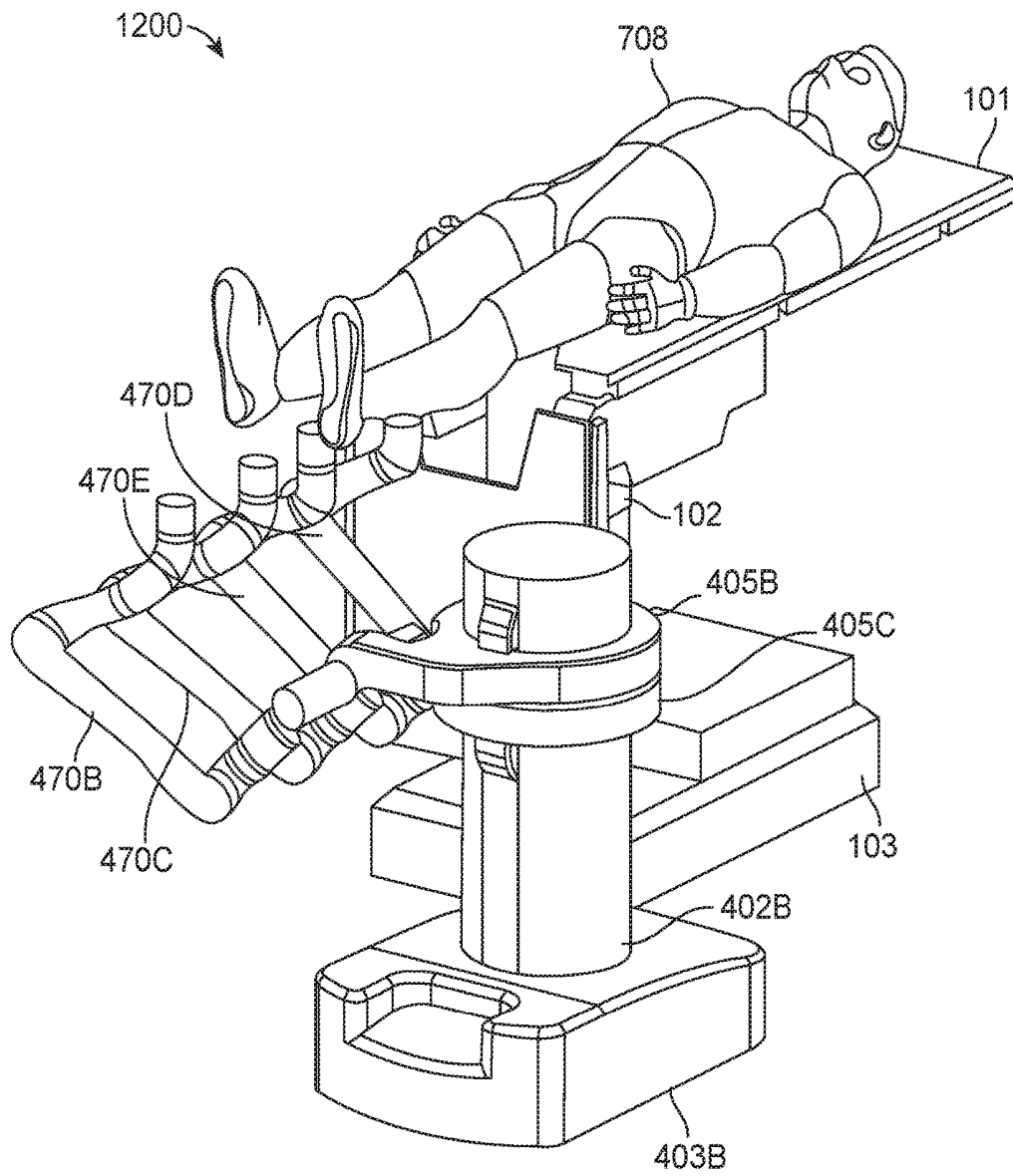

FIG. 12

SURGICAL ROBOTICS SYSTEM**CROSS-REFERENCE TO RELATED APPLICATIONS**

This application is a continuation of prior, U.S. application Ser. No. 15/154,762, filed on May 13, 2016, now issued as U.S. Patent No. 9,622,827, which claims the benefit of and priority to U.S. Provisional Application No. 62/162,486 filed May 15, 2015, U.S. Provisional Application No. 62/162,467 filed May 15, 2015, U.S. Provisional Application No. 62/193,604 filed Jul. 17, 2015, U.S. Provisional Application No. 62/201,518 filed Aug. 5, 2015, U.S. Provisional Application No. 62/203,530 filed Aug. 11, 2015, and U.S. Provisional Application No. 62/235,394 filed Sep. 30, 2015, which are each incorporated by reference herein in its entirety. This application relates to virtual rails that may be incorporated into a surgical robotics system, such as those disclosed in U.S. application Ser. No. 14/871,253, which is incorporated by reference herein in its entirety.

BACKGROUND**1. Field of Art**

This description generally relates to surgical robotics, and particularly to a robotics system configurable for a variety of surgical procedures.

2. Description of the Related Art

Robotic technologies have a range of applications. In particular, robotic arms help complete tasks that a human would normally perform. For example, factories use robotic arms to manufacture automobiles and consumer electronics products. Additionally, scientific facilities use robotic arms to automate laboratory procedures such as transporting microplates. Recently, physicians have started using robotic arms to help perform surgical procedures. For instance, physicians use robotic arms to control surgical instruments inside a patient. However, existing medical systems including robotic arms have a high capital cost and are typically specialized to perform limited types of surgical procedures. Thus, physicians or their assistants may need to obtain multiple robotic arm systems to accommodate a range of surgical procedures. Manually reconfiguring a robotic arm system for each surgical procedure is also time-consuming and physically demanding for the physicians.

SUMMARY

A surgical robotics system with robotic arms is configurable to perform a variety of surgical procedures. The surgical robotics system includes a table, column, base, and robotic arms that are either column-mounted, rail-mounted, or mounted on a separate unit (e.g., a free-standing column). In a column-mounted configuration, the column includes column rings that translate vertically and rotate about the column. The robotic arms are attached to the column rings. In a rail-mounted configuration, the base includes base rails that translate along the base. The robotic arms are attached to the base rails. In both configurations, the robotic arms move independently from each other and include a multiple arm segments. Each arm segment provides an additional degree of freedom to the robotic arm. Thus, the surgical robotics system may position the robotic arms into numerous configurations to access different parts of a patient's body. For example, the robotic arms access the lower area of the body for ureteroscopy, the core (abdomen) area of the body for prostatectomy, and the upper area of the body for

bronchoscopy. The configurability of the robotic arms is an advantage because physicians may use the same surgical robotics system to perform a wide range of surgical procedures.

The surgical robotics system includes several features that provide additional advantages. For example, the table includes a swivel segment that rotates laterally using double curved rails or a swivel mechanism with bearings. Rotating a patient on the table laterally provides the robotic arms—or a physician—greater access to operate on the patient. Further, the double curved rails enable the table to support high cantilever loads of the patient's weight in a rotated position. In another example, the robotic arms are configurable into a compact stowed position and stored inside the base. The base protects stored robotic arms from contamination or de-sterilization when not in use.

BRIEF DESCRIPTION OF DRAWINGS

FIG. 1 is an isometric view of a surgical robotics system according to an embodiment.

FIG. 2A is an isometric view of a table of the surgical robotics system according to one embodiment.

FIG. 2B is a top view of the table according to one embodiment.

FIG. 2C is a top view of a swivel segment of a table according to one embodiment.

FIG. 2D is a top view of a swivel segment of the table according to one embodiment.

FIG. 2E is an isometric exploded view of components of a swivel mechanism according to one embodiment.

FIG. 2F is a cross sectional view of the swivel mechanism shown in FIG. 2E according to one embodiment.

FIG. 2G is a bottom view of the swivel mechanism shown in FIG. 2E according to one embodiment.

FIG. 2H is an isometric view of a folding segment of the table according to one embodiment.

FIG. 2I is another isometric view of a folding segment of the table according to one embodiment.

FIG. 2J is an isometric view of a trapdoor of the table according to one embodiment.

FIG. 2K is an isometric view of pivots of the table according to one embodiment.

FIG. 2L is a side view of the table rotated about an axis of pitch according to one embodiment.

FIG. 2M is an isometric view of the table rotated about an axis of row according to one embodiment.

FIG. 3A is a side cutaway view of a column of the surgical robotics system according to one embodiment.

FIG. 3B is an isometric cutaway view of the column according to one embodiment.

FIG. 3C is a top view of the column according to one embodiment.

FIG. 4A is an isometric view of a surgical robotics system with a column-mounted robotic arm according to one embodiment.

FIG. 4B is an isometric view of a surgical robotics system with column-mounted robotic arms according to one embodiment.

FIG. 5A is an isometric view of a column ring of the surgical robotics system according to one embodiment.

FIG. 5B is a bottom view of a set of column rings underneath a table according to one embodiment.

FIG. 5C is an isometric view of the set of column rings mounted to a column according to one embodiment.

FIG. 5D is an isometric cutaway view of an arm mount of a column ring according to one embodiment.

FIG. 5E is an isometric cutaway view of the arm mount in a telescoped configuration according to one embodiment.

FIG. 6A is an isometric view of a robotic arm of the surgical robotics system according to one embodiment.

FIG. 6B is an isometric view of an arm segment joint of the robotic arm according to one embodiment.

FIG. 6C is an isometric view of another arm segment joint of the robotic arm according to one embodiment.

FIG. 7A is an isometric view of a surgical robotics system with column-mounted arms configured to access the lower body area of a patient according to one embodiment.

FIG. 7B is a top view of the surgical robotics system with column-mounted arms configured to access the lower body area of the patient according to one embodiment.

FIG. 7C is an isometric view of an imaging device and a surgical robotics system with column-mounted arms configured to access the lower body area of a patient according to one embodiment.

FIG. 7D is a top view of the imaging device and the surgical robotics system with column-mounted arms configured to access the lower body area of the patient according to one embodiment.

FIG. 7E is an isometric view of the surgical robotics system with column-mounted arms configured to access the core body area of a patient according to one embodiment.

FIG. 7F is an isometric view of the surgical robotics system with column-mounted arms configured to access the upper body area of a patient according to one embodiment.

FIG. 8A is an isometric view of a base of a surgical robotics system according to one embodiment.

FIG. 8B is an isometric view of open panels of the base according to one embodiment.

FIG. 8C is an isometric view of robotic arms stowed inside a base of a surgical robotics system according to one embodiment.

FIG. 8D is an isometric view of robotic arms stowed underneath a table of a surgical robotics system according to one embodiment.

FIG. 8E is an isometric view of robotic arms stowed above a base of a surgical robotics system according to one embodiment.

FIG. 8F is another isometric view of robotic arms stowed above a base of a surgical robotics system according to one embodiment.

FIG. 8G is an isometric view of outrigger casters on a base of a surgical robotics system according to one embodiment.

FIG. 8H is another isometric view of the outrigger casters on the base of the surgical robotics system according to one embodiment.

FIG. 8I is a side view of an outrigger caster in a mobile configuration according to one embodiment.

FIG. 8J is a side view of the outrigger caster in a stationary configuration according to one embodiment.

FIG. 9A is an isometric view of a surgical robotics system with a rail-mounted robotic arm according to one embodiment.

FIG. 9B is an isometric view of a surgical robotics system with rail-mounted robotic arms according to one embodiment.

FIG. 10A is an isometric view of base rails of a surgical robotics system according to one embodiment.

FIG. 10B is an isometric view of arm mounts on the base rail according to one embodiment.

FIG. 10C is an isometric cutaway view of an arm mount on the base rail according to one embodiment.

FIG. 10D is cross sectional views of the base rail according to one embodiment.

FIG. 11 is an isometric view of a surgical robotics system with column-mounted robotics arms and rail-mounted robotic arms according to one embodiment.

FIG. 12 is an isometric view of a surgical robotics system with column-mounted robotics arms on a platform separate from a table and a base of the surgical robotics system according to one embodiment.

Reference will now be made in detail to several embodiments, examples of which are illustrated in the accompanying figures. It is noted that wherever practicable similar or like reference numbers may be used in the figures and may indicate similar or like functionality. The figures depict embodiments of the described system (or method) for purposes of illustration only. One skilled in the art will readily recognize from the following description that alternative embodiments of the structures and methods illustrated herein may be employed without departing from the principles described herein.

DETAILED DESCRIPTION

I. System Overview

FIG. 1 is an isometric view of a surgical robotics system **100** according to an embodiment. A user, e.g., a physician or assistant, uses the surgical robotics system **100** to perform robotically-assisted surgery on a patient. The surgical robotics system **100** includes a table **101**, column **102**, and base **103** physically coupled together. Although not shown in FIG. 1, the table **101**, column **102**, and/or base **103** may house, connect to, or use electronics, fluidics, pneumatics, aspiration, or other electrical and mechanical components that support the function of the surgical robotics system **100**.

The table **101** provides support for a patient undergoing surgery using the surgical robotics system **100**. Generally, the table **101** is parallel to the ground, though the table **101** may change its orientation and configuration to facilitate a variety of surgical procedures. The table **101** is further described with reference to FIGS. 2A-I in Section II. Table.

The column **102** is coupled to the table **101** on one end and coupled to the base **103** on the other end. Generally, the column **102** is cylindrically shaped to accommodate column rings coupled to the column **102**, which are further described with reference to FIGS. 5A-E in Section V. Column Ring, however the column **102** may have other shapes such as oval or rectangular. The column **102** is further described with reference to FIGS. 3A-B in Section III. Column.

The base **103** is parallel to the ground and provides support for the column **102** and the table **101**. The base **103** may include wheels, treads, or other means of positioning or transporting the surgical robotics system **100**. The base **103** is further described with reference to FIGS. 8A-E in Section VIII. Base.

Alternative views and embodiments of the surgical robotics system **100** including the above mentioned components are further illustrated and described at least in U.S. Provisional Application No. 62/162,486 filed May 15, 2015 and U.S. Provisional Application No. 62/162,467 filed May 15, 2015.

II. Table

FIG. 2A is an isometric view of a table **201A** of the surgical robotics system **100** according to one embodiment. The table **201A** is an embodiment of the table **101** in FIG. 1. The table **201A** includes a set of one or more segments. Generally, a user changes the configuration of the table **201A** by configuring the set of segments. The surgical robotics system **100** may also configure the segments automatically, for example, by using a motor to reposition a

segment of the set of segments. An example set of segments is shown in FIG. 2A, and includes a swivel segment **210**, center segment **212**, foldable segment **214**, detachable segment **216**, and table base **218**. The swivel segment **210**, center segment **212**, and foldable segment **214** are coupled to the table base **218**. FIG. 2A shows the detachable segment **216** separated from the table base **218**, though the detachable segment **216** may also be coupled to the table base **218**. In various implementations, additional or fewer segments may be used.

An advantage of configuring the set of segments of the table **201A** is that a configured table **201A** may provide greater access to a patient on the table **201A**. For instance, the surgical robotics system **100** performs a surgical procedure on the patient that requires access to the groin area of the patient. When a patient is laying face-up on a typical surgical bed, there is more access to the patient's head, arms, and legs than to the patient's groin area. Since the groin area is located toward the center of the patient's body, the legs often obstruct access to the groin area. The detachable segment **216** is detachable from the table **201A**. The table **201A** without the detachable segment **216** provides greater access to the groin area of a patient lying on the table **201A** with the patient's head toward the side of the table **201A** with the swivel segment **210**. In particular, removing the detachable segment **216** opens more space, for example, to insert a surgical instrument into the groin area. If additional space is required to access the groin area, the foldable segment **214** may be folded down, away from the patient (further described in FIG. 2H). The center segment **212** includes a cutout section **220**, which also provides greater access to the groin area.

The swivel segment **210** pivots laterally relative to the table **201A**. The swivel segment **210** includes an arcuate edge **222** and the center segment **212** also includes in arcuate edge **224**. Due to the arcuate edges, there is minimal gap between the swivel segment **210** and the center segment **212** as the swivel segment **210** pivots away from or toward the table **201A**. A configuration of the table **201A** with the swivel segment **210** pivoted away from the table **201A** provides greater access to the groin area because the other segments of the table **201A** are not obstructing the groin area. An example of this configuration is further described with respect to FIGS. 7C-D in Section VII. A. Lower Body Surgery. Additionally, the swivel segment **210** also includes a cutout section **226**, which provides yet greater access to the groin area.

FIG. 2B is a top view of the table **201A** according to one embodiment. Specifically, FIG. 2B shows the table base **218** with a partial cutaway view and a portion of the swivel segment **210**. Components inside the swivel segment **210** are exposed for purposes of illustration. The table base **218** includes double curved rails **230**, that is, two curved linear rails (also referred to as a first bearing subassembly). The swivel segment **210** also includes double curved rails **232** (also referred to as a second bearing subassembly). The first bearing assembly coupled to the second bearing assembly may be referred to as a bearing mechanism. The double curved rails **230** of the table base **218** engage with the double curved rails **232** of the swivel segment **210**. Both double curved rails are concentric to a virtual circle **234**. The swivel segment **210** pivots about an axis passing through a point **236** at the center of the virtual circle **234** perpendicular to the plane of the table base **218**. The double curved rails **230** of the table base **218** include a first carriage **238** and a second carriage **240**. Similarly, the double curved rails **232** of the swivel segment **210** include a first carriage **242** and a second

carriage **244**. The carriages provide structural support and negate moment loads, which enables the double curved rails to support high cantilevered loads up to at least 500 pounds. For instance, pivoting a patient away from the table **201A** generates a high cantilevered load on the double curved rails supporting the patient's weight. The table base **218** and swivel segment **210** may include additional load-sharing components such as rollers, cam followers, and bearings. In some embodiments, the swivel segment **210** and table base **218** each include a single curved rail instead of double curved rails. Further, each curved rail may include additional or fewer carriages.

FIG. 2C is a top view of the swivel segment **210** of the table **201A** according to one embodiment. The center of mass **250** illustrates the center of mass of the swivel segment **210** and a patient (not shown) lying on the swivel segment **210**. The swivel segment **210** is pivoted at an angle α about the axis **236**. Compared to the center of mass **246** shown in FIG. 2D, the center of mass **250** is closer toward the table base **218** (corresponding to table base **218B** in FIG. 2D), even though the swivel segments in both FIG. 2C and FIG. 2D are each pivoted at the same angle α . Keeping the center of mass **250** close toward the table **218** helps the swivel segment **210** support greater cantilever loads—due to the patient—without tipping over the surgical robotics system. In some embodiments, the swivel segment **210** may be rotated up to an angle of 30 degrees or 45 degrees relative to table base **218**, while keeping the center of mass of the swivel segment **210** above the table **201A**.

FIG. 2D is a top view of a swivel segment **210A** of a table **201B** according to one embodiment. Specifically, the table **201B** includes a table base **218A** and a swivel segment **210A**. The table **201B** does not include double curved rails, but instead includes a swivel mechanism **278** that is further described below with reference to FIGS. 2E-G. The center of mass **246** illustrates the center of mass of the swivel segment **210A** and a patient (not shown) lying on the swivel segment **210A**. The swivel segment **210A** is pivoted at an angle α about an axis **248**. Accordingly, the center of mass **246** is positioned off of the table base **218A**.

FIG. 2E is an isometric exploded view of components of a swivel mechanism **278** (which can also be referred to as a bearing mechanism) of the table **201B** according to one embodiment. The swivel mechanism **278** includes a first bearing subassembly coupled to a second bearing subassembly. In particular, the swivel mechanism **278** includes a harmonic drive motor **280**, static plate **281**, shim **282**, inner bearing race **283**, bearing **284**, outer bearing race cleat **285**, inner bearing race support **286**, static ring **287**, motor housing mount **288**, encoder strip **289**, drive plate **290**, encoder sensor **291**, and swivel insert **292**. The motor housing mount **288** is stationary relative to the table base **218A**. The harmonic drive motor **280** rotates the swivel segment **210A** about the axis **248**. The first bearing subassembly includes the components described above that are coupled to the table base **218A**. The second bearing subassembly includes the components described above that are coupled to the swivel segment **210A**.

FIG. 2F is a cross sectional view of the swivel mechanism **278** shown in FIG. 2E according to one embodiment. The harmonic drive motor **280** is coupled to the motor housing mount **288**. The motor housing mount **288** is coupled to the static ring **287** and the static plate **281**. The static plate **281** is coupled to the table base **218A** using the shim **282** such that the harmonic drive motor **280** is also stationary relative to the table base **218A**.

The harmonic drive motor **280** includes a driving axle **294** coupled to a driving face **296** such that the driving axle **294** and driving face **296** rotate together. The driving face **296** is coupled to the drive plate **290**. The drive plate **290** is coupled to the inner bearing race support **286**. The inner bearing race support **286** is coupled to the swivel insert **292** and the inner bearing race cleat **283**. The inner bearing race support **286** is movably coupled to the table base **218A** by the bearing **284** (e.g., a cross roller bearing). The swivel insert **292** is coupled to the swivel segment **210A** such that rotating the driving axle **294** and driving face **296** causes the swivel segment **210A** to rotate in the same direction. Though not shown in FIG. 2F, the swivel mechanism **278** may include additional components between the static plate **281** and the inner bearing race cleat **283** to provide additional stability, e.g., in the form of a physical hard stop. Further, though not shown in FIG. 2F, the encoder sensor **291** is coupled to the motor housing mount **288** by the encoder strip **289**. The encoder sensor **291** records information about the rotation of the swivel segment **210A**, e.g., the position of the swivel segment **210A** up to an accuracy of 0.1 degrees at 0.01 degree resolution. FIG. 2F shows several screws (or bolts) that are used to couple components of the swivel mechanism, though it should be noted that the components may be coupled using other methods, e.g., welding, press fit, gluing, etc.

The swivel mechanism **278** allows the harmonic drive motor **280** to rotate the swivel segment **210A** with precise control, while supporting a load of up to 500 pounds, e.g., from a patient lying on the swivel segment **210A**. In particular, the harmonic drive motor **280** may rotate the swivel segment **210A** up to a rotational velocity of 10 degrees per second, and up to 45 degrees in either direction about the axis **248**. Further, the swivel segment **210A** is rotated such that the maximum velocity of the center of mass of the patient is 100 millimeters per second, and the time to the maximum velocity is 0.5 seconds. In some embodiments, one of the bearings of the swivel mechanism is a cross roller bearing—e.g., with ball bearings with a bearing friction coefficient of approximately 0.0025—that helps further provide stability to allow the precise rotation of the swivel segment **210A**, while maintaining cantilever loads from the patient's weight. The harmonic drive motor **280** can generate up to 33 Newton meters of torque to rotate the swivel segment **210A** with the weight of the patient. In some embodiments, the harmonic drive motor **280** includes an internal brake with a holding torque of at least 40 Newton meters.

FIG. 2G is a bottom view of the swivel mechanism shown in FIG. 2E according to one embodiment. The harmonic drive motor **280** is exposed such that electrical wires, e.g., from a column of the surgical robotics system, may be coupled to the harmonic drive motor **280** to provide control signals to the harmonic drive motor **280**.

FIG. 2H is an isometric view of a foldable segment **214C** of a table **201C** according to one embodiment. The table **201C** is an embodiment of table **201A** in FIG. 2A. The table **201C** also includes a center segment **212C** coupled to a table base **218C**. The foldable segment **214C** rotates using bearings about an axis **252** parallel to the table base **218C**. The foldable segment **214C** is rotated such that the foldable segment **214C** is orthogonal to the table base **218C** and the center segment **212C**. In other embodiments, the foldable segment **214C** may be rotated to other angles relative to the table base **218C** and the center segment **212C**. The foldable segment **214C** includes a cutout section **254**, for example, to

provide greater access to a patient lying on the table **201C**. In other embodiments, the foldable segment **214C** does not include a cutout section.

FIG. 2I is another isometric view of a foldable segment **214D** of a table **201D** according to one embodiment. The table **201D** is an embodiment of table **201A** in FIG. 2A. The foldable segment **214D** is rotated such that the foldable segment **214D** and the table base **218D** is positioned at an angle β relative to each other. The table **201D** includes a mechanism for the foldable segment **214D** and the center segment **212D** to maintain the rotated position while supporting the weight of a patient on the table **201D**. For example, the mechanism is a friction brake at the joint of the foldable segment **214D** and the center segment **212D** that holds the two segments at the angle β . Alternatively, the foldable segment **214D** rotates about the center segment **212D** using a shaft and the mechanism is a clutch that locks the shaft, and thus keeps the two segments at a fixed position. Though not shown in FIG. 2I, the table **201D** may include motors or other actuators to automatically rotate and lock the foldable segment **214D** to a certain angle relative to the center segment **212D**. Rotating the foldable segment **214D** is advantageous, for example, because the corresponding configuration of the table **201D** provides greater access to the area around the abdomen of a patient lying on the table **201D**.

FIG. 2J is an isometric view of a trapdoor **256** of a table **201E** according to one embodiment. The table **201E** is an embodiment of table **201A** in FIG. 2A. Specifically, the table **201E** includes the trapdoor **256** and a drainage component **258** positioned below the trapdoor **256**. The trapdoor **256** and drainage component **258** collect waste materials such as fluid (e.g., urine), debris (e.g., feces) that are secreted or released by a patient lying on the table during a surgical procedure. A container (not shown) may be positioned below the drainage component **258** to collect and store the waste materials. The trapdoor **256** and drainage component **258** are advantageous because they prevent waste materials from soiling or de-sterilizing equipment such as other components of the surgical robotic system **100** or other surgical tools in an operating room with the surgical robotic system **100**.

FIG. 2K is an isometric view of pivots of the table **201A** according to one embodiment. Specifically, the table **201A** includes a first pivot **260** and a second pivot **262**. The table **201A** rotates about a first axis **264**. A user, e.g., a physician, may rotate the table **201A** about the first axis **264** or the second axis **266** manually or assisted by the surgical robotics system **100**. The surgical robotics system **100** may also rotate the table **201A** automatically, for example, by using control signals to operate a motor coupled to the first pivot **260** or the second pivot **262**. The motor **280** is coupled to the first pivot **260**. Rotation of the table **201A** may provide greater access to certain areas of a patient lying on the table **201A** during a surgical procedure. Specifically, the table **201A** is configured to orient a patient lying on the table **201A** in a Trendelenburg position by rotating about the first axis **264**. Rotation of the table **201A** is further described in FIGS. 2L-M.

FIG. 2L is a side view of the table **201A** rotated about the axis of pitch **264** according to one embodiment. Specifically, the table **201A** is rotated to an angle γ relative to a plane **268** parallel to the ground.

FIG. 2M is an isometric view of the table **201A** rotated about the axis of roll **266** according to one embodiment. Specifically, the table **201A** is rotated to an angle δ relative to the plane **268** parallel to the ground. The table **201A** is

illustrated as transparent to expose components underneath the table 201A. The table includes a set of rails 270. The table 201A may translate laterally along an axis 266 parallel to the set of rails 270. The surgical robotics system 100 translates the table 201A laterally using, for example, a motor or other means of actuation (not shown). A user of the surgical robotics system 100 may also manually translate the table 201A, or with assistance from the surgical robotics system 100.

Alternative views and embodiments of the table 201A including the above mentioned components are further illustrated and described at least in U.S. Provisional Application No. 62/235,394 filed Sep. 30, 2015.

III. Column

FIG. 3A is a side cutaway view of the column 102 of the surgical robotics system 100 according to one embodiment. The column 102 includes electrical and mechanical and other types of components to perform functions of the surgical robotics system 100. The column 102 includes a pitch rotation mechanism 310, column telescoping mechanism 320, ring telescoping mechanisms 330A and 330B, and ring rotation mechanisms 340A and 340B. The ring rotation mechanisms 340A and 340B are further described in FIG. 3B.

The surgical robotics system 100 rotates the table 101 about the axis of pitch 264 (also illustrated previously in FIGS. 2K-L) using the pitch rotation mechanism 310. The pitch rotation mechanism 310 includes a pitch rotation motor 312, right angle gearbox 314, pitch rotation lead screw 316, and pitch rotation bracket 318. The pitch rotation motor 312 is coupled to the right angle gearbox 314. The pitch rotation motor 312 is orthogonal to the pitch rotation lead screw 316. The pitch rotation lead screw 316 is movably coupled to the pitch rotation bracket 318. The right angle gearbox 314 is coupled to the pitch rotation lead screw 316. Output rotation of the pitch rotation motor 312 causes translational motion of the pitch rotation lead screw along an axis 311. Accordingly, translational motion of the pitch rotation lead screw 318 causes the table 101 to rotate about the axis of pitch 264.

The surgical robotics system 100 translates the table vertically using the column telescoping mechanism 320. The column telescoping mechanism 320 includes a column telescoping motor 322, column telescoping lead screw 324, and column telescoping rail 326. The column telescoping motor 322 is coupled to the column telescoping lead screw 324. The column telescoping motor 322 and the column telescoping lead screw 324 are stationary relative to the base 103. The column telescoping lead screw 324 is engaged with the column telescoping rail 326. Output rotation of the column telescoping motor 322 causes the column telescoping rail 326 to translate along a vertical axis 321 along the column telescoping lead screw 324. As the column telescoping rail 326 translates in the positive direction along the vertical axis 321, the height of the column 102 and the table 101 increases.

The column 102 also includes a lower column segment 350, middle column segment 352, and upper column segment 354. The lower column segment 350 is coupled to the base 103 and stationary relative to the base 103. The middle column segment 352 is movably coupled to the lower column segment 350. The upper column segment 354 is movably coupled to the middle column segment 352. In other embodiments, a column 102 may include additional or fewer column segments.

The upper column segment 354 and/or the middle column segment 352 also translate along the vertical axis 321 to

extend the height of the column 102. Similarly, as the column telescoping rail 326 translates in the negative direction along the vertical axis 321, the height of the column 102 and the table 101 decreases. Further, the upper column segment 354 and/or the middle column segment 352 also translate along the vertical axis 321, collapsing over the lower column segment 350. A table 101 with adjustable height is advantageous because the table 101 facilitates a variety of surgical procedures. Specifically, one surgical procedure requires a patient lying on the table 101 to be positioned at a height lower than the height of a patient lying on the table 101 for a different surgical procedure. In some embodiments, the column telescoping mechanism 320 uses other means of actuation such as hydraulics or pneumatics instead of—or in addition to—motors.

The surgical robotics system 100 translates column rings 305A and 305B vertically using the ring telescoping mechanisms 330A and 330B. The ring telescoping mechanism 330A includes a ring telescoping motor 332, ring telescoping lead screw 334, and ring telescoping rail 336. Column rings are further described with reference to FIGS. 5A-E in Section V. Column Ring. Column rings 305A and 305B are movably coupled to the column 102 and translate along a vertical axis 331. Generally, a column 102 includes a ring telescoping mechanism for each column ring of the column 102. Specifically, the column 102 includes ring telescoping mechanism 330A and second ring telescoping mechanism 330B. The ring telescoping motor 332 is coupled to the ring telescoping lead screw 334. The ring telescoping motor 332 and the ring telescoping lead screw 334 are stationary relative to the base 103. The ring telescoping lead screw 334 is engaged with the ring telescoping rail 336. The ring telescoping rail 336 is coupled to the column ring 305A. Output rotation of the ring telescoping motor 332 causes the ring telescoping rail 336 to translate along the vertical axis 331 and along the ring telescoping lead screw 334. As the ring telescoping rail 336 translates in the positive direction or negative direction along the vertical axis 331, the height of a corresponding column ring increases or decreases, respectively.

FIG. 3B is an isometric cutaway view of the column 102 according to one embodiment. The column 102 includes a first accordion panel 360A and a second accordion panel 360B. The accordion panels 360A and 360B extend or fold as the surgical robotics system 100 translates column rings 305A and 305B in the positive direction or negative direction along the vertical axis 331, respectively. The accordion panels 360A and 360B are advantageous because they protect electrical and mechanical and other types of components inside the column 102 (e.g., the pitch rotation mechanism 310, column telescoping mechanism 320, ring telescoping mechanisms 330A and 330B, and ring rotation mechanisms 340A and 340B) from becoming soiled or de-sterilized by fluid waste and other hazards. FIG. 3B shows an isometric view of the ring rotation mechanism 340A, while the ring rotation mechanism 340B is obscured by the column 102.

The surgical robotics system 100 rotates column rings 305A and 305B using the ring rotation mechanisms 340A and 340B, respectively. The ring telescoping rail 336 is coupled to the ring rotation motor 342 by a ring rotation bracket 344. The ring rotation motor 342 is coupled to a set of gears 346. The set of gears 346 includes a driving gear 346G. The driving gear 346G is engaged with a column ring rail 348 of the column ring 305A. Output rotation of the ring rotation motor 342 causes the set of gears 346 and the driving gear 346G to rotate. Accordingly, the rotation of the

driving gear **346G** causes the column ring **305A** to rotate about a vertical axis **341** concentric to the column **102**. The column **102** includes another ring rotation mechanism **340B** corresponding to the column ring **305B**. Generally, both ring rotation mechanisms **340A** and **340B** and column rings **305A** and **305B** will be substantially the same, however in other implementations they may be constructed using different mechanisms.

FIG. 3C is a top view of the ring rotation mechanism **340A** according to one embodiment. For purposes of clarity, FIG. 3C only shows the driving gear **346G**, the column ring **305A**, and the column ring rail **348** of the ring rotation mechanism **340A**. In an example use case, the surgical robotics system **100** rotates the driving gear **346G** clockwise to rotate the column ring rail **348**—and thus, the column ring **305A**—clockwise about the vertical axis **341**.

Alternative views and embodiments of the column **103** including the above mentioned components are further illustrated and described at least in U.S. Provisional Application No. 62/162,486 filed May 15, 2015 and U.S. Provisional Application No. 62/162,467 filed May 15, 2015.

IV. Column-Mounted Robotic Arms

FIG. 4A is an isometric view of a surgical robotics system **400A** with a column-mounted robotic arm **470A** according to one embodiment. The surgical robotics system **400A** includes a set of robotic arms, a set of column rings, table **401A**, column **402A**, and base **403A**. The surgical robotics system **400A** is an embodiment of the surgical robotics system **100** shown in FIG. 1. Generally, the set of robotic arms includes one or more robotic arms, such as robotic arm **470A**, where the robotic arms are coupled to one or more column rings, such as column ring **405A**. Column rings are described in more detail with respect to FIGS. 5A-E in Section V. Column Ring below. Robotic arms are described in more detail with respect to FIGS. 6A-C in Section VI. Robotic Arm below. Column rings **405A** are movably coupled to the column **402A**. Thus, a robotic arm **470A** attached to a column **405A** may be referred to as a column-mounted robotic arm **470A**. As introduced above, the surgical robotics system **400A** uses robotic arms **470A** to perform surgical procedures on a patient lying on the table **401A**.

FIG. 4B is an isometric view of a surgical robotics system **400B** with column-mounted robotic arms according to one embodiment. The surgical robotics system **400B** is an embodiment of the surgical robotics system **400A** shown in FIG. 4A. The surgical robotics system **400B** includes multiple robotic arms, i.e., a first robotic arm **470B**, second robotic arm **470C**, third robotic arm **470D**, and fourth robotic arm **470E**, as well as multiple column rings, i.e., a first column ring **405B** and second column ring **405C**. In other embodiments, the surgical robotics system **400B** may include additional or fewer robotic arms and/or column rings. Further, the robotic arms may be coupled to column rings in various configurations. For example, three robotic arms may be coupled to a column ring. Additionally, the surgical robotics system **400B** may include three column rings each coupled to two robotic arms.

Alternative views and embodiments of the surgical robotics system **400B** including the above mentioned components with column-mounted robotic arms are further illustrated and described at least in U.S. Provisional Application No. 62/162,486 filed May 15, 2015 and U.S. Provisional Application No. 62/162,467 filed May 15, 2015.

V. Column Ring

FIG. 5A is an isometric view of a column ring **505** of a surgical robotics system—for example, surgical robotics system **100**, **400A**, or **400B**—according to one embodiment.

The column ring **505** includes a column ring rail **510**, arm mount pivot **512**, arm mount base **514**, and a set of arm mounts. The set of arm mounts includes one or more arm mounts. Specifically, the set of arm mounts in FIG. 5A includes a first arm mount **506A** and a second arm mount **506B**. Generally, each arm mount of the set of arm mounts and the arm mount base **514** are cylindrically shaped.

The first arm mount **506A** and the second arm mount **506B** are movably coupled to the arm mount base **514**. The first arm mount **506A** and the second arm mount **506B** may rotate—together or independently—about the axis **511** concentric to the arm mount base **514**. For example, the surgical robotics system **400B** rotates the first arm mount **506A** and the second arm mount **506B** using a motor or other means of actuation (not shown) inside the arm mount base **514** or arm mounts. In some embodiments, the first arm mount **506A** and the second arm mount **506B** rotate at predetermined increments, e.g., increments of 15 degrees.

The arm mount base **514** is coupled to the arm mount pivot **512**. The arm mount pivot **512** uses a motor or other means of actuation (not shown) inside the arm mount pivot **512** to rotate the arm mount base **514** about the axis **521** orthogonal to the axis **511**. The arm mount pivot **512** is coupled to, and stationary relative to, the column ring rail **510**. Rotating the arm mount base **514** is advantageous because robotic arms (and arm mounts) coupled to the arm mount base **514** may be reoriented in response to rotation of the table **401B**. Accordingly, robotic arms coupled to the arm mounts of the arm mount base **514** have greater access to a patient lying on the table **401B**.

FIG. 5B is a bottom view of the set of column rings underneath the table **401B** of FIG. 4B according to one embodiment. The set of column rings includes the first column ring **405B** and the second column ring **405C**. Note that FIG. 5B shows the first column ring **405B** and the second column ring **405C** aligned such that the arm mounts are on the same side of the table **401B**, while FIG. 4B shows the first column ring **405B** and the second column ring **405C** positioned such that the arm mounts are on opposite sides of the table **401B**. The surgical robotics system **400B** may rotate the column rings **405B** and **405C** to position the arm mounts in other configurations. For example, two arm mounts are positioned on one side of the table **401B** and two arm mounts are positioned on an opposite side of the table **401B**. By rotating column rings independently from each other around the column, the surgical robotics system **400B** may configure the arm mounts—and thus, robotic arms mounted to the arm mounts—in a greater number of possible positions. Due to this configurability, the surgical robotics system **400B** accommodates a variety of surgical procedures because the robotic arms can access any area (e.g., upper body, core body, or lower body) of the body of a patient lying on the table **401B**. In some embodiments, each arm mount of the column rings include a notch **516** which facilitates the attachment of a robotic arm to the arm mount.

FIG. 5C is an isometric view of the set of column rings mounted to the column **402B** of FIG. 4B according to one embodiment. Similarly to FIG. 5B, FIG. 5C shows all the arm mounts aligned on the same side of the surgical robotics system **400B**.

FIG. 5D is an isometric cutaway view of an arm mount **506C** of a column ring according to one embodiment. The arm mount **506C** includes an arm mount telescoping mechanism **520** and a set of arm mount segments. The arm mount

telescoping mechanism **520** includes an arm mount telescoping motor **522**, arm mount telescoping lead screw **524**, and arm mount telescoping rail **526**. Generally, the set of arm mount segments includes one or more arm mount segments. Specifically, the set of arm mount segments in FIG. **5D** includes a lower arm mount segment **530**, middle arm mount segment **532**, and upper arm mount segment **534**. A robotic arm segment **571** (e.g., of the robotic arm **470B** in FIG. **4B**) is coupled to the upper arm mount segment **534**. The middle arm mount segment **532** and the upper arm mount segment **534** are movably coupled to the lower arm mount segment **530**. The lower arm mount segment **530** is coupled to an arm mount base (e.g., arm mount base **514** in FIG. **5A**).

The surgical robotics system **400B** translates the arm mount **506C** along an axis **531** using the arm mount telescoping mechanism **520**. In FIG. **5D**, the axis **531** is in a horizontal orientation, though it should be noted that, in other embodiments, the axis **531** is in a vertical or any other orientation. The arm mount telescoping motor **522** is coupled to the arm mount telescoping rail **526**. The arm mount telescoping rail **526** is engaged with the arm mount telescoping lead screw **524**. The arm mount telescoping lead screw **524** is stationary relative to the lower arm mount segment **530**. Output rotation of the arm mount telescoping motor **522** causes the arm mount telescoping rail **526** to translate along the vertical axis **531**. Translation of the arm mount **506C** is advantageous because, if the arm mount **506C** is extended, a robotic arm mounted to the arm mount **506C** may have greater access to a patient lying on the table **401B** during a surgical procedure.

FIG. **5E** is an isometric cutaway view of the arm mount **506C** in a telescoped configuration according to one embodiment. In the telescoped configuration, the upper arm mount segment **534** and the middle arm mount segment **532** extend in the positive axis **531** direction to facilitate extension of the arm mount **506C**.

Alternative views and embodiments of the column ring **505** including the above mentioned components are further illustrated and described at least in U.S. Provisional Application No. 62/162,486 filed May 15, 2015 and U.S. Provisional Application No. 62/162,467 filed May 15, 2015.

VI. Robotic Arm

FIG. **6A** is an isometric view of a robotic arm **670** of a surgical robotics system—for example, surgical robotics system **100**, **400A**, or **400B**—according to one embodiment. Generally, the robotic arm **670** includes a set of robotic arm segments such as robotic arm segments **671**, **672**, **673**, **674**, **675**, **676**, and **677**. Each arm segment is movably coupled to at least one other arm segment at an arm segment joint. In particular, the first arm segment **671** is movably coupled to the second arm segment **672**, the second arm segment **672** is movably coupled to the third arm segment **673**, and so forth. The first arm segment **671** is movably coupled to an arm mount (e.g., arm mount **506A** in FIG. **5A**). The seventh arm segment **677** (or the last arm segment of a set of arm segments including a number of arm segments different than seven), is coupled to a surgical instrument. The seventh arm segment **677** may also include mechanisms to hold a surgical instrument such as a clamp or robotic fingers. The robotic arm **670** uses electrical and mechanical components, such as motors, gears, and sensors, inside the robotic arm segments to rotate the arm segments at the arm segment joints.

The robotic arm **670** receives control signals from a robotic arm control system, for example, housed in the column **402B** in FIG. **4B**. In some embodiments, the robotic arm **670** receives control signals from a robotic arm control

system located outside of the column **402B** or separate from the surgical robotics system **400B**. Generally, the robotic arm **670** may include sensors that provide sensor data to the robotic arm control system. Specifically, pressure sensors provide force feedback signals and encoders or potentiometers provide measurements of rotation of arm segments. The robotic arm control system uses the sensor data to generate the control signals provided to the robotic arm **670**. Since each arm segment may rotate with respect to another adjacent segment, each arm segment provides an additional degree of freedom to the mechanical system of the robotic arm **670**. By rotating the robotic arm segments, the surgical robotics system **400B** positions a surgical instrument coupled to the robotic arm **670** such that the surgical instrument has access to a patient undergoing a surgical procedure. Configurations of robotic arms of the surgical robotics system **400B** are further described with reference to FIGS. **7A-F** in Section VII. System Orientations for Performing Surgical Procedures.

FIG. **6B** is an isometric view of an arm segment joint **610** of the robotic arm **670** according to one embodiment. The first arm segment **671A** and the second arm segment **672A** are embodiments of any of the arm segments in FIG. **6A**. The arm segments **671A** and **672A** are cylindrically shaped and joined at the plane **612**. The first arm segment **671A** rotates relative to the second arm segment **672A** about an axis **611** perpendicular to the plane **612**. Further, the axis **611** is perpendicular to the plane **614** of the second arm segment **672A** and perpendicular to the plane **616** of the first arm segment **671A**. That is, the axis **611** is longitudinal relative to the arm segments **671A** and **672A**.

FIG. **6C** is an isometric view of another arm segment joint **620** of the robotic arm **670** according to one embodiment. The arm segments **671B** and **672B** are joined at the plane **622**. Unlike the cylindrically shaped arm segments shown in FIG. **6B**, the arm segments **671B** and **672B** each include a curved section **628** and **630**, respectively. The first arm segment **671B** rotates relative to the second arm segment **672B** about an axis **621** perpendicular to the plane **622**. The axis **621** is not perpendicular to the plane **624** of the arm segment **672B** and not perpendicular to the plane **626** of the arm segment **671B**. In some embodiments, the axis of rotation is perpendicular to a plane of one arm segment, but not perpendicular to a plane of the other arm segment of an arm segment joint.

Alternative views and embodiments of the robotic arm **670** including the above mentioned components are further illustrated and described at least in U.S. Provisional Application No. 62/162,486 filed May 15, 2015 and U.S. Provisional Application No. 62/162,467 filed May 15, 2015.

VII. System Orientations for Performing Surgical Procedures

The surgical robotics system **400B** in FIG. **4B** performs a variety of surgical procedures using column-mounted robotic arms of the set of robotic arms. The surgical robotics system **400B** configures the column-mounted robotic arms to access portions of a patient lying on the table **401B** before, during, and/or after a surgical procedure. The column-mounted robotic arms access portions near the groin of the patient for surgical procedures such as ureteroscopy, percutaneous nephrolithotomy (PCNL), colonoscopy, and fluoroscopy. The column-mounted robotic arms to access portions near the core (e.g., abdomen) area the patient for surgical procedures such as prostatectomy, colectomy, cholecystectomy, and inguinal hernia. The column-mounted robotic arms to access portions near the head of the patient for

surgical procedures such as bronchoscopy, endoscopic retrograde cholangiopancreatography (ERCP).

The surgical robotics system **400B** automatically reconfigures the column-mounted robotic arms, column rings, column, and table to perform different surgical procedures. The features of each subsystem and component of the surgical robotics system **400B** enable the same set of robotic arms to access a large working volume, and multiple working volumes (based on the configuration), to perform a variety of surgical procedures on the patient. In particular, as mentioned above, the robotic arms may be configured in a first configuration to access the patients' groin area, in a second configuration to access the patients' abdomen area, and in a third configuration to access the patients' head area, in addition to other possible configurations. The degrees of freedom provided by the arm segments of the robotic arms, column rings, column, and table contribute to the wide range of configurations. The surgical robotics system **400B** includes a computer system that stores computer program instructions, for example within a non-transitory computer-readable storage medium such as a persistent magnetic storage drive, solid state drive, etc. When executed by a processor of the computer system, the instructions cause the components of the surgical robotics system **400B** to automatically reconfigure without the need for intervention, or with minimal intervention, from a user, e.g., a physician. For example, based on the instructions, the computer system sends an electronic control signal to motors of the robotics arms. In response to receiving the control signal, the motors rotate arm segments of the robotics arms into a certain position. The physician or another user may design a configuration of the surgical robotics system by creating the instructions and providing the instructions to the computer system. For example, the instructions are uploaded to a database of the computer system. The automatic configurability of the surgical robotics system **400B** is an advantage because the automatic configurability saves resources. Specifically, the surgical robotics system **400B** reduces the amount of time taken by users to setup the surgical robotics system **400B** for a surgical procedure. Further, by using the surgical robotics system **400B** for a variety of surgical procedures, users reduce the amount of surgical equipment that they need to purchase, maintain, store, and learn to operate.

Alternative views and embodiments of use cases of the surgical robotics system **400B** with column-mounted robotic arms including the above mentioned components are further illustrated and described at least in U.S. Provisional Application No. 62/162,486 filed May 15, 2015 and U.S. Provisional Application No. 62/162,467 filed May 15, 2015.

VII. A. Lower Body Surgery

FIG. 7A is an isometric view of a surgical robotics system **700A** with column-mounted arms configured to access the lower body area of a patient **708** according to one embodiment. The surgical robotics system **700A** is an embodiment of—though includes more components than—the surgical robotics system **400B** in FIG. 4B. Specifically, the surgical robotics system **700A** includes a set of robotic arms (including five robotic arms in total) and a set of three column rings. A first robotic arm **770A** and a second robotic arm **770B** are coupled to a first column ring **705A**. A third robotic arm **770C** and a fourth robotic arm **770D** are coupled to a second column ring **705B**. A fifth robotic arm **770E** is coupled to a third column ring **705C**. FIG. 7A shows a wireframe of the patient **708** lying on the table **701** undergoing a surgical procedure, e.g., ureteroscopy, requiring access to the lower

body area of the patient **708**. Legs of the patient **708** are not shown as to not obscure portions of the surgical robotics system **700A**.

The surgical robotics system **700A** configures the set of robotic arms to perform a surgical procedure on the lower body area of the patient **708**. Specifically, the surgical robotics system **700A** configures the set of robotic arms to manipulate a surgical instrument **710**. FIG. 7A shows the set of robotic arms inserting the surgical instrument **710** along a virtual rail **790** into the groin area of the patient **708**. Generally, a virtual rail **790** is a co-axial trajectory along which the set of robotic arms translates a surgical instrument (typically a telescoping instrument). The second robotic arm **770B**, the third robotic arm **770C**, and the fifth robotic arm **770E** are coupled, e.g., holding, the surgical instrument **710**. The first robotic arm **770A** and the fourth robotic arm **770D** are stowed to the sides of the surgical robotics system because they are not necessarily required to for the surgical procedure—or at least part of the surgical procedure—shown in FIG. 7A. The robotic arms are configured such that they manipulate the surgical instrument **710** from a distance away from the patient **708**. This is advantageous, for example, because there is often limited space available closer toward the patient's body or there is a sterile boundary around the patient **708**. Further, there may also be a sterile drape around surgical equipment. During a surgical procedure, only sterile objects are allowed pass the sterile boundary. Thus, the surgical robotics system **700A** may still use robotic arms that are positioned outside of the sterile boundary and that are covered with sterilized drapes to perform a surgical procedure.

In one embodiment, the surgical robotics system **700A** configures the set of robotic arms to perform an endoscopy surgical procedure on the patient **708**. The set of robotic arms hold an endoscope, e.g., the surgical instrument **710**. The set of robotic arms insert the endoscope into the patient's body via an opening in the groin area of the patient **708**. The endoscope is a flexible, slender, and tubular instrument with optical components such as a camera and optical cable. The optical components collect data representing images of portions inside the patient's body. A user of the surgical robotics system **700A** uses the data to assist with performing the endoscopy.

FIG. 7B is a top view of the surgical robotics system **700A** with column-mounted arms configured to access the lower body area of the patient **708** according to one embodiment.

FIG. 7C is an isometric view of an imaging device **740** and a surgical robotics system **700B** with column-mounted arms configured to access the lower body area of a patient **708** according to one embodiment. The surgical robotics system **700B** is an embodiment of the surgical robotics system **400B** in FIG. 4B. The surgical robotics system **700B** includes a pair of stirrups **720** that support the legs of the patient **708**, and thus exposing the groin area of the patient **708**. Generally, the imaging device **740** captures images of body parts or other objects inside a patient **708**. The imaging device **740** may be a C-arm, also referred to as a mobile C-arm, which is often used for fluoroscopy type surgical procedures, or another type of imaging device. A C-arm includes a generator, detector, and imaging system (not shown). The generator is coupled to the bottom end of the C-arm and faces upward toward the patient **708**. The detector is coupled to the top end of the C-arm and faces downward toward the patient **708**. The generator emits X-ray waves toward the patient **708**. The X-ray waves penetrate the patient **708** and are received by the detector. Based on the received X-ray waves, the imaging system **740**

generates the images of body parts or other objects inside the patient 708. The swivel segment 210 of the table 401B is rotated laterally such that the groin area of the patient 708 is aligned in between the generator and detector of the C-arm imaging device 740. The C-arm is a physically large device with a footprint that needs to be stationed underneath the patient. In particular, the generator of the C-arm needs to be underneath the operative area of the patient, e.g., the abdomen area. In typical surgical beds mounted to a column, the column interferes with the positioning of the C-arm generator, e.g., because the column is also underneath the operative area. In contrast, due to the configurability of the swivel segment 210, the surgical robotics system 700B may configure the table 401B such that the C-arm, the robotic arms, and a user (e.g., physician) have a sufficient range of access to perform a surgical procedure on a working area of the patient's body. In one example use case, the table 401B is translated laterally along a longitudinal axis of the table 401B such that the robotic arms can access the groin or lower abdomen area of a patient on the table 401B. In another example use case, by rotating the swivel segment 210 away from the column 402B, the generator of the C-arm 740 may be positioned underneath the groin area of the patient 708. The swivel segment 210—with a patient lying on the swivel segment 210—may be rotated at least to 45 degrees relative to a longitudinal axis of the table 401B without tipping over the surgical robotics system. In particular, the surgical robotics system does not tip because the center of mass of the surgical robotics system (e.g., the center of mass of the combined, at least, table, bed, and base) is positioned above a footprint of the base. Outrigger casters, further described with reference to FIGS. 8G-J in Section VIII. Base, may provide further stability to prevent the surgical robotics system from tipping over when a swivel segment is rotated away from the table.

The surgical robotics system 700B uses a set of column-mounted robotic arms to manipulate a surgical instrument 710. Each of the robotic arms is coupled to, e.g., holding, the surgical instrument 710. The surgical robotics system 700B uses the robotic arms to insert the surgical instrument 710 into the groin area of the patient along a virtual rail 790.

FIG. 7D is a top view of the imaging device 740 and the surgical robotics system 700B with column-mounted arms configured to access the lower body area of the patient 708 according to one embodiment.

VII. B. Core Body Surgery

FIG. 7E is an isometric view of the surgical robotics system 700B (or 400B) with column-mounted arms configured to access the core body area of a patient 708 according to one embodiment. The surgical robotics system 700B has been reconfigured from the configuration shown in FIG. 7C-D where the robotic arms access the lower body area of the patient 708. In embodiments where the table includes a swivel segment 210, the swivel segment 210 of the table is rotated in-line with the rest of the table. The patient 708 lying on the table 401B is undergoing a surgical procedure, e.g., prostatectomy or laparoscopy, requiring access to the core body area of the patient 708. Each robotic arm is manipulating a surgical instrument to perform the surgical procedure. The surgical robotics system 700B raises the column rings 405B and 405C toward the table 401B so that the robotic arms have greater access the patient 708. Further, the surgical robotics system 700B rotates the column rings such that two of the robotic arms extend from one side of the table 401B and the other two robotic arms extend from the opposite side of the 401B. Thus, the robotic arms are less

likely to interfere with each other (e.g., a robotic arm blocking the motion of another robotic arm) during the surgical procedure.

VII. C. Upper Body Surgery

FIG. 7F is an isometric view of the surgical robotics system 700B (or 400B) with column-mounted arms configured to access the upper body area of a patient 708 according to one embodiment. The surgical robotics system 700B has been reconfigured from the configuration shown in FIG. 7E where the robotic arms access the core body area of the patient 708. In embodiments where the table includes a swivel segment 210, the swivel segment 210 of the table is rotated in-line with the rest of the table. The patient 708 lying on the table 401B is undergoing a surgical procedure, e.g., bronchoscopy, requiring access to the upper body area of the patient 708, specifically the head of the patient 708. The robotic arm 470C and the robotic arm 470D are inserting a surgical instrument 710D, e.g., a bronchoscope, into the mouth of the patient 708 along a virtual rail 790. The robotic arm 470B is coupled to, e.g., holding, an introducer 750. The introducer 750 is a surgical instrument that directs the bronchoscope into the mouth of the patient 708. Specifically, the trajectory of the bronchoscope along the virtual rail 790 begins parallel to the patient 708. The introducer 750 changes the angle of the virtual rail 790 just before the bronchoscope enters the mouth. The robotic arm 470E (not shown in FIG. 7F) is not used for the surgical procedure, and thus is stowed away.

VIII. Base

FIG. 8A is an isometric view of a base 403A of a surgical robotics system 800A according to one embodiment. The surgical robotics system 800A is an embodiment of the surgical robotics system 400B in FIG. 4B. The surgical robotics system 800A stores column-mounted robotic arms and/or column rings (not shown) inside the base 403B when the robotic arms are not in use. The base 403B includes a first panel 820A and a second panel 820B that cover stored robotic arms. The first panel 820A and the second panel 820B are advantageous because they prevent waste materials from de-sterilizing or otherwise contaminating stored robotic arms.

FIG. 8B is an isometric view of open panels of the base 403B according to one embodiment. The first panel 820A and the second panel 820B pivot away from the column 802A such that column-mounted robotic arms have access to inside the base 403B. The first panel 820A includes a cutout 830A and the second panel 820B includes a cutout 830B. The cutouts 830A and 830B conform to the shape of the column 402B such that the panels 820A and 820B form a seal around the column 402B when closed. The surgical robotics system 800A may automatically open and close the first panel 820A and the second panel 820B using motors or other means of actuation. A user of the surgical robotics system 800A may also manually open and close the first panel 820A and the second panel 820B.

FIG. 8C is an isometric view of a robotic arm stowed inside a base 403B of a surgical robotics system 800B according to one embodiment. The surgical robotics system 800B is an embodiment of the surgical robotics system 400B in FIG. 4B. The surgical robotics system 800B stores column-mounted robotic arms 470B and 470D and column rings 405B and 405C inside the base 403B when the robotic arms are not in use. The base 403B includes a first panel 820A and a second panel 820B that cover stored robotic arms and column rings. The first panel 820A includes a cutout 830C. The second panel 820B also includes a cutout (not shown due to being obscured by other components).

The cutouts conform to the shape of the column **402B** such that the panels **820A** and **820B** form a seal around the column **402B** when closed.

The first panel **820A** and a second panel **820B** translate laterally to provide access for the robotic arms and column rings into the base **403B**. FIG. **8C** shows the first panel **820A** and a second panel **820B** translated to form an opening. The opening may be large enough to provide access for a robotic arm, but not too large as to still provide protection to the robotic arms even when the panels are open. The robotic arm **470D** and column ring **405C** are stowed inside the base **403B**. The robotic arm **470B** and column ring **405B** are outside the base **403B**, though they may also be stowed inside the base **403B**. The surgical robotics system **800B** may automatically open and close the first panel **820A** and the second panel **820B** using motors or other means of actuation. A user of the surgical robotics system **800B** may also manually open and close the first panel **820A** and the second panel **820B**.

FIG. **8D** is an isometric view of robotic arms stowed underneath the table **701** of the surgical robotics system **700A** according to one embodiment. Specifically, the arm segments of each robotic arm rotate such that the robotic arm is in a compact configuration for stowage. The surgical robotics system **700A** raises the first column ring **705A** and the second column ring **705B**, and lowers the third column ring **705C** toward the center of the column **702**. This way, the robotic arms have enough space in the stowed configuration without interfering with each other. In one embodiment, the column **702** includes covers (e.g., similar to panels **820A** and **820B**) over the robotics arms to protect the robotic arms from contamination or damage.

FIG. **8E** is an isometric view of robotic arms stowed above the base **403B** of the surgical robotics system **400B** according to one embodiment. The robotic arms **470B**, **470C**, **470D**, and **470E** are in a stowed configuration. Specifically, the arm segments of each robotic arm rotate such that the robotic arm is in a compact configuration for stowage. The surgical robotics system **400B** lowers the first column ring **405B** and the second column ring **405C** along the column **402B** such that the stowed robotic arms rest on the base **403B** and are away from the table **401B**. A cover (not shown) such as a drape or panel may be used to cover the stowed robotic arms for protection from de-sterilization or other contamination.

FIG. **8F** is another isometric view of robotic arms stowed above the base **403B** of the surgical robotics system **800C** according to one embodiment. The robotic arms are rail-mounted instead of column-mounted. Rail-mounted robotic arms are further described with reference to FIGS. **9A-B** and FIGS. **10A-D** in Section IX. Rail-Mounted Robotic Arms and Section X. Rails, respectively. The surgical robotics system **800C** is an embodiment of the surgical robotics system **900B** further described with reference to FIG. **9B** in Section IX. Rail-Mounted Robotic Arms. The robotic arms **870C**, **870D**, **870E**, **870F**, **870G**, and **870H** are in a stowed configuration.

FIG. **8G** is an isometric view of outrigger casters on a base **803** of a surgical robotics system according to one embodiment. The base **803** shown in FIG. **8G** includes four outrigger casters **840A**, **840B**, **840C**, and **840D**, each substantially the same as each other and positioned at a different corner of the base **803**, though it should be noted that, in other embodiments, a base may include any number of outrigger casters positioned in other locations on the base. The outrigger casters **840A**, **840B**, **840C**, and **840D** are each in a mobile configuration, i.e., the caster wheel physically

contacts the ground. Thus, a user of the surgical robotics system may transport the surgical robotics system using the caster wheels, e.g., to a storage area when the surgical robotics system is not in use.

FIG. **8H** is another isometric view of the outrigger casters **840A**, **840B**, **840C**, and **840D** on the base **803** of the surgical robotics system according to one embodiment. The outrigger casters **840A**, **840B**, **840C**, and **840D** are each in a stationary configuration, i.e., the outrigger caster is rotated such that the caster wheel does not physically contact the ground. Thus, the surgical robotics system may be stabilized and immobilized during a surgical procedure.

FIG. **8I** is a side view of the outrigger caster **840A** in a mobile configuration according to one embodiment. The outrigger caster **840A** includes a caster wheel **842** movably coupled to an outrigger mount **844**. The outrigger mount **844** is coupled to a foot **846**. The first linkage **848** is movably coupled to the outrigger mount **844** by the first hinge **850**. The second linkage **852** is movably coupled to the outrigger mount **844** by the second hinge **854**. In the mobile configuration, the caster wheel **842** may rotate to move the outrigger caster **840** along the ground.

FIG. **8J** is a side view of the outrigger caster **840A** in a stationary configuration according to one embodiment. In the stationary configuration, the caster wheel **842** may freely rotate, but the caster wheel **842** does not move the outrigger caster **840A** because the caster wheel **842** is not physically in contact with the ground. The surgical robotics system (or a user) rotates the outrigger caster **840A**, e.g., 90 degrees, to change the outrigger caster **840A** from the mobile configuration to the stationary configuration. Thus, the foot **846** now physically contacts the ground, and helps prevent the surgical robotics system from moving. The foot **846** may have a larger footprint relative to the caster wheel **842** to provide additional stability on the ground. The linkages **848** and **852** are positioned such that they do not interfere with the rotational path of the outrigger caster **840A**. Combining the caster wheel **842** and the foot **846** in the outrigger caster **840A** is advantageous, e.g., because the outrigger caster **840A** allows the surgical robotics system to change between the mobile and stationary configurations using a compact mechanism, compared to having separate mechanisms for casters and stabilization. Further, in use cases of surgical robotics systems including swivel segments that rotate a patient lying on the swivel segment away from a corresponding table (e.g., as illustrated in FIGS. **7C-D**), the feet of outrigger casters (in the stationary configuration) help prevent the surgical robotics system from tipping over due to the center of mass of the patient extending beyond the table base.

Alternative views and embodiments of the base **403B** including the above mentioned components are further illustrated and described at least in U.S. Provisional Application No. 62/203,530 filed Aug. 11, 2015.

IX. Rail-Mounted Robotic Arms

FIG. **9A** is an isometric view of a surgical robotics system **900A** with a rail-mounted robotic arm according to one embodiment. The surgical robotics system **900A** includes a set of robotic arms (including at least arm **470A**) and a set of base rails (including at least base rail **980A**). The robotic arm **470A** is coupled to the base rail **980A**. Base rails are further described with respect to FIGS. **10A-D** in Section X. Rails below. The base rail **980A** is movably coupled to the base **103**. Thus, the robotic arm **470A** may be referred to as a rail-mounted robotic arm **470A**.

FIG. **9B** is an isometric view of a surgical robotics system **900B** with rail-mounted robotic arms according to one

embodiment. The surgical robotics system **900B** includes robotic arms **470B**, **470C**, **470D**, and **470E** each coupled to a first base rail **980B** or a second base rail **980C**. The first base rail **980B** and the second base rail **980C** are movably coupled to the base **103**.

In other embodiments, the surgical robotics system **900B** may include additional or fewer robotic arms and/or base rails. Further, the robotic arms may be coupled to base rails in various configurations. For example, three robotic arms may be coupled to a base rail. Additionally, the surgical robotics system **900B** may include three base rails each coupled to a robotic arm.

The surgical robotics system **900B** may translate robotic arms mounted to a base rail by translating the base rails relative to the base **103**. Base rails may translate beyond the starting footprint of the base **103**, which allows the robotic arms to operate in a larger volume of space. Further, the surgical robotics system **900B** may translate robotic arms mounted to a base rail independently from each other by translating the robotic arms relative to the base rail. This is advantageous, for example, because the surgical robotics system **900B** may position the robotic arms in different configurations to perform a variety of surgical procedures.

Alternative views and embodiments of the surgical robotics system **900B** with rail-mounted robotic arms including the above mentioned components are further illustrated and described at least in U.S. Provisional Application No. 62/193,604 filed Jul. 17, 2015 and U.S. Provisional Application No. 62/201,518 filed Aug. 5, 2015.

X. Rails

FIG. **10A** is an isometric view of base rails of a surgical robotics system **1000** according to one embodiment. A base rail includes a set of one or more arm mounts each movably coupled to the base rail. Further, each arm mount is an embodiment of the arm mount **506A** or **506B** previously described with reference to FIG. **5A** in Section V. Column Ring. Specifically, the base rail **980B** includes arm mounts **1006A**, **1006B**, and **1006C**.

FIG. **10B** is an isometric view of arm mounts on the base rail **980B** according to one embodiment. The arm mounts **1006A**, **1006B**, and **1006C** each include a belt and pinion assembly. Specifically, the belt and pinion assembly of arm mount **1006A** includes a bracket **1012**, motor **1014**, belt **1016**, and pinion **1018**. The belt and pinion assemblies of arm mount **1006B** and **1006C** are constructed similarly.

The surgical robotics system **1000** translates arm mounts—and thus, robotic arms mounted to the arm mounts—along base rails using the belt and pinion assemblies. Specifically, the arm mount **1006A** is movably coupled to a channel **1020** of the base rail **980B** by the bracket **1012**. The bracket **1012** is coupled to motor **1014**, belt **1016**, and pinion **1018**. The motor **1014** is coupled to the pinion **1018** by the belt **1016**. Thus, output rotation of the motor **1014** causes the pinion **1018** to rotate. The pinion **1018** is engaged with a rail lead screw **1010** of the base rail **980B**. Rotation of the pinion **1018** causes the arm mount **1006A** to translate along the base rail **980B** parallel to the rail lead screw **1010**.

FIG. **10C** is an isometric cutaway view of an arm mount **1006A** on the base rail **980B** according to one embodiment. The arm mount **1006A** includes a belt and pinion assembly. Specifically, the belt and pinion assembly includes a motor **1014**, belt **1016**, pinion **1018**, and bearing **1022**. The surgical robotics system **1000** translates the arm mount **1006A**—and thus, a robotic arm mounted to the arm mount **1006A**—along the base rail **980B** using the belt and pinion assembly. The motor **1014** is coupled to the pinion **1018** by the belt **1016**. Thus, output rotation of the motor **1014** causes the

pinion **1018** to rotate. The pinion **1018** is coupled to the bearing **1022**. In some embodiments, the bearing **1022** forms a rack and pinion assembly with the base rail **980B**. Specifically, the bearing **1022** is a gear (i.e., the pinion) and is engaged with a rack **1024** of the base rail **980B**. Rotation of the pinion **1018** causes the bearing **1022** to translate along the base rail **980B** parallel to the rack **1024**. Thus, the arm mount **1006A** also translates along the base rail **980B**.

FIG. **10D** is cross sectional views of the base rail **980B** according to one embodiment. The cross sectional view **1000A** shows a basic profile of an embodiment of the base rail **980B**. The cross sectional view **1000B** shows a reinforced profile of an embodiment of the base rail **980B**. The lower segment **1030B** of the reinforced profile is larger in size than the lower segment **1030A** of the basic profile. Thus, the reinforced profile is an advantage, for example, because it enables the base rail **980B** to withstand greater loads relative to the basic profile. Both the basic and the reinforced profiles have a T-slot attachment **1040**, which engages with a corresponding T-slot on a base of a surgical robotics system.

Alternative views and embodiments of the base rails **980A**, **980B**, and **980C** including the above mentioned components are further illustrated and described at least in U.S. Provisional Application No. 62/193,604 filed Jul. 17, 2015 and U.S. Provisional Application No. 62/201,518 filed Aug. 5, 2015.

XI. Alternate Configurations

XI. A. Hybrid Configuration

FIG. **11** is an isometric view of a surgical robotics system **1100** with column-mounted robotics arms and rail-mounted robotic arms according to one embodiment. Due to the hybrid configuration including both column-mounted robotics arms and rail-mounted robotic arms, the surgical robotics system **1100** may configure the robotic arms in a greater number of (or different types of) positions compared to surgical robotics systems with column-mounted robotics arms only or rail-mounted robotic arms only. Further, the surgical robotics system **1100** takes advantage of the rotational motion of robotic arms using the column rings as well as translational motion of the robotic arms using the base rails.

XI. B. Cart-Based Robotic Arm Column

FIG. **12** is an isometric view of a surgical robotics system **1200** with column-mounted robotics arms on a column **402B** and base **403B** separate, e.g., as a free standing cart, from a table **101**, column **102**, and base **103** of the surgical robotics system **1200** according to one embodiment. The surgical robotics system **1200** configures the robotic arms to access the lower body area of patient **708** lying on the table **101**. In one embodiment, mounting the robotic arms on a cart including the column **402B** separate from the column **102** coupled to the table **101** with the patient is advantageous. For example, because the surgical robotics system **1200** may configure the robotic arms to a greater number of (or different types of) positions compared to surgical robotics systems with robotics arms mounted to the same column as the table, which are limited at least in the angles where the table extends past the column **102**. Further, the cart may include outrigger casters (e.g., previously described with reference to FIGS. **8G-J** in Section VIII. Base) that allow users to more easily transport the robotic arms or keep the cart stationary. Mounting the robotic arms separately can also reduce the number of components and complexity of the column coupled to the table with the patient.

Alternative views and embodiments of the surgical robotics system **1100**, the surgical robotics system **1200**, and other

surgical robotics systems including the above mentioned components are further illustrated and described at least in U.S. Provisional Application No. 62/162,486 filed May 15, 2015, U.S. Provisional Application No. 62/162,467 filed May 15, 2015, U.S. Provisional Application No. 62/193,604 filed Jul. 17, 2015, U.S. Provisional Application No. 62/201,518 filed Aug. 5, 2015, U.S. Provisional Application No. 62/203,530 filed Aug. 11, 2015, and U.S. Provisional Application No. 62/235,394 filed Sep. 30, 2015.

XII. Additional Considerations

Upon reading this disclosure, those of skill in the art will appreciate still additional alternative structural and functional designs through the disclosed principles herein. Thus, while particular embodiments and applications have been illustrated and described, it is to be understood that the disclosed embodiments are not limited to the precise construction and components disclosed herein. Various modifications, changes and variations, which will be apparent to those skilled in the art, may be made in the arrangement, operation and details of the method and apparatus disclosed herein without departing from the spirit and scope defined in the appended claims.

As used herein any reference to “one embodiment” or “an embodiment” means that a particular element, feature, structure, or characteristic described in connection with the embodiment is included in at least one embodiment. The appearances of the phrase “in one embodiment” in various places in the specification are not necessarily all referring to the same embodiment.

Some embodiments may be described using the expression “coupled” and “connected” along with their derivatives. For example, some embodiments may be described using the term “coupled” to indicate that two or more elements are in direct physical or electrical contact. The term “coupled,” however, may also mean that two or more elements are not in direct contact with each other, but yet still co-operate or interact with each other. The embodiments are not limited in this context unless otherwise explicitly stated.

As used herein, the terms “comprises,” “comprising,” “includes,” “including,” “has,” “having” or any other variation thereof, are intended to cover a non-exclusive inclusion. For example, a process, method, article, or apparatus that comprises a list of elements is not necessarily limited to only those elements but may include other elements not expressly listed or inherent to such process, method, article, or apparatus. Further, unless expressly stated to the contrary, “or” refers to an inclusive or and not to an exclusive or. For example, a condition A or B is satisfied by any one of the following: A is true (or present) and B is false (or not present), A is false (or not present) and B is true (or present), and both A and B are true (or present).

In addition, use of the “a” or “an” are employed to describe elements and components of the embodiments herein. This is done merely for convenience and to give a general sense of the invention. This description should be read to include one or at least one and the singular also includes the plural unless it is obvious that it is meant otherwise.

What is claimed is:

1. A system comprising:

- a table for supporting a patient positioned on the table;
- a column coupled to the table;
- a base coupled to the column;
- a column ring coupled to the column and configured to linearly translate relative to the table; and
- a robotic arm coupled to the base and configured to manipulate a medical instrument relative to the patient

positioned on the table, wherein the robotic arm is further configured to be stowable within a volume of the base.

2. The system of claim 1, wherein the column ring is further configured to rotate around the column.

3. The system of claim 1, wherein the table comprises a table portion that is configured to be rotatable about a pivot.

4. The system of claim 1, wherein the table comprises a rail that is configured to translate relative to the column.

5. The system of claim 1, wherein the column ring further comprises an arm mount configured to position the robotic arm.

6. The system of claim 1, further comprising an angle rotation mechanism configured to change an angle of the table relative to the column.

7. The system of claim 6, wherein the angle rotation mechanism is configured to change the angle of the table relative to the column in at least two degrees of freedom.

8. The system of claim 1, wherein the column is cylindrical.

9. The system of claim 1, wherein the column ring is circular.

10. The system of claim 1, wherein the medical instrument comprises at least one of a catheter, an endoscope, and a laparoscope.

11. The system of claim 1, wherein the base comprises a panel configured to cover the volume in the base.

12. The system of claim 11, wherein the panel of the base is mechanically actuated.

13. The system of claim 11, wherein the panel is configured to translate laterally in order to allow the robotic arm to be stowed within the volume.

14. The system of claim 11, wherein the volume is sized to stow the column ring.

15. The system of claim 14, wherein the column ring is configured to translate into the volume in the base for stowage of the column ring.

16. A method comprising:

positioning a patient on a table, the table coupled to a column and a base;

translating a column ring along the column, the column ring coupled to the column and comprising an arm mount;

positioning a robotic arm relative to the patient, the robotic arm coupled to the arm mount; and

directing a medical instrument towards a location within the patient, the medical instrument coupled to the robotic arm.

17. The method of claim 16, the method further comprising rotating the column ring around the column.

18. The method of claim 16, the method further comprising changing an angle of the table relative to the column, wherein the table comprises an angle rotation mechanism configured to change the angle of the table relative to the column.

19. The method of claim 18, wherein changing the angle of the table comprises changing the angle in two degrees of freedom.

20. The method of claim 16, the method further comprising translating a panel in the base, the panel being configured to cover a volume of the base, and the volume being configured to stow the robotic arm and the column ring.

21. The method of claim 20, wherein the translating of the column ring comprises vertically translating the column ring from the volume in the base.

22. The method of claim 16, the method further comprising rotating a portion of the table about a pivot.

25

23. The method of claim 16, the method further comprising translating the table relative to the column.

24. The method of claim 16, wherein the positioning of the robotic arm comprises moving the arm mount to position the robotic arm proximate to the patient.

25. The method of claim 24, wherein the moving of the arm mount comprises rotating the arm mount along an arm mount axis.

26. The method of claim 16, wherein the directing of the medical instrument comprises directing the medical instrument through at least one of a small incision and a natural orifice.

27. The method of claim 26, wherein the medical instrument comprises at least one of a catheter, an endoscope, and a laparoscope.

28. The method of claim 16, wherein the translating the column ring, the positioning of the robotic arm, and the directing of the medical instrument are performed with minimal user intervention.

29. The method of claim 16, wherein the column ring is circular.

30. The method of claim 16, wherein the column is cylindrical.

* * * * *

26

专利名称(译)	手术机器人系统		
公开(公告)号	US10500001	公开(公告)日	2019-12-10
申请号	US15/453798	申请日	2017-03-08
[标]申请(专利权)人(译)	AURIS手术机器人技术		
申请(专利权)人(译)	AURIS手术机器人，INC.		
[标]发明人	YU ALAN MOLL FREDERIC H RICHTER BENJAMIN OLSON MARK H GONZALEZ JASON TUCKER KYLE ANDREW MAEDER YORK PAXTON SCHULTE GREGORY T		
发明人	YU, ALAN MOLL, FREDERIC H. RICHTER, BENJAMIN OLSON, MARK H. GONZALEZ, JASON TUCKER, KYLE ANDREW MAEDER-YORK, PAXTON SCHULTE, GREGORY T.		
IPC分类号	A61B34/30 A61G13/06 A61G13/04 A61B1/00 A61G13/02 A61G7/075 A61G7/015 A61G7/008 A61G7/005 A61B34/00 A61B34/35 A61G13/12 A61G13/10 A61G13/08		
CPC分类号	A61B34/30 A61G7/005 A61G7/0755 A61G13/02 A61G13/1245 A61G13/04 A61G7/015 A61B34/70 A61G13/06 A61G7/008 A61B34/35 A61B1/00149 A61G13/08 A61G13/102 Y10S901/28 A61B2034/302 Y10S901/02 Y10S901/27 A61B2034/301		
审查员(译)	阮瞳V		
优先权	62/162486 2015-05-15 US 62/162467 2015-05-15 US 62/193604 2015-07-17 US 62/201518 2015-08-05 US 62/203530 2015-08-11 US 62/235394 2015-09-30 US		
其他公开文献	US20170172673A1		
外部链接	Espacenet		

摘要(译)

具有机械臂的外科手术机器人系统可配置为执行各种外科手术程序。 外科手术机器人系统包括桌子，立柱，底座和机械臂，它们可以立柱安装，导轨安装或安装在单独的单元上。 在安装在色谱柱上的配置中，色谱柱包括垂直旋转并绕色谱柱旋转的色谱柱环。 机械臂连接到柱环。 在导轨安装配置中，基座包括沿基座平移的基座导轨。 机械臂连接到基座导轨。 在两种配置中，机械臂彼此独立移动，并包括多个臂段。 每个臂段为机械臂提供了额外的自由度。 因此，外科手术机器人系统可以将机器人臂定位成多种构造以接近患者身体的不同部分。

