



US008475455B2

(12) **United States Patent**
McClurken et al.

(10) **Patent No.:** **US 8,475,455 B2**
(45) **Date of Patent:** **Jul. 2, 2013**

(54) **FLUID-ASSISTED ELECTROSURGICAL
SCISSORS AND METHODS**

(75) Inventors: **Michael E. McClurken**, Durham, NH
(US); **Roger D. Greeley**, Portsmouth,
NH (US); **John W. Berry**, Bel Air, MD
(US)

(73) Assignee: **Medtronic Advanced Energy LLC**,
Minneapolis, MN (US)

(*) Notice: Subject to any disclaimer, the term of this
patent is extended or adjusted under 35
U.S.C. 154(b) by 1337 days.

(21) Appl. No.: **10/532,704**

(22) PCT Filed: **Oct. 28, 2003**

(86) PCT No.: **PCT/US03/34306**

§ 371 (c)(1),
(2), (4) Date: **May 2, 2006**

(87) PCT Pub. No.: **WO2004/039416**

PCT Pub. Date: **May 13, 2004**

(65) **Prior Publication Data**

US 2006/0235379 A1 Oct. 19, 2006

Related U.S. Application Data

(60) Provisional application No. 60/422,190, filed on Oct.
29, 2002.

(51) **Int. Cl.**
A61B 18/14 (2006.01)

(52) **U.S. Cl.**
USPC 606/52; 606/51; 606/207

(58) **Field of Classification Search**

USPC 606/32-52, 205-207
See application file for complete search history.

(56) **References Cited**

U.S. PATENT DOCUMENTS

623,022	A	4/1899	Johnson	
1,735,271	A	11/1929	Groff	
1,814,791	A	7/1931	Ende	
2,002,594	A	5/1935	Wappler et al.	
2,031,682	A	2/1936	Wappler et al.	
2,102,270	A	12/1937	Hyams	
2,275,167	A	3/1942	Bierman	
2,568,234	A *	9/1951	Haufrect	606/174
2,888,928	A	6/1959	Seiger	
3,084,433	A *	4/1963	Kimmel	30/254
3,163,166	A	12/1964	Brant et al.	
3,682,130	A	8/1972	Jeffers	

(Continued)

FOREIGN PATENT DOCUMENTS

DE	1 007 960	5/1957
EP	0 175 595	3/1986

(Continued)

OTHER PUBLICATIONS

Supplemental European Search Report dated Mar. 21, 2006 issued in
related European Patent Application No. 03781437.3-2305.

Primary Examiner — Linda Dvorak

Assistant Examiner — Ronald Hupczey, Jr.

(74) *Attorney, Agent, or Firm* — Jeffrey J. Hohenshell

(57) **ABSTRACT**

An electrosurgical scissors comprising an end effector com-
prising a first blade member and a second blade member, the
first blade member and the second blade member pivotally
connected; an electrical connector configured to couple the
scissors to a power source; and a fluid passage in fluid com-
munication with at least one fluid outlet.

20 Claims, 12 Drawing Sheets

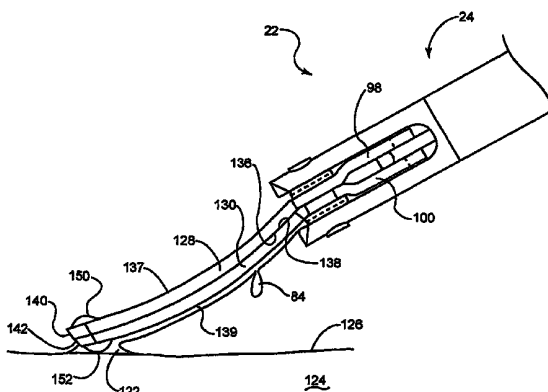
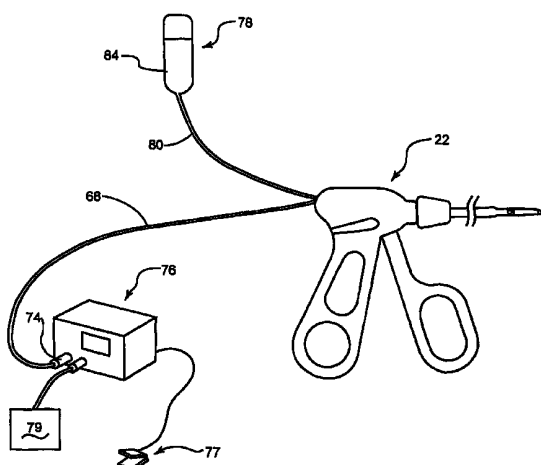

U.S. PATENT DOCUMENTS

3,750,650 A	8/1973	Ruttgers	5,431,649 A	7/1995	Mulier et al.
3,901,241 A	8/1975	Allen, Jr.	5,433,708 A	7/1995	Nichols et al.
4,037,590 A	7/1977	Dohring et al.	5,437,662 A	8/1995	Nardella
4,060,088 A	11/1977	Morrison, Jr. et al.	5,437,664 A	8/1995	Cohen et al.
4,116,198 A	9/1978	Roos	5,441,498 A	8/1995	Perkins
4,244,371 A	1/1981	Farin	5,441,503 A	8/1995	Considine et al.
4,276,874 A	7/1981	Wolvek et al.	5,445,638 A	8/1995	Rydell et al.
4,301,802 A	11/1981	Poler	5,456,682 A	10/1995	Edwards et al.
4,307,720 A	12/1981	Weber, Jr.	5,456,684 A	10/1995	Schmidt et al.
4,321,931 A	3/1982	Hon	5,458,596 A	10/1995	Lax et al.
4,326,529 A	4/1982	Doss et al.	5,458,597 A	10/1995	Edwards et al.
4,342,218 A	8/1982	Fox	5,458,598 A	10/1995	Feinberg et al.
4,355,642 A	10/1982	Alferness	5,460,629 A	10/1995	Shlain et al.
4,381,007 A	4/1983	Doss	5,462,521 A	10/1995	Brucker et al.
4,532,924 A	8/1985	Auth et al.	5,472,441 A	12/1995	Edwards et al.
4,548,207 A	10/1985	Reimels	5,472,443 A	12/1995	Cordis et al.
4,567,890 A	2/1986	Ohta et al.	5,487,385 A	1/1996	Avitall
4,602,628 A	7/1986	Allen, Jr.	5,490,819 A	2/1996	Nicholas et al.
4,671,274 A	6/1987	Sorochenko	5,500,012 A	3/1996	Brucker et al.
4,674,499 A	6/1987	Pao	5,514,130 A	5/1996	Baker
4,920,982 A	5/1990	Goldstein	5,522,815 A	6/1996	Durgin, Jr. et al.
4,931,047 A	6/1990	Broadwin et al.	5,536,267 A	7/1996	Edwards et al.
4,932,952 A	6/1990	Wojciechowiec, Jr.	5,540,562 A	7/1996	Giter
4,943,290 A	7/1990	Rexroth et al.	5,542,928 A	8/1996	Evans et al.
4,950,232 A	8/1990	Ruzicka et al.	5,558,671 A	9/1996	Yates
4,976,711 A	12/1990	Parins et al.	5,562,503 A	10/1996	Ellman et al.
4,985,030 A	1/1991	Melzer et al.	5,562,703 A	10/1996	Desai
4,998,933 A	3/1991	Eggers et al.	5,564,440 A	10/1996	Swartz et al.
5,009,656 A	4/1991	Reimels	5,569,242 A	10/1996	Lax et al.
5,013,312 A	5/1991	Parins et al.	5,569,243 A	10/1996	Kortenbach et al.
5,035,696 A	7/1991	Rydell	5,573,424 A	11/1996	Poppe
5,071,419 A	12/1991	Rydell et al.	5,573,533 A	11/1996	Strul
5,080,660 A	1/1992	Buelna	5,575,810 A	11/1996	Swanson et al.
5,122,138 A	6/1992	Manwaring	5,584,872 A	12/1996	LaFontaine et al.
5,125,928 A	6/1992	Parins et al.	5,599,346 A	2/1997	Edwards et al.
5,147,357 A	9/1992	Rose et al.	5,599,350 A	2/1997	Schulze et al.
5,151,102 A	9/1992	Kamiyama et al.	5,605,539 A	2/1997	Buelna et al.
5,156,613 A	10/1992	Sawyer	5,609,151 A	3/1997	Mulier et al.
5,167,659 A	12/1992	Ohtomo et al.	5,611,813 A *	3/1997	Lichtman 606/205
5,171,311 A	12/1992	Rydell et al.	5,620,415 A *	4/1997	Lucey et al. 604/22
5,190,541 A	3/1993	Abele et al.	5,633,578 A	5/1997	Eggers et al.
5,195,959 A	3/1993	Smith	5,637,110 A *	6/1997	Pennybacker et al. 606/46
5,197,963 A	3/1993	Parins	5,640,955 A	6/1997	Ockuly et al.
5,197,964 A	3/1993	Parins	5,643,197 A	7/1997	Brucker et al.
5,217,460 A	6/1993	Knoepfler	5,647,869 A	7/1997	Goble et al.
5,234,428 A	8/1993	Kaufman	5,647,871 A	7/1997	Levine et al.
5,242,441 A	9/1993	Avitall	5,653,692 A	8/1997	Masterson et al.
5,242,442 A	9/1993	Hirschfeld	5,658,281 A *	8/1997	Heard 606/48
5,269,780 A	12/1993	Roos	5,660,836 A	8/1997	Knowlton
5,269,781 A	12/1993	Hewell, III	5,676,662 A	10/1997	Fleischhacker et al.
5,277,696 A	1/1994	Hagen	5,676,693 A	10/1997	LaFontaine
5,281,215 A	1/1994	Milder	5,681,282 A	10/1997	Eggers et al.
5,281,216 A	1/1994	Klicek	5,683,366 A	11/1997	Eggers et al.
5,282,799 A	2/1994	Rydell	5,683,384 A	11/1997	Gough et al.
5,290,286 A *	3/1994	Parins	5,687,723 A	11/1997	Avitall
5,300,087 A *	4/1994	Knoepfler 606/207	5,688,270 A	11/1997	Yates et al.
5,313,943 A	5/1994	Houser et al.	5,693,045 A	12/1997	Eggers
5,318,589 A *	6/1994	Lichtman 606/205	5,697,281 A	12/1997	Eggers et al.
5,322,055 A *	6/1994	Davison et al. 601/2	5,697,536 A	12/1997	Eggers et al.
5,322,503 A	6/1994	Desai	5,697,882 A	12/1997	Eggers et al.
5,330,521 A	7/1994	Cohen	5,697,909 A	12/1997	Eggers et al.
5,334,193 A	8/1994	Nardella	5,697,927 A	12/1997	Imran et al.
5,342,357 A	8/1994	Nardella	5,702,386 A	12/1997	Stern et al.
5,342,359 A	8/1994	Rydell	5,709,680 A	1/1998	Yates et al.
5,348,554 A	9/1994	Imran et al.	5,713,896 A	2/1998	Nardella
5,352,222 A *	10/1994	Rydell 606/37	5,718,241 A	2/1998	Ben-Haim et al.
5,364,394 A	11/1994	Mehl	5,718,701 A	2/1998	Shai et al.
5,383,874 A	1/1995	Jackson et al.	5,718,703 A	2/1998	Chin
5,383,876 A	1/1995	Nardella	5,722,400 A	3/1998	Ockuly et al.
5,395,312 A	3/1995	Desai	5,725,524 A	3/1998	Mulier et al.
5,395,363 A	3/1995	Billings et al.	5,730,127 A	3/1998	Avitall
5,401,272 A	3/1995	Perkins	5,735,846 A	4/1998	Panescu et al.
5,403,311 A	4/1995	Abele et al.	5,743,903 A	4/1998	Stern et al.
5,403,312 A	4/1995	Yates et al.	5,746,739 A	5/1998	Sutter
5,405,344 A	4/1995	Williamson et al.	5,749,869 A	5/1998	Lindenmeier et al.
5,405,376 A	4/1995	Mulier et al.	5,755,717 A	5/1998	Yates et al.
5,417,672 A	5/1995	Nita et al.	5,755,753 A	5/1998	Knowlton
5,417,709 A *	5/1995	Slater 606/205	5,766,153 A	6/1998	Eggers et al.
			5,766,167 A	6/1998	Eggers et al.

FIG. 3

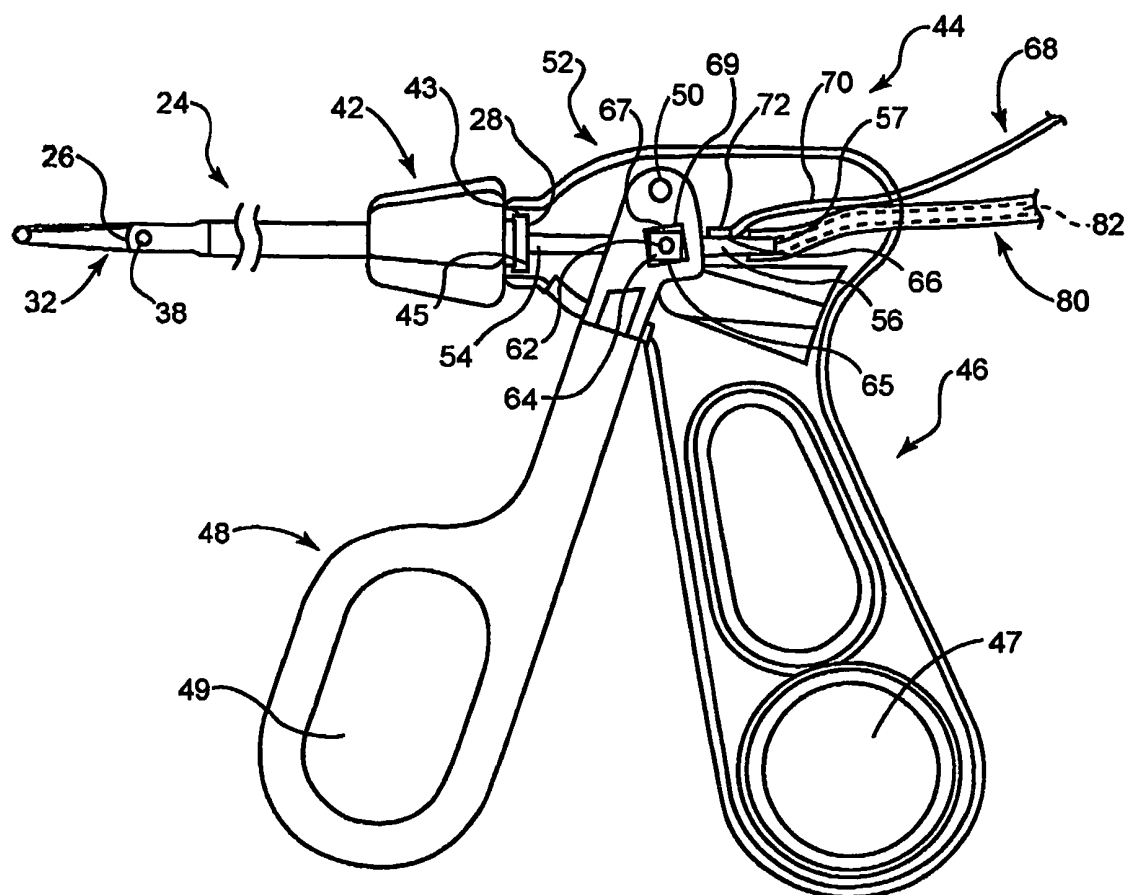

FIG. 4

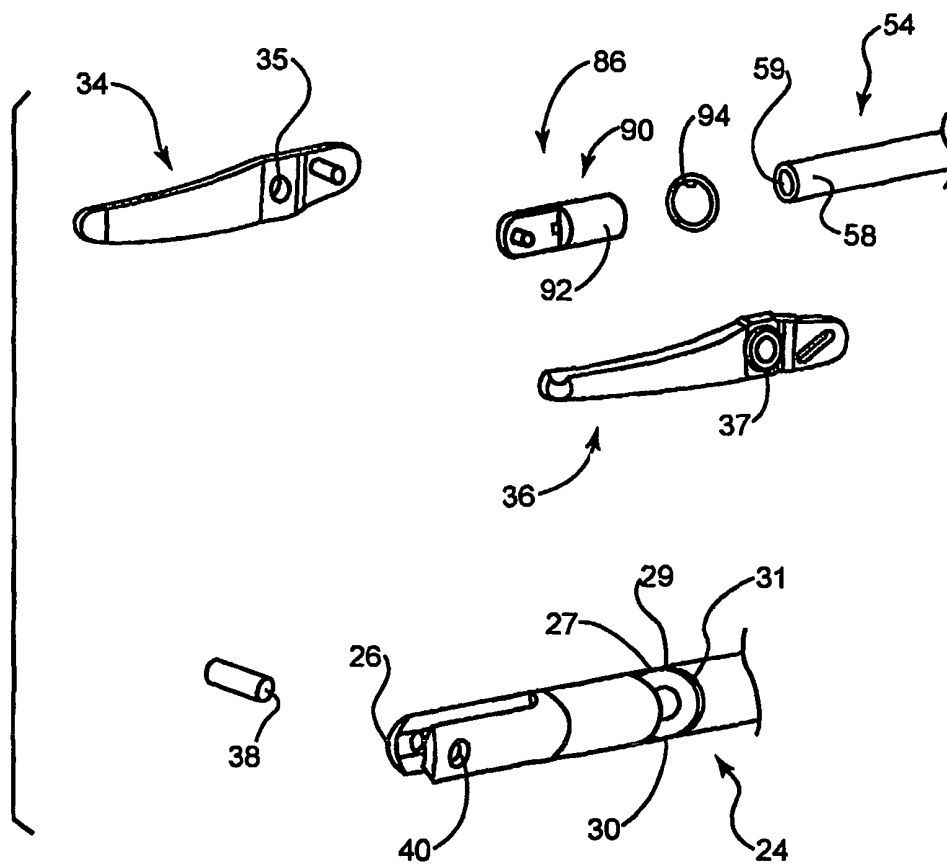

FIG.5

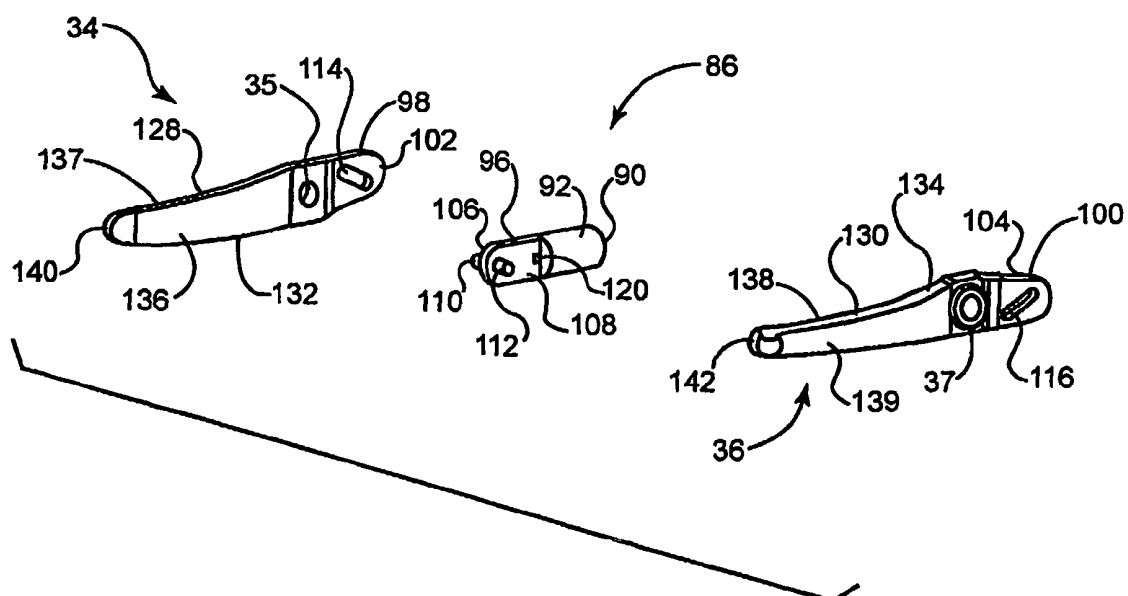

FIG. 6

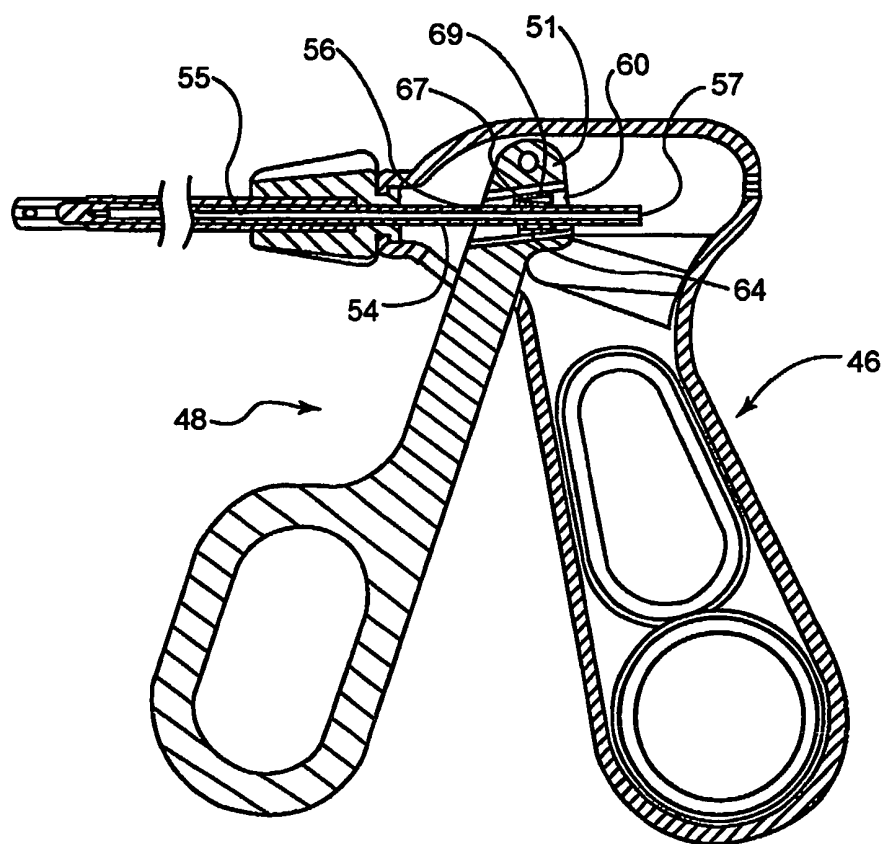

FIG. 7

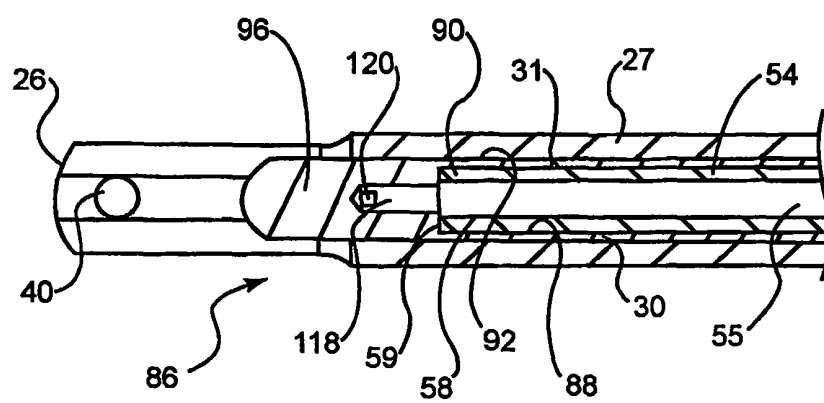

FIG.8

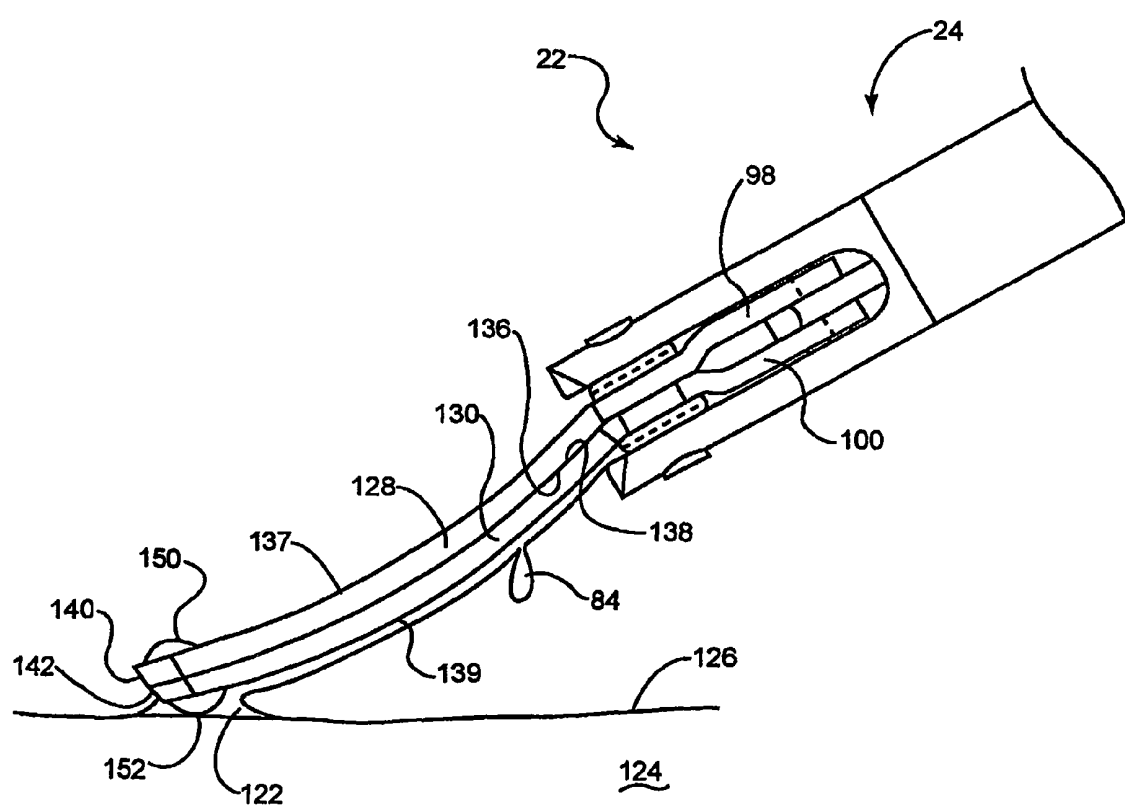

FIG.9

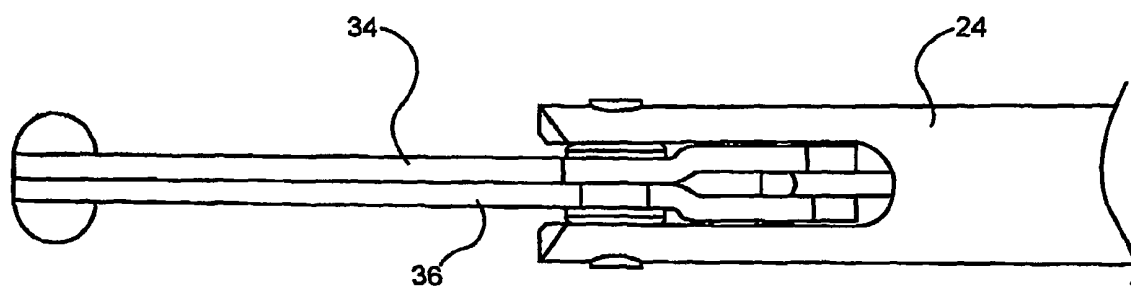

FIG.10

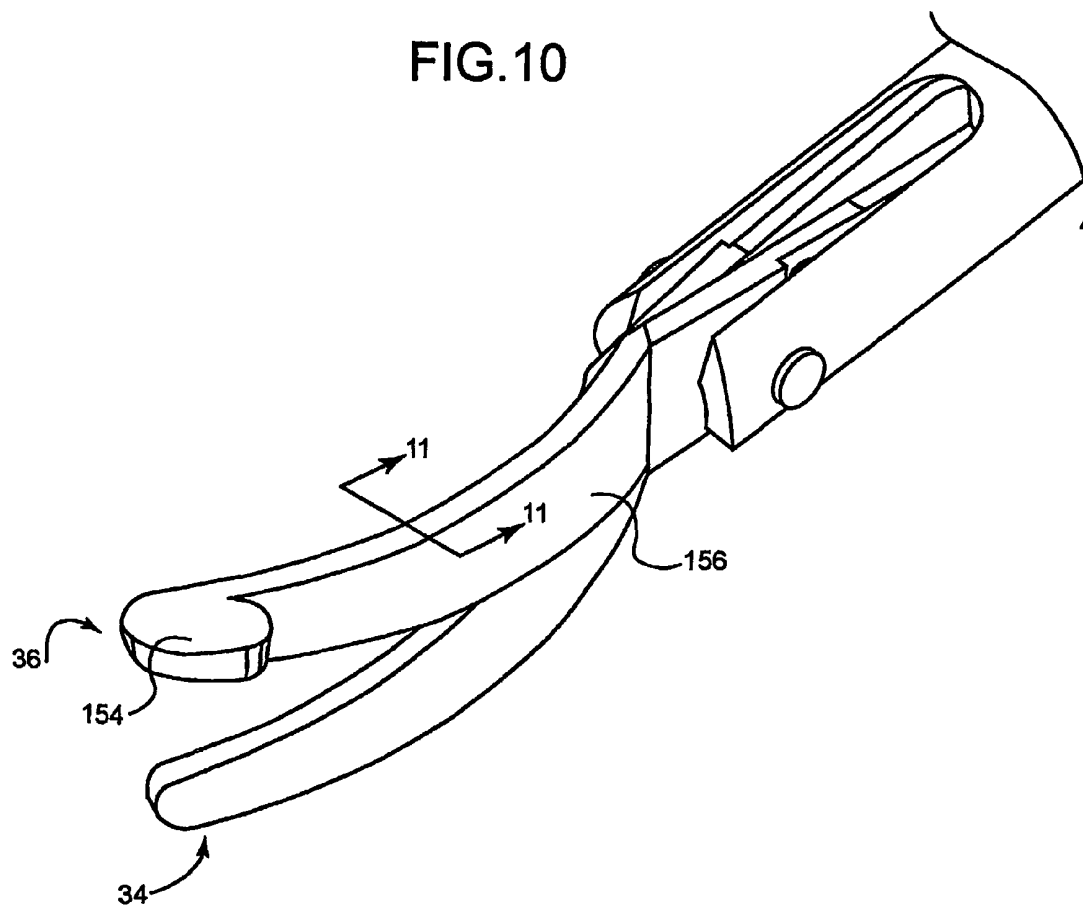

FIG. 11

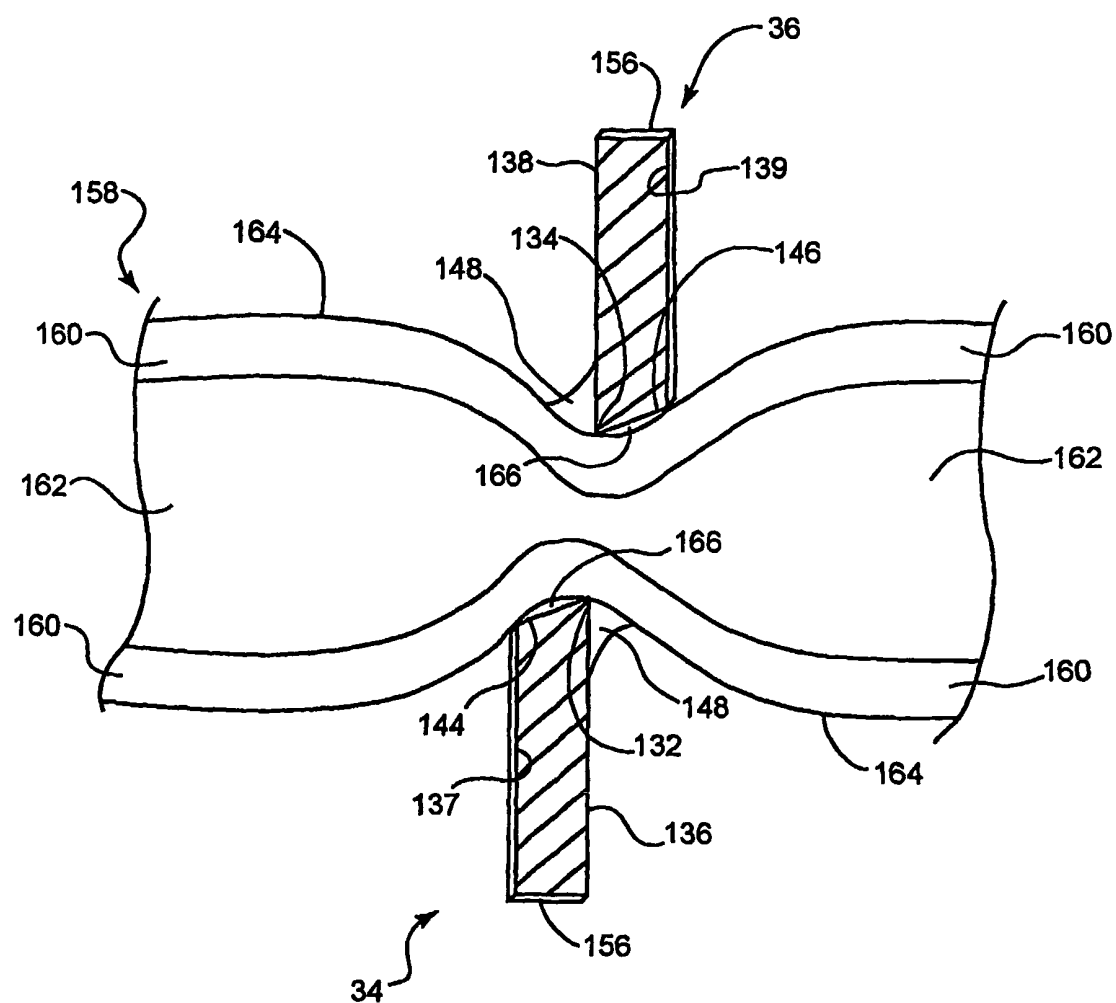
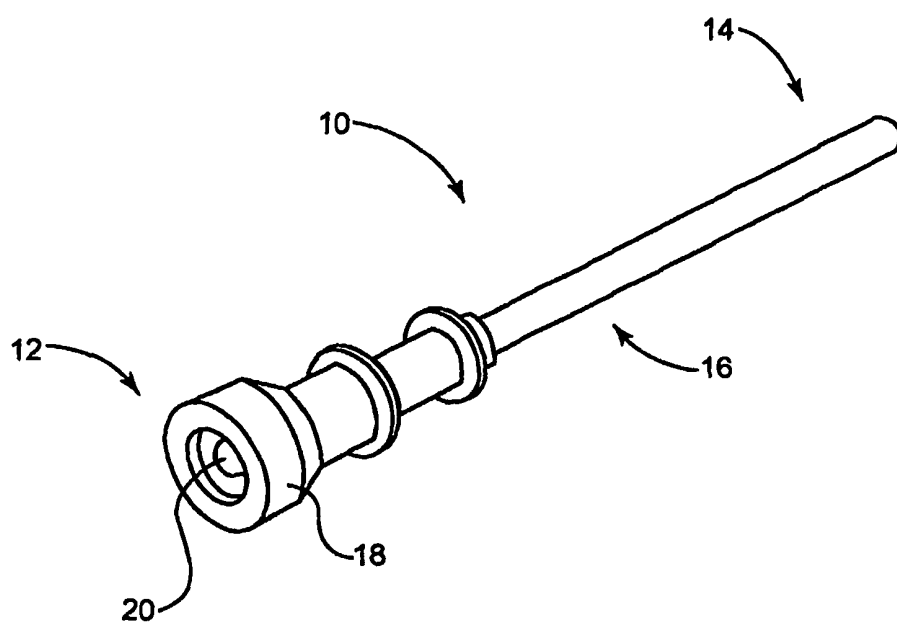

FIG. 12



5,785,705	A	7/1998	Baker	6,032,674	A	3/2000	Eggers et al.
5,785,706	A	7/1998	Bednarek	6,033,398	A	3/2000	Farley et al.
5,792,140	A	8/1998	Tu et al.	6,035,238	A	3/2000	Ingle et al.
5,797,905	A	8/1998	Fleischman et al.	6,036,687	A	3/2000	Laufer et al.
5,797,960	A	8/1998	Stevens et al.	6,045,532	A	4/2000	Eggers et al.
5,800,413	A	9/1998	Swartz et al.	6,047,700	A	4/2000	Eggers et al.
5,800,482	A	9/1998	Pomeranz	6,048,333	A	4/2000	Lennox et al.
5,807,393	A	9/1998	Williamson et al.	6,053,172	A	4/2000	Hovda et al.
5,807,395	A	9/1998	Mulier et al.	6,053,912	A	4/2000	Panescu et al.
5,810,764	A	9/1998	Eggers et al.	6,056,744	A	5/2000	Edwards
5,810,805	A	9/1998	Sutcu et al.	6,056,745	A	5/2000	Panescu et al.
5,810,811	A	9/1998	Yates et al.	6,056,747	A	5/2000	Saadat et al.
5,817,093	A	10/1998	Williamson et al.	6,059,781	A	5/2000	Yamanashi et al.
5,823,956	A	10/1998	Roth et al.	6,063,079	A	5/2000	Hovda et al.
5,827,271	A	10/1998	Buyse et al.	6,063,081	A	5/2000	Mulier et al.
5,827,281	A *	10/1998	Levin 606/51	6,066,134	A	5/2000	Eggers et al.
5,833,703	A	11/1998	Manushakian	6,066,139	A	5/2000	Ryan et al.
5,843,019	A	12/1998	Eggers et al.	6,068,627	A	5/2000	Orszulak et al.
5,843,021	A	12/1998	Edwards et al.	6,068,653	A	5/2000	LaFontaine
5,843,078	A	12/1998	Sharkey	6,071,280	A	6/2000	Edwards et al.
5,843,152	A	12/1998	Tu et al.	6,073,051	A	6/2000	Sharkey et al.
5,855,614	A	1/1999	Stevens et al.	6,074,389	A	6/2000	Levine et al.
5,860,951	A	1/1999	Eggers et al.	6,080,151	A	6/2000	Swartz et al.
5,860,974	A	1/1999	Abele	6,081,749	A	6/2000	Ingle et al.
5,861,002	A	1/1999	Desai	6,083,237	A	7/2000	Huitema et al.
5,861,021	A	1/1999	Thome et al.	6,086,585	A	7/2000	Hovda et al.
5,868,739	A	2/1999	Lindenmeier et al.	6,086,586	A	7/2000	Hooven
5,871,469	A	2/1999	Eggers et al.	6,091,995	A	7/2000	Ingle et al.
5,871,524	A	2/1999	Knowlton	6,093,186	A	7/2000	Goble
5,873,855	A	2/1999	Eggers et al.	6,095,149	A	8/2000	Sharkey et al.
5,876,398	A	3/1999	Mulier et al.	6,096,037	A	8/2000	Mulier et al.
5,888,198	A	3/1999	Eggers et al.	6,099,514	A	8/2000	Sharkey et al.
5,891,095	A	4/1999	Eggers et al.	6,102,046	A	8/2000	Weinstein et al.
5,891,141	A	4/1999	Rydell	6,105,581	A	8/2000	Eggers et al.
5,891,142	A	4/1999	Eggers et al.	6,109,268	A	8/2000	Thapliyal et al.
5,893,848	A	4/1999	Negus et al.	6,113,596	A *	9/2000	Hooven et al. 606/42
5,895,355	A	4/1999	Schaer	6,113,597	A	9/2000	Eggers et al.
5,895,417	A	4/1999	Pomeranz et al.	6,117,109	A	9/2000	Eggers et al.
5,897,553	A	4/1999	Mulier et al.	6,122,549	A	9/2000	Sharkey et al.
5,902,272	A	5/1999	Eggers et al.	H1904	H	10/2000	Yates et al.
5,902,328	A	5/1999	LaFontaine et al.	6,126,682	A	10/2000	Sharkey et al.
5,904,711	A	5/1999	Flom et al.	6,135,999	A	10/2000	Fanton et al.
5,906,613	A	5/1999	Mulier et al.	6,141,576	A	10/2000	Littmann et al.
5,913,854	A	6/1999	Maguire et al.	6,142,992	A	11/2000	Cheng et al.
5,913,856	A	6/1999	Chia et al.	6,149,620	A	11/2000	Baker et al.
5,919,191	A	7/1999	Lennox et al.	6,159,194	A	12/2000	Eggers et al.
5,919,219	A	7/1999	Knowlton	6,159,208	A	12/2000	Hovda et al.
5,921,982	A	7/1999	Lesh et al.	6,165,169	A	12/2000	Panescu et al.
5,921,983	A	7/1999	Shannon, Jr.	6,165,175	A	12/2000	Wampler et al.
5,925,045	A	7/1999	Reimels et al.	6,168,594	B1	1/2001	LaFontaine et al.
5,935,123	A	8/1999	Edwards et al.	6,171,275	B1	1/2001	Webster, Jr.
5,948,011	A	9/1999	Knowlton	6,174,308	B1	1/2001	Goble et al.
5,951,549	A	9/1999	Richardson et al.	6,174,309	B1	1/2001	Wrublewski et al.
5,954,716	A	9/1999	Sharkey et al.	6,176,857	B1	1/2001	Ashley
5,957,919	A	9/1999	Laufer	6,179,824	B1	1/2001	Eggers et al.
5,964,755	A	10/1999	Edwards	6,179,836	B1	1/2001	Eggers et al.
5,971,983	A	10/1999	Lesh	6,183,469	B1	2/2001	Thapliyal et al.
5,976,128	A	11/1999	Schilling et al.	6,190,381	B1	2/2001	Olsen et al.
5,980,504	A	11/1999	Sharkey et al.	6,190,384	B1	2/2001	Ouchi
5,980,516	A	11/1999	Mulier et al.	6,193,715	B1	2/2001	Wrublewski et al.
5,989,248	A	11/1999	Tu et al.	6,193,716	B1	2/2001	Shannon, Jr.
5,992,418	A	11/1999	de la Rama et al.	6,203,542	B1	3/2001	Ellsberry et al.
5,993,412	A	11/1999	Deily et al.	6,210,402	B1	4/2001	Olsen et al.
6,003,517	A	12/1999	Sheffield et al.	6,210,410	B1	4/2001	Farin et al.
6,004,316	A	12/1999	Laufer	6,210,411	B1	4/2001	Hofmann et al.
6,004,319	A	12/1999	Goble et al.	6,212,426	B1	4/2001	Swanson
6,007,570	A	12/1999	Sharkey et al.	6,216,704	B1	4/2001	Ingle et al.
6,010,500	A	1/2000	Sherman et al.	6,217,576	B1	4/2001	Tu et al.
6,015,391	A	1/2000	Rishton et al.	6,221,039	B1	4/2001	Durgin et al.
6,015,407	A	1/2000	Rieb et al.	6,221,069	B1	4/2001	Daikuzono
6,016,809	A	1/2000	Mulier et al.	6,224,592	B1	5/2001	Eggers et al.
6,017,338	A	1/2000	Brucker et al.	6,224,593	B1	5/2001	Ryan et al.
6,018,676	A	1/2000	Davis et al.	6,226,554	B1	5/2001	Tu et al.
6,019,757	A	2/2000	Scheldrup	6,228,078	B1	5/2001	Eggers et al.
6,024,733	A	2/2000	Eggers et al.	6,228,082	B1	5/2001	Baker et al.
6,024,744	A *	2/2000	Kese et al. 606/51	6,231,591	B1	5/2001	Desai
6,027,501	A	2/2000	Goble et al.	6,235,020	B1	5/2001	Cheng et al.
6,030,379	A	2/2000	Panescu et al.	6,236,891	B1	5/2001	Ingle et al.
6,032,077	A	2/2000	Pomeranz	6,238,387	B1	5/2001	Miller, III

FLUID-ASSISTED ELECTROSURGICAL SCISSORS AND METHODS

CROSS REFERENCE TO RELATED APPLICATIONS

This patent application is a U.S. national stage application of PCT international patent application serial no. PCT/US2003/034306, filed Oct. 28, 2003, which claims priority under 35 U.S.C. §119(e) to U.S. provisional application Ser. No. 60/422,190, filed Oct. 29, 2002.

The entire disclosure of each of these patent applications is incorporated herein by reference to the extent it is consistent.

This application is being filed on 28 Oct. 2003 as a PCT International Patent application in the name of TissueLink Medical, Inc. (a U.S. national corporation), applicant for the designation of all countries except the US, and Michael E. McClurken, Roger D. Greeley, and John W. Berry (all US citizens), applicants for the designation of the US only.

FIELD

This invention relates generally to the field of medical devices, systems and methods for use upon a body during surgery. More particularly, the invention relates to electrosurgical devices, systems and methods for use upon tissues of a human body during surgery, particularly open surgery and minimally invasive surgery such as laparoscopic surgery.

BACKGROUND

As is well known in electrosurgery, with a monopolar device configuration, electrical power is delivered from a power source to an active terminal provided with the device. The electrical energy from the device then is passed through the patient generally to a large surface, electrically dispersive ground pad, often referred to as the return terminal, located on the back or other suitable anatomical location of the patient, and then back to the power source. Conversely, bipolar devices include both the active and return electrodes on the device. Electrical current flows from the active electrode generally through localized tissue and then to the return electrode and back to the power source.

One often cited advantage of bipolar devices as compared to monopolar devices is the elimination of electrical current flowing through the patient to a ground pad. However, devices such as bipolar scissors tend to be fairly complex in attempting to electrically isolate the active electrical terminal (pole) from the other return electrical terminal (pole). Furthermore, as disclosed in U.S. Pat. No. 5,658,281 in the name of Heard entitled "Bipolar Electrosurgical Scissors and Method Of Manufacture", one of the advantages of monopolar electrosurgical tools is that the surgeon can apply electrosurgical current whenever the conductive portion of the tool is in electrical contact with the patient. Thus, a surgeon may operate with monopolar electrosurgical tools from many different angles. In contrast, bipolar tools suffer from the drawback that the surgeon must carefully position the tool to ensure that both electrical poles are in electrical contact with the patient in order to apply electrosurgical current. This may limit the range of motion and the angle from which the surgeon can effectively use the bipolar tool.

However, with dry tip electrosurgical devices, both monopolar and bipolar, the temperature of tissue being treated may rise significantly higher than 100° C., possibly

resulting in tissue desiccation, tissue sticking to the electrodes, tissue perforation, char formation and smoke generation.

One attempt with monopolar scissors, in order to restrict the electric current flow through the patient, has been to decrease the size of the active electrode to only a portion of the confronting (shearing) surfaces. In this manner, the chance that a surgeon may inadvertently conduct current into and burn surrounding tissue is also reduced. One such solution, as disclosed in U.S. Pat. No. 5,827,281 in the name of Levin entitled "Insulated Surgical Scissors," is to entirely cover the pair of opposing cutting blades with an electrically and thermally insulative material except along corresponding segments of the confronting surfaces. Thus, this '281 patent does not recognize any benefit to providing electrically active surfaces on the pair of opposing cutting blades other than certain segments of the confronting surfaces and aims to prevent such. However, the need for this insulative material also increases the complexity of the scissors.

However, the teachings of the U.S. Pat. No. 5,827,281 patent are somewhat in contrast to the U.S. Pat. No. 5,658,281 patent. The U.S. Pat. No. 5,658,281 patent discloses that it would be desirable to allow surgeons to use the exterior surfaces of the scissors to coagulate tissue. However, the U.S. Pat. No. 5,658,281 patent does not address how to reduce the burning of surrounding tissue addressed by the U.S. Pat. No. 5,827,281 patent, nor any other concerns of tissue desiccation, tissue sticking to the electrodes, coagulum build-up on the electrodes, tissue perforation, char formation and smoke generation which may occur with use of dry electrosurgical devices.

In light of the above, it is an object of the invention to provide devices, systems and methods which overcome the limitations of the art.

SUMMARY OF THE INVENTION

According to the present invention, radio frequency electrical power from a device is coupled to tissue through a coupling of fluid, also provided from the device, to inhibit such undesirable effects of tissue desiccation, sticking to the device, coagulum build-up on the device, tissue perforation, char formation and smoke generation. Specifically with regards to inhibiting tissue desiccation, one key factor is to inhibit the tissue temperature from exceeding 100° C. where the intracellular water may boil away, leaving the tissue extremely dry and much less electrically conductive.

According to one embodiment, electrosurgical scissors are provided comprising an end effector comprising a first blade member and a second blade member with the first blade member and the second blade member pivotally connected, an electrical connector configured to couple the scissors to a power source; and a fluid passage in fluid communication with at least one fluid outlet.

BRIEF DESCRIPTION OF THE DRAWINGS

To better understand and appreciate the invention, refer to the following detailed description in connection with the accompanying drawings, hand and computer generated:

FIG. 1 is a schematic side view of an exemplary device as part of a system according to the present invention;

FIG. 2 is a schematic isometric view of the device shown in FIG. 1 with a portion of the handle removed;

FIG. 3 is a schematic side view of the device shown in FIG. 2 with power cable and fluid line connected to the device;

FIG. 4 is a schematic, close-up, exploded isometric view of a distal portion of the device shown in FIG. 3;

FIG. 5 is another schematic, close-up, exploded isometric view of a distal portion of the device shown in FIG. 3;

FIG. 6 is a schematic, cross-sectional side view of the device shown in FIG. 2 with the blade members removed;

FIG. 7 is a schematic, close-up, cross-sectional side view of a distal portion of the device shown in FIG. 6;

FIG. 8 is a schematic, close-up, top view of a distal portion of the device shown in FIG. 2 in the presence of tissue;

FIG. 9 is a schematic, close-up, top view of a distal portion of an alternative embodiment of the device of FIG. 2;

FIG. 10 is a schematic, close-up, isometric view of a distal portion of another alternative embodiment of the device of FIG. 2;

FIG. 11 is a schematic, close-up, cross-sectional view taken along line 11-11 of FIG. 10 with tissue located between the blade members; and

FIG. 12 is an isometric view of a cannula which may be used with the device of the present invention.

DETAILED DESCRIPTION

Throughout the present description, like reference numerals and letters indicate corresponding structure throughout the several views, and such corresponding structure need not be separately discussed. Furthermore, any particular feature (s) of a particular exemplary embodiment may be equally applied to any other exemplary embodiment(s) of this specification as suitable. In other words, features between the various exemplary embodiments described herein are interchangeable as suitable, and not exclusive. Also, from the specification, it should be clear that any use of the terms "distal" and "proximal" are made in reference to the user of the device, and not the patient.

An exemplary electrosurgical device according to the present invention will now be described in detail. The electrosurgical device may be used with the system of the invention to be described herein. However, it should be understood that the description of the combination is for purposes of illustrating the system of the invention only. Consequently, it should be understood that the electrosurgical device of the present invention can be used alone, or in conjunction with, the system of the invention. Conversely, it should be equally understood that the system of the present invention can be used with a wide variety of devices.

The electrosurgical devices disclosed herein may be configured for both open and laparoscopic surgery. For laparoscopic surgery, the devices are preferably configured to fit through either a 5 mm or 10 mm trocar cannula. When used in conjunction with a cannula, the devices disclosed herein eliminate the need to switch instruments from the cannula for the purposes of coagulating and cutting tissue.

An exemplary electrosurgical device of the present invention, which may be used in conjunction with one or more aspects of the system of the present invention, is shown at reference character 22 in FIG. 1. As shown, device 22 preferably comprises electrosurgical scissors, and more particularly laparoscopic electrosurgical scissors. When device 22 comprises laparoscopic electrosurgical scissors, preferably device 22 is configured to extend through a working channel of a trocar cannula.

Device 22 is designed and configured to coagulate and seal tissue from the flow of bodily fluids and/or air by shrinking the tissue (particularly collagen in the tissue and particularly vessels) and cut tissue. More specifically, device 22 can be painted over a raw, oozing surface of tissue to seal the tissue

against bleeding, or focused on individual large vessels, such as to seal a bleeding vessel which has been cut or to occlude a vessel prior to its being cut.

As shown in FIG. 1, the system of the invention includes both a fluid source 78 and a power source 76 coupled to device 22 as discussed in greater detail below. As shown, fluid source 78 comprises an I.V. bag. The power source 76 shown in FIG. 1 preferably comprises a generator which provides alternating current, radio-frequency electrical energy at various rates (i.e. power). As to the frequency of the RF electrical energy, it is preferably provided within a frequency band (i.e. a continuous range of frequencies extending between two limiting frequencies) in the range between and including about 9 kHz (kilohertz) to 300 GHz (gigahertz). More preferably, the RF energy is provided within a frequency band in the range between and including about 50 kHz (kilohertz) to 50 MHz (megahertz). Even more preferably, the RF energy is provided within a frequency band in the range between and including about 200 kHz (kilohertz) to 2 MHz (megahertz). Most preferably, RF energy is provided within a frequency band in the range between and including about 400 kHz (kilohertz) to 600 kHz (kilohertz). The power from the power source 76 to device 22 is preferably turned on and off via a footswitch 77 or other easily operated switch connected to the power source 76.

As best shown in FIGS. 2 and 3, device 22 preferably includes an intermediate portion comprising an elongated, hollow, electrically insulated, rigid shaft 24 having a distal end 26, a proximal end 28 and a central lumen 30 (shown in FIG. 7). While shown greatly shortened as indicated by the break lines, the length of shaft 24 is preferably in the range between and including about 5 inches to 15 inches.

As best shown in FIG. 4, for strength purposes, shaft 24 preferably comprises an inner, cylindrical metal tube 27, such as stainless steel, with the outer layer 29 of insulating material applied thereon, such as a polymer, ceramic or glass material. Where the outer layer 29 comprises a polymer, preferably the outer layer is provided in the form of a shrink wrap sleeve which may be heated and thereafter shrunk directly onto the metal tube 27 in a manner known in the art. In other embodiments, cylindrical tube 27 may comprise an electrically insulating material itself, such as a polymer, ceramic or glass material, thus eliminating the need for outer layer 29.

Also as shown in FIGS. 2 and 3, device 22 also preferably includes an end effector 32. As best shown in FIGS. 4 and 5, end effector 32 comprises two cooperating, relatively moveable blade members 34, 36. Blade members 34, 36 extend distally from and are pivotally coupled adjacent the distal end 26 of the shaft 24 such that they hinge about a pivot 38 provided, for example, by a separate metal pin, extending through a fixed pivot hole 40 of shaft 24 and aligning holes 35, 37 in the blade members 34, 36.

Returning to FIGS. 2 and 3, device 22 also preferably includes a collar 42 for rotating the entire shaft 24 and end effector 32 relative to a proximal handle 44 comprising an electrically insulated first handle member 46 and an electrically insulated second handle member 48, which are coupled adjacent the proximal end 28 of shaft 24. As shown in FIGS. 2 and 3, a mirrored half of the first handle member 46, which is preferably formed from two separately formed mating pieces, has been removed to expose the inner workings of the handle 44. The first and second handle members 46, 48 are preferably made electrically insulating by virtue of being molded of an electrically insulating polymer material.

First handle member 46 is preferably coupled to the proximal end 28 of the shaft 24 by means a circular flange lip 43 of the shaft 24 contained within a mating and interlocking cir-

cular recess 45 formed in the first handle member 46, while the second handle member 48 is pivotally coupled to the first handle member 46 about a pivot 50 provided, for example, by a pin. The second handle member 48 is indirectly coupled to the blade members 34, 36 through a push/pull rod assembly 52 extending through the lumen 30 of the elongated shaft 24 so that axial reciprocal movement of the push/pull rod assembly 52 relative to shaft 24 opens and closes the blade members 34, 36. In this manner, shaft 24 functions as a guide barrel for the rod 54 of the push/pull rod assembly 52.

As best shown in FIGS. 2 and 6, a proximal portion 56 of a rod 54 extends through a longitudinally orientated (i.e. extending proximally and distally with respect to device 22) slotted receptacle 60 extending through a head portion 51 of second handle member 48. Returning to FIG. 3, rod 54 is preferably coupled to second handle member 48 such that the position of rod 54 relative to the position of the second handle member 48 may be adjustably fixed thereto (e.g. to accommodate manufacturing). As shown, rod 54 is coupled to the second handle member 48 by a mechanical fastener 62 comprising here, for example, a set screw. However, rather than threading the screw into a threaded hole in handle 48 and into contact with the rod 54, preferably the set screw 62 is threaded into the side wall of metal sleeve 64. In this manner the strength of the threaded connection is substantially increased with less likelihood of stripping threads. Screw 62 is preferably treaded through the side wall of sleeve 64 such that the distal end surface of the set screw 62 engages and locks against a side surface of the rod 54 intersecting the threaded hole in the sleeve 64.

As shown in FIGS. 2 and 3, once sleeve 64 is fixed to rod 54, the sleeve 64 is then coupled to handle 48 by being located in a fastener or sleeve interlocking receptacle 65. As receptacle 65 moves proximally and distally with the movement of handle 48, the surfaces of the receptacle accordingly act on the opposing surfaces of the sleeve 64 to move the sleeve 64 and fixed rod 54 in unison with the handle 48.

In addition, rod 54 is also preferably pivotally coupled to the second handle member 48 about a pivot connection, provided here, for example, by the sleeve 64 and receptacle 65 interaction. As shown in FIGS. 3 and 6, certain surfaces 69 of receptacle 65 are spaced from interacting surfaces 67 of the sleeve 64 to allot for limited pivotal movement between sleeve 64 and receptacle 65.

Continuing with FIG. 3, the grasping first handle member 46 also provides a pistol grip configuration while second handle member 48 provides a trigger or lever configuration. Also as shown, first handle member 46 is provided with a thumb loop 47 while second handle member 48 is provided with a finger loop 49 for easier grasping and manipulation of device 22. With the configuration shown, as the first and second handle members 46, 48 are moved towards one another, rod 54 is moved proximally to close the blade members 34, 36 relative to one another. Conversely, when the first and second handle members 46, 48 are moved apart from one another, rod 54 is moved distally to open the blade members 34, 36 relative to one another.

As shown in FIGS. 1 and 3, device 22 is preferably connected to a power source 76 (shown in FIG. 1) via proximal portion 56 of rod 54. As shown, to provide power to device 22, an electrical connection to a power source 76 is preferably provided with a cable 68. As shown in FIG. 3, cable 68 comprises an insulated wire 70, comprising a wire conductor 72, and a plug 74 (shown in FIG. 1). With regards to the electrical connection, rod 54 is coupled to one end of cable 68 by a soldered connection 66 while the other end of the cable

68 is coupled to power source 76 with plug 74 inserted into a plug receptacle of the power source 76.

With the above configuration, device 22 may be electrically energized for coagulating and cutting tissue to be discussed in greater detail herein. As constructed, electrical power provided to rod 54 from power source 76, which may be referred to as the active terminal, will also flow to blade members 34, 36 by virtue of their mechanical and metallic coupling to the rod 54, as well as tube 27 of shaft 24. Thus, the device 22 comprises a monopolar configuration, i.e., electrical power is delivered from the power source 76 via a single conductor 72 to each of the blade members 34, 36 (each comprising a metal such as titanium or stainless steel), with both blade members consequently being at substantially the same voltage or electrical potential. The return for the electrical energy from device 22 is through the patient (not shown) generally to a large surface, electrically dispersive ground pad 79 (shown in FIG. 1), often referred to as the return or indifferent terminal, located on the patient, typically on the back or other suitable anatomical location, and then back to the power source 76, as is well-known in the art.

Continuing with FIGS. 1 and 3, device 22 is preferably connected to a fluid source 78 (shown in FIG. 1) also via proximal portion 56 of rod 54. As shown, to provide fluid 84 to device 22, a fluid connection to a fluid source 78 is preferably provided with an input fluid line 80. As shown in FIG. 3, input fluid line 80 comprises a flexible fluid line made from a polymeric material, such as polyvinylchloride (PVC) or polyolefin (e.g. polypropylene, polyethylene) and has a fluid passage 82 (lumen). With regards to the fluid connection, rod 54 is coupled to one end of fluid line 80 by interference fitting the lumen 82 of the input fluid line 80 over the proximal end 57 and outside diameter of rod 54 to provide a press fit seal there between. Additionally an adhesive may be disposed there between to strengthen the seal. The other end of input fluid line 80 may be directly connected to fluid source 78.

Fluid source 78 preferably provides an electrically conductive fluid 84, which preferably is a saline solution and, more preferably sterile, physiologic saline. It should be understood that where description herein references the use of saline as the fluid 84, other electrically conductive fluids can be used in accordance with the invention.

For example, in addition to the conductive fluid comprising physiologic saline (also known as "normal" saline, isotonic saline or 0.9 weight-volume percentage sodium chloride (NaCl) solution), the conductive fluid may comprise hypertonic saline solution, hypotonic saline solution, Ringers solution, lactated Ringer's solution, Locke-Ringer's solution, or any other electrolyte solution. In other words, a solution that conducts electricity via an electrolyte, a substance (salt, acid or base) that dissociates into electrically charged ions when dissolved in a solvent, such as water, resulting solution comprising an ionic conductor.

In certain embodiments as discussed herein, hypertonic saline, saturated with NaCl to a concentration of about 15% (weight-volume percentage), may be preferred to physiologic saline to reduce the electrical resistivity of the saline from about 50 ohm-cm at 0.9% to about 5 ohm-cm at 15%. This ten-fold reduction in electrical resistivity of the conductive fluid will enhance the reduction in heating (both resistance heating and conduction heating) of tissue and the conductive fluid itself as shown herein.

While a conductive fluid is preferred, as will become more apparent with further reading of this specification, the fluid 84 may also comprise an electrically non-conductive fluid. The use of a non-conductive fluid is less preferred to that of a conductive fluid as the non-conductive fluid does not conduct

electricity. However, the use of a non-conductive fluid still provides certain advantages over the use of a dry electrode including, for example, reduced occurrence of tissue sticking to the blade members 34, 36, cooling of tissue and/or the blade members 34, 36, and removal of any coagula, if existent, from the blade members 34, 36 and/or the tissue treatment site. Therefore, it is also within the scope of the invention to include the use of a non-conducting fluid, such as, for example, deionized water. Other non-conductive fluids include 5% w/v dextrose injection USP and 10% w/v dextrose injection USP (i.e. sterile solutions of 5 g and 10 g dextrose hydrous in 100 ml water, respectively); 1.5% w/v glycine irrigation USP (i.e. sterile solution of 1.5 g glycine in 100 ml water); 5% w/v, 10% w/v, 15% w/v and 20% w/v mannitol injection USP (i.e. sterile solution of 5 g, 10 g, 15 g and 20 g mannitol in 100 ml water, respectively); 3% sorbitol irrigation USP (i.e. sterile solution of 3 g sorbitol in 100 ml water); 0.54% sorbitol/2.75% mannitol irrigation USP (i.e. sterile solution of 0.54 g sorbitol and 2.75 g mannitol in 100 ml water); and sterile water for irrigation USP.

Once the input fluid line 80 is coupled to rod 54, the fluid passage 82 provided by fluid line 80 is now fluidly coupled to fluid passage 55, here provided by the bore or lumen, of rod 54 (shown in FIGS. 6 and 7). In this manner fluid 84 from fluid source 78 may flow towards the distal end of device 22.

As best shown in FIGS. 4 and 7, the distal end 59 of rod 54 is preferably coupled to a connector member 86. More specifically, as shown in FIG. 7, a distal portion 58 of rod 54 is interference fit (pressed) into rod connector portion comprising a circular receptacle portion 88. Alternatively, the outer side wall of distal portion 58 of rod 54 may be provided with external threads configured to mate with internal threads contained on the inner side wall of receptacle portion 88.

Continuing with FIGS. 4 and 7, a circular portion 90 of connector member 86 is configured to have an outer diameter slightly smaller (e.g. about 0.001 inches to 0.040 inches) than the inner diameter of tube 27. In this manner, outer circular surface 92 of connector member 86 may easily slide along inner surface 31 of tube 27 with the reciprocal movement of rod 54 while, at the same time, receptacle portion 88 of connector member 86 is able to position the distal portion 58 of rod 54 towards the center of tube 27. In order to inhibit the back flow of fluid 84 (which has been provided from device 22 to a tissue treatment site or by virtue of the orientation of device 22 with the distal end positioned above the proximal end) into lumen 30, preferably the outer diameter of the circular portion 90 fits with the inner surface 31 of tube 27 to substantially seal the lumen 30 of tube 27 and handle 44 against the back flow of fluid 84 therein. In order to increase the seal, a separate seal member 94 (shown in FIG. 4) may be placed between surfaces 92 and 31, such as a flexible O-ring gasket. Alternatively, the O-ring gasket may be located near between a proximal portion 56 of rod 54 and a proximal portion of shaft 24.

As best shown in FIG. 5, located distally from receptacle portion 88, connector member 86 comprises a blade member connector portion 96, which has a substantially planar tongue extending distally relative to the circular receptacle portion 88, and which is sandwiched between and spaces apart the proximal portions 98, 100 of blade members 34, 36 respectively. As shown, flat interior surfaces 102, 104 of blade members 34, 36, which face one another, overlie opposing flat surfaces 106, 108 of blade member connector portion 96.

Continuing with FIG. 5, blade member connector portion 96 includes opposing pins 110, 112 extending laterally from opposing surfaces 106, 108. Pins 110, 112 are configured to fit within and travel along the slotted recesses 114, 116 in

surfaces 102, 104 of blade members 34, 36 to open and close blade members 34, 36 relative to each other. More specifically, as pins 110, 112 move proximally while in recesses 114, 116 (due to proximal movement of rod 54), blade members 34, 36 rotate in opposing directions relative to each other around pivot 38 and close relative to one another. Conversely, as pins 110, 112, move distally while in recesses 114, 116 (due to distal movement of rod 54), blade members 34, 36, which still rotate in opposing directions relative to each other, now rotate in opposing directions to their closing directions around pivot 38, to open relative to one another. As shown, in order to facilitate the opening and closing movement of blade members 34, 36, the orientation of recesses 114, 116 is such that they are orientated in opposing directions relative to one another.

In order to expel fluid 84 which has flowed distally in lumen 55 of rod 54 from device 22, the connector member 86 is preferably provided with one or more apertures in fluid communication with lumen 55, the apertures providing a fluid outlet for fluid 84. As best shown in FIG. 7, the bottom wall of receptacle portion 88 includes an aperture 118 there through to provide a fluid outlet 120 for fluid 84. As shown in FIG. 7, fluid outlet 120 is located proximal to the distal end 26 of shaft 24 such that it is remote from the tissue interacting portions of blade members 34, 36. Stated another way, fluid outlet 120 is recessed and protected within the distal end 26 of shaft 24 which provides a location substantially inaccessible to direct contact or occlusion with tissue. While only a single fluid outlet 120 is shown, it should be understood that additional fluid outlets (with varying locations) may be similarly incorporated to the extent necessary.

As shown in FIG. 8, during use of device 22 for coagulating tissue, a fluid coupling 122, preferably comprising a discrete localized web, provides a film of fluid 84 between the surface 126 of the tissue 124 and blade members 34, 36. When a user of device 22 places the blade members 34, 36 at a tissue treatment site and moves the blade members 34, 36 across the surface 126 of the tissue 124, fluid 84 is simultaneously expelled from fluid outlet 120 around and onto the proximal portions 98, 100 and to the distal portions 128, 130 of blade members 34, 36 and thereafter onto the surface 126 of tissue 124 via fluid coupling 122. The fluid 84 flows from the distal end of connector 86 towards the distal portions 128, 130 and ends 140, 142 of blade members 34, 36 due to the force of gravity, and the orientation of the device 22, which is almost always with the distal end downward. Surface tension forces tend to keep the fluid 84 from dripping off the blade members 34, 36 before the fluid 84 reaches the distal ends 140, 142 of blade members 34, 36 and the contact with tissue 124.

Fluid 84 lubricates the surface 126 of the tissue 124 and facilitates the movement of blade members 34, 36 across the surface 126 of the tissue 124 and, in the instance of an electrically conductive fluid, provides an electrical coupling between the device 22 and the tissue 124. During movement of the blade members 34, 36, the user of device 22 typically slides the blade members 34, 36 across the surface 126 of the tissue 124 back and forth with a painting motion while using the fluid 84 as, among other things, a lubricating coating. Preferably the thickness of the fluid coupling 122 between the blade members 34, 36 and the surface 126 of the tissue 124 is in the range between and including about 0.05 mm to 2.5 mm. More preferably, the fluid coupling 122 between the blade members 34, 36 and the surface 126 of the tissue 124 is in the range between and including about 0.1 mm to 1.0 mm.

Preferably tissue coagulation is performed with blade member exterior side surfaces 137, 139 of blade members 34, 36 which oppose blade member interior side shearing sur-

faces 136, 138, respectively. As shown in FIG. 8, in order to better facilitate sliding of device 22 on the surface 126 of tissue 124, preferably the distal portions 128, 130 of blade members 34, 36 proximally adjacent distal ends 140, 142 may each comprise opposing bulbous portions, here having preferably smooth (i.e. devoid of edges), semi-circular surfaces 150, 152 (preferably of about 180 degrees and having a surface finish in the range between and including about 16-64 microinches RMS (Root Mean Square)) provided by enlarged semi-circular regions. Consequently, when blade members 34, 36 are closed together, the two opposing semi-circular regions may provide a spherical distal end tip for device 22. In this manner, the distal end surface area of device 22 is increased to provide an appropriate power density for coagulating tissue with a painting motion. For example, for a power level of 50 watts, which is a typical upper limit for most laparoscopic procedures, a spherical cross-sectional dimension, here diameter, in the range of between and including about 2 to 2.5 millimeters has been found to work best. If the power can be as high as 100 watts, then the dimension should be larger, in the range of between and including about 3 to 4 millimeters. If the power is smaller, for instance 25 watts, then the dimension should be smaller, in the range between and including about 1.25 to 1.75 millimeters. Furthermore, in order to further facilitate tissue coagulation, preferably the distal portions 128, 130 of blade members 34, 36 are arcuate to provide a convex surface 139 of blade member 36 which may be more easily positioned against tissue and slide there along.

When electric current is applied to blade members 34, 36, heating of the tissue 124 occurs by means of electrical resistance heating. In other words, increasing the temperature of the tissue 124 as a result of electric current flow through the tissue, with the associated electrical energy being converted into thermal energy (i.e. heat) via accelerated movement of ions as a function of the tissue's electrical resistance. Resistance heating provides direct, instantaneous heating inside tissue 124 due to the current flow through tissue 124.

Device 22 is particularly useful to a surgeon who wishes to coagulate and seal tissue, including vessels such as blood vessels, prior to tissue 124 being cut with blade members 34, 36. More specifically, as blade members 34, 36 are moved along the surface 126 of tissue 124, tissue 124 there beneath is coagulated. As known in the art, when exposed to heat, the collagen of the blood vessels will shrink, thus decreasing the diameter and associated lumen of the vessel. Certain vessels, depending on size and proximity to surface 126 of tissue 124 will become completely occluded (e.g. vessels up to about 1 mm in diameter and 1-5 mm deep), while vessels greater than 1 mm may become only partially occluded and need additional treatment with another device, such as a clip applicator, or with suture ligation. Some vessels, such as those 1 mm diameter or less, may not be initially sealed because they are too deep in the tissue, but these may be occluded as the device 22 is used to coag and cut deeper into the tissue.

Once surface 126 of tissue 124 is adequately treated with device 22, at least one of the distal ends 140, 142 of blade members 34, 36 may be used to pierce and perforate tissue 124, such as through the capsule of a liver. Preferably, the depth of the perforation is no deeper than the depth of tissue treatment provided by the surface coagulation to avoid possible puncturing of an untreated vessel. After making the first perforation in tissue 124, a second perforation laterally spaced from the first perforation may be made, also into treated tissue 124. Thereafter, the portion of tissue 124 between the first and second perforations may be located between shearing edges 132, 134 and shearing surfaces 136,

138 and thereafter cut when blade members 34, 36 are closed together. In alternative embodiments, both perforations may be made simultaneously with distal ends 140, 142 of blade members 34, 36. In still other embodiments, only one perforation made may be made. In this manner one blade member 34 may be located in the perforation while the distal end 142 of the other blade member 36 is laterally spaced and pressed against the surface 126 of tissue 124 to cut the tissue 124 when blade members 34, 36 are closed together. In still other embodiments, no perforations of tissue 124 may be required prior to cutting as where tissue 124 may be manipulated and located between the shearing edges 132, 134 and shearing surfaces 136, 138 of open blade members 34, 36 without the need for the perforations.

It should be noted that, as shown, preferably distal ends 140, 142 of blade members 34, 36 are blunt. In other words distal ends 140, 142 of blade members 34, 36 preferably do not comprise a distal end point. The distal ends 140, 142 of blade members 34, 36 preferably are not pointed so that the distal ends 140, 142 of blade members 34, 36 will slide along the tissue surface 126 while the blade members 34, 36 are moved along the tissue surface 126 with a back and forth painting motion, and while tissue coagulation is performed with blade member exterior side surfaces 137, 139 of blade members 34, 36.

In the instance of parenchyma tissue, such as for liver, the distal end 140, 142 of one or both of blade members 34, 36 may be used to simultaneously blunt dissect and coagulate tissue without first perforating the tissue 124. As the surface 126 of tissue 124 is coagulated under and around the at least one of the blade members 34, 36, the blade member may then be used to blunt dissect into the coagulated parenchyma, with the distal ends 140, 142. As the device 22 enters an elongated crevice in the surface 126 of the tissue 124 formed by the blunt dissection, shearing edges 132, 134 of blade members 34, 36 may be used to further blunt dissect the coagulated parenchyma on the sidewalls of the crevice, or blunt dissect and coagulate simultaneously. Blunt dissection of the coagulated parenchyma is performed by continuous abrading or splitting apart of the parenchyma with the substantially the same back and forth motion as coagulation of the surface 126 of the tissue 124. However, with blunt dissection, the surgeon typically applies more force to the tissue. In various embodiments, once the parenchyma is coagulated, blunt dissection may be performed with or without the radio frequency power (i.e. on or off) and/or with or without the presence of fluid 84.

In yet another technique, blade members 34, 36 may be used for wedge dissection. In other words, while blade members 34, 36 are in the closed position and without tissue 124 there between, they are wedged into tissue 124, preferably between adjacent tissue planes. Thereafter, the blade members 34, 36 may be slowly opened and, due to the separation forces placed on the tissue 124 at the distal ends 140, 142 of the blade members 34, 36, the tissue will dissect.

The above techniques can also be used on other parenchymal organs such as the pancreas, the kidney, and the lung. In addition, it may also be useful on muscle tissue and subcutaneous fat. Its use can also extend to benign tumors, cysts or other tissue masses found in the urological or gynecological areas. It would also enable the removal of highly vascularized tumors such as hemangiomas.

The use of the disclosed devices can result in significantly lower blood loss during surgical procedures such as liver resections. Typical blood loss for a right hepatectomy can be in the range of 500-1,000 cubic centimeters. Use of the devices disclosed herein to perform pre-transection coagulation of the liver can result in blood loss in the range of 50-300

cubic centimeters. Such a reduction in blood loss can reduce or eliminate the need for blood transfusions, and thus the cost and negative clinical consequences associated with blood transfusions, such as prolonged hospitalization and a greater likelihood of cancer recurrence. Use of the device can also provide improved sealing of bile ducts, and reduce the incidence of post-operative bile leakage, which is considered a major surgical complication.

In addition to liver resections, device 22 may be particularly useful to a surgeon performing a laparoscopic cholecystectomy (abbr. "lap chole") for the case of, for instance, either acute cholecystitis or an intrahepatic gallbladder in that the device provides multi-functional uses. More particularly, device 22 is useful to the surgeon for coagulation and dissection of an inflamed serosal layer of tissue 124 between the liver and gallbladder, which may include tough, fibrous, highly vascular connecting tissue between the organs.

The power provided from the surgical device 22 is generally in the range between and including about 20 watts to 150 watts, and more preferably in the range between and including about 50 watts to 100 watts. The fluid provided from the surgical device 22 is generally in the range between and including about 1 cubic centimeter per minute to 100 cubic centimeters per minute, and more preferably in the range between and including about 5 cubic centimeter per minute to 25 cubic centimeters per minute. For a more complete discussion of an exemplary power to fluid flow rate relationship see U.S. Publication No. 2002/0062123 in the name of McClurken entitled "Fluid-Assisted Medical Devices, Fluid Delivery Systems And Controllers For Such Devices, And Methods" published May 23, 2002.

In order to minimize the sticking of tissue, particularly coagulum, to blade members 34, 36, but yet adequately heat the tissue for treatment, preferably the temperature of the tissue should remain in the range between and including about 75° C. to 120° C. As known in the art, tissue containing Type I collagen (e.g., walls of blood vessels, bronchi, bile ducts, etc.) shrinks when exposed to about 85° C. for an exposure time of 0.01 seconds, or when exposed to about 65° C. for an exposure time of 15 minutes. An exemplary target temperature/time for tissue shrinkage is about 75° C. with an exposure time of about 1 second. More generally, the power provided to the tissue should be sufficient to shrink collagen in the range between and including about 1 second to 10 seconds after RF activation. An exemplary method of controlling the tissue temperature below 120° C. is to remove excess heat generated in the tissue by means of fluid 84, particularly by boiling the fluid coupling 122. Where fluid 84 comprises saline, the fluid 84 boils at approximately 100° C. to remove heat from the tissue and inhibit the tissue temperature from exceeding 100° C. For a more detailed discussion, see U.S. Publication No. 2002/0062123 in the name of McClurken as identified above.

Thus far the device 22 has been described relative to use with scissors with curved blade members 34, 36. In still other embodiments, as shown in FIG. 9, the device of the present invention may comprise straight blade members 34, 36.

In yet another embodiment as shown in FIG. 10, only blade members 36 of electrosurgical device 22 has a bulbous portion 154, thus providing an asymmetric tip. Also different from previous embodiments, as shown the exterior side surfaces 137, 139 of blade members 34, 36 include a covering 156 of electrically insulating material, such as a polymer, ceramic or glass, except for the surface 152 of bulbous portion 154. An exemplary polymer comprises fluorine and, more particularly, polytetrafluoroethylene. In this manner, electrical current from blade members 34, 36 may be concentrated

into tissue through bulbous portion 154. From the above description it should be understood that in other embodiments, covering 152 may also be used when neither of blade members 34, 36 include a bulbous portion 154.

While exterior bulbous portion 154 is configured to coagulate tissue, blade members 34, 36 are also used to coagulate and cut tissue, and particularly seal vessels 158, such as blood vessels, as shown in FIG. 11. When blade members 34, 36 are electrified and provide RF power to tissue including a blood vessel 158, the collagen in the tissue and forming the wall 160 begins to shrink as discussed above. As the vessel 158 continues to shrink, the lumen 162 goes from being partially occluded to being completely occluded.

Due to tissue irregularities, the surface 164 of the vessel 158 to be treated may be uneven or undulated with microscopic peaks and valleys. Consequently, with conventional scissors, the area of direct electrical coupling of the vessel 158 to the scissors can be limited to the isolated peaks in the tissue surface 164. In this situation, upon the application of RF power to vessel 158, the electrical coupling of only the tissue peaks to the scissors may result in corresponding increase in current density through the electrically coupled peaks which has the ability to desiccate and char the vessel 158 at these isolated locations. In other locations, the electric current in the form of a spark may jump a gap created between a valley in the surface 164 of the vessel 158 and the scissors and burn, or even perforate, the vessel 158.

Also with conventional scissors, there may be a decrease in the electrical coupling between the surface 164 of vessel 158 and scissor surfaces upon tissue shrinkage and/or desiccation during treatment. As tissue shrinks and/or desiccates during treatment, the surface 164 of vessel 158 may lose contact with the scissors, which, similar to above, decreases the area of electrical coupling therebetween and correspondingly increases the current density and associated heat at the locations which remain electrically coupled. This difficulty is further exacerbated if the tissue is undulated as described above.

To offset a decrease in electrical coupling between the scissors and vessel 158 as the vessel shrinks, the user of conventional scissors may be required to further close or push the scissors into increased contact with the vessel 158. However, with the increased force placed on the vessel 158, there may be increased risk of inadvertently severing the vessel with a shearing edges 132, 134 of the scissors before the vessel is completely occluded.

As shown in FIG. 11, in addition to direct electrical coupling of the surface 164 of vessel 158 to the tissue abutting surfaces 144, 146 of blade members 34, 36, the surface 164 of vessel 158 is indirectly coupled to the shearing surfaces 136, 138 of blade members through fluid coupling 148 comprising an electrically conductive fluid 84. Furthermore, fluid coupling 148 couples the tissue abutting surfaces 144, 146 of blade members 34, 36 at locations where there may be a gap 166 and no direct contact between the surface 164 of vessel 158 to the tissue abutting surfaces 144, 146 of blade members 34, 36.

The fluid coupling 148, preferably comprising saline, inhibits the desiccation, tissue sticking to the shearing surfaces 136, 138 and tissue abutting surfaces 144, 146 of blade members 34, 36, tissue perforation, char formation, smoke generation and sparking encountered with conventional scissors. When an electrically conductive fluid 84 such as saline is used, the fluid cools the tissue while at the same time better dispersing the electrical current into the tissue more uniformly to inhibit heating of the tissue to where desiccation, charring, smoking, sticking and burning occur.

In addition to fluid coupling **148** offsetting (reducing) increases in current densities associated with undulated tissue, or tissue otherwise poorly coupled to the device, fluid coupling **148** also offsets increases in current densities due to so called “edge effects” often associated with sharp edges of electrodes. For example, the sharpness of shearing edges **132**, **134** of device **22** may give rise to an increase in current density into tissue adjacent thereto. In providing fluid coupling **148** adjacent each side of shearing edges **132**, **134**, the increase in current density will be offset by the presence of fluid coupling **148** which spreads the electrical current transmission into the tissue over a larger surface area.

As previously disclosed, the electrosurgical devices **22** disclosed herein may be used in conjunction with a cannula as illustrated in FIG. **12** at reference character **10**, during laparoscopic surgery such as, for example, a laparoscopic cholecystectomy. Cannula **10** comprises a proximal portion **12** separated from a distal portion **14** by an elongated rigid shaft portion **16**. Proximal portion **12** of cannula **10** preferably comprises a head portion **18** connected to rigid shaft portion **16**, preferably by threaded engagement. Most importantly, cannula **10** has a working channel **20** which extends through head portion **18** and shaft portion **16** from proximal portion **12** to distal portion **14** of cannula **10**. In one particular embodiment, during insertion into cannula **10**, the electrosurgical devices disclosed herein configured to enter the proximal end of working channel **20**, move along the channel **20** distally, and then be extended from the distal end of the working channel **20**. In the same embodiment, during retraction from cannula **10**, electrosurgical devices disclosed herein are configured to enter the distal end of working channel **20**, move along the channel **20** proximally, and then be removed from the proximal end of working channel **20**.

For purposes of the appended claims, the term “tissue” includes, but is not limited to, organs (e.g. liver, lung, spleen, gallbladder), highly vascular tissues (e.g. liver, spleen), soft tissues, hard tissues and tissue masses (e.g. tumors).

While a preferred embodiment of the present invention has been described, it should be understood that various changes, adaptations and modifications can be made therein without departing from the spirit of the invention and the scope of the appended claims. The scope of the invention should, therefore, be determined not with reference to the above description, but instead should be determined with reference to the appended claims along with their full scope of equivalents.

For example, while the above description of the coupling and operation between rod **54** and first and second handle members **46**, **48** has been presented in detail, it should be understood not to constitute a limitation of the invention and that a variety of mechanisms may be employed. Similarly to the coupling and operation between rod **54** and first and second handle members **46**, **48**, the coupling of blade members **34**, **36** to the distal end portion **58** of rod **54** for controlling or effecting the relative movement of blade members **34**, **36** at the distal end of device **22** may be performed by a variety of mechanisms known in the art and the specific structures disclosed should be understood not to constitute a limitation of the invention.

Furthermore, it should be understood that the appended claims do not necessarily comprise the broadest scope of the invention which the Applicant is entitled to claim, or the only manner(s) in which the invention may be claimed, or that all recited features are necessary.

We claim:

1. A fluid-assisted electrosurgical scissors to treat tissue, the scissors comprising:

an end effector comprising a first blade member and a second blade member, the first blade member and the second blade member pivotally connected and arranged to cut tissue;

at least one of the first blade member and the second blade member electrically coupled to an electrical connector connectable to a radio frequency power source;

the first blade member comprising a first blade member shearing edge extending to a distal end of the first blade member and the second blade member comprising a second blade member shearing edge extending to a distal end of the second blade member;

the first blade member comprising a first blade member distal portion and the second blade member comprising a second blade member distal portion, wherein at least one of the distal portions further comprises a bulbous portion protruding from a respective one of the first blade member or second blade member, the bulbous portion being bulbous relative to a remainder of the respective one of the first blade member or the second blade member, wherein the bulbous portion has an exposed electrically-conductive surface;

a fluid passage in fluid communication with at least one fluid outlet, wherein the at least one fluid outlet is positioned to expel fluid to the end effector;

a shaft having a first lumen, wherein the end effector is connected to the shaft; and

a rod having a second lumen providing a portion of the fluid passage, wherein a portion of the rod is positioned in the first lumen.

2. The electrosurgical scissors of claim 1, wherein the rod comprises a first end positioned in the first lumen and a second end connected to a fluid line.

3. The electrosurgical scissors of claim 1, wherein the at least one fluid outlet is located within the shaft.

4. The electrosurgical scissors of claim 1, wherein:

the first blade member comprises a first blade member exterior surface;

the second blade member comprises a second blade member exterior surface;

at least one of the exterior surfaces is configured to slide along tissue at the treatment site such that fluid expelled from the at least one fluid outlet creates a fluid coupling between the exterior surface and the tissue; and

radio frequency power is provided to the tissue from the scissors.

5. A fluid-assisted electrosurgical scissors to treat tissue, the scissors comprising:

an end effector comprising a first blade member and a second blade member, the first blade member and the second blade member pivotally connected and arranged to cut tissue;

at least one of the first blade member and the second blade member electrically coupled to an electrical connector connectable to a radio frequency power source;

the first blade member comprising a first blade member shearing edge extending to a distal end of the first blade member and the second blade member comprising a second blade member shearing edge extending to a distal end of the second blade member;

the first blade member comprising a first blade member distal portion and the second blade member comprising a second blade member distal portion, wherein at least one of the distal portions further comprises a bulbous portion protruding from an exterior side of a respective one of the first blade member or second blade member, the bulbous portion being bulbous relative to a remain-

15

der of the respective one of the first blade member or second blade member, wherein:
 the bulbous portion has an exposed electrically-conductive surface serving as an electrode pole configured to operate in a monopolar configuration, the exposed electrically-conductive surface facing opposite of an interior side surface of the respective blade member which is provided with the shearing edge;
 a fluid passage in fluid communication with at least one fluid outlet; and
 the at least one fluid outlet positioned to expel a fluid to the end effector to create a fluid coupling between the end effector and tissue at a treatment site and wherein the at least one fluid outlet is obstructed from contact with tissue by at least one of the blade members.
 6. The electrosurgical scissors of claim 5 are monopolar electrosurgical scissors.
 7. The electrosurgical scissors of claim 5 are laparoscopic electrosurgical scissors.
 8. The electrosurgical scissors of claim 5 wherein:
 the first blade member comprises a first blade member exterior surface;
 the second blade member comprises a second blade member exterior surface; and
 at least one of the first blade member exterior surface and the second blade member exterior surface at least partially comprises an electrically insulative material.
 9. The electrosurgical scissors of claim 5 wherein:
 the first blade member comprises a first blade member shearing surface;
 the second blade member comprises a second blade member shearing surface; and
 the first blade member shearing surface and the second blade member shearing surface face one another when the first blade member and the second blade member are in a closed position.
 10. The electrosurgical scissors of claim 5 further comprising:
 a push rod;
 a lumen located within the push rod; and
 the lumen providing a portion of the fluid passage.

16

11. The electrosurgical scissors of claim 5 wherein:
 the fluid passage passes through a connector member which couples the blade members to a push rod.
 12. The electrosurgical scissors of claim 5 wherein:
 the at least one fluid outlet is provided by a connector member which couples the blade members and a push rod.
 13. The electrosurgical scissors of claim 5 wherein:
 at least one of the blade members is curved.
 14. The electrosurgical scissors of claim 5 wherein:
 the first blade member comprises a first blade member exterior surface;
 the second blade member comprises a second blade member exterior surface;
 at least one of the exterior surfaces is configured to slide along the tissue at the treatment site such that the fluid coupling is between the exterior surface and the tissue; and
 radio frequency power is provided to the tissue from the scissors.
 15. The electrosurgical scissors of claim 5 wherein:
 the first blade member distal portion and the second blade member distal portion each comprise a bulbous portion protruding from the exterior side of each respective blade member.
 16. The electrosurgical scissors of claim 5 wherein:
 the bulbous portion protrudes from a convex side of the respective blade member.
 17. The electrosurgical Scissors of claim 5 wherein:
 the bulbous portion is hemispherical.
 18. The electrosurgical scissors of claim 17 wherein:
 the exposed electrically-conductive surface of the hemispherical bulbous portion is a hemispherical surface.
 19. The electrosurgical scissors of claim 5 wherein:
 the at least one fluid outlet is further positioned to provide fluid adjacent each side of at least one of the shearing edges.
 20. The electrosurgical scissors of claim 5 wherein:
 the bulbous portion is located only on the exterior side of the respective blade member.

* * * * *

6,238,391	B1	5/2001	Olsen et al.	6,494,902	B2	12/2002	Hoey et al.
6,238,393	B1	5/2001	Mulier et al.	6,497,704	B2	12/2002	Ein-Gal
6,241,753	B1	6/2001	Knowlton	6,497,705	B2	12/2002	Comben
6,241,754	B1	6/2001	Swanson et al.	6,506,189	B1	1/2003	Rittman, III et al.
6,251,110	B1	6/2001	Wampler	6,508,815	B1	1/2003	Strul et al.
6,254,600	B1	7/2001	Willink et al.	6,517,536	B2	2/2003	Hooven et al.
6,258,086	B1	7/2001	Ashley et al.	6,526,320	B2	2/2003	Mitchell
6,258,087	B1	7/2001	Edwards et al.	6,537,248	B2	3/2003	Mulier et al.
6,261,311	B1	7/2001	Sharkey et al.	6,537,272	B2	3/2003	Christopherson et al.
6,264,650	B1	7/2001	Hovda et al.	6,539,265	B2	3/2003	Medhkour et al.
6,264,651	B1	7/2001	Underwood et al.	6,558,379	B1	5/2003	Batchelor et al.
6,264,652	B1	7/2001	Eggers et al.	6,558,385	B1	5/2003	McClurken et al.
6,264,654	B1	7/2001	Swartz et al.	6,575,969	B1	6/2003	Rittman, III et al.
6,266,551	B1	7/2001	Osadchy et al.	6,577,902	B1	6/2003	Laufer et al.
6,277,112	B1	8/2001	Underwood et al.	6,579,288	B1	6/2003	Swanson et al.
6,280,440	B1	8/2001	Gocho	6,585,732	B2	7/2003	Mulier et al.
6,283,961	B1	9/2001	Underwood et al.	6,602,248	B1	8/2003	Sharps et al.
6,283,988	B1	9/2001	Laufer et al.	6,603,988	B2	8/2003	Dowlatschahi
6,283,989	B1	9/2001	Laufer et al.	6,610,060	B2	8/2003	Mulier et al.
6,290,715	B1	9/2001	Sharkey et al.	6,613,048	B2	9/2003	Mulier et al.
6,293,942	B1	9/2001	Goble et al.	6,623,515	B2	9/2003	Mulier et al.
6,293,945	B1	9/2001	Parins et al.	6,626,899	B2	9/2003	Houser et al.
6,296,636	B1	10/2001	Cheng et al.	6,645,202	B1	11/2003	Pless et al.
6,296,638	B1	10/2001	Davison et al.	6,666,862	B2	12/2003	Jain et al.
6,296,640	B1	10/2001	Wampler et al.	6,669,692	B1	12/2003	Nelson et al.
6,299,633	B1	10/2001	Laufer	6,676,660	B2	1/2004	Wampler
6,302,903	B1	10/2001	Mulier et al.	6,679,882	B1	1/2004	Kornerup
6,306,134	B1	10/2001	Goble et al.	6,682,501	B1	1/2004	Nelson et al.
6,309,387	B1	10/2001	Eggers et al.	6,682,527	B2	1/2004	Strul
6,311,090	B1	10/2001	Knowlton	6,682,528	B2	1/2004	Frazier et al.
6,312,408	B1	11/2001	Eggers et al.	6,685,700	B2	2/2004	Behl et al.
6,312,430	B1	11/2001	Wilson et al.	6,685,701	B2	2/2004	Orszulak et al.
6,315,777	B1	11/2001	Comben	6,685,704	B2	2/2004	Greep
6,322,549	B1	11/2001	Eggers et al.	6,689,129	B2	2/2004	Baker
6,322,559	B1	11/2001	Daulton et al.	6,689,131	B2	2/2004	McClurken
6,327,505	B1	12/2001	Medhkour et al.	6,692,489	B1	2/2004	Heim et al.
6,328,735	B1	12/2001	Curley et al.	6,694,984	B2	2/2004	Habib
6,328,736	B1	12/2001	Mulier et al.	6,695,837	B2	2/2004	Howell
6,336,926	B1	1/2002	Goble	6,695,840	B2	2/2004	Schulze
6,350,262	B1	2/2002	Ashley	6,699,240	B2	3/2004	Francischelli
6,350,276	B1	2/2002	Knowlton	6,699,242	B2	3/2004	Heggeness
6,352,533	B1	3/2002	Ellman et al.	6,699,244	B2	3/2004	Carranza et al.
6,355,032	B1	3/2002	Hovda et al.	6,699,268	B2	3/2004	Kordis et al.
6,358,245	B1	3/2002	Edwards et al.	6,702,810	B2	3/2004	McClurken et al.
6,358,248	B1	3/2002	Mulier et al.	6,702,812	B2	3/2004	Cosmescu
6,363,937	B1	4/2002	Hovda et al.	6,706,039	B2	3/2004	Mulier et al.
6,371,956	B1	4/2002	Wilson et al.	6,712,074	B2	3/2004	Edwards et al.
6,379,350	B1	4/2002	Sharkey et al.	6,712,811	B2	3/2004	Underwood et al.
6,379,351	B1	4/2002	Thapliyal et al.	6,712,813	B2	3/2004	Ellman et al.
6,391,025	B1	5/2002	Weinstein et al.	6,712,816	B2	3/2004	Hung et al.
6,391,028	B1	5/2002	Fanton et al.	6,716,211	B2	4/2004	Mulier et al.
6,402,742	B1	6/2002	Blewett et al.	6,719,754	B2	4/2004	Underwood et al.
6,409,722	B1	6/2002	Hoey et al.	6,723,094	B1	4/2004	Desinger
6,409,723	B1	6/2002	Edwards	6,726,683	B1	4/2004	Shaw
H2037	H	7/2002	Yates et al.	6,726,684	B1	4/2004	Woloszko et al.
6,416,507	B1	7/2002	Eggers et al.	6,726,686	B2	4/2004	Buyse et al.
6,416,508	B1	7/2002	Eggers et al.	6,730,081	B1	5/2004	Desai
6,416,509	B1	7/2002	Goble et al.	6,733,496	B2	5/2004	Ashley et al.
6,425,877	B1	7/2002	Edwards	6,733,498	B2	5/2004	Paton et al.
6,432,103	B1	8/2002	Ellsberry et al.	6,733,501	B2	5/2004	Levine
6,440,130	B1	8/2002	Mulier et al.	6,736,810	B2	5/2004	Hoey et al.
6,443,952	B1	9/2002	Mulier et al.	6,740,058	B2	5/2004	Lal et al.
6,451,017	B1	9/2002	Moutafis et al.	6,740,079	B1	5/2004	Eggers et al.
6,458,123	B1	10/2002	Brucker et al.	6,740,082	B2	5/2004	Shaddock
6,458,130	B1	10/2002	Frazier et al.	6,740,084	B2	5/2004	Ryan
6,461,350	B1	10/2002	Underwood et al.	6,740,102	B2	5/2004	Hess et al.
6,461,354	B1	10/2002	Olsen et al.	6,743,197	B1	6/2004	Edwards
6,461,357	B1	10/2002	Sharkey et al.	6,743,229	B2	6/2004	Buyse et al.
6,464,695	B2	10/2002	Hovda et al.	6,743,230	B2	6/2004	Lutze et al.
6,468,270	B1	10/2002	Hovda et al.	6,746,447	B2	6/2004	Davison et al.
6,468,274	B1	10/2002	Alleyne et al.	6,755,825	B2	6/2004	Shoenman et al.
6,468,275	B1	10/2002	Wampler et al.	6,755,827	B2	6/2004	Mulier et al.
6,471,698	B1	10/2002	Edwards et al.	6,757,565	B2	6/2004	Sharkey et al.
6,475,216	B2	11/2002	Mulier et al.	6,758,846	B2	7/2004	Goble et al.
6,478,793	B1	11/2002	Cosman et al.	6,761,718	B2	7/2004	Madsen
6,482,202	B1	11/2002	Goble et al.	6,764,487	B2	7/2004	Mulier et al.
6,485,490	B2	11/2002	Wampler et al.	6,770,070	B1	8/2004	Balbierz
6,488,680	B1	12/2002	Francischelli et al.	6,770,071	B2	8/2004	Woloszko et al.
6,493,589	B1	12/2002	Medhkour et al.	6,770,072	B1	8/2004	Truckai et al.

6,772,012 B2	8/2004	Ricart et al.	7,004,942 B2	2/2006	Laird et al.
6,772,013 B1	8/2004	Ingle et al.	7,008,419 B2	3/2006	Shaddock
6,775,575 B2	8/2004	Bommannan et al.	7,008,421 B2	3/2006	Daniel et al.
6,776,780 B2	8/2004	Mulier et al.	7,033,348 B2	4/2006	Alfano et al.
6,780,177 B2	8/2004	Shafirstein et al.	7,033,356 B2	4/2006	Latterell et al.
6,780,180 B1	8/2004	Goble et al.	7,041,096 B2	5/2006	Malis et al.
6,786,906 B1	9/2004	Cobb	7,041,101 B2	5/2006	Eggers
6,796,981 B2	9/2004	Wham et al.	7,041,102 B2	5/2006	Truckai et al.
6,800,077 B1	10/2004	Mucko et al.	7,052,494 B2	5/2006	Goble et al.
6,802,842 B2	10/2004	Ellman et al.	7,060,064 B2	6/2006	Allen et al.
6,802,843 B2	10/2004	Truckai et al.	7,063,670 B2	6/2006	Sampson et al.
6,808,525 B2	10/2004	Latterell et al.	7,066,932 B1	6/2006	Morgan et al.
6,813,520 B2	11/2004	Truckai et al.	7,066,936 B2	6/2006	Ryan
6,814,714 B1	11/2004	Novak et al.	7,070,596 B1	7/2006	Woloszko et al.
6,814,731 B2	11/2004	Swanson	7,070,604 B1	7/2006	Garito et al.
6,821,273 B2	11/2004	Mollenauer	7,074,217 B2	7/2006	Strul et al.
6,827,713 B2	12/2004	Bek et al.	7,074,219 B2	7/2006	Levine et al.
6,827,725 B2	12/2004	Batchelor et al.	7,083,601 B1	8/2006	Cosmescu
6,832,997 B2	12/2004	Uchida et al.	7,087,051 B2	8/2006	Bourne et al.
6,835,195 B2	12/2004	Schulze et al.	7,087,053 B2	8/2006	Vannev
6,836,688 B2	12/2004	Ingle et al.	7,094,215 B2	8/2006	Davison et al.
6,843,789 B2	1/2005	Goble	7,101,387 B2	9/2006	Garabedian et al.
6,845,264 B1	1/2005	Skladnev et al.	7,104,986 B2	9/2006	Hovda et al.
6,849,073 B2	2/2005	Hoey et al.	7,112,199 B2	9/2006	Cosmescu
6,855,145 B2	2/2005	Ciarrocca	7,115,139 B2	10/2006	McClurken et al.
6,858,028 B2	2/2005	Mulier et al.	7,125,406 B2	10/2006	Given
6,860,882 B2	3/2005	Battles et al.	7,147,634 B2	12/2006	Nesbitt
6,863,669 B2	3/2005	Spitzer	7,147,635 B2	12/2006	Ciarrocca
6,864,686 B2	3/2005	Novak et al.	7,147,637 B2	12/2006	Goble
6,881,214 B2	4/2005	Cosman et al.	7,147,638 B2	12/2006	Chapman et al.
6,882,885 B2	4/2005	Levy, Jr. et al.	7,150,746 B2	12/2006	DeCesare et al.
6,887,237 B2	5/2005	McGaffigan	7,150,747 B1	12/2006	McDonald et al.
6,887,240 B1	5/2005	Lands et al.	7,150,748 B2	12/2006	Ebbutt et al.
6,893,435 B2	5/2005	Goble	7,153,300 B2	12/2006	Goble
6,893,440 B2	5/2005	Durgin et al.	7,156,845 B2	1/2007	Mulier et al.
6,896,672 B1	5/2005	Eggers et al.	7,166,105 B2	1/2007	Mulier et al.
6,896,674 B1	5/2005	Woloszko et al.	7,166,106 B2	1/2007	Bartel et al.
6,899,712 B2	5/2005	Moutafis et al.	7,169,143 B2	1/2007	Eggers et al.
6,905,497 B2	6/2005	Truckai et al.	7,169,144 B2	1/2007	Hoey et al.
6,905,499 B1	6/2005	Mucko et al.	7,207,471 B2	4/2007	Heinrich et al.
6,911,019 B2	6/2005	Mulier et al.	7,232,440 B2	6/2007	Dumbauld et al.
6,915,806 B2	7/2005	Pacek et al.	7,247,155 B2	7/2007	Hoey et al.
6,921,398 B2	7/2005	Carmel et al.	7,261,711 B2	8/2007	Mulier et al.
6,921,399 B2	7/2005	Carmel et al.	7,309,325 B2	12/2007	Mulier et al.
6,923,803 B2	8/2005	Goble	7,311,708 B2	12/2007	McClurken
6,923,805 B1	8/2005	LaFontaine et al.	7,322,974 B2	1/2008	Swoyer et al.
6,926,706 B1	8/2005	Sealfon	7,361,175 B2	4/2008	Suslov
6,926,716 B2	8/2005	Baker et al.	7,364,579 B2	4/2008	Mulier et al.
6,926,717 B1	8/2005	Garito et al.	2001/0014819 A1	8/2001	Ingle et al.
6,929,640 B1	8/2005	Underwood et al.	2001/0020167 A1	9/2001	Woloszko et al.
6,929,641 B2	8/2005	Goble et al.	2001/0023365 A1	9/2001	Medhkour et al.
6,929,642 B2	8/2005	Xiao et al.	2001/0025178 A1	9/2001	Mulier et al.
6,929,644 B2	8/2005	Truckai et al.	2001/0032002 A1	10/2001	McClurken et al.
6,929,645 B2	8/2005	Battles et al.	2001/0039419 A1	11/2001	Francischelli et al.
6,932,810 B2	8/2005	Ryan	2001/0041921 A1	11/2001	Mulier et al.
6,932,815 B2	8/2005	Sutter	2001/0051802 A1	12/2001	Woloszko et al.
6,942,661 B2	9/2005	Swanson	2001/0051804 A1	12/2001	Mulier et al.
6,949,096 B2	9/2005	Davison et al.	2002/0002393 A1	1/2002	Mitchell
6,949,098 B2	9/2005	Mulier et al.	2002/0010463 A1	1/2002	Mulier et al.
6,951,559 B1	10/2005	Greep	2002/0013582 A1	1/2002	Mulier et al.
6,953,461 B2	10/2005	McClurken et al.	2002/0016589 A1	2/2002	Swartz et al.
6,960,204 B2	11/2005	Eggers et al.	2002/0019628 A1	2/2002	Comben
6,960,207 B2	11/2005	Vannev et al.	2002/0022870 A1	2/2002	Truckai et al.
6,960,210 B2	11/2005	Lands et al.	2002/0026186 A1	2/2002	Woloszko et al.
6,962,589 B2	11/2005	Mulier et al.	2002/0026187 A1	2/2002	Swanson
6,964,274 B1	11/2005	Ryan et al.	2002/0029036 A1	3/2002	Goble et al.
6,964,661 B2	11/2005	Rioux et al.	2002/0035361 A1	3/2002	Houser et al.
6,966,907 B2	11/2005	Goble	2002/0035387 A1	3/2002	Mulier et al.
6,966,909 B2	11/2005	Marshall et al.	2002/0049438 A1	4/2002	Sharkey et al.
6,971,394 B2	12/2005	Sliwa, Jr. et al.	2002/0049439 A1	4/2002	Mulier et al.
6,974,452 B1	12/2005	Gille et al.	2002/0049483 A1	4/2002	Knowlton
6,974,453 B2	12/2005	Woloszko et al.	2002/0058933 A1	5/2002	Christopherson et al.
6,979,332 B2	12/2005	Adams	2002/0058935 A1	5/2002	Hoey et al.
6,984,231 B2	1/2006	Goble et al.	2002/0062123 A1	5/2002	McClurken et al.
6,986,769 B2	1/2006	Nelson et al.	2002/0095150 A1	7/2002	Goble
6,991,631 B2	1/2006	Woloszko et al.	2002/0095151 A1	7/2002	Dahla et al.
7,001,380 B2	2/2006	Goble	2002/0095152 A1	7/2002	Ciarrocca et al.
7,001,382 B2	2/2006	Gallo, Sr.	2002/0099366 A1	7/2002	Dahla et al.
7,004,941 B2	2/2006	Tvinnereim et al.	2002/0115991 A1	8/2002	Edwards

2002/0115992	A1	8/2002	Utley et al.	2004/0143258	A1	7/2004	Fuimaono
2002/0120259	A1	8/2002	Letlice et al.	2004/0143259	A1	7/2004	Mulier et al.
2002/0120260	A1	8/2002	Morris et al.	2004/0143263	A1	7/2004	Schechter et al.
2002/0120261	A1	8/2002	Morris et al.	2004/0147902	A1	7/2004	McGuckin, Jr. et al.
2002/0128650	A1	9/2002	McClurken	2004/0147916	A1	7/2004	Baker
2002/0133148	A1	9/2002	Daniel et al.	2004/0147922	A1	7/2004	Keppel
2002/0151884	A1	10/2002	Hoey et al.	2004/0147925	A1	7/2004	Buyse et al.
2002/0156511	A1	10/2002	Habib	2004/0162552	A1	8/2004	McClurken
2002/0161364	A1 *	10/2002	Mulier et al. 606/49	2004/0162554	A1	8/2004	Lee et al.
2002/0169446	A1	11/2002	Mulier et al.	2004/0162557	A1	8/2004	Tetzlaff et al.
2002/0177846	A1	11/2002	Mulier et al.	2004/0162572	A1	8/2004	Sauer
2002/0183733	A1	12/2002	Mulier et al.	2004/0167508	A1	8/2004	Wham et al.
2002/0188284	A1	12/2002	To et al.	2004/0172111	A1	9/2004	Hijii et al.
2002/0193851	A1	12/2002	Silverman et al.	2004/0176760	A1	9/2004	Qiu
2002/0198524	A1	12/2002	Mulier et al.	2004/0176761	A1	9/2004	Desinger
2003/0004510	A1	1/2003	Wham et al.	2004/0176762	A1	9/2004	Lawes et al.
2003/0032955	A1	2/2003	Mulier et al.	2004/0181219	A1	9/2004	Goble et al.
2003/0073989	A1	4/2003	Hoey et al.	2004/0181250	A1	9/2004	Adams et al.
2003/0114850	A1	6/2003	McClurken et al.	2004/0186469	A1	9/2004	Wolosko et al.
2003/0181902	A1	9/2003	Mulier et al.	2004/0186470	A1	9/2004	Goble et al.
2003/0204185	A1	10/2003	Sherman et al.	2004/0186535	A1	9/2004	Knowlton
2003/0216733	A1	11/2003	McClurken et al.	2004/0193148	A1	9/2004	Wham et al.
2004/0015162	A1	1/2004	McGaffigan	2004/0193150	A1	9/2004	Sharkey et al.
2004/0015163	A1	1/2004	Buyse et al.	2004/0193152	A1	9/2004	Sutton et al.
2004/0015215	A1	1/2004	Fredricks et al.	2004/0193211	A1	9/2004	Voegele et al.
2004/0015216	A1	1/2004	DeSisto	2004/0199156	A1	10/2004	Rioux et al.
2004/0015218	A1	1/2004	Finch et al.	2004/0199160	A1	10/2004	Slater
2004/0019350	A1	1/2004	O'Brien et al.	2004/0206365	A1	10/2004	Knowlton
2004/0024395	A1	2/2004	Ellman et al.	2004/0210213	A1	10/2004	Fuimaono et al.
2004/0024396	A1	2/2004	Eggers	2004/0210214	A1	10/2004	Knowlton
2004/0024398	A1	2/2004	Hovda et al.	2004/0215181	A1	10/2004	Christopherson et al.
2004/0024399	A1	2/2004	Sharps et al.	2004/0215182	A1	10/2004	Lee
2004/0030327	A1	2/2004	Golan	2004/0215183	A1	10/2004	Hoey et al.
2004/0030328	A1	2/2004	Eggers et al.	2004/0215184	A1	10/2004	Eggers et al.
2004/0030330	A1	2/2004	Brassell et al.	2004/0215185	A1	10/2004	Truckai et al.
2004/0030332	A1	2/2004	Knowlton et al.	2004/0215188	A1	10/2004	Mulier et al.
2004/0030333	A1	2/2004	Goble	2004/0215235	A1	10/2004	Jackson et al.
2004/0034340	A1	2/2004	Biscup	2004/0215296	A1	10/2004	Ganz et al.
2004/0034346	A1	2/2004	Stern et al.	2004/0220561	A1	11/2004	Kirwan, Jr. et al.
2004/0034349	A1	2/2004	Kirwan, Jr. et al.	2004/0220562	A1	11/2004	Garabedian et al.
2004/0034400	A1	2/2004	Ingle et al.	2004/0225288	A1	11/2004	Buyse et al.
2004/0039429	A1	2/2004	Daniel et al.	2004/0230190	A1	11/2004	Dahla et al.
2004/0044341	A1	3/2004	Truckai et al.	2004/0236322	A1	11/2004	Mulier et al.
2004/0054363	A1	3/2004	Vaska et al.	2004/0236324	A1	11/2004	Muller et al.
2004/0054365	A1	3/2004	Goble	2004/0243125	A1	12/2004	Dycus et al.
2004/0054366	A1	3/2004	Davison et al.	2004/0243163	A1	12/2004	Casiano et al.
2004/0054369	A1	3/2004	Nelson et al.	2004/0249371	A1	12/2004	Dycus et al.
2004/0054370	A1	3/2004	Given	2004/0249374	A1	12/2004	Tetzlaff et al.
2004/0059328	A1	3/2004	Daniel et al.	2004/0249425	A1	12/2004	Roy et al.
2004/0059363	A1	3/2004	Alvarez et al.	2004/0260279	A1	12/2004	Goble et al.
2004/0064023	A1	4/2004	Ryan et al.	2004/0260280	A1	12/2004	Sartor
2004/0064137	A1	4/2004	Pellegrino et al.	2004/0260368	A1	12/2004	Ingle et al.
2004/0068306	A1	4/2004	Shadduck	2005/0010205	A1	1/2005	Hovda et al.
2004/0068307	A1	4/2004	Goble	2005/0010212	A1	1/2005	McClurken et al.
2004/0073205	A1	4/2004	Treat et al.	2005/0015085	A1	1/2005	McClurken et al.
2004/0073208	A1	4/2004	Sutter	2005/0015086	A1	1/2005	Platt
2004/0078034	A1	4/2004	Acker et al.	2005/0015130	A1	1/2005	Gill
2004/0078037	A1	4/2004	Batchelor et al.	2005/0021025	A1	1/2005	Buyse et al.
2004/0078038	A1	4/2004	Desinger et al.	2005/0021026	A1	1/2005	Baily
2004/0082946	A1	4/2004	Malis et al.	2005/0021027	A1	1/2005	Shields et al.
2004/0082952	A1	4/2004	Dycus et al.	2005/0033278	A1	2/2005	McClurken et al.
2004/0087937	A1	5/2004	Eggers et al.	2005/0033292	A1	2/2005	Teitelbaum et al.
2004/0087939	A1	5/2004	Eggers et al.	2005/0038471	A1	2/2005	Chan et al.
2004/0087940	A1	5/2004	Jahns et al.	2005/0043728	A1	2/2005	Ciarrocca
2004/0087943	A1	5/2004	Dycus et al.	2005/0049583	A1	3/2005	Swanson
2004/0088029	A1	5/2004	Yamamoto	2005/0049586	A1	3/2005	Daniel et al.
2004/0092925	A1	5/2004	Rizoiu et al.	2005/0055019	A1	3/2005	Skarda
2004/0092926	A1	5/2004	Hoey et al.	2005/0055020	A1	3/2005	Skarda
2004/0097919	A1	5/2004	Wellman et al.	2005/0059966	A1	3/2005	McClurken et al.
2004/0102770	A1	5/2004	Goble	2005/0070888	A1	3/2005	Dimatteo et al.
2004/0102824	A1	5/2004	Sharkey et al.	2005/0070891	A1	3/2005	DeSisto
2004/0116923	A1	6/2004	Desinger	2005/0070894	A1	3/2005	McClurken
2004/0122420	A1	6/2004	Amoah	2005/0070896	A1	3/2005	Daniel et al.
2004/0122423	A1	6/2004	Dycus et al.	2005/0080410	A1	4/2005	Rioux et al.
2004/0122494	A1	6/2004	Eggers et al.	2005/0080413	A1	4/2005	Canady
2004/0138654	A1	7/2004	Goble	2005/0085804	A1	4/2005	McGaffigan
2004/0138655	A1	7/2004	McClurken et al.	2005/0085809	A1	4/2005	Mucko et al.
2004/0138657	A1	7/2004	Bourne et al.	2005/0085880	A1	4/2005	Truckai et al.
2004/0143257	A1	7/2004	Fuimaono	2005/0090816	A1	4/2005	McClurken et al.

US 8,475,455 B2

Page 7

2005/0090819	A1	4/2005	Goble	2006/0041254	A1	2/2006	Francischelli et al.
2005/0096649	A1	5/2005	Adams	2006/0041255	A1	2/2006	Eggers et al.
2005/0096651	A1	5/2005	Truckai et al.	2006/0047275	A1	3/2006	Goble
2005/0101951	A1	5/2005	Wham et al.	2006/0047280	A1	3/2006	Goble et al.
2005/0101952	A1	5/2005	Lands et al.	2006/0047331	A1	3/2006	Lax et al.
2005/0101965	A1	5/2005	Ryan	2006/0052770	A1	3/2006	Mulier et al.
2005/0107778	A1	5/2005	Rioux et al.	2006/0064085	A1	3/2006	Schechter et al.
2005/0107779	A1	5/2005	Ellman et al.	2006/0064101	A1	3/2006	Arramon
2005/0107784	A1	5/2005	Moses et al.	2006/0074411	A1	4/2006	Carmel et al.
2005/0107786	A1	5/2005	Canady	2006/0074414	A1	4/2006	Mulier et al.
2005/0113820	A1	5/2005	Goble et al.	2006/0079872	A1	4/2006	Eggleston
2005/0113825	A1	5/2005	Cosmescu	2006/0079888	A1	4/2006	Mulier et al.
2005/0124987	A1	6/2005	Goble	2006/0084968	A1	4/2006	Truckai et al.
2005/0130929	A1	6/2005	Boyd	2006/0095026	A1	5/2006	Ricart et al.
2005/0131402	A1	6/2005	Ciarrocca et al.	2006/0095031	A1	5/2006	Ormsby
2005/0137590	A1	6/2005	Lawes et al.	2006/0095034	A1	5/2006	Garito et al.
2005/0137662	A1	6/2005	Morris et al.	2006/0095075	A1	5/2006	Burkinshaw et al.
2005/0143729	A1	6/2005	Francischelli et al.	2006/0095103	A1	5/2006	Eggers et al.
2005/0154385	A1	7/2005	Heim et al.	2006/0100619	A1	5/2006	McClurken et al.
2005/0154433	A1	7/2005	Levy, Jr. et al.	2006/0106376	A1	5/2006	Godara et al.
2005/0159739	A1	7/2005	Paul et al.	2006/0106379	A1	5/2006	O'Brien et al.
2005/0159740	A1	7/2005	Paul et al.	2006/0111705	A1	5/2006	Janzen et al.
2005/0159778	A1	7/2005	Heinrich et al.	2006/0111709	A1	5/2006	Goble et al.
2005/0159797	A1	7/2005	Chandran et al.	2006/0111710	A1	5/2006	Goble et al.
2005/0165444	A1	7/2005	Hart et al.	2006/0111711	A1	5/2006	Goble
2005/0171524	A1	8/2005	Stern et al.	2006/0111741	A1	5/2006	Nardella
2005/0171526	A1	8/2005	Rioux et al.	2006/0116675	A1	6/2006	McClurken et al.
2005/0171532	A1	8/2005	Ciarrocca	2006/0122593	A1	6/2006	Jun et al.
2005/0171533	A1	8/2005	Latterell et al.	2006/0129145	A1	6/2006	Woloszko et al.
2005/0171534	A1	8/2005	Habib	2006/0129185	A1	6/2006	Paternuosto
2005/0171583	A1	8/2005	Mosher et al.	2006/0142757	A1	6/2006	Daniel et al.
2005/0177150	A1	8/2005	Amoah et al.	2006/0149225	A1	7/2006	McClurken
2005/0177209	A1	8/2005	Leung et al.	2006/0167446	A1	7/2006	Pozzato
2005/0187543	A1	8/2005	Underwood et al.	2006/0167449	A1	7/2006	Mulier et al.
2005/0187599	A1	8/2005	Sharkey et al.	2006/0167451	A1	7/2006	Cropper
2005/0203503	A1	9/2005	Edwards et al.	2006/0178667	A1	8/2006	Sartor et al.
2005/0203504	A1	9/2005	Wham et al.	2006/0178668	A1	8/2006	Albritton, IV
2005/0209591	A1	9/2005	Sutter	2006/0178670	A1	8/2006	Woloszko et al.
2005/0209621	A1	9/2005	Gordon et al.	2006/0178699	A1	8/2006	Surti
2005/0222602	A1	10/2005	Sutter et al.	2006/0184164	A1	8/2006	Malis et al.
2005/0222611	A1	10/2005	Weitkamp	2006/0184167	A1	8/2006	Vaska et al.
2005/0228372	A1	10/2005	Truckai et al.	2006/0189977	A1	8/2006	Allen et al.
2005/0245918	A1	11/2005	Sliwa, Jr. et al.	2006/0189979	A1	8/2006	Esch et al.
2005/0245921	A1	11/2005	Strul et al.	2006/0195079	A1	8/2006	Eberl
2005/0245922	A1	11/2005	Goble	2006/0200123	A1	9/2006	Ryan
2005/0245923	A1	11/2005	Christopherson et al.	2006/0217700	A1	9/2006	Garito et al.
2005/0250477	A1	11/2005	Eastwood et al.	2006/0217701	A1	9/2006	Young et al.
2005/0251128	A1	11/2005	Amoah	2006/0217707	A1	9/2006	Daniel et al.
2005/0251134	A1	11/2005	Woloszko et al.	2006/0224154	A1	10/2006	Shadduck et al.
2005/0256519	A1	11/2005	Goble et al.	2006/0235286	A1	10/2006	Stone et al.
2005/0261676	A1	11/2005	Hall et al.	2006/0235377	A1	10/2006	Earley et al.
2005/0261677	A1	11/2005	Hall et al.	2006/0235379	A1	10/2006	McClurken et al.
2005/0267465	A1	12/2005	Hillier et al.	2006/0241577	A1	10/2006	Balbierz et al.
2005/0267467	A1	12/2005	Paul et al.	2006/0241587	A1	10/2006	Heim et al.
2005/0267468	A1	12/2005	Truckai et al.	2006/0241588	A1	10/2006	Heim et al.
2005/0267469	A1	12/2005	Blocher	2006/0241589	A1	10/2006	Heim et al.
2005/0273092	A1	12/2005	G. et al.	2006/0247614	A1	11/2006	Sampson et al.
2005/0273097	A1	12/2005	Ryan	2006/0259025	A1	11/2006	Dahla
2005/0277915	A1	12/2005	DeCesare et al.	2006/0259031	A1	11/2006	Carmel et al.
2005/0277916	A1	12/2005	DeCesare et al.	2006/0259070	A1	11/2006	Livneh
2005/0277917	A1	12/2005	Garito et al.	2006/0264927	A1	11/2006	Ryan
2005/0283147	A1	12/2005	Yachi	2006/0264929	A1	11/2006	Goble et al.
2005/0283148	A1	12/2005	Janssen et al.	2006/0264931	A1	11/2006	Chapman et al.
2005/0283149	A1	12/2005	Thorne et al.	2006/0271033	A1	11/2006	Ein-Gal
2005/0283150	A1	12/2005	Moutafis et al.	2006/0271036	A1	11/2006	Garabedian et al.
2005/0283151	A1	12/2005	Ebbutt et al.	2006/0271042	A1	11/2006	Latterell et al.
2005/0288661	A1	12/2005	Sauvageau et al.	2006/0276783	A1	12/2006	Cosmescu
2005/0288665	A1	12/2005	Woloszko	2006/0276785	A1	12/2006	Asahara et al.
2006/0004356	A1	1/2006	Bilski et al.	2007/0000501	A1	1/2007	Wert et al.
2006/0009760	A1	1/2006	Mulier et al.	2007/0010812	A1	1/2007	Mittelstein et al.
2006/0009762	A1	1/2006	Whayne	2007/0016182	A1	1/2007	Lipson et al.
2006/0015097	A1	1/2006	Mulier et al.	2007/0049920	A1	3/2007	McClurken et al.
2006/0020265	A1	1/2006	Ryan	2007/0093808	A1	4/2007	Mulier et al.
2006/0025765	A1	2/2006	Landman et al.	2007/0118114	A1	5/2007	Miller et al.
2006/0025766	A1	2/2006	Heinrich et al.	2007/0208332	A1	9/2007	Mulier et al.
2006/0030912	A1	2/2006	Eggers et al.	2008/0015563	A1	1/2008	Hoey et al.
2006/0036235	A1	2/2006	Swoyer et al.	2008/0071270	A1	3/2008	Desinger et al.
2006/0036237	A1	2/2006	Davison et al.				
2006/0036239	A1	2/2006	Canady				

FOREIGN PATENT DOCUMENTS

EP	0 853 922	7/1998	WO	WO 99/66850 A1	12/1999
EP	1 095 627 A1	5/2001	WO	WO 00/78240 A1	12/2000
FR	2 235 669	1/1975	WO	WO 01/28444 A1	4/2001
JP	57-117843	7/1982	WO	WO 01/80757 A2	11/2001
JP	5-092009	4/1993	WO	WO 2005/122938 A1	12/2005
JP	7-124245	5/1995	WO	WO 2006/062916 A2	6/2006
WO	WO 97/05829 A1	2/1997	WO	WO 2006/062939 A2	6/2006
WO	WO 98/38932 A1	9/1998			

* cited by examiner

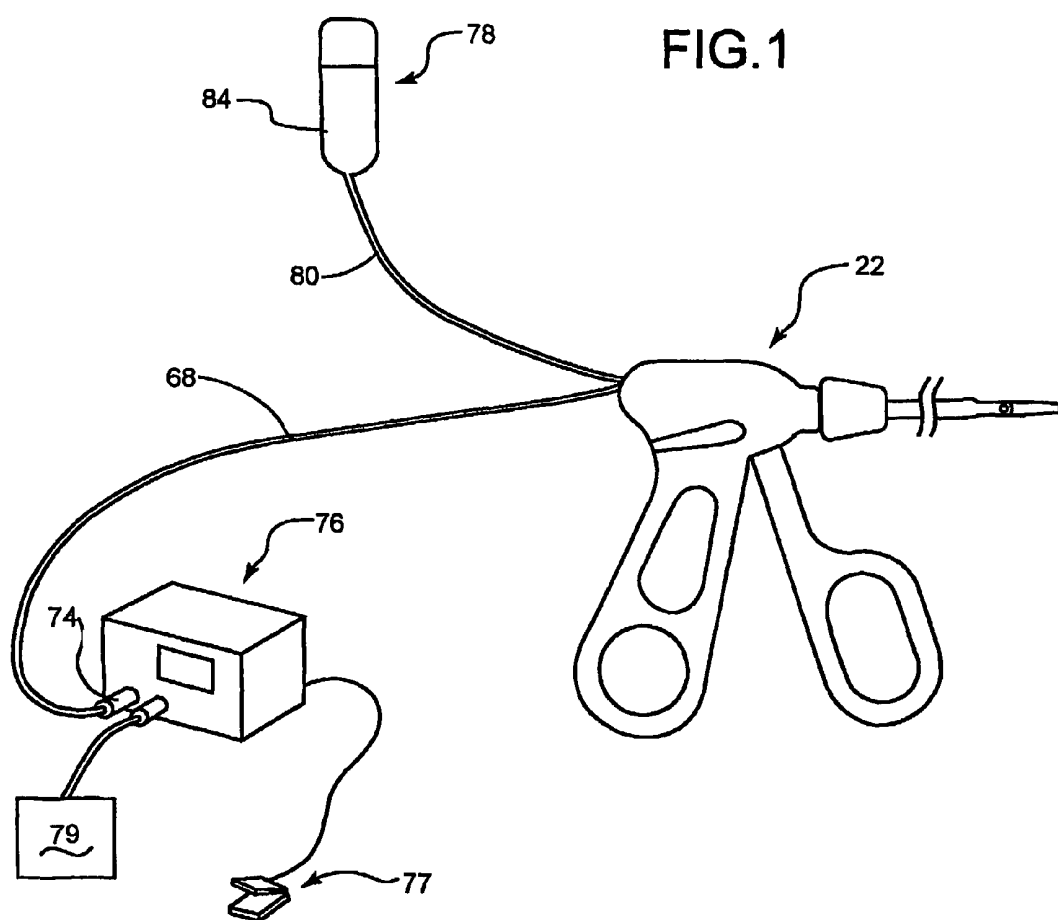
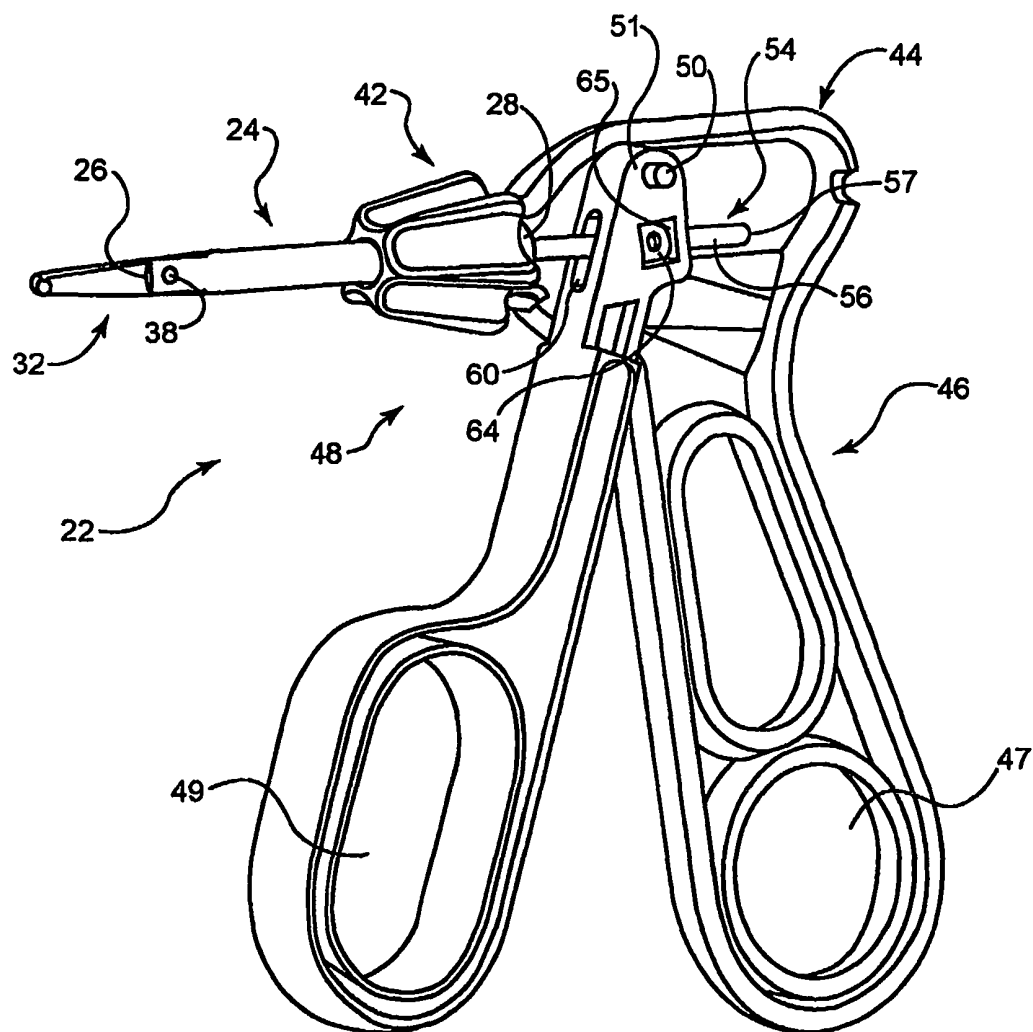

FIG.2



专利名称(译)	流体辅助电外科剪刀和方法		
公开(公告)号	US8475455	公开(公告)日	2013-07-02
申请号	US10/532704	申请日	2003-10-28
[标]申请(专利权)人(译)	TISSUELINK医疗		
申请(专利权)人(译)	TISSUELINK MEDICAL , INC.		
当前申请(专利权)人(译)	美敦力公司ADVANCED ENERGY LLC		
[标]发明人	MCCLURKEN MICHAEL E GREELEY ROGER D BERRY JOHN W		
发明人	MCCLURKEN, MICHAEL E. GREELEY, ROGER D. BERRY, JOHN W.		
IPC分类号	A61B18/14 A61B17/28 A61B17/32 A61B18/18 A61L A61M1/00		
CPC分类号	A61B18/1445 A61B17/3201 A61B2017/2936 A61B2017/2945 A61B2018/1432 A61B2018/146 A61B2218/002		
优先权	60/422190 2002-10-29 US		
其他公开文献	US20060235379A1		
外部链接	Espacenet USPTO		

摘要(译)

一种电外科剪刀，包括末端执行器，该末端执行器包括第一刀片构件和第二刀片构件，第一刀片构件和第二刀片构件可枢转地连接；电连接器，被配置为将剪刀连接到电源；流体通道与至少一个流体出口流体连通。

