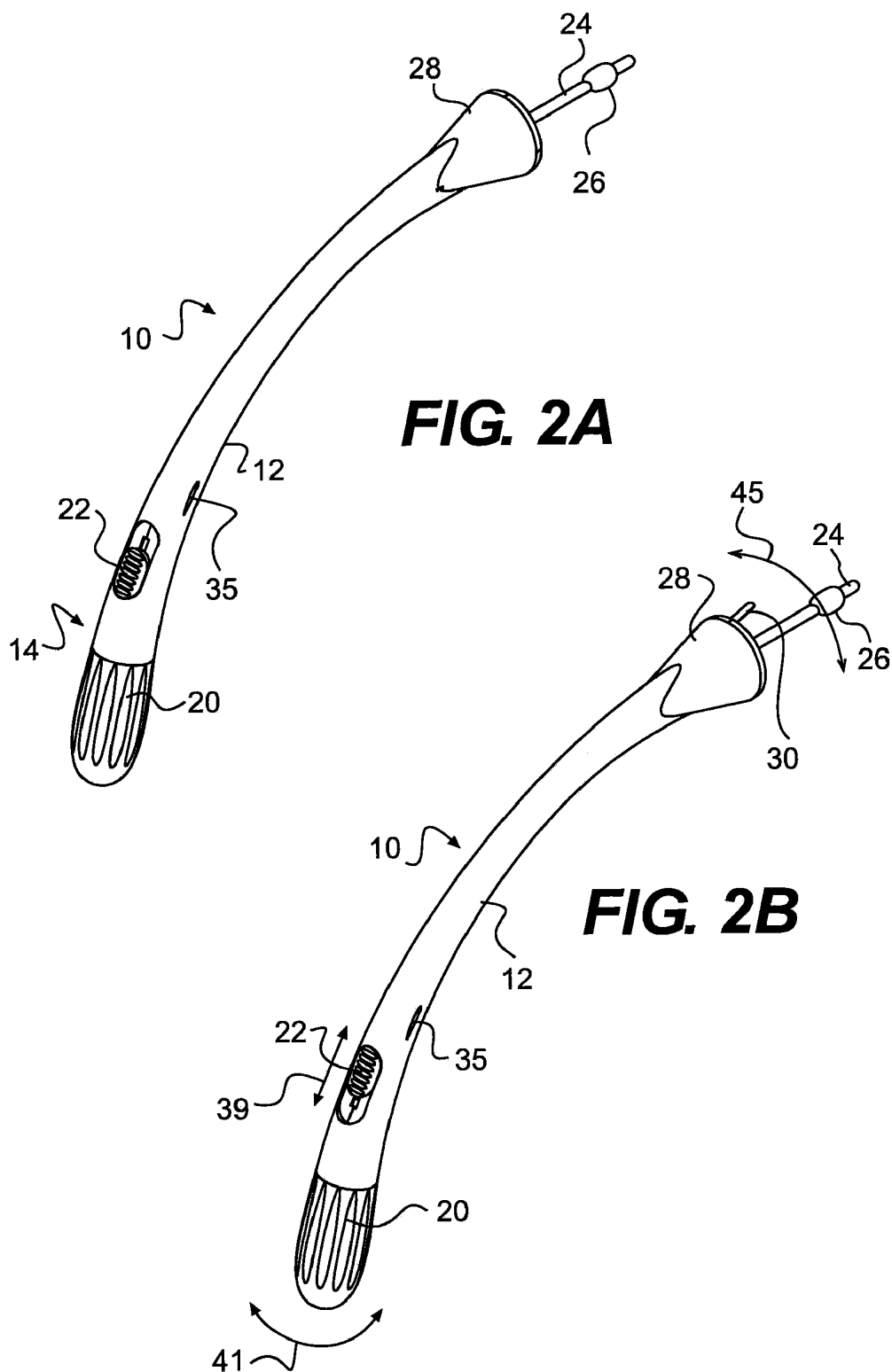

FIG. 1



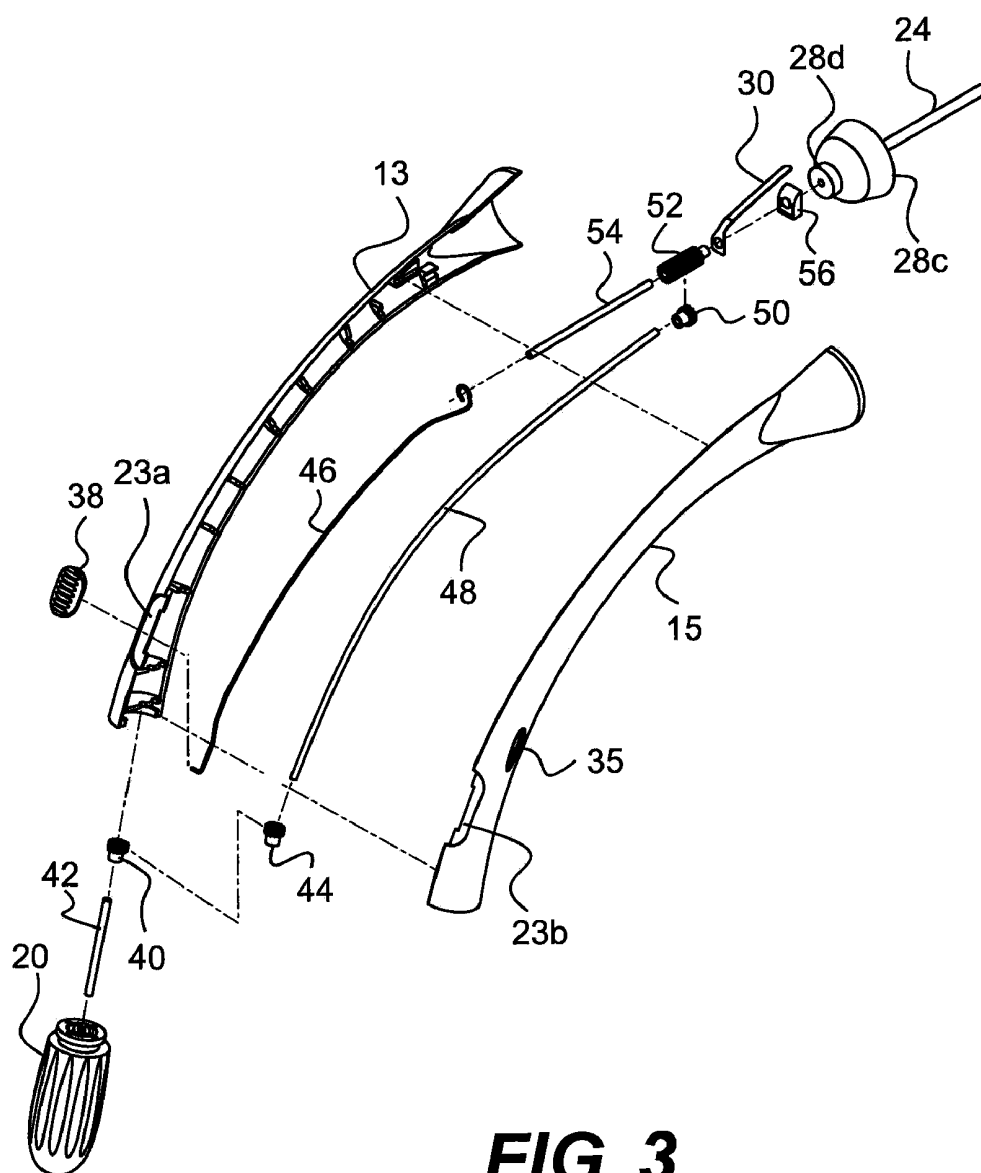

FIG. 3

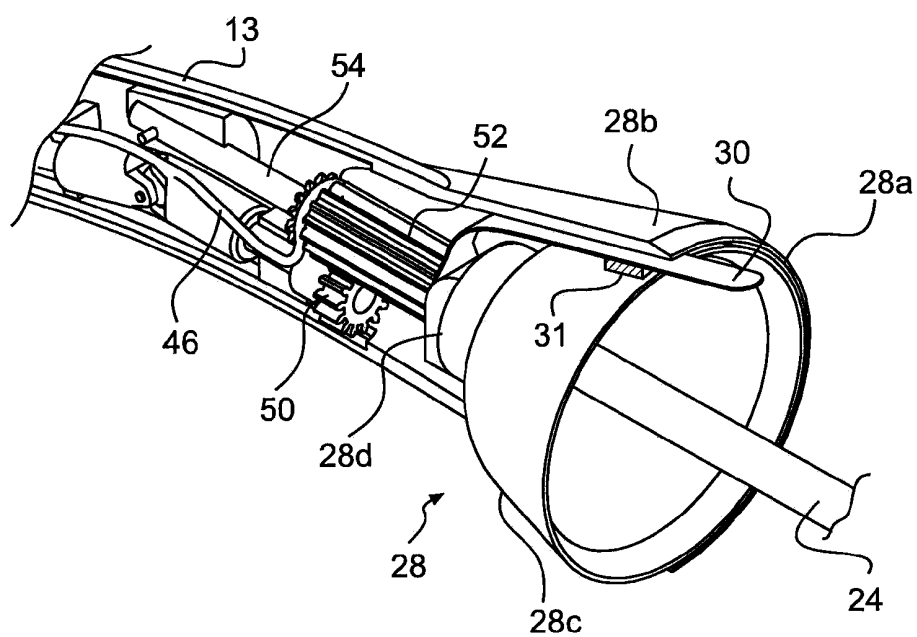

FIG. 4A

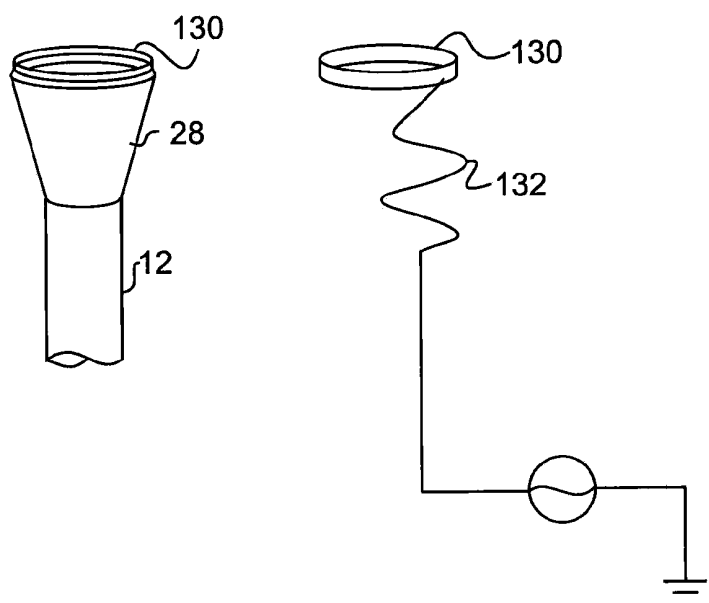

FIG. 4B

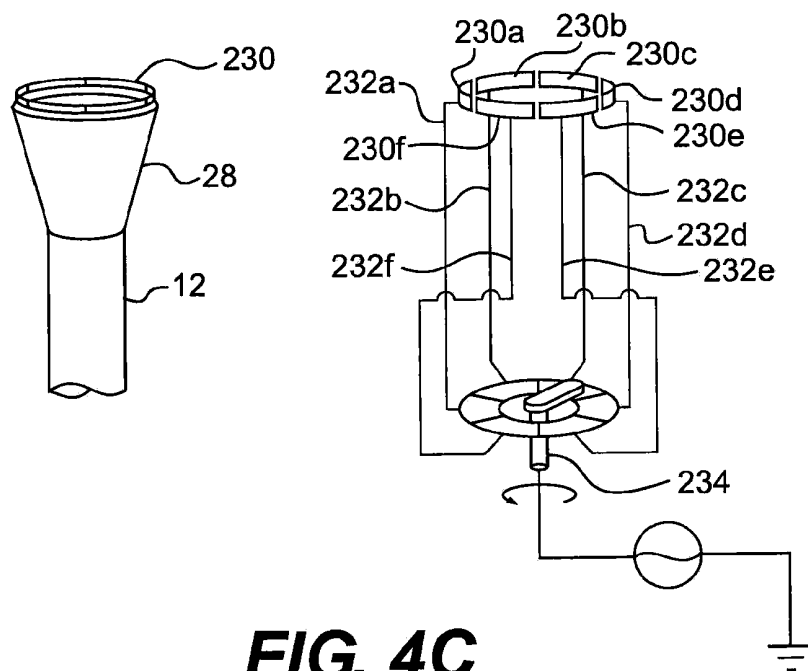
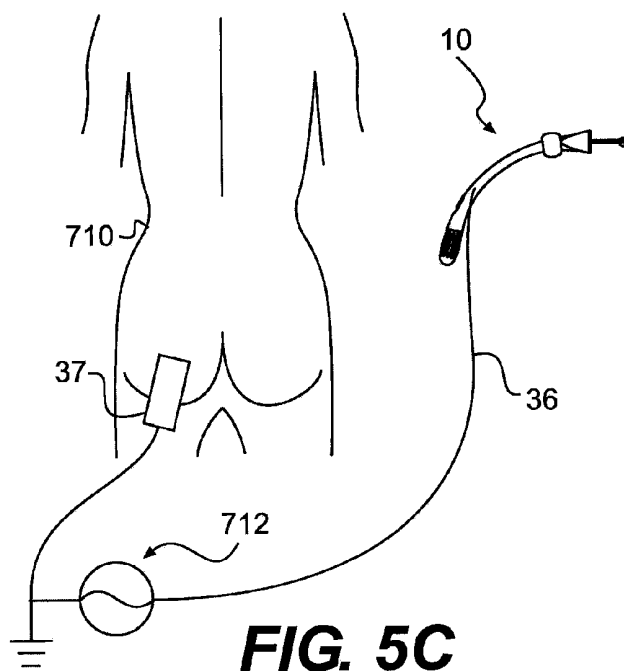
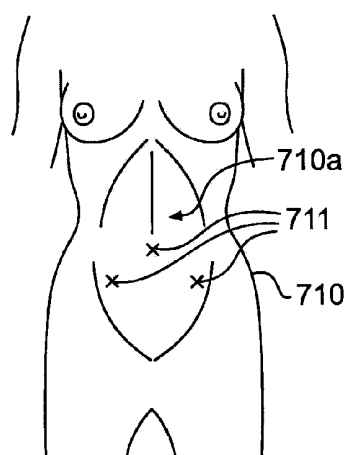
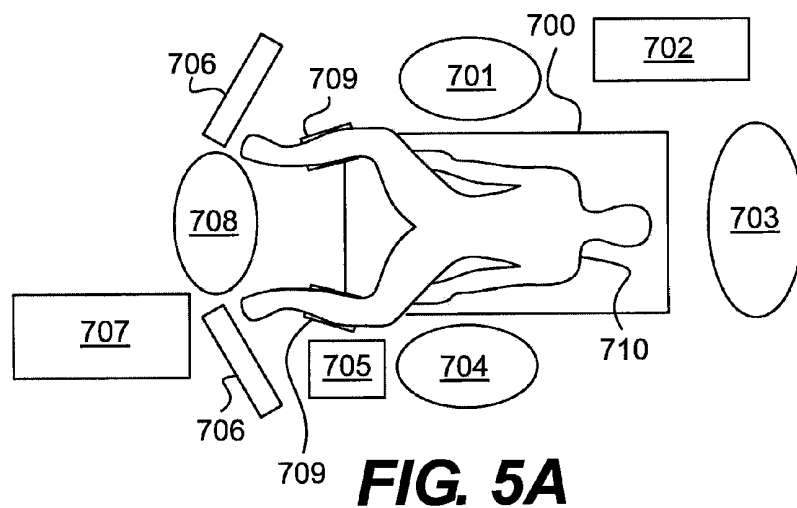

FIG. 4C



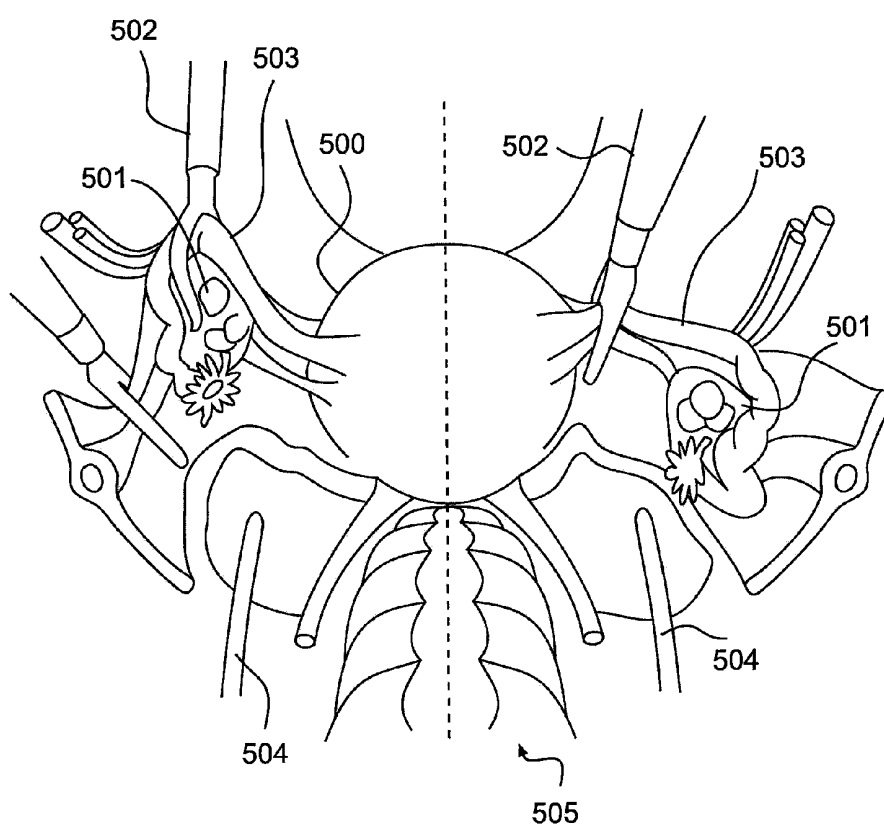

FIG. 6

FIG. 7A

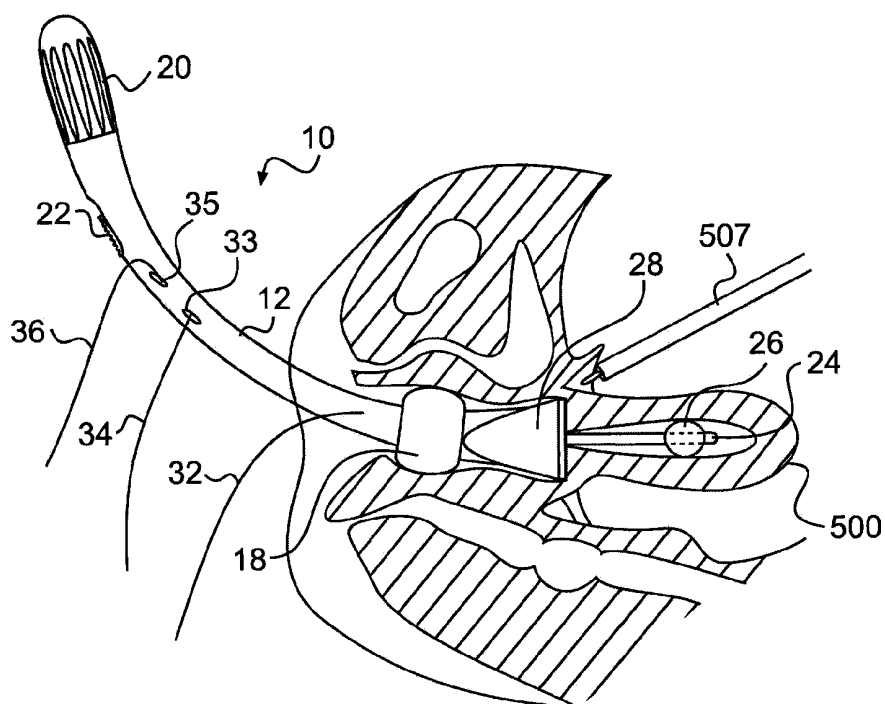
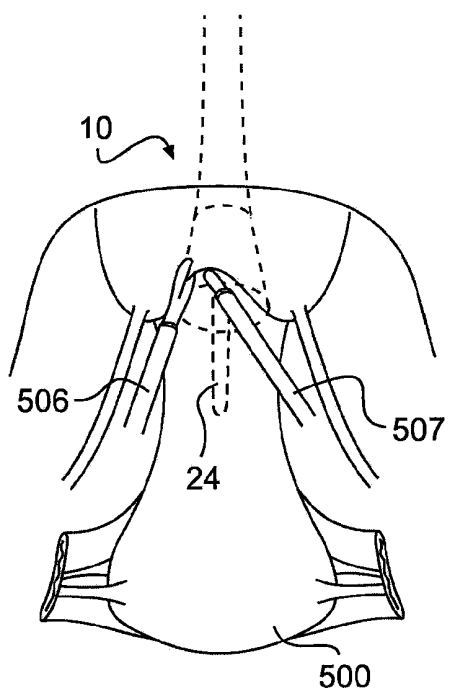

FIG. 7B

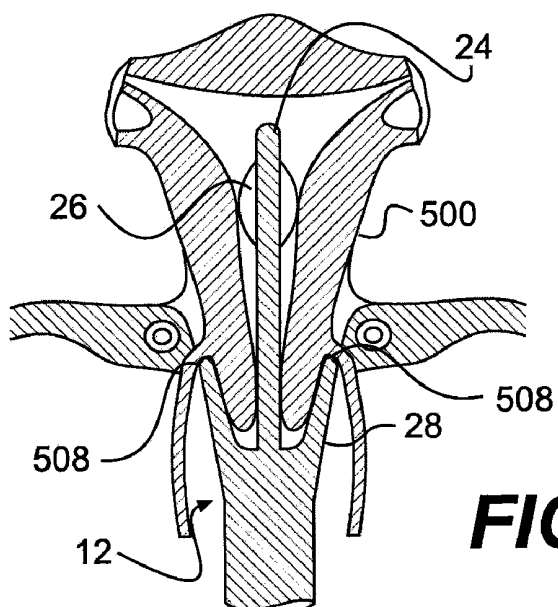

FIG. 8A

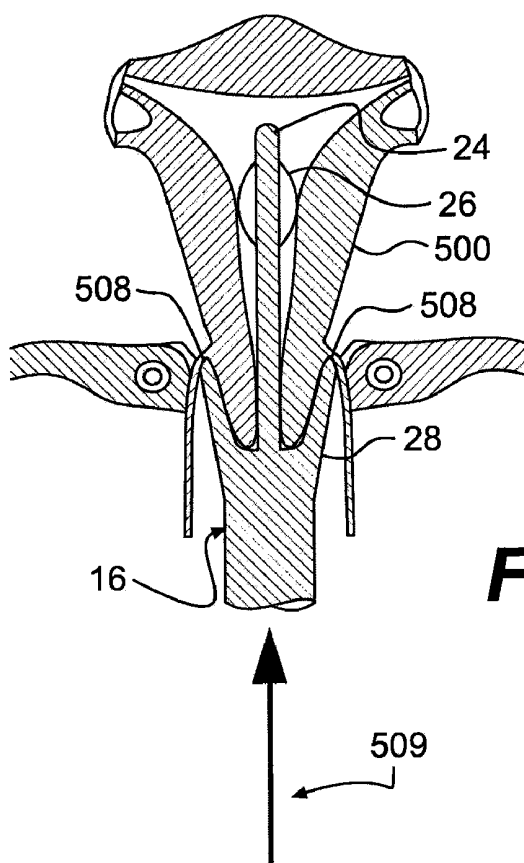

FIG. 8B

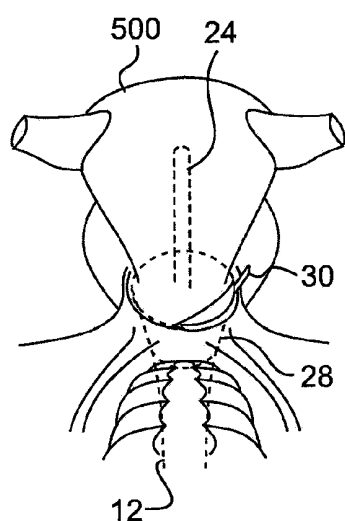

FIG. 9A

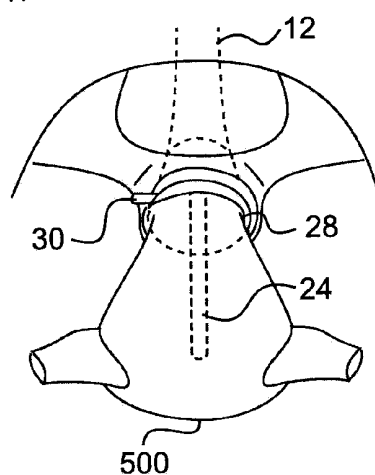
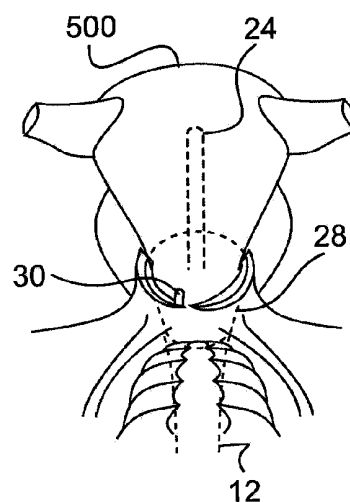

FIG. 9B

FIG. 9C



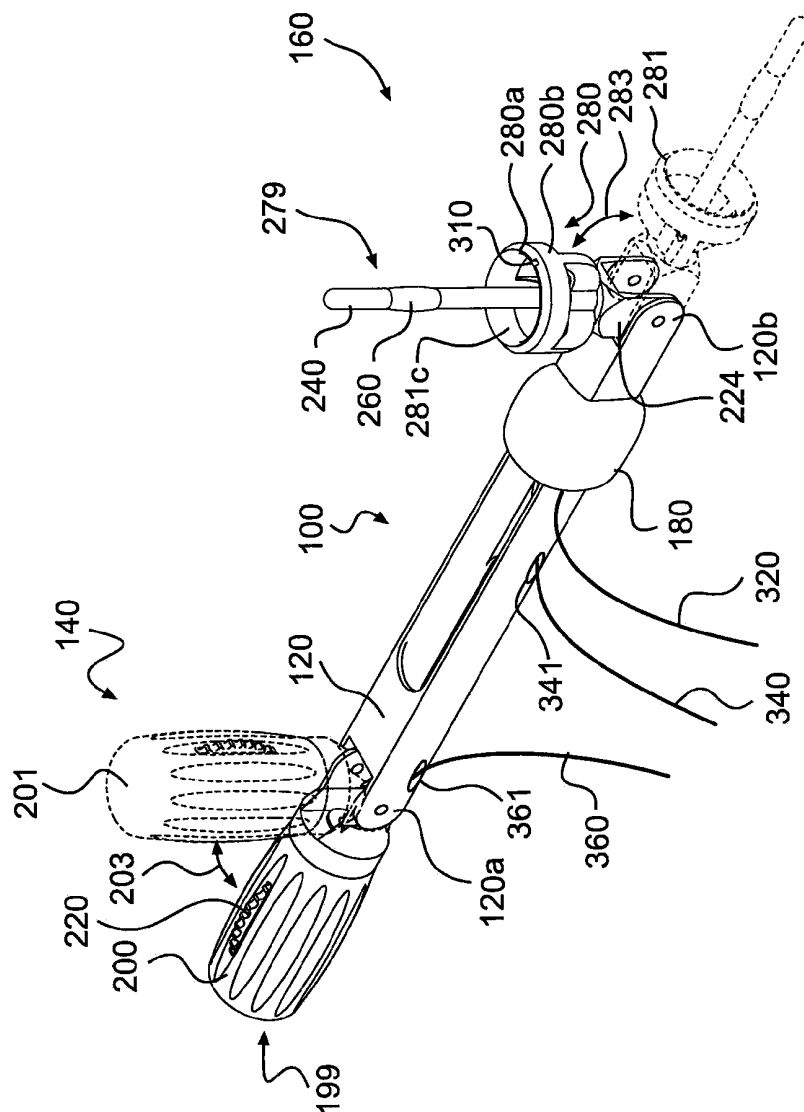

FIG. 10

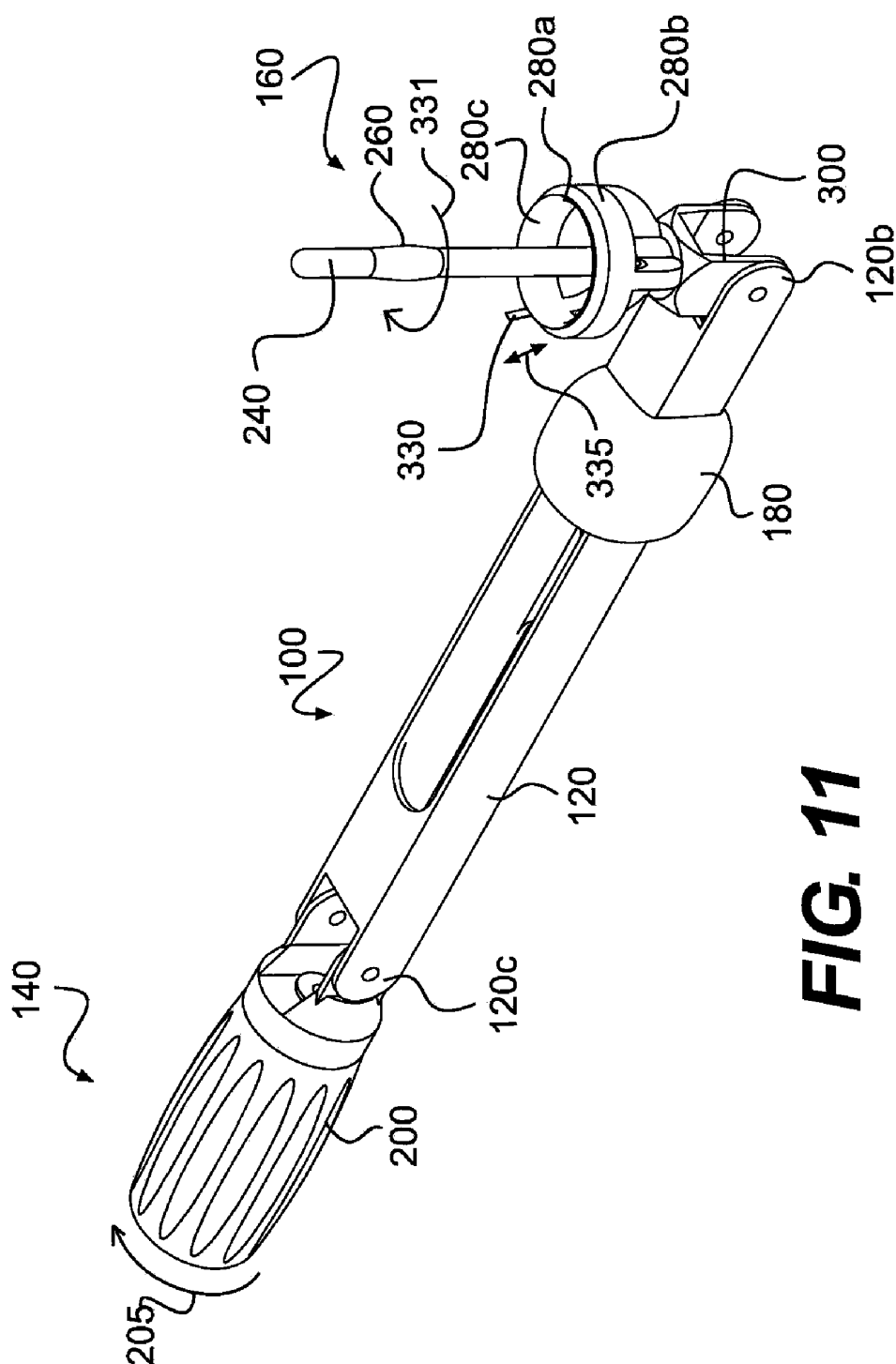

FIG. 12A

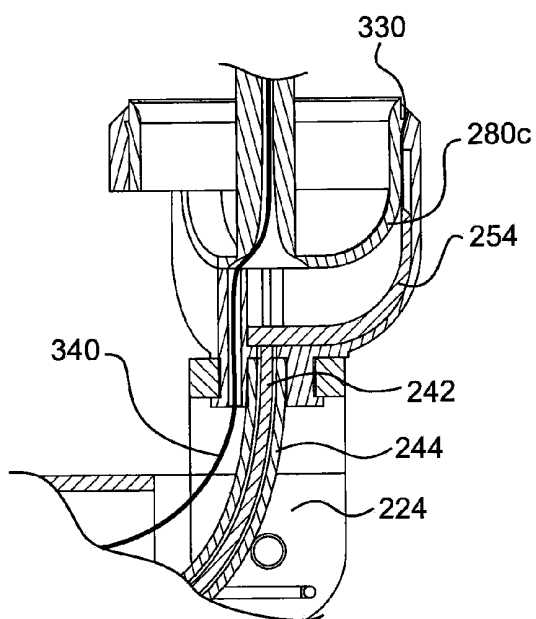
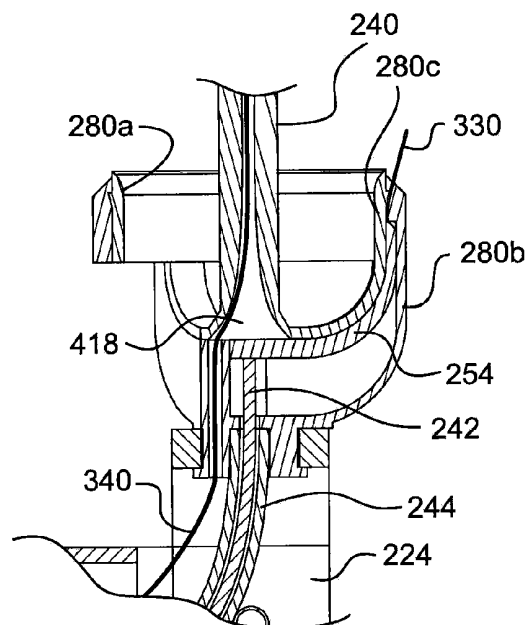
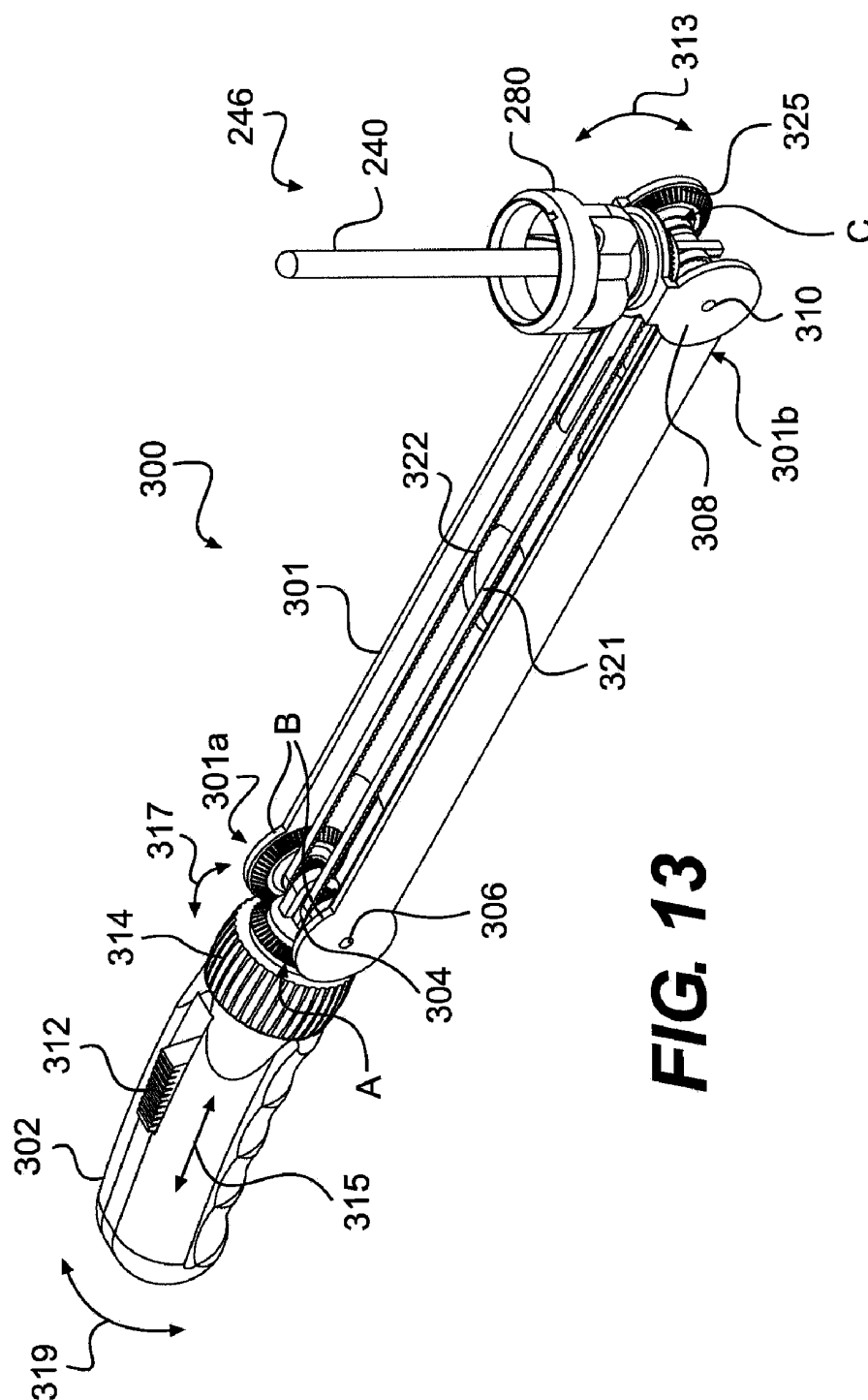

FIG. 12B



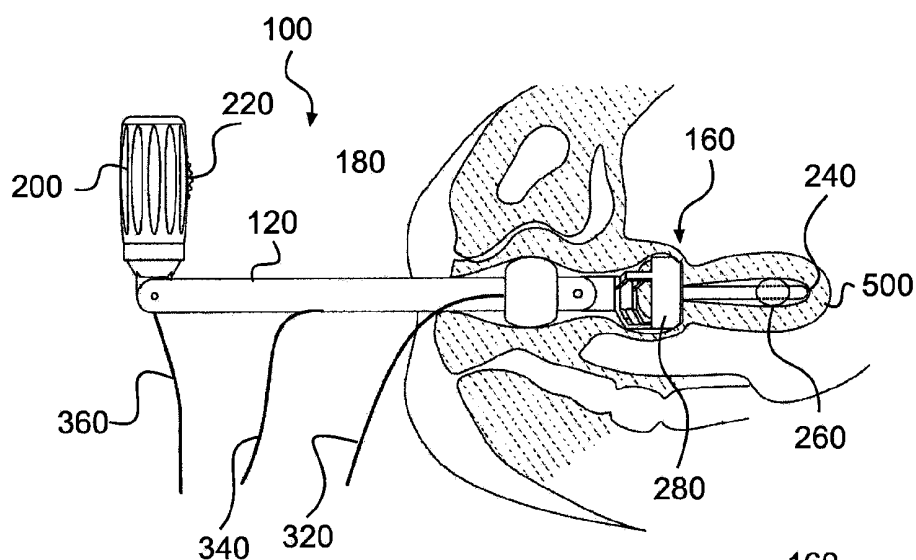

FIG. 14A

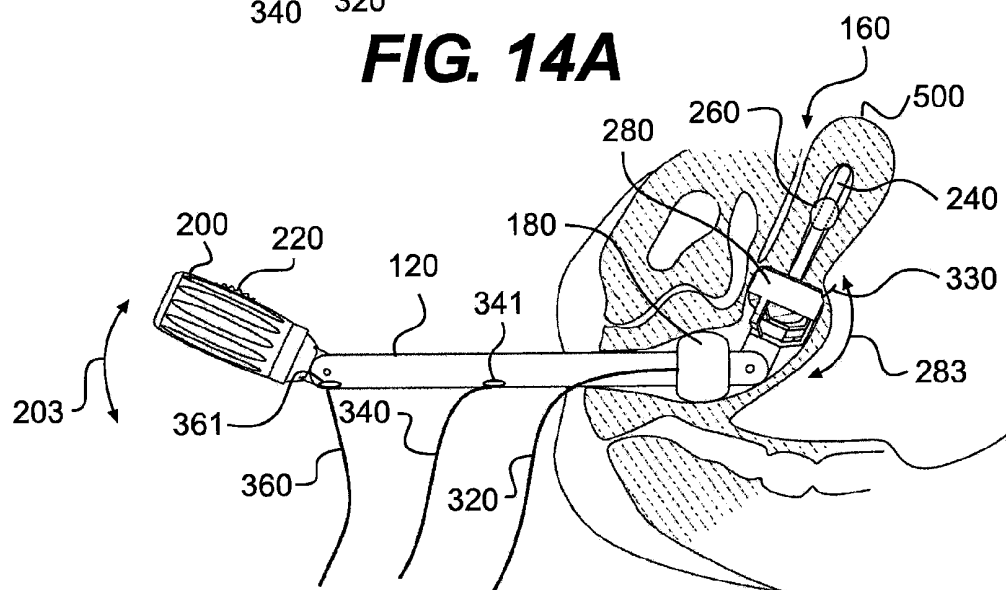

FIG. 14B

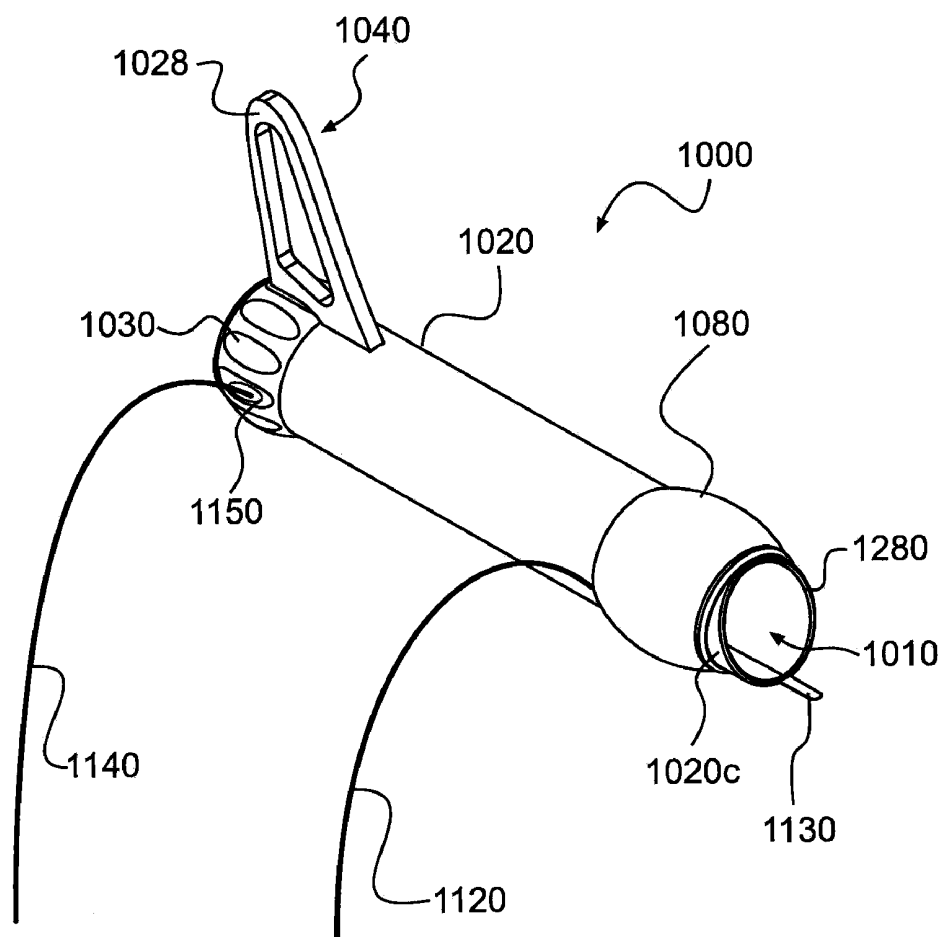

FIG. 15

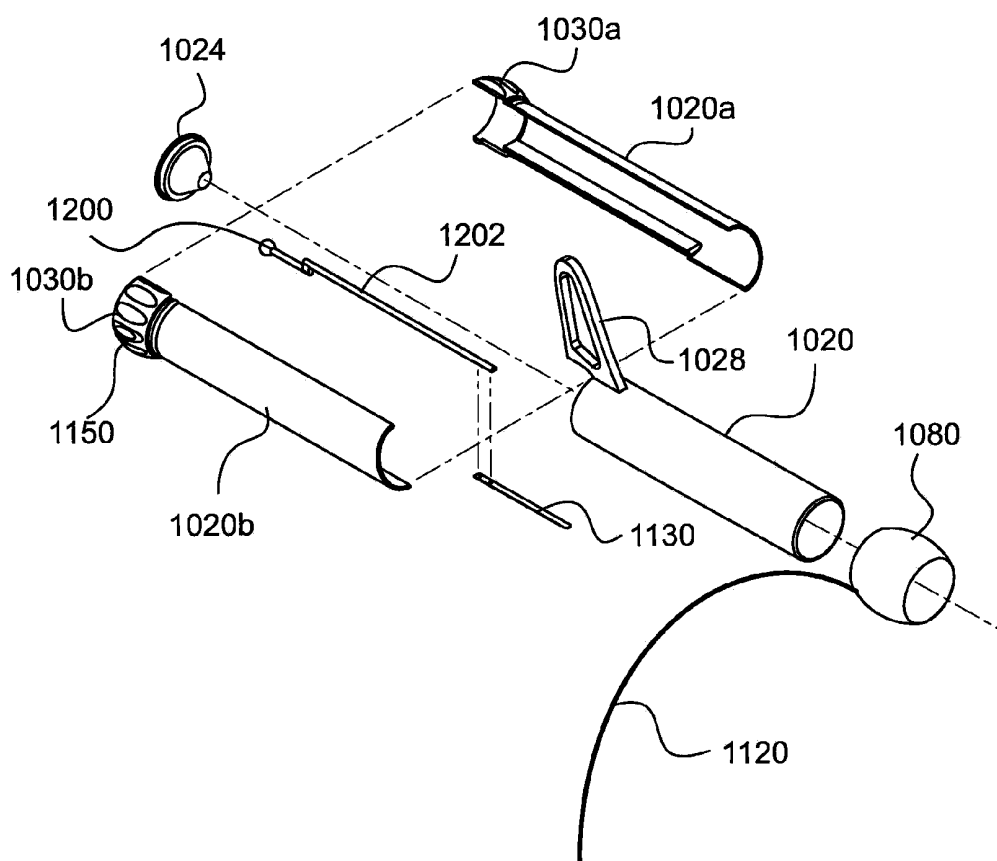

FIG. 16

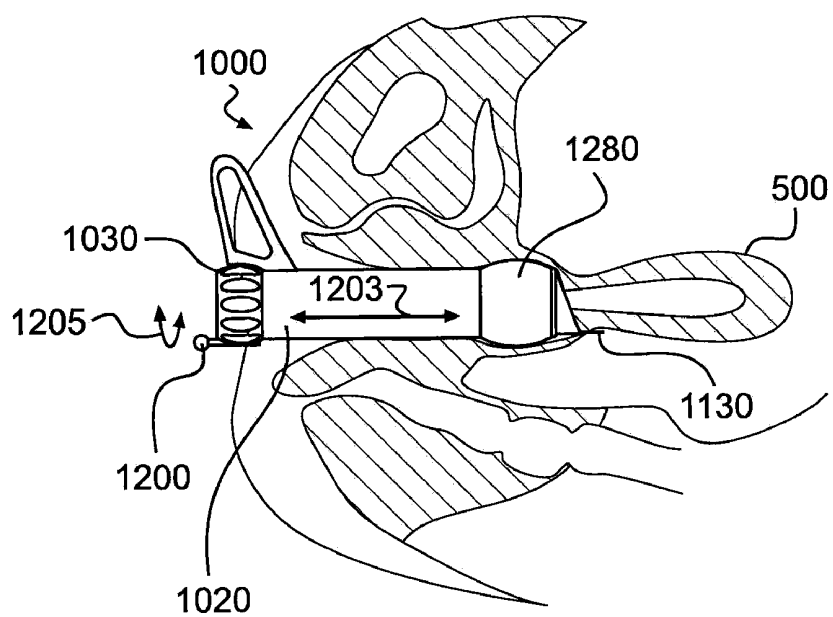

FIG. 17A

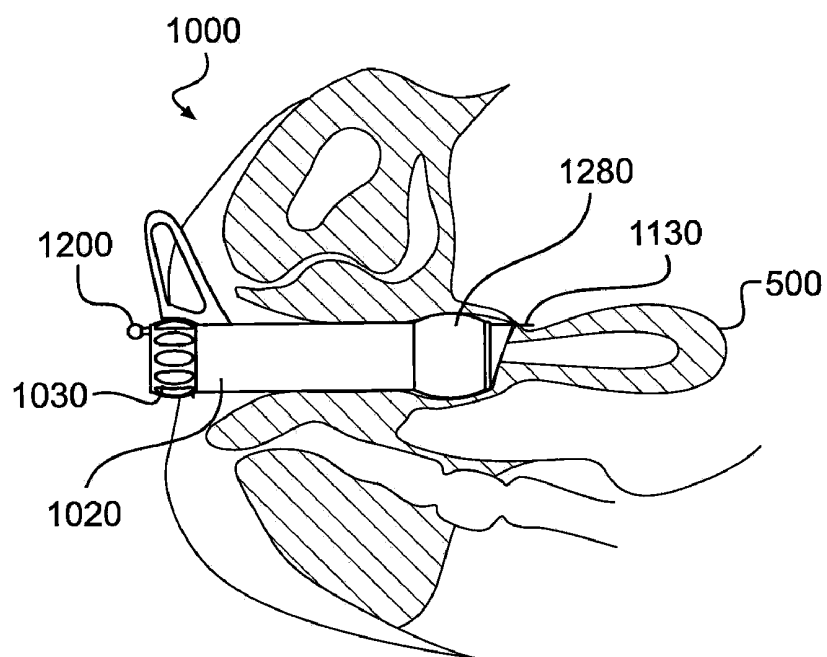

FIG. 17B

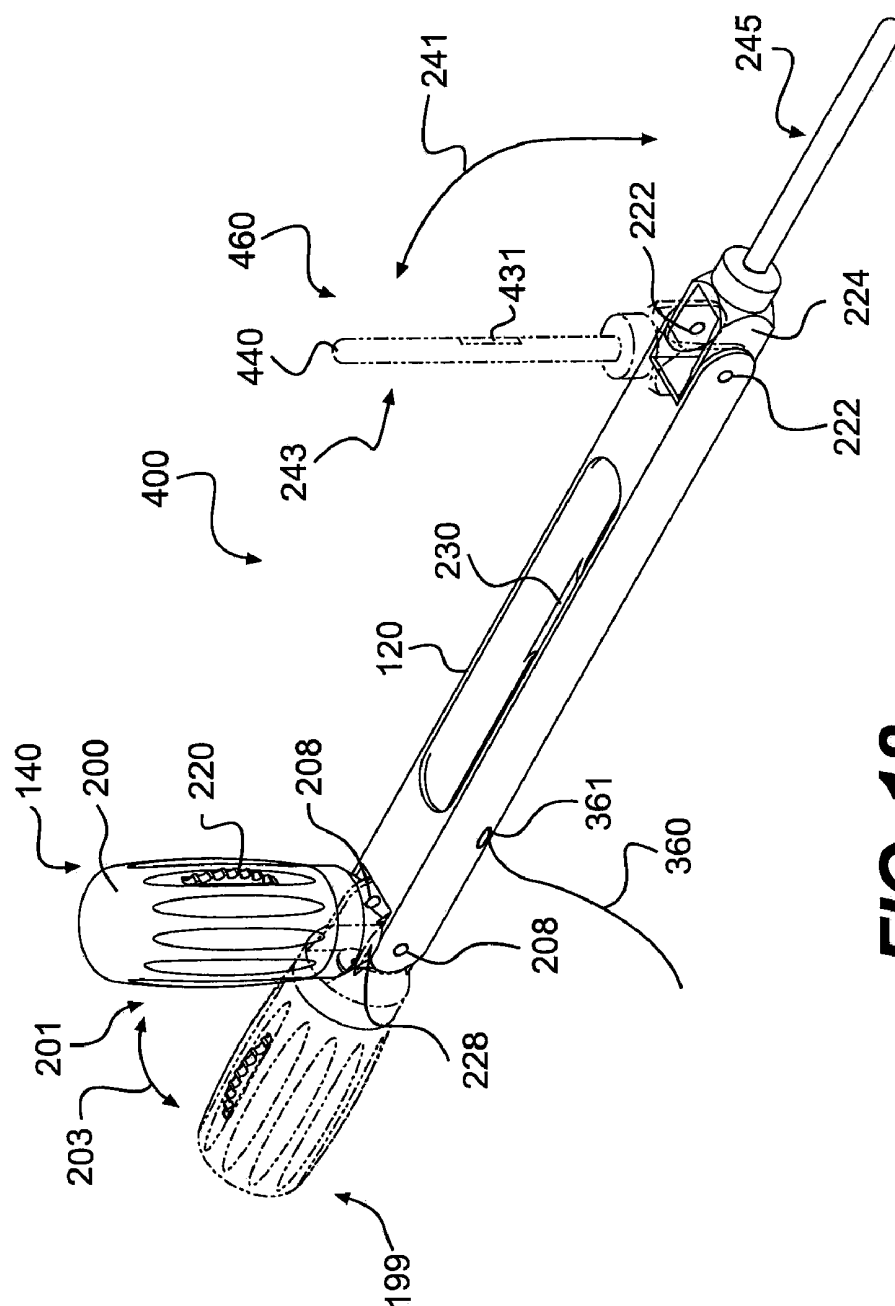

FIG. 18

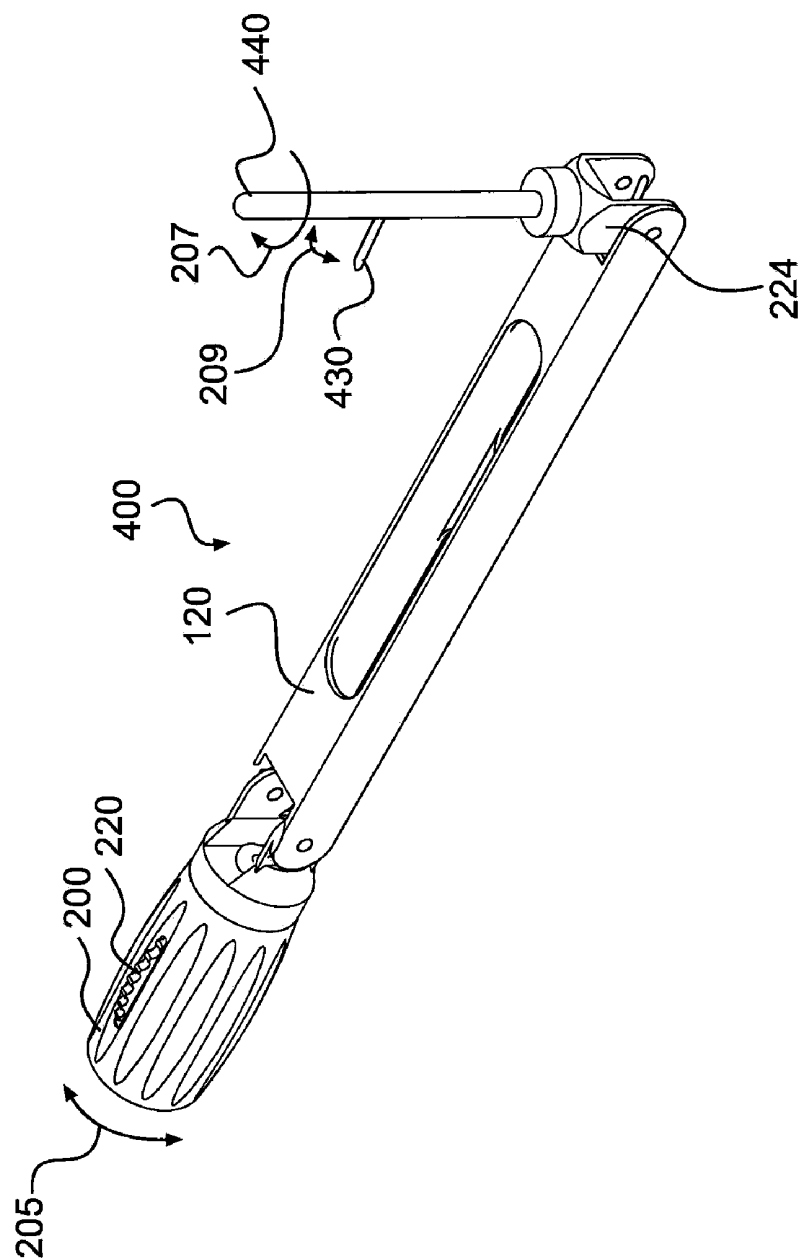

FIG. 19

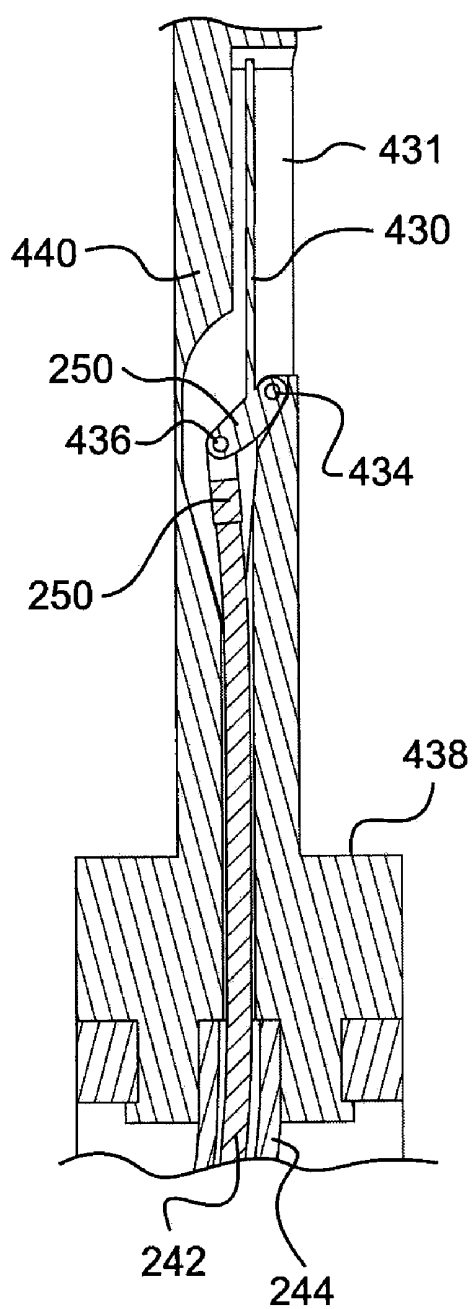

FIG. 20

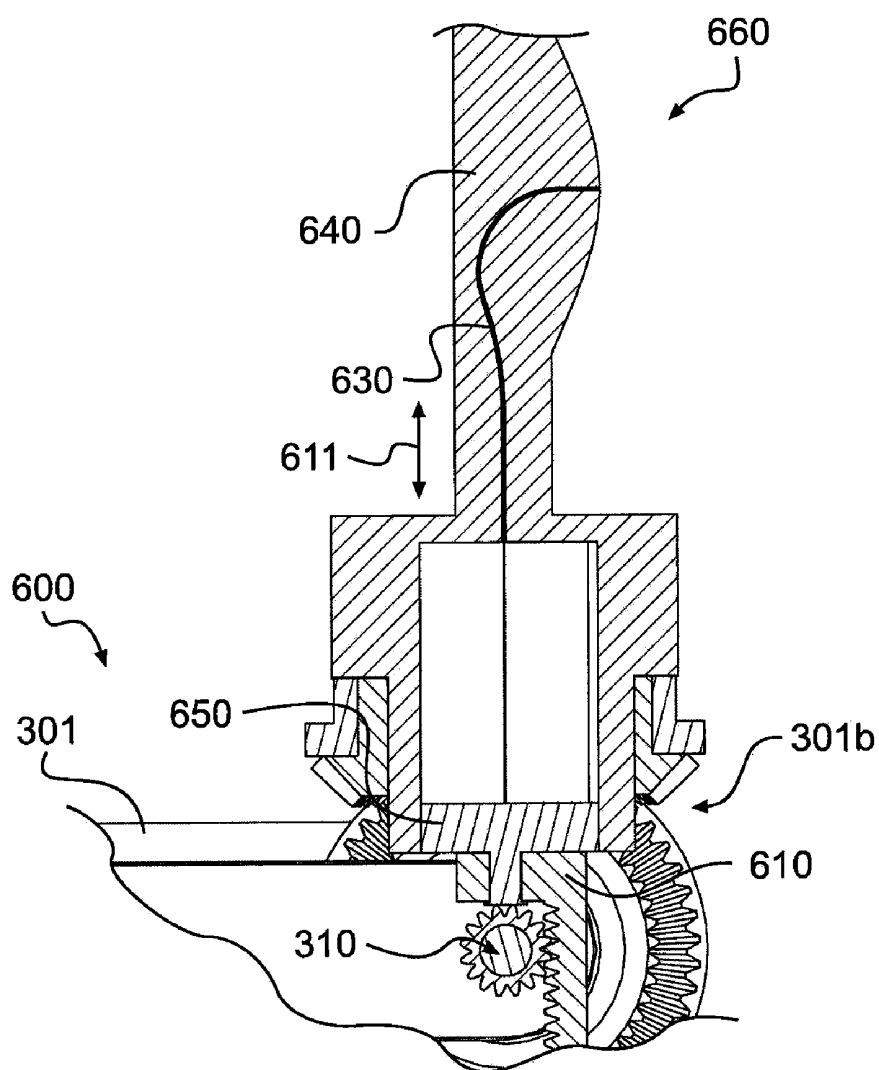

FIG. 21A

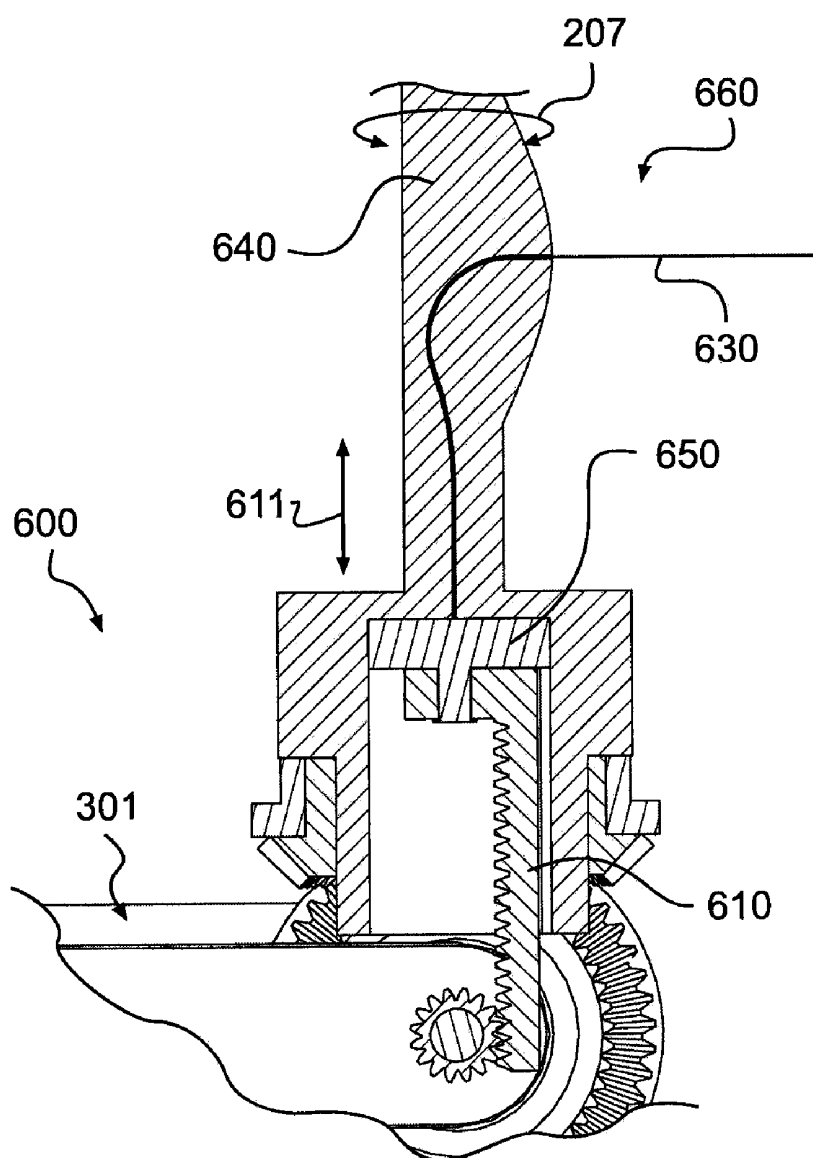

FIG. 21B

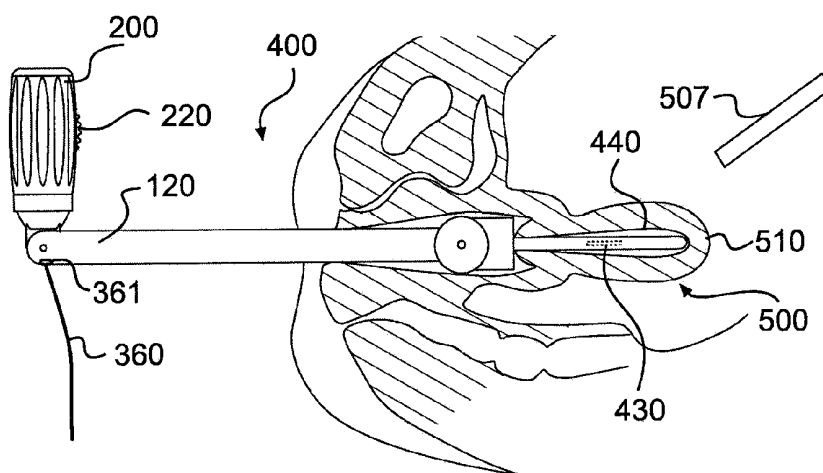

FIG. 22A

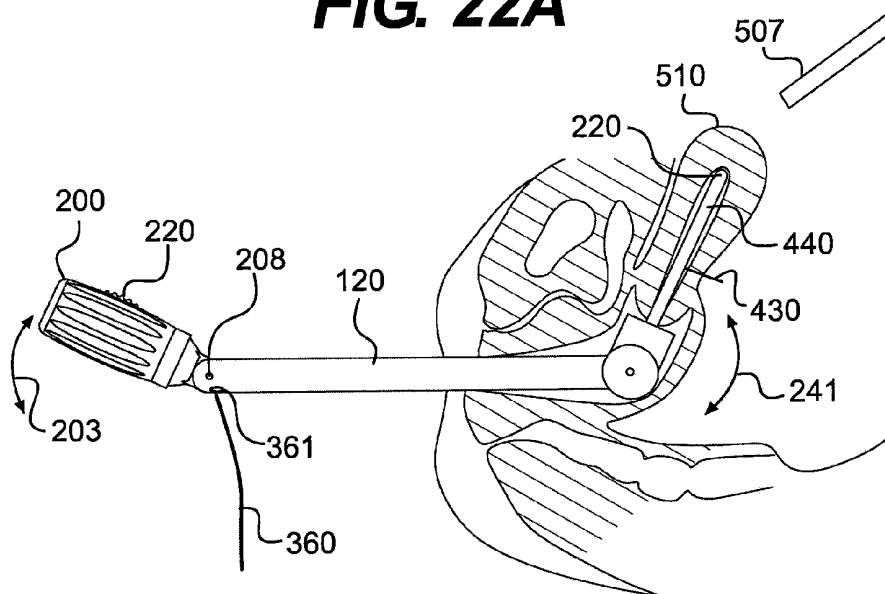

FIG. 22B

FIG. 23

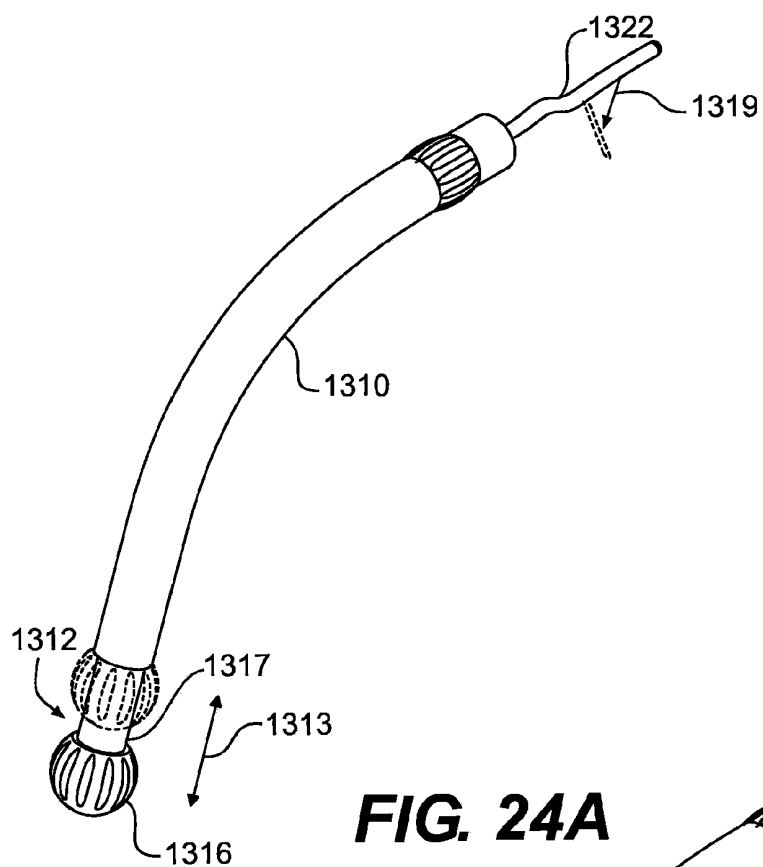

FIG. 24A

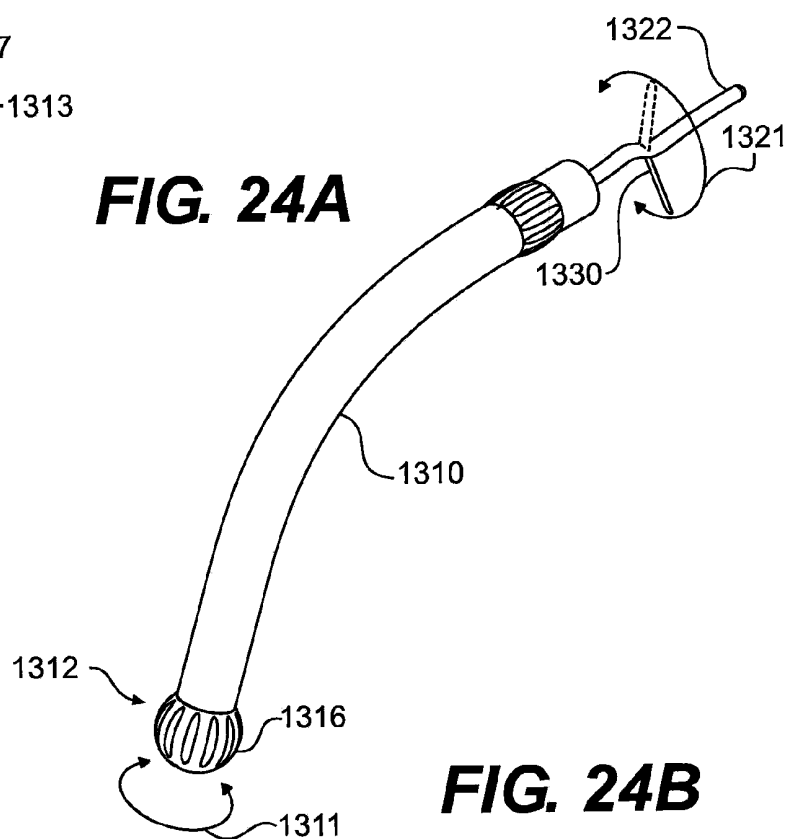

FIG. 24B

FIG. 25

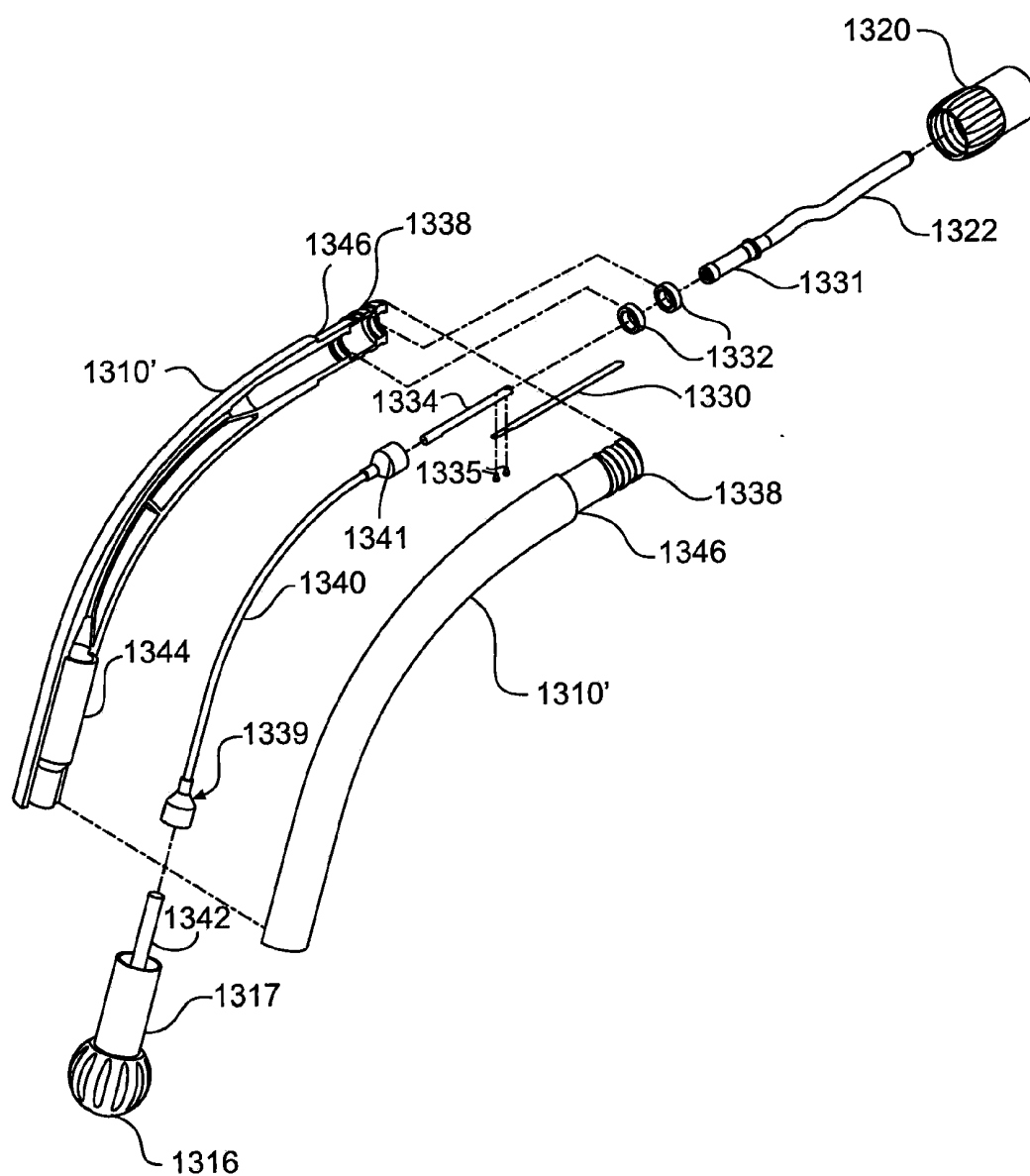

FIG. 26

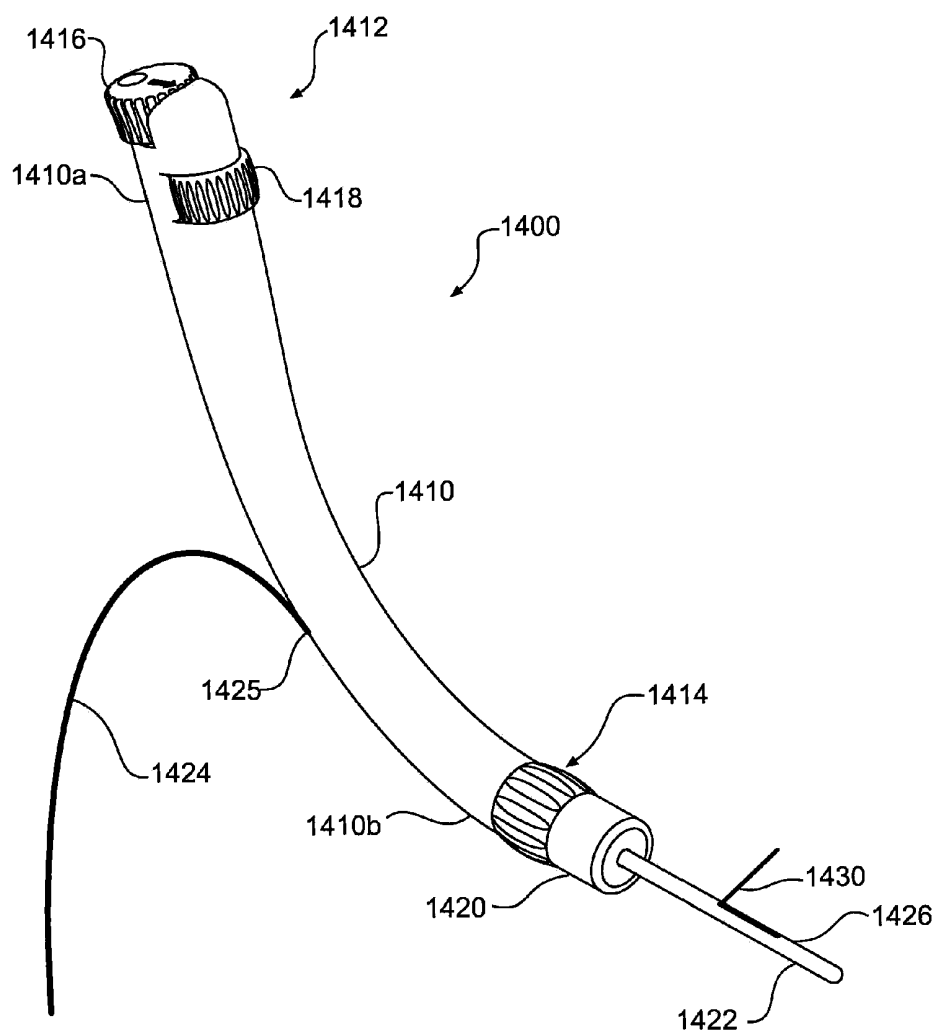
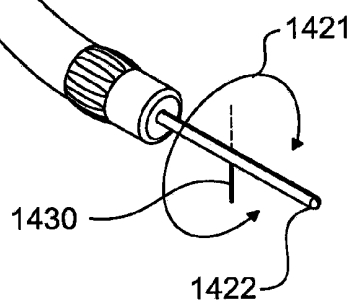
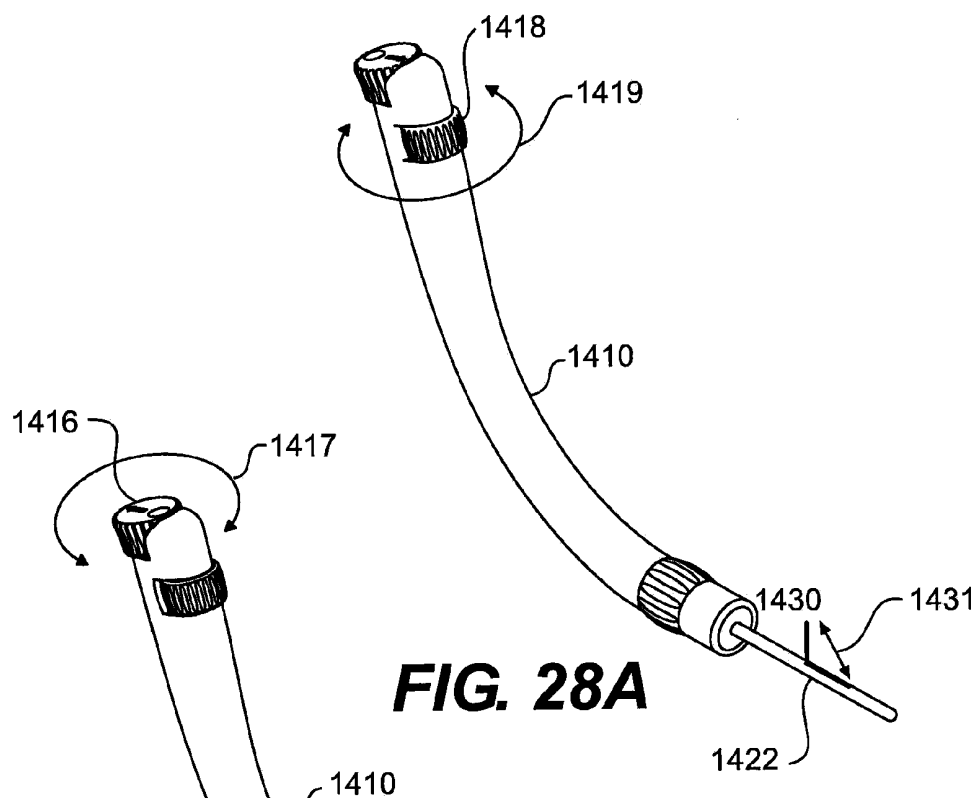

FIG. 27



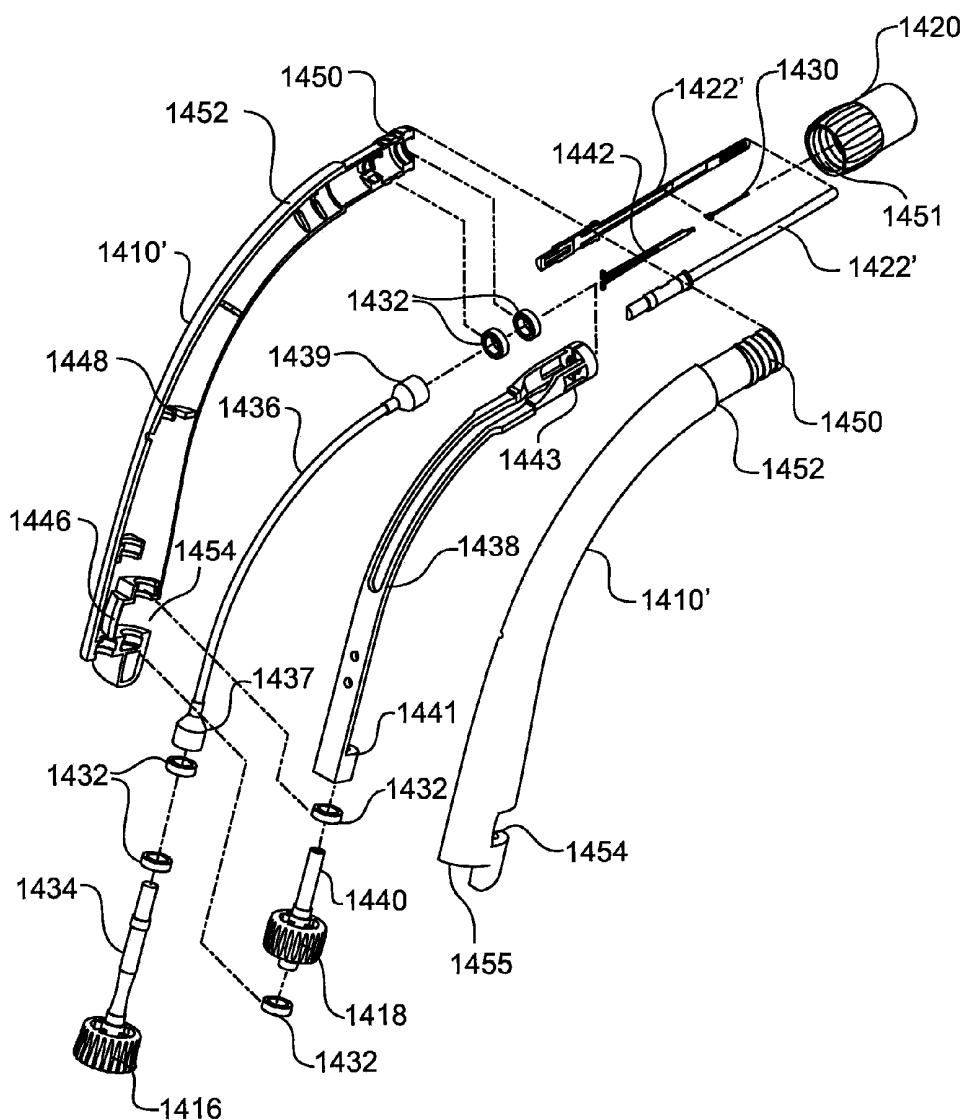

FIG. 29

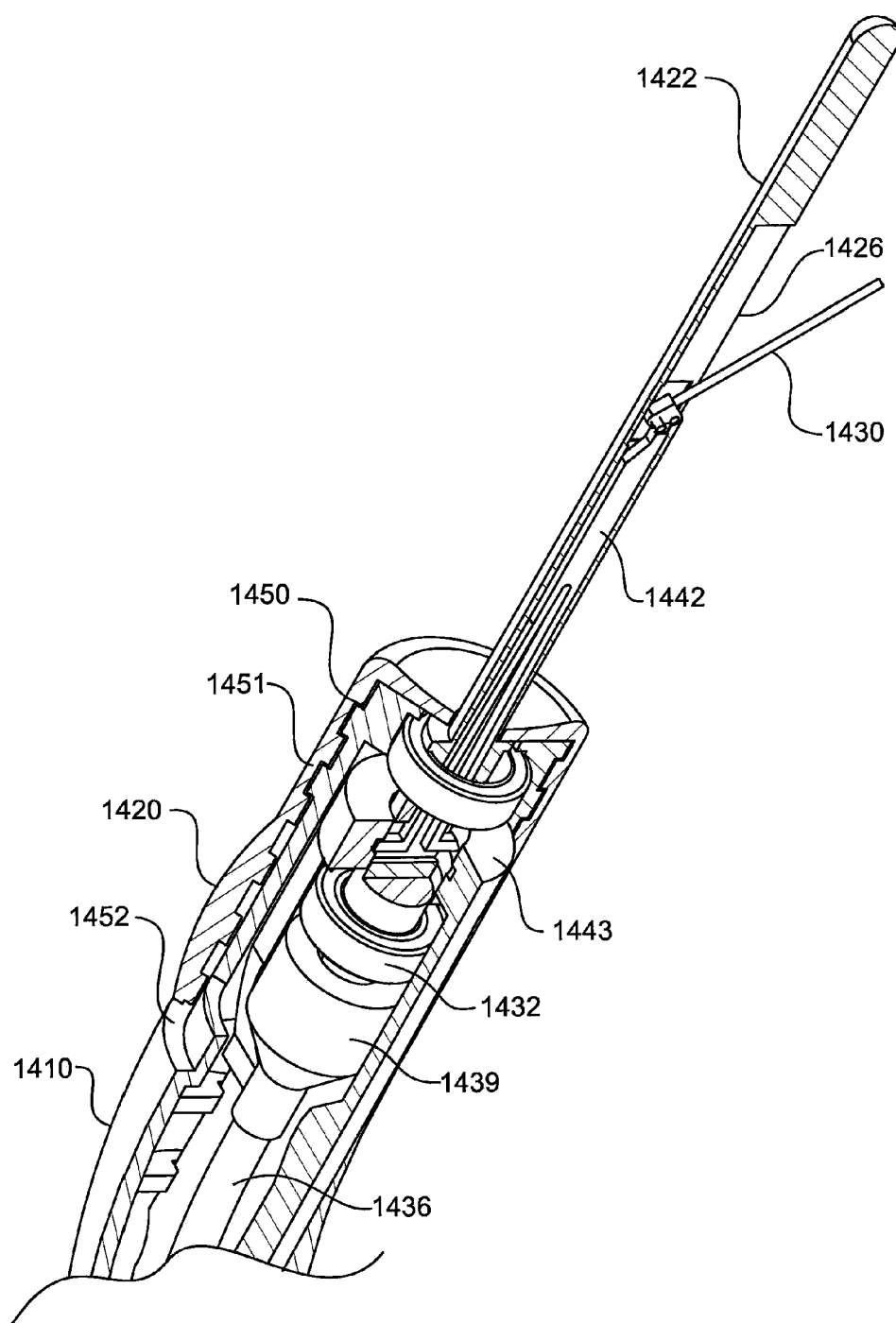

FIG. 30

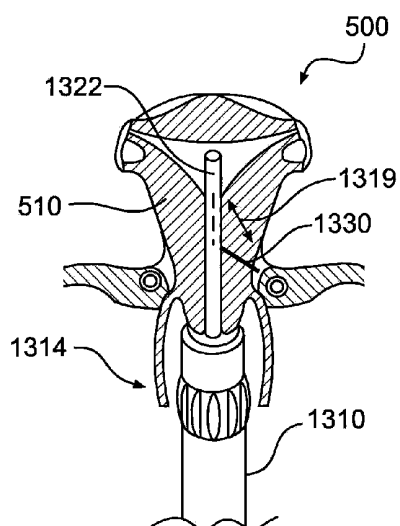

FIG. 31A

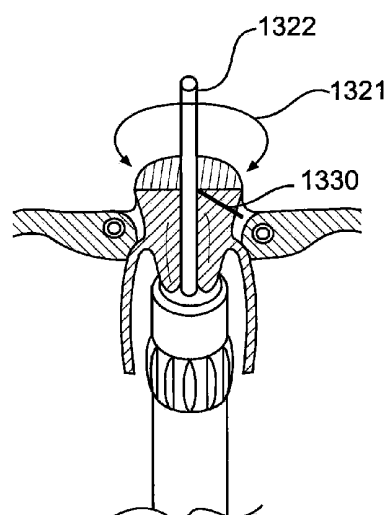

FIG. 31B

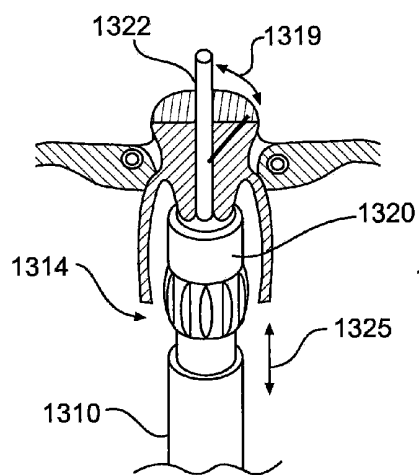

FIG. 31C

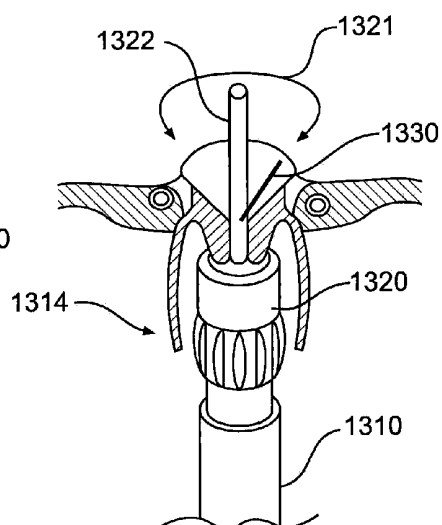

FIG. 31D

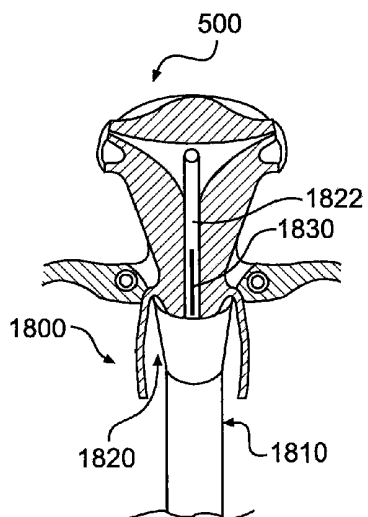

FIG. 32A

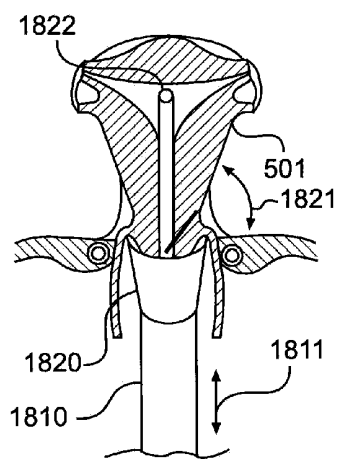

FIG. 32B

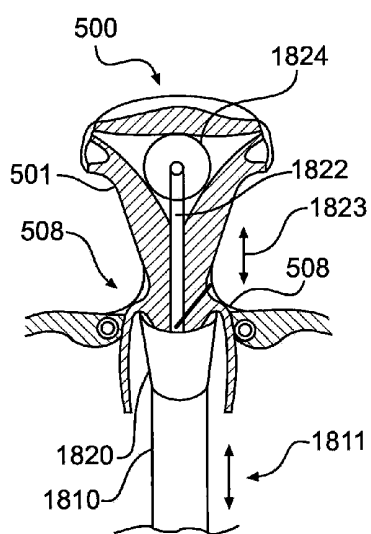

FIG. 32C

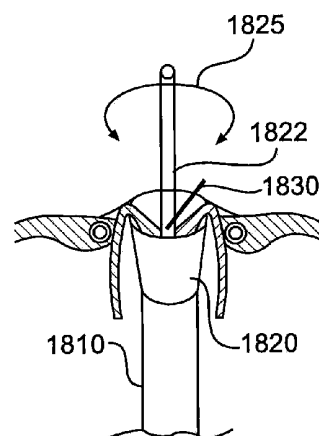

FIG. 32D

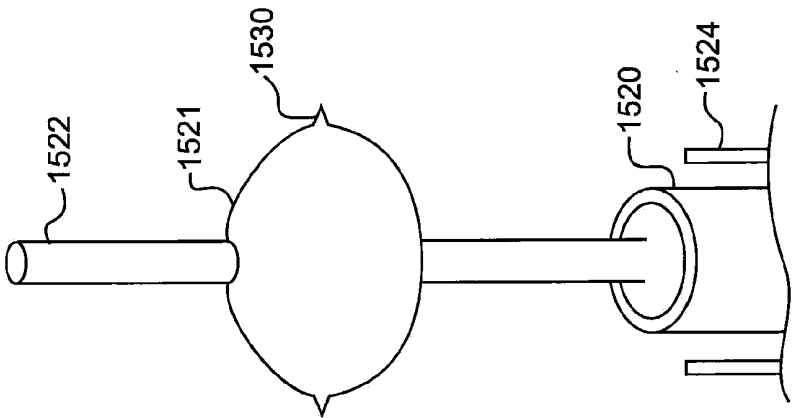

FIG. 33B

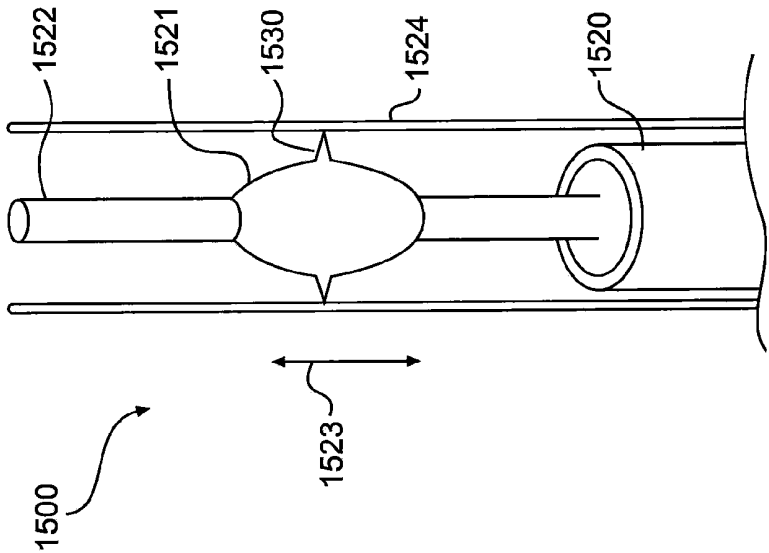

FIG. 33A

FIG. 34B

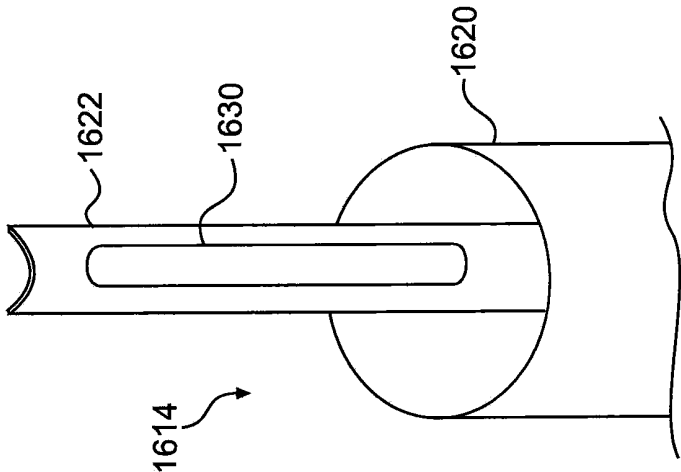
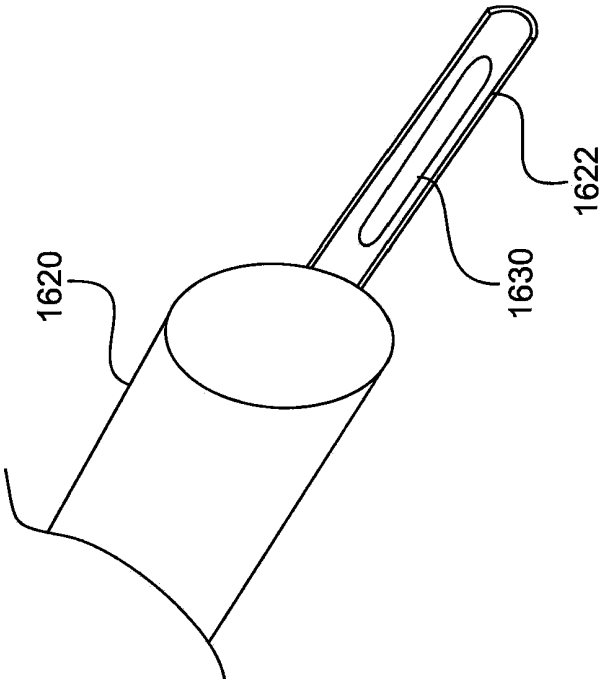

FIG. 34A

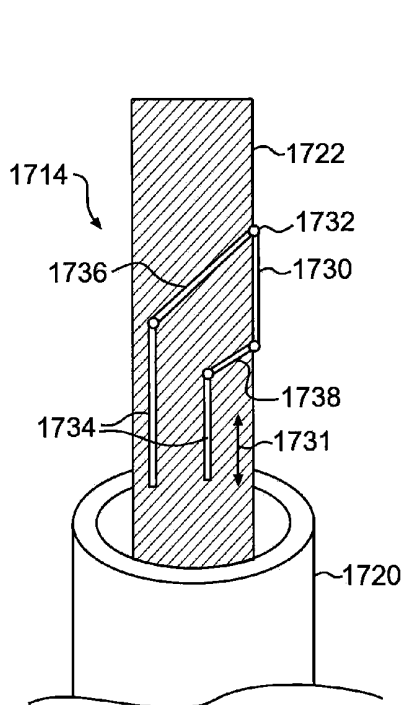

FIG. 35A

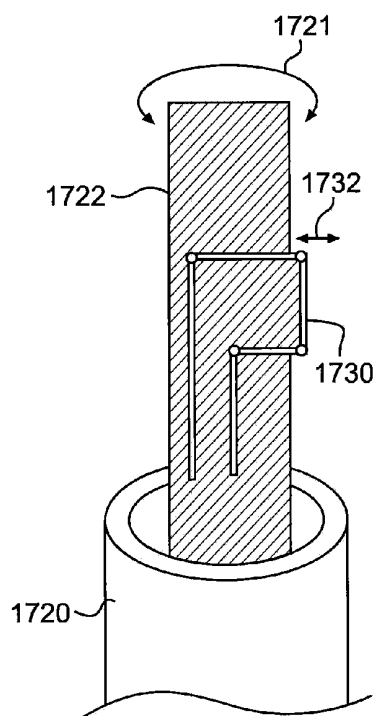

FIG. 35B

APPARATUS FOR TREATING A PORTION OF A REPRODUCTIVE SYSTEM AND RELATED METHODS OF USE

CROSS-REFERENCE TO RELATED APPLICATION

[0001] This patent application claims the benefits of priority under 35 U.S.C. §§119-120 to U.S. Provisional Application No. 61/420,308, filed on Dec. 6, 2010, entitled IMPROVED METHOD FOR TOTAL LAPROSCOPIC HYSTERECTOMY AND LAPROSCOPIC SUPRACERVICAL HYSTERECTOMY USING A NOVEL UTERINE AMPUTATION DEVICE, the entire disclosure of which is incorporated herein by reference.

FIELD OF THE INVENTION

[0002] Embodiments of the present disclosure generally relate to devices and methods for treating a portion of a reproductive system of a female patient. More particularly, embodiments of the present disclosure relate to devices and methods for uterine amputation, among other things.

BACKGROUND OF THE INVENTION

[0003] The female reproductive system includes, among other things, ovaries, fallopian tubes, a uterus, a cervix, and a vagina. As a result of certain gynecological conditions, such as cancers or severe pain and heavy bleeding, however, it sometimes becomes necessary to treat a patient's uterus. One option for treating the uterus includes surgically removing the uterus via a hysterectomy procedure.

[0004] One hysterectomy procedure is known as a radical hysterectomy and it involves the complete removal of a patient's uterus, cervix, upper vagina, and parametrium. Another hysterectomy procedure is known as a total hysterectomy and it involves the complete removal of a patient's uterus and cervix. In some cases, however, a patient may only require a supracervical hysterectomy (also known as a partial hysterectomy), which involves the removal of the uterus but otherwise leaves the cervix in situ.

[0005] Initially, hysterectomy procedures were performed via an incision in a patient's abdomen. With advancement in surgical tools and procedures, however, hysterectomy procedures have evolved to include vaginal and laparoscopic techniques. Today, therefore, hysterectomy procedures typically involve one of four primary approaches: total abdominal hysterectomy (TAH), total vaginal hysterectomy (TVH), total laparoscopic hysterectomy (TLH), and laparoscopic supracervical hysterectomy (LSH).

[0006] The medical literature has increasingly shown that the TLH and LSH approaches are preferred over the conventional TAH and TVH approaches. The TLH and LSH approaches are preferred because of several patient benefits, including, for example, less postoperative pain, shorter hospital stays, and faster recovery times. However, only a small percentage of hysterectomies performed each year are conducted via the TLH or LSH approach. Often, the reasons for performing a hysterectomy without using a TLH or LSH approach include the inherent limitations of laparoscopic surgery in general. These limitations include limited visibility, difficulty in manipulating internal organs with laparoscopic tools, and subsequent control of the operative field. In addition, surgeons often cite an increase in complication rates for avoiding TLH or LSH approaches. One such complication

includes vaginal cuff dehiscence, which is thought to be caused by a tendency to "wander" during the cauterization/cutting procedure used to excise the uterus. Accordingly, there is a need for apparatuses and methods that are less invasive, allow for uniform excision, and/or reduce operation time.

SUMMARY OF THE INVENTION

[0007] Embodiments of the present disclosure provide apparatuses and methods for treating a portion of a reproductive system.

[0008] An aspect of the present disclosure includes a medical device for performing a surgical procedure. The medical device may include an elongate member having a proximal end, a distal end, and a lumen extending therebetween. The medical device may also include a handle connected to the proximal end of the elongate member, an end effector assembly connected to the distal end of the elongate member, and a cutting device configured to extend from the end effector assembly, wherein the cutting device has a retracted configuration in which the cutting device is withdrawn into the end effector assembly and a deployed configuration in which the cutting device extends from the end effector assembly.

[0009] In various embodiments, the medical device may include one or more of the following additional features: the end effector assembly may include a cup; the end effector assembly may include an elongate manipulation member having a proximal portion, a distal portion, and a central portion extending therebetween, wherein the central portion may include a substantially uniform cross-section; the cutting device may be further configured to rotate about a longitudinal axis of the end effector assembly; a first actuator may control deployment of the cutting device and a second actuator may control rotation of the cutting device; the cutting device may be a monopolar cauterizing instrument; the cutting device may be a bipolar cauterizing instrument; the medical device may further comprise an expandable member secured to a distal portion of the medical device; the expandable member may be secured to the elongate member; the medical device may further comprise an expandable member secured to the elongate manipulation member; the medical device may further comprise an elongate manipulation member extending distally from within the cup; the medical device may further comprise a first expandable member secured to a distal portion of the elongate member; the medical device may further comprise a second expandable member secured to the elongate manipulation member; the cup may include a first cup portion and a second cup portion disposed within the first cup portion, wherein a gap exists between the first and second cup portions, and the cutting device is slidably disposed within the gap; the cutting device may be a cautery ring; the cautery ring may include a segmented ring; the expandable member may be disposed proximally of the end effector assembly; the end effector assembly may be configured to pivot relative to the elongate member; the end effector assembly may be removably secured to the distal end of the elongate member; and the end effector assembly may be longitudinally movable relative to a distal end of the elongate member.

[0010] In another aspect, a method for performing a laparoscopic hysterectomy procedure may include inserting a medical device into a vaginal canal of a patient. The medical device may include an elongate member having a proximal end, a distal end, and a lumen extending therebetween, a handle connected to the proximal end of the elongate member, an end

effector assembly connected to the distal end of the elongate member, and a cutting device configured to extend from the end effector assembly, wherein the cutting device has a retracted configuration in which the cutting device is withdrawn into the end effector assembly and a deployed configuration in which the end effector extends from the end effector assembly. The method may further include positioning the end effector adjacent tissue associated with one of uterine or cervical tissues, deploying the cutting device, and creating an incision to excise at least a uterus of the patient from surrounding tissue.

[0011] In various embodiments, the medical device may include one or more of the following additional features: the end effector may include a cup and an elongate manipulation member extending distally from within the cup; the medical device may further include a first expandable member disposed on the elongate member at a location proximal of the end effector assembly; the method may further comprise expanding the expandable member to occlude the vaginal canal; prior to the step of deploying the cutting device, the method may further include pivoting the elongate manipulation member to alter a positioning of the uterus; prior to the step of deploying the cutting device, the method may further include positioning a rim of the cup against a vaginal formice and exerting a cephalad force on the vaginal formice; creating an incision to separate at least a uterus of the patient from surrounding tissue may include rotating the cutting device; the cutting device may be a monopolar cautery instrument; the cutting device may be a bipolar cautery instrument; the medical device may include a second expandable member secured to the elongate manipulation member; the cutting device may be a cautery ring; the cautery ring may include a segmented ring; rotating the cutting device may include rotating the end effector assembly; the end effector assembly may be removably secured to the distal end of the elongate member; the end effector assembly may be longitudinally movable relative to the distal end of the elongate member; the method may further comprise the step of removing cervical tissue; and creating an incision to excise at least a uterus of the patient from surrounding tissue may include excising the uterus and a cervix of the patient.

[0012] A further aspect may include a medical device for performing a surgical procedure. The medical device may include an elongate member having a proximal end, a distal end, and a lumen extending therebetween, a handle connected to the proximal end of the elongate member, an end effector assembly connected to the distal end of the elongate member, a cutting device configured to extend from the end effector assembly, wherein the cutting device has a retracted configuration in which the cutting device is withdrawn into the end effector assembly and a deployed configuration in which the cutting device extends from the end effector assembly, wherein the cutting device is configured to rotate about a longitudinal axis of the end effector assembly, and wherein the cutting device includes a cauterizing instrument. The medical device may also include an expandable member positioned on the elongate member at a location proximal of the end effector assembly.

[0013] Additional objects and advantages of the disclosure will be set forth in part in the description that follows, and in part will be obvious from the description, or may be learned by practice of the disclosed embodiments. The objects and

advantages of the disclosure will be realized and attained by means of the elements and combinations particularly pointed out in the appended claims.

[0014] It is to be understood that both the foregoing general description and the following detailed description are exemplary and explanatory only, and are not restrictive of the invention, as claimed.

BRIEF DESCRIPTION OF THE DRAWINGS

[0015] The accompanying drawings, which are incorporated in and constitute a part of this specification, illustrate several embodiments of the disclosure and, together with the description, serve to explain the principles of the embodiments disclosed herein.

[0016] FIG. 1 is a perspective view of a medical device for performing a total laparoscopic hysterectomy (TLH) procedure, according to a first embodiment of the present disclosure.

[0017] FIG. 2A is a perspective view of the medical device of FIG. 1 having a cutting device in a retracted position.

[0018] FIG. 2B is a perspective view of the medical device of FIG. 1 having a cutting device in a deployed position.

[0019] FIG. 3 is an exploded view of the medical device of FIG. 1.

[0020] FIG. 4A is a sectional view of a distal end of the medical device of FIG. 1.

[0021] FIG. 4B depicts an alternate embodiment of a cutting device for use with the medical devices disclosed herein.

[0022] FIG. 4C depicts a further embodiment of a cutting device for use with the medical devices disclosed herein.

[0023] FIG. 5A is a top view of a preoperative patient setup.

[0024] FIG. 5B is an anterior view of a patient being prepared for a laparoscopic hysterectomy procedure.

[0025] FIG. 5C is a posterior view of a patient being prepared for a laparoscopic hysterectomy procedure.

[0026] FIG. 6 is an internal view of a body portion undergoing a step of cutting ligamentous structures in a laparoscopic hysterectomy procedure.

[0027] FIG. 7A is an internal view of a body portion showing laparoscopic tools in conjunction with the medical device of FIG. 1 inserted into a vaginal cavity for performing a TLH procedure.

[0028] FIG. 7B is a cross-sectional view of the body portion of FIG. 7A showing a laparoscopic tool in conjunction with the medical device of FIG. 1 inserted into a vaginal cavity for performing a TLH procedure.

[0029] FIG. 8A is a cross-sectional view of a body portion showing a cup of the distal end of the medical device of FIG. 1 engaging vaginal formices of a patient.

[0030] FIG. 8B is a cross-sectional view of a body portion showing the colpotomy cup inserted and extending into an apex of the vaginal formices following a cephalad push.

[0031] FIGS. 9A-9C are sectional views of a body portion showing the cutting device of FIG. 4A excising the uterine cervix from the vagina during a TLH procedure.

[0032] FIG. 10 is a perspective view of a medical device for use in performing a TLH procedure, according to a second embodiment of the present disclosure.

[0033] FIG. 11 is a perspective view of the medical device of FIG. 10 showing rotated configurations of its proximal and distal ends, and with a cutting device in a deployed configuration.

[0034] FIGS. 12A-12B are cross-sectional views of a cup of the medical device of FIG. 10 with a cutting device in deployed and retracted configurations, respectively.

[0035] FIG. 13 is a perspective view of a medical device for use in performing a TLH procedure, according to a third embodiment of the present disclosure.

[0036] FIG. 14A is a cross-sectional view of a body portion showing the medical device of FIG. 10 inserted into a vaginal cavity for performing a TLH procedure.

[0037] FIG. 14B is a cross-sectional view of a body portion showing the medical device of FIG. 10 inserted into a vaginal cavity and manipulating a position of a uterus for performing a TLH procedure.

[0038] FIG. 15 is a perspective view of a medical device for use in performing a TLH procedure, according to a fourth embodiment of the present disclosure.

[0039] FIG. 16 is an exploded view of the medical device of FIG. 15.

[0040] FIGS. 17A-17B are cross-sectional views of a body portion showing the medical device of FIG. 15 with a deployed cutting device separating the uterus during a TLH procedure.

[0041] FIG. 18 is a perspective view of a medical device for use in performing a laparoscopic supracervical hysterectomy (LSH) procedure, according to a fifth embodiment of the present disclosure.

[0042] FIG. 19 is a perspective view of the medical device of FIG. 18 showing a cutting device in a deployed configuration.

[0043] FIG. 20 is a cross-sectional view of a distal end of the medical device of FIG. 18 showing a cutting device in a retracted configuration.

[0044] FIGS. 21A-21B are cross-sectional views of a distal end of a medical device for use in performing an LSH procedure, according to a sixth embodiment of the present disclosure, showing a cutting device in retracted and deployed configurations, respectively.

[0045] FIG. 22A is a cross-sectional view of a body portion showing the medical device of FIG. 18 inserted into a vaginal cavity for performing an LSH procedure.

[0046] FIG. 22B is a cross-sectional view of a body portion showing the medical device of FIG. 18 inserted into a vaginal cavity and manipulating the position of a uterus for performing an LSH procedure.

[0047] FIG. 23 is a perspective view of a medical device for use in performing an LSH procedure, according to a seventh embodiment of the present disclosure.

[0048] FIGS. 24A-24B are perspective views of the medical device of FIG. 23 with a cutting device in retracted and deployed positions, respectively.

[0049] FIG. 25 is a sectional view of a distal end of the medical device of FIG. 23.

[0050] FIG. 26 is an exploded view of the medical device of FIG. 23.

[0051] FIG. 27 is a perspective view of a medical device for use in performing an LSH procedure, according to an eighth embodiment of the present disclosure.

[0052] FIGS. 28A-28B are perspective views of the medical device of FIG. 27 with a cutting device in first and second rotational positions, respectively.

[0053] FIG. 29 is an exploded view of the medical device of FIG. 27.

[0054] FIG. 30 is a sectional view of a distal end of the medical device of FIG. 27.

[0055] FIGS. 31A-31B are sectional views of a body portion showing the medical device of FIG. 27 excising the uterus during an LSH procedure.

[0056] FIGS. 31C-31D are sectional views of a body portion showing the medical device of FIG. 27 performing a conoscopy of cervical tissue.

[0057] FIGS. 32A-32D illustrate a method for performing LSH and conization procedures.

[0058] FIGS. 33A-33B depict an embodiment of a cutting device in retracted and deployed positions, respectively.

[0059] FIGS. 34A-34B are perspective views of another embodiment of a cutting device for performing a conization procedure.

[0060] FIGS. 35A-35B depict another embodiment of a cutting device for performing a conization procedure, in retracted and deployed positions, respectively.

DESCRIPTION OF THE EMBODIMENTS

[0061] Reference will now be made in detail to exemplary embodiments of the present disclosure, examples of which are illustrated in the accompanying drawings. Wherever possible, the same reference numbers will be used throughout the drawings to refer to the same or like parts.

[0062] Embodiments of the present disclosure generally relate to medical devices and methods for performing female pelvic surgical procedures, which may include, but are not limited to, removing a body organ such as a uterus or other structure associated with a reproductive system. More particularly, embodiments of the present disclosure relate to devices and methods for performing total laparoscopic hysterectomy (TLH) and laparoscopic supracervical hysterectomy (LSH) procedures. It should be emphasized, however, that the embodiments of the present disclosure may also be utilized in abdominal hysterectomies and other female pelvic surgical procedures. Furthermore, at least the devices disclosed herein may be used in the removal of other organs in both males and females.

[0063] FIG. 1 illustrates a medical device 10 for performing a TLH procedure, in accordance with a first embodiment of the present disclosure. Medical device 10 may include an elongate member 12, an end effector assembly 16, and a handle portion 14. For purposes of this disclosure, “proximal” refers to the end closer to the device operator during use, and “distal” refers to the end further from the device operator during use. End effector assembly 16 may be disposed at a distal end portion 12b of elongate member 12, and handle portion 14 may be disposed at a proximal end portion 12a of elongate member 12.

[0064] Elongate member 12 may be a unitary hollow structure, including, but not limited to, a curved tube made from any known suitable biocompatible material having sufficient flexibility and/or rigidity to traverse a vaginal canal. Alternatively, elongate member 12 may include two halves 13, 15 (FIG. 3) that may be connected by welding, soldering, or any other connection means known to those skilled in the art. Biocompatible materials may include, but are not limited to, rubber, silicon, synthetic plastics, stainless steel, ePTFE, PTFE, metal-polymer composites, and metal alloys of nickel, titanium, copper cobalt, vanadium, chromium, and iron. In one embodiment, the material forming elongate member 12 may be a superelastic material such as nitinol, which is a nickel-titanium alloy.

[0065] Elongate member 12 may have any desired cross-sectional shape and desired dimension, so long as it may be

received in a vaginal canal. Elongate member 12 may also have an atraumatic exterior configuration. Such exterior configurations may include, but are not limited to, a rounded external surface. In addition, elongate member 12 may have any suitable coating such as, for example, an anesthetic or lubricious coating on an exterior surface of elongate member 12. Elongate member 12 may further include one or more lumens or internal channels (not shown) for the passage of a variety of surgical equipment, including, but not limited to, imaging devices and tools for irrigation, insufflation, vacuum suctioning, biopsies, and drug delivery. In one embodiment, medical device 10 may also include multiple openings 33, 35 in its exterior surface. The openings 33, 35 may be connected to the one or more lumens/channels in elongate member 12, which may be used as an entrance/exit location for an electrical line 36 providing electrical current to medical device 10 or for expansion lines 32, 34 providing an expansion source to expandable members 18, 26.

[0066] End effector assembly 16 may extend distally from distal end portion 12b of elongate member 12. End effector assembly 16 may be made integrally with elongate member 12. Alternatively, end effector assembly 16 may be a separate portion rigidly secured to elongate member 12 through any connection means known to those skilled in the art. Such connection means may include, but are not limited to, welding and soldering. An advantage of having end effector assembly 16 being a separate portion from elongate member 12 includes ease of sterilizing end effector assembly 16 after use. End effector assembly 16 may be re-usable or disposable. A disconnectable end effector assembly 16 may also allow for a device operator to have multiple end effector assemblies 16 in a variety of dimensions, such that the device operator can choose an appropriately sized end effector assembly 16 based on a patient's anatomy.

[0067] End effector assembly 16 may include multiple components, including, but not limited to, a cup 28, a manipulation device 24, and a cutting device 30. End effector assembly 16 may also have suitable illumination and imaging devices (not shown). The illumination device may be used to illuminate and help demarcation of the bladder and vasculature. Cup 28 may have any suitable shape and/or configuration, and may be any desired dimension such that it may be received in a patient's vaginal cavity. In the embodiment illustrated in FIG. 1, cup 28 may include a rounded perimeter forming a circular or oval shape.

[0068] Cup 28 may also include a substantially conical shape that tapers into an enlarged edge 28a. Enlarged edge 28a may have any suitable atraumatic configuration. For example, edge 28a may be rounded. Edge 28a may also have a textured geometry or other geometric configuration (e.g., tines, barbs, etc.) to aid in frictionally gripping patient tissue to maintain desired placement of medical device 10. An exterior surface of cup 28 may have an atraumatic configuration like that of the exterior surface of elongate member 12. Such atraumatic configurations may include, but are not limited to, a smoothed material surface. In addition, portions of cup 28 may include any suitable coating, including, but not limited to, an anesthetic or lubricious coating on an exterior of cup 28.

[0069] FIG. 4A illustrates an embodiment of cup 28. Cup 28 may include an inner cup portion 28c positioned within an outer cup portion 28b. There may be enough space between inner cup portion 28c and outer cup portion 28b to allow cutting device 30 to move between the directions indicated by arrow 43 (FIG. 1) and rotated along the directions indicated

by arrow 45 (FIG. 2B). Cup 28 may also include a sealing mechanism 31, through which cutting device 30 may protrude, to keep unwanted material (e.g., tissue or blood) from entering a space between inner cup portion 28c and outer cup portion 28b. Sealing mechanism 31 may also limit the back and forth (e.g., lateral) motion of cutting device 30 within the space, so as to avoid potential wandering of cutting device 30 as cutting device 30 is moved along the directions indicated by arrow 45. In one embodiment, sealing mechanism 31 may include a strip of elastomeric material that engages a portion of cutting member 30. Although FIG. 4A shows a single sealing mechanism 31, those of ordinary skill in the art will understand that any suitable number of sealing mechanisms 31 may be provided. For example, a second sealing mechanism may be disposed on inner cup portion 28c.

[0070] Cutting device 30 may be configured to move relative to edge 28a between a retracted position shown in FIG. 2A and a deployed position shown in FIG. 2B along the directions shown by arrow 43 (FIG. 1). Movement between the deployed and retracted positions may be accomplished via a first actuating mechanism 22. In one embodiment, first actuating mechanism 22 may be a slide actuator 38 connected to a proximal end of a first rod 46 within elongate member 12. First rod 46 may be operatively connected to cutting device 30 at its distal end. Accordingly, axial movement of first actuating mechanism 22 in the directions indicated by arrow 39 may cause axial movement of cutting device 30 in the directions indicated by arrow 43. It is contemplated, however, that first actuating mechanism 22 may be a button or any other actuating mechanism known to one skilled in the art for controlled deployment of cutting device 30. First actuating mechanism 22 may also include a stop 56 within medical device 10 for preventing cutting device 30 from being deployed beyond a desired distance. First actuating mechanism 22 may also include a ratcheting detent or locking mechanism to maintain cutting device 30 at its desired deployed or retracted orientations.

[0071] Cutting device 30 may also be configured to move along edge 28a about cup 28 in the direction shown by arrow 45. It is shown in FIGS. 1-3 that handle portion 14 may extend from proximal end portion 12a of elongate member 12. Handle portion 14 may include ergonomic and/or geometric structures that may assist a device operator with gripping medical device 10. For example, in some embodiments, handle portion 14 may include finger grips. Handle portion 14 may also include a second actuating mechanism 20. Rotational movement of cutting device 30 may be accomplished via second actuating mechanism 20. Second actuating mechanism 20 may be any actuating mechanism known to one skilled in the art for controlling rotation of cutting device 30. For example, second actuation mechanism 20 may be configured to rotate relative to elongate member 12. Rotation of second actuating mechanism 20 may cause rotation of a rod 48 within elongate member 12. Rod 48 may be attached to second actuating mechanism 20 at one end (e.g., the proximal end) and to a gear mechanism 50, 52 at its other end (e.g., the distal end). Gear mechanism 50, 52 may also be operatively connected to cutting device 30. Accordingly, rotational movement of second actuation mechanism 20 in the directions indicated by arrow 41 may cause rotational movement of cutting device 30 in the directions indicated by arrow 45. Second actuating mechanism 20 may also include a ratcheting detent or locking mechanism to maintain cutting device 30 in a desired orientation or location, if necessary.

[0072] Cutting device 30 may be any known cutting device, including, but not limited to, cautery blades, radio-frequency (RF) devices, cryoablation catheters, lasers, cautery forceps/scissors, microwave probes, sharpened blades, and/or ultrasonic ablation devices. In one embodiment, cutting device 30 may be an electrocautery device connected through electrical line 36 to an energy source 712 (FIG. 5C) such as, for example, an RF generator. Cutting device 30 may be monopolar, as illustrated in FIG. 5C, or bipolar. In monopolar embodiments, for example, medical device 10 may further include a grounding pad 37 for placement under the patient, as is well known in the art. In bipolar embodiments, cutting device 30 may include two opposing, coacting components that serve to complete the cautery circuit.

[0073] In monopolar embodiments, one or more surfaces of cutting device 30 may be coated with a suitable coating. In one embodiment, the coating may be a dielectric coating. The electrical properties of the coating may be chosen to maximize the flow of electrical cutting current flowing from a leading edge of cutting device 30 while minimizing total current flow through the patient. For example, one or more surfaces of cutting device 30 may be coated with a material that increases the electrical resistance to the flow of current from the one or more surfaces of cutting device 30 while other portions (e.g., edges) of cutting device 30 may remain uncoated. Suitable coating materials may include, but are not limited, to rubber, silicone, and plastics such as PTFE.

[0074] FIGS. 4B and 4C illustrate alternative embodiments of cutting device 30. For example, cutting device 30 may be a ring 130 or substantially ring-like 230. The ring may be a single continuous ring 130 that is deployable/retractable as one, unitary portion; or ring 230 may contain multiple segmented sections 230a-f. Segmented sections 230a-f may be formed by overmolding a continuous ring with plastic or other insulating material to form exposed, segmented sections 230a-f. In such embodiments, ring 230 may be connected to an electrode. Alternatively, each segmented section 230a-f may be discrete and attached to individual wires 232a-f through a switch 234 to an electrosurgical generator, such that each segment 230a-f may be deployed independently and/or each segment 230a-f may be selectively turned on, if each segment is deployed at the same time, using switch 234 as a selector. Further, a computer (not shown) may be in communication with segmented sections 230a-f for selectively controlling deployment, rotation, and actuation of each segmented section 230a-f. Accordingly, switch 234 may be a microcontroller capable of executing a software control program.

[0075] Manipulation device 24 may be fixed to cup 28 and extend distally from cup 28. In some embodiments, manipulation device 24 may be integral with cup 28. In other embodiments, however, manipulation device 24 may be removably coupled to cup 28. In still other embodiments, manipulation device 24 may be slidably disposed in relation to cup 28. Manipulation device 24 may be a malleable or flexible elongate member made from any suitable biocompatible material known to one of ordinary skill in the art having sufficient flexibility to traverse vaginal and uterine cavities.

[0076] Manipulation device 24 may have any desired cross-sectional shape and/or configuration, and may be any desired dimension that can be received within the vaginal and uterine cavities. For example, manipulation device 24 may be a hollow structure with one or more lumens or channels (not shown) providing a passage for surgical equipment. Surgical

equipment may include, but is not limited to, optical scopes, illumination devices, and/or tools for irrigation, insufflation, biopsies, vacuum suctioning, closure of the vaginal cuff and/or drug delivery. Manipulation device 24 may further have an atraumatic configuration on its distal end portion and exterior surface. Such exterior configurations may include, but are not limited to, a smoothed, rounded surface. In addition, manipulation device 24 may include any suitable coating, such as an anesthetic, antibacterial, or lubricious coating.

[0077] At least one expandable member may be disposed on an exterior surface of medical device 10. In one embodiment, as shown in FIG. 1, first and second expandable members 18, 26 may be disposed on exterior surfaces of elongate member 12 and manipulation device 24, respectively. First expandable member 18 may be an occluder in the form of a vaginal dam in order to prevent passage alongside of medical device 10. For example, during a hysterectomy procedure, the abdomen may be inflated with gas to create space for visualization and uterine movement, and first expandable member 18 may prevent that gas from prematurely escaping during a hysterectomy procedure. Second expandable member 26 may be used to retain medical device 10 in a desired location within a uterine cavity. For example, second expandable member 26 may serve to secure manipulation device 24 relative to a uterus when the uterus is removed transvaginally during a TLH procedure.

[0078] The phrase "expandable member" generally relates to any expandable structure, including inflatable structures, mechanically expandable structures, and deformable structures, such as foamed rubbers. In one embodiment, expandable members 18, 26 may be inflatable balloons with any degree of elasticity, so long as they are capable of inflation to a desired dimension to maintain the position of medical device 10 within the vaginal and uterine cavities. Expandable members 18, 26 may be thin-walled structures made of material of low elasticity (which does not stretch significantly during inflation) or highly elastic material (which does stretch significantly during inflation). Expandable members 18, 26 may also be made from polyethylene terephthalate (PET), polyurethanes, polyethylenes and ionomers, copolyesters, rubbers, polyamides, silicone, latex, or any other suitable materials known in the art.

[0079] Expandable members 18, 26 may be fluidly connected to fluid sources via expansion lines. For example, first and second expandable members 18, 26 may be connected via first and second expansion lines 32, 34 to fluid sources such as, for example, saline. Fluid source connections may allow for inflation of expandable members 18, 26 from a collapsed configuration to an expanded configuration. Fluid sources may also allow for deflation of expandable members 18, 26 from an expanded configuration to a collapsed configuration. Expandable members 18, 26 may additionally include sensors and indicators to monitor various properties during inflation and deflation, including, but not limited to, safety features, such as a pressure limiting valve and/or a pressure sensor to monitor the force expandable members 18, 26 may exert on a patient's vaginal and uterine cavities. Expandable members 18, 26 may also include radiopaque and/or sonoreflective markers so that one could visualize and monitor the expansion of expandable members 18, 26.

[0080] Alternatively, expandable members 18, 26 may be mechanically expandable members, including, but not limited to, cages, foams, and stents. In embodiments with mechanically expandable members 18, 26, expansion lines

32, 34 may be substituted for control lines leading to mechanical actuating and retracting means for selectively expanding and collapsing expandable members **18, 26**. For example, mechanical actuating and retracting means may include retractable covers, biodegradable sleeves, motor attachments, or any other suitable actuating means known to those skilled in the art. Mechanical expandable members **18, 26** may also be provided with sensors, indicators, or radio-paque and/or sonoreflective markers to monitor properties during expansion and retraction of expandable members **18, 26** within vaginal and uterine cavities.

[0081] Turning now to FIGS. **5A-5C, 6, 7A-7B, 8A-8B, and 9A-9C** in the present disclosure, there is illustrated an embodiment of a method for performing a TLH procedure. The patient may be prepared for the surgery according to procedures that are well known in the surgical arts. For example, patient **710** may be oriented in a supine-lithotomy configuration on operating table **700**, such that patient **710**'s legs may rest in raised stirrups **709**. Alongside operating table **700**, a surgeon **704**, an anesthesiologist **703**, and a medical assistant **708** may be present. Additionally, the operating room may be provided with equipment to assist in the surgery, including, but not limited to, monitors **706**, a foot switch **705**, an electrosurgical generator **702**, and an instrument table **707**. The personnel and equipment may be arranged in any desired order and/or configuration.

[0082] Once patient **710** is prepared, medical device **10** is inserted into the vaginal and uterine cavities, and the first and second expandable members **18, 26** (FIG. **7B**) are expanded to abut tissue in the vaginal and uterine cavities in order to properly position medical device **10** and facilitate occlusion in the vaginal cavity. The abdominal cavity **710a** may then be insufflated to create space and facilitate accessibility and visibility of the female pelvic organs. Multiple laparoscopic incisions **711** may further be cut in the patient's abdomen area to facilitate the introduction of surgical instruments. As shown in FIG. **5C**, prior to insertion of medical device **10**, cutting device **30** may be connected through an electrical line **36** to an energy source **712** such as, for example, a radio-frequency (RF) or electrosurgical generator.

[0083] Turning now to FIGS. **6 and 7A-7B**, surgical instruments **502, 506, 507** may be inserted through incisions **711** in order to, for example, facilitate cutting of ligamentous structures **503** and/or to illuminate/visualize areas of interest. In some embodiments, medical device **10** may be inserted into a vaginal cavity and advanced to uterus **500** after surgical instruments **502, 506, 507** have been inserted into the patient **710**, or one or more preparation steps have been completed. Further, manipulation device **24** of medical **10** may be positioned to extend into the uterine cavity. Once end effector assembly **16** of medical device **10** has been inserted into the vaginal and uterine cavities, expandable members **18, 26** may be expanded from a collapsed configuration to an expanded configuration via expansion lines **32, 34**, or any other means discussed in the present disclosure.

[0084] Manipulation device **24** may be at least partially positioned within the uterus **500**, and cup **28** may engage vaginal fornices **508**, as shown in FIG. **8A**. FIG. **8B** illustrates that a device operator may then apply a cephalad force to medical device **10** in the direction of arrow **509**, allowing cup **28** to tent vaginal fornices **508**, thereby preparing uterus **500** for cutting/excision.

[0085] As illustrated in FIGS. **9A-9C**, a device operator may then actuate first actuating mechanism **22** in the direction

of arrow **39** to advance cutting device **30** from a retracted position to a deployed position, which may create an incision in vaginal fornix tissue. Second actuating mechanism **20** may be rotated along the direction of arrow **41** relative to elongate member **12** to move cutting device **30** along edge **28a** of cup **28**. In this manner, cutting device **30** may create a substantially rounded, uniform colpotomy incision to separate uterus **500**, along with the cervix, from the vaginal apex. Upon completion of uterine and cervical excision, the vaginal cuff opening left behind may be closed using means known to those skilled in the art, including, but not limited to, sutures, staples, and/or glue. Additionally, uterus **500** may be removed by any suitable means known in the art. In some embodiments, additional tools and/or equipment may be used to, for example, cut uterine tissue into small pieces for extraction. One example of such a tool may include a morcellator. In addition, or alternatively, a suctioning device may be used to remove the entire uterus or any of its portions.

[0086] FIG. **10** illustrates a further embodiment of a medical device **100** for performing a TLH procedure. Medical device **100** may include one or more features of medical device **10** of FIG. **1**. For example, medical device **100** may include an elongate member **120**, an end effector assembly **160**, a handle portion **140**, and expandable members **180, 260**. Substantively, elongate member **120** may be similar to elongate member **12** of FIG. **1**.

[0087] End effector assembly **160** may be pivotally secured to distal end **120b** of elongate member **120**, such that it may pivot between a first position **279** and a second position **281** along a first pivotal path **283**. Additionally, handle portion **140** may be pivotally secured to a proximal end **120a** of elongate member **120**, such that it may pivot between a first position **199** and a second position **201** along a second pivotal path **203**. Movement of end effector assembly **160** between its first and second positions **279, 281** may be controlled by movement of handle portion **140**. Additionally, end effector assembly **160** and handle portion **140** may each be secured to elongate member **120** via any type of pivot mechanism known to those skilled in the art. For example, in one embodiment, end effector assembly **160** and handle portion **140** may each be secured to elongate member **120** via a hinge **224**, which may include a pivot pin.

[0088] End effector assembly **160** may be a separately connected portion to elongate member **120** and may be reusable or disposable. End effector assembly **160** may also be produced in a variety of dimensions to accommodate a variety of patient anatomies.

[0089] End effector assembly **160** may include multiple components, including, but not limited to, a cup **280**, a manipulation device **240**, and a cutting device **330**. Manipulation device **240** may be substantively similar to manipulation device **24** of FIG. **1**. However, manipulation device **240** may be configured to rotate relative to elongate member **120**, as shown in FIG. **10**. Cup **280** may include one of more of the features of cup **28** of FIG. **1**. For example, cup **280** may have an enlarged edge **280a** that is atraumatic and/or textured to aid in gripping a cervix to maintain desired placement of medical device **100**. Cup **280** may also have an atraumatic exterior surface **280b** with a coating affixed thereto. Cup **280** may also be configured to rotate relative to elongate member **120**.

[0090] Cup **280** may have any shape and/or configuration, and may be any desired dimension such that it can be received in a patient's vaginal cavity. FIGS. **12A and 12B** illustrate that cup **280** may include an inner cup portion **280c** and an outer

cup portion **280b**. Inner cup portion **280c** may have a bottom surface that is spaced from a lower surface of outer cup portion **280b**. Inner and outer cup portions **280c**, **280b** may include through-openings in outer surfaces of each portion. Alternatively, inner and outer cup portions **280c**, **280b** may be solid pieces with no through-openings.

[0091] Cup **280** may also include a cutting device **330** located in recess **310** (FIG. 10) and a cutting device carrier **254** located in a space between an outer, bottom surface of inner cup portion **280c** and an inner surface of outer cup portion **280b**. A control rod **242** may be connected to cutting device carrier **254** and to a first actuating mechanism **220** within handle portion **140**. First actuating mechanism **220** may be any actuating mechanism capable of creating axial motion. Such actuating mechanisms may include, but are not limited to, a slide actuator or push button. In one embodiment, first actuating mechanism **220** may be a thumbwheel. Rotation of thumbwheel **220** may cause cutting device carrier **254** to move within the space between inner cup portion **280c** and outer cup portion **280b**, thereby causing movement of cutting device **330** between retracted and deployed configurations in the directions shown by arrow **335**, as shown in FIGS. 11 and 12A-12B.

[0092] With reference to FIG. 11, cutting device **330** may also be configured to rotate about cup **280** in the direction of arrow **331** due to operation of second actuating mechanism **200**. Second actuating mechanism **200** may be any actuating mechanism known to one skilled in the art that provides rotation of cutting device **330**. For example, second actuating mechanism **200** may be configured to rotate relative to elongate member **120** in the direction of arrow **205**. Control rods **242**, **244** may be connected to second actuating mechanism **200** such that rotation of second actuating mechanism **200** may cause control rods **242**, **244** to transfer rotational force to cutting device **330**. Alternatively, second actuating mechanism **200** may be configured to transfer rotational force to cup **280**, such that cup **280** and cutting device **330** rotate together.

[0093] Each of first and second actuating mechanisms **220**, **200** may also comprise a ratcheting detent or a locking mechanism to maintain cutting device **330** in any desired orientation.

[0094] Cutting device **330** may include one or more of the features of cutting device **30** of FIG. 1. For example, cutting device **330** may be any cutting device known to those skilled in the art, including an electrocautery device connected through an electrical line **360** to an energy source (e.g., an electrosurgical generator). Electrical line **360** may be connected to cutting device **330** via an exterior opening **361**. Cutting device **330** may also comprise one of the ring-shaped configurations **130**, **230** illustrated in FIGS. 4B and 4C. In one embodiment, cutting device **330** may be made of a flexible material such that it may project out to a desired cutting angle when deployed, as illustrated in FIGS. 12A and 12B. The desired cutting angle may be formed between an inner surface of outer cup portion **280b** and an outer surface of inner cup portion **280c**. In one embodiment, the desired cutting angle may be between approximately 10 and 45 degrees and preferably approximately 15 degrees; however, the cutting angle may be any value that accomplishes a TLH procedure.

[0095] As shown in FIG. 11, medical device **100** may also include at least one expandable member on elongate member **120** and/or manipulation device **240**. Expandable members **180**, **260** may be substantively similar to expandable members **18**, **26** of FIG. 1. For example, first and second expand-

able members **180**, **260** may be connected to first and second expansion source lines **320**, **340**. First and second expansion source lines **320**, **340** may be connected to a lumen or channel (not shown) in medical device **100** via exterior openings **341**.

[0096] FIG. 13 illustrates another embodiment of medical device **300** for performing TLH procedures. Medical device **300** may include one or more features of medical device **100** in FIG. 10. For example, medical device **300** may include the same features of cup **280** and manipulation device **240** as illustrated in medical device **100** shown in FIG. 10.

[0097] Medical device **300** may also include an elongate member **301**, an end effector assembly **246**, and a handle portion **302**. Elongate member **301** may include one or more features of elongate member **120** in FIG. 10. In addition, or alternatively, elongate member **301** may be a hollow structure including a mechanical system of gears and belts as an alternative to the control rod **242** system discussed above. Gears and belts may include, but are not limited to, slot gears **325**, toothed gears **304**, and toothed belts **321**, **322**. Handle portion **302** may be pivotally secured to elongate member **301** at its proximal end **301a**. Handle portion **302** may be rotated about a pivot rod **306** in the direction shown by arrow **319**. End effector assembly **246** may be pivotally secured to elongate member **301** at its distal end **301b** via pivot rod **310**. Movement of handle portion **302** in the direction of arrow **319** may cause movement of end effector assembly **246** in the direction of arrow **313**.

[0098] Further, movement of a first actuating mechanism **312** in the direction of arrow **315** may cause deployment of cutting device **330** via a series of independent translational and rotational movements. Translational movement of first actuating mechanism **312** may cause rotational movement of gears A and C and one of toothed belts **321**, **322**. Rotational movement of gears A and C and one of toothed belts **321**, **322** may then cause translational movement in end effector assembly **246**, resulting in deployment of cutting device **330**. Similarly, rotational movement of second actuating mechanism **314** in the direction shown by arrow **317** may cause rotation of cutting device **330** via a series of independent rotational movements.

[0099] FIGS. 14A and 14B of the present disclosure illustrate an embodiment of a method for performing a TLH procedure using medical device **100** of FIG. 10. Alternatively, medical device **300** of FIG. 13 may be used for the TLH procedure in place of medical device **100** of FIG. 10. The method illustrated in FIGS. 14A and 14B follows the same preparation steps as the method illustrated in FIGS. 5A-5C, 6, and 7A-7B. After expandable members **180**, **260** have been expanded such that they abut tissue in the vaginal and uterine cavities, a device operator may rotate handle portion **140** in the directions of arrow **203**. Rotation of handle portion **140** may cause manipulation device **240** to move uterus **500** in the cephalad directions shown by arrow **283** and may cause cup **280** to tent vaginal fornices **508**, placing uterus **500** in a desired excisional orientation. Cutting device **330** may then be deployed and rotated via the use of first and second actuating mechanisms **220**, **200** in order to create a uniform, rounded colpotomy incision to separate uterus **500**, along with the cervix, from the vaginal apex. Upon completion of uterine and cervical excision, the vaginal cuff opening left behind may be sutured or otherwise closed as known to those skilled in the art.

[0100] FIG. 15 illustrates another medical device **1000** for performing a TLH procedure, in accordance with a fourth

embodiment of the present disclosure. Medical device **1000** may include one or more of the features of any of the other embodiments disclosed herein. For example, medical device **1000** may include a first elongate member **1020** and a second elongate member (collectively referred to as “**1020a-b**”) disposed therein. The second elongate member **1020a-b** may include two halves **1020a**, **1020b**. First and second elongate members **1020**, **1020a-b** may be hollow, tubular structures and may have any cross-sectional shape and desired dimension, so long as they may be received in a vaginal canal. First elongate member **1020** may be a unitary structure. The second elongate member **1020a-b** may also be a unitary structure. Alternatively, as noted above, the second elongate member **1020a-b** may include two halves **1020a**, **1020b**, as shown in FIG. 16. Halves **1020a**, **1020b** may be connected via welding, soldering, or any other connection means known to those skilled in the art. Elongate members **1020**, **1020a-b** may also include an atraumatic exterior surface with an affixed coating like the exterior surface of elongate member **12** in FIG. 1. Second elongate member **1020a-b** may be coaxially disposed within a central lumen of first elongate member **1020**. In some embodiments, second elongate member **1020a-b** may be rotationally and/or axially movable within first elongate member **1020**.

[**1011**] First and second elongate members **1020**, **1020a-b** may also include one or more lumens or channels **1010**, respectively, with the lumens potentially providing passage for a variety of surgical equipment. In one embodiment, medical device **1000** may include an opening **1150** in an exterior surface. Opening **1150** may be in communication with central lumen or channel **1010** for receiving an electrical line **1140** to power a cutting device **1130**. Although the depicted embodiment illustrates opening **1150** disposed on control member **1030**, opening **1150** may be disposed on any suitable external surface of elongate member **1020**. Medical device **1000** may further include a cover **1024** at a proximal end of first and second elongate members **1020**, **1020a-b** such that cover **1024** may act as a seal. Cover **1024** may also include an opening therethrough, facilitating insertion of surgical equipment through the one or more lumens or channels **1010** in medical device **1000**.

[**1012**] Second elongate member **1020a-b** may include an atraumatic distal end **1280**, which may further comprise suitable geometric configurations to aid in maintaining medical device **1000** in a desired location within a patient. In one embodiment, distal end **1280** may be tapered to provide an angled cutting plane. Medical device **1000** may also include at least one expandable member **1080** along with an expansion source line **1120** connected to expandable member **1080**. Although the depicted embodiment illustrates expandable member **1080** being closer to distal end **1280**, expandable member **1080** may be positioned anywhere along the length of medical device **1000**.

[**1013**] A cutting device **1130** may be disposed within medical device **1000** between halves **1020a**, **1020b** of second elongate member **1020a-b**. In one embodiment, cutting device **1130** may be movable between a retracted position and a deployed position, in which cutting device **1130** extends distally beyond distal end **1280** of second elongate member **1020a-b**. Although the depicted embodiment illustrates cutting device **1130** extending straight out of medical device **1000**, cutting device **1130** may extend at any suitable angle. Cutting device **1130** may be operatively connected to a first control rod **1200**, which may extend to a proximal end of

medical device **1000**. As shown in FIG. 16, for example, first control rod **1200** may be connected to cutting device **1130** by a second control rod **1202**. First and second control rods **1200**, **1202** may be separate rods or a unitary piece, such that first control rod **1200** may be offset from second control rod **1202**.

[**1014**] Medical device **1000** may further include a handle portion **1040**, including, but not limited to, a gripping member **1028** and a control member **1030**. Additionally, first control rod **1200** may extend proximally from handle portion **1040**. In use, a device operator may maintain first elongate member **1020** and handle portion **1040** in a fixed position when positioning medical device **1000** against a patient's vaginal formices **508**. The device operator may manipulate first control rod **1200** to move cutting device **1130** axially along an axis that is parallel to a longitudinal axis of medical device **1000**. The device operator may then rotate control member **1030**, which may cause cutting device **1130** to rotate in the same direction as control member **1030**.

[**1015**] FIGS. 17A and 17B of the present disclosure illustrate a method for performing a TLH procedure using medical device **1000** shown in FIG. 15. The method illustrated in FIGS. 17A and 17B follows the same preparation steps as the method illustrated in FIGS. 5A-5C, 6, and 7A-7B. After insertion of medical device **1000** into a vaginal cavity, distal end **1280** of medical device **1000** may engage one or more vaginal formices **508**. Surgical equipment may also be inserted through a central lumen **1010** of medical device **1000** to aid in the procedure. In one embodiment, expandable member **1080** may be expanded such that it abuts tissue in a vaginal cavity and acts as an occluder, so as to prevent inflation gases from prematurely escaping from the patient's abdomen. Second control rod **1202** and cutting device **1130** are located between halves **1020a**, **1020b** of second elongate member **1020a-b**, which further fit within first elongate member **1020**. As previously discussed, a device operator may extend cutting device **1130** by sliding first control rod **1200** in the directions of arrow **1203**. Upon deployment of cutting device **1130**, the device operator may then rotate the cutting device **1130** by rotating control member **1030** in the directions of arrow **1205** relative to first elongate member **1020** and gripping member **1028** in order to create a uniform, rounded incision to excise the uterus **500**, along with the cervix, from the vaginal apex. Upon completion of uterine and cervical excision, the vaginal cuff opening left behind may then be sutured or otherwise closed as known to those skilled in the art.

[**1016**] FIG. 18 illustrates a medical device **400** for a laparoscopic supracervical hysterectomy (LSH) procedure, in accordance with a fifth embodiment of the present disclosure. Medical device **400** may include one or more of the features of medical device **100** illustrated in FIG. 10. For example, medical device **400** may include an elongate member **120** and a handle portion **140**. Medical device **400** may also include an end effector assembly **460**. End effector assembly **460** may be capable of pivoting between a first position **243** and a second position **245** in the directions of arrow **241** in response to pivotal motion of handle portion **140** between its first pivotal position **199** and second pivotal position **201** in the directions of arrow **203**.

[**1017**] End effector assembly **460** may include a manipulation device **440** with a cutting device **430** located therein. Cutting device **430** may include one or more of the features of cutting device **130** described in FIG. 10. Cutting device **430** may be any cutting device known to those skilled in the art and may be configured to move relative to manipulation

device **440** between a deployed position, illustrated in FIG. **19**, and a retracted position, illustrated in FIG. **18**, in the directions of arrow **209**. In its retracted position (FIG. **20**), cutting device **430** may be maintained within a recess **431** in manipulation device **440**. Recess **431** may be any suitable shape, size, and/or configuration, so long as it may maintain cutting device **430** therein. For example, in one embodiment, recess **431** may be rectangular. Further, manipulation device **440** may include multiple recesses **431**, with each recess **431** maintaining a cutting device **430** therein.

[**0108**] Deployment and retraction of cutting device **430** may be controlled by a first actuating mechanism **220** that may transfer force to cutting device **430** via a control rod **242** and a hinge mechanism **250**, as illustrated in FIG. **20**. First actuating mechanism **220** and control rod **242** may substantially include the features of first actuating mechanism **220** and control rod **242** of medical device **100** shown in FIG. **10**. Hinge mechanism **250** may be any type of pivoting mechanism known to those skilled in the art. Hinge mechanism **250** may also be operably connected to cutting device **430** and may include multiple pivot points **434**, **436** within recess **431**. Pivoting movement of hinge mechanism **250** about pivot points **434**, **436** may cause cutting device **430** to move between its deployed and retracted configurations.

[**0109**] Cutting device **430** may also be configured to rotate with manipulation device **440** in the directions of arrow **207** (FIG. **19**). Rotation of cutting device **430** may be controlled by a second actuating mechanism **200**. Second actuating mechanism **200** may be operably connected to cutting device **430** via control rod **242**. Second actuating mechanism **200** and control rod **242** may substantially include the features of second actuating mechanism **200** and control rod **242** of medical device **100** shown in FIG. **10**. For example, rotation of second actuating mechanism **200** in the directions of arrow **205** may cause control rod **242** to transfer rotational force to cutting device **430**.

[**0110**] Manipulation device **440** may include one or more features of manipulation device **240** shown in FIG. **10**. For example, manipulation device **440** may include an atraumatic exterior with a coating to facilitate insertion of medical device **400** into a patient. Manipulation device **440** may also include one or more lumens for insertion of surgical equipment, including, but not limited to, imaging and illumination devices, suction devices, biopsy tools, and drug-delivery mechanisms.

[**0111**] In order to maintain medical device **400** within a patient, manipulation device **440** may further include a gripping structure on its exterior surface (e.g., tines or barbs). Alternatively, medical device **400** may include expandable members like expandable members **180**, **260** illustrated in FIG. **10** of the present disclosure.

[**0112**] FIGS. **21A** and **21B** illustrate a cross-sectional view of a distal end of a medical device **600** for an LSH procedure, in accordance with a sixth embodiment of the present disclosure. Medical device **600** may include one or more features of medical device **100** shown in FIG. **10**, medical device **300** shown in FIG. **13**, and medical device **400** shown in FIG. **18**. For example, medical device **600** may include an elongate member **301** with an end effector assembly **660** at its distal end **301b**. Medical device **600** may also include expandable members like expandable members **180**, **260** illustrated in FIG. **10** of the present disclosure. Further, as discussed in the present disclosure in relation to medical device **300** of FIG.

13, end effector assembly **660** may pivot about rod **310** due to movement from handle portion **302** in combination with a system of gears and belts.

[**0113**] End effector assembly **660** may include a manipulation device **640** and a cutting device **630**. Manipulation device **640** may include one or more features of manipulation device **440** shown in FIG. **18**, including, but not limited to, an atraumatic exterior surface with a coating, one or more lumens, and a means for maintaining medical device **600** within a patient.

[**0114**] Cutting device **630** may be configured to move between a retracted position (FIG. **21A**) and a deployed position (FIG. **21B**). Cutting device **630** may be deployed via a plunger **610**. Plunger **610** may be part of a ratcheting system (FIG. **21A**) that is operatively connected to cutting device carrier **650** and cutting device **630**. Translational movement of a first actuating mechanism **312** may cause rotational movement of gears and belts, which in turn may cause translational movement of plunger **610** and cutting device carrier **650** in the directions of arrow **611**, resulting in deployment and retraction of cutting device **630**.

[**0115**] Cutting device **630** may be any cutting device known to those skilled in the art, such that cutting device **630** can be deployed and retracted along a path that may include linear and/or nonlinear sections (e.g., flexible blade or laser). Cutting device **630** may also be configured to rotate with manipulation device **640** in the directions of arrow **207** in response to rotation of a second actuating member **314** in the directions of arrow **317**. Although the depicted embodiment illustrates cutting device **630** deployed at an angle of 90 degrees relative to manipulation device **640**, cutting device **630** may extend at any suitable angle, preferably approximately between 15 and 90 degrees.

[**0116**] FIGS. **22A** and **22B** of the present disclosure illustrate a method for performing an LSH procedure using medical device **400** of FIG. **18**. Alternatively, medical device **600** of FIGS. **21A-21B** may be used for the LSH procedure in place of medical device **400** of FIG. **18**. The method illustrated in FIGS. **22A** and **22B** follows the same preparation steps as the method illustrated in FIGS. **5A-5C** and **6**. Medical device **400** may be maintained in a desired position via expandable members or other gripping means. A device operator may rotate handle portion **140** in the directions of arrow **203**. Rotation of handle portion **140** may cause manipulation device **440** to pivot uterus **500** in the directions of arrow **241**, which may place uterus **500** in a desired cutting orientation. Cutting device **430** may then be deployed and rotated via the use of the first and second actuating mechanisms **220**, **200** in order to create a uniform, rounded incision to excise the uterine fundus **510** from the cervix, which is left in situ. Once uterine fundus **510** is withdrawn using accepted techniques to those skilled in the art, the vaginal cuff opening left behind is sutured or otherwise closed as known to those skilled in the art.

[**0117**] FIG. **23** illustrates another medical device **1300** for performing an LSH procedure, in accordance with a seventh embodiment of the present disclosure. Medical device **1300** may include one or more features of any of the other embodiments disclosed herein. For example, medical device **1300** may include an elongate member **1310**, a handle portion **1312**, an end effector assembly **1314**, and an expandable member **1318**. End effector assembly **1314** may be disposed

at a distal end **1310b** of elongate member **1310**, and handle portion **1312** may be disposed at a proximal end **1310a** of elongate member **1310**.

[0118] Substantively, elongate member **1310** may be similar to elongate member **12** of FIG. 1. For example, elongate member **1310** may be a unitary hollow tube having sufficient flexibility to traverse a vaginal canal. Alternatively, elongate member **1310** may include two halves **1310'** (FIG. 26) that may be connected via any connection means (e.g., welding, soldering, etc.) known to those skilled in the art. Elongate member **1310** may be curved along its length and include a proximal end **1310a** and a distal end **1310b**. Proximal end **1310a** may include an opening in communication with a central lumen **1344** of elongate member **1310**. Central lumen **1344** may also be in communication with an opening **1325** in an exterior surface of elongate member **1310**. Opening **1325** in the exterior surface of elongate member **1310** may allow for passage of an electrical line **1324** providing electrical current cutting device **1330**. Distal end **1310b** may include a stop surface for providing a point beyond which, end effector assembly **1314** may not traverse. Further, distal end **1310b** may include threads **1338** configured to mate with corresponding threads **1336** on end effector assembly **1314**.

[0119] End effector assembly **1314** may extend distally from distal end **1310b** of elongate member **1310** and may be removably attached to distal end **1310b** by any connection means known to those skilled in the art. For example, as discussed above, in one embodiment, end effector assembly **1314** may include threads **1336** configured to mate with corresponding threads **1338** at distal end **1310b** of elongate member **1310**. Alternatively, end effector assembly **1314** may be telescopically connected to distal end **1310b** of elongate member **1310**, such that a connector portion **1320** of end effector assembly **1314** may be slidably engaged within central lumen **1344** of elongate member **1310**. End effector assembly **1314** may be reusable or disposable. Alternatively, end effector assembly **1314** may be integral with elongate member **1310**.

[0120] End effector assembly **1314** may include multiple components, including, but not limited to, a connector portion **1320**, a manipulation device **1322**, and a cutting device **1330**. Manipulation device **1322** may extend through an opening, discussed in greater detail below, in connector portion **1320** and may be independently movable relative to connector portion **1320**. Manipulation device **1322** may be disposable or reusable and may have any shape, configuration, and/or dimension, such that it may be received in a patient's vaginal cavity. For example, in one embodiment, manipulation device **1322** may include an s-shaped curve along its length. Alternatively, manipulation device **1322** may be substantially straight along its length, similar to manipulation device **440** of medical device **400** shown in FIG. 18. Manipulation device **1322** may also be a hollow tube with a lumen (not shown) for allowing passage of illumination and imaging devices, as well as tools for suction, irrigation, drug delivery, and uterine removal and manipulation. Further, manipulation device **1322** may have an atraumatic exterior configuration with a rounded surface and/or an anesthetic or lubricious coating.

[0121] Manipulation device **1322** may further include an expandable member (not shown) for securing medical device **1300** relative to a uterus. The expandable member may also serve the purpose of tensioning the uterine wall in an area of an incision made by cutting device **1330**. Substantively, the expandable member may be similar to expandable member

26 of medical device **10** shown in FIG. 1. For example, the expandable member may be any suitable expansion means (e.g., balloon, cage, foam, etc.), and may be expanded via an expansion line (not shown), which may run through an opening similar to opening **1325** in the exterior surface of elongate member **1310**.

[0122] Connector portion **1320** may be a hollow, cap-like structure having an opening configured to receive distal end **1310b** of elongate member **1310**. As discussed above, a distal end-face of connector portion **1320** may include an opening through which manipulation device **1322** may pass. Connector portion **1320** may have a textured gripping portion on an exterior surface (FIG. 23) for allowing a device operator to rotate end effector assembly **1314** in the directions shown by arrow **1315**. Rotation of connector portion **1320** in the directions shown by arrow **1315** may, as a result of the connection between threads **1336**, **1338**, result in translational movement of end effector assembly **1314** in the directions shown by arrow **1325**. As discussed above, connector portion **1320** may further be telescopically connected to distal end **1310b** of elongate member **1310**, such that it may move in the directions shown by arrow **1325** relative to elongate member **1310** (FIG. 31C). Connector portion **1320** may also include a locking mechanism (not shown) in order to maintain a desired relationship relative to elongate member **1310**. In additional embodiments, a distal end of connector portion **1320** may include integrated visualization devices, such as, e.g., light sources or light guide tubes and/or cameras. Furthermore, such embodiments may be configured to deliver irrigation and/or suction to the surgical site.

[0123] Connector portion **1320** may be any shape and/or configuration, such that it may be received in a patient's vaginal cavity. For example, in one embodiment, connector portion **1320** may be a cup with an enclosed edge for engaging vaginal formices (FIGS. 32A-32D). Further, connector portion **1320** may have any suitable atraumatic configuration at its distal end, including, but not limited to, a rounded exterior surface. Connector portion **1320** may also include a textured geometry on its exterior surface for frictionally gripping patient tissue to aid in maintaining desired placement of medical device **1300**.

[0124] Medical device **1300** may further include handle portion **1312** extending proximally from proximal end **1310a** of elongate member **1310**. Handle portion **1312** may include a gripping portion **1316** and a telescoping portion **1317**. Telescoping portion **1317** may be an elongate structure having a diameter that is less than the diameter of the opening at proximal end **1310a** of elongate member **1310**, thereby allowing telescoping portion **1317** to slide within central lumen **1344** of elongate member **1310** in the directions shown by arrow **1313**. Gripping portion **1316** may extend proximally from telescoping portion **1317** and may include a textured surface for aiding a device operator with manipulation of handle portion **1312**. In addition to telescopic movement, handle portion **1312** may be rotated relative to elongate member **1310** in the directions shown by arrow **1311**.

[0125] Movement of handle portion **1312** relative to elongate member **1310** may control movement of cutting device **1330**. For example, as illustrated in FIG. 24A, the device operator may move handle portion **1312** in the directions of arrow **1313** to move cutting device **1330** in the direction of arrow **1319** between a deployed position and a retracted position. Further, as illustrated in FIG. 24B, the device operator may rotate handle portion **1312** in the directions of arrow

1311 to rotate cutting device **1330** in the directions of arrow **1321**. Although cutting device **1330** is illustrated as being deployed perpendicularly to manipulation device **1322**, cutting device **1330** may be deployed at any suitable angle. For example, a suitable deployment angle from manipulation device **1322** may be anywhere in the range of approximately 15 degrees to 90 degrees, and preferably approximately 45 degrees. Accordingly, handle portion **1312** may include features (e.g., markings) to indicate the deployed and/or rotational positions of cutting device **1330** relative to, e.g., the central axis of manipulation device **1322**.

[0126] As illustrated in FIGS. **25** and **26**, medical device **1300** may further include multiple components within central lumen **1344** of elongate member **1310** that are operably connected to handle portion **1312** for controlling movement of cutting device **1330**. For example, telescoping portion **1317** may include a first rod **1342** that may be operably connected to a first end **1339** of a plunger **1340**. A second end **1341** of plunger **1340** may be operably connected to a second rod **1334**, which may be pivotally connected by pins **1335** to cutting device **1330**. Bearings **1332** may support and aid rotation of manipulation device **1322** in the directions of arrow **1321**. Bearings **1332** may further provide a stop surface for plunger **1340**, such that second end **1341** of plunger **1340** may not move beyond that point. In use, movement of handle portion **1312** in the directions shown by arrow **1313** may cause first rod **1342** to act on plunger **1340**, which in turn may cause second rod **1334** to move within a lumen in a proximal end **1331** of manipulation device **1322** and pivot cutting device **1330** in the direction shown by arrow **1319** into a deployed configuration. Further, rotation of handle portion **1312** in the directions of arrow **1311** may cause first rod **1342** to act on plunger **1340**, which may operably act on proximal end **1331** of manipulation device **1322**, causing rotation of manipulation device **1322** with cutting device **1330**.

[0127] Cutting device **1330** may be any known cutting device to those skilled in the art, including, but not limited to, radio-frequency (RF) devices, lasers, microwave probes, and/or ultrasonic ablation devices. As illustrated in FIG. **25**, cutting device **1330** may also be a flexible cautery blade configured to conform the curvature of manipulation device **1322** when cutting device **1330** is in a retracted position within manipulation device **1322**. Alternatively, cutting device **1330** may be a substantially flat and/or rigid blade, similar to cutting device **430** of medical device **400** shown in FIG. **19**. As discussed above, cutting device **1330** may be connected to electrical line **1324**, and electrical line **1324** may further extend through opening **1325** in the exterior surface of elongate member **1310**, thereby allowing for a connection to an external energy source (not shown). FIG. **25** also depicts a single cutting device **1330** in a retracted position within manipulation device **1322**. Alternatively, medical device **1300** may include multiple cutting devices **1330** circumferentially spaced around manipulation device **1322**, such that each cutting device **1330** may be independently deployed. In embodiments with multiple cutting devices **1330**, it is contemplated that cutting devices **1330** may be collectively deployed as well.

[0128] In some embodiments, medical device **1300** may further include an expandable member **1318** on an exterior surface of elongate member **1310**. Expandable member **1318** may be substantially similar to expandable member **18** of medical device **10** shown in FIG. **1**. For example, expandable member **1318** may be an occluder in the form of a vaginal dam

for preventing leakage of a gas upon inflation of a patient's abdomen. Expandable member **1318** may also be connected to expansion control line **1326** for moving expandable member **1318** between deployed and retracted configurations. In embodiments where expandable member **1318** is inflatable, expansion control line **1326** may provide a passageway for inflation fluids. Expandable member **1318** may also include sensors, radiopaque markers, and/or pressure limiting valves for monitoring the force expandable member **1318** may exert on a patient's tissue and for monitoring the relative expansion of expandable member **1318**.

[0129] FIG. **27** illustrates another medical device **1400** for performing an LSH procedure, in accordance with an eighth embodiment of the present disclosure. Medical device **1400** may include one or more features of any of the embodiments disclosed herein. For example, elongate member **1410**, end effector assembly **1414**, and cutting device **1430** may be substantially similar to elongate member **1310**, end effector assembly **1314**, and cutting device **1330**, respectively, of medical device **1300** in FIG. **23**. Further, medical device **1400** may include an expandable member (not shown) on elongate member **1410** that is substantially similar to expandable member **1318** of medical device **1300** in FIG. **23**.

[0130] Elongate member **1410** may be a curved, hollow tube that may be a unitary structure or may include two halves **1410'**. Elongate member **1410** may be any shape and/or configuration, and may be made of a biocompatible material with sufficient flexibility/rigidity to traverse a patient's vaginal and uterine cavities. Elongate member **1410** may further include a proximal end **1410a**, a distal end **1410b**, and an opening **1425**. Opening **1425** may be substantially similar to opening **1325** in elongate member **1310** shown in FIG. **23**. For example, opening **1425** may serve as an entry/exit point for an electrical line **1424** that may be connected to cutting device **1430**. Further, distal end **1410b** may be substantially similar to distal end **1310b** of medical device **1300** shown in FIG. **23**. For example, distal end **1410b** may include threads **1450** configured to mate with corresponding threads **1451** on end effector assembly **1414**. Distal end **1410b** may also include a stop surface **1452** for limiting movement of end effector assembly **1414** relative to elongate member **1410**. Other embodiments of medical device **1400** may include a cup (not shown) configured to engage vaginal/cervical tissue to make them taut.

[0131] End effector assembly **1414** may be substantially similar to end effector assembly **1314** of medical device **1300** shown in FIG. **23**. For example, end effector assembly **1414** may include a manipulation device **1422** that is substantially similar to manipulation device **1322** of medical device **1300** shown in FIG. **23**. As illustrated in FIG. **27**, manipulation device **1422** may be a substantially straight, elongate member. Alternatively, manipulation device **1422** may include an S-shaped configuration, or any other suitable geometric features, along its length, similar to manipulation device **1322** shown in FIG. **23**. Manipulation device **1422** may also include an expandable member (not shown) for securing medical device **1400** relative to a uterus and/or for tensioning the uterine wall in an area of an incision made by cutting device **1430**, as discussed above in relation to manipulation device **1322** shown in FIG. **23**.

[0132] End effector assembly **1414** may also include a connector portion **1420** that is substantially similar to connector portion **1320** of medical device **1300** shown in FIG. **23**. For example, connector portion **1420** may be a hollow structure

having an opening at a distal end with a diameter sufficient to receive distal end **1410b** of elongate member **1410**. Further, as discussed above, connector portion **1420** may include threads **1451** configured to mate with threads **1450** on distal end **1410b** of elongate member. Connector portion **1420** may also include a textured gripping portion on an exterior surface thereby allowing a device operator to move end effector assembly **1414** relative to elongate member **1410**.

[0133] Proximal end **1410a** of elongate member **1410** may include first and second seats **1454**, **1455** for housing first and second actuating mechanisms **1416**, **1418**, which may control movement of cutting device **1430**. Although the depicted embodiment illustrates two such seats, those of ordinary skill in the art will recognize that a greater or lesser number of seats may be provided on elongate member **1410**. First seat **1454** may be an opening through the exterior surface of elongate member **1410** and may be in communication with a central lumen **1448** in elongate member **1410**. As illustrated in FIG. 29, the opening of first seat **1454** may include a back portion **1446** such that the opening may not extend completely through elongate member **1410**. Second seat **1455** may be a ledge at proximal end **1410a** of elongate member **1410** with an opening in communication with central lumen **1448** of elongate member **1410** (FIG. 29). Second seat **1455** may also be located at the proximal-most portion of medical device **1400**. Indeed, a portion of second seat **1455** may include a proximal end face of elongate member **1410**.

[0134] As discussed above, medical device **1400** may include first and second actuating mechanisms **1418**, **1416** for controlling movement of cutting device **1430**. First and second actuating mechanisms **1418**, **1416** may be any movable device capable of deploying and rotating cutting device **1430**, including, but not limited to, thumbwheels, push buttons, and switches. In one embodiment, first and second actuating mechanisms **1418**, **1416** may be knobs capable of rotating in the directions of arrows **1417** and **1419**, respectively (FIGS. 28A-28B). Rotation of first actuating mechanism **1418** may control deployment of cutting device **1430** in the directions of arrow **1431**, and rotation of second actuating mechanism **1416** may control rotation of manipulation device **1422** with cutting device **1430** relative to elongate member **1410** in the directions of arrow **1421**.

[0135] As shown in FIGS. 29 and 30, medical device **1400** may further include multiple components in operable communication with first and second actuating mechanisms **1418**, **1416** for controlling deployment and rotation of cutting device **1430**. First actuating mechanism **1418** may include a first rod **1440**, which may be in communication via a screw mechanism with a first end **1441** of a first plunger **1438**, housed within central lumen **1448** of elongate member **1410**. A second end **1443** of first plunger **1438** may be in communication with a second rod **1442** pivotally attached to cutting device **1430**. In its retracted position (not shown), cutting device **1430** may be housed within an opening **1426** in manipulation device **1422** (FIG. 30). Medical device **1400** may also include a plurality of bearings **1432** to provide rotational support. Bearings **1432** may also act as stop surfaces and aid in maintaining desired distances between certain components (FIG. 30). In use, rotation of first actuating mechanism **1418** may cause first rod **1440** to act on first plunger **1438**, and in turn, act on second rod **1442** to pivot cutting device **1430** to a deployed configuration (FIG. 28A).

[0136] Second actuating mechanism **1416** may further include a third rod **1434** that acts on a second plunger **1436**.

Rotation of second actuating mechanism **1416** may cause second plunger **1436** to translate a rotational force to a proximal end of manipulation device **1422**, which subsequently may result in rotation of manipulation device **1422** and cutting device **1430** relative to elongate member **1410**.

[0137] Cutting device **1430** may be substantively similar to cutting device **1330** of medical device **1300** shown in FIG. 23. For example, cutting device **1430** may be any cutting device known to those of skill in the art, such as a laser, RF device, or microwave probe. FIG. 30 illustrates that cutting device **1430** may also be a flat, cautery blade connected to electrical line **1424**, which may be connected to an external energy source (not shown). Further, as shown in FIGS. 28A-28B and 30, cutting device **1430** may deploy at any suitable angle (e.g., 45 degrees, 90 degrees, etc.).

[0138] FIGS. 31A and 31B of the present disclosure illustrate an embodiment of a method for performing an LSH procedure using medical device **1300** of FIG. 23. Alternatively, medical device **1400** of FIG. 27 may be used for the LSH procedure in place of medical device **1300** of FIG. 23. The method illustrated in FIGS. 31A and 31B follows the same preparation steps as illustrated in FIGS. 5A-5C and 6. A device operator may move handle portion **1312** in the direction of arrow **1313**, such that telescoping portion **1317** may slide within lumen **1344** of elongate member **1310**, in the direction of arrow **1313**, to deploy cutting device **1330**. The device operator may then rotate handle portion **1312** in the direction of arrow **1311**, such that cutting device **1330** may rotate relative to elongate member **1310** in order to create a uniform, rounded incision to excise the uterine fundus **510** from the cervix, which is left in situ. The uterine fundus **510** is then withdrawn using accepted techniques, and the vaginal cuff opening left behind may be sutured or otherwise closed as known to those skilled in the art.

[0139] FIGS. 31C and 31D of the present disclosure illustrate an embodiment of a method for performing a conoscopy of the cervix. A conoscopy of the cervix may involve coring out tissue in the cervix after the uterine fundus **510** is removed during an LSH procedure. A device operator may position medical device **1300** for a conoscopy by partially retracting cutting device **1330** and by moving end effector assembly **1314** relative to elongate member **1310** in the direction of arrow **1325**. Cutting device **1330** may be partially retracted, as shown in FIG. 31C, in the direction of arrow **1319**, until a desired angle of cutting device **1330** is reached. The desired angle may be in the range of fifteen (15) to ninety (90) degrees, inclusive. FIG. 31D illustrates that, upon retracting cutting device **1330** to the desired angle, the device operator may rotate handle portion **1312** in the direction of arrow **1311** in order to rotate cutting device **1330** relative to elongate member **1310**, such that coring of cervical tissue may be achieved.

[0140] FIGS. 32A-32D illustrate a medical device **1800** for performing an LSH procedure according to a ninth embodiment of the present disclosure. FIGS. 32A-32D also illustrate a method for performing an LSH procedure and a conoscopy using the ninth embodiment of the present disclosure. Medical device **1800** may be substantively similar to medical device **1300** shown in FIG. 23 and medical device **1400** shown in FIG. 27. For example, medical device **1800** may include an elongate member **1810**, a manipulation device **1822**, a cutting device **1830**, and a connector portion **1820**. Elongate member **1810**, manipulation device **1822**, and cutting device **1830** may be substantively similar to elongate

member 1310, manipulation device 1322, and cutting device 1330, respectively, of medical device 1300 in FIG. 23. Manipulation device 1822 may include an expandable member 1824 for tensioning the uterine wall, as discussed above in relation to manipulation device 1322 of medical device 1300 shown in FIG. 23. Alternatively, tensioning of uterine wall may be accomplished using any means known to those skilled in the art. For example, tensioning of uterine wall may occur via gripping tools (e.g., forceps, prongs) that may extend through any suitable lumen in medical device 1800 and into the uterine cavity to grasp the uterine wall. Alternatively, a gripping tool (not shown) may be advanced into a patient's abdominal cavity through, e.g., a laparoscopic port, to facilitate gripping a portion of the patient's uterus and pulling proximally. Additionally, connector portion 1820 may be a cup for applying a cephalad force to a patient such that formices 508 may be tented, thereby creating space and allowing easier removal of the uterine fundus 510.

[0141] In use, after a patient is prepared and medical device 1800 is inserted, a device operator may push medical device 1800 to apply a cephalad force in the directions of arrow 1811 to tent formices 508. The device operator may then deploy cutting device 1830 in the directions of arrow 1821, as illustrated in FIG. 32B. Prior to rotating cutting device 1830, the device operator may expand expandable member 1824 on manipulation device 1822 in order to exert tensioning forces on the uterine wall at an area of the incision in the directions of arrow 1823. Cutting device 1830 may then be rotated in the directions of arrow 1825 in order to excise the uterine fundus 510 and perform a conoscopy procedure. The vaginal cuff opening left behind may be sutured or otherwise closed as known to those skilled in the art.

[0142] FIGS. 33A and 33B illustrate a medical device 1500 for performing an LSH procedure, according to a tenth embodiment of the present disclosure. Medical device 1500 may include one or more features of the embodiments disclosed herein. For example, medical device 1500 may include a connector portion 1520, a manipulation device 1522, and a cutting device 1530. As an alternative to an elongate blade, cutting device 1530 may be located on an expandable member 1521. Cutting device 1530 may be any cutting device 1530 known to those skilled in the art, including, but not limited to, a ring affixed to expandable member 1521 or individual/segmented cutting portions affixed to expandable member 1521 at predetermined positions. Expandable member 1521 may be substantively similar to expandable members 18 and 26 of medical device 10, shown in FIG. 1. For example, expandable member 1521 may include an expansion line (not shown) and may be any expandable member 1521 known to those skilled in the art, including, but not limited to, a balloon, a cage, and an open cell foam. In some embodiments, expandable member 1521 may be self-expanding. Expandable member 1521 may also include pressure sensors, pressure valves, and/or radiopaque markers for sensing and/or visualizing relative expansion of expandable member 1521.

[0143] Cutting device 1530 may include a retracted configuration (FIG. 33A) and a deployed configuration (FIG. 33B). In the retracted position, medical device 1500 may include a sheath 1524 that may protect tissue from cutting device 1530; and in the deployed configuration, sheath 1524 may be removed and expandable member 1521 may be expanded using techniques known to those skilled in the art. In use, a device operator may move sheath 1524 in the direc-

tions of arrow 1523 and expand expandable member 1521 into the deployed configuration, thus allowing cutting device 1530 to contact and pierce a patient's tissue. The device operator may further rotate a handle portion of medical device 1500 (not shown) in order to rotate manipulation device 1522 with cutting device 1530 relative to an elongate member (not shown), creating a uniform, rounded incision to excise the uterine fundus 510.

[0144] FIGS. 34A and 34B illustrate an end effector assembly 1614 for performing a conoscopy of the cervix, in accordance with an eleventh embodiment of the present disclosure. End effector assembly 1614 may include one or more features of end effector assemblies 1314 and 1414, shown in FIGS. 23 and 27, respectively. For example, end effector assembly 1614 may include a connector portion 1620, a manipulation device 1622, and a cutting device 1630. As an alternative to an elongate blade, cutting device 1630 may be a sharpened edge of an opening that is integral with manipulation device 1622. Further, manipulation device 1622 may be located at an outer edge of connector portion 1620 and may include a curved outer surface. Manipulation device 1622 may also be angled relative to a longitudinal axis of connector portion 1620. Edges of cutting device 1630 may be sharp enough to core out tissue as cutting device 1630 is rotated relative to an elongate member (not shown) during a conoscopy procedure.

[0145] FIGS. 35A and 35B illustrate another end effector assembly 1714 for performing a conoscopy of the cervix, in accordance with a twelfth embodiment of the present disclosure. End effector assembly 1714 may include one or more features of end effector assemblies 1314 and 1414, shown in FIGS. 23 and 27, respectively. For example, end effector assembly 1714 may include a connector portion 1720, a manipulation device 1722, and a cutting device 1730. Cutting device 1730 may include a retracted configuration (FIG. 35A) and a deployed configuration (FIG. 35B). Cutting device 1730 may be any known cutting device to those skilled in the art, such as, for example, an elongate blade, and may be attached to deployment bars 1734, 1736, and 1738 per linkages 1732.

[0146] In use, a device operator may move first deployment bar 1734 in the direction of arrow 1731, and second deployment bars 1736, 1738 may be pivoted to a horizontal configuration (FIG. 35B), which may push cutting device 1730 out of manipulation device 1722. Manipulation device 1722 with cutting device 1730 may further be rotated relative to an elongate member (not shown) in the direction of arrow 1721 in order to core out cervical tissue during a conoscopy procedure. Alternatively, an end of cutting device 1730 may be disconnected from one second deployment bar 1736 or 1738 and linkage 1732 in order to deploy cutting device 1730 at a suitable angle for an LSH procedure.

[0147] Those of ordinary skill in the art will readily recognize that any of the above-described devices and methods, or aspects thereof, may be automated with the aid of, e.g., a computer or suitable processing circuitry. In such embodiments, the computer or processor may include suitable algorithms or logic to activate and effect any of the aspects described above. For example, the computer may be configured to effect deployment of a cutting device. In another embodiment, the computer may be configured to automatically move the cutting device to excise tissue.

[0148] Other embodiments of the present disclosure will be apparent to those skilled in the art from consideration of the specification and practice of the present disclosure disclosed

herein. It is intended that the specification and examples be considered as exemplary only, with a true scope and spirit of the present disclosure being indicated by the following claims.

What is claimed is:

1. A medical device for performing a surgical procedure, the medical device comprising:

an elongate member having a proximal end, a distal end, and a lumen extending therebetween;

a handle connected to the proximal end of the elongate member;

an end effector assembly connected to the distal end of the elongate member; and

a cutting device configured to extend from the end effector assembly, wherein the cutting device has a retracted configuration in which the cutting device is withdrawn into the end effector assembly and a deployed configuration in which the cutting device extends from the end effector assembly.

2. The medical device of claim 1, wherein the end effector assembly includes a cup.

3. The medical device of claim 1, wherein the end effector assembly includes an elongate manipulation member having a proximal portion, a distal portion, and a central portion extending therebetween, wherein the central portion includes a substantially uniform cross-section.

4. The medical device of claim 1, wherein the cutting device is further configured to rotate about a longitudinal axis of the end effector assembly.

5. The medical device of claim 4, wherein a first actuator controls deployment of the cutting device and a second actuator controls rotation of the cutting device.

6. The medical device of claim 1, wherein the cutting device is a monopolar cauterizing instrument.

7. The medical device of claim 1, wherein the cutting device is a bipolar cauterizing instrument.

8. The medical device of claim 1, further comprising an expandable member secured to a distal portion of the medical device.

9. The medical device of claim 8, wherein the expandable member is secured to the elongate member.

10. The medical device of claim 3, further comprising an expandable member secured to the elongate manipulation member.

11. The medical device of claim 2, further comprising an elongate manipulation member extending distally from within the cup.

12. The medical device of claim 11, further comprising a first expandable member secured to a distal portion of the elongate member.

13. The medical device of claim 12, further comprising a second expandable member secured to the elongate manipulation member.

14. The medical device of claim 2, wherein the cup includes a first cup portion and a second cup portion disposed within the first cup portion, wherein a gap exists between the first and second cup portions, and the cutting device is slidably disposed within the gap.

15. The medical device of claim 1, wherein the cutting device is a cautery ring.

16. The medical device of claim 15, wherein the cautery ring includes a segmented ring.

17. The medical device of claim 9, wherein the expandable member is disposed proximally of the end effector assembly.

18. The medical device of claim 1, wherein the end effector assembly is configured to pivot relative to the elongate member.

19. The medical device of claim 1, wherein the end effector assembly is removably secured to the distal end of the elongate member.

20. The medical device of claim 1, wherein the end effector assembly is longitudinally movable relative to a distal end of the elongate member.

21. A method for performing a laparoscopic hysterectomy procedure, the method comprising:

inserting a medical device into a vaginal canal of a patient, the medical device comprising:

an elongate member having a proximal end, a distal end, and a lumen extending therebetween;

a handle connected to the proximal end of the elongate member;

an end effector assembly connected to the distal end of the elongate member; and

a cutting device configured to extend from the end effector assembly, wherein the cutting device has a retracted configuration in which the cutting device is withdrawn into the end effector assembly and a deployed configuration in which the cutting device extends from the end effector assembly;

positioning the end effector adjacent tissue associated with one of uterine or cervical tissues;

deploying the cutting device; and

creating an incision to excise at least a uterus of the patient from surrounding tissue.

22. The method of claim 21, wherein the end effector includes a cup and an elongate manipulation member extending distally from within the cup.

23. The method of claim 22, wherein the medical device further includes a first expandable member disposed on the elongate member at a location proximal of the end effector assembly.

24. The method of claim 23, further comprising expanding the expandable member to occlude the vaginal canal.

25. The method of claim 22, wherein, prior to the step of deploying the cutting device, the method further includes pivoting the elongate manipulation member to alter a positioning of the uterus.

26. The method of claim 22, wherein, prior to the step of deploying the cutting device, the method further includes positioning a rim of the cup against a vaginal formice and exerting a cephalad force on the vaginal formice.

27. The method of claim 21, wherein creating an incision to separate at least a uterus of the patient from surrounding tissue includes rotating the cutting device.

28. The method of claim 21, wherein the cutting device is a monopolar cautery instrument.

29. The method of claim 21, wherein the cutting device is a bipolar cautery instrument.

30. The method of claim 23, wherein the medical device includes a second expandable member secured to the elongate manipulation member.

31. The method of claim 21, wherein the cutting device is a cautery ring.

32. The method of claim 21, wherein the cautery ring includes a segmented ring.

33. The method of claim 27, wherein rotating the cutting device includes rotating the end effector assembly.

34. The method of claim **21**, wherein the end effector assembly is removably secured to the distal end of the elongate member.

35. The method of claim **21**, wherein the end effector assembly is longitudinally moveable relative to the distal end of the elongate member.

36. The method of claim **21**, further comprising the step of removing cervical tissue.

37. The method of claim **21**, wherein creating an incision to excise at least a uterus of the patient from surrounding tissue includes excising the uterus and a cervix of the patient.

38. A medical device for performing a surgical procedure, the medical device comprising:

an elongate member having a proximal end, a distal end, and a lumen extending therebetween;

a handle connected to the proximal end of the elongate member;

an end effector assembly connected to the distal end of the elongate member;

a cutting device configured to extend from the end effector assembly, wherein the cutting device has a retracted configuration in which the cutting device is withdrawn into the end effector assembly and a deployed configuration in which the cutting device extends from the end effector assembly, wherein the cutting device is configured to rotate about a longitudinal axis of the end effector assembly, and wherein the cutting device includes a cauterizing instrument; and

an expandable member positioned on the elongate member at a location proximal of the end effector assembly.

* * * * *

专利名称(译)	用于治疗生殖系统的一部分的装置和相关的使用方法		
公开(公告)号	US20120143209A1	公开(公告)日	2012-06-07
申请号	US13/214595	申请日	2011-08-22
[标]申请(专利权)人(译)	SOULOR手术		
申请(专利权)人(译)	SOULOR外科器械公司		
当前申请(专利权)人(译)	SOULOR外科器械公司		
[标]发明人	BRECHEEN ROGER M KOEHLER JOHN H		
发明人	BRECHEEN, ROGER M. KOEHLER, JOHN H.		
IPC分类号	A61B17/42		
CPC分类号	A61B17/42 A61B17/4241 A61B18/14 A61B18/1482 A61B2017/4225 A61B2018/00601 A61B2017/4216 A61B2017/2929		
优先权	61/420308 2010-12-06 US		
其他公开文献	US8608738		
外部链接	Espacenet USPTO		

摘要(译)

用于执行外科手术的医疗装置可包括细长构件，细长构件具有近端，远端和在它们之间延伸的内腔。医疗装置还可包括连接到细长构件的近端的手柄，连接到细长构件的远端的末端执行器组件，以及构造成从末端执行器组件延伸的切割装置，其中切割装置具有缩回构造，其中切割装置被缩回到末端执行器组件中；以及展开构造，其中切割装置从末端执行器组件延伸。

