



US009301723B2

(12) **United States Patent**  
**Brannan et al.**

(10) **Patent No.:** **US 9,301,723 B2**  
(45) **Date of Patent:** **Apr. 5, 2016**

(54) **MICROWAVE ENERGY-DELIVERY DEVICE  
AND SYSTEM**

(71) Applicant: **Covidien LP**, Mansfield, MA (US)

(72) Inventors: **Joseph D. Brannan**, Erie, CO (US);  
**Casey M. Ladtkow**, Erie, CO (US);  
**Darion R. Peterson**, Boulder, CO (US);  
**Eric W. Larson**, Thornton, CO (US);  
**William J. Dickhans**, Longmont, CO  
(US); **Richard A. Willyard**, Longmont,  
CO (US); **Jason A. Case**, Longmont, CO  
(US)

(73) Assignee: **Covidien LP**, Mansfield, MA (US)

(\*) Notice: Subject to any disclaimer, the term of this  
patent is extended or adjusted under 35  
U.S.C. 154(b) by 160 days.

(21) Appl. No.: **13/835,283**

(22) Filed: **Mar. 15, 2013**

(65) **Prior Publication Data**

US 2014/0276033 A1 Sep. 18, 2014

(51) **Int. Cl.**

**A61B 5/05** (2006.01)

**A61B 6/03** (2006.01)

(Continued)

(52) **U.S. Cl.**

CPC ..... **A61B 6/03** (2013.01); **A61B 18/1815**  
(2013.01); **A61B 19/5244** (2013.01); **A61B**  
**19/56** (2013.01); **A61B 2018/00023** (2013.01);  
**A61B 2018/0066** (2013.01); **A61B 2018/00482**  
(2013.01); **A61B 2018/00511** (2013.01); **A61B**  
**2018/00529** (2013.01); **A61B 2018/00541**  
(2013.01); **A61B 2018/00577** (2013.01); **A61B**  
**2018/00642** (2013.01); **A61B 2018/00684**  
(2013.01); **A61B 2018/00702** (2013.01); **A61B**  
**2018/00708** (2013.01); **A61B 2018/00761**  
(2013.01);

(Continued)

(58) **Field of Classification Search**

CPC .. **A61B 6/03**; **A61B 19/5244**; **A61B 18/1815**;  
**A61B 2019/5251**; **A61B 19/56**; **A61B**

2019/5272; **A61B 2019/5466**; **A61B 2019/545**;  
**A61B 2018/00023**; **A61B 2018/00577**; **A61B**  
**2019/5287**; **A61B 2018/00529**; **A61B**  
**2018/00797**; **A61B 2019/507**; **A61B 2018/004**  
USPC ..... 600/407-436  
See application file for complete search history.

(56) **References Cited**

**U.S. PATENT DOCUMENTS**

5,342,357 A 8/1994 Nardella  
5,364,392 A 11/1994 Warner et al.

(Continued)

**FOREIGN PATENT DOCUMENTS**

JP 2001518351 A 10/2001  
JP 2011516184 A 5/2011

(Continued)

**OTHER PUBLICATIONS**

European Search Report, Application No. EP 14 16 0251 dated Sep.  
25, 2014.

(Continued)

Primary Examiner — Sanjay Cattungal

(57) **ABSTRACT**

An ablation system including an image database storing a plurality of computed tomography (CT) images of a luminal network and a navigation system enabling, in combination with an endoscope and the CT images, navigation of a locatable guide and an extended working channel to a point of interest. The system further includes one or more fiducial markers, placed in proximity to the point of interest and a percutaneous microwave ablation device for applying energy to the point of interest.

**30 Claims, 20 Drawing Sheets**

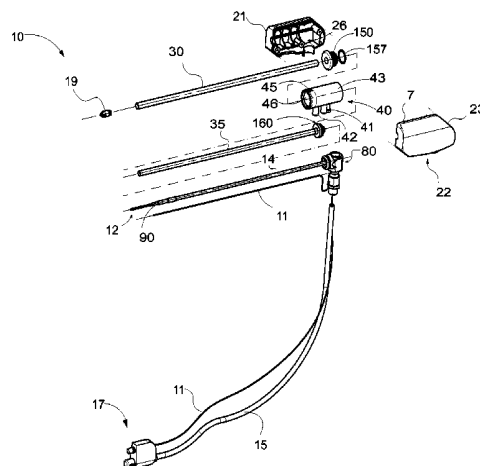

- (51) **Int. Cl.**  
*A61B 18/18* (2006.01)  
*A61B 18/00* (2006.01)  
*A61B 19/00* (2006.01)
- (52) **U.S. Cl.**  
 CPC ..... *A61B2018/00797* (2013.01); *A61B 2018/00803* (2013.01); *A61B 2018/00821* (2013.01); *A61B 2018/00898* (2013.01); *A61B 2018/00904* (2013.01); *A61B 2018/00982* (2013.01); *A61B 2018/1861* (2013.01); *A61B 2019/507* (2013.01); *A61B 2019/5251* (2013.01); *A61B 2019/5272* (2013.01); *A61B 2019/5287* (2013.01); *A61B 2019/545* (2013.01); *A61B 2019/5466* (2013.01)
- (56) **References Cited**  
 U.S. PATENT DOCUMENTS
- |              |      |         |                                |
|--------------|------|---------|--------------------------------|
| 5,685,839    | A    | 11/1997 | Edwards et al.                 |
| 6,239,724    | B1   | 5/2001  | Doron et al.                   |
| 6,419,680    | B1   | 7/2002  | Cosman et al.                  |
| 6,427,089    | B1   | 7/2002  | Knowlton                       |
| 6,575,969    | B1   | 6/2003  | Rittman, III et al.            |
| 6,689,127    | B1   | 2/2004  | Gough et al.                   |
| 6,898,454    | B2   | 5/2005  | Atalar et al.                  |
| 7,047,063    | B2   | 5/2006  | Burbank et al.                 |
| 7,294,127    | B2   | 11/2007 | Leung et al.                   |
| 7,783,336    | B2   | 8/2010  | Macfarlane et al.              |
| 7,871,406    | B2   | 1/2011  | Nields et al.                  |
| 8,027,712    | B2   | 9/2011  | Sioshansi et al.               |
| 8,155,416    | B2   | 4/2012  | Nields et al.                  |
| 8,181,995    | B2   | 5/2012  | DeCarlo                        |
| 8,224,424    | B2   | 7/2012  | Burbank et al.                 |
| 8,280,486    | B2   | 10/2012 | Miller et al.                  |
| 8,287,463    | B2   | 10/2012 | Field et al.                   |
| 8,306,602    | B2   | 11/2012 | Sirimanne et al.               |
| 8,480,665    | B2   | 7/2013  | DeCarlo                        |
| 8,494,246    | B2   | 7/2013  | Trumer et al.                  |
| 2001/0056289 | A1 * | 12/2001 | Sippensgroenewegen ..... 607/5 |
| 2002/0026187 | A1   | 2/2002  | Swanson                        |
| 2003/0028095 | A1   | 2/2003  | Tulley et al.                  |
| 2004/0030262 | A1 * | 2/2004  | Fisher et al. .... 600/564     |
| 2004/0049254 | A1   | 3/2004  | Longo                          |
| 2005/0080333 | A1   | 4/2005  | Piron et al.                   |
| 2005/0245920 | A1   | 11/2005 | Vitullo et al.                 |
- |              |      |         |                                  |
|--------------|------|---------|----------------------------------|
| 2006/0004351 | A1   | 1/2006  | Arless et al.                    |
| 2006/0173280 | A1   | 8/2006  | Goosen et al.                    |
| 2007/0299353 | A1 * | 12/2007 | Harlev et al. .... 600/509       |
| 2008/0033286 | A1 * | 2/2008  | Whitmore et al. .... 600/426     |
| 2008/0033424 | A1   | 2/2008  | van der Weide et al.             |
| 2008/0269601 | A1   | 10/2008 | Schwamb                          |
| 2009/0018403 | A1   | 1/2009  | Black et al.                     |
| 2009/0080604 | A1   | 3/2009  | Shores et al.                    |
| 2009/0216115 | A1   | 8/2009  | Seiler et al.                    |
| 2010/0234726 | A1   | 9/2010  | Sirimanne et al.                 |
| 2011/0077638 | A1   | 3/2011  | Brannan                          |
| 2011/0118723 | A1 * | 5/2011  | Turner et al. .... 606/33        |
| 2011/0200171 | A1 * | 8/2011  | Beetel et al. .... 378/65        |
| 2011/0238083 | A1 * | 9/2011  | Moll et al. .... 606/130         |
| 2012/0172860 | A1   | 7/2012  | Brannan                          |
| 2012/0259326 | A1   | 10/2012 | Brannan et al.                   |
| 2013/0116679 | A1 * | 5/2013  | Van Der Weide et al. .... 606/33 |
| 2013/0225942 | A1   | 8/2013  | Holsing et al.                   |
| 2013/0225943 | A1   | 8/2013  | Holsing et al.                   |
| 2013/0225973 | A1   | 8/2013  | Gertner                          |
| 2013/0225994 | A1   | 8/2013  | Hsu et al.                       |
| 2013/0231556 | A1   | 9/2013  | Holsing et al.                   |
| 2013/0338477 | A1 * | 12/2013 | Glossop et al. .... 600/407      |
- FOREIGN PATENT DOCUMENTS
- |    |            |    |         |
|----|------------|----|---------|
| JP | 2012187405 | A  | 10/2012 |
| WO | 2011063061 | A2 | 5/2011  |
| WO | 2012071388 | A2 | 5/2012  |
| WO | 2014025551 | A1 | 2/2014  |
- OTHER PUBLICATIONS
- European Search Report, Application No. EP 14 16 0251 dated Jul. 4, 2014.
- European Search Report, Application No. EP 14 16 0251 dated May 26, 2014.
- European Search Report, Application No. EP 14 16 0222 dated May 28, 2014.
- European Search Report, Application No. EP 14 16 0223 dated Jun. 3, 2014.
- Japanese Office Action, Application No. 2014-104075 dated May 19, 2015.
- European Examination Report, Application No. 14 160 223.5 dated Aug. 5, 2015.
- Japanese Pre-trial Examination report from Appl. No. 2014-104075 dated Oct. 27, 2015.
- \* cited by examiner

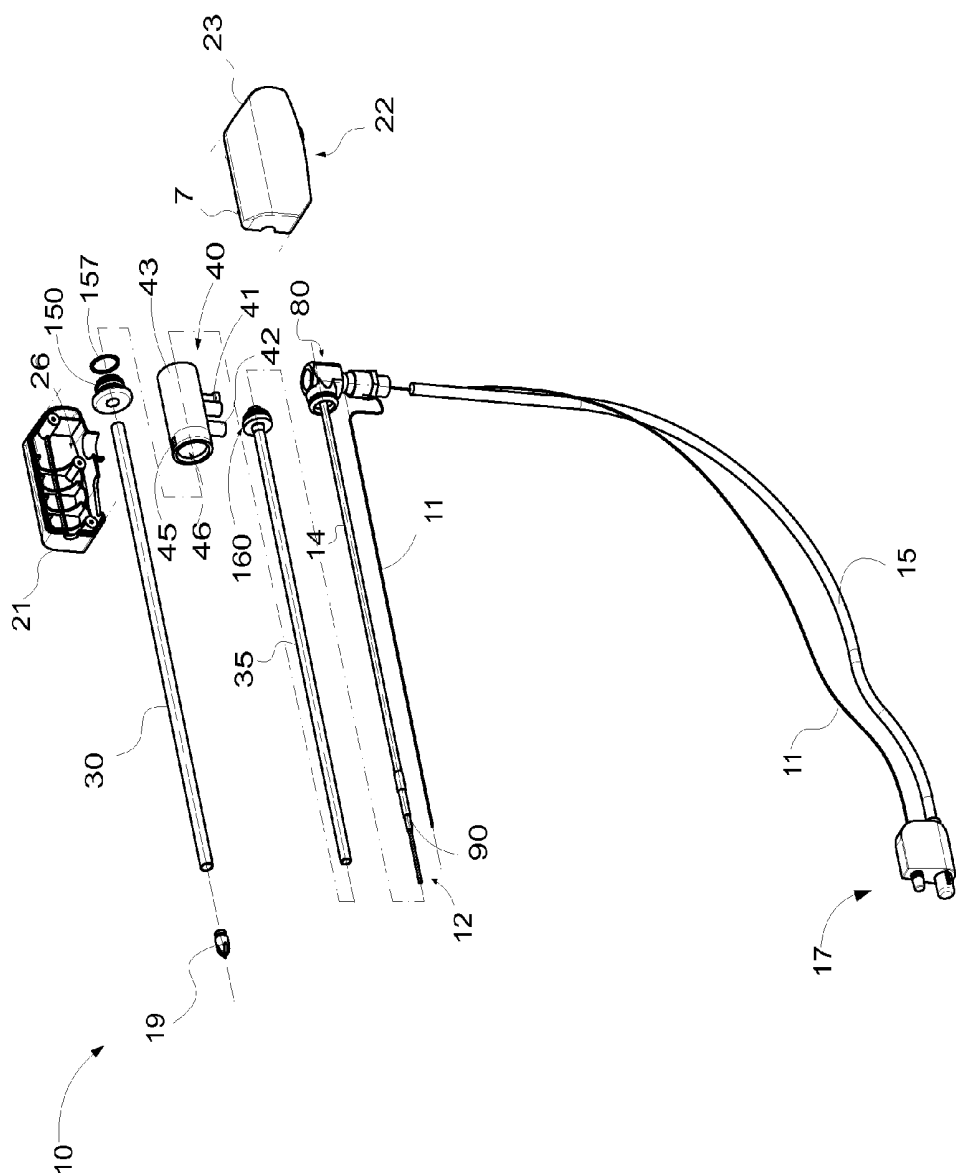

**FIG. 1**

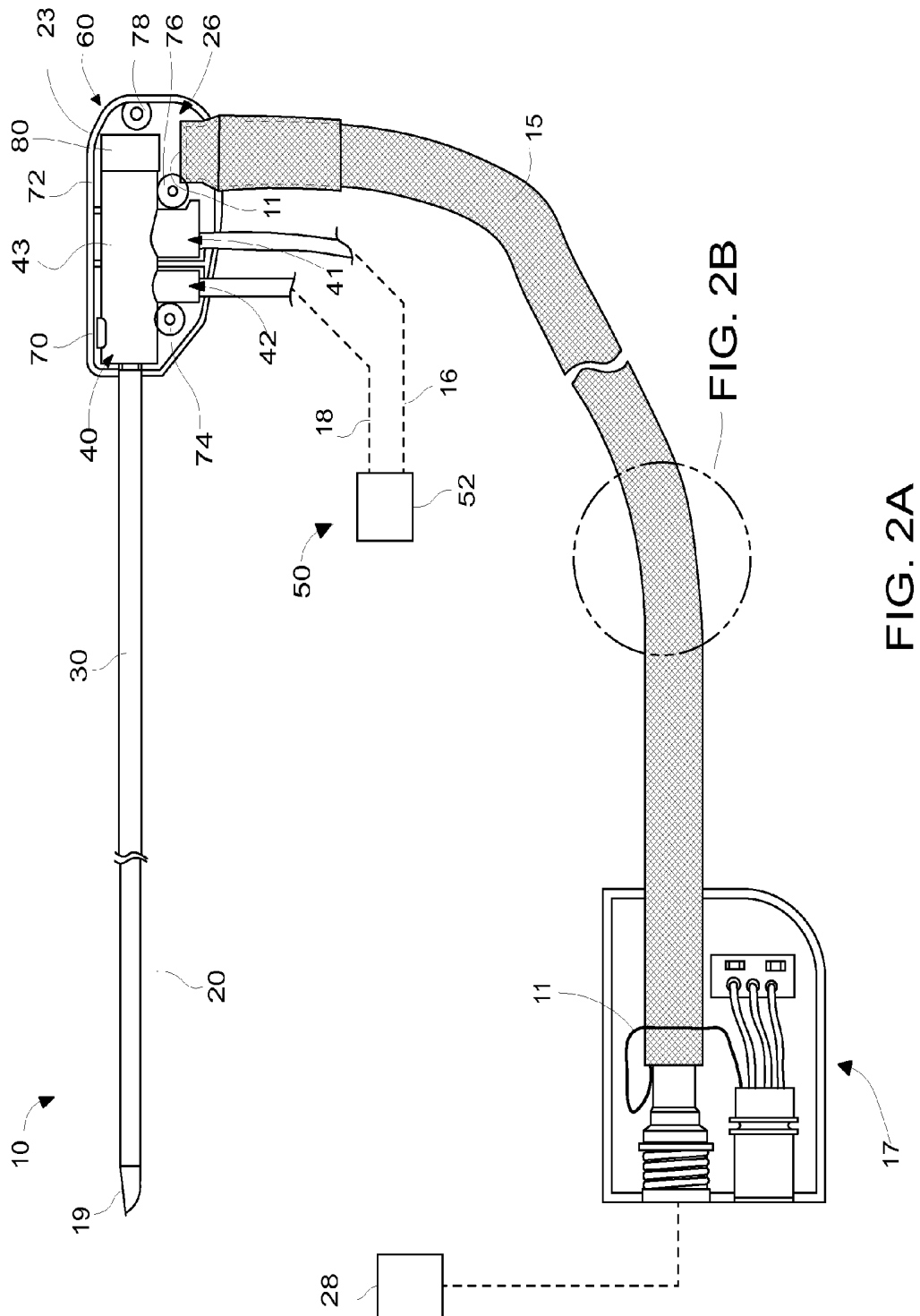

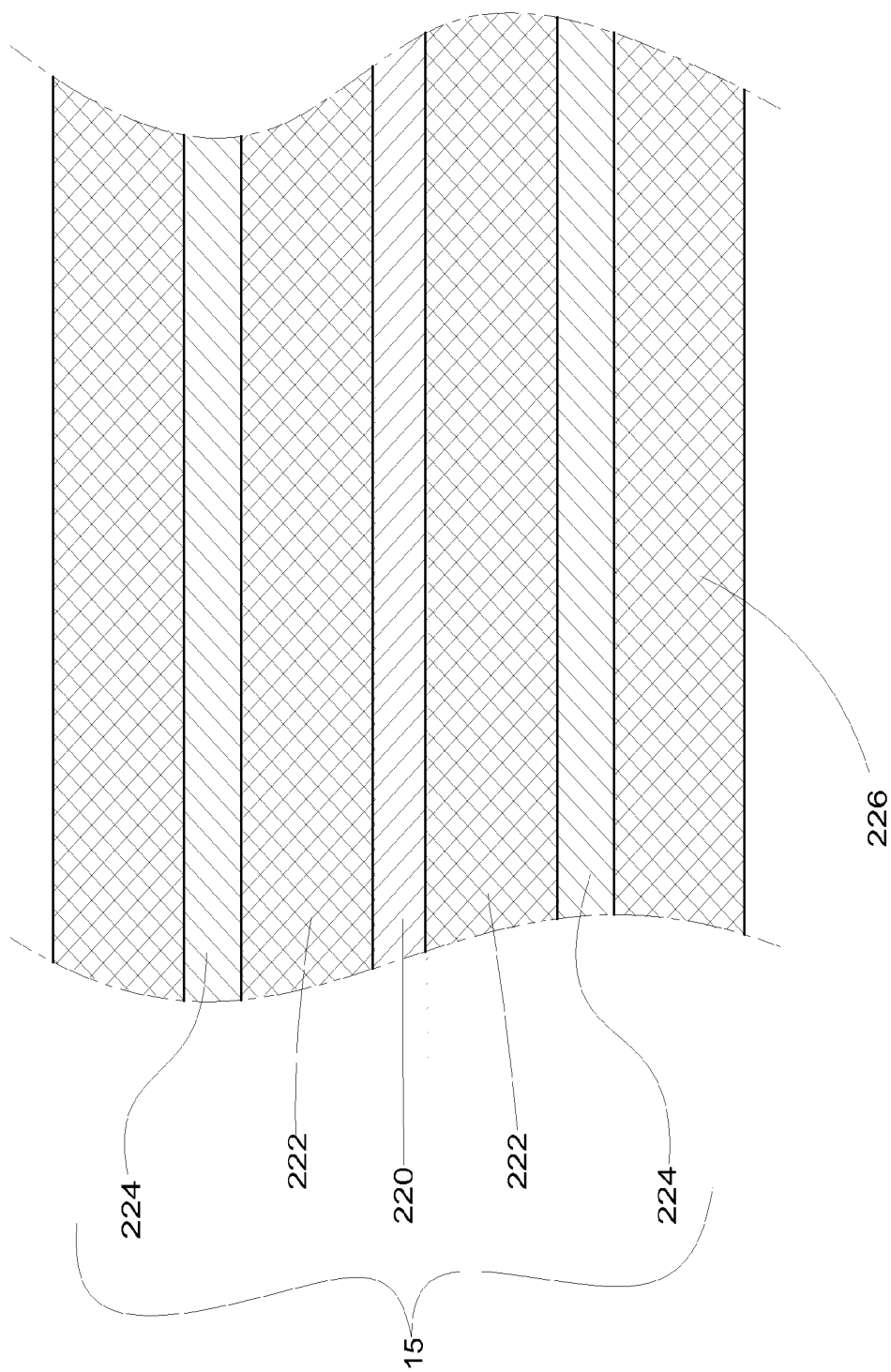

Fig. 2B

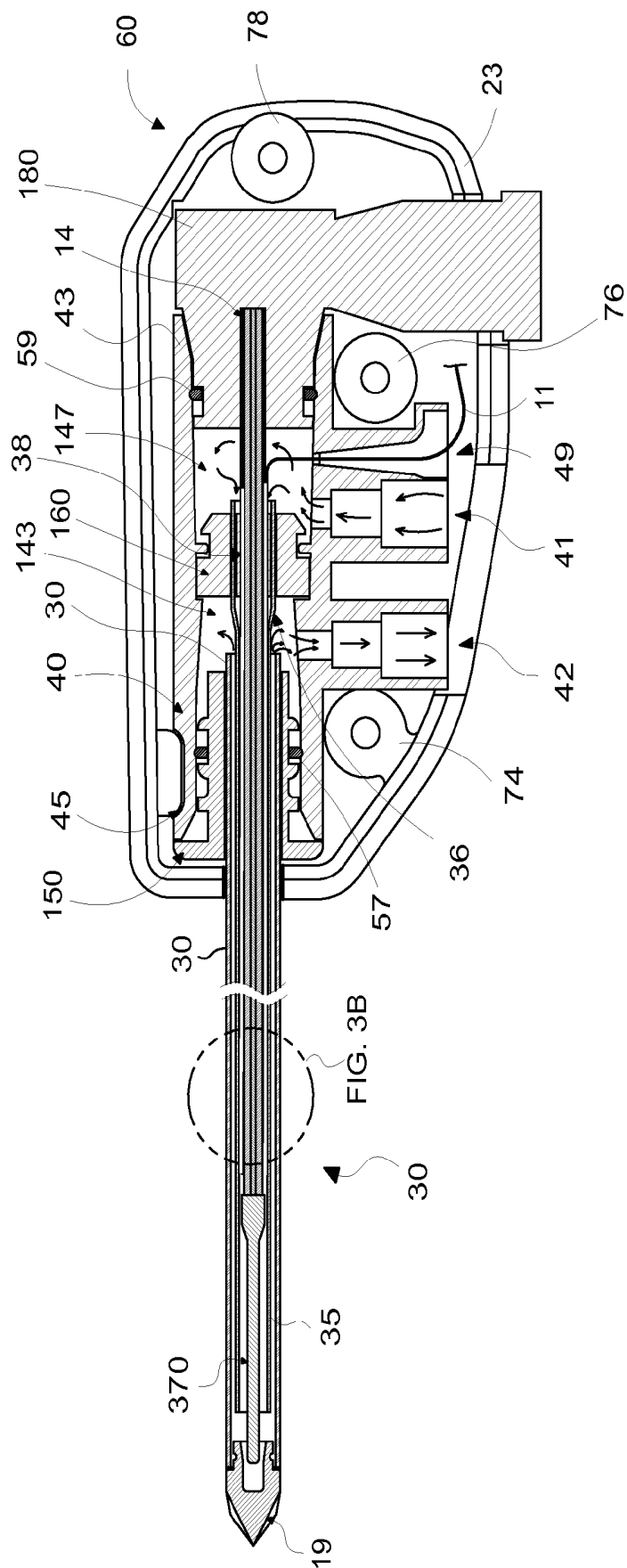

FIG. 3A

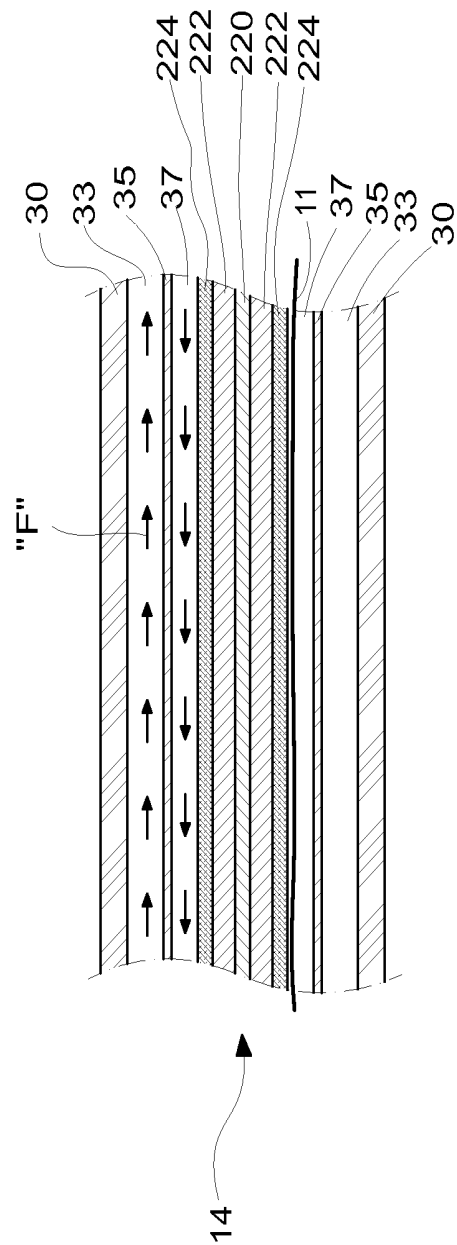

FIG. 3B

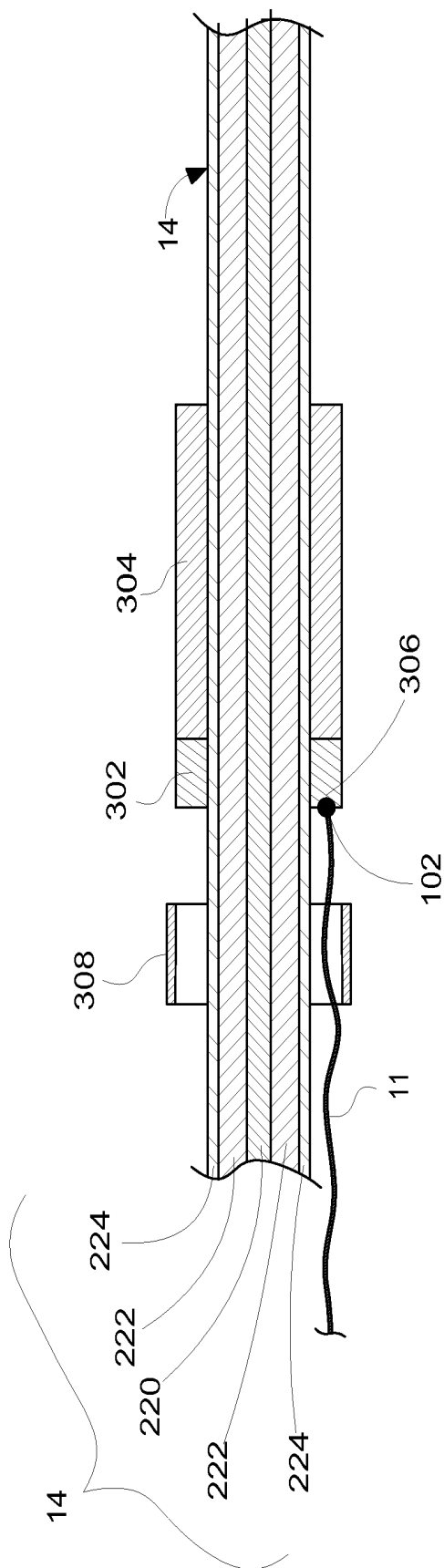

FIG. 4



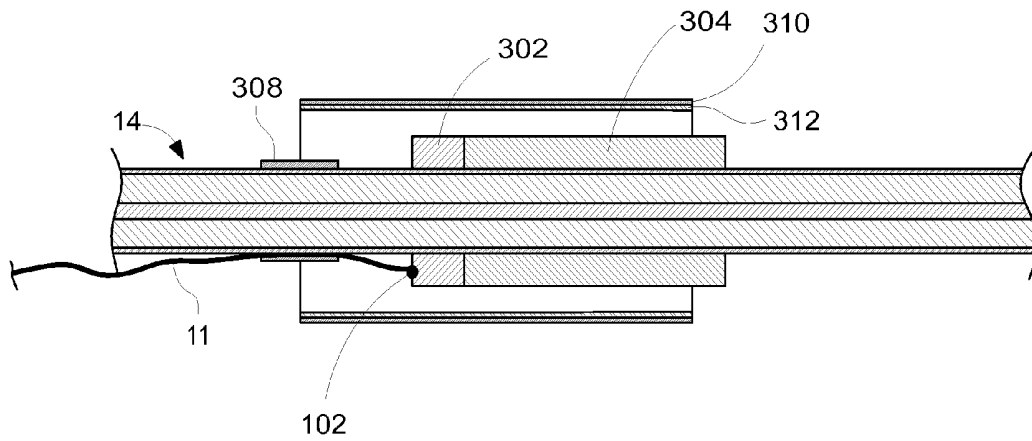

FIG. 5

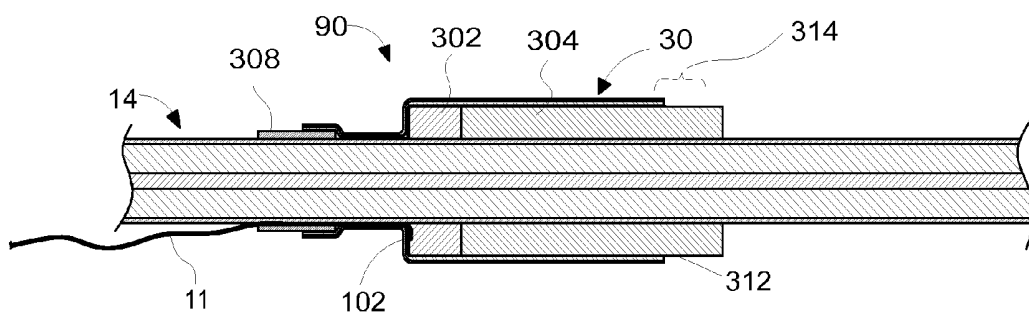

FIG. 6

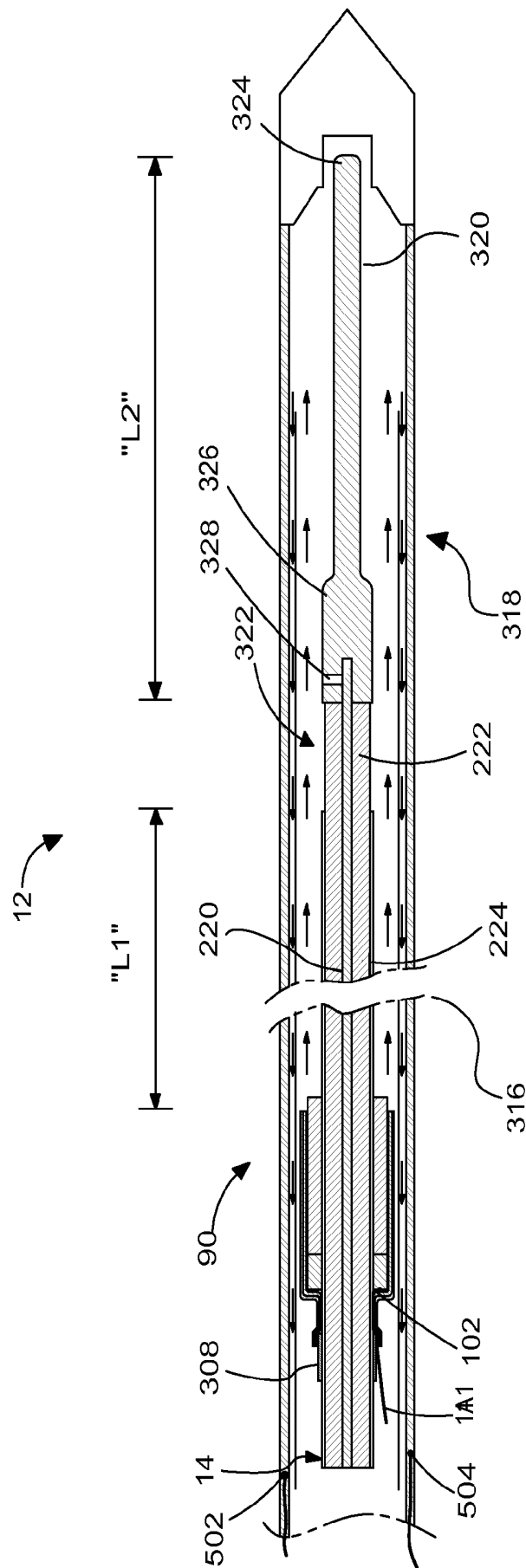

FIG. 7A

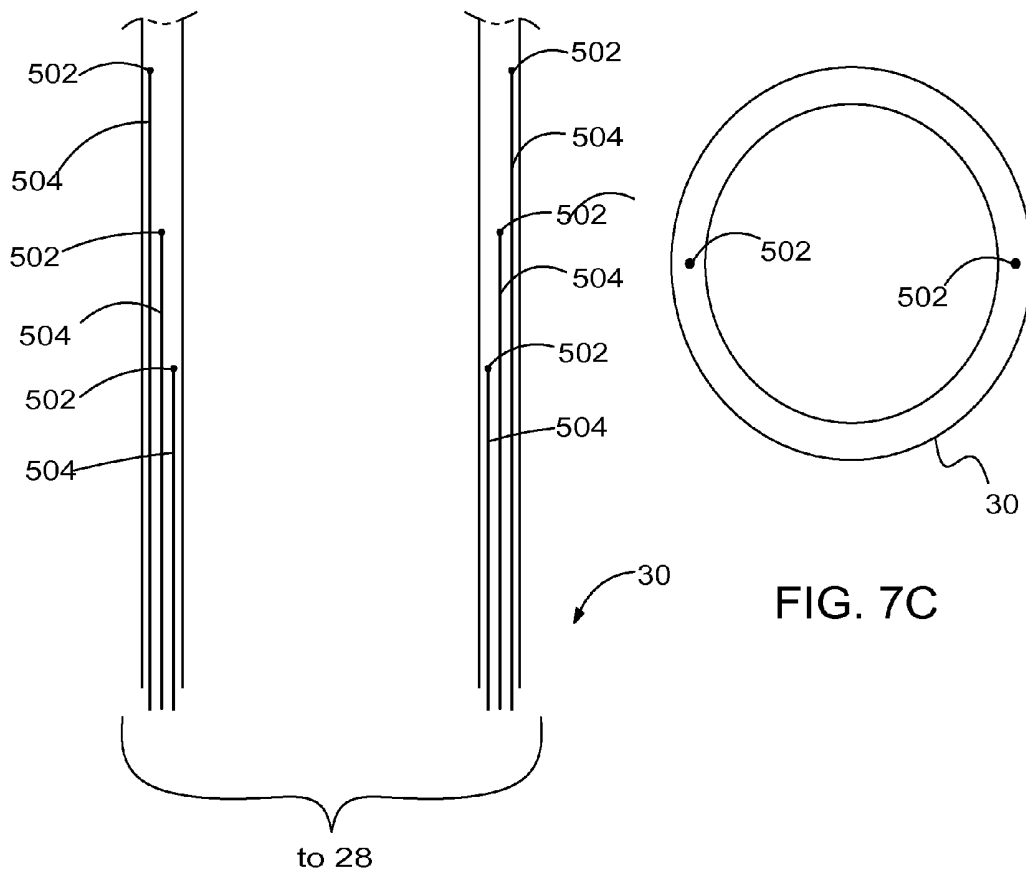

FIG. 7B

FIG. 7C

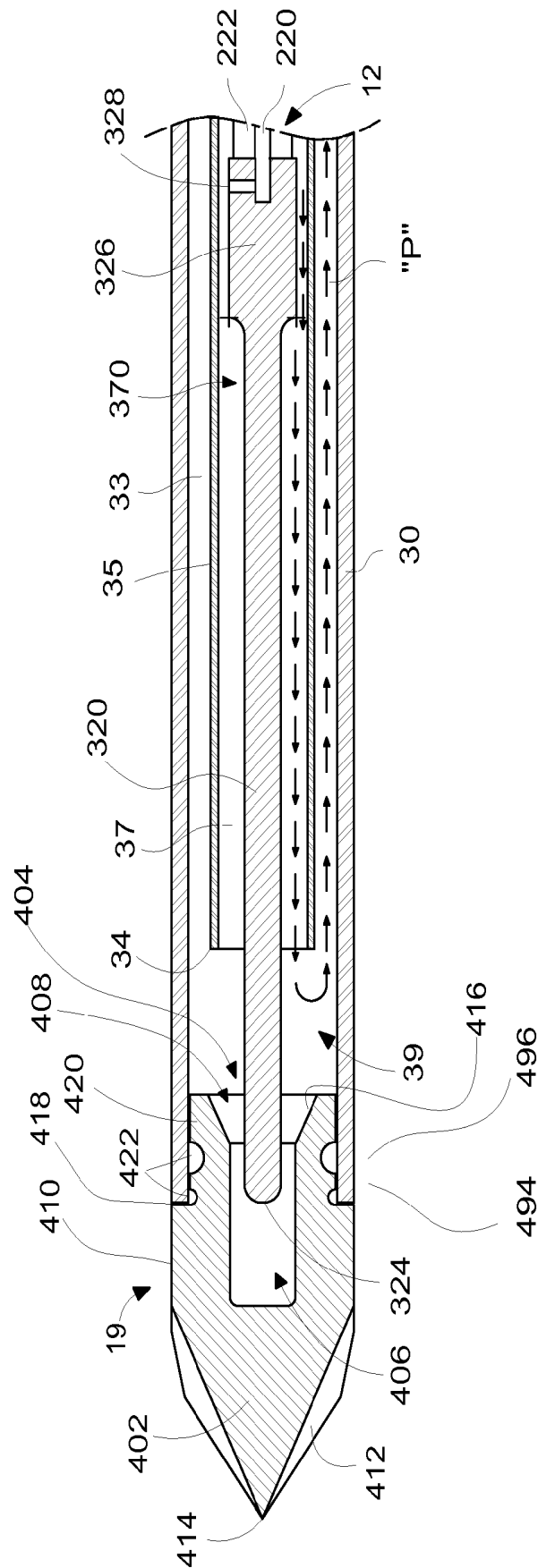

FIG. 8

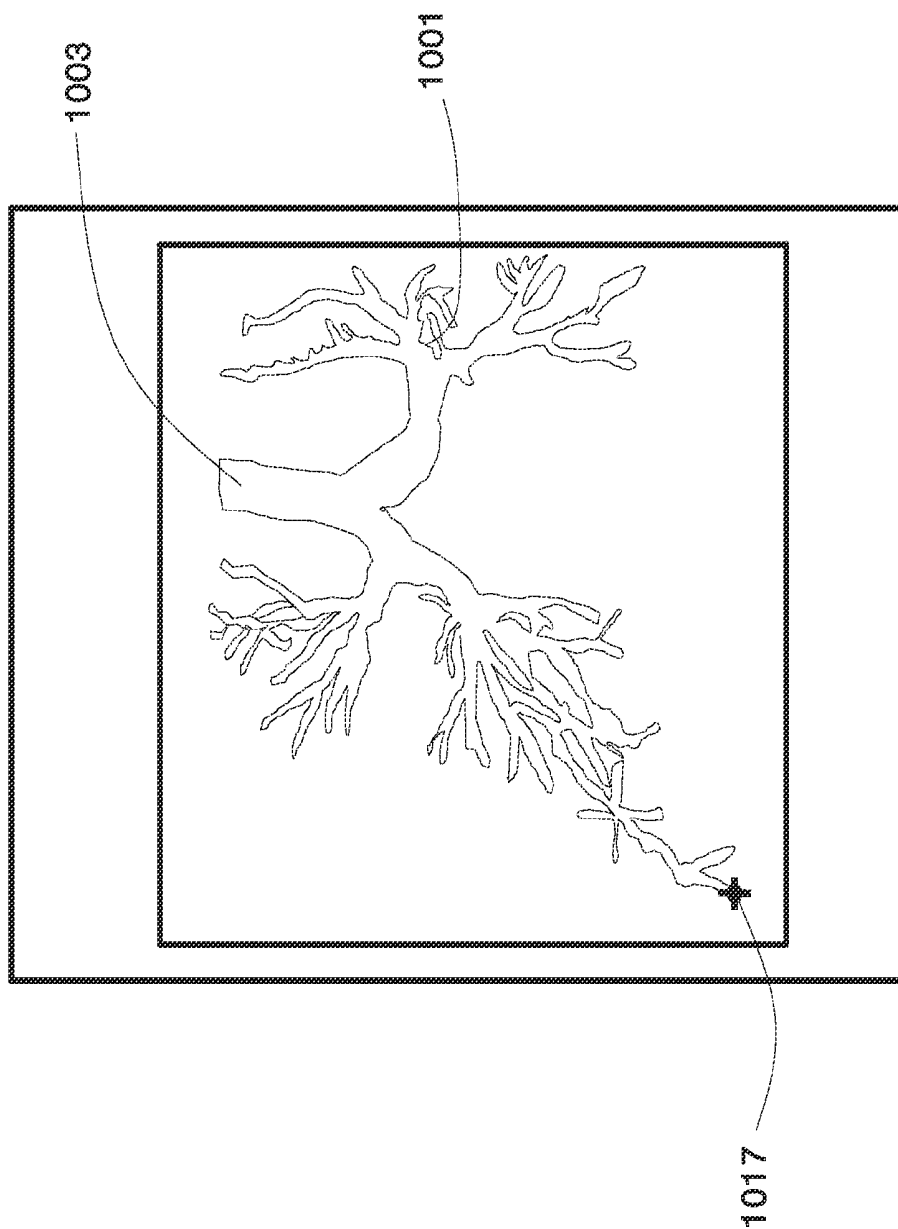

FIG. 9

1013

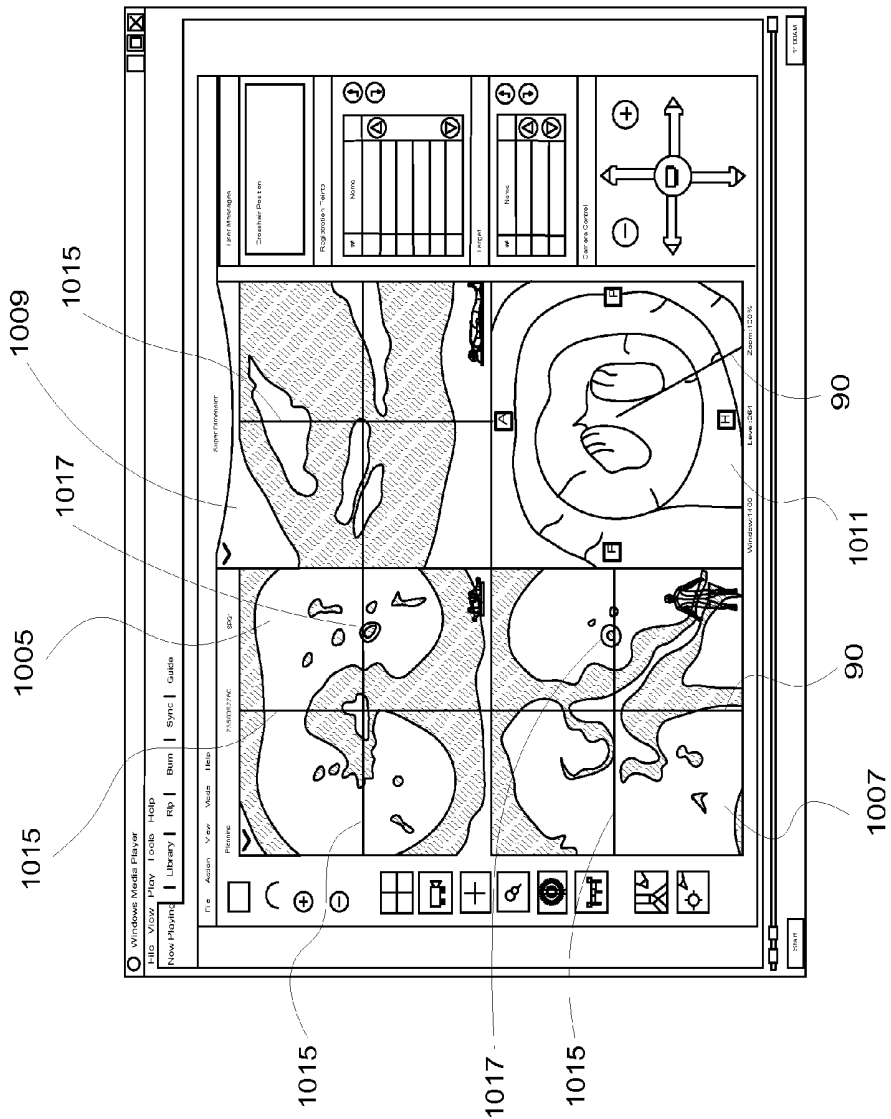

FIG. 10

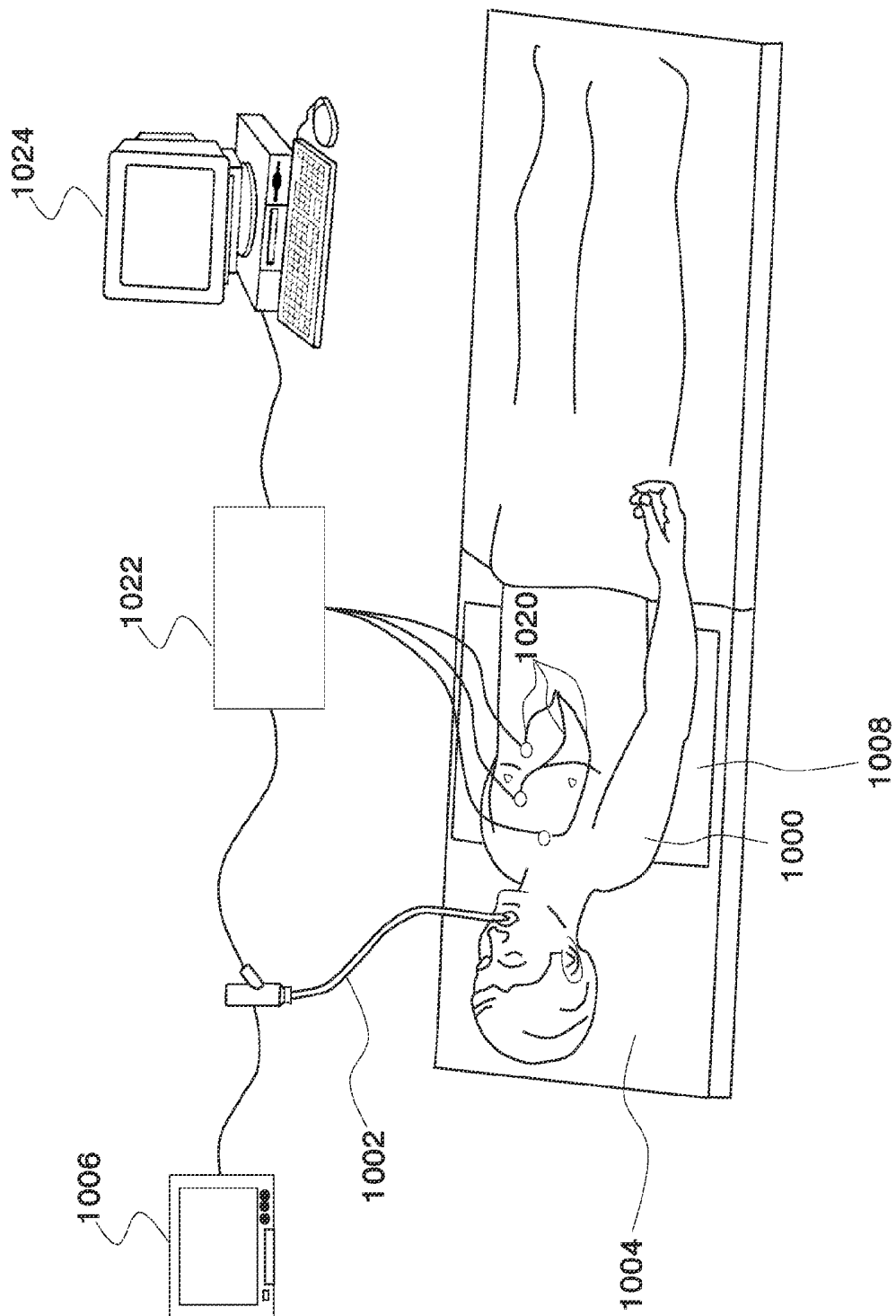

FIG. 11

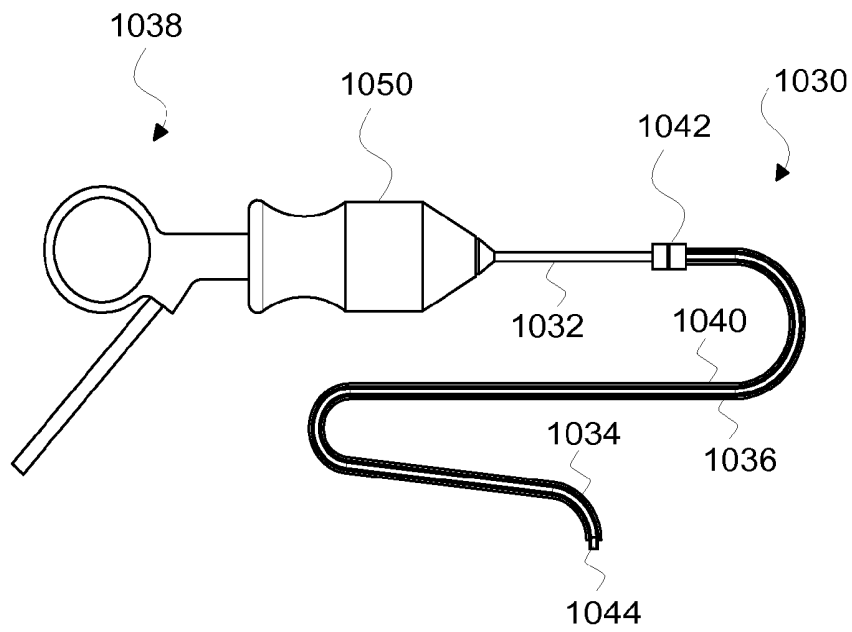

FIG. 12

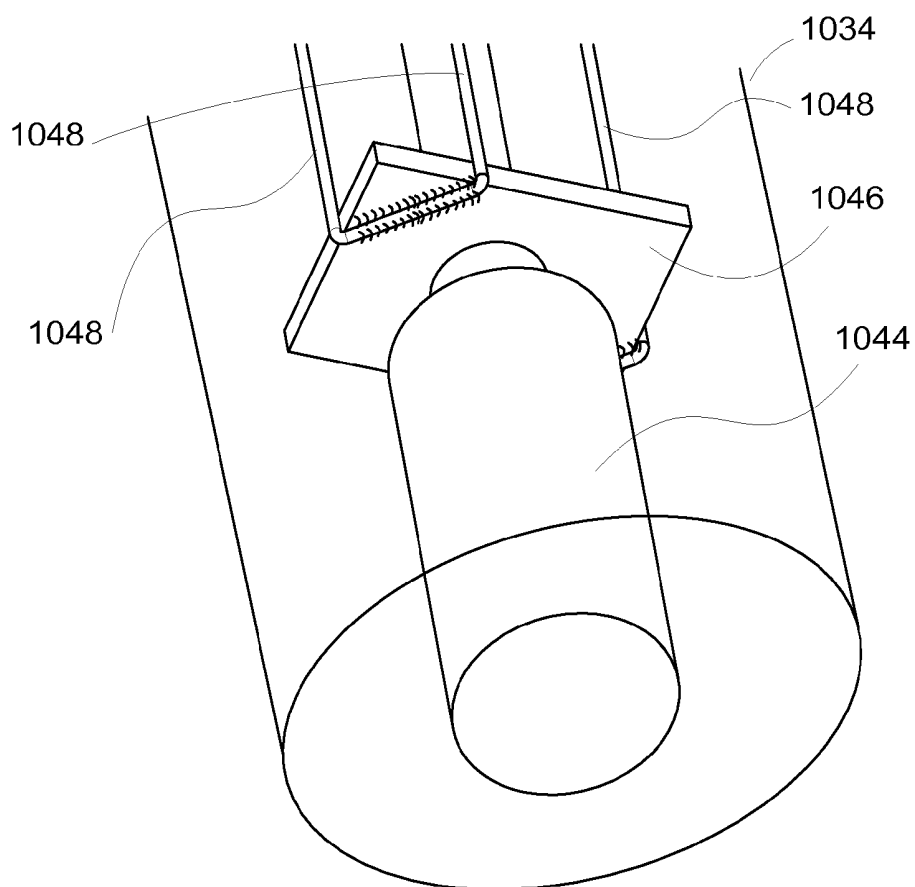

FIG. 13



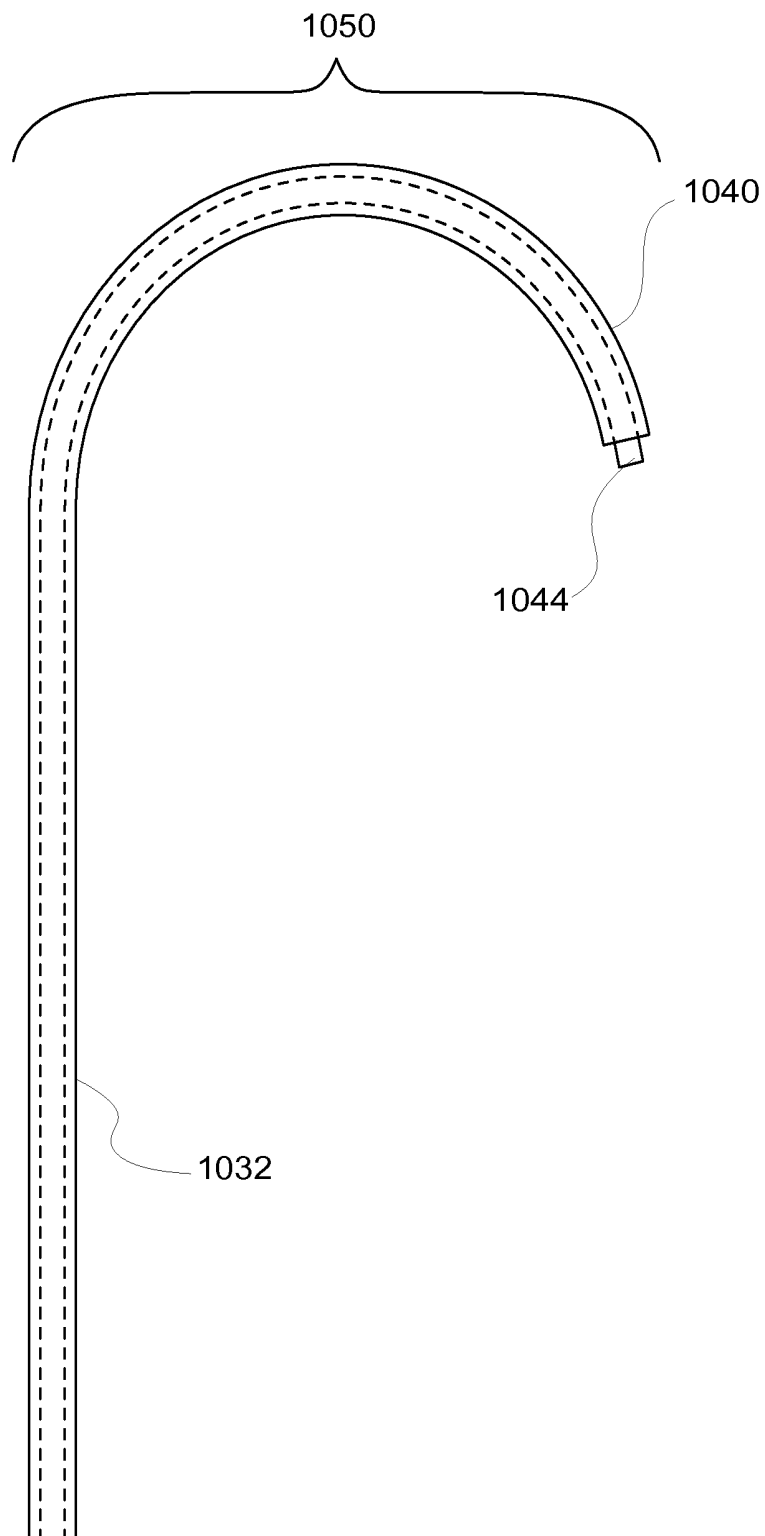

FIG. 14

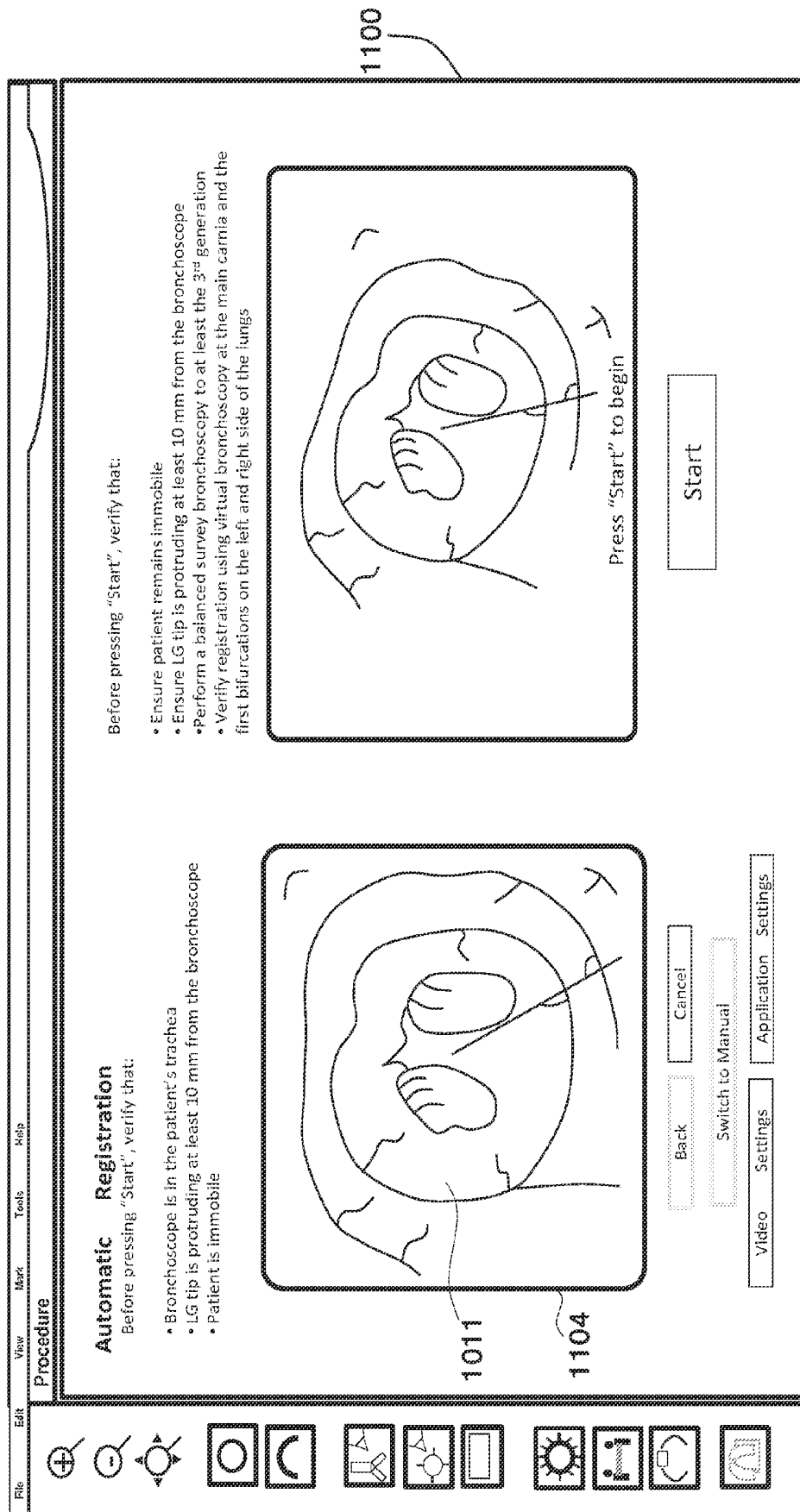

FIG. 15

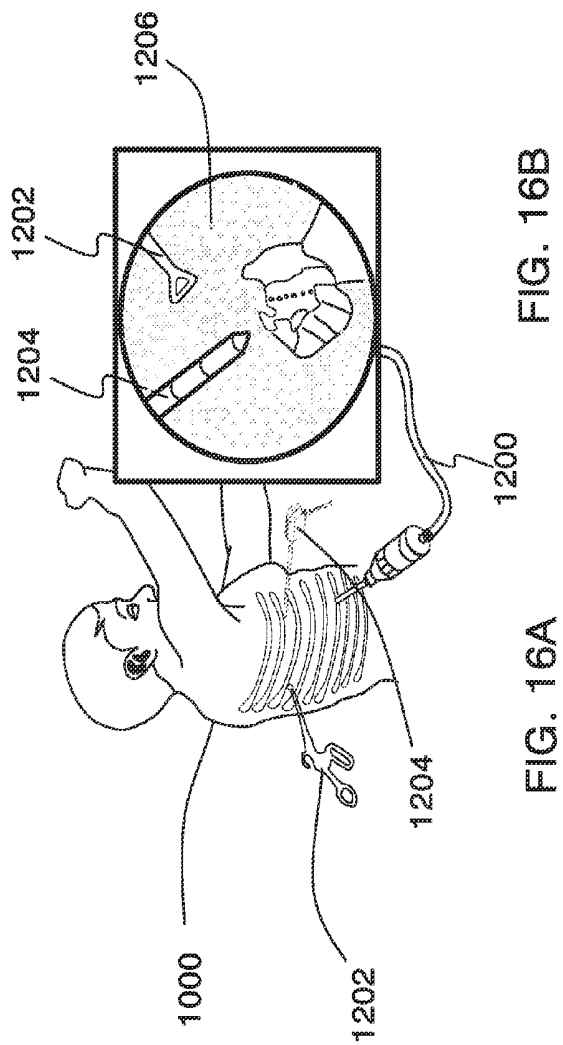
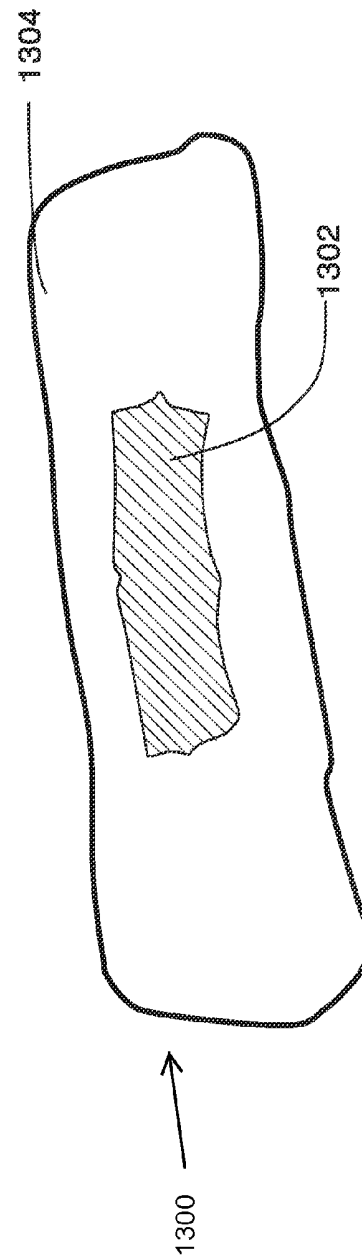

FIG. 16B



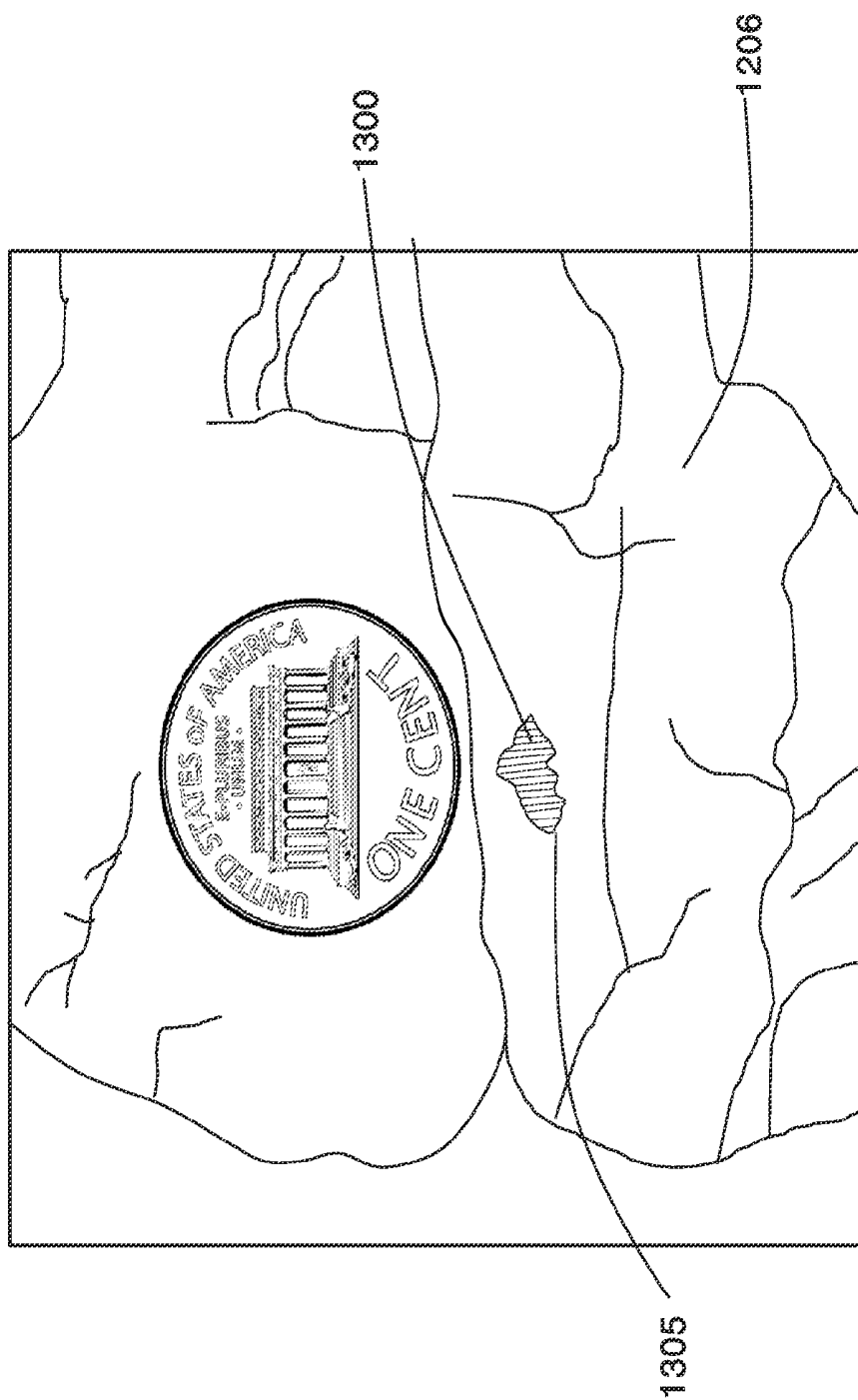

FIG. 18

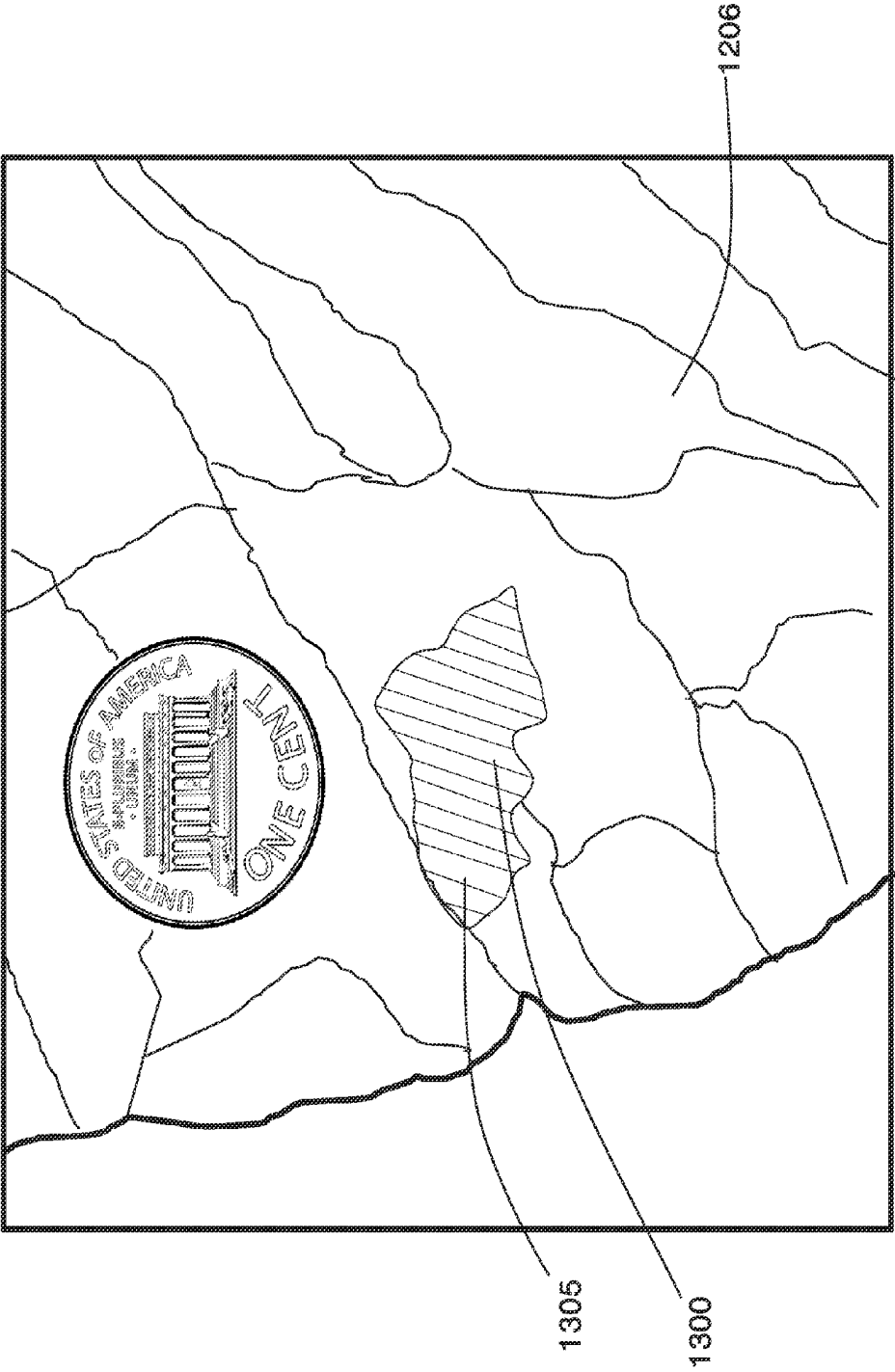

FIG. 19

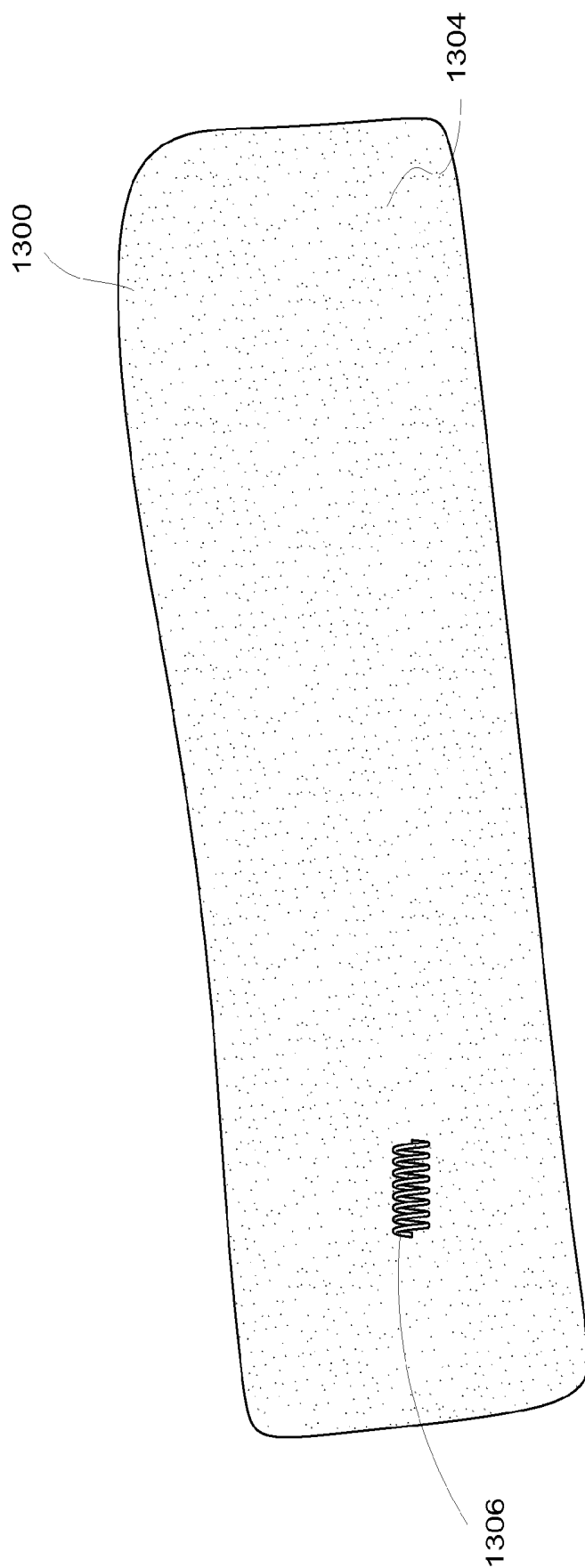

FIG. 20

1

## MICROWAVE ENERGY-DELIVERY DEVICE AND SYSTEM

### BACKGROUND

#### 1. Technical Field

The present disclosure relates to microwave surgical devices suitable for use in tissue ablation applications.

#### 2. Discussion of Related Art

Treatment of certain diseases requires the destruction of malignant tissue growths, e.g., tumors. Electromagnetic radiation can be used to heat and destroy tumor cells. Treatment may involve inserting ablation probes into tissues where cancerous tumors have been identified. Once the probes are positioned, electromagnetic energy is passed through the probes into surrounding tissue.

In the treatment of diseases such as cancer, certain types of tumor cells have been found to denature at elevated temperatures that are slightly lower than temperatures normally injurious to healthy cells. Known treatment methods, such as hyperthermia therapy, heat diseased cells to temperatures above 41° C. while maintaining adjacent healthy cells below the temperature at which irreversible cell destruction occurs. These methods involve applying electromagnetic radiation to heat or ablate tissue.

Electrosurgical devices utilizing electromagnetic radiation have been developed for a variety of uses and applications. Typically, apparatus for use in ablation procedures include a power generation source, e.g., a microwave or radio frequency (RF) electrosurgical generator that functions as an energy source and a surgical instrument (e.g., microwave ablation probe having an antenna assembly) for directing energy to the target tissue. The generator and surgical instrument are typically operatively coupled by a cable assembly having a plurality of conductors for transmitting energy from the generator to the instrument, and for communicating control, feedback and identification signals between the instrument and the generator.

There are several types of microwave probes in use, e.g., monopole, dipole and helical, which may be used in tissue ablation applications. In monopole and dipole antenna assemblies, microwave energy generally radiates perpendicularly away from the axis of the conductor. Monopole antenna assemblies typically include a single, elongated conductor. A typical dipole antenna assembly includes two elongated conductors that are linearly-aligned and positioned end-to-end relative to one another with an electrical insulator placed therebetween. Helical antenna assemblies include helically-shaped conductor configurations of various dimensions, e.g., diameter and length. The main modes of operation of a helical antenna assembly are normal mode (broadside), in which the field radiated by the helix is maximum in a perpendicular plane to the helix axis, and axial mode (end fire), in which maximum radiation is along the helix axis.

The particular type of tissue ablation procedure may dictate a particular ablation volume in order to achieve a desired surgical outcome. Ablation volume is correlated with antenna design, antenna performance, antenna impedance, ablation time and wattage, and tissue characteristics, e.g., tissue impedance.

Because of the small temperature difference between the temperature required for denaturing malignant cells and the temperature normally injurious to healthy cells, a known heating pattern and precise temperature control is needed to lead to more predictable temperature distribution to eradicate the tumor cells while minimizing the damage to otherwise healthy tissue surrounding the tissue to which electrosurgical

2

energy is being applied. Fluid-cooled or dielectrically-buffered microwave devices may be used in ablation procedures. During operation of the microwave ablation device, if the flow of coolant or buffering fluid is interrupted, the microwave ablation device may exhibit rapid failures due to the heat generated from the increased reflected power.

### SUMMARY

One aspect of the present disclosure is directed to an ablation system comprising including an image database storing a plurality of computed tomography (CT) images of a luminal network, and a navigation system enabling, in combination with an endoscope and the CT images, navigation of a locatable guide and an extended working channel to a point of interest. The system also includes one or more fiducial markers, placed in proximity to the point of interest, and a percutaneous microwave ablation device for applying energy to the point of interest. The percutaneous microwave ablation device, locatable guide, and extended working channel are sized for navigation and ablation of lung tissue. According to a further aspect of the present disclosure, the system may include a planning system enabling viewing of the CT images to determine a path through the luminal network to the point of interest.

In the system, the fiducial markers may be placed through the extended working channel within the luminal network. Additionally or alternatively the system may include a plurality of fiducial markers on an exterior of the luminal network. The system may include a transmitter generating an electromagnetic field about the luminal network. The electromagnetic field and the fiducial markers on the exterior of the luminal network may enable the navigation system to determine the position of the locatable guide within the luminal network. Still further, the determination of the position of the locatable guide enables the navigation system to display a graphic representation of the location of the locatable guide based on the CT image data. The graphic representation may include a path the locatable guide and the extended working channel must follow to reach the point of interest. The location of the locatable guide and the CT image data may be registered to one another.

In accordance with another aspect of the present disclosure, the system may include a laparoscope to view an exterior portion of the luminal network and a laparoscopic image display device. According to a further aspect of the present disclosure the fiducial markers placed in proximity to the point of interest include a hydrogel material that expands following implantation. The fiducial markers may include a dye that dissipates from the marker over time and when the marker is placed proximate an exterior surface of the luminal network is visible through the laparoscope to identify the point of interest. Further, the fiducial markers may include a radiologically opaque marker enabling the position of the marker to be determined using imaging modalities.

According to a further aspect of the present disclosure the system includes a microwave generator connected to the percutaneous ablation device. The system may also include a fluid cooling system supplying cooling fluid to the percutaneous ablation device.

In yet a further aspect of the present disclosure the percutaneous ablation device comprises a temperature sensor sensing the temperature of a balloon. The temperature sensor may be positioned in contact with a balloon short electrically connected to an outer conductor of the percutaneous ablation device.

A further aspect of the present disclosure is directed to a system including a microwave ablation device configured for insertion into a patient percutaneously. The microwave ablation device includes a radiating section and a proximal handle. The system includes a cooling system configured to provide cooling to the microwave ablation device during an ablation procedure, and a temperature sensing system configured to sense a temperature of tissue proximate the radiating section of the microwave ablation device. Still further, the system includes an energy source providing microwave energy to the microwave ablation device and a navigation system configured to indicate to a user a location of an ablation target and a pathway to the target.

The system includes at least one temperature sensor on the radiating section sensing the temperature of tissue adjacent the microwave ablation device and receiving temperature data from each of the temperature sensors. The temperature data provides feedback to the energy source to control the operation of the energy source.

According to a further aspect of the system, the temperature sensing system compares the received temperature data to temperature profiles stored in a memory for determining whether sufficient energy has been applied to the tissue. The temperature sensing system may store in the memory radiation patterns associated with the received temperature data, a duration of energy application, and a power setting of the energy source.

According to a further aspect of the present disclosure, the navigation system employs a planning phase and a navigation phase. The planning phase may employ a CT image to identify a target. Further, the navigation phase may require registration of a second image to the CT image, and may employ one or more fiducial markers placed using the navigation system at a target location. The fiducial markers may include a releasable dye to mark the location of the marker.

#### BRIEF DESCRIPTION OF THE DRAWINGS

Objects and features of the presently disclosed energy-delivery devices with a fluid-cooled probe assembly and systems including the same will become apparent to those of ordinary skill in the art when descriptions of various embodiments thereof are read with reference to the accompanying drawings, of which:

FIG. 1 is an exploded view of a medical device in accordance with an embodiment of the present disclosure;

FIG. 2A is a schematic diagram of a medical device including a probe, a hub assembly, and a generator connector assembly in accordance with an embodiment of the present disclosure;

FIG. 2B is cross-sectional view of the coaxial cable in accordance with an embodiment of the present disclosure;

FIG. 3A is an enlarged, cross-sectional view of the probe and hub assembly shown in FIG. 2A in accordance with an embodiment of the present disclosure;

FIG. 3B is an enlarged, cross-sectional view of the indicated area of detail of FIG. 3A, in accordance with an embodiment of the present disclosure;

FIG. 4 is an enlarged, cross-sectional view of the portion of the feedline of a probe assembly of the present disclosure during the assembly process in accordance with an embodiment of the present disclosure;

FIG. 5 is an enlarged, cross-sectional view of the portion of the feedline of a probe assembly of the present disclosure during the assembly process in accordance with an embodiment of the present disclosure;

FIG. 6 is an enlarged, cross-sectional view of the portion of a completed feedline in accordance with an embodiment of the present disclosure;

FIG. 7A is a cross-sectional view of a portion of a probe assembly in accordance with an embodiment of the present disclosure;

FIG. 7B is a longitudinal cross-sectional view of the probe assembly of FIG. 7A depicting an array of temperature sensors.

FIG. 7C is a cross-sectional view of the probe assembly of FIG. 7A depicting temperature sensors.

FIG. 8 is an enlarged, cross-sectional view of the distal portions of the probe feedline and radiating portions of a medical device, in accordance with an embodiment of the present disclosure;

FIG. 9 is a screen shot of a CT based luminal navigation system in accordance with an embodiment of the present disclosure;

FIG. 10 is a screen shot of a CT based luminal navigation system in accordance with an embodiment of the present disclosure;

FIG. 11 is perspective view of a luminal navigation system in accordance with an embodiment of the present disclosure;

FIG. 12 is a side view of a luminal catheter delivery assembly in accordance with an embodiment of the present disclosure;

FIG. 13 is a perspective view of a catheter manipulation system in accordance with an embodiment of the present disclosure;

FIG. 14 is a side view of a catheter in accordance with an embodiment of the present disclosure;

FIG. 15 is a screen shot of a CT based luminal navigation system in accordance with an embodiment of the present disclosure;

FIG. 16A is a side view of a patient undergoing a VATS procedure in accordance with an embodiment of the present disclosure;

FIG. 16B is an image as presented on a video monitor during a VATS procedure in accordance with an embodiment of the present disclosure;

FIG. 17 is a perspective view of a marker in accordance with an embodiment of the present disclosure;

FIG. 18 is a perspective view of lung tissue having the marker of FIG. 17 implanted therein;

FIG. 19 is a perspective view of the marker of FIG. 18 at a some time after implantation;

FIG. 20 is a perspective view of a marker in accordance with an embodiment of the present disclosure.

#### DETAILED DESCRIPTION

The present disclosure is generally directed to a microwave ablation probe and a system for placement of the probe in a desired location within the body. One aspect of the present disclosure is implementing the percutaneous microwave ablation probe in combination with the i-Logic® target identification, navigation, and marker placement systems developed by superDimension, Ltd. In particular the present disclosure describes devices and systems for the treatment of lung cancer and other lung diseases through microwave ablation of targets identified in the patient for treatment, however the application of the present disclosure and the embodiments described herein are not limited to application of any particular tissue or organ for treatment, indeed, it is contemplated that the systems and methods of the present disclosure may be used to treat liver tissue, kidney tissue, pancreatic tissue, gastrointestinal tissue, interstitial masses, and other portions



of the body known to those of skill in the art to be treatable via microwave ablation. These and other aspects of the present disclosure are described in greater detail below.

Hereinafter, embodiments of energy-delivery devices with a fluid-cooled probe assembly and systems including the same of the present disclosure are described with reference to the accompanying drawings. Like reference numerals may refer to similar or identical elements throughout the description of the figures. As shown in the drawings and as used in this description, and as is traditional when referring to relative positioning on an object, the term “proximal” refers to that portion of the apparatus, or component thereof, closer to the user and the term “distal” refers to that portion of the apparatus, or component thereof, farther from the user.

This description may use the phrases “in an embodiment,” “in embodiments,” “in some embodiments,” or “in other embodiments,” which may each refer to one or more of the same or different embodiments in accordance with the present disclosure.

Electromagnetic energy is generally classified by increasing energy or decreasing wavelength into radio waves, microwaves, infrared, visible light, ultraviolet, X-rays and gamma-rays. As it is used in this description, “microwave” generally refers to electromagnetic waves in the frequency range of 300 megahertz (MHz) ( $3 \times 10^8$  cycles/second) to 300 gigahertz (GHz) ( $3 \times 10^{11}$  cycles/second). As it is used in this description, “ablation procedure” generally refers to any ablation procedure, such as, for example, microwave ablation, radiofrequency (RF) ablation, or microwave or RF ablation-assisted resection.

As it is used in this description, “energy applicator” generally refers to any device that can be used to transfer energy from a power generating source, such as a microwave or RF electrosurgical generator, to tissue. For the purposes herein, the term “energy applicator” is interchangeable with the term “energy-delivery device”. As it is used in this description, “transmission line” generally refers to any transmission medium that can be used for the propagation of signals from one point to another. As it is used in this description, “fluid” generally refers to a liquid, a gas or both.

As it is used in this description, “length” may refer to electrical length or physical length. In general, electrical length is an expression of the length of a transmission medium in terms of the wavelength of a signal propagating within the medium. Electrical length is normally expressed in terms of wavelength, radians or degrees. For example, electrical length may be expressed as a multiple or sub-multiple of the wavelength of an electromagnetic wave or electrical signal propagating within a transmission medium. The wavelength may be expressed in radians or in artificial units of angular measure, such as degrees. The electrical length is in general different from the physical length. By the addition of an appropriate reactive element (capacitive or inductive), the electrical length may be made significantly shorter or longer than the physical length.

Various embodiments of the present disclosure provide an energy-delivery device with a fluid-cooled probe assembly including a balun and temperature sensor disposed in association with the balun. Embodiments may be suitable for utilization in open surgical applications. Embodiments may be suitable for utilization with hand-assisted, endoscopic and laparoscopic surgical procedures such as Video Assisted Thoracic Surgery. Embodiments may be implemented using electromagnetic radiation at microwave frequencies, RF frequencies or at other frequencies. An electrosurgical system including the presently disclosed energy-delivery device with a fluid-cooled probe assembly disposed in fluid communica-

tion with a coolant supply system via a hub **40** according to various embodiments is configured to operate at frequencies between about 300 MHz and about 10 GHz. During operation, cooling the probe assembly may enhance the overall heating pattern of the antenna assembly, prevent damage to the antenna assembly, and/or prevent harm to the clinician or patient.

Various embodiments of the presently disclosed energy-delivery device with a fluid-cooled probe assembly including a balun and temperature sensor disposed in association with the balun are suitable for microwave or RF ablation and for use to pre-coagulate tissue for microwave or RF ablation-assisted surgical resection. Although various methods described hereinbelow are targeted toward microwave ablation and the complete destruction of target tissue, it is to be understood that methods for directing electromagnetic radiation may be used with other therapies in which the target tissue is partially destroyed or damaged, such as, for example, to prevent the conduction of electrical impulses within heart tissue. In addition, although the following description describes the use of a dipole microwave antenna, the teachings of the present disclosure may also apply to a monopole, helical, or other suitable type of microwave antenna or RF electrode.

FIG. 1 is an exploded view of a medical device **10** in particular the medical device **10** is a microwave antenna. Medical device **10** includes an outer tubular member **30**, an inner tubular member **35**, a feedline **14**, an antenna assembly **12**, and a tip **19**, which, when assembled, form a probe assembly, or portions thereof. Medical device **10** generally includes two housing halves **21** and **22**, which, when assembled, form a handle body **23**. Handle body **23** defines a handle-body chamber **26** therein. Medical device **10** includes a hub **40** (as well as other components described herein) disposed, at least in part, within the handle-body chamber **26**.

Hub **40** includes a hub body **43** defining a hub-body chamber **46** therein. Medical device **10** includes a hub cap **150** and a hub divider **160**, which are configured to be receivable within the hub-body chamber **46** in sealing engagement with the inner walls of the hub body **43**. Outer tubular member **30**, the inner tubular member **35**, the hub **40**, and the components cooperative therewith (e.g., hub cap **150** and hub divider **160**) are adapted to maintain fluid flow to the antenna assembly **12**. Hub body **43** generally includes a first port **41** and a second port **42**, e.g., to allow fluid communication with a coolant supply system (e.g., coolant supply system **50** shown in FIG. 2A) via one or more coolant paths (e.g., first coolant path **16** and second coolant path **18** shown in FIG. 2A). First port **41** and the second port **42** may be of any suitable shape, e.g., rectangular, cylindrical, etc., and may include a groove adapted to receive an o-ring or other suitable sealing element.

In some embodiments, the hub body **43** may include one or more mechanical interfaces, e.g., recess **45**, adapted to matingly engage with one or more corresponding mechanical interfaces (e.g., tab **70** shown in FIG. 2A) associated with the handle body **23**, e.g., to align the hub **40** within the handle-body chamber **26** and/or to fixedly secure the hub **40** within the handle-body chamber **26**. Similarly, each of the housing halves **21**, **22** may include a series of mechanical interfacing components, e.g., alignment pins **74**, **76**, and **78**, configured to matingly engage with a corresponding series of mechanical interfaces (not shown), e.g., to align the two housing halves **21**, **22** about the components and assemblies of the medical device **10**. It is contemplated that the housing halves (as well as other components described herein) may be assembled together with the aid of alignment pins, snap-like interfaces, tongue and

groove interfaces, locking tabs, adhesive ports, etc., utilized either alone or in combination for assembly purposes.

Hub divider **160** is configured and utilized to divide the hub-body chamber **46** into a first chamber, e.g., disposed in fluid communication with the first port **41**, and a second chamber, e.g., disposed in fluid communication with the second port **42**. The first chamber (e.g., first chamber **147** shown in FIG. **3A**) generally fluidly connects the first port **41** to the inner tubular member **35**. The second chamber (e.g., second chamber **143** shown in FIG. **3A**) generally fluidly connects the second port **42** to the inner tubular member **30**.

In some embodiments, the inner walls of the hub body **43** may include a configuration of engagement portions adapted to provide sealing engagement with the hub cap **150** and/or the hub divider **160**. In some embodiments, as shown in FIG. **1**, an o-ring **157** is provided for engagement with the hub cap **150**. O-ring **157** may provide sealing force that permits flexing and/or other slight movement of the hub cap **150** relative to the hub **40** under fluid-pressure conditions. Hub cap **150** and the hub divider **160** are described in more detail later in this disclosure with reference to FIG. **3A**.

Outer tubular member **30** and the inner tubular member **35** may be formed of any suitable non-electrically-conductive material, such as, for example, polymeric or ceramic materials. In some embodiments, as shown in FIGS. **3A** and **3B**, the inner tubular member **35** is coaxially disposed around the feedline **14** and defines a first lumen **37** therebetween, and the outer tubular member **30** is coaxially disposed around the inner tubular member **35** and defines a second lumen **33** therebetween.

Probe assembly **20** generally includes an antenna assembly **12** having a first radiating portion (e.g., distal radiating section **318** shown in FIG. **7A**) and a second radiating portion (e.g., proximal radiating section **316** shown in FIG. **7A**). Antenna assembly **12**, which is described in more detail later in this disclosure, is operably coupled by the feedline **14** to a transition assembly **80** shown in FIG. **1**, which is adapted to transmit the microwave energy, from the cable assembly **15** to the feedline **14**. A connector assembly **17** shown in FIG. **1** is adapted to further operably connect the medical device **10** to a microwave generator **28** (shown in FIG. **2A**).

Feedline **14** may be any suitable transmission line, e.g., a coaxial cable. In some embodiments, as shown in FIGS. **3A** and **3B**, the feedline includes an inner conductor **220**, an outer conductor **224** coaxially disposed around the inner conductor **220**, and a dielectric material **222** disposed therebetween. Dielectric material **222** may be formed from any suitable dielectric material, e.g., polyethylene, polyethylene terephthalate, polyimide, or polytetrafluoroethylene (PTFE). Inner conductor **220** and the outer conductor **224** may be formed from any suitable electrically-conductive material. In some embodiments, the inner conductor **220** is formed from a first electrically-conductive material (e.g., stainless steel) and the outer conductor **224** is formed from a second electrically-conductive material (e.g., copper). Electrically-conductive materials used to form the feedline **14** may be plated with other materials, e.g., other conductive materials, such as gold or silver, to improve their properties, e.g., to improve conductivity, decrease energy loss, etc. Feedline **14** may have any suitable length defined between its proximal and distal ends. In accordance with various embodiments of the present disclosure, the feedline **14** is coupled at its proximal end to a transition assembly **80** and coupled at its distal end to the antenna assembly **12**. Feedline **14** is disposed at least in part within the inner tubular member **35**.

FIG. **2A** shows a medical device **10** incorporated into an operational system including a microwave generator **28** and a

coolant supply system **50**. Medical device **10** includes a probe assembly **20** and a handle assembly **60**. Probe assembly **20** generally includes the outer tubular member **30**, the inner tubular member **35**, the feedline **14**, the antenna assembly **12**, and the tip **19** shown in FIG. **1**. Handle assembly **60** generally includes a handle body **23** defining a handle-body chamber **26** therein. Medical device **10** also includes the hub **40** shown in FIG. **1** (as well as other components described herein) disposed, at least in part, within the handle-body chamber **26**.

Probe assembly **20** may include a balun **90** (shown in FIGS. **1** and **7**) disposed proximal to and spaced apart a suitable length from the feed pint **322**. The balun **90**, which is described in more detail later in this disclosure, generally includes a balun short, a balun insulator, and an electrically-conductive layer disposed around the outer peripheral surface of the balun insulator, or portions thereof. In some embodiments, the probe assembly **20** includes a temperature sensor **102** (e.g., shown in FIG. **7**) disposed in association with the balun **90**.

As shown in FIG. **2A**, the probe **20** is operably coupled by a cable assembly **15** to a connector assembly **17**. Connector assembly **17** is a cable connector suitable to operably connect the medical device **10** to a microwave generator **28**. The connector may house a memory (e.g., an EEPROM) storing a variety of information regarding the cable assembly **15** and the medical device **10**. For example, the memory may include identification information that can be used by the microwave generator **28** to ensure that only properly identified medical devices **10** are connected thereto. In addition, the memory may store operating parameters of the medical device **10** (e.g., time, power, and dosage limits), cable compensation parameters of the cable assembly **15**, and information regarding the usage of the medical device **10** or the cable assembly **15**. Usage monitoring may enable limiting re-use of the medical device **10** beyond a certain number of energizations or a single use of the device. Such usage limitations may optionally be reset via reprocessing as is commonly understood in the art. Still further, the connector assembly **17** may include sensor electronics related to radiometry and temperature sensing as described elsewhere herein. Cable assembly **15** may be any suitable, flexible transmission line, and particularly a coaxial cable as shown in FIG. **2B**, including an inner conductor **2220**, a dielectric material **2222** coaxially surrounding the inner conductor **2220**, and an outer conductor **2224** coaxially surrounding the dielectric material **2222**. Cable assembly **15** may be provided with an outer coating or sleeve **2226** disposed about the outer conductor **2224**. Sleeve **2226** may be formed of any suitable insulative material, and may be applied by any suitable method, e.g., heat shrinking, over-molding, coating, spraying, dipping, powder coating, and/or film deposition.

During microwave ablation the probe **20** is inserted into or placed adjacent to tissue and microwave energy is supplied thereto. One or more visualization techniques including Ultrasound, computed tomography (CT), fluoroscopy, and direct visualization may be used to accurately guide the probe **100** into the area of tissue to be treated, as will be described in detail below. Probe **20** may be placed percutaneously or surgically, e.g., using conventional surgical techniques by surgical staff. A clinician may pre-determine the length of time that microwave energy is to be applied. Application duration may depend on many factors such as tumor size and location and whether the tumor was a secondary or primary cancer. The duration of microwave energy application using the probe **20** may depend on the progress of the heat distribution within the tissue area that is to be destroyed and/or the surrounding tissue.

According to various embodiments, the probe assembly 20 is configured to circulate coolant fluid “F”, e.g., saline, water or other suitable coolant fluid, to remove heat generated by the antenna assembly 12 and/or heat that may be generated along the length of the feedline 14, or portions thereof, during the delivery of energy.

In some embodiments, as shown in FIG. 3B, the first lumen 37 is utilized as a fluid inflow conduit and the second lumen 33 is utilized as a fluid outflow conduit. In other embodiments, the first lumen 37 may serve as a fluid outflow conduit and the second lumen 33 may serve as a fluid inflow conduit. Outer tubular member 30 and/or the inner tubular member 35 may be adapted to circulate coolant fluid therethrough, and may include baffles, multiple lumens, flow restricting devices, or other structures that may redirect, concentrate, or disperse flow depending on their shape. The size and shape of the inner tubular member 35, the outer tubular member 30, the first lumen 37, and the second lumen 33 may be varied from the configuration depicted in FIGS. 3A and 3B.

In some embodiments, at least a portion of the inner tubular member 35 and/or at least a portion of the outer tubular member 30 (e.g., a distal portion) may include an integrated, spiraling metallic wire to add shape-memory properties to the probe 20 to aid in placement. In some embodiments, the inner tubular member 35 and/or the outer tubular member 30 may increase in stiffness and exhibit increased shape-memory properties along their length distally toward the antenna assembly 12.

In some embodiments, the first port 41 and the second port 42 are coupled in fluid communication with a coolant supply system 50 via one or more coolant paths 16 and 18 coupled to and in fluid communication with the probe 20 via first and second chambers, 147 and 143 as shown in FIG. 3A. Coolant supply system 50 may be adapted to circulate coolant fluid “F” into and out of the medical device 20. Coolant source 52 may be any suitable housing containing a reservoir of coolant fluid “F”, and may maintain coolant fluid “F” at a predetermined temperature. For example, the coolant source 52 may include a cooling unit (not shown) capable of cooling the returning coolant fluid “F” from the antenna assembly 12 via the hub 40.

Coolant fluid “F” may be any suitable fluid that can be used for cooling or buffering the probe assembly 20, e.g., deionized water, or other suitable cooling medium. Coolant fluid “F” may have dielectric properties and may provide dielectric impedance buffering for the antenna assembly 12. Coolant fluid “F” composition may vary depending upon desired cooling rates and the desired tissue impedance matching properties. Various fluids may be used, e.g., liquids including, but not limited to, water, saline, perfluorocarbon, such as the commercially available Fluorinert® perfluorocarbon liquid offered by Minnesota Mining and Manufacturing Company (3M), liquid chlorodifluoromethane, etc. In other variations, gases (such as nitrous oxide, nitrogen, carbon dioxide, etc.) may also be utilized as the cooling fluid. In yet another variation, a combination of liquids and/or gases, including, for example, those mentioned above, may be utilized as the coolant fluid “F”.

Coolant supply system 50 generally includes a first coolant path 16 leading from the coolant source 52 to the first port 41 (also referred to herein as the fluid inlet port), and a second coolant path 18 leading from the second port 42 (also referred to herein as the fluid outlet port) to the coolant source 52. In some embodiments, the first coolant path 16 includes a coolant supply line 31, e.g., leading from the coolant source 118 to the fluid inlet port 41, and the second coolant path 18 includes a coolant supply line 32, e.g., leading from the coolant source

52 to fluid outlet port 42. In some embodiments, the first coolant path 16 includes a fluid-movement device (not shown) configured to move coolant fluid “F” through the first coolant path 16. Second coolant path 18 may additionally, or alternatively, include a fluid-movement device (not shown) configured to move coolant fluid “F” through the second coolant path 18. Examples of coolant supply system embodiments are disclosed in commonly assigned U.S. patent application Ser. No. 12/566,299 filed on Sep. 24, 2009, entitled “OPTICAL DETECTION OF INTERRUPTED FLUID FLOW TO ABLATION PROBE”, and U.S. application Ser. No. 13/835,625 filed on Mar. 15, 2013 entitled “RECIRCULATING COOLING SYSTEM FOR ENERGY DELIVERY DEVICE” the disclosure of which is incorporated herein by reference.

FIG. 3A shows the probe assembly 20 disposed in part within the hub 40, wherein the hub cap 150 and the hub divider 160 are disposed in sealing engagement with the inner walls of the hub body 43, and a proximal portion of the probe assembly 20 is disposed in association with the hub cap 150 and hub divider 160. Hub divider 160 generally divides the hub-body chamber 46 (shown in FIG. 1) into a first chamber 147 and a second chamber 143, respectively. First chamber 147 is disposed in fluid communication with the first port 41. Second chamber 143 is disposed in fluid communication with the second port 42. In some embodiments, as shown in FIG. 3A, the proximal end of the inner tubular member 35 is disposed within the first chamber 147, wherein the first lumen 37 is disposed in fluid communication with the first port 41, and the proximal end of the outer tubular member 30 is disposed within the second chamber 143, wherein the second lumen 33 is disposed in fluid communication with the second port 42.

In some embodiments, as shown in FIG. 3A, the inner tubular member 35 includes a first portion having a first outer diameter, a second portion having a second outer diameter greater than the first outer diameter, and a neck portion 36 disposed therebetween. In some embodiments, the opening in the hub divider 160 is configured for sealing engagement with the second portion of inner tubular member 35 having the second outer diameter. In some embodiments, located within the interior of the second portion of the inner tubular member 35 is a high hoop strength metal cylinder 38. The metal cylinder 38 engages the inner diameter of the inner tubular member 35. The hub divider 160 is formed of an elastomeric material and when forced into place within the hub 40, as shown in FIG. 3A, the elastomeric material of the hub divider 160 creates an improved water tight seal separating the first hub chamber 147 from the second hub chamber 143. The metal cylinder 38 improves this seal by ensuring better contact between the elastomeric material of the hub divider 160 and the inner tubular member 35 upon application of lateral forces to the hub divider 160.

Hub body 43 may be configured to sealingly engage the coolant supply lines forming coolant paths 16 and 18 to fluid inlet port 41 and fluid outlet port 42. Fluid inlet port 41 and the fluid outlet port 42 may have any suitable configuration, including without limitation nipple-type inlet fittings, compression fittings, and recesses, and may include an o-ring type elastomeric seal.

FIG. 3B shows a portion of the probe assembly 20 of FIG. 3A including the first lumen 37, shown disposed between the outer tubular member 30 and inner tubular member 35, the second lumen 33, shown disposed between the inner tubular member 35 and the feedline 14, and a transmission line 11 extending longitudinally within the second lumen 33. As indicated by the direction of the arrow-headed lines in FIG. 3B, the first lumen 37 serves as an inflow conduit for coolant

fluid “F” and the second lumen **33** serves as an outflow conduit for coolant fluid “F,” however as noted above these could be reversed without departing from the scope of the present disclosure.

As shown in FIG. 1, Probe assembly **20** may include a balun **90** disposed proximal to and spaced apart a suitable length from the feed point **322**. In some embodiments, the balun **90** may be a quarter-wavelength,  $\frac{1}{4}\lambda$ , balun, or a  $\frac{3}{4}\lambda$  balun. Odd harmonics (e.g.,  $\frac{1}{4}\lambda$ ,  $\frac{3}{4}\lambda$ , etc.) may cause a current null at the balun entrance, which helps maintain a desired radiation pattern.

During a manufacturing sequence in accordance with the present disclosure, the component parts of the balun **90**, according to the embodiment shown in FIG. 6, are assembled, and, during the manufacturing sequence, as illustratively depicted in FIGS. 4-6, a temperature sensor **102** is coupled to the balun short **302** of the balun **90**.

FIG. 4 shows a portion of the feedline **14** including the inner conductor **220**, the outer conductor **224** coaxially disposed around the inner conductor **220**, and the dielectric material **222** disposed therebetween, shown with a balun short **302** coaxially disposed around a portion of the outer conductor **224**. During medical device assembly, balun short **302** is coupled, deposited or otherwise formed onto, or joined to, the outer conductor **224**. Balun short **302** may be formed as a single structure and electrically coupled to the outer conductor **224**, e.g., by solder or other suitable electrical connection. Balun short **302** may be formed of any suitable electrically-conductive materials, e.g., copper, gold, silver or other conductive metals or metal alloys. In some embodiments, the balun short **302** has a generally ring-like or truncated tubular shape. Balun short **302** is electrically coupled to the outer conductor **224** of the feedline **14** by any suitable manner of electrical connection, e.g., soldering, welding, or laser welding. The size and shape of the balun short **302** may be varied from the configuration depicted in FIG. 4.

FIG. 4 further depicts a dielectric layer **304** (also referred to herein as a balun insulator) coaxially disposed around the outer conductor **224** and coupled thereto. Balun insulator **304** may be formed of any suitable insulative material, including, but not limited to, ceramics, water, mica, polyethylene, polyethylene terephthalate, polyimide, polytetrafluoroethylene (PTFE) (e.g., Teflon®, manufactured by E. I. du Pont de Nemours and Company of Wilmington, Del., United States), glass, metal oxides or other suitable insulator, and may be formed in any suitable manner. In some embodiments, as shown in FIG. 4, the balun insulator **304** is a dielectric sleeve. Balun insulator **304** may be grown, deposited or formed by any other suitable technique. In some embodiments, the balun insulator **304** is formed from a material with a dielectric constant in the range of about 1.7 to about 10.

FIG. 4 further depicts a temperature sensor **102** disposed in contact with a proximal end of the balun short **302**. Temperature sensor **102** is coupled to a transmission line **11** extending generally along a longitudinal axis of the feedline **14**. In some embodiments, the temperature sensor **102** is a thermocouple and the transmission line **11** is a thermocouple wire. The thermocouple wire may be a two lead wire thermocouple wire, for example it may be comprised of an insulated (anodized) side-by-side constantine wire and a copper wire. The balun short **302** may include an engagement element **306** adapted to engage with the temperature sensor **102**, e.g., to facilitate electrical and mechanical coupling of the temperature sensor **102** and the balun short **302**. In some embodiments, the engagement element **306** may be a groove, slot, or recess cut into the balun short **302**. Alternatively, the temperature sensor **102** may be soldered to balun short **302**. Place-

ment of the thermocouple **102** directly against the balun short **302** improves the sensitivity and thermo-profiling characteristics of the medical device **10**, particularly as compared to traditional thermocouples in microwave ablation devices, which measure the temperature of the cooling fluid. As will be appreciated by those of skill in the art the temperature of the coolant will lag the temperature of the balun itself, and thus provide only approximate indications of the temperature of the elements which are heated during operation. As a result, in instances where little or no coolant is flowing, the temperature of the balun **90** and feedline **14** associated therewith can increase faster than that of the coolant and result in damage to medical device **10** even before triggering a shut-off of the system based on the temperature the coolant. Accordingly, improved safety and performance can be achieved by direct sensing of temperature of the balun **90**.

Still further, FIG. 4 depicts a heat-shrink tubing **308** disposed in a first configuration around the outer conductor. During assembly, the heat-shrink tubing **308** is utilized to secure a portion of the transmission line **11** to the feedline **14**. Heat-shrink tubing **308** may be any suitable tubing material with the capability to respond to heat and bind around an object, and may have any suitable length. In some embodiments, the heat-shrink tubing **308** may be a thermoplastic.

FIG. 5 shows the feedline of FIG. 4 following application of heat to the heat shrink tubing **308**. During assembly, securing a portion of the transmission line **11** to the feedline **14**, as shown in FIG. 6 keeps the transmission line stable and helps to maintain the electrical and mechanical coupling of the temperature sensor **102** and the balun short **302** during subsequent assembly operations. FIG. 5 further shows a second heat shrink tubing **310** disposed in a first configuration.

The tubing member **310** includes an inner layer of an electrically-conductive material **312**. Electrically-conductive layer **312** may be formed of any suitable electrically-conductive material, e.g., metallic material. In one embodiment the metallic material of electrically conductive layer **312** is formed of a silver ink deposited or layered on an interior surface of the heat shrink tubing **310**. The heat shrink tubing member **310** may have a length from about 1 to about 3 inches in length. However, the shape and size of the tubing member **310** and balun insulator **304** may be varied from the configuration depicted in FIG. 5 without departing from the scope of the present disclosure. Indeed, though described as one embodiment, the orientation and implementation of the feed line **14** as well as other aspects of the present disclosure is not so limited. For example, the feed line **14** may incorporate one or more aspects of the ablation system described in U.S. application Ser. No. 13/836,203 filed on Mar. 15, 2013 entitled “MICROWAVE ABLATION CATHETER AND METHOD OF UTILIZING THE SAME,” the entire content of which is incorporated herein by reference.

FIG. 6 shows the balun **90** after the application of thermal energy to the heat shrink tubing **310** and the resultant shrinkage. As shown FIG. 16, the electrically-conductive material **312** is disposed in intimate contact with the balun short **302** and a portion of the balun insulator **304**. In some embodiments, as shown in FIG. 6, a portion of the balun insulator **304** may extend distally beyond the distal end of the heat shrink tubing **310** and electrically conductive layer **312**, to create gap **314**. Gap **314** improves the microwave performance of the probe **20** and can assist in achieving a desired ablation pattern. More specifically, the gap **314** ensures adequate coupling of microwave energy from the proximal radiating section **316** into the balun **90**, improving the performance of the balun **90** over a wide range of tissue dielectric conditions. Further, FIG. 6 shows the heat shrink tubing **310** securing the portion of the

transmission line 11 between heat shrink tubing 308 and the balun short 302 to the feedline 14 preventing its movement and substantially preventing the temperature sensor 102 from being removed from physical contact with the balun short 302.

FIG. 7A shows a portion of the probe assembly 100 that includes the balun 90 of FIG. 6 connected to the antenna assembly 12. In operation, microwave energy having a wavelength,  $\lambda$ , is transmitted through the antenna assembly 12 and radiated into the surrounding medium, e.g., tissue. The length of the antenna for efficient radiation may be dependent on the effective wavelength,  $\lambda_{eff}$ , which is dependent upon the dielectric properties of the treated medium. Antenna assembly 12 through which microwave energy is transmitted at a wavelength,  $\lambda$ , may have differing effective wavelengths,  $\lambda_{eff}$ , depending upon the surrounding medium, e.g., liver tissue as opposed to breast tissue, lung tissue, kidney tissue, etc.

Antenna assembly 12, according to the embodiment shown in FIG. 7, includes a proximal radiating section 316 having a length "L1", a distal radiating section 318 including an electrically-conductive element 320 having a length "L2", and a feed point 322 disposed therebetween. In some embodiments, the proximal radiating section 316 may have a length "L1" in a range from about 0.05 inches to about 0.50 inches. Electrically-conductive element 320 may be formed of any suitable electrically-conductive material, e.g., metal such as stainless steel, aluminum, titanium, copper, or the like. In some embodiments, the electrically-conductive element 320 may have a length "L2" in a range from about 0.15 inches to about 1.0 inches.

As shown in FIG. 7A electrically-conductive element 320 has a stepped configuration, such that the outer diameter of the distal portion 324 is less than the outer diameter of the proximal portion 326. Further, the inner conductor 220 of the feedline 14 is arranged such that it extends past the distal end of the insulator 222 and into the proximal portion 326 of the electrically-conductive element 320. A hole 328, formed in the proximal portion 326 approximately at 90 degrees to the inner conductor 220 allows for solder, a set screw, or other securing mechanisms to physically secure the electrically conductive element 320 to the inner conductor 220 and thereby with the feedline 14 of the medical device 20.

FIG. 7B depicts a further embodiment of the present disclosure in which rather than or in addition to the temperature sensor 102 located at the balun short 302, one or more temperature sensors 502 are placed in or on the outer tubular member 30. The outer tubular member 30 formed for example of an epoxy filled glass fiber material. As such the outer tubular member may be formed of a plurality of layers of glass fiber material. During the manufacturing process, one or more temperature sensors 502 may be imbedded in the layup of the glass fiber material. The temperature sensors 502, include wires 504 which connect back to the handle body 23 and ultimately generator 28 or a separate temperature controller (not shown). As an alternative to placing the temperature sensors within the layup of the outer tubular member 30, the outer tubular member 30 may be first formed and then subsequently machined to include one or more slots in which the temperature sensors 502 and wires 504 may be secured, using for example an epoxy material.

According to one embodiment at least one temperature sensor 502 is located at approximately the proximal end of the balun 90. This is approximately the same location as the temperature sensor 102 of FIG. 6 (i.e. about three inches from the distal tip of the medical device 10), but on the outer tubular member 30 as opposed to the balun short 302. This location

has been identified as particularly useful in sensing two problems that can occur during operation, no fluid in the medical device 10, and no fluid flow through the medical device 10. These can occur where the clinician fails to connect the cooling system to the medical device or where the clinician fails to turn on the cooling fluid pump, or where there is some other cooling system malfunction. In any instance, the result of the lack of fluid or fluid flow along the outer tubular member 30 can result in it heating to 45° C., which can lead to unintended cell death in the surrounding tissue. The temperature sensors 502 can be employed as a safety indicator and cause the generator 28 to shut down and or issue an alarm as temperatures approach a pre-determined threshold, and thus prevent injury to the patient.

While described above as a single temperature sensor 502, multiple temperature sensors may be used as shown in FIG. 7A. Alternatively, an array of the temperature sensors 502 located at different positions along the length of the outer tubular member 30 may be employed to determine the temperature at different positions along its length as shown in FIG. 7B. These may be at approximately 0.8, 1.0, 1.2, and 1.4 inches from the distal tip of the medical device 10. Using this array, a thermographic profile of the tissue can be created for review and analysis during and after the procedure. For example by sensing the temperature at each temperature sensor 502 the progression of the treatment may be monitored or a terminal threshold of the treatment may be monitored for and end the treatment. The temperature sensors 502 of the array can detect the rising temperature of the ablation field and can be correlated with the ablation growth in the surrounding tissue.

The array of temperature sensors 502 as shown in FIG. 7B may be in addition to the temperature sensor 502 on the outer tubular member at approximately the balun short 302, and/or the temperature sensor 102 in contact with the balun short 302.

In a further embodiment, and as depicted in FIG. 7C, the temperature sensors are located as near the outer periphery of the outer tubular member 30 as possible. In such an embodiment the temperature sensor thus provides a closer approximation of the temperature of the tissue immediately surrounding the outer tubular member 30.

The temperature sensors 502 may be incorporated as part of a temperature monitoring system, e.g., microwave thermometry incorporated into the microwave generator 28 to provide feedback to the generator, or alternatively the temperature monitoring system may be housed in a separate box (not shown) providing audible or visual feedback to the clinician during use of the medical device 10. The temperature sensors 502 are utilized to observe/monitor tissue temperatures in or adjacent an ablation zone. The temperature monitoring system can be, for example, a radiometry system, a thermocouple based system, or any other tissue temperature monitoring system known in the art. In either embodiment, the temperature monitoring system may be configured to provide tissue temperature and ablation zone temperature information to the microwave generator 28 (or other suitable control system).

In at least one embodiment, the tissue temperature and/or ablation zone temperature information may be correlated to specific known ablation zone sizes or configurations that have been gathered through empirical testing and stored in one or more data look-up tables and stored in memory of the temperature monitoring system and/or the microwave generator 28. The configurations may also be based on the observed size and type of tissue to be ablated. Still further, the temperature monitoring system may enable a clinician, having ascertained

the size of a target to enter the size into the system and have the system calculate a proposed course of treatment including one or more of a power setting, a number of medical device to be employed, and the duration or number of serial energy applications to achieve a desired ablation zone effective for treating the target tissue. The data look-up tables may be accessible by a processor of the temperature sensing system and/or microwave generator **28** and accessed by the processor while the medical device **10** is energized and treating target tissue. In this embodiment, the temperature sensors **502** provide tissue temperature and/or ablation zone temperature to the microprocessor which then compares the tissue temperature and/or ablation zone temperature to the ablation zone sizes stored in the data look-up tables. The microprocessor may then send a command signal to one or more modules of the temperature sensing monitoring system and/or the generator **28** to automatically adjust the microwave energy output to the medical device **10**. Alternatively, a manual adjustment protocol may be utilized to control the microwave energy output to the medical device **10**. In this embodiment, the microprocessor may be configured to provide one or more indications (e.g., visual, audio and/or tactile indications) to a user when a particular tissue temperature and/or ablation zone temperature is matched to a corresponding ablation zone diameter or configuration. The temperature monitoring system can be incorporated into one or more components (e.g., a software graphical interface configured for display on a monitor **1006**).

FIG. **8** shows a distal portion of the probe assembly **20** including the tip **19**, distal portions of the inner and outer tubular members, **35** and **30**, respectively, and an inflow/outflow junction **39**. Inflow/outflow junction **39** is defined, at least in part, by the outer tubular member **30** and extends distally from the distal end **34** of inner tubular member **35**. Tip **19** generally includes a tip body **402** defining an interior chamber **404** disposed within a proximal portion of the tip **19**. In some embodiments, the interior chamber **404** includes a distal chamber portion **406** and a proximal chamber portion **408** adapted to be coupled in fluid communication with the inflow/outflow junction **39**. Tip body **402** includes a lateral portion **410**, and may include a tapered portion **412**, which may terminate in a sharp tip **414** to allow for insertion into tissue with minimal resistance. Tapered portion **412** may include other shapes, such as, for example, a tip **414** that is rounded, flat, square, hexagonal, or cylindroconical. In some embodiments, the outer diameter of the lateral portion **410** of the tip body **402** is substantially the same as the outer diameter of the outer tubular member **30**.

Tip **19** may be formed of a material having a high dielectric constant, and may be a trocar, e.g., a zirconia ceramic. In some embodiments, the interior chamber **404** is configured to receive a distal end **324** of the electrically-conductive element **320** of the antenna assembly **12**. The placement of the distal end **324** within interior chamber **404** in combination the shape of the tip **19** dielectrically buffers electromagnetic energy within close proximity to the antenna assembly **12**, specifically around the distal end **324** of the electrically conductive element **320**. This arrangement promotes a desirable electromagnetic wave pattern whereby tissue beyond the tip **19** is heated sufficiently to kill diseased cells residing distally away from the probe placement. The projection of electromagnetic energy distally from the tip **19** from the antenna assembly **12** may be described as a microwave field lensing effect. In some embodiments, as shown in FIG. **8**, the inner wall of the tip body **402** defining the interior chamber **404** includes a tapered portion **416**, e.g., to facilitate the placement of the distal end **324** of the electrically-conductive element

**320** into the chamber **404**, and/or to facilitate fluid flow between the interior chamber **404** and the inflow/outflow junction **39**. The shape and size of the distal chamber portion **406** and the proximal chamber portion **408** may be varied from the configuration depicted in FIG. **8A** without departing from the scope of the present disclosure.

In some embodiments, as shown in FIG. **8**, the tip body **402** includes a generally L-shaped engagement portion **418** defined, at least in part, by a lateral portion **420** of the tip body **402**, wherein the engagement portion **418** is adapted to engage an end portion and the inner surface of the outer tubular member **30**. In some embodiments, the outer diameter of the lateral portion **420** of the tip body **402** is less than the inner diameter of the outer tubular member **30**, e.g., to provide space for a heat-resistant adhesive material (e.g., material **422** shown in FIG. **8**), or other suitable material.

FIG. **8** shows the tip **19** disposed in association with the outer tubular member **30**, wherein the distal end **324** of the electrically-conductive element **320** of the antenna assembly **12** is disposed within a portion of the interior chamber **404**. Tip **19** and the outer tubular member **30** may be sealably connected together with a heat-resistant adhesive material **422** or other suitable material, e.g., disposed between the inner wall of the outer tubular member **30** and lateral surface **420** of the tip **19**. It is to be understood, however, that sealing engagement between the tip **19** and the outer tubular member **30** may be provided by any suitable technique.

The above-described energy-delivery devices with a fluid-cooled probe assembly are capable of directing energy into tissue, and may be suitable for use in a variety of procedures and operations. The above-described energy-delivery device embodiments may be suitable for utilization with hand-assisted, endoscopic and laparoscopic surgical procedures. The above-described energy-delivery device embodiments may also be suitable for utilization in open surgical applications.

One aspect of the present disclosure is the use of the microwave ablation devices described above used for treatment of cancers and other diseases of the lungs. Location and treatment of lung diseases, particularly cancers due to smoking, is quite challenging due to the tortuous paths of the lung passages, the extremely small size of peripheral lung passages, the movement of the lungs during both diagnostics procedures and treatment.

As a practical matter the most effective method of identifying targets involves the use of a computed tomographic (CT) image. By way of introduction, the use of CT as a diagnostic tool has now become routine and CT results are now frequently the primary source of information available to the practitioner regarding the size and location of a lesion. This information is used by the practitioner in planning an operative procedure such as a biopsy, but is only available as "offline" information which must typically be memorized to the best of the practitioner's ability prior to beginning a procedure. As will be discussed below, in addition to inputting target information, integration with the CT data provides improved system functionality, thereby greatly facilitating the planning of a pathway to an identified target as well as providing the ability to navigate through the body to the target location.

One aspect of the present disclosure relates to a system and method for constructing, selecting and presenting pathway(s) to a target location within an anatomical luminal network in a patient. These embodiments of the present disclosure are particularly, but not exclusively, suited for guiding and navigating a probe through the bronchial airways of the lungs. This embodiment of the present disclosure includes a preoperative and an operative component. The preoperative com-

ponent is conducted prior to navigation and can be categorized as pathway planning. The operative component is conducted during navigation and can be categorized as navigation.

The pathway planning phase includes three general steps, each of which is described in more detail below. The first step involves using a software graphical interface for generating and viewing a three-dimensional model of the bronchial airway tree ("BT"). The second step involves using the software graphical interface for selection of a pathway on the BT, either automatically, semi-automatically, or manually, if desired. The third step involves an automatic segmentation of the pathway(s) into a set of waypoints along the path that can be visualized on a display. It is to be understood that the airways are being used herein as an example of a branched luminal anatomical network. Hence, the term "BT" is being used in a general sense to represent any such luminal network and not to be construed to only refer to a bronchial tree, despite that the initials "BT" may not apply to other networks.

Using a software graphical interface **1001** as shown in FIG. **9**, for generating and viewing a BT, starts with importing CT scan images of a patient's lungs, preferably in a DICOM format, into the software. The data may be imported into the software using any data transfer media, including but not limited to CDs, memory cards, network connections, etc. The software processes the CT scans and assembles them into a three-dimensional CT volume by arranging the scans in the order they were taken and spacing them apart according to the setting on the CT when they were taken. The software may perform a data fill function to create a seamless three-dimensional model. The software uses the newly-constructed CT volume to generate a three-dimensional map, or BT, of the airways. The three dimensional map can either be skeletonized, such that each airway is represented as a line, or it may be include airways having dimensions representative of their respective diameters. Preferably, when the BT is being generated, the airways are marked with an airflow direction (inhalation, exhalation, or separate arrows for each) for later use during the pathway generation step. The software then displays a representation of the three-dimensional map **1003** on the software graphical interface **1001**.

FIG. **10** depicts a further software graphical interface **1013** in which three views of the CT image are presented along with a computer generated model of the interior of the BT. As shown, the top left image **1005** is the lateral view of the CT volume of the lungs, i.e. as though looking parallel to the spine of the patient. The lower-left image **1007** is a birds-eye view of the CT volume of the lungs. The upper-right image **1009** is a side view of the CT volume of the lungs. Finally, the lower-right image **1011** is a three-dimensional perspective view inside a virtual airway of the BT. Cross-hairs **1015** span over three of the images to show the position in the CT image in all three planes.

A user presented with the graphical interface **1013** is able to scroll through the CT image, in any of the presented views and identify one or more targets. These targets are typically masses or tumors that the medical professional would like to biopsy or treat, and to which the medical professional would like to use the system to navigate. Once one or more targets are identified in the images **1005-1009**, and selected by a medical professional using the target selection tool incorporated in the software, the targets automatically appear on the image of the BT as targets **1017** in FIG. **10**.

Next, the software selects a pathway to the target. In one embodiment, the software includes an algorithm that does this by beginning at the selected target and following lumina back to the entry point. Using the airways as an example, the

target is first selected. The software then selects a point in the airways nearest the target. If the point closest to the target is in an airway segment that is between branches, the software has to choose between two directional choices. The pathway to the target may be determined using airway diameter. Moving toward the entry point (the trachea) results in an increased airway diameter while moving distally results in a decreased airway diameter. If the point closest to the target is in an airway segment that includes one or more branches, the choices are more numerous but the following the path of the greatest increase in airway diameter will still result in the correct path to the entry point. Though unlikely, in the event that an incorrect path is taken, the software would eventually detect an inevitable decrease in diameter, if this is the case, the software would automatically abort that path and revert to the last decision-making point. The algorithm will resume, blocking off the incorrect path as an option.

After the pathway has been determined, or concurrently with the pathway determination, the suggested pathway is displayed for user review. Preferably, the entire BT will be displayed with the suggested pathway highlighted in some fashion. The user will have zoom and pan functions for customizing the display. This is important as the software may identify a solution that rotation or zooming of the BT will show is less than ideal. For example, a planned route may include a 90 degree turn to reach the target. Such turns are nearly impossible for current catheter systems, as will be described in greater detail below, to accomplish, particularly as the airway passages become smaller. Thus, by rotating and zooming the image, a medical professional can determine a preferable route (e.g., one where the target is accessed in a more direct line from the airway). There may be additional reasons for editing the pathway, for example, though the targeted lesion is closest to a particular airway, there may be an artery or a lobe division between the selected airway and the target. Hence, it is important to provide the user with editing ability. In addition to the above described techniques for determining a pathway to a target, the present disclosure may also employ the techniques described in commonly assigned U.S. application Ser. No. 13/838,805 filed on Mar. 15, 2013 entitled "PATHWAY PLANNING SYSTEM AND METHOD," the entire contents of which is incorporated herein by reference.

This image **1011** is a CT-based "virtual bronchoscopy" which depicts simulated views similar to the actual bronchoscope views. The technology of virtual bronchoscopy is described in commonly assigned U.S. Pat. Nos. 6,246,784 and 6,345,112 both to Summers et al., as well as the references cited therein, all of which are hereby incorporated herein by reference. Once the pathway is edited, as necessary, the user can follow a fly-through virtual bronchoscopy image **1011**. The software generates a colored line which represents the pathway determined above. The medical professional is to follow the pathway through the trachea, and the airways until reaching the target. As can be appreciated, as the airways get smaller and smaller the ability of the software to resolve the airways becomes increasingly difficult, and the display **1011** may eventually not depict a clear airway lumen. Regardless, the target **1017** will be displayed in the computer generated image **1011** and allow the utilization of the system for pathway planning purposes.

Having identified a pathway in the BT connecting the trachea in a CT image with a target, a system is necessary to reach the target for biopsy of the target and eventually treatment if necessary. One such system is depicted in FIG. **11**. Specifically, FIG. **11** shows a patient **1000** lying on an operating table **1002**. A bronchoscope **1004** is inserted into his



lungs. Bronchoscope **1004** is connected to the monitoring equipment **1006**, and typically includes a source of illumination and a video imaging system. In certain cases, the devices of the present disclosure may be used without a bronchoscope, as will be described below. A position measuring system monitors the position of the patient **1000**, thereby defining a set of reference coordinates. A particularly preferred position measuring system is a six degrees-of-freedom electromagnetic position measuring system according to the teachings of U.S. Pat. No. 6,188,355 and published PCT Application Nos. WO 00/10456 and WO 01/67035, which are incorporated herein by reference. In this case, a transmitter arrangement **1008** is implemented as a mat positioned beneath patient **1000**. A number of miniature sensors **1020** are interconnected with a tracking module **1022** which derives the location of each sensor **1020** in 6 DOF (degrees of freedom). At least one, and preferably three, reference sensors **1020** are attached to the chest of patient **1000** and their 6 DOF coordinates sent to a computer **1024** where they are used to calculate the patient coordinate frame of reference.

FIG. **12** depicts a catheter assembly **1030**, constructed and operative according to the teachings of the present disclosure. Catheter assembly **1030** includes a locatable guide **1032** which has a steerable distal tip **1034**, a flexible body **1036** and, at its proximal end, a control handle **1038**. Guide **1032** is inserted into a sheath **1040** within which it is locked in position by a locking mechanism **1042**. A position sensor element **1044**, operating as part of the position measuring system of FIG. **11**, is integrated with distal tip **1034** and allows monitoring of the tip position and orientation (6 DOF) relative to the reference coordinate system.

There are several methods of steering the catheter **30**. In a first method, a single direction of deflection may be employed. Alternatively, a multi-directional steering mechanism with a manual direction selector may be employed to allow selection of a steering direction by the practitioner without necessitating rotation of the catheter body. FIG. **13** depicts a system for multi-directional steering using at least three, and preferably four, elongated tensioning elements ("steering wires") **1048** are attached. Steering wires **1048** are deployed such that tension on each wire individually will steer the tip towards a predefined lateral direction. In the case of four wires, the directions are chosen to be opposite directions along two perpendicular axes. In other words, the four wires are deployed such that each wire, when actuated alone, causes deflection of said tip in a different one of four predefined directions separated substantially by multiples of 90°. For practical reasons of ease of manufacture and reliability, wires **1048** are preferably implemented as pairs of wires formed from a single long wire extending from handle **1038** to tip **1034**, bent over part of base **1046**, and returning to handle **1038**, as shown.

A third alternative employs a catheter assembly **1030** having a curved or hooked configuration as shown in FIG. **14**. In such a system, it is the catheter sheath **1040** that is formed with a curved tip **1050**. The locatable guide **1032** is inserted into the sheath **1040** such that the sensor element **1044** projects from the distal tip of the sheath **1040**. The sheath **1040** and the locatable guide **1032** are locked together such that they are advanced together into the lung passages of the patient **1000**. The user when needing to select a path for further insertion of the catheter assembly **1030** simply rotates the locked together sheath **1040** and locatable guide **1032**. It has been found that the pre-forming of the curved tip **1050** of the sheath **1040** facilitates advancement by requiring only one hand of the user, and minimizing fatiguing motions such as squeezing of the control handle **1038** to release a locking

mechanism or to advance the sheath **1040** or locatable guide **1032**. This alternative is currently marketed by Covidien LP under the name EDGE®. Differing amounts of pre-curve implemented in the sheath **1040** can be used, however, common curvatures include 45, 90, and 180 degrees. The 180 degree sheath has been found particularly useful for directing the locatable guide **1032** to posterior portions of the upper lobe of the lung which can be particularly difficult to navigate.

As noted above, the present disclosure employs CT data (images) for the route planning phase. CT data is also used for the navigation phase. CT data is preferable to other imaging modalities because it has its own system of coordinates. Matching the two systems of coordinates, that of the CT and that of the patient, is commonly known as registration. Registration is generally performed by identifying locations in both the CT and on or inside the body, and measuring their coordinates in both systems.

Methods of manual and semi-automated registration of CT data and patient data are described in detail in for example U.S. Pat. No. 7,233,820 assigned to Covidien LP and incorporated herein by reference. While still a viable methods of registration, because particularly manual registration is somewhat time consuming and requires multiple steps, many practitioners rely on the automatic registration techniques the software of the current disclosure enables. However, in some instances, particularly if the CT image data is not of sufficient quality it may still be necessary or desirable to conduct manual registration.

Automatic registration has become the norm for most procedures because while the manual fiducial point designation of the above referenced registration techniques is highly effective, the choice of number of points sampled necessarily represents a tradeoff between accuracy and efficiency. Similarly, while the semi-automated technique is a viable option it requires an image sensor at the distal end of the catheter assembly which adds increased complexity to the system.

Automatic registration techniques are described in detail in commonly assigned U.S. patent application Ser. No. 12/780,678, which is incorporated herein by reference. Automatic registration between a digital image of a branched structure and a real-time indicator representing a location of a sensor inside the branched structure is achieved by using the sensor **1044** to "paint" a digital picture of the inside of the structure. Once enough location data has been collected, registration is achieved. The registration is "automatic" in the sense that navigation through the branched structure necessarily results in the collection of additional location data and, as a result, registration is continually refined.

The automatic registration method comprises the following steps and a system is adapted to perform the following steps: moving a locatable guide **1032** containing a location sensor **1044** within a branched structure of a patient **1000**; recording data pertaining to locations of said sensor while said sensor is moving through said branched structure using the transmitter arrangement **1008**; comparing a shape resulting from said data to an interior geometry of passages of said three-dimensional model of said branched structure; and determining a location correlation between said shape and said three-dimensional model based on said comparison.

Another aspect of the method comprises the following steps performed by the software of the present disclosure: identifying non-tissue space (e.g. air filled cavities) in said three-dimensional model; moving a locatable guide **1032** through at least one lumen of said branched structure while recording position data of a location sensor **1044** in said locatable guide **1032**; and aligning an image representing a location of said probe with an image of said three-dimen-



sional model based on said recorded position data and an assumption that said probe remains located in non-tissue space in said branched structure. Thus the software is capable of performing steps of comparing a shape, and determining a location correlation, or aligning an image.

The registration techniques operates on the premises that (1) the endoscope remains in the airways at all times and (2) recording the movement of a sensor on an endoscope results in a vastly greater sample set than recording discrete positions of a sensor on a stationary endoscope.

The registration methods may be referred to as "feature-based registration." When the CT scans are taken, the CT machine records each image as a plurality of pixels. When the various scans are assembled together to form a CT volume, voxels (volumetric pixels) appear and can be defined as volume elements, representing values on a regular grid in three dimensional space. Each of the voxels is assigned a number based on the tissue density Hounsfield number. This density value can be associated with gray level or color using well known window-leveling techniques.

The sensing volume of the electromagnetic field of the transmitter arrangement **1008** is also voxelized by digitizing it into voxels of a specific size compatible with the CT volume. Each voxel visited by the location sensor **1044** can be assigned a value that correlates to the frequency with which that voxel is visited by the location sensor **1044**. The densities of the voxels in the CT volume are adjusted according to these values, thereby creating clouds of voxels in the CT volume having varying densities. These voxel clouds or clusters thus match the interior anatomical features of the lungs.

By using a voxel-based approach, registration is actually accomplished by comparing anatomical cavity features to cavity voxels, as opposed to anatomical shapes or locations to structure shapes or locations. An advantage of this approach is that air-filled cavities are of a predictable range of densities. Air filled cavities may be identified as non-tissue space in the CT volume, which is a three-dimensional model. The location sensor **1044** may be moved through the lumen while recording position data thereof. This allows for aligning an image representing a location of said location sensor with an image of said three-dimensional model based on said recorded position data and an assumption that said probe remains located in non-tissue space. When moving the location sensor **1044** within a branched structure, data is recorded pertaining to locations of the location sensor **1044** while it is moving through said branched structure. Then a shape resulting from said data is compared to an interior geometry of passages of said three-dimensional model of said branched structure generated from the CT data. This provides for determining a location correlation between said shape and said three-dimensional model based on said comparison.

Registration using the technique of the present disclosure is accomplished by placing a location sensor **1044** into the airways and continually recording its position. This continues until there is enough data for a shape-matching algorithm to determine that the "painted" shape can only fit within the 3D CT volume in one place and orientation. Another way to accomplish initial registration is to simply navigate the probe down a plurality of various airways, preferably selected in both lungs. As stated above, the more airways visited, the smaller the registration error.

Yet a further procedure is described with reference to FIG. 15. In the method of FIG. 15 the bronchoscope **1004** is inserted into the patient **1000**, as shown in FIG. 11. The locatable guide **1032** is extended beyond the end of the sheath **1040**, both of which extend approximately 10 mm past the distal end of the bronchoscope **1004**.

Once in place in the patient **1000**, a screen **1100** will be displayed by the software on the monitoring equipment **1006** (FIG. 11). The right image is the actual bronchoscopic image **1102** generated by the bronchoscope **1004**. Initially there is no image displayed in the left image **1104**, this will be a virtual bronchoscopy, as discussed above, generated from the CT image data, once registration is complete.

Starting with the locatable guide **1036**, and specifically the sensor element **1044** approximately 3-4 cm above the main carina, as viewed through the bronchoscope **1004**, the bronchoscope is advanced into both the right and left lungs to the fourth generation of the lung passages. By traversing these segments of the lungs, sufficient data is collected as described above such that registration can be accomplished. When registration is achieved, which may be indicated to the user by highlighting the virtual bronchoscopy image **1104** in green, or some other visual indicator, the registration can be checked. This is accomplished by again directing the bronchoscope to image the main carina and both of the right upper lobe and left upper lobe carina. Visual comparison by the user confirms that the registration is accurate. If needed, rotation of the visual bronchoscopy by the user can correct minor image issues. If the user is displeased with the results, or is unable to achieve registration, perhaps due to a prior resection or treatment of the patient's lungs, manual registration is always available for use, as described above.

Now that the targets have been identified, the pathway planned, the bronchoscope **1004** including locatable guide **1032** inserted into the patient **1000**, and the virtual bronchoscopy image registered with the image data of the bronchoscope **1004**, the system is ready to navigate the location sensor **1044** to the target within the patient's lungs. The computer **1024** provides a display similar to that shown in FIG. 10 identifying the target **1017** and depicting the virtual bronchoscopy image **1011**. However, appearing in each of the images on the display is the pathway from the current location of the location sensor **1044** to the target **1017**. This is the pathway that was established during the pathway planning phase discussed above. The pathway may be represented, for example, by a colored line. Also appearing in each image is a representation of the distal tip of the locatable guide **1032** and location sensor **1044**. By advancing the locatable guide **1032** and following the pathway the medical professional is able to follow the identified pathway to the target **1017**. At times, as discussed above, the virtual bronchoscopy image **1017** may not provide sufficient accuracy, particularly at the pleura boundaries of the lungs. In such instances the user can rely on the CT images **1005-1009** to provide greater details. Though shown with just three views in images **1005-1009**, there are in fact a wide variety of images that can be employed here, mostly derived from the CT imaging data.

Although the position of the location sensor **1044** is measured in real time, the target **1017** location is not. The target **1017** is generally considered fixed relative to the patient's body position **1000** which is monitored in real time by sensors **1020** (FIG. 12). However, navigation accuracy may decrease as a result of cyclic chest movement resulting from breathing. Preferably, precautions are taken to reduce the effects of this cyclic movement including reducing the respiration rate of the patient. In addition this movement may be accounted for in the software by sampling the position sensors positions **1020** selectively so that measurements are only made at an extreme of a cyclic motion. The extremes of the motion of the patient's chest can readily be identified by the cyclic displacement of sensors **1020** during the breathing cycle. It may be preferred to use the maximum exhalation state for measurements since this state typically remains steady for a relatively

larger proportion of the breath cycle than the maximum inhalation state. Alternatively, measurements can be taken continuously, and the cyclic variations eliminated or reduced by additional processing. This processing may include applying a low-frequency filter to the measurements. Alternatively, an average of the measurements over a time period of the cyclic motion may be calculated and used to assist in approximating the location of the target. This is assisted by knowing whether the CT data was derived with the patient in a fully inhaled or exhaled position, which can be used for comparison and greater approximation of positioning.

Once the locatable guide **1032** has successfully been navigated to the target **1017** location, the locatable guide **1032** is preferably removed, leaving sheath **1040** in place as a guide channel for bringing a tool to the target location **1017**. The medical tools may be biopsy tools that can be used to sample the target **1017**. These samples are retrieved and a determination is made whether treatment of the target is necessary. Details of this system are included in U.S. Pat. No. 7,233,820, already incorporated herein by reference.

A further use of the sheath **1040** following removal of the locatable guide **1032** is as a conduit for the placement of one or more markers (**1300** FIG. 17) within the patient. These markers can be used for a variety of purposes including identifying tumors and lesions for follow-up analysis and monitoring, to identify locations that biopsy sampling has been undertaken, and to identify the boundaries or the center of a tumor or lesion for application of treatment. Other uses will be understood by those of skill in the art as falling within the scope of the present disclosure.

The placement of markers can be particularly useful in the context of performing a video assisted thoracoscopic surgery (VATS) lung procedure. VATS procedures performed on a patient **1000** of FIG. 16A involves inserting a video scope **1200** (camera) and laparoscopic tools including a forceps **1202** and an ablation probe **1204** into the chest cavity of the patient **1000** though one or more ports formed in the chest wall. The video scope **1200** allows the surgeon to visualize the lung **1206** on a monitor **1208**, as depicted in FIG. 16B. The ablation probe **1204** is inserted into the tissue of the lung **1206** and energized in order to ablate the tissue of interest and treat the lung tissue as described above.

Though described here with respect to treatment of lung tissue embodiments of the present disclosure are equally applicable for use in treatment of other tissues. For example, it is contemplated that the systems and methods of the present disclosure may be used to treat liver tissue, kidney tissue, pancreatic tissue, gastrointestinal tissue, interstitial masses, and other portions of the body known to those of skill in the art to be treatable via microwave ablation.

Returning to the treatment of lung tissue, lung lesions, especially small ones or those located on closer to the pleura boundaries are difficult for thoracic medical professionals to identify and treat visually. To most clearly distinguish the tissue of interest, the medical professional should have either a tactile or a visible marker placed near the tissue of interest to help target the tissue slated for removal or ablation.

Accordingly to one embodiment of the present disclosure, using the system described above with reference to FIGS. 11 and 12, a medical professional is able to navigate a sheath **1040** through the working channel of a bronchoscope **1004** by manipulating control handle **1038** and therewith locatable guide **1032** to position a sensor **1044** proximal tissue of interest. This navigation of the lung must be performed while the lungs are inflated, or at least undergoing normal, albeit slowed respiration by the patient. According to at least one embodiment, with the sheath **1040** remaining in place, the

locatable guide **1032** is removed from the sheath **1040**, the medical professional is able to use the sheath **1044** to deploy one or more markers to identify the location of interest. As noted, above, this may be in order to return to this location for further study, treatment, biopsy, etc., or this may be used to identify locations for VATS procedures.

Though described herein with respect to a particular planning and navigation systems, other pathway planning and navigation systems may be employed without departing from the scope of the present disclosure. For example, the systems described in commonly assigned U.S. patent application Ser. Nos. 13/477,279; 13/477,291; 13/477,374; 13/477,395; 13/477,406; and 13/477,417, the entire contents of which are incorporated herein by reference, as well as those systems described for example is U.S. Pat. No. 7,876,942 currently assigned to Activiewes, LTD.

In order to perform VATS procedures, following placement of the markers the lung **1206**, or a portion of the lung **1206** is typically deflated. Deflation makes room for the video scope **1206** and other necessary tools (e.g., forceps **1202**). Further, this deflation leads greater energy absorption during microwave ablation because of the lower dielectric constant and dissipation factor of air as compared to lung tissue, accordingly removal of the air increase the overall absorption of microwave energy by the lung tissue, leading to higher tissue temperatures. Additionally, deflation reduces the thermal cooling which would otherwise occur from respiration of the lung, further increasing thermal ablation effectiveness.

A variety of techniques for identification of the location of implanted markers can be employed including fluoroscopy, ultrasound, and other imaging modalities. These are particularly useful when the marker is equipped with a radio-opaque portion, formed of, for example, gold. VATS procedures in particular lend themselves to visual identification, particularly when performing treatment of tissues near the pleura boundaries of the lungs. Some techniques to improve visualization involve the injection of inks or dyes into the patient to identify the location of the marker. These techniques tend to be more of a clinician based ad hoc solution to visual identification.

As an initial matter visualizing of markers of any kind, especially in a discolored and diseased lung tissue, can be very difficult. Further, traditional dyes and solutions tend to be spread too broadly for accurate identification of the tissue to be identified, particularly if the marker is placed more than a few hours before the surgical procedure. Typically surgery must be undertaken within 72 hours of dye injection. Gold fiducial markers on the other hand are difficult if not impossible to identify without some imaging modality, and sometimes currently available fiducial markers tend to migrate over time, or even as a result of a patient cough.

One embodiment of the present disclosure is directed to placement of a marker using the system described herein to promote visual identification of the tissue of interest during VATS and so that the tissue can be percutaneously ablated using the microwave system of FIG. 2A. FIG. 17 shows such a marker **1300**. The marker **1300** of FIG. 17 is made of made of a biocompatible material and includes an expanding material such as an implant grade hydrogel. In its dehydrated state, depicted in FIG. 18 as the darker cylinder **1302**, the marker **1300** is compatible with and fits within the inner diameter of a sheath **1040** of the catheter assembly **1030** of FIG. 12. For example, the diameter of the marker **1300** in its dehydrated state may be approximately 2 mm.

One method of deployment is to use a push catheter (not shown) to force the marker **1300** through the sheath **1040**. Markings on the push catheter enable the medical profes-

sional to know when the marker **1300** has been deployed out the distal end of the sheath **1040**. Placement of the marker **1300** may be either into the airway directly or alternatively, into a void created using a biopsy tool. The void may be in for example a tumor or mass and may allow for clear identification of the center of the tumor for ablation purposes.

The color of the dark cylinder **1302** is due to the expanding material enclosed therein having absorbed an ink material, such as methylene blue, indigo carmine, isosulfan blue, gentian violet, or others known to those of skill in the art. In one alternative, rather than an ink a radio opaque fluid/gel may also be employed.

Once placed in the body, the expanding material, such as a hydrogel, absorbs water and begins to expand until achieving an expanded size **1304**. Similar technologies are currently employed for placing breast biopsy markers. Over a short period of time the expanding material swells which assists in securing the marker **1300** in place. According to the present disclosure, in addition to the foregoing, while fluid is being absorbed into the hydrogel, the ink in the hydrogel can begin to leave the hydrogel via osmosis. However, because of the hydrogel material the rate of osmosis of the ink is metered, such that migration of the ink is greatly reduced as compared to direct injection of the inks as discussed above. One advantage of using ink is that it has the ability to penetrate calcified lesions or surrounding parenchyma of the lung **1206** and to clearly identify its location to a surgeon when viewing the lungs through a video scope **1200**, as shown in FIG. **16B**.

FIG. **18** depicts the effect of the implantation of a marker **1300** in a lung **1206** according to the present disclosure. Specifically FIG. **18** provides the image a medical professional might see when viewing lung **1206** through a video scope **1200**. The dime is placed in the image for size comparison purposes. This image is as one might see shortly (approximately 1-hour) after implantation, of marker **1300** near the pleura boundary of a lung **1206**. FIG. **19** depicts the same marker **1300** approximately 16 hours after implantation in the lung **1206** and while the lung **1206** is in a deflated state. As can be seen by the comparison the ink **1305** in the marker **1300** clearly defines the location of the marker **1300** on the lung **1206**, but has not diffused to the point of marking too much of the lung **1206**, and thus provides a good indication of the location of the marker **1300**. Thus the tissue of interest can be readily visualized by a medical professional performing a VATS procedure, for example to perform microwave ablation as disclosed herein. Further, as a result of the use of the marker **1300**, even a small area of interest can be identified and a biopsy sample taken or surgical procedure undertaken and trauma to surrounding, otherwise healthy tissue can be minimized. Though shown above after 16 hours of implantation, it is contemplated that markers of the present disclosure can be implanted up to one week prior to the procedure and still provide useable identification of the tissue of interest.

Another aspect of the marker of the present disclosure is that it may optionally contain a metallic or radio opaque marker within it. Metals usable for such a configuration include titanium, gold, and others. As shown in FIG. **20**, the marker **1300** is depicted in its expanded state **1304**, but without ink **1305**, encloses a metallic (radio opaque) marker **1306**. This metallic marker **1306** allows the position of the marker **1300** to be determined using fluoroscopy or other imaging modalities, to assist the surgeon. In the embodiments disclosed herein, the expandable material is preferably biodegradable, thus over time, for example 4-6 weeks the expandable material will degrade and be absorbed by the body.

Although embodiments have been described in detail with reference to the accompanying drawings for the purpose of

illustration and description, it is to be understood that the inventive processes and apparatus are not to be construed as limited thereby. It will be apparent to those of ordinary skill in the art that various modifications to the foregoing embodiments may be made without departing from the scope of the disclosure.

What is claimed is:

1. An ablation system comprising:

an image database including a plurality of computed tomography (CT) images of a luminal network;

a navigation system enabling, in combination with an endoscope and the CT images, navigation of a locatable guide and an extended working channel to a point of interest;

one or more fiducial markers, placed in proximity to the point of interest; and

a percutaneous microwave ablation device for applying energy to the point of interest, the percutaneous microwave ablation device including:

a feedline;

a balun disposed on an outer conductor of the feedline; and

a balun short electrically connecting the balun to the outer conductor.

2. The ablation system of claim 1, wherein the fiducial markers are placed through the extended working channel within the luminal network.

3. The ablation system of claim 1, further comprising a planning system enabling viewing of the CT images to determine a path through the luminal network to the point of interest.

4. The ablation system of claim 1, further comprising a transmitter generating an electromagnetic field about the luminal network.

5. The ablation system of claim 4, further comprising a plurality of fiducial markers on an exterior of the luminal network.

6. The ablation system of claim 5, wherein the electromagnetic field and the fiducial markers on the exterior of the luminal network enable the navigation system to determine the position of the locatable guide within the luminal network.

7. The ablation system of claim 6, wherein the determination of the position of the locatable guide enables the navigation system to display a graphic representation of the location of the locatable guide based on the CT image data.

8. The ablation system of claim 7, wherein the graphic representation includes a path the locatable guide and the extended working channel must follow to reach the point of interest.

9. The ablation system of claim 6, wherein the location of the locatable guide and the CT image data are registered to one another.

10. The ablation system of claim 1, further comprising a laparoscope to view an exterior portion of the luminal network.

11. The ablation system of claim 10, further comprising a laparoscopic image display device.

12. The ablation system of claim 1, wherein the one or more fiducial markers placed in proximity to the point of interest include a hydrogel material that expands following implantation.

13. The ablation system of claim 12, wherein the one or more fiducial markers include a dye that dissipates from the marker over time and when the marker is placed proximate an exterior surface of the luminal network is visible through the laparoscope to identify the point of interest.

27

14. The ablation system of claim 12, wherein the one or more fiducial markers include a radiologically opaque marker enabling the position of the marker to be determined using imaging modalities.

15. The ablation system of claim 1, further comprising a microwave generator connected to the percutaneous ablation device.

16. The ablation system of claim 1, further comprising a fluid cooling system supplying cooling fluid to the percutaneous ablation device.

17. The ablation system of claim 1, wherein the percutaneous ablation device comprises a temperature sensor sensing the temperature of the balun therein.

18. The ablation system of claim 17, wherein the temperature sensor is positioned in contact with the balun short electrically connected to the outer conductor of the percutaneous ablation device.

19. The system of claim 1, wherein the percutaneous microwave ablation device, locatable guide, and extended working channel are sized for navigation and ablation of lung tissue.

20. An ablation system, comprising:

a microwave ablation device configured to be inserted into a patient percutaneously and having a radiating section and a proximal handle;

a cooling system configured to provide cooling to the microwave ablation device during an ablation procedure;

a temperature sensing system configured to sense a temperature of tissue proximate the radiating section of the microwave ablation device;

an energy source configured to provide microwave energy to the microwave ablation device; and

a navigation system configured to indicate to a user a location of an ablation target and a pathway to the target, wherein the microwave ablation device includes:

a feedline;

28

a balun disposed on an outer conductor of the feedline; and

a balun short electrically connecting the balun to the outer conductor.

21. The ablation system of claim 20, further comprising at least one temperature sensor on the radiating section sensing the temperature of tissue adjacent the microwave ablation device.

22. The ablation system of claim 21, wherein the temperature sensing system receives temperature data from each of the temperature sensors.

23. The ablation system of claim 22, wherein the temperature data provides feedback to the energy source to control the operation of the energy source.

24. The ablation system of claim 23, wherein the temperature sensing system compares the received temperature data to temperature profiles stored in a memory for determining whether sufficient energy has been applied to the tissue.

25. The ablation system of claim 22, wherein the temperature sensing system stores in the memory radiation patterns associated with the received temperature data, a duration of energy application, and a power setting of the energy source.

26. The ablation system of claim 20, wherein the navigation system employs a planning phase and a navigation phase.

27. The ablation system of claim 26, wherein the planning phase employs a CT image to identify the ablation target.

28. The ablation system of claim 26, wherein the navigation phase requires registration of a second image to the CT image.

29. The ablation system of claim 20 further comprising one or more fiducial markers placed using the navigation system at the ablation target.

30. The ablation system of claim 29, wherein the fiducial marker includes a releasable dye to mark the location of the marker.

\* \* \* \* \*

专利名称(译)	微波能量输送装置和系统		
公开(公告)号	<a href="#">US9301723</a>	公开(公告)日	2016-04-05
申请号	US13/835283	申请日	2013-03-15
[标]申请(专利权)人(译)	柯惠有限合伙公司		
申请(专利权)人(译)	COVIDIEN LP		
当前申请(专利权)人(译)	COVIDIEN LP		
[标]发明人	BRANNAN JOSEPH D LADTKOW CASEY M PETERSON DARION R LARSON ERIC W DICKHANS WILLIAM J WILLYARD RICHARD A CASE JASON A		
发明人	BRANNAN, JOSEPH D. LADTKOW, CASEY M. PETERSON, DARION R. LARSON, ERIC W. DICKHANS, WILLIAM J. WILLYARD, RICHARD A. CASE, JASON A.		
IPC分类号	A61B5/05 A61B18/18 A61B6/03 A61B18/00		
CPC分类号	A61B18/1815 A61B34/20 A61B6/03 A61B2018/00702 A61B2018/00708 A61B2018/00761 A61B2018/00023 A61B2018/0066 A61B2018/00482 A61B2018/00511 A61B2018/00529 A61B2018/00541 A61B2018/00577 A61B2018/00642 A61B2018/00684 A61B2018/00797 A61B2018/00803 A61B2018/00821 A61B2018/00898 A61B2018/00904 A61B2018/00982 A61B2018/1861 A61B2034/107 A61B2034/2051 A61B2034/2072 A61B2090/363 A61B2090/395 A61B2090/3966 A61B34/25 A61B2017/00123 A61B2018/00333 A61B2018/00678 A61B2018/1838 A61B2018/1846 A61B2018/1853 A61B2018/1892 A61B34/10 A61B2018/00666 A61B2018/00791		
其他公开文献	US20140276033A1		
外部链接	<a href="#">Espacenet</a> <a href="#">USPTO</a>		

#### 摘要(译)

一种消融系统，包括存储管腔网络的多个计算机断层摄影（CT）图像的图像数据库和导航系统，该导航系统能够结合内窥镜和CT图像，将可定位导向器和扩展工作通道导航到一个点出于兴趣。该系统还包括一个或多个基准标记，放置在感兴趣点附近，以及经皮微波消融装置，用于将能量施加到感兴趣点。

