



US 20050023324A1

(19) **United States**(12) **Patent Application Publication** (10) **Pub. No.: US 2005/0023324 A1**
(43) **Pub. Date: Feb. 3, 2005**
Doll et al.(54) **SURGICAL STAPLING INSTRUMENT
HAVING A SINGLE LOCKOUT MECHANISM
FOR PREVENTION OF FIRING****Publication Classification**(51) **Int. Cl.⁷** **A61B 17/04**(52) **U.S. Cl.** **227/175.2**(76) **Inventors:** **Kevin Doll**, Mason, OH (US); **Michael Earl Setser**, Burlington, KY (US);
Frederick E. Shelton IV, Hillsboro, OH (US); **Kenneth Wales**, Mason, OH (US)(57) **ABSTRACT**

Correspondence Address:

PHILIP S. JOHNSON
JOHNSON & JOHNSON
ONE JOHNSON & JOHNSON PLAZA
NEW BRUNSWICK, NJ 08933-7003 (US)

A surgical instrument for laparoscopic and endoscopic clinical procedures simultaneously severs and staples tissue clamped in an end effector comprising an elongate channel, which holds a staple cartridge, and a pivotally attached anvil. An E-beam firing bar engages the channel and selectively engages the anvil during distal firing movements, wherein the tissue is severed and stapled driven upward from the staple cartridge to form against the anvil. In particular, a wedge integral to the staple cartridge is driven distally by a middle pin of the firing bar to effect stapling. A single lockout of the elongate channel responds to the presence of the wedge sled in its unfired position to allow the firing bar to fire. Otherwise, the single lockout prevents firing when the staple cartridge is missing or spent.

(21) **Appl. No.:** **10/687,503**(22) **Filed:** **Oct. 15, 2003****Related U.S. Application Data**

(63) Continuation-in-part of application No. 10/441,424, filed on May 20, 2003.

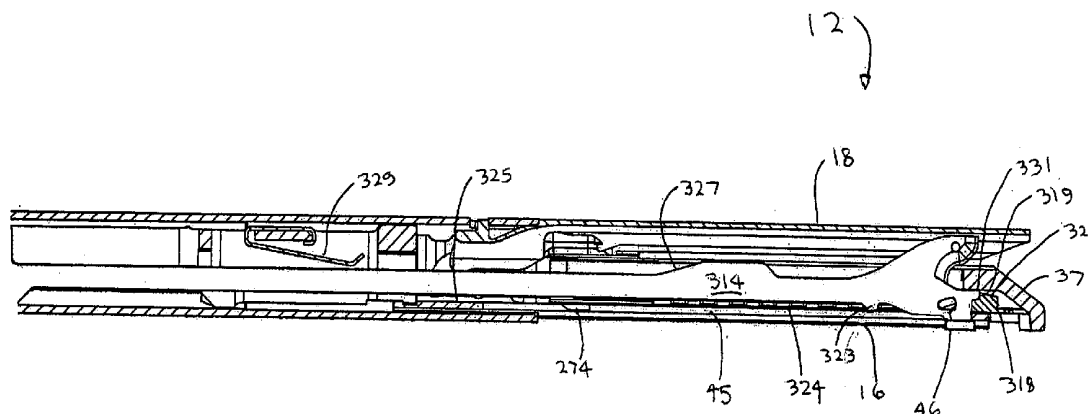

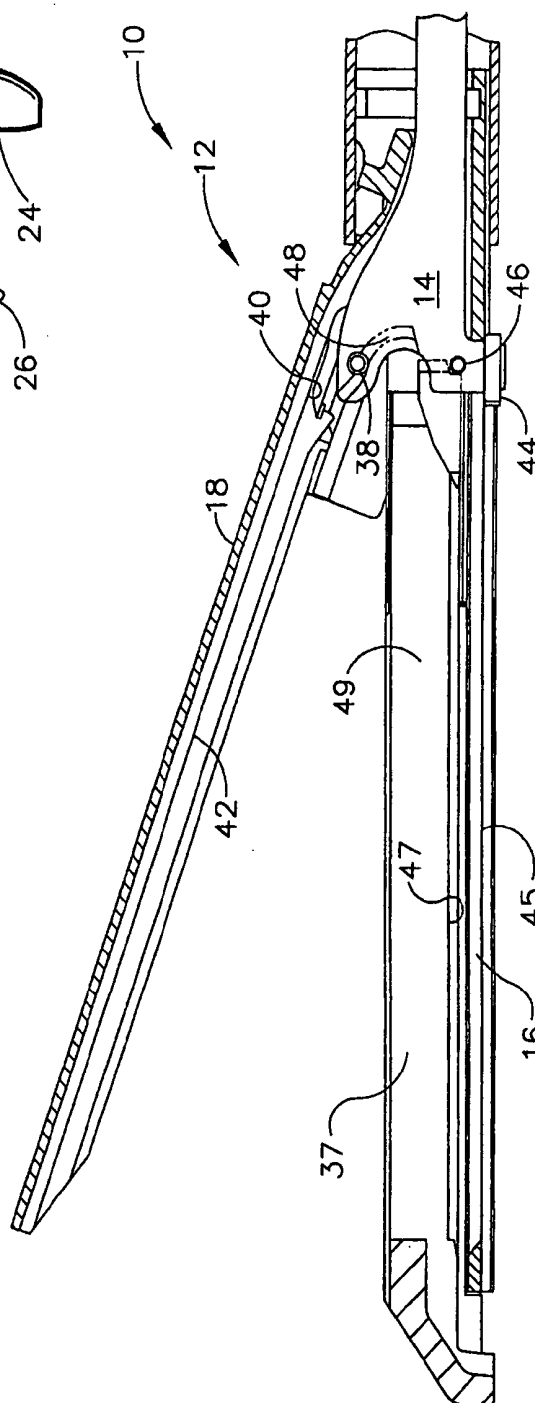
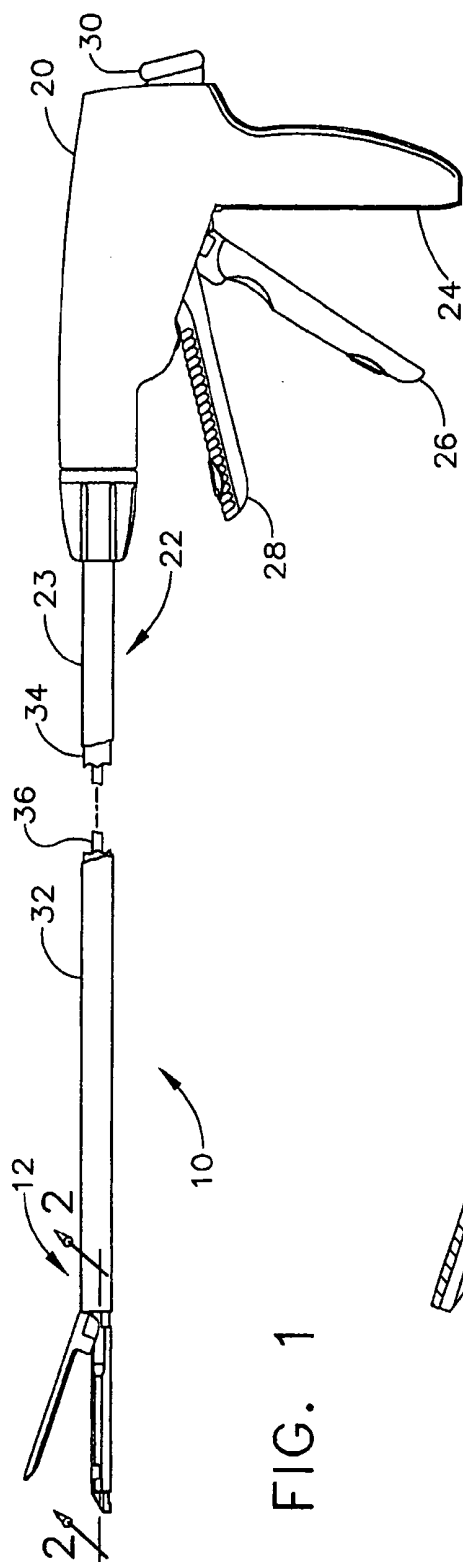

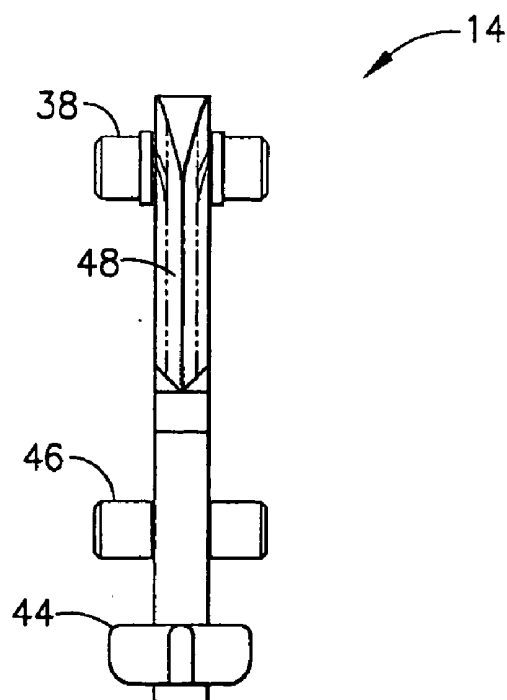
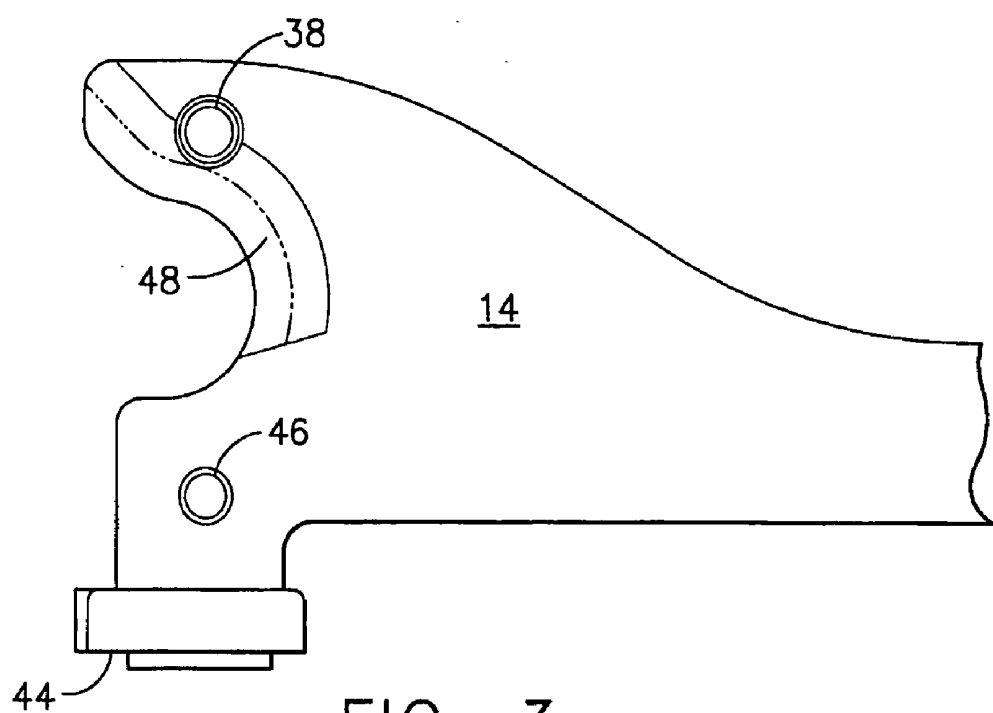

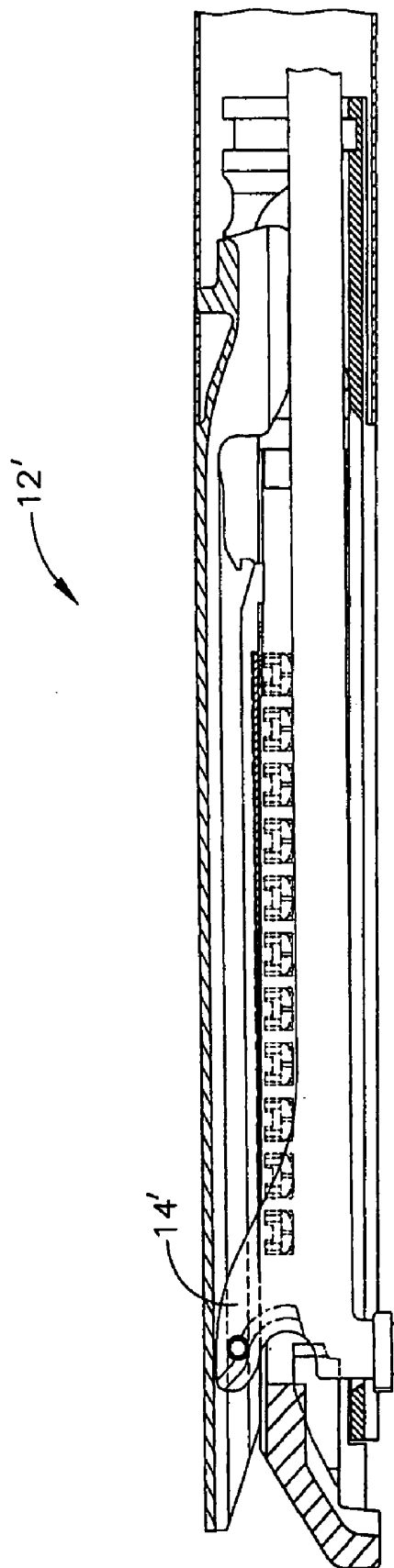
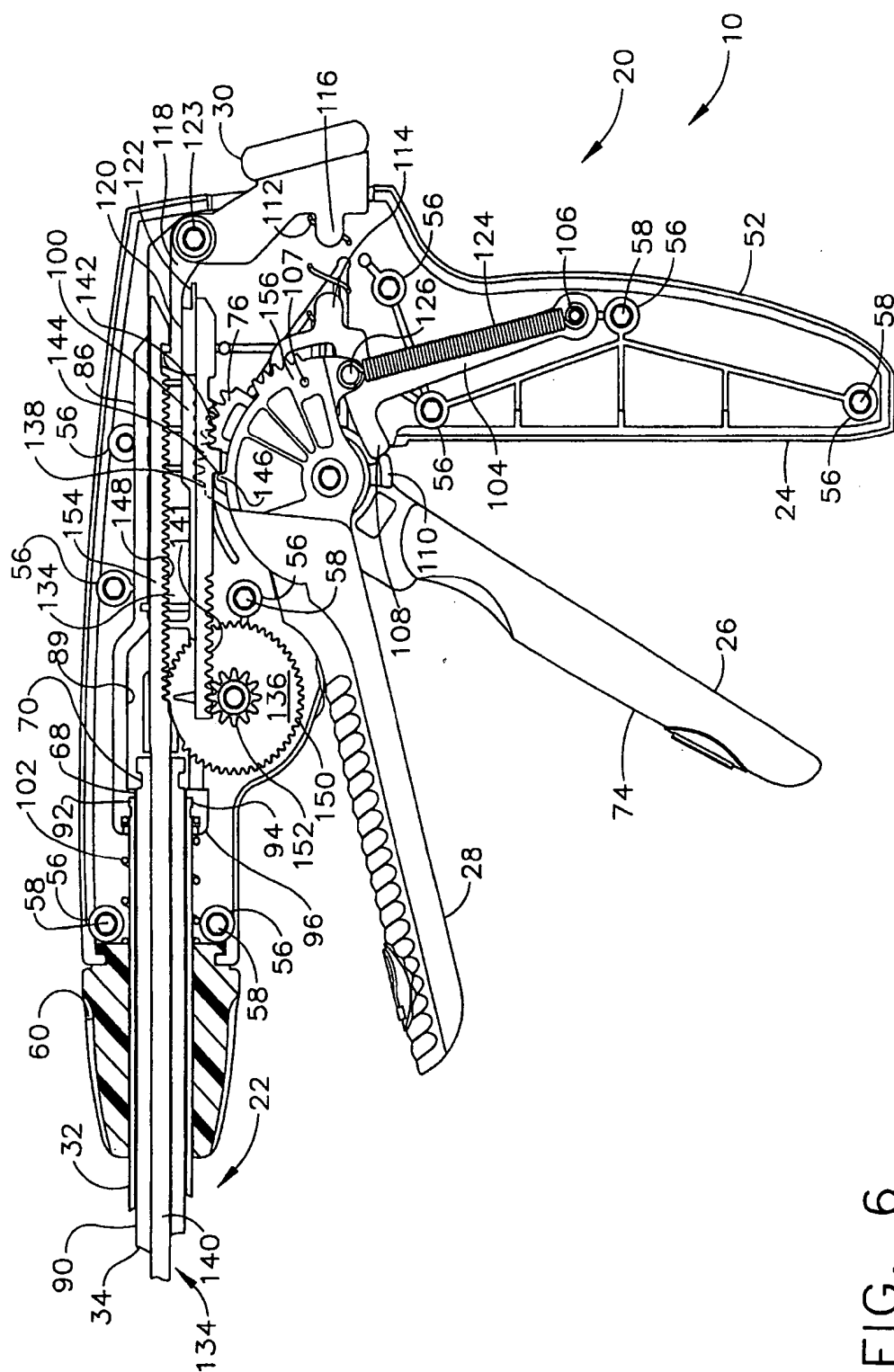

FIG. 5



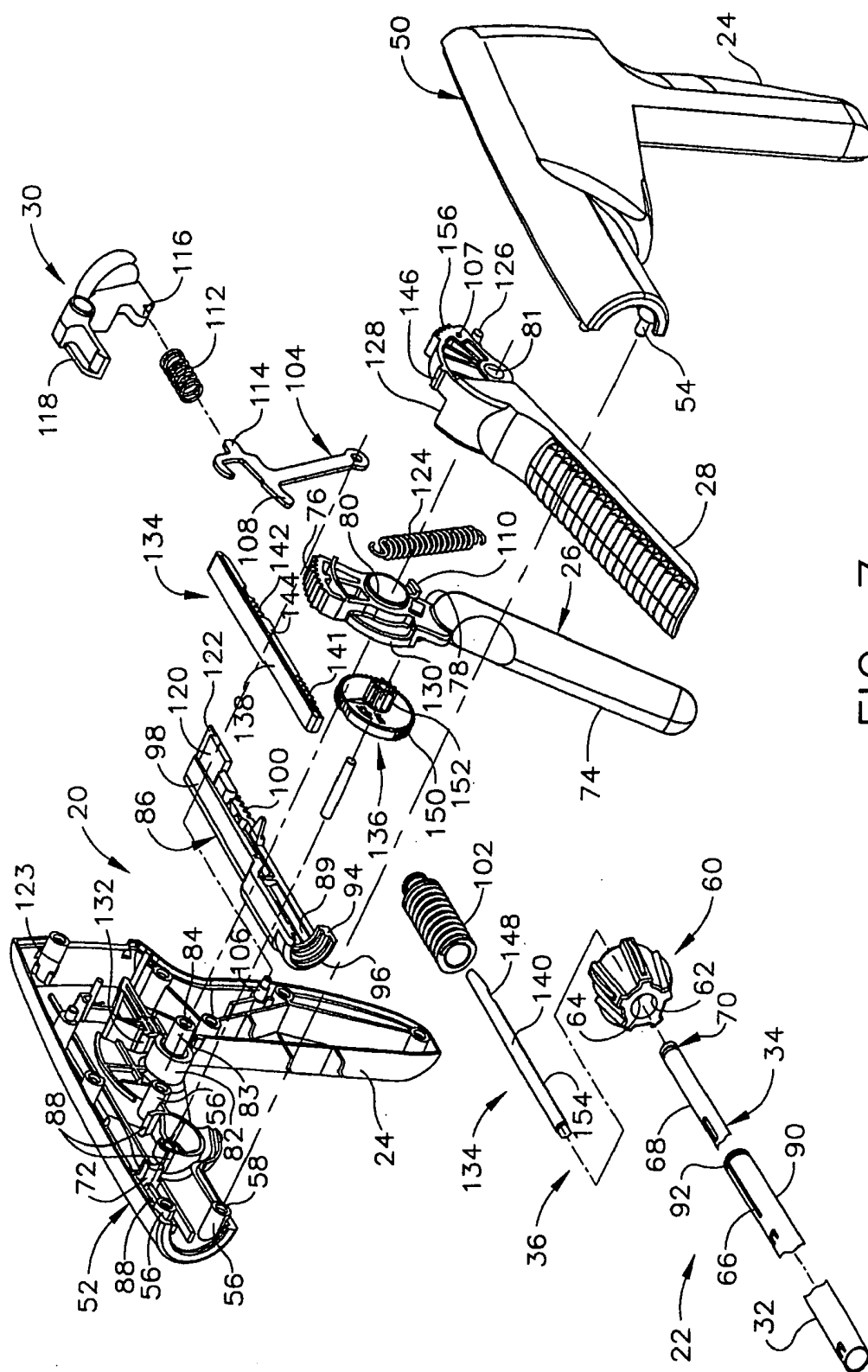

FIG. 7

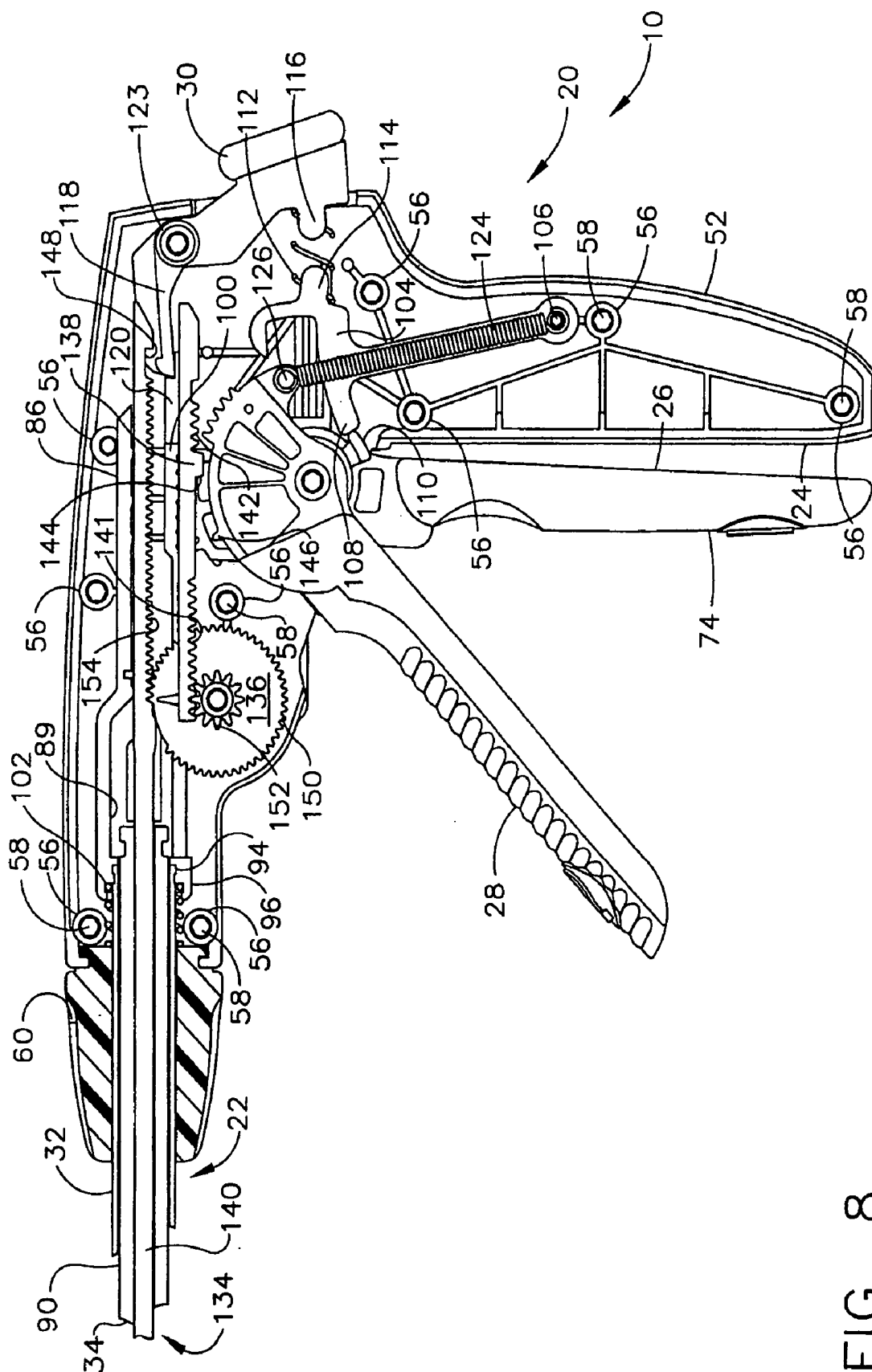

FIG. 8

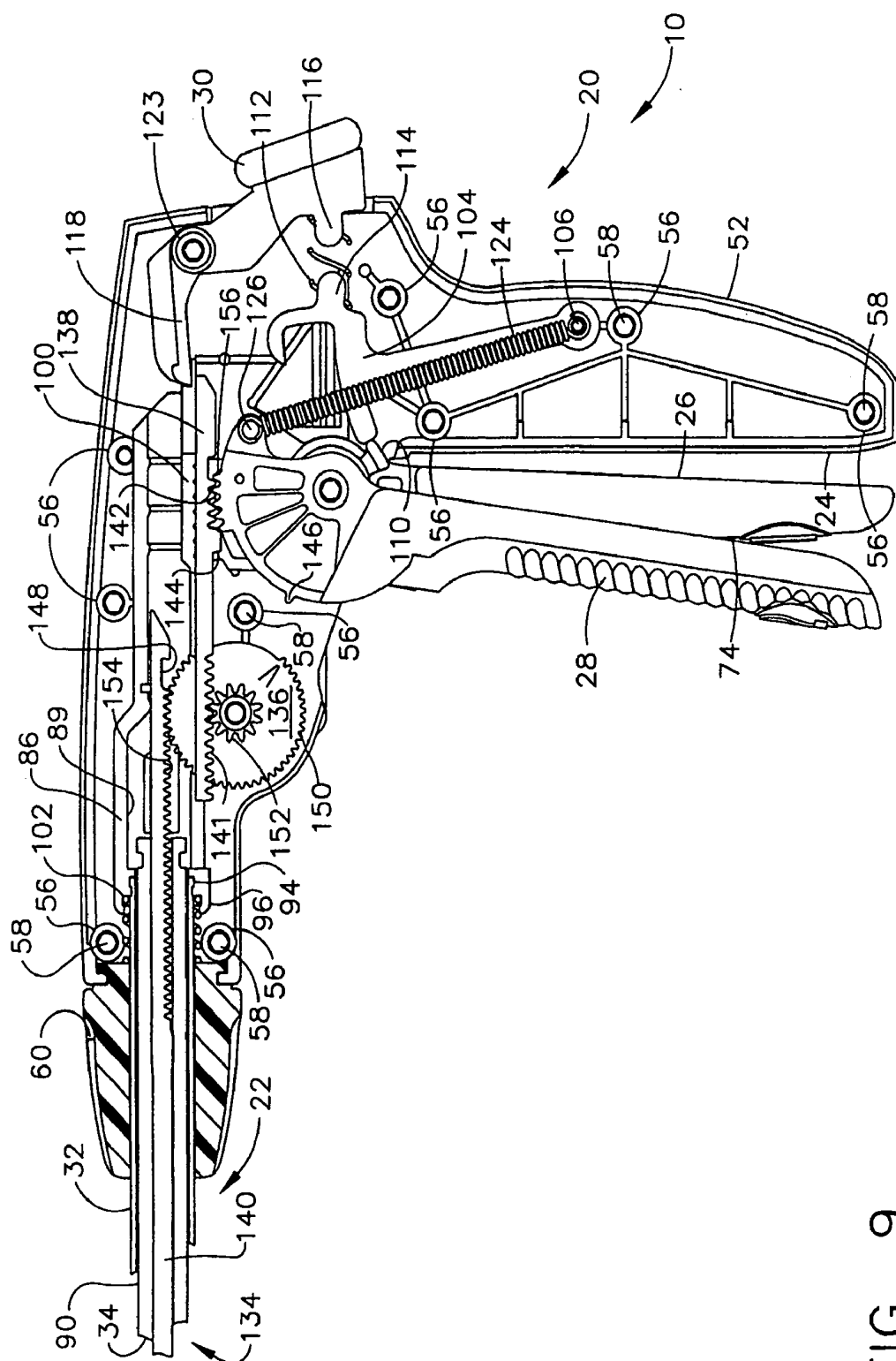

Fig. 9

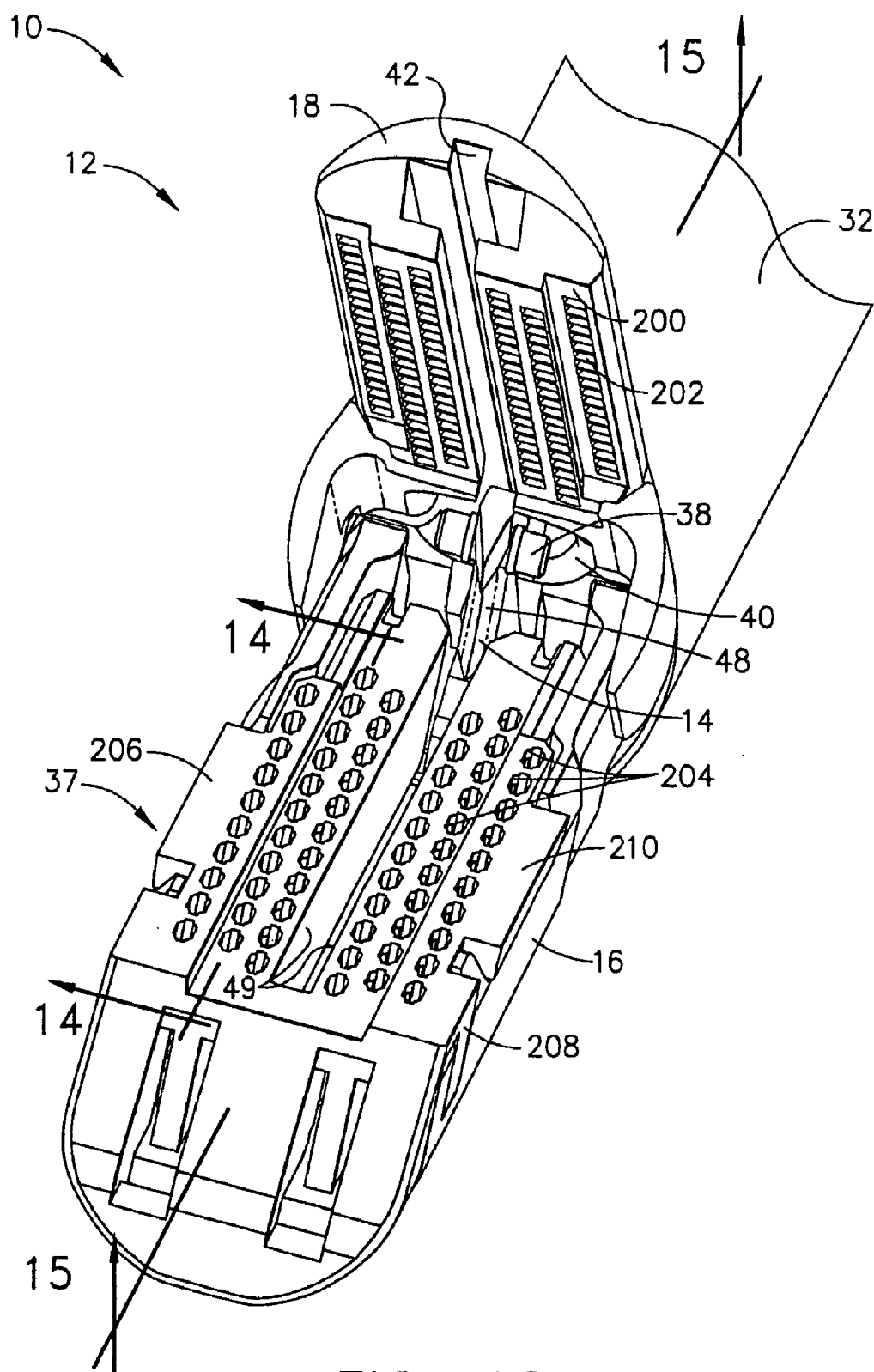
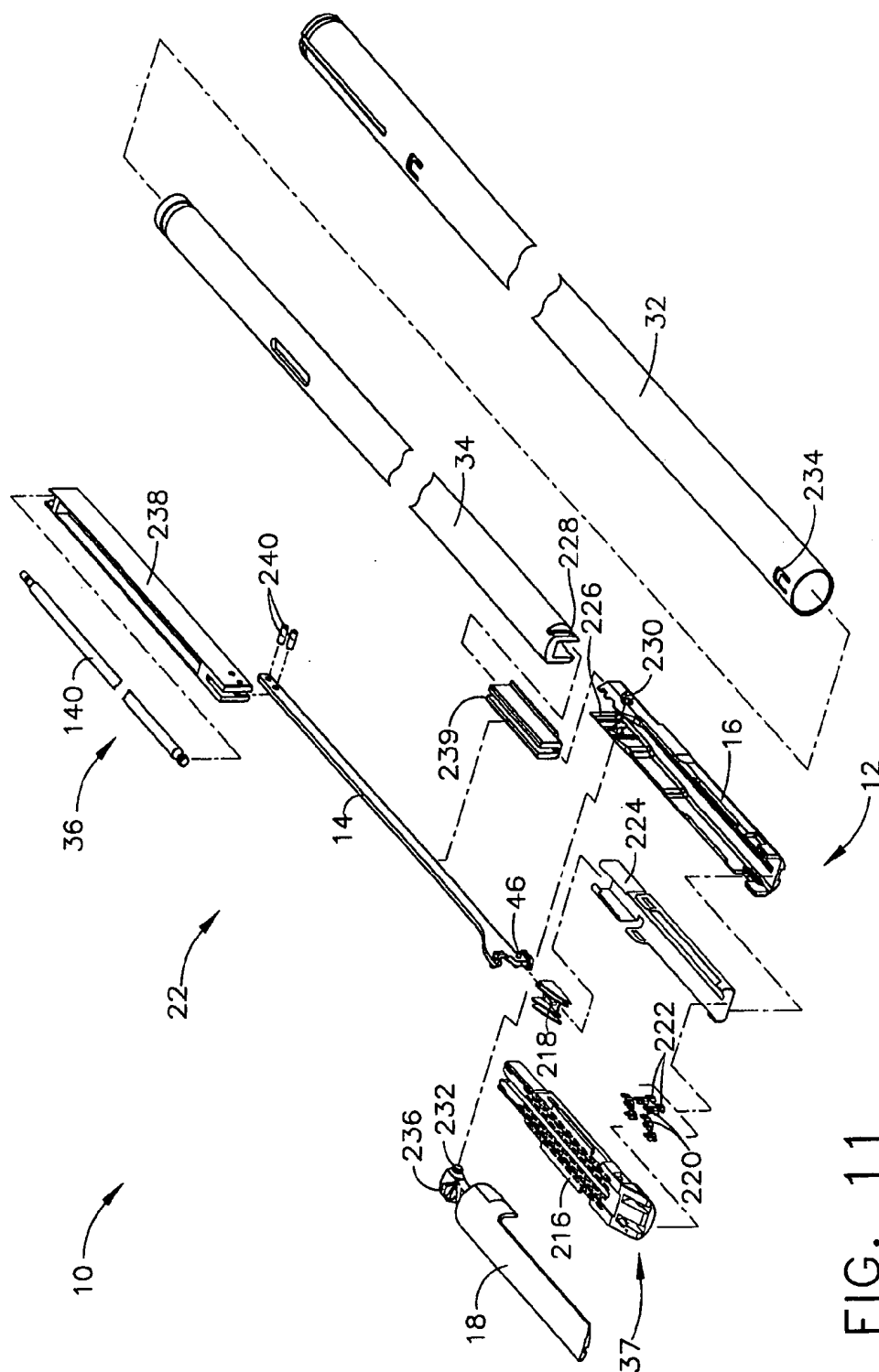

FIG. 10



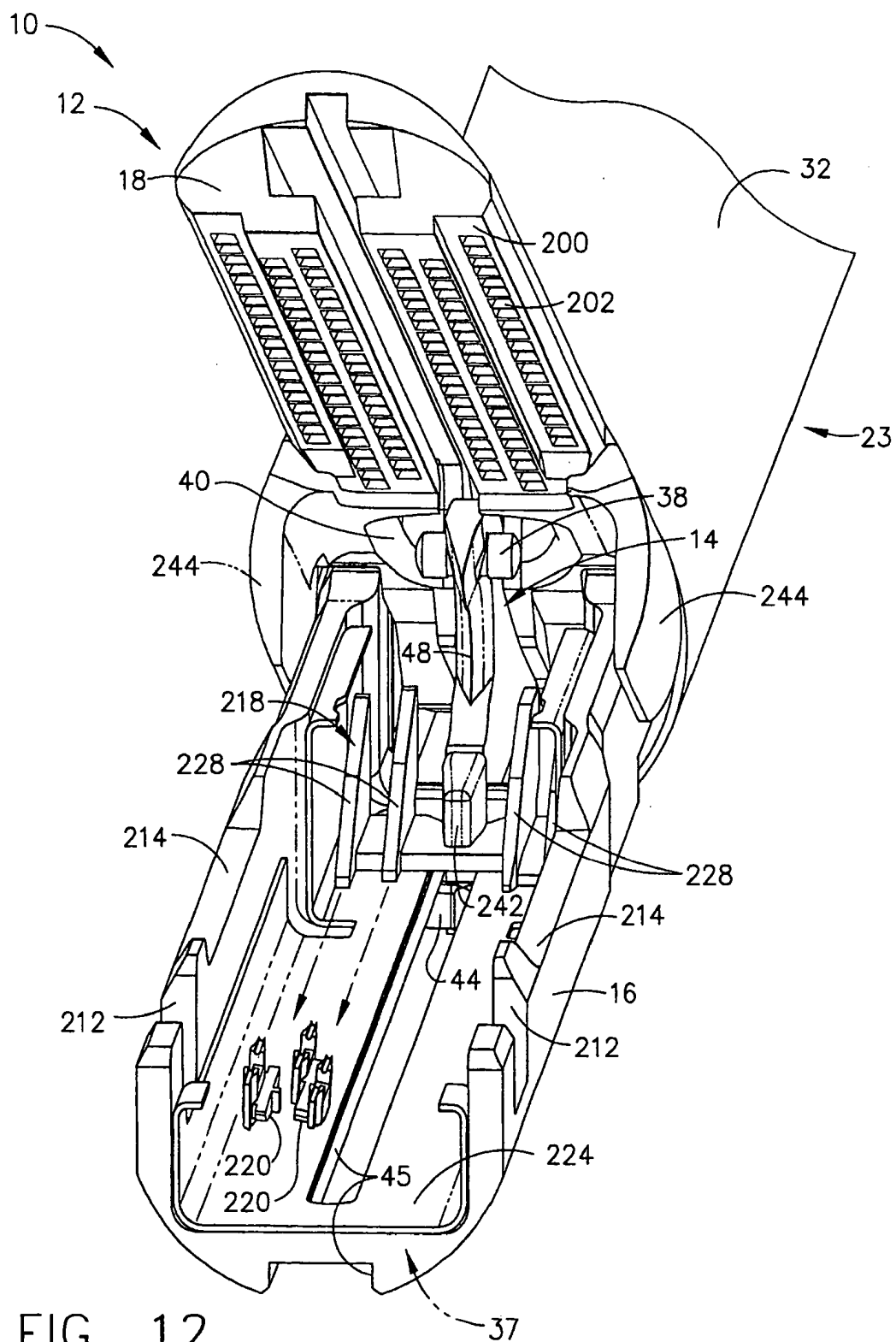

FIG. 12

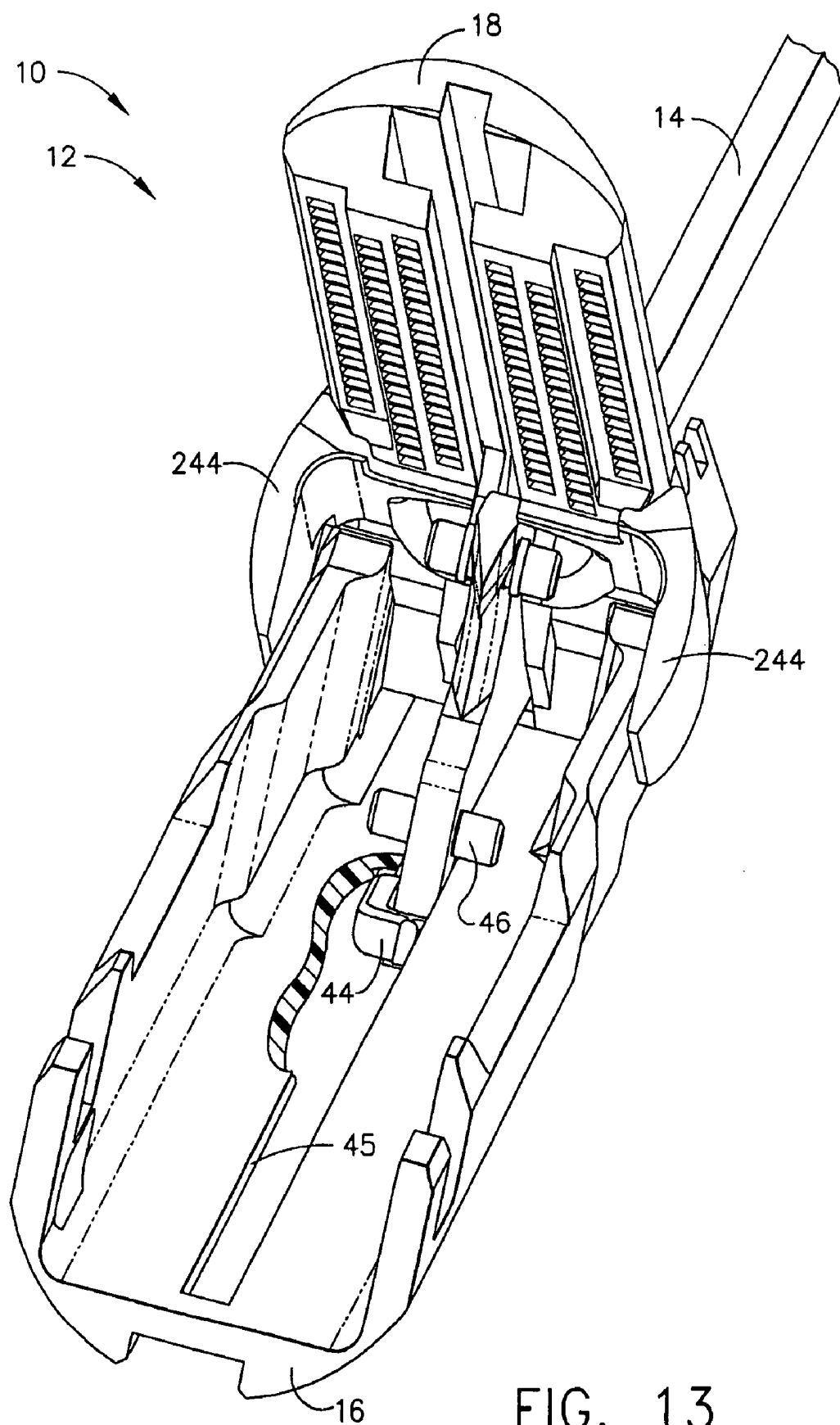

FIG. 13

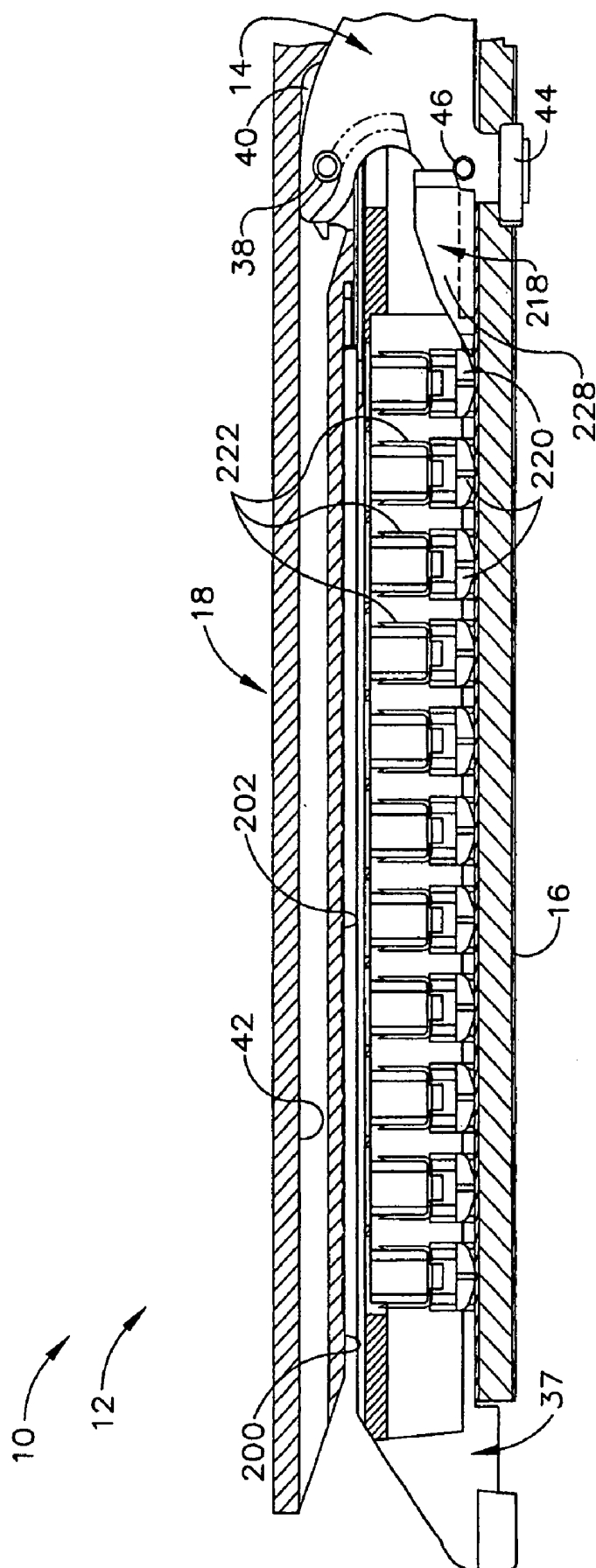
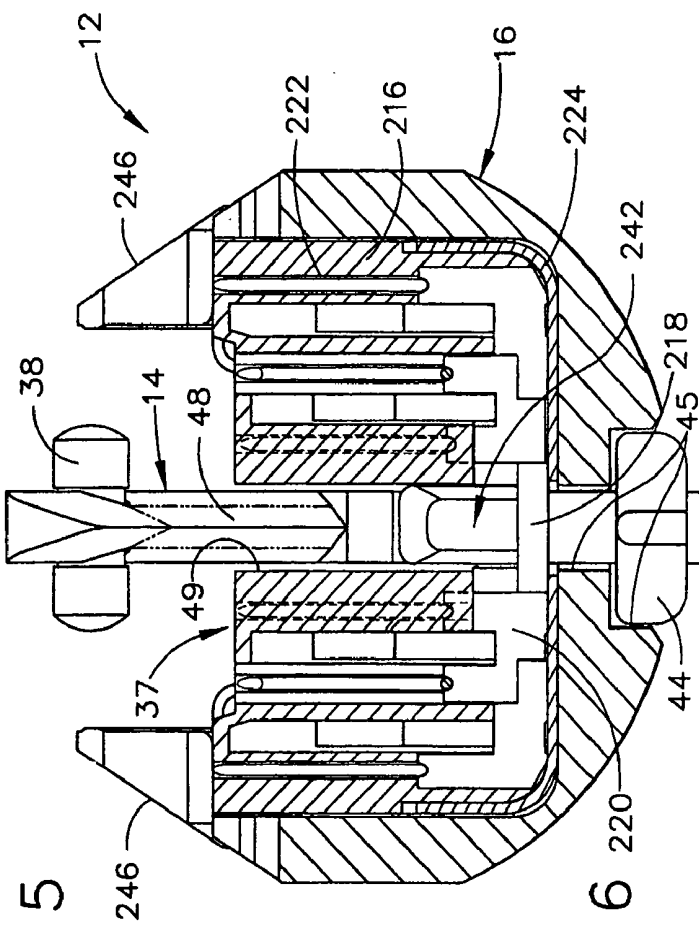
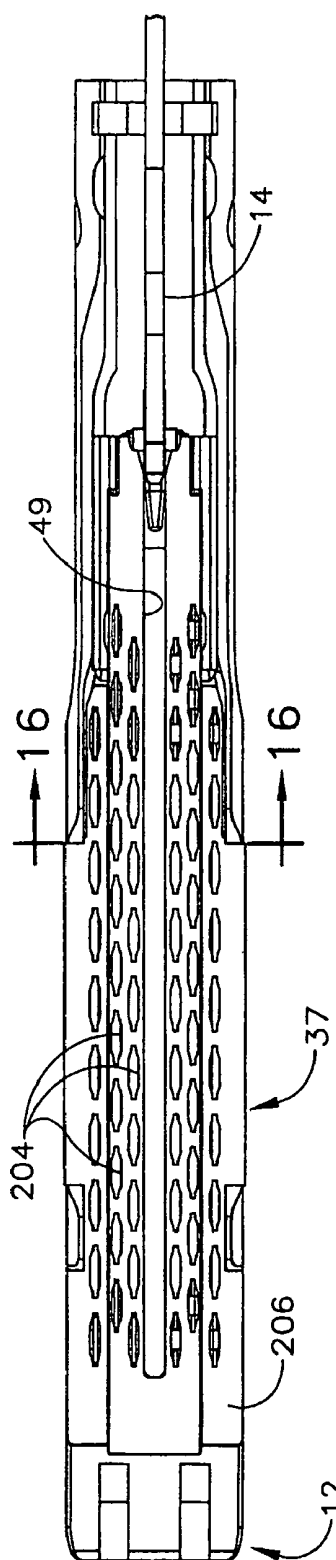

FIG. 14



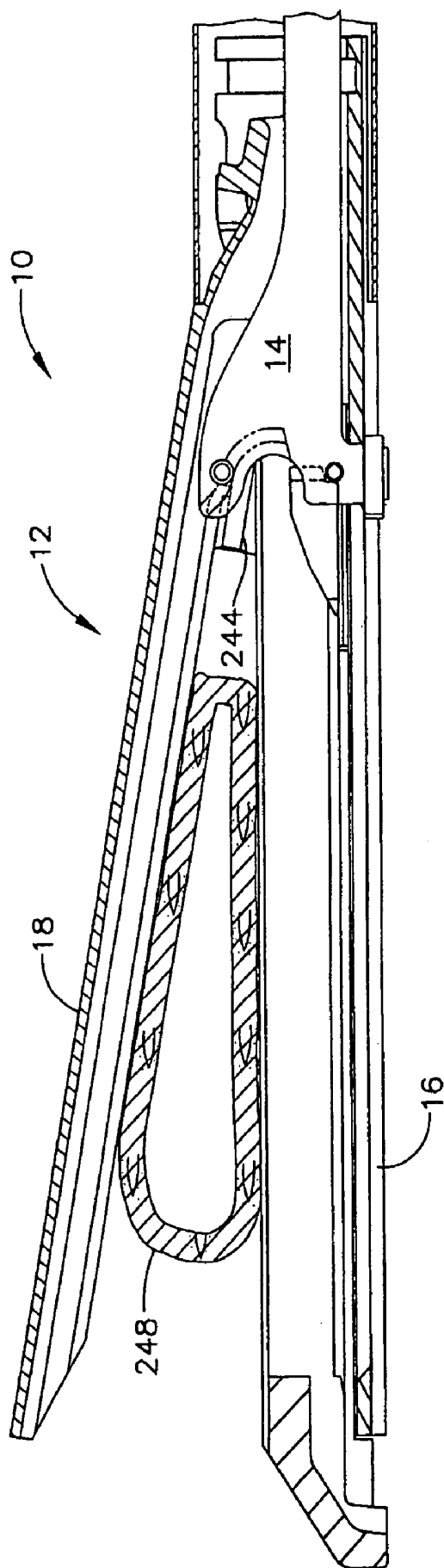

FIG. 17

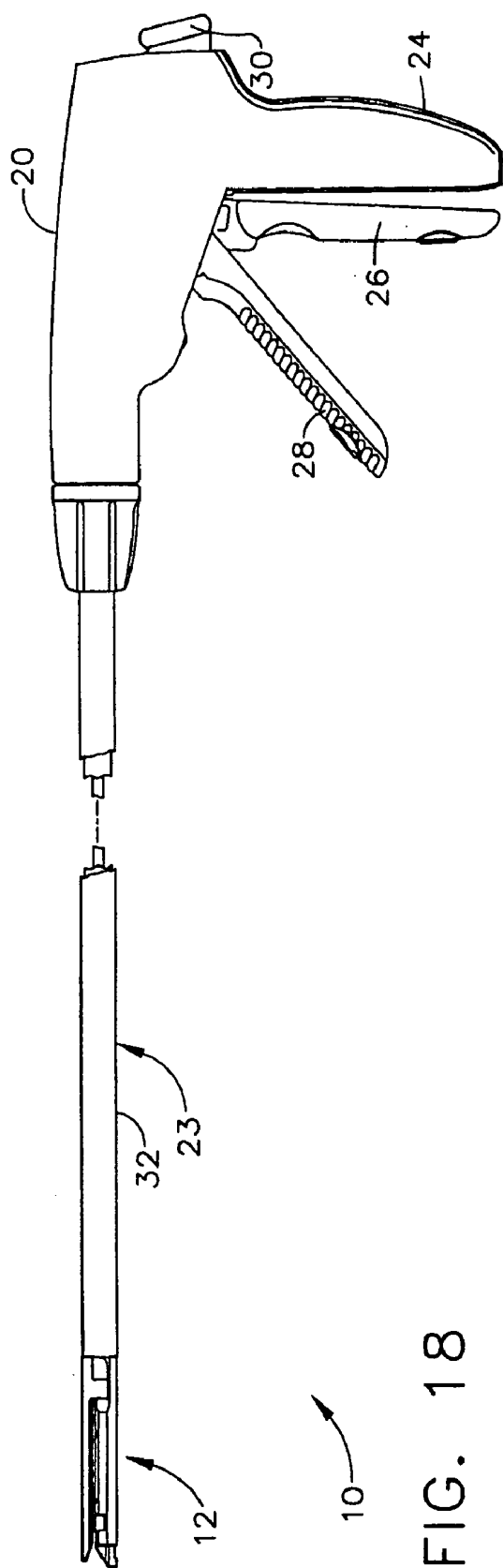

FIG. 18

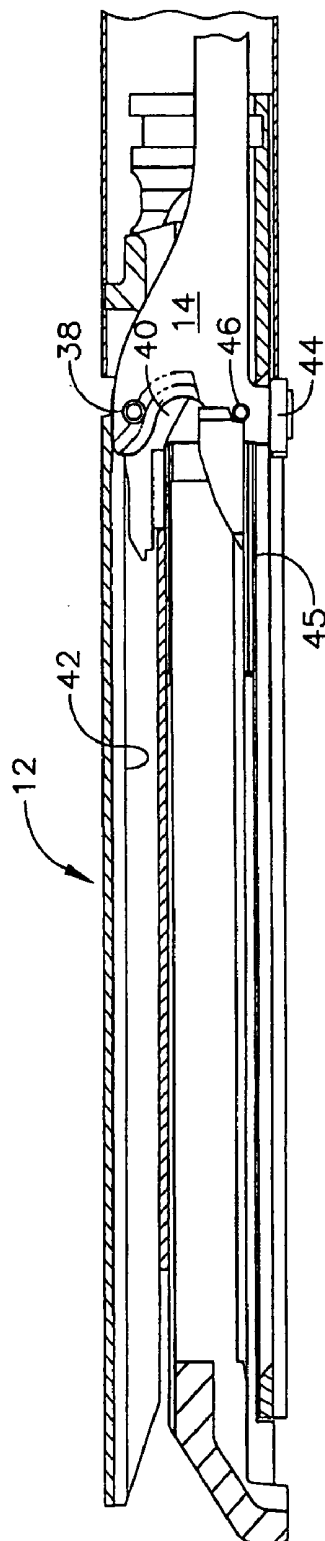

FIG. 19

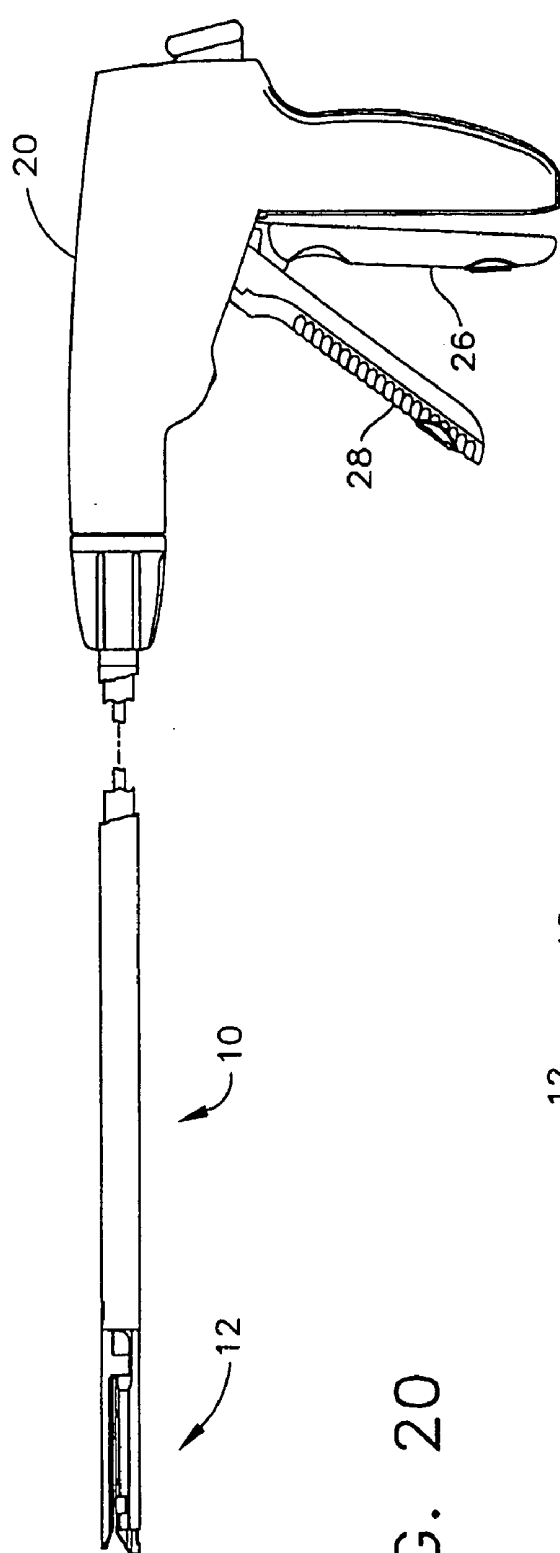

FIG. 20

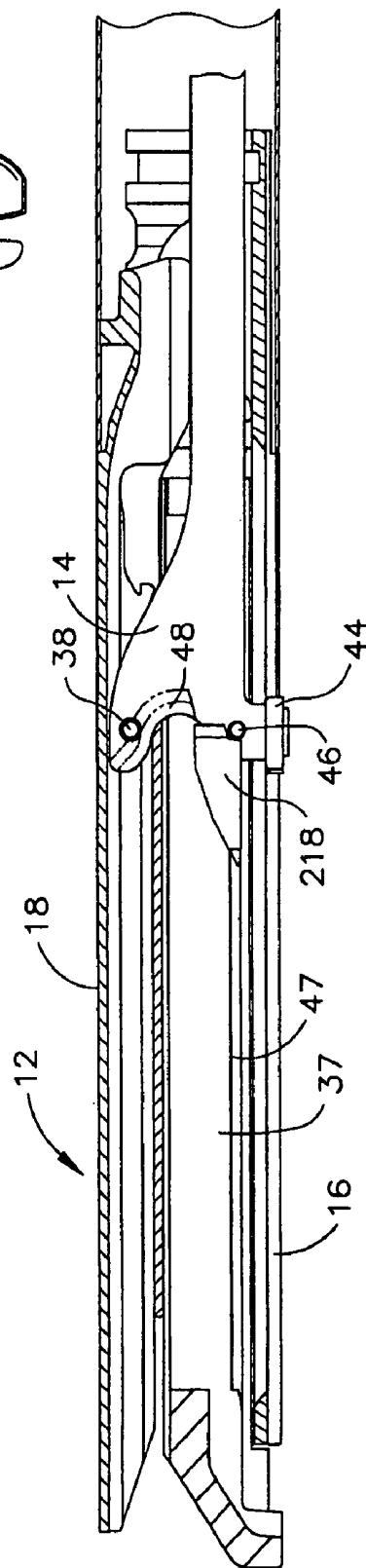

FIG. 21

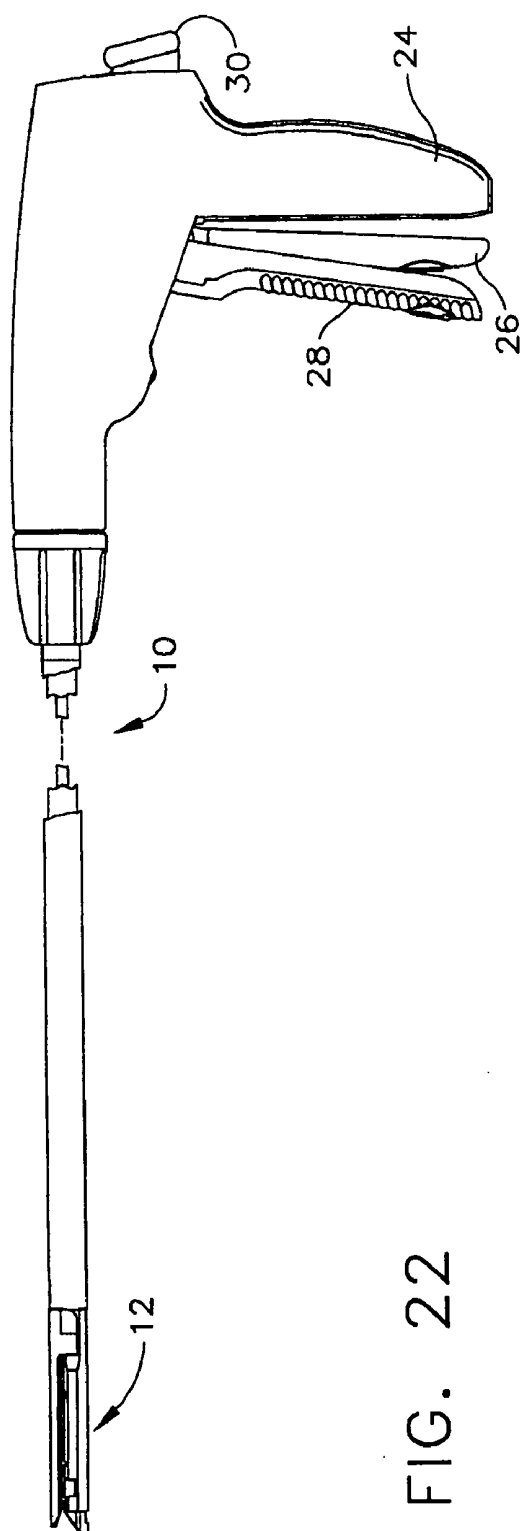

FIG. 22

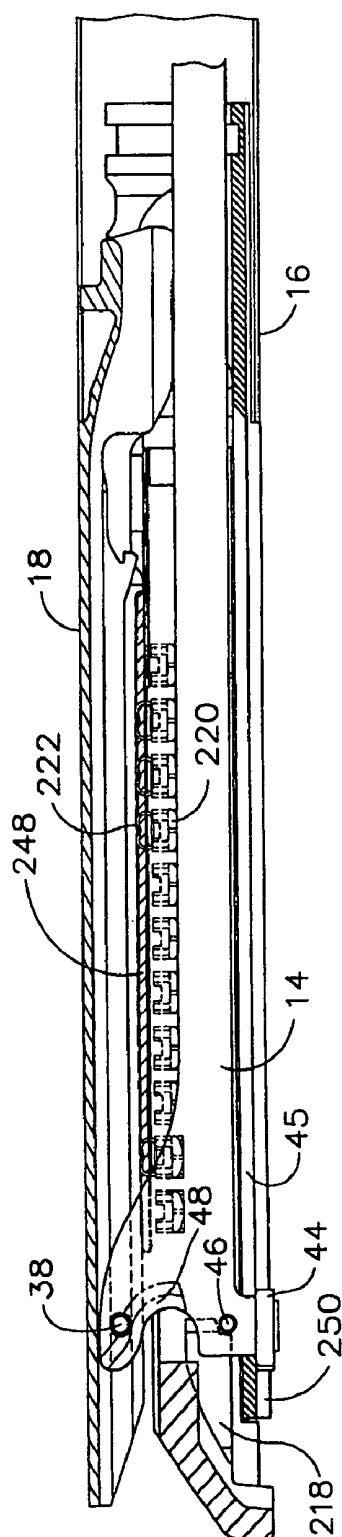

FIG. 23

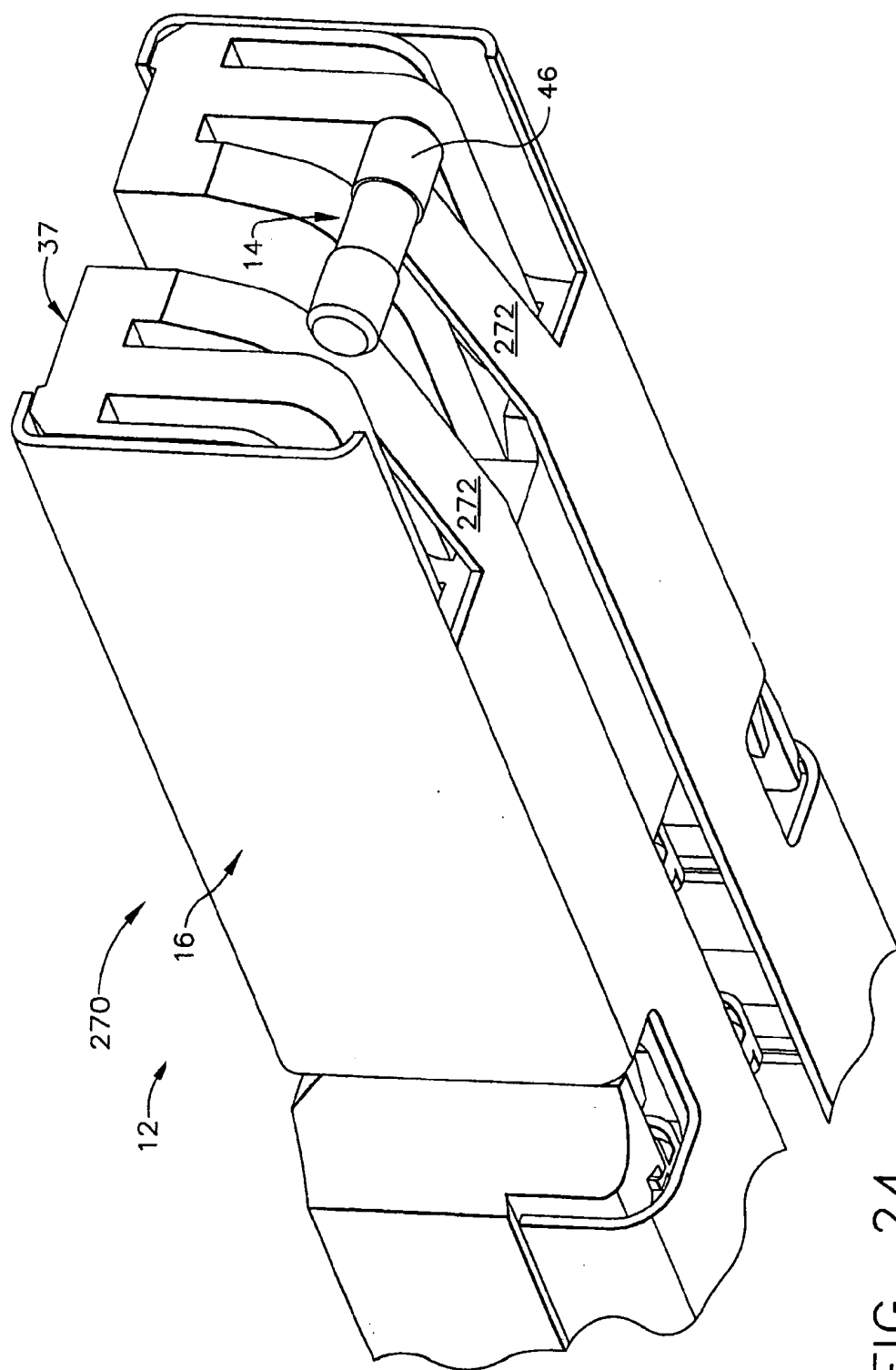

FIG. 24

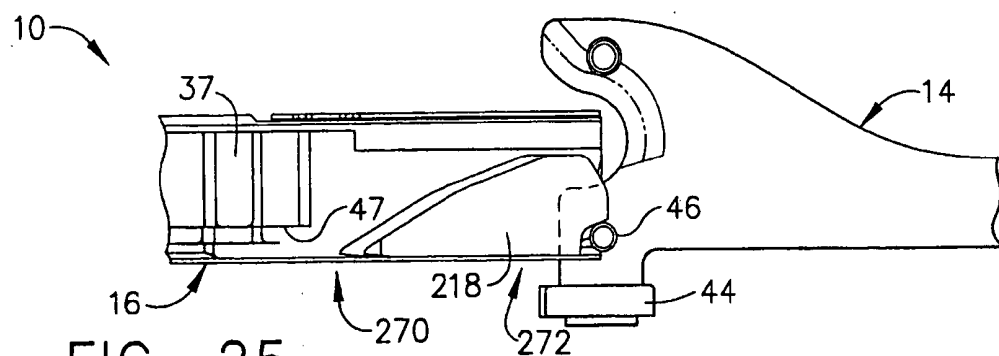

FIG. 25

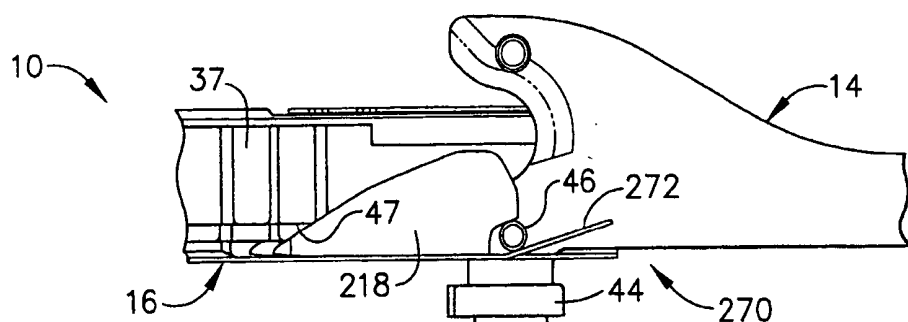

FIG. 26

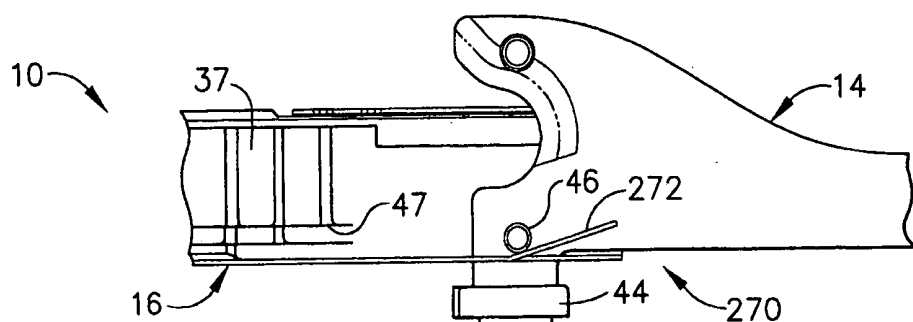

FIG. 27

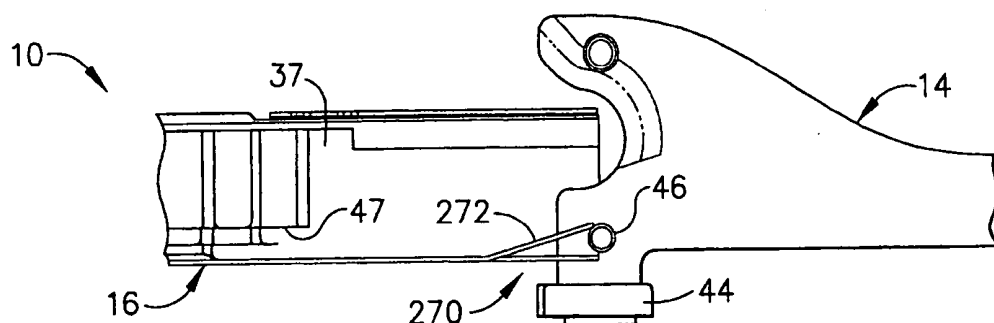

FIG. 28

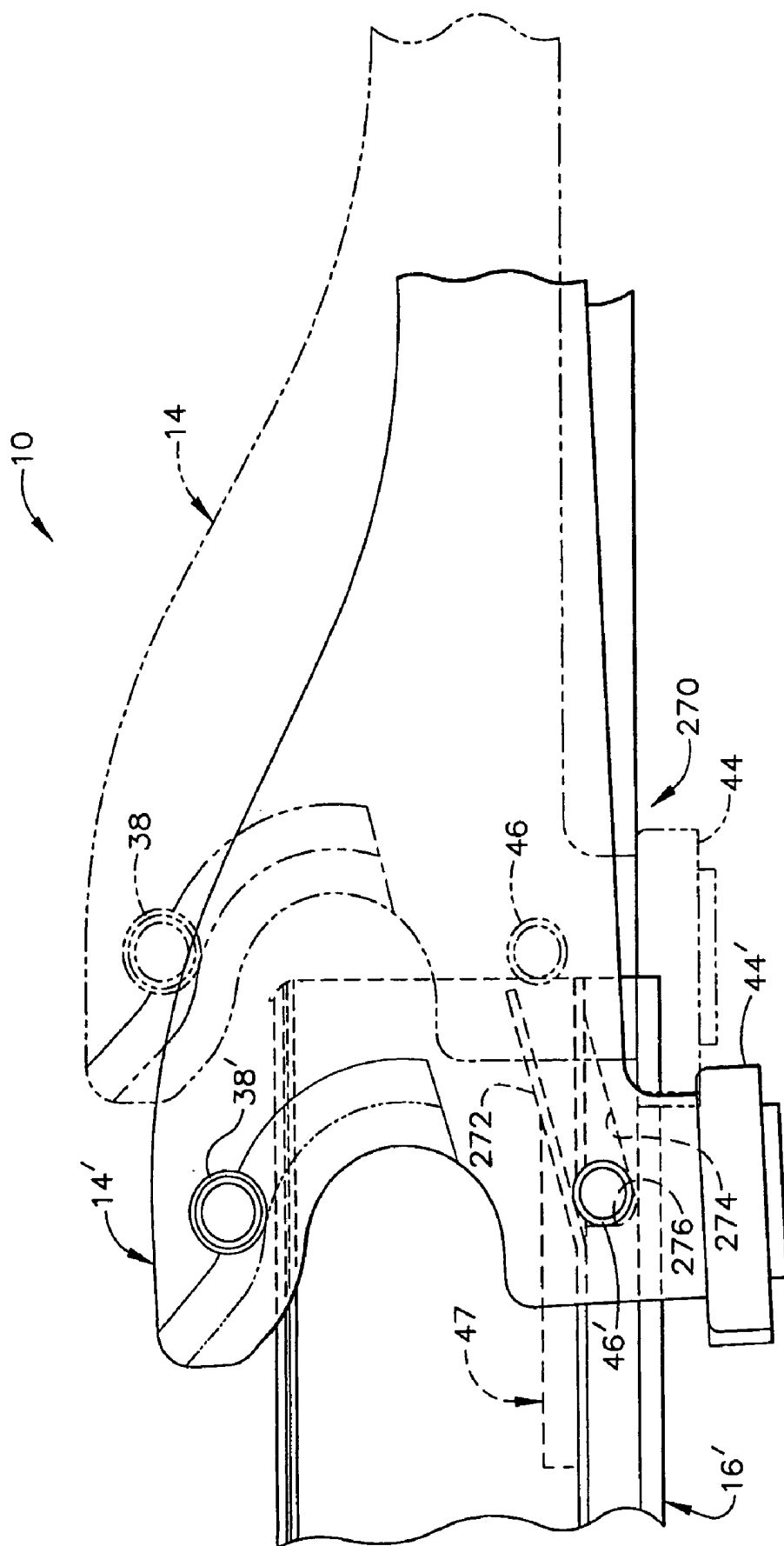

FIG. 29

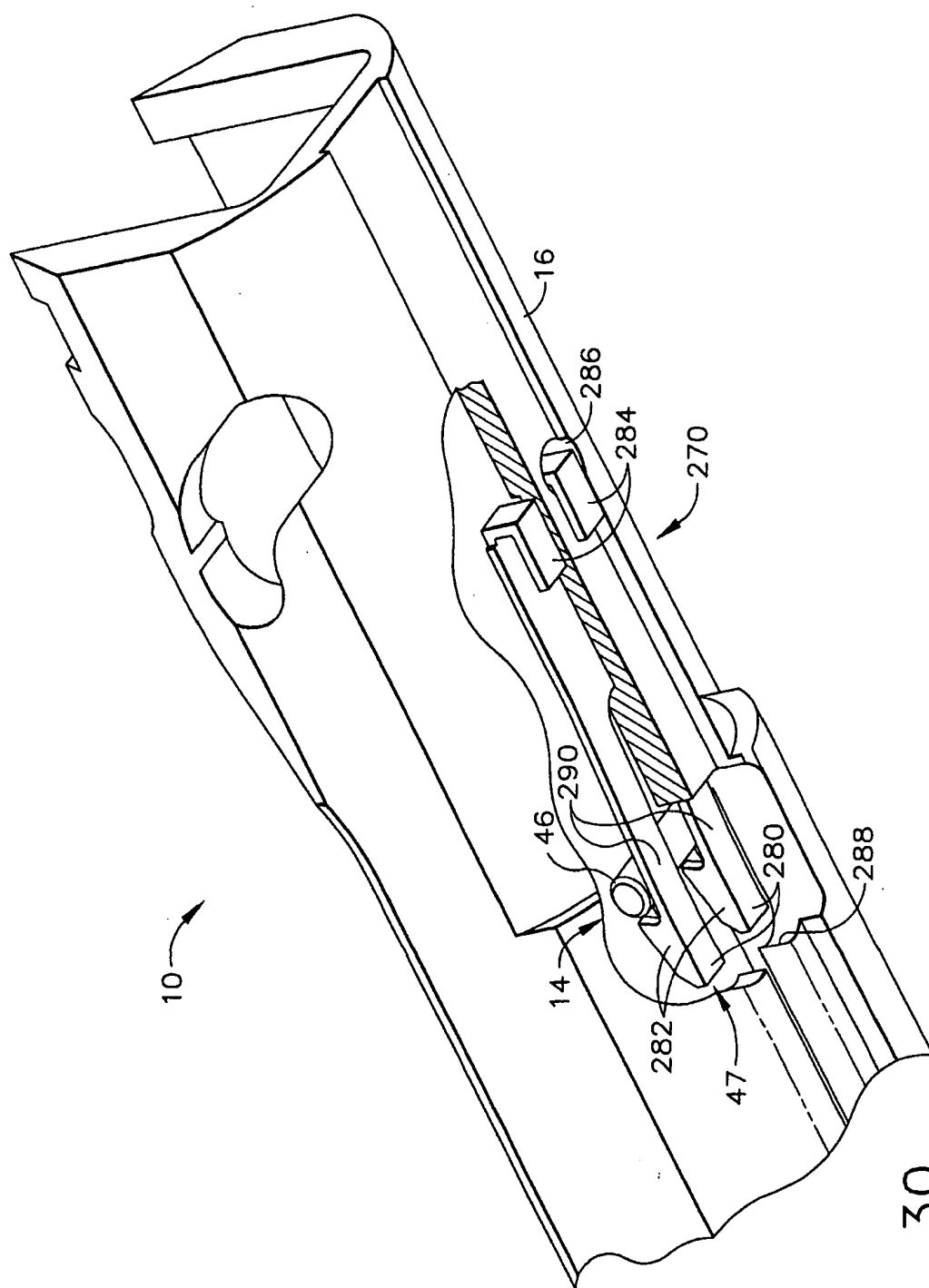
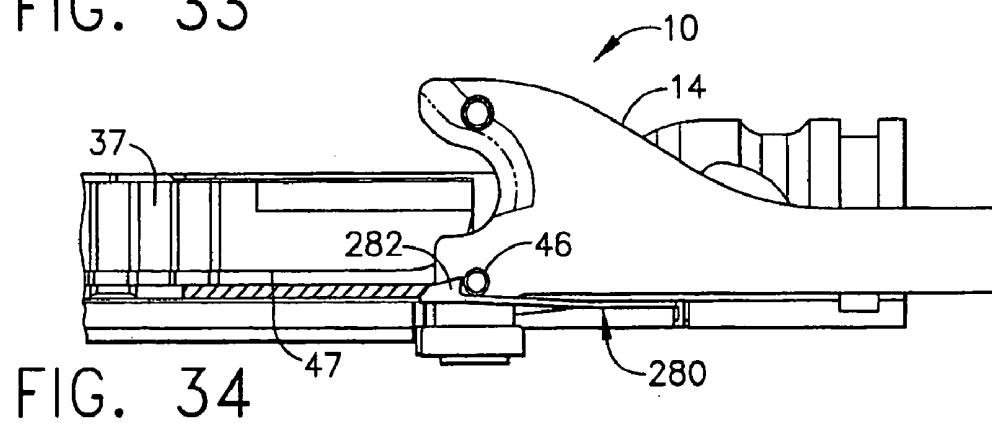
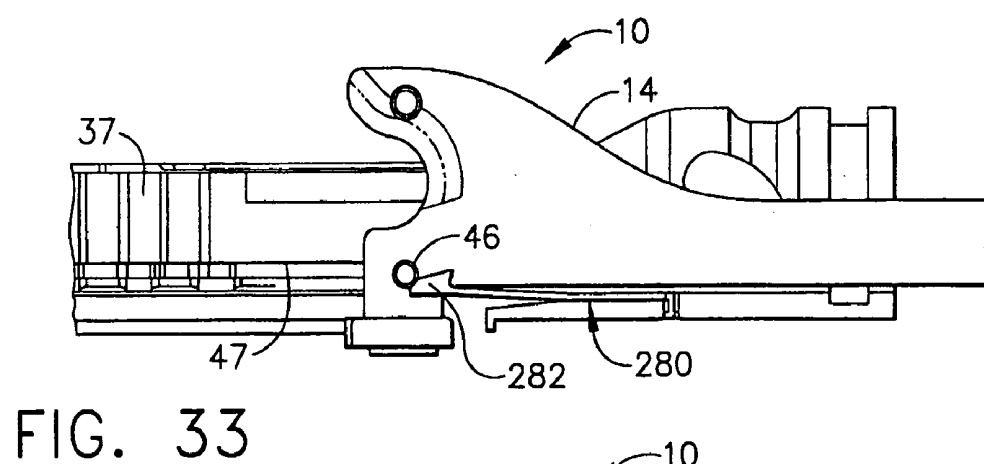
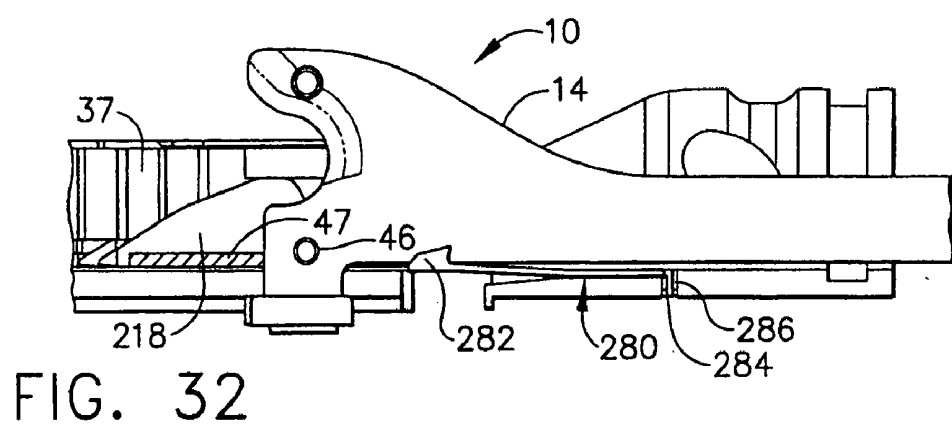
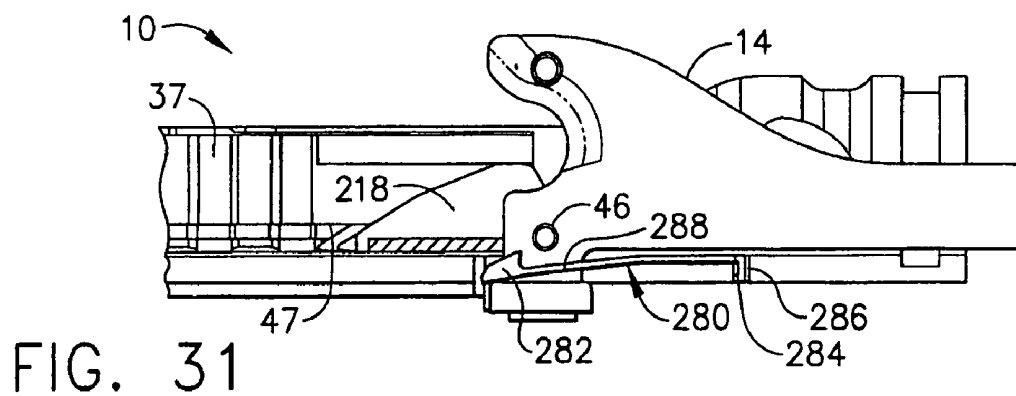

FIG. 30



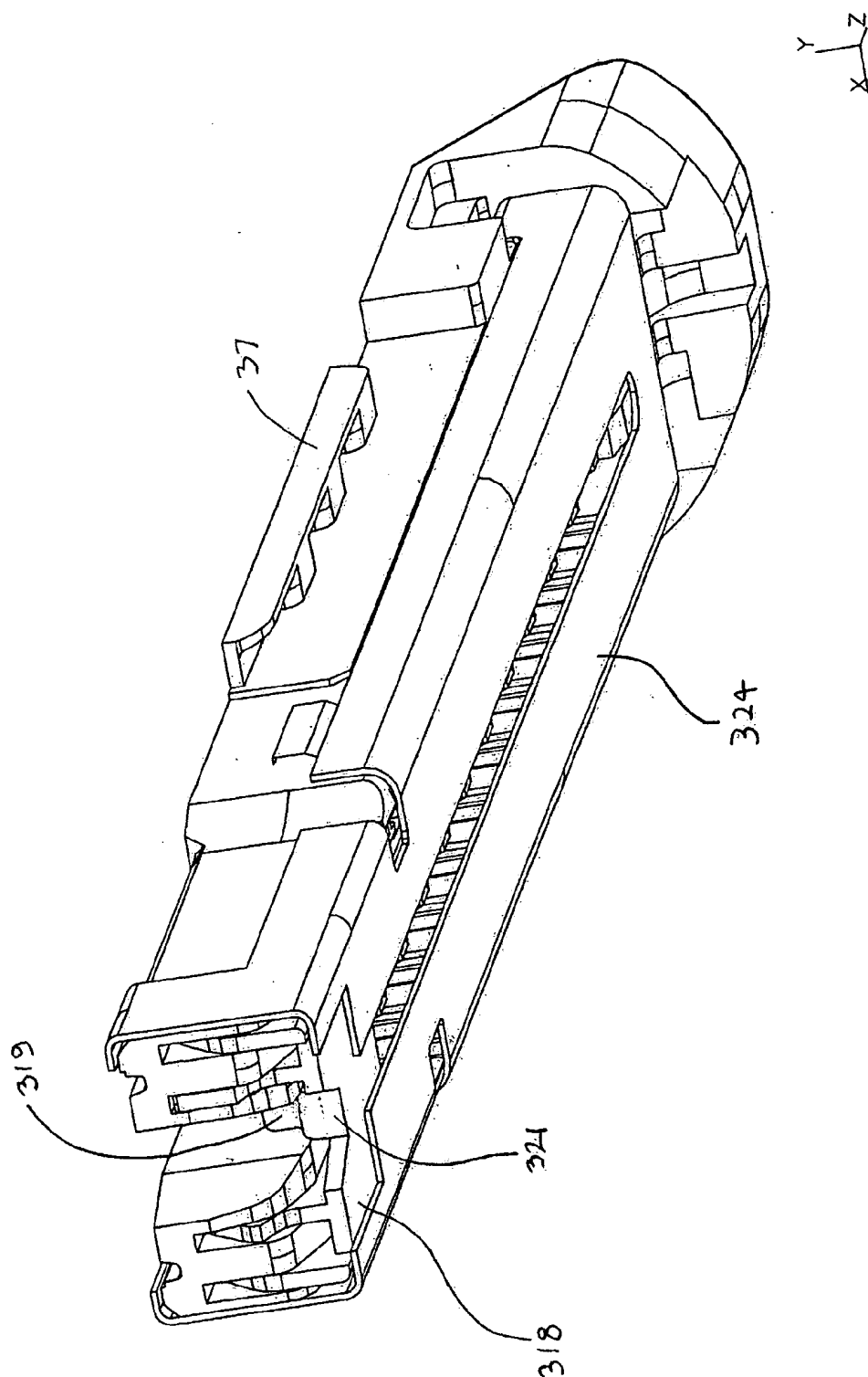

FIG. 35

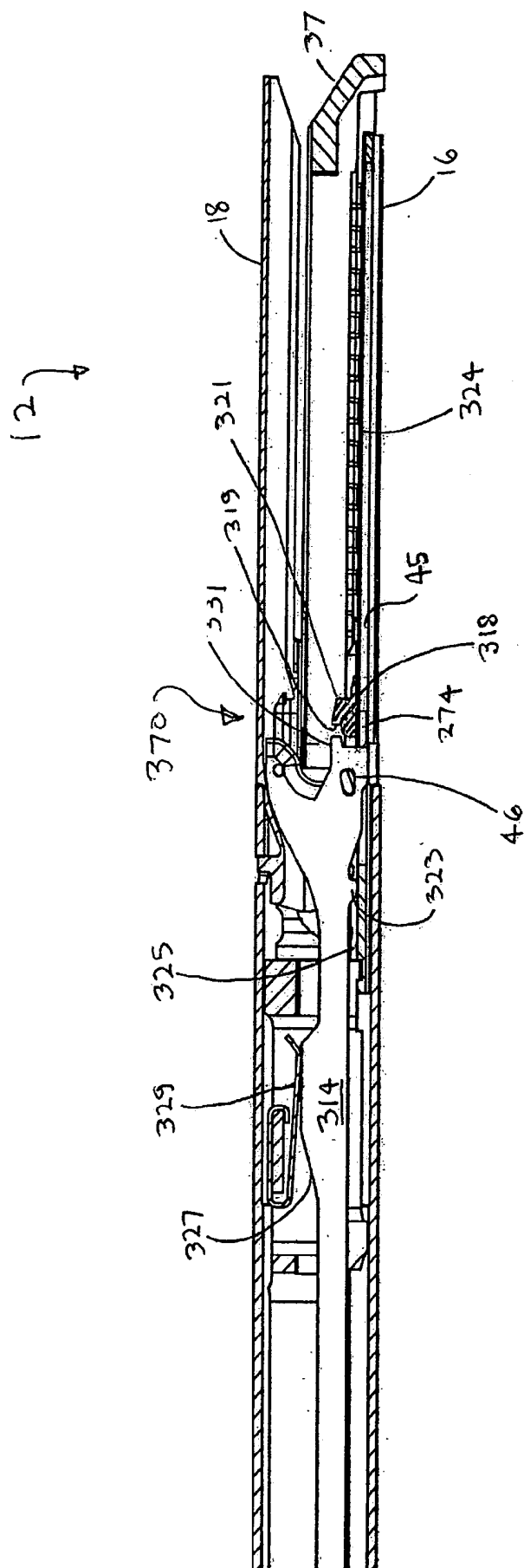

FIG. 36

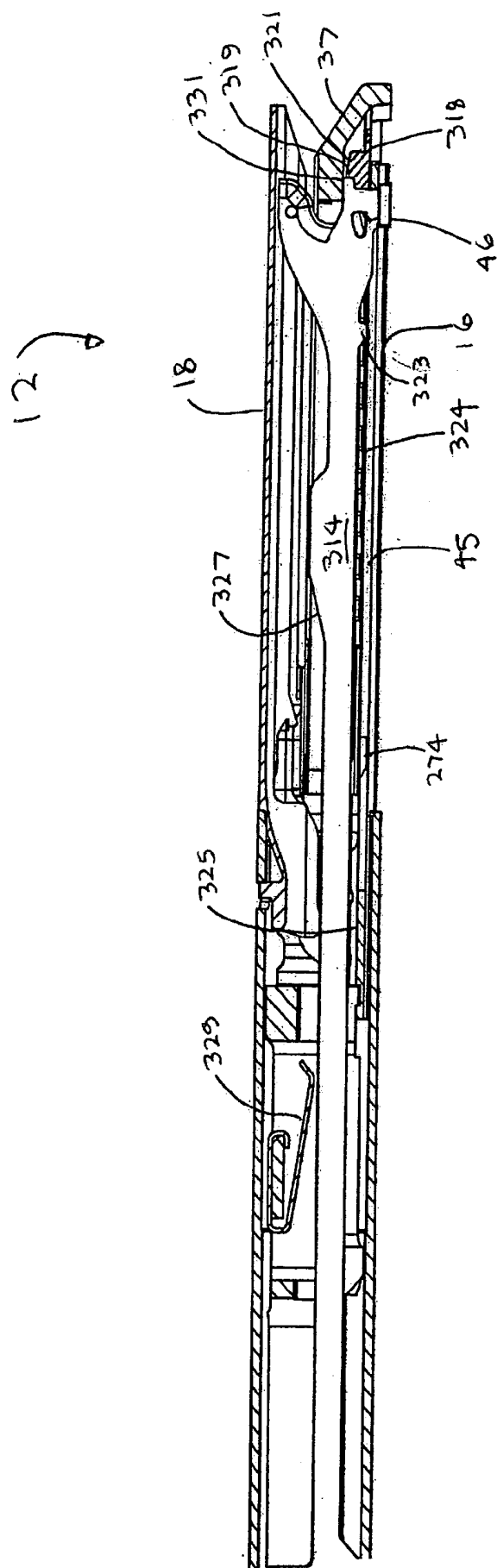

FIG. 37

12)

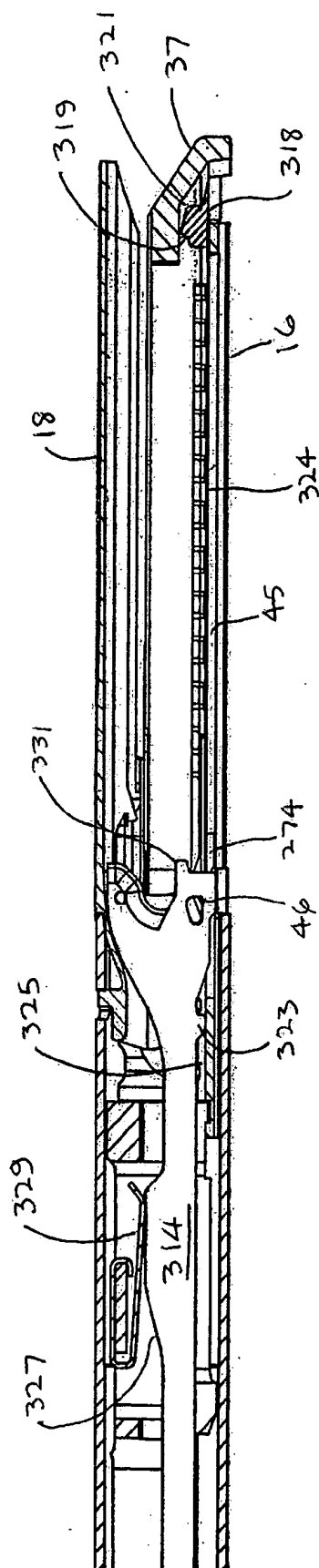
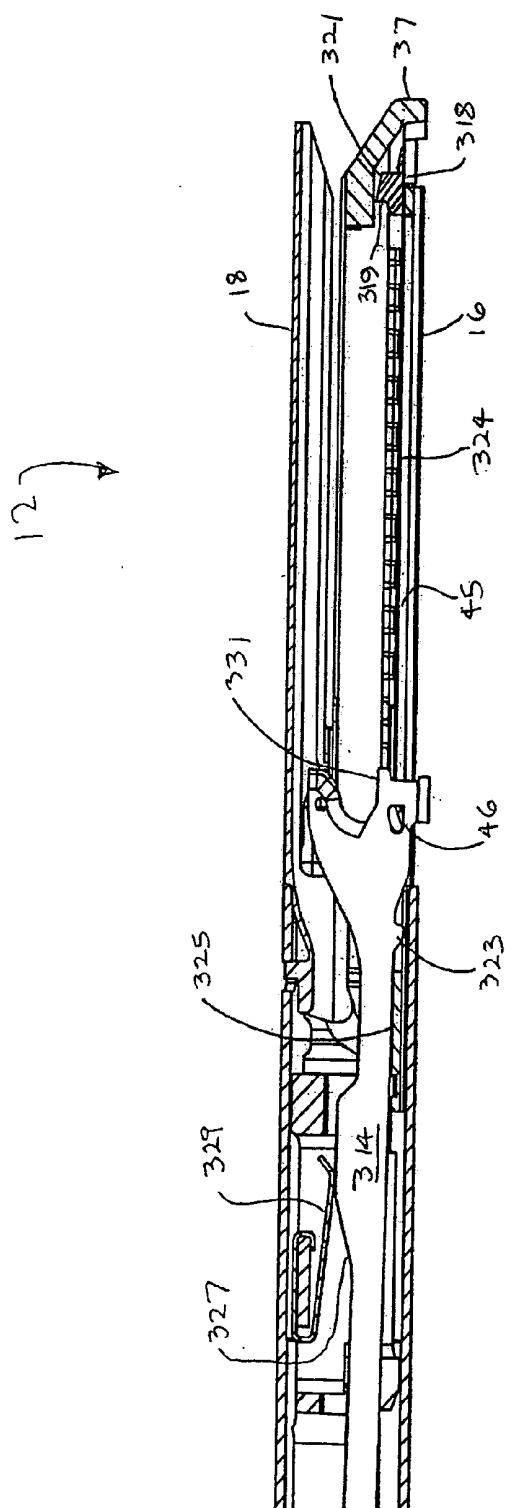

FIG. 38



Fl. 39

SURGICAL STAPLING INSTRUMENT HAVING A SINGLE LOCKOUT MECHANISM FOR PREVENTION OF FIRING

CROSS REFERENCE TO RELATED APPLICATIONS

[0001] The present application is continuation in part of U.S. patent application Ser. No. 10/441,424 filed on May 20, 2003; Entitled: Surgical Stapling Instrument Having a Single Lockout Mechanism for Prevention of Firing.

FIELD OF THE INVENTION

[0002] The present invention relates in general to surgical stapler instruments that are capable of applying lines of staples to tissue while cutting the tissue between those staple lines and, more particularly, to improvements relating to stapler instruments and improvements in processes for forming various components of such stapler instruments.

BACKGROUND OF THE INVENTION

[0003] Surgical staplers have been used in the prior art to simultaneously make a longitudinal incision in tissue and apply lines of staples on opposing sides of the incision. Such instruments commonly include a pair of cooperating jaw members that, if the instrument is intended for endoscopic or laparoscopic applications, are capable of passing through a cannula passageway. One of the jaw members receives a staple cartridge having at least two laterally spaced rows of staples. The other jaw member defines an anvil having staple-forming pockets aligned with the rows of staples in the cartridge. The instrument includes a plurality of reciprocating wedges which, when driven distally, pass through openings in the staple cartridge and engage drivers supporting the staples to effect the firing of the staples toward the anvil.

[0004] An example of a surgical stapler suitable for endoscopic applications is described in U.S. Pat. No. 5,465,895, which advantageously provides distinct closing and firing actions. Thereby, a clinician is able to close the jaw members upon tissue to position the tissue prior to firing. Once the clinician has determined that the jaw members are properly gripping tissue, the clinician can then fire the surgical stapler, thereby severing and stapling the tissue. The simultaneous severing and stapling avoids complications that may arise when performing such actions sequentially with different surgical tools that respectively only sever or staple.

[0005] It is often advantageous to build an end effector for the surgical stapler that is reusable. For instance, one patient may need a series of severing and stapling operations. Replacing an entire end effector for each operation tends to be economically inefficient. This is especially true if the end effector is built to be strong and reliable over repeated operations. To that end, staple cartridges are fitted into the end effector prior to each operation of the surgical stapler. Thus, a much smaller amount of the surgical staples is discarded after each use.

[0006] While the staple cartridge provides numerous advantages, it is desirable to prevent inadvertent firing of the surgical stapler when an unfired staple cartridge is not present. Otherwise, the severing of tissue may occur without the staples to minimize bleeding.

[0007] It is particularly desirable that preventing such inadvertent firing be accomplished in a reliable way that is not subject to an intervening malfunction. Moreover, for ease of manufacturing and assembly, it is further desirable that the lockout features be accomplished with a minimum number of components.

[0008] U.S. Pat. No. 5,129,570 by Schulze et al. discloses several lockout devices that prevent inadvertent firing when a cartridge is not present, and when the cartridge is spent or previously fired. Whereas the '570 devices do indeed lock-out the device, the solutions were complex and required a number of extra components.

[0009] Consequently, a significant need exists for an improved surgical stapling and severing instrument that prevents inadvertent firing (i.e., severing and stapling) when a staple cartridge is not installed or is spent, having been previously fired.

BRIEF SUMMARY OF THE INVENTION

[0010] The invention overcomes the above-noted and other deficiencies of the prior art by providing a single lockout mechanism that prevents firing a surgical stapling and severing instrument when either a staple cartridge is not installed or is spent. In particular, the single lock mechanism prevents distal movement of a firing bar, and thus severing of tissue, in instances where simultaneous stapling would not occur.

[0011] In one aspect of the invention, a surgical stapling instrument includes a cartridge containing a plurality of staples and a wedge member. The wedge member is moveable longitudinally within the cartridge to eject the staples from the cartridge. A firing member is provided that is cooperatively engagable with the wedge member and longitudinally moveable to eject staples. A locking mechanism prevents distal movement of the firing bar after at least one of the staples has been ejected and the firing bar has been moved proximally a predetermined distance. The wedge member biases the firing member into an unlocked position prior to the staples being deployed. The wedge and the firing bar are not cooperatively engaged when the instrument is in a locked position.

[0012] These and other objects and advantages of the present invention shall be made apparent from the accompanying drawings and the description thereof.

BRIEF DESCRIPTION OF THE FIGURES

[0013] The accompanying drawings, which are incorporated in and constitute a part of this specification, illustrate embodiments of the invention, and, together with the general description of the invention given above, and the detailed description of the embodiments given below, serve to explain the principles of the present invention.

[0014] **FIG. 1.** depicts a partially cut-away side elevation view of a surgical stapling and severing instrument in an open position.

[0015] **FIG. 2** depicts a cross-sectional side elevation detail view along the line 2-2 of **FIG. 1** of an end effector of the surgical stapling and severing instrument.

[0016] **FIG. 3** depicts an enlarged side elevation view of the firing bar of the surgical stapling and severing instrument of **FIG. 2**.

[0017] FIG. 4 depicts an enlarged front view of the firing bar of the surgical stapling and severing instrument of FIG. 2.

[0018] FIG. 5 depicts a cross-sectional side elevation detail view of an alternative end effector for the surgical stapling and severing instrument of FIG. 1, incorporating a firing bar that lacks a middle pin for preventing pinching of the end effector.

[0019] FIG. 6 depicts a side elevational view of a handle portion of a proximal end of the surgical stapling and severing instrument of FIG. 1 with a left side removed to expose interior parts in an unclamped, unfired ("start") position.

[0020] FIG. 7 depicts a perspective, exploded view of the handle portion of the proximal end of the surgical stapling and severing instrument of FIG. 1.

[0021] FIG. 8 depicts a side elevational view of the handle portion of the proximal end of the surgical stapling and severing instrument of FIG. 1 with the left side removed to expose interior parts in the closed ("clamped") position.

[0022] FIG. 9 depicts a side elevational view of the handle portion of proximal end of surgical stapling and severing instrument of FIG. 1 with the left side removed to expose interior parts in the stapled and severed ("fired") position.

[0023] FIG. 10 depicts an isometric view of the end effector at the distal end of the surgical stapling and severing instrument of FIG. 1 with the anvil in the up or open position exposing the staple cartridge and cutting edge of the firing bar.

[0024] FIG. 11 depicts an isometric, exploded view of the implement portion of the surgical stapling and severing instrument of FIG. 1.

[0025] FIG. 12 depicts an isometric view of the end effector at the distal end of the surgical stapling and severing instrument of FIG. 1 with the anvil in the up or open position with the cartridge largely removed exposing a single staple driver and a double staple driver as exemplary and the wedge sled in its start position against a middle pin of the firing bar.

[0026] FIG. 13 depicts an isometric view of the distal end of the surgical stapling and severing instrument of FIG. 1 with the anvil in the up or open position with the staple cartridge completely removed and a portion of an elongate channel removed to expose a lowermost pin of the firing bar.

[0027] FIG. 14 depicts a side elevation view in section showing a mechanical relationship between the anvil, elongate channel, and staple cartridge in the closed position of the surgical stapling and severing instrument of FIG. 1, the section generally taken along lines 14-14 of FIG. 10 to expose wedge sled, staple drivers and staples but also depicting the firing bar along the longitudinal centerline.

[0028] FIG. 15 depicts a section view of the end effector of the surgical stapling and severing instrument with the cartridge and firing bar in the start position taken along line 15-15 of FIG. 10.

[0029] FIG. 16 depicts a section view taken along line 16-16 of FIG. 15 showing the cross-sectional relationship

between the firing bar, elongate channel, wedge sled, staple drivers, staples and staple cartridge.

[0030] FIG. 17 depicts a side elevation section view of the surgical stapling and severing instrument of FIG. 1 taken along the longitudinal centerline of the end effector in a partially closed but unclamped position gripping tissue.

[0031] FIG. 18 depicts a partially cut-away side elevational view of the surgical stapling and severing instrument of FIG. 1 in the closed or clamped position.

[0032] FIG. 19 depicts a side elevation view in centerline section of the distal end of the surgical stapling and severing instrument of FIG. 1 in the closed or clamped position with tissue properly compressed.

[0033] FIG. 20 depicts a partially cut-away side elevation view of the surgical stapling and severing instrument of FIG. 1 in a partially fired position.

[0034] FIG. 21 depicts a view in centerline section of the distal end of the surgical stapling and severing instrument of FIG. 1 in a partially fired position.

[0035] FIG. 22 depicts a partially cut-away side elevation view of the surgical stapling and severing instrument of FIG. 1 in a fully fired position.

[0036] FIG. 23 depicts a view in centerline section of the distal end of the surgical stapling and severing instrument of FIG. 1 in a fully fired position.

[0037] FIG. 24 depicts a perspective view looking distally at the elongate channel of FIG. 1 partially cut away to expose a cartridge body and a single lockout mechanism engaging a middle pin of a firing bar.

[0038] FIGS. 25-28 depict a cross-sectional side detail view of the single lockout mechanism, staple cartridge and firing bar of FIG. 24, sequentially shown in a cartridge loaded and unfired state in FIG. 25, a cartridge being fired state in FIG. 26, a spent cartridge with firing bar being retracted state in FIG. 27, and spent cartridge with firing bar retracted state in FIG. 28.

[0039] FIG. 29 depicts the single lockout mechanism of FIG. 24 further incorporating a lockout trough.

[0040] FIG. 30 depicts a bottom perspective view of an elongate channel of FIG. 1 partially cut away to show another single lockout mechanism engaging the middle pin of a firing bar when a staple cartridge is missing.

[0041] FIGS. 31-34 depict a cross-sectional side detail view of the single lockout mechanism of FIG. 30, sequentially shown in a cartridge loaded and unfired state in FIG. 31, a cartridge being fired state in FIG. 32, a spent cartridge with firing bar being retracted state in FIG. 33, and a spent cartridge with firing bar retracted state in FIG. 34. FIG. 35 depicts a bottom perspective view of a proximal end of a cartridge of FIG. 10 showing an alternate wedge sled having a notch therein and an open cartridge tray having an open passageway therein.

[0042] FIGS. 36-39 depict a cross-sectional side detail view of an alternate lockout mechanism utilizing a lockout trough, staple cartridge and firing bar, sequentially shown in a cartridge loaded and unfired state in FIG. 36, a cartridge

being in a fully fired state in **FIG. 37**, a spent cartridge with firing bar being retracted state in **FIG. 38**, and the firing bar locked out in **FIG. 39**.

DETAILED DESCRIPTION OF THE INVENTION

[0043] Turning to the Drawings, wherein like numerals denote like components throughout the several views, **FIG. 1** and **2** depict a surgical stapling and severing instrument **10** that is capable of practicing the unique benefits of the present invention. The surgical stapling and severing instrument **10** incorporates an end effector **12** having an E-beam firing mechanism ("firing bar") **14** that advantageously controls the spacing of the end effector **12**. In particular, an elongate channel **16** and a pivotally translatable anvil **18** are maintained at a spacing that assures effective stapling and severing. Furthermore, firing (i.e., severing and stapling) is prevented from occurring if the instrument is not capable of stapling with a single lockout mechanism, which is described in more detail below.

[0044] The surgical and stapling and severing instrument **10** includes a handle portion **20** connected to an implement portion **22**, the latter further comprising a shaft **23** distally terminating in the end effector **12**. The handle portion **20** includes a pistol grip **24** toward which a closure trigger **26** is pivotally drawn by the clinician to cause clamping, or closing, of the anvil **18** toward the elongate channel **16** of the end effector **12**. A firing trigger **28** is farther outboard of the closure trigger **26** and is pivotally drawn by the clinician to cause the stapling and severing of clamped tissue in the end effector **12**.

[0045] It will be appreciated that the terms "proximal" and "distal" are used herein with reference to a clinician gripping a handle of an instrument. Thus, the end effector **12** is distal with respect to the more proximal handle portion **20**. It will be further appreciated that for convenience and clarity, spatial terms such as "vertical" and "horizontal" are used herein with respect to the drawings. However, surgical instruments are used in many orientations and positions, and these terms are not intended to be limiting and absolute.

[0046] Closure trigger **26** is actuated first. Once the clinician is satisfied with the positioning of the end effector **12**, the clinician may draw back the closure trigger **26** to its fully closed, locked position proximate to the pistol grip **24**.

[0047] Then, the firing trigger **28** is actuated. The firing trigger **28** springedly returns when the clinician removes pressure. A release button **30** when depressed on the proximal end of the handle portion **20** releases any locked closure trigger **26**.

[0048] A closure sleeve **32** encloses a frame **34**, which in turn encloses a firing drive member **36** that is positioned by the firing trigger **28**. The frame **34** connects the handle portion **20** to the end effector **12**. With the closure sleeve **32** withdrawn proximally by the closure trigger **26** as depicted, the anvil **18** springedly opens, pivoting away from the elongate channel **16** and translating proximally with the closure sleeve **32**.

[0049] The elongate channel **16** receives a staple cartridge **37** that is responsive to the firing bar **14** to drive staples into forming contact with the anvil **18**. It will be appreciated that although a readily replaceable staple cartridge **37** is advantageously described herein, a staple cartridge **37** consistent with aspects of the present invention may be permanently affixed or integral to the elongate channel **16**, for instance when a larger portion of the end effector **12** is replaced after each firing.

tageously described herein, a staple cartridge **37** consistent with aspects of the present invention may be permanently affixed or integral to the elongate channel **16**, for instance when a larger portion of the end effector **12** is replaced after each firing.

[0050] E-Beam Firing Mechanism

[0051] With particular reference to **FIGS. 2-4**, the firing bar **14** includes three vertically spaced pins that control the spacing of the end effector **12** during firing. In particular, an upper pin **38** is staged to enter an anvil pocket **40** near the pivot between the anvil **18** and elongate channel **16**. When fired with the anvil **18** closed, the upper pin **38** advances distally within a longitudinal anvil slot **42** extending distally through anvil **18**. Any minor upward deflection in the anvil **18** is overcome by a downward force imparted by the upper pin **38**.

[0052] Firing bar **14** also includes a lower most pin, or firing bar cap, **44** that upwardly engages a channel slot **45** in the elongate channel **16**, thereby cooperating with the upper pin **38** to draw the anvil **18** and the elongate channel **16** slightly closer together in the event of excess tissue clamped therebetween.

[0053] The firing bar **14** advantageously includes a middle pin **46** that passes through a firing drive slot **47** formed in a lower surface of the cartridge **37** and an upward surface of the elongate channel **16**, thereby driving the staples therein as described below. The middle pin **46**, by sliding against the elongate channel **16**, advantageously resists any tendency for the end effector **12** to be pinched shut at its distal end. To illustrate an advantage of the middle pin **46**, **FIG. 5** depicts an alternative end effector **12'** that lacks a middle pin on a firing bar **14'**. In this depiction, the end effector **12'** is allowed to pinch shut at its distal end, which tends to impair desired staple formation.

[0054] Returning to **FIGS. 2-4**, a distally presented cutting edge **48** between the upper and middle pins **38**, **46** on the firing bar **14** traverses through a proximally presented, vertical slot **49** in the cartridge **37** to sever clamped tissue. The affirmative positioning of the firing bar **14** with regard to the elongate channel **16** and anvil **18** assure that an effective cut is performed.

[0055] Cambered Anvil with Selected Cartridge Gap

[0056] The affirmative vertical spacing provided by the E-Beam firing bar **14** is suitable for the limited size available for endoscopic devices. Moreover, the E-Beam firing bar **14** enables fabrication of an anvil **16** with a camber imparting a vertical deflection at its distal end, similar to the position depicted in **FIG. 5**. This cambered anvil **16** advantageously assists in achieving the desired gap in the end effector **12** even with an anvil **16** reduced thickness, which is thus more suited to the size limitations of an endoscopic device.

[0057] The E-Beam firing bar **14** further enables increased applications, especially in combination with a range of configurations of staple cartridges. For instance, a clinician may select a gray staple cartridge yielding a 0.02 mm tissue gap, a white staple cartridge yielding a 0.04 mm tissue gap, a blue cartridge yielding a 0.06 mm tissue gap, or a green cartridge yielding a 0.10 mm tissue gap. The vertical height of each respective staple cartridge in combination with the length of staples and an integral wedge sled (described in

more detail below) predetermines this desired tissue thickness with the anvil 18 appropriately vertically spaced by the E-Beam firing bar 14.

[0058] Two-Axis Handle

[0059] With reference to **FIGS. 6-9**, the handle portion 20 is comprised of first and second base sections 50 and 52, which are molded from a polymeric material such as a glass-filled polycarbonate. The first base section 50 is provided with a plurality of cylindrical-shaped pins 54. The second base section 52 includes a plurality of extending members 56, each having a hexagonal-shaped opening 58. The cylindrical-shaped pins 54 are received within the hexagonal-shaped openings 58 and are frictionally held therein for maintaining the first and second base sections 50 and 52 in assembly.

[0060] A rotating knob 60 has a bore 62 extending completely through it for engaging and rotating the implement portion 22 about its longitudinal axis. The rotating knob 60 includes an inwardly protruding boss 64 extending along at least a portion of the bore 62. The protruding boss 64 is received within a longitudinal slot 66 formed at a proximal portion of the closure sleeve 32 such that rotation of the rotating knob 60 effects rotation of the closure sleeve 32. It will be appreciated that the boss 64 further extends through frame 34 and into contact with a portion of the firing drive member 36 to effect their rotation as well. Thus, the end effector 12 (not shown in **FIGS. 6-9**) rotates with the rotating knob 60.

[0061] A proximal end 68 of the frame 34 passes proximally through the rotating knob 60 and is provided with a circumferential notch 70 that is engaged by opposing channel securement members 72 extending respectively from the base sections 50 and 52. Only the channel securement member 72 of the second base section 52 is shown. The channel securement members 72 extending from the base sections 50, 52 serve to secure the frame 34 to the handle portion 20 such that the frame 34 does not move longitudinally relative to the handle portion 20.

[0062] The closure trigger 26 has a handle section 74, a gear segment section 76, and an intermediate section 78. A bore 80 extends through the intermediate section 78. A cylindrical support member 82 extending from the second base section 52 passes through the bore 80 for pivotally mounting the closure trigger 26 on the handle portion 20. A second cylindrical support member 83 extending from the second base section 52 passes through a bore 81 of firing trigger 28 for pivotally mounting on the handle portion 20. A hexagonal opening 84 is provided in the cylindrical support member 83 for receiving a securement pin (not shown) extending from the first base section 50.

[0063] A closure yoke 86 is housed within the handle portion 20 for reciprocating movement therein and serves to transfer motion from the closure trigger 26 to the closure sleeve 32. Support members 88 extending from the second base section 52 and securement member 72, which extends through a recess 89 in the yoke 86, support the yoke 86 within the handle portion 20.

[0064] A proximal end 90 of the closure sleeve 32 is provided with a flange 92 that is snap-fitted into a receiving recess 94 formed in a distal end 96 of the yoke 86. A proximal end 98 of the yoke 86 has a gear rack 100 that is

engaged by the gear segment section 76 of the closure trigger 26. When the closure trigger 26 is moved toward the pistol grip 24 of the handle portion 20, the yoke 86 and, hence, the closure sleeve 32 move distally, compressing a spring 102 that biases the yoke 86 proximally. Distal movement of the closure sleeve 32 effects pivotal translation movement of the anvil 18 distally and toward the elongate channel 16 of the end effector 12 and proximal movement effects closing, as discussed below.

[0065] The closure trigger 26 is forward biased to an open position by a front surface 130 interacting with an engaging surface 128 of the firing trigger 28. Clamp first hook 104 that pivots top to rear in the handle portion 20 about a pin 106 restrains movement of the firing trigger 28 toward the pistol grip 24 until the closure trigger 26 is clamped to its closed position. Hook 104 restrains firing trigger 28 motion by engaging a lockout pin 107 in firing trigger 28. The hook 104 is also in contact with the closure trigger 26. In particular, a forward projection 108 of the hook 104 engages a member 110 on the intermediate section 78 of the closure trigger 26, the member 110 being outward of the bore 80 toward the handle section 74. Hook 104 is biased toward contact with member 110 of the closure trigger 26 and engagement with lockout pin 107 in firing trigger 28 by a release spring 112. As the closure trigger 26 is depressed, the hook 104 is moved top to rear, compressing the release spring 112 that is captured between a rearward projection 114 on the hook 104 and a forward projection 116 on the release button 30.

[0066] As the yoke 86 moves distally in response to proximal movement of the closure trigger 26, an upper latch arm 118 of the release button 30 moves along an upper surface 120 on the yoke 86 until dropping into an upwardly presented recess 122 in a proximal, lower portion of the yoke 86. The release spring 112 urges the release button 30 outward, which pivots the upper latch arm 118 downwardly into engagement with the upwardly presented recess 122, thereby locking the closure trigger 26 in a tissue clamping position, such as depicted in **FIG. 8**.

[0067] The latch arm 118 can be moved out of the recess 122 to release the anvil 18 by pushing the release button 30 inward. Specifically, the upper latch arm 118 pivots upward about pin 123 of the second base section 52. The yoke 86 is then permitted to move proximally in response to return movement of the closure trigger 26.

[0068] A firing trigger return spring 124 is located within the handle portion 20 with one end attached to pin 106 of the second base section 52 and the other end attached to a pin 126 on the firing trigger 28. The firing return spring 124 applies a return force to the pin 126 for biasing the firing trigger 28 in a direction away from the pistol grip 24 of the handle portion 20. The closure trigger 26 is also biased away from pistol grip 24 by engaging surface 128 of firing trigger 28 biasing front surface 130 of closure trigger 26.

[0069] As the closure trigger 26 is moved toward the pistol grip 24, its front surface 130 engages with the engaging surface 128 on the firing trigger 28 causing the firing trigger 28 to move to its "firing" position. When in its firing position, the firing trigger 28 is located at an angle of approximately 45° to the pistol grip 24. After staple firing, the spring 124 causes the firing trigger 28 to return to its initial position. During the return movement of the firing trigger 28, its engaging surface 128 pushes against the front

surface **130** of the closure trigger **26** causing the closure trigger **26** to return to its initial position. A stop member **132** extends from the second base section **52** to prevent the closure trigger **26** from rotating beyond its initial position.

[0070] The surgical stapling and severing instrument **10** additionally includes a reciprocating section **134**, a multiplier **136** and a drive member **138**. The reciprocating section **134** comprises a wedge sled in the implement portion **22** (not shown in FIG. 6-9) and a metal drive rod **140**.

[0071] The drive member **138** includes first and second gear racks **141** and **142**. A first notch **144** is provided on the drive member **138** intermediate the first and second gear racks **141**, **142**. During return movement of the firing trigger **28**, a tooth **146** on the firing trigger **28** engages with the first notch **144** for returning the drive member **138** to its initial position after staple firing. A second notch **148** is located at a proximal end of the metal drive rod **140** for locking the metal drive rod **140** to the upper latch arm **118** of the release button **30** in its unfired position.

[0072] The multiplier **136** comprises first and second integral pinion gears **150** and **152**. The first integral pinion gear **150** is engaged with a first gear rack **154** provided on the metal drive rod **140**. The second integral pinion gear **152** is engaged with the first gear rack **141** on the drive member **138**. The first integral pinion gear **150** has a first diameter and the second integral pinion gear **152** has a second diameter which is smaller than the first diameter.

[0073] FIGS. 6, 8 and 9 depict respectively the handle portion **20** in the start position (open and unfired), a clamped position (closed and unfired) and a fired position. The firing trigger **28** is provided with a gear segment section **156**. The gear segment section **156** engages with the second gear rack **142** on the drive member **138** such that motion of the firing trigger **28** causes the drive member **138** to move back and forth between a first drive position, shown in FIG. 8, and a second drive position, shown in FIG. 9. In order to prevent staple firing before tissue clamping has occurred, the upper latch arm **118** on the release button **30** is engaged with the second notch **148** on the drive member **138** such that the metal drive rod **140** is locked in its proximal-most position, as depicted in FIG. 6. When the upper latch arm **118** falls into the recess **122**, the upper latch arm **118** disengages with the second notch **148** to permit distal movement of the metal drive rod **140**, as depicted in FIG. 9.

[0074] Because the first gear rack **141** on the drive member **138** and the gear rack **154** on the metal drive rod **140** are engaged with the multiplier **136**, movement of the firing trigger **28** causes the metal drive rod **140** to reciprocate between a first reciprocating position, shown in FIG. 8, and a second reciprocating position, shown in FIG. 9. Since the diameter of the first pinion gear **150** is greater than the diameter of the second pinion gear **152**, the multiplier **136** moves the reciprocating section **134** a greater distance than the drive member **138** is moved by the firing trigger **28**. The diameters of the first and second pinion gears **150** and **152** may be changed to permit the length of the stroke of the firing trigger **28** and the force required to move it to be varied.

[0075] It will be appreciated that the handle portion **20** is illustrative and that other actuation mechanisms may be employed. For instance, the closing and firing motions may be generated by automated means.

[0076] Separate and Distinct Closing and Firing End Effector

[0077] The end effector **12** of the surgical stapling and severing instrument **10** is depicted in further detail in FIGS. 10-16. As described above, the handle portion **20** produces separate and distinct closing and firing motions that actuate the end effector **12**. The end effector **12** advantageously maintains the clinical flexibility of this separate and distinct closing and firing (i.e., stapling and severing). In addition, the end effector **12** introduces the aforementioned ability to affirmatively maintain the closed spacing during firing after the clinician positions and clamps the tissue. Both features procedurally and structurally enhance the ability of the surgical stapling and severing instrument **10** by ensuring adequate spacing for instances where an otherwise inadequate amount of tissue is clamped and to enhance the clamping in instances where an otherwise excessive amount of tissue has been clamped.

[0078] FIG. 10 depicts the end effector **12**, which is in an open position by a retracted closure sleeve **32**, with a staple cartridge **37** installed in the elongate channel **16**. On a lower surface **200** of the anvil **18**, a plurality of stapling forming pockets **202** are arrayed to correspond to a plurality of stapler apertures **204** in an upper surface **206** of the staple cartridge **37**. The firing bar **14** is at its proximal position, with the upper pin **38** aligned in a noninterfering fashion with the anvil pocket **40**. The anvil pocket **40** is shown as communicating with the longitudinal anvil slot **42** in the anvil **18**. The distally presented cutting edge **48** of the firing bar **14** is aligned with and proximally from removed from the vertical slot **49** in the staple cartridge **37**, thereby allowing removal of a spent cartridge and insertion of an unfired cartridge, which is snapfit into the elongate channel **16**. Specifically, extension features **208**, **210** of the staple cartridge **37** engage recesses **212**, **214** (shown in FIG. 12) of the elongate channel **16**.

[0079] FIG. 11 shows the implement portion **22** of the surgical stapling and severing instrument **10** in disassembled form. The staple cartridge **37** is shown as being comprised of a cartridge body **216**, a wedge sled **218**, single and double drivers **220**, staples **222**, and a cartridge tray **224**. When assembled, the cartridge tray **224** holds the wedge sled **218**, single and double drivers **220**, and staples **222** inside the cartridge body **216**.

[0080] Having a wedge sled **218** integral to the staple cartridge **37** enables a number of flexible design options as compared to incorporating camming surfaces onto a firing bar itself. For instance, a number of different staple cartridges may be selected for use in the instrument **10** with each staple cartridge having a different configuration of rows of staples, each thus having a unique wedge sled configured to contact the middle pin **46** of the firing bar **14** while causing the driving of the staples **222**. As another example, the integral wedge sled **218** provides an opportunity for a number of lockout features, described in greater detail in the first and third aforementioned co-pending applications.

[0081] The elongate channel **16** has a proximally placed attachment cavity **226** that receives a channel anchoring member **228** on the distal end of the frame **34** for attaching the end effector **12** to the handle portion **20**. The elongate channel **16** also has an anvil cam slot **230** that pivotally receives an anvil pivot **232** of the anvil **18**. The closure

sleeve 32 that encompasses the frame 34 includes a distally presented tab 234 that engages an anvil feature 236 proximate but distal to the anvil pivot 232 on the anvil 18 to thereby effect opening and closing of the anvil 18. The firing drive member 36 is shown as being assembled from the firing bar 14 attached to a firing connector 238 by pins 240, which in turn is rotatingly and proximally attached to the metal drive rod 140. The firing bar 14 is guided at a distal end of the frame by a slotted guide 239 inserted therein.

[0082] With particular reference to FIG. 12, a portion of the staple cartridge 37 is removed to expose portions of the elongate channel 16, such as recesses 212, 214 and to expose some components of the staple cartridge 37 in their unfired position. In particular, the cartridge body 216 (shown in FIG. 11) has been removed. The wedge sled 218 is shown at its proximal, unfired position with a pusher block 242 contacting the middle pin 46 (not shown in FIG. 12) of the firing bar 14. The wedge sled 218 is in longitudinal sliding contact upon the cartridge tray 224 and includes wedges 228 that force upward the single and double drivers 220 as the wedge sled 218 moves distally. Staples 222 (not shown in FIG. 12) resting upon the drivers 220 are thus also forced upward into contact with the anvil forming pockets 202 on the anvil 18 to form closed staples. Also depicted is the channel slot 45 in the elongate channel 16 that is aligned with the vertical slot 49 in the staple cartridge 37.

[0083] FIG. 13 depicts the end effector 12 of FIG. 12 with all of the staple cartridge 37 removed to show the middle pin 46 of the firing bar 14 as well as portion of the elongate channel 16 removed adjacent to the channel slot 45 to expose the firing bar cap 44. In addition, portions of the shaft 23 are removed to expose a proximal portion of the firing bar 14. Projecting downward from the anvil 18 near the pivot, a pair of opposing tissue stops 244 prevent tissue being positioned too far up into the end effector 12 during clamping.

[0084] FIG. 14 depicts the end effector 12 closed in a tissue clamping position with the firing bar 14 unfired. The upper pin 38 is in the anvil pocket 40, vertically aligned with the anvil slot 42 for distal longitudinal movement of the firing bar 14 during firing. The middle pin 46 is positioned to push the wedge sled 218 distally so that wedge 228 sequentially contacts and lifts double drivers 220 and the respective staples 222 into forming contact with staple forming pockets 202 in the lower surface 200 of the anvil 18.

[0085] FIG. 15 depicts the upper surface 206 of the staple cartridge 37 with the firing bar 14 in its unfired, proximal position. The stapler apertures 204 are arrayed on each side of the vertical slot 49 in the staple cartridge 37.

[0086] FIG. 16 depicts the end effector 12 near the pivot showing that the elongate channel 16 has opposing ramp portions 246 to thereby cooperate with the tissue stops 244 of the anvil 18 (not shown in FIG. 16) to prevent tissue from jamming the end effector 12. Also depicted in greater detail are the double drivers 220 and their relation to the staples 222.

[0087] Operation

[0088] In use, the surgical stapling and severing instrument 10 is used as depicted in FIGS. 1, 2, and 17-23. In FIGS. 1-2, the instrument 10 is in its start position, having had an unfired, fully loaded staple cartridge 37 snap-fitted

into the distal end of the elongate channel 16. Both triggers 26, 28 are forward and the end effector 12 is open, such as would be typical after inserting the end effector 12 through a trocar or other opening into a body cavity. The instrument 10 is then manipulated by the clinician such that tissue 248 to be stapled and severed is positioned between the staple cartridge 37 and the anvil 18, as depicted in FIG. 17.

[0089] With reference to FIGS. 18-19, next, the clinician moves the closure trigger 26 proximally until positioned directly adjacent to the pistol grip 24, locking the handle portion 20 into the closed and clamped position. The retracted firing bar 14 in the end effector 12 does not impede the selective opening and closing of the end effector 12, but rather resides within the anvil pocket 40. With the anvil 18 closed and clamped, the E-beam firing bar 14 is aligned for firing through the end effector 12. In particular, the upper pin 38 is aligned with the anvil slot 42 and the elongate channel 16 is affirmatively engaged about the channel slot 45 by the middle pin 46 and the firing bar cap 44.

[0090] With reference to FIGS. 20-21, after tissue clamping has occurred, the clinician moves the firing trigger 28 proximally causing the firing bar 14 to move distally into the end effector 12. In particular, the middle pin 46 enters the staple cartridge 37 through the firing drive slot 47 to effect the firing of the staples 222 (not shown in FIGS. 20-21) via wedge sled 218 toward the anvil 18. The lower most pin, or firing bar cap 44, cooperates with the middle pin 46 to slidably position cutting edge 48 of the firing bar 14 to sever tissue. The two pins 44, 46 also position the upper pin 38 of the firing bar 14 within longitudinal anvil slot 42 of the anvil 18, affirmatively maintaining the spacing between the anvil 18 and the elongate channel 16 throughout its distal firing movement.

[0091] With reference to FIGS. 22-23, the clinician continues moving the firing trigger 28 until brought proximal to the closure trigger 26 and pistol grip 24. Thereby, all of the ends of the staples 222 are bent over as a result of their engagement with the anvil 18. The firing bar cap 44 is arrested against a firing bar stop 250 projecting toward the distal end of the channel slot 45. The cutting edge 48 has traversed completely through the tissue. The process is complete by releasing the firing trigger 28 and by then depressing the release button 30 while simultaneously squeezing the closure trigger 26 to open the end effector 12.

[0092] Single Lockout for Missing/Spent Staple Cartridge

[0093] As described above, the E-beam firing bar 14 provides unique capabilities for affirmatively spacing the end effector 12 while simultaneously severing tissue and effecting the forming of staples on each side of the cut. With reference to FIG. 24, preventing the distal movement of the firing bar 14 thus prevents the inadvertent severing of tissue. A single lockout mechanism 270 advantageously responds to a missing staple cartridge 37 or a spent staple cartridge 37, the latter condition depicted in FIG. 24, by blocking the middle pin 46 of the firing bar (only the middle pin of the firing bar being shown in FIG. 24).

[0094] In particular, the single lockout mechanism 270 is depicted as a pair of bent spring fingers 272 positioned in the elongate channel 16 to respond to both conditions: missing cartridge and spent cartridge. In particular, the bent spring fingers 272 raise up to block the middle pin 46 of the firing

bar 14 when the wedge sled 218 (not shown in FIG. 24) is not present, such as when the cartridge 37 is removed or when the cartridge 37 has been fired.

[0095] FIGS. 25-28 depict the single lockout mechanism 270, specifically the bent spring fingers 272 sequentially as the surgical stapling and severing instrument 10 is fired. In FIG. 25, an unfired staple cartridge 37 has been inserted into the elongate channel 16 with the wedge sled 218 depressing the bent spring fingers 272 so that the firing drive slot 47 formed between the cartridge 37 and the elongate channel 16 is unimpeded.

[0096] In FIG. 26, firing of the cartridge 37 has commenced, with the wedge sled 218 and the middle pin 46 of the firing bar 14 having distally traversed off of the bent spring fingers 272, which then spring up into the firing drive slot 47.

[0097] In FIG. 27, the staple cartridge 37 is now spent with the wedge sled 218 fully driven distally and no longer depicted. The firing bar 14 is being retracted proximally. Since the bent spring fingers 272 pivot from a more distal point, the firing bar 14 is able to ride up onto the bent spring fingers 272 during retraction, causing them to be depressed out of the firing drive slot 47.

[0098] In FIG. 28, the firing bar 14 is fully retracted and now confronts a non-depressed pair of bent spring fingers 272 to prevent distal movement. The single lockout mechanism 270 thereby activated remains during the period in which the spent staple cartridge 37 is removed until an unfired staple cartridge 37 is installed.

[0099] FIG. 29 depicts a lockout trough 274 that may advantageously be included in the single lockout mechanism 270 in order to provide increased mechanical strength. In some applications, it may be desirable to resist strong firing motions without damaging the bent spring fingers 272. The lockout trough 274 communicates with the firing drive slot 47 when the bent spring fingers 272 are not depressed. Moreover, the lockout trough 274 is downwardly ramped in a distal direction such that the middle pin 46 of the firing bar 14 is directed toward an abutting surface 276 at a distal end of the lockout trough 274, thereby reacting the distal movement of the firing bar 14 into an elongate channel 16'. In particular, the firing bar 14 in its initial position moves to a distal and lowered position, depicted at 14', wherein the middle pin 46 moves to a position depicted as 46'. It will be appreciated that the upper pin 38 and lower firing bar cap 44, as each moves to distal and lowered positions 38' and 44' respectively, position the middle pin 46 against elongate channel 16 so that the middle pin 46 enters the lockout trough 274.

[0100] It will be further appreciated that the firing bar 14' may be readily retracted from the lockout trough 274. Moreover, insofar as the upper pin 38' would be engaging the anvil 18 (not shown in FIG. 29) in this position, the clinician would have to retract the firing bar 14' so that the anvil 18 could be opened in order to insert an unfired staple cartridge 37, and thus the firing bar 14 would be fully retracted and would not impede the depressing of the bent spring fingers 272 to their inactivated position.

[0101] FIG. 30 depicts another single lockout mechanism 270, depicted as a pair of lockout hooks 280 having ramped ends 282 distally placed with regard to attachment devices

284 inserted through apertures 286 in the elongate channel 16. The ramped ends 282 lie above a hook recess 288 defined in the elongate channel 16. Thus, when each ramped end 282 is contacted by a wedge sled 218 of an unfired staple cartridge 37 (not shown in FIG. 30), the ramped ends 282 are depressed into the hook recess 288, thereby clearing the way for the middle pin 46 of the firing bar 14 (only the middle pin shown in FIG. 30) to move distally to fire the staple cartridge 37. A thin shaft 290 coupling the attachment devices 284 to respectively to the ramped end 282 of each lockout hook 280 resiliently responds to absence of a wedge sled 218, as depicted, wherein the ramped ends 282 return to impede the firing drive slot 47 to block a retracted middle pin 46 of the firing bar.

[0102] FIGS. 31-34 depict the sequence of operation of the lockout hooks 280. In FIG. 31, the staple cartridge 37 is unfired so that the distally positioned wedge sled 218 depresses the ramped ends 282 into the hook recess 288, allowing the middle pin 46 of the firing bar 14 to move distally during firing, as depicted in FIG. 32. With the wedge sled 218 and middle pin 46 distally removed with respect to the lockout mechanism 270, the ramped ends 282 resiliently raise out of the hook recess 282 to occupy the firing drive slot 47.

[0103] In FIG. 33, the firing bar 14 is being retracted to the point of contacting the ramped ends 282 of the lockout hook 280. Since the distal end of the ramped ends 282 is lower than the proximal part of the ramped ends 282, the middle pin 46 of the firing bar 14 rides over the ramped ends 282, forcing them down into the hook recess 288 until middle pin 46 is past the ramped ends 282, as depicted in FIG. 34, wherein the ramped ends 282 resiliently spring back up to block the middle pin 46. Thus, the firing bar 14 is prevented from distal movement while the spent staple cartridge 37 is replaced with an unfired staple cartridge 37.

[0104] FIGS. 35-39 shows yet another alternate embodiment of a single lockout mechanism 370 that utilizes a locking trough 274 within the elongate channel 16. As shown in FIG. 35, the cartridge 37 is loaded with single and double drivers 220 and staples 222 (not shown) and all are unmodified. An open cartridge tray 324 is attached to cartridge 372 and a coupling wedge sled 318 slidably mounted within. An open passageway 317 is located at a distal end of the open cartridge tray 324 to provide passage of the middle pin 46 of the firing bar 14. A notch 319 can be seen located in a central nub 321 of the coupling wedge sled 318.

[0105] FIG. 36 is a side section view of the assembled end effector 12 of the surgical stapling and severing instrument 10 in the unfired position showing the elements of the alternate embodiment of the lockout mechanism 370.

[0106] For this alternate mechanism, a coupling firing bar 314 is used with a support member or heel 323 in sliding contact with a floor 325 of the elongate channel 16. As shown, when firing bar 314 is fully retracted proximally, heel 323 is located proximally to a distal end of the channel slot 45 that extends longitudinally along the bottom of elongate channel 16. A spring bump 327 also extends upwards on coupling firing bar 314 to compress a leaf spring 329 and to exert a downward bias on coupling firing bar 314. This downward bias ensures contact of the heel 323 with the floor 325.

[0107] A coupling feature 331 extends distally from the coupling firing bar 314. With an unfired cartridge installed, coupling feature 331 is adjacent to but not contacting the notch 319 within nub 321 of coupling wedge sled 318. When the instrument is fired, the coupling firing bar 314 moves distally bringing coupling feature 331 into cooperative engagement with the notch 319 of the coupling wedge sled 318 and begins to push sled 318 distally. With additional distal movement of the coupling firing bar 314, heel 323 slides off the floor 325 and is exposed to the open channel slot 45. The cooperative engagement of the coupling feature 331 with the notch 319 prevents downward movement of the firing bar 14 (from the bias of leaf spring 327) during the firing stroke. Thus, during firing, firing bar 314 is held suspended over the open channel slot 45 and open lockout trough 274 located within elongate channel 16. As firing bar 314 moves distally during the firing stroke, spring bump 327 passes leaf spring 329 and reduces the downward bias from spring 329. FIG. 37 shows the coupling firing bar 314 at the end of the firing stroke with the coupling feature 331 in cooperative engagement with notch 319 of the coupling wedge sled. If the firing bar 314 is retracted at any point during the firing stroke, the coupling feature 331 disengages with the coupling wedge sled 318 and sled 318 remains stationary in the cartridge 37.

[0108] FIG. 38 shows the lockout mechanism 370 locked out. In this view, firing bar 314 retracted to the proximal most position after firing. As the firing bar 314 retracts, the coupling feature 331 disengages from the stationary coupling wedge sled 318 and coupling firing bar 314 drops under spring bias until the middle pin 46 of firing bar 314 contacts and slides on an inner floor of the open cartridge tray 324. Firing bar 314 continues to retract, bringing angled surface spring bump 327 back into contact with the leaf spring 329 to increase the downward bias. Middle pin 46 continues to slide distally on the floor of open cartridge tray 324 until the open passageway 317 (FIG. 35) of the open cartridge tray 324 is reached and middle pin 46 drops through open passageway 317 and into lockout trough 274. As the proximal movement of firing bar 314 continues, the middle pin 46 slides up the angled proximal surface of lockout trough 274 and pin 46 begins sliding on floor 325 of the elongate channel 16. Continued proximal movement of firing bar 314 brings an angled proximal surface of heel 323 into contact with a proximal end of channel slot 45 and lifts firing bar 314 up. This upwards motion lifts and disengages middle pin 46 from the floor 325 and further compresses leaf spring 329.

[0109] Should an attempt be made to fire the surgical stapling and severing instrument 10 again, the lockout mechanism 370 will lock out as follows. Pulling on the firing trigger 28 a second time moves firing bar 314 distally from the position of FIG. 38 and heel 273 slides off the floor 325 and into the channel slot 45. Since the coupling wedge sled 318 is not in the distalmost position, cooperative coupling cannot occur between the wedge sled 318 and firing bar 314 and leaf spring 329 biases firing bar 314 downwards until middle pin 46 of the firing bar 314 is contacting and sliding on the floor 325. Since middle pin 46 extends laterally in either side of firing bar 314, the pins contact the floor 325 on either side of the channel slot 45. As shown in FIG. 39, further distal movement of the coupling firing bar 314 drops middle pin 46 into lockout trough 274 where firing bar 14 is locked by contact of middle pin 46 with vertical abutting

surface 276 of lockout trough 274 (FIG. 29). In this locked position, leaf spring 329 applies a downward bias on firing bar 314 to prevent the middle pin 46 from moving vertically and out of lockout trough 274 should the shaft be inverted. Release of the firing trigger 28 will retract the firing bar 314 to the position of FIG. 38. Any additional firing motions will move firing bar 314 back to the locked position of FIG. 39 until a fresh cartridge 37 is installed with a coupling wedge sled 318 in the distalmost position. Thus, when an unfired cartridge is used, the coupling wedge sled 318 acts as a bridge to hold the firing bar 14 up above the channel slot 45 and lockout trough 274 during the firing stroke. Once the coupling wedge sled 318 moves distally passes the lockout trough 274 and the firing bar 314 is retracted, the instrument will lock out.

[0110] While the present invention has been illustrated by description of several embodiments and while the illustrative embodiments have been described in considerable detail, it is not the intention of the applicant to restrict or in any way limit the scope of the appended claims to such detail. Additional advantages and modifications may readily appear to those skilled in the art.

[0111] For example, a single lockout mechanism may comprise a spring-loaded plunger encompassed within the elongate channel 16 that moves upwardly into the firing drive slot 47 when not contacted by the wedge sled 218 with the plunger presenting a hooked or otherwise

What is claimed:

1. A surgical stapling instrument comprising:

a cartridge containing a plurality of staples and a wedge member, said wedge member moveable longitudinally within said cartridge to eject said staples from said cartridge;

a firing member cooperatively engagable with said wedge member and longitudinally moveable in a distal direction to eject said staples; and

a locking mechanism for preventing distal movement of said firing bar after at least one of said said staples has been ejected and said firing bar has been moved proximally a predetermined distance, wherein said wedge member biases said firing member into an unlocked position prior to said staples being deployed and wherein said wedge and said firing bar are not cooperatively engaged when said instrument is in a locked position.

2. The surgical device according to claim 1 further including a biasing feature which biases said firing bar in an unlocked position prior to said firing bar engaging said wedge member.

3. The surgical device according to claim 2 wherein said biasing feature is attached to said firing bar.

4. The surgical instrument of claim 1 wherein at least one of said wedge or said firing member includes a coupling feature, said coupling feature cooperatively engaging said firing bar to said wedge member and preventing engagement of said firing bar with said lockout.

5. The surgical instrument of claim 4 wherein said coupling feature is an extension member cooperatively engagable with at least one of said wedge member or said firing bar.

6. The surgical instrument of claim 5 including a reception feature on at least one of said wedge member or said firing bar to cooperatively receive said extension member.

7. The surgical instrument of claim 1 further including at least one pin member extending from said firing bar, at least one of said pin members engaging with said locking mechanism to lock said firing bar.

8. The surgical instrument of claim 1 further including a spring, said spring normally biasing said firing member towards said locking member.

9. The surgical instrument of claim 1 wherein said firing bar includes a sharp edge for cutting tissue.

10. A surgical stapling instrument comprising:

an elongate channel extending from said surgical stapling instrument;

a cartridge supported in said elongate channel and containing a plurality of staples and a wedge member, said wedge member moveable longitudinally within said cartridge to eject said staples from said cartridge;

a firing member cooperatively engagable with said wedge member and longitudinally moveable in a distal direction to eject said staples; and

a locking mechanism for locking said firing bar to said elongate channel by preventing distal movement of said firing bar after at least one of said said staples has been ejected and said firing bar has been moved proximally a predetermined distance, wherein said wedge member biases said firing member into an unlocked position prior to said staples being deployed and wherein said wedge and said firing bar are not cooperatively engaged when said instrument is in a locked position.

11. The surgical device according to claim 10 further including a biasing feature which operably engages with said elongate channel to bias said firing bar in an unlocked position prior to said firing bar engaging said wedge member.

12. The surgical device according to claim 11 wherein said biasing feature is attached to said firing bar.

13. The surgical instrument of claim 17 wherein said channel includes an open channel slot for passage of the firing member therein, said channel slot having a distal end and a proximal end distal to said biasing feature, wherein when said biasing feature of said firing bar moves longitudinally a predetermined distance, said biasing member disengages with said channel.

14. The surgical stapling instrument of claim 10 wherein said elongate channel includes at least one reception feature for locking engagement with said firing bar.

15. The surgical stapling instrument of claim 14 including at least one pin member extending from said firing bar, at

least one of said at least one pin members capable of locking engagement with said at least one reception feature of said elongate channel.

16. The surgical stapling instrument of claim 10 including a spring member for normally biasing said firing member towards locking engagement with said elongate channel.

17. The surgical instrument of claim 10 wherein at least one of said wedge or said firing member includes a coupling feature, said coupling feature cooperatively engaging said firing bar to said wedge member and preventing engagement of said firing bar with said lockout.

18. The surgical instrument of claim 17 wherein said coupling feature is an extension member cooperatively engagable with at least one of said wedge member or said firing bar.

19. The surgical instrument of claim 18 including a reception feature on at least one of said wedge member or said firing bar to cooperatively receive said extension member.

20. The surgical instrument of claim 10 including a support member on said firing bar, said support member interacting with said channel to align said firing member with said wedge member until said firing member cooperatively engages with said wedge member during an initial portion of said longitudinal movement.

21. The surgical instrument of claim 8 wherein said firing member includes a sharp for cutting tissue.

22. A surgical stapling instrument comprising:

a cartridge containing a plurality of staples and a wedge member, said wedge member moveable longitudinally within said cartridge to eject said staples from said cartridge;

firing member cooperatively engagable with said wedge member and longitudinally moveable in a distal direction to eject said staples; and

a locking mechanism for preventing distal movement of said firing bar after at least one of said staples has been ejected and said firing bar has been moved proximally a predetermined distance, wherein said wedge member biases said firing member into an unlocked position prior to said staples being deployed and wherein said wedge and said firing bar are not cooperatively engaged when said instrument is in a locked position

a firing trigger operably coupled to said locking mechanism and said firing bar, said firing trigger capable of at least one actuation to move said firing member distally.

* * * * *

专利名称(译)	外科缝合器械具有单个锁定机构以防止发射		
公开(公告)号	US20050023324A1	公开(公告)日	2005-02-03
申请号	US10/687503	申请日	2003-10-15
[标]申请(专利权)人(译)	DOLL KEVIN 塞斯特MICHAEL EARL 谢尔顿检基E 威尔士KENNETH		
申请(专利权)人(译)	DOLL KEVIN 塞斯特MICHAEL EARL 谢尔顿检基E. 威尔士KENNETH		
当前申请(专利权)人(译)	ETHICON LLC		
[标]发明人	DOLL KEVIN SETSER MICHAEL EARL SHELTON FREDERICK E IV WALES KENNETH		
发明人	DOLL, KEVIN SETSER, MICHAEL EARL SHELTON, FREDERICK E. IV WALES, KENNETH		
IPC分类号	A61B17/068 A61B17/072 A61B17/04		
CPC分类号	A61B17/07207 A61B2017/00398 A61B2019/4873 A61B2017/07285 A61B2017/2923 A61B2017/07214 A61B2090/0814		
其他公开文献	US7380695		
外部链接	Espacenet USPTO		

摘要(译)

用于腹腔镜和内窥镜临床手术的外科器械同时切断并缝合夹在末端执行器中的组织，该末端执行器包括保持钉仓的细长通道和枢转连接的砧座。电子束击发杆接合通道并在远侧击发运动期间选择性地接合砧座，其中组织被切断并被钉钉从钉仓向上驱动以形成抵靠砧座。特别地，与钉仓成一体的楔形件由击发杆的中间销向远侧驱动以实现钉合。细长通道的单个锁定响应于楔形滑板在其未击发位置的存在，以允许击发杆发射。否则，单个锁定装置可防止在钉仓丢失或耗尽时发射。

