



US010238398B2

(12) **United States Patent**  
**Hughett, Sr. et al.**

(10) **Patent No.:** **US 10,238,398 B2**  
(45) **Date of Patent:** **\*Mar. 26, 2019**

(54) **CLIP DEPLOYMENT TOOL AND  
ASSOCIATED METHODS**

(71) Applicant: **AtriCure, Inc.**, Mason, OH (US)

(72) Inventors: **James David Hughett, Sr.**, Acworth,  
GA (US); **Keith Edward Martin**,  
Dayton, OH (US); **Kenneth Lance  
Miller**, Hamilton, OH (US); **Michael  
Dolgin**, Cincinnati, OH (US)

(73) Assignee: **AtriCure, Inc.**, Mason, OH (US)

(\*) Notice: Subject to any disclaimer, the term of this  
patent is extended or adjusted under 35  
U.S.C. 154(b) by 228 days.

This patent is subject to a terminal dis-  
claimer.

(21) Appl. No.: **15/014,314**

(22) Filed: **Feb. 3, 2016**

(65) **Prior Publication Data**

US 2016/0151072 A1 Jun. 2, 2016

**Related U.S. Application Data**

(63) Continuation of application No. 13/355,169, filed on  
Jan. 20, 2012, now Pat. No. 9,282,973.

(51) **Int. Cl.**

**A61B 17/128** (2006.01)

**A61B 17/122** (2006.01)

**A61B 17/00** (2006.01)

**A61B 17/29** (2006.01)

(52) **U.S. Cl.**

CPC ..... **A61B 17/1285** (2013.01); **A61B 17/1227**  
(2013.01); **A61B 2017/00584** (2013.01); **A61B**  
**2017/00867** (2013.01); **A61B 2017/2946**  
(2013.01)

(58) **Field of Classification Search**

CPC ..... A61B 17/0057; A61B 17/10; A61B 17/12;  
A61B 17/122; A61B 17/1222; A61B  
17/1227; A61B 17/128; A61B 17/1285;  
A61B 2017/00575; A61B 2017/00584;  
A61B 2017/00592; A61B 2017/00623;  
A61B 2017/00867

See application file for complete search history.

(56) **References Cited**

**U.S. PATENT DOCUMENTS**

5,540,706 A \* 7/1996 Aust ..... A61B 17/32002  
606/170  
5,609,599 A \* 3/1997 Levin ..... A61B 17/083  
606/151  
5,643,291 A \* 7/1997 Pier ..... A61B 17/122  
606/139

(Continued)

*Primary Examiner* — Ryan J Severson

(74) *Attorney, Agent, or Firm* — Dorton & Willis LLP;  
Ryan Willis

(57) **ABSTRACT**

A laparoscopic device comprising: (a) a housing operatively  
coupled to a first control and a second control; (b) an end  
effector operatively coupled to the first control, the end  
effector comprising a first component and a second compo-  
nent selectively repositionable with respect to one another  
within an X-Y plane, the end effector also including a third  
component selectively repositionable with respect to the  
second component within an Y-Z plane; (c) a laparoscopic  
conduit extending between the housing and the end effector;  
and, (d) an occlusion clip deployment device operatively  
coupled to the end effector and the second control.

**22 Claims, 36 Drawing Sheets**

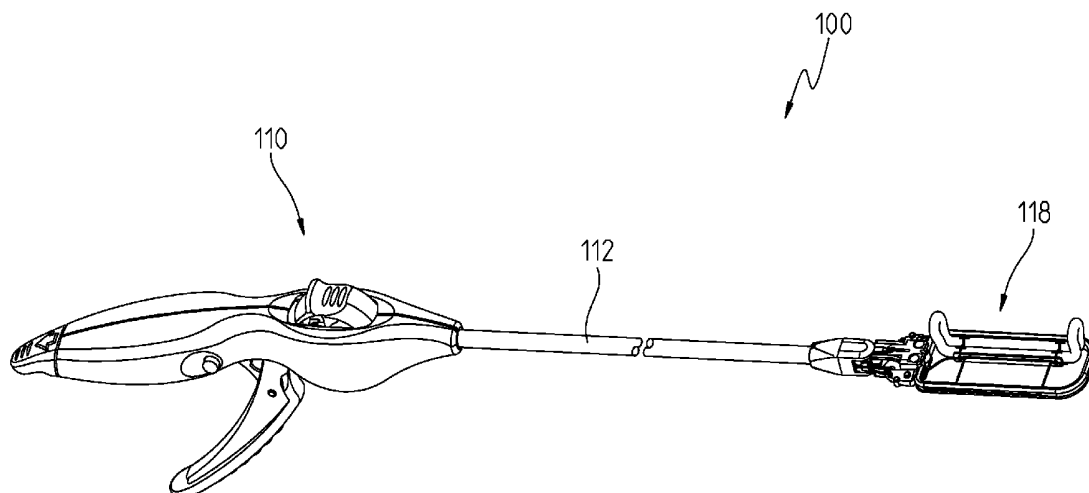

(56)

**References Cited**

## U.S. PATENT DOCUMENTS

5,921,997 A *	7/1999	Fogelberg .....	A61B 17/122	2006/0020271 A1 *	1/2006	Stewart .....	A61B 17/0057
			606/151				606/139
6,638,297 B1 *	10/2003	Huitema .....	A61B 17/0644	2007/0108252 A1 *	5/2007	Racenet .....	A61B 17/07207
			606/213				227/176.1
6,896,684 B2 *	5/2005	Monassevitch .....	A61B 17/064	2008/0033457 A1 *	2/2008	Francischelli .....	A61B 17/0057
			606/142				606/142
6,981,628 B2 *	1/2006	Wales .....	A61B 17/07207	2009/0012545 A1 *	1/2009	Williamson, IV ...	A61B 17/083
			227/175.1				606/157
7,424,965 B2 *	9/2008	Racenet .....	A61B 17/07207	2010/0204716 A1 *	8/2010	Stewart .....	A61B 17/0057
			227/180.1				606/142
7,645,285 B2 *	1/2010	Cosgrove .....	A61B 17/12	2013/0131649 A1 *	5/2013	Hughett, Sr. ....	A61B 17/1227
			606/142				606/1
7,896,895 B2 *	3/2011	Boudreaux .....	A61B 17/064	2013/0190777 A1 *	7/2013	Hughett, Sr. ....	A61B 17/1227
			606/157				606/142
8,172,870 B2 *	5/2012	Shipp .....	A61B 17/1285	2015/0173767 A1 *	6/2015	Monti .....	A61B 17/1227
			606/139				606/142
8,795,325 B2 *	8/2014	Taylor .....	A61B 17/2909	2016/0113651 A1 *	4/2016	Privitera .....	A61B 17/1227
			606/205				606/142
9,265,486 B2 *	2/2016	Hughett, Sr. ....	A61B 17/1227	2016/0113656 A1 *	4/2016	Privitera .....	A61B 17/1227
9,282,973 B2 *	3/2016	Hughett, Sr. ....	A61B 17/1227				606/142
2002/0177859 A1 *	11/2002	Monassevitch .....	A61B 17/064	2016/0151070 A9 *	6/2016	Monti .....	A61B 17/1227
			606/139				606/142
2005/0149069 A1 *	7/2005	Bertolero .....	A61B 1/12	2016/0151072 A1 *	6/2016	Hughett, Sr. ....	A61B 17/1227
			606/151				606/142

\* cited by examiner

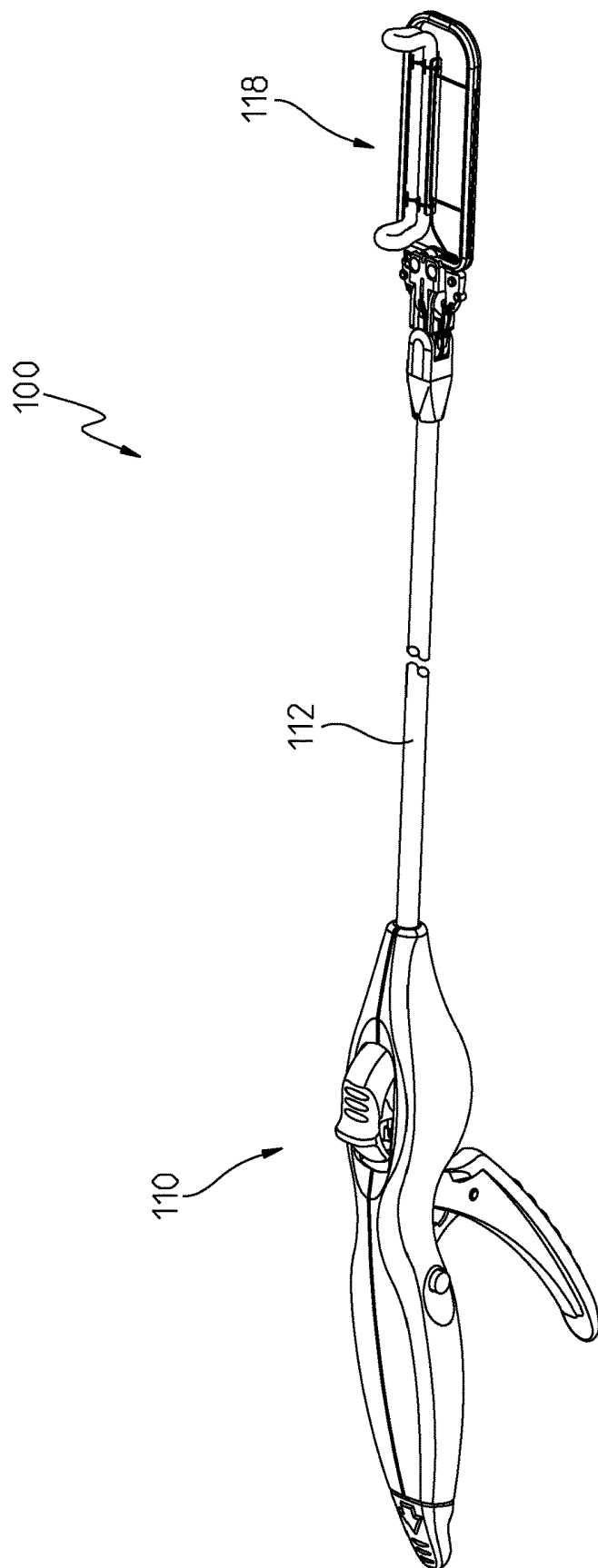

Fig. 1

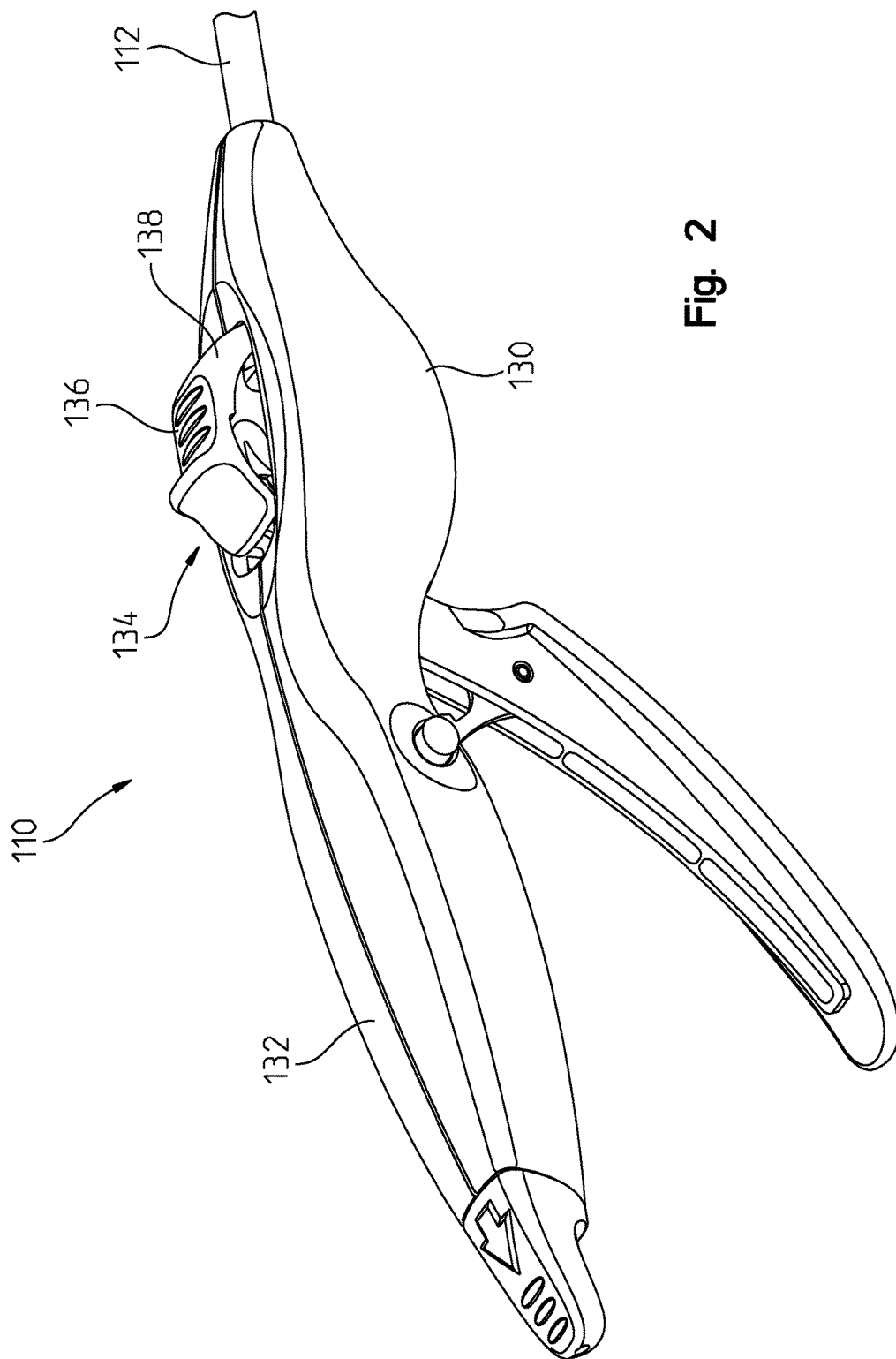

Fig. 2

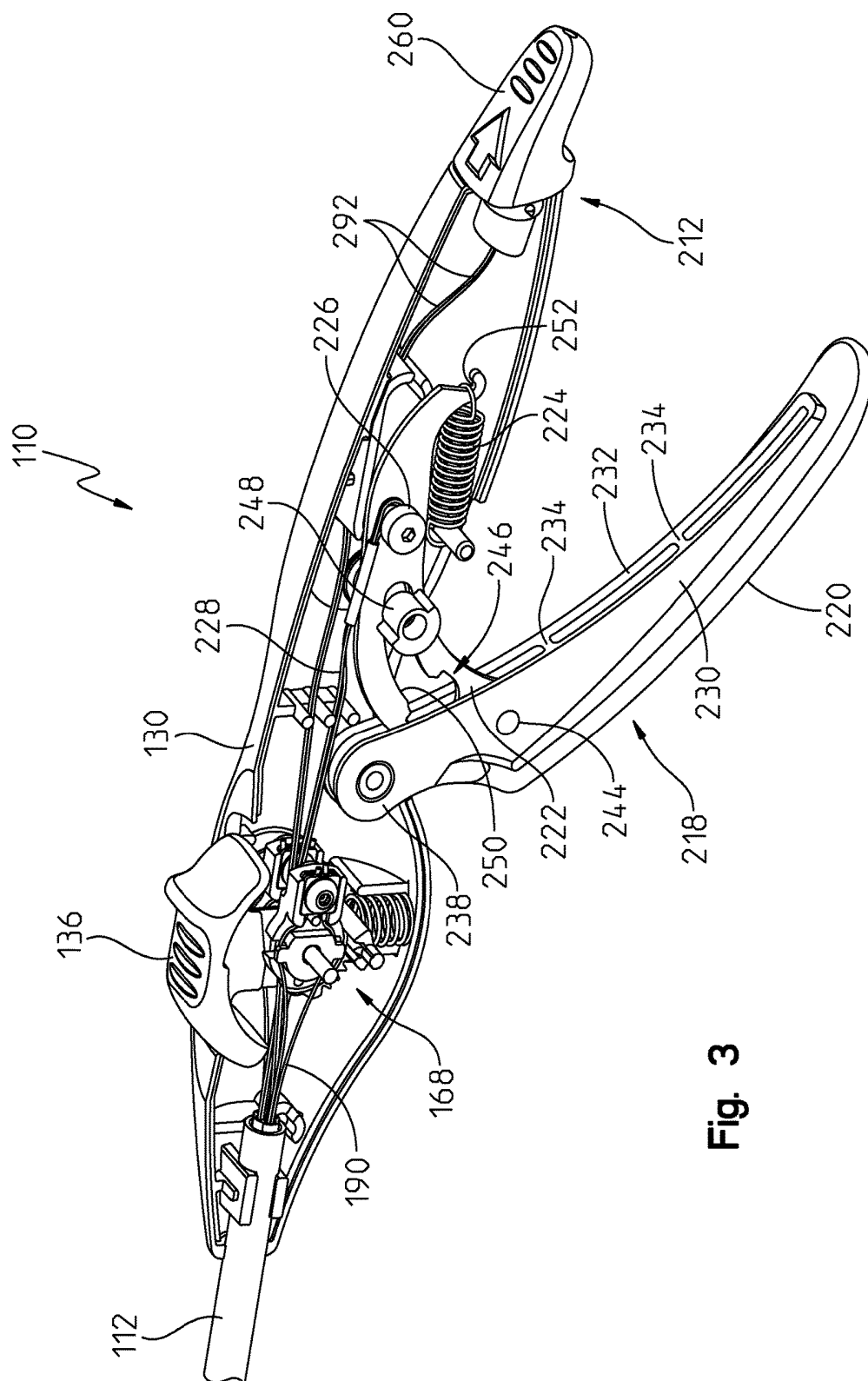

Fig. 3

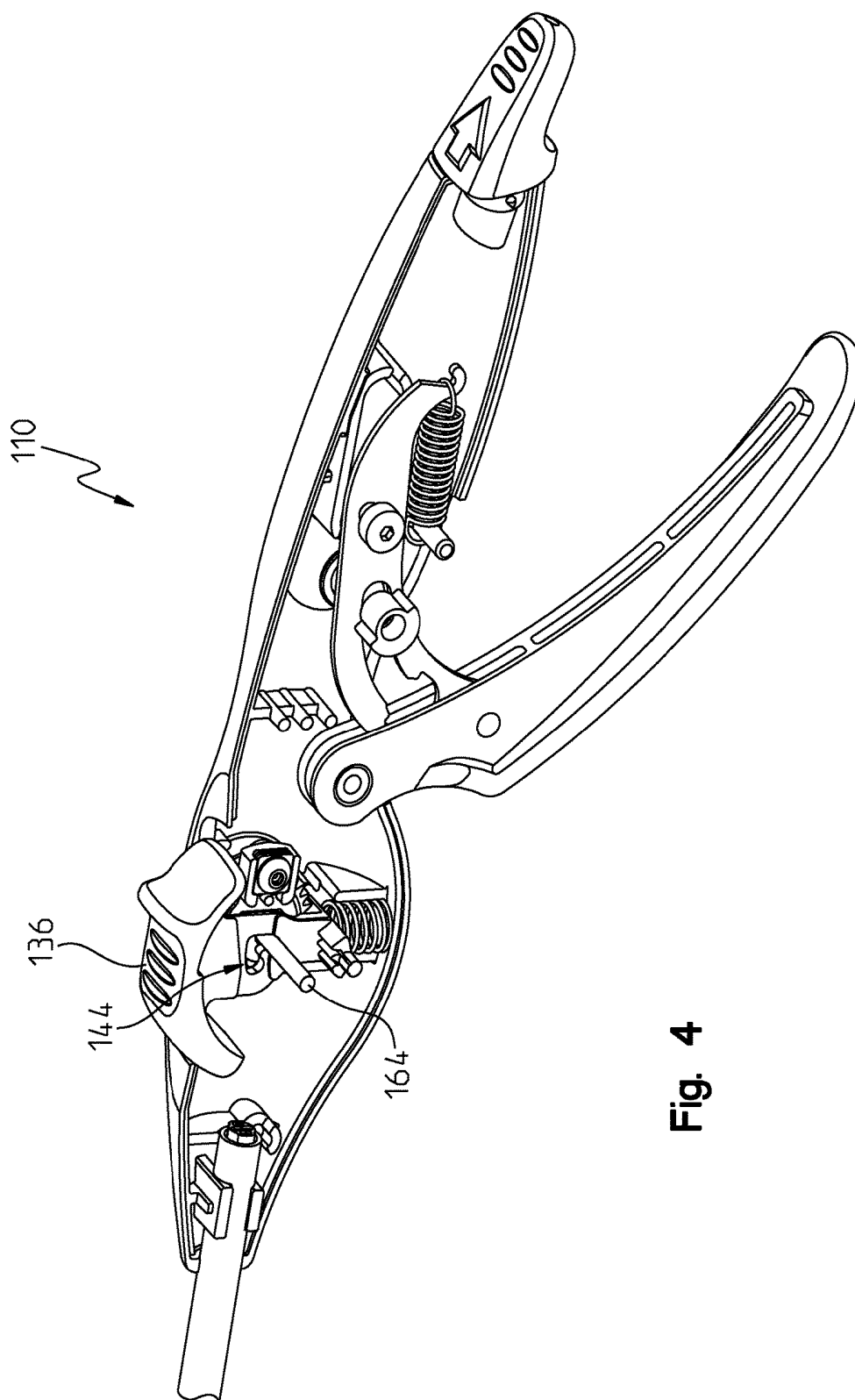

Fig. 4

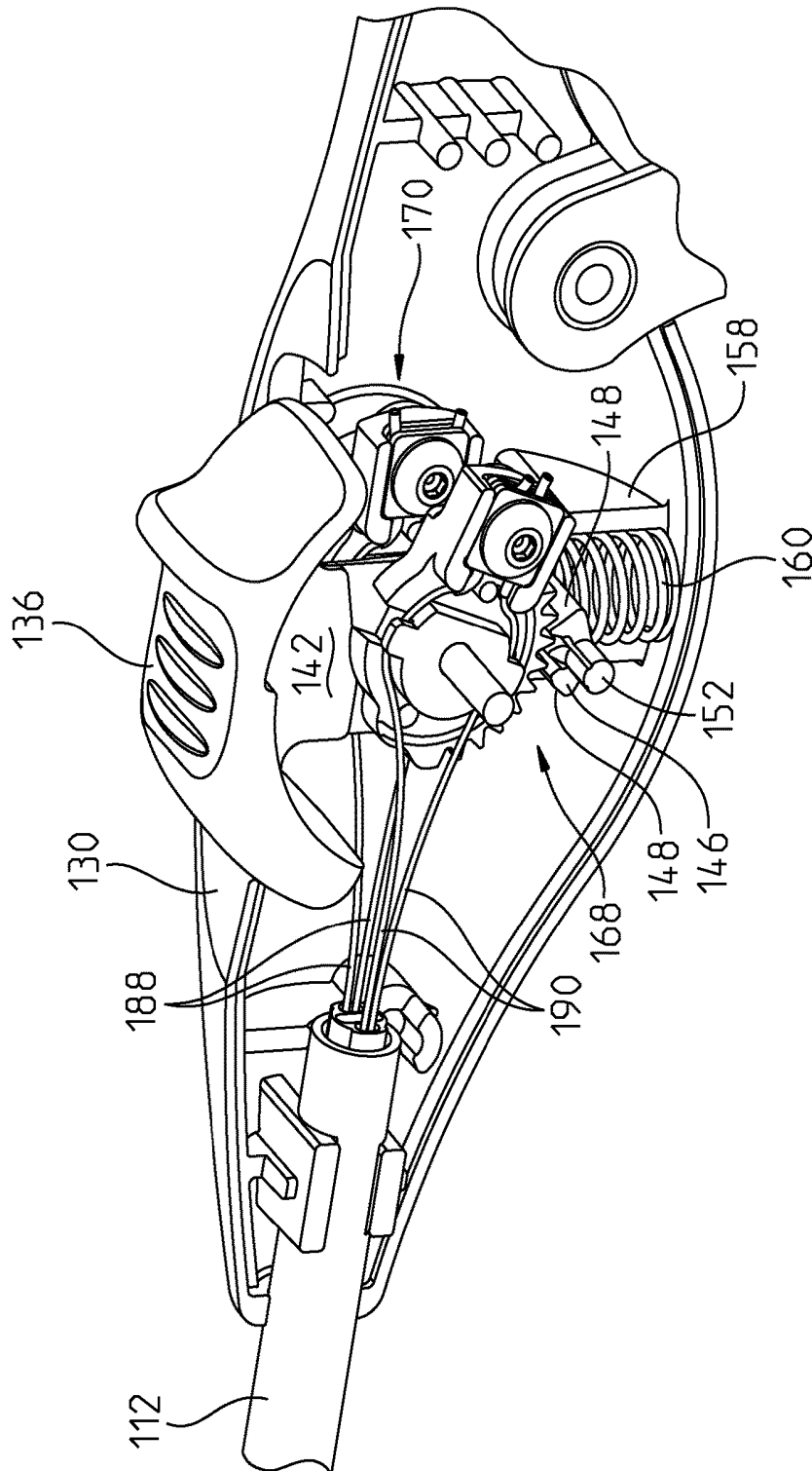

Fig. 5

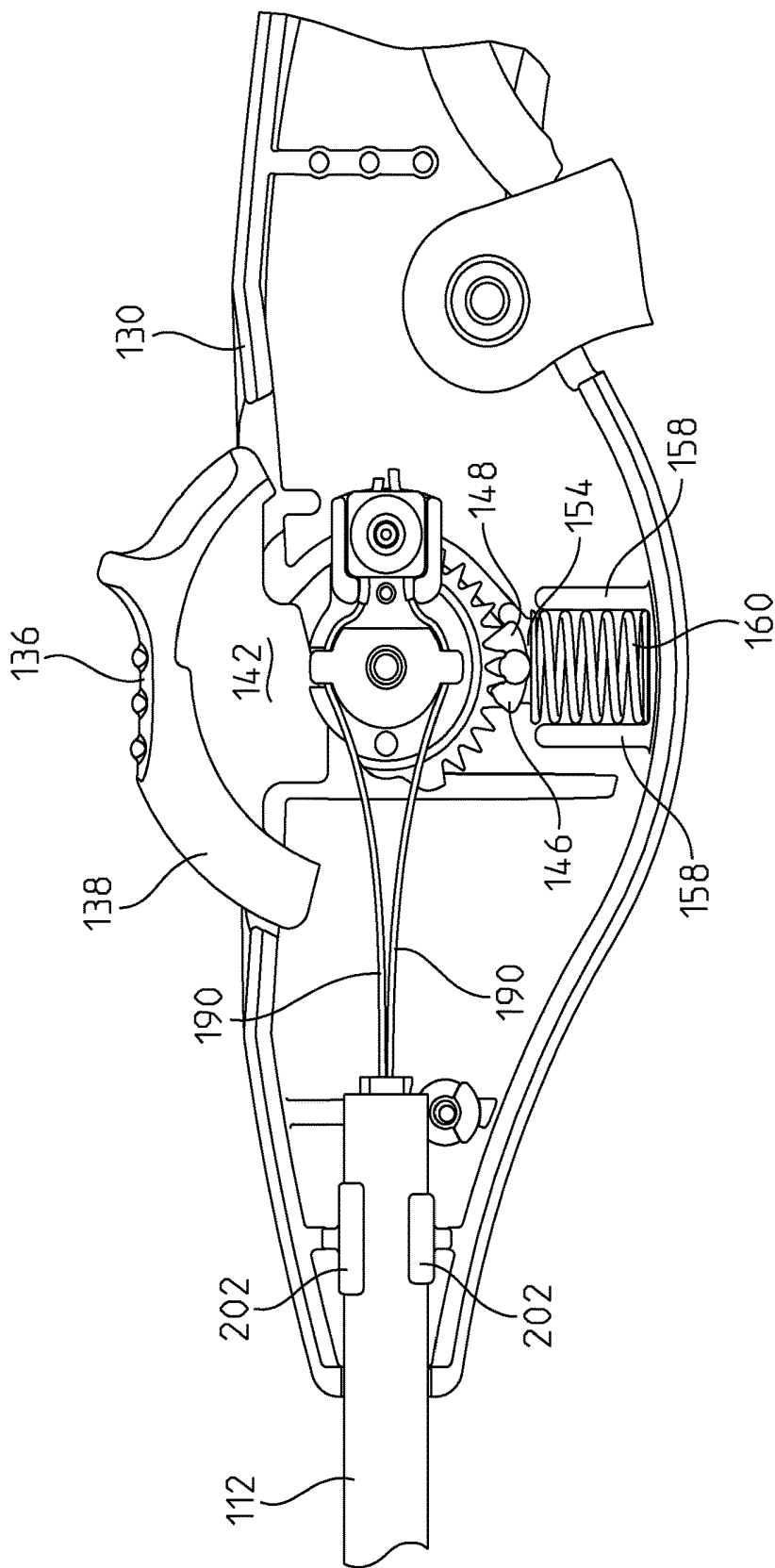

Fig. 6

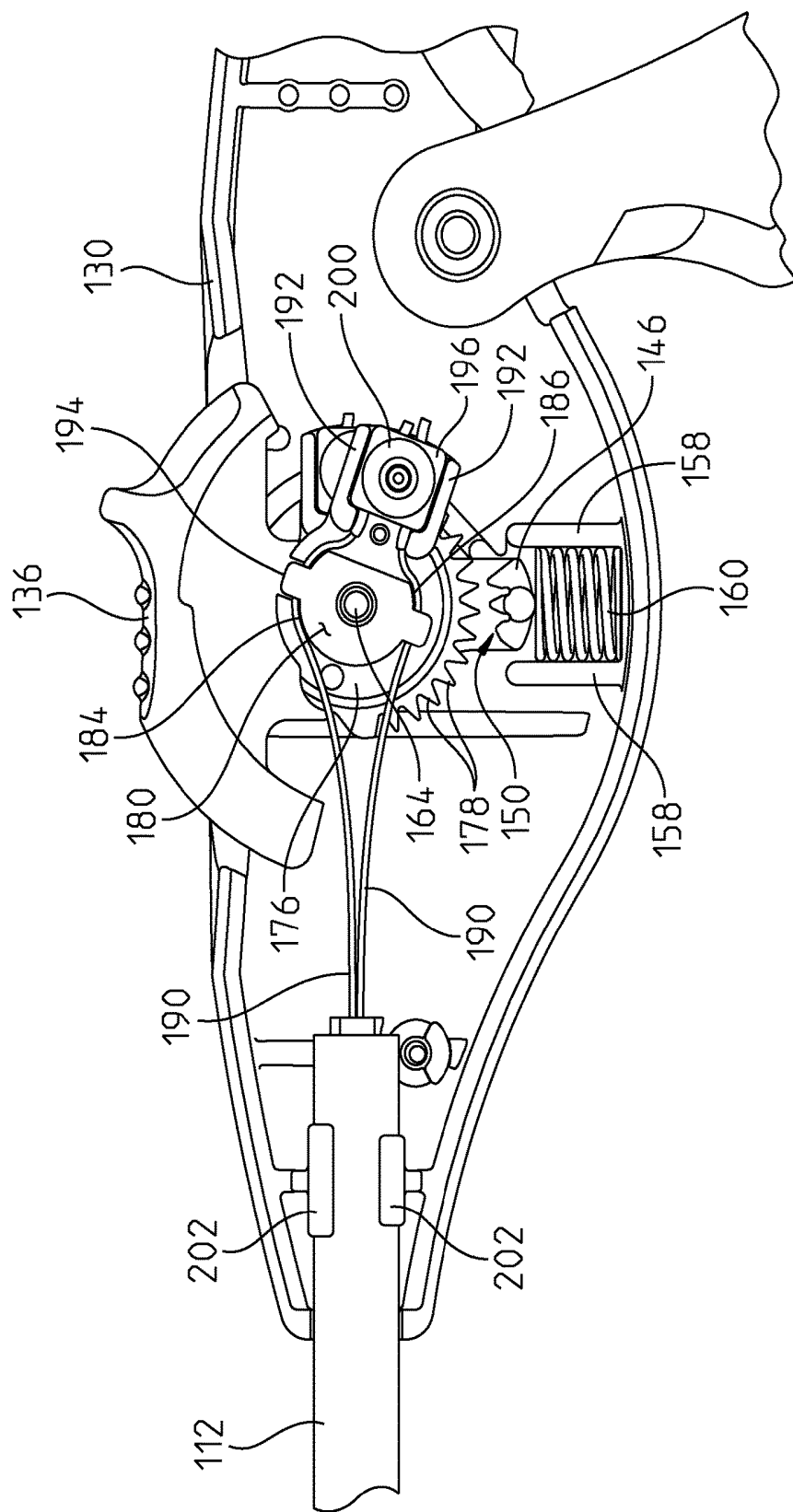

Fig. 7

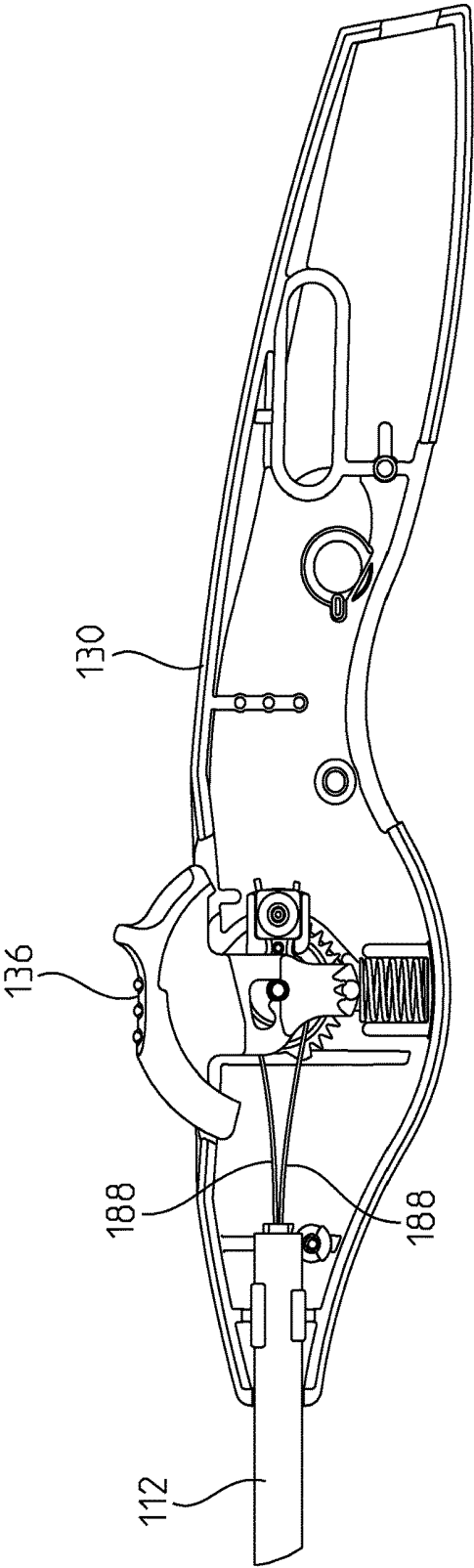
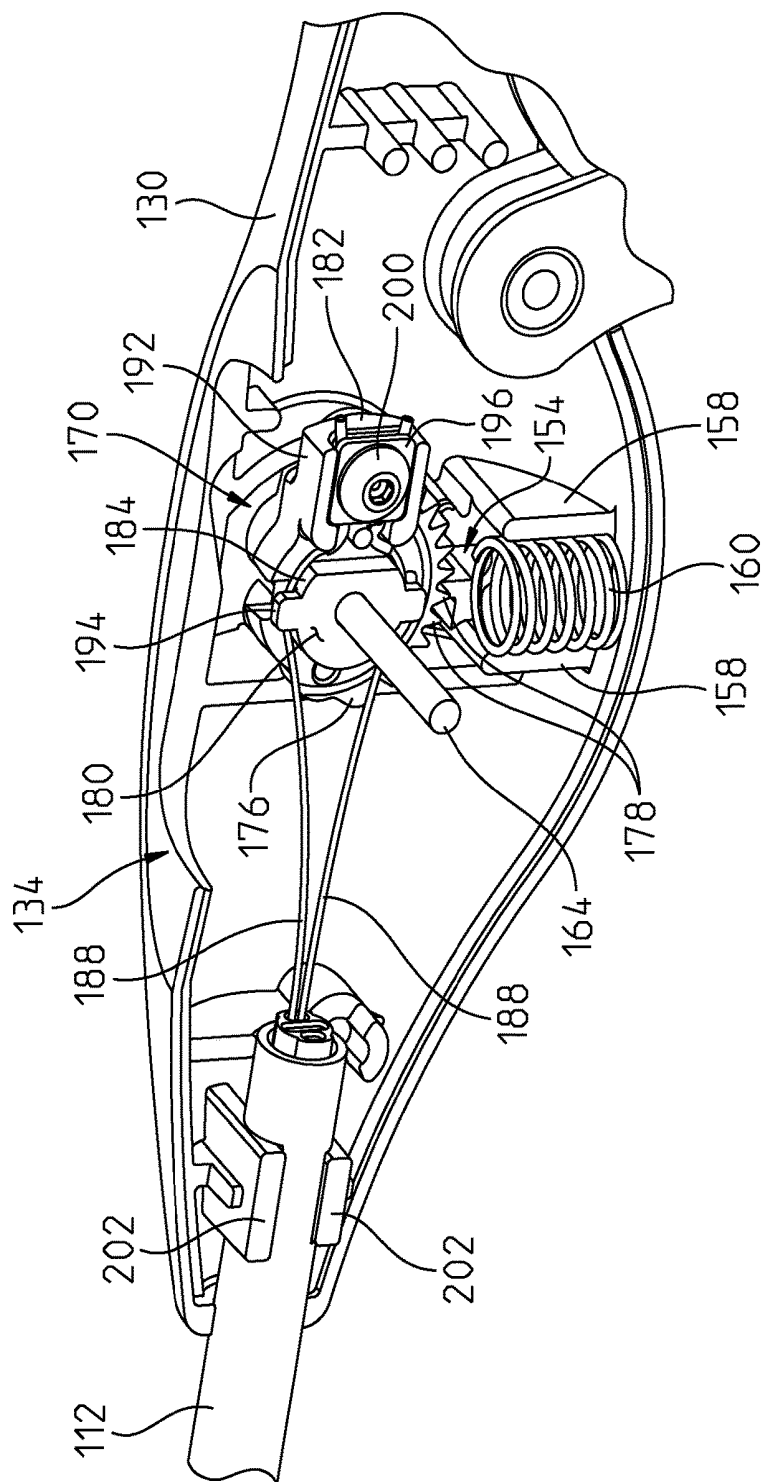
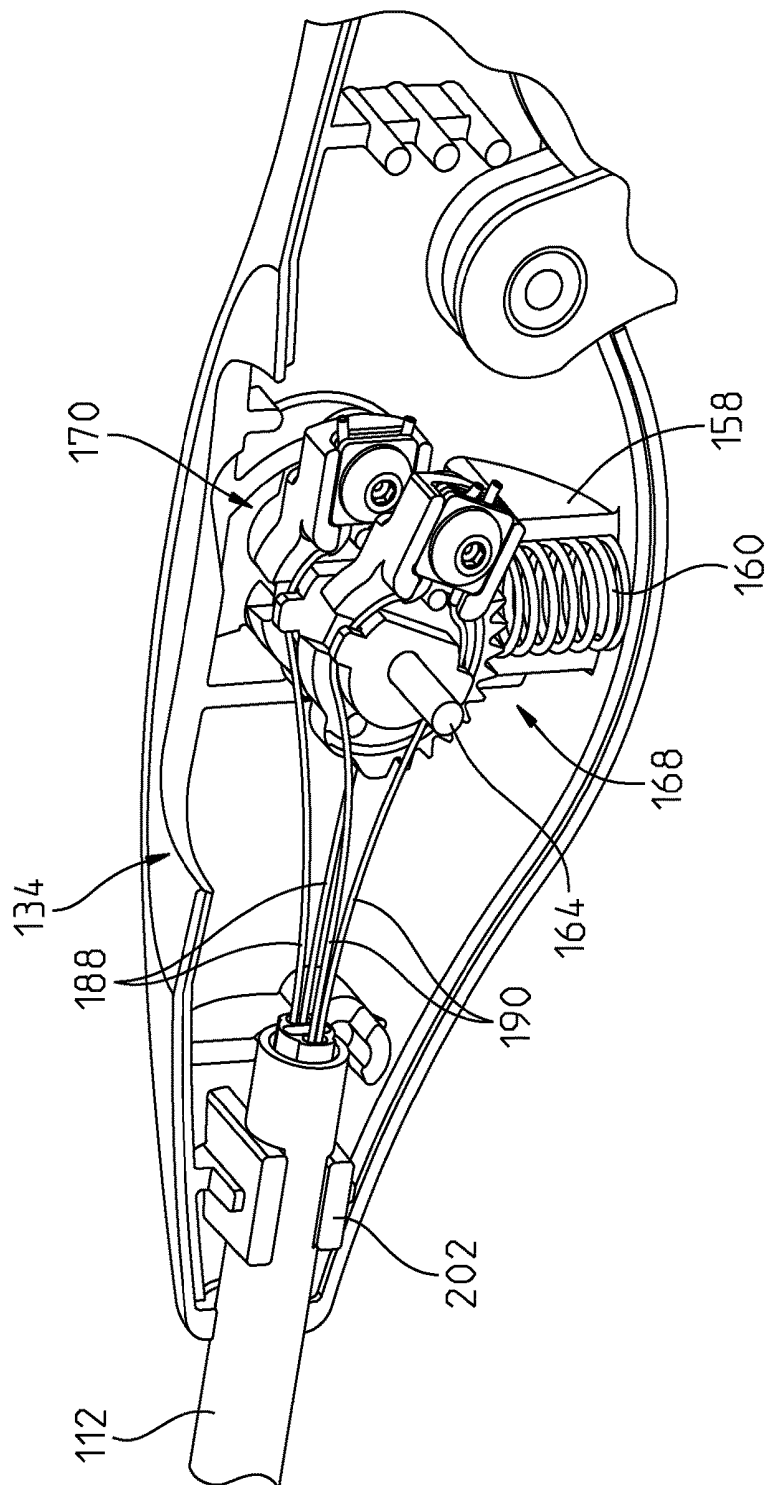

Fig. 8

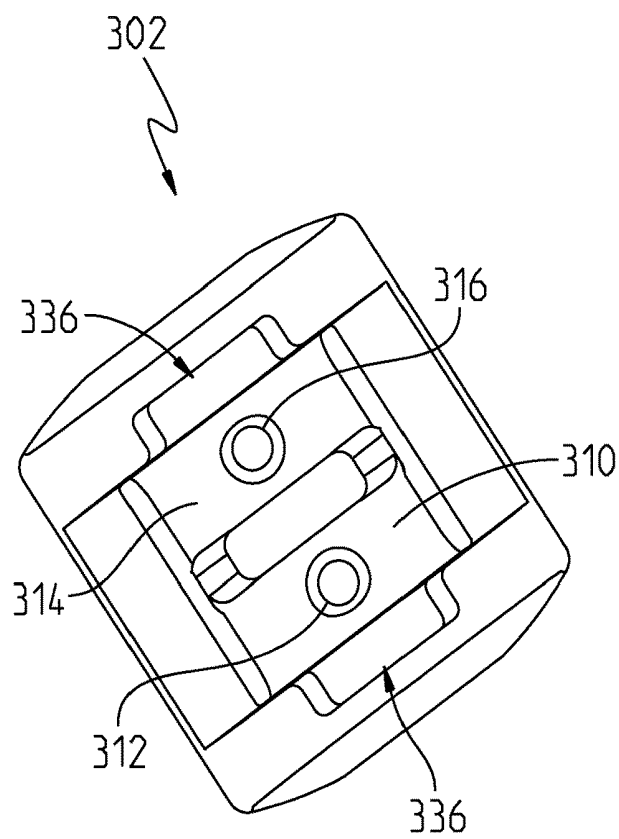
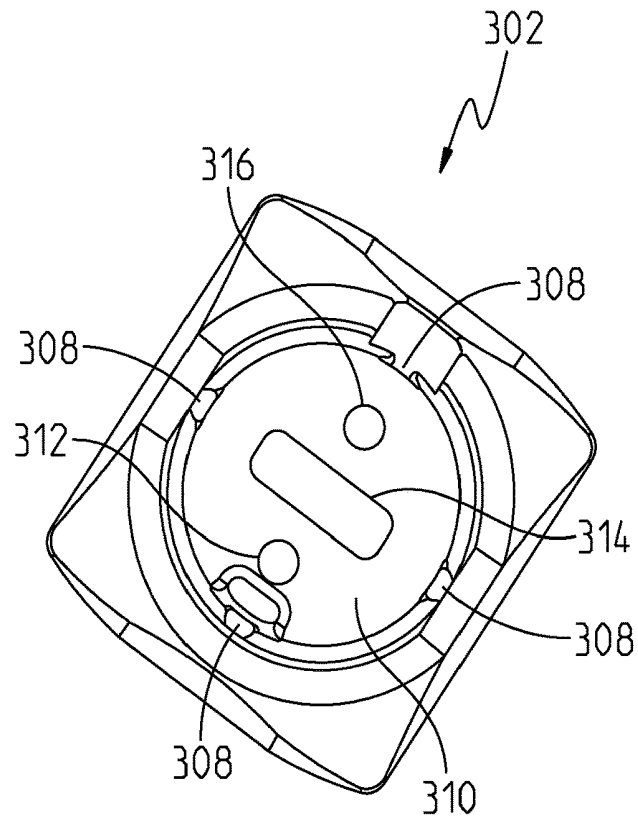

**Fig. 9**

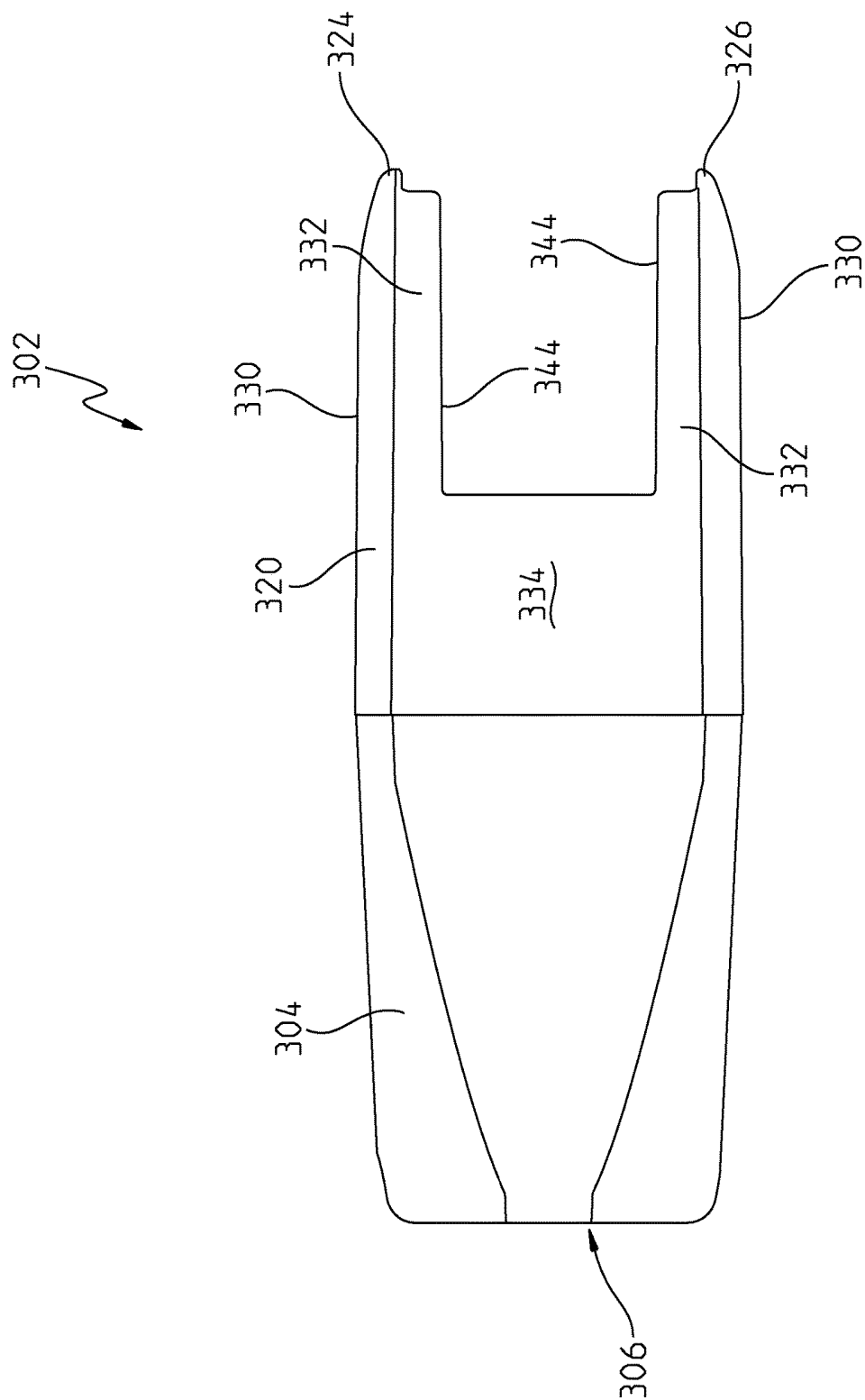

**Fig. 10**

**Fig. 11**



**Fig. 12**



**Fig. 13**

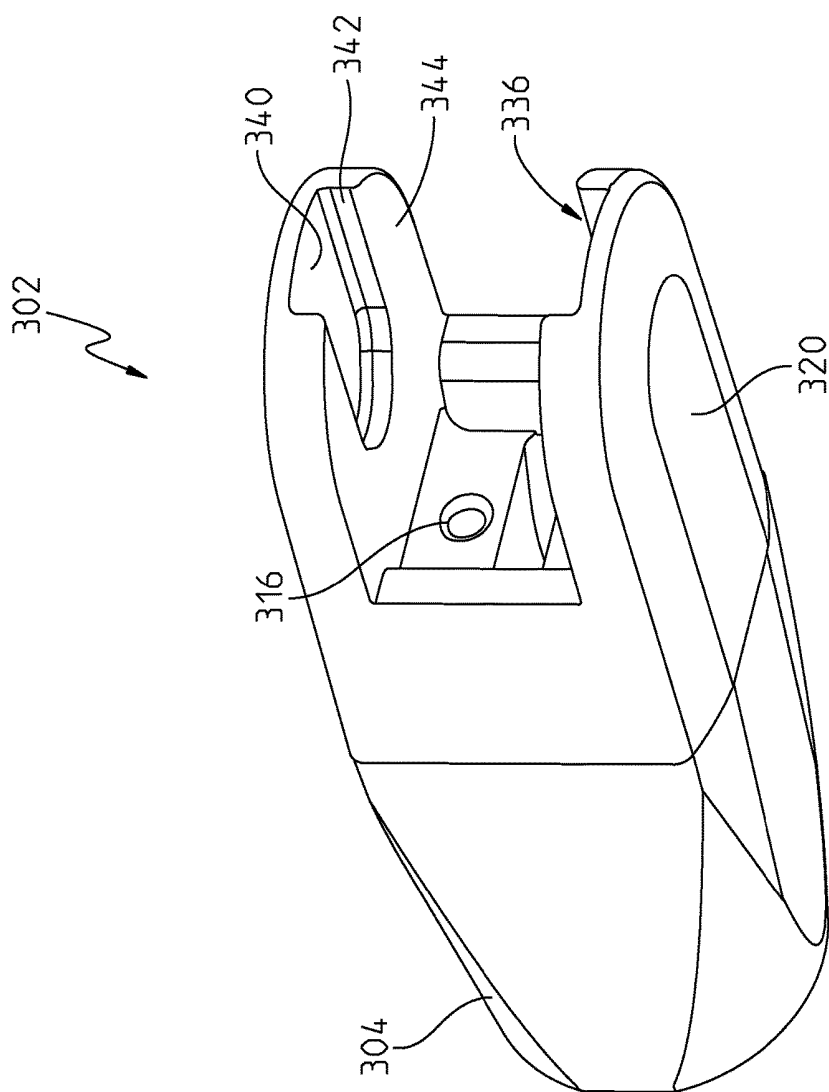
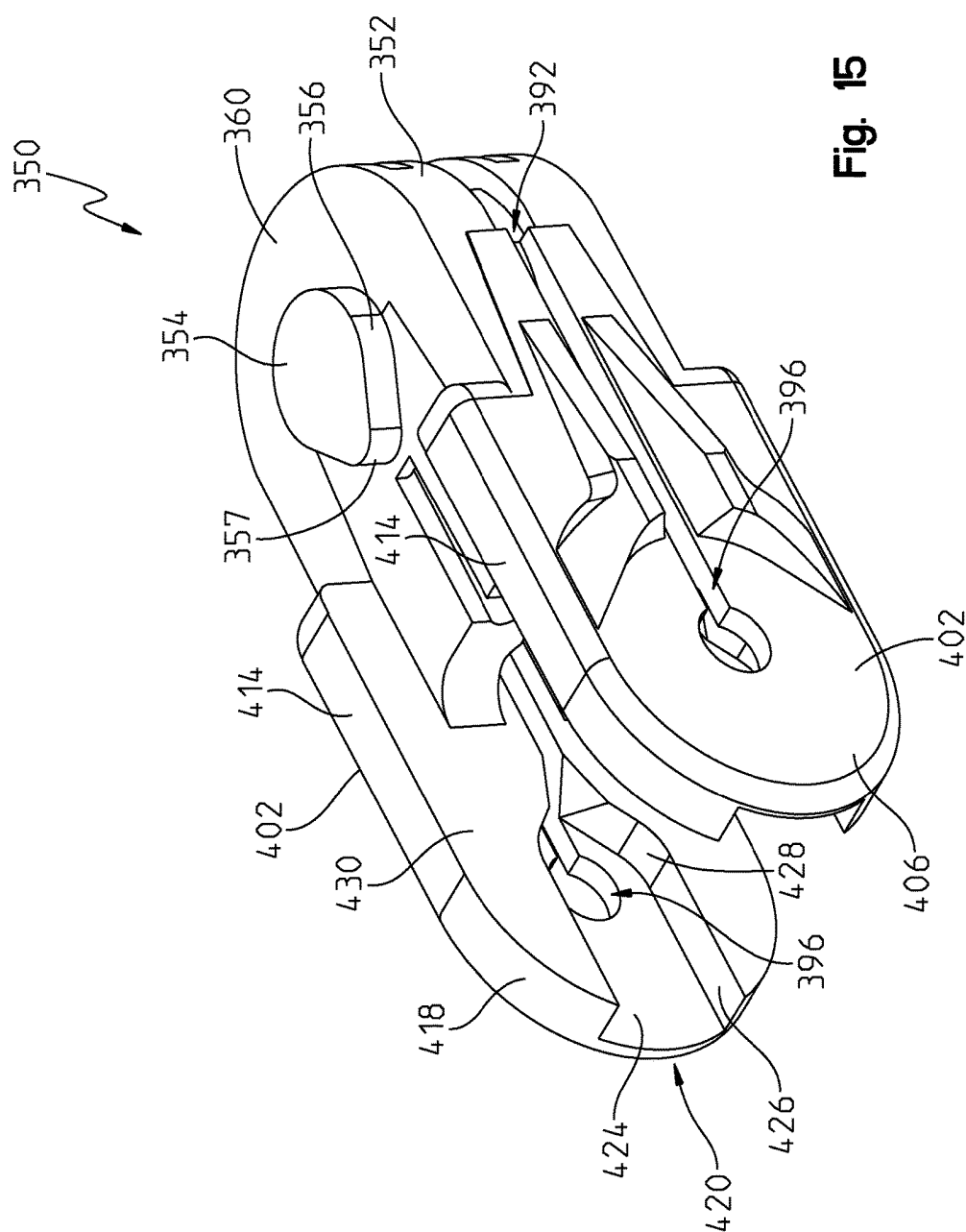

Fig. 14



**Fig. 15**

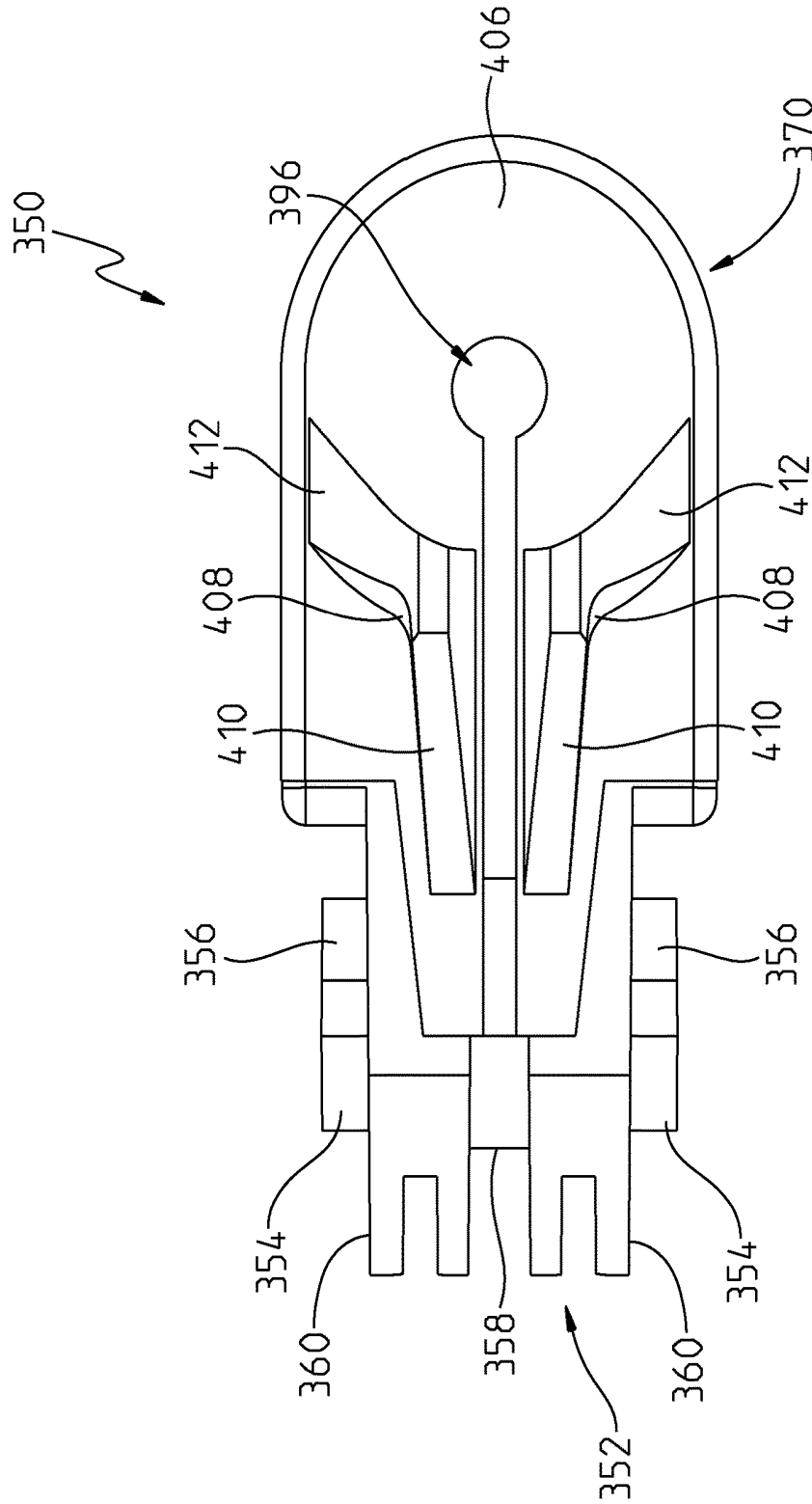

Fig. 16

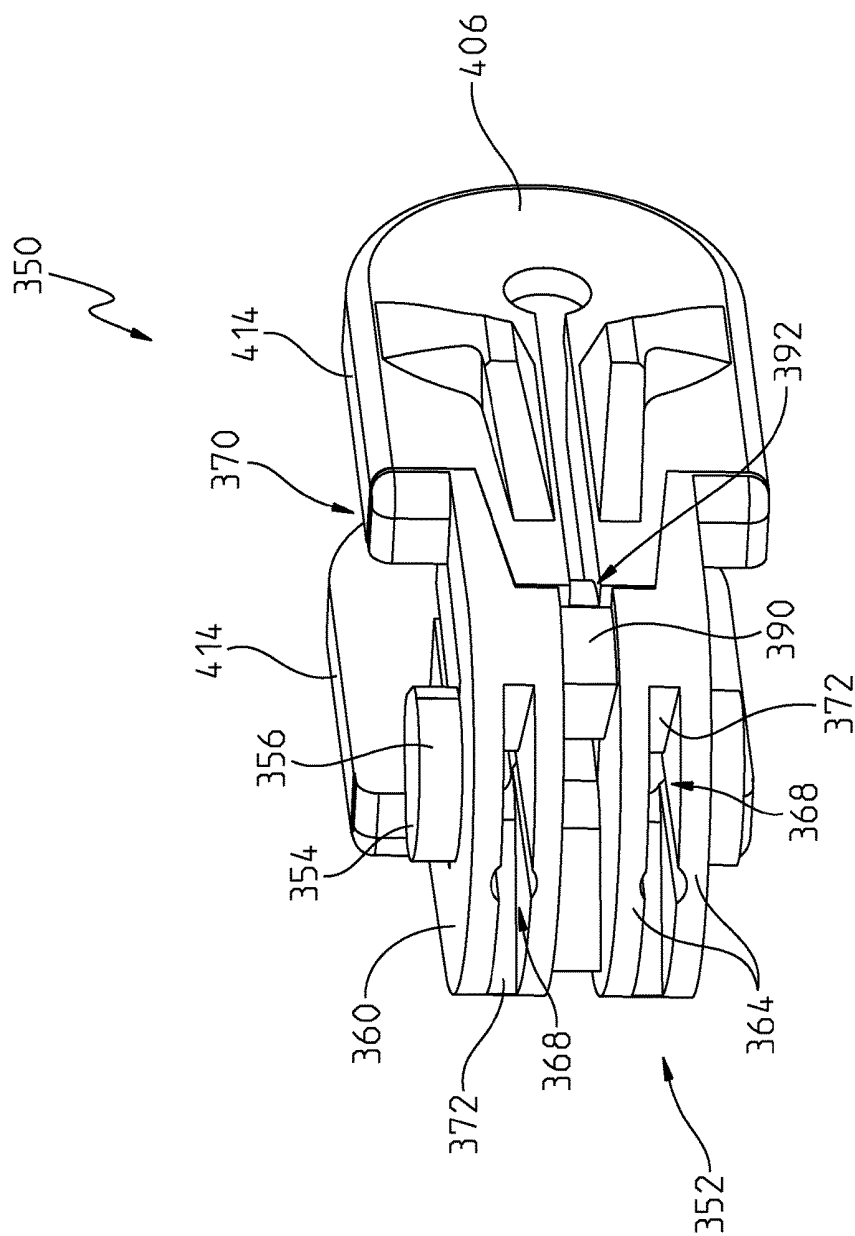

Fig. 17

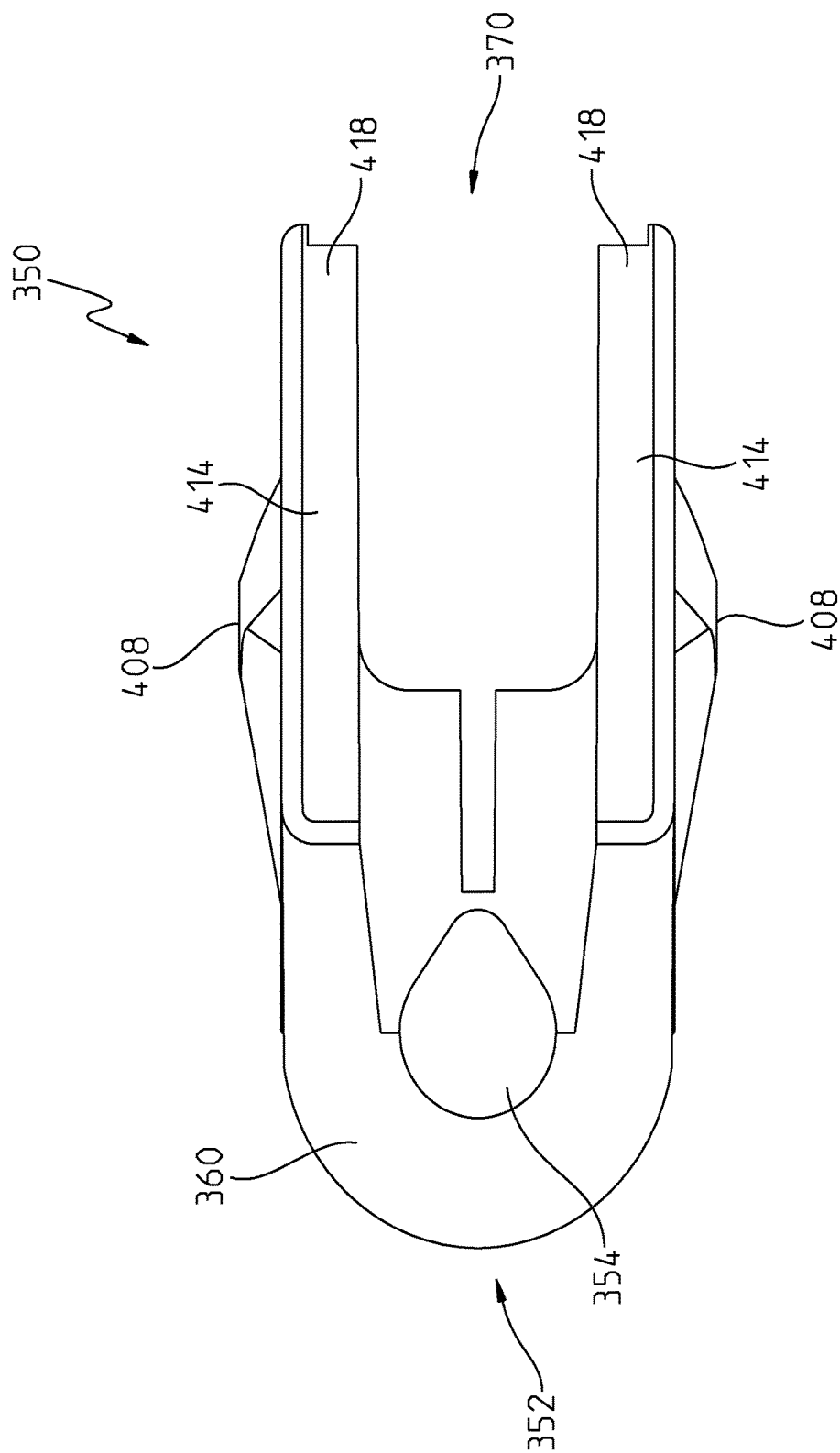
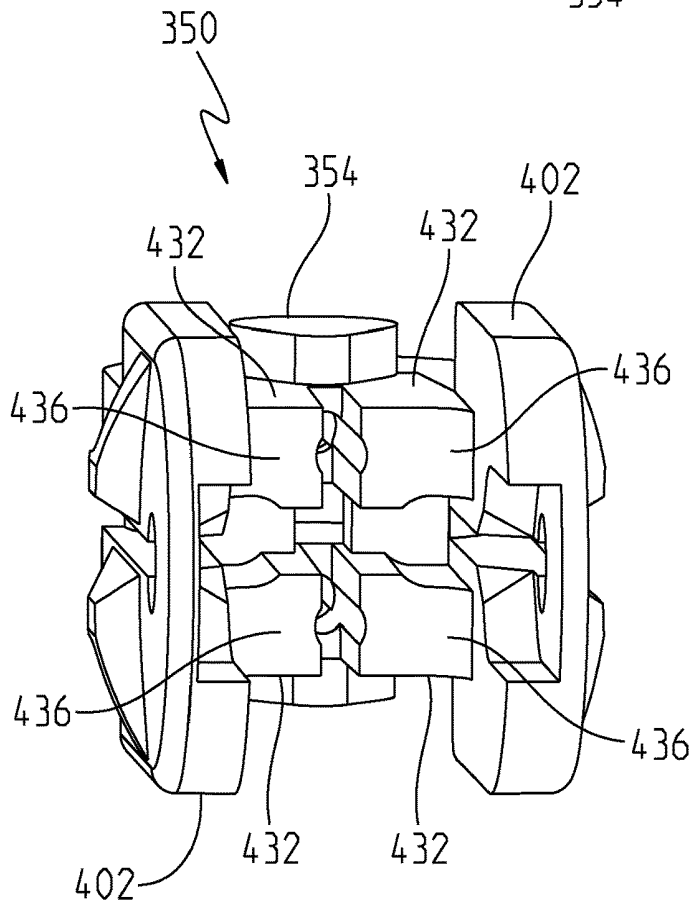
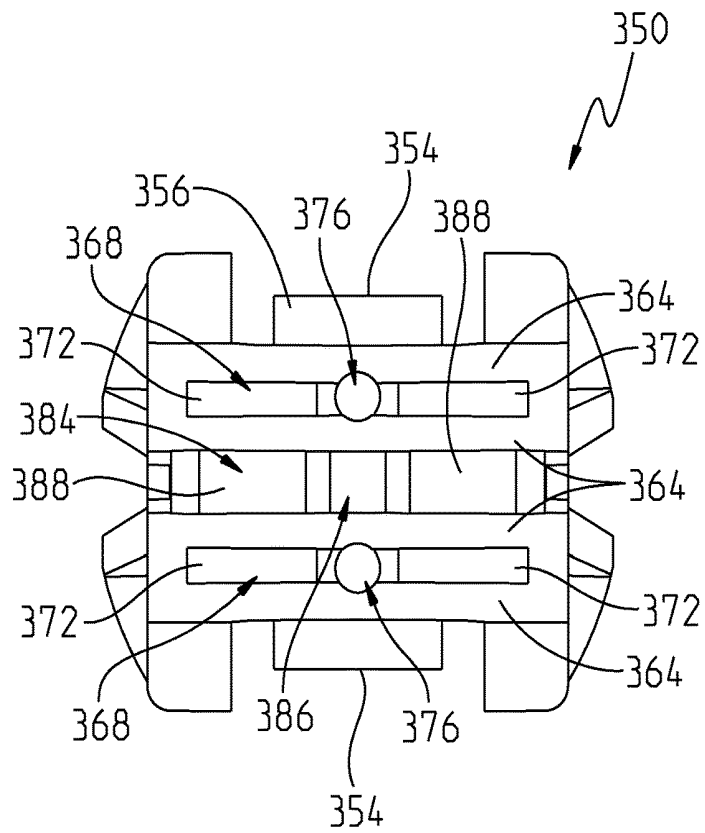
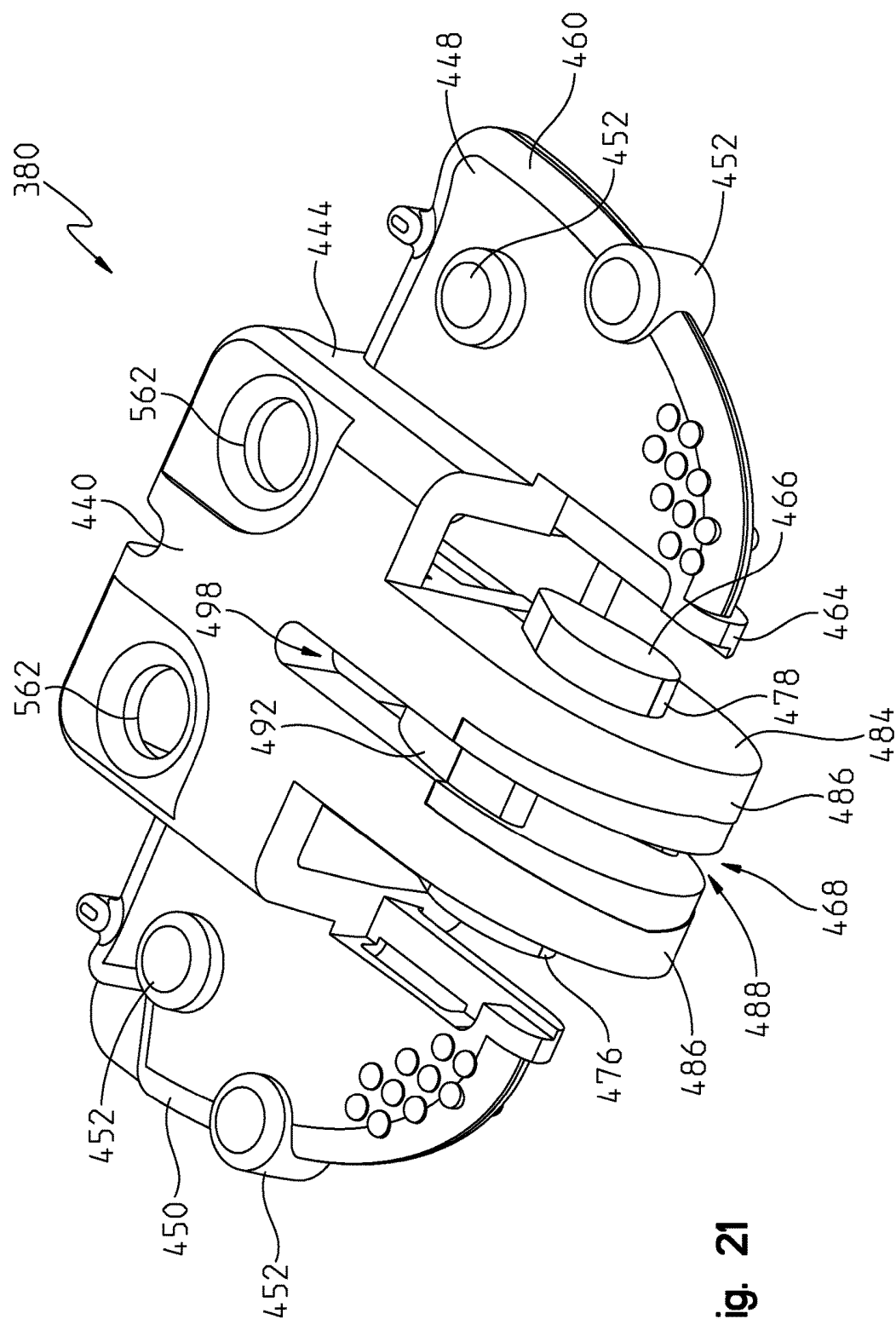

Fig. 18

**Fig. 19**



**Fig. 20**



**Fig. 21**

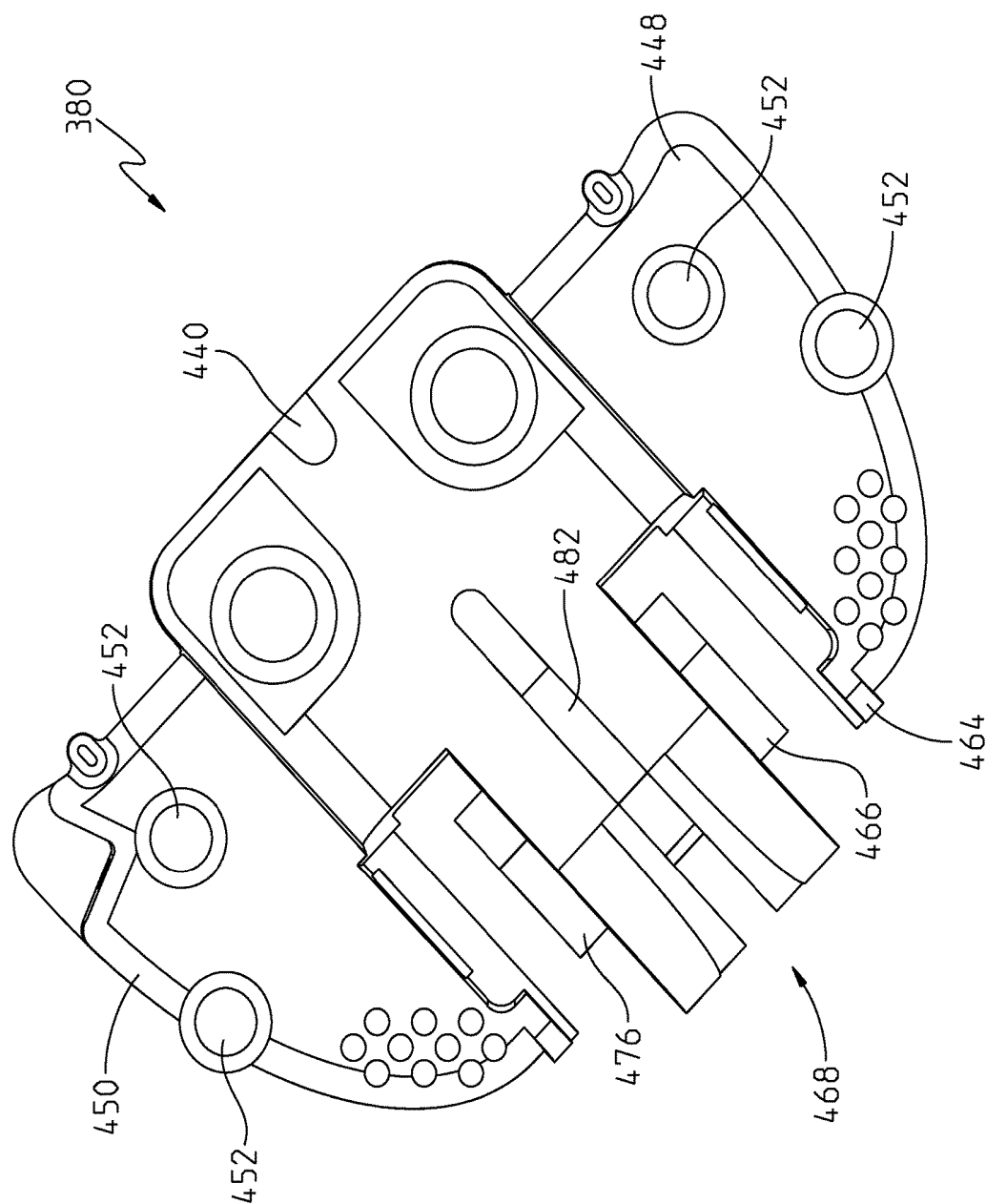
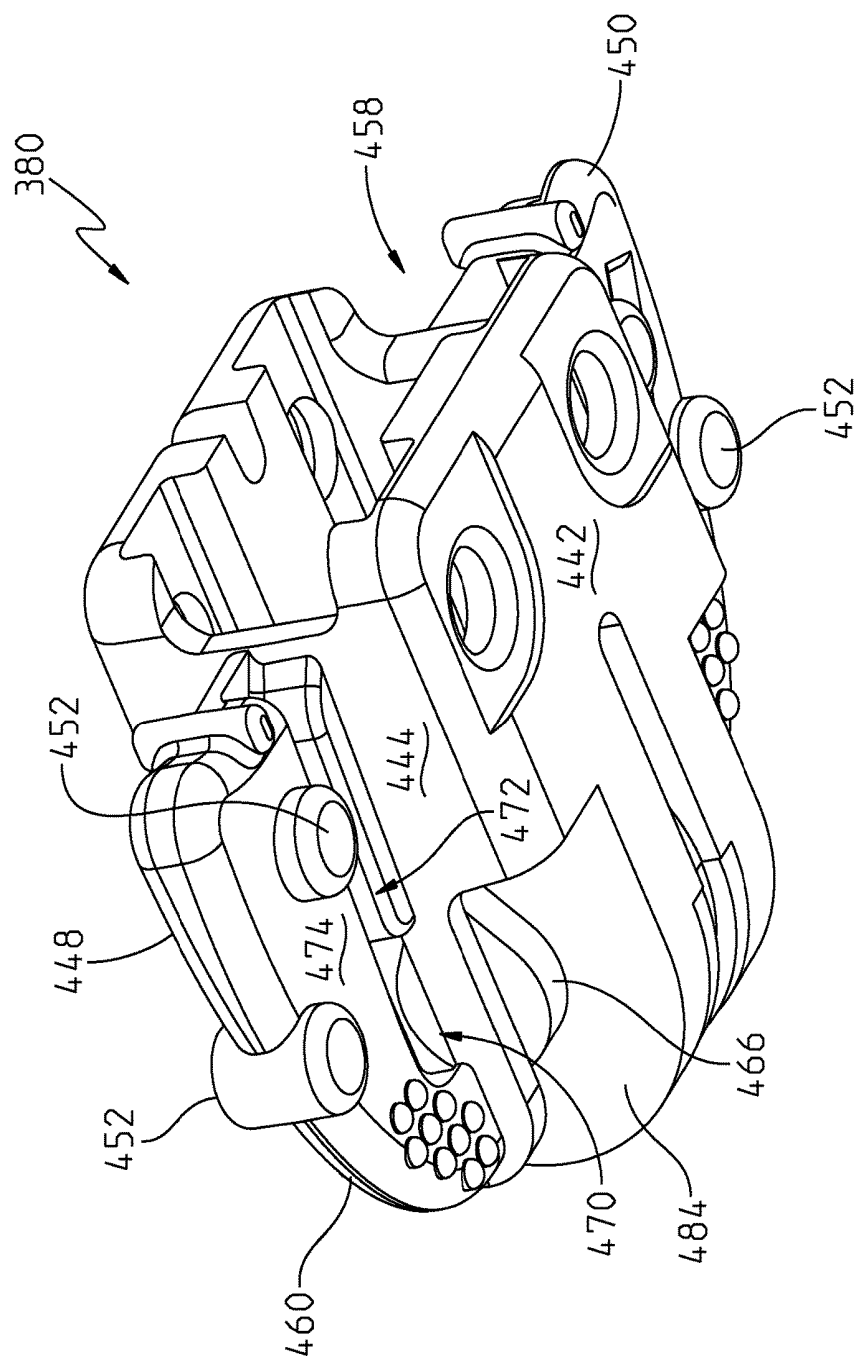

Fig. 22



**Fig. 23**

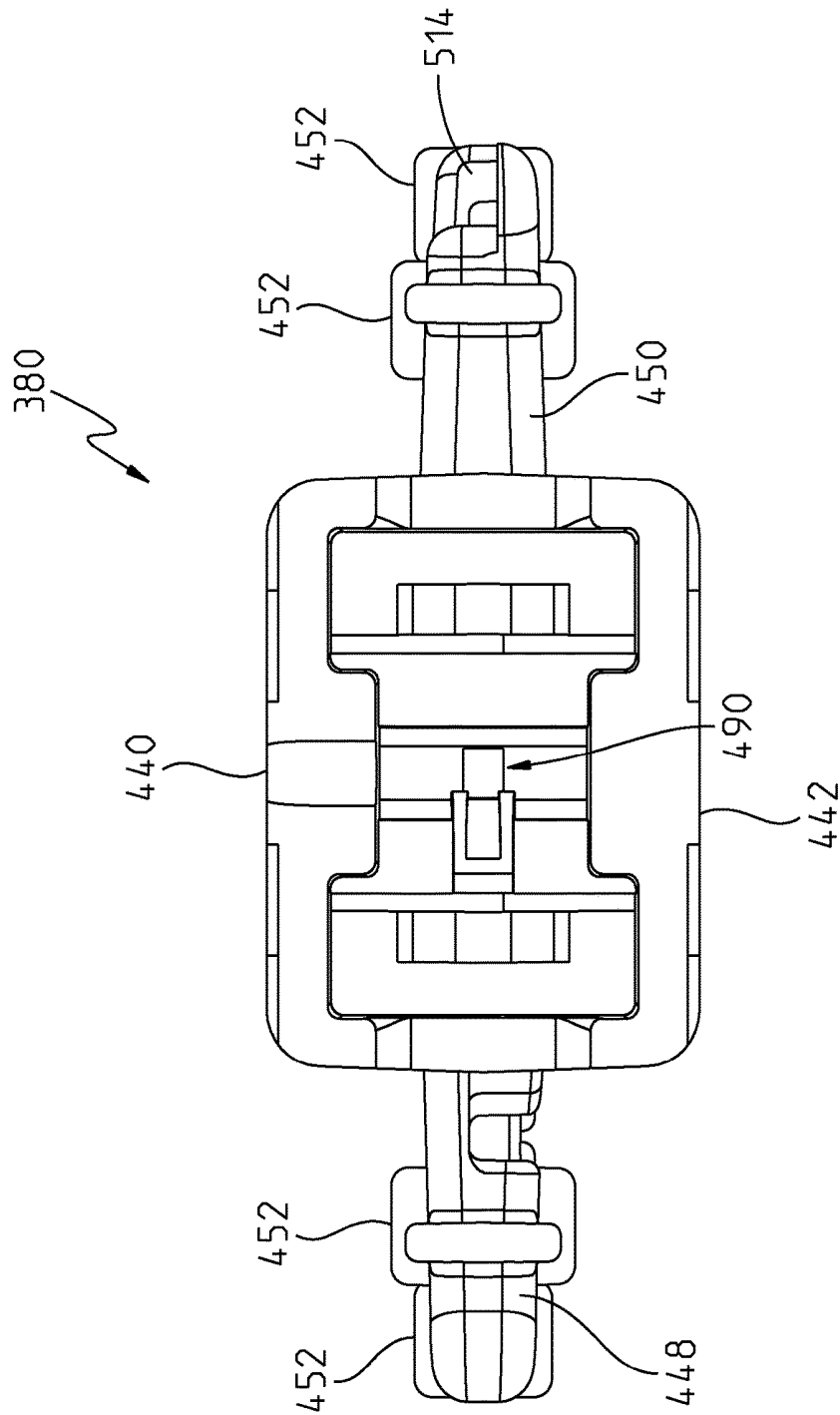
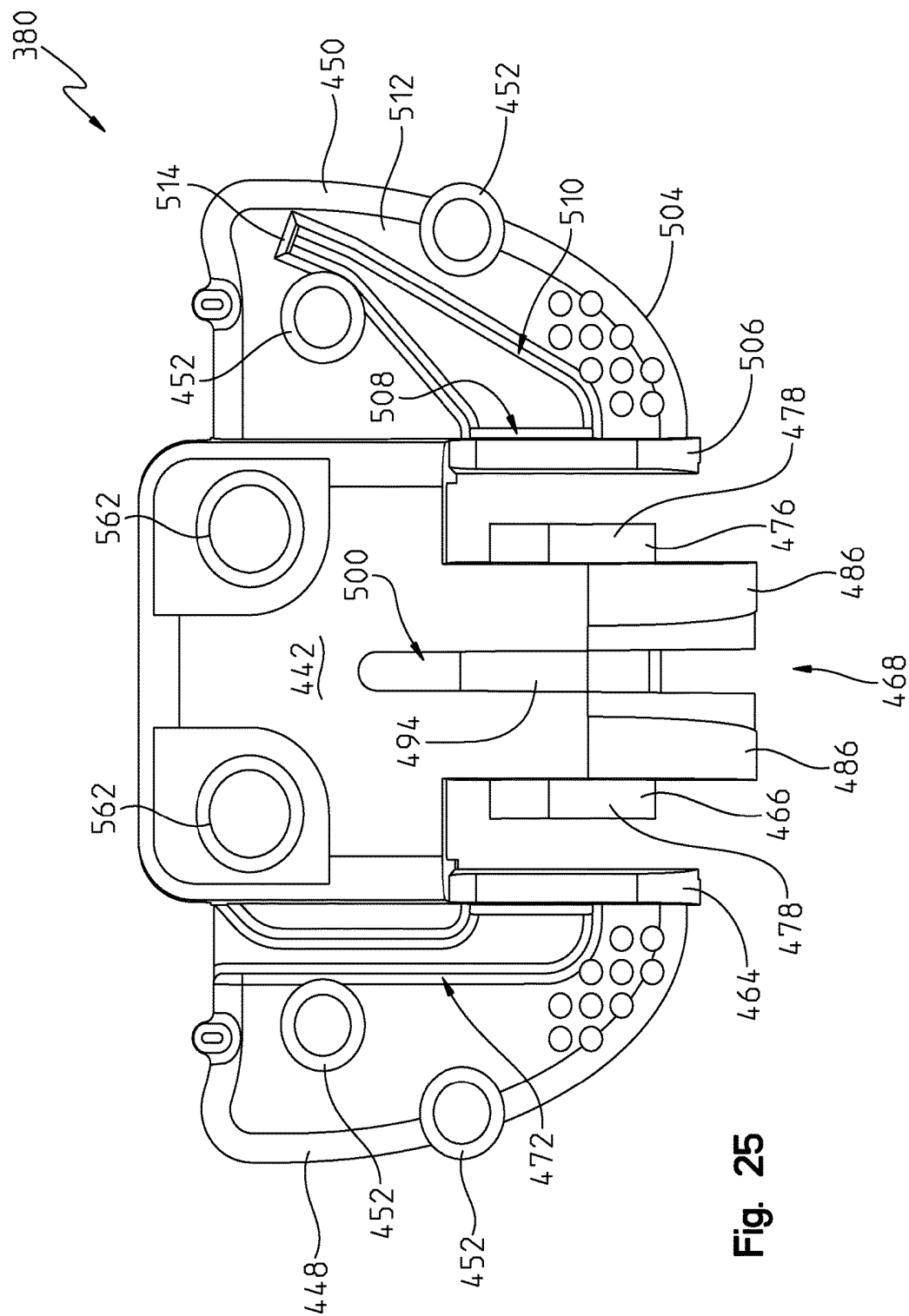

Fig. 24



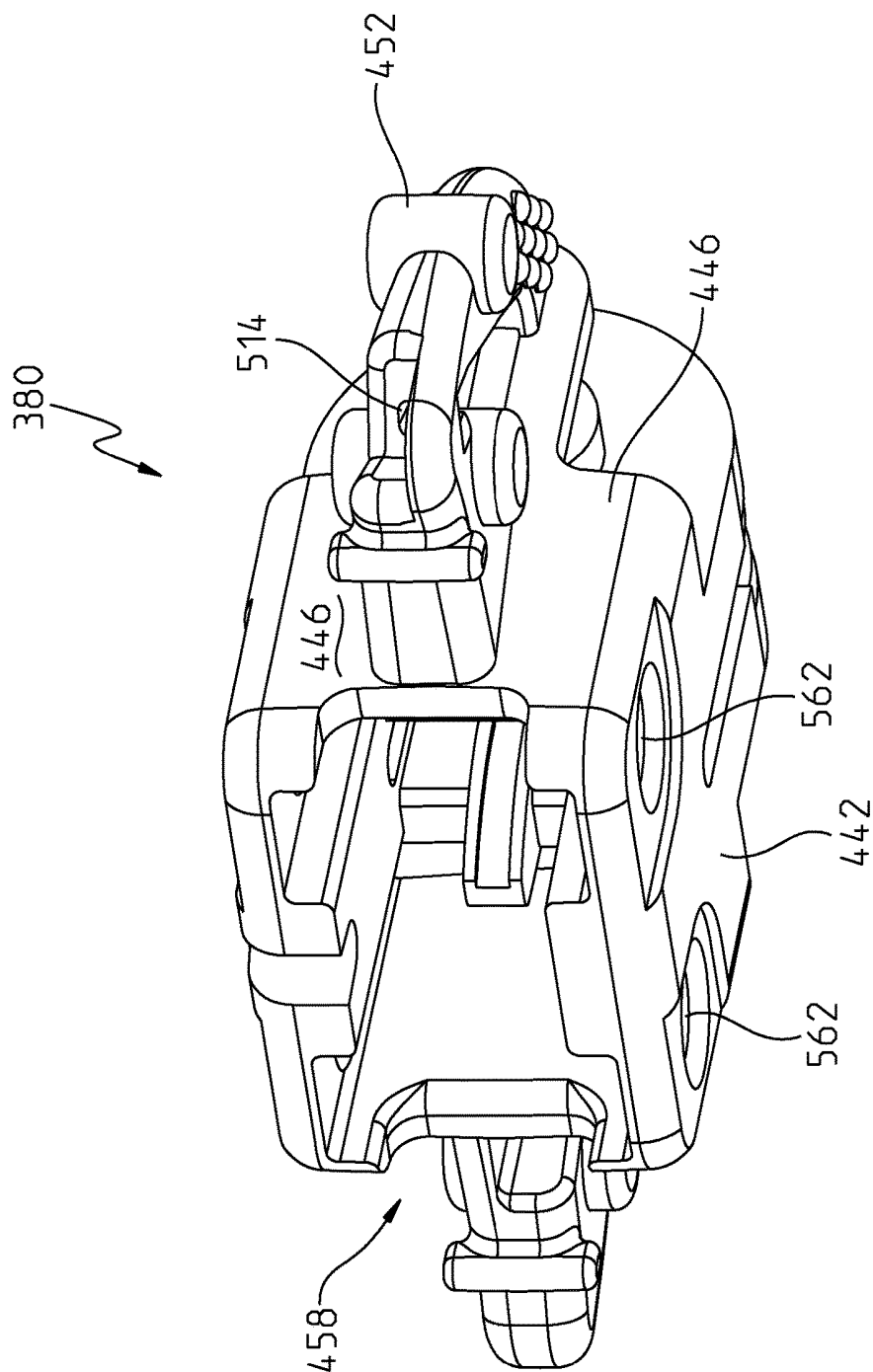

Fig. 26

Fig. 27

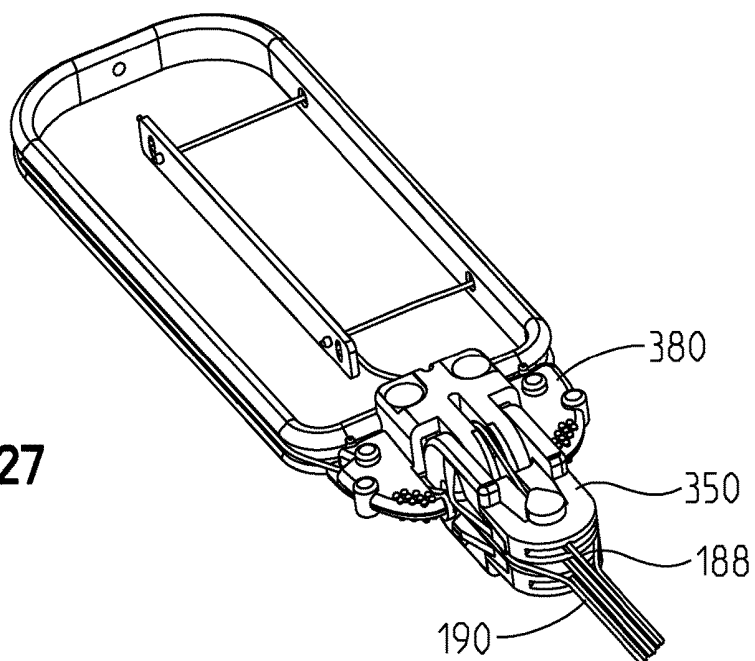
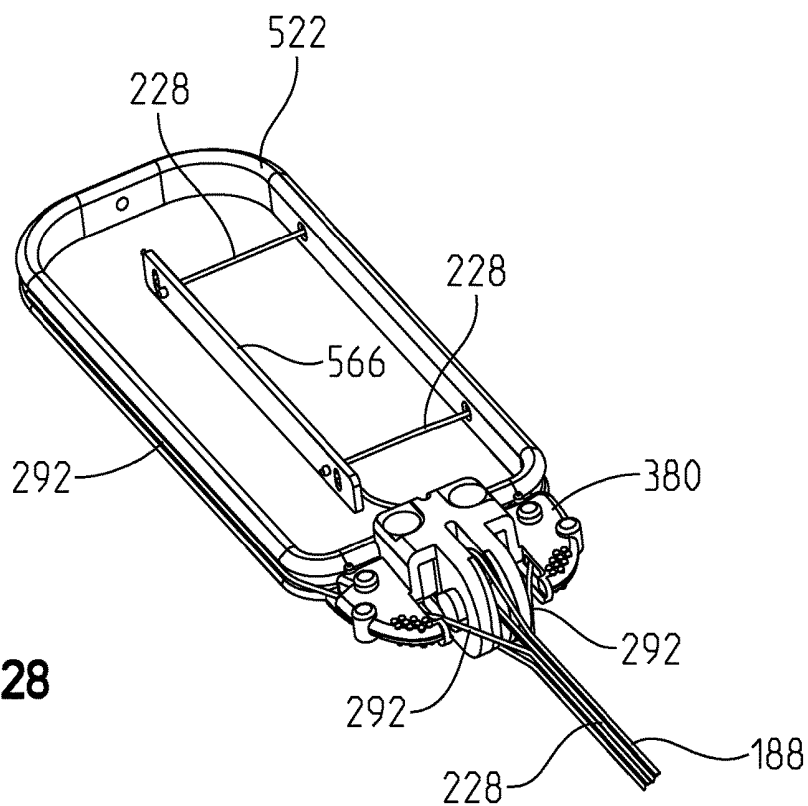
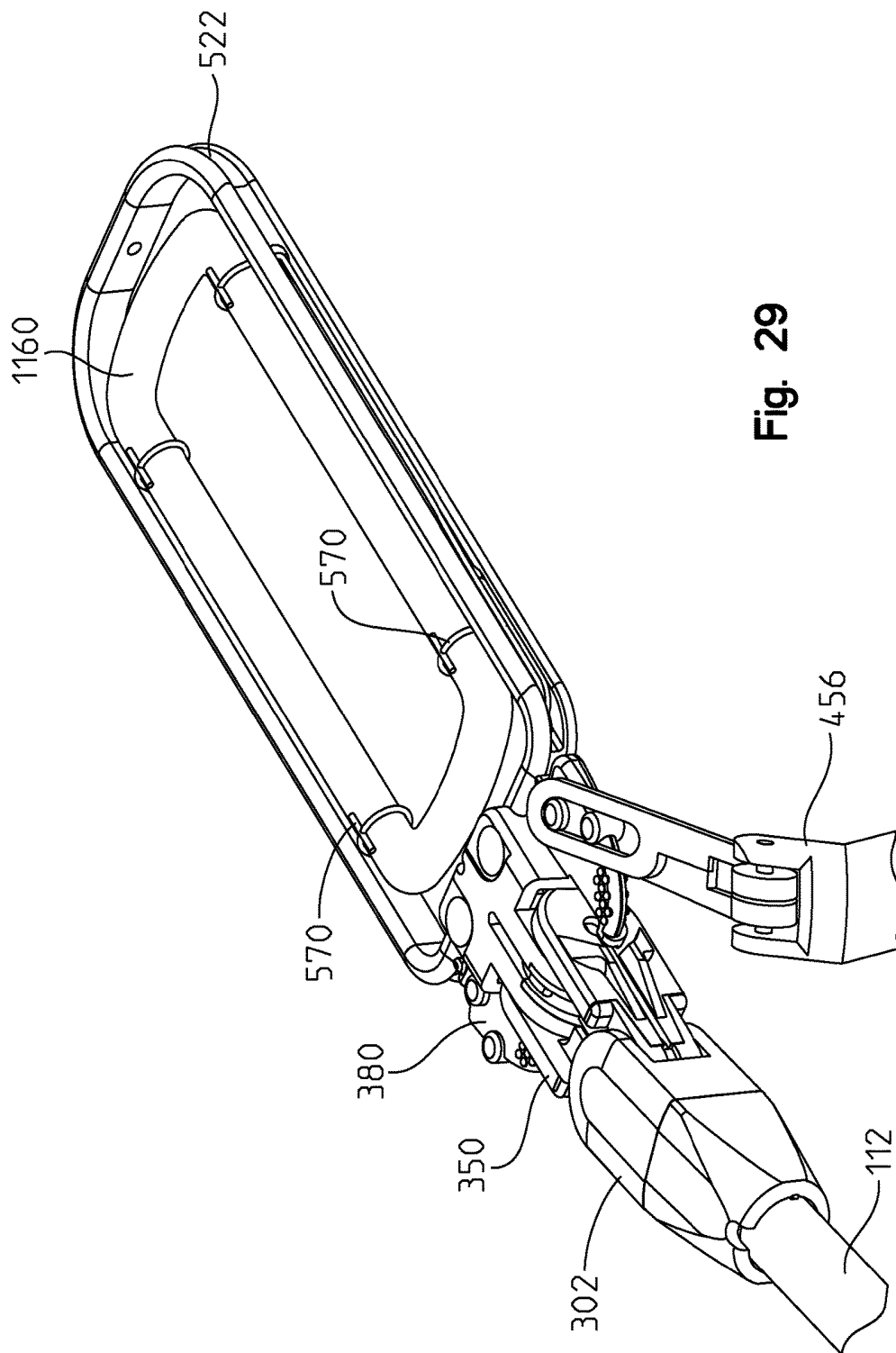

Fig. 28





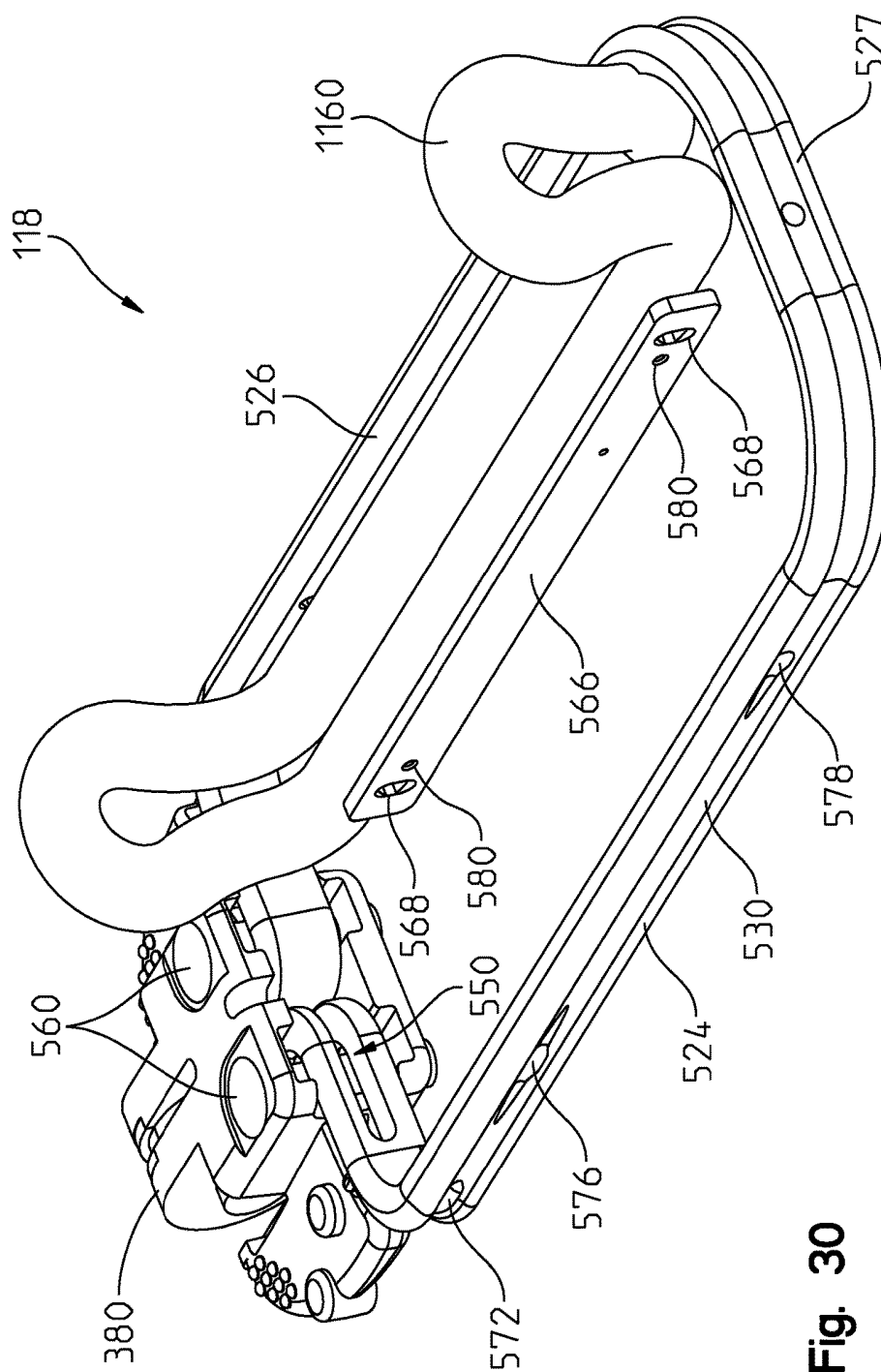

Fig. 30

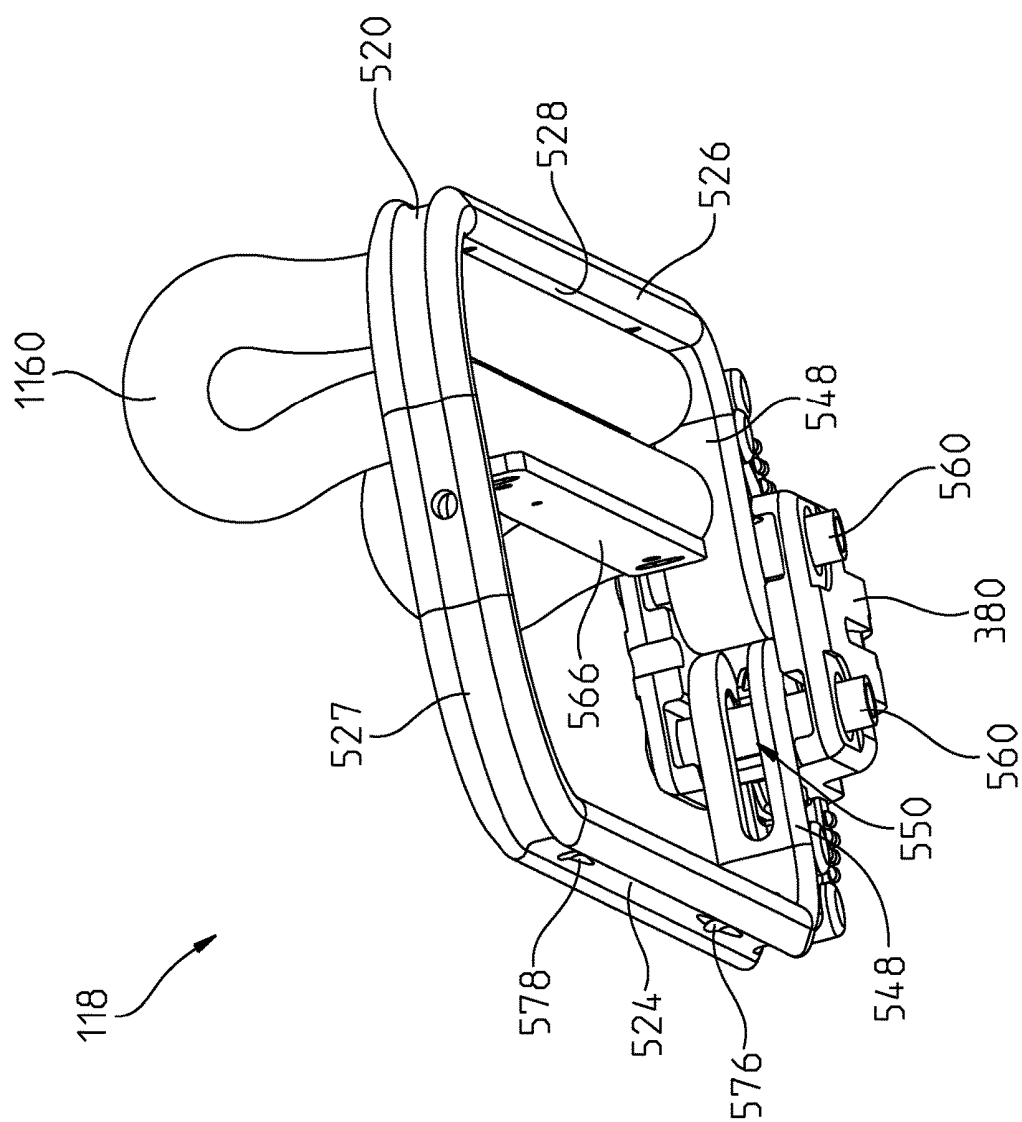

Fig. 31

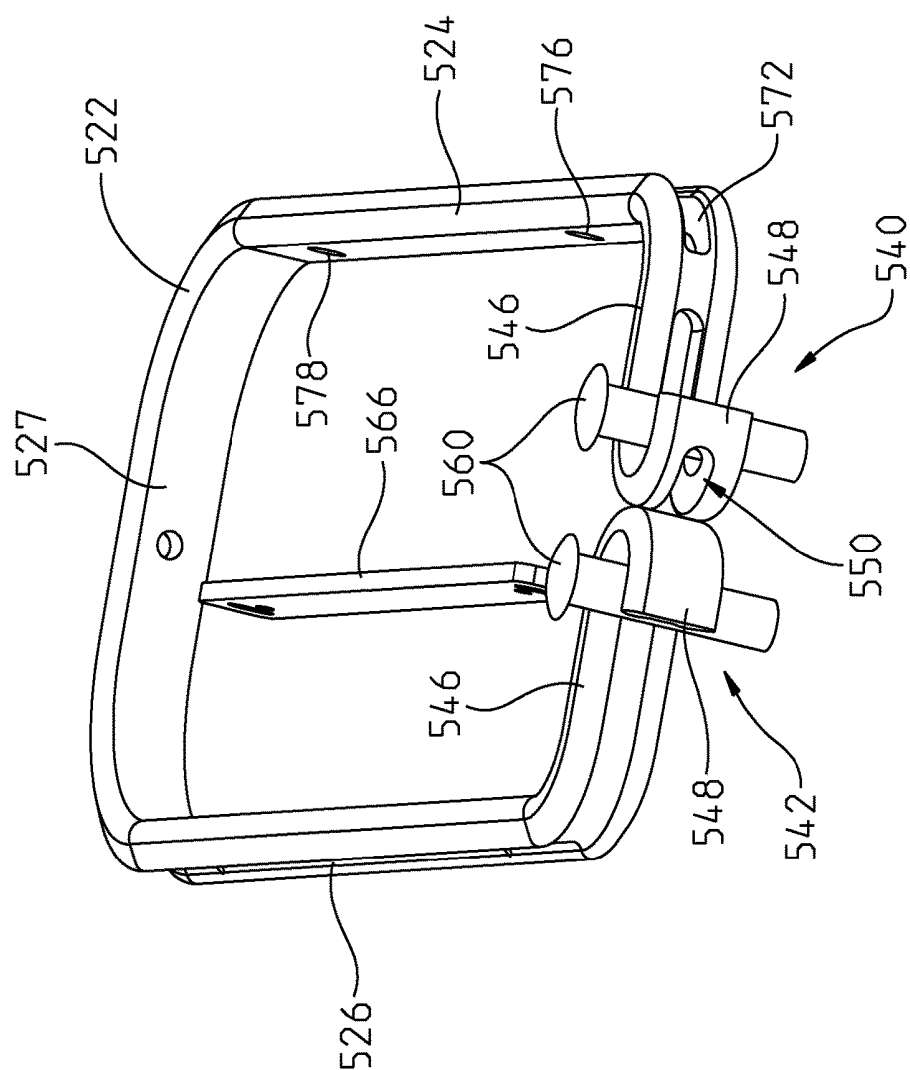

Fig. 32

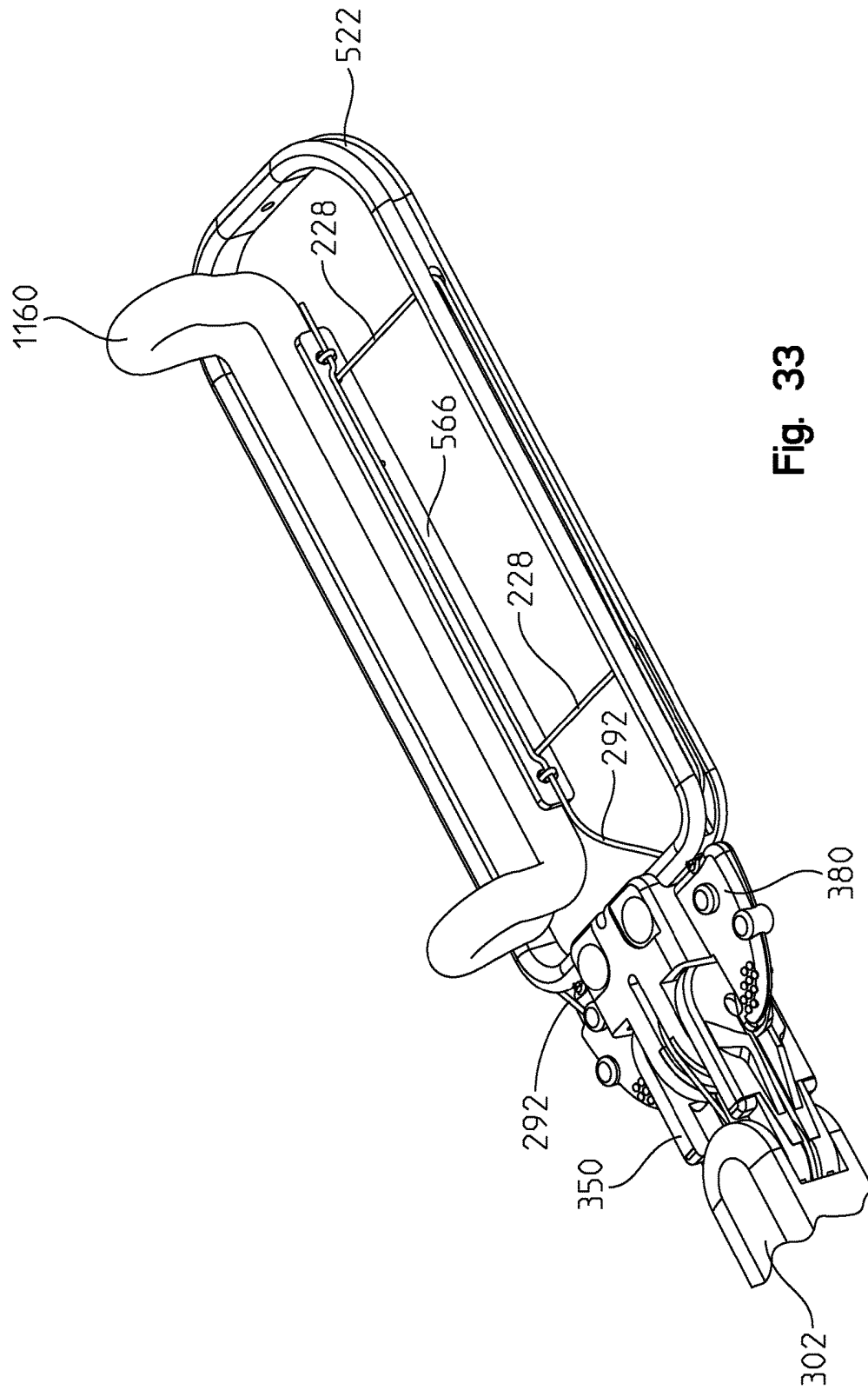

Fig. 33

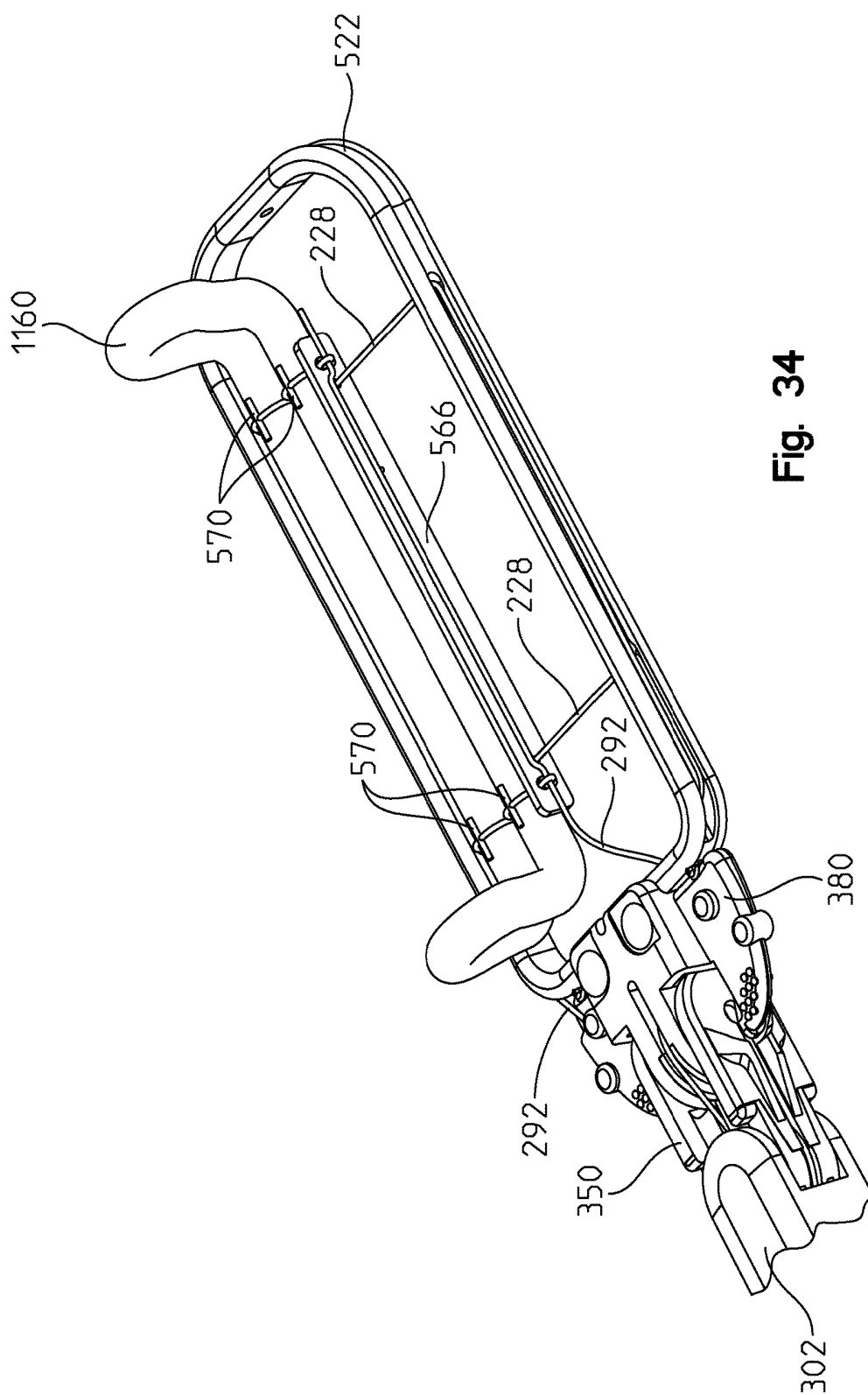
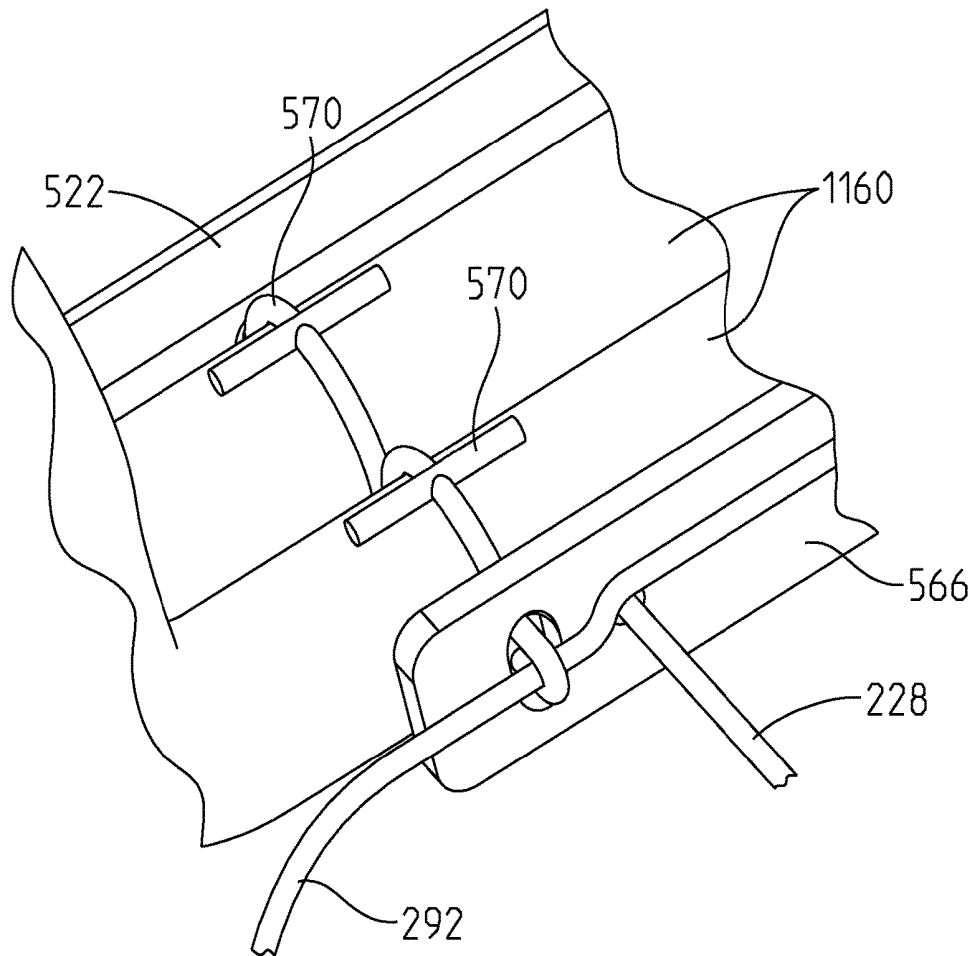
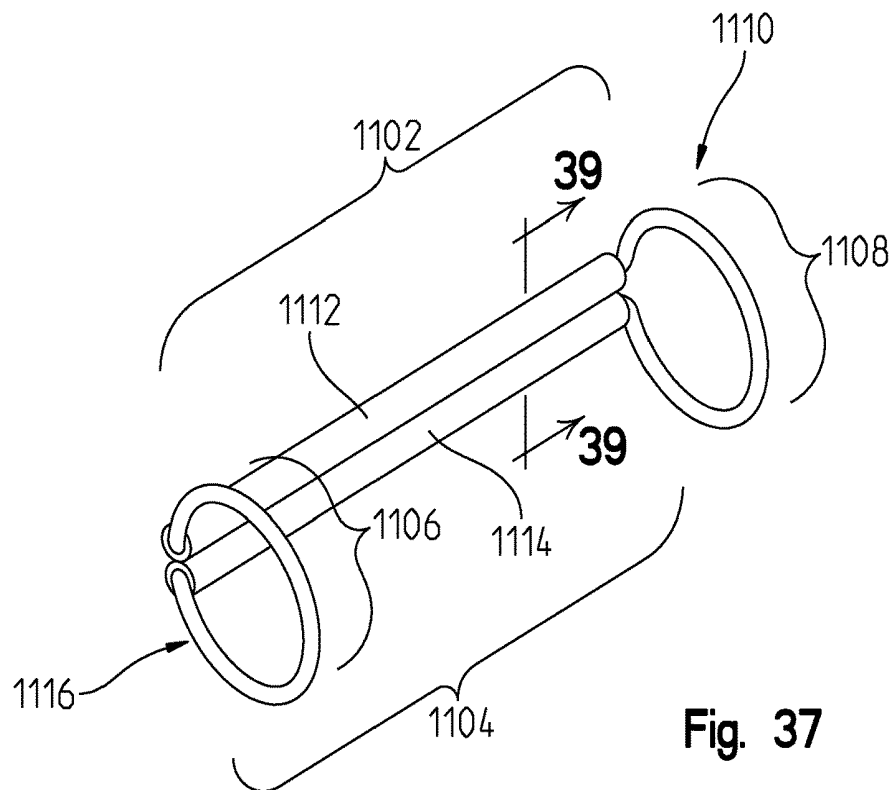
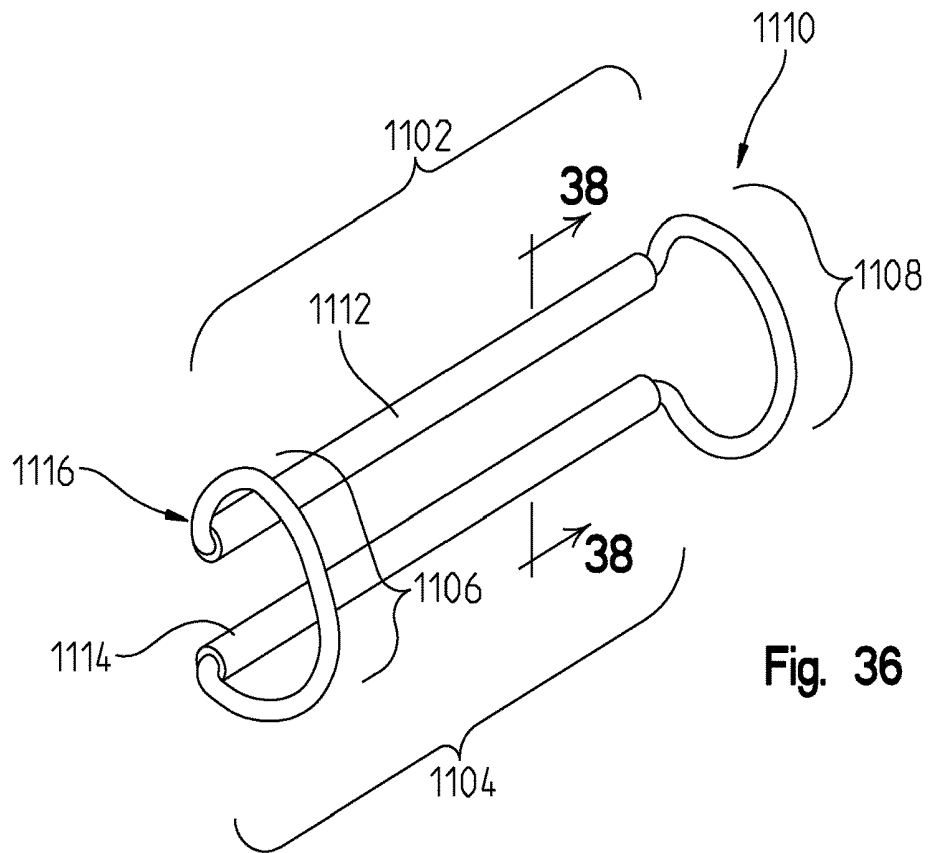

Fig. 34

**Fig. 35**



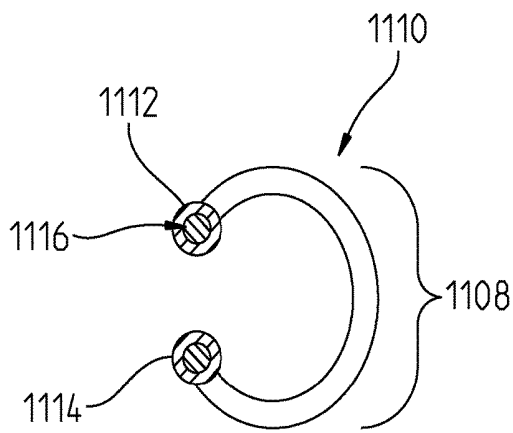

Fig. 38

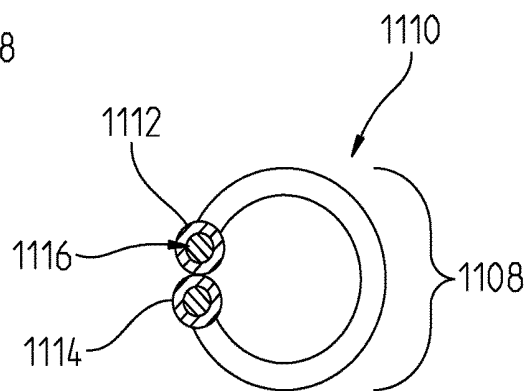

Fig. 39

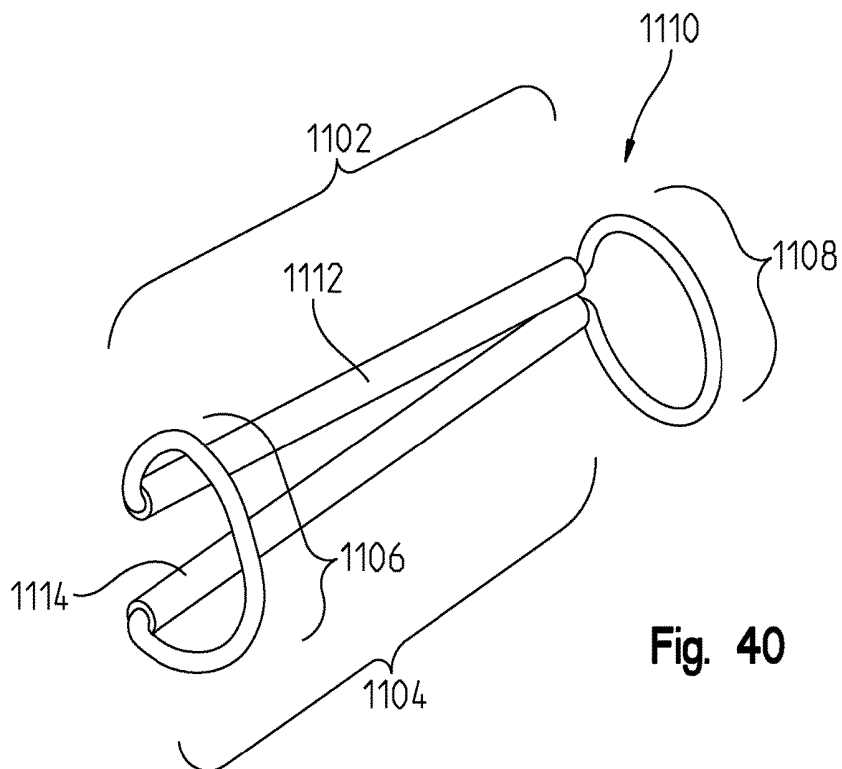

Fig. 40

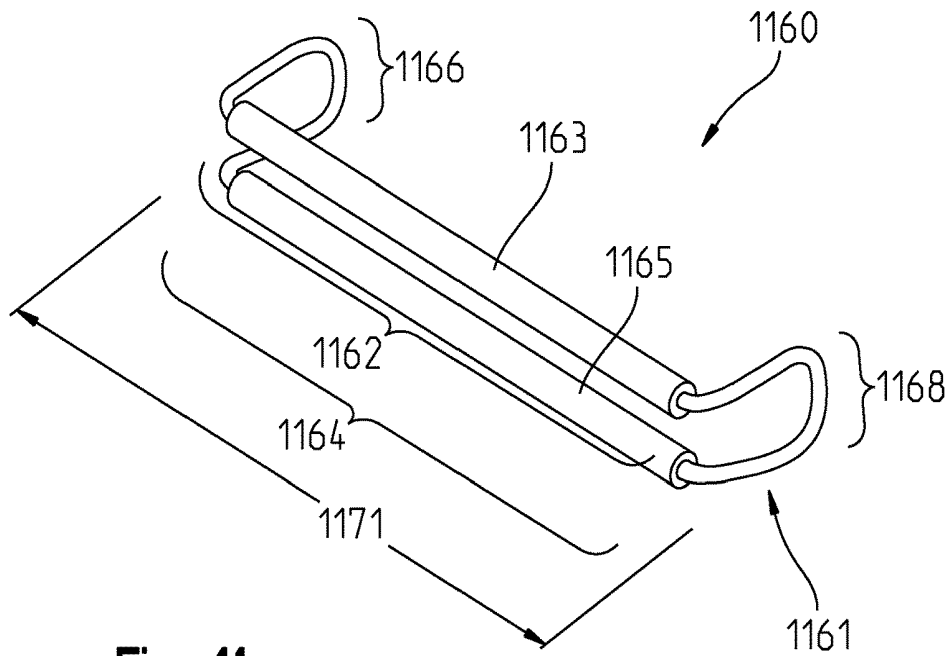

Fig. 41

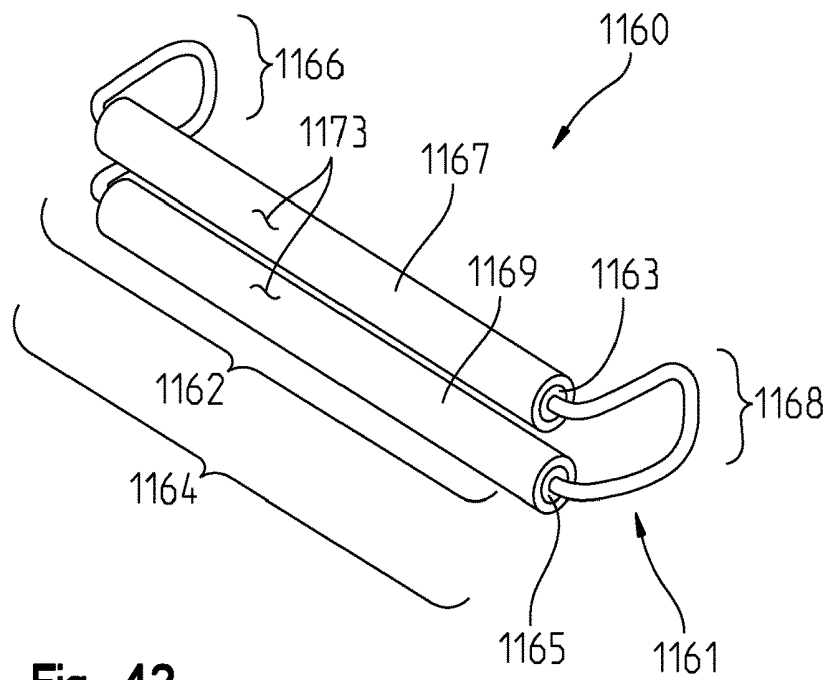

Fig. 42

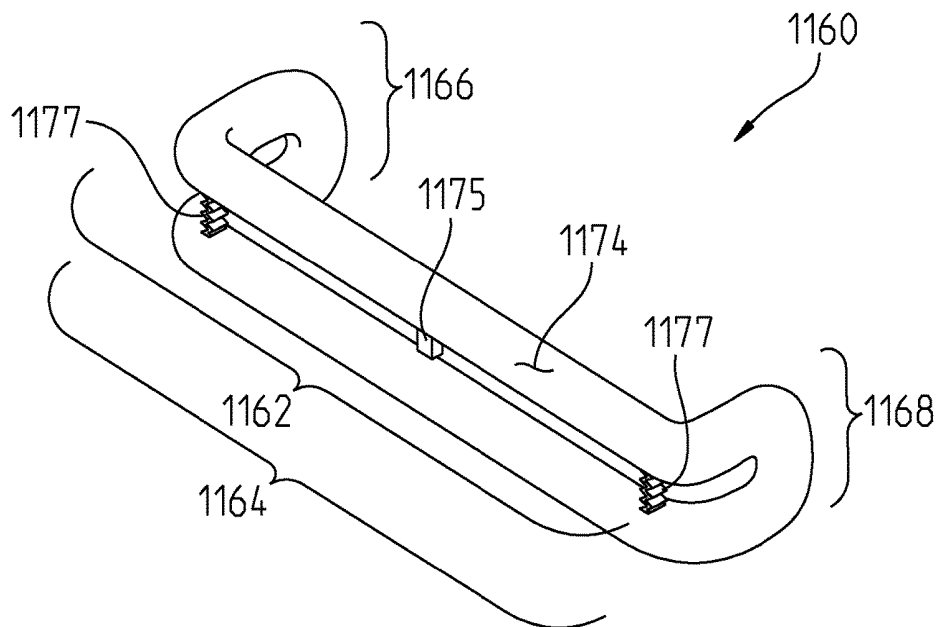

Fig. 43

1

**CLIP DEPLOYMENT TOOL AND  
ASSOCIATED METHODS****CROSS REFERENCE TO RELATED  
APPLICATIONS**

This application is a continuation of, and claims priority under 35 U.S.C. § 120 to, U.S. Nonprovisional patent application Ser. No. 13/355,169, filed Jan. 20, 2012, the disclosure of which is incorporated herein by reference.

**FIELD OF THE INVENTION**

The present disclosure relates to deployment of an occlusion clip and, more specifically, to devices and methods utilized to deploy an occlusion clip using a handheld device.

**INTRODUCTION TO THE INVENTION**

The exemplary embodiments disclosed herein include one or more active or passive repositioning mechanisms. As will be discussed in more detail hereafter, an active repositioning mechanism provides for infinite adjustments as the user is physically operating a control to directly manipulate the repositioning of an end effector or a device mounted to an end effector. In contrast, a passive repositioning mechanism can be thought of as acting similar to a light switch, either off or on. In this manner, the passive repositioning mechanism either allows or disallows repositioning of the end effector or a device mounted to the end effector, but is not responsible for actively manipulating the aspect ultimately repositioned. Put another way, the passive repositioning system allows for free movement of the end effector or a device mounted to the end effector within the relevant range of motion when the mechanism is in the “on” position, but locks movement when the mechanism is in the “off” position. In exemplary form, a laparoscopic device may incorporate passive repositioning mechanisms to control movements in different directions, such as pitch and yaw.

It is a first aspect of the present invention to provide a laparoscopic device comprising: (a) a housing operatively coupled to a first control and a second control; (b) an end effector operatively coupled to the first control, the end effector comprising a first component and a second component selectively repositionable with respect to one another within an X-Y plane, the end effector also including a third component selectively repositionable with respect to the second component within an Y-Z plane; (c) a laparoscopic conduit extending between the housing and the end effector; and, (d) an occlusion clip deployment device operatively coupled to the end effector and the second control.

In a more detailed embodiment of the first aspect, the handle housing is operatively coupled to a third control, the third control is operatively coupled to the occlusion clip and the occlusion clip deployment device, and the third control controls disengagement of the occlusion clip from the occlusion clip deployment device. In yet another more detailed embodiment, the first control includes a first passive constraint and a second passive constraint, the first passive constraint in an unlocked position allows free motion between the first component and the second component within the X-Y plane, the first passive constraint in a locked position retards free motion between the first component and the second component within the X-Y plane, the second passive constraint in an unlocked position allows free motion between the second component and the third component within the Y-Z plane, and the second passive con-

2

straint in a locked position retards free motion between the second component and the third component within the Y-Z plane. In a further detailed embodiment, the first passive constraint includes at least one connection wire in tension that is operatively coupled to the second component and to the housing, and the second passive constraint includes at least one connection wire in tension that is operatively coupled to the third component and to the housing. In still a further detailed embodiment, the first control includes a repositionable button selectively coupled to a first reel and a second reel, where the button is repositionable between a locked and an unlocked position, where the locked position retards rotation of the first reel and the second reel, and where the unlocked position allows rotation of the first reel and the second reel, the first reel is operatively coupled to a first connection line operatively coupled to the first component, the second reel is operatively coupled to a second connection line operatively coupled to the second component, and wherein the first reel is independently repositionable with respect to the second reel.

In yet another more detailed embodiment of the first aspect, the second control includes a lever operatively coupled and selectively repositionable with respect to the housing, the lever being operatively coupled to a first connection line operatively coupled to the occlusion clip deployment device so that movement of the lever is operative to reposition at least a portion of the occlusion clip deployment device, the lever is repositionable between a locked and an unlocked position, the unlocked position allows the lever to be repositioned, and the locked position retards the lever from being repositioned. In still another more detailed embodiment, the laparoscopic device further includes a third control operatively coupled to the housing, wherein the third control is operatively coupled to a first connection line operatively coupled to the occlusion clip deployment device so that movement of the third control is operative to reposition at least a portion first connection line with respect to the occlusion clip deployment device. In a further detailed embodiment, the third control includes a plug detachable from the housing, the plug is repositionable from an attached position coupled to the housing to a detached position decoupled from the housing, and repositioning the plug from the attached position to the detached position causes more of the first connection line to be drawn into the housing and further away from the occlusion clip deployment device. In still a further detailed embodiment, the laparoscopic device further includes an occlusion clip operatively coupled to the clip deployment device using the first connection line. In a more detailed embodiment, the end effector includes a robotic grasping feature to facilitate grasping and repositioning of the end effector by a robotic grasper.

It is a second aspect of the present invention to provide a laparoscopic device comprising: (a) a housing operatively coupled to a first control; (b) an end effector operatively coupled to the first control, the end effector comprising a clevis selectively repositionable with respect to a dual pivot joint within an X-Y plane, the dual pivot joint selectively repositionable with respect to a yoke within an Y-Z plane; (c) a laparoscopic conduit extending between the housing and the end effector.

In a more detailed embodiment of the second aspect, the first control includes a first line and a second line extending along the laparoscopic conduit concurrently coupled to the dual pivot joint, the first line impacting movement of the dual pivot joint with respect to the clevis in a first direction within the X-Y plane, the second line impacting movement

3

of the dual pivot joint with respect to the clevis in a second direction, generally opposite the first direction, within the X-Y plane, and the first control includes a third line and a fourth line extending along the laparoscopic conduit concurrently coupled to the yoke, the third line impacting movement of the yoke with respect to the dual pivot joint in a third direction within the Y-Z plane, the fourth line impacting movement of the yoke with respect to the dual pivot joint in a fourth direction, generally opposite the third direction, within the Y-Z plane. In yet another more detailed embodiment, the first line and the second line are coupled to a first actuator mounted to the housing, the first actuator is repositionable and operative to reposition the first line and the second line in order to create movement between the clevis and dual pivot joint, the third line and the fourth line are coupled to a second actuator mounted to the housing, the second actuator is repositionable and operative to reposition the third line and the fourth line in order to create movement between the yoke and dual pivot joint. In a further detailed embodiment, the first actuator comprises a first reel upon which at least a portion of the first line and the second line are wound, the second actuator comprises a second reel upon which at least a portion of the third line and the fourth line are wound, repositioning of the first reel is operative to distally reposition one of the first line and the second line, while repositioning of the first reel is operative to proximally reposition the other of the first line and the second line, repositioning of the second reel is operative to distally reposition one of the third line and the fourth line, while repositioning of the second reel is operative to proximally reposition the other of the third line and the fourth line.

In yet another more detailed embodiment of the second aspect, the first control includes a brake that may be selectively applied to the first actuator and the second actuator to retard movement of the dual pivot joint with respect to the clevis within the X-Y plane and movement of the yoke with respect to the dual pivot joint within the Y-Z plane. In still another more detailed embodiment, the brake comprises a spring biased button operatively coupled to a series of teeth, the first reel includes a series of teeth, the second reel includes a series of teeth, and engagement between at least one of the series of teeth operatively coupled to the spring biased button and at least one of the series of teeth of the first reel and least one of the series of teeth of the second reel is operative to retard movement of the dual pivot joint with respect to the clevis within the X-Y plane and movement of the yoke with respect to the dual pivot joint within the Y-Z plane. In a further detailed embodiment, the laparoscopic device further includes an occlusion clip deployment device operatively coupled to the end effector and to a second control, where the housing is operatively coupled to the second control, and the second control includes a clip repositioning line extending along the laparoscopic conduit, the clip repositioning line impacting movement of the occlusion clip deployment device between a first position and a second position. In still a further detailed embodiment, the second control includes a lever operatively coupled and selectively repositionable with respect to the housing, the lever being operatively coupled to the clip repositioning line so that movement of the lever is operative to reposition the occlusion clip deployment device, the lever is repositionable between a locked and an unlocked position, the unlocked position allows the lever to be repositioned, and the locked position retards the lever from being repositioned. In a more detailed embodiment, the laparoscopic device further includes a deployment control operatively coupled to the housing, the deployment control including a deployment

4

line extending along the laparoscopic conduit and concurrently mounted to a deployment plug removably fastened to the housing. In a more detailed embodiment, the laparoscopic device further includes an occlusion clip operatively coupled to the occlusion clip deployment device using the deployment line. In another more detailed embodiment, the occlusion clip includes a first jaw opposing a second jaw, a first retainer loop at least partially circumscribes the first jaw, at least a portion of the occlusion clip deployment device, and at least a portion of the deployment line, a second retainer loop at least partially circumscribes the second jaw, at least a portion of the occlusion clip deployment device, and at least a portion of the deployment line. In yet another more detailed embodiment, the end effector includes a robotic grasping feature to facilitate grasping and repositioning of the end effector by a robotic grasper.

It is a third aspect of the present invention to provide a laparoscopic device comprising: (a) a laparoscopic handle; (b) a laparoscopic conduit operatively coupled to the laparoscopic handle; (c) a laparoscopic end effector operatively coupled to the laparoscopic conduit; (d) a passive control allowing repositioning of an end effector with respect to the laparoscopic conduit within an X-Y plane and a Y-Z plane when the passive control is disengaged and retarding repositioning of the end effector with respect to the laparoscopic conduit within the X-Y plane and the Y-Z plane when the passive control is engaged.

#### BRIEF DESCRIPTION OF THE DRAWINGS

FIG. 1 is an elevated perspective view of an exemplary laparoscopic device in accordance with the instant disclosure.

FIG. 2 is an elevated perspective view of the proximal end of the exemplary laparoscopic device of FIG. 1.

FIG. 3 is an elevated perspective view of the proximal end of the exemplary laparoscopic device of FIG. 2, without the left side housing.

FIG. 4 is a profile view of the proximal end of the exemplary laparoscopic device of FIG. 2, without the left side housing and without some of the internal components in order to show the axle in a distal portion of a through hole in the repositionable button.

FIG. 5 is an elevated perspective view of a distal portion of the proximal end of the exemplary laparoscopic device of FIG. 2, without the left side housing and without the clip release wires and the draw wires, and with the pitch and yaw controls in an unlocked position.

FIG. 6 is a profile view of a distal portion of the proximal end of the exemplary laparoscopic device of FIG. 2, without the left side housing and without the clip release wires and the draw wires, and with the pitch and yaw controls in a locked position.

FIG. 7 is a profile view of a distal portion of the proximal end of the exemplary laparoscopic device of FIG. 2, without the left side housing and without the clip release wires and the draw wires, and with the pitch and yaw controls in the unlocked position.

FIG. 8 is a profile view of a distal portion of the proximal end of the exemplary laparoscopic device of FIG. 2, without the left side housing, the clip release wires, the draw wires, and the yaw control.

FIG. 9 is an elevated perspective view of a distal portion of the proximal end of the exemplary laparoscopic device of FIG. 2, without the left side housing, the clip release wires, the draw wires, and the yaw control.

FIG. 10 is an elevated perspective view of a distal portion of the proximal end of the exemplary laparoscopic device of FIG. 2, without the left side housing, the clip release wires, the draw wires, and the control button.

FIG. 11 is an end view, from the proximal end, of an exemplary clevis of the exemplary laparoscopic device of FIG. 1.

FIG. 12 is an end view, from the distal end, of the exemplary clevis of FIG. 11.

FIG. 13 is a profile view of the exemplary clevis of FIG. 11.

FIG. 14 is an elevated perspective view of the exemplary clevis of FIG. 11.

FIG. 15 is an elevated perspective view, from a distal end, of an exemplary dual pivot joint of the exemplary laparoscopic device of FIG. 1.

FIG. 16 is a profile view of the exemplary dual pivot joint of FIG. 15.

FIG. 17 is an elevated perspective view, from a proximal end, of the exemplary dual pivot joint of FIG. 15.

FIG. 18 is a top view of the exemplary dual pivot joint of FIG. 15.

FIG. 19 is an end view, from the proximal end, of the exemplary dual pivot joint of FIG. 15.

FIG. 20 is another elevated perspective view, from a distal end, of the exemplary dual pivot joint of FIG. 15.

FIG. 21 is an elevated perspective view, from a proximal end, of an exemplary yoke of the exemplary laparoscopic device of FIG. 1.

FIG. 22 is a top view of the exemplary yoke of FIG. 21.

FIG. 23 is an underneath perspective view, from a lateral side, of the exemplary yoke of FIG. 21.

FIG. 24 is a distal view of the exemplary yoke of FIG. 21.

FIG. 25 is a bottom view of the exemplary yoke of FIG. 21.

FIG. 26 is another underneath perspective view, from the opposite lateral side, of the exemplary yoke of FIG. 21.

FIG. 27 is an elevated perspective view, from the proximal end, of the exemplary dual pivot joint and yoke mounted to a clip deployment device, where the view shows the both sets of connection wires, the draw wires, and the clip release wires.

FIG. 28 is an elevated perspective view, from the proximal end, of the exemplary yoke mounted to a clip deployment device, where the view shows one set of connection wires, the draw wires, and the clip release wires.

FIG. 29 is an elevated perspective view, from the proximal end, of the exemplary clevis, dual pivot joint, and yoke mounted to a clip deployment device and an occlusion clip, where the yoke is being grasped by a robotic grasper.

FIG. 30 is an elevated perspective view, from the distal end, of the exemplary yoke mounted to a clip deployment device, where the view is devoid of the draw wires and the clip release wires.

FIG. 31 is an underneath perspective view, from the distal end, of the exemplary yoke mounted to a clip deployment device, where the view is devoid of the draw wires and the clip release wires.

FIG. 32 is an elevated perspective view, from the proximal end, of the exemplary clip deployment device and retention dowels, where the view is devoid of the draw wires and the clip release wires.

FIG. 33 is an elevated perspective view, from the proximal end and lateral side, of the exemplary clevis, dual pivot joint, and yoke mounted to a clip deployment device and an occlusion clip, where the draw wires and the clip release wires are shown.

FIG. 34 is an elevated perspective view, from the proximal end and lateral side, of the exemplary clevis, dual pivot joint, and yoke mounted to a clip deployment device and an occlusion clip, where the draw wires, the clip release wires, and the suture loops are shown.

FIG. 35 is a magnified elevated perspective view showing the attachment between the occlusion clip and the clip deployment device, as well as the interaction of the draw wires and the clip release wires.

FIG. 36 is a perspective view of an exemplary clamp in an open position that may be used with the exemplary laparoscopic device of FIG. 1.

FIG. 37 is a perspective view of the exemplary clamp of FIG. 36 in a closed position.

FIG. 38 is a cross-sectional view of the exemplary clamp of FIG. 36 in its open configuration, showing the wire member, rigid tubular members, and the urging members.

FIG. 39 is a cross-sectional view of the exemplary clamp of FIG. 37 in its closed configuration, showing the wire member, rigid tubular members, and the urging members.

FIG. 40 is a perspective view of the exemplary claims of FIGS. 36-39 and showing the ability to close in a non-parallel fashion.

FIG. 41 is a perspective view of the first stage of assembly of an alternate embodiment of a clamp, showing a wire member surrounded by rigid tubular members.

FIG. 42 is a perspective view of the second stage of assembly of the clamp of FIG. 41, in which platens have been added over the rigid tubular members.

FIG. 43 is a perspective view of the clamp of FIGS. 41 and 42, once an outer fabric covering has been disposed over the entire surface of the clamp.

## DETAILED DESCRIPTION

The exemplary embodiments of the present disclosure are described and illustrated below to encompass surgical equipment and, more specifically, to surgical equipment that may be used in minimally invasive procedures. The disclosure also relates to surgical equipment to facilitate the positioning and deployment of an atrial appendage occlusion device. In addition, the disclosure relates to surgical equipment that is adapted to accommodate or work in tandem with flexible endoscopes. Of course, it will be apparent to those of ordinary skill in the art that the embodiments discussed below are exemplary in nature and may be reconfigured without departing from the scope and spirit of the present disclosure. However, for clarity and precision, the exemplary embodiments as discussed below may include optional steps, methods, and features that one of ordinary skill should recognize as not being a requisite to fall within the scope of the present disclosure.

Referring to FIG. 1, an exemplary clip deployment apparatus 100 comprises a controller 110 mounted to a proximal portion of a rigid or semi-rigid conduit 112 that is relatively linear. The controller 110 includes various controls in order to manipulate a repositionable mechanism operatively coupled to an end effector 118, where the repositionable mechanism is mounted to a distal portion of the conduit 112. In this exemplary embodiment, the repositionable mechanism is coupled to an end effector comprising a clip deployment device 118. But as will be discussed in more detail hereafter, the end effector 118 may comprise any number of devices such as, without limitation, forceps, ablation rails, jaws, linear cutters, ablation pens, ablation clamps, illuminated dissectors, and non-illuminated dissectors.

The exemplary repositionable mechanism incorporates a dual passive mechanism. The first passive mechanism is operative to control the pitch (i.e., up and down) of the end effector **118**, while the second passive mechanism is operative to control the yaw (i.e., side to side) of the end effector.

Referencing FIGS. 1-10, the controller **110** is coupled to the conduit **112** in order to manipulate a repositionable mechanism operatively coupled to the end effector **118**. The controller **110** comprises a right side housing **130** and a left side housing **132** that cooperatively define an internal cavity and corresponding openings to accommodate throughput of certain controls. A first of these openings is a dorsal opening **134** that accommodates throughput of a repositionable button **136**. As will be discussed in more detail hereafter, the repositionable button **136** may be manipulated vertically to lock and unlock the repositionable mechanisms, as well as forward-to-rearward to lock and unlock the position of the button itself, in order to provide for or constrain lateral and vertical adjustability of the end effector **118**.

The repositionable button **136** comprises a proximal-to-distal arcuate top **138** that includes bumps and a proximal ridge to accommodate the thumb of a user being positioned on top of the button. The medial-to-lateral width of the arcuate top **138** is generally constant and overlaps a vertical, planar appendage **142** that extends from the underside of the arcuate top. This vertical appendage **142** has a relatively constant and minimal medial-to-lateral dimension, but includes a proximal-to-lateral dimension that tapers from a maximum where the appendage extends from the arcuate top, to a minimum where the appendage ends. Extending through this vertical appendage **142** is a U-shaped through hole **144** that is partially occupied by an axle **164**. This U-shaped through hole **144** allows the button **136** to be vertically repositioned with respect to the axle **164** so that active pressure is required to maintain a depressed button position when the axle is in a distal portion of the through hole. Instead of having to maintain pressure upon the button **136** to sustain it in a depressed position, the user may choose to rotate the button with respect to the axle **164** in order to seat the axle in a proximal portion of the through hole **144**, thus effectively locking the button in the depressed position. In order to unlock the button **136**, a user simply rotates or pushes the button proximally to cause the axle **164** into the distal portion of the through hole **144**.

At the end of the appendage **142**, a pair of tooth receivers **146** extend outward in the medial and lateral directions from opposing sides of the appendage. The tooth receivers **146** each include a series of longitudinal pyramidal shapes **148** that are in parallel and radially arranged in order to define a series of corresponding longitudinal pyramidal cavities **150**. At the medial end of the medial tooth receiver **146** and at the lateral end of the lateral tooth receiver **146** is a cylindrical projection **152** that is received within corresponding vertical, oblong grooves **154** on the interior of the housings **130**, **132**. These grooves **154** inhibit significant medial-to-lateral and proximal-to-distal travel of the tooth receivers **146** as the tooth receivers are vertically repositioned. In other words, as the button **136** is depressed vertically, the toothed receivers **146** are vertically repositioned in a corresponding vertical manner. In this way, the movement of the toothed receivers **146** is directly attributable to the movement of the button **136** as the toothed receivers are indirectly mounted to the button via the appendage **142**.

The button **136** is biased vertically to its highest vertical position shown in FIG. 6. To achieve this bias, the housings **130**, **132** include parallel walls **158** that cooperate to form medial-to-lateral trench within which at least one spring **160**

is seated. The spring **160** is rated at a sufficient spring force to overcome the weight of the button **136**, appendage **142**, tooth receivers **146**, and cylindrical projections **152** to force the button to its highest vertical position. But the spring force is not so great that it requires too great a force from a user's thumb to depress the button **136** and overcome the bias of the spring **160**.

An axle **164** extends in the medial-to-lateral direction within the interior cavity cooperatively defined by the housings **130**, **132**. This axle **164** is cylindrical in shape and includes a constant longitudinal diameter, thereby giving the axle a circular circumference. In exemplary form, the medial and lateral ends of the axle **164** are received within corresponding cylindrical cavities (not shown) on the interior of the housings. The depth of these cavities is not so great as to cover the majority of the axle **164**. The exposed cylindrical portion of the axle **164** is operative to receive a pair of toothed assemblies **168**, **170** that are interposed by the appendage **142**, which itself includes a vertical, oblong orifice (not shown) to accommodate throughput of the axle and vertical travel of the appendage with respect to the axle, which has a fixed orientation. In exemplary form, the toothed assemblies **168**, **170** include a through cylindrical orifice **172** allowing the assemblies to rotate on the outside of the axle.

Each of the toothed assemblies **168**, **170** are identical to each other. Accordingly, a redundant description of the second toothed assembly has been omitted in furtherance of brevity. The toothed assemblies **168**, **170** include a wheel **176** having circumferentially distributed teeth **178** that are sized to engage a respective tooth receivers **146** and be received within the longitudinal pyramidal cavities **150** when the tooth receivers in a raised vertical position (see FIG. 6). In exemplary form, the spring rate of the spring **160** is chosen to allow the tooth receivers **146** to be depressed by forces applied to the toothed assemblies **168**, **170** above a predetermined threshold. For example, a high load applied to the end effector in any one direction may result in repositioning of one or both of the toothed assemblies **168**, **170**, thereby causing a wheel **176** and its teeth **178** to rotate and correspondingly depress against the corresponding tooth receiver **146**, which depresses against the spring **160** to compress the spring, thus allowing one or both wheels to rotate to avoid breaking any of the components.

The wheel **176** has a generally uniform width but for a pair of outgrowths **180**, **182**. The first outgrowth **180** is generally centered radially with respect to the wheel and partially defines the through orifice **172** that receives the axle **164**. This first outgrowth **180** is semicircular in shape extends medially from the wheel **176** and includes a corresponding top and bottom arcuate surfaces **184**, **186** that are radially inset with respect to the wheel. These arcuate surfaces **184**, **186** act as camming surfaces for respective connection wires **188**, **190** that extend from the second outgrowth **182**. The first outgrowth **180** also includes a pair of vertical flanges **194** that extend from the arcuate surfaces **184**, **186** and cooperate with the circumferential ends of the wheels in order to provide medial and lateral guides for the connection wires **188**, **190** so that the connection wires stay therebetween. The second outgrowth **182** is proximally oriented with respect to the first outgrowth **180** and includes a rectangular profile with a pair of L-shaped walls **192** and floor **196** cooperating to define an internal cavity. An opening (not shown) extends through the floor and into the cavity. This opening receives a fastener (such as a screw) **200** around which the connection wires **188**, **190** are wound and secured in place. The fastener **200** is also recessed within the

cavity so that the L-shaped walls 192 extend laterally beyond the end of the fastener. Accordingly, the connection wires 188, 190 extending from the fastener are threaded through a gap between the L-shaped walls 192, with one of the wires being threaded over the top arcuate surface 184, while the second wire is threaded under the bottom arcuate surface 186. Thereafter, the wires 188, 190 extend distally and taper to extend through a respective eyelet opening at the proximal end of the conduit 112.

Each of the toothed assemblies 168, 170 is independently rotatably repositionable with respect to one another. The first toothed assembly 168 is operative provide part of a passive repositionable mechanism in order to control the pitch (i.e., up and down) of the end effector 118, while the second toothed assembly 170 is operative to provide part of a passive repositionable mechanism in order to control the yaw (i.e., side to side) of the end effector. In exemplary form, when the button 136 is not depressed, the spring 160 is operative to bias the toothed receivers 146 into engagement with the teeth 178 of the toothed assemblies 168, 170, thereby inhibiting rotation of the toothed assemblies around the axle 164. When the tooth assemblies 168, 170 are locked in position (see FIG. 6) the end effector 118 cannot be repositioned in the vertical direction (i.e., affecting pitch) or in the medial-to-lateral direction (i.e., affecting yaw). Thus, when the tooth assemblies 168, 170 are locked in position (see FIG. 6), so too is the end effector 118 locked in position.

In order to change the vertical or medial-to-lateral position of the end effector 118, a user would depress the button 136. By depressing the button 136, the toothed receivers 146 are operative to further compress the spring 160 and disengage the toothed assemblies 168, 170. More specifically, the longitudinal pyramidal shapes 148 and corresponding longitudinal pyramidal cavities 150 no longer engage the teeth 178 of the toothed assemblies 168, 170, thereby allowing rotation of the toothed assemblies around the axle 164. By allowing free rotation of the toothed assemblies 168, 170 around the axle 164, the connection wires 188, 190 linking the end effector 118 and the toothed assemblies may be repositioned, which allows the end effector to be freely repositionable in the vertical direction (i.e., affecting pitch) and in the medial-to-lateral direction (i.e., affecting yaw). After the respective vertical and medial-to-lateral position of the end effector 118 has been reached, the user would discontinue depressing the button 136 to lock in the relative vertical and medial-to-lateral positions. In order to lock in the positions, the spring 160 forces the toothed receivers 146 upward and into engagement with the toothed assemblies 168, 170. Because the toothed assemblies 168, 170 include teeth 178 that engage the longitudinal pyramidal shapes 148 of the toothed receivers 146, the spring 160 will direct the toothed receivers upward and cause the toothed assemblies to possibly rotate slightly about the axle 164 so that the teeth are fully received within the longitudinal pyramidal cavities 150. If the position of the end effector 118 is such that the teeth 178 are aligned with the longitudinal pyramidal cavities 150, then the vertical and medial-to-lateral positions will be precisely maintained because of the tension on the connection wires 188, 190. But if the position of the end effector 118 is such that the teeth 178 are slightly misaligned with the longitudinal pyramidal cavities 150, then the vertical and medial-to-lateral positions will be changed as the toothed assemblies 168, 170 rotate slightly about the axle 164 so that the teeth are fully received within the longitudinal pyramidal cavities 150. After the teeth 178 are aligned and received within the longitudinal pyramidal cavities 150,

the vertical and medial-to-lateral positions will be precisely maintained because of the tension on the connection wires 188, 190.

In order to maintain the orientation of the semi-rigid conduit (which carries the connection wires 188, 190) with respect to the housings 130, 132, a distal portion of the right side housing 130 includes a pair of detents 202 that engage the conduit 112. These detents 202 inhibit longitudinal movement of the conduit 112 with respect to the controller 110. Both detents 202 extend in parallel to one another and extend from an interior circumferential surface of the right side housing 130.

The right and left side housings 130, 132 cooperate to delineate a handle mechanism port 210 and a proximal port 212 open to the interiors of the respective housings. The handle mechanism port 210 accommodates throughput of a portion of a handle mechanism 218 that comprises a repositionable lever 220, a drive plate 222, a return spring 224, and a wire retainer 226. As will be discussed in more detail hereafter, the wire retainer 226 is concurrently coupled to draw wires 228 and the drive plate 222 so that movement of the lever 220 is operative to open and close an occlusion clip 1160 (compare FIGS. 29 and 34), such as during an atrial appendage occlusion clip deployment surgical procedure. A more detailed explanation of the respective components of the handle mechanism 218 follows.

The repositionable lever 220 includes an arcuate, ventral gripping surface that may include a series of convex bumps longitudinally spaced apart to facilitate gripping by a user. Opposite the ventral gripping surface is a corresponding interior surface from which a pair of spaced apart, parallel vertical walls 230, 232 extend. The vertical walls 230, 232 are also connected to one another via a plurality of cross walls 234. The vertical walls 230, 232 each include a distal upstanding loop 238 that provides a through opening in the medial-to-lateral direction to receive a axle 240 extending from the right side housing 130 around which the lever 220 rotates. Extending distally from the loop 238, the walls 230, 232 include a circular opening extending in the medial-to-lateral direction that receives a pin 244 in order to repositionably mount the drive plate 222 to the lever 220.

The exemplary drive plate 222 comprises an arcuate, flat plate sized to fit between the walls 230, 232 of the lever 220. A distal end of the plate 222 includes an opening to receive the pin 244. Extending proximally from the opening is an elongated, arcuate opening 246 adapted to receive a dowel 248 extending from the interior of the right side housing 130. In this manner, the dowel 248 is repositioned with respect to the opening 246 as the lever 220 repositions the drive plate 222. In exemplary form, the opening is partially defined by a lip 250 that acts to retain the dowel 248 in a static position after the lever 220 is fully closed. At the same time, the proximal end of the drive plate 222 includes an orifice 252 that receives a portion of the spring 224 in order to bias the lever 220 to the open position shown in FIG. 3. The opposing end of the spring 224 is mounted to a dowel 254 that extends from the interior of the right side housing 220.

The controller 110 also includes a removable stem 260 that is seated within the proximal port 212 of the housings 130, 132. The removable stem 260 is coupled to one or more clip release wires 292 (in this case, two clip release wires) that act to disconnect an occlusion clip from the clip deployment device 118. In this manner, the stem 260 may be removed from the proximal end of the controller 110, thereby drawing the release wire(s) proximally and disconnecting the occlusion clip from the clip deployment device

118. In this exemplary embodiment, the stem 260 is secured within the proximal port 212 via a friction fit that may be overcome by the user applying pressure to the stem to move it proximally with respect to the controller 110. But it is also within the scope of the disclosure to use detents or other affirmative release mechanisms to release the stem 260 from the controller 110.

The controller 110 is mounted to a rigid or semi-rigid conduit 112 that is relatively linear and has a relatively constant circular cross section. In this exemplary embodiment, the conduit 112 is fabricated from stainless steel and includes a proximal circular opening and a distal circular opening. The proximal circular opening provides access between the interior of the conduit 112 and the interior of the controller 110. More specifically, the hollow interior of the conduit 112 accommodates throughput of the connection wires 188, 190 and the clip release wires 292. The conduit 112 includes a proximal section having a pair of rectangular, arcuate cut-outs providing respective recesses for the detents 202 of the right side housing 130 to occupy and mount the conduit 112 to the housings 130, 132.

In addition, the conduit 112 may be relatively linear but include two additional orifices that accommodate a separate conduit (not shown) adapted to provide a separate avenue for an exploratory tool. Exemplary exploratory tools for use with the instant semi-rigid conduit include, without limitation, forceps, ablation rails, jaws, linear cutters, ablation pens, ablation clamps, illuminated dissectors, and non-illuminated dissectors. The exemplary exploratory tool may be used in combination with the end effector, which is manipulated by the repositionable mechanism.

Referring to FIGS. 11-14, a distal portion of the exemplary repositionable mechanism comprises a clevis 302 having a partially enclosed proximal section 304 that delineates a cavity 306 receives a distal section of the conduit 112 to mount the clevis to the conduit. On the interior of the cavity 306 are four equidistantly, radially spaced apart ribs 308 that extend longitudinally and in parallel to one another. The ribs 308 operate to decrease the diameter of the cavity 306 so that the ribs contact the exterior, circumferential surface of the conduit 112 to mount the conduit to the clevis 302 via a friction fit. Each of the ribs 308 terminates distally at a wall 310 extending normal to the longitudinal direction of the ribs. The wall 310 includes a series of orifices 312, 314, 316 that accommodate throughput of the connection wires 188, 190 and the clip release wires 292. In exemplary form, the first orifice 312 accommodates throughput of the first connection wire 188, while the second orifice 314 accommodates throughput of the clip release wires 292, while the third orifice 316 accommodates throughput of the second connection wire 190. The wall 310 also bridges the proximal section 304 and a distal section 320 of the clevis 302.

The distal section 320 of the clevis 302 includes a pair of distal projections 324, 326 extending away from the wall 310 to create a ceiling and floor. The projections 324, 326 are oriented to provide a gap therebetween extending in proximal-to-distal direction and in a medial-to-lateral direction. Each projection 324, 326 includes a mildly convex outer surface 330 that is jointed by a peripheral surface 332 that is rounded to at the distal tip. The peripheral surfaces 332 are jointed by respective exterior side surfaces 334. Each projection 324, 326 includes a depression 336 that originates at the distal tip of the clevis 302 and extends proximally. The bounds of the depression 336 are delineated by a planar bottom surface 340, a horseshoe (i.e., semicircular) peripheral surface 342, and a planar base surface 344. The arcuate

contour of the peripheral surface 342 is operative to allow a dual pivot joint to 350 to pivot in a single plane with respect to the clevis 302.

Referring to FIGS. 15-20, the dual pivot joint 350 comprises a proximal section 352 having a pair of plateaus 354 that extend in opposite directions from one another. Each plateau 354 includes a teardrop shaped circumferential surface 356 with the rounded portion of the surface adapted to have an arcuate curvature that approximates the arcuate curvature of the peripheral surface 342 of the clevis 302. The plateaus 354 are interposed by a platform 358 having opposed, generally planar parallel surfaces 360. Accordingly, the dual pivot joint 350 may pivot with respect to the clevis 302 by the plateaus 354 pivoting or rotating with respect to the peripheral surface 342, while the planar surfaces 360 contact the planar base surfaces 344 of the clevis to limit significant vertical play between the clevis and dual pivot joint. The pointed aspect of each circumferential surface 356 cooperates with the straight walls of the peripheral surface 342 of the clevis 302 to provide stops that limit the pivotal motion of the dual pivot joint 350 with respect to the clevis 302 to no more than fifty-five degrees from center (total range of motion of approximately 110 degrees). As will be understood by those skilled in the art, the range of travel may be increased by increasing the angle of the pointed aspect of the circumferential surfaces. Conversely, the range of travel may be decreased by decreasing the angle of the pointed aspect of the circumferential surfaces.

A proximal aspect of the platform 358 is rounded and includes two pair of arcuate walls 364 that are spaced apart from one another to create a gap 368 that tapers distally to create a cylindrical through hole 376 extending into the interior of a distal aspect 370 of the dual pivot joint. The tapered feature of each gap 368 is partially defined by a pair of angled faces 372 that operate to allow the connection wires 188 to be fed in between the walls 364, through the cylindrical hole 376 and into the interior of the distal aspect, where the wires are ultimately connected to a yoke 380. The tapered nature of each gap 368 ensures that the connection wires 188 do not become bound up by pivoting action of the dual pivot joint 350 with respect to the clevis 302. But for the tapered nature of the gap 368, pivoting action beyond center of the dual pivot joint 350 with respect to the clevis 302 would cause the path of the connection wires 188 to be lengthened, thereby resulting in pivoting of the yoke 380 with respect to the dual pivot joint.

Interposing the two pair of arcuate walls 364 and respective gaps 368 is a centered gap 384 that also tapers distally to create a through hole 386 having a rectangular, rounded cross-section that extends into the interior of the distal aspect 370 of the dual pivot joint. The tapered feature of this centered gap 384 is partially defined by a pair of angled faces 388 that operate to allow the draw wire 228 and clip release wires 292 to be fed in between the walls 364, through the hole 386, and into the interior of the distal aspect, where the wires are ultimately fed through a clip deployment frame 520. The tapered nature of this gap 384 ensures that the draw wire 228 and clip release wires 292 do not become bound up by pivoting action of the dual pivot joint 350 with respect to the clevis 302. But for the tapered nature of the gap 384, pivoting action beyond center of the dual pivot joint 350 with respect to the clevis 302 would cause the path of the draw wire 228 and clip release wires 292 to be lengthened, thereby potentially resulting in premature release of the clip 1160 and opening of the clip.

Adjoining the angled faces **388** is an arcuate wall **390** that curves around a lateral edge of the proximal section **352** and extends into the interior of the distal section **370**. The arcuate wall **390** is inset within the proximal section **352** to create a lateral trench **392** on the right and left sides. Each lateral trench **392** ends distally proximate a lateral, longitudinal opening **396** extending through right and left side paddles **402**. This pair of lateral trenches **390** respectively receives one of the connection wires **190** so that the ends of each connection wire extend into the interior of the distal section **370**. Each end of the connection wire **190** is enlarged to prohibit the end from passing through the longitudinal opening **396**. In other words, the longitudinal opening **396** is sized to allow throughput of the connection wire **190** along the longitudinal length of the connection wire, but is sized to prohibit throughput of the enlarged end of the connection wire. In this manner, tension can be applied the connection wires **190** in order to cause the dual pivot joint **350** to pivot with respect to the clevis **302**. By applying tension to the right side connection wire **190**, the dual pivot joint pivots to the right side. Conversely, by applying tension to the left side connection wire **190**, the dual pivot joint pivots to the left side.

The right side paddle **402** is a mirror image of the left side paddle. Accordingly, for purposes of explanation, only a single paddle will be described. Each paddle **402** includes a lateral exterior surface **406** that is substantially planar but for a pair of projections **408** that are spaced apart from one another by the longitudinal opening **396** extending therebetween. Each projection **408** includes a linear aspect **410** that extends in parallel with the longitudinal opening **396** and a curved aspect **412**. As will be discussed in more detail hereafter, the curved aspect **412** has a curvature that mirrors the arcuate motion of the yoke **380**. The paddle **402** includes a vertical height extending above and below the proximal section **352**. The top and bottom surfaces **414** of the paddle **402** are generally planar and are bridged by a curved circumferential surface **418**. The lateral or widthwise dimension of the paddle **402** is substantially uniform, from proximal to distal, but for an interior depression **420** that is open on the distal end of the paddle and extends proximally to intersect the longitudinal opening **396**. The depression **420** is partially defined by a planar wall **424** that is perpendicular to a second planar wall **426** with an arcuate transition therebetween. At the same time, a third wall **428** is also perpendicular to the planar wall **424** and includes an arcuate profile that corresponds to the arcuate profile of a plateau of the yoke **380**. An interior planar wall **430** of each paddle **402** intersects a pair of rectangular projections **432**. Each rectangular projection **432** includes a distal wall **436** that is arcuate from right to left. The arcuate curvature of the distal wall generally tracks the arcuate profile of a portion of the yoke **380**.

Referring to FIGS. 21-26, the yoke **380** comprises a hollow box having a roof **440**, a floor, **442**, a right side wall **444**, and a left side wall **446**. The front of the box is open and reveals the interior cavity. Extending laterally outward from the right and left side walls **444**, **446** are respective right and left wings **448**, **450**.

Each wing **448**, **450** includes a pair of circumferential projections **452** that extend vertically therethrough to protrude above and below the wing. In this exemplary embodiment, the projections are sized and spaced apart to facilitate grasping of the yoke **380** by a robotic grasper **456** (see FIG. 29). A distal portion of the each wing **448**, **450** is generally flush with walls defining a distal recess **458** within the respective right and right and left side walls **444**, **446**. As

will be discussed in more detail hereafter, the distal recess is sized to accommodate partial insertion of the clip deployment frame **520**.

The right wing **448** is laterally widest at its distal end and tapers in a widthwise dimension, bounded by an arcuate peripheral surface **460**. The proximal portion of the right wing **448** extends proximally beyond the hollow box and includes a planar guide **464** that is parallel to a right side plateau **466** extending from a proximal section **468** of the yoke **380**. A hole **470** extends through the planar guide **464** and extends into communication with an underneath trench **472** formed into the bottom surface **474** of the right wing. This underneath trench **472** terminates distally at the distal end of the right wing **448**. In particular, one of the clip deployment wires **292** is fed past the proximal section **468**, through the hole **470**, and along this underneath trench **472** to exit and extend distally from the trench.

The proximal section **468** includes right and left side plateaus **466**, **476** that extend in opposite directions from one another. Each plateau **466**, **476** includes a teardrop shaped circumferential surface **478** with the rounded portion of the surface adapted to have an arcuate curvature that approximates the arcuate curvature of the third wall **428** of the dual pivot joint **350**. The plateaus **466**, **476** are interposed by a platform **482** having opposed, generally planar parallel surfaces **484**. Accordingly, the yoke **380** may pivot with respect to the dual pivot joint **350** by the plateaus **466**, **476** pivoting or rotating with respect to the third wall **428**. The pointed aspect of each circumferential surface **478** cooperates with the straight walls of the second planar wall **426** of the dual pivot joint **350** to provide stops that limit the pivotal motion of the dual pivot joint with respect to the yoke to no more than fifty-five degrees from center (total range of motion of approximately 110 degrees). As will be understood by those skilled in the art, the range of travel may be increased by increasing the angle of the pointed aspect of the circumferential surfaces. Conversely, the range of travel may be decreased by decreasing the angle of the pointed aspect of the circumferential surfaces.

A proximal aspect of the platform **482** is rounded and includes two pair of arcuate, solid walls **486** that are spaced apart from one another to create a gap **488** that tapers distally to create a through hole **490** extending into the interior of the hollow box. The tapered feature of this gap **488** is partially defined by a pair of angled faces that operate to allow the draw wires **228** to be fed in between the walls **486**, through the hole **490** and fed through the clip deployment frame **520**, where the wires are ultimately connected to an occlusion clip **1160** (see FIG. 30). The tapered nature of this gap **488** ensures that the draw wires **228** do not become bound up by pivoting action of the yoke **380** with respect to the dual pivot joint **350**. But for the tapered nature of the gap **488**, pivoting action beyond center of the yoke **380** with respect to the dual pivot joint **350** would cause the path of the draw wires **228** to be lengthened, thereby resulting in potentially premature opening of the occlusion clip **1160**.

Interposing the solid walls **486** and inset therein are top and bottom arcuate walls **492**, **494**. The arcuate nature of these walls **492**, **494**, teamed with being inset in between the solid walls **486** creates a groove that feeds respective top and bottom holes **498**, **500** that are open to the interior of the hollow box. In exemplary form, each connection wire **188** is received within the respective grooves so that the distal ends of the connection wires extend into the interior of the hollow box. Each end of the connection wires **188** is enlarged to prohibit the end from passing through the top and bottom holes **498**, **500**. In other words, the holes **498**, **500** are sized

to allow throughput of the connection wires **188**, but are sized to prohibit throughput of the enlarged end of the connection wires. In this manner, tension can be applied the connection wires **188** in order to cause the yoke **380** to pivot with respect to the dual pivot joint **350**. By applying tension to the top side connection wire **188**, the yoke pivots upward with respect to the dual pivot joint **350**. Conversely, by applying tension to the bottom connection wire **188**, the yoke pivots downward with respect to the dual pivot joint **350**.

Adjacent the platform **482**, on the left side, is the left wing **450**. The left wing **450** is laterally widest at its distal end and tapers in a widthwise dimension, bounded by an arcuate peripheral surface **504**. The proximal portion of the left wing **450** extends proximally beyond the hollow box and includes a planar guide **506** that is parallel to the left side plateau **476**. A hole **508** extends through the planar guide **506** and extends into communication with an underneath trench **510** formed into the bottom surface **512** of the left wing. This underneath trench **510** terminates prior to reaching the distal end of the left wing **450**. In particular, the trench **510** terminates and feeds into a distal tunnel **514** that extends through a distal portion of the left wing **450**. In this exemplary embodiment, a second of the clip deployment wires **292** is fed past the proximal section **468**, through the hole **508**, along this underneath trench **510**, through the tunnel **514** and exits distally from the tunnel.

Referring to FIGS. 27-35, the clip deployment device **118** is partially received within the interior of the hollow box. In exemplary form, the clip deployment device **118** includes a rectangular frame **520** having parallel longitudinal sides **524**, **526** that are connected to one another via a distal cross-member **527** with rounded corners therebetween. In this exemplary embodiment, each parallel side **524**, **526** includes a substantially planar interior wall **528** and a concave exterior wall **530**, opposite the interior wall. The concave nature of the exterior wall **530** creates a longitudinal channel, with one exterior channel receiving a first of the clip deployment wires **292**. In addition, the parallel sides **524**, **526** may include one or more through orifices extending through the interior and exterior walls **528**, **530**.

The proximal end of the rectangular frame **522** includes a pair of rounded corners that extend from the parallel sides **524**, **526**. Each rounded corner on the proximal end forms part of an S-shaped retainer **540**, **542** that is partially received within the hollow box interior of the yoke **380**. More specifically, both S-shaped retainers **540**, **542** comprise a first rounded corner that transitions into a straight segment **546**, which transitions into a semicircular segment **548**. The S-shaped retainers **540**, **542** are mirror images of one another, except that the one retainer **540** includes an orifice **550** that extends through the interior and exterior surfaces and along the majority of the straight and semicircular segments **546**, **548**.

In order to secure the clip deployment device **118** to the yoke **380**, two dowels **560** are inserted through corresponding holes **562** in the top and bottom surfaces **440**, **442** of the yoke. The holes **562** are sized to retain the dowels **560** in position. But before the dowels **560** are inserted into the holes **562**, the S-shaped retainers **540**, **542** are inserted into the interior of the yoke **380**. In exemplary form, the vertical dimension of the S-shaped retainers **540**, **542** is such that the retainers are wedged in between the top and bottom walls **440**, **442** of the yoke **380**. Moreover, the collective lengthwise dimension of the S-shaped retainers **540**, **542** is such that the retainers are wedged in between the right and left side walls **444**, **446**. In this manner, even absent the dowels

**560**, there is not significant play between the clip deployment device **118** to the yoke **380** in the vertical and lateral directions. In order to reduce play in the proximal-to-distal direction, the dowels **560** are inserted through the holes **562** after the semicircular segment **548** of each S-shaped retainers **540**, **542** is positioned to partially outline an imaginary cylinder extending through the holes. This locks the S-shaped retainers **540**, **542** in position with respect to the yoke **380**, thereby mounting the clip deployment device **118** to the yoke.

The orifice **550** of the one retainer **540** provides an egress hole through which a second of the clip deployment wires **292** passes through. The second of the clip deployment wires **292** extends into the interior of the rectangular frame **522** and passes longitudinally along the exterior of an elongated deployment plate **566**. The deployment plate **566** includes a pair of orifices **568** near the proximal and distal ends of the plate. As will be discussed in more detail hereafter, the orifices **568** receive suture loops **570** that are captured by the clip deployment wire **292** passing therethrough.

The orifice **550** also provides an egress hole through which the draw wires **228** pass through. The draw wires **228** are initially routed into the interior of the rectangular frame **522** to pass through an orifice **572** in one of the proximal rounded corners. Both wires **228** extend along the longitudinal channel of one of the parallel sides **524** created by the concave exterior wall **530**. One of the wires passes through a first proximal orifice **576** in the first parallel side **524**, while the second wire continues to extend along the longitudinal channel until reaching a second distal orifice **578**. Both wires **228** then extend into the interior of the rectangular frame **522** and pass perpendicularly through a second set of orifices **580** of the elongated deployment plate **566**. This second set of orifices **580** are inset with respect to the pair of orifices **568** near the proximal and distal ends of the plate. The wires are joined and create a closed loop coupled to the deployment plate **566**.

Referring to FIGS. 36-38 show one embodiment of a left atrial appendage occlusion clamp **1110** in an open position with spaced apart rigid clamping portions **1102**, **1104** and resilient or elastic urging members **1106**, **1108** at opposite ends of each clamping portion **1102**, **1104**. Clamping portions **1102**, **1104** may be tubular, and both clamping portions **1102**, **1104** may be at least substantially parallel to each other when arrest, i.e., when they are not being used to clamp tissue. Clamping portions **1102**, **1104** may also be of substantially equal length or of different length, and each may be of larger outer diameter than the wire that may be used to form each of the urging members **1106**, **1108**. In this regard, the wire forming urging members **1106**, **1108** can extend through the hollow interiors of the clamping portions **1102**, **1104**. In this illustrative example, the urging members **1106**, **1108** are each shaped as a loop. The planes defined by the looped configuration of each of the urging members **1106**, **1108** may be substantially parallel to each other and, in turn, substantially perpendicular to each of the clamping portions **1102**, **1104**. Of course, other angular orientations are possible as well.

FIGS. 37-39 show the same clamp **1110** of FIGS. 36-38 with the clamping portions **1102**, **1104** in their normally biased together positions. Contact between the clamping portions **1102**, **1104** may occur initially along their entire parallel lengths as shown. Of course, when clamping portions **1102**, **1104** are covered in fabric or other material as later described, contact may occur between the fabric or other material instead. In FIGS. 36-39, only the structure and relative positions of the rigid members **1102**, **1104** and

urging members **1106**, **1108** are shown. The final assembly is depicted in FIGS. **40-42** which, although describing a slightly different embodiment, show the general steps in the construction of each embodiment. The clamping portions **1102**, **1104** may be made from rigid tubes **1112**, **1114** of a rigid metal such as titanium disposed over a wire member **1116**. In this embodiment, titanium is used for its compatibility with MRI imaging, its biocompatibility and its galvanic compatibility with the wire member **1116** when the wire member **1116** is formed from superelastic materials such as a nickel titanium alloy. This embodiment and the other embodiments disclosed herein may use a superelastic material such as a nickel titanium alloy to form the urging members **1106**, **1108**. Superelastic properties will allow the material to be greatly extended to open the clamping portions **1106**, **1108** of the clamp **1110** without permanently deforming the material. These superelastic materials can also be compatible with MRI imaging and easily tolerated as an implant material in the body. The rigid tubular members **1112**, **1114** of this embodiment are mechanically fastened to the underlying wire member **1116** preferably by mechanically swaging the titanium tubes **1112**, **1114** to the wire members **1116**. Although a single, continuous wire member is shown directed through both clamping portions **1102**, **1104** and urging members **1106**, **1108**, the clamp **1110** of this embodiment may also be made with two or more wires, or with any other suitable components.

As shown in FIG. **40**, in addition to being able to close on tissue or anatomical structure in a parallel fashion, the clamp **1110** can also apply force to the anatomical structure in a nonparallel clamping fashion. This allows the clamp **1110** to accommodate non-uniform tissue thickness over the length of the clamping portions **1102**, **1104**. In addition, with separate urging members **1106**, **1108** at opposite ends of the clamping portions **1102**, **1104** the nonparallel clamping can originate from either side of the clamp **1110**. The nonparallel clamping feature of this embodiment allows the clamp **1110** to accommodate a wide range of hollow anatomical structures with varying wall thicknesses throughout its length and breadth. For example, some anatomical structures such as atrial appendages of the heart have internal structures called trabeculae, which are non-uniform and very often cause variable thicknesses across one or more of their dimensions. Nonuniform clamping, therefore, can be advantageous in this application for this reason or for other reasons.

FIG. **41** shows an alternate embodiment of a clamp **1160** including two urging members **1166**, **1168** shaped to resemble a letter "U" instead of the more circular loop configuration of the embodiment of FIGS. **36-39**. As is the case with the first clamp **1110**, the U-shaped urging members **1166**, **1168** of clamp **1160** may also lie in planes generally parallel to each other and perpendicular to the axes of the clamping portions **1162**, **1164**. A potential use of the embodiment of FIG. **41** may lie in the lesser force exerted by U-shape urging members **1166**, **1168** on the clamping portions **1162**, **1164** with respect to the force exerted by the loop-shape urging members **1106**, **1108** of clamp **1110** in FIGS. **36-39**, making it more suitable for clamping of anatomical structures not requiring a relatively high clamping force. The U-shape configuration of the urging members **1166**, **1168** generally requires less space in the direction perpendicular to the axes of the clamping portions **1162**, **1164**. FIG. **41** shows a first stage of assembly of the clamp **1160**, where the rigid tubular members **1163**, **1165** are joined with the superelastic wire member **1161**. In this embodiment, mechanical swaging is used to join the tubular mem-

bers **1163**, **1165** to the wire **1161**. However, adhesives or laser welding or other methods of attachment could be easily used instead. Similarly, it will be appreciated that rigid tubular members **1163**, **1165** may not necessarily need to be bonded to wire member **1161** at all. One may rely, for example, on designing the rigid tubular members **1163**, **1165** so that their inside diameters simply closely fit over the wire **1161**. In addition, the rigid tubular members **1163**, **1165** could take on many different cross sectional shapes. Cross-sectional shapes such as ovals, triangles or rectangles with rounded edges could be preferable and may eliminate the addition of the load spreading platens **1167**, **1169** shown in FIG. **42**, as these alternate shapes may provide a larger area of contact against the anatomical structure to be engaged by the clamp **1150**. Since different anatomical structures greatly vary from subject to subject, it is advantageous to have a manufacturing method in which the length **1171** of the clamp **1160** can be easily varied. By cutting rigid members **1163**, **1165** to various different lengths, different size assemblies can be configured.

FIG. **42** shows the next step in the assembly of the clamp. Load spreading platens **1167**, **1169** made of plastic or other biocompatible material such as urethane, may be slipped over the titanium or other suitable material tubing that forms rigid tubular members **1163**, **1165**, to provide a resilient surface **1173** to spread the load out onto a larger surface area, thereby preventing point source loading of the tissue which might otherwise result in cutting of the tissue before it has had a chance to become internally fused. The platens **1167**, **1169** can be assembled and applied over the rigid tubular members **1163**, **1165** prior to the swaging step or platens **1167**, **1169** can alternatively be manufactured in such a way so as to have a longitudinal split which allows the material to be opened and forced onto the rigid tubular members **1163**, **1165**.

FIG. **43** shows the clamp **1160** after a fabric cover material **1174** made of material such as polyester has been sewn around the clamping portions **1162**, **1164** and urging members **1166**, **1168**. It will be appreciated that this material or any other similar materials may be used as a full or partial covering in any of the disclosed embodiments. Such a material is preferably suitable to engage the tissue of the anatomical structure being clamped as well as that of surrounding areas. Preferably, the material **1174** is circular warp knit fabric tube, with a diameter of approximately 4 to 5 mm and made from a combination of  $\frac{4}{100}$ ,  $\frac{2}{100}$  and  $\frac{1}{100}$  textured polyester. The material **1174** may also be heat-treated to cause a velour effect. The fabric or other material **1174** is furthermore sewn or otherwise applied over the urging members **1166**, **1168**. In addition, fabric pieces **1177** may be attached at opposite respective ends of clamping portions **1162**, **1164** to prevent any part of the engaged anatomical structure from escaping the annular occlusion area between the clamping portions **1162**, **1164**. In other words, fabric pieces **1177** act as tissue blocking members or dams at opposite ends of the clamp. This or another tissue blocking feature may also be implemented into any other embodiment. This is desirable as it minimizes the probability of unintentionally leaving any part of the engaged anatomical structure unclamped. The material **1177**, like material **1174**, can also promote tissue in-growth.

Following from the above description and invention summaries, it should be apparent to those of ordinary skill in the art that, while the methods and apparatuses herein described constitute exemplary embodiments of the present invention, it is to be understood that the inventions contained herein are not limited to the above precise embodiment and that

19

changes may be made without departing from the scope of the invention as defined by the following proposed points of novelty. Likewise, it is to be understood that it is not necessary to meet any or all of the identified advantages or objects of the invention disclosed herein in order to fall within the scope of the invention, since inherent and/or unforeseen advantages of the present invention may exist even though they may not have been explicitly discussed herein.

What is claimed is:

1. A surgical device comprising:

a housing operatively coupled to a first control and a second control;

an end effector operatively coupled to the first control, the end effector comprising a first component and a second component selectively repositionable with respect to one another as part of a first degree of freedom, the end effector also including a third component selectively repositionable with respect to the second component as part of a second degree of freedom;

a surgical conduit mounted to and extending between the housing and the end effector; and,

wherein the end effector includes an occlusion clip deployment device operatively coupled to the third component and the second control, the occlusion clip deployment device includes an enclosed frame delineating an opening, the enclosed frame sized to circumscribe a left atrial appendage.

2. The surgical device of claim 1, further comprising a left atrial appendage occlusion clip having opposing beams biased toward one another, the occlusion clip removably mounted to the occlusion clip deployment device, wherein:

the housing is operatively coupled to a third control;

the third control is operatively coupled to the occlusion clip and the occlusion clip deployment device; and, the third control governs removal of the occlusion clip from the occlusion clip deployment device.

3. The surgical device of claim 1, wherein:

the first control includes a first passive constraint and a second passive constraint;

the first passive constraint in an unlocked position allows free motion between the first component and the second component within the first degree of freedom;

the first passive constraint in a locked position retards free motion between the first component and the second component within the first degree of freedom;

the second passive constraint in an unlocked position allows free motion between the second component and the third component within the second degree of freedom; and,

the second passive constraint in a locked position retards free motion between the second component and the third component within the second degree of freedom.

4. The surgical device of claim 3, wherein:

the first passive constraint includes at least one connection line in tension that is operatively coupled to the second component and to the housing; and,

the second passive constraint includes at least one connection line in tension that is operatively coupled to the third component and to the housing.

5. The surgical device of claim 1, wherein:

the first control includes a repositionable button selectively coupled to a first reel and a second reel, where the button is repositionable between a locked and an unlocked position, where the locked position retards

20

rotation of the first reel and the second reel, and where the unlocked position allows rotation of the first reel and the second reel;

the first reel is operatively coupled to a first connection line operatively coupled to the first component;

the second reel is operatively coupled to a second connection line operatively coupled to the second component; and,

wherein the first reel is independently repositionable with respect to the second reel.

6. The surgical device of claim 1, wherein:

the second control includes a lever operatively coupled and selectively repositionable with respect to the housing, the lever being operatively coupled to a first connection line operatively coupled to the occlusion clip deployment device so that movement of the lever is operative to reposition at least a portion of the occlusion clip deployment device;

the lever is repositionable between a locked and an unlocked position;

the unlocked position allows the lever to be repositioned; and,

the locked position retards the lever from being repositioned.

7. The surgical device of claim 1, further comprising a third control operatively coupled to the housing, wherein the third control is operatively coupled to a first connection line operatively coupled to the occlusion clip deployment device so that movement of the third control is operative to reposition at least a portion of the first connection line with respect to the occlusion clip deployment device.

8. The surgical device of claim 7, wherein:

the third control includes a plug detachable from the housing; and,

the plug is repositionable from an attached position coupled to the housing to a detached position decoupled from the housing;

repositioning the plug from the attached position to the detached position causes more of the first connection line to be drawn into a distal portion of the housing.

9. The surgical device of claim 8, further comprising an occlusion clip operatively coupled to the clip deployment device using the first connection line.

10. The surgical device of claim 1, wherein the end effector includes a robotic grasping feature to facilitate grasping and repositioning of the end effector by a robotic grasper.

11. A surgical device comprising:

a housing operatively coupled to a first control;

an end effector operatively coupled to the first control, the end effector comprising a dual pivot joint providing a first degree of freedom within a first plane and a second degree of freedom within a second plane, the second plane being non-coplanar with the first plane;

a surgical conduit operatively coupled to and extending between the housing and the end effector;

wherein the end effector includes an occlusion clip deployment device operatively coupled to the dual pivot joint, the occlusion clip deployment device includes an enclosed frame delineating an opening, the enclosed frame sized to circumscribe a left atrial appendage.

12. The surgical device of claim 11, wherein:

the dual pivot joint is operatively coupled to a clevis and a yoke;

the first control includes a first line and a second line extending along the surgical conduit concurrently

21

coupled to the dual pivot joint, the first line impacting movement of the dual pivot joint with respect to the clevis within the first degree of freedom, the second line impacting movement of the dual pivot joint with respect to the clevis within the first degree of freedom; 5 and,

the first control includes a third line and a fourth line extending along the surgical conduit concurrently coupled to the yoke, the third line impacting movement of the yoke with respect to the dual pivot joint within the second degree of freedom, the fourth line impacting movement of the yoke with respect to the dual pivot joint within the second degree of freedom. 10

**13.** The surgical device of claim **12**, wherein:

the first line and the second line are coupled to a first actuator mounted to the housing; 15

the first actuator is repositionable and operative to reposition the first line and the second line in order to create movement between the clevis and dual pivot joint;

the third line and the fourth line are coupled to a second actuator mounted to the housing; 20

the second actuator is repositionable and operative to reposition the third line and the fourth line in order to create movement between the yoke and dual pivot joint. 25

**14.** The surgical device of claim **13**, wherein:

the first actuator comprises a first reel upon which at least a portion of the first line and the second line are wound; the second actuator comprises a second reel upon which at least a portion of the third line and the fourth line are wound; 30

repositioning of the first reel is operative to distally reposition one of the first line and the second line, while repositioning of the first reel is operative to proximally reposition the other of the first line and the second line; 35 repositioning of the second reel is operative to distally reposition one of the third line and the fourth line, while repositioning of the second reel is operative to proximally reposition the other of the third line and the fourth line. 40

**15.** The surgical device of claim **14**, wherein the first control includes a brake that may be selectively applied to the first actuator and the second actuator to retard movement of the dual pivot joint with respect to the clevis within the X-Y plane and movement of the yoke with respect to the dual pivot joint within the Y-Z plane. 45

**16.** The surgical device of claim **14**, wherein:

the brake comprises a spring biased button operatively coupled to a series of teeth; 50

the first reel includes a series of teeth; and  
the second reel includes a series of teeth; and

22

engagement between at least one of the series of teeth operatively coupled to the spring biased button and at least one of the series of teeth of the first reel and at least one of the series of teeth of the second reel is operative to retard movement of the dual pivot joint with respect to the clevis within the X-Y plane and movement of the yoke with respect to the dual pivot joint within the Y-Z plane.

**17.** The surgical device of claim **11**, further comprising a second control operatively coupled to the housing, wherein the second control includes a clip repositioning line extending along the surgical conduit, the clip repositioning line impacting movement of the occlusion clip deployment device between a first position and a second position.

**18.** The surgical device of claim **17**, wherein:

the second control includes a lever operatively coupled and selectively repositionable with respect to the housing, the lever being operatively coupled to the clip repositioning line so that movement of the lever is operative to reposition the occlusion clip deployment device;

the lever is repositionable between a locked and an unlocked position;

the unlocked position allows the lever to be repositioned; and,

the locked position retards the lever from being repositioned.

**19.** The surgical device of claim **11**, further comprising a deployment control operatively coupled to the housing, the deployment control including a deployment line extending along the surgical conduit and concurrently mounted to a deployment plug removably fastened to the housing.

**20.** The surgical device of claim **19**, further comprising an occlusion clip operatively coupled to the occlusion clip deployment device using the deployment line.

**21.** The surgical device of claim **20**, wherein:

the occlusion clip includes a first jaw opposing a second jaw;

a first retainer loop at least partially circumscribes the first jaw, at least a portion of the occlusion clip deployment device, and at least a portion of the deployment line;

a second retainer loop at least partially circumscribes the second jaw, at least a portion of the occlusion clip deployment device, and at least a portion of the deployment line.

**22.** The surgical device of claim **11**, wherein the end effector includes a robotic grasping feature to facilitate grasping and repositioning of the end effector by a robotic grasper.

\* \* \* \* \*

专利名称(译)	剪辑部署工具和相关方法		
公开(公告)号	<a href="#">US10238398</a>	公开(公告)日	2019-03-26
申请号	US15/014314	申请日	2016-02-03
[标]申请(专利权)人(译)	阿特瑞克尔公司		
申请(专利权)人(译)	ATRICURE INC.		
当前申请(专利权)人(译)	ATRICURE INC.		
[标]发明人	HUGHETT SR JAMES DAVID MARTIN KEITH EDWARD MILLER KENNETH LANCE DOLGIN MICHAEL		
发明人	HUGHETT, SR., JAMES DAVID MARTIN, KEITH EDWARD MILLER, KENNETH LANCE DOLGIN, MICHAEL		
IPC分类号	A61B17/128 A61B17/122 A61B17/00 A61B17/29		
CPC分类号	A61B17/1285 A61B17/1227 A61B2017/2946 A61B2017/00867 A61B2017/00584		
其他公开文献	US20160151072A1		
外部链接	<a href="#">Espacenet</a>		

#### 摘要(译)

一种腹腔镜装置，包括：(a)可操作地连接到第一控制器和第二控制器的壳体；(b)可操作地连接到第一控制器的末端执行器，末端执行器包括第一部件和第二部件，第一部件和第二部件可在XY平面内相对于彼此选择性地重新定位，末端执行器还包括相对于第一部件可选择地重新定位的第三部件。YZ平面内的第二个分量；(c)在外壳和末端执行器之间延伸的腹腔镜导管；(d)可操作地连接到末端执行器和第二控制器的闭塞夹子展开装置。

