



US007749241B2

(12) **United States Patent**
Hermann et al.

(10) **Patent No.:** **US 7,749,241 B2**
(45) **Date of Patent:** **Jul. 6, 2010**

(54) **BALLOON DISSECTING INSTRUMENTS**

(75) Inventors: **George D. Hermann**, Portola Valley, CA
(US); **Fred H. Co**, Santa Clara, CA
(US); **Douglas S. Sutton**, Pacifica, CA
(US)

(73) Assignee: **General Surgical Innovations, Inc.**,
Mansfield, MA (US)

(*) Notice: Subject to any disclaimer, the term of this
patent is extended or adjusted under 35
U.S.C. 154(b) by 1185 days.

(21) Appl. No.: **11/262,830**

(22) Filed: **Oct. 31, 2005**

(65) **Prior Publication Data**

US 2006/0058830 A1 Mar. 16, 2006

Related U.S. Application Data

(60) Division of application No. 10/448,937, filed on May 30, 2003, now Pat. No. 7,037,317, which is a continuation of application No. 09/385,125, filed on Aug. 27, 1999, now Pat. No. 6,596,010, which is a continuation-in-part of application No. 08/963,132, filed on Oct. 28, 1997, now Pat. No. 6,004,340, which is a continuation of application No. 08/815,398, filed on Mar. 10, 1997, now abandoned, which is a continuation-in-part of application No. 08/688,044, filed on Jul. 29, 1996, now abandoned, which is a continuation-in-part of application No. 08/447,124, filed on May 22, 1995, now Pat. No. 5,702,417, application No. 11/262,830, which is a continuation-in-part of application No. 08/926,796, filed on Sep. 10, 1997, now Pat. No. 5,993,472, which is a continuation-in-part of application No. 08/688,044, filed on Jul. 29, 1996, now abandoned, which is a continuation-in-part of application No. 08/447,124, filed on May 22, 1995, now Pat. No. 5,702,417.

(51) **Int. Cl.**
A61B 17/00 (2006.01)

(52) **U.S. Cl.** **606/190**

(58) **Field of Classification Search** 606/190-198,
606/201, 1; 604/96.01, 97.01, 103.05
See application file for complete search history.

(56) **References Cited**

U.S. PATENT DOCUMENTS

3,259,132 A 7/1966 Katter

(Continued)

FOREIGN PATENT DOCUMENTS

DE 526 423 6/1931

(Continued)

OTHER PUBLICATIONS

European Search Report for EP 98942353.8-1526 date of completion is Mar. 21, 2007 (3 pgs).

(Continued)

* cited by examiner

Primary Examiner—Kevin T Truong

(57) **ABSTRACT**

Balloon loaded dissection devices and methods for using such devices are disclosed. The devices include an elongate balloon and may be provided with a central lumen. The device may have a guide tube to provide columnar support. In a further aspect, the guide tube may have a spoon-shaped shroud attached to a distal end. The guide tube receives the guide rod, scope or other surgical instrument and may have a stop member. By using the guide rod or scope as a pushing member, the device may be advanced alongside the vessel it is desired to dissect free from attached tissue. A balloon cover may be provided to surround the balloon and facilitate compression of the balloon after it is deflated. In an additional feature, the guide rod and/or tubular member are plastically bendable into a curved shape such that the balloon dissector may be adjusted.

19 Claims, 14 Drawing Sheets

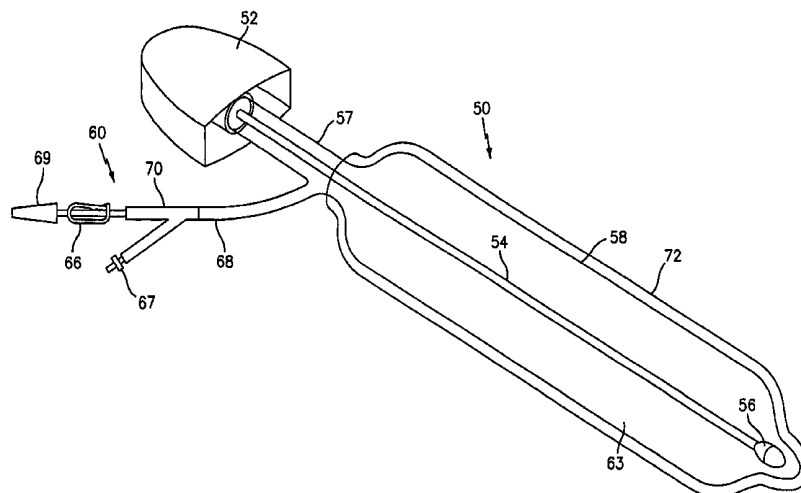

U.S. PATENT DOCUMENTS

4,312,353 A 1/1982 Shahbadian
 4,493,711 A 1/1985 Chin et al.
 4,702,252 A 10/1987 Brooks et al.
 4,779,611 A 10/1988 Grooters et al.
 4,832,691 A 5/1989 Witzel
 4,932,959 A 6/1990 Hortzewski et al.
 5,032,113 A 7/1991 Burns
 5,183,463 A 2/1993 Debbas
 5,188,630 A 2/1993 Christoudias
 5,197,971 A 3/1993 Bonutti
 5,226,880 A 7/1993 Martin
 5,269,753 A 12/1993 Wilk
 5,307,814 A 5/1994 Kressel et al.
 5,331,975 A 7/1994 Bonutti
 5,346,504 A 9/1994 Ortiz et al.
 5,359,995 A 11/1994 Sewell, Jr.
 5,373,840 A 12/1994 Knighton
 5,383,889 A 1/1995 Warner et al.
 5,391,178 A 2/1995 Yapor
 5,425,357 A 6/1995 Moll et al.
 5,454,365 A 10/1995 Bonutti
 5,458,639 A 10/1995 Tsukashima et al.
 5,496,276 A 3/1996 Wang et al.
 5,496,345 A 3/1996 Kieturakis et al.
 5,514,153 A 5/1996 Bonutti
 5,522,788 A 6/1996 Kuzmak
 5,540,711 A * 7/1996 Kieturakis et al. 606/190

5,601,589 A 2/1997 Fogarty et al.
 5,634,935 A 6/1997 Taheri
 5,667,479 A 9/1997 Kieturakis
 5,667,480 A 9/1997 Knight et al.
 5,667,520 A 9/1997 Bonutti
 5,722,934 A 3/1998 Knight et al.
 5,730,748 A 3/1998 Fogarty et al.
 5,762,604 A 6/1998 Kieturakis
 5,772,680 A * 6/1998 Kieturakis et al. 606/190
 5,797,947 A 8/1998 Mollenauer
 5,800,394 A 9/1998 Yoon et al.
 5,814,060 A 9/1998 Fogarty et al.
 5,843,116 A 12/1998 Crocker et al.
 5,868,775 A 2/1999 Bircoll
 6,015,421 A 1/2000 Echeverry et al.

FOREIGN PATENT DOCUMENTS

EP 0 492 361 7/1992
 EP 0 630 659 12/1994
 EP 0 769 270 A1 4/1997
 WO WO 98/40117 A 9/1998
 WO WO 99/12602 3/1999

OTHER PUBLICATIONS

Supplementary European Search Report for EP 99971686.3-
 1526 date of completion is Jun. 13, 2007 (3 pages).
 European Search Report for corresponding EP 09000061
 date of mailing is Mar. 3, 2010 (3 pages).

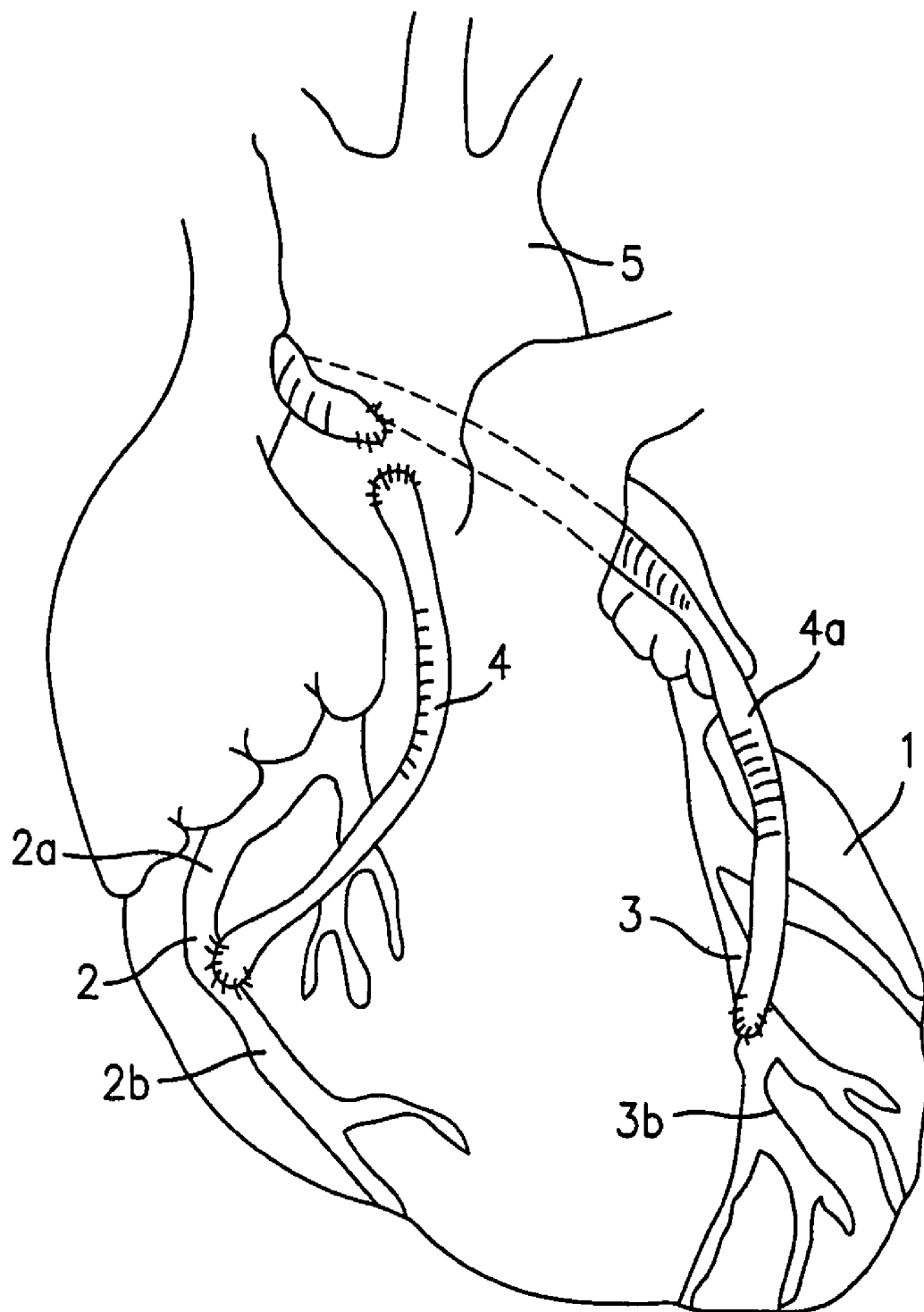

FIG. 1

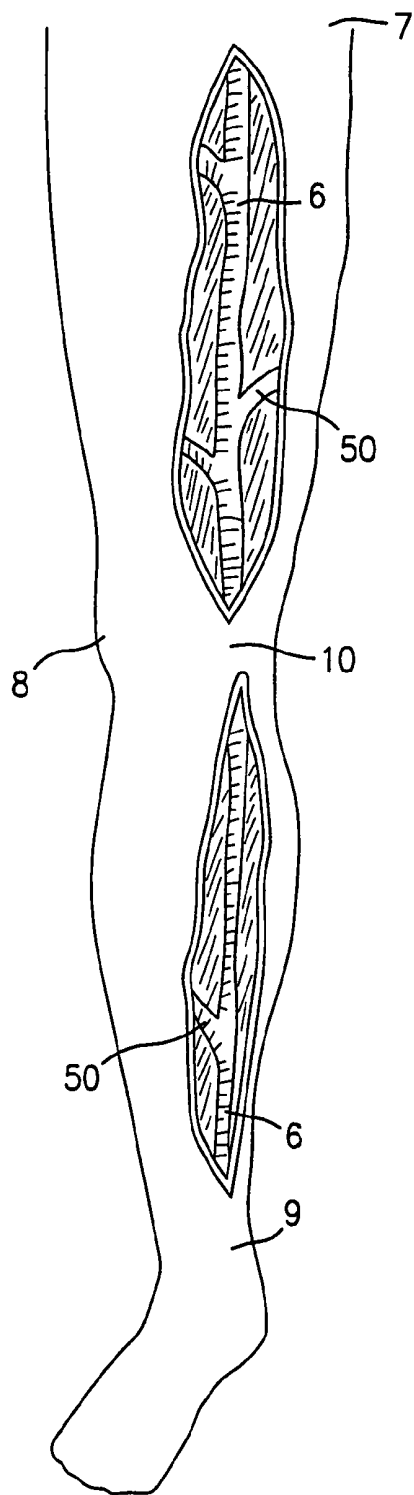

FIG. 2

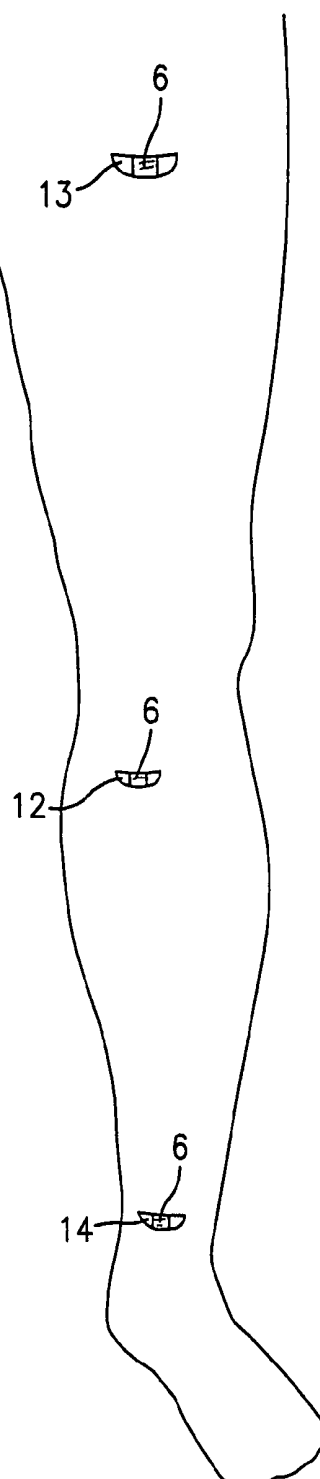

FIG. 3

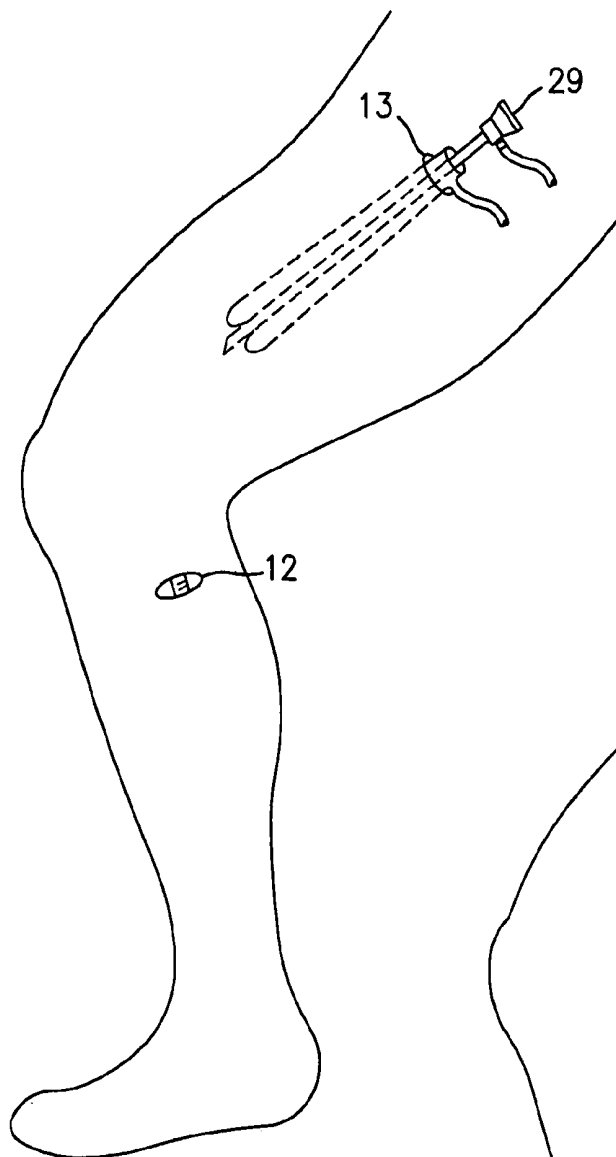

FIG. 3a

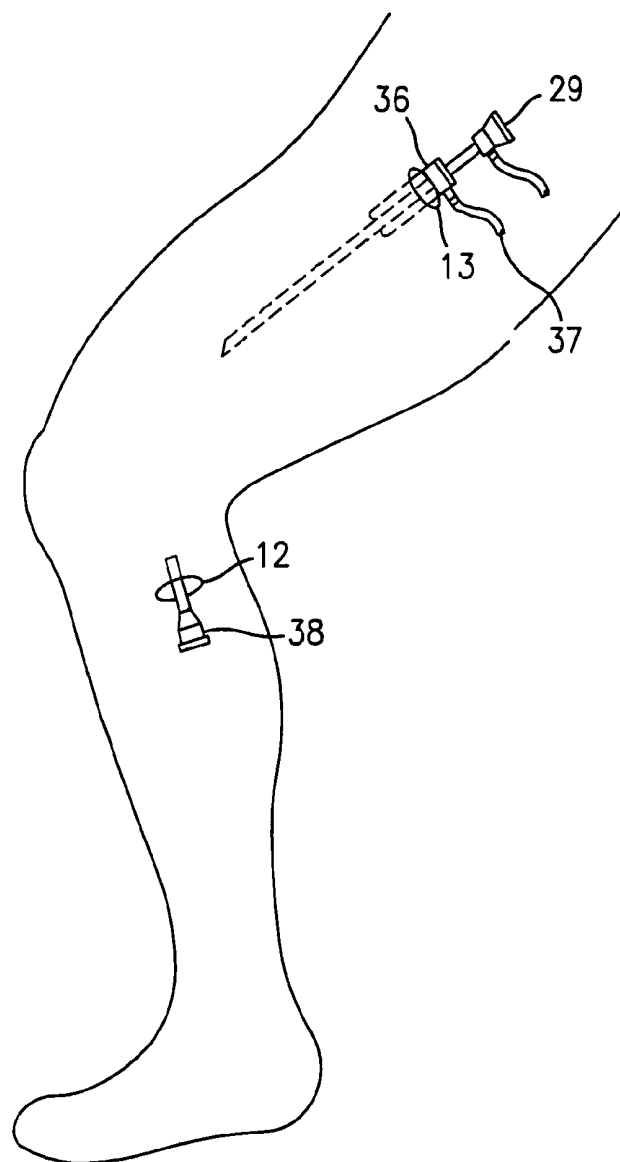

FIG. 3b

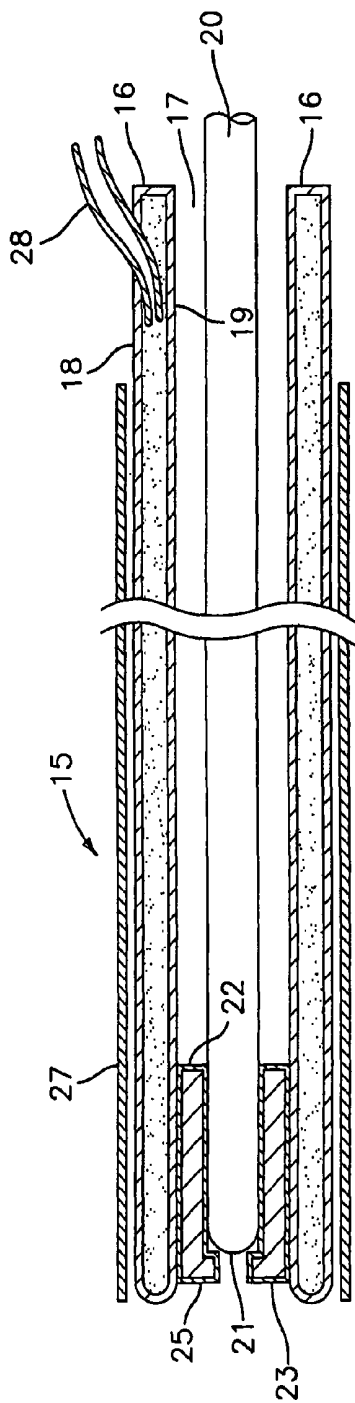

FIG. 4

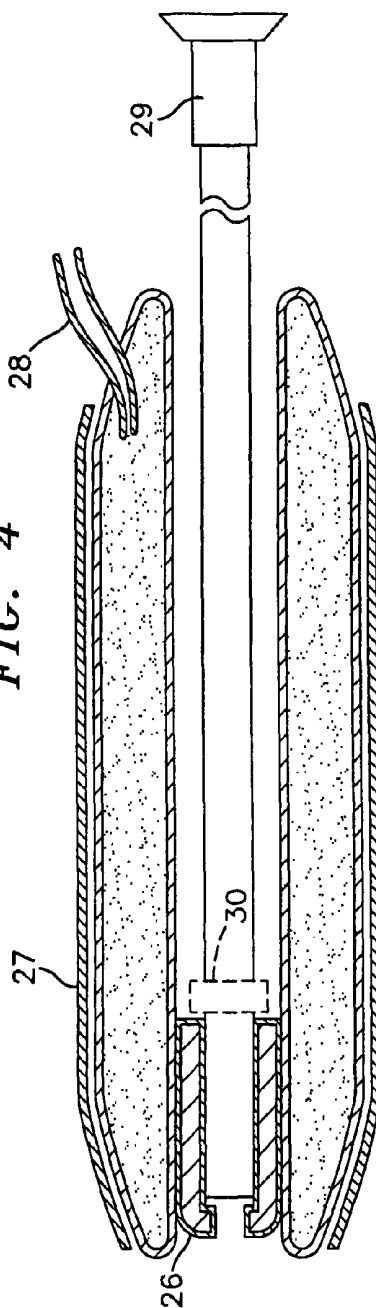

FIG. 5

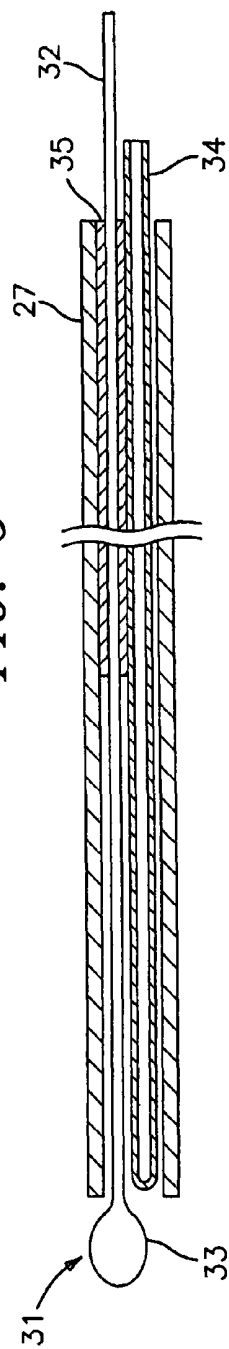

FIG. 6

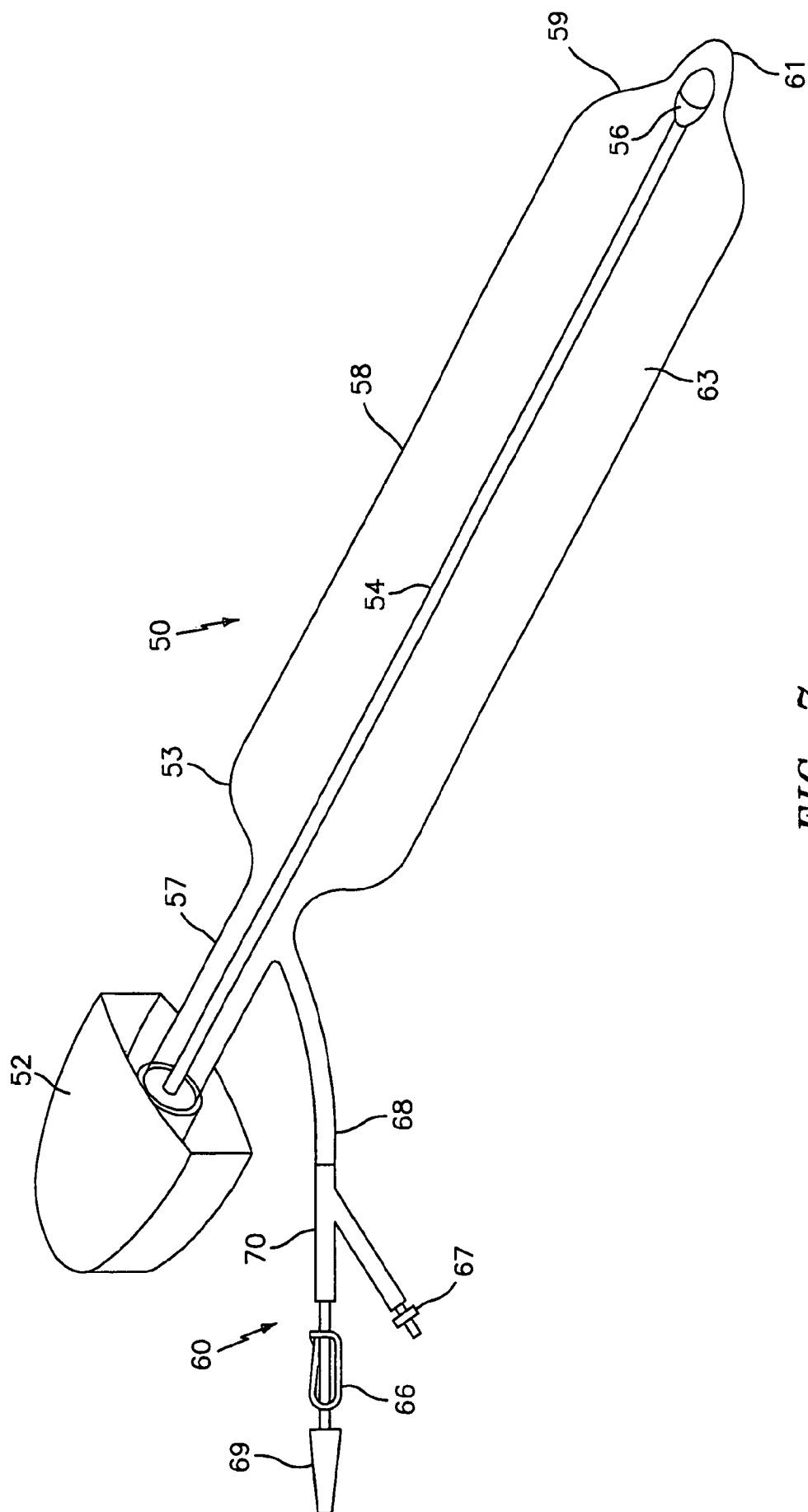

FIG. 7

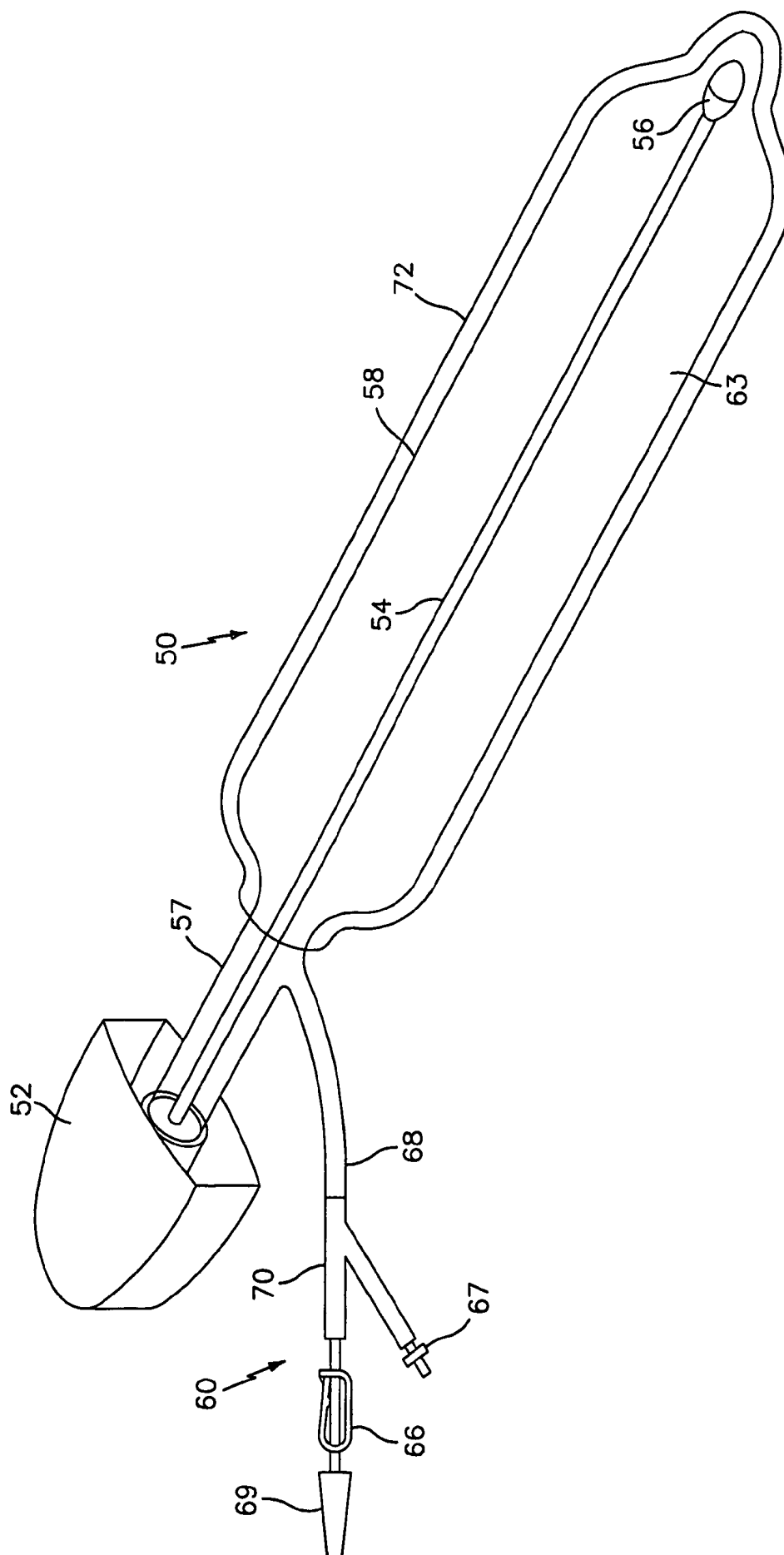

FIG. 8

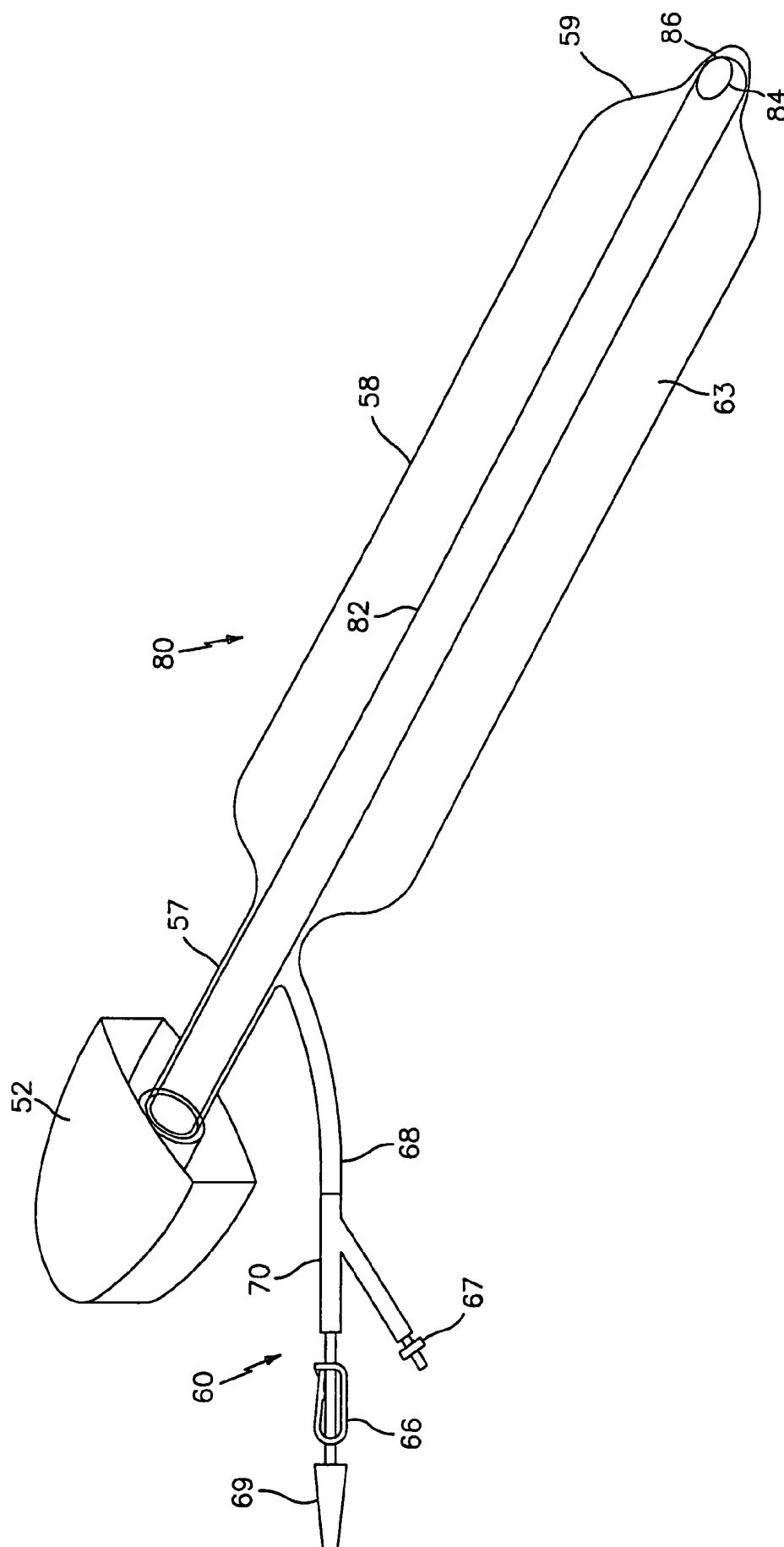

FIG. 9

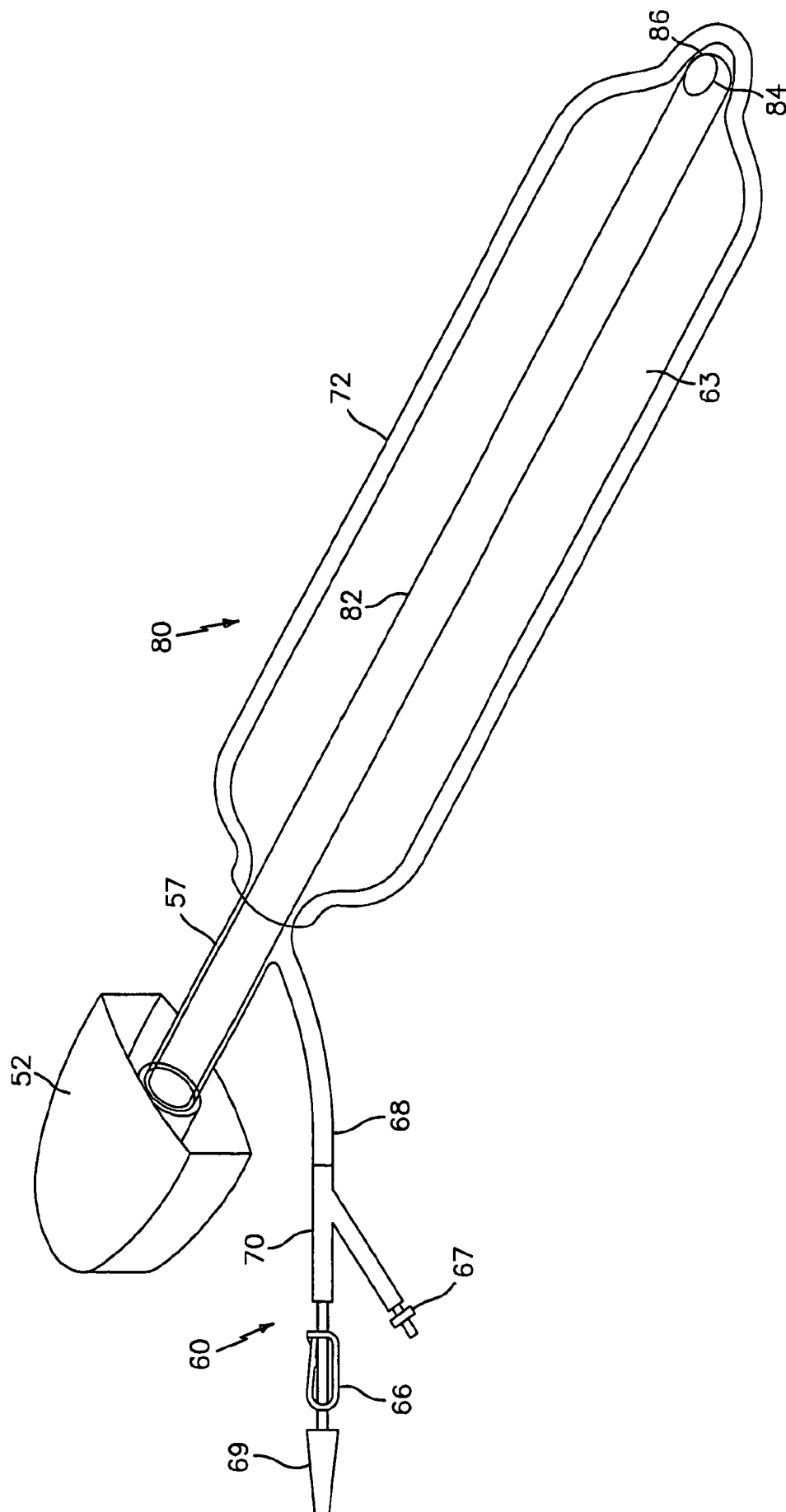

FIG. 10

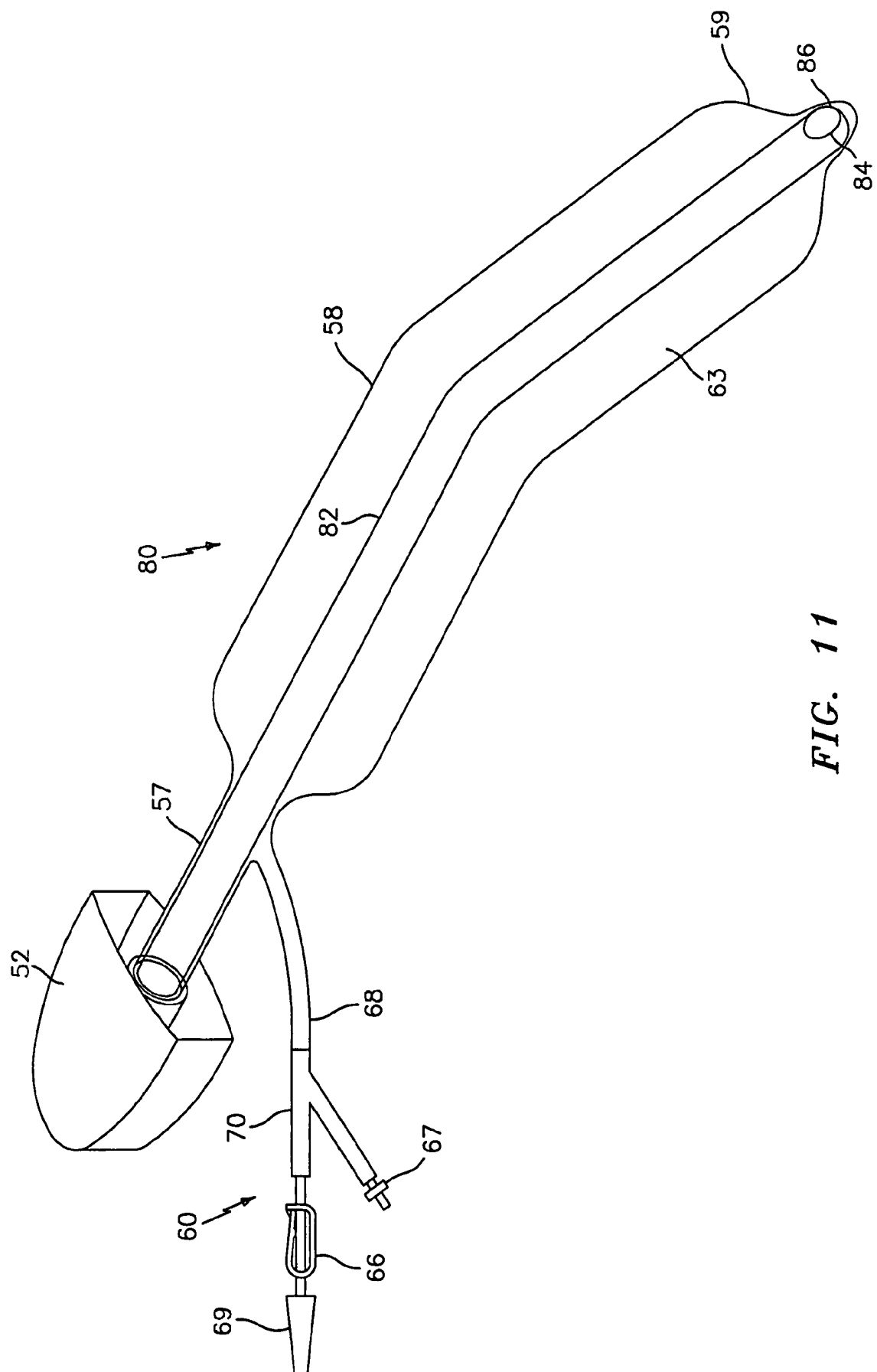

FIG. 11

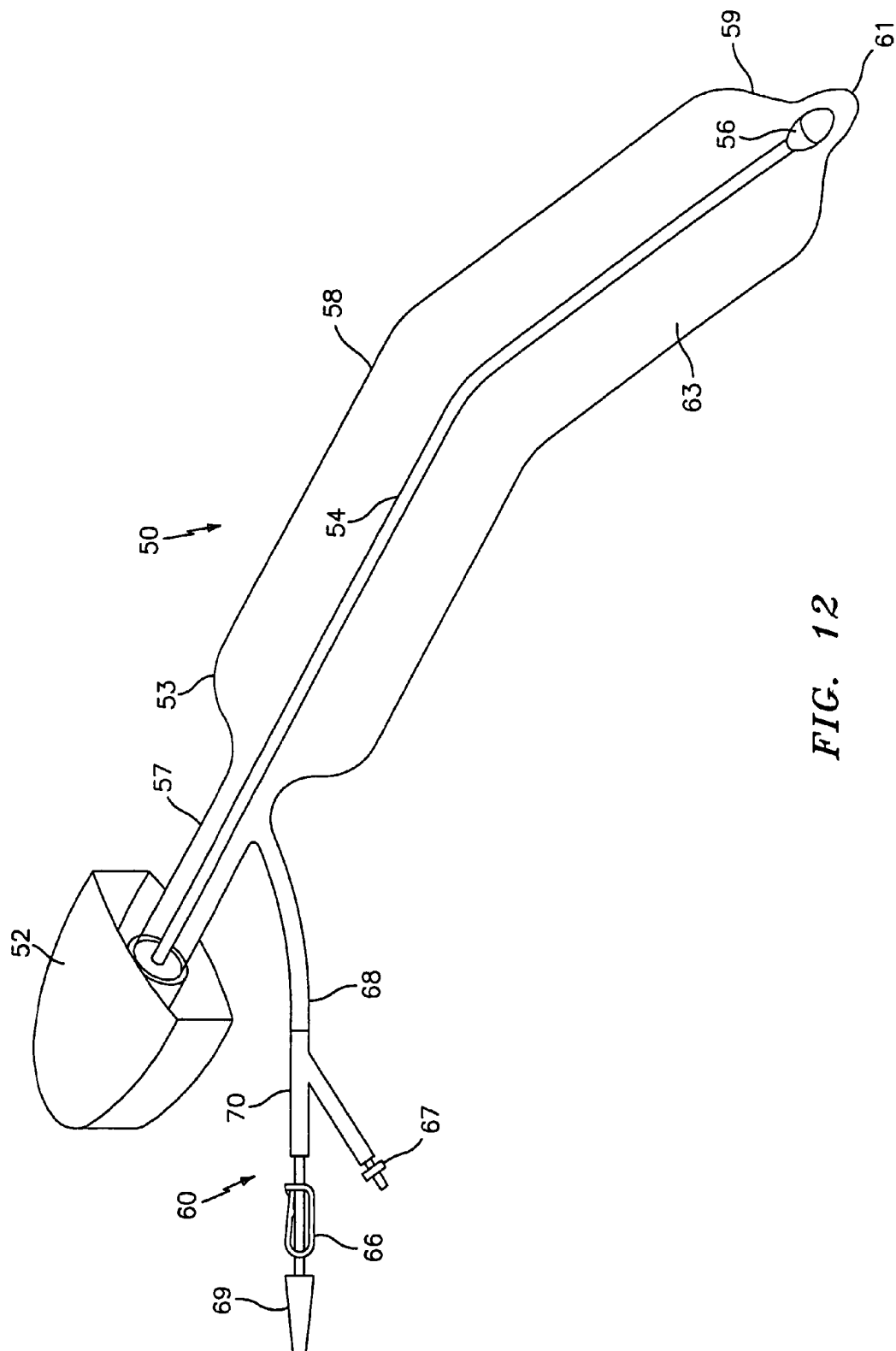

FIG. 12

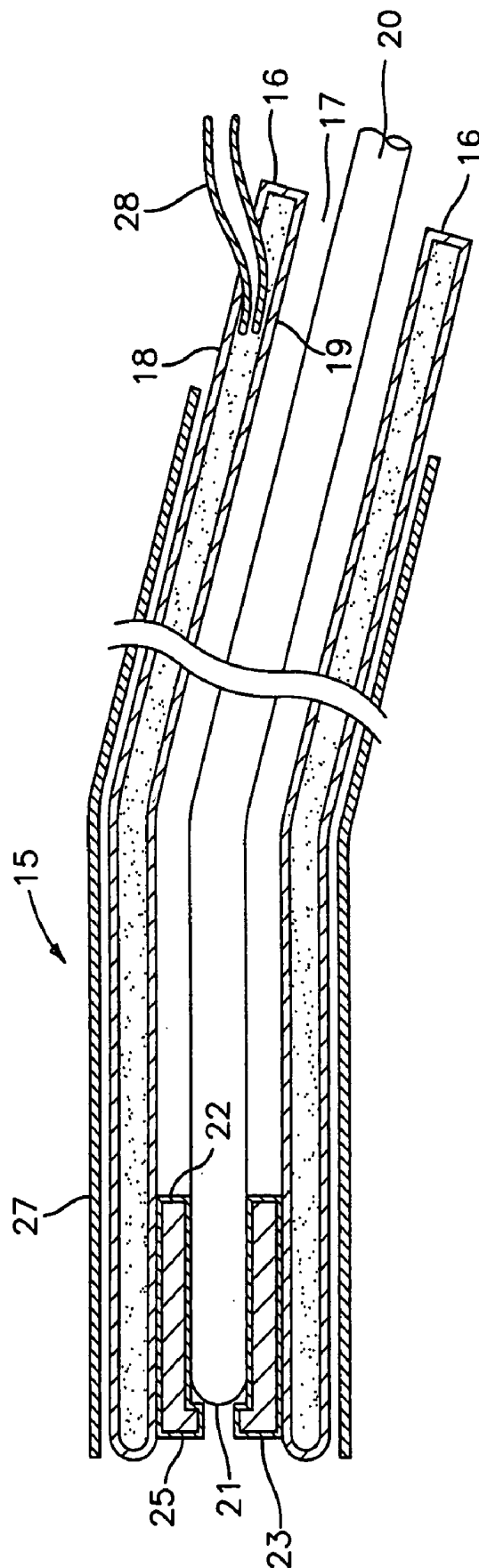

FIG. 13

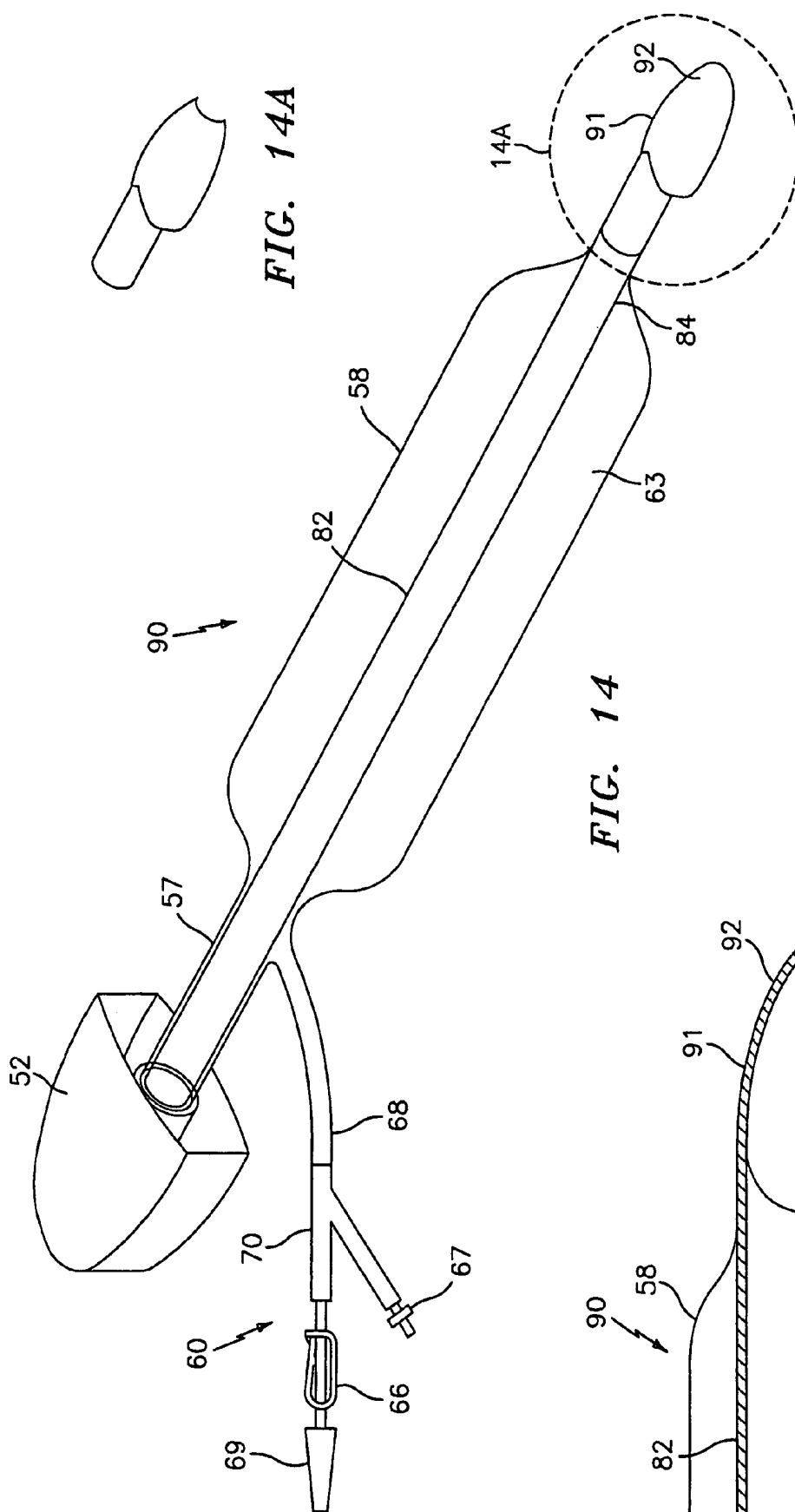
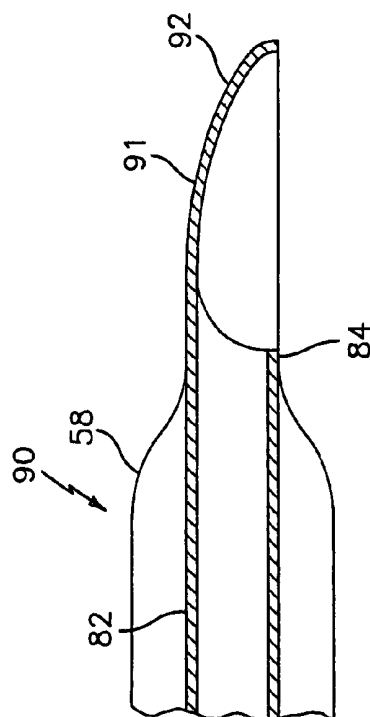

FIG. 14



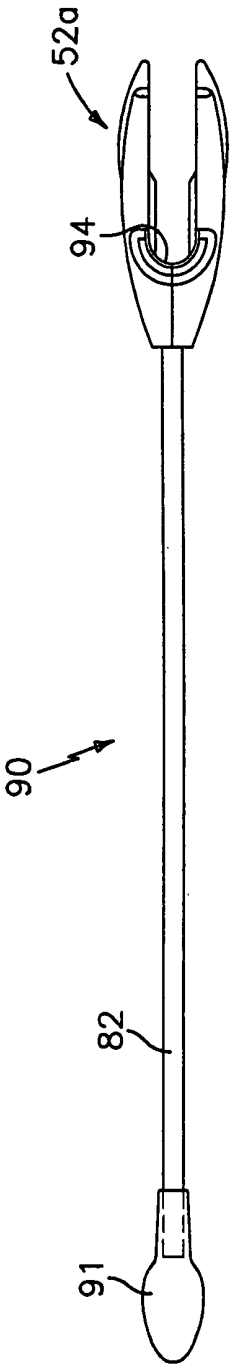

FIG. 16

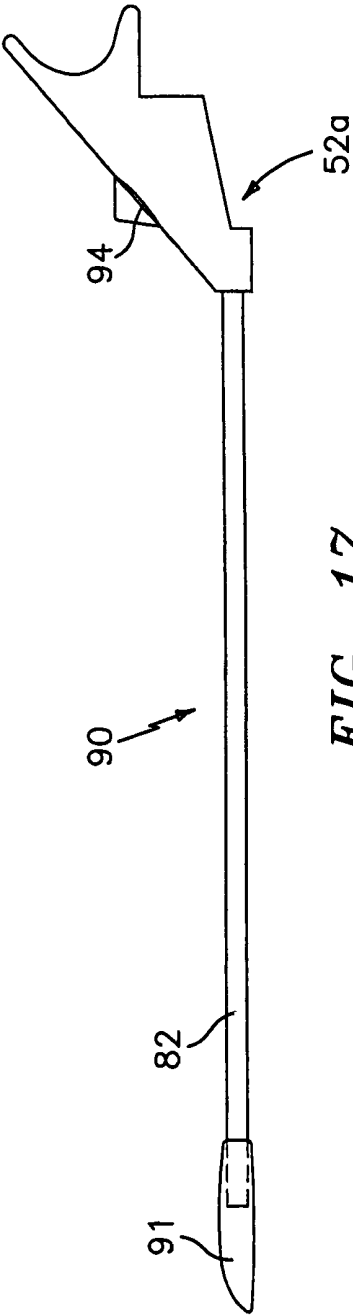

FIG. 17

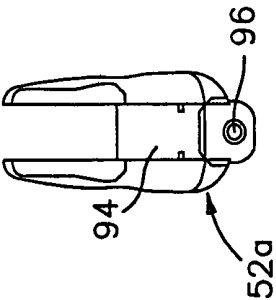
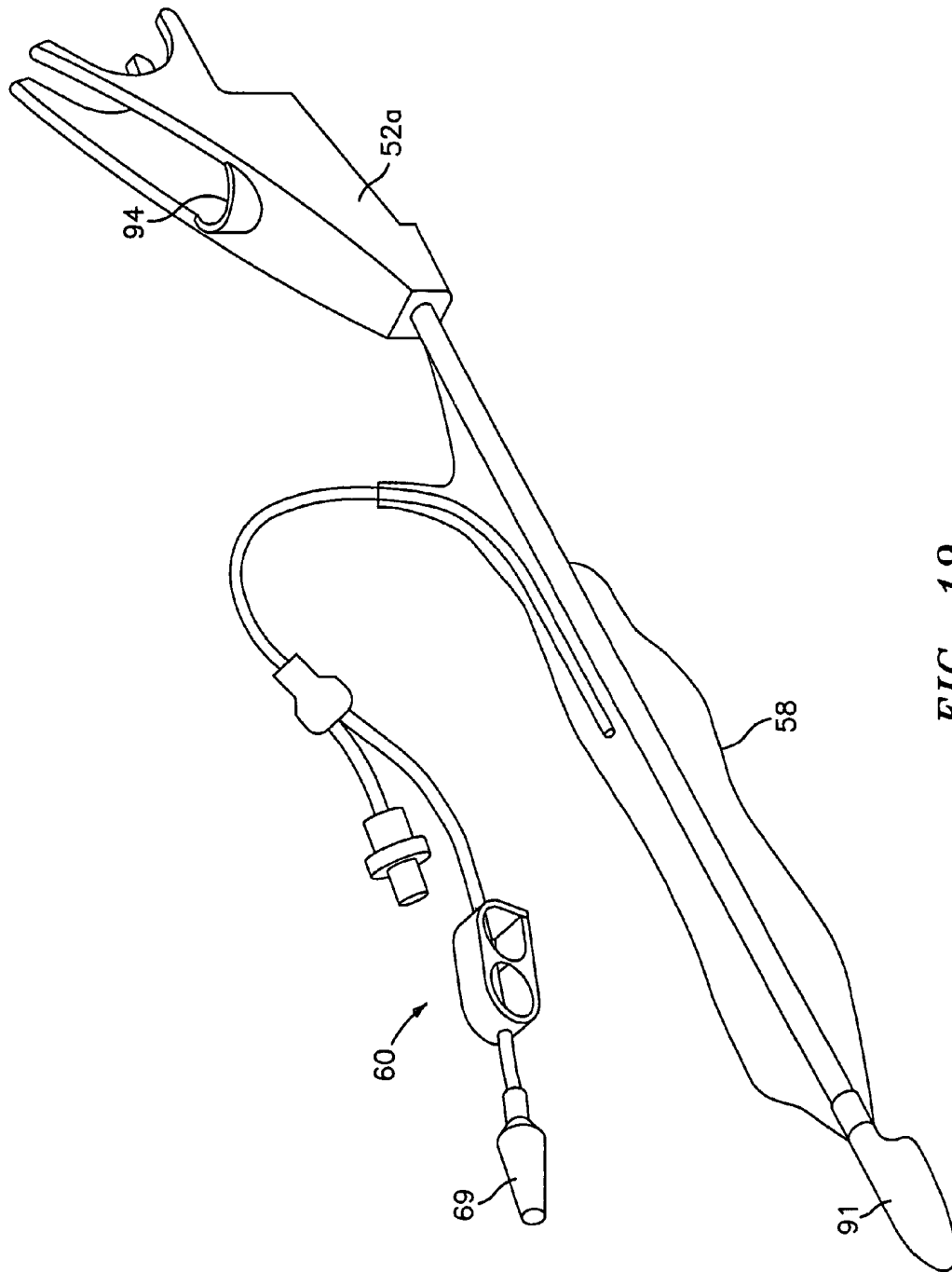

FIG. 18



BALLOON DISSECTING INSTRUMENTS**CROSS REFERENCE TO RELATED APPLICATIONS**

This is a divisional of U.S. application of Ser. No. 10/448, 937 filed May 30, 2003 now U.S. Pat. No. 7,037,317, which is a continuation of U.S. application Ser. No. 09/385,125 filed Aug. 27, 1999 now U.S. Pat. No. 6,569,010, which is a continuation-in-part of U.S. application Ser. No. 08/963,132, filed on Oct. 28, 1997 now U.S. Pat. No. 6,004,340, which is a continuation of U.S. application Ser. No. 08/815,398, filed Mar. 10, 1997, now abandoned, which is a continuation-in-part of U.S. application Ser. No. 08/688,044, filed on Jul. 29, 1996 now abandoned, which is a continuation-in-part of U.S. application Ser. No. 08/447,124, filed on May 22, 1995 now U.S. Pat. No. 5,702,417. This application also a continuation-in-part of U.S. application Ser. No. 08/926,796, filed Sep. 10, 1997 now U.S. Pat. No. 5,993,472, file wrapped as U.S. application Ser. No. 08/960,793, filed on Oct. 30, 1997, which is a continuation-in-part of U.S. application Ser. No. 08/688,044, filed on Jul. 29, 1996 now abandoned, which is a continuation-in-part of U.S. application Ser. No. 08/477,124, filed on May 22, 1995 now U.S. Pat. No. 5,702,417. The priority of these prior applications are expressly claimed and their disclosures are hereby incorporated by reference in their entirety.

FIELD OF THE INVENTION

This invention relates to methods and devices for endoscopic vascular surgery, in particular to methods and devices for dissecting tissue to create a working space adjacent a blood vessel.

BACKGROUND OF THE INVENTION

Numerous surgical procedures have been developed to replace arteries that have become blocked by disease. The aortocoronary bypass surgery is perhaps the most important of these bypass operations. The coronary arteries supply blood to the heart. As a result of aging and disease, coronary arteries may become blocked by plaque deposits, stenosis, or cholesterol. In some instances, these blockages can be treated with atherectomy, angioplasty or stent placement, and coronary bypass surgery is not required. Coronary bypass surgery is required when these other methods of treatment cannot be used or have failed to clear the blocked artery. In coronary bypass surgery, a vein is harvested from elsewhere in the body and grafted into place between the aorta and the coronary artery below the point of blockage. An illustration of this surgery is shown in FIG. 1, which shows the heart 1 and the right anterior coronary artery 2 and the left anterior coronary artery 3 which supply blood to the heart. The right anterior coronary artery 2 is blocked in its proximal segment at 2a, as shown. This blockage has been bypassed by grafting a segment of vein 4 between the aorta 5 and the distal segment 2b of the right anterior coronary artery 2. Similarly, the left anterior coronary artery 3 may be blocked, and may require bypass with a length of vein 4a between the aorta and the distal segment 3b of the left anterior artery. The operation requires access to the heart, which means that the chest cavity must be opened completely.

The coronary bypass surgery requires a length of vein or artery for the graft. It is preferred to use a vein taken from the patient undergoing the bypass surgery. The patient is a ready source of suitable veins that will not be rejected by the body

after transplantation and grafting onto the aorta and coronary artery. The saphenous vein in the leg is the best substitute for small arteries such as the coronary arteries, and it is the preferred vein for use in coronary bypass surgery. This is because the saphenous vein is typically 3 to 5 mm in diameter, about the same size as the coronary arteries. Also, the venous system of the legs is sufficiently redundant so that after removal of the saphenous vein, other veins that remain in the leg are adequate to provide return blood flow. The cephalic vein in the arm is an alternative that is sometimes used.

A typical operation previously required to harvest the saphenous vein is illustrated in FIG. 2. The surgeon cuts into the leg to allow access to the saphenous vein and cuts the vein from the leg. To expose the saphenous vein 6, the surgeon makes a series of incisions from the groin 7 to the knee 8 or the ankle 9, leaving a one or more skin bridges 10 along the line of the incisions. Some surgeons make one continuous incision from the groin to the knee or ankle. Handling of the vein must be kept to a minimum, but the vein must be dissected free from connective tissue. After exposing the vein, the surgeon grasps it with his fingers while stripping off the surrounding tissues with dissecting scissors or other scraping instruments. The surgeon uses his fingers and blunt dissection tools to pull and lift (or mobilize) the vein from the surrounding tissue. The vein is mobilized or pulled as far as possible through each incision. To reach under the skin bridges, the surgeon lifts the skin with retractors and digs the vein free. While stripping the vein, the surgeon will encounter the various tributary veins that feed into the saphenous vein. These tributaries must be ligated and divide. To divide and ligate tributaries that lie under the skin bridges, the surgeon may need to cut one end of the saphenous vein and pull it under the skin bridge to gently pull the vein out from under the skin bridge until the tributary is sufficiently exposed so that it may be ligated and divided. When the vein has been completely mobilized, the surgeon cuts the proximal and distal ends of the vein and removes the vein from the leg. After removal, the vein is prepared for implantation into the graft site, and the long incisions made in the leg are stitched closed.

The procedure described above can be used to harvest veins for a femoral popliteal bypass, in which an occluded femoral artery is bypassed from above the occlusion to the popliteal artery near the level of the knee. The procedure can also be used to harvest veins for the revascularization of the superior mesenteric artery which supplies blood to the abdominal cavity and intestines. In this case, the harvested vein is inserted between the aorta to the distal and patent (unblocked) section of the mesenteric artery. For bypass grafts of the lower popliteal branches in the calf, the procedure can be used to harvest the umbilical vein. The harvested vein can also be used for a vein loop in the arm (for dialysis) between the cephalic vein and brachial artery.

As can be seen from the description above, the vein harvesting operation is very traumatic in its own right. In the case of coronary artery bypass, this operation is carried out immediately before the open chest operation required to graft the harvested vein into the coronary arteries. The vein harvesting operation is often the most troublesome part of the operation. The long incisions created in the leg can be slow to heal and very painful. Complications resulting from the vein harvesting operation can also hinder the patient's recovery from the entire operation.

The method of vein harvesting presented herein is accomplished with laparoscopic procedures. This allows the veins to be harvested in an operation that requires only a few small incisions. Endoscopic surgical techniques for operations such as gall bladder removal and hernia repair are now common.

The surgeon performing the operation makes a few small incisions and inserts long tools, including forceps, scissors, and staplers, into the incision and deep into the body. Viewing the tools through a laparoscope or a video display from the laparoscope, the surgeon can perform a wide variety of maneuvers, including cutting and suturing operations, necessary for a wide variety of surgical procedures and operations.

Minimally invasive procedures for vein removal have been proposed. U.S. Pat. No. 5,373,840 to Knighton, entitled, "Endoscope and Method for Vein Removal," shows a method of cutting the saphenous vein at one end, and grasping the vein with graspers or forceps, then sliding a ring over the vein while holding it. Knighton uses a dissecting tool with an annular cutting ring, and requires that the saphenous vein be overrun or progressively surrounded with the dissecting tool and the endoscope, so that after the endoscope has been inserted as far as it will go, the entire dissected portion of the vein has been pulled into the lumen of the endoscope. As shown in FIGS. 1 and 10 of Knighton, the method requires deployment of forceps inside the annular dissection loop, and it requires deployment of the loop and graspers inside the endoscope lumen. The blood vessel must be cut and grasped by the forceps before it can be dissected by the dissecting ring.

SUMMARY OF THE INVENTION

The methods and devices disclosed herein allow surgeons to harvest veins, or dissect along other elongate structures without making long incisions through the skin to access the structure as previously required. The present devices permit minimally invasive procedures which, in the case of a saphenous vein harvest, require just two small incisions, one at either end of the saphenous vein, to be performed. The procedure is accomplished with laparoscopic instruments under the guidance of a laparoscope.

In a first preferred embodiment, a blunt loaded balloon dissector has an elongate balloon of any suitable length which may be formed of an elastic or non-elastic material. The balloon may be of double walled construction and may be provided with a central lumen which may receive a guide rod, scope or other surgical instrument. The device may have a support tube secured to the inner wall of the balloon to provide columnar support for the apparatus.

The guide rod and/or support tube are normally straight and must have sufficient rigidity to bluntly dissect while tunneling between connected tissue layers. In a further aspect of the present invention, the guide rod and/or support tube, while being rigid enough to bluntly dissect, are also plastically bendable into curved shapes when subjected to bending moments substantially greater than the bending moments encountered when dissecting between tissue layers. The guide rod and/or support tube permanently retain the curved shape under the forces and conditions of blunt dissection. The support tube receives the guide rod, scope or other surgical instrument and may have a stop member to translate pushing force applied to the guide rod or scope to pushing force on the apparatus. By using the guide rod or scope as a pushing member the apparatus may be advanced alongside the vessel it is desired to dissect free from attached tissue. A balloon cover which may be elastic or resilient is provided to surround the balloon and facilitate compression of the balloon after it is deflated.

In another embodiment of the invention, another pushable balloon dissection device is provided which also may utilize an elongate balloon. The balloon in this embodiment may have a central lumen to receive a scope or other laparoscopic instrument. The apparatus has a guide tube which receives a

guide rod with a slender metal rod and enlarged tip. The guide rod is utilized as a pushing member. A resilient balloon cover may also be provided in this embodiment to compress the balloon upon deflation.

In yet another preferred embodiment of the invention, a pushable balloon dissection apparatus may have an elongate balloon disposed over an elongate shaft or tubular member such that the shaft or tubular member resides within the interior space of the balloon. The balloon dissector may be advanced between the tissue planes it is desired to dissect and then inflated to create a tunnel alongside a vessel or other elongate structure. The balloon may then be serially deflated, further advanced and reinflated to enlarge the tunnel. When the apparatus is provided with a tubular member, a laparoscope may be inserted into the bore of the tubular member and utilized as a pushing member to advance the apparatus and to provide observation of the procedure. A resilient balloon cover may also be utilized in this embodiment to assist in deflating and compressing the balloon to facilitate redeployment of the apparatus.

In another aspect of the invention, a preferably transparent, or translucent, shroud may be attached to the distal end of the tubular member. The shroud extends beyond the distal end of the tubular member. A distal section of the shroud covers the opening of the tubular member such that there is an open space between the distal end of the tubular member and the distal section of the shroud. The shroud may have a generally spoon-shaped form. The shroud can be used to perform blunt dissection and/or retraction to create an open space for viewing or for performing surgical procedures. A resilient balloon cover may also be used with the tubular member having a shroud to compress the balloon upon deflation.

In still another aspect of the present invention, the dissector may have an ergonomic handle at its proximal end. The handle is designed to fit comfortably in one hand of a surgeon and to provide the surgeon greater control of the dissector during insertion and placement. The ergonomic handle may be adapted to receive and to provide supplementary support for a scope instrument, and can also hold a light source for the scope instrument.

The method of vein harvesting disclosed herein utilizes an elongate tubular balloon to dissect a tunnel alongside the vein to be harvested. The elongate balloon may be wrapped around a guide rod or endoscope and inserted through a small incision in the leg and pushed along the vein to create a small tunnel over the vein. The elongate balloon may be provided with a balloon cover which may be a separate removable cover or attached to the balloon. When the balloon is in place adjacent the vein to be dissected, the removable balloon cover (if provided) may be removed and the balloon inflated to enlarge the tunnel and create a working space for insertion of endoscopic instruments. The guide rod or endoscope may be removed to allow other endoscopic instruments to be passed into the tunnel through the balloon.

In a preferred method of harvesting the saphenous vein, the surgeon makes one small incision at each end of the saphenous vein. After making the incisions, the surgeon inserts a tunneling instrument or blunt dissector which carries a long balloon into one incision and advances or pushes the dissector along the saphenous vein to make a small tunnel along the saphenous vein. The surgeon then inflates the long balloon to enlarge the tunnel. When the tunnel is enlarged to an appropriate size, the surgeon removes the balloon and seals the tunnel at both ends. The surgeon may then injects carbon dioxide into the tunnel at sufficient pressure (typically 5-15 mm Hg) to inflate the tunnel and create room for laparoscopic instruments. The surgeon then inserts a laparoscope through

5

the seal to provide a view of the procedure, and inserts a laparoscopic vein harvesting device, such as one of the hooked vein harvesting devices disclosed in copending U.S. application Ser. No. 08/444,424 entitled, "Methods and devices for Blood Vessel Harvesting," into the leg to dissect the connective tissue from the vein, identify side branches, and remove the vein from the leg. The disclosure of the aforementioned application Ser. No. 08/444,424 is hereby incorporated by reference in its entirety. After the vein is loosened or dissected free from its channel in the leg, the surgeon can cut the proximal and distal ends of the vein and easily pull the vein from the leg. The small skin incisions are then stitched so that they may heal. The small incisions heal much more readily, with fewer complications and far less pain, than the open procedures now in use.

BRIEF DESCRIPTION OF THE DRAWINGS

FIG. 1 is a front view of the heart showing a vein grafted from the aorta to the right anterior coronary artery, bypassing the proximal segment of the right anterior coronary artery.

FIG. 2 is a view of the leg showing the incisions necessary for harvesting the saphenous vein using a traditional open procedure.

FIGS. 3, 3a and 3b are views of the leg showing the incisions necessary for harvesting the saphenous vein according to the methods presented herein.

FIG. 4 shows a balloon dissector according to the invention uninflated and ready for insertion.

FIG. 5 shows a balloon dissector according to the invention in its inflated state.

FIG. 6 is a cross-section of an alternate embodiment of a balloon dissector according to the invention in its uninflated state.

FIG. 7 is an isometric view of a balloon dissector according to the invention, illustrating the balloon dissector in its expanded state.

FIG. 8 is a view of the balloon dissector illustrated in FIG. 7 with a resilient balloon cover surrounding the elongate balloon.

FIG. 9 is an isometric view of another embodiment of a balloon dissector according to the invention with visualization capability illustrated in its expanded state.

FIG. 10 is a view of the balloon dissector illustrated in FIG. 9 with a resilient balloon cover surrounding the elongate balloon.

FIG. 11 is a perspective view of a balloon dissector having a bendable guide rod and support tube according to the invention.

FIG. 12 is a perspective view of a balloon dissector having a bendable guide rod according to the present invention.

FIG. 13 is a perspective view of a balloon dissector having a bendable tubular member according to the present invention.

FIG. 14 is an isometric view of a balloon dissector having a shroud according to the present invention.

FIG. 14A is an isometric view of an alternative form.

FIG. 15 is an enlarged cross sectional view of the shroud and distal end of the balloon dissector of FIG. 14.

FIG. 16 is a top plan view of a balloon dissector with the balloon apparatus omitted showing the ergonomic handle of the present invention.

FIG. 17 is a side elevation view of the balloon dissector of FIG. 13.

FIG. 18 is an elevation view of the proximal end of the balloon dissector of FIG. 13.

6

FIG. 19 is an isometric view of a balloon dissector with the ergonomic handle of the present invention.

DETAILED DESCRIPTION OF A PREFERRED EMBODIMENT

FIG. 4 shows an embodiment of a balloon loaded blunt dissector 15 in its uninflated state, with a balloon 16 packed inside the device. The balloon 16 is a nonelastic balloon or bladder and is cylindrical or tubular with a central lumen 17. The balloon 16 has two walls 18 and 19 and may be described as a double walled balloon tube. The balloon 16 may be made of polyethylene, polyurethane, polyamide and other nonelastic materials as well as latex and other elastic materials. The balloon 16 may be any suitable length, for example 12 to 24 inches long, to provide of a tunnel of convenient length when harvesting the saphenous vein. The balloon 16 may be any convenient diameter or width, for example 2 to 3 inches, to allow laparoscopic instruments to fit and operate conveniently within the tunnel created by the balloon 16. The balloon tube 16 may have any suitable cross-sectional shape.

A guide rod 20 with a blunt or rounded tip 21 is disposed in the central lumen 17 of the double walled balloon tube 16. The guide rod 20 is used as a pushing member to push the balloon 16 through body tissue. A support tube 22 may be provided to give some columnar support to the device and provide a stop member or coupling member to translate pushing force applied to the guide rod 20 to pushing action on the balloon tube 16. The support tube 22 may be secured to the inner wall of the balloon tube 16 in any suitable fashion. The support tube 22 may have an overhanging lip 23 which obstructs passage of the guide rod 20 or endoscope 29 (if provided). Alternatively, the guide rod 20 or endoscope 29 can be fitted with a stop collar 30 to engage the support tube 22 (as shown in FIG. 5). The support tube 22 may have a square tip 25 as in FIG. 4 or a rounded tip 26 as shown in FIG. 5. The guide rod 20 and support tube 22 are used to push the balloon 16 along the saphenous vein or other desired pathway between tissue layers.

The guide rod 20 and support tube 22 are normally straight (as shown in FIG. 4) and are of sufficient rigidity to bluntly dissect between tissue layers. In addition, the guide rod 20 and support tube 22 may be configured such that they are plastically bendable into curved shapes when subjected to bending moments substantially greater than the bending moments encountered when used to dissect between tissue layers (see FIG. 13). The bendable guide rod 20 and/or support tube 22 are made of materials and are proportioned such that they permanently retain the curved shape and have sufficient rigidity in the curved shape to bluntly dissect between tissue layers. In this way, the dissector 15 can be bent into a desired segment of dissection alongside a curved elongate structure or to maneuver the dissector 15 around an obstruction blocking the path to the area to be dissected. It is contemplated that the tunneling members (including tubes, rods, shafts, etc.) in any of the embodiments disclosed herein may have the plastically bendable properties as described for the embodiments of FIGS. 11-13.

Use of the support tube 22 permits the guide rod 20 or endoscope 29, if utilized as the pushing member, to be removably received by the apparatus 15. This allows the apparatus 15 to use fairly expensive and nondisposable devices such as the endoscope as the pushing member. If visualization is not needed or desired, the balloon 16 may be sealed to a disposable pushing member and may be coupled to the pushing member with adhesives, heat sealing or integral construction or any other coupling means. A balloon cover 27 surrounds

the balloon tube 16 and provides a protective sheath during placement of the balloon loaded dissector 15. The balloon cover 27 may be a thin sheath of polyethylene or other plastic film, or it may be a more rigid tube of PVC, PTFE, PETG, polyethylene or other plastic.

The balloon cover 27 may be elastic or resilient so that it serves to compress the balloon 16, so that the balloon 16 quickly and automatically collapses upon deflation. The balloon cover 16 may be made resilient by choosing a resilient material such as a thin sheet of polyethylene which is sufficiently resilient and elastic under the pressure used to inflate the balloon 16. The balloon 16 itself may also be made of polyethylene, and may be a thick polyethylene which is non-elastomeric under range of pressure used to inflate the balloon 16. When the balloon 16 and balloon cover 27 are made of the same material or a miscible material, the balloon 16 may be heat sealed to the balloon cover 27 at various points to prevent the balloon cover 27 from inadvertently slipping off the balloon 16. When the balloon 16 and balloon cover 27 are made of different or immiscible materials, they may be attached with adhesive or through the use of other suitable fasteners.

In the preferred embodiment of a method of using the devices disclosed herein, the surgeon uses a balloon loaded dissector to create a working space under the skin and over the saphenous vein suitable for laparoscopic techniques. The surgeon makes one or more incisions as shown in FIG. 3, to expose the saphenous vein. These incisions are referred to as cut-downs. An incision at the knee 12, an incision at the groin 13, or an incision close to the ankle 14 can be used. In FIG. 3, the saphenous vein 6 can be seen through the cut-downs 12, 13 and 14. It will be apparent from the description that the use of three or four incisions to harvest the entire saphenous vein is merely a matter of convenience, and those particularly skilled in laparoscopic procedures may require fewer incisions, and smaller incisions than illustrated may be required. If the dissector 15 is configured with a bendable guide rod 20 and support tube 22, the surgeon first bends the guide rod 20 and support tube 22 into the desired shape.

After insertion, the balloon loaded blunt dissector 15 is pushed along the blood vessel until the balloon tube 16 is located over the desired length of the saphenous vein. When the balloon 16 is properly in place it occupies a narrow tunnel over the saphenous vein. When in place, the balloon 16 is inflated through inflation tube 28. As shown in FIG. 5, the outer walls expand under inflation and the balloon cover 27 stretches as the balloon 16 is inflated. The expansion of the balloon 16 enlarges the tunnel. The outer diameter of the balloon tube 16 defines the size of the tunnel that is created, and the outer diameter may be controlled during manufacture and during inflation. Also as shown in FIG. 5, the guide rod 20 may be conveniently replaced with an endoscope 29 which can also serve as the pushing member. The endoscope 29 can be chosen to have an outer diameter matching the support tube, or it can be provided with a stop collar 30, both constructions serving to couple the endoscope 29 to the balloon tube 16 so that pushing on the endoscope 29 serves to push the balloon 16 into the body.

When the balloon 16 is deflated through the inflation tube 28, the balloon cover 27 serves to compress and collapse the balloon 16 and squeeze the inflation fluid out of the balloon 16, thus returning the balloon 16 to the collapsed state shown in FIG. 4. After the balloon 16 has been collapsed by the elastic force of the balloon cover 27, the device 15 may be further advanced or pulled-back from its position in the body, and repositioned at another area of interest. When the balloon 16 is repositioned, it may be reinflated to enlarge the tunnel. The balloon 16 may be repeatedly inflated and deflated in this

manner. Alternatively, the balloon cover 27 may be removed by pulling it proximally out of the incision to allow the balloon 16 to expand.

FIG. 6 shows an alternate embodiment of a balloon loaded blunt dissector. The guide rod 31 is provided with a slender metal rod 32 fitted with an enlarged tip or olive tip 33. The guide rod 31 may be replaced by a scope if visualization is desired. The balloon 34 is a long slender cylindrical balloon, with or without a central lumen. A guide tube 35 is attached to the outside of the balloon 34 and the guide rod 31 fits through the guide tube 35. The balloon 34 is uninflated in FIG. 6, and the balloon 34 and guide tube 35 are shown inside the balloon cover 27. The balloon 34 of FIG. 6 is used in the same way as the balloon 16 of FIGS. 4 and 5.

In operation, the apparatus is slipped over an endoscope (if utilized) or guide rod 31 and the balloon cover 27 is slipped over the apparatus. It is expected that use of an endoscope will be preferred, because it allows for visualization of the anatomy at its distal tip as the apparatus pushes through the fat layer overlying the saphenous vein. The apparatus is inserted either directly into the incision or is introduced through a cannula. After the guide rod 31 and balloon 34 are in place over the blood vessel, the balloon cover 27 can be pulled out of the incision, and may be provided with a weakened section to facilitate removal. The balloon cover 27 may be pulled back gradually as the balloon 34 is inserted to uncover that portion of the balloon 34 which is inside the body, and the balloon 34 can be inflated to dissect a larger tunnel in the early stages of insertion. The balloon cover 27 may also be left in place and, if made of a resilient material, can be used to compress the balloon 34 after deflation to facilitate repositioning of the assembly.

After full insertion, in a preferred method of use, the balloon 34 may be left in place in the tunnel while the endoscope is utilized to view the interior surfaces of the body at the tip of the apparatus, as shown in FIG. 3a. If the balloon 34 is provided with a central lumen, endoscopic instruments may be passed through said central lumen to perform surgical procedures on body parts such as the saphenous vein and communicating veins of the leg. In situations where it is desirable to insufflate the tunnel created by the balloon 34, the balloon 34 may be deflated and pulled out of the tunnel through cut-down 13, and a cannula port 36 with insufflation tube 37 may be inserted into the same cut-down as shown in FIG. 3b. A secondary endoscopic access port 38 may be inserted into the knee incision 12 to pass a variety of instruments into the work space.

The step of removing the balloon cover 27 may be avoided if the balloon cover 27 is perforated along a number of longitudinal lines and sealed to the balloon 34 along longitudinal lines, so that expansion of the balloon 34 tears the balloon cover 27 to allow expansion, but the pieces stay fixed to the balloon 34 so that they may be removed easily.

Another embodiment of a balloon dissection apparatus 50 is illustrated in FIG. 7. In this embodiment, the balloon dissector 50 includes a handle 52, a tunneling rod 54 which may be provided with a blunt tip 56, and an elongate balloon 58 having an inflation harness 60 extending from the balloon 58. The tunneling shaft 54 is normally straight and is formed of a suitable material such as surgical stainless steel to provide adequate rigidity for the shaft 54 to serve as a blunt obturator for tunneling between tissue layers.

In a further aspect of the present invention, the tunneling shaft 54 may be plastically bendable into curved shapes (see FIG. 12). The bendable tunneling shaft 54 is constructed so that it permanently retains the curved shape and has sufficient rigidity in the curved shape to bluntly dissect between tissue

layers. Then, similar to the dissector **15** described above, the dissector **50** can be bent into a curved shape to facilitate the dissection procedure (see FIG. **12**). For example, the dissector **50** may be curved to approximate the shape of an elongate structure it is desired to dissect free of connective tissue, or to facilitate the maneuvering of the dissector around an obstruction.

When the balloon dissector **50** is configured as an extraluminal balloon dissector to harvest the saphenous vein in the leg, for example, the tunneling shaft **54** may have a length of about 12 inches, and a diameter of approximately $\frac{1}{8}$ inch. Alternatively, the tunneling shaft **54** may be formed from a semi-flexible material, such as plastic, for example, to accommodate situations where it is desirable to provide a tunneling shaft with the capability to navigate somewhat torturous passages within the body. The tunneling shaft **54** may be mounted in the handle **52** using any suitable fastening system, e.g., gluing or a compression fit. The blunt tip **56**, which may be integrally formed with the tunneling shaft **54** or a separate member, provides a blunt distal end on the tunneling shaft **54**. Although an olive-shaped tip **56** is illustrated, other shapes providing a blunt surface are possible. The blunt tip **56** may also be omitted.

The elongate balloon **58** has distal and proximal ends **59** and **53** and a neck portion **57** extending from the proximal end **53** of the balloon **58**. For the purposes of this application, an elongate balloon is defined as a balloon having an axial length substantially greater than its transverse diameter when the balloon is inflated. As illustrated in FIG. **7**, the elongate balloon **58** is mounted over the tunneling shaft **54** such that the tunneling shaft **54** lies within the interior space **63** of the balloon **58**. The distal end **59** of the balloon **58** is preferably provided with a nipple or pocket **61** that may mate against the distal tip **56** of the tunneling shaft **54** to help protect against stretching or tearing of the distal tip of the balloon during tunneling. As will be described below, this construction permits the tunneling shaft **54** to be used as a pushing member to advance the deflated balloon **58** alongside a blood vessel or other elongate structure it is desired to dissect free of connected tissues.

The neck portion **57** of the balloon **58** may be secured inside the handle **52** in a fluid-tight fashion. Alternatively, the neck portion **57** may be secured to the tunneling shaft **54** by any suitable bonding system such as gluing or clamping. When the neck portion **57** is mounted in the handle **52** as illustrated in FIG. **7**, the balloon inflation harness **60** may extend from the neck portion of the elongate balloon **57** to provide a fluid passageway into the interior space **63** of the balloon **58**.

One example of a suitable balloon inflation assembly is illustrated in FIG. **7** in the form of balloon inflation harness **60**. Balloon inflation harness **60** includes a tube **68** which extends from the balloon **58** and is connected to a wye fitting **70**. A luer-type fitting with check valve **67**, is connected to one port of the wye fitting **70** and an evacuation fitting **69** is connected to the other port of the wye fitting **70**. A pinch clamp **66** is provided to close off the fluid passageway from the wye fitting **70** to the evacuation fitting **69**. The balloon inflation harness **60** illustrated is of the same type as described in copending application Ser. No. 08/570,766, filed on Dec. 12, 1995, the disclosure of which is hereby incorporated by reference in its entirety. Of course, numerous other suitable balloon inflation assemblies are possible.

In the FIG. **7** example, the elongate balloon **58** is inflated by closing the pinch clamp **66** and injecting a suitable inflation fluid, preferably saline solution, although other fluids such as air may be utilized instead, through the fitting **67** into the

balloon inflation lumen **68**, which is in communication with the interior space **63** of the balloon **58**.

As one alternative to the balloon inflation harness **60**, the handle **52** may be provided with an inflation port which is in communication with the proximal end of the neck portion **57** of the elongate balloon **58**. In this alternative embodiment, inflation fluid is injected through the inflation port in the handle **52** directly into the neck portion **57** of the balloon **58**.

The balloon **58** is preferably constructed of a medical grade nonelastomeric material of suitable type such as a polyurethane according to known fabrication techniques so as to have a predetermined elongate shape. Although all nonelastomeric materials exhibit some degree of elasticity, for the purposes of this application, a nonelastomeric material is one which remains substantially inelastic over the desired inflation pressure ranges utilized for the particular procedure. Although an elastomeric balloon may be utilized with the balloon dissector **50**, it is preferable to use an inelastic balloon so that the expansion envelope of the balloon can be more precisely predicted. In contrast, an elastomeric balloon tends to inflate following the path of least tissue resistance and localized differences in tissue resistance may cause an undesirable aneurysm in the balloon leading to nonuniform dissection.

In a preferred method of use, an incision is made in the body proximate the elongate structure within the body it is desired to dissect free of connective tissue. The surgeon identifies the appropriate tissue planes dissection is desired to occur along and the balloon dissector **50** is inserted, either directly or with the aid of a cannula, through the incision into the body and advanced following the identified tissue planes. If the balloon dissector **50** is configured with a bendable guide rod **54**, then prior to insertion into the body, the surgeon bends the guide rod **54** into the desired shape. The surgeon uses the handle **52** and pushes the balloon dissector **50** as a blunt obturator following the tissue planes adjacent the elongate structure until a desired location for deployment of the dissector **50** is reached. As the dissector **50** is advanced within the body, its progress may be monitored through the skin by direct observation and/or manual palpation. depending on the procedure, varying amounts of the overall length of the elongate balloon **58** may be disposed within the incision.

Once the desired location for dissection has been reached through blunt tunneling, the elongate balloon **58** may be inflated by closing the pinch clamp **66** and communicating an inflation fluid through the balloon inflation harness **60** into the interior space **63** of the balloon **58**. As it inflates, the balloon **58** expands into the predetermined elongate shape and dissects tissue away from the elongate structure to create a tunnel alongside the elongate structure. After the tunnel has been created, the dissector **50** may be deflated by releasing the pinch clamp **66** and applying vacuum to the male evacuation fitting **69**. After deflation, the dissector **50** may be removed from the body through the incision, or further advanced alongside the elongate structure and reinflated to enlarge the tunnel.

After the dissector has been removed from the body, a cannula and skin seal assembly of the type disclosed in application Ser. No. 08/570,766, for example, may be inserted into the incision and the skin seal advanced into the incision to create a substantially gas-tight seal with the incision. The space created by the balloon dissector **50** may then be insufflated by injecting an appropriate insufflation gas through a port provided on the cannula should an insufflated operating space be desired.

Use of the dissector **50** specifically contemplates multiple serial balloon dissections. The dissector **50** may be advanced into the body in stages along the identified natural tissue

planes by repeatedly advancing and deploying the dissector **50** to dissect a tunnel of the desired length alongside the elongate structure. The process of advancing the dissector **50**, inflating the balloon **58**, and deflating the balloon **58** may be repeated in serial fashion until the desired tunnel has been created. In the embodiment of the balloon dissector **50** illustrated in FIG. 7, a vacuum may be drawn on the balloon **58** to deflate and contract the balloon **58** so that the dissector **50** can be repositioned and redeployed as needed.

The balloon dissector **50** is illustrated in FIG. 8 with an elastomeric balloon cover **72** that surrounds the elongate balloon **58**. The dissector **50** is in all other respects identical to the FIG. 7 embodiment. The cover **72** preferably has a diameter such that when the balloon **58** is in a deflated condition, the cover **72** compresses the balloon **58** around the shaft **54**. The use of the cover **72** thus aids in the serial redeployment of the balloon **58** by automatically causing the balloon to return to a compressed state upon deflation. The elastomeric cover **72** may be formed from a resilient material such as a thin sheet of polyurethane which is sufficiently resilient and elastic under the pressure used to inflate the balloon **58**, or it may be formed from an elastomer such as silicon or latex rubber.

The cover **72** may be bonded to the balloon **58** at various points using known bonding techniques to prevent the cover **72** from inadvertently slipping off the balloon **58**. Alternatively, the cover **72** may have a diameter closely matching the diameter of the shaft **54** so that the cover **72** is retained in position by its elastic compression on the shaft **54**, or by friction. The cover **72** may also completely cover the elongate balloon **58** and be secured in the handle **52**. In this case, the cover **72** may be inflated independently of the elongate balloon **58** to provide a balloon with elastomeric characteristics, i.e., localized tissue expansion following the path of least tissue resistance.

As an alternative embodiment, the elongate balloon **58** may be elastic and the cover **72** may be inelastic such that the inelastic cover **72** acts to limit expansion of the elongate balloon **58**.

It is also possible to utilize a separate removable cover of the type disclosed in co-pending application Ser. No. 08/570,766, for example, or an integral balloon cover which separates upon expansion of the balloon as described with reference to previous embodiments.

Another embodiment of a balloon dissector **80** is illustrated in FIG. 9. The balloon dissector **80** differs from the balloon dissector **50** only in that the tubular member **82** replaces the tunneling shaft **54** and an opening in communication with the bore in the tubular member **82** is provided in the handle **52**. As shown in FIG. 11, the tubular member **82** may be bendable and have similar characteristics, as described for the bendable tunneling shaft **54**, described above. In this embodiment, the tubular member **82** serves as a scope cover to provide the dissector **80** with visualization capability when used in conjunction with a laparoscope. The tubular member **82** has an internal diameter, such as 10 mm for example, sized to receive a conventional laparoscope. The tubular member **80** may be formed of any suitable material, such as plastic for example.

The tubular member **82** may have an open distal end **84** as illustrated in FIG. 9 to permit observation with the laparoscope through the open distal end **84**. As shown in FIG. 9, the open distal end **84** of the tubular member **82** may be cut away at a 45 degree angle, for example, and provided with a lip **86** which serves to capture the distal end of the laparoscope when inserted to prevent the laparoscope from extending beyond the open distal end **84**. Alternatively, the open distal end **84** of the tubular member **82** may be squared off and the lip **86** provided by rolling the open distal end inward. The distal end

of the tubular member **82** may also be closed and rounded if visualization through an open distal end is not desired.

An instrument seal, which may comprise an area of reduced internal diameter in the tubular member **82**, may be provided to prevent the balloon inflation fluid from leaking out of the handle **52** during balloon inflation. Alternatively, or in combination with the area of reduced diameter in the tubular member **82**, an instrument seal of the type illustrated in application Ser. No. 08/570,766 may be provided in the handle **52**.

In addition to the balloon inflation options described with regard to the FIGS. 7 and 8 embodiments, the elongate balloon **58** of the dissector **80** may be inflated by injecting the inflation fluid through an inflation port in the handle **52** directly into a lumen in the tubular member **82**. If the tubular member **82** has the presently preferred open distal end construction, the inflation fluid may be communicated through the bore in the tubular member **82** and out the open distal end **84** into the interior space **63** of the balloon **58**. If a closed-ended tubular member **82** is utilized, inflation may be through a separate lumen formed in the wall of the tubular member **82** which opens into the interior space **63** of the balloon **58**.

To prepare for tunneling dissection, a laparoscope, which may be a conventional 10 mm laparoscope, for example, is inserted through the handle **52** and advanced into the bore of the tubular member **82** until the distal extremity of the laparoscope is captured by the lip **86** in the open distal end **84** of the tubular member **82**. The lip **86** in the open distal end **84** thus prevents the laparoscope from being advanced beyond the open distal end of the tubular member **82**. Although an angled scope will provide the best visualization through the open distal end **84** of the tubular member **82**, a straight scope may also be utilized.

The balloon dissector **80** is then inserted through the incision and tunneled bluntly following the desired tissue planes using the laparoscope and tubular member **82** as a blunt obturator. The procedure to be followed is the same as previously described with regard to the FIGS. 7 and 8 embodiments with the exception that the progress of the operation may be observed through the laparoscope during tunneling dissection. During the tunneling stage, the distal end of the laparoscope looks out through the open distal end **84** of the tubular member **82** obstructed by only a single and preferably transparent layer of the elongate balloon **58**. Moreover, when the balloon **58** is inflated to create a tunnel alongside the desired elongate structure, the laparoscope may be utilized to observe the progress of the dissection.

FIG. 10 illustrates the addition of a resilient cover **72** to the balloon dissector **80** having visualization capabilities. The cover **72** may be of the same construction as previously described and may function in an equivalent manner to automatically compress the elongate balloon **58** about the tubular member **82** upon deflation.

Another embodiment of a balloon dissector **90** is illustrated in FIGS. 14-15. The balloon dissector **90** is substantially identical to the FIG. 9 embodiment, except for the addition of a substantially rigid shroud **91** on a distal end of a tubular member **82** and a modified configuration of the balloon **58**. In a preferred form, the shroud **91** is generally in the shape of a spoon. The balloon **58** of the balloon dissector **90** does not extend over the distal end **84** of the tubular member **82** as in the FIG. 9 embodiment. Instead, the balloon **58** is sealed to the outside surface of the tubular member **82** near the distal end **84** of the tubular member **82**.

The shroud **91** is preferably transparent or translucent and substantially rigid. For example, the shroud **91** may be made of PVC, PTFE, PETG, polyethylene, or other preferred plas-

13

tics, such as Lexan® polycarbonate. The shroud **91** may be formed integrally with the tubular member **82** or the shroud **91** may be a separate part suitably attached to the tubular member **82**.

The shroud **91** comprises a surface at its proximal end which matches the shape of the tubular member **82** at the intersection with the tubular member **82**. The width of the shroud **91** preferably increases as the shroud **91** extends distally and, at the same time, bends across the opening of the tubular member **82** to form a hood. Preferably, the distal section **92** of the shroud **91** essentially covers at least an imaginary distal extension of the tubular member **82**. Optionally, the shroud **91** may have a tunnel or notch **100** at the distal end as depicted in FIG. **14A** which shows only the shroud **91**. The notch **100** is useful when dissecting along a blood vessel, because the notch **100** conforms around the vessel and helps prevent or reduce undesired trauma to the vessel. The notch **100** also provides an unobstructed viewing window for an endoscope.

There is an open space between the distal end **84** of the tubular member **82** and the distal section **92** of the shroud **91**. This space provides a clear viewing area between the distal end **84** of the tubular member **82** and the shroud **91**. The space between the distal section **92** of the shroud **91** and the distal end **84** of the tubular member **82** also allows instrument access to the surrounding tissue. For example, an endoscope with an instrument channel (not shown) may be inserted into the tubular member **82** through an opening in the handle **52**. The shroud **91** may be transparent so that a laparoscope inserted into the tubular member **82** can view beyond the distal end of the balloon dissector **90** to facilitate advancement of the balloon dissector **90**. Although a specific shaped shroud **91** has been described, it should be understood that, alternative shapes may be utilized, such as a section of a sphere. Furthermore, it is contemplated that the shroud **91** may be utilized on any of the tunneling devices disclosed herein, with only minor modifications. For example, any of the bendable embodiments shown in FIGS. **11-13** may be fitted with a shroud **91** on the distal end of the balloon dissector.

The procedure for using the balloon dissector **90** is similar to the procedure described above with respect to the FIG. **10** embodiment. The balloon dissector **90** is pushed using the handle **52** through an incision in the body and advanced along or between the appropriate tissue planes, and the balloon may be inflated to further dissect or retract. The shroud **91** performs blunt dissection as the balloon dissector **90** is advanced along the desired tissue planes. The shroud **91** may also be used to simply retract tissue away from an elongate structure in order to provide a clear space for viewing or for performing a procedure, such as ligation.

Turning now to FIGS. **16-19**, a balloon dissector **90** is shown with an ergonomic handle **52a**. The ergonomic handle **52a** may be used in place of the handle **52** seen in FIGS. **7-11** and may be made of any suitable material, including plastic or metal. The ergonomic handle **52a** may be any convenient shape, though the preferred shape is as shown in FIGS. **13-16**. This shape allows the surgeon to grip the dissector **90** securely in one hand and maintain fine motor control of the dissector **90** when advancing or pulling it back from its position in the body. The ergonomic handle **52a** has a receptacle **94** adapted to receive and provide support for a standard scope light (not shown). The scope light may be secured by threads or any other conventional fastening means. In addition, if the ergonomic handle **52a** is attached to the tubular member **82** as shown in FIGS. **13-16**, the ergonomic handle **52a** will also have an opening **96** in communication with the bore in the

14

tubular member **82**, similar to the configuration described earlier in connection with FIG. **9**. It should be understood that the ergonomic handle **52a** may be used with any of the balloon dissector embodiments disclosed herein.

The procedure for using the balloon dissector **90** shown in FIGS. **16-19** is substantially the same as the procedure described above with respect to the embodiment in FIGS. **14-15**.

In an alternative embodiment where the balloon dissector **90** does not have a handle **52**, the tubular member **82** may be fitted with a stop, such as a collar, to engage an instrument or guide rod used as a pushing member to push the balloon dissector **90** through body tissue. Alternatively, an instrument or guide rod may be provided with a stop collar to engage the tubular member **82**.

The balloon dissector **90** may be configured with any of the balloon inflation options described above with respect to the embodiments in FIGS. **7, 8, and 9**. These include: a balloon harness **60**, an inflation port in the handle **52** which is in communication with the interior of the balloon **58**, or an inflation port in the handle **52** in communication with a lumen, which may be either integral with or attached to the tubular member **82**.

Any of the covers of the types described above may be added to the balloon dissector **90**. The cover may be of similar construction as previously described, except the cover is not closed at its distal end and therefore does not enclose the shroud **91**. The cover may function in an equivalent manner to automatically compress the elongate balloon **58** about the tubular member **82** during deflation.

The balloon loaded devices disclosed herein can be used in other procedures besides dissection for vein harvesting. The description of the devices in that environment is intended to be illustrative of the device only. It is readily apparent that the devices and methods may be used for tunneling and enlarging working spaces over other long structures in the body. Various arteries and veins must be exposed and mobilized for other operations, such as popliteal bypass, or a dialysis vein loop. In these operations, a vein must be harvested, and the sites at which the vein will be attached or anastomosed must also be uncovered. The balloon loaded devices may also be used to gain access to any blood vessel for any type of vascular surgery. For example, communicating veins or perforators in the calf may be exposed by dissecting the muscles deep within the calf to expose these blood vessels to accomplish a Linton procedure laparoscopically. The devices and methods may be used to expose those portions of the arteries to which grafts will be placed.

Other vessels may be dissected from surrounding tissue, such as fallopian tubes, spermatic cords, bile ducts, intestines and others. These vessels may be dissected and mobilized laparoscopically using the devices and techniques described above. Embodiments of the device may also be used to retrofit a scope with a balloon dissector to dissect a tunnel under direct vision. Alternatively, the balloon can be used to guide or support a scope within an existing space that needs period of dilation to permit advancement of the scope. For example, a colonoscope may be fitted with one of the balloon devices disclosed herein and the device used to facilitate insertion of the colonoscope into the colon, especially around the splenic flexure, by inflating the balloon when the tip of the colonoscope approaches the splenic flexure. A urethral scope may be fitted with the devices disclosed herein to facilitate insertion of the scope into the urethra, which often requires dilation before insertion of a scope. The disclosed devices may be used in combination with a scope as an anchor, which while inflated serves to hold the scope in place within the body.

15

While the preferred embodiments of the devices and methods have been described, they are merely illustrative of the principles of the invention. Other embodiments and configurations may be devised without departing from the spirit of the inventions and the scope of the appended claims.

What is claimed is:

1. A method of creating a tunnel near an anatomical structure within a body comprising the steps of:

making an incision in the body proximate the anatomical structure;

providing a surgical apparatus including:

an elongate shaft having proximal and distal ends, the elongate shaft having sufficient rigidity to push through body tissue free of naturally occurring openings in the body tissue alongside an elongate structure,

a handle operably mounted on the proximal end of the elongate shaft, the handle including a receptacle configured to releasably receive an instrument, wherein the receptacle defines an elongated slot laterally spaced from the elongated shaft,

an elongate balloon capable of assuming deflated and inflated states on the elongate shaft, the elongate balloon having an axial length substantially greater than a transverse diameter of the elongate balloon when the elongate balloon is in the inflated state, the balloon defining an inflatable interior space into which a fluid is introduced to inflate the balloon, the distal end of the elongate shaft located inside the inflatable interior space, and

a fluid passageway in communication with the inflatable interior space in the elongate balloon for communicating an inflation fluid to the elongate balloon;

inserting the surgical apparatus through the incision;

advancing the surgical apparatus through layers of tissue to the location of the anatomical structure; and

inflating the balloon to form a tunnel by dissecting tissue away from the elongate structure.

2. The method of claim 1, further comprising the steps of: deflating the balloon; repositioning the surgical apparatus by moving the balloon tube through the layers of tissue to a point remote from the point where the balloon was first inflated; and inflating the balloon again to selectively enlarge the tunnel.

3. The method of claim 1, further comprising the step of: bending the shaft prior to inserting the surgical apparatus.

4. The method of claim 1, wherein the surgical apparatus further includes a balloon cover.

5. The method of claim 4, further comprising the step of: inflating the cover.

6. The method of claim 4, wherein the balloon cover is formed from an elastomeric material having sufficient elasticity to collapse the balloon about the tubular member when the elongate balloon is deflated.

7. The method of claim 5, further comprising the step of: allowing the cover to compress the balloon, deflating the balloon, and then inflating the balloon.

8. The method of claim 3, wherein the balloon cover is bonded to the balloon.

9. A method of creating a tunnel near an anatomical structure within a body comprising the steps of:

16

making an incision in the body proximate the anatomical structure;

providing a surgical apparatus including

an elongate shaft having proximal and distal ends, the elongate shaft having sufficient rigidity to push through body tissue free of naturally occurring openings in the body tissue alongside an elongate structure,

a handle operably mounted on the proximal end of the elongate shaft, the handle including a receptacle configured to releasably receive an instrument, wherein the receptacle defines an elongated slot laterally spaced from the elongated shaft, and

a lumen therein for receiving a surgical instrument an elongate balloon capable of assuming deflated and inflated states on the elongate shaft, the elongate balloon having an axial length substantially greater than a transverse diameter of the elongate balloon when the elongate balloon is in the inflated state, the balloon defining an inflatable interior space into which a fluid is introduced to inflate the balloon, the distal end of the elongate shaft located inside the inflatable interior space, and a fluid passageway in communication with the inflatable interior space in the elongate balloon for communicating an inflation fluid to the elongate balloon;

inserting the surgical apparatus through the incision; advancing the surgical apparatus through layers of tissue to the location of the anatomical structure; and

inflating the balloon to form a tunnel by dissecting tissue away from the elongate structure.

10. The method of claim 9, wherein the step of advancing includes tunneling through tissue using a laparoscope.

11. The method of claim 9, further comprising the steps of: observing tissue when the balloon is inflated.

12. The method of claim 9, further comprising the steps of: deflating the balloon; repositioning the surgical apparatus by moving the balloon tube through the layers of tissue to a point remote from the point where the balloon was first inflated; and inflating the balloon again to selectively enlarge the tunnel.

13. The method claim 9, further comprising the step of: inserting a laparoscope into the lumen of the shaft; and viewing the path between the tissue layers through the laparoscope as the surgical apparatus is advanced through the tissue layers to the location of the anatomical structure.

14. The method of claim 13, wherein the elongate shaft further has an open distal end.

15. The method of claim 13, wherein the open distal end includes a lip partially blocking the lumen.

16. The method of claim 1, wherein the instrument is a scope light.

17. The method of claim 9, wherein the instrument is a scope light.

18. The method of claim 1, wherein the handle includes a pair of spaced members defining the receptacle therebetween.

19. The method of claim 9, wherein the handle includes a pair of spaced members defining the receptacle therebetween.

* * * * *

专利名称(译)	气球解剖仪器		
公开(公告)号	US7749241	公开(公告)日	2010-07-06
申请号	US11/262830	申请日	2005-10-31
[标]申请(专利权)人(译)	海尔曼·乔治δ CO FRED H SUTTON DOUGLAS小号		
申请(专利权)人(译)	海尔曼·乔治δ CO FRED H SUTTON DOUGLAS小号		
当前申请(专利权)人(译)	普外科创新股份有限公司.		
[标]发明人	HERMANN GEORGE D SUTTON DOUGLAS S		
发明人	HERMANN, GEORGE D. SUTTON, DOUGLAS S.		
IPC分类号	A61B17/00 A61B1/00 A61B17/02 A61B17/22 A61B17/32 A61F2/958 A61M25/01 A61M29/02		
CPC分类号	A61B17/00008 A61B17/0218 A61M25/10 A61M29/02 A61B1/00082 A61B1/00154 A61B2017/00243 A61B2017/00336 A61B2017/00557 A61B2017/22072 A61B2017/320044 A61B2017/320048 A61M25/0102 A61M25/1002 A61M25/1011 A61M2025/0197 A61M2025/09183 A61M2025/1075 A61M2025/1093		
其他公开文献	US20060058830A1		
外部链接	Espacenet USPTO		

摘要(译)

公开了装有气囊的解剖装置和使用这种装置的方法。该装置包括细长球囊并且可以设置有中央内腔。该装置可具有引导管以提供柱状支撑。在另一方面，引导管可具有附接到远端的勺形护罩。引导管接收引导杆，窥镜或其他手术器械并且可以具有止动构件。通过使用导杆或镜子作为推动构件，该装置可以沿着希望从附着的组织切开的血管前进。可以提供气球盖以围绕气球并且在球囊放气之后促进球囊的压缩。在另外的特征中，导杆和/或管状构件可塑性弯曲成弯曲形状，使得可以调节球囊解剖器。

