



US007588583B2

(12) **United States Patent**
Hamilton et al.

(10) **Patent No.:** **US 7,588,583 B2**
(45) **Date of Patent:** **Sep. 15, 2009**

(54) **SUTURING DEVICE, SYSTEM AND METHOD**

7,185,597 B1 3/2007 Phillips et al.

(75) Inventors: **Henry Hamilton**, Hillsborough, CA
(US); **Yuri Belman**, Mountain View, CA
(US)

(Continued)

(73) Assignee: **Rhaphis Medical, Inc.**, Incline Village,
NV (US)

FOREIGN PATENT DOCUMENTS

EP 1 862 125 12/2007

(*) Notice: Subject to any disclaimer, the term of this
patent is extended or adjusted under 35
U.S.C. 154(b) by 522 days.

(Continued)

(21) Appl. No.: **11/227,981**

OTHER PUBLICATIONS

(22) Filed: **Sep. 14, 2005**

“Quik-Stitch® Endoscopic Suturing System” <http://paresurgical.com.com> [downloaded from Internet Apr. 10, 2008] 1 page total.

(65) **Prior Publication Data**

US 2007/0060930 A1 Mar. 15, 2007

(Continued)

(51) **Int. Cl.**
A61B 17/04 (2006.01)

Primary Examiner—Darwin P Erez

(52) **U.S. Cl.** **606/144**; 806/139

(74) *Attorney, Agent, or Firm*—Townsend and Townsend and
Crew LLP

(58) **Field of Classification Search** 606/139,
606/144–148

(57) **ABSTRACT**

See application file for complete search history.

(56) **References Cited**

U.S. PATENT DOCUMENTS

5,665,096 A *	9/1997	Yoon	606/139
5,749,879 A *	5/1998	Middleman et al.	606/139
5,897,563 A	4/1999	Yoon et al.	
5,908,429 A *	6/1999	Yoon	606/144
5,938,668 A *	8/1999	Scirica et al.	606/145
5,954,733 A *	9/1999	Yoon	606/147
5,993,466 A *	11/1999	Yoon	606/147
6,004,332 A *	12/1999	Yoon et al.	606/144
6,071,289 A *	6/2000	Stefanchik et al.	606/147
6,086,601 A *	7/2000	Yoon	606/148
6,126,665 A *	10/2000	Yoon	606/144
6,159,224 A *	12/2000	Yoon	606/147
6,206,894 B1	3/2001	Thompson et al.	
6,638,286 B1 *	10/2003	Burbank et al.	606/157
7,001,400 B1	2/2006	Modesitt et al.	

Improved medical suturing devices, systems, and methods may hold a suture needle at a fixed location relative to a handle of the device, allowing the surgeon to grasp and manipulate the handle of the suturing device to insert the needle through tissues in a manner analogous to use of a standard needle gripper. Cycling the handle from a closed position to an open position and back to the closed position may alternate the device between gripping the needle with a first clamp (for example, along a proximal portion of the needle) to gripping the needle with a second clamp (for example, along a distal portion of the needle) and optionally back to gripping with the first clamp, with the needle often staying at a substantially fixed location relative to the suturing device body.

15 Claims, 13 Drawing Sheets

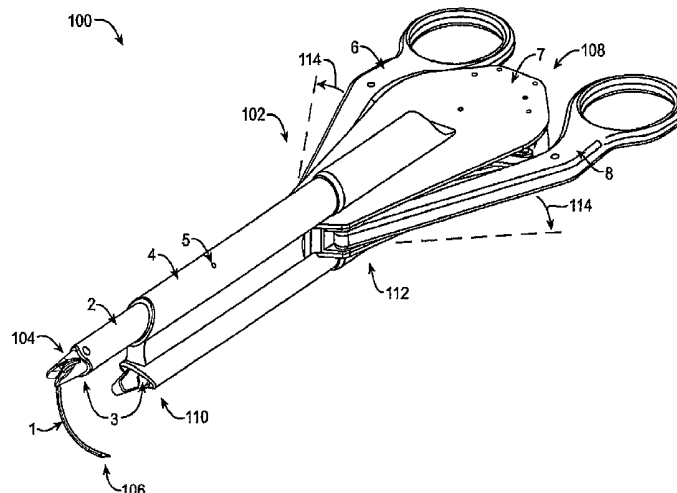

U.S. PATENT DOCUMENTS

7,338,504	B2	3/2008	Gibbens, III et al.
2006/0079914	A1	4/2006	Modesitt et al.
2006/0142785	A1	6/2006	Modesitt et al.
2006/0173469	A1	8/2006	Klein et al.
2006/0190035	A1	8/2006	Hushka et al.
2006/0212048	A1	9/2006	Crainich
2007/0060931	A1	3/2007	Hamilton et al.
2007/0167959	A1	7/2007	Modesitt et al.
2007/0179509	A1	8/2007	Nagata et al.

FOREIGN PATENT DOCUMENTS

WO	WO 2006/012128	A2	2/2006
WO	WO 2006/023348	A1	3/2006
WO	WO 2006/125835	A1	11/2006
WO	WO 2007/033314	A2	3/2007
WO	WO 2007/037326	A1	4/2007
WO	WO 2007/089603	A2	8/2007
WO	WO 2007/129121	A1	11/2007
WO	WO 2007/135629	A1	11/2007

OTHER PUBLICATIONS

“The Running Device™—Surgery’s Best Suturing Technology™”
<http://www.Isolutions.com/home.html> [downloaded from Internet
 Apr. 10, 2008] 1 page total.

“Autosuture—Advancing Possibilities in Surgery™” <http://www.autosuture.com/autosuture/> [downloaded from Internet Apr. 10, 2008] 1 page total.

“Endo Stitch™ 10 mm Suturing Device Instructions for Use and product description,” 4 pages downloaded from internet May 20, 2005, by United States Surgical, a division of Tyco Healthcare Group LP (2005).

“Fastclose™ Device, Instructions for use,” product brochure, 2 pages published by SutureTek, Inc. (2001).

“SutureTek—SutureTek Products—FastClose™ Device,” product brochure, 2 pages downloaded from internet May 20, 2005, by SutureTek, Inc. (2001).

“SutureTek—SutureTek Products—The Technology,” product brochure, 1 page downloaded from internet May 20, 2005, by SutureTek™, Inc. (2001).

“SutureTek—SutureTek Products—FastClose in Use,” product brochure, 1 page downloaded from internet May 20, 2005, by SutureTek™, Inc. (2001).

“Home Page for Auto Suture,” product brochure, 1 page downloaded from internet May 20, 2005, by United States Surgical, a division of Tyco Healthcare Group LP (2005).

International Search Report and Written Opinion of PCT Application No. PCT/US06/35804, dated Jul. 11, 2008, 8 pages total.

* cited by examiner

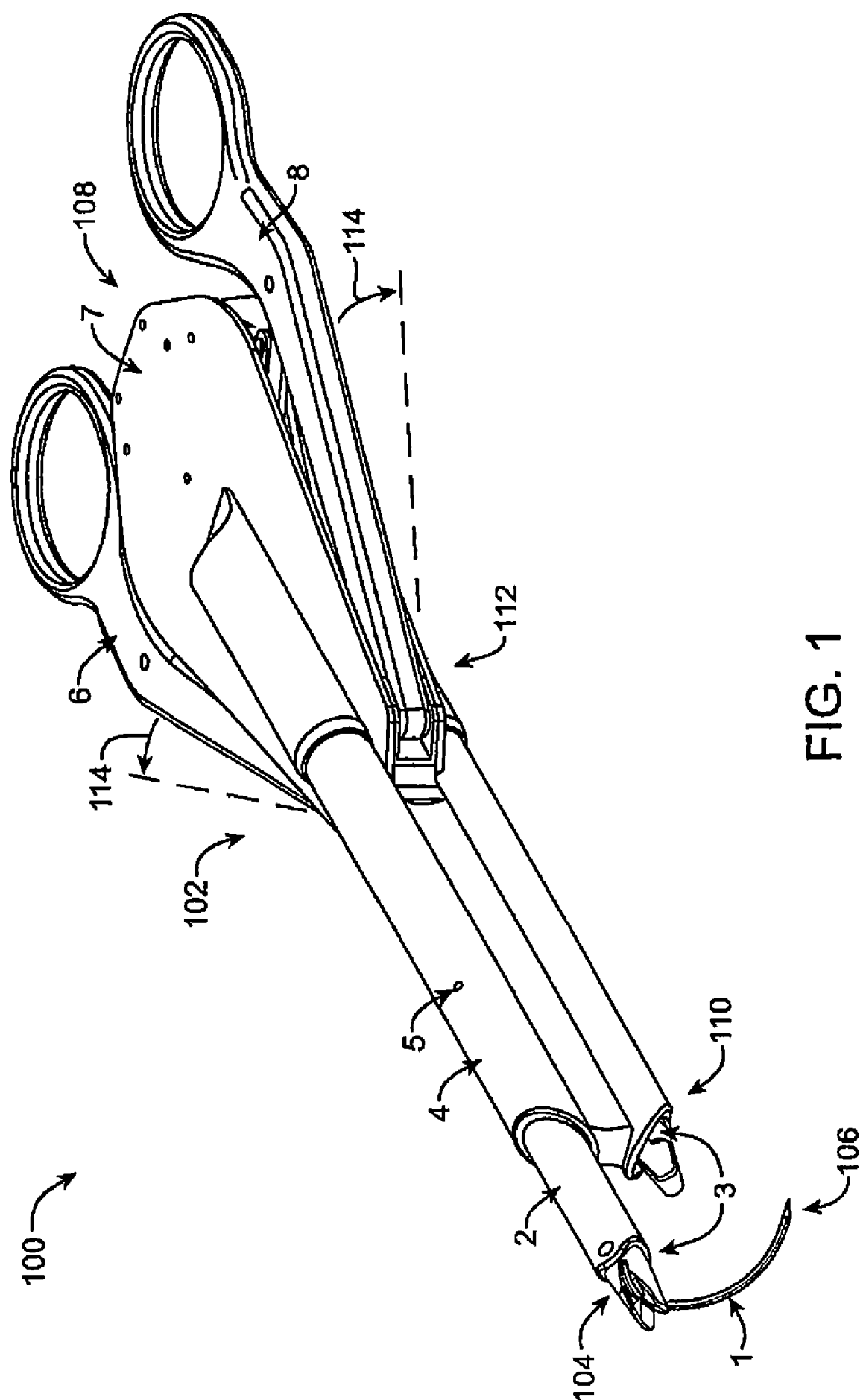

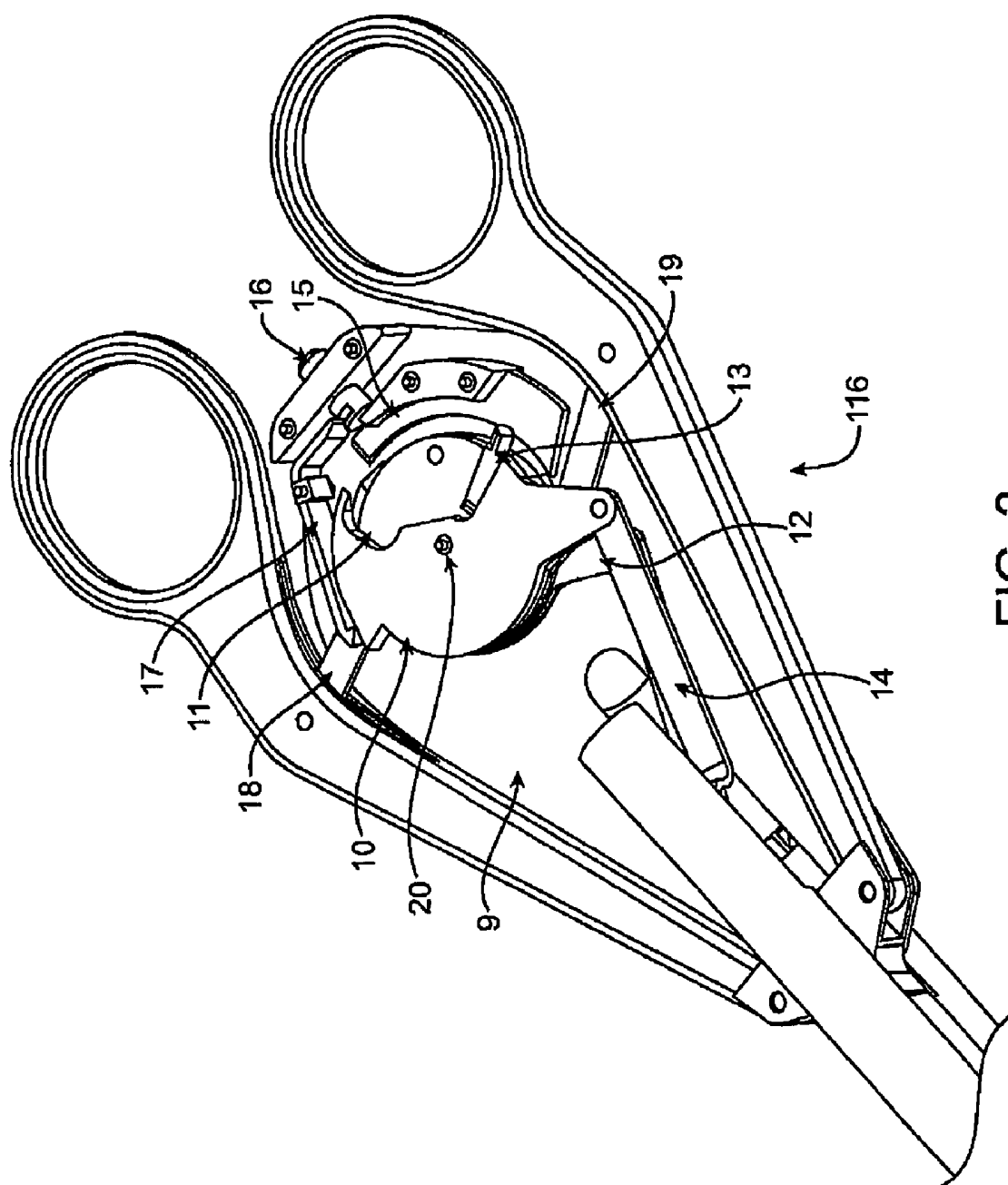

FIG. 2

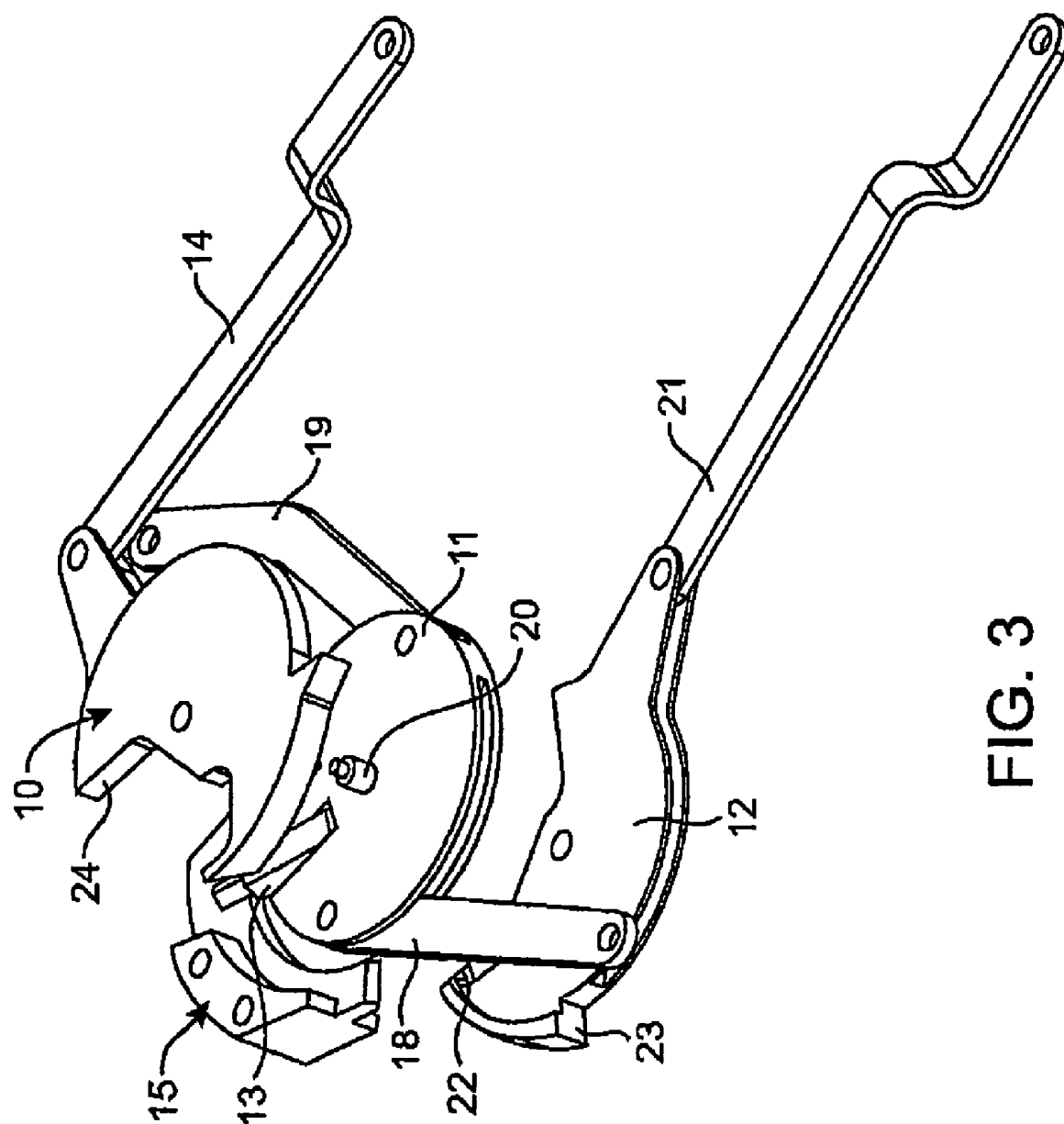
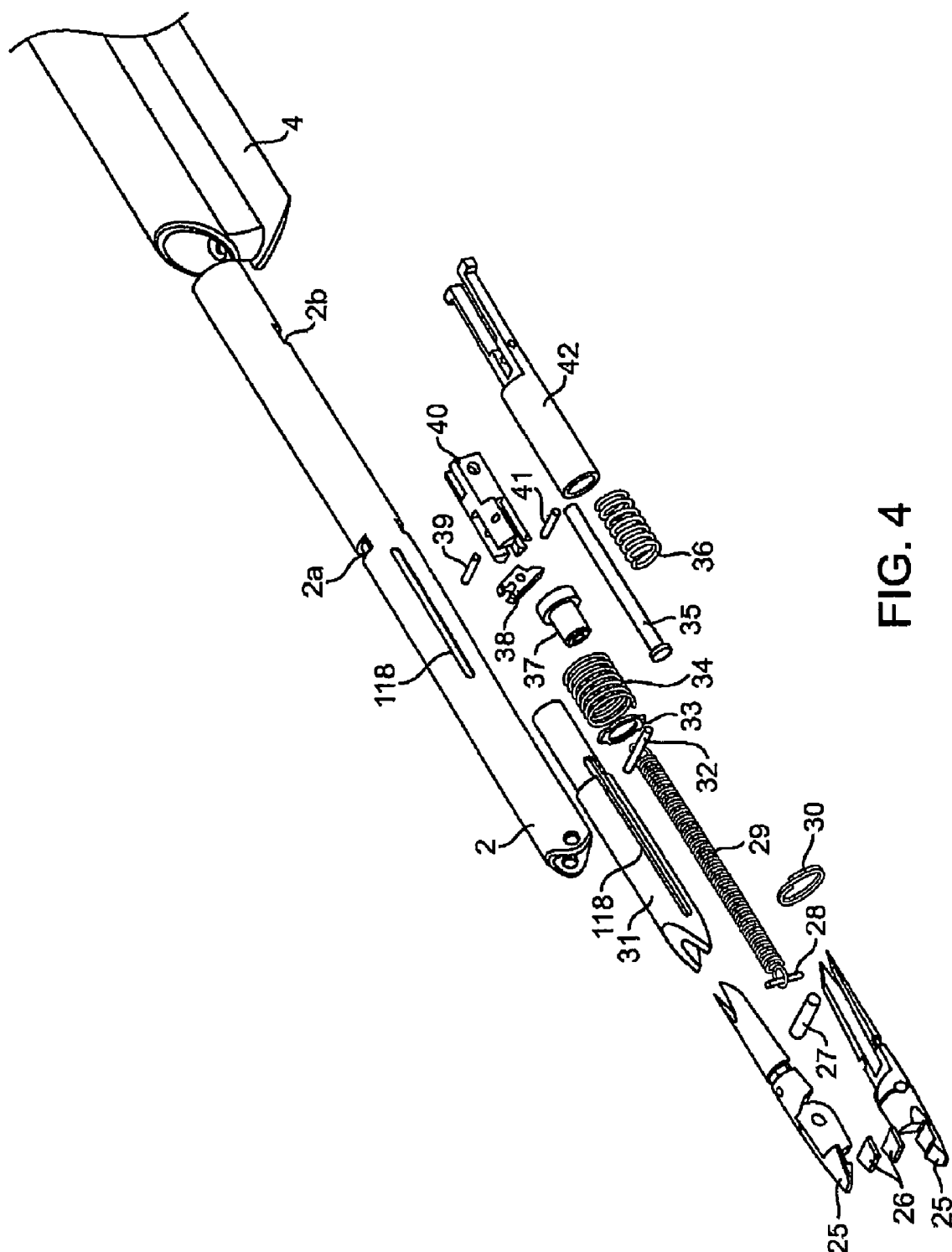

FIG. 3



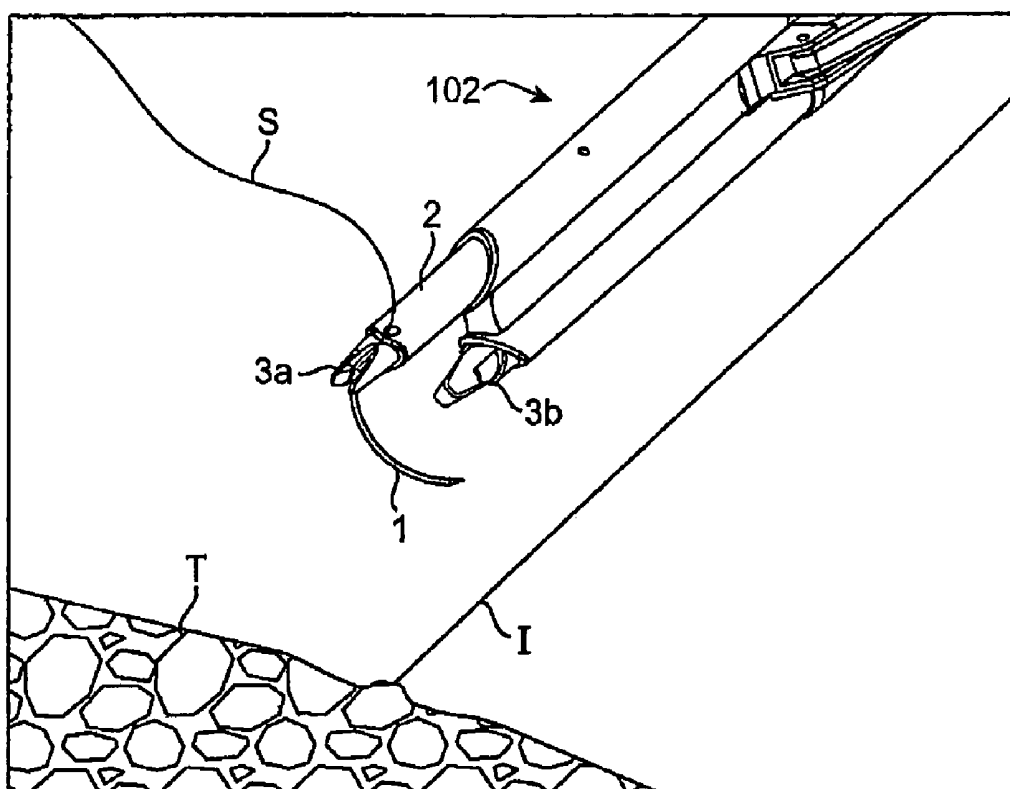

FIG. 5

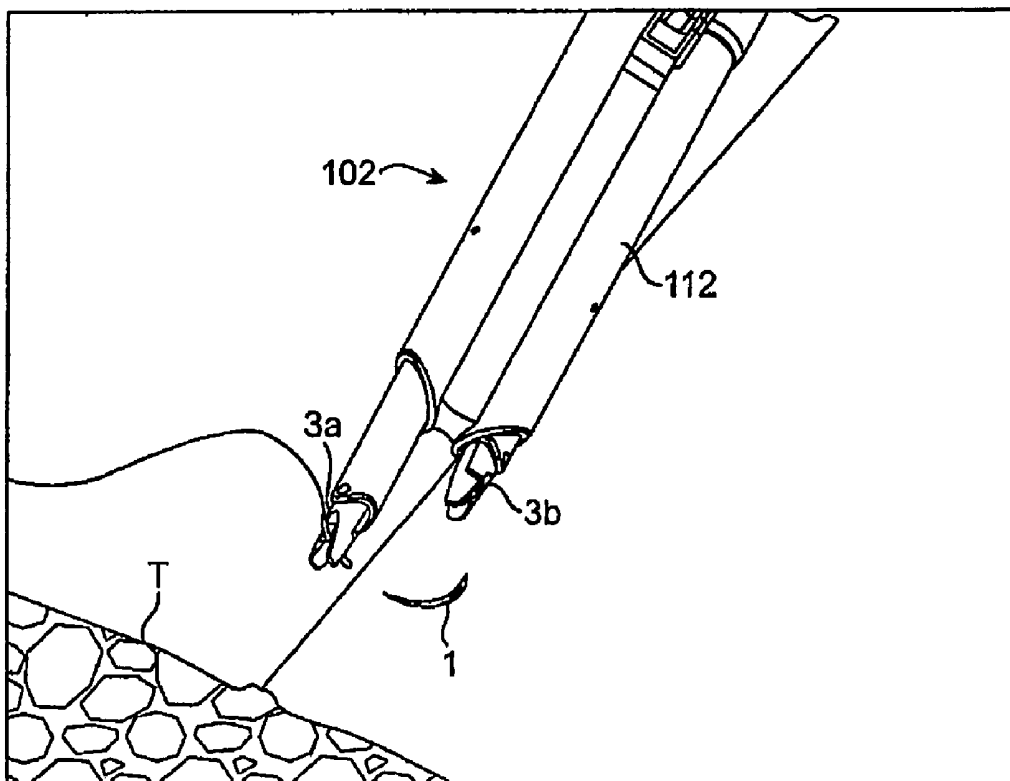

FIG. 6

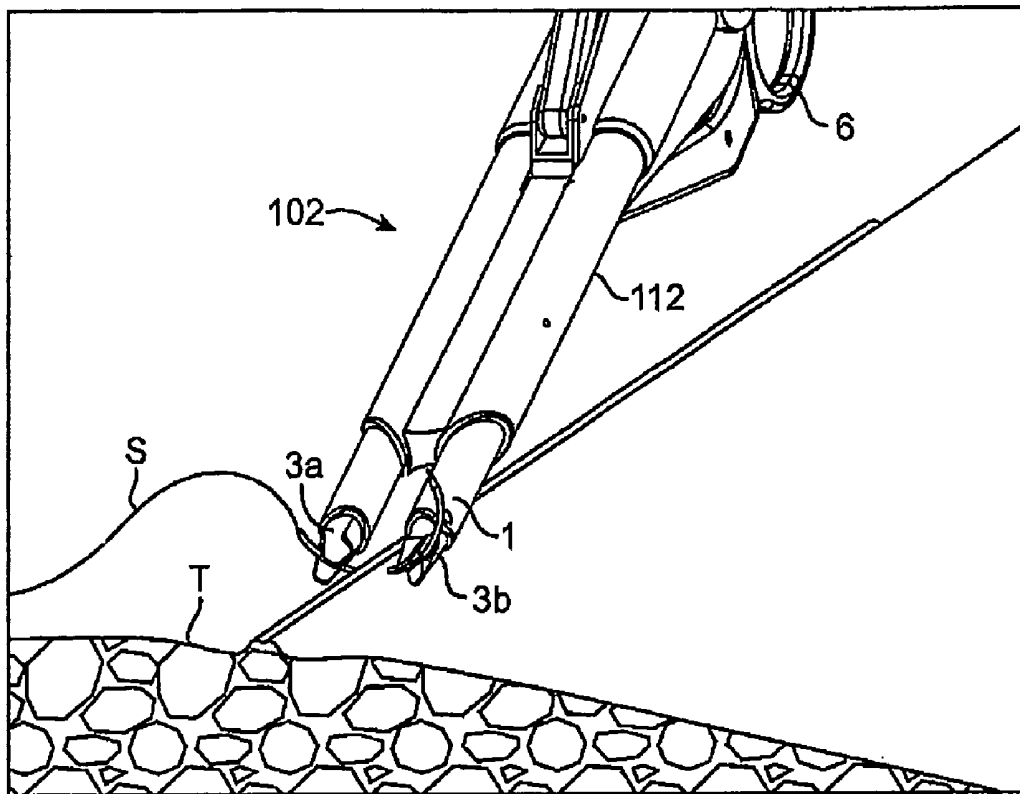

FIG. 7

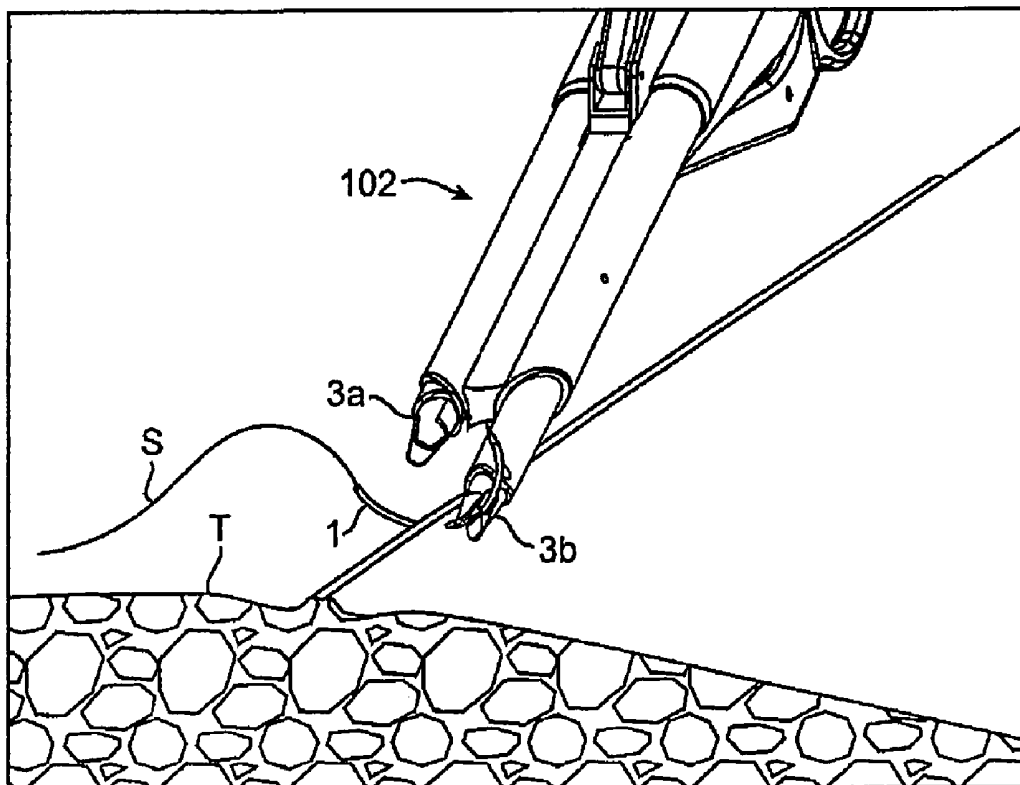

FIG. 8

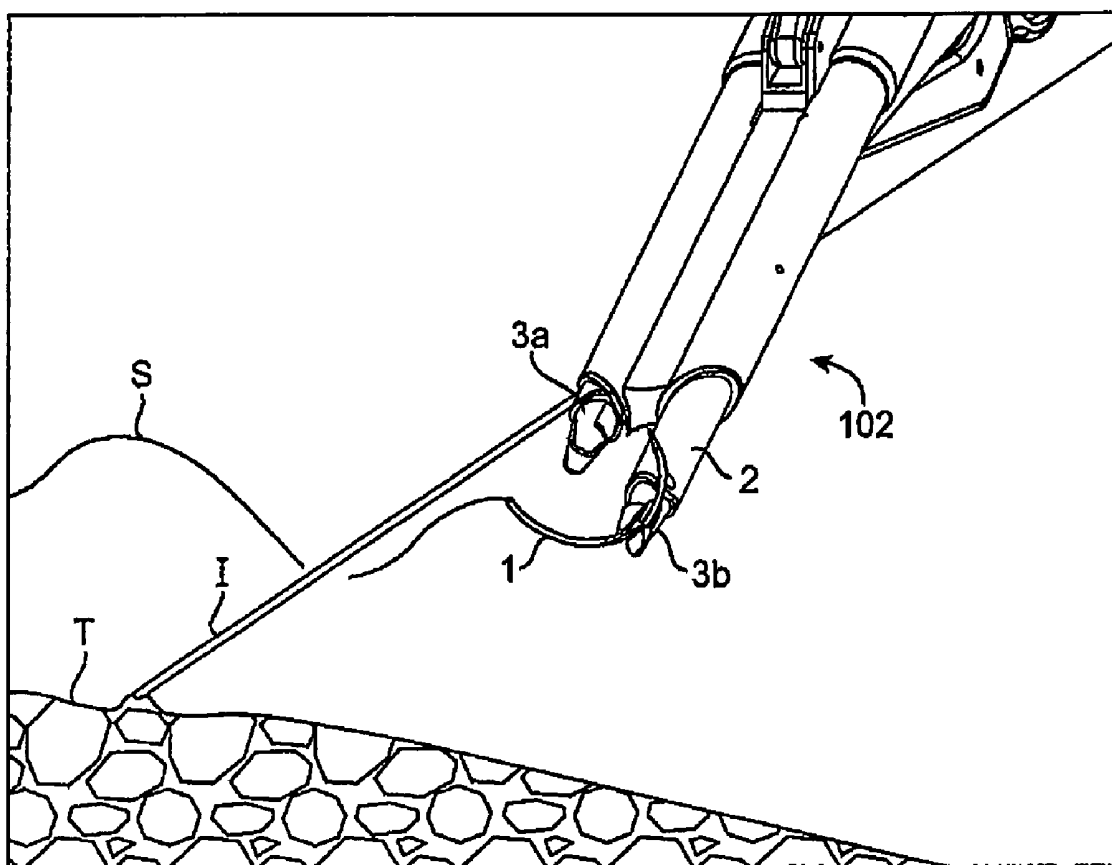
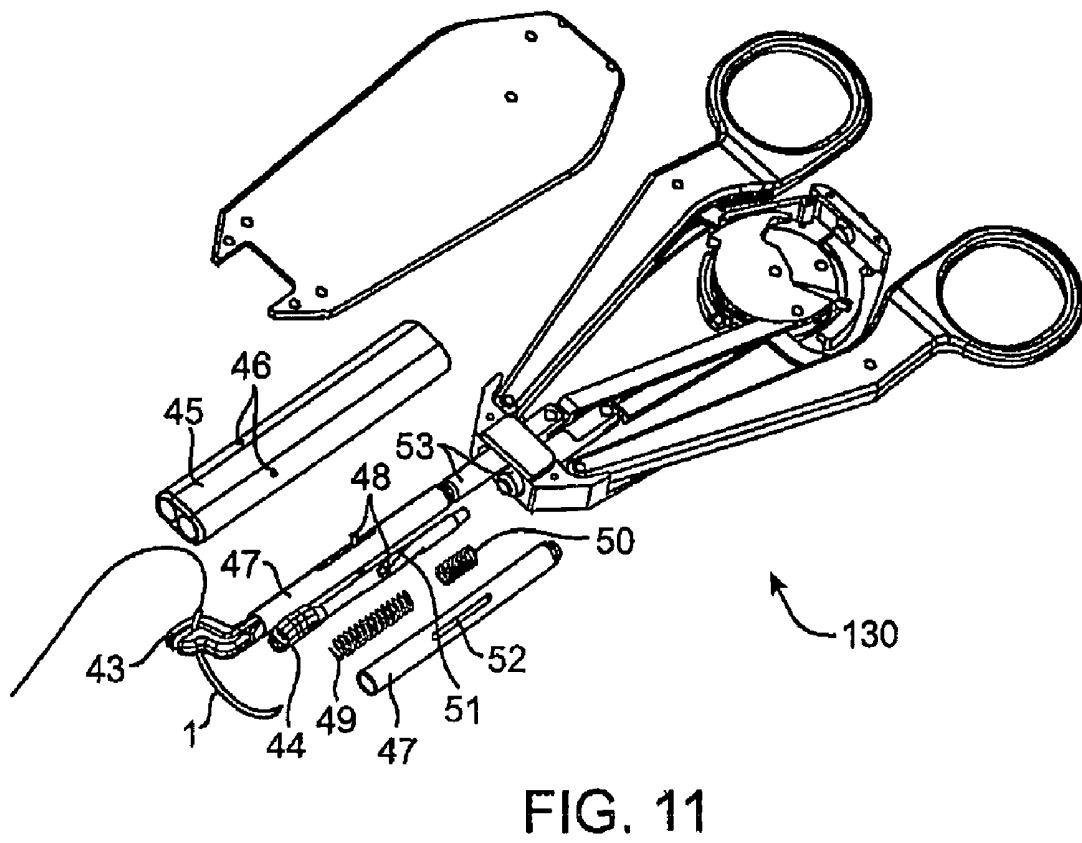
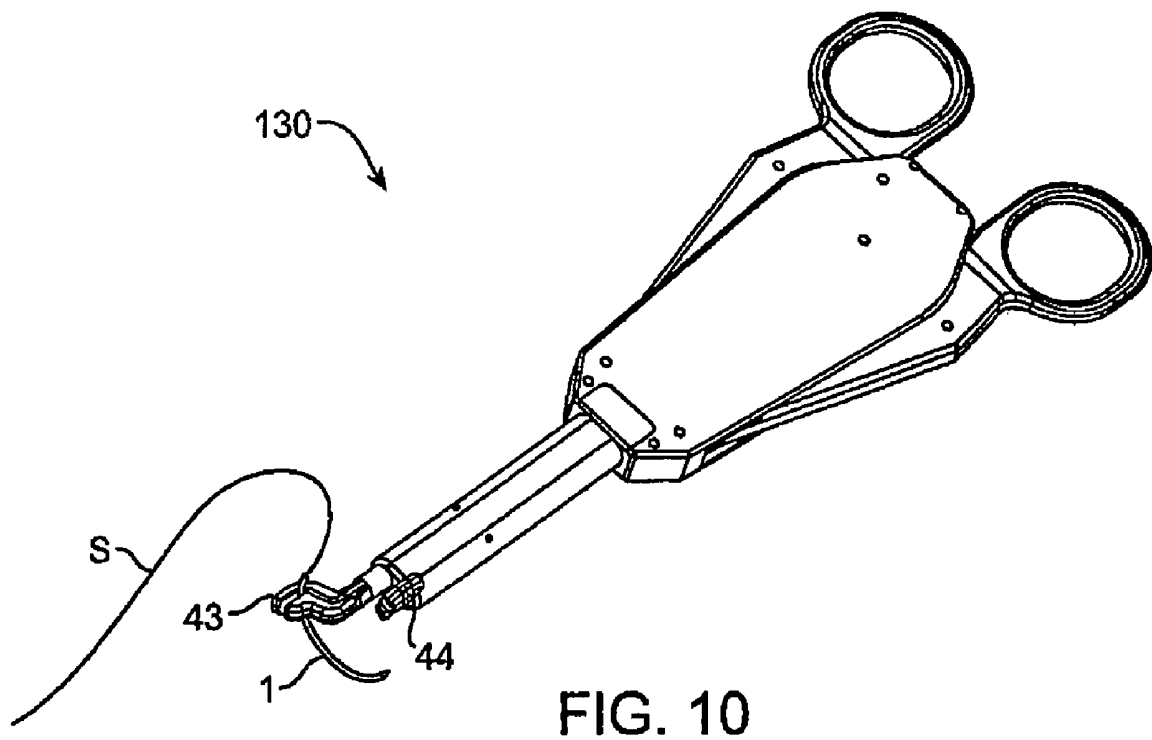

FIG. 9



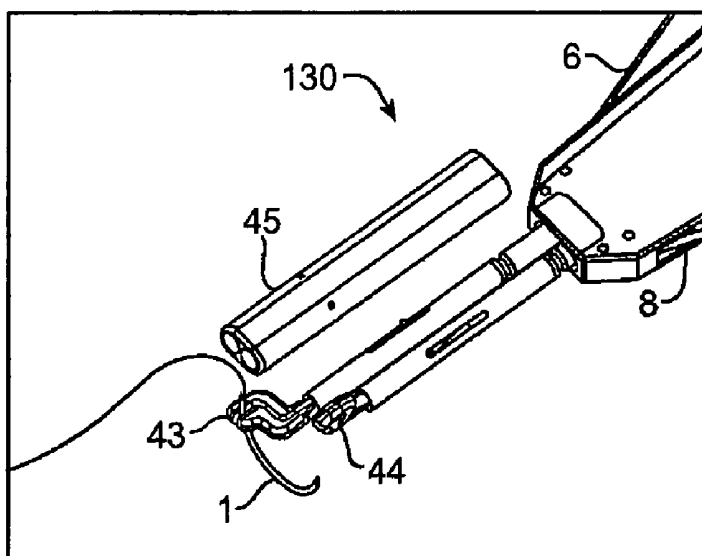

FIG. 12

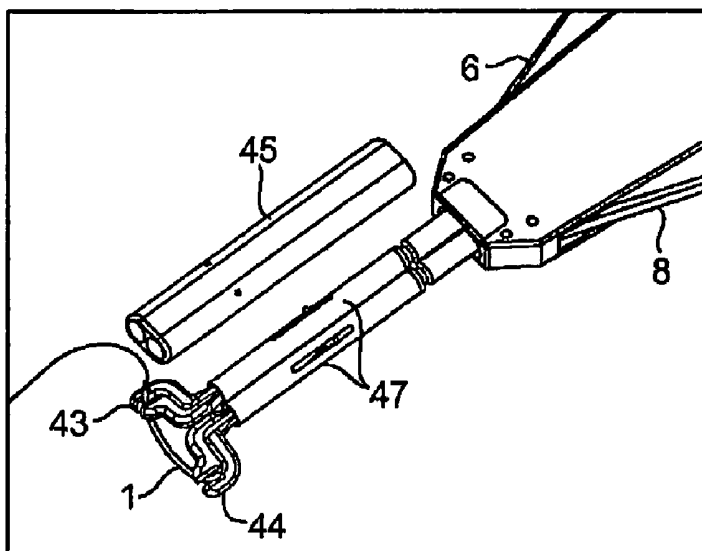

FIG. 13

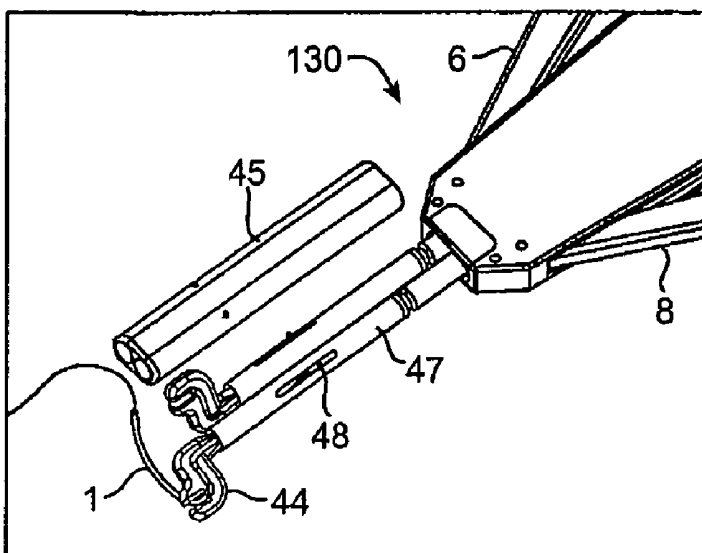
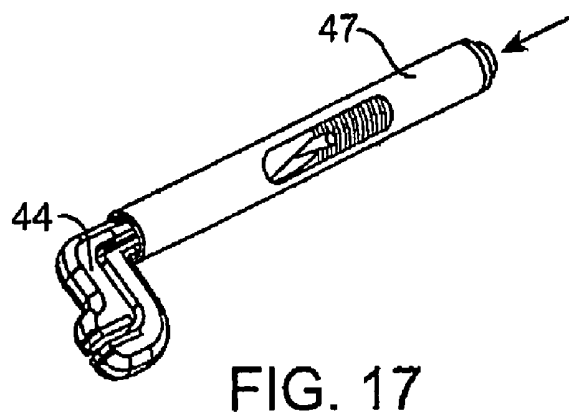
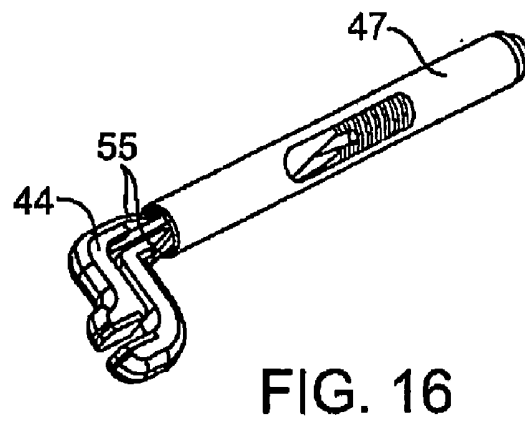
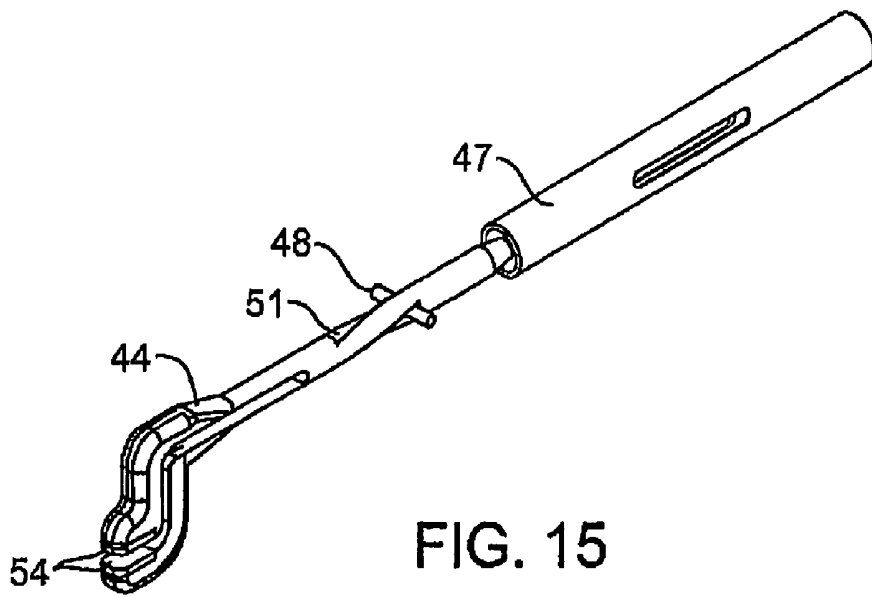
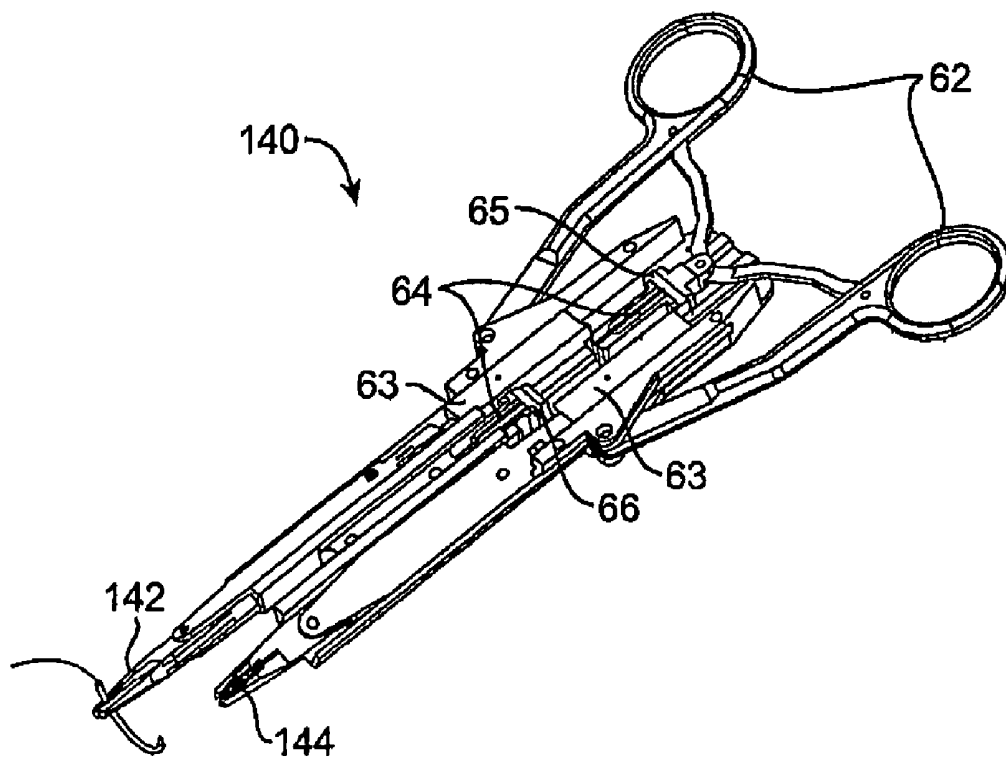
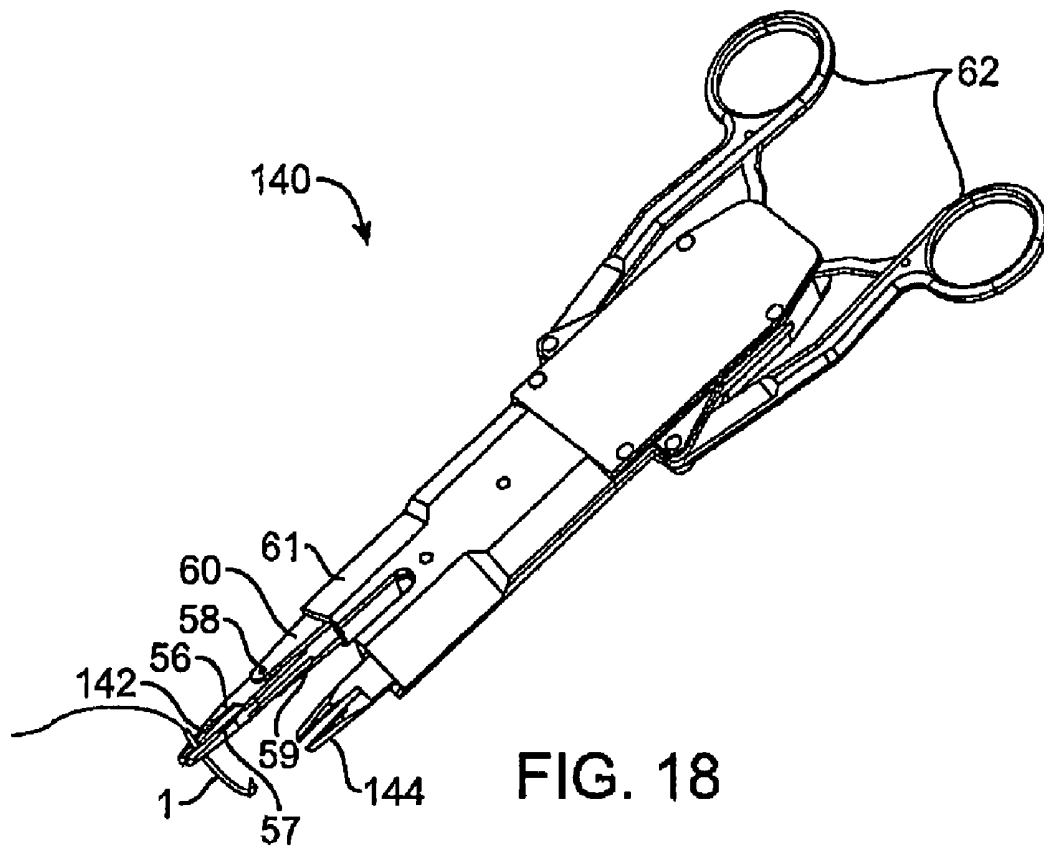
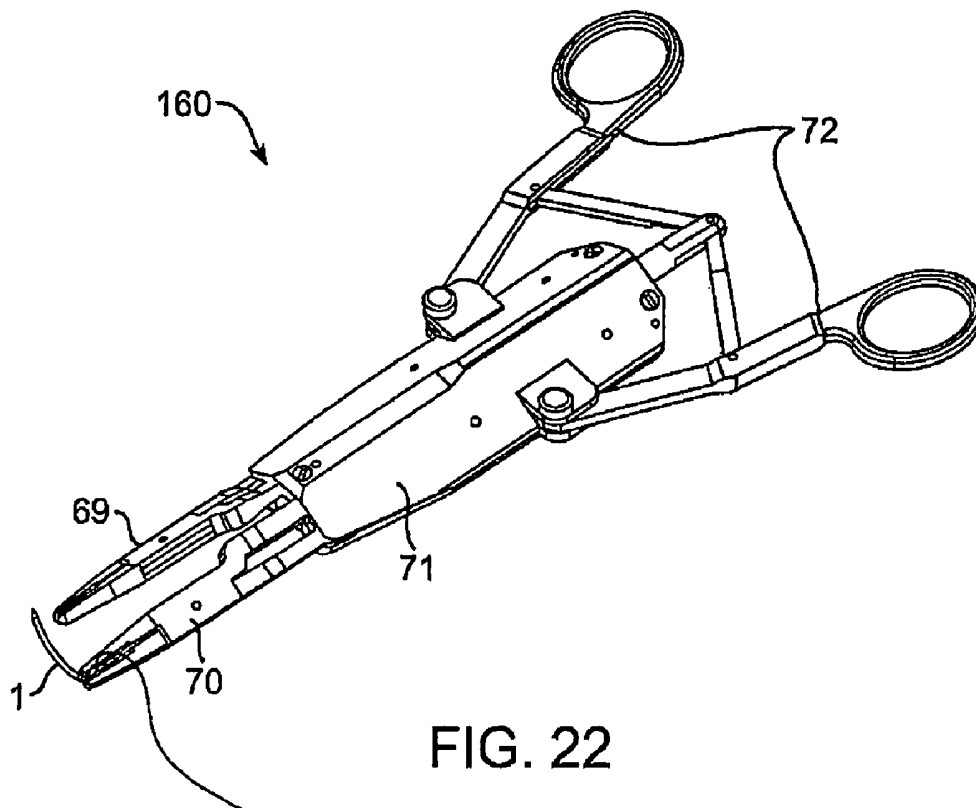
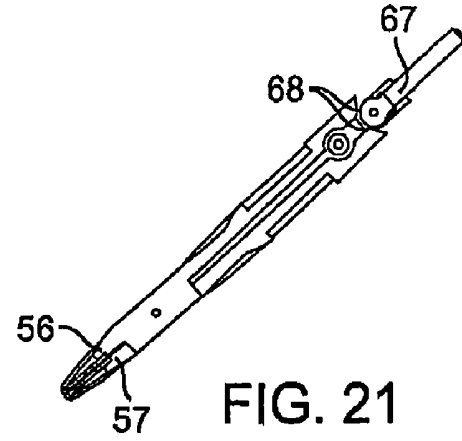
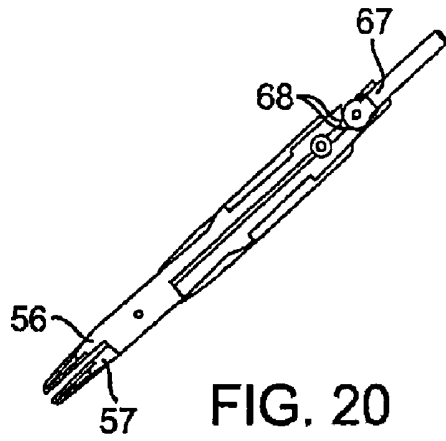
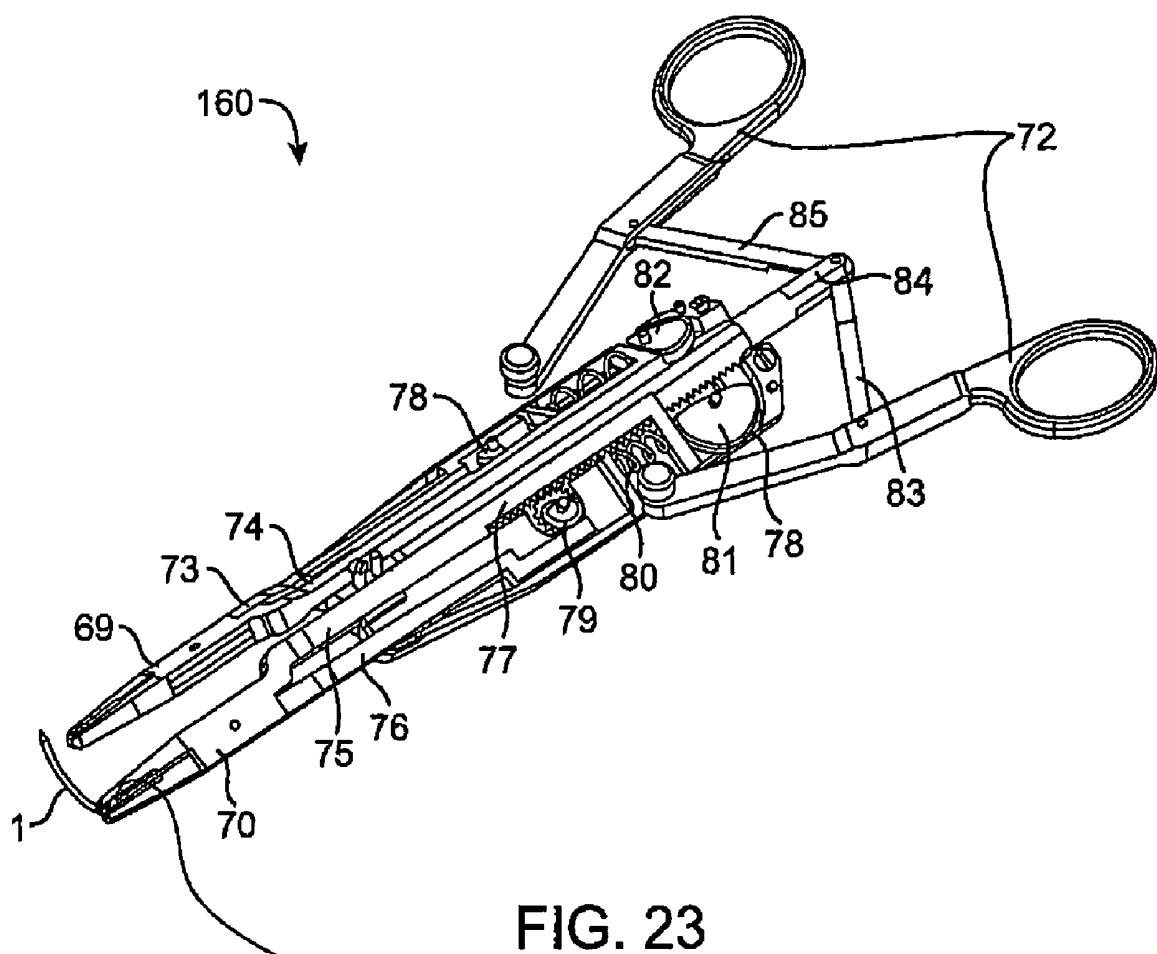

FIG. 14









SUTURING DEVICE, SYSTEM AND METHOD**BACKGROUND OF THE INVENTION**

The present invention generally relates to medical devices, systems, and methods. In specific embodiments, the invention provides devices, systems, and methods for suturing tissues in open surgery, minimally invasive surgical procedures, and the like.

Although many aspects of surgery have changed radically over the last several decades, some surgical techniques have remained remarkably constant. For example, as was true fifty years ago, suturing remains a common technique for approximation of tissues, ligation of tissues, affixing tissues together, and the like.

Suture has been used in open surgical procedures for generations to therapeutically treat diseased tissue and to close surgical access sites and other wounds. More recently, the use of minimally invasive surgical techniques has expanded, with surgical therapies often being performed at internal surgical sites. Although a wide variety of visualization techniques (including laparoscopes and other endoscopic viewing devices, fluoroscopy and other remote imaging modalities, and the like) have been developed to allow surgeons to view these internal surgical sites, and although a large variety of new tissue treatment techniques have been developed (including ultrasound techniques, electrosurgical techniques, cryosurgical techniques, and the like) and are now widely available, many modern surgical interventions continue to rely on suturing.

A wide variety of alternatives to suturing of tissues have been developed, and have gained varying degrees of acceptance in certain surgical procedures. Staples and tissue adhesives are used quite frequently in many open and minimally invasive surgical settings, and a variety of tissue welding techniques have also been proposed. Nonetheless, suturing remains ubiquitous in surgery, as suturing provides a number of advantages over many of the alternatives.

Suture's advantages include the large knowledge and skill base that surgeons have developed over the years. Additionally, a variety of off-the-shelf, pre-packaged surgical needles with suture are available from a large number of suppliers at very reasonable cost. Surgeons are able to precisely control the location of suture stitches by grasping the suture needle and first pushing it and then pulling it through the target tissue. In open surgery the surgeon may manually grasp the suture needle directly with his or her hand, although both open and minimally invasive procedures are often performed by grasping the needle with a needle grasping tool and manipulating the tool to place the suture stitches. The results obtained using suture are highly predictable, although dependent on the skill of the surgeon. In light of its advantages, the use of suture does not appear likely to disappear any time soon, with even modern robotic surgical techniques often making use of suture.

Although suture remains popular in surgery at least in part due to its significant advantages, suturing is not without disadvantages. In particular, placing a large number of suture stitches can be tiring and quite time-consuming. Manipulation of a suture needle can be difficult even in open surgery due to the limited space that is often available around the target tissues. The challenges of manipulating suture needles may be even greater in minimally invasive surgical procedures, where the needles are often manipulated using long-handled tools extending through a small aperture, typically while viewing the procedure on a display which is offset from the surgical site. Tying knots with a desired amount of tension

and the like may call for intricate and precise manipulation of the suture, further complicating and delaying open and minimally-invasive surgeries. In fact, the time spent closing/suturing the access site may be significantly greater than the time spent treating the underlying target tissues for many procedures.

There have been a variety of proposals for modifications to standard surgical suturing structures and methods to try to address the above disadvantages. At least some of these proposals may seek to rely on specialized and/or proprietary suturing needle systems, which could increase costs and preclude their wide acceptance, especially in third world countries. Unfortunately, many proposals for modifying existing suturing techniques may also decrease the surgeon's control over the placement of the suture, such as by relying on an automated or indirect mechanical movement of a device to drive a suture needle into and/or through tissues. While these new proposals have in the past or may in the future gain varying degrees of acceptance in one or more surgical procedures, standard suturing techniques continue to predominate throughout surgery in general.

In light of the above, it would be desirable to provide improved suturing devices, systems, and methods. It would be generally desirable to maintain some, most, or all of the advantages of standard suturing techniques, preferably while decreasing the time required for suturing, the strain on the surgeon, the training involved in achieving competence or time-efficiency in suturing techniques, or the like. It would be particularly advantageous if these improvements could be provided without requiring extensive capital investments for new equipment, without significant increases in complexity of the suturing process, or without having to resort to specialized or proprietary suturing needles and the like.

BRIEF SUMMARY OF THE INVENTION

The present invention generally provides improved medical suturing devices, systems, and methods. Embodiments of the invention provide improved suturing devices and methods that maintain some or all of the advantages of standard open and/or minimally invasive suturing techniques while providing enhanced speed and ease of use. Exemplary suturing devices may hold a suture needle at a fixed location relative to a handle of the device, allowing the surgeon to grasp and manipulate the handle so as to insert the needle through the tissues to be sutured in a manner closely analogous to use of a standard needle gripper. Cycling of the handle of the device from a closed position to an open position and back to the closed position may result in the needle being alternately gripped by a first clamp (for example, along a proximal portion of the needle, suitable for insertion of the tip of the needle into and through tissue), and then by a second clamp (for example, along a distal portion of the needle, suitable for pulling the protruding needle out from the tissue), and optionally again by the first clamp (ready for initiation of the next stitch). The needle will often remain at a substantially fixed location relative to the body and handle of the suturing device during at least the insertion and/or pulling of the needle through the tissue, allowing the surgeon to maintain precise control over needle movement and positioning of the suture. Advantageously, standard off-the-shelf suturing needles with their attached suture may be used, and the device may be employed in an open surgical setting or a minimally invasive procedure.

In a first aspect, the invention provides a suturing method. The suturing method comprises inserting a distal portion of a suturing needle distally through a tissue by moving a body of

a suturing device. The body is moved while a clamp of the suturing device holds the needle at a fixed location relative to the body. The distal portion of the needle is grasped with a second clamp of the suturing device, and the proximal portion of the needle is released from the first clamp. The proximal portion of the needle is pulled through the tissue by moving the body while the second clamp holds the needle.

The second clamp will often hold the needle at a fixed location relative to the body of the suturing device while the needle is pulled free. The needle may also remain at a substantially fixed location relative to the body of the suturing device while alternating the clamps, for example, by grasping the proximal portion of the needle with the first clamp and only then releasing the distal portion of the needle from the second clamp. The inserting of the distal portion of the needle into the tissue with the first clamp, switching clamps, and then pulling the proximal portion of the needle through the tissue with the second clamps can significantly facilitate forming a plurality of suture stitches, and may avoid completely releasing the needle and/or re-aligning the needle with the device each time a stitch is formed. Handling the needle back and forth between the first and second clamps will often be effected by actuating a handle of the suturing device with a hand of a surgeon, the handle typically moving from an open handed configuration to a closed grasp configuration. Preferably, the handle will be in the closed grasp configuration at least while inserting the distal portion of the needle into tissues.

In the exemplary embodiments, cycling the handle (for example, from closed to open, and back to closed) alternates which clamp of the suturing device is supporting the needle from the first clamp, to the second clamp, and back to the first clamp. By having both clamps supporting the needle for at least a portion of the handle actuation cycle, unintended movement of the needle relative to the body of the device (and the handle) can be inhibited.

The suturing device body will often include a housing containing a linkage, and the linkage may include an alternatable drive element. The linkage will often drivingly couple the handle to the first and second clamps. With each handle actuation cycle, the alternatable drive element may move back and forth between a first configuration and a second configuration. In its first configuration, the alternatable drive element may drive a first portion of the linkage coupled to the first clamp. In its second configuration the alternatable drive element may drive a second portion of the linkage coupled to the second clamp.

In an exemplary embodiment, the handle actuation cycle may effect rotation of a drive wheel. The first and second linkage portions may each comprise a driven wheel, and the alternatable drive element in the first configuration may drivingly couple the drive wheel with the driven wheel of the first linkage portion. In the second configuration of the alternatable drive element, it may drivingly couple the drive wheel with a driven wheel of the second linkage portion. The alternatable drive element may be, for example, slidably or pivotally attached to the drive wheel and may move back and forth so as to engage surfaces of the driven wheels on either side of the drive wheel, with the wheels being driven about a common axis. Other linkage embodiments may employ an alternatable drive element in the form of a slider having alternative positions during axial movement, or the like. Still further alternative linkage embodiments may employ rack and pinion gears and cams, cables, and/or the like, with or without alternatable drive elements.

In many embodiments, the first clamp will be displaced laterally from around an axis of the needle when the second

clamp is used to move the needle through tissue. Similarly, the second clamp may be displaced laterally from around the needle when the first clamp is used to move the needle through tissue. Each clamp may, for example, be mounted to an associated shaft, and these shafts may reciprocate so as to extend distally from a housing of the body before closing of the clamp around the needle. In some embodiments, the clamp may also pivot about an axis of the shaft while moving between a retraced position and an extended needle grasping position. A spring or other biasing means may inhibit closing of the clamp before the clamp is properly disposed around the needle, or the linkage may otherwise be configured to extend the shaft before closing of the clamp. In some embodiments, the shafts, clamps, and needle may move axially slightly relative to the housing of the body when the handle is cycled.

Conveniently, a release input may be provided on the suturing device so as to release the needle from both the first and second clamps. The needle may comprise an off-the-shelf needle which is sold primarily for standard open or laparoscopic procedures. These needles often come prepackaged with suture, and are available in a large variety of needle sizes and configuration, suture types (including resorbable and non-resorbable sutures), and the like, often at very modest costs. Alternatively, specialized needles may also be employed.

In another aspect, the invention provides a suturing device for use with a suture needle. The device comprises a body having a proximal end and a distal end. A first clamp is disposed near the distal end of the body. A second clamp is also disposed near the distal end of the body. A linkage effects movement of the first and second clamps between a grasping configuration and a displaced configuration. Each clamp grasps the needle at an associated grasping location in the grasping configuration, and is laterally displaced from the needle in the displaced configuration. The grasping locations are fixed relative to the body.

In another aspect, the invention provides a suturing device for use with a suturing needle. The device comprises a body having a proximal end and a distal end. A handle is disposed near the proximal end of the body. The handle is actuatable from a first configuration to a second configuration and back to the first configuration so as to define an actuation cycle. A first clamp and a second clamp are disposed near the distal end of the body, and the clamps are coupled to the handle so that an actuation cycle initiated while the first clamp is grasping the needle results in grasping of the needle with the second clamp and release of the needle from the first clamp, and then in the first clamp grasping the needle and the needle being released from the second clamp.

BRIEF DESCRIPTION OF THE DRAWINGS

FIG. 1 is a perspective view of an exemplary embodiment of a suturing device with one of the clamps of the suturing device grasping a suturing needle.

FIG. 2 is a perspective view of a proximal portion of the suturing device of FIG. 1, with a cover removed from a proximal housing of the suturing device to show a portion of a linkage coupling a handle of the suturing device to the clamps of the suturing device.

FIG. 3 is an exploded perspective view of components of the linkage shown in FIG. 2.

FIG. 4 is an exploded view of a distal portion of the suturing device of FIG. 1, showing components of a clamp along with a reciprocable shaft and elements of the linkage that effect movement of the reciprocable shaft and actuation of the clamp.

FIGS. 5-9 are perspective views showing use of the device of FIG. 1 for suturing tissues.

FIG. 10 is a perspective view of an alternative suturing device having first and second clamps which both reciprocate and rotate away from a suturing needle after releasing of the needle from the clamp.

FIG. 11 is an exploded view of the suturing device of FIG. 10 showing some of the components of its drive linkage.

FIGS. 12-14 are partially exploded perspective views showing a portion of an actuation cycle of the suturing device of FIG. 10, and showing how the clamps both reciprocate and rotate away from the suturing needle.

FIGS. 15-17 are perspective views of components of the suturing device of FIG. 10, showing how rotation of the reciprocable shaft is effected.

FIG. 18 is a perspective view of another an alternative suturing device which holds a suture needle so that an axis of the needle extends along an actuation plane of a handle of the device.

FIG. 19 is a perspective view of a suturing system including the suturing device and needle of FIG. 18, with a cover removed so as to show components of a linkage coupling the actuatable handles of the device to clamps for holding the needle.

FIGS. 20 and 21 are detailed views illustrating reciprocable shafts and drive linkages configured to effect movement and actuation of the clamps in the suturing device of FIG. 18.

FIG. 22 is a perspective view of yet another alternative suturing device and system having a drive system including a rack and cams.

FIG. 23 is a perspective view of the suturing device of FIG. 22 with a cover removed so as to show components of the drive system of the device.

DETAILED DESCRIPTION OF THE INVENTION

The present invention is generally directed to improved medical suturing devices, systems, and methods. Exemplary embodiments of the invention provide improved suturing devices and methods for suturing tissues that can significantly increase the speed and ease of suturing, particularly when suturing of long incisions or where large numbers of stitches are to be deployed.

The invention should find a wide variety of applications for stitching anatomical tissues in both humans and animals. Along with endoscopic operations (for example, in laparoscopy) these structures and methods may find use in other areas of surgery where tissues are to be stitched, providing particular advantages for stitching of large incisions by increasing the ease and speed with which each individual stitch may be placed, as well as facilitating and expediting the formation of knots in the suture. The suturing devices and associated methods described herein may, for example, be used suture a wide variety of strata of anatomical tissues, including (but not limited to) subcutaneous layers, fascia, the outer skin, various organs (including the uterus), and the like. While exemplary embodiments are set forth below, these suturing devices and methods may be applicable to a wide variety of suturing operations, including open surgery, large and small cavity procedures, endoscopic procedures, microsurgery (including for suturing of veins, arteries, and the like), and many specialized surgeries. Embodiments of these devices and methods may be particularly useful for surgeries involving long incisions, including plastic surgeries. A wide variety of blood vessels, including both veins and arteries, may also be stitched using the techniques described herein, for formation of anastomoses and the like. Along with

increasing the speed and/or ease of forming surgical suture stitches, embodiments of the invention will often maintain the control a doctor has over the placement of the sutures by maintaining a fixed relationship between the movements of the doctor's hand and the insertion and withdrawal of the suturing needle. Hence, among the procedures which may benefit from the invention are subcuticular peritoneum, fascia closure, and skin closure.

While embodiments of the invention may include (or be used within) a powered or automated system, optionally making use of electromechanical power, hydraulic power, or the like (for example, with some embodiments being included within a robotic system), other embodiments may be configured for manual manipulation by one or more hands of a surgeon, often without having to resort to complex sub-systems or external power.

Many embodiments of the devices described herein will be sterilizable so as to allow repeated use. Sterilization may be effected using autoclave techniques, chemical sterilization, irradiation, or the like, with most or all of the structures of the suturing device being formed of materials suitable for repeated sterilization (such as stainless steel, other metals and alloys, and the like). In general, the suturing device may comprise one or more plastics and/or metals common to surgical devices. Although specialized or proprietary suturing needles may be employed in some embodiments (for example, needles having flat gripping surfaces so as to maintain an alignment between the needle and an associated clamp), many embodiments of the suturing device will be suitable for use with standard off-the-shelf suture needles such as those packaged with any of a wide variety of permanent or resorbable suture materials in a hermetically sealed package. In fact, the invention may find some of its most immediate applications for facilitating surgical procedures performed manually in Third World countries, allowing physicians to treat a larger number of patients with greater ease than can be done using standard suturing techniques, but without the cost or complexity of recently-proposed automated suturing systems.

Referring now to FIG. 1, an exemplary suturing system 100 generally includes a suturing device 102 and a needle 1. Needle 1 generally has a proximal end 104 and a distal end 106, with at least the distal end being sharpened to facilitate insertion of the needle distally into and through tissues. Surgical needles are often formed with a curving shape between the proximal and distal ends, and are often packaged with a suture extending from proximal end 104, with the needle sometimes being referred to as an acus.

Suturing device 102 generally has a body 112 having a proximal end 108 and a distal end 110. A pair of clamps 3 are disposed near the distal end 110, while first and second handles 6, 8 are disposed near proximal end 108. Body 112 may include a proximal housing 7 and a distal extension 4. The distal extension may have a pair of channels, with each channel reciprocatably receiving a shaft 2 supporting an associated clamp 3.

In this embodiment, clamps 3 are mirror-symmetric, although they may alternatively have differing shapes. Clamps 3 are generally offset so as to grip axially offset portions of needle 1, with one of the clamps gripping a more proximal portion of the needle and the other clamp gripping a more distal portion of the needle. When handles 6, 8 are in a close-handed configuration as illustrated in FIG. 1, only one of clamps 3 will typically grip needle 1, the other clamp being retracted proximally away from the needle. Handles 6, 8 have openings for receiving fingers of the surgeon's hand, and the surgeon will typically actuate the handles by opening them

7

from the closed-handed configuration shown to an open-handed configuration 114. Starting with handles 6, 8 in the closed (as shown in FIG. 1), when the handle is moved to open-handed configuration 114 and is then returned to the closed-handed configuration, the handle may be described as having completed an actuation cycle.

With each actuation cycle of handles 6, 8, the clamp 3 supporting needle 1 is alternated so that a needle initially supported by grasping the needle in first clamp along a proximal portion of the needle will, when handles 6, 8 are in open-handed configuration 114, instead be supported by the second clamp along a more distal portion of the needle. As handles 6, 8 move back to the closed-handed configuration to complete the cycle, the clamps again alternate, so that closing of the handle results in extension of the proximal clamp, gripping of needle 1 with that proximal clamp, release of the needle from the distal clamp, and retraction of the distal clamp. The position of needle 1 relative to body 112 may remain substantially fixed throughout the handle actuation cycle, although the shafts may move axially slightly as the needle goes from being held by one clamp, to both clamps, and then to the other clamp, with this movement of the needle being less than a length of the needle.

Referring now to FIGS. 1 and 2, handles 6, 8 are pivotally attached to housing 7 of body 112. Housing 7 generally includes at least one lid 9 (the top lid shown removed in FIG. 2), with the proximal housing preferably including opposed first and second lids 9 on opposed major surfaces of the body. Lids 9 and the other structures of housing 7 generally enclose a drive linkage 116 coupling handles 6, 8 to clamps 3. In the embodiment of FIGS. 1-9, drive linkage 116 generally includes a drive wheel 11 and two driven wheels 10 and 12. The driven wheels 10 and 12 are mirror-symmetric and joined by tie rods 14 and 21 to clamps 3.

Referring now to FIGS. 1-3, driven wheel 10 has a thrust surface 24, while driven wheel 12 has a stop surface 23 and an incline 22. The driving wheel is supported so as to rotate about an axle 20, the driving wheel also having a lug 13. The driving wheel 11 is coupled to handles 6, 8 by ties 18 and 19, so that actuation of the handles relative to the body 7 induces rotation of driving wheel 11 about the axle. The driven wheels 10, 12 rotate coaxially with driven wheel 11.

Lug 13 generally comprises an alternatable configuration driving element. Lug 13 either drivingly couples driving wheel 11 with driven wheel 10, or with driven wheel 12, depending on the configuration of lug 13 at the time. More specifically, when lug 13 is disposed above a guide 15 as shown in FIG. 2, the lug drivingly couples the driving wheel 11 with the upper driven wheel 10. When lug 13 is disposed below guide 15, the lug drivingly engages driven wheel 12, and is disengaged from driven wheel 10. A reset or release input button 16 interacts with guide 15 and a spring-loaded positioning arm 17 so as to allow both clamps 3 to release needle 1.

As can be understood with reference to FIGS. 1-4, each clamp 3 is connected by an associated shaft 2 to the remaining components of drive linkage 116. Shafts 2 each include a lengthwise slot 118 (see FIG. 4), which allows the shaft to move within the channels of body extension 4. Guiding pins 32 ride in slots 118, and the guiding pins 32 are also fixed in extensions 4 within openings 5.

Moving wedges 31 within shafts 2 also have lengthwise slots 118 for receiving guiding pins 32. The wedge surfaces of moving wedges 32 engage corresponding surfaces of working jaws 25, with the working jaws forming the open and closable structure of clamps 3. More specifically, distal movement of moving wedge 31 against a corresponding surface of

8

working jaws 25 closes clamps 3, the working jaws being attached to a distal clevis of shaft 2 by axle 27. A spring ring 30 biases working jaws 25 to an open configuration, allowing them to move around and capture needle 1 before the working jaws are forced shut by the moving wedges.

Working jaws 25 may have a variety of surfaces for holding needle 1, the clamps preferably holding the needle so that movement of the needle relative to suturing device 100 is inhibited during stitching. The surfaces of working jaws 25 may be hardened by deposition of diamond or a diamond-like carbon, or inserts 26 of a material harder than that of working jaws 25 may be provided. Optionally, working jaws 25 may have hard-surfaced inserts comprising tungsten and/or cobalt, with the inserts optionally being fabricated using powder sintering or the like.

A return spring 28 extends between pin 28 in working jaws 25 and the guiding pin 32, with the return spring partially fixed within a lumen of moving wedge 31. A spring 34 in the proximal portion of moving wedge 31 is held by a plug 37, with the distal end of spring 34 interacting with shaft 2 via thrust ring 33. Spring 34 can bring the moving wedge 31 into a position suitable for releasing the working jaws. A compensation spring 36 pressed against plug 37 writes on a rod 35 of a pusher 42 so as to maintain a desired axial force. Pusher 42 has an insert 40, which is connected with the pusher 42 by pin 39 and lug 38. The lug rotates about axle 41.

When handles 6 and 8 are moved apart to an open-handed configuration 114, a retracted clamp 3 and its associated shaft 2 moves from within a channel of body extension 4. While retracted, the moving wedge 31 is biased by spring 34 away from working jaws 25, so that spring ring 30 is free to open the clamp to allow it to extend around needle 1. Extension of compensating spring 34 may be at its greatest point while the associated clamp 3 is retracted, and insert 40 extends from pusher 42 with lug 38 in the insert.

As handles 6 and 8 are brought together, driving wheel 11 is turned by connector ties 18, 19. Lug 38 interacts with thrust surface 24 of driven wheel 10 and moves the driven wheel 10 in rotation. The motion of driven wheel 10 is transferred by tie rod 14 so as to move insert 40 axially along body extension 4. The insert, in turn, moves the pusher 42 along body extension 4, the relative position of the insert 40 and pusher 42 being maintained by an inner surface of shaft 2 interacting with plug 30 so as to inhibit rotation of the plug about axle 41. Pusher 42 presses spring 34 and compensation spring 32, and via plug 37 and thrust ring 33, moves shaft 2. The movement of shaft 2 overcomes spring 29 and extends the shaft from the channel of body extension 4.

During distal movement of pusher 42, spring 34 and compensating spring 36 are sufficiently stiff so as to inhibit elongation, as their spring coefficients are significantly higher than that of return spring 29. However, engagement between an end of slot 118 in shaft 2 and guiding pin 32 eventually inhibits further distal movement of the shaft.

Once shaft 2 has stopped its distal movement (due to engagement of lengthwise slot 118 with guiding pin 32), spring 34 begins to contract, its rigidity being lower than that of compensating spring 26. As a result, moving wedge 31 begins to extend distally relative to working jaws 25, the corresponding surfaces of the wedge and working jaws sliding against each other so as to move the proximal ends of the working jaws apart and bringing the distal needle gripping inserts 26 of working jaws 25 together so as to grasp needle 1. As spring 34 contracts, contraction of compensation spring 36 also begins and the insert 40 moves. When lug 38 extends into and/or engages window 2a of shaft 2, pusher 42 engages a surface of body extension 4 or proximal housing 7, and axial

movement of the pusher stops. Insert **40** continues moving, so that lug **38** rotates around axle **41**. The lug interacts with an edge of shaft **2** and, overcoming compensation spring **36**, starts to draw shaft **2** and its contents into body extension **4**.

The clamping force on needle **1** by clamps **3** may be determined by the spring characteristics of compensating spring **36** so as to remain within a desired range. Advantageously, the clamping force imposed by suturing device **100** on needle **1** may correspond to forces applied by standard needle holders. Thrust surface **23** of driven wheel **12** approaches a tooth of spring-loaded fixing arm **17**, and overcoming the spring, the thrust surface passes under the tooth, releasing the tooth so that the tooth and thrust surface are positioned for neutral engagement. After the thrust surface **23** of the driven wheel **12** passes beyond the tooth of spring loaded fixing arm **17**, engagement of the thrust surface and tooth inhibit the return of the driving linkage **116** to its prior configuration, thereby inhibiting the release of needle **1** from the closed working jaws **25** so that the needle is not dropped.

As handles **6, 8** continue to move toward the open-handed configuration of the handle actuation cycle, movement of driven wheel **12** is inhibited by spring-loaded fixing arm **17**. Driving wheel **11** nonetheless turns, and is reset. More specifically, incline **22** of driven wheel **12** moves lug **13** from a configuration above guide **15** to a configuration in which the lug is disposed under the guide. Hence, when handles **6, 8** continue to move, here towards a closed-handed configuration, the lug **13** will interact with thrust surface **24** of the driven wheel **10**. The description above regarding driven wheel **12** is thus repeated but with driven wheel **10** instead. When moving under the spring-loaded fixing arm **17**, the thrust surface **23** of driven wheel **12** lifts the spring-loaded fixing arm **17** and releases driven wheel **10**.

By action of spring **34**, moving wedge **31** is retracted proximally from between the proximal ends of working jaws **25**, so that the proximal ends of the working jaws are brought together by spring-loaded ring **30**. Distal ends of working jaws **25** thereby move apart and the needle is released.

Each repeated opening and closing actuating cycle of handles **6, 8** alternates the needle between being held by one, and then the other of clamps **3**, and often back to the first clamp. In other embodiments, each handle actuation cycle effects transfer of the needle from one clamp to the other, with the needle returning to be held solely by the first clamp only with a second handle actuation cycle. Regardless, during each cycle each retracted clamp is preferably extended around an associated portion of needle **1** and is closed before the previously extended clamp opens, so that the needle is held continuously by at least one of clamps **3** throughout the handle actuation cycle.

If it is desired to release needle **1** from suturing device **112** at any time during, before, or after a handle actuation cycle, release can be effected by pressing on release input button **16**. Pressing on button **16** causes spring-loaded fixing arm **17** to lift away from driven wheels **10** and **12**, thereby resetting the clamps in their proximal opened configuration.

Referring now to FIGS. **5-9**, the use of suturing device **102** for suturing an incision **I** in tissue **T** can be understood. Initially, handles **6, 8** (see FIG. **1**) are in a closed-handed configuration and the handles are grasped by a hand of a surgeon. Needle **1** is supported by a first clamp **3a**, with the first clamp grasping a proximal portion of the needle adjacent a suture **S**. The second clamp **3b** is retracted proximally away from needle **1**, so that a distal portion of the needle is free and exposed, as illustrated in FIG. **5**.

As can be understood with reference to FIG. **6**, the surgeon manually moves suturing device **102** by manipulating

handles **6, 8** so as to insert a distal portion of suturing needle **1** through tissue **T**. Advantageously, body **112** and linkage **116** (see FIG. **2**) of suturing device **102** inhibits relative movement of needle **1** relative to the body and handles **6, 8** of the suturing device while the handles are closed. This allows the surgeon to precisely control movement of the needle **1** as it is inserted through the tissue, in a manner analogous to manual manipulation of the needle using a standard needle grasper or forceps. As can be understood with reference to FIGS. **6** and **7**, once the distal portion of needle **1** extends sufficiently through the tissue, handles **6, 8** can be cycled through at least a portion of their actuation cycle. Through the linkage **116**, second clamp **3b** is extended distally from body **112** of suturing device **102**, grasping the distal portion of needle **1**. The first clamp **3a** then releases needle **1** and is withdrawn proximally from around the needle, as illustrated in FIG. **8**.

As can be understood with reference to FIGS. **8** and **9**, once needle **1** is held by second clamp **3b**, the surgeon can again manipulate the needle by moving handles **6, 8**. In some embodiments, the surgeon can grasp the handles in an open-handed configuration while pulling the needle free from the tissue, while in other embodiments the needle will be pulled after the handle has returned to the closed-handed configuration. Regardless, the surgeon uses the handles, body, and clamp **3b** to pull the proximal portion of needle **1** through tissue **T**, thereby leaving suture **S** inserted across incision **I**.

Prior to initiating a second stitch, the surgeon can cycle handles **6, 8** by closing the handles with his/her hand, or by opening and closing the handles through a full actuation cycle. This results in grasping of needle **1** by first clamp **3a** and release of the needle by second clamp **3b**, exposing the distal portion of the needle and displacing the second clamp from the needle so that the needle is ready to again insert through tissue **T**, as can be understood with reference to FIG. **5**. The process can then be repeated without ever having to completely release needle **1**, and by simply actuation of handles **6, 8** after insertion of the distal portion of the needle through the tissue and again after each pulling of the needle free. The process is repeated to form as many stitches as is desired. Analogous insertion of the distal portion of the needle through loops of suture, actuation of the handle, and pulling the needle free can be used to quickly and easily form knots.

As can be understood from the illustrations in FIGS. **5-9**, and as may be indicated by the detailed description above of the articulation of the drive linkage, shafts **2** extending distally from body **112** to clamps **3a, 3b** may move slightly during the handle actuation cycle, for example, with the shaft supporting the clamp initially holding needle **1** retracting slightly into body **112** as the other shaft extends. Nonetheless, each clamp holds the needle at a fixed location while the surgeon holds the handles **6, 8** in the closed configuration and inserts or withdraws the needle into or from the tissue.

Referring now to FIGS. **10-22**, a wide variety of alternative linkage mechanisms, clamp structures, housing, handles, and the like may be employed. Referring first to FIG. **10**, an alternative suturing device **130** may include clamps **43, 44** which both retract proximally and rotate away from needle when not used to hold the needle. Referring now to FIGS. **10-17**, and avoiding describing structures which are substantially similar to those described above, clamps **43** and **44** have bent-shaped inserts **54** made of a hard alloy (see FIG. **15**). Proximal ends of clamps **43** and **44** may have conical surfaces **55** which are located, sized, and configured so as to interact with a distal port of shaft **47**, and more specifically, so that proximally withdrawing the working jaws of clamps **43, 44** into sleeve **47** closes the working jaws of these clamps.

11

Shaft 47 has a lengthwise slot 52 for receiving a guiding pin, while a proximal extension of the working jaws of clamps 43, 44 has a spiral lengthwise slot 51 receiving guiding pin 48. Shafts 47 are connected with pushers 53, and ride in distal body extension 45, with the distal body extension again having openings for receiving the guiding pins.

In alternative suturing device 120, as the guiding pins 45 ride within spiral slot 51 due to axial motion of clamps 43, 44, the clamp rotates away from a needle 1 about the axis of shaft 47 when the clamp retracts proximally.

The rotation of clamps 43, 44 with axial movement of shafts 47 as effected by actuation of handles 6, 8 can be understood with reference to FIGS. 12-13. As can be seen in FIG. 12, a first rotatable clamp 43 holds a proximal portion of needle 1 while handles 6, 8 are in a closed-handed configuration, while second rotatable clamp 44 is both withdrawn proximally and rotated clear of the needle. As the handles begin to open, as illustrated in FIG. 13, distal movement of shaft 47 of second rotatable clamp 44 imparts a twisting motion to the clamp due to the interaction between the guiding pin 48 and the helical slot 51 (see FIG. 11). The second rotatable clamp 44 can rotate into position and extend around needle 1, with the second clamp 44 grasping needle 1 and first clamp 43 withdrawn proximally and rotated free from the needle when the handles are in their fully opened configuration. Once again, a full actuation cycle from a closed configuration to an open configuration and back to a closed configuration may result in the needle alternating from being grasped by the first clamp along a proximal portion of the needle, then being grasped by the second clamp along a more distal portion of the needle (with the handles in the open configuration), and with the needle again being grasped solely by the first clamp when the handles are returned to the closed configuration. The structure and rotation of rotatable clamps 43, 44, along with the associated interaction between shaft 47 and guiding pin 48 are also illustrated in FIGS. 15-17.

Referring now to FIGS. 18-21, a still further alternative suturing device 140 has first and second clamps 142, 144 formed by working jaws 56, 57 connected at an axle 58. The shafts supporting clamps 142, 144 here comprise flattened structures 60 located within channels of body extension 61. Shafts 60 interact with rods 67 of pusher 63. This linkage couples handles 62 to clamps 142, 144 using a moveable rod 65 and an immovable fixing arm 66, along with a flat spring 64. Rods 67 of pushers 63 have inclines 68 which function to open and close the clamps, as can be understood with reference to FIGS. 20 and 21.

Note that in embodiment 140, needle 1 generally extends along a plane of actuation of handle 62. In contrast, in suturing device 102, illustrated in FIG. 1, needle 1 generally extends across the handle actuation plane. Ergonomically, there may be advantages in orienting the needle so that it traverses the handle actuation plane as shown in FIG. 1. Such a configuration may conveniently be used by either a right hand or a left hand of the surgeon, although embodiments configured for use by only one or the other may also be provided.

Referring now to FIGS. 22 and 23, yet another alternative suturing device 160 has an external appearance somewhat similar to suturing device 140 of FIGS. 18 and 19, but makes use of a significantly different linkage mechanism for coupling handle 72 to clamps 69, 70. The clamps again extend from associated channels in body 71, but the linkage here makes use of a rack 77 actuated by a rod 84.

First clamp 69 has elongate levers 73 and 74, while second clamp 70 has levers 75 and 76. Tie rods 83 and 85 axially actuate rack 77 via rod 84, resulting in rotation of cams 78, 79,

12

and large cams 81, 82. The large cams axially extend associated levers 74 and 75 so as to axially extend their associated clamps, while a spring 80 proximally withdraws the clamps when allowed by their cams. The small cams open and close the clamps via levers 73 and 76, with the levers generally acting as followers along the cam surfaces.

While exemplary embodiments of the invention have been described in detail, by way of example and for clarity of understanding, a variety of modifications, changes, and adaptations will be obvious to those of skill in the art. For example, along with the exemplary drive linkages described herein, still further drive linkages may be provided, including those making use of cables and pulleys, worm gears, and the like. Hence, the scope of the present invention is limited solely by the appended claims.

What is claimed is:

1. A suturing method comprising:

inserting a distal portion of a suturing needle distally through a tissue by moving a body of a suturing device while a first clamp of the suturing device holds the needle at a fixed location relative to the body;

grasping the distal portion of the needle with a second clamp of the suturing device;

releasing the proximal portion of the needle from the first clamp;

wherein grasping and releasing of the clamps is effected by moving a handle between a first configuration relative to the body and a second configuration relative to the body, movement of the handle from the first configuration to the second configuration and back to the first configuration defining a handle actuation cycle, each handle actuation cycle alternating a configuration of an alternatable drive element of a linkage between a first configuration and a second configuration;

pulling the proximal portion of the needle through the tissue by moving the body while the second clamp holds the needle;

repeating the handle actuation cycle after pulling the needle from the tissue; and

repeating the handle actuation cycle after again inserting the needle into the tissue and before again pulling the needle from the tissue;

wherein each handle actuation cycle initiated with the alternatable drive element in the first configuration causes the alternatable drive element to drive a first linkage portion coupled to the first clamp so that the first clamp grasps the needle and causes the needle to be released from the second clamp, and wherein each handle actuation cycle initiated with the alternatable drive element in the second configuration causes the alternatable drive element to drive a second linkage portion coupled to the second clamp so that the second clamp grasps the needle and causes the needle to be released from the first clamp, such that the needle alternates between being supported by the first clamp and being supported by the second clamp with each handle actuation cycle.

2. The suturing method of claim 1, wherein the second clamp fixedly holds the needle relative to the body while pulling the proximal portion of the needle through the tissue.

3. The suturing method of claim 2, further comprising: grasping the proximal portion of the needle with the first clamp and then releasing the distal portion of the needle from the second clamp; and

repeating the inserting of the distal portion and pulling of the proximal portion so as to define a plurality of suture stitches.

13

4. The suturing method of claim 3, wherein the grasping and releasing steps are effected by actuating the handle of the suturing device with a hand of a surgeon.

5. The suturing method of claim 1, wherein the suturing device grasps the needle with both the first and second clamps before releasing of the first clamp and before releasing of the second clamp.

6. The suturing method of claim 1, wherein the handle actuation cycle rotates a drive wheel, wherein the first and second linkage portions each comprise a driven wheel, wherein the alternatable drive element in the first configuration drivingly couples the drive wheel with the driven wheel of the first linkage portion, and wherein the alternatable drive element in the second configuration drivingly couples the drive wheel with the driven wheel of the second linkage portion.

7. The suturing method of claim 1, wherein the first clamp is displaced laterally from around the needle when the second clamp is inserting the needle, and wherein the second clamp is displaced laterally from around the needle when the first clamp is pulling the needle.

8. The suturing method of claim 7, wherein each clamp is mounted to an associated reciprocable shaft, and wherein grasping of the needle with each clamp comprises distally extending the associated shaft from a proximal housing of the body, and thereafter closing the clamp around the needle.

14

9. The suturing method of claim 8, wherein grasping of the needle with each clamp further comprising rotating the clamp about an axis of the shaft between a retracted position and an extended grasping position.

10. The suturing method of claim 8, wherein at least one associated spring inhibits closing of each clamp before the clamp is adjacent the needle.

11. The suturing method of claim 1, further comprising actuating a release input of the suturing device so as to release the needle from the first and second clamps.

12. The suturing method of claim 1, wherein the needle comprises an off-the-shelf needle sold primarily for standard open or laparoscopic surgery.

13. The suturing method of claim 1, wherein the alternatable drive element pivots between the first configuration and the second configuration.

14. The suturing method of claim 13, wherein a ramp surface engages the alternatable drive element during the handle actuation cycle so as to pivot the alternatable drive element between the first configuration and the second configuration.

15. The suturing method of claim 13, wherein the alternatable drive element in the first configuration is disengaged from the second portion of the linkage, and wherein the drive element in the second configuration is disengaged from the first portion of the linkage.

* * * * *

UNITED STATES PATENT AND TRADEMARK OFFICE
CERTIFICATE OF CORRECTION

PATENT NO. : 7,588,583 B2
APPLICATION NO. : 11/227981
DATED : September 15, 2009
INVENTOR(S) : Hamilton et al.

Page 1 of 1

It is certified that error appears in the above-identified patent and that said Letters Patent is hereby corrected as shown below:

On the Title page,

[*] Notice: Subject to any disclaimer, the term of this patent is extended or adjusted under 35 USC 154(b) by 522 days.

Delete the phrase "by 522 days" and insert -- by 888 days --

Signed and Sealed this

Twenty-seventh Day of April, 2010

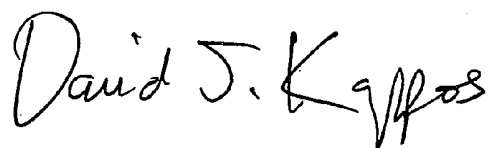
A handwritten signature in black ink that reads "David J. Kappos". The signature is written in a cursive, flowing style with a large initial 'D' and a stylized 'K'.

David J. Kappos
Director of the United States Patent and Trademark Office

UNITED STATES PATENT AND TRADEMARK OFFICE
CERTIFICATE OF CORRECTION

PATENT NO. : 7,588,583 B2
APPLICATION NO. : 11/227981
DATED : September 15, 2009
INVENTOR(S) : Hamilton et al.

Page 1 of 1

It is certified that error appears in the above-identified patent and that said Letters Patent is hereby corrected as shown below:

On the Title Page:

The first or sole Notice should read --

Subject to any disclaimer, the term of this patent is extended or adjusted under 35 U.S.C. 154(b) by 1254 days.

Signed and Sealed this

Twenty-first Day of September, 2010

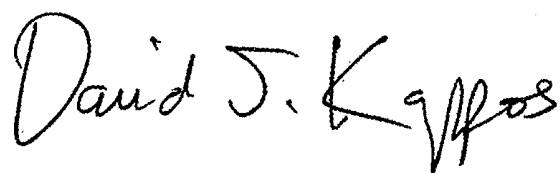
A handwritten signature in black ink, reading "David J. Kappos". The signature is written in a cursive, flowing style with a large initial "D" and a stylized "K".

David J. Kappos
Director of the United States Patent and Trademark Office

专利名称(译)	缝合装置，系统和方法		
公开(公告)号	US7588583	公开(公告)日	2009-09-15
申请号	US11/227981	申请日	2005-09-14
申请(专利权)人(译)	RHAPHIS MEDICAL , INC.		
当前申请(专利权)人(译)	RHAPHIS MEDICAL , INC.		
[标]发明人	HAMILTON HENRY BELMAN YURI		
发明人	HAMILTON, HENRY BELMAN, YURI		
IPC分类号	A61B17/04		
CPC分类号	A61B17/062 A61B17/0469 A61B2017/00367 A61B17/2841		
代理机构(译)	TOWNSEND和TOWNSEND和机组LLP		
其他公开文献	US20070060930A1		
外部链接	Espacenet USPTO		

摘要(译)

改进的医疗缝合装置，系统和方法可以将缝合针保持在相对于装置的手柄的固定位置，允许外科医生抓握并操纵缝合装置的手柄以便以类似于以下的方式将针插入组织。使用标准针夹。将手柄从闭合位置循环到打开位置并返回到闭合位置可以使装置在用第一夹子（例如，沿着针的近端部分）夹住针头之间交替，以用第二夹子夹住针头（例如，沿着针的远端部分并且可选地返回到用第一夹具夹持，其中针通常相对于缝合装置主体停留在基本固定的位置。

