



US 20180042658A1

(19) **United States**(12) **Patent Application Publication**
Shelton, IV et al.(10) **Pub. No.: US 2018/0042658 A1**(43) **Pub. Date: Feb. 15, 2018**(54) **ELECTROSURGICAL (RF) MEDICAL
INSTRUMENTS FOR CUTTING AND
COAGULATING TISSUE**(71) Applicant: **Ethicon LLC**, Guaynabo, PR (US)(72) Inventors: **Frederick E. Shelton, IV**, Hillsboro,
OH (US); **David C. Yates**, West
Chester, OH (US); **Chester O. Baxter,
III**, Loveland, OH (US); **John V. Hunt**,
Cincinnati, OH (US); **Jennifer M.
Mallow**, Cincinnati, OH (US); **Barry
C. Worrell**, Centerville, OH (US);
Taylor W. Aronhalt, Loveland, OH
(US); **Kevin L. Houser**, Springboro,
OH (US); **Geoffrey S. Strobl**,
Williamsburg, OH (US)(21) Appl. No.: **15/792,311**(22) Filed: **Oct. 24, 2017****Related U.S. Application Data**(63) Continuation of application No. 14/026,662, filed on
Sep. 13, 2013, now Pat. No. 9,814,514.**Publication Classification**(51) **Int. Cl.****A61B 18/12** (2006.01)**A61B 18/14** (2006.01)**A61B 18/00** (2006.01)(52) **U.S. Cl.**CPC **A61B 18/12** (2013.01); **A61B 18/1485**
(2013.01); **A61B 18/1447** (2013.01); **A61B**
18/1482 (2013.01); **A61B 2018/1467**
(2013.01); **A61B 2018/1465** (2013.01); **A61B**
2018/1455 (2013.01); **A61B 2018/1412**
(2013.01); **A61B 2018/1407** (2013.01); **A61B***2018/128* (2013.01); *A61B 2018/126*
(2013.01); *A61B 2018/1253* (2013.01); *A61B*
2018/124 (2013.01); *A61B 2018/1226*
(2013.01); *A61B 2018/00958* (2013.01); *A61B*
2018/00952 (2013.01); *A61B 2018/00904*
(2013.01); *A61B 2018/00892* (2013.01); *A61B*
2018/00827 (2013.01); *A61B 2018/00791*
(2013.01); *A61B 2018/00767* (2013.01); *A61B*
2018/00732 (2013.01); *A61B 2018/0072*
(2013.01); *A61B 2018/00714* (2013.01); *A61B*
2018/00648 (2013.01); *A61B 2018/0063*
(2013.01); *A61B 2018/00619* (2013.01); *A61B*
2018/00607 (2013.01); *A61B 2018/00601*
(2013.01); *A61B 2018/00595* (2013.01); *A61B*
2018/00589 (2013.01); *A61B 2018/00577*
(2013.01); *A61B 2018/00559* (2013.01); *A61B*
2018/00339 (2013.01); *A61B 2018/00214*
(2013.01); *A61B 2018/00196* (2013.01); *A61B*
2018/0016 (2013.01); *A61B 2018/00148*
(2013.01); *A61B 2018/00136* (2013.01); *A61B*
2018/0013 (2013.01); *A61B 2018/00101*
(2013.01); *A61B 2018/00083* (2013.01); *A61B*
2018/00077 (2013.01); *A61B 2090/0807*
(2016.02); *A61B 2018/147* (2013.01); *A61B*
2090/065 (2016.02); *A61B 2018/1495*
(2013.01); *A61B 2018/1475* (2013.01)

(57)

ABSTRACT

An electrosurgical device is disclosed. The electrosurgical device includes a handle, a shaft extending distally from the handle, and an end effector coupled to a distal end of the shaft. The end effector comprises a first electrode and a second electrode. The second electrode includes a first position and a second position. The second electrode is configured to move from the first position to the second position when a force is applied to the end effector by a tissue section. The first electrode and the second electrode define a treatment area when the second electrode is in the second position.

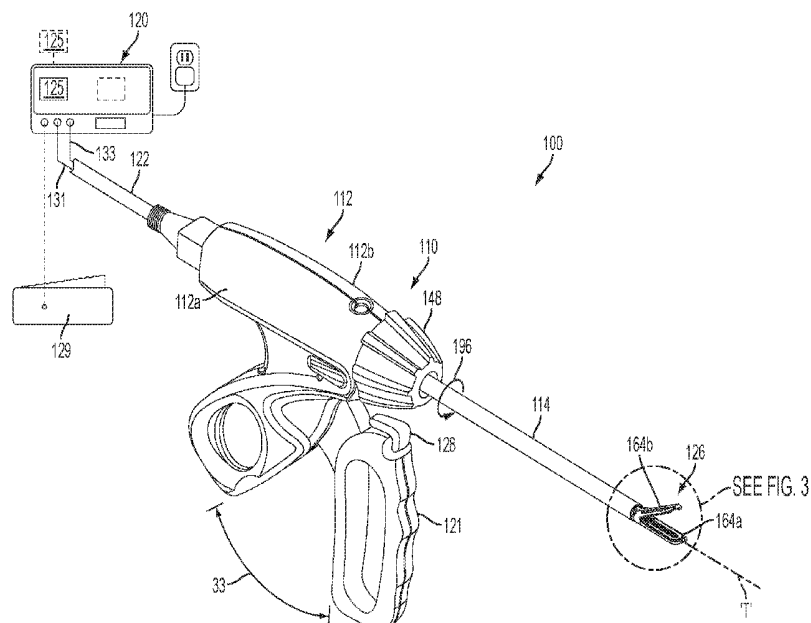

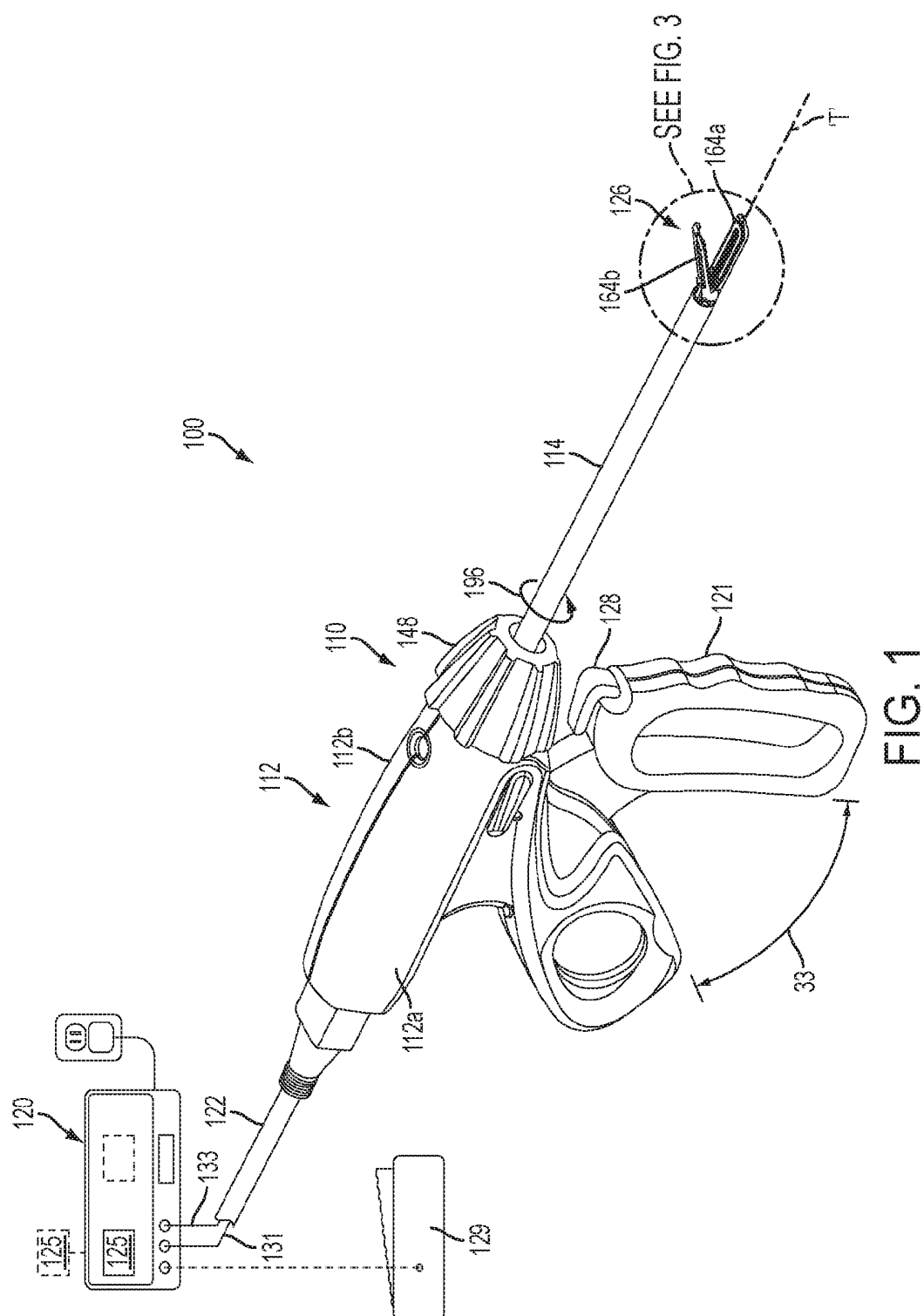

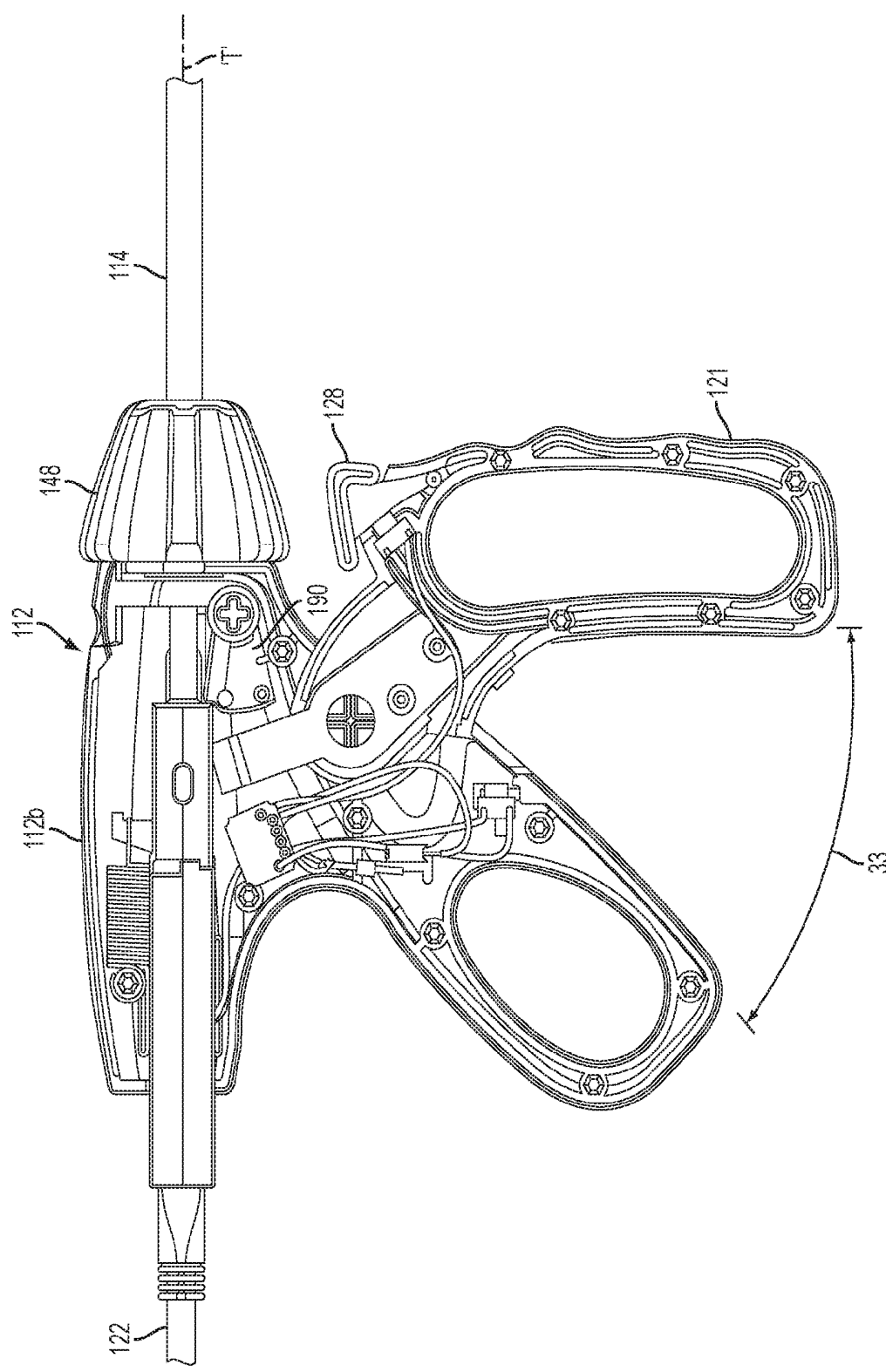

FIG. 2

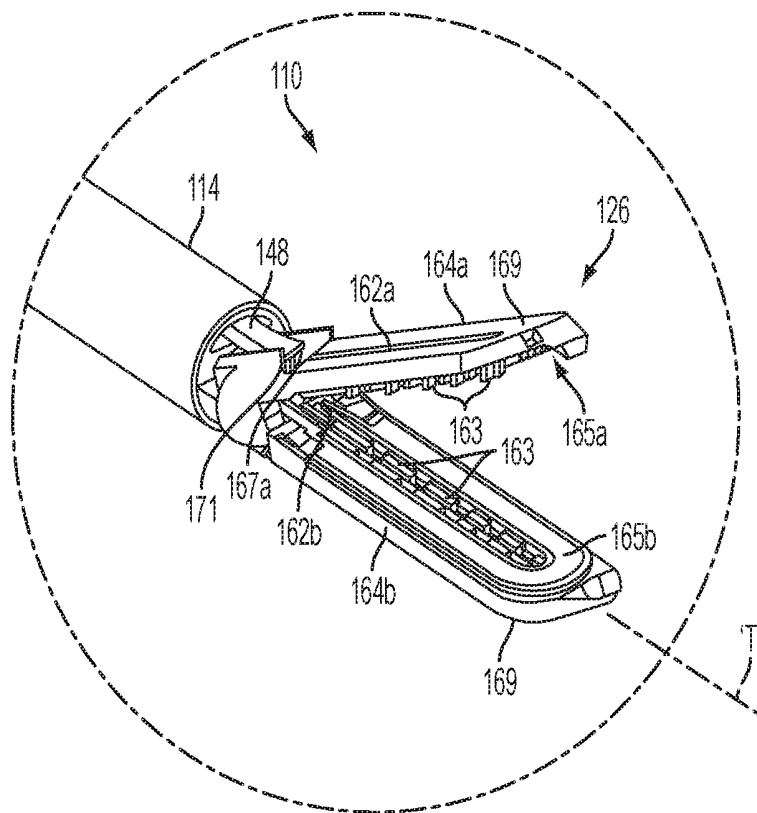

FIG. 3

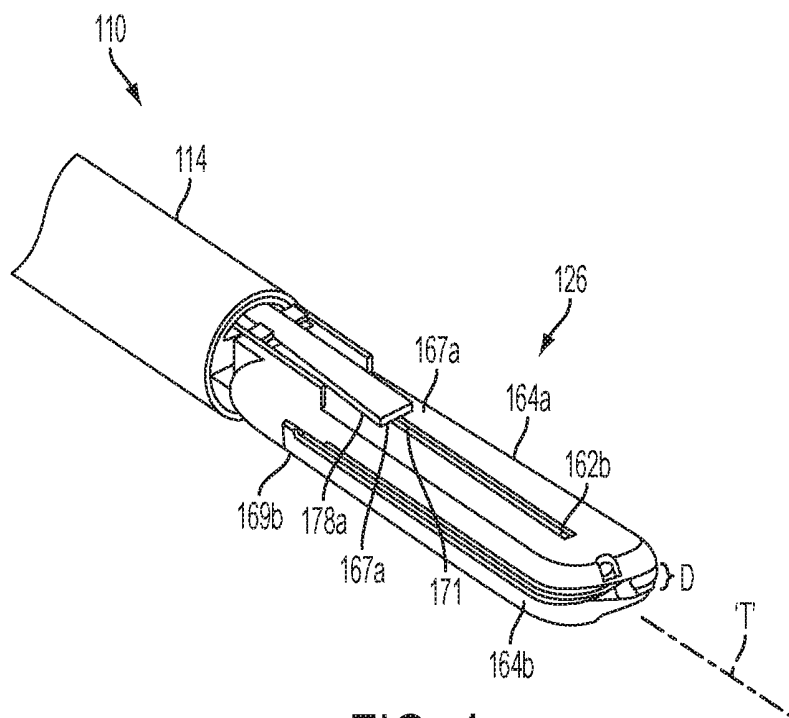

FIG. 4

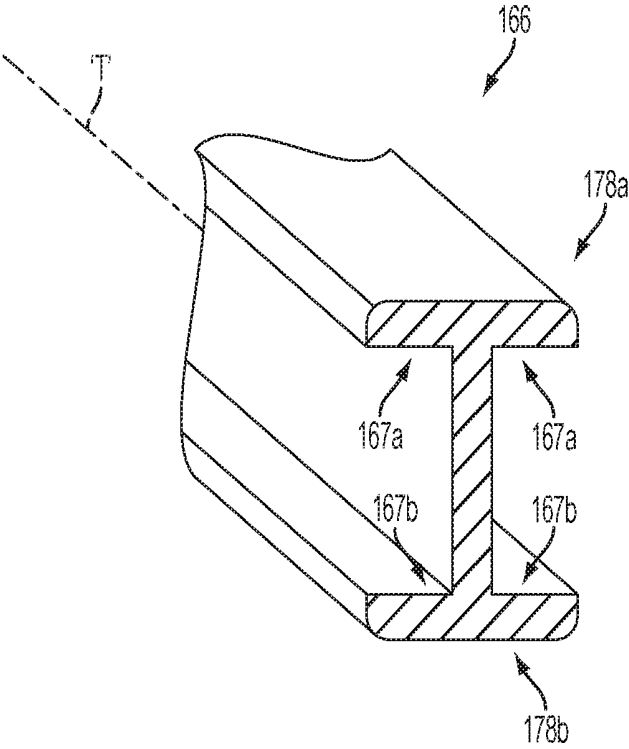

FIG. 5

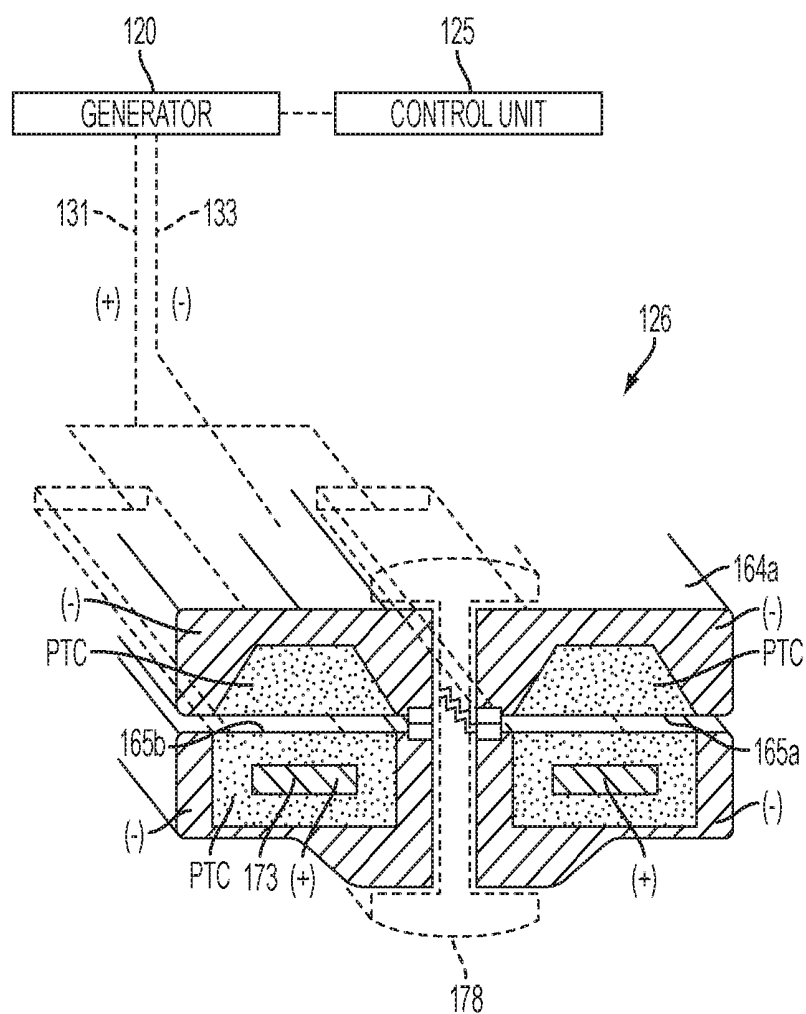

FIG. 6

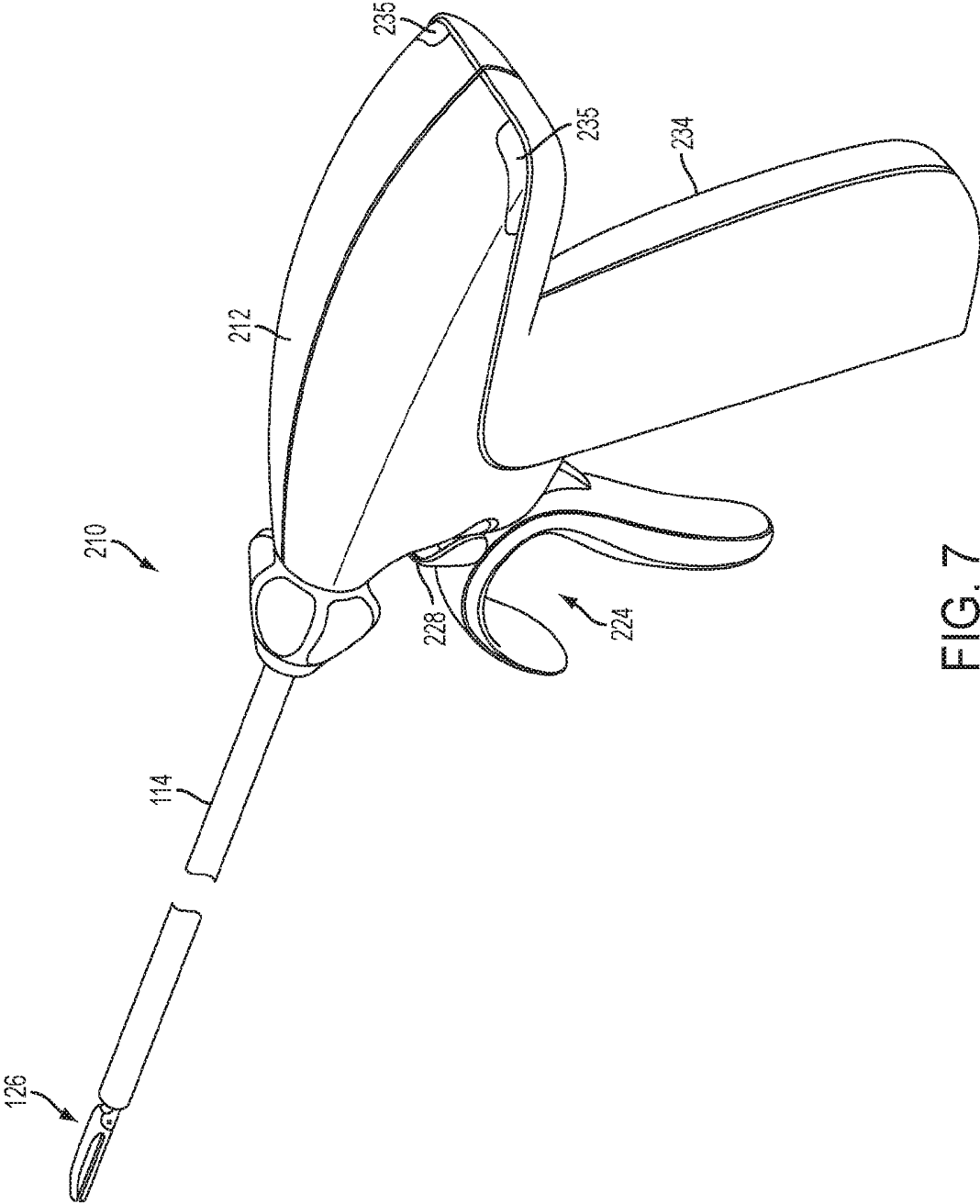

FIG. 7

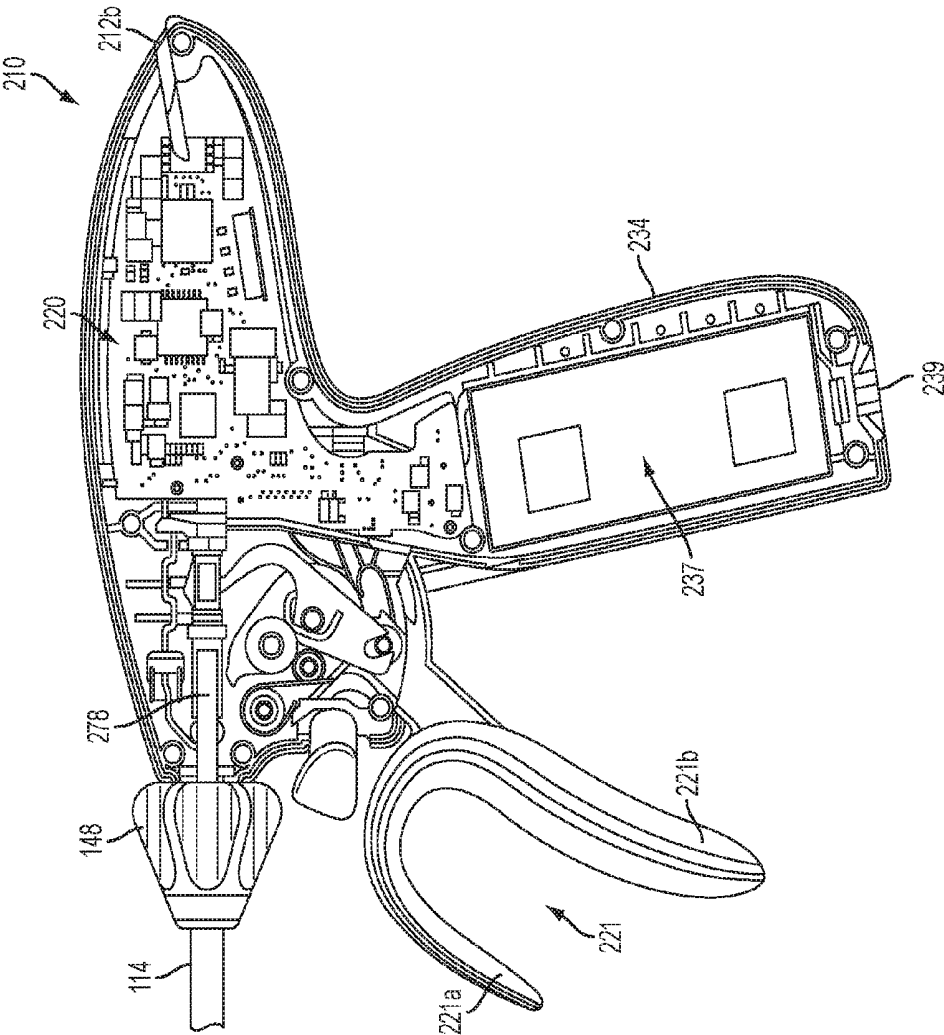

FIG. 8A

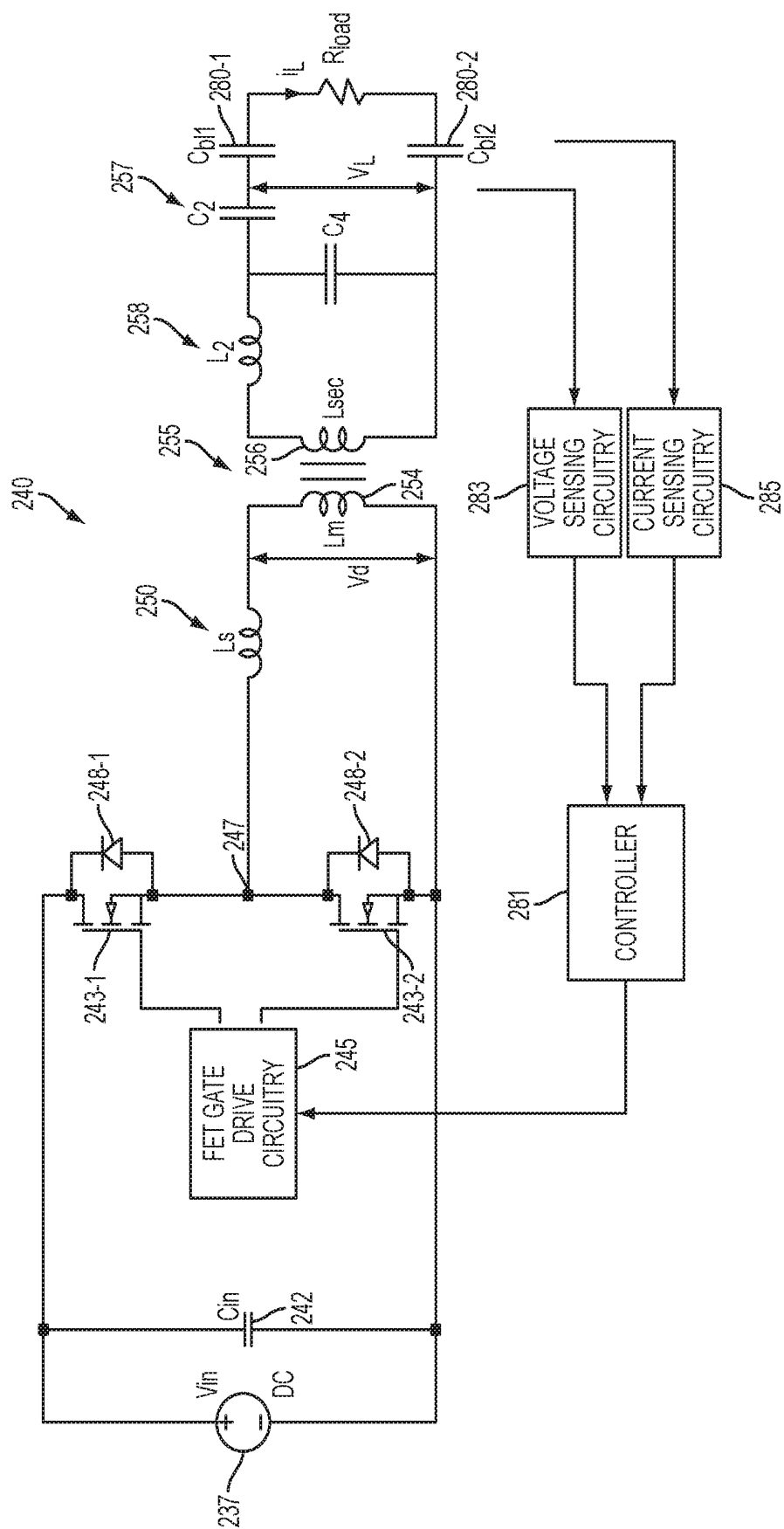

FIG. 8B

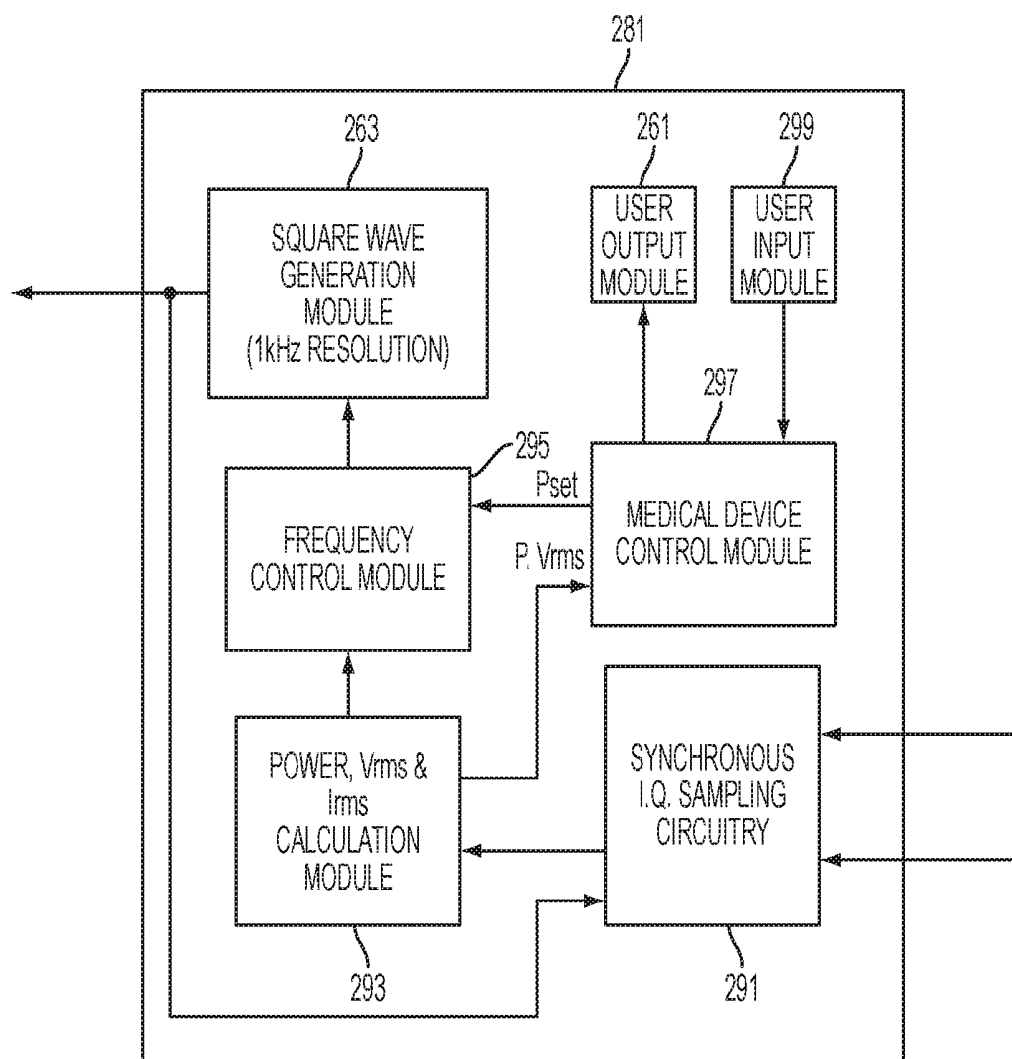

FIG. 8C

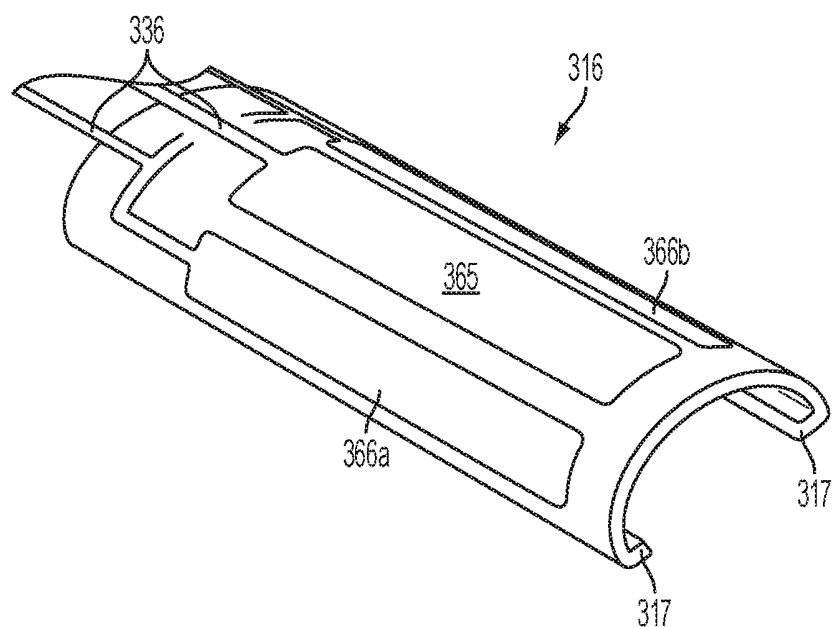

FIG. 9

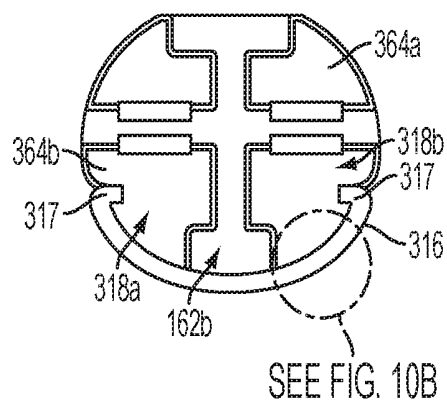

FIG. 10A

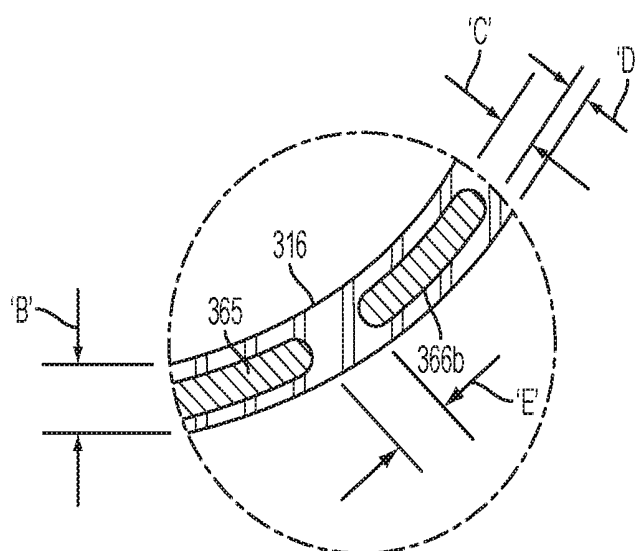

FIG. 10B

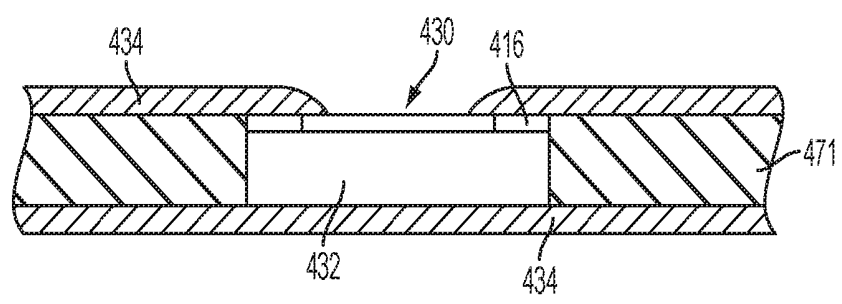

FIG. 11

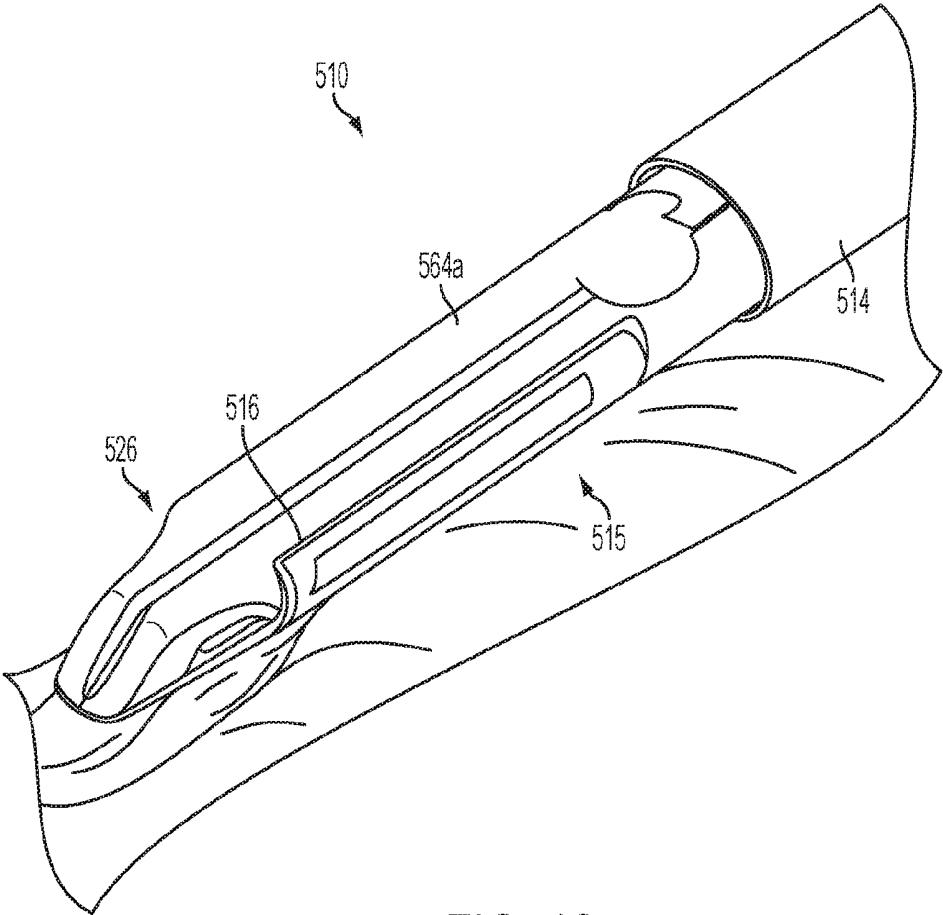

FIG. 12

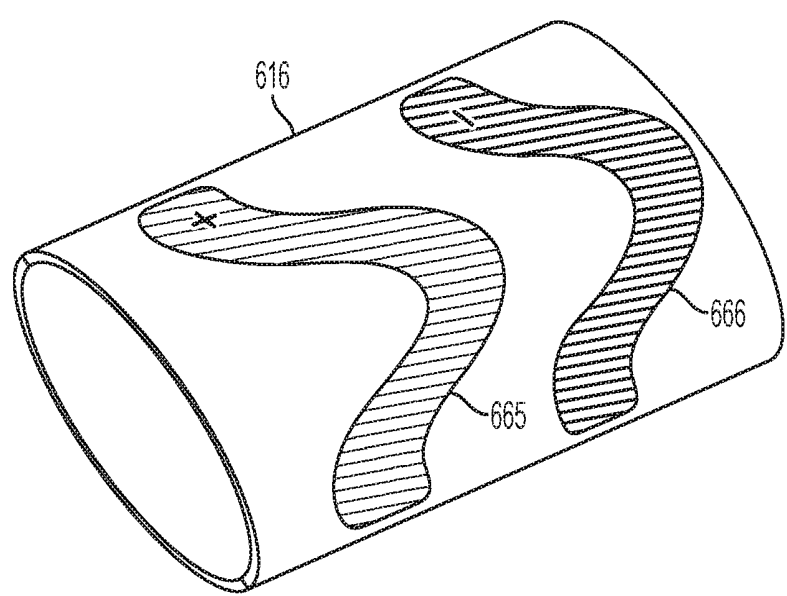

FIG. 13

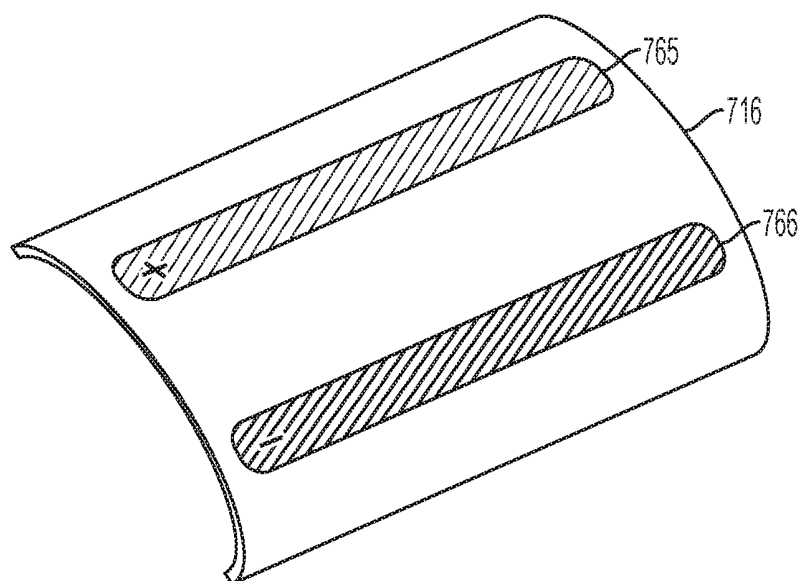

FIG. 14

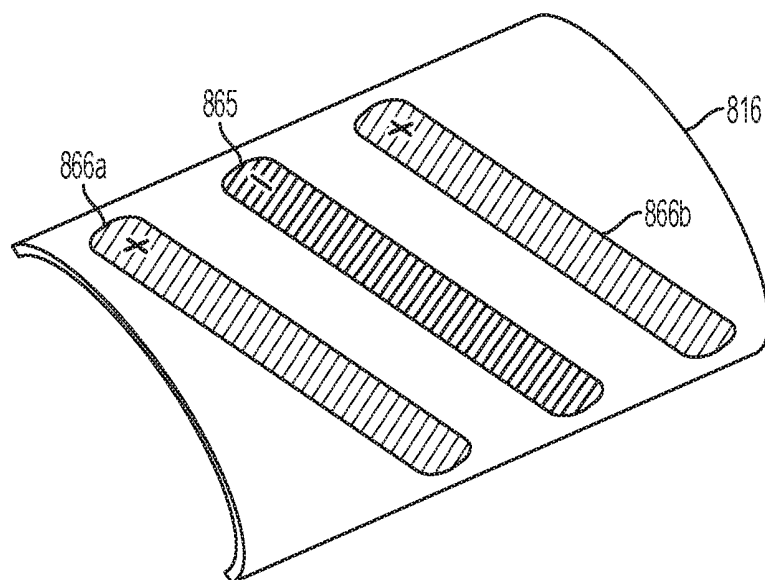
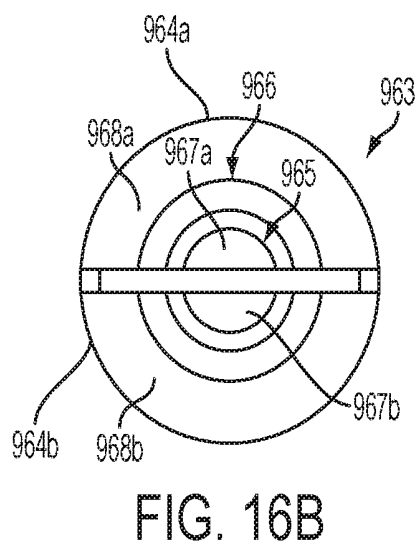
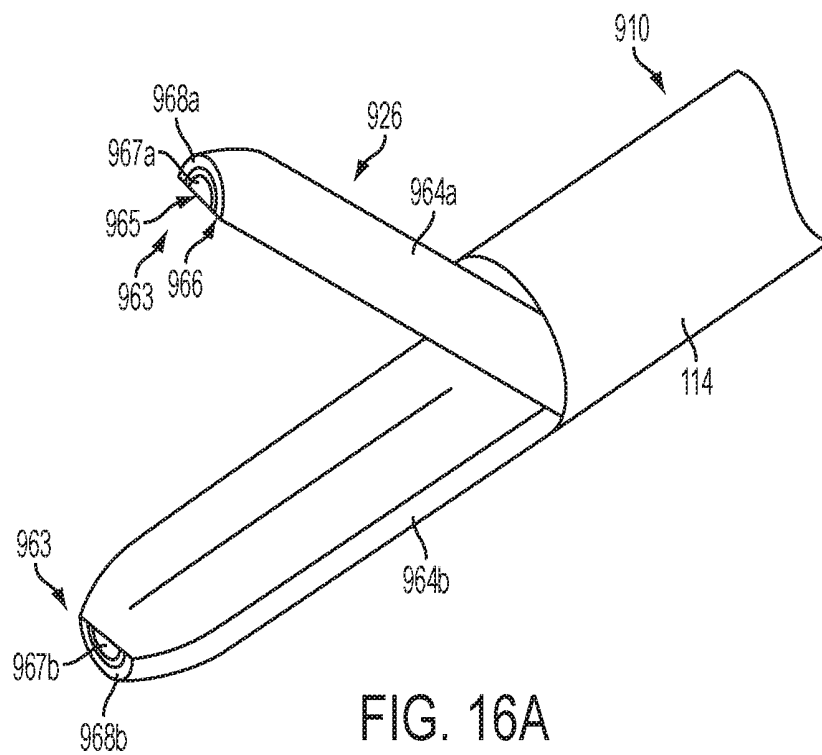

FIG. 15



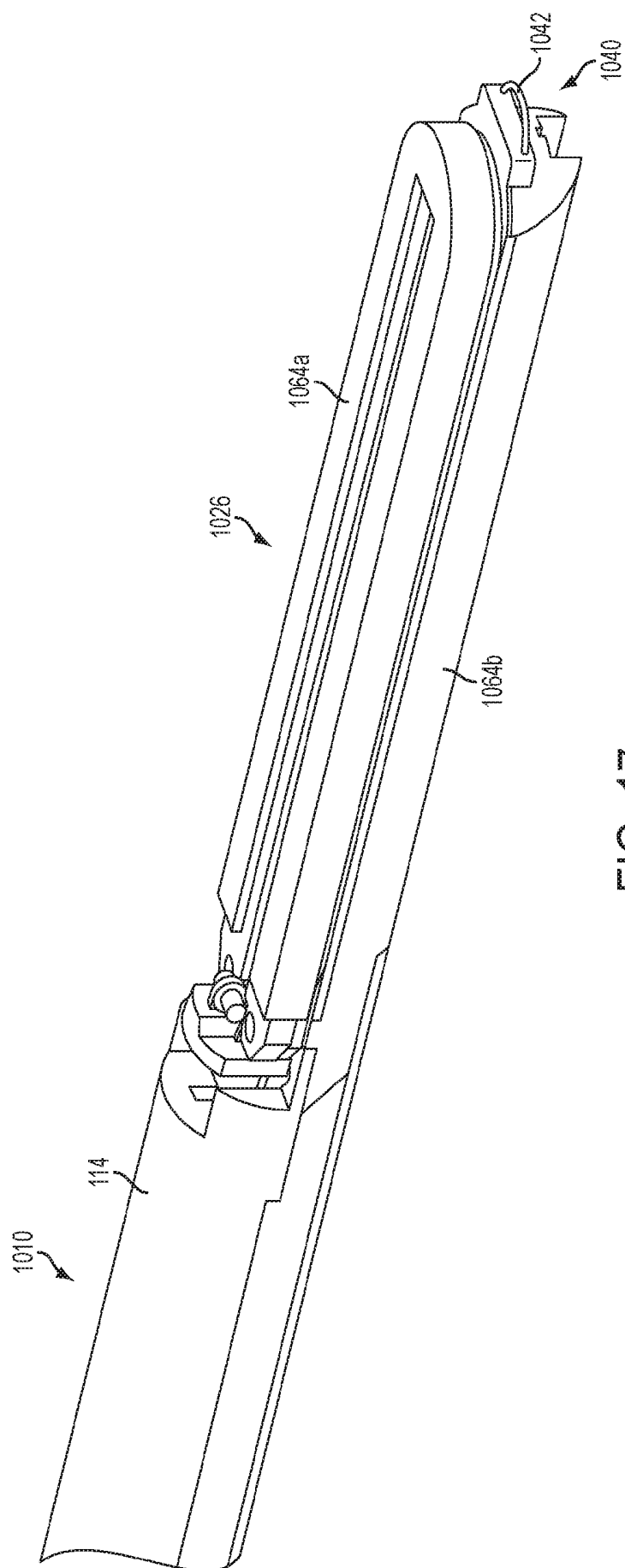

FIG. 17

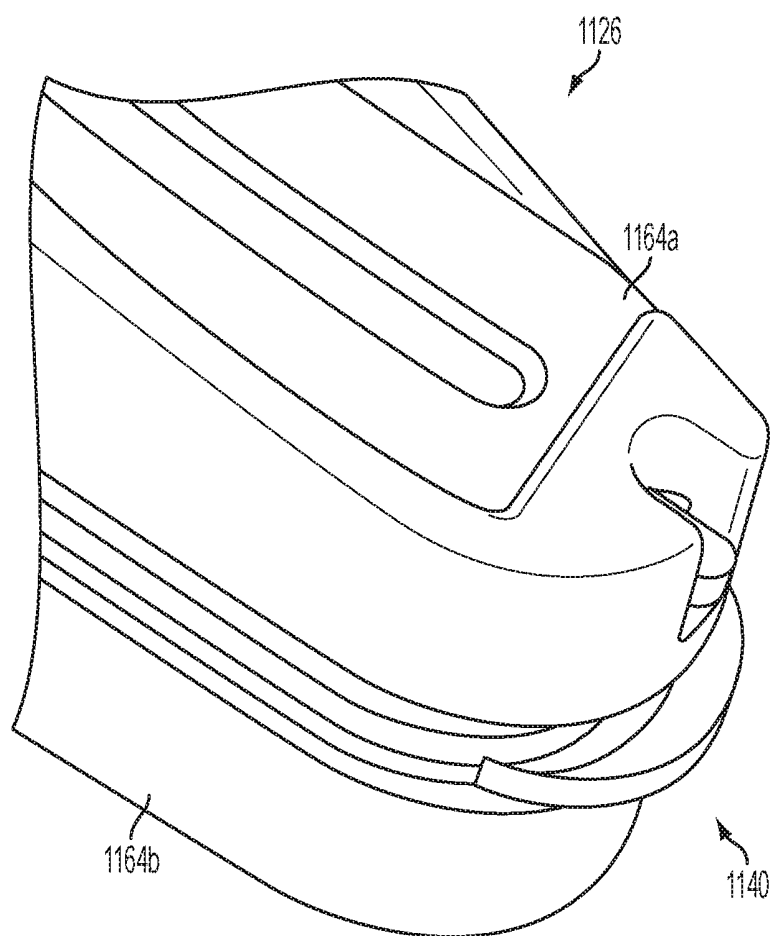

FIG. 18

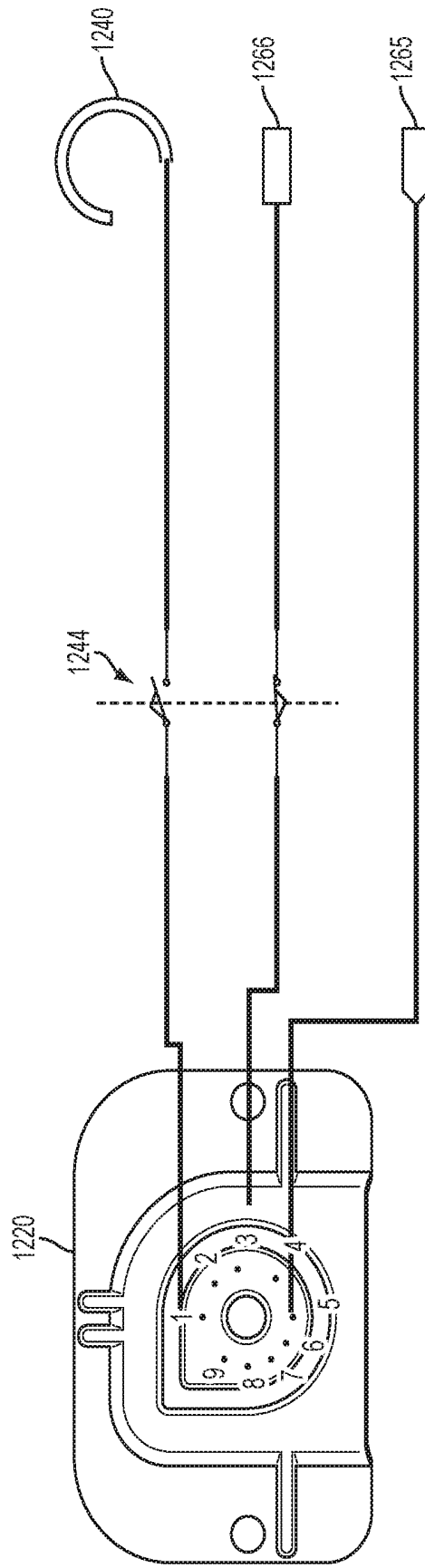

FIG. 19

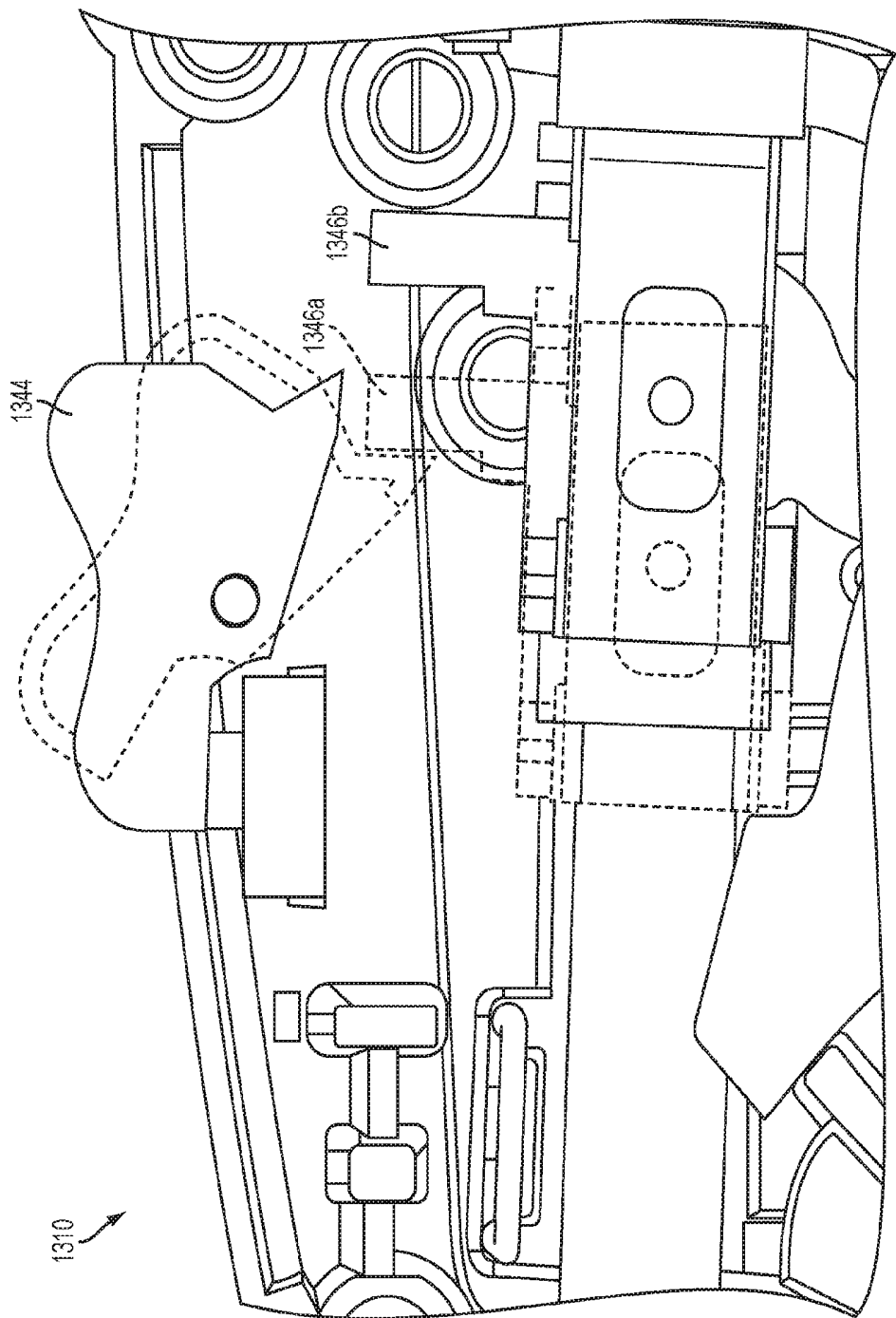

FIG. 20

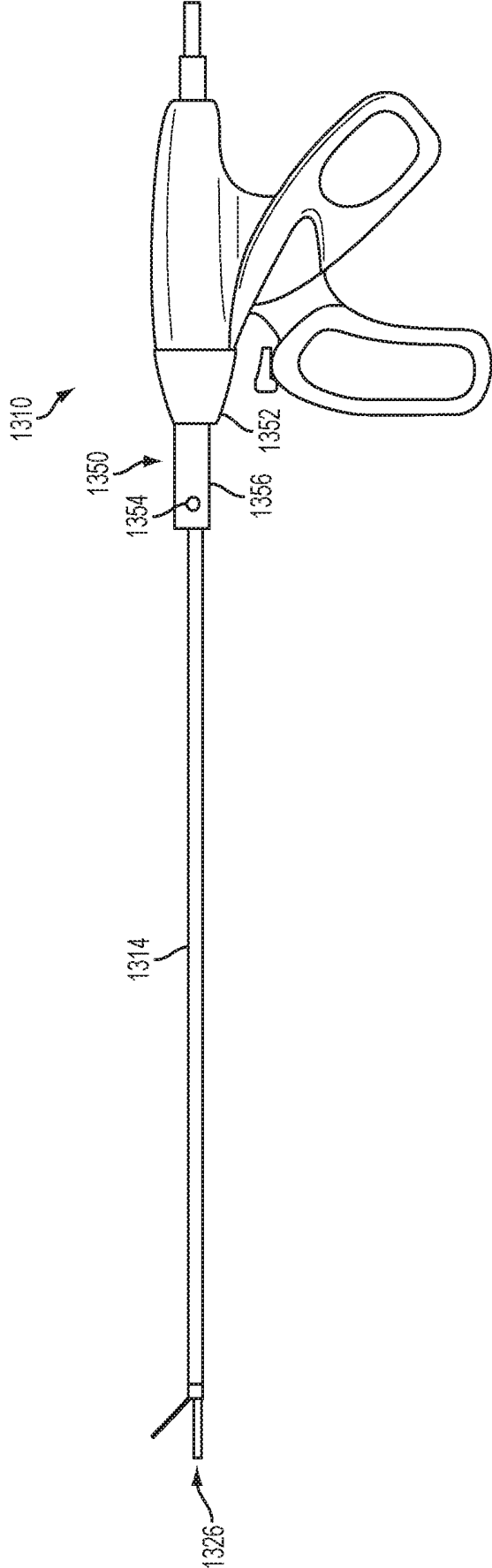

FIG. 21

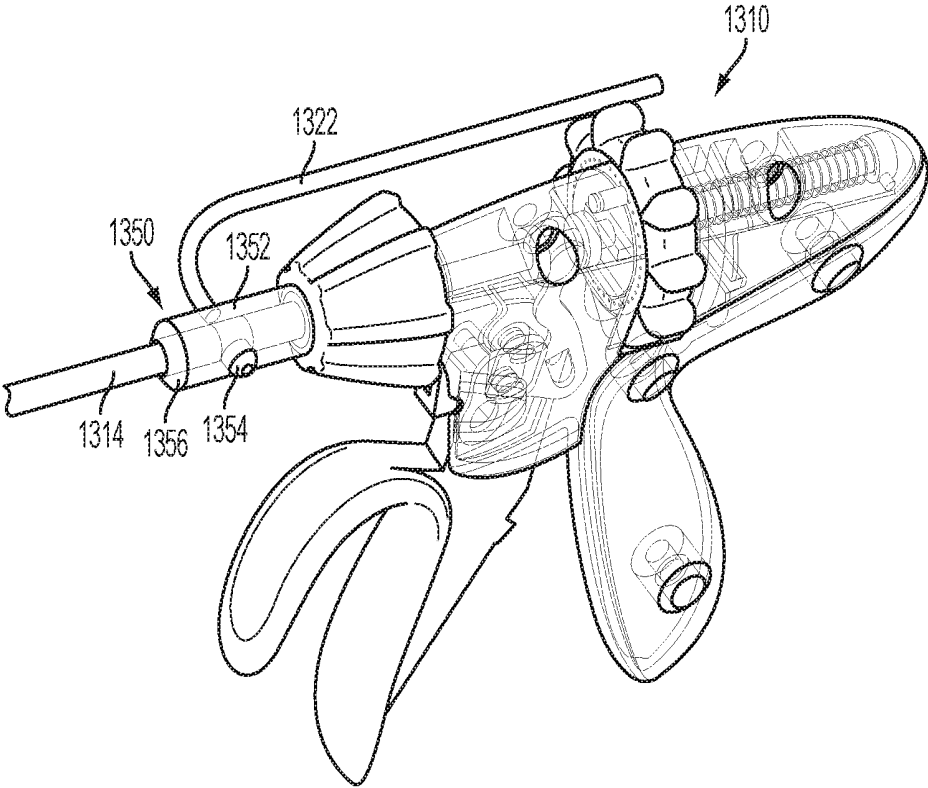
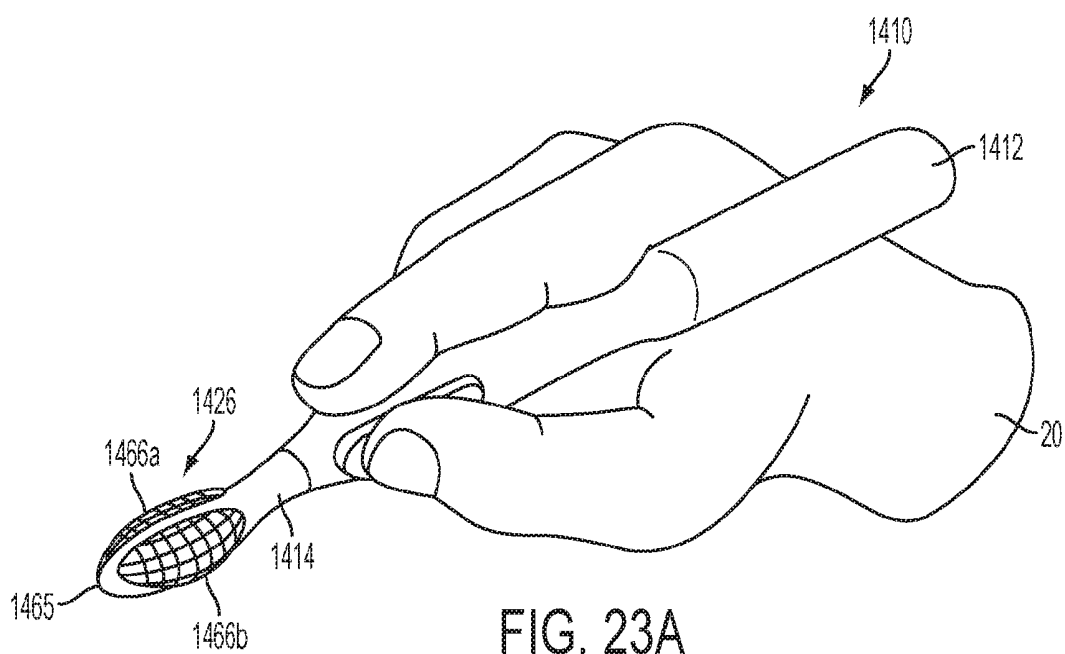

FIG. 22



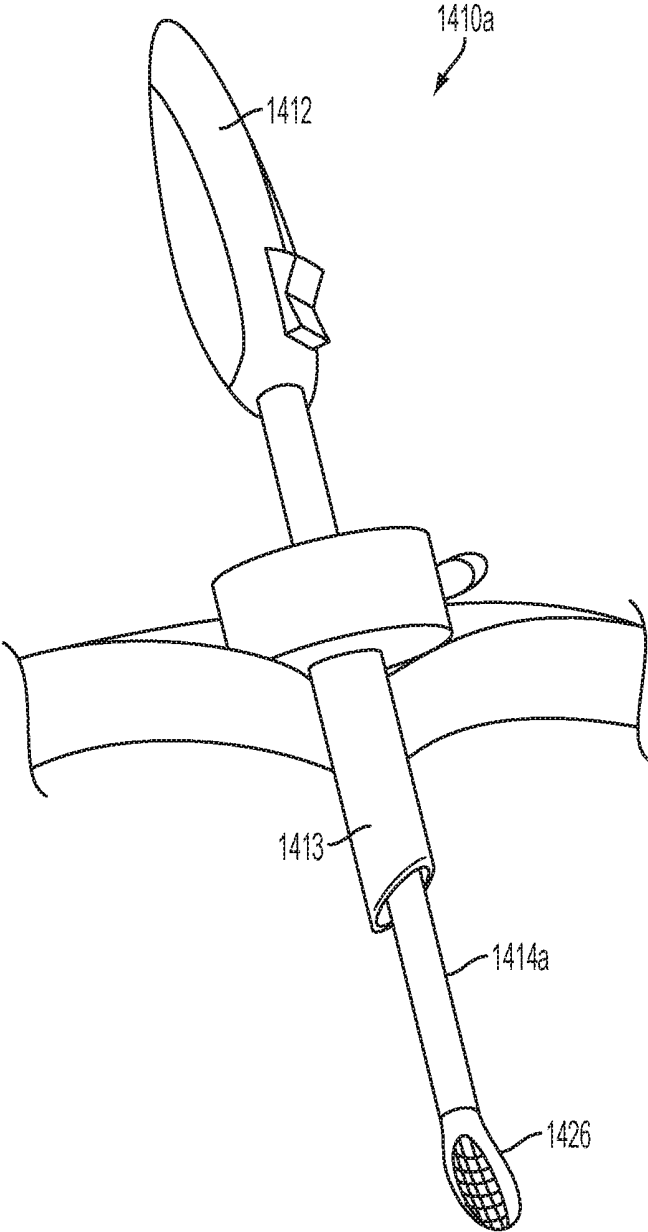
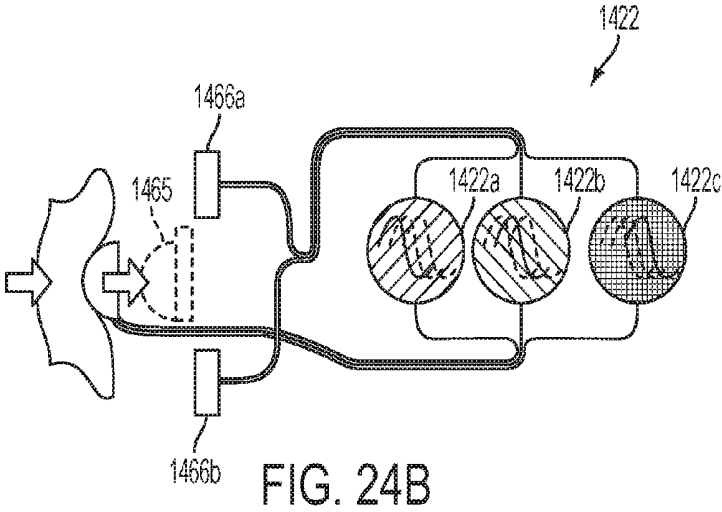
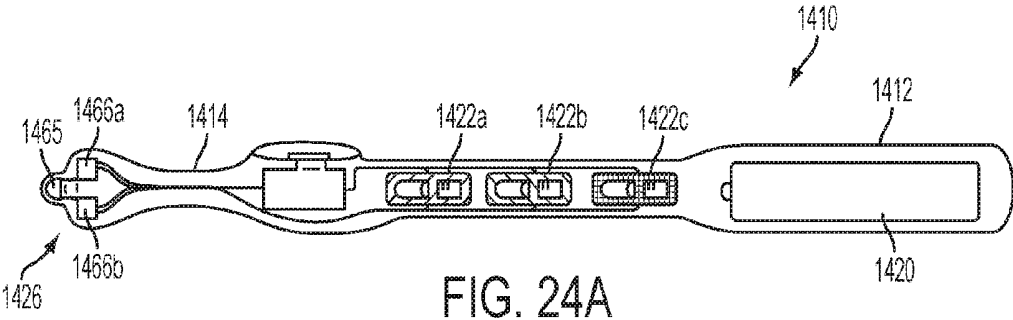

FIG. 23B



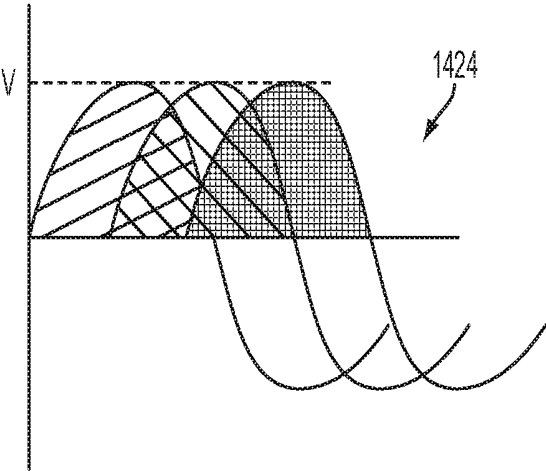

FIG. 25A

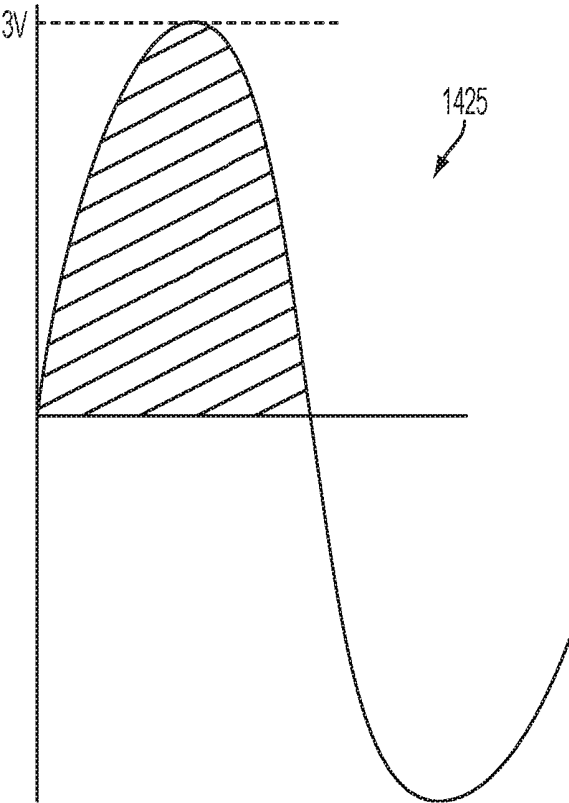

FIG. 25B

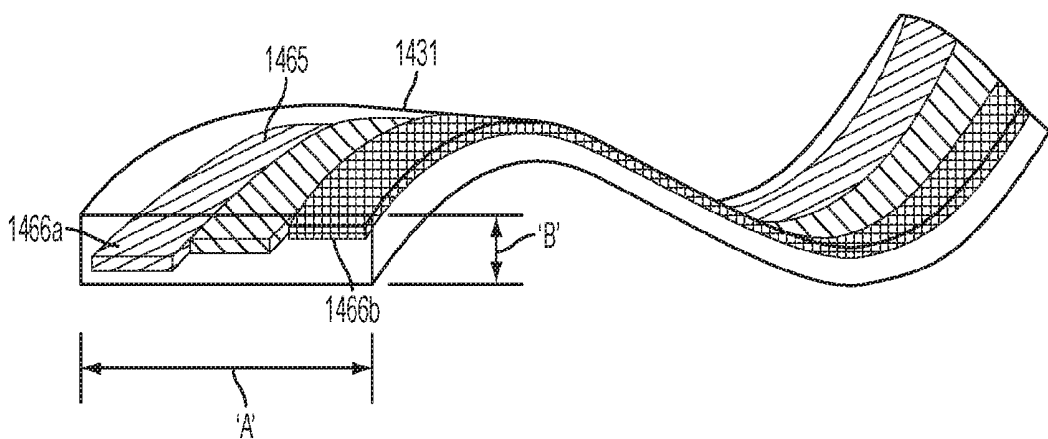
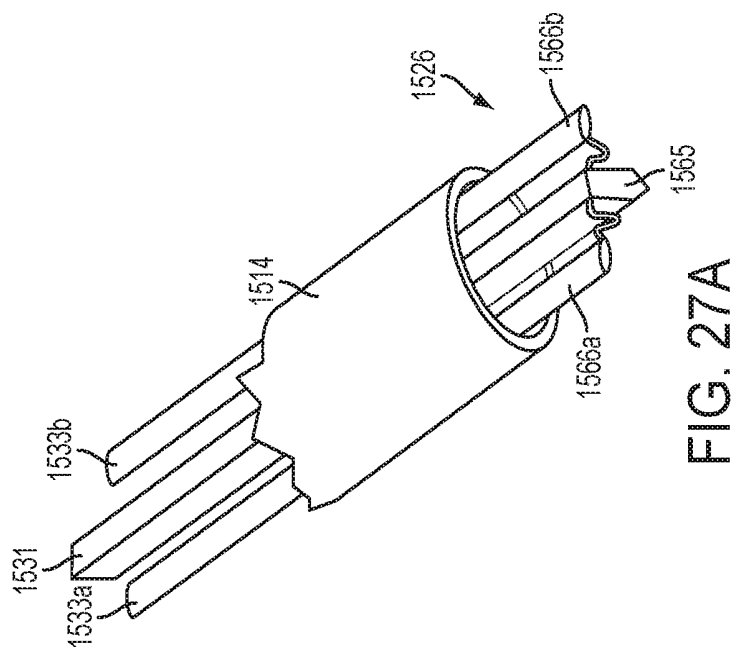
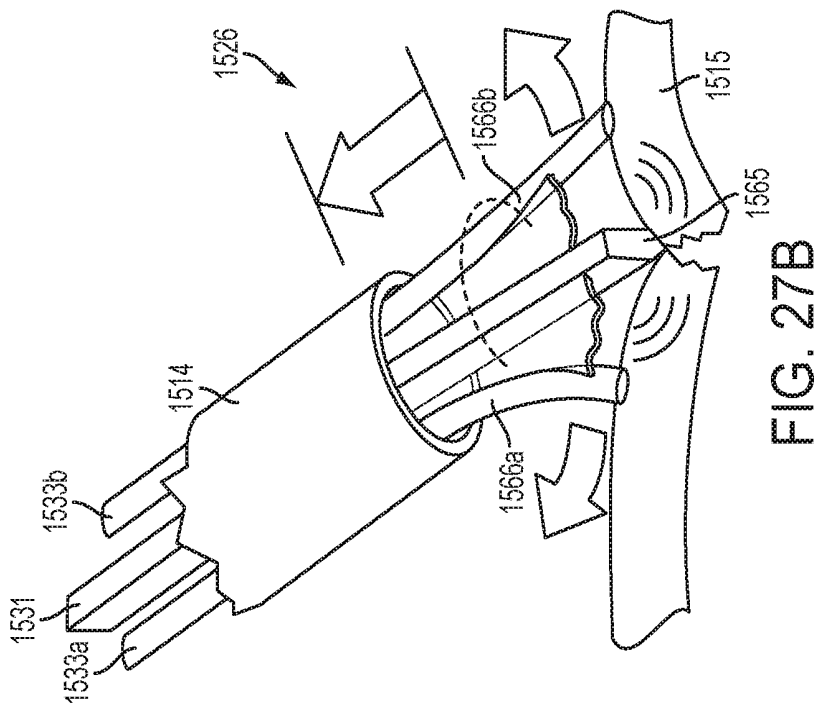
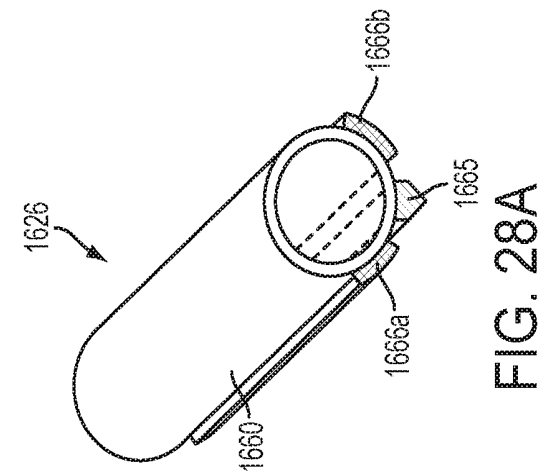
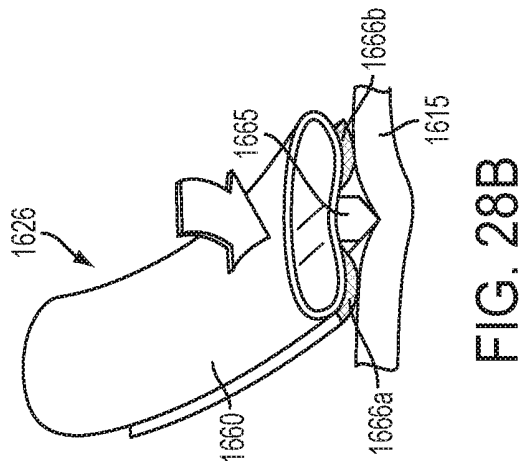
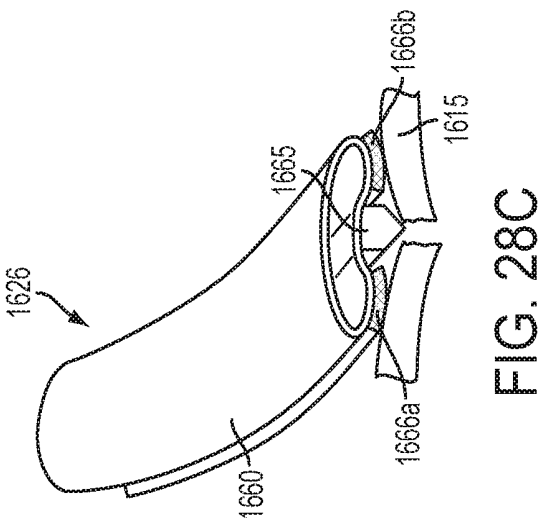

FIG. 26





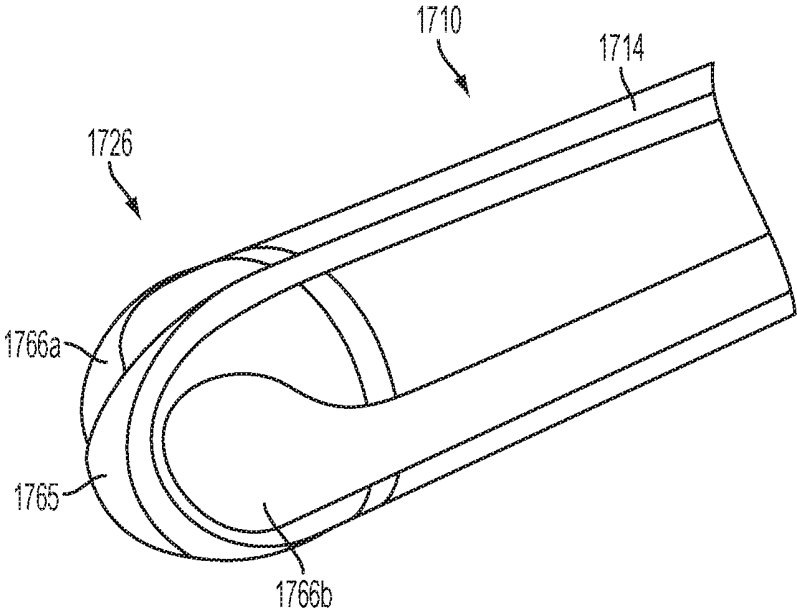

FIG. 29

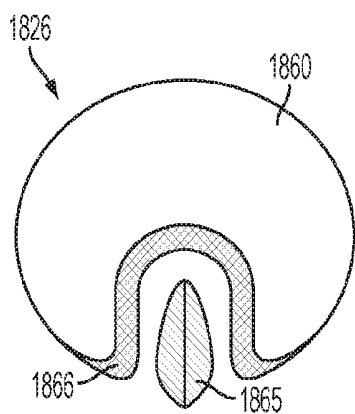

FIG. 30A

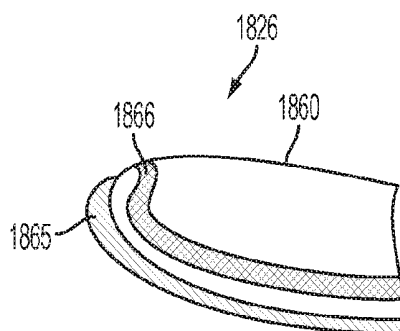

FIG. 30B

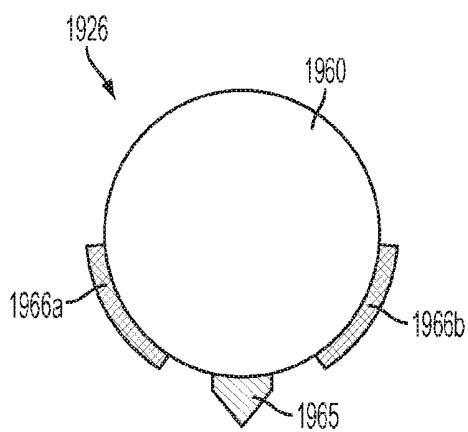

FIG. 30C

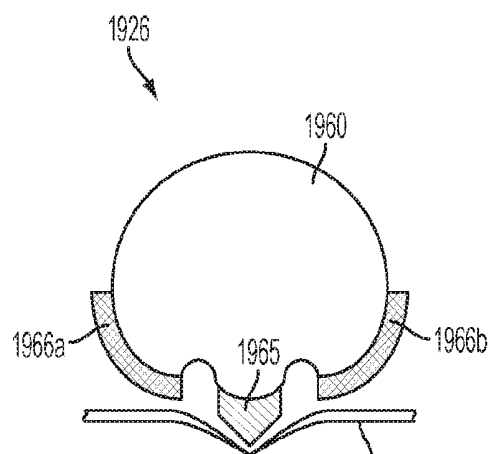

FIG. 30D

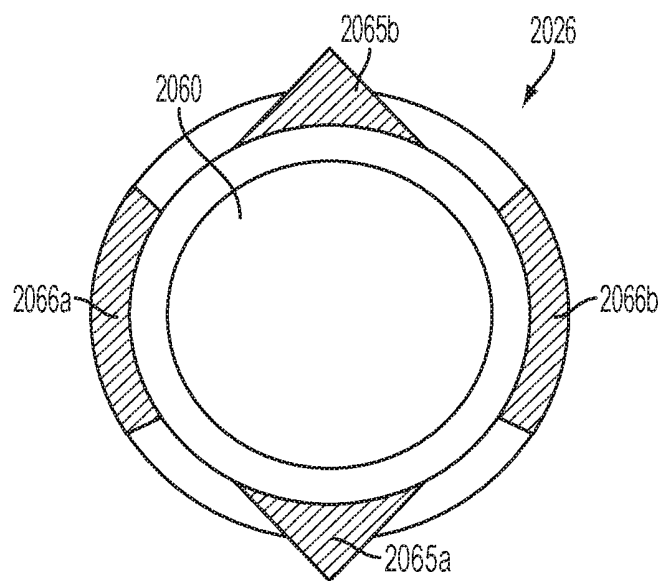

FIG. 30E

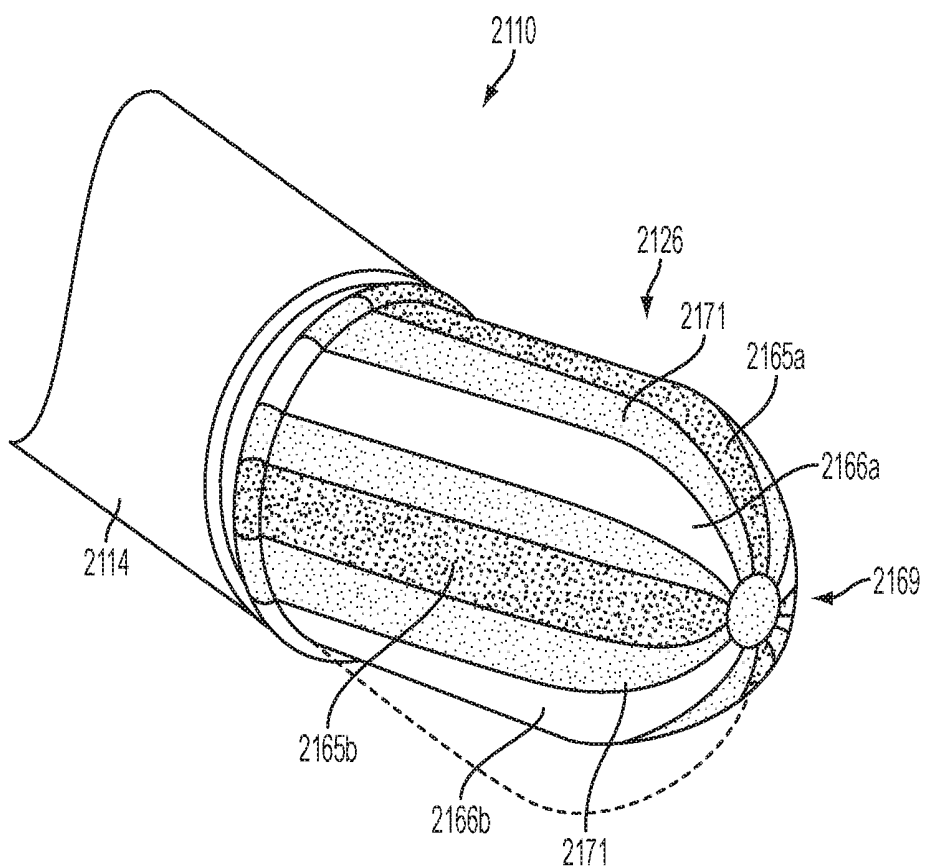

FIG. 31A

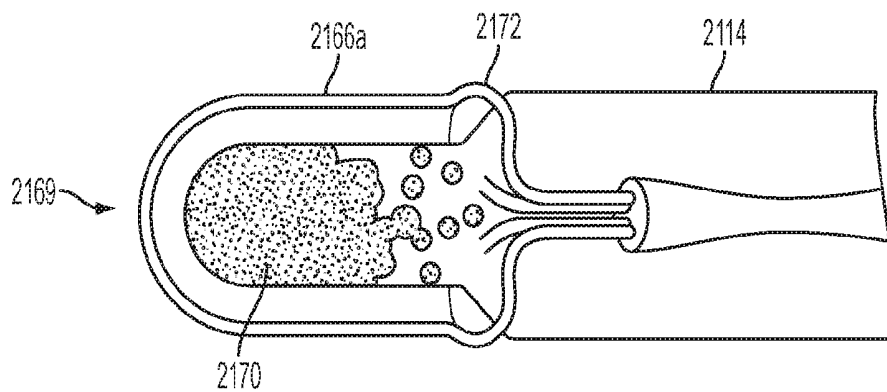

FIG. 31B

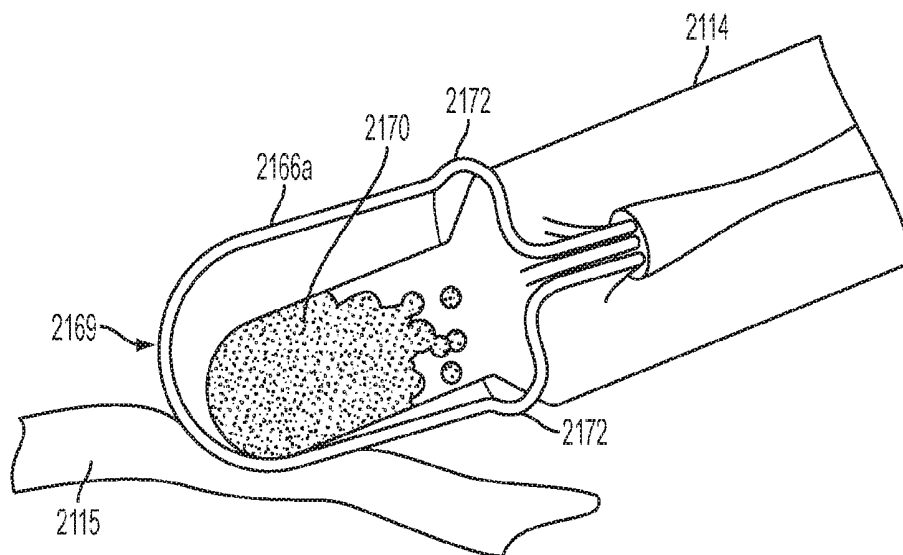

FIG. 31C

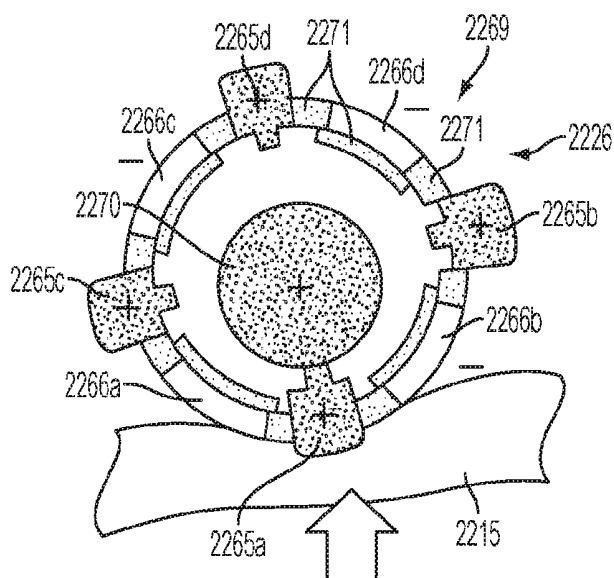

FIG. 32

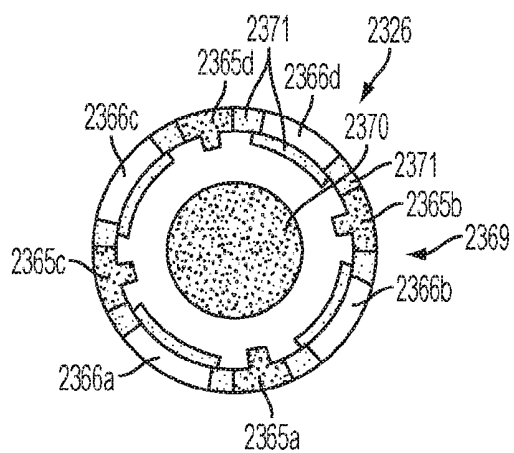

FIG. 33A

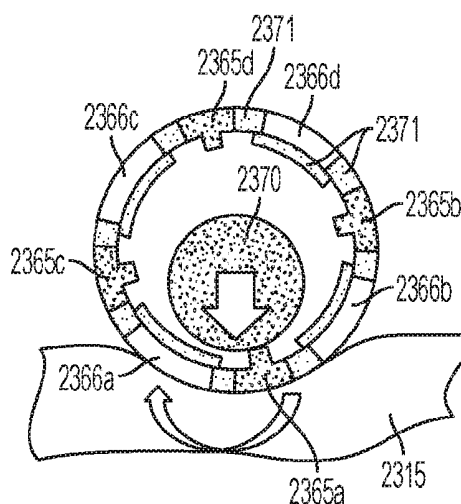

FIG. 33B

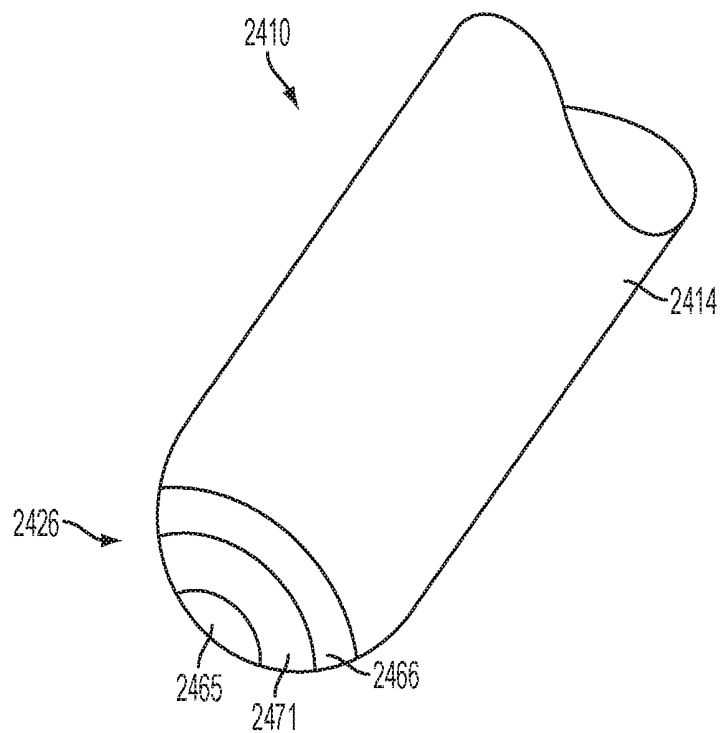

FIG. 34

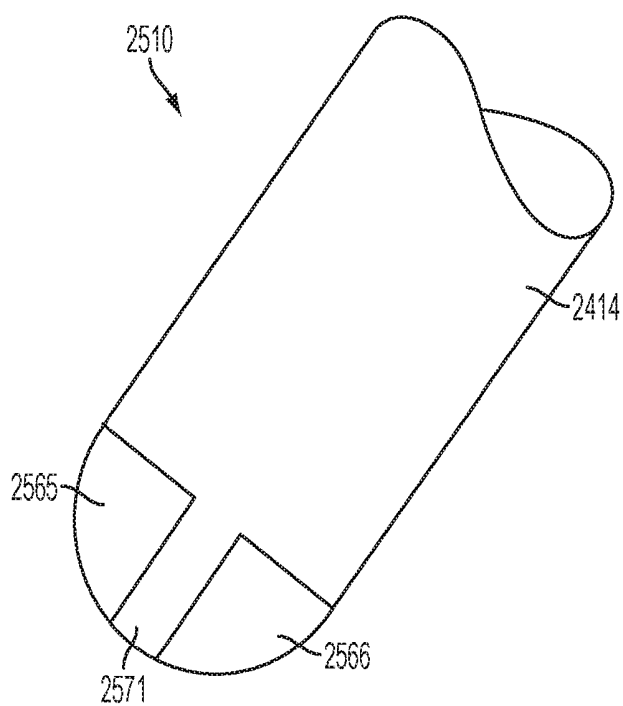
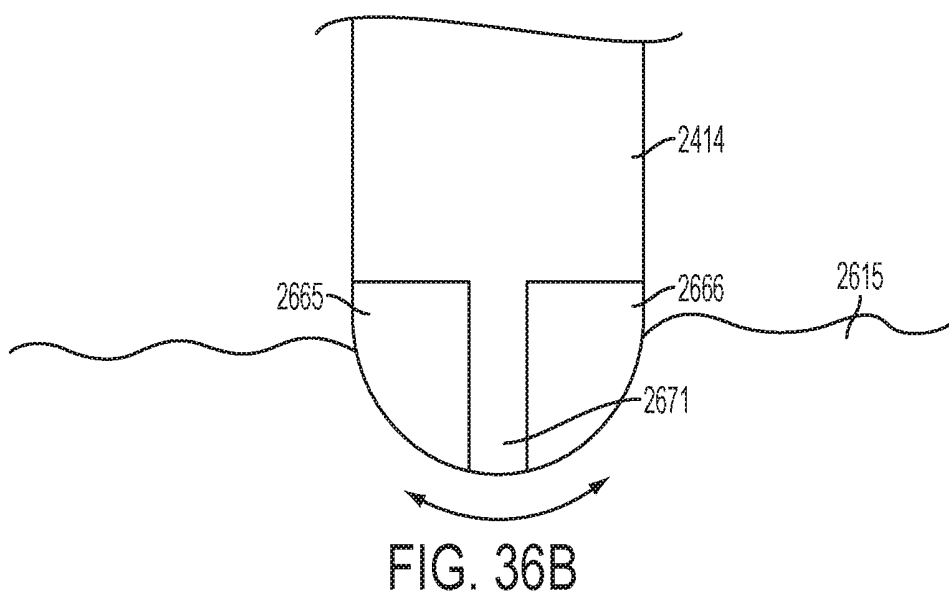
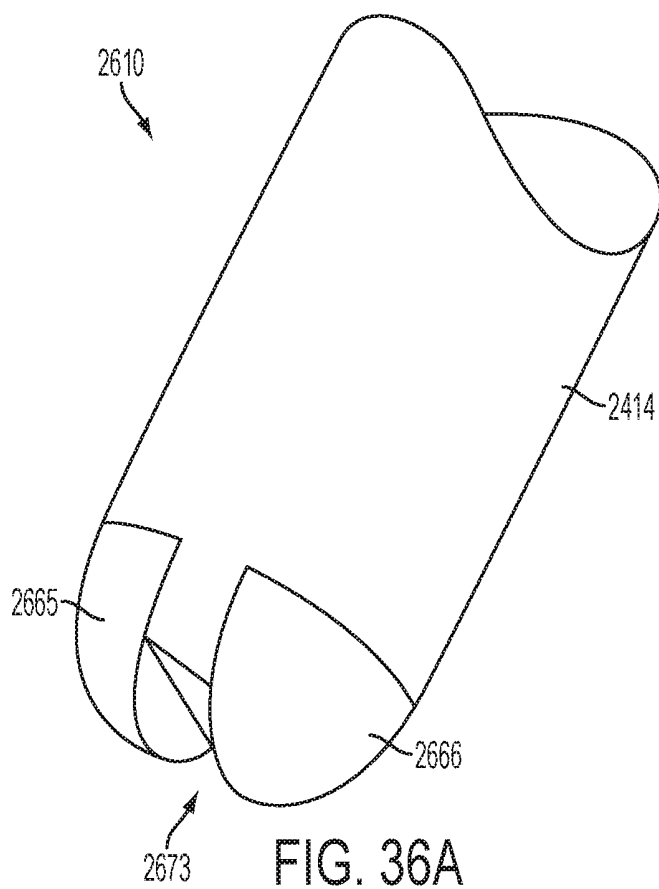

FIG. 35



ELECTROSURGICAL (RF) MEDICAL INSTRUMENTS FOR CUTTING AND COAGULATING TISSUE

CROSS-REFERENCE TO RELATED APPLICATION

[0001] This application is a continuation application claiming priority under 35 U.S.C. §120 to U.S. patent application Ser. No. 14/026,662, entitled ELECTROSURGICAL (RF) MEDICAL INSTRUMENTS FOR CUTTING AND COAGULATING TISSUE, filed Sep. 13, 2013, now U.S. Patent Application Publication No. 2015/0080891, the entire disclosure of which is hereby incorporated by reference herein.

BACKGROUND

[0002] Electrosurgical devices are used in many surgical operations. Electrosurgical devices apply electrical energy to tissue in order to treat tissue. An electrosurgical device may comprise an instrument having a distally-mounted end effector comprising one or more electrodes. The end effector can be positioned against tissue such that electrical current is introduced into the tissue. Electrosurgical devices can be configured for bipolar or monopolar operation. During bipolar operation, current is introduced into and returned from the tissue by active and return electrodes, respectively, of the end effector. During monopolar operation, current is introduced into the tissue by an active (or source) electrode of the end effector and returned through a return electrode (e.g., a grounding pad) separately located on a patient's body. Heat generated by the current flow through the tissue may form hemostatic seals within the tissue and/or between tissues and thus may be particularly useful for sealing blood vessels, for example. The end effector of an electrosurgical device sometimes also comprises a cutting member that is movable relative to the tissue and the electrodes to transect the tissue.

[0003] Electrical energy applied by an electrosurgical device can be transmitted to the instrument by a generator. The electrical energy may be in the form of radio frequency ("RF") energy. RF energy is a form of electrical energy that may be in the frequency range of 100 kHz to 1 MHz. During its operation, an electrosurgical device can transmit low frequency RF energy through tissue, which causes ionic agitation, or friction, in effect resistive heating, thereby increasing the temperature of the tissue. Because a sharp boundary may be created between the affected tissue and the surrounding tissue, surgeons can operate with a high level of precision and control, without sacrificing un-targeted adjacent tissue. The low operating temperatures of RF energy may be useful for removing, shrinking, or sculpting soft tissue while simultaneously sealing blood vessels. RF energy may work particularly well on connective tissue, which is primarily comprised of collagen and shrinks when contacted by heat.

SUMMARY

[0004] In various embodiments, an electrosurgical (RF) device is provided. The electrosurgical device comprises a handle, a shaft extending distally from the handle, and an end effector coupled to a distal end of the shaft. The end effector comprises a first electrode and a second electrode. The second electrode comprises a first position and a second position. The second electrode is configured to move from

the first position to the second position when a force is applied to the end effector by a tissue section. The first electrode and the second electrode define a treatment area when the second electrode is in the second position.

[0005] In various embodiments, a base cap configured to interface with an electrosurgical instrument is provided. The base cap comprises an electrode layer configured to provide electrosurgical signals to a tissue section in contact with the base cap, a heat sink layer configured to prevent heat transfer between the base cap and the electrosurgical instrument, and sealing layer configured to seal the base cap. The base cap is removably coupled to the electrosurgical instrument.

[0006] In various embodiments, an electrosurgical (RF) device is provided. The electrosurgical device comprises a waveform generator configured to produce an electrosurgical signal comprising at least a first phase and a second phase, a first conductor configured to receive the first phase of the electrosurgical signal, and a second conductor configured to receive the second phase of the electrosurgical signal.

[0007] In various embodiments, an electrosurgical (RF) instrument is provided. The electrosurgical instrument comprises a handle, a shaft extending distally from the handle, and an end effector coupled to the distal end of the shaft. The end effector comprises a first jaw member comprising a first electrode and a second jaw member comprising a second electrode, wherein the first and second electrodes comprise a fluoropolymer material comprising an electrically conductive mica additive.

[0008] In various embodiments, a bipolar temperature controlled tissue ablation surgical device is provided. The surgical device comprises a handle, a shaft extending distally from the handle, and an end effector coupled to a distal end of the shaft. The end effector comprises a source electrode comprising a positive temperature controlled (PTC) material and a return electrode electrically isolated from the source electrode, wherein the source electrode and the return electrode are configured to receive a bipolar electrosurgical signal.

[0009] In various embodiments, an electrosurgical (RF) device is provided. The electrosurgical device comprises a handle, a shaft extending distally from the handle, and an end effector coupled to a distal end of the handle. The end effector comprises an upper jaw comprising a first electrode, a lower jaw comprising a second electrode, and a power tip extending from a distal end of the lower jaw. The power tip comprises an electrode configured to receive electrosurgical energy.

[0010] In various embodiments, a monopolar add-on for an electrosurgical device comprising a power tip is provided. The monopolar add-on comprises a handle configured to interface with a shaft of the electrosurgical device and a slip ring coupled to the handle. The slip ring is configured to interface with a conductor disposed within the shaft of the electrosurgical device. The conductor is coupled to a power tip located at the distal end of the electrosurgical instrument. The monopolar add-on further comprises a cable coupled to the slip ring. The cable is configured to couple to a monopolar generator. The monopolar add-on further comprises a switch configured to control delivery of a monopolar electrosurgical signal from the monopolar generator to the power tip.

FIGURES

[0011] The features of the various embodiments are set forth with particularity in the appended claims. The various embodiments, however, both as to organization and methods of operation, together with advantages thereof, may best be understood by reference to the following description, taken in conjunction with the accompanying drawings as follows:

[0012] FIG. 1 illustrates a perspective view of one embodiment of an electrical energy surgical instrument.

[0013] FIG. 2 illustrates a side-view of a handle of one embodiment of the surgical instrument of FIG. 1 with a half of a handle body removed to illustrate some of the components therein.

[0014] FIG. 3 illustrates a perspective view of one embodiment of the end effector of the surgical instrument of FIG. 1 with the jaws open and the distal end of an axially movable member in a retracted position.

[0015] FIG. 4 illustrates a perspective view of one embodiment of the end effector of the surgical instrument of FIG. 1 with the jaws closed and the distal end of an axially moveable member in a partially advanced position.

[0016] FIG. 5 illustrates a perspective view of one embodiment of the axially moveable member of the surgical instrument of FIG. 1.

[0017] FIG. 6 illustrates a section view of one embodiment of the end effector of the surgical instrument of FIG. 1.

[0018] FIG. 7 illustrates a perspective view of one embodiment of a cordless electrical energy surgical instrument.

[0019] FIG. 8A illustrates a side view of a handle of one embodiment of the surgical instrument of FIG. 7 with half of the handle body removed to illustrate various components therein.

[0020] FIG. 8B illustrates one embodiment of an RF drive and control circuit.

[0021] FIG. 8C illustrates one embodiment of the main components of a control circuit.

[0022] FIG. 9 illustrates one embodiment of a molded base cap configured to interface with the bottom jaw of the end effector of the surgical instrument in FIGS. 1 and 7.

[0023] FIGS. 10A and 10B illustrate one embodiment of a molded base cap interfaced with the bottom jaw of an electrosurgical end effector, where FIG. 10B is a detailed view of a section of the molded base cap shown in FIG. 10A.

[0024] FIG. 11 illustrates one embodiment of the base cap of FIG. 9 comprising an electrode layer, a heat sink layer, and a sealing layer applied in a laminate structure.

[0025] FIG. 12 illustrates one embodiment of the base cap of FIG. 9 in contact with and energizing a tissue section.

[0026] FIGS. 13-15 illustrate various electrode arrangements for various embodiments of the base cap of FIG. 9.

[0027] FIGS. 16A and 16B illustrate one embodiment of a surgical instrument, such as the surgical instrument shown in FIGS. 1 and 7, comprising an end effector where the end effector comprises a tissue ablation tip and where FIG. 16A illustrates a perspective view of the end effector with a jaw member in an open position and FIG. 16B illustrates an end view of the end effector with the jaw members in a closed position.

[0028] FIG. 17 illustrates one embodiment of an end effector for an electrosurgical device comprising a power tip.

[0029] FIG. 18 illustrates one embodiment of the end effector of FIG. 17 comprising a half-circle power tip.

[0030] FIG. 19 illustrates one embodiment of an electrical connection between a generator, a power tip, a ground electrode, and a plurality of electrodes disposed within a clamp jaw end effector.

[0031] FIG. 20 illustrates one embodiment of a two-pole switch configured to control operation of a power tip, such as the power tip of FIG. 17.

[0032] FIGS. 21 and 22 illustrate one embodiment of an electrosurgical device comprising a power tip configured to receive a monopolar add-on device.

[0033] FIG. 23A illustrates one embodiment of a cordless electrosurgical instrument comprising a pencil grip handle.

[0034] FIG. 23B illustrates one embodiment of a cordless electrosurgical instrument comprising a pencil grip handle and a laparoscopic shaft.

[0035] FIG. 24A illustrates one embodiment of a side view of the electrosurgical instrument of FIG. 23 with a half of a handle body removed to illustrate some of the components therein.

[0036] FIG. 24B illustrates one embodiment of a multi-phase signal generation element.

[0037] FIG. 25A illustrates an energy density curve of a three-phase multi-phase electrosurgical signal.

[0038] FIG. 25B illustrates an energy density of a single-phase electrosurgical signal.

[0039] FIG. 26 illustrates one embodiment of a flat flex circuit conductor configured to transmit a multi-phase electrosurgical signal.

[0040] FIGS. 27A and 27B illustrate one embodiment of a bipolar end effector configured to deliver bipolar RF energy to a tissue section.

[0041] FIGS. 28A-28C illustrate one embodiment of a bipolar end effector configured to deliver bipolar RF energy to a tissue section and comprising a deformable tube.

[0042] FIG. 29 illustrates one embodiment of a deformable cautery pencil tip end effector.

[0043] FIGS. 30A-30E illustrate various embodiments of deformable cautery pencil tip end effectors similar to the deformable cautery pencil tip end effector of FIG. 30.

[0044] FIGS. 31A-31C illustrate one embodiment of a pencil-style electrosurgical instrument comprising a multiple electrode pencil tip end effector.

[0045] FIG. 32 illustrates one embodiment of a multiple-electrode pencil tip end effector comprising flexible plate source electrodes.

[0046] FIGS. 33A and 33B illustrate one embodiment of a multiple-electrode pencil tip end effector comprising a plurality of internal projections configured to prevent contact between an internal source electrode and a plurality of return electrodes.

[0047] FIG. 34 illustrates one embodiment of a bipolar pencil tip end effector comprising a PTC electrode and a return electrode.

[0048] FIG. 35 illustrates one embodiment of a bipolar pencil tip end effector comprising a PTC electrode and a return electrode comprising hemispheres on a tip of the end effector.

[0049] FIGS. 36A and 36B illustrate one embodiment of a bipolar pencil tip end effector comprising a PTC electrode and a return electrode comprising hemispheres on a tip of the end effector and comprising a tissue gap between the PTC electrode and the return electrode.

DESCRIPTION

[0050] Reference will now be made in detail to several embodiments, including embodiments showing example implementations of electrosurgical medical instruments for cutting and coagulating tissue. Wherever practicable similar or like reference numbers may be used in the figures and may indicate similar or like functionality. The figures depict example embodiments of the disclosed surgical instruments and/or methods of use for purposes of illustration only. One skilled in the art will readily recognize from the following description that alternative example embodiments of the structures and methods illustrated herein may be employed without departing from the principles described herein.

[0051] Various embodiments of surgical instruments that utilize therapeutic and/or subtherapeutic electrical energy to treat tissue or provide feedback to the generators (e.g., electrosurgical instruments). The embodiments are adapted for use in a manual or hand-operated manner, although electrosurgical instruments may be utilized in robotic applications as well. FIG. 1 is a perspective view of one example embodiment of a surgical instrument system 100 comprising an electrical energy surgical instrument 110. The electrosurgical instrument 110 may comprise a proximal handle 112, a distal working end or end effector 126 and an introducer or elongated shaft 114 disposed in-between.

[0052] The electrosurgical system 100 can be configured to supply energy, such as electrical energy, ultrasonic energy, heat energy, or any combination thereof, to the tissue of a patient either independently or simultaneously, for example. In one example embodiment, the electrosurgical system 100 includes a generator 120 in electrical communication with the electrosurgical instrument 110. The generator 120 is connected to the electrosurgical instrument 110 via a suitable transmission medium such as a cable 122. In one example embodiment, the generator 120 is coupled to a controller, such as a control unit 125, for example. In various embodiments, the control unit 125 may be formed integrally with the generator 120 or may be provided as a separate circuit module or device electrically coupled to the generator 120 (shown in phantom to illustrate this option). Although in the presently disclosed embodiment, the generator 120 is shown separate from the electrosurgical instrument 110, in one example embodiment, the generator 120 (and/or the control unit 125) may be formed integrally with the electrosurgical instrument 110 to form a unitary electrosurgical system 100, where a battery located within the electrosurgical instrument 110 is the energy source and a circuit coupled to the battery produces the suitable electrical energy, ultrasonic energy, or heat energy. One such example is described herein below in connection with FIGS. 7-8C.

[0053] The generator 120 may comprise an input device 135 located on a front panel of the generator 120 console. The input device 135 may comprise any suitable device that generates signals suitable for programming the operation of the generator 120, such as a keyboard, or input port, for example. In one example embodiment, various electrodes in the first jaw 164a and the second jaw 164b may be coupled to the generator 120. The cable 122 may comprise multiple electrical conductors for the application of electrical energy to positive (+) and negative (−) electrodes of the electrosurgical instrument 110. The control unit 125 may be used to activate the generator 120, which may serve as an electrical source. In various embodiments, the generator 120 may comprise an RF source, an ultrasonic source, a direct current

source, and/or any other suitable type of electrical energy source, for example, which may be activated independently or simultaneously.

[0054] In various embodiments, the electrosurgical system 100 may comprise at least one supply conductor 131 and at least one return conductor 133, wherein current can be supplied to the electrosurgical instrument 100 via the supply conductor 131 and wherein the current can flow back to the generator 120 via the return conductor 133. In various embodiments, the supply conductor 131 and the return conductor 133 may comprise insulated wires and/or any other suitable type of conductor. In certain embodiments, as described below, the supply conductor 131 and the return conductor 133 may be contained within and/or may comprise the cable 122 extending between, or at least partially between, the generator 120 and the end effector 126 of the electrosurgical instrument 110. In any event, the generator 120 can be configured to apply a sufficient voltage differential between the supply conductor 131 and the return conductor 133 such that sufficient current can be supplied to the end effector 126.

[0055] FIG. 2 is a side view of one example embodiment of the handle 112 of the surgical instrument 110. In FIG. 2, the handle 112 is shown with half of a first handle body 112a (see FIG. 1) removed to illustrate various components within the second handle body 112b. The handle 112 may comprise a lever arm 121 (e.g., a trigger) which may be pulled along a path 33. The lever arm 121 may be coupled to an axially moveable member 178 (FIGS. 3-6) disposed within the elongated shaft 114 by a shuttle 184 operably engaged to an extension 198 of lever arm 121. The shuttle 184 may further be connected to a biasing device, such as a spring 188, which may also be connected to the second handle body 112b, to bias the shuttle 184 and thus the axially moveable member 178 in a proximal direction, thereby urging the jaws 164a and 164b to an open position as seen in FIG. 1. Also, referring to FIGS. 1-2, a locking member 190 (see FIG. 2) may be moved by a locking switch 128 (see FIG. 1) between a locked position, where the shuttle 184 is substantially prevented from moving distally as illustrated, and an unlocked position, where the shuttle 184 may be allowed to freely move in the distal direction, toward the elongated shaft 114. The handle 112 can be any type of pistol-grip or other type of handle known in the art that is configured to carry actuator levers, triggers or sliders for actuating the first jaw 164a and the second jaw 164b. In some embodiments, the handle 112 may comprise a pencil-style handle. The elongated shaft 114 may have a cylindrical or rectangular cross-section, for example, and can comprise a thin-wall tubular sleeve that extends from handle 112. The elongated shaft 114 may include a bore extending there-through for carrying actuator mechanisms, for example, the axially moveable member 178, for actuating the jaws and for carrying electrical leads for delivery of electrical energy to electrosurgical components of the end effector 126.

[0056] The end effector 126 may be adapted for capturing and transecting tissue and for contemporaneously welding the captured tissue with controlled application of energy (e.g., RF energy). The first jaw 164a and the second jaw 164b may close to thereby capture or engage tissue about a longitudinal axis “T” defined by the axially moveable member 178. The first jaw 164a and second jaw 164b may also apply compression to the tissue. In some embodiments, the elongated shaft 114, along with the first jaw 164a and second

jaw **164b**, can be rotated a full 360° degrees, as shown by the arrow **196** (see FIG. 1), relative to the handle **112**. For example, a rotation knob **148** may be rotatable about the longitudinal axis of the shaft **114** and may be coupled to the shaft **114** such that rotation of the knob **148** causes corresponding rotation of the shaft **114**. The first jaw **164a** and the second jaw **164b** can remain openable and/or closeable while rotated.

[0057] FIG. 3 shows a perspective view of one example embodiment of the end effector **126** with the jaws **164a**, **164b** open, while FIG. 4 shows a perspective view of one embodiment of the end effector **126** with the jaws **164a**, **164b** closed. As noted above, the end effector **126** may comprise the upper first jaw **164a** and the lower second jaw **164b**, which may be straight or curved. The first jaw **164a** and the second jaw **164b** may each comprise an elongated slot or channel **162a** and **162b**, respectively, disposed outwardly along their respective middle portions. Further, the first jaw **164a** and the second jaw **164b** may each have tissue-gripping elements, such as teeth **163**, disposed on the inner portions of the first jaw **164a** and the second jaw **164b**. The first jaw **164a** may comprise an upper first jaw body **162a** with an upper first outward-facing surface and an upper first energy delivery surface **165a**. The second jaw **164b** may comprise a lower second jaw body **162b** with a lower second outward-facing surface and a lower second energy delivery surface **165b**. The first energy delivery surface **165a** and the second energy delivery surface **165b** may both extend in a “U” shape about the distal end of the end effector **126**.

[0058] The lever arm **121** of the handle **112** (FIG. 2) may be adapted to actuate the axially moveable member **178**, which also may function as a jaw-closing mechanism. For example, the axially moveable member **178** may be urged distally as the lever arm **121** is pulled proximally along the path **33** via the shuttle **184**, as shown in FIG. 2 and discussed above. FIG. 5 is a perspective view of one example embodiment of the axially moveable member **178** of the surgical instrument **110**. The axially moveable member **178** may comprise one or several pieces, but in any event, may be movable or translatable with respect to the elongated shaft **114** and/or the jaws **164a**, **164b**. Also, in at least one example embodiment, the axially moveable member **178** may be made of 17-4 precipitation hardened stainless steel. The distal end of axially moveable member **178** may comprise a flanged “I”-beam configured to slide within the channels **162a** and **162b** in jaws **164a** and **164b**. The axially moveable member **178** may slide within the channels **162a**, **162b** to open and close the first jaw **164a** and the second jaw **164b**. The distal end of the axially moveable member **178** may also comprise an upper flange or “c”-shaped portion **178a** and a lower flange or “c”-shaped portion **178b**. The flanges **178a**, **178b** respectively define inner cam surfaces **167a** and **167b** for engaging outward facing surfaces of the first jaw **164a** and the second jaw **164b**. The opening-closing of jaws **164a** and **164b** can apply very high compressive forces on tissue using cam mechanisms which may include movable “I-beam” axially moveable member **178** and the outward facing surfaces **169a**, **169b** of jaws **164a**, **164b**.

[0059] More specifically, referring now to FIGS. 3-5, collectively, the inner cam surfaces **167a** and **167b** of the distal end of axially moveable member **178** may be adapted to slidably engage the first outward-facing surface **369a** and the second outward-facing surface **369b** of the first jaw **164a**

and the second jaw **164b**, respectively. The channel **162a** within first jaw **164a** and the channel **162b** within the second jaw **164b** may be sized and configured to accommodate the movement of the axially moveable member **178**, which may comprise a tissue-cutting element **171**, for example, comprising a sharp distal edge. FIG. 4, for example, shows the distal end of the axially moveable member **178** advanced at least partially through channels **162a** and **162b** (FIG. 3). The advancement of the axially moveable member **178** may close the end effector **126** from the open configuration shown in FIG. 3. In the closed position shown by FIG. 4, the upper first jaw **164a** and the lower second jaw **164b** define a gap or dimension D between the first energy delivery surface **165a** and second energy delivery surface **165b** of the first jaw **164a** and the second jaw **164b**, respectively. In various embodiments, dimension the D can equal from about 0.0005" to about 0.040", for example, and in some embodiments, between about 0.001" to about 0.010", for example. Also, the edges of the first energy delivery surface **165a** and the second energy delivery surface **165b** may be rounded to prevent the dissection of tissue.

[0060] FIG. 6 is a section view of one example embodiment of the end effector **126** of the surgical instrument **110**. The engagement, tissue-contacting, surface **165b** of the lower jaw **164b** is adapted to deliver energy to tissue, at least in part, through a conductive-resistive matrix, such as a variable resistive PTC body, as discussed in more detail below. At least one of the upper and lower jaws **164a**, **164b** may carry at least one electrode **173** configured to deliver the energy from the generator **120** to the captured tissue. The engagement, tissue-contacting, surface **165a** of the upper jaw **164a** may carry a similar conductive-resistive matrix (i.e., a PTC material), or in some embodiments the surface may be a conductive electrode or an insulative layer, for example. Alternatively, the engagement surfaces of the jaws can carry any of the energy delivery components disclosed in U.S. Pat. No. 6,773,409, filed Oct. 22, 2001, entitled ELECTROSURGICAL JAW STRUCTURE FOR CONTROLLED ENERGY DELIVERY, the entire disclosure of which is incorporated herein by reference.

[0061] The first energy delivery surface **165a** and the second energy delivery surface **165b** each may be in electrical communication with the generator **120**. The first energy delivery surface **165a** and the second energy delivery surface **165b** may be configured to contact tissue and deliver electrosurgical energy to captured tissue which are adapted to seal or weld the tissue. The control unit **125** regulates the electrical energy delivered by electrical generator **120** which in turn delivers electrosurgical energy to the first energy delivery surface **165a** and the second energy delivery surface **165b**. The energy delivery may be initiated by an activation button **128** (FIG. 2) operably engaged with the lever arm **121** and in electrical communication with the generator **120** via a cable **122**. In one example embodiment, the electrosurgical instrument **110** may be energized by the generator **120** by way of a foot switch **129** (FIG. 1). When actuated, the foot switch **129** triggers the generator **120** to deliver electrical energy to the end effector **126**, for example. The control unit **125** may regulate the power generated by the generator **120** during activation. Although the foot switch **129** may be suitable in many circumstances, other suitable types of switches can be used, such as, for example, a thumb switch.

[0062] As mentioned above, the electrosurgical energy delivered by electrical generator 120 and regulated, or otherwise controlled, by the control unit 125 may comprise radio frequency (RF) energy, or other suitable forms of electrical energy. Further, the opposing first and second energy delivery surfaces 165a and 165b may carry variable resistive PTC bodies that are in electrical communication with the generator 120 and the control unit 125. Additional details regarding electrosurgical end effectors, jaw closing mechanisms, and electrosurgical energy-delivery surfaces are described in the following U.S. patents and published patent applications: U.S. Pat. Nos. 7,087,054; 7,083,619; 7,070,597; 7,041,102; 7,011,657; 6,929,644; 6,926,716; 6,913,579; 6,905,497; 6,802,843; 6,770,072; 6,656,177; 6,533,784; and 6,500,112; and U.S. Patent Application Publication Nos. 2010/0036370 and 2009/0076506, all of which are incorporated herein by reference in their entirety and made part of this specification.

[0063] In one example embodiment, the generator 120 may be implemented as an electrosurgery unit (ESU) capable of supplying power sufficient to perform bipolar electrosurgery using radio frequency (RF) energy. In one example embodiment, the ESU can be a bipolar ERBE ICC 150 sold by ERBE USA, Inc. of Marietta, Ga. In some embodiments, such as for bipolar electrosurgery applications, a surgical instrument having an active electrode and a return electrode can be utilized, wherein the active electrode and the return electrode can be positioned against, adjacent to and/or in electrical communication with, the tissue to be treated such that current can flow from the active electrode, through the PTC bodies and to the return electrode through the tissue. Thus, in various embodiments, the electrosurgical system 100 may comprise a supply path and a return path, wherein the captured tissue being treated completes, or closes, the circuit. In one example embodiment, the generator 120 may be a monopolar RF ESU and the electrosurgical instrument 110 may comprise a monopolar end effector 126 in which one or more active electrodes are integrated. For such a system, the generator 120 may require a return pad in intimate contact with the patient at a location remote from the operative site and/or other suitable return path. The return pad may be connected via a cable to the generator 120. In other embodiments, the operator may provide sub-therapeutic RF energy levels for purposes of evaluating tissue conditions and providing feedback in the electrosurgical system 100. Such feedback may be employed to control the therapeutic RF energy output of the electrosurgical instrument 110.

[0064] During operation of electrosurgical instrument 100, the user generally grasps tissue, supplies energy to the grasped tissue to form a weld or a seal (e.g., by actuating button 128 and/or pedal 129), and then drives a tissue-cutting element 171 at the distal end of the axially moveable member 178 through the grasped tissue. According to various embodiments, the translation of the axial movement of the axially moveable member 178 may be paced, or otherwise controlled, to aid in driving the axially moveable member 178 at a suitable rate of travel. By controlling the rate of the travel, the likelihood that the captured tissue has been properly and functionally sealed prior to transection with the cutting element 171 is increased.

[0065] FIG. 7 is a perspective view of one example embodiment of a surgical instrument system 200 comprising a cordless electrical energy surgical instrument 210. The

electrosurgical system 200 is similar to the electrosurgical system 100. The electrosurgical system 200 can be configured to supply energy, such as electrical energy, ultrasonic energy, heat energy, or any combination thereof, to the tissue of a patient either independently or simultaneously as described in connection with FIG. 1, for example. The electrosurgical instrument 210 may utilize the end effector 126 and elongated shaft 114 described here in conjunction with a cordless proximal handle 212. In one example embodiment, the handle 212 includes a generator circuit 220 (see FIG. 8A). The generator circuit 220 performs a function substantially similar to that of generator 120. In one example embodiment, the generator circuit 220 is coupled to a controller, such as a control circuit. In the illustrated embodiment, the control circuit is integrated into the generator circuit 220. In other embodiments, the control circuit may be separate from the generator circuit 220.

[0066] In one example embodiment, various electrodes in the end effector 126 (including the first and second jaws 164a, 164b thereof) may be coupled to the generator circuit 220. The control circuit may be used to activate the generator 220, which may serve as an electrical source. In various embodiments, the generator 220 may comprise an RF source, an ultrasonic source, a direct current source, and/or any other suitable type of electrical energy source, for example. In one example embodiment, a button 128 may be provided to activate the generator circuit 220 to provide energy to the end effector 126.

[0067] FIG. 8A is a side view of one example embodiment of the handle 212 of the cordless surgical instrument 210. In FIG. 8A, the handle 212 is shown with half of a first handle body removed to illustrate various components within the second handle body 234. The handle 212 may comprise a lever arm 224 (e.g., a trigger) which may be pulled along a path 33 around a pivot point. The lever arm 224 may be coupled to an axially moveable member 278 disposed within the elongated shaft 114 by a shuttle operably engaged to an extension of lever arm 221. In one example embodiment, the lever arm 221 defines a shepherd's hook shape comprising a distal trigger hook 221a and a proximal trigger portion 221b. As illustrated, the distal trigger hook 221a may have a first length while the proximal trigger portion 221b may have a second length with the second length greater than the first length.

[0068] In one example embodiment, the cordless electrosurgical instrument comprises a battery 237. The battery 237 provides electrical energy to the generator circuit 220. The battery 237 may be any battery suitable for driving the generator circuit 220 at the desired energy levels. In one example embodiment, the battery 237 is a 1030 mAh, triple-cell Lithium Ion Polymer battery. The battery may be fully charged prior to use in a surgical procedure, and may hold a voltage of about 12.6V. The battery 237 may have two fuses fitted to the cordless electrosurgical instrument 210, arranged in line with each battery terminal. In one example embodiment, a charging port 239 is provided to connect the battery 237 to a DC current source (not shown).

[0069] The generator circuit 220 may be configured in any suitable manner. In some embodiments, the generator circuit comprises an RF drive and control circuit 240 and a controller circuit 282. FIG. 8B illustrates an RF drive and control circuit 240, according to one embodiment. FIG. 8B is a part schematic part block diagram illustrating the RF drive and control circuitry 240 used in this embodiment to

generate and control the RF electrical energy supplied to the end effector 126. As will be explained in more detail below, in this embodiment, the drive circuitry 240 is a resonant mode RF amplifier comprising a parallel resonant network on the RF amplifier output and the control circuitry operates to control the operating frequency of the drive signal so that it is maintained at the resonant frequency of the drive circuit, which in turn controls the amount of power supplied to the end effector 126. The way that this is achieved will become apparent from the following description.

[0070] As shown in FIG. 8B, the RF drive and control circuit 240 comprises the above described battery 237 are arranged to supply, in this example, about 0V and about 12V rails. An input capacitor (C_{in}) 242 is connected between the 0V and the 12V for providing a low source impedance. A pair of FET switches 243-1 and 243-2 (both of which are N-channel in this embodiment to reduce power losses) is connected in series between the 0V rail and the 12V rail. FET gate drive circuitry 245 is provided that generates two drive signals—one for driving each of the two FETs 243. The FET gate drive circuitry 245 generates drive signals that causes the upper FET (243-1) to be on when the lower FET (243-2) is off and vice versa. This causes the node 247 to be alternately connected to the 12V rail (when the FET 243-1 is switched on) and the 0V rail (when the FET 243-2 is switched on). FIG. 8B also shows the internal parasitic diodes 248-1 and 248-2 of the corresponding FETs 243, which conduct during any periods that the FETs 243 are open.

[0071] As shown in FIG. 8B, the node 247 is connected to an inductor-inductor resonant circuit 250 formed by inductor L_s 252 and inductor L_m 254. The FET gate driving circuitry 245 is arranged to generate drive signals at a drive frequency (f_d) that opens and crosses the FET switches 243 at the resonant frequency of the parallel resonant circuit 250. As a result of the resonant characteristic of the resonant circuit 250, the square wave voltage at node 247 will cause a substantially sinusoidal current at the drive frequency (f_d) to flow within the resonant circuit 250. As illustrated in FIG. 8B, the inductor L_m 254 is the primary of a transformer 255, the secondary of which is formed by inductor L_{sec} 256. The inductor L_{sec} 256 of the transformer 255 secondary is connected to an inductor-capacitor-capacitor parallel resonant circuit 257 formed by inductor L_2 258, capacitor C_4 260, and capacitor C_2 262. The transformer 255 up-converts the drive voltage (V_d) across the inductor L_m 254 to the voltage that is applied to the output parallel resonant circuit 257. The load voltage (V_L) is output by the parallel resonant circuit 257 and is applied to the load (represented by the load resistance R_{load} 259 in FIG. 8B) corresponding to the impedance of the forceps' jaws and any tissue or vessel gripped by the end effector 126. As shown in FIG. 8B, a pair of DC blocking capacitors C_{bl} 280-1 and 280-2 is provided to prevent any DC signal being applied to the load 259.

[0072] In one embodiment, the transformer 255 may be implemented with a Core Diameter (mm), Wire Diameter (mm), and Gap between secondary windings in accordance with the following specifications:

[0073] Core Diameter, D (mm)

[0074] $D=19.9 \times 10^{-3}$

[0075] Wire diameter, W (mm) for 22 AWG wire

[0076] $W=7.366 \times 10^{-4}$

[0077] Gap between secondary windings, in gap=0.125

[0078] $G=\text{gap}/25.4$

[0079] In this embodiment, the amount of electrical power supplied to the end effector 126 is controlled by varying the frequency of the switching signals used to switch the FETs 243. This works because the resonant circuit 250 acts as a frequency dependent (loss less) attenuator. The closer the drive signal is to the resonant frequency of the resonant circuit 250, the less the drive signal is attenuated. Similarly, as the frequency of the drive signal is moved away from the resonant frequency of the circuit 250, the more the drive signal is attenuated and so the power supplied to the load reduces. In this embodiment, the frequency of the switching signals generated by the FET gate drive circuitry 245 is controlled by a controller 281 based on a desired power to be delivered to the load 259 and measurements of the load voltage (V_L) and of the load current (I_L) obtained by conventional voltage sensing circuitry 283 and current sensing circuitry 285. The way that the controller 281 operates will be described in more detail below.

[0080] In one embodiment, the voltage sensing circuitry 283 and the current sensing circuitry 285 may be implemented with high bandwidth, high speed rail-to-rail amplifiers (e.g., LMH6643 by National Semiconductor). Such amplifiers, however, consume a relatively high current when they are operational. Accordingly, a power save circuit may be provided to reduce the supply voltage of the amplifiers when they are not being used in the voltage sensing circuitry 283 and the current sensing circuitry 285. In one embodiment, a step-down regulator (e.g., LT1502 by Linear Technologies) may be employed by the power save circuit to reduce the supply voltage of the rail-to-rail amplifiers and thus extend the life of the battery 237.

[0081] FIG. 8C illustrates the main components of the controller 281, according to one embodiment. In the embodiment illustrated in FIG. 8C, the controller 281 is a microprocessor based controller and so most of the components illustrated in FIG. 8C are software based components. Nevertheless, a hardware based controller 281 may be used instead. As shown, the controller 281 includes synchronous I,Q sampling circuitry 291 that receives the sensed voltage and current signals from the sensing circuitry 283 and 285 and obtains corresponding samples which are passed to a power, V_{rms} and I_{rms} calculation module 293. The calculation module 293 uses the received samples to calculate the RMS voltage and RMS current applied to the load 259 (FIG. 8B; end effector 126 and tissue/vessel gripped thereby) and from them the power that is presently being supplied to the load 259. The determined values are then passed to a frequency control module 295 and a medical device control module 297. The medical device control module 297 uses the values to determine the present impedance of the load 259 and based on this determined impedance and a pre-defined algorithm, determines what set point power (P_{set}) should be applied to the frequency control module 295. The medical device control module 297 is in turn controlled by signals received from a user input module 299 that receives inputs from the user (for example pressing buttons or activating the control levers 114, 110 on the handle 104) and also controls output devices (lights, a display, speaker or the like) on the handle 104 via a user output module 261.

[0082] The frequency control module 295 uses the values obtained from the calculation module 293 and the power set point (P_{set}) obtained from the medical device control module 297 and predefined system limits (to be explained below), to determine whether or not to increase or decrease the applied

frequency. The result of this decision is then passed to a square wave generation module **263** which, in this embodiment, increments or decrements the frequency of a square wave signal that it generates by 1 kHz, depending on the received decision. As those skilled in the art will appreciate, in an alternative embodiment, the frequency control module **295** may determine not only whether to increase or decrease the frequency, but also the amount of frequency change required. In this case, the square wave generation module **263** would generate the corresponding square wave signal with the desired frequency shift. In this embodiment, the square wave signal generated by the square wave generation module **263** is output to the FET gate drive circuitry **245**, which amplifies the signal and then applies it to the FET **243-1**. The FET gate drive circuitry **245** also inverts the signal applied to the FET **243-1** and applies the inverted signal to the FET **243-2**.

[0083] The electrosurgical instrument **210** may comprise additional features as discussed with respect to the electrosurgical system **100** illustrated in FIGS. 1-6. Those skilled in the art will recognize that electrosurgical instrument **210** may include a rotation knob **148**, an elongated shaft **114**, and an end effector **126**. These elements function in a substantially similar manner to that discussed above with respect to the electrosurgical system **100** illustrated in FIGS. 1-6. In one example embodiment, the cordless electrosurgical instrument **210** may include visual indicators **235**. The visual indicators **235** may provide a visual indication signal to an operator. In one example embodiment, the visual indication signal may alert an operator that the device is on, or that the device is applying energy to the end effector. Those skilled in the art will recognize that the visual indicators **235** may be configured to provide information on multiple states of the device.

[0084] In some embodiments, one or more of the components of the upper and lower jaws **164a**, **164b** may comprise a fluoropolymer material comprising an electrically conductive mica additive. For example, in one embodiment, the tissue contact surfaces **165a**, **165b** of the upper and lower jaws **164a**, **164b** may comprise the fluoropolymer material. In some embodiments, the fluoropolymer material may comprise polytetrafluoroethylene (PTFE). PTFE comprises a non-stick, non-electrically conductive material. Electrically conductive mica comprises mica coated with a conductive material, such as, for example, nickel or silver. The electrically conductive mica additive may allow the PTFE material to transmit an electrosurgical signal from a conductor to a tissue section.

[0085] In some embodiments, a fluoropolymer material comprising an electrically conductive mica additive may be added to one or more components of the upper and lower jaws **164a**, **164b** as a compression molded structural component adhered to and/or overmolded to a substrate such as, for example, stainless steel. In one embodiment, the fluoropolymer material may be applied as a spray to a supporting metal structure, such as, for example, stainless steel. The fluoropolymer material may comprise a thickness of, for example, 5-20 microns. In some embodiments the fluoropolymer material may comprise a mica content of 0.1-10% by weight.

[0086] FIG. 9 illustrates one embodiment of a one-piece flexible snap-on base cap **316**. The base cap **316** may be configured to interface with the end effector **126**, for example, by snapping or clipping onto the lower jaw **164b**.

The base cap **316** may comprise at least one source electrode **365** and one or more return electrodes **366a**, **366b**. The source electrode **365** and the return electrodes **366a**, **366b** may be coupled to a generator, for example the generator **120** shown in FIG. 1, when the base cap **316** is coupled to an end effector **126**. The base cap **316** may comprise one or more flex circuits **336** configured to couple the electrodes **365**, **366a**, **366b** to, for example, the conductors **131**, **133** located within the shaft **114** of the electrosurgical device **110**.

[0087] In some embodiments, the base cap **316** may comprise one or more molded hook caps **317** for mounting the base cap **316** to a lower jaw **164b**. The molded hook caps **317** may be bonded into the base cap **316**, for example, as part of an electrode layer. The molded hook caps **317** may be configured to interface with one or more features of the lower jaw **164b** to mount the base cap **316** onto the lower jaw **164b**.

[0088] FIGS. 10A and 10B illustrate one embodiment of the base cap **316** coupled to an end effector **326**, where FIG. 10B is a detailed view of a section of the molded base cap shown in FIG. 10A. The base cap **316** may comprise one or more features, such as, for example, the molded hook caps **317**, configured to interface with one or more features of the end effector **326**. The end effector **326** may comprise one or more overhangs **318a**, **318b** configured to interface with the molded hook caps **317** formed on the base cap **316**. In some embodiments, the base cap **316** may be configured to cover an I-Beam channel **162b** in a lower jaw **164b** of the electrosurgical device **110**. FIG. 10B illustrates a detailed cross-sectional view of the base cap **316**. In one embodiment, the base cap **316** may comprise a width 'B' of approximately 0.01"-0.02". The electrodes **365**, **366a**, **366b** may comprise, for example, a printed circuit comprising a width 'C' of approximately 0.005" with a clearance 'D' of approximately 0.002" on either side of the electrodes **365**, **366a**, **366b**. The electrodes **365**, **366a**, **366b** may comprise a spacing 'E', for example, of approximately 0.006"-0.008" within the base cap **316**.

[0089] As shown in FIG. 10B, the base cap **316** may comprise a source electrode **365** and one or more return electrodes **366a**, **366b**. The source electrode **365** and the return electrodes **366a**, **366b** may comprise a flexible, printed circuit. The electrodes **365**, **366a**, **366b** may be coupled to a source conductor **131** and a return conductor **133** of the electrosurgical device **110** through flex circuit **336**. In operation, the base cap **316** may be used for bipolar coagulation and/or cautery of a tissue section in contact with the base cap **316**. The base cap **316** may allow treatment of a tissue section located between the return electrodes **366a**, **366b** while protecting the electrosurgical instrument **310**, such as, for example, the I-Beam channel **162b**, from debris and fouling during application of electrosurgical energy.

[0090] In some embodiments, the base cap **316** may comprise one or more laminate layers. FIG. 11 illustrates one embodiment of a base cap **416** comprising an electrode layer **430**, a heat sink layer **432**, and a sealing layer **434** applied in a laminate structure. The sealing layer **434** may comprise a flex circuit formed thereon. The flex circuit may be configured to provide a connection with the supply conductor **1** and the return conductor from the generator, for example, the generator **120** shown in FIG. 1. In the illustrated embodiment, the electrode layer **430** may comprise a direct contact metal electrode **465** configured for direct

application of electrosurgical energy to a tissue section. In some embodiments, the electrode layer 430 may comprise an inductive coupling electrode (not shown). A direct contact electrode embodiment may require less voltage to weld tissue but may be affected by becoming dirty or fouled over time. In some embodiments, a biocompatible dielectric grease or coating may be included on the direct contact metal electrode 465 to minimize degradation in performance. In some embodiments, an isolative material may be deposited between the electrodes 465 in the electrode layer 430. For example, in one embodiment, an isolative plastic 436 may be bonded onto base cap 416 around the printed electrodes 465.

[0091] The base cap 416 may comprise an insulative layer 432 configured to isolate the electrodes from the lower jaw 164b of the electrosurgical instrument 110. A middle electrode layer 430 may comprise a plurality of printed electrodes 465. The printed electrodes 465 may comprise flexible circuits. An outer sealing layer 434 may be disposed over the insulative layer 432 and the electrode layer 430 to seal the base cap. The sealing layer 434 may comprise any suitable material, such as, for example, polyethylene, polypropylene, and/or nylon. The sealing layer 434 may comprise any suitable thickness, such as, for example, 1 to 2 mils. In some embodiments, the inner layer may comprise a thickness of between 0.01" to 0.015" with each of the electrodes comprising a thickness of about 0.005". In some embodiments, the electrodes may comprise a specific spacing on the base cap, such as, for example, a spacing of 0.06" to 0.08".

[0092] FIG. 12 illustrates one embodiment of an electrosurgical instrument 510 comprising an end effector 526. A base cap 516 is coupled to the end effector 526. The base cap 516 may be configured to provide electrosurgical energy to a tissue section 515. An operator may apply a force to the tissue section 515 using the base cap 516. The base cap 516 may apply an electrosurgical signal to the tissue section 515. The base cap 516 may be used, for example, to provide touch-up electrosurgical treatment after a cutting and sealing operation performed by the end effector 526. The base cap 516 may be configured to cover an I-beam slot 162b in the lower jaw 564b to prevent debris from entering into, or damage occurring to, the I-beam slot 162b during touch-up electrosurgical treatment.

[0093] FIGS. 13-15 illustrate base caps comprising various electrode arrangements. FIG. 13 illustrates a base cap 616 comprising a first electrode 665a and a second electrode 665b. The first electrode 665a and the second electrode 665b define a treatment area therebetween. When the base cap 616 is in contact with a tissue section and an electrosurgical signal is applied to the first electrode 665a and the second electrode 665b, for example, by a generator 120, a tissue weld may occur between the first electrode 665a and the second electrode 665b. FIG. 14 illustrates one embodiment of base cap 716 comprising longitudinal first and second electrodes 765a, 765b. FIG. 15 illustrates one embodiment of base cap 816 comprising a source electrode 865 and two return electrodes 866a, 866b. The treatment area of the base cap 816 may comprise the area between the two return electrodes 866a, 866b, as current may flow from the source electrode 865 into both of the return electrodes 866a, 866b.

[0094] In some embodiments, the electrosurgical instrument 110 may comprise additional tissue treatment features. FIGS. 16A and 16B illustrate one embodiment of an elec-

tro-surgical instrument 910 comprising an end effector 926. The end effector 926 may comprise a tissue ablation tip 963. In FIG. 16A a perspective of the end effector 926 shows a jaw member in an open position and in FIG. 16B an end view of the end effector 926 shows the jaw members in a closed position. With reference now to both FIGS. 16A and 16B, a central electrode 965 may be deposited on the upper jaw 964a and the lower jaw 964b. The central electrode 965 may be separated into an upper hemisphere 967a formed on the upper jaw 964a and a lower hemisphere 967b formed on the lower jaw 964b. A return electrode 966 may be formed on the distal end of the upper jaw 964a and the lower jaw 964b. The return electrode 966 may comprise, for example, a ring electrode. The return electrode 966 may be concentric with the central electrode 965. The return electrode 966 may be separated into an upper hemisphere 968a formed on the upper jaw 964a and a lower hemisphere 968b formed on the lower jaw 964b. The central electrode 965 and the return electrode 966 may be coupled to the generator 120 through the upper jaw 964a and/or the lower jaw 964b. In some embodiments, the central electrode 965 may comprise a PTC material. As the temperature of a tissue section increases due to treatment by the electrosurgical device 910, the PTC material of the central electrode 965 may limit the current flow through the tissue section, providing temperature controlled-limits for delivered electrosurgical energy.

[0095] In some embodiments, only one hemisphere of the central electrode 965 and/or the return electrode 966 may be coupled to the generator 120. For example, in one embodiment, only the upper hemispheres of the central electrode 967a and/or the return electrode 968a may be coupled to the generator 120. In this embodiment, when the upper jaw 964a and the lower jaw 964b are in an open position, only the upper hemispheres 967a, 968a of the central electrode 965 and the return electrode 966 may be active. When the upper jaw 964a and the lower jaw 964b are in a closed position, current may flow to the lower hemispheres 967b, 968b from the upper hemispheres 967a, 968a of the electrodes 965, 966.

[0096] The electrosurgical device 910 may comprise a closure switch configured to indicate closure of the upper jaw 964a and the lower jaw 964b and to control operation of the tissue ablation tip 963. For example, in one embodiment, a closure switch may be configured to control operation of the tissue ablation tip 963. When the upper jaw 964a and the lower jaw 964b are in an open position, the closure switch may prevent operation of the tissue ablation tip 963. When the upper jaw 964a and the lower jaw 964b are in a closed position, the closure switch may allow operation of the tissue ablation tip 963. In another embodiment, the closure switch may be configured to switch between monopolar and bipolar treatments. For example, in one embodiment, when the upper jaw 964a and the lower jaw 964b are in an open position, the closure switch may configure the upper hemisphere 967a of the central electrode 965 and/or the upper hemisphere 968a of the return electrode 966 for monopolar electrosurgical treatment. When the upper jaw 964a and the lower jaw 964b are in a closed position, the closure switch may provide bipolar electrosurgical energy to the tissue ablation tip 963.

[0097] In some embodiments, the electrosurgical instrument 110 may comprise a power tip. FIG. 17 illustrates one embodiment of an end effector 1026 comprising a power tip 1040. The power tip 1040 may comprise an electrode 1042

disposed at the distal end of the end effector **1026**. The end effector **1026** may comprise an upper jaw **1064a** and a lower jaw **1064b**. The power tip **1040** may be disposed on the distal end of the lower jaw **1064b**. The power tip **1040** may comprise a wire and/or other conductive material configured to receive monopolar and/or bipolar RF energy. The power tip **1040** may be configured to allow a surgeon to generate anotomy, or aperture, in a tissue section, by applying a force to the tissue section using the power tip **1040**. Monopolar or bipolar RF energy may be applied to the power tip **1040** to cause heating of the tissue section. FIG. **18** illustrates one embodiment of a half-circle power tip **1140** disposed on the distal end of a lower jaw **1164b**. The half-circle power tip **1140** may be similar to the wire power tip **1040** shown in FIG. **17**.

[0098] In some embodiments, the power tip **1040** may be coupled to a generator configured to generate an ultrasonic signal and/or an RF signal, such as, for example, the generator **120** shown in FIG. **1**. In one embodiment, the power tip **1040** may be configured to receive the signal from an ultrasonic module and/or an electrosurgical module of the generator **120**. The power tip **1040** may be configured to provide monopolar and/or bipolar energy to a tissue section. In bipolar mode, one or more electrodes in the upper jaw **1064a** and/or the lower jaw **1064b** may function as return electrodes.

[0099] FIG. **19** illustrates one embodiment of an electrical connection between a generator **1220**, a power tip **1240**, a ground electrode **1266**, and one or more electrodes **1265** disposed in a clamp jaw, such as, for example, the upper jaw **1064a** and the lower jaw **1064b**. A switch **1244**, such as, for example, a two-pole switch **1344** (see FIG. **20**), may be configured to control delivery of energy to the power tip **1240**. For example, in a first position, the power tip **1240** may be configured to receive a signal from the electrosurgical module and/or the ultrasonic module of the generator **1220**. In a second position, the power tip **1240** may be deactivated and one or more electrodes **1265** in the clamp jaw **1064a**, **1064b** may be configured to receive energy from the electrosurgical module of the generator **1220**. FIG. **20** illustrates one embodiment of a two-pole switch **1344** configured to control the operation of a power tip **1240**. The switch **1344** may be configured to alternate between monopolar and bipolar electrosurgical energy. In some embodiments, the two-pole switch **1344** may be configured to switch delivery of electrosurgical energy from one or more electrodes **1265** to a power tip **1240**.

[0100] In some embodiments, a monopolar add-on device may be configured to interface with the electrosurgical instrument **110** and/or a power tip **1240**. For example, as shown in FIGS. **21** and **22**, an electrosurgical instrument **1310** may be configured to receive a monopolar add-on device **1350**. The monopolar add-on device **1350** may comprise an annular slip ring **1352**. The monopolar add-on device **1350** may be configured to slide and/or clip onto the electrosurgical device **1310**, for example, over the shaft **1314**. The monopolar add-on device **1350** may be located, for example, on the shaft **1314** distal of a rotator **148**. The annular slip ring **1352** may be configured to interface with one or more of the conductors located in the shaft **1314**. In some embodiments, the monopolar add-on may comprise a power switch **1354** and a power cord **1322** configured to interface with a monopolar generator (not shown).

[0101] In some embodiments, the monopolar add-on device **1350** may comprise a pencil grip **1356**. The pencil grip **1356** may enable a surgeon to perform touch-up and/or other precise monopolar treatment without the need to switch devices. In some embodiments, the monopolar add-on device **1350** may be configured to disable bipolar operation of the electrosurgical device **1310** when the monopolar add-on device **1350** is interfaced with the electrosurgical device **1310**. In some embodiments, the monopolar add-on device **1350** may be controlled by a foot controller (not shown).

[0102] In some embodiments, the monopolar add-on device **1350** may be configured to provide monopolar energy to a power tip disposed on the distal end of the electrosurgical device **1310**. For example, as shown in FIG. **17**, a power tip **1040** may be disposed on the distal end of an end effector **1026**. The power tip **1040** may be configured to receive monopolar energy from the monopolar add-on device **1350**. The power tip **1040** may be coupled to a conductor configured to interface with the slip ring **1352** of the monopolar add-on device **1350**.

[0103] FIG. **23A** illustrates one embodiment of an electrosurgical instrument **1410** comprising a pencil-grip handle **1412**. The pencil-grip handle **1412** may provide precise control of the electrosurgical instrument **1410** for performing spot and/or small section treatment. In one embodiment, the pencil-grip handle **1412** may be coupled to a shaft **1414**. The shaft **1414** may comprise various lengths such as, for example, a shorter length for open-surgery electrosurgical instruments or a longer shaft for laparoscopic/endoscopic electrosurgical instruments. The shaft **1414** may be coupled to an end effector **1426**. FIG. **23B** illustrates one embodiment of an electrosurgical instrument **1410a** configured for laparoscopic surgical procedures. The surgical instrument **1410a** is similar to the electrosurgical instrument **1410**. The surgical instrument **1410a** comprises the handle **1412**, a laparoscopic shaft **1414a**, and the end effector **1426**. The surgical instrument **1410a** may be inserted into a patient through, for example, a trocar **1413**.

[0104] In some embodiments, the end effector **1426** may comprise one or more electrodes for providing electrosurgical instrument to a tissue section. For example in some embodiments, the end effector **1426** may be configured to provide monopolar and/or bipolar RF energy to a treatment site. The end effector **1426** may comprise one or more electrodes configured to deliver monopolar and/or bipolar energy to a tissue section. For example, in one embodiment, the end effector **1426** may comprise at least one source electrode **1465** and at least one return electrode **1466** configured to deliver bipolar RF energy to a tissue section in contact with the end effector **1426**. In some embodiments, the end effector **1426** may be configured to receive ultrasonic energy.

[0105] One embodiment of a cordless cautery bipolar pencil **1410** is now disclosed with reference to FIGS. **23A** and **24A**. The cordless cautery bipolar pencil **1410** may utilize the shaft **1414** and/or the end effectors **1426**, **1526**, **1626**, **1726**, **1926**, **2026**, **2126**, **2226**, **2326**, **2426**, **2526**, **2626** discussed with respect to FIGS. **23A-34**. In various embodiments, the cordless cautery bipolar pencil **1410** may be configured to provide bipolar energy to a treatment area through the end effector **1426**. FIG. **24A** illustrates a cross-sectional view of the cordless cautery bipolar pencil **1410** shown in FIG. **23A**. The cordless cautery bipolar pencil

1410 may comprise a power source **1420**, such as, for example, a battery, rechargeable or non-rechargeable. The cordless cautery bipolar pencil **1410** may comprise one or more signal generation circuits **1422a**, **1422b**, **1422c**. In some embodiments, the signal generation circuits **1422a-c** may comprise a multi-phase power generation circuit **1422**.

[0106] A multi-phase power generation circuit **1422** may be configured to produce multi-phase power for the bipolar end effector **1426**. The multi-phase power generation circuit **1422** may provide any suitable multi-phase signal, such as, for example, a three-phase signal, to the end effector **1426**. The use of a multi-phase signal may reduce the current and/or voltage requirements of the bipolar end effector **1426** while still delivering the same amount of energy density to the electrodes **1465**, **1466a**, **1466b**. By reducing the current requirements of the end effector **1426**, the impact of heat generation at the electrodes **1465**, **1466a**, **1466b** may be reduced. For example, when a three-phase signal is used, the current/voltage requirements of the electrosurgical device **1410** may be three times less than the current/voltage requirements of a single-phase electrosurgical system. By reducing the current requirement by a factor of three, the impact of heat generation, i^2R , may be reduced by a factor of nine.

[0107] FIG. 24B illustrates one embodiment of a multi-phase signal generation element **1422**. A plurality of single-phase signal generators **1422a-c** may be configured to generate a single-phase bipolar electrosurgical signal. The plurality of single phase signals may be combined to generate the multi-phase bipolar signal. Each of the single-phase signal generators **1422a-c** may be coupled to a source electrode **1465** and one or more return electrodes **1466a**, **1466b**. Although a three-phase multi-phase signal generator **1422** is illustrated, those skilled in the art will recognize that any number of single-phase generators **1422a-c** may be combined in a multi-phase signal generator.

[0108] FIG. 25A illustrates the energy density of a three-phase multi-phase signal **1424**. FIG. 25B illustrates the energy density of a single-phase electrosurgical signal **1425**. As shown in FIGS. 25A and 25B, the energy density of a three-phase signal with a maximum voltage 'v' is equal to the energy density of a single-phase signal **1425** with a maximum voltage of '3v', or three times the voltage of the multi-phase signal **1424**. The use of a multi-phase signal may allow treatment of a tissue section using a lower voltage and/or lower current signal. The lower voltage and/or lower current of the multi-phase signal **1424** may allow the use of a thinner conductor than a conductor used for a single-phase signal **1425**. For example, in one embodiment, a 34 gauge wire used for a single-phase signal **1425** may be replaced with three circuit paths of $0.001" \times 0.020"$ per conductor. In some embodiments, the multi-phase conductors may comprise flat conductors. For example, in one embodiment, the multi-phase circuit paths may comprise flat flex circuits. FIG. 26 illustrates one embodiment of a flat multi-phase signal conductor **1431**.

[0109] A multi-phase signal, such as, for example, the multi-phase signal **1424** illustrated in FIG. 25A, may be transmitted to the end effector **1426** and the tissue section by a flat flex circuit conductor **1431**. In one, non-limiting embodiment, the flat conductor **1431** may comprise a circuit path ('A' \times 'B') of $0.1" \times 0.01"$. The flex circuit flat conductor **1431** may facilitate connections and lamination of the circuit paths on top of one another, reducing the area needed for

multiple circuit paths. In one embodiment, individual conductor circuit paths **1465**, **1466a**, **1466b** may comprise, for example, a circuit path of $0.02" \times 0.001"$.

[0110] In one embodiment, an end effector of an electrosurgical instrument, such as, for example, electrosurgical instruments **110**, **1410** shown in FIGS. 1 and 23A, may comprise one or more electrodes configured to deliver bipolar RF energy to a tissue section in contact with the end effector. FIGS. 27A and 27B illustrate one embodiment of a bipolar end effector **1526** configured to deliver bipolar RF energy to a tissue section. The bipolar end effector **1526** may comprise one or more electrodes **1565**, **1566a**, **1566b**. The one or more electrodes **1565**, **1566a**, **1566b** may be deployable from the shaft **1514**. For example, in one embodiment, the one or more electrodes **1565**, **1566a**, **1566b** may be coupled to conductors **1531**, **1533a**, **1533b** extending through the shaft **1514** to the proximal end of an electrosurgical device **1510**. A surgeon may slide the conductors **1531**, **1533a**, **1533b** distally and/or proximally to deploy or retract the one or more electrodes **1565**, **1566a**, **1566b** from the shaft **1514**. In some embodiments, the electrodes **1565**, **1566a**, **1566b** may be coupled to an actuator (not shown) for deploying the electrodes **1565**, **1566a**, **1566b** from the shaft **1514**.

[0111] In some embodiments, the end effector **1526** may comprise at least one source electrode **1565**. The source electrode **1565** may be coupled to, for example, a positive pole of a bipolar RF energy source. The end effector **1526** may comprise a plurality of return electrodes **1566a**, **1566b**. The plurality of return electrodes **1566a**, **1566b** may be coupled to, for example, a negative pole of a bipolar RF energy source. The source electrode **1565** and the plurality of return electrodes **1566a**, **1566b** may be deployable from the shaft **1514** to define a treatment area. In some embodiments, the plurality of return electrodes **1566a**, **1566b** may define a treatment area with the source electrode **1565** located substantially at the center of the treatment area. For example, as shown in FIG. 27A, the end effector **1526** comprises a first return electrode **1566a** and a second return electrode **1566b**. The first and second return electrodes **1566a**, **1566b** are located on opposite sides of the source electrode **1565**. A user may deploy the electrodes **1565**, **1566a**, **1566b** from the shaft **1514**. The electrodes **1565**, **1566a**, **1566b** may contact a tissue section **1515** and may define a treatment area in which bipolar energy may be delivered to the tissue section **1515**.

[0112] In one embodiment, the plurality of return electrodes **1566a**, **1566b** may be biased away from the source electrode **1565**. For example, in one embodiment, the first return electrode **1566a** and the second return electrode **1566b** may be spring-biased away from the source electrode **1565**. When the biased return electrodes **1566a**, **1566b** are deployed from the shaft **1514**, the return electrodes **1566a**, **1566b** may fan out to define a wider treatment area (see FIG. 27B). In some embodiments, the return electrodes **1566a**, **1566b** may be biased away from the tissue section **1515** and the source electrode **1565** may be biased towards the tissue section. In order to create a circuit between the source electrode **1565** and the return electrodes **1566a**, **1566b**, the end effector **1526** may be pressed into the tissue section **1515** until the return electrodes **1566a**, **1566b** are in contact with the tissue section **1515**. In this embodiment, the center source electrode **1565** exerts a higher pressure on the tissue section **1515** than the outer return electrodes **1566a**, **1566b**.

If drawn along the tissue section **1515**, the high pressure center source electrode **1565** may cut the tissue section **1515** like a blade. The area between the source electrode **1565** and the return electrodes **1566a**, **1566b** may be simultaneously coagulated during cutting.

[0113] FIGS. **28A-28C** illustrate one embodiment of a bipolar electrosurgical end effector **1626** comprising a deformable tube **1660**. The deformable tube **1660** may have a plurality of electrodes **1665**, **1666a**, **1666b** disposed on the outer surface of the deformable tube **1660**. The deformable tube **1660** may provide mechanical forces similar to those discussed above with respect to FIGS. **27A** and **27B**. For example, in one embodiment, the end effector **1626** may comprise a deformable tube **1660** comprising a source electrode **1665**, a first return electrode **1666a**, and a second return electrode **1666b**. The first and second return electrodes **1666a**, **1666b** may be disposed on opposite sides of the deformable tube **1660**. In operation, a surgeon may move the end effector **1626** into contact with a tissue section. The operator may apply a force to the source electrode **1665** by applying a distal force to, for example, a pencil-grip handle (not shown). The force applied to the source electrode **1665** may cause the deformable tube **1660** to flex or deform into, for example, an oval configuration, as shown in FIG. **28B**.

[0114] The first and second return electrodes **1666a**, **1666b** may be arranged on the outer surface of the deformable tube **1660** such that when the deformable tube **1660** is in a deformed state, such as, for example, due to a force applied by a tissue section **1615** to the source electrode **1665**, the first and second return electrodes **1666a**, **1666b** rotate into contact with the tissue section **1615** to define a treatment area. In some embodiments, the source electrode **1665** may comprise a high pressure electrode and/or a blade. As shown in FIG. **28C**, the end effector **1626** may be drawn along the tissue section **1615** to cut the tissue section **1615** at the source electrode **1665** and simultaneously coagulate the tissue section **1615** between the source electrode **1665** and each of the return electrodes **1666a**, **1666b**.

[0115] FIG. **29** illustrates one embodiment of a deformable cautery pencil tip end effector **1726**. The deformable cautery pencil tip end effector **1726** may comprise at least one high pressure electrode **1765**, a first distributed pressure electrode **1766a**, and a second distributed pressure electrode **1766b**. The deformable cautery pencil tip end effector **1726** may comprise a deformable section **1760**. As the end effector **1726** is pressed into a tissue section by an operator, the deformable cautery pencil tip end effector **1726** may deform at the deformable section **1760** to provide contact between the first and second distributed pressure electrodes **1766a**, **1766b** and the tissue section. In some embodiments, the deformable cautery pencil tip end effector **1726** may comprise a circular cross-section when in a rest state and may deform into an oval cross-section when a force is applied to the high pressure electrode **1765**.

[0116] In some embodiments, the high pressure electrode **1765** may comprise a rigid electrode configured to focus pressure applied by an operator into a small surface area tip. The distributed pressure electrodes **1766a**, **1766b** may comprise flexible electrodes comprising larger surface areas than the high pressure electrode **1765**. In some embodiments, the high pressure electrode **1765** may be coupled to a positive pole of a bipolar RF generator and the distributed pressure electrodes **1766a**, **1766b** may be coupled to a negative pole of a bipolar RF generator, such as, for example, the genera-

tor **120** shown in FIG. **1**. In some embodiments, the high pressure electrode **1765** may comprise a longitudinally rigid tip configured to provide longitudinal stiffness and strength to the deformable cautery pencil tip end effector **1626**.

[0117] In some embodiments, cutting may occur at the tip of the high pressure electrode **1765** due to the high, tight energy density at the tip. Simultaneous with the cutting, coagulation may occur in a treatment area located between the high pressure electrode **1765** and the distributed pressure electrodes **1766a**, **1766b**. Additional coagulation may occur over the surface area of the distributed pressure electrodes **1766a**, **1766b** in contact with the tissue section. In some embodiments, the high pressure electrode **1765** and/or the distributed pressure electrodes **1766a**, **1766b** may comprise a metal material. The distributed pressure electrodes **1766a**, **1766b** may comprise, for example, a super-elastic metal such as, for example, nitinol.

[0118] FIGS. **30A-30E** illustrate various embodiments of deformable cautery pencil tip end effectors. For example, FIG. **30A** illustrates a distal end of a deformable cautery pencil tip end effector **1826** comprising a longitudinal high pressure electrode **1865** and a continuous distributed pressure electrode **1866**. FIG. **30B** illustrates a side-view of the end effector **1826**. As illustrated in FIGS. **30A** and **30B**, the distributed pressure electrode **1866** is disposed about the high pressure electrode **1865** to provide a contact area on both sides of the longitudinal high pressure electrode **1866**. FIGS. **30C** and **30D** illustrate one embodiment of a single-sided bipolar bladed pencil end effector **1926**. The single-sided end effector **1926** may comprise a longitudinal high pressure electrode **1965**, a first distributed pressure electrode **1966a**, and a second distributed pressure electrode **1966b**. FIG. **30D** illustrates the single-sided end effector **1926** in a deformed position when pressure is applied to a tissue section **1915** by the longitudinal high pressure electrode **1965**. As shown in FIG. **30D**, when a force is applied to the high pressure electrode **1965** by a tissue section **1915**, the end effector **1926** deforms to allow the first and second distributed electrodes **1966a**, **1966b** to rotate into contact with the tissue section **1915** and provide a current path for delivering bipolar electrosurgical energy to the tissue section **1915**.

[0119] FIG. **30E** illustrates one embodiment of a double-sided bipolar bladed pencil end effector **2026**. The double-sided end effector **2026** may comprise a first high pressure electrode **2065a** and a second high pressure electrode **2065b** disposed on opposite sides of the end effector **2026**. A first distributed pressure electrode **2066a** and a second distributed pressure electrode **2066b** may be disposed on opposite sides of the end effector **2026** between the high pressure electrodes **2065a**, **2065b**. The end effector **2026** may comprise a deformable section **2060** such that if a force is applied by either of the high pressure electrodes **2065a**, **2065b** to a tissue section, the deformable section **2060** may deform to allow the distributed pressure electrodes **2066a**, **2066b** to contact the tissue section and define a treatment area therebetween.

[0120] FIGS. **31A-31C** illustrate one embodiment of a pencil-style electrosurgical instrument **2110** comprising a multiple-electrode pencil tip end effector **2126**. The multiple-electrode pencil tip end effector **2126** may comprise a plurality of source electrodes **2165a-2165b** and a plurality of return electrodes **2166a-2166b**. In some embodiments, the plurality of source electrodes **2165a-B** and the plurality of

return electrodes **2166a-B** may comprise an alternating arrangement about the perimeter of the multiple-electrode pencil tip end effector **2126**. The plurality of source electrodes **2165a-B** and the plurality of return electrodes **2166a-B** may define a hollow-dome head **2169**. The dome head **2169** may be attached to the shaft **2114**.

[0121] In some embodiments, the return electrodes **2166a-B** may be coupled to an RF generator through one or more conductors (not shown) extending through the shaft **2114**. An internal source electrode **2170** may be located within the dome head **2169**. The internal source electrode **2170** may be coupled to the RF generator through a conductor **2131** extending through the shaft **2114**. In some embodiments, when a force is applied to the dome head **2169**, such as, for example, by pushing the dome head **2169** in to a tissue section **2115**, the dome head **2169** and/or the internal source electrode **2170** may flex to create a connection between the internal source electrode **2170** and at least one of the plurality of source electrodes **2165a-B** located on the dome head **2169**. The source electrodes **2165a-B** may comprise, for example, metallic plates. In some embodiments, the source electrodes **2165a-B** and the return electrodes **2166a-B** on the dome head **2169** may be separated by an electrical insulator **2171**. In some embodiments, a switch (not shown) may be located on the handle of the electrosurgical device **2110**. The switch may selectively energize the internal source electrode **2170**. In a deactivated state, the end effector **2126** may be used as a non-electrosurgical peanut dissector until cautery of tissue is desired. When cautery of a tissue section **2115** is desired, an operator may actuate the switch to active the internal source electrode **2170**. The electrosurgical instrument **2110** may be used, for example, for spot cauterization and/or treatment of tissue sections in an active state.

[0122] For example, as shown in FIG. 31B, the exterior dome head **2169** may be coupled to the shaft **2114** by a flexible elastomer **2172**. The flexible elastomer **2172** may allow the dome head **2169** to flex when a force is applied to the dome head **2169** by, for example, pushing the dome head **2169** into a tissue section. FIG. 31A illustrates the dome head **2169** in a flexed position, with an unflexed position being shown in phantom. FIGS. 31B and 31C each show a cross-section side-view of the end effector **2126**. As shown in FIG. 31B, when the end effector **2126** is in an unflexed position, the internal source electrode **2170** is isolated from the dome head **2169**. When a force is applied to the dome head **2169**, for example, by tissue section **2115**, the flexible elastomer **2172** allows the dome head **2169** to flex at the connection between the dome head **2169** and the shaft **2114**. In a flexed position, as shown in FIG. 31C, the internal source electrode **2170** is in contact with at least one of the source electrodes **2165a** of the dome head **2169**.

[0123] FIG. 32 illustrates one embodiment of a multiple-electrode pencil tip end effector **2226** comprising flexible plate source electrodes **2265a-2265D**. The source electrodes **2265a-D** may comprise a flexible material configured to allow the source electrodes **2265a-D** to flex relative to the return electrodes **2266a-2266D** while maintaining a rigid dome head **2269**. In other embodiments, the electrical insulator **2271** and/or the return electrodes **2266a-D** may comprise a flexible material. When a force is applied to the dome head **2269**, the flexible plate source electrodes **2265a-D** may flex, causing at least one of the flexible plate source elec-

trodes **2265a-D** to contact the internal source electrode **2270**. The internal source electrode **2270** may comprise a rigidly fixed electrode.

[0124] FIGS. 33A and 33B illustrate one embodiment of a multiple-electrode pencil tip end effector **2326**. The multiple-electrode end effector **2326** may comprise one or more internal features to prevent contact between the internal source electrode **2370** and the return electrodes **2366a-D**. The dome head **2369** may comprise a plurality of source electrodes **2365a-2365D**. Each of the source electrodes **2365a-D** may comprise an internal projection **2373a-2373D**. The internal projections **2373a-D** may be configured to allow a connection between the internal source electrode **2370** and at least one of the source electrodes **2365a-D** while preventing contact between the internal source electrode **2370** and the plurality of return electrodes **2366a-2366D**. In some embodiments, the internal projections **2373a-D** may be configured to allow the internal source electrode **2370** to interact with only one of the plurality of source electrodes **2365a-D** when force is applied to the dome head **2369**.

[0125] In operation, a surgeon may apply a distal force to a handle (not shown) of a pencil-type electrosurgical instrument comprising a pencil-tip end effector, such as, for example, the multiple-electrode pencil tip end effector **2326** shown in FIGS. 33A and 33B. The distal force may push the dome head **2369** of the pencil tip end effector **2326** into contact with a tissue section **2315**. The force applied by the tissue section **2315** to the dome head **2369** may cause the dome head **2369**, one or more source electrodes **2365a-D**, and/or the internal source electrode **2370** to flex, allowing a first source electrode **2365a** nearest the tissue section **2315** to contact the internal source electrode **2370**. When the internal source electrode **2370** contacts the first source electrode **2365a** on the dome head **2369**, current is allowed to flow through the tissue section **2315** and into the nearest return electrode in contact with the tissue section, such as the first return electrode **2366a**. The current delivered through the first source electrode **2365a** and the first return electrode **2366a** to the tissue section **2315** may cause cautery of the tissue section **2315**. In some embodiments, the current may flow along the shortest path, such as, for example, from the first source electrode **2365a**, through a tissue section **2315**, and back through the first return electrode **2366a**. Cautery of the tissue may be limited to an area of tissue in contact with the pressurized surface of the dome head **2369**. In some embodiments, the width of the electrical insulator **2371** located between the source electrode **2365a** and the return electrode **2366a** may determine the width of the cautery surface.

[0126] In some embodiments, a multiple-electrode pencil tip end effector, such as, for example, the pencil-tip end effectors **2126**, **2226**, **2326** illustrated in FIGS. 31A-33B, may comprise any suitable head-shape, such as, for example, a shovel head, a sharp pointed head, an asymmetric head, a cubic head, a cone head, and/or any other suitable shape. In some embodiments, the head may comprise a retractable blade such that, when desired, an operator may deploy the blade, activate the internal source electrode, and apply a pressure at the blade to simultaneously cut and cause cautery around the blade. In some embodiments, the pencil-tip end effectors **2226**, **2326**, **2426** may comprise interchangeable end effectors, such that an operator may vary tips during a surgical procedure without the need to change handles.

[0127] FIG. 34 illustrates one embodiment of a bipolar electrosurgical instrument 2410 comprising a bipolar pencil tip end effector 2426. The bipolar pencil-tip end effector 2426 may comprise a PTC electrode 2465. The PTC electrode 2465 may comprise a PTC material. The PTC electrode 2465 may comprise a central core electrode located at the distal end of the end effector 2426. A return electrode 2466 may be disposed on the distal end of the end effector 2426. The return electrode 2466 may comprise a ring electrode located concentrically with the PTC electrode 2465. An insulator 2471 may separate the PTC electrode 2465 and the return electrode 2466. Electrosurgical energy may be delivered to the PTC electrode 2465 and the return electrode 2466 from, for example, a generator such as the generator 120 illustrated in FIG. 1. In operation, the PTC electrode 2465 and the return electrode 2466 may be configured to deliver bipolar electrosurgical energy to a tissue section in contact with the end effector 2426. As the temperature of the tissue section increases, the PTC material of the PTC electrode 2465 may limit the current flow through the tissue section, providing temperature control during tissue ablation. In the embodiment of FIG. 34, the return electrode 2466 fully surrounds the PTC electrode 2465, which may minimize stray currents during tissue ablation. The end effector 2426 may be suitable for various tissue treatments, including, for example, spinal disc ablation, endometrial ablation, and/or other precision ablation procedures.

[0128] FIG. 35 illustrates one embodiment of an end effector 2526 comprising a PTC electrode 2565 and a return electrode 2566. The PTC electrode 2565 and the return electrode 2566 may comprise hemispheres on the tip of the end effector 2526. The PTC electrode 2565 and the return electrode 2566 hemispheres may be separated by an insulator 2571. In some embodiments, such as the embodiment shown in FIG. 36A, the space between the PTC electrode 2665 and the return electrode 2666 hemispheres may define a step/cavity for receiving tissue therebetween. FIG. 36B illustrates treatment of a tissue section 2615 utilizing the end effector 2626. An operator may apply a distal force to a handle (not shown) coupled to the end effector 2626. The distal force may cause the end effector 2626 to apply a force to the tissue section 2615. An electrosurgical signal may be applied to the tissue section 2615 by the PTC electrode 2665 and the return electrode 2666. The combination of the distal force and the electrosurgical energy may be used for spot cautery and/or the generation of anotomy within a patient.

[0129] It will be appreciated that the terms “proximal” and “distal” are used throughout the specification with reference to a clinician manipulating one end of an instrument used to treat a patient. The term “proximal” refers to the portion of the instrument closest to the clinician and the term “distal” refers to the portion located furthest from the clinician. It will further be appreciated that for conciseness and clarity, spatial terms such as “vertical,” “horizontal,” “up,” or “down” may be used herein with respect to the illustrated embodiments. However, surgical instruments may be used in many orientations and positions, and these terms are not intended to be limiting or absolute.

[0130] Various embodiments of surgical instruments and robotic surgical systems are described herein. It will be understood by those skilled in the art that the various embodiments described herein may be used with the described surgical instruments and robotic surgical systems.

The descriptions are provided for example only, and those skilled in the art will understand that the disclosed embodiments are not limited to only the devices disclosed herein, but may be used with any compatible surgical instrument or robotic surgical system.

[0131] Reference throughout the specification to “various embodiments,” “some embodiments,” “one example embodiment,” or “an embodiment” means that a particular feature, structure, or characteristic described in connection with the embodiment is included in at least one example embodiment. Thus, appearances of the phrases “in various embodiments,” “in some embodiments,” “in one example embodiment,” or “in an embodiment” in places throughout the specification are not necessarily all referring to the same embodiment. Furthermore, the particular features, structures, or characteristics illustrated or described in connection with one example embodiment may be combined, in whole or in part, with features, structures, or characteristics of one or more other embodiments without limitation.

[0132] While various embodiments herein have been illustrated by description of several embodiments and while the illustrative embodiments have been described in considerable detail, it is not the intention of the applicant to restrict or in any way limit the scope of the appended claims to such detail. Additional advantages and modifications may readily appear to those skilled in the art. For example, it is generally accepted that endoscopic procedures are more common than laparoscopic procedures. Accordingly, the present invention has been discussed in terms of endoscopic procedures and apparatus. However, use herein of terms such as “endoscopic”, should not be construed to limit the present invention to an instrument for use only in conjunction with an endoscopic tube (e.g., trocar). On the contrary, it is believed that the present invention may find use in any procedure where access is limited to a small incision, including but not limited to laparoscopic procedures, as well as open procedures.

[0133] It is to be understood that at least some of the figures and descriptions herein have been simplified to illustrate elements that are relevant for a clear understanding of the disclosure, while eliminating, for purposes of clarity, other elements. Those of ordinary skill in the art will recognize, however, that these and other elements may be desirable. However, because such elements are well known in the art, and because they do not facilitate a better understanding of the disclosure, a discussion of such elements is not provided herein.

[0134] While several embodiments have been described, it should be apparent, however, that various modifications, alterations and adaptations to those embodiments may occur to persons skilled in the art with the attainment of some or all of the advantages of the disclosure. For example, according to various embodiments, a single component may be replaced by multiple components, and multiple components may be replaced by a single component, to perform a given function or functions. This application is therefore intended to cover all such modifications, alterations and adaptations without departing from the scope and spirit of the disclosure as defined by the appended claims.

[0135] Any patent, publication, or other disclosure material, in whole or in part, that is said to be incorporated by reference herein is incorporated herein only to the extent that the incorporated materials does not conflict with existing definitions, statements, or other disclosure material set forth

in this disclosure. As such, and to the extent necessary, the disclosure as explicitly set forth herein supersedes any conflicting material incorporated herein by reference. Any material, or portion thereof, that is said to be incorporated by reference herein, but which conflicts with existing definitions, statements, or other disclosure material set forth herein will only be incorporated to the extent that no conflict arises between that incorporated material and the existing disclosure material.

[0136] Various aspects of the subject matter described herein are set out in the following numbered clauses:

[0137] 1. An end effector for an electrosurgical device, the end effector comprising:

[0138] a first electrode; and

[0139] a second electrode movable from a first position to a second position when a force is applied to the end effector, wherein the first electrode and the second electrode define a treatment area when the second electrode is in the second position.

[0140] 2. The end effector of clause 1, wherein the end effector comprises a third electrode movable from a first position and a second position, wherein the second electrode and the third electrode are disposed on opposite sides of the first electrode, wherein the second electrode and the third electrode have an opposite polarity of the first electrode, and wherein when a force is applied to the end effector the second electrode and the third electrode transition from the first position to the second position to define the treatment area therebetween.

[0141] 3. The end effector of clause 2, wherein the first electrode, the second electrode, and the third electrode are slidably deployable from the shaft, wherein the second electrode and the third electrode are biased away from the first electrode, and wherein the first electrode, the second electrode, and the third electrode may be energized when in a deployed state.

[0142] 4. The end effector of clause 2, comprising a deformable tip, wherein when a force is applied to the first electrode, the deformable tip deforms to move the second electrode and the third electrode into the second position to define a treatment area therebetween, and wherein the first electrode comprises a high pressure electrode.

[0143] 5. The end effector of clause 4, wherein the high pressure electrode comprises a blade.

[0144] 6. The end effector of clause 4, wherein the deformable tip comprises a deformable tube.

[0145] 7. The end effector of clause 6, wherein the deformable tip comprises a circular orientation in a rest position, and wherein the deformable tip assumes an oval cylinder configuration when the force is applied to the tip.

[0146] 8. The end effector of clause 2, comprising:

[0147] a plurality of source electrodes and a plurality of return electrodes, wherein the plurality of source electrodes and the plurality of return electrodes are arranged in an alternating configuration, wherein the plurality of source electrodes and the plurality of return electrodes define a cavity, and wherein the plurality of source electrodes and the plurality of return electrodes are separated by an insulator; and an internal source electrode disposed within the cavity, wherein the source electrode is configured to make contact with at least one of the plurality of source electrodes when a force is applied to the electrosurgical tip.

[0148] 9. The end effector of clause 8, comprising at least one internal connection point on each of the plurality of

source electrodes, wherein the internal connection point is configured to allow a connection between the plurality of source electrodes and the internal source electrode, and wherein the internal connection point is configured to prevent a connection between the plurality of return electrodes and the internal source electrode.

[0149] 10. The end effector of clause 9, comprising a flexible connection at a proximal end of the end effector, wherein when a force is applied to the end effector, the flexible connection flexes to deflect at least one of the plurality of source electrodes into contact with the internal source electrode.

[0150] 11. The end effector of clause 9, comprising a flexible connection at a proximal end of the internal source electrode, wherein when a force is applied to the end effector, the flexible connection flexes to deflect the internal source electrode into contact with at least one of the source electrodes.

[0151] 12. The end effector of clause 1, wherein the first electrode comprises a positive temperature coefficient (PTC) material configured to limit the current flow through the first electrode based on the temperature of the first electrode.

[0152] 13. The end effector of clause 12, wherein the first electrode is disposed on a distal end of the end effector, and wherein the second electrode comprises a ring located concentric with the first electrode.

[0153] 14. The end effector of clause 1, comprising an electrosurgical generator coupled to the end effector, wherein the electrosurgical generator is configured to produce a high frequency, multi-phase electrosurgical signal, wherein the electrosurgical generator is coupled to the first electrode and the second electrode.

[0154] 15. A base cap configured to interface with an electrosurgical device, the base cap comprising:

[0155] an electrode layer configured to provide electrosurgical signals to a tissue section in contact with the base cap;

[0156] a heat sink layer configured to prevent heat transfer between the base cap and the electrosurgical device; and

[0157] a sealing layer configured to seal the base cap, wherein the base cap is removably coupled to the electrosurgical device.

[0158] 16. The base cap of clause 15, wherein the base cap is configured to removably couple to a lower jaw of the electrosurgical device.

[0159] 17. The base cap of clause 16, comprising at least one molded hook configured to interface with at least one overhang formed on the lower jaw of the electrosurgical device.

[0160] 18. The snap cap of clause 15, wherein the electrode layer comprises a direct contact metal electrode.

[0161] 19. The snap cap of clause 15, wherein the electrode comprises an inductive coupling electrode.

[0162] 20. The snap cap of clause 15, comprising a flex circuit deposited on the sealing layer, wherein the flex circuit is configured to provide a connection between the electrode layer and a source and return path within the electrosurgical device.

[0163] 21. An electrosurgical device comprising:

[0164] a waveform generator configured to produce an electrosurgical signal comprising at least a first phase and a second phase;

[0165] a first conductor configured to receive the first phase of the electrosurgical signal; and

[0166] a second conductor configured to receive the second phase of the electrosurgical signal.

[0167] 22. The electrosurgical device of clause 21, comprising a third conductor, wherein the electrosurgical signal comprises a third phase, and wherein the third conductor is configured to receive the third phase of the electrosurgical signal.

[0168] 23. The electrosurgical device of clause 22, comprising a laminate strip coupled to a distal end of the electrosurgical device, the laminate strip comprising at least the first flat conductor flex circuit, the second flat conductor flex circuit, and the third flat conductor flex circuit.

[0169] 24. The electrosurgical device of clause 22, the waveform generator comprising:

[0170] a first signal generator to generate the first phase of the electrosurgical signal;

[0171] a second signal generator to generate the second phase of the electrosurgical signal; and

[0172] a third signal generator to generate the third phase of the electrosurgical signal.

[0173] 25. The electrosurgical (RF) device of clause 22, wherein the first conductor, the second conductor, and the third conductor comprise a flat, flexible circuit.

[0174] 26. The electrosurgical device of clause 25, wherein the flat, flexible circuit comprises a circuit path of approximately 0.1"×0.01".

[0175] 27. An end effector for an electrosurgical device, the end effector comprising:

[0176] a first jaw member comprising a first electrode; and

[0177] a second jaw member comprising a second electrode, wherein the first and second electrodes comprise a fluoropolymer material comprising an electrically conductive mica additive.

[0178] 28. The end effector of clause 27, wherein the fluoropolymer comprises polytetrafluoroethylene (PTFE).

[0179] 29. The end effector of clause 27, wherein the fluoropolymer material comprises a thickness of 5-21 microns, and wherein the fluoropolymer material comprise 0.1-10% of the electrically conductive mica additive by weight.

[0180] 30. An end effector for an electrosurgical device, the end effector comprising:

[0181] a source electrode comprising a positive temperature controlled (PTC) material; and

[0182] a return electrode electrically isolated from the source electrode, wherein the source electrode and the return electrode are configured to receive a bipolar electrosurgical signal.

[0183] 31. The end effector of clause 30, wherein the end effector comprises a spherical tip, wherein the source electrode comprises a central core of the spherical tip, and wherein the return electrode comprises a ring electrode disposed on the spherical tip and concentric with the source electrode.

[0184] 32. The end effector of clause 30, wherein the end effector comprises:

[0185] a first hemisphere comprising the source electrode;

[0186] a second hemisphere comprising the return electrode; and

[0187] an insulator located between the source electrode and the return electrode.

[0188] 33. The end effector of clause 32, wherein the insulator comprises an air gap.

[0189] 34. An electrosurgical instrument comprising:

[0190] a handle;

[0191] a shaft extending distally from the handle;

[0192] an end effector coupled to a distal end of the handle, the end effector comprising:

[0193] an upper jaw comprising a first electrode;

[0194] a lower jaw comprising a second electrode;

[0195] a power tip extending from a distal end of the lower jaw, wherein the power tip comprises an electrode configured to receive electrosurgical energy.

[0196] 35. The electrosurgical instrument of clause 34, wherein the electrosurgical instrument is coupled to a generator, wherein the generator comprises a bipolar signal generator and a harmonic signal generator, wherein the bipolar signal generator is configured to generate bipolar electrosurgical signal, wherein the harmonic signal generator is configured to generate a sub-100 kHz signal, wherein the first and second electrodes are coupled to the bipolar signal generator, and wherein the power tip is coupled to the harmonic signal generator.

[0197] 36. The electrosurgical instrument of clause 34, comprising a switch configured to control operation of the first electrode, the second electrode, and the power tip, wherein when the switch is in a first position, the first electrode and the second electrode are configured to receive a bipolar electrosurgical signal, and wherein when the switch is in a second position, the power tip is configured to receive a monopolar electrosurgical signal.

[0198] 37. A monopolar add-on for an electrosurgical device comprising a power tip, the monopolar add-on comprising:

[0199] a handle configured to interface with a shaft of the electrosurgical device;

[0200] a slip ring coupled to the handle, the slip ring configured to interface with a conductor disposed within the shaft of the electrosurgical device, wherein the conductor is coupled to a power tip located at the distal end of the electrosurgical instrument;

[0201] a cable coupled to the slip ring, the cable configured to couple to a monopolar generator; and

[0202] a switch configured to control delivery of a monopolar electrosurgical signal from the monopolar generator to the power tip.

What is claimed is:

1. An electrosurgical instrument comprising:

a pencil-grip handle;

a shaft coupled to the pencil grip handle; and

an end effector coupled to the shaft, wherein the end effector comprises:

a body;

a source electrode; and

one or more return electrodes,

wherein the source electrode and the one or more return electrodes are configured to provide an electrosurgical signal to a tissue.

2. The electrosurgical instrument of claim 1, wherein the electrosurgical signal comprises a radio frequency (RF) signal.

3. The electrosurgical instrument of claim 1, wherein the pencil-grip handle comprises a power source and is cordless.

4. The electrosurgical instrument of claim 1, wherein the source electrode is disposed on a center portion of the body and the one or more return electrodes are disposed on a lateral portion of the body.

5. The electrosurgical instrument of claim 1, wherein the body defines an oval shape.

6. The electrosurgical instrument of claim 1, wherein the one or more return electrodes each comprise a first return electrode and a second return electrode.

7. The electrosurgical instrument of claim 6, further comprising an electrosurgical generator coupled to the end effector, wherein the electrosurgical generator is configured to produce the electrosurgical signal comprising a first phase, a second phase, and a third phase, wherein the electrosurgical generator is coupled to the source electrode, the first return electrode, and the second return electrode.

8. The electrosurgical instrument of claim 7, wherein the source electrode is configured to receive the first phase of the electrosurgical signal, the first return electrode is configured to receive the second phase of the electrosurgical signal, and the second return electrode is configured to receive the third phase of the electrosurgical signal.

9. The electrosurgical instrument of claim 7, wherein the electrosurgical generator comprises:

- a first signal generator to generate the first phase of the electrosurgical signal;
- a second signal generator to generate the second phase of the electrosurgical signal; and
- a third signal generator to generate the third phase of the electrosurgical signal.

10. The electrosurgical instrument of claim 1, wherein the length of the shaft is sized and configured for a laparoscopic surgical procedure.

11. The electrosurgical instrument of claim 1, wherein the source electrode comprises a positive temperature controlled (PTC) material.

12. An electrosurgical instrument comprising:

- a handle;
- a shaft coupled to the handle;
- an end effector coupled to the shaft, wherein the end effector comprises:
 - a body;
 - a source electrode;
 - a first return electrode; and
 - a second return electrode; and
- a multi-phase electrosurgical signal generator coupled to the end effector, wherein the multi-phase electrosurgical signal generator is configured to produce an elec-

tro-surgical signal comprising a first phase, a second phase, and a third phase, wherein the multi-phase electrosurgical signal generator is coupled to the source electrode, the first return electrode, and the second return electrode,

wherein the source electrode, the first return electrode, and the second return electrode are configured to provide the electrosurgical signal to a tissue.

13. The electrosurgical instrument of claim 12, wherein the electrosurgical signal comprises a bipolar radio frequency (RF) signal.

14. The electrosurgical instrument of claim 12, wherein the handle comprises a power source and is cordless.

15. The electrosurgical instrument of claim 12, wherein the source electrode is disposed on a center portion of the body and the first and second return electrodes are disposed on a lateral portion of the body.

16. The electrosurgical instrument of claim 12, wherein the body defines an oval shape.

17. The electrosurgical instrument of claim 12, wherein the source electrode is configured to receive the first phase of the electrosurgical signal, the first return electrode is configured to receive the second phase of the electrosurgical signal, and the second return electrode is configured to receive the third phase of the electrosurgical signal.

18. The electrosurgical instrument of claim 12, wherein the multi-phase electrosurgical signal generator comprises:

- a first signal generator to generate the first phase of the electrosurgical signal;
- a second signal generator to generate the second phase of the electrosurgical signal; and
- a third signal generator to generate the third phase of the electrosurgical signal.

19. The electrosurgical instrument of claim 12, wherein the length of the shaft is sized and configured for a laparoscopic surgical procedure.

20. The electrosurgical instrument of claim 12, wherein the handle comprises a pencil grip, which enables precise control of the electrosurgical instrument for performing small section treatment.

* * * * *

专利名称(译)	用于切割和凝固组织的电外科 (RF) 医疗器械		
公开(公告)号	US20180042658A1	公开(公告)日	2018-02-15
申请号	US15/792311	申请日	2017-10-24
[标]申请(专利权)人(译)	ETHICON , LLC		
申请(专利权)人(译)	ETHICON LLC		
当前申请(专利权)人(译)	ETHICON LLC		
[标]发明人	SHELTON IV FREDERICK E YATES DAVID C BAXTER III CHESTER O HUNT JOHN V MALLOW JENNIFER M WORRELL BARRY C ARONHALT TAYLOR W HOUSER KEVIN L STROBL GEOFFREY S		
发明人	SHELTON, IV, FREDERICK E. YATES, DAVID C. BAXTER, III, CHESTER O. HUNT, JOHN V. MALLOW, JENNIFER M. WORRELL, BARRY C. ARONHALT, TAYLOR W. HOUSER, KEVIN L. STROBL, GEOFFREY S.		
IPC分类号	A61B18/12 A61B18/14 A61B18/00		
CPC分类号	A61B2018/0016 A61B2018/0063 A61B18/1485 A61B18/1482 A61B2090/0807 A61B18/12 A61B18/1447 A61B2090/065 A61B2018/1495 A61B2018/1475 A61B2018/1467 A61B2018/1465 A61B2018/1455 A61B2018/1412 A61B2018/1407 A61B2018/147 A61B2018/1253 A61B2018/1226 A61B2018/128 A61B2018/126 A61B2018/124 A61B2018/00958 A61B2018/00952 A61B2018/00904 A61B2018/00892 A61B2018/00827 A61B2018/00791 A61B2018/00767 A61B2018/00732 A61B2018/00714 A61B2018/00648 A61B2018/00619 A61B2018/00607 A61B2018/00601 A61B2018/00595 A61B2018/00589 A61B2018/00577 A61B2018/00559 A61B2018/00339 A61B2018/00214 A61B2018/00196 A61B2018/00148 A61B2018/00136 A61B2018/00101 A61B2018/00083 A61B2018/00077 A61B2018/0072 A61B2018/0013		
外部链接	Espacenet USPTO		

摘要(译)

公开了一种电外科装置。电外科装置包括手柄，从手柄向远侧延伸的轴，以及连接到轴的远端的末端执行器。末端执行器包括第一电极和第二电极。第二电极包括第一位置和第二位置。第二电极构造成当力通过组织切片施加到末端执行器时从第一位置移动到第二位置。当第二电极处于第二位置时，第一电极和第二电极限定治疗区域。

