



US008562592B2

(12) **United States Patent**
Conlon et al.

(10) **Patent No.:** **US 8,562,592 B2**
(45) **Date of Patent:** **Oct. 22, 2013**

(54) **COMPOUND ANGLE LAPAROSCOPIC
METHODS AND DEVICES**

(75) Inventors: **Sean P. Conlon**, Loveland, OH (US);
William B. Weisenburgh, II,
Maineville, OH (US)

(73) Assignee: **Ethicon Endo-Surgery, Inc.**, Cincinnati,
OH (US)

(*) Notice: Subject to any disclaimer, the term of this
patent is extended or adjusted under 35
U.S.C. 154(b) by 453 days.

3,503,396 A	3/1970	Pierie et al.
3,654,965 A	4/1972	Gramain
4,041,931 A	8/1977	Elliott et al.
4,048,987 A	9/1977	Hurson
4,112,932 A	9/1978	Chiulli
4,120,302 A	10/1978	Ziegler
4,306,545 A	12/1981	Ivan et al.
4,373,532 A	2/1983	Hill et al.
4,402,683 A	9/1983	Kopman
4,417,888 A	11/1983	Cosentino et al.
4,559,947 A	12/1985	Renger et al.
4,608,977 A	9/1986	Brown
4,669,473 A	6/1987	Richards et al.
4,821,719 A	4/1989	Fogarty

(Continued)

(21) Appl. No.: **12/775,724**

FOREIGN PATENT DOCUMENTS

(22) Filed: **May 7, 2010**

DE	4324254 C1	1/1995
EP	0568383	11/1993

(65) **Prior Publication Data**

US 2011/0276057 A1 Nov. 10, 2011

(Continued)

OTHER PUBLICATIONS

(51) **Int. Cl.**

A61B 17/00 (2006.01)

A61B 19/00 (2006.01)

A61B 1/00 (2006.01)

U.S. Appl. No. 12/399,473, filed Mar. 6, 2009 entitled Methods and
Devices for Providing Access Into a Body Cavity.

(Continued)

(52) **U.S. Cl.**

USPC **606/1**; 606/130; 600/141; 600/142

Primary Examiner — Gary Jackson

Assistant Examiner — Richard Louis

(58) **Field of Classification Search**

USPC 606/1, 208, 130, 205, 206, 207;
600/101, 564, 204, 102, 104, 141–412,
600/139, 114; 138/119, 120; 74/490.1,
74/490.5; 604/19, 523, 528; 901/14–18,
901/50

See application file for complete search history.

(57)

ABSTRACT

Methods and devices are provided for performing minimally
invasive surgical procedures. In one embodiment, a surgical
device is provided that include an elongate shaft having a
distal portion configured to be movable between a first con-
figuration in which the distal portion of the shaft is substan-
tially straight or linear and a second configuration in which
the distal portion of the shaft is articulated at a compound
angle. The shaft's distal portion can include two articulation
joints to facilitate formation of the compound angle.

(56) **References Cited**

U.S. PATENT DOCUMENTS

2,129,391 A	9/1938	Wappler	
2,765,930 A *	10/1956	Greer et al.	414/7
3,402,710 A	9/1968	Paleschuck	

18 Claims, 10 Drawing Sheets

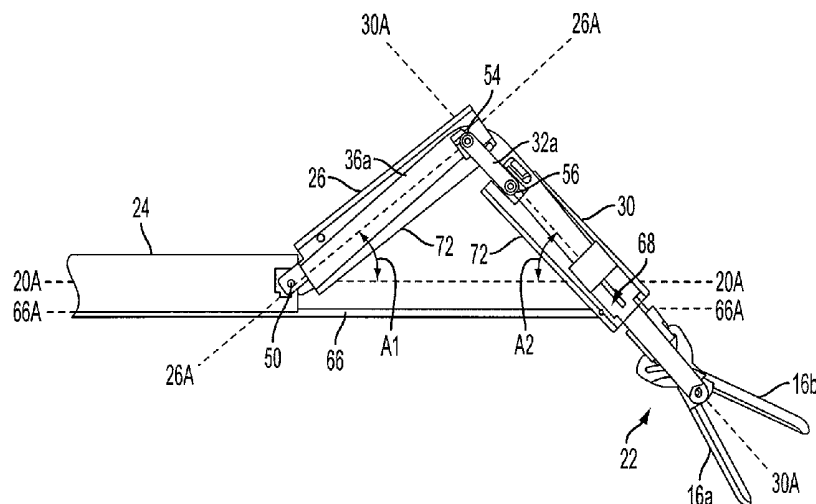

(56)

References Cited

U.S. PATENT DOCUMENTS

4,831,070 A	5/1989	McInally et al.	5,676,146 A	10/1997	Scarborough
4,880,015 A	11/1989	Nierman	5,676,657 A	10/1997	Yoon
5,027,800 A	7/1991	Rowland	5,681,324 A	10/1997	Kammerer et al.
5,141,498 A	8/1992	Christian	5,695,448 A	12/1997	Kimura et al.
5,183,471 A	2/1993	Wilk	5,700,275 A	12/1997	Bell et al.
5,197,955 A	3/1993	Stephens et al.	5,704,534 A	1/1998	Huitema et al.
5,201,742 A	4/1993	Hasson	5,713,919 A	2/1998	Lahr
5,207,213 A	5/1993	Auhll et al.	5,716,327 A	2/1998	Warner et al.
5,209,737 A	5/1993	Ritchart et al.	5,716,407 A	2/1998	Knapp et al.
5,209,741 A	5/1993	Spaeth	5,728,121 A	3/1998	Bimbo et al.
5,209,747 A	5/1993	Knoepfler	5,735,289 A	4/1998	Pfeffer et al.
5,269,772 A	12/1993	Wilk	5,743,456 A	4/1998	Jones et al.
5,275,614 A	1/1994	Haber et al.	5,743,851 A	4/1998	Moll et al.
5,308,336 A	5/1994	Hart et al.	5,766,205 A	6/1998	Zvenyatsky et al.
5,312,023 A	5/1994	Green et al.	5,772,654 A	6/1998	Leyva
5,330,437 A	7/1994	Durman	5,782,812 A	7/1998	Hart et al.
5,330,502 A	7/1994	Hassler et al.	5,782,859 A	7/1998	Nicholas et al.
5,342,396 A	8/1994	Cook	5,792,165 A	8/1998	Klieman et al.
5,345,927 A	9/1994	Bonutti	5,797,959 A	8/1998	Castro et al.
5,350,391 A	9/1994	Iacovelli	5,803,919 A	9/1998	Hart et al.
5,360,428 A	11/1994	Hutchinson, Jr.	5,813,409 A	9/1998	Leahy et al.
5,362,294 A	11/1994	Seitzinger	5,814,058 A	9/1998	Carlson et al.
5,366,478 A	11/1994	Brinkerhoff et al.	5,816,257 A	10/1998	Chin
5,368,597 A	11/1994	Pagedas	5,827,319 A	10/1998	Carlson et al.
5,374,277 A	12/1994	Hassler	5,827,323 A	10/1998	Klieman et al.
5,383,888 A	1/1995	Zvenyatsky et al.	5,836,960 A	11/1998	Kolesa et al.
5,385,553 A	1/1995	Hart et al.	5,840,078 A	11/1998	Yerys
5,385,560 A	1/1995	Wulf	5,853,395 A	12/1998	Crook et al.
5,391,154 A	2/1995	Young	5,865,807 A	2/1999	Blake, III
5,398,617 A	3/1995	Deandrea	5,876,447 A	3/1999	Arnett
5,403,342 A	4/1995	Tovey et al.	5,891,013 A	4/1999	Thompson
5,417,203 A	5/1995	Tovey et al.	5,893,878 A	4/1999	Pierce
5,443,452 A	8/1995	Hart et al.	5,906,577 A	5/1999	Beane et al.
5,443,484 A	8/1995	Kirsch et al.	5,941,890 A	8/1999	Voegele et al.
5,445,648 A	8/1995	Cook	5,947,922 A	9/1999	MacLeod
5,456,684 A	10/1995	Schmidt et al.	5,957,913 A	9/1999	de la Torre et al.
5,480,410 A	1/1996	Cuschieri et al.	5,971,995 A	10/1999	Rousseau
5,489,256 A	2/1996	Adair	5,977,431 A	11/1999	Knapp et al.
5,489,290 A	2/1996	Furnish	5,990,382 A	11/1999	Fox
5,501,653 A	3/1996	Chin	6,007,561 A	12/1999	Bourque et al.
5,514,157 A	5/1996	Nicholas et al.	6,024,708 A	2/2000	Bales et al.
5,520,609 A	5/1996	Moll et al.	6,024,736 A	2/2000	de la Torre et al.
5,520,678 A	5/1996	Heckele et al.	6,027,522 A	2/2000	Palmer
5,545,123 A	8/1996	Ortiz et al.	6,033,428 A	3/2000	Sardella
5,545,179 A	8/1996	Williamson, IV	RE36,702 E	5/2000	Green et al.
5,547,458 A	8/1996	Ortiz et al.	6,074,419 A	6/2000	Healy et al.
5,549,637 A	8/1996	Crainich	6,077,288 A	6/2000	Shimomura et al.
5,569,205 A	10/1996	Hart et al.	6,086,603 A	7/2000	Termin et al.
5,569,254 A	10/1996	Carlson et al.	6,093,141 A	7/2000	Mosseri et al.
5,571,090 A	11/1996	Sherts	6,110,154 A	8/2000	Shimomura et al.
5,582,577 A	12/1996	Lund et al.	6,110,182 A	8/2000	Mowlai-Ashtiani
5,582,617 A	12/1996	Klieman et al.	6,120,513 A	9/2000	Bailey et al.
5,584,850 A	12/1996	Hart et al.	6,123,689 A	9/2000	To et al.
5,586,977 A	12/1996	Dorsey, III	6,126,671 A	10/2000	Richards et al.
5,591,182 A	1/1997	Johnson	6,132,385 A	10/2000	Vain
5,595,193 A	1/1997	Walus et al.	6,149,642 A	11/2000	Gerhart et al.
5,607,450 A	3/1997	Zvenyatsky et al.	6,156,045 A	12/2000	Ulbrich et al.
5,609,601 A	3/1997	Kolesa et al.	6,156,184 A	12/2000	Antonucci et al.
5,618,294 A	4/1997	Aust et al.	6,159,200 A	12/2000	Verdura et al.
5,624,381 A	4/1997	Kieturakis	6,162,196 A	12/2000	Hart et al.
5,626,608 A	5/1997	Cuny et al.	6,165,184 A	12/2000	Verdura et al.
5,630,831 A	5/1997	Lahr	6,171,282 B1	1/2001	Ragsdale
5,634,882 A	6/1997	Gagner	6,197,034 B1	3/2001	Gvozdic et al.
5,634,883 A	6/1997	Chin et al.	6,217,555 B1	4/2001	Hart et al.
5,634,911 A	6/1997	Hermann et al.	6,220,248 B1	4/2001	Voegele et al.
5,634,937 A	6/1997	Mollenauer et al.	6,228,055 B1	5/2001	Foerster et al.
5,636,645 A	6/1997	Ou	6,245,011 B1 *	6/2001	Dudda et al. 600/104
5,640,977 A	6/1997	Leahy et al.	6,245,052 B1	6/2001	Orth et al.
5,643,283 A	7/1997	Younker	6,248,062 B1	6/2001	Adler et al.
5,643,301 A	7/1997	Mollenauer	6,258,069 B1	7/2001	Carpentier et al.
5,647,372 A	7/1997	Tovey et al.	6,258,102 B1	7/2001	Pagedas
5,653,705 A	8/1997	de la Torre et al.	6,261,302 B1	7/2001	Voegele et al.
5,665,093 A	9/1997	Atkins et al.	6,264,599 B1	7/2001	Slater et al.
5,667,527 A	9/1997	Cook	6,290,705 B1	9/2001	Chan et al.
5,672,168 A	9/1997	de la Torre et al.	6,293,966 B1	9/2001	Frantzen
			6,315,770 B1	11/2001	de la Torre et al.
			6,319,246 B1	11/2001	de la Torre et al.
			6,347,940 B1	2/2002	Gordils Wallis et al.
			6,348,034 B1	2/2002	Thompson

(56)

References Cited

U.S. PATENT DOCUMENTS

6,352,503	B1	3/2002	Matsui et al.	2003/0113540	A1	6/2003	Anderson et al.
6,400,979	B1	6/2002	Stoianovici et al.	2003/0139756	A1	7/2003	Brustad
6,425,903	B1	7/2002	Voegelé	2003/0206860	A1	11/2003	Bleyer et al.
6,443,960	B1	9/2002	Brabrand et al.	2003/0208207	A1	11/2003	Layer
6,447,443	B1	9/2002	Keogh et al.	2003/0225420	A1	12/2003	Wardle
6,447,489	B1	9/2002	Peterson	2003/0229338	A1	12/2003	Irion et al.
6,454,783	B1	9/2002	Piskun	2003/0236549	A1	12/2003	Bonadio et al.
6,458,077	B1	10/2002	Boebel et al.	2004/0015185	A1	1/2004	Ewers et al.
6,471,714	B1	10/2002	Kim	2004/0023161	A1	2/2004	Yamaguchi et al.
6,485,467	B1	11/2002	Crook et al.	2004/0024304	A1	2/2004	Foerster et al.
6,551,270	B1	4/2003	Bimbo et al.	2004/0068291	A1	4/2004	Suzuki
6,551,282	B1	4/2003	Exline et al.	2004/0106942	A1	6/2004	Taylor et al.
6,578,577	B2	6/2003	Bonadio et al.	2004/0106986	A1	6/2004	Andersson et al.
6,579,304	B1	6/2003	Hart et al.	2004/0138525	A1*	7/2004	Saadat et al. 600/104
6,589,167	B1	7/2003	Shimomura et al.	2004/0138528	A1	7/2004	Richter et al.
6,605,063	B2	8/2003	Bousquet	2004/0147933	A1	7/2004	McGovern
6,613,068	B2	9/2003	Ouchi et al.	2004/0167545	A1	8/2004	Sadler et al.
6,623,426	B2	9/2003	Bonadio et al.	2004/0193212	A1	9/2004	Taniguchi et al.
6,634,883	B2	10/2003	Ranalli	2004/0215063	A1	10/2004	Bonadio et al.
6,663,641	B1	12/2003	Kovac et al.	2004/0225323	A1	11/2004	Nagase et al.
6,665,554	B1	12/2003	Charles et al.	2004/0230160	A1	11/2004	Blanco
6,666,854	B1	12/2003	Lange	2004/0230161	A1	11/2004	Zeiner
6,669,674	B1	12/2003	Macoviak et al.	2004/0243108	A1	12/2004	Suzuki
6,673,092	B1	1/2004	Bacher	2004/0254426	A1	12/2004	Wenchell
6,706,033	B1	3/2004	Martinez et al.	2004/0260198	A1	12/2004	Rothberg et al.
6,706,050	B1	3/2004	Giannadakis	2004/0260337	A1	12/2004	Freed
6,725,083	B1	4/2004	De Santis et al.	2005/0020884	A1	1/2005	Hart et al.
6,764,473	B2	7/2004	Morton	2005/0033312	A1	2/2005	Suzuki
6,766,186	B1	7/2004	Hoyns et al.	2005/0033342	A1	2/2005	Hart et al.
6,807,965	B1	10/2004	Hickle	2005/0033357	A1	2/2005	Braun
6,810,880	B1	11/2004	Jennings, Jr. et al.	2005/0085842	A1	4/2005	Eversull et al.
6,818,007	B1	11/2004	Dampney et al.	2005/0107809	A1	5/2005	Litscher et al.
6,821,247	B2	11/2004	Vierra et al.	2005/0124912	A1	6/2005	Griego et al.
6,846,287	B2	1/2005	Bonadio et al.	2005/0137609	A1	6/2005	Guiraudon
6,908,430	B2	6/2005	Caldwell et al.	2005/0148823	A1	7/2005	Vaugh et al.
6,936,061	B2	8/2005	Sasaki	2005/0155611	A1	7/2005	Vaugh et al.
6,939,296	B2	9/2005	Ewers et al.	2005/0192483	A1	9/2005	Bonadio et al.
6,945,932	B1	9/2005	Caldwell et al.	2005/0209608	A1	9/2005	O'Heeron
6,966,876	B2	11/2005	Irion et al.	2005/0222582	A1	10/2005	Wenchell
6,972,026	B1	12/2005	Caldwell et al.	2005/0228224	A1	10/2005	Okada et al.
6,994,712	B1	2/2006	Fisher et al.	2005/0267419	A1	12/2005	Smith
7,008,377	B2	3/2006	Beane et al.	2005/0273084	A1	12/2005	Hinman et al.
7,014,628	B2	3/2006	Bousquet	2005/0273132	A1	12/2005	Shluzas et al.
7,021,173	B2	4/2006	Stoianovici et al.	2005/0277946	A1	12/2005	Greenhalgh
7,047,063	B2	5/2006	Burbank et al.	2006/0016853	A1	1/2006	Racenet
7,052,454	B2	5/2006	Taylor	2006/0020241	A1	1/2006	Piskun et al.
7,083,576	B2	8/2006	Zarins et al.	2006/0020281	A1	1/2006	Smith
7,083,626	B2	8/2006	Hart et al.	2006/0020287	A1	1/2006	Lee et al.
7,087,071	B2	8/2006	Nicholas et al.	2006/0042636	A1	3/2006	Nalagatla et al.
7,118,528	B1	10/2006	Piskun	2006/0071432	A1	4/2006	Staudner
7,147,650	B2	12/2006	Lee	2006/0149137	A1	7/2006	Pingleton et al.
7,163,510	B2	1/2007	Kahle et al.	2006/0212062	A1	9/2006	Farascioni
7,201,734	B2	4/2007	Hickle	2006/0224129	A1	10/2006	Beasley et al.
7,208,005	B2	4/2007	Frecker et al.	2006/0224164	A1	10/2006	Hart et al.
7,214,185	B1	5/2007	Rosney et al.	2006/0229501	A1	10/2006	Jensen et al.
7,247,154	B2	7/2007	Hickle	2006/0229641	A1	10/2006	Gupta et al.
7,311,661	B2	12/2007	Heinrich	2006/0229665	A1*	10/2006	Wales et al. 606/205
7,331,661	B2	2/2008	Silverbrook et al.	2006/0241651	A1	10/2006	Wilk
7,338,473	B2	3/2008	Campbell et al.	2006/0241671	A1	10/2006	Greenhalgh
7,344,547	B2	3/2008	Piskun	2006/0247499	A1	11/2006	Butler et al.
7,347,862	B2	3/2008	Layer	2006/0247500	A1	11/2006	Voegelé et al.
7,416,533	B2	8/2008	Gellman et al.	2006/0247516	A1	11/2006	Hess et al.
7,615,005	B2	11/2009	Stefanchik et al.	2006/0247586	A1	11/2006	Voegelé et al.
2001/0034528	A1	10/2001	Foerster et al.	2006/0247673	A1	11/2006	Voegelé et al.
2001/0053510	A1	12/2001	Ranalli	2006/0247678	A1	11/2006	Weisenburgh et al.
2002/0007112	A1	1/2002	Rupp et al.	2006/0258899	A1	11/2006	Gill et al.
2002/0026201	A1	2/2002	Foerster et al.	2006/0259071	A1	11/2006	Nicholas et al.
2002/0103434	A1	8/2002	Swanbom	2006/0259073	A1	11/2006	Miyamoto et al.
2002/0156432	A1	10/2002	Racenet et al.	2006/0264706	A1	11/2006	Piskun
2002/0173805	A1	11/2002	Matsuno et al.	2006/0270911	A1	11/2006	Voegelé et al.
2002/0193815	A1	12/2002	Foerster et al.	2007/0049966	A1	3/2007	Bonadio et al.
2003/0028179	A1	2/2003	Piskun	2007/0060939	A1	3/2007	Lancial et al.
2003/0073882	A1*	4/2003	Smid et al. 600/104	2007/0085232	A1	4/2007	Brustad et al.
2003/0100814	A1	5/2003	Kindlein	2007/0088202	A1	4/2007	Albrecht et al.
2003/0109898	A1	6/2003	Schwarz et al.	2007/0088277	A1	4/2007	McGinley et al.
				2007/0106317	A1	5/2007	Shelton et al.
				2007/0118021	A1	5/2007	Pokorney
				2007/0151566	A1	7/2007	Kahle et al.
				2007/0162072	A1	7/2007	Nicholas et al.

(56)

References Cited

U.S. PATENT DOCUMENTS

2007/0185453	A1	8/2007	Michael et al.	
2007/0208312	A1	9/2007	Norton et al.	
2007/0244358	A1	10/2007	Lee	
2007/0250113	A1	10/2007	Hegeman et al.	
2007/0255219	A1	11/2007	Vaugh et al.	
2007/0260114	A1	11/2007	Miyamoto et al.	
2008/0027476	A1	1/2008	Piskun	
2008/0051739	A1	2/2008	McFarlane	
2008/0065021	A1	3/2008	Jenkins et al.	
2008/0065107	A1	3/2008	Larkin et al.	
2008/0119821	A1	5/2008	Agnihotri et al.	
2008/0147113	A1	6/2008	Nobis et al.	
2008/0154299	A1	6/2008	Livneh	
2008/0183044	A1	7/2008	Colleran et al.	
2008/0255420	A1	10/2008	Lee et al.	
2008/0255519	A1	10/2008	Piskun et al.	
2008/0262492	A1	10/2008	Lee	
2008/0269727	A1	10/2008	Lee	
2008/0294191	A1	11/2008	Lee	
2009/0005799	A1	1/2009	Franer et al.	
2009/0062618	A1	3/2009	Drew et al.	
2009/0088792	A1 *	4/2009	Hoell et al.	606/206
2009/0171147	A1	7/2009	Lee et al.	
2009/0206129	A1	8/2009	Doll et al.	
2009/0306658	A1	12/2009	Nobis et al.	
2009/0326325	A1	12/2009	Naito et al.	
2010/0081863	A1	4/2010	Hess et al.	
2010/0081864	A1	4/2010	Hess et al.	
2010/0081880	A1	4/2010	Widenhouse et al.	
2010/0081881	A1	4/2010	Murray et al.	
2010/0081882	A1	4/2010	Hess et al.	
2010/0081883	A1	4/2010	Murray et al.	
2010/0081995	A1	4/2010	Widenhouse et al.	
2010/0130817	A1 *	5/2010	Conlon	600/106
2010/0228090	A1	9/2010	Weisenburgh, II et al.	
2010/0228091	A1	9/2010	Widenhouse et al.	
2010/0228092	A1	9/2010	Ortiz et al.	
2010/0228094	A1	9/2010	Ortiz et al.	
2010/0228096	A1	9/2010	Weisenburgh, II et al.	
2010/0228198	A1	9/2010	Widenhouse et al.	
2010/0312060	A1	12/2010	Widenhouse et al.	
2010/0312061	A1	12/2010	Hess et al.	
2010/0312064	A1	12/2010	Weisenburgh, II et al.	
2010/0312065	A1	12/2010	Shelton, IV et al.	
2011/0087269	A1 *	4/2011	Stokes et al.	606/206

FOREIGN PATENT DOCUMENTS

EP	0621009	4/1994
EP	0646358	4/1995
EP	0776231	B1 6/1997
EP	950376	10/1999
EP	0966924	A1 12/1999
EP	0996925	A1 5/2000
EP	1219251	A1 7/2002
EP	1219252	A1 7/2002
EP	1219253	A1 7/2002
EP	1350476	10/2003
EP	1731105	A1 12/2006
FR	2710270	A1 3/1995
JP	2000033089	2/2000
JP	2006320750	11/2006
WO	WO-9608208	A1 3/1996
WO	WO-9608897	A1 3/1996
WO	WO-9712557	A1 4/1997
WO	WO-9729709	A1 8/1997
WO	WO-9735521	A1 10/1997
WO	WO-9810712	A1 3/1998
WO	WO-9903536	A1 1/1999
WO	WO-0030592	A1 6/2000
WO	WO-0032253	A1 6/2000
WO	WO-0217810	A2 3/2002
WO	WO-0239890	A2 5/2002
WO	WO-0239918	A1 5/2002

WO	WO-02058543	A2 8/2002
WO	WO-02094133	A1 11/2002
WO	WO-03005890	A2 1/2003
WO	WO-03067341	A2 8/2003
WO	WO-03077730	A2 9/2003
WO	WO-03091839	A2 11/2003
WO	WO-2005087112	A1 9/2005
WO	WO-2005094432	A2 10/2005
WO	WO-2006110733	A2 10/2006
WO	WO-2007119232	A2 10/2007
WO	WO-2008012787	A2 1/2008
WO	WO-2008024502	A2 2/2008
WO	WO-2009073577	A2 6/2009
WO	WO-2010303114	3/2010

OTHER PUBLICATIONS

U.S. Appl. No. 12/399,482, filed Mar. 6, 2009 entitled Methods and Devices for Providing Access Into a Body Cavity.

U.S. Appl. No. 12/399,547, filed Mar. 6, 2009 entitled Surgical Access Devices and Methods Providing Seal Movement in Pre-defined Paths.

U.S. Appl. No. 12/399,625, filed Mar. 6, 2009 entitled Methods and Devices for Providing Access Into a Body Cavity.

U.S. Appl. No. 12/399,633, filed Mar. 6, 2009 entitled Methods and Devices for Providing Access Into a Body Cavity.

U.S. Appl. No. 12/399,656, filed Mar. 6, 2009 entitled Surgical Access Devices and Methods Providing Seal Movement in Pre-defined Movement Regions.

U.S. Appl. No. 12/512,542, filed Jul. 30, 2009 entitled Methods and Devices for Providing Access Into a Body Cavity.

U.S. Appl. No. 12/512,568, filed Jul. 30, 2009 entitled Methods and Devices for Providing Access Into a Body Cavity.

U.S. Appl. No. 12/766,086, filed Apr. 23, 2010 entitled Methods and Devices for Accessing a Body Cavity.

International Search Report for PCT/US2011/035511 dated Oct. 10, 2011.

"Applied GelPort System" by Applied Medical Resources Corporation (2004).

"Bard® Bi-Directional and Kelly-Wick Tunnelers—Instructions for Use," by Bard Peripheral Vascular (Apr. 2006).

"intrack XT—Low Profile Atraumatic Clamps," by Novare Surgical Systems, Inc. (2002).

"I Lap Disc Hand Access Device—Ref. Ld111," by Ethicon Endo-Surgery, Inc. (date unknown but no later than May 15, 2007, date of citation in U.S. Appl. No. 11/398,985; 1 page).

"Adult Cardiac Surgical Instruments," from the website of Genesee BioMedical, Inc. (date of first publication unknown; downloaded May 3, 2007; 4 pages).

"Applied GelPort Advanced Access Device," by Applied Medical Resources Corporation (Nov. 2002).

"Hand Instruments," from the website of Olympus Surgical America (date of first publication unknown; downloaded May 3, 2007; 4 pages).

"Pen Competitors," (date of first publication unknown but no later than May 15, 2007, date of citation in U.S. Appl. No. 11/398,985; 1 page).

Advanced Surgical Concepts (ASC), 510(k) TriPort Laparoscopic Access Device, Dec. 26, 2007, 8 pages.

Ashida, R. et al., "Indocyanine Green is an Ideal Dye for Endoscopic Ultrasound-Guided Fine-Needle Tattooing of Pancreatic Tumors" *Endoscopy*, 38, pp. 190-192 (2006).

Desai, M. et al., "Laparoscopic and Robotic Urology: Scarless single port transumbilical nephrectomy and pyeloplasty: first clinical report," *Journal Compilation*, 2008 BJU International, 101, 83-88.

http://www.innomedic.de/en/products/innomotion_overview.php (Innomedic Products), accessed Oct. 24, 2006.

<http://www.intuitivesurgical.com/products/index.aspx> (Intuitive Surgical Products), accessed Oct. 24, 2006.

http://www.lap-laser.com/e/laser_m/prod/med.html (LAP Laser Application), accessed Oct. 24, 2006.

(56)

References Cited

OTHER PUBLICATIONS

Ideas for Surgery.com, "Surgeon performs single-port laparoscopic surgery," dated Dec. 1, 2007.

Lee, D.I. et al., "Novel Approach to Minimizing Trocar Sites during Challenging Hand-Assisted Laparoscopic Surgery Utilizing the Gelpoint: Trans-Gel Instrument Insertion and Utilization," *Journal of Endourology*, vol. 17, No. 2, pp. 69-71 (Mar. 2003).

Maurin, et al., "A new robotic system for CT-guided percutaneous procedures with haptic feedback," LSIIT (UMR CNRS-ULP 7005), Louis Pasteur University, Bd. S. Brant, BP 10413, Strasbourg Illkirch 67412, France.

Maurin, et al., "A Parallel 5 DOF Positioner for Semi-Spherical Workspaces", Proceedings of DETC'04, ASME 2004 Design Engineering Technical Conferences and Computers and Information in Engineering Conference, Sep. 28-Oct. 2, 2004, Salt Lake City Utah USA.

Maurin, et al., "A Parallel Robotic System with Force Sensors for Percutaneous Procedures Under CT-Guidance", LSIIT (UMR CNRS-ULP 7005), Strasbourg I University Bd. S. Brant, BP 10413, 67412 Illkirch cedex, France.

Stoianovici, et al., "A Novel Mechanical Transmission Applied to Percutaneous Renal Access", DSC-vol. 61, Proceedings of the ASME Dynamic Systems and Control Division 1997.

Twentieth Edition—Illustrations of Surgical Instruments, by the Kny-Scheerer Company, New York, USA, pp. 1003, 1026, 1028-1029, 1133, 2034, 2068-2069, 2097-2099, 2132, 2137, 2144, 2155-2156, 2162, 2167-2171, 2173, 2175, 2244, 2255, 2281-2282, 2327, 2333, 2338-2348, 2352, 2355, 2359, 2371, 3017, 3039-3073, 3132, 3165, 3168-3169, 3208-3209, 3219 (Jul. 1915).

URobotics, Brady Urological Institute, Johns Hopkins Medical Institutions, "Z-Stage PAKY", date of publication unknown but no later than Oct. 26, 2006 (date of citation in U.S. Appl. No. 11/307,231).

URobotics, Brady Urological Institute, Johns Hopkins Medical Institutions, "PAKY Needle Driver," date of publication unknown but no later than Oct. 26, 2006 (date of citation in U.S. Appl. No. 11/307,231).

URobotics, Brady Urological Institute, Johns Hopkins Medical Institutions, "The RCM Robot", date of publication unknown but no later than Oct. 26, 2006 (date of citation in U.S. Appl. No. 11/307,231).

Webpage of Novare Surgical, Inc. featuring clamps (date of first publication unknown; downloaded Feb. 23, 2004; 1 page).

* cited by examiner

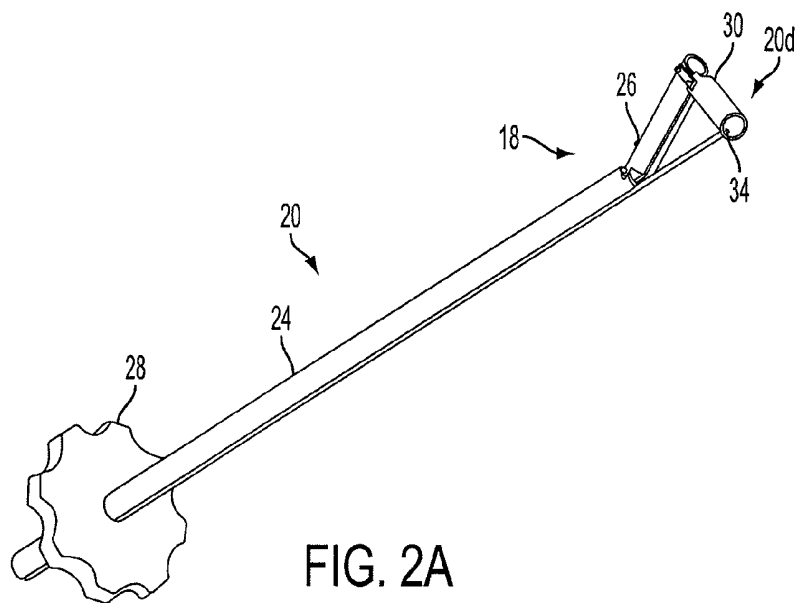
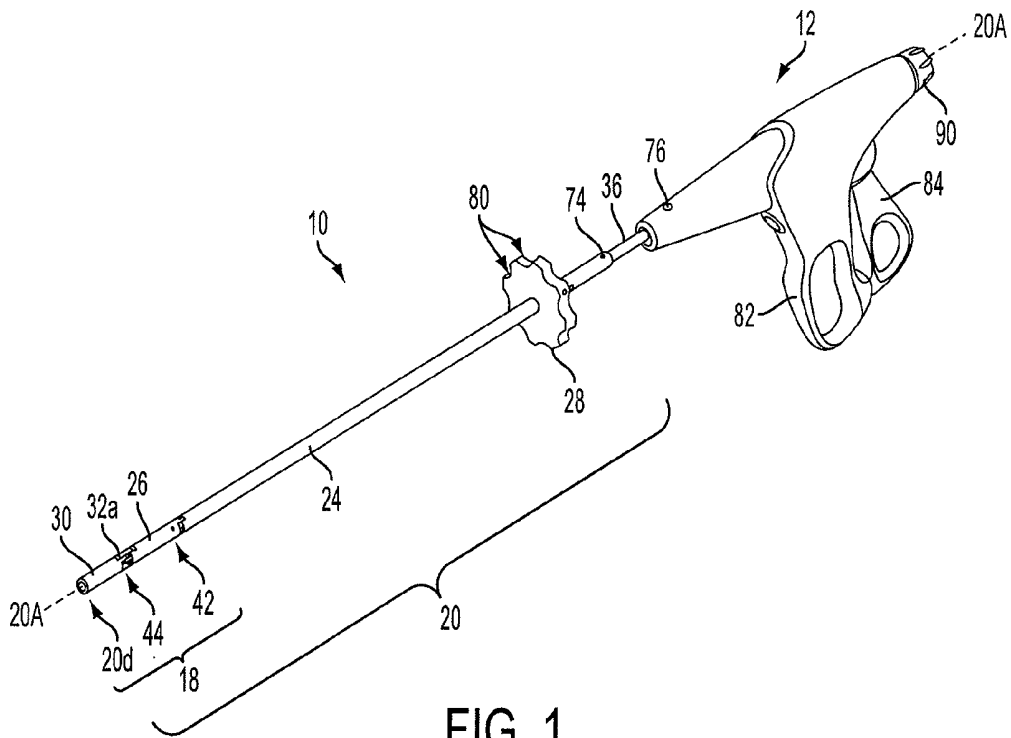

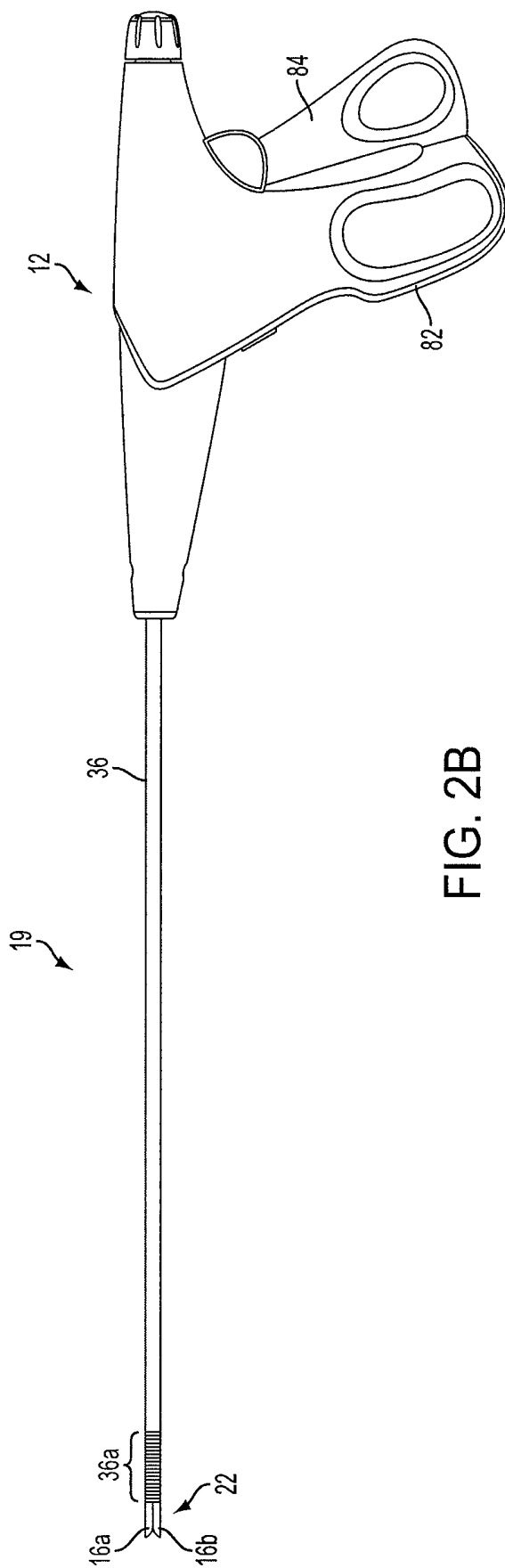

FIG. 2B

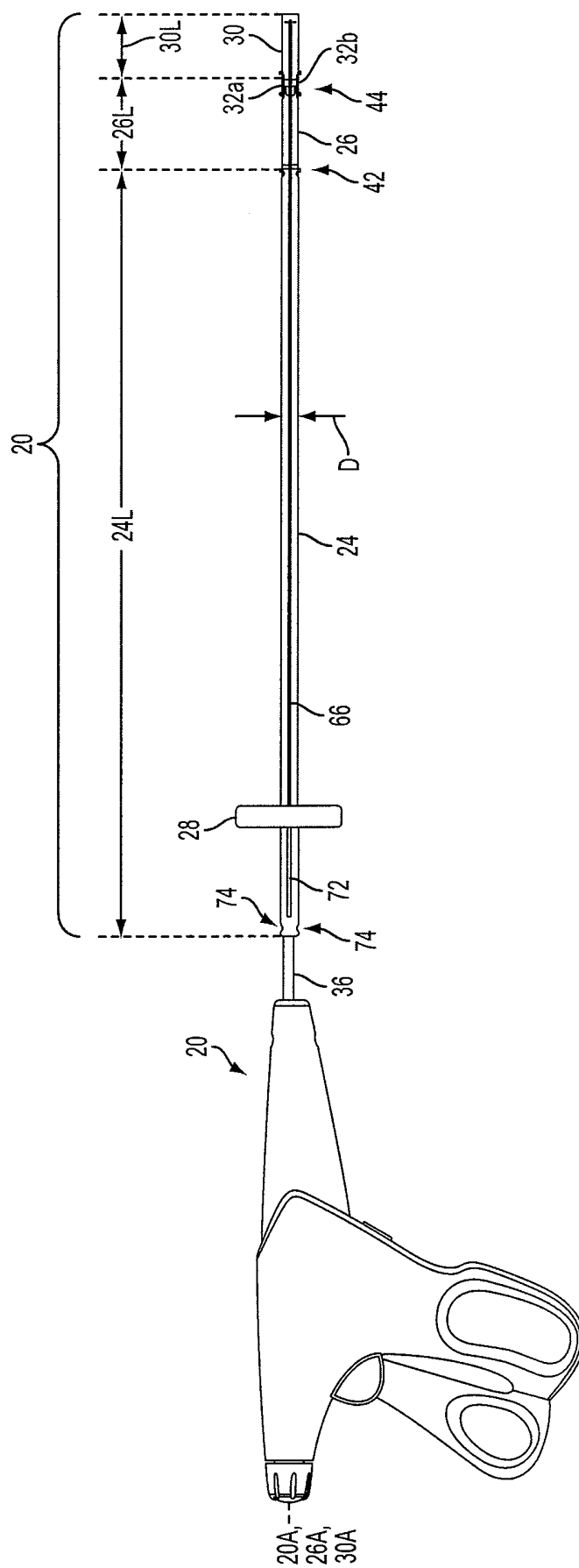

FIG. 3

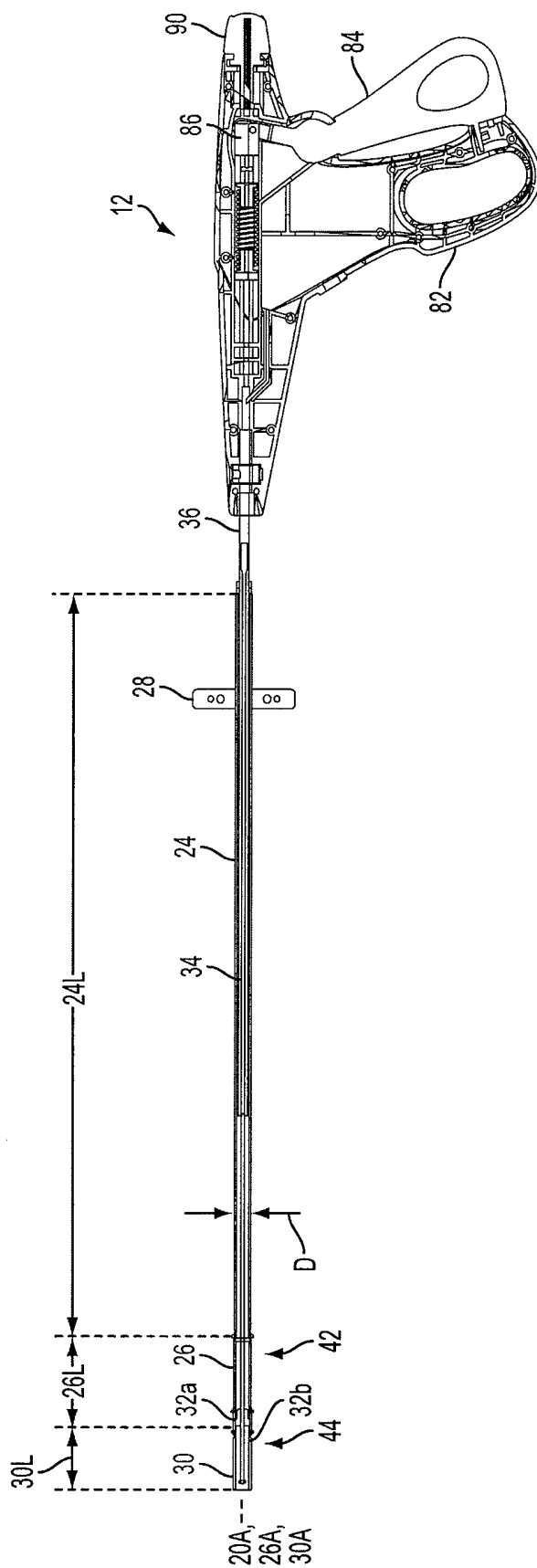

FIG. 4

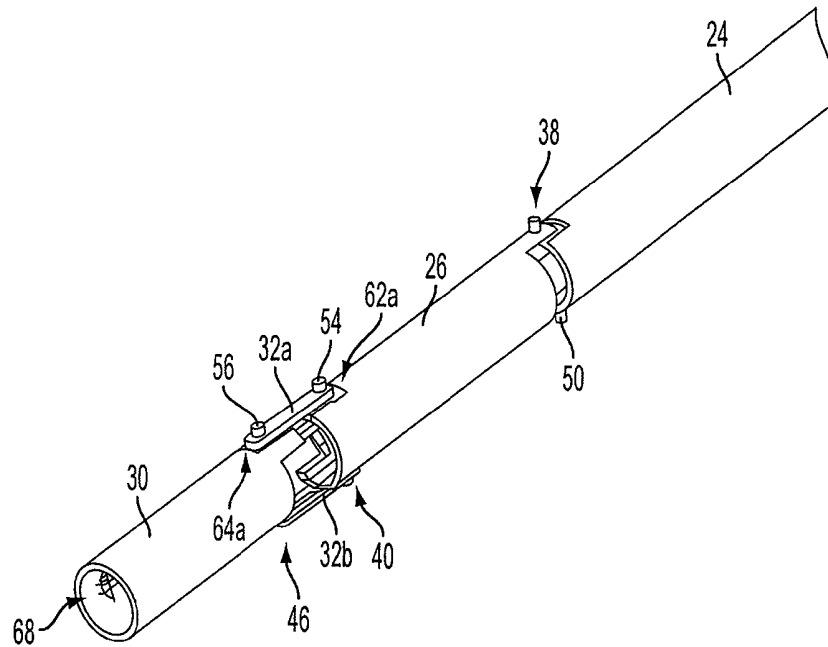

FIG. 5

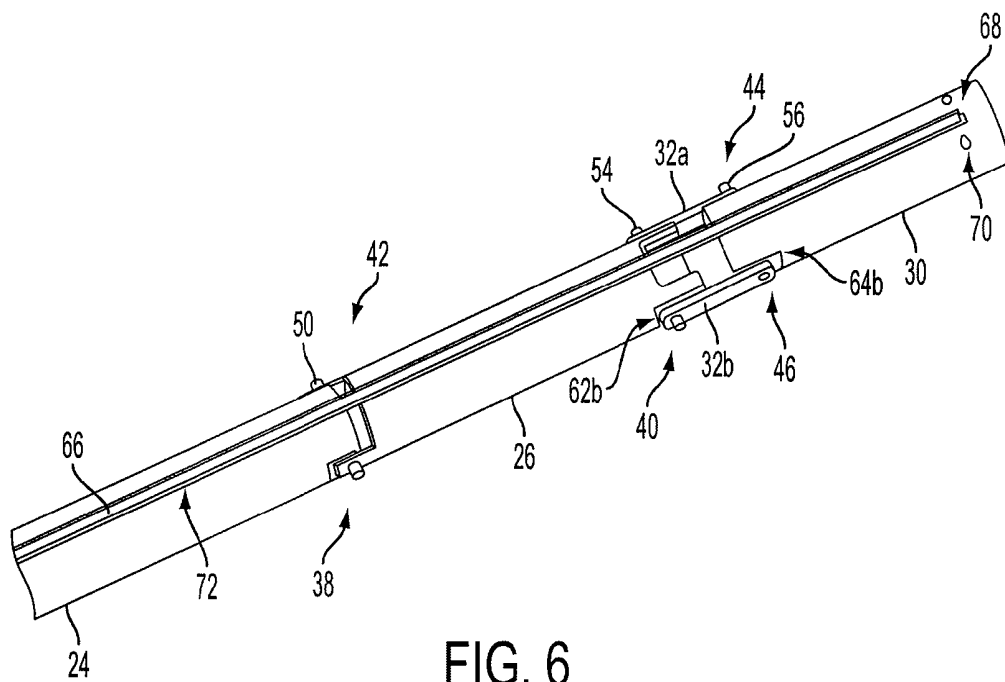

FIG. 6

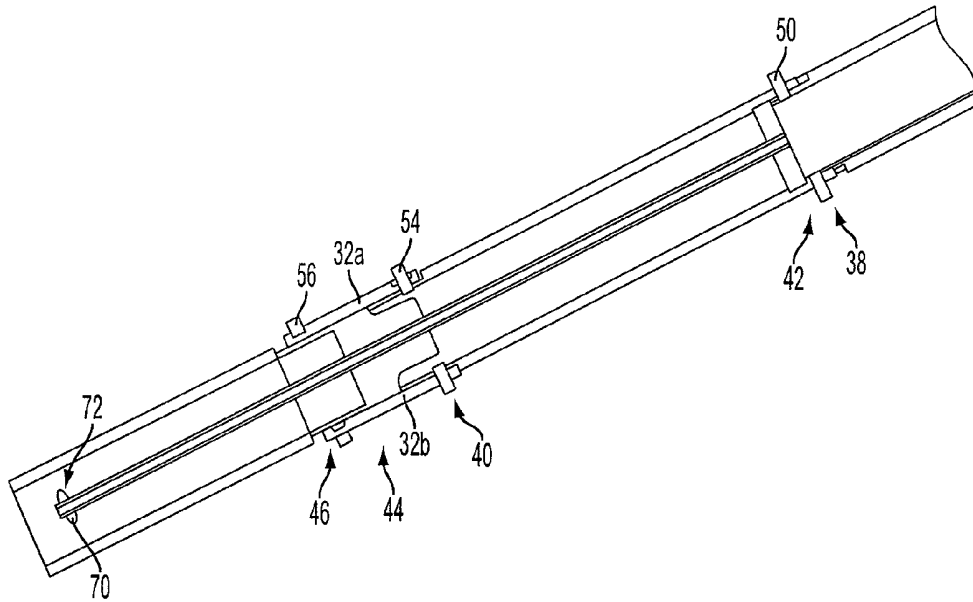

FIG. 7

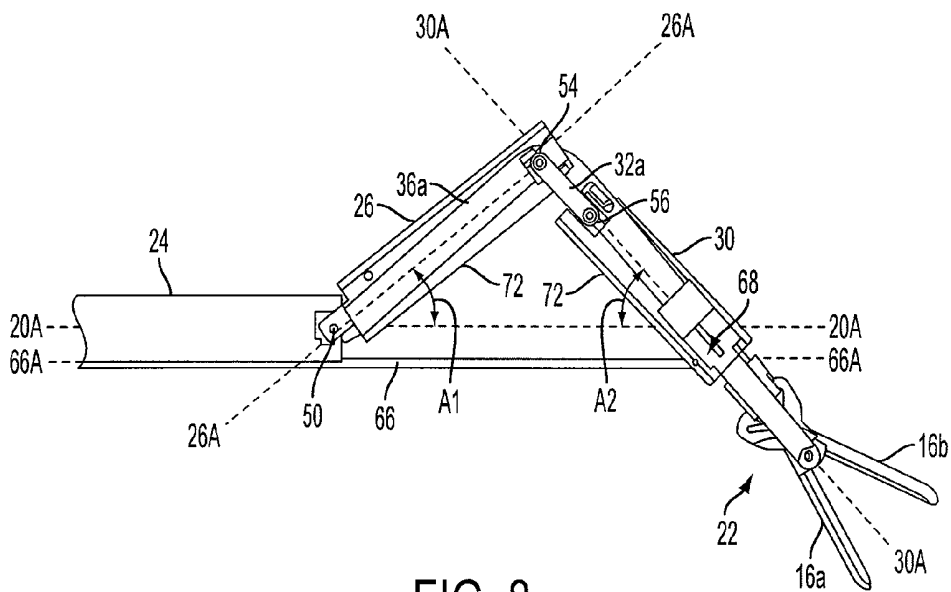

FIG. 8

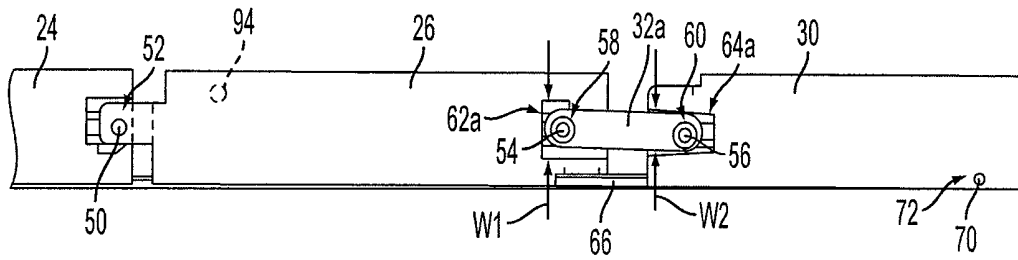

FIG. 9

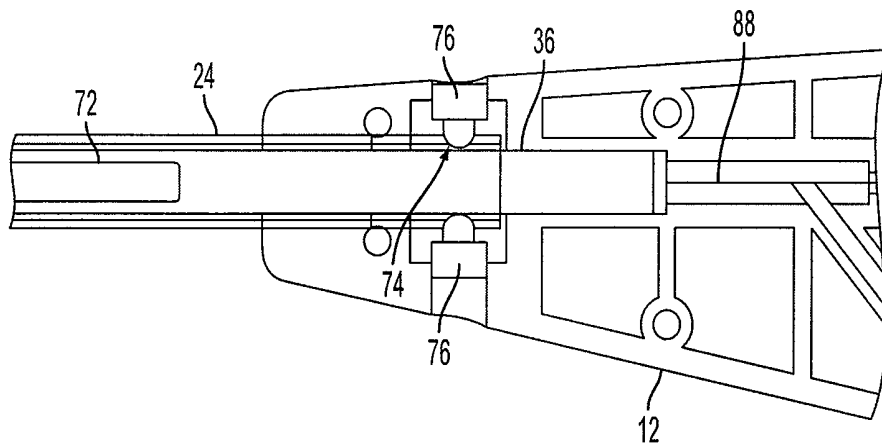

FIG. 10

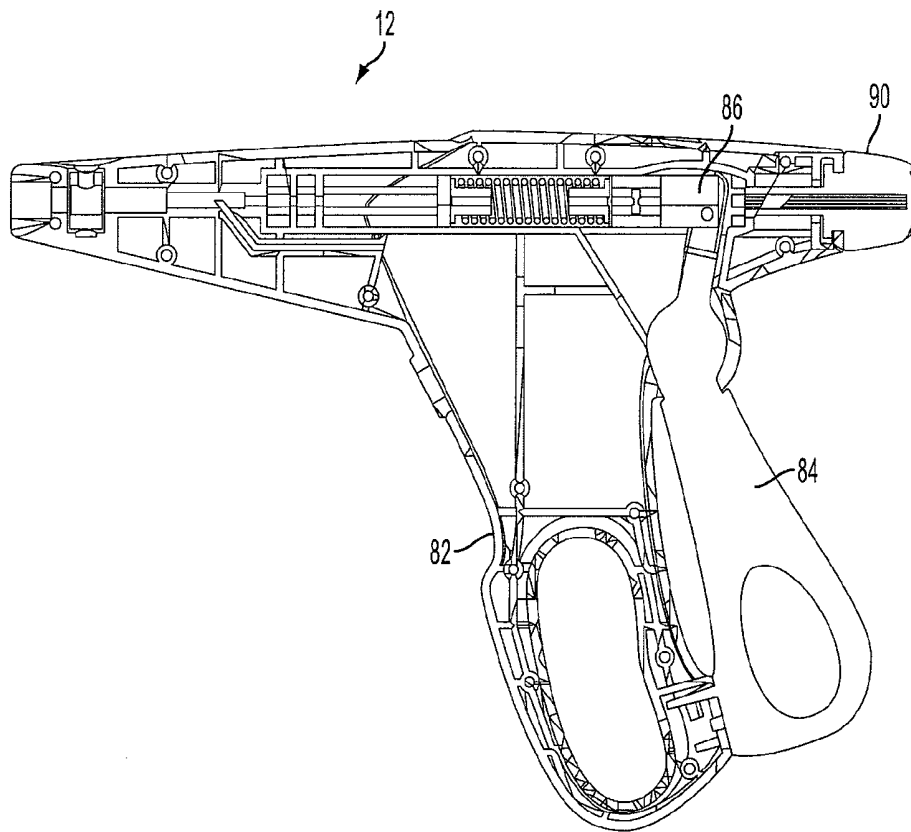

FIG. 11

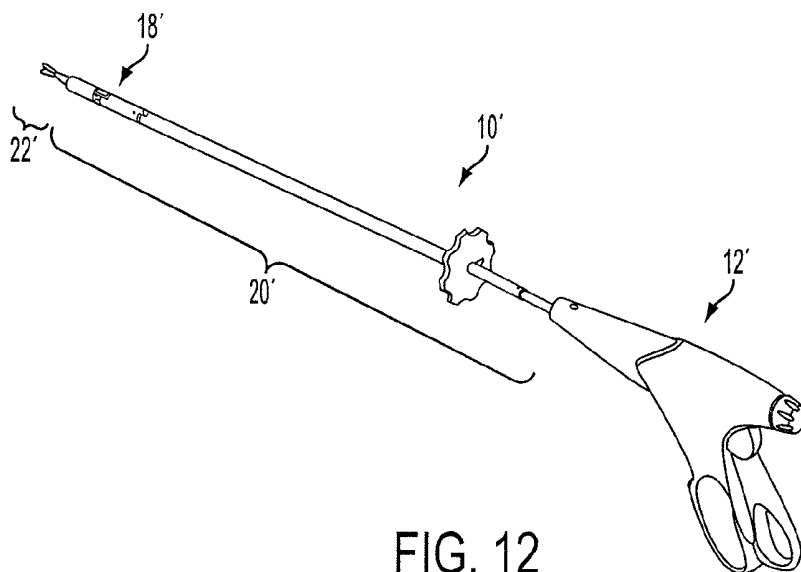

FIG. 12

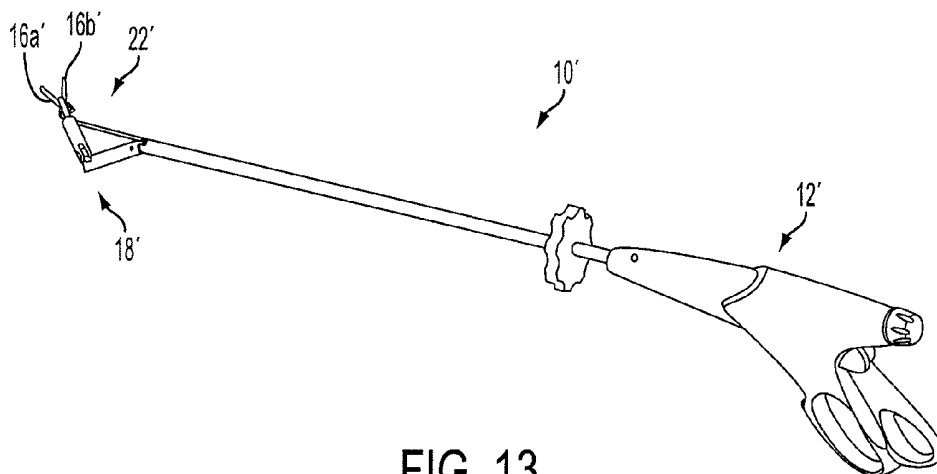

FIG. 13

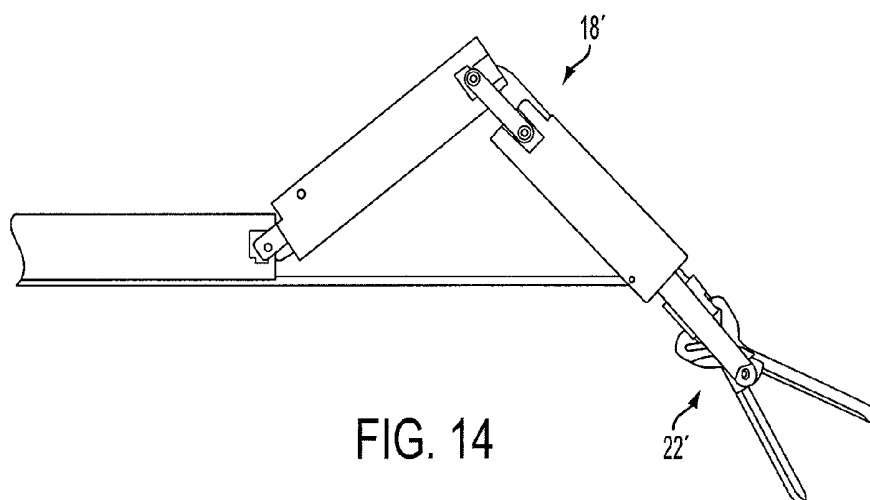

FIG. 14

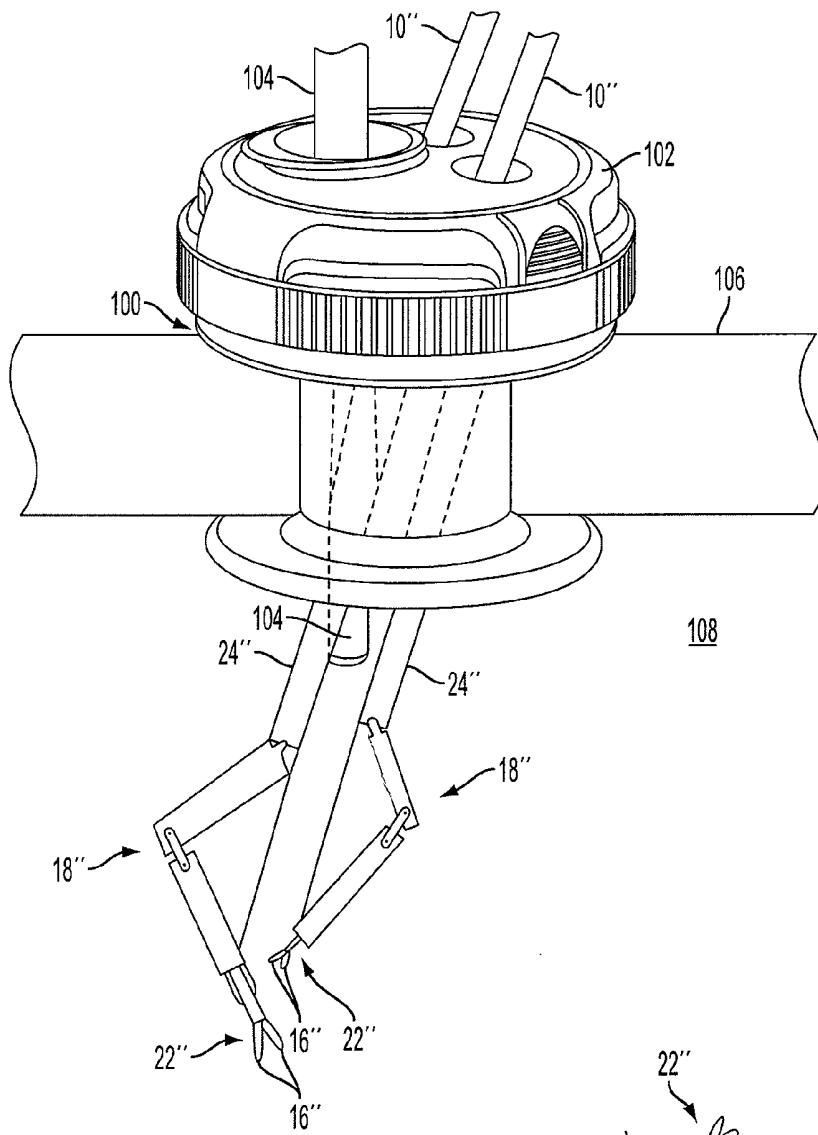

FIG. 15

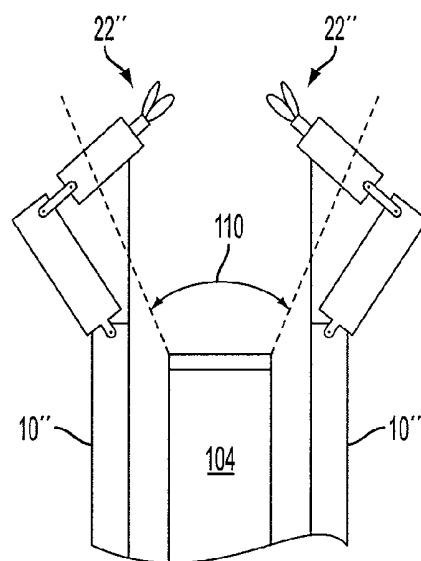

FIG. 16

COMPOUND ANGLE LAPAROSCOPIC METHODS AND DEVICES

FIELD OF THE INVENTION

The present invention relates to methods and devices for performing minimally invasive surgical procedures.

BACKGROUND OF THE INVENTION

Many surgical procedures involve inserting various instruments through the working channel of a surgical access device. The instruments are used to view, engage, and/or treat tissue within a body cavity or other surgical site to achieve a diagnostic or therapeutic effect. In laparoscopic abdominal procedures for example, the abdominal cavity is generally insufflated with CO₂ gas to a pressure of around 15 mm Hg. The abdominal wall is pierced and a plurality of tubular cannulas, each defining a working channel, are inserted at various points into the abdominal cavity. A laparoscopic telescope connected to an operating room monitor can be used to visualize the operative field and can be placed through one of the cannulas. Other laparoscopic instruments such as graspers, dissectors, scissors, retractors, etc. can be placed through the other cannula(s) to facilitate various manipulations by the surgeon. In this type of procedure, because of the positioning of the cannulas, it can be relatively easy to "triangulate" the tips of two separate instruments, e.g., bring the tips together at a single point within the abdominal cavity. For example, a first instrument could be passed through a cannula in the left side of the patient's abdomen and operated with the surgeon's left hand while a second instrument could be passed through another cannula in the right side of the patient's abdomen and operated with the surgeon's right hand. The surgeon can then easily bring the tips of the two instruments together at an internal point, e.g. in the center of the patient's abdomen. A laparoscope viewing instrument can also be passed through a third cannula, positioned for example in the center of the patient's abdomen, such that the tips of the two instruments can be easily visualized from above.

In other surgical procedures, however, visualization and triangulation is not as straightforward. For example, in Single Incision Laparoscopic Surgery (SILS) or Single Site Laparoscopic Surgery (SSLs), a single laparoscopic entry point is formed, e.g., through the navel. An access device having one or more working channels, and typically a plurality of working channels, is then installed in the entry point and all instruments required for performing the surgery are inserted through this same access device. In such procedures, the elongate shafts of the various instruments end up being generally parallel to one another while inserted through the access device. This can make it very difficult to triangulate the tips of two instruments within the abdominal cavity, especially if the instruments do not have distal articulation capabilities. In addition, since the viewing scope is inserted generally along the same axis as the various other instruments, it can be difficult or impossible to see the tips of the instruments. Furthermore, the handles of the various instruments often end up being positioned in close proximity to one another and create a so-called "chopstick" effect, which describes interference between the surgeon's hands, between the surgeon's hands and the instruments, and between the instruments. Interference between the handles and/or the positioning of the handles can limit maneuverability and/or lead to discomfort for the surgeon. These problems can unduly lengthen the duration of the surgery, potentially increasing the risk of patient complications. Also, in cases where it is impossible to

achieve adequate triangulation and/or visualization, a second or even third entry point must be formed, increasing trauma to the patient and creating additional scars.

Even in multiple-incision procedures or where triangulation and visualization is possible (e.g., where one or more of the devices includes a distal articulation capability), triangulation, visualization, comfort, and maneuverability can still be sub-optimal.

Accordingly, there is a need for methods and devices which allow laparoscopic procedures to be performed with an enhanced ability to triangulate and visualize surgical instruments and with improved surgeon comfort and instrument maneuverability.

SUMMARY OF THE INVENTION

The present invention generally provides methods and devices for performing minimally invasive surgical procedures. In one embodiment, an articulating laparoscopic access device is provided that includes an elongate shaft, first and second linkages, and a linkage bar. The first and second linkages and the linkage bar each have proximal and distal ends. The proximal end of the first linkage is pivotally coupled to the distal end of the elongate shaft at a first pivot point. The proximal end of the linkage bar is pivotally coupled to the distal end of the first linkage by a second pivot point, and the distal end of the linkage bar is pivotally coupled to the proximal end of the second linkage by a third pivot point. A first range of motion of the linkage bar about the third pivot point is less than a second range of motion of the linkage bar about the second pivot point. The distal end of the first linkage, the proximal end of the second linkage, and the linkage bar are movable between a first position longitudinally aligned with a longitudinal axis of the elongate shaft and a second position displaced from the longitudinal axis of the elongate shaft.

The device can include an actuator. The distal end of the second linkage can be pivotally coupled to the actuator at a fourth pivot point. The actuator can be movable longitudinally relative to the elongate shaft to longitudinally move the distal end of the second linkage.

The linkages and the linkage bar can have a variety of configurations and be coupled together in a variety of ways. For example, the proximal end of the linkage bar can be seated within a first groove formed in the distal end of the first linkage, and the distal end of the linkage bar can be seated within a second groove formed in the proximal end of the second linkage. The first groove can define the first range of motion, and the second groove can define the second range of motion. For another example, the elongate shaft, the first linkage, and the second linkage can have an inner lumen extending longitudinally therethrough for receiving a tool.

An end effector can be coupled to the distal end of the second linkage. The end effector can have a variety of configurations, but in one embodiment, it can include opposed jaws. The device can include an actuator configured to move the opposed jaws between a closed position and an open position. The actuator can extend through the elongate shaft, the first linkage, and the second linkage and be coupled to a proximal end of the opposed jaws.

In another aspect, a laparoscopic system is provided that includes an articulation device and a tool. The articulation device has an elongate shaft, a first linkage coupled to the elongate shaft at a first joint, and a second linkage coupled to the first linkage at a second joint. The second joint is movable radially outward relative to an axis extending longitudinally along the elongate shaft, and a distal end of the second linkage

3

is constrained to longitudinal movement along the axis. The tool has a flexible elongate shaft with an end effector on a distal end thereof. The flexible elongate shaft is disposable through a lumen extending through the elongate shaft, the first linkage, and the second linkage such that the end effector extends from the distal end of the second linkage. The flexible elongate shaft is bendable to conform to a shape of the lumen as the second joint is moved radially outward.

The system can include an actuator extending along the elongate shaft and having a distal end coupled to the distal end of the second linkage. The actuator can be longitudinally movable relative to the axis to move the distal end of the second linkage along the axis. The distal end of the actuator can be coupled to the distal end of the second linkage at a pivot point such that the second linkage is configured to pivot about the pivot point relative to the actuator. In some embodiments, the actuator is rigid. The system can optionally include a lock configured to lock the actuator in a fixed position relative to the shaft and the first and second linkages.

The first and second joints can be configured in any number of ways. For example, the first joint can include a pivot point formed between a distal end of the elongate shaft and a proximal end of the first linkage, and/or the second joint can include a linkage bar having a proximal end pivotally coupled to a distal end of the first linkage at a first pivot point and a distal end pivotally coupled to a proximal end of the second linkage at a second pivot point. For another example, the end effector can be angularly oriented relative to the axis when the second joint is disposed radially outward from the axis.

In yet another aspect, a method for laparoscopic surgery is provided that includes inserting a first tool through a first port formed in a housing disposed within tissue to position a distal end of the first tool within a body cavity, inserting a second tool through a second port formed in the housing to position a distal end of the second tool within the body cavity, inserting a flexible elongate shaft through a lumen of one of the first and second tools, actuating the first tool to cause a distal portion of the first tool disposed within the body cavity to form a compound angle, and actuating the second tool to cause a distal portion of the second tool disposed within the body cavity to form a compound angle. The flexible elongate shaft bends to conform to a shape of the lumen with the distal portion of the one of the first and second tools. When proximal portions of each of the first and second tools are substantially parallel, actuating the first and second tools causes end effectors at the distal ends of the first and second tools to be oriented toward one another without causing the distal portions of the first and second tools to intersect. In some embodiments, actuating the first tool can include longitudinally moving a first actuator extending along a first elongate shaft of the first tool, and actuating the second tool can include longitudinally moving a second actuator extending along a second elongate shaft. The method can optionally include engaging a lock of at least one of the first and second tools to maintain the compound angle of the one of the first and second tools in a fixed position.

The end effector can have a variety of configurations. In some embodiments, the method can include actuating the first tool to move opposed jaws of the end effector of the first tool between a closed position and an open position, wherein the formed compound angle of the first tool remains fixed during actuation of the first tool.

BRIEF DESCRIPTION OF THE DRAWINGS

The invention will be more fully understood from the following detailed description taken in conjunction with the accompanying drawings, in which:

4

FIG. 1 is a perspective view of one embodiment of a laparoscopic device including a handle and an articulatable shaft extending distally from the handle, the shaft being in a straight configuration;

FIG. 2A is a perspective view of the articulatable shaft of FIG. 1 showing the shaft in an articulated configuration;

FIG. 2B is a perspective view of the device of FIG. 1 showing an inner shaft having an end effector coupled to a distal end thereof with the articulatable shaft omitted for clarity;

FIG. 3 is a side view of the device of FIG. 1;

FIG. 4 is a cross-sectional side view of the device of FIG. 3;

FIG. 5 is a perspective view of a distal portion of the shaft of the device of FIG. 1;

FIG. 6 is another perspective view of a distal portion of the shaft of the device of FIG. 1;

FIG. 7 is a cross-sectional perspective view of the shaft of the device of FIG. 1;

FIG. 8 is a side, partially transparent view of a distal portion of the device of FIG. 1 with the end effector shown;

FIG. 9 is a side view of a distal portion of the shaft of the device of FIG. 1;

FIG. 10 is a partial, cross-sectional view of the handle and the shaft of the device of FIG. 1;

FIG. 11 is a cross-sectional view of the handle of the device of FIG. 1;

FIG. 12 is a perspective view of one embodiment of a laparoscopic device including a handle and a cannulated articulatable shaft extending distally from the handle, the shaft being in a straight configuration;

FIG. 13 is a perspective view of one embodiment of a laparoscopic device including a handle and an articulatable shaft extending distally from the handle, the shaft being in an articulated configuration and having an end effector coupled to a distal end thereof;

FIG. 14 is a perspective view of a distal portion of the device of FIG. 13;

FIG. 15 is a perspective, partially cross-sectional view of a surgical access device positioned within a tissue opening and having two laparoscopic devices and a scoping device inserted therethrough and positioned within a body cavity, the laparoscopic devices each having a shaft in an articulated configuration; and

FIG. 16 is a side view of distal portions of the laparoscopic devices and the scoping device of FIG. 15 positioned in the body cavity.

DETAILED DESCRIPTION OF THE INVENTION

Certain exemplary embodiments will now be described to provide an overall understanding of the principles of the structure, function, manufacture, and use of the devices and methods disclosed herein. One or more examples of these embodiments are illustrated in the accompanying drawings. Those skilled in the art will understand that the devices and methods specifically described herein and illustrated in the accompanying drawings are non-limiting exemplary embodiments and that the scope of the present invention is defined solely by the claims. The features illustrated or described in connection with one exemplary embodiment may be combined with the features of other embodiments. Such modifications and variations are intended to be included within the scope of the present invention.

Various exemplary devices and methods are provided for performing minimally invasive surgical procedures. In general, the devices and methods allow a shaft of a surgical

instrument to form a compound angle, thereby facilitating optimal positioning of a working distal end of the instrument relative to a surgical site. In an exemplary embodiment, a laparoscopic device includes an elongate shaft having a distal portion configured to be movable between a first configuration in which the distal portion of the shaft is substantially straight or linear and a second configuration in which the distal portion of the shaft is bent at a compound angle. In an exemplary embodiment, the shaft's distal portion can include two articulation joints to facilitate formation of the compound angle. The shaft's distal portion can be configured to be articulated in a wide range of compound angles. The shaft's distal portion can also be configured to be locked in a fixed articulated position, thereby allowing the device to be easily held in a desired bent position. The device can thus be inserted into a patient's body with the shaft in the first configuration, and it can be subsequently manipulated to move the shaft from the first configuration to the second configuration to allow the device's working distal end, e.g., an end effector, to be optimally angled within the body relative to a surgical site and/or any other surgical instruments at the surgical site. The shaft can also be configured to move from the second configuration to the first configuration to ease removal of the device from the patient. Such a configuration can be particularly advantageous where two or more instruments are inserted into a patient's body cavity through the same entry port in tissue because it can allow for triangulation. In particular, distal tips of the instruments can be brought together at a single point within the body cavity, even though the instruments' shafts extend generally parallel to one another.

A person skilled in the art will appreciate that while the methods and devices are described in connection with laparoscopic procedures in which one or more surgical instruments are inserted into a patient's body through an artificial opening, e.g., an incision, the methods and devices disclosed herein can be used in numerous surgical procedures and with numerous surgical instruments. By way of non-limiting example, the methods and devices can be used in open surgical procedures.

A person skilled in the art will also appreciate that the devices disclosed herein can be inserted into a body in any way, such as through a natural orifice, through an incision or puncture hole formed in tissue, etc. The devices can be inserted directly into a patient's body or can be inserted through an access device having a working channel through which a shaft of a surgical instrument can be advanced. A person skilled in the art will further appreciate that an access device can be configured to allow insertion of a single surgical instrument therethrough, such as with a straight cannula, or to allow simultaneous insertion of multiple instruments therethrough, such as with a surgical access device having multiple sealing ports each defining a working channel. Devices disclosed herein can alternatively or additionally be introduced into a body through an auxiliary passageway along the outside of a scoping device or other surgical instrument, as will be appreciated by a person skilled in the art. Exemplary embodiments of a surgical instrument that provides such an auxiliary passageway are described in more detail in U.S. Pat. No. 7,615,005 issued Nov. 10, 2009 entitled "Medical Apparatus For Use With An Endoscope," which is hereby incorporated by reference in its entirety.

In an exemplary embodiment, shown in FIGS. 1-4, a surgical device 10 is provided that includes a proximal handle 12 having a shaft assembly 20 surrounding an elongate shaft 36 extending distally therefrom. The shaft 36 can have a working element or end effector 22, generally referred to as an "end effector," at a distal end thereof. As shown in FIGS. 2A and

2B, the device 10 in the illustrated embodiment includes the shaft assembly 20 and a tool 19 including the shaft 36 releasably receivable within the shaft assembly 20 such that the end effector 22 at a distal end of the shaft 36 can extend distally beyond a distal end 20d of the shaft assembly 20. As discussed further below, articulation of the shaft assembly 20 can articulate a distal portion 36a of the shaft 36. Although the shaft assembly 20 and the tool 19 can be separate units as in the illustrated embodiment, the shaft assembly 20 and the tool 19 can be integrally formed, as also discussed further below. The end effector 22 is omitted from FIGS. 1, 3, and 4 for clarity. The end effector 22 in the illustrated embodiment includes a tissue grasper having a pair of opposed jaws 16a, 16b configured to move between open and closed positions, but as will be appreciated by a person skilled in the art the end effector 22 can include any tool, e.g., a grasper, a dissector, scissors, forceps, a retractor, a light, etc. As discussed further below, the handle 12 can be configured to operate the end effector 22, and a control knob 28 at a location distal of the handle 12 can be configured to facilitate articulation and/or rotation of at least a portion of the shaft assembly 20.

The shaft assembly 20 can have a variety of sizes, shapes, and configurations. The shaft assembly 20 can be rigid, flexible, or a combination thereof. Portions of the shaft assembly 20 can be less flexible or more rigid than a remainder of the shaft assembly 20 to facilitate insertion through tissue and/or operation of the end effector 22. As in the illustrated embodiment, the distal portion 36a of the shaft 36 can be flexible, and a remainder of the tool 19, as well as the shaft assembly 20, can be rigid. Having a rigid shaft assembly 20 and a shaft 36 rigid along a substantial longitudinal length thereof can help facilitate translation of forces in articulating and actuating the device 10 as discussed further below.

As mentioned above, the shaft assembly 20 can be tubular, and it can have an inner lumen 34 extending therethrough, as shown in FIG. 4, which can receive the shaft 36. A person skilled in the art will also appreciate that although the inner lumen 34 in the illustrated embodiment extends along a longitudinal axis of the shaft assembly 20 through the shaft assembly 20 and the handle 12, the inner lumen 34 can be at least partially radially/laterally offset from the shaft's longitudinal axis 20A, extend through the shaft assembly 20 and only a portion of the handle 12, and/or extend only through a portion of the shaft assembly 20. The device's inner lumen 34 can be configured to slidably receive the shaft 36 such that when the shaft 25 extends through the device's articulation assembly 18, articulation of the articulation assembly 18 can correspondingly articulate the shaft 36 at the flexible portion 36a thereof in a compound angle and thus facilitate optimal positioning of the end effector 22. The tool's handle and/or a portion of the tool's shaft 36 can be configured to lock to shaft assembly 20, e.g., with a J-lock, spring-loaded detent, etc., to help prevent unintentional movement of the end effector 22 when it is optimally positioned relative to the device's shaft assembly 20.

The shaft assembly 20 can have any longitudinal length, although in an exemplary embodiment it is long enough to allow the handle 12 and the control knob 28 to be manipulated outside a patient's body when the device 10 is partially inserted into the body with the end effector 22 disposed within a body cavity, e.g., have a longitudinal length of about 33 cm. In this way, the shaft assembly 20 and the end effector 22 can be easily manipulated when the device 10 is in use during a surgical procedure. The shaft assembly 20 can have any diameter D, e.g., less than or equal to about 10 mm, and more particularly less than or equal to about 5 mm, to allow for insertion of the shaft assembly 20 through an access

device, such as during a laparoscopic surgical procedure. The end effector **22** coupled to the shaft's distal end can have a diameter equal to or less than the shaft's diameter D, at least when the jaws **16a**, **16b** are in a closed position, to further facilitate insertion of the device's distal portion into a patient's body.

In an exemplary embodiment, the shaft assembly **20** can be substantially cylindrical to help the shaft assembly **20** pass smoothly into a body. The shaft assembly **20** can have any constant or varying shape along its longitudinal length, and the shaft's diameter D can be uniform or non-uniform along its longitudinal length. In an exemplary embodiment, as shown in FIGS. **3** and **4**, the shaft assembly **20** can have a substantially uniform diameter D along its longitudinal length except at one or both of the articulation joints **42**, **44**, which can have diameters that differ from the shaft's diameter D, as discussed further below.

Generally, the shaft assembly **20** can include an articulation assembly **18** surrounding at least the distal portion **36a** of the shaft **36** when the shaft **36** is received within the shaft assembly **20**. The articulation assembly **18** can be movable relative to the shaft **36** to articulate the distal portion of the shaft assembly **20** and the distal portion **36a** of the shaft **36** received therein and generally aligned with the articulation assembly **18**. Generally, the articulation assembly **18** can be configured to be movable between a linear or straight configuration, generally referred to as a "straight configuration," in which the articulation assembly **18** extends substantially parallel to a longitudinal axis **20A** of the shaft assembly **20**, as illustrated in FIGS. **2-4**, and an articulated, bent, or compound angle configuration, generally referred to as an "articulated configuration," in which portions of the articulation assembly **18** do not extend parallel to the longitudinal axis **20A**, as illustrated in FIG. **1**. In the illustrated exemplary embodiment, the articulation assembly **18** is biased to the straight configuration, e.g., in a configuration with the knob **28** slid distally because of a tendency of the shaft's distal portion **36a** to return to a straight or linear configuration. As will be appreciated by a person skilled in the art, the articulation assembly **18** can be biased in any other way, e.g., using a shape memory material, it can be unbiased, or it can be biased to the articulated configuration. Although the articulation assembly **18** can be located anywhere along the shaft assembly **20**, e.g., positioned at a mid-portion thereof, as shown in the illustrated embodiment, it can be located in a distal portion thereof such that a distal portion of the device **10** can be configured to articulate to form a compound angle. Similarly, the flexible distal portion **36a** of the shaft **36** can be located anywhere along the shaft **36**, as in the illustrated embodiment, it can be located in a distal portion thereof. Although the shaft assembly **20** can be configured to bend any number of times to form a compound angle, the articulation assembly **18** in the illustrated embodiment is articulated at first and second articulation joints **42**, **44** to form a triangulated compound angle, as discussed in further detail below.

The articulation assembly **18** can have a variety of sizes, shapes, and configurations. Generally, it can include a plurality of sections, segments, or linkages, generally referred to as "linkages," along the shaft's longitudinal length to facilitate articulation of the shaft assembly **20**. As shown in the embodiment illustrated in FIGS. **1-11**, the articulation assembly **18** can include a proximal elongate shaft **24**, a first linkage **26** coupled to a distal end of the proximal shaft **24**, and a second linkage **30** coupled to a distal end of the first linkage **30**. The first and second linkages **26**, **30** can be coupled together with at least one bar or rod, generally referred to as a "linkage bar" located between the first and second linkages **26**, **30**. In the

illustrated embodiment, the articulation assembly **18** includes identical first and second linkage bars **32a**, **32b** on opposite sides of the shaft assembly **20**, e.g., separated about 180° from one another around the shaft's circumference. While two shaft linkages are illustrated in the embodiment of FIGS. **1-11**, a person skilled in the art will appreciate that in other embodiments, the device can include any number of linkages.

As shown in FIG. **8**, when the articulation assembly **18** is in the articulated configuration, and the tool **19** is inserted therein such that the end effector **22** extends distally beyond the assembly's distal end **20d**, the end effector **22** can be configured to be oriented transverse to, and optionally to intersect or "cross," the shaft's longitudinal axis **20A**, which can facilitate optimal positioning of the end effector **22** relative to other devices and/or a surgical site, and which can reduce a "chopstick" effect between the device **10** and any other adjacent surgical instruments. Depending on the size of the first and second linkages **26**, **30** and on the amount the articulation assembly **18** is articulated, the distal portion of second linkage **30** can also intersect or "cross" the shaft's longitudinal axis **20A**.

The proximal shaft **24** and the linkages **26**, **30** can have a variety of sizes, shapes, and configurations. For example, the proximal shaft **24** and the linkages **26**, **30** can each be in the form of a relatively rigid tubular section, e.g., made from a generally non-bendable material such as a hard polymer or titanium, with the inner lumen **34** extending therethrough. As shown in FIGS. **3** and **4** of the illustrated embodiment, the proximal shaft **24** can have a longer longitudinal length **24L** than the first and second linkages **26**, **30** alone or together. Also as in the illustrated embodiment, a longitudinal length **26L** of the first linkage **26** can be longer than a longitudinal length **30L** of the second linkage **30**. Alternatively, the longitudinal length **30L** of the second linkage **30** can be larger than the longitudinal length **26L** of the first linkage **26**, or the first and second linkages **26**, **30** can have substantially equal longitudinal lengths **26L**, **30L**.

As shown in FIGS. **2-4**, a proximal portion of the shaft **36** can be disposed within the handle **12** with a remainder of the shaft **36** extending distally from the handle **12** in a generally straight line parallel to the shaft's longitudinal axis **20A**. The distal portion of the shaft **36** can be at least partially received in the inner lumen **34** and surrounded by the proximal shaft **24**, which can be slidable around and relative to the shaft **36** to facilitate articulation at the articulation joints **42**, **44**, as discussed further below.

The articulation assembly **18** can be configured to facilitate smooth and controlled articulation of the shaft assembly **20** relative to the handle **12** with the first articulation joint **42** being located between the proximal shaft **24** and the first linkage **26** to allow the proximal shaft **24** and the first linkage **26** to be angled relative to one another, and with the second articulation joint **44** being located between the first and second linkages **26**, **30** to allow the first and second linkages **26**, **30** to be angled relative to one another offset from the shaft's longitudinal axis **20A**. The proximal shaft **24** and the linkages **26**, **30** can thus be configured to articulate to form a compound angle. The proximal shaft **24** can be configured to be in a fixed position along the shaft's longitudinal axis **20A** when the articulation assembly **18** is in the straight configuration, as shown in FIGS. **1** and **3-6**, and in the articulated configuration, as shown in FIG. **8**. In contrast, the first and second linkages **26**, **30** and the linkage bars **32a**, **32b** can be configured to be longitudinally aligned with the shaft's longitudinal axis **20A** when the articulation assembly **18** is in the straight configuration, as shown in FIGS. **1**, **3-7**, and **9**, and the first and second linkages **26**, **30** can be angularly oriented relative

to the shaft's longitudinal axis 20A with the linkage bars 32a, 32b positioned away from the axis 20A when the articulation assembly 18 is in the articulated configuration, as shown in FIG. 8. As mentioned above, the end effector 22 can be coupled to a distal end of the shaft assembly 20 such that the end effector 22 is positioned distal to the articulation joints 42, 44. This can allow the end effector 22 to articulate with the articulation assembly 18 and thereby be angularly oriented relative to the shaft's longitudinal axis 20A in coordination with the second linkage 30, as illustrated in FIG. 8. In this way, the shaft assembly 20 can be inserted into a patient's body, and the distal portion thereof can be articulated inside the body without altering the angular position of the proximal portion of the shaft assembly 20, e.g., the proximal shaft 24, that extends through an opening in the body, either directly or through an access device. The end effector 22 can thus be oriented to extend toward and in a facing relationship with the longitudinal axis 20A.

With the articulation assembly 18 in the articulated configuration, a compound angle is formed, with the respective axes 20A, 26A, 30A of the proximal shaft 24 and the linkages 26, 30 intersecting one another. The axes 20A, 26A, 30A can, however, all lie within a common plane.

The proximal shaft 24 and the linkages 26, 30 can be coupled together in a variety of ways. As illustrated in the embodiment of FIGS. 5-9, a distal end of the proximal shaft 24 can be pivotally coupled to a proximal end of the first linkage 26 at a first pivot point 38 to form the first articulation joint 42. The first linkage 26 can thereby be configured to pivot or rotate, as shown in FIG. 8, relative to the proximal shaft 24 and the handle 12 about the first pivot point 38, which can have an axis that is generally perpendicular to the longitudinal axis 20A of the proximal shaft 24. The proximal end of the first linkage 26 can thus be in a fixed position relative to the shaft's longitudinal axis 20A, and the distal end of the first linkage 26 can be free to move radially inward toward and outward away from the shaft's longitudinal axis 20A. The first and second linkages 26, 30 can also be connected together in a pivotal relationship, via the linkage bars 32a, 32b, to form the second articulation joint 44. A distal end of the first linkage 26 can be pivotally coupled to proximal ends of each of the linkage bars 32a, 32b at a second pivot point 40 at the second articulation joint 44, and a proximal end of the second linkage 30 can be pivotally coupled to distal ends of each of the linkage bars 32a, 32b at a third pivot point 46 at the second articulation joint 44. The first linkage 26 can thereby be configured to pivot or rotate relative to the second linkage 30, the proximal shaft 24, and the handle 12 about the second pivot point 40, and the second linkage 30 can thereby be configured to pivot or rotate relative to the first linkage 26, the proximal shaft 24, and the handle 12 about the third pivot point 46. The second and third pivot points 40, 46 can each have an axis that is generally perpendicular to the longitudinal axis 20A of the proximal shaft 24. In this way, the first and second linkages 26, 30 can both articulate on a same side of the shaft assembly 20, e.g., on a same side relative to the proximal shaft 24, to allow the end effector 22 to intersect or "cross" the shaft's longitudinal axis 20A. In other words, a longitudinal axis 26A of the first linkage 26 and a longitudinal axis 30A of the second linkage 30 and the end effector 22 can be parallel to the longitudinal axis 20A of the proximal shaft 24 when the articulation assembly 18 is in the straight configuration, as shown in FIGS. 3 and 4. When the articulation assembly 18 is in the articulated configuration, the longitudinal axes 26A, 30A of the first and second linkages 26, 30 can be transverse relative to the shaft's longitudinal axis 20A at first and second angles A1, A2, respectively, to angularly

orient the end effector 22. The first and second linkages 26, 30 can be configured to be angularly oriented such that their longitudinal axes 26A, 30A can be substantially perpendicular to one another. The measure of the first and second angles A1, A2 can depend, at least in part, upon the sizes and shapes of the proximal shaft 24, the linkages 26, 30, and the linkage bars 32a, 32b. The angles A1, A2 each being substantially at 0° correspond to the articulation assembly 18 being in the straight configuration. The second and third pivot points 40, 46, can be offset from and positioned a distance apart from the linkages' longitudinal axes 26A, 30A taken along a cross-section of the linkages 26, 30, e.g., offset from center. Such offset pivot point(s) can help guide the first and second linkages 26, 30 in desired articulated directions at the second articulation joint 44.

The proximal shaft 24, the linkages 26, 30, and the linkage bars 32a, 32b can be pivotally coupled together in any way at their associated ones of the pivot points 38, 40, 46, as will be appreciated by a person skilled in the art. As in the illustrated embodiment shown in FIGS. 5-9, a first pin 50 can be inserted, e.g., by press fit, through respective first holes 52 formed in the distal end of the proximal shaft 24 and the proximal end of the first linkage 26 to form a pivot hinge-type joint at the first pivot point 38 between the adjacent proximal shaft 24 and first linkage 26. Similarly, second and third pins 54, 56 can be respectively inserted through second and third holes 58, 60 to pivotally couple the linkage bars 32a, 32b to the first and second linkages 26, 30 at, respectively, the second and third pivot points 40, 46.

The first and second linkages 26, 30 can respectively include grooves formed therein at the second and third pivot points 40, 46 that can be configured to seat the linkage bars 32a, 32b. By seating the linkage bars 32a, 32b, the grooves can be configured to help reduce the diameter of the device's distal portion including the linkage bars 32a, 32b, which can help ease insertion and removal of the device's distal portion to and from a patient's body. However, as in the illustrated embodiment, the linkage bars 32a, 32b can be configured to not be seated flush or sub-flush within the grooves but instead can extend laterally/radially outward from outer surfaces of the first and second linkages 26, 30 such that the shaft's diameter D is larger at the second articulation joint 44 than elsewhere along the shaft's longitudinal length. In one embodiment, the grooves can be configured to define ranges of motion about the second and third pivot points 40, 46.

First and second grooves 62a, 64a seating the first linkage bar 32a, shown in FIGS. 5 and 9, are discussed below in more detail, but as will be appreciated by a person skilled in the art, third and fourth grooves 62b, 64b seating the second linkage bar 32b, shown in FIG. 6, on an opposite side of the shaft assembly 20 can be similarly configured. The first groove 62a formed in the distal end of the first linkage 26 can be configured to seat the proximal end of the first linkage bar 32a, and the second groove 64a formed in the proximal end of the second linkage 30 can be configured to seat the distal end of the first linkage bar 32a. The first and second grooves 62a, 64a can have any size and shape that allow the respective proximal and distal ends of the first linkage bar 32a to be seated therein. In an exemplary embodiment, a maximum width W1 of the first groove 62a can be larger than a maximum width W2 of the second groove 64a, where the widths W1, W2 are measured perpendicular to the shaft's longitudinal axis 20A when the articulation assembly 18 is in the straight configuration, as illustrated in FIG. 9. Such relative sizing of the first and second grooves 62a, 64a can allow the first linkage bar 32a to have a first range of motion about the second pivot point 40 located within the first groove 62a that

is more than a second range of motion of the first linkage bar 32a about the third pivot point 46 located within the second groove 64a. In this way, the first linkage bar 32a can be free to move between a first position generally aligned with or parallel to the first and second linkages' longitudinal axes 26A, 30A when the articulation assembly 18 is in the straight configuration, as illustrated in FIG. 9, and to a second, different position angularly oriented relative to the first linkage's longitudinal axis 26A when the articulation assembly 18 is in the articulated configuration, as illustrated in FIG. 8. When the articulation assembly 18 has been articulated to a maximum extent, such as shown in FIG. 8, the first groove 62a can allow the first linkage bar 32a to pivot to be generally aligned with or parallel to the second linkage's longitudinal axis 30A. The maximum width W1 of the first groove 62a can define the first range of motion of the first linkage bar 32a relative to the shaft's axis 20A and hence also a maximum possible degree value of the second angle A2 and a range of motion for the second linkage 30 and the end effector 22. A person skilled in the art will appreciate that relative ranges of motions of the first and second linkage bars 32a, 32b about the second and third pivot points 40, 46 can be achieved using the grooves 62a, 62b, 64a, 64b and/or in other ways, e.g., by providing linkages or linkage bars of different relative longitudinal lengths, by providing a stop element such as a protrusion extending radially outward from a sidewall of one or both of the first and second linkages 26, 30 to prevent rotation of the linkage bars 32a, 32b beyond a certain point, etc. A person skilled in the art will also appreciate that the device 10 can lack any or all of the grooves 62a, 62b, 64a, 64b and thus not limit ranges of motion of about the second and third pivot points 40, 46.

Although the end effector 22 can be pivotally coupled to the second linkage's distal end such that it can pivot or articulate relative to the second linkage 30, in the illustrated embodiment, a proximal end of the end effector 22 is non-pivotally coupled to a distal end of the second linkage 30, e.g., welded, snapped, or press fit thereon, which can allow the end effector 22 to articulate with the second linkage 30 relative to the first linkage 26, the proximal shaft 24, and the handle 12. The end effector 22 can additionally or alternatively be configured to be movable relative to the second linkage 30, such as by being rotatable relative thereto and/or by opening and closing the jaws 16a, 16b, as discussed further below.

Although the end effector 22 is removably and replaceably coupled to the second linkage 30 in the device 10 of FIGS. 1-11 (the end effector 22 is omitted for clarity in FIGS. 1, 3-7 and 9) via the tool 19 proximally inserted therein and moved distally beyond the second linkage's distal end, the end effector 22 can be removably and replaceably coupled to the second linkage 30 in any other way, such as by using any attachment element, e.g., complementary threads on the distal end of the shaft and a proximal end of the end effector, as will be appreciated by a person skilled in the art. In this way, different end effectors having different sizes and/or functions can be selectively attached to the device 10.

In one exemplary embodiment, illustrated in FIGS. 12-14, a surgical device 10' is provided that includes a proximal handle 12' having an elongated, tubular shaft assembly 20' extending distally therefrom. The device 10' can be configured and used similar to the device 10 of FIGS. 1-11, but it can have an end effector fixedly attached to a distal end of the shaft assembly 20'. Although, as mentioned above, an end effector can be removably and replaceably coupled to a distal end of the shaft assembly 20' using an attachment element. The end effector 22' is shown in FIGS. 12-14 as a grasper including jaws 16a, 16b, a person skilled in the art will appreciate

that any type of end effector can be coupled to the device 10'. Similar to that discussed herein regarding the device 10, an articulation assembly 18' can be configured to articulate the shaft assembly 20' and angularly orient the end effector 22'.

Referring again to the embodiment of FIGS. 1-11, the device 10 can include an articulation actuator configured to articulate the articulation assembly 18 at the first and second articulation joints 42, 44 to form a compound angle. The articulation actuator can have a variety of configurations, but in the illustrated embodiment the articulation actuator includes a rigid, linear or straight rod or bar 66, generally referred to as an "actuator," configured to move relative to the proximal shaft 24 and the two linkages 26, 30 to bend the articulation assembly 18 at the articulation joints 42, 44. Having a rigid articulation actuator can facilitate smooth, controlled articulation of the articulation assembly 18, although the articulation actuator can be flexible or partially flexible, e.g., a flexible cable. The actuator 66 can be solid or can have one or more hollow portions.

As shown in FIGS. 3 and 5-9, the actuator 66 can include a rigid rod having a distal end pivotally coupled to the second linkage 30 at a fourth pivot point 68, and having a proximal end coupled to the device 10 at a location proximal to the first articulation joint 42. The actuator 66 can be pivotally coupled to the second linkage 30 in any way, such as with a pin (not shown) inserted through respective holes 70 formed in the distal end of the actuator 66 and in the second linkage 30. As in the illustrated exemplary embodiment, the fourth pivot point 68 can be located at a distal end of the second linkage 30, which can facilitate controlled articulation and stabilization of the articulation assembly 18. The actuator's proximal end can be coupled to the device 10 in any way and at any location such that movement of the knob 28 is configured to move the actuator 66. The proximal shaft 24 and linkages 26, 30 can include a channel 72 formed therein that can be configured to movably receive the actuator 66. The channel 72 can extend longitudinally along a full or partial longitudinal length of any of the proximal shaft 24 and linkages 26, 30. Although the channel 72 extends along all of the proximal shaft 24 and the linkages 26, 30 in the illustrated embodiment, the channel 72 can extend along only a portion of the shaft assembly 20, e.g., only along the proximal shaft 24. By being configured to seat the actuator 66 such that the actuator 66 sits flush or sub-flush therein, the channel 72 can be configured to help reduce a diameter of the shaft assembly 20, which can help ease insertion and removal of the device's distal portion to and from a patient's body. Although the actuator 66 in the illustrated embodiment includes a single rod, a person skilled in the art will appreciate that the actuator 66 can include multiple rods.

The actuator 66 can extend longitudinally parallel to the longitudinal axis 20A when the articulation assembly 18 is not articulated, but a longitudinal axis 66A of the actuator 66 can be offset from and be parallel to the shaft's longitudinal axis 20A, as shown in FIG. 8. Having such an offset longitudinal axis 66A can reduce clutter in the shaft's lumen 34 and can facilitate articulation of the articulation assembly 18.

As mentioned above, the actuator 66 can be movable relative to the proximal shaft 24. As in the illustrated embodiment, the actuator 66 can be movable longitudinally in proximal and distal directions parallel to the shaft's longitudinal axis 20A to articulate the articulation assembly 18. In response to selective movement of the control knob 28, the actuator 66 can be configured to move longitudinally relative to the shaft's longitudinal axis 20A, e.g., along the actuator's longitudinal axis 66A parallel to the shaft's longitudinal axis

20A. More particularly, when the articulation assembly 18 is in the straight configuration, or when it is not maximally articulated in the articulated configuration, longitudinal movement of the control knob 28 along the shaft's longitudinal axis 20A in a proximal direction can move the proximal shaft 24 longitudinally in a proximal direction over the shaft 36, and it can move the actuator 66 longitudinally in a proximal direction, thereby pulling the distal end of the second linkage 30 proximally to pivot the second linkage 30 relative to the actuator 66 at the fourth pivot point 68. Although the actuator 66 and the second linkage 30 can be pivotally coupled together at the fourth pivot point 38, the distal end of the second linkage 30 can be constrained to longitudinal movement along the longitudinal axis 66A of the actuator 66, and thus parallel to the shaft's longitudinal axis 20A, as the actuator 66 moves proximally and distally, as shown in FIG. 8. Such constrained movement can facilitate controlled, predictable movement of the second linkage 30 and hence of the end effector 22 coupled to the distal end thereof. The pivotal movement of the second linkage 30 about the fourth pivot point 68 can translate motion to the first pivot point 38 at the first articulation joint 42 and to the second and third pivot points 40, 46 at the second articulation joint 44 to form a compound angle.

The articulation assembly 18 can be similarly straightened using the actuator 66. When the articulation assembly 18 is in the articulated configuration, longitudinal movement of the control knob 28 along the shaft's longitudinal axis 20A in a distal direction can distally, longitudinally move the proximal shaft 24 over the shaft 36 and distally, longitudinally move the actuator 66, thereby pivoting the second linkage 30 relative to the actuator 66 at the fourth pivot point 68. The pivotal movement of the second linkage 30 about the fourth pivot point 68 can translate motion to the first and second articulation joints 42, 44 to decrease the compound angle, if not move the articulation assembly 18 from the articulated configuration to the straight configuration.

With the actuator 66 coupled to the distal end of the second linkage 30, the articulation assembly 18 can be bent in a distal-to-proximal direction whether it is being increased or decreased in amount of articulation. In other words, longitudinal movement of the actuator 66 can cause the second linkage 30 to pivot about the third pivot point 46 prior to the first linkage 26 pivoting about the second pivot point 40, and it can cause the first linkage 26 to pivot about the second pivot point 40 prior to the first linkage 26 pivoting about the first pivot point 38.

The articulation actuator can optionally include a second actuator (not shown) configured to further facilitate articulation at the first articulation joint 42. The second actuator can have a distal end coupled to the proximal end of the first linkage 26, e.g., at a coupling point 94 shown in FIG. 9, and it can have a proximal end coupled to the device 10 at a location proximal to the first articulation joint 42. The second actuator can be rigid and/or flexible, although in an exemplary embodiment at least a distal portion of the second actuator can be flexible to allow the second actuator to bend at the first articulation joint 42. In one exemplary embodiment, the second actuator can include a flexible cable extending parallel to the shaft's longitudinal axis 20A within the inner lumen 34, although the second actuator can be positioned outside or partially outside the lumen 34. The second actuator can be configured to be pulled in a proximal direction, such as by manipulating a lever or knob located at the handle 12 or at a proximal portion of the shaft assembly 20, to pull the first linkage 26 at the coupling point 94 and help pivot the first linkage 26 about the first pivot point 38. The second actuator

can be coupled to a dedicated lever or knob or to the control knob 28 coupled to the actuator 66. The coupling point 94 can include a fixed coupling point, such as if the second actuator is welded or crimped to the first linkage 26, or can be a movable coupling point, such as with a cam slidably received in a slot formed in the first linkage 26. The coupling point 94 can be laterally/radially offset from the shaft's central longitudinal axis, which in the illustrated embodiment is shown as the longitudinal axis 20A, by being near an outer edge of the first linkage 26, as shown in the embodiment illustrated in FIG. 9. Such an offset position can facilitate movement of the first linkage 26 and changing of the first angle A1 when the second actuator is pulled.

The articulation actuator can be freely longitudinally movable to allow the articulation assembly 18 to articulate any amount at any angles A1, A2. However, the control knob 28 can be configured to be manually held in a fixed position to hold the articulation assembly 18 at a desired compound angle. The device 10 can include a lock configured to mechanically hold the articulation assembly 18 in a fixed position when it is in the articulated configuration, which can ease manipulation of the device 10 when the articulation assembly 18 is articulated. As in the illustrated embodiment, the device 10 can include a lock configured to lock the articulation assembly 18 in a fixed position when it is at a maximum amount of articulation. The lock can have a variety of configurations, as will be appreciated by a person skilled in the art.

In the illustrated embodiment, as shown in FIGS. 2, 3, and 10, the lock includes holes 74 formed in a proximal end of the proximal shaft 24 and complementary pins 76 extending radially inward in a distal portion of the handle 12. The pins 76 can be spring-loaded or otherwise biased to a radially-inward position. Although holes 74 are shown formed in the proximal shaft 24, a person skilled in the art will appreciate that the proximal shaft 24 could instead have depressions or indentations formed therein for receiving the pins 76. A person skilled in the art will also appreciate that although the lock includes two holes 74 and two pins 76, the device's lock can include any number of complementary holes and pins. When the proximal shaft 24 moves a sufficient proximal distance relative to the handle 12, e.g., by pulling the control knob 28 proximally, the holes 74 can align with the pins 76 such that the pins 76 can snap into the holes 74. The engagement of the pins 76 within the holes 74 can hold the proximal shaft 24 in a fixed position relative to the handle 12, thus maintaining the actuator 66 and a remainder of the articulation assembly 18, e.g., the first and second linkages 26, 30, in a fixed position relative to the handle 12 and to each other. The lock can be disengaged in any way, such as by moving the control knob 28 distally to move the proximal shaft 24 distally and thereby snap the pins 76 out of the holes 74.

In addition to being longitudinally movable relative to the handle 12, the control knob 28 can be configured to rotate relative thereto to rotate the shaft assembly 20 about the longitudinal axis 20A. If the end effector 22 is attached to the shaft's distal end, as opposed to being attached to an independent tool inserted through the device such as in the embodiment illustrated in FIGS. 12-14, rotation of the shaft assembly 20 can also rotate the end effector 22. The control knob 28 can be rotatable any amount in clockwise and/or counterclockwise directions. In the illustrated embodiment, the control knob 28 is rotatable 360° in both clockwise and counterclockwise directions when the lock is not engaged, e.g., when the pins 76 are not engaged with the holes 74. When the lock is engaged, the shaft assembly 20 can be prevented from rotating. The proximal shaft 24 can include a

15

plurality of holes **74** arranged radially around its circumference or perimeter to allow the pins **76** to engage holes in the proximal shaft **24** when the proximal shaft **24** is in a variety of rotated orientations.

The control knob **28** can include at least one gripping feature **80**, shown in FIG. **1**, formed thereon that can be configured to facilitate manipulation of the control knob **28**. The gripping feature **80** in the illustrated embodiment includes a plurality of finger depressions around a perimeter of the control knob **28**, but a person skilled in the art will appreciate that the control knob **28** can additionally or alternatively include any one or more gripping features, e.g., a textured surface, a finger loop, a non-slip coating, etc.

As mentioned above, the device **10** includes a handle **12** having controls configured to operate the end effector **22**, e.g., to actuate and/or rotate the end effector **22**. As in the embodiment illustrated in FIGS. **4**, **10**, and **11**, the handle **12** can include an actuator configured to actuate the end effector **22**, e.g., to open and close the jaws **16a**, **16b**. The actuator can have a variety of sizes, shapes, and configurations, but as in the illustrated embodiment, it can include a translator element **88** extending distally from the handle **12**, through the shaft **36**, and to the end effector **22**. The translator element **88** can include an actuator, cable, wire, or rod, generally referred to as a "translator element," shown in FIG. **10**, having a proximal end coupled to an activator member in the handle **12** and a distal end coupled to the end effector **22**, with a length between the proximal and distal ends extending through the shaft assembly **20**. The translator element **88** can include a singular element, e.g., one flexible cable, or it can include multiple elements, e.g., a proximal rigid rod and a distal flexible cable. In an exemplary embodiment, at least a distal portion of the translator element **88** is flexible. By being flexible in at least a distal portion thereof, e.g., in a portion extending through the articulation assembly **18**, the translator element **88** can allow for actuation of the end effector **22** and articulation of the articulation assembly **18** at the articulation joints **42**, **44**. In the illustrated embodiment, the translator element **88** includes a flexible cable. The flexible cable can be formed of any pliable material, e.g., an electroactive polymer, a shape memory material such as Nitinol, etc., and can be attached to the handle **12** and the end effector **22** in any way, e.g., crimped, tied, etc.

The activator member in the handle **12** can vary, but as in the illustrated embodiment, it can include a ratchet **86** driven by a thumb trigger **84**. The ratchet **86** can be configured to longitudinally translate the translator element **88** parallel to the longitudinal axis **20A** in response to manual pressure on the trigger **84**. As the trigger **84** is pivoted relative to a pistol handle grip **82**, the trigger **84** ratchets the translator element **88** proximally or distally through the shaft **36**, the proximal shaft **24**, and the two linkages **26**, **30** to move the jaws **16a**, **16b**, whether the articulation assembly **18** is articulated or not.

As mentioned above, and as will be appreciated by a person skilled in the art, the handle **12** can include any rotating mechanism configured to rotate the end effector **22** before and/or after the articulation assembly **18** is articulated, such as a knob **90** as shown, a lever, a wired or wireless electronic control, etc. The knob **90** can include at least one gripping feature, e.g., raised ridges **92**, configured to facilitate manipulation of the knob **90**. The knob **90** can be coupled to the translator element **88** and be configured to rotate the translator element **88** a full 360° clockwise and/or counterclockwise to correspondingly rotate the end effector **22** about the second linkage's longitudinal axis **30A**, which as mentioned above is the same as the shaft's longitudinal axis **20A** when the articu-

16

lation assembly **18** is in the straight configuration. The knobs **28**, **90** can thus allow for separate, relative rotation between the shaft assembly **20** and the end effector **22**. By extending through the shaft assembly **20** whether it is articulated or not, the translator element **88** can allow the end effector **22** to be rotated about the shaft's longitudinal axis **20A** relative to the shaft assembly **20** with the articulation assembly **18** in either the straight or articulated configuration.

In use, as shown in an exemplary embodiment in FIG. **15**, one or more surgical devices **10"** can be inserted through an opening **100** in tissue **106** to access a body cavity **108** underlying the tissue **106** where the devices **10"** can perform any type of surgical procedure. The devices **10"** can generally each be configured and used similar to the device **10** of FIGS. **1-11**. As mentioned above, a person skilled in the art will appreciate that while the devices **10"** are shown in the illustrated embodiment in use in a laparoscopic procedure and inserted into the body cavity **108**, e.g., the abdominal cavity, through a multiple port access device **102** positioned in the tissue opening **100**, e.g., an incision at the navel, any of the surgical devices disclosed herein can be used in a variety of surgical procedures and inserted into a patient's body in any number of ways. Prior to insertion of any instruments through the multiple port access device **102**, insufflation can be provided through an insufflation port, as will be appreciated by a person skilled in the art. A scoping device **104** can also be inserted through the multiple port access device **102** to provide visualization. Non-limiting examples of a scoping device include an endoscope, a laparoscope, and a colonoscope.

The multiple port access device **102** can include multiple instrument openings each configured to receive an instrument inserted therethrough. Each opening can have an associated sealing port that can be configured to provide at least one instrument seal that forms a seal around an instrument disposed therethrough, but otherwise does not form a seal when no instrument is disposed therethrough, at least one channel seal or zero-closure seal that seals a working channel created by the sealing port when no instrument is disposed therethrough, or a combination instrument seal and channel seal that is effective to both form a seal around an instrument disposed therethrough and to form a seal in the working channel when no instrument is disposed therethrough. Exemplary embodiments of multiple port access devices are described in more detail in U.S. patent application Ser. No. 12/399,482 filed Mar. 6, 2009 entitled "Methods And Devices For Providing Access Into A Body Cavity," U.S. patent application Ser. No. 12/399,473 filed Mar. 6, 2009 entitled "Methods And Devices For Providing Access Into A Body Cavity," U.S. patent application Ser. No. 12/512,542 filed Jul. 30, 2009 entitled "Methods And Devices For Providing Access Into A Body Cavity," U.S. patent application Ser. No. 12/512,568 filed Jul. 30, 2009 entitled "Methods And Devices For Providing Access Into A Body Cavity," U.S. patent application Ser. No. 12/399,633 filed Mar. 6, 2009 entitled "Methods And Devices For Providing Access Into A Body Cavity," U.S. patent application Ser. No. 12/399,625 filed Mar. 6, 2009 entitled "Methods And Devices For Providing Access Into A Body Cavity," U.S. patent application Ser. No. 12/399,547 filed Mar. 6, 2009 entitled "Surgical Access Devices And Methods Providing Seal Movement In Predefined Paths," U.S. patent application Ser. No. 12/399,656 filed Mar. 6, 2009 entitled "Surgical Access Devices And Methods Providing Seal Movement In Predefined Movement Regions," and U.S. patent application Ser. No. 12/766,086 filed Apr. 23, 2010

entitled "Methods And Devices For Accessing A Body Cavity," which are hereby incorporated by reference in their entirety.

The devices 10" can be simultaneously or sequentially inserted through the multiple port access device 102 with the articulation assemblies 18" in straight configurations to position distal portions of the devices' proximal shafts 24" within the body cavity 108. The proximal shafts 24" inserted through the multiple port access device 102 can each extend generally parallel to one another, e.g., have parallel longitudinal axes. If one or both of the end effectors 22" are not already coupled to the devices 10", e.g., if the end effector is located at a distal end of a separate tool not yet inserted through the articulation assembly, the tool can be inserted therethrough to position the end effector(s) 22" distal to the articulation assembly or assemblies 18". Such separate tools having end effectors at distal ends thereof can be inserted after the articulation assemblies 18" have been articulated, but it can be easier and faster to articulate the tools with the articulation assemblies 18" rather than navigate the tools through previously-articulated articulation assemblies 18". After the distal portions of the proximal shafts 24" and the end effector 22" have been positioned within the body cavity 108, control knobs (not shown) of the devices 10" can be manipulated, simultaneously or sequentially, to move the articulation assemblies 18" from straight configurations to articulated configurations and to allow the end effectors 22" to be brought together in a non-interfering, cooperative, facing relationship and to be within a viewing range 110 of the scoping device 104, as illustrated in FIG. 16. In this way, the proximal shafts 24" of the devices 10" can each extend generally parallel to one another while the articulation assemblies 18" are articulated such that the end effectors 22" can be angularly oriented toward a same target tissue and/or toward one another in a cooperative relationship. The devices' handles (not shown) coupled to proximal ends of the proximal shafts 24" can thus be more easily manipulated outside the body, e.g., with a reduced "chopstick" effect. The devices' articulation assemblies 18" can be articulated any amount, including not at all, same or different from one another, and can be selectively adjusted during the surgical procedure to form larger or smaller compound angles as desired. The devices' shafts can also be rotated relative to the devices' handles, the end effectors 22" can be rotated relative to their respective device shafts, and the end effectors' jaws 16" can be opened and closed. The devices 10" can thus allow the articulation assemblies 18" to be easily inserted into a body in straight configurations through a single, relatively small opening 100 and be subsequently articulated to optimally position the end effectors 22" relative to the surgical site, to each other, to the scoping device 104, and to any other tools within the body cavity 108. Because the device 10" can be articulated, its end effector 22" can be positioned at an angle with respect to a remainder of the proximal shaft 24" thereof, triangulation and visualization can be improved. In other words, even though the devices 10" and the scoping device 104 are inserted through a common incision, it is still possible to see the end effectors 22" of the devices 10" and to bring the end effectors 22" of the two instruments devices 10" together in a facing relationship at a single point within the body cavity 108.

The devices 10" can also be easily removed from the patient's body by moving the articulation assemblies 18" from articulated configurations to straight configurations. The multiple port access device 102 can be configured to allow further adjustment of instruments inserted there-

through, such as by allowing collective rotation of the instruments around a central axis of the multiple port access device 102.

A proximal housing portion of the multiple port access device 102 can be configured to be removable from a distal retractor portion of the multiple port access device 102. Thus, at any point before, during, or after a surgical procedure, the proximal housing portion can in full or part be released from the distal retractor portion, and the distal retractor portion can be removed from the tissue 106. With the proximal housing portion of the multiple port access device 102 disengaged from the distal retractor portion and with the distal retractor portion still positioned in the tissue opening 100, a working channel of the distal retractor portion can provide access to the body cavity 108 underlying the tissue 106. One or more of the devices 10" and/or other surgical instruments can be advanced through the working channel, such as a waste removal bag configured to hold waste material, e.g., dissected tissue, excess fluid, etc., from the body cavity 108. The bag can be introduced into the body cavity 108 through the distal retractor portion's working channel or other access port. A person skilled in the art will appreciate that one or more surgical instruments can be advanced through the distal retractor portion's working channel before and/or after the proximal housing portion has been attached to the distal retractor portion. A surgical drape can optionally be placed over the distal retractor portion and the tissue opening 100 during removal of the distal retractor portion to help reduce dispersion of bodily fluid outside the surgical space.

The devices disclosed herein can be designed to be disposed of after a single use, or they can be designed to be used multiple times. In either case, however, the device can be reconditioned for reuse after at least one use. Reconditioning can include any combination of the steps of disassembly of the device, followed by cleaning or replacement of particular pieces, and subsequent reassembly. In particular, the device can be disassembled, and any number of the particular pieces or parts of the device can be selectively replaced or removed in any combination, e.g., an end effector, a proximal housing portion of a surgical access device, an end effector, etc. Upon cleaning and/or replacement of particular parts, the device can be reassembled for subsequent use either at a reconditioning facility, or by a surgical team immediately prior to a surgical procedure. Those skilled in the art will appreciate that reconditioning of a device can utilize a variety of techniques for disassembly, cleaning/replacement, and reassembly. Use of such techniques, and the resulting reconditioned device, are all within the scope of the present application.

Preferably, the invention described herein will be processed before surgery. First, a new or used instrument is obtained and if necessary cleaned. The instrument can then be sterilized. In one sterilization technique, the instrument is placed in a closed and sealed container, such as a plastic or TYVEK bag. The container and instrument are then placed in a field of radiation that can penetrate the container, such as gamma radiation, x-rays, or high-energy electrons. The radiation kills bacteria on the instrument and in the container. The sterilized instrument can then be stored in the sterile container. The sealed container keeps the instrument sterile until it is opened in the medical facility.

One skilled in the art will appreciate further features and advantages of the invention based on the above-described embodiments. Accordingly, the invention is not to be limited by what has been particularly shown and described, except as indicated by the appended claims. All publications and references cited herein are expressly incorporated herein by reference in their entirety.

What is claimed is:

1. An articulating laparoscopic access device, comprising:
an elongate shaft;
a first linkage having proximal and distal ends, the proximal end of the first linkage being pivotally coupled to a distal end of the elongate shaft at a first pivot point; and
a second linkage having proximal and distal ends
an actuator coupled to the distal end of the second linkage and being longitudinally movable relative to the elongate shaft; and
first and second linkage bars coupled to opposite sides of each of the first and second linkages, each linkage bar having proximal and distal ends, the proximal end of each of the first and second linkage bars being pivotally coupled to the distal end of the first linkage by a second pivot point, and the distal end of each of the first and second linkage bars being pivotally coupled to the proximal end of the second linkage by a third pivot point, wherein a first range of motion of the linkage bars is limited such that the first range of motion of the linkage bars about the third pivot point is less than a second range of motion of the linkage bars about the second pivot point; and
wherein the distal end of the first linkage, the proximal end of the second linkage, and the first and second linkage bars are movable between a first position longitudinally aligned with a longitudinal axis of the elongate shaft and a second position displaced from the longitudinal axis of the elongate shaft, and wherein the actuator constrains the distal end of the second linkage to movement along the longitudinal axis of the elongate shaft.
2. The device of claim 1, wherein the distal end of the second linkage is pivotally coupled to the actuator at a fourth pivot point.
3. The device of claim 1, wherein the proximal end of each of the first and second linkage bars is seated within a first groove formed in the distal end of the first linkage, and wherein the distal end of each of the first and second linkage bars is seated within a second groove formed in the proximal end of the second linkage, and wherein the first groove defines the first range of motion and the second groove defines the second range of motion.
4. The device of claim 1, wherein the elongate shaft, the first linkage, and the second linkage have an inner lumen extending longitudinally therethrough for receiving a tool.
5. The device of claim 1, further comprising an end effector coupled to the distal end of the second linkage.
6. The device of claim 5, wherein the end effector includes opposed jaws, and the device includes an actuator extending through the elongate shaft, the first linkage, and the second linkage and coupled to a proximal end of the opposed jaws, the actuator being configured to move the opposed jaws between a closed position and an open position.

7. A laparoscopic system, comprising:
an articulation device having,
an elongate shaft,
a first linkage coupled to the elongate shaft at a first joint,
a second linkage coupled to the first linkage at a second joint, the second joint being movable radially outward relative to a central axis extending longitudinally along the elongate shaft, and
an actuator coupled to a distal end of the second linkage and being longitudinally movable relative to the elongate shaft; and
a tool having a flexible elongate shaft with an end effector on a distal end thereof, the flexible elongate shaft being disposable through a lumen extending through the elongate shaft, the first linkage, and the second linkage such that the end effector extends from the distal end of the second linkage, wherein the flexible elongate shaft is bendable to conform to a shape of the lumen as the second joint is moved radially outward;
wherein the actuator constrains the distal end of the second linkage to movement along a longitudinal axis of the actuator.
8. The system of claim 7, wherein the first joint comprises a pivot point formed between a distal end of the elongate shaft and a proximal end of the first linkage.
9. The system of claim 7, wherein the second joint comprises a linkage bar having a proximal end pivotally coupled to a distal end of the first linkage at a first pivot point and a distal end pivotally coupled to a proximal end of the second linkage at a second pivot point.
10. The system of claim 7, wherein the end effector is angularly oriented relative to the axis when the second joint is disposed radially outward from the axis.
11. The system of claim 7, wherein the actuator extends along the elongate shaft and has a proximal end positioned proximal to the first joint.
12. The system of claim 11, wherein the distal end of the actuator is coupled to the distal end of the second linkage at a pivot point such that the second linkage is configured to pivot about the pivot point relative to the actuator.
13. The system of claim 11, further comprising a lock configured to lock the actuator in a fixed position relative to the shaft and the first and second linkages.
14. The system of claim 11, wherein the actuator is rigid.
15. The device of claim 1, wherein, when the device is in the second position, longitudinal axes of the first and second linkages are transverse relative to the longitudinal axis of the elongate shaft at first and second angles.
16. The device of claim 1, wherein the proximal end of the first linkage is fixed relative to the longitudinal axis of the elongate shaft.
17. The device of claim 1, wherein the actuator is a rigid rod.
18. The system of claim 11, wherein the actuator is configured to move proximally to move the second joint radially outward relative to the central axis of the elongate shaft.

* * * * *

专利名称(译)	复合角度腹腔镜方法和装置		
公开(公告)号	US8562592	公开(公告)日	2013-10-22
申请号	US12/775724	申请日	2010-05-07
[标]申请(专利权)人(译)	伊西康内外科公司		
申请(专利权)人(译)	爱惜康内镜手术，INC.		
当前申请(专利权)人(译)	爱惜康内镜手术，INC.		
[标]发明人	CONLON SEAN P WEISENBURGH II WILLIAM B		
发明人	CONLON, SEAN P. WEISENBURGH, II, WILLIAM B.		
IPC分类号	A61B17/00 A61B1/00 A61B19/00		
CPC分类号	A61B17/29 A61B17/3421 A61B17/3423 A61B2017/00738 A61B2017/2905 A61B2017/2906 A61B2017/2908 A61B2017/2927 A61B2017/3466 A61B2019/305 A61B17/00234 A61B17/28 A61B2017/00367 A61B2090/035		
审查员(译)	JACKSON，GARY		
助理审查员(译)	LOUIS，RICHARD		
其他公开文献	US20110276057A1		
外部链接	Espacenet USPTO		

摘要(译)

提供了用于执行微创外科手术的方法和装置。在一个实施例中，提供了一种外科装置，其包括细长轴，该细长轴具有远端部分，该远端部分构造成可在第一构型和第二构型之间移动，在第一构型中，轴的远侧部分基本上是直的或线性的，轴以复合角度铰接。轴的远侧部分可以包括两个铰接接头以便于形成复合角。

