



(51) International Patent Classification:

A61B 17/29 (2006.01) A61B 17/06 (2006.01)
A61B 17/04 (2006.01) A61B 17/062 (2006.01)

(21) International Application Number:

PCT/US2011/060572

(22) International Filing Date:

14 November 2011 (14.11.2011)

(25) Filing Language:

English

(26) Publication Language:

English

(30) Priority Data:

61/413,696 15 November 2010 (15.11.2010) US

(71) Applicant (for all designated States except US):

ETHICON ENDO-SURGERY, INC. [US/US]; 4545
Creek Road, Cincinnati, OH 45242 (US).

(72) Inventors; and

(75) Inventors/Applicants (for US only): **WOODARD, James, A., Jr.** [US/US]; 4534 Wesley Court, Mason, OH 45040 (US). **LESKO, Jason, R.** [US/US]; 215 Lyness Avenue, Harrison, OH 45030 (US).

(74) Agents: **ULMER, Andrew, B.** et al.; Frost Brown Todd

LLC, 3300 Great American Tower, 301 East Fourth Street,
Cincinnati, OH 45202 (US).

(81) Designated States (unless otherwise indicated, for every

kind of national protection available): AE, AG, AL, AM, AO, AT, AU, AZ, BA, BB, BG, BH, BR, BW, BY, BZ, CA, CH, CL, CN, CO, CR, CU, CZ, DE, DK, DM, DO, DZ, EC, EE, EG, ES, FI, GB, GD, GE, GH, GM, GT, HN, HR, HU, ID, IL, IN, IS, JP, KE, KG, KM, KN, KP, KR, KZ, LA, LC, LK, LR, LS, LT, LU, LY, MA, MD, ME, MG, MK, MN, MW, MX, MY, MZ, NA, NG, NI, NO, NZ, OM, PE, PG, PH, PL, PT, QA, RO, RS, RU, RW, SC, SD, SE, SG, SK, SL, SM, ST, SV, SY, TH, TJ, TM, TN, TR, TT, TZ, UA, UG, US, UZ, VC, VN, ZA, ZM, ZW.

(84) Designated States (unless otherwise indicated, for every

kind of regional protection available): ARIPO (BW, GH, GM, KE, LR, LS, MW, MZ, NA, RW, SD, SL, SZ, TZ, UG, ZM, ZW), Eurasian (AM, AZ, BY, KG, KZ, MD, RU, TJ, TM), European (AL, AT, BE, BG, CH, CY, CZ, DE, DK, EE, ES, FI, FR, GB, GR, HR, HU, IE, IS, IT, LT, LU, LV, MC, MK, MT, NL, NO, PL, PT, RO, RS, SE, SI, SK, SM, TR), OAPI (BF, BJ, CF, CG, CI, CM, GA, GN, GQ, GW, ML, MR, NE, SN, TD, TG).

Published:

— with international search report (Art. 21(3))

(54) Title: LAPAROSCOPIC SUTURING INSTRUMENT WITH DUAL-ACTION NEEDLE GRASPERS

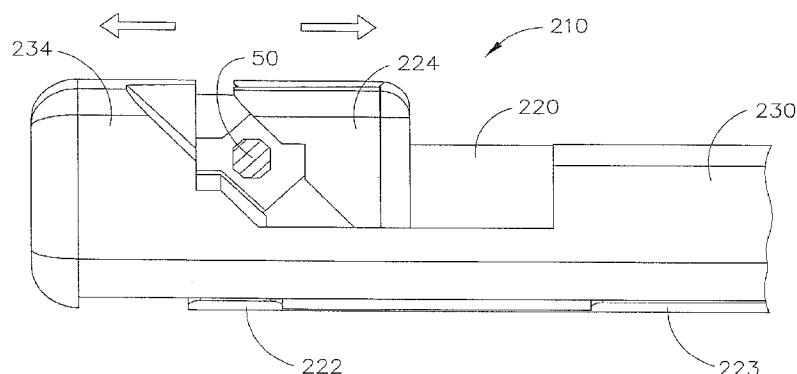

Fig. 6A

(57) Abstract: A suture needle driving instrument comprises a shaft, an end effector, and a grasping actuation assembly. The end effector is located at the distal end of the shaft and includes a pair of grasping arms. Each grasping arm comprises a respective pair of jaws. Each pair of jaws is operable to cooperate to grasp and release a suture needle. The grasping actuation assembly is operable to drive one jaw of each pair in one direction while simultaneously driving the other jaw of the pair in an opposite direction, to selectively grasp or release the suture needle. The actuation assembly may include a drive shaft having separate threaded regions with opposing pitch. The end effector is further operable to pass the needle from one arm to the other arm during a suturing procedure. The instrument may be used through a trocar during minimally invasive surgery.



- 1 -

LAPAROSCOPIC SUTURING INSTRUMENT WITH DUAL-ACTION NEEDLE GRASPERS

James A. Woodard, Jr.

Jason R. Lesko

PRIORITY

[0001] This application claims priority to U.S. Provisional Application Serial No. 61/413,696, filed November 15, 2010, entitled "Perpendicular Architecture Gen II," the disclosure of which is incorporated by reference herein.

BACKGROUND

[0002] In some settings it may be desirable to perform a surgical procedure in a minimally invasive manner, such as through a trocar or other type of access cannula. Examples of trocars include the various ENDOPATH® EXCEL™ products by Ethicon Endo-Surgery, Inc. of Cincinnati, Ohio. Such trocars may present different inner diameters, such as those ranging from approximately 4.7 mm to approximately 12.9 mm, allowing a surgeon to choose a particular trocar based on a balance of considerations such as access needs and incision size. In some minimally invasive surgical procedures, at least two trocars may be inserted through the abdominal wall of the patient. An imaging device such as an endoscope may be inserted through one of the trocars to provide visualization of the surgical site. A surgical instrument may be inserted through another one of the trocars to perform surgery at the site. In procedures performed within the abdominal cavity, the cavity may be insufflated with pressurized carbon dioxide to provide more room for visualization and manipulation of instruments. In some settings, additional trocars may be used to provide access for additional surgical instruments. Minimally invasive surgery may also be performed through access portals such as the Single Site Laparoscopy Access System by Ethicon Endo-Surgery, Inc. of Cincinnati, Ohio, which provides ports for more than one surgical instrument through a single incision in a patient.

- 2 -

[0003] It may also be desirable to use sutures during some minimally invasive surgical procedures, such as to close an opening, to secure two layers of tissue together, to provide an anastomosis, etc. Such use of sutures may be in addition to or in lieu of using other devices and techniques such as clips, staples, electrosurgical sealing, etc. Performing suturing through trocars or other minimally invasive access ports may be more difficult than suturing in an open surgical procedure. For instance, manipulating a needle and suture with conventional tissue graspers through trocars may be relatively difficult for many surgeons. Thus, improved laparoscopic surgical instruments may make suturing procedures performed through trocars relatively easier. Examples of surgical instruments configured to facilitate suturing through trocars include the LAPRA-TY® Suture Clip Applier, the Suture Assistant, and the ENDOPATH® Needle Holder, all of which are by Ethicon Endo-Surgery, Inc. of Cincinnati, Ohio. Additional suturing instruments are disclosed in U.S. Patent No. 7,628,796, entitled "Surgical Suturing Apparatus with Anti-Backup System," issued December 8, 2009, the disclosure of which is incorporated by reference herein; U.S. Patent No. 6,071,289, entitled "Surgical Device for Suturing Tissue," issued June 6, 2000, the disclosure of which is incorporated by reference herein; U.S. Patent Application No. 13/156,420, entitled "Laparoscopic Suture Device with Asynchronous In-Line Needle Movement," filed June 9, 2011, the disclosure of which is incorporated by reference herein; and U.S. Provisional Patent Application No. 61/355,832, entitled "Laparoscopic Suture Device," filed June 17, 2010, the disclosure of which is incorporated by reference herein.

[0004] Exemplary suturing needles are disclosed in U.S. Patent No. 6,056,771, entitled "Radiused Tip Surgical Needles and Surgical Incision Members," issued May 2, 2000, the disclosure of which is incorporated by reference herein; U.S. Pub. No. 2010/0100125, entitled "Suture Needle and Suture Assembly," published April 22, 2010, the disclosure of which is incorporated by reference herein; U.S. Provisional Application Serial No. 61/413,680, filed November 15, 2010, entitled "Custom Needle for Suture Instrument," the disclosure of which is incorporated by reference herein; and U.S. Patent Application Serial No. [ATTORNEY DOCKET NO. END6906USNP], entitled "Needle for

- 3 -

Laparoscopic Suturing Instrument,” filed on even date herewith, the disclosure of which is incorporated by reference herein.

[0005] While a variety of devices and methods have been made and used for suturing tissue, it is believed that no one prior to the inventor(s) has made or used the technology described herein.

BRIEF DESCRIPTION OF THE DRAWINGS

[0006] While the specification concludes with claims which particularly point out and distinctly claim this technology, it is believed this technology will be better understood from the following description of certain examples taken in conjunction with the accompanying drawings, in which like reference numerals identify the same elements and in which:

[0007] FIG. 1 depicts a perspective view of an exemplary laparoscopic suturing instrument;

[0008] FIG. 2 depicts a side elevational view of an exemplary laparoscopic suturing needle for use with the suturing instrument of FIG. 1;

[0009] FIG. 3A depicts a perspective view of the end effector of the suturing instrument of FIG. 1 with the needle of FIG. 2, in a first operational configuration;

[00010] FIG. 3B depicts a perspective view of the end effector and needle of FIG. 3A, in a second operational configuration;

[00011] FIG. 3C depicts a perspective view of the end effector and needle of FIG. 3A, in a third operational configuration;

[00012] FIG. 4 depicts a first partial perspective view of a first needle grasping arm of the end effector of FIG. 3A;

- 4 -

- [00013] FIG. 5 depicts a second partial perspective view of the first needle grasping arm of FIG. 4;
- [00014] FIG. 6A depicts a partial side elevational view of the first needle grasping arm of FIG. 4, in a first operational configuration;
- [00015] FIG. 6B depicts a partial side elevational view of the first needle grasping arm of FIG. 4, in a second operational configuration;
- [00016] FIG. 7 depicts a partial exploded view of the first needle grasping arm of FIG. 4;
- [00017] FIG. 8 depicts a first partial perspective view of a second needle grasping arm of the end effector of FIG. 3A;
- [00018] FIG. 9 depicts a second partial perspective view of the second needle grasping arm of FIG. 8;
- [00019] FIG. 10A depicts a partial side elevational view of the second needle grasping arm of FIG. 8, in a first operational configuration;
- [00020] FIG. 10B depicts a partial side elevational view of the second needle grasping arm of FIG. 8, in a second operational configuration;
- [00021] FIG. 11 depicts a partial exploded view of the second needle grasping arm of FIG. 8;
- [00022] FIG. 12A depicts an end view of the end effector and needle of FIG. 3A, during an exemplary first stage of operation;
- [00023] FIG. 12B depicts an end view of the end effector and needle of FIG. 3A, during an exemplary second stage of operation;
- [00024] FIG. 12C depicts an end view of the end effector and needle of FIG. 3A, during an exemplary third stage of operation;

- 5 -

- [00025] FIG. 12D depicts an end view of the end effector and needle of FIG. 3A, during an exemplary fourth stage of operation;
- [00026] FIG. 12E depicts an end view of the end effector and needle of FIG. 3A, during an exemplary fifth stage of operation;
- [00027] FIG. 12F depicts an end view of the end effector and needle of FIG. 3A, during an exemplary sixth stage of operation;
- [00028] FIG. 12G depicts an end view of the end effector and needle of FIG. 3A, during an exemplary seventh stage of operation;
- [00029] FIG. 12H depicts an end view of the end effector and needle of FIG. 3A, during an exemplary eighth stage of operation;
- [00030] FIG. 13A depicts a partial perspective view of an exemplary alternative end effector, during an exemplary first stage of operation;
- [00031] FIG. 13B depicts a partial perspective view of the end effector of FIG. 13A, during an exemplary second stage of operation;
- [00032] FIG. 13C depicts a partial perspective view of the end effector of FIG. 13A, during an exemplary third stage of operation; and
- [00033] FIG. 13D depicts a partial perspective view of the end effector of FIG. 13A, during an exemplary fourth stage of operation.
- [00034] The drawings are not intended to be limiting in any way, and it is contemplated that various embodiments of the technology may be carried out in a variety of other ways, including those not necessarily depicted in the drawings. The accompanying drawings incorporated in and forming a part of the specification illustrate several aspects of the present technology, and together with the description serve to explain the principles of the technology; it being understood, however, that this technology is not limited to the precise arrangements shown.

DETAILED DESCRIPTION

[00035] The following description of certain examples of the technology should not be used to limit its scope. Other examples, features, aspects, embodiments, and advantages of the technology will become apparent to those skilled in the art from the following description, which is by way of illustration, one of the best modes contemplated for carrying out the technology. As will be realized, the technology described herein is capable of other different and obvious aspects, all without departing from the technology. Accordingly, the drawings and descriptions should be regarded as illustrative in nature and not restrictive.

[00036] It should therefore be understood that any one or more of the teachings, expressions, embodiments, examples, etc. described herein may be combined with any one or more of the other teachings, expressions, embodiments, examples, etc. that are described herein. The following-described teachings, expressions, embodiments, examples, etc. should therefore not be viewed in isolation relative to each other. Various suitable ways in which the teachings herein may be combined will be readily apparent to those of ordinary skill in the art in view of the teachings herein. Such modifications and variations are intended to be included within the scope of the claims.

[00037] I. Overview

[00038] FIG. 1 shows an exemplary laparoscopic suturing instrument (10). Instrument (10) of this example includes a handle portion (20), a shaft (100) extending distally from handle portion (20), and an end effector (200) at the distal end of shaft (100). Handle portion (20) includes a grip (22), a rocker (24), an integral power source (26), and a motor (28) in communication with the integral power source (26). Rocker (24) is resiliently biased to a generally vertical position (e.g., generally perpendicular to grip (22)), though rocker (24) may be rocked forwardly or rearwardly. In addition or in the alternative, rocker (24) may be rocked to the left or to the right. Rocker (24) is operable to actuate features of end effector (200) as will be described in greater detail below. Of

- 7 -

course, rocker (24) is merely one example of a user input feature, and any other suitable type of user input feature may be used.

[00039] Integral power source (26) comprises a rechargeable battery in the present example, though it should be understood that any other suitable power source may be used. By way of example only, instrument (10) may use a power source that is external to instrument (10) (e.g., coupled with instrument (10) via a cable, etc.). Similarly, while end effector (200) is powered by motor (28) in the present example, it should be understood that any other suitable source may be used, including but not limited to a manually operable mechanism. Various other suitable components, features, and configurations for handle portion (20) will be apparent to those of ordinary skill in the art in view of the teachings herein. By way of example only, handle portion (20) may be constructed in accordance with at least some of the teachings of U.S. Provisional Patent Application No. 61/355,832, the disclosure of which is incorporated by reference herein; and/or in accordance with at least some of the teachings of U.S. Patent Application No. 13/156,420, the disclosure of which is incorporated by reference herein.

[00040] Shaft (100) of the present example has an outer diameter sized to permit shaft (100) to be inserted through a conventional trocar (not shown). Shaft (100) also has a length sized to permit end effector (200) to be positioned at a surgical site within a patient while also allowing handle portion (20) to be manipulated by a user (e.g., a surgeon) from a location outside the patient when shaft (100) is disposed in a trocar. Of course, shaft (100) need not necessarily be dimensioned for use through a trocar. For instance, instrument (10) may be used and/or configured for use in open surgical procedures.

[00041] In some versions, shaft (100) includes one or more articulating features, allowing end effector (200) to be articulated to various angles and positions relative to the longitudinal axis defined by shaft (100). Merely illustrative examples of such articulation are taught in U.S. Provisional Application Serial No. 61/355,832, the disclosure of which is incorporated by reference herein. Various other suitable ways in which articulation may be provided will be apparent to those of ordinary skill in the art in view of the

- 8 -

teachings herein. In addition or in the alternative, shaft (100) may be rotatable about the longitudinal axis, relative to handle portion (20), to selectively position end effector (200) at various angular orientations about the longitudinal axis. Of course, a user may rotate the entire instrument (10) about the longitudinal axis to selectively position end effector (200) at various angular orientations about the longitudinal axis.

[00042] End effector (200) of the present example includes a first grasping arm (210) and a second grasping arm (250). As will be described in greater detail below, arms (210, 250) are configured to alternately throw and catch a curved suturing needle (50) along a path/plane that is substantially perpendicular to the longitudinal axis defined by shaft (100). Alternatively, arms (210, 250) may be configured to alternately throw and catch needle (50) along a path that is substantially parallel to the longitudinal axis defined by shaft (100); or along some other path.

[00043] In some versions, arms (210, 250) pass needle (50) back and forth from arm (210) to arm (250) and from arm (250) to arm (210) in an oscillating motion (i.e., back and forth in opposite directions), such that needle (50) does not traverse a circular path as needle (50) is being passed between arms (210, 250). Such action of needle (50) may be referred to as a “reverse reset.” In some other versions, needle (50) may be passed between arms (210, 250) along a circular path in a single direction. Such action of needle (50) may be referred to as a “forward reset.” By way of example only, arms (210, 250) may move in accordance with at least some of the teachings of U.S. Provisional Patent Application No. 61/355,832, the disclosure of which is incorporated by reference herein; and/or in accordance with at least some of the teachings of U.S. Patent Application No. 13/156,420, the disclosure of which is incorporated by reference herein. Regardless of whether arms (210, 250) move synchronously or asynchronously, arms (210, 250) may be configured to grip and/or compress tissue that is positioned between arms (210, 250) when arms are in approximated positions, which may facilitate passage of needle (50) through the tissue.

- 9 -

[00044] FIG. 2 shows needle (50) in greater detail. Needle (50) of this example includes a sharp tip (52), a blunt end (54), and a pair of grasping regions (56, 58) configured for grasping by arms (210, 250). In particular, grasping regions (56, 58) comprise scallops in the present example, though it should be understood that grasping regions (56, 58) may have various other configurations. A suture (60) is secured to a mid-region of needle (50). The configuration and relationship of suture (60) and needle (50) provides an exit of suture (60) from needle (50) at an angle that is generally tangent to or oblique relative to the curvature of needle (50). Such an angle may provide reduced drag forces and/or reduced tissue trauma as compared to drag forces and/or tissue trauma that might otherwise be encountered using a needle with a suture that exits at a generally perpendicular angle.

[00045] While the example described below includes just a single strand of suture extending from the needle, it should be understood that two or more strands may extend from the needle (e.g., double leg suture, etc.). As yet another merely illustrative example, suture (60) may be secured to blunt end (54) of needle (50) instead of being secured to a mid-region of needle (50). In still other versions, end (54) includes a sharp tip instead of being blunt. It should also be understood that needle (50) may be straight instead of curved in some versions. By way of example only, needle (50) may be constructed in accordance with at least some of the teachings of U.S. Provisional Application Serial No. 61/413,680; U.S. Patent Application Serial No. [ATTORNEY DOCKET NO. END6906USNP]; U.S. Patent No. 6,056,771; and/or U.S. Pub. No. 2010/0100125. Still other suitable configurations for needle (50) will be apparent to those of ordinary skill in the art in view of the teachings herein.

[00046] It should also be understood that needle (50) may be constructed using various techniques. By way of example only, needle (50) may be constructed using metal-injection-molding (MIM) processes. Needle (50) may also be formed from a sheet, wire, tube, extrusion, or other components that are bent, stamped, coined, milled, otherwise machined, and/or otherwise formed. Other suitable ways in which needle (50) may be

- 10 -

constructed will be apparent to those of ordinary skill in the art in view of the teachings herein.

[00047] II. Exemplary End Effector

[00048] As noted above, end effector (200) comprises a pair of grasping arms (210, 250) that are operable to selectively grasp needle (50) during a suturing procedure. Grasping arms (210, 250) are exposed relative to an endcap (102) of shaft (100). Each grasping arm (210, 250) extends along a respective axis that is parallel to yet offset from the center axis of shaft (100). First grasping arm (210) maintains a fixed rotational position relative to shaft (100) during operation of instrument (10) in the present example. In some other versions, first grasping arm (210) is rotatable about its own longitudinal axis, relative to shaft (100). Second grasping arm (250) of the present example is rotatable about its longitudinal axis. Such motion can be seen in the series shown by FIGS. 3A-3C.

[00049] FIG. 3A shows first grasping arm (210) grasping needle (50), with second grasping arm (250) rotated away from needle (50), exposing sharp tip (52) of needle (50). FIG. 3B shows second grasping arm (250) rotated toward needle (50) to a position enabling second grasping arm (250) to grasp needle (50) and first grasping arm (210) to release needle (50). FIG. 3C shows second grasping arm (250) rotated away from first grasping arm (210), pulling needle (50) away from second grasping arm (250). After reaching this position, second grasping arm (250) may be rotated back to the position shown in FIG. 3B, to thereby pass needle (50) back to first grasping arm (210); then rotate back to the position shown in FIG. 3A to start the cycle over again.

[00050] In the examples described herein, needle (50) is driven along a plane that is substantially perpendicular to the longitudinal axis of shaft (100). In some other examples, needle (50) is driven along a plane that is oblique relative to the longitudinal axis of shaft (100) or substantially parallel to the longitudinal axis of shaft (100). During some uses of instrument (10), needle (50) may deviate from the desired perpendicular plane. Such deviation may be due to manufacturing tolerances, deflections caused by tissue or other structures, and/or for other reasons. Such deviation may be accentuated by

- 11 -

using a needle (50) having a relatively great length. As will be described below, end effector (200) of the present example is configured to readily accommodate and correct such off-plane deviations. In other words, arms (210, 250) are operable to grasp needle (50) even in instances where needle (50) has deviated away from the expected perpendicular plane of motion; and arms (210, 250) are further operable to redirect a deviated needle (50) back onto the expected perpendicular plane of motion.

[00051] It should be noted that suture (60) is omitted from FIGS. 3A-3C for clarity. Various components of grasping arms (210, 250) will be described in greater detail below. Various ways in which grasping arms (210, 250) may be used will also be described in greater detail below. Other suitable components of and uses for grasping arms (210, 250) will be apparent to those of ordinary skill in the art in view of the teachings herein.

[00052] A. Exemplary First Grasping Arm

[00053] FIGS. 4-7 show first grasping arm (210) in greater detail. First grasping arm (210) comprises a first jaw (220) and a second jaw (230). Jaws (220, 230) are substantially aligned with each other and are slidable longitudinally relative to each other. Jaw (220) includes a pair of flanges (222, 223) that are received through corresponding openings (232, 233) of jaw (230) during assembly of arm (210). Thereafter, flanges (222, 223) prevent jaws (220, 230) from deflecting transversely away from each other. Jaws (220, 230) also include complementary needle grasping features (224, 234) that are configured to selectively grasp needle (50) as will be described in greater detail below. The proximal portion of jaw (220) includes a transversely extending fin (226). Likewise, the proximal portion of jaw (230) also includes a transversely extending fin (236). Fins (226, 236) are slidably disposed in corresponding distal slots (241, 242) of a sheath (240). Sheath (240) extends along the length of shaft (100) and is substantially fixed within shaft (100). In particular, sheath (240) does not rotate or translate relative to shaft (100) in this example. Sheath (240) thus provides a mechanical ground in the angular direction. It should therefore be understood that the relationship between fins (226, 236) and slots

- 12 -

(241, 242) prevent first grasping arm (210) from rotating relative to shaft (100). In some other versions, however, first grasping arm (210) is rotatable relative to shaft (100) (e.g., by rotating sheath (240) within shaft (100), etc.). It should also be understood that, in the present example, the relationship between fins (226, 236) and slots (241, 242) still permits jaws (220, 230) to translate relative to sheath (240) and shaft (100).

[00054] As best seen in FIGS. 6A-6B, jaws (220, 230) are simultaneously movable in opposite directions to selectively expand or reduce an opening formed by grasping features (224, 234) to receive needle (50). For instance, in FIG. 6A, jaw (220) has moved proximally toward shaft (100) and jaw (230) has simultaneously moved distally away from shaft (100) to enlarge the opening defined by grasping features (224, 234) to receive needle (50). In FIG. 6B, jaw (220) has moved distally away from shaft (100) and jaw (230) has simultaneously moved proximally toward shaft (100) to reduce the opening defined by grasping features (224, 234) to securely grasp needle (50). In some other versions, one jaw (220, 230) remains longitudinally stationary while the other jaw translates longitudinally to grasp or release needle (50) between grasping features (224, 234). However, it should be understood that in versions such as the present example where jaws (220, 230) both move simultaneously in opposite directions, such motion may further promote alignment of needle (50) within grasping features (224, 234) as compared to versions where one jaw (220, 230) always stays longitudinally fixed relative to shaft (100). In other words, having both grasping features (224, 234) always spaced equidistantly away from the intended path of needle (50) (regardless of whether jaws (220, 230) are open as shown in FIG. 6A or closed as shown in FIG. 6B) may better accommodate incidental deflections of needle (50) away from that intended path in either direction during use of instrument (10). Arm (210) may thus be particularly suited to accommodate instances where needle (50) has deviated away from the expected perpendicular plane of motion as described above.

[00055] FIG. 7 shows exemplary features that may be used to provide the simultaneous opposing motion of jaws (220, 230) described above. In particular, FIG. 7 shows a drive shaft (244) that includes a first threaded section (246) and a second threaded section

- 13 -

(248). Drive shaft (244) is coaxially positioned within sheath (240) and is rotatable within sheath (240). Drive shaft (244) is rotatably driven by motor (28) in handle portion (20). The threading of first threaded section (246) is oriented opposite to the threading of second threaded section (248), such that threaded sections (246, 248) have opposite pitches. The proximal portions of jaws (220, 230) together encompass the distal portion of drive shaft (244). In particular, the proximal portion of jaw (220) includes threading (228) that meshes with first threaded section (246); while the proximal portion of jaw (230) includes threading (238) that meshes with second threaded section (248). It should therefore be understood that threading (228) has a pitch that is opposite to the pitch of threading (238). It should also be understood that, due to the relationships and orientations of threaded sections (246, 248) and threading (228, 238), drive shaft (244) will cause jaws (220, 230) to simultaneously translate away from each other (FIG. 6A) when drive shaft (244) is rotated in one direction; while drive shaft (244) will cause jaws (220, 230) to simultaneously translate toward each other (FIG. 6B) when drive shaft (244) is rotated in the other direction.

[00056] It should be understood that the opposing thread configuration described above may require relatively low torsional force to rotate drive shaft (244) to drive jaws (220, 230) toward and away from each other. It should also be understood that the opposing thread configuration described above may provide a relatively high holding force. For instance, when needle grasping features (224, 234) are driven toward each other to secure needle (50) as shown in FIG. 6B, and needle (50) is off-plane for whatever reason (e.g., incidentally oriented slightly obliquely relative to the longitudinal axis of shaft (100), etc.), the needle holding forces at grasping features (224, 234) may be self-reinforcing due to opposing forces provided through the opposing thread configuration described above, providing a mechanical advantage to urge needle (50) back into the desired planar orientation, even if tissue or some other structure is resisting such movement of needle into the desired planar orientation. Similarly, the opposing thread configuration described above may provide friction that acts as an anti-backup feature, substantially resisting inadvertent separation of grasping features (224, 234), thereby providing a very secure hold of needle (50). Other suitable components that may be used to provide

- 14 -

opposing motion of grasping features (224, 234) (e.g., a pinion with opposing racks, etc.) will be apparent to those of ordinary skill in the art in view of the teachings herein.

[00057] As noted above, drive shaft (244) may be selectively driven in either rotational direction by motor (28), such as in response to actuation of rocker (24). Alternatively, any other motive source and/or user input feature may be used. It should also be understood that, while drive shaft (244) rotates about an axis that is parallel to the axis of shaft (100), alternative drive systems that include a rotary member may provide rotation of such a rotary member about an axis that is not parallel to the axis of shaft (100). For instance, a pinion based drive system may provide rotation of a drive pinion about an axis that is perpendicular to the axis of shaft (100). Other suitable ways in which jaws (220, 230) may be actuated will be apparent to those of ordinary skill in the art in view of the teachings herein.

[00058] B. Exemplary Second Grasping Arm

[00059] FIGS. 8-11 show second grasping arm (250) in greater detail. Second grasping arm (250) comprises a first jaw (260) and a second jaw (270). Jaws (260, 270) are substantially aligned with each other and are slidable longitudinally relative to each other. Jaw (260) includes a pair of flanges (262, 263) that are received through corresponding openings (272, 273) of jaw (270) during assembly of arm (250). Thereafter, flanges (262, 263) prevent jaws (260, 270) from deflecting transversely away from each other. Jaws (260, 270) also include complementary needle grasping features (264, 274) that are configured to selectively grasp needle (50) as will be described in greater detail below. The proximal portion of jaw (260) includes a transversely extending fin (266). Likewise, the proximal portion of jaw (270) also includes a transversely extending fin (276). Fins (266, 276) are slidably disposed in corresponding distal slots (281, 282) of a sheath (280), which will be described in greater detail below. Each jaw (260, 270) of second grasping arm (250) includes a dogleg section (252, 254). Each dogleg section (252, 254) forms a pair of right angles between a proximal portion (256) of grasping arm (250) and a distal portion (258) of grasping arm (250). The configuration of dogleg sections (252, 254)

- 15 -

provides distal portion (258) in a parallel yet offset position relative to proximal portion (256). Thus, when grasping arm (250) is rotated about a longitudinal axis extending along the length of the proximal portion (256) of grasping arm (250), the distal portion (258) of grasping arm (250) rotates in an orbital motion about that longitudinal axis. Such motion will be described in greater detail below.

[00060] Sheath (280) extends along the length of shaft (100) and is partially fixed within shaft (100). In particular, sheath (280) does not translate relative to shaft (100) in this example, though sheath (280) is rotatable relative to shaft (100). For instance, sheath (280) may be selectively rotated in either direction by motor (28) (e.g., in response to actuation of rocker (24), etc.). It should therefore be understood that rotation of sheath (280) relative to shaft (100) will provide rotation of second grasping arm (250) relative to shaft (100), due to the relationship between fins (266, 276) and slots (281, 282). As noted above, when second grasping arm (250) is rotated by sheath (280), the distal portion (258) of grasping arm (250) rotates in an orbital motion about the longitudinal axis that is defined by both sheath (280) and the proximal portion (256) of grasping arm (250). In some other versions, second grasping arm (250) is non-rotatable relative to shaft (100). It should also be understood that, in the present example, the relationship between fins (266, 276) and slots (281, 282) permits jaws (260, 270) to translate relative to sheath (280) and shaft (100).

[00061] As best seen in FIGS. 10A-10B, jaws (260, 270) are simultaneously movable in opposite directions to selectively expand or reduce an opening formed by grasping features (264, 274) to receive needle (50). For instance, in FIG. 10A, jaw (260) has moved proximally toward shaft (100) and jaw (270) has simultaneously moved distally away from shaft (100) to enlarge the opening defined by grasping features (264, 274) to receive needle (50). In FIG. 10B, jaw (260) has moved distally away from shaft (100) and jaw (270) has simultaneously moved proximally toward shaft (100) to reduce the opening defined by grasping features (264, 274) to securely grasp needle (50). In some other versions, one jaw (260, 270) remains longitudinally stationary while the other jaw translates longitudinally to grasp or release needle (50) between grasping features (264,

- 16 -

274). However, it should be understood that in versions such as the present example where jaws (260, 270) both move simultaneously in opposite directions, such motion may further promote alignment of needle (50) within grasping features (264, 274) as compared to versions where one jaw (260, 270) always stays longitudinally fixed relative to shaft (100). In other words, having both grasping features (264, 274) always spaced equidistantly away from the intended path of needle (50) (regardless of whether jaws (260, 270) are open as shown in FIG. 10A or closed as shown in FIG. 10B) may better accommodate incidental deflections of needle (50) away from that intended path in either direction during use of instrument (10). Arm (250) may thus be particularly suited to accommodate instances where needle (50) has deviated away from the expected perpendicular plane of motion as described above.

[00062] FIG. 11 shows exemplary features that may be used to provide the simultaneous opposing motion of jaws (260, 270) described above. In particular, FIG. 11 shows a drive shaft (284) that includes a first threaded section (286) and a second threaded section (288). Drive shaft (284) is coaxially positioned within sheath (280) and is rotatable within sheath (280). Drive shaft (284) is rotatably driven by motor (28) in handle portion (20). The threading of first threaded section (286) is oriented opposite to the threading of second threaded section (288), such that threaded sections (286, 288) have opposite pitches. The proximal portions of jaws (260, 270) together encompass the distal portion of drive shaft (284). In particular, the proximal portion of jaw (260) includes threading (268) that meshes with first threaded section (286); while the proximal portion of jaw (270) includes threading (278) that meshes with second threaded section (288). It should therefore be understood that threading (268) has a pitch that is opposite to the pitch of threading (278). It should also be understood that, due to the relationships and orientations of threaded sections (286, 288) and threading (268, 278), drive shaft (284) will cause jaws (260, 270) to simultaneously translate away from each other (FIG. 10A) when drive shaft (284) is rotated in one direction; while drive shaft (284) will cause jaws (260, 270) to simultaneously translate toward each other (FIG. 10B) when drive shaft (284) is rotated in the other direction.

- 17 -

[00063] In some settings, the rotational position of sheath (280) is fixed relative to shaft (100) when drive shaft (284) is rotated relative to shaft (100). Thus, sheath (280) substantially holds the rotational position of jaws (260, 270) when drive shaft (284) is rotated. In some other settings, sheath (280) and drive shaft (284) are rotated simultaneously relative to shaft (100). In some such instances, sheath (280) and drive shaft (284) are rotated in the same direction and at the same speed, such that drive shaft (284) and jaws (260, 270) are rotated in the same direction and at the same speed. Thus, the longitudinal positioning of jaws (260, 270) remains fixed during such rotation. As another merely illustrative variation, sheath (280) and drive shaft (284) may be rotated simultaneously relative to shaft (100), but at different speeds and/or in different directions. Such a scheme provides a rotation differential between jaws (260, 270) and drive shaft (284), such that jaws (260, 270) may open or close while second grasping arm (250) is simultaneously being rotated relative to shaft (100).

[00064] It should be understood that the opposing thread configuration described above may require relatively low torsional force to rotate drive shaft (284) to drive jaws (260, 270) toward and away from each other. It should also be understood that the opposing thread configuration described above may provide a relatively high holding force. For instance, when needle grasping features (264, 274) are driven toward each other to secure needle (50) as shown in FIG. 10B, and needle (50) is off-plane for whatever reason (e.g., incidentally oriented slightly obliquely relative to the longitudinal axis of shaft (100), etc.), the needle holding forces at grasping features (264, 274) may be self-reinforcing due to opposing forces provided through the opposing thread configuration described above, providing a mechanical advantage to urge needle (50) back into the desired planar orientation, even if tissue or some other structure is resisting such movement of needle into the desired planar orientation. Similarly, the opposing thread configuration described above may provide friction that acts as an anti-backup feature, substantially resisting inadvertent separation of grasping features (264, 274), thereby providing a very secure hold of needle (50). Other suitable components that may be used to provide opposing motion of grasping features (264, 274) (e.g., a pinion with opposing racks, etc.) will be apparent to those of ordinary skill in the art in view of the teachings herein.

- 18 -

[00065] As noted above, drive shaft (284) may be selectively driven in either rotational direction by motor (28), such as in response to actuation of rocker (24). Sheath (280) may also be driven by motor (28). Alternatively, any other motive source and/or user input feature may be used. It should also be understood that, while drive shaft (284) rotates about an axis that is parallel to the axis of shaft (100), alternative drive systems that include a rotary member may provide rotation of such a rotary member about an axis that is not parallel to the axis of shaft (100). For instance, a pinion based drive system may provide rotation of a drive pinion about an axis that is perpendicular to the axis of shaft (100). Other suitable ways in which one or more components of second grasping arm (250) may be actuated will be apparent to those of ordinary skill in the art in view of the teachings herein.

[00066] III. Exemplary Method of Operation

[00067] FIGS. 12A-12H depict a merely exemplary method for using surgical instrument (10). In particular, FIG. 12A shows end effector (200) positioned adjacent to apposed layers (300, 302) of tissue. End effector (200) is positioned such that the longitudinal axis (130) of shaft (100) is substantially parallel to the outer edges (304, 306) of tissue layers (300, 302). In this sense, "substantially parallel" simply means that end effector (200) is oriented in relation to tissue layers (300, 302) in a manner sufficient to enable needle (50) to be passed through tissue layers (300, 302). It should therefore be understood that longitudinal axis (130) need not necessarily be truly parallel with outer edges (304, 306), though longitudinal axis (130) may in fact be truly parallel with outer edges (304, 306) in some instances. It should also be understood that instrument (10) and needle (50) may be used to secure tissue together in an edge-to-edge arrangement rather than securing apposed layers (300, 302) as shown. Other suitable settings in which instrument (10) and needle (50) may be used will be apparent to those of ordinary skill in the art in view of the teachings herein. It should also be understood that the curved configuration of needle (50) may provide a more intuitive operation for the surgeon than a straight needle would, such as by providing better predictability for where sharp tip (52) will come through tissue.

- 19 -

[00068] As shown in FIG. 12A, first grasping arm (210) is securely holding needle (50), with sharp tip (52) exposed. In particular, grasping portions (224, 234) of jaws (220, 230) hold needle (50) at grasping region (56). Needle (50) is oriented along a plane that is substantially transverse to longitudinal axis (130). Once end effector (200) has been positioned as shown in FIG. 12A, the entire instrument (10) is rotated about longitudinal axis (130) to drive sharp tip (52) through tissue layers (300, 302), as shown in FIG. 12B. In the example shown, the rotational direction for instrument (10) is counterclockwise viewed from the distal end toward the proximal end, though it should be understood that instrument (10) may be rotated clockwise instead (e.g., depending on the orientation of sharp tip (52)). During the transition from the position of FIG. 12A to the position of FIG. 12B, the rotational position of grasping arms (210, 250) relative to shaft (100) remains fixed, such that grasping arms (210, 250) rotate unitarily with shaft (100) about longitudinal axis (130). The longitudinal position of jaws (220, 230, 260, 270) also remains fixed during this transition. As can also be seen in FIG. 12B, needle (50) has started to pull suture (60) through tissue layers (300, 302) at this stage. It should be understood that, in the stages shown in FIGS. 12A-12B, grasping arms (210, 250) and needle (50) are in the same rotational positions relative to shaft (100) as shown in FIG. 3A. It should also be noted that the configuration of end effector (200) and needle (50) may provide the surgeon with enhanced visibility of sharp tip (52) exiting tissue layers (300, 302) during the transition from FIG. 12A to FIG. 12B, particularly with arm (250) being rotated out of the way at this stage.

[00069] After needle (50) has been driven at least partially through tissue layers (300, 302), second grasping arm (250) is rotated about its own axis (140) toward needle (50) as shown in FIG. 12C. Such rotation is provided by rotating sheath (280) relative to shaft (100). The rotational position of shaft (100) relative to axis (130) remains fixed during the transition from the configuration shown in FIG. 12B to the configuration shown in FIG. 12C. It should be understood that, in the stage shown in FIG. 12C, grasping arms (210, 250) and needle (50) are in the same rotational positions relative to shaft (100) as shown in FIG. 3B.

- 20 -

[00070] In some versions, jaws (260, 270) are already opened (as shown in FIG. 10A) by the time second grasping arm (250) starts rotating from the position shown in FIG. 12B to the position shown in FIG. 12C. In some other versions, jaws (260, 270) are actively opened during the transition from the position shown in FIG. 12B to the position shown in FIG. 12C, such that jaws (260, 270) are fully open by the time second grasping arm (250) reaches the position shown in FIG. 12C. Once second grasping arm (250) reaches the position shown in FIG. 12C, jaws (260, 270) close (as shown in FIG. 10B) to grasp needle (50) at grasping region (58) with grasping features (264, 274). In addition, jaws (220, 230) open (as shown in FIG. 8A) to release needle (50) from grasping features (224, 234) at grasping region (56). In some versions, jaws (260, 270) close to grasp needle (50) at substantially the same time as jaws (220, 230) open to release needle (50). In some other versions, jaws (220, 230) do not open to release needle (50) until jaws (260, 270) have closed to grasp needle (50). Various suitable timing schemes and ways in which such schemes may be carried out will be apparent to those of ordinary skill in the art in view of the teachings herein.

[00071] Once control of needle (50) has been effectively passed from grasping arm (210) to grasping arm (250), grasping arm (250) is rotated about axis (140) to the position shown in FIG. 12D. Such rotation is provided by once again rotating sheath (280) relative to shaft (100). The rotational position of shaft (100) relative to axis (130) continues to be fixed during the transition from the configuration shown in FIG. 12C to the configuration shown in FIG. 12D. It should be understood that, in the stage shown in FIG. 12D, grasping arms (210, 250) and needle (50) are in the same rotational positions relative to shaft (100) as shown in FIG. 3C. As can also be seen in FIG. 12D, grasping arm (250) pulls suture (60) through tissue layers (300, 302) during the transition from FIG. 12C to FIG. 12D.

[00072] After reaching the configuration shown in FIG. 12D, the surgeon pulls the entire end effector (200) away from tissue layers (300, 302), along a path that is substantially transverse to axis (130), as shown in FIG. 12E. It should be understood that this path may be oblique relative to axis (130) and/or edges (304, 306), helical, and/or of any other

- 21 -

suitable configuration. It should also be understood that neither arm (210, 250) is rotated relative to shaft (100) in the present example during the transition from the position shown in FIG. 12D to the position shown in FIG. 12E. Thus, in the stage shown in FIG. 12E, grasping arms (210, 250) and needle (50) are still in the same rotational positions relative to shaft (100) as shown in FIG. 3C. In moving instrument (10) away from tissue layers (300, 302) during the transition to the position shown in FIG. 12E, suture (60) is pulled further through tissue layers (300, 302).

[00073] With end effector (200) positioned sufficiently away from tissue layers (300, 302), second grasping arm (250) is rotated about axis (140) to the position shown in FIG. 12F. The rotational position of shaft (100) relative to axis (130) remains fixed during the transition from the configuration shown in FIG. 12E to the configuration shown in FIG. 12F. It should be understood that, in the stage shown in FIG. 12F, grasping arms (210, 250) and needle (50) are in the same rotational positions relative to shaft (100) as shown in FIG. 3B. End effector (200) is positioned far enough away from tissue layers (300, 302) during the transition from the position shown in FIG. 12E to the position shown in FIG. 12F such that blunt end (54) of needle (50) does not touch tissue layers (300, 302). The rotation of second grasping arm (250) to the position shown in FIG. 12F places grasping region (58) of needle (50) back between grasping portions (224, 234) of jaws (220, 230).

[00074] In some versions, jaws (220, 230) are already opened (as shown in FIG. 8A) by the time second grasping arm (250) starts rotating from the position shown in FIG. 12E to the position shown in FIG. 12F. In some other versions, jaws (220, 230) are actively opened during the transition from the position shown in FIG. 12E to the position shown in FIG. 12F, such that jaws (220, 230) are fully open by the time second grasping arm (250) reaches the position shown in FIG. 12F. Once second grasping arm (250) reaches the position shown in FIG. 12F, jaws (220, 230) close (as shown in FIG. 8B) to grasp needle (50) at grasping region (56) with grasping portions (224, 234). In addition, jaws (260, 270) open (as shown in FIG. 10A) to release needle (50) from grasping portions (264, 274) at grasping region (58). In some versions, jaws (220, 230) close to grasp

- 22 -

needle (50) at substantially the same time as jaws (260, 270) open to release needle (50). In some other versions, jaws (260, 270) do not open to release needle (50) until jaws (220, 240) have closed to grasp needle (50). Various suitable timing schemes and ways in which such schemes may be carried out will be apparent to those of ordinary skill in the art in view of the teachings herein.

[00075] Once control of needle (50) has been effectively passed from grasping arm (250) back to grasping arm (210), grasping arm (250) is rotated about axis (140) to the position shown in FIG. 12G. Such rotation is provided by once again rotating sheath (280) relative to shaft (100). The rotational position of shaft (100) relative to axis (130) continues to be fixed during the transition from the position shown in FIG. 12F to the position shown in FIG. 12G. It should be understood that, in the stage shown in FIG. 12G, grasping arms (210, 250) and needle (50) are in the same rotational positions relative to shaft (100) as shown in FIG. 3A.

[00076] Once grasping arm (250) has been rotated away from needle (50) as shown in FIG. 12G, the entire instrument (10) is once again rotated about longitudinal axis (130) to position sharp tip (52) above tissue layers (300, 302), as shown in FIG. 12H. In the example shown, the rotational direction for instrument (10) is again counterclockwise viewed from the distal end toward the proximal end, though it should be understood that instrument (10) may be rotated clockwise instead (e.g., depending on the orientation of sharp tip (52)). During this transition, the rotational position of grasping arms (210, 250) relative to shaft (100) remains fixed, such that grasping arms (210, 250) rotate unitarily with shaft (100) about longitudinal axis (130). The longitudinal position of jaws (220, 230, 260, 270) also remains fixed during this transition. In the stage shown in FIG. 12H, grasping arms (210, 250) and needle (50) remain in the same rotational positions relative to shaft (100) as shown in FIG. 3A.

[00077] Having reached the configuration shown in FIG. 12H, end effector (200) may be moved back toward tissue layers (300, 302), such as along a path transverse to axis (130), to again reach the position shown in FIG. 12A. The above described cycle may then be

- 23 -

repeated as many times as desired until an appropriate number of stitches have been made through tissue layers (300, 302). The free end of suture (50) may then be knotted, clipped, or otherwise secured.

[00078] It should be understood that instrument (10) may be advanced distally or proximally along axis (130) in each stitching cycle, each stitching cycle being represented by the succession of stages depicted in FIGS. 12A-12H. For instance, instrument (10) may be advanced distally or proximally along axis (130) during the transition from the position shown in 12E to the position shown in 12F. As another merely illustrative example, instrument (10) may be advanced distally or proximally along axis (130) during the transition from the position shown in 12G to the position shown in 12H. Other suitable stages at which instrument (10) may be advanced distally or proximally will be apparent to those of ordinary skill in the art in view of the teachings herein. It should be understood that the distance of each incremental distal or proximal movement of instrument (10) during successive stitching cycles may be selected based on a desired stitch density along the length of the tissue being sutured. It should also be understood that, once stitching is complete, suture (60) may define a generally helical path through tissue layers (300, 302). Other suitable ways in which instrument (10) may be used will be apparent to those of ordinary skill in the art in view of the teachings herein.

[00079] As should be apparent to those of ordinary skill in the art, needle (50) of the present example orbits about axis (140), which is offset from axis (130) of shaft (100) in the present example. This may enable needle (50) to travel about an arc having a radius that is greater than the radius of a trocar through which shaft (100) is inserted. In other words, the circumferential path of needle (50) need not be limited to the circumference of the trocar through which shaft (100) is inserted when the orbital axis of needle (50) is offset from axis (130) of shaft (100). Thus, the configuration of end effector (200) in the present example may permit a larger radius needle to be used, and larger stitches to be made, than what would be permitted if the orbital motion of needle (50) were centered

- 24 -

about axis (130) of shaft (100). In some other versions, needle (50) does move in an orbital fashion about axis (130) of shaft (100).

[00080] IV. Exemplary Alternative End Effector

[00081] FIGS. 13A-13D depict an exemplary alternative end effector (400) disposed at the distal end of a shaft (500). End effector (400) of this example comprises a first arm (410) and a second arm (450). Either or both arms (410, 450) may be driven by a motor, manual mechanism, and/or some other feature. First arm (410) includes a needle grasping feature (412) and a dogleg section (414). Second arm (450) includes a needle grasping feature (462) and a dogleg section (464). Needle grasping features (412, 462) are each operable to selectively grasp and release a needle (600). Various suitable components and configurations for needle grasping features (412, 462) will be apparent to those of ordinary skill in the art in view of the teachings herein. Dogleg sections (414, 464) are configured such that the distal portions of arms (410, 450) are spaced apart to a distance exceeding the outer diameter of shaft (500). Each arm (410, 450) is independently rotatable about its own respective axis, relative to shaft (500). In some other versions, only one arm (410, 450) is rotatable relative to shaft (500) while the rotational position of the other arm (450) remains fixed relative to shaft (500).

[00082] Needle (600) of this example includes a first sharp tip (602) and a second sharp tip (604). A suture (610) is secured to a mid-region of needle (600). Needle (600) may be constructed in accordance with various teachings above and/or in accordance with at least some of the teachings of one or more of the references that are cited herein. Various suitable configurations for needle (600) will be apparent to those of ordinary skill in the art.

[00083] In a merely exemplary use of end effector (400) and needle (600), end effector (400) and needle (600) are positioned with sharp tip (604) adjacent to tissue (700) as shown in FIG. 13A. Then, the entire assembly of shaft (400) and end effector (400) is rotated approximately 90° counterclockwise to the position shown in FIG. 13B. The positions of arms (410, 450) remain substantially fixed relative to shaft (500) during this

- 25 -

transition. As can be seen in FIG. 13B, sharp tip (604) is driven through tissue (700) during the transition from FIG. 13A to FIG. 13B. Next, arm (410) is rotated clockwise toward sharp tip (604) to the position shown in FIG. 13C. The rotational position of shaft (500) and arm (450) remain substantially fixed during this transition. With arm (410) at the position shown in FIG. 13C, grasping feature (412) grasps needle (600) and grasping feature (452) releases needle (600). As described above, this grasping and releasing may occur in stages and/or simultaneously.

[00084] Once control of needle (600) has been effectively passed from arm (450) to arm (410), arm (410) is rotated counterclockwise to the position shown in FIG. 13D. The rotational position of shaft (500) and arm (450) remain substantially fixed during this transition. The movement of arm (410) from the position shown in FIG. 13C to the position shown in FIG. 13D pulls needle (600) and suture (610) through tissue (700). At this stage, arm (410) may continue to rotate counterclockwise relative to shaft (500) until tip (602) clears tissue (700). Alternatively, shaft (500) and the entire end effector (400) may be rotated counterclockwise until tip (602) clears tissue (700). Next, there are at least two options for further operation. One option is to pull shaft (500) and end effector (400) transversely away from tissue (700); then pass needle (600) back to arm (450) while needle (600) is away from tissue (700), to repeat the process beginning back at the type of stage shown in FIG. 13A. Another option is to simply advance shaft (500) and end effector (400) distally or proximally; then to rotate either arm (410) or the entire assembly of shaft (500) and end effector (400) to drive tip (602) back through tissue (700). After tip (602) is driven back through tissue (700), arm (450) may take control of needle (600) from arm (410), and the process may be repeated beginning back at the type of stage shown in FIG. 13A. Still other suitable ways in which end effector (400) and needle (600) may be used will be apparent to those of ordinary skill in the art in view of the teachings herein.

[00085] In some variations, needle (600) includes graduations facilitating selective gripping of needle (600) at different locations along the length of needle (600), allowing more or less of each end of needle (600) to be exposed relative to each arm (410, 450).

- 26 -

In addition or in the alternative, a taper at each end of needle (600) may prevent needle (600) from being passed too far through each needle grasping feature (412, 462).

[00086] While terms such as “clockwise” and “counterclockwise” have been used to describe directions of rotational movement during exemplary uses of end effectors (200, 400), it should be understood that these specific rotational directions are being provided only in reference to the examples depicted in the drawings. It is contemplated that rotational movement may be provided in directions opposite to those used above. Therefore, use of the terms “clockwise” and “counterclockwise” in the above examples should not be viewed as limiting in any way.

[00087] V. Miscellaneous

[00088] It should be understood that any one or more of the teachings, expressions, embodiments, examples, etc. described herein may be combined with any one or more of the other teachings, expressions, embodiments, examples, etc. that are described herein. The following-described teachings, expressions, embodiments, examples, etc. should therefore not be viewed in isolation relative to each other. Various suitable ways in which the teachings herein may be combined will be readily apparent to those of ordinary skill in the art in view of the teachings herein. Such modifications and variations are intended to be included within the scope of the claims.

[00089] Versions of the devices described above may have application in conventional medical treatments and procedures conducted by a medical professional, as well as application in robotic-assisted medical treatments and procedures. By way of example only, various teachings herein may be readily incorporated into a robotic surgical system such as the DAVINCI™ system by Intuitive Surgical, Inc., of Sunnyvale, California.

[00090] Versions described above may be designed to be disposed of after a single use, or they can be designed to be used multiple times. Versions may, in either or both cases, be reconditioned for reuse after at least one use. Reconditioning may include any combination of the steps of disassembly of the device, followed by cleaning or

- 27 -

replacement of particular pieces, and subsequent reassembly. In particular, some versions of the device may be disassembled, and any number of the particular pieces or parts of the device may be selectively replaced or removed in any combination. Upon cleaning and/or replacement of particular parts, some versions of the device may be reassembled for subsequent use either at a reconditioning facility, or by a user immediately prior to a procedure. Those skilled in the art will appreciate that reconditioning of a device may utilize a variety of techniques for disassembly, cleaning/replacement, and reassembly. Use of such techniques, and the resulting reconditioned device, are all within the scope of the present application.

[00091] By way of example only, versions described herein may be sterilized before and/or after a procedure. In one sterilization technique, the device is placed in a closed and sealed container, such as a plastic or TYVEK bag. The container and device may then be placed in a field of radiation that can penetrate the container, such as gamma radiation, x-rays, or high-energy electrons. The radiation may kill bacteria on the device and in the container. The sterilized device may then be stored in the sterile container for later use. A device may also be sterilized using any other technique known in the art, including but not limited to beta or gamma radiation, ethylene oxide, or steam.

[00092] Having shown and described various versions in the present disclosure, further adaptations of the methods and systems described herein may be accomplished by appropriate modifications by one of ordinary skill in the art without departing from the scope of the present invention. Several of such potential modifications have been mentioned, and others will be apparent to those skilled in the art. For instance, the examples, versions, geometrics, materials, dimensions, ratios, steps, and the like discussed above are illustrative and are not required. Accordingly, the scope of the present invention should be considered in terms of the following claims and is understood not to be limited to the details of structure and operation shown and described in the specification and drawings.

- 28 -

I/we claim:

1. An apparatus, comprising:
 - (a) a shaft, wherein the shaft has a distal end;
 - (b) an end effector located at the distal end of the shaft, wherein the end effector comprises:
 - (i) a first needle grasping member, and
 - (ii) a second needle grasping member, wherein the first and second needle grasping members are operable to cooperatively grasp and release a suture needle; and
 - (c) a grasping actuation assembly, wherein the grasping actuation assembly is operable to simultaneously drive the first needle grasping member distally relative to the shaft and the second needle grasping member proximally relative to the shaft to grasp a suture needle.
2. The apparatus of claim 1, wherein the grasping actuation assembly is further operable to simultaneously drive the first needle grasping member proximally relative to the shaft and the second needle grasping member distally relative to the shaft to release a suture needle.
3. The apparatus of claim 1, wherein the shaft and the end effector are dimensioned to fit through a surgical trocar.
4. The apparatus of claim 1, further comprising a handle assembly positioned at a proximal end of the shaft, wherein the handle assembly is operable to selectively activate the grasping actuation assembly.
5. The apparatus of claim 4, wherein the handle assembly further includes at least one motor in communication with the grasping actuation assembly.

- 29 -

6. The apparatus of claim 1, wherein the first needle grasping member is slidably coupled with the second needle grasping member.

7. The apparatus of claim 1, wherein the first needle grasping member comprises a linearly movable first jaw having a first linear drive feature coupled with the grasping actuation assembly, wherein the second needle grasping member comprises a linearly movable second jaw having a second linear drive feature coupled with the grasping actuation assembly, wherein the first and second jaw are linearly movable along a common axis.

8. The apparatus of claim 7, wherein the grasping actuation assembly comprises a drive shaft having a first threaded section and a second threaded section, wherein the first threaded section has threading oriented in a first direction, wherein the second threaded section has threading oriented in a second direction, wherein the second direction is opposite from the first direction such that first and second threaded sections have opposing pitch.

9. The apparatus of claim 8, wherein the first linear drive feature comprises a threading meshing with the threading of the first threaded section of the drive shaft, wherein the second linear drive feature comprises a threading meshing with the threading of the second threaded section of the drive shaft.

10. The apparatus of claim 1, wherein the end effector comprises a first arm and a second arm, wherein the first and second needle grasping members together define at least part of the first arm.

11. The apparatus of claim 10, wherein the shaft defines a longitudinal axis, wherein the first arm extends along a first arm axis, wherein the first arm axis is offset from the longitudinal axis of the shaft.

12. The apparatus of claim 11, wherein the first arm is rotatable relative to the shaft about the first arm axis.

- 30 -

13. The apparatus of claim 11, wherein the first arm further includes a dogleg feature, wherein the dogleg feature is positioned between a distal portion of the first arm and a proximal portion of the first arm, wherein the proximal portion of the first arm extends along the first arm axis, wherein the distal portion of the first arm extends along an axis that is parallel to yet offset from the first arm axis.

14. The apparatus of claim 10, wherein the second arm comprises a third needle grasping member and a fourth needle grasping member, wherein the third needle grasping member and the fourth needle grasping member are operable to cooperatively grasp and release a suture needle.

15. The apparatus of claim 14, wherein the grasping actuation assembly is further operable to simultaneously drive the third needle grasping member distally relative to the shaft and the fourth needle grasping member proximally relative to the shaft to grasp a suture needle.

16. The apparatus of claim 14, wherein the end effector is operable to selectively pass a suture needle between the first arm and the second arm.

17. An apparatus, comprising:

- (a) a shaft, wherein the shaft has a distal end;
- (b) an end effector located at the distal end of the shaft, wherein the end effector comprises:
 - (i) a first needle grasping jaw, and
 - (ii) a second needle grasping jaw, wherein the first and second needle grasping jaws are operable to cooperatively grasp and release a suture needle; and
- (c) a rotary member operable to simultaneously drive the first needle grasping jaw distally relative to the shaft and the second needle grasping jaw proximally relative to the shaft to grasp a suture needle, wherein the rotary

- 31 -

member is operable to convert rotary motion in a single direction into simultaneous linear motion of the grasping jaws in opposing directions.

18. The apparatus of claim 17, wherein the shaft defines a longitudinal axis, wherein the end effector is further operable to drive a suture needle along a plane that is perpendicular to the longitudinal axis of the shaft.

19. A method of operating an instrument to drive a suture needle through tissue, wherein the instrument comprises a first needle grasping arm and a second needle grasping arm, wherein the first needle grasping arm comprises a first jaw and a second jaw, wherein the first and second jaws are configured to cooperate to grasp and release a suture needle, the method comprising:

- (a) driving the first jaw distally while simultaneously driving the second jaw proximally, to grasp the needle with the first arm;
- (b) rotating the first arm about an axis to drive the needle through tissue;
- (c) grasping the needle with the second arm; and
- (d) releasing the needle from the first arm, wherein the act of releasing the needle from the first arm comprises driving the first jaw proximally while simultaneously driving the second jaw distally.

20. The method of claim 19, wherein the second arm comprises a third jaw and a fourth jaw, wherein the third and fourth jaws are configured to cooperate to grasp and release a suture needle, wherein the act of grasping the needle with the second arm comprises driving the third jaw distally while simultaneously driving the fourth jaw proximally.

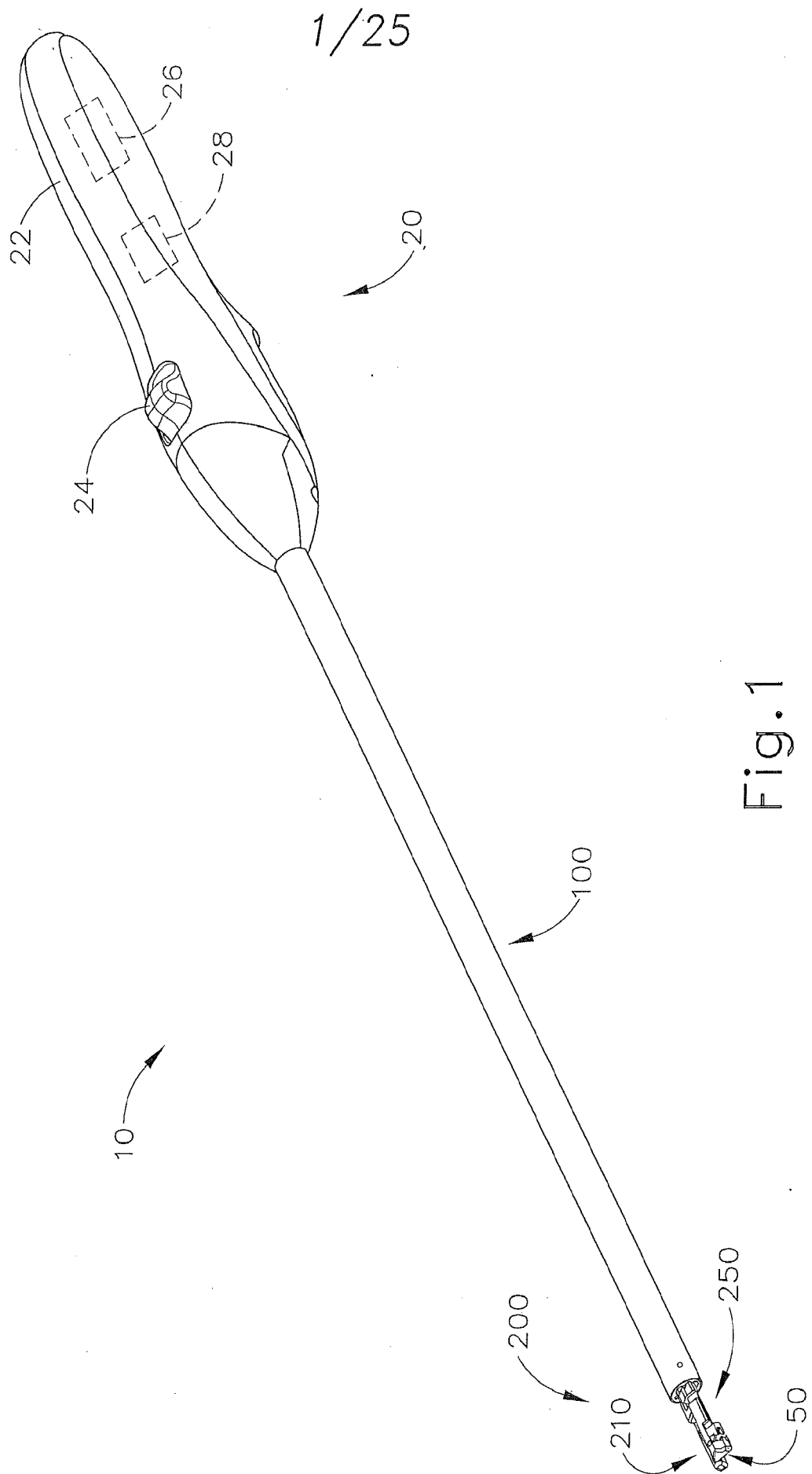

2/25

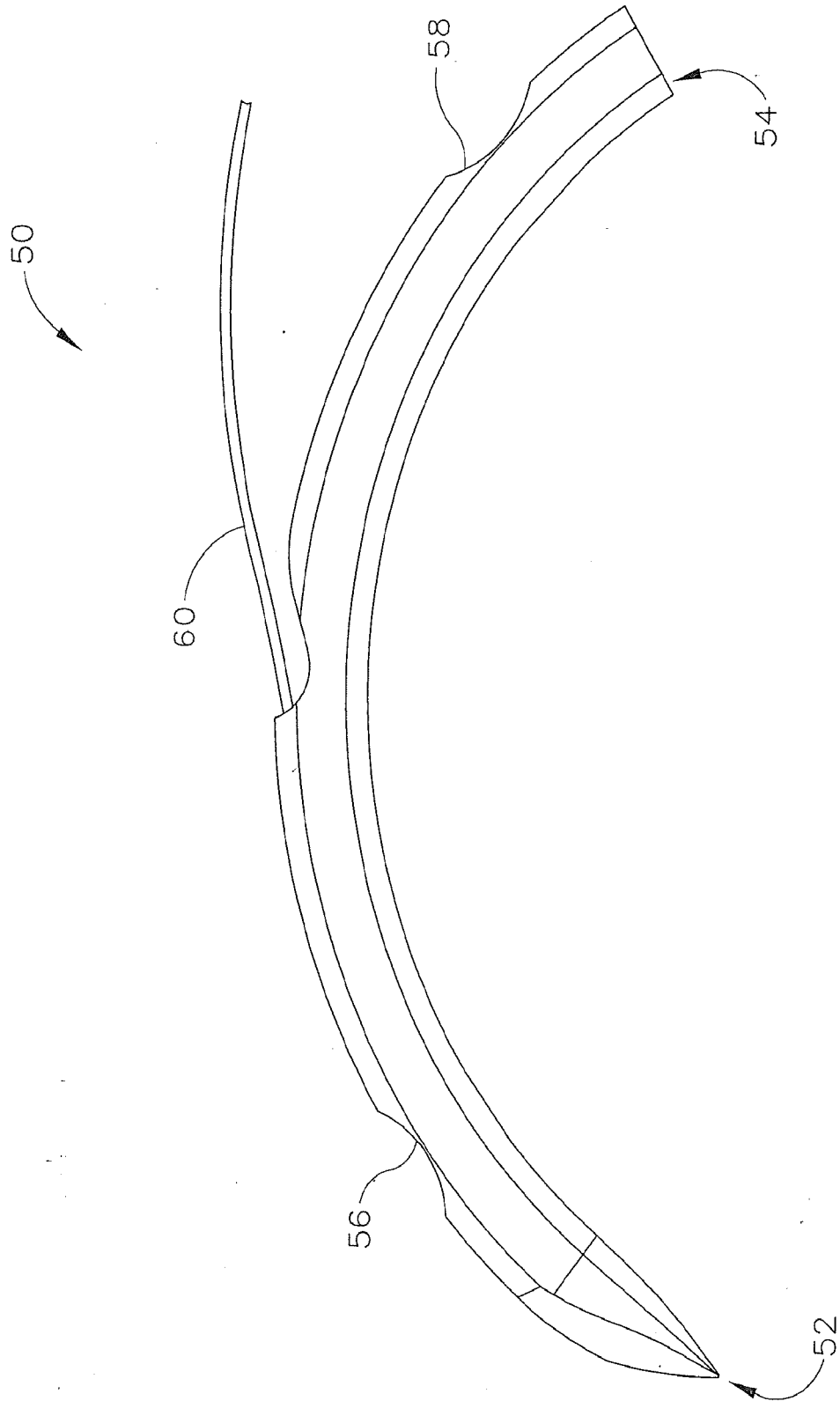

Fig. 2

3/25

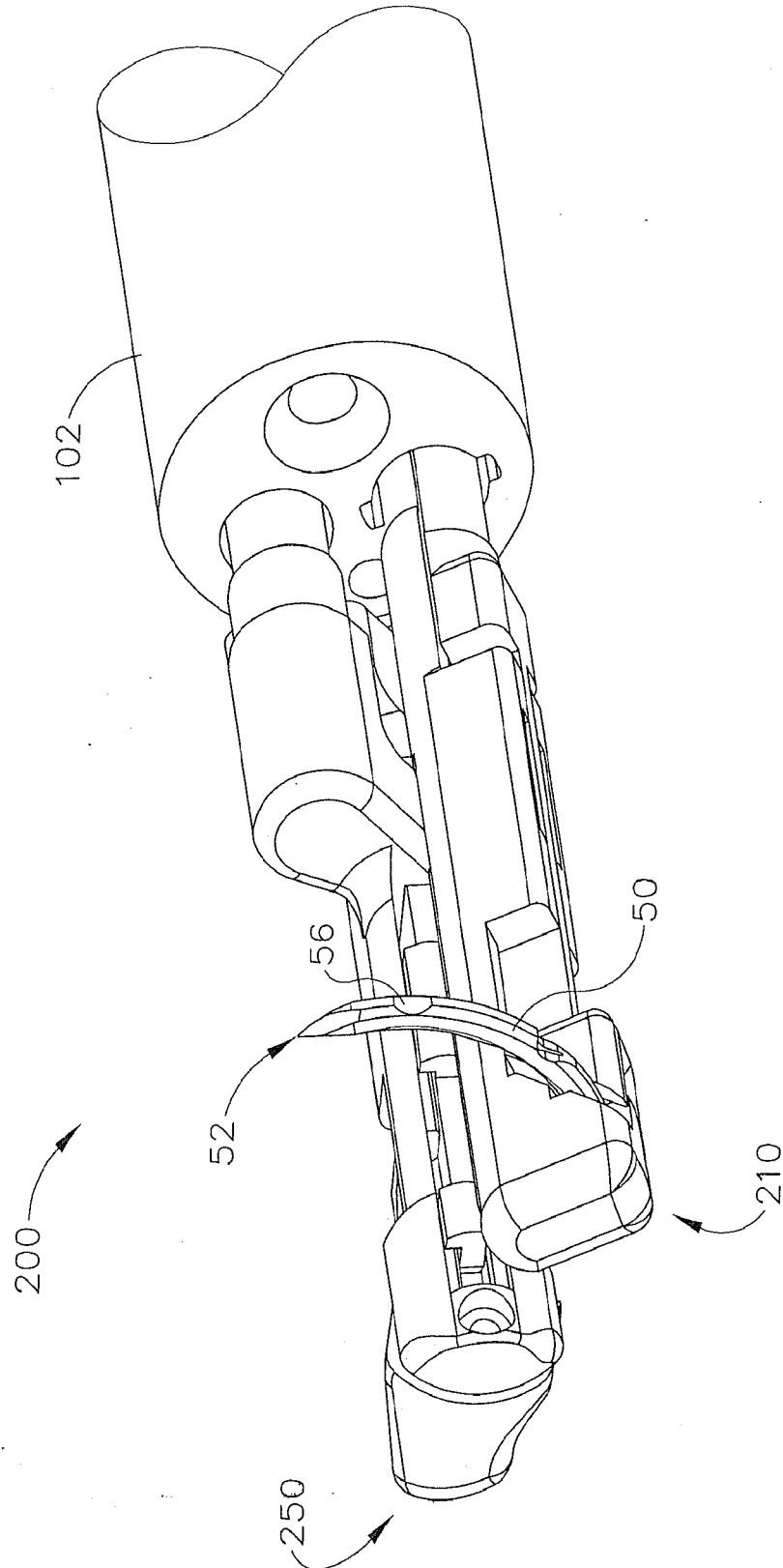

Fig. 3A

4/25

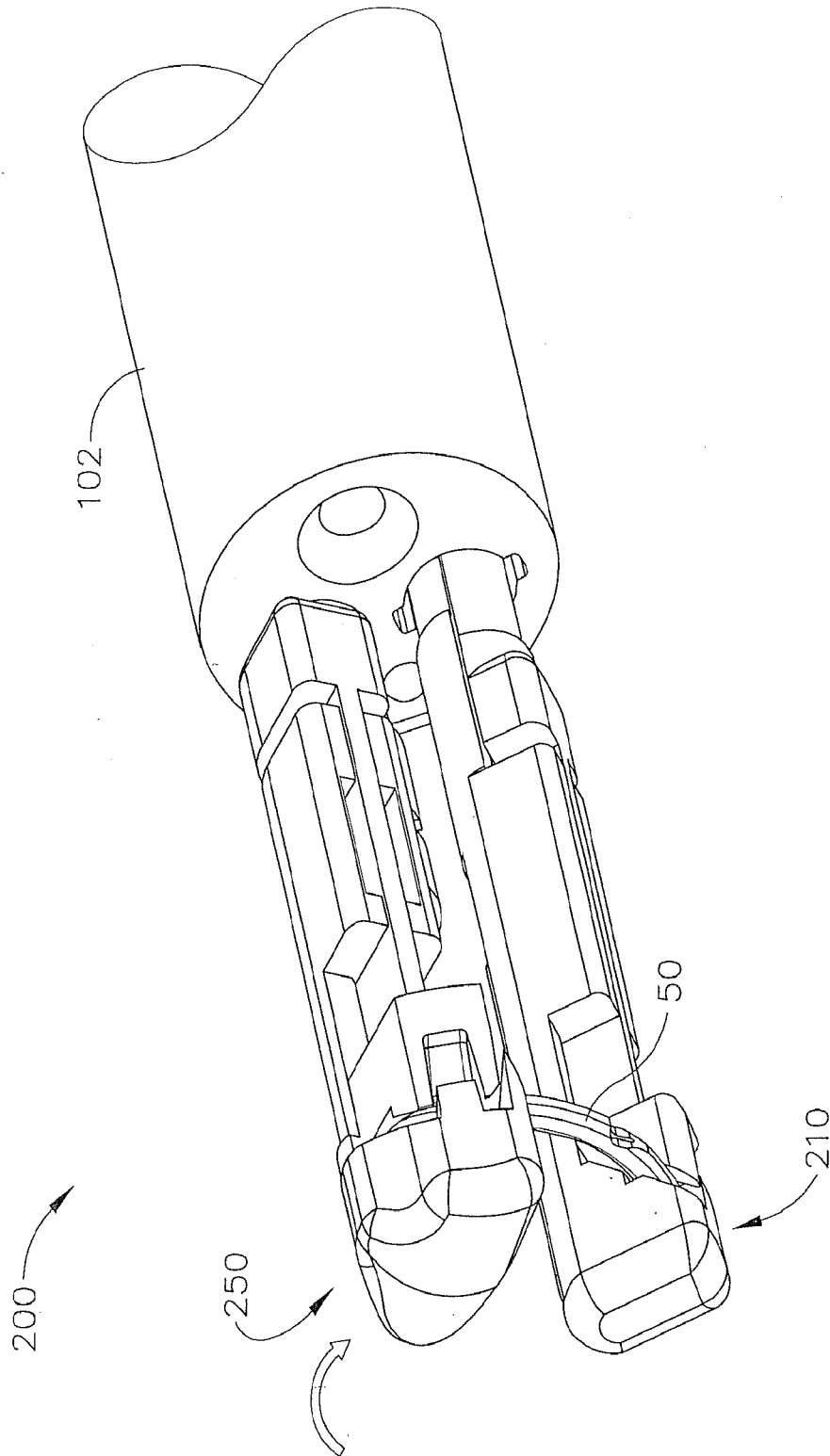

Fig. 3B

5/25

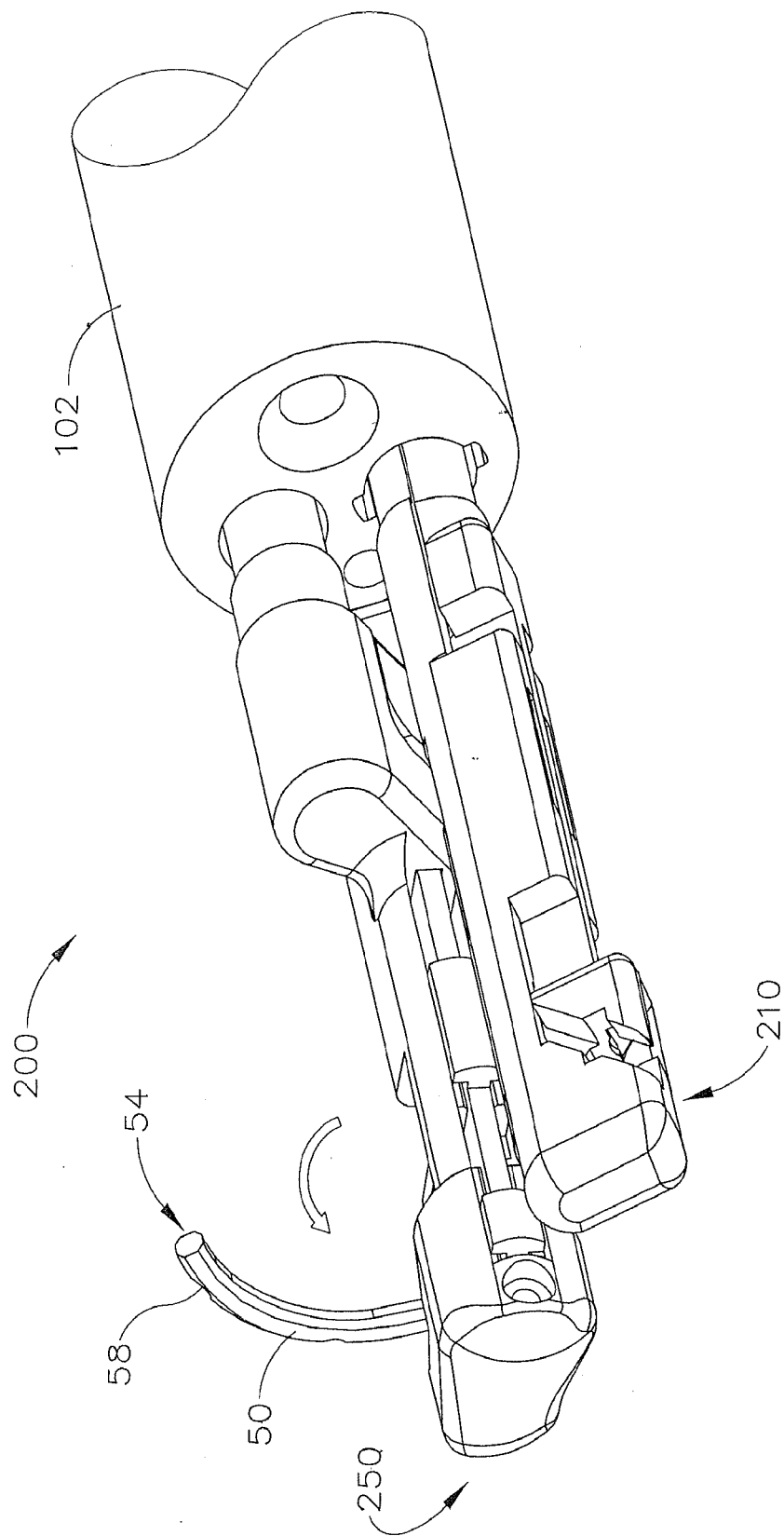

Fig. 3C

6/25

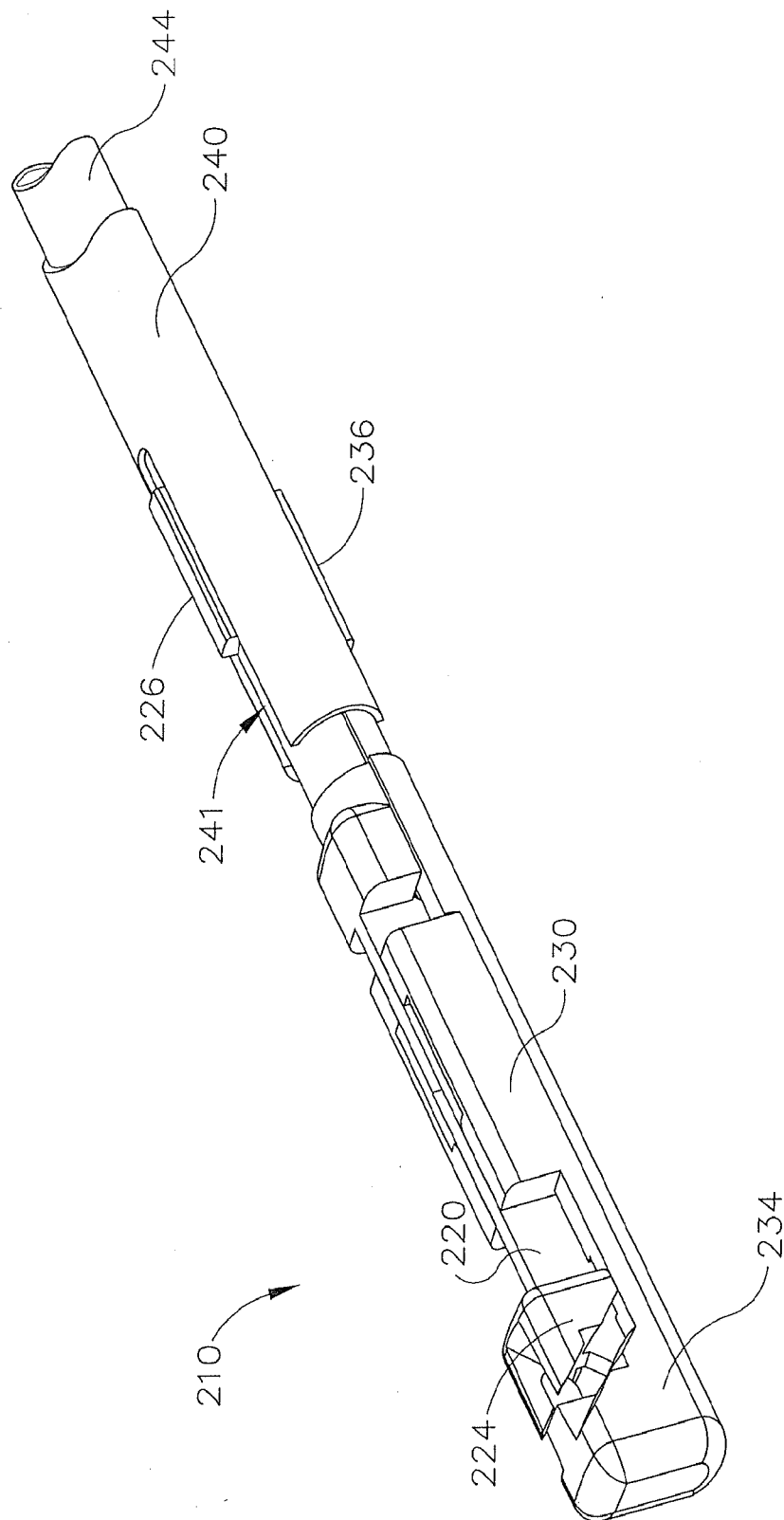

Fig. 4

7/25

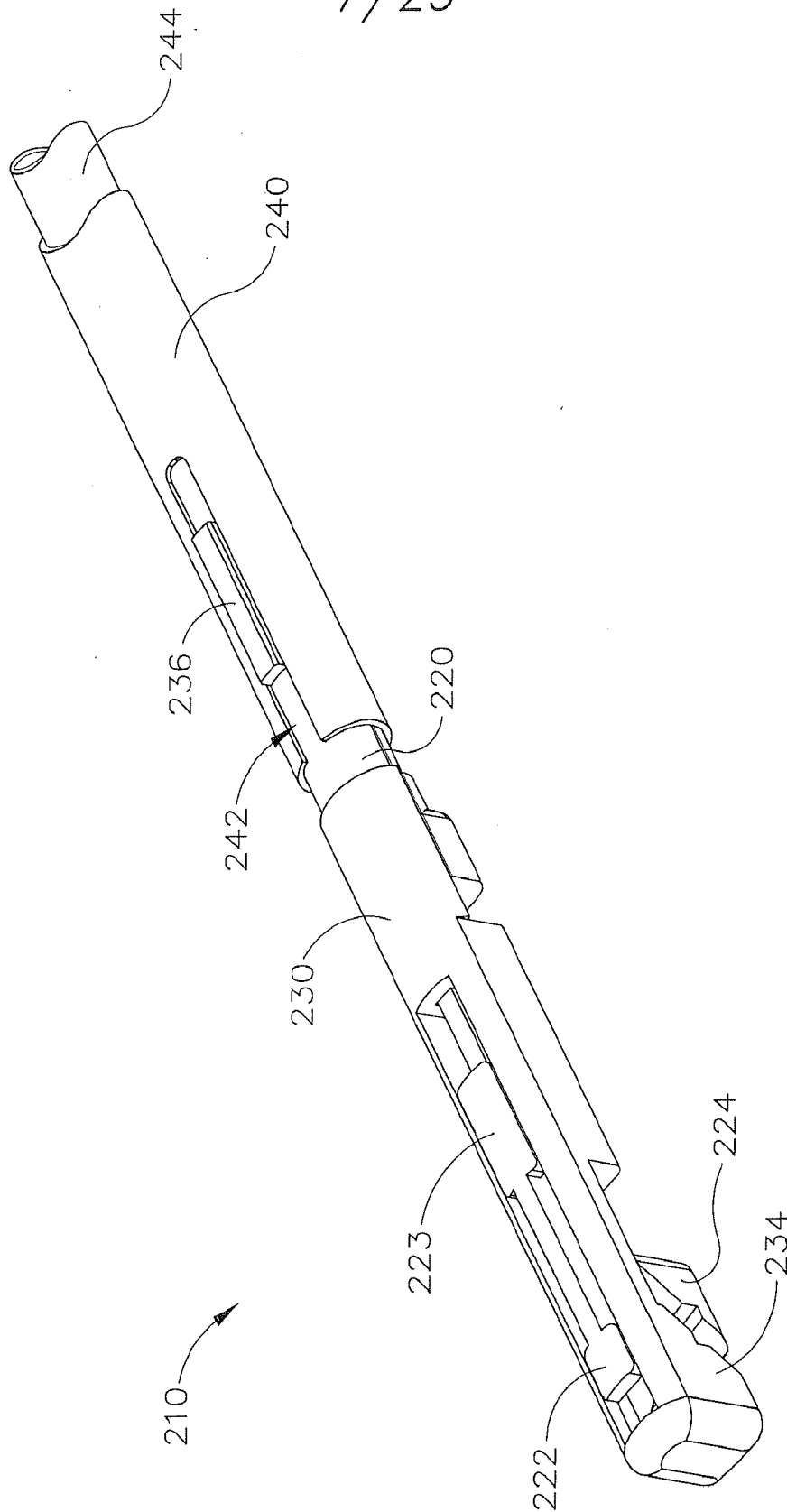

Fig. 5

8/25

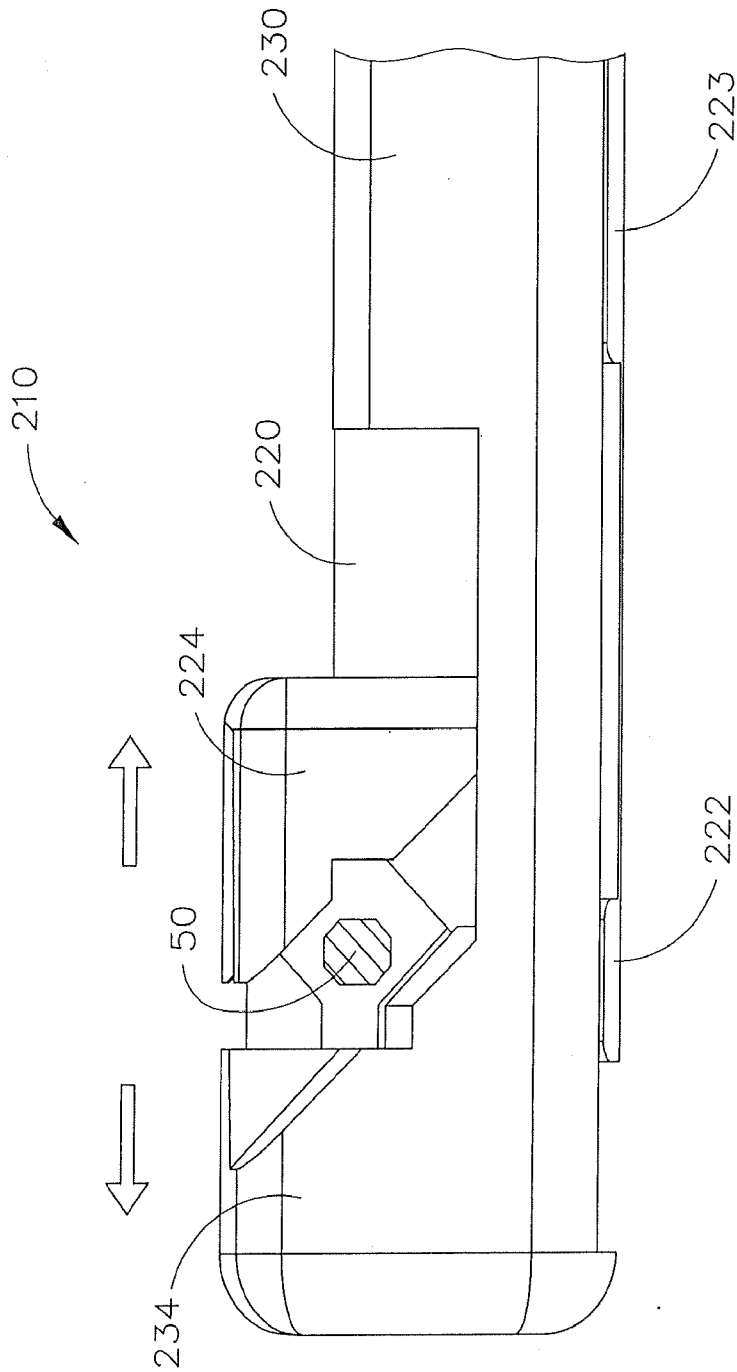

Fig. 6A

9/25

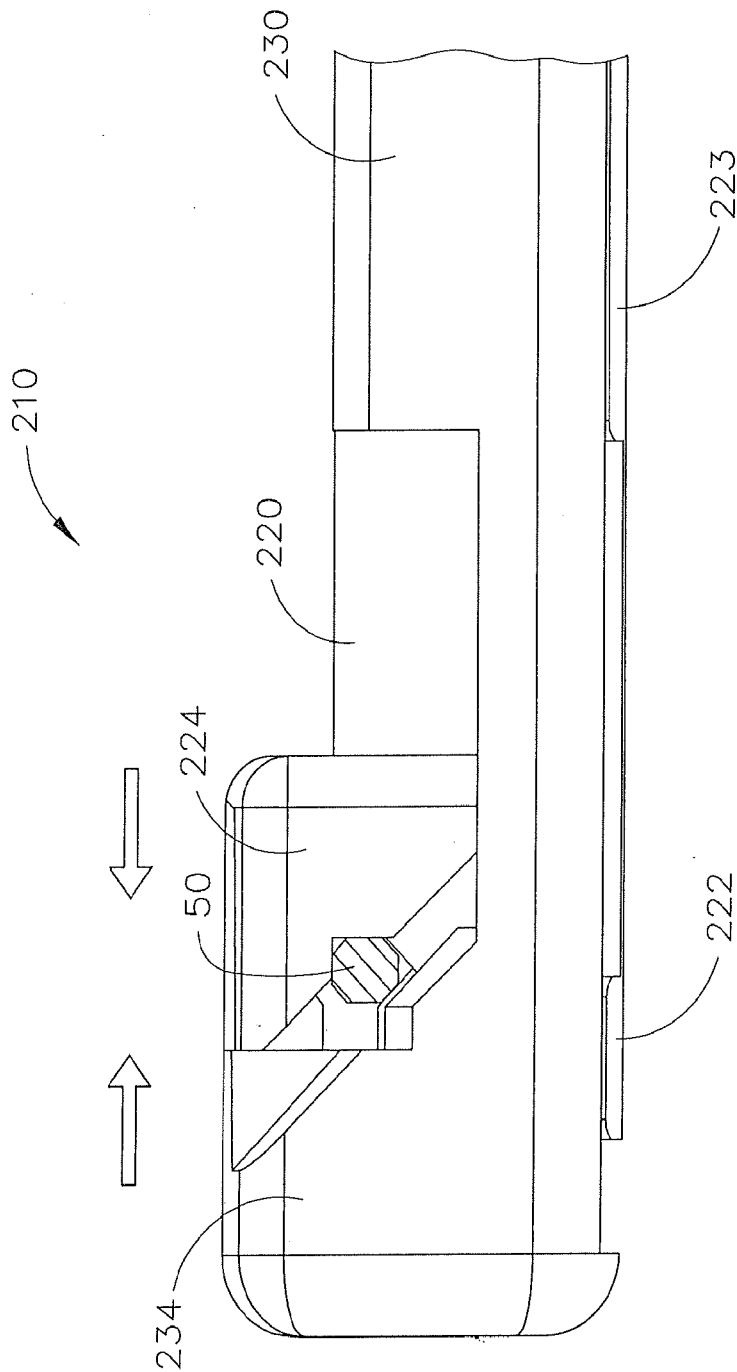

Fig. 6B

10/25

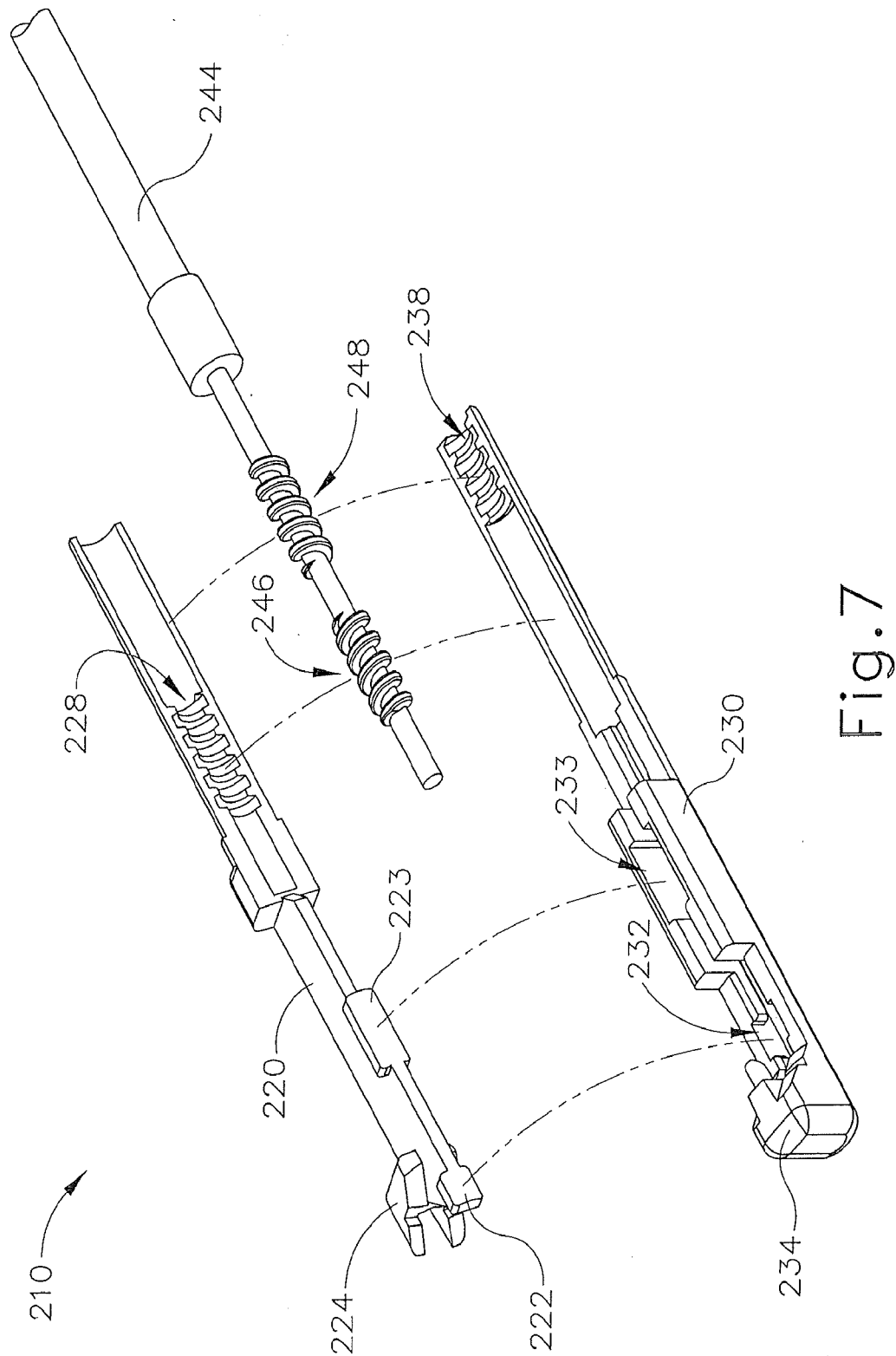

Fig. 7

11/25

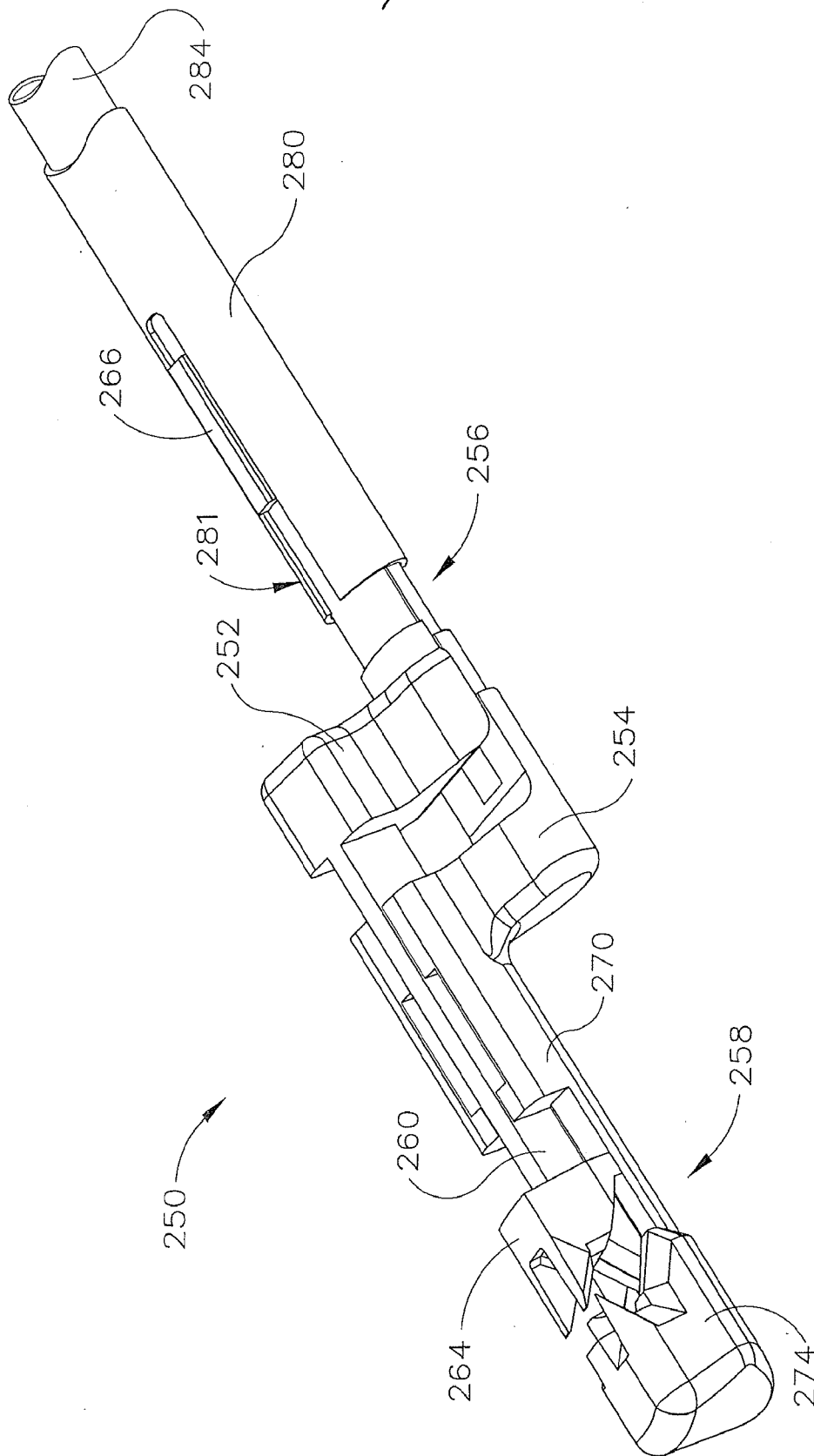

Fig. 8

12/25

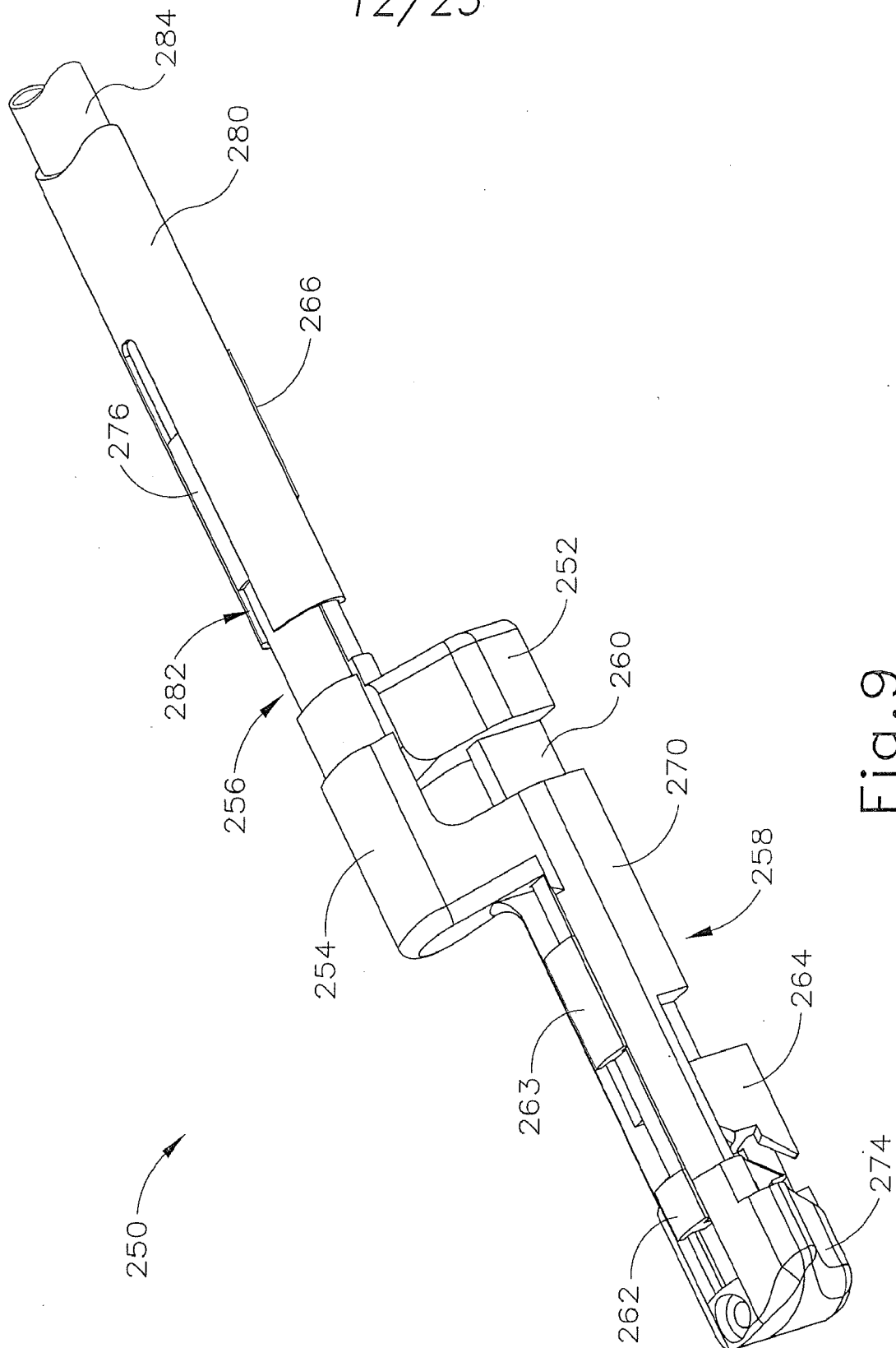

Fig. 9

13/25

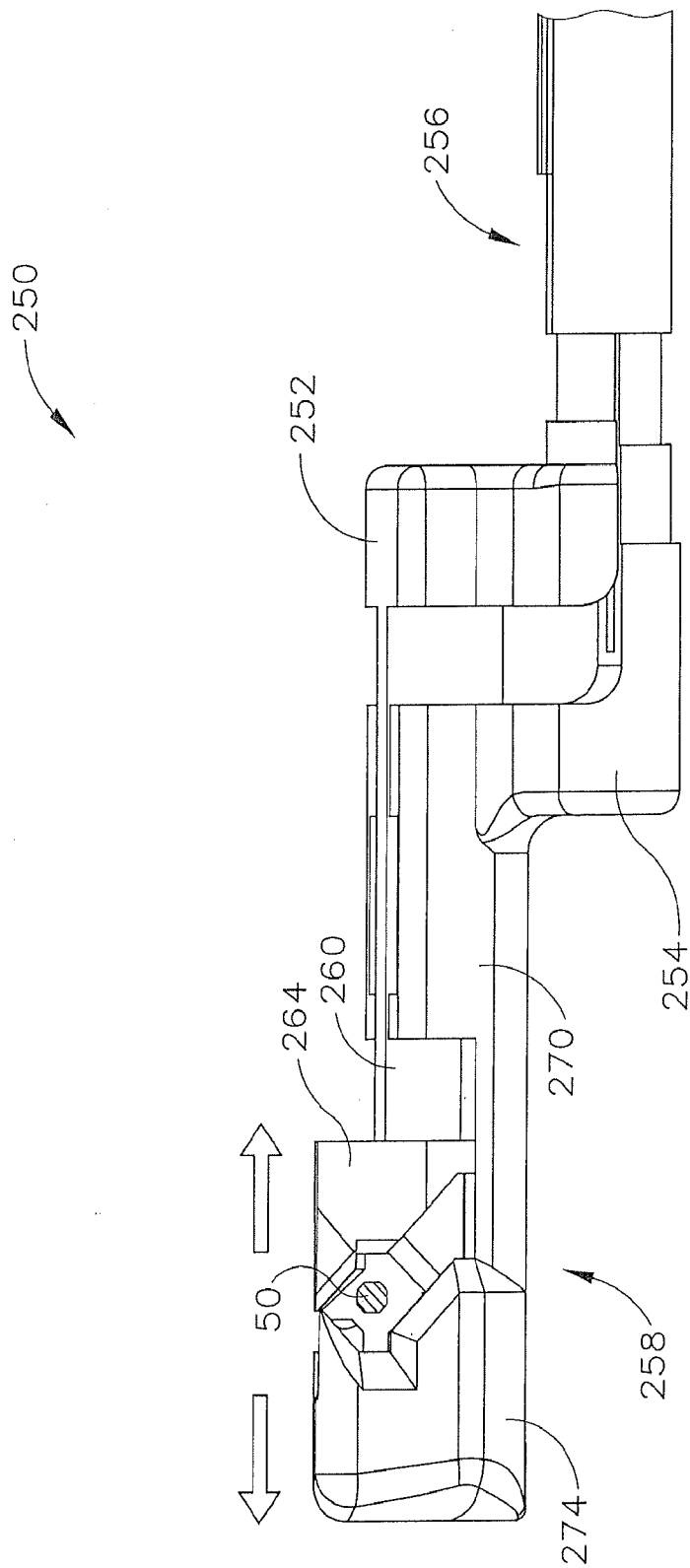

Fig.10A

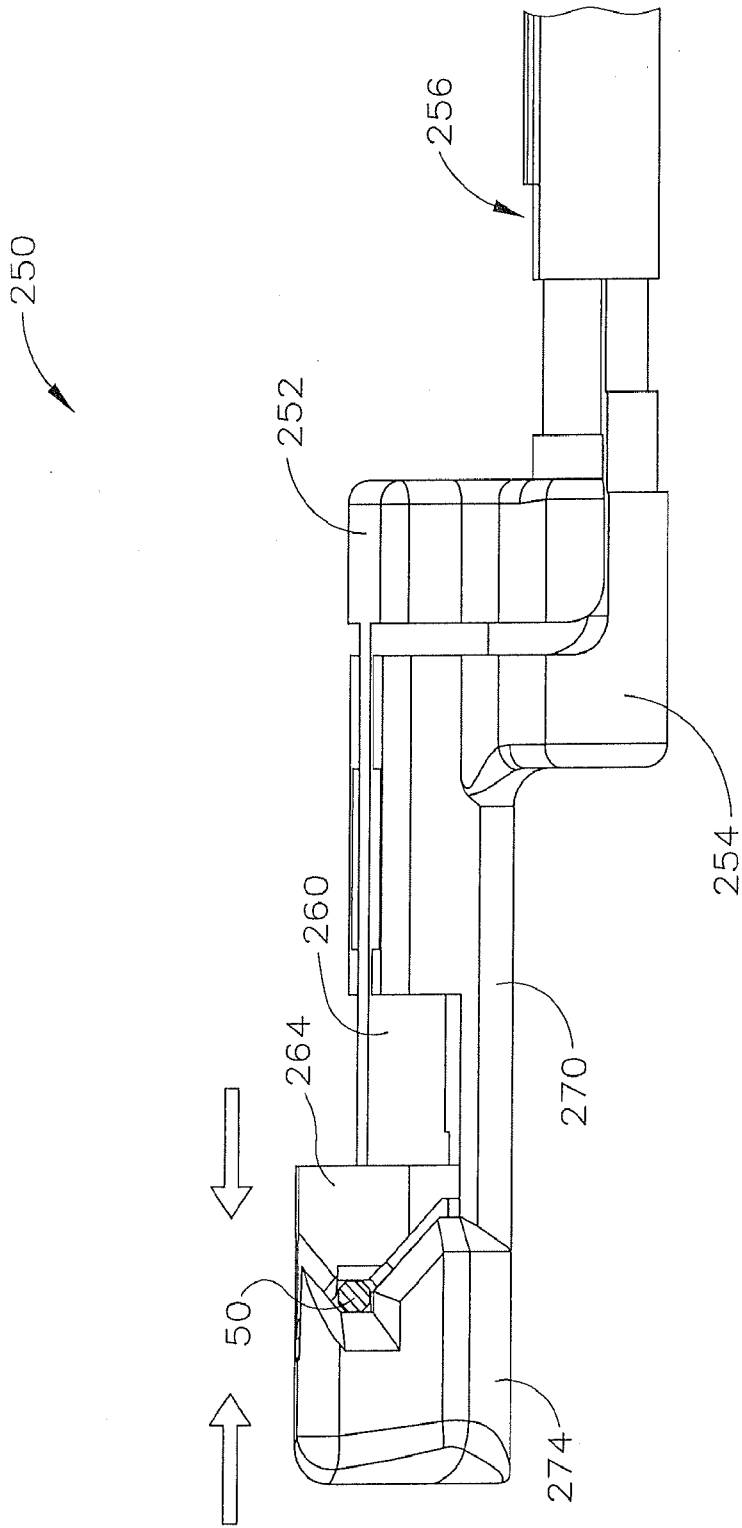

Fig. 10B

15/25

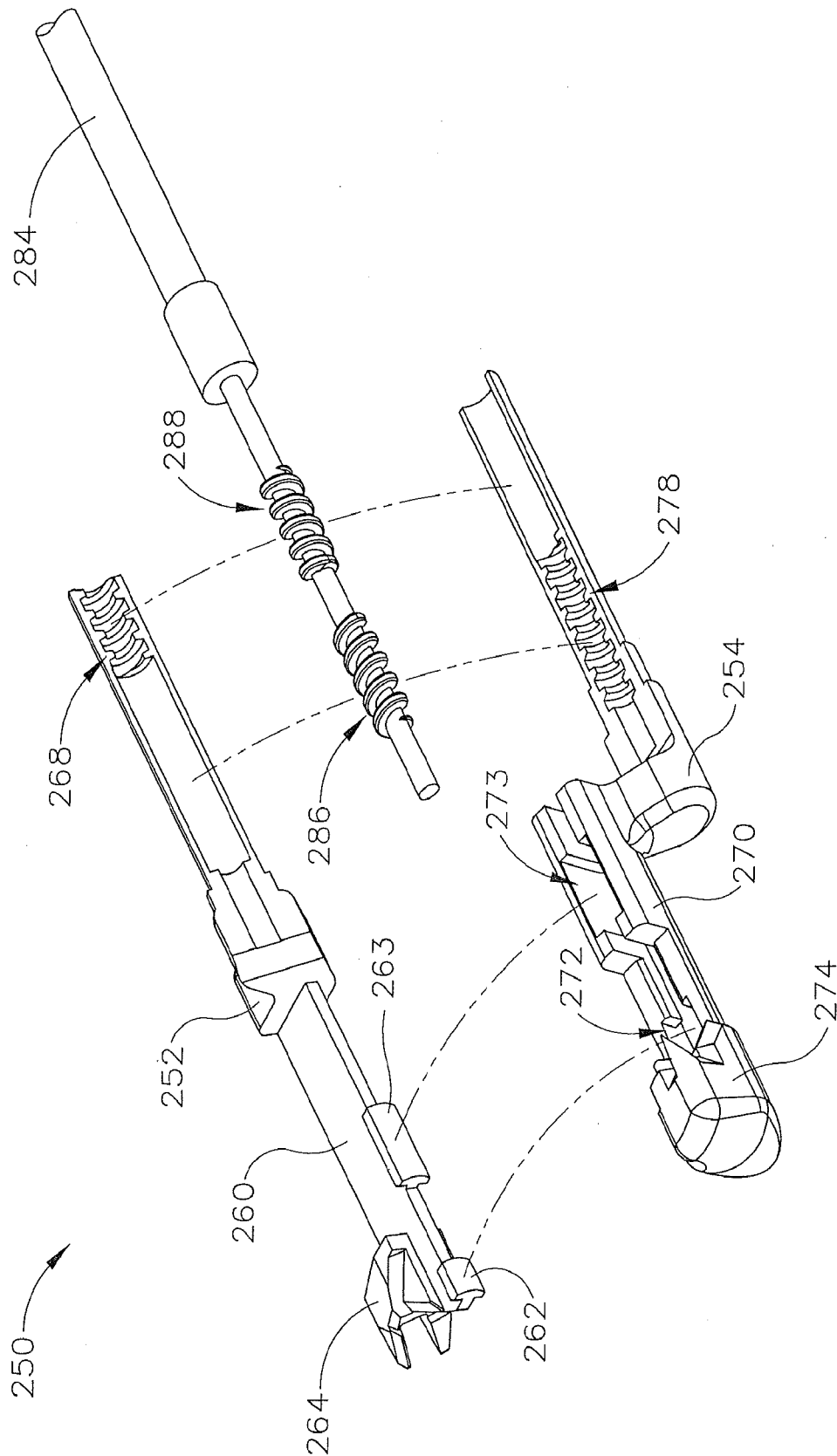

Fig. 11

16/25

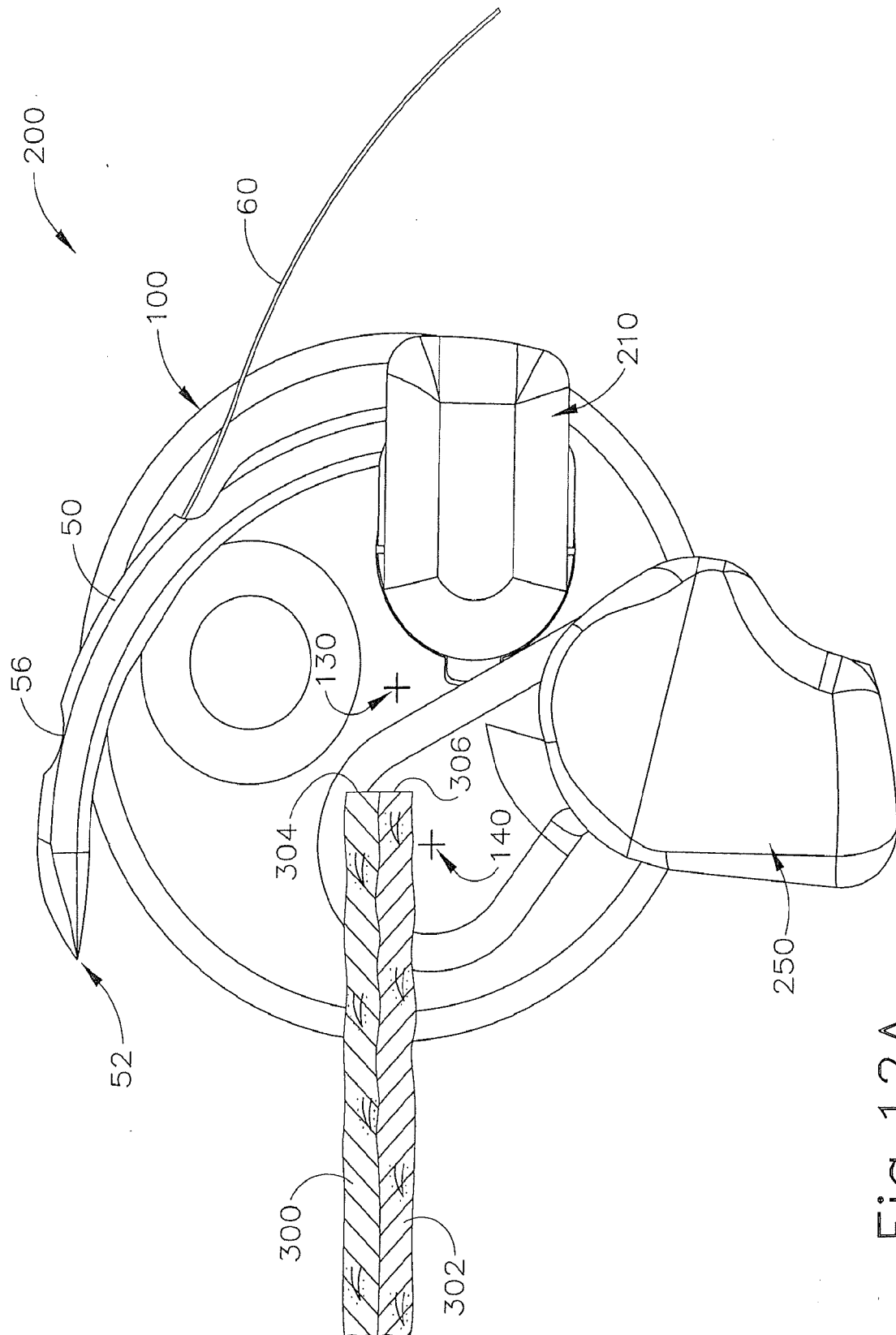

Fig. 12A

17/25

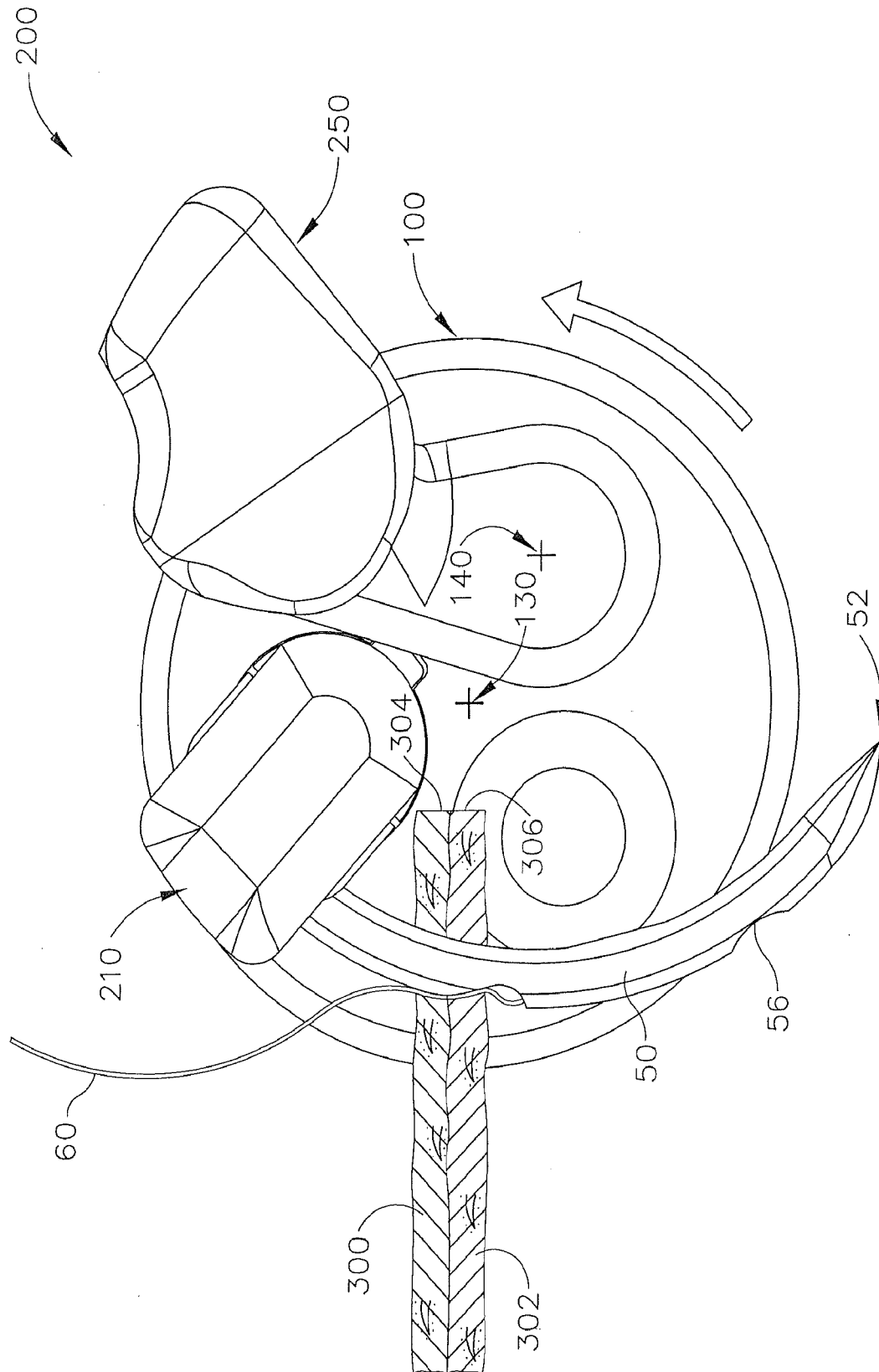

Fig. 12B

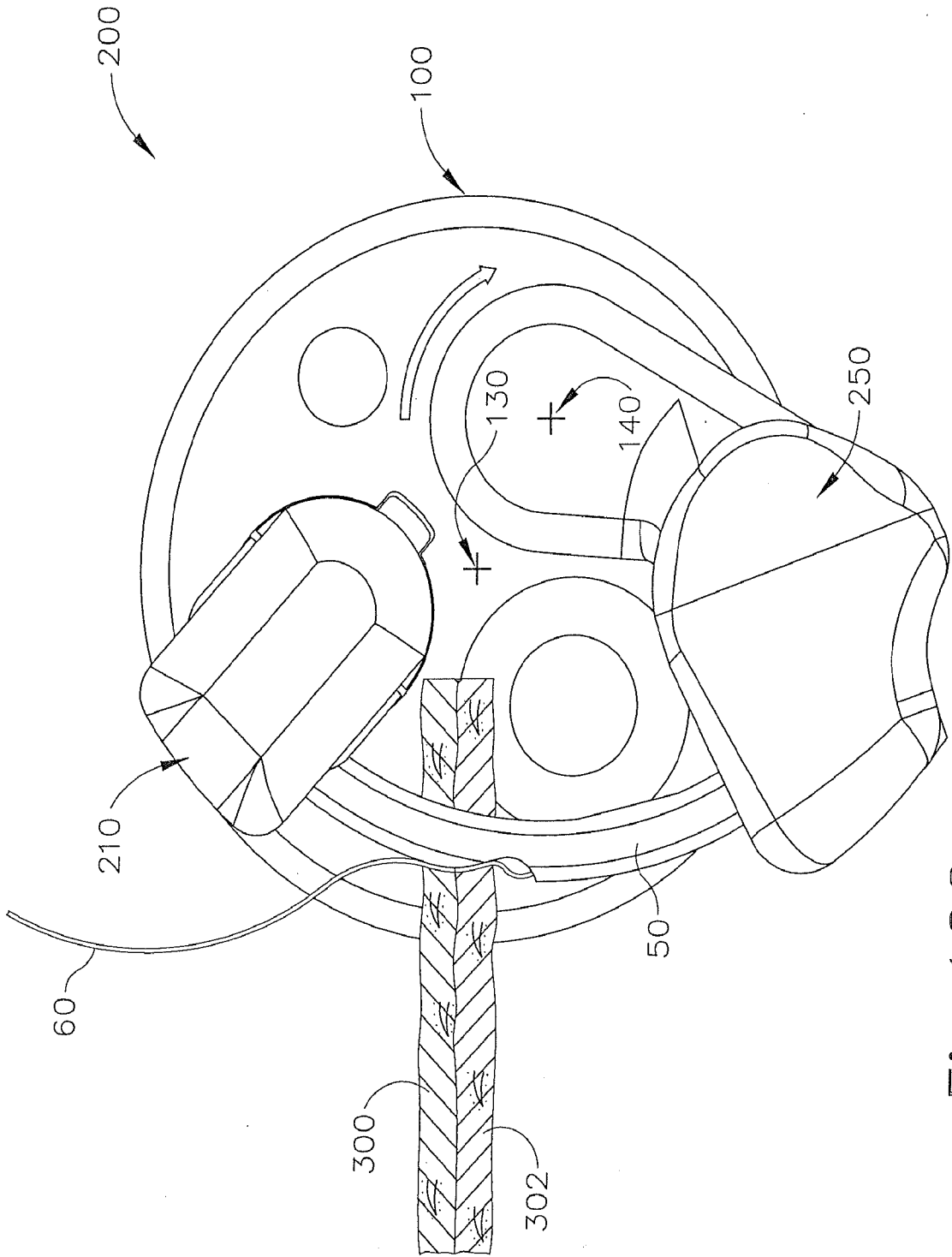

Fig. 12C

19/25

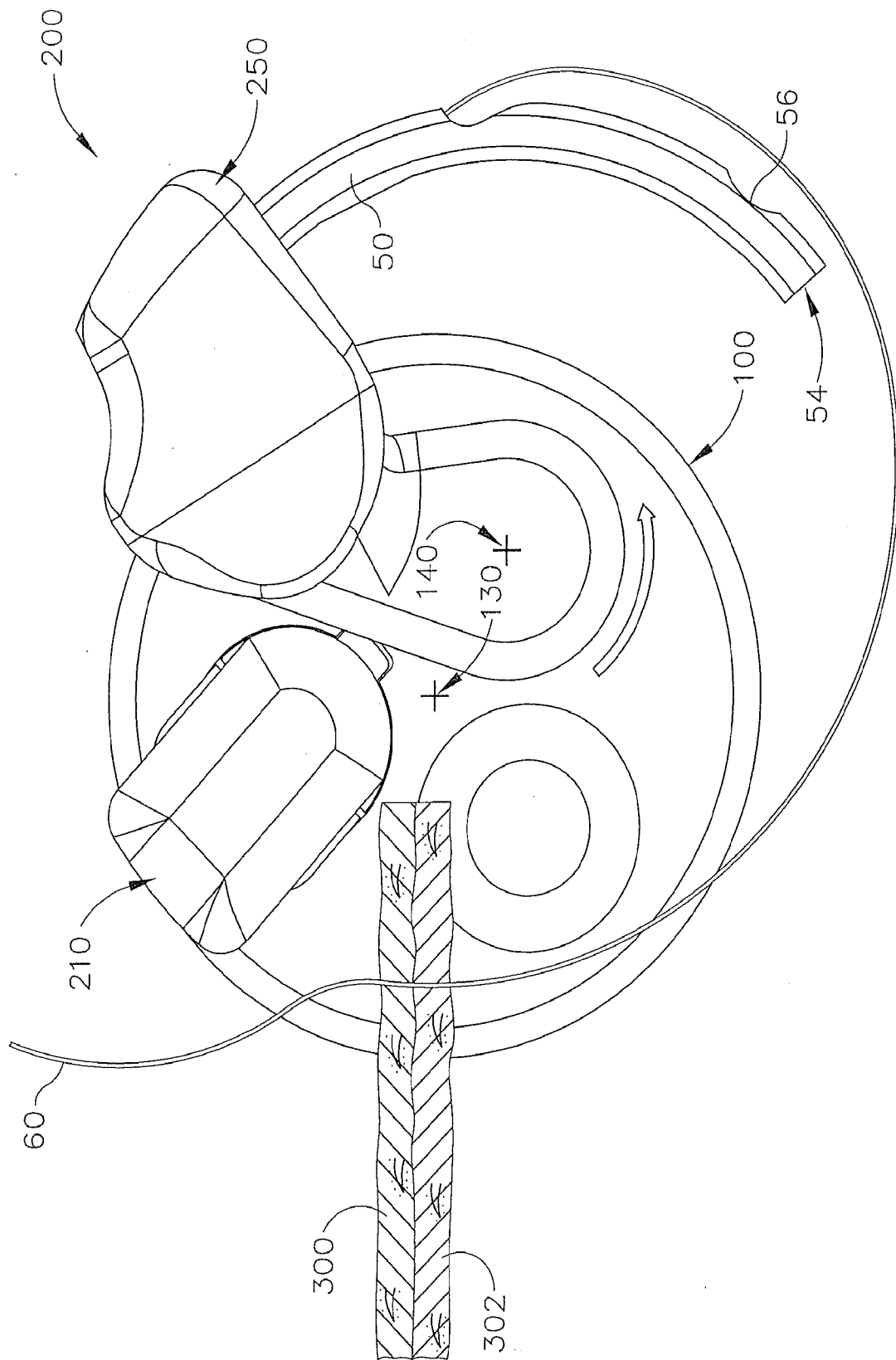
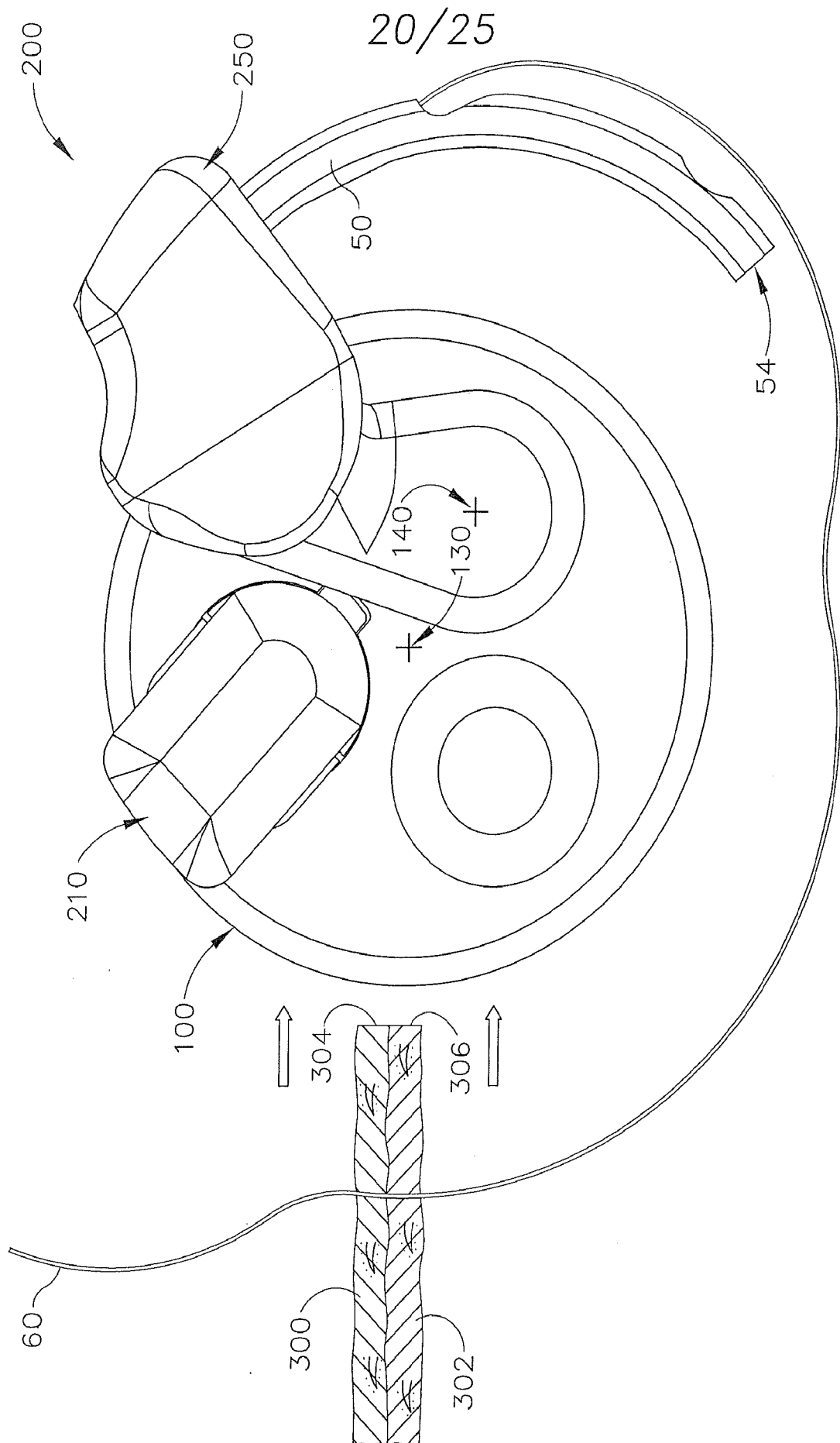

Fig. 12D



21/25

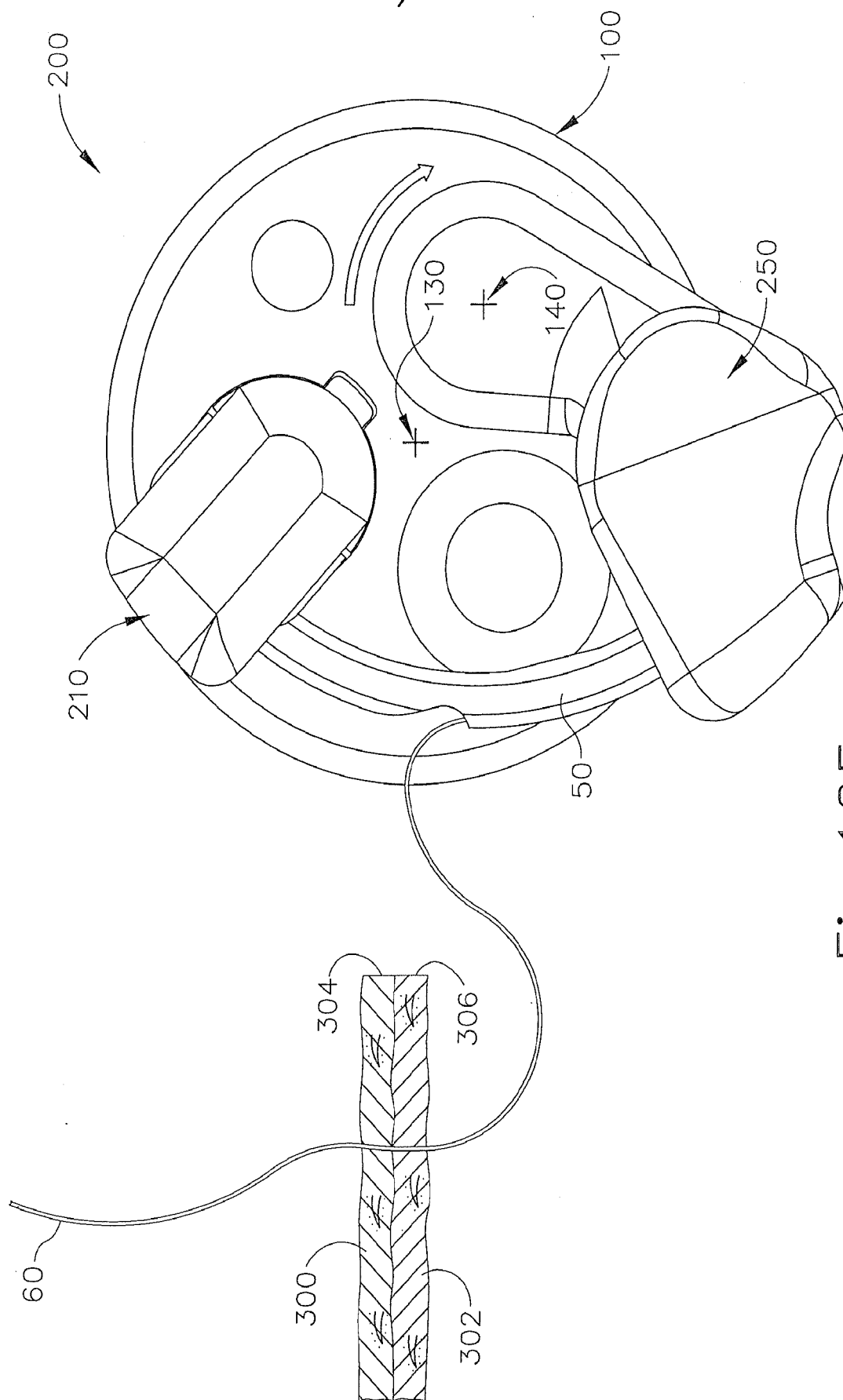

Fig. 12F

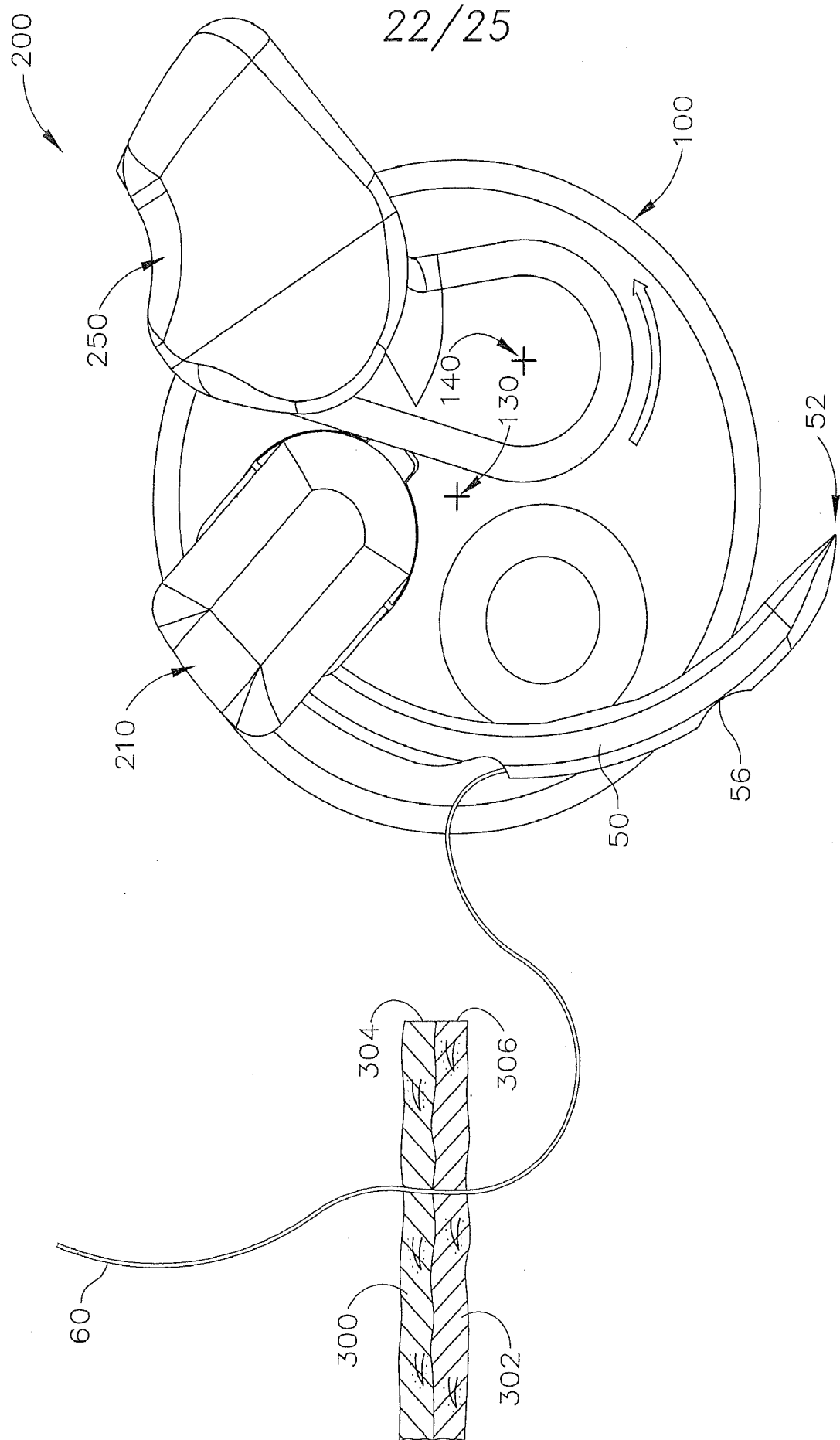

Fig. 12G

23/25

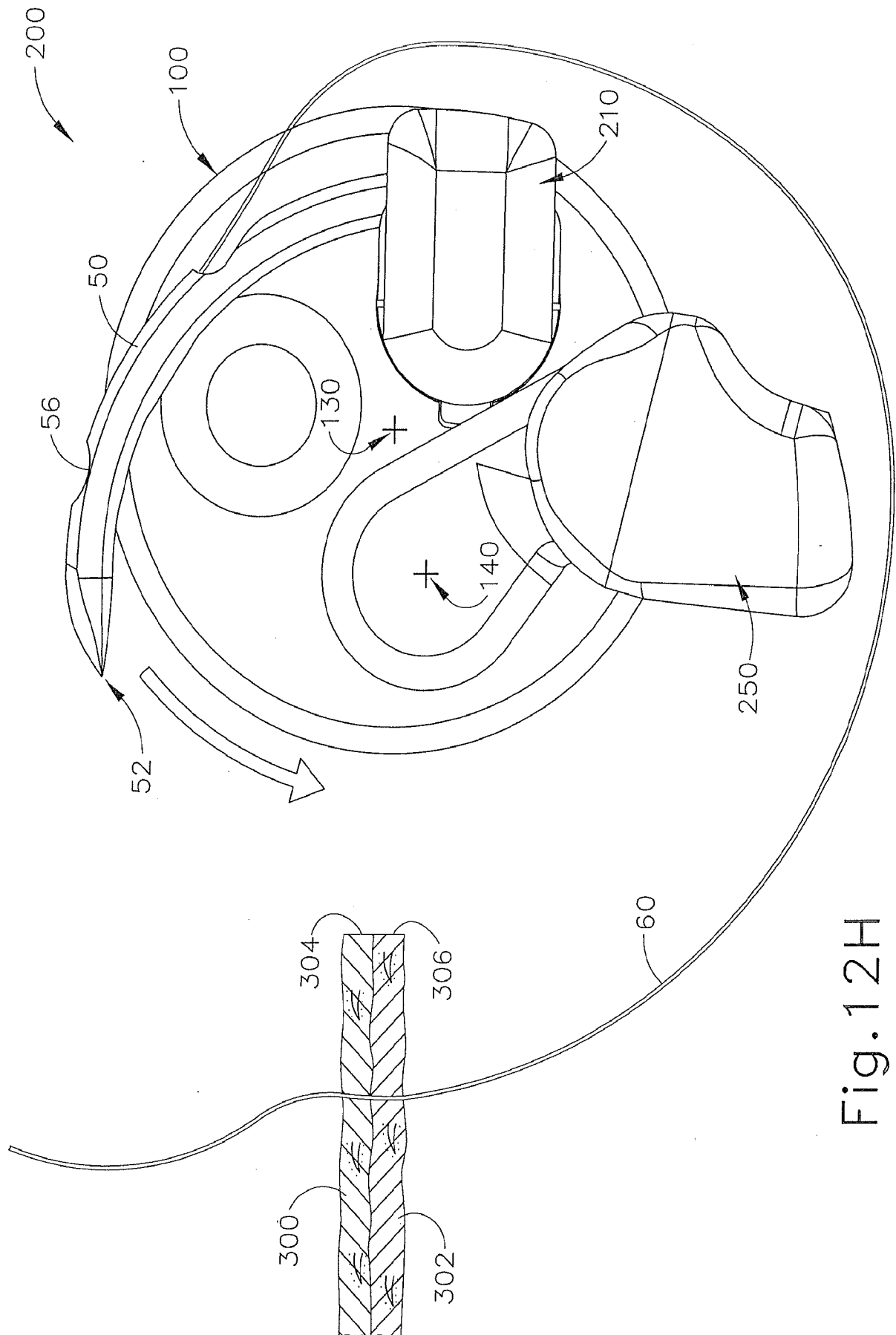

Fig.12H

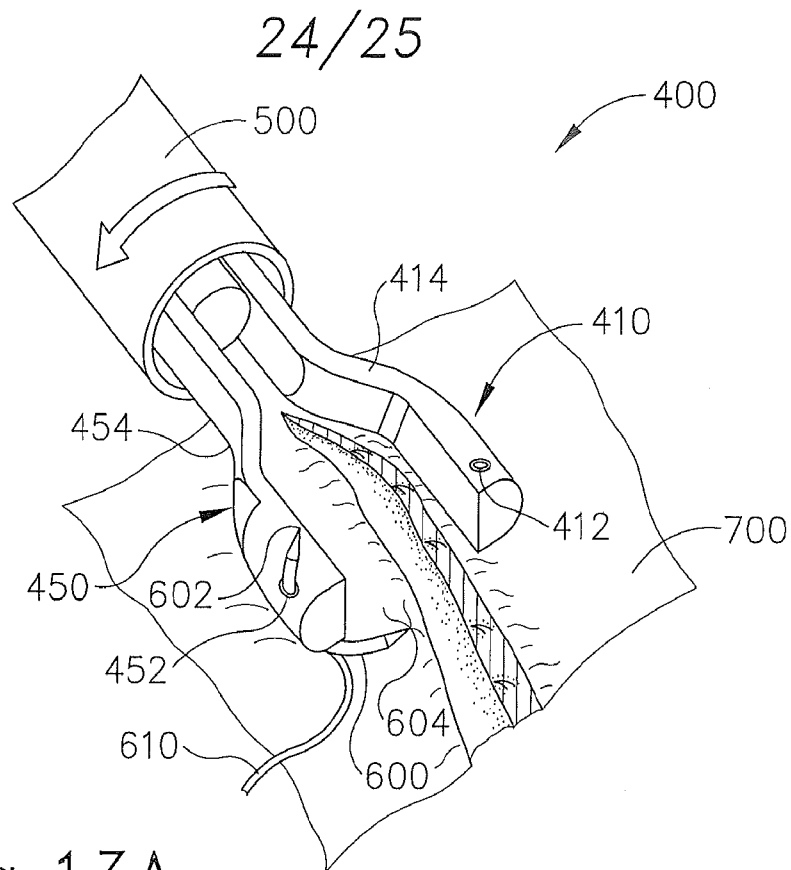

Fig.13A

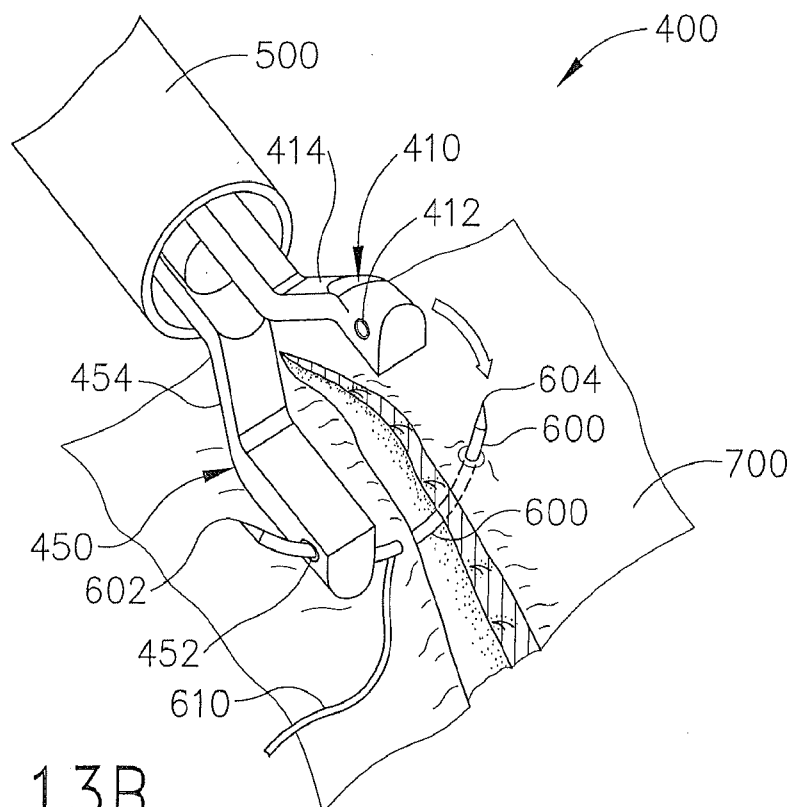

Fig.13B

25/25

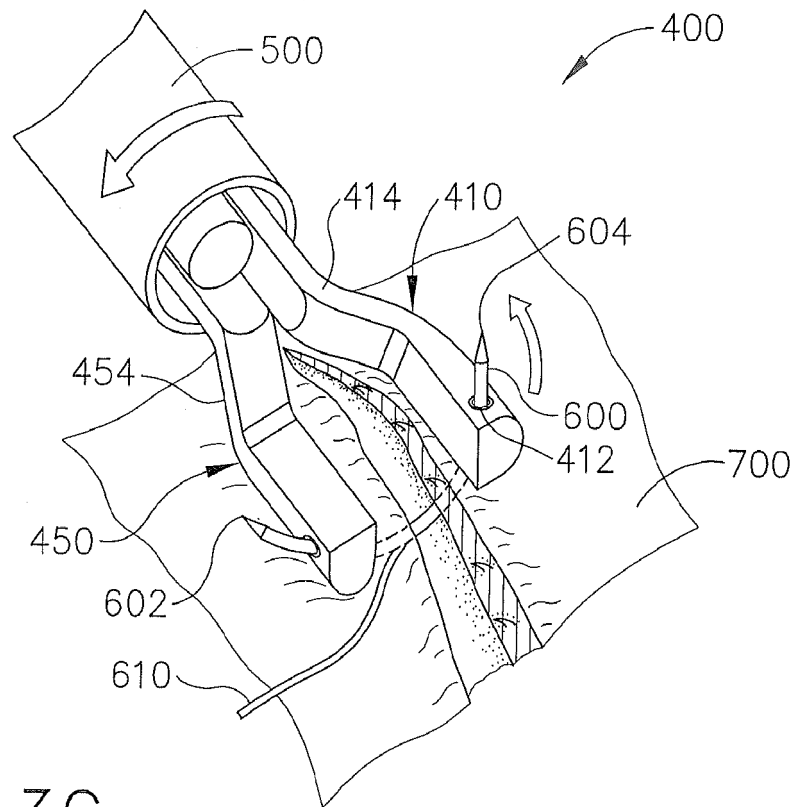

Fig. 13C

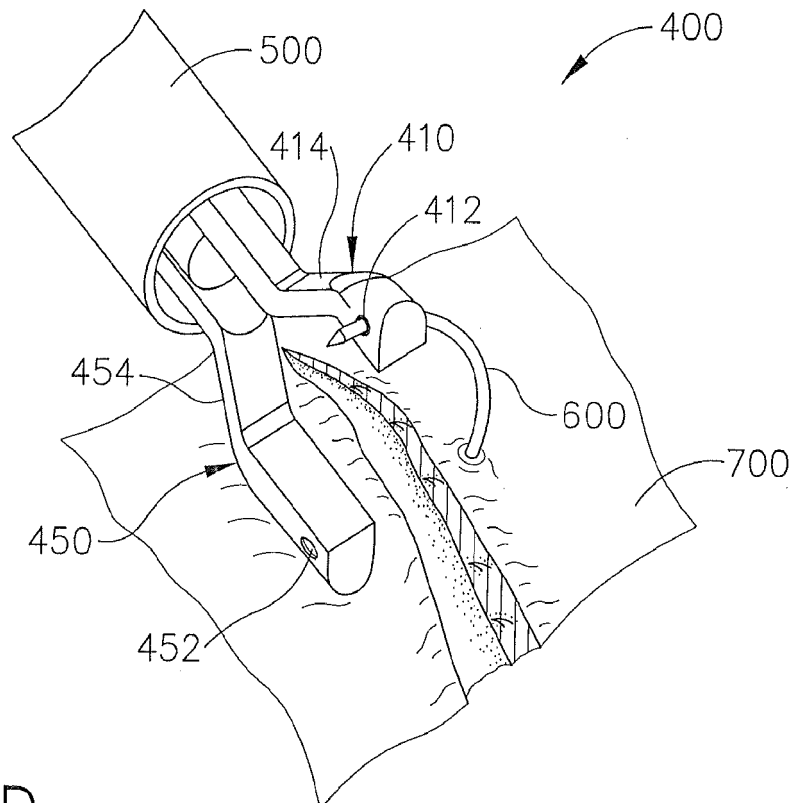

Fig. 13D

INTERNATIONAL SEARCH REPORT

International application No

PCT/US2011/060572

A. CLASSIFICATION OF SUBJECT MATTER

INV. A61B17/29 A61B17/04
 ADD. A61B17/06 A61B17/062

According to International Patent Classification (IPC) or to both national classification and IPC

B. FIELDS SEARCHED

Minimum documentation searched (classification system followed by classification symbols)

A61B

Documentation searched other than minimum documentation to the extent that such documents are included in the fields searched

Electronic data base consulted during the international search (name of data base and, where practical, search terms used)

EPO-Internal, WPI Data

C. DOCUMENTS CONSIDERED TO BE RELEVANT

Category*	Citation of document, with indication, where appropriate, of the relevant passages	Relevant to claim No.
X A	WO 99/65398 A1 (YOON INBAE [US]) 23 December 1999 (1999-12-23) page 7, line 17 - page 17, line 16; figures 1-15 -----	1-6, 11-18 7-10
X A	US 6 206 894 B1 (THOMPSON BENNIE [US] ET AL) 27 March 2001 (2001-03-27) column 5, line 60 - column 13, line 53; figures 1-14 -----	1-6, 11-18 7-10
X A	WO 98/48705 A1 (YOON INBAE [US]; YOON SAMUEL C [US]) 5 November 1998 (1998-11-05) page 7, last paragraph - page 25, paragraph 2; figures 1-24 ----- -/-	1-6, 11-18 7-10



Further documents are listed in the continuation of Box C.



See patent family annex.

* Special categories of cited documents :

"A" document defining the general state of the art which is not considered to be of particular relevance

"E" earlier document but published on or after the international filing date

"L" document which may throw doubts on priority claim(s) or which is cited to establish the publication date of another citation or other special reason (as specified)

"O" document referring to an oral disclosure, use, exhibition or other means

"P" document published prior to the international filing date but later than the priority date claimed

"T" later document published after the international filing date or priority date and not in conflict with the application but cited to understand the principle or theory underlying the invention

"X" document of particular relevance; the claimed invention cannot be considered novel or cannot be considered to involve an inventive step when the document is taken alone

"Y" document of particular relevance; the claimed invention cannot be considered to involve an inventive step when the document is combined with one or more other such documents, such combination being obvious to a person skilled in the art.

"&" document member of the same patent family

Date of the actual completion of the international search

3 February 2012

Date of mailing of the international search report

13/02/2012

Name and mailing address of the ISA/

European Patent Office, P.B. 5818 Patentlaan 2
 NL - 2280 HV Rijswijk
 Tel. (+31-70) 340-2040,
 Fax: (+31-70) 340-3016

Authorized officer

Neef, Tatjana

INTERNATIONAL SEARCH REPORT

International application No.
PCT/US2011/060572

Box No. II Observations where certain claims were found unsearchable (Continuation of item 2 of first sheet)

This international search report has not been established in respect of certain claims under Article 17(2)(a) for the following reasons:

1. ☒ Claims Nos.: 19, 20
because they relate to subject matter not required to be searched by this Authority, namely:
Rule 39.1(iv) PCT - Method for treatment of the human or animal body by surgery
2. ☐ Claims Nos.:
because they relate to parts of the international application that do not comply with the prescribed requirements to such an extent that no meaningful international search can be carried out, specifically:
3. ☐ Claims Nos.:
because they are dependent claims and are not drafted in accordance with the second and third sentences of Rule 6.4(a).

Box No. III Observations where unity of invention is lacking (Continuation of item 3 of first sheet)

This International Searching Authority found multiple inventions in this international application, as follows:

1. ☐ As all required additional search fees were timely paid by the applicant, this international search report covers all searchable claims.
2. ☐ As all searchable claims could be searched without effort justifying an additional fees, this Authority did not invite payment of additional fees.
3. ☐ As only some of the required additional search fees were timely paid by the applicant, this international search report covers only those claims for which fees were paid, specifically claims Nos.:
4. ☐ No required additional search fees were timely paid by the applicant. Consequently, this international search report is restricted to the invention first mentioned in the claims; it is covered by claims Nos.:

Remark on Protest

- ☐ The additional search fees were accompanied by the applicant's protest and, where applicable, the payment of a protest fee.
- ☐ The additional search fees were accompanied by the applicant's protest but the applicable protest fee was not paid within the time limit specified in the invitation.
- ☐ No protest accompanied the payment of additional search fees.

INTERNATIONAL SEARCH REPORT

International application No

PCT/US2011/060572

C(Continuation). DOCUMENTS CONSIDERED TO BE RELEVANT

Category*	Citation of document, with indication, where appropriate, of the relevant passages	Relevant to claim No.
X	US 5 582 617 A (KLIEMAN CHARLES H [US] ET AL) 10 December 1996 (1996-12-10)	1-5,17,18
A	column 8, line 44 - column 20, line 19; figures 2C,2D3,3A,5C, 2327A28,32C	6-16
A	----- US 2004/068274 A1 (HOOVEN MICHAEL D [US]) 8 April 2004 (2004-04-08) paragraph [0030] - paragraph [0054]; figures 1-10	1-18
A	----- US 5 300 082 A (SHARPE LESLIE A [US] ET AL) 5 April 1994 (1994-04-05) column 2, line 31 - column 4, line 24; figures 1-5	1-18
A	----- US 2 363 334 A (JONES WILLIAM O) 21 November 1944 (1944-11-21) page 1, right-hand column, line 27 - page 2, right-hand column, line 37; figures 1-10	1-18

INTERNATIONAL SEARCH REPORT

Information on patent family members

International application No

PCT/US2011/060572

Patent document cited in search report	Publication date	Patent family member(s)	Publication date
WO 9965398	A1	23-12-1999	AU 4574499 A 05-01-2000
		US 6224614 B1 01-05-2001	
		WO 9965398 A1 23-12-1999	

US 6206894	B1	27-03-2001	NONE

WO 9848705	A1	05-11-1998	AU 7468898 A 24-11-1998
		CA 2288189 A1 05-11-1998	
		EP 0987987 A1 29-03-2000	
		JP 2002501413 A 15-01-2002	
		US 6004332 A 21-12-1999	
		US 6126665 A 03-10-2000	
		WO 9848705 A1 05-11-1998	

US 5582617	A	10-12-1996	US 5582617 A 10-12-1996
		US 5817119 A 06-10-1998	

US 2004068274	A1	08-04-2004	AU 2003299197 A1 23-04-2004
		EP 1549239 A1 06-07-2005	
		US 2004068274 A1 08-04-2004	
		WO 2004030553 A1 15-04-2004	

US 5300082	A	05-04-1994	NONE

US 2363334	A	21-11-1944	NONE

专利名称(译)	腹腔镜缝合器具双动针刺器		
公开(公告)号	EP2640286A1	公开(公告)日	2013-09-25
申请号	EP2011791369	申请日	2011-11-14
[标]申请(专利权)人(译)	伊西康内外科公司		
申请(专利权)人(译)	爱惜康内镜手术，INC.		
当前申请(专利权)人(译)	爱惜康内镜手术，INC.		
[标]发明人	WOODARD JAMES A JR LESKO JASON R		
发明人	WOODARD, JAMES, A., JR. LESKO, JASON, R.		
IPC分类号	A61B17/29 A61B17/04 A61B17/06 A61B17/062		
CPC分类号	A61B17/0469 A61B17/0491 A61B17/062 A61B17/0625 A61B17/29 A61B2017/06047 A61B2017/0609 A61B2017/2903 A61B2017/2906 A61B2017/2929 A61B2017/2944		
优先权	61/413696 2010-11-15 US		
外部链接	Espacenet		

摘要(译)

缝合针驱动器械包括轴，末端执行器和抓握致动组件。末端执行器位于轴的远端，并包括一对抓握臂。每个抓握臂包括相应的一对钳口。每对钳口可操作以协作以抓住和释放缝合针。抓握致动组件可操作以沿一个方向驱动每对中的一个钳口，同时沿相反方向驱动该对中的另一个钳口，以选择性地抓住或释放缝合针。致动组件可包括具有相对螺距的单独螺纹区域的驱动轴。末端执行器还可操作以在缝合过程期间将针从一个臂传递到另一个臂。在微创手术期间，可以通过套管针使用该器械。