

(19)



(11)

**EP 3 028 653 A1**

(12)

**EUROPEAN PATENT APPLICATION**

(43) Date of publication:  
**08.06.2016 Bulletin 2016/23**

(51) Int Cl.:  
**A61B 17/128 (2006.01)**

(21) Application number: **15197251.0**

(22) Date of filing: **01.12.2015**

(84) Designated Contracting States:  
**AL AT BE BG CH CY CZ DE DK EE ES FI FR GB  
GR HR HU IE IS IT LI LT LU LV MC MK MT NL NO  
PL PT RO RS SE SI SK SM TR**  
Designated Extension States:  
**BA ME**  
Designated Validation States:  
**MA MD**

(30) Priority: **02.12.2014 US 201462086250 P**  
**16.11.2015 US 201514941714**

(71) Applicant: **Covidien LP**  
**Mansfield, MA 02048 (US)**

(72) Inventors:  
• **ASIDO, Norvin**  
**Southington, CT Connecticut 06489 (US)**  
• **TOKARZ, Christopher A.**  
**Torrington, CT Connecticut 06790 (US)**

(74) Representative: **Soames, Candida Jane**  
**Maschio & Soames IP Limited**  
**20 Carlton Crescent**  
**Southampton, SO15 2ET (GB)**

(54) **LAPAROSCOPIC SURGICAL LIGATION CLIP APPLIER**

(57) A ligation clip applier is provided and includes a handle assembly supporting an advancing mechanism removably and slidably supported within a barrel housing of the handle assembly, and a clip module removably and selectively connected to the handle assembly. The clip module includes a housing defining a proximal end, a distal end and a lumen therethrough, the clip module housing including an annular flange extending radially

into the lumen thereof; and a jaw blade slidably supported within the lumen of the clip module housing. The jaw blade includes a pair of jaws disposed within the distal end of the clip module housing, the pair of jaws being biased to an open condition, wherein each jaw includes a respective cam tooth projecting therefrom, wherein the cam teeth are in operative registration with, and proximal of, the annular flange of the clip module housing.

**EP 3 028 653 A1**

## Description

### CROSS-REFERENCE TO RELATED APPLICATION

**[0001]** The present application claims the benefit of and priority to U.S. Provisional Patent Application Serial No. 62/086,250, filed on December 2, 2014, the entire content of which is incorporated herein by reference.

### BACKGROUND

#### Technical Field

**[0002]** The present disclosure relates generally to a medical instrument for use with a surgical ligation clip. More particularly, the present disclosure is directed to a modular applier for positioning, securing, and closing a surgical ligation clip (from a plurality of ligation clips loaded into a clip cartridge or clip pack) around a vessel to be occluded.

#### Description of Related Art

**[0003]** Endoscopic staplers and clip appliers are known in the art and are used for a number of distinct and useful surgical procedures. In the case of a laparoscopic surgical procedure, access to the interior of an abdomen is achieved through narrow tubes or cannulas inserted through a small entrance incision in the skin. Minimally invasive procedures performed elsewhere in the body are often generally referred to as endoscopic procedures. Typically, a tube or cannula device is extended into the patient's body through the entrance incision to provide an access port. The port allows the surgeon to insert a number of different surgical instruments therethrough using a trocar and for performing surgical procedures far removed from the incision.

**[0004]** During a majority of these procedures, the surgeon must often terminate the flow of blood or another fluid through one or more vessels. The surgeon will often apply a surgical clip to a blood vessel or another duct to prevent the flow of body fluids therethrough during the procedure. An endoscopic clip applier is known in the art for applying a single clip during an entry to the body cavity. Such clips are typically fabricated from a biocompatible material and are usually compressed over a vessel. Once applied to the vessel, the compressed clip terminates the flow of fluid therethrough.

**[0005]** Endoscopic clip appliers including movable jaws that are able to apply multiple clips in endoscopic or laparoscopic procedures during a single entry into the body cavity are described in commonly-assigned U.S. Pat. Nos. 5,084,057 and 5,100,420 to Green et al., which are both incorporated by reference in their entirety. Another multiple endoscopic clip applier is disclosed in commonly-assigned U.S. Pat. No. 5,607,436 by Pratt et al., the contents of which is also hereby incorporated by reference herein in its entirety. These devices are typically,

though not necessarily, used during a single surgical procedure. U.S. Pat. No. 5,695,502 to Pier et al., the disclosure of which is hereby incorporated by reference herein, discloses a resterilizable surgical clip applier. The clip applier advances and forms multiple clips during a single insertion into the body cavity. This resterilizable clip applier is configured to receive and cooperate with an interchangeable clip magazine so as to advance and form multiple clips during a single entry into a body cavity.

**[0006]** Other clip appliers include fixed jaws that apply a single clip in an endoscopic or laparoscopic procedure and which then have to be withdrawn from the body cavity in order to be loaded with an additional single clip, for further application within the body cavity. U.S. Pat. No. 5,354,304 to Allen et al., the disclosure of which is hereby incorporated by reference herein, discloses such a fixed jaw surgical clip applier. Generally, use of these appliers includes actuation by a surgeon of the applier to fire the single clip, withdrawal of the applier from the body cavity of the patient, removal of the expired clip cartridge (having contained the single clip) from the handle assembly of the applier, and loading of a new clip cartridge onto the handle assembly in order to fire another surgical clip.

**[0007]** Accordingly, a need exists for laparoscopic surgical clip appliers that include reusable handle assemblies, reusable shaft assemblies, and disposable clip cartridge assemblies, with each clip cartridge assembly being loaded with a plurality of surgical ligation clips.

### SUMMARY

**[0008]** The present disclosure relates to laparoscopic modular surgical clip appliers capable of positioning, securing, and closing a surgical ligation clip (from a plurality of ligation clips loaded into a clip cartridge or clip pack) around a vessel to be occluded.

**[0009]** According to an aspect of the present disclosure, a ligation clip applier is provided. The ligation clip applier includes a handle assembly, and a clip module.

**[0010]** The handle assembly includes a barrel housing defining a cavity therein; a fixed handle extending from the barrel housing; a trigger pivotably connected to the fixed handle, the trigger including a proximal end extending into the cavity of the barrel housing; an elongate neck portion supported on and extending from the barrel housing, the elongate neck portion includes a tubular shaft defining a lumen therethrough, wherein the lumen of the tubular shaft of the neck portion extends into the cavity of the barrel housing; and an advancing mechanism removably and slidably supported within the barrel housing and the lumen of the tubular shaft of the neck portion, wherein the advancing mechanism is actuatable by the trigger.

**[0011]** The advancing mechanism includes an advancing shaft having a proximal end and a distal end; an actuator supported at the distal end of the advancing shaft; and a biasing member urging the advancing shaft in a proximal direction.

**[0012]** The clip module is removably and selectively connected to a distal end of the tubular shaft of the neck portion. The clip module includes a housing defining a proximal end, a distal end and a lumen therethrough, the proximal end of the clip module housing being configured for selective connection to the distal end of the tubular shaft of the neck portion, the clip module housing including an annular flange extending radially into the lumen thereof.

**[0013]** The clip module includes a jaw blade slidably supported within the lumen of the clip module housing. The jaw blade includes a pair of jaws disposed within the distal end of the clip module housing, the pair of jaws being biased to an open condition, wherein each jaw includes a respective cam tooth projecting therefrom, wherein the cam teeth are in operative registration with, and proximal of, the annular flange of the clip module housing; and a stem extending proximally from the pair of jaws, wherein a proximal end of the stem is engagable by the distal end of the actuator of the advancing mechanism.

**[0014]** The clip module may further include a biasing member configured to maintain the jaw blade in a retracted position relative to the clip module housing.

**[0015]** The jaw blade of the clip module may be movable between an advanced position and the retracted position, wherein in the advanced position, the cam teeth of the pair of jaws of the jaw blade engage the annular flange of the clip module housing, wherein the pair of jaws are approximated to a closed condition; and in the retracted position, the cam teeth of the pair of jaws of the jaw blade are disengaged from the annular flange of the clip module housing, wherein the pair of jaws are in the open condition.

**[0016]** The biasing member of the clip module may be a coil spring including a first end secured to a relatively distal portion of the jaw blade, and a second end secured to a relatively proximal end of the clip module housing.

**[0017]** In use, during an actuation of the trigger of the handle assembly, the proximal end of the trigger may engage the proximal end of the advancing shaft of the advancing mechanism to distally advance the advancing shaft.

**[0018]** In use, during the distal advancement of the advancing shaft, the actuator of the advancing assembly may engage the proximal end of the stem of the jaw blade to distally advance the jaw blade.

**[0019]** The clip module housing may define a radial groove formed in an outer surface thereof, wherein the radial groove is located adjacent a proximal end of the clip module housing.

**[0020]** The tubular shaft of the elongate neck portion may include a latch pivotally supported adjacent a distal end thereof, wherein the latch includes a proximal end and a distal end, wherein the distal end of the latch includes a radially inwardly extending pawl.

**[0021]** The pawl of the latch of the tubular shaft may be configured to selectively engage the radial groove of

the clip module housing, to selectively secure the clip module to the elongate shaft.

**[0022]** In use, upon an actuation of the trigger, the proximal end of the trigger may act on a proximal end of the actuator of the advancing mechanism to distally advance the actuator.

**[0023]** Also in use, upon distal advancement of the actuator, the distal end of the actuator may act on the proximal end of the stem of the jaw blade to distally advance the jaw blade.

**[0024]** Further, in use, upon distal advancement of the jaw blade, the cam teeth of the pair of jaws of the jaw blade may engage the annular flange of the clip module housing, whereby the pair of jaws are approximated to the closed condition.

**[0025]** According to another aspect of the present disclosure, a clip module for selective connection to a handle assembly and actuatable by an advancing mechanism of the handle assembly, is provided. The clip module includes a housing defining a proximal end, a distal end and a lumen therethrough, the proximal end of the clip module housing being configured for selective connection to a distal end of a tubular shaft of the handle assembly, the clip module housing including an annular flange extending radially into the lumen thereof.

**[0026]** The clip module also includes a jaw blade slidably supported within the lumen of the clip module housing. The jaw blade includes a pair of jaws disposed within the distal end of the clip module housing, the pair of jaws being biased to an open condition, wherein each jaw includes a respective cam tooth projecting therefrom, wherein the cam teeth are in operative registration with, and proximal of, the annular flange of the clip module housing; and a stem extending proximally from the pair of jaws. A proximal end of the stem is engagable by the advancing mechanism of the handle assembly.

**[0027]** The clip module may further include a biasing member configured to maintain the jaw blade in a retracted position relative to the clip module housing.

**[0028]** The jaw blade of the clip module may be movable between an advanced position and the retracted position, wherein in the advanced position, the cam teeth of the pair of jaws of the jaw blade engage the annular flange of the clip module housing, wherein the pair of jaws are approximated to a closed condition; and in the retracted position, the cam teeth of the pair of jaws of the jaw blade are disengaged from the annular flange of the clip module housing, wherein the pair of jaws are in the open condition.

**[0029]** The biasing member of the clip module may be a coil spring including a first end secured to a relatively distal portion of the jaw blade, and a second end secured to a relatively proximal end of the clip module housing.

**[0030]** In use, during an actuation of the advancing mechanism of the handle assembly, the stem of the jaw blade may be acted on to distally advance the jaw blade.

**[0031]** The clip module housing may define a radial groove formed in an outer surface thereof, wherein the

radial groove is located adjacent a proximal end of the clip module housing.

## BRIEF DESCRIPTION OF THE DRAWINGS

**[0032]** A particular embodiment of a laparoscopic surgical clip applier is disclosed herein with reference to the drawings wherein:

FIG. 1 is a side elevational view of a ligation surgical clip applier in accordance with the present disclosure;

FIG. 2 is a perspective view, with parts separated, of a handle assembly and a proximal end of a neck portion of the ligation surgical clip applier of FIG. 1; FIG. 3 is a perspective view of an advancing mechanism of the ligation surgical clip applier of FIG. 1; FIG. 4 is a schematic, side elevational view of a distal end of the neck portion of the ligation surgical clip applier of FIG. 1, with a loaded laparoscopic clip module attached thereto;

FIG. 5 is a schematic, cross-sectional, side elevational view of the distal end of the neck portion of the ligation surgical clip applier and the laparoscopic clip module shown in FIG. 4;

FIG. 6 is a cross-sectional, elevational view of the proximal end of the ligation surgical clip applier illustrating the handle assembly in three different positions;

FIG. 7 is a schematic, side elevational view of the distal end of the neck portion of the ligation surgical clip applier of FIG. 1, illustrating a firing of the loaded laparoscopic clip module attached thereto; and

FIG. 8 is a schematic, side elevational view of the distal end of the neck portion of the ligation surgical clip applier of FIG. 1, illustrating an expired laparoscopic clip module attached thereto.

## DETAILED DESCRIPTION OF EMBODIMENTS

**[0033]** Embodiments of ligation surgical clip appliers, in accordance with the present disclosure, will now be described in detail with reference to the drawing figures wherein like reference numerals identify similar or identical structural elements. As shown in the drawings and described throughout the following description, as is traditional when referring to relative positioning on a surgical instrument, the term "proximal" refers to the end of the apparatus which is closer to the user and the term "distal" refers to the end of the apparatus which is further away from the user.

**[0034]** As shown in FIG. 1, a ligation surgical clip applier, in accordance with an embodiment of the present disclosure, is generally designated as 100. Clip applier 100 includes a handle assembly 110, an elongated and round or cylindrical neck portion or assembly 120 projecting from or extending from handle assembly 110, and a ligation clip module 140 that can be removably and

selectively mounted on a distal end of neck portion 120. As will be described in greater detail below, a plurality of surgical ligation clips "C" (FIGS. 5 and 7) are loaded into ligation clip module 140. Also, as will be described in greater detail below, in operation, as handle assembly 110 is actuated, a single ligation clip "C" is fired and formed around a vessel to be ligated.

**[0035]** Handle assembly 110, as shown in FIGS. 1 and 2, includes a fixed handle 112 and a squeezable trigger 114 pivotally attached to fixed handle 112 at pivot shaft 116. Squeezable trigger 114 includes a proximal actuating end 114a.

**[0036]** Handle assembly 110 include a housing, in the form of a barrel, 118 supported on fixed handle 112. Barrel 118 is configured to receive a proximal end of neck portion 120. A threaded end cap 119 closes a proximal end of barrel 118. As shown in FIG. 2, barrel 118 is formed of a first barrel portion 118a, a second barrel portion 118b and a third barrel portion 118c of progressively smaller diameters, that together form a telescope-like appearing structure. Third barrel portion 118c includes a radially projecting lip at its distal end.

**[0037]** The proximal end of elongated neck portion or assembly 120, as shown in FIG. 2, includes a hollow tube or shaft 122 and a collar 124 secured thereto and open at its proximal end. The proximal end of hollow shaft 122 has two oppositely disposed J-shaped notches 122a (e.g., "bayonet locks" or channels), to secure elongated neck portion 120 to handle assembly 110.

**[0038]** The shaft 122 and collar 124, as well as the entire handle assembly 110, may be made of high grade surgical steel, such as, for example, stainless steel, or from a high strength autoclavable polymer or the like.

**[0039]** To assemble neck portion 120 and handle assembly 110, a resilient wave washer and a first bushing are placed over the proximal end of shaft 122. The shaft 122 is inserted into the open distal end of the barrel assembly 118 until a rim on the first bushing abuts the circumferential lip on third barrel portion 118c, as illustrated in FIG. 6. A second bushing, having a cylindrical portion and a circumferential rim, and a bayonet ring lock are then inserted into the open proximal end of barrel 118 and over the proximal end of shaft 122. Referring momentarily to FIG. 6, the second bushing is inserted until a rim thereof abuts a radially projecting ridge formed between second barrel portion 118b and third barrel portion 118c of barrel 118. The bayonet ring lock may include a pair of opposed pins, protruding inwardly from its inner cylindrical surface, that are configured to fit into the J-shaped notches 122a and lock elongated neck portion 120 in handle assembly 110.

**[0040]** With reference to FIGS. 3 and 6, neck portion 120 includes an advancing mechanism 130 slidably disposed within hollow shaft 122 thereof. Advancing mechanism 130 includes an advancing shaft 132 supports, at its distal end, an actuator 134. As shown in FIG. 3, actuator 134 has a cylindrical portion 134a and tapers to a flat blade-like portion 134b having a substantially rectan-

gular cross-sectional profile.

**[0041]** Advancing shaft 132 is urged toward the proximal end of neck portion 120 by a compression return spring 136. A proximal end of spring 136 may abut against a shaft adapter 138.

**[0042]** With the neck portion 120 connected to barrel 118 of handle assembly 110, advancing shaft 132 is assembled in neck portion 120 by inserting advancing shaft 132 in the proximal end of barrel 118. As shown in FIG. 6, a short stop pin 122a extends inwardly from the inner surface of hollow shaft 122 in an intermediate region thereof. When advancing shaft 132 is inserted through the hollow shaft 132, the sliding bushing abuts against stop pin 122a and becomes arrested at that position. Further insertion of advancing shaft 132 causes spring 136 to engage shaft adapter 138, thereby biasing advancing shaft 132 in the rearward direction against proximal actuating end 114a of squeezable trigger 114. When advancing shaft 132 is fully inserted into neck portion 120, the end cap 119 may be placed or screwed onto proximal end of barrel 118.

**[0043]** With reference to FIG. 6, when squeezable trigger 114 is pivoted in the counterclockwise direction about the pivot shaft 116, the top or actuating end 114a of squeezable trigger 114 engages the proximal end of the shaft adapter 138 thereby urging advancing shaft 132 distally against the biasing force of spring 136.

**[0044]** FIG. 5 illustrates how ligation clip module 140 is attached to the distal end of hollow shaft 122. Specifically, a spring-loaded latch 126 is pivotably mounted in a wall of hollow shaft 122. A distal end of latch 126 is provided with a pawl 126a. The ligation clip module 140 has a reduced diameter housing section 142b which fits into the open distal end of hollow shaft 122. To secure ligation clip module 140 in hollow shaft 122, a proximal end of latch 126 is pressed down (in the direction of arrow "A") to raise pawl 126a. The reduced diameter housing section 142b of ligation clip module 140 is then inserted into the open distal end of hollow shaft 122, and the proximal end of latch 126 is released so that pawl 126a catches a transverse or radial groove 142c in the reduced diameter housing section 142b of ligation clip module 140 to securely lock ligation clip module 140 in neck portion 120. Advantageously, pawl 126a of latch 126 may be provided with a cam surface that rides up on the proximal extreme of reduced diameter housing section 142b of ligation clip module 140. In this way, the cam surface of pawl 126a is automatically guided to groove 142c of ligation clip module 140 when ligation clip module 140 is inserted into neck portion 120.

**[0045]** As a safety feature, when latch 126 is pivoted to the open position, the proximal end of latch 126 abuts flat blade-like portion 134b of actuator 134 and prevents advancing shaft 132 from moving farther forwardly in hollow shaft 122.

**[0046]** Similarly, when ligation clip module 140 is properly mounted in neck portion 120 and advancing shaft 132 is advanced to apply a ligation clip, as described

below, cylindrical section 134a of actuator 134 prevents the proximal end of latch 126 from being depressed to release ligation clip module 140.

**[0047]** With reference to FIGS. 4, 5, 7 and 8, the individual components of ligation clip module 140 are shown. Ligation clip module 140 includes a housing 142 having a distal housing section 142a of a first diameter, and proximal housing section 142b having a second diameter that is reduced from the first diameter. Proximal housing section 142b defines an outer annular groove or recess 142c therein. A lumen 142d extends longitudinally through housing 142. Housing 142 includes an annular flange 142e defining a camming surface that extends radially inward, at a distal end of housing 142.

**[0048]** Ligation clip module 140 includes a jaw blade 144 slidably supported within lumen 142d of housing 142. Jaw blade 144 includes a pair of jaws 144a projecting from or extending distally from within housing 142, and a proximal stem 144b extending proximally through lumen 142d of housing 142. Jaw blade 144 is fabricated from a resilient material, such as, for example, stainless steel, and is formed such that the pair of jaws 144a are spaced apart from one another or are biased apart from one another. Each jaw 144a includes a cam tooth 144c projecting therefrom and configured to engage annular flange 142e of housing 142 when jaw blade 144 is advanced distally. In operation, with reference to FIGS. 7 and 8, as jaw blade 144 is advanced distally, cam teeth 144c of the pair of jaws 144a engage annular flange 142e of housing 142 thereby resulting in a closure or approximation of the pair of jaws 144.

**[0049]** Ligation clip module 140 further includes a biasing member 146 functioning to maintain jaw blade 144 in a retracted position relative to housing 142, whereby the pair of jaws 144a are maintained in an open condition due to a natural spring bias thereof. Alternatively, biasing member 146 may function to act on jaw blade 144 such that an outer surface of the pair of jaws 144a cam against a distal edge of annular flange 142e of housing 142. In an embodiment for example, biasing member 146 may be a coil spring disposed about stem 144b of jaw blade 144, and may include a first end secured to a relatively distal portion of jaw blade 144 (e.g., secured to a collar or flange of jaw blade 144), and a second end secured to a relatively proximal portion of housing 142.

**[0050]** As can be appreciated, ligation clip module 140 is disposable. In addition, different size modules for mounting various size ligation clips can be easily connected to the same hollow shaft 122 by using a standard size reduced diameter proximal section 142b of housing 142.

**[0051]** With reference to FIGS. 5-8, an exemplary operation of clip applier 100 is described. As illustrated in FIG. 5, with ligation clip module 140 secured onto neck portion 120, a ligation clip "C" (FIGS. 5 and 7) is loaded in the pair of jaws 144a of ligation clip module 140, and is ready to be fired. With clip applier 100 loaded with a ligation clip module 140 holding ligation clip "C" between

the pair of jaws 144a, and ready to be fired, the ligation clip "C" may be positioned around a vessel to be ligated.

**[0052]** With reference to FIGS. 6 and 7, with the ligation clip "C" in position around the vessel to be ligated, squeezing or actuation of trigger 114 causes advancing shaft 132 (FIGS. 3 and 6) of neck portion 120 to be advanced distally, as indicated by arrow "B" of FIG. 7. As advancing shaft 132 of neck portion 120 is advanced distally, flat blade-like portion 134b of actuator 134 is advanced into abutment with stem 144b of jaw blade 144. Additionally, as advancing shaft 132 of neck portion 120 is advanced distally, return spring 136 of advancing mechanism 130 is compressed.

**[0053]** The flat blade-like portion 134b of actuator 134 forces jaw blade 144 in a distal direction, thereby driving the cam teeth 144c of the pair of jaws 144a against annular flange 142e of housing 142 of ligation clip module 140, and thereby closing or approximating the pair of jaws 144a, against a spring bias thereof, to form ligation clip "C". As jaw blade 144 is advanced distally, biasing member 146 is stretched or lengthened.

**[0054]** Following formation of ligation clip "C", with reference to FIG. 8, trigger 114 is released, whereby return spring 136 is free to expand and thus withdraw advancing shaft 132 of neck portion 120. As advancing shaft 132 of neck portion 120 is withdrawn from flat blade-like portion 134b of actuator 134 is retracted from contact with stem 144b of jaw blade 144. As actuator 134 is retracted from stem 144b of jaw blade 144, biasing member 146 is free to recompress or retract, thereby withdrawing cam teeth 144c of the pair of jaws 144a away from annular flange 142e of housing 142 of ligation clip module 140, and thereby permitting the pair of jaws 144a to open due to the spring bias thereof.

**[0055]** With continued reference to FIG. 8, with actuator 134 retracted, flat blade-like portion 134b of actuator 134 is in registration with the proximal end of latch 126 of neck portion 120. As so positioned, the proximal end of latch 126 may be pressed down (in the direction of arrow "A" of FIG. 5) to raise and disengage pawl 126a from the transverse or radial groove 142c of the reduced diameter proximal housing section 142b of ligation clip module 140 to thereby permit disconnection of spent ligation clip module 140 from neck portion 120. Alternatively, the spent ligation clip module 140 may be reloaded with a new ligating clip (contained in a clip pack), prior to disconnection of ligation clip module 140 from neck portion 120 and discarding thereof.

**[0056]** A new ligation clip module 140 can then be inserted and secured in the hollow shaft 122 of neck portion 120, and clip applier 100 is once again ready to fire another ligating clip "C".

**[0057]** Ligation clips "C" may be contained in clip packs containing a plurality of clips, such as, for example, six (6) clips of the like. Clip packs may be loaded with a full set of metal clips (e.g., titanium, stainless steel or metal alloys), a full set of polymer clips (e.g., biocompatible or bioabsorbable), or a combination thereof.

**[0058]** Although a specific embodiment of the present disclosure has been described above in detail, it will be understood that this description is merely for purposes of illustration. Various modifications of and equivalent structures corresponding to the disclosed aspects of the preferred embodiments in addition to those described above may be made by those skilled in the art without departing from the spirit of the present disclosure which is defined in the following claims, the scope of which is to be accorded the broadest interpretation so as to encompass such modifications and equivalent structures.

**[0059]** The invention may be described by reference to the following numbered paragraphs:-

1. A ligation clip applier, comprising:

a handle assembly including:

a barrel housing defining a cavity therein;  
a fixed handle extending from the barrel housing;  
a trigger pivotably connected to the fixed handle, the trigger including a proximal end extending into the cavity of the barrel housing;  
an elongate neck portion supported on and extending from the barrel housing, the elongate neck portion includes a tubular shaft defining a lumen therethrough, wherein the lumen of the tubular shaft of the neck portion extends into the cavity of the barrel housing; and  
an advancing mechanism removably and slidably supported within the barrel housing and the lumen of the tubular shaft of the neck portion, wherein the advancing mechanism is actuatable by the trigger, the advancing mechanism including:

an advancing shaft having a proximal end and a distal end;  
an actuator supported at the distal end of the advancing shaft; and  
a biasing member urging the advancing shaft in a proximal direction; and

a clip module removably and selectively connected to a distal end of the tubular shaft of the neck portion, the clip module including:

a housing defining a proximal end, a distal end and a lumen therethrough, the proximal end of the clip module housing being configured for selective connection to the distal end of the tubular shaft of the neck portion, the clip module housing including an annular flange extending radially into the lumen thereof; and

a jaw blade slidably supported within the lumen of the clip module housing, the jaw blade including:

a pair of jaws disposed within the distal end of the clip module housing, the pair of jaws being biased to an open condition, wherein each jaw includes a respective cam tooth projecting therefrom, wherein the cam teeth are in operative registration with, and proximal of, the annular flange of the clip module housing; and  
a stem extending proximally from the pair of jaws, wherein a proximal end of the stem is engagable by the distal end of the actuator of the advancing mechanism.

2. The ligation clip applier according to paragraph 1, wherein the clip module further includes a biasing member configured to maintain the jaw blade in a retracted position relative to the clip module housing.
3. The ligation clip applier according to paragraph 2, wherein the jaw blade of the clip module is movable between an advanced position and the retracted position, wherein:

in the advanced position, the cam teeth of the pair of jaws of the jaw blade engage the annular flange of the clip module housing, wherein the pair of jaws are approximated to a closed condition; and  
in the retracted position, the cam teeth of the pair of jaws of the jaw blade are disengaged from the annular flange of the clip module housing, wherein the pair of jaws are in the open condition.

4. The ligation clip applier according to paragraph 3, wherein the biasing member of the clip module is a coil spring including a first end secured to a relatively distal portion of the jaw blade, and a second end secured to a relatively proximal end of the clip module housing.
5. The ligation clip applier according to paragraph 3, wherein, during an actuation of the trigger of the handle assembly, the proximal end of the trigger engages the proximal end of the advancing shaft of the advancing mechanism to distally advance the advancing shaft.
6. The ligation clip applier according to paragraph 5, wherein, during the distal advancement of the advancing shaft, the actuator of the advancing assembly engages the proximal end of the stem of the jaw blade to distally advance the jaw blade.
7. The ligation clip applier according to paragraph 1, wherein the clip module housing defines a radial

groove formed in an outer surface thereof, wherein the radial groove is located adjacent a proximal end of the clip module housing.

8. The ligation clip applier according to paragraph 7, wherein the tubular shaft of the elongate neck portion includes a latch pivotally supported adjacent a distal end thereof, wherein the latch includes a proximal end and a distal end, wherein the distal end of the latch includes a radially inwardly extending pawl.

9. The ligation clip applier according to paragraph 8, wherein the pawl of the latch of the tubular shaft is configured to selectively engage the radial groove of the clip module housing, to selectively secure the clip module to the elongate shaft.

10. The ligation clip applier according to paragraph 1, wherein upon an actuation of the trigger, the proximal end of the trigger acts on a proximal end of the actuator of the advancing mechanism to distally advance the actuator.

11. The ligation clip applier according to paragraph 10, wherein upon distal advancement of the actuator, the distal end of the actuator acts on the proximal end of the stem of the jaw blade to distally advance the jaw blade.

12. The ligation clip applier according to paragraph 11, wherein upon distal advancement of the jaw blade, the cam teeth of the pair of jaws of the jaw blade engage the annular flange of the clip module housing, whereby the pair of jaws are approximated to the closed condition.

13. A clip module for selective connection to a handle assembly and actuatable by an advancing mechanism of the handle assembly, the clip module comprising:

a housing defining a proximal end, a distal end and a lumen therethrough, the proximal end of the clip module housing being configured for selective connection to a distal end of a tubular shaft of the handle assembly, the clip module housing including an annular flange extending radially into the lumen thereof;  
a jaw blade slidably supported within the lumen of the clip module housing, the jaw blade including:

a pair of jaws disposed within the distal end of the clip module housing, the pair of jaws being biased to an open condition, wherein each jaw includes a respective cam tooth projecting therefrom, wherein the cam teeth are in operative registration with, and proximal of, the annular flange of the clip module housing; and  
a stem extending proximally from the pair of jaws, wherein a proximal end of the stem is engagable by the advancing mechanism of the handle assembly.

14. The clip module according to paragraph 13, further comprising a biasing member configured to maintain the jaw blade in a retracted position relative to the clip module housing.

15. The clip module according to paragraph 14, wherein the jaw blade of the clip module is movable between an advanced position and the retracted position, wherein:

in the advanced position, the cam teeth of the pair of jaws of the jaw blade engage the annular flange of the clip module housing, wherein the pair of jaws are approximated to a closed condition; and

in the retracted position, the cam teeth of the pair of jaws of the jaw blade are disengaged from the annular flange of the clip module housing, wherein the pair of jaws are in the open condition.

16. The clip module according to paragraph 15, wherein the biasing member of the clip module is a coil spring including a first end secured to a relatively distal portion of the jaw blade, and a second end secured to a relatively proximal end of the clip module housing.

17. The clip module according to paragraph 16, wherein, during an actuation of the advancing mechanism of the handle assembly, the stem of the jaw blade is acted on to distally advance the jaw blade.

18. The clip module according to paragraph 13, wherein the clip module housing defines a radial groove formed in an outer surface thereof, wherein the radial groove is located adjacent a proximal end of the clip module housing.

## Claims

1. A ligation clip applier, comprising:

a handle assembly including:

a barrel housing defining a cavity therein;  
a fixed handle extending from the barrel housing;

a trigger pivotably connected to the fixed handle, the trigger including a proximal end extending into the cavity of the barrel housing;

an elongate neck portion supported on and extending from the barrel housing, the elongate neck portion includes a tubular shaft defining a lumen therethrough, wherein the lumen of the tubular shaft of the neck portion extends into the cavity of the barrel housing; and

an advancing mechanism removably and

slidably supported within the barrel housing and the lumen of the tubular shaft of the neck portion, wherein the advancing mechanism is actuatable by the trigger, the advancing mechanism including:

an advancing shaft having a proximal end and a distal end;

an actuator supported at the distal end of the advancing shaft; and

a biasing member urging the advancing shaft in a proximal direction; and

a clip module removably and selectively connected to a distal end of the tubular shaft of the neck portion, the clip module including:

a housing defining a proximal end, a distal end and a lumen therethrough, the proximal end of the clip module housing being configured for selective connection to the distal end of the tubular shaft of the neck portion, the clip module housing including an annular flange extending radially into the lumen thereof; and

a jaw blade slidably supported within the lumen of the clip module housing, the jaw blade including:

a pair of jaws disposed within the distal end of the clip module housing, the pair of jaws being biased to an open condition, wherein each jaw includes a respective cam tooth projecting therefrom, wherein the cam teeth are in operative registration with, and proximal of, the annular flange of the clip module housing; and

a stem extending proximally from the pair of jaws, wherein a proximal end of the stem is engagable by the distal end of the actuator of the advancing mechanism.

2. The ligation clip applier according to claim 1, wherein the clip module further includes a biasing member configured to maintain the jaw blade in a retracted position relative to the clip module housing; preferably wherein the jaw blade of the clip module is movable between an advanced position and the retracted position, wherein:

in the advanced position, the cam teeth of the pair of jaws of the jaw blade engage the annular flange of the clip module housing, wherein the pair of jaws are approximated to a closed condition; and

in the retracted position, the cam teeth of the



- pair of jaws of the jaw blade are disengaged from the annular flange of the clip module housing, wherein the pair of jaws are in the open condition.
3. The ligation clip applier according to claim 2, wherein the biasing member of the clip module is a coil spring including a first end secured to a relatively distal portion of the jaw blade, and a second end secured to a relatively proximal end of the clip module housing; and/or wherein, during an actuation of the trigger of the handle assembly, the proximal end of the trigger engages the proximal end of the advancing shaft of the advancing mechanism to distally advance the advancing shaft.
  4. The ligation clip applier according to claim 3, wherein, during the distal advancement of the advancing shaft, the actuator of the advancing assembly engages the proximal end of the stem of the jaw blade to distally advance the jaw blade.
  5. The ligation clip applier according to any preceding claim, wherein the clip module housing defines a radial groove formed in an outer surface thereof, wherein the radial groove is located adjacent a proximal end of the clip module housing.
  6. The ligation clip applier according to claim 5, wherein the tubular shaft of the elongate neck portion includes a latch pivotally supported adjacent a distal end thereof, wherein the latch includes a proximal end and a distal end, wherein the distal end of the latch includes a radially inwardly extending pawl; preferably wherein the pawl of the latch of the tubular shaft is configured to selectively engage the radial groove of the clip module housing, to selectively secure the clip module to the elongate shaft.
  7. The ligation clip applier according to any preceding claim, wherein upon an actuation of the trigger, the proximal end of the trigger acts on a proximal end of the actuator of the advancing mechanism to distally advance the actuator.
  8. The ligation clip applier according to claim 7, wherein upon distal advancement of the actuator, the distal end of the actuator acts on the proximal end of the stem of the jaw blade to distally advance the jaw blade.
  9. The ligation clip applier according to claim 8, wherein upon distal advancement of the jaw blade, the cam teeth of the pair of jaws of the jaw blade engage the annular flange of the clip module housing, whereby the pair of jaws are approximated to the closed condition.
  10. A clip module for selective connection to a handle assembly and actuatable by an advancing mechanism of the handle assembly, the clip module comprising:
    - a housing defining a proximal end, a distal end and a lumen therethrough, the proximal end of the clip module housing being configured for selective connection to a distal end of a tubular shaft of the handle assembly, the clip module housing including an annular flange extending radially into the lumen thereof;
    - a jaw blade slidably supported within the lumen of the clip module housing, the jaw blade including:
      - a pair of jaws disposed within the distal end of the clip module housing, the pair of jaws being biased to an open condition, wherein each jaw includes a respective cam tooth projecting therefrom, wherein the cam teeth are in operative registration with, and proximal of, the annular flange of the clip module housing; and
      - a stem extending proximally from the pair of jaws, wherein a proximal end of the stem is engagable by the advancing mechanism of the handle assembly.
  11. The clip module according to claim 12, further comprising a biasing member configured to maintain the jaw blade in a retracted position relative to the clip module housing.
  12. The clip module according to claim 10 or claim 11, wherein the jaw blade of the clip module is movable between an advanced position and the retracted position, wherein:
    - in the advanced position, the cam teeth of the pair of jaws of the jaw blade engage the annular flange of the clip module housing, wherein the pair of jaws are approximated to a closed condition; and
    - in the retracted position, the cam teeth of the pair of jaws of the jaw blade are disengaged from the annular flange of the clip module housing, wherein the pair of jaws are in the open condition.
  13. The clip module according to claim 12, wherein the biasing member of the clip module is a coil spring including a first end secured to a relatively distal portion of the jaw blade, and a second end secured to a relatively proximal end of the clip module housing.
  14. The clip module according to any of claims 10 to 13, wherein, during an actuation of the advancing mech-

anism of the handle assembly, the stem of the jaw blade is acted on to distally advance the jaw blade.

15. The clip module according to any of claims 10 to 14, wherein the clip module housing defines a radial groove formed in an outer surface thereof, wherein the radial groove is located adjacent a proximal end of the clip module housing.

10

15

20

25

30

35

40

45

50

55

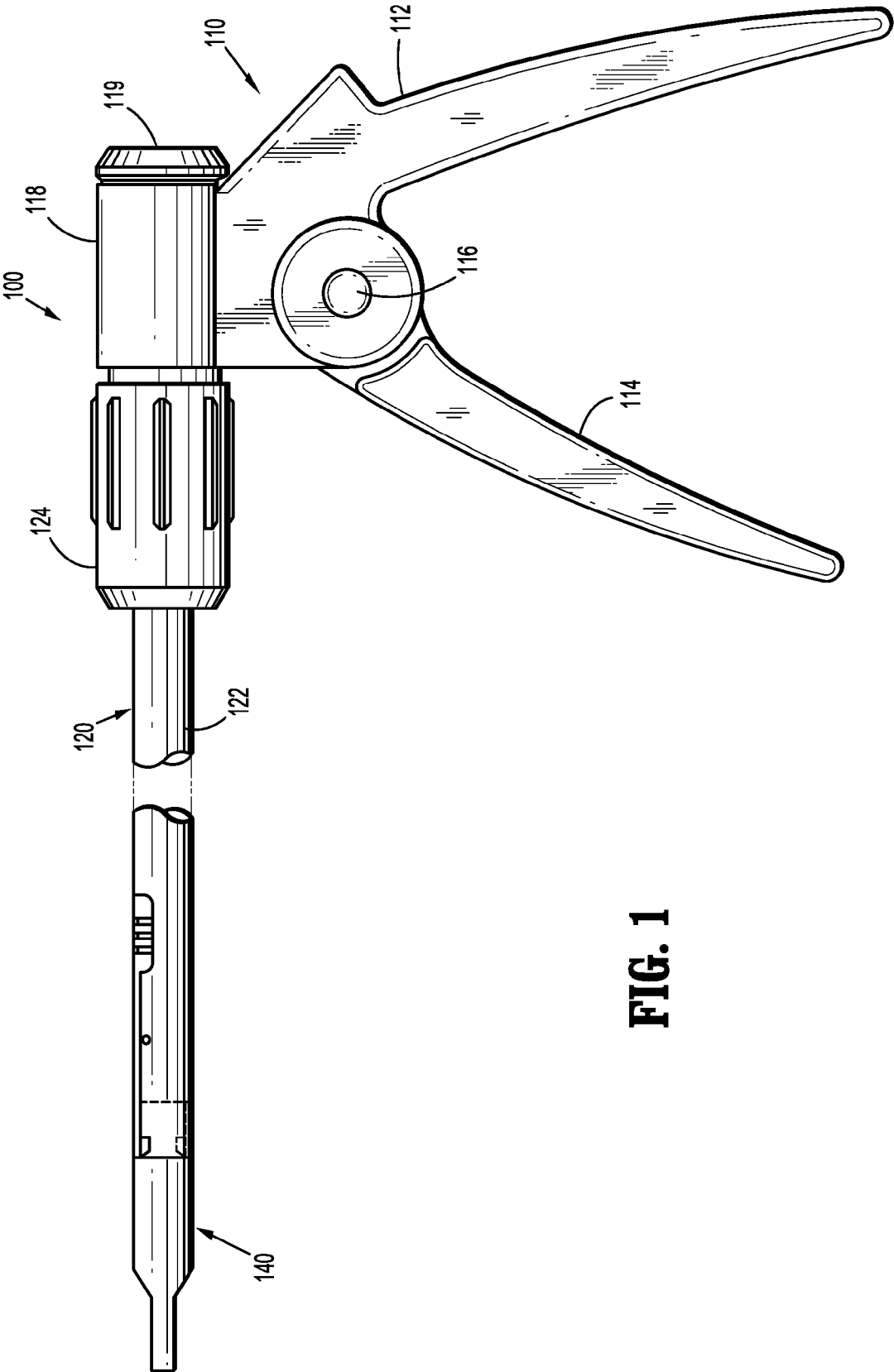

**FIG. 1**

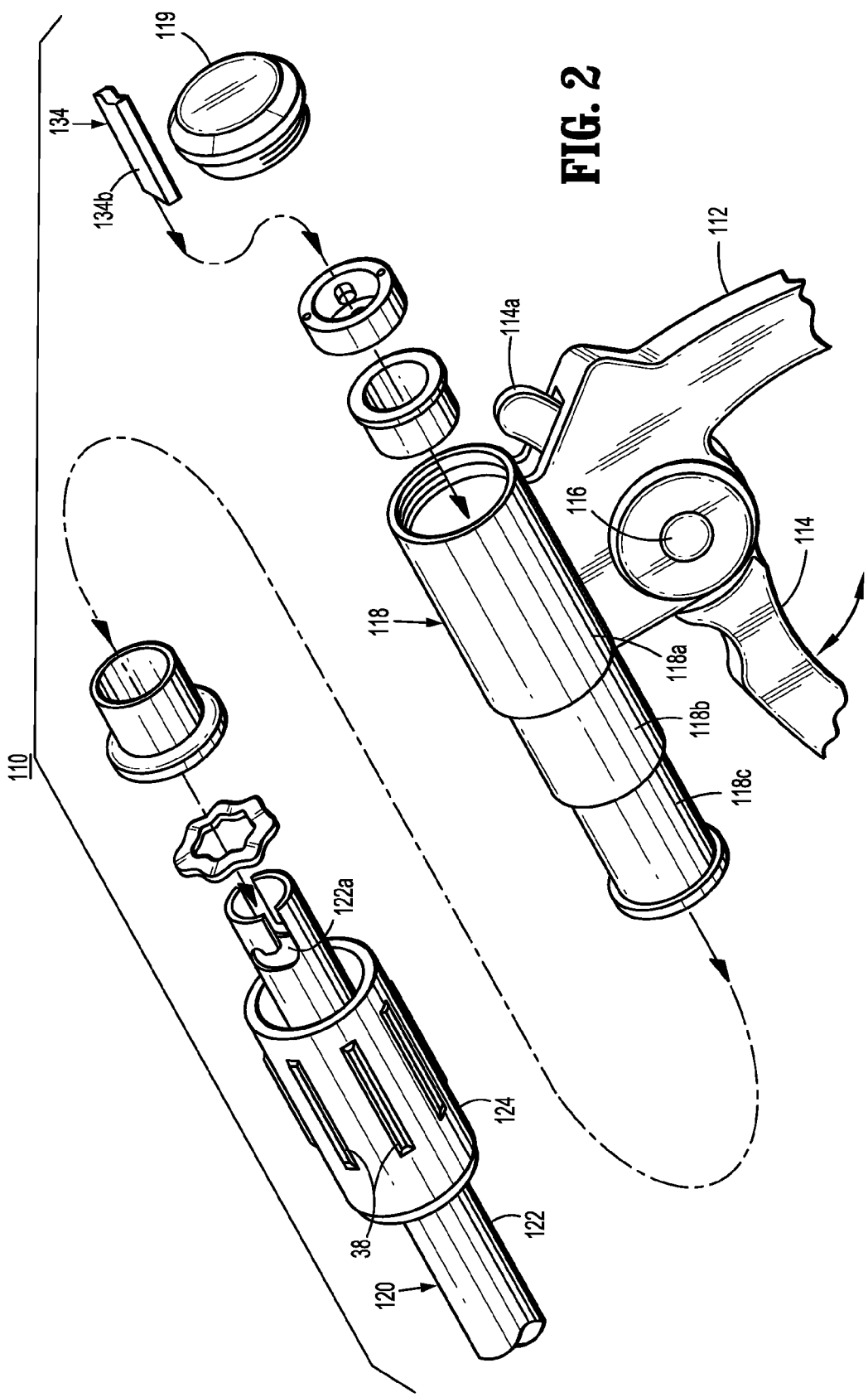
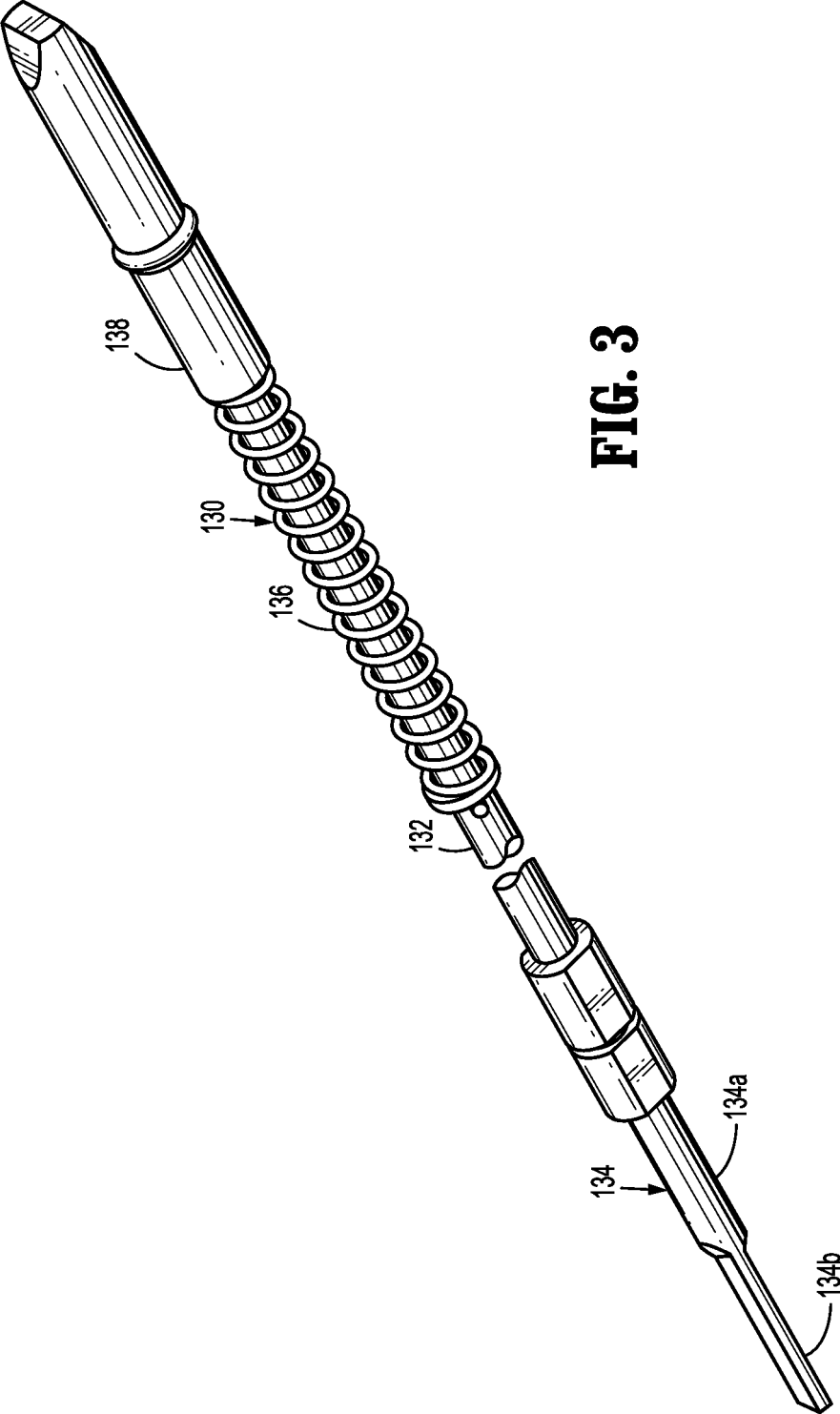

FIG. 2



**FIG. 3**

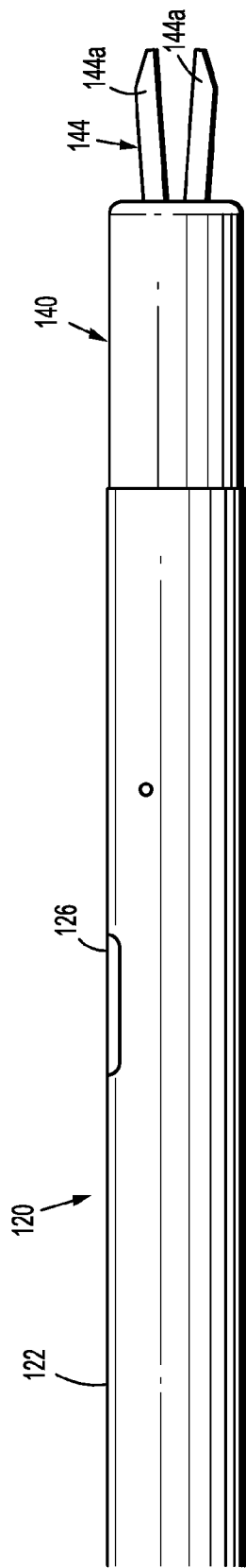

FIG. 4

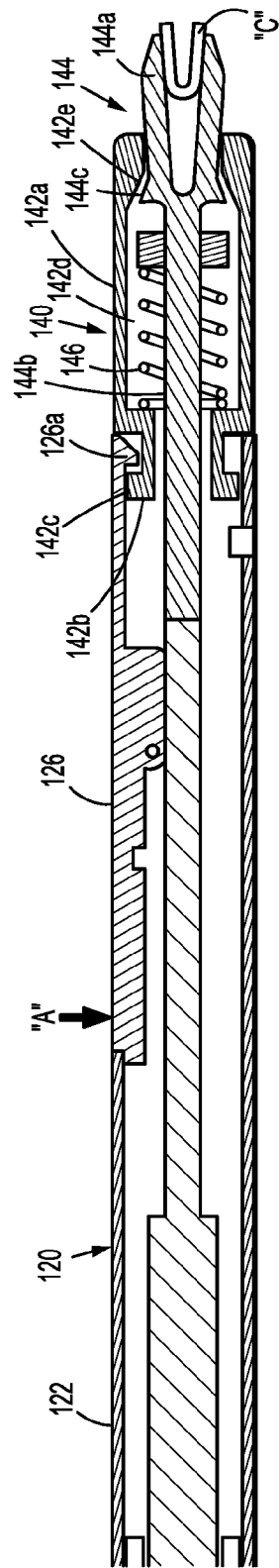
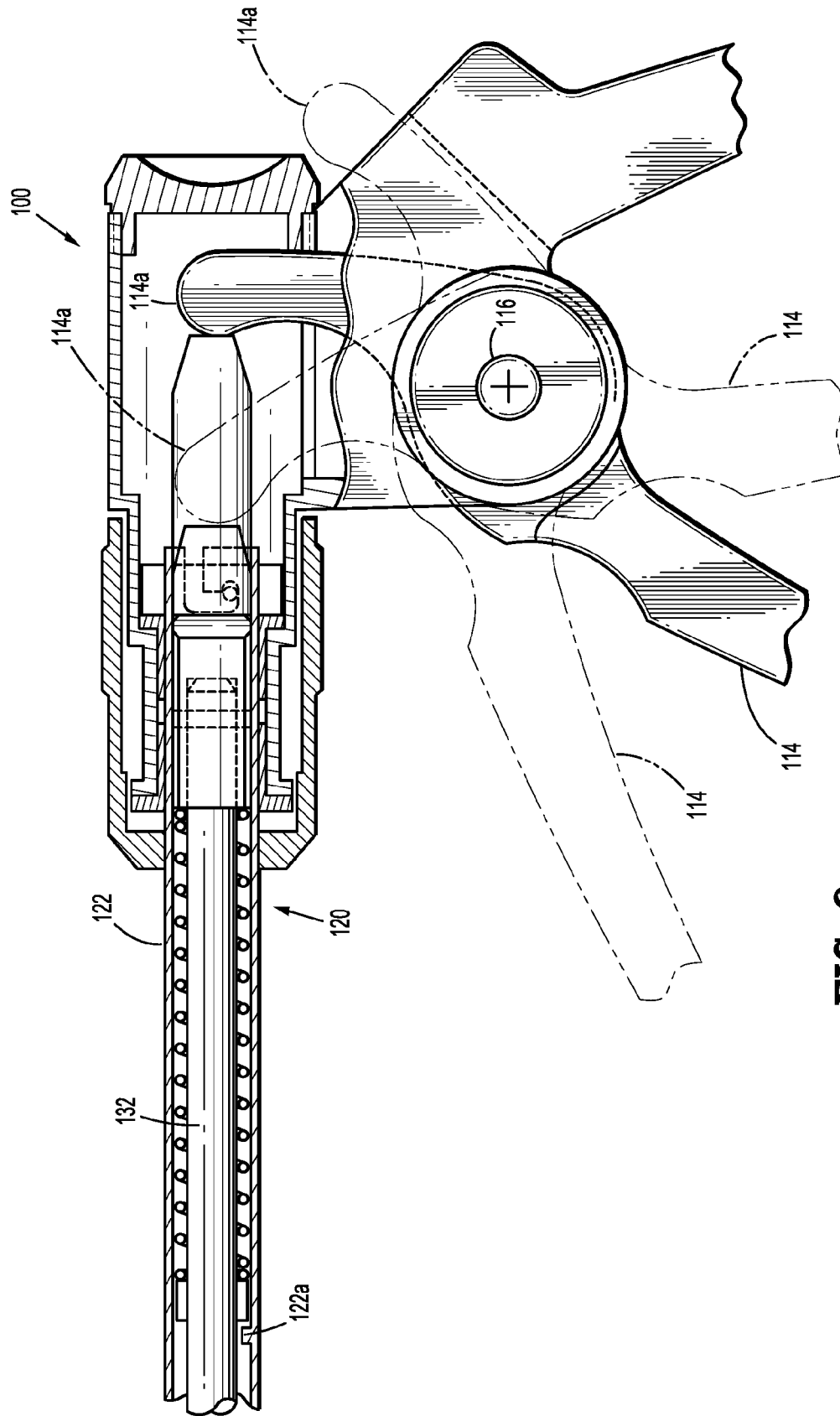
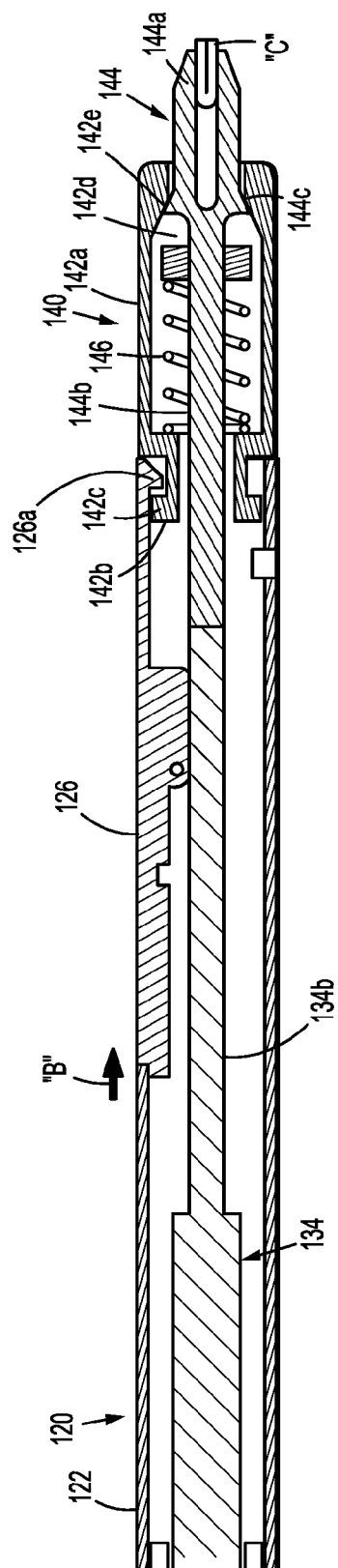

FIG. 5



**FIG. 6**



**FIG. 7**

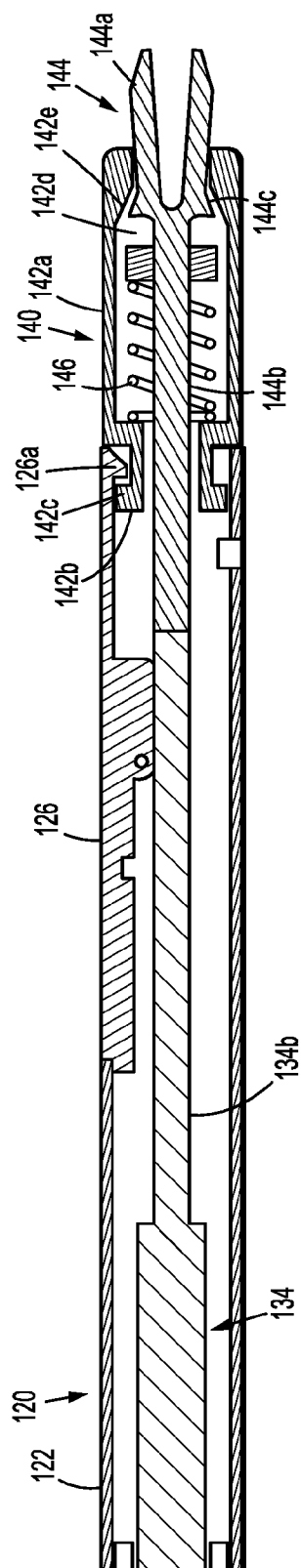

**FIG. 8**





## EUROPEAN SEARCH REPORT

Application Number  
EP 15 19 7251

5

10

15

20

25

30

35

40

45

50

55

DOCUMENTS CONSIDERED TO BE RELEVANT			
Category	Citation of document with indication, where appropriate, of relevant passages	Relevant to claim	CLASSIFICATION OF THE APPLICATION (IPC)
X	US 2009/264904 A1 (ALDRICH GEORGE [US] ET AL) 22 October 2009 (2009-10-22)  * paragraphs [0020] - [0022], [0031]; figures 2,4a,4b *	1,4,5,7,9,10,12,14,15	INV. A61B17/128
X	EP 0 760 230 A1 (UNITED STATES SURGICAL CORP [US]) 5 March 1997 (1997-03-05) * column 19, lines 32-50; figure 15 *	1,4,7,8,10,14	
X	DE 20 2011 000755 U1 (AESCULAP AG [DE]) 1 June 2011 (2011-06-01) * paragraphs [0048] - [0061]; figures 1,4,5 *	10,14	
X	WO 01/65997 A2 (BLAKE JOSEPH W III [US]) 13 September 2001 (2001-09-13) * pages 6-7; figures 1-2 *	10	
X	US 2014/005693 A1 (SHELTON IV FREDERICK E [US] ET AL) 2 January 2014 (2014-01-02) * paragraphs [0079], [0093]; claim 1 *	10,12	
A	GB 2 132 899 A (ETHICON INC) 18 July 1984 (1984-07-18) * claim 1; figures 1-3 *	1-15	TECHNICAL FIELDS SEARCHED (IPC)  A61B
The present search report has been drawn up for all claims			
Place of search <b>Munich</b>		Date of completion of the search <b>1 April 2016</b>	Examiner <b>Chopinaud, Marjorie</b>
CATEGORY OF CITED DOCUMENTS X : particularly relevant if taken alone Y : particularly relevant if combined with another document of the same category A : technological background O : non-written disclosure P : intermediate document T : theory or principle underlying the invention E : earlier patent document, but published on, or after the filing date D : document cited in the application L : document cited for other reasons & : member of the same patent family, corresponding document			

EPO FORM 1503 03/82 (P04C01)

**ANNEX TO THE EUROPEAN SEARCH REPORT  
ON EUROPEAN PATENT APPLICATION NO.**

EP 15 19 7251

5 This annex lists the patent family members relating to the patent documents cited in the above-mentioned European search report.  
The members are as contained in the European Patent Office EDP file on  
The European Patent Office is in no way liable for these particulars which are merely given for the purpose of information.

01-04-2016

Patent document cited in search report	Publication date	Patent family member(s)	Publication date
US 2009264904 A1	22-10-2009	NONE	
EP 0760230 A1	05-03-1997	AU 720144 B2	25-05-2000
		AU 6429396 A	06-03-1997
		CA 2183497 A1	01-03-1997
		DE 69601561 D1	01-04-1999
		DE 69601561 T2	15-07-1999
		EP 0760230 A1	05-03-1997
		ES 2128134 T3	01-05-1999
		JP 3729572 B2	21-12-2005
		JP H09164144 A	24-06-1997
		US 5782396 A	21-07-1998
		US 2008017693 A1	24-01-2008
		US 2008251570 A1	16-10-2008
		US 2008290135 A1	27-11-2008
		US 2010096433 A1	22-04-2010
		US 2010243710 A1	30-09-2010
		US 2011168758 A1	14-07-2011
		US 2011297730 A1	08-12-2011
		US 2012160894 A1	28-06-2012
		US 2012318845 A1	20-12-2012
		US 2013256384 A1	03-10-2013
		US 2014158746 A1	12-06-2014
		US 2015034697 A1	05-02-2015
DE 202011000755 U1	01-06-2011	NONE	
WO 0165997 A2	13-09-2001	AU 7209701 A	17-09-2001
		CA 2401885 A1	13-09-2001
		EP 1322231 A2	02-07-2003
		JP 2004512858 A	30-04-2004
		US 6423079 B1	23-07-2002
		WO 0165997 A2	13-09-2001
US 2014005693 A1	02-01-2014	CN 104487006 A	01-04-2015
		EP 2866685 A1	06-05-2015
		JP 2015521905 A	03-08-2015
		US 2014005693 A1	02-01-2014
		WO 2014004257 A1	03-01-2014
GB 2132899 A	18-07-1984	AR 226382 A1	30-06-1982
		AU 7679681 A	27-05-1982
		BE 891182 A1	18-05-1982
		BR 8107476 A	10-08-1982
		CA 1165201 A	10-04-1984
		CH 653877 A5	31-01-1986

EPO FORM P0459

For more details about this annex : see Official Journal of the European Patent Office, No. 12/82

**ANNEX TO THE EUROPEAN SEARCH REPORT  
ON EUROPEAN PATENT APPLICATION NO.**

EP 15 19 7251

5 This annex lists the patent family members relating to the patent documents cited in the above-mentioned European search report.  
The members are as contained in the European Patent Office EDP file on  
The European Patent Office is in no way liable for these particulars which are merely given for the purpose of information.

01-04-2016

Patent document cited in search report	Publication date	Patent family member(s)	Publication date
		DE 3145489 A1	29-07-1982
		DK 512081 A	20-05-1982
		ES 272482 U	01-03-1984
15		ES 275393 U	16-02-1984
		ES 276166 U	16-10-1984
		FI 813668 A	20-05-1982
		FR 2494108 A1	21-05-1982
		GB 2088723 A	16-06-1982
20		GB 2132899 A	18-07-1984
		GR 68173 B	09-11-1981
		IL 64304 A	30-04-1985
		IN 154839 B	15-12-1984
		JP S57112856 A	14-07-1982
25		NL 8105245 A	16-06-1982
		NO 813912 A	21-05-1982
		PH 18244 A	03-05-1985
		PL 233591 A1	19-07-1982
		PT 73999 A	01-12-1981
		TR 21126 A	17-10-1983
30		US 4430997 A	14-02-1984
		ZA 8108012 A	27-07-1983
-----			
35			
40			
45			
50			
55			

EPO FORM P0459

For more details about this annex : see Official Journal of the European Patent Office, No. 12/82

**REFERENCES CITED IN THE DESCRIPTION**

*This list of references cited by the applicant is for the reader's convenience only. It does not form part of the European patent document. Even though great care has been taken in compiling the references, errors or omissions cannot be excluded and the EPO disclaims all liability in this regard.*

**Patent documents cited in the description**

- US 62086250 A [0001]
- US 5084057 A [0005]
- US 5100420 A, Green [0005]
- US 5607436 A, Pratt [0005]
- US 5695502 A, Pier [0005]
- US 5354304 A, Allen [0006]

专利名称(译)	腹腔镜手术结扎夹应用器		
公开(公告)号	<a href="#">EP3028653A1</a>	公开(公告)日	2016-06-08
申请号	EP2015197251	申请日	2015-12-01
[标]申请(专利权)人(译)	柯惠有限合伙公司		
申请(专利权)人(译)	COVIDIEN LP		
当前申请(专利权)人(译)	COVIDIEN LP		
[标]发明人	ASIDO NORVIN TOKARZ CHRISTOPHER A		
发明人	ASIDO, NORVIN TOKARZ, CHRISTOPHER A.		
IPC分类号	A61B17/128		
CPC分类号	A61B17/122 A61B17/1285 A61B2017/00004 A61B2017/12004 A61B2017/2929 A61B17/128 A61B2017/0046 A61B2017/00477		
优先权	62/086250 2014-12-02 US 14/941714 2015-11-16 US		
其他公开文献	EP3028653B1		
外部链接	<a href="#">Espacenet</a>		

#### 摘要(译)

提供了一种结扎夹具施放器，其包括手柄组件和夹子模块，所述手柄组件支撑可拆卸地且可滑动地支撑在手柄组件的枪管壳体內的推进机构，夹子模块可拆卸地且选择性地连接到手柄组件。夹子模块包括壳体，壳体限定近端，远端和穿过其中的内腔，夹子模块壳体包括径向延伸到其内腔中的环形凸缘；夹爪刀片可滑动地支撑在夹子模块壳体的内腔中。钳口刀片包括设置在夹子模块壳体的远端内的一对钳口，该对钳口被偏置到打开状态，其中每个钳口包括从其突出的相应凸轮齿，其中凸轮齿可操作地对准。夹子模块壳体的环形凸缘的近端部分。

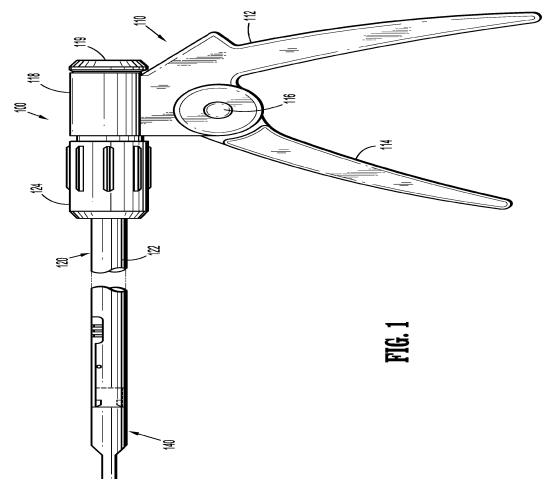

FIG. 1