



(11) **EP 2 433 588 B1**

(12) **EUROPEAN PATENT SPECIFICATION**

(45) Date of publication and mention
of the grant of the patent:
30.10.2019 Bulletin 2019/44

(51) Int Cl.:
A61F 2/00 (2006.01) A61B 17/00 (2006.01)

(21) Application number: **11250799.1**

(22) Date of filing: **14.09.2011**

(54) **Device for rolling and inserting a prosthetic patch into a body cavity**

Vorrichtung zum Rollen und Einsetzen eines Prothesepflasters in eine Körperhöhle

Dispositif pour rouler et insérer un patch prothétique dans une cavité du corps

(84) Designated Contracting States:
**AL AT BE BG CH CY CZ DE DK EE ES FI FR GB
GR HR HU IE IS IT LI LT LU LV MC MK MT NL NO
PL PT RO RS SE SI SK SM TR**

(30) Priority: **24.09.2010 US 889774**

(43) Date of publication of application:
28.03.2012 Bulletin 2012/13

(73) Proprietor: **Covidien LP
Mansfield, MA 02048 (US)**

(72) Inventors:
• **Levin, Ofek
20115 Moshav Amirim (IL)**

• **Levey, Arie
52489 Ramat-Gan (IL)**

(74) Representative: **Soames, Candida Jane
Edwards Angell Palmer
& Dodge Innovations LLP
10 Carlton Crescent
Southampton SO15 2EZ (GB)**

(56) References cited:
**EP-A1- 0 625 334 WO-A1-2010/019655
WO-A2-2009/136399 US-A- 5 263 969
US-A- 5 464 403 US-A1- 2005 021 122
US-B1- 6 214 020**

EP 2 433 588 B1

Note: Within nine months of the publication of the mention of the grant of the European patent in the European Patent Bulletin, any person may give notice to the European Patent Office of opposition to that patent, in accordance with the Implementing Regulations. Notice of opposition shall not be deemed to have been filed until the opposition fee has been paid. (Art. 99(1) European Patent Convention).

Description

FIELD OF THE INVENTION

[0001] This invention generally relates to minimal invasive surgery. More specifically the current invention relates to an apparatus especially adapted to fold prosthetic patches and to insert said patches into a body cavity through a cannula or an incision.

BACKGROUND OF THE INVENTION

[0002] An object of the present invention is to provide apparatus for performing corrective surgery on internal wounds such as hernia where invasion of the patient's body tissues is minimized and resultant trauma is reduced.

[0003] A hernia is a protrusion of a tissue, structure, or part of an organ through the muscular tissue or the membrane by which it is normally contained. In other words a hernia is a defect in the abdominal wall through which a portion of the intra-abdominal contents can protrude. This often causes discomfort and an unsightly, visible bulge in the abdomen. When such a hernia defect occurs in the abdominal region, conventional corrective surgery has required opening the abdominal cavity by surgical incision through the major abdominal muscles. While this technique provides for effective corrective surgery of the hernia defect, it has the disadvantage of requiring a hospital stay of as much as a week, during which pain is frequently intense, and it requires an extended period of recuperation. After the conventional surgery patients frequently

cannot return to a full range of activity and work schedule for a month or more. Accordingly, medical science has sought alternative techniques that are less traumatic to the patient and provide for more rapid recovery.

[0004] Laparoscopy is the science of introducing a viewing instrument through a port into a patient's body, typically the abdominal cavity, to view its contents. This technique has been used for diagnostic purposes for more than 75 years. Operative laparoscopy is performed through tiny openings in the abdominal wall called ports. In most surgical techniques several ports, frequently three to six, are used. Through one port is inserted the viewing device, which conventionally comprises a fiber optic rod or bundle having a video camera affixed to the outer end to receive and display images from inside the body. The various surgical instruments are inserted through other ports to do the surgery that normally would be performed through an open incision through the abdominal wall. Because the laparoscopic surgical techniques require only very small holes through the abdominal wall or other portions of the body, a patient undergoing such surgery may frequently leave the hospital within one day after the surgery and resume a full range of normal activities within a few days thereafter.

[0005] In repairing hernia the physician needs to first

roll the patch in order to insert the same into the abdominal cavity.

[0006] Such rolling of the patch can be a time consuming process and sometimes even a highly difficult procedure. In addition, insufficient rolling of said patch may damage the patch during its insertion and may require operation of large forces during said insertion; such forces may lead to patient injuries and/or damage to the insertion tool.

[0007] Thus, there is still a long felt need for a device that will enable an easy rolling of the patch prior to the insertion of the same to the abdominal cavity.

[0008] An apparatus for rolling a patch onto a spool, closing a sleeve around the wound patch, and then releasing the spool, is known from WO 2009/136399. EP 0625334 describes a fork with branches for rolling a wound prosthesis, and a tubular sheath adapted to receive the fork and the wound prosthesis. US 2005/0021122 describes a device with an elongated shaft and a hinged tube having a closed and open configuration for receipt of a prosthesis.

SUMMARY OF THE INVENTION

[0009] The present invention is defined in independent claims 1 and 9 and certain optional features thereof are defined in the dependent claims. In so far as the terms "invention", "example" and "embodiment" are used herein, this will be interpreted in such a way that the only protection sought is for the invention as claimed. Additional embodiments are shown for illustration only.

[0010] It is one object of the present invention to provide a patch rolling apparatus (PRA) adapted to enable a tight and easy rolling of a prosthetic patch onto a surgical tool such that a minimum effective cross-section of said rolled prosthetic patch perpendicular to the direction of insertion, prior to, and during, said insertion into either a cannula or an opening is obtained. Exemplary surgical tools include patch deployment devices as described in U.S. patent application serial number 12/834,456.

[0011] It is another object of the present invention to provide the PRA as defined above, wherein said PRA comprises at least two sections 101 hinge-like coupled together; said PRA is characterized by at least two configurations: (i) an open configuration (OC) in which said two sections are apart to create a gap W into which said prosthetic patch can be inserted; and, (ii) a closed configuration (CC) in which said gap is minimized or eliminated such that said PRA substantially envelopes said prosthetic patch and enables said rolling of said prosthetic patch.

[0012] It is another object of the present invention to provide the PRA as defined above, additionally comprising a locking section (LS) 104 adapted to maintain said PRA 100 in its said closed configuration.

[0013] It is another object of the present invention to provide the PRA as defined above, wherein said LS comprising a locking hook 200, attached to at least one sec-

tion 101 of said PRA 100 and a locking groove 105 located on the second section 101 of said PRA 100.

[0014] It is another object of the present invention to provide the PRA as defined above, wherein said LS comprising and a release tab 107 adapted to allow said release of said locking; such that once said release tab 107 is pressed said PRA is transformed into said open configuration.

[0015] It is another object of the present invention to provide the PRA as defined above, wherein said LS additionally comprising an automatic release section (ARS) which automatically releases the two sections 101 of said PRA 100 once said patch 201 is at least partially inserted into said body cavity; said ARS comprising a tilted tab 109 and pin 110.

[0016] It is another object of the present invention to provide the PRA as defined above, wherein said PRA 100 additionally comprising an anti-buckling section ABS 112 adapted to prevent buckling of said distal portion 203 of said PIS 202 during said insertion of said patch 201.

[0017] It is another object of the present invention to provide the PRA as defined above, wherein said PRA 100 additionally comprising an insertion tip 113 adapted to enable better insertion of said PRA.

[0018] A method of use comprises the following steps:

- a. obtaining said prosthetic patch to be rolled on said surgical tool
- b. obtaining a patch rolling apparatus (PRA) comprising at least two sections 101 hinge-like coupled together; said PRA is characterized by at least two configurations: (i) an open configuration (OC) in which said two sections are apart to create a gap W into which said prosthetic patch can be inserted; and, (ii) a closed configuration (CC) in which said gap is minimized or eliminated such that said PRA substantially envelopes said prosthetic patch and enables said rolling of said prosthetic patch;
- c. configuring said PRA to be in said OC;
- d. at least partially coupling said patch to said surgical tool;
- e. inserting said surgical tool coupled to said patch into said PRA through said gap W;
- f. rolling said patch inside said PRA 100 while continually transforming said PRA from its said open configuration into its said closed configuration;

[0019] It is disclosed to provide the method as defined above, additionally comprising step of continue rotating said patch 201 inside said PRA 100 until the entire patch 201 is rolled inside PRA 100.

[0020] It is disclosed to provide the PRA as defined above, additionally comprising step of inserting said rolled patch 201 into a body cavity through a laparoscopic cannula or through an incision.

[0021] It is disclosed to provide the PRA as defined above, additionally comprising step of transforming said PRA 100 into its said open configuration and de-coupling

it from said surgical tool.

[0022] It is disclosed to provide the PRA as defined above, additionally comprising step of providing said PRA with a locking section (LS) 104 adapted to maintain said PRA 100 in its said closed configuration.

[0023] It is disclosed to provide the PRA as defined above, additionally comprising step of providing said PRA with a release tab 107 adapted to allow said release of said locking; such that once said release tab 107 is pressed said PRA is transformed into said Oc. It is another object of the present invention to provide the PRA as defined above, additionally comprising step of providing said PRA with an automatic release section (ARS) which automatically releases the two sections 101 of said PRA 100; said ARS comprising a tilted tab 109 and pin 110.

[0024] It is disclosed to provide the PRA as defined above, additionally comprising step of providing said PRA with an anti-buckling section ABS 112.

[0025] It is further disclosed to provide the PRA as defined above, additionally comprising step of providing said PRA with an insertion tip 113.

BRIEF DESCRIPTION OF THE DRAWINGS

[0026] The invention is herein described, by way of example only, with reference to the accompanying drawings, wherein:

Figs. 1A-1B illustrate an example of a device for facilitating rolling of a mesh.

Figs. 2A-2G illustrate a method in which said PRA 100 is being utilized together with a patch introducing system 202 (PIS).

Figs. 3A-3B illustrate another example in which a locking section (LS) is used.

Figs. 3C-3F illustrate another example in which an automatic release section (ARS) is used.

Figs. 4A-4B illustrate another example in which an anti-buckling section ABS 112 and an insertion tip 113 is used.

Figs. 4C illustrates the present invention in which insertion fins 401 and 402 are used.

Figs. 5A-5E illustrates another example in which a furling clip is used.

DETAIL DESCRIPTION OF THE SPECIFIC EMBODIMENTS

[0027] The following description is provided, alongside all chapters of the present invention, so as to enable any person skilled in the art to make use of the invention and

sets forth the best modes contemplated by the inventor of carrying out this invention. Various modifications, however, is adapted to remain apparent to those skilled in the art, since the generic principles of the present invention have been defined specifically to provides a device and method for rolling and inserting a prosthetic patch into a body cavity.

[0028] The present invention provides a patch rolling apparatus (PRA) wherein said PRA is adapted to assist in rolling a prosthetic patch (e.g. hernia patch) onto a surgical tool (e.g. grasper, patch deployment system) such that said patch can be inserted into a body cavity (e.g. abdominal cavity) during a minimal invasive surgery.

[0029] It should be emphasized that some of the major advantages of the present invention, with respect to the prior art, is the ability roll prosthetic patches, especially large patches, faster and easier relatively to the current manual rolling manner.

[0030] Furthermore, the present invention enables an easier insertion of said patch into said body cavity relatively to the current manner.

[0031] The term **"Hernia"** refers hereinafter to umbilical hernia, hiatal hernia, ventral hernia, postoperative hernia, epigastric hernia, spiegelian hernia, inguinal hernia and femoral hernia, generally any abdominal wall related hernia.

[0032] The term **"mesh deployment system"** refers hereinafter to any device adapted to deploy a mesh/patch during a hernia surgery.

[0033] The term **"hinge"** or **"hinge-like connection"** refers hereinafter as to a type of bearing that connects two solid objects, typically allowing only a limited angle of rotation between them. Two objects connected by an ideal hinge rotate relative to each other about a fixed axis of rotation (the geometrical axis of the hinge). Hinges may be made of flexible material or of moving components. The term **"hinge like connection"** can refer to a standard hinge or to a living hinge (i.e., a thin flexible hinge (flexure bearing) made from plastic that joins two rigid parts together while allowing them to bend along the line of the hinge).

[0034] The term **"minimally invasive surgery"** refers hereinafter to procedures that avoid open invasive surgery in favor of closed or local surgery with fewer traumas. Furthermore, the term refers to a procedure that is carried out by entering the body through the skin or through a body cavity or anatomical opening, but with the smallest damage possible.

[0035] The term **"pressurized body cavity"** refers hereinafter to a body cavity (e.g. intraperitoneal cavity) which is insufflated by gas (e.g. CO₂) during a minimal invasive surgery.

[0036] The term **"closed configuration"** refers hereinafter to the configuration of the PRA 100 shown in figure 1B.

[0037] The term **"open configuration"** refers hereinafter to the configuration of the PRA 100 shown in figure

1A.

[0038] Before explaining the figures, it should be understood that the invention is not limited in its application to the details of construction and the arrangement of the components set forth in the following description or illustrated in the drawings. The invention can be carried out in various ways.

[0039] Reference is now made to Fig 1A-1B illustrating an example of a device for facilitating rolling of a mesh. According to this embodiment a patch rolling apparatus (PRA) 100 is provided. Said PRA 100 comprises two sections 101 connected to each another via a hinge 102 such that a movement of each of said sections relatively to each other is enabled along and around said hinge 102. Hinge 102 can be either a living hinge on a conventional hinge.

[0040] Said PRA 100 is characterized by two separate configurations: an open configuration (OC), as can be seen in Fig 1A and a closed configuration (CC), as can be seen in Fig 1B.

[0041] In the open configuration said two sections 101 are positioned apart from each other such that a gap (W) is created between them, through which a pre-rolled patch can be at least partially inserted and encapsulated within said two sections 101.

[0042] In the closed configuration said two portions 101 are substantially adjacent to one another, creating an internal cavity 103. In an embodiment said cavity 103 contains no sharp edges so as to prevent any damage that may be caused to the patch during said rolling operation. Reference is now being made to Figs. 2A-2G illustrating a method in which said PRA 100 is utilized together with a patch introducing system 202 (PIS) in order to roll and insert a patch 201 into a body cavity of a patient during a surgery (e.g. laparoscopic hernia repair surgery).

[0043] PIS 202 is define as a surgical tool intended to insert a patch into the abdominal cavity, e.g. a patch deployment system (as illustrated in Figs 2A-2G), a patch introducer, a laparoscopic grasper or any combination thereof.

[0044] PIS 202 comprises a distal portion 203 (on which said patch 201 is rolled), proximal portion 204 (which is held by the surgeon) and a shaft 205 connecting said proximal portion 204 and distal portion 203 together.

[0045] The method comprises steps selected inter alia from:

1. Obtaining a patch 201 and a PIS 202.
2. Attaching said patch 201 to said distal portion of said PIS 202 (Fig 2A).
3. Obtaining PRA 100 in its said open configuration.
4. Inserting said distal portion 203 of said PIS 202 and at least a portion of said patch 201 into said PRA 100 through said gap W (Fig 2B).
5. Rotating (rolling) said distal portion 203 and said patch 201 inside said PRA 100 while continually transforming said PRA from its said open configura-

tion into its said closed configuration (Fig 2C).

6. Continue rotating said distal portion 203 and said patch 201 inside said PRA 100 until the entire patch 201 is rolled inside PRA 100 (Fig 2D).

7. Inserting said rolled patch 201 into a body cavity (e.g. abdominal cavity) through a laparoscopic cannula 206 or through an incision (Fig 2E-2F).

8. Transforming said PRA 100 into its said open configuration and de-coupling it from said PIS 202 (Fig 2G).

[0046] It should be mentioned that during said insertion of said patch into said body cavity, the distal portion can be subjected to large forces and therefore may be buckle or deformed.

in order to prevent such deformation, said PRA 100 additionally provides external support in order to prevent said buckling or deformation.

[0047] It also should be mentioned that said PRA 100 holds said patch 201 tightly rolled during said insertion to said body cavity. As a result said insertion is made with less resistance and therefore is faster and safer compare to manual insertion.

[0048] Reference is now being made to Figs. 3A-3B which describe another embodiment. According the this embodiment, said PRA 100 additionally comprises locking section (LS) 104 which is adapted to hold said PRA 100 in its said closed configuration.

[0049] Additionally said LS 104 allows the surgeon to release said locking when desired. According to this embodiment, said LS 104 comprises a locking hook 200, attached to one section 101 of said PRA 100 and a locking groove 105 located on the outer surface of the second section 101 of said PRA 100.

[0050] Said locking hook 200 comprises a locking tab 106, adapted to be hinged inside said groove 105 and a release tab 107, adapted to allow said release of said locking.

[0051] Fig 3A describes said PRA 100 in its said open configuration; as can be seen from this figure, in the open configuration said locking tab 106 is not hinged inside said groove 105, therefore a free motion of said two sections 101 is enabled.

[0052] Once the said PRA 100 is transformed into its said close configuration, said locking tab 106 is inserted into said groove 105; and, therefore holding the two sections 101 together (see Fig. 3B). In order to reopen said PRA 100, the surgeon presses the release tab 107 of said LS 104 therefore elevating said hook tab out of said groove 105 and releasing the two sections 101 from one another.

[0053] Reference is now being made to Figs. 3C-3F which illustrate another example of a device for facilitating rolling of a mesh. According to this embodiment, said LS 104 additionally comprises an automatic release section (ARS) which automatically releases the two sections 101 of said PRA 100 once said patch 201 is at least partially inserted into said body cavity.

[0054] Said ARS comprises a tab 109 and a pin 110. Said tab 109 has a tilted end and is initially located at the proximal end (relative to the surgeon) of said groove 105. Said pin 110 is located inside a hole 111 at section 101.

5 **[0055]** Once said PRA 100 is transformed into its said closed configuration said locking hook 110 is inserted into said groove 105 (see Fig. 3D).

[0056] Once said rolled patch is at least partially inserted into said body cavity, the proximal portion 204 of said PIS 202 pushes said pin 110 and said tab 109 toward the distal end of said groove 105.

[0057] As a result tab 109 is pushing said locking tab 106 out of said groove and therefore releasing the two sections 101 (see Figs. 3E and 3F).

15 **[0058]** Reference is now being made to Figs. 4A-4B which illustrate another example of a device for facilitating rolling of a mesh. According to this embodiment, said PRA 100 additionally comprises an anti-buckling section ABS 112 and an insertion tip 113.

20 **[0059]** Said ABS 112 is characterized by having a smaller inner diameter than the rest of said PRA 100. Said ABS 112 is adapted to tightly envelope the shaft of said PIS 202 such that lateral movement between said distal portion 203 of said PIS 202 and said shaft of said PIS is limited and therefore the risk that the distal portion of said PIS will buckle is reduced.

[0060] Said insertion tip 113 is characterized by having a conical shape and is adapted to assist inserting said rolled patch 201 into said body cavity through an incision. 30 Once said patch is completely rolled inside said PRA the surgeon can at least partially insert said insertion tip 113 into said incision, therefore said rolled patch is substantially centered in relation to said incision during the initial stage of said insertion; in addition, said insertion tip 113 opens said incision and allowing an easier insertion of said patch into said body cavity through said incision.

35 **[0061]** Reference is now made to Figure 4C which illustrate an embodiment of the present invention. According to this embodiment, said PRA 100 additionally comprises insertion fins 401 and 402. These fins are adapted to allow a better insertion of a mesh through a port or an incision by opening the valve (in the case of a port) or the subcutaneous layer (in a case on an incision). This spreading is important since sometimes the port's valve or the tissue may drag the furled mesh backward along the shaft of the instrument during the insertion process, thus increasing its overall cross section and interfering with the insertion process. Spreading of the valve or the tissue reduces the overall friction, therefore allowing better insertion. The fins may be covered by a cap 403.

45 **[0062]** Figure 5A-5E illustrate an embodiment of a furling clip (FC) 500. Said FC 500 is adapted to assist in rolling a prosthetic mesh around a surgical instrument (e.g. Grasper, mesh deployment device) by securing said patch to the shaft of said surgical instrument during said rolling. Said FC 500 is removed once such rolling is at least partially obtained.

[0063] In an embodiment, described in Figure 5A-5B,

said FC 500 comprises two sections 501 and 502 which are connected via a hinge 504. A spring 503 is placed between sections 501 and 502 in order to provide clamping force. A clamping edge 505 is located at the distal end of each section 501 and 502, said clamping edge 505 is adapted to hold said mesh and said shaft of said instrument, while allowing the mesh to be rolled only around them and not around the sections 501 & 502; therefore allowing better rolling of the mesh around the shaft and enabling the removal of said FC 500 from said shaft once said rolling is accomplished. Once the proximal end of each section 501 and 502 is squeezed, the two clamping edges are distanced from one another, hence, allowing to locate said FC 500 on said shaft (Fig 5B). once the pressure is removed spring 503 clamp said FC 500 on said mesh and shaft.

[0064] Figs 5C-5E describes a method of using FC 500 during rolling of a mesh 201 on a surgical instrument 509. In this case the instrument is a standard grasper which comprises a handle 508, a shaft 509 and a forceps 507 (Fig 5C). During the operation, the surgeon places a mesh 201 on top of the shaft 509 and secures it by forceps 507 (Fig 5D). In order to prevent slipping of the rear portion of the mesh, and in order to facilitate tight and even rolling of the mesh 201 around the shaft 509, the surgeon places a FC 500 at the proximal edge of the mesh 201 (Fig 5E). Said clamping edges 505 of said edge are protrude beyond the edge of each section 501 and 502, enabling the surgeon to roll the mesh around them. The rolling can be made either manually or by a patch rolling apparatus. Once said patch 201 is substantially rolled, said FC 500 is removed from the shaft 509 by squishing sections 501 & 502 and pulling FC 500 back, then the mesh 201 is inserted to the abdominal cavity.

Claims

1. A device for facilitating rolling of a surgical mesh onto a surgical instrument, the device comprising a sleeve (100) comprising two portions (101) longitudinally hingedly connected to each other to provide a slit along a length of the sleeve (100), wherein the sleeve (100) has an open configuration for operably coupling with an unrolled mesh (201) on a surgical instrument (202), and a closed configuration wherein the two portions are substantially adjacent to one another to form an internal cavity (103) for facilitating rolling of the mesh (201) onto the instrument (202);
characterized in that insertion fins (401, 402) are connected to the distal end of the sleeve, the insertion fins being adapted to open valves of surgical ports.
2. The device according to claim 1, further comprising a locking mechanism (104) for locking the sleeve (100) when it is in the closed configuration.

3. The device according to claim 2 wherein the locking mechanism (104) further comprises a member that provides for automatic release of the locked sleeve (100) once the mesh (201) is at least partially inserted into a body cavity.
4. The device according to any preceding claim, further comprising an insertion tip (113).
5. The device according to any preceding claim, wherein the fins cause spreading of a subcutaneous layer of tissue.
6. The device according to any preceding claim, wherein the mesh (201) is a patch.
7. The device according to any preceding claim, wherein the device is a patch deployment apparatus or a laparoscopic grasper.
8. The device according to any preceding claim, further comprising a member at a distal portion (101) of the sleeve (100) that prevents buckling of a shaft of a patch deployment apparatus or a laparoscopic grasper.
9. A kit comprising: a patch introducing system, comprising a distal portion (101), on which said patch maybe rolled, a proximal portion (101) and a shaft connecting said proximal portion (101) and said distal portion (101) and a device according to any of claims 1 to 8.
10. A kit according to claim 9 further comprising a patch.
11. A kit according to claim 10 wherein the patch is a mesh.

Patentansprüche

1. Vorrichtung zum Ermöglichen des Rollens eines chirurgischen Netzes auf ein chirurgisches Instrument, wobei die Vorrichtung eine Hülse (100) umfasst, die zwei Abschnitte (101) umfasst, die in Längsrichtung gelenkig miteinander verbunden sind, um einen Schlitz entlang einer Länge der Hülse (100) bereitzustellen, wobei die Hülse (100) eine offene Konfiguration zum funktionsfähigen Koppeln mit einem abgerollten Netz (201) an einem chirurgischen Instrument (202) und eine geschlossene Konfiguration aufweist, wobei die zwei Abschnitte im Wesentlichen benachbart zueinander sind, um einen inneren Hohlraum (103) zum Ermöglichen des Rollens des Netzes (201) auf das Instrument (202) zu bilden;
dadurch gekennzeichnet, dass Einführrippen (401, 402) mit dem distalen Ende der Hülse verbun-

den sind, wobei die Einführrippen angepasst sind, um Ventile von chirurgischen Öffnungen zu öffnen.

2. Vorrichtung nach Anspruch 1, weiter umfassend einen Verriegelungsmechanismus (104) zum Verriegeln der Hülse (100), wenn sie sich in der geschlossenen Konfiguration befindet. 5
3. Vorrichtung nach Anspruch 2, wobei der Verriegelungsmechanismus (104) weiter ein Element umfasst, das für eine automatische Freigabe der verriegelten Hülse (100) sorgt, sobald das Netz (201) zumindest teilweise in einen Körperhohlraum eingefügt wird. 10
4. Vorrichtung nach einem vorstehenden Anspruch, weiter umfassend eine Einführspitze (113). 15
5. Vorrichtung nach einem vorstehenden Anspruch, wobei die Rippen eine Spreizung einer subkutanen Gewebeschicht bewirken. 20
6. Vorrichtung nach einem vorstehenden Anspruch, wobei das Netz (201) ein Pflaster ist. 25
7. Vorrichtung nach einem vorstehenden Anspruch, wobei die Vorrichtung eine Pflasterbereitstellungsvorrichtung oder ein laparoskopischer Greifer ist.
8. Vorrichtung nach einem vorstehenden Anspruch, weiter umfassend ein Element an einem distalen Abschnitt (101) der Hülse (100), das ein Knicken eines Schafts einer Pflasterbereitstellungsvorrichtung oder eines laparoskopischen Greifers verhindert. 30
9. Kit umfassend: ein Pflastereinführsystem, das einen distalen Abschnitt (101), an dem das Pflaster gerollt werden kann, einen proximalen Abschnitt (101) und einen den proximalen Abschnitt (101) und den distalen Abschnitt (101) verbindenden Schaft umfasst, und eine Vorrichtung nach einem der Ansprüche 1 bis 8. 35
10. Kit nach Anspruch 9, weiter umfassend ein Pflaster. 40
11. Kit nach Anspruch 10, wobei das Pflaster ein Netz ist. 45

Revendications

1. Dispositif pour faciliter le roulage d'un treillis chirurgical sur un instrument chirurgical, le dispositif comprenant un manchon (100) comprenant deux parties (101) longitudinalement reliées l'une à l'autre de manière articulée pour fournir une fente sur une longueur du manchon (100), dans lequel le manchon (100) a une configuration ouverte pour un couplage fonctionnel avec un treillis 50

déroulé (201) sur un instrument chirurgical (202), et une configuration fermée dans laquelle les deux parties sont sensiblement adjacentes l'une à l'autre pour former une cavité interne (103) pour faciliter le roulage du treillis (201) sur l'instrument (202) ; **caractérisé en ce que** des ailettes d'insertion (401, 402) sont reliées à l'extrémité distale du manchon, les ailettes d'insertion étant adaptées pour ouvrir des valves d'orifices chirurgicaux.

2. Dispositif selon la revendication 1, comprenant en outre un mécanisme de verrouillage (104) pour verrouiller le manchon (100) quand il est dans la configuration fermée.
3. Dispositif selon la revendication 2 dans lequel le mécanisme de verrouillage (104) comprend en outre un élément qui permet la libération automatique du manchon (100) verrouillé une fois que le treillis (201) est au moins partiellement inséré dans une cavité corporelle.
4. Dispositif selon l'une quelconque des revendications précédentes, comprenant en outre une pointe d'insertion (113). 25
5. Dispositif selon l'une quelconque des revendications précédentes, dans lequel les ailettes entraînent l'écartement d'une couche de tissu sous-cutanée.
6. Dispositif selon l'une quelconque des revendications précédentes, dans lequel le treillis (201) est un patch.
7. Dispositif selon l'une quelconque des revendications précédentes, dans lequel le dispositif est un appareil de déploiement de patch ou un dispositif de saisie laparoscopique. 35
8. Dispositif selon l'une quelconque des revendications précédentes, comprenant en outre un élément au niveau d'une partie distale (101) du manchon (100) qui empêche le gauchissement d'un arbre d'un appareil de déploiement de patch ou d'un dispositif de saisie laparoscopique. 40
9. Kit comprenant : un système d'introduction de patch, comprenant une partie distale (101), sur laquelle ledit patch peut être roulé, une partie proximale (101) et un arbre reliant ladite partie proximale (101) et ladite partie distale (101) et un dispositif selon l'une quelconque des revendications 1 à 8. 50
10. Kit selon la revendication 9 comprenant en outre un patch. 55
11. Kit selon la revendication 10 dans lequel le patch est

un treillis.

5

10

15

20

25

30

35

40

45

50

55

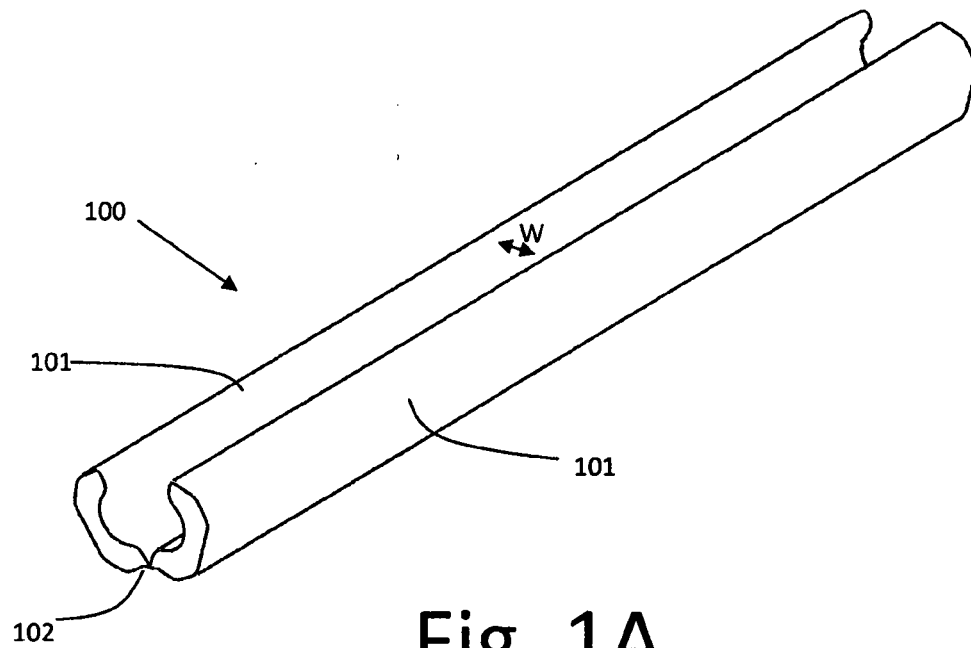

Fig. 1A

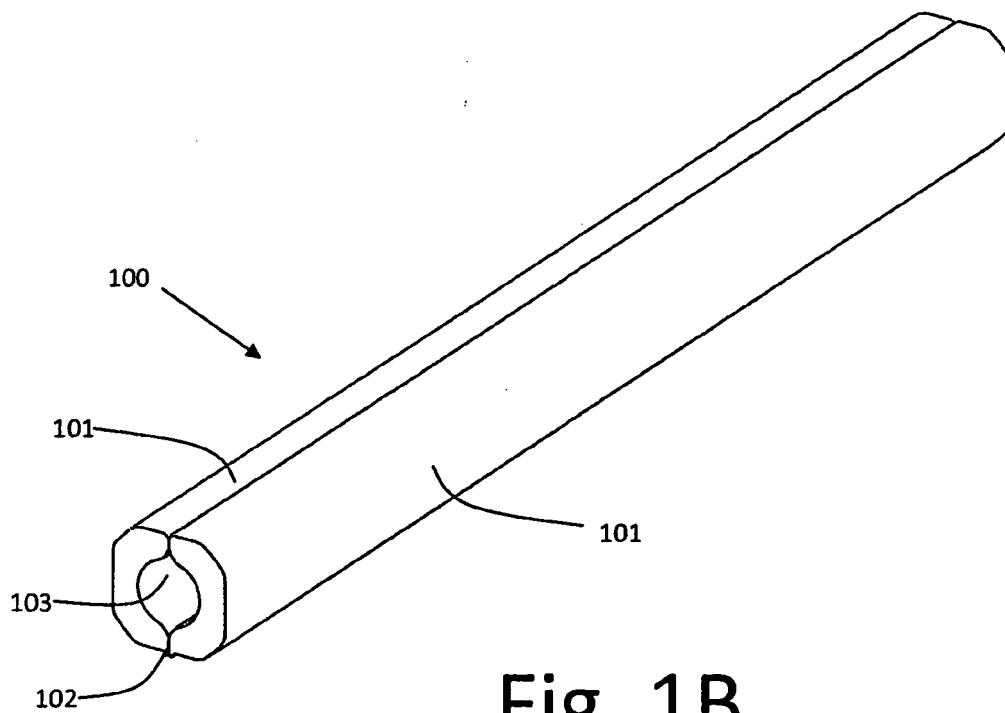

Fig. 1B

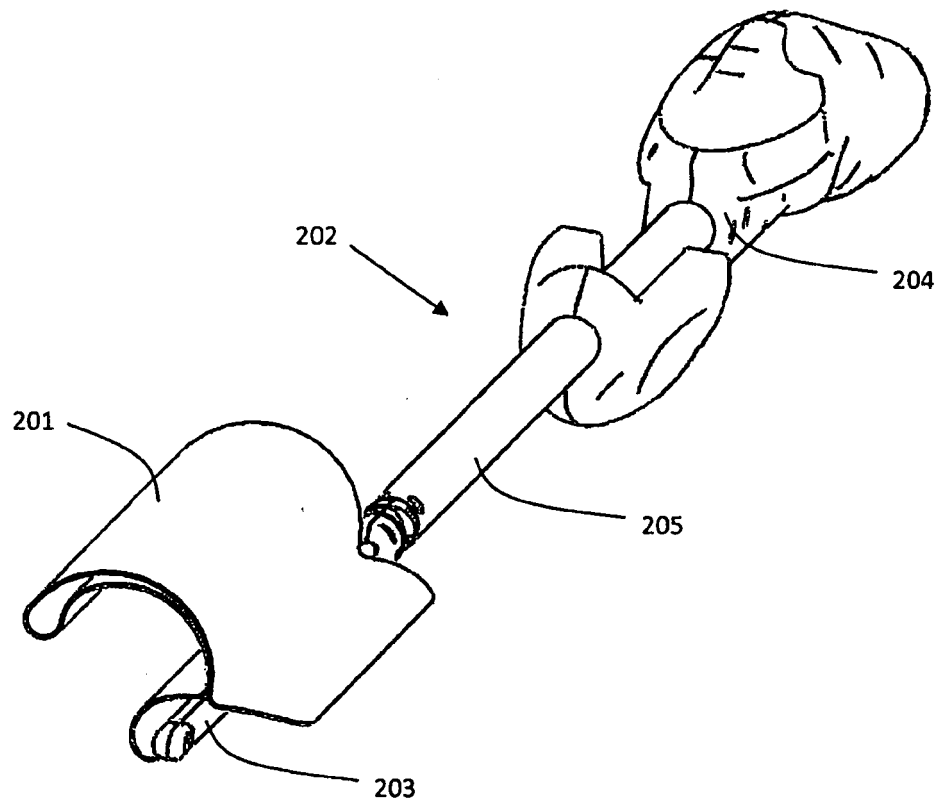

Fig. 2A

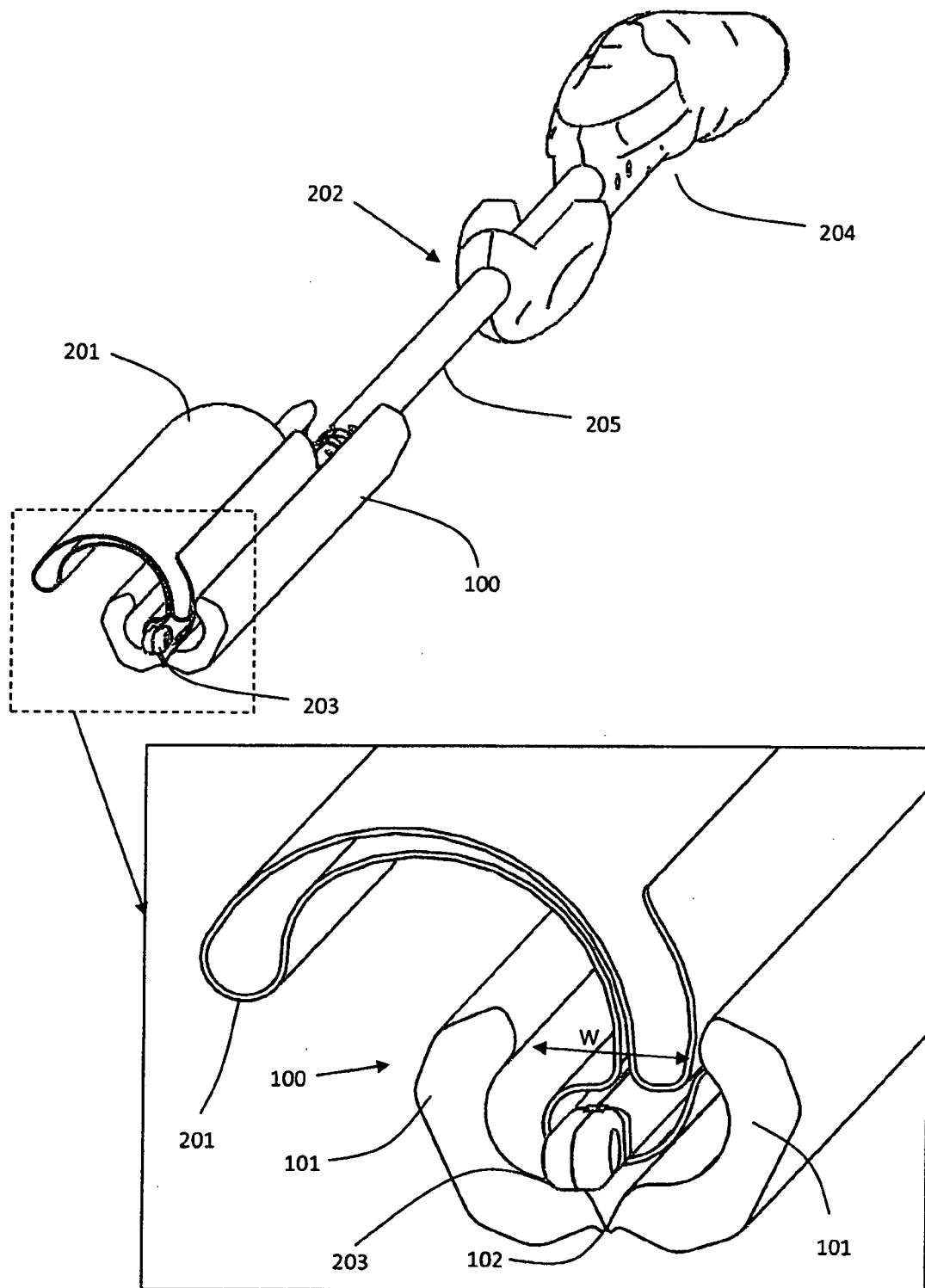

Fig. 2B

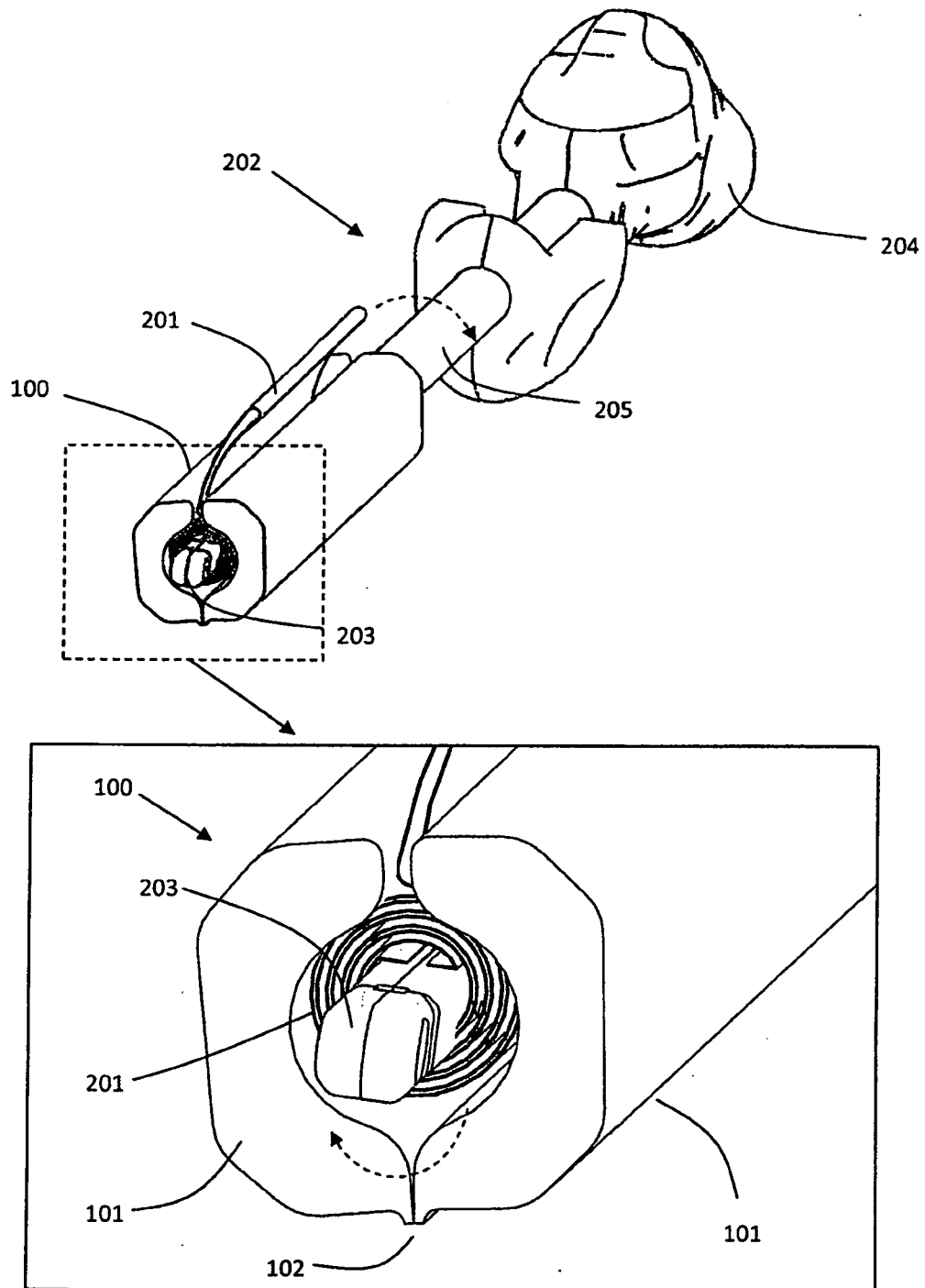

Fig. 2C

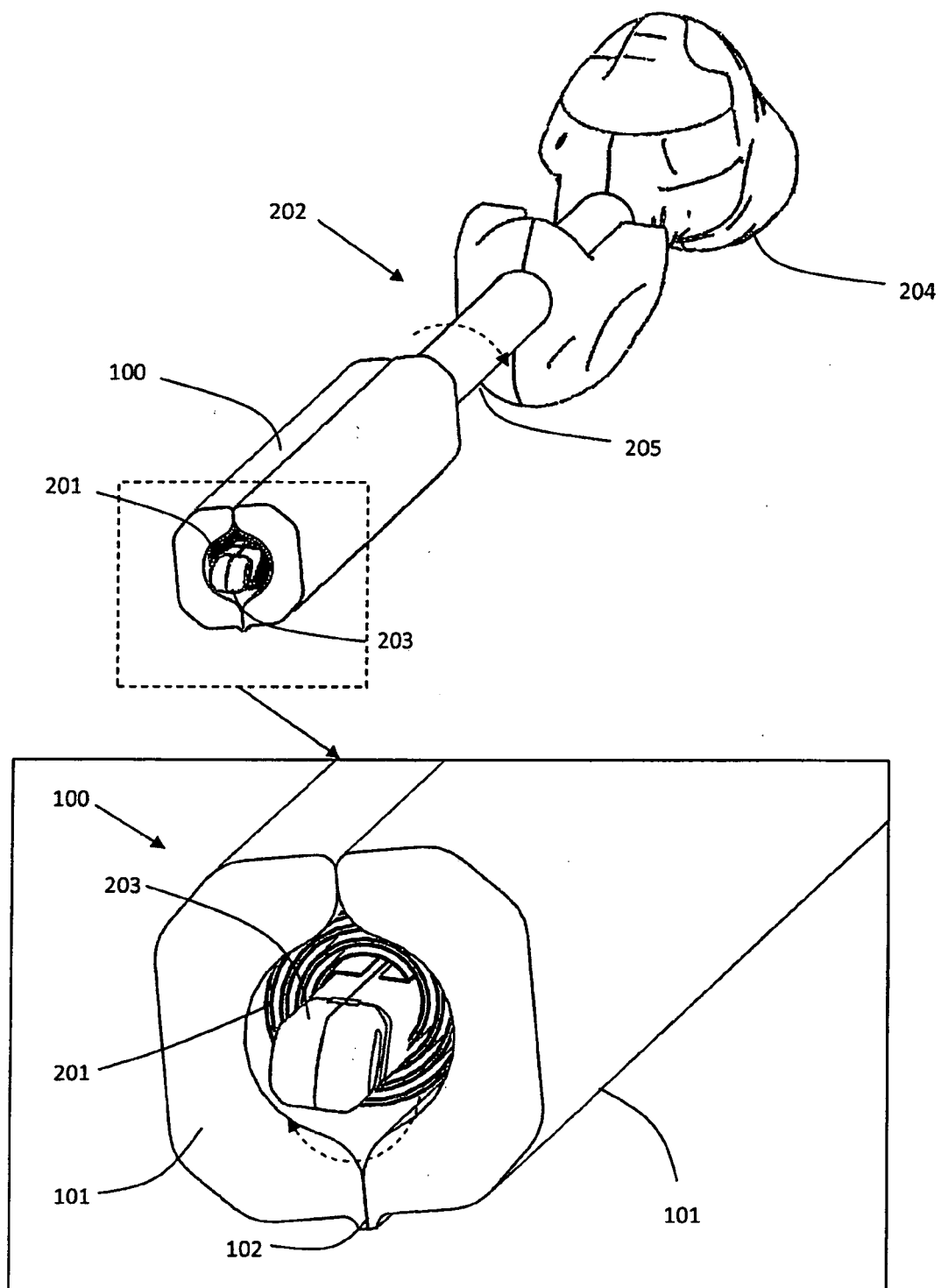

Fig. 2D

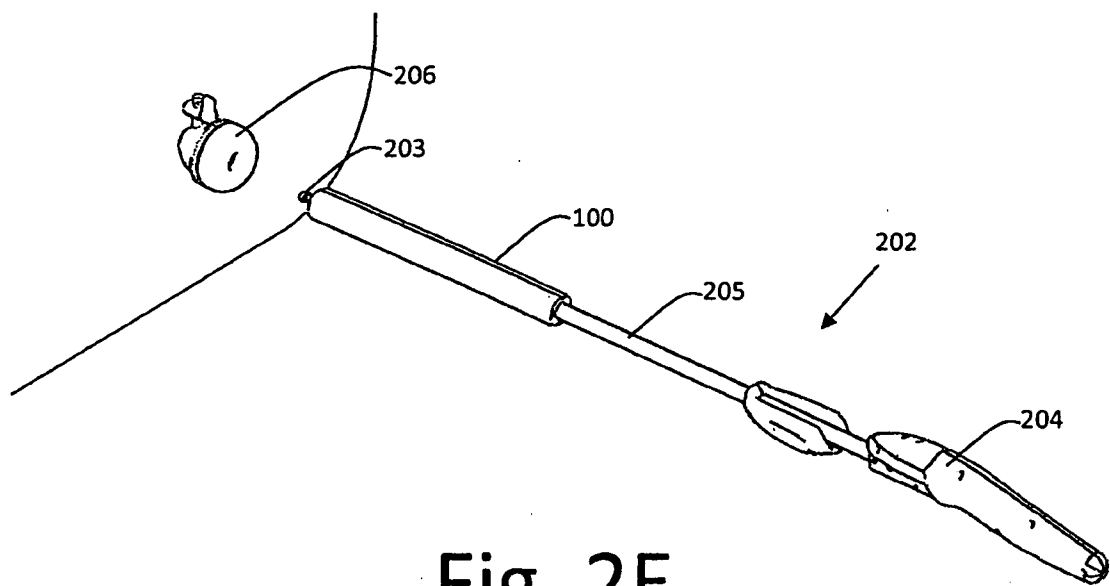

Fig. 2E

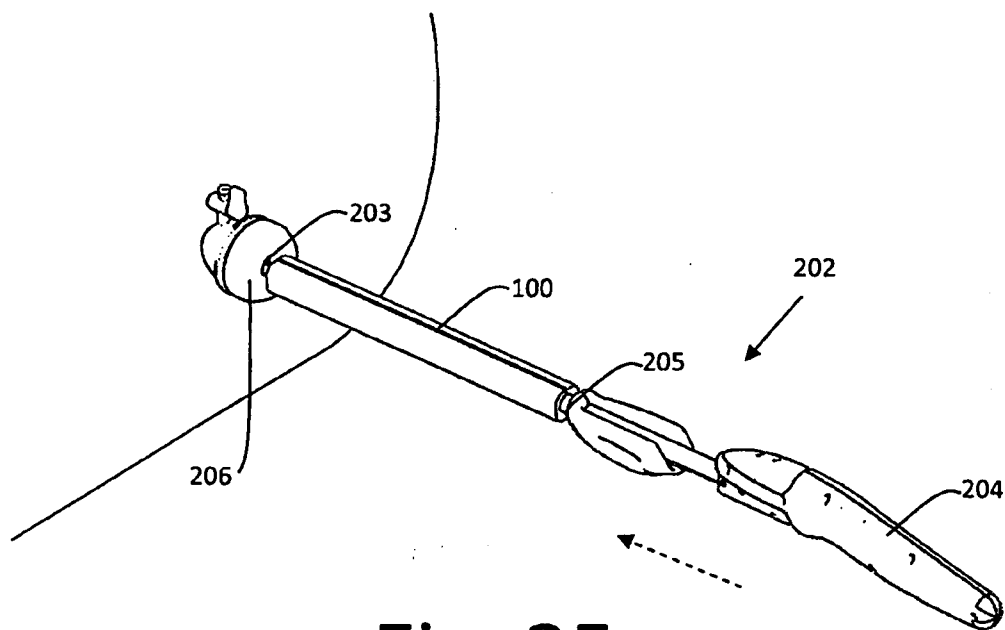
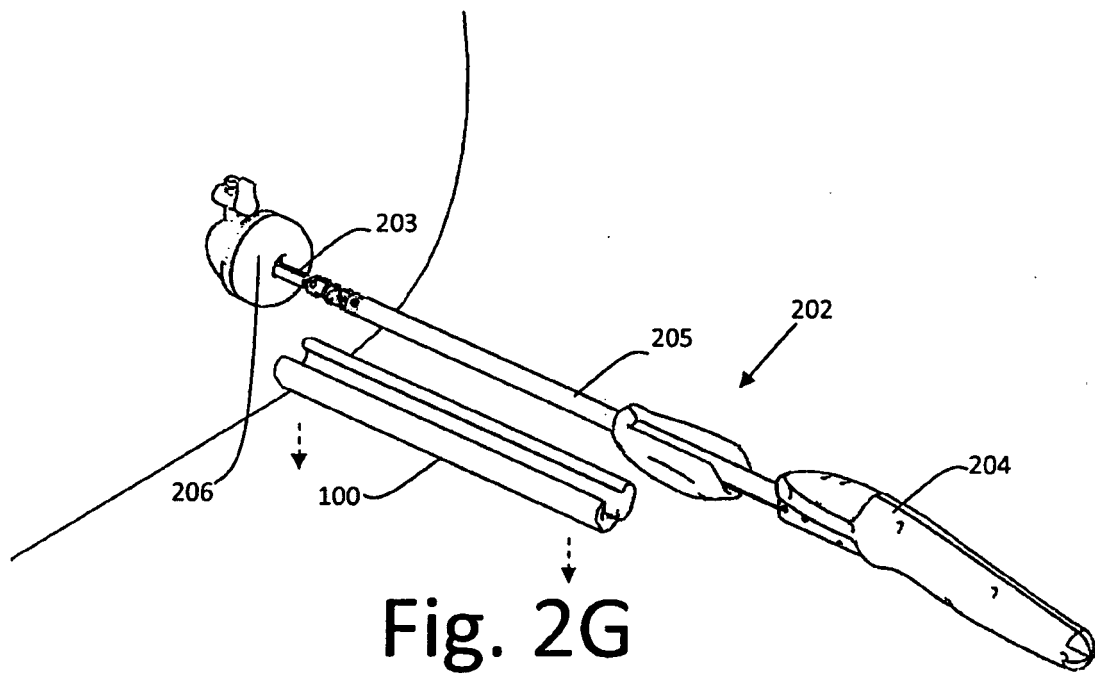

Fig. 2F



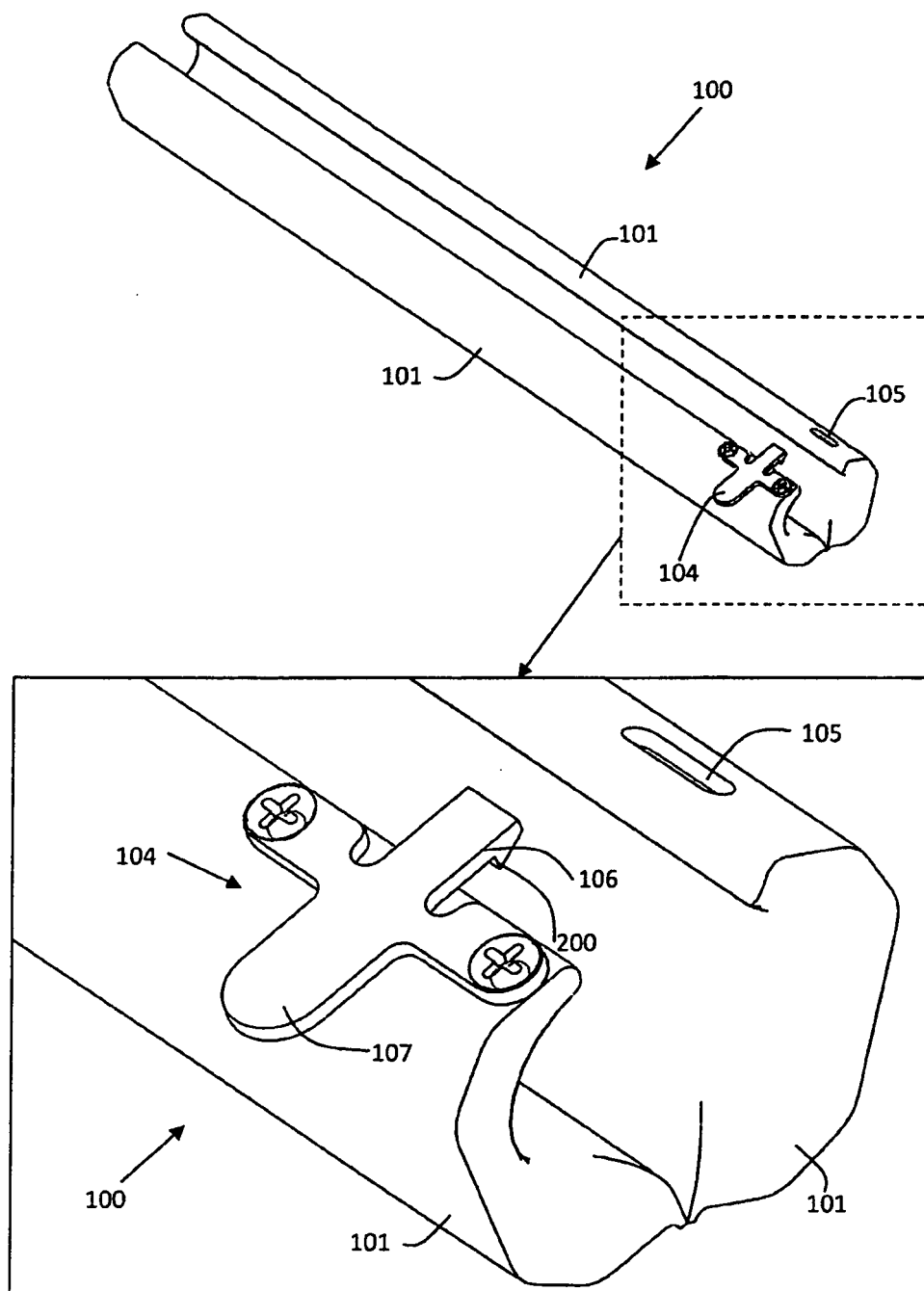

Fig. 3A

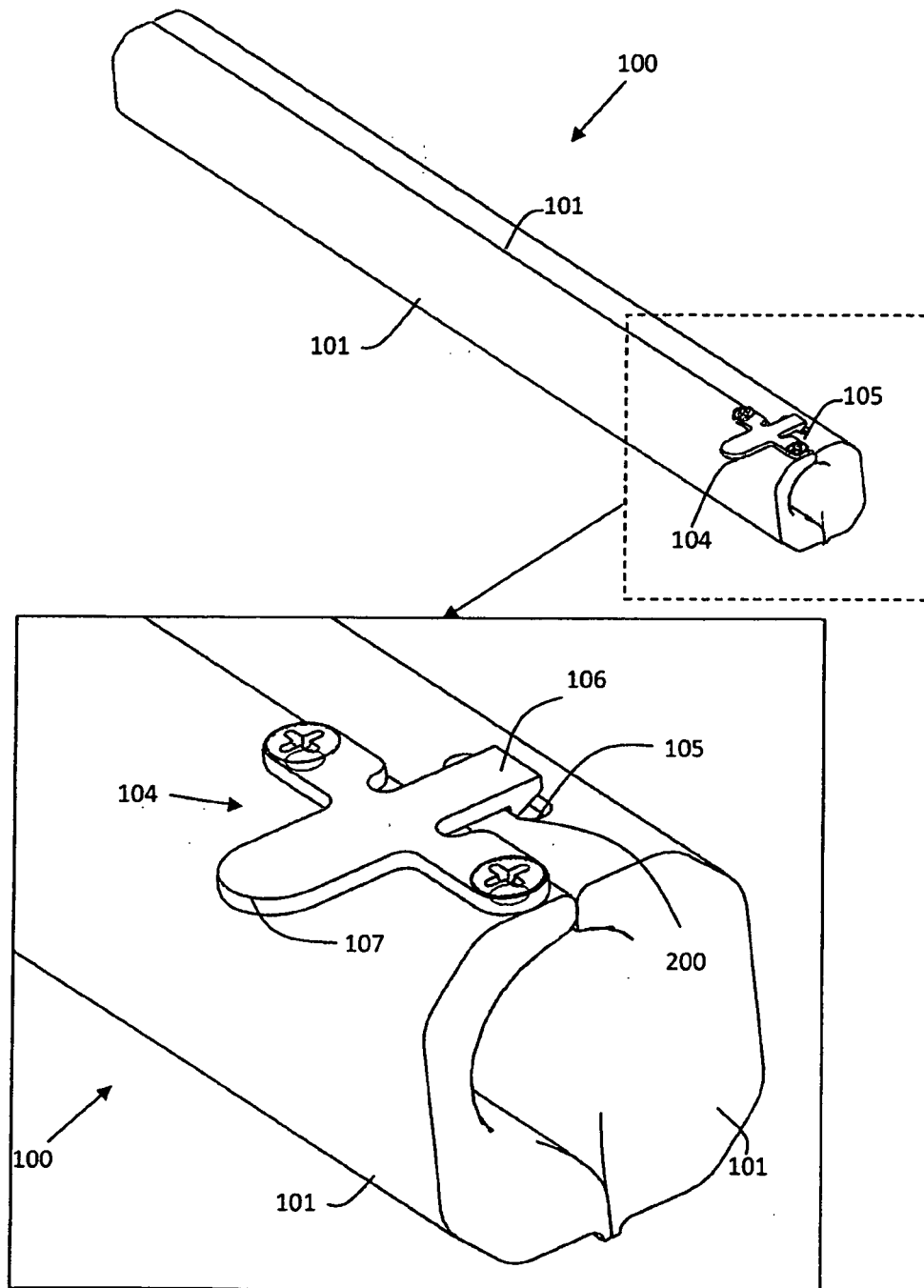

Fig. 3B

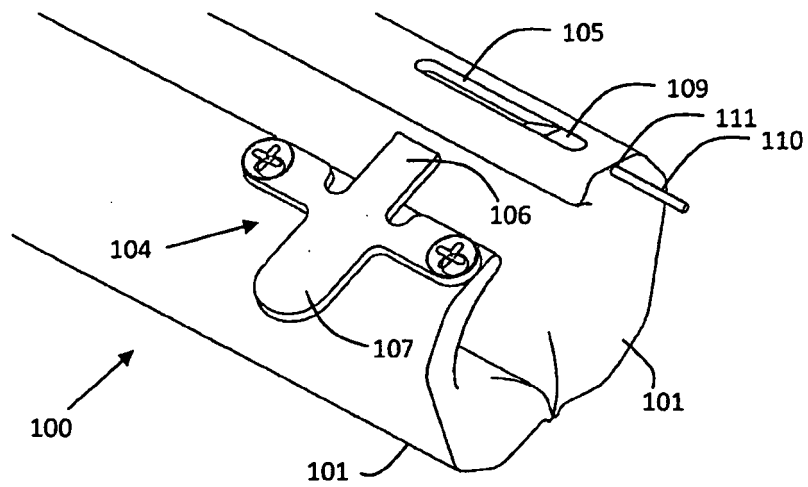

Fig. 3C

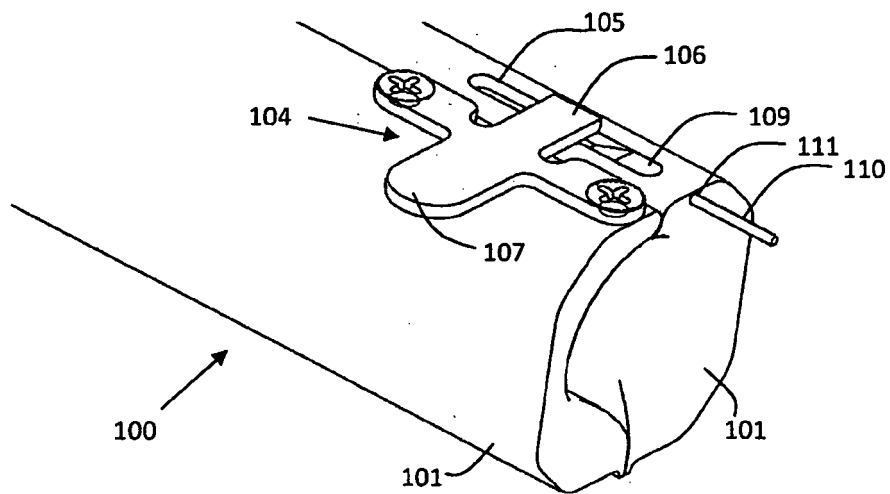

Fig. 3D

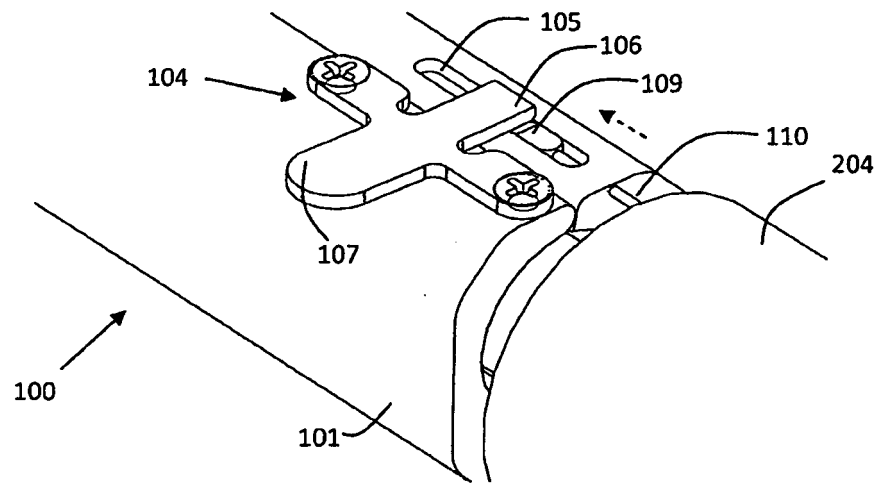

Fig. 3E

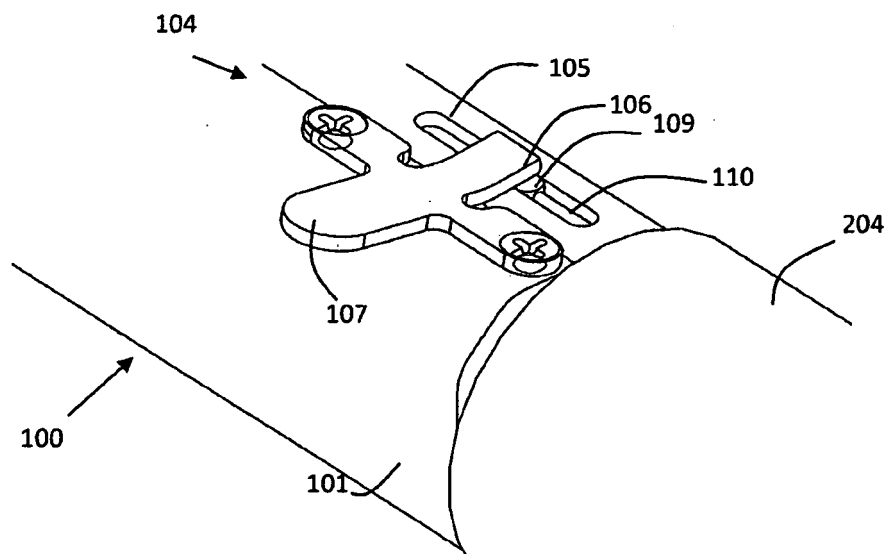

Fig. 3F

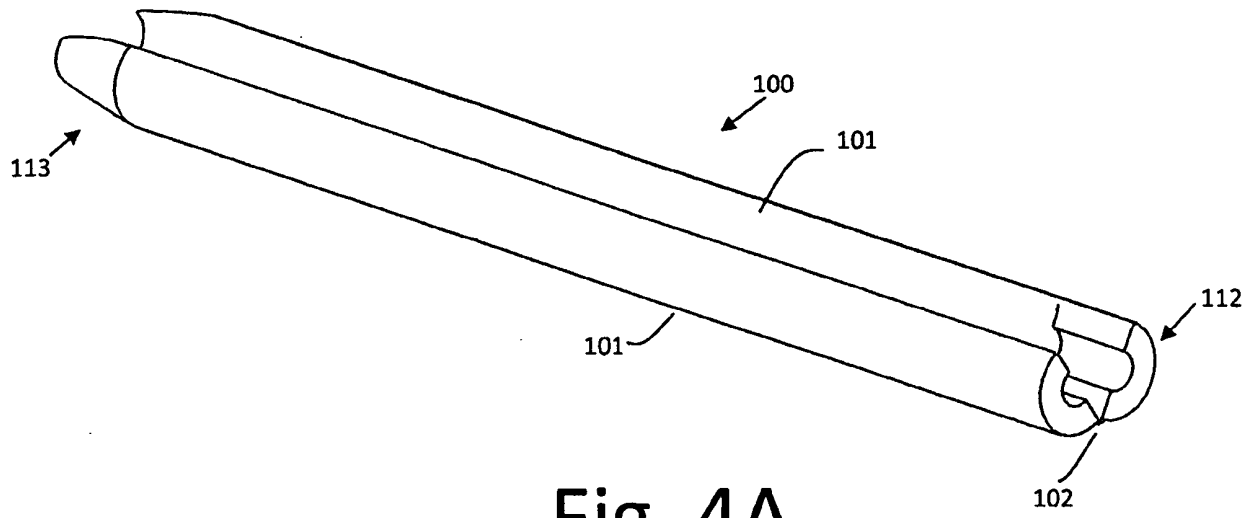

Fig. 4A

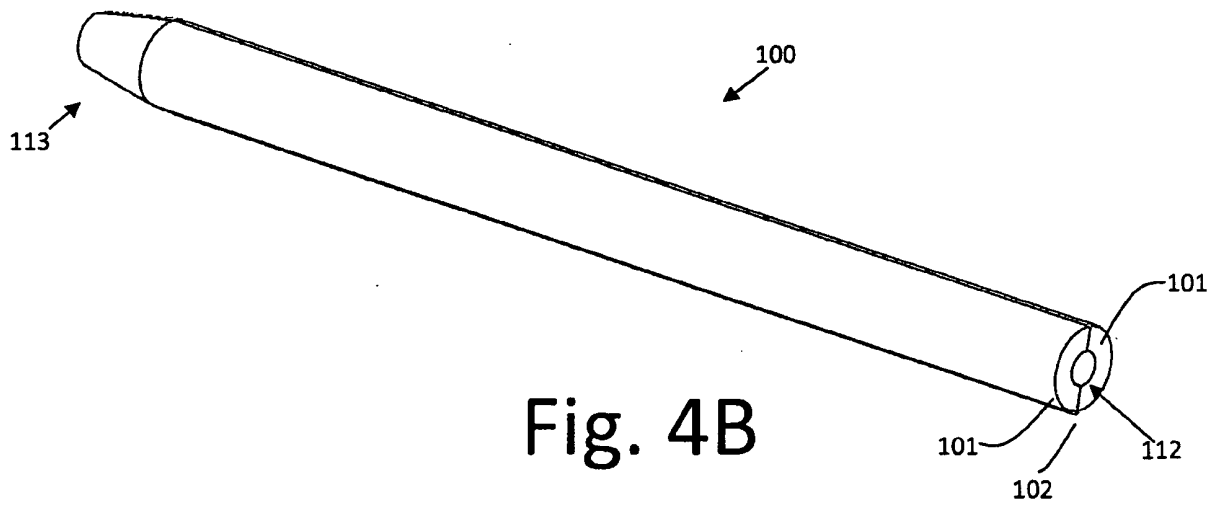

Fig. 4B

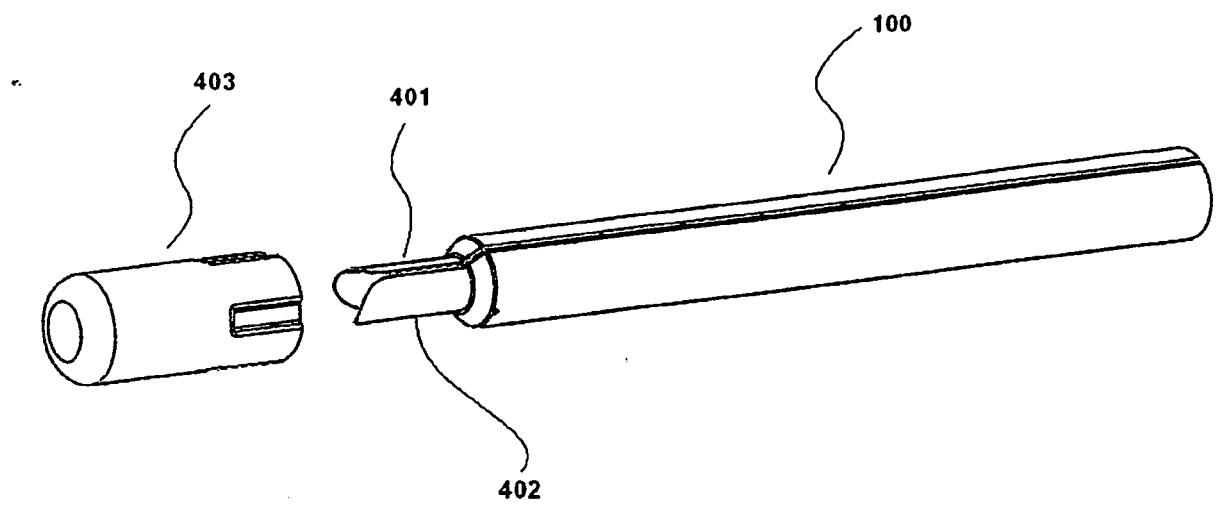

Fig. 4C

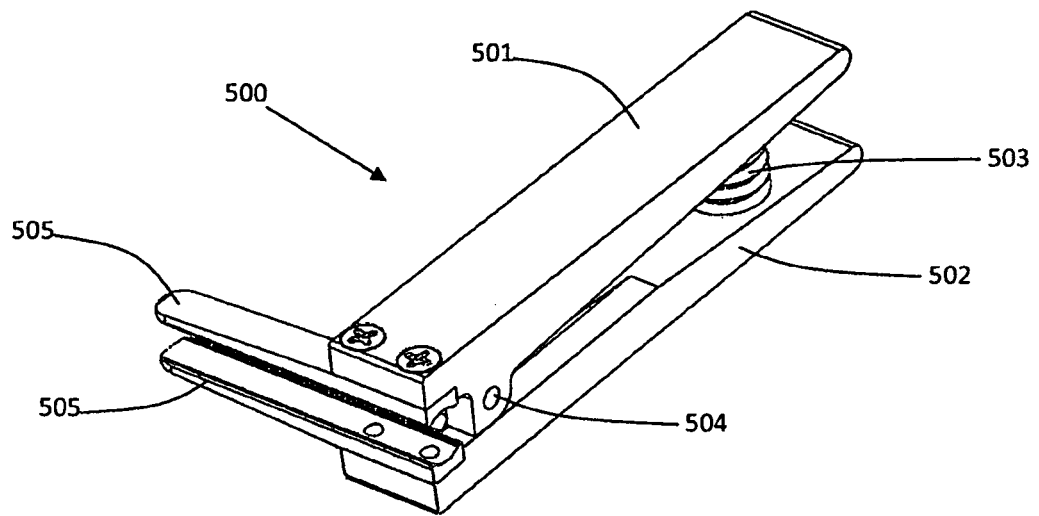

Fig. 5A

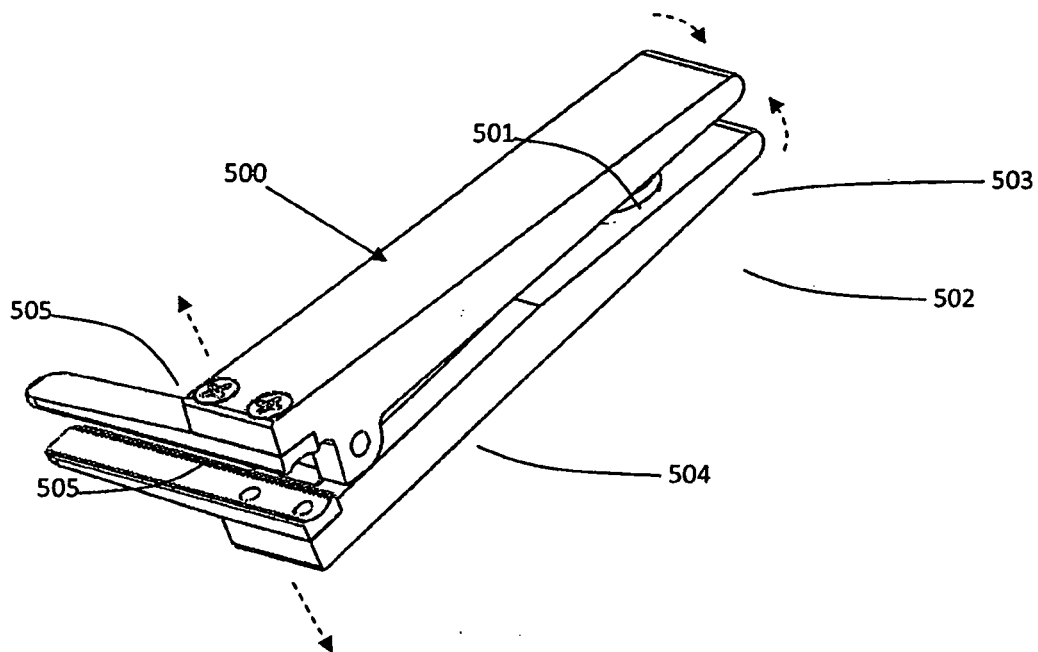

Fig. 5B

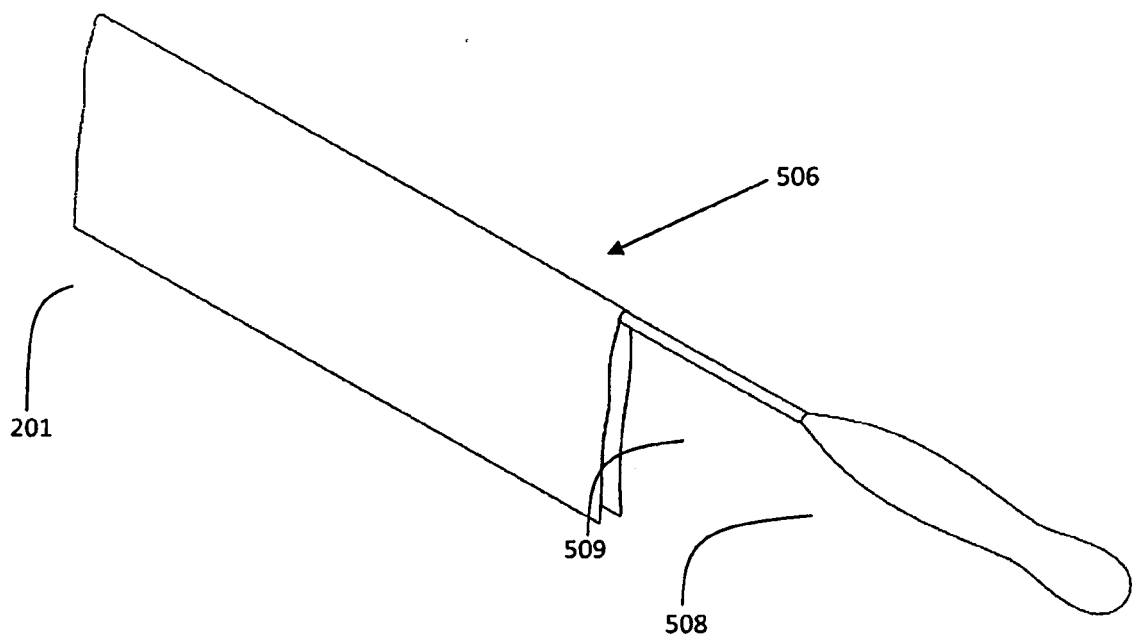
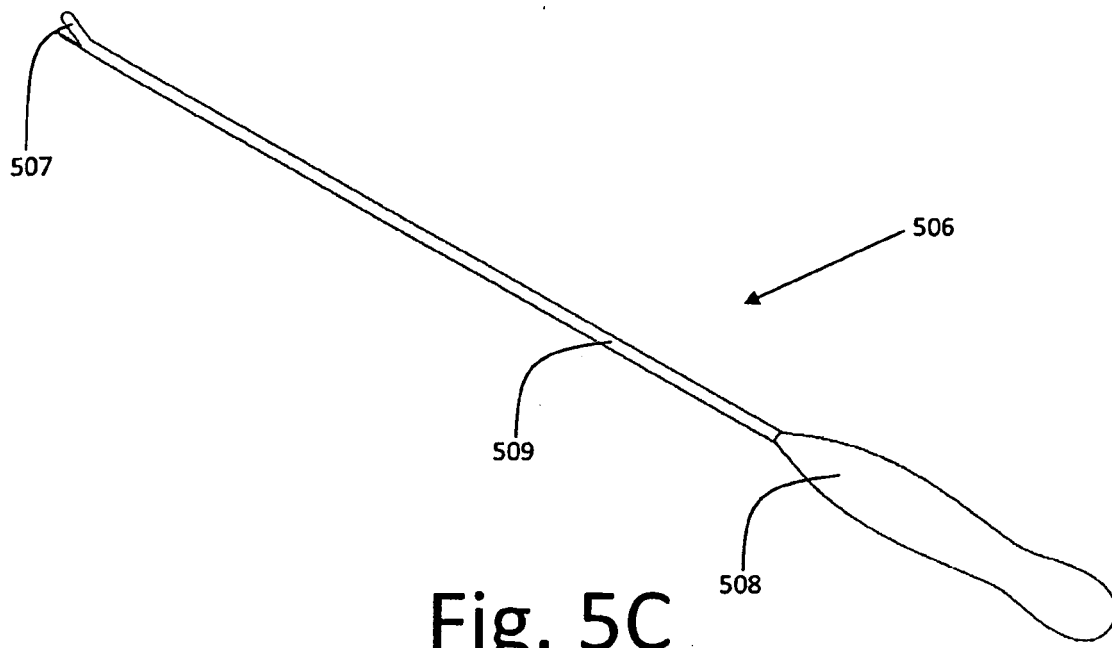

Fig. 5D

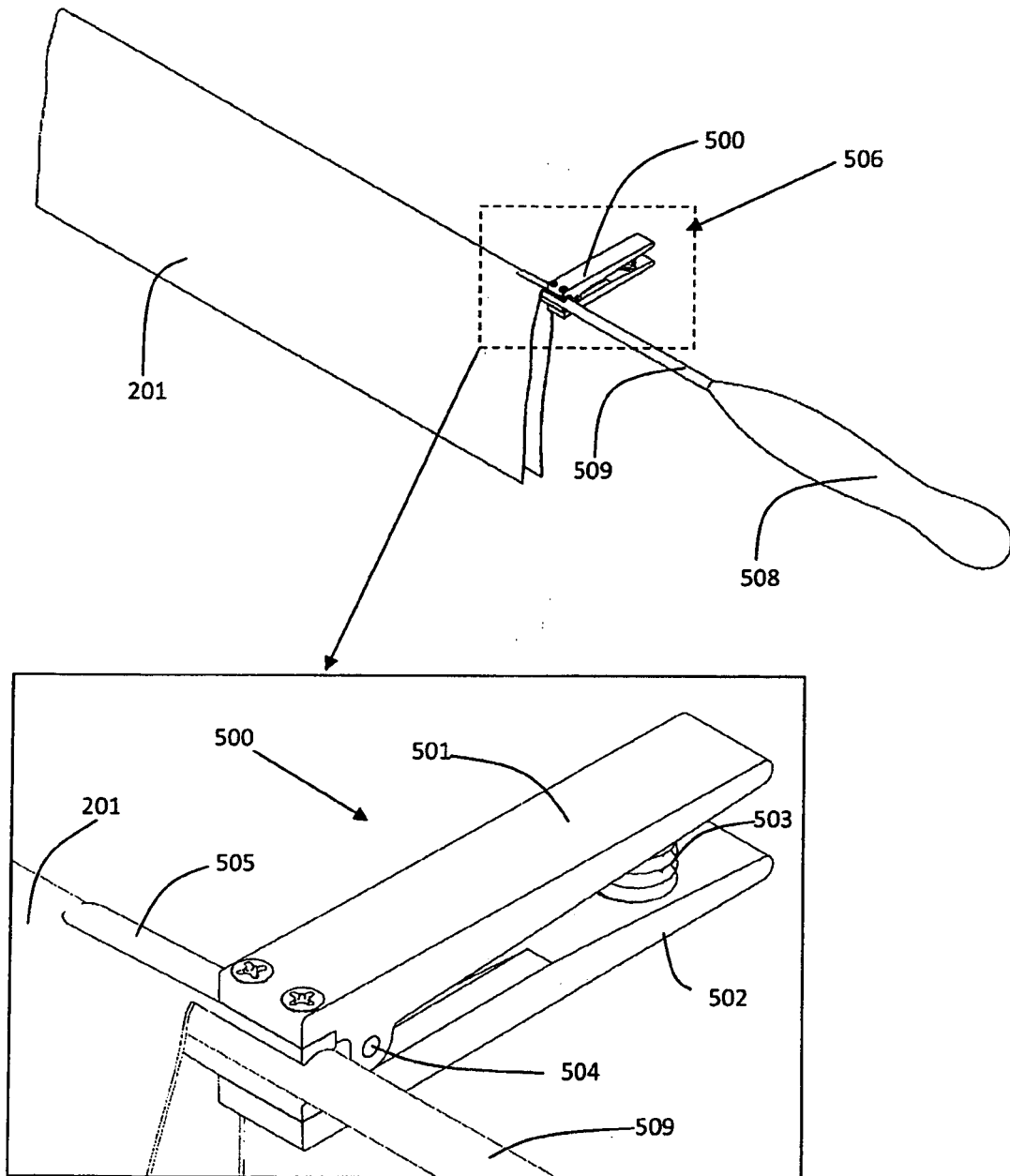

Fig. 5E

REFERENCES CITED IN THE DESCRIPTION

This list of references cited by the applicant is for the reader's convenience only. It does not form part of the European patent document. Even though great care has been taken in compiling the references, errors or omissions cannot be excluded and the EPO disclaims all liability in this regard.

Patent documents cited in the description

- WO 2009136399 A [0008]
- EP 0625334 A [0008]
- US 20050021122 A [0008]
- US 834456 [0010]

专利名称(译)	用于将假体贴片滚动并插入体腔的装置		
公开(公告)号	EP2433588B1	公开(公告)日	2019-10-30
申请号	EP2011250799	申请日	2011-09-14
[标]申请(专利权)人(译)	柯惠有限合伙公司		
申请(专利权)人(译)	泰科医疗集团LP		
当前申请(专利权)人(译)	COVIDIEN LP		
[标]发明人	LEVIN OFEK LEVEY ARIE		
发明人	LEVIN, OFEK LEVEY, ARIE		
IPC分类号	A61F2/00 A61B17/00		
优先权	12/889774 2010-09-24 US		
其他公开文献	EP2433588A2 EP2433588A3		
外部链接	Espacenet		

摘要(译)

用于促进将手术网状物滚动到手术器械上的装置，该装置包括套管（100），该套管（100）具有沿着套管的长度的狭缝（101），其中套管具有用于与展开的网状物（201）可操作地联接的开口构造。）并置于手术器械上，并具有闭合结构以利于将网状物滚动到器械上。

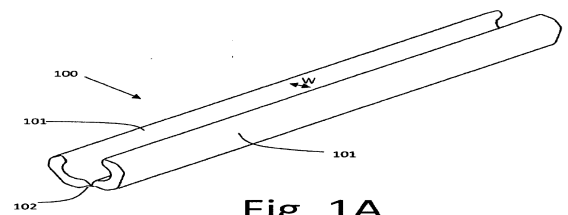

Fig. 1A

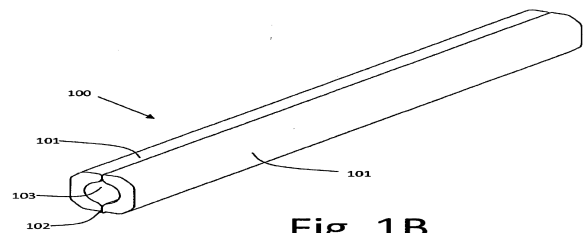

Fig. 1B