

(19)



(11)

EP 1 974 676 A1

(12)

EUROPEAN PATENT APPLICATION

(43) Date of publication:

01.10.2008 Bulletin 2008/40

(51) Int Cl.:

A61B 17/068 (2006.01)

A61B 17/072 (2006.01)

A61B 17/28 (2006.01)

A61B 19/00 (2006.01)

(21) Application number: **08251188.2**

(22) Date of filing: **28.03.2008**

(84) Designated Contracting States:

**AT BE BG CH CY CZ DE DK EE ES FI FR GB GR
HR HU IE IS IT LI LT LU LV MC MT NL NO PL PT
RO SE SI SK TR**

Designated Extension States:

AL BA MK RS

(30) Priority: **28.03.2007 US 729008**

(71) Applicant: **Ethicon Endo-Surgery, Inc.**

Cincinnati, OH 45242 (US)

(72) Inventors:

- **Boudreaux, Chad P.**
Cincinnati, OH 45242 (US)
- **Timperman, Eugene L.**
Cincinnati, OH 45240 (US)
- **Fugikawa, Leslie M.**
Cincinnati, OH 45218 (US)

(74) Representative: **Tunstall, Christopher Stephen et al**

**Carpmaels & Ransford
43-45 Bloomsbury Square
London WC1A 2RA (GB)**

(54) **Laparoscopic tissue thickness and clamp load measuring devices**

(57) A surgical instrument having opposed jaws that can be selectively moved between open and closed positions. Various embodiments include components for measuring the thickness of tissue clamped between the opposed jaws. Some embodiments are configured to ascertain the amount of compressive force that is being applied to the tissue while the thickness of the tissue is being determined. The tissue thickness data is displayed on the instrument itself and/ or on a display that is remote

from the instrument. The various embodiments may comprise different types of surgical instruments such as surgical staplers and graspers. A jaw arrangement with jaws shaped to define a cradle that corresponds to a cross-sectional shape of an object is also disclosed. The components that generate the thickness data may be electrically or mechanically actuated.

EP 1 974 676 A1

Description

FIELD OF THE INVENTION

[0001] The present invention relates in general to laparoscopic and endoscopic surgical instruments and, more particularly, to endoscopic surgical devices and grasping devices configured to enable the surgeon to measure tissue thickness and clamping loads.

BACKGROUND OF THE INVENTION

[0002] Endoscopic surgical instruments are often preferred over traditional open surgical devices since a smaller incision tends to reduce the post-operative recovery time and complications. Consequently, significant development has gone into a range of endoscopic surgical instruments that are suitable for precise placement of a distal end effector at a desired surgical site through a cannula of a trocar. These distal end effectors engage the tissue in a number of ways to achieve a diagnostic or therapeutic effect (e.g., endocutter, grasper, cutter, staplers, clip applier, access device, drug/gene therapy delivery device, and energy device using ultrasound, RF, laser, etc.).

[0003] Known surgical staplers include an end effector that simultaneously makes a longitudinal incision in tissue and applies lines of staples on opposing sides of the incision. The end effector includes a pair of cooperating jaw members that, if the instrument is intended for endoscopic or laparoscopic applications, are capable of passing through a cannula passageway. One of the jaw members receives a staple cartridge having at least two laterally spaced rows of staples. The other jaw member defines an anvil having staple-forming pockets aligned with the rows of staples in the cartridge. The instrument commonly includes a plurality of reciprocating wedges which, when driven distally, pass through openings in the staple cartridge and engage drivers supporting the staples to effect the firing of the staples toward the anvil.

[0004] When using an endocutter during endoscopic surgery, it is often difficult for the surgeon to determine the thickness of the tissue that they are about to transect. The thickness of the tissue determines the type of cartridge/staple they need in order to properly seal the transection. Often times, the surgeon must make the thickness determination based upon their visual observations of the tissue on a monitor or, if possible, they use their hands to feel the thickness of the tissue.

[0005] Another type of device that is commonly employed during laparoscopic surgery is known as a grasper. Such graspers typically have a pair of opposing jaws that are used to grasp tissue or portions of other surgical instruments during the surgical procedure. Such grasping devices, however, also lack means for determining tissue thicknesses. In addition, the jaw arrangements employed by such graspers are often ill-suited to effectively grip and manipulate other surgical instruments

used during the operation.

[0006] Consequently, a significant need exists for a laparoscopic device that would permit a surgeon to accurately and repeatably measure tissue thickness to enable the surgeon to select a proper staple cartridge to perform a transection. There is a further need for graspers that have tissue thickness measuring capabilities and jaws designed to effectively grasp other surgical instruments therebetween.

[0007] The foregoing discussion is intended only to illustrate some of the shortcomings present in the field of the invention at the time, and should not be taken as a disavowal of claim scope.

15 SUMMARY

[0008] In one aspect of the invention, there is provided a surgical instrument that comprises a pair of opposing jaws, wherein at least one jaw is selectively movable relative to the other jaw in response to opening and closing motions applied thereto for selectively clamping tissue therebetween. An output generator is associated with the pair of opposing jaws and is capable of generating tissue thickness data or indicia that represents a thickness of the tissue that is clamped between the pair of opposing jaws. The surgical instrument may further include a display for displaying the tissue thickness data or indicia thereon. In various embodiments, the tissue thickness data or indicia may be displayed on a display located on the surgical instrument itself or it may be displayed on a display located remote from the surgical instrument.

[0009] In another general aspect of various embodiments of the present invention there is provided a surgical instrument that comprises a handle assembly and an end effector for performing a surgical operation. The end effector is coupled to the handle assembly and has opposed jaw members for selectively clamping tissue therebetween in response to opening and closing motions applied thereto. A closure drive is supported by the handle assembly and is configured to generate the opening and closing motions for selective application to the end effector. The end effector may include at least one signal generator for generating signals corresponding to a thickness of the tissue clamped between the opposed jaw members. The instrument may further include a signal processor for receiving said signals from the signal generator and calculating the thickness of the tissue. In addition, a display communicates with the signal processor for displaying the tissue thickness thereon.

[0010] In still another general aspect of various embodiments of the present invention there is provided a jaw arrangement for a surgical instrument that comprises a first jaw that is operably coupleable to the surgical instrument and has a distal end and a first clamping face and at least one first nodule that is formed on the first clamping face. The arrangement further includes a second jaw that has a distal end and a second clamping face. At least one second nodule is formed on the second

clamping face. The second jaw is operably coupleable to the surgical instrument relative to the first jaw such that the first and second distal ends of the first and second jaws, respectively may be selectively moved toward and away from each other upon application of open and closing motions to at least one of the first and second jaws from the surgical instrument such that as the first and second distal ends are moved towards each other, the first and second distal ends and the first and second nodules cooperate to define a cradle area therebetween sized to grippingly support therein an object having a specific cross-sectional shape.

[0011] In another aspect of the present invention, there is provided a surgical instrument that may comprise a handle assembly and a pair of opposing jaws that are operably coupled to the handle assembly. The opposing jaws may be selectively movable between open and closed positions for clamping tissue therebetween. The surgical instrument may further include a closure drive that is operably supported by the handle assembly for selectively applying opening and closing motions to the pair of opposing jaws. An output generator may cooperate with the closure drive to display reference indicia that corresponds to a thickness of the tissue clamped between the pair of opposing jaws.

[0012] These and other objects and advantages of the present invention shall be made apparent from the accompanying drawings and the description thereof.

BRIEF DESCRIPTION OF THE FIGURES

[0013] The accompanying drawings, which are incorporated in and constitute a part of this specification, illustrate embodiments of the invention, and, together with the general description of the invention given above, and the detailed description of the embodiments given below, serve to explain various principles of the present invention.

[0014] FIG. 1 is a perspective view of a surgical stapling and severing instrument of various embodiments of the present invention;

[0015] FIG. 2 is a left side perspective view of an end effector embodiment of the present invention;

[0016] FIG. 3 is a cross-sectional view of the end effector of FIG. 2 with a portion of tissue clamped between the anvil and tissue measurement cartridge;

[0017] FIG. 4 is a cross-sectional view of the end effector of FIG. 3 taken along line 4-4 in FIG. 3;

[0018] FIG. 5 is a schematic diagram of a strain gauge and operating system arrangement of various embodiments of the present invention;

[0019] FIG. 6 is a cross-sectional view of another end effector embodiment of the present invention with tissue clamped between the anvil and the tissue measurement cartridge;

[0020] FIG. 7 is a schematic diagram of a strain gauge and operating system arrangement of another embodiment of the present invention;

[0021] FIG. 8 is a side elevational view of a grasper embodiment of the present invention with the left hand side of the handle casing removed to show the various components supported within the handle assembly;

5 **[0022]** FIG. 9 is an exploded assembly view of a portion of the grasper rod arrangement employed in the grasper embodiment depicted in FIG. 8;

[0023] FIG. 10 is a schematic view of various components of the grasper embodiment of FIG. 8 with the jaws thereof in an open position;

10 **[0024]** FIG. 11 is another schematic view of various components of the grasper embodiment of FIG. 8 with the jaws thereof clamping a portion of tissue therebetween;

15 **[0025]** FIG. 12 is another schematic view of various components of the grasper embodiment of FIG. 8 with the jaws thereof in a fully closed position;

[0026] FIG. 13 is a right side elevational view of another grasper embodiment of the present invention;

20 **[0027]** FIG. 14 is a side elevational view of a jaw arrangement of other embodiments of the present invention;

[0028] FIG. 15 is a side view of another surgical instrument embodiment of the present invention;

25 **[0029]** FIG. 16 is an exploded assembly view of a portion of the surgical instrument of FIG. 15;

[0030] FIG. 17 is a cross-sectional view of a handle assembly of the surgical instrument of FIGS. 15 and 16 with some components thereof shown in solid form for clarity;

30 **[0031]** FIG. 18 is a cross-sectional view of the surgical instrument of FIGS. 15-17 in a fully closed and locked position with some components thereof shown in solid form for clarity;

35 **[0032]** FIG. 19 is another cross-sectional view of the surgical instrument of FIGS. 15-18 in a fully open position with some components thereof shown in solid form for clarity;

40 **[0033]** FIG. 20 is another cross-sectional view of the surgical instrument of FIGS. 15-19 in a fully closed position and with the release trigger in a fully depressed position with some components thereof shown in solid form for clarity;

45 **[0034]** FIG. 21 is another cross-sectional view of the surgical instrument of FIGS. 15-20 in a tissue clamping position with some components thereof shown in solid form for clarity;

50 **[0035]** FIG. 22 is a cross-sectional view of the surgical instrument of FIGS. 15-21 in a position wherein the clinician is applying excessive clamping force to the tissue with some components thereof shown in solid form for clarity; and

55 **[0036]** FIG. 23 is another cross-sectional view of the surgical instrument of FIGS. 15-22 in a tissue clamping position wherein the user can read the reference indicia corresponding to a thickness "t" of the tissue clamped thereby.

DETAILED DESCRIPTION

[0037] Certain exemplary embodiments will now be described to provide an overall understanding of the principles of the structure, function, manufacture, and use of the devices and methods disclosed herein. One or more examples of these embodiments are illustrated in the accompanying drawings. Those of ordinary skill in the art will understand that the devices and methods specifically described herein and illustrated in the accompanying drawings are nonlimiting exemplary embodiments and that the scope of the various embodiments of the present invention is defined solely by the claims. The features illustrated or described in connection with one exemplary embodiment may be combined with the features of other embodiments. Such modifications and variations are intended to be included within the scope of the present invention.

[0038] The present invention generally relates to methods and devices for measuring the thickness of tissue to be transected or otherwise manipulated during endoscopic and laparoscopic procedures. In one exemplary embodiment, the measuring device can be employed in connection with an endocutter for transecting and stapling tissue. Such endocutters typically include an end effector with opposing jaws that are adapted to receive the target tissue therebetween. As will be described in connection with one exemplary embodiment, the end effector is attached to a handle assembly by an elongated shaft assembly. The handle assembly is equipped with a closure trigger that enables the surgeon to selectively open and close the end effector jaws. The end effector is also equipped with a firing drive system for driving a knife through the staple cartridge and clamped tissue while also driving the staples housed within the staple cartridge into forming contact with an anvil. Other exemplary embodiments comprise a surgical device that has a pair of opposed jaws for simply manipulating and grasping tissue, other surgical instruments, etc.

[0039] As the present Detailed Description proceeds, a person of ordinary skill in the art will appreciate that the surgical instruments described herein can have a variety of configurations, and that one or more of the various tissue measurement features of the various embodiments of the present invention disclosed herein can be successfully used in a variety of different grasping device/end effectors known in the art for grasping/manipulating tissue or other objects. Thus, the term "surgical instrument" as used herein is intended to include any device that has opposed movable jaws that come together to grasp, clamp, cut, dissect, staple, etc.

[0040] Turning to the Drawings, wherein like numerals denote like components throughout the several views, FIGS. 1 and 2 depict a surgical stapling and severing instrument 10 that is capable of practicing various unique benefits of the present invention. The surgical stapling and severing instrument 10 incorporates an end effector 12 that has a first jaw 14 and a second jaw 16. In various

embodiments, the second jaw 16 may comprise elongate channel 17 and the first jaw may comprise an anvil 15 that is pivotally attached to the elongate channel 17, forming opposing jaws for clamping tissue to be severed and stapled. Those of ordinary skill in the art will understand that the exemplary endocutter embodiment depicted in the Figures comprises one endocutter version with which various embodiments of the present invention may be successfully employed. However, various embodiments of the present invention may be used in connection with a variety of different endocutter instruments. For example, various embodiments of the present invention may be used in connection with those surgical instruments disclosed in U.S. Patent No. 6,978,921 to Shelton, IV et al., entitled Surgical Stapling Instrument Incorporating an E-Beam Firing Mechanism, the disclosure of which is herein incorporated by reference.

[0041] As can be seen in FIG. 1, the end effector 12 may be coupled to a handle assembly 20 by an elongate shaft assembly 18. An implement portion 22, formed by the end effector 12 and shaft assembly 18, may be advantageously sized for insertion through a trocar or small laparoscopic opening to perform an endoscopic surgical procedure while being controlled by a surgeon grasping the handle assembly 20. The handle assembly 20 may include features that allow separate closure motions and firing motions, lockouts to prevent inadvertent or ill-advised firing of the end effector, as well as enabling multiple firing strokes to effect firing (i.e., severing and stapling) of the end effector 12 while indicating the degree of firing to the surgeon.

[0042] To these ends, a closure tube 24 of the shaft assembly 18 may be coupled between a closure trigger 26 (FIG. 1) and the anvil 15 to cause closure of the end effector 12. Within the closure tube 24, a frame 28 may be coupled between the elongate channel 17 and the handle assembly 20 to longitudinally position and support the end effector 12. A rotation knob 30 may be coupled with the frame 28, and both elements may be rotatably coupled to the handle assembly 20. Thus, the surgeon can rotate the end effector 12 by turning the rotation knob 30 which causes rotation of the closure tube 24. The frame 28 extends through the closure tube 24 along with a firing rod 32 which is positioned for longitudinal movement and is operably coupled to a firing trigger 34. In the embodiment depicted in FIG. 1, the closure trigger 26 is distal to a pistol grip 36 of the handle assembly 20 with the firing trigger 34 distal to both the pistol grip 36 and closure trigger 26.

[0043] It will be appreciated that the terms "proximal" and "distal" are used herein with reference to a clinician gripping a handle of an instrument. Thus, the end effector 12 is distal with respect to the more proximal handle assembly 20. Analogous terms such as "front" and "back" similarly correspond respectively to distal and proximal. It will be further appreciated that for convenience and clarity, spatial terms such as "vertical", "horizontal", "up" and "down" are used herein with respect to the drawings.

However, surgical instruments are used in many orientations and positions, and these terms are not intended to be limiting and absolute.

[0044] The present invention is being discussed in terms of endoscopic procedures and apparatus. However, use herein of terms such as "endoscopic", should not be construed to limit the present invention to a surgical stapling and severing instrument for use only in conjunction with an endoscopic tube (i.e., trocar). On the contrary, it is believed that the present invention may find use in any procedure where access is limited to a small incision, including but not limited to laparoscopic procedures, as well as open procedures.

[0045] With particular reference to FIG. 3, the anvil 15 is pivotally coupled to the elongate channel 17 by a pair of laterally projecting anvil pivot pins 54 that are proximal to a vertically projecting anvil feature 56 (FIG. 4). The anvil pivot pins 54 translate within kidney shaped openings 58 in the elongate channel 17 to open and close anvil 15 relative to elongate channel 17. The anvil feature 56 engages a tab 59 (FIG. 1) extending inwardly in a tab aperture 60 on a distal end 62 of the closure tube 24. Thus, when the closure tube 24 moves proximally from its open position, the tab 59 of the closure tube 24 draws the anvil feature 56 proximally, and the anvil pivot pins 54 follow the kidney shaped openings 58 of the elongate channel 17 causing the anvil 15 to simultaneously translate proximally and rotate upward to the open position. When the closure tube 24 moves distally, the tab 59 in the tab aperture 60 releases from the anvil feature 56 and the distal edge 64 pushes on the anvil face 50, closing the anvil 15.

[0046] It should be appreciated that, although a non-articulating shaft assembly 18 is illustrated herein, applications of the present invention may include instruments capable of articulation, such as those described in three commonly owned U.S. patents and two commonly owned U.S. Patent applications, the disclosure of each being hereby incorporated by reference in their entirety: (1) U.S. Patent No. 7,111,769 to Kenneth S. Wales, Douglas B. Hoffman, Frederick E. Shelton IV, and Jeffrey S. Swayze, issued September 26, 2006, entitled "Surgical instrument Incorporating An Articulation Mechanism Having Rotation About the Longitudinal Axis"; (2) U.S. Patent No. 6,981,628 to Kenneth S. Wales, issued January 3, 2006, entitled "Surgical Instrument With A Lateral-Moving Articulation Control"; (3) U.S. Patent No. 7,055,731 to Frederick E. Shelton IV, Michael E. Setser, William B. Weisenburgh II, issued June 6, 2006 entitled "Surgical Stapling Instrument Incorporating A Tapered Firing Bar For Increased Flexibility Around The Articulation Joint"; (4) U.S. Patent Publication No. 2005/0006429 entitled "Surgical Stapling Instrument Having Articulation Joint Support Plates For Supporting A Firing Bar", Ser. No. 10/615,971, to Kenneth S. Wales and Joseph Charles Hueil, filed 9 July 2003; and (5) U.S. Patent Application entitled "Surgical Stapling Instrument Incorporating An Articulation Joint For a Firing Bar Track", Ser.

No. 10/615,962, to Brian J. Hemmelgarn, filed 9 July 2003. Those of ordinary skill in the art will readily understand, however, that the unique and novel aspects of various features of the present invention may be employed in connection with still other types of articulating surgical instruments without departing from the spirit and scope of the present invention.

[0047] With reference to FIGS. 2 and 3, the elongate channel 17 is configured to removably receive a thickness measurement cartridge 100 therein. Thickness measurement cartridge 100 may resemble a conventional staple cartridge. However, thickness measurement cartridge 100 lacks the staples and staple firing drivers and may also differ from a conventional staple cartridge in at least the manners described below. In particular, the body portion 102 of the thickness measurement cartridge 100 may have an upstanding clamping nodule 110 that is formed on a distal end 101 of the cartridge 100. The clamping nodule 110 may be so oriented on the distal end 101 of the cartridge 100 such that when the cartridge 100 is installed in the elongate channel 17, the clamping nodule 110 is located over a first conventional strain gauge 120 that is mounted within the elongate channel 17. The purpose of the first strain gauge 120 will be discussed in further detail below.

[0048] As can also be seen in FIGS. 2 and 3, the thickness measurement cartridge 100 may also include a thickness or anvil probe 130 that is mounted within the cartridge body 102. More specifically, as can be seen in FIG. 3, the anvil probe 130 may include a first portion 132 that is mounted within the cartridge body 102 and a second deflectable portion 134 that protrudes upwardly from the cartridge body 102 for contact with the underside 19 of the anvil 15. The anvil probe 130 may be fabricated from metal or other suitable material and may be associated with a second strain gauge 140 that is mounted in the cartridge body 102. The first and second strain gauges 120, 140 may each be coupled to a battery or other source of electrical power 150, an amplifier 152, a digital-to-analog converter 154, a conventional central processing unit "CPU" 156, and a display unit 158. The battery 150, amplifier 152, the converter 154, CPU 156 and display unit 158 may be housed within the handle assembly 20. Each strain gauge may have its own amplifier. The first and second strain gauges 120, 140 and the source of electrical power 150, amplifier, 152, converter 154 and CPU 156 may collectively form an output generator generally designated as 118. In alternative embodiments, the CPU 156 may also be coupled to a wireless signal generator 160 that transmits the thickness data to a remote (i.e., not supported by the handle assembly 20) monitor 162. See FIG. 5. The measurement cartridge 100 may be formed with a pin and socket connection (not shown) to facilitate electrical communication between the second strain gauge 140 and conductors in the elongate channel 17 that extend through the shaft 18 and are ultimately coupled to the CPU 156 and/or source of electrical power 150.

[0049] Operation of a thickness measurement cartridge 100 of various embodiments of the present invention will now be described with reference to FIGS. 1, 3, 4, and 5. Prior to installing a conventional staple cartridge into the elongate channel 17 of the instrument 10, the surgeon may first install the thickness measurement cartridge 100 into the elongate channel 17. The thickness measurement cartridge 100 may be fabricated with retention features that are commonly found on conventional staple cartridges to removably retain the thickness measurement cartridge 100 within the elongate channel 17. When installed, a pin and socket connector or other arrangement may connect the second strain gauge 140 to the source of electrical power 150 and amplifier 152.

[0050] In laparoscopic and endoscopic surgical procedures, a small incision or puncture is made in the patient's body to provide access for a tube or cannula device. Once extended into the patient's body, the cannula allows insertion of various surgical instruments to perform the surgery. After the surgeon has installed the thickness measurement cartridge 100 in the elongate channel 17, the surgeon may then insert the implement 22 through the cannula (not shown) so that a portion T' of the tissue "T" to be transected is positioned between the underside 19 of the anvil 15 and the measurement cartridge 100. See FIG. 3. The surgeon then moves the closure trigger 26 towards the pistol grip 36 to move the closure tube 24 in a known manner to pivot the anvil 15 in a closing direction. As the anvil 15 is pivoted in the closing direction, a portion of the tissue "T" to be transected is clamped between the underside 19 of the anvil 15 and the nodule 110. As can be most particularly seen in FIGS. 3 and 4, a pivot protrusion 104 may be formed on the underside of the cartridge body 102 to rest on the bottom of the elongate cartridge 17 to thereby enable the cartridge body 102 to pivot thereon.

[0051] As the anvil 15 begins to clamp the tissue "T" between the underside 19 of the anvil 15 and the nodule 110, the first strain gauge 120 is placed under load and may act as a resistor, such that, as the load that is applied to the first strain gauge 120, the first strain gauge 120 either increases or decreases the amount of resistance to the electricity supplied to it from the source of electrical power 150. The amplifier 152 amplifies the signal from the first strain gauge 120 and feeds the amplified signal into the digital-to-analog converter 154 that changes raw current into digital data. The digital data is then sent to the CPU 156 which interprets the digital signal and mathematically transforms the data into a first amount of strain or load which is displayed by the handle display 158 and/or is sent to a wireless signal generator 160 which wirelessly transmits the data to a remote monitor 162. See FIG. 5. The surgeon continues to close the anvil 15 until the display indicates that the tissue "T" within the first and second jaws 14, 16 has been clamped under a predetermined amount of clamping load. For example, the predetermined amount of clamping load or force may be eight grams. Such force may not, for example, dam-

age the tissue "T", but may provide a reference point for repeatability purposes.

[0052] As the anvil 15 is being closed, the undersurface 19 of the anvil 15 starts to impart a load onto the anvil probe 134 which is conveyed to the second strain gauge 140 located in the cartridge 100. The amplifier 152 amplifies the output signal from the second strain gauge 140 and feeds the amplified signal into the digital-to-analog converter 154 that changes raw current into digital data. The digital data is then transmitted to the CPU 156 which interprets the digital signal and mathematically transforms the data into a tissue thickness that is displayed on the handle display 158 and/or is transmitted to the wireless signal generator 160 for sending to a remote monitor 162. After the surgeon has determined the thickness "t" of the tissue to be transected, the implement portion 22 is withdrawn to enable the thickness measurement cartridge 100 to be replaced with the appropriate staple cartridge. The measurement cartridge 100 may then be resterilized for the next procedure or simply disposed of.

[0053] In an alternative embodiment as depicted in FIGS. 6 and 7, the measurement cartridge 100' lacks the nodule and the first strain gauge that was included in the measurement cartridge 100 as described above. This embodiment may only be equipped with a strain gauge 140'. Thus, in this embodiment, the output generator 118' may comprise the source of electrical power 150, the strain gauge 140', the amplifier 152, the converter 154, and the CPU 156. Otherwise, cartridge 100' may be substantially identical to cartridge 100. FIG. 7 is a schematic drawing of the interface between the strain gauge 140' and the CPU 156. In this embodiment, the CPU 156 employs an algorithm that compares the strain values over time and waits until the strain is no longer changing within a desired delta, before it displays the final load reading or calculated tissue thickness "t" on the display. In addition, a switch 164 (mechanically or electrically activated) could be associated with the clamping trigger 26 for detecting the position of the clamping trigger 26. The switch 164 may communicate with the CPU 156 such that the CPU 156 would not start to process the strain loads until the clamping trigger 26 reached a predetermined position.

[0054] FIGS. 8-12 illustrate another surgical instrument 300 in the form of a grasper 302 that may employ various unique and novel features of various embodiments of the present invention. Such graspers 302 are known in the art and, therefore, the known features thereof, will not be discussed in great detail herein beyond what may be needed to fully understand and appreciate various embodiments of the subject invention. Examples of such devices are disclosed in U.S. Patent No. 6,117,158 to Measamer et al. and U.S. Patent No. 5,735,874 to Measamer et al., the disclosures of which are herein incorporated by reference.

[0055] As can be seen in FIG. 8, the grasper 302 includes an end effector 312 that has a first jaw 314 and a

second jaw 316 that are operably mounted to a grasper rod 400 that protrudes distally from a handle assembly 320. As is known, a proximal portion 402 of the grasper rod 400 may be rotatably supported within the handle assembly 320 and coupled to a rotation knob 330 rotatably supported on the handle assembly 320. Such arrangement permits the surgeon to rotate the grasper rod 400 (and jaws 314, 316) relative to the handle assembly 320. As can also be seen in FIG. 8, the grasper rod 400 extends through a closure tube 324 that also protrudes from the handle assembly 320.

[0056] As is known in the art, as the jaws 314 and 316 are pivotally coupled to a distal end 404 of the grasper rod 400 and may be retained in the open position illustrated in FIG. 8 by a spring arrangement (not shown). The jaws 314 and 316 are caused to close when their respective proximal ends 315, 317 are brought into contact with a distal end 325 of the closure tube 324 as the grasper rod 400 is drawn in the proximal direction in response to the actuation of a closure trigger 326 attached to the handle assembly 320. As can be seen in FIG. 8, the closure trigger 326 is pivotally mounted on a pivot rod 328 for selective pivotal travel therearound. The closure trigger 326 has an arcuate follower arm 340 attached thereto that is constrained to pivot along an arcuate path within the handle assembly 320 as the closure trigger 326 is pivoted between the open position shown in FIG. 8 and a closed position wherein the proximal end 327 of the pivot trigger 326 is substantially adjacent to a grip portion 336 of the handle assembly 330. Supported within the handle assembly 320 is a closure spring 342 that is arranged to engage the distal end of the follower arm 340 to bias the closure trigger 326 in the open position. In various embodiments, the grasper 320 may further include a locking trigger assembly 350 for locking the closure trigger 326 and ultimately the jaws 314, 316 in a specific clamping position. The construction and operation of such locking trigger assembly 350 is known in the art and therefore will not be described in detail herein.

[0057] As can be seen in FIG. 8, the grasper 302 is provided with an output generator generally designated as 500. In various embodiments, the output generator 500 may include a first gear 502 in the form of an arcuate arm 504 that has a series of gear teeth 510 formed on a distal end 506 thereof. A proximal end 508 is attached to the closure trigger 326. The gear teeth 510 are arranged in meshing engagement with the teeth of a second or closure gear 520 which is nonrotatably coupled to a bell crank 530. The second gear 520 may be rotatably supported on a second pivot rod 514 within the handle housing 320. As can be seen in FIG. 8, a distal end 532 of the bell crank 530 has a series of crank teeth 534 formed thereon and a retainer tab 538 formed on a proximal end 536 thereof. Thus, by pivoting the closure trigger 326 toward the grip portion 330, the bell crank 530 is rotated in a clockwise direction "CW" as shown in FIG. 8.

[0058] Also in this embodiment, a series of rings 550 may be formed on a portion of the grasper rod 400. The

rings 550 are located on the grasper rod 400 for selective engagement with the crank teeth 534. A lug 552 is also formed adjacent the proximal-most ring 550. As can be seen in FIGS. 8 and 9, the proximal end 410 of the grasper rod 400 may be attached to a reference scale arm 560 by means of a linkage arm assembly 570. As was discussed above, it may be desirable for the surgeon to be able to rotate the grasper rod 400 relative to the handle assembly 320 to facilitate accurate positioning of the jaws 314 and 316. Thus, in various embodiments, the proximal end 410 of the grasper rod 400 may be attached to the linkage arm assembly by a gimble-like joint assembly, generally designated as 580. As shown in FIG. 9, the gimble-like joint assembly 580 may include a collar 582 that has two circumferentially opposed pivot pins 584, 586 protruding therefrom. The collar 584 is received on a shoulder portion 412 of the grasper rod 400 and retained thereon by a screw 414 that threadably engages the proximal end 410 of the grasper rod 400 as shown. Those of ordinary skill in the art will understand that such arrangement serves to permit the grasper rod 400 to freely rotate within the collar 582 while being attached thereto.

[0059] As can also be seen in FIG. 9, the linkage arm assembly 570 may comprise a right linkage arm 572 that is pivotally attached to the right pivot pin 584 and a left linkage arm 574 that is attached to the left pivot pin 586. The proximal end 573 of the right linkage arm 572 and the proximal end 575 of the left linkage arm 574 may be pivotally attached to the scale arm 560 by a pivot pin 590. Thus, such arrangement enables grasper rod 400 to be linked to the scale arm 560 while permitting free rotation of the grasper rod 400 relative thereto. In various embodiments, the lower end 562 of the scale arm 560 may be pivotally coupled to handle case 320 by a pivot pin 564 to enable the scale arm 560 to pivot in sync with the grasper rod 400.

[0060] As can be seen in FIG. 8, the lower portion 562 of the scale arm 560 may also be attached to a load applying assembly 600. In various embodiments, the load applying assembly may comprise a pin 610 that is sized to move axially within a cavity 323 formed in the handle case 321. A measurement spring 612 is located within the cavity 323 for biasing the pin 610 in a distal direction "DD". As will be further discussed below, the measurement spring 612 may be sized to apply an 8 gram or other predetermined load to close the jaws 314, 316 when the closure trigger 326 has been pivoted to a certain position. The distal end of the pin 614 may be pivotally coupled to the scale arm 560 by a pin 620 that is received in an elongated slot 563 formed in the bottom end of the scale arm. See FIGS. 10-12. A reference scale 566 may be attached to or formed on the upper end of the scale arm 560 as shown. The reference scale 566 may be provided with reference indicia 568, the purpose of which will be discussed in further detail below. Also in the embodiment depicted in FIG. 8, a shroud 630 may protrude from the bell crank 530. The shroud 630 may

have a first reference window 632 therethrough. In addition, a window 329 is also provided through the handle case 321 to enable the surgeon to read the reference indicia 568 on the reference scale 566 that is aligned therewith. See FIG. 10.

[0061] The operation of the grasper 302 may be further appreciated from reference to FIGS. 10-12 which schematically illustrate one method of operation. FIG. 10 illustrates the grasper 302 in schematic form with the jaws 314, 316 in the fully open position. When in that position, the closure spring 342 biases the closure trigger 326 away from the grip portion (not illustrated in FIG. 10). The closure spring 342 may be sized relative to the measurement spring 612 such that the closure spring 342 is stronger than the measurement spring 612 to cause the closure trigger 326 to be pivoted to the open position when the grasper 302 is unactuated. In FIG. 10, the closure spring 342 is biasing the closure trigger 326 in the counterclockwise "CCW" direction. As can be seen in FIGS. 8 and 10, when the grasper rod 400 is in the fully opened position, none of the teeth 534 on the bell crank 530 are in engagement with any of the rings 550 on the grasper rod 400 and the retention tab 538 on the bell crank 530 is in contact with the lug 552 on the grasper rod 400. In addition, the end of the shroud 630 extends between the reference scale 566 and the viewing window 329 in the handle case 321 so that the surgeon will only see the shroud 630 when looking through the window 329; no reference indicia 568 would be viewable in the window 329.

[0062] FIG. 11 illustrates use of the grasper 302 in schematic form to measure the thickness "t" of the tissue "T". As can be seen in that Figure, the closure trigger 326 has been pulled in the CCW direction against the closing force of the closing spring 342 to cause the bell crank 530 to rotate in the CW direction to move the retention tab 538 out of engagement with the lug 552 on the grasper rod 400. When the retention tab 538 has been moved out of engagement with lug 552, the grasper rod 400 is caused to move in the proximal direction "PD" by means of scale arm 560. In particular, the lower end 562 of the scale arm 560 is moved in the distal direction by the pin 610 which causes the scale arm 560 to pivot about the pivot pin 564 and pull the grasper rod 400 in the proximal direction "PD". As the measurement spring 612 expands, the position where the pin 610 engages the scale arm 560 in the slot 563 will change - moving further from the pivot rod 564. Thus, as the measurement spring force reduces (resulting from extension of the measurement spring 612), the mechanical advantage of the scale arm 560 would increase to maintain a constant load on the grasper jaws 314, 316. As the grasper rod 400 moves in the proximal direction "PD", it causes the jaws 314 and 316 to close upon the tissue "T". In various embodiments, the measurement spring 612 may be sized such that a predetermined amount of clamping load is applied to the tissue "T". For example, in one exemplary embodiment, the measurement spring 612 is sized such that approx-

imately eight grams of closure load is applied to the tissue "T".

[0063] When in the tissue "T" has been clamped between the jaws 314, 316 solely under the clamping load of the measurement spring 612, a corresponding one of the reference indicia 568 will be aligned with the viewing window 329 in the handle case 321. The surgeon can then position the closure trigger 326 to cause the bell crank 530 and shroud 630 to move to a position wherein the viewing window 632 in the shroud 630 is in alignment with the viewing 329 window to permit the surgeon to view the reference indicia 568 through the viewing windows 329, 632 as shown in FIG. 11. When in that position, the bell crank 530 is not influencing the position of the grasping rod 530. The position of the grasping rod 400 is solely controlled by the influence of the measuring spring 612 on the scale arm 560 in the manner described above. Thus, when in that position, the surgeon is viewing the reference indicia 568 associated with the thickness of the tissue "T" as it is clamped between the jaws 314, 316 under that predetermined load. Those of ordinary skill in the art will appreciate that the measurement spring and measurement lever may be constructed/calibrated such that the reference indicia 568 correspond to the thickness of the tissue "T" that is clamped under that load.

[0064] FIG. 12 illustrates the position of the various grasper components when the surgeon has completely closed the jaws 314, 316 with no tissue clamped therebetween. As can be seen in that Figure, the surgeon has pulled the closure trigger 326 to the point wherein the measurement spring 612 has biased the scale arm 560 to pull the grasper rod 400 far enough in the proximal direction "PD" to cause the jaws 314, 316 to completely close. When the surgeon releases the closure trigger 326, the closure spring 342, which is stronger than the measurement spring 612, biases the closure trigger 326 to the open position. As the closure trigger 326 rotates to the open position, it causes the bell crank 530 to pivot in the CCW direction in FIG. 12 to bring the retainer tab 538 into engagement with the lug 552 on the grasper rod 400 to drive the grasper rod 400 in the distal direction "DD" until the grasper rod 400 reaches the open position (FIG. 10).

[0065] Thus, various embodiments of the grasper 302 may be used in the following manner. The surgeon may initially close the jaws 314, 316 to enable the implement portion 322 to be inserted through the cannula or other opening. After the implement portion 322 has been inserted into the patient, the surgeon may release the closure trigger 326 to permit the jaws 314, 316 to open. The surgeon may then manipulate the instrument until the target tissue "T" is oriented between the jaws 314, 316. The jaws 314, 316 may then be closed on the target tissue "T" by depressing the closure trigger 326 towards the grip portion 336 of the handle assembly 320. As the surgeon continues to depress the closure trigger 326, he or she can observe the viewing window 329 in the handle assembly 320 until the reference indicia 568 which cor-

responds to the tissue thickness under a predetermined clamping load is viewable. Further depressing of the closure trigger 326 would further draw the grasper rod 400 in the proximal direction "PD" by virtue of the engagement of the teeth 534 on the bell crank 530 with one or more rings 550 on the grasper rod 400 and thereby apply further clamping force to the tissue "T". In doing so, however, the movement of the bell crank 530 and shroud 630 causes the viewing window 632 in the shroud 630 to move out of alignment with the viewing window 329 in the handle casing 321. Thus, the surgeon is unable to view the reference indicia 568 when the tissue "T" has been placed under a clamping load that is greater than the desired predetermined clamping load. If the surgeon desires to take a thickness reading, he or she simply must start to release the closure trigger 326 until the window 632 in the shroud 630 once again aligns with the window 329 in the handle casing to permit viewing of the reference indicia.

[0066] FIG. 13 illustrates another surgical instrument 700 in the form of a grasper 702 that may employ various unique and novel features of various embodiments of the present invention. In this embodiment, a conventional grasper arrangement may be employed. Such grasper 702 may include an end effector 712 that has a first jaw 714 and a second jaw 716 that are operably mounted to a grasper rod 800 that protrudes distally from a handle assembly 720. As is known, a proximal portion 802 of the grasper rod 800 is rotatably supported within the handle assembly 720 and coupled to a rotation knob 730 rotatably supported on the handle assembly 720. Such arrangement permits the surgeon to rotate the grasper rod 800 relative to the handle assembly 720. As can also be seen in FIG. 13, the grasper rod 800 may extend through a closure tube 724 that also protrudes from the handle assembly 720.

[0067] As is known in the art, the jaws 714 and 716 may be pivotally coupled to a distal end 804 of the grasper rod 800 and may be retained in the open position illustrated in FIG. 13 by a spring arrangement (not shown). The jaws 714 and 716 are caused to close when their proximal ends 715, 717, respectively are brought into contact with a distal end 725 of the closure tube 724 as the grasper rod 800 is drawn in the proximal direction in response to the actuation of a closure trigger 726 attached to the handle assembly 720. The construction and operation of the closure trigger and its interaction with the grasper rod 800 are known in the art and therefore will not be discussed in detail herein.

[0068] In various embodiments, however, a strain gauge 900 may be oriented for interaction with the grasper rod 800 such that as the grasper rod is moved in the proximal direction "PD" by depressing the closure trigger 726, the strain gauge 900 measures the strain on the closure rod 800. As can be seen in FIGS. 14, the strain gauge 900 is coupled to a battery or other source of electrical power 910, an amplifier 912, a digital-to-analog converter 914, a conventional central processing unit "CPU"

916, and a display unit 918. In various embodiments, the strain gauge 900, source of electrical power 910, the amplifier 912, converter 914 and CPU 916 may be collectively referred to as an output generator, generally designated as 930. In alternative embodiments, the CPU 916 may also be coupled to a wireless signal generator 920 that transmits the thickness data to a remote monitor 922.

[0069] In this embodiment, the CPU 916 employs an algorithm that compares the strain values over time and waits until the strain is no longer changing within a given delta for example, less than 1 to 2 % variation, before it displays the final load reading or calculated tissue thickness "t" on the display. Such variation may be measured in raw voltage (strain gauge acts as a resistor to modify voltage according to how much it is stressed or pulled or compressed), deflection after the data is translated from voltage to strain, or tissue thickness when the strain is translated into thickness. In addition, a switch (mechanically or electrically activated) could be associated with the clamping trigger for detecting the position of the clamping trigger. The switch 164 may communicate with the CPU 156 such that the CPU 156 would not start to process the strain loads until the closure trigger 26 reached a predetermined position.

[0070] Another feature of various embodiments of the present invention is depicted in FIG. 14. In particular, FIG. 14 illustrates jaws 710, 720 that may be used in connection with any of the grasper embodiments described herein or other conventional grasper arrangements wherein it may be advantageous to grasp and manipulate another surgical instrument such as, an endocutter or the like. In the embodiment depicted in FIG. 15, the first jaw 710 may have a clamping face 711 and a distal end 712 that curves downward. The second jaw 720 has a clamping face 721 and a distal end 722 that curves upwardly. A somewhat curved nodule 714 may be formed on the clamping face 711 of the first jaw 710 and another somewhat curved nodule 724 may be formed on the clamping face 721 of the second jaw 720. In this embodiment, the nodules 714, 724 may be so oriented and shaped to cooperate with the respective distal ends 712, 722 of the first and second jaws 710, 720 so as to form a cradle, generally designated as 730, for receiving and supporting a portion of a surgical instrument 750 that has a substantially circular cross-sectional shape. Such arrangement serves to provide a positive support for the surgical instrument 750 within the first and second jaws 710, 720 and enables the surgeon to accurately manipulate the instrument 750 using the grasper. Those of ordinary skill in the art will understand that, in other embodiments of the present invention, the sizes, shapes and numbers of nodules may vary and/or the distal ends of the jaws may have different shapes to better form a cradle that corresponds to the cross-sectional shape of the instrument to be grasped between the jaws. Thus, the scope and protection afforded to these various embodiments should not be limited to use of two nodules having the specific shapes illustrated in FIG. 14.

[0071] FIGS. 15-23 illustrate another surgical instrument 1000 in the form of a grasper 1002 that may employ certain unique and novel features of various embodiments of the present invention. In various embodiments, the grasper 1002 may include an end effector 1012 that has a first jaw 1014 and a second jaw 1016 that are operably mounted to a grasper rod 1100 that protrudes distally from a handle assembly 1020. See FIG. 19. The grasper rod 1100 may be axially received within a tube 1024 that may be rotatably affixed to the handle assembly 1020. A rotation knob 1030 may be rotatably affixed to the handle assembly 1020 as shown in FIG. 19 and be attached to the tube 1024 such that rotation of the rotation knob 1030 relative to the handle assembly 1020 may also result in the rotation of the end effector 1012 relative to the handle assembly 1020. The jaws 1014 and 1016 may be pivotally coupled to a distal end 1104 of the grasper rod 1100 by corresponding linkages 1106, 1108. Movement of the grasper rod 1100 in the distal direction "DD" will cause the jaws to 1014, 1016 to pivot closed.

[0072] In various embodiments, the grasper rod 1100 may be selectively moved by actuation of a closure trigger 1026 that is pivotally supported by the handle assembly 1020. More specifically and with reference to FIGS. 17 and 18, a proximal end 1102 of the grasper rod 1100 may be attached to a calibrated spring slide 1200 housed within the handle assembly 1020. In various embodiments for example, the proximal end 1102 of the grasper rod 1100 may be formed with a T-shaped portion 1103 that is configured to be received in a correspondingly shaped cavity 1204 in a distal end portion 1202 of the calibrated spring slide 1200. The calibrated spring slide 1200 is configured to be movably received in an elongated opening 1040 in the handle assembly 1020 and has an actuator opening 1208 therein for receiving a lever arm 1028 formed on the closure trigger 1026. The lever arm 1028 may also protrude through the actuator opening 1208 into a corresponding opening 1212 in a window slide 1210 that is configured to be slidably supported within a window slide cavity 1040 formed in the handle assembly 1020. The window slide 1210 may have blocking portions 1214 formed thereon that, as will be discussed in further detail below, serve to block corresponding window openings 1022 formed in the handle assembly 1020. Thus, by pivoting the closure trigger 1026 toward the pistol grip portion 1025 of the handle assembly 1020, the lever arm 1028 causes the calibration spring slide 1200 and the window slide 1210 to move in the proximal "PD" direction. In various embodiments, a window slide spring 1216 may be supported by the handle assembly 1020 to bias the window slide 1210 in the distal "DD" direction.

[0073] As can also be seen in FIGS. 16-23, the grasper 1002 may also be configured with a releasable lock assembly, generally designated as 1220. In various embodiments, the lock assembly 1220 may comprise a lever lock arm 1222 that is attached to or protrudes from the closure trigger 1026 that is pivotally journaled on a pivot stud 1023 or other member formed on or otherwise at-

tached to the handle assembly 1020. See FIG. 16. A torque spring 1230 may also be journaled on the pivot stud 1023 to apply a biasing force to the closure trigger 1026 to bias the closure trigger 1026 to an open position as illustrated in FIG. 18. In various embodiments, the lever lock arm 1222 may comprise a piece of metal or other suitable material that is attached to the closure trigger 1026 and is configured to extend into a lock cavity 1027 formed in the handle assembly 1020. Extending into the lock cavity 1027 is a lock member that has a serrated or toothed end 1242 that is configured to selectively engage a portion of the lever lock arm 1222 and retain it within the lock cavity 1027. As shown in FIGS. 16-23, a lock spring 1250 may be supported in the handle assembly 1020 for biasing the lock member 1240 into retaining engagement with a portion of the lever lock arm 1222. To enable the clinician to selectively release the lock member 1240 out of retaining engagement with the lever lock arm 1222, a release trigger 1260 may be provided. In various embodiments, the release trigger 1260 may have a proximal end 1262 portion that is slidably received within a trigger cavity 1029 in the handle assembly. The proximal end 1262 of the release trigger 1260 is also configured to extend into a cavity 1244 formed in the lock member 1240. Depressing the release trigger 1260 toward the pistol grip portion 1025 of the handle assembly 1020 causes the proximal end 1262 of the release trigger 1260 to cooperate with an angled surface 1246 within the cavity 1244 to cause the lock member 1240 to moved downwardly against the lock spring 1250 to enable the lever lock arm 1222 to be released from the lock cavity 1027. When the lever lock arm 1222 is released, the closure trigger 1026 may pivot to an open position under the influence of the torque spring 1230.

[0074] Various embodiments may further include an output generator generally designated as 1201. In various embodiments, the output generator may include a reference dial 1270 that is rotatably supported on a dial stud 1272 formed or otherwise supported within the handle assembly 1020. The reference dial 1270 may be provided with reference indicia 1274, the purpose of which will be discussed in further detail below. In addition, the output generator 1201 may further include drive gear 1280 may be formed or otherwise attached to the reference dial 1270 as shown in FIG. 16. The drive gear 1280 is arranged for meshing engagement with gear teeth 1206 formed on the calibrated spring slide 1204. Also in various embodiments, the output generator may, for example, include a calibrated spring 1290 provided on the distal end 1202 of the calibrated spring slide 1200 and be received within a corresponding cavity 1292 in the handle housing 1020. As will be appreciated from the discussion to follow, the output generator 1201 in various embodiments is mechanically actuated or powered. As used herein, the term "mechanically actuated" means that the output generator is actuated without any electrically generated input.

[0075] Operation of various embodiments of the grasp-

er 1002 may be understood from reference to FIGS. 18-23. FIG. 18 illustrates the grasper 1002 in a "fully closed" and locked position. When the closure trigger 1026 is in the fully depressed position, the lever arm 1028 is positioned within the lever arm cavity 1208 in the calibrated spring slide 1200 to permit the calibrated spring slide 1200 to slide proximally under the biasing force created by the calibration spring 1292. As the calibrated spring slide 1200 moves proximally, it drives the reference dial 1270 in a clockwise direction by virtue of the meshing engagement between the teeth 1206 and the drive gear 1280. In various embodiments, the calibrated spring 1292 may be sized such that the "0" on the reference dial 1270 is aligned with the window 1022 in the handle assembly 1020. To return to a fully open position (FIG. 19), the clinician depresses the release trigger 1260 as shown in FIG. 23 which releases the lever lock arm 1222 and permits the closure trigger 1026 to return to the open position under the force of the torque spring 1230. As the closure trigger 1026 moves to the open position, the lever arm portion 1028 pivots in a counter-clockwise direction within the opening 1212 in the window slide 1210 thereby permitting the window slide 1210 to be biased in the distal direction by the window slide spring 1216 such that the blocking portions 1214 block the windows 1022 in the handle assembly 1020. In addition, the lever arm portion 1028 pushes the calibrated spring slide 1200 distally which moves the grasper rod 1100 distally to open the jaws 1014 and 1016.

[0076] When the clinician desires to clamp the tissue "T" between the jaws 1014, 1016 as shown in FIG. 21, the clinician moves the end effector 1012 into position and depresses the release trigger 1260 to permit the closure trigger 1026 to begin to be depressed. When in that position, the window slide 1210 is positioned in its distal-most position and the blocking portions 1214 thereof do not obscure the windows 1022 in the housing assembly. As the closure trigger 1026 is depressed, the calibrated spring slide 1200 moves proximally which draws the grasper rod 1110 proximally and causes the jaws 1014 and 1016 to clamp the tissue "T" therebetween (FIG. 21). The clinician continues to depress the closure trigger 1026 until the closure trigger has pivoted to a point wherein the lever arm portion 1028 biases the window slide 1210 proximally to a position wherein the blocking portions 1214 block the windows 1022 in the handle assembly 1020. See FIG. 22. The clinician thereafter slightly releases the closure trigger 1026 to a point wherein the reference indicia 1274 on the reference dial 1270 is viewable through the windows 1022 in the handle assembly 1020. See Fig. 23. Those of ordinary skill in the art will appreciate that the reference indicia may be associated with a particular thickness "t" of tissue "T". For example, the number 1 on the reference dial 1270 may represent an approximate tissue thickness of 1mm; the number 2 may represent an approximate tissue thickness of 2mm and so on. It will be further understood that such unique and novel arrangement enables the clinician to obtain a

thickness measurement of the tissue "T" at a predetermined clamping load (resulting from the calibrated spring 1292). For example, the calibrated spring 1292 may be sized to apply an approximate clamping load of 8grams/mm squared when the grasper is positioned to indicate the tissue thickness. If the clinician "over clamps" the tissue, the window slide 1210 moves to a position wherein the blocking portions 1214 block the windows 1022 to thereby prevent the clinician from reading the reference indicia 1274.

[0077] While the present invention has been illustrated by description of several embodiments and while the illustrative embodiments have been described in considerable detail, it is not the intention of the applicant to restrict or in any way limit the scope of the appended claims to such detail. Additional advantages and modifications may readily appear to those skilled in the art. Those of ordinary skill in the art will readily appreciate the different advantages provided by these various embodiments. For example, various embodiments of the present invention enable the surgeon to determine the thickness of the desired target tissue to enable the properly sized implementations (staple cartridges, etc.) to be employed. Various embodiments are also constructed to enable the surgeon to take such tissue thickness measurements under a predetermined compressive load.

[0078] While several embodiments of the invention have been described, it should be apparent, however, that various modifications, alterations and adaptations to those embodiments may occur to persons skilled in the art with the attainment of some or all of the advantages of the invention. For example, according to various embodiments, a single component may be replaced by multiple components, and multiple components may be replaced by a single component, to perform a given function or functions. This application is therefore intended to cover all such modifications, alterations and adaptations without departing from the scope and spirit of the disclosed invention as defined by the appended claims.

[0079] The devices disclosed herein can be designed to be disposed of after a single use, or they can be designed to be used multiple times. In either case, however, the device can be reconditioned for reuse after at least one use. Reconditioning can include a combination of the steps of disassembly of the device, followed by cleaning or replacement of particular pieces, and subsequent reassembly. In particular, the device can be disassembled, and any number of particular pieces or parts of the device can be selectively replaced or removed in any combination. Upon cleaning and/or replacement of particular parts, the device can be reassembled for subsequent use either at a reconditioning facility, or by a surgical team immediately prior to a surgical procedure. Those of ordinary skill in the art will appreciate that the reconditioning of a device can utilize a variety of different techniques for disassembly, cleaning/replacement, and reassembly. Use of such techniques, and the resulting reconditioned device, are all within the scope of the

present application.

[0080] Preferably, the invention described herein will be processed before surgery. First a new or used instrument is obtained and, if necessary, cleaned. The instrument can then be sterilized. In one sterilization technique, the instrument is placed in a closed and sealed container, such as a plastic or TYVEK® bag. The container and instrument are then placed in a field of radiation that can penetrate the container, such as gamma radiation, x-rays, or higher energy electrons. The radiation kills bacteria on the instrument and in the container. The sterilized instrument can then be stored in the sterile container. The sealed container keeps the instrument sterile until it is opened in the medical facility.

[0081] Any patent, publication, or other disclosure material, in whole or in part, that is said to be incorporated by reference herein is incorporated herein only to the extent that the incorporated materials does not conflict with existing definitions, statements, or other disclosure material set forth in this disclosure. As such, and to the extent necessary, the disclosure as explicitly set forth herein supersedes any conflicting material incorporated herein by reference. Any material, or portion thereof, that is said to be incorporated by reference herein, but which conflicts with existing definitions, statements, or other disclosure material set forth herein will only be incorporated to the extent that no conflict arises between that incorporated material and the existing disclosure material.

[0082] The invention which is intended to be protected is not to be construed as limited to the particular embodiments disclosed. The embodiments are therefore to be regarded as illustrative rather than restrictive. Variations and changes may be made by others without departing from the spirit of the present invention. Accordingly, it is expressly intended that all such equivalents, variations and changes which fall within the spirit and scope of the present invention as defined in the claims be embraced thereby.

[0083] The following is a non-exhaustive list of embodiments which may be claimed.

1. A surgical instrument, comprising:

a pair of opposing jaws, wherein at least one jaw is selectively movable relative to the other jaw in response to opening and closing motions applied thereto for selectively clamping tissue therebetween;
an output generator associated with said pair of opposing jaws, said output generator generating tissue thickness data representing a thickness of the tissue clamped between said pair of opposing jaws; and
a display for displaying said tissue thickness data thereon.

2. The surgical instrument of embodiment 1 wherein

said output generator comprises:

at least one strain gauge for generating a strain signal corresponding to the tissue thickness of the tissue clamped between said pair of opposing jaws; and
a processor communicating with said at least one strain gauge for receiving said strain signal therefrom and generating said tissue thickness data corresponding thereto and communicating said tissue thickness data to said display.

3. The surgical instrument of embodiment 1 wherein said pair of opposing jaws comprises:

a first jaw sized to removably support a cartridge therein;
a second jaw movably coupled to said first jaw and being selectively movable between open and closed positions relative to said elongate channel in response to application of said open and closing motions thereto and wherein said output generator comprises:

a measurement cartridge removably supportable in said elongate channel;
a strain gauge associated with said measurement cartridge for generating a strain signal corresponding to the tissue thickness of tissue clamped between the measurement cartridge and the second jaw; and
a processor communicating with said at least one strain gauge for receiving said strain signals therefrom and calculating said tissue thickness data corresponding to said tissue thickness and communicating said tissue thickness data to said display.

4. The surgical instrument of embodiment 3 wherein said strain gauge is supported by said measurement cartridge and has a deflectable portion for contact with said second jaw.

5. The surgical instrument of embodiment 3 wherein said strain gauge comprises:

a first strain gauge supported by said elongate channel such that when said measurement cartridge is supported by said elongate channel, said first strain gauge generates a first strain signal corresponding to an amount of compressive load experienced thereby when the tissue is clamped between a portion of said measurement cartridge and said second jaw, said first strain gauge communicating with said processor such that upon receipt of said first strain signal, said processor transmits data corresponding to said compressive load to said display; and

an a second strain gauge supported by said measurement cartridge and having a deflectable portion for contact with said second jaw as the tissue is clamped between said portion of said measurement cartridge and said second jaw, said second strain gauge generating a second strain signal corresponding to the thickness of the tissue clamped between the jaws, said second strain gauge communicating with said processor such that upon receipt of said second strain signal, said processor generates said tissue thickness data corresponding to the tissue thickness and transmits said tissue thickness data to said display.

6. The surgical instrument of embodiment 1 further comprising:

a handle assembly supporting said display thereon;
a grasper rod operably supported by said handle assembly and coupled to said pair of opposing jaws for transmitting said open and closing motions thereto wherein said output generator cooperates with said grasper rod to display on said display said tissue thickness data corresponding to a thickness of tissue clamped between said pair of opposing jaws.

7. The surgical instrument of embodiment 6 wherein said indicia is only viewable on said handle assembly when the opposing jaws are applying a predetermined amount of compressive force to the tissue clamped therebetween.

8. The surgical instrument of embodiment 1 further comprising:

a handle assembly;
a grasper rod operably supported by said handle assembly and coupled to said pair of opposing jaws for transmitting said open and closing motions thereto upon selective actuation of a closure trigger operably coupled to said handle assembly and wherein said output generator comprises:

a strain gauge associated with said grasper rod for generating strain signals as said grasper rod applies said closing motion to said opposing jaws to clamp the tissue therebetween; and
a processor communicating with said strain gauge for receiving said strain signals therefrom and calculating said tissue thickness data corresponding to said tissue thickness and communicating said tissue thickness data to said display.

9. The surgical instrument of embodiment 1 wherein said opposing jaws are shaped to accommodate an object therebetween having a specific cross-sectional shape.

10. The surgical instrument of embodiment 9 wherein each said jaw of said pair of opposing jaws has a distal end and at least one nodule protruding from a clamping face thereof such that as said opposing jaws are moved towards each other, said distal ends and nodules thereof define a cradle area therebetween sized to grippingly support therein an object having a specific cross-sectional shape.

11. A method for processing an instrument for surgery, the method comprising:

obtaining the surgical instrument of embodiment 1;
sterilizing the surgical instrument; and
storing the instrument in a sterile container.

12. A surgical instrument, comprising:

a pair of opposing jaws, wherein at least one jaw is selectively movable relative to the other jaw in response to opening and closing motions applied thereto for selectively clamping tissue therebetween;
means cooperating with said pair of opposing jaws for selectively applying said open and closing motions thereto;
means for generating a signal corresponding to a thickness of tissue clamped between said pair of opposing jaws;
means for converting said signal to tissue thickness data corresponding to the thickness of tissue clamped between said pair of opposing jaws; and
means for displaying said tissue thickness data.

13. The surgical instrument of embodiment 12 wherein said means for selectively applying said opening and closing motions to said pair of opposing jaws is operably coupled to said pair of opposing jaws and a handle assembly and wherein said means for displaying is supported by said handle assembly.

14. The surgical instrument of embodiment 12 wherein said means for selectively applying said opening and closing motions to said pair of opposing jaws is operably coupled to said pair of opposing jaws and a handle assembly and wherein said means for displaying is located remote from said handle assembly.

15. A surgical instrument comprising:

a handle assembly;
 an end effector for performing a surgical operation, said end effector coupled to said handle assembly and having opposed jaw members for selectively clamping tissue therebetween in response to opening and closing motions applied thereto;
 a closure drive supported by said handle assembly and configured to generate said opening and closing motions for selective application to said end effector;
 at least one signal generator in said end effector for generating signals corresponding to a thickness of the tissue clamped between said opposed jaw members.
 a signal processor for receiving said signals from said signal generator and calculating the thickness of the tissue; and
 a display communicating with said signal processor for displaying the tissue thickness thereon.

16. The surgical instrument of embodiment 15 further comprising a measurement cartridge, comprising:

a cartridge body sized to be removably supported in said end effector; and
 a strain gauge supported by said cartridge body and configured to communicate with said signal processor when said cartridge body is removably supported in said end effector, said strain gauge generating strain signals corresponding to a thickness of tissue clamped by said end effector.

17. The surgical instrument of embodiment 16 further comprising another strain gauge supported within said end effector and communicating with said processor, said another strain gauge generating another strain signal corresponding to an amount of compressive load applied to the tissue clamped by said end effector.

18. A surgical method, comprising:

providing a surgical instrument of embodiment 16;
 installing the measurement cartridge in the end effector;
 clamping tissue to be severed and stapled within the end effector;
 observing the tissue thickness on the display;
 releasing the tissue from the end effector;
 removing the measurement cartridge from the end effector;
 selecting a staple cartridge having staples for stapling the tissue based on the tissue thickness displayed on the display;

installing the staple cartridge in the end effector;
 reclamping the tissue in the end effector; and
 actuating the staple cartridge to sever and staple the tissue clamped in the end effector.

19. A jaw arrangement for a surgical instrument, said jaw arrangement comprising:

a first jaw operably coupleable to the surgical instrument and having a distal end and a first clamping face and at least one first nodule formed on said first clamping face; and
 a second jaw having a distal end and a second clamping face and at least one second nodule formed on said second clamping faces, said second jaw operably coupleable to the surgical instrument relative to said first jaw such that said first and second distal ends of said first and second jaws, respectively may be selectively moved toward and away from each other upon application of open and closing motions to at least one of said first and second jaws from the surgical instrument such that as said first and second distal ends are moved towards each other, said first and second distal ends and said first and second nodules cooperate to define a cradle area therebetween sized to grippingly support therein an object having a specific cross-sectional shape.

20. The jaw arrangement of embodiment 19 wherein said specific cross-sectional shape is circular.

21. A surgical instrument, comprising:

a handle assembly;
 a pair of opposing jaws operably coupled to said handle assembly, said opposing jaws being selectively movable between open and closed positions for clamping tissue therebetween;
 a closure drive operably supported by said handle assembly for selectively applying opening and closing motions to said pair of opposing jaws; and
 an output generator cooperating with said closure drive to display reference indicia corresponding to a thickness of the tissue clamped between said pair of opposing jaws.

22. The surgical instrument of embodiment 21 wherein reference indicia corresponding to a thickness of the tissue is only observable when said pair of opposing jaws is applying a predetermined clamping load to the tissue.

23. The surgical instrument of embodiment 21 further comprising a lock member for selectively locking the opposing jaws in position.

24. The surgical instrument of embodiment 21 wherein said output generator is mechanically actuated.

Claims

1. A surgical instrument, comprising:

a pair of opposing jaws, wherein at least one jaw is selectively movable relative to the other jaw in response to opening and closing motions applied thereto for selectively clamping tissue therebetween;
an output generator associated with said pair of opposing jaws, said output generator generating tissue thickness data representing a thickness of the tissue clamped between said pair of opposing jaws; and
a display for displaying said tissue thickness data thereon.

2. The surgical instrument of claim 1 wherein said output generator comprises:

at least one strain gauge for generating a strain signal corresponding to the tissue thickness of the tissue clamped between said pair of opposing jaws; and
a processor communicating with said at least one strain gauge for receiving said strain signal therefrom and generating said tissue thickness data corresponding thereto and communicating said tissue thickness data to said display.

3. The surgical instrument of claim 1 wherein said pair of opposing jaws comprises:

a first jaw sized to removably support a cartridge therein;
a second jaw movably coupled to said first jaw and being selectively movable between open and closed positions relative to said elongate channel in response to application of said open and closing motions thereto and wherein said output generator comprises:

a measurement cartridge removably supportable in said elongate channel;
a strain gauge associated with said measurement cartridge for generating a strain signal corresponding to the tissue thickness of tissue clamped between the measurement cartridge and the second jaw; and
a processor communicating with said at least one strain gauge for receiving said strain signals therefrom and calculating said tissue thickness data corresponding to said

tissue thickness and communicating said tissue thickness data to said display.

4. The surgical instrument of claim 3 wherein said strain gauge is supported by said measurement cartridge and has a deflectable portion for contact with said second jaw.

5. The surgical instrument of claim 3 wherein said strain gauge comprises:

a first strain gauge supported by said elongate channel such that when said measurement cartridge is supported by said elongate channel, said first strain gauge generates a first strain signal corresponding to an amount of compressive load experienced thereby when the tissue is clamped between a portion of said measurement cartridge and said second jaw, said first strain gauge communicating with said processor such that upon receipt of said first strain signal, said processor transmits data corresponding to said compressive load to said display; and
an a second strain gauge supported by said measurement cartridge and having a deflectable portion for contact with said second jaw as the tissue is clamped between said portion of said measurement cartridge and said second jaw, said second strain gauge generating a second strain signal corresponding to the thickness of the tissue clamped between the jaws, said second strain gauge communicating with said processor such that upon receipt of said second strain signal, said processor generates said tissue thickness data corresponding to the tissue thickness and transmits said tissue thickness data to said display.

6. The surgical instrument of claim 1 further comprising:

a handle assembly supporting said display thereon;
a grasper rod operably supported by said handle assembly and coupled to said pair of opposing jaws for transmitting said open and closing motions thereto wherein said output generator cooperates with said grasper rod to display on said display said tissue thickness data corresponding to a thickness of tissue clamped between said pair of opposing jaws.

7. The surgical instrument of claim 6 wherein said indicia is only viewable on said handle assembly when the opposing jaws are applying a predetermined amount of compressive force to the tissue clamped therebetween.

8. The surgical instrument of claim 1 further comprising:

a handle assembly;
 a grasper rod operably supported by said handle assembly and coupled to said pair of opposing jaws for transmitting said open and closing motions thereto upon selective actuation of a closure trigger operably coupled to said handle assembly and wherein said output generator comprises:

a strain gauge associated with said grasper rod for generating strain signals as said grasper rod applies said closing motion to said opposing jaws to clamp the tissue therebetween; and
 a processor communicating with said strain gauge for receiving said strain signals therefrom and calculating said tissue thickness data corresponding to said tissue thickness and communicating said tissue thickness data to said display.

9. The surgical instrument of claim 1 wherein said opposing jaws are shaped to accommodate an object therebetween having a specific cross-sectional shape.

10. The surgical instrument of claim 9 wherein each said jaw of said pair of opposing jaws has a distal end and at least one nodule protruding from a clamping face thereof such that as said opposing jaws are moved towards each other, said distal ends and nodules thereof define a cradle area therebetween sized to grippingly support therein an object having a specific cross-sectional shape.

11. A surgical instrument, comprising:

a pair of opposing jaws, wherein at least one jaw is selectively movable relative to the other jaw in response to opening and closing motions applied thereto for selectively clamping tissue therebetween;
 means cooperating with said pair of opposing jaws for selectively applying said open and closing motions thereto;
 means for generating a signal corresponding to a thickness of tissue clamped between said pair of opposing jaws;
 means for converting said signal to tissue thickness data corresponding to the thickness of tissue clamped between said pair of opposing jaws; and
 means for displaying said tissue thickness data.

12. A surgical instrument comprising:

a handle assembly;
 an end effector for performing a surgical opera-

tion, said end effector coupled to said handle assembly and having opposed jaw members for selectively clamping tissue therebetween in response to opening and closing motions applied thereto;

a closure drive supported by said handle assembly and configured to generate said opening and closing motions for selective application to said end effector;

at least one signal generator in said end effector for generating signals corresponding to a thickness of the tissue clamped between said opposed jaw members

a signal processor for receiving said signals from said signal generator and calculating the thickness of the tissue; and

a display communicating with said signal processor for displaying the tissue thickness thereon.

13. A jaw arrangement for a surgical instrument, said jaw arrangement comprising:

a first jaw operably coupleable to the surgical instrument and having a distal end and a first clamping face and at least one first nodule formed on said first clamping face; and

a second jaw having a distal end and a second clamping face and at least one second nodule formed on said second clamping faces, said second jaw operably coupleable to the surgical instrument relative to said first jaw such that said first and second distal ends of said first and second jaws, respectively may be selectively moved toward and away from each other upon application of open and closing motions to at least one of said first and second jaws from the surgical instrument such that as said first and second distal ends are moved towards each other, said first and second distal ends and said first and second nodules cooperate to define a cradle area therebetween sized to grippingly support therein an object having a specific cross-sectional shape.

14. A surgical instrument, comprising:

a handle assembly;
 a pair of opposing jaws operably coupled to said handle assembly, said opposing jaws being selectively movable between open and closed positions for clamping tissue therebetween;
 a closure drive operably supported by said handle assembly for selectively applying opening and closing motions to said pair of opposing jaws; and
 an output generator cooperating with said closure drive to display reference indicia corre-

sponding to a thickness of the tissue clamped
between said pair of opposing jaws.

5

10

15

20

25

30

35

40

45

50

55

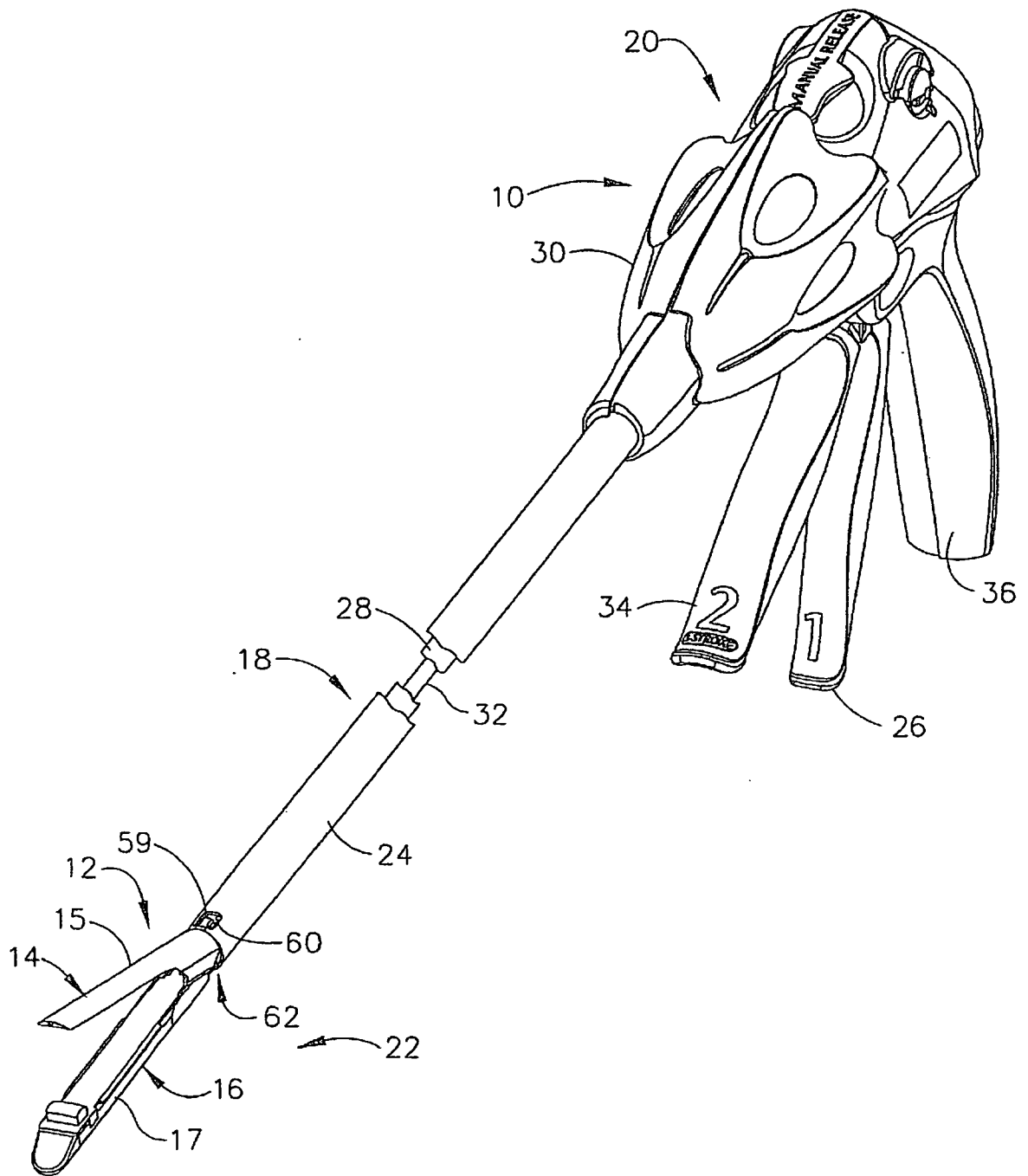

FIG. 1

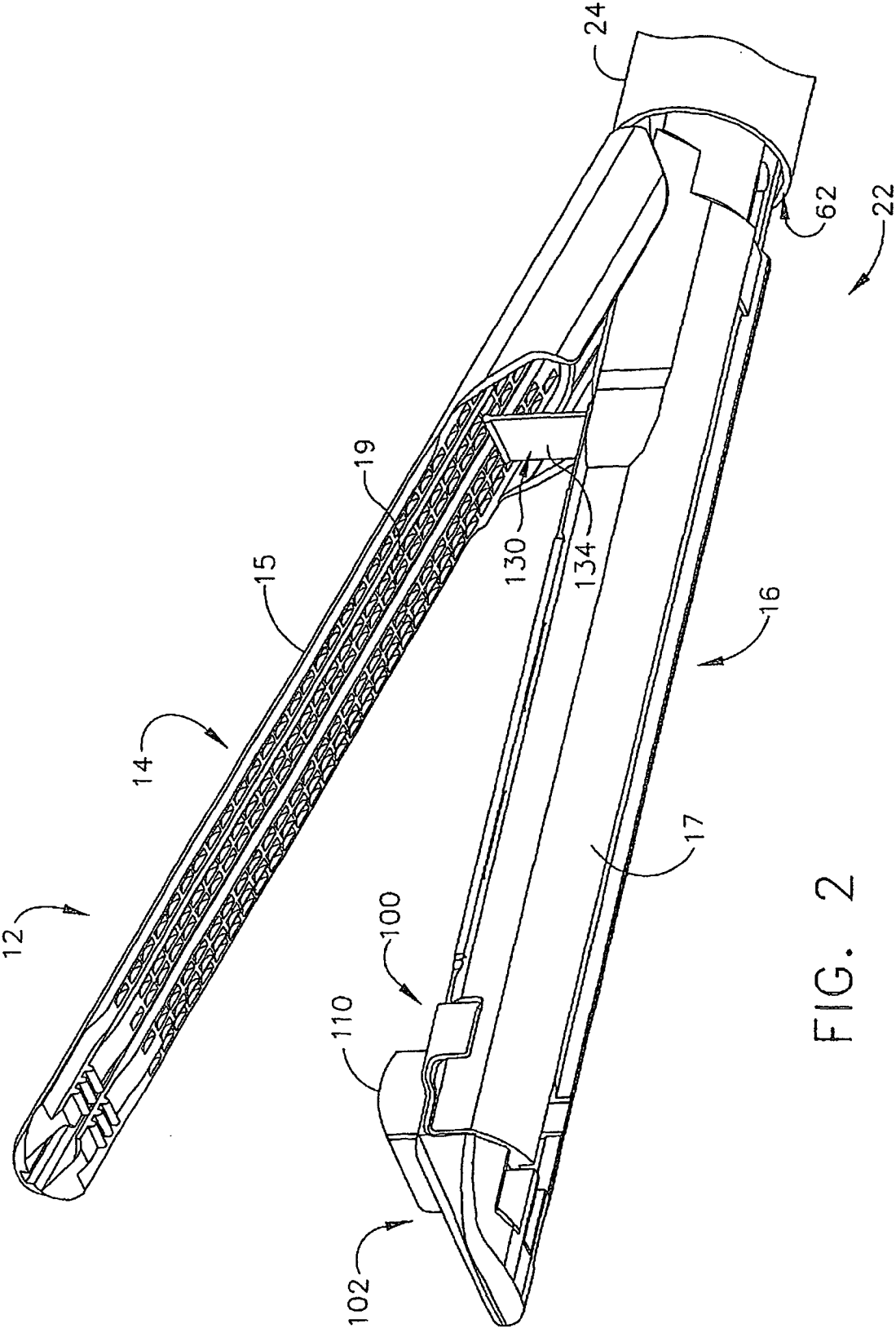

FIG. 2

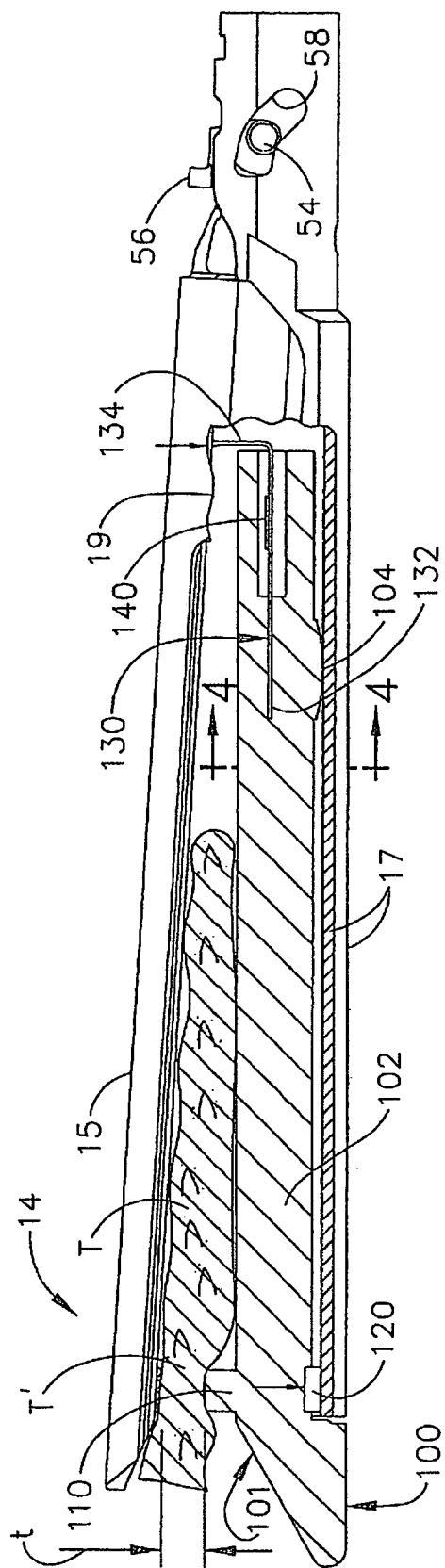

FIG. 3

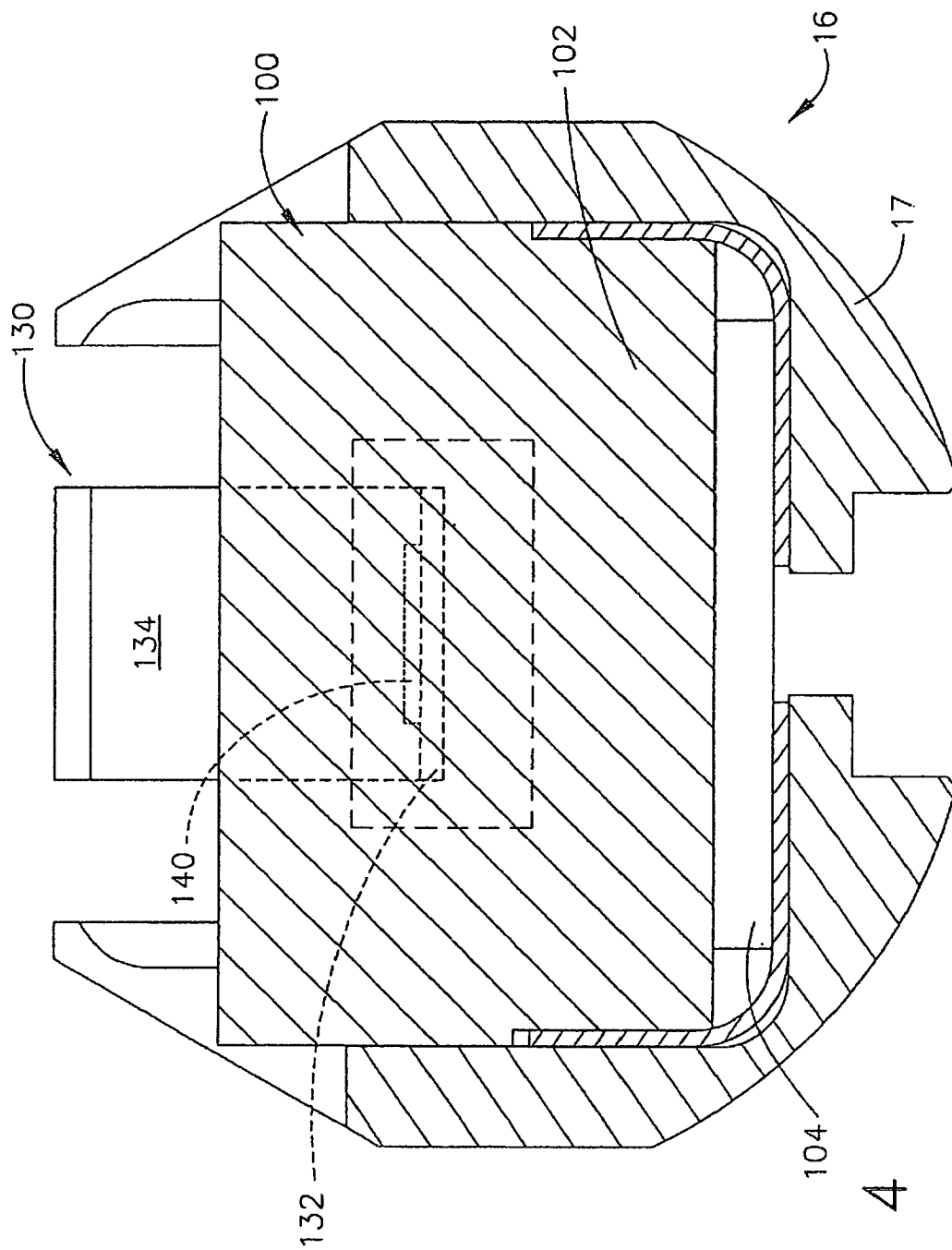

FIG. 4

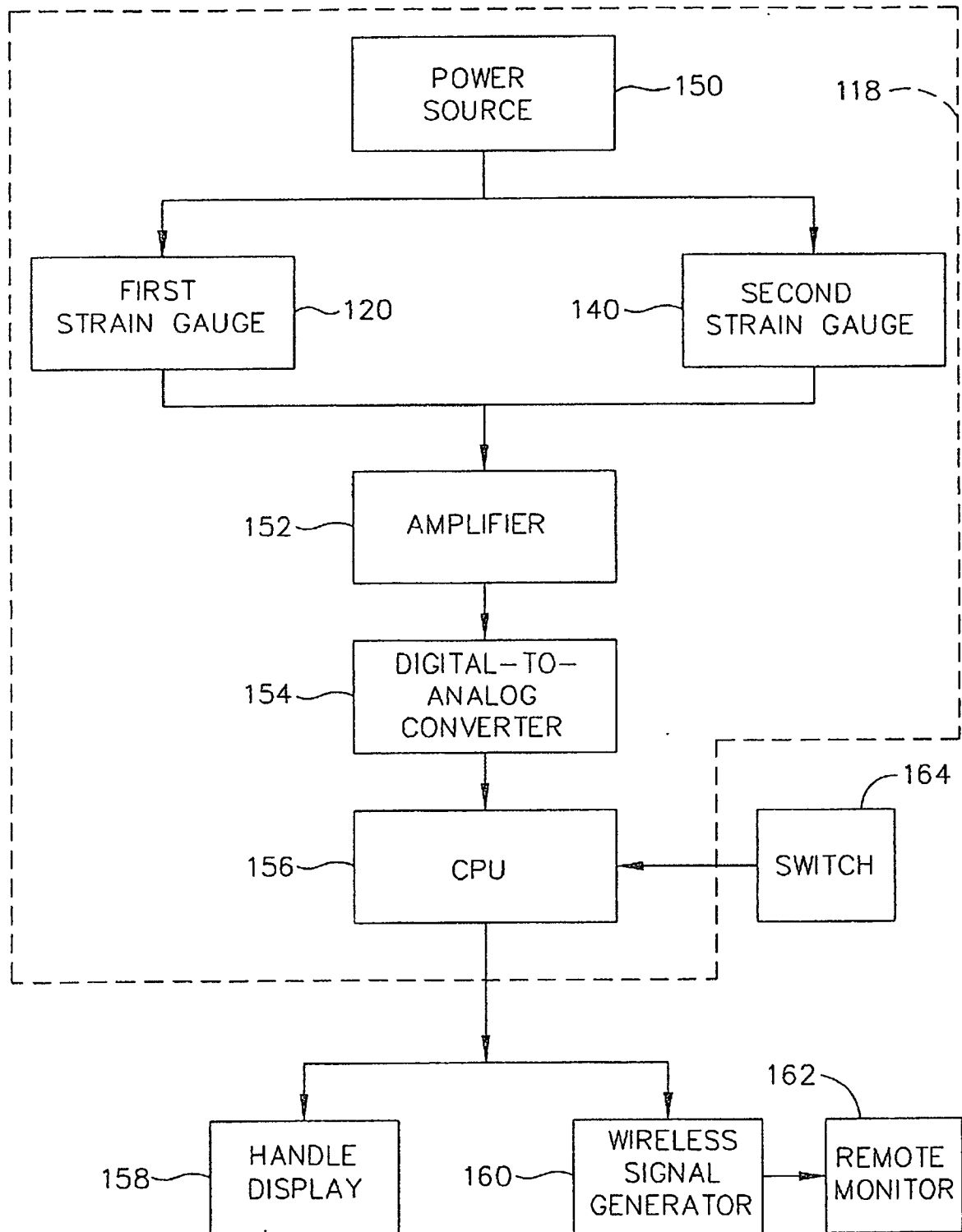
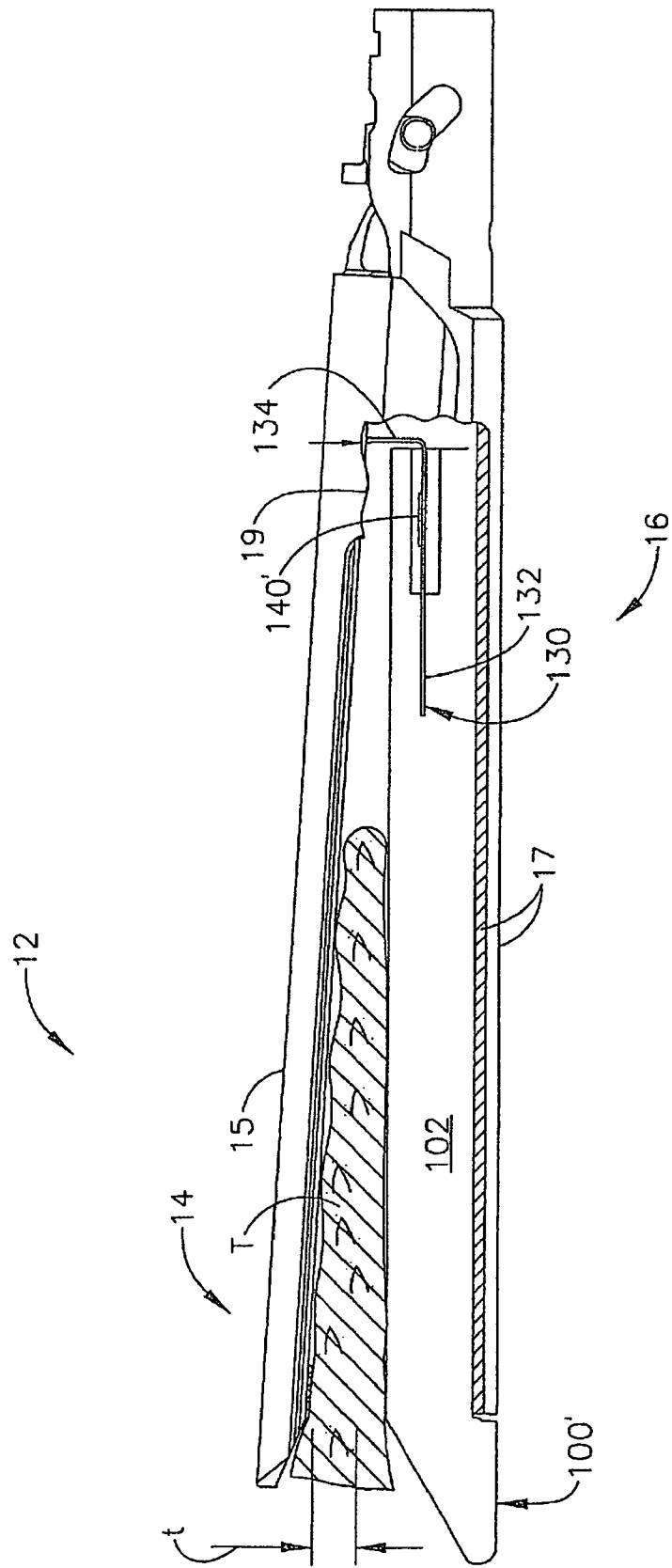

FIG. 5



60

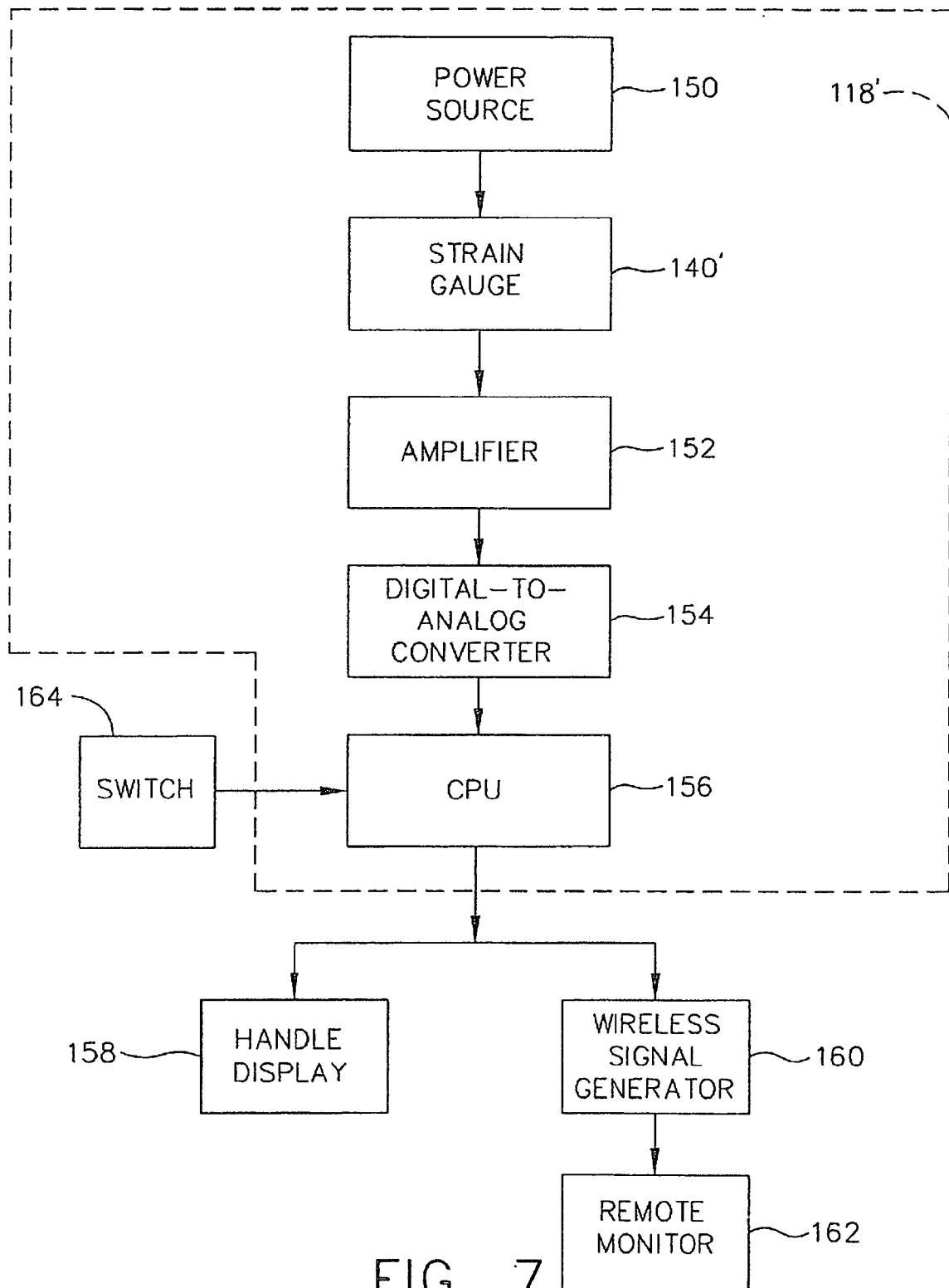

FIG. 7

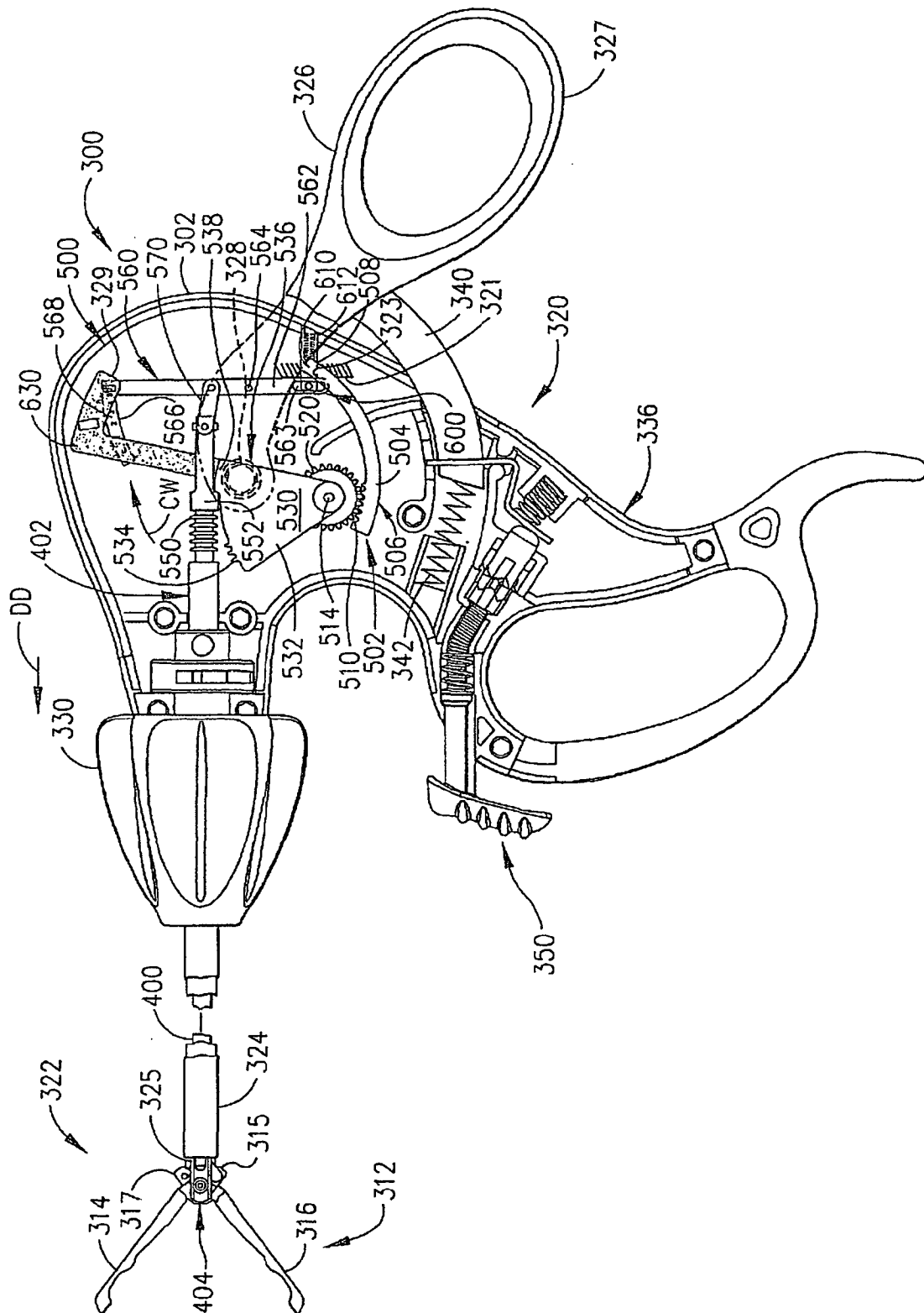

Fig. 8

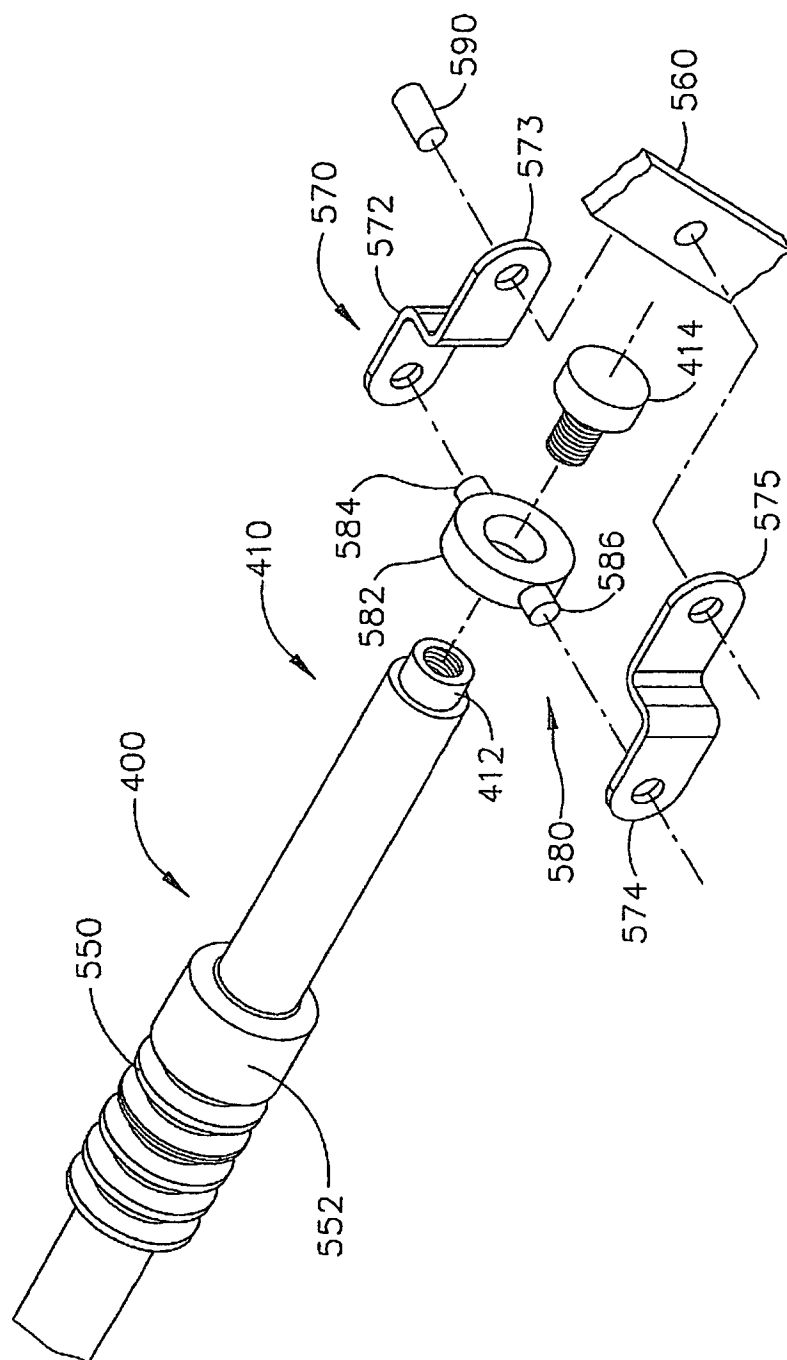

FIG. 9

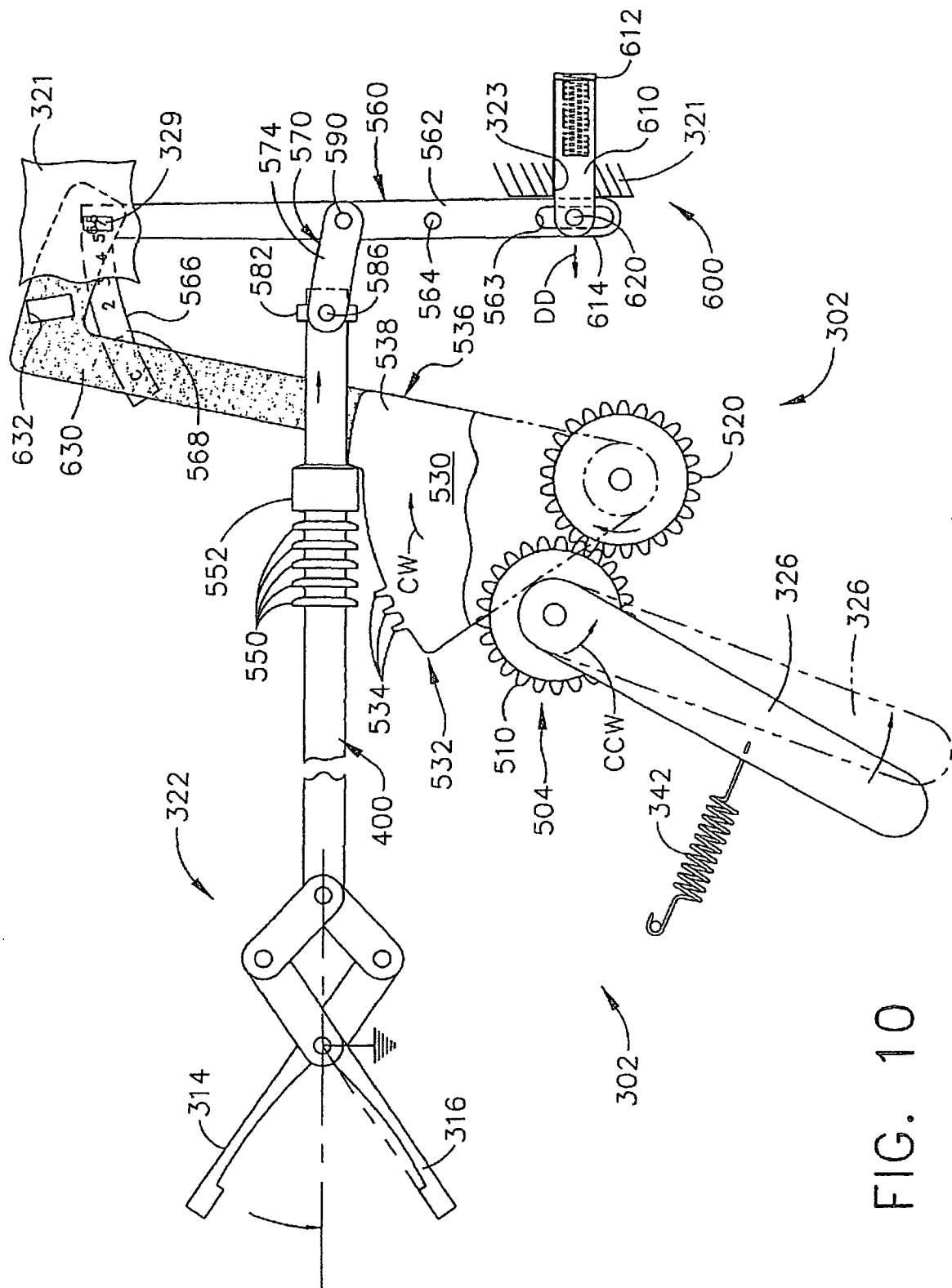

FIG. 10

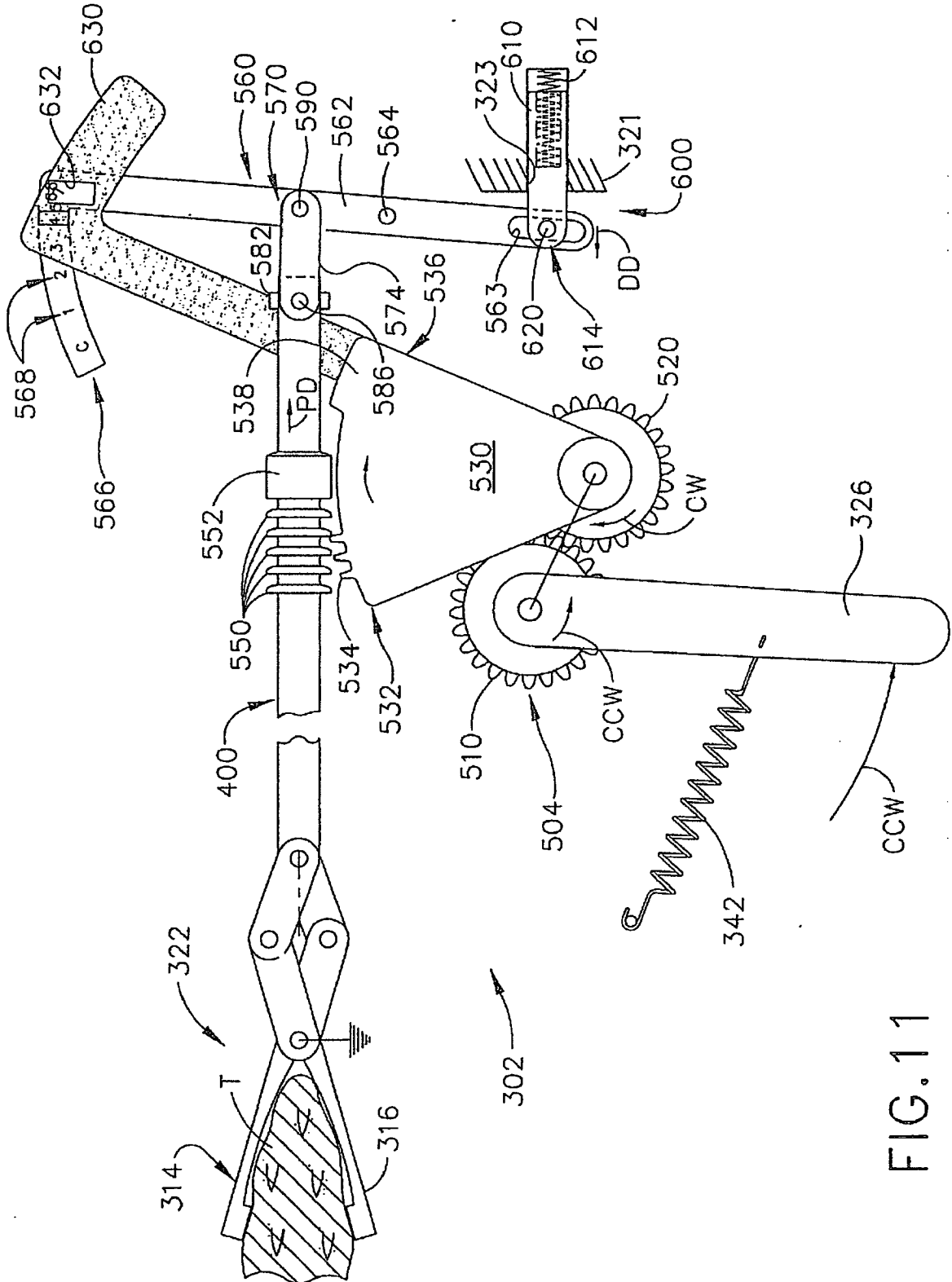

FIG. 11

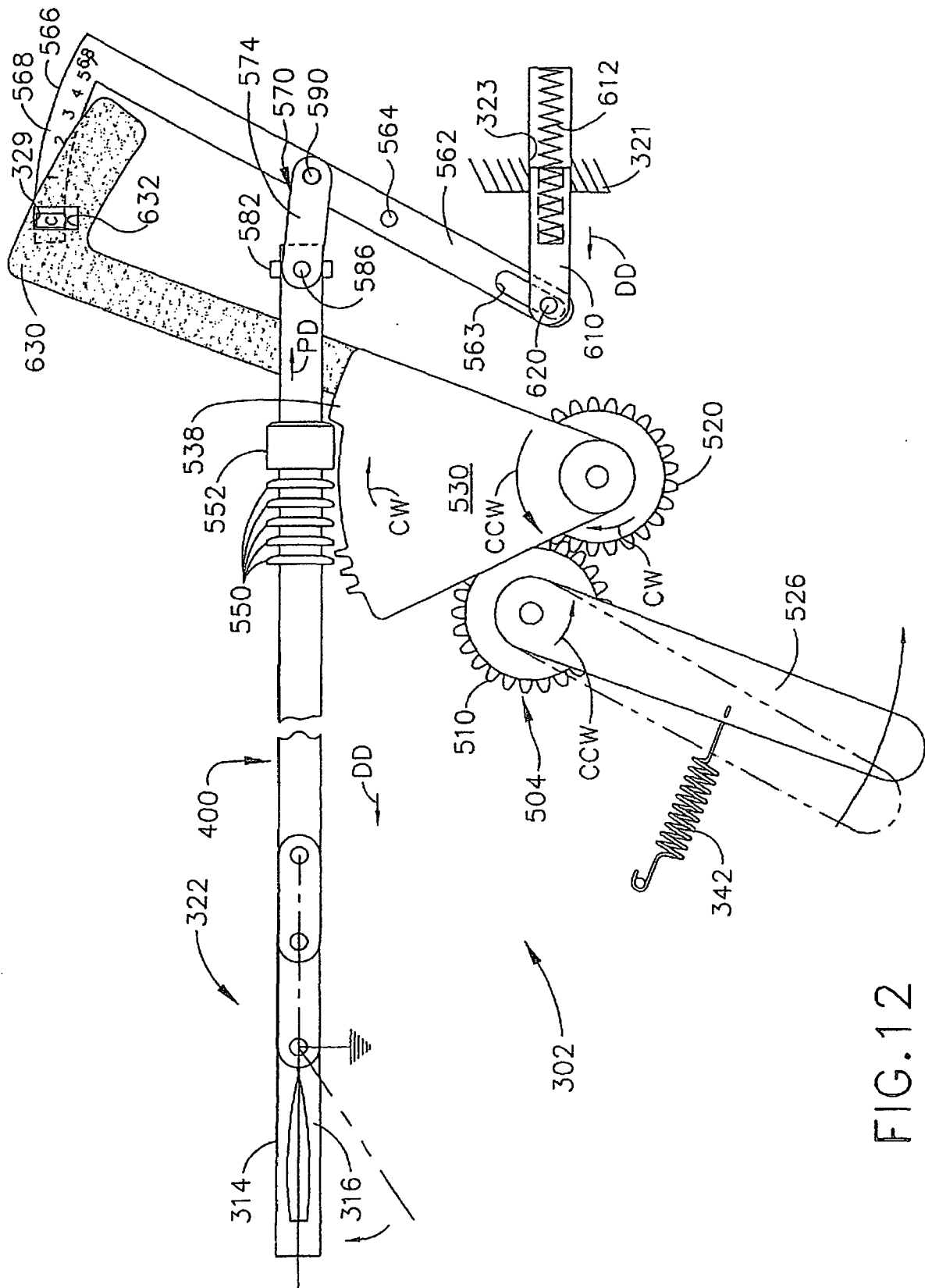

FIG. 12

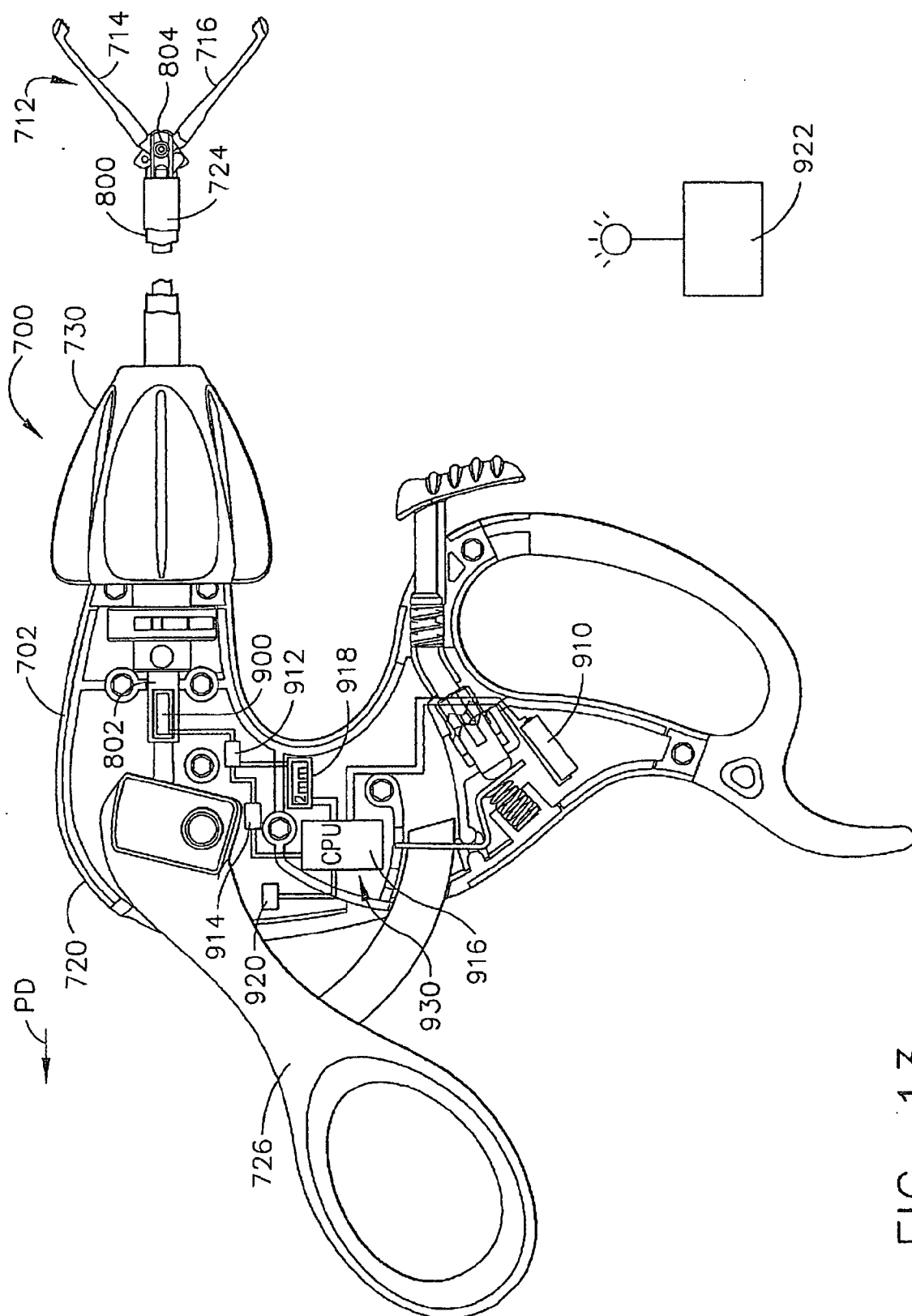

FIG. 13

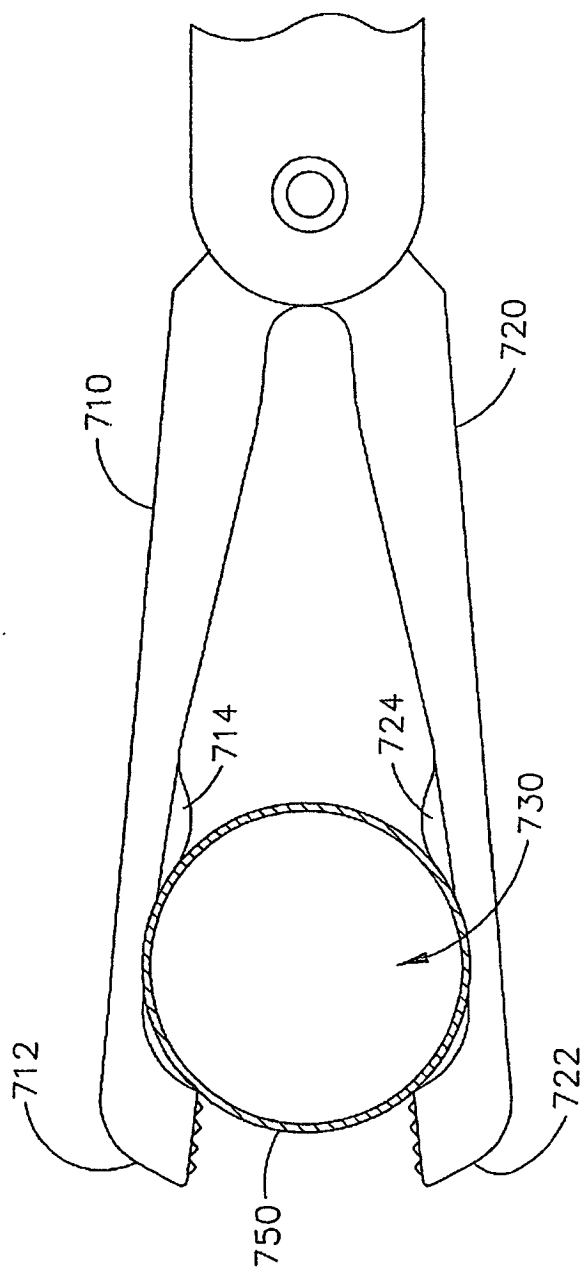

FIG. 14

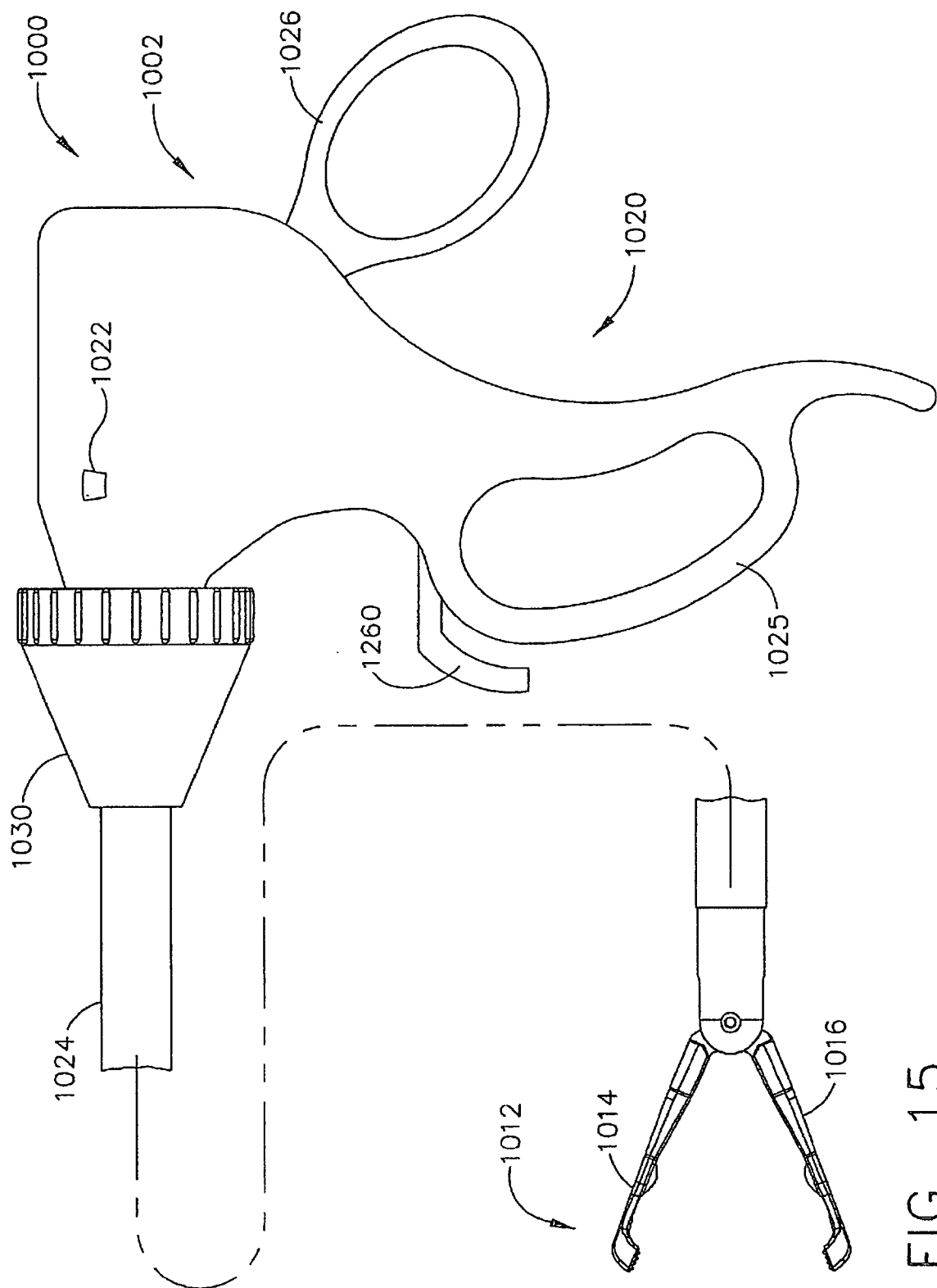

FIG. 15

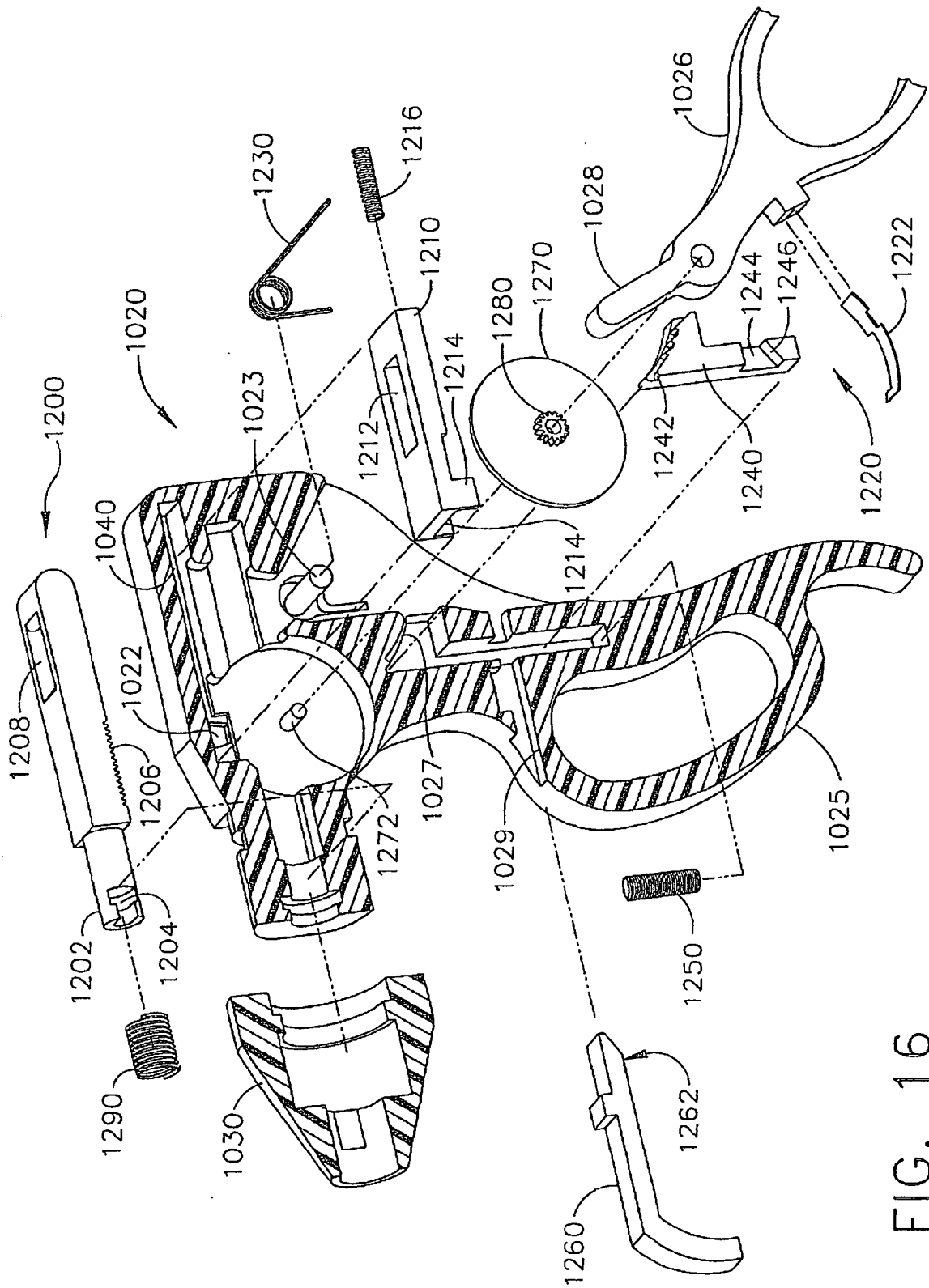

FIG. 16

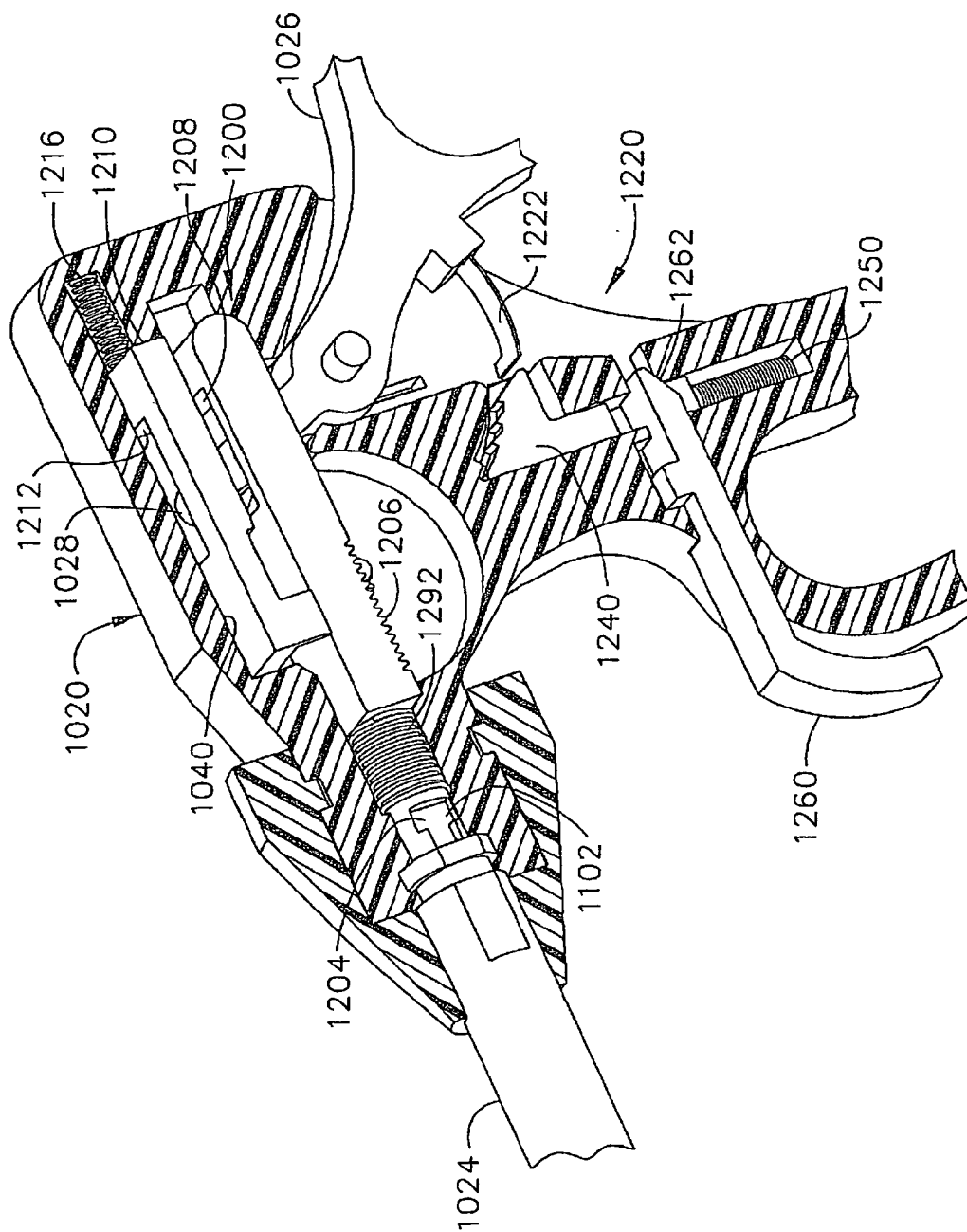

FIG. 17

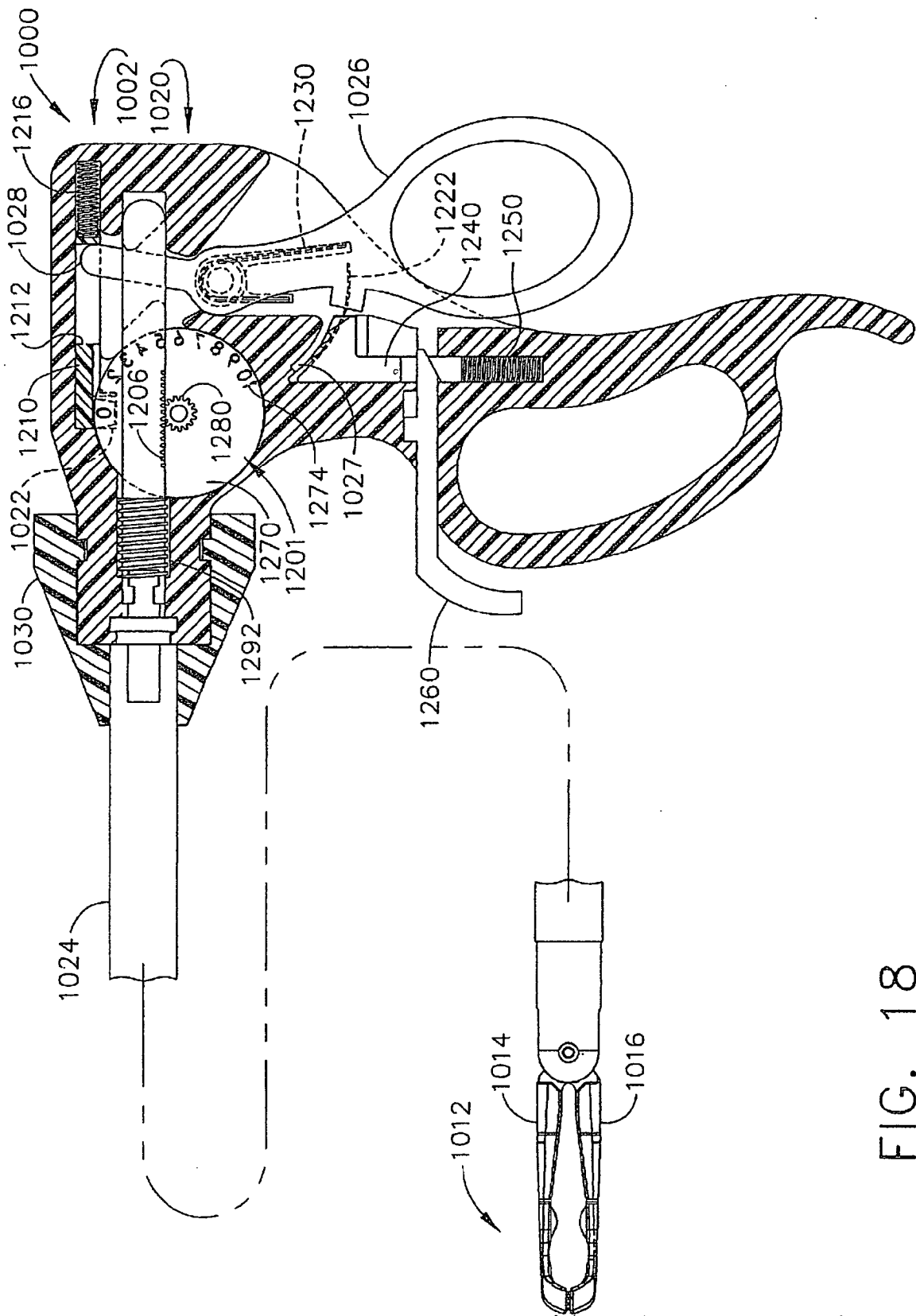

FIG. 18

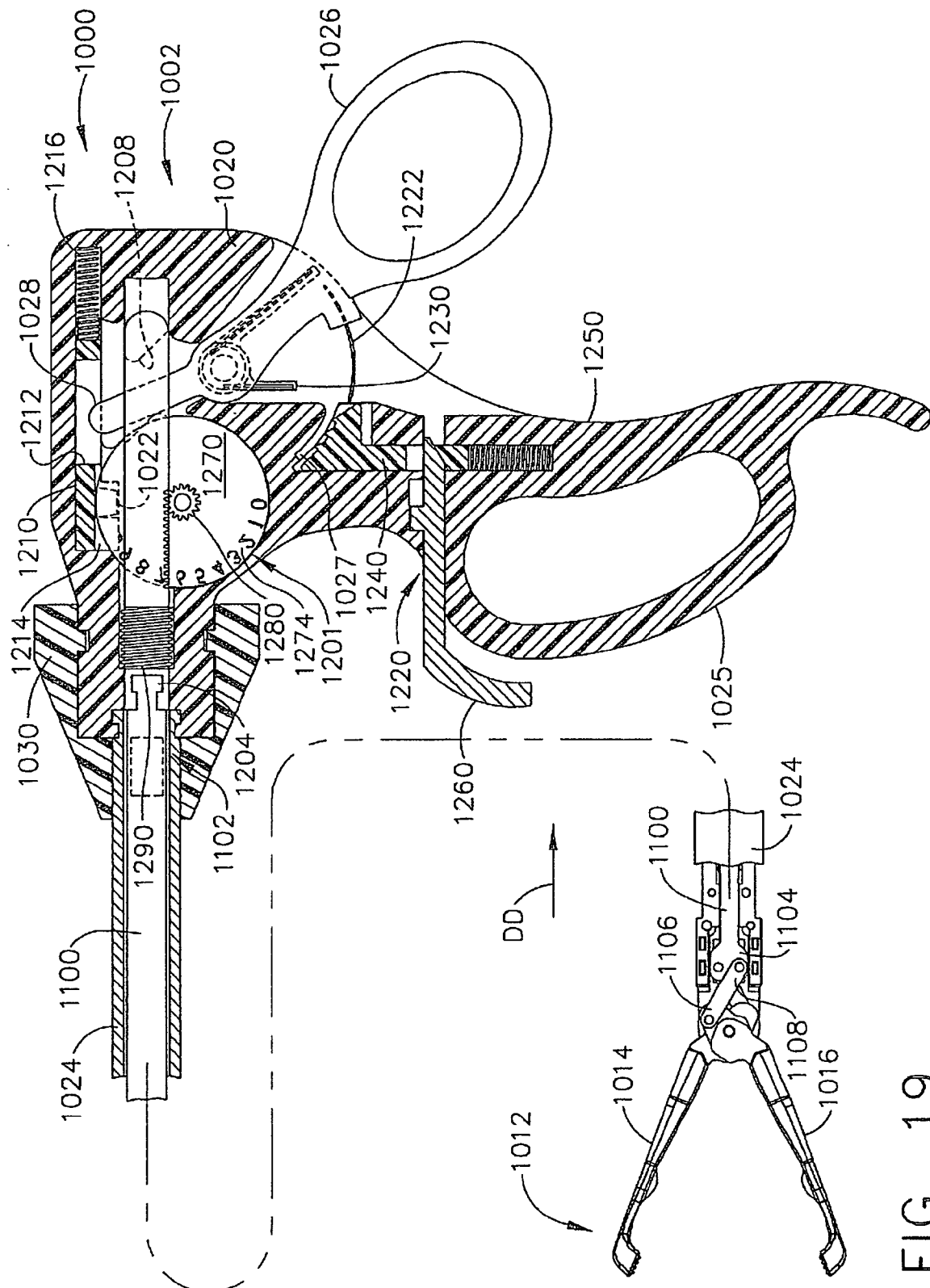

FIG. 19

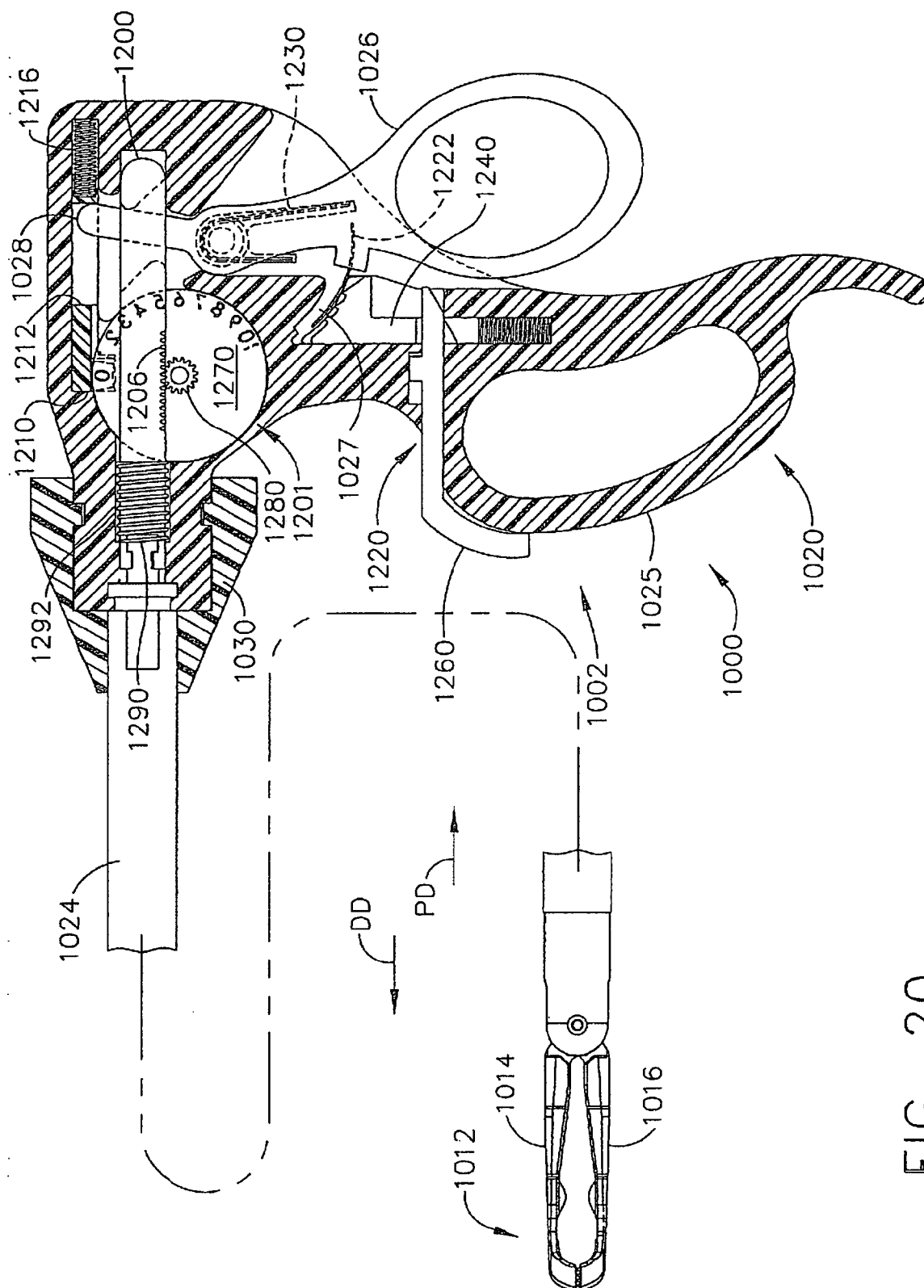

FIG. 20

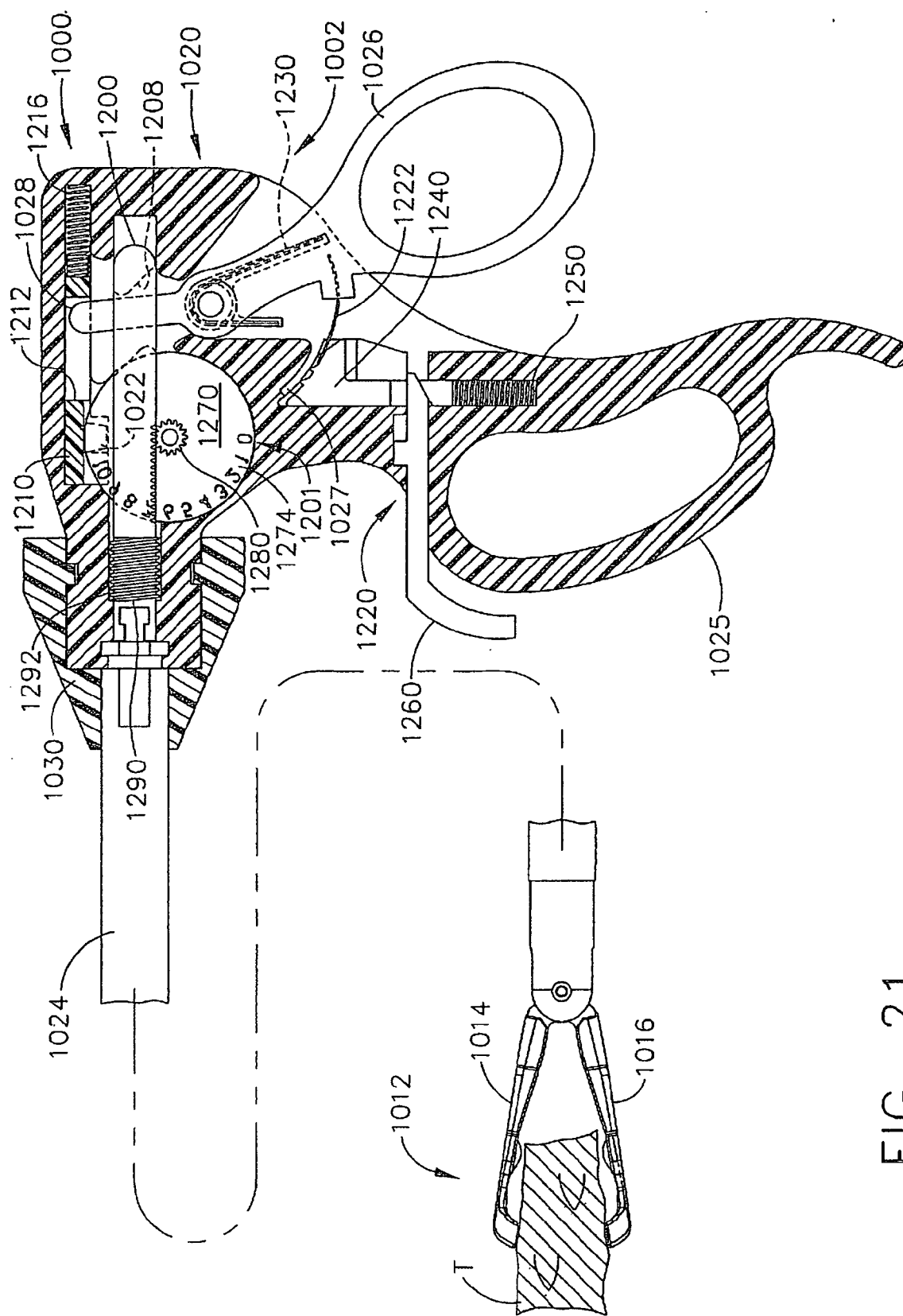

FIG. 21

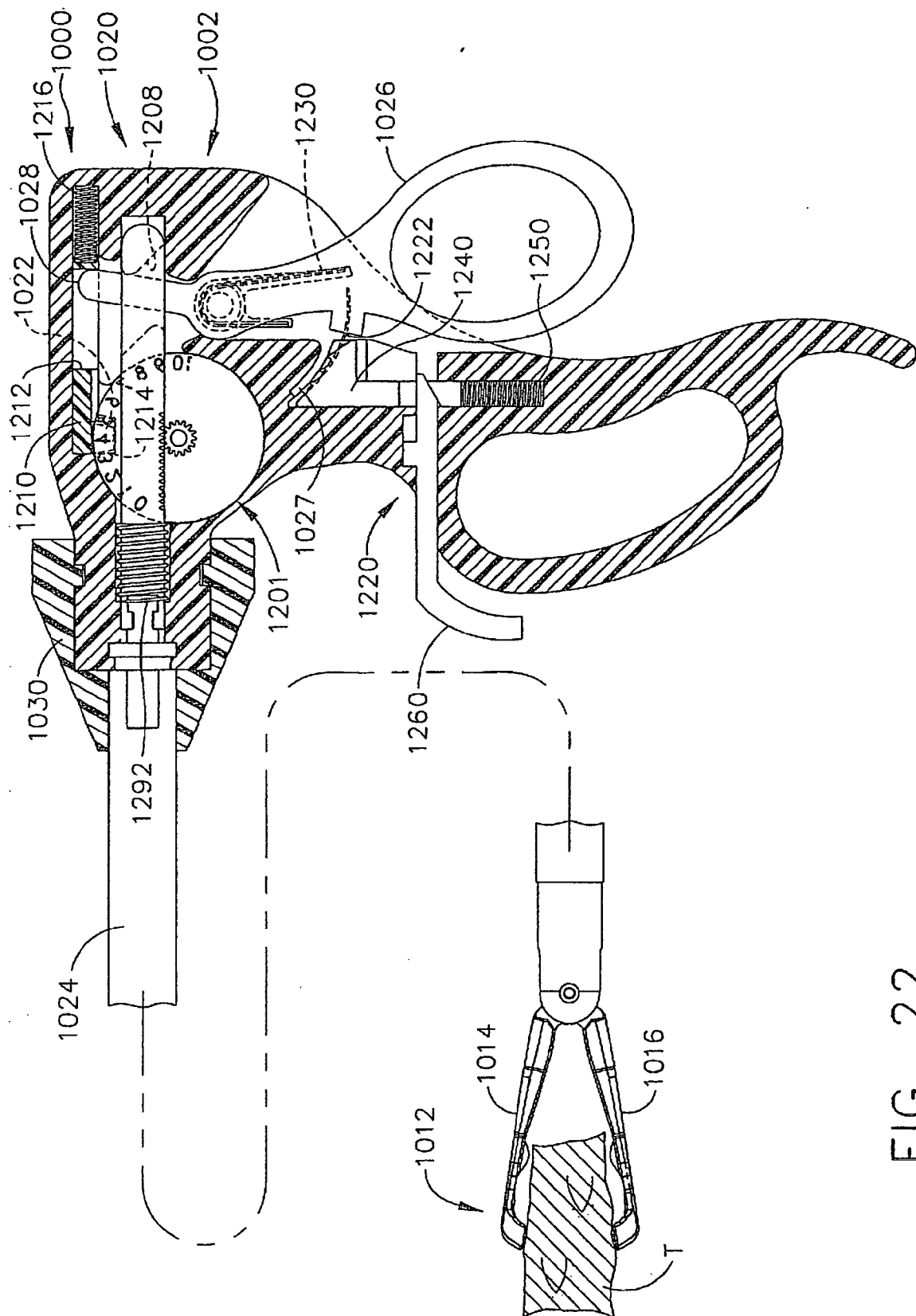

FIG. 22

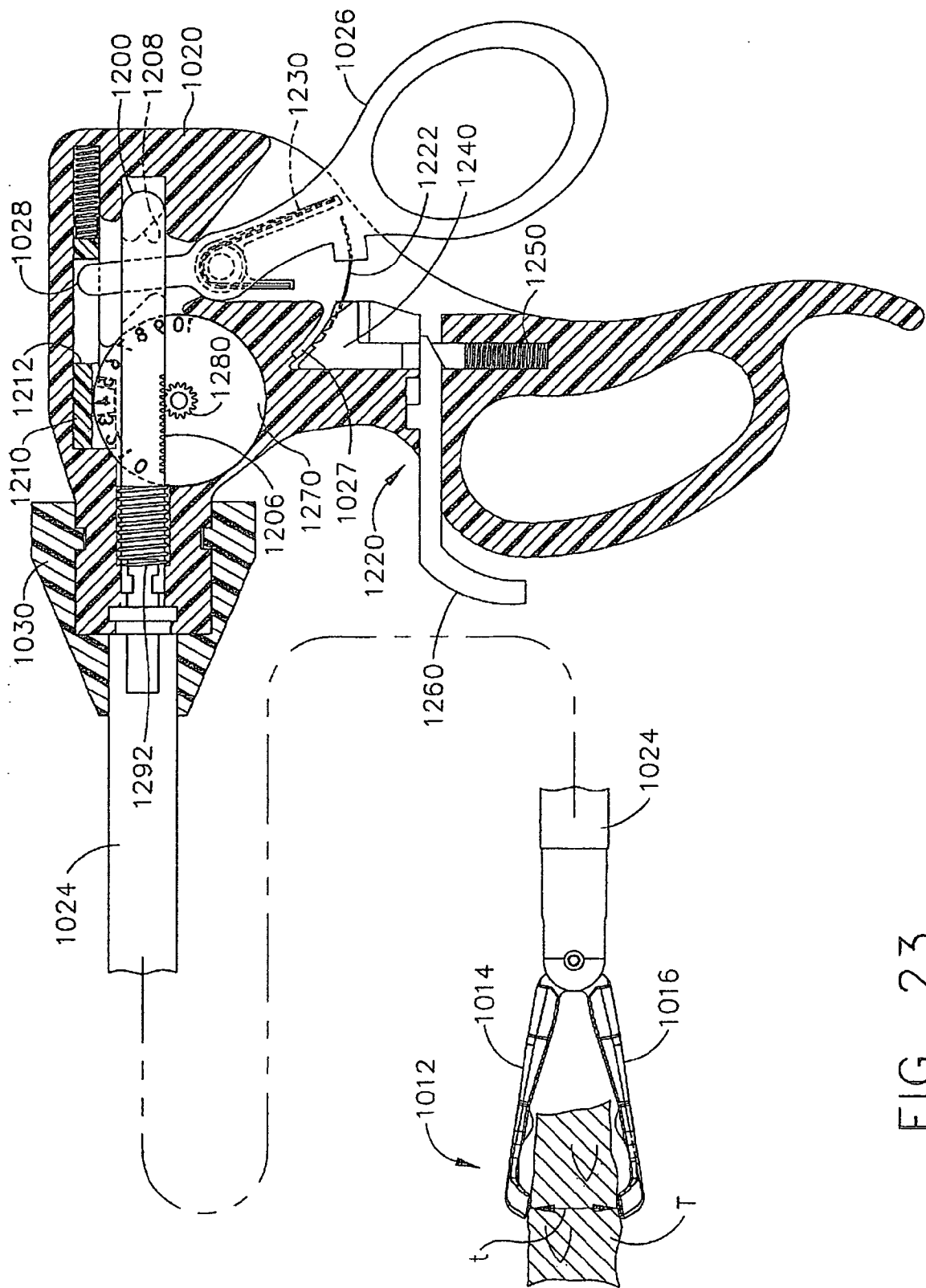

FIG. 23



European Patent
Office

EUROPEAN SEARCH REPORT

Application Number
EP 08 25 1188

DOCUMENTS CONSIDERED TO BE RELEVANT			
Category	Citation of document with indication, where appropriate, of relevant passages	Relevant to claim	CLASSIFICATION OF THE APPLICATION (IPC)
X	EP 1 728 475 A (TYCO HEALTHCARE [US]) 6 December 2006 (2006-12-06) * column 5, paragraph 46 - column 15, paragraph 98 * * figures 1-19 *	1-3,6, 11,12,14	INV. A61B17/068 A61B17/072 A61B17/28
X	WO 03/090630 A (TYCO HEALTHCARE [US]; HEINRICH RUSSELL [US]; CUNY DOUGLAS J [US]) 6 November 2003 (2003-11-06) * page 3, line 12 - line 21 * * page 10, line 21 - page 23, line 15 *	1-3,6, 11,12,14	ADD. A61B19/00
Y	WO 2005/112808 A (MEDTRONIC INC [US]; FRANCISCHELLI DAVID E [US]; MEHRA RAHUL [US]; WARM) 1 December 2005 (2005-12-01) * page 6, line 4 - page 9, line 13 * * figures 1-5 *	9,10,13	
X	WO 00/24322 A (APPLIED MED RESOURCES [US]; TAYLOR SCOTT [US]) 4 May 2000 (2000-05-04) * page 5, line 25 - page 6, line 31 * * figures 14-17 *	1,11,12, 14	
Y	US 5 533 521 A (GRANGER RICHARD N [US]) 9 July 1996 (1996-07-09) * column 3, line 27 - column 8, line 20 * * figures 1-7 *	9,10,13	
A		1,3,11, 12,14	TECHNICAL FIELDS SEARCHED (IPC) A61B
The present search report has been drawn up for all claims			
Place of search The Hague		Date of completion of the search 24 June 2008	Examiner Compos, Fabien
CATEGORY OF CITED DOCUMENTS X : particularly relevant if taken alone Y : particularly relevant if combined with another document of the same category A : technological background O : non-written disclosure P : intermediate document T : theory or principle underlying the invention E : earlier patent document, but published on, or after the filing date D : document cited in the application L : document cited for other reasons & : member of the same patent family, corresponding document			

1
EPO FORM 1503 03.82 (P04C01)

**ANNEX TO THE EUROPEAN SEARCH REPORT
ON EUROPEAN PATENT APPLICATION NO.**

EP 08 25 1188

This annex lists the patent family members relating to the patent documents cited in the above-mentioned European search report. The members are as contained in the European Patent Office EDP file on
The European Patent Office is in no way liable for these particulars which are merely given for the purpose of information.

24-06-2008

Patent document cited in search report	Publication date	Patent family member(s)	Publication date
EP 1728475	A	06-12-2006	AU 2006202353 A1 21-12-2006
		CA 2549301 A1 03-12-2006	
		JP 2006334417 A 14-12-2006	

WO 03090630	A	06-11-2003	AU 2003245246 A1 10-11-2003
		CA 2483094 A1 06-11-2003	
		EP 1496805 A2 19-01-2005	
		JP 2005523105 T 04-08-2005	
		US 2005131390 A1 16-06-2005	

WO 2005112808	A	01-12-2005	EP 1748741 A1 07-02-2007
		US 2005256522 A1 17-11-2005	

WO 0024322	A	04-05-2000	CA 2347286 A1 04-05-2000
		EP 1123051 A1 16-08-2001	
		JP 2002528161 T 03-09-2002	

US 5533521	A	09-07-1996	NONE

REFERENCES CITED IN THE DESCRIPTION

This list of references cited by the applicant is for the reader's convenience only. It does not form part of the European patent document. Even though great care has been taken in compiling the references, errors or omissions cannot be excluded and the EPO disclaims all liability in this regard.

Patent documents cited in the description

- US 6978921 B, Shelton, IV **[0040]**
- US 7111769 B, Kenneth S. Wales, Douglas B. Hoffman, Frederick E. Shelton IV, and Jeffrey S. Swayze **[0046]**
- US 6981628 B, Kenneth S. Wales **[0046]**
- US 7055731 B, Frederick E. Shelton IV, Michael E. Setser, William B. Weisenburgh II **[0046]**
- US 20050006429 A **[0046]**
- US 10615971 B, Kenneth S. Wales and Joseph Charles Hueil **[0046]**
- US 10615962 B, Brian J. Hemmelgarn **[0046]**
- US 6117158 A, Measamer **[0054]**
- US 5735874 A, Measamer **[0054]**

专利名称(译)	腹腔镜组织厚度和夹钳负荷测量装置		
公开(公告)号	EP1974676A1	公开(公告)日	2008-10-01
申请号	EP2008251188	申请日	2008-03-28
[标]申请(专利权)人(译)	伊西康内外科公司		
申请(专利权)人(译)	爱惜康内镜手术，INC.		
当前申请(专利权)人(译)	爱惜康内镜手术，INC.		
[标]发明人	BOUDREAUX CHAD P TIMPERMAN EUGENE L FUGIKAWA LESLIE M		
发明人	BOUDREAUX, CHAD P. TIMPERMAN, EUGENE L. FUGIKAWA, LESLIE M.		
IPC分类号	A61B17/068 A61B17/072 A61B17/28 A61B19/00		
优先权	11/729008 2007-03-28 US		
其他公开文献	EP1974676B1		
外部链接	Espacenet		

摘要(译)

一种具有相对钳口的手术器械，其可以在打开和闭合位置之间选择性地移动。各种实施例包括用于测量夹在相对的钳口之间的组织厚度的部件。一些实施例被配置成确定在确定组织的厚度时施加到组织的压缩力的量。组织厚度数据显示在仪器本身和/或远离仪器的显示器上。各种实施例可包括不同类型的手术器械，例如外科缝合器和抓紧器。还公开了一种钳口装置，其钳口形状形成限定与物体的横截面形状相对应的支架。产生厚度数据的组件可以是电动或机械致动的。

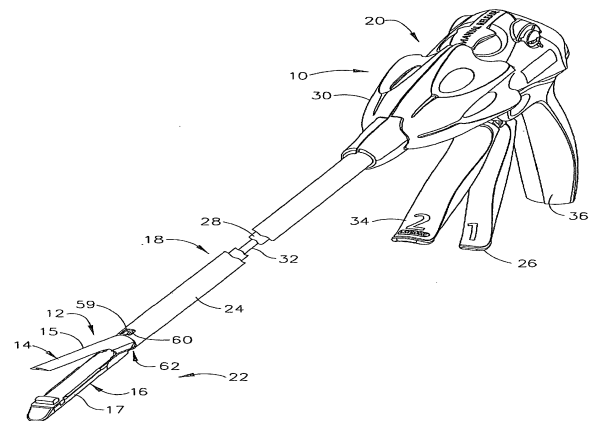

FIG. 1