



Europäisches Patentamt
European Patent Office
Office européen des brevets



(11)

EP 1 479 347 A1

(12)

EUROPEAN PATENT APPLICATION

(43) Date of publication:

24.11.2004 Bulletin 2004/48

(51) Int Cl.⁷: **A61B 17/072**

(21) Application number: **04252978.4**

(22) Date of filing: **20.05.2004**

(84) Designated Contracting States:

**AT BE BG CH CY CZ DE DK EE ES FI FR GB GR
HU IE IT LI LU MC NL PL PT RO SE SI SK TR**

Designated Extension States:

AL HR LT LV MK

• **Setzer, Michael E.**

Burlington Kentucky 41005 (US)

• **Weisenburgh, William B.**

Maineville Ohio 45039 (US)

(30) Priority: **20.05.2003 US 441580**

(71) Applicant: **ETHICON ENDO-SURGERY, INC.**
Cincinnati, Ohio 45242 (US)

(74) Representative:

Tunstall, Christopher Stephen et al

Carpmaels & Ransford,

43-45 Bloomsbury Square

London WC1A 2RA (GB)

(72) Inventors:

• **Shelton IV, Frederick E.**

Hillsboro Ohio 45133 (US)

(54) **Surgical stapling instrument having a firing lockout for an unclosed anvil**

(57) A surgical instrument for laparoscopic and endoscopic clinical procedures simultaneously severs and staples tissue clamped in an end effector comprising an elongate channel, which holds a staple cartridge, and a pivotally attached anvil. An E-beam firing bar engages the channel and selectively engages the anvil during distal firing movements, wherein the tissue is severed

and stapled driven upward from the staple cartridge to form against the anvil. In particular an upper pin of the firing bar is disengaged from the anvil before firing. A ramped transition from an anvil to an anvil slot avoids misfiring when the end effector has clamped too much tissue, yet assists in successfully clamping a slightly excess amount of tissue.

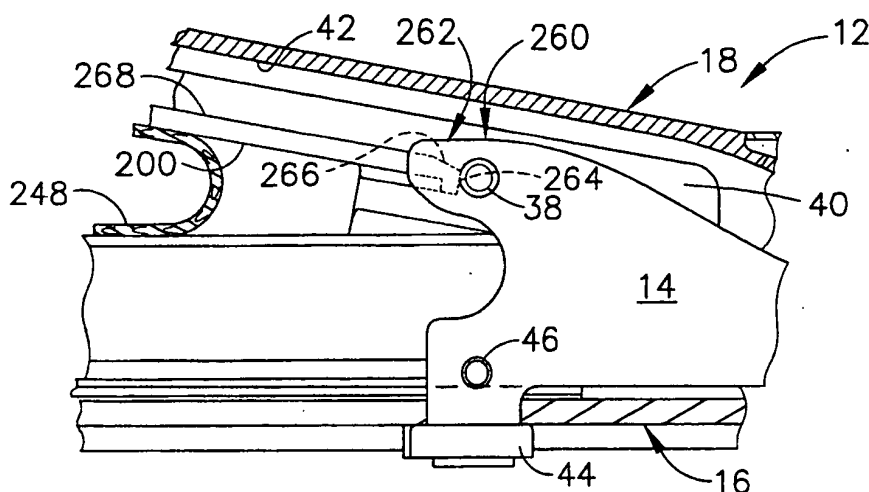

FIG. 24

EP 1 479 347 A1

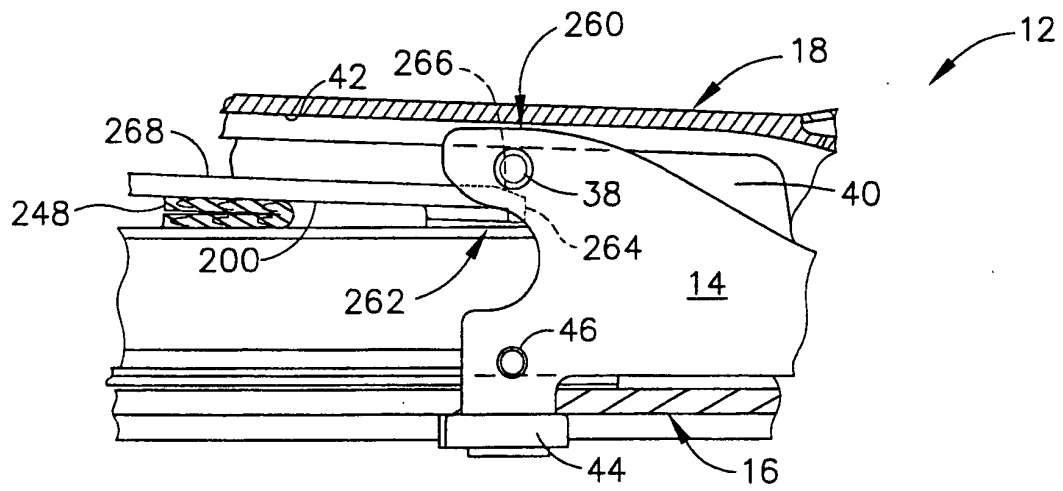

FIG. 25

Description

Cross Reference to Related Applications

[0001] The present application is related to four co-pending and commonly-owned applications filed on even date herewith, the disclosure of each is hereby incorporated by reference in their entirety, these four applications being respectively entitled:

- (1) "SURGICAL STAPLING INSTRUMENT HAVING A SINGLE LOCKOUT MECHANISM FOR PREVENTION OF FIRING" to Frederick E. Shelton IV, Mike Setser, and Bruce Weisenburgh;
- (2) "SURGICAL STAPLING INSTRUMENT HAVING SEPARATE DISTINCT CLOSING & FIRING SYSTEMS" to Frederick E. Shelton, Mike Setser, and Brian J. Hemmelgarn;
- (3) "SURGICAL STAPLING INSTRUMENT HAVING A SPENT CARTRIDGE LOCKOUT" to Frederick E. Shelton IV, Mike Setser, Bruce Weisenburgh; and
- (4) "SURGICAL STAPLING INSTRUMENT INCORPORATING AN E-BEAM FIRING MECHANISM" to Frederick E. Shelton IV, Mike Setser, and Bruce Weisenburgh.

Field of the Invention

[0002] The present invention relates in general to surgical stapler instruments that are capable of applying lines of staples to tissue while cutting the tissue between those staple lines and, more particularly, to improvements relating to stapler instruments and improvements in processes for forming various components of such stapler instruments.

Background of the Invention

[0003] Surgical staplers have been used in the prior art to simultaneously make a longitudinal incision in tissue and apply lines of staples on opposing sides of the incision. Such instruments commonly include a pair of cooperating jaw members that, if the instrument is intended for endoscopic or laparoscopic applications, are capable of passing through a cannula passageway. One of the jaw members receives a staple cartridge having at least two laterally spaced rows of staples. The other jaw member defines an anvil having staple-forming pockets aligned with the rows of staples in the cartridge. The instrument includes a plurality of reciprocating wedges which, when driven distally, pass through openings in the staple cartridge and engage drivers supporting the staples to effect the firing of the staples toward the anvil.

[0004] An example of a surgical stapler suitable for endoscopic applications is described in U.S. Pat. No. 5,465,895, which advantageously provides distinct closing

and firing actions. Thereby, a clinician is able to close the jaw members upon tissue to position the tissue prior to firing. Once the clinician has determined that the jaw members are properly gripping tissue, the clinician can then fire the surgical stapler, thereby severing and stapling the tissue. The simultaneous severing and stapling avoids complications that may arise when performing such actions sequentially with different surgical tools that respectively only sever or staple.

[0005] One specific advantage of being able to close upon tissue before firing is that the clinician is able to verify via an endoscope that a sufficient amount of tissue has been captured between opposing jaws. Otherwise, opposing jaws may be drawn too close together, especially pinching at their distal ends, and thus not effectively forming closed staples in the severed tissue. Moreover, a firing bar that traverses between opposing jaws to sever the tissue and to drive the wedges that drive the staples may encounter resistance due to the pinched opposing jaws. At the other extreme, clamping upon too much tissue may create similar problems. The cutting edge may incompletely sever the tissue and/or the staples may not fully form. Relying upon endoscopic verification of proper clamping may be undesirable or ineffective in all instances to detect when too much or too little tissue has been clamped.

[0006] Thus, while such surgical staplers have been a significant advance in surgical procedures, an opportunity has been recognized for enhancing their effectiveness. In particular, it would be desirable to affirmatively maintain proper spacing between the opposing jaws during firing and to prevent entirely severing and stapling unless the thickness is appropriate for ensuring an effective operation.

[0007] Consequently, a significant need exists for an improved surgical stapling and severing instrument that maintains proper spacing in its end effector to achieve proper stapling of the severed tissue that prevents firing (i.e., severing and stapling) when the opposing jaws are not closed.

Brief Summary of the Invention

[0008] The invention overcomes the above-noted and other deficiencies of the prior art by providing a firing mechanism that is distally extended within an end effector of a surgical stapling and severing instrument. The end effector closes and clamps tissue separately from firing (i.e., severing and stapling), providing the clinical flexibility. Yet, the firing mechanism affirmatively engages the end effector during firing to assure proper spacing to achieve proper severing and staple formation. This selective engagement of the end effector by the firing mechanism is enhanced with an anvil lockout mechanism that prevents instances where the anvil is not adequately closed to ensure proper spacing of the end effector.

[0009] In one aspect of the invention, a surgical in-

strument includes a handle portion operable to produce a firing motion that actuates an implement portion. This implement portion has an elongate channel that receives a staple cartridge opposed by a pivotally attached anvil. A firing mechanism engages the elongate channel along its longitudinal length during firing. The firing mechanism selectively engages the anvil with an anvil lockout mechanism. In particular, a blunted ramp portion of an anvil slot includes a blunt surface that abuts an upper device on the firing mechanism when the anvil is pivoted away from a fully closed position. The blunted ramp portion advantageously includes a ramped portion that transitions the upper device of the firing mechanism into an anvil slot when a slight excess of clamped tissue may be overcome by the affirmative spacing capability of the firing mechanism. Thus, the instrument is allowed to fire only when the amount of clamped tissue is within a desired range that assures proper severing and stapling.

[0010] In another aspect of the invention, the handle portion produces a separate closure motion and a separate firing motion. The anvil further includes a recess that allows the firing device to be disengaged from the anvil as the anvil responds to the closure motion. The anvil lockout mechanism is positioned between the anvil recess and an anvil channel so that an upper member of the firing device is selectively engaged.

[0011] In yet a further aspect of the invention, the implement portion of an end effector and shaft are sized for use through a cannula passageway. The end effector responds separately to the closing and firing motions from the handle portion. An anvil lockout mechanism of the end effector precludes distal movement of the firing device when an anvil open condition exists.

[0012] These and other objects and advantages of the present invention shall be made apparent from the accompanying drawings and the description thereof.

Brief Description of the Figures

[0013] The accompanying drawings, which are incorporated in and constitute a part of this specification, illustrate embodiments of the invention, and, together with the general description of the invention given above, and the detailed description of the embodiments given below, serve to explain the principles of the present invention.

[0014] FIG. 1 depicts a partially cut-away side elevation view of a surgical stapling and severing instrument in an open position.

[0015] FIG. 2 depicts a cross-sectional side elevation detail view along the line 2-2 of FIG. 1 of an end effector of the surgical stapling and severing instrument.

[0016] FIG. 3 depicts an enlarged side elevation view of the firing bar of the surgical stapling and severing instrument of FIG. 2.

[0017] FIG. 4 depicts an enlarged front view of the firing bar of the surgical stapling and severing instrument

of FIG. 2.

[0018] FIG. 5 depicts a cross-sectional side elevation detail view of an alternative end effector for the surgical stapling and severing instrument of FIG. 1, incorporating a firing bar that lacks a middle pin for preventing pinching of the end effector.

[0019] FIG. 6 depicts a side elevational view of a handle portion of a proximal end of the surgical stapling and severing instrument of FIG. 1 with a left side removed to expose interior parts in an unclamped, unfired ("start") position.

[0020] FIG. 7 depicts a perspective, exploded view of the handle portion of the proximal end of the surgical stapling and severing instrument of FIG. 1.

[0021] FIG. 8 depicts a side elevational view of the handle portion of the proximal end of the surgical stapling and severing instrument of FIG. 1 with the left side removed to expose interior parts in the closed ("clamped") position.

[0022] FIG. 9 depicts a side elevational view of the handle portion of proximal end of surgical stapling and severing instrument of FIG. 1 with the left side removed to expose interior parts in the stapled and severed ("fired") position.

[0023] FIG. 10 depicts an isometric view of the end effector at the distal end of the surgical stapling and severing instrument of FIG. 1 with the anvil in the up or open position exposing the staple cartridge and cutting edge of the firing bar.

[0024] FIG. 11 depicts an isometric, exploded view of the implement portion of the surgical stapling and severing instrument of FIG. 1.

[0025] FIG. 12 depicts an isometric view of the end effector at the distal end of the surgical stapling and severing instrument of FIG. 1 with the anvil in the up or open position with the cartridge largely removed exposing a single staple driver and a double staple driver as exemplary and the wedge sled in its start position against a middle pin of the firing bar.

[0026] FIG. 13 depicts an isometric view of the distal end of the surgical stapling and severing instrument of FIG. 1 with the anvil in the up or open position with the staple cartridge completely removed and a portion of an elongate channel removed to expose a lowermost pin of the firing bar.

[0027] FIG. 14 depicts a side elevation view in section showing a mechanical relationship between the anvil, elongate channel, and staple cartridge in the closed position of the surgical stapling and severing instrument of FIG. 1, the section generally taken along lines 14-14 of FIG. 10 to expose wedge sled, staple drivers and staples but also depicting the firing bar along the longitudinal centerline.

[0028] FIG. 15 depicts a section view of the end effector of the surgical stapling and severing instrument with the cartridge and firing bar in the start position taken along line 15-15 of FIG. 10.

[0029] FIG. 16 depicts a section view taken along line

16-16 of Fig. 15 showing the cross-sectional relationship between the firing bar, elongate channel, wedge sled, staple drivers, staples and staple cartridge.

[0030] FIG. 17 depicts a side elevation section view of the surgical stapling and severing instrument of FIG. 1 taken along the longitudinal centerline of the end effector in a partially closed but unclamped position gripping tissue.

[0031] FIG. 18 depicts a partially cut-away side elevational view of the surgical stapling and severing instrument of FIG. 1 in the closed or clamped position.

[0032] FIG. 19 depicts a side elevation view in centerline section of the distal end of the surgical stapling and severing instrument of FIG. 1 in the closed or clamped position with tissue properly compressed.

[0033] FIG. 20 depicts a partially cut-away side elevation view of the surgical stapling and severing instrument of FIG. 1 in a partially fired position.

[0034] FIG. 21 depicts a view in centerline section of the distal end of the surgical stapling and severing instrument of FIG. 1 in a partially fired position.

[0035] FIG. 22 depicts a partially cut-away side elevation view of the surgical stapling and severing instrument of FIG. 1 in a fully fired position.

[0036] FIG. 23 depicts a view in centerline section of the distal end of the surgical stapling and severing instrument of FIG. 1 in a fully fired position.

[0037] FIG. 24 depicts a side elevational view in centerline section of an end effector for the instrument of FIG. 1 incorporating a firing lockout for an anvil not closed, with the end effector having clamped an inappropriately excessive thickness of tissue.

[0038] FIG. 25 depicts a side elevational view in centerline section of the end effector of FIG. 24, with the end effector having clamped an excessive but acceptable thickness of tissue.

[0039] FIG. 26 depicts a side elevational view in centerline section of the end effector of FIGS. 24-25, with the end effector having clamped a modest thickness of tissue.

Detailed Description of the Invention

[0040] Turning to the Drawings, wherein like numerals denote like components throughout the several views, FIG. 1 and 2 depict a surgical stapling and severing instrument 10 that is capable of practicing the unique benefits of the present invention. The surgical stapling and severing instrument 10 incorporates an end effector 12 having an E-beam firing mechanism ("firing bar") 14 that advantageously controls the spacing of the end effector 12. In particular, an elongate channel 16 and a pivotally translatable anvil 18 are maintained at a spacing that assures effective stapling and severing. Furthermore, firing is prevented from occurring if the anvil 18 is not adequately closed with an anvil lockout mechanism, which is described in more detail below.

[0041] The surgical and stapling and severing instru-

ment 10 includes a handle portion 20 connected to an implement portion 22, the latter further comprising a shaft 23 distally terminating in the end effector 12. The handle portion 20 includes a pistol grip 24 toward which a closure trigger 26 is pivotally drawn by the clinician to cause clamping, or closing, of the anvil 18 toward the elongate channel 16 of the end effector 12. A firing trigger 28 is farther outboard of the closure trigger 26 and is pivotally drawn by the clinician to cause the stapling and severing of clamped tissue in the end effector 12.

[0042] It will be appreciated that the terms "proximal" and "distal" are used herein with reference to a clinician gripping a handle of an instrument. Thus, the end effector 12 is distal with respect to the more proximal handle portion 20. It will be further appreciated that for convenience and clarity, spatial terms such as "vertical" and "horizontal" are used herein with respect to the drawings. However, surgical instruments are used in many orientations and positions, and these terms are not intended to be limiting and absolute.

[0043] Closure trigger 26 is actuated first. Once the clinician is satisfied with the positioning of the end effector 12, the clinician may draw back the closure trigger 26 to its fully closed, locked position proximate to the pistol grip 24. Then, the firing trigger 28 is actuated. The firing trigger 28 springedly returns when the clinician removes pressure. A release button 30 when depressed on the proximal end of the handle portion 20 releases any locked closure trigger 26.

[0044] A closure sleeve 32 encloses a frame 34, which in turn encloses a firing drive member 36 that is positioned by the firing trigger 28. The frame 34 connects the handle portion 20 to the end effector 12. With the closure sleeve 32 withdrawn proximally by the closure trigger 26 as depicted, the anvil 18 springedly opens, pivoting away from the elongate channel 16 and translating proximally with the closure sleeve 32.

[0045] The elongate channel 16 receives a staple cartridge 37 that is responsive to the firing bar 14 to drive staples into forming contact with the anvil 18. It will be appreciated that although a readily replaceable staple cartridge 37 is advantageously described herein, a staple cartridge 37 consistent with aspects of the present invention may be permanently affixed or integral to the elongate channel 16, for instance when a larger portion of the end effector 12 is replaced after each firing.

E-BEAM FIRING MECHANISM

[0046] With particular reference to FIGS. 2-4, the firing bar 14 includes three vertically spaced pins that control the spacing of the end effector 12 during firing. In particular, an upper pin 38 is staged to enter an anvil pocket 40 near the pivot between the anvil 18 and elongate channel 16. When fired with the anvil 18 closed, the upper pin 38 advances distally within a longitudinal anvil slot 42 extending distally through anvil 18. Any minor upward deflection in the anvil 18 is overcome by a

downward force imparted by the upper pin 38.

[0047] Firing bar 14 also includes a lower most pin, or firing bar cap, 44 that upwardly engages a channel slot 45 in the elongate channel 16, thereby cooperating with the upper pin 38 to draw the anvil 18 and the elongate channel 16 slightly closer together in the event of excess tissue clamped therebetween.

[0048] The firing bar 14 advantageously includes a middle pin 46 that passes through a firing drive slot 47 formed in a lower surface of the cartridge 37 and an upward surface of the elongate channel 16, thereby driving the staples therein as described below. The middle pin 46, by sliding against the elongate channel 16, advantageously resists any tendency for the end effector 12 to be pinched shut at its distal end. To illustrate an advantage of the middle pin 46, FIG. 5 depicts an alternative end effector 12' that lacks a middle pin on a firing bar 14'. In this depiction, the end effector 12' is allowed to pinch shut at its distal end, which tends to impair desired staple formation.

[0049] Returning to FIGS. 2-4, a distally presented cutting edge 48 between the upper and middle pins 38, 46 on the firing bar 14 traverses through a proximally presented, vertical slot 49 in the cartridge 37 to sever clamped tissue. The affirmative positioning of the firing bar 14 with regard to the elongate channel 16 and anvil 18 assure that an effective cut is performed.

CAMBERED ANVIL WITH SELECTED CARTRIDGE GAP

[0050] The affirmative vertical spacing provided by the E-Beam firing bar 14 is suitable for the limited size available for endoscopic devices. Moreover, the E-Beam firing bar 14 enables fabrication of an anvil 16 with a camber imparting a vertical deflection at its distal end, similar to the position depicted in FIG. 5. This cambered anvil 16 advantageously assists in achieving the desired gap in the end effector 12 even with an anvil 16 reduced thickness, which is thus more suited to the size limitations of an endoscopic device.

[0051] The E-Beam firing bar 14 further enables increased applications, especially in combination with a range of configurations of staple cartridges. For instance, a clinician may select a gray staple cartridge yielding a 0.02 mm tissue gap, a white staple cartridge yielding a 0.04 mm tissue gap, a blue cartridge yielding a 0.06 mm tissue gap, or a green cartridge yielding a 0.10 mm tissue gap. The vertical height of each respective staple cartridge in combination with the length of staples and an integral wedge sled (described in more detail below) predetermines this desired tissue thickness with the anvil 18 appropriately vertically spaced by the E-Beam firing bar 14.

TWO-AXIS HANDLE

[0052] With reference to FIGS. 6-9, the handle portion

20 is comprised of first and second base sections 50 and 52, which are molded from a polymeric material such as a glass-filled polycarbonate. The first base section 50 is provided with a plurality of cylindrical-shaped pins 54. The second base section 52 includes a plurality of extending members 56, each having a hexagonal-shaped opening 58. The cylindrical-shaped pins 54 are received within the hexagonal-shaped openings 58 and are frictionally held therein for maintaining the first and second base sections 50 and 52 in assembly.

[0053] A rotating knob 60 has a bore 62 extending completely through it for engaging and rotating the implement portion 22 about its longitudinal axis. The rotating knob 60 includes an inwardly protruding boss 64 extending along at least a portion of the bore 62. The protruding boss 64 is received within a longitudinal slot 66 formed at a proximal portion of the closure sleeve 32 such that rotation of the rotating knob 60 effects rotation of the closure sleeve 32. It will be appreciated that the boss 64 further extends through frame 34 and into contact with a portion of the firing drive member 36 to effect their rotation as well. Thus, the end effector 12 (not shown in FIGS. 6-9) rotates with the rotating knob 60.

[0054] A proximal end 68 of the frame 34 passes proximally through the rotating knob 60 and is provided with a circumferential notch 70 that is engaged by opposing channel securement members 72 extending respectively from the base sections 50 and 52. Only the channel securement member 72 of the second base section 52 is shown. The channel securement members 72 extending from the base sections 50, 52 serve to secure the frame 34 to the handle portion 20 such that the frame 34 does not move longitudinally relative to the handle portion 20.

[0055] The closure trigger 26 has a handle section 74, a gear segment section 76, and an intermediate section 78. A bore 80 extends through the intermediate section 78. A cylindrical support member 82 extending from the second base section 52 passes through the bore 80 for pivotally mounting the closure trigger 26 on the handle portion 20. A second cylindrical support member 83 extending from the second base section 52 passes through a bore 81 of firing trigger 28 for pivotally mounting on the handle portion 20. A hexagonal opening 84 is provided in the cylindrical support member 83 for receiving a securement pin (not shown) extending from the first base section 50.

[0056] A closure yoke 86 is housed within the handle portion 20 for reciprocating movement therein and serves to transfer motion from the closure trigger 26 to the closure sleeve 32. Support members 88 extending from the second base section 52 and securement member 72, which extends through a recess 89 in the yoke 86, support the yoke 86 within the handle portion 20.

[0057] A proximal end 90 of the closure sleeve 32 is provided with a flange 92 that is snap-fitted into a receiving recess 94 formed in a distal end 96 of the yoke 86. A proximal end 98 of the yoke 86 has a gear rack

100 that is engaged by the gear segment section 76 of the closure trigger 26. When the closure trigger 26 is moved toward the pistol grip 24 of the handle portion 20, the yoke 86 and, hence, the closure sleeve 32 move distally, compressing a spring 102 that biases the yoke 86 proximally. Distal movement of the closure sleeve 32 effects pivotal translation movement of the anvil 18 distally and toward the elongate channel 16 of the end effector 12 and proximal movement effects closing, as discussed below.

[0058] The closure trigger 26 is forward biased to an open position by a front surface 130 interacting with an engaging surface 128 of the firing trigger 28. Clamp first hook 104 that pivots top to rear in the handle portion 20 about a pin 106 restrains movement of the firing trigger 28 toward the pistol grip 24 until the closure trigger 26 is clamped to its closed position. Hook 104 restrains firing trigger 28 motion by engaging a lockout pin 107 in firing trigger 28. The hook 104 is also in contact with the closure trigger 26. In particular, a forward projection 108 of the hook 104 engages a member 110 on the intermediate section 78 of the closure trigger 26, the member 110 being outward of the bore 80 toward the handle section 74. Hook 104 is biased toward contact with member 110 of the closure trigger 26 and engagement with lockout pin 107 in firing trigger 28 by a release spring 112. As the closure trigger 26 is depressed, the hook 104 is moved top to rear, compressing the release spring 112 that is captured between a rearward projection 114 on the hook 104 and a forward projection 116 on the release button 30.

[0059] As the yoke 86 moves distally in response to proximal movement of the closure trigger 26, an upper latch arm 118 of the release button 30 moves along an upper surface 120 on the yoke 86 until dropping into an upwardly presented recess 122 in a proximal, lower portion of the yoke 86. The release spring 112 urges the release button 30 outward, which pivots the upper latch arm 118 downwardly into engagement with the upwardly presented recess 122, thereby locking the closure trigger 26 in a tissue clamping position, such as depicted in FIG. 8.

[0060] The latch arm 118 can be moved out of the recess 122 to release the anvil 18 by pushing the release button 30 inward. Specifically, the upper latch arm 118 pivots upward about pin 123 of the second base section 52. The yoke 86 is then permitted to move proximally in response to return movement of the closure trigger 26.

[0061] A firing trigger return spring 124 is located within the handle portion 20 with one end attached to pin 106 of the second base section 52 and the other end attached to a pin 126 on the firing trigger 28. The firing return spring 124 applies a return force to the pin 126 for biasing the firing trigger 28 in a direction away from the pistol grip 24 of the handle portion 20. The closure trigger 26 is also biased away from pistol grip 24 by engaging surface 128 of firing trigger 28 biasing front surface 130 of closure trigger 26.

[0062] As the closure trigger 26 is moved toward the pistol grip 24, its front surface 130 engages with the engaging surface 128 on the firing trigger 28 causing the firing trigger 28 to move to its "firing" position. When in its firing position, the firing trigger 28 is located at an angle of approximately 45° to the pistol grip 24. After staple firing, the spring 124 causes the firing trigger 28 to return to its initial position. During the return movement of the firing trigger 28, its engaging surface 128 pushes against the front surface 130 of the closure trigger 26 causing the closure trigger 26 to return to its initial position. A stop member 132 extends from the second base section 52 to prevent the closure trigger 26 from rotating beyond its initial position.

[0063] The surgical stapling and severing instrument 10 additionally includes a reciprocating section 134, a multiplier 136 and a drive member 138. The reciprocating section 134 comprises a wedge sled in the implement portion 22 (not shown in FIG. 6-9) and a metal drive rod 140.

[0064] The drive member 138 includes first and second gear racks 141 and 142. A first notch 144 is provided on the drive member 138 intermediate the first and second gear racks 141, 142. During return movement of the firing trigger 28, a tooth 146 on the firing trigger 28 engages with the first notch 144 for returning the drive member 138 to its initial position after staple firing. A second notch 148 is located at a proximal end of the metal drive rod 140 for locking the metal drive rod 140 to the upper latch arm 118 of the release button 30 in its unfired position.

[0065] The multiplier 136 comprises first and second integral pinion gears 150 and 152. The first integral pinion gear 150 is engaged with a first gear rack 154 provided on the metal drive rod 140. The second integral pinion gear 152 is engaged with the first gear rack 141 on the drive member 138. The first integral pinion gear 150 has a first diameter and the second integral pinion gear 152 has a second diameter which is smaller than the first diameter.

[0066] FIGS. 6, 8 and 9 depict respectively the handle portion 20 in the start position (open and unfired), a clamped position (closed and unfired) and a fired position. The firing trigger 28 is provided with a gear segment section 156. The gear segment section 156 engages with the second gear rack 142 on the drive member 138 such that motion of the firing trigger 28 causes the drive member 138 to move back and forth between a first drive position, shown in FIG. 8, and a second drive position, shown in FIG. 9. In order to prevent staple firing before tissue clamping has occurred, the upper latch arm 118 on the release button 30 is engaged with the second notch 148 on the drive member 138 such that the metal drive rod 140 is locked in its proximal-most position, as depicted in FIG. 6. When the upper latch arm 118 falls into the recess 122, the upper latch arm 118 disengages with the second notch 148 to permit distal movement of the metal drive rod 140, as depicted in

FIG. 9.

[0067] Because the first gear rack 141 on the drive member 138 and the gear rack 154 on the metal drive rod 140 are engaged with the multiplier 136, movement of the firing trigger 28 causes the metal drive rod 140 to reciprocate between a first reciprocating position, shown in FIG. 8, and a second reciprocating position, shown in FIG. 9. Since the diameter of the first pinion gear 150 is greater than the diameter of the second pinion gear 152, the multiplier 136 moves the reciprocating section 134 a greater distance than the drive member 138 is moved by the firing trigger 28. The diameters of the first and second pinion gears 150 and 152 may be changed to permit the length of the stroke of the firing trigger 28 and the force required to move it to be varied.

[0068] It will be appreciated that the handle portion 20 is illustrative and that other actuation mechanisms may be employed. For instance, the closing and firing motions may be generated by automated means.

SEPARATE AND DISTINCT CLOSING AND FIRING END EFFECTOR

[0069] The end effector 12 of the surgical stapling and severing instrument 10 is depicted in further detail in FIGS. 10-16. As described above, the handle portion 20 produces separate and distinct closing and firing motions that actuate the end effector 12. The end effector 12 advantageously maintains the clinical flexibility of this separate and distinct closing and firing (i.e., stapling and severing). In addition, the end effector 12 introduces the aforementioned ability to affirmatively maintain the closed spacing during firing after the clinician positions and clamps the tissue. Both features procedurally and structurally enhance the ability of the surgical stapling and severing instrument 10 by ensuring adequate spacing for instances where an otherwise inadequate amount of tissue is clamped and to enhance the clamping in instances where an otherwise excessive amount of tissue has been clamped.

[0070] FIG. 10 depicts the end effector 12, which is in an open position by a retracted closure sleeve 32, with a staple cartridge 37 installed in the elongate channel 16. On a lower surface 200 of the anvil 18, a plurality of stapling forming pockets 202 are arrayed to correspond to a plurality of stapler apertures 204 in an upper surface 206 of the staple cartridge 37. The firing bar 14 is at its proximal position, with the upper pin 38 aligned in a non-interfering fashion with the anvil pocket 40. The anvil pocket 40 is shown as communicating with the longitudinal anvil slot 42 in the anvil 18. The distally presented cutting edge 48 of the firing bar 14 is aligned with and proximally from removed from the vertical slot 49 in the staple cartridge 37, thereby allowing removal of a spent cartridge and insertion of an unfired cartridge, which is snapfit into the elongate channel 16. Specifically, extension features 208, 210 of the staple cartridge 37 engage recesses 212, 214 (shown in FIG. 12) of the elongate

channel 16.

[0071] FIG. 11 shows the implement portion 22 of the surgical stapling and severing instrument 10 in disassembled form. The staple cartridge 37 is shown as being comprised of a cartridge body 216, a wedge sled 218, single and double drivers 220, staples 222, and a cartridge tray 224. When assembled, the cartridge tray 224 holds the wedge sled 218, single and double drivers 220, and staples 222 inside the cartridge body 216.

[0072] Having a wedge sled 218 integral to the staple cartridge 37 enables a number of flexible design options as compared to incorporating camming surfaces onto a firing bar itself. For instance, a number of different staple cartridges may be selected for use in the instrument 10 with each staple cartridge having a different configuration of rows of staples, each thus having a unique wedge sled configured to contact the middle pin 46 of the firing bar 14 while causing the driving of the staples 222. As another example, the integral wedge sled 218 provides an opportunity for a number of lockout features, described in greater detail in the first and third aforementioned co-pending applications.

[0073] The elongate channel 16 has a proximally placed attachment cavity 226 that receives a channel anchoring member 228 on the distal end of the frame 34 for attaching the end effector 12 to the handle portion 20. The elongate channel 16 also has an anvil cam slot 230 that pivotally receives an anvil pivot 232 of the anvil 18. The closure sleeve 32 that encompasses the frame 34 includes a distally presented tab 234 that engages an anvil feature 236 proximate but distal to the anvil pivot 232 on the anvil 18 to thereby effect opening and closing of the anvil 18. The firing drive member 36 is shown as being assembled from the firing bar 14 attached to a firing connector 238 by pins 240, which in turn is rotatably and proximally attached to the metal drive rod 140. The firing bar 14 is guided at a distal end of the frame by a slotted guide 239 inserted therein.

[0074] With particular reference to FIG. 12, a portion of the staple cartridge 37 is removed to expose portions of the elongate channel 16, such as recesses 212, 214 and to expose some components of the staple cartridge 37 in their unfired position. In particular, the cartridge body 216 (shown in FIG. 11) has been removed. The wedge sled 218 is shown at its proximal, unfired position with a pusher block 242 contacting the middle pin 46 (not shown in FIG. 12) of the firing bar 14. The wedge sled 218 is in longitudinal sliding contact upon the cartridge tray 224 and includes wedges 228 that force upward the single and double drivers 220 as the wedge sled 218 moves distally. Staples 222 (not shown in FIG. 12) resting upon the drivers 220 are thus also forced upward into contact with the anvil forming pockets 202 on the anvil 18 to form closed staples. Also depicted is the channel slot 45 in the elongate channel 16 that is aligned with the vertical slot 49 in the staple cartridge 37.

[0075] FIG. 13 depicts the end effector 12 of FIG. 12 with all of the staple cartridge 37 removed to show the

middle pin 46 of the firing bar 14 as well as portion of the elongate channel 16 removed adjacent to the channel slot 45 to expose the firing bar cap 44. In addition, portions of the shaft 23 are removed to expose a proximal portion of the firing bar 14. Projecting downward from the anvil 18 near the pivot, a pair of opposing tissue stops 244 prevent tissue being positioned too far up into the end effector 12 during clamping.

[0076] FIG. 14 depicts the end effector 12 closed in a tissue clamping position with the firing bar 14 unfired. The upper pin 38 is in the anvil pocket 40, vertically aligned with the anvil slot 42 for distal longitudinal movement of the firing bar 14 during firing. The middle pin 46 is positioned to push the wedge sled 218 distally so that wedge 228 sequentially contacts and lifts double drivers 220 and the respective staples 222 into forming contact with staple forming pockets 202 in the lower surface 200 of the anvil 18.

[0077] FIG. 15 depicts the upper surface 206 of the staple cartridge 37 with the firing bar 14 in its unfired, proximal position. The stapler apertures 204 are arrayed on each side of the vertical slot 49 in the staple cartridge 37.

[0078] FIG. 16 depicts the end effector 12 near the pivot showing that the elongate channel 16 has opposing ramp portions 246 to thereby cooperate with the tissue stops 244 of the anvil 18 (not shown in FIG. 16) to prevent tissue from jamming the end effector 12. Also depicted in greater detail are the double drivers 220 and their relation to the staples 222.

OPERATION

[0079] In use, the surgical stapling and severing instrument 10 is used as depicted in FIGS 1, 2, and 17-23. In FIGS. 1-2, the instrument 10 is in its start position, having had an unfired, fully loaded staple cartridge 37 snap-fitted into the distal end of the elongate channel 16. Both triggers 26, 28 are forward and the end effector 12 is open, such as would be typical after inserting the end effector 12 through a trocar or other opening into a body cavity. The instrument 10 is then manipulated by the clinician such that tissue 248 to be stapled and severed is positioned between the staple cartridge 37 and the anvil 18, as depicted in FIG. 17.

[0080] With reference to FIGS. 18-19, next, the clinician moves the closure trigger 26 proximally until positioned directly adjacent to the pistol grip 24, locking the handle portion 20 into the closed and clamped position. The retracted firing bar 14 in the end effector 12 does not impede the selective opening and closing of the end effector 12, but rather resides within the anvil pocket 40. With the anvil 18 closed and clamped, the E-beam firing bar 14 is aligned for firing through the end effector 12. In particular, the upper pin 38 is aligned with the anvil slot 42 and the elongate channel 16 is affirmatively engaged about the channel slot 45 by the middle pin 46 and the firing bar cap 44.

[0081] With reference to FIGS. 20-21, after tissue clamping has occurred, the clinician moves the firing trigger 28 proximally causing the firing bar 14 to move distally into the end effector 12. In particular, the middle pin 46 enters the staple cartridge 37 through the firing drive slot 47 to effect the firing of the staples 222 (not shown in FIGS. 20-21) via wedge sled 218 toward the anvil 18. The lower most pin, or firing bar cap 44, cooperates with the middle pin 46 to slidably position cutting edge 48 of the firing bar 14 to sever tissue. The two pins 44, 46 also position the upper pin 38 of the firing bar 14 within longitudinal anvil slot 42 of the anvil 18, affirmatively maintaining the spacing between the anvil 18 and the elongate channel 16 throughout its distal firing movement.

[0082] With reference to FIGS. 22-23, the clinician continues moving the firing trigger 28 until brought proximal to the closure trigger 26 and pistol grip 24. Thereby, all of the ends of the staples 222 are bent over as a result of their engagement with the anvil 18. The firing bar cap 44 is arrested against a firing bar stop 250 projecting toward the distal end of the channel slot 45. The cutting edge 48 has traversed completely through the tissue. The process is complete by releasing the firing trigger 28 and by then depressing the release button 30 while simultaneously squeezing the closure trigger 26 to open the end effector 12.

[0083] While the present invention has been illustrated by description of several embodiments and while the illustrative embodiments have been described in considerable detail, it is not the intention of the applicant to restrict or in any way limit the scope of the appended claims to such detail. Additional advantages and modifications may readily appear to those skilled in the art.

[0084] For example, the affirmative spacing of the anvil 18 and elongate channel 16 is achieved in part with two pins 44, 46 on the firing bar 14 engaging opposite sides of a channel slot 47 and a single upper pin 38 entrained within an anvil slot 42. It would be consistent with aspects of the invention for the anvil to be captured by opposing pins on either side of a longitudinal slot and/or for an elongate channel to have an internal slot that entrains a lower pin.

[0085] For another example, although the E-beam firing beam 14 has advantages for an endoscopically employed surgical severing and stapling instrument 10, a similar E-Beam may be used in other clinical procedures. It is generally accepted that endoscopic procedures are more common than laparoscopic procedures. Accordingly, the present invention has been discussed in terms of endoscopic procedures and apparatus. However, use herein of terms such as "endoscopic", should not be construed to limit the present invention to a surgical stapling and severing instrument for use only in conjunction with an endoscopic tube (i.e., trocar). On the contrary, it is believed that the present invention may find use in any procedure where access is limited to a small incision, including but not limited to laparoscopic

procedures, as well as open procedures.

[0086] For yet another example, although an illustrative handle portion 20 described herein is manually operated by a clinician, it is consistent with aspects of the invention for some or all of the functions of a handle portion to be powered (e.g., pneumatic, hydraulic, electro-mechanical, ultrasonic, etc.). Furthermore, controls of each of these functions may be manually presented on a handle portion or be remotely controlled (e.g., wireless remote, automated remote console, etc.).

[0087] As yet an additional example, although a simultaneous stapling and severing instrument is advantageously illustrated herein, it would be consistent with aspects of the invention for stapling to comprise other types of fasteners and attachment techniques.

ANVIL NOT CLOSED LOCKOUT

[0088] FIGS. 24-26 depict in greater detail an anvil lockout mechanism 260 that advantageously avoids abnormal operation of the end effector 12 due to an excess amount of clamped tissue 248. In particular, the anvil lockout mechanism 260 avoids a misfire wherein the firing bar 14 partially or fully fires, severing tissue, but wherein staples are not properly formed on each side of the incision to close the incision severed tissue.

[0089] In FIG. 24, the end effector 12 has been clamped closed. However, the clamped tissue 248 is slightly thicker than an appropriate range. Thus, the anvil 18 is pivoted away from the elongate channel 16, even though the closure trigger 26 of the handle portion may be indicating closed and locked, as in FIG. 8.

[0090] Returning to FIG. 24, the firing bar 14 is depicted as having been moved distally a short distance from its fully proximal, unfired position, indicating that the clinician has begun to draw the firing trigger 28 to the pistol grip 24 (not shown in FIG. 24). The anvil lockout mechanism 260 is formed by the interaction between the upper pin 38 of the firing bar 14 and a blunted ramp surface 262 of the lower surface 200 of the anvil 18. In situations such as depicted FIG. 24 when the anvil 18 is not sufficiently closed, the upper pin 38 abuts a blunted surface 264 of the blunted ramp surface 262 that prevents further distal movement of the firing bar 14. The clinician thus receives tactile feedback that the firing trigger 28 is prevented from further distal movement, providing an opportunity to release the closure trigger 26 and to recamp an appropriate amount of tissue 248. The anvil lockout mechanism 260 thus avoids severing tissue when effective stapling is not assured.

[0091] FIG. 25 depicts a more optimal situation wherein the amount of tissue 248 that is clamped in the end effector 12 is within an acceptable range, although toward the maximum amount allowed. Moreover, this is an instance wherein the affirmative spacing capability of the end effector 12 may be employed to draw down the anvil 18 during firing to achieve the desired spacing for effective staple formation. The anvil lockout mechanism

260 assists in achieving this spacing by transitioning the upper pin 38 from a ramped surface 266 onto an inner surface 268 of the anvil slot 42. The ramped surface 266 from the blunted surface 264 to the inner surface 268 has a slope selected to provide a smooth transition to the point where the firing bar 14 will have achieved sufficient mechanism advantage to draw down the anvil 18 before encountering the first staples.

[0092] FIG. 26 depicts another optimal situation wherein the anvil lockout mechanism 260 does not interact with the upper pin 38 of the firing bar. As an illustration, the end effector 12 is depicted as having clamped a minimal amount of tissue 248. The end effector 12 may even be initially pinched at its distal end such as due to external pressure on the end effector 12. The upper pin 38 is aligned with the anvil slot 42 and enters without necessarily contacting the anvil lockout mechanism. Thereafter the upper pin 38 reacts vertically against the anvil slot 42 as necessary to ensure that the anvil 18 and elongate channel 16 are appropriately spaced at the point at which the staples are being formed.

[0093] While the present invention has been illustrated by description of several embodiments and while the illustrative embodiments have been described in considerable detail, it is not the intention of the applicant to restrict or in any way limit the scope of the appended claims to such detail. Additional advantages and modifications may readily appear to those skilled in the art.

[0094] For example, although an upper pin 38 selectively engaging an anvil slot 42 is depicted in the illustrative embodiment, it will be appreciated that an anvil lockout mechanism may be formed with an anvil that has a slot that transversely completely through the anvil such that a firing bar engaged both a top and bottom surface of the anvil as the firing bar moves distally.

Claims

1. A surgical instrument comprising: a handle portion operable to produce a firing motion;

an implement portion responsive to the firing motions from the handle portion, the implement portion comprising:

an elongate channel coupled to the handle portion and including a channel slot,
a staple cartridge received by the elongate channel,
an anvil pivotally coupled to the elongate channel and including an anvil channel,
a firing device longitudinally engaging the elongate channel and engageable to the anvil, and
an anvil lockout mechanism oriented to impede the firing device from engaging the anvil when the anvil is open.

2. The surgical instrument of claim 1, wherein anvil includes an upper device operable to engage the anvil channel, the anvil lockout comprising a blunted ramp surface transitioning the upper device into the anvil channel when the anvil is closed. 5
3. The surgical instrument of claim 1, wherein the implement portion further comprises a staple cartridge received in the elongate channel, the firing device operable to actuate the staple cartridge during firing. 10
4. The surgical instrument of claim 1, wherein the anvil includes a recess proximate to the firing device when in an unfired position and a longitudinal anvil channel communicating with the recess for receiving the upper member of the firing device when fired. 15
5. The surgical instrument of claim 4, wherein the elongate channel includes a longitudinal channel and lower portion of the firing device further comprises a middle member and a lower member oppositely engaging the longitudinal channel. 20
6. The surgical instrument of claim 1, wherein the elongate channel includes a longitudinal channel and lower portion of the firing device further comprises a middle member and a lower member oppositely engaging the longitudinal channel 25
7. A surgical instrument comprising: 30
 - a handle portion operable to separately produce a firing motion and a closing motion; 35
 - an implement portion responsive to the separate firing and closing motions from the handle portion, the implement portion comprising:
 - an elongate channel coupled to the handle portion, 40
 - an anvil pivotally coupled to the elongate channel and including a recess and an anvil channel,
 - a firing device including a distally presented cutting edge longitudinally received between the elongate channel and the anvil, 45
 - an upper member engageable to the anvil channel and a lower portion longitudinally engaging the elongate channel, the upper member residing within the anvil recess when in an unfired position to allow the separate closing motion of the anvil, and 50
 - an anvil lockout mechanism communicating between the anvil recess and the anvil channel wherein the anvil lockout mechanism blocks the upper member when the anvil is not closed. 55
8. The surgical instrument of claim 7, wherein the anvil lockout mechanism comprises a surface of the anvil channel proximally terminating in a blunted surface positioned to abut the firing device when the anvil is raised.
9. The surgical instrument of claim 8, wherein the anvil lockout mechanism further comprises a blunted ramp surface communicating between an inner surface and the blunted surface of the anvil channel.
10. An endo-surgical instrument, comprising:
 - a handle portion operable to separately produce a firing motion and a closing motion;
 - an end effector sized for insertion through an endo-surgical cannula passageway; and
 - a shaft attached between the handle portion and the end effector and operably configured to separately transfer the firing and closing motions therebetween;
 - the end effector further comprising:
 - an elongate channel coupled to the shaft,
 - an anvil pivotally coupled to the elongate channel responsive to the closing motion to move between an open position to a closed position,
 - a firing device longitudinally received between the elongate channel and the anvil and including an upper member engageable to the anvil channel during distal movement for firing, and
 - an anvil lockout mechanism operably configured to preclude distal movement of the firing device in response to an anvil open condition.

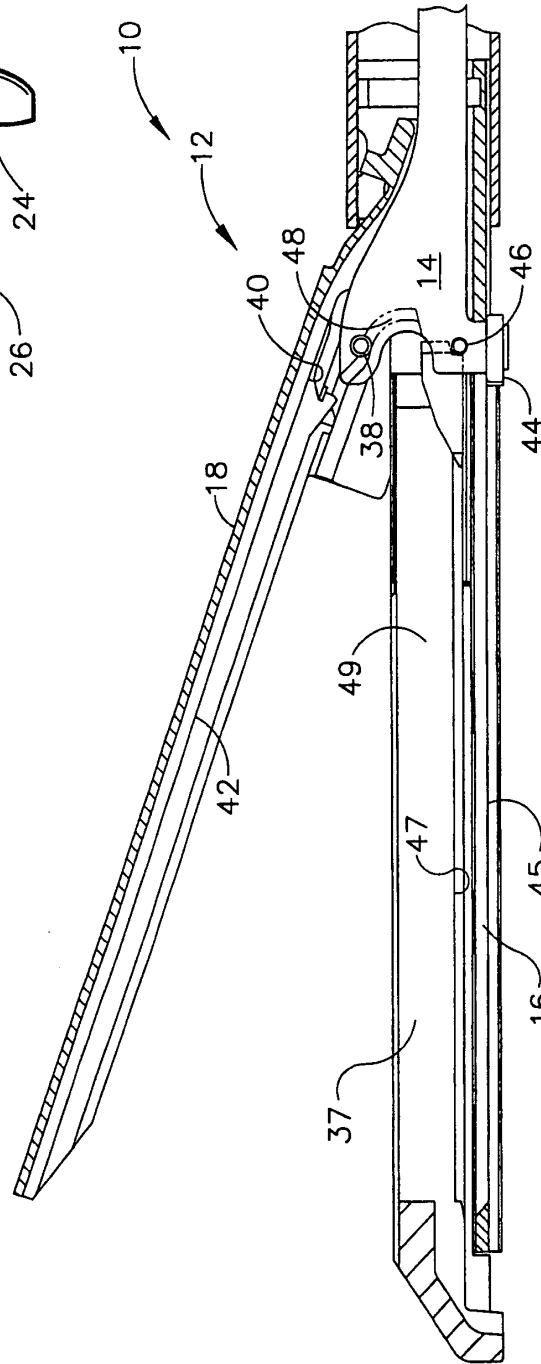
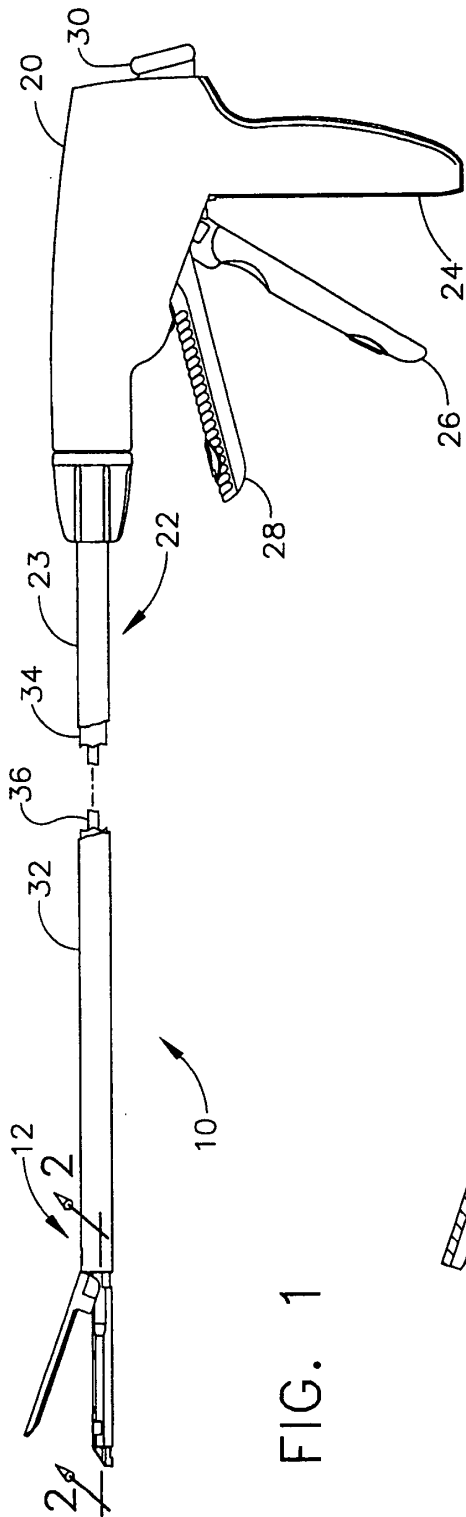

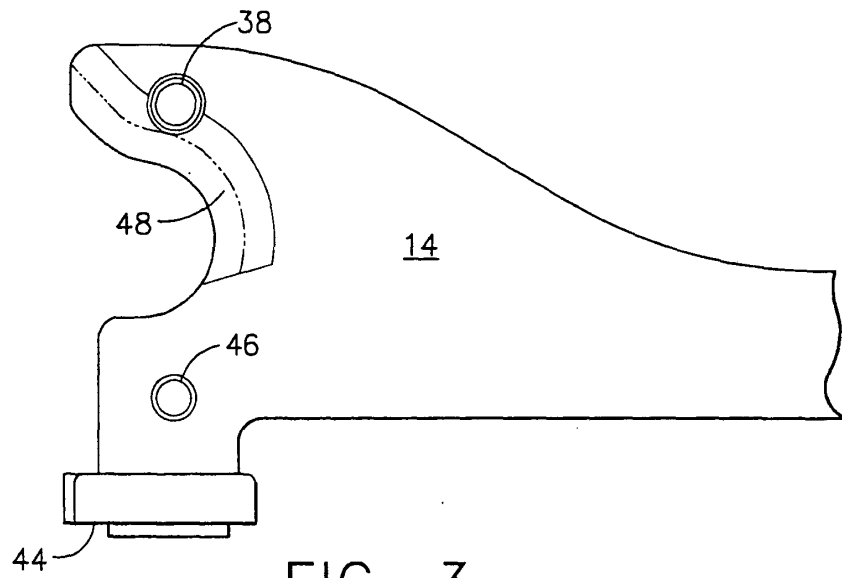

FIG. 3

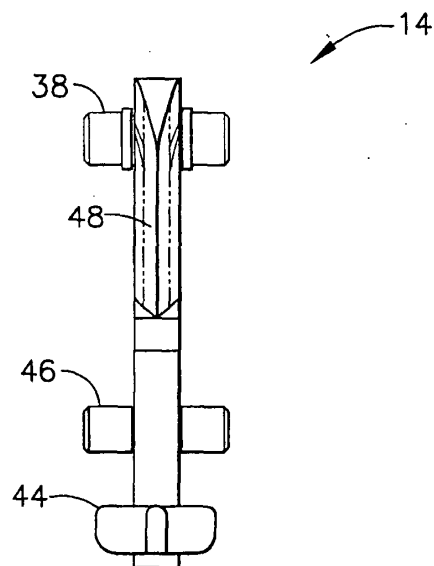

FIG. 4

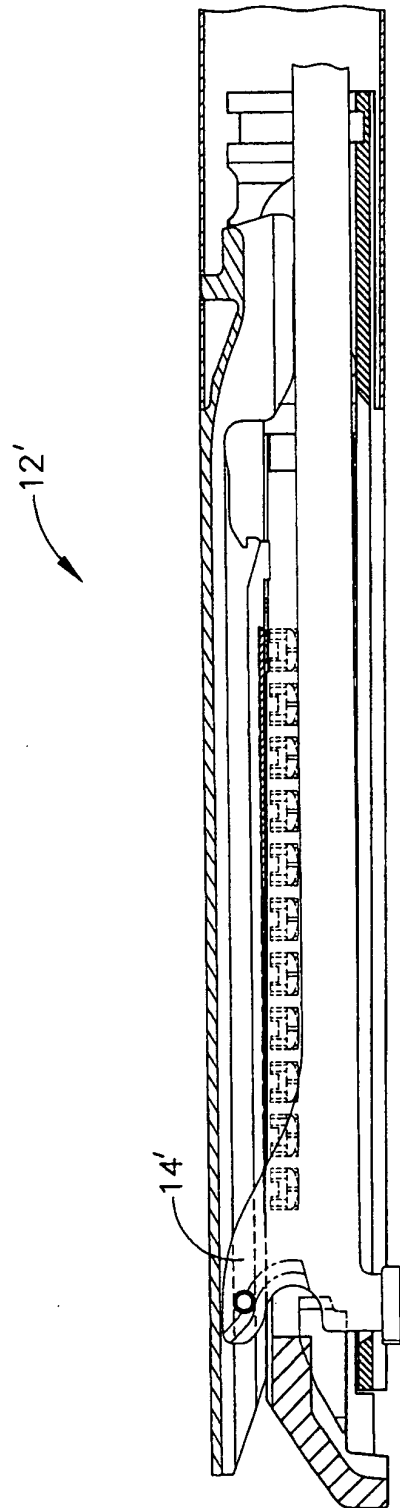

FIG. 5

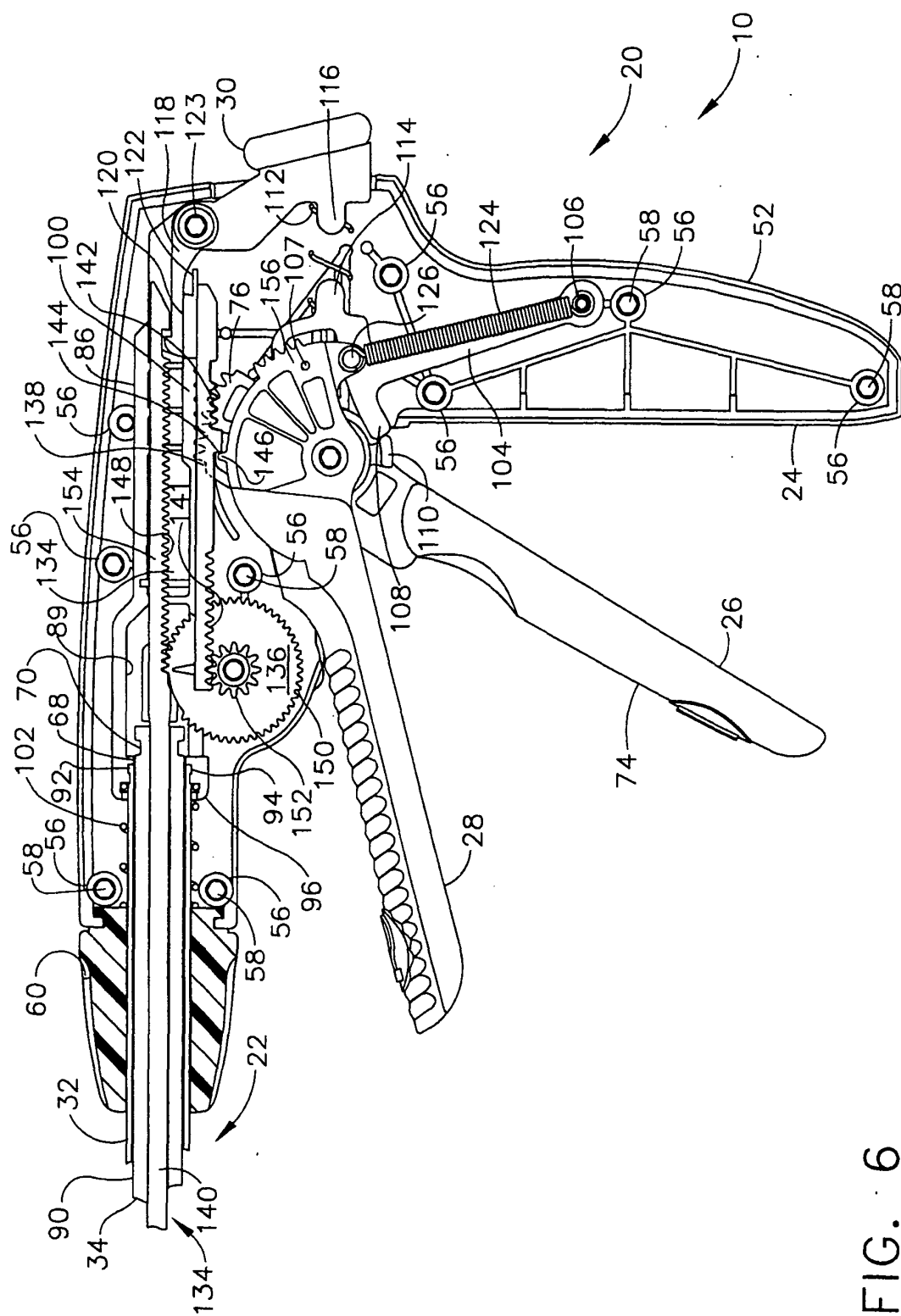

FIG. 6

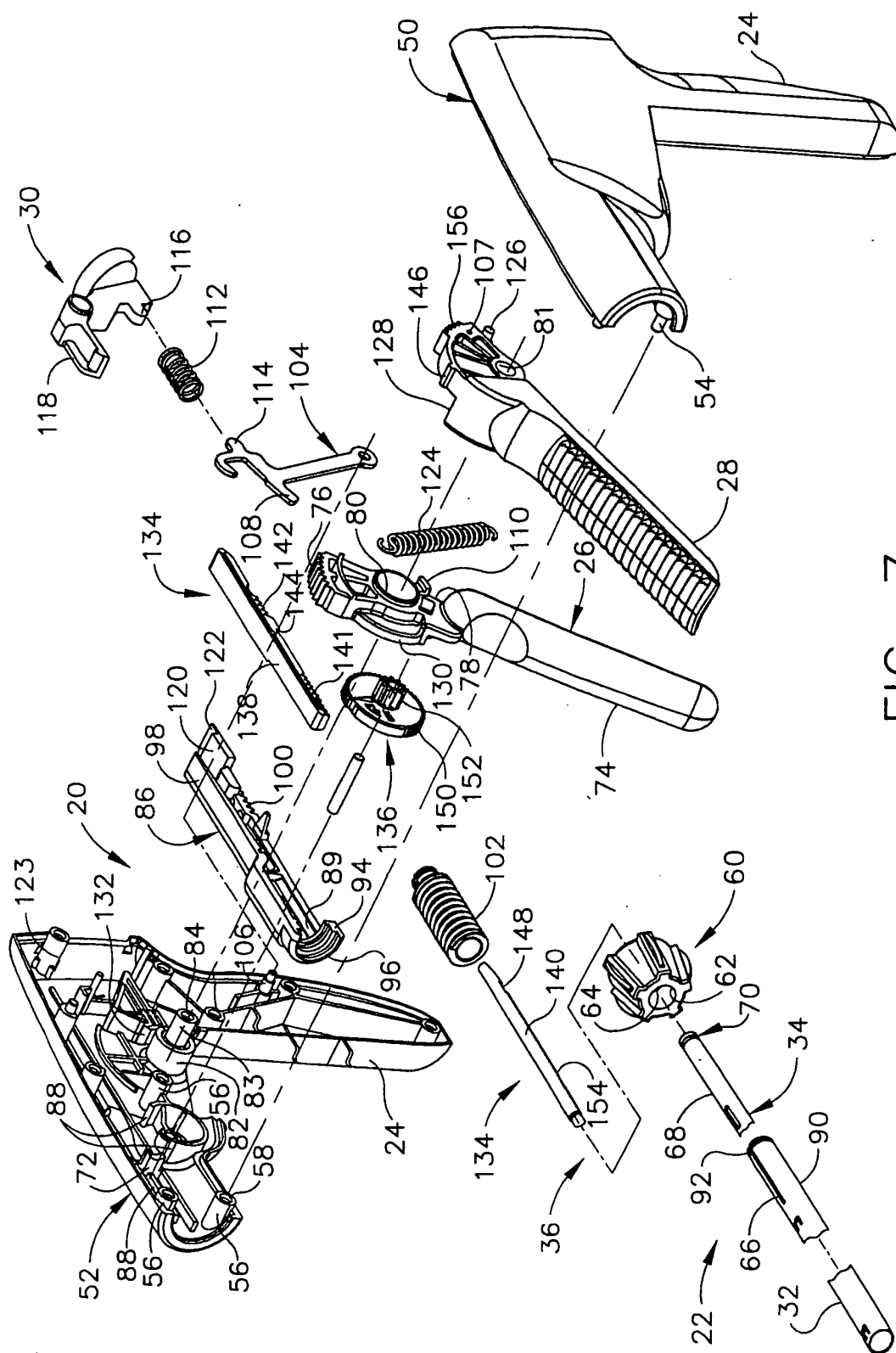

FIG. 7

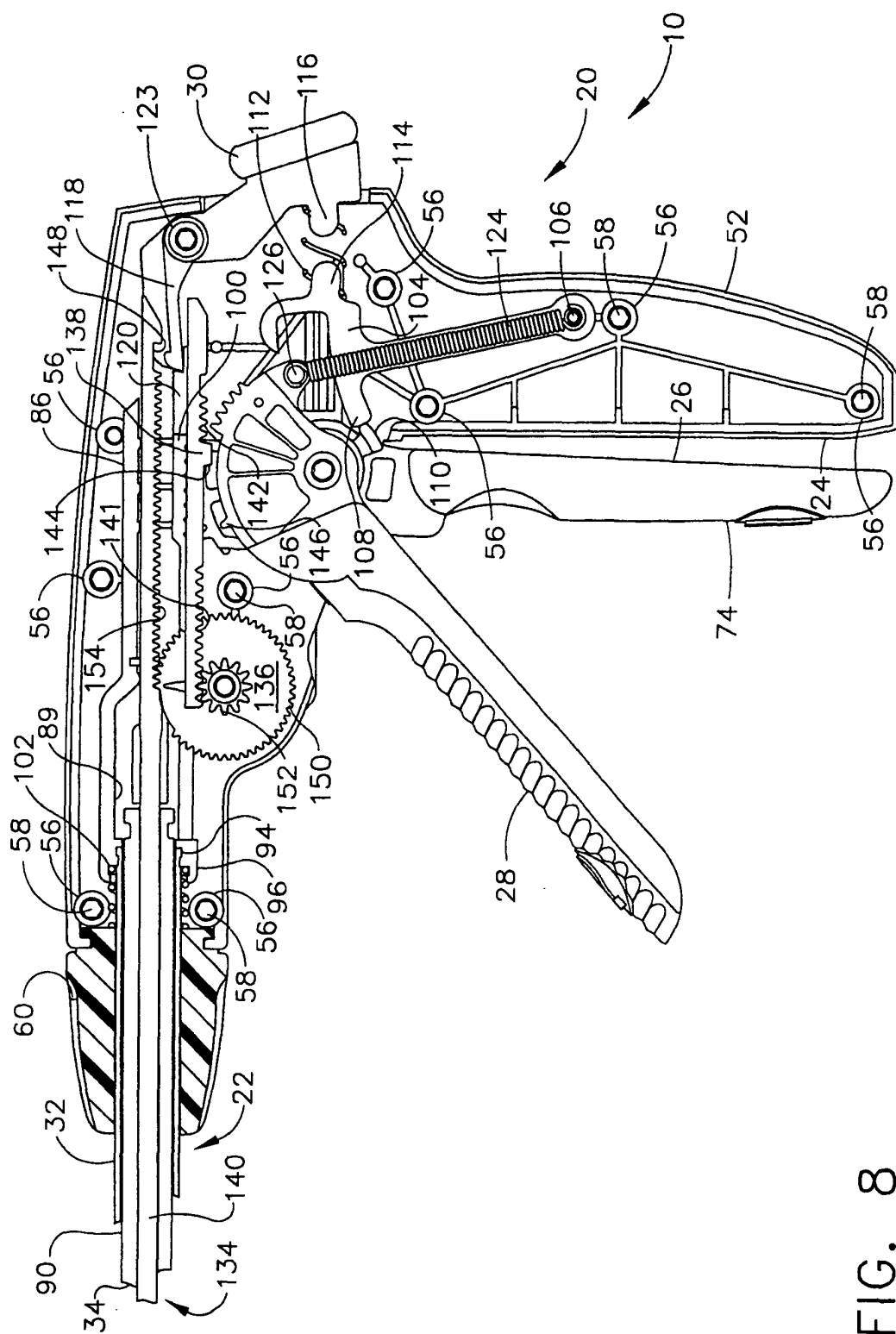

FIG. 8

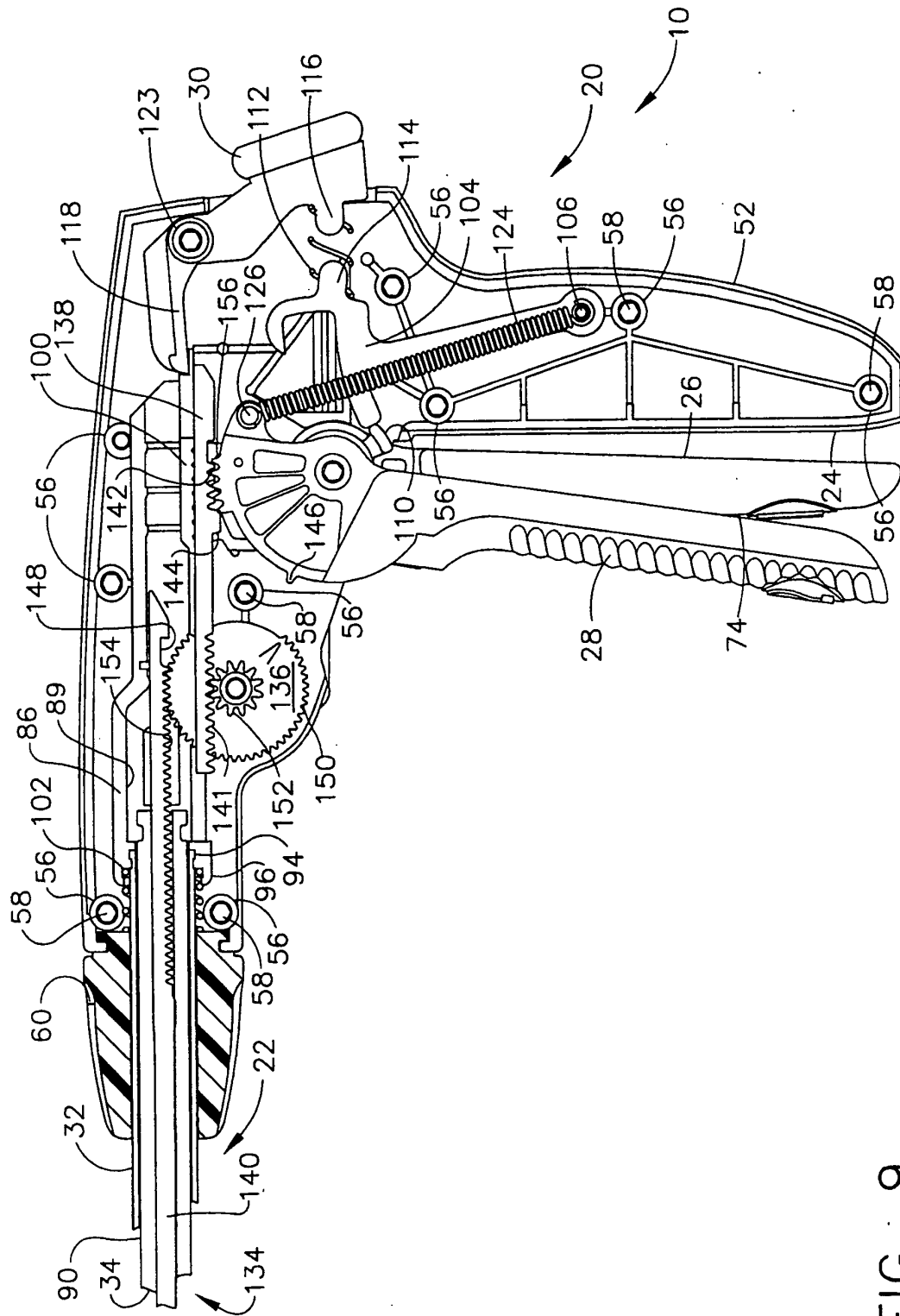

FIG. 9

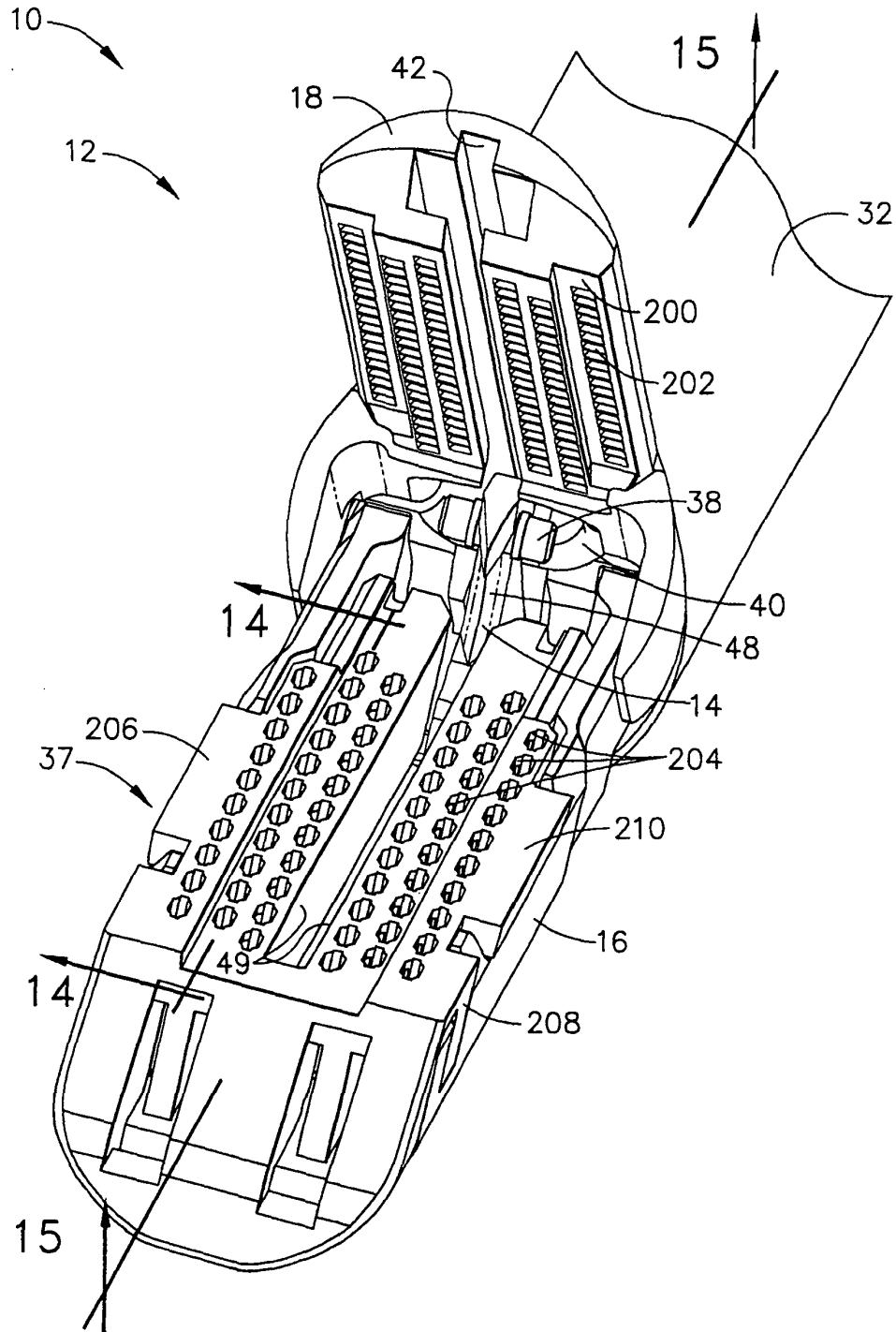

FIG. 10

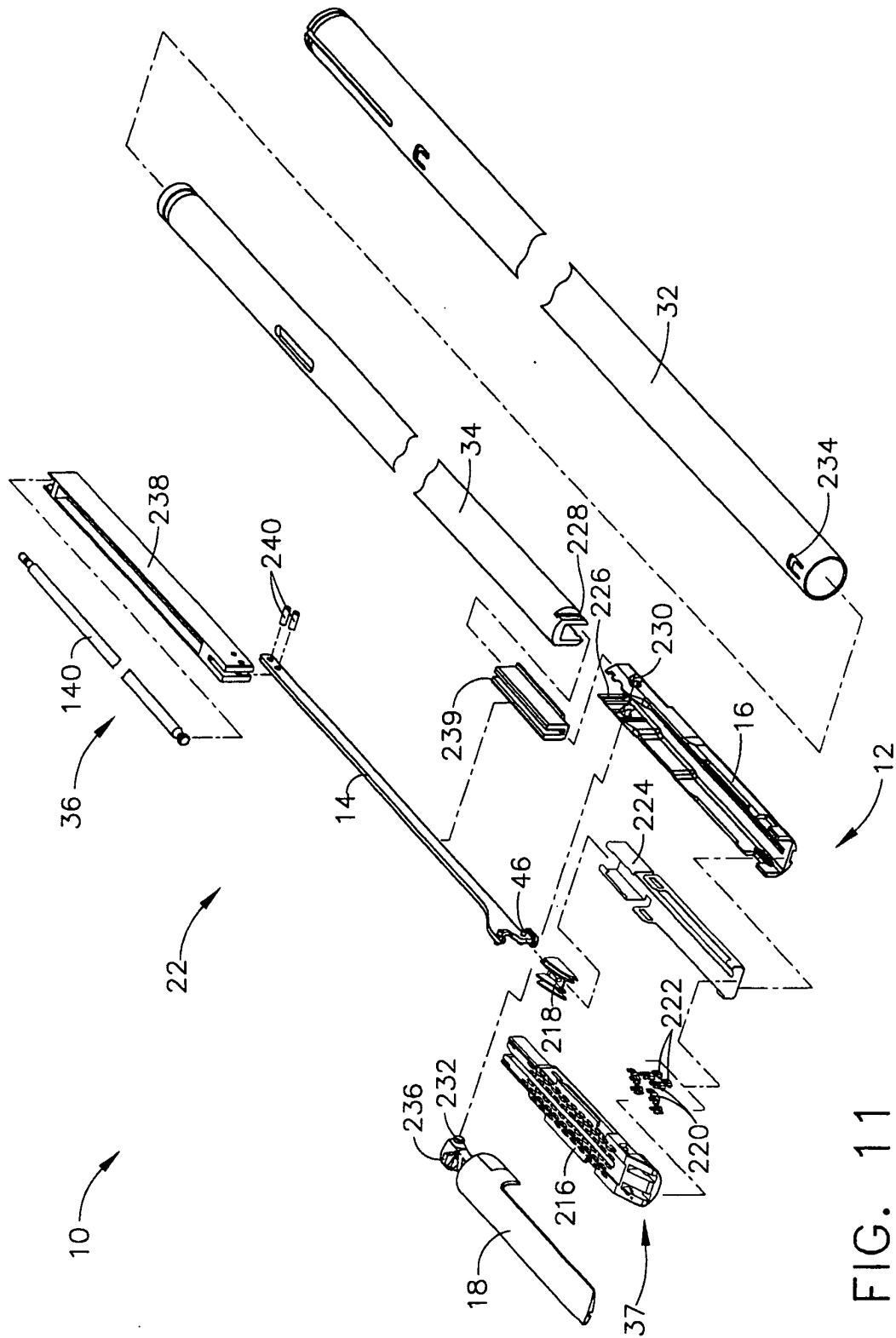

Fig. 11

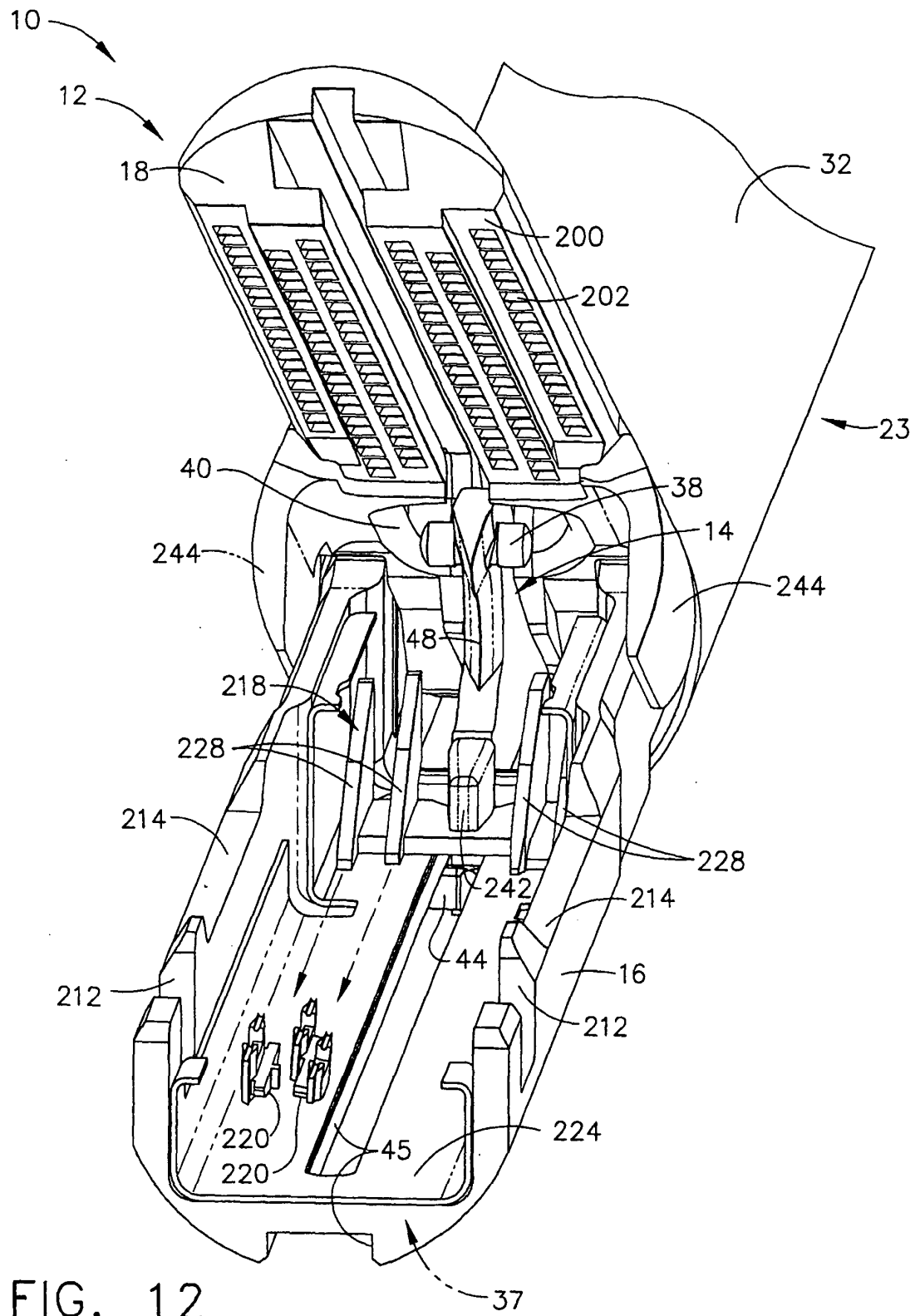

FIG. 12

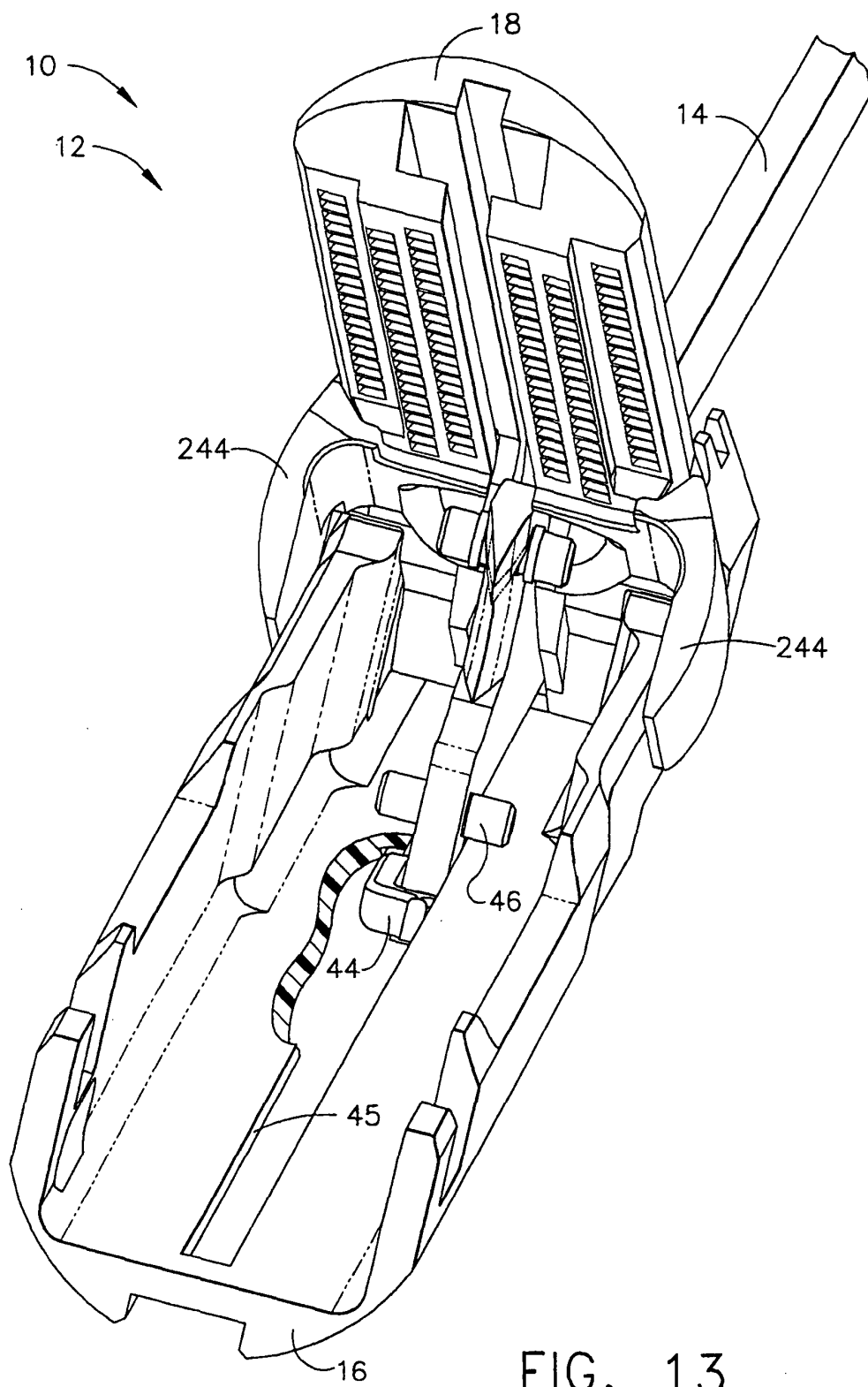

FIG. 13

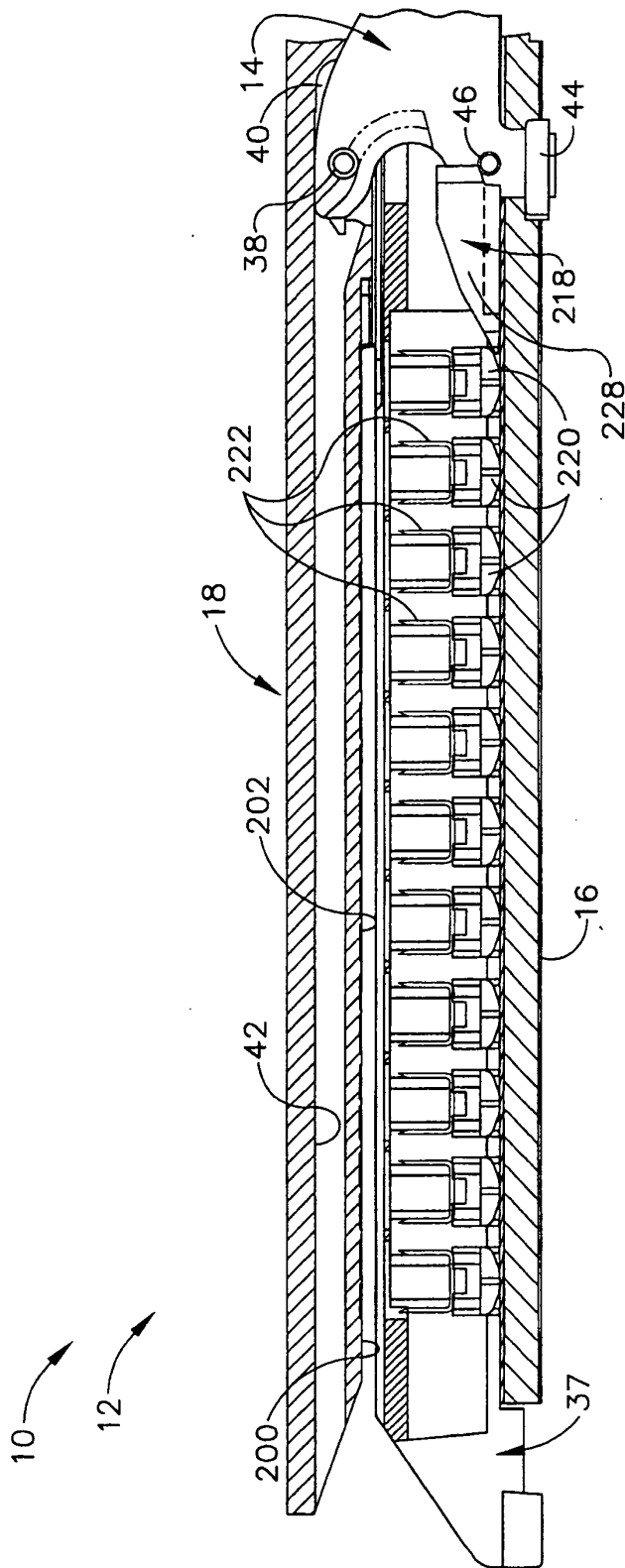
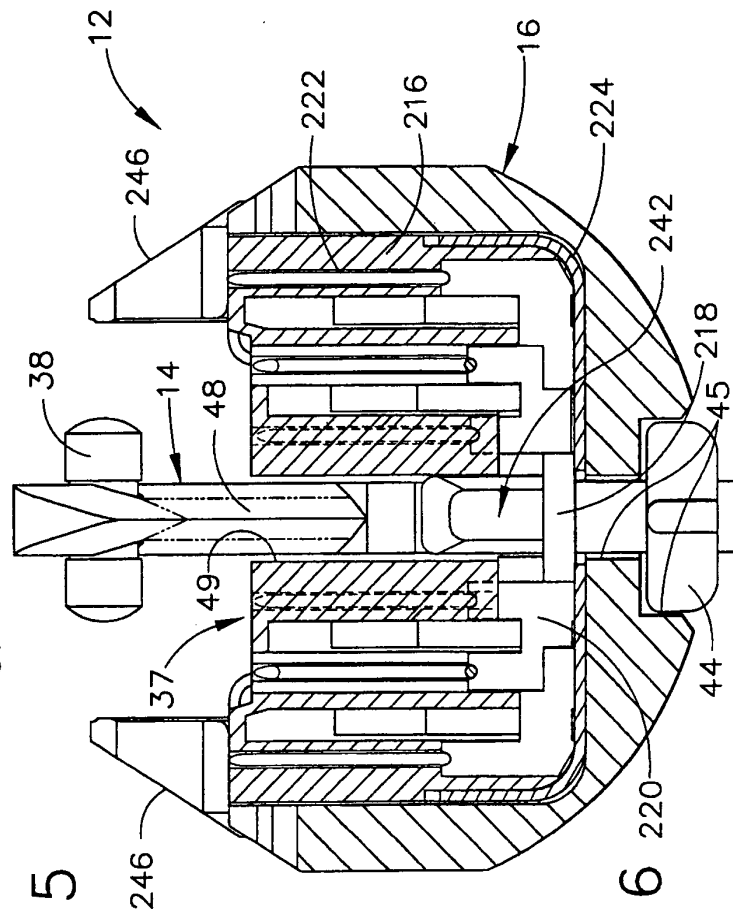
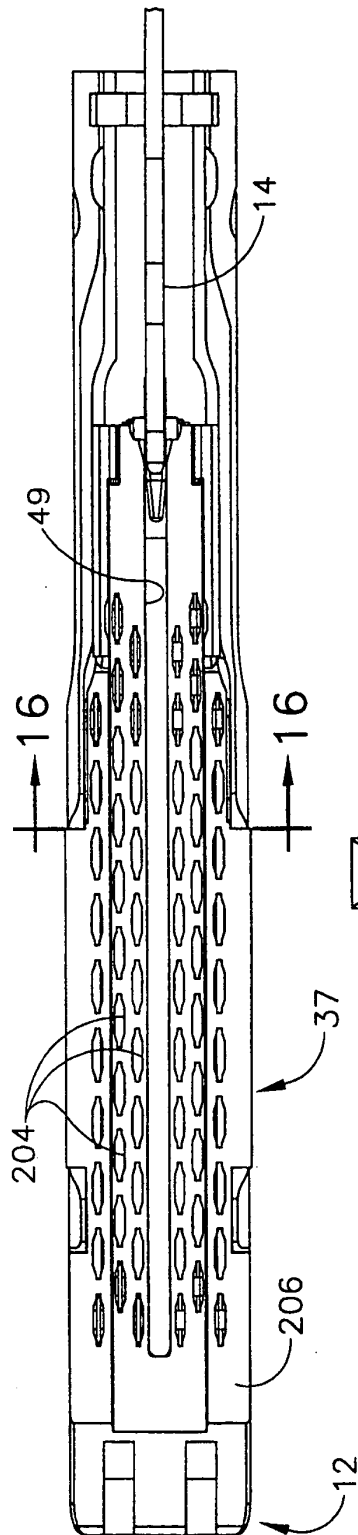

FIG. 14



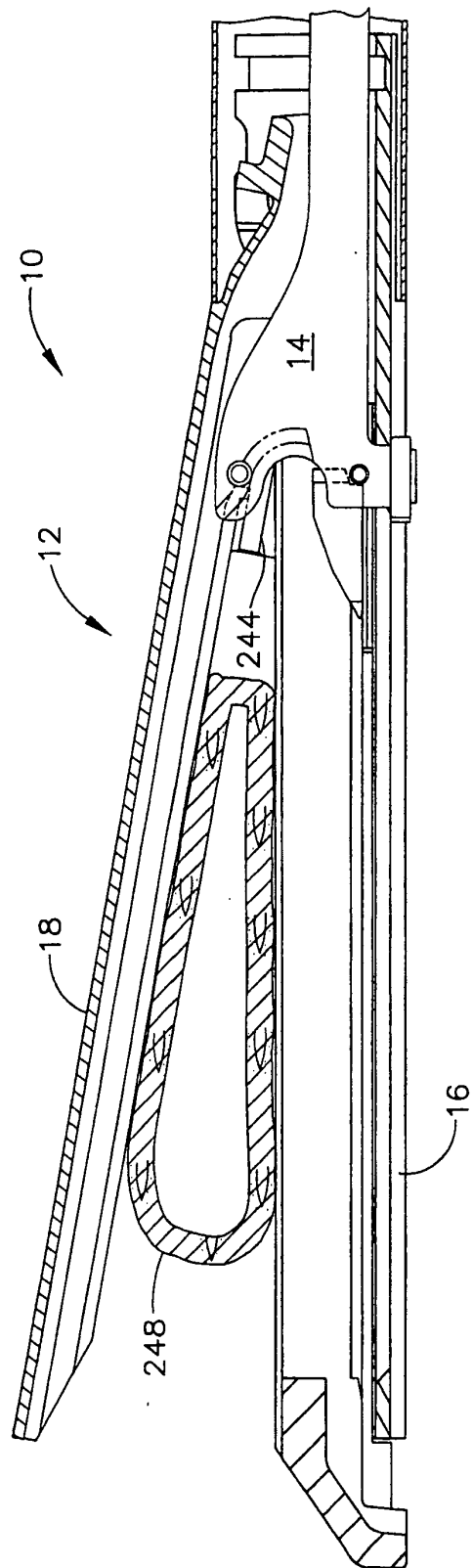
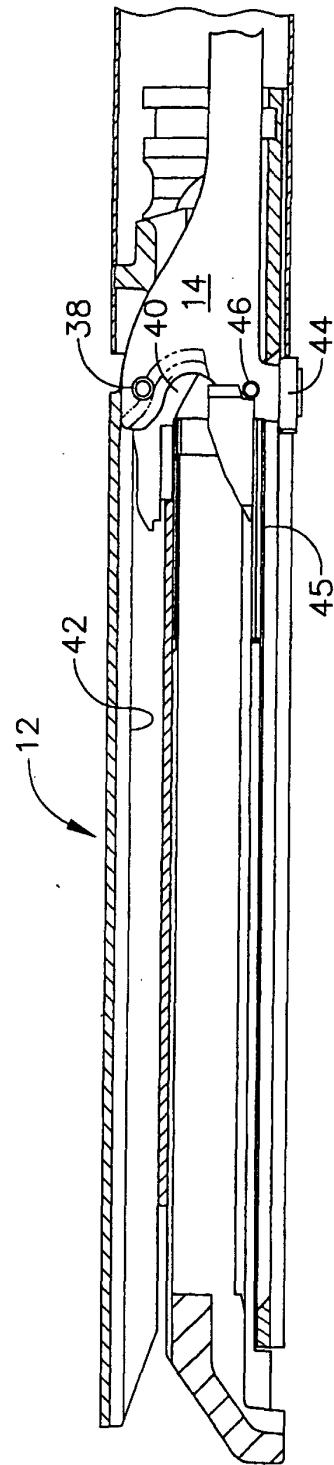
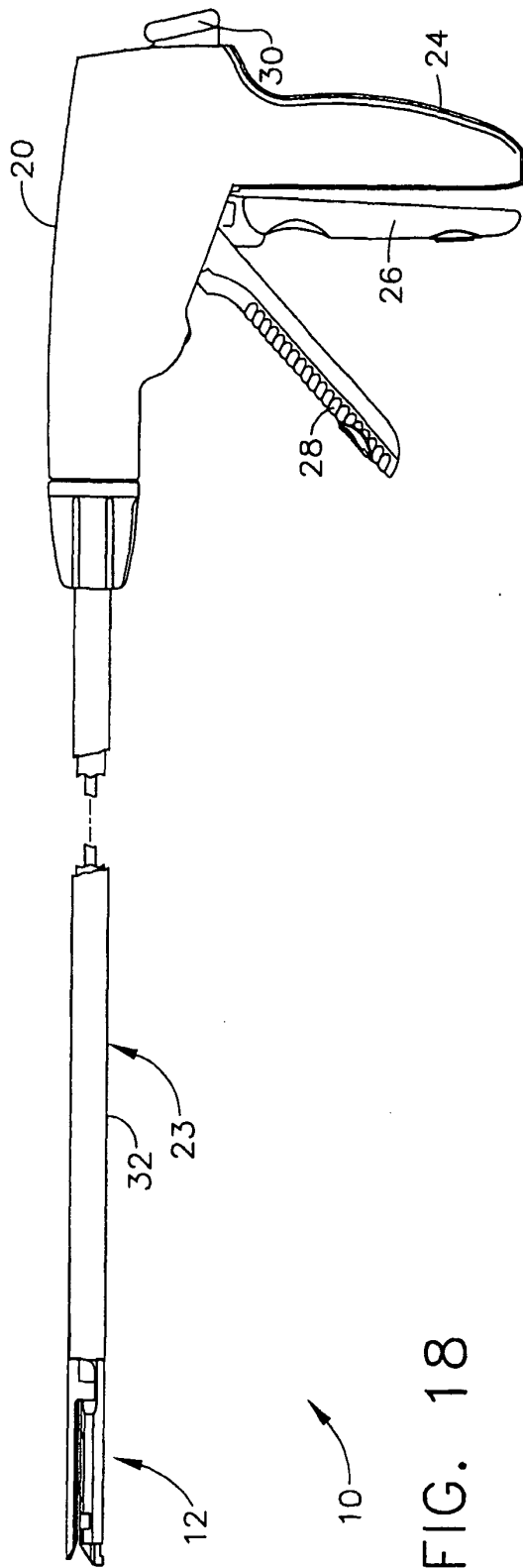

FIG. 17



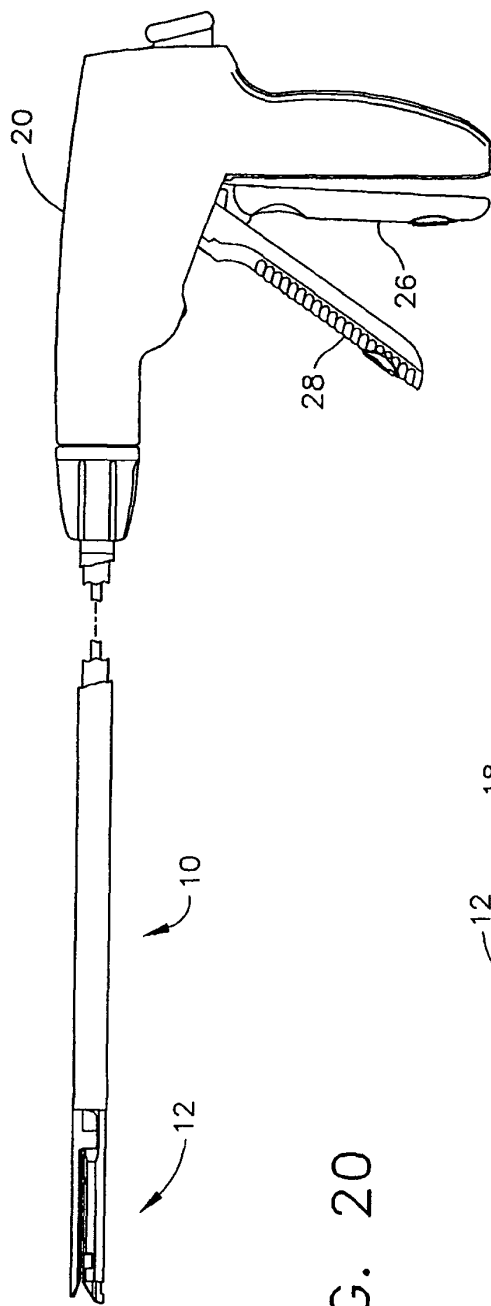

FIG. 20

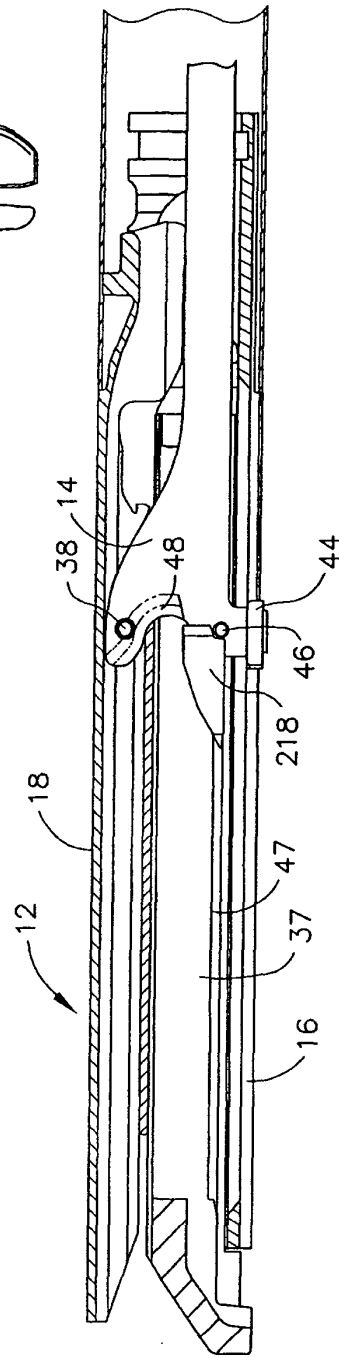

FIG. 21

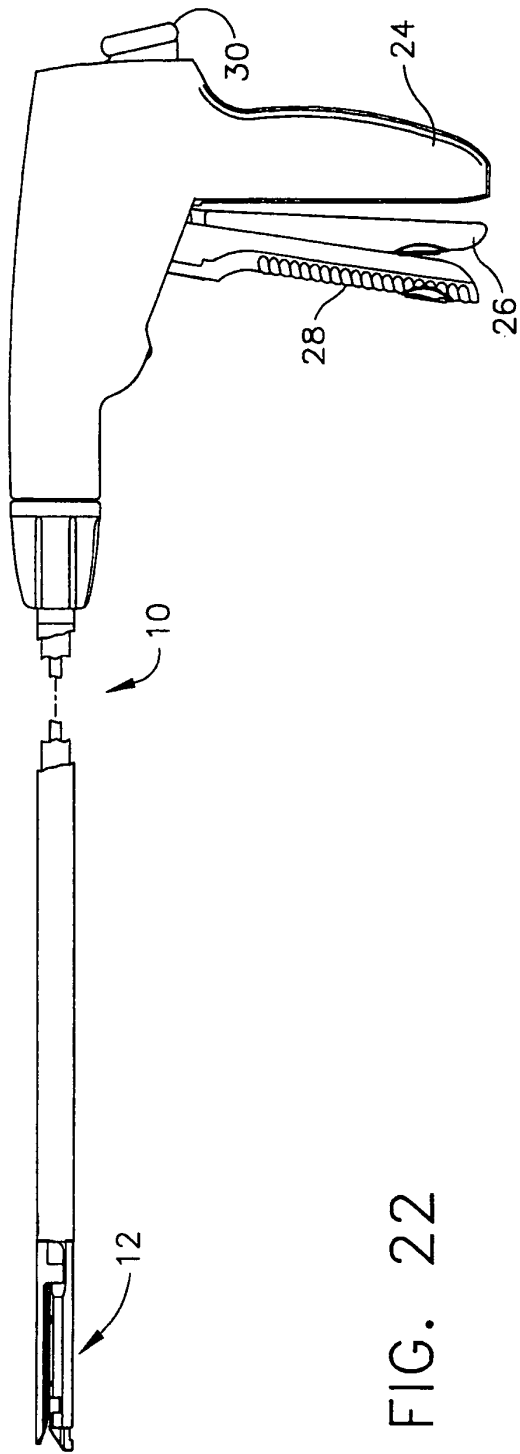

FIG. 22

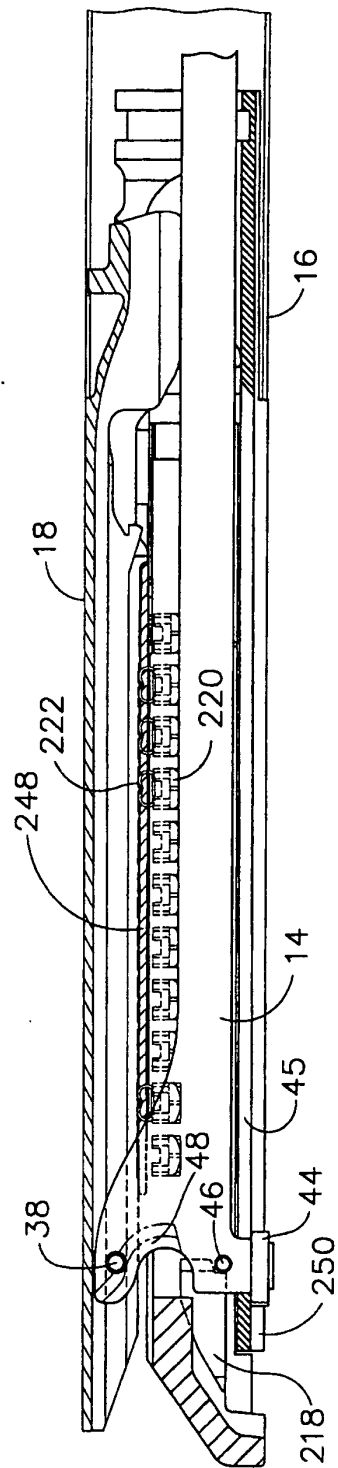

FIG. 23

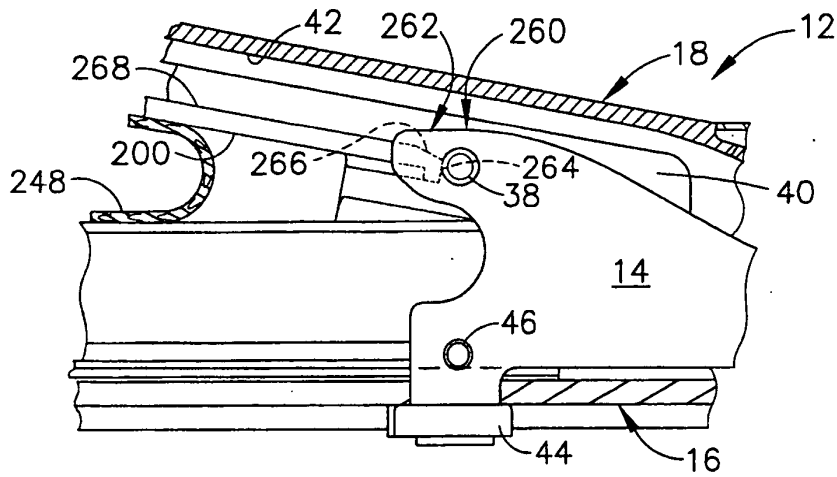

FIG. 24

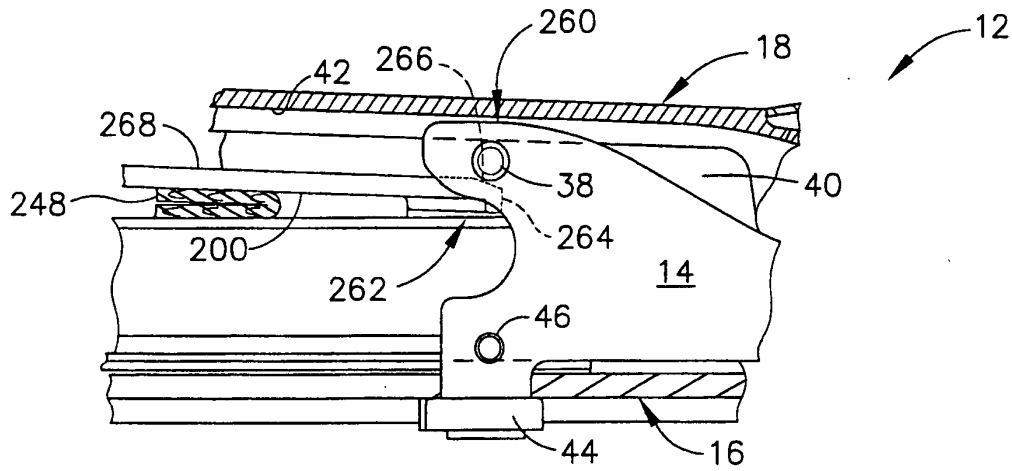

FIG. 25

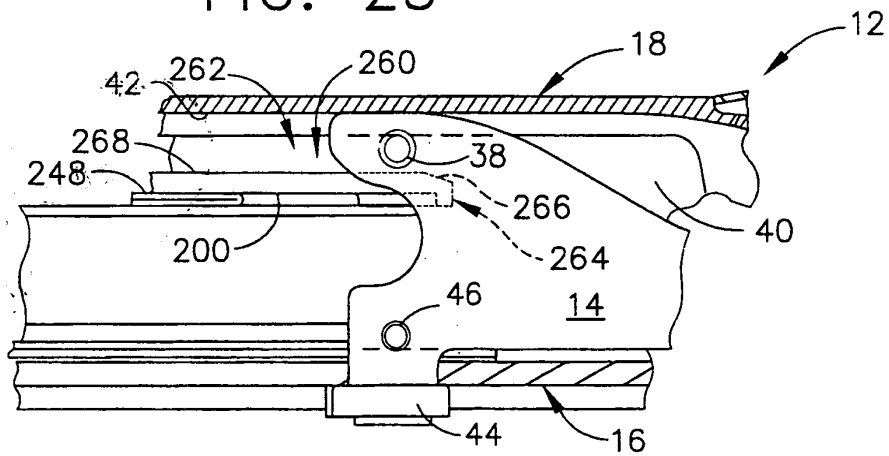

FIG. 26



European Patent
Office

EUROPEAN SEARCH REPORT

Application Number
EP 04 25 2978

DOCUMENTS CONSIDERED TO BE RELEVANT			
Category	Citation of document with indication, where appropriate, of relevant passages	Relevant to claim	CLASSIFICATION OF THE APPLICATION (Int.Cl.7)
X	US 6 109 500 A (ALLI) 29 August 2000 (2000-08-29) * figures 3,6 *	1,7,10	A61B17/072
X	US 6 010 054 A (JOHNSON) 4 January 2000 (2000-01-04) * column 28, paragraph 5; figures 8,10,19,33-35 *	10	
A,D	US 5 465 895 A (KNODEL) 14 November 1995 (1995-11-14)		
The present search report has been drawn up for all claims			TECHNICAL FIELDS SEARCHED (Int.Cl.7)
			A61B
Place of search		Date of completion of the search	Examiner
The Hague		13 September 2004	Barton, S
<p>CATEGORY OF CITED DOCUMENTS</p> <p>X : particularly relevant if taken alone Y : particularly relevant if combined with another document of the same category A : technological background O : non-written disclosure P : intermediate document</p> <p>T : theory or principle underlying the invention E : earlier patent document, but published on, or after the filing date D : document cited in the application L : document cited for other reasons</p> <p>& : member of the same patent family, corresponding document</p>			

EPO FORM 1503 03/82 (P04C01)

**ANNEX TO THE EUROPEAN SEARCH REPORT
ON EUROPEAN PATENT APPLICATION NO.**

EP 04 25 2978

This annex lists the patent family members relating to the patent documents cited in the above-mentioned European search report.
The members are as contained in the European Patent Office EDP file on
The European Patent Office is in no way liable for these particulars which are merely given for the purpose of information.

13-09-2004

Patent document cited in search report	Publication date	Patent family member(s)	Publication date
US 6109500	A	29-08-2000	NONE
US 6010054	A	04-01-2000	NONE
US 5465895	A	14-11-1995	US 5487500 A 30-01-1996
			US 5597107 A 28-01-1997
			US 5562241 A 08-10-1996
			US 5662258 A 02-09-1997

EPO FORM P0459

For more details about this annex : see Official Journal of the European Patent Office, No. 12/82

专利名称(译)	外科缝合器械具有用于未闭合的砧座的击发锁定装置		
公开(公告)号	EP1479347A1	公开(公告)日	2004-11-24
申请号	EP2004252978	申请日	2004-05-20
[标]申请(专利权)人(译)	伊西康内外科公司		
申请(专利权)人(译)	爱惜康内镜手术，INC.		
当前申请(专利权)人(译)	爱惜康内镜手术，INC.		
[标]发明人	SHELTON IV FREDERICK E SETZER MICHAEL E WEISENBURGH WILLIAM B		
发明人	SHELTON IV, FREDERICK E. SETZER, MICHAEL E. WEISENBURGH, WILLIAM B.		
IPC分类号	A61B17/072		
CPC分类号	A61B17/07207 A61B2017/07214 A61B2017/0725 A61B2017/07285		
优先权	10/441580 2003-05-20 US		
其他公开文献	EP1479347B1		
外部链接	Espacenet		

摘要(译)

用于腹腔镜和内窥镜临床手术的外科器械同时切断并缝合夹在末端执行器中的组织，该末端执行器包括保持钉仓的细长通道和枢转连接的砧座。电子束击发杆接合通道并在远侧击发运动期间选择性地接合砧座，其中组织被切断并被钉钉从钉仓向上驱动以形成抵靠砧座。特别地，击发杆的上销在击发之前从砧座脱离。从砧座到砧座槽的斜坡过渡避免了当末端执行器夹住过多组织时的失火，但有助于成功夹紧稍微过量的组织。

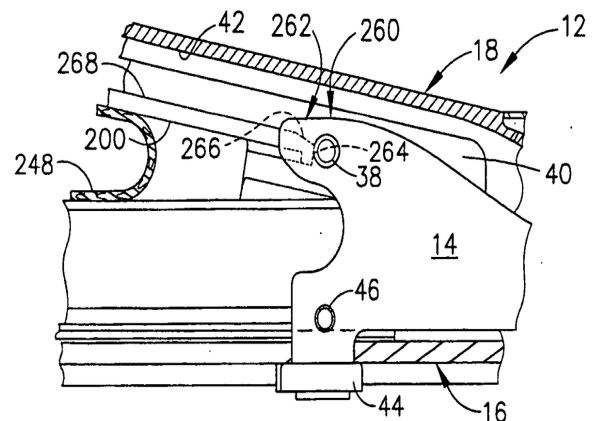

FIG. 24