



(51) International Patent Classification:

A61B 17/29 (2006.01) A61B 17/28 (2006.01)
A61B 17/00 (2006.01) A61B 19/00 (2006.01)

(21) International Application Number:

PCT/GB2009/050203

(22) International Filing Date:

27 February 2009 (27.02.2009)

(25) Filing Language:

English

(26) Publication Language:

English

(30) Priority Data:

0803773.1 29 February 2008 (29.02.2008) GB

(71) Applicant (for all designated States except US): **SURGICAL INNOVATIONS LIMITED** [GB/GB]; Clayton Wood House, 6 Clayton Wood Bank, Leeds West Yorkshire LS16 6QZ (GB).

(72) Inventors; and

(75) Inventors/Applicants (for US only): **MAIN, David** [GB/GB]; c/o Surgical Innovations Limited, Clayton Wood House, 6 Clayton Wood Bank, Leeds West Yorkshire LS16 6QZ (GB). **HELLINGA, Anna Sophia** [GB/GB]; c/o Surgical Innovations Limited, Clayton Wood House, 6 Clayton Wood Bank, Leeds West Yorkshire LS16 6QZ (GB). **MORAN, Peter** [GB/GB]; c/o Surgical Innovations Limited, Clayton Wood House, 6 Clayton Wood Bank, Leeds West Yorkshire LS16 6QZ (GB).

(74) Agents: **BROWN, George** et al.; Urquhart-Dykes & Lord LLP, Tower North Central, Merrion Way, Leeds West Yorkshire LS2 8PA (GB).

(81) Designated States (unless otherwise indicated, for every kind of national protection available): AE, AG, AL, AM, AO, AT, AU, AZ, BA, BB, BG, BH, BR, BW, BY, BZ, CA, CH, CN, CO, CR, CU, CZ, DE, DK, DM, DO, DZ, EC, EE, EG, ES, FI, GB, GD, GE, GH, GM, GT, HN, HR, HU, ID, IL, IN, IS, JP, KE, KG, KM, KN, KP, KR, KZ, LA, LC, LK, LR, LS, LT, LU, LY, MA, MD, ME, MG, MK, MN, MW, MX, MY, MZ, NA, NG, NI, NO, NZ, OM, PG, PH, PL, PT, RO, RS, RU, SC, SD, SE, SG, SK, SL, SM, ST, SV, SY, TJ, TM, TN, TR, TT, TZ, UA, UG, US, UZ, VC, VN, ZA, ZM, ZW.

(84) Designated States (unless otherwise indicated, for every kind of regional protection available): ARIPO (BW, GH, GM, KE, LS, MW, MZ, NA, SD, SL, SZ, TZ, UG, ZM, ZW), Eurasian (AM, AZ, BY, KG, KZ, MD, RU, TJ, TM), European (AT, BE, BG, CH, CY, CZ, DE, DK, EE, ES, FI, FR, GB, GR, HR, HU, IE, IS, IT, LT, LU, LV, MC, MK, MT, NL, NO, PL, PT, RO, SE, SI, SK, TR), OAPI (BF, BJ, CF, CG, CI, CM, GA, GN, GQ, GW, ML, MR, NE, SN, TD, TG).

Published:

- with international search report (Art. 21(3))
- before the expiration of the time limit for amending the claims and to be republished in the event of receipt of amendments (Rule 48.2(h))

(54) Title: HANDLE FOR A SURGICAL INSTRUMENT AND SURGICAL INSTRUMENT ASSEMBLY

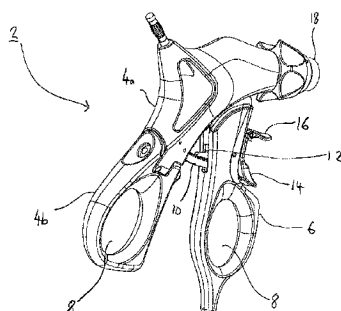

Fig. 1A

(57) Abstract: A handle (3) for a surgical instrument, and in particular a handle for use with keyhole surgery, endoscopic and laparoscopic instruments is disclosed. In one embodiment, the present invention provides a handle for a surgical instrument comprising one part with a pivoting or articulated end portion (4b), and a means for indexing the pivoting movement of the end portion. The indexing means allows adjustment of the angle of the end portion together with improved control and tactile feedback to the user. In another aspect, the present invention provides a handle for a surgical instrument comprising one part with a pivoting or articulated end portion, and a means for locking the movement of the end portion. The locking means can be moved between locked and unlocked positions. The end portion can be pivoted or articulated to a desired angle and the locking means moved to a position to prevent movement of the end portion holding it at the desired angle. This improves control and tactile feedback to the user.

-1-

HANDLE FOR A SURGICAL INSTRUMENT AND SURGICAL INSTRUMENT ASSEMBLY

The present invention relates to a handle for use with surgical instruments and in particular to a handle for use with keyhole surgery, endoscopic and laparoscopic instruments. The present application also relates to a surgical instrument assembly and system including such a handle.

Keyhole surgery, endoscopic and laparoscopic techniques are known and have been developed to allow surgery with smaller incisions than were previously the case. In general the techniques require the insertion of a long, slender instrument into a body cavity via a small incision. The instruments may comprise an endoscope for visualising the body cavity and one or more other instruments for carrying out a surgical procedure, for example a biopsy.

Surgical instruments for use in these techniques are controlled by a handle attached to the shaft of the instrument. The handle allows the surgeon to manipulate the instrument and operate it as required. One form of handle which is in widespread use comprises two members that can pivot relative to one another to operate the instrument. The members typically define openings for receiving a surgeon's digits, so they can be moved in the same way as scissors. For example, the pivoting movement of the members may be converted into movement of jaws at the end of the surgical instrument. A feature of a pivotal connection is that the two members move relative to one another in the same plane.

In use the handle may have to be moved into a position where the arc of relative movement of the two members is in a plane which is not comfortable for the surgeon's wrist. For example the surgeon's wrist may need to be rotated to an extreme angle. It is desirable to avoid this.

In an effort to solve this problem a handle where one of the members is articulated, having an end portion that can pivot laterally relative to the plane of the arc of relative movement has been proposed in NL-C-1012856. This articulation has been found to improve the

-2-

ergonomics of the handle and reduce the likelihood of a surgeon's wrist being at an extreme angle. US-5,472,451 (Freitas et al) also discusses an endoscopic hand held grip including a pivot portion through which the thumb of the operator is received. However, the applicant has found that the movement of the end portion or pivot portion makes the control less predictable and reduces the feedback received by the surgeon from the instrument in use. As a result, some surgeons have preferred to use handles without articulated or pivoting components, despite the problems with rotation of the wrist to sometimes extreme angles.

10 It would be desirable to provide a handle for a surgical instrument in which rotation of the user's wrist to extreme angles is avoided, while retaining good feedback and control for the user.

In one aspect, the present invention provides a handle for a surgical instrument comprising one part with a pivoting or articulated end portion, and a means for indexing the pivoting movement of the end portion. The applicant has found that the indexing means allows adjustment of the angle of the end portion together with improved control and tactile feedback to the user, compared with not including the indexing means.

20 In another aspect, the present invention provides a handle for a surgical instrument comprising one part with a pivoting or articulated end portion, and a means for locking the movement of the end portion. The applicant has found that the locking means, when in a position to prevent movement of the end portion, improves control and tactile feedback. In use the locking would typically be disengaged while the user positions the instrument, and engaged to prevent movement of the end portion before operating the instrument.

According to the present invention there is provided a handle for a surgical instrument, the handle comprising:

a first part comprising:

30 a main portion; and
an end portion which is pivotally connected to the main portion;

-3-

a second part which is pivotally connected to the main portion of the first part such that the first and second parts can move relative to each other; and

an indexing means for limiting the movement of the end portion to predetermined positions relative to the main portion and for retaining the end portion in one of the
5 predetermined positions.

The first and second parts may comprise openings for receiving a users digits. The pivotal connection of the second part to the main portion may have an axis which is substantially perpendicular to the axis of the pivotal connection between the main portion and the end
10 portion. Any suitable way of connecting the parts to provide pivotal movement may be utilised. For example, the pivotal connection between the end portion and main portion may be implemented by a pin joint, or by a flexible connecting strip that enables relative pivotal movement by its flexing.

15 The relative movement of the first and second parts results in the operation of a surgical instrument connected to the handle. The indexing means allows adjustment of the angle of the end portion together with improved control and tactile feedback to the user, compared with the prior art. The indexing means acts to retain the end portion in a predetermined position, reducing the chance of the end portion moving relative to the main portion during
20 operation of a surgical instrument.

The indexing means may be an indexing mechanism. In one embodiment the indexing means comprises a series of depressions spaced apart from each other formed in the main portion. A bearing is retained in the end portion, and is resiliently biased towards the main
25 portion so that it engages one of the series of depressions to provide the indexing.

In one embodiment the bearing is substantially spherical, this allows it to move more easily from one depression to the next. Other bearing shapes, such as cylindrical, are also suitable.

30

In one embodiment the handle further comprises a locking means configured to be movable between locked and unlocked positions. In the locked position the end portion is

-4-

prevented from moving relative to the main portion. This allows a further improvement to the user's control of the handle and the feedback received. The locking means may be a locking mechanism.

- 5 According to another aspect of the invention, there is provided a handle for a surgical instrument, the handle comprising:

a first part comprising:

a main portion; and

an end portion which is pivotally connected to the main portion;

- 10 a second part which is pivotally connected to the main portion of the first part such that the first and second parts can move relative to each other; and

a locking means configured to be movable between locked and unlocked positions, and wherein in the locked position the end portion is prevented from moving relative to the main portion.

15

The locking means provides an improvement in the tactile feedback and control of the handle over prior art handles without locking.

- The locking means may be a locking mechanism. One embodiment of the locking means
20 comprises a shaft having a longitudinal projection configured to engage a corresponding recess formed in the end portion and, in the locked position, to also engage a corresponding recess formed in the main portion. With this embodiment, the construction may be simplified if the shaft also forms the axis about which the end portion pivots relative to the main portion.

25

In an alternative embodiment the locking means comprises a slider provided on the end portion, wherein the slider has a protrusion that, in the locked position, engages a corresponding recess formed in the main portion. This enables locking to be provided with a simple construction.

30

The handle may further comprise a ratchet means for allowing movement of the first part towards the second part and for resisting movement of the first part away from the second

-5-

part. This is particularly useful if the surgical instrument to which the handle is attached exerts a resilient force, for example jaws which are closed against a resilient force, such as might be provided by a spring. The ratchet means may be a ratchet mechanism.

- 5 The handle may further comprise a trigger configured to engage a pawl of the ratchet means and for disengaging the ratchet when pressed. The handle may further comprise a ratchet disengaging lever connected to the trigger and movable between a first position, in which the trigger must be pressed to disengage the ratchet, and a second position, in which the ratchet is disengaged.

10

- The ratchet disengaging lever is substantially flush with the surface of the trigger when in the second position, which improves the ergonomics of the handle in use. A further advantage of this construction is that it allows a ratchet disengaging lever to be provided on a part of the handle that moves relative to the surgical instrument operated by the
- 15 handle. The lever must be able to move by a certain distance between the first and second positions to provide its function. In the first position the lever is closer to the parts of the handle that do not move relative to the tool. This restricts the space available for lever and can restrict the space for a user to place there finger on top of the lever to operate it. By folding the lever flush with the trigger in the second position, the space occupied in the
- 20 first position is minimised allowing more space for a user to place their finger on top of it to operate it. This is particularly advantageous in the restricted space available when the lever is provided on a part of the handle that moves relative to the tool.

- Advantageously, the ratchet disengaging lever comprises at least one extension for
- 25 enabling a user to move the lever from the second position to the first position. The extension can extend beyond the surface of the trigger, so that when the ratchet disengaging lever is in the second position, flush with the surface of the trigger, a user can still easily operate the ratchet disengaging lever using the extension to move it back to the first position.

30

The design of the ratchet disengaging lever described above is therefore particularly suitable for handles in which the ratchet disengaging lever is mounted on a part of the

-6-

handle that moves relative to the surgical instrument. In some embodiments, the features of the ratchet disengaging lever described above may be provided without locking or indexing means.

- 5 The handle of the present invention may be used in a surgical instrument assembly. The surgical instrument assembly may further comprise connection means for releasably connecting the surgical instrument to the handle. In that case, it can form of the basis of a surgical instrument system comprising various different handles and instruments. For example, the same handle may be used with different instruments, or an additional handle
10 may be provided in addition to the handle of the present invention.

Embodiments of the present invention will now be described by way of example with reference to the accompanying drawings, in which like reference numerals indicate like parts, and in which:

15

Figures 1A-C depict a perspective view of an embodiment of the present invention with an end portion at different orientations relative to a main portion;

Figure 2 depicts a cross section of the embodiment of Figures 1A-C;

- Figures 3A and 3B are exploded diagrams of a combined index and locking mechanism
20 according to an embodiment of the present invention;

Figure 4 depicts a perspective view of a second embodiment of a handle according to the present invention, attached to the shaft of a surgical instrument;

Figures 5A and 5B depict the handle of Figure 4 in locked and unlocked configurations, respectively;

- 25 Figure 6 depicts an exploded view of the locking mechanism of the handle of Figure 4;
Figures 7A and 7B depict partial perspective views from different angles of a ratchet disengaging lever; and

Figure 8 depicts one example of a surgical instrument assembly using the handle of the present invention.

30

Figure 1A depicts a perspective view of an embodiment of the handle 2 of the present invention. A cross section of the embodiment of Figure 1A is depicted in Figure 2. The

-7-

handle 2 comprises a first part and a second part 6 which are pivotally connected to each other. The first part comprises a main portion 4a and an end portion 4b pivotally connected to the main portion 4a. The axis of the pivotal connection between the end portion 4b and the main portion 4a is substantially perpendicular to the axis of the pivotal connection between the first part and the second part 6.

Figures 1B and 1C depict perspective views of the embodiment of Figure 1A with the end portion 4b in different positions relative to the main portion 4a.

- 10 The second part 6 and the end portion 4b comprise openings 8, which are sized to receive on or more of a user's digits in use. Preferably, the openings 8 are sized so that a user can insert one or more fingers into the opening of the second part 6 and a thumb into the end portion 4b.
- 15 The handle also comprises a ratchet 10 and pawl 12 that act to allow movement of the second part 6 towards the first part but to resist the movement of the second part 6 away from the first part. A trigger 14 is provided on the second part 6 that, when pressed towards the first part by a user, acts on the pawl 12 to disengage it from the ratchet 10, allowing free movement of the second part 6 relative to the first part (both towards and
- 20 away from the first part).

A ratchet disengaging lever 16 is provided on trigger 14. The ratchet disengaging lever 16 can be moved between a first position, away from the trigger 14 (as depicted in Figure 1A, 1B and 1C) and a second position where it rests against the surface of the trigger 14 (as

25 depicted in Figures 7A and 7B). In the second position the ratchet disengaging lever is flush with the surface of the trigger 14.

The shape of the ratchet disengaging lever 16 can be seen more clearly in Figures 7A and 7B. These show partial perspective views of the handle from different angles. An

30 extension 15 is formed on the ratchet disengaging lever 16 that projects beyond the surface of the trigger 14 when the ratchet disengaging lever 16 is in the second position. The extension 15 allows a user to move the ratchet disengaging lever out of the second position

-8-

more easily – otherwise the flush position can make it difficult for a user to grasp the ratchet disengaging lever 16. The extension 15 is preferably provided on both sides, but could also be provided on one side only.

- 5 The handle 2 also has a connector 18 at it's distal end for connection of a surgical instrument. The connector is a ball and socket type connector, for example those used on tools and handles commercially available from Surgical Innovations Ltd.

- 10 As can be seen most clearly from the cross section of Figure 2, the pivotal connection between the second part 6 and the main portion 4a of the first part is provided by a pin joint 20. The second part 6 is connected to a link 22 so that the rotational movement of the second part 6 relative to the main portion 20 is converted in a linear translation that can be transferred to a surgical instrument connected to the connector 18.

- 15 The cross section of Figure 2 also shows the leaf spring 24 that provides a resilient force that urges the pawl 12 against the ratchet 10. The cam profile of the ratchet disengaging lever 16 is also visible, so that in the second position, folded flush with the trigger 14, the ratchet disengaging lever 16 acts against the pawl 12 to move it out of engagement with the ratchet 10.

20

The embodiment comprises an indexing and a locking mechanism which will now be described with reference to the cross section of Figure 2 and the exploded diagrams of Figures 3A and 3B.

- 25 A shaft 26 provides the pivotal connection between the end portion 4b and the main portion 4a. The shaft 26 has a projection 28 which extends from the surface of the shaft 26 and is oriented parallel to the longitudinal axis. The shaft engages corresponding recesses 30, 32 which are formed in the end portion 4b and the main portion 4a respectively.
- 30 Two circumferential grooves 34, 36 are formed in the surface of the shaft 26 which engage a ball bearing 38 retained in the main portion 4a. The ball bearing 38 is urged towards the grooves by a helical spring 40. The force of the ball bearing 38 against the shaft 26 holds

-9-

it in place and allows for two positions of the shaft. In one position, with the ball bearing 38 engaged with groove 36, the shaft is positioned so that the projection 28 engages only recess 30, enabling pivotal movement between the end portion 4b and the main portion 4a. In a second position, with the ball bearing 38 engaged with groove 34, the shaft is

5 positioned so that the projection 28 engages both the recess 30 of the end portion 4b and one of the recesses 32 formed in the main portion 4a, preventing relative movement of the end portion 4b and main portion 4a. The combination of the projection 28 and the recesses 30, 32 therefore forms a locking mechanism.

- 10 To provide indexing of the end portion position a plurality of depressions 42 are formed in the end portion. In this embodiment five depressions 42 are formed, although other embodiments may provide more or less than this. A ball bearing 44 is received in the end portion 4b and resiliently urged against the end of the main portion 4a by a helical spring 46. The ball bearing 44 is therefore urged into one of the depressions 42, engaging the
- 15 depressions 42 to provide indexing. The resilient force from the helical spring 46 means that some force is required to compress the spring before the end portion 4b can be moved significantly relative to the main portion 4a. This provides a force to prevent movement of the end portion when the lock formed by the projection 28 on the shaft is not engaged.
- 20 The recesses 32 for locking the position of the end portion are formed at corresponding radial positions around the shaft 26 as the depressions 42. This enables the indexing to locate the end portion 4b into a position at which it can be locked easily, if required.

This handle of the embodiment is made from an injection-moulded high temperature

25 polymer, although other manufacturing techniques and materials may also be used. For example the handle may be machined from medical-grade materials.

In use, it is envisaged that the user will initially deploy the handle 2 with the end portion 4b parallel with main portion 4a and the shaft 26 in the locked position. This ensures that

30 the handle 2 can be used with good control and tactile feedback. If, during manoeuvring of the handle 2, this initial position causes a users wrist to be at an extreme angle, the shaft can be moved by a simple push action into the unlocked position. The end portion 4b is

-10-

then moved to the desired position. The indexing mechanism provides resistance against movement out of the selected position and the handle can be operated in that position. For improved certainty that the end portion 4b will remain at the same position relative to the main portion 4a, the lock can optionally be engaged.

5

Thus, this embodiment allows a user to adjust the relative position of the end portion 4b to avoid a wrist being at an uncomfortable angle. In addition the indexing and locking enable the tool to have improved control and tactile feedback when the end portion 4b is not parallel to the main portion 4a.

10

A second embodiment of the present invention is depicted in Figure 4. This embodiment uses a slider mechanism to lock the angle of the end portion relative to the main portion. The construction of this embodiment is the same as the first embodiment, save as described below.

15

Figure 4 depicts a perspective view of a second embodiment of a handle 50 according to the invention. The handle 50 includes a slider 52 for locking relative movement of the end portion 54b relative to the main portion 54a. The handle 50 is shown attached to the shaft 51 of a surgical instrument. Figures 5A and 5B are partial perspective views of the handle 20 50, showing the slider 52 in the locked position (Figure 5A) and the unlocked position (Figure 5B).

An exploded view of the locking mechanism of the second embodiment is depicted in Figure 6. The slider 52 is received in a generally cuboid-shaped opening 56 formed in the 25 end portion 54b. The opening 56 has longitudinal projections 58 formed in its side walls that engage corresponding grooves 60 formed in the edge of the slider 52, so that the slider 52 is retained on the end portion 54b by the engagement of the longitudinal projections 58 with the grooves 60 and can slide relative to the end portion 54b. A locking projection 62 extends from the end of the slider 52. On the main portion 54a, a series of recesses 64 are 30 formed to receive the projection 62. A space 66 is provided before the recesses 64 begin. The recesses 64 are aligned with the indexing positions provided by the indexing means.

-11-

In use, the locking mechanism of this embodiment is operated by sliding the slider 52 towards or away from the main portion 54a. When the slider is moved away from the main portion 54a, the locking mechanism is in the unlocked position and the projection 62 is in the space 66, allowing movement of the end portion 54b relative to the main portion 54a.

- 5 When the slider 52 is moved towards the main portion 54a, the locking mechanism is in the locked position and the projection 62 engages a recess 64 and prevents movement of the end portion 54b relative to the main portion 54a.

- 10 In an alternative construction of the embodiment of Figure 4, a resilient member, for example a spring (not illustrated), is provided in the end portion 54b. This provides a force that acts on the slider 52 to urge it towards the locked position. With this alternative construction, the force provided by the spring will act to keep the slider 52 in the locked position in the absence of a force applied to the slider by a user.

- 15 In a further variation of the construction, holding means (not illustrated) can be provided in the handle and slider that interact to hold the slider 52 in the unlocked position when it has been moved away from the locked position by a predetermined amount. For example a protrusion and corresponding recess can be provided. With this variation the user can choose to use the spring biasing of the slider 52 by not moving the slider 52 far out of the
20 locked position, or avoid the spring biasing by moving the slider 52 far enough out of the locked position to engage the holding means.

- One example of a surgical instrument assembly according to the present invention is depicted in Figure 8. As depicted in the Figure 8 the handle of the Figure 4 embodiment is
25 connected to a single use "clinching" insert tool 68. It will be appreciated that the assembly could use any other surgical instrument for use in keyhole surgery, endoscopic or laparoscopic techniques.

- Although specific locking and indexing mechanisms have been described in the
30 embodiments above, the invention is not limited to such mechanisms.

-12-

The embodiments described above provide a combined indexing and locking mechanism. However, in alternative embodiments, the indexing features may be provided without locking features and the locking features may be provided without indexing features.

CLAIMS

1. A handle for a surgical instrument, the handle comprising:
a first part comprising:
5 a main portion; and
an end portion which is pivotally connected to the main portion;
a second part which is pivotally connected to the main portion of the first part
such that the first and second parts can move relative to each other; and
an indexing means for limiting the movement of the end portion to predetermined
10 positions relative to the main portion and for retaining the end portion in one of the
predetermined positions.
2. A handle according to claim 1, wherein the indexing means comprises:
a series of depressions spaced apart from each other formed in the main portion;
15 and
a bearing retained in the end portion, wherein the bearing is resiliently biased
towards the main portion and engages one of the series of depressions to provide the
indexing.
- 20 3. A handle according to claim 2, wherein the bearing is substantially spherical.
4. A handle according to any one of the preceding claims, further comprising a
locking means configured to be movable between locked and unlocked positions, and
wherein in the locked position the end portion is prevented from moving relative to the
25 main portion.
5. A handle for a surgical instrument, the handle comprising:
a first part comprising:
a main portion; and
30 an end portion which is pivotally connected to the main portion;
a second part which is pivotally connected to the main portion of the first part
such that the first and second parts can move relative to each other; and

-14-

a locking means configured to be movable between locked and unlocked positions, and wherein in the locked position the end portion is prevented from moving relative to the main portion.

- 5 6. A handle according to claim 4 or 5, wherein the locking means comprises a shaft having a longitudinal projection configured to engage a corresponding recess formed in the end portion and, in the locked position, to also engage a corresponding recess formed in the main portion.
- 10 7. A handle according to claim 6, wherein the shaft forms the axis about which the end portion pivots relative to the main portion.
8. A handle according to claim 4 or 5, wherein the locking means comprises a slider provided on the end portion, wherein the slider has a protrusion that, in the locked position,
15 engages a corresponding recess formed in the main portion.
9. A handle according to any one of the preceding claims, further comprising a ratchet means for allowing movement of the first part towards the second part and for resisting movement of the first part away from the second part.
- 20 10. A handle according to claim 9, further comprising a trigger configured to engage a pawl of the ratchet means and for disengaging the ratchet when pressed.
11. A handle according to claim 10, further comprising a ratchet disengaging lever
25 connected to the trigger and movable between a first position, in which the trigger must be pressed to disengage the ratchet, and a second position, in which the ratchet is disengaged, wherein the ratchet disengaging lever is substantially flush with the surface of the trigger when in the second position.
- 30 12. A handle according to claim 11, wherein the ratchet disengaging lever comprises at least one extension for enabling a user to move the lever from the second position to the first position.

-15-

13. A surgical instrument assembly comprising a handle according to any one of the preceding claims and a surgical instrument; wherein relative movement of the first and second parts causes operation of the surgical instrument.

5

14. A surgical instrument assembly according to claim 13, further comprising connection means for releasably connecting the surgical instrument to the handle.

15. A surgical instrument system comprising a surgical instrument assembly
10 according to claim 14, and at least one additional handle or surgical instrument.

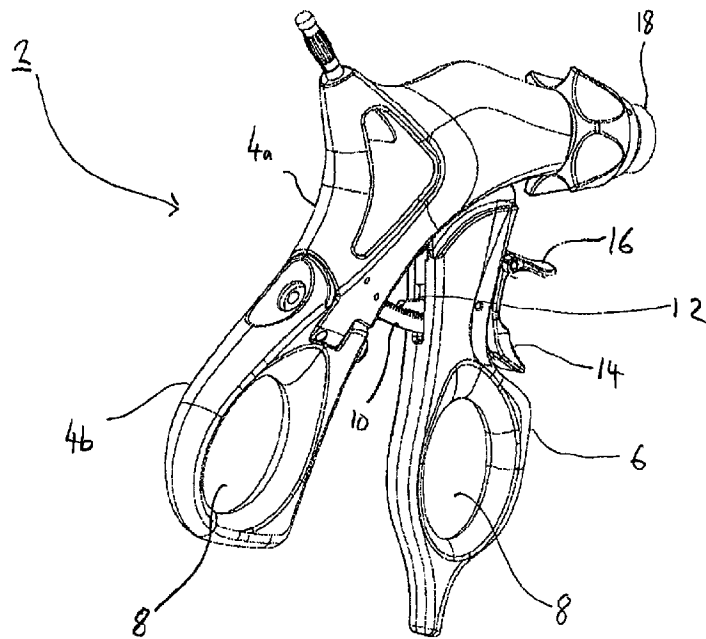

Fig. 1A

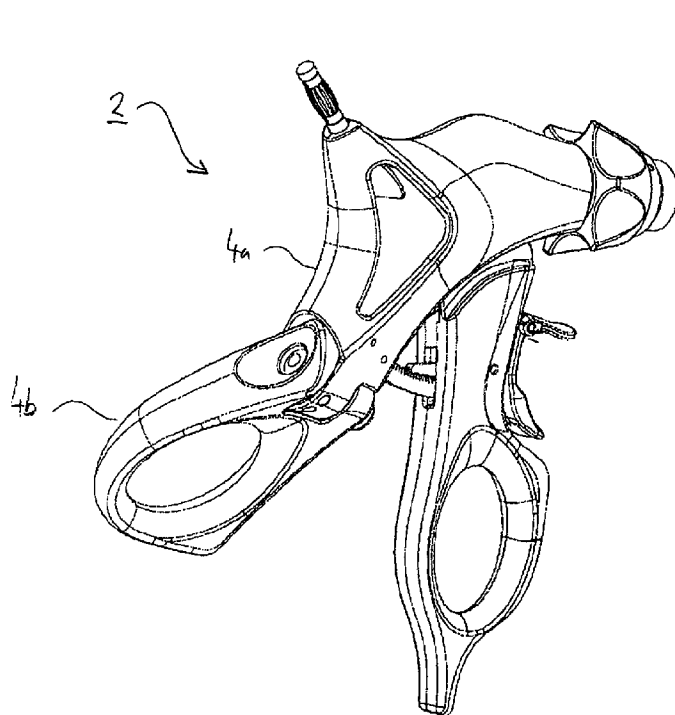

Fig. 1B

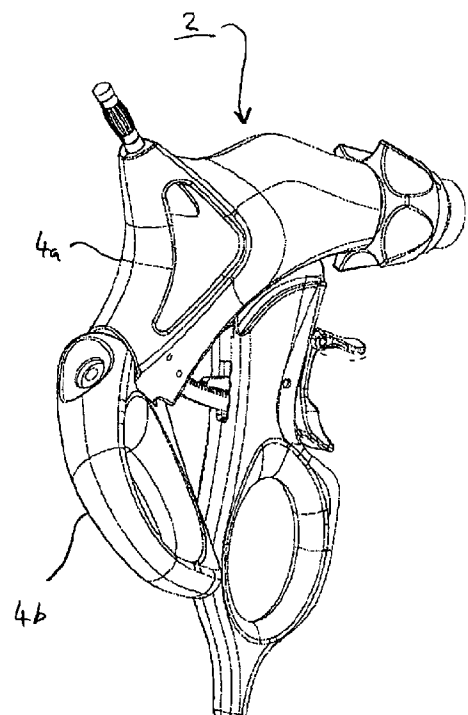

Fig. 1C

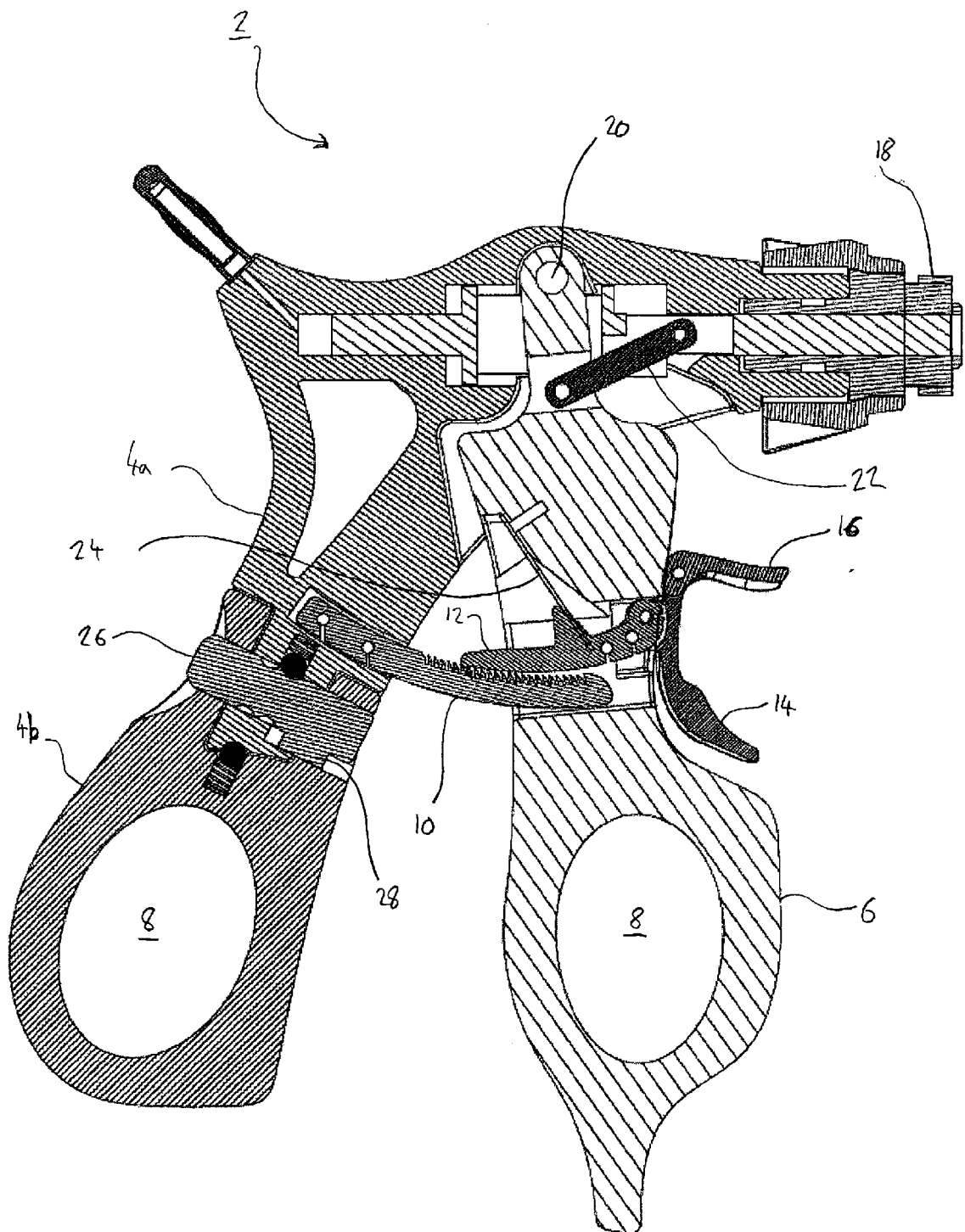

Fig. 2

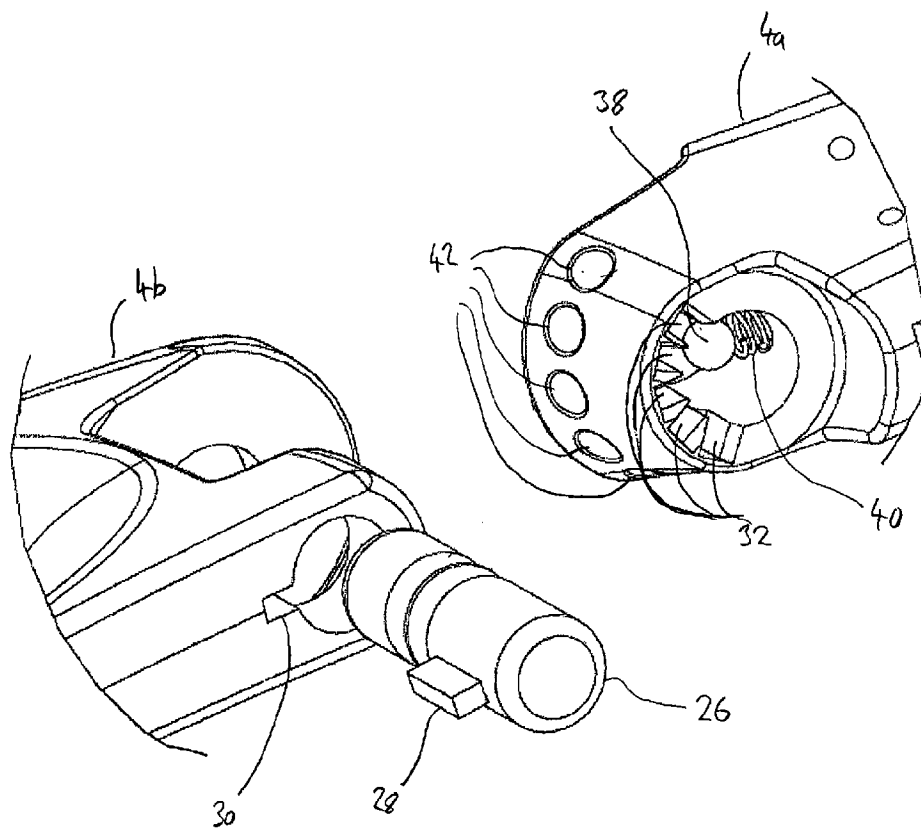

Fig. 3A

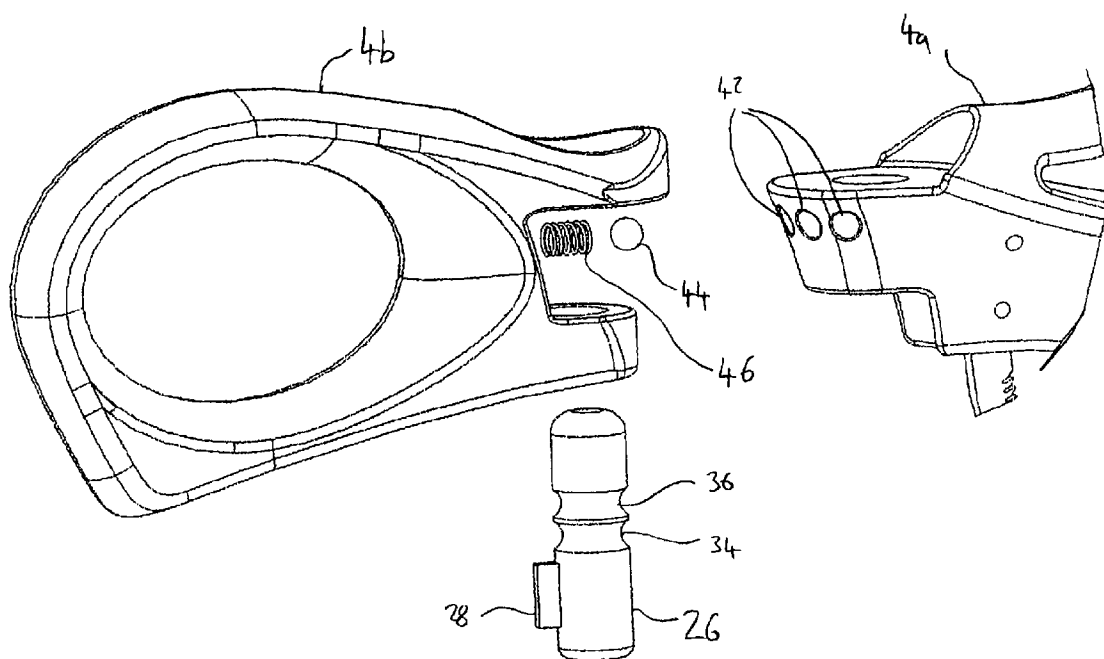

Fig. 3B

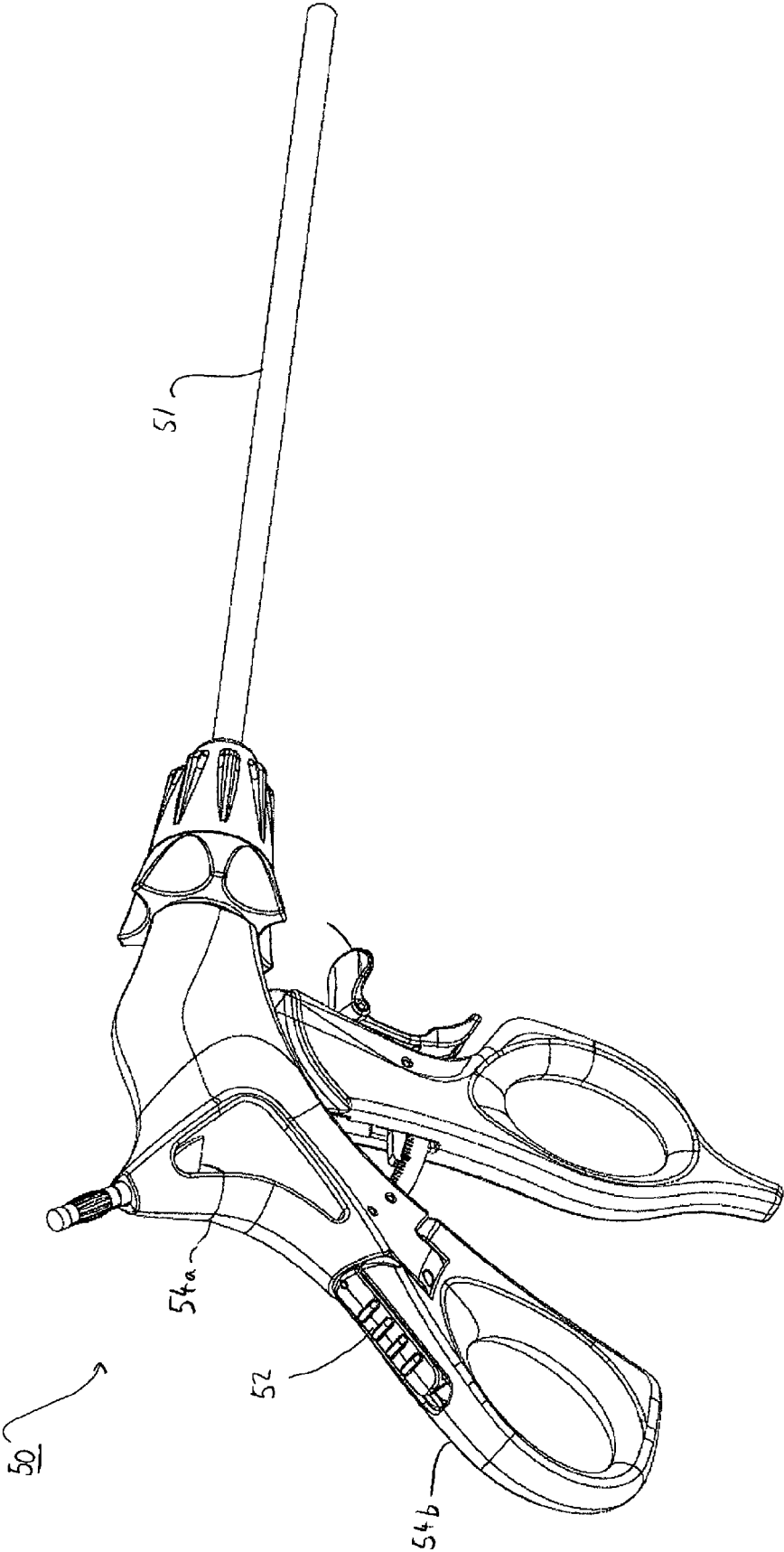

Fig. 4

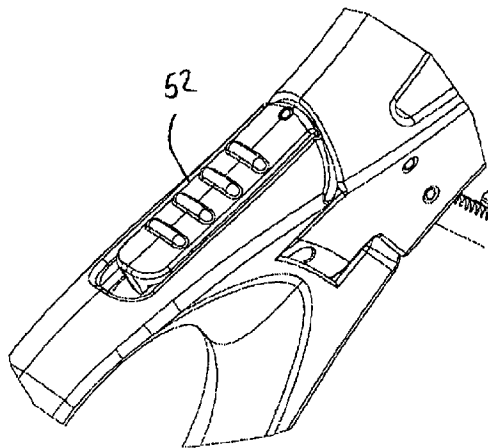

Fig. 5A

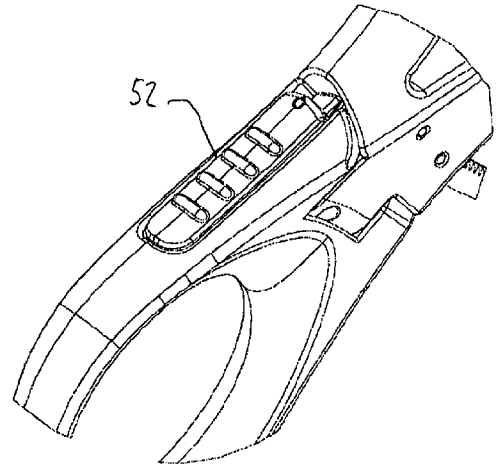

Fig. 5B

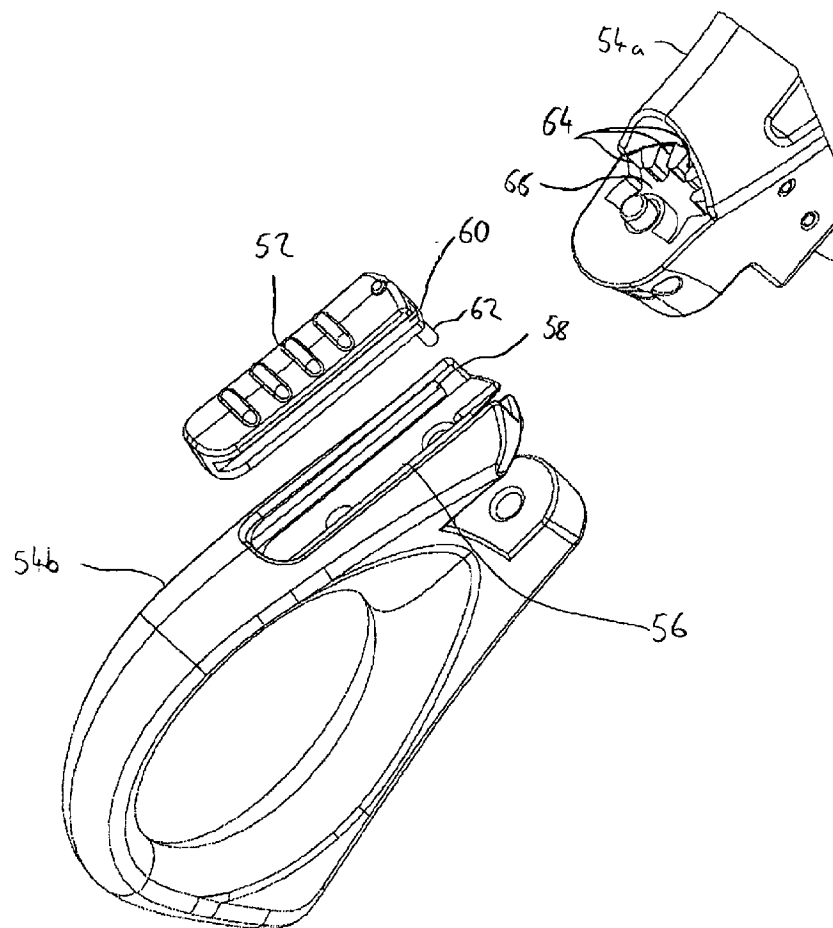

Fig. 6

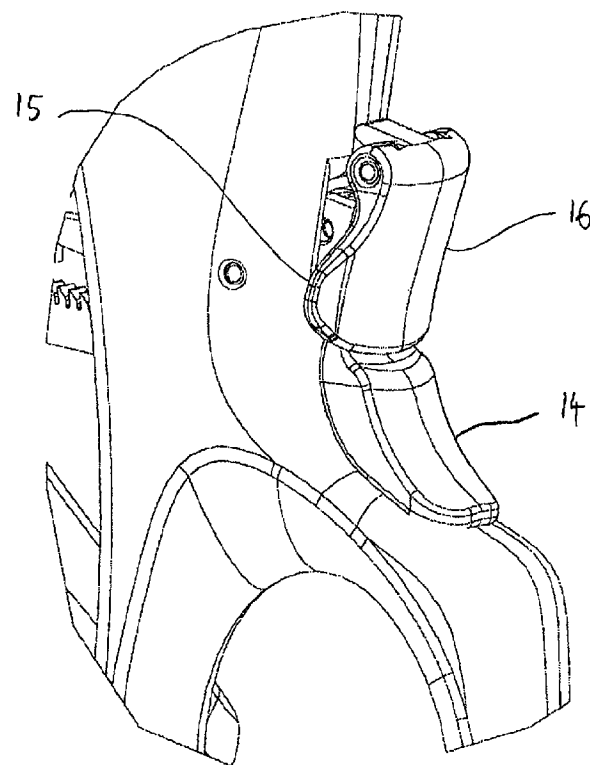

Fig. 7A

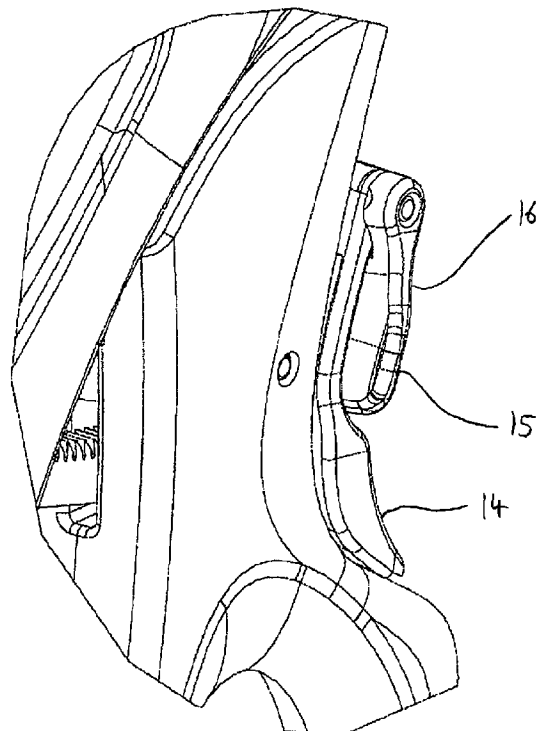

Fig. 7B

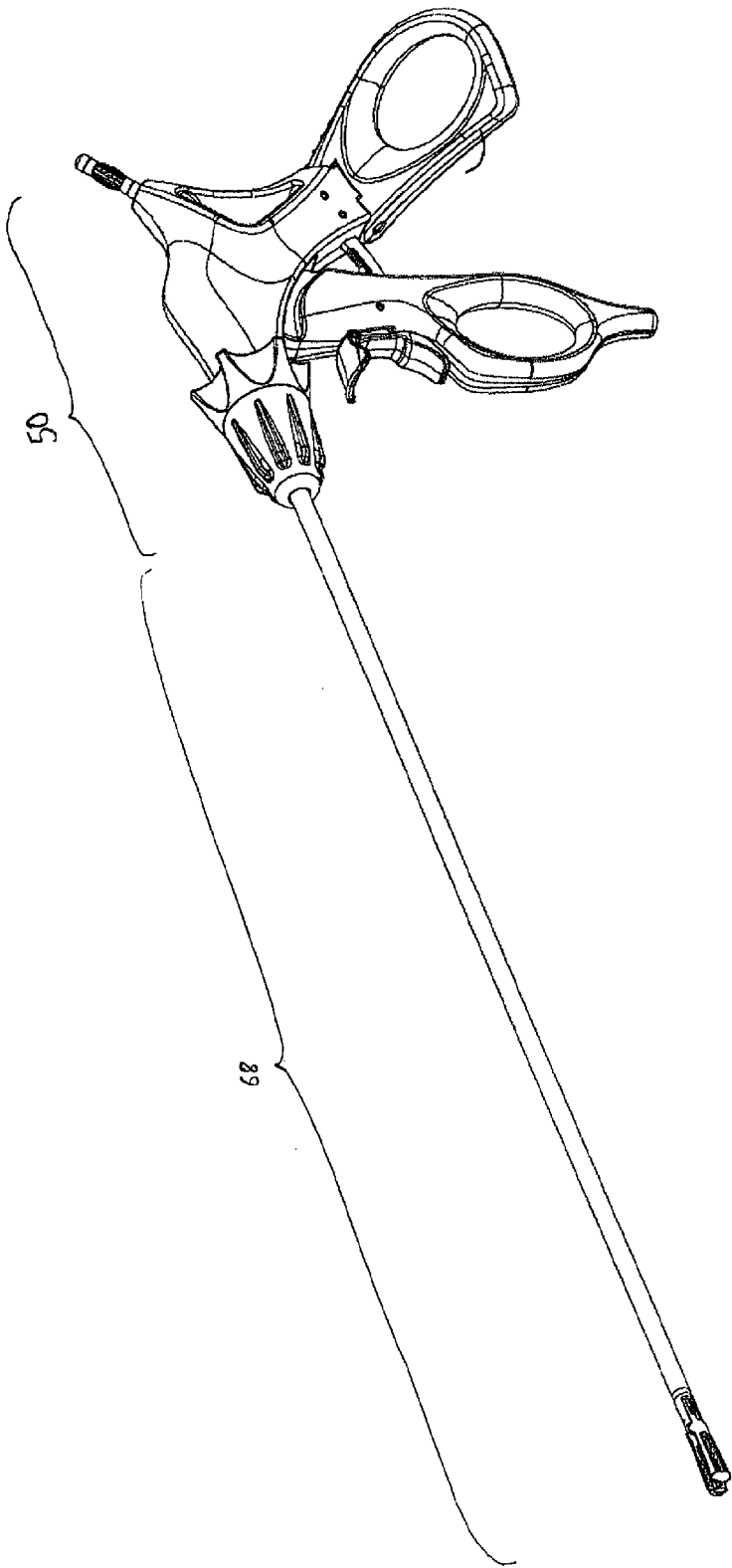

Fig. 8

INTERNATIONAL SEARCH REPORT

International application No
PCT/GB2009/050203

A. CLASSIFICATION OF SUBJECT MATTER

INV. A61B17/29
ADD. A61B17/00 A61B17/28 A61B19/00

According to International Patent Classification (IPC) or to both national classification and IPC

B. FIELDS SEARCHED

Minimum documentation searched (classification system followed by classification symbols)
A61B

Documentation searched other than minimum documentation to the extent that such documents are included in the fields searched

Electronic data base consulted during the international search (name of data base and, where practical, search terms used)

EP0-Internal

C. DOCUMENTS CONSIDERED TO BE RELEVANT

Category*	Citation of document, with indication, where appropriate, of the relevant passages	Relevant to claim No.
X	DE 44 28 479 A1 (AESCULAP WERKE AG [DE]) 15 February 1996 (1996-02-15) columns 4,5; figures 4-7	1,4-7,13
E	DE 20 2008 014698 U1 (ZEPF MARTIN [DE]) 30 April 2009 (2009-04-30) paragraphs [0045], [0050]; figures 1-16	1-3
X	WO 2008/002574 A (ALLEGIANCE CORP [US]; CARPENTER DAVID [US]; LEMIEUX ERIN-ANNE [US]; SK) 3 January 2008 (2008-01-03) the whole document	1-3,9-15

☐ Further documents are listed in the continuation of Box C.

☒ See patent family annex.

* Special categories of cited documents :

- *A* document defining the general state of the art which is not considered to be of particular relevance
- *E* earlier document but published on or after the international filing date
- *L* document which may throw doubts on priority claim(s) or which is cited to establish the publication date of another citation or other special reason (as specified)
- *O* document referring to an oral disclosure, use, exhibition or other means
- *P* document published prior to the international filing date but later than the priority date claimed

- *T* later document published after the international filing date or priority date and not in conflict with the application but cited to understand the principle or theory underlying the invention
- *X* document of particular relevance; the claimed invention cannot be considered novel or cannot be considered to involve an inventive step when the document is taken alone
- *Y* document of particular relevance; the claimed invention cannot be considered to involve an inventive step when the document is combined with one or more other such documents, such combination being obvious to a person skilled in the art.
- *&* document member of the same patent family

Date of the actual completion of the international search

21 July 2009

Date of mailing of the international search report

30/07/2009

Name and mailing address of the ISA/
European Patent Office, P.B. 5818 Patentlaan 2
NL - 2280 HV Rijswijk
Tel. (+31-70) 340-2040,
Fax: (+31-70) 340-3016

Authorized officer

Herberhold, C

INTERNATIONAL SEARCH REPORT

Information on patent family members

International application No

PCT/GB2009/050203

Patent document cited in search report	Publication date	Patent family member(s)	Publication date
DE 4428479 A1	15-02-1996	NONE	
DE 202008014698 U1	30-04-2009	DE 102007053061 A1	07-05-2009
WO 2008002574 A	03-01-2008	CA 2655528 A1	03-01-2008
		EP 2037823 A2	25-03-2009
		US 2007299469 A1	27-12-2007

专利名称(译)	用于手术器械和手术器械组件的手柄		
公开(公告)号	EP2259732A1	公开(公告)日	2010-12-15
申请号	EP2009714278	申请日	2009-02-27
申请(专利权)人(译)	手术INNOVATIONS LIMITED		
当前申请(专利权)人(译)	手术INNOVATIONS LIMITED		
[标]发明人	MAIN DAVID HELLINGA ANNA SOPHIA MORAN PETER		
发明人	MAIN, DAVID HELLINGA, ANNA SOPHIA MORAN, PETER		
IPC分类号	A61B17/29 A61B17/00 A61B17/28 A61B19/00		
CPC分类号	A61B17/2909 A61B2017/00424 A61B2017/00464 A61B2017/2837 A61B2017/2911 A61B2017/292 A61B2017/2925 A61B2017/2946 A61B2090/0811 A61B17/00234 A61B2017/0042 A61B2017/291		
优先权	2008003773 2008-02-29 GB		
其他公开文献	EP2259732B1		
外部链接	Espacenet		

摘要(译)

公开了一种用于外科器械的手柄 (3) , 特别是用于锁孔手术, 内窥镜和腹腔镜器械的手柄。在一个实施例中, 本发明提供了一种用于外科器械的手柄, 其包括具有枢转或铰接端部 (4b) 的一个部件, 以及用于指示端部的枢转运动的装置。分度装置允许调节端部的角度以及改善对使用者的控制和触觉反馈。在另一方面, 本发明提供了一种用于外科器械的手柄, 其包括具有枢转或铰接端部的一个部件, 以及用于锁定端部的运动的装置。锁定装置可以在锁定位置和解锁位置之间移动。端部可以枢转或铰接到所需的角度的, 并且锁定装置移动到一个位置, 以防止将端部保持在所需角度的端部移动。这改善了对用户的控制和触觉反馈。