



(12) **EUROPEAN PATENT APPLICATION**
published in accordance with Art. 153(4) EPC

(43) Date of publication:
28.03.2012 Bulletin 2012/13

(51) Int Cl.:
A61B 19/00 (2006.01)

(21) Application number: **10777402.8**

(86) International application number:
PCT/ES2010/000224

(22) Date of filing: **20.05.2010**

(87) International publication number:
WO 2010/133733 (25.11.2010 Gazette 2010/47)

(84) Designated Contracting States:
AL AT BE BG CH CY CZ DE DK EE ES FI FR GB GR HR HU IE IS IT LI LT LU LV MC MK MT NL NO PL PT RO SE SI SK SM TR

• **CASALS GELPI, Alicia**
E-08034 Barcelona (ES)
• **FRIGOLA BOURLON, Manel**
E-08034 Barcelona (ES)

(30) Priority: **22.05.2009 ES 200901313**

(74) Representative: **ZBM Patents**
Zea, Barlocchi & Markvardsen
Plaza Catalunya, 1
08002 Barcelona (ES)

(72) Inventors:
• **AMAT GIRBAU, Josep**
E-08034 Barcelona (ES)

(54) **ROBOTIC SYSTEM FOR LAPAROSCOPIC SURGERY**

(57) It comprises a supporting structure (230) in which at least one arm (210; 220) is slidably attached. Each arm (210; 220) comprises first and second members (300, 400) hinged to each other. The first member (300) is rotatably hinged to the supporting structure (230) and it can be rotated about a longitudinal axis (L1) and the second member (400) may receive a joint having at

least two degrees of freedom (550) for attaching a tool (900). The longitudinal axis (L1) of the first member (300) is substantially perpendicular to an axis (L2) joining the first member (300) and the second member (400) to each other.

A simplified architecture is obtained allowing for accurate and efficient spatial movement of the tool holding arm (210; 220).

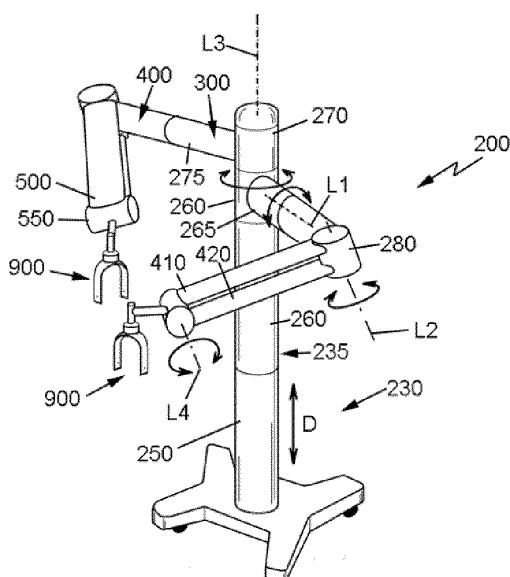

FIG.3

Description

Field of the Invention

[0001] The present invention relates to a robotic system for holding and handling a surgical tool or instrument for surgery, particularly for minimally invasive laparoscopic surgery. The robotic system of the invention comprises a supporting structure to which one or more arms that can be remotely operated from a tele-operation station are slidably attached.

[0002] Each of said arms attached to the supporting structure is configured as an articulated assembly comprising two elements. Both elements are hinged to each other and, in turn, the first member can be rotated relative to the supporting structure.

Background art

[0003] The invention finds general application in the field of robotic surgery and particularly in the field of minimally invasive surgery. In minimally invasive surgery smaller incisions are made as compared to those in conventional surgery that require a very precise operation of the surgical tool. Through these incisions surgical operations are carried out, including introducing of vision cameras (laparoscopy) for obtaining images of internal organs and transmitting them to a television monitor through which the surgeon can be guided to perform such surgical procedures.

[0004] These surgical procedures through robotic surgery are performed remotely by using tele-operation stations connected to a robotic system via dedicated communication lines.

[0005] Robotic systems include architectures designed to behave like a human arm, allowing a robot arm to be arranged in different positions. These architectures are formed by one or several arms mounted on a supporting structure and formed by hinged members so they can be moved properly in the space to operate a tool, terminal organ or end effector, such as a gripper or other device to perform surgical operations. Movement is driven by commands that are remotely received through the tele-operation station.

[0006] Each of said arms is an articulated structure comprising several members hinged to each other and rotatably mounted to the supporting structure. One example of robot arm architecture with articulated members is the robot known as *Scara*, with freedom of movement in the X and Y axes, although they are limited in their movements in the vertical axis Z, where simple and short-distance procedures are usually performed.

[0007] The limitations of these architectures are typically overcome through an intensive use of complex electronics and mechanisms in order to provide a robotic system suitable for minimally invasive surgery. This involves an undesirably costly robotic system due to complexity as a whole.

[0008] Document US2003208186 describes a robotic mechanism with three degrees of freedom comprising a supporting structure to which an arm is slidably attached vertically. The arm comprises a first member and a second member hinged to each other. The first member is in turn hinged to the supporting structure and by means of it a tool can be positioned. However, such architecture has the disadvantage that it does not allow the tool to be properly positioned in order to insert it by a surgical instrument (trocar).

[0009] Document US5762458 refers to a system for performing minimally invasive cardiac surgery procedures. This system comprises articulated arms adapted to handle a tool in space. Said arms have several degrees of freedom and, in one embodiment, they are provided with three motor driven joints (that can be driven in displacement and rotation), two passive joints and one motor driven joint that can be rotated for driving a tool placed at the arm end. This robotic system has the disadvantage that it does not allow for a fully effective positioning of the tool through the incision in the patient.

Summary of the invention

[0010] The present invention provides a robotic system for laparoscopic surgery, particularly but not exclusively, for minimally invasive surgery. The robotic system of the invention has a substantially simpler construction than robotic systems used for the same purpose so far. In addition to the structural simplicity of the robotic system provided herein, the invention features a robotic system for laparoscopic surgery with a particular architecture capable of properly positioning a tool, terminal organ or end effector, such as a gripper or device to perform surgical operations, with high mobility for being properly introduced through an incision in the patient.

[0011] The robotic system for minimally invasive laparoscopic surgery of the invention comprises a supporting structure comprising a vertical column around which longitudinal axis arms can be rotated. The column may be mounted on a stationary platform that is preferably provided with wheels for ease of movement if necessary. One or more robotic arms are slidably attached vertically to the column. In the event that more than one robotic arm is provided on the supporting structure, said arms are attached such that they can be slidably displaced vertically in order to adjust their height from the ground and therefore allowing a surgical tool to be effectively positioned in a proper position.

[0012] Each of the arms of the robotic system comprises a first member and a second member. Both the first and second members are hinged to each other through a shaft or joint. On the other hand, the first member of the arm is rotatably mounted on the supporting structure and, in turn, said first member is adapted to be rotated about its longitudinal axis. Particularly, the first member of the arm is rotatably mounted on an extension integral with the supporting structure.

[0013] The second member of the robotic arm is adapted to receive a joint with at least two passive degrees of freedom at one end thereof for attaching a surgical tool or instrument. In the event that more than one robotic arm is provided, the arms can be rotated independently of each other around the longitudinal axis of the supporting structure. This architecture provides a significantly simplified assembly.

[0014] In some embodiments of the invention, said joint having at least two degrees of freedom for attaching a tool may have three degrees of freedom, such as a gimbal-type joint. One-axis stability (usually in the axis of the tool or instrument direction) and spatial movement suitable for operations of the tool through the incision in the patient by introducing two passive degrees of freedom in the system are thus achieved.

[0015] Thus, the assembly is provided with a total of five degrees of freedom (four plus the supporting structure vertical displacement for positioning and manoeuvrability of the tool) so the tool can be always positioned in the direction defined by the penetration site into the cavity made in the patient (for example, the abdominal cavity) through the trocar.

[0016] In one embodiment, the longitudinal axis of the first member of the robotic arm can be at least substantially perpendicular to the joint axis of the first member and the second member.

[0017] The second member of the arm may comprise two rods arranged substantially parallel to each other and separated by a distance suitable for providing therein and hinged thereto one end of the first member of the arm. This allows collision free rotation of the first and the second members of the robotic arm.

[0018] Other objects, advantages and features of the robotic system for minimally invasive laparoscopic surgery of the invention will be apparent from the description of a preferred embodiment of the invention. This description is given by way of non-limitative example and it is illustrated in the accompanying drawings.

Brief description of the drawings

[0019] In the drawings,

Figure 1 is a diagram of a tele-operation system fitted with robotic systems according to the invention;

Figure 2 is a perspective view of one embodiment of the robotic system of the invention comprising a two-arm structure;

Figure 3 is a perspective view of one embodiment of the robotic system of the invention, and

Figure 4 is a diagrammatic view of the kinematic chain of the robotic system where the degrees of freedom are shown.

Description of one preferred embodiment

[0020] A tele-operation system 100 for performing minimally invasive laparoscopic surgery is shown in the figures. The tele-operation system 100 comprises a workstation 110 having two robotic systems 200 according to the invention and a tele-operation station 120 for operation and control of the robotic system 200. The tele-operation station 120 includes a three-dimensional control system 130 for displaying the workplace scene with a desired magnification factor (zoom) and a perspective that can be controlled through the movements of one of the available arms.

[0021] The operator's control commands can be converted by the tele-operation station 120 into the operation of the robotic system 200 enhancing the manual operator's capabilities and operations can be controlled for more reliability. This allows the articulated robotic arms 210, 220 of the robotic system 200 to be gesturally operated and controlled through the movements of the operator's arms. The movements that the operator is capable to perform with his/her two hands can be applied to any of the arms 210, 220, at will, with the help of auxiliary actuating pedals (not shown). The robotic arms 210, 220 of the robotic system 200 (shown in figure 3) can be electrically actuated for locating and positioning each of the tools, terminal organs or end effectors 900 (such as grippers or surgical devices suitable for performing operations).

[0022] The link between tele-operation station 120 and the robotic system 200 is performed through a control unit 140. The control unit 140 is configured by a computer network that allow for real time control of the path of the robotic arms 210, 220 and positioning of surgical tools 900 controlled by the arms 210, 220, so that they all times conform with the movements of the operator's commands. The control unit 140 also performs movement coordination in order to avoid collisions between the arms 210, 220, and monitoring and correcting of the paths thereof according to operator's predefined criteria. The control unit 140 allows the operation with floating reference axes, which are reset in position and orientation at the operator's will in order to facilitate operation of the task in the vertical field position, although the operation is performed within the abdominal capacity of the patient 600 in other positions. It also allows the scale factor to be changed in order to adjust centimetre movements in the actuation station into millimetre movements as necessary. Such unit 140 further allows restraints on the workload of each of the arms 210, 220 to be defined in order to increase safety of patient 600. Through the unit 140 it is also possible to display the usable working space of the arms 210, 220 in order to facilitate initial proper positioning thereof over the operating table 700 and over the patient 600.

[0023] The signal 150 received from the tele-operation station 120 through magnetic position sensors 450 provides information 460 about the paths of the tools 900.

Other position detection means, such as potentiometric or inertial sensors are also possible. This allows operator's movement capability to be facilitated as well as the mechanical constraints of most common 6D actuators to be avoided. A control 600 of the robotic system 200 and a control 650 of the tools 900 as well as a control 660 to avoid collisions are thus made possible.

[0024] The workstation 110 comprises one or more robotic system 200 according to the invention. Figure 3 shows one of said robotic systems 200 in detail. As it can be seen, each robotic system 200 comprises two arms 210, 220 mounted on a common supporting structure 230. Each arm 210, 220 has a load capacity such that forces up to 2.5 Kg can be applied and it is adapted to operate alongside the operating table 700, on either side thereof, or simultaneously using both of them, one on each side of the operating table 700. The arms 210, 220 of the robotic system 200 can be moved in space to cover an appropriate minimum working volume. The working volume is defined by a set of points where the tool 900 of each arm 210, 220 can be positioned, and corresponds to the volume enclosed by the surfaces determined by the points accessed by the tool 900 with its structure fully extended and fully retracted. In the structure of the embodiment, the minimum working volume corresponds to a hemisphere of radius 50 cm arranged centred on the same fixed centre but adjustable in height, and with accuracies of better than 1 mm.

[0025] In the embodiment shown in figures 2 and 3, the supporting structure 230 comprises a vertical column 235 fixed on a platform 240 having lockable wheels 245 for ease of movement. The platform 240 comprises a lower section 250 and two upper sections 260, 270, rotatably mounted to each other and to the lower section 250. The lower portion 250 of the supporting structure 230 is secured to the platform 240 for holding the robotic system 200 during operation. The upper sections 260, 270 of column 235 are mounted so that they can slide vertically according to the vertical direction indicated at D, that is, substantially perpendicular to the platform 240 of the supporting structure 230. The vertical linear displacement D of the upper sections 260, 270 allows the height of the robotic arms 210, 220 to the ground to be adjusted independently and thus the proper positioning of the tool 900.

[0026] For simplicity in the description the structure of one of the arms 210 of the robotic system 200 will be described below, although it will be understood that each of said arms 210, 220 has the same or a technically equivalent configuration.

[0027] The robotic arm 210 of the system described according to the invention comprises two members 300, 400 hinged to each other.

[0028] The first member 300 is an elongated body that is mounted on the supporting structure 230 so that it can be rotated about a longitudinal axis L1 of the first member 300. More specifically, this first member 300 is rotatably mounted on an extension 265 integral with the upper sec-

tion 260 (the other robot arm 220 is rotatably mounted on the extension 275 corresponding to the upper section 270). The first member 300 can be thus rotated relative to the extension 265 of the upper section 260 of the robotic arm 210 around the longitudinal axis L1 and both arms 210, 220 can be rotated independently around the longitudinal axis L3 of the supporting structure 230, that is, the column 235.

[0029] The second member 400 of the robotic arm 210 is hinged to the first member 300 of the robotic arm 210 via a joint 280 so that they can be rotated about an axis L2, as it can be seen in figure 3. The longitudinal axis L1 of the first member 300 is substantially perpendicular to the axis L2 of the joint 280 of the first member 300 and the second member 400.

[0030] As it can be seen, the second articulated member 400 is formed with two rods 410, 420, which in the embodiment of the figures has an elliptical cross section. It will be understood, however, that the two rods 410, 420 may have other different geometries. The two rods 410, 420 are arranged parallel to each other spaced at a given distance in order to allow the second member 400 to be joined to one end of the first member 300 while preventing both members 300, 400, of the arm 210 from colliding with each other when rotating around axis L2 of the joint 280 arranged on a common end of both rods 410, 420 of the arm 210.

[0031] The opposite end 500 of both rods 410, 420 of the arm 210 is adapted for attaching of a surgical tool or instrument 900 through a pivot axis L4. The pivot axis L4 avoids collisions between the tool 900 and the rods 410, 420 of the second member 400 of the arm 210, 220. A mechanical joint 550 is provided at end 500 which allows the positioning of the tool 900 within the working space to be controlled in an appropriate manner for the operations through the incision in the patient 600. This mechanical joint 550 is a joint having two or more degrees of freedom adapted for attaching of the surgical tool or instrument 900. In the embodiment of the figures, the mechanical joint 550 is a joint having three degree of freedom, such as a gimbal-type joint. This allows two additional passive degrees of freedom to be introduced as well as one-axis stability (usually the positioning axis of tool 900) to be provided. The tool 900 can be therefore positioned always in a direction defined by the penetration site 950 into the cavity performed in the patient 600 (e.g. abdominal cavity), as shown in figure 4.

[0032] A manual adjustment fastening member for the trocars may be provided. This fastening member comprises a suspension member that may be manually attached to the supporting structure 230. At one end thereof two elements secured to this suspension member are supported through two manually lockable ball joints that allow the respective trocars to be fastened through a gimbal-type joint for reducing efforts performed with the surgical instrument or tool 900 on the patient's abdomen 600.

[0033] Figure 4 schematically shows the kinematic

chain of the mechanical structure of one embodiment of the robotic system 200 of the invention. As shown, each arm 210, 220 of the system 200 is an open kinematic chain of the D-G-G-G-G+gimbal type with five degrees of freedom allowing for relative movement of the different elements 235, 300, 400, 900 between each two consecutive links of the structure.

[0034] Apart from the prismatic joint (vertical translational movement D), the four joints according to axes L1, L2, L3 and L4 are motor driven with the displacement D being shared by the two arms 210, 220.

[0035] Although the present invention has been described in the specification and illustrated in the accompanying drawings with reference to a preferred embodiment thereof, the robotic system of the invention is susceptible of several changes without departing from the scope of protection defined in the following claims.

Claims

1. Robotic system (200) for laparoscopic surgery comprising a supporting structure (230) in which at least one arm (210; 220) is slidably attached, said arm (210; 220) comprising a first member (300) and a second member (400) hinged to each other, the first member (300) being rotatably hinged on the supporting structure (230), **characterized in that** the first member (300) is adapted to be rotated around a longitudinal axis (L1) and the second member (400) is adapted to receive a joint having at least two degrees of freedom (550) for attaching a tool (900).
2. Robotic system (200) as claimed in claim 1, wherein said longitudinal axis (L1) of the first member (300) is at least substantially perpendicular to a joint axis (L2) for joining the first member (300) and the second member (400) to each other.
3. Robotic system (200) as claimed in claim 1 or 2, wherein the supporting structure (230) comprises a vertical column around which longitudinal axis (L3) the arms (210, 220) can be rotated.
4. Robotic system (200) as claimed in claim 1, wherein the joint having at least two degrees of freedom (500) for attaching a tool (900) is a gimbal-type joint.
5. Robotic system (200) as claimed in any of the preceding claims, wherein the second articulated element (400) consists of two parts (410, 420) on which the first member of the arm (300) is hinged.
6. Robotic system (200) as claimed in any of the preceding claims, wherein it comprises at least two of said arms (210, 220) hinged on said supporting structure (230).

7. Robotic system (200) as claimed in claim 6, wherein said arms (210, 220) can be rotated independently of each other around the longitudinal axis (L3) of the supporting structure (230).

8. Robotic system (200) as claimed in any of the preceding claims, wherein the first member (300) is rotatably mounted on an extension (265; 275) integral with the supporting structure (230).

FIG.1

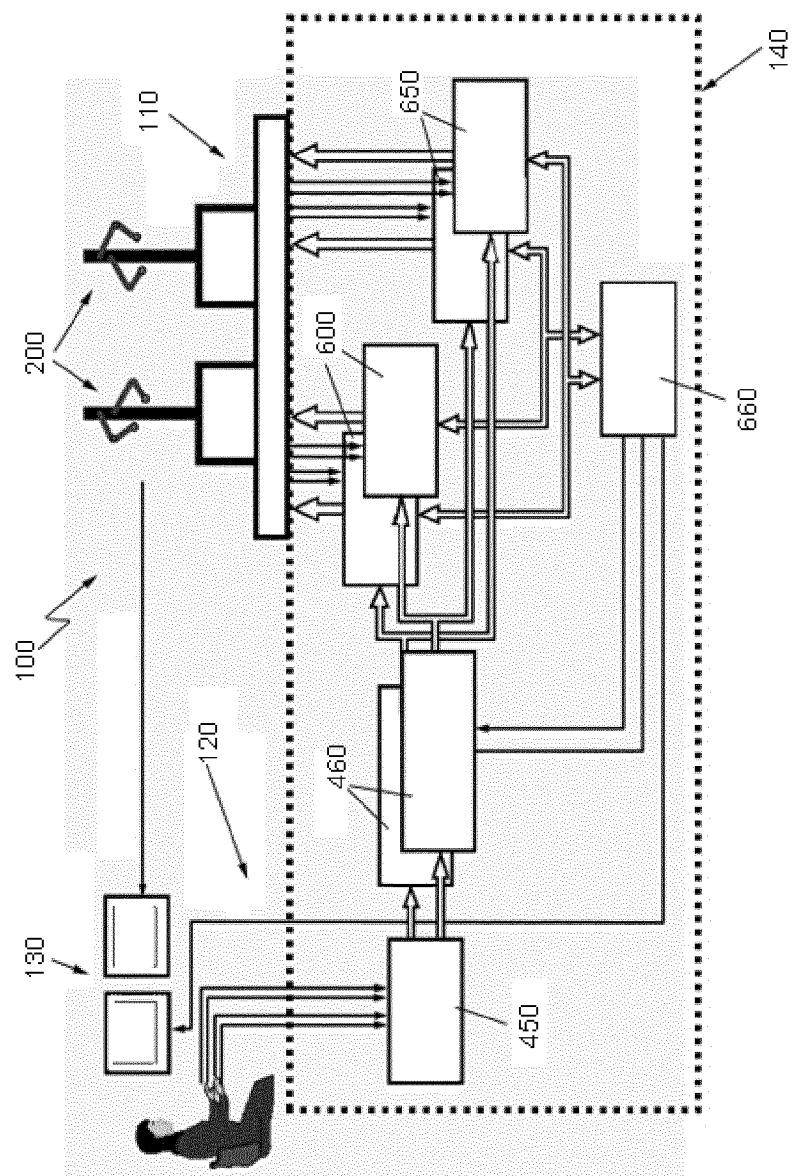

FIG. 2

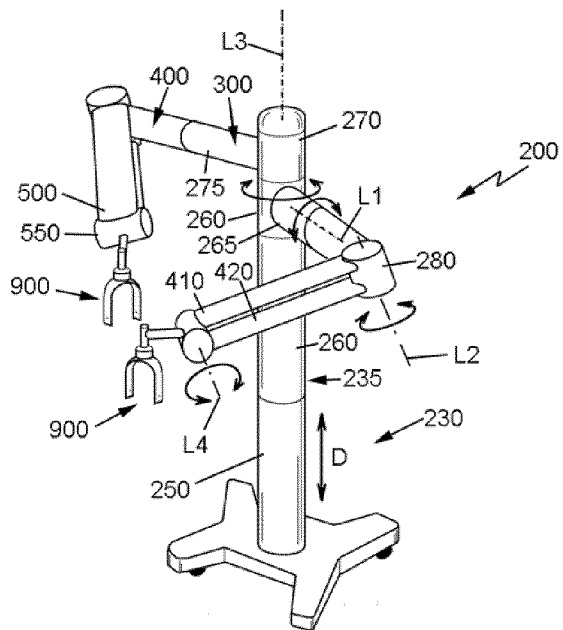
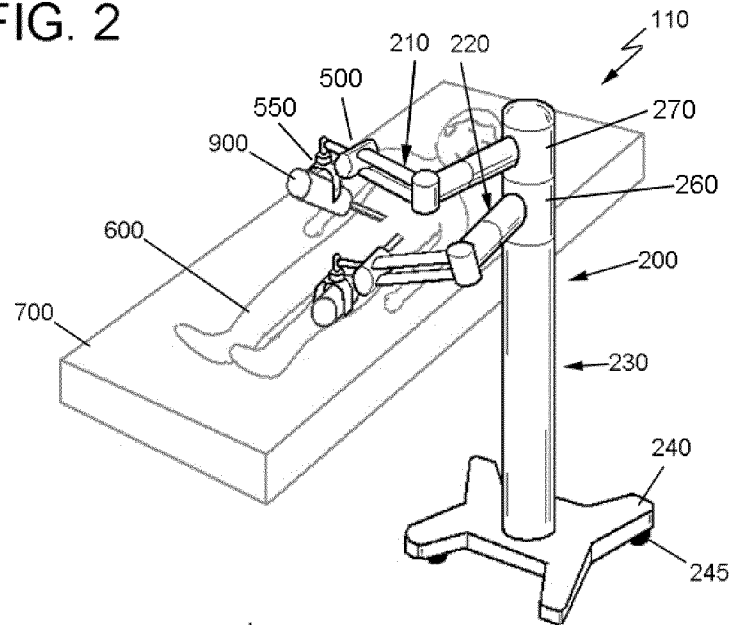
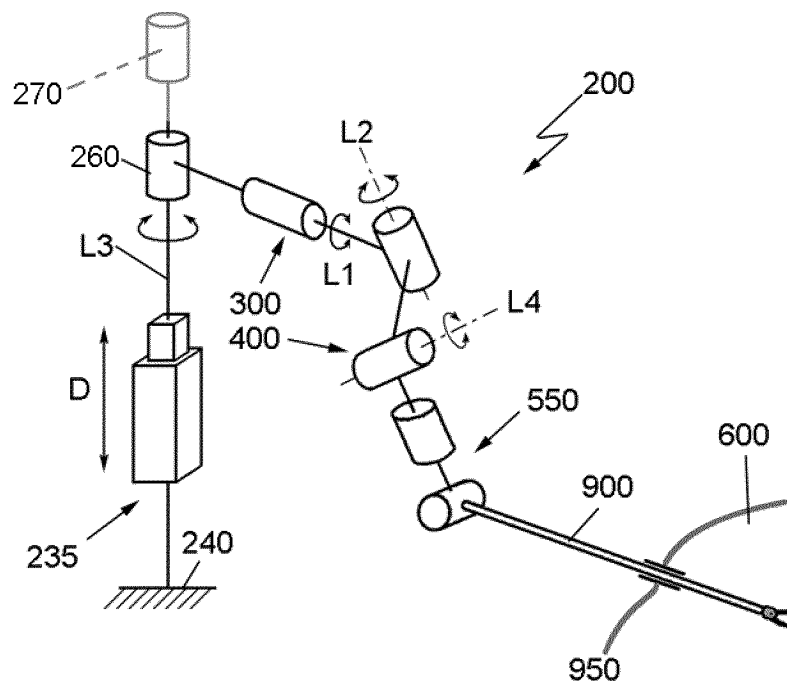

FIG.3

FIG. 4



INTERNATIONAL SEARCH REPORT

International application No.
PCT/ES2010/000224

A. CLASSIFICATION OF SUBJECT MATTER

A61B 19/00 (2006.01)

According to International Patent Classification (IPC) or to both national classification and IPC

B. FIELDS SEARCHED

Minimum documentation searched (classification system followed by classification symbols)
A61B

Documentation searched other than minimum documentation to the extent that such documents are included in the fields searched

DOCUMENTOS ESPAÑOLES DE PATENTES Y MODELOS DE UTILIDAD.

Electronic data base consulted during the international search (name of data base and, where practicable, search terms used)

IVENES, EPODOC, PAJ, WPI, ECLA.

C. DOCUMENTS CONSIDERED TO BE RELEVANT

Category*	Citation of document, with indication, where appropriate, of the relevant passages	Relevant to claim No.
P, X	WO 2010050771 A2 (JEONG) 06.05.2010, paragraphs [50-57]; figures 1-5.	1-4, 8
A	ES 2248066 T3 (INTUITIVE SURGICAL INC.) 16.03.2006, page 8, line 35 - page 10, line 37; figures 1-5.	1-3, 6-8
A	US 6246200 B1 (INTUITIVE SURGICAL INC.) 12.06.2001, column 5, line 48 - column 12, line 42; figures.	1-3, 6-8
A	WO 2006091494 A1 (MAKO SURGICAL CORPORATION) 31.08.2006, paragraphs [109-112]; figures 1-2C.	1-4, 8
A	US 7155316 B2 (MICROBOTICS CORPORATION) 26.12.2006, column 13, lines 6-60; figures 2-3, 5.	1-2, 6-8

☒ Further documents are listed in the continuation of Box C.☒ See patent family annex.

* Special categories of cited documents:

"A" document defining the general state of the art which is not considered to be of particular relevance.

"E" earlier document but published on or after the international filing date

"L" document which may throw doubts on priority claim(s) or which is cited to establish the publication date of another citation or other special reason (as specified)

"O" document referring to an oral disclosure use, exhibition, or other means

"P" document published prior to the international filing date but later than the priority date claimed

"T"

later document published after the international filing date or priority date and not in conflict with the application but cited to understand the principle or theory underlying the invention

"X"

document of particular relevance; the claimed invention cannot be considered novel or cannot be considered to involve an inventive step when the document is taken alone

"Y"

document of particular relevance; the claimed invention cannot be considered to involve an inventive step when the document is combined with one or more other documents, such combination being obvious to a person skilled in the art

"&"

document member of the same patent family

Date of the actual completion of the international search

04.October.2010 (04.10.2010)

Date of mailing of the international search report

(08/10/2010)

Name and mailing address of the ISA/
O.E.P.M.Paseo de la Castellana, 75 28071 Madrid, España.
Facsimile No. 34 91 3495304

Authorized officer

J. Cuadrado Prados

Telephone No. +34 91 349 55 22

Form PCT/ISA/210 (second sheet) (July 2009)

INTERNATIONAL SEARCH REPORT

International application No.

PCT/ES2010/000224

C (continuation). DOCUMENTS CONSIDERED TO BE RELEVANT		
Category*	Citation of documents, with indication, where appropriate, of the relevant passages	Relevant to claim No.
A	ES 2264158 T3 (INTUITIVE SURGICAL INC.) 16.12.2006, page 5, line 24 - page 7, line 4; figures 1, 3.	1-3

Form PCT/ISA/210 (continuation of second sheet) (July 2009)

INTERNATIONAL SEARCH REPORT

Information on patent family members

International application No.

PCT/ES2010/000224

Patent document cited in the search report	Publication date	Patent family member(s)	Publication date
WO 2010050771 A	06.05.2010	KR 20100048789 A	11.05.2010
ES 2248066 T	16.03.2006	WO 0060521 A	12.10.2000
		US 6424885 B	23.07.2002
		EP 1269389 AB	02.01.2003
		EP 20000919930	29.03.2000
		US 2003004610 A	02.01.2003
		US 6671581 B	30.12.2003
		US 2004039485 A	26.02.2004
		AT 305639 T	15.10.2005
		US 2006106493 A	18.05.2006
		US 7155315 B	26.12.2006
		DE 60022911 T	22.06.2006
US 6246200 B	12.06.2001	WO 0007503 A	17.02.2000
		AU 5391999 A	28.02.2000
		EP 19990939671	03.08.1999
		US 2001013764 A	16.08.2001
		US 6441577 B	27.08.2002
		US 6788018 B	07.09.2004
		US 2004261179 A	30.12.2004
		US 6933695 B	23.08.2005
WO 2006091494 A	31.08.2006	WO 03077101 A	18.09.2003
		AU 2003218010 A	22.09.2003
		US 2004024311 A	05.02.2004
		US 7206626 B	17.04.2007
		US 2004034302 A	19.02.2004
		US 7206627 B	17.04.2007
		US 2004034283 A	19.02.2004
		US 7747311 B	29.06.2010
		US 2004034282 A	19.02.2004
		US 2004106916 A	03.06.2004
		CA 2532469 A	03.02.2005
		WO 2005009215 A	03.02.2005
		US 2006142657 A	29.06.2006
		EP 1680007 A	19.07.2006
		EP 20040757075	16.07.2004
		CA 2598627 A	31.08.2006
		US 2007142751 A	21.06.2007
		CN 101031236 A	05.09.2007
		CN 100579448 C	13.01.2010
		AU 2006341557 A	18.10.2007
		WO 2007117297 A	18.10.2007
		CA 2637651 A	18.10.2007
		JP 2007534351 T	29.11.2007
		EP 1871267 A	02.01.2008
		EP 20060735388	21.02.2006
		CN 101160104 A	09.04.2008
		EP 1973487 A	01.10.2008
		EP 20060850614	27.12.2006

Form PCT/ISA/210 (patent family annex) (July 2009)

INTERNATIONAL SEARCH REPORT

Information on patent family members

International application No.

PCT/ES2010/000224

Patent document cited in the search report	Publication date	Patent family member(s)	Publication date
		JP 2008538184 T	16.10.2008
		US 2009000626 A	01.01.2009
		US 2009000627 A	01.01.2009
		US 2009012531 A	08.01.2009
		US 2009012532 A	08.01.2009
		CN 101426446 A	06.05.2009
		JP 2009524149 T	25.06.2009
		US 2010137882 A	03.06.2010
US 7155316 B	26.12.2006	CA 2633137 A	13.02.2004
		CA 2437286 AC	13.02.2004
		WO 2004014244 A	19.02.2004
		AU 2003257309 A	25.02.2004
		US 2004111183 A	10.06.2004
		EP 1531749 A	25.05.2005
		EP 20030783876	13.08.2003
		US 2007032906 A	08.02.2007
		US 2008004632 A	03.01.2008
		US 2008161677 A	03.07.2008
		US 2008161830 A	03.07.2008
		EP 2070487 A	17.06.2009
		EP 20080012412	13.08.2003
		US 2010063630 A	11.03.2010
ES 2264158 T	16.12.2006	WO 9729690 A	21.08.1997
		CA 2547686 A	21.08.1997
		CA 2246713 AC	21.08.1997
		AU 2131897 A	02.09.1997
		US 5762458 A	09.06.1998
		EP 0883376 AB	16.12.1998
		EP 19970906691	19.02.1997
		US 5855583 A	05.01.1999
		CN 1216454 A	12.05.1999
		US 5971976 A	26.10.1999
		US 6001108 A	14.12.1999
		KR 19990087101 A	15.12.1999
		US 6007550 A	28.12.1999
		JP 2000505328 T	09.05.2000
		US 6063095 A	16.05.2000
		US 6102850 A	15.08.2000
		US 6132441 A	17.10.2000
		US 6244809 B	12.06.2001
		US 6436107 B	20.08.2002
		US 2003065310 A	03.04.2003
		US 7025761 B	11.04.2006
		US 2003078474 A	24.04.2003
		US 2003083650 A	01.05.2003
		US 2003083648 A	01.05.2003
		US 2003083651 A	01.05.2003
		US 6994703 B	07.02.2006
		US 2003100817 A	29.05.2003

Form PCT/ISA/210 (patent family annex) (July 2009)

INTERNATIONAL SEARCH REPORT

Information on patent family members

International application No.

PCT/ES2010/000224

Patent document cited in the search report	Publication date	Patent family member(s)	Publication date
		US 6905460 B	14.06.2005
		US 2003125716 A	03.07.2003
		US 7025064 B	11.04.2006
		IL 125822 A	06.07.2003
		US 2003139733 A	24.07.2003
		US 7507199 B	24.03.2009
		US 2003139753 A	24.07.2003
		US 7027892 B	11.04.2006
		US 6699177 B	02.03.2004
		RU 2233626 C	10.08.2004
		US 2004186345 A	23.09.2004
		US 7083571 B	01.08.2006
		US 6905491 B	14.06.2005
		US 2005228365 A	13.10.2005
		US 2005234433 A	20.10.2005
		AT 323446 T	15.05.2006
		US 2006142881 A	29.06.2006
		US 7390325 B	24.06.2008
		US 2006167441 A	27.07.2006
		DE 69735708 T	28.09.2006
		US 7118582 B	10.10.2006
		JP 2007125404 A	24.05.2007
		JP 4176126 B	05.11.2008
		US 2008103524 A	01.05.2008
		US 2008215065 A	04.09.2008
		US 7695481 B	13.04.2010
		US 2008221731 A	11.09.2008
		US 7785320 B	31.08.2010
		US 2008228196 A	18.09.2008
		US 2008312668 A	18.12.2008
		US 2010217284 A	26.08.2010
<hr/>			

REFERENCES CITED IN THE DESCRIPTION

This list of references cited by the applicant is for the reader's convenience only. It does not form part of the European patent document. Even though great care has been taken in compiling the references, errors or omissions cannot be excluded and the EPO disclaims all liability in this regard.

Patent documents cited in the description

- US 2003208186 A [0008]
- US 5762458 A [0009]

专利名称(译)	腹腔镜手术机器人系统		
公开(公告)号	EP2433585A4	公开(公告)日	2015-11-04
申请号	EP2010777402	申请日	2010-05-20
[标]申请(专利权)人(译)	加泰罗尼亚理工大学		
申请(专利权)人(译)	Universitat 大学POLITÈCNICA DE CATALUNYA		
当前申请(专利权)人(译)	Universitat 大学POLITÈCNICA DE CATALUNYA		
[标]发明人	AMAT GIRBAU JOSEP CASALS GELPI ALICIA FRIGOLA BOURLON MANEL		
发明人	AMAT GIRBAU, JOSEP CASALS GELPI, ALICIA FRIGOLA BOURLON, MANEL		
IPC分类号	A61B19/00 A61B34/30 A61B34/37		
CPC分类号	A61B34/37 A61B34/30		
优先权	2009001313 2009-05-22 ES		
其他公开文献	EP2433585B1 EP2433585A1		
外部链接	Espacenet		

摘要(译)

它包括支撑结构 (230) , 其中至少一个臂 (210 ; 220) 可滑动地附接在其中。 每个臂 (210 ; 220) 包括彼此铰接的第一和第二构件 (300、400) 。 第一构件 (300) 可旋转地铰接到支撑结构 (230) , 并且其可以绕纵向轴线 (L1) 旋转, 并且第二构件 (400) 可以接收具有至少两个自由度的接头 (550) , 用于 安装工具 (900) 。 第一构件 (300) 的纵向轴线 (L1) 基本垂直于将第一构件 (300) 和第二构件 (400) 彼此连接的轴线 (L2) 。 获得简化的结构, 以允许工具保持臂 (210 ; 220) 的精确和有效的空间运动。