



(11) **EP 2 068 295 B1**

(12) **EUROPEAN PATENT SPECIFICATION**

(45) Date of publication and mention
of the grant of the patent:
03.09.2014 Bulletin 2014/36

(51) Int Cl.:
G09B 23/28 (2006.01) **A61B 17/00** (2006.01)
A61B 19/00 (2006.01)

(21) Application number: **08020955.4**

(22) Date of filing: **03.12.2008**

(54) **Laparoscopic training apparatus**

Laparoskopievorrichtung

Appareil de laparoscopie

(84) Designated Contracting States:
**AT BE BG CH CY CZ DE DK EE ES FI FR GB GR
HR HU IE IS IT LI LT LU LV MC MT NL NO PL PT
RO SE SI SK TR**

(30) Priority: **03.12.2007 EP 07023329**

(43) Date of publication of application:
10.06.2009 Bulletin 2009/24

(73) Proprietor: **Endosim Limited
Belfast,
BT5 6GX (GB)**

(72) Inventors:
• **Niblock, Ian
Belfast BT5 6GX
County Antrim (GB)**

- **O'Sullivan, Ray
Kells Road, Kilkenny (IE)**
- **Bailie, Robert
County Down BT19 1XX (GB)**
- **Prendiville, Walter
Rathcoole
County Dublin (IE)**

(74) Representative: **Kelly, Donal Morgan et al
FRKelly
27 Clyde Road
Dublin 4 (IE)**

(56) References cited:
**DE-B3- 10 304 736 US-A1- 2004 024 418
US-B1- 6 377 011 US-B1- 6 659 776**

Note: Within nine months of the publication of the mention of the grant of the European patent in the European Patent Bulletin, any person may give notice to the European Patent Office of opposition to that patent, in accordance with the Implementing Regulations. Notice of opposition shall not be deemed to have been filed until the opposition fee has been paid. (Art. 99(1) European Patent Convention).

EP 2 068 295 B1

Description

Field of the Invention

[0001] The present invention relates to a laparoscopic apparatus. In particular, the invention finds utility as a training apparatus for laparoscopic surgery techniques.

Background

[0002] Laparoscopic surgery is a modern surgical technique performed through small incisions, which involves the visualisation of body cavities using telescopes with attached camera systems. Trocars or cannulae are inserted through the incisions to facilitate the smooth passage of telescopes and slender long instruments into these cavities. A fundamental feature of laparoscopic surgery is the use of a laparoscope: a telescopic rod lens system that is usually connected to a visual acquisition device, such as a camera. Most typically, a fibre optic cable system connected to a 'cold' light source such as halogen or xenon is used to illuminate the operative field. The internal appearances of the body cavities are visualised on visual display monitors. The monitor image is 2-dimensional, and the movement of the instruments is seen in parallax. These combined features mean that surgeons training in this field of surgery not only have to learn individual surgical procedures, they must also become comfortable working in a 3-dimensional environment which has been translated to a 2-dimensional output.

[0003] The restricted vision, the difficulty in handling of the instruments, the acquisition of new hand-eye co-ordination skills, the lack of tactile perception and the limited working area are factors which add to the technical complexity of this surgical approach. For these reasons, minimally invasive surgery has emerged as a highly competitive new sub-specialty within various fields of surgery. Surgical residents, who wish to focus on this area of surgery, gain additional training during one or two years of fellowship after completing their basic surgical residency. Accordingly, the use of a simulator allows the trainee surgeon not only to learn the skills that when eventually combined, become a procedure, but they can also experience the unique appreciation of 2-dimensional visualisation of the 3-dimensional surgical field.

[0004] A simulator replicating the laparoscopic environment as experienced in an operating theatre, is superior to other inanimate simulators. Any learned procedure is a combination of several different skills, in other words all procedures can be broken down into individual component skills. These skills include the ability to correctly orientate a camera, manipulate objects in 3 dimensions, cut tissue, and suture (stitch). The simulator facilitates the trainee in attaining proficiency at these tasks prior to actually entering the operating room environment.

[0005] Once a surgical trainee or surgeon acquires a skills set, they can then move on to performing a variety

of surgical procedures. It is estimated that individual skills have to be repeated up to 30 times before a surgeon is considered proficient. This also applies to entire procedures. A simulator can also help simulate an entire procedure, where the skills are combined on a suitable model, again without endangering a patient. For example a laparoscopic cholecystectomy (removal of a gall bladder), the most common laparoscopic procedure performed, is a combination of grasping, dissection, clipping and cutting. All these skills can be simulated and indeed the procedure itself can then be performed on a simple model.

[0006] A laparoscopic apparatus according to the preamble of claim 1 is disclosed in US 2004/024418 A1.

[0007] It is an object of the present invention to provide a laparoscopic apparatus for the training of medical professionals, particularly those engaged in the field of laparoscopic surgery. In particular, it is envisaged that the present invention will provide a realistic surgical experience by mimicking the sensation of carrying out surgical techniques on a patient.

Summary of the Invention

[0008] According to the present invention as defined in claim 1, there is provided a laparoscopic apparatus comprising a housing; a joint in operative association with the housing and adapted to substantially accommodate a laparoscopic tool, in use, through the joint, the joint permitting movement of the laparoscopic tool, in use; and resistance means in operative association with the joint, adapted to provide resistance to movement of the laparoscopic tool, in use.

[0009] Preferably, the housing comprises a base and a lid.

[0010] Preferably, the lid is generally curved in form, to substantially mimic the form of a human torso.

[0011] Preferably, the laparoscopic tool is a visual acquisition device.

[0012] Preferably, the joint further comprises a substantially hollow generally cylindrical tube, which is open at both ends.

[0013] Preferably, the joint permits concurrent movement of the laparoscopic tool (for example, the visual acquisition device) in all three axes. Further preferably, the joint is a rotatable joint.

[0014] Preferably, the joint is adapted to simulate the resistive forces experienced during laparoscopic surgical techniques.

[0015] The joint comprises a ball-and-socket joint. The joint comprises a ball rotatably enagagable within a socket

[0016] The joint comprises a ball, and a socket within which the ball is at least partially housed; the ball being rotatably engagable within the socket, and the socket being adapted to provide resistance to movement of the ball.

[0017] Preferably, the socket is generally annular in

form, and shaped and dimensioned to accommodate the ball therein.

[0018] Preferably, the ball is generally conoid. Although, it will be seen that the ball can be any form that permits triaxial rotation within the socket.

[0019] The socket comprises a first section and a second section, spaced apart, shaped and dimensioned to house the ball therebetween. The socket comprises a first section, and a second section spaced apart by a distance from the first section; the socket being shaped and dimensioned to house the ball therebetween.

[0020] Preferably, the first section can be removably mounted to the housing of the laparoscopic apparatus. Preferably, the first section is mounted by a plurality of clips.

[0021] Preferably, the first and second sections are biased towards one another by the resistance means. Alternatively, the first and second sections are biased away from one another by the resistance means. The resistance means may comprise at least one resiliently deformable resilient member. Preferably, the at least one resilient member extends between the first and second sections of the socket. Optionally, the resilient member is in operable association with one or both of the first and second sections of the socket. Further optionally, at least one of a respective terminal end of the resilient member is attached to one or both of the first and second sections.

[0022] Preferably, the resilient member is elastic.

[0023] Optionally, the resilient member comprises a spring. The spring may be, for example, a torsion spring, such as a coil spring or helical spring; or a flat spring, such as a leaf spring. The spring may be a compression spring or a tension spring. The coil or helical spring may be a compression coil or a tension coil.

[0024] Preferably, the distance between the first and second sections of the socket is defined by the spring in operable association with one or both of the first and second sections.

[0025] Preferably, the spring extends between the first and second sections.

[0026] Preferably, the resistance is adjustable by altering the pressure applied to the ball by the socket.

[0027] The resistance is adjustable, by altering the distance between the first and second sections of the socket.

[0028] Optionally, the resistance means further comprises means to adjust the distance between the first and second sections of the socket. The adjusting means can be in operable association with one or both of the first and second sections.

[0029] Preferably, the adjusting means further comprises at least one actuator, which facilitates the adjustment of the relative distance between the first and second sections.

[0030] Preferably, the at least one actuator is a screw fixing.

[0031] Preferably, the spring is loaded by a screw fixing.

[0032] Optionally, a buffer is provided between the first

and second sections of the socket. Further optionally, a buffer is provided between the ball and at least one of the first and second sections. Preferably, the buffer is formed from a deformable material, such as rubber.

5 **[0033]** Optionally, the housing of the laparoscopic apparatus further comprises one or more apertures through each of which a laparoscopic tool can pass, in use; the aperture being overlaid by a membrane to at least partially resist the laparoscopic tool, when the laparoscopic tool is applied thereto. It will be appreciated that when there are several apertures, the respective laparoscopic tools can be the same or different.

10 **[0034]** Preferably, the membrane comprises a synthetic skin. Further preferably, the membrane comprises a pad.

15 **[0035]** Preferably, the pad is adapted to simulate the resistive forces experienced during laparoscopic surgical techniques.

20 **[0036]** Preferably, the pad comprises an outer membrane, and a core. Preferably, the outer membrane at least partially surrounds the surface of the core.

25 **[0037]** Preferably, the outer membrane is formed from at least one synthetic material selected from the group including, but not limited to: synthetic latex, natural latex, a silicone elastomer, and a hydrocarbon solvent.

[0038] Preferably, the synthetic material is inert.

[0039] Preferably, the hydrocarbon solvent is a medium evaporating hydrocarbon solvent.

30 **[0040]** Preferably, the core comprises at least one silicone elastomer.

[0041] Preferably, the silicone elastomer is a pourable room temperature vulcanising silicone rubber. Further preferably, it holds a Shore A Hardness of about 14.

35 **[0042]** Optionally, the core further comprises a liquid silicone elastomer.

[0043] Preferably, the pad is flexible. Optionally, it is extensible.

40 **[0044]** Optionally, the housing defines an internal chamber having a platform. Preferably, the position of the platform relative to the opening is adjustable.

[0045] Optionally, the laparoscopic apparatus further comprises a moveable platform. Preferably, the movable platform is located within the base of the laparoscopic apparatus.

45 **[0046]** Preferably, the platform comprises a first side and second side, the position of at least one of the first side and the second being adjustable relative to the opening.

50 **[0047]** Further preferably, the position of each side of the platform can be altered independently of any other side.

[0048] Optionally, a drawer is provided in the laparoscopic apparatus to accommodate instruments or any similar implements.

55 **[0049]** For the purposes of this specification, what is meant by the term "laparoscopic tool" is any instrument that may be used during the course of a laparoscopic operation, and is intended to include, but is not limited to

cannulae, telescopes, and trocars.

Brief Description of the Drawings

[0050] An embodiment of the invention will now be described, by way of example, with reference to the accompanying drawings, in which:

Figure 1 is a perspective view of a laparoscopic apparatus according to a preferred embodiment of the present invention;

Figure 2 is an exploded perspective view of a base section of the laparoscopic apparatus of Figure 1;

Figure 3 is a cross-sectional side view along the line A-B of Figure 2;

Figure 4 is a plan view of a lid section of the laparoscopic apparatus of Figure 1;

Figure 5 is an exploded perspective view of a rotatable joint of the lid section of Figure 4;

Figure 6 is a cross-sectional side view of the rotatable joint of Figure 4 in use;

Figure 7A is a cross-sectional view of an incision aperture of the lid of Figure 4; and

Figure 7B is an exploded perspective view of an incision aperture of Figure 7B.

Detailed Description of the Drawings

[0051] Referring now to Figure 1 of the drawings, there is shown a laparoscopic apparatus 10 according to a preferred embodiment of the present invention. The laparoscopic apparatus 10 comprises a base section 12, and a lid section 14.

[0052] Figure 2 is an exploded perspective view of the base section 12 of the laparoscopic apparatus 10. The base section 12 comprises a hollow substantially parallelepiped-shaped body 16, with an open, in use, uppermost face. A generally planar platform 18 is located within the body 16, and is of similar size to a, in use, bottom face of the body 16. A generally obround-shaped elongate aperture 20 is provided on at least one face of the body. Each elongate aperture 20 is substantially perpendicular to the longitudinal axis of the body 16. A hinge projection 22 is provided, which is cooperably attached to at least one side of the platform 18. The hinge projection 22 facilitates relative rotational motion between the platform 18 and the hinge projection 22. A screw threaded fixing bolt 26 is provided, which locates through the elongate aperture 20, and engages with the hinge projection 22 (See Figure 3). An annular washer 24 is provided, which locates between the face of the body 16 and the fixing bolt 26, and engages with a numerical scale rule 25 to facilitate accurate quantitative placement of the hinge projection 22 relative to the elongate aperture 20. Adjusting the position of the fixing bolt 26 relative to the elongate aperture 20 can thereby temporarily alter the relative height of the side of the platform 18. A generally planar elliptical-shaped mount 28 is provided on each of

two respective opposing sides of the body 16, and each is substantially parallel to and continuous with the respective sides of the body 16.

[0053] Figure 4 is a plan view of the lid section 14 of the laparoscopic apparatus 10. The lid section 14 is generally rectangular in shape, and curved in form, Figure 1. A number of apertures 34 are provided through the lid section 14. A joint 32 is provided through which, a laparoscopic tool 42, Figure 6, can be mounted.

[0054] Figure 5 is an exploded perspective view of the joint 32, which comprises a socket 35 and a ball 39. The socket 35 comprises an annular second section 36, which is inter-engaging with an annular first section 36'. The ball 39 comprises a generally hemi-spherical outer member 40' and a generally hemi-spherical inner member 40. A generally hollow cylindrical tube 41, is provided through each of the hemi-spherical members 40, 40', and, in use, is substantially coaxial with the socket 35. When in use, the socket 35 interengages with the ball 39, facilitating rotation of the ball 39 through multiple planes relative to the socket 35.

[0055] In use, the first annular section 36' is spaced a distance apart from the second annular section 36, and the ball 39 is housed therebetween. The distance between the first annular section 36' and the second annular section 36 is defined by resistance means in the form of four springs 38. The springs 38 extend between each of the first annular section 36' and the second annular section 36. In an embodiment of the invention, the spring 38 is a compression spring, whereby the first annular section 36' and the second annular section 36 are biased away from each other. In an alternative embodiment, the spring 38 is a tension spring, whereby the first annular section 36' and the second annular section 36 are biased toward each other. In either case, the respective terminal ends of the spring 38 can be attached to one or both of the first annular section 36' and the second annular section 36.

[0056] It is, however, envisaged that the socket 35 may be formed from a resilient material, which can be adapted to apply varying pressure to the ball 39. In such an example, the socket 35 is the resistance means.

[0057] Four screws 38' are provided, in use, to adjust the pressure applied to the ball 39 by the socket 35, and in the preferred embodiment illustrated, by adjusting the distance between the first annular section 36' and the second annular section 36. Each screw 38' extends between the first annular section 36' and the second annular section 36, and is in operable association with either of the sections 36, 36'. The first annular section 36' is provided with a complementary screw thread (not shown), with which each of the screws 38' can reversibly engage, in use. Rotation of the screw 38' in a first direction will advance the screw 38' toward the first annular section 36', thereby decreasing the distance between the first annular section 36' and the second annular section 36. Rotation of the screw 38' in a second, opposing direction will retract the screw 38' toward the first annular section

36', thereby increasing the distance between the first annular section 36' and the second annular section 36.

[0058] Figure 6 is a cross-sectional side view of the joint 32, in use, with a laparoscopic tool 42 mounted thereto. The first section 36' of the socket 35 is attached to the lid section 14, Figure 4, by a set of clips 37. The second section 36 of the socket 35 is attached to the first section 36' by four spring biased screws 38, 38', surrounding the hemi-spherical members 40, 40' of the ball 39. The ball 39 is positioned between the first section 36' and the second section 36 of the socket 35. The spring biased screws 38, 38' allow the level of friction to be adjusted between the first section 36' and the second section 36 of the socket 35, resultantly adjusting the friction between the socket 35 and the ball 39. The laparoscopic tool 42 is a telescope comprising a camera 44, which is mounted within the telescope body. An optical connection 46 transmits visual graphics from the camera 44 to a visual display unit (not shown).

[0059] Figure 7A is a cross-sectional view of an aperture 34 of the lid section 14 of the laparoscopic apparatus 10. The aperture 34 comprises an annular housing 52 and a pad 50. The pad 50 is generally cylindrical in shape. The annular housing 52 is generally annular in form and is shaped and dimensioned to accommodate the pad 50, within the inner edge of the annular housing 52. The annular housing 52 locates in a recessed opening 48 in the housing 30 of the lid section 14 of the laparoscopic apparatus 10. Preferably, the pad 50 is formed from a material that is deformable under a first given pressure, but is severable under a second higher given pressure, so as to provide a realistic response representative of skin, when an instrument is applied with force against the pad 50.

[0060] The present invention finds utility in the training of medical professionals, such as trainee surgeons. In particular, the present invention finds utility as an affordable and portable platform that effectively demonstrates or trains laparoscopic skills and techniques by providing a realistic physical experience with real-time interaction outside of the operating room. The present invention allows a trainee surgeon to master the skills required to compensate for the narrow field of view, limitation of work space, and the lack of depth sensation associated with this field of surgery. The shape and dimension of the apparatus offers a realistic semblance to the human torso; and the integrated adaptable joint allows for a variety of laparoscopic instruments, including canulae, trocars and telescopes, to be used in a realistic fashion to augment both basic and advanced laparoscopic experiences, and ultimately to develop the coordination, technique, and precision of the trainee surgeon. The incision pads also lend to the realistic experience by mimicking the response of human skin to the application of a surgical instrument. Use of the invention in cooperative association with a visual display system also affords the user the opportunity to become acquainted with visualising a 3-dimensional operative field as a 2-dimensional output,

and the imposition associated therewith. Moreover, the simple and lightweight design makes the apparatus easy to assemble and transport. Taken together, the present invention provides a realistic surgical experience, by simulating the response of an actual human torso, without endangering patients or animal models.

Claims

1. A laparoscopic apparatus comprising a housing; a socket; a joint comprising a ball rotatably engagable within the socket (35) being shaped and dimensioned to at least partially house the ball therebetween, wherein the joint is in operative association with the housing and adapted to substantially accommodate a laparoscopic tool, in use, through the joint, and wherein the joint permits movement of the laparoscopic tool, in use; and resistance means in operative association with the joint, adapted to adjust resistance to movement of the laparoscopic tool, in use;
characterised in that the socket comprises a first section (36'), and a second section (36) spaced apart by a distance from the first section, and the resistance means is adjustable, by altering the distance between the first and second sections of the socket.
2. A laparoscopic apparatus as claimed in claim 1, wherein the distance between the first and second sections of the socket is defined by a resilient member extending between the first and second sections.
3. A laparoscopic apparatus as claimed in claim 2, wherein the first and second sections of the socket are biased away from one another by the resilient member.
4. A laparoscopic apparatus as claimed in claim 2 or 3, wherein the distance between the first and second sections of the socket is adjusted by an actuator in operable association with at least one of the first and second sections.
5. A laparoscopic apparatus as claimed in claim 3, wherein the resilient member is a spring.
6. A laparoscopic apparatus as claimed in claim 4, wherein the actuator is a screw fixing.
7. A laparoscopic apparatus as claimed in claim 6, wherein rotation of the screw in a first direction / advances the first section toward the second section.
8. A laparoscopic apparatus as claimed in claim 6, wherein rotation of the screw in a second, opposing direction retracts the first section from the

second section.

Patentansprüche

1. Laparoskopische Vorrichtung, umfassend ein Gehäuse; eine Aufnahme; ein Gelenk, umfassend eine Kugel, die drehbar in der Aufnahme (35) eingreifen kann, die dazu geformt und dimensioniert ist, die Kugel mindestens teilweise unterzubringen, wobei sich das Gelenk in wirksamer Verbindung mit dem Gehäuse befindet und dazu angepasst ist, im Gebrauch ein laparoskopisches Werkzeug im Wesentlichen durch das Gelenk aufzunehmen und wobei das Gelenk die Bewegung des laparoskopischen Werkzeugs im Gebrauch ermöglicht; und ein Widerstandsmittel in wirksamer Verbindung mit dem Gelenk, das dazu angepasst ist, den Widerstand gegen Bewegung des laparoskopischen Werkzeugs im Gebrauch zu verstellen; **dadurch gekennzeichnet, dass** die Aufnahme weiter einen ersten Abschnitt (36') und einen um eine Entfernung von dem ersten Abschnitt beabstandeten zweiten Abschnitt (36) umfasst und das Widerstandsmittel durch Verändern der Entfernung zwischen dem ersten und dem zweiten Abschnitt der Aufnahme verstellbar ist.
2. Laparoskopische Vorrichtung nach Anspruch 1, wobei die Entfernung zwischen dem ersten und dem zweiten Abschnitt der Aufnahme von einem elastischen Element definiert wird, das sich zwischen dem ersten und dem zweiten Abschnitt erstreckt.
3. Laparoskopische Vorrichtung nach Anspruch 2, wobei der erste und der zweite Abschnitt der Aufnahme von dem elastischen Element voneinander weg vorgespannt werden.
4. Laparoskopische Vorrichtung nach Anspruch 2 oder 3, wobei die Entfernung zwischen dem ersten und dem zweiten Abschnitt der Aufnahme von einer Betätigungsverrichtung verstellt wird, die sich in betätigbarer Verbindung mit dem ersten und/oder dem zweiten Abschnitt befindet.
5. Laparoskopische Vorrichtung nach Anspruch 3, wobei es sich bei dem elastischen Element um eine Feder handelt.
6. Laparoskopische Vorrichtung nach Anspruch 4, wobei es sich bei der Betätigungsverrichtung um ein Schraubenbefestigungselement handelt.
7. Laparoskopische Vorrichtung nach Anspruch 6, wobei die Drehung der Schraube in einer ersten Richtung den ersten Abschnitt auf den zweiten Abschnitt zu voranbewegt.

8. Laparoskopische Vorrichtung nach Anspruch 6, wobei die Drehung der Schraube in einer zweiten, entgegengesetzten Richtung den ersten Abschnitt von dem zweiten Abschnitt zurückzieht.

Revendications

1. Appareil laparoscopique comprenant un logement ; une emboîture, une articulation comprenant une rotule engageable avec faculté de rotation dans l'emboîture (35) conformée et dimensionnée pour au moins recevoir partiellement la rotule, dans lequel l'articulation est opérationnellement associée au logement et adaptée pour recevoir la majeure partie d'un outil laparoscopique, durant l'utilisation, à travers l'articulation, et dans lequel l'articulation permet le mouvement de l'outil laparoscopique, durant l'utilisation ; et un moyen de résistance associé opérationnellement à l'articulation, adapté pour régler la résistance au mouvement de l'outil laparoscopique, durant le service ; **caractérisé en ce que** l'emboîture comprend une première section (36') et une seconde section (36) espacée par une certaine distance de la première section, et le moyen de résistance est réglable, en modifiant la distance entre les première et seconde sections de l'emboîture.
2. Appareil laparoscopique selon la revendication 1, dans lequel la distance entre les première et seconde sections de l'emboîture est définie par un élément élastique s'étendant entre les première et seconde sections.
3. Appareil laparoscopique selon la revendication 2, dans lequel les première et seconde sections de l'emboîture sont écartées l'une de l'autre par une charge préliminaire exercée par l'élément élastique.
4. Appareil laparoscopique selon la revendication 2 ou 3, dans lequel la distance entre les première et seconde sections de l'emboîture est réglée par un actionneur en association opérationnelle avec au moins l'une des première et seconde sections.
5. Appareil laparoscopique selon la revendication 3, dans lequel l'élément élastique est un ressort.
6. Appareil laparoscopique selon la revendication 4, dans lequel l'actionneur est une fixation de vis.
7. Appareil laparoscopique selon la revendication 6, dans lequel la rotation de la vis dans un premier sens avance la première section vers la seconde section.
8. Appareil laparoscopique selon la revendication 6, dans lequel la rotation de la vis dans un second sens

opposé rétracte la première section de la seconde section.

5

10

15

20

25

30

35

40

45

50

55

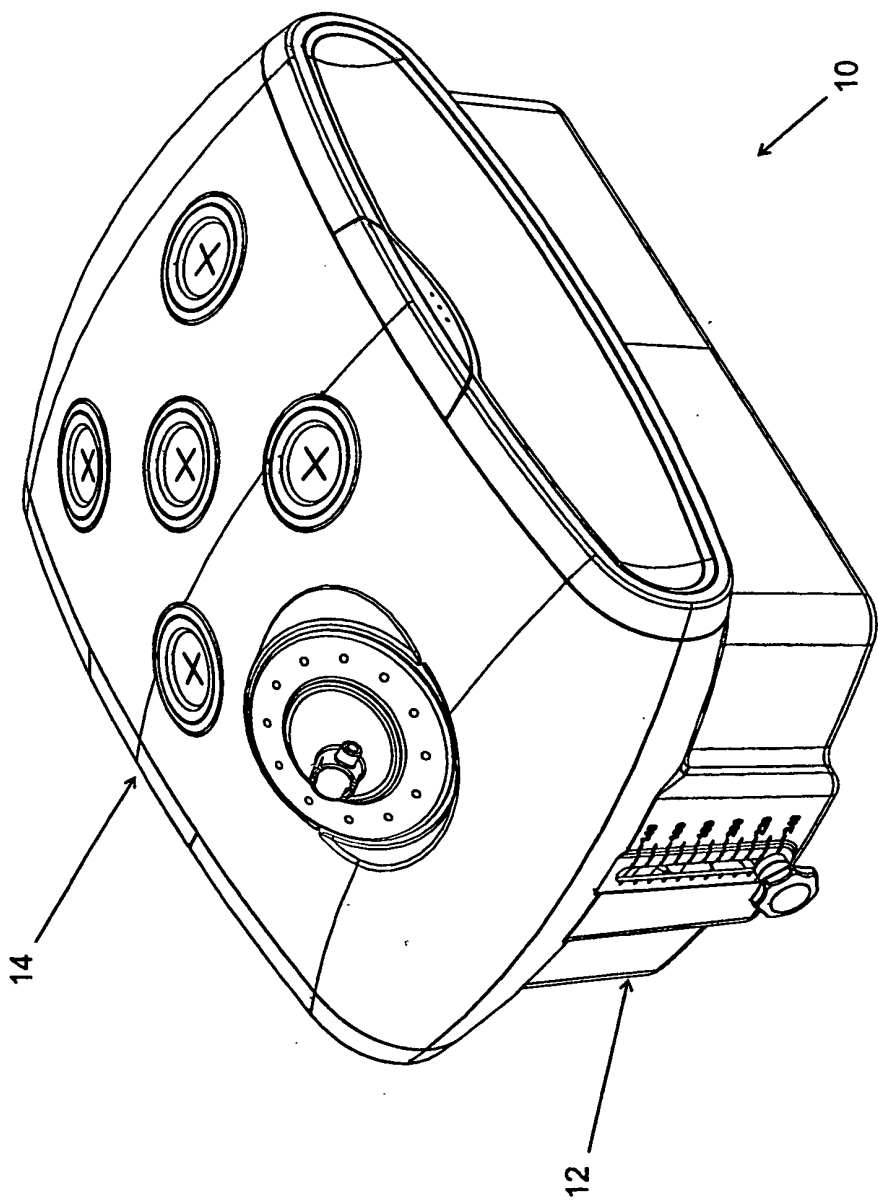

Figure 1

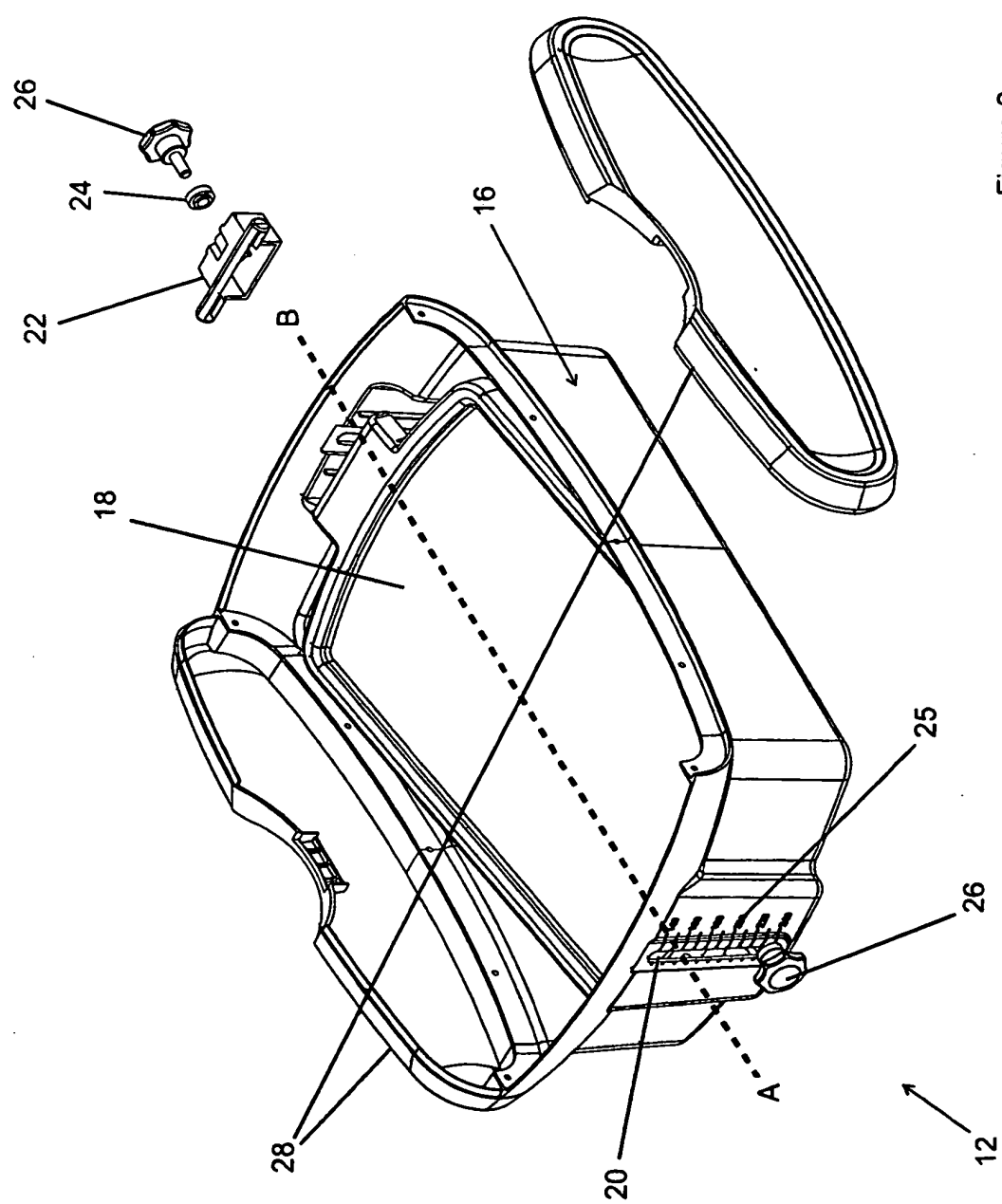

Figure 2

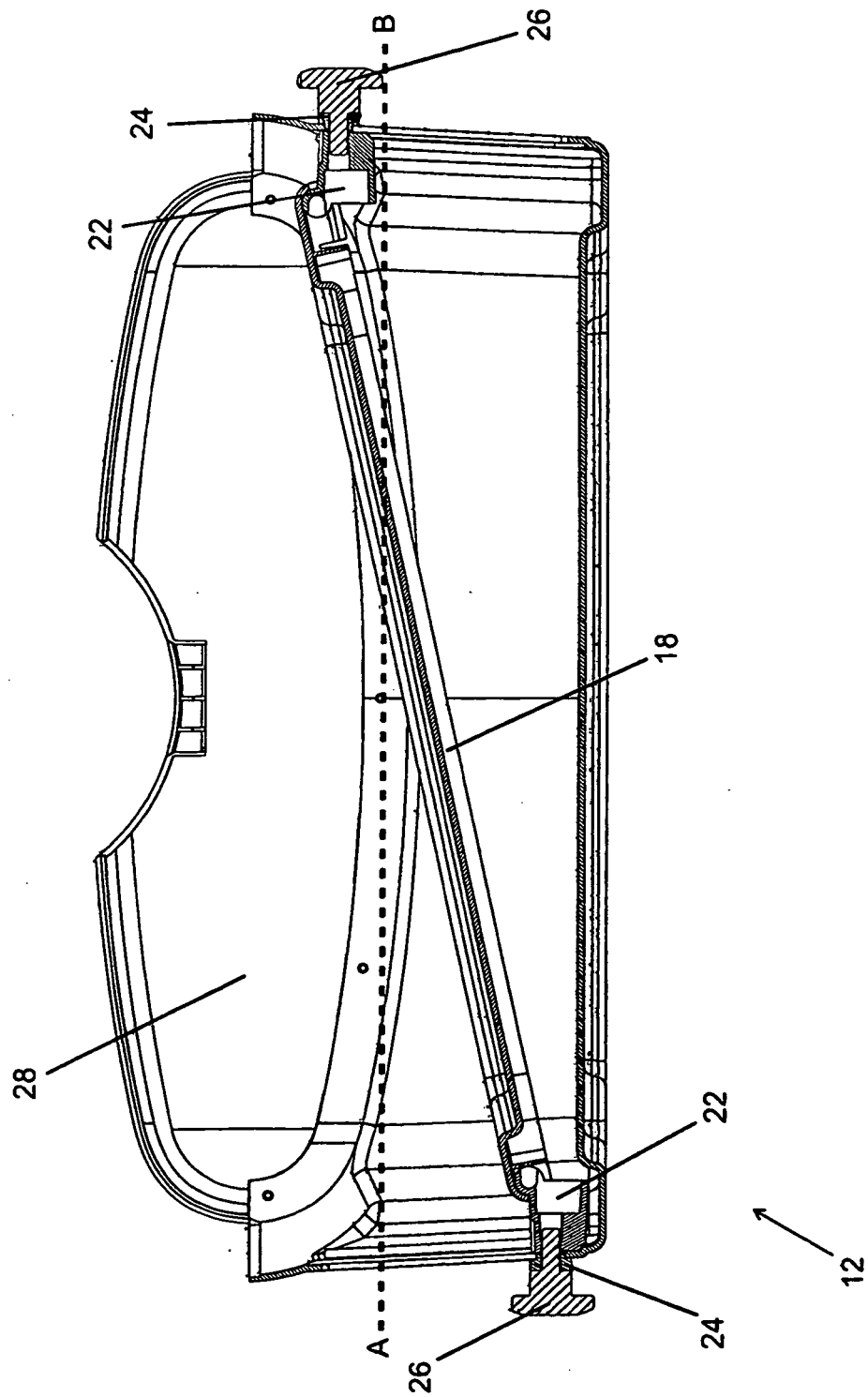

Figure 3

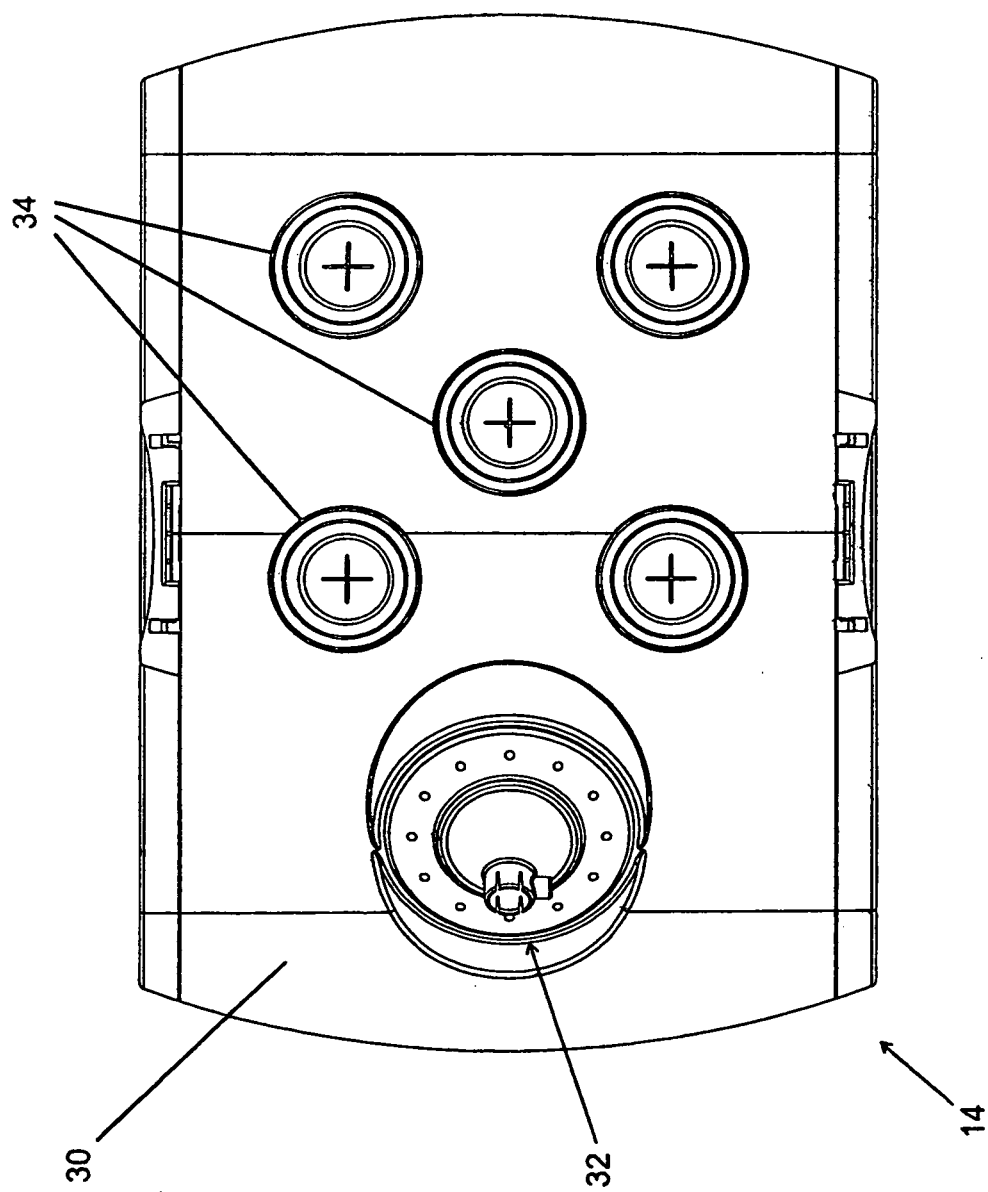

Figure 4

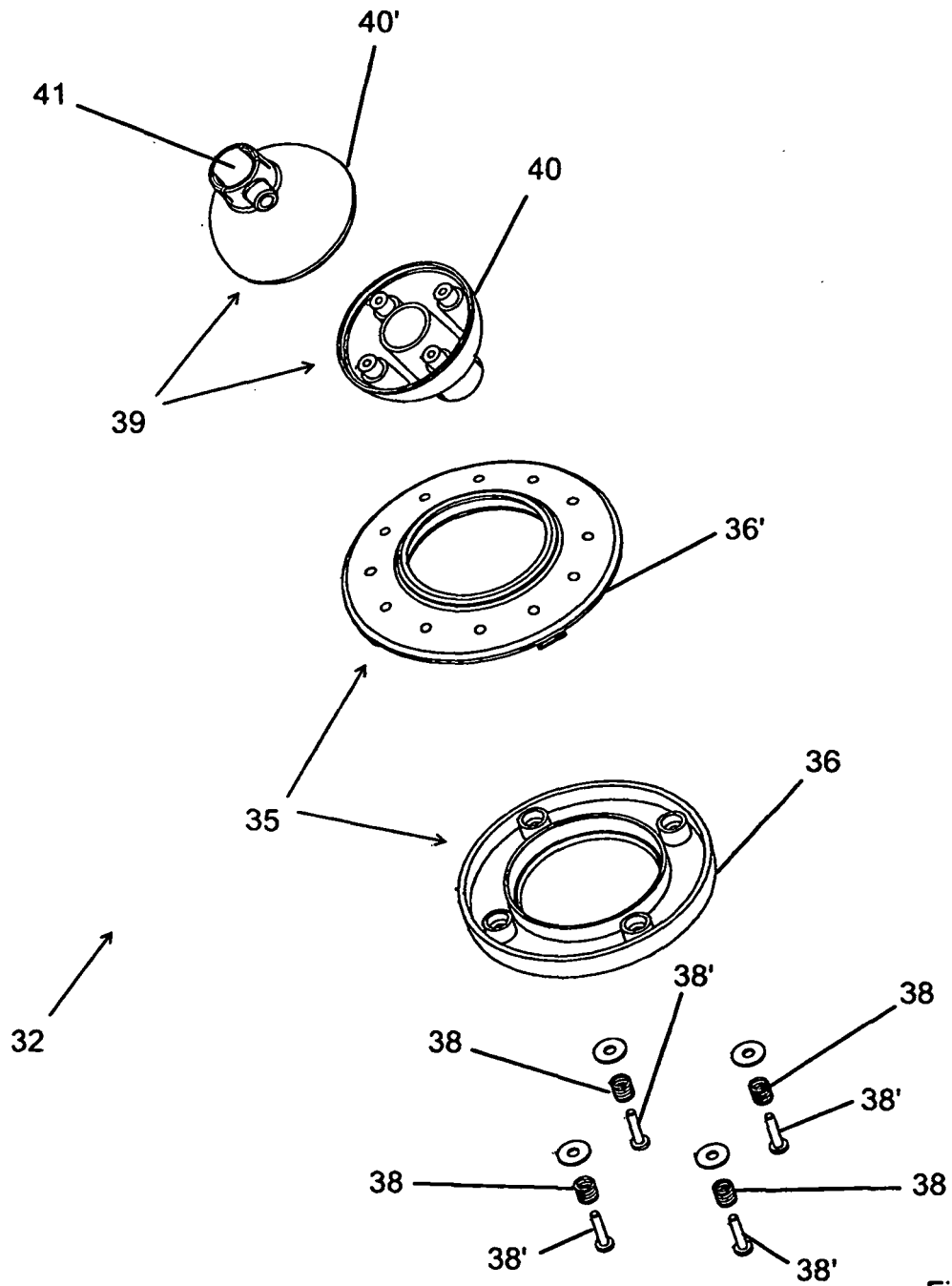

Figure 5

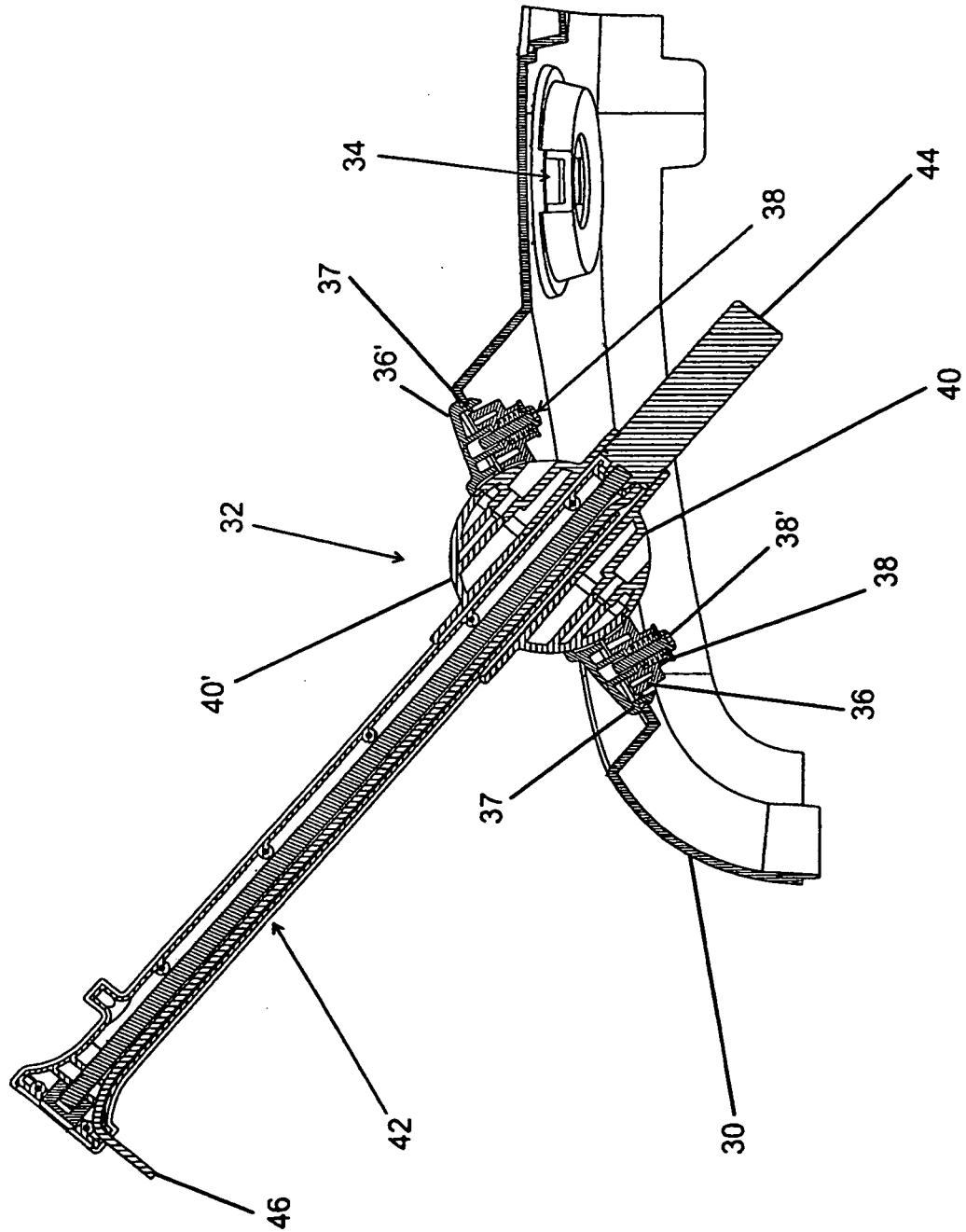

Figure 6

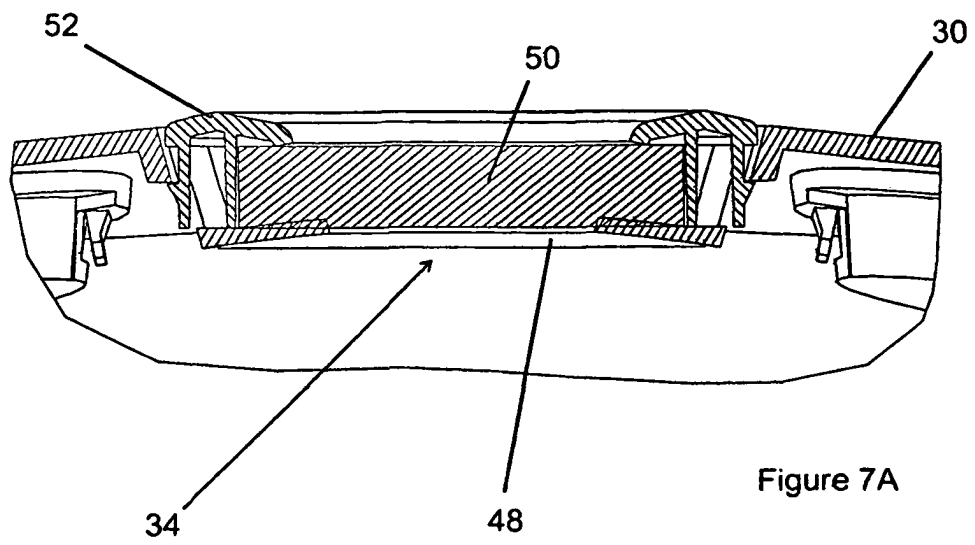

Figure 7A

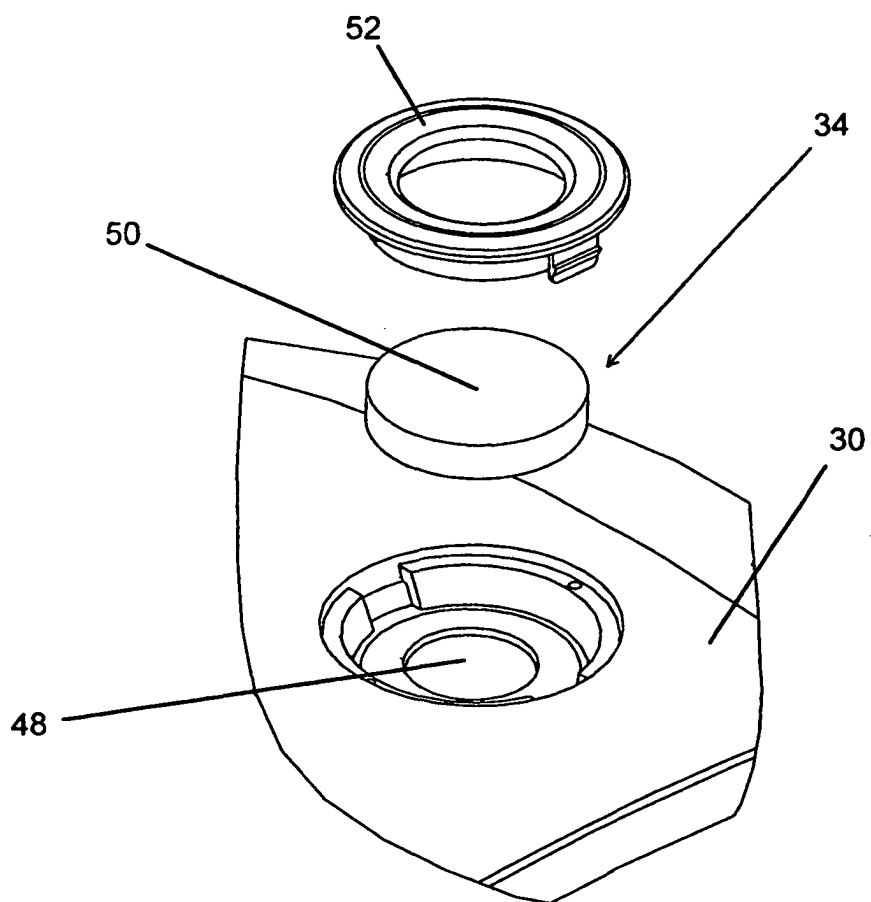

Figure 7B

REFERENCES CITED IN THE DESCRIPTION

This list of references cited by the applicant is for the reader's convenience only. It does not form part of the European patent document. Even though great care has been taken in compiling the references, errors or omissions cannot be excluded and the EPO disclaims all liability in this regard.

Patent documents cited in the description

- US 2004024418 A1 [0006]

专利名称(译)	腹腔镜训练器具		
公开(公告)号	EP2068295B1	公开(公告)日	2014-09-03
申请号	EP2008020955	申请日	2008-12-03
[标]申请(专利权)人(译)	ENDOSIM		
申请(专利权)人(译)	ENDOSIM有限公司		
当前申请(专利权)人(译)	ENDOSIM有限公司		
[标]发明人	NIBLOCK IAN OSULLIVAN RAY BAILIE ROBERT PRENDIVILLE WALTER		
发明人	NIBLOCK, IAN O'SULLIVAN, RAY BAILIE, ROBERT PRENDIVILLE, WALTER		
IPC分类号	G09B23/28 A61B17/00 A61B19/00		
CPC分类号	G09B23/285 A61B34/76 A61B2017/00716		
优先权	2007023329 2007-12-03 EP		
其他公开文献	EP2068295A2 EP2068295A3		
外部链接	Espacenet		

摘要(译)

腹腔镜装置技术领域本发明涉及腹腔镜装置 (10)。特别是, 它涉及一种用于训练医疗专业人员的装置, 特别是那些从事腹腔镜手术领域的医疗专业人员。装置 (10) 包括壳体;接头 (32) 与壳体可操作地连接并且适于在使用中通过接头 (32) 基本上容纳腹腔镜工具 (42), 接合部 (32) 允许腹腔镜工具 (42) 在使用中移动;阻力意味着与关节 (32) 可操作地关联, 适于在使用中调节对腹腔镜工具 (42) 的运动的阻力。因此, 本发明通过模仿对患者进行外科手术技术的感觉来提供真实的手术体验。

