

(19)
(12)

(KR)
(A)

(51) 。 Int. Cl. 7
G01N 29/10

(11)
(43)

2003-0043695
2003 06 02

(21) 10-2002-0073357
(22) 2002 11 25

(30) JP-P-2001-00359945 2001 11 26 (JP)

(71) 53188 3000

(72) 가 4 7-127 가
가 4 7-127 가

(74)

:

(54)

(3), (4), (5) (2) (6)가 ,
(11), (12) (13)가 , 가 , (10)가 .

1

1 1 ,

2 1 (10) A-A ,

3 (6) 가 (6) ,

4 2 (20) ,

5	4	(20)	B-B	,
6	4	(20)		,
7	3	(30)		,
8	7	(30)	C-C	,
9	4	(40)		,
10	9	(40)	D-D	,
11	5	(50)		,
12	11	(50)	E-E	,
13	6	(60)		,
14	13	(60)	F-F	,
15				,
16	15			.

2 : 3 :
4 : 5 :
6 :
10, 20, 30, 40, 50, 60 :
11, 21, 31, 41, 51, 61 :
12, 22, 32, 42, 52, 62 :
13, 23, 33, 43, 53, 63 :
14, 24, 34, 44, 54, 64 :

(grippability) (subject) , ,
가 ,
(lesion) ,

가
 16 15 가
 (100) (102b) (102) (3) 15 16 (102) (3) (102a)
) (101)
 (3) (broad) (4) (5) (2) (2)
 가 (() (102) (103)
 (103)
 (2) (102)
 (104)가 (104) (105)가
 (3) (4) (101)
 (4) (3) (5) (2) (4)
) (2)
 (104) (101)
 (solvent)가
 가 (100)
 (intestine), (vagina),
 (102a, 102b), (101) (103)
 (mold) 가 가
 가 (102)가 (102)
 가 가
 가
 1 가
 가
 1 가
 2 가
 가
 가

가 .

1

1 , , 가 (10) , (10)가 (10)가 1

3 가 .

1 1 (10) A-A . 1 2 , (10) 2 1 (3), (4),
(5) (6) (3) (4) (6) (5) (2) (12) (2) , (6)
(2) (()) . (4), (5) (2) (2) (6)

(12) (11) (3) (12) (2)
(13) (13) (2) 가
(2) (12) (14)

(3) (4) (11)
(3) (4) (11)
(4) (5) (2) (3) (4) (())
(2) (2) (3) (4) (11)
(14) , 가 (11)

가 , 가 (10)

가 , 가 (10)

(10) , (3), (4), (5) (6)
(6) (12) (12) (11)
(13)

(6) (2) (6)
(6) (6) 가 (6) (16a, 16b)
(6) (15) (16a) (16) (6a) (16b)

3 (6) (15) (15) (6a)
(6)가 (16a) (11)가 (12) (16b) (6) (15)
(10) (6) (3) (11) (12) (16a) (6a) (())
11) (11)

(11) (13)가 1 (10) (12)
(12) 가 , 가 (10)

, (11), (12) (13)가 (13) , (14) (sea m) (12) (10)

(2) (4) (5) (2) (5) (4) 가 .

2

, 2 가 (12), (11) (13)가 1 (10) , 2 (20) 1 (10) , .

4 2 (20) B-B (20) 5 4 (22) 4 (3) (2) (3) (4) (5) (2) , (2) () .

(22) 가 (24) (20) (2) (22) (23) (23) (23) (2) (24) , (2) (slip stopper) .

(3) (4) (21) , (3) (4) (4) (5) (2) (3) () (2) .

, (24) , (21) 가 (2) 0) , , , , .

, 6 (20) (21), (20) (22a) 6 (22b) (20) .

(22a, 22b) (23a) (23 b) (24) (23a, 23b) 2 (two-color) (22a, 22b) ,

(20) (21), (22a) (22b) (22b) (20) (3), (4), (5) (21), (22a) (22b) (22b) (20)

, (23) (22)가 2 가 2 .

(24) (23)가 , , (2) (4) (5) , (2)

(5) (4) 가 .

3

, 3 가 . (12), (11) (13)가 1
(10) , 3 (30)
(10) , 1
(10) , .
7 3 (30) 8 7
(30) C-C (30) (32)
(31) (33) (3) ,
(4), (5) (6) .
(3) (6) , (3)
(4) (5) (2) , (2) (())
(4), (5) (2) (6) (2)
.
(31) (3) (33) (2)
(33) (33) (2) 가
(31) (2) (32) , (34)
(33)가
(3) (4) (31)
, , (3) (4)
(4) (5) (2) (3) (())
, (34) , (31)
, 가
, 가 , (30)
, , , ,
(30) , (3), (4), (5) (2)
(6) , (6) (31) (33)
(30)가 , (32)
, (31) (33)가 (32)가 3 가 ,
(30) , 가 , (30)
, (32)가 , (30) , 가 .
(2) (4) (5) , (2)
(5) (4) 가 .

4

, 4 가 , 가 1
(10) , 4 (40)
(10) , 1

9 (40) 4 D-D (40) 9 10 (40) 10 (3), (42)
(4), (5) (6) (3) (4) (5) (6) (2) (2)
(2) () (4), (5) (2)
(6)
(42) (11) (3) (40) (2)
(42) (43) (43) , (42)
(2) 가 (44) (2) , (42)
(3) (4) (41)
(4) (5) (2) (3) (4)
() (2)
(44) , 가 (41) (4)
0) , , , ,
(40) , (3), (4), (5) (6)
(43) (6) (6) (42) (42)
(41) ,
(42) , (41)가 4 (40) (42)
(42) 가 , (42) 가 (41)
(41), (42)가
(44) (42)
(40)
(2) (4) (5) , (2)
(5) (4) 가 .

5
, 5 가 , 5 가 1
(10) , 5 (50)
(10) , 1
11 5 (50) 11 12 (50) 12 11
(51) E-E (51) (52) (52)
(4) (5) (2) (3) ()
(51), (3), (4), (5) (2) (6)
(52) (2) (52) (53) (53)
(2) 가 (54)

(3) (4) (51)

(4) (5) (2) (3) (4)

(2) (54) (51)

0) 가 (5)

(50) (6) (51), (3), (4), (5)

(52) (6) (53)가 (6)

(53)가 4 (50) (52) (52)

가 (53)가 (53)

(54) (51)가 가 (52) (53) 가

가 가 (3) (51) (51)가 (6)

(2) (4) (5) (2)

(5) (4) 가

6

6 가 1 5 가

13 6 (60) F-F 13 14 (60) 14 13 (64)가

(62) (3) (62) (2) (3) (61)가

(3)가 (61) (62) (62)

(60) (2) (62) (63) (63)

(2) (63) (64) (2)

(3) (4) (5) (2) (2)

(3) (4) (61)

(4) (5) (2) (3) (4)

(2)

, (64) , (61)
 . , 가 .
 , (63) (62) 2 2 . 2
 , (60) 가 ,
 .
 , (63)가 , (63)
 , (64)
 6 , 6 1 5 2
 .
 (2) (4) (5) (2)
 (5) (4) 가 .
 가 .
 ,
 , 가 , 가 ,

(57)

1.

가

2.

가

가

3.

2

4.

가

가

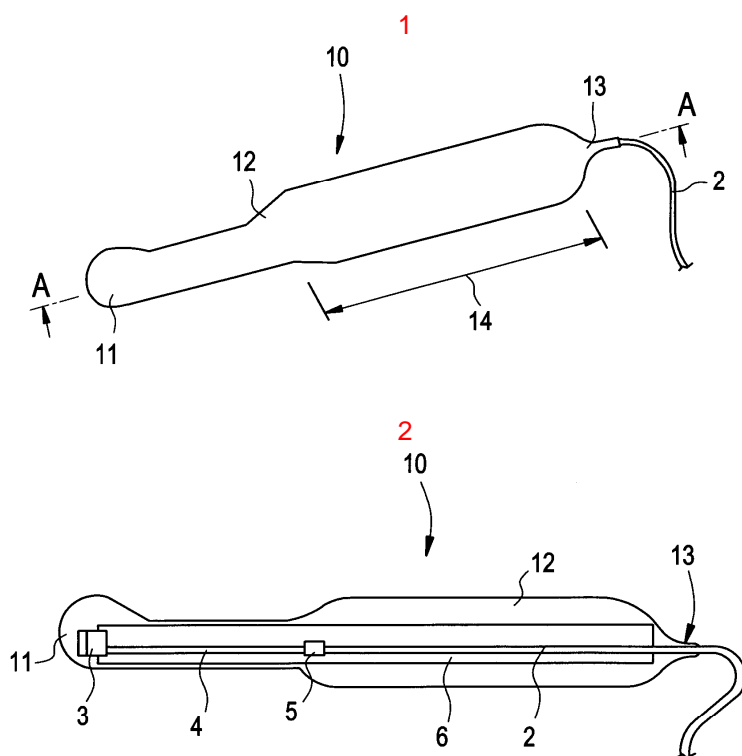

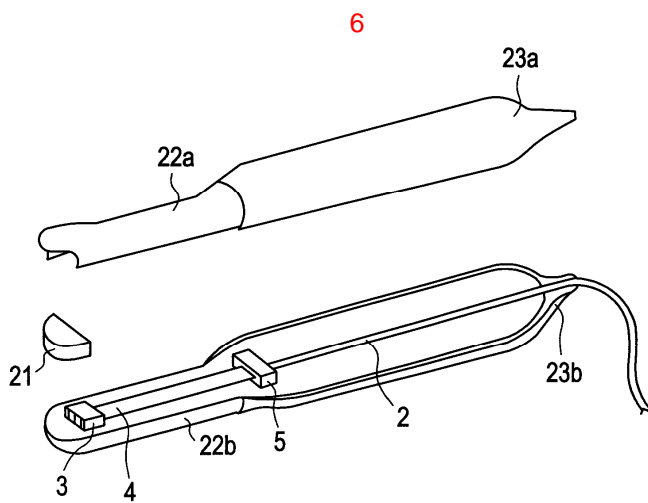
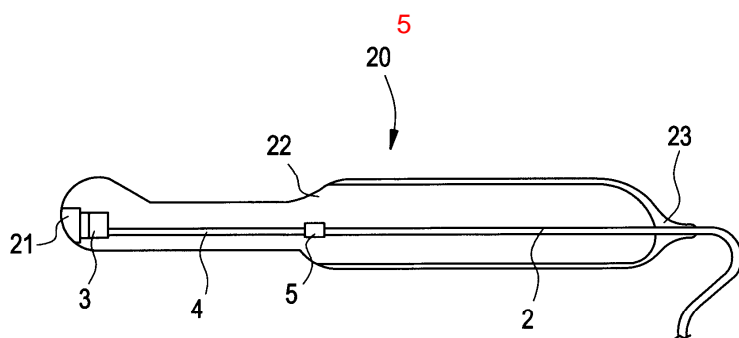
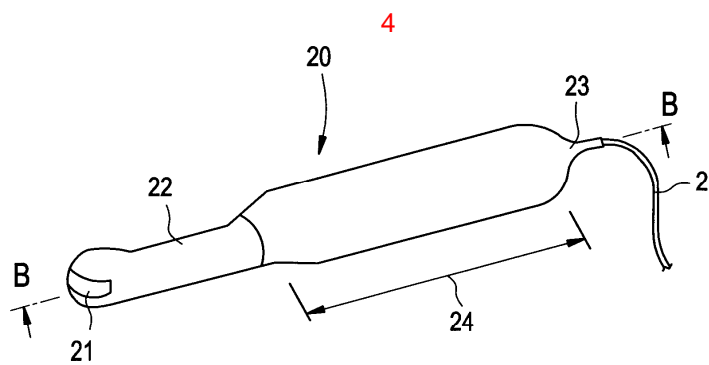
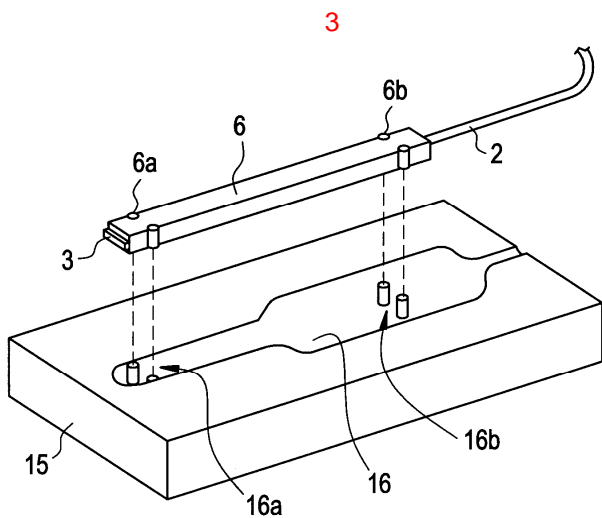

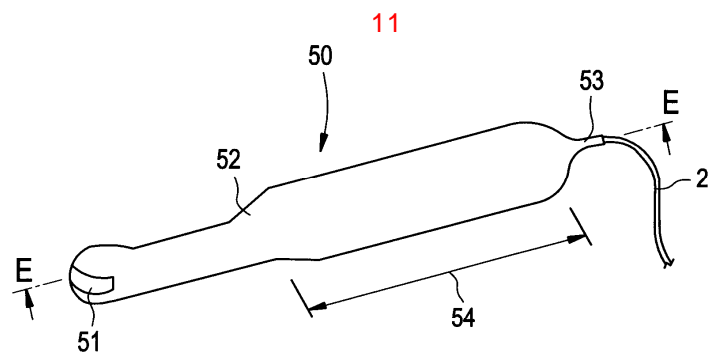
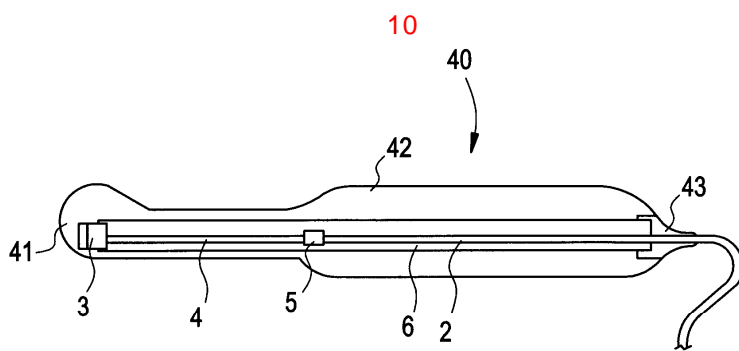
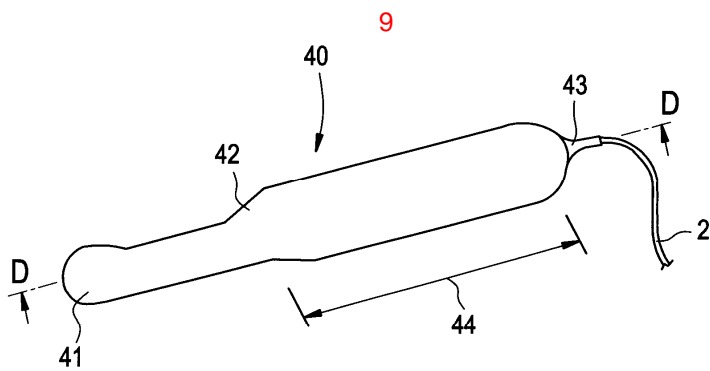
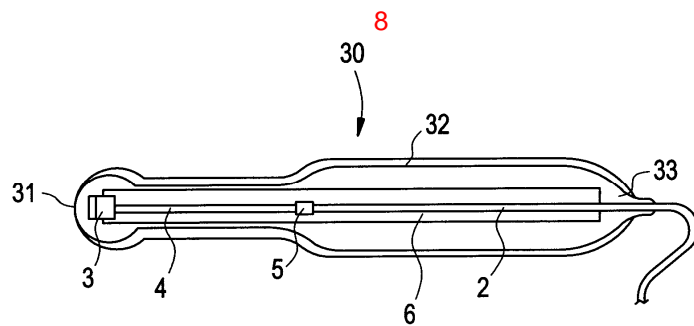
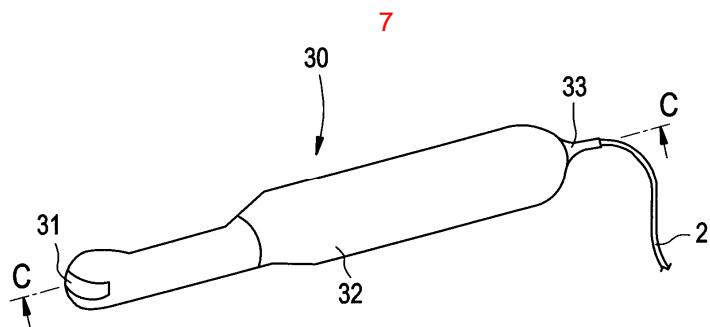

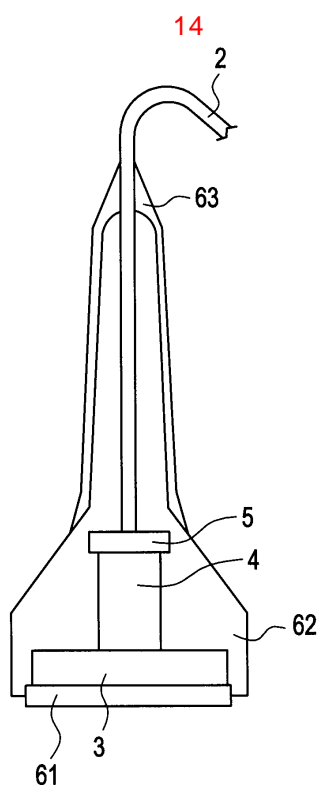
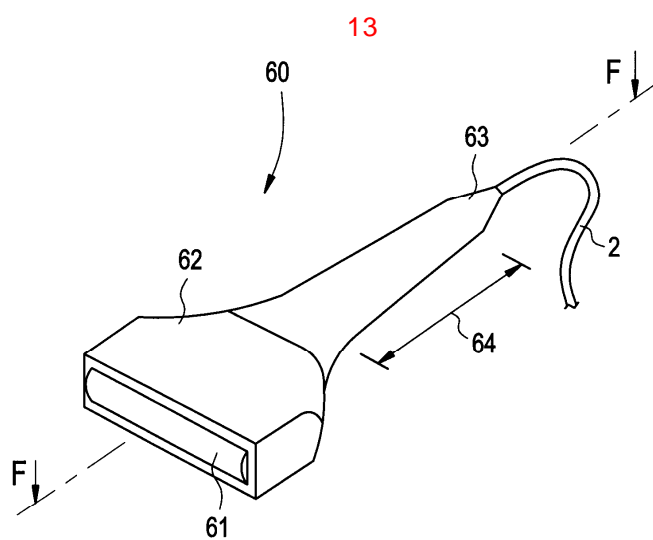
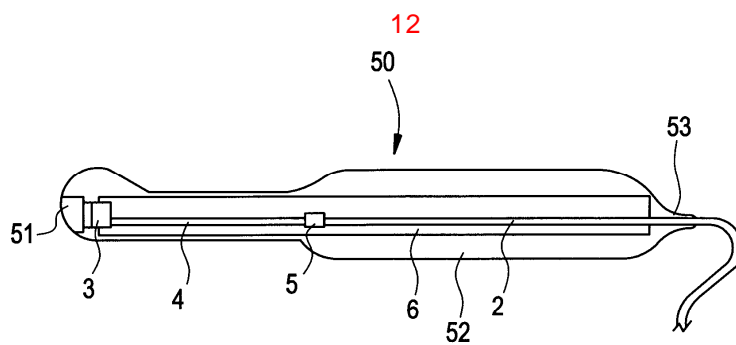

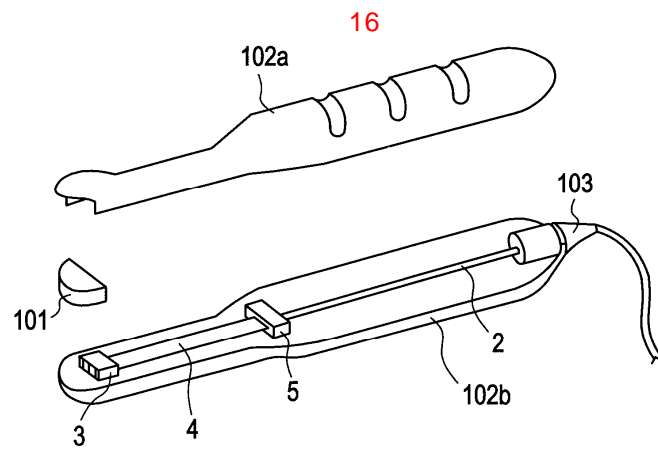
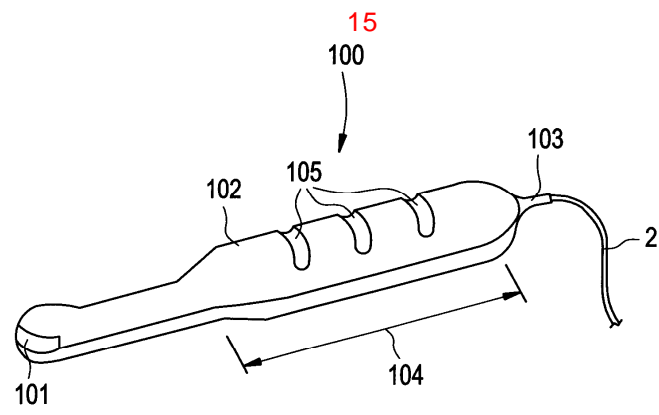

专利名称(译)	超声波探头		
公开(公告)号	KR1020030043695A	公开(公告)日	2003-06-02
申请号	KR1020020073357	申请日	2002-11-25
申请(专利权)人(译)	지이메디컬시스템즈글로벌테크놀로지컴파니엘엘씨		
当前申请(专利权)人(译)	지이메디컬시스템즈글로벌테크놀로지컴파니엘엘씨		
[标]发明人	UMEDA MANABU 우메다마나부 NOZAKI MITSUHIRO		
发明人	우메다마나부 노자키미츠히로		
IPC分类号	A61B8/12 H04R1/02 G01N29/265 G01N29/24 A61B8/00 G01N29/10		
CPC分类号	A61B8/4455 A61B8/12 A61B8/445		
代理人(译)	KIM, CHANG SE 张居正, KU SEONG		
优先权	2001359945 2001-11-26 JP		
其他公开文献	KR100491235B1		
外部链接	Espacenet		

摘要(译)

超声波探头和模具的构件数量减少，制造成本降低。并且为了提高抓握性，将超声波元件（3），宽幅电缆（4）以及连接器（5）和连接电缆（2）配合的固定构件（6）插入模具内。并且，超声透镜部分（11），壳体（12）和衬套部分（13）通过嵌件成型被模制成一体。使用一个模具减少了组装步骤的数量，减少了超声波探头（10）制造的构件的数量。可以实现制造成本的降低。

