

(12) **Patent Application Publication**
Nita et al.

(43) **Pub. Date:** **May 8, 2008**

Publication Classification

(51) **Int. Cl.**

A61B 8/00 (2006.01)

A61M 25/098 (2006.01)

(52) **U.S. Cl.** 600/466; 604/529

Correspondence Address:

Raymond Sun

Law Offices of Raymond Sun

12420 Woodhall Way

Tustin, CA 92782 (US)

(21) Appl. No.: 12/004,984

(22) Filed: **Dec. 21, 2007**

Related U.S. Application Data

(63) Continuation-in-part of application No. 11/594,663, filed on Nov. 7, 2006.

(57)

ABSTRACT

An ultrasound catheter has an elongate flexible catheter body having a lumen extending longitudinally therethrough, and an ultrasound transmission member extending longitudinally through the lumen of the catheter body. The ultrasound transmission member has a proximal end that is coupled to a separate ultrasound generating device, and a distal tip that is attached to the distal end of the ultrasound transmission member and which is located at the distal end of the catheter body. The ultrasound transmission member is directly attached to the catheter body and/or to a guidewire tube either directly or via an attachment device. The catheter has an additional radiopaque marker positioned on the distal end the catheter.

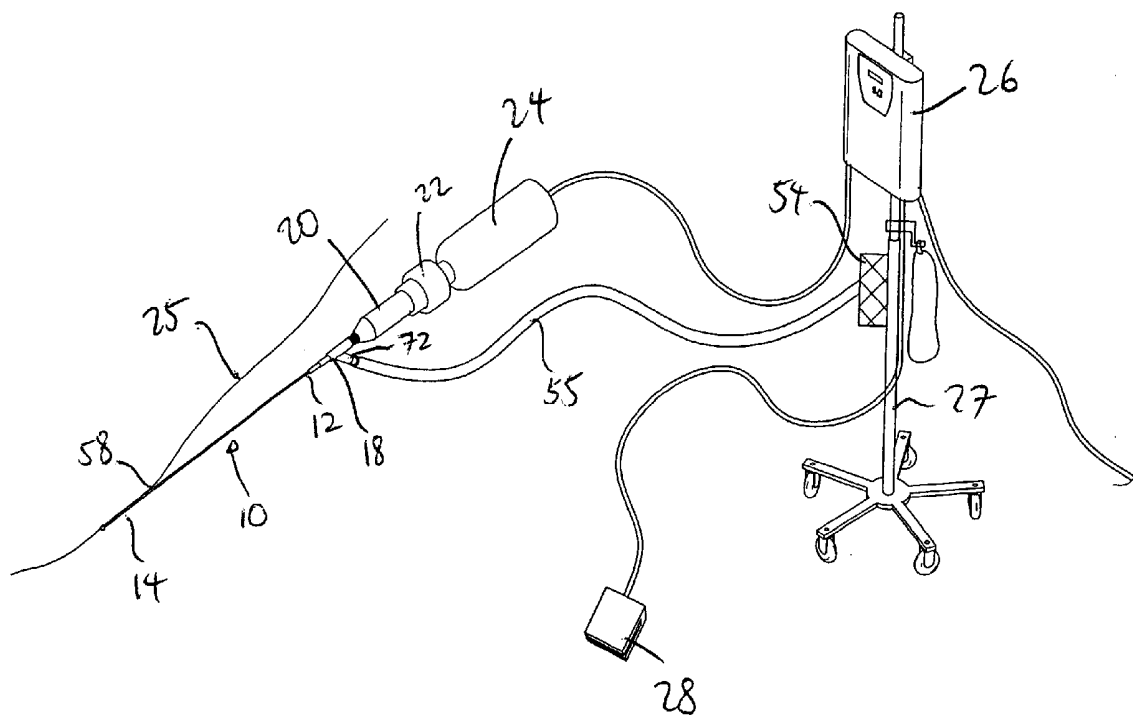

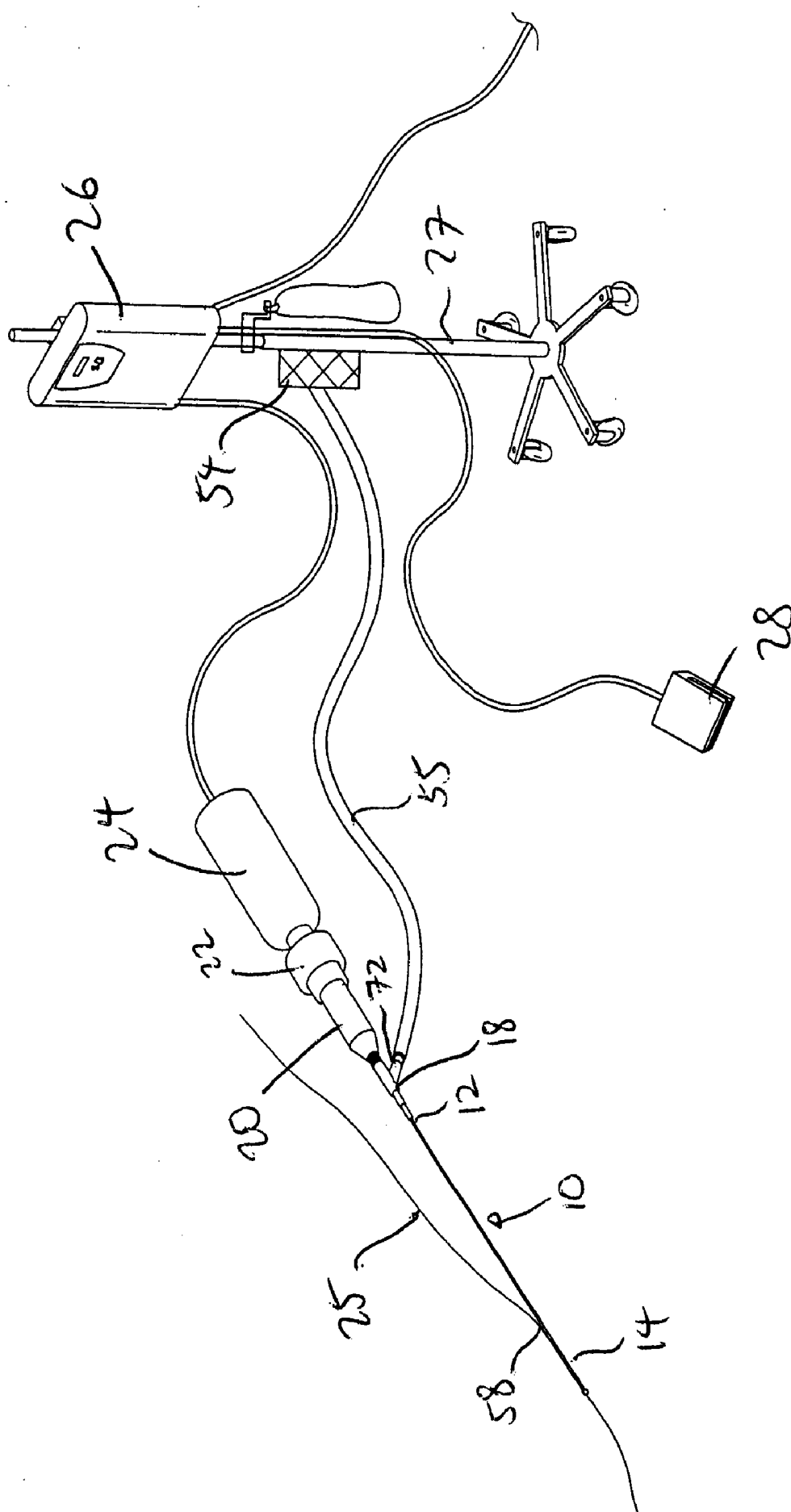
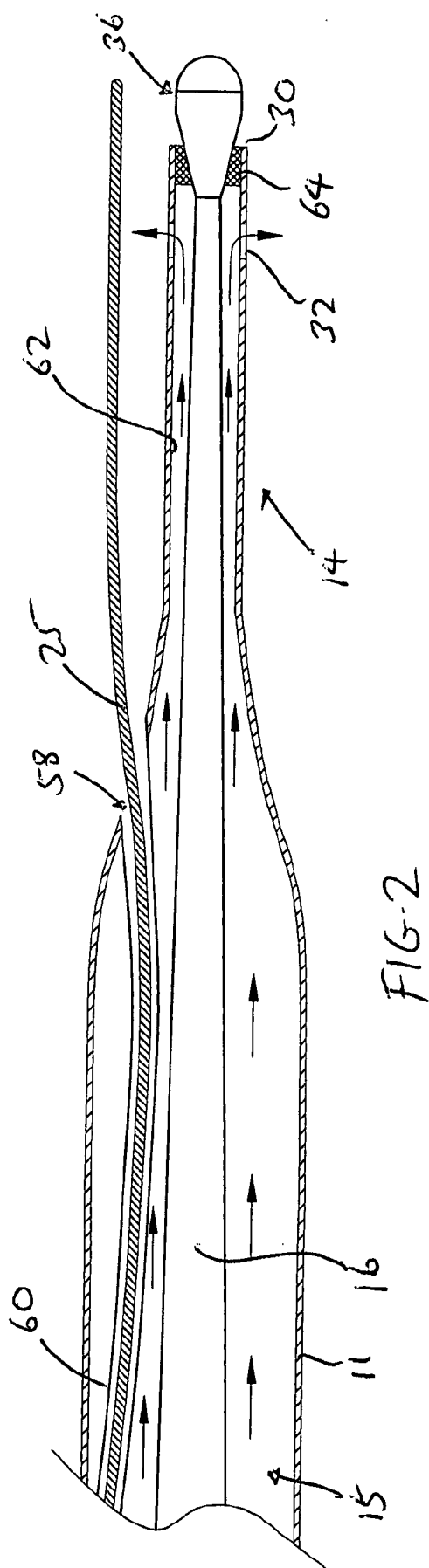
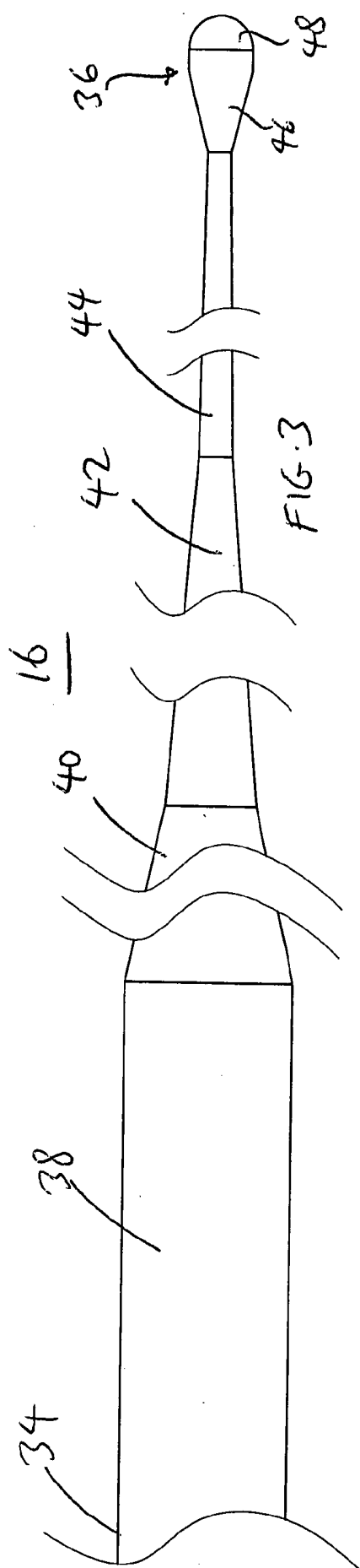
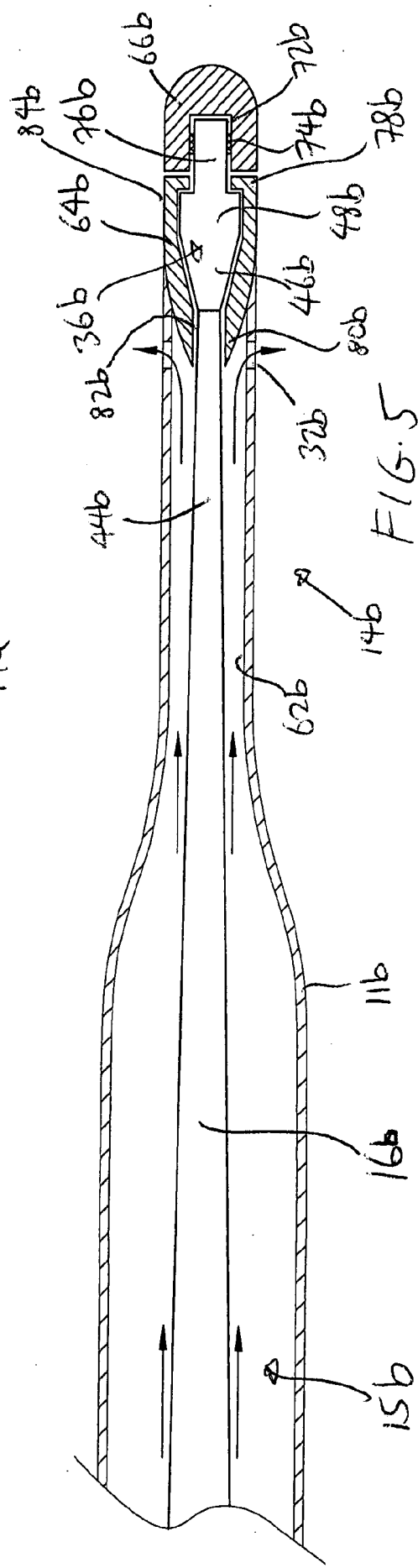
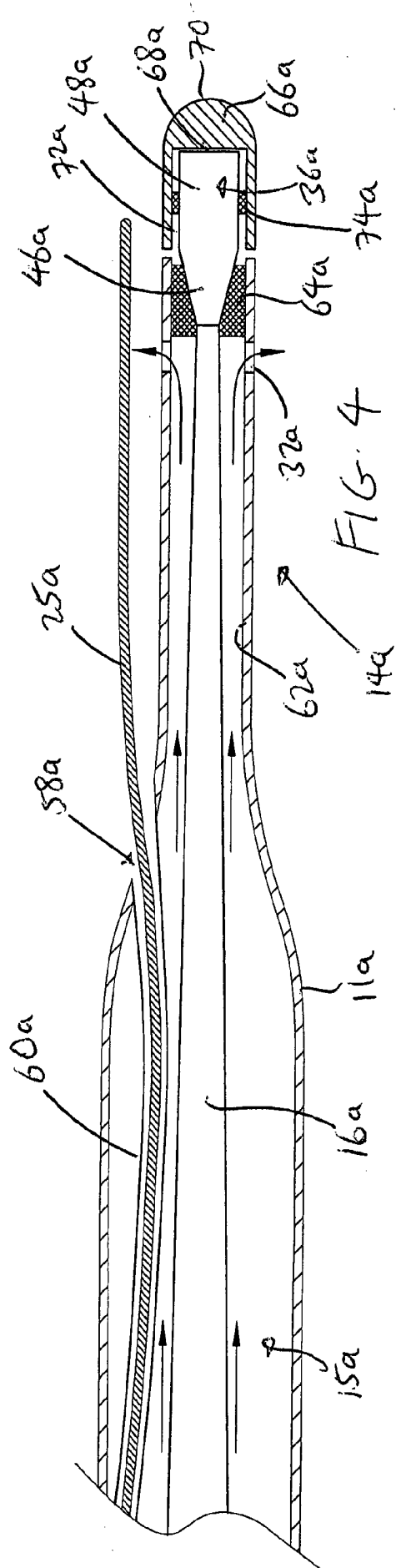
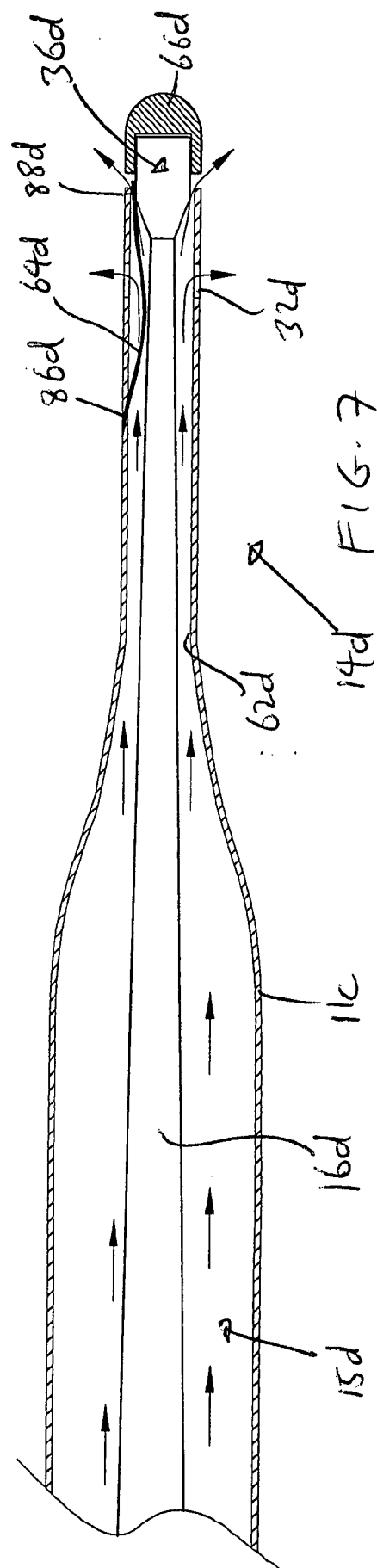
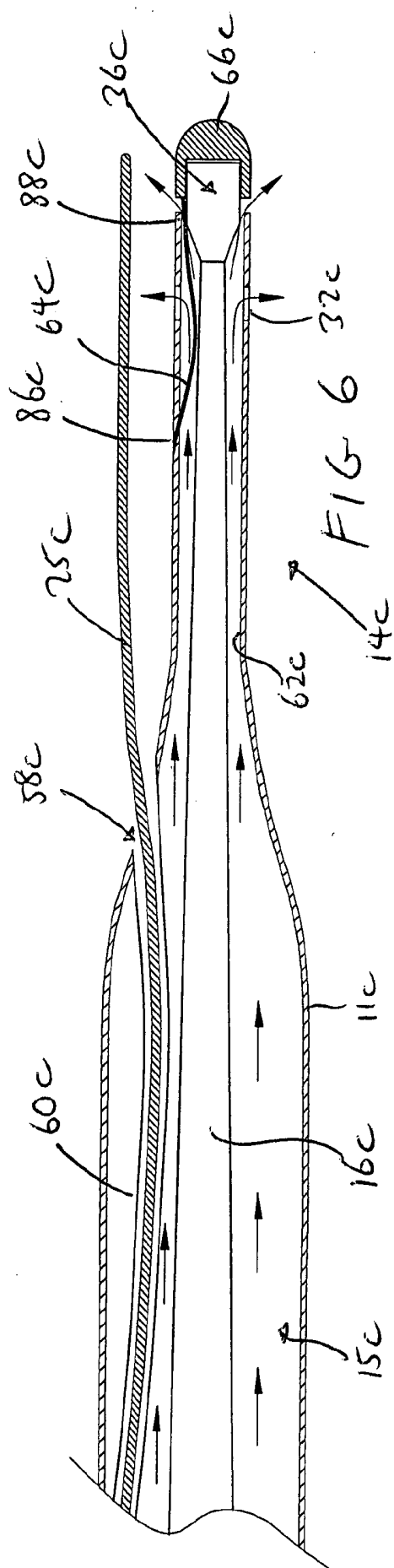
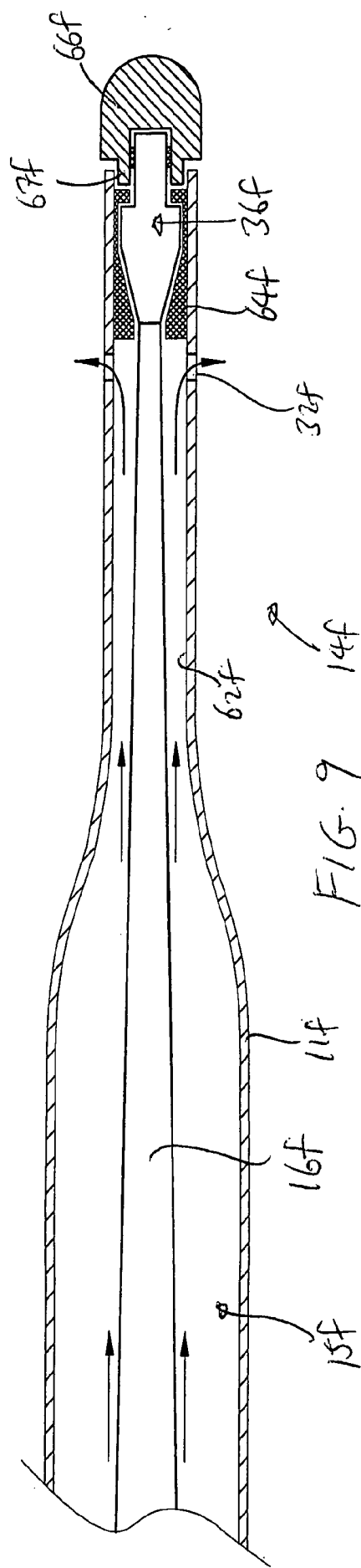
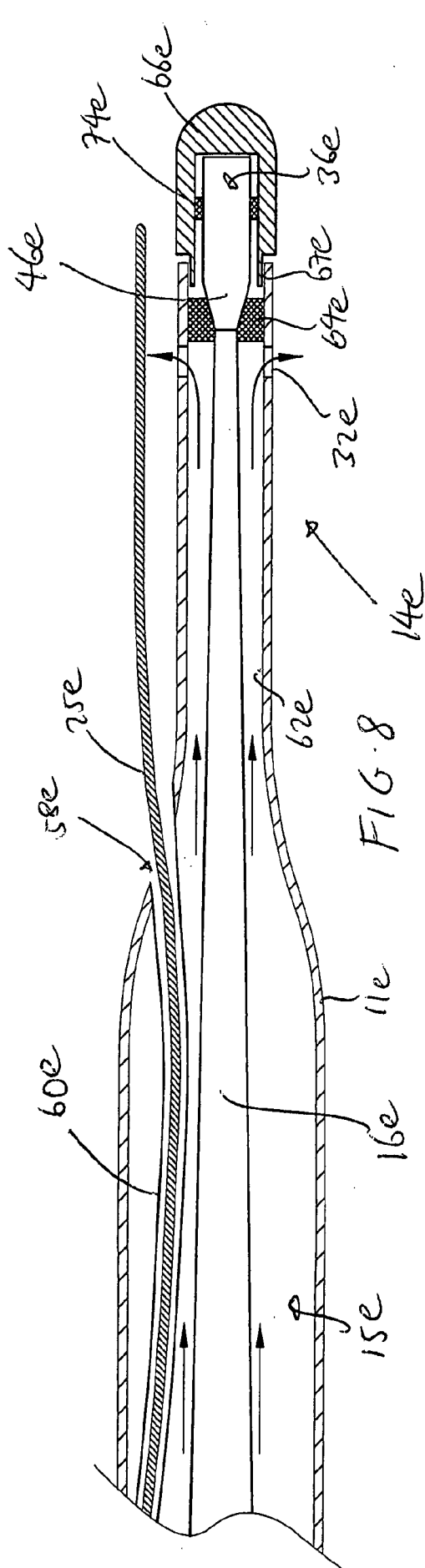

FIG. 1









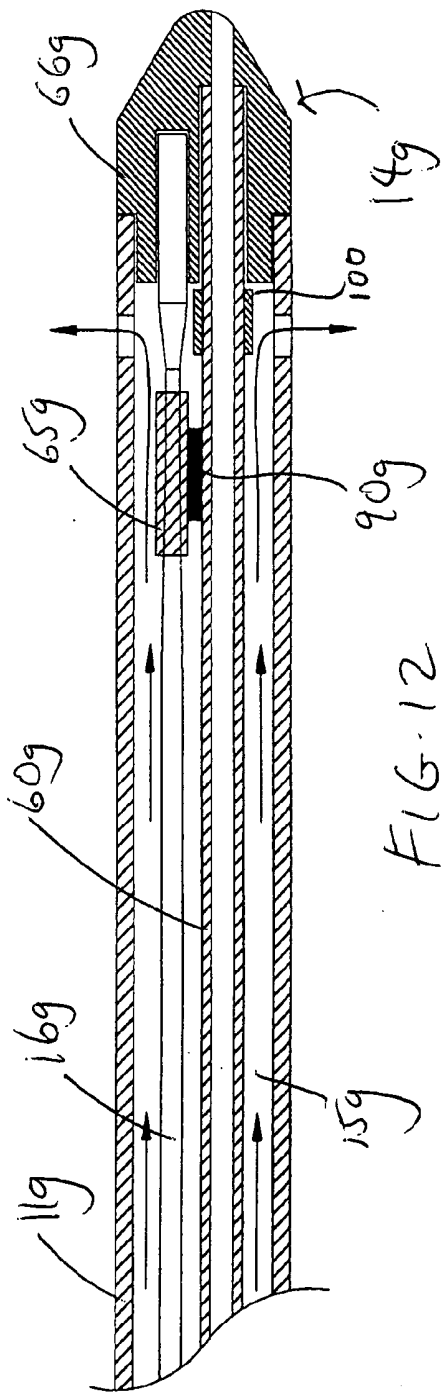
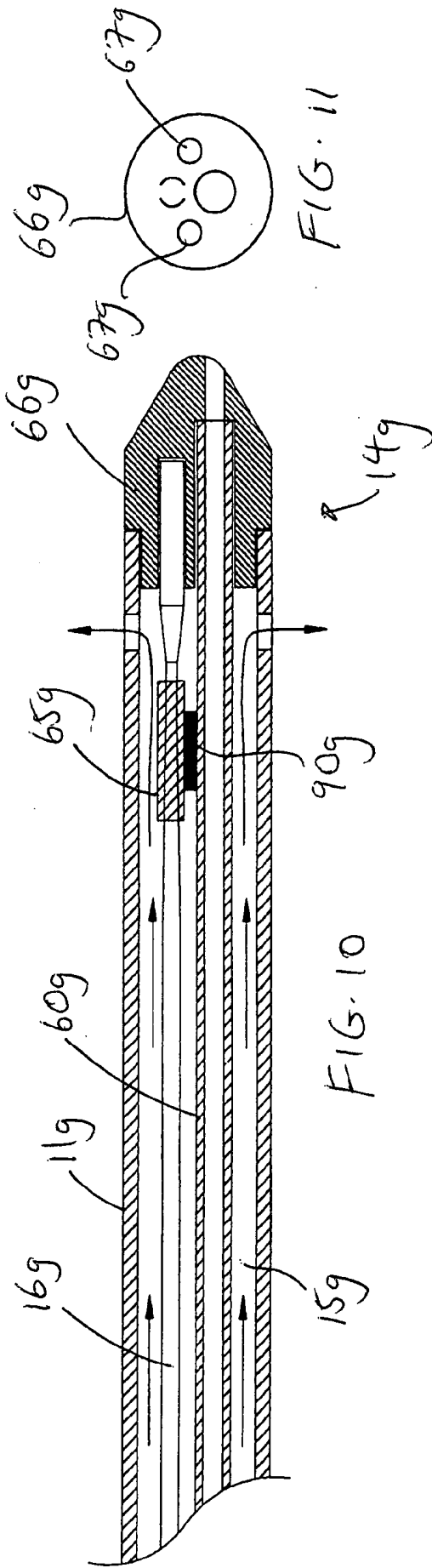

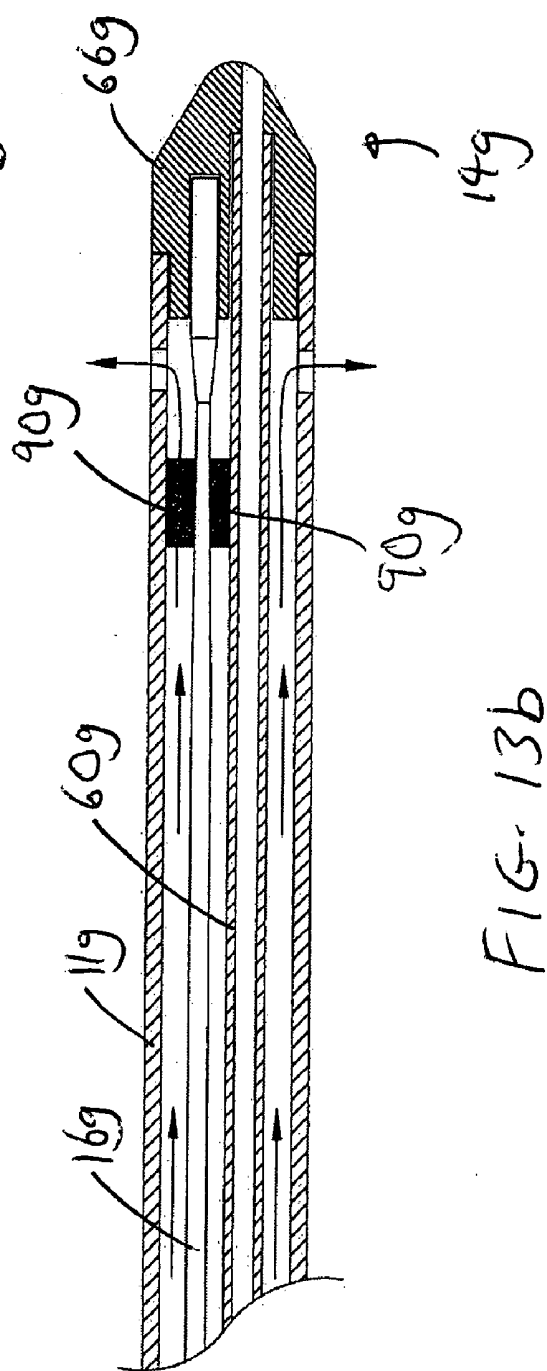
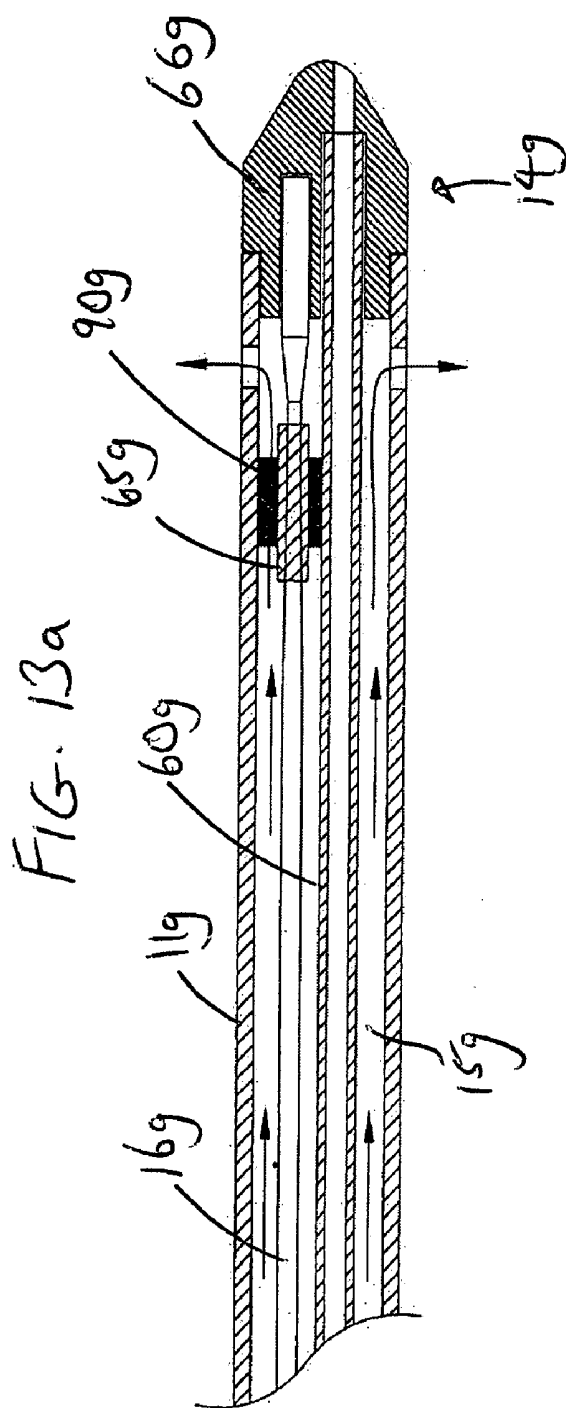
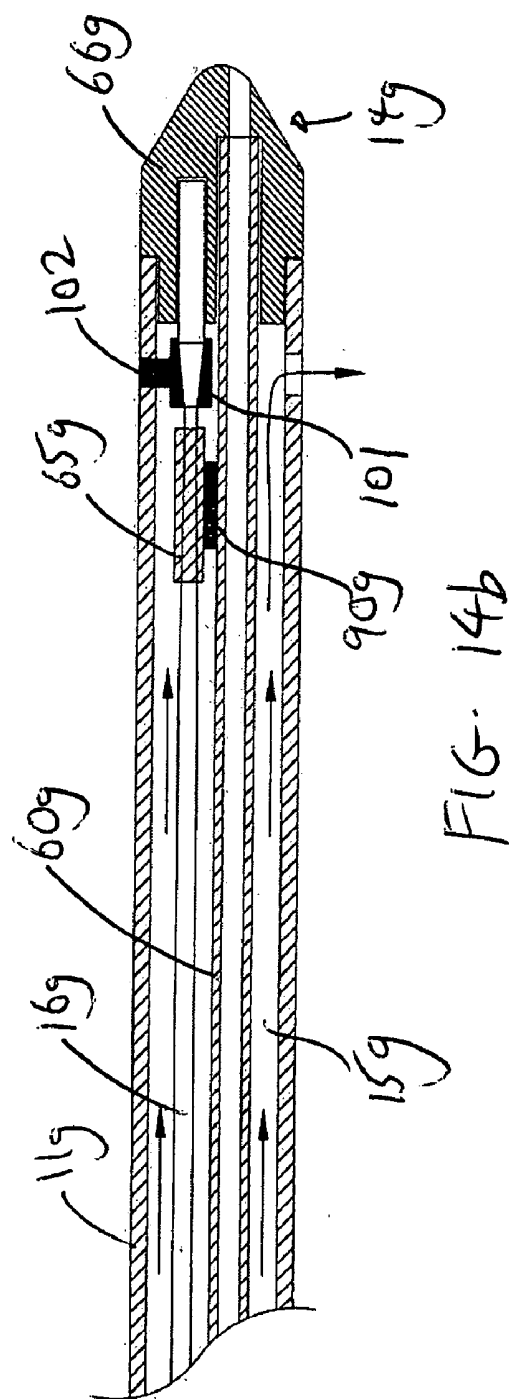
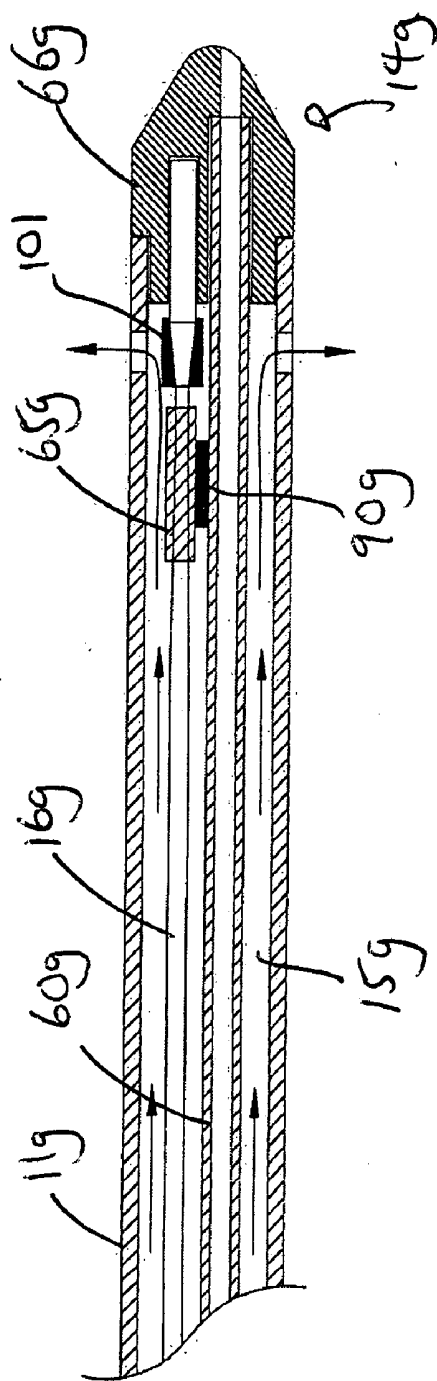
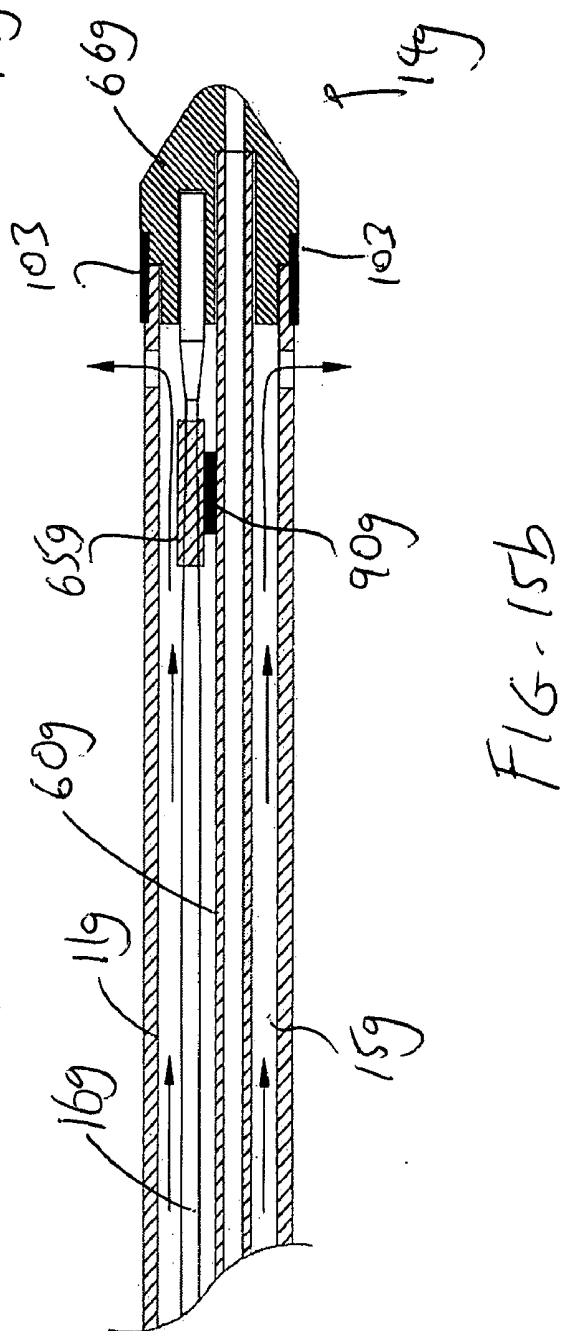
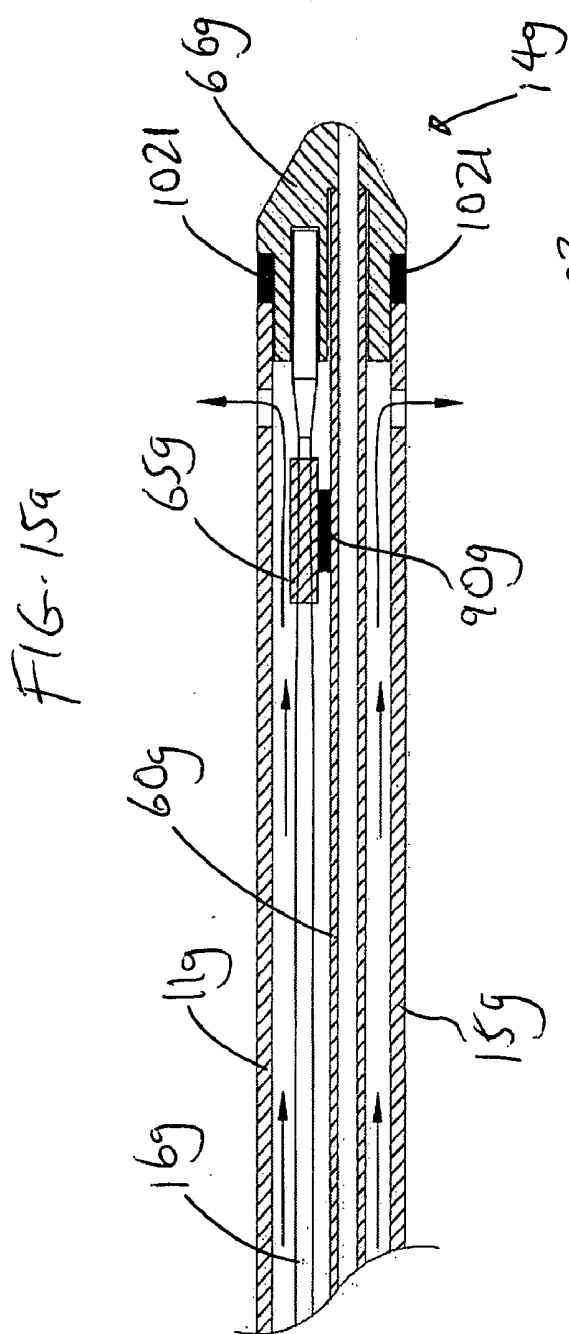

FIG. 14a





ULTRASOUND CATHETER HAVING PROTECTIVE FEATURE AGAINST BREAKAGE

BACKGROUND OF THE INVENTION

[0001] 1. Field of the Invention

[0002] The present invention pertains to medical equipment, and more particularly, to a therapeutic ultrasound system for ablating obstructions within tubular anatomical structures such as blood vessels. The ultrasound system includes a protective feature that minimizes the introduction of debris into the patient's vasculature if the ultrasound transmission member were to break, fracture or become dislodged during a medical procedure.

[0003] 2. Description of the Prior Art

[0004] A number of ultrasound systems and devices have heretofore been proposed for use in ablating or removing obstructive material from blood vessels. Ultrasound catheters have been utilized to ablate various types of obstructions from blood vessels of humans and animals. Successful applications of ultrasound energy to smaller blood vessels, such as the coronary arteries, requires the use of relatively small diameter ultrasound catheters which are sufficiently small and flexible to undergo transluminal advancement through the tortuous vasculature of the aortic arch and coronary tree. However, because of its small diameter, the ultrasound transmission member which extends through such catheters is particularly susceptible to losses in the transmitted ultrasound energy, and breakage.

[0005] Breakage of ultrasound transmission members often occurs near the proximal end thereof, generally at the coupling between the ultrasound catheter coupling and the ultrasound transducer. This is believed to be because energy concentrations and stresses are highest at these points. Thus, any external forces applied to the ultrasound transmission member in this region may result in stresses exceeding the elastic limit of the ultrasound transmission member.

[0006] Breakage of ultrasound transmission members can also occur near the distal end thereof, generally at the area of the smallest cross-section. To minimize breakage of the ultrasound transmission wire at the distal end, a smaller distal tip with less mass or a tip made of polymer or a lower density metal may be utilized to further reduce stress at the distal in on the transmission wire. It is important that any debris resulting from the breakage of the ultrasound transmission member not be allowed to be introduced into a patient's vasculature during a medical procedure.

[0007] Thus, there still exists a need to further improve efficacy of the ultrasound systems and protect against breakage of the ultrasound transmission member during a medical procedure.

SUMMARY OF THE DISCLOSURE

[0008] It is an object of the present invention to provide an ultrasound catheter system with a protective feature that prevents or minimizes the introduction of debris into the patient's vasculature if the ultrasound transmission member were to break or fracture during a medical procedure.

[0009] In order to accomplish the objects of the present invention, there is provided an ultrasound catheter having an elongate flexible catheter body having a lumen extending

longitudinally therethrough, and an ultrasound transmission member extending longitudinally through the lumen of the catheter body. The ultrasound transmission member has a proximal end that is coupled to a separate ultrasound generating device, and a distal end that terminates at the distal end of the catheter body. The ultrasound transmission member is directly attached to the guidewire tube and/or the catheter body, and such attachment can be accomplished using a direct attachment or via an attachment member. A radiopaque marker or sleeve can also be positioned on the distal end of the ultrasound catheter to improve its visibility.

BRIEF DESCRIPTION OF THE DRAWINGS

[0010] FIG. 1 is a perspective view of an ultrasound system according to the present invention.

[0011] FIG. 2 is a cross-sectional view of the distal end of an ultrasound catheter that can be used with the system of FIG. 1 according to one embodiment thereof.

[0012] FIG. 3 is a side sectional view of an ultrasound transmission member that can be used with the system of FIG. 1.

[0013] FIGS. 4-9 are cross-sectional views of the distal end of various ultrasound catheters that can be used with the system of FIG. 1 according to different embodiments thereof.

[0014] FIG. 10 illustrates the distal end of an ultrasound catheter according to another embodiment of the present invention that can be used with the system of FIG. 1, where the ultrasound transmission member is attached to the guidewire tube.

[0015] FIG. 11 is a front view of the distal end of the catheter of FIG. 10.

[0016] FIG. 12 illustrates a modification that can be made to the ultrasound catheter of FIG. 10 with a radiopaque marker located on the distal portion of the guidewire lumen.

[0017] FIGS. 13a and 13b illustrate a modification that can be made to the ultrasound catheter of FIG. 10 with the ultrasound transmission member attached to the guidewire tube and the catheter body.

[0018] FIGS. 14a and 14b illustrate a modification that can be made to the ultrasound catheter of FIG. 10 with a radiopaque marker located on the distal portion of the ultrasound transmission member.

[0019] FIGS. 15a and 15b illustrate a modification that can be made to the ultrasound catheter of FIG. 10 with a radiopaque marker positioned on the distal tip and a radiopaque marker positioned partially on the catheter body and partially on the distal tip.

DETAILED DESCRIPTION OF THE PREFERRED EMBODIMENTS

[0020] The following detailed description is of the best presently contemplated modes of carrying out the invention. This description is not to be taken in a limiting sense, but is made merely for the purpose of illustrating general principles of embodiments of the invention. The scope of the invention is best defined by the appended claims. In certain instances, detailed descriptions of well-known devices, compositions,

components, mechanisms and methods are omitted so as to not obscure the description of the present invention with unnecessary detail.

[0021] FIG. 1 illustrates an ultrasound system according to the present invention for use in ablating and removing occlusive material inside the vessel of an animal or human. Referring to FIGS. 1 and 2, the ultrasound system includes an ultrasound catheter device 10 which has an elongate catheter body 11 having a proximal end 12, a distal end 14, and defining at least one lumen 15 extending longitudinally there-through. The ultrasound catheter device 10 is operatively coupled at its proximal end 12, by way of a Y-connector 18, a catheter knob 20, and a slide collar 22, to an ultrasound transducer 24. The ultrasound transducer 24 is connected to a signal generator 26, which can be provided with a foot actuated on-off switch 28. The signal generator 26 can be supported by an IV pole 27. When the on-off switch 28 is depressed, the signal generator 26 sends an electrical signal to the ultrasound transducer 24, which converts the electrical signal to ultrasound energy. Such ultrasound energy subsequently passes through the catheter device 10 and is delivered to the distal end 14. A guidewire 25 may be utilized in conjunction with the catheter device 10, as will be more fully described below.

[0022] The catheter body 11 is formed of a flexible polymeric material such as nylon (Pebax™) manufactured by Atochimie, Cour be Voie, Hauts Ve-Sine, France. The flexible catheter body 11 is preferably in the form of an elongate tube having one or more lumens extending longitudinally there-through. The catheter body 11 defines a main lumen 15. Extending longitudinally through the main lumen 15 is an elongate ultrasound transmission member 16 having a proximal end which is removably connectable to the ultrasound transducer 24 via a sonic connector (not shown) such that ultrasound energy will pass through the ultrasound transmission member 16. As such, when the foot actuated on-off switch 28 operatively connected to the ultrasound transducer 24 is depressed, ultrasound energy will pass through the ultrasound transmission member 16 to the distal end 14 of the catheter body 11.

[0023] A guidewire port 58 is provided in the catheter body 11 at any location along the catheter body 11. A guidewire lumen 60 extends from the guidewire port 58 through the main lumen 15 of the catheter body 11 in a manner that is concomitant to the length of the ultrasound transmission member 16. In one embodiment, the guidewire port 58 can be provided at a location that is closer to the proximal end 12 than to the distal end 14 of the catheter.

[0024] In one embodiment, the ultrasound transmission member 16 may be formed of any material capable of effectively transmitting the ultrasonic energy from the ultrasound transducer 24 to the distal end 14 of the ultrasound transmission member 16, and is preferably made from metal or metal alloys. It is possible to form all or a portion of the ultrasound transmission member 16 with one or more materials which exhibit super-elasticity. Such materials should preferably exhibit super-elasticity consistently within the range of temperatures normally encountered by the ultrasound transmission member 16 during operation of the catheter device 10.

[0025] Specifically, all or part of the ultrasound transmission member 16 may be formed of one or more metal alloys known as "shape memory alloys". Examples of super-elastic

metal alloys which are usable to form the ultrasound transmission member 16 of the present invention are described in detail in U.S. Pat. Nos. 4,665,906 (Jervis); 4,565,589 (Harrison); 4,505,767 (Quin); and 4,337,090 (Harrison). The disclosures of U.S. Pat. Nos. 4,665,906; 4,565,589; 4,505,767; and 4,337,090 are expressly incorporated herein by reference insofar as they describe the compositions, properties, chemistries, and behavior of specific metal alloys which are super-elastic within the temperature range at which the ultrasound transmission member 16 of the present invention operates, any and all of which super-elastic metal alloys may be usable to form the super-elastic ultrasound transmission member 16.

[0026] The frontal portion of the Y-connector 18 is connected to the proximal end 12 of the catheter 10 using techniques that are well-known in the catheter art. An injection pump 54 or IV bag (not shown) or syringe (not shown) can be connected, by way of an infusion tube 55, to an infusion port or sidearm 72 of the Y-connector 18 (see FIG. 1). The injection pump can be used to infuse coolant fluid into and/or through the main lumen 15 of the catheter 10, with the coolant fluid exiting via irrigation outlets 32 (see FIG. 2) provided adjacent the distal end 14 of the catheter 10. Such flow of coolant fluid may be utilized to prevent overheating of the ultrasound transmission member 16 extending longitudinally through the main lumen 15. Such flow of the coolant fluid through the main lumen 15 of the catheter 10 also serves to bathe the outer surface of the ultrasound transmission member 16, thereby providing for an equilibration of temperature between the coolant fluid and the ultrasound transmission member 16. Thus, the temperature and/or flow rate of coolant fluid may be adjusted to provide adequate cooling and/or other temperature control of the ultrasound transmission member 16. The irrigation fluid can include a pharmacological agent and/or microbubbles.

[0027] In addition to the foregoing, the injection pump 54 or syringe may be utilized to infuse a radiographic contrast medium into the catheter 10 for purposes of imaging. Examples of iodinated radiographic contrast media which may be selectively infused into the catheter 10 via the injection pump 54 are commercially available as Angiovisc 370 from Berlex Labs, Wayne, N.J. and Hexabrix from Mallinckrodt, St. Louis, Mo.

[0028] The proximal end of the Y-connector 18 is attached to the distal end of the catheter knob 20 by threadably engaging the proximal end of the Y-connector 18 inside a threaded distal bore (not shown) at the distal end of the catheter knob 20.

[0029] The proximal end of the ultrasound transmission member 16 is attached to a sonic connector (not shown) which is configured to effect operative and removable attachment of the proximal end of the ultrasound transmission member 16 to the horn of the ultrasound transducer 24. The sonic connector is preferably configured and constructed to permit passage of ultrasound energy through the ultrasound transmission member 16 with minimal lateral side-to-side movement of the ultrasound transmission member 16 while, at the same time, permitting unrestricted longitudinal forward/backward vibration or movement of the ultrasound transmission member 16. Examples of ultrasound transducers, sonic connectors and their connections are illustrated in U.S. Pat. Nos. 6,702,748, 6,855,123, 6,942,620 and 6,942,677, whose disclosures are incorporated by this reference as though set forth fully herein.

[0030] Referring to FIGS. 2 and 3, the ultrasound transmission member 16 can have progressively tapered regions extending from the proximal end 34 thereof to the distal tip 36 thereof. For example, the proximal-most region 38 can have a constant diameter which is the greatest diameter along the length of the ultrasound transmission member 16. The region 38 transitions at its distal end to a first tapered region 40 which gradually decreases in diameter to its distal end to a second tapered region 42, which gradually decreases in diameter to its distal end to a third tapered region 44, which gradually decreases in diameter to its distal end to the distal tip 36. Each tapered region 40, 42, 44 can have a continuous taper, and be tapered to different degrees, such that the region 40 has a greater taper than the region 42, which in turn has a greater taper than the region 44. The distal-most part of the region 44 can have the smallest diameter along the entire ultrasound transmission member 16. The continuously decreasing tapering from the proximal to the distal direction shown in FIG. 3 allows for improved ultrasound energy propagation. The distal tip 36 can have a proximal section 46 which gradually increases in diameter until it reaches the proximal end of a distal section 48. The distal section 48 can have a bulbous configuration having a rounded or curved distal-most end that is adapted to contact the obstruction for ablation thereof. Thus, the distal tip 36 can have an enlarged size when compared to the rest of the ultrasound transmission member 16 so that the distal tip 36 can function as the distal head for the catheter 10.

[0031] In the embodiment shown in FIG. 2, the distal end 14 of the catheter body 11 has an opening 30, and the distal tip 36 of the ultrasound transmission member 16 is secured to the inner wall 62 of the main lumen 15 of the catheter body 11 adjacent the opening 30. The securement can be accomplished by an attachment mechanism 64 (which can be glue, welding or fusing) at the location of the proximal section 46 and the inner wall 62, so that part of the proximal section 46 is received inside the main lumen 15 and with the distal section 48 of the distal tip 36 extending outside the main lumen 15 of the catheter body 11. The opening 30 of the catheter body 11 is closed by the connection of the distal tip 36 to the catheter body 11. The construction shown in FIG. 2 directly attaches the ultrasound transmission member 16 to the catheter body 11 (via the attachment mechanism 64), which provides additional protection if the ultrasound transmission member 16 experiences breakage. In particular, if the ultrasound transmission member 16 fractures, breaks or splinters, the distal tip 36 will still remain secured to the catheter body 11 via the attachment device 64, and will not become dislodged from the catheter body 11. Thus, the embodiment of FIG. 2 does not employ a separate distal head for the catheter 10, but instead utilizes the distal tip 36 of the ultrasound transmission member 16 as a distal head which is secured directly to the distal end of the catheter body 11.

[0032] FIGS. 4-5 illustrate two different embodiments of a distal end of the catheter 10 which utilize the same principles and general construction as in FIG. 2, except that a distal cap is secured to the distal tip of the ultrasound transmission member. Therefore, the same numeral designations are used in FIGS. 2, 4 and 5 to designate the same or similar elements, except that an "a" and a "b" are added to the numeral designations in FIGS. 4 and 5, respectively. The differences between the embodiment of FIG. 2 and the embodiments in FIGS. 4 and 5 are described below.

[0033] The distal end 14a in FIG. 4 differs from the distal end 14 in FIG. 2 in that a protective cap 66a is secured to the distal section 48a of the distal tip 36a of the ultrasound transmission member 16a. The cap 66a can function as the tip of the catheter 10. The distal tip 36a itself has a different configuration from the distal tip 36 in FIG. 2 in that the distal section 48a is not bulbous or curved, but instead has a constant diameter that terminates distally at a flat distal end 68a. The cap 66a has a cylindrical configuration with an opened proximal end and a curved or bulbous distal end 70a. The distal section 48a of the distal tip 36a is received into the hollow bore 72a of the cap 66a via the opened proximal end of the cap 66a, and is secured to the cap 66a inside the bore 72a via an attachment device 74a (which can be the same as the attachment device 64). The cap 66a can be made of a radiopaque material to improve the visibility of the distal tip 36a.

[0034] In addition, instead of the attachment mechanism 64, the embodiments of FIGS. 4-5 provide an intermediate member 64a. The intermediate member 64a can be a cylindrical component that is positioned around the ultrasound transmission member 16a, and between the ultrasound transmission member 16a and the inner wall 62a of the catheter body 11a. The intermediate member 64a (as well as 64 and 64b) is preferably made from a material that does not effectively transfer or conduct heat, and which is easy to attach to the ultrasound transmission member 16a and the catheter body 11a. Examples of the material can include certain epoxies, polymers, plastics and rubber. According to one embodiment, the intermediate member 64a can be fused to the ultrasound transmission member 16a and the inner wall 62a. According to another embodiment, the intermediate member 64a can be bonded to the ultrasound transmission member 16a and the inner wall 62a. According to yet another embodiment, the intermediate member 64a can be fused to the ultrasound transmission member 16a and bonded to the inner wall 62a. The intermediate member 64a serves as a safety feature to hold the ultrasound transmission member 64a within the catheter body 11 in the event the ultrasound transmission member 16a experiences breakage at a location proximal to the intermediate member 64a. However, the intermediate member 64a will not be able to hold the distal tip 36a if the breakage occurs at the distal tip 36a.

[0035] The distal end 14b in FIG. 5 differs from the distal end 14a in FIG. 4 in the following ways. First, the guidewire port 58a, guidewire 25a, and guidewire lumen 60a have been omitted. Second, the distal tip 36b itself has a different configuration from the distal tip 36a in FIG. 4 in that a distal extension 76b extends distally from the distal section 48b. The distal extension 76b has a smaller constant diameter than the diameter of the enlarged distal section 48b, and the distal extension 76b is received into the hollow bore 72b of the cap 66b via the opened proximal end of the cap 66b, and is secured to the cap 66b inside the bore 72b via an attachment mechanism 74b (which can be the same as the attachment mechanism 64). The cap 66b can also be made of a radiopaque material to improve the visibility of the distal tip 36b.

[0036] Third, the intermediate member 64b in FIG. 5 has a different configuration as the intermediate member 64a. The intermediate member 64b has a generally conical configuration, having a wider diameter at its distal end 78b (which resembles the base of the cone) and a narrower diameter or dimension at its proximal end 80b (which resembles the nar-

rowed tip of a cone). The hollow interior **82b** of the intermediate member **64b** has the greatest inner diameter adjacent its distal end **78b** and decreases to its smallest inner diameter adjacent the proximal end **80b**. This configuration for the intermediate member **64b** allows the ultrasound transmission member **16b** to be fitted and retained inside the hollow interior **82b** without the need to directly attach the ultrasound transmission member **16b** to the intermediate member **64b**. Specifically, the sections **46b**, **48b** can be retained inside the hollow interior **82b**, with the transition between the region **44b** and the distal tip **36b** (i.e., where the diameter of the ultrasound transmission member **16b** is the smallest) received in the narrow opening of the proximal end **80b** of the intermediate member **64b**. In other words, the proximal end **80b** overlaps a dimensional step (i.e., the transition between the region **44b** and the distal tip **36b**) on the ultrasound transmission member **16b**. The distal extension **76b** extends through another opening at the distal end **78b** of the intermediate member **64b**. To provide additional protection or safety, any or all of the sections **46b**, **48b** can also be bonded to the inner wall of the intermediate member **64b**. The outer surface **84b** of the intermediate member **64b** may be attached to the opened distal end of the catheter body **11b** by bonding, fusing or glue, and part of the intermediate member **64b** extends beyond the distal end of the catheter body **11b**.

[0037] Comparing the embodiments of FIGS. 4 and 5, the intermediate member **64b** has an "overlapped" configuration, which provides added protection because the intermediate member **64b** is seated on a dimensional step along the ultrasound transmission member **16b**, and will always hold the proximal portions of the ultrasound transmission member **16b** within the catheter body **11b** as long as the intermediate member **64b** is attached to the catheter body **11b**.

[0038] FIG. 6 illustrates a modification that can be made to the embodiment in FIG. 4. The embodiments in FIGS. 4 and 6 utilize the same principles and general construction, so the same numeral designations are used in FIGS. 4 and 6 to designate the same or similar elements, except that a "c" is added to the numeral designations in FIG. 6.

[0039] In FIG. 6, the catheter body **11c**, the guidewire port **58c**, the guidewire lumen **60c**, the guidewire **25c**, the ultrasound transmission member **16c** and the cap **66c** can be the same as the catheter body **11a**, the guidewire port **58a**, the guidewire lumen **60a**, the guidewire **25a**, the ultrasound transmission member **16a** and the cap **66a** in FIG. 4. The primary difference is that the intermediate member **64a** is now embodied in the form of an anchor wire **64c**, which can be either a polymer or a metal. One end **86c** of the wire **64c** can be attached (e.g., by glue, fusing, bonding) to the inner wall **62c** of the catheter body **11c**, and the other end **88c** of the wire **64c** can be attached (e.g., by glue, bonding or welding) to the distal tip **36c** and to the cap **66c**. If the ultrasound transmission member **16c** breaks at any location, then the ultrasound transmission member **16c** will be retained inside the catheter body **11c**.

[0040] FIG. 7 illustrates a modification that can be made to the embodiment in FIG. 6. Specifically, the embodiments in FIGS. 6 and 7 are the same except that the guidewire port **58c**, the guidewire lumen **60c** and the guidewire **25c** are omitted in FIG. 7, and the anchor wire **64d** is attached to the distal end of the ultrasound transmission member **16d** but not attached to the cap **66d**. Therefore, the same numeral designations are

used in FIGS. 6 and 7 to designate the same elements, except that a "d" is added to the numeral designations in FIG. 7, and no further description of the elements in FIG. 7 is needed.

[0041] Attaching the anchor wire **64c** or **64d** to the cap **66c** or **66d**, or not attaching the anchor wire **64c** or **64d** to the cap **66c** or **66d**, provides different options. Attaching the anchor wire **64c** to the cap **66c** prevents dislodgement of the cap **66c** or the distal tip **36c** if the breakage occurs near or at the distal tip **36c**. However, breakage at such locations is rare, so the embodiment in FIG. 7 (where the anchor wire **64d** is not attached to the cap **66d**) can also be employed.

[0042] FIG. 8 illustrates another modification that can be made to the embodiment in FIG. 4. Specifically, the embodiments in FIGS. 4 and 8 are the same, except that the proximal portion of the cap **66e** has an annular edge **67e** that extends into the interior of the catheter body **11e**. Therefore, the same numeral designations are used in FIGS. 4 and 8 to designate the same elements, except that an "e" is added to the numeral designations in FIG. 8, and no further description of the elements in FIG. 8 is needed. The annular edge **67e** is not attached to the catheter body **11e**, and is maintained separate from the catheter body **11e**. One benefit which is provided by extending a portion of the cap **66e** into the catheter body **11e** is that this arrangement provides a smooth and friendly transition between the distal cap **66e** and the catheter body **11e**. This smooth transition facilitates navigation of the distal end **14e** through tortuous anatomy. Also, the non-affixed tip of the catheter body **11e** can result in the improved transmission of ultrasound energy from the transducer to the distal end **14e**.

[0043] FIG. 9 illustrates a modification that can be made to the embodiment in FIG. 5. Specifically, the embodiments in FIGS. 5 and 9 are the same except that the intermediate member **64f** is completely retained inside the catheter body **11f**, and the proximal portion of the cap **66f** has an annular edge **67f** that extends into the interior of the catheter body **11f**. Therefore, the same numeral designations are used in FIGS. 5 and 9 to designate the same elements, except that an "f" is added to the numeral designations in FIG. 9, and no further description of the elements in FIG. 9 is needed.

[0044] A guidewire has been included in the embodiments of FIGS. 2, 4, 6 and 8, while the guidewire has been omitted in the embodiments of FIGS. 5, 7 and 9. Embodiments showing the use or omission of a guidewire are shown for reference only. The principles of the present invention may be applied to catheters that include, or not include, a guidewire. The use or omission of a guidewire depends upon the choice of the clinician, and is often dictated by the access difficulty or specific clinical situations. For example, if the target lesion is located on a straight portion of the vessel, use of a non-guidewire embodiment will be feasible and relatively easy. On the other hand, if the target lesion is located in a tortuous location of the vessel, then use of a guidewire embodiment will help the clinician to navigate the distal tip **36** to the location of the lesion.

[0045] FIGS. 10-11 illustrate a different embodiment of the present invention where the ultrasound transmission member is directly connected to the guidewire tube. Since the embodiment of FIGS. 10-11 utilize the similar principles and constructions as the other embodiments, the same numeral designations are used in FIG. 10 to designate the same elements as in the earlier embodiments, except that a "g" is added to the numeral designations. The ultrasound catheter has an elon-

gate catheter body 11g, and at least one lumen 15g extending longitudinally therethrough. A guidewire lumen is defined by a guidewire tube 60g which extends through the lumen 15g inside the catheter body 11g and has a distal end that extends through a distal tip or cap 66g. The cap 66g has at least one irrigation outlet hole 67g that communicates with the lumen 15g. The ultrasound transmission member 16g extends longitudinally through the lumen 15g of the catheter body 11g, and its distal end is secured in a proximal bore of the cap 66g. The ultrasound transmission member 16g is attached adjacent its distal end to the guidewire tube 60g. The attachment can be accomplished by the direct use of glue, welding or fusing. Also, the attachment may be accomplished by using an attachment member 65g, which can be glued, welded or fused to the ultrasound transmission member 16g and guidewire tube 60g. The attachment member 65g can be tubular. The construction shown in FIG. 10 shows the ultrasound transmission member 16g attached to the guidewire tube 60g via the attachment member 65g (which can be a polymer sleeve) using any applicable glue 90g. The cap 66g and the ultrasound transmission member 16g may be made of the same or different materials connected together. Both these parts may also be manufactured entirely from a single piece of material without the need to separately connect each other.

[0046] FIG. 12 shows the catheter of FIG. 10 modified to include an additional radiopaque marker 100 attached to the distal portion of the guidewire tube 60g. If the cap 66g is very small or made of a polymer or a low density metal, these materials exhibit a relatively low visibility under fluoroscopy. In such a case, an additional radiopaque marker may be needed to improve visibility of the distal end 14g of the catheter. The radiopaque marker 100 may be placed around the guidewire tube 60g, or attached to the guidewire tube, or to the catheter body 11g (not shown), or to the ultrasound transmission member 16g (not shown), or both, using any applicable methods such as a glue or thermal fusing. The radiopaque marker 100 may also be positioned inside the distal end of the catheter body 11g (not shown) or inside the distal cap 66g (not shown). The radiopaque marker may be provided in the form of a tubular sleeve or coil (not shown). A radiopaque rod or wire (not shown) positioned inside the hole 67g may serve the same purpose as well. Such a sleeve, coil, rod or wire may be made of any radiopaque material including but not limited to platinum or gold.

[0047] FIG. 13a shows the catheter of FIG. 10 modified so that the distal end of the ultrasound transmission member 16g is attached to the guidewire tube 60g and the catheter body 11g via attachment member 65g using applicable glue 90g for further preventing or minimizing the introduction of debris into the patient's vasculature if the ultrasound transmission member 16g were to break or fracture during a medical procedure.

[0048] FIG. 13b shows the catheter of FIG. 10 modified so that the ultrasound transmission member 16g is directly attached to the guidewire tube 60g and the catheter body 11g using any applicable glue 90g, and eliminating the attachment member 65g as shown in the FIG. 13a.

[0049] FIG. 14a shows the catheter of FIG. 10 modified to include an additional radiopaque marker 101 positioned on the distal portion of the ultrasound transmission member 16g. Alternatively, the radiopaque marker 101 may be positioned freely on the ultrasound transmission member 16g and

attached to the catheter body 11g using any applicable glue 120 as shown in FIG. 14b. The radiopaque marker 101 may be positioned freely or attached/affixed to the ultrasound transmission member 16g using any known technique, including but not limited to welding, soldering, fusing, glue or bonding.

[0050] FIG. 15a shows the catheter of FIG. 10 modified to include an additional radiopaque marker 1021 positioned solely on the cap 66g of the catheter 14g. Alternatively, a radiopaque marker 103 may be positioned partially on the cap 66g and partially on the catheter body 11g, as shown in FIG. 15b. The radiopaque marker 1021 may be positioned freely or attached to the cap 66g using known technique, such as welding, soldering, fusing, glue, or bonding. If the radiopaque marker 103 is partially located on the catheter body 11g and partially on the cap 66g, it can also be positioned freely or attached to one or both of these components.

[0051] While the description above refers to particular embodiments of the present invention, it will be understood that many modifications may be made without departing from the spirit thereof. The accompanying claims are intended to cover such modifications as would fall within the true scope and spirit of the present invention.

What is claimed is:

1. An ultrasound catheter, comprising:

an elongate flexible catheter body having a proximal end, a distal end and a lumen extending longitudinally therethrough;

an ultrasound transmission member extending longitudinally through the lumen of the catheter body, the ultrasound transmission member having a proximal end that is coupled to a separate ultrasound generating device;

a tip positioned at the distal end of the catheter body and secured to the distal end of the ultrasound transmission member; and

a guidewire tube extending at least partially through the lumen of the catheter body and attached to the ultrasound transmission member.

2. The catheter of claim 1, wherein the guidewire tube is attached to the tip.

3. The catheter of claim 1, wherein the ultrasound transmission member is attached to the guidewire tube via an attachment member.

4. The catheter of claim 3, wherein the attachment member is an adhesive.

5. The catheter of claim 3, wherein the attachment member is an intermediate member.

6. The catheter of claim 5, wherein the intermediate member is made of polymer.

7. The catheter of claim 5, wherein the attachment member has a tubular configuration.

8. The catheter of claim 1, further including a fluid outlet port positioned at the distal end of the catheter and communicating with the lumen.

9. The catheter of claim 1, wherein the ultrasound transmission member is irremovably attached to the guidewire tube.

10. The catheter of claim 5, wherein the intermediate member is attached to the ultrasound transmission member, the guidewire tube and the catheter body.

11. The catheter of claim 1, wherein the ultrasound transmission wire is further attached to the catheter body.

12. An ultrasound catheter comprising:
an elongate flexible catheter body having a proximal end, a distal end and a lumen extending longitudinally there-through;
an ultrasound transmission member extending longitudinally through the lumen of the catheter body, the ultrasound transmission member having a proximal end that is coupled to a separate ultrasound generating device;
a tip positioned on the distal end of the catheter body and secured to the distal end of the ultrasound transmission member; and
a radiopaque marker located on the distal end of the catheter.
13. The catheter of claim 12, wherein the radiopaque marker has a tubular configuration.

14. The catheter of claim 12, wherein the radiopaque marker is located on the catheter body.
15. The catheter of claim 12, wherein the radiopaque marker is located inside the catheter body.
16. The catheter of claim 15, wherein the radiopaque marker is located on the guidewire tube.
17. The catheter of claim 12, wherein the radiopaque marker is located on the ultrasound transmission member.
18. The catheter of claim 17, wherein the radiopaque marker is attached to the catheter body.
19. The catheter of claim 12, wherein the radiopaque marker is located on the tip.
20. The catheter of claim 12, wherein the radiopaque marker is partially located on the tip and partially located on the catheter body.

* * * * *

专利名称(译)	超声导管具有防止破损的保护特征		
公开(公告)号	US20080108902A1	公开(公告)日	2008-05-08
申请号	US12/004984	申请日	2007-12-21
[标]申请(专利权)人(译)	NITA HENRY 阮SIMON		
申请(专利权)人(译)	NITA HENRY 阮SIMON		
当前申请(专利权)人(译)	FLOWCARDIA INC.		
[标]发明人	NITA HENRY NGUYEN SIMON		
发明人	NITA, HENRY NGUYEN, SIMON		
IPC分类号	A61B8/00 A61M25/098		
CPC分类号	A61B17/22012 A61B19/54 A61B2017/22014 A61M25/0082 A61B2017/22039 A61M25/0068 A61M25/0069 A61B2017/22038 A61B90/39		
其他公开文献	US8496669		
外部链接	Espacenet USPTO		

摘要(译)

超声导管具有细长的柔性导管主体，其具有纵向延伸穿过其中的内腔，以及纵向延伸穿过导管主体的内腔的超声传输构件。超声传输构件具有近端和远端尖端，近端耦合到单独的超声发生装置，远端尖端附接到超声传输构件的远端并且位于导管主体的远端。超声传输构件直接或经由附接装置直接附接到导管主体和/或导丝管。导管具有位于导管远端的另外的不透射线标记物。

