



US 20010020128A1

(19) **United States**(12) **Patent Application Publication**
Morris et al.(10) **Pub. No.: US 2001/0020128 A1**(43) **Pub. Date: Sep. 6, 2001**(54) **ULTRASONIC DENSITOMETER WITH
PRE-INFLATED FLUID COUPLING
MEMBRANES**(76) Inventors: **Richard F. Morris**, Stoughton, WI
(US); **Steven Morris**, Madison, WI
(US); **David R. Strait**, Madison, WI
(US)Correspondence Address:
STEVEN J. WIETRZNY
Quarles and Brady LLP
411 East Wisconsin Avenue
Milwaukee, WI 53202 (US)

application No. 08/466,495, filed on Jun. 6, 1995, now Pat. No. 5,603,325, which is a continuation-in-part of application No. 08/397,027, filed on Mar. 1, 1995, now Pat. No. 5,483,965, which is a continuation of application No. 08/072,799, filed on Jun. 4, 1993, now abandoned, which is a continuation-in-part of application No. 07/895,494, filed on Jun. 8, 1992, now Pat. No. 5,343,863, which is a continuation-in-part of application No. 07/772,982, filed on Oct. 7, 1991, now Pat. No. 5,119,820, which is a continuation of application No. 07/343,170, filed on Apr. 25, 1989, now Pat. No. 5,054,490, which is a continuation-in-part of application No. 07/193,295, filed on May 11, 1988, now Pat. No. 4,930,511.

(21) Appl. No.: **09/746,269**(22) Filed: **Dec. 21, 2000****Related U.S. Application Data**

(60) Division of application No. 09/277,481, filed on Mar. 26, 1999, which is a non-provisional of provisional application No. 60/080,158, filed on Mar. 31, 1998 and which is a continuation-in-part of application No. 09/094,073, filed on Jun. 9, 1998, now Pat. No. 6,027,449, which is a continuation-in-part of application No. 08/795,025, filed on Feb. 4, 1997, now Pat. No. 5,840,029, which is a continuation-in-part of

Publication Classification

(51) **Int. Cl.⁷** **A61B 8/00**; **A61B 8/06**
(52) **U.S. Cl.** **600/437**; **600/449**

(57) **ABSTRACT**

A contained water ultrasonic densitometer employs pre-inflated bladders holding coupling fluid about ultrasonic transducers. The bladders in a relaxed state define a cavity smaller than the human heel so that when the heel is inserted, the bladders conform to the heel in a wiping action removing entrapped air.

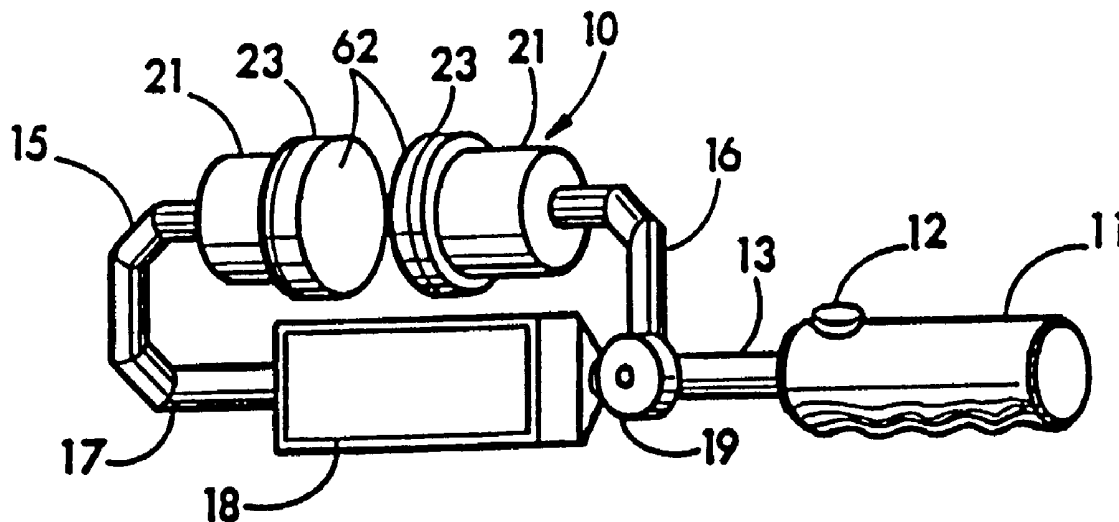

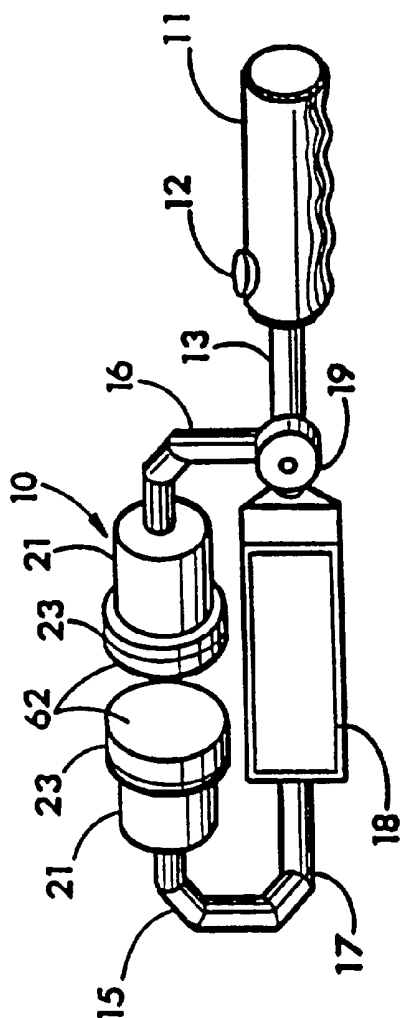

FIG. 1

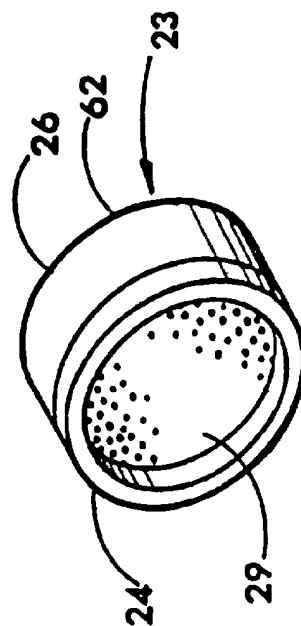

FIG. 2

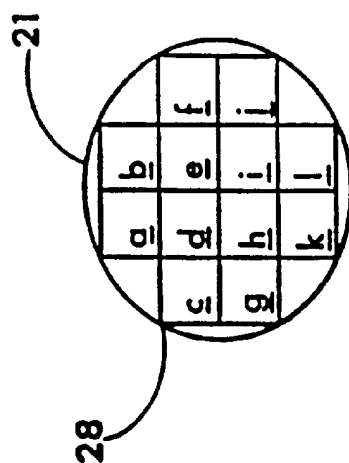
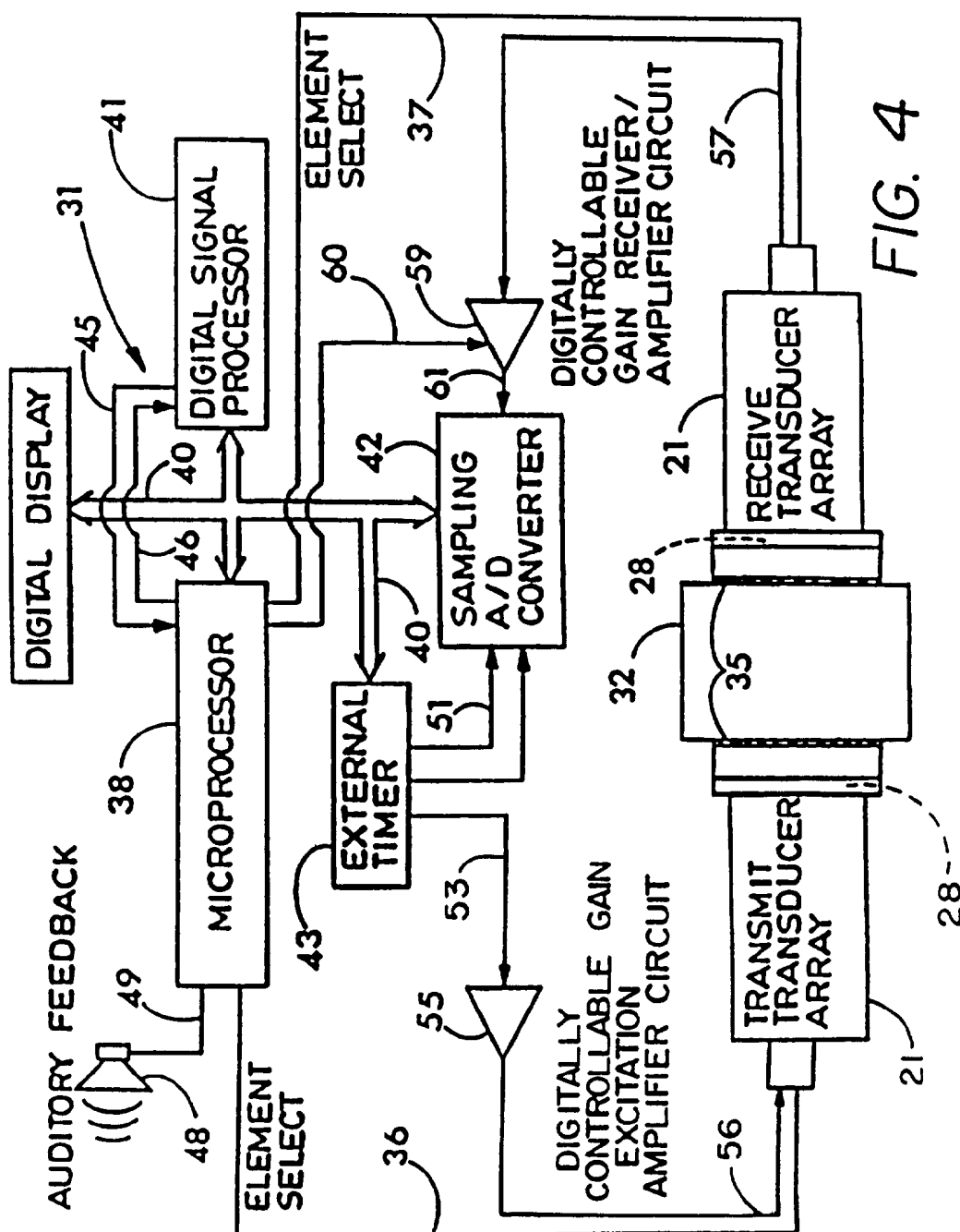

FIG. 3



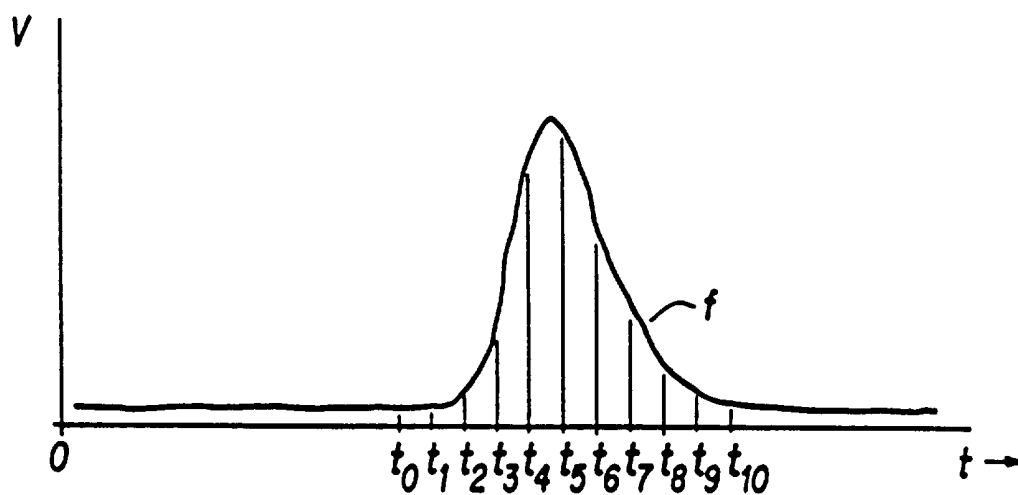

FIG. 5

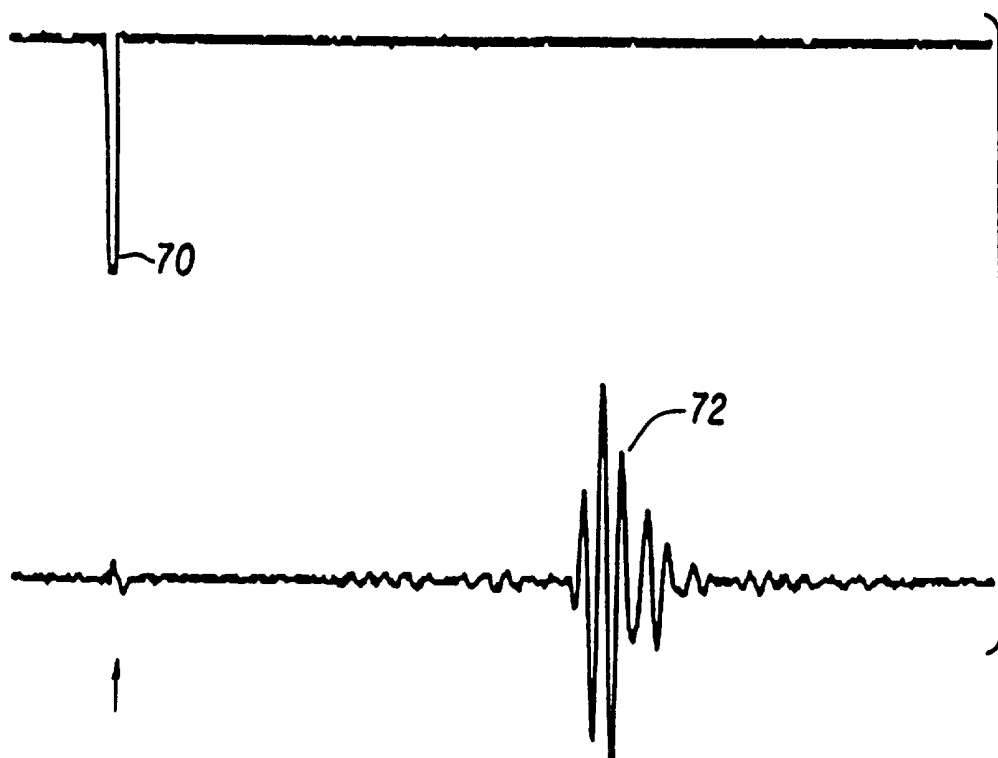

FIG. 7

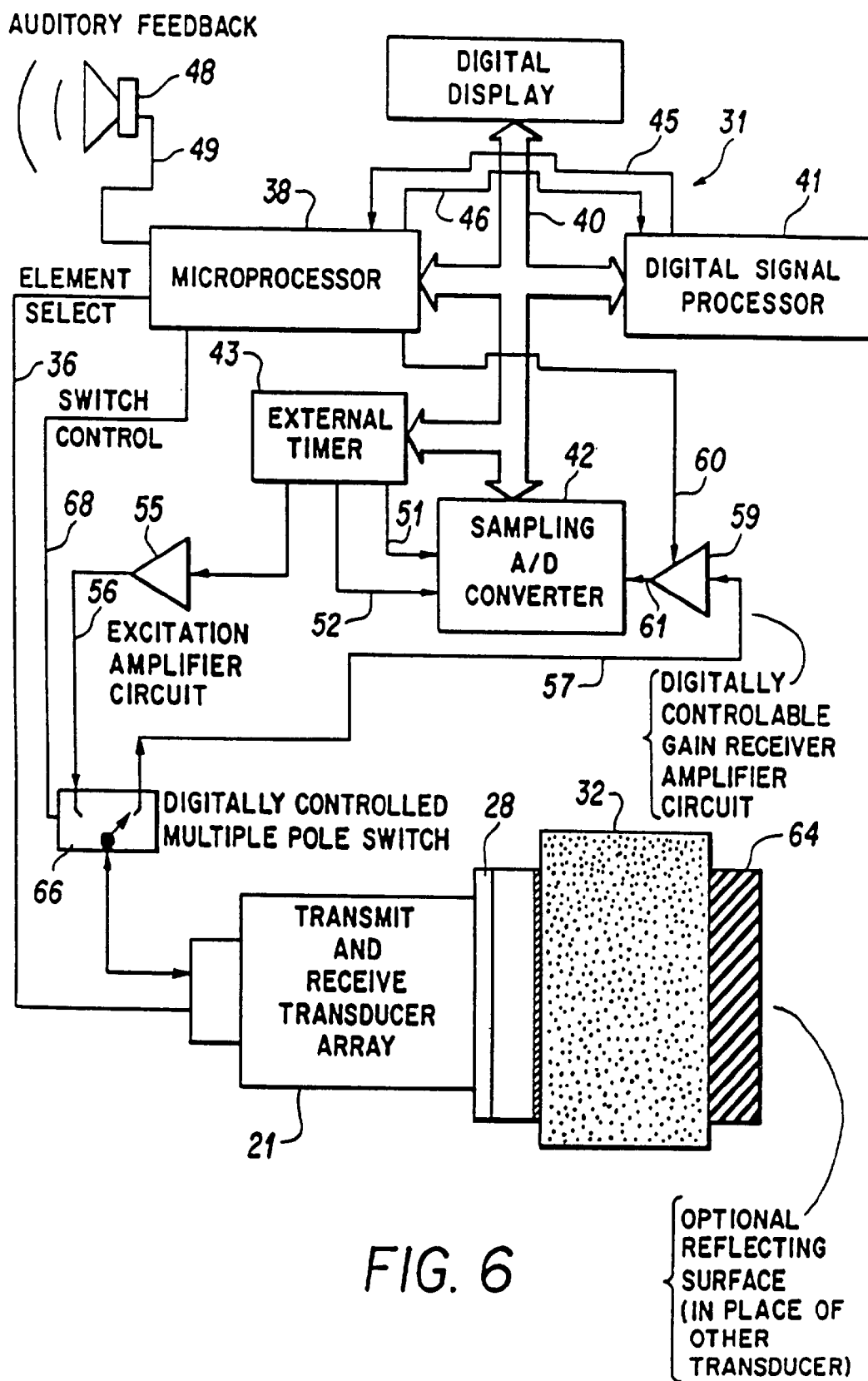

FIG. 6

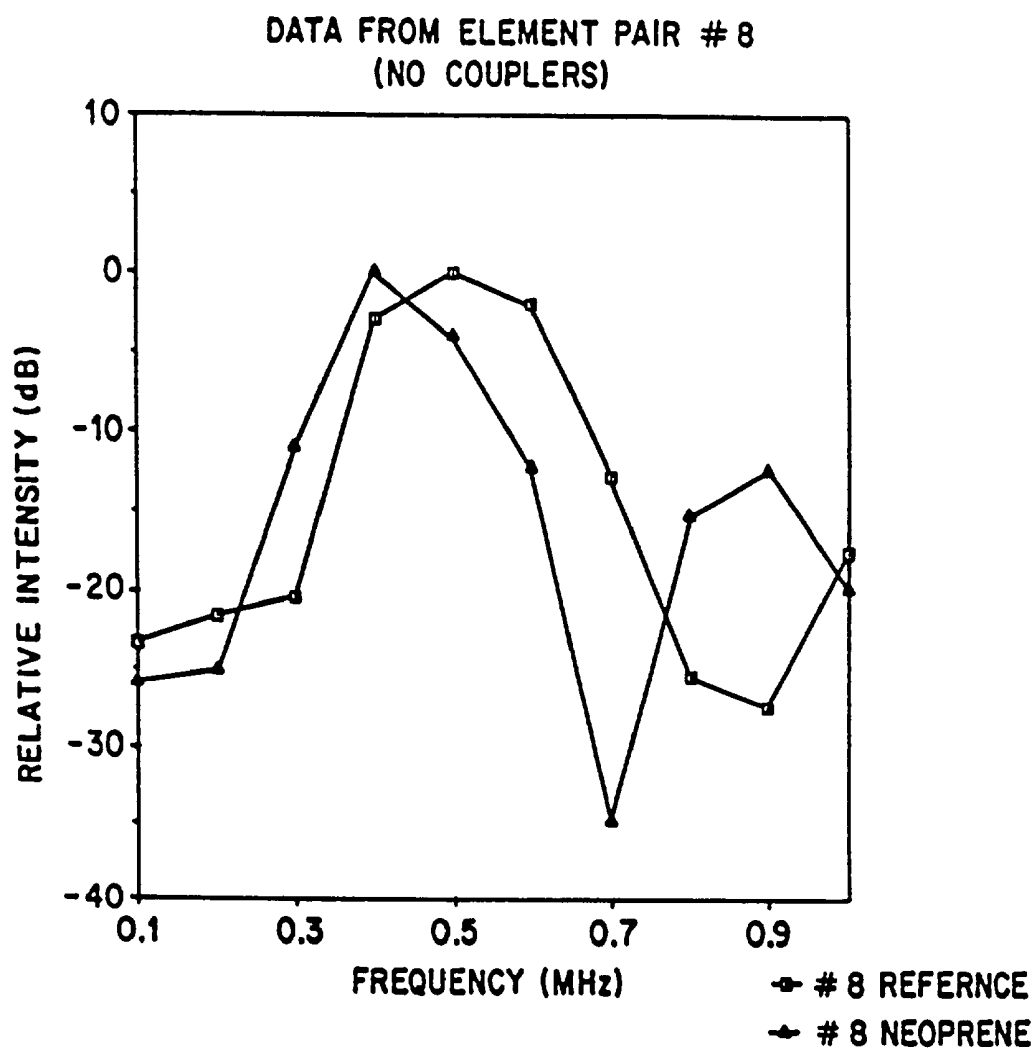

FIG. 8

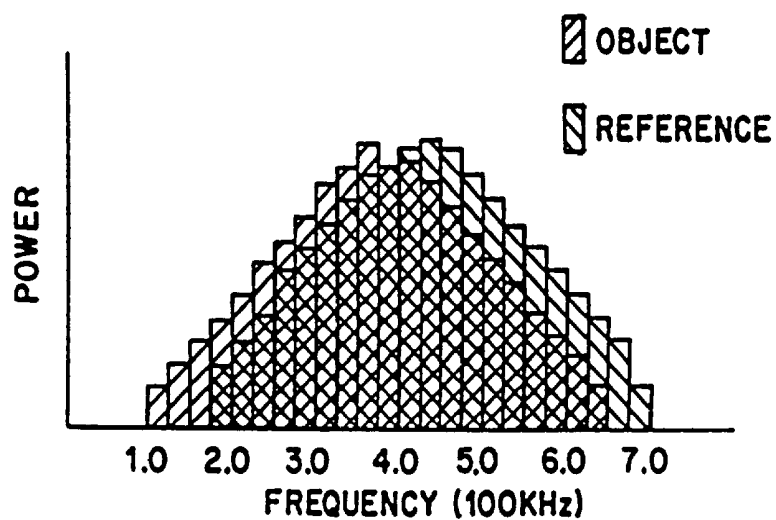

FIG. 9

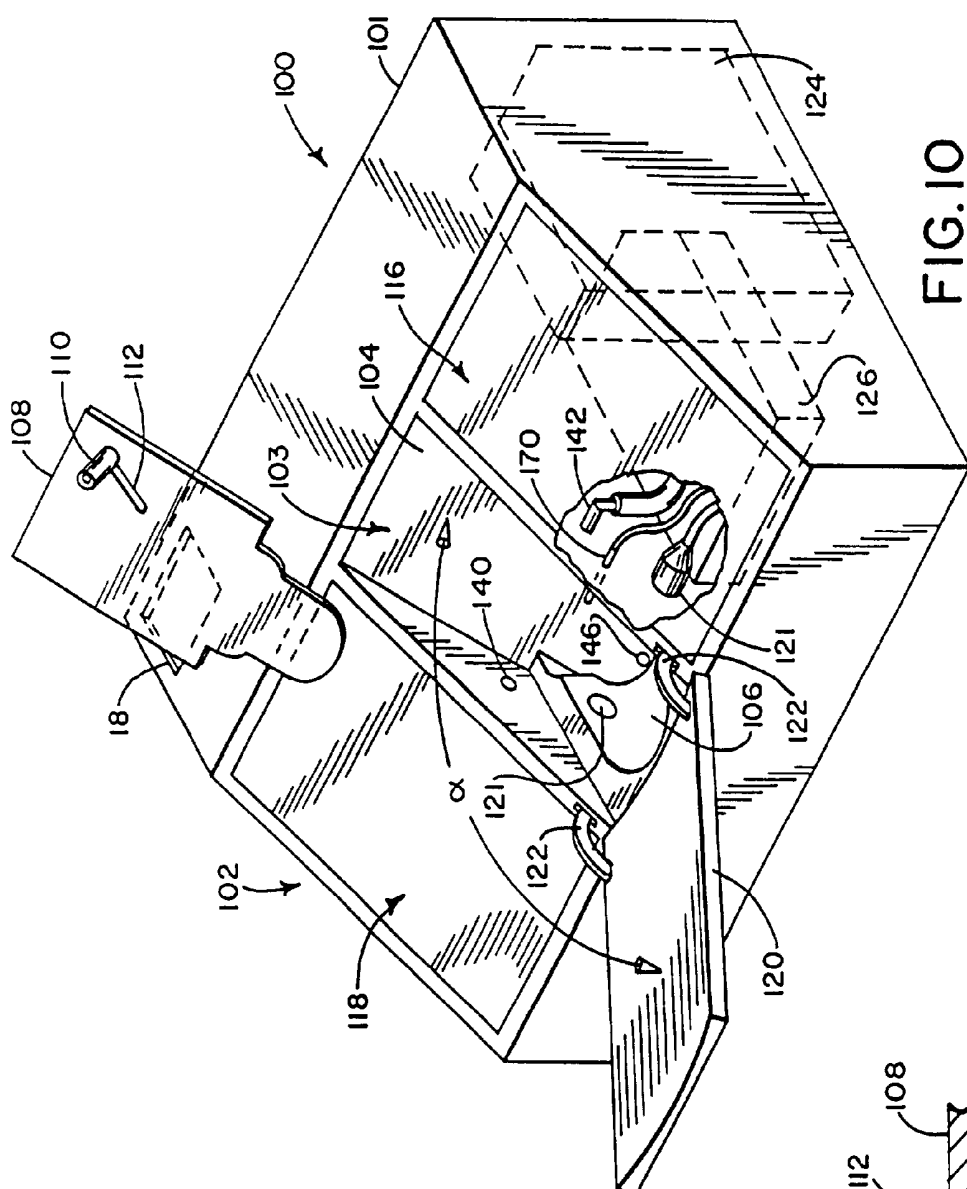

FIG. 10

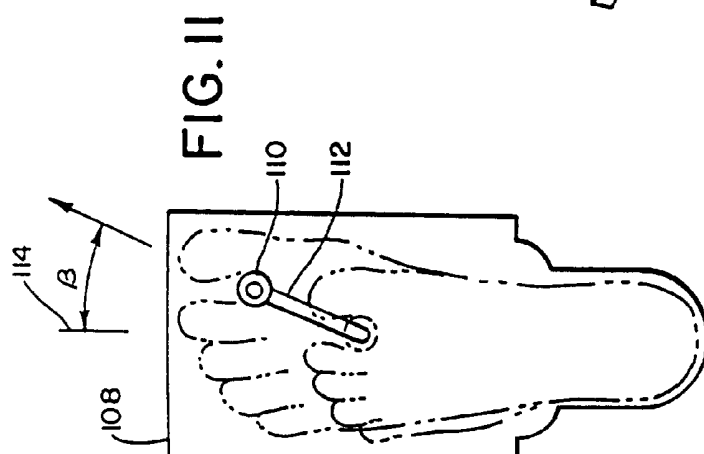

FIG. 11

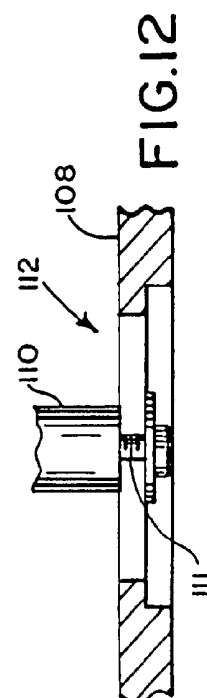

FIG. 12

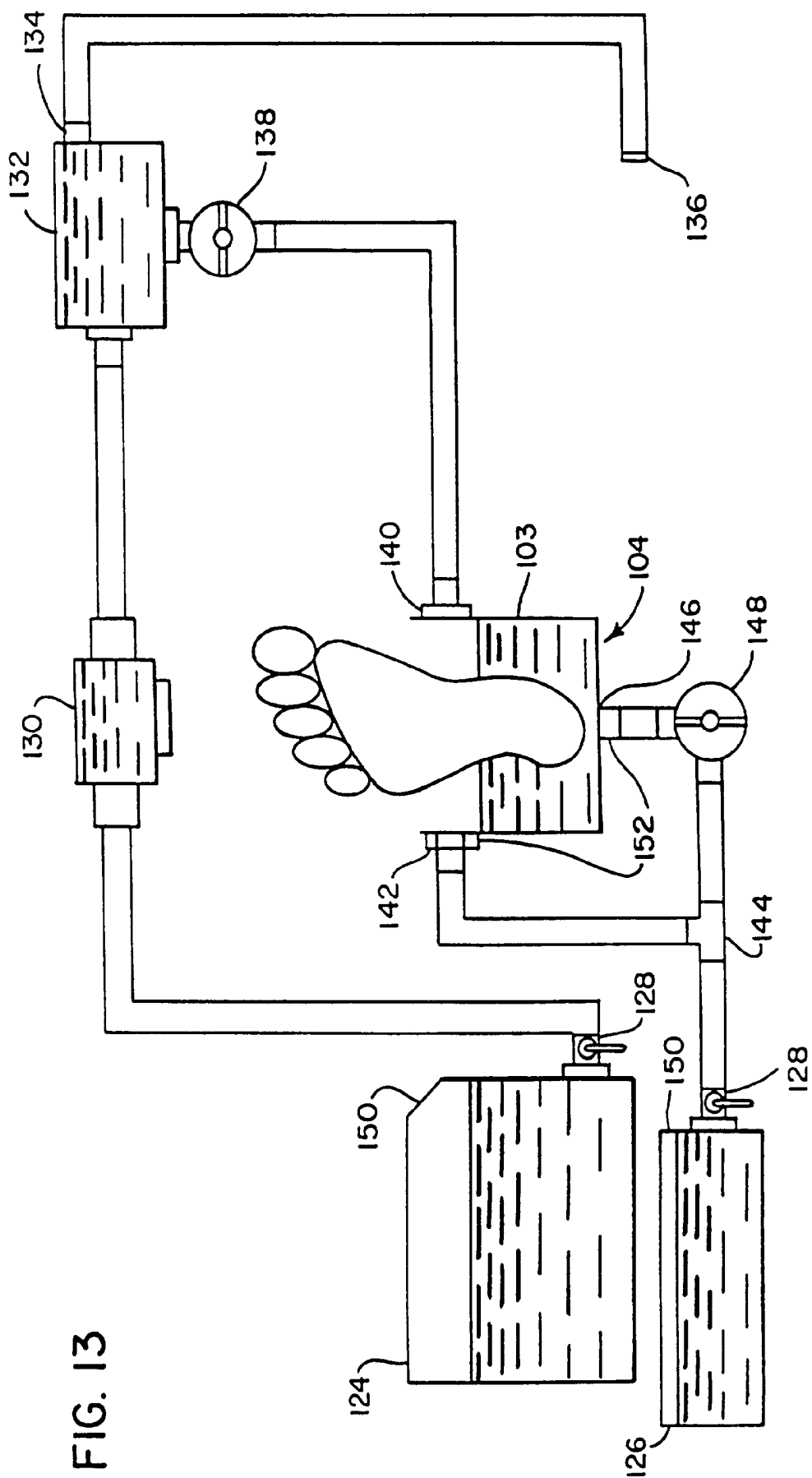
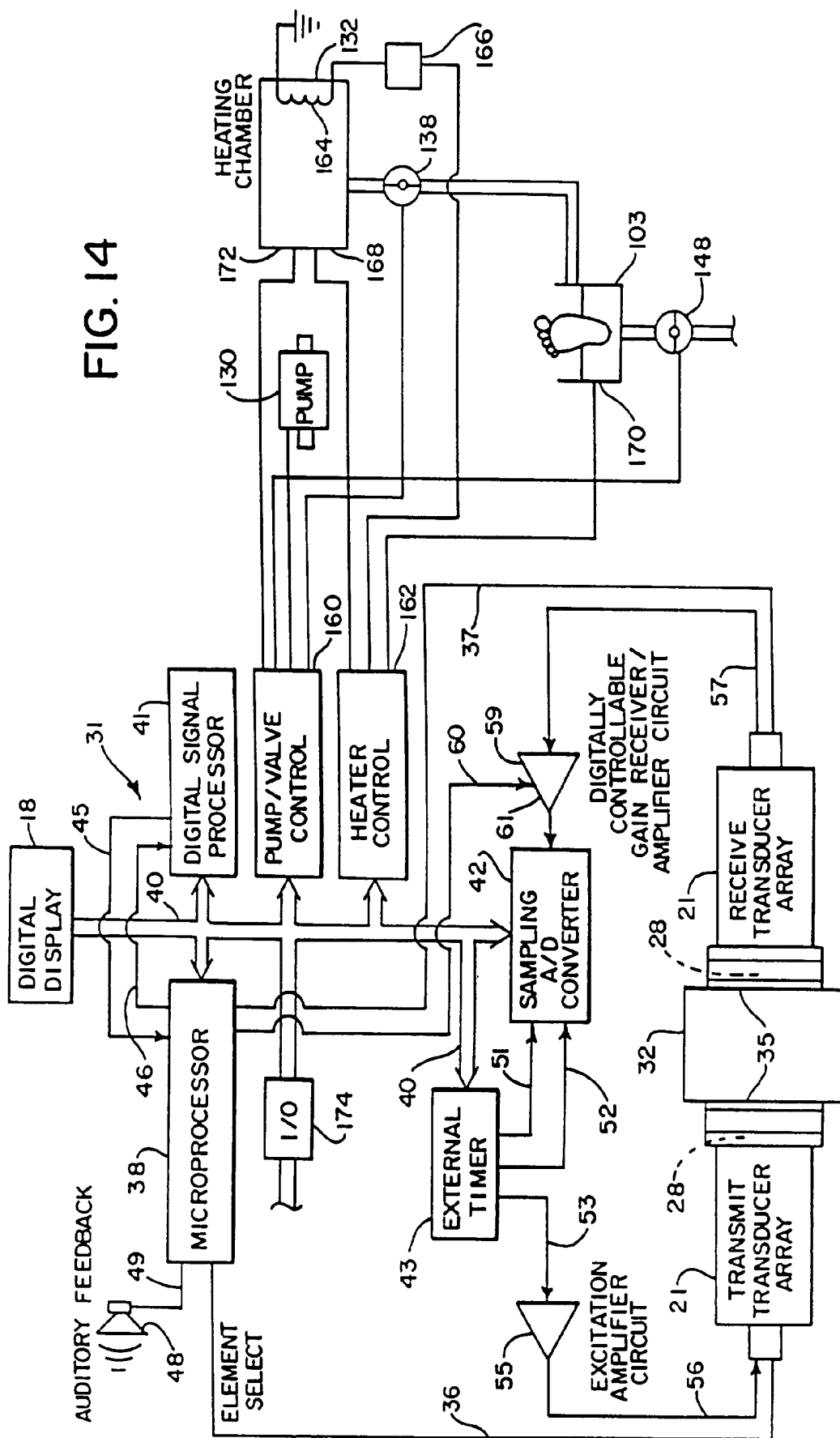

FIG. 14



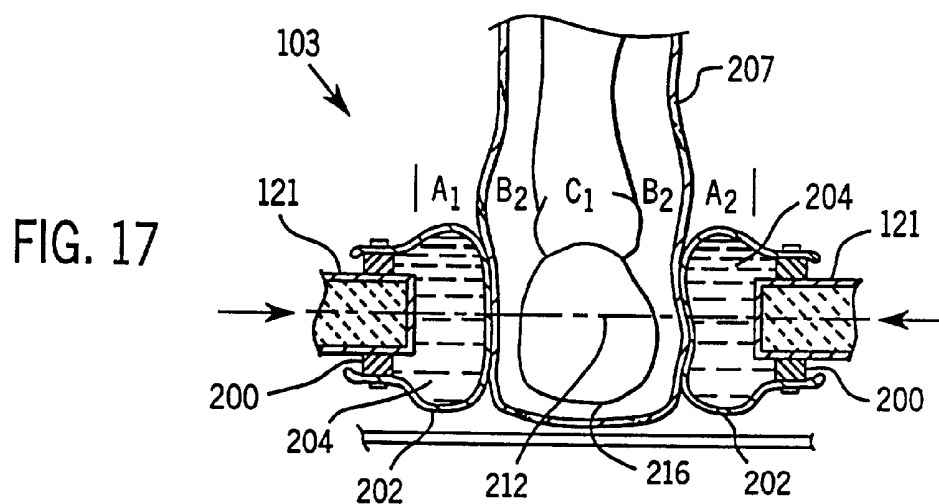
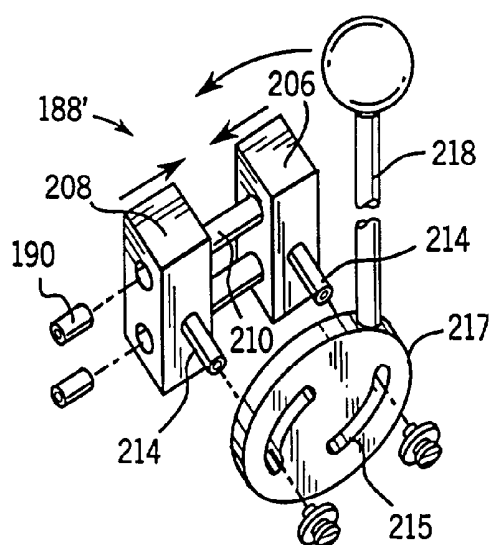
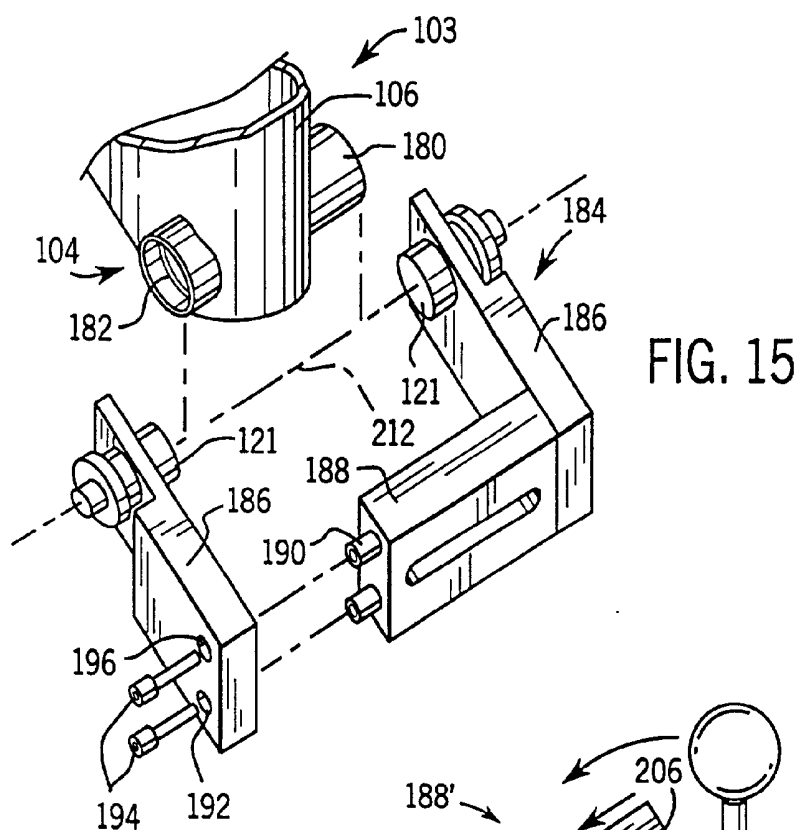

FIG. 18

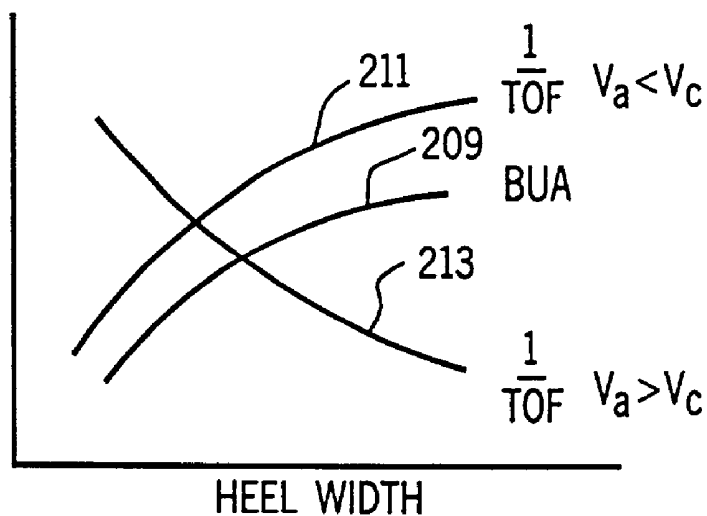
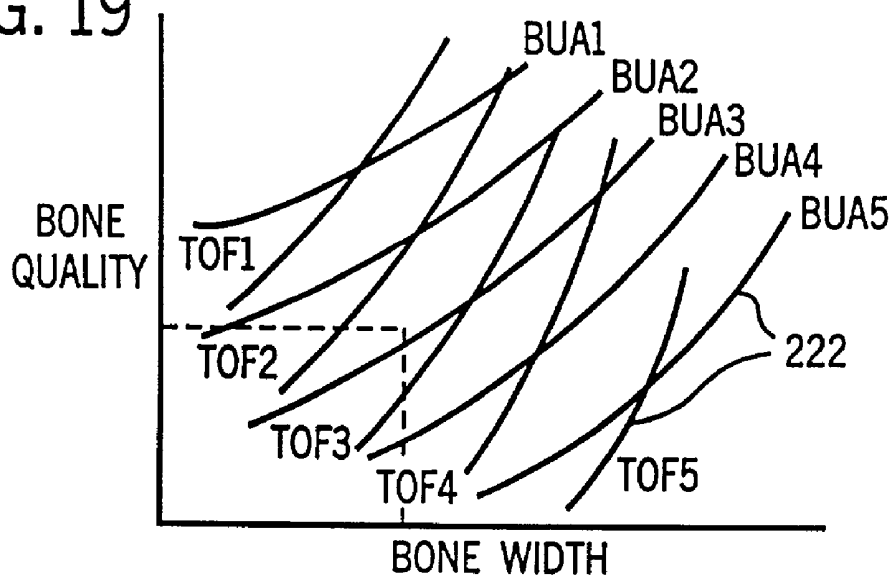
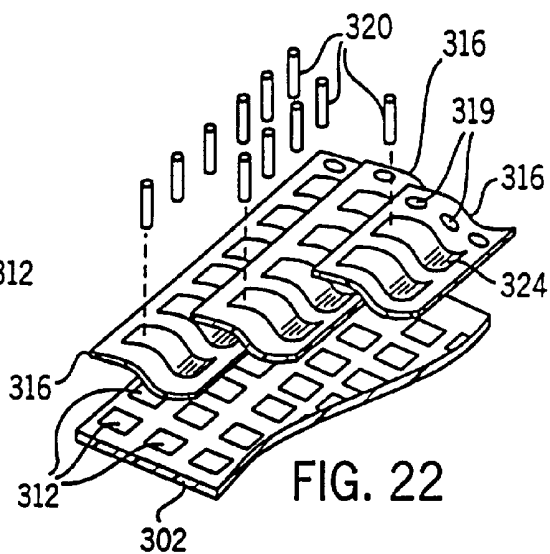
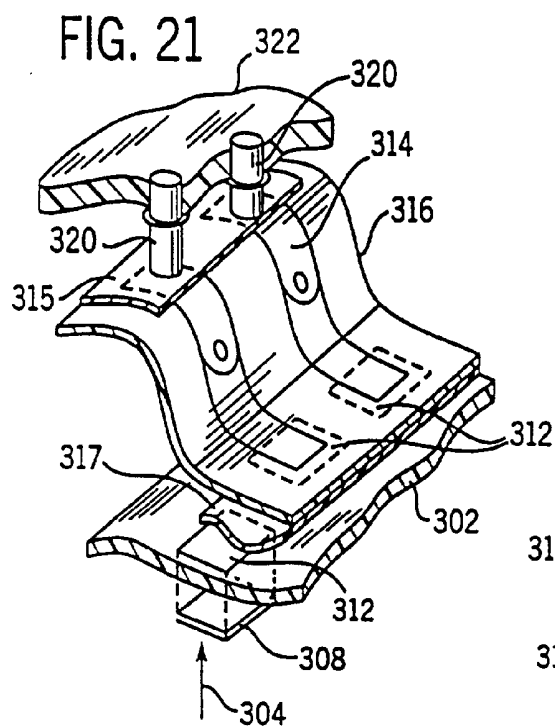
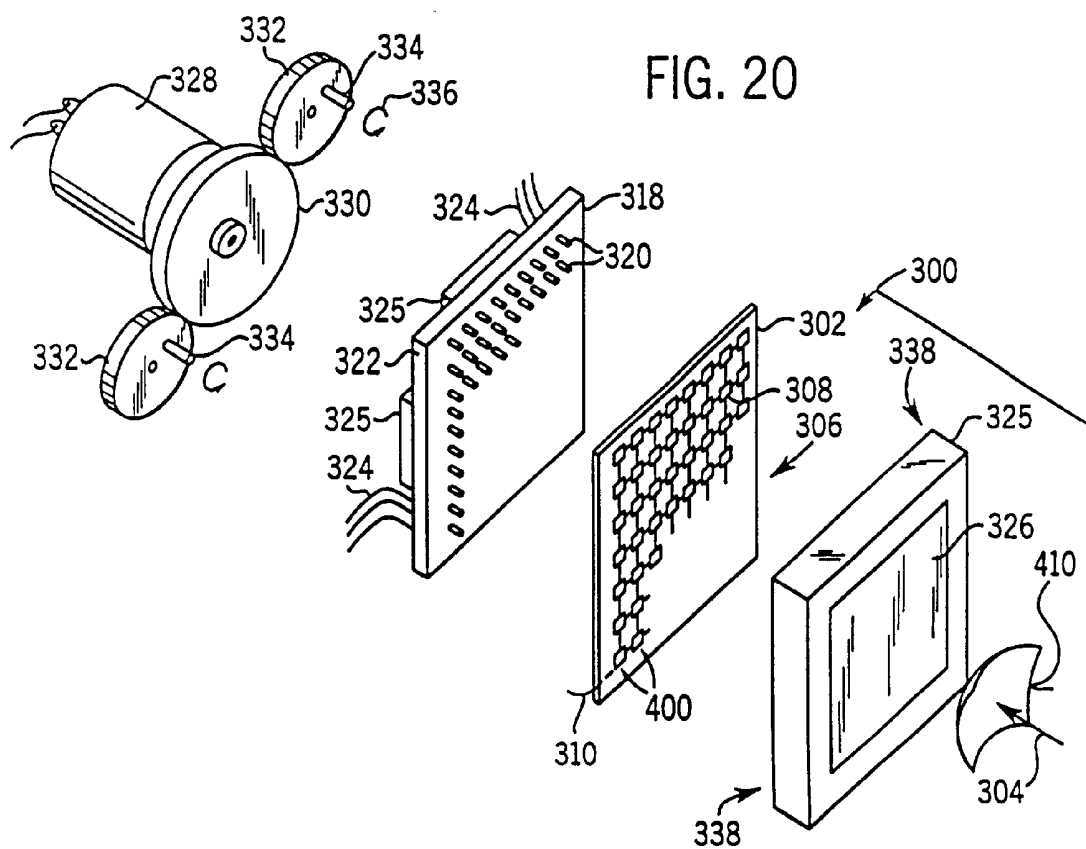

FIG. 19





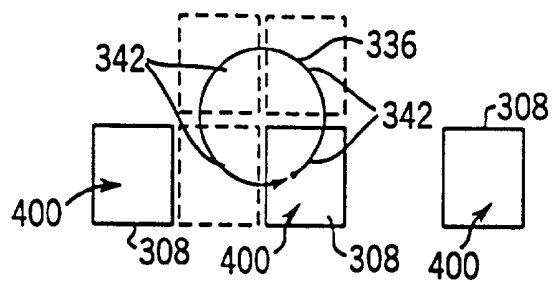

FIG. 23

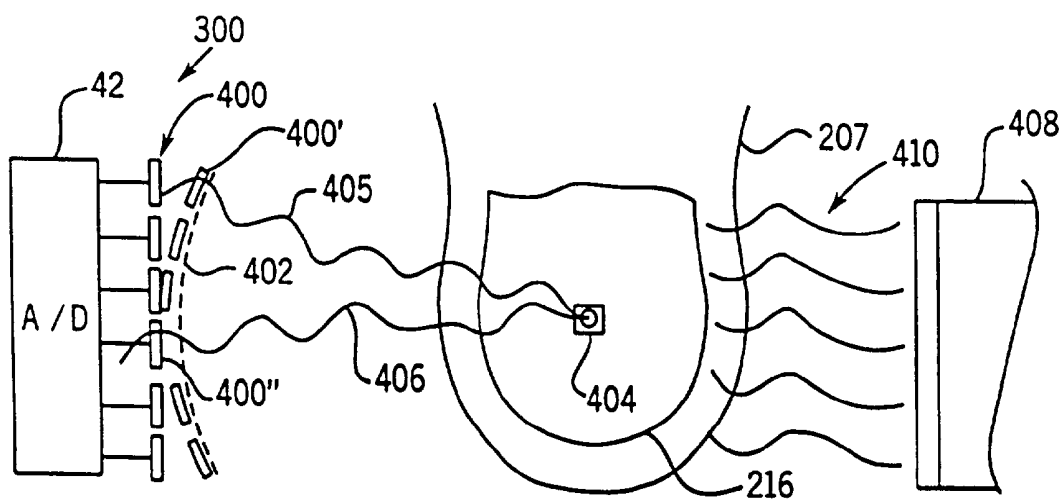

FIG. 24

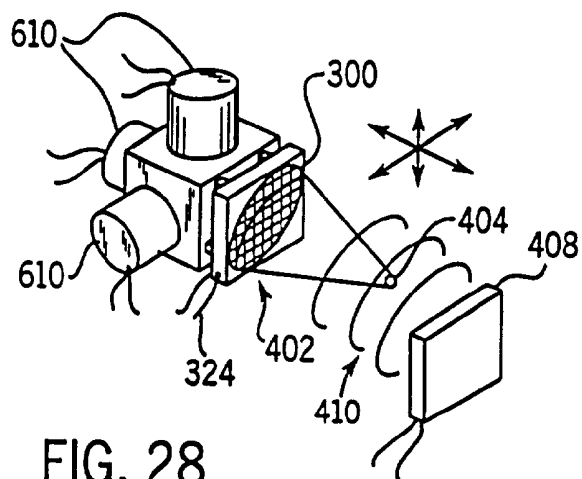

FIG. 28

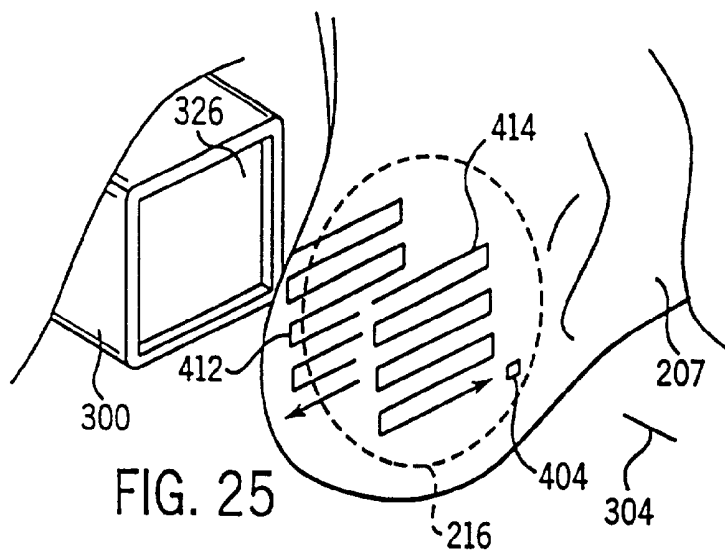

FIG. 25

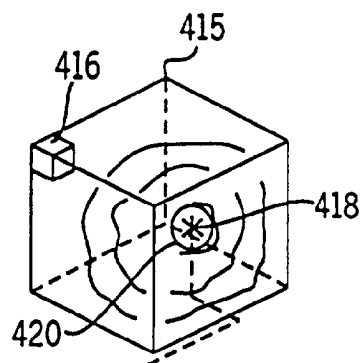
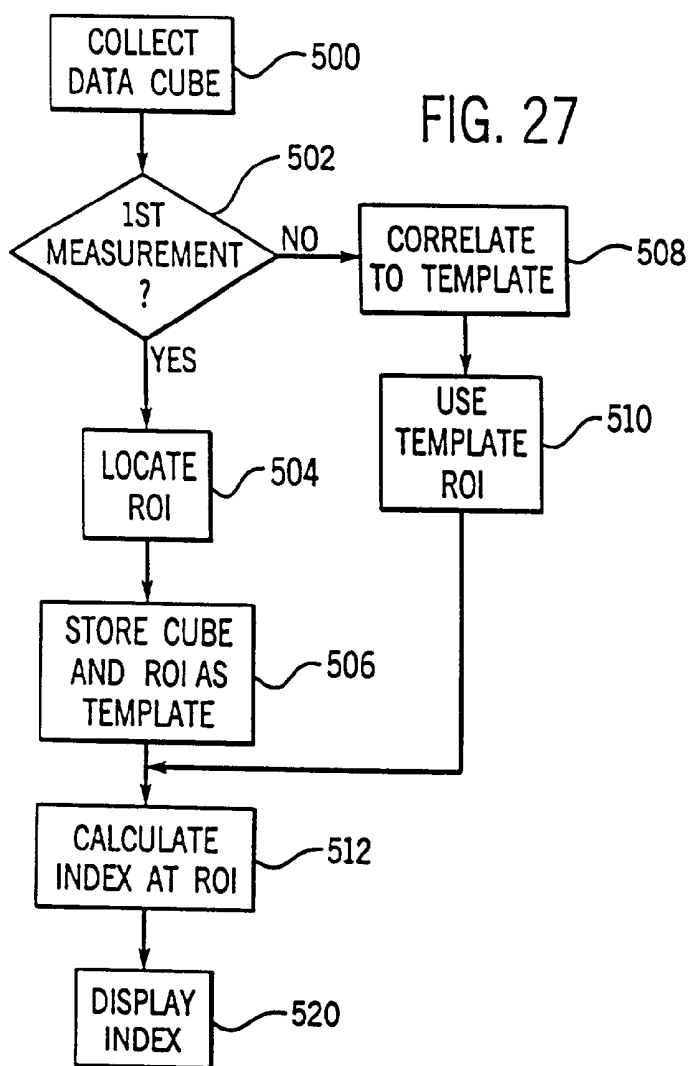

FIG. 26



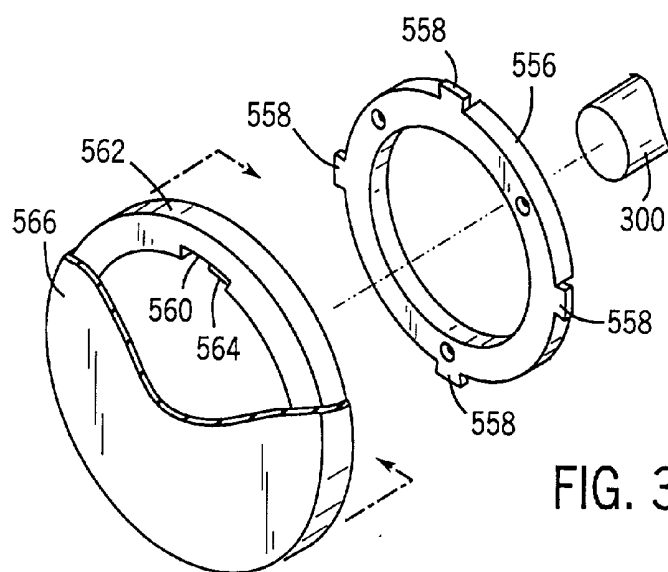
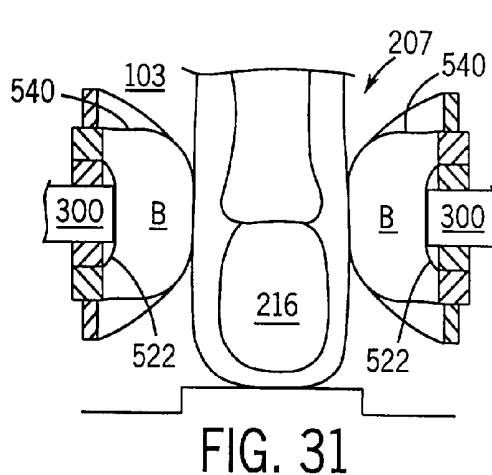
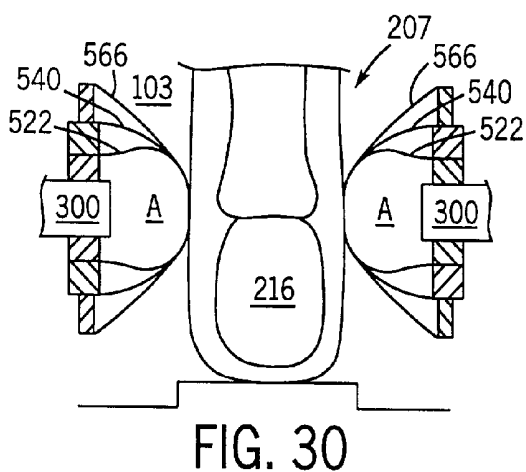
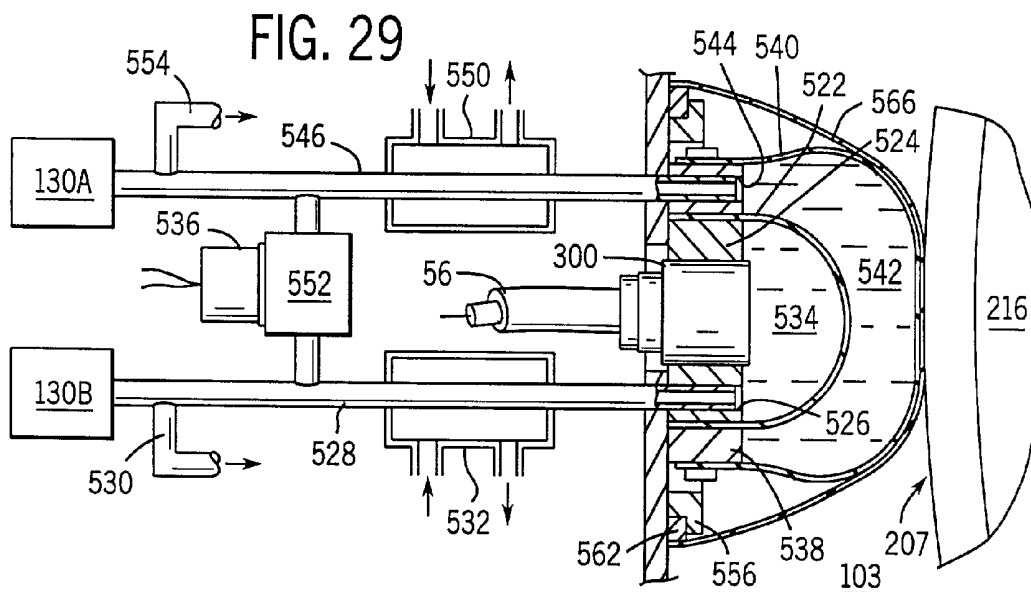

FIG. 33

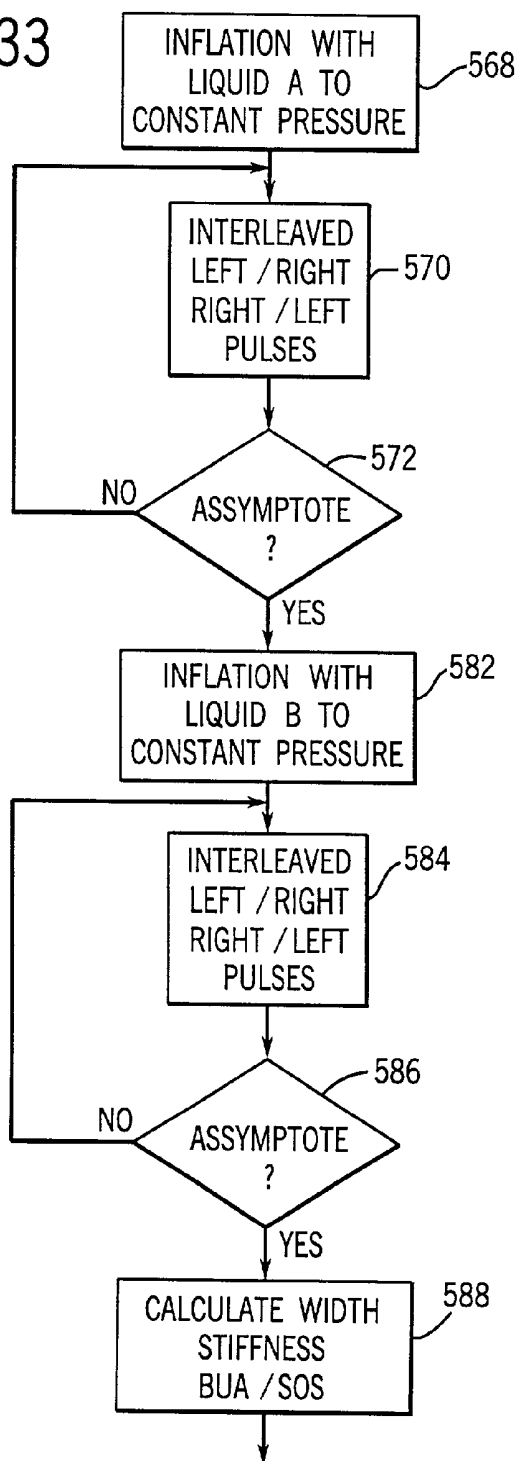
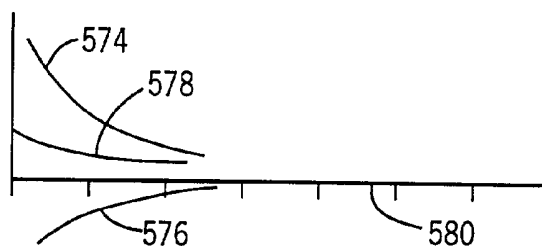

FIG. 34



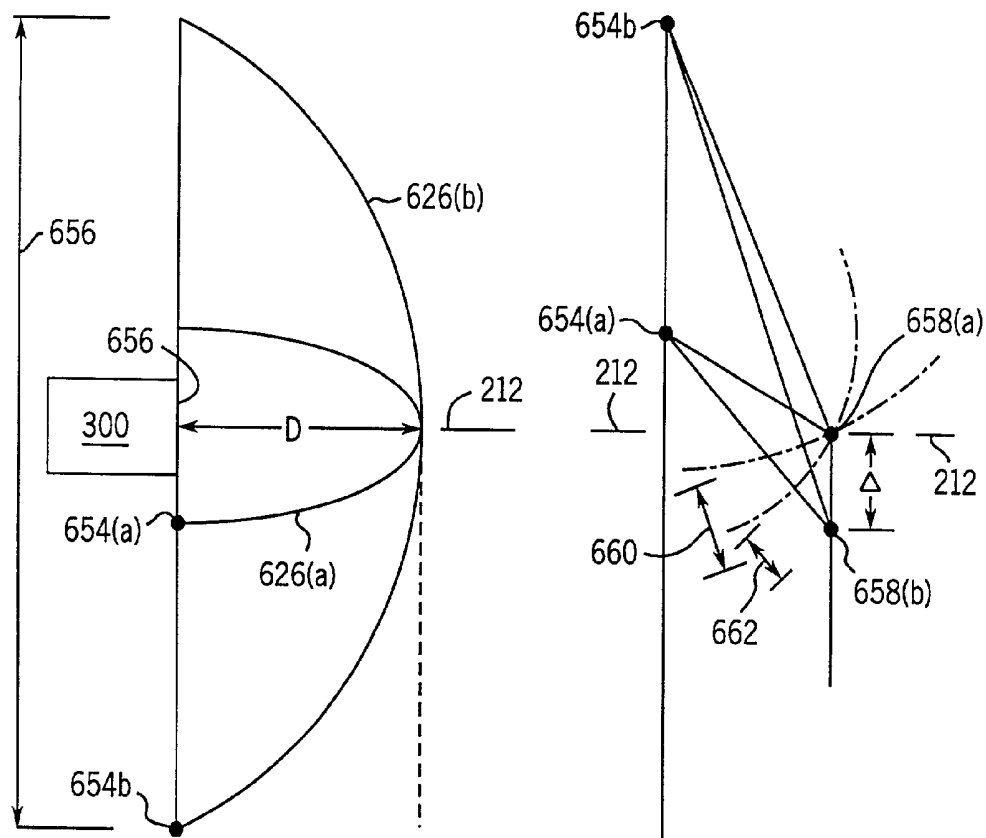

FIG. 35

FIG. 36

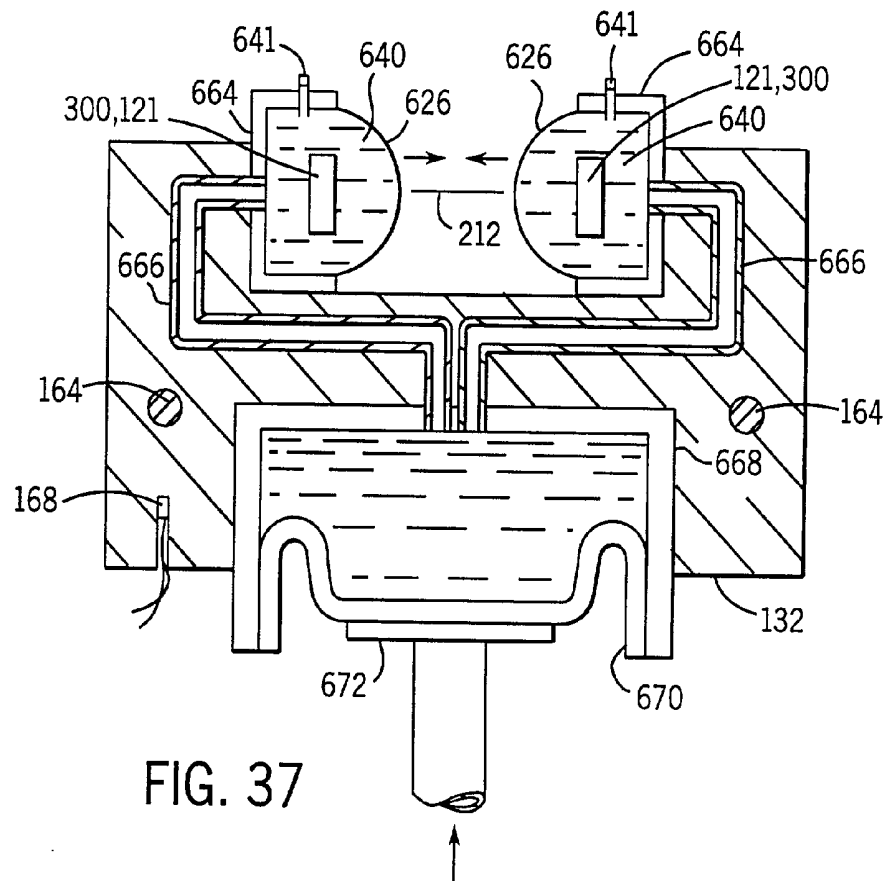

FIG. 37

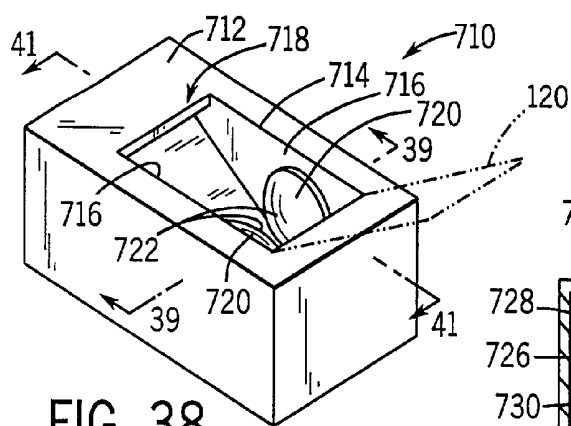

FIG. 38

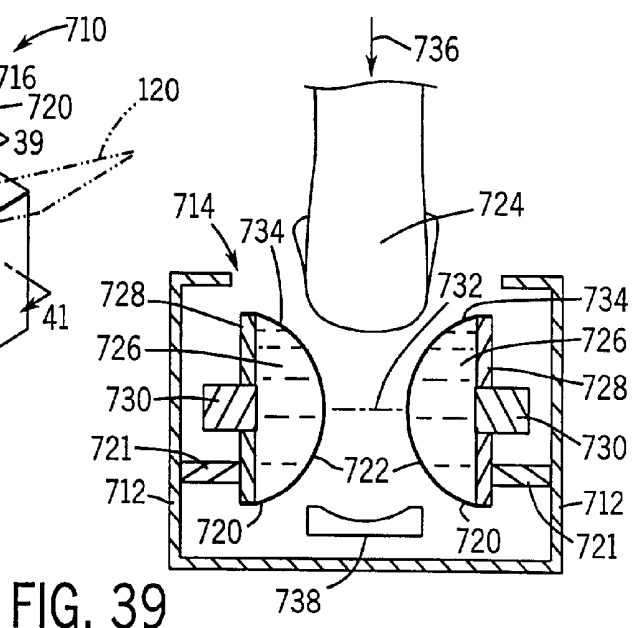

FIG. 39

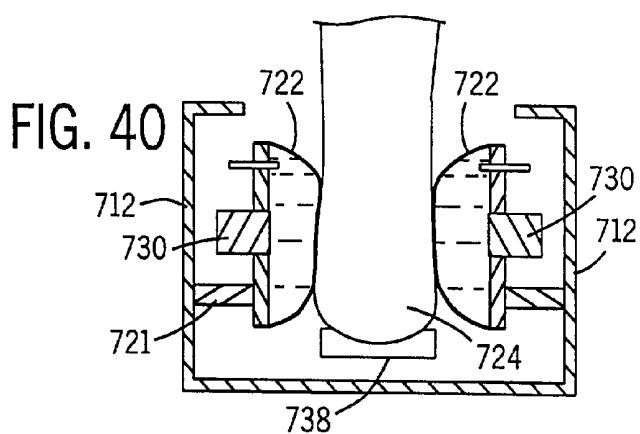

FIG. 40

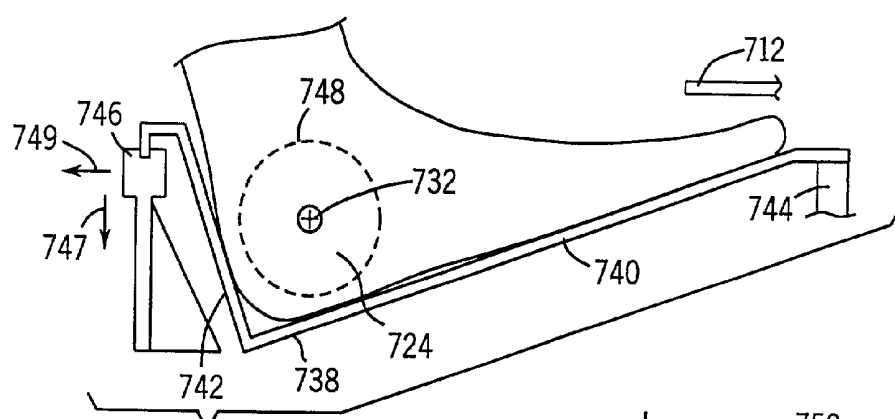

FIG. 41

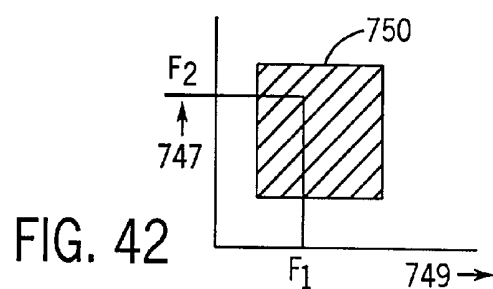

FIG. 42

ULTRASONIC DENSITOMETER WITH PRE-INFLATED FLUID COUPLING MEMBRANES

[0001] This application claims the benefit of provisional application Ser. No. 60/080,158 filed Mar. 31, 1998 and is a continuation-in-part of U.S. patent application Ser. No. 09/094,073 filed Jun. 9, 1998 which is a continuation of U.S. patent application Ser. No. 08/466,494 filed Jun. 6, 1995, which is a continuation-in-part of U.S. patent application Ser. No. 08/397,027 filed Mar. 1, 1995, now U.S. Pat. No. 5,483,965 which is a continuation of U.S. patent application Ser. No. 08/72,799 filed Jun. 4, 1993, abandoned, which is a continuation-in-part of U.S. patent application Ser. No. 07/895,494 filed Jun. 8, 1992, now U.S. Pat. No. 5,343,863 which is a continuation-in-part of U.S. patent application Ser. No. 07/772,982 filed Oct. 7, 1991, now U.S. Pat. No. 5,119,820, which is a continuation of U.S. patent application Ser. No. 07/343,170 filed Apr. 25, 1989 now U.S. Pat. No. 5,054,490, which is a continuation-in-part of Ser. No. 07/193,295 filed May 11, 1988, now U.S. Pat. No. 4,930,511.

BACKGROUND OF THE INVENTION

[0002] 1. Field of the Invention

[0003] The present invention relates to ultrasonic densitometer equipment using ultrasonic sound waves to measure bone integrity, and in particular, to an ultrasonic densitometer in which the ultrasound is conducted to a human heel through liquid filled bladders.

[0004] 2. Description of the Prior Art

[0005] Various devices presently exist which may be used to measure the physical properties and integrity of a member such as a bone. Non-invasive density measuring devices can be used to determine cumulative internal damage caused by micro-crushing and micro-fracturing occurring in the bones of humans or animals such as race horses. Additionally, osteoporosis, or loss of bone mineralization, detection in humans and its cure or prevention are increasingly becoming areas of intense medical and biological interest. As the average age of the human population increases, a greater number of patients are developing complications due to rapid trabecular bone loss.

Early Work

[0006] U.S. Pat. No. 3,847,141 to Hoop discloses a device for measuring the density of a bone structure, such as a finger bone or heel bone, to monitor the calcium content thereof. The device includes a pair of opposed spaced ultrasonic transducers which are held within a clamping device clamped on the bone being analyzed. A pulse generator is coupled to one of the transducers to generate an ultrasonic sound wave which is directed through the bone to the other transducer. An electric circuit couples the signals from the receive transducer back to the pulse generator for retriggering the pulse generator in response to those signals. The pulses therefore are produced at a frequency proportional to the transit time that the ultrasonic wave takes to travel through the bone structure which is directly proportional to the speed of the sound through the bone. The speed of sound through a bone has been found to be proportional to the density of the bone. Thus the frequency at which the pulse generator is retriggered is proportional to the density of the bone.

[0007] Another device and method for establishing, in vivo the strength of a bone is disclosed in U.S. Pat. Nos. 4,361,154 and 4,421,119 to Pratt, Jr. The device includes a launching transducer and a receiving transducer which are connected by a graduated vernier and which determine the speed of sound through the bone to determine its strength. The vernier is used to measure the total transit distance between the surfaces of the two transducers.

[0008] Lees (Lees, S. (1986) *Sonic Properties of Mineralized Tissue, Tissue Characterization With Ultrasound*, CRC publication 2, pp. 207-226) discusses various studies involving attenuation and speed of sound measurements in both cortical and spongy (cancellous or trabecular) bone. The results of these studies reveal a linear relationship between the wet sonic velocity and wet cortical density, and between the dry sonic velocity and the dry cortical density. The transit times of an acoustic signal through a bone member therefore are proportional to the bone density. Langton, et al. (Langton, C. M., Palmer, S. D., and Porter, S. W., (1984), *The Measurement of Broad Band Ultrasonic Attenuation in Cancellous Bone, Eng. Med.*, 13, 89-91) published the results of a study of ultrasonic attenuation versus frequency in the os calcis (heel bone) that is utilized through transmission techniques. These authors suggested that attenuation differences observed in different subjects were due to changes in the mineral content of the os calcis. They also suggested that low frequency ultrasonic attenuation may be a parameter useful in the diagnosis of osteoporosis or as a predictor of possible fracture risk.

Current Devices

[0009] A common site for the ultrasonic measurement is the os calcis of the human heel. In one ultrasonic densitometer design for measuring this site, opposed ultrasonic transducers are placed on opposite sides of a receptacle sized to hold the human foot. The receptacle is filled with water of a controlled temperature which serves to couple the ultrasonic energy from a first transducer, through the gap between that transducer and the human heel, and from an exit point of the human heel back through a corresponding gap between the exit point and the receiving transducer. To the extent that the water approximates the acoustic impedance of the soft tissue surrounding the heel, coupling of ultrasonic energy through the heel is improved and the precision of the measurement increased.

[0010] While a water filled receptacle provides a simple mechanism for coupling ultrasonic energy to the heel, it may be desired to contain the water behind a flexible membrane or the like so as to reduce the possibility of spilling or contaminating the water. It is known to contain water within flexible bladders and to mount those bladders on an adjusting mechanism so that the bladders may be moved to compress the heel between them. This movement of the bladder supports may be augmented with limited inflation of the bladders and/or movement of the transducers. Such compressive type bladder systems create a risk of air entrapment between the bladders and the heel such as may affect the quality of the measurements. For this reason it is known to use a conical shaped membrane that initially contacts the heel at a single point and, with further compression, expands outward to reduce air entrapment. Such membranes are difficult to fabricate and do not conform well to essentially flat opposed surfaces of the heel.

BRIEF SUMMARY OF THE INVENTION

[0011] The present invention provides a contained-water ultrasonic densitometer using stationary pre-inflated bladders. The bladders are arranged to form a cavity between them slightly smaller than the heel and the heel is slid in between the bladders. The sliding provides a wiping action that helps eliminate air trapped between the bladders and the foot.

[0012] Specifically, the densitometer provides pre-inflated bladders opposed along an ultrasonic propagation axis. A coupling material is contained within the bladders and ultrasonic transducers are positioned within the bladders to direct ultrasonic signals through the coupling material along an ultrasonic propagation axis between the transducers. The bladders are compliant so as to permit them to move apart to allow insertion of a human heel. The shape and composition of the bladder surfaces allow the bladders to slide over and conform with the heel while remaining substantially in alignment with the propagation axis.

[0013] Thus, it is one object of the invention to provide a contained-water ultrasonic densitometer having significantly decreased air entrapment between the bladders and the foot. The sliding action of the foot against the compliant membranes tends to reduce and eliminate entrapped air.

[0014] The first ultrasonic transducer may be held in opposition to a second ultrasonic transducer both with fixed separation and the first and second bladder surfaces may be mounted to a fixed support.

[0015] Thus it is another object of the invention to provide a greatly simplified mechanism for a contained water ultrasonic densitometer eliminating the need for a sliding mechanism to engage the bladders with the foot or repeated pumping and deflation of the bladders between measurements.

[0016] The bladder surfaces may be comprised of an elastomeric membrane having a surface coding of ultrasonic coupling gel.

[0017] Thus it is another object of the invention to provide a surface that easily slides along the surface of the human heel while also providing good coupling for the last interface between the bladder surface and the human heel.

[0018] The foregoing and other objects and advantages of the invention will appear from the following description. In this description, reference is made to the accompanying drawings which form a part hereof and in which there is shown by way of illustration, a preferred embodiment of the invention. Such embodiment does not necessarily represent the full scope of the invention, however, and reference must be made therefore to the claims for interpreting the scope of the invention.

BRIEF DESCRIPTION OF THE SEVERAL VIEWS OF THE DRAWINGS

[0019] FIG. 1 is a perspective view of the ultrasound densitometer device constructed in accordance with the present invention;

[0020] FIG. 2 is a perspective view of an acoustic coupler, two of which are shown in FIG. 1;

[0021] FIG. 3 is a front view of a transducer face from which acoustic signals are transmitted or by which acoustic signals are received, the face of the other transducer being the mirror image thereof;

[0022] FIG. 4 is a schematic block diagram view of the circuitry of the ultrasound densitometer device constructed in accordance with the present invention;

[0023] FIG. 5 illustrates the method of sampling a received waveform used by the circuit of FIG. 4;

[0024] FIG. 6 is a schematic block diagram view of the circuitry of an alternative embodiment of an ultrasound densitometer constructed in accordance with the present invention;

[0025] FIG. 7 is a sample of an actual ultrasonic pulse and response from an ultrasonic densitometer according to the present invention;

[0026] FIG. 8 is a sample plot of relative ultrasound pulse intensity over frequency range;

[0027] FIG. 9 is a graph in frequency domain illustrating the shift in attenuation versus frequency characteristic of a measured object as compared to a reference;

[0028] FIG. 10 is a perspective view of an alternative embodiment of the present invention showing a basin for receiving a patient's foot and having integral opposed ultrasonic transducers;

[0029] FIG. 11 is a plan view of a foot plate and toe peg used with the embodiment of FIG. 10;

[0030] FIG. 12 is a cross-sectional detail of the foot plate of FIG. 11 showing the method of attaching the sliding toe peg of the foot plate;

[0031] FIG. 13 is a block diagram of a system for transporting the acoustic coupling liquid used in the embodiment of FIG. 10;

[0032] FIG. 14 is a schematic block diagram view of the circuitry of the embodiment of FIG. 10;

[0033] FIG. 15 is an exploded view of the underside of the foot basin of FIG. 10 showing a c-clamp for holding the opposed ultrasonic transducers in precise alignment and separation;

[0034] FIG. 16 is a perspective detailed view of the shank of the c-clamp of FIG. 15 showing a lever for moving the separation of the transducers between an open and precisely separated closed position;

[0035] FIG. 17 is a cross-section of a human heel and ultrasonic transducers of the basin of FIG. 10 showing flexible liquid filled bladders surrounding the transducers and providing a coupling path between the transducers and the heel;

[0036] FIG. 18 is a plot of the inverse of time of flight (TOF) for two bone conditions and broadband ultrasonic attenuation (BUA) as a function of heel width showing their opposite functional dependencies;

[0037] FIG. 19 is a plot of bone quality versus bone width as might be obtained from empirical measurement of multiple bone phantoms and as may be used to eliminate bone width effects in the ultrasonic assessment of bone quality;

[0038] FIG. 20 is an exploded view of the elements of an ultrasonic detector array showing a driving mechanism for improving the resolution of the acquired data and the location of a piezoelectric film detector array above a spatially offset connector;

[0039] FIG. 22a is a detailed perspective fragmentary view of the piezoelectric film detector with electrodes on its surface as communicating with connector terminals via acoustically transparent conductors;

[0040] FIG. 22b is a detailed fragmentary view of the piezoelectric film of FIG. 22a showing a method of assembling the acoustically transparent conductors;

[0041] FIG. 23 is a detailed view of the face of the detector showing its displacement by the driving mechanism of FIG. 20;

[0042] FIG. 24 is a figure similar to that of FIG. 17 showing use of the detector array to provide focused reception at a point within a patient's heel;

[0043] FIG. 25 is a perspective view in phantom of a patient's heel showing a raster scan pattern of a reception point within the heel to measure volumetric bone density variations within an inner and outer portion of the os calcis;

[0044] FIG. 26 is a schematic representation of a data cube collected in the scanning shown in FIG. 25 with isodensity lines used to locate a measurement region of interest;

[0045] FIG. 27 is a flow chart of the operation of the present invention in locating a region of interest uniformly over several patient visits;

[0046] FIG. 28 is a perspective view of an embodiment of the invention using a fixed focus transducer array mechanically scanned to provide a plurality of spatially separated measurements;

[0047] FIG. 29 is a partial cross-sectional view of an alternative embodiment to FIG. 17 using overlapping inflatable bladders;

[0048] FIG. 30 is a figure similar to FIG. 17 showing the bladders inflated in a first mode using a first coupling liquid;

[0049] FIG. 31 is a figure similar to that of FIG. 30 showing the bladders inflated in a second mode using a second coupling liquid in the inner bladder.

[0050] FIG. 32 is a perspective exploded view and partial cutaway of an outer bladder element adapted for disposable use;

[0051] FIG. 33 is a flowchart describing a program executed with a microprocessor 38 of FIG. 4 using the bladder configuration of FIG. 29; and

[0052] FIG. 34 is a graph representing variations in value of attenuation, speed of sound and a combined stiffness quantity as a function of time.

[0053] FIG. 35 is a simplified cross-sectional view of a flexible membrane according to the present invention showing a hemispherical distention for improved patient immobilization;

[0054] FIG. 36 is geometric diagram showing representational stretching of membranes with cross axis patient movement for membranes of two different aspects;

[0055] FIG. 37 is a cross sectional view of a closed system for distending two membranes using a rolling diaphragm pump element;

[0056] FIG. 38 is a perspective view of a contained-water ultrasonic densitometer system of the present invention showing a receptacle for receiving a human foot holding opposed pre-inflated bladder surfaces;

[0057] FIG. 39 is a cross-sectional view along line 39-39 of FIG. 38 showing configuration of the bladders within the receptacle prior to insertion of a human foot;

[0058] FIG. 40 is a figure similar to that of FIG. 39 showing deformation of the bladders and engagement of the heel against a stop plate upon insertion of the heel within the receptacle of the ultrasonic densitometer;

[0059] FIG. 41 is a cross-sectional view taken along lines 41-41 of FIG. 38 showing seating of the foot against the stop plate of FIG. 40 and measurement of the forces so produced to ensure proper seating of the foot; and

[0060] FIG. 42 is a chart showing downward and backward forces imparted by the foot on the stop plate and a defined region of proper force enabling a measurement by the densitometer.

DETAILED DESCRIPTION OF THE INVENTION

Caliper Embodiment

[0061] Referring more particularly to the drawings, wherein like numbers refer to like parts, FIG. 1 shows a portable ultrasound densitometer 10 for measuring the physical properties and integrity of a member, such as a bone, in vivo. The densitometer 10 as shown in FIG. 1 includes a handle 11 with actuator button 12. Extending linearly from the handle 11 is a connection rod 13. The densitometer 10 also includes a fixed arm 15 and an adjustable arm 16. The fixed arm 15 preferably is formed continuously with the connection rod 13, and therefore is connected to an end 17 of the connection rod 13. The adjustable arm 16 is slidably mounted on the connection rod 13 between the handle 11 and a digital display 18 mounted on the rod 13. The knob 19 may be turned so as to be locked or unlocked to allow the adjustable arm 16 to be slid along the connection rod 13 so that the distance between the arms 15 and 16 may be adjusted.

[0062] Connected at the end of the fixed arm 15 is a first (left) transducer 21 and at the end of the adjustable arm 16 is a second (right) transducer 21. As shown in FIGS. 1 and 2, each of the transducers 21 has mounted on it a respective compliant acoustic coupler 23 to acoustically couple the transducer to the object being tested. The acoustic coupler 23 includes a plastic ring 24 and attached pad 26 formed of urethane or other compliant material. FIG. 3 shows a face 28 of the first (left) transducer 21 which is normally hidden behind the compliant pad 26 of the acoustic coupler 23. The transducer face 28 normally abuts against the inner surface 29 of the pad 26 shown in FIG. 2. The transducer face 28 shown in FIG. 3 includes an array of twelve transducer elements labeled a-l. The second (right) transducer 21 includes a face 28 which is the mirror image of that shown in FIG. 3.

[0063] FIG. 4 generally shows in schematic fashion the electronic circuitry 31 of the densitometer 10, which is physically contained in the housing of the digital display 18. An object 32 is placed between the two transducers 21 so that acoustic signals may be transmitted through the object. This object 32 represents a member, such as a bone, or some material with known acoustic properties such as distilled water or a neoprene reference block. As shown in the embodiment illustrated in FIG. 4, the leftmost transducer 21 is a transmit transducer and the rightmost transducer 21 is a receive transducer. In fact though, either or both of the transducers 21 may be a transmit and/or receive transducer. The transmit and receive transducers 21 of the circuit of FIG. 4 are connected by element select signals 36 and 37 to a microprocessor 38. The microprocessor 38 is programmed to determine which one of the respective pairs of transducer elements a through l are to be transmitting and receiving at any one time. This selection is accomplished by the element select signal lines 36 and 37, which may be either multiple signal lines or a serial data line to transmit the needed selection data to the transducers 21. The microprocessor 38 is also connected by a data and address bus 40 to the digital display 18, a digital signal processor 41, a sampling analog to digital converter 42, and a set of external timers 43. The microprocessor 38 has "on board" electrically programmable non-volatile random access memory (NVRAM) and, perhaps as well, conventional RAM memory, and controls the operations of the densitometer 10. The digital signal processor 41 has "on board" read-only memory (ROM) and performs many of the mathematical functions carried out by the densitometer 10 under the control of the microprocessor 38. The digital signal processor 41 specifically includes the capability to perform discrete Fourier transforms, as is commercially available in integrated circuit form presently, so as to be able to convert received waveform signals from the time domain to the frequency domain. The microprocessor 38 and digital signal processor 41 are interconnected also by the control signals 45 and 46 so that the microprocessor 38 can maintain control over the operations of the digital signal processor 41 and receive status information back. Together the microprocessor 38 and the digital signal processor 41 control the electrical circuit 31 so that the densitometer 10 can carry out its operations, which will be discussed below. An auditory feedback mechanism 48, such as an audio speaker, can be connected to the microprocessor 38 through an output signal 49.

[0064] The external timer 43 provides a series of clock signals 51 and 52 to the A/D converter 42 to provide time information to the A/D converter 42 so that it will sample at timed intervals electrical signals which it receives ultimately from the transmit transducer, in accordance with the program in the microprocessor 38 and the digital signal processor 41. The external timer 43 also creates a clock signal 53 connected to an excitation amplifier 55 with digitally controllable gain. Timed pulses are generated by the timer 43 and sent through the signal line 53 to the amplifier 55 to be amplified and directed to the transmit transducer 21 through the signal line 56. The transmit transducer 21 converts the amplified pulse into an acoustic signal which is transmitted through the object or material 32 to be received by the receive transducer 21 which converts the acoustic signal back to an electrical signal. The electrical signal is directed through output signal 57 to a receiver amplifier 59 which amplifies the electrical signal.

[0065] The excitation amplifier circuit 55 is preferably a digitally controllable circuit designed to create a pulsed output. The amplification of the pulse can be digitally controlled in steps from one to ninety-nine. In this way, the pulse can be repetitively increased in amplitude under digital control until a received pulse of appropriate amplitude is received at the receiver/amplifier circuit 59, where the gain is also digitally adjustable.

[0066] Connected to the receiver amplifier circuit 59 and integral therewith is a digitally controllable automatic gain control circuit which optimizes the sensitivity of the receive transducer 21 and the amplifier circuit 59 to received acoustic signals. The microprocessor 38 is connected to the amplifier circuit and automatic gain control 59 through signal line 60 to regulate the amplification of the amplifier circuit and gain control 59. The amplified electric signals are directed through lead 61 to the A/D converter 42 which samples those signals at timed intervals. The A/D converter 42 therefore in effect samples the received acoustic signals. As a series of substantially identical acoustic signals are received by the receive transducer 21, the A/D converter 42 progressively samples an incremental portion of each successive signal waveform. The microprocessor 38 is programmed so that those portions are combined to form a digital composite waveform which is nearly identical to a single waveform. This digitized waveform may be displayed on the digital display 18, or processed for numerical analysis by the digital signal processor 41.

[0067] The densitometer constructed in accordance with FIGS. 1-4 can be operated in one or more of several distinct methods to measure the physical properties of the member, such as integrity or density. The different methods, as described in further detail below, depend both on the software programming the operation of the microprocessor 34 as well as the instructions given to the clinician as to how to use the densitometer. The different methods of use may all be programmed into a single unit, in which case a user-selectable switch may be provided to select the mode of operation, or a given densitometer could be constructed to be dedicated to a single mode of use. In any event, for the method of use of the densitometer to measure the physical properties of a member to be fully understood, it is first necessary to understand the internal operation of the densitometer itself.

[0068] In any of its methods of use, the densitometer is intended to be placed at some point in the process on the member whose properties are being measured. This is done by placing the transducers 21 on the opposite sides of the member. To accomplish this, the knob 19 is loosened to allow the adjustable arm 16 to be moved so that the transducers 21 can be placed on opposite sides of the member, such as the heel of a human patient. The outside surfaces of the pads 26 can be placed against the heel of the subject with an ultrasound gel 35 or other coupling material placed between the pads 26 and subject 32 to allow for improved transmission of the acoustic signals between the member 32 and transducers 21. Once the transducers 21 are properly placed on the member, the knob 19 may be tightened to hold the adjustable arm 16 in place, with the transducers 21 in spaced relation to each other with the member 32 therebetween. The actuator button 12 may then be pressed so that acoustic signals will be transmitted through the member 32 to be received by the receive

transducer 21. The electronic circuit of FIG. 4 receives the electrical signals from the receive transducer 21, and samples and processes these signals to obtain information on the physical properties and integrity of the member 32 in vivo. The microprocessor 38 is programmed to indicate on the digital display 18 when this information gathering process is complete. Alternatively, the information may be displayed on the digital display 18 when the information gathering process is completed. For example, the transit time of the acoustic signals through the member 32 could simply be displayed on the digital display 18.

[0069] Considering in detail the operation of the circuitry of FIG. 4, the general concept is that the circuitry is designed to create an ultrasonic pulse which travels from transmit transducer 21 through the subject 32 and is then received by the receive transducer 21. The circuitry is designed to both determine the transit time of the pulse through the member 32 (also called time of flight ("TOF")), to ascertain the attenuation of the pulse through the member 32, and to be able to reconstruct a digital representation of the waveform of the pulse after it has passed through the member 32, so that it may be analyzed to determine the attenuation at selected frequencies. To accomplish all of these objectives, the circuitry of FIG. 4 operates under the control of the microprocessor 38. The microprocessor 38 selectively selects, through the element select signal lines 36, a corresponding pair or a group of the elements a through I on the face of each of the transducers 21. The corresponding elements on each transducer are selected simultaneously while the remaining elements on the face of each transducer are inactive. With a given element, say for example element a selected, the microprocessor then causes the external timer 43 to emit a pulse on signal line 53 to the excitation amplifier circuit 55. The output of the excitation amplifier 55 travels along signal line 56 to element a of the transmit transducer 21, which thereupon emits the ultrasonic pulse. The corresponding element a on the receive transducer 21 receives the pulse and presents its output on the signal line 57 to the amplifier circuit 59. What is desired as an output of the A/D converter 42 is a digital representation of the analog waveform which is the output of the single transducer element which has been selected. Unfortunately, "real time" sampling A/D converters which can operate rapidly enough to sample a waveform at ultrasonic frequencies are relatively expensive. Therefore it is preferred that the A/D converter 42 be an "equivalent time" sampling A/D converter. By "equivalent time" sampling, it is meant that the A/D converter 42 samples the output of the transducer during a narrow time period after any given ultrasonic pulse. The general concept is illustrated in FIG. 5. The typical waveform of a single pulse received by the receive transducer 21 and imposed on the signal line 57 is indicated by a function "f". The same pulse is repetitively received as an excitation pulse and is repetitively launched. The received pulse is sampled at a sequence of time periods labeled t_0 - t_{10} . In other words, rather than trying to do a real-time analog to digital conversion of the signal f, the signal is sampled during individual fixed time periods t_0 - t_{10} after the transmit pulse is imposed, the analog value during each time period is converted to a digital function, and that data is stored. Thus the total analog waveform response can be recreated from the individual digital values created during each time period t, with the overall fidelity of the recreation of the waveform dependent on the number of time periods t which are

sampled. The sampling is not accomplished during a single real time pulse from the receive transducer 21. Instead, a series of pulses are emitted from the transmit transducer 21. The external timer is constructed to provide signals to the sampling A/D converter 42 along signal lines 51 and 52 such that the analog value sampled at time period t_0 when the first pulse is applied to a given transducer element, then at time t_1 during the second pulse, time t_2 during the third pulse, etc. until all the time periods are sampled. Only after the complete waveform has been sampled for each element is the next element, i.e. element b, selected. The output from the A/D converter 42 is provided both to the microprocessor 38 and to the signal processor 41. Thus the digital output values representing the complex waveform f of FIG. 5 can be processed by the signal processor 41 after they are compiled for each transducer element. The waveform can then be analyzed for time delay or attenuation for any given frequency component with respect to the characteristic of the transmitted ultrasonic pulse. The process is then repeated for the other elements until all elements have been utilized to transmit a series of pulses sufficient to create digital data representing the waveform which was received at the receive transducer array 21. It is this data which may then be utilized in a variety of methods for determining the physical properties of the member. Depending on the manner in which the densitometer is being utilized and the data being sought, the appropriate output can be provided from either the microprocessor 38 or the signal processor 41 through the digital display 18.

[0070] Because the ultrasonic pulsing and sampling can be performed so rapidly, at least in human terms, the process of creating a sampled ultrasonic received pulse can optionally be repeated several times to reduce noise by signal averaging. If this option is to be implemented, the process of repetitively launching ultrasonic pulses and sampling the received waveform as illustrated in FIG. 5 is repeated one or more times for each element in the array before proceeding to the next element. Then the sampled waveforms thus produced can be digitally averaged to produce a composite waveform that will have a lesser random noise component than any single sampled waveform. The number of repetitions necessary to sufficiently reduce noise can be determined by testing in a fashion known to one skilled in the art.

[0071] Having thus reviewed the internal operation of the densitometer of FIGS. 1-4, it is now possible to understand the methods of use of the densitometer to measure the physical properties of the member. The first method of use involves measuring transit time of an ultrasonic pulse through a subject and comparing that time to the, time an ultrasonic pulse requires to travel an equal distance in a substance of known acoustic properties such as water. To use the densitometer in this procedure, the adjustable arm 16 is adjusted until the member of the subject, such as the heel, is clamped between the transducers 21. Then the knob 19 is tightened to fix the adjustable arm in place. The actuator button 12 is then pressed to initiate a pulse and measurement. Next the densitometer is removed from the subject while keeping the knob 19 tight so that the distance between the transducers 21 remains the same. The device 10 is then placed about or immersed in a standard material 32 with known acoustic properties, such as by immersion in a bath of distilled water. The actuator button 12 is pressed again so that acoustic signals are transmitted from the transmit transducer 21 through the material 32 to the receive transducer

21. While it is advantageous to utilize the whole array of elements a through l for the measurement of the member, it may only be necessary to use a single pair of elements for the measurement through the standard assuming only that the standard is homogeneous, unlike the member. The signal profiles received by the two measurements are then analyzed by the microprocessor **38** and the signal processor **41**. This analysis can be directed both to the comparative time of transit of the pulse through the subject as compared to the standard and to the characteristics of the waveform in frequency response and attenuation through the subject as compared to the standard.

[0072] Thus in this method the densitometer may determine the physical properties and integrity of the member **32** by both or either of two forms of analysis. The densitometer may compare the transit time of the acoustic signals through the member with the transit time of the acoustic signals through the material of known acoustic properties, and/or the device **10** may compare the attenuation as a function of frequency of the broadband acoustic signals through the member **32** with the attenuation of corresponding specific frequency components of the acoustic signals through the material of known acoustic properties. The "attenuation" of an acoustic signal through a substance is the diminution of the ultrasonic waveform from the propagation through either the subject or the standard. The theory and experiments using both of these methods are presented and discussed in Rossman, P. J., *Measurements of Ultrasonic Velocity and Attenuation In The Human Os Calcis and Their Relationships to Photon Absorptiometry Bone Mineral Measurements* (1987) (a thesis submitted in partial fulfillment of the requirements for the degree of Master of Science at the University of Wisconsin-Madison). Tests have indicated that there exists a linear relationship between ultrasonic attenuation (measured in decibels) (dB)) at specific frequencies, and those frequencies. The slope (dB/MHz) of the linear relationship, referred to as the broadband ultrasonic attenuation, is dependent upon the physical properties and integrity of the substance being tested. With a bone, the slope of the linear relationship would be dependent upon the bone mineral density. Thus broadband ultrasonic attenuation through a bone is a parameter directly related to the quality of the cancellous bone matrix.

[0073] The microprocessor **38** may therefore be programmed so that the device determines the physical properties and integrity of the member by comparing either relative transit times and/or relative broadband ultrasonic attenuation through the member and a material of known acoustic properties. When comparing the transit times, the microprocessor **38** may be programmed most simply so that the electronics, having received the acoustic signals after they have been transmitted through the member, determines the "member" transit time of those acoustic signals through the member, and after the acoustic signals have been transmitted through the material of known acoustic properties, determines the "material" transit time of the acoustic signals through the material. These time periods may be measured most simply by counting the number of clock pulses of known frequency emitted by the timer **43** between the time of launching the pulse and the sensing of the received pulse at the A/D converter **42**. The microprocessor **38** then makes a mathematical "time" comparison of the member transit time to the material transit time and then relates that mathematical time comparison to the physical properties and

integrity of the member. The mathematical time comparison may be made by either determining a difference between the member transit time and the material transit time, or by determining a ratio between the member transit time and the material transit time.

[0074] As a second method of using the densitometer, it may also determine the physical properties and integrity of the member **32** by determining and comparing the attenuation of the broadband frequency components of the acoustic signals through the member without reference to a material having known acoustic properties. Using this method, the comparison of velocity to a standard is not necessary and absolute transit time of the pulse need not be calculated since it is attenuation that is measured. In such a mode, it is preferable that the transmit transducer **21** transmits an acoustic signal which has a broad range of frequency components, such as a simple ultrasonic pulse. In any case, the acoustic signal should have at least one specific frequency component.

[0075] In this attenuation comparison mode, the microprocessor **38** is programmed so that after the receive transducer **21** receives the acoustic signals transmitted through the bone member **32**, it determines the absolute attenuation through the member **32** of the frequency component spectrum of the acoustic signals. It is to facilitate the measurement of attenuation that the excitation amplifier circuit **55** and the receiver amplifier **59** have amplification levels which may be digitally controlled. By successively varying the gain of the amplifiers **55** and **59** on successive pulses, the circuit of **FIG. 4** can determine what level of gain is necessary to place the peak of the received waveform at a proper voltage level. This gain is, of course, a function of the level of attenuation of the acoustic pulse during transit through the member **32**. After the receive transducer **21** receives acoustic signals, microprocessor **38** in conjunction with the signal processor **41** determines the absolute attenuation of individual specific frequency components of the received acoustic signal transmitted through the material. The digital signal processor **41** then makes mathematical "attenuation" comparisons of the corresponding individual specific frequency components through the member. A set of mathematical attenuation comparisons between corresponding frequency components may be thereby obtained, one comparison for each frequency component compared. The manner in which the attenuation functions with respect to frequency can thus be derived. The microprocessor **38** and digital signal processor **41** then relate that function to the physical properties and integrity of the member.

[0076] Shown in **FIG. 7** is a sample broadband ultrasonic pulse and a typical received waveform. To achieve an ultrasonic signal that is very broad in the frequency domain, i.e., a broadband transmitted signal, an electronic pulse such as indicated at **70** is applied to the selected ultrasonic transducer in the transmit array **21** which then resonates with a broadband ultrasonic emission. The received signal, such as indicated at **72** in **FIG. 7** in a time domain signal plot, is then processed by discrete Fourier transform analysis so that it is converted to the frequency domain. Shown in **FIG. 8** is a pair of plots of sample received signals, in frequency domain plots, showing the shift in received signal intensity as a function of frequency between a reference object and a plug of neoprene placed in the instrument. **FIG. 9** illustrates a similar comparison, with **FIG. 8** using relative attenuation

in the vertical dimension and **FIG. 9** using power of the received signal using a similar reference material. Both representations illustrate the difference in relative intensities as a function of frequency illustrating how broadband ultrasonic attenuation varies from object to object. The actual value calculated, broadband ultrasonic attenuation, is calculated by first comparing the received signal against the reference signal, then performing the discrete Fourier transform to convert to frequency domain, then performing a linear regression of the difference in attenuation slope to derive broadband ultrasonic attenuation.

[0077] The mathematics of the discrete Fourier transform are such that another parameter related to bone member density may be calculated in addition to, or in substitution for, broadband attenuation (sometimes referred to as “attenuation” or “BUA” below). When the discrete Fourier transform is performed on the time-domain signal, the solution for each point includes a real member component and an imaginary member component. The values graphed in **FIGS. 8 and 9** are the amplitude of the received pulse as determined from this discrete Fourier transform by taking the square root of the sum of the squares of the real component and the imaginary component. The phase angle of the change in phase of the ultrasonic pulse as it passed through the member can be calculated by taking the arctangent of the ratio of the imaginary to the real components. This phase angle value is also calculated to bone member density.

[0078] The microprocessor **38** may also be programmed so that the densitometer simultaneously performs both functions, i.e. determines both transit time and absolute attenuation of the transmitted acoustic signals, first through the member and then through the material with known acoustic properties. The densitometer may then both derive the broadband ultrasonic attenuation function and make a mathematical time comparison of the member transit time to the material transit time. The microprocessor **38** and digital signal processor **41** then relate both the time comparison along with the attenuation function to the physical properties and integrity, or density of the member **32**.

[0079] In yet another possible mode of operation, the microprocessor **38** may be programmed so that the densitometer **10** operates in a mode whereby the need for calculating either the relative transit time or the attenuation of the acoustic signals through a material of known acoustic properties is eliminated. In order to operate in such a mode, the microprocessor **38** would include a database of normal absolute transit times which are based upon such factors as the age, height, weight, race or the sex of the individual being tested as well as the distance between the transducers or the thickness or size of the member. This database of normal transit times can be stored in the non-volatile memory or could be stored in other media. When testing an individual in this mode, the relevant factors for the individual are placed into the microprocessor **38** to select the pertinent normal transit time based on those factors. The transducers **21** are placed on the bone member being tested as described above. When the actuator button **12** is pressed, the acoustic signals are transmitted through the member **32**. The receive transducer **21** receives those signals after they have been transmitted through the member, and the electronics **31** then determine the “member” transit time of the acoustic signals through the member. The microprocessor **38**

and digital signal processor **41** then make a mathematical comparison of the measured member transit time to the selected database normal transit time, and relate the mathematical time comparison to the physical properties and integrity, or density of the member, which is displayed.

[0080] As an alternative output of the densitometer of the present invention, the digital display **18** could also include a display corresponding to the pattern of the array of elements on the face of the transducer **21** as seen in **FIG. 3**. This display could then display, for each element a through **l**, a gray scale image proportional to the parameter, i.e. transit time or attenuation, being measured. This image may provide a visual indication to an experienced clinician as to the physical properties of the member present in the patient.

[0081] Shown in **FIG. 6** is a circuit schematic for an alternative embodiment of an ultrasonic densitometer constructed in accordance with the present invention. In the circuit of **FIG. 6**, parts having similar structure and function to their corresponding parts in **FIG. 4** are indicated with similar reference numerals.

[0082] The embodiment of **FIG. 6** is intended to function with only a single transducer array **21** which functions both as the transmit and the receive transducer array. An optional reflecting surface **64** may be placed on the opposite side of the member **32** from the transducer array **21**. A digitally controlled multiple pole switch **66**, preferably an electronic switch rather than a mechanical one, connects the input to and output from the elements of the transducer array **21** selectively either to the excitation amplifier **55** or to the controllable gain receiver/amplifier circuit **59**. The switch **66** is connected by a switch control line **68** to an output of the microprocessor **38**.

[0083] In the operation of the circuit of **FIG. 6**, it functions in most respects like the circuit of **FIG. 4**, so only the differences need be discussed. During the launching of an ultrasonic pulse, the microprocessor **38** causes a signal to appear on the switch control line **68** to cause the switch **66** to connect the output of the excitation amplifier **55** to the selected element in the transducer array **21**. Following completion of the launching of the pulse, the microprocessor **38** changes the signal on the switch control line **68** to operate the switch **66** to connect the selected element or elements as an input to the amplifier **59**. Meanwhile, the pulse propagates through the member **32**. As the pulse transits through the member, reflective pulses will be generated as the pulse crosses interfaces of differing materials in the member and, in particular, as the pulse exits the member into the air at the opposite side of the member. If the transition from the member to air does not produce a sufficient reflective pulse, the reflecting surface **64** can be placed against the opposite side of the member to provide an enhanced reflected pulse.

[0084] The embodiment of **FIG. 6** can thus be used to analyze the physical properties and integrity of a member using only one transducer **21**. All of the methods described above for such measurements may be used equally effectively with this version of the device. The transit time of the pulse through the member can be measured simply by measuring the time period until receipt of the reflected pulse, and then simply dividing by two. This time period can be compared to the transit time, over a similar distance, through a standard medium such as water. The time period for receipt of the reflected pulse could also be simply compared to

standard values for age, sex, etc. Attenuation measurements to detect differential frequency measurement can be directly made on the reflected pulse. If no reflecting surface **64** is used, and it is desired to determine absolute transit time, the thickness of the member or sample can be measured.

[0085] The use of the multi-element ultrasonic transducer array for the transducers **21**, as illustrated in **FIG. 3**, enables another advantageous feature of the instrument of **FIGS. 1-9**. In using prior art densitometers, it was often necessary to precisely position the instrument relative to the body member of the patient being measured to have useful results. The difficulty arises because of heterogeneities in the bone mass and structure of actual body members. A measurement taken at one location of density may be significantly different from a measurement taken close by. Therefore prior art instruments fixed the body member precisely so that the measurement could be taken at the precise location each time.

[0086] The use of the ultrasonic transducer array obviates the need for this precise positioning. Using the instrument of **FIGS. 1-9**, the instrument performs a pulse and response, performs the discrete Fourier transform, and generates a value for broadband ultrasonic attenuation for each pair of transducer elements a through l. Then the microprocessor **38** analyzes the resulting array of bone ultrasonic density measurements to reproducibly identify the same region of interest each time. In other words, since the physical array of transducers is large enough to reliably cover at least the one common region of interest each time, the measurement is localized at the same locus each time by electrically selecting the proper location for the measurement from among the locations measured by the array. The instrument of **FIGS. 1-9** is conveniently used by measuring the density of the os calcis as measured through the heel of a human patient. When used in this location, it has been found that a region of interest in the os calcis can be located reliably and repeatedly based on the comparisons of broadband ultrasonic attenuation at the points in the array. The region of interest in the os calcis is identified as a local or relative minimum in broadband ultrasonic attenuation and/or velocity closely adjacent the region of highest attenuation values in the body member. Thus repetitive measurements of the broadband ultrasonic attenuation value at this same region of interest can be reproducibly taken even though the densitometer instrument **10** is only generally positioned at the same location for each successive measurement.

[0087] This technique of using a multiple element array to avoid position criticality is applicable to other techniques other than the determination of broadband ultrasonic attenuation as described here. The concept of using an array and comparing the array of results to determine measurement locus would be equally applicable to measurements taken of member-density based on speed of sound transit time, other measurements of attenuation or on the calculation of phase angle discussed above. The use of such a multiple-element array, with automated selection of one element in the region of interest, can also be applied to other measurement techniques useful for generating parameters related to bone member density, such as measuring speed changes in the transmitted pulse such as suggested in U.S. Pat. No. 4,361,154 to Pratt, or measuring the frequency of a "sing-around" self-triggering pulse as suggested in U.S. Pat. No. 3,847,141 to Hoop. The concept which permits the position independence feature is that of an array of measurements generating

an array of data points from which a region of interest is selected by a reproducible criterion or several criteria. The number of elements in the array also clearly can be varied with a larger number of elements resulting in a greater accuracy in identifying the same region of interest.

[0088] In this way, the ultrasound densitometer of the present invention provides a device capable of rapid and efficient determination of the physical properties of a member in vivo without the use of radiation. Because the densitometer is constructed to operate under the control of the microprocessor **38**, it can be programmed to operate in one of several modes, as discussed above. This allows both for flexibility to clinical goals as well as efficient use of the device.

Basin Embodiment

[0089] Shown in **FIG. 10** is another variation on an ultrasonic densitometer constructed in accordance with the present invention. In the densitometer **100** of **FIG. 10**, there are two ultrasonic transducer arrays **121**, which are generally similar to the ultrasonic transducer arrays **21** of the embodiment of **FIG. 1**, except that the transducer arrays **21** are fixed in position rather than movable.

[0090] The densitometer **100** includes a generally box-shaped mounting case **101** with sloping upper face **102** in which is formed a basin **103**. The basin **103** is sized to receive a human foot and is generally trigonous along a vertical plane aligned with the length of the foot so that when the foot is placed within the basin **103**, the toes of the foot are slightly elevated with respect to the heel of the foot.

[0091] The transducer arrays **121** are positioned in the case **101** so that they extend into the basin **103** to be on opposite sides of the heel of the foot placed in the basin **103**. When the foot is in position within the basin **103**, the sole of the foot may rest directly on a bottom **104** of the basin **103** with the heel of the foot received within a curved pocket **106** forming a back wall of the basin **103**. As so positioned, the transducer arrays **121** are on either side of the os calcis. It has been demonstrated that placing the transducer approximately 4 centimeters up from the sole and 3.5 centimeters forwardly from the rearward edge of the heel places the transducers in the desired region and focused on the os calcis.

[0092] The foot may, alternatively, rest on a generally planar foot plate **108** having a contour conforming to the bottom **104** and placed against the bottom **104** between the foot and the bottom **104**. The foot plate **108** holds an upwardly extending toe peg **110** for use in reducing motion of the foot during the measurement process. Referring to **FIG. 11**, the toe peg **110** is sized to fit between the big toe and the next adjacent toe of a typical human foot and is mounted in a slot **112** so as to be adjustable generally along the length of the foot to accommodate the particular length of the foot.

[0093] The slot **112** cants inward toward a medial axis **114** of the foot, defined along the foot's length, as one moves along the slot **112** towards the portion of the foot plate **108** near the heel of the foot. This canting reflects the general relation between foot length and width and allows simple adjustment for both dimensions at once.

[0094] The toe peg **110** is sized to fit loosely between the toes of the foot without discomfort and does not completely

prevent voluntary movement of the foot. Nevertheless, it has been found that the tactile feedback to the patient provided by the toe peg **110** significantly reduces foot movement during operation of the densitometer **100**. Two different foot plates **108**, being mirror images of each other, are used for the left and right foot.

[0095] Referring to **FIG. 12**, the toe peg **110** is held to the slot **112** by a fastener **111** having a threaded portion which engages corresponding threads in the toe peg **110**. The head of the threaded fastener **111** engages the slot **112** so as to resist rotation. Thus, the toe peg **110** may be fixed at any position along the length of the slot **112** by simply turning the toe peg **110** slightly about its axis to tighten the threaded fastener **111** against the foot plate **108**.

[0096] Referring again to **FIG. 10**, the basin **103** of the densitometer **100** is flanked, on the upper face **102** of the enclosure **101**, by two foot rest areas **116** and **118** on the left and right side respectively. For examination of a patient's right foot, the patient's left foot may rest on foot rest area **118** while the patient's right foot may be placed within basin **103**. Conversely, for examination of the patient's left foot, the left foot of the patient is placed within basin **103** and the patient's right foot may rest on foot rest area **116**. The foot rest areas have a slope conforming to that of the upper face **102** and approximately that of bottom **104**. The flanking foot rest areas **116** and **118** allow the densitometer **100** to be used in comfort by a seated patient.

[0097] When the densitometer **100** is not in use, the basin area **103** is covered with a generally planar cover **120** hinged along the lower edge of the basin **103** to move between a closed position substantially within the plane of the upper face **102** and covering the basin **103**, and an open position with the plane of the cover **120** forming an angle α with the bottom **104** of the basin **103** as held by hinge stops **122**. The angle α is approximately 90° and selected so as to comfortably support the calf of the patient when the patient's foot is in place within basin **103**. To that end, the upper surface of the cover **120**, when the cover **120** is in the open position, forms a curved trough to receive a typical calf.

[0098] The support of the patient's calf provided by the cover **120** has been found to reduce foot motion during operation of the densitometer **100**.

[0099] Referring now to **FIGS. 10 and 12**, because the densitometer **100** employs fixed transducers **121**, a coupling liquid is provided in the basin **103** to provide a low loss path for acoustic energy between the transducers **121** and the patient's foot regardless of the dimensions of the latter. The coupling liquid is preferably water plus a surfactant, the latter which has been found to improve the signal quality and consistency of the reading of the densitometer. The surfactant may be, for example, a commercially available detergent. It will be recognized, however, that other flowable, acoustically conductive media may be used to provide acoustic coupling, and hence, that the term "coupling liquid" should be considered to embrace materials having a viscosity higher than that of water such as, for example, water based slurries and thixotropic gels.

[0100] For reasons of hygiene, the exhaustion of the surfactant, and possible reduction of signal quality with the collection of impurities in the coupling liquid, it has been determined that the liquid in the basin **103** should be

changed in between each use of the densitometer **103**. Changing this liquid is time consuming and ordinarily would require convenient access to a sink or the like, access which is not always available. Failure to change the liquid may have no immediate visible effect, and hence changing the liquid is easy to forget or delay. For this reason, the present embodiment employs an automated liquid handling system linked to the ultrasonic measurement operation through circuitry controlled by microprocessor **38** to be described.

[0101] Referring to **FIG. 13** in the present embodiment, premixed water and surfactant for filling the basin **103** are contained in a removable polypropylene supply tank **124**, whereas exhausted water and surfactant from the basin **103** are received by a similar drain tank **126**. Each tank **124** and **126** contains a manual valve **128** which is opened when the tanks are installed in the densitometer **100** and closed for transporting the tanks to a remote water supply or drain. The supply tank **124** and the drain tank **126** have vents **150**, at their upper edges as they are normally positioned, to allow air to be drawn into or expelled from the interior of the tanks **124** and **126** when they are in their normal position within the densitometer **100** and valves **128** are open. The tanks **124** and **126** hold sufficient water for approximately a day's use of the densitometer **100** and thus eliminate the need for convenient access to plumbing.

[0102] The valve **128** of the supply tank **124** connects the tank through flexible tubing to a pump **130** which may pump liquid from the supply tank **124** to a heating chamber **132**.

[0103] Referring to **FIG. 14**, the heating chamber **132** incorporates a resistive heating element **164** which is supplied with electrical current through a thermal protection module in thermal contact with the coupling liquid in the heating chamber **132**. The thermal protection module **166** includes a thermostat and a thermal fuse, as will be described below. A thermistor **168**, also in thermal communication with the liquid in the heating chamber, provides a measure of the liquid's temperature during operation of the densitometer **100**. The heater chamber **132** additionally incorporates an optical level sensor **172**. The level sensor **172** detects the level of liquid in the heating chamber **132** by monitoring changes in the optical properties of a prism system when the prism is immersed in liquid as opposed to being surrounded by air. The operation of the thermistor **168** and the level sensor **172** will be described further below.

[0104] Referring again to **FIG. 13**, the heating chamber **132** communicates through an overflow port **134** and flexible tubing to an overflow drain outlet **136**. The overflow outlet **136** is positioned at the bottom of the densitometer **100** removed from its internal electronics. The overflow port **134** is positioned above the normal fill height of the heating chamber **132** as will be described in detail below.

[0105] The heating chamber **132** also communicates, through its lowermost point, with an electrically actuated fill valve **138** which provides a path, through flexible tubing, to a fill port **140** positioned in the wall of basin **103**.

[0106] In the opposite wall of the basin **103** is an overflow port **142** which opens into the basin **103** at a point above the normal fill height of the basin **103** and which further communicates, through a T-connector **144**, to the drain tank **126**.

[0107] A drain **146**, in the bottom **104** of the basin **103**, provides a path to an electronically actuated drain valve **148**.

The drain valve **148** operates to allow liquid in the basin **103** to flow through the drain **146** to the T-connector **144** and into the drain tank **126**. The overflow port **142** and drain **146** incorporate screens **152** to prevent debris from clogging the tubing or the drain valve **148** communicating with the drain tank **126**.

[0108] Referring now to **FIGS. 10 and 13**, the supply tank **124** and the drain tank **126** are positioned within the case **101** of the densitometer **100** and located at a height with respect to the basin **103** so that liquid will drain from the basin **103** into the drain tank **126** solely under the influence of gravity and so that gravity alone is not sufficient to fill the basin **103** from supply tank **124** when fill valve **138** is open. Further, the heating chamber **132** is positioned above the basin **103** so that once the heating chamber **132** is filled with liquid by pump **130**, the filling of the basin **103** from the heating chamber **132** may be done solely by the influence of gravity. Accordingly, the operation of the densitometer in filling and emptying the basin **103** is simple and extremely quiet.

[0109] In those situations where plumbing is readily accessible, either or both of the supply and drain tanks **124** and **126** may be bypassed and direct connections made to existing drains or supply lines. Specifically, the pump **130** may be replaced with a valve (not shown) connecting the heating chamber **132** to the water supply line. Conversely, the connection between the T-connector **144** and the drain tank **126** may be re-routed to connect the T-connector **144** directly to a drain.

[0110] Even with the constant refreshing of the coupling liquid in the basin **103** by the liquid handling system of the present invention, the liquid contacting surfaces of the basin **103**, the heating chamber **132**, the valves **138** and **148**, and the connecting tubing are susceptible to bacterial colonization and to encrustation by minerals. The coatings of colonization or encrustation are potentially unhygienic and unattractive. Sufficient build-up of minerals or bacteria may also adversely affect the operation of the densitometer **100** either by restricting liquid flow through the tubing, by interfering with the operation of the valves **138** or **148**, or by adversely affecting the acoustical properties of the transducer array **121**.

[0111] For this reason, the densitometer **100** is desirably periodically flushed with an antibacterial solution and a weak acid, the latter to remove mineral build-up. These measures are not always effective or may be forgotten, and hence, in the present invention critical water contacting surfaces are treated with a superficial antibacterial material which is also resistant to mineral encrustation. The preferred treatment is the SPI-ARGENT™ surface treatment offered by the Spire Corporation of Bedford, Mass. which consists of an ion beam assisted deposition of silver into the treated surfaces. The resulting thin film is bactericidal, fungistatic, biocompatible, and mineral resistant. The properties of being both bactericidal and fungistatic are generally termed infection resistant.

[0112] This surface treatment is applied to the water contacting surfaces of the basin **103**, the heating chamber **132** and the critical moving components of the valves **138** and **148**.

[0113] Referring now to **FIG. 14**, the general arrangement of the electrical components of **FIG. 4** is unchanged in the

ultrasonic densitometer **100** of **FIG. 10** except for the addition of I/O circuitry and circuitry to control the pump **130**, valves **138** and **148**, and heating chamber **132** of the liquid handling system. In particular, microprocessor **38** now communicates through bus **40** with an I/O module **174**, a pump/valve control circuit **160** and a heater control circuit **162**.

[0114] I/O module **174** provides the ability to connect a standard video display terminal or personal computer to the densitometer **100** for display of information to the user or for subsequent post processing of the data acquired by the densitometer and thus allows an alternative to microprocessor **38** and display **18** for processing and displaying the acquired ultrasound propagation data.

[0115] The pump/valve control circuit **160** provides electrical signals to the fill valve **138** and the drain valve **148** for opening or closing each valve under the control of the microprocessor **38**. The pump/valve control circuit **160** also provides an electrical signal to the pump **130** to cause the pump to begin pumping water and surfactant from the supply tank **124** under the control of microprocessor **38**, and receives the signal from the level sensor **172** in the heating chamber **132** to aid in the control of the pump **130** and valve **138**.

[0116] The heater control circuit **162** controls the current received by the resistive heating element **164** and also receives the signal from a thermistor **168** in thermal contact with the heating chamber **132**. A second thermistor **170**, positioned in basin **103** to be in thermal contact with the liquid in that basin **103**, is also received by the heater control circuit **162**.

[0117] Referring now to **FIGS. 13 and 14**, during operation of the densitometer **100** and prior to the first patient, the basin **103** will be empty, the supply tank **124** will be filled and contain a known volume of water and surfactant, and the drain tanks **126** will be empty. Both manual valves **128** will be open to allow flow into or out of the respective tanks **124** and **126** and the electrically actuated fill valve **138** and drain valve **148** will be closed.

[0118] Under control of microprocessor **38**, the pump/valve control circuit **160** provides current to the pump **130** which pumps water and surfactant upward into heating chamber **132** until a signal is received from level sensor **172**. When the heating chamber **132** is filled to the proper level as indicated by level sensor **172**, the signal from level sensor **172** to pump/valve control circuit **160** causes the pump **130** to be turned off. At this time, a predetermined volume of liquid is contained in heating chamber **132** which translates to the proper volume needed to fill basin **103** for measurement.

[0119] Under command of microprocessor **38**, the heater control circuit **162** provides a current through thermal protection module **166** to resistive heating element **164**. The temperature of the liquid in the heating chamber **132** is monitored by thermistor **168** and heating continues until the liquid is brought to a temperature of approximately 39° C. The thermistor and a thermal fuse (not shown) of the thermal protection module **166** provide additional protection against overheating of the liquid. The thermistor opens at 50° C. and resets automatically as it cools and the thermal fuse opens at 66° C. but does not reset and must be replaced. The opening

of either the thermistor or the thermal fuse interrupts current to the resistive heating element **164**.

[0120] When the liquid in the heating chamber **132** is brought to the correct temperature, fill valve **138** is opened by microprocessor **38**, through pump/valve control circuit **160**, and liquid flows under the influence of gravity into the basin **103** at the proper temperature. The control of the temperature of the liquid serves to insure the comfort of the patient whose foot may be in the basin **103** and to decrease any temperature effects on the sound transmission of the water and surfactant.

[0121] Once the heated liquid has been transferred from the heating chamber **132** to the basin **103**, the fill valve **138** is closed and the pump **130** is reactivated to refill the heating chamber **132**. Thus, fresh liquid for the next measurement may be heated during the present measurement to eliminate any waiting between subsequent measurements.

[0122] With liquid in place within the basin **103**, the measurement of the os calcis by the densitometer **100** may begin. In this respect, the operation of the ultrasonic densitometer of FIG. 10 is similar to that of the embodiment of FIG. 1 except that the order of pulsing and measurement can be varied. In the apparatus of FIG. 1, the measurement pulse through the member was generally performed before the reference pulse through homogenous standard, i.e. water. In the densitometer **100** of FIG. 10, since the distance between the transducers **121** is fixed, the reference pulse through the homogenous standard material, which is simply the liquid in basin **103**, may be conducted before or after a measurement pulse through a live member is performed. In fact, because the temperature of the liquid in the basin **103** is held steady by the temperature control mechanism as described, the standard transmit time measurement can be made once for the instrument and thereafter only measurement pulses need be transmitted.

[0123] Preferably, the standard transit time measurement is stored as a number in the memory of microprocessor **38** during the initial calibration of the unit at the place of manufacture or during subsequent recalibrations. During the calibration of the densitometer **100**, the signal from the thermistor **170** is used to produce a transit time corrected for the temperature of the liquid according to well known functional relations linking the speed of sound in water to water temperature. It is this corrected transit time that is stored in the memory associated with microprocessor **38** as a stored standard reference.

[0124] The transit time of the measurement pulses is compared to the stored standard reference transit times through the coupling liquid to give an indication of the integrity of the member just measured. Thus, one may dispense with the reference pulse entirely. Empirical tests have determined that by proper selection of a standard reference value stored in the memory of microprocessor **38** and by holding the liquid in the basin within a temperature range as provided by the heating chamber **132**, no reference pulse need be launched or measured.

[0125] Using this variation, a mathematical comparison of the measured transit time, or transit velocity, must be made to the standard. Since, in the interests of accuracy, it is preferred to use both changes in transit time (velocity) and changes in attenuation to evaluate a member in vivo, the

following formula has been developed to provide a numerical value indicative of the integrity and mineral density of a bone:

$$\text{bone integrity value} = A(\text{SOS} - B) + C(\text{BUA} - D) \quad (1)$$

[0126] In this formula, "SOS" indicates the speed of sound, or velocity, of the measurement ultrasonic pulse through the member, and is expressed in meters per second. The speed of sound (SOS) value is calculated from the measured transit time by dividing a standard value for the member width by the actual transit time measured. For an adult human heel, it has been found that assuming a standard human heel width of 40 mm at the point of measurement results in such sufficient and reproducible accuracy that actual measurement of the actual individual heel is not needed.

[0127] BUA is broadband ultrasonic attenuation, as described in greater detail above. The constants A, B, C, and D offset and scale the influence of the BUA measurement relative to the SOS measurement to provide a more effective predictor of bone density. These constants may be determined empirically and may be selected for the particular machine to provide numbers compatible with dual photon absorptiometry devices, such as an estimated bone mineral density (BMD) value, and to reduce bone width effects. Since this method utilizing ultrasonic measurement of the heel is quick and free from radiation, it offers a promising alternative for evaluation of bone integrity. It will be understood that multiple SOS and BUA values may be obtained, averaged, then combined per the above formula, or that each SOS and BUA value may be combined to produce a bone integrity value and the multiple bone integrity values then averaged.

[0128] The densitometer **100** may be used with or without an array of ultrasonic transducers in the transducers **121**. In its simplest form the mechanical alignment of the heel in the device can be provided by the shape and size of the basin **103**. While the use of an array, and region-of-interest scanning as described above, is most helpful in ensuring a reproducible and accurate measurement, mechanical placement may be acceptable for clinical utility, in which case only single transducer elements are required.

[0129] Upon completion of the measurement, the drain valve **148** is opened by microprocessor **38** through pump/valve control circuitry **160**, and the liquid in the basin **103** is drained through "T"**144** to the drain tank **126**. At the beginning of the next measurement, the drain valve **148** is closed and liquid is again transferred from the heating chamber **132** as has been described.

[0130] With repeated fillings and drainings of the basin **103**, the level of liquid in the fill tank **124** decreases with a corresponding increase in the level of the liquid in the drain tank **126**. The height of the liquid in each tank **124** and **126** may be tracked by a conventional level sensor such as a mechanical float or a capacitive type level sensor.

[0131] Preferably no additional level sensor is employed. The volume of liquid for each use of the densitometer **100** is known and defined by the fill level of the heating chamber **132**. The microprocessor **38** may therefore track the level of liquid remaining in the supply tank **124** by counting the number of times the basin **103** is filled to provide a signal to the user, via the display **18** or a remote video display

terminal (not shown), indicating that the tanks **124** and **125** need to be refilled and drained respectively. This signal to the user is based on the number of times the basin **103** is filled and a calculation of the relative volumes of the heating chamber **132** and supply tank **124**.

[0132] After completion of the use of the densitometer **100** for a period of time, the densitometer may be stored. In a storage mode, after both the supply tank **124** and drain tank **126** have been manually emptied, the microprocessor **38** instructs the pump/valve control circuit **160** to open both the fill valve **138** and the drain valve **148** and to run the pump **130**. The drain valve **138** is opened slightly before the pump **130** is actuated to prevent the rush of air from causing liquid to flow out of the overflow port **134**.

[0133] Referring now to FIGS. **10** and **15**, the transducers **121** are inserted into the basin **103** through tubular sleeves **180** extending outward from the walls of the basin **103** at the curved pocket along an axis **212** of the opposed transducers **121**. The tubular sleeves **180** define a circular bore in which the transducers **121** may be positioned. Each transducer **121** seals the sleeve **180** by compression of o-ring **182** positioned on the inner surface of the sleeve **180**.

[0134] Although the transducers **121** fit tightly within the sleeves **180**, their separation and alignment are determined not by the sleeves **180** but by an independent C-brace **184** comprising a first and second opposed arm **186** separated by a shank **188**. A transducer **121** is attached to one end of each of the arms **186**, the other ends of the arms **186** fitting against the shank **188**.

[0135] The arms **186** are generally rectangular blocks transversely bored to receive the cylindrically shaped transducers **121** at one end and to hold them along axis **212**. The other ends of the arms **186** provide planar faces for abutting the opposite ends of the block like shank **188**, the abutting serving to hold the arms **186** opposed and parallel to each other.

[0136] Although the angles of the arms **186** with respect to the shank **188** are determined by the abutment of the planar faces of the arms **186** and the ends of the shank **188**, alignment of the arms **186** with respect to the shank **188** is provided by dowel tubes **190** extending outward from each end of the shank **188** to fit tightly within corresponding bores in the first and second arm **186**.

[0137] Cap screws **194** received in counterbored holes in the arms **186** pass through the arms **186**, the dowel tubes **190** are received by threaded holes in the shank **188** to hold the arm **186** firmly attached to the shank **188**. The dowel tubes **190** and surfaces between the arms **186** and shank **188** serve to provide extremely precise alignment and angulation of the transducers **121**, and yet a joint that may be separated to permit removal of the transducers **121** from the densitometer **10** for replacement or repair.

[0138] Transducers **121** are matched and fitted to the arms **186** in a controlled factory environment to provide the necessary acoustic signal strength and reception. In the field, the shank **188** may be separated from one or both arms **186** by loosening of the cap screws **194** so as to allow the transducers **121** extending inward from the arms **186** to be fit within the sleeves **180**. Proper alignment and angulation of the transducers is then assured by reattaching the arm or arms **186** removed from the shank **188** to the shank **188** to

be tightened thereto by the cap screws **194**. Thus, the alignment of the transducers is not dependent on the alignment of the sleeves **180** which may be molded of plastic and thus be of relatively low precision. Nor must alignment be tested while the transducers are in the sleeves **180** attached to the basin **103** but may be checked in a central controlled environment.

Flexible Bladder with Moving Supports

[0139] Referring now to FIGS. **16** and **17**, in yet another embodiment of the present invention, the opposed transducers **121** are fitted with annular collars **200** which in turn are attached to flexible bladders **202** extending inward to the basin **103**, each bladder **202** containing a liquid or semi-liquid coupling material **204**.

[0140] The bladders **202** serve to contain the gel about the face of the transducers **121** and conform to the left and right sides of a patient's heel **207**, respectively, to provide a path between the transducers **121** and the soft tissue and bone of the heel **207** without intervening air. The bladder **202** further prevents the coupling material from direct contact with the heel to permit selection of the coupling material **204** from a broader range of materials.

[0141] Compression of the bladders **202** against the heel **207**, so as to provide the necessary coupling, is provided by a telescoping shank **181** shown in FIG. **16**. In this alternative embodiment of the C-brace **184** of FIG. **15**, the shank **188** has been cut into two portions **206** and **208** slidably connected together by dowel pins **210** to provide necessary motion of the transducers **121** inward along their axis to compress the bladders **202** against the heel **207**. One end of each dowel pin **210** is press fit within bores in the shank **188** parallel to the axis **212** of the opposed transducers in portion **206**. The other ends of the dowel pins **210** slide within larger bores in portion **208** so that portions **208** and **206** may slide toward and away from each other parallel to the axis **212**. With such motion, the attached arms **186** move towards and away from each other adjusting the separation of the transducers **121** between an open position for insertion of the heel **207** and a closed position of known separation and orientation where portions **208** and **206** abut.

[0142] Control of the separation is provided by means of cam pins **214** protruding from portions **206** and **208** on the side away from the extension of the arms **186** and generally perpendicular to the axis **212**. These pins **214** are received by spiral shaped slots in a cam disk **217** fitting over the cam pins **214**. The disk includes radially extending lever **218** whose motion rotates the disk causing the cam pins **214** within the slots **215** to be moved together or apart depending on motion of lever **218**.

[0143] Thus, the transducers **121** may be moved apart together with the bladders **202** for insertion of the heel **207** into the basin **103**. Once the heel is in place, motion of the lever **218** closes the transducers **121** to a predetermined fixed separation compressing the bladders **202** snugly against the sides of the heel **207**. The elasticity of the bladder filled with coupling material **204** provides an expanding force against the heel **207** to closely conform the surface of the bladder **202** to the heel **207**.

[0144] The collars **200** may provide a conduit for electrical wiring (not shown) including wiring attached to a

temperature sensor for monitoring the temperature of the contained coupling material **204** and heater elements for heating the temperature of the contained coupling material to a predetermined temperature. As has been described above, the controlled heating provides both for comfort to the patient and for reproducibility of the measurements which may be influenced by the temperature of the contained coupling material **204**.

Cancellation of Heel Width Variations

[0145] Referring to **FIGS. 17 and 18**, generally the thicker the calcaneus **216** of the heel **207**, the greater the attenuation of an acoustic signal passing through the heel **207** between transducers **121**. Correspondingly, with greater attenuation, the slope of attenuation as a function of frequency, generally termed broadband ultrasonic attenuation (BUA) also increases as shown generally in **FIG. 18** by plot **209**. This assumes generally that the coupling medium **204** is of low or essentially constant attenuation as a function of frequency. Greater BUA is generally correlated to higher bone quality.

[0146] For constant heel thickness, lower TOF (faster sound speed) corresponds generally to higher bone quality. The time of flight (TOF) of an acoustic pulse between the transducers **121** will be proportional to the time of flight of the acoustic pulse through regions A of **FIG. 17** comprising the path length through coupling gel **204**, regions B comprising the path length through soft tissue of the heel **207** surrounding the calcaneus **216**, and region C comprising the path length through the heel bone or calcaneus **216**. Thus,

$$TOF = \frac{1}{V_A} A + \frac{1}{V_B} B + \frac{1}{V_C} C \quad (2)$$

[0147] where V_A , V_B , and V_C are the average speed of sound through the coupling gel, soft tissue and bone respectively and A, B, C are the path lengths through these same materials. Provided that the separation between the transducers **121** is a constant value K, then time of flight will equal:

$$TOF = \frac{1}{V_A} (K - C - B) + \frac{1}{V_B} B + \frac{1}{V_C} C \quad (3)$$

[0148] The change in time of flight as a function the thickness of the bone C (the 5 derivative of TOF with respect to C) will thus generally be equal to:

$$\frac{1}{V_C} - \frac{1}{V_A}.$$

[0149] Referring now to **FIG. 18**, if the velocity of sound through the coupling medium **204** is greater than that through the bone being measured

$$\left(V_A > V_C, \text{ or } \frac{1}{V_C} > \frac{1}{V_A} \right),$$

[0150] then the functional relationship of TOF to heel width will be one of increasing as the heel becomes wider (indicated at plot **213** showing values of 1/TOF). On the other hand, if the velocity of sound through the coupling medium **204** is less than that through the bone being measured

$$\left(V_C > V_A, \text{ but } \frac{1}{V_A} > \frac{1}{V_C} \right),$$

[0151] then the functional relationship of TOF to heel width will be one of decreasing as the heel becomes wider (indicated at plot **211** showing values of 1/TOF).

[0152] A combined bone quality figure may be obtained by combining BUA and 1/TOF measurements (1/TOF because BUA increases but TOF decreases with denser bone). Further, if (1) the conditions of ultrasonic propagation are adjusted so that the slope of 1/TOF with heel width is opposite in sign to the slope of BUA with heel width (i.e., $V_A > V_C$) and (2) the BUA and 1/TOF measurements are weighted with respect to each other so that the opposite slopes of the BUA and 1/TOF are equal, then the algebraic combination of the BUA and TOF, through addition for example, will produce a bone quality measurement substantially independent of heel width for a range of bone qualities.

[0153] This can be intuitively understood by noting that as the heel gets wider, it displaces some of the coupling gel **204** from between the heel **207** and each transducer **121**, and by displacing material that conducts sound slower than the bone being measured increasing the total speed with which the sound is conducted.

[0154] Note that a similar effect may be obtained by proper scaling and combination of BUA and TOF by multiplication and that other functions of attenuation and TOF could be used taking advantage of their functional independence and their functional dependence in part on heel width.

[0155] Referring now to **FIG. 19**, generally BUA and TOF are functionally related to both bone quality and bone width. It should be possible, therefore, to solve the equations governing these relationships for bone quality alone and thus to eliminate the effect of the common variable of heel width. With such an approach, the variable of heel width is eliminated not just for a portion but through the entire range of bone measurement provided that the coupling medium is different from the bone being measured so that there will be a width effect in both BUA and TOF measurements.

[0156] Approximations of the algebraic relationships describing the functional dependence of BUA and TOF on bone quality and bone width, can be obtained through the construction of a set of bone phantoms of different widths and bone qualities when using a particular coupling gel. Generally, for each value of BUA or TOF the data will describe a curve **222** linking that value with different combinations of bone quality and bone width. This data may be

placed in a look-up table in the memory of the microprocessor of the densitometer as has been previously described.

[0157] After BUA and TOF values are determined, the data of the look-up table (comprising many bone quality and bone width pairs for each of the determined BUA and TOF values) are scanned to find a bone quality and width data pair for the BUA value matching a bone quality and width data pair for the TOF value. This is equivalent to finding the intersection of the two curves 222 associated with the measured BUA and TOF values. The matching bone quality values of the data base will give a bone quality having little or no bone width influence. This value may be displayed to the clinician. It is noted that the previously described technique of summing weighted values of BUA and 1/TOF is but a specialized form of this process of algebraic solution.

[0158] Alternatively, a matching bone width value can be identified, being the width of the measured heel, and used to correct either of the BUA or TOF values for display to the clinician in circumstances where BUA or TOF values are preferred for diagnosis.

[0159] This ability to cancel out heel width effects will work only for bone qualities where the relationship between the coupling gel 204 and the calcaneus 216 are such as to provide a functional dependence on heel width. Cancellation will not occur, for example, if the density of the calcaneus 216 being measured is substantially equal to the sound speed of the coupling gel 204 and thus where displacement of the coupling gel by similar bone will have no net effect on time of flight. Thus the coupling gel must be properly selected. In this case, materials having higher sound speed may be selected for the coupling material. The difference between the coupling gel and the bone being measured will influence the accuracy of the cancellation of heel width effects.

[0160] Moderating this desire to improve heel width effects is the importance of keeping the coupling gel 204 close to the acoustic properties of the soft tissue of the heel 207 both to prevent reflection by impedance mismatch and to prevent variations in the thickness of the soft tissue in regions B from adding additional uncertainty to the measurement. The coupling medium of water provides good matching to the soft tissue of the heel 207 and has a sound velocity very close to bone and some osteoporotic conditions. Weighting of the attenuation and propagation time may be made for water.

[0161] Although the preferred embodiment of the invention contemplates display of a bone quality value or corrected TOF or BUA values, it will be recognized that the same effect might be had by displaying uncorrected BUA or TOF values on a chart and establishing a threshold for strong or weak bone based on the corrections determined as above.

Ultrasonic Densitometer with Scannable Focus

[0162] Referring now to FIG. 20, a receiving transducer array 300, similar to array 21 described with respect to FIG. 1, may be positioned adjacent to the heel of a patient (not shown) to receive an ultrasonic wave 410 along axis 304. The receiving transducer array 300 includes a piezoelectric sheet 302 of substantially square outline positioned normal to the transmission axis 304 and is divided into transducer elements 400 as will be described, each which receives a different portion of the ultrasonic wave 410 after passage through the heel.

[0163] The piezoelectric sheet 302 may be constructed of polyvinylidene fluoride and has a front face 306 covered with a grid of interconnected square electrodes 308 deposited on the front face by vacuum metallization. These square electrodes 308 are arranged at the interstices of a rectangular grid to fall in rectilinear rows and columns. Referring also to FIG. 23, each square electrode 308 is spaced from its neighboring electrodes 308 by approximately its width. These square electrodes 308 are connected together by metallized traces (not shown) and to a common voltage reference by means of a lead 310.

[0164] In the manufacture of the piezoelectric sheet 302, the polyvinylidene sheet is polarized to create its piezoelectric properties by heating and cooling the sheet in the presence of a polarizing electrical field according to methods generally understood in the art. In the present invention, this polarizing field is applied only to the area under the square electrodes 308 so that only this material is piezoelectric and the material between square electrodes 308 has reduced or no piezoelectric properties. As will be understood below, this selective polarization of the piezoelectric sheet 302 provides improved spatial selectivity in distinguishing between acoustic signals received at different areas on the piezoelectric sheet.

[0165] Referring now to FIG. 22, opposite each electrode 308 on the back side of the piezoelectric sheet 302 furthest from the source of the ultrasonic wave 410 is a second electrode 312 having substantially the same dimensions as the square electrodes 308 and aligned with corresponding square electrodes 308 along transmission axis 304.

[0166] Referring to FIGS. 20 and 22a, a connector board 318 of areal dimension substantially equal to the piezoelectric sheet 302 has, extending from its front surface, a number of conductive pins 320 corresponding to the pads 316 in number and location. The pins 320 are stake-type terminals mounted to an epoxy glass printed circuit board 322 of a type well known to those of ordinary skill in the art. Each conductive pin 320 is connected directly to a preamplifier and then by means of printed circuit traces to a multiplexer 325 to a reduced number of control and data lines 324 which may be connected to the microprocessor 38 of the densitometer through an A to D converter 42 described previously with respect to FIG. 1 and as is well understood in the art. The preamplifiers allow grounding of those electrodes 312 not active during scanning to reduce cross-talk between electrodes 312.

[0167] As shown in FIG. 22a, the pins 320 of the connector board 318 are electrically connected to electrodes 312 on the back surface of the piezoelectric sheet 302 by means of a strip of thin (0.0005") Mylar 316 having conductive fingers 314 on its surfaces. The conductive fingers 314 on the front and rear surfaces of the Mylar strip 316 are in electrical communication through a plated-through hole 313 in the Mylar 316 connecting the fingers 314.

[0168] Each conductive pin 320 is attached to a conductive finger 314 at one edge of the Mylar strip 316 at the rear of the Mylar strip 316 (according to the direction of the acoustic wave) by means of an anisotropically conductive adhesive film 315 providing electrical conduction only along its thinnest dimension, thus from pin 320 to finger 314 but not between fingers 314 or pins 320. Anisotropically conductive film suitable for this purpose is commercially avail-

able from 3M corporation of Minnesota under the trade name of 3M Z-Axis Adhesive Film.

[0169] The other end of each plated finger **314** on the front of the Mylar strip **316** is then connected to an electrode **312** by a second layer of anisotropically conductive adhesive film **317**. The Mylar strip **316** flexes to allow the pins **320** to be spaced away from the electrode **312** to reduce reflections off the pins **320** such as may cause spurious signals at the piezoelectric sheet **302**. The Mylar strip **316** and conductive fingers **314** are essentially transparent to the acoustic wave.

[0170] Referring to FIG. 22b, the Mylar strips **316** and adhesive film **315** and **317** allow rapid assembly of the transducer **300**. A single layer of conductive film **317** (not shown in FIG. 22b) may be applied over the entire rear surface of the piezoelectric sheet **302** and electrodes **312**. Next a plurality of overlapping Mylar strips **316** may be laid down upon this surface, each Mylar strip **316** extending laterally across the piezoelectric sheet **302** with transversely extending conductive fingers **314** for each electrode **312** of one row of conductive electrode **312**. The overlapping of the Mylar strips **316** ensures that only a front edge of each strip **316** adheres to the piezoelectric sheet **302**. Guide holes **319** in the laterally extreme edges of the Mylar strips **316** fit into pins in a jig (not shown) to ensure alignment of fingers **314** with electrodes **312**.

[0171] Next, a second layer of the anisotropically conductive adhesive film **315** is placed on the rear surfaces of the overlapping Mylar strips **316** and the conductive pins **320** pressed down on this film **315**, aligned with the other ends of the conductive fingers **314** to attach to their respective fingers **314**. The conductive pins **320** are then raised and fixed in spaced apart relationship with the piezoelectric sheet **302**, the Mylar strips **316** flexing to accommodate this displacement.

[0172] The ultrasonic wave **410** passing through portions of the piezoelectric sheet **302** between electrodes **308** and **312** may thereby be measured at a number of points over the surface of the piezoelectric sheet by the electric signals generated and collected by electrodes **308** and **312** according to multiplexing methods well known in the art. Each electrode pair **308** and **312** provides an independent signal of the acoustic energy passing through the area of the piezoelectric sheet **302** embraced by the electrode pair.

[0173] A protective frame **325** encloses the piezoelectric sheet **302** and connector board **318** protecting them from direct contact with water of the basin **103** shown in FIGS. 10 and 15 into which the receiving transducer array **300** may be placed. The frame **325** holds on its front face an acoustically transparent and flexible material **326** such as a Teflon film so that the ultrasonic wave **410** may pass into the frame to reach the piezoelectric sheet **302**.

[0174] The above described array may be used either to receive or transmit acoustic waves and is not limited to use in the medical area but may provide an inexpensive and rugged industrial acoustic array useful for a variety of purposes including industrial ultrasonic imaging and the construction of high frequency synthetic aperture microphones.

[0175] Positioned behind the frame **325** is an electric motor **328** driving a central gear **330** about an axis aligned

with transmission axis **304** and approximately centered within the frame **325**. The central gear **330** in turn engages two diagonally opposed planet gears **332** also turning about axes aligned with the transmission axis. Each planet gear **332** has a rod **334** extending forwardly from a front face of the planet gear **332** but offset from the planet gear's axis to move in an orbit **336** thereabout. The orbit **336** has a diameter approximately equal to the spacing between electrodes **308**.

[0176] The rods **334** engage corresponding sockets **338** on the back side of the frame **325** at its opposed corners. Thus activation of the motor **328** causes the piezoelectric sheet **302** and connector board **318** to follow the orbit **336** while maintaining the rows and columns of detector elements **400** in horizontal and vertical alignment, respectively.

[0177] Referring now to FIG. 23, a sampling of the signals from the detector elements **400** may be made at four points **342** in the orbit **336** at which each electrode **308** is first at a starting position, and then is moved half the inter-electrode spacing upward, leftward, or upward and leftward. The effect of this motion of the detector elements **400** is to double the spatial resolution of the received acoustic signals without increasing the amount of wiring or the number of detector elements **400**. The sampling of acoustic energy at each of the points **342** is stored in the memory of the microprocessor and can be independently processed to derive attenuation, BUA or time of flight measurements or a combination of these measurements. These measurements are then converted to an intensity value of an image so that each pixel of the image has an intensity value proportional to the measured parameter. A clinician viewing the image thus obtains not merely an image of the bone, but an image that indicates bone quality at its various points.

[0178] A transmitting ultrasonic transducer **408** is positioned opposite the receiving transducer array **300** from the heel **207** and produces a generally planar ultrasonic wave **410** passing into the heel. Generally, the acoustic signal received by each transducer element **400** will have arrived from many points of the heel.

[0179] Referring now to FIG. 24, if the transducer elements **400** were focused as indicated by depicted transducer elements **400'** to follow a hemisphere **402** having a radius and hence focus at a particular volume element or voxel **404** within the heel, acoustic signals from other voxels could be canceled providing greater selectivity in the measurement. In this focusing of the transducer elements **400'**, the signals from each of the elements **400'** are summed together. Constructive and destructive interference of ultrasonic waves **410** from the heel **207** serve to eliminate acoustic signals not flowing directly from focus volume element **404**.

[0180] For example as depicted, two acoustic signals **405** and **406** from focus voxel **404** both crest at the location of a transducer element **400'** as a result of the equidistance of each transducer element **400'** from focus voxel **404**. When the signals from transducer elements **400'** are summed, the signal from focus voxel **404** will increase. In contrast, acoustic signals from other voxels not equidistant to transducer elements **400'** will tend to cancel each other when summed and thus decrease.

[0181] The present invention does not curve the transducer elements **400** into a hemisphere but accomplishes the same

effect while retaining the transducer element **400** in a planar array by delaying the signals received by the transducer elements **400** as one moves toward the centermost transducer element **400** so as to produce an effective hemispherical array. Like a hemispherical array, the center-most transducer elements **400** appear to receive the acoustic wave a little later than the transducer elements **400** at the edge of the receiving transducer array **300**. By using a phase delay of the signals instead of curving the receiving array **300**, the position of the focus voxel **404** at which the receiving array **300** is focused, may be scanned electrically as will be described. The signals from each of the transducer elements **400** are received by the A/D converter **42** and stored in memory. Phase shifting as described simply involves shifting the point at which one starts reading the stored signals.

[0182] Adjusting the phase of the acoustic signals received by each of the transducer elements **400** allows the location of the focus voxel **404** from which data is obtained to be scanned through the heel. The phase is simply adjusted so that the effective arrival time of an acoustic signal originating at the desired location is the same for each of the transducer elements **400**.

[0183] Referring now to FIG. 25, the location of focus voxel **404** may be moved in a first and second raster scan pattern **412** and **414** (as readings are taken over many ultrasonic pulses) to obtain separated planes of data normal to the transmission axis **304**. The first plane of data **412** may, for example, be positioned near the outer edge of the os calcis **216** to measure the cortical bone quality while the second plane **414** may be placed in a centered position in the trabecular bone to obtain a somewhat different reading, both readings providing distinct data about the bone.

[0184] It will be understood that this same approach of scanning in different planes may be used to obtain a volume of data within the heel **207**, in this case, the focus voxel **404** being moved to points on a three dimensional grid.

[0185] In another embodiment (not shown) the transmitting ultrasonic transducer may be an array and the phases of the ultrasonic signals transmitted by each of the elements of the array may be phased so as to focus on a particular voxel within the heel. In this case, the receiving array may be a single broad area detector or may also be an array focused on the same voxel for increased selectivity. The focus point of the transmitting and receiving arrays may also be shifted with respect to each other to investigate local sound transfer phenomenon. As before, the focal points of either array may be steered electrically by the microprocessor through a shifting of the phases of the transmitted and received signals. To collect data, each element of the transmit array may be energized individually while all receive elements of the receive array are read. This may be continued until each of the elements of the transmit array have been energized.

[0186] Alternatively, referring to FIG. 28, the receiving array **300** may be actually formed so that its elements follow along the hemisphere **402** so as to have a fixed focus on focus voxel **404**. Additional circuitry to effect the phase adjustment needed to focus the array is not needed in this case. The receiving array **300** is attached to an X-Y-Z table **600** providing motion in each of three Cartesian axes under the control of the microprocessor via stepper motors **610**. At each different location of the table **600**, data may be collected from focus voxel **404** to establish the data points on

the three dimensional grid. The transmitting array **408** may be held stationary or may be moved with the scanning of the receiving array **300** and may be focused as well.

[0187] Referring now to FIG. 26, such a data volume **415** may include a plurality of data voxels **416** each providing a measured member parameter for the bone or tissue at that point in the heel. A point of minimum bone density **418** may be found within this data volume **415** and used to identify a region of interest **420** which will serve as a standard region for measuring the bone density of the heel. This region may be automatically found after collection of the data volume **415** and only those voxels **416** within the region of interest **420** may be used for a displayed measurement. This automatic location of a region of interest **420** provides a much more precise bone characterization.

[0188] Acquiring a data volume **415** also provides the opportunity to use the extra data outside the region of interest **420** to ensure that the same region of interest **420** is measured in the patient's heel over a series of measurements made at different times. The data volume **415** may be stored in memory as a template that may be matched to subsequently acquired data volumes. The region of interest **420** spatially located with respect to the first template, may then be used as the region of interest for the subsequent data volumes aligned with that template to provide more repeatability in the measurement.

[0189] Referring now to FIG. 27 in such a template system in a first step **500**, a collection of a data volume **415** within the heel is obtained. At decision block **502**, if this is a first measurement of a particular patient, a region of interest **420** is identified at process block **504** from this data, as a predetermined volume centered about a point of minimum bone density **418** as described with respect to FIG. 26. At process block **506**, the data volume is stored as a template along with the region of interest defined with respect to the data of the template.

[0190] Referring again to decision block **502** on a subsequent measurement of a patient, the program may proceed to process block **508** and the template previously established may be correlated to a new data volume **415** collected at process block **500**. The correlation process involves shifting the relative locations of the two data volumes to minimize a difference between the values of each data voxel **416** of the data volumes. In most situations, this will accurately align the two data volumes so that corresponding voxels **416** of the two data volumes **415** measure identical points within the patient's heel. The region of interest **420** associated with the template is then transferred to the new data volume as it has been shifted into alignment with the template so that the identical region of interest may be measured in a patient even if the patient's foot has taken a different alignment with respect to the transducer array **300** and **408**. This use of the template's region of interest **420** is indicated by process block **510**.

[0191] At process block **512**, an index is calculated at the region of interest **420** for the new data volume **415** being typically an average value of a bone parameter such as BUA or time of flight for the voxels **416** within the region of interest **420**. This data is then displayed to the clinician at process block **520** as has been described.

Overlapping Bladder Embodiment

[0192] Referring now to FIG. 29, in an alternative embodiment, a transducer array 300, as has been described above, or an array 21, described with respect to FIG. 3, may extend into the basin 103 which is no longer filled with water. Instead, the transducer array 300 is coupled to the heel 207 through three concentric overlapping bladder walls.

[0193] The first, internal bladder 522 is supported about the transducer array 300 by means of an annular collar 524 to provide an enclosed volume in much the same manner as has been described with respect to the bladder 202 of FIG. 17 with the exception that the annular collar 524 includes an orifice 526 allowing a first coupling liquid to be introduced into the bladder 522 through delivery pipe 528 as driven by pump 130B. A branch connection 530 to delivery pipe 528 provides the same coupling liquid to an identical and opposing transducer/bladder assembly on the other side of the heel, not shown in FIG. 29.

[0194] A heat exchanger 532, as is well understood in the art, couples to the delivery pipe 528 to ensure that the coupling liquid 534 is at a constant predetermined temperature to which the device has been previously calibrated. The heat exchanger 532 may make use of a circulating exchanger liquid preheated to a constant temperature by means of a combination thermostat and electric heater (not shown) well known in the art. A pressure transducer 536 communicating with the delivery pipe 528 measures the pressure of the coupling liquid 534 and is used to control the pump 130B so that the bladder 522 is inflated only to a predetermined pressure. This ensures a repeatable and predetermined deformation of the soft tissue of the heel 207 and provides, to the extent possible, a reproducible and constant coupling between the transducer array 300 and the heel 207.

[0195] Coaxially about annular collar 524 is a second annular collar 538 supporting on its outer edge an second bladder 540 providing a second enclosed volume between itself and bladder 524 to hold a second coupling liquid 542. Second coupling liquid 542 differs from coupling liquid 534 by having either significantly different ultrasonic attenuation characteristics or a significantly different sound speed characteristics for reasons as will be describe below. The annular collar 538 holding the second bladder 540 is also pierced by an orifice 544 connecting to a delivery pipe 546, which like delivery pipe 528, passes through a heat exchanger 550 supplied with the same liquid at the same temperature as heat exchanger 532. Delivery pipe 546 also communicates with pressure transducer 536 through a coupler 552 which prevents intermingling of the liquids in delivery pipe 528 and 546. Delivery pipe 546 includes a branch connection 554, which like branch connection 530, provides a comparable liquid at a comparable temperature to the opposed transducer not shown in FIG. 29. A separate pump 130A delivers the coupling liquid 542 from a distinct reservoir from that connected to pump 130B.

[0196] The bladders 522 and 540 for both transducers are sufficiently flexible and have ample size so that either bladder 522 or 540 through inflation to a pressure less than the predetermined pressure controlled by pressure transducer 536 will bridge any gap between the transducer array 300 and the heel 207, thus allowing the transducer arrays 300 to be fixed in separation. This both simplifies mechanical construction and eliminates errors resulting from uncer-

tainty about the separation distance of the transducer arrays 300 as is inherent in any movable system.

Bladder Replacement Mechanism

[0197] Referring now to FIGS. 29 and 32, outside of annular collar 538 is yet another annular locking collar 556 mounted along with the other annular collars 538 and 524 against one wall of the basin 103 about the transducer arrays 300. Locking collar 556 includes radially outward extending tabs 558 which engage notches 560 in a stretcher ring 562 which may be installed against and removed from locking collar 556 by passing the notches 560 over the tabs 558 and giving the stretcher ring 562 a partial clockwise turn to move the locking tabs 558 into undercut portions 564, thereby retaining stretcher ring 562 against the wall of the wall of basin 103 against outward forces away from the transducer array 300. The stretcher ring is covered with a third flexible bladder 566 which envelopes both bladders 522 and 540 and yet which is easily removed and may be disposed of to provide for hygienic reuse of bladder 540 and 522. Because the third flexible bladder 566 is not required to retain a liquid and is disposable, it may be made from a lighter and less resilient material.

Second Width Correction and Extrapolation of Measurement

[0198] The apparatus of FIG. 29 is controlled by means of the microprocessor 38 (previously described and shown in FIG. 14) having connections to the pressure transducer 536 and pumps 130A and 130B as indicated in FIG. 33. Referring now to FIG. 33, at a beginning of a measurement session, as indicated by process block 568, pump 130B is activated to inflate inner bladders 522 of opposed transducer arrays 300, as shown in FIG. 30, with liquid A to a constant pressure, thus extending the bladders 522 outward against the sides of the heel to oppose the os calcis 216. Any liquid in bladder 540 is withdrawn by pump 130A and bladder 566 is vented to allow for the free expansion of bladder 522.

[0199] At process block 570, series of pulse measurements, as has been described before with respect to the array structures of this invention, are made but with an alternating of the transmitting transducer between the left and right side of the heel 207 with the opposed transducer serving as the receiving transducer. Pairs of such measurements may be averaged together to reduce the variation in heel measurement, however, it will also be understood that other statistical techniques may be applied to the left-going and right-going pulses to detect, for example, abnormal situations indicated by the deviation between these pulses being too great.

[0200] At decision block 572 one of three operations may be performed. First, the deviation between successive measurements at process block 570 may be compared until the deviations drop below a predetermined amount indicating that an asymptote in the measurements has been reached. Alternatively and preferably, the successive ultrasonic measurements may be fit to a decaying exponential or other similar curve until the deviation between that projected curve and the actual curve drops below a predetermined amount. Then the asymptote for the projected curve may be used as a final value. Alternatively, attenuation and speed of sound measurements may be made at process block 570 and

combined to reduce the asymptotic variation in the successive measurements. These combined measurements may also be fit to a curve as previously described.

[0201] Referring momentarily to FIG. 34, the present inventors have recognized that in apparatus of this type, the measured values of sound speed 574 tend to decline with time whereas measured values of broad band ultrasonic attenuation (BUA) 576 tend to rise with time. A combination of these values reflected in a stiffness measurement 578 such as may be an empirically weighted sum of BUA and SOS converges more quickly to the asymptote value 580.

[0202] Referring again to FIG. 33, once an asymptote value for the ultrasonic measurements has been determined from which bone health measurements can be made the process may conclude. Alternatively, the coupling liquid A from bladder 522 is withdrawn and bladder 540 is inflated with coupling liquid B having a different sound speed as shown in FIG. 31 by process block 582. The pressure and temperature of the coupling liquid B are controlled to be the same as coupling liquid A. As before, with process block 570, interleaved left to right, right to left ultrasonic measurements are then taken as indicated by process block 584..

[0203] Next, at decision block 586, an asymptote value is again derived, as has been described, and the program proceeds to process block 588 where width of the heel is calculated by the following means:

[0204] Assuming that liquid A has a sound speed of A, liquid B has a sound speed of B, the soft tissue about the heel has a sound speed of C, and the os calcis 216 has a sound speed of D, then the time of flight between the transducer arrays 300 will be described by the following equation:

$$t_1 = w_1/A + w_2/C + w_3/D \quad (4)$$

[0205] where, w_1 is the total distance between the transducer array 300 and the heel, w_2 is the total distance through soft tissue, and w_3 is the total distance through the os calcis 216. Similarly for coupling liquid B, the time of flight will be

$$t_2 = w_1/B + w_2/C + w_3/D \quad (5)$$

[0206] Accordingly, a difference in time of flight with coupling liquid A and B yields a value of the heel width w_1 as follows::

$$w_1 = (t_1 - t_2) / (A - B) \quad (6)$$

[0207] If the os calcis is assumed to have a substantially constant width, the amount of soft tissue may be deduced and this width of soft tissue or the heel width itself may be used to make an empirical correction to the bone health measurement as previously described.

[0208] It will be understood from this description that the same procedure may be adopted using coupling liquids A and B that have different attenuations and in fact liquids having both variations in attenuation and sound speed may be used.. Further, all the bladders may be replaceable through the use of sealing members such as o-rings to provide a good seal on a replaceable bladder.

Oversized Bladder

[0209] Referring now to FIG. 35, the shape of the flexible membrane 626 in the foregoing examples is controlled in

shape so as to provide a maximum resistance to movement of the patient member 207 across the axis 212 when the member 207 is in contact with the membrane 626. In the prior art, membrane 626a was attached about transducer 300 at a periphery 654a conforming closely to the active front surface 656 of the transducer 300. During operation, the membrane 626a extends a distance D along axis 212 by an amount intended to bridge the gap between the transducers 300 and a patient member (not shown in FIG. 35) for different sized patient members while providing ample clearance for insertion and removing of the patient member.

[0210] The present invention recognizes that superior patient immobilization is obtained by expanding the point of peripheral attachment of the membrane 626b to an outer periphery 654b substantially greater than the ultimate extension distance D and preferably greater than twice D. Generally, it is desired that the surface of the membrane 626 extending the distance D while retaining a generally hemispherical shape such as is believed to provide greatest resistance to cross axis motion. Recognizing that the membrane 626 may take on other than a circular periphery, the diameter of the periphery as used herein will refer to the diameter of a circle circumscribed within the periphery 654b.

[0211] Referring now to FIG. 36, the advantage of the expanded periphery 654b may be seen by imagining the displacement of a point 658a on the membrane 626 to a new location 658b displaced across axis 212 such as might be caused by motion of the patient member. Such motion would require a substantially greater stretching of the membrane 626(b) with respect to the periphery 654b as shown by displacement distance 660 than it would require of the membrane 626(a) with respect to the periphery 654a as shown by displacement 662. A greater displacement from these points corresponds to a greater stretching of the curved membrane 626(b), thus a greater restoring force provided by the membrane 626(b) in preventing that movement. Motion of the patient member along axis 212 may be controlled by controlling the pressure within the membrane 626 to provide the desired degree of immobilization.

Inflated Bladder with Fixed Bladder Support

[0212] Referring now to FIG. 37, the benefits of a closed environment for the acoustic coupling fluid 640 may also be obtained in an inflation-type system wherein cylindrical chambers 664 having open ends facing each other along axis 212 with front opposed surfaces enclosed by membranes 626 and rear surfaces connected by means of hydraulic tubing 666 to pump chamber 668. The chambers 664 are fixed in separation and with respect to the transducers contained therein. The transducers may be any combination of arrays 300 and/or individual transducers 121 as have been previously described. Valves 641 communicating with the interior of the chambers 664 may allow removal of coupling fluid 640 or the bleeding out of entrapped air. An open face of the pump chamber 668 may be closed by a rolling diaphragm 670 being essentially a flexible membrane attached at its edges to close the chamber 558 and attached at its center to a piston 672. Displacement of the piston 672 in toward the chamber 668 creates a predefined reduction in volume of the chamber 668 causing, through hydraulic equalization, a distention of membranes 626 outward toward the patient member contained between them. The rolling

diaphragm 670 requires no sliding seals, as are found in conventional piston pumps, nor creates the possibility of backwash as can occur with peristaltic-type pumps. Further, the flow rate provided to the chambers 664 need not be measured in order to determine the amount of distention of the membranes 626 as there will be a fixed and easily calculated relationship between movement of the piston 672 and distention of the membranes 626. This relationship is not as easily calculated with pumps requiring check valves or having backwash or leakage. By hermetically closing the coupling fluid 640 from outside environments, the coupling fluid may be degassed and contamination may be essentially eliminated.

[0213] The transducer chambers 664, interconnecting hydraulic tubing, and 666 pump chamber 668 all may be partially formed from or incorporated into a thermally conductive matrix such as an aluminum block to form an effective a single heating chamber whose temperature may be controlled by activation of resistance heating elements 164 also in thermal communication with the heating chamber 132 and monitored by thermistor 168 as previously disclosed. This arrangement eliminates the need for separate thermal regulation circuitry for each of these elements and provides good uniformity of temperature of the various elements.

[0214] The chamber 558 may be in communication with a pressure sensor and the piston 672 further controlled to monitor the pressure in the chamber 558 to substantially 1 PSIG. As will be described below, this same mechanism may be used to pre-inflate the membranes 626 prior to insertion of the patient's foot. In this case, the pressure sensor may be used to monitor the pressure as a function of volume of liquid in the chambers 664, and hence inflation of the membranes 626, to determine that the patient's foot is not in place during the inflation process. Presence of the patient's foot would increase the pressure sensed by the pressure sensor for a given inflation volume and thus may also be used to confirm that the patient's foot has been inserted.

Pre-Inflated Bladder System

[0215] Referring now to FIG. 38, an ultrasonic densitometer 710 includes a housing 712 having an aperture 714 and its upper surface exposing a receptacle 718 sized to receive a human heel therein when the housing 712 placed on the floor in front of a seated patient.

[0216] Attached to left and right walls 716 of a receptacle 718 and positioned below the aperture 714 are left and right bladders 720 presenting opposed convex bladder surfaces 722 formed of distended membranes. It will be recognized that a similar system may be used with a single bladder in a reflection mode where one of the bladders 720 is replaced simply by a soft material providing support for the side of the heel. Further, the bladders 720 may be used not with single transducers but with transducer arrays or a combination of single transducers or single elements of array transducers and arrays may be used.

[0217] Referring also to FIG. 39, prior to insertion of the patient's heel 724, the bladders 720 are pre-inflated so that surfaces 722 define therebetween a cavity sized to be smaller than a standard human heel 724. The bladders 720 are pre-inflated with a coupling liquid, typically water 726, to

distend a sheet of silicone rubber to a nearly hemispherical configuration as described above. While the bladders 720 are pre-inflated before the heel 724 is inserted, they are initially inflated by a pump system such as described above and may be deflated for storage or shipping. The act of inflation is, of course, intrinsic to any inflated bladder.

[0218] The water is contained between each bladder surface 722 and a corresponding backer plate 728 is attached to the membrane of the bladder 720 at its circular periphery. Positioned within the cavity defined by the backer plate 728 and the bladder surface 722 is an ultrasonic transducer 730 as described above. The transducers 730 and backer plates 728 are held by structure 721 in fixed separation and essentially fixed with respect to the foot plate 738 as will be described.

[0219] The ultrasonic transducers 730 are aligned along an ultrasonic propagation axis 732 extending therebetween and intersecting the center of the bladder surfaces 722. A thin coating of ultrasonic coupling gel 734 is placed on the outer surface of the membrane forming the bladder surface 722 to provide lubrication and coupling for the later insertion of a heel 724.

[0220] Referring now to FIGS. 39 and 40, the heel 724 may be inserted in a downward direction 736 across (i.e., perpendicular) to the ultrasonic propagation axis 732 so as to slide pass past the bladder surfaces 722 deforming them inward, the heel 724 to abut a heel plate 738 stopping further downward motion of the heel 724. The elastic nature of the membranes of bladder surfaces 722 causes the surfaces 722 to deform as they slide along the outer surfaces of the heel 724 in a wiping action reducing entrapment of air between the bladder surfaces 722 and the heel 724. The hemispherical shape of the bladder surfaces 722 and the material of their construction allows them to conform to the shape of the heel 724 and remain substantially aligned with the ultrasonic transducers 730 during the insertion of the heel in contrast to other bladder shapes which as a result of their longitudinal extension or conical shape may collapse or fold over with the insertion of a the heel.

[0221] Referring now to FIG. 41, the heel plate 738 may generally have a lower surface 740 supporting the sole of the foot and back surface 742 perpendicular to surface 740 supporting the back of the heel 724. Surfaces 740 and 742 may be generally perpendicular to each other with 740 tipped upward toward the toe end with respect to the upper surface of the housing 712. The toe end of surface 740 may rest to pivot about a lower support fulcrum 744 while the upper edge of back surface 742 may be engaged by a stationary load cell 746 fixed with respect to the housing 712.

[0222] The load cell 746 may measure downward pressure 747 of the heel 724 on the plate 738 and backward pressure 749 of the heel 724 on the surface 742 so as to insure proper seating of the heel 724 against the plate 738 and proper location of the ultrasonic propagation axis 732 in the desired region of the os calcis 748.

[0223] Referring now to FIG. 42, the downward force 747 (F1) and backward force 749 (F2) may be monitored by the microprocessor 38 (described above) so as to ensure that the forces (F1 and F2) of a given measurement lie within a desired range 750 indicating proper seating of the foot

against the plate 738 without undue force thereon and indicating further that the calf of a patient's leg abutting a calf support 120 (shown in FIG. 38 in phantom) is not holding the back of the heel 724 away from surface 742.

[0224] In an alternate embodiment, not shown, the bladders 720 may be pre-inflated so as to touch and in this way provide an acoustic path directly from one ultrasonic transducer 730 to the other without air gap or intervening heel 724. This provides a separation distance of zero. This configuration may be used to provide a pre-measurement standard pulse between ultrasonic transducers 734 as has been previously described, and/or to provide a positive indication (by measurement of the ultrasonic propagation) as to whether the patient's heel 724 has been inserted between the bladders or not. The shape and composition of the bladders 720 is such as to allow the foot to slide between the bladders 720 even when there is initially no appreciable gap between the bladders 724.

[0225] It will be within the understanding of one of ordinary skill in the art, that the features of the various embodiments described herein may be interchanged with other embodiments to effect the purposes described herein and therefore that the inventor contemplates the construction of commercial devices including either combinations of features of several embodiments disclosed herein or less than all the features of any one embodiment. It is specifically intended that the present invention not be specifically limited to the embodiments and illustrations contained herein, but embrace all such modified forms thereof as come within the scope of the following claims.

We claim:

1. An ultrasonic densitometer comprising:

a pre-inflated acoustic coupling system presenting bladder surfaces opposed along an ultrasonic propagation axis and, prior to insertion of a human heel, separated by a distance smaller than the width of a human heel;

a coupling material contained within the bladder surfaces;

a first ultrasonic transducer communicating with the coupling material and positioned to direct ultrasonic signals through the coupling material along the ultrasonic propagation axis;

circuitry for excitation of the first ultrasonic transducer to measure propagation of ultrasonic signals;

wherein the bladder surfaces are shaped to remain aligned with the propagation axis and in sliding contact with a human heel, when the human heel is inserted between the bladder surfaces across the ultrasonic propagation axis.

2. The ultrasonic densitometer of claim 1 wherein the bladder surfaces are substantially hemispherical.

3. The ultrasonic densitometer of claim 1 wherein the first and second bladder surfaces are attached to a fixed support surface and wherein the ultrasonic transducer is fixed with respect to the fixed support surface.

4. The ultrasonic densitometer of claim 1 including further a second ultrasonic transducer opposed to the first ultrasonic transducer having fixed separation with respect to the first ultrasonic transducer.

5. The ultrasonic densitometer of claim 1 further including a pump for pre-inflating the bladder system with the coupling material prior to use.

6. The ultrasonic densitometer of claim 1 further including a valve for releasing material from within the bladder system.

7. The ultrasonic densitometer of claim 1 wherein the bladders surfaces are comprised of an elastomeric membrane having a surface coating of ultrasonic coupling gel.

8. The ultrasonic densitometer of claim 1 including a foot support positioned beneath the opposed bladder surfaces with respect to a direction of insertion of the human heel, wherein the foot support includes at least one sensor indicating seating of a human foot against the foot support.

9. The ultrasonic densitometer of claim 8 wherein the sensor is a force sensor indicating a force selected from the group consisting of downward force normal to the sole of a human foot seated against the foot support and backward force parallel the sole of a human foot seated against the foot support.

10. The ultrasonic densitometer of claim 1 wherein the first ultrasonic transducer is selected from the group consisting of: a single ultrasonic transducer element and an array of ultrasonic transducer elements.

11. The ultrasonic densitometer of claim 1 including a second ultrasonic transducer opposed to the first ultrasonic transducer, wherein the second ultrasonic transducer is selected from the group consisting of: a single ultrasonic transducer element and an array of ultrasonic transducer elements.

12. An ultrasonic densitometer comprising:

a presence sensor providing a signal indicating the presence of a patient's foot at a measurement location;

at least one bladder positioned with respect to the measurement location to present a bladder surface adjacent to a patient's foot located in the measurement location;

a pump communicating with the bladder to inflate the bladder with a coupling material contained behind the bladder surface;

circuitry communicating with the pump and the sensing means to produce an error condition when the pump inflates the bladder while a foot is positioned measurement location;

a first ultrasonic transducer coupled to the coupling material and positioned to direct ultrasonic signals through the coupling material toward the measurement location along the ultrasonic propagation axis;

circuitry for excitation of the first ultrasonic transducer for measurement of propagation of ultrasonic signals;

whereby the patient's foot must be slid across the pre-inflated bladder to avoid an error condition.

13. The ultrasonic densitometer of claim 12 wherein the error condition is a display to the operator.

14. The ultrasonic densitometer of claim 12 wherein the sensing means is a force sensor communicating with a foot support to sense the pressure of the patient's foot against the foot support.

15. The ultrasonic densitometer of claim 12 wherein sensing means is a pressure sensor communicating with the bladder to measure excess pressure therein.

16. The ultrasonic densitometer of claim 12 wherein the first ultrasonic transducer is selected from the group consisting of: a single ultrasonic transducer element and an array of ultrasonic transducer elements.

17. The ultrasonic densitometer of claim 12 including a second ultrasonic transducer opposed to the first ultrasonic transducer, wherein the second ultrasonic transducer is selected from the group consisting of: a single ultrasonic transducer element and an array of ultrasonic transducer elements.

18. A method of making ultrasonic measurements of a human heel comprising the steps of:

- (a) supporting a first and second bladder surface to define therebetween a distance smaller than the human heel, the first and second bladder surfaces containing a coupling material;
- (b) directing at least one ultrasonic transducer through the coupling material along an ultrasonic propagation axis between the first and second bladder surfaces;
- (c) inserting a human heel across the propagation axis between the first and second bladder surfaces causing deformation of the bladder surfaces to enlarge the cavity to accept the human heel; and
- (d) exciting the ultrasonic transducer to perform a measurement of the human heel.

19. The method claim 18 including the step of applying an ultrasonic coupling gel to the bladder surfaces prior to insertion of the foot at step (c).

20. The method of claim 18 including the step of pre-inflating the first and second bladder surfaces with coupling material prior to step (a).

21. The method of claim 20 including the step of sensing the presence of a human heel between the first and second bladder surfaces prior to pre-inflation of the bladders and when a human heel is in place in the cavity prior to pre-inflation creating an error condition.

22. The method of claim 20 including the step of releasing coupling material from within the first and second bladder surfaces after step (d).

23. An ultrasonic densitometer comprising:

a patient support;

an ultrasonic transducer system including at least one ultrasonic transducer positioned with respect to the patient support to direct ultrasonic signals through a patient positioned by the patient support and to receive the ultrasonic signals after attenuation by the patient;

a coupling volume positioned between the ultrasonic transducer and the patient, the coupling volume alternatively occupied by a first coupling material having a first known sound propagation property and a second coupling material having a second known sound propagation property different from the first sound propagation property; and

a computer communicating with the ultrasonic transducer system to measure a first ultrasound propagation through both the patient and the first coupling material and a second ultrasonic propagation through both the patient and the second coupling material, the computer executing a stored program to compare the first and second ultrasonic propagations to produce an indication of bone quality of bone within the patient.

24. The ultrasonic densitometer of claim 23 wherein the coupling volume holds a first and second overlapping flexible bladder alternately filled with liquid first and second coupling materials.

25. The ultrasonic densitometer of claim 23 wherein the first and second coupling materials have different sound attenuations.

26. The ultrasonic densitometer of claim 23 wherein the first and second coupling materials have different sound propagation speeds.

27. An ultrasonic densitometer for measuring bone in vivo comprising:

an ultrasonic transducer system including at least one ultrasonic transducer positioned with respect to the bone to direct ultrasonic signals through the bone and to receive the ultrasonic signals after attenuation by the bone;

a computer communicating with the ultrasonic transducer system to:

- (i) measure a series of ultrasound signals through the bone as a function of time;
- (ii) fit the measured series to a predetermined asymptotic curve; and
- (iii) output a measurement based on the asymptotic curve.

28. The ultrasonic densitometer of claim 27 wherein the output is based on a portion of the asymptotic curve beyond the measured series.

29. The ultrasonic densitometer of claim 27 wherein the transducer array system includes two transducers opposed about the bone and wherein the ultrasonic transducer system alternates the direction of propagation of ultrasound through the bone between the two transducers.

30. The ultrasonic densitometer of claim 27 wherein the measure of the series of ultrasound signals is a measure of a speed of ultrasonic propagation.

31. The ultrasonic densitometer of claim 27 wherein the measure of the series of ultrasound signals is a measure of ultrasonic attenuation.

32. The ultrasonic densitometer of claim 27 wherein the measure of the series of ultrasound signals is a combination of measures of speed of ultrasonic propagation and ultrasonic attenuation.

* * * * *

专利名称(译)	超声波密度计，带有预充气的液体耦合膜		
公开(公告)号	US20010020128A1	公开(公告)日	2001-09-06
申请号	US09/746269	申请日	2000-12-21
[标]申请(专利权)人(译)	MORRIS RICHARD F MORRIS史蒂芬 海峡戴维r		
申请(专利权)人(译)	MORRIS RICHARD F. MORRIS史蒂芬 海峡DAVID R.		
当前申请(专利权)人(译)	MORRIS RICHARD F. MORRIS史蒂芬 海峡DAVID R.		
[标]发明人	MORRIS RICHARD F MORRIS STEVEN STRAIT DAVID R		
发明人	MORRIS, RICHARD F. MORRIS, STEVEN STRAIT, DAVID R.		
IPC分类号	A61B8/00 A61B8/02 A61B8/06 A61B8/08		
CPC分类号	A61B8/0875 A61B8/4483		
优先权	60/080158 1998-03-31 US		
其他公开文献	US6520914		
外部链接	Espacenet USPTO		

摘要(译)

所容纳的水超声密度计采用预充气的气囊，其保持围绕超声换能器的耦合流体。处于松弛状态的气囊限定了比人脚跟小的空腔，使得当脚后跟插入时，气囊在擦拭动作中与脚跟相符，从而去除夹带的空气。

