



US009310474B2

(12) **United States Patent**
Huang et al.

(10) **Patent No.:** **US 9,310,474 B2**
(45) **Date of Patent:** **Apr. 12, 2016**

(54) **PORTABLE ULTRASOUND IMAGING DEVICES**

(71) Applicant: **CHISON MEDICAL IMAGING CO., LTD.**, Wuxi, Jiangsu Province (CN)

(72) Inventors: **Mingjin Huang**, Wuxi (CN); **Feng Zhou**, Wuxi (CN)

(73) Assignee: **Chison Medical Imaging, Inc.**, Jiangsu (CN)

(*) Notice: Subject to any disclaimer, the term of this patent is extended or adjusted under 35 U.S.C. 154(b) by 528 days.

(21) Appl. No.: **13/909,087**

(22) Filed: **Jun. 4, 2013**

(65) **Prior Publication Data**

US 2014/0355374 A1 Dec. 4, 2014

(51) **Int. Cl.**
A61B 8/02 (2006.01)
G01S 7/52 (2006.01)
A61B 8/00 (2006.01)

(52) **U.S. Cl.**
CPC **G01S 7/52079** (2013.01); **A61B 8/4427** (2013.01); **A61B 8/462** (2013.01); **Y10T 16/5323** (2015.01)

(58) **Field of Classification Search**
CPC A61B 19/5244; A61B 18/14; A61B 18/02; A61B 19/5212; A61B 8/12; A61B 18/1492; A61B 19/54; A61B 8/4427; A61B 8/462; G01S 7/52; G01S 7/52079; Y10T 16/5323
USPC 367/11; 16/239; 248/351; 128/200.16; 128/900-916

See application file for complete search history.

(56) **References Cited**

U.S. PATENT DOCUMENTS

5,942,978 A * 8/1999 Shafer E05B 73/0017
340/10.5
5,943,890 A * 8/1999 Field E05B 27/0039
70/337
2005/0154303 A1 * 7/2005 Walker G01S 15/8979
600/443

OTHER PUBLICATIONS

Philips VISIQ system Video <http://www.healthcare.philips.com/main/products/ultrasound/systems/visiq/#&&/wEXAQUOY3V-ycmVudFRhYIBhdGgFEERldGFpbHM6T3ZlcnZpZXdwGB6s-7Z5i1iyK2qCyu+ZlAjHM5w==> date: 2015.*

(Continued)

Primary Examiner — Luke Ratcliffe

Assistant Examiner — Amienatta M Ndure Jobe

(74) *Attorney, Agent, or Firm* — Finnegan, Henderson, Farabow, Garrett & Dunner, LLP

(57) **ABSTRACT**

A portal ultrasound imaging apparatus having an adjustable hinge assembly, which includes a key having a narrower end and an end wider in the circumferential direction of the hinge assembly. The key is movable in a slot in an axial direction of the hinge assembly to a locked position, where the side surfaces of the key presses against the walls of the slot to eliminate circumferential gaps between the key and the slot. When at the locked position in the slot, the key can be pushed towards the opposite of the axial direction to an unlocked position where an angular lock of the hinge assembly is released, allowing the hinge assembly to be adjusted to a desired angular coupling. The key can then be pushed in the axial direction back to the locked position in the slot to prevent change in the coupling angle of the hinge assembly.

20 Claims, 10 Drawing Sheets

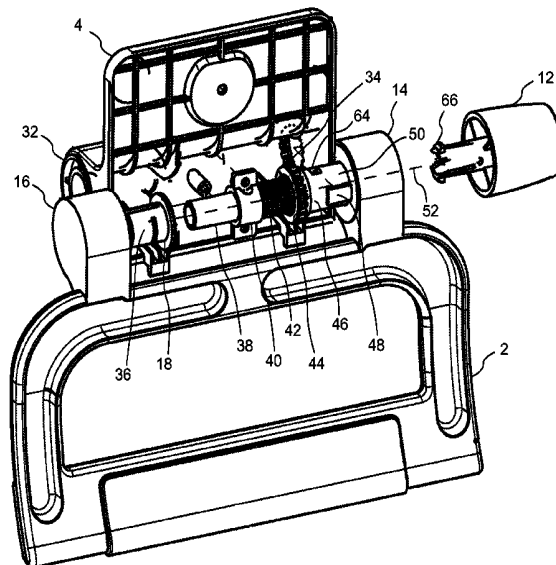

(56)

References Cited

OTHER PUBLICATIONS
KX5200 Veterinary Ultrasound Scanner Portable Ultrasound Live-
stock Pet Cattle Animals Ultrasound With Battery 6.5MHz Rectal
Probe <http://www.dhgate.com/store/product/kx5200-veterinary->

[ultrasound-scanner-portable/246912128.html](http://www.dhgate.com/store/product/kx5200-veterinary-ultrasound-scanner-portable/246912128.html) Copyright Notice ©
2004-2015 DHgate.com All rights reserved.*
David Lenovo Yoga Tablet 2 Teardown Nov. 8, 2014 [http://www.
myfixguide.com/manual/lenovo-yoga-tablet-2-disassembly/](http://www.myfixguide.com/manual/lenovo-yoga-tablet-2-disassembly/).*

* cited by examiner

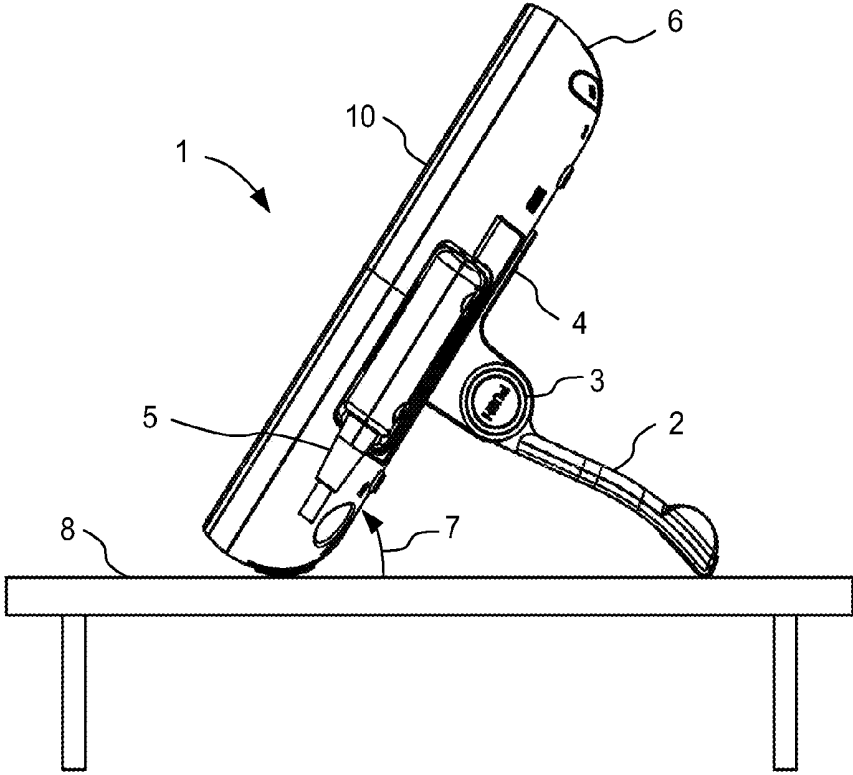

Figure 1

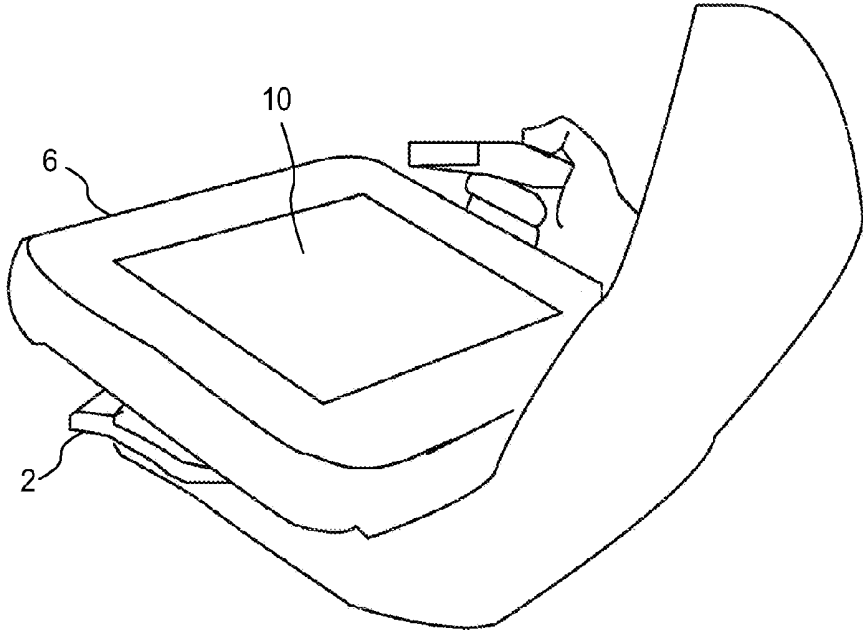

Figure 2

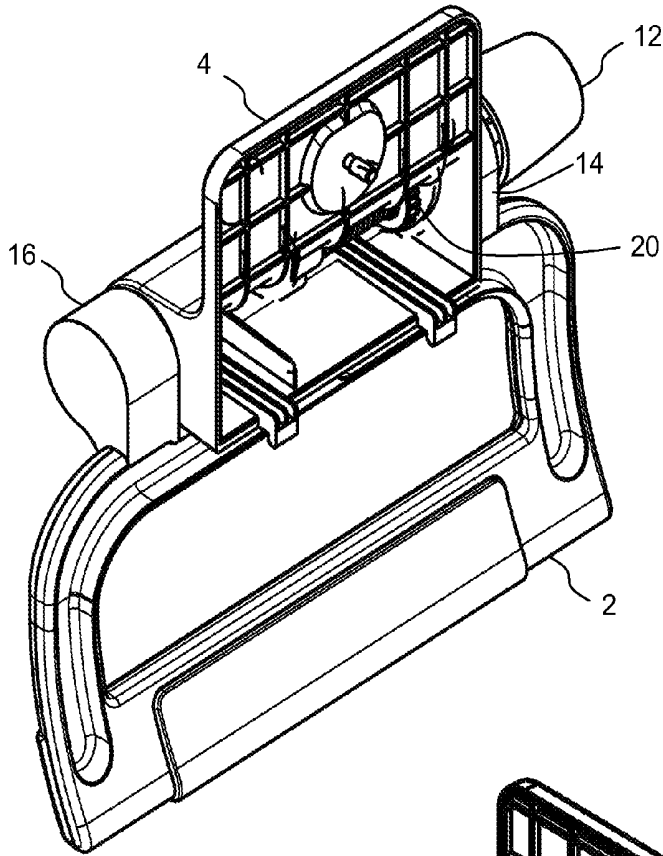

Figure 3

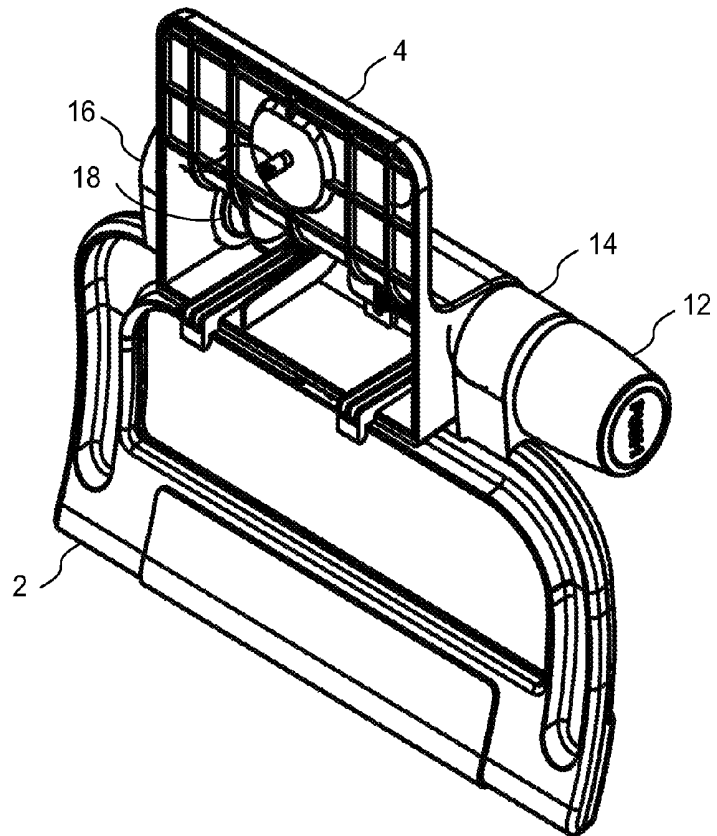

Figure 4

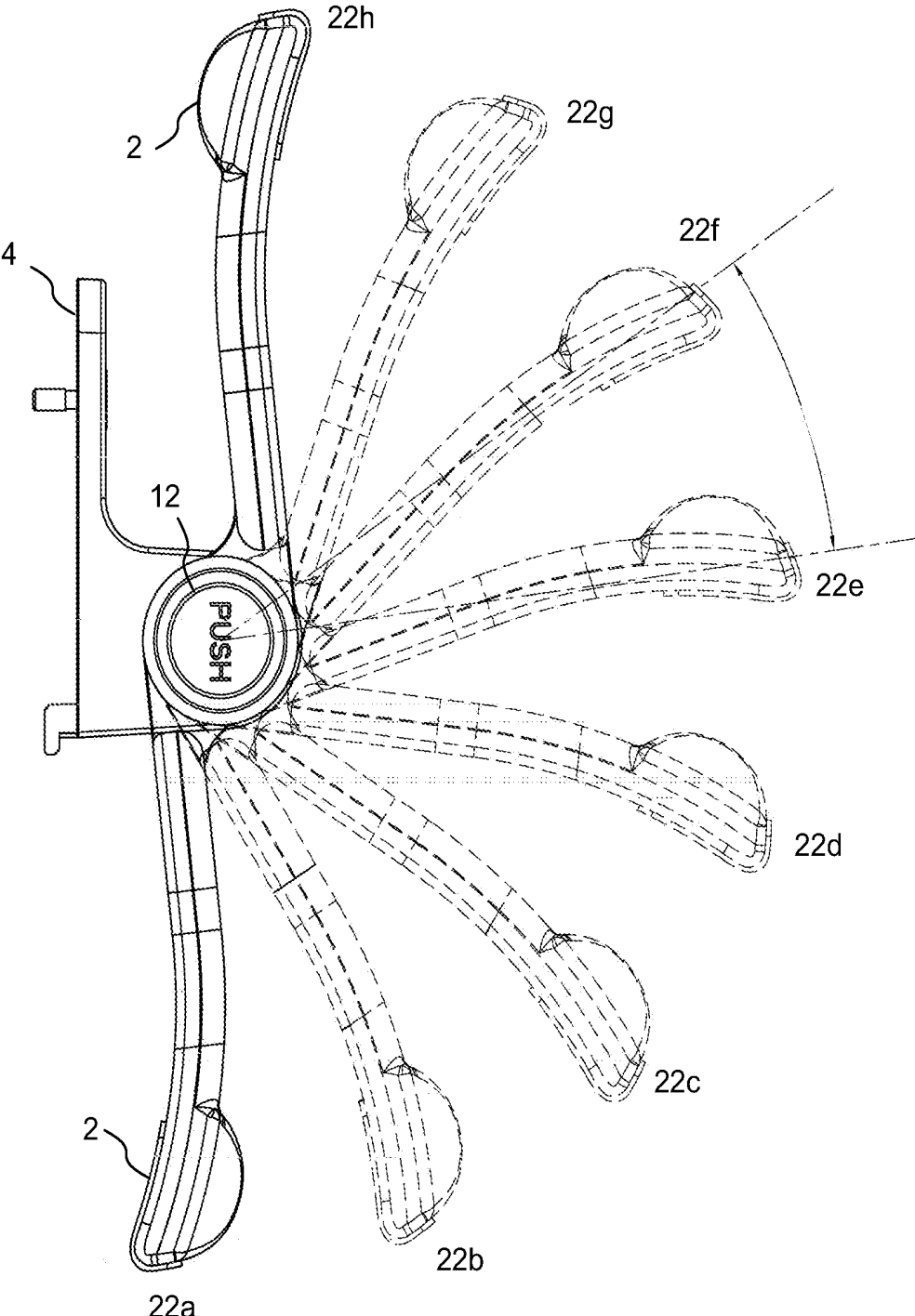

Figure 5

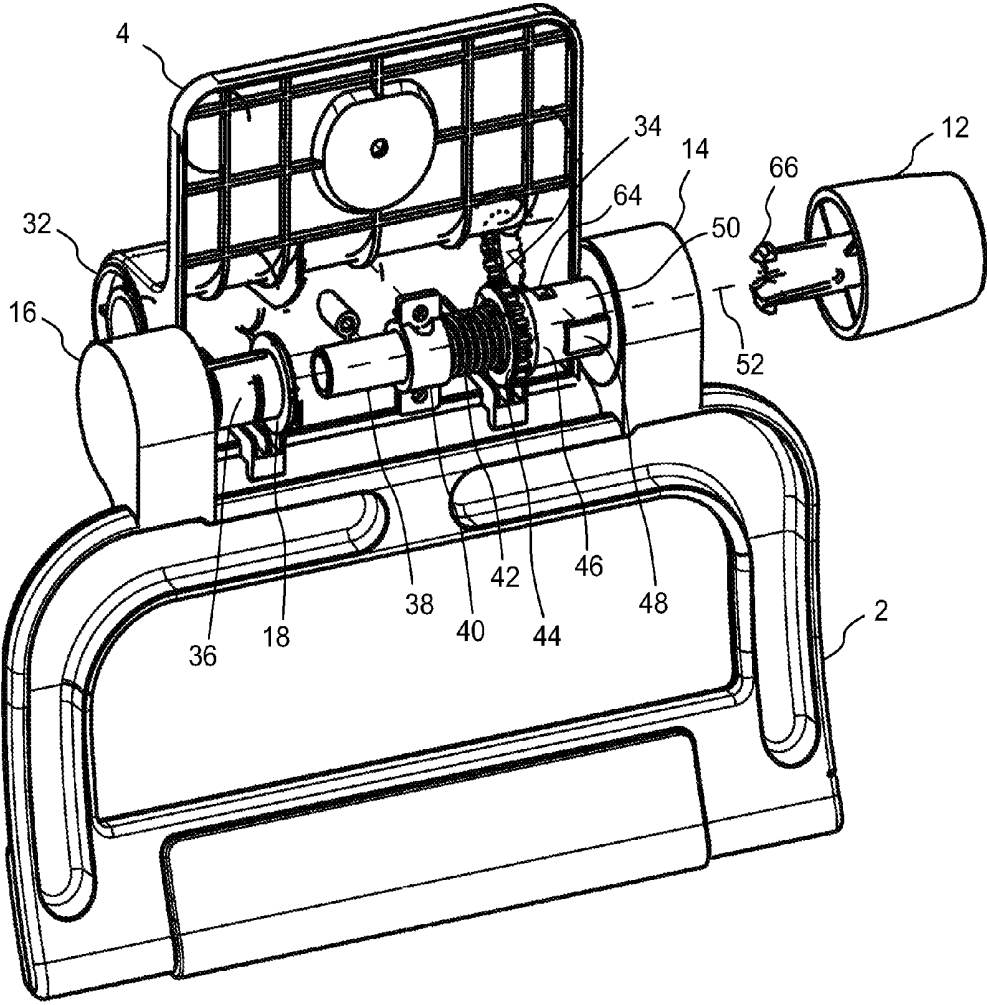

Figure 6

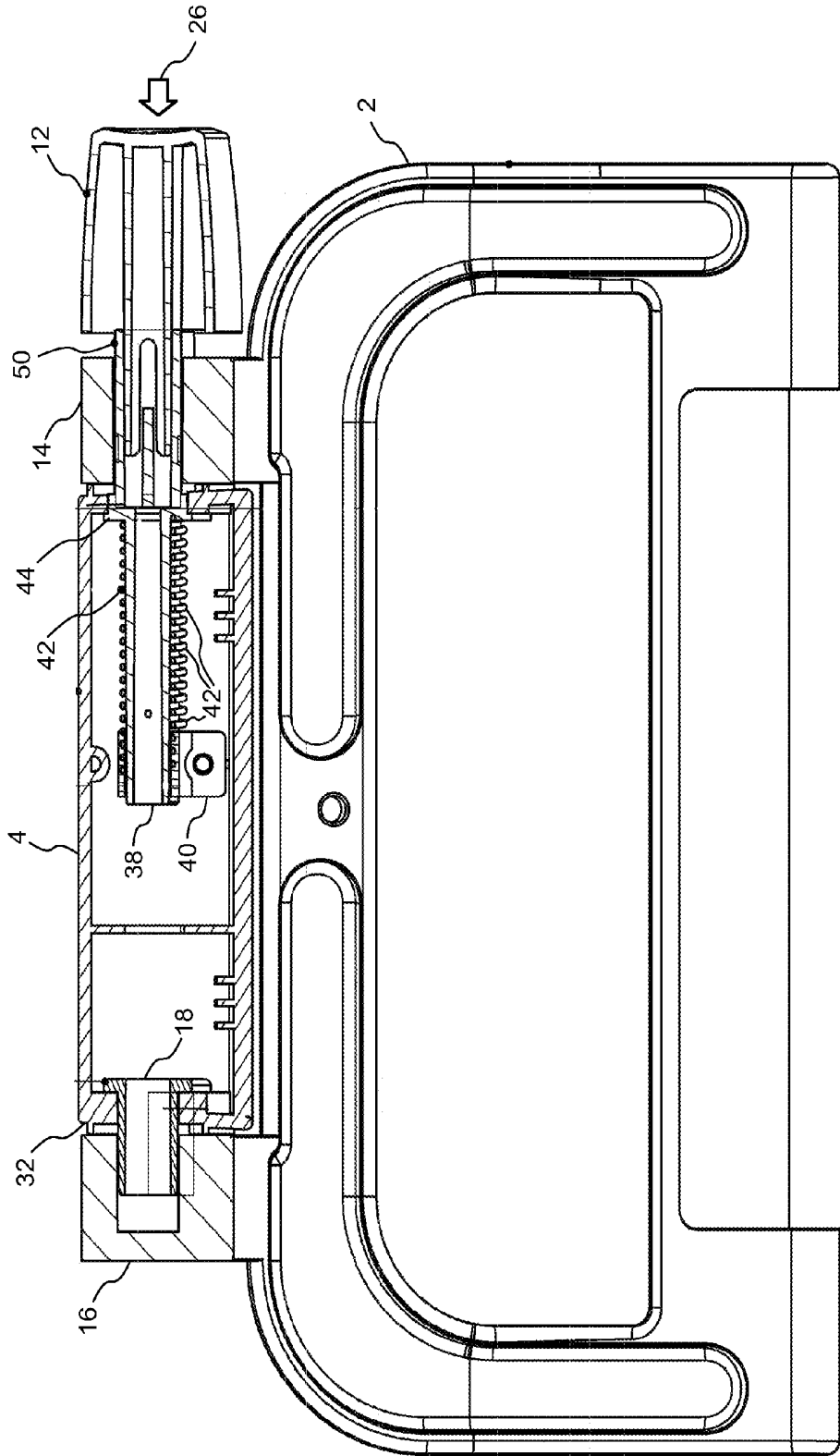

Figure 7

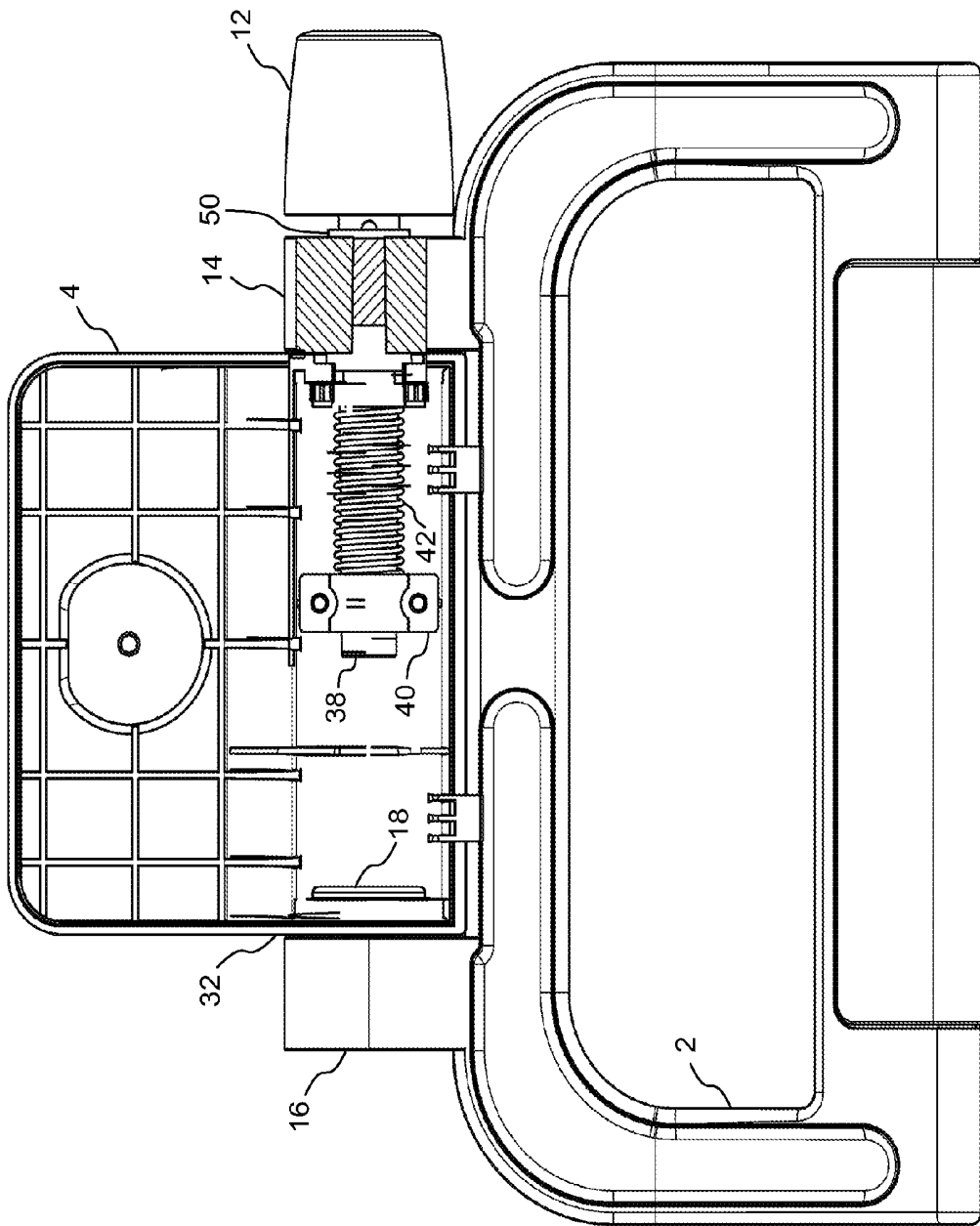

Figure 8

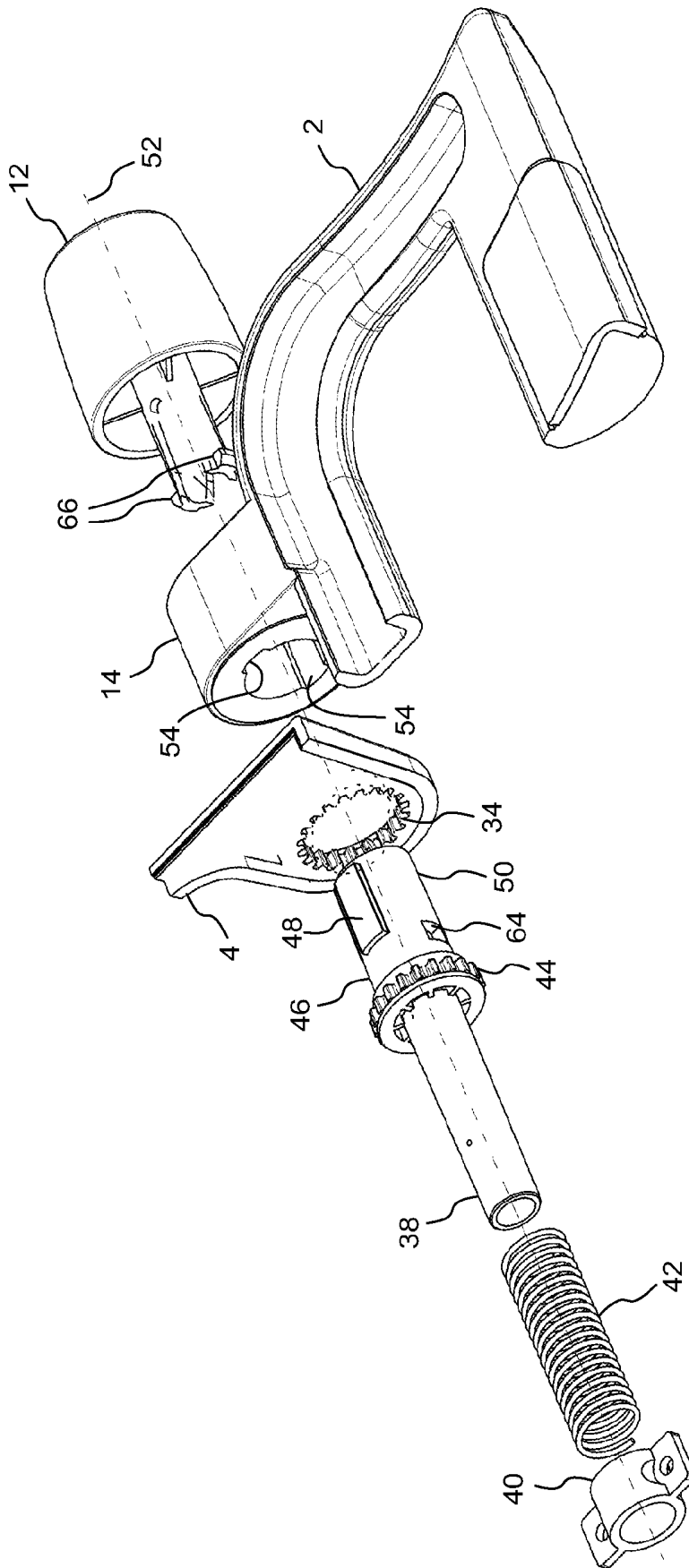

Figure 9

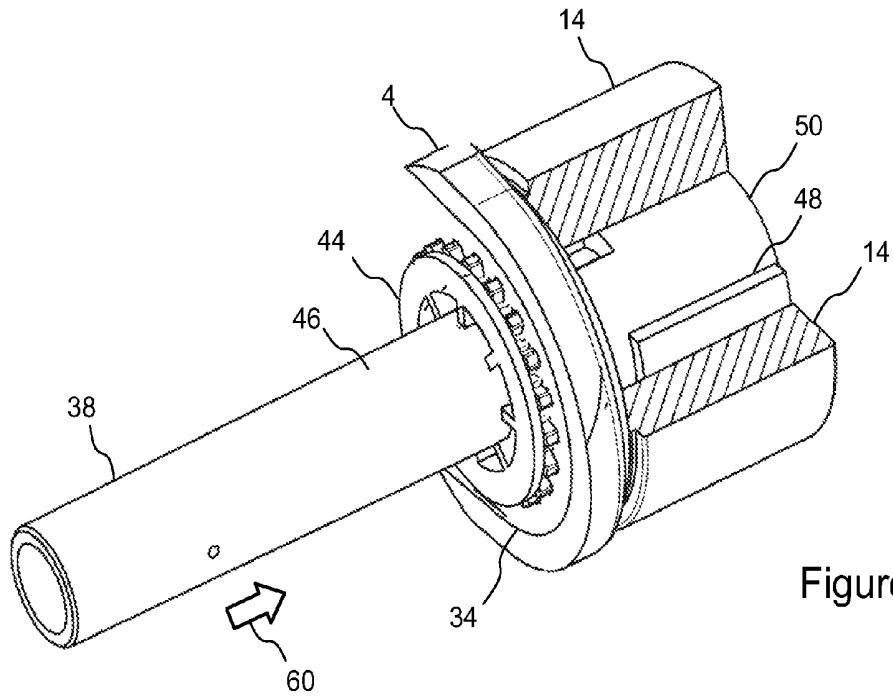

Figure 10

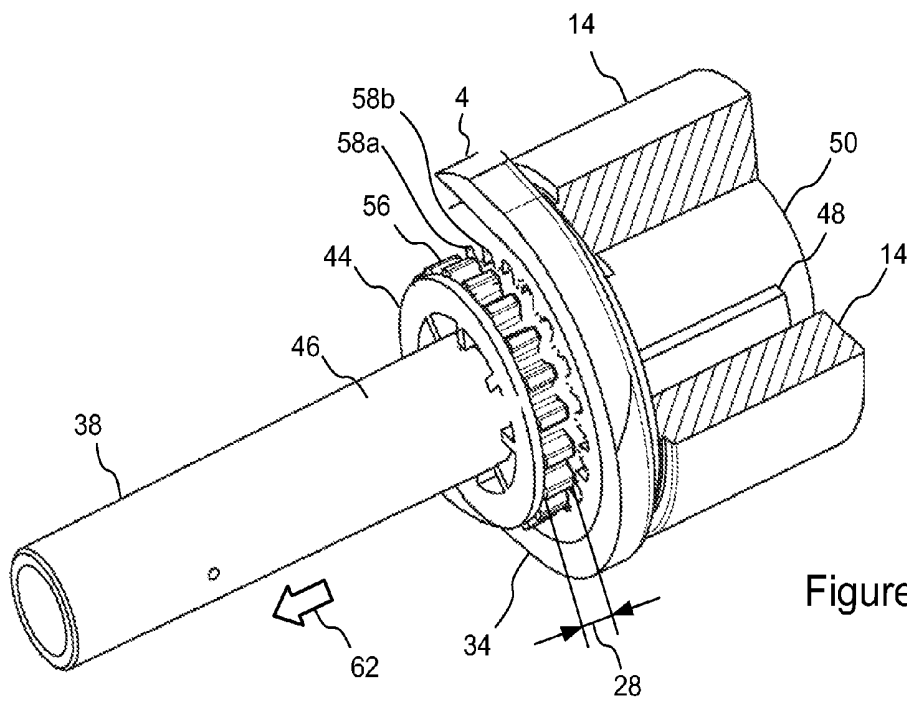

Figure 11

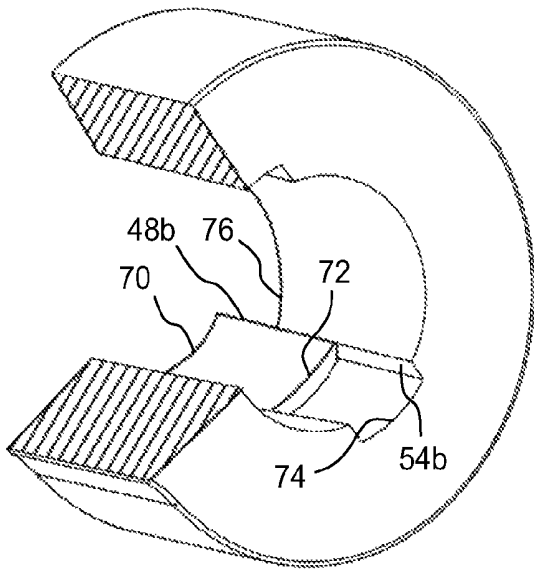
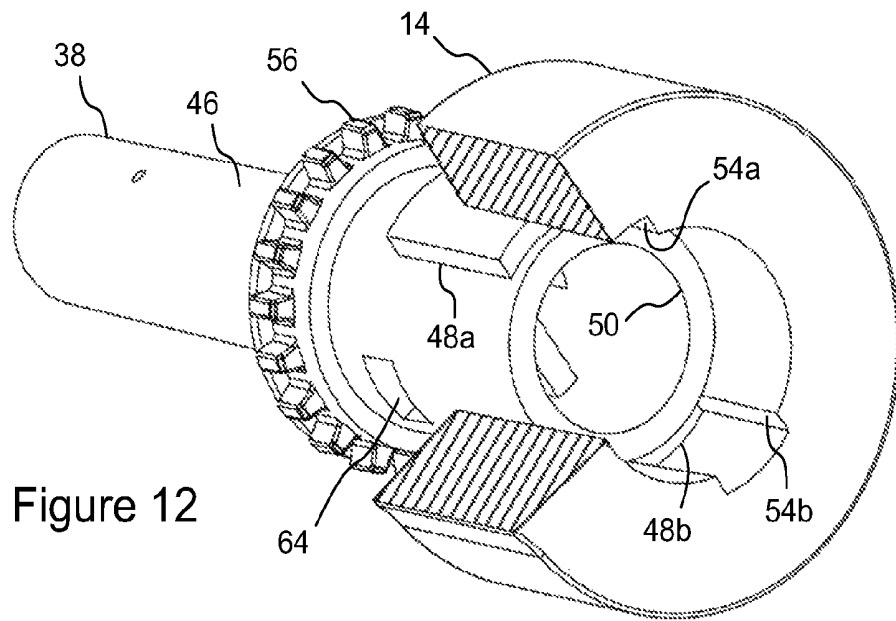
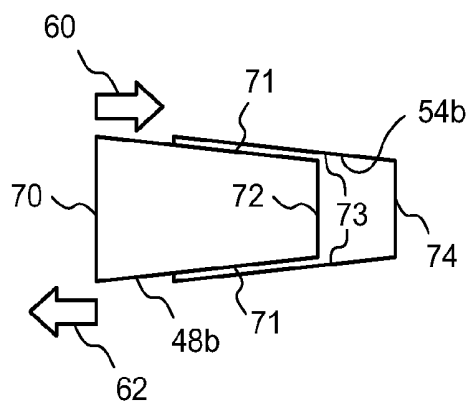

Figure 14



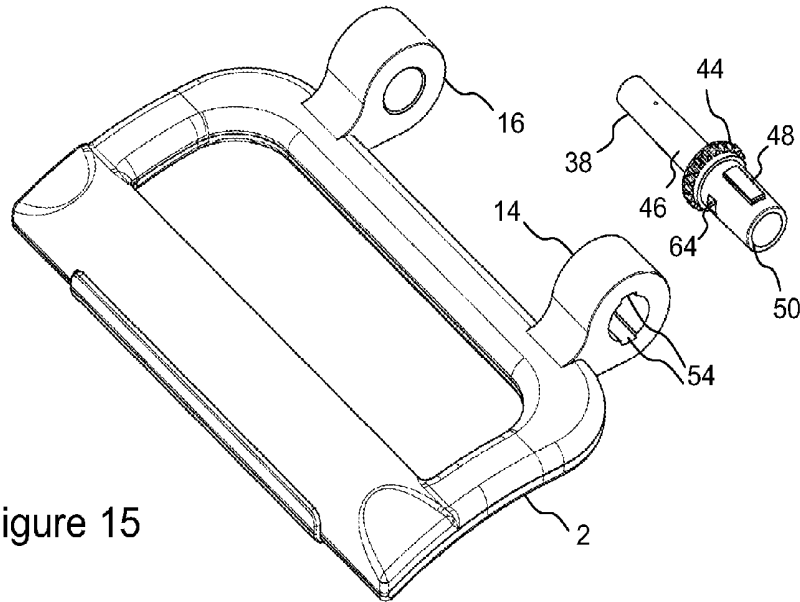

Figure 15

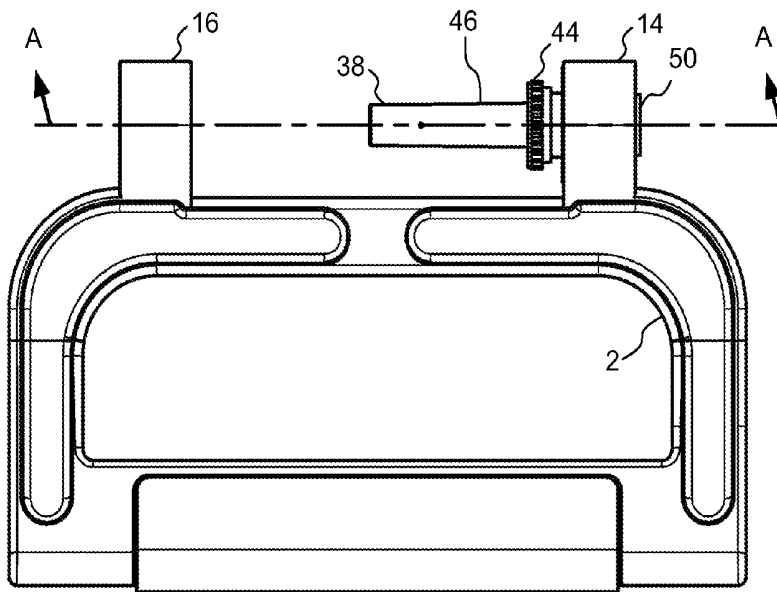

Figure 16

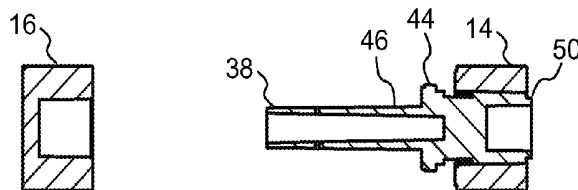

Figure 17

PORTABLE ULTRASOUND IMAGING DEVICES

FIELD OF THE TECHNOLOGY

The present disclosure relates to ultrasound imaging devices in general, and more particularly but not limited to, portal devices with adjustable support components.

BACKGROUND

Chinese Patent Application Nos. 201110178175.8 and 201120223929.2, published Jan. 4, 2012 and Mar. 7, 2013 respectively, and entitled "Handheld ultrasonic diagnostic apparatus", discloses portable ultrasonic diagnostic devices that have an adjustable support component.

SUMMARY OF THE DESCRIPTION

Some embodiments are summarized in this section.

In one aspect, a portable ultrasound imaging apparatus includes: a housing; a display device mounted on the housing; a processor disposed within the housing and coupled with the display device to present ultrasound images; a beam-former disposed within the housing and coupled with the processor to control an ultrasound transducer; a support component hingedly coupled with the housing to allow the support component to rotate with respect to the housing about an axis parallel to an edge of the display device; and an adjustable assembly coupled between the support component and the housing.

When the adjustable assembly is in a first configuration, the support component is locked to the housing with respect to rotation about the axis. When the adjustable assembly is in a second configuration, the support component is rotatable about the axis with respect to the housing.

The adjustable assembly can include: a key extending in parallel to the axis; and walls extending in parallel to the key to define a slot configured to accommodate the key. When the key moves in a first direction parallel to the axis to a first position in the slot, at least a portion of side surfaces of the key is in contact with the walls to prevent the key from moving in the slot in the first direction beyond the first position; when the key is at the first position in the slot, the adjustable assembly is locked in the first configuration, and the key is movable in a second direction opposite to the first direction to a second position in the slot to provide a gap between the walls and the side surfaces of the key; and when the key is at the second position in the slot, the adjustable assembly is in the second configuration and allows the support component to rotate about the axis with respect to the housing.

For example, the key has a first end and a second end; the key extending from the first end to the second end in the first direction; a width of the second end of the key is smaller than a width of the first end of the key; the side surfaces of the key extends from the first end to the second end; and the side surfaces are separated in a circumferential direction about the axis.

For example, a height of the second end of the key in a radial direction about the axis is equal to a height of the first end of the key in the radial direction about the axis. In another example, a height of the second end of the key in a radial direction about the axis is smaller than a height of the first end of the key in the radial direction about the axis.

For example, when the key is at the first position in the slot, a distance between the walls at the first end of the key is equal

to the width of the first end of the key, and a distance between the walls at the second end of the key is equal to the width of the second end of the key.

For example, the adjustable assembly includes a spring element configured to push the key in the first direction.

For example, the adjustable assembly further includes a push knob configured to be pushed by a user against the spring element to move the key in the second direction.

For example, when the key is at the first position in the slot, the gap is eliminated.

For example, the adjustable assembly further includes a first set of teeth and a second set of teeth corresponding to the first set of teeth; both the first set of teeth and the second set of teeth are evenly distributed in a circumferential direction about the axis; when the key is at the first position in the slot, the first set of teeth engages with the second set of teeth to lock the support component to the housing with respect to rotation about the axis; and when the key is at the second position in the slot, the first set of teeth disengages with the second set of teeth to allow the support component rotate about the axis with respect to the housing.

For example, the housing includes a back cover; the walls defining the slot are fixedly coupled with the support component; the first set of teeth is fixedly coupled with the back cover; and the second set of teeth is fixedly coupled with the key.

For Example, adjustable assembly further includes a tubular component having a first end and a second end; the first end of the tubular component is hingedly coupled with the back cover and rotatable about the back cover along the axis; and the key is on an outer surface of the second end of the tubular component.

For example, the second set of teeth is formed on the tubular component.

In another aspect, a portable display apparatus includes: a display device; a support component hingedly coupled with the display device to allow the support component to rotate with respect to the display device along an axis; and an adjustable assembly coupled between the support component and the display device.

The adjustable assembly may include: a key having a first end and a second end, the key extending from the first end to the second end in a first direction parallel to the axis, the key having side surfaces extending from the first end to the second end, the side surfaces of the key separated by a distance in a circumferential direction about the axis; and walls substantially in parallel with the side surfaces of the key to define a slot for the key.

When the key moves along the first direction to a first position in the slot, contacting between at least a portion of the side surfaces of the key and the walls prevents the key from moving in the first direction in the slot beyond the first position; when the key is at the first position in the slot, the key is movable only in a second direction opposite to the first direction, the key movable in the second direction to a second position in the slot; when the key is at the first position in the slot, the support component is locked to the display device with respect to rotation along the axis; and when the key is at the second position in the slot, the support component is rotatable along the axis with respect to the display device.

For example, a width of the second end of the key is smaller than a width of the first end of the key.

For example, when the key is at the first position in the slot, a distance between the walls at the first end of the key is equal to the width of the first end of the key, and a distance between the walls at the second end of the key is equal to the width of the second end of the key.

For example, the adjustable assembly can include: a spring element configured to push the key in the first direction; a push knob configured to be pushed by a user against the spring element to move the key in the second direction; a first set of teeth evenly distributed along a circumferential direction about the axis; and a second set of teeth evenly distributed along a circumferential direction about the axis. When the key is at the first position in the slot, the first set of teeth are in gaps between second set of teeth, and the second set of teeth are in gaps between first set of teeth to lock the support component to the display device with respect to rotation about the axis; and when the key is at the second position in the slot, the first set of teeth and the second set of teeth are not in contact with each other to allow the support component to rotate about the axis with respect to the display device.

For example, the display device includes a back cover; the first set of teeth is fixedly coupled with the back cover; the walls defining the slot are fixedly coupled with the support component; and the second set of teeth is fixedly coupled with the key.

For example, adjustable assembly further includes a tubular component having a first end and a second end; the first end of the tubular component is hingedly coupled with the back cover and rotatable about the back cover along the axis; and the key is positioned on an outer surface of the second end of the tubular component.

For example, the set of teeth is formed on the tubular component; and the component defining a set of slots is disposed along the axis between the set of teeth and the key.

In a further aspect, an adjustable hinge assembly includes: a tubular component having a first end and a second end, the tubular component extending from the first end to the second end in a first direction along an axis and having 1) a key formed on the second end and extending in parallel to the axis, the key having side surfaces extending in the first direction and separated by a distance in a circumferential direction about the axis, and 2) a plurality of first teeth evenly distributed in the circumferential direction about the axis. The adjustable hinge assembly includes: a first component having a ring structure defining an opening configured to accept the second end of the tubular component, the ring structure having walls extending in the first direction and separated by a distance in the circumferential direction about the axis, the walls defining a slot for the key; a second component having a plurality of second teeth corresponding to the plurality of the first teeth and evenly distributed in the circumferential direction about the axis; a spring element configured to push the tubular component in the first direction; and a push knob coupled with the second end of the tubular component to allow a user to push against the spring element to move the tubular component in a second direction opposite to the first direction.

When the spring element pushes the tubular component in the first direction to a first position, contacting between the side surfaces of the key and the walls prevents the tubular component from moving further in the first direction beyond the first position; and the plurality of first teeth engages with the plurality of second teeth to lock the first component with respect to the second component with respect to rotation about the axis;

When the push knob is pushed to move tubular component in the second direction to a second position, a gap is provided between the side surfaces of the key and the walls defining the slot; and the plurality of first teeth disengages with the plurality of second teeth to allow the first component to rotate about the axis relative to the second component.

For example, the key has a first key end and a second key end; the key extending from the first key end to the second key end in the first direction; the side surfaces are separated by: a first distance in the circumferential direction about the axis at the first key end; and a second distance in the circumferential direction about the axis at the second key end, where the first distance is larger than the second distance.

Other features will be apparent from the accompanying drawings and from the detailed description which follows.

BRIEF DESCRIPTION OF THE DRAWINGS

The embodiments are illustrated by way of example and not limitation in the figures of the accompanying drawings in which like references indicate similar elements.

FIGS. 1 and 2 illustrate a portable ultrasound imaging apparatus having an adjustable support component adjustable and locked to different positions relative to the housing of the portable ultrasound imaging apparatus

FIGS. 3-4 illustrate an adjustable support component coupled with a back cover of a portable ultrasound image apparatus.

FIG. 5 illustrates adjustable positions of an adjustable support component with respect to a back cover.

FIG. 6 shows components of an adjustable assembly according to one embodiment.

FIGS. 7 and 8 show coupling of components of an adjustable assembly according to one embodiment.

FIG. 9 shows an exploded view of an adjustable hinge assembly according to one embodiment.

FIGS. 10 to 14 illustrate a mechanism to adjust a hingedly coupling angle according to one embodiment.

FIGS. 15 to 17 show structural details of components of an adjustable hinge assembly according to one embodiment.

DETAILED DESCRIPTION

The following description and drawings are illustrative and are not to be construed as limiting. Numerous specific details are described to provide a thorough understanding. However, in certain instances, well known or conventional details are not described in order to avoid obscuring the description. References to one or an embodiment in the present disclosure are not necessarily references to the same embodiment; and, such references mean at least one.

FIGS. 1 and 2 illustrate a portable ultrasound imaging apparatus having an adjustable support component adjustable and locked to different positions relative to the housing of the portable ultrasound imaging apparatus.

In FIG. 1, a portable ultrasound imaging apparatus 1 includes a housing 6 and a support component 2. The support component 2 is hingedly 3 coupled to a back cover 4 of the housing 6.

The portable ultrasound imaging apparatus 1 has a display device 10 mounted on the front side of the housing 6, a processor disposed within the housing 6 and coupled with the display device 10 to present ultrasound images, and a beam-former disposed within the housing 6 and coupled with the processor to control an ultrasound transducer 5.

In FIG. 1, the hinge coupling 3 between the back cover 4 and the support component 2 is adjusted to, and locked at, an angle suitable for placing the portable ultrasound imaging apparatus 1 on a flat surface 8 in a position where the display device 10 is raised up to an angle 7 on the surface 8 for viewing. The angle 7 is adjustable via adjusting the coupling angle between the back cover 4 and the support component 2.

In FIG. 1, the ultrasound transducer 5 is attached to the side of the housing 6. The ultrasound transducer 5 can be detached from the housing 6 for handheld operations, as illustrated in FIG. 2.

In FIG. 2, the support component 2 is adjusted to a position to allow the portable ultrasound imaging apparatus 1 to rest on an arm of a user.

FIGS. 3-4 illustrate an adjustable support component coupled with a back cover of a portable ultrasound image apparatus.

In FIG. 3, the back cover 4 is hingedly coupled with the support component 2 via a ring structure 14, and an angular locking mechanism 20, and a hinge support 16. The ring structure 14 and the hinge support 16 are fixedly coupled with the support component 2.

In FIG. 3, a push knob 12 is coupled with locking mechanism 20. The push knob can be pushed towards the hinge support 16 to release the angular locking mechanism 20. When the angular locking mechanism 20 is released, the back cover 4 can be rotated relative to the support component 2 along an axis along the center of the hinge support 16 to the center of the ring structure 14.

FIG. 4 shows a tubular element 18 hingedly coupled the left side of the back cover 4 to the hinge support 16. The coupling among the hinge support 16, the left side of the back cover 4 and the tubular element 18 allows the left side of the back cover 4 to rotate freely about the axis relative to the hinge support 16.

Details of the locking mechanism 20 are illustrated in FIG. 9 and other figures and discussed further below.

FIG. 5 illustrates adjustable positions of the adjustable support component 2 with respect to the back cover 4. In FIG. 5, the push knob 12 can be pushed in to release the locking mechanism 20 and thus allow the support component 2 to be rotated to various positions (e.g., 22a to 22h) relative to the back cover 4. After the support component 2 is adjusted to a desirable position (e.g., from 22e to 22f), the pressure on the push knob 12 can be released to engage the locking mechanism 20.

When the locking mechanism 20 is engaged, the locking mechanism 20 prevents the support component 2 from rotating relative to the back cover 4.

FIG. 6 shows components of an adjustable assembly according to one embodiment. In FIG. 6, the hinge assembly has an axis 52 along the center of the hinge support 16 to the center of the ring structure 14.

As illustrated in FIG. 6, the left side of the back cover 4 has a circular portion 32 with a circular opening; and the tubular portion 36 of the tubular element 18 is configured to be inserted through the circular opening of the circular portion 32 of the back cover 4 near the hinge support 16 and inserted into the hinge support 16. The circular portion 32 of the back cover 4 is configured to be sandwiched between the hinge support 16 and an end portion of the tubular element 18. Thus, the left side of the back cover 4 can rotate freely about relative to the hinge support 16.

As illustrated in FIG. 6, a circular bracket 40 is configured to be attached to the back cover 4. A left end 38 of a tubular component 46 of the locking mechanism 20 is hingedly coupled with the circular bracket 40 such that the left end 38 of the tubular component 46 can rotate within the circular bracket 40.

As illustrated in FIG. 6, the tubular component 46 of the locking mechanism 20 has a tooth portion 44. A spring element 42 is coupled between the circular bracket 40 and the tooth portion 44 to push the tubular component 46 of the lock mechanism 20 towards the ring structure 14.

As illustrated in FIG. 6, the right end 50 of the tubular component 46 of the locking mechanism 20 has a key 48. The right end 50 with the key 48 is to be inserted into the opening of the ring structure 14 through an opening in a tooth portion 34 at the right side of the back cover 4. Thus, the tooth portion 34 of the back cover 4 is configured to be sandwiched between the tooth portion 44 of the tubular component 46 and the ring structure 14.

As illustrated in FIG. 6, the tooth portion 44 of the tubular component 46 has a set of teeth evenly distributed in a circumferential direction relative to the axis 52 of the hinge assemble. The tooth portion 34 of the back cover 4 has a set of teeth corresponding to the set of teeth of the tooth portion 44 of the tubular component 46.

When the teeth of the tooth portion 44 engage with the teeth of the back cover 4, each of the teeth of the tooth portion 44 is inserted between a gap between two teeth of the back cover 4; and each of the teeth of the back cover 4 is inserted between a gap between two teeth of the tooth portion 44. Thus, when the teeth of the tooth portion 44 engage with the teeth of the back cover 4, the tubular component 46 of the locking mechanism 20 is locked to the back cover 4 to prevent the tubular component 46 from rotation about the back cover 4 along the axis 52 of the hinge assembly.

When the tubular component 46 of the lock mechanism 20 is pushed towards the hinge support 16, the tooth portion 44 moves along the axis 52 of the hinge assembly relative to the teeth of the back cover 4; thus teeth of the tooth portion 44 of the tubular component 46 disengage with the teeth of the back cover 4; and the tubular component 46 of the locking mechanism 20 is then free to rotate along the axis 52 of the hinge assembly relative to the teeth of the back cover 4.

As illustrated in FIG. 6, the key 48 is fixedly coupled on the right end 50 of the tubular component 46. The key 48 is configured to be inserted in a slot in the ring structure 14. The side walls of the slot can contact the side surfaces of the key 48 to limit the rotation of the tubular component 46 of the locking mechanism 20 with respect to the ring structure 14.

When the right end 50 of the tubular component 46 and the key 48 of the tubular component 46 of the lock mechanism 20 are moved in a direction pointing from the hinge support 16 towards the ring structure 14, the gap between the side walls of the slot and the key 48 is reduced and eventually eliminated at a locked position where the contact between the side walls of the slot and the key 48 prevents the key 48 from moving further in the direction pointing from the hinge support 16 to the ring structure 14.

As illustrated in FIG. 6, when the key 48 is at the locked position inside the slot in the ring structure 14, the teeth of the tooth portion 44 are configured to engage with the teeth of the back cover. Thus, when the key 48 is at the locked position inside the slot in the ring structure 14, the tubular component 46 of the locking mechanism 20 is locked to both the ring structure 14 and the back cover 4, via the key 48 and the teeth of the tooth portion 44 respectively; and thus, the support component 2 and the back cover 4 are locked into a particular angular coupling relative to the axis 52 of the hinge assembly.

As illustrated in FIG. 6, the push knob 12 has a click-to-lock portion 66 that can be inserted into the right end 50 of the tubular component 46 of the locking mechanism 20 and click into the opening 64 to attach the push knob 12 to the tubular component 46. Thus, when the push knob 12 is pushed along the direction pointing from the ring structure 14 towards the hinge support 16, the coupling between the click-to-lock portion 66 of the push knob 12 and the opening 64 of the tubular component 46 allows the tubular component 46 of the locking mechanism 20 to be pushed against the spring ele-

ment 42 to move to an unlocked position, where the teeth of the tooth portion 44 of the tubular component 46 disengage with the teeth of the back cover 4, and a gap is provided between the side walls of the slot in the ring structure 14 and the key 48.

FIGS. 7 and 8 show coupling of components of an adjustable assembly according to one embodiment.

In FIG. 7, a cross section through the axis 52 of the hinge assembly is shown. In FIG. 7, the pushed knob 12 is inserted in and clicked into the right end 46 of the tubular component of the locking mechanism 20. The right end 50 of the tubular component 46 is inserted in the ring structure 14. The spring element 42 pushes the tooth portion 44 of the tubular component 46 of the locking mechanism 20 so that the teeth of the tooth portion 44 engage with the teeth of the back cover 4. The left end 38 of the tubular component 46 of the locking mechanism 20 is in the circular bracket 44 to allow rotation about the axis 52 of the hinge assembly.

In FIG. 7, the push knob 12 can be pushed in a direction 26 to move the tooth portion 44 towards the hinge support 16 and release the angular locking mechanism.

FIG. 8 shows a front view of the back cover 4, with a cross section view of the ring structure.

FIG. 9 shows an exploded view of an adjustable hinge assembly according to one embodiment. The adjustable hinge assembly allows the coupling between two components, such as the tooth portion 34 of the back cover 4 for a display device 10 of a portable ultrasound imaging apparatus 1 and the support component 2 of the portable ultrasound imaging apparatus 1, to be adjusted to, and then locked at, a desirable angle, in accordance with the spacing determined by the number of teeth configured on the tooth portion 44 of the angular locking mechanism 20.

In FIG. 9, the tooth portion 34 of the hinge assembly is illustrated to be connected to the back cover 4 of the housing 6 of a portable ultrasound imaging device. The tooth portion 34 can be connected to other display devices, such as a computer monitor, an all-in-one computer, a touch screen of a portable computer, etc., or other devices.

In FIG. 9, a portion of the support component 2 is not shown. It is understood that the support component 2 can have a shape and design different from the support component 2 illustrated in various figures, such as FIGS. 1, 3-4 and 6.

As illustrated in FIG. 9, the tubular portion 50 is configured to be inserted through the opening of the tooth portion 34 of the component 4 and inserted into the ring structure 14 of the component 2.

The keys 48 on the outer surface of the tubular portion 50 of the tubular component 46 are configured to be inserted into the slots 54 in the ring structure 14 and thus limit and/or eliminate relative rotation between the tubular portion 50 and ring structure 14, with respect to the axis 52 of the hinge assembly.

FIG. 9 illustrates the use of two keys 48 in two slots 54. More or less key/slot pairs can be used in alternative configurations.

As illustrated in FIG. 9, the tubular portion 38 is configured to be inserted into the spring 42 and the circular bracket 40 such that the tubular portion 38 is hingedly coupled with the circular bracket 40.

The circular bracket 40 can be fixedly coupled to one of the component 4 and the component 2 to provide stability for the assembly along the axis 52.

The tooth portion 44 between the tubular portions 38 and 50 is configured to be insertable into the opening of the tooth portion 34 of the component 4. When the tooth portion 44 is inserted into the tooth portion 34, each tooth in the tooth

portion 44 is between a corresponding gap between two teeth in the tooth portion 34; and each tooth in the tooth portion 34 is between a corresponding gap between two teeth in the tooth portion 44. The teeth in the tooth portions 44 and 34 are evenly distributed circumferentially about the axis 52. Thus, the tooth portion 44 can be rotated about the axis 52 and then be inserted in the opening of the tooth portion 34 of the component 4. The number of teeth in the tooth portion determines the minimum angle that the tubular component can be rotated between insertions into the opening of the tooth portion 34 of the component 4.

When the tooth portion 44 is not inserted into the opening of the tooth portion 34, the component 4 and the tubular component can be rotate relative to each other along the axis 52.

In FIG. 9, the push knob 12 has two click-to-lock tips 66 for locking to the openings 64 on the tubular portion 50. More or less click-to-lock tips may be used in alternative configurations. In an alternative configuration, the push knob 12 is not used; and the end of the tubular portion 50 may be pushed directly to move the tubular component 46.

After the push knob 12 is locked with the tubular portion 50, the tubular component 46 can be pushed along the axis to compress the spring element 42 to an unlocked position where the tooth portion 44 of the tubular component is not in the opening of the tooth portion 34 of the component 4.

When the push knob 12 is not pressed, the spring element 42 is configured to press the tooth portion 44 such that, when the teeth of the tooth portion 44 of the tubular component 46 is aligned with the tooth portion 34 of the component 4, the tooth portion 44 is inserted into the opening of the tooth portion 34 of component 4.

In FIG. 9, the key 48 has a circumferential width that is smaller at an end close to the push knob 12 and larger at an opposite end. Thus, when the key 48 is inserted into the slot 54 along the axis, a gap between the side surfaces of the key 48 and the side walls of the slot 54 is reduced and eventually eliminated when the key 48 is a locked position in the slot 54, as further illustrated in FIG. 14.

FIGS. 10 to 14 illustrate a mechanism to adjust a hingedly coupling angle according to one embodiment.

FIG. 10 illustrates a locked position where the tooth portion 44 of the tubular component 46 is inserted in the direction 60 into the opening of the tooth portion 34 of the component 4. The contacting between the teeth of the tubular component 46 and the teeth of the component 4 prevents the component 4 from rotating with respect to the tubular component 46; and the contacting between the side surfaces of the key 48 and side walls of the slot 54 in the ring structure 14 prevents the component 2 from rotating with respect to the tubular component.

FIG. 11 illustrates an unlocked position, after the tubular component moves a distance 28 along the direction 62 relative to the tooth portion 34 of the component 4. Since the teeth of the tubular component 46 and the teeth of the component 4 are not in contact with each other, the component 4 is free to rotate with respect to the tubular component 46 and thus the component 2; and a gap is provided between the side surfaces of the key 48 and side walls of the slot 54 in the ring structure 14.

In FIG. 12, a portion of the ring structure 14 and the tooth portion 34 of the component 4 are not shown to illustrate the keys 48a and 48b in the respective slots 54a and 54b in the ring structure 14 in an unlocked position.

FIG. 13 illustrates the key 48b in the slot 54b. In FIG. 13, the circumferential width 72 of the end of the key 48b in the slot is smaller than the circumferential width 70 of the oppo-

site end of the key **48b**; and the circumferential width of the slot **54a** at the end **74** is small than the circumferential width of the slot **54a** at the end **76**. Thus, the more key **48b** is inserted into the slot **54b** towards the end **74**, the smaller is the circumferential gap between the key and the side walls of the slot **54b**.

FIG. **14** shows a top view of the key **48a** in relation with the slot **54b**. In FIG. **14**, there is a gap between the side surfaces **71** of the key **48b** and the side walls **73** of the slot **54b**. Since the width **70** of the left end of the key **14** is larger than the width **72** of the right end of the key **14**, the gap is reduced when the key **48b** is moved into the slot **54b** in the direction **60**. When the key **48b** moves in the direction **60** to a position where the slot **54b** having a shape matching the shape of the key **48b**, the gap is eliminated and the key **48b** cannot move further in the direction **60**. When the key **48b** moves to in the direction **62**, the gap is provided and increased.

Eliminating the gap between the side surfaces of the key **48** and the side walls of the slot **54** eliminates unwanted rotation between the components **2** and **4** when the hinge assembly is in the locked position.

Optionally, the thickness (or height in the radial direction about the axis **25**) of the key **48b** can also be configured to vary from small at the end **72** to large at the end **70**. The depth of the slot **54b** varies from small to large according to the thickness profile of the key **48b**, such that when the key **48b** is inserted into the slot, the top surface of the key **48b** is in contact with the roof of the slot **54b**, in a way similar to the side surfaces of the key **49b** in contact with the side walls of the slot **54b**.

FIGS. **15** to **17** show structural details of components of an adjustable hinge assembly according to one embodiment.

FIG. **15** shows a view of the support component **2** in relation with the tubular component **46** of the locking mechanism **20**. The support component **2** has the hinge support **16** and the ring structure **14**. The tubular component **46** of the locking mechanism **20** has tubular portions **38** and **50**, the keys **48**, the tooth portion **44**, and openings **64** for coupling with click-to-lock tips **66** of the push knob **12**. The ring structure **14** has slots **54** for the respective keys **48**.

FIG. **16** shows a view of the tubular component **46** being inserted into the ring structure **14** of the support component **2**. A cross section view, along the line A-A, of the hinge support **16** the tubular component **46** and the ring structure **14** is provided in FIG. **17**.

In the foregoing specification, the disclosure has been described with reference to specific exemplary embodiments thereof. It will be evident that various modifications may be made thereto without departing from the broader spirit and scope as set forth in the following claims. The specification and drawings are, accordingly, to be regarded in an illustrative sense rather than a restrictive sense.

What is claimed is:

1. A portable ultrasound imaging apparatus, comprising:
 - a housing;
 - a display device amounted on the housing;
 - a processor disposed within the housing and coupled with the display device to present ultrasound images;
 - a beamformer disposed within the housing and coupled with the processor to control an ultrasound transducer;
 - a support component hingedly coupled with the housing to allow the support component to rotate with respect to the housing about an axis parallel to an edge of the display device; and
 - an adjustable assembly coupled between the support component and the housing;

wherein when the adjustable assembly is in a first configuration, the support component is locked to the housing with respect to rotation about the axis;

wherein when the adjustable assembly is in a second configuration, the support component is rotatable about the axis with respect to the housing;

wherein the adjustable assembly includes

a key extending in parallel to the axis; and

walls extending in parallel to the key to define a slot configured to accommodate the key;

wherein when the key moves in a first direction parallel to the axis to a first position in the slot, at least a portion of side surfaces of the key is in contact with the walls to prevent the key from moving in the slot in the first direction beyond the first position;

wherein when the key is at the first position in the slot, the adjustable assembly is locked in the first configuration, and the key is movable in a second direction opposite to the first direction to a second position in the slot to provide a gap between the walls and the side surfaces of the key; and

wherein when the key is at the second position in the slot, the adjustable assembly is in the second configuration and allows the support component to rotatable about the axis with respect to the housing.

2. The portable ultrasound imaging apparatus of claim **1**, wherein the key has a first end and a second end; the key extending from the first end to the second end in the first direction; a width of the second end of the key is smaller than a width of the first end of the key; the side surfaces of the key extends from the first end to the second end; and the side surfaces are separated in a circumferential direction about the axis.

3. The portable ultrasound imaging apparatus of claim **2**, wherein a height of the second end of the key in a radial direction about the axis is smaller than a height of the first end of the key in the radial direction about the axis.

4. The portable ultrasound imaging apparatus of claim **2**, wherein when the key is at the first position in the slot, a distance between the walls at the first end of the key is equal to the width of the first end of the key, and a distance between the walls at the second end of the key is equal to the width of the second end of the key.

5. The portable ultrasound imaging apparatus of claim **4**, wherein the adjustable assembly includes a spring element configured to push the key in the first direction.

6. The portable ultrasound imaging apparatus of claim **5**, wherein the adjustable assembly further includes a push knob configured to be pushed by a user against the spring element to move the key in the second direction.

7. The portable ultrasound imaging apparatus of claim **6**, wherein when the key is at the first position in the slot, the gap is eliminated.

8. The portable ultrasound imaging apparatus of claim **6**, wherein the an adjustable assembly further includes a first set of teeth and a second set of teeth corresponding to the first set of teeth;

wherein both the first set of teeth and the second set of teeth are evenly distributed in a circumferential direction about the axis;

wherein when the key is at the first position in the slot, the first set of teeth engages with the second set of teeth to lock the support component to the housing with respect to rotation about the axis; and

wherein when the key is at the second position in the slot, the first set of teeth disengages with the second set of

teeth to allow the support component rotate about the axis with respect to the housing.

9. The portable ultrasound imaging apparatus of claim 8, wherein the housing includes a back cover; the walls defining the slot are fixedly coupled with the support component; the first set of teeth is fixedly coupled with the back cover; and the second set of teeth is fixedly coupled with the key.

10. The portable ultrasound imaging apparatus of claim 9, wherein adjustable assembly further includes a tubular component having a first end and a second end; the first end of the tubular component is hingedly coupled with the back cover and rotatable about the back cover along the axis; and the key is on an outer surface of the second end of the tubular component.

11. The portable ultrasound imaging apparatus of claim 9, wherein the second set of teeth is formed on the tubular component.

12. A portable display apparatus, comprising:
a display device;

a support component hingedly coupled with the display device to allow the support component to rotate with respect to the display device along an axis; and

an adjustable assembly coupled between the support component and the display device, the adjustable assembly including

a key having a first end and a second end, the key extending from the first end to the second end in a first direction parallel to the axis, the key having side surfaces extending from the first end to the second end, the side surfaces of the key separated by a distance in a circumferential direction about the axis; and walls substantially in parallel with the side surfaces of the key to define a slot for the key;

wherein when the key moves along the first direction to a first position in the slot, contacting between at least a portion of the side surfaces of the key and the walls prevents the key from moving in the first direction in the slot beyond the first position;

wherein when the key is at the first position in the slot, the key is movable only in a second direction opposite to the first direction, the key movable in the second direction to a second position in the slot;

wherein when the key is at the first position in the slot, the support component is locked to the display device with respect to rotation along the axis; and

wherein when the key is at the second position in the slot, the support component is rotatable along the axis with respect to the display device.

13. The portable display apparatus of claim 12, wherein a width of the second end of the key is smaller than a width of the first end of the key.

14. The portable display apparatus of claim 13, wherein when the key is at the first position in the slot, a distance between the walls at the first end of the key is equal to the width of the first end of the key, and a distance between the walls at the second end of the key is equal to the width of the second end of the key.

15. The portable display apparatus of claim 14, wherein the adjustable assembly includes:

a spring element configured to push the key in the first direction;

a push knob configured to be pushed by a user against the spring element to move the key in the second direction; a first set of teeth evenly distributed along a circumferential direction about the axis; and

a second set of teeth evenly distributed along a circumferential direction about the axis;

wherein when the key is at the first position in the slot, the first set of teeth are in gaps between second set of teeth, and the second set of teeth are in gaps between first set of teeth to lock the support component to the display device with respect to rotation about the axis; and

wherein when the key is at the second position in the slot, the first set of teeth and the second set of teeth are not in contact with each other to allow the support component to rotate about the axis with respect to the display device.

16. The portable display apparatus of claim 15, wherein the display device includes a back cover; the first set of teeth is fixedly coupled with the back cover; the walls defining the slot are fixedly coupled with the support component; and the second set of teeth is fixedly coupled with the key.

17. The portable display apparatus of claim 16, wherein adjustable assembly further includes a tubular element having a first end and a second end; the first end of the tubular component is hingedly coupled with the back cover and rotatable about the back cover along the axis; and the key is positioned on an outer surface of the second end of the tubular component.

18. The portable display apparatus of claim 16, wherein the set of teeth is formed on the tubular component; and the component defining a set of slots is disposed along the axis between the set of teeth and the key.

19. An adjustable hinge assembly, comprising:

a tubular component having a first end and a second end, the tubular component extending from the first end to the second end in a first direction along an axis and having a key formed on the second end and extending in parallel to the axis, the key having side surfaces extending in the first direction and separated by a distance in a circumferential direction about the axis; and a plurality of first teeth evenly distributed in the circumferential direction about the axis;

a first component having a ring structure defining an opening configured to accept the second end of the tubular component, the ring structure having walls extending in the first direction and separated by a distance in the circumferential direction about the axis, the walls defining a slot for the key;

a second component having a plurality of second teeth corresponding to the plurality of the first teeth and evenly distributed in the circumferential direction about the axis;

a spring element configured to push the tubular component in the first direction; and

a push knob coupled with the second end of the tubular component to allow a user to push against the spring element to move the tubular component in a second direction opposite to the first direction;

wherein when the spring element pushes the tubular component in the first direction to a first position, contacting between the side surfaces of the key and the walls prevents the tubular component from moving further in the first direction beyond the first position, and

the plurality of first teeth engages with the plurality of second teeth to lock the first component with respect to the second component with respect to rotation about the axis;

wherein when the push knob is pushed to move tubular component in the second direction to a second position, a gap is provided between the side surfaces of the key and the walls defining the slot, and

the plurality of first teeth disengages with the plurality of second teeth to allow the first component to rotate about the axis relative to the second component.

20. The adjustable hinge assembly of claim **19**, wherein the key has a first key end and a second key end; the key extending 5
from the first key end to the second key end in the first direction; the side surfaces are separated by
a first distance in the circumferential direction about the axis at the first key end, and
a second distance in the circumferential direction about the 10
axis at the second key end;
wherein the first distance is larger than the second distance.

* * * * *

专利名称(译)	便携式超声成像设备		
公开(公告)号	US9310474	公开(公告)日	2016-04-12
申请号	US13/909087	申请日	2013-06-04
[标]申请(专利权)人(译)	黄振紧 周峰		
申请(专利权)人(译)	黄, 振紧 周, 冯		
当前申请(专利权)人(译)	CHISON医疗成像, INC.		
[标]发明人	HUANG MINGJIN ZHOU FENG		
发明人	HUANG, MINGJIN ZHOU, FENG		
IPC分类号	A61B8/02 A61B8/00 G01S7/52		
CPC分类号	G01S7/52079 A61B8/4427 A61B8/462 Y10T16/5323		
其他公开文献	US20140355374A1		
外部链接	Espacenet USPTO		

摘要(译)

一种具有可调节铰链组件的门式超声成像设备，其包括具有较窄端部和在铰链组件的圆周方向上较宽的端部的键。钥匙可在铰链组件的轴向方向上的槽中移动到锁定位置，其中钥匙的侧表面压靠在槽的壁上，以消除钥匙和槽之间的周向间隙。当处于槽中的锁定位置时，钥匙可以朝向轴向的相反方向推动到解锁位置，在该解锁位置，铰链组件的角度锁定被释放，允许铰链组件被调节到期望的角度耦合。然后将键沿轴向推回到槽中的锁定位置，以防止铰链组件的连接角度的变化。

