



(19) **United States**

(12) **Patent Application Publication**

Acuna et al.

(10) **Pub. No.: US 2020/0155117 A1**

(43) **Pub. Date: May 21, 2020**

(54) **ULTRASOUND TRANSDUCER HOLDER FOR VASCULAR ASSESSMENTS DURING HYPEREMIC BLOOD FLOW**

Publication Classification

(51) **Int. Cl.**
A61B 8/00 (2006.01)
A61B 8/06 (2006.01)
(52) **U.S. Cl.**
CPC *A61B 8/4209* (2013.01); *A61B 8/06* (2013.01); *A61B 8/4455* (2013.01); *A61B 8/4483* (2013.01); *A61B 8/4461* (2013.01)

(71) Applicant: **Board of Regents, The University of Texas System, Austin, TX (US)**

(72) Inventors: **Francisco Morales Acuna, El Paso, TX (US); Luis A. Ochoa, El Paso, TX (US); Alvaro N. Gurovich, El Paso, TX (US)**

(57) **ABSTRACT**

An ultrasound transducer probe holder device comprising a support piece; a base connected to the support piece; a cylindrical orifice within the support piece; a housing extending from the orifice and defining a cavity; a sleeve for insertion within the orifice; and an adjustment screw fitted in the housing for contact with the sleeve. The device supports and maintains the position of an ultrasound transducer probe to provide for a hands-free application of the device during different modalities of exercise required to instigate hyperemic conditions while providing x, y, z, positional adjustments of the probe relative to the patient.

(21) Appl. No.: **16/591,798**

(22) Filed: **Oct. 3, 2019**

Related U.S. Application Data

(60) Provisional application No. 62/768,794, filed on Nov. 16, 2018.

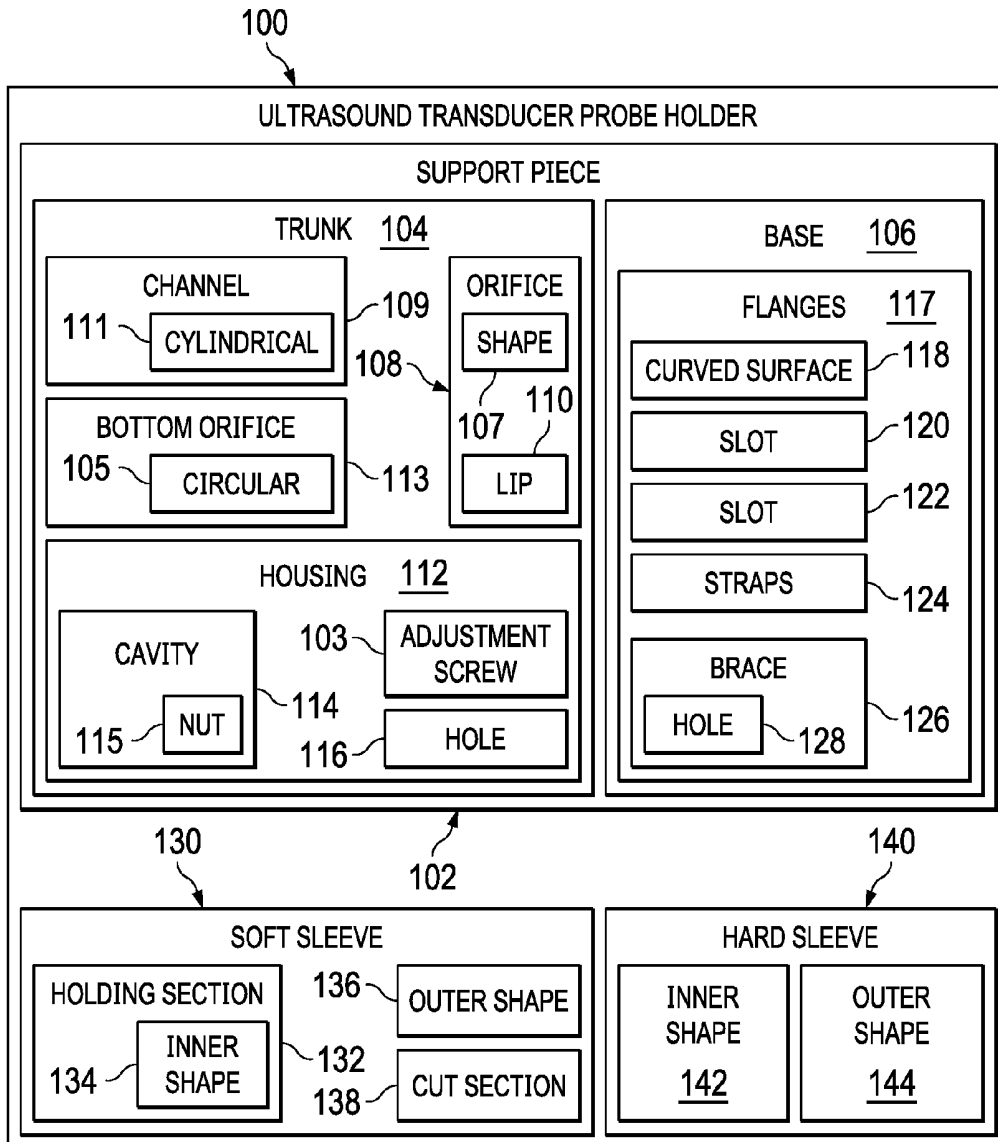

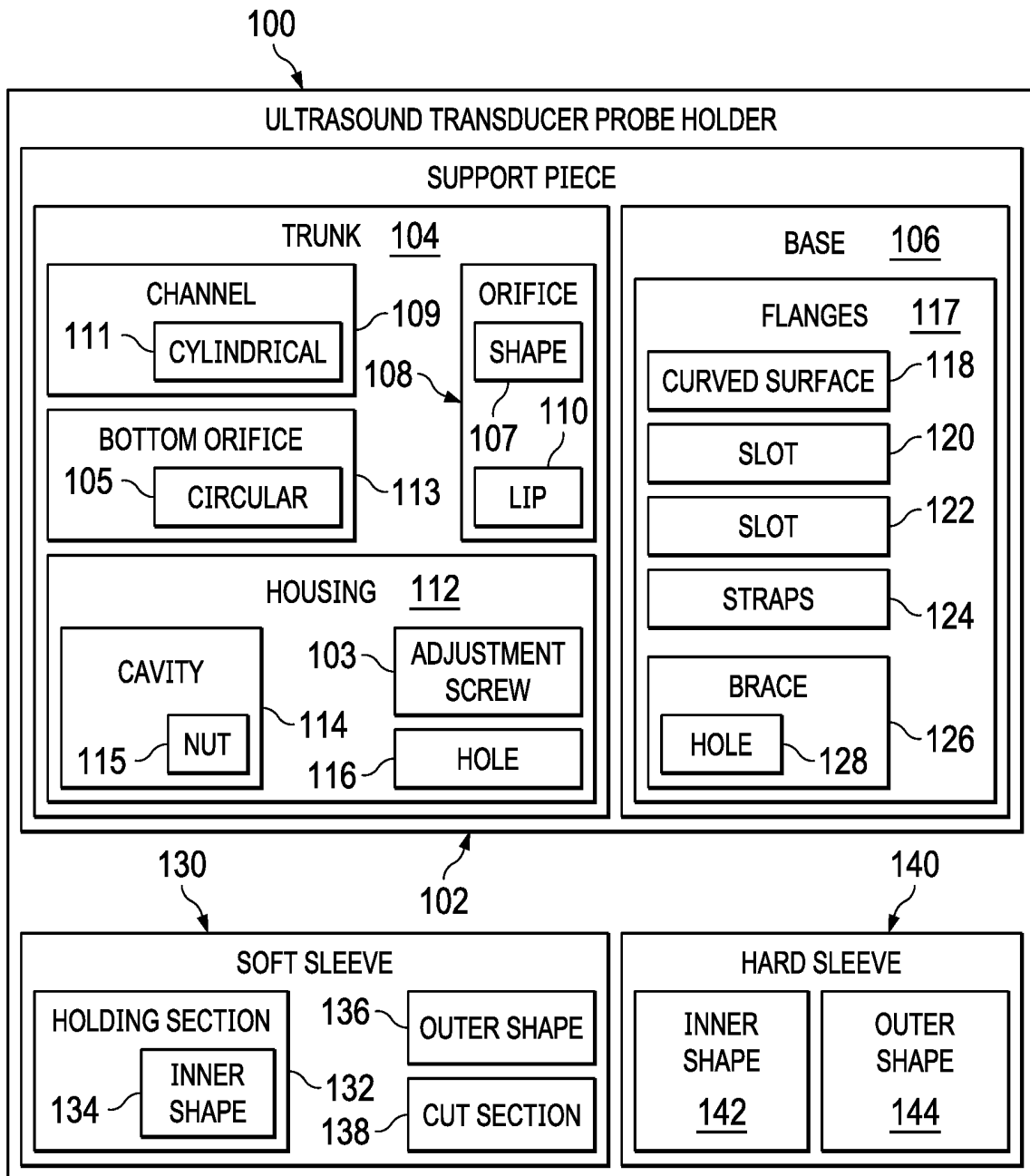
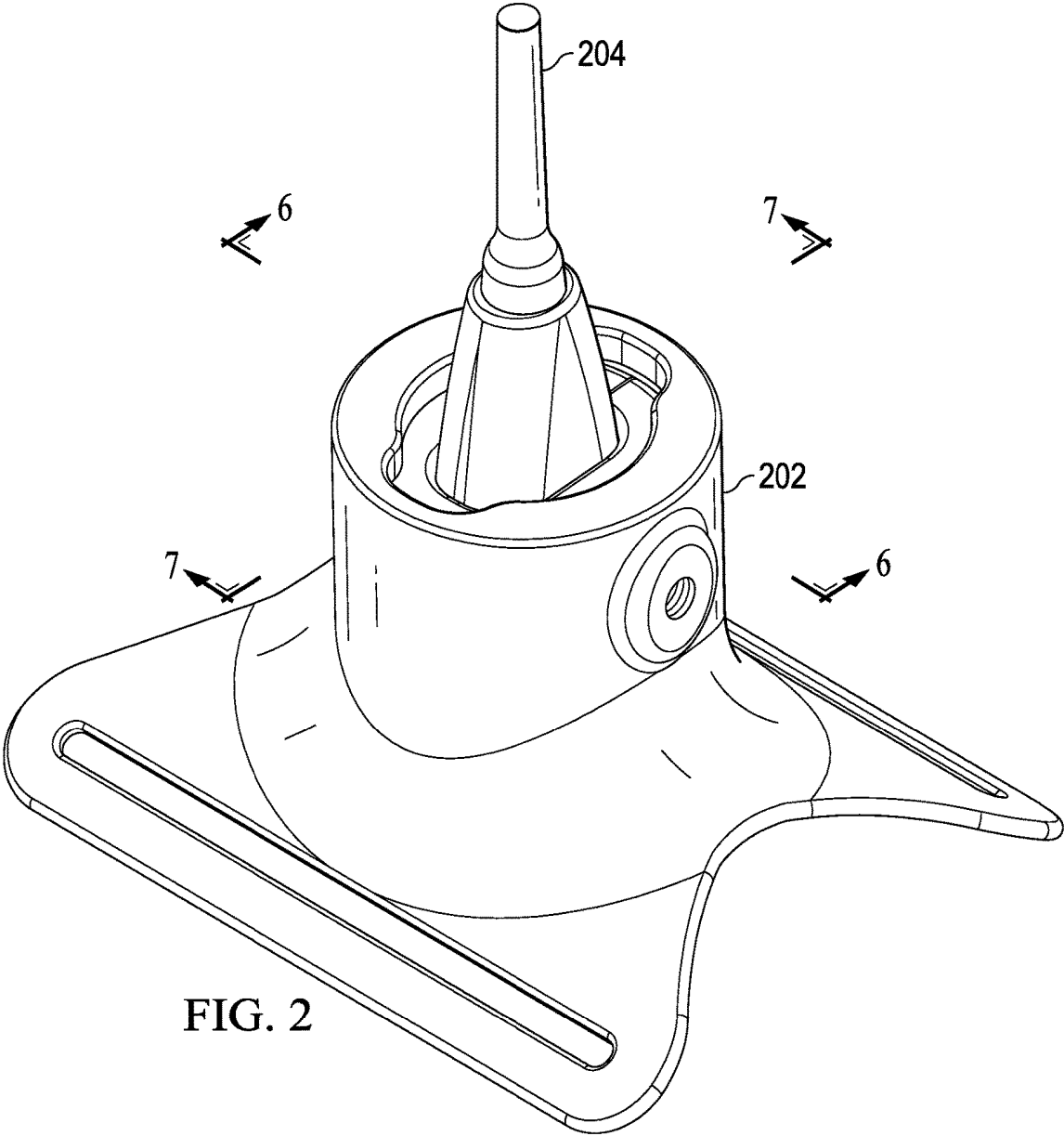
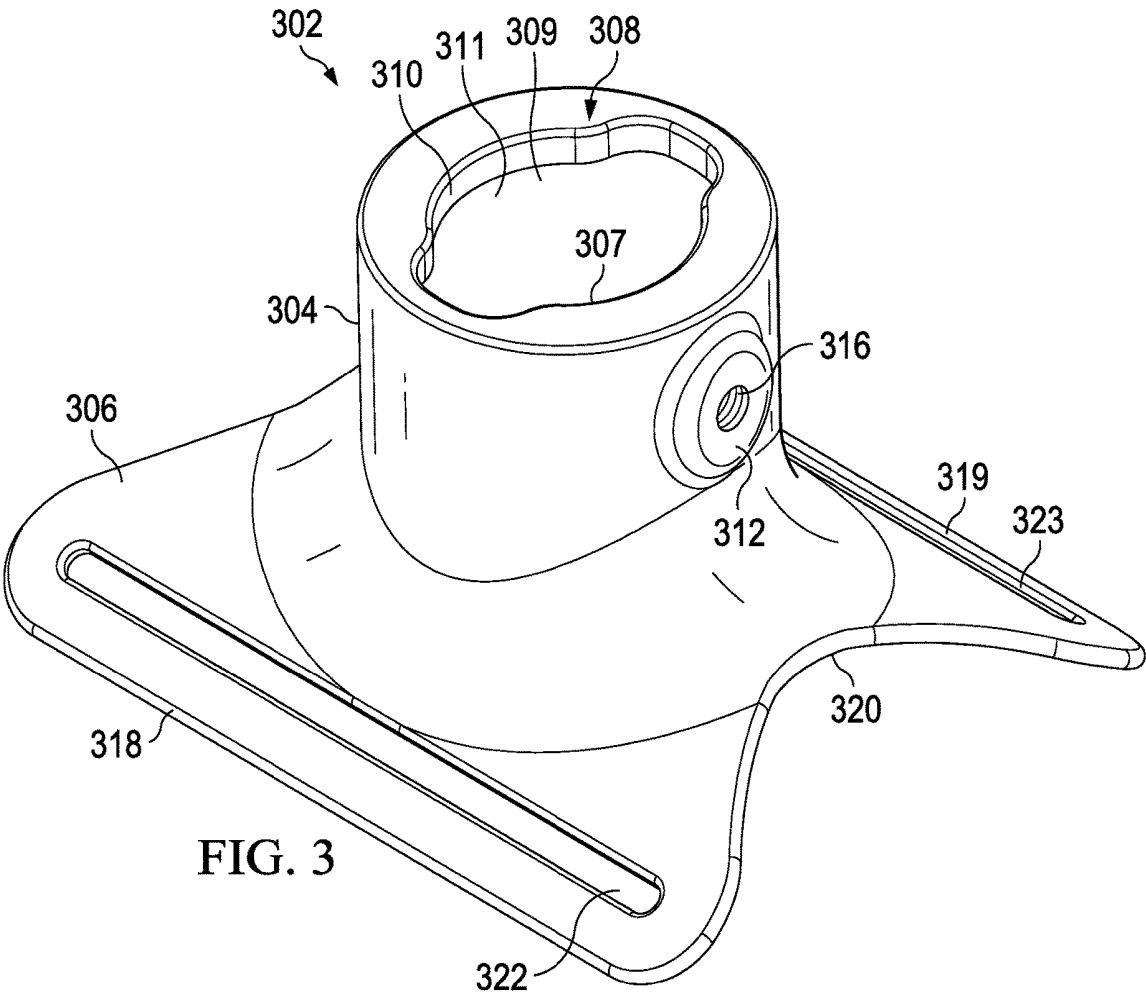

FIG. 1





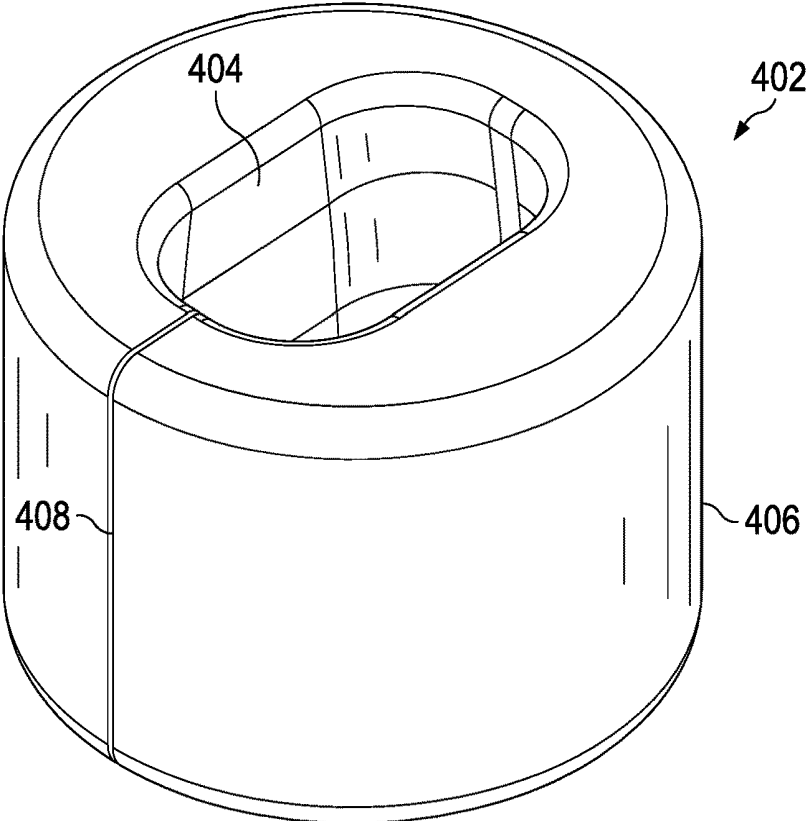

FIG. 4

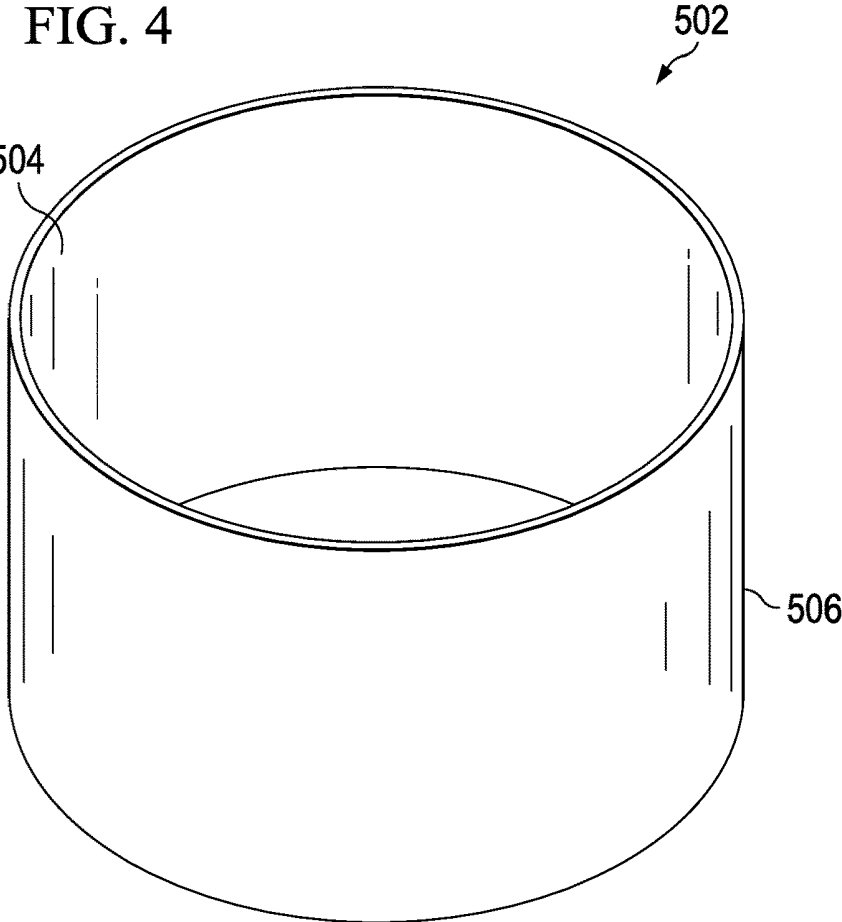

FIG. 5

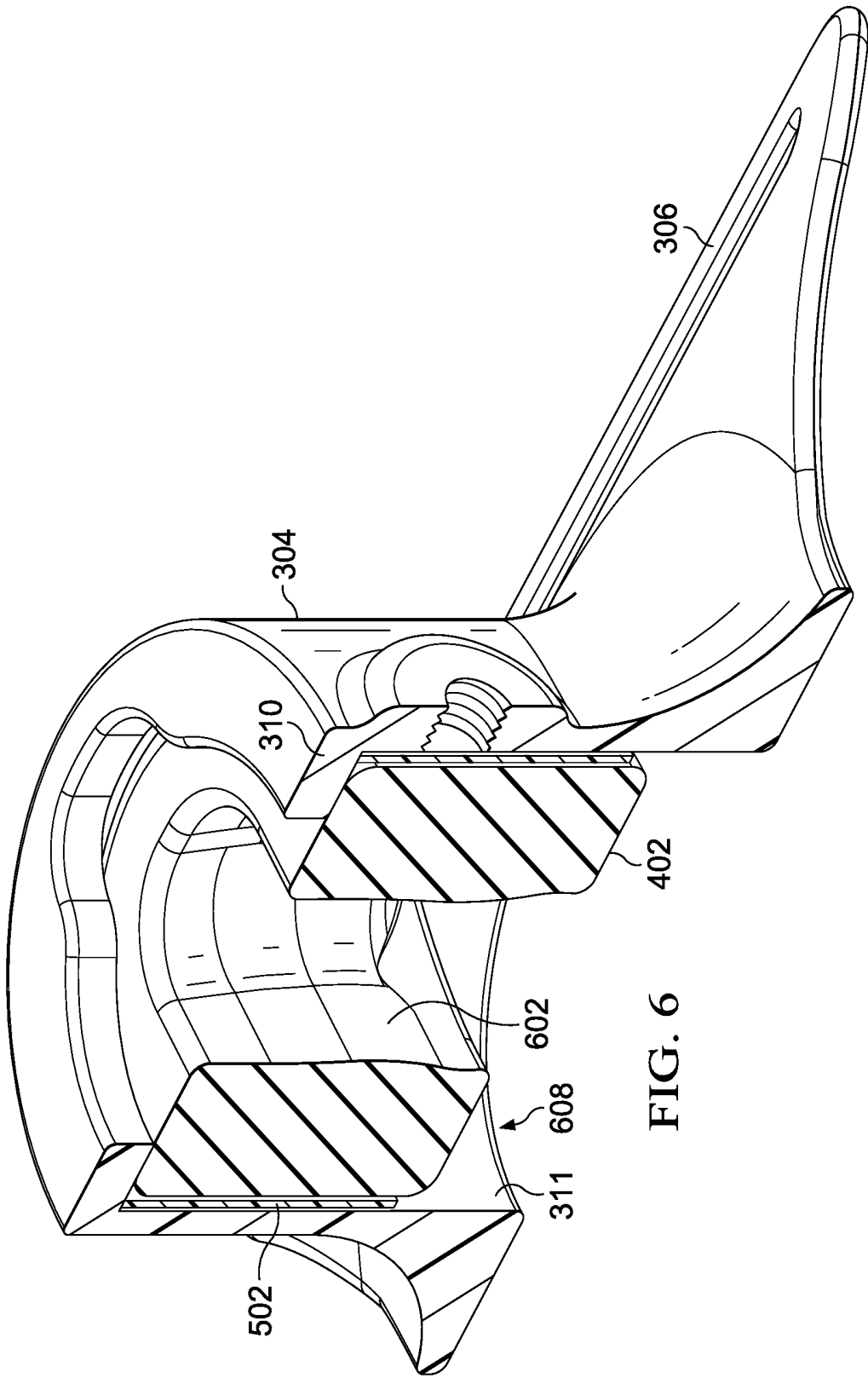

FIG. 6

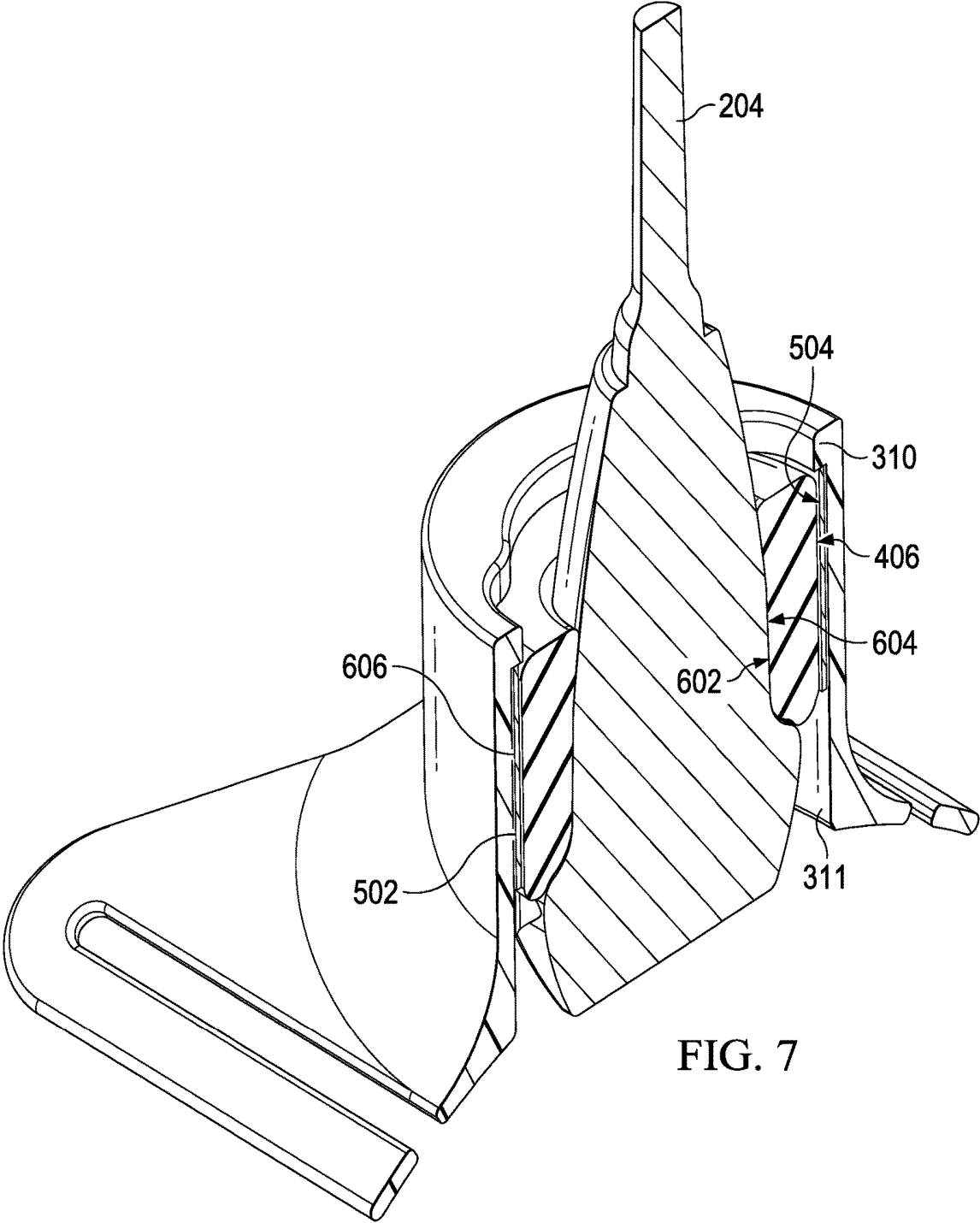

FIG. 7

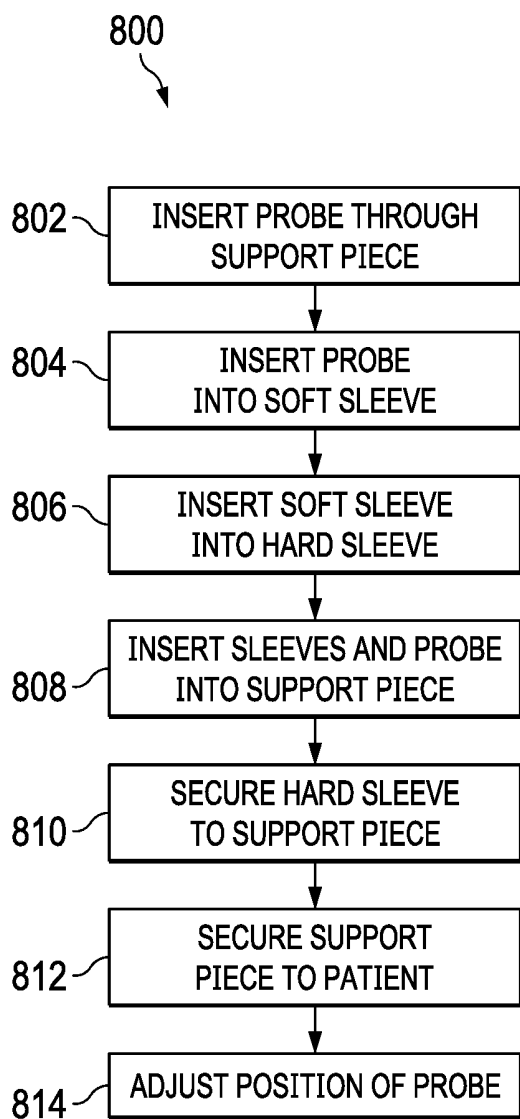

FIG. 8

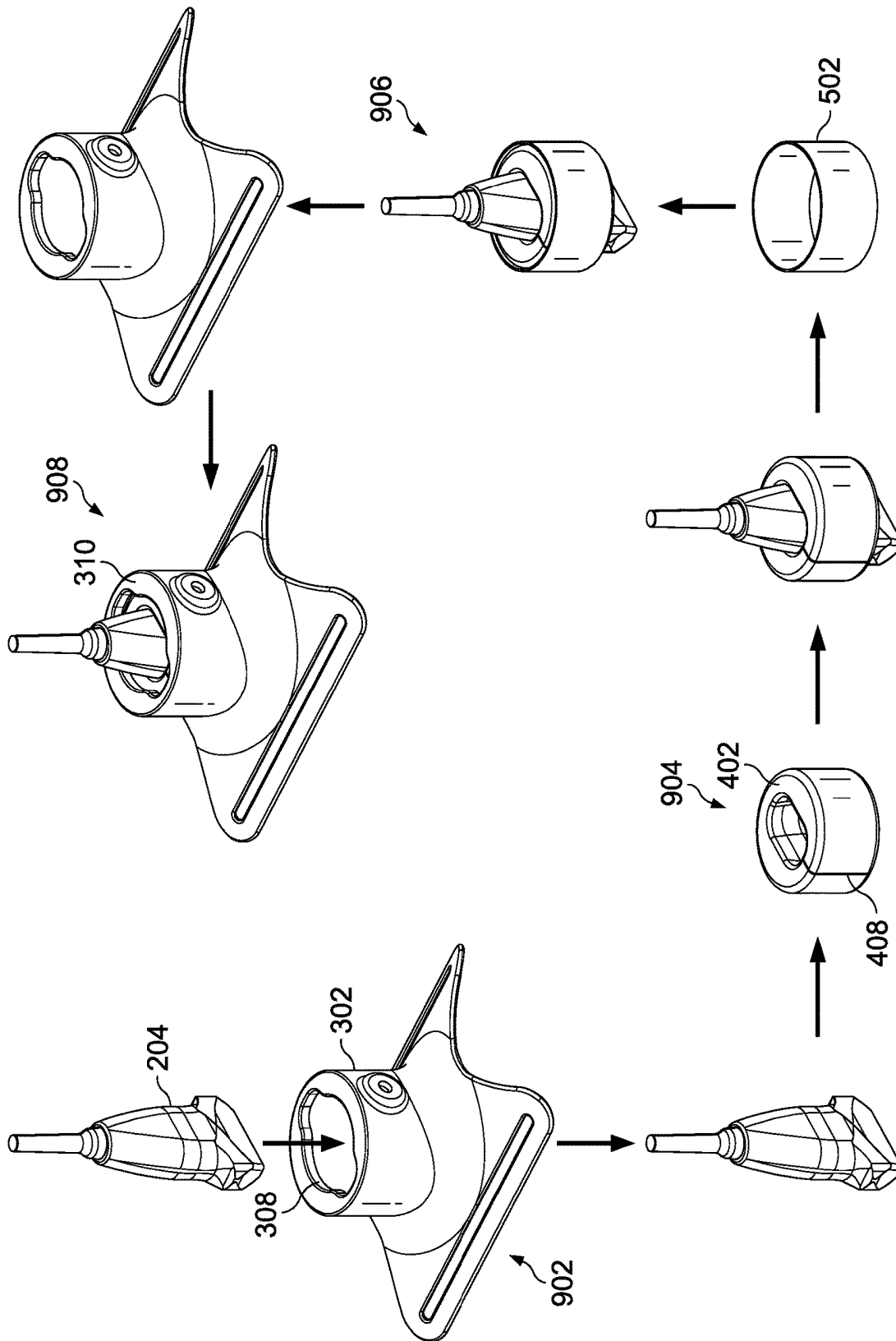

FIG. 9

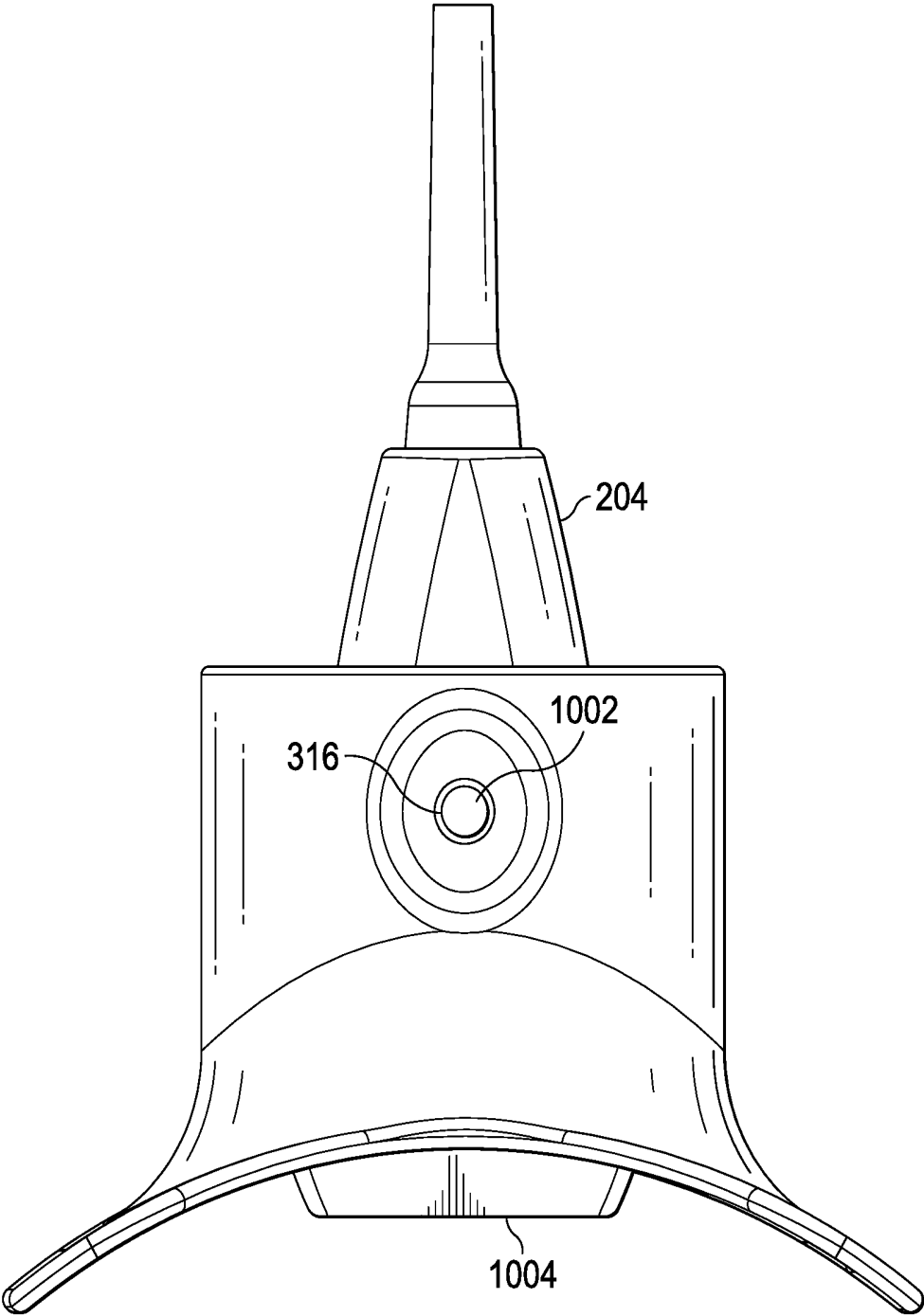
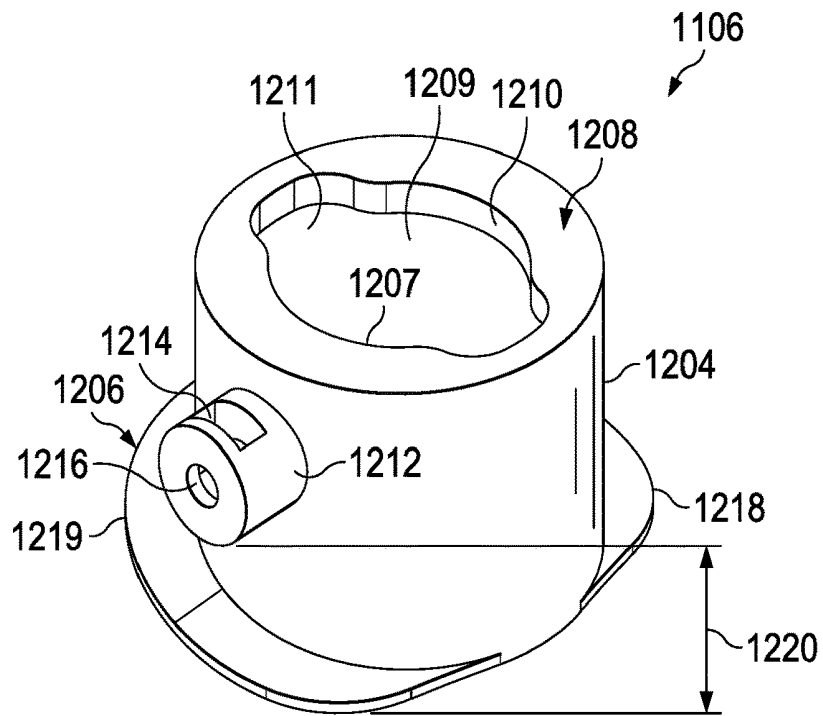
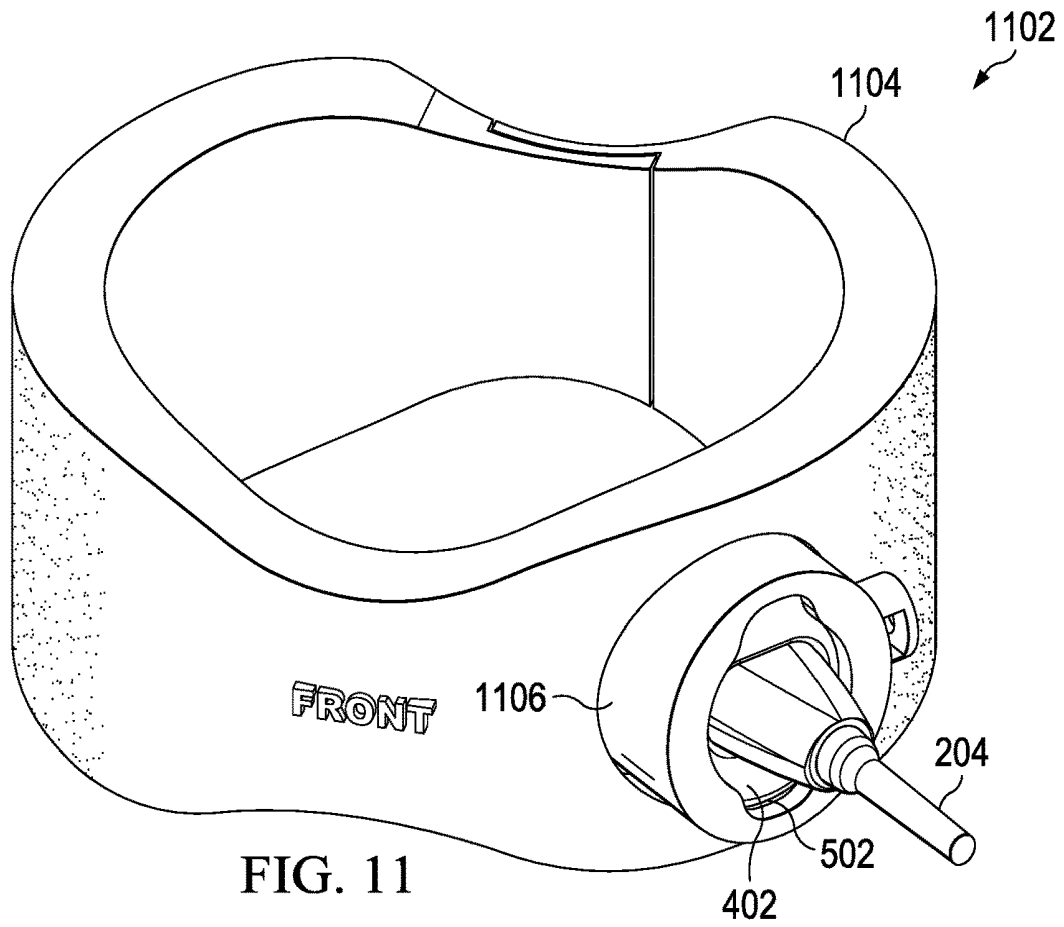

FIG. 10



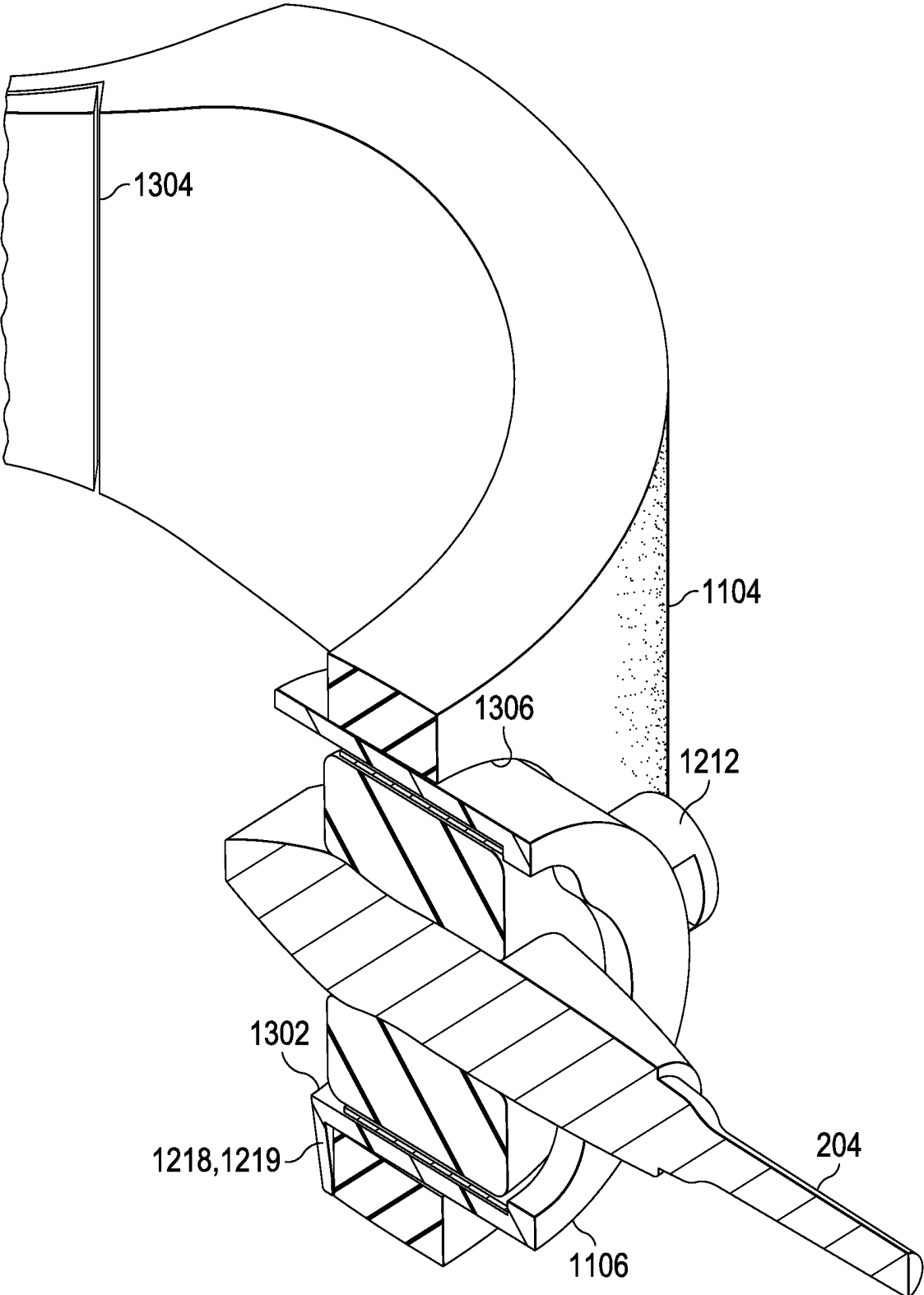

FIG. 13

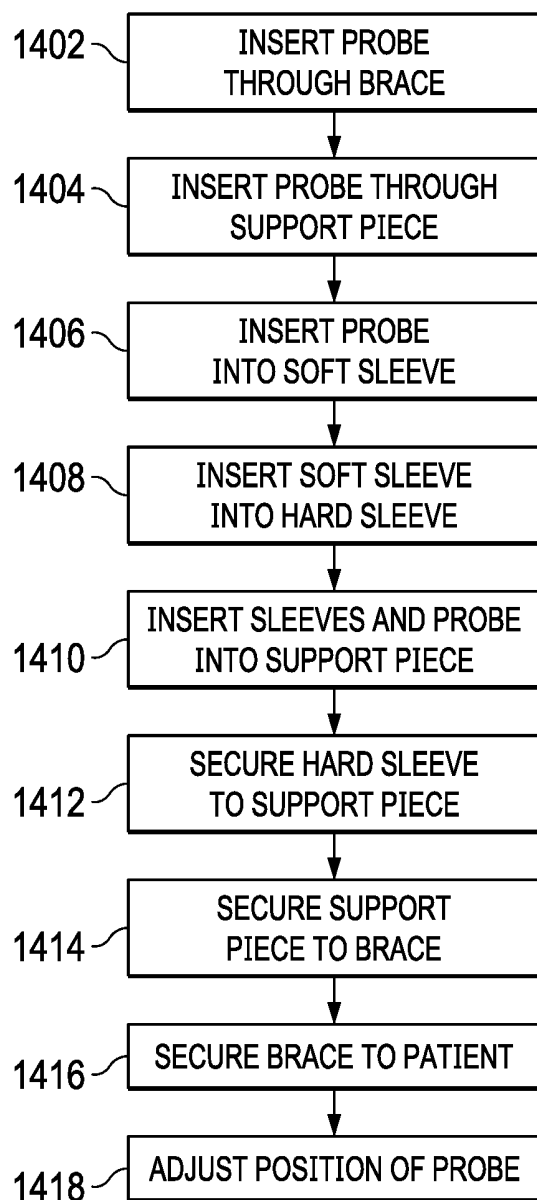

FIG. 14

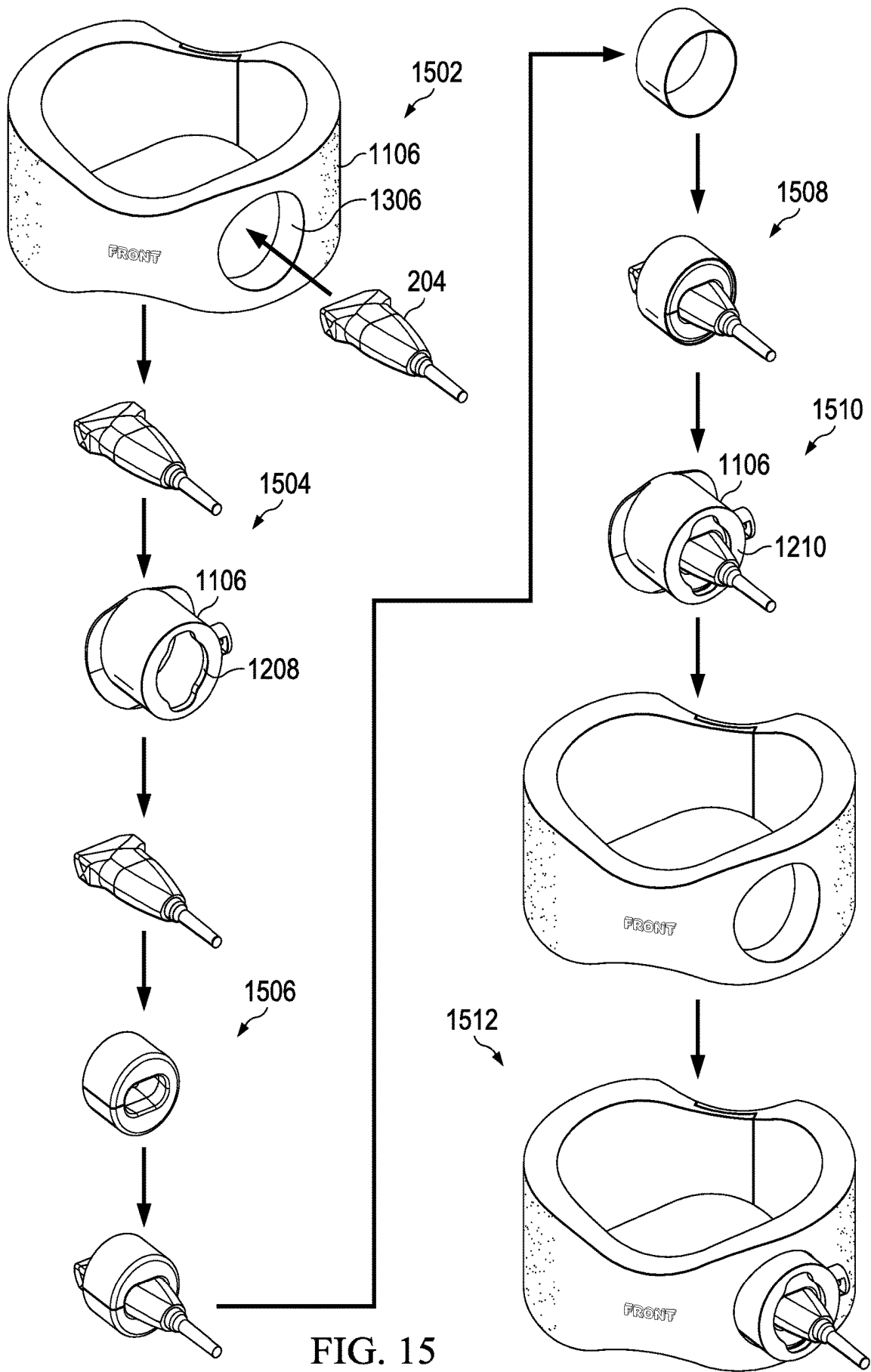

FIG. 15

**ULTRASOUND TRANSDUCER HOLDER FOR
VASCULAR ASSESSMENTS DURING
HYPEREMIC BLOOD FLOW**

CROSS-REFERENCE TO RELATED
APPLICATION(S)

[0001] This application claims the benefit of priority to U.S. Provisional Patent Application No. 62/768,794, filed Nov. 16, 2018, the entire contents of which are incorporated herein by reference.

BACKGROUND INFORMATION

1. Field

[0002] The present disclosure relates to ultrasound imaging and more particular to methods and devices for positioning ultrasound transducers for vascular assessments during hyperemic conditions.

2. Background

[0003] The first step of the development of cardiovascular diseases is a process known as endothelial dysfunction (ED) in which the inner layer of the arteries is unable to generate several biochemical protective molecules necessary to maintain homeostasis. Flow mediated dilation (FMD) is a clinical, noninvasive way to test for ED. FMD uses ultrasound imaging of the brachial, popliteal, and femoral arteries to test their dilatory capacity in response to hyperemic flow after a 5-minute occlusion period.

[0004] Although FMD has been used in research for more than 20 years showing significant results relevant to vascular physiology, it has not been able to translate its performance to the doctor office. More current studies involving vascular health are employing ultrasound imaging of the brachial and carotid arteries to assess the behavior of blood flow during exercise, but they have found many difficulties in the image acquisition.

[0005] To date, vascular assessments using ultrasound imaging, such as FMD, are operator dependent because a trained sonographer must hold the transducer probe of the ultrasound in the same position on the patient continuously for approximately ten minutes. This task is difficult to accomplish because the hand of the operator may fatigue causing movement of the probe and affecting the measurements. Maintaining the position of the probe is further complicated by movement of the patient during the different modalities of exercise in order to instigate hyperemic conditions required for the test.

SUMMARY

[0006] An example ultrasound transducer probe holder device includes a trunk section with an orifice in communication with a channel within the trunk section, a base connected to the trunk section, a sleeve removably located within the channel, and an adjustment screw fitted in the housing, wherein the adjustment screw is movable into the channel to secure the sleeve to the trunk section.

[0007] An example method of securing an ultrasound transducer probe holder device to a patient includes inserting an ultrasound transducer probe through an orifice in communication with a channel within a support piece, inserting the ultrasound transducer probe into a sleeve, inserting the sleeve with the ultrasound transducer probe into the support

piece, securing the sleeve to the support piece, and securing the support piece to the patient.

[0008] This summary is provided to introduce a selection of concepts that are further described below in the detailed description. This summary is not intended to identify key or essential features of the claimed subject matter, nor is it intended to be used as an aid in limiting the scope of claimed subject matter.

BRIEF DESCRIPTION OF THE DRAWINGS

[0009] The novel features believed characteristic of the illustrative embodiments are set forth in the appended claims. The illustrative embodiments, however, as well as a preferred mode of use, further objectives and features thereof, will best be understood by reference to the following detailed description of an illustrative embodiment of the present disclosure when read in conjunction with the accompanying drawings, wherein:

[0010] FIG. 1 is an illustration of a block diagram of an ultrasound transducer probe holder device in accordance with an illustrative embodiment.

[0011] FIG. 2 illustrates an ultrasound transducer probe holder device in use, in accordance with an illustrative embodiment;

[0012] FIG. 3 illustrates a support piece, in accordance with an illustrative embodiment;

[0013] FIG. 4 illustrates a soft sleeve, in accordance with an illustrative embodiment;

[0014] FIG. 5 illustrates a hard sleeve, in accordance with an illustrative embodiment;

[0015] FIGS. 6-7 illustrate an ultrasound transducer probe holder device in use in cross section taken along lines 6-6 and 7-7 of FIG. 2, in accordance with an illustrative embodiment;

[0016] FIG. 8 is a flowchart of a method of securing an ultrasound transducer probe holder device to a patient, in accordance with an illustrative embodiment;

[0017] FIG. 9 illustrates a method of securing an ultrasound transducer probe holder in an ultrasound transducer probe holder device in accordance with an illustrative embodiment;

[0018] FIG. 10 illustrates an ultrasound transducer probe holder device in use, in accordance with an illustrative embodiment;

[0019] FIG. 11 illustrates an ultrasound transducer probe holder device in use, in accordance with an illustrative embodiment;

[0020] FIG. 12 illustrates a support piece, in accordance with an illustrative embodiment;

[0021] FIG. 13 illustrate an ultrasound transducer probe holder device in use in cross section, in accordance with an illustrative embodiment;

[0022] FIG. 14 is a flowchart of a method of securing an ultrasound transducer probe holder device to a patient, in accordance with an illustrative embodiment; and

[0023] FIG. 15 illustrates a method of securing an ultrasound transducer probe holder in an ultrasound transducer probe holder device in accordance with an illustrative embodiment.

DETAILED DESCRIPTION

[0024] The illustrative embodiments disclose an ultrasound transducer probe holder device that assists with

vascular assessments via ultrasound imaging. The device allows practitioners to use FMD testing in the brachial, femoral, popliteal, or carotid arteries to assess blood flow patterns and velocities as well as arterial diameters during exercise conditions while decreasing the variability of the vascular imaging. No external human manipulation is needed during the imaging procedure once the device is properly positioned. The device improves the accuracy and reproducibility of non-invasive clinical tests to detect cardiovascular diseases through ultrasound imaging.

[0025] The device is proportioned in accordance with the specifications of commercially-available ultrasound transducers. The device may be created using a digital and 3D printer process. The device is adjustable to their respective surface (e.g. arm, leg, and neck). The device supports the transducer probe of ultrasound components to provide for a hands-free application of ultrasound imaging with x, y, z, and angular adjustments for location and pressure on the patient. The device can maintain the image even during limb motion so it can be used to assess the vasculature during different modalities of exercise (e.g. running, strength training, boxing training, cycling, arm-cranking).

[0026] To date, vascular assessments using ultrasound imaging, such as FMD, are operator dependent because a trained sonographer must hold the probe of the ultrasound in the same position on the patient continuously for at least 10 minutes. This task is difficult to accomplish because the hand of the operator will fatigue after a couple of minutes and will affect the measurements. Also, there is some risk of tendinopathies on the sonographer if the procedure is repeated too many times during a period. An alternative method for collecting FMD images is attaching the transducer probe to an external stereotaxic arm. However, if the patient moves, the image will be lost and the sonographer still must maintain a hand on the probe continuously to ensure a good quality image. With the disclosed device there is no need of external human manipulation during the procedure once the device is correctly located, avoiding the error of measurement and preventing any kind of injury to the sonographer for the extended data taking cycle. The device is attached to the patient's arm, leg, or neck, so even if the patient moves, the image is not lost, and there is no need to restart the test procedure.

[0027] The device is designed to improve the acquisition of images during vascular assessments with ultrasound imaging during hyperemic conditions, such as FMD and exercise, without external human manipulation, allowing for a more comfortable and reliable testing procedure. Additionally, the shape of the device allows the sonographer to easily adjust the position and orientation of the probe before starting any measurements. The device is form fitting, and so it is comfortable for the patient and allows for some minor movement of the patient during the data taking process. Further, previous studies involving the assessment of the vasculature during exercise have been limited only to cycling activities and as mentioned before, the device can be employed in a wide variety of activities.

[0028] The device was tested during FMD in 26 healthy young subjects. The coefficient of variation for baseline artery diameter, peak artery diameter, % FMD, and delta-FMD were $0.26\pm 0.39\%$, $0.40\pm 0.42\%$, $6.44\pm 6.1\%$, and $6.27\pm 6.09\%$, respectively. The results (Attached as Appendix A) show an excellent reliability for the use of the device for FMD. The device was also employed in the analysis of

blood flow patterns of the carotid and brachial artery during exercise at different intensities. The device was comfortable for the subjects and clear ultrasound images of the vessels throughout the exercise bouts was obtained.

[0029] With reference to FIG. 1, an illustration of a block diagram of an ultrasound transducer probe holder device is depicted in accordance with an illustrative embodiment. In the illustrative examples, the same reference numeral may be used in more than one figure. This reuse of a reference numeral in different figures represents the same element in the different figures.

[0030] In the illustrative example, ultrasound transducer probe holder 100 may be comprised of support piece 102, soft sleeve 130, and hard sleeve 140.

[0031] Support piece 102 may be comprised of trunk 104 and base 106. Trunk 104 may be unitarily formed with base 106. Trunk 104 may be connected to base 106.

[0032] Trunk 104 may include orifice 108. Orifice 108 may have a 2D shape 107 that mimics the shape of the transducer probe to allow probe insertion. Orifice may include lip 110. Orifice 108 leads to channel 109 of trunk 104. Channel 109 may have cylindrical shape 111. Channel 109 passes through trunk 104 and base 106. Channel 109 may include bottom orifice 113. Bottom orifice 113 may be circular 105 shaped. Trunk 104 may include housing 112. Housing 112 may define cavity 114 sized to accept nut 115. Housing may include hole 116 sized to engage adjustment screw 103.

[0033] Base 106 may include flanges 117. Flanges may have curved surface 118. Flanges may further include slots 120, 122 for accommodation of attachment straps 124. Support piece may be secured to flexible brace 126 with trunk 104 extending through hole 128 in brace 126 such that flanges 117 and housing 112 abuts brace 126 on opposite sides of hole 128.

[0034] Soft sleeve 130 may comprise holding section 132. Holding section 132 is a channel through soft sleeve 130 that may have inner shape 134 shaped to accommodate an ultrasound transducer probe. Soft sleeve 130 may include a generally round outer shape 136. Soft sleeve 130 may include cut section 138 which allows soft sleeve 130 to be opened in order to accommodate insertion of an ultrasound transducer probe within holding section 132.

[0035] Hard sleeve 140 may comprise inner shape 142 shaped to accommodate soft sleeve 130. Inner shape 142 mimics outer shape 136 of soft sleeve 130. Hard sleeve 140 may include a generally round outer shape 144. Outer shape 144 is sized to be fitted within channel 109 of support piece 102.

[0036] FIG. 2 illustrates an ultrasound transducer probe holder device with an ultrasound transducer probe, in accordance with an illustrative embodiment. Ultrasound transducer probe holder 202 is an example of one implementation of ultrasound transducer probe holder 100 in FIG. 1. Ultrasound transducer probe holder 202 may position ultrasound transducer probe 204 against the arm, leg, or neck of a patient to provide hands-free operation of FMD testing on a subject during exercise conditions. Ultrasound transducer probe holder 202 may include a support piece, a hard sleeve, and a soft sleeve. The support piece and the hard sleeve may comprise a shore D material plastic, for example, polycarbonate material crafted with 3D printing. The soft sleeve

may comprise a shore A material, for example, a silicone or urethane material and manufactured through room temperature vulcanization molding.

[0037] FIG. 3 illustrates support piece 302 of ultrasound transducer probe holder 202 in accordance with an illustrative embodiment. Support piece 302 is an example of one implementation of support piece 102 in FIG. 1. Support piece 302 may include trunk section 304 and base 306. Trunk section 304 and base 306 may be of unitary construction. Trunk section 304 may be connected to base 306.

[0038] Trunk section 304 may include orifice 308 leading to channel 309. Channel 309 extends through trunk section 304 and base 306. Channel 309 may have cylindrical shape 311. Channel 309 may include orifice 308 with a 2D shape 307 of the transducer probe to allow probe insertion, and a bottom round orifice (shown as bottom orifice 608 of FIG. 6) to allow insertion of the sleeves. Orifice 308 of trunk section 304 may include lip 310. Lip 310 may contact the hard sleeve (shown as hard sleeve 502 of FIG. 5) and the soft sleeve (shown as soft sleeve 402 of FIG. 4) when the sleeves are positioned within channel 309 of support piece 302 to prevent the sleeves from exiting the support piece 302 through orifice 308. Trunk section 304 may include housing 312. Housing 312 defines threaded hole 316 sized to accommodate an adjustment screw. Threaded hole 316 leads to channel 309. An adjustment screw in threaded hole 316 may contact the hard sleeve when the hard and soft sleeves are both positioned within channel 309 of support piece 302. The adjustment screw is used to fix the position of the sleeves relative to support piece 302. It is possible to operate ultrasound transducer probe holder 202 with both the hard sleeve and the soft sleeve in conjunction within the support piece 302. It is also possible to operate ultrasound transducer probe holder 202 with the hard sleeve absent. When the hard sleeve is absent, the adjustment screw contacts the soft sleeve to secure the position of the soft sleeve relative to support piece 302. With the hard sleeve in place, the hard sleeve prolongs the life of the soft sleeve after repeated tightening and loosening of the adjustment screw.

[0039] Base 306 may include flanges 318, 319 extending from trunk section 304. Flanges 318, 319 of base 306 may form curved surface 320. Curved surface 320 is shaped to contact a subject for a comfortable and secure placement on an appendage or neck of a patient. Flanges 318, 319 may include slots 322, 323 for accommodating straps having a hook and loop fastener arrangement for securing ultrasound transducer probe holder 202 to a patient. The straps allow for adjustment to accommodate various sizes of patient appendages.

[0040] FIG. 4 illustrates soft sleeve 402 of ultrasound transducer probe holder 202 in accordance with an illustrative embodiment. Soft sleeve 402 is an example of one implementation of soft sleeve 130 in FIG. 1. Soft Sleeve 402 may include holding section 404. Holding section 404 is a channel through soft sleeve 402 that is shaped to snugly accommodate an ultrasound transducer probe. Soft sleeve 402 may include a generally round outer shape 406. Outer shape 406 is sized to be fitted within hard sleeve 502, that at the same time is to be fitted within channel 309 of support piece 302. Soft sleeve 402 may include cut section 408. Cut section 408 extends through to holding section 404 and allows soft sleeve 402 to be opened in order to accommodate insertion of an ultrasound transducer probe within holding section 404.

[0041] FIG. 5 illustrates hard sleeve 502 of ultrasound transducer probe holder 202 in accordance with an illustrative embodiment. Hard sleeve 502 is an example of one implementation of hard sleeve 140 in FIG. 1. Hard Sleeve 502 has inner shape 504 shaped to accommodate soft sleeve 402. Inner shape 504 of hard sleeve 502 mimics outer shape 406 of soft sleeve 402. Hard sleeve 502 may include a generally round outer shape 506. Outer shape 506 is sized to be fitted within channel 309 of support piece 302. Outer shape 506 allows rotation of hard sleeve 502, and thus soft sleeve 402 within, with respect to support piece 302 for positioning and visualization of an ultrasound transducer probe.

[0042] As best illustrated in FIGS. 6-7, inner shape 602 of soft sleeve 402 mimics outer shape 604 of ultrasound transducer probe 204, allowing better holding of and avoiding movement of the transducer probe during testing. Outer shape 606 of hard sleeve 502 allows hard sleeve 502 to be inserted in to channel 309 through bottom orifice 608 and rotate within channel 309 of support piece 302. Bottom orifice 608 is circular in shape. Outer shape 606 of hard sleeve 502 mimics inner cylindrical shape 311 of channel 309 and the circular shape of bottom orifice 608. The shore A material selected for soft sleeve 402 allows certain angular and x, y, z movements of ultrasound transducer probe 204 for final adjustment relative to the patient. The shore A material selected also provides certain compression that helps ultrasound transducer probe 204 to be touching, tight and secured to a patient appendage, allowing a better visualization of blood flow.

[0043] Lip 310 prevents soft sleeve 402 and hard sleeve 502 and thus ultrasound transducer probe 204 held within soft sleeve 402 from exiting support piece 302 through orifice 308.

[0044] FIG. 8 is a flow chart of the steps 800 to secure ultrasound transducer probe holder 202 to a patient, in accordance with an illustrative embodiment. At 802, ultrasound transducer probe 204 is inserted through orifice 308 of support piece 302, through channel 309 of support piece 302, and out through bottom orifice 608 of channel 309. At 804, ultrasound transducer probe 204 is inserted into soft sleeve 402 by opening soft sleeve 402 at cut section 408. If hard sleeve 502 is to be used, at 806, soft sleeve 402 with ultrasound transducer probe 204 within, is inserted into hard sleeve 502. At 808, hard sleeve 502 and soft sleeve 402 with ultrasound transducer probe 204 within or just soft sleeve 402 with ultrasound transducer probe 204 within, are pulled up through bottom orifice 608 of channel 309 of support piece 302. At 810, hard sleeve 502 with soft sleeve 402 within (or just soft sleeve 402 if hard sleeve 502 is absent) is fixed relative to support piece 302 with an adjustment screw. The adjustment screw engaged with threaded hole 316 is tightened such that the adjustment screw abuts hard sleeve 502 (or soft sleeve 402 if hard sleeve 502 is not present). At 812, support piece 302 is secured to the appendage of a patient using the hook and loop fasteners through slots 322, 323. At 814, if needed, the position of ultrasound transducer probe 204 is adjusted. The flexibility of the shore A material comprising soft sleeve 402 allows positional adjustments. The adjustment screw may be loosened to make further positional adjustments.

[0045] The operations described above are not relegated to the order the operations were presented. Some operations can be performed prior to previously described operations

and some can be performed simultaneously. The order the operations were presented does not imply an order for the operations to be performed in.

[0046] FIG. 9 illustrates a method of securing ultrasound transducer probe 204 in ultrasound transducer probe holder 202 in accordance with an illustrative embodiment. At 902, ultrasound transducer probe 204 is inserted through orifice 308 of support piece 302. At 904, ultrasound transducer probe 204 is inserted into soft sleeve 402 by opening soft sleeve 402 at cut section 408. This is possible because of the flexible shore A material of soft sleeve 402 is made out of. At 906, soft sleeve 402 with ultrasound transducer probe 204 within, is inserted into hard sleeve 502. At 908, hard sleeve 502 (with soft sleeve 402 within and with ultrasound transducer probe 204 within soft sleeve 402) is pulled up through bottom orifice 608 of channel 309 of support piece 302. Hard sleeve 502 and soft sleeve 402 may abut lip 310. Hard sleeve 502 with soft sleeve 402 is free to rotate within channel 309 of support piece 302. An adjustment screw threadably engaged with support piece 302 abuts hard sleeve 502 to fix hard sleeve 502 and soft sleeve 402 and ultrasound transducer probe 204 with respect to support piece 302 thus securing ultrasound transducer probe 204 in ultrasound transducer probe holder 202. When hard sleeve 502 is absent, the adjustment screw threadably engaged with support piece 302 abuts soft sleeve 402 to fix soft sleeve 402 and ultrasound transducer probe 204 with respect to support piece 302 thus securing ultrasound transducer probe 204 in ultrasound transducer probe holder 202.

[0047] FIG. 10 illustrates an ultrasound transducer probe holder device in use, in accordance with an illustrative embodiment. Hard sleeve 502 is fixed relative to support piece 302 with adjustment screw 1002. Adjustment screw 1002, engaged with threaded hole 316, is tightened such that adjustment screw 1002 abuts hard sleeve 502. In the absence of hard sleeve 502, soft sleeve 402 is fixed relative to support piece 302 with adjustment screw 1002. Adjustment screw 1002, engaged with threaded hole 316, is tightened such that adjustment screw 1002 abuts soft sleeve 402. Support piece 302 is secured to the appendage of a patient using the hook and loop fasteners through slots 322, 323. Adjustment of the position of tip 1004 of ultrasound transducer probe 204 is such that tip 1004 is tightly touching patient appendage. Ultrasound transducer probe holder 202 ensures reduced movement of ultrasound transducer probe 204 during exercise movements which in turn provides for better visualization of blood flow than current FMD techniques.

[0048] FIG. 11 illustrates an ultrasound transducer probe holder device with an ultrasound transducer probe, in accordance with an illustrative embodiment. Ultrasound transducer probe holder 1102 is an example of one implementation of ultrasound transducer probe holder 100 in FIG. 1. Ultrasound transducer probe holder 1102 may position ultrasound transducer probe 204 against the arm, leg, or neck of a patient to provide hands-free operation of FMD testing on a subject during exercise conditions. Ultrasound transducer probe holder 1102 may include brace 1104, support piece 1106, hard sleeve 502, and soft sleeve 402. The support piece and the hard sleeve may comprise a shore D material plastic, for example, polycarbonate material crafted with 3D printing. The soft sleeve may comprise a shore A material, for example, a silicone or urethane material and manufactured through room temperature vulcanization molding. The brace may comprise a soft foam material.

[0049] FIG. 12 illustrates support piece 1106 of ultrasound transducer probe holder 1102 in accordance with an illustrative embodiment. Support piece 1106 is an example of one implementation of support piece 102 in FIG. 1. Support piece 1106 may include trunk section 1204 and base 1206. Trunk section 1204 and base 1206 may be of unitary construction. Trunk section 1204 may be connected to base 1206.

[0050] Trunk section 1204 may include orifice 1208 leading to channel 1209. Channel 1209 extends through trunk section 1204 and base 1206. Channel 1209 may have cylindrical shape 1211. Channel 1209 may include orifice 1208 with a 2D shape 1207 of the transducer probe to allow probe insertion, and a bottom round orifice (shown as bottom orifice 1302 of FIG. 13) to allow insertion of the sleeves. Orifice 1208 of trunk section 1204 may include lip 1210. Lip 1210 may contact the hard sleeve (shown as hard sleeve 502 of FIG. 5) and the soft sleeve (shown as soft sleeve 402 of FIG. 4) when the sleeves are positioned within channel 1209 of support piece 1106 to prevent the sleeves from exiting the support piece 1106 through orifice 1208. Trunk section 1204 may include housing 1212. Housing 1212 may define cavity 1214 sized to accommodate a threaded nut. Housing 1212 may include hole 1216 sized to accommodate an adjustment screw. Hole 1216 may intersect cavity 1214 and lead to channel 1209. Hole 1216 may be a threaded hole which eliminates the need for a threaded nut within cavity 1214. An adjustment screw in hole 1216 may contact the hard sleeve when the hard and soft sleeves are both positioned within channel 1209 of support piece 1106. The adjustment screw is used to fix the position of the sleeves relative to support piece 1106. It is possible to operate ultrasound transducer probe holder 1102 with both the hard sleeve and the soft sleeve in conjunction within the support piece 1106. It is also possible to operate ultrasound transducer probe holder 1102 with the hard sleeve absent. When the hard sleeve is absent, the adjustment screw contacts the soft sleeve to secure the position of the soft sleeve relative to support piece 1106.

[0051] Base 1206 may include flanges 1218, 1219 extending from trunk section 1204. Flanges 1218, 1219 define space 1220 between flanges 1218, 1219 and housing 1212. Space 1220 is sized to accommodate the thickness of brace 1104. Brace 1104 is for securing ultrasound transducer probe holder 1102 to a patient. The flexibility of the material comprising brace 1104 allows for adjustment to accommodate various sizes of patient appendages.

[0052] As best illustrated in FIG. 13, support piece 1106 is press fit within hole 1306 of brace 1104. Brace 1104, or rather the thickness thereof, fits in space 1220 defined between housing 1212 and flanges 1218, 1219 of support piece 1106. The soft material comprising brace 1104 allow hole 1306 to stretch and accommodate support piece 1106. Housing 1212 and flanges 1218, 1219 prevent support piece 1106 from inadvertent removal of support piece 1106 and ultrasound transducer probe 204 within from hole 1306 in brace 1104. Brace further includes cut line 1304 to allow brace 1104 to be placed around an appendage of neck of a patient.

[0053] Outer shape 606 of hard sleeve 502 allows hard sleeve 502 to be inserted in to channel 309 through bottom orifice 1302 and rotate within channel 309 of support piece

1106. Bottom orifice **1302** is circular in shape. Outer shape **606** of hard sleeve **502** mimics the circular shape of bottom orifice **1302**.

[0054] FIG. 14 is a flow chart of the steps **1400** to secure ultrasound transducer probe holder **1102** to a patient, in accordance with an illustrative embodiment. At **1402**, ultrasound transducer probe **204** is passed through hole **1306** of brace **1104**. At **1404** ultrasound transducer probe **204** is inserted through orifice **1208** of support piece **1106**, through channel **1209** of support piece **1106**, and out through bottom orifice **1302** of channel **1209**. At **1406**, ultrasound transducer probe **204** is inserted into soft sleeve **402** by opening soft sleeve **402** at cut section **408**. If hard sleeve **502** is to be used, at **1408**, soft sleeve **402** with ultrasound transducer probe **204** within, is inserted into hard sleeve **502**. At **1410**, hard sleeve **502** and soft sleeve **402** with ultrasound transducer probe **204** within or just soft sleeve **402** with ultrasound transducer probe **204** within, are pulled up through bottom orifice **1302** of channel **1209** of support piece **1106**. At **1412**, hard sleeve **502** with soft sleeve **402** within (or just soft sleeve **402** if hard sleeve **502** is absent) is fixed relative to support piece **1106** with an adjustment screw. The adjustment screw engaged with hole **1216** is tightened such that the adjustment screw abuts hard sleeve **502** (or soft sleeve **402** if hard sleeve **502** is not present). At **1414**, support piece **1106** with the transducer probe securely held within is secured with a friction fit in hole **1306** of brace **1104**. Support piece **1106** is passed through hole **1306** such that housing **1212** is adjacent an outside surface of brace **1104** while flanges **1218**, **1219** abut an inside surface of brace **1104**. Space **1220** is sized to accept the thickness of brace **1104**. The soft material of brace **1104** allow hole **1306** to stretch such that brace **1104** grips support piece **1106**. At **1416**, brace **1104** with support piece **1106** securely held within is secured to the appendage of a patient by opening brace **1104** at cut line **1304** and wrapping brace **1104** around an appendage of a patient. At **1418**, if needed, the position of ultrasound transducer probe **204** is adjusted. The flexibility of the shore A material comprising soft sleeve **402** allows positional adjustments. The adjustment screw may be loosened to make further positional adjustments.

[0055] FIG. 15 illustrates a method of securing ultrasound transducer probe **204** in ultrasound transducer probe holder **1102** in accordance with an illustrative embodiment. At **1502** ultrasound transducer probe **204** is inserted through hole **1306** of brace **1104**. At **1504**, ultrasound transducer probe **204** is inserted through orifice **1208** of support piece **1106**. At **1506**, ultrasound transducer probe **204** is inserted into soft sleeve **402** by opening soft sleeve **402** at cut section **408**. This is possible because of the flexible shore A material of soft sleeve **402** is made out of. At **1508**, soft sleeve **402** with ultrasound transducer probe **204** within, is inserted into hard sleeve **502**. At **1510**, hard sleeve **502** (with soft sleeve **402** within and with ultrasound transducer probe **204** within soft sleeve **402**) is pulled up through bottom orifice **1302** of channel **1209** of support piece **1106**. Hard sleeve **502** and soft sleeve **402** may abut lip **1210**. Hard sleeve **502** with soft sleeve **402** is free to rotate within channel **1209** of support piece **1106**. An adjustment screw threadably engaged with support piece **1106** abuts hard sleeve **502** to fix hard sleeve **502** and soft sleeve **402** and ultrasound transducer probe **204** with respect to support piece **1106** thus securing ultrasound transducer probe **204** in ultrasound transducer probe holder **1102**. When hard sleeve **502** is absent, the adjustment screw

threadably engaged with support piece **1106** abuts soft sleeve **402** to fix soft sleeve **402** and ultrasound transducer probe **204** with respect to support piece **1106** thus securing ultrasound transducer probe **204** in ultrasound transducer probe holder **202**. At **1512**, support piece **1106** with ultrasound transducer probe **204** secured within is pulled into and secured within hole **1306** of brace **1104**.

[0056] The description of the different illustrative embodiments has been presented for purposes of illustration and description, and is not intended to be exhaustive or limited to the embodiments in the form disclosed. Many modifications and variations will be apparent to those of ordinary skill in the art. Further, different illustrative embodiments may provide different features as compared to other illustrative embodiments. The embodiment or embodiments selected are chosen and described in order to best explain the principles of the embodiments, the practical application, and to enable others of ordinary skill in the art to understand the disclosure for various embodiments with various modifications as are suited to the particular use contemplated.

What is claimed is:

1. An ultrasound transducer probe holder device, comprising:
 - a trunk section with an orifice in communication with a channel within the trunk section;
 - a base connected to the trunk section;
 - a sleeve removably located within the channel; and
 - an adjustment screw fitted in the trunk section, wherein the adjustment screw is movable into the channel to secure the sleeve to the trunk section.
2. The ultrasound transducer probe holder device of claim 1, wherein the channel has a cylindrical shape.
3. The ultrasound transducer probe holder device of claim 1, wherein the channel has a cylindrical shape and the sleeve has a round outer shape that matches the cylindrical shape of the channel such that the sleeve is receivable into the channel.
4. The ultrasound transducer probe holder device of claim 1, wherein the orifice has a 2D shape such that an ultrasound transducer probe is insertable through the orifice in communication with the channel.
5. The ultrasound transducer probe holder device of claim 1, wherein the orifice includes a lip such that the sleeve is retained within the trunk section.
6. The ultrasound transducer probe holder device of claim 1, further comprising a threaded hole in the trunk section engaged with the adjustment screw where the threaded hole leads to the channel.
7. The ultrasound transducer probe holder device of claim 1, further comprising slots in the base for accommodating fastener straps.
8. The ultrasound transducer probe holder device of claim 1, wherein the sleeve has a holding section with a shape such that an ultrasound transducer probe is receivable within the holding section.
9. The ultrasound transducer probe holder device of claim 1, wherein the sleeve further comprises:
 - a holding section such that a transducer probe is insertable within the holding section; and
 - a cut section in the holding section such that the sleeve is openable to accommodate the transducer probe within the holding section.

10. The ultrasound transducer probe holder device of claim 1, wherein the channel has a cylindrical shape and the sleeve has a round outer shape sized to the cylindrical shape.

11. The ultrasound transducer probe holder device of claim 1, wherein the sleeve comprises a soft sleeve and a hard sleeve.

12. The ultrasound transducer probe holder device of claim 1, wherein the sleeve comprises a soft sleeve and a hard sleeve and wherein the channel has a cylindrical shape and the hard sleeve has a round outer shape sized to the cylindrical shape.

13. The ultrasound transducer probe holder device of claim 1, further comprising a flexible brace having a hole, wherein the trunk section extends through the hole and the base includes flanges configured to abut an inside surface of the flexible brace.

14. A method of securing an ultrasound transducer probe holder device to a patient, comprising:

inserting an ultrasound transducer probe through an orifice in communication with a channel within a support piece;

inserting the ultrasound transducer probe into a sleeve;

inserting the sleeve with the ultrasound transducer probe into the support piece;

securing the sleeve to the support piece; and
securing the support piece to the patient.

15. The method of claim 14, further comprising adjusting a position of the ultrasound transducer probe relative to the patient.

16. The method of claim 14, wherein securing the sleeve to the support piece includes rotating an adjustment screw housed in the support piece.

17. The method of claim 14, wherein securing the support piece to the patient includes accommodating fastener straps through slots in the support piece.

18. The method of claim 14, wherein securing the support piece to the patient includes securing the support piece in a hole of a brace and securing the brace to the patient.

19. The method of claim 14, further comprising adjusting a position of a tip of the ultrasound transducer probe while within the sleeve such that the tip is contacting the patient.

20. The method of claim 14, wherein the sleeve comprises a soft sleeve and a hard sleeve.

* * * * *

专利名称(译)	充血血流中用于血管评估的超声换能器支架		
公开(公告)号	US20200155117A1	公开(公告)日	2020-05-21
申请号	US16/591798	申请日	2019-10-03
申请(专利权)人(译)	BOARD校董, 得克萨斯州大学系统		
当前申请(专利权)人(译)	BOARD校董, 得克萨斯州大学系统		
[标]发明人	GUROVICH ALVARO N		
发明人	ACUNA, FRANCISCO MORALES OCHOA, LUIS A. GUROVICH, ALVARO N.		
IPC分类号	A61B8/00 A61B8/06		
CPC分类号	A61B8/4209 A61B8/4455 A61B8/4461 A61B8/06 A61B8/4483 A61B8/4227		
优先权	62/768794 2018-11-16 US		
外部链接	Espacenet USPTO		

摘要(译)

一种超声换能器探针支架装置, 包括支撑件; 连接到支撑件的基座; 支撑件内的圆柱形孔; 从孔口延伸并限定腔的壳体; 用于插入孔口的套筒; 调节螺钉安装在外壳中, 用于与套筒接触。该设备支撑并保持超声换能器探头的位置, 以便在引发充血状况所需的不同运动方式下, 以免提方式使用该设备, 同时提供探头相对于患者的x, y, z位置调整。

