



US009649092B2

(12) **United States Patent**
Fearnot et al.

(10) **Patent No.:** **US 9,649,092 B2**
(45) **Date of Patent:** **May 16, 2017**

(54) **DEVICES AND METHODS FOR THREE-DIMENSIONAL INTERNAL ULTRASOUND USAGE**

(58) **Field of Classification Search**
USPC 600/467
See application file for complete search history.

(71) Applicant: **Muffin Incorporated**, West Lafayette, IN (US)

(56) **References Cited**

(72) Inventors: **Neal E. Fearnot**, West Lafayette, IN (US); **Peter S. McKinnis**, West Lafayette, IN (US); **Sarah Robbins**, Lafayette, IN (US); **Yun Zhou**, West Lafayette, IN (US)

U.S. PATENT DOCUMENTS

4,421,118 A * 12/1983 Dow et al. 600/446
4,785,816 A * 11/1988 Dow et al. 600/446
(Continued)

(73) Assignee: **Muffin Incorporated**, West Lafayette, IN (US)

JP 2004/129697 4/2004
WO WO 2012/061643 A1 5/2012

FOREIGN PATENT DOCUMENTS

(*) Notice: Subject to any disclaimer, the term of this patent is extended or adjusted under 35 U.S.C. 154(b) by 138 days.

OTHER PUBLICATIONS

International Search Report and Written Opinion issued in PCT/US2013/064570, dated Jan. 24, 2014.

(21) Appl. No.: **14/051,868**

(Continued)

(22) Filed: **Oct. 11, 2013**

Primary Examiner — James Kish

(65) **Prior Publication Data**

(74) *Attorney, Agent, or Firm* — Woodard, Emhardt, Moriarty, McNett & Henry LLP; Christopher Brown

US 2014/0107491 A1 Apr. 17, 2014

Related U.S. Application Data

(57) **ABSTRACT**

(60) Provisional application No. 61/727,680, filed on Nov. 17, 2012, provisional application No. 61/713,172, filed on Oct. 12, 2012.

There are disclosed embodiments of devices and methods for imaging the inside of a body part, particularly a blood vessel. In particular embodiments, a catheter has a tip chamber, within which is an ultrasound transducer mounted on a pivot mechanism, a motor for turning the transducer, and an implement for pivoting the transducer. Examples of such an implement are a linear motor, a shaft or filament, and the pivot mechanism may be biased to return to a base position when the implement is not pivoting the transducer. In other embodiments, a mirror reflecting ultrasound signals from the transducer may be rotated and/or pivoted, using similar mechanisms.

(51) **Int. Cl.**
A61B 8/14 (2006.01)
A61B 8/00 (2006.01)
(Continued)

(52) **U.S. Cl.**
CPC **A61B 8/4466** (2013.01); **A61B 8/12** (2013.01); **A61B 8/445** (2013.01); **A61B 8/4461** (2013.01);
(Continued)

26 Claims, 5 Drawing Sheets

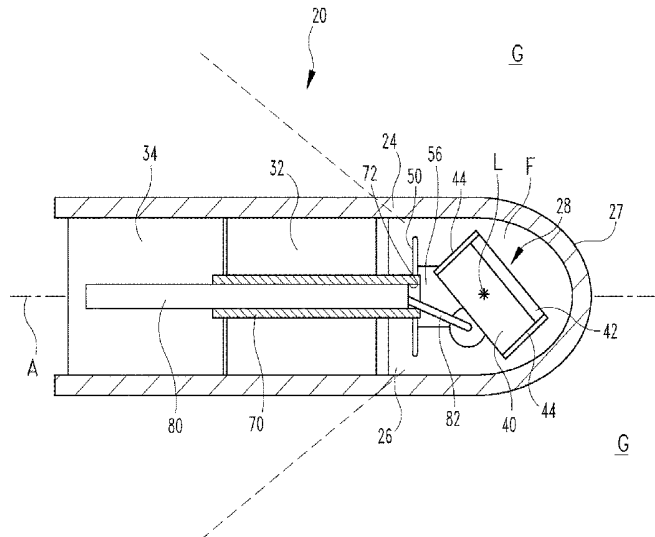

- | | | |
|------|--|---|
| (51) | <p>Int. Cl.
 <i>A61B 8/12</i> (2006.01)
 <i>B06B 1/06</i> (2006.01)
 <i>G10K 11/00</i> (2006.01)
 <i>G10K 11/35</i> (2006.01)
 <i>A61B 8/08</i> (2006.01)
 <i>G01S 15/89</i> (2006.01)</p> | <p>2007/0149917 A1 6/2007 Bennett et al.
 2008/0097403 A1 4/2008 Donaldson et al.
 2008/0177138 A1* 7/2008 Courtney et al. 600/109
 2008/0221506 A1 9/2008 Rodriguez et al.
 2009/0306518 A1 12/2009 Kurse et al.
 2010/0036258 A1 2/2010 Dietz et al.
 2010/0160788 A1 6/2010 Davies et al.
 2010/0234736 A1 9/2010 Corl
 2010/0249602 A1 9/2010 Buckley et al.
 2010/0249604 A1 9/2010 Hastings et al.
 2011/0021924 A1 1/2011 Sethuraman et al.
 2011/0071401 A1 3/2011 Hastings et al.
 2011/0196286 A1 8/2011 Robertson et al.
 2011/0263986 A1* 10/2011 Park et al. 600/462
 2011/0301508 A1 12/2011 Sethuraman et al.
 2012/0172698 A1 7/2012 Teo et al.</p> |
| (52) | <p>U.S. Cl.
 CPC <i>A61B 8/4483</i> (2013.01); <i>B06B 1/06</i>
 (2013.01); <i>G01S 15/894</i> (2013.01); <i>G01S</i>
 <i>15/8943</i> (2013.01); <i>G10K 11/004</i> (2013.01);
 <i>G10K 11/352</i> (2013.01); <i>A61B 8/0891</i>
 (2013.01); <i>A61B 8/483</i> (2013.01); <i>G01S</i>
 <i>15/8918</i> (2013.01)</p> | |

(56) **References Cited**

U.S. PATENT DOCUMENTS

5,373,845	A *	12/1994	Gardineer et al.	600/445
6,371,915	B1	4/2002	Koger et al.	
8,206,307	B2	6/2012	Barnard et al.	
2002/0082503	A1*	6/2002	Chandrasekaran et al. ..	600/466
2002/0087083	A1	7/2002	Nix et al.	
2002/0143252	A1*	10/2002	Dunne et al.	600/437
2006/0030797	A1	2/2006	Zhou et al.	
2006/0173348	A1	8/2006	Wilser et al.	
2007/0038114	A1	2/2007	Couvillon, Jr.	

OTHER PUBLICATIONS

International Search Report and Written Opinion issued in PCT/
 US2013/064579, dated Jan. 23, 2014.

International Search Report and Written Opinion issued in PCT/
 US2013/064606, mailed Jan. 8, 2014.

International Search Report and Written Opinion issued in PCT/
 US2013/064611, dated Jan. 28, 2014.

International Search Report and Written Opinion issued in PCT/
 US2013/064618, dated Jan. 24, 2014.

* cited by examiner

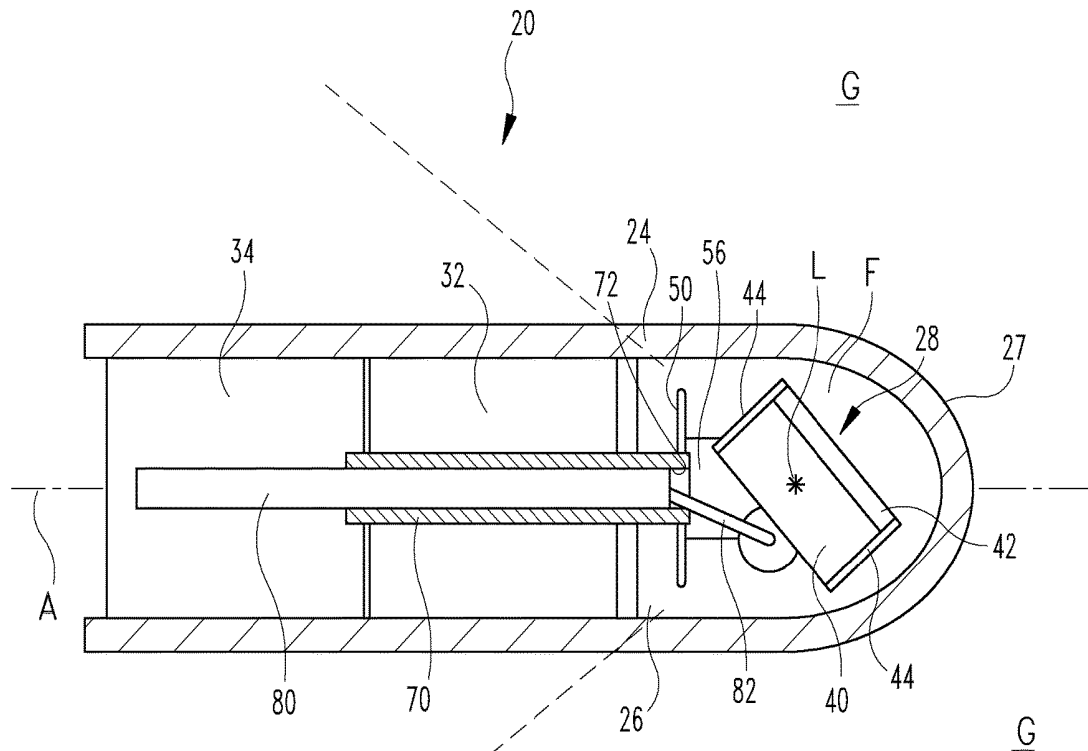

Fig. 1

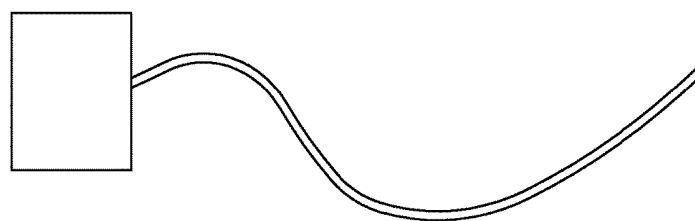

Fig. 1A

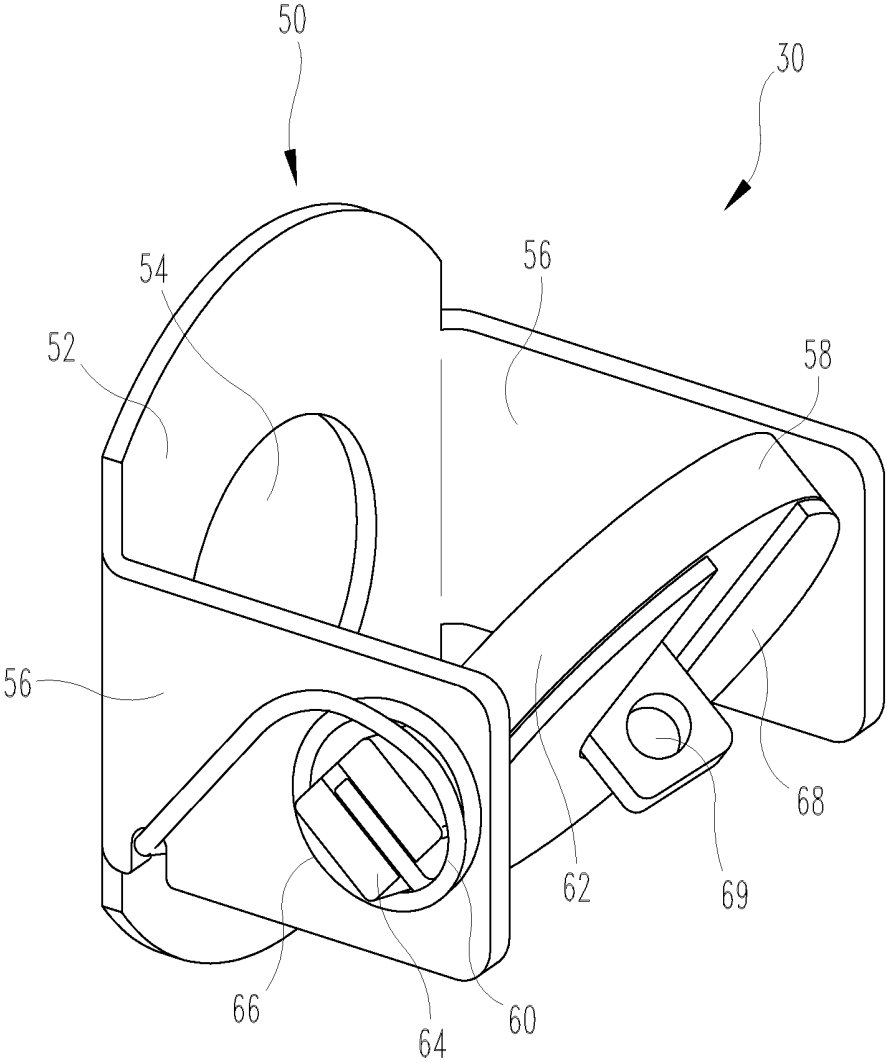

Fig. 2

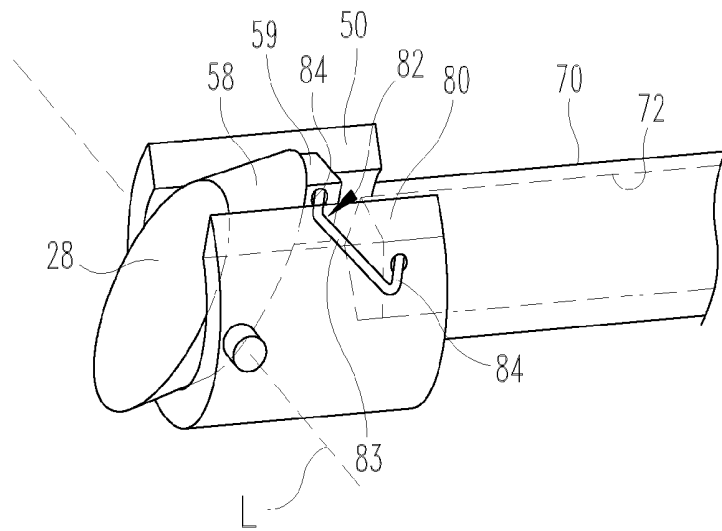

Fig. 3

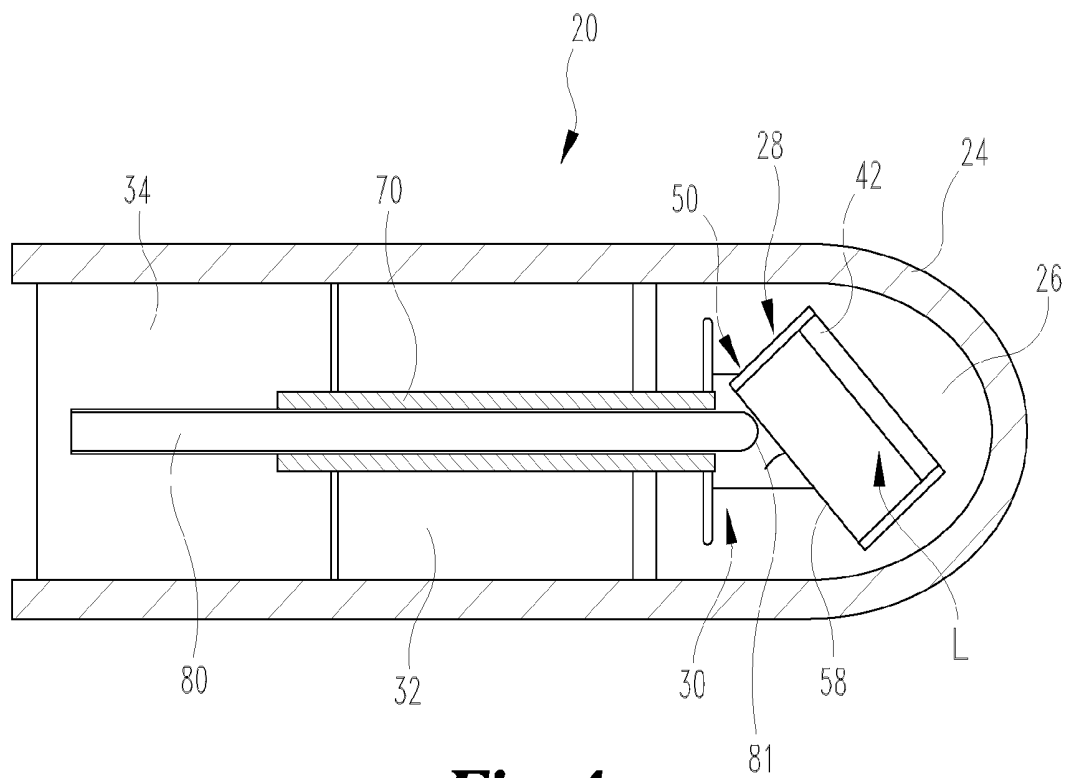

Fig. 4

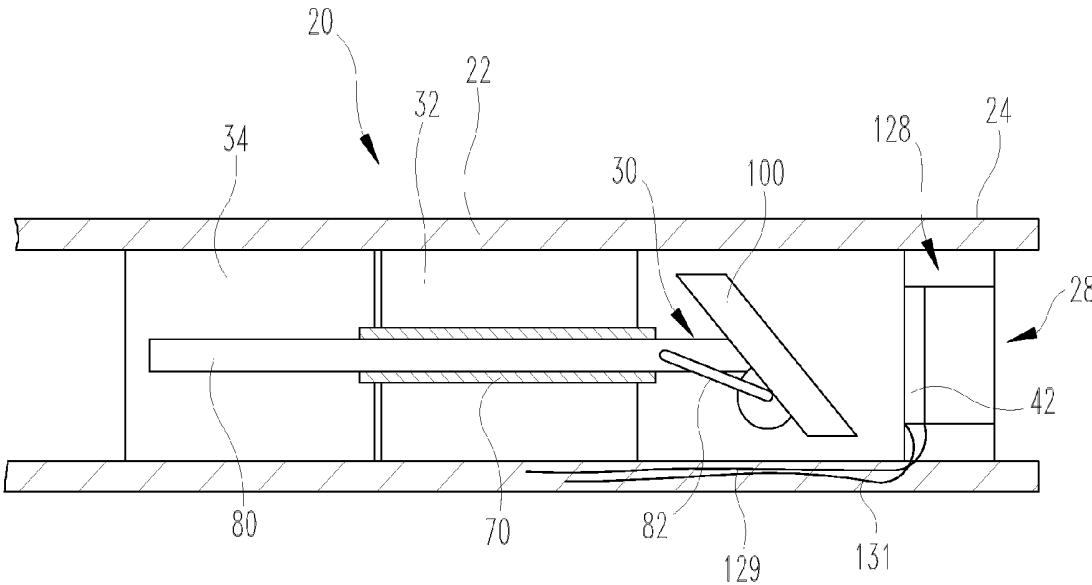

Fig. 5

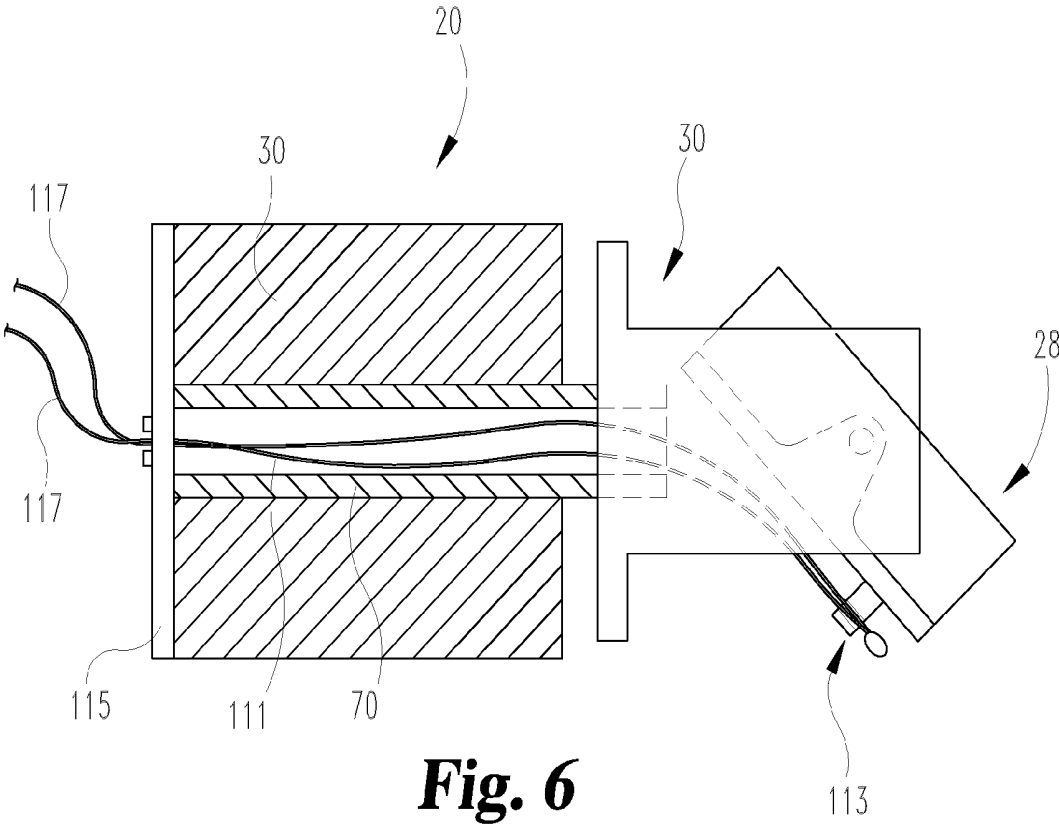

Fig. 6

DEVICES AND METHODS FOR THREE-DIMENSIONAL INTERNAL ULTRASOUND USAGE

CROSS-REFERENCE TO RELATED APPLICATIONS

The present application claims the benefit of U.S. Provisional Application Ser. No. 61/727,680, filed on Nov. 17, 2012, and U.S. Provisional Application Ser. No. 61/713,172, filed on Oct. 12, 2012, and incorporates by reference the same herein in its entirety.

The present disclosure concerns devices and methods for ultrasound use within the human body, including devices and methods for employing ultrasound to image the interior of vessels, such as blood vessels.

BACKGROUND

Devices have been proposed for using ultrasound imaging within blood vessels to view the condition of the vessel and/or placement or condition of a device placed in the vessel. However, a number of problems with such devices remain. For example, many such devices provide at best an image of a cross section of tissue or other items of interest, i.e. a thin, disk-shaped slice of the interior of a blood vessel with a portion in the center that is not within the range of the ultrasound beam. Current ultrasound imaging thus takes only a view of a two-dimensional cross section. In some other devices, the ultrasound beam is directed at a fixed angle that is not substantially perpendicular to the longitudinal axis (e.g. at 45 degrees). In this case the imaged region is static in the form of a portion of the surface of a cone, also with a center portion that is not within the range of the ultrasound beam. In either case, in order to visualize the entirety of a significant length within the body (e.g. surfaces or portions of tissue, or of devices), the device must be moved along that length, with respective images of cross sections at particular locations taken. Such movement may be inexact, and may include risks associated with blind insertion of the device through the vessel. It is also slow. Typical pull back images take on the order of 30 s to perform (at a speed of about 0.1 mm/s).

Three-dimensional intravascular ultrasound (IVUS) images may be acquired by one-dimensional arrays connected to a mechanical actuator, to move the arrays within the vessel. Such designs are expensive and generally require more space in a device than many vessels will permit. To achieve good image quality, such array transducers must simultaneously transmit and receive on many separate channels. That condition requires many expensive and bulky coaxial cables. Fewer coaxial cables can be used, but doing so reduces the quality of the image and image frame rate.

There remains a need for accurate and efficient application of ultrasound in three dimensions along a substantial length of a vessel or other bodily area, for example to provide a physician with a real-time view along that length. There also remains a need for devices that can view a medical device and one or more tissues or tissue parts simultaneously, particularly in cases in which the device and tissue(s) could not have been imaged reliably in any two-dimensional plane.

SUMMARY

Among other things, there is disclosed apparatus and methods for providing an ultrasound beam with two con-

trollable degrees of freedom within the body of a patient. For example, such apparatus can include a transducer for emitting and/or receiving ultrasound signals, and a rotary motor including a rotatable shaft extending substantially along a rotating axis, wherein operation of the rotary motor rotates the rotatable shaft around the rotating axis. A pivoting mechanism, such as a gimbal mount, is operationally connected to the rotatable shaft of the rotary motor. The pivoting mechanism rotates with the rotatable shaft, and has a base and pivoting member that is pivotable with respect to the base around a pivoting axis, the pivoting axis being substantially perpendicular to the rotating axis. A forcing member is operationally connected to the pivoting member, wherein a force applied to or via the forcing member (which may be a longitudinal force) controls pivoting of the pivoting member around the pivoting axis. In particular examples, the forcing member is a longitudinal member and/or movable with respect to the rotatable shaft. An example of such a forcing member includes a filament such that pulling the filament results in pivoting the pivoting member around the pivoting axis. A gimbal mount apparatus or other pivoting mechanism with control of its angular velocity so that the density of ultrasound scan lines is more uniform is contemplated.

The rotatable shaft may have a longitudinal lumen in some embodiments, and the forcing member can extend at least partially through the lumen. Exemplary forcing members include a longitudinal shaft, e.g. a shaft of a linear motor, the longitudinal shaft extending substantially along the rotating axis, wherein operation of the linear motor moves the longitudinal shaft along the rotating axis. The longitudinal shaft may be operationally connected to the pivoting member to control the pivoting of the pivoting member around the pivoting axis during both turning of the rotatable shaft and operation of the transducer. Particular examples include those where the rotatable shaft of the rotary motor has a lumen therethrough, and the longitudinal shaft of the linear motor has at least a portion extending within the lumen of the rotatable shaft and a distal portion outside of the lumen. The longitudinal shaft may be directly connected to the pivoting member, and/or may have a rounded distal end in contact with the pivoting member. The longitudinal shaft can be connected to the pivoting member by a C-shaped connector, and may be movable in two directions along the rotating axis by the linear motor, wherein movement of the rotating shaft in a first linear direction pivots the pivoting member in a first pivoting direction, and movement of the rotating shaft in a second linear direction pivots the pivoting member in an opposite second pivoting direction. Another type of longitudinal member can include a shape-memory actuator, such as one that contracts when heated to pivot a pivoting member. In these and other examples, a transmission converts linear motion (e.g. of a shaft) to pivoting motion of the pivoting member.

Further examples of such apparatus include those in which the transducer is fixed with respect to or is at least a part of the pivoting member, so that the transducer rotates with the rotatable shaft of the rotary motor, and those in which a mirror fixed with respect to or at least a part of the pivoting member (e.g. a pivoting member which is or includes a mirror) rotates with the rotatable shaft of the rotary motor, and reflects an ultrasonic beam from the transducer. The recited pivoting member is spring-biased in some embodiments to an initial orientation relative to the

base, and when force applied to or via the forcing member is released, the pivoting member returns toward the initial orientation.

A tubular member for housing the transducer, rotary motor, gimbal mount or other pivoting mechanism and at least part of the longitudinal member is provided in particular embodiments. Such a tubular member may have a distal chamber defined at least in part by a wall portion of the tubular member, the distal chamber housing at least the transducer and a medium, the wall portion and the medium having similar acoustic impedance to the part of the body into which the tubular member is inserted, so that reflection of ultrasound at the boundary of the medium and the wall portion and at the boundary of the wall portion and body environment is reduced to a level acceptable for imaging through the boundary. The pivotable member optimally has a range of motion around the pivoting axis of a magnitude of at least 150 degrees, particularly for embodiments in which a transducer is connected to the pivoting member. In configurations in which a mirror is or is attached to the pivoting member, for every 1 degree the mirror moves with the pivoting member, the ultrasound beam moves 2 degrees, and so smaller ranges of motion may be adequate. For example, in designs in which placement of the mirror and transducer limits the forward-looking ability of the ultrasound beam (e.g. because the transducer is forward of the mirror and thus in the way of part of the beam) a range of motion about the pivoting axis of about 60 degrees is adequate, since for every 1 degree the mirror moves the ultrasound beam moves 2 degrees, and since some embodiments of mirror designs cannot be forward looking because the transducer is in the way. In some embodiments, e.g. those in which the transducer is fixed with respect to or is at least part of the pivotable member, the pivotable member has a range of motion such that the transducer can be oriented so that it emits ultrasound signals substantially along the rotary motor's axis of rotation and away from the rotary motor.

With the use of two independent mechanical motors, as further described below, the transducer sweep pattern may be set arbitrarily. This allows the transducer to acquire images in flexible ways not possible with existing ultrasound devices. For example, the disclosed transducer system may acquire images in any plane passing through the transducer. Additionally, the transducer may sweep through a three-dimensional region of tissue. The motor platform allows a flexible choice of the sweep pattern. In most dynamic applications where frame rate is important, the image will be restricted to a single plane or small three-dimensional sector. Embodiments in which the rotation of the rotatable shaft about the rotating axis (the rotary motor's axis of rotation) and the pivoting of the pivoting member about the pivoting axis are separably operable at one or more frequencies, so that the user can choose from multiple ultrasound scan patterns. In embodiments in which a rotary motor and linear motor are used, as one illustration, the rotary motor and linear motor are separably operable at one or more frequencies, so that the user can choose from multiple scan patterns. The rotary motor and pivoting mechanism (e.g. via a linear motor) can be configured so that the rotary motor turns faster when the pivoting mechanism is in a state such that the ultrasound signals are pointing in a direction close to the motor's axis of rotation (e.g. more forward-looking), and the rotary motor turns slower when the pivoting mechanism is in a state such that the ultrasound signals are pointing in a direction further from the motor's axis of rotation (e.g. more side-looking). That is, as the signals (or ultrasound beam) move with the pivoting mechanism toward the rotating axis,

the angular speed of the signals increases, and as the signals move with the pivoting mechanism away from the rotating axis, the angular speed of the signals decreases.

Certain embodiments discussed herein allow images to be acquired in the forward (i.e. generally away from the user) direction. Forward-looking applications open new possibilities for therapeutic guidance. It also allows the placement of the ultrasound catheter with forward visualization, so that the physician can observe with ultrasound the path of the ultrasound catheter and need not place it "blindly." In existing ultrasound catheters, the image plane is behind the distal tip of the device, and so the tip's location is always unobservable via the catheter itself. The ability of the current embodiments to see forward during placement eliminates or reduces hazards of blind placement and/or the need for an external monitor for the ultrasound catheter's progress.

The embodiments disclosed herein are intended to use ultrasound imaging to guide diagnostic or therapeutic medical procedures, including interventions. Examples of such procedures include those in the circulatory system, including IVUS procedures. Three-dimensional capability of the imaging system is considered a major advantage for use in many therapies because of the inherently three-dimensional nature of many procedures. As one example, placement of an abdominal aortic aneurysm graft requires that a guide wire be fed through the contralateral limb of the patient. The location of both the wire tip and the contralateral limb must be known and updated in real time during the placement. Such information cannot be contained in a two-dimensional image or projection, and so use of two-dimensional imaging devices require a "guess and check" method of placement, under external fluoroscopic guidance or two-dimensional ultrasound.

BRIEF DESCRIPTION OF THE DRAWINGS

FIG. 1 is a schematic part cross-sectional side view of an embodiment of an end portion of a three-dimensional internal ultrasound device.

FIG. 1A is a schematic representation of the embodiment of a three-dimensional ultrasound device as in FIG. 1.

FIG. 2 is a perspective view of an embodiment of a pivoting mechanism useful in the embodiment of FIG. 1.

FIG. 3 is a perspective view of another embodiment of a pivoting mechanism useful in the embodiment of FIG. 1.

FIG. 4 is a schematic part cross-sectional side view of an embodiment similar to that of FIG. 1 with a particular embodiment of internal structure.

FIG. 5 is a schematic part cross-sectional side view of an embodiment similar to that of FIG. 1, showing a pivotable mirror and a stationary transducer.

FIG. 6 is a schematic part cross-sectional side view of an embodiment similar to that of FIG. 1, showing shape-memory actuator.

DETAILED DESCRIPTION OF THE ILLUSTRATED EMBODIMENTS

For the purposes of promoting an understanding of the principles of the disclosure, reference will now be made to the embodiments illustrated in the drawings and specific language will be used to describe the same. It will nevertheless be understood that no limitation of the scope of the claims is thereby intended, such alterations and further modifications in the illustrated embodiments, and such further applications of the principles of the disclosure as

illustrated therein being contemplated as would normally occur to one skilled in the art to which the disclosure relates.

Referring now generally to the drawings, there are shown embodiments of a device **20** for internal ultrasound procedures. Such devices may be diagnostic or therapeutic (including interventional) in application, and include devices inserted percutaneously, subcutaneously or endoluminally into the patient. Examples of such devices include embodiments designed for intravascular ultrasound (IVUS) imaging or treatment.

In the embodiment of FIG. 1, device **20** is a catheter or other flexible elongated or tubular member **22** having a wall **24** defining an internal chamber **26**, with catheter **22** being sized and configured for insertion into and/or travel along the vascular system. Within catheter **22** and chamber **26** in this embodiment are a transducer **28**, a pivoting mechanism **30** for transducer **28**, a rotary motor **32**, and a linear motor **34**. As will be discussed further below, transducer **28** can be turned around a rotating axis of device **20** as well as pivoted around an axis substantially perpendicular to that rotating axis, allowing the direction of ultrasound emission and reception to extend forward and rearward of the location of transducer **28**. In the illustrated embodiments, the rotating axis is the longitudinal axis of device **20**, and the pivoting axis is a lateral axis (e.g. perpendicular to the longitudinal axis).

Catheter **22** in the illustrated embodiment is an elongated device of plastic or other sturdy flexible material presents a barrier to the passage of ultrasound signals small enough (i.e. the difference in acoustic impedance at the boundary of the material and the substances adjacent it) that ultrasound images may be reasonably acquired through the barrier. For example, when used within a blood vessel containing body tissues and blood, it is preferable for catheter **22** to be at least partially (e.g. at least in and/or adjacent to wall **24**) constructed of a material which has acoustic impedances similar to that of body fluids such as blood. It will be understood that only the distal end of catheter **22** (e.g. wall **24**) need be acoustically transparent, but more or all of catheter **22** may be made of the same material as wall **24** in some embodiments. Possible materials could include, for example, a polymer material such as polyethylene (PE), polymethylpentene (PMP), or acrylonitrile butadiene styrene (ABS). It has been determined that a preferred thickness of at least the portion of catheter **22** which serves as the viewing window should be approximately $\frac{1}{2}$ of the wavelength corresponding to center frequency.

Wall **24** surrounds chamber **26**, which is at the distal end of device **20** in the illustrated embodiment, and extends proximally. The proximal end of wall **24** and/or catheter **22** may extend outside of the patient during use, and may end in a handle or other operating portion (e.g. an imaging system and/or a maneuvering system schematically indicated at **35** in FIG. 1A). Particular embodiments of catheter **22** or at least chamber **26** are cylindrical, and are sized for insertion into and passage through blood vessels, such as insertion into the femoral artery and passage through it toward the heart. Wall **24** may have a port **27** or other feature to allow injection of fluid into chamber **26** to give chamber **26** ultrasound characteristics similar or substantially identical to that of wall **24** and the surrounding bodily environment (e.g. the blood stream). Sealing members are placed between motor **32** and chamber **26** or the portion of chamber **26** containing transducer **28** and a fluid, in the illustrated embodiments.

Transducer **28** is indicated schematically in the drawings. The term "transducer" should be understood to include an

assembly of two or more parts as well as a single piece. It will further be understood that "transducer" as used herein includes devices that transmit ultrasound (i.e. transform an electrical (RF) signal to ultrasound), receive ultrasound (i.e. transform ultrasound to an electrical (RF) signal), or both. If multiple transducers or pieces are provided, transmission of ultrasound may occur at one and reception at another. Transducer(s) as described herein may have one or more piezoelectric elements as respective transducers, and may operate in combination with other transducers within or outside the body. As examples, "transducer" as used herein includes a single element transducer on a rotating and pivoting member, a one-dimensional array of elements on a rotating and pivoting member, and a stationary single element transducer generally aimed at a mirror on a rotating and pivoting member.

An exemplary transducer **28** includes a body or backing layer **40** with a transducer element **42** attached to one side of body **40**, and one or more clamping rings **44**. An impedance matching layer (not shown) may also be attached to transducer element **42**, e.g. opposite body **40**. Positioning element **42** as indicated, on the side of body **40**, allows both a generally lateral (i.e. away from the rotating axis) and forward ultrasound beam direction depending on pivoting, as further discussed below. Body **40** may substantially absorb ultrasound signals, so that such signals are effectively only projected in one general direction outward from element **42**, e.g. to one side or in a limited angular range radially from body **40**. Clamping rings **44** have been determined to improve efficiency and mechanical stability of transducer **28**. Transducer **28** is capable of sending and receiving ultrasound waves in a range of frequencies which are typically used in medical ultrasound procedures, such as, for example, in the range from 2 MHz to 50 MHz.

Transducer **28** is electronically connected to a power source and to an imaging system. Examples of connections include conductors (e.g. wires or cables) along wall **24**, through a central lumen of a motor shaft, via slip ring connections, and/or via metallic film(s) along wall **24**. Embodiments of examples are discussed and shown in Application Ser. Nos. 61/713,143 (entitled "Feedback/Registration Mechanism for Ultrasound Devices" and filed on Oct. 12, 2012) and 61/713,186 (entitled "Mechanical Scanning Ultrasound Transducer with Micromotor" and filed on Oct. 12, 2012), each of which is incorporated by reference herein in its entirety.

Transducer **28** is mounted in a pivoting mechanism **30** to permit transducer **28** to turn around a rotating axis as well as pivot around a pivoting axis. In the illustrated embodiments, the pivoting mechanism is a two-axis gimbal or gimbal-type mounting, having an outer frame piece or base **50** including a center portion **52** with a hole **54** therethrough and matching arms **56** extending laterally of hole **54** from center portion **52**. Hole **54** is sized and configured to accommodate a portion of a shaft from rotary motor **32**, so that the shaft can turn pivoting mechanism **30**. A pivoting element **58** fits into holes **60** in arms **56**. Pivoting element **58** in the illustrated embodiment is a circular disk **62** having side ears **64** that fit into holes **60** and act as an axle, so that element **58** can pivot around the axis defined by ears **64**. One or more springs **66** bias pivoting element **58** to a particular initial or original position. In the illustrated embodiment, a torsion spring **66** is connected to an arm **56** at or toward one end, and to an ear **64** at the other (e.g. by inserting an end of spring **66** into a groove in ear **64**). A second torsion spring **66** may be similarly attached to the other arm **56** and ear **64**, which are not visible in FIG. 2. The particular embodiment shown in

FIG. 2 includes a plate 68 fixed to element 58, with plate 68 having a hole 69 for attaching a filament (e.g. suture, string or similar item, not shown). Such a filament can extend from plate 68 through catheter 22 and can be pulled or used to transmit pulling force to plate 68, to pivot element 58.

In particular embodiments, pivoting element 58 may be a backing, base or substrate on which body 40 of transducer 28, or transducer 28 itself, is fixed. In other embodiments, body 40 may include ears so as to become the pivoting element in mounting 30, or a separate axle may be provided with mounting 30 to which body 40 of transducer 28 is directly or indirectly fixed. Mounting 30 permits transducer 28 to turn around a rotating axis, via transmission of rotational motion from rotary motor 32 to mechanism 30, and to pivot transducer 28 at the same time, via pulling or pushing force on body 40 of transducer 28 or a disk portion of pivoting element 58 to move it around the transverse axis formed by pivoting element 58 or a similar axle. Pivoting element 58 is thus able to rotate about both the pivoting and axial directions.

Rotary motor 32 includes a rotating shaft 70 for connecting to mechanism 30, as by interference or similar fit or by other fixed attachment (e.g. by adhesive, solder or welding) within hole 54 of mounting 30. Rotary motor 32 is a microminiature motor in particular embodiments suitable for containment within chamber 26 of catheter 22. Examples of such microminiature motors include piezoelectric or electromagnetic motors of a size and configuration suitable for containment within chamber 26 of catheter 22 may be used. For example, a particular embodiment of motor 32 is a three-phase, coreless, brushless DC electromagnetic motor, which has few components, small size and minimal complexity. In other examples, a piezoelectric microminiature motor may be used for its advantage of not requiring a gearhead (mechanical transmission) to achieve high torque, and to eliminate problems with torque cables and rotary transformers. A microminiature motor 32 (e.g. electromagnetic or piezoelectric) has a diameter in the range of 0.3 mm to 4 mm in particular embodiments, for example approximately 2.0 mm. Shaft 70 is hollow (i.e. defining a lumen 72 therethrough) in a particular embodiment, and extends through the entirety of motor 32 (e.g. a dual shaft motor). Lumen 72 through shaft 70 permits pulling or pushing mechanisms, electrical conductors, guide wires, or other structures to pass through shaft 70. Pulling or pushing mechanisms, as discussed further herein, operate pivoting element 58.

Rotary motor 32 may be configured to rotate shaft 70 continuously in a single rotational direction. In such embodiments, pivoting mechanism 30 and transducer 28 are rotated around the rotating axis of shaft 70 in that single rotational direction. One or more of the back EMF, the ultrasound signal emitted and/or received by transducer 28, and motor saliency can be used as a feedback mechanism to precisely control the rotational position of rotary motor 32 (and transducer 28 rotated by it) relative to the rest of device 20, ensuring proper registration of images obtained through transducer 28. Registration can be accomplished via methods and structures discussed in Application Ser. No. 61/713,143 entitled "Feedback/Registration Mechanism for Ultrasound Devices" and filed on Oct. 12, 2012, which is incorporated by reference herein in its entirety. Rotary motor 32 may alternatively be configured to run in a reciprocating motion, with shaft 70 switching between rotation in a first rotary direction (e.g. for a predetermined time, arc or number of turns) and rotation in a second, opposite, rotary direction (e.g. for a predetermined time, arc or number of

turns). Hall sensors (not shown), or ultrasound, back EMF, motor saliency, or a combination of one or more of these, may be used in such a reciprocating embodiment to control and/or monitor angular position of motor 32. Methods and structures relating to a reciprocating motor are discussed in Application Ser. No. 61/713,135, entitled "Reciprocating Internal Ultrasound Transducer Assembly" and filed on Oct. 12, 2012, which is incorporated by reference herein in its entirety.

In the illustrated embodiment, linear motor 34 has a shaft 80 that passes through lumen 72 of hollow shaft 70 of rotary motor 32, with a portion of the distal end of shaft 80 extending beyond the end of shaft 70. As indicated above, shaft 80 may be configured to join with shaft 70 so that rotation of shaft 70 also rotates shaft 80, or in other embodiments shaft 80 may remain unrotated by shaft 70 during use, as with a bearing or spacing arrangement (not shown). In either case, shaft 80 is able to move linearly (longitudinally) within and with respect to shaft 70, so that the amount of shaft 80 extending from the end of shaft 70 can vary. As will be discussed further below, the activation of motor 34 may extend and/or retract shaft 80 with respect to shaft 70, so as to use shaft 80 to transmit force to pivoting mechanism 30.

Linear motor 34, in one example, is an electromagnetic motor similar to a voice coil, used extensively for loudspeakers, which operate by creating a high static magnetic flux (e.g. by a permanent magnet) in the lateral direction (e.g. perpendicular to the rotating axis of the motor). An electrically conductive coil is placed through this flux and when current is applied to the coil a force in the axial direction is created, pulling or pushing shaft 80. The placement of the coil, permanent magnet, and magnetic conductors is relatively flexible, and many configurations are possible. Because of angular symmetry, the system can be designed so that shaft 80 can rotate relative to the stator without effecting motor performance. Thus, in some embodiments shaft 80 can rotate with shaft 70 of rotary motor 32 to simplify the system 20, while in other embodiments shaft 80 will remain stationary with respect to the shaft 70 of rotary motor 32.

Shaft 80 is a transmission element, transmitting force generated by linear motor 34 to pivoting element 58 in the illustrated embodiments. As examples, shaft 80 may be a single item that provides forward (pushing) force when linear motor 34 is activated. When motor 34 is deactivated (i.e. forward pushing force is released), then shaft 80 may retract, as by being pushed backward through action of spring 66 on the above-described embodiment of pivoting mechanism 30. In another embodiment (FIG. 3, described further below), single shaft 80 is connected to a C-shaped connector 82, which is also connected to pivoting element 58. In this embodiment, linear motor 34 provides both push and pull control, with activation of linear motor 34 in one mode to push shaft 80 and connector 82, thereby pushing pivoting element 58 and rotating it in one direction around a pivoting axis. Activation of motor 34 in a second mode pulls shaft 80 and connector 82 backward, rotating pivoting element 58 in the opposite direction.

In embodiments in which a bias (e.g. spring 66) is provided, pivoting member 58 (along with transducer 28) and shaft 80 are pushed back by the bias. Where there is no activation or energizing of linear motor 34, shaft 80 and pivoting member 58 will be at an initial static position. In particular embodiments, that initial static position is such that transducer 28 faces substantially laterally (i.e. perpendicularly) to the rotating axis A of device 20, while in other

embodiments that initial static position may be such that transducer 28 is turned substantially rearward (i.e. away from the distal end of device 20), e.g. at an angle that would allow some or all of ultrasound signals from transducer 28 to clear motor 32 and/or motor 34. As seen in FIG. 1, a field of range of the ultrasound beam or signals is indicated by dashed lines oblique to axis A, and encompasses the volume around distal end of device 20, e.g. 270 degrees or more in a given plane. With the bias, motor 34 can be calibrated so that a particular amount of forward force by motor 34, applied against the known bias, will result in a particular amount of travel of shaft 80 and pivoting of pivoting member 58, and therefore a known angle for transducer 28 relative to device 20 and the vessel in which it is placed.

An example of a push-pull mechanism connecting shaft 80 with pivoting member 58 is shown in FIG. 3. A C-shaped connector 82 has a middle portion 83 and two end portions 84 that are substantially perpendicular to middle portion 83 in this embodiment. One end portion 84 is attached to pivoting member 58, as through insertion into a hole in pivoting member 58, which may be in an extension on member 58 as exemplified in FIG. 3. The other end portion 84 is attached to shaft 80 in much the same way, as by inserting it into a hole in shaft 80. End portions 84 are pivotable with respect to their respective connected parts (pivoting member 58 or shaft 80 in particular embodiments). Forward motion (to the left in FIG. 3) of shaft 80 pushes connector 82, with one end portion 84 pushing on pivoting member 58 to pivot it around pivoting axis L. In the illustrated embodiment, such pushing causes a counterclockwise rotation of pivoting member 58 around axis L, as viewed in FIG. 3. Retraction of shaft 80 via reversal of linear motor 34 pulls connector 82, with an end portion 84 pulling pivoting member 58 to pivot it clockwise (as viewed in FIG. 3) around pivoting axis L. Control of the position of shaft 80 thus controls the angular position of pivoting member 58 and transducer 28.

The embodiment of a pivoting mechanism 30 shown in FIG. 3 has many similarities to FIG. 2, and shows a substantially U-shaped pivoting frame or base 50 within which is pivotably fitted a pivoting member 58. Pivoting member 58 is fitted so as to be pivotable within frame 50 around pivoting axis L. In this embodiment, transducer 28 is at least part of the pivoting member, and conductors to transducer 28 are not shown for clarity in the drawing. Pivoting member 58 in this embodiment includes an extension 59 with a hole for connector 82. As seen in FIG. 3, in this embodiment extension 59 is at or adjacent the perimeter of pivoting member 58. Shaft 70 of rotary motor 32 and shaft 80 of linear motor 34 are shown.

In the embodiment of FIG. 4, shaft 80 has a rounded tip portion 81 that is adapted to engage pivoting member 58 on a side opposite to transducer 28 or transducer element 42. Pivoting member 58 and transducer 28 are connected to a base or frame 50 so that they can pivot about pivoting axis L. As shaft 80 is moved forward (rightward, as seen in FIG. 4), it pushes pivoting member 58 at a point offset from the pivoting axis L. Pivoting member 58 rotates around the pivoting axis L (clockwise as seen in FIG. 4) against the bias of pivoting member 58 (e.g. from spring 66 seen in FIG. 2). When pushing force is partially or entirely released, the bias returns pivoting member toward or to an initial position, pushing shaft 80 proximally. Rounded tip portion 81 is advantageous as it permits the application of the pushing force while pivoting member 58 of a pivoting mechanism 30 is turning around the rotating axis, and presents a small surface (e.g. a tangent point) against pivoting member 58,

reducing friction between tip portion 81 and pivoting member 58. In embodiments in which no spring or similar bias is provided for mounting element 30, a feedback sensor (not shown) can be operatively connected to shaft 80 to determine how far shaft 80 is extended from shaft 70, and thereby how much pivoting of pivoting member 58 has taken place. A return force or bias can be provided by centripetal force.

Device 20 provides an ultrasound signal sweep or field that not only turns around the rotating axis A of device 20 but also is pivotable to look forward and/or rearward of the particular position of transducer 28. For example, a pivoting element (e.g. element 58 with transducer 28) is able to rotate about both pivoting and rotating axes. In embodiments having linear motor 34, shaft 80 is operatively connected to mounting element 30.

Other embodiments for controlling the pivoting of transducer 28 are also contemplated. For example, a length of flexible material 90, such as a cord, string, suture or similar filament, can be placed along device 20, through hollow shaft 70 of rotary motor 32 to plate 68 of pivoting element 58. Pulling cord 90 transmits tension to pivoting element 58, resulting in pivoting in a clockwise direction (as seen in the example of FIG. 2) against the bias of torsion spring 66. When pulling on cord 90 ceases, the bias of spring 66 returns pivoting element 58 (and transducer 28) to an original static position. Such a cord 90 may be attached to linear motor 34 and/or shaft 80, so that linear motor 34 provides pulling force.

As another example, a push-only linear force may be provided, against a bias provided in an opposing direction to the bias indicated above by torsion spring 66. A rigid shaft 102 is attached to linear motor 34, and activation of linear motor 34 forces shaft 102 forward, in turn pushing the side of pivoting element 58 and causing rotation of pivoting element 58.

In other embodiments of device 20 in which motion around one axis (a pivoting or rotational axis) of transducer 28 is preferred to be slower, a shape memory actuator (SMA) can be employed. For instance, where a slower pivoting axis is desired, the SMA may be used as a forcer in place of shaft 80 and linear motor 34. The SMA uses a material that changes shape as one or more operating characteristics changes. A typical example is a wire of nickel-titanium alloy configured to contract when heated due to the material's shape memory properties, with the contraction being about 3% of the total length of the wire. The wire may be heated by current passing through it, and when such current is removed, the wire cools and expands toward its original length. Bias force may be provided to assist the expansion.

In FIG. 6, there is shown an embodiment of device 20 in which a wire 111 of one or more filaments of SMA material, e.g. nickel-titanium wire as noted above, fits through lumen 72 in shaft 70 of rotary motor 32 to link to a pivoting mechanism 30, as at a slip tension joint 113. Slip tension joint 113 allows transducer 28 to rotate, while wire 111 does not rotate. Wire 111 is connected to a rigid plate 115 that constrains linear motion of wire 111, which in this embodiment is fixed to motor 32. Wire 111 is further connected to a source of electrical current, as by one or more wires 117. When the current is applied, wire 111 warms (e.g. a cycle on the order of 0.1 seconds for small diameter wire), and as it warms, it changes shape by contracting in length generally along the rotating axis within shaft 70, causing the inclination of wire 111 to decrease (i.e. point more toward the rotating (longitudinal) axis of device 20). The contraction and/or inclination change by wire 111 pulls on a portion of

pivoting mechanism 30 (e.g. slip tension joint 113), pivoting the pivoting mechanism around the pivoting axis, substantially as described above when shaft 80 moves along the rotating axis. Discontinuing the current allows wire 111 to cool and extend toward its prior length, and as described above, such a change can be turned into pivoting of transducer 28 back to an original position or orientation, as by a bias.

Embodiments noted above have placed transducer 28 in contact or association with pivoting element 58, so that turning mounting member 30 via rotary motor 32 and adjusting pivoting element 58 via linear motor 34 acts essentially directly on transducer 28. In these embodiments, transducer 28 is turned and pivoted to emit and receive ultrasound signals directly to the vessel or other tissue. It will be understood that other embodiments of device 20 (e.g. FIG. 5) can include a mirror 100 attached to or associated with pivoting mechanism 30 (e.g. particularly pivoting member 58), so that mirror 100 turns through the action of rotary motor 32 and pivots through the action of linear motor 34. A stationary transducer 128 (at the distal end of device 20 in this embodiment) emits ultrasound signals which reflect from mirror 100 to the tissue, and mirror 100 reflects the returning signal to transducer 128. Conductors 129, 131 are provided to transfer electrical signals to transducer 128 for creation of ultrasound waves, and to transfer signals representing ultrasound echoes from transducer 28 to an imaging system. The ultrasound beam from and to transducer 128 moves two degrees for every one degree of pivoting by mirror 100, in such embodiments, and thus such embodiments provide a similar or wider field for the ultrasound beam as is provided above, with a smaller or similar linear motion or force provided by linear motor 34.

To address ultrasound reflectivity at the boundary between chamber 26 and blood or other body fluid in which device 20 is placed, a fluid F is placed in chamber 26 that presents ultrasound-carrying characteristics that are similar to the fluid outside of chamber 26. In embodiments used for IVUS procedures, examples of fluid F can be a saline solution, mineral oil, castor oil or other types of oils, or alcohols, so that the ultrasound characteristics (e.g. acoustic impedance) within chamber 26 are similar to those outside chamber 26 (i.e., blood in a blood vessel). A port P may be placed in the wall 24 bounding chamber 26 to allow a user to inject fluid F into chamber 26 just prior to use of device 20. Port P can then self-seal, so that little or no fluid F escapes from chamber 26. One or more seals may be placed in device 20 to separate fluid F in chamber 26 from motor(s) 32, 34. Saline and/or alcohol have very good acoustic transmission and low viscosity (low friction), but they are corrosive and must be injected or otherwise placed in chamber 26 at the time of use. Oils (e.g. mineral or castor oil) have slightly worse acoustic properties and much higher viscosity (higher friction), but may be placed in chamber 26 well before using device 20.

An example of using device 20 in the context of IVUS will now be given. As previously noted, it will be understood that devices as disclosed herein may be used in other types of internal procedures as well.

Device 20 is prepared (e.g. by injecting fluid F into chamber 26, if not already present) and inserted into a blood vessel of a patient and maneuvered to a desired location within the vasculature. Transducer 28 may be operated during travel to the desired location, since the transducer 28 can be pivoted through use of linear motor 34 or other linear force-provider to face at least generally forward of device 20. Throughout placement and at a desired imaging location,

rotary motor 32 can be operated to turn transducer around the rotating axis to provide images around device 20, and linear motor 34 (as one example) can be operated to pivot transducer around a pivoting axis to shift the ultrasound field forward and/or backward. Controls for motors 32 and/or 34 (not shown) may be provided to maintain one or both at a particular rotational speed or pattern. For example, modalities such as a spin around the rotating axis of between 30-100 Hz may be combined with a slower pivoting around the pivoting axis of about 1-2 Hz, to provide clear images forward and backward in a defined pattern. It has also been determined that a relatively slow spin around the rotating axis (e.g. about 1-2 Hz) combined with pivoting around the pivoting axis more rapidly, e.g. near a resonant frequency of device 20 can provide good results. A modality providing a faster rotation around the rotating axis when transducer 28 is pointed closer to the rotating axis and slower rotation around the rotating axis when transducer 28 is further from the rotating axis is also useful for improving the image frame rate and clarity. Imaging continues, with adjustments to the positioning of transducer 28 and the ultrasound field, as the physician deems necessary or useful.

Embodiments of device 20 used in IVUS would preferably be about 2.7-3.00 mm or less in diameter, so as to be effective in the human vasculature. Linear motor 34 and rotary motor 32 each may have a length of approximately 2.5 mm in particular embodiments. With mounting 30 and transducer (piezoelectric element) 28 included, an overall length may be approximately 10 mm in overall length. While device 20 is described in part above in the context of intravascular (IVUS) uses, it will be understood that embodiments of device 20 could also be used for other medical procedures and/or with a variety of other medical devices. The versatility of the embodiments described herein allows IVUS to be used to guide percutaneous therapeutic interventions such as for example embolism coils, stents, filters, graphs, balloons, biopsies, and administering therapeutics, etc. Device 20 can be used to locate various anatomical landmarks that will be used to correctly place or guided therapy. Typical landmarks include confluences, bifurcations, side branches, nearby vessels, nearby nerves, the heart, and other tissues adjacent to vessels or other orifices containing the IVUS transducer. Device 20 can also be used to locate diseased tissue that will be treated or avoided. Device 20 can be used during a biopsy to provide an image of a needle being deployed into tissue. During a TIPS procedure an image can be produced to allow a physician to watch a needle being placed into the portal vein. For AAA delivery, device 20 can allow a physician to place a guide wire into a contralateral leg. Device 20 could also be used to image the location of a deployed implantable device both during and after deployment.

In the use of the terms "rotation" or "rotational," e.g. with respect to a rotational axis, it should be understood that even though rotation often implies an angle change much greater than 360°, the devices disclosed herein may be configured in certain embodiments so that the rotational angle may rotate through angles less than 360°. Similarly, in the use of the terms "pivot" or "pivoting," e.g. with respect to a pivoting axis, it should be understood that even though the term pivot often implies an angle change less than 360°, the devices disclosed herein may be configured in certain embodiments so that the pivoting angle may pivot through angles greater than 360°. In some instances the term "pivot" may be considered by some more natural than "rotate" or vice versa, but for the purposes of this application the terms "rotate" and

“pivot” are used for clarity to indicate the axis about which a change in angle occurs, not the nature or magnitude of the angle change.

While the embodiments have been illustrated and described in detail in the drawings and foregoing description, the same is to be considered as illustrative and not restrictive in character, it being understood that only particular embodiments have been shown and described and that all changes and modifications that come within the spirit of the disclosure are desired to be protected. It will be understood that features or attributes noted with respect to one or more specific embodiments may be used or incorporated into other embodiments of the structures and methods disclosed.

What is claimed is:

1. An apparatus for ultrasound procedures, comprising:
 - a catheter/tubular member for insertion into the body and defining a chamber in a distal end of the catheter/tubular member;
 - a transducer for emitting and/or receiving ultrasound signals within the chamber;
 - a rotary motor including a rotatable shaft extending substantially along a rotating axis, the rotary motor being within or adjacent the chamber and at least a distal end of the rotatable shaft extending within the chamber, wherein operation of the rotary motor rotates the rotatable shaft around the rotating axis;
 - a pivoting mechanism operationally connected to the rotatable shaft of the rotary motor so that the pivoting mechanism rotates in response to rotation of the rotatable shaft, the pivoting mechanism having a base located on and centered with respect to the rotating axis and a pivoting member that is pivotable with respect to the base around a pivoting axis, the pivoting axis being substantially perpendicular to the rotating axis,
 - a forcing member operationally connected to the pivoting member, wherein a force applied via the forcing member controls pivoting of the pivoting member around the pivoting axis.
2. The apparatus of claim 1, wherein the forcing member is movable with respect to the rotatable shaft.
3. The apparatus of claim 1, wherein the rotatable shaft has a longitudinal lumen, and wherein the forcing member extends at least partially through the lumen.
4. The apparatus of claim 1, wherein the forcing member comprises a filament such that pulling the filament results in pivoting the pivoting member around the pivoting axis.
5. The apparatus of claim 1, wherein the forcing member comprises a longitudinal shaft of a linear motor, the longitudinal shaft extending substantially on the rotating axis, wherein operation of the linear motor moves the longitudinal shaft along the rotating axis, the longitudinal shaft being operationally connected to the pivoting member to control the pivoting of the pivoting member around the pivoting axis during both turning of the rotor and operation of the transducer.
6. The apparatus of claim 5, wherein the rotatable shaft of the rotary motor has a lumen therethrough, and wherein the longitudinal shaft of the linear motor has at least a portion extending within the lumen of the rotatable shaft and a distal portion outside of the lumen.
7. The apparatus of claim 6, wherein the longitudinal shaft is directly connected to the pivoting member.
8. The apparatus of claim 7, wherein the longitudinal shaft has a rounded distal end in contact with the pivoting member.

9. The apparatus of claim 6, wherein the longitudinal shaft is connected to the pivoting member by a pivoting connector.

10. The apparatus of claim 9, wherein the longitudinal shaft is movable in two directions along the rotating axis by the linear motor, wherein movement of the longitudinal shaft in a first linear direction pivots the pivoting member in a first pivoting direction, and movement of the longitudinal shaft in a second linear direction pivots the pivoting member in an opposite second pivoting direction.

11. The apparatus of claim 5, including a tubular member having a wall defining a chamber at the distal-most end of the tubular member, and wherein the transducer, rotary motor, linear motor and pivoting mechanism are within the chamber, and wherein at least part of the chamber is filled with coupling fluid.

12. The apparatus of claim 1, wherein the rotation of the rotatable shaft about the rotating axis and the pivoting of the pivoting member about the pivoting axis are separably operable at one or more frequencies, so that the user can choose from multiple ultrasound scan patterns.

13. The apparatus of claim 12, further comprising a control for the rotary motor for attaining a modality in which the rotary motor turns faster when the pivoting mechanism is in a state such that the ultrasound signals are pointing in a direction closer to the rotary motor's axis of rotation, and the rotary motor turns slower when the pivoting mechanism is in a state such that the ultrasound signals are pointing in a direction further from the rotary motor's axis of rotation.

14. The apparatus of claim 1, wherein the transducer is fixed with respect to the pivoting member, so that the transducer rotates with the rotatable shaft of the rotary motor and pivots with the pivoting member.

15. The apparatus of claim 1, further comprising a mirror fixed with respect to the pivoting member, so that the mirror rotates with the rotatable shaft of the rotary motor and pivots with the pivoting member, and reflects an ultrasonic beam from the transducer.

16. The apparatus of claim 15, wherein the pivoting member comprises the mirror.

17. The apparatus of claim 1, wherein the pivoting member is spring-biased to an initial orientation relative to the base, and when force applied via the forcing member is released, the pivoting member returns toward the initial orientation.

18. The apparatus of claim 1, wherein the pivotable member has a range of motion around the pivoting axis of a magnitude between at least 150 degrees and 360 degrees.

19. The apparatus of claim 1, wherein the transducer is fixed with respect to the pivotable member, and the pivotable member has a range of motion such that the transducer can be oriented so that it emits ultrasound signals substantially along the rotating axis and away from the rotary motor.

20. The apparatus of claim 1, wherein the pivoting mechanism is a gimbal mount apparatus.

21. The apparatus of claim 20, further comprising a tubular member for housing the transducer, rotary motor, gimbal mount and at least part of the longitudinal member, the tubular member having a distal chamber defined at least in part by a wall portion of the tubular member, the distal chamber housing at least the transducer and a medium, the wall portion and the medium having similar ultrasound passage characteristics to the part of the body into which the tubular member is inserted, so that reflection of ultrasound at the boundary of the medium and the wall portion and at the boundary of the wall portion and body environment is reduced to a level acceptable for imaging through the boundary.

22. The apparatus of claim 1, wherein the longitudinal member comprises a shape memory actuator.

15

23. The apparatus of claim 1, including a tubular member having a wall defining a chamber at the distal-most end of the tubular member, and wherein the transducer, rotary motor, and pivoting mechanism are within the chamber, and wherein at least part of the chamber is filled with coupling fluid.

24. The apparatus of claim 1, wherein the transducer has a position within the chamber, and wherein the transducer has a signal sweep that extends both forward and backward of the position of the transducer.

25. An apparatus for ultrasound procedures, comprising: a tubular member having an internal chamber at an application end of the apparatus, the chamber adapted to be placed in and through blood vessels, the chamber adapted to contain a coupling fluid in at least part of the chamber;

a rotary motor in the chamber including a rotatable shaft extending substantially along a rotating axis, wherein operation of the rotary motor rotates the rotatable shaft around the rotating axis;

16

a linear motor having a longitudinal shaft, the rotating axis extending through the longitudinal shaft and the longitudinal shaft extending through the rotatable shaft; a transducer for emitting and/or receiving ultrasound signals mounted in a pivoting mechanism, the transducer and pivoting mechanism being in the chamber, the pivoting mechanism having a base fixed to the rotatable shaft on and centered with respect to the rotating axis and a pivoting member that is pivotable with respect to the base around a pivoting axis, the pivoting axis being substantially perpendicular to and intersecting the rotating axis,

wherein operation of the linear motor moves the longitudinal shaft along the rotating axis, the longitudinal shaft being operationally connected to the pivoting member to control the pivoting of the pivoting member around the pivoting axis during both turning of the rotor and operation of the transducer.

26. The apparatus of claim 25, wherein the rotating axis and the pivoting axis both intersect the transducer.

* * * * *

专利名称(译)	用于三维内部超声使用的装置和方法		
公开(公告)号	US9649092	公开(公告)日	2017-05-16
申请号	US14/051868	申请日	2013-10-11
[标]申请(专利权)人(译)	玛芬股份有限公司		
申请(专利权)人(译)	MUFFIN INCORPORATED		
当前申请(专利权)人(译)	MUFFIN INCORPORATED		
[标]发明人	FEARNOT NEAL E MCKINNIS PETER S ROBBINS SARAH ZHOU YUN		
发明人	FEARNOT, NEAL E. MCKINNIS, PETER S. ROBBINS, SARAH ZHOU, YUN		
IPC分类号	A61B8/14 A61B8/00 A61B8/12 B06B1/06 G10K11/00 G10K11/35 A61B8/08 G01S15/89		
CPC分类号	A61B8/4466 A61B8/12 A61B8/445 A61B8/4461 A61B8/4483 B06B1/06 G01S15/894 G01S15/8943 G10K11/004 G10K11/352 A61B8/0891 A61B8/483 G01S15/8918		
代理人(译)	BROWN, CHRISTOPHER		
审查员(译)	基士JAMES		
优先权	61/727680 2012-11-17 US 61/713172 2012-10-12 US		
其他公开文献	US20140107491A1		
外部链接	Espacenet USPTO		

摘要(译)

公开了用于对身体部位，特别是血管内部成像的装置和方法的实施例。在特定实施例中，导管具有尖端腔室，其中是安装在枢转机构上的超声换能器，用于转动换能器的马达，以及用于枢转换能器的工具。这种工具的示例是线性马达，轴或细丝，并且当工具不使换能器枢转时，枢转机构可被偏置以返回到基部位置。在其他实施例中，使用类似的机构可以旋转和/或枢转反射来自换能器的超声信号的镜子。

