

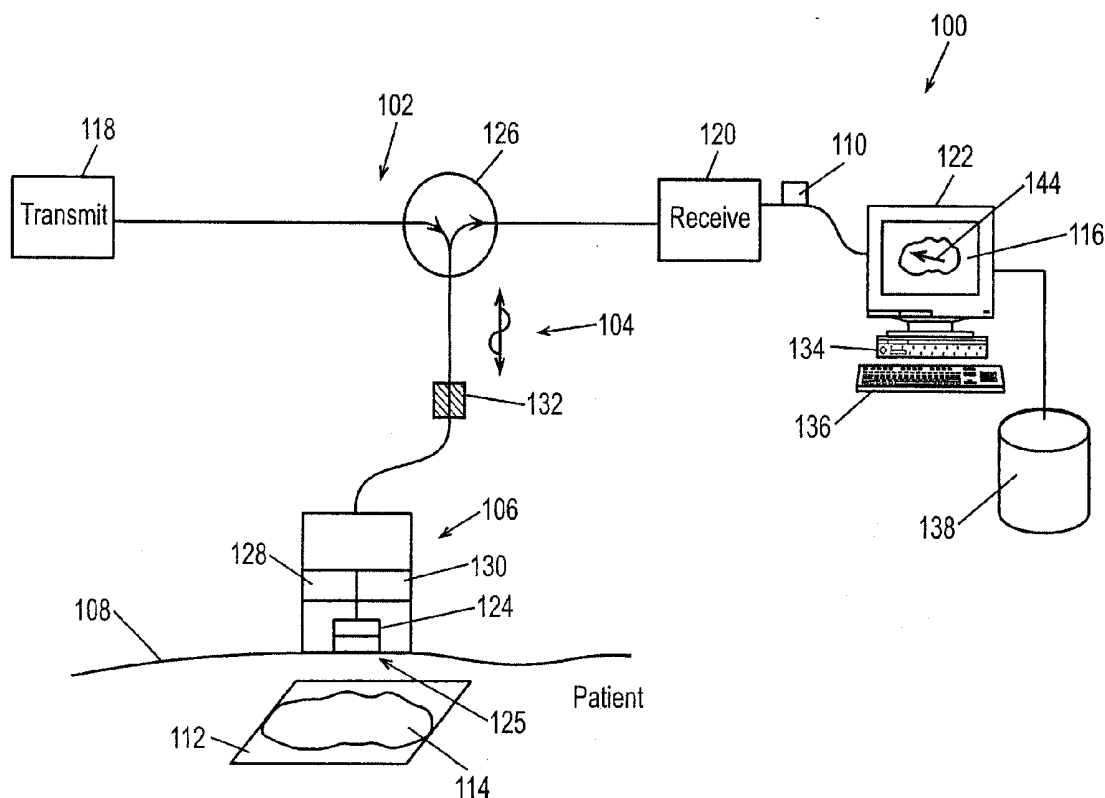

US 20080015438A1

(19) **United States**(12) **Patent Application Publication**
Mehi et al.(10) **Pub. No.: US 2008/0015438 A1**(43) **Pub. Date: Jan. 17, 2008**(54) **HIGH FREQUENCY, HIGH FRAME-RATE
ULTRASOUND IMAGING**(76) Inventors: **James I. Mehi**, Thornhill (CA);
Nicholas Christopher Chaggares,
Peterborough (CA); **Stuart Foster**,
Toronto (CA); **Robert McConaghy**,
Kirkland, WA (US)Correspondence Address:
NEEDLE & ROSENBERG, P.C.
SUITE 1000
999 PEACHTREE STREET
ATLANTA, GA 30309-3915 (US)(21) Appl. No.: **11/776,401**(22) Filed: **Jul. 11, 2007****Related U.S. Application Data**(63) Continuation of application No. 10/683,890, filed on
Oct. 10, 2003, now Pat. No. 7,255,678.(60) Provisional application No. 60/417,164, filed on Oct.
10, 2002. Provisional application No. 60/468,958,
filed on May 9, 2003. Provisional application No.
60/468,956, filed on May 9, 2003. Provisional appli-
cation No. 60/470,234, filed on May 14, 2003.**Publication Classification**(51) **Int. Cl.**
A61B 8/14 (2006.01)
(52) **U.S. Cl.** **600/447**; 600/453; 600/459;
600/463(57) **ABSTRACT**

A system for producing an ultrasound image comprises a scan head having a transducer capable of generating ultrasound energy at a frequency of at least 20 megahertz (MHz), and a processor for receiving ultrasound energy and for generating an ultrasound image at a frame rate of at least 15 frames per second (fps).



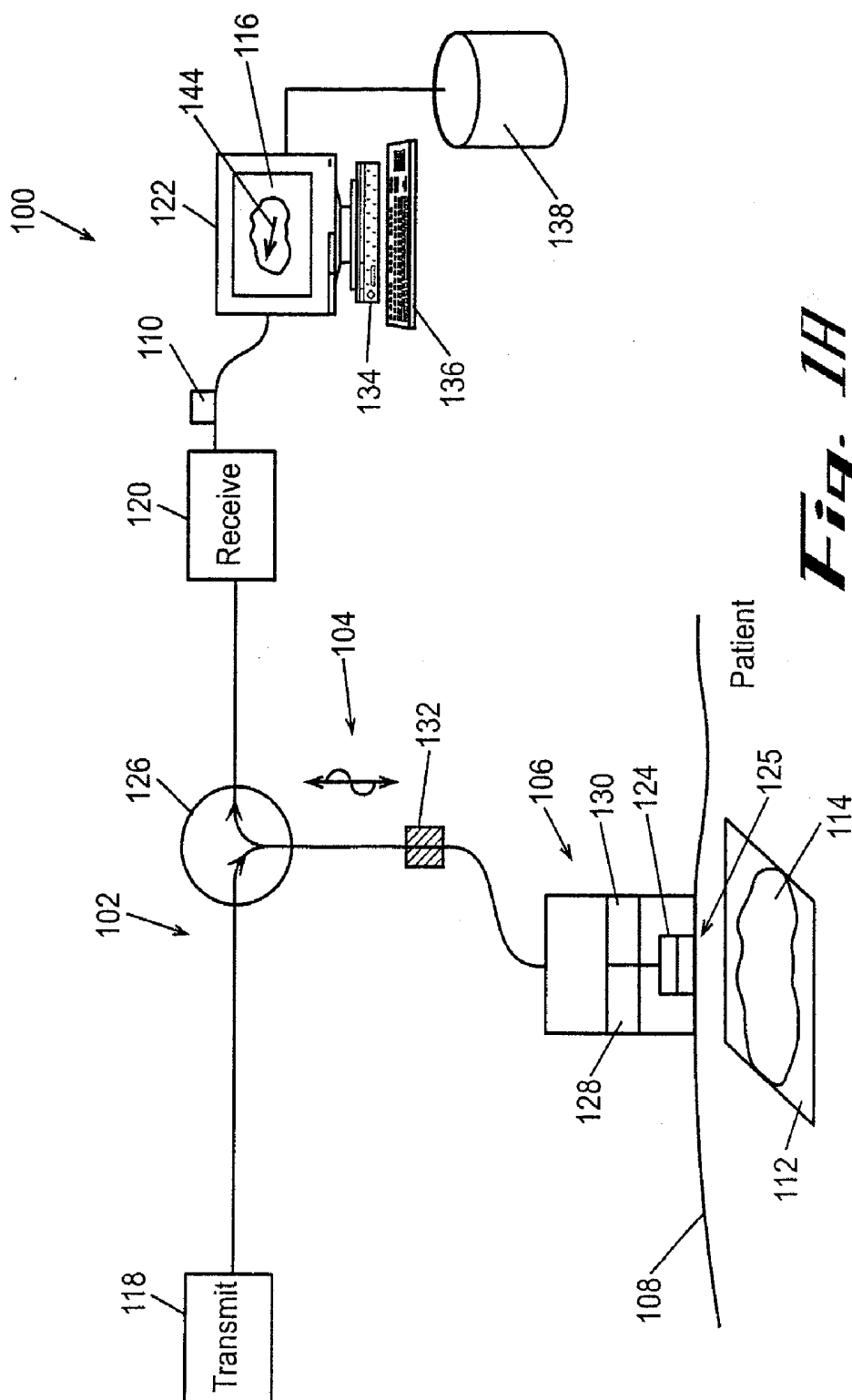

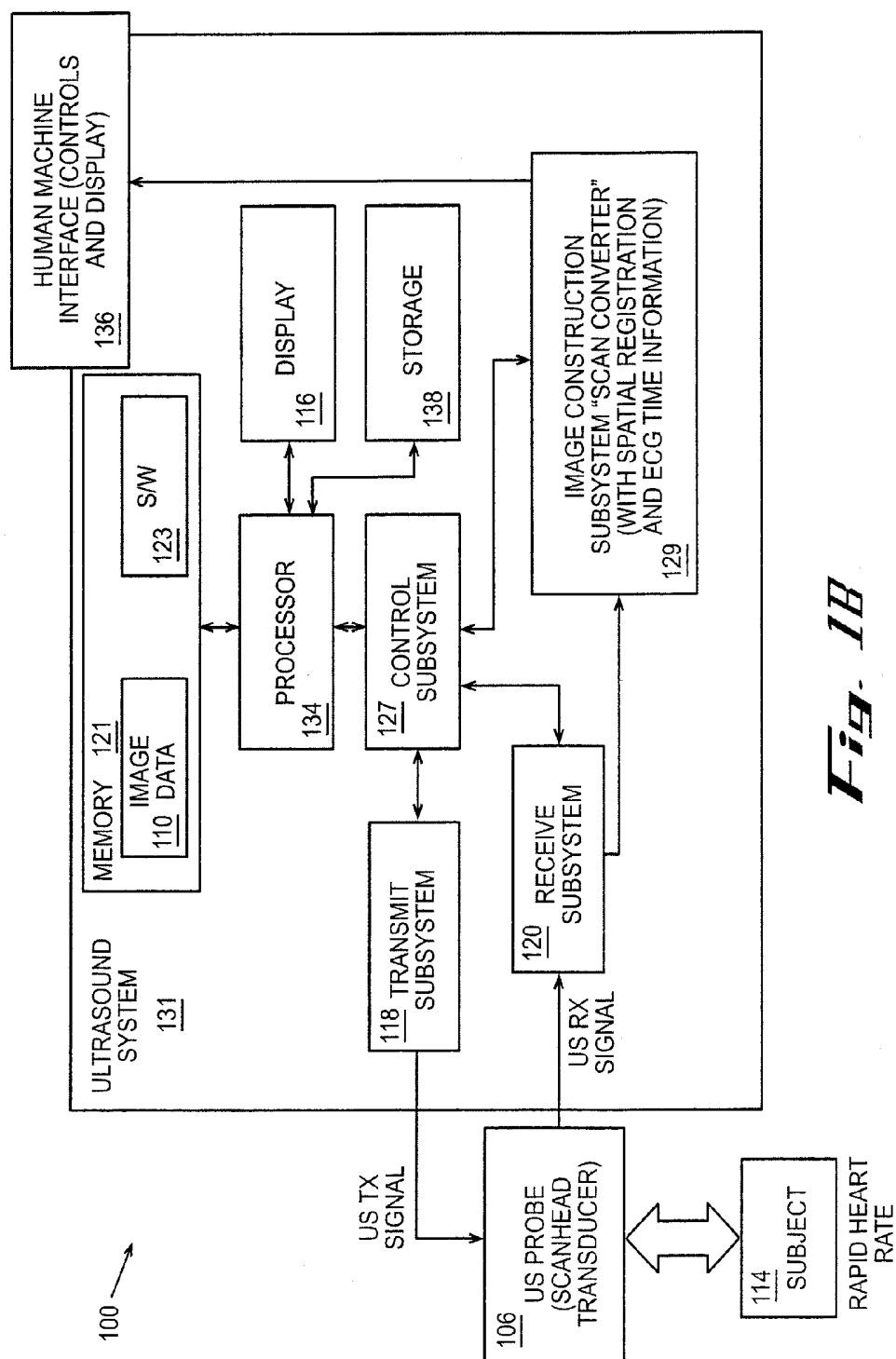

Fig. 1B

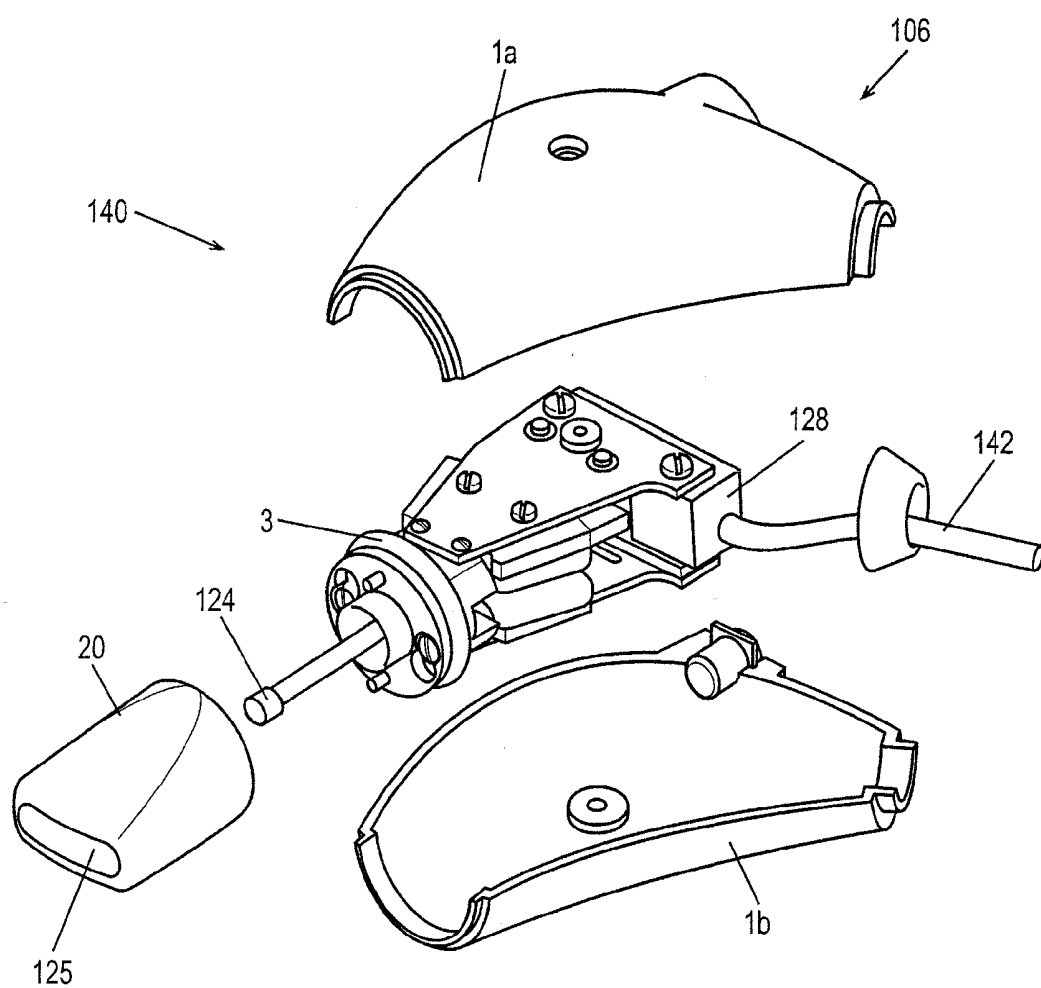

Fig. 2

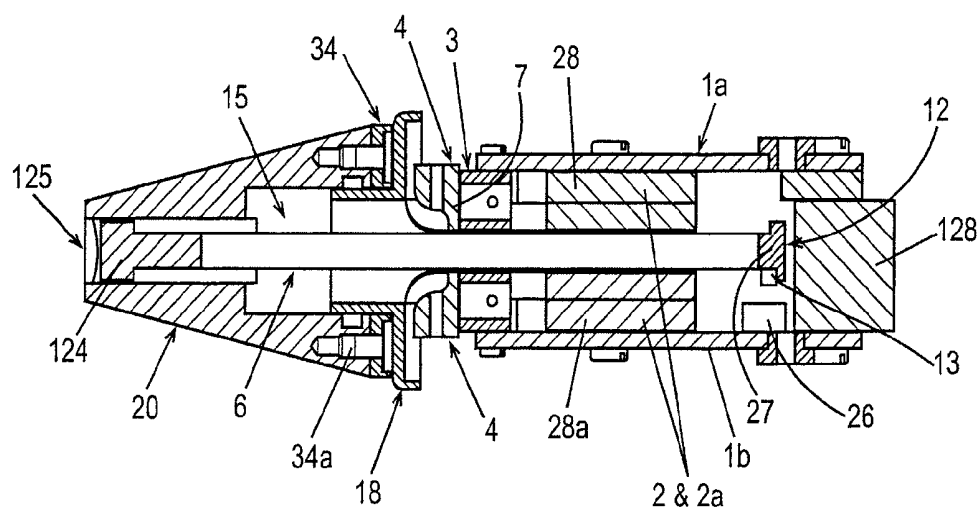

Fig. 3A

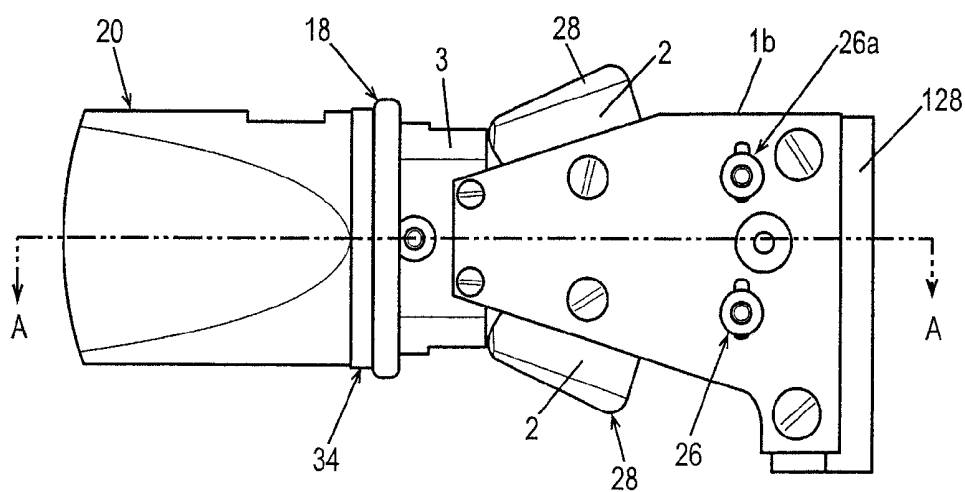
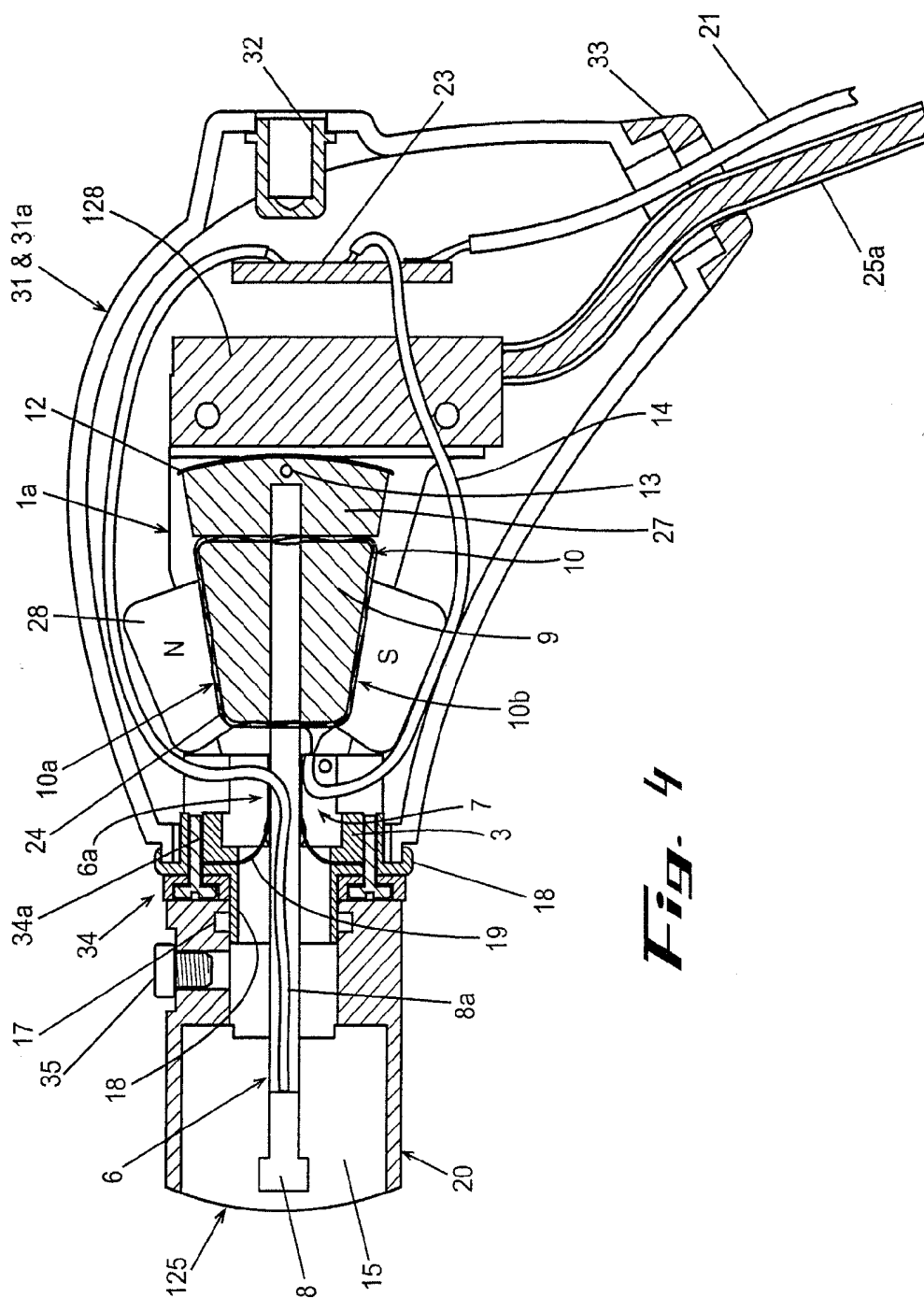

Fig. 3B



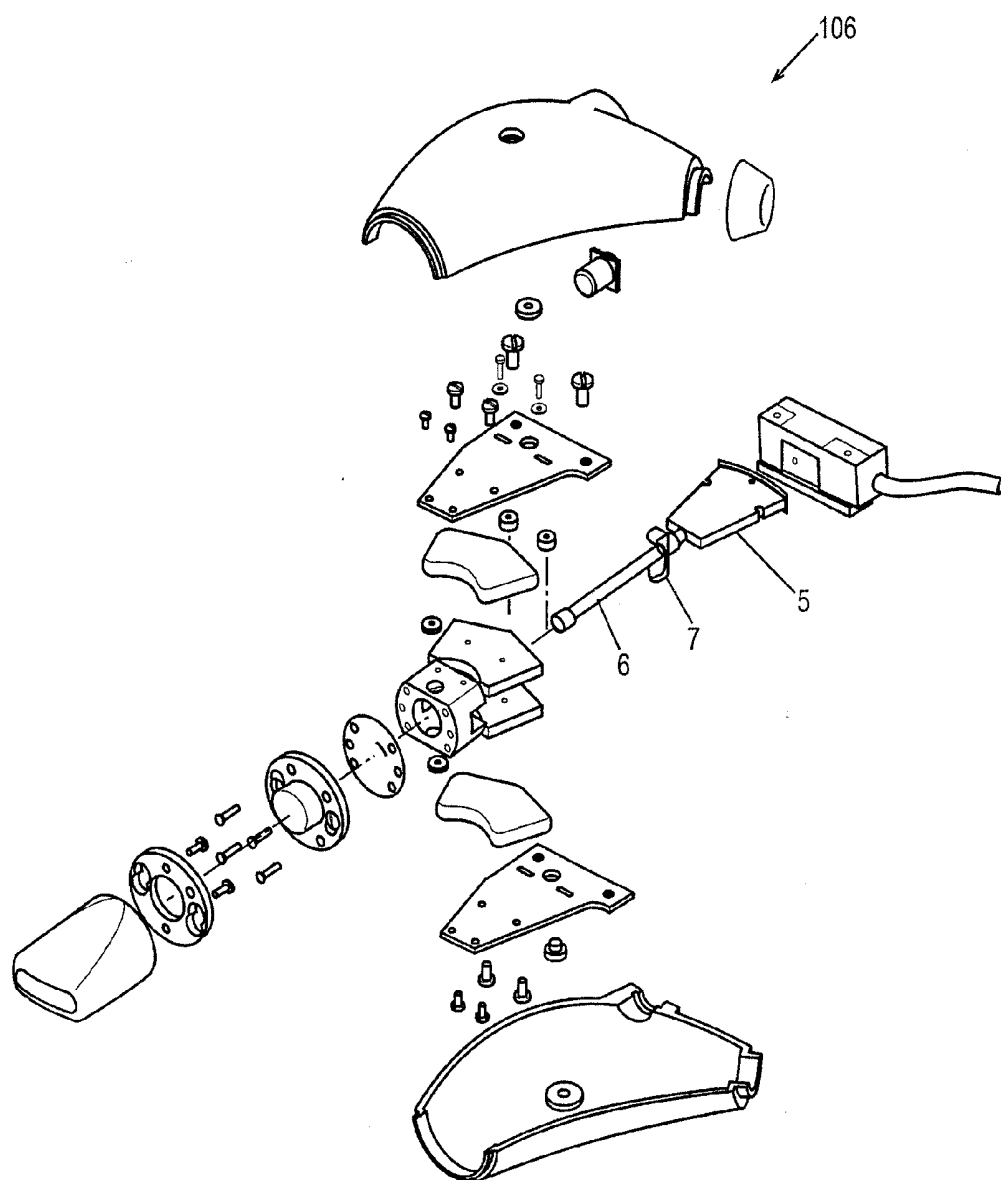
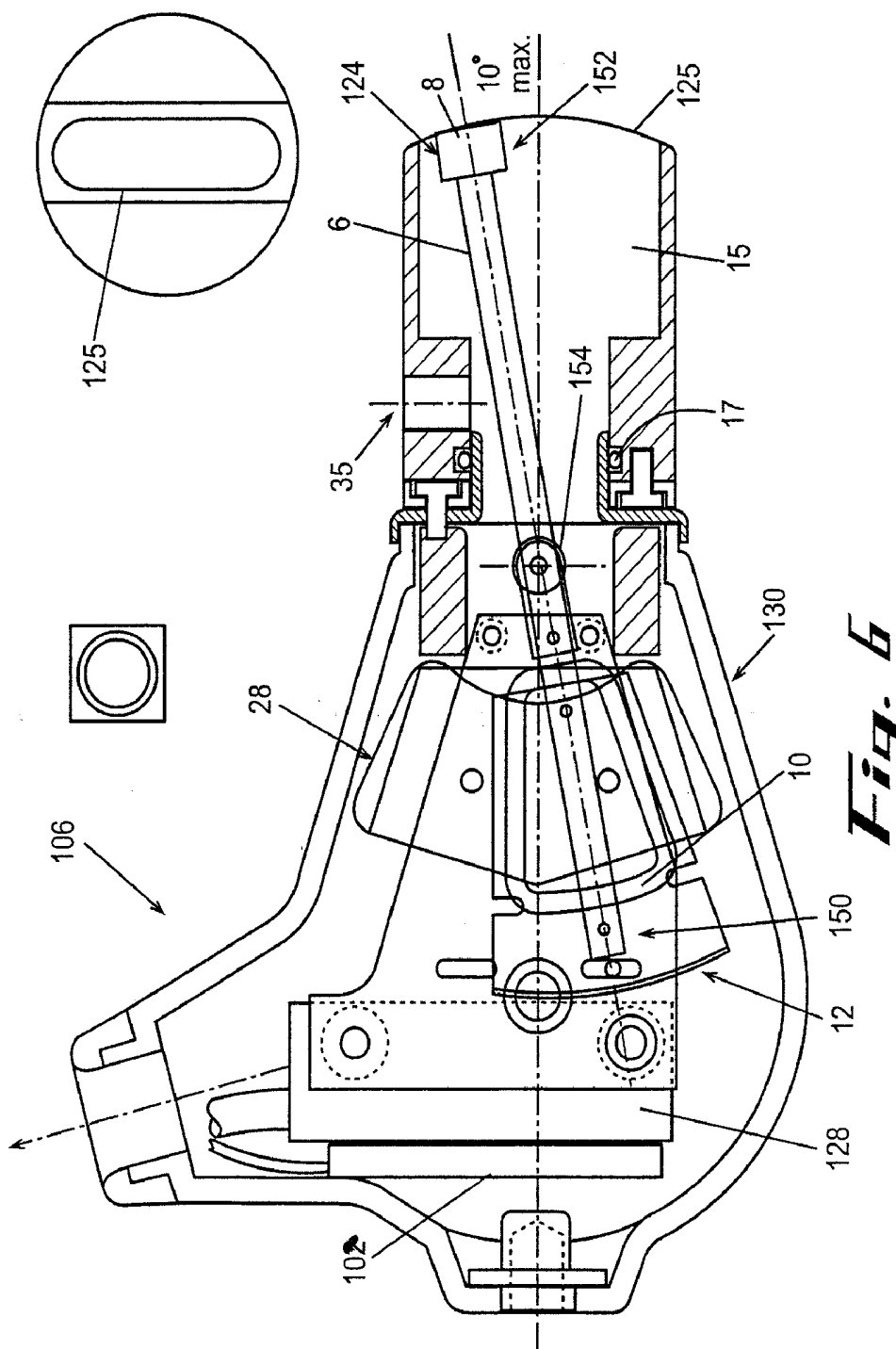

Fig. 5



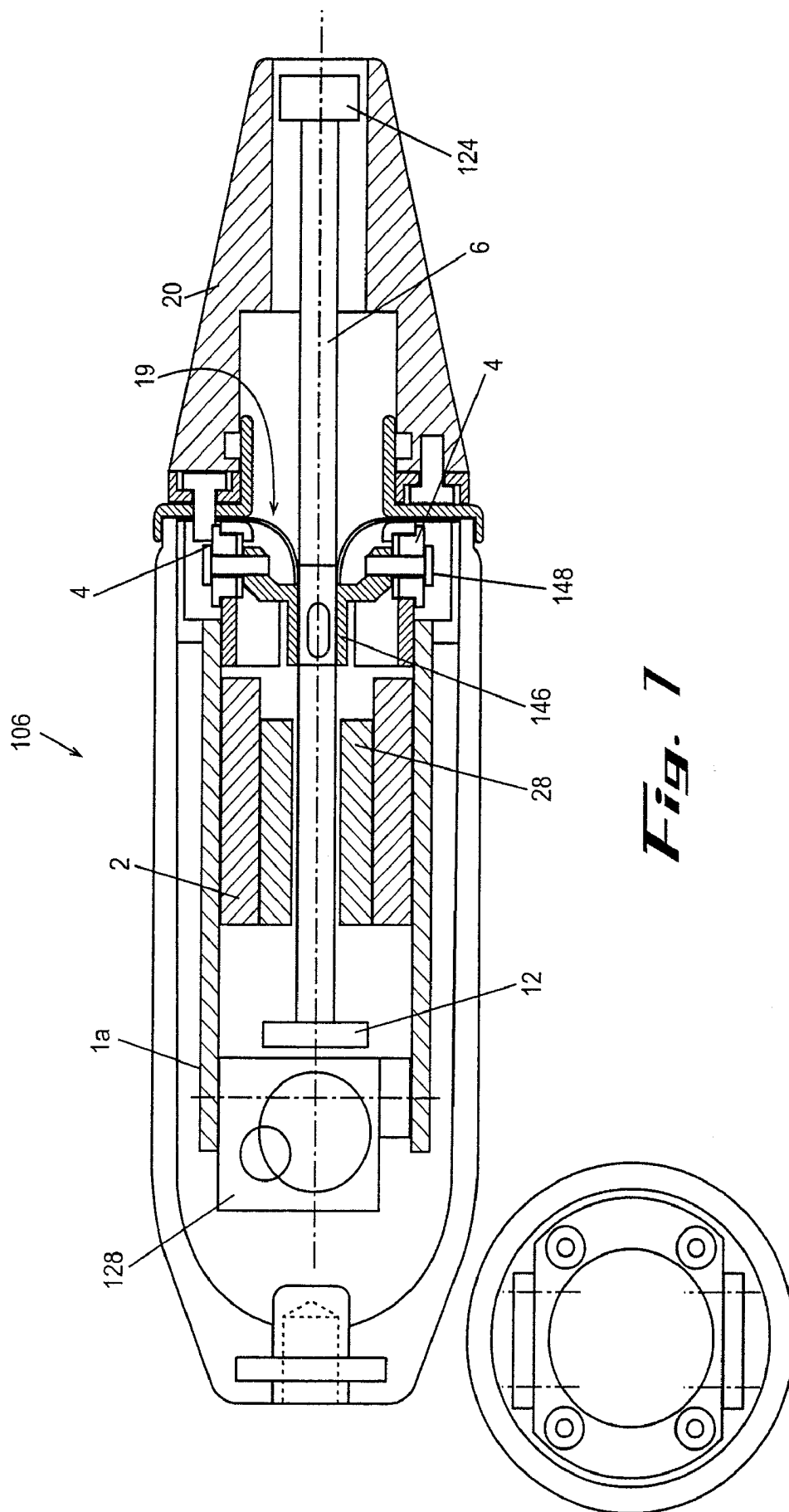

Fig. 7

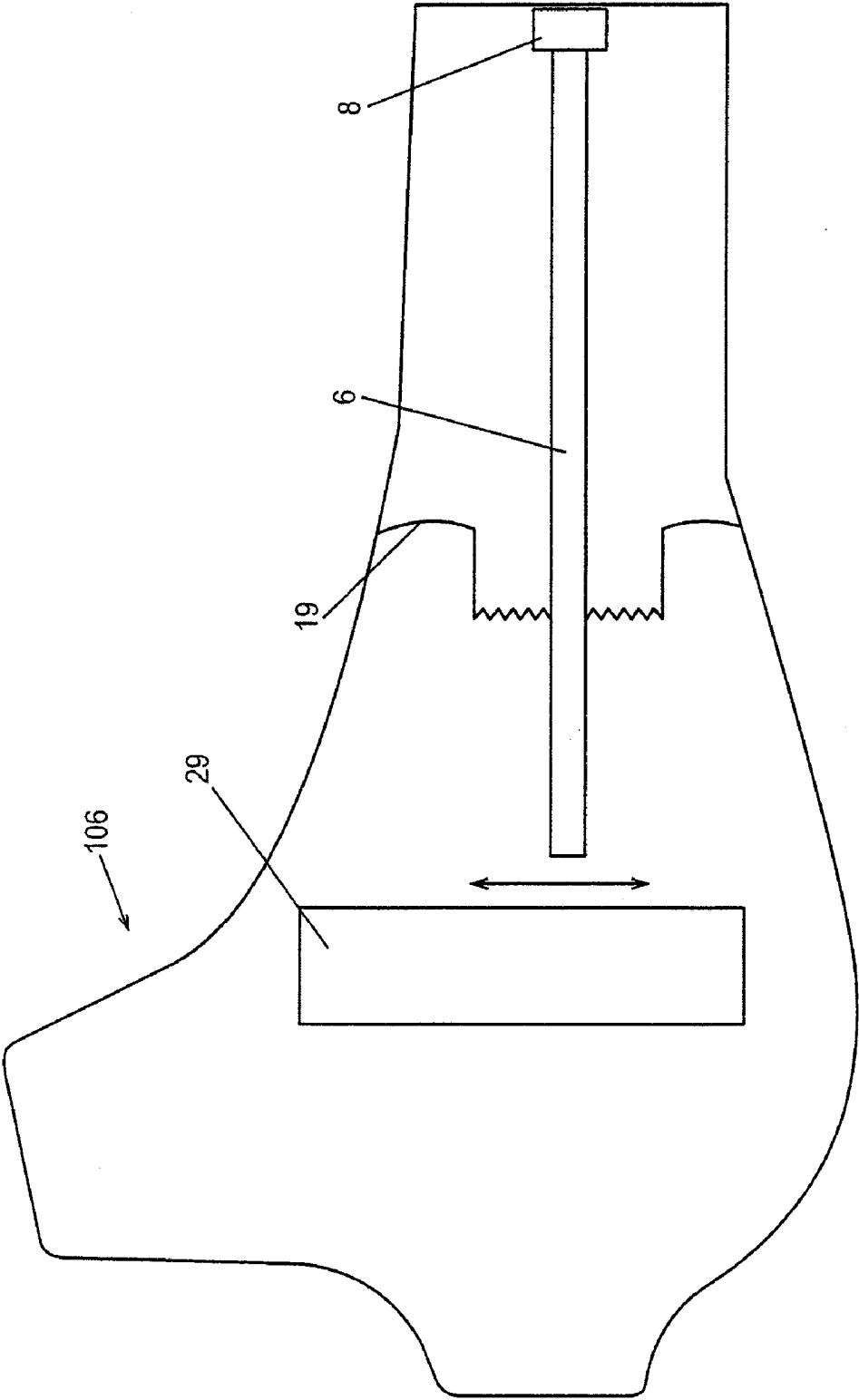
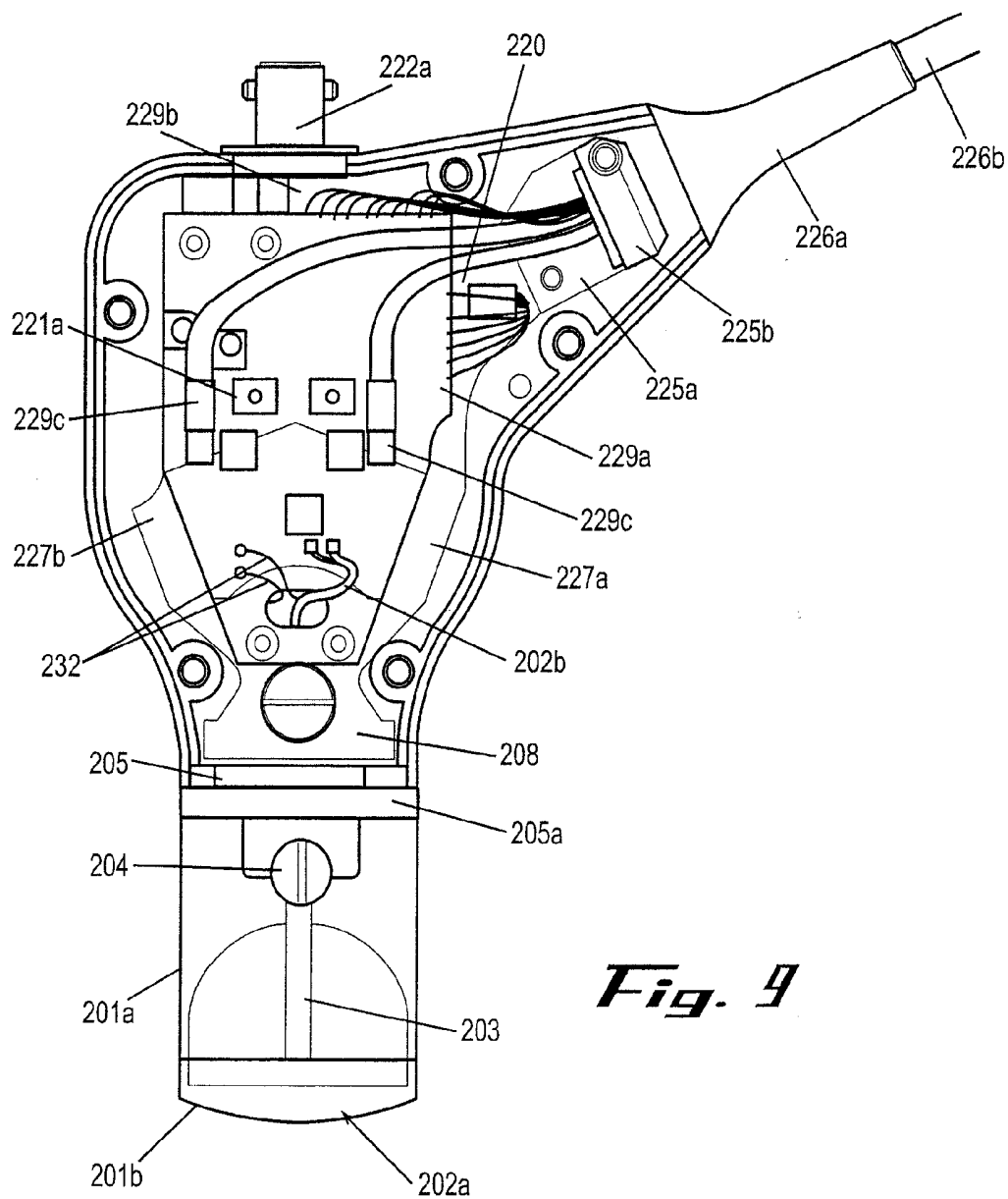

Fig. 8



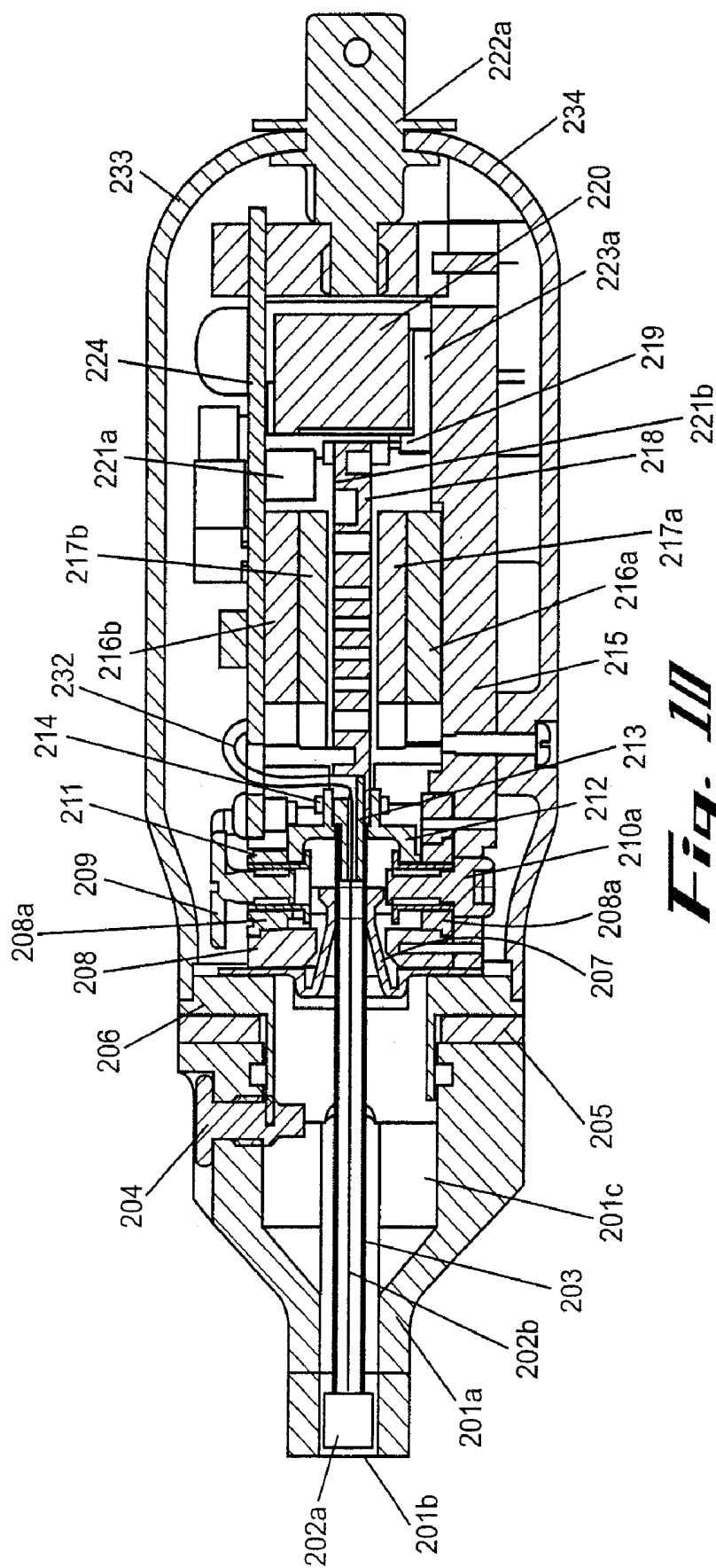
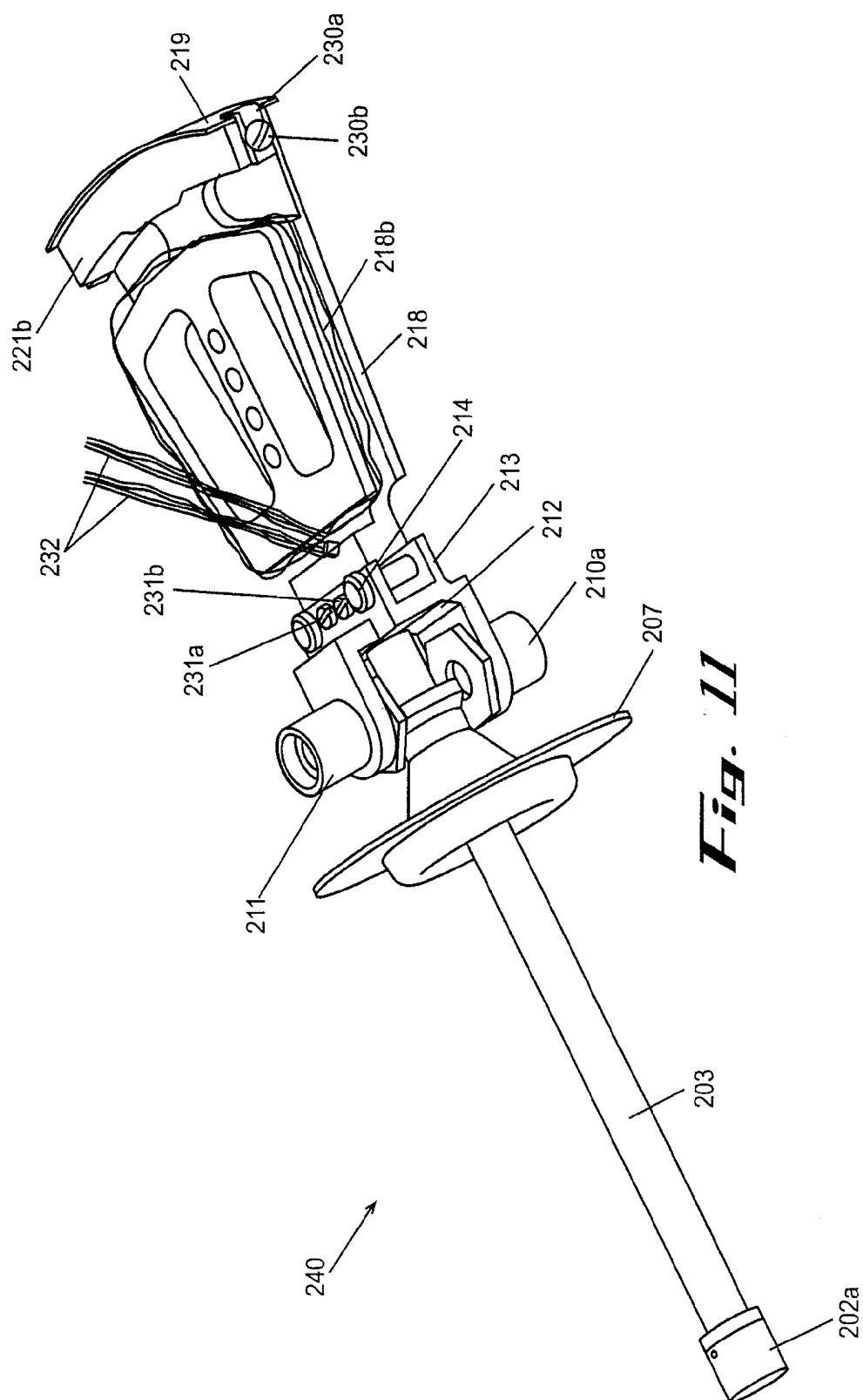
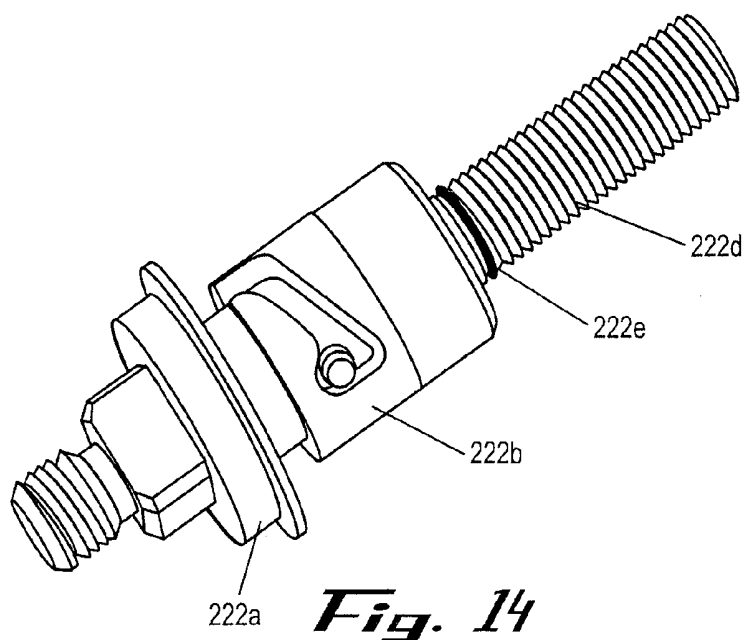
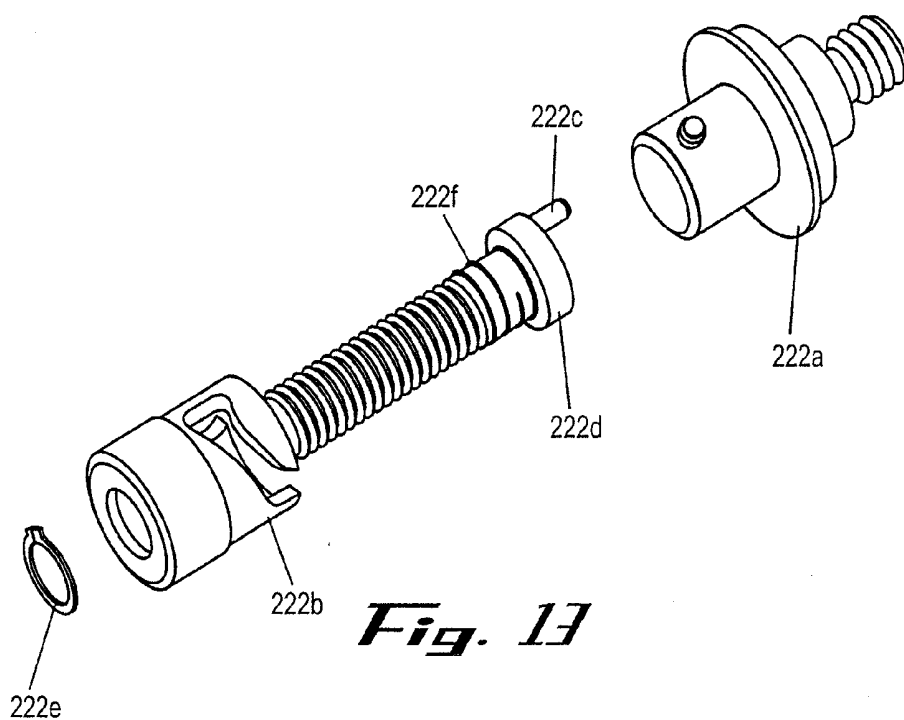
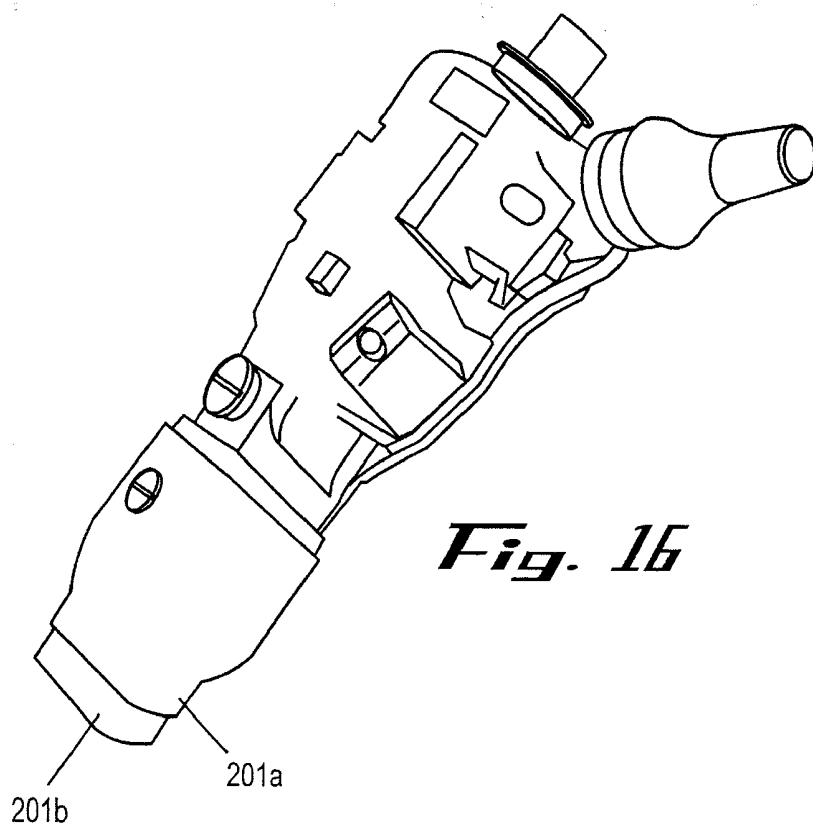
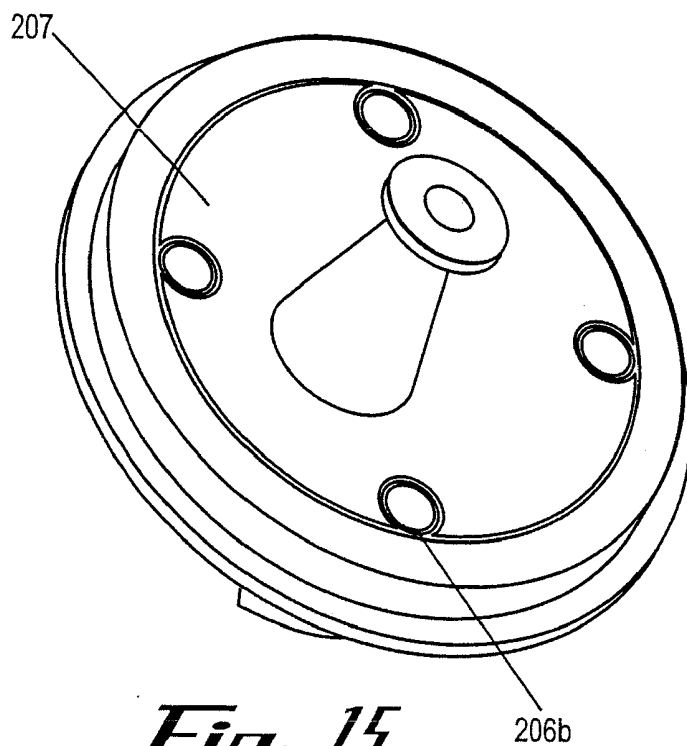

Fig. 111







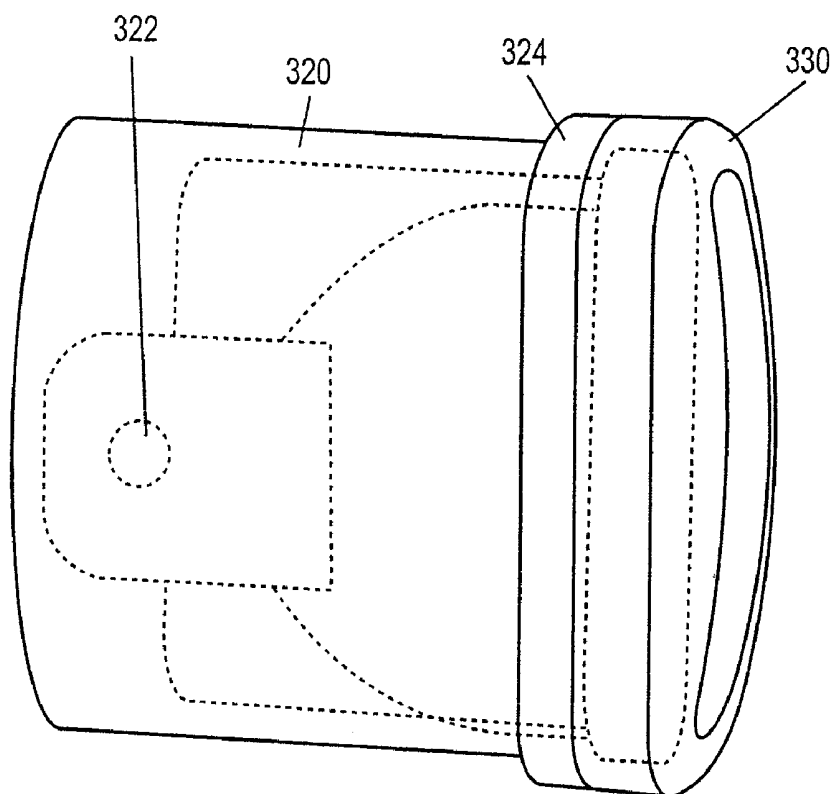

Fig. 17A

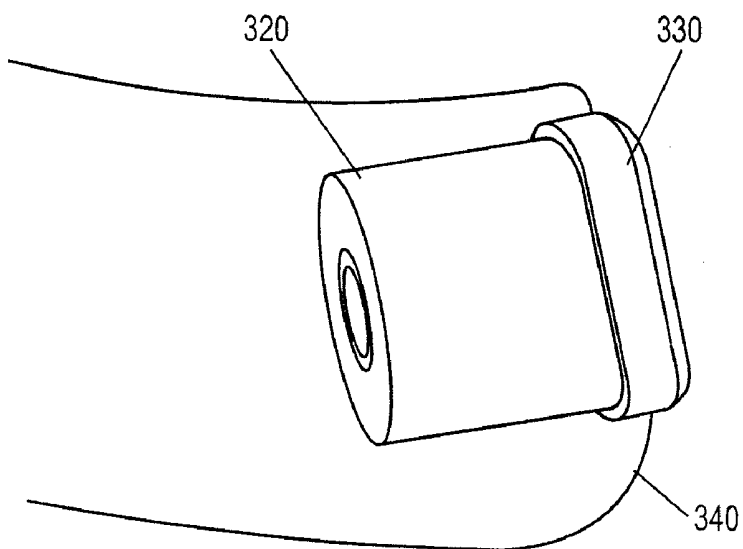

Fig. 17B

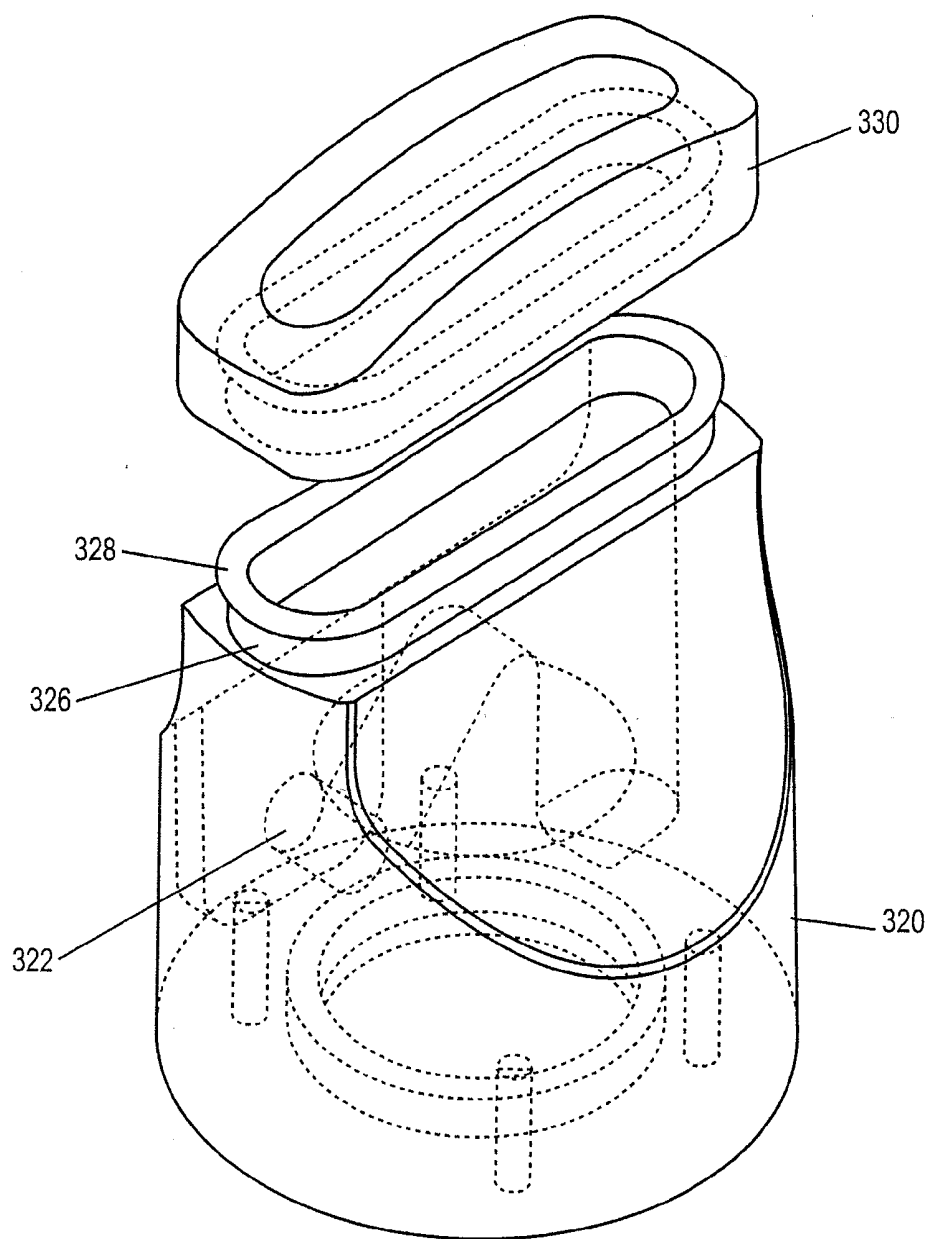

Fig. 1B

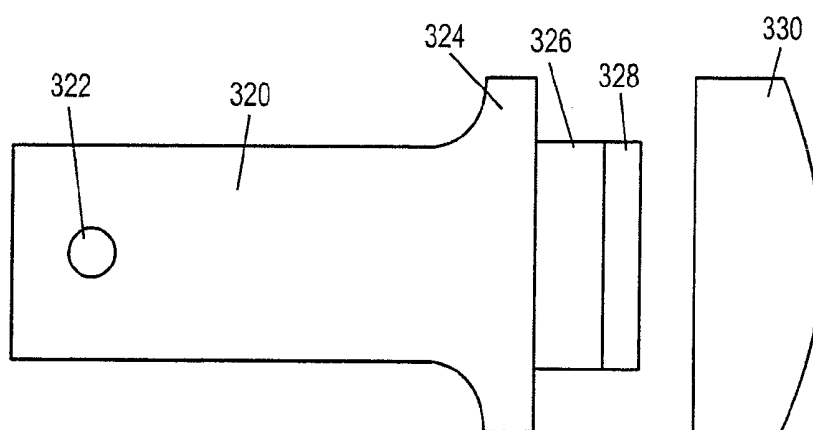

Fig. 19A

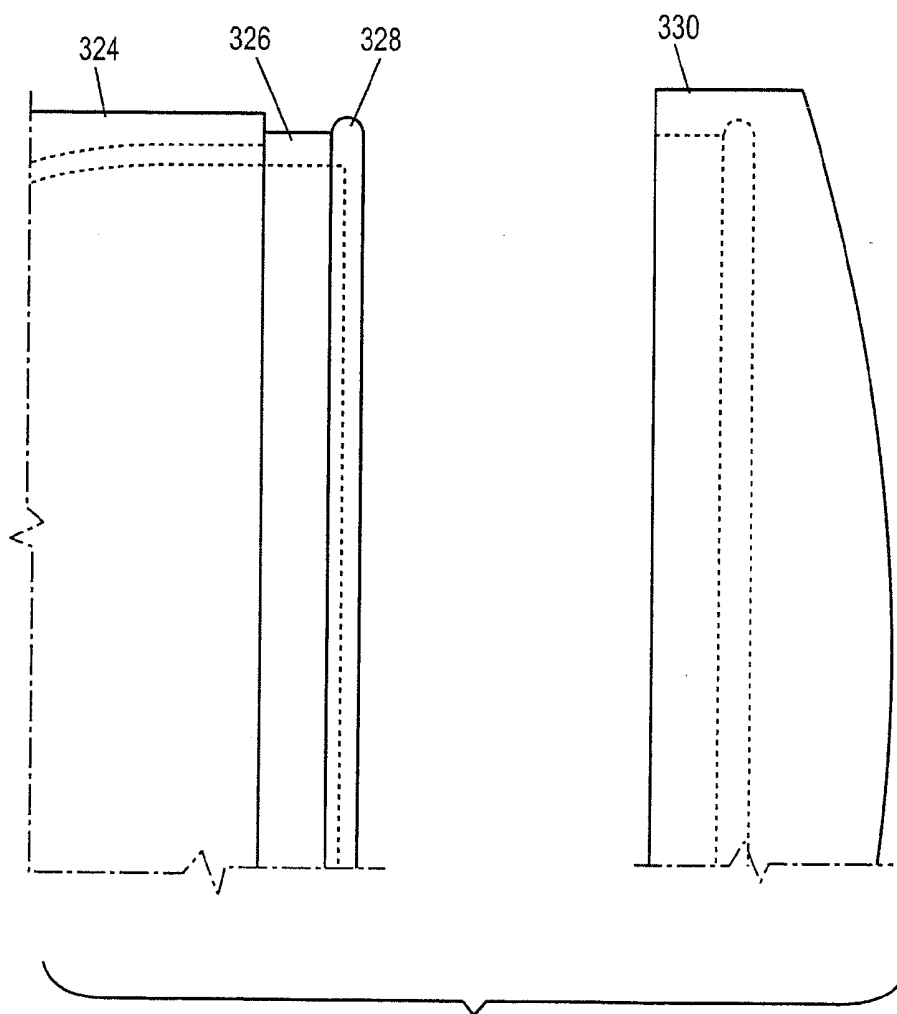

Fig. 19B

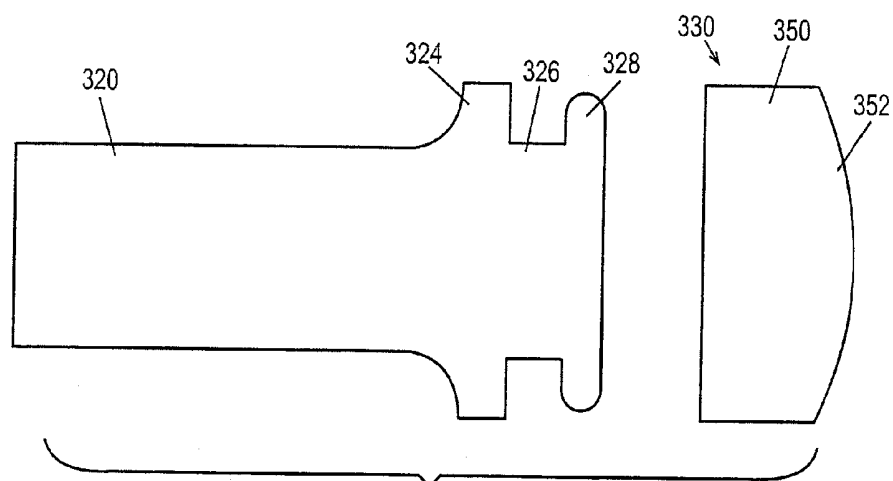

Fig. 20

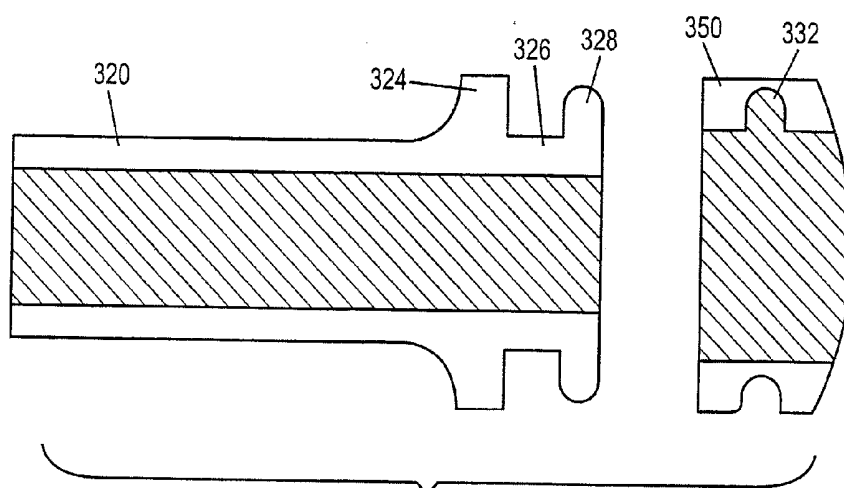

Fig. 21

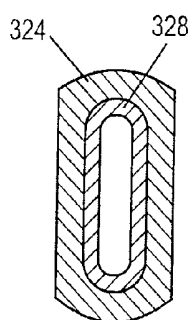

Fig. 22

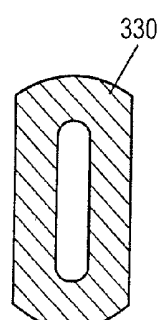

Fig. 23

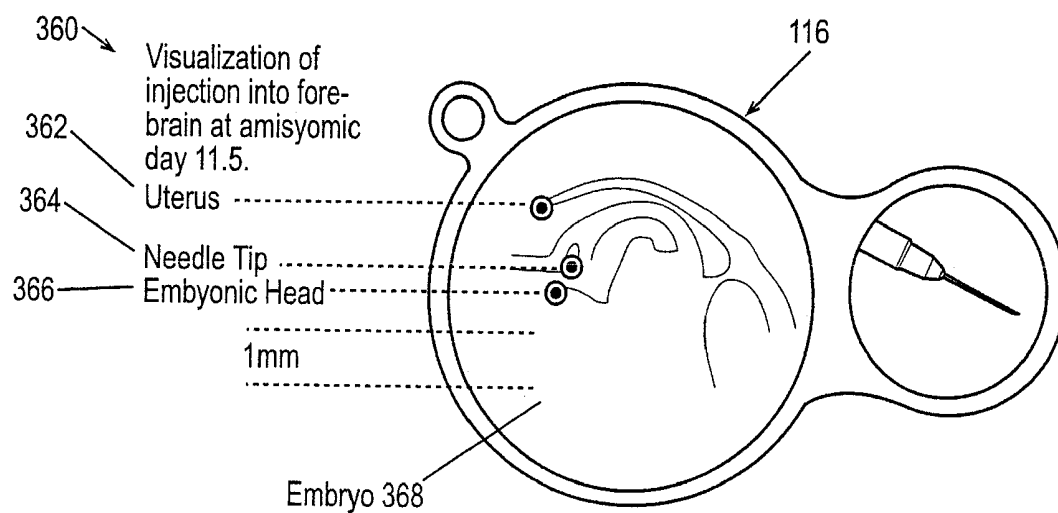
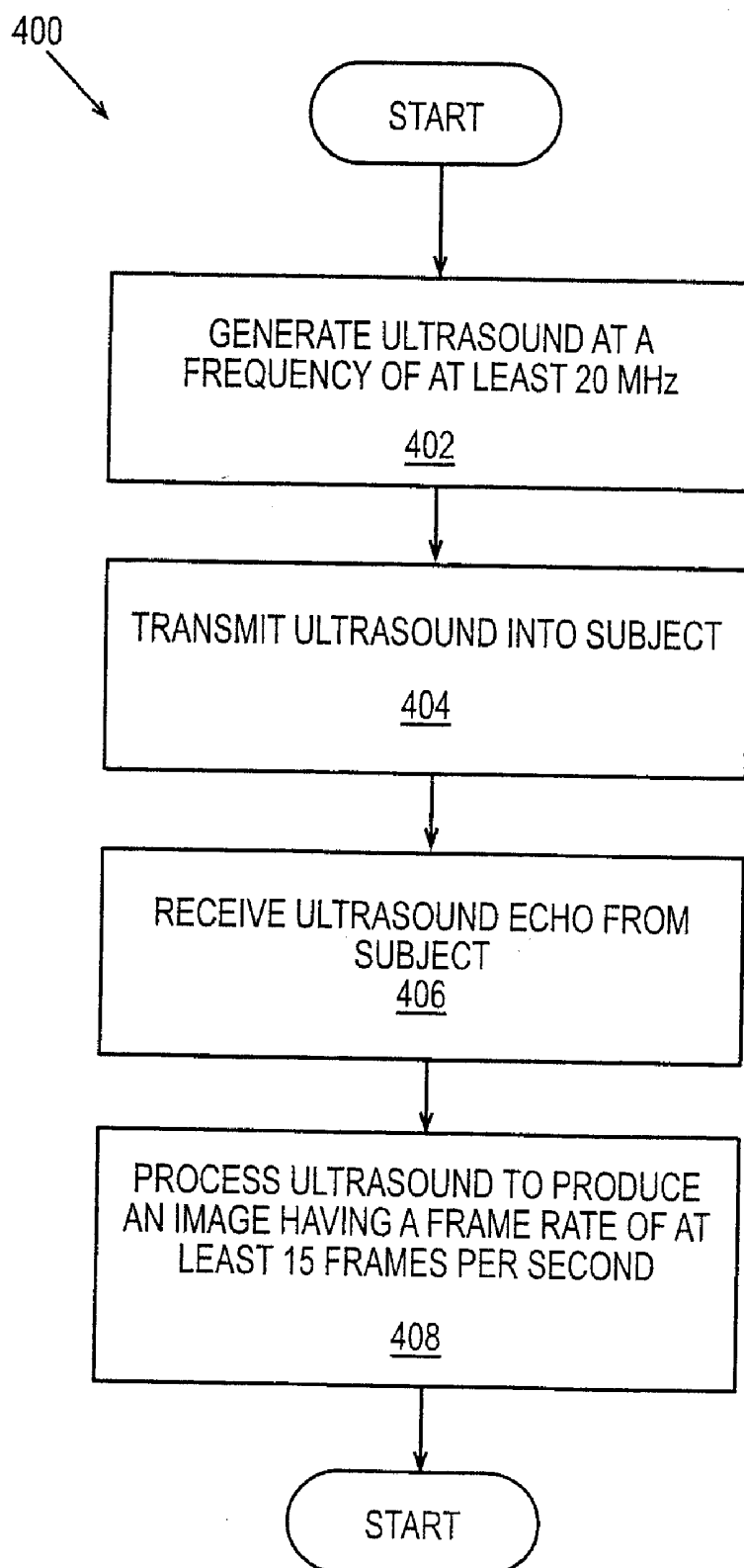

Fig. 24

***Fig. 25***

HIGH FREQUENCY, HIGH FRAME-RATE ULTRASOUND IMAGING

CROSS-REFERENCE TO RELATED APPLICATIONS

[0001] This application is a continuation of U.S. application Ser. No. 10/683,890, entitled “#HIGH FREQUENCY, HIGH FRAME-RATE ULTRASOUND IMAGING SYSTEM,” filed on Oct. 10, 2003, which priority to and the benefit of U.S. Provisional Application No. 60/417,164, entitled “#RMV SCANHEAD SYSTEM,” (attorney docket No. 14157PRO), filed on Oct. 10, 2002; U.S. Provisional Application No. 60/468,958, entitled “#SCAN HEAD FOR ULTRASOUND IMAGING SYSTEM,” (attorney docket No. T00518-0005-USP2 (190304-327786)), filed on May 9, 2003; U.S. Provisional Application No. 60/468,956, entitled “#REMOVABLE ACOUSTIC WINDOW,” (attorney docket No. T00518-0014-PROV-US (190304-326186)), filed on May 9, 2003; and U.S. Provisional Application No. 60/470,234, entitled “#METHOD AND APPARATUS FOR OBTAINING AN ULTRASOUND IMAGE,” (attorney docket No. T00518-0011-USP 1 (190304-325200)), filed on May 14, 2003, all of which are incorporated in this document by reference.

BACKGROUND

[0002] Scanheads that were developed in the late 1970's and early 1980's for imaging human tissue are still useful for many ultrasound imaging applications. A transducer located in the scanhead comprises discs of piezoelectric material, which when excited electrically vibrated at a frequency usually chosen to be between 2 and 10 MHz. At these frequencies, the vibrational energy of the transducer was directional and radiated from two faces of a thin circular disc in reasonably well-defined beams. In general, the energy radiating from the back of the transducer is absorbed by a suitable material while that from the front is coupled to the patient by a fluid capable of transmitting ultrasound energy with low loss characteristics. Emerging through a thin, low-loss cap, the energy is further coupled to the patient with a sonolucent gel applied to the patient's skin. Echoes resulting from the interaction of the ultrasound energy with body tissue traverse the same path in reverse, and when they strike the transducer generate an electrical signal whose strength is a function of the echogenicity of a target within the patient and the target's depth below the patient's skin. The location in depth is determined from the time interval between the transmit pulse and the received echo. With this information and the directional information delivered by a position encoder coupled to the transducer, the scanheads generate a gray-scale image of the tissue lying in a scan plane within the patient, which is refreshed and updated with every sweep of the transducer across the image plane. Two sweeps of the transducer comprises one operating cycle, referred to as 1 Hz, and equates to two frames per second.

[0003] Two dimensional ultrasound images (also known as B-scans) are made up of a number of adjacent lines of ultrasound data called A-scans, which are acquired from the scanhead through successive sweeps of the transducer. The line of ultrasound data is acquired when a transducer transmits the ultrasound pulse into the tissue being studied and then receives the ultrasound signal reflected by the tissue along a beam axis of the transducer. The lines of ultrasound

data are located within the same plane and are usually spaced at constant intervals. Each line of data is acquired with the ultrasound beam axis moved laterally within the plane by a known incremental distance. The ultrasound image may have a linear format, in which the lines are parallel to one another and equally spaced, or a sector format, in which the lines radiate from an apex with equal angles between them. To produce a linear format image, the transducer is moved laterally, without altering the angle between the transducer and the line along which it is moved. To produce a sector format image, the transducer is mounted to a fixture, which rotates about an apex, causing the transducer to move in an arc. As the transducer moves, the position within the scan plane is tracked so that an associated ultrasound system can display the ultrasound line data at the correct locations within the displayed image.

[0004] Early clinical diagnostic ultrasound systems used wobbler scanheads to produce the sector format images. These systems used low frequency ultrasound, in the 2 to 5 MHz range. The wobbler scanheads usually consisted of the transducer located within a fluid filled chamber, a motor, a position encoder, and an acoustic window through which the ultrasound passed. The motor drive mechanism usually moved the transducer through an arc, resulting in a sector scan type image format while the position encoder kept track of the transducer position. The wall of the fluid filled chamber, which faced the tissue being imaged, acted as an acoustic window, which was usually made of a hard plastic material. This window allowed ultrasound to pass through with little attenuation. Further, in general, there is a reflected ultrasound wave which does not pass through the window. This wave can reverberate between the transducer and the window several times before dissipating. The reverb components, which strike the transducer, can cause an undesirable artifact in the ultrasound image. The magnitude of the reflected wave is determined by the acoustic impedance mismatch between the material used for the window and the fluid in the transducer chamber. The amount of attenuation is determined by the window material, which occurs as the ultrasound energy passes through the window. Both attenuation and reflections at the window are undesirable.

[0005] In the 80's these mechanically scanned transducers began to be replaced by solid state devices which consist of a plurality of narrow piezoelectric elements which, when excited sequentially, can be used to build up an image. These “#linear array” scanheads had been developed at the same time as the mechanical ones, but delivered poorer image quality. Further work, throughout the 80's and 90's resulted in the development of “#phased array” scanheads, which have the ability to excite groups of elements in ways that allows electronic beam steering and focusing, which in general produce better images than any mechanical scanhead and at frame rates of 60 frames per second. Today, phased arrays are universally used for ultrasound imaging of human tissue. However, a typical phased array system using a transducer operating at five MHz might have a spatial resolution of 0.5 mm.

[0006] One disadvantage with higher operating frequencies is as the operating frequency increases, fabrication difficulties make it challenging to build a phased array type imaging system. As a result, current systems operating in the 30-40 MHz range typically use mechanically scanned single element transducers, in scanheads similar in operating prin-

cial to the mechanically scanned systems described above. However, high frequencies generally result in higher attenuation and thus the attenuation due to an acoustic window is increased significantly. Accordingly, current high frequency transducers use a non-encapsulated transducer, which is moved back and forth with a linear servo-motor and position encoder system. At higher frequencies (greater than 30 MHz), transducer encapsulation is impractical due to a breakdown of theoretical properties and characteristics of materials with higher frequencies.

[0007] For high frequency transducers, since it is not encapsulated, the moving transducer is exposed. Acoustic coupling to the tissue being imaged is accomplished by creating a mound of ultrasound gel on the surface of the tissue, into which the moving transducer is lowered. Satisfactory imaging depends on the existence of a continuous layer of gel between the transducer and the tissue. If the transducer loses contact with the gel, or if an air bubble forms on the surface of the transducer, imaging will be compromised or even impossible. This type of imaging is restricted to relatively low frame rates, because a rapidly moving transducer will disrupt the gel layer and is more likely to lose contact. Further disadvantages of exposed transducers are that they can create a hazard to delicate tissue, and can also expose the transducer to possible damage from impact.

[0008] A further disadvantage in mechanical ultrasound scanheads is the use of moving magnet motors. The attraction of the moving magnet type is that there is no need for flexible wires to deliver power to the drive coil because the drive coil is stationary and the permanent magnet is attached to the moving member or rotor. Furthermore, the magnet type motor is inefficient. The usual mechanical scanhead consumes up to three Watts of electrical power, which is converted into heat that must be dissipated through plastic walls of the scanhead housing. As the housing is generally a poor conductor of heat the internal temperature of the scanhead may rise, which in time can degrade materials, alter the acoustic properties of the device, and can even be uncomfortable to the subject. Another reason the magnet motor is inefficient is that in an effort to keep the oscillating mass low, the moving magnets are kept relatively small. To achieve a certain torque, motor currents are correspondingly high, which gives rise to a high I^2R loss. These losses increase roughly as the square of the scanning rate.

SUMMARY

[0009] In one embodiment, the high-frequency, high frame-rate ultrasound imaging system comprises a scan head having a transducer capable of generating ultrasound energy at a frequency of at least 20 megahertz (MHz), and a processor for receiving ultrasound energy and for generating an ultrasound image at a frame rate of at least 15 frames per second (fps).

[0010] Related methods of operation are also provided. Other systems, methods, features, and advantages of the high-frequency, high frame-rate ultrasound imaging system will be or become apparent to one with skill in the art upon examination of the following figures and detailed description. It is intended that all such additional systems, methods, features, and advantages be included within this description, be within the scope of the high-frequency, high frame-rate ultrasound imaging system, and be protected by the accompanying claims.

BRIEF DESCRIPTION OF THE FIGURES

[0011] The high-frequency, high frame-rate ultrasound imaging system can be better understood with reference to the following figures. The components within the figures are not necessarily to scale, emphasis instead being placed upon clearly illustrating the principles of the high-frequency, high frame-rate ultrasound imaging system. Moreover, in the figures, like reference numerals designate corresponding parts throughout the different views.

[0012] FIG. 1A is a diagram of one embodiment of a scanhead system.

[0013] FIG. 1B is a block diagram illustrating the ultrasound imaging system of FIG. 1A.

[0014] FIG. 2 is a perspective view of a scanhead of the system of FIG. 1.

[0015] FIG. 3A is a side view of the scanhead of FIG. 2.

[0016] FIG. 3B is a top view of the scanhead of FIG. 2.

[0017] FIG. 4 is section A-A view of the scanhead of FIG. 3B.

[0018] FIG. 5 is a detailed schematic view illustrating the scan head of FIGS. 3A, 3B and 4.

[0019] FIG. 6 provides further details of the scanhead of FIG. 4.

[0020] FIG. 7 provides further details of the scanhead of FIG. 3A.

[0021] FIG. 8 demonstrates alternative motions of the pivot tube 6.

[0022] FIG. 9 is a diagram of another embodiment of a scanhead of the system of FIG. 1A.

[0023] FIG. 10 is a longitudinal cross section of the scanhead of FIG. 9.

[0024] FIG. 11 is a perspective view of an armature assembly in the scanhead of FIG. 9.

[0025] FIG. 12 is a perspective view of a portion of the scanhead of FIG. 9.

[0026] FIG. 13 is an exploded view of a release assembly of the scanhead of FIG. 9.

[0027] FIG. 14 is an assembled view of the quick release assembly of FIG. 13.

[0028] FIG. 15 is a perspective view of a seal of the scanhead of FIG. 9.

[0029] FIG. 16 is a perspective view of the scanhead of FIG. 9 in a testing configuration.

[0030] FIG. 17A is a perspective view of a nosepiece for the scanhead of FIG. 9.

[0031] FIG. 17B is a perspective view of the nosepiece of FIG. 17 shown with an optional shroud.

[0032] FIG. 18 is another view of the nosepiece of FIG. 17 in a separated position.

[0033] FIG. 19A is side view of FIG. 17.

[0034] FIG. 19B is a detail view of FIG. 19A.

[0035] FIG. 20 is a cross section of FIG. 17.

[0036] FIG. 21 is a cutaway of FIG. 17.

[0037] FIG. 22 is an end view of nosepiece of FIG. 17.

[0038] FIG. 23 is an end view of acoustic window of FIG. 17.

[0039] FIG. 24 is a screen shot depicting an image on the display.

[0040] FIG. 25 is a flow chart illustrating the operation of one aspect of the high-frequency, high frame-rate ultrasound imaging system.

DETAILED DESCRIPTION

[0041] Referring to FIG. 1A, an ultrasound scanning system 100 has an electronics circuit 102 for transmitting and receiving a series of ultrasound pulses 104 to and from a probe or scanhead 106. The scanhead 106 can be situated on a subject 108 to record image data 110 of a scan plane 112, representing a cross section of a target 114 for display on a display 116. The target 114 may be, for example, the organ of a small animal, such as a mouse, a rat or another research subject. Examples of organs that can be imaged include, but are not limited to, a lung, a heart, a brain, a kidney, a liver and blood flowing within the subject. Further, the ultrasound imaging system can be used to image a neo-plastic condition. The circuit 102 has a transmit subsystem 118 for generating the pulses 104 and a receive subsystem 120 for receiving the corresponding echo pulses 104, which are directed to a computer 122 for processing and eventual display as the image scan data 110. The scanhead 106 is coupled at 126 to the circuit 102. The scanhead 106 has a transducer assembly 124, with a membrane 125, which is coupled to a position encoder 128 in conjunction with a torque motor 130. The encoder 128 and motor 130 monitor the position of the transducer assembly 124 within the scanhead 106. The corresponding position data 132 is transmitted with the pulses 104, representing the image data 110, to the computer 122. The scanhead 106 can be used as an encapsulated real-time probe for recording and displaying image data 110 obtained in real-time at high frequencies, such as but not limited to greater than 20 MHz and including 25 MHz, 30 MHz, 35 MHz, 40 MHz, 45 MHz, 50 MHz, 55 MHz, 60 MHz and higher. Further, transducer operating frequencies significantly greater than those mentioned above are also contemplated.

[0042] Referring again to FIG. 1A, the system 100 also includes a system processor 134. The processor 134 is coupled to the display or monitor 116 and to a human-machine interface 136, such as a keyboard, mouse, or other suitable device. If the monitor 116 is touch sensitive, then the monitor 116 can be employed as the input element for the human-machine interface 136. A computer readable storage medium 138 is coupled to the processor 134 for providing instructions to the processor 134 to instruct and/or configure the operation of the monitor 116 for recording and displaying the data 110, 132 on the monitor 116. The computer readable medium 138 can include hardware and/or software such as, by way of example only, magnetic disks, magnetic tape, optically readable medium such as CD ROM's, and semi-conductor memory such as PCMCIA cards. In each case, the medium 138 may take the form of a portable item such as a small disk, floppy diskette, cassette, or it may take the form of a relatively large or immobile item such as hard

disk drive, solid state memory card, or RAM coupled to the processor 134. It should be noted that the above listed example mediums 138 can be used either alone or in combination.

[0043] FIG. 1B is a block diagram illustrating the ultrasound imaging system 100 of FIG. 1A. The system 100 operates on a subject 114. The ultrasound probe 106 can be placed in proximity to the subject 114 to obtain image information.

[0044] The ultrasound system 131 includes a control subsystem 127, a scan converter 129, the transmit subsystem 118, the receive subsystem 120 and the user input device 136. The processor 134 is coupled to the control subsystem 127 and the display 116 is coupled to the processor 134. A memory 121 is coupled to the processor 134. The memory 121 can be any type of computer memory, and is typically referred to as random access memory "RAM," in which the software 123 of the high-frequency, high frame-rate ultrasound imaging system executes.

[0045] The high-frequency, high frame-rate ultrasound imaging system can be implemented using a combination of hardware and software. The hardware implementation of the high frequency, high frame-rate ultrasound imaging system can include any or a combination of the following technologies, which are all well known in the art: discrete electronic components, a discrete logic circuit(s) having logic gates for implementing logic functions upon data signals, an application specific integrated circuit having appropriate logic gates, a programmable gate array(s) (PGA), a field programmable gate array (FPGA), etc.

[0046] The software for the high frequency, high frame-rate ultrasound imaging system comprises an ordered listing of executable instructions for implementing logical functions, and can be embodied in any computer-readable medium for use by or in connection with an instruction execution system, apparatus, or device, such as a computer-based system, processor-containing system, or other system that can fetch the instructions from the instruction execution system, apparatus, or device and execute the instructions.

[0047] In the context of this document, a "computer-readable medium" can be any means that can contain, store, communicate, propagate, or transport the program for use by or in connection with the instruction execution system, apparatus, or device. The computer readable medium can be, for example but not limited to, an electronic, magnetic, optical, electromagnetic, infrared, or semiconductor system, apparatus, device, or propagation medium. More specific examples (a non-exhaustive list) of the computer-readable medium would include the following: an electrical connection (electronic) having one or more wires, a portable computer diskette (magnetic), a random access memory (RAM), a read-only memory (ROM), an erasable programmable read-only memory (EPROM or Flash memory) (magnetic), an optical fiber (optical), and a portable compact disc read-only memory (CDROM) (optical). Note that the computer-readable medium could even be paper or another suitable medium upon which the program is printed, as the program can be electronically captured, via for instance optical scanning of the paper or other medium, then compiled, interpreted or otherwise processed in a suitable manner if necessary, and then stored in a computer memory.

[0048] The memory 121 also includes the image data obtained by the ultrasound system 100. A computer readable

storage medium **138** is coupled to the processor for providing instructions to the processor to instruct and/or configure processor to perform steps or algorithms related to the operation of the ultrasound system **131**, as further explained below. The computer readable medium can include hardware and/or software such as, by way of example only, magnetic disks, magnetic tape, optically readable medium such as CD ROM's, and semiconductor memory such as PCMCIA cards. In each case, the medium may take the form of a portable item such as a small disk, floppy diskette, cassette, or it may take the form of a relatively large or immobile item such as hard disk drive, solid state memory card, or RAM provided in the support system. It should be noted that the above listed example mediums can be used either alone or in combination.

[0049] The ultrasound system **131** includes a control subsystem **127** to direct operation of various components of the ultrasound system **131**. The control subsystem **127** and related components may be provided as software for instructing a general purpose processor or as specialized electronics in a hardware implementation. The ultrasound system **131** includes a scan converter **129** for converting the electrical signals generated by the received ultrasound echoes to data that can be manipulated by the processor **134** and that can be rendered into an image on the display **116**. The control subsystem **127** is connected to a transmit subsystem **118** to provide an ultrasound transmit signal to the ultrasound probe **106**. The ultrasound probe **106** in turn provides an ultrasound receive signal to a receive subsystem **120**. The receive subsystem **120** also provides signals representative of the received signals to the scan converter **129**. The receive subsystem **120** is also connected to the control subsystem **127**. The scan converter **32** is directed by the control subsystem **127** to operate on the received data to render an image for display using the image data **110**.

[0050] The ultrasound system **131** transmits and receives ultrasound data through the ultrasound probe **106**, provides an interface to a user to control the operational parameters of the imaging system **100**, and processes data appropriate to formulate still and moving images that represent anatomy and/or physiology. Images are presented to the user through the interface display **116**.

[0051] The human-machine interface **136** of the ultrasound system **131** takes input from the user, and translates such input to control the operation of the ultrasound probe **106**. The human-machine interface **136** also presents processed images and data to the user through the display **116**.

[0052] Referring to FIG. 2, a frame **140** of the scanhead **106** consists of two side plates **1a** and **1b**, which are attached to a position encoder **128** at a proximal end and to a pivot frame **3** at a distal end. The position encoder **128** may be, for example, an optical encoder such as a Renishaw RGB25. A nosepiece **20** can be releasably attached to the distal end of the scanhead **106**. The side plates **1a** and **1b** provide a housing to allow for both hand held scanning and fixtured scanning with the scanhead **106**. In addition, the housing provides a strain relieved entry/exit point for cables **142** to and from the scanhead **106**. The housing may include an RF shielding component.

[0053] Referring to FIGS. 3A, 3B, 4 and 5 a pair of ball bearings **4** are positioned in the pivot frame **3** to locate a rotor assembly **5**, which allows the transducer assembly **124**

to pivot freely back and forth through an angle of approximately 20 degrees. The rotor assembly **5** comprises a pivot tube **6** to which is connected a yoke **7**. Screws through the pivot bearings **4** secure them to the yoke **7**. A transducer **8** of the assembly **124** is connected to the distal end of the pivot tube **6**, and its' coaxial signal cable **8a** extends through the pivot tube **6** and out through a slot **6a**, and is affixed to a circuit board **23** of the circuit **102** (see FIG. 1A). At the proximal end of the rotor assembly **5**, a lightweight yet stiff paddle **9** supports a rotor coil **10a** and **10b**, an encoder code track **12** and a Hall sensor magnet **13**. A flexible coax cable **14** leads from the rotor assembly **5** from the side opposite the transducer coax **8a**. Both of these are arranged to flex freely without binding or touching other structures as the transducer assembly **124** oscillates back and forth within the scanhead **106**. Overall is fitted a plastic housing **31** and **31a**. A mount nut **32** is secured between the two housing halves **31**, **31a** on assembly. The mount nut **32** has a threaded hole by which the scanhead **106** can be attached to a support arm (not shown), if desired.

[0054] Further referring to FIGS. 3A, 3B and 4, the nosepiece **20** is filled with an acoustic coupling fluid **15**. The distal end of the scanhead **106** is sealed by the acoustic window **125**, which comprises acoustically transparent plastic film and which will be described in further detail below. An o-ring **17** creates a seal between the nosepiece **20** and the nose **18** of the pivot frame **3**. A rubber seal diaphragm **19** is located between the nose **18** and the pivot frame **3** making a fluid tight seal. Another fluid tight seal is created between the seal diaphragm and the pivot tube **6** because a hole for the pivot tube **6** in the seal diaphragm **19** is smaller than the pivot tube, creating a tight seal when the seal diaphragm **19** is placed over the pivot tube **6** during assembly. During operation, the seal diaphragm **19** flexes to allow the pivot tube **6** to oscillate back and forth while maintaining the fluid seal there-between. To reduce the degree of flexing of the seal diaphragm **19**, it contacts the pivot tube **6** approximately at its pivot point. The yoke **7** straddles this point to clear the seal diaphragm **19**. A locking plate **34**, comprising, for example, a bayonet-type locking mechanism is located on the back of the nosepiece **20**. When the nosepiece **20** is placed over the nose **18**, the heads of two screws **34a** pass through holes in the locking plate **34**. A twist of approximately 10 degrees in one direction causes the shank of screws **34a** to travel in short curved slots in the locking plate **34**, trapping the heads of screws **34a** as shown and locking the nosepiece **20** to the scanhead pivot frame **3**. It is noted that the nosepiece **20** can be removed by simply reversing this action. A fill port **35** can be used to initially fill a hollow cavity **15** in nosepiece **20** with acoustic fluid, and to periodically access the cavity **15** to remove any bubbles that may appear.

[0055] Referring again to FIGS. 3A, 3B and 4, the transducer assembly **124** is attached to the distal end of the pivot tube **6**, creating a fluid tight seal. When in motion, the distal face of the transducer **8** remains a fixed distance (such as, but not limited to, between 0.5 mm to 1 mm) from the acoustic window **125**. The coaxial electrical cable **8a**, carrying signals to and from the transducer **8**, leads down the center of the pivot tube **6** and emerges through the slot **6a** near the pivot axis, thus minimizing motion of the coax cable **8a**. A slack length of coax cable **8a** absorbs relative motion during operation, situated between the slot **6a** and its termination point at the proximal end, i.e. the small printed wiring board

(PWB) **23**. To this end, the coax cable **8a** and the coax cable **14** are constructed to have a long flex life. For example, the cables **8a** and **14** may be constructed using a small diameter (approx. 1 mm), and fine conductors, thereby enhancing flexibility. The PWB **23** contains a pre-amplifier for signals coming from the transducer **8**, and acts as a termination point for the signal, power and ground wires from the two Hall sensors **13**. The PWB **23** also receives wires **21** entering the scanhead **106** through a cable cap **33** and an encoder cable **25a**.

[0056] Referring to FIGS. 3A, 3B, and 4 rotor windings **10a** and **10b**, also shown combined in FIG. 6 as numeral **10**, an encoder code track **12** and the Hall sensor actuating magnets **13** are all bonded to the proximal end of the pivot tube **6**. An intermediate support structure **27** can be made of rigid polyethylene foam sandwiched between, for example, thin (0.1 mm) epoxy-glass board, forming a lightweight but rigid core to support the rotor windings **24** and the encoder code track **12**, in particular.

[0057] Referring to FIG. 3B and FIG. 4, the backing iron plates **2** and **2a** are attached on the inside face of the side plates **1a** and **1b**. Field magnets **28** and **28a** are bonded to the backing iron plates **2** and **2a**, respectively. The field magnets **28** and **28a** are magnetized through their thin direction, normal to their facing sides. Each magnet **28**, **28a** has four poles; half of each face is a north pole and the other half is a south pole. The rotor assembly **5** moves back and forth in the gap between the two magnets **28**, **28a**. The south pole of magnet **28** faces the north pole across the gap of magnet **28a**. The north pole of magnet **28** faces the south pole of magnet **28a**. There are two pole gaps between the facing magnets **28**, **28a**, polarized in opposite directions. A portion **10a** of the rotor coil **10** is constrained to oscillate within the confines of one pole gap, and another portion **10b** oscillates in the other gap.

[0058] Referring to FIG. 5, an exploded view of the scanhead **106** including the rotor assembly **5**, is shown.

[0059] Referring to FIG. 6, the torque motor **130** rotates the tube or support arm **6** on the pivot back and forth through a limited angle, i.e. approximately 10-14 degrees. The transducer assembly **124** is connected to one end of the support arm **6**, and the position encoder code track **12** is connected to the other end. The transducer **8** of the assembly **124** is aimed such that a focused ultrasound beam can be directed along the longitudinal axis of the pivot tube **6**, away from the pivot point. The case and nosepiece **20** surround the torque motor **130**, position encoder **128** and transducer **8** such that the transducer **8** is located within the nosepiece section **20**. The nosepiece section **20** can be filled with water (or another medium suitable for conducting ultrasound); the torque motor **130** and position encoder **128** are dry due to the seal **19**. The pivot tube **6** passes through the flexible seal **19**, enabling the pivot tube **6** to move back and forth. The acoustic window **125** can be located at the end of the nosepiece **20**.

[0060] The position encoder **128** used in the scanhead **106** is, for example, an optical encoder capable of 1 micron (μm) resolution. The position encoder **128** works in conjunction with a reticulated tape strip referred to herein as the encoder code track **12**. The position encoder **128** makes use of an optical sensor to count the passage of reticules on the encoder code track **12** as they pass a sensor associated with

the position encoder **128**. The sensor can sense both direction of travel of the proximal end **150** of the pivot tube **6**, and track the position of the travel of the distal end **152** of the pivot tube **6** to within 1 micron.

[0061] Referring again to FIG. 6, the encoder code track **12** can be connected to the rear of the pivot tube **6** of the scanhead **106** at a known radial distance from the pivot point **154** of the pivot tube **6**. The encoder code track **12** is attached to a precise surface having a radius such that the encoder code track **12** is everywhere tangential to a chord traced out by the pivot tube **6**. As the pivot tube **6** pivots, the encoder code track **12** passes back and forth under the optical sensor in the position encoder **128**. The result is the digitization of the position of the distal end **152** of the pivot tube **6** at the radius at which the encoder code track **12** is fixed. The position information can be used to determine the location of the transducer **8** located the same radial distance from the pivot point on the other end of the pivot tube **6**. Dissimilar distances of the proximal end **150** and distal end **152** measured from the pivot point **154** can also be used, if desired. The optical coupling between the position encoder **128** and the proximal end **150** of the pivot tube **6** reduces the transmission of electronic noise generated by the position encoder **128** and the circuit **102** from the transducer **8**.

[0062] The transducer **8** can be a high-frequency single-element focused piezoelectric ultrasonic transducer, with a frequency greater than 30 MHz and can be around 40 MHz. The transducer **8** receives the RF electrical pulse **104** as input and produces an ultrasonic acoustic pulse **104** as output during the transmit phase of operation of the circuit **102** (see FIG. 1A and FIG. 1B). The reverse process is performed during the receive phase such that the input to the transducer **8** is an ultrasonic acoustic pulse **104** which is converted by the transducer **8** into a radio frequency electrical signal, represented by data **110**. The transducer **8** used in the scanhead **106** can be a broadband transducer **8** fabricated in such a way to ensure a good acoustic match to the acoustic medium in the cavity **15**.

[0063] The pivot tube **6** can be an ultra light weight stainless steel tube fixed by the bearing assembly **4** in such a way that it pivots about its midpoint **154**. The transducer **8** is connected to one end of the pivot tube **6**, while the encoder code track **12** is connected to the other end of the pivot tube **6**. The pivot tube **6** houses the coils of the torque motor **130** between the bearing assembly **4** and the encoder code track **12**, thus forming an integral part of the torque motor **130**. Made of tubing, the pivot tube **6** also acts as a conduit for the transducer coax cable **8a**.

[0064] Referring to FIG. 7, the pivot axis bearing **4** comprises a pair of ball bearings and an off axis, or offset, clamp **146**, which holds the pivot tube **6**. The offset clamp **146** allows the pivot point of the pivot tube **6** to remain accessible for the routing of cables **8a** and mechanical attachment to and from the pivot tube **6**. The bearing **4** can be fabricated with precise bearings and accurately machined components to ensure highly repeatable one axis rotation about the pivot point **154**. The offset clamp **146** is connected to the pivot tube **6** at one end and is rotatably attached to the pivot point **154** at the other end through pins **148**.

[0065] The flexible seal **19** can be attached to the midpoint of the pivot tube **6**, and the rear of the nose piece **20** bayonet quick release assembly comprising the locking plate **34** and

the two screws **34a**. The seal **19** can be made of an elastomer membrane that is fastened so that it forms a fluid tight seal between the pivot tube **6** and the nosepiece **20**. The seal **19** separates the fluid filled nosepiece **20** from the remainder of the housing which remains dry.

[0066] Two Hall sensors **13** are placed in the housing of the scanhead **106** so that they sense the travel of the pivot tube **6** past their respective sensors **13**. The sensors **13** are placed so that they produce a signal at the maximum safe travel of the torque motor **130**. The limit switches **13** are also placed symmetrically about the pivot point **154** so that they can be used to home the system to a zero deflection, homed, or normal position.

[0067] The hollow cavity **15** in the nose piece **20** can be fluid filled. The nosepiece **20** provides a mounting structure to which the acoustic window **125** can be attached. The nosepiece **20** features a drain/fill screw as a fill port **35** through which fluid may be added or removed from the cavity **15**. The nosepiece **20** can contain part of a bayonet style quick release assembly allowing it to be removed and changed quickly without the need for tools, while ensuring a fluid tight seal.

[0068] The acoustic window **125** comprises a thin membrane of a material well acoustically matched to the fluid in the cavity **15**. The acoustic window **125** can be held in a position so that it remains close to and normal to the face of the transducer **8** over the full extent of transducer travel (approximately 0.5 mm to 1 mm, for example). Material from which to form the acoustic window were initially selected or rejected based on known bulk acoustic properties. The membrane can be chosen to exhibit acoustic impedance in the range of 1.3 to 1.7 megaRayles (MRayles), such as 1.5 megarayles. Mechanical constraints such as the manner in which the membrane is attached affect the acoustic impedance and the resulting suitability for use as the acoustic window **125**. Material from which the acoustic window can be fabricated include polyester films ranging in thickness from about 0.9 μm to 4.5 μm , polytetrafluoroethylene (PTFE) in thicknesses of 5 μm , 10 μm , 15 μm , and 25 μm , low density polyethylene (LDPE) in thicknesses of 15 μm , 25 μm , and 50 μm , polycarbonate in a thickness of 2 μm , polypropylene in a thickness of 4 μm , latex elastomer in a thickness of 60 μm , and silicone elastomer in a thickness of 25 μm were tested in a variety of configurations including varying the angle of incidence of the ultrasound beam to the membrane forming the acoustic window **125** from 90 degrees to 110 degrees. These materials and thicknesses were used with transducer frequencies of 30-40 MHz. Thinner membranes could be used as the frequency increases. In addition, the encapsulated coupling fluid can be varied to improve the acoustic match with the membrane of the acoustic window **125**. For example, ethylene glycol, triethylene glycol, water, light paraffin oil and various aqueous solutions of glycols can be used. Water as a coupling fluid and a 25 μm thick membrane of LDPE can be used as the membrane for the acoustic window **125**. Further, an acoustic window **125** formed of 5 μm thick or 15 μm thick PTFE are provided. In addition, thin silicone elastomer can also be provided for the membrane forming the acoustic window **125**. The acoustic window **125** maintains a fluid tight seal between the nosepiece **20** and the outer environment of the scanhead **106**. Accordingly, the acoustic window **125** used with a high frequency ultrasound transducer **8** is thin, and

can be composed of a material that has an acoustic impedance very close to that of the fluid in the cavity **15**.

[0069] The electronics circuit **102** provides both a low noise RF preamplifier and a proprietary high fidelity protection circuit to the scanhead **106**. The electronics circuit **102** protects sensitive receive instruments in the receive subsystem **120** from the high energy pulse **104** used to drive the transducer **8**. The low-noise preamplifier boosts the signal of the transducer **8** with minimal distortion.

[0070] Referring again to FIGS. 3A, 3B and 4 during operation of the scanhead **106**, when a direct current (DC) voltage signal is applied through the rotor coil **10** through the coax cable **14**, the Lorentz forces generated by the currents in rotor coil portion **10a** and rotor coil portion **10b** act in the same sense, causing the rotor assembly **5** to rotate either clockwise or anti-clockwise about the pivot bearings **4**, depending on the polarity of the applied voltage. When the scanhead **106** is started, a DC voltage signal is applied to the rotor coil **10** to drive the rotor assembly **5** towards one end of its range of motion. Before the rotor assembly **5** reaches the end of travel, the Hall sensor **13** triggers one of two Hall sensor magnets **26** and **26a**, one at each end of travel fixed to side plates **1a** and **1b**. The control subsystem **127** responds by reversing the polarity of the voltage supplied to the rotor, driving the rotor assembly **5** in the opposite direction until the other Hall sensor **13** is triggered. All this time, the position encoder **128** reads the encoder code track **12** and determines the position of the transducer **8** relative to the two end-of-travel events indicated by the Hall sensors **13**. The control system can now drive the transducer **8** back and forth over whatever path and velocity profile is programmed into the controller, using the signals from the position encoder **128** for positional feedback.

[0071] For example, M-mode and Doppler are two other modes of operation for which the scanhead **106** is suited. For either of these modes, the rotor assembly **5** is electrically driven to a fixed position, usually under operator control using a joystick associated with the human-machine interface **136** for input commands. The operator (not shown) can view an image frozen in time on the display **116**, or a series of images, which are periodically updated, and manipulate the direction in which the transducer **8** is pointing. An electronic representation **144** (FIG. 1A) of the direction in which the transducer **8** is pointing can be displayed over the ultrasound image on the display **116**, and can be used for visual feedback. For the diagnostic imaging of tissue, the propagation path of ultrasound should be entirely within water or another fluid which has acoustic impedance very close to that of tissue. An air gap, or a material located in the path which creates an acoustic impedance mismatch can cause unwanted reflections, which appear as artifacts in the image on the display **116**. Usually a coupling gel, which has acoustic properties very similar to water, can be used between the scanhead **106** and the tissue being imaged.

[0072] Further, the torque motor **130** in conjunction with the position encoder **29** and encoder code track **12** run in a closed loop. They act as a servo-motor and are controlled by a motor control system associated with the processor **134** so that the pivot tube **6**, which can be fixed in place by the pivot bearings **4**, rotates back and forth about the pivot axis **154** in a controlled manner. The transducer **8** can be fixed to the end of the pivot tube **6** opposite the encoder code track **12**.

The pivot tube 6 moves the transducer 8, which is scanned back and forth within the fluid filled nosepiece 20. The location of the transducer 8 is known at all times to within 1 micron. The transducer 8 transmits and receives ultrasonic information which is received and amplified via the circuit 102, and then sent to the processor 134. Due to the light-weight precision nature of the design, this process can be accomplished at 15 Hz allowing for the production of real-time images for display of the image data 110 on the display 116. Operating the transducer 8 at a frequency of 15 Hz equates to a frame rate of 30 frames per second, as two sweeps of the transducer 8 through its range of motion equates to one Hz. Further, the oscillating frequency of the transducer 8 may be increased to increase the frame rate. Further, depending on the frequency of the ultrasound energy transmitted by the transducer, the ultrasound system 131 provides images having a spatial resolution of less than 30 microns. For example, at a frequency of approximately 25 MHz, the spatial resolution is approximately 75-100 microns. As the transducer frequency increases, the spatial resolution improves. At high transducer frequencies in the range of 40 MHz to 60 MHz, spatial resolution may exceed 30 microns. The high operating frequency of the transducer and the precise mechanical positioning of the transducer with an accuracy of approximately 1 μm allow the ultrasound system 131 to provide real-time ultrasound images having spatial resolution in excess of 30 μm .

[0073] Further, the scanhead 106 can be designed for use either by hand or on a fixture. The scanhead 106 can also be used as an immersion style scanner in a water bath or it can be coupled with gel to the tissue to be scanned. In these situations, the membrane of the acoustic window 125 may be removed.

[0074] In summary, the scanhead 106 is an electrically driven handheld imaging device that oscillates the ultrasound transducer 8 in a fan-shaped arc while maintaining good acoustic coupling between the transducer 8 and the subject 108 being imaged. The position encoder 128 delivers real-time position information to the controlling system processor 134. As the transducer 8 moves, signals from the position encoder 128 trigger transmit pulses 104 and communicate to the system processor 134 the position at which the resulting data stream 110 collected between those pulses 104 should be displayed in the electronic image that comprises the visual output on the display 116. The scanhead 106 can move the transducer 8 continuously back and forth within a fluid environment over a distance of approximately 10 mm in a controlled manner at a rate up to and exceeding 15 Hz, which corresponds to a frame rate of 30 frames per second. The position encoder 128 in the scanhead 106 can record the position of the transducer 8 in real time with an accuracy of 1 μm , and can position the transducer 8 at an arbitrary location within the scan region to an accuracy of 1 μm . The scanhead 106 includes the acoustic window 125 through which the ultrasound energy can be directed towards the subject 108 being imaged. The acoustic window 125 allows the transmission of high frequency ultrasound with minimum attenuation and/or reflection. The scanhead 106 can be sufficiently compact to be easily hand held, and can achieve positioning accuracy to 1 μm with a 15 Hz mechanical pivoting scanning and positioning system. The acoustic window 125 can be compatible with the transmission of high frequency ultrasound energy, at frequencies in excess of 60 MHz. The scanhead 106 can have image

resolution smaller than 30 μm , with an imaged region of approximately 8 mm by 8 mm for the scan plane 112 (see FIG. 1A).

[0075] The scanhead 106 uses a single moving part, the pivot tube 6, and a limited angle torque motor 130 of the moving coil type. The torque motor 130 produces large torque force with little current draw because the non-moving field magnets 28 and 28a are relatively large and are made of a high energy product material, such as, but not limited to, neodymium iron-boron, which maintains a very high B field across the rotor windings 24. Another benefit of using a moving coil type motor is that the rotor mass, and rotational inertia, can be minimized, which helps to reduce power consumption and vibration. Small structures within the subject 108 being imaged at 40 MHz or greater are often associated with rapid movement. Therefore, such a design allows for operating speeds of 30 Hz or higher, corresponding to 60 frames per second.

[0076] The flex seal 19 (see FIG. 4) isolates the fluid in the cavity 15 from the elements on the opposite side of the flex seal 19. The flex seal 19 can be located near the pivot point 154 of the rotor assembly 5 by using the offset clamp 146 to allow the pivot bearings 4 to straddle the point where the flex seal 19 can be attached to the pivot tube 6, which helps to minimize the stresses on the flex seal 19. The attachment of the flex seal 19 can be accomplished by a simple friction fit between the hole in the flex seal 19 and the pivot tube 6. The flex seal 19 can be made of a polyurethane elastomer possessing high fatigue life.

[0077] The portion of the pivot tube 6 immersed in the acoustic fluid, and the transducer 8, which can be wholly immersed, can be designed to be neutrally buoyant. When in motion, neutral buoyancy helps cancel vibration that could otherwise be a consequence of the motion of the transducer 8 and pivot tube 6. In fact, in another embodiment of the present invention, the entire oscillating mechanism on either side of the pivot point 154 can be so adjusted to be neutrally buoyant and operates entirely immersed in the acoustic fluid. This can help to eliminate virtually all vibration that would otherwise be transmitted to the operator and the subject 108.

[0078] Further, the nosepiece 20 can be easily removed and replaced by the operator. The simplified removal and replacement of the nosepiece 20 facilitates the replacement of a damaged acoustic window 125 or contaminated acoustic fluid. The fill port can be provided on the side of the nosepiece 20 to initially fill the cavity 15 with acoustic fluid when the nosepiece 20 is installed and to displace any bubbles with additional fluid should they develop with use. A simple bayonet type twist lock can be used to secure the nosepiece 20 to the body of the scanhead 106. If the nosepiece 20 should be sterile, as it might for some uses, it can be disposable. An integral part of such a replaceable nosepiece 20 can be a sterile drape or sheath, made of thin plastic, heat sealed or otherwise attached to the base of the nosepiece 20, which could be an injection molded plastic part. The scanhead 106 can also be operated, if desired, with the acoustic window 125 removed.

[0079] Referring to FIG. 8, the scanhead 106 can be designed for reciprocal motion of the arm 6 with an appropriate flex seal 19, if desired. The flex seal 19 could be of an accordion design, if desired.

[0080] Another embodiment of the scanhead 106 is shown in FIGS. 9 and 10. This embodiment of the scanhead,

referred to using reference numeral **206**, has many components similar in function to components in the previous embodiment, which will be understood from the previous description. The scanhead **206** includes a chassis **215** capable of supporting all of the components of the scanhead **206**. A circuit board **224** is integrated into the scan head **206**. The chassis **215** supports a strain relief clamp base **225a**, a strain relief clamp **225b** and a strain relief **226a** for securely holding a cable assembly **226b** at a proximal end of the chassis **215**. The cable assembly **226b** connects to electrical connectors **229a**, **229b** on the circuit board **224**. The circuit board **224** includes a motor control element, position monitoring circuit and communicates RF signals between the transducer and the processing elements in the ultrasound system **131** (see FIG. 1B).

[0081] The chassis **215** supports a pivot frame **208** that in turn supports a yolk **212** attached to armature **240** (FIG. 11) at a distal end of the chassis **215**. The armature **240** is described in further detail below with reference to FIG. 11.

[0082] A bayonet style lock plate **205a** interfaces with a fixture on a nose **205** that is mounted to the pivot frame **208**. The lock plate **205a** is attached to a removable nosepiece **201a**. The nosepiece **201a** has an acoustic window including a membrane **201b** mounted at one end thereof. The nosepiece **201a** surrounds a coupling fluid cavity **201c**. The assembly comprising the nosepiece **201a** and lock plate **205a** is mounted onto the scan head **206** via the bayonet style lock system.

[0083] The coupling fluid cavity **201c** surrounds a transducer **202a**, which is attached to the support arm **203**. The transducer **202a** is connected to a transducer coaxial cable **202b**, which is connected at the opposite end to the circuit board **224**. The nosepiece **201a** includes a fill port to fill the coupling fluid cavity **201c** with a coupling fluid. The fill port is sealed by a fill port screw **204**. A molded rubber seal **207** is mounted on the support arm **203** and disposed between the fluid cavity **201c** and a pivot frame **208**.

[0084] A bearing assembly including a bearing preload screw **209**, precision radial ball bearings **208a**, and a fixing screw **210a** affixes the armature assembly **240**, to the pivot frame **208**, with low radial drag and virtually no radial or axial play. A yoke **212** is provided straddling the support arm **203** and fixed to the rotor **218** with rotor adhesive pins **214**.

[0085] A partial assembly **250** of the scan head **206** shown in FIG. 12 includes a rear backing iron **216a**, a pair of backing iron posts **227a** and **227b**, rear field magnet **217a**. A magnet wire coil **218b** wound around the rotor **218** to form the armature of the torque motor. An optical encoder code track **219** is attached to one end of the rotor **218** such that it is at all points tangent to the motion of the torque motor. An optical encoder read head **220** is affixed to an encoder adjustment slide **223a** as shown in FIG. 12. The encoder adjustment slide **223a** is fitted to the chassis **215** so that it can slide allowing adjustment of the optical read head **220** with respect to the encoder code track **219**, which is fixed to the armature **240**. The movement is precise and controlled, and when the encoder read head **220** is in the optimal position such that maximum signal strength is obtained at the encoder read head **220**, the read head adjustment slide **223a** is locked in place with read head locking screws **223c**. Because the optical encoder is focused, it can be positioned at a known distance from the reflective encoder code track

219. This distance corresponds to a maximum encoder signal. A helical spring **223d** coupled to the read head adjustment screw **223b** helps prevent backlash. The optical read head **220** combined with the encoder code track **219** allows the position of the armature **240** to be recorded with an accuracy of 1 μm . A pair of optical limit switches **221a** are provided on the circuit board **224** for determining the absolute position of the armature **240** with respect to the chassis **215**, and to protect against over travel of the armature **240**. A reflective surface **221b** attached to the rotor **218** reflects signals from the optical limit switch **221a**.

[0086] As shown in FIGS. 9 and 10, the chassis **215** includes a quick release hard mount jack **222a**. This mechanism is part of a quick release assembly, which is described in greater detail below with reference to FIGS. 13 and 14.

[0087] A case comprising a case top **233**, a case bottom **234** and a case gasket **228** provides a fluid-tight seal around the internal components of the scan head **206**. The case top **233** and case bottom **234** as well as the case gasket **228** are coated with an electrically conductive coating **251** to improve RF shielding.

[0088] Referring to FIG. 11, the armature **240**, the support arm **203**, the transducer, **202a**, and the molded seal **207**, are shown in more detail. The armature **240** can be fabricated from precision machined components, which facilitates manufacturability, reduces cost, and improves performance compared to the composite construction used in the embodiment referred to above. The support arm **203** is removable and can be mounted via the support arm mount **213** and two shoulder bolts **231a** and **231b**, which locate into precision holes in the yoke **212** and the rotor **218**. It will be recognized therefore that a damaged transducer **202a** and/or molded seal **207** may be replaced without replacing the entire armature **240**.

[0089] The encoder code track **219** is made from a spring steel substrate. The encoder code track **219** can be installed using a technique which avoids prebending of the encoder code track **219**. Prebending may damage the encoder code track **219**. Two encoder code track retainers **230a** hold the encoder code track **219** at each end, forcing the spring steel to take the exact curvature of the rotor **218**. The encoder track retainers **230a** are fixed in place using screws **230b**. Alternatively, a light string may be tied around screws **230b** and adhered, using, for example, a glue, to the ends of the encoder code track **219**.

[0090] The scanhead **206** of this embodiment provides a sweep angle greater than 22 degrees included. The sweep angle refers to the motion of the transducer **202a** defined by the Hall sensor **13**, the two Hall sensor magnets **26** and **26a**, and the limit switches **221a**. In addition to the increased sweep angle due to the removable support arm **203**, the length of the support arm **203** may be changed, during manufacture or after, such as during field service, to accommodate different imaging requirements. The support arm **203** can be a length such that the transducer **202a** is approximately 20 percent farther from the pivot point **154** than the encoder code track **219** (see FIG. 9). This configuration provides a scan width of over 15 mm measured at the transducer **202a**.

[0091] The scan head **206** in this embodiment is assembled on the rigid chassis **215**. The scan head **206** can

be assembled to complete functionality on the chassis 215 so that testing can be performed without the case 233, 234 in place. The design of the chassis 215 therefore allows verification of wire routing and strain relief, electrical inspection, tuning of the optical encoder read head 220, and function verification of the limit switches 221a.

[0092] Referring to FIGS. 13 and 14, the quick release hard mount is shown in more detail. The quick release mechanism uses a spring loaded bayonet lock to quickly mount and remove the scanhead 206. The quick release hard mount plug 222b includes a locating pin 222c at the end proximal to the quick release hard mount jack 222a. The hard mount plug 222b includes a quick release upper feature 222d adjacent to the locating pin 222c, and a helical spring 222f adjacent to the locating pin 222c. The locating pin 222c allows the scanhead 106 to be mounted and remounted in precise 90 degree increments. A retaining ring 222e bears against the hard mount plug 222b when attached to the hard mount jack 222a as seen in FIG. 14.

[0093] Referring to FIG. 15, the nose 205 is shown in more detail. The nose 205 includes gasket bosses 206b, which prevent damage to the molded seal 207 (FIG. 11) when clamping the molded seal 207 between the nose 205 and the pivot frame 208. The seal 207 can be made from a soft, flexible elastomer. The molded shape provides a centered rest position and eliminates stretch mode deformation of the seal 207 during operation. By contrast, a flat seal undergoes both bending and stretching during operation, resulting in two distinct loads on the motor, which can be difficult to compensate for. The molded seal 207 can be designed like a shifter boot on an automobile's gear shift. It undergoes only bending deformation, which results in a lower and more uniform load on the motor.

[0094] The scanhead 206 includes an integral circuit board 224 that integrates motor control functions, position monitoring functions, and the transmission and reception of RF signals. In addition, the circuit board 224 houses the optical limit switches 221a. The circuit board 224 can be prefabricated and tested. The circuit board 224 allows the routing of the transducer coaxial cable 202b and the motor wires 232 to be made with a minimal drag on the motor by placing the connection points nearly over the pivot point.

[0095] The case 233, 234 can be non-load bearing and can be a purely protective part of the scanhead 206. It serves to waterproof and keep the internal components of the scanhead 206 free of contamination. The case 233, 234 can be secured to the chassis 215 by screws. Alternatively, the two halves 233, 234 of the case may be glued, or otherwise adhered, together to make the scanhead 206 tamper and water resistant.

[0096] The nosepiece 201a may include a disposable acoustic window. Referring to FIGS. 17A, 17B, 18, 19A, 19B and 20-23, the structure of the nosepiece 320 and acoustic window 330 are shown. The acoustic window 330 is similar to the acoustic window 125 described above. The nosepiece 320 includes a fill port 322 for receiving fluid. The nosepiece 320 has a shoulder 324 at the end proximal to the acoustic window 330 when attached. A recess 326 and a lip 328 are located adjacent the shoulder 324 for forming a snap fit with the acoustic window 330.

[0097] FIG. 17B shows the nosepiece 320 with an optional shroud 340 attached. The shroud 340 attaches to the acoustic

window 330 to protect the nosepiece 320 and scanhead 206 from contamination by liquid or biological material.

[0098] As shown in FIG. 21, the acoustic window 330 includes a groove 332 with a shape complementary to the lip 328 in the nosepiece 320.

[0099] The acoustic window 330 can be designed to overcome the specific challenges of encapsulating a high frequency high-resolution ultrasonic probe in a variety of demanding environments. The acoustic window 330 provides an inexpensive means for protecting the transducer and allowing imaging in a sterile environment without unduly compromising acoustic performance. The acoustic window 330 can be constructed from a molded plastic frame comprising a fluid tight mechanical snap-on attachment structure. The acoustic window 330 can be a molded, disposable element, which 'snaps' onto a permanent machined nosepiece, yielding the fluid filled encapsulated nose of the probe. Tools are not required to remove or attach the acoustic window to the nosepiece. For example, the shape of the acoustic window permits attachment to the nosepiece of the transducer using a simple rolling motion. The acoustic window can be any shape depending upon the nosepiece to be covered. A thin film of a sonolucent material forms a membrane 352 that can be attached to the front face of a frame 350. The frame 350 and the membrane 352 comprise the acoustic window 330.

[0100] The characteristics and thickness of the material forming the membrane of the acoustic window are chosen to suit the characteristics of the specific probe to be encapsulated. Sonolucent materials, for example those disclosed in U.S. Pat. Nos. 5,479,927; 5,983,123; and 6,574,499, which are incorporated by reference in their entireties, can be used to produce the membrane 352 of the acoustic window 330. In one aspect, the sonolucent material can be a polyester, a polycarbonate, an acrylic, a thermoplastic elastomer, or a silicone elastomer. Examples of sonolucent materials include, but are not limited to, Surllyn® ionomers, such as Surllyn® 8940, and Kapton®, available from E.I. Du Pont de Nemours and Company, Wilmington, Del.; polymethyl pentenes, such as TPX® MX-002, TPX® 95 and MX-004, available from Mitsui & Co., Tokyo, Japan; Teflon®, Mylar®, polyethylene, such as low density polyethylene, polycarbonate, polypropylene, and various polyurethane films. In one embodiment, the sonolucent material can be extruded to a certain thickness and heat welded to the frame 350 of the acoustic window 330 to form a fluid tight seal. The thickness of the membrane 352 will vary depending upon the sonolucent material selected. In one aspect, the membrane 352 has a thickness of less than or equal to 25 μm . In another embodiment, the thickness of the membrane 352 can range from 1 μm to 25 μm . The technology used for sealing the membrane 352 to the frame 350 will vary depending on the sonolucent material selected. Examples of methods for sealing the membrane 352 to the frame 350 include, but are not limited to, adhesives, welding techniques (e.g., RF, ultrasonic, and thermal), and mechanical seals.

[0101] Referring to FIGS. 20 and 21, the snap structure comprises a groove 332 in the frame 350. The nosepiece 320 to which the acoustic window 330 will attach incorporates a lip 328. The lip 328 can be slightly oversized negative with respect to the groove 332 in the frame 330. The acoustic

window 330 can be pressed onto the nosepiece 320 so that a positive fit is obtained when fully in place due to the seal formed between the lip 328 and the groove 332. This fit is also fluid tight due to the interference type fit of the groove 332 and lip 328. Before fitting the acoustic window 330 onto the nosepiece 320, the nosepiece can be partially filled with a coupling fluid. Examples of coupling fluid include, but are not limited to, water, ethylene glycol, triethylene glycol, light paraffin oil and various aqueous solutions of glycols. After fitting the acoustic window 330, air bubbles can be removed and the nosepiece/acoustic window assembly fully filled with coupling fluid via the fill port 322 located on the side of the nosepiece 320.

[0102] For environments requiring complete isolation of the probe from the surroundings, a sheathed version of the acoustic window 330 includes a heat sealed sheath 340 of polyethylene film that can be designed to fit back over the probe and up the cable. The sheath can be formed as part of the disposable acoustic window 330, so that when sterilization is desired the entire window and sheath can be removed and discarded.

[0103] In an alternative embodiment, the high-frequency, high frame-rate ultrasound imaging system may be used to image a syringe, catheter, or other invasive element inserted into a subject. FIG. 24 is a screen shot depicting an image 360 on the display 116. The image includes an embryo 368. The embryo 368 includes a head 366 and a uterus 362. The ultrasound system 131 can be used to visualize and guide the needle 364 as it enters the uterus 362 of the embryo 368.

[0104] FIG. 25 is a flow chart 400 illustrating the operation of one aspect of the high-frequency, high frame-rate ultrasound imaging system. The blocks in the flow chart may be executed in the order shown, out of the order shown, or concurrently. In block 402, the transducer 8 generates ultrasound energy at a frequency of at least 20 MHz.

[0105] In block 404, the ultrasound energy is transmitted by the transmit subsystem 118 into the subject 114 (FIG. 1). In block 406, the receive subsystem 120 receives the returned ultrasound echo pulses 104 and communicates the received ultrasound to the control subsystem 127 for processing by the processor 134 and the scan converter 129.

[0106] In block 408, the received ultrasound is processed by the processor 134 and the scan converter 129, under the direction of the software 123, to generate an image on the display 116. The image has a frame rate of at least 15 frames per second (fps).

[0107] Although the high-frequency, high frame-rate ultrasound imaging system has been described with reference to certain specific embodiments, various modifications thereof will be apparent to those skilled in the art without departing from the scope of the high-frequency, high frame-rate ultrasound imaging system as outlined in the claims appended hereto.

What is claimed is:

1. A scanhead for use with an ultrasound imaging system, comprising:

a transducer assembly comprising a single element ultrasonic transducer that is configured to generate ultrasound at a frequency of at least 20 megahertz (20

MHz), to transmit at least a portion of the generated ultrasound into a subject and to receive ultrasound energy from the subject;

an elongate member having a proximal end, wherein the elongate member is configured to pivot about a pivot axis spaced from the proximal end, and wherein the transducer assembly is non-rotatably coupled to the proximal end of the elongate member;

a means for oscillating the transducer along a reciprocating convex arcuate path at a frequency of at least 7.5 Hz, wherein a portion of the means for oscillating is fixed relative to the elongate member and moves along a reciprocating arcuate route remote from the reciprocating arcuate path of the transducer such that movement of the portion of the means for oscillating causes a complementary and opposite movement of the transducer, and wherein the reciprocating arcuate path of the transducer is co-planar to the reciprocating arcuate route of the portion of the means for oscillating; and

a means for sensing the spatial position of a proximal end of the portion of the means for oscillating along the reciprocating arcuate route to determine the position of the transducer along its arcuate path.

2. The scanhead of claim 1, wherein the transducer is a broadband transducer.

3. The scanhead of claim 1, wherein the transducer assembly and at least a portion of the elongate member are located within an enclosed volume, and wherein the enclosed volume is at least partially filled with a fluid.

4. The scanhead of claim 3, wherein the enclosed volume is partially defined by an acoustically penetrable membrane and wherein the acoustically penetrable membrane is positioned such that at least a portion of the generated ultrasound can pass therethrough the membrane before being transmitted into the subject.

5. The scanhead of claim 4, wherein the acoustically penetrable membrane comprises a material selected from the group consisting of: polyester, polycarbonate, acrylic, thermoplastic elastomer, silicone elastomer, latex elastomer, Surlyn® ionomer, Surlyn® 8940, Kapton®, polymethyl pentene, TPX® MX-002, TPX® 95, MX-004; Teflon®, Mylar®, polyethylene, polytetrafluoroethylene, polycarbonate, polypropylene, and polyurethane films.

6. The scanhead of claim 1, further comprising a position encoder configured to determine the position of the transducer along its reciprocating arcuate path.

7. The scanhead of claim 6, wherein the position encoder is configured such that the position of the transducer can be accurately tracked along the reciprocating arcuate path to within about 1.0 micron (μm) of the actual transducer position.

8. The scanhead of claim 1, wherein the means for oscillating comprises a limited angle motor.

9. An ultrasound imaging system, comprising:

the scanhead of claim 1; and

a processor configured to process the received ultrasound to provide an image having a frame rate of at least 15 frames per second (fps).

10. The system of claim 9, wherein the processor is further configured to produce an ultrasound image having a spatial resolution of less than about 100 microns (μm).

11. The system of claim 10, wherein the processor is further configured to produce an ultrasound image having a spatial resolution of about and between 75-100 microns (μm).

12. The system of claim 10, wherein the processor is further configured to produce an ultrasound image having a spatial resolution of about and between 30-100 microns (μm).

13. The system of claim 9, wherein the transducer can be oscillated along the reciprocating arcuate path at a frequency of at least 15 Hz, and wherein the processor is configured to provide an image having a frame rate of at least 30 fps and a spatial resolution of less than about 100 microns (μm).

14. An ultrasound imaging system, comprising:
the scanhead of claim 1;

a processor configured to process the received ultrasound to provide an image having a frame rate of at least 15 frames per second (fps); and

a means for positioning the transducer to within about 1 micron (μm) of a predetermined location along the reciprocating arcuate path.

15. The ultrasound imaging system of claim 14, wherein the processor is further configured to provide a pulsed-wave Doppler image.

16. The ultrasound imaging system of claim 14, wherein the processor is further configured to provide an M-Mode image.

* * * * *

专利名称(译)	高频率，高帧率超声成像		
公开(公告)号	US20080015438A1	公开(公告)日	2008-01-17
申请号	US11/776401	申请日	2007-07-11
[标]申请(专利权)人(译)	MEHI詹姆斯一世 CHAGGARES NICHOLASÇ FOSTER STUART MCCONAGHY ROBERT		
申请(专利权)人(译)	MEHI詹姆斯一世 CHAGGARES NICHOLASÇ FOSTER STUART MCCONAGHY ROBERT		
当前申请(专利权)人(译)	VISUALSONICS		
[标]发明人	MEHI JAMES I CHAGGARES NICHOLAS CHRISTOPHER FOSTER STUART MCCONAGHY ROBERT		
发明人	MEHI, JAMES I. CHAGGARES, NICHOLAS CHRISTOPHER FOSTER, STUART MCCONAGHY, ROBERT		
IPC分类号	A61B8/14 G01S7/52 G01S7/521 G01S15/89		
CPC分类号	G01S7/52034 A61B8/4461 G01S7/52085 G01S15/894 G01S15/8956 A61B8/5207 A61B8/0841 A61B8/467 A61B8/461 A61B8/4483 A61B8/54 A61B8/4281 A61B8/14 A61B8/0866 G01S7/52079 A61B8/4245 A61B8/4254		
优先权	60/417164 2002-10-10 US 60/470234 2003-05-14 US 60/468958 2003-05-09 US 60/468956 2003-05-09 US		
外部链接	Espacenet USPTO		

摘要(译)

一种用于产生超声图像的系统包括：扫描头，具有能够以至少20兆赫兹 (MHz) 的频率产生超声能量的换能器;以及处理器，用于接收超声能量并用于以帧速率生成超声图像。每秒至少15帧 (fps) 。

