



US010456510B2

(12) **United States Patent**
Kucklick

(10) **Patent No.:** **US 10,456,510 B2**
(45) **Date of Patent:** ***Oct. 29, 2019**

(54) **ANTI-EXTRAVASATION CATHETER**

(71) Applicant: **Cannuflow, Inc.**, San Jose, CA (US)

(72) Inventor: **Theodore R. Kucklick**, San Jose, CA (US)

(73) Assignee: **Cannuflow, Inc.**, Campbell, CA (US)

(*) Notice: Subject to any disclaimer, the term of this patent is extended or adjusted under 35 U.S.C. 154(b) by 53 days.

This patent is subject to a terminal disclaimer.

(21) Appl. No.: **14/178,094**

(22) Filed: **Feb. 11, 2014**

(65) **Prior Publication Data**

US 2014/0163459 A1 Jun. 12, 2014

Related U.S. Application Data

(63) Continuation of application No. 13/746,659, filed on Jan. 22, 2013, now Pat. No. 8,647,322, which is a continuation of application No. 11/585,716, filed on Oct. 24, 2006, now Pat. No. 8,357,126.

(51) **Int. Cl.**

<i>A61M 1/00</i>	(2006.01)
<i>A61B 5/00</i>	(2006.01)
<i>A61M 25/00</i>	(2006.01)
<i>A61B 5/0215</i>	(2006.01)
<i>A61B 5/145</i>	(2006.01)
<i>A61M 5/14</i>	(2006.01)
<i>A61M 5/50</i>	(2006.01)
<i>A61B 5/01</i>	(2006.01)
<i>A61B 5/053</i>	(2006.01)

(52) **U.S. Cl.**

CPC *A61M 1/0084* (2013.01); *A61B 5/0084* (2013.01); *A61B 5/14539* (2013.01); *A61M 1/0058* (2013.01); *A61M 5/14* (2013.01); *A61M 5/5086* (2013.01); *A61M 25/0026* (2013.01); *A61M 25/0029* (2013.01); *A61B 5/01* (2013.01); *A61B 5/02152* (2013.01); *A61B 5/053* (2013.01); *A61M 25/007* (2013.01); *A61M 2025/0004* (2013.01); *A61M 2025/0036* (2013.01); *A61M 2025/0039* (2013.01)

(58) **Field of Classification Search**

CPC *A61M 1/0058*; *A61M 1/0084*; *A61M 2025/0004*; *A61M 2025/0036*; *A61M 2025/0039*; *A61M 25/0026*; *A61M 25/0029*; *A61M 25/007*; *A61M 5/14*; *A61M 5/5086*

See application file for complete search history.

(56) **References Cited**

U.S. PATENT DOCUMENTS

4,583,968 A *	4/1986	Mahurkar	<i>A61M 5/1582</i>
				604/43
4,717,379 A *	1/1988	Ekholmer	<i>A61M 25/007</i>
				604/43

(Continued)

Primary Examiner — Nathan R Price

Assistant Examiner — Weng Lee

(74) *Attorney, Agent, or Firm* — Susan L. Crockett, Esq.; Niky Economy Syrengelas, Esq.; Crockett & Crockett, PC

(57) **ABSTRACT**

The disclosed devices and methods provide for the minimization of fluid extravasation during use of infusion catheters such as peripherally inserted central catheters and central venous catheters. The anti-extravasation catheter allows a surgeon to drain fluids from soft tissue surrounding an infusion site while also providing fluid inflow to a patient.

17 Claims, 7 Drawing Sheets

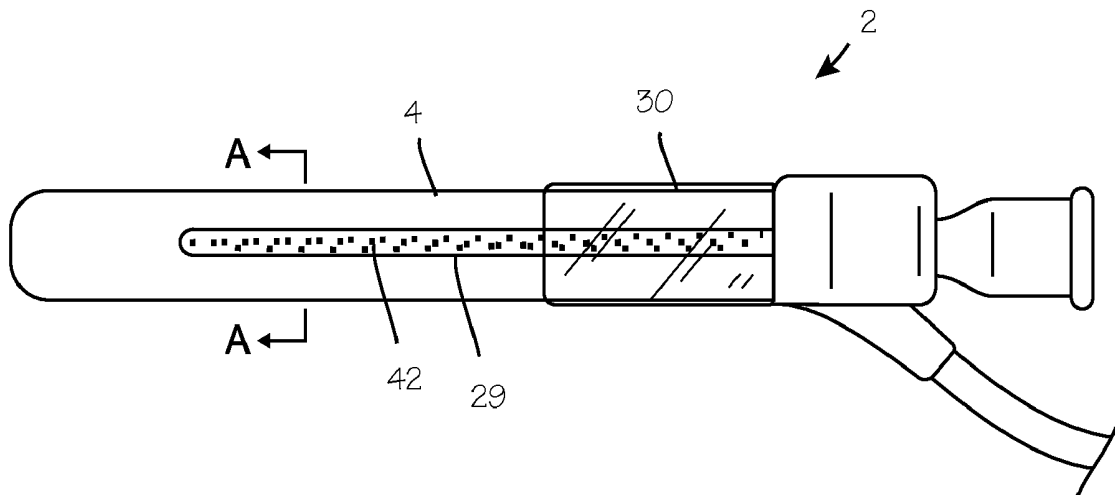

(56)

References Cited

U.S. PATENT DOCUMENTS

4,973,321 A * 11/1990 Michelson A61B 1/00094
600/114
5,394,886 A * 3/1995 Nabai A61B 17/0057
600/567
6,980,852 B2 * 12/2005 Jersey-Willuhn A61B 5/0536
600/547
2003/0093029 A1 * 5/2003 McGuckin, Jr. A61M 1/285
604/43
2003/0204161 A1 * 10/2003 Ferek-Petric A61N 1/40
604/20

* cited by examiner

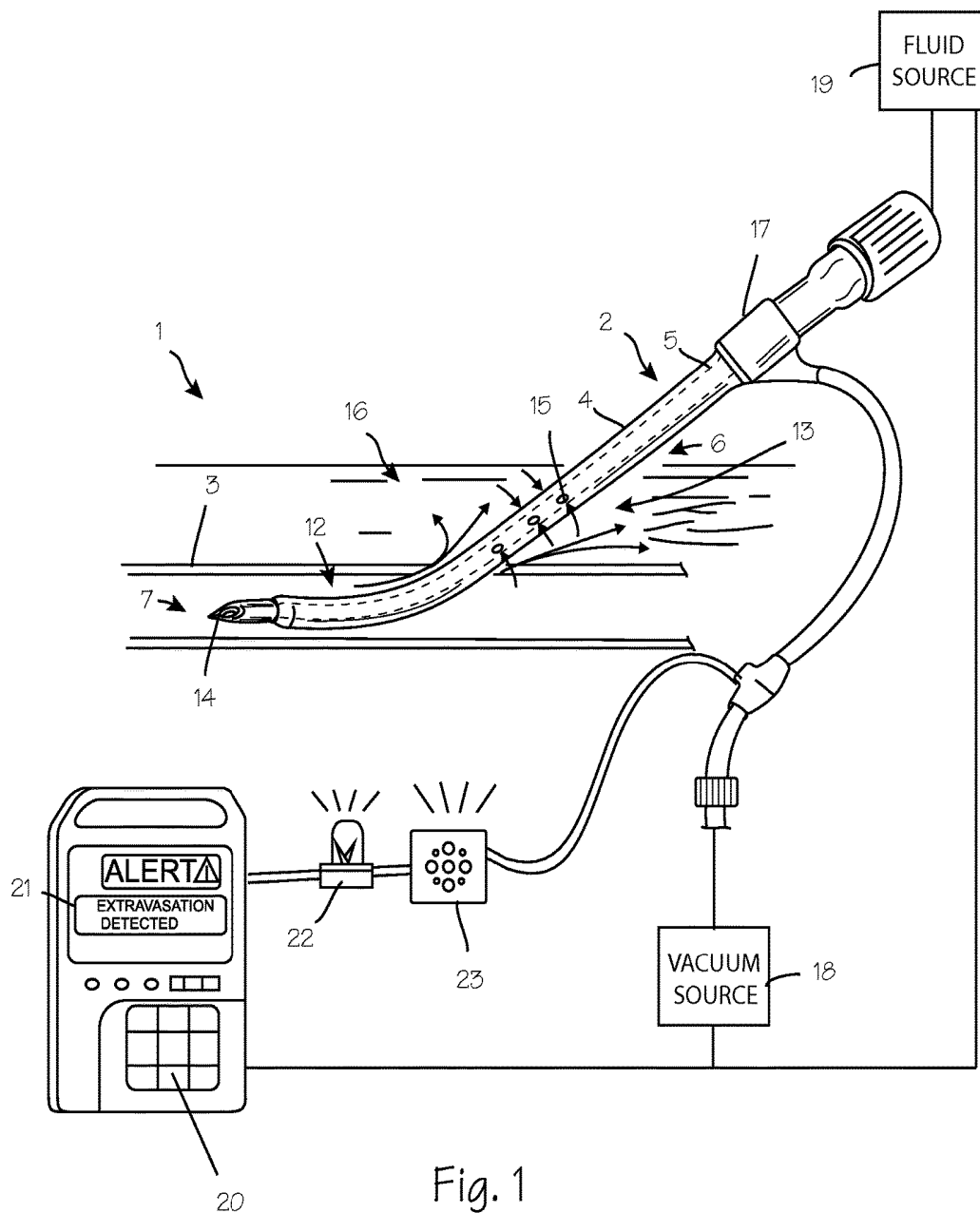

Fig. 1

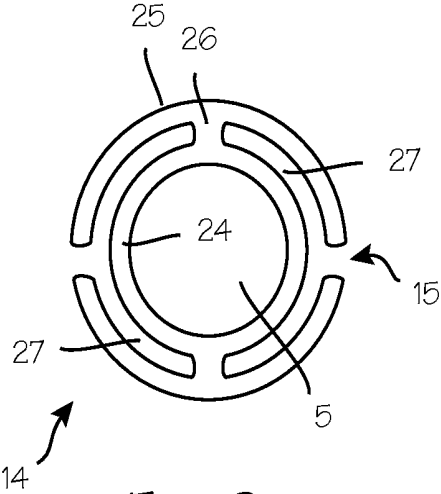

Fig. 2

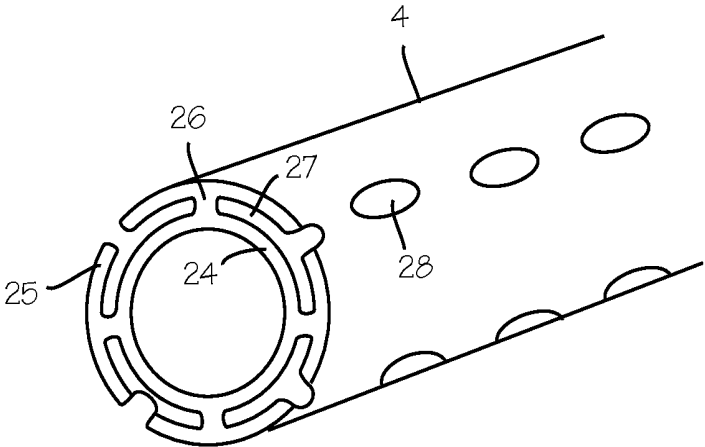

Fig. 3

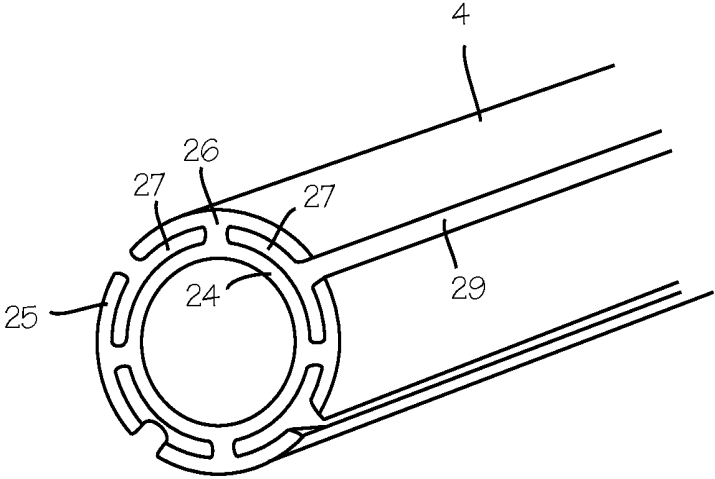

Fig. 4

Fig. 5

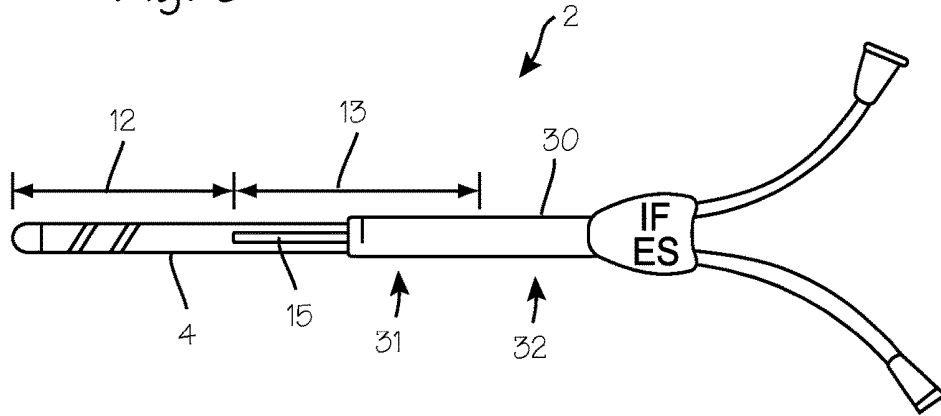
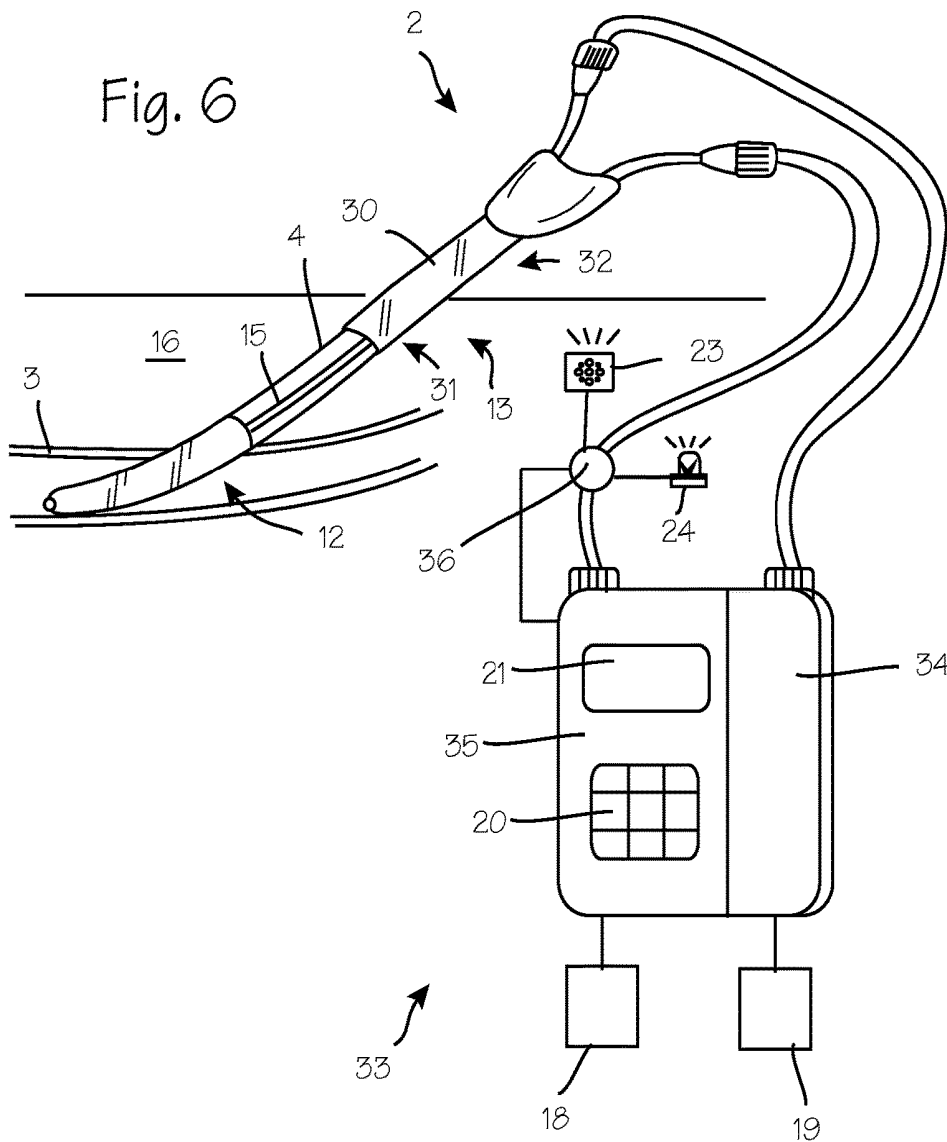

Fig. 6



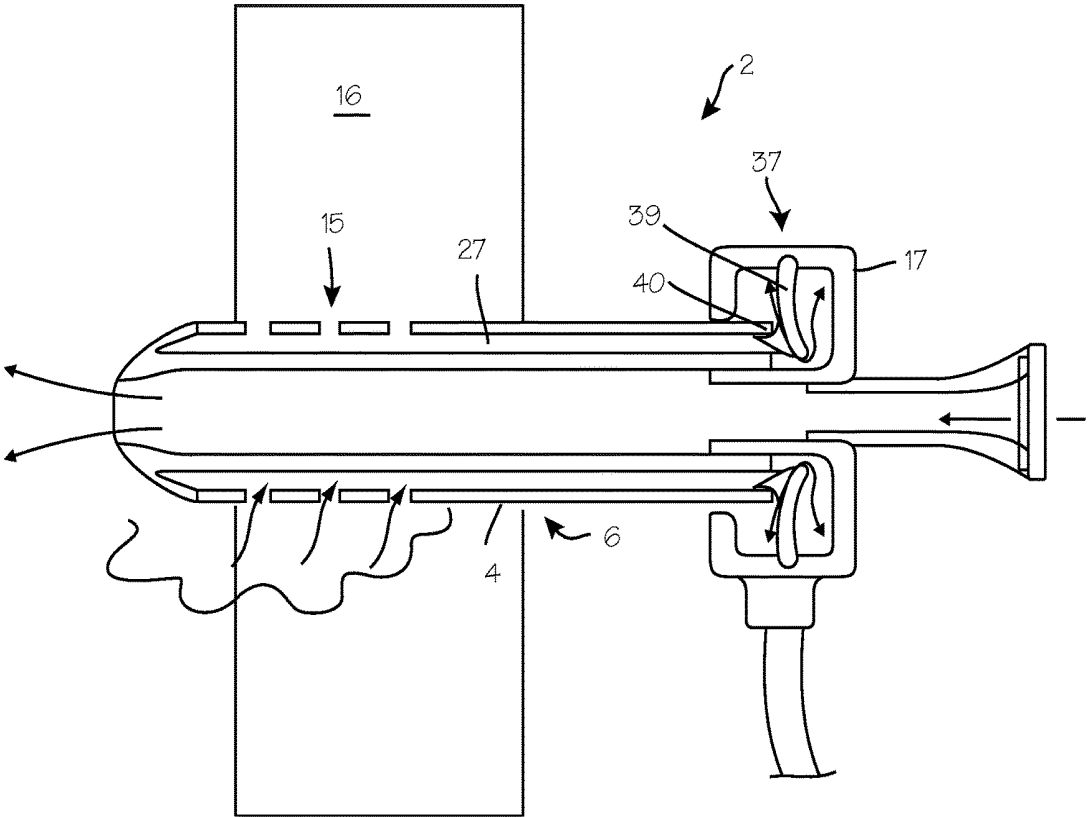

Fig. 7

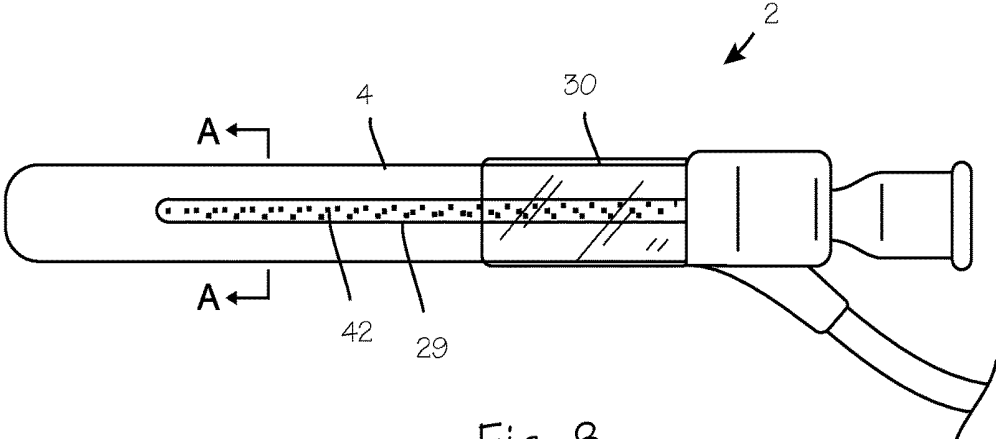

Fig. 8

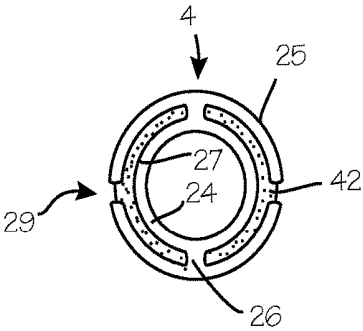
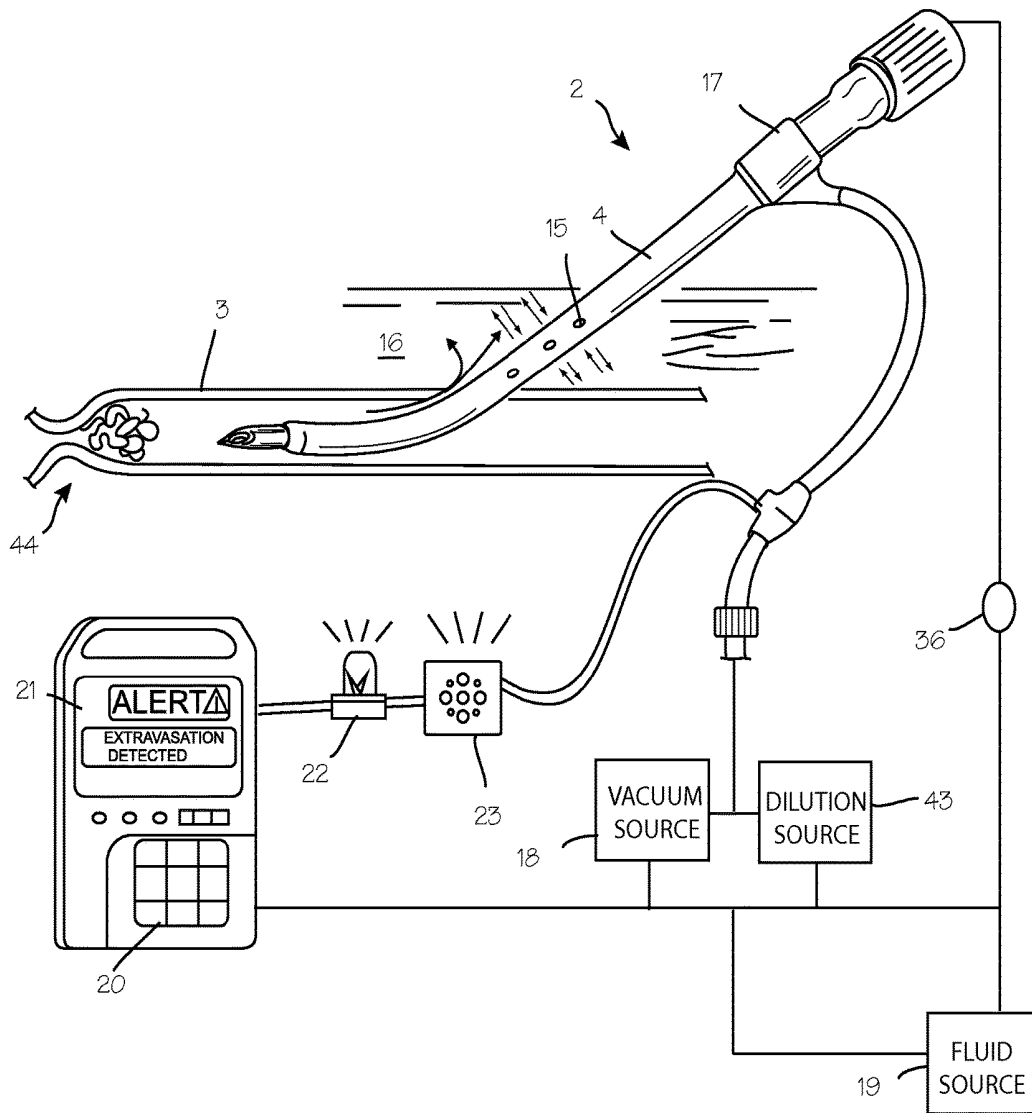

Fig. 9

Fig. 10



ANTI-EXTRAVASATION CATHETER

This application is a continuation of U.S. application Ser. No. 13/746,659, filed Jan. 22, 2013, now U.S. Pat. No. 8,647,322 which is a continuation of Ser. No. 11/585,716, filed Oct. 24, 2006, now U.S. Pat. No. 8,357,126.

FIELD OF THE INVENTIONS

The inventions described below relate to the field of catheters and more specifically, to catheters inserted into the central venous system.

BACKGROUND OF THE INVENTIONS

An infusion catheter, such as a peripheral intravenous catheter, is a thin flexible tube that is inserted into a peripheral vein, usually in the bend of the arm of a patient. Once inserted, the infusion catheter is threaded along the peripheral vein with the tip ideally positioned for infusion of fluids where they can be quickly diluted. Peripheral catheters as well as other types of catheters including peripherally inserted central catheters, central venous catheters and Hickman lines can remain in place for extended periods of time within a patient (up to six months). Infusion catheters have been available for many years and are typically used to administer fluids such as parenteral nutrition, chemotherapy, vasopressor (adrenalin-like medications), antibiotics and other hypertonic/caustic solutions. These catheters may also be used for blood draws. The use of such catheters avoids the complications associated with the direct puncture of the central venous circulation system. However, using a peripherally inserted central catheter to administer fluids to a patient is not without its drawbacks.

A common problem with the infusion of solutions into a patient is extravasation. Extravasation is the collection of interstitial fluid such as blood, nutritional fluids or medications into tissue surrounding an infusion site. Fluid escaping into the soft tissues surrounding the infusion site can have adverse effects on the patient. Some of these effects include the forming of blood clots in veins (thrombophlebitis), arterial injury, nerve injury, the compression of blood vessels and nerves and infection.

Extravasation of certain medications can also lead to other injuries commonly referred to as "IV burns." Leakage of cytotoxic drugs, intravenous nutrition, solutions of calcium, potassium, bicarbonate and even dextrose solutions outside the vein can cause skin necrosis. Other complications may include scarring around tendons, nerves and joints, especially on the dorsum of the hand or in the antecubital region. Extravasation may even cause skin loss above the area of injury and may require skin grafting.

In cancer treatment, accidental extravasation is a feared complication, especially from drugs such as the anthracyclines, mitomycin, vincristine, and vinorelbine, which are examples of vesicant drugs. Vesicant drugs cause tissue destruction upon infiltration. In this context, extravasation is the unintended presence of a vesicant outside the vascular bed or vasculature.

Accidental extravasation has been estimated to occur in up to 6% of all patients receiving chemotherapy. Chemotherapeutic agents, such as the anthracyclines, are especially likely to cause severe tissue damage on extravasation. The tissue injury may not appear for several days or even weeks, but when it appears it may continue to worsen for months, due to drug recycling into adjacent tissue.

The danger of the adverse effects as well as kinks or clogs in the catheter may require catheters to be removed from a patient and reinserted in another location. Furthermore, extravasation may result in longer recovery time, pain and discomfort in patients. Because of the effects caused by extravasation, devices and methods are needed to reduce extravasation caused by the use of infusion.

SUMMARY

The devices and methods shown below provide for the minimization of fluid extravasation during use of infusion catheters including peripheral catheters and central venous catheters. The anti-extravasation catheter allows a surgeon to drain fluids from soft tissue surrounding an insertion point or an infusion site while also providing fluid inflow to a patient.

The anti-extravasation catheter comprises a multi-lumen flexible tube characterized by a distal end, a proximal end, a proximal portion and a distal portion. The proximal end of the tube is provided with fluid ports, a manifold and other means of controlling the flow of fluid inside the tube. The distal portion of the tube is provided with one or more outflow holes. The proximal portion of the tube is provided with a plurality of drainage apertures. Each drainage aperture communicates with one or more drainage lumens inside the tube, thereby allowing fluid to drain from the tissue surrounding the insertion point of the catheter to sinks or vacuum sources located outside the patient. When the anti-extravasation catheter is disposed within the patient, the drainage holes are placed in fluid communication with tissue outside of the insertion site. The anti-extravasation catheter allows a physician to administer solutions to the patient while reducing the amount of fluid extravasation occurring in tissue surrounding the insertion point near the site of infusion.

BRIEF DESCRIPTION OF THE DRAWINGS

FIG. 1 is a patient with an anti-extravasation catheter inserted into a peripheral vein.

FIG. 2 is a cross-sectional view of the anti-extravasation catheter.

FIG. 3 is a sectional view of the proximal portion of the catheter wherein the drainage apertures are comprised of a pattern of substantially circular fenestrations.

FIG. 4 is a catheter wherein the drainage aperture comprises a longitudinal channel.

FIG. 5 is an anti-extravasation catheter with an outer sleeve.

FIG. 6 is a side view of an anti-extravasation catheter with the outer sleeve in use.

FIG. 7 illustrates an anti-extravasation catheter with an over-pressure valve.

FIG. 8 illustrates the anti-extravasation catheter with the fluid management system comprising a dissolvable plug disposed within the drainage lumen.

FIG. 9 is a sectional view of the catheter of FIG. 8.

FIG. 10 illustrates the anti-extravasation catheter as part of an irrigation system.

DETAILED DESCRIPTION OF THE INVENTIONS

FIG. 1 is a patient 1 with an anti-extravasation catheter 2 inserted into a peripheral vein 3. The anti-extravasation catheter comprises a tube 4 having a central lumen 5 (shown

in phantom) extending from the proximal end to the distal end. The tube has a length and an outer diameter suitable for extending from an insertion point 6 on a patient to a treatment/infusion site 7. The insertion point is the place where the catheter is inserted in a patient. The infusion site is the area in the body where the catheter infuses a fluid. A peripheral intravenous catheter typically comprises a shorter tube (a few centimeters long) inserted through the skin into a peripheral vein. In the case of a peripherally inserted central catheter, the tube will be sized and dimensioned to extend from a peripheral insertion point to the central venous system including the superior vena cava or the right atrium. When the infusion catheter is a central venous catheter, the tube is sized and dimensioned to extend from a subclavian, internal jugular or a femoral vein to the superior vena cava or right atrium. The tube is constructed of a material suitable for insertion into the venous system of a patient such as silicone, nylon, polycarbonate urethane, polyurethane, polydimethylsiloxane and polyethylene glycol.

The length of the tube 4 is characterized by a distal section 12 (the venous section) and a proximal interstitial section 13 (the interstitial section). The distal end of the tube may contain a hollow penetrating element 14 in fluid communication with the central lumen 5 to facilitate insertion of the catheter into the patient. The proximal (interstitial) section of the tube is provided with a plurality of drainage apertures 15. The proximal section of the tube is placed in contact with tissue 16 surrounding the insertion point and the peripheral vein 3 of the patient when the catheter 2 is disposed within the patient 1. The drainage apertures 15 are disposed in such a way that the apertures 15 are placed in fluid communication with tissue surrounding the insertion point where interstitial fluid collection may occur when the catheter is in use. Each drainage aperture 15 communicates with one or more drainage lumens disposed within the tube, thereby allowing fluid to drain from the tissue surrounding the insertion point to a vacuum source or sinks located outside the patient in fluid communication with the drainage lumens.

The proximal end of the tube is provided with a manifold or hub 17. The hub is in fluid communication with the central lumen and the drainage lumens. The hub is adapted for coupling to a vacuum source 18 and fluid source 19. The fluid source is placed in fluid communication with the central lumen of the catheter through the hub to facilitate the flow of fluids into the patient. The vacuum source is placed in fluid communication with the drainage lumens to facilitate removal of interstitial fluid. A control system 20 may be operably connected to the fluid source to deliver fluid and to the vacuum source to remove interstitial fluid by activating the vacuum source. Interstitial fluid is removed through one or more drainage apertures in fluid communication with the drainage lumens and the vacuum source. The control system may also be provided with a display 21 as well as an audio 22 and/or visual 23 warning system that indicates when extravasation is occurring.

FIG. 2 is a cross-sectional view of the anti-extravasation catheter. As seen in FIG. 2, the tube 4 comprises an inner tube 24 and an outer tube 25 disposed about the outer tube and one or more ribs 26 extending between the inner tube and outer tube. The inner tube, the outer tube and the plurality of ribs bound one or more drainage lumens 27 disposed between the inner tube and the outer tube that extend longitudinally along the tube 4. Drainage apertures 15 are in fluid communication with one or more drainage lumens disposed within the tube.

Drainage apertures 15 may comprise a variety of patterns or configurations that allow for the effective removal of interstitial fluid. The size and pattern of the drainage apertures can be used to regulate fluid removal. FIG. 3 is a view of the proximal portion of the tube 4 wherein the drainage apertures are comprised of a pattern substantially circular fenestrations 28. The tube 4 has one or more drainage lumens disposed within the tube and running longitudinally along the catheter tube. A plurality of ribs 26 project from the inner tube 24 to the outer tube 25 forming the plurality of drainage lumens 27. Substantially circular fenestrations are disposed along the proximal portion of the outer tube. Each substantially circular fenestration communicates with one or more drainage lumens 27 disposed within the tube.

FIG. 4 is a sectional view of the proximal portion of the catheter wherein the drainage apertures are comprised of a plurality of longitudinal channels 29. The tube 4 has one or more drainage lumens 27 disposed within the tube and running longitudinally along the catheter tube. A plurality of ribs project from the inner tube 24 to the outer tube 25 forming the plurality of drainage lumens 27. Longitudinal channels are disposed along the proximal portion of the outer tube much like a Blake's drain. Each longitudinal channel communicates with one or more drainage lumens 27 disposed within the tube.

FIG. 5 is an anti-extravasation catheter with an outer sleeve. A second tube or outer sleeve 30 is disposed over the outer diameter of the catheter tube to limit exposure of the drainage apertures to the tissue surrounding the insertion point. A first portion 31 of outer sleeve is partially disposed about the proximal section (interstitial portion) of the catheter disposed within the patient. A second portion 32 of the outer sleeve is disposed about that proximal section of the catheter that is not inserted into the patient. Use of one or more outer sleeves 30 limits exposure of the drainage apertures to the tissue surrounding 16 the insertion site. This regulates the amount of fluid that can drain from the tissue.

FIG. 6 is a side view of the anti-extravasation catheter 2 with the sleeve 30 in use. The catheter is disposed within the peripheral vein of the patient. The outer sleeve 30 is disposed over the outer diameter of the tube 4 to limit exposure of the drainage apertures to the tissue surrounding the insertion site. The first portion 31 of outer sleeve is disposed about that portion of the proximal section of the catheter disposed within the patient. The second portion 32 of the outer sleeve is disposed about the proximal section of the catheter that is not inserted into the patient. The sleeve 30 regulates the exposure of the drainage apertures to the tissue surrounding the insertion point. Tissue 16 surrounding the insertion point and peripheral vein 3 may contain extravasated fluid. The drainage apertures 29 allow this fluid to drain from the tissue and use of the sleeve regulates fluid removal.

The anti-extravasation catheter in FIG. 6 is part of a complete fluid management system 33 comprising infusion pump 34, fluid source 19, vacuum pump 35, vacuum source 18 or sink, and control system 20. The control system may be provided with the display 21, the audio alarm system 22 and/or the visual alarm system 23. The alarm systems are activated when extravasation occurs during the infusion of medicines into the patient 1. The alarm can be triggered by a pressure transducer 36 operably connected to the control system and placed in fluid communication with one or more drainage lumens. Drainage apertures may also be disposed along the substantial length of the tube when the catheter is part of the complete fluid management system or when multiple sleeves are used. When fluid pressure in the drain-

age lumen exceeds a safe threshold of pressure the control system can activate a vacuum pump located outside and remove fluid from the tissue surround the infusion site.

FIG. 7 illustrates the anti-extravasation catheter 2 with an over-pressure valve 37. The valve is operably disposed within the hub 17 and is placed in fluid communication with the drainage apertures 15 through the drainage lumens 27 in the tube 4. The over-pressure valve is a relief valve comprising a flexible closure member 39 having a spring constant sufficient to press the closure member against the valve seat 40 surrounding the drainage lumens 27 until pressure exceeds a predetermined safe threshold. The closure member is an annular membrane and member may be manufactured from a suitable polymer. The proximal section of the closure member 39 is coupled to the hub wall while the distal section presses against the valve seat occluding the drainage lumens 27. The valve allows the drainage lumen 27 in the device to open to the vacuum source and drain extravasated interstitial fluid from tissue 16 when pressure from the fluid exceeds the predetermined pressure threshold. The valve also acts as a barrier to outside contaminants. When fluid pressure in the drainage lumen 27 exceeds a safe threshold, such as a pressure in the range of approximately 1 mm/Hg to about 20 mm/Hg, the valve 37 opens to remove fluid from the tissue surrounding the insertion point 6 and the infusion site.

FIG. 8 illustrates the anti-extravasation catheter 2 with the fluid management system comprising a dissolvable plug 42 disposed within the drainage lumen. The catheter in FIG. 8 is shown with longitudinal channels 29 and outer sleeve 30. In a fluid management system comprising a dissolvable plug 42, the drainage lumens 27 of the anti-extravasation catheters illustrated in FIGS. 1 through 8 are filled with a dissolvable plug 42 comprising materials that dissolve when the materials come in contact with therapeutic agents being infused into the patient. The dissolvable plug may comprise materials such as starches, gelatins, lactose, sucrose, sugars, or cellulose. The dissolvable plug may be coated with a water-resistant polymer or polysaccharide coating as well. The drainage apertures (longitudinal channel 29) disposed on the tube are placed in fluid communication with tissue surrounding the insertion point when an anti-extravasation catheter is disposed within a patient. Should extravasation of the infused medications occur in the tissue surrounding the insertion point, the infused medications will be placed in contact with the dissolvable plug 42 disposed within the drainage lumens 27. This contact or exposure will cause the dissolvable plug 42 within the drainage lumens to dissolve, opening the drainage lumens and allowing interstitial fluid to drain from the tissue.

FIG. 9 is a sectional view of the tube 4 with the dissolvable plug. The tube 4 has one or more apertures and one or more drainage lumens 27 disposed within the tube and running longitudinally along the catheter tube. A plurality of ribs 26 project from the inner tube 24 to the outer tube 25 forming the plurality of drainage lumens 27. Longitudinal channels are disposed along the proximal portion of the outer tube much like a Blake's drain. Each longitudinal channel communicates with one or more drainage lumens 27 disposed within the tube.

FIG. 10 illustrates the anti-extravasation catheter as part of an irrigation system. Certain therapeutic solutions used in chemotherapy can have detrimental effects on non-cancerous tissue. Flushing and evacuating dangerous infusates may be required should extravasation occur. In an anti-extravasation catheter with an irrigation system, the anti-extravasation catheter of FIGS. 1 through 9 is provided with hub 17

that is suitable for coupling to therapeutic fluid source 19, vacuum source 18 and an antidote or dilution source 43. An antidote is a compound that blocks or attenuates the local tissue toxicity caused by a therapeutic fluid or agent. The vacuum source and dilution source are placed in fluid communication with one or more drainage lumens through the hub 17. Thus, the drainage lumens can function as inflow and/or outflow lumens. Pressure transducer 36 is operably connected to control system 20 and the central lumen of the tube 4. The transducer 36 is able to measure pressure in the vein of the patient. Other sensors that may detect extravasation may be provided with the anti-extravasation catheter and operably coupled to the catheter including electrical impedance sensors, Ph sensors, optical sensors or tissue temperature sensors. (The infiltration of an infusate into interstitial tissue may result in one or more changes in impedance, Ph or temperature.)

Extravasation can result from a thrombosed or collapsed vein 44. A collapsed vein will cause a pressure increase within the vein of the patient due to the backflow of an infusate. When a pressure increase exceeding an acceptable threshold is detected by pressure transducer 36, the control system 20 may operate a pump operably coupled to the dilution source to flush the surrounding tissue. Tissue 16 is flushed using the fluid from the dilution source that is placed in fluid communication with the tissue through one or more drainage lumens and one or more drainage apertures. The control system can also operate the vacuum source to aspirate the interstitial fluid from the tissue. Interstitial fluid is removed through one or more drainage apertures in fluid communication with the drainage lumens and the vacuum source. The control system can be programmed to perform cycles of infusion and aspiration to more completely dilute and remove harmful agents from the soft tissue surround the insertion point of the catheter. A display 21 as well as an audio 22 and/or visual 23 warning system that indicates when extravasation is occurring may also be provided with the control system.

Current prior art catheters used in chemotherapeutic sessions do not provide for the removal of interstitial fluid while simultaneously infusing therapeutic agents into a patient. The anti-extravasation catheter 2 is especially suitable for the infusion of therapeutic agents used in chemotherapy. When the catheter is in use, the physician provides the anti-extravasation catheter 2 with at least one drainage aperture 15 disposed on the proximal portion of the catheter. The catheter is inserted into the vein of a patient at the insertion point 6. The catheter 2 extends from the insertion point to the infusion site 7 when functionally disposed with the patient 1. The catheter 2 is disposed inside the patient 1 in such a way that the drainage aperture 15 is placed in fluid communication with tissue 16 surrounding the vein 3 and the insertion point 6.

The catheter 2 is operably connected to a therapeutic solution/fluid source 19 and a vacuum source 19 through the hub 17. During chemotherapy, the therapeutic solution is infused into the patient through the catheter. During the infusion, extravasation may occur by fluid leaking from the infusion site into tissue surrounding the vein and the insertion point. This extravasated fluid is drained from tissue surrounding the catheter insertion point and the vein 3 during a chemotherapeutic session through the drainage aperture. The tissue 16 may also be treated by an antidote that is provided through the aperture if necessary.

While the preferred embodiments of the devices and methods have been described in reference to the environment in which they were developed, they are merely illus-

trative of the principles of the inventions. Other embodiments and configurations may be devised without departing from the spirit of the inventions and the scope of the appended claims.

I claim:

1. An anti-extravasation system comprising:
 a catheter having a length and outer diameter suitable for extending from a peripheral vein insertion point on a patient to a treatment site, said catheter characterized by an elongated venous section located distal to an interstitial section and comprising:
 an inflow lumen;
 at least one drainage lumen;
 a dissolvable plug disposed within the at least one drainage lumen; and
 a plurality of apertures disposed only in the interstitial section of the catheter, said plurality of apertures in fluid communication with the at least one drainage lumen and adapted to drain fluid from tissue surrounding the insertion point when the catheter is operably disposed within the patient;
 wherein the venous section of the catheter comprises a uniform outer surface and is structured to prevent fluid communication between the outer surface of the venous section and the at least one drainage lumen; and
 a hub proximal to the interstitial section and placed in fluid communication with the inflow lumen and the at least one drainage lumen.
2. The system of claim 1 wherein the catheter is sized and dimensioned such that the interstitial section resides in body tissue overlying the insertion point in a peripheral vein and the venous section of the catheter resides in the central venous system of the patient when disposed within the patient.
3. The system of claim 1 wherein the catheter is sized and dimensioned such that the interstitial section resides in body tissue overlying the insertion point in a peripheral vein and the venous section of the catheter resides in the peripheral vein.
4. The system of claim 1 wherein the plurality of apertures comprise longitudinal channels.
5. The system of claim 1 wherein the plurality of apertures comprise fenestrations.
6. The system of claim 1 further comprising an extravasation sensor operably coupled to the catheter, said sensor selected from the group consisting of a temperature sensor, a pressure sensor, a conductivity sensor, an optical sensor and a Ph sensor.
7. The system of claim 6 further comprising a control system operably coupled to the catheter, said control system adapted to detect the occurrence of extravasation and alert a user when extravasation occurs.
8. The system of claim 1 wherein the dissolvable plug comprises a material selected from the group consisting of starches, gelatins, lactose, sucrose, sugars and cellulose.
9. The system of claim 1 further comprising an over-pressure valve in fluid communication with the drainage lumen.
10. The system of claim 1 further comprising an outer sleeve disposed over the outer diameter of the catheter.

11. The system of claim 1 further comprising an anti-extravasation agent source placed in fluid communication with the drainage lumen.

12. A method for performing chemotherapy comprising:
 providing a chemotherapy therapeutic fluid source;
 providing an anti-extravasation catheter, said catheter having a length and outer diameter suitable for extending from a peripheral vein insertion point on a patient to a treatment site, said catheter characterized by an elongated venous section located distal to an interstitial section and comprising:
 an inflow lumen;
 at least one drainage lumen; and
 a plurality of apertures disposed only in the interstitial section of the catheter, said plurality of apertures in fluid communication with the at least one drainage lumen and adapted to drain fluid from tissue surrounding the insertion point when the catheter is operably disposed within the patient;
 a dissolvable plug disposed within the at least one drainage lumen and in fluid communication with the plurality of apertures;
 wherein the venous section of the catheter comprises a uniform outer surface and is structured to prevent fluid communication between the outer surface of the venous section and the at least one drainage lumen;
 disposing the anti-extravasation catheter inside a patient;
 placing the plurality of apertures in fluid communication with tissue surrounding the insertion point;
 infusing the chemotherapy therapeutic fluid into the patient through the catheter; and
 draining interstitial fluid from tissue surrounding the catheter insertion point during a chemotherapeutic session through the plurality of apertures.

13. The method of claim 12 wherein the dissolvable plug comprises a material selected from the group consisting of starches, gelatins, lactose, sucrose, sugars and cellulose.

14. The method of claim 12 further comprising the steps of:

- providing an antidote source; and
- infusing the antidote into the tissue.

15. The method of claim 14 further comprising the step of cycling between infusing the antidote to the tissue and aspirating the interstitial fluid from the tissue surrounding through the catheter.

16. The method of claim 12 further comprising the step of detecting the occurrence of extravasation with an extravasation sensor operably coupled to the catheter, said sensor selected from the group consisting of a temperature sensor, a pressure sensor, a conductivity sensor and a Ph sensor.

17. The method of claim 16 further comprising the steps of:

- providing a control system operably connected to the catheter, said control system adapted to detect the occurrence of extravasation; and
- alerting a user of the occurrence of extravasation using the control system.

* * * * *

专利名称(译)	防渗导管		
公开(公告)号	US10456510	公开(公告)日	2019-10-29
申请号	US14/178094	申请日	2014-02-11
[标]申请(专利权)人(译)	坎努弗洛公司		
申请(专利权)人(译)	CANNUFLOW INC.		
当前申请(专利权)人(译)	CANNUFLOW INC.		
[标]发明人	KUCKLICK THEODORE R		
发明人	KUCKLICK, THEODORE R.		
IPC分类号	A61B5/145 A61B5/00 A61M1/00 A61B5/0215 A61M5/14 A61M25/00 A61M5/50 A61B5/053 A61B5/01		
CPC分类号	A61M1/0058 A61M5/14 A61M1/0084 A61M5/5086 A61B5/14539 A61M25/0026 A61B5/0084 A61M25/0029 A61B5/01 A61M25/007 A61M2025/0036 A61B5/02152 A61B5/053 A61M2025/0039 A61M2025/0004		
助理审查员(译)	李, 翁		
其他公开文献	US20140163459A1		
外部链接	Espacenet		

摘要(译)

所公开的装置和方法提供了在使用输注导管（例如外围插入的中央导管和中央静脉导管）期间使液体外渗最小化的功能。防渗出导管允许外科医生从输液部位周围的软组织中排出液体，同时还向患者提供液体流入。

