



US010271754B2

(12) **United States Patent**  
**Bahney et al.**

(10) **Patent No.:** **US 10,271,754 B2**  
(45) **Date of Patent:** **Apr. 30, 2019**

(54) **PHYSIOLOGICAL MONITORING DEVICE**

(71) Applicant: **iRhythm Technologies, Inc.**, San Francisco, CA (US)

(72) Inventors: **Timothy J. Bahney**, San Francisco, CA (US); **Hung H. Ho**, San Francisco, CA (US); **Shena H. Park**, San Francisco, CA (US); **Genaro S. Sepulveda**, San Francisco, CA (US); **Mark J. Day**, San Francisco, CA (US); **Yuriko Tamura**, Belmont, CA (US)

(73) Assignee: **iRhythm Technologies, Inc.**, San Francisco, CA (US)

(\* ) Notice: Subject to any disclaimer, the term of this patent is extended or adjusted under 35 U.S.C. 154(b) by 0 days.

(21) Appl. No.: **16/006,719**

(22) Filed: **Jun. 12, 2018**

(65) **Prior Publication Data**

US 2018/0289274 A1 Oct. 11, 2018

**Related U.S. Application Data**

(63) Continuation of application No. 14/162,656, filed on Jan. 23, 2014.

(60) Provisional application No. 61/756,326, filed on Jan. 24, 2013.

(51) **Int. Cl.**

**A61B 5/0402** (2006.01)  
**A61B 5/0408** (2006.01)  
**A61B 5/00** (2006.01)

(52) **U.S. Cl.**

CPC ..... **A61B 5/0408** (2013.01); **A61B 5/6833** (2013.01); **A61B 5/721** (2013.01); **A61B 2562/0219** (2013.01); **A61B 2562/125** (2013.01); **A61B 2562/164** (2013.01)

(58) **Field of Classification Search**

CPC ..... A61B 5/04; A61B 5/6831; A61B 5/0402  
USPC ..... 600/382, 386, 388, 393, 508-509  
See application file for complete search history.

(56) **References Cited**

U.S. PATENT DOCUMENTS

1,497,079 A 6/1924 Gullborg  
2,179,922 A 11/1939 Dana  
2,201,645 A 5/1940 Epner  
2,311,060 A 2/1943 Lurrain  
2,500,840 A 3/1950 Lyons  
3,215,136 A 11/1965 Holter et al.  
3,547,107 A 12/1970 Chapman et al.  
3,870,034 A 3/1975 James

(Continued)

FOREIGN PATENT DOCUMENTS

AU 2011252998 8/2015  
AU 2014209376 6/2017

(Continued)

OTHER PUBLICATIONS

US 8,750,980 B2, 06/2014, Katra et al. (withdrawn)

(Continued)

*Primary Examiner* — Joseph A Stoklosa  
*Assistant Examiner* — Brian M Antiskay

(74) *Attorney, Agent, or Firm* — Knobbe, Martens, Olson & Bear, LLP

(57) **ABSTRACT**

The present invention relates to a physiological monitoring device. Some embodiments of the invention allow for long-term monitoring of physiological signals. Further embodiments may also allow for the monitoring of secondary signals such as motion.

**20 Claims, 17 Drawing Sheets**

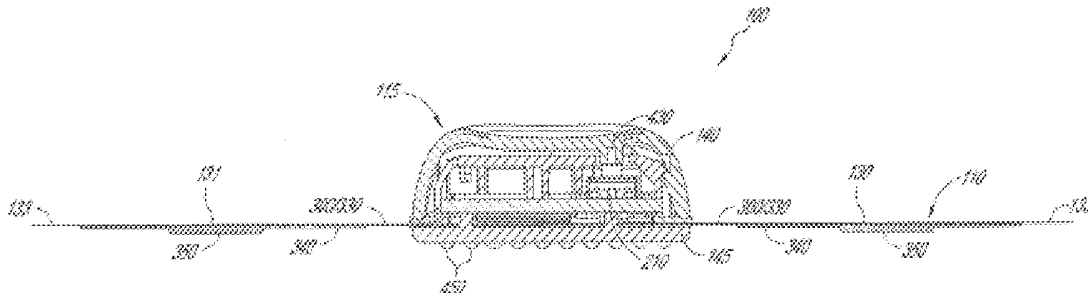

(56)

## References Cited

## U.S. PATENT DOCUMENTS

3,882,853	A	5/1975	Gofman	6,178,357	B1	1/2001	Gliner et al.
3,911,906	A	10/1975	Reinhold	6,200,265	B1	3/2001	Walsh et al.
4,023,312	A	5/1977	Stickney	6,225,901	B1	5/2001	Kail
4,027,664	A	6/1977	Heavner, Jr. et al.	6,232,366	B1	5/2001	Wang et al.
4,121,573	A	10/1978	Crovella et al.	6,238,338	B1	5/2001	DeLuca et al.
4,123,785	A	10/1978	Cherry et al.	6,248,115	B1	6/2001	Halk
4,126,126	A	11/1978	Bare	6,287,252	B1	9/2001	Lugo
4,202,139	A	5/1980	Hong et al.	6,290,707	B1	9/2001	Street
4,274,420	A	6/1981	Hymes	6,315,719	B1	11/2001	Rode et al.
4,274,429	A	6/1981	Tam et al.	6,379,237	B1	4/2002	Gordon
4,286,610	A	9/1981	Jones	6,385,473	B1	5/2002	Haines et al.
4,333,475	A	6/1982	Moreno et al.	6,389,308	B1	5/2002	Shusterman
4,361,990	A	12/1982	Link	6,416,471	B1	7/2002	Kumar et al.
4,381,792	A	5/1983	Busch	6,434,410	B1 *	8/2002	Cordero ..... A61B 5/04085 600/396
4,438,767	A	3/1984	Nelson	6,441,747	B1	8/2002	Khair et al.
4,459,987	A	7/1984	Pangburn	6,454,708	B1	9/2002	Ferguson et al.
4,535,783	A	8/1985	Marangoni	6,456,871	B1	9/2002	Hsu et al.
4,537,207	A	8/1985	Gilhaus	6,456,872	B1 *	9/2002	Faisandier ..... A61B 5/04085 600/390
4,572,187	A	2/1986	Schettrumpf	6,464,815	B1	10/2002	Beaudry
4,621,465	A	11/1986	Pangburn	6,493,898	B1	12/2002	Woods et al.
4,622,979	A	11/1986	Katchis et al.	6,496,705	B1	12/2002	Ng et al.
4,658,826	A	4/1987	Weaver	6,510,339	B2	1/2003	Kovtun et al.
4,712,552	A	12/1987	Pangburn	6,546,285	B1	4/2003	Owen et al.
4,736,752	A	4/1988	Munck et al.	6,564,090	B2	5/2003	Taha et al.
4,925,453	A	5/1990	Kannankeril	6,569,095	B2	5/2003	Eggers
4,938,228	A	7/1990	Righter et al.	6,577,893	B1	6/2003	Besson et al.
4,981,141	A	1/1991	Segalowitz	6,580,942	B1	6/2003	Willshire
5,003,987	A	4/1991	Grinwald	6,585,707	B2	7/2003	Cabiri et al.
5,027,824	A	7/1991	Dougherty et al.	6,589,170	B1	7/2003	Flach et al.
5,082,851	A	1/1992	Appelbaum et al.	6,589,187	B1	7/2003	Dimberger et al.
5,086,778	A	2/1992	Mueller et al.	6,605,046	B1	8/2003	Del Mar et al.
5,191,891	A	3/1993	Righter	6,615,083	B2	9/2003	Kupper
5,205,295	A	4/1993	Del Mar et al.	6,622,035	B1	9/2003	Merilainen
5,226,425	A	7/1993	Righter	6,626,865	B1	9/2003	Prisell
5,228,450	A	7/1993	Sellers	6,656,125	B2	12/2003	Misczynski et al.
5,230,119	A	7/1993	Woods et al.	6,664,893	B1	12/2003	Eveland et al.
5,289,824	A	3/1994	Mills et al.	6,665,385	B2	12/2003	Rogers et al.
5,305,746	A	4/1994	Fendrock	6,690,959	B2	2/2004	Thompson
5,309,909	A	5/1994	Gadsby	6,694,177	B2	2/2004	Eggers et al.
5,365,935	A	11/1994	Righter et al.	6,701,184	B2	3/2004	Henkin
5,458,141	A	10/1995	Neil	6,711,427	B1	3/2004	Ketelhohn
5,483,967	A	1/1996	Ohtake	6,730,028	B2	5/2004	Eppstein
5,489,624	A	2/1996	Kantner et al.	6,773,396	B2	8/2004	Flach et al.
5,511,553	A	4/1996	Segalowitz	6,775,566	B2	8/2004	Nissila
5,515,858	A	5/1996	Myllymaki	6,801,137	B2	10/2004	Eggers
5,536,768	A	7/1996	Kantner et al.	6,801,802	B2	10/2004	Sitzman et al.
5,581,369	A	12/1996	Righter et al.	6,871,089	B2	3/2005	Korzinov et al.
5,626,140	A	5/1997	Feldman et al.	6,871,211	B2	3/2005	Labounty et al.
5,634,468	A	6/1997	Platt et al.	6,875,174	B2	4/2005	Braun et al.
5,645,063	A	7/1997	Straka	6,875,174	B2	4/2005	Braun et al.
5,645,068	A	7/1997	Mezack et al.	6,881,191	B2	4/2005	Oakley et al.
5,730,143	A	3/1998	Schwarzberg	6,893,396	B2	5/2005	Schulze et al.
5,749,365	A	5/1998	Magill	6,897,788	B2	5/2005	Khair et al.
5,749,367	A	5/1998	Gamlyn et al.	6,904,312	B2	6/2005	Bardy
5,771,524	A	6/1998	Woods et al.	6,925,324	B2	8/2005	Shusterman
5,772,604	A	6/1998	Langberg et al.	6,940,403	B2	9/2005	Kail
5,776,072	A	7/1998	Hsu et al.	6,954,163	B2	10/2005	Toumazou et al.
5,881,743	A	3/1999	Nadel	6,957,107	B2	10/2005	Rogers et al.
5,931,791	A	8/1999	Saltzstein et al.	6,987,965	B2	1/2006	Ng et al.
5,941,829	A	8/1999	Saltzstein et al.	7,002,468	B2	2/2006	Eveland et al.
5,957,854	A	9/1999	Besson et al.	7,020,508	B2	3/2006	Stivoric et al.
5,959,529	A	9/1999	Kail	7,024,248	B2	4/2006	Penner et al.
6,013,007	A	1/2000	Root et al.	7,031,770	B2	4/2006	Collins et al.
6,032,060	A	2/2000	Carim	7,072,708	B1	7/2006	Andresen et al.
6,038,469	A	3/2000	Karlsson et al.	7,072,709	B2	7/2006	Xue
6,044,515	A	4/2000	Zygmunt	7,076,283	B2	7/2006	Cho et al.
6,093,146	A	7/2000	Filangeri	7,076,287	B2	7/2006	Rowlandson
D429,336	S	8/2000	Francis et al.	7,076,288	B2	7/2006	Skinner
6,102,856	A	8/2000	Groff et al.	7,076,289	B2	7/2006	Sarkar et al.
6,117,077	A	9/2000	Del Mar et al.	7,079,977	B2	7/2006	Osorio et al.
6,132,371	A	10/2000	Dempsey et al.	7,082,327	B2	7/2006	Houben
6,134,480	A	10/2000	Minogue	7,089,048	B2	8/2006	Matsumura et al.
6,136,008	A	10/2000	Becker et al.	7,099,715	B2	8/2006	Korzinov et al.
6,161,036	A	12/2000	Matsumura et al.	7,117,031	B2	10/2006	Lohman et al.
6,169,915	B1	1/2001	Krumbiegel et al.	7,120,485	B2	10/2006	Glass et al.
				7,130,396	B2	10/2006	Rogers et al.
				7,161,484	B2	1/2007	Tsoukalis
				7,171,166	B2	1/2007	Ng et al.

(56)

## References Cited

## U.S. PATENT DOCUMENTS

7,179,152	B1	2/2007	Rhoades	8,412,317	B2	4/2013	Mazar
7,186,264	B2	3/2007	Liddicoat et al.	8,425,414	B2	4/2013	Eveland
7,193,264	B2	3/2007	Lande	8,449,471	B2	5/2013	Tran
7,194,300	B2	3/2007	Korzinov	8,452,356	B2	5/2013	Vestel et al.
7,206,630	B1	4/2007	Tarler	8,460,189	B2	6/2013	Libbus et al.
7,212,850	B2	5/2007	Prystowsky et al.	8,473,039	B2	6/2013	Michelson et al.
7,222,054	B2	5/2007	Geva	8,473,047	B2	6/2013	Chakravarthy et al.
7,242,318	B2	7/2007	Harris	8,478,418	B2	7/2013	Fahey
7,266,361	B2	9/2007	Burdett	8,483,809	B2	7/2013	Kim et al.
7,316,671	B2	1/2008	Lastovich et al.	8,500,636	B2	8/2013	Tran
7,349,947	B1	3/2008	Slage et al.	8,515,529	B2	8/2013	Pu et al.
7,354,423	B2	4/2008	Zelickson et al.	8,525,673	B2	9/2013	Tran
7,387,607	B2	6/2008	Holt et al.	8,535,223	B2	9/2013	Corroy et al.
7,444,177	B2	10/2008	Nazeri	8,538,503	B2	9/2013	Kumar et al.
7,477,933	B2	1/2009	Ueyama	8,540,731	B2	9/2013	Kay
7,478,108	B2	1/2009	Townsend et al.	8,560,046	B2	10/2013	Kumar et al.
7,481,772	B2	1/2009	Banet	8,562,527	B2	10/2013	Braun et al.
7,482,314	B2	1/2009	Grimes et al.	8,571,645	B2	10/2013	Wu et al.
7,502,643	B2	3/2009	Farrington et al.	8,591,430	B2	11/2013	Amurthur et al.
7,539,533	B2	5/2009	Tran	8,594,763	B1	11/2013	Bibian
7,542,878	B2	6/2009	Nanikashvili	8,626,262	B2	1/2014	McGusty et al.
7,587,237	B2	9/2009	Korzinov et al.	8,639,319	B2	1/2014	Hugh et al.
7,630,756	B2	12/2009	Linker	8,668,643	B2	3/2014	Kinast
7,632,174	B2	12/2009	Gringer et al.	8,684,900	B2	4/2014	Tran
7,672,714	B2	3/2010	Kuo et al.	8,684,925	B2	4/2014	Amurthur et al.
7,715,905	B2	5/2010	Kurzweil et al.	8,688,189	B2	4/2014	Shennib
7,729,753	B2	6/2010	Kremliovskiy et al.	8,688,190	B2	4/2014	Libbus et al.
7,733,224	B2	6/2010	Tran	8,688,202	B2	4/2014	Brockway et al.
D621,048	S	8/2010	Severe et al.	8,718,742	B2	5/2014	Beck et al.
7,815,494	B2	10/2010	Gringer et al.	8,718,752	B2	5/2014	Libbus et al.
7,841,039	B1	11/2010	Squire	8,731,632	B1	5/2014	Sereboff et al.
7,889,070	B2	2/2011	Reeves et al.	8,738,118	B2	5/2014	Moon et al.
D634,431	S	3/2011	Severe et al.	8,782,308	B2	7/2014	Vlach
7,904,133	B2	3/2011	Gehman et al.	8,790,257	B2	7/2014	Libbus et al.
7,907,956	B2	3/2011	Uhlik	8,795,174	B2	8/2014	Manicka et al.
7,907,996	B2	3/2011	Prystowsky et al.	8,818,481	B2	8/2014	Bly et al.
7,941,207	B2	5/2011	Korzinov	8,823,490	B2	9/2014	Libbus et al.
7,970,450	B2	6/2011	Kroecker et al.	8,838,218	B2	9/2014	Khair
7,996,075	B2	8/2011	Korzinov et al.	8,874,185	B2	10/2014	Sonnenborg
7,996,187	B2	8/2011	Nanikashvili et al.	8,903,477	B2	12/2014	Berkner
8,002,701	B2	8/2011	Michael et al.	8,903,484	B2	12/2014	Mazar
8,077,042	B2	12/2011	Peeters	8,909,330	B2	12/2014	McCombie et al.
8,103,333	B2	1/2012	Tran	8,909,832	B2	12/2014	Vlach et al.
8,108,036	B2	1/2012	Tran	8,926,509	B2	1/2015	Magar et al.
8,116,841	B2	2/2012	Bly et al.	8,945,019	B2	2/2015	Prystowsky et al.
8,156,945	B2	4/2012	Hart	8,954,129	B1	2/2015	Schlegel et al.
D659,836	S	5/2012	Bensch et al.	8,956,293	B2	2/2015	McCombie et al.
8,200,319	B2	6/2012	Pu et al.	8,968,195	B2	3/2015	Tran
8,214,007	B2	7/2012	Baker et al.	8,972,000	B2	3/2015	Manera
8,150,502	B2	8/2012	Kumar et al.	8,979,755	B2	3/2015	Szydlo-Moore et al.
8,160,682	B2	8/2012	Kumar et al.	9,014,777	B2	4/2015	Woo
8,244,335	B2*	8/2012	Kumar ..... A61B 5/0006 600/509	9,015,008	B2	4/2015	Geva et al.
8,249,686	B2	8/2012	Libbus et al.	9,017,255	B2	4/2015	Raptis et al.
8,261,754	B2	9/2012	Pitstick	9,017,256	B2	4/2015	Gottesman
8,265,907	B2	9/2012	Nanikashvili et al.	9,021,161	B2	4/2015	Vlach et al.
RE43,767	E	10/2012	Eggers et al.	9,021,165	B2	4/2015	Vlach
8,280,749	B2	10/2012	Hsieh et al.	9,026,190	B2	5/2015	Shenasa et al.
8,285,356	B2	10/2012	Bly et al.	9,037,223	B2	5/2015	Oral et al.
8,290,129	B2	10/2012	Rogers et al.	9,044,148	B2	6/2015	Michelson et al.
8,290,574	B2	10/2012	Field et al.	9,084,548	B2	7/2015	Bouguerra
8,301,219	B2	10/2012	Chen et al.	9,095,274	B2	8/2015	Fein et al.
8,301,236	B2	10/2012	Baumann et al.	9,101,264	B2	8/2015	Acquista
8,311,604	B2	11/2012	Rowlandson et al.	9,138,144	B2	9/2015	Geva
8,315,687	B2	11/2012	Cross et al.	9,149,228	B2	10/2015	Kinast
8,315,695	B2	11/2012	Sebelius et al.	9,173,670	B2	11/2015	Sepulveda et al.
8,323,188	B2	12/2012	Tran	9,179,851	B2	11/2015	Baumann et al.
8,326,394	B2	12/2012	Rowlandson et al.	9,211,076	B2	12/2015	Kim
8,326,407	B2	12/2012	Linker	9,226,679	B2	1/2016	Balda
8,328,718	B2	12/2012	Tran	9,241,649	B2	1/2016	Kumar et al.
8,343,116	B2	1/2013	Ignon	9,241,650	B2	1/2016	Amirim
8,374,688	B2	2/2013	Libbus et al.	9,277,864	B2	3/2016	Yang et al.
8,386,009	B2*	2/2013	Lindberg ..... A61B 5/0245 600/386	9,282,894	B2	3/2016	Banet et al.
8,406,843	B2	3/2013	Tiegs et al.	9,345,414	B1	5/2016	Bardy et al.
				9,355,215	B2	5/2016	Vlach
				9,357,939	B1	6/2016	Nosrati
				9,364,150	B2	6/2016	Sebelius et al.
				9,398,853	B2	7/2016	Nanikashvili
				9,414,786	B1	8/2016	Brockway et al.
				9,433,367	B2	9/2016	Felix et al.

(56)		References Cited				
		U.S. PATENT DOCUMENTS				
9,439,566	B2	9/2016	Arne et al.	2007/0270678	A1 11/2007	Fadem et al.
9,439,599	B2*	9/2016	Thompson .....	2007/0293776	A1 12/2007	Korzinov et al.
9,445,719	B2	9/2016	Libbus et al.	2008/0039730	A1 2/2008	Pu et al.
9,451,890	B2	9/2016	Gitlin et al.	2008/0091089	A1 4/2008	Guillory et al.
9,451,975	B2	9/2016	Sepulveda et al.	2008/0108890	A1 5/2008	Teng et al.
9,474,445	B2	10/2016	Eveland	2008/0114232	A1 5/2008	Gazit
9,474,461	B2	10/2016	Fisher et al.	2008/0139953	A1* 6/2008	Baker .....
D773,056	S	11/2016	Vlach			A61B 5/0006 600/509
9,492,084	B2	11/2016	Behar et al.	2008/0275327	A1 11/2008	Faarbaek et al.
9,504,423	B1	11/2016	Bardy et al.	2008/0288026	A1 11/2008	Cross et al.
9,579,020	B2	2/2017	Libbus et al.	2009/0062670	A1 3/2009	Sterling et al.
9,597,004	B2	3/2017	Hughes et al.	2009/0073991	A1 3/2009	Landrum et al.
9,615,793	B2	4/2017	Solosko et al.	2009/0076336	A1 3/2009	Mazar et al.
9,655,518	B2	5/2017	Lin	2009/0076340	A1* 3/2009	Libbus .....
9,655,538	B2	5/2017	Felix et al.			A61B 5/0006 600/301
9,706,938	B2	7/2017	Chakravarthy et al.	2009/0076341	A1 3/2009	James et al.
9,775,534	B2	10/2017	Korzinov et al.	2009/0076342	A1 3/2009	Amurthur et al.
9,782,095	B2	10/2017	Ylostalo et al.	2009/0076343	A1 3/2009	James et al.
9,839,363	B2	12/2017	Albert	2009/0076344	A1 3/2009	Libbus et al.
9,901,274	B2	2/2018	Bishay et al.	2009/0076345	A1 3/2009	Manicka et al.
2001/0056262	A1	12/2001	Cabiri et al.	2009/0076346	A1 3/2009	James et al.
2002/0067256	A1	6/2002	Kail	2009/0076349	A1 3/2009	Libbus et al.
2002/0082491	A1	6/2002	Nissila	2009/0076350	A1 3/2009	Bly et al.
2002/0087167	A1	7/2002	Winitzky	2009/0076364	A1 3/2009	Libbus et al.
2002/0180605	A1	12/2002	Ozguz et al.	2009/0076397	A1 3/2009	Libbus et al.
2003/0069510	A1	4/2003	Semler	2009/0076401	A1 3/2009	Mazar et al.
2003/0083559	A1	5/2003	Thompson	2009/0076559	A1 3/2009	Libbus et al.
2003/0149349	A1	8/2003	Jensen	2009/0182204	A1 7/2009	Semler et al.
2003/0176795	A1	9/2003	Harris et al.	2009/0253975	A1 10/2009	Tiegs
2003/0195408	A1	10/2003	Hastings	2009/0292194	A1 11/2009	Libbus et al.
2003/0199811	A1	10/2003	Sage, Jr. et al.	2010/0022864	A1 1/2010	Cordero
2003/0212319	A1*	11/2003	Magill .....	2010/0042113	A1 2/2010	Mah
			A61B 5/0408 600/382	2010/0049006	A1 2/2010	Magar et al.
2004/0032957	A1	2/2004	Mansy et al.	2010/0051039	A1 3/2010	Ferrara
2004/0068195	A1	4/2004	Massicotte et al.	2010/0056881	A1 3/2010	Libbus et al.
2004/0077954	A1	4/2004	Oakley et al.	2010/0057056	A1 3/2010	Gurtner
2004/0215091	A1	10/2004	Lohman et al.	2010/0081913	A1 4/2010	Cross et al.
2004/0236202	A1	11/2004	Burton	2010/0145359	A1 6/2010	Keller
2004/0254587	A1	12/2004	Park	2010/0191310	A1 7/2010	Bly
2004/0260189	A1	12/2004	Eggers et al.	2010/0234716	A1 9/2010	Engel
2005/0096513	A1	5/2005	Ozguz et al.	2010/0249625	A1 9/2010	Lin
2005/0101875	A1	5/2005	Semler et al.	2010/0268103	A1 10/2010	McNamara et al.
2005/0118246	A1	6/2005	Wong et al.	2010/0331711	A1 12/2010	Krauss et al.
2005/0119580	A1	6/2005	Eveland	2011/0021937	A1 1/2011	Hugh et al.
2005/0165323	A1	7/2005	Montgomery et al.	2011/0087083	A1 4/2011	Poeze et al.
2005/0204636	A1	9/2005	Azar et al.	2011/0144470	A1 6/2011	Mazar et al.
2005/0277841	A1	12/2005	Shennib	2011/0160601	A1 6/2011	Wang et al.
2005/0280531	A1	12/2005	Fadem et al.	2011/0166468	A1 7/2011	Prystowsky et al.
2006/0030781	A1	2/2006	Shennib	2011/0190650	A1 8/2011	McNair
2006/0030782	A1	2/2006	Shennib	2011/0237922	A1 9/2011	Parker, III et al.
2006/0047215	A1	3/2006	Newman et al.	2011/0306862	A1 12/2011	Hayes-Gill
2006/0084883	A1	4/2006	Linker	2012/0029307	A1 2/2012	Paquet et al.
2006/0142648	A1	6/2006	Banet et al.	2012/0071730	A1 3/2012	Romero
2006/0142654	A1	6/2006	Rytky	2012/0071731	A1 3/2012	Gottesman
2006/0149156	A1	7/2006	Cochran et al.	2012/0071743	A1* 3/2012	Todorov .....
2006/0155173	A1	7/2006	Anttila et al.			G06F 19/3481 600/372
2006/0155183	A1	7/2006	Kroecker et al.	2012/0083670	A1 4/2012	Rotondo et al.
2006/0155199	A1	7/2006	Logier et al.	2012/0088999	A1 4/2012	Bishay et al.
2006/0155200	A1	7/2006	Ng et al.	2012/0101396	A1 4/2012	Solosko et al.
2006/0161064	A1	7/2006	Watrous et al.	2012/0108917	A1 5/2012	Libbus et al.
2006/0161065	A1	7/2006	Elion	2012/0108920	A1 5/2012	Bly et al.
2006/0161066	A1	7/2006	Elion	2012/0110226	A1 5/2012	Vlach et al.
2006/0161067	A1	7/2006	Elion	2012/0110228	A1 5/2012	Vlach et al.
2006/0161068	A1	7/2006	Hastings et al.	2012/0110228	A1 5/2012	Vlach et al.
2006/0224072	A1	10/2006	Shennib	2012/0172676	A1 7/2012	Penders et al.
2006/0264767	A1	11/2006	Shennib	2012/0197150	A1 8/2012	Cao et al.
2007/0003695	A1	1/2007	Tregub et al.	2012/0209102	A1 8/2012	Ylostalo et al.
2007/0010729	A1	1/2007	Virtanen	2012/0215123	A1 8/2012	Kumar et al.
2007/0027388	A1	2/2007	Chou	2012/0220835	A1 8/2012	Chung
2007/0088419	A1*	4/2007	Fiorina .....	2012/0259233	A1 10/2012	Chan et al.
			A61N 1/0476 607/152	2012/0271141	A1 10/2012	Davies
2007/0156054	A1	7/2007	Korzinov et al.	2012/0310070	A1* 12/2012	Kumar .....
2007/0225611	A1	9/2007	Kumar et al.			A61B 5/6833 600/391
2007/0249946	A1	10/2007	Kumar et al.	2012/0323257	A1 12/2012	Sutton
2007/0255153	A1	11/2007	Kumar et al.	2012/0330126	A1* 12/2012	Hoppe .....
						A61B 5/0002 600/391
				2013/0046151	A1 2/2013	Bsoul et al.
				2013/0085347	A1 4/2013	Manicka et al.
				2013/0096395	A1 4/2013	Katra et al.
				2013/0116533	A1 5/2013	Lian et al.

(56)

## References Cited

## FOREIGN PATENT DOCUMENTS

U.S. PATENT DOCUMENTS						
2013/0116585	A1	5/2013	Bouguerra	CA	2752154	8/2010
2013/0144146	A1	6/2013	Linker	CA	2797980	11/2011
2013/0150698	A1	6/2013	Hsu et al.	CA	2898626	7/2014
2013/0225938	A1	8/2013	Vlach	CA	2651203	9/2017
2013/0225967	A1	8/2013	Esposito	EP	01782729	A1 5/2007
2013/0226018	A1	8/2013	Kumar et al.	EP	1981402	10/2008
2013/0245415	A1	9/2013	Kumar et al.	EP	2262419	A2 12/2010
2013/0245472	A1	9/2013	Eveland	EP	2395911	A2 12/2011
2013/0253285	A1	9/2013	Bly et al.	EP	2568878	A2 3/2013
2013/0274584	A1	10/2013	Brion et al.	EP	2635179	A1 9/2013
2013/0296680	A1	11/2013	Linker	EP	2635180	A1 9/2013
2013/0300575	A1	11/2013	Kurzweil et al.	EP	2948050	A1 12/2015
2013/0324868	A1	12/2013	Kaib et al.	EP	2983593	2/2016
2013/0331663	A1	12/2013	Albert et al.	EP	3165161	5/2017
2013/0331665	A1	12/2013	Bly et al.	EP	3212061	9/2017
2013/0338448	A1	12/2013	Libbus et al.	GB	2299038	A 9/1996
2014/0012154	A1	1/2014	Mazar	GB	2348707	A 10/2000
2014/0058280	A1	2/2014	Cheffes et al.	JP	08-317913	A 3/1996
2014/0094709	A1	4/2014	Korzinov et al.	JP	2000-126145	A 5/2000
2014/0100432	A1	4/2014	Golda et al.	JP	2001-057967	A 3/2001
2014/0171751	A1	6/2014	Sankman et al.	JP	2004-121360	A 4/2004
2014/0116825	A1	7/2014	Kurzweil et al.	JP	2007-045967	A 2/2007
2014/0206976	A1	7/2014	Thompson et al.	JP	2007-097822	A 4/2007
2014/0206977	A1	7/2014	Bahney et al.	JP	2007-296266	A 11/2007
2014/0275928	A1	9/2014	Acquista et al.	JP	2009-525816	A 7/2009
2014/0330136	A1	11/2014	Manicka et al.	JP	5203973	B2 6/2013
2015/0022372	A1	1/2015	Vosch	JP	5559425	B2 7/2014
2015/0057512	A1	2/2015	Kapoor	JP	2014-236982	12/2014
2015/0073252	A1	3/2015	Mazar	JP	2016-504159	2/2016
2015/0081959	A1	3/2015	Vlach et al.	JP	2017-136380	8/2017
2015/0082623	A1	3/2015	Felix et al.	JP	6198849	9/2017
2015/0087921	A1	3/2015	Felix et al.	KR	10-1513288	4/2015
2015/0087922	A1	3/2015	Bardy et al.	WO	WO 99/023943	5/1999
2015/0087923	A1	3/2015	Bardy et al.	WO	WO 01/016607	3/2001
2015/0087933	A1	3/2015	Gibson et al.	WO	WO 2004/100785	11/2004
2015/0087948	A1	3/2015	Bishay et al.	WO	WO 2005/025668	3/2005
2015/0087949	A1	3/2015	Felix et al.	WO	WO 2005/037946	4/2005
2015/0087950	A1	3/2015	Felix et al.	WO	WO 2005/084533	9/2005
2015/0087951	A1	3/2015	Felix et al.	WO	WO 2006/094513	9/2006
2015/0088007	A1	3/2015	Bardy et al.	WO	WO 2007/049080	3/2007
2015/0088020	A1	3/2015	Dreisbach et al.	WO	WO 2007/036748	4/2007
2015/0094556	A1	4/2015	Geva et al.	WO	WO 2007/063436	6/2007
2015/0173671	A1	6/2015	Paalasmaa et al.	WO	WO 2007/071180	6/2007
2015/0238107	A1	8/2015	Acquista et al.	WO	WO 2007/072069	6/2007
2015/0289814	A1	10/2015	Magar et al.	WO	WO 2007/092543	8/2007
2015/0297134	A1	10/2015	Albert et al.	WO	WO 2008/005015	1/2008
2015/0327781	A1	11/2015	Hernandez-Silverira et al.	WO	WO 2008/005016	1/2008
2015/0351799	A1	12/2015	Sepulveda et al.	WO	WO 2008/057884	5/2008
2015/0374244	A1	12/2015	Yoo et al.	WO	WO 2008/120154	10/2008
2016/0022161	A1	1/2016	Khair	WO	WO 2009/074928	6/2009
2016/0029906	A1	2/2016	Tompkins et al.	WO	WO 2009/112976	9/2009
2016/0066808	A1	3/2016	Hijazi	WO	WO 2009/112979	9/2009
2016/0113520	A1	4/2016	Manera	WO	WO 2009/134826	11/2009
2016/0120433	A1	5/2016	Hughes et al.	WO	WO 2010/104952	9/2010
2016/0120434	A1	5/2016	Park et al.	WO	WO 2010/105203	9/2010
2016/0128597	A1	5/2016	Lin et al.	WO	WO 2010/093900	10/2010
2016/0135746	A1	5/2016	Kumar et al.	WO	WO 2011/077097	6/2011
2016/0157744	A1	6/2016	Wu et al.	WO	WO 2011/143490	11/2011
2016/0166155	A1	6/2016	Banet et al.	WO	WO 2011/149755	12/2011
2016/0192852	A1	7/2016	Bozza et al.	WO	WO 2012/009453	1/2012
2016/0192855	A1	7/2016	Geva et al.	WO	WO 2012/061509	5/2012
2016/0192856	A1	7/2016	Lee	WO	WO 2012/061518	5/2012
2016/0198972	A1	7/2016	Lee et al.	WO	WO 2012/125425	9/2012
2016/0232807	A1	8/2016	Ghaffari et al.	WO	WO 2012/160550	11/2012
2016/0262619	A1	9/2016	Marcus et al.	WO	WO 2014/051563	4/2014
2016/0287177	A1	10/2016	Huppert et al.	WO	WO 2014/116825	7/2014
2016/0287207	A1	10/2016	Xue	WO	WO 2014/168841	10/2014
2016/0296132	A1	10/2016	Bojovic et al.	WO	WO 2016/070128	5/2016
2016/0302726	A1	10/2016	Chang	WO	WO 2016/181321	11/2016
2016/0317048	A1	11/2016	Chan et al.	WO	WO 2017/039518	3/2017
2016/0317057	A1	11/2016	Li et al.	WO	WO 2017/041014	3/2017
2016/0367164	A1	12/2016	Felix et al.			
2016/0374583	A1	12/2016	Cerruti et al.			
2017/0065823	A1	3/2017	Kaib et al.			
2017/0188872	A1	7/2017	Hughes et al.			

## OTHER PUBLICATIONS

U.S. Appl. No. 15/005,854, filed Jan. 25, 2016, Kumar et al.

(56)

**References Cited**

## OTHER PUBLICATIONS

3M Corporation, "3M Surgical Tapes—Choose the Correct Tape" quicksheet (2004).

Del Mar et al.; The history of clinical holter monitoring; A.N.E.; vol. 10; No. 2; pp. 226-230; Apr. 2005.

Enseleit et al.; Long-term continuous external electrocardiographic recording: a review; Eurospace; vol. 8; pp. 255-266; 2006.

Hoefman et al.; Optimal duration of event recording for diagnosis of arrhythmias in patients with palpitations and light-headedness in the general practice; Family Practice; Dec. 7, 2006.

International Search Report and Written Opinion for International Application No. PCT/US2014/012749 dated Mar. 21, 2014 in 20 pages.

Kennedy et al.; The history, science, and innovation of holter technology; A.N.E.; vol. 11; No. 1; pp. 85-94; 2006.

Mundt et al. "A Multiparameter Wearable Physiologic Monitoring System for Space and Terrestrial Applications" IEEE Transactions on Information Technology in Biomedicine, vol. 9, No. 3, pp. 382-384, Sep. 2005.

Reiffel et al.; Comparison of autotriggered memory loop recorders versus standard loop recorders versus 24-hour holter monitors for arrhythmia detection; Am. J. Cardiology; vol. 95; pp. 1055-1059; May 1, 2005.

Scapa Medical product listing and descriptions (2008) available at <http://www.caapana.com/productlist.jsp> and <http://www.metplus.co.rs/pdf/prospekti/Samolepljivemedicinsketrake.pdf>; retrieved via WayBack Machine Sep. 24, 2012.

Ward et al.; Assessment of the diagnostic value of 24-hour ambulatory electrocardiographic monitoring; Biotelemetry Patient monitoring; vol. 7; 1980.

Ziegler et al.; Comparison of continuous versus intermittent monitoring of atrial arrhythmias; Heart Rhythm; vol. 3; No. 12; pp. 1445-1452; Dec. 2006.

Zimetbaum et al.; The evolving role of ambulatory arrhythmia monitoring in general clinic practice; Ann. Intern. Med.; vol. 130; pp. 846-8556; 1999.

Zimetbaum et al.; Utility of patient-activated cardiac event recorders in general clinical practice; The Amer. J. of Cardiology; vol. 79; Feb. 1, 1997.

\* cited by examiner

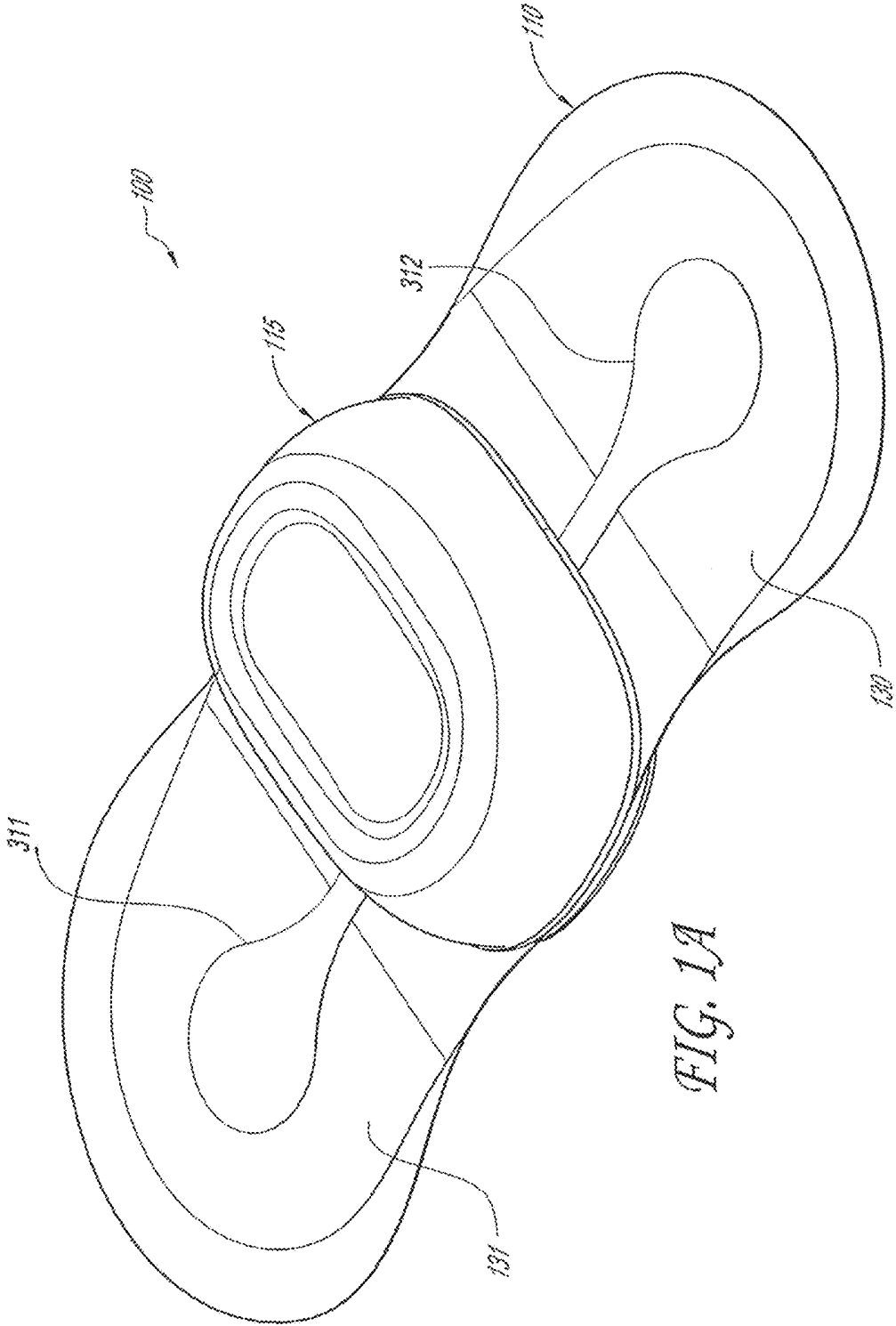

FIG. 1A

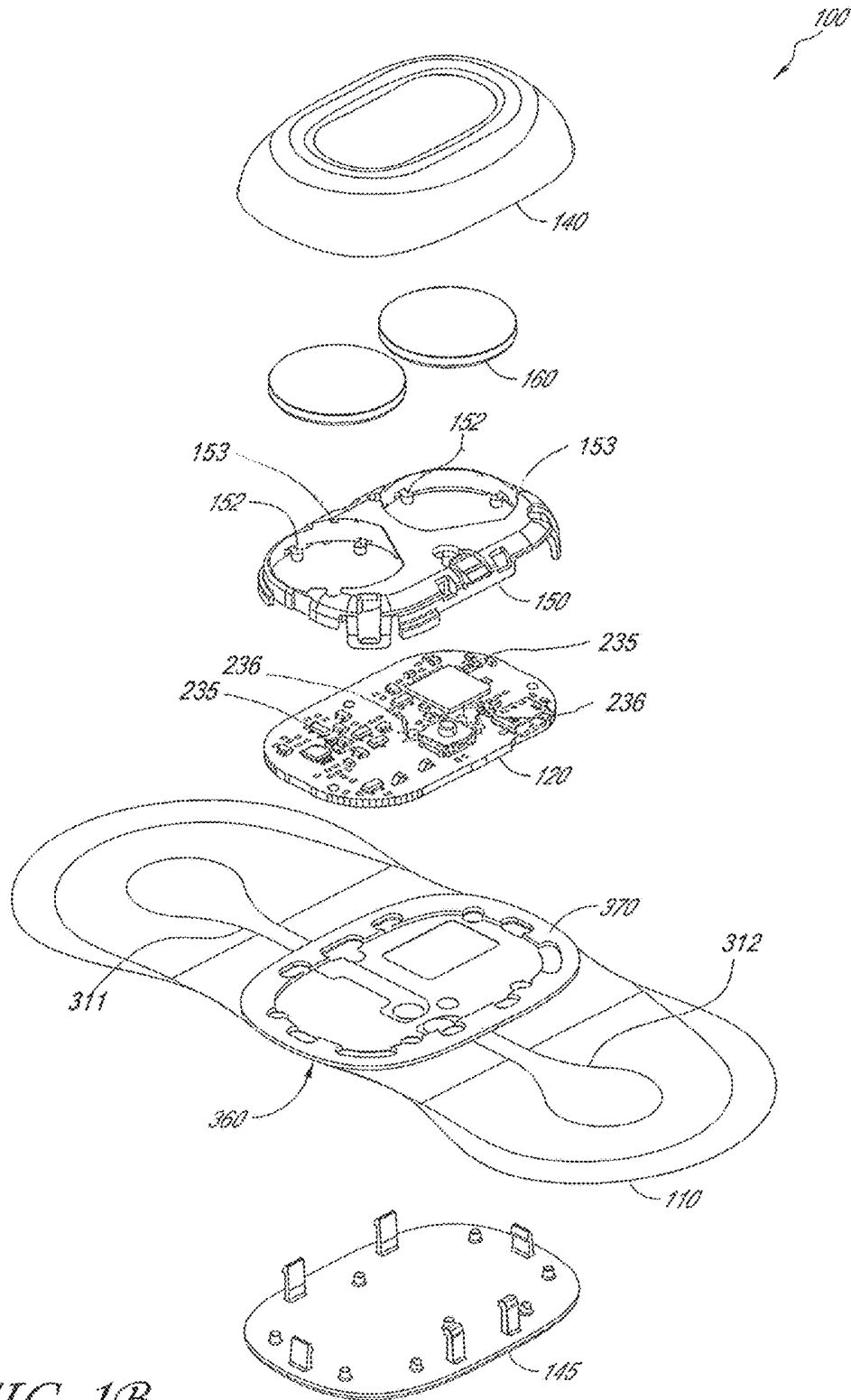

FIG. 1B

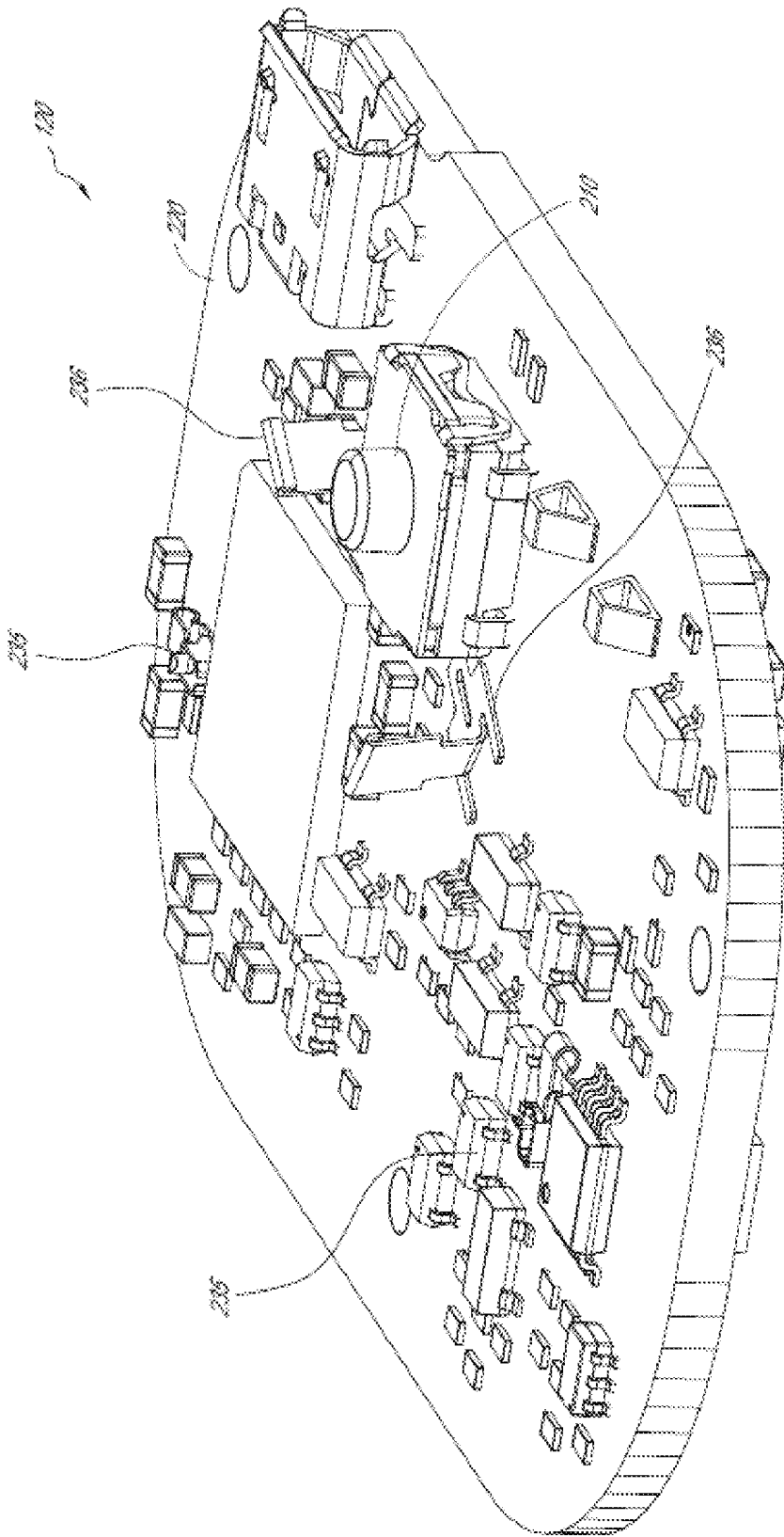

FIG. 2A

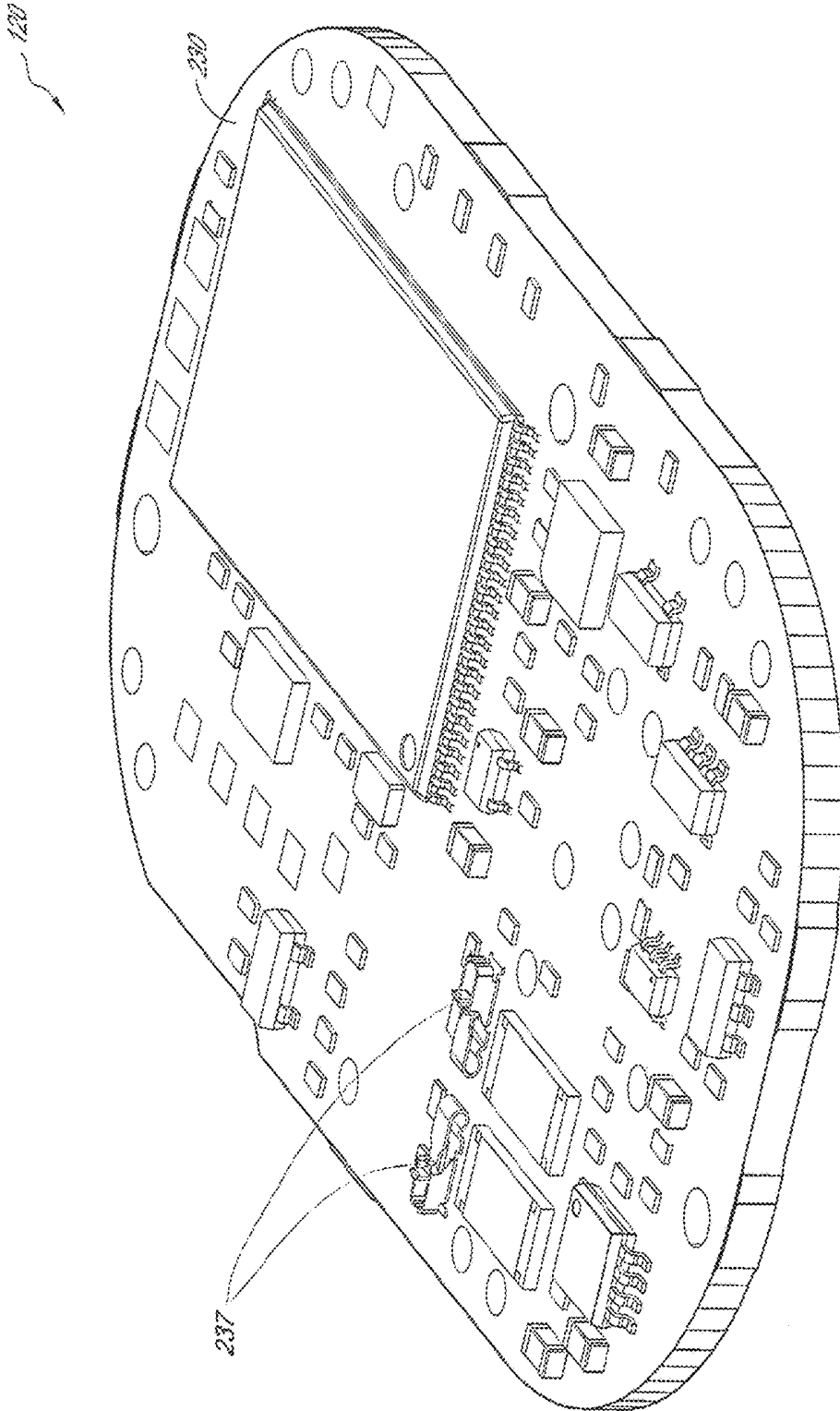

FIG. 2B

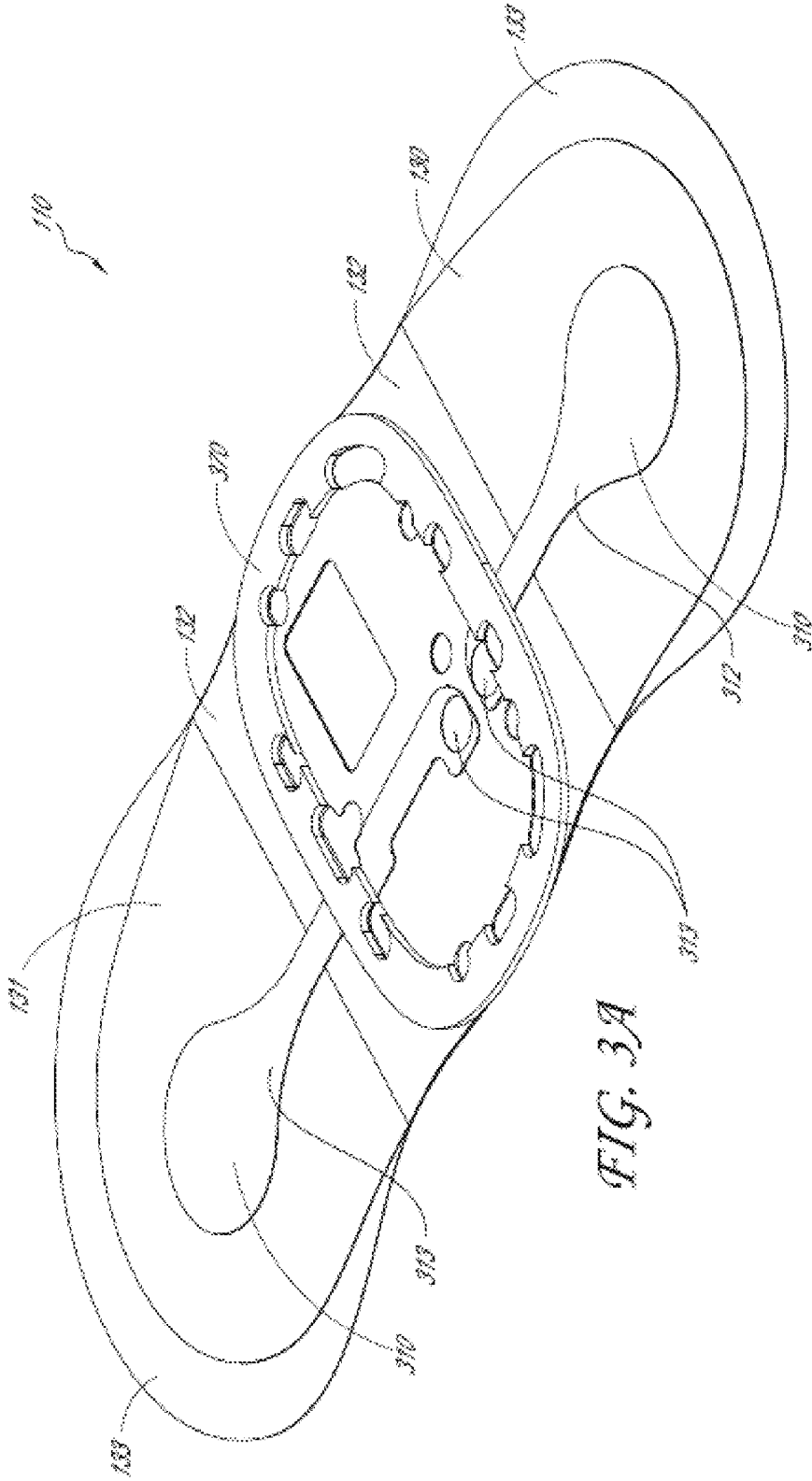

FIG. 3A

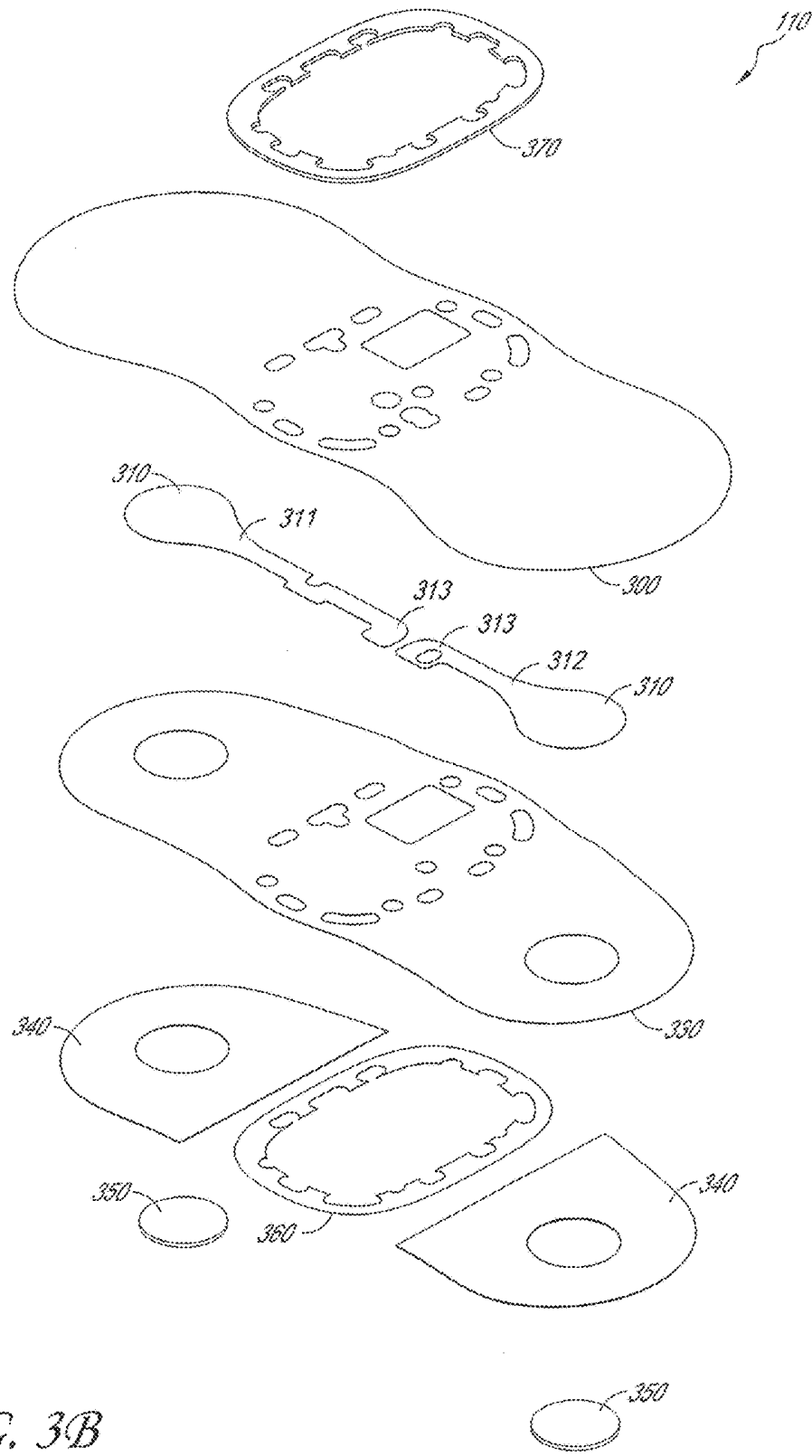

FIG. 3B

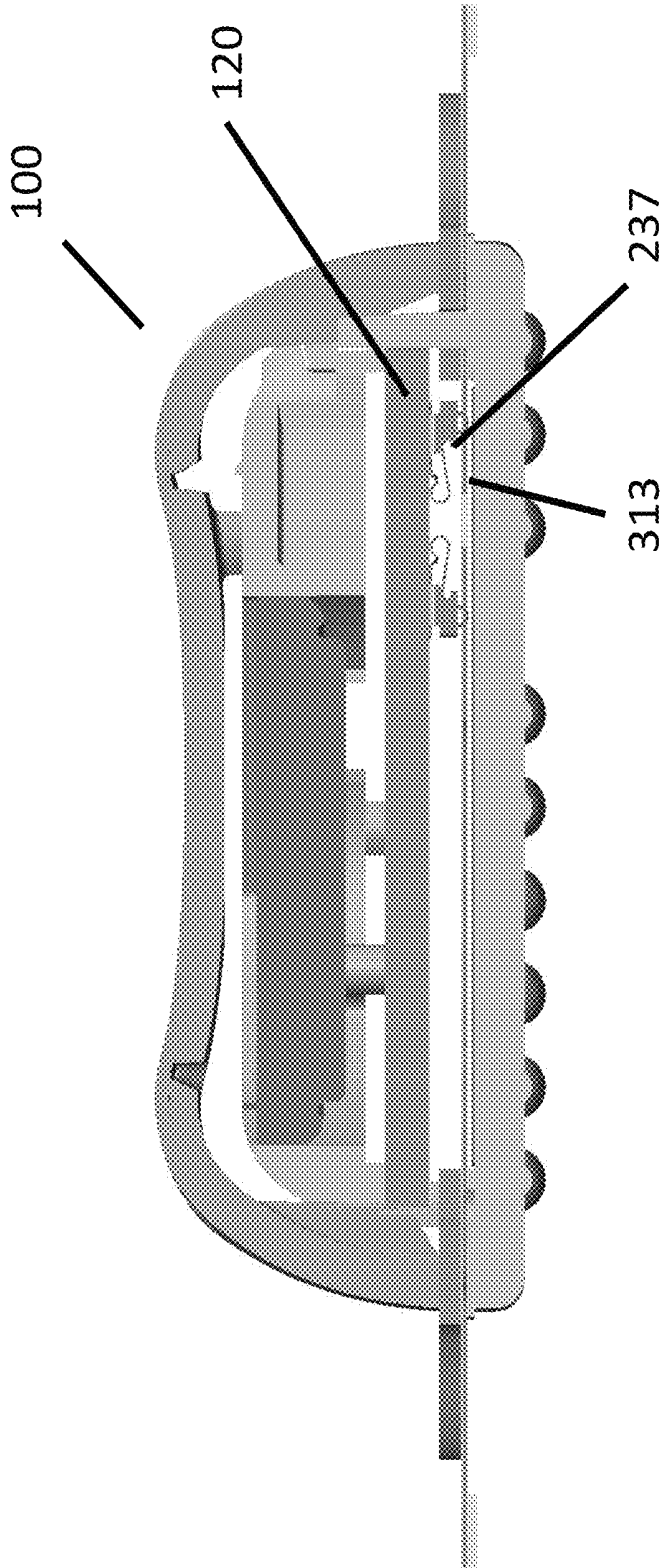

FIG. 3C

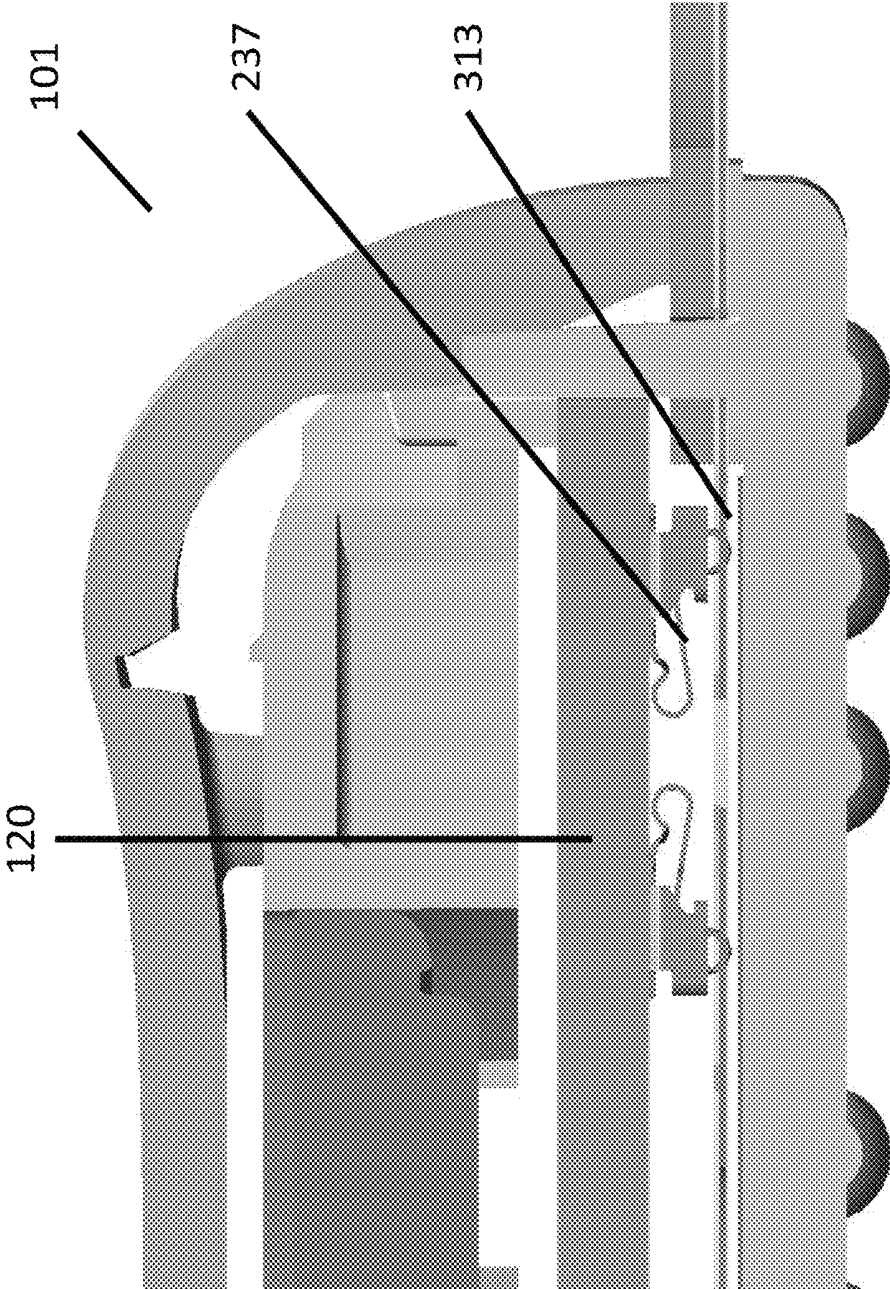

FIG. 3D

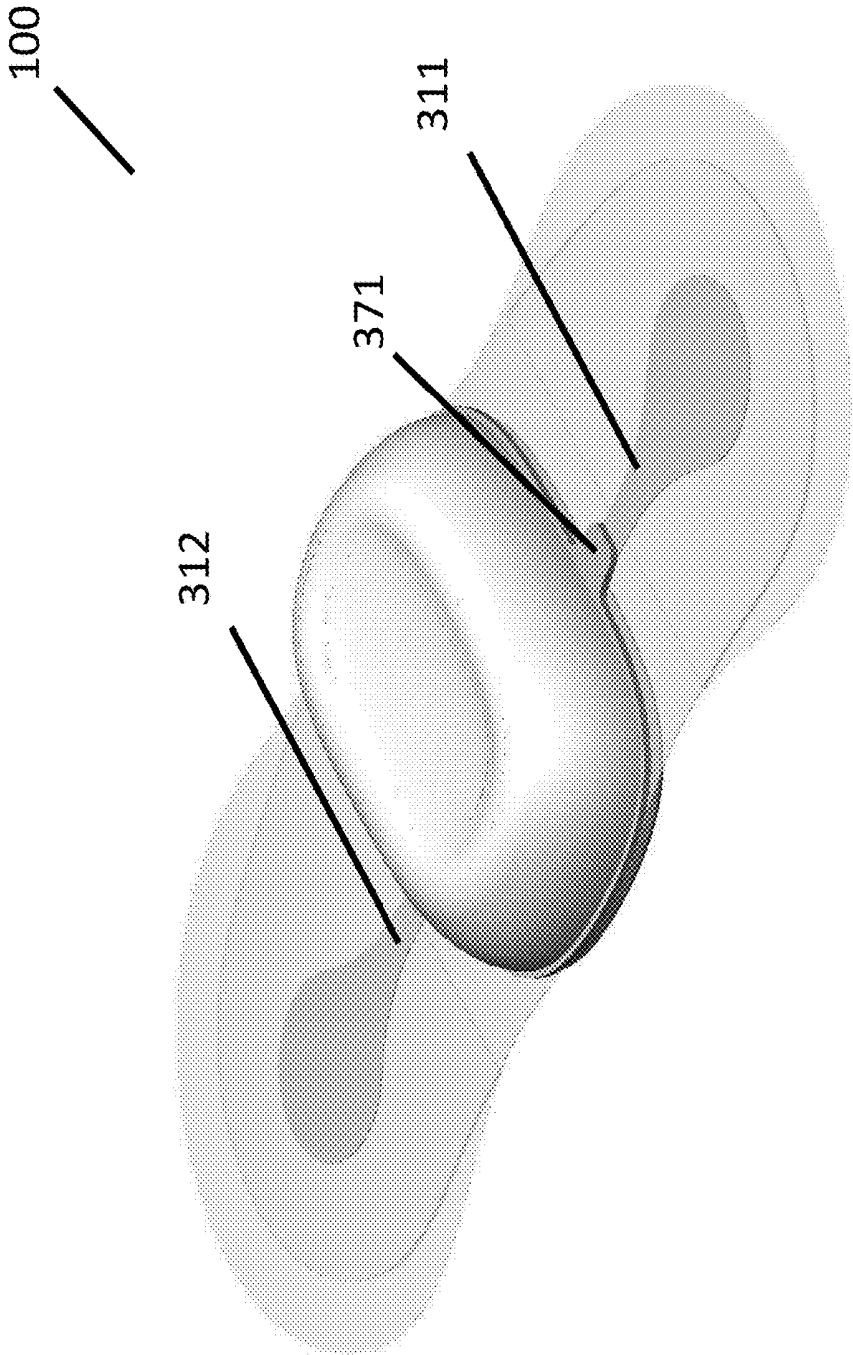

FIG. 3E

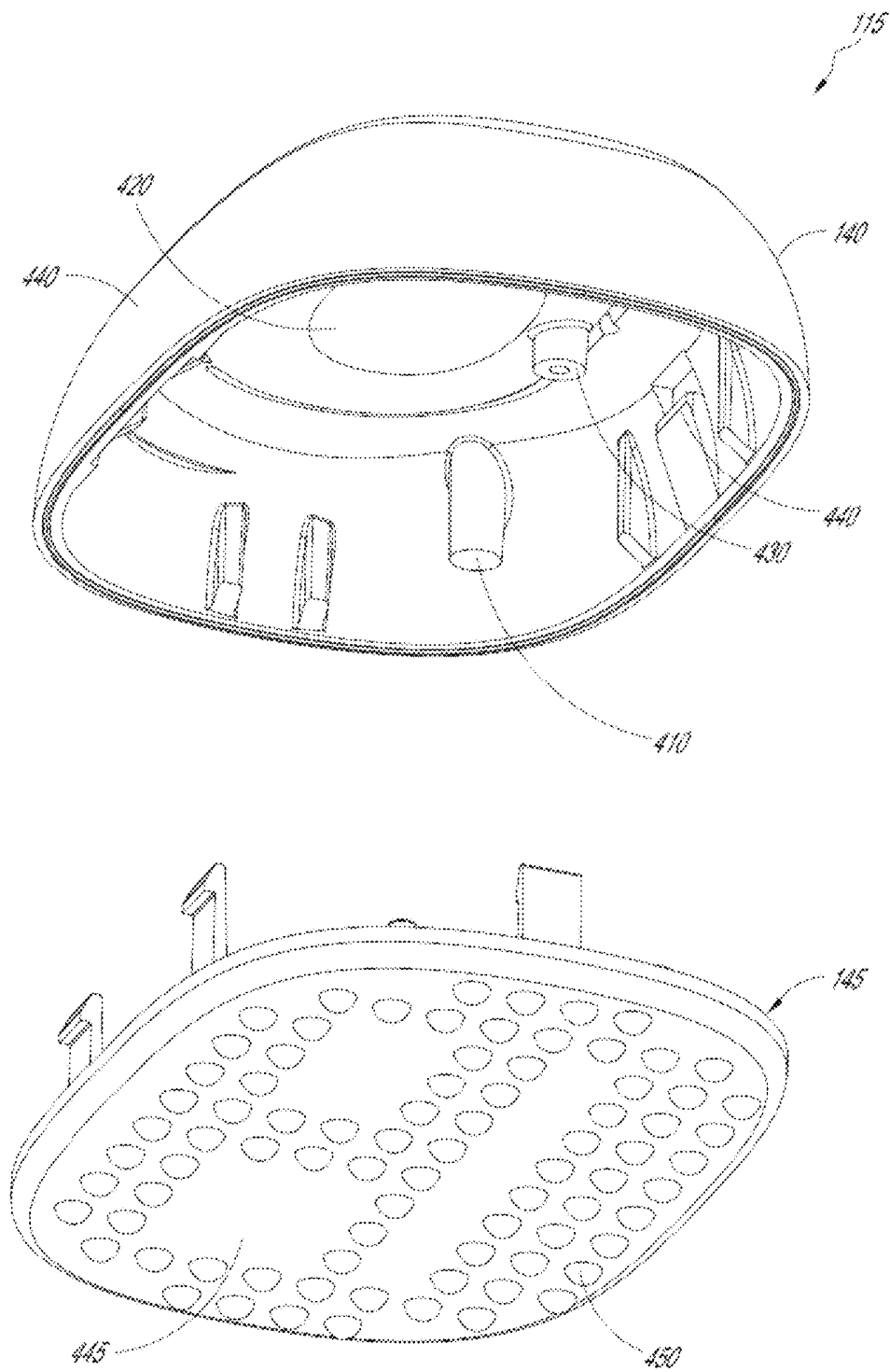

FIG. 4

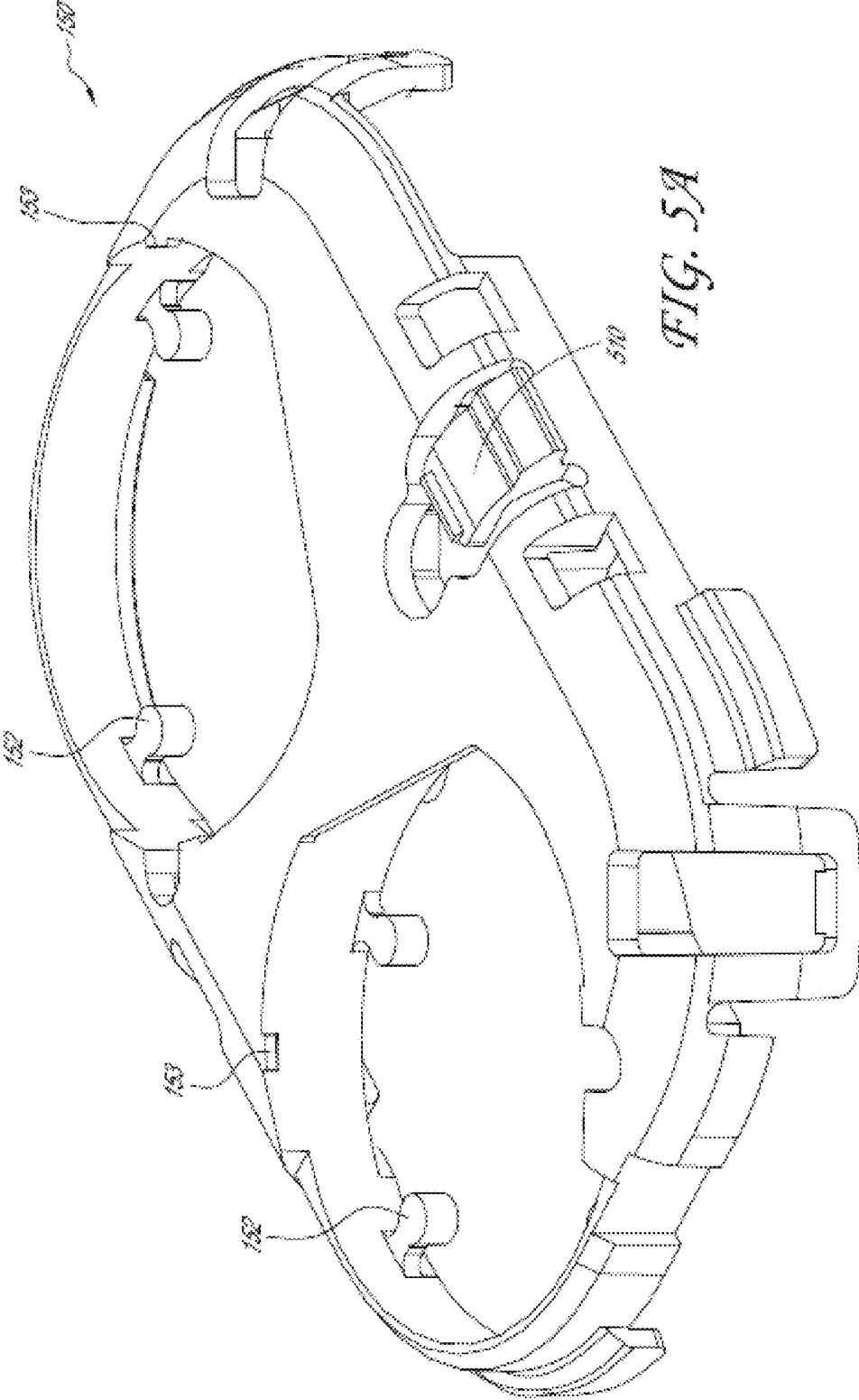

FIG. 5A

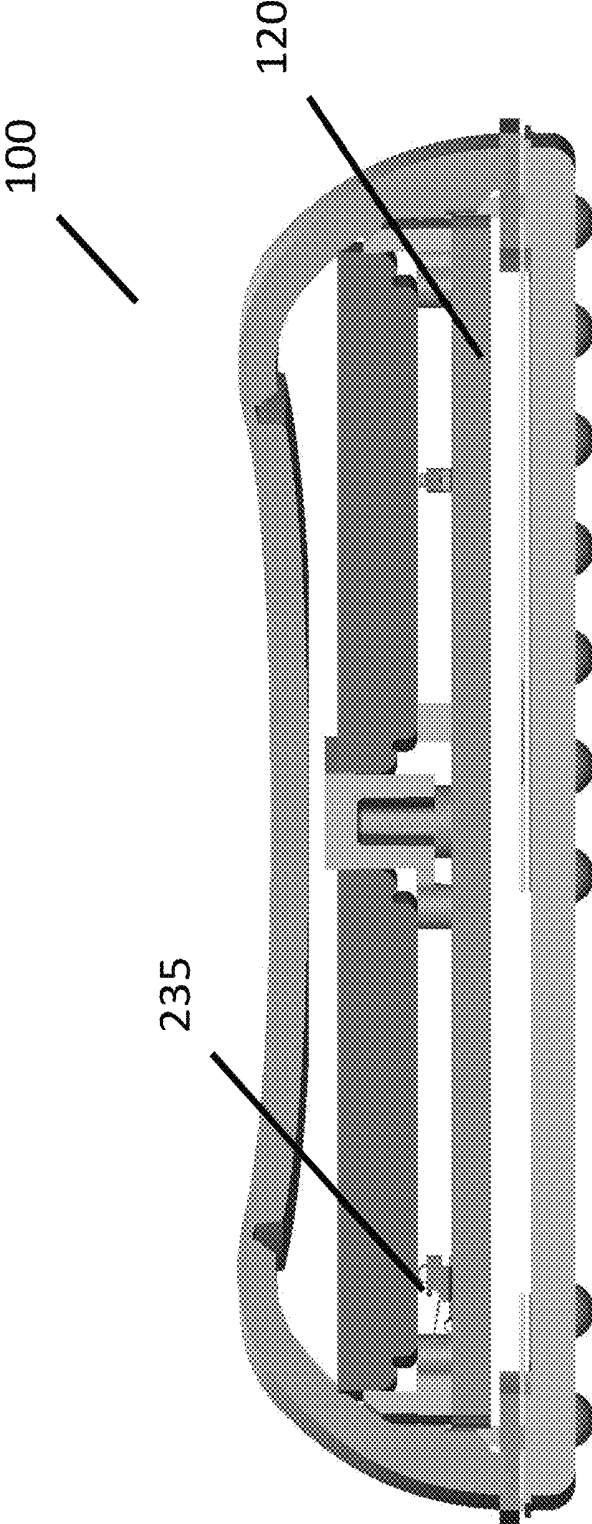

FIG. 5B

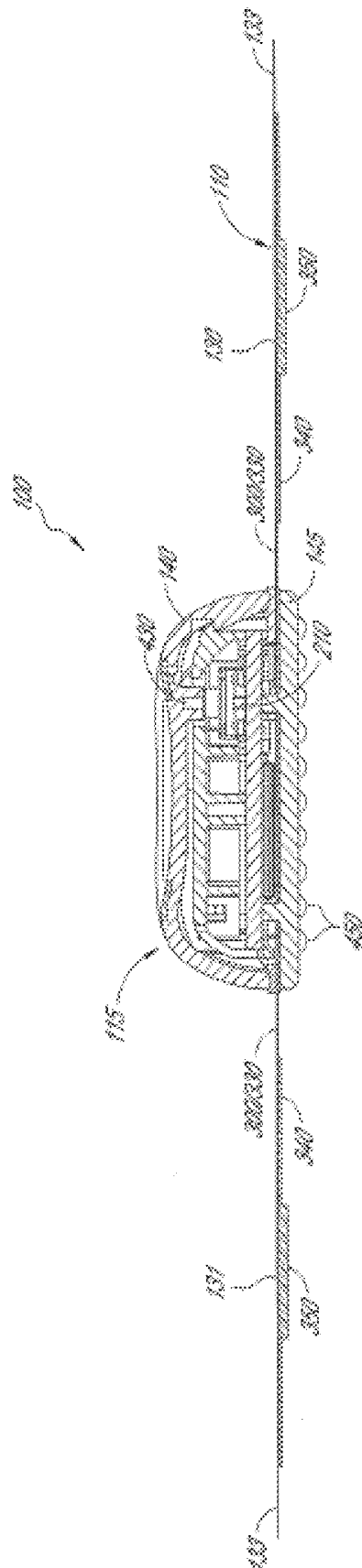

FIG. 6A

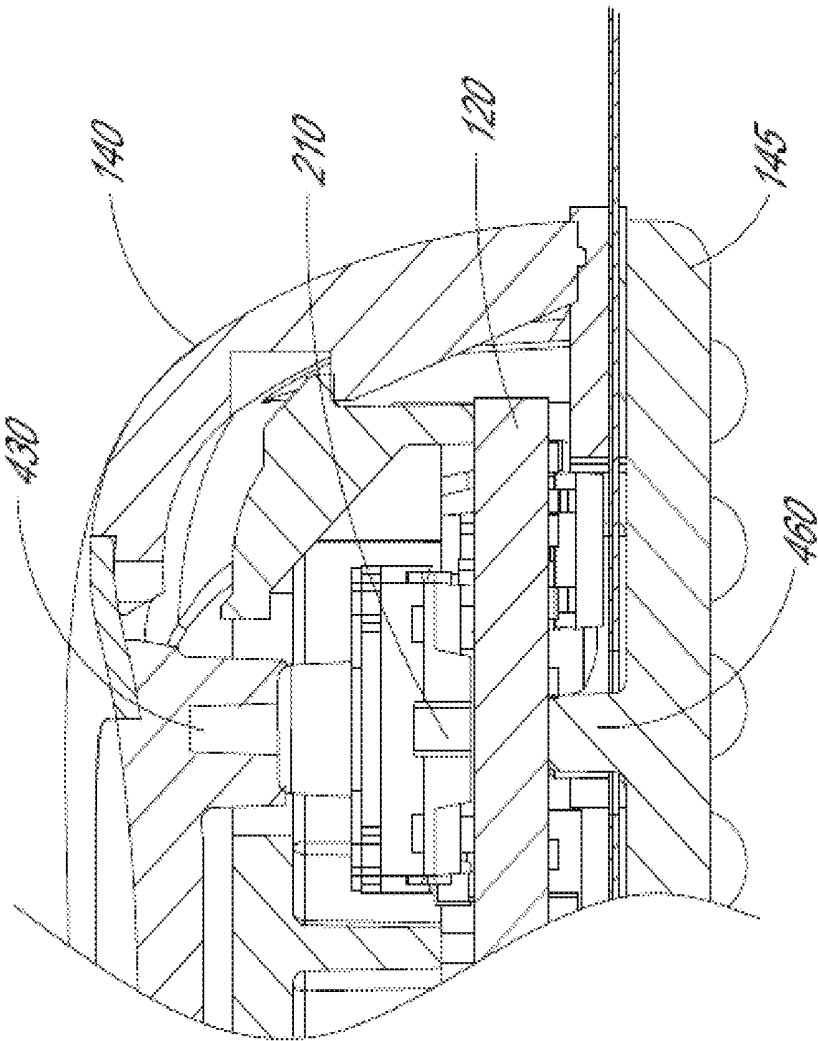

FIG. 6B

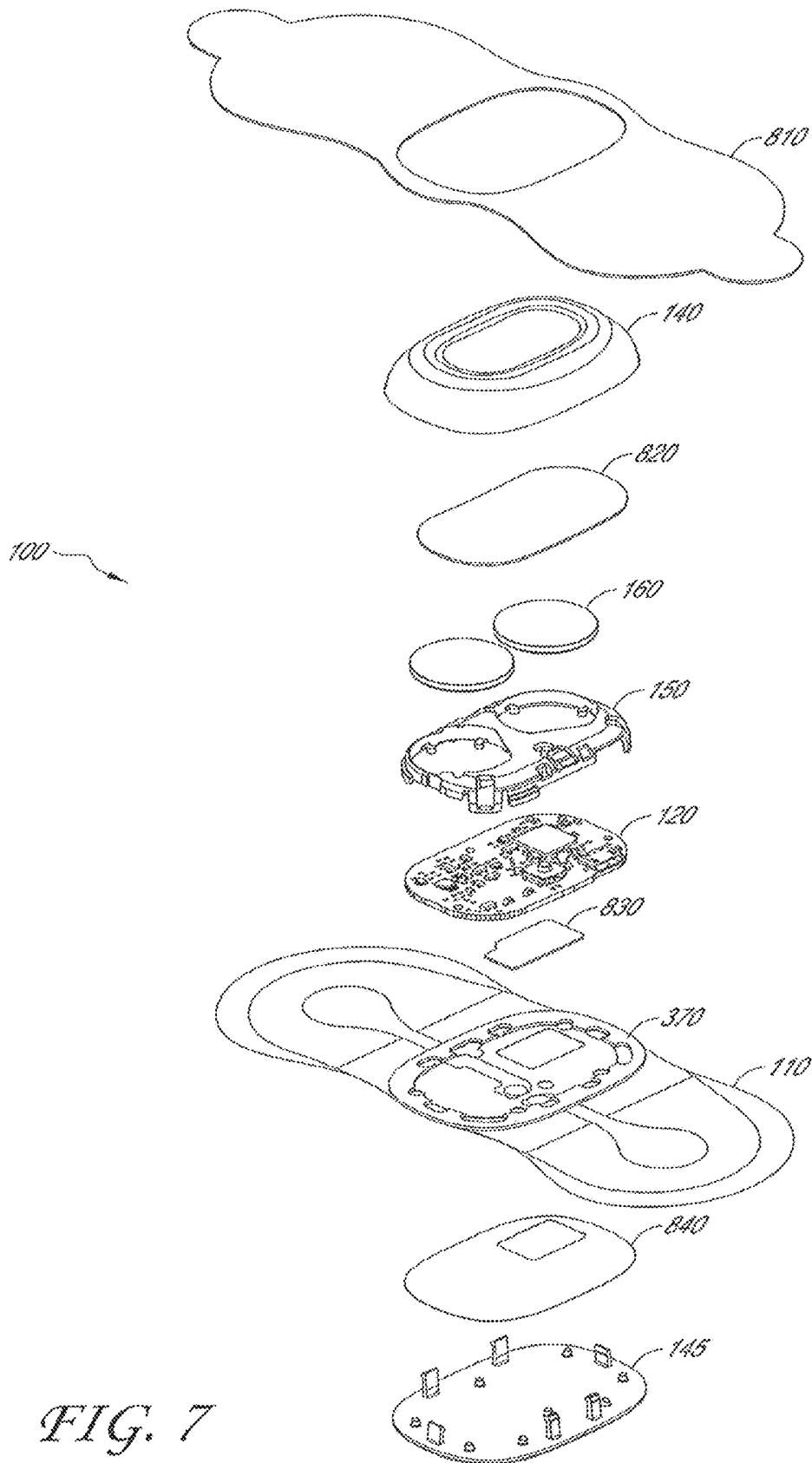
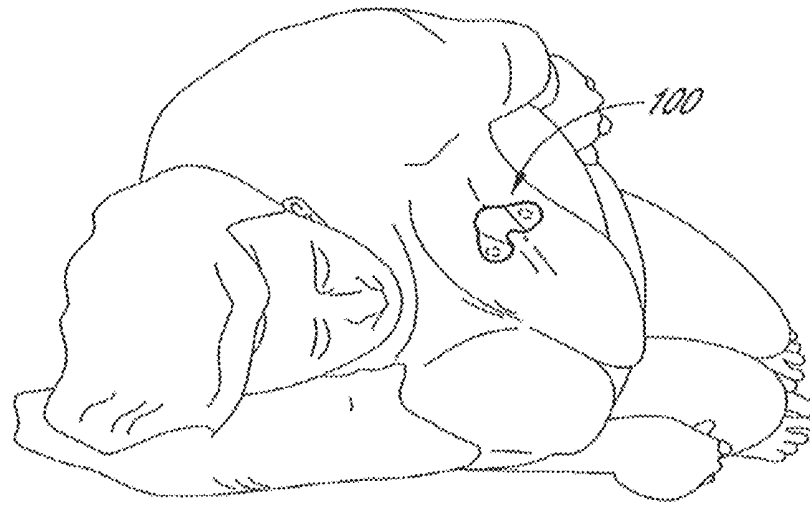
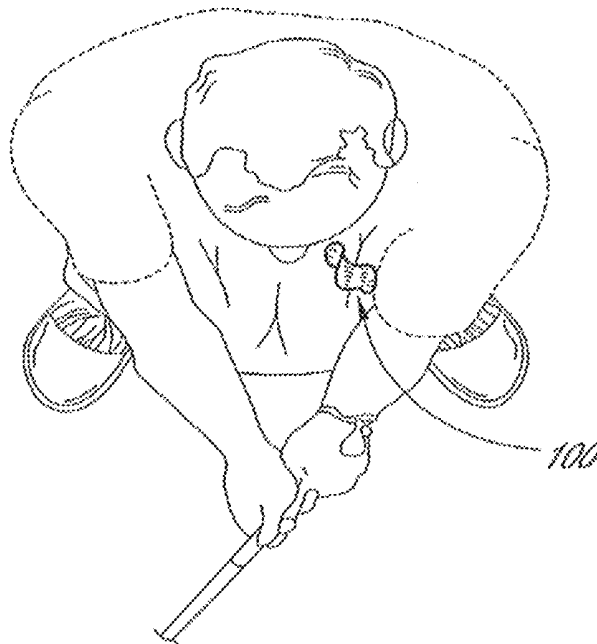

FIG. 7



*FIG. 8A*



*FIG. 8B*

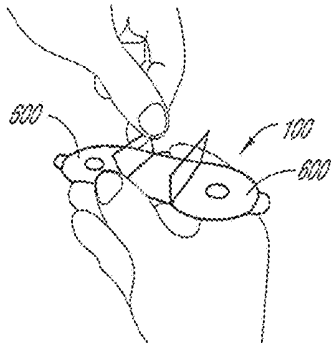

FIG. 9A

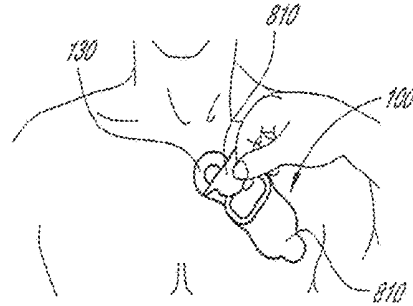

FIG. 9D

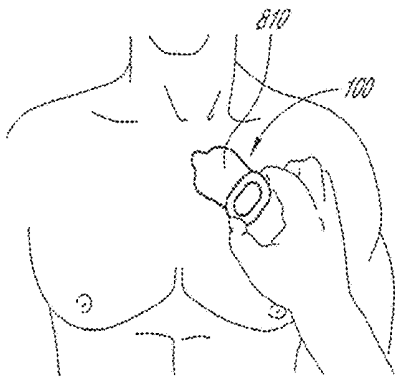

FIG. 9B

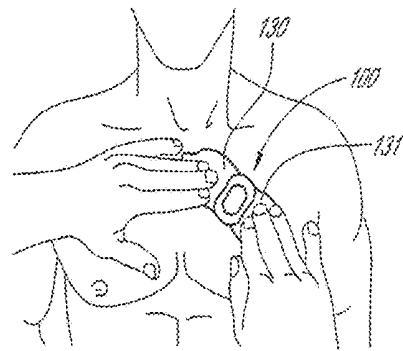

FIG. 9E

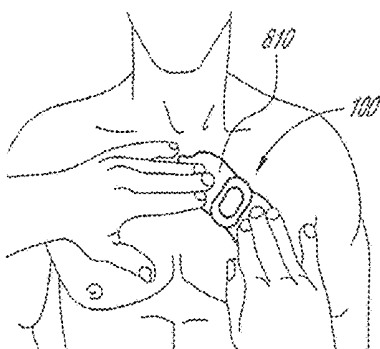

FIG. 9C

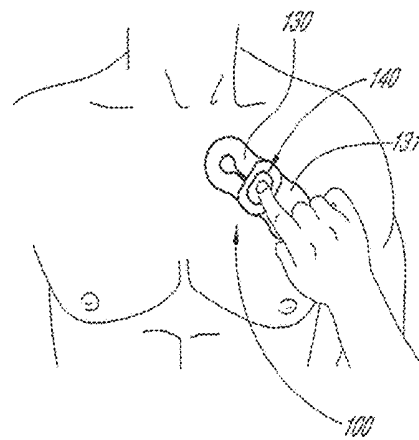

FIG. 9F

**PHYSIOLOGICAL MONITORING DEVICE****CROSS-REFERENCE TO RELATED APPLICATIONS**

This application is a continuation of U.S. patent application Ser. No. 14/162,656, filed, Jan. 23, 2014, which claims the benefit of U.S. Provisional Application No. 61/756,326, filed Jan. 24, 2013, entitled PHYSIOLOGICAL MONITORING DEVICE. The contents of the aforementioned applications are hereby incorporated by reference in their entireties as if fully set forth herein. The benefit of priority to the foregoing application is claimed under the appropriate legal basis, including, without limitation, under 35 U.S.C. § 119(e).

**BACKGROUND****Field of the Invention**

The invention relates generally to medical devices. More specifically, the invention relates to a physiological monitoring device and method for use.

**Description of the Related Art**

Abnormal heart rhythms, or arrhythmias, may cause various types of symptoms, such as loss of consciousness, palpitations, dizziness, or even death. An arrhythmia that causes such symptoms is often an indicator of significant underlying heart disease. It is important to identify when such symptoms are due to an abnormal heart rhythm, since treatment with various procedures, such as pacemaker implantation or percutaneous catheter ablation, can successfully ameliorate these problems and prevent significant symptoms and death.

Since the symptoms listed above can often be due to other, less serious causes, a key challenge is to determine when any of these symptoms are due to an arrhythmia. Oftentimes, arrhythmias occur infrequently and/or episodically, making rapid and reliable diagnosis difficult. Currently, cardiac rhythm monitoring is primarily accomplished through the use of devices, such as Holter monitors, that use short-duration (<1 day) electrodes affixed to the chest. Wires connect the electrodes to a recording device, usually worn on a belt. The electrodes need daily changing and the wires are cumbersome. The devices also have limited memory and recording time. Wearing the device interferes with patient movement and often precludes performing certain activities while being monitored, such as bathing. All of these limitations severely hinder the diagnostic usefulness of the device, the compliance of patients using the device and the likelihood of capturing all important information. Lack of compliance and the shortcomings of the devices often lead to the need for additional devices, follow-on monitoring or other tests to make a correct diagnosis.

Current methods to correlate symptoms with the occurrence of arrhythmias, including the use of cardiac rhythm monitoring devices, such as Holter monitors and cardiac event recorders, are often not sufficient to allow an accurate diagnosis to be made. In fact, Holter monitors have been shown to not lead to a diagnosis up to 90% of the time (“Assessment of the Diagnostic Value of 24-Hour Ambulatory Electrocardiographic Monitoring”, by D E Ward et al. Biotelemetry Patient Monitoring, vol. 7, published in 1980).

Additionally, the medical treatment process to actually obtain a cardiac rhythm monitoring device and initiate

monitoring is typically very complicated. There are usually numerous steps involved in ordering, tracking, monitoring, retrieving, and analyzing the data from such a monitoring device. In most cases, cardiac monitoring devices used today are ordered by a cardiologist or a cardiac electrophysiologist (EP), rather than the patient’s primary care physician (PCP). This is of significance since the PCP is often the first physician to see the patient and determine that the patient’s symptoms could be due to an arrhythmia. After the patient sees the PCP, the PCP will make an appointment for the patient to see a cardiologist or an EP. This appointment is usually several weeks from the initial visit with the PCP, which in itself leads to a delay in making a potential diagnosis as well as increases the likelihood that an arrhythmia episode will occur and go undiagnosed. When the patient finally sees the cardiologist or EP, a cardiac rhythm monitoring device will usually be ordered. The monitoring period can last 24-48 hours (Holter monitor) or up to a month (cardiac event monitor or mobile telemetry device). Once the monitoring has been completed, the patient typically must return the device to the clinic, which itself can be an inconvenience. After the data has been processed by the monitoring company or by a technician on-site at a hospital or office, a report will finally be sent to the cardiologist or EP for analysis. This complex process results in fewer patients receiving cardiac rhythm monitoring than would ideally receive it.

To address some of these issues with cardiac monitoring, the assignee of the present application developed various embodiments of a small, long-term, wearable, physiological monitoring device. One embodiment of the device is the Zio® Patch ([www.irhythmtech.com](http://www.irhythmtech.com)). Various embodiments are also described, for example, in U.S. Pat. Nos. 8,150,502, 8,160,682, 8,244,335, 8,560,046, and 8,538,503, the full disclosures of which are hereby incorporated by reference. Generally, the physiological monitors described in the above references fit comfortably on a patient’s chest and are designed to be worn for at least one week and typically two to three weeks. The monitors detect and record cardiac rhythm signal data continuously while the device is worn, and this cardiac rhythm data is then available for processing and analysis.

These smaller, long-term physiological monitoring devices provided many advantages over prior art devices. At the same time, further improvements are desired. One of the most meaningful areas for improvement exists around increasing fidelity of the recorded ECG signal. This is particularly important for single-channel embodiments where a second vector of ECG is not available to clarify whether aberrances in signal are due to arrhythmia or signal artifact. Increases in signal to noise ratio as well as reduction of motion artifact improve efficiency in both algorithmic and human analysis of the recorded ECG signal.

Signal quality is important throughout the duration of wear, but it is particularly critical where the patient marks the record, indicating an area of symptomatic clinical significance. Marking the record is most easily enabled through a trigger located on the external surface of the device. However, since the trigger is part of a skin-contacting platform with integrated electrodes, the patient can introduce significant motion artifacts when feeling for the trigger. A desirable device improvement would be a symptom trigger that can be activated with minimal addition of motion artifact.

Secondly, patient compliance and device adhesion performance are two factors that govern the duration of the ECG record and consequently the diagnostic yield. Compli-

ance can be increased by improving the patient's wear experience, which is affected by wear comfort, device appearance and the extent to which the device impedes the normal activities of daily living. Given that longer ECG records provide greater diagnostic yield and hence value, improvements to device adhesion and patient compliance are desirable.

Finally, it is desirable for the device to be simple and cost effective to manufacture, enabling scalability at manufacturing as well as higher quality due to repeatability in process. Simplicity of manufacture can also lead to ease of disassembly, which enables the efficient recovery of the printed circuit board for quality-controlled reuse in another device. Efficient reuse of this expensive component is critical for decreasing the cost of the diagnostic monitor. At least some of the objectives will be met by the embodiments described below.

### BRIEF SUMMARY

Embodiments described herein are directed to a physiological monitoring device that may be worn continuously and comfortably by a human or animal subject for at least one week or more and more typically two to three weeks or more. In one embodiment, the device is specifically designed to sense and record cardiac rhythm (i.e., electrocardiogram, ECG) data, although in various alternative embodiments one or more additional physiological parameters may be sensed and recorded. The physiological monitoring device includes a number of features to facilitate and/or enhance the patient experience, to make diagnosis of cardiac arrhythmias more accurate, and to make manufacture of the device more simple and cost effective.

In some embodiments, an electronic device for monitoring physiological signals in a mammal comprises:

at least two flexible wings extending laterally from a rigid housing, wherein the flexible wings comprise a first set of materials which enable the wings to conform to a surface of the mammal and the rigid housing comprises a second set of materials;

a printed circuit board assembly housed within the rigid housing, wherein the rigid housing is configured to prevent deformation of the printed circuit board in response to movement of the mammal;

at least two electrodes embedded within the flexible wings, the electrodes configured to provide conformal contact with the surface of the mammal and to detect the physiological signals of the mammal;

at least two electrode traces embedded within the wings and mechanically decoupled from the rigid housing, the electrode traces configured to provide conformal contact with the surface of the mammal and transmit electrical signals from the electrodes to the printed circuit board assembly; and,

at least one hinge portion connecting the wings to the rigid housing, the hinge portions configured to flex freely at the area where it is joined to the rigid housing.

In certain embodiments, each wing may comprise an adhesive. In embodiments, the electrodes can be in the same plane as the adhesive. In certain embodiments, each wing comprises at least one rim, wherein the rim is thinner than an adjacent portion of each wing. The rigid housing may further comprise dimples configured to allow for airflow between the rigid housing and the surface of the mammal. In certain embodiments, the rim is configured to prevent the release of a portion of the wing from the surface of the mammal. In some embodiments, an electronic device for

monitoring physiological systems may comprise a measuring instrument configured to detect motion signals in at least one axis. This measuring instrument may be an accelerometer that can be configured to detect motion signals in three axes.

In embodiments, the motion signals can be collected in time with the physiological signals. In certain embodiments, a motion artifact is identified when the physiological signals and the motion signals match. Further embodiments may call for an event trigger coupled to the printed circuit board assembly. In some embodiments, the event trigger input is supported by the rigid housing so as to prevent mechanical stress on the printed circuit board when the trigger is activated. The event trigger may be concave and larger than a human finger such that the event trigger is easily located. In certain embodiments, the electrode traces are configured to minimize signal distortion during movement of the mammal. In particular embodiments, gaskets may be used as a means for sealable attachment to the rigid housing.

In certain embodiments, a method for monitoring physiological signals in a mammal may comprise:

attaching an electronic device to the mammal, wherein the device comprises:

at least two electrodes configured to detect physiological signals from the mammal,

at least one measuring instrument configured to detect secondary signals, and

at least two electrode traces connected to the electrodes and a rigid housing; and,

comparing the physiological signals to the secondary signals to identify an artifact.

In certain embodiments, identification of an artifact comprises a comparison between the frequency spectrum of the physiological signals and the frequency spectrum of the secondary signals. In embodiments, the secondary signals comprise motion signals that may be used to derive the activity and position of the mammal. In certain embodiments, the secondary signals are collected in three axes. In some embodiments, a tertiary signal may also be collected. In certain embodiments, the secondary signals comprise information about the connection between the electronic device and the mammal. In some embodiments, the secondary signals may be used to detect when the mammal is sleeping.

In some embodiments, a method of removing and replacing portions of a modular physiological monitoring device may comprise

applying the device of claim 1 to a mammal for a period of time greater than 7 days and collecting physiological data;

using the device of claim 1 to detect a first set of physiological signals;

removing the device of claim 1 from the surface of the mammal;

removing a first component from the device of claim 1; and,

incorporating the first component into a second physiological monitoring device, the second physiological monitoring device configured to detect a second set of physiological signals.

In some embodiments, the first component is electrically connected to other device components without the use of a permanent connection. In some embodiments, the device may further comprise spring connections. In certain embodiments, the first component may be preserved for a second use by a rigid housing to prevent damage. In particular embodiments, the first component is secured within a device

by a mechanism that is capable of re-securing a second component once the first component is removed.

These and other aspects and embodiments of the invention are described in greater detail below, with reference to the drawing figures.

#### BRIEF DESCRIPTION OF THE DRAWINGS

FIGS. 1A and 1B are perspective and exploded views, respectively, of a physiological monitoring device, according to one embodiment;

FIGS. 2A and 2B are top perspective and bottom perspective views, respectively, of a printed circuit board assembly of the physiological monitoring device;

FIGS. 3A-E are perspective and exploded views of a flexible body and gasket of the physiological monitoring device;

FIG. 4 is an exploded view of a rigid housing of the physiological monitoring device;

FIG. 5A-B is a perspective view of a battery holder of the physiological monitoring device;

FIGS. 6A and 6B are cross sectional views of the physiological monitoring device;

FIG. 7 is an exploded view of the physiological monitoring device including a number of optional items, according to one embodiment;

FIGS. 8A and 8B are perspective views of two people wearing the physiological monitoring device, illustrating how the device bends to conform to body movement and position; and

FIGS. 9A-9F illustrate various steps for applying the physiological monitor to a patient's body, according to one embodiment.

#### DETAILED DESCRIPTION

The following description is directed to a number of various embodiments. The described embodiments, however, may be implemented and/or varied in many different ways without departing from the scope of the invention. For example, the described embodiments may be implemented in any suitable device, apparatus, or system to monitor any of a number of physiological parameters. For example, the following discussion focuses primarily on long-term, patch-based cardiac rhythm monitoring devices. In one alternative embodiment, a physiological monitoring device may be used, for example, for pulse oximetry and diagnosis of obstructive sleep apnea. In various alternative embodiments, one size of physiological monitor may be used for adult patients and another size may be used for pediatric patients. The method of using a physiological monitoring device may also vary. In some cases, a device may be worn for one week or less, while in other cases, a device may be worn for at least seven days and/or for more than seven days, for example between fourteen days and twenty-one days or even longer. Many other alternative embodiments and applications of the described technology are possible. Thus, the following description is provided for exemplary purposes only. Throughout the specification, reference may be made to the term "conformal." It will be understood by one of skill in the art that the term "conformal" as used herein refers to a relationship between surfaces or structures where a first surface or structure fully adapts to the contours of a second surface or structure.

Referring to FIGS. 1A and 1B, perspective and exploded views of one embodiment of a physiological monitoring device 100 are provided. As seen in FIG. 1A, physiological

monitoring device 100 may include a flexible body 110 coupled with a watertight, rigid housing 115. Flexible body 110 (which may be referred to as "flexible substrate" or "flexible construct") typically includes two wings 130, 131, which extend laterally from rigid housing 115, and two flexible electrode traces 311, 312, each of which is embedded in one of wings 130, 131. Each electrode trace 311, 312 is coupled, on the bottom surface of flexible body 110, with a flexible electrode (not visible in FIG. 1A). The electrodes are configured to sense heart rhythm signals from a patient to which monitoring device 100 is attached. Electrode traces 311, 312 then transmit those signals to electronics (not visible in FIG. 1A) housed in rigid housing 115. Rigid housing 115 also typically contains a power source, such as one or more batteries.

As will be explained in further detail below, the combination of a highly flexible body 110, including flexible electrodes and electrode traces 311, 312, with a very rigid housing 115 may provide a number of advantages. For example, flexible body 110 includes a configuration and various features that facilitate comfortable wearing of device 100 by a patient for fourteen (14) days or more without removal. Rigid housing 115, which typically does not adhere to the patient in the embodiments described herein, includes features that lend to the comfort of device 100. Rigid housing 115 also protects the electronics and power source contained in housing 120, enhances the ability of a patient to provide an input related to a perceived cardiac event, and allows for simple manufacturing and reusability of at least some of the contents of housing 115. These and other features of physiological monitoring device 100 are described in greater detail below.

Referring now to FIG. 1B, a partially exploded view of physiological monitoring device 100 illustrates component parts that make up, and that are contained within, rigid housing 115 in greater detail. In this embodiment, rigid housing 115 includes an upper housing member 140, which detachably couples with a lower housing member 145. Sandwiched between upper housing member 140 and lower housing member 145 are an upper gasket 370, and a lower gasket 360 (not visible on FIG. 1B but just below upper gasket 370). Gaskets 370, 360 help make rigid housing member 115 watertight when assembled. A number of components of monitoring device 100 may be housed between upper housing member 140 and lower housing member 145. For example, in one embodiment, housing 115 may contain a portion of flexible body 110, a printed circuit board assembly (PCBA) 120, a battery holder 150, and two batteries 160. Printed circuit board assembly 120 is positioned within housing 115 to contact electrode traces 311, 312 and batteries 160. In various embodiments, one or more additional components may be contained within or attached to rigid housing 115. Some of these optional components are described further below, in reference to additional drawing figures.

Battery holder 150, according to various alternative embodiments, may hold two batteries (as in the illustrated embodiment), one battery, or more than two batteries. In other alternative embodiments, other power sources may be used. In the embodiment shown, battery holder 150 includes multiple retain tabs 153 for holding batteries 160 in holder 150. Additionally, battery holder 150 includes multiple feet 152 to establish correct spacing of batteries 160 from the surface of PCBA 120 and ensure proper contact with spring fingers 235 and 236. Spring fingers 235 and 236 are used in this embodiment rather than soldering batteries 160 to PCBA 120. Although soldering may be used in alternative

embodiments, one advantage of spring fingers **235** and **236** is that they allow batteries **160** to be removed from PCBA **120** and holder **150** without damaging either of those components, thus allowing for multiple reuses of both. Eliminating solder connections also simplifies and speeds up assembly and disassembly of monitoring device **100**.

In some embodiments, upper housing member **140** may act as a patient event trigger. When a patient is wearing physiological monitoring device **100** for cardiac rhythm monitoring, it is typically advantageous for the patient to be able to register with device **100** (i.e., log into the device's memory) any cardiac events perceived by the patient. If the patient feels what he/she believes to be an episode of heart arrhythmia, for example, the patient may somehow trigger device **100** and thus provide a record of the perceived event. At some later time, the patient's recorded perceived event could be compared with the patient's actual heart rhythm, recorded by device **100**, and this may help determine whether the patient's perceived events correlate with actual cardiac events. One problem with patient event triggers in currently available wearable cardiac rhythm monitoring devices, however, is that a small trigger may be hard to find and/or activate, especially since the monitoring device is typically worn under clothing. Additionally, pressing a trigger button may affect the electronics and/or the electrodes on the device in such a way that the recorded heart rhythm signal at that moment is altered simply by the motion caused to the device by the patient triggering. For example, pressing a trigger may jar one or both of the electrodes in such a way that the recorded heart rhythm signal at that moment appears like an arrhythmia, even if no actual arrhythmia event occurred. Additionally, there is a chance that the trigger may be inadvertently activated, for instance while sleeping or laying on the monitoring device.

In the embodiment shown in FIGS. **1A** and **1B**, however, rigid housing **115** is sufficiently rigid, and flexible body **110** is sufficiently flexible, that motion applied to housing **115** by a patient may rarely or ever cause an aberrant signal to be sensed by the electrodes. In this embodiment, the central portion of upper housing member **140** is slightly concave and, when pressed by a patient who is wearing device **100**, this central portion depresses slightly to trigger a trigger input on PCBA **120**. Because the entire upper surface of rigid housing **115** acts as the patient event trigger, combined with the fact that it is slightly concave, it will generally be quite easy for a patient to find and push down the trigger, even under clothing. Additionally, the concave nature of the button allows it to be recessed which protects it from inadvertent activations. Thus, the present embodiment may alleviate some of the problems encountered with patient event triggers on currently available heart rhythm monitors. These and other aspects of the features shown in FIGS. **1A** and **1B** will be described in further detail below.

Referring now to FIGS. **2A** and **2B**, printed circuit board assembly **120** (or "PCBA") may include a top surface **220**, a bottom surface **230**, a patient trigger input **210** and spring contacts **235**, **236**, and **237**. Printed circuit board assembly **120** may be used to mechanically support and electrically connect electronic components using conductive pathways, tracks or electrode traces **311**, **312**. Furthermore, because of the sensitive nature of PCBA **120** and the requirement to mechanically interface with rigid body **115**, it is beneficial to have PCBA **120** be substantially rigid enough to prevent unwanted deflections which may introduce noise or artifact into the ECG signal. This is especially possible during patient trigger activations when a force is transmitted through rigid body **115** and into PCBA **120**. One way to

ensure rigidity of the PCBA is to ensure that the thickness of the PCBA is relatively above a certain value. For example, a thickness of at least about 0.08 cm is desirable and, more preferably, a thickness of at least about 0.17 cm is desirable. In this application, PCBA **120** may also be referred to as, or substituted with, a printed circuit board (PCB), printed wiring board (PWB), etched wiring board, or printed circuit assembly (PCA). In some embodiments, a wire wrap or point-to-point construction may be used in addition to, or in place of, PCBA **120**. PCBA **120** may include analog circuits and digital circuits.

Patient trigger input **210** may be configured to relay a signal from a patient trigger, such as upper housing member **140** described above, to PCBA **120**. For example, patient trigger input **210** may be a PCB switch or button that is responsive to pressure from the patient trigger (i.e., the upper surface of upper housing portion **140**). In various embodiments, patient trigger input **210** may be a surface mounted switch, a tactile switch, an LED illuminated tactile switch, or the like. In some embodiments, patient trigger input **210** may also activate an indicator, such as an LED.

One important challenge in collecting heart rhythm signals from a human or animal subject with a small, two-electrode physiological monitoring device such as device **100** described herein, is that having only two electrodes can sometimes provide a limited perspective when trying to discriminate between artifact and clinically significant signals. For example, when a left-handed patient brushes her teeth while wearing a small, two-electrode physiological monitoring device on her left chest, the tooth brushing may often introduce motion artifact that causes a recorded signal to appear very similar to Ventricular Tachycardia, a serious heart arrhythmia. Adding additional leads (and, hence, vectors) is the traditional approach toward mitigating this concern, but this is typically done by adding extra wires adhered to the patient's chest in various locations, such as with a Holter monitor. This approach is not consistent with a small, wearable, long term monitor such as physiological monitoring device **100**.

An alternate approach to the problem described above is to provide one or more additional data channels to aid signal discrimination. In some embodiments, for example, device **100** may include a data channel for detecting patch motion. In certain embodiments, an accelerometer may provide patch motion by simply analyzing the change in magnitude of a single axis measurement, or alternatively of the combination of all three axes. The accelerometer may record device motion at a sufficient sampling rate to allow algorithmic comparison of its frequency spectrum with that of the recorded ECG signal. If there is a match between the motion and recorded signal, it is clear that the device recording in that time period is not from a clinical (e.g., cardiac) source, and thus that portion of the signal can be confidently marked as artifact. This technique may be particularly useful in the tooth brushing motion example aforementioned, where the rapid frequency of motion as well as the high amplitude artifact is similar to the heart rate and morphology, respectively, of a potentially life-threatening arrhythmia like Ventricular Tachycardia.

In some embodiments, using the magnitude of all three axes for such an analysis would smooth out any sudden changes in values due to a shift in position rather than a change in activity. In other embodiments, there may be some advantage in using a specific axis of measurement such as along the longitudinal axis of the body to focus on a specific type of artifact introduced by upward and downward movements associated with walking or running. In a similar vein,

the use of a gyroscope in conjunction with the accelerometer may provide further resolution as to the nature of the motion experienced. While whole body movements may be sufficiently analyzed with an accelerometer on its own, specific motion of interest such as rotational motion due to arm movement is sufficiently complex that an accelerometer alone might not be able to distinguish.

In addition to detecting motion artifact, an accelerometer tuned to the dynamic range of human physical activities may provide activity levels of the patient during the recording, which can also enhance accuracy of algorithmic true arrhythmia detection. Given the single-lead limitation of device **100**, arrhythmias that require observation of less prominent waves (e.g. P-wave) in addition to rate changes such as Supraventricular Tachycardia pose challenges to both computerized algorithms as well as the trained human eye. This particular arrhythmia is also characterized by the sudden nature of its onset, which may be more confidently discriminated from a non-pathological Sinus Tachycardia if a sudden surge in the patient's activity level is detected at the same time as the increase in heart rate. Broadly speaking, the provision of activity information to clinical professionals may help them discriminate between exercise-induced arrhythmia versus not. As with motion artifact detection, a single-axis accelerometer measurement optimized to a particular orientation may aid in more specifically determining the activity type such as walking or running. This additional information may help explain symptoms more specifically and thereby affect the subsequent course of therapeutic action.

In certain embodiments, an accelerometer with 3 axes may confer advantages beyond what magnitude of motions can provide. When the subject is not rapidly moving, 3-dimensional accelerometer readings may approximate the tilt of PCBA **120**, and therefore body orientation relative to its original orientation. The original body orientation can be assumed to be in either an upright or supine position which is required for appropriate positioning and application of the device to the body. This information may aid in ruling out certain cardiac conditions that manifest as beat-to-beat morphology changes, such as cardiac alternans where periodic amplitude changes are observed, often in heart failure cases. Similar beat-to-beat morphology changes are observable in healthy subjects upon shift in body position due to the shift in heart position relative to the electrode vector, for example from an upright to a slouching position. By design, the single-channel device **100** does not have an alternate ECG channel to easily rule out potential pathological shifts in morphology, however, correlation with shifts in body orientation will help explain these normal changes and avoid unnecessary treatment due to false diagnosis.

In other embodiments, the accelerometer may also be used as a sleep indicator, based on body orientation and movement. When presenting clinical events (e.g., pauses), it is diagnostically helpful to be able to present information in a manner that clearly separates events that occurred during sleep from those during waking hours. In fact, certain algorithms such as for ECG-derived respiratory rate only make sense to run when the patient is in a relatively motionless state and therefore subtle signal modulation introduced by chest movement due to breathing is observable. Respiratory rate information is useful as one channel of information necessary to detect sleep apnea in certain patient populations.

In certain embodiments, the accelerometer may also be used to detect free-falls, such as fainting. With an accelerometer, device **100** may be able to mark fainting (syncope)

and other free-fall events without relying on patient trigger. In order to allow timely detection of such critical events, yet considering the battery and memory limitations of a small, wearable device such as device **100**, acquisition of accelerometer readings may be done in bursts, where only interesting information such as a potential free fall is written to memory at a high sampling rate. An expansion of this event-trigger concept is to use specific tapping motions on device **100** as a patient trigger instead of or in conjunction with the button previously described. The use and detection of multiple types of tapping sequences may provide better resolution and accuracy into what exactly the patient was feeling, instead of relying on the patient to manually record their symptom and duration in a trigger log after the fact. An example of such added resolution is to indicate the severity of the symptom by the number of sequential taps.

Alternatively, in other embodiments, an optical sensors may be used to distinguish between device motion and patient body motion. Further, in additional embodiments, the device may not require a button or trigger.

Another optional data channel that may be added to physiological monitoring device **100** is a channel for detecting flex and/or bend of device **100**. In various embodiments, for example, device **100** may include a strain gauge, piezoelectric sensor or optical sensor to detect motion artifact in device **100** itself and thus help to distinguish between motion artifact and cardiac rhythm data. Yet another optional data channel for device **100** may be a channel for detecting heart rate. For example, a pulse oximeter, microphone or stethoscope may provide heart rate information. Redundant heart rate data may facilitate discrimination of ECG signals from artifact. This is particularly useful in cases where arrhythmia such as Supraventricular Tachycardia is interrupted by artifact, and decisions must be made whether the episode was actually multiple shorter episodes or one sustained episode. Another data channel may be included for detecting ambient electrical noise. For example, device **100** may include an antenna for picking up electromagnetic interference. Detection of electromagnetic interference may facilitate discrimination of electrical noise from real ECG signals. Any of the above-described data channels may be stored to support future noise discrimination or applied for immediate determination of clinical validity in real-time.

With reference now to FIGS. 3A and 3B, flexible body **110** is shown in greater detail. As illustrated in FIG. 3A, flexible body **110** may include wings **130**, **131**, a thin border **133** (or "rim" or "edge") around at least part of each wing **130**, **131**, electrode traces **311**, **312**, and a hinge portion **132** (or "shoulder") at or near a junction of each wing **130**, **131** with rigid housing **115**. Also shown in FIG. 3A is upper gasket **370**, which is not considered part of flexible body **110** for this description, but which facilitates attachment of flexible body **110** to rigid housing **115**.

Hinge portions **132** are relatively thin, even more flexible portions of flexible body **110**. They allow flexible body **110** to flex freely at the area where it is joined to rigid housing **115**. This enhances comfort, since when the patient moves, housing **115** can freely lift off of the patient's skin. Electrode traces **311**, **312** are also very thin and flexible, to allow for patient movement without signal distortion. Borders **133** are portions of flexible body **110** that is thinner than immediately adjacent portions and that provide for a smooth transition from flexible body **110** to a patient's skin, thus preventing edge-lift and penetration of dirt or debris below flexible body **110**.

As shown in greater detail in FIG. 3B, flexible body **110** may include multiple layers. As mentioned previously, upper

gasket 370 and lower gasket 360 are not considered part of flexible body 110 for the purposes of this description but are shown for completeness of description. This distinction is for ease of description only, however, and should not be interpreted to limit the scope of the claimed invention. Flexible body 110 may include a top substrate layer 300, a bottom substrate layer 330, an adhesive layer 340, and flexible electrodes 350. Top and bottom substrate layers 300, 330 may be made of any suitable, flexible material, such as one or more flexible polymers. Suitable flexible polymers can include, but are not limited to, polyurethane, polyethylene, polyester, polypropylene, nylon, teflon and carbon impregnated vinyl. The material of substrate layers 300, 330 may be selected based on desired characteristics. For example, the material of substrate layers 300, 330 may be selected for flexibility, resilience, durability, breathability, moisture transpiration, adhesion and/or the like. In one embodiment, for example, top substrate layer 300 may be made of polyurethane, and bottom substrate layer 330 may be made of polyethylene or alternatively polyester. In other embodiments, substrate layers 300, 330 may be made of the same material. In yet another embodiment, substrate layer 330 may contain a plurality of perforations in the area over adhesive layer 340 to provide for even more breathability and moisture transpiration. In various embodiments, physiological monitoring device 100 may be worn continuously by a patient for as many as 14-21 days or more, without removal during the time of wear and with device 100 being worn during showering, exercising and the like. Thus, the material(s) used and the thickness and configuration of substrate layers 300, 330 may be essential to the function of physiological monitoring device 100. In some embodiments, the material of substrate layers 300, 330 acts as an electric static discharge (ESD) barrier to prevent arcing.

Typically, top and bottom substrate layers 300, 330 are attached to one another via adhesive placed on one or both layers 300, 330. For example, the adhesive or bonding substance between substrate layers 300, 330 may be an acrylic-based, rubber-based, or silicone-based adhesive. In other alternative embodiments, flexible body 110 may include more than two layers of flexible material.

In addition to the choice of material(s), the dimensions—thickness, length and width—of substrate layers 300, 330 may be selected based on desired characteristics of flexible body 110. For example, in various embodiments, the thickness of substrate layers 300, 330 may be selected to give flexible body 110 an overall thickness of between about 0.1 mm to about 1.0 mm. According to various embodiments, flexible body 110 may also have a length of between about 7 cm and 15 cm and a width of about 3 cm and about 6 cm. Generally, flexible body 110 will have a length sufficient to provide a necessary amount of separation between electrodes 350. For example, a distance from the center of one electrode 350 to the center of the other electrode 350 should be at least about 6.0 cm and more preferably at least about 8.5 cm. This separation distance may vary, depending on the application. In some embodiments, substrate layers 300, 330 may all have the same thickness. Alternatively, the two substrate layers 300, 330 may have different thicknesses.

As mentioned above, hinge portions 132 allow the rigid body 115 to lift away from the patient while flexible body 110 remains adhered to the skin. The functionality of hinge portions 132 is critical in allowing the device to remain adhered to the patient throughout various activities that may stretch and compress the skin. Furthermore, hinge portions 132 allow for significantly improved comfort while wearing the device. Generally, hinge portions 132 will be sufficiently

wide enough to provide adequate lift of rigid body 115 without creating too large of a peel force on flexible body 110. For example, in various embodiments, the width of hinge portion 132 should be at least about 0.25 cm and more preferably at least about 0.75 cm.

Additionally, the shape or footprint of flexible body 110 may be selected based on desired characteristics. As seen in FIG. 3A, wings 130, 131 and borders 133 may have rounded edges that give flexible body 110 an overall “peanut” shape. However, wings 130, 131 can be formed in any number of different shapes such as rectangles, ovals, loops, or strips. In the embodiment shown in FIGS. 3A and 3B, the footprint top substrate layer 300 is larger than the footprint of bottom substrate layer 330, with the extension of top substrate layer 300 forming borders 133. Thus, borders 133 are made of the same polyurethane material that top layer 300 is made of. Borders 133 are thinner than an adjacent portion of each wing 130, 131, since they include only top layer 300. The thinner, highly compliant rim 133 will likely enhance adherence of physiologic monitoring device 100 to a patient, as it provides a transition from an adjacent, slightly thicker portion of wings 130, 131 to the patient’s skin and thus helps prevent the edge of device 110 from peeling up off the skin. Border 133 may also help prevent the collection of dirt and other debris under flexible body 110, which may help promote adherence to the skin and also enhance the aesthetics of device 110. In alternative embodiments, the footprint of substrate layers 300, 330 may be the same, thus eliminating borders 133.

While the illustrated embodiments of FIGS. 1A-3B include only two wings 130, 131, which extend from rigid housing 115 in approximately opposite directions (i.e., at a 180-degree angle relative to each other), other configurations are possible in alternative embodiments. For example, in some embodiments, wings 130, 131 may be arranged in an asymmetrical orientation relative to one another and/or one or more additional wings may be included. As long as sufficient electrode spacing is provided to permit physiological signal monitoring, and as long as wings 130, 131 are configured to provide extended attachment to the skin, any suitable configuration and number of wings 130, 131 and electrode traces 311, 312 may be used. The embodiments described above have proven to be advantageous for adherence, patient comfort and accuracy of collected heart rhythm data, but in alternative embodiments it may be possible to implement alternative configurations.

Adhesive layer 340 is an adhesive that is applied to two portions of the bottom surface of bottom substrate layer 330, each portion corresponding to one of wings 130, 131. Adhesive layer 340 thus does not extend along the portion of bottom substrate layer 330 upon which rigid housing 115 is mounted. Adhesive layer 340 may be made of any suitable adhesive, although certain adhesives have been found to be advantageous for providing long term adhesion to patient skin with relative comfort and lack of skin irritation. For example, in one embodiment, adhesive layer 340 is a hydrocolloid adhesive. In another embodiment, the adhesive layer 340 is comprised of a hydrocolloid adhesive that contains naturally-derived or synthetic absorbent materials which take up moisture from the skin during perspiration.

Each of the two portions of adhesive layer 340 includes a hole, into which one of electrodes 350 fits. Electrodes 350 made of flexible material to further provide for overall conformability of flexible body 110. In one embodiment, for example, flexible electrodes 350 may be made of a hydrogel 350. Electrodes 350 generally provide conformal, non-irritating contact with the skin to provide enhanced electrical

connection with the skin and reduce motion artifact. In some embodiments, hydrogel electrodes **350** may be punched into adhesive layer **340**, thus forming the holes and filling them with hydrogel electrodes **350**. In one alternative embodiment, electrodes **350** and adhesive **340** may be replaced with an adhesive layer made of a conductive material, such that the entire adhesive layer on the underside of each wing **130**, **131** acts as an electrode. Such an adhesive layer may include a hybrid adhesive/conductive substance or adhesive substance mixed with conductive elements or particles. For example, in one embodiment, such an adhesive layer may be a hybrid of a hydrogel and a hydrocolloid adhesive.

As discussed above, in some embodiments, adhesive layer **340** may cover a portion of the underside of lower substrate layer **330**, such that at least a portion of the bottom side of flexible body **110** does not include adhesive layer **340**. As seen in FIG. 3A, hinges **132** may be formed in the flexible body **110** as portions of each wing **130**, **131** on which adhesive layer **340** is not applied. Hinge portions **132** are generally located at or near the junction of flexible body **110** with rigid housing **115**, and thus provide for flexing of device **100** to accommodate patient movement. In some embodiments, hinge portions **132** may have a width that is less than that of adjacent portions of wings **130**, **131**, thus giving device **100** its “peanut” shape mentioned above. As shown in FIG. 8, as a subject moves, device **100** flexes along with patient movement. Device flexion may be severe and is likely to occur many times during long term monitoring. Hinge portions **132** may allow for dynamic conformability to the subject, while the rigidity of rigid housing **115** may allow housing **115** to pop up off the patient’s skin during device flexion, thus preventing peeling of the device **100** off of the skin at its edge.

Flexible body **110** further includes two electrode traces **311**, **312** sandwiched between upper substrate layer **300** and lower substrate layer **330**. Each electrode trace **311**, **312** may include an electrode interface portion **310** and an electrocardiogram circuit interface portion **313**. As illustrated in FIGS. 3C and 3D, ECG circuit interface portions **313** are in physical contact with spring fingers **237** and provide electrical communication with PCBA **120** when device **100** or zoomed-in device portion **101** is assembled. Electrode interface portions **310** contact hydrogel electrodes **350**. Thus, electrode traces **311**, **312** transmit cardiac rhythm signals (and/or other physiological data in various embodiments) from electrodes **350** to PCBA **120**.

The material and thickness of electrode traces **311**, **312** are important for providing a desired combination of flexibility, durability and signal transmission. For example, in one embodiment, electrode traces **311**, **312** may include a combination of silver (Ag) and silver chloride (AgCl). The silver and silver chloride may be disposed in layers. For example, one embodiment of electrode traces **311**, **312** may include a top layer of silver, a middle layer of carbon impregnated vinyl, and a bottom (patient-facing) layer of silver chloride. In another embodiment, both top and bottom layers of electrode traces **311**, **312** may be made of silver chloride. In one embodiment, the top and bottom layers may be applied to the middle layer in the form of silver ink and silver chloride ink, respectively. In an alternative embodiment, each electrode trace may include only two layers, such as a top layer of silver and a bottom layer of silver chloride. In various embodiments, the material of a bottom layer of each electrode trace **311**, **312**, such as AgCl, may be selected to match the chemistry of the hydrogel electrodes **350** and create a half-cell with the body of the subject.

The thickness of the electrode traces **311**, **312** may be selected to optimize any of a number of desirable properties. For example, in some embodiments, at least one of the layers of electrode traces **311**, **312** can be of a sufficient thickness to minimize or slow depletion of the material from an anode/cathode effect over time. Additionally, the thickness may be selected for a desired flexibility, durability and/or signal transmission quality. Flexible electrode traces **311**, **312** generally may help provide conformal contact with the subject’s skin and may help prevent electrodes **350** from peeling or lifting off of the skin, thereby providing strong motion artifact rejection and better signal quality by minimizing transfer of stress to electrodes **350**.

As mentioned above, in some embodiments, top gasket **370** and bottom gasket **360** may be attached upper substrate **300** and lower substrate **330** of flexible body **110**. Gaskets **360**, **370** may be made of any suitable material, such as urethane, which provides a water tight seal between the upper housing member **140** and lower housing member **145** of rigid housing **115**. In one embodiment, top gasket **370** and/or bottom gasket **360** may include an adhesive surface. FIG. 3E depicts yet another embodiment where top gasket **370** includes tabs **371** that protrude away from the profile of top housing **140** while still being adhered to upper substrate **300**. The tabs **371** cover a portion of electrode traces **311**, **312** and provide a strain relief for the traces at the point of highest stress where the flexible body meets the rigid housing.

With reference now to FIG. 4, upper housing member **140** and lower housing member **145** of rigid housing **115** are shown in greater detail. Upper and lower housing members **140**, **145** may be configured, when coupled together with gaskets **360**, **370** in between, to form a watertight enclosure for containing PCBA **120**, battery holder **150**, batteries **160** and any other components contained within rigid housing **115**. Housing members **140**, **145** may be made of any suitable material to protect internal components, such as water resistant plastic. In one embodiment, upper housing member **140** may include a rigid sidewall **440**, a light pipe **410** to transmit visual information from the LEDs on the PCBA through the housing member, a slightly flexible top surface **420**, and an inner trigger member **430** extending inward from top surface **420**. Top surface **420** is configured to be depressed by a patient when the patient perceives what he or she believes to be an arrhythmia or other cardiac event. When depressed, top surface **420** depresses inner trigger member **430**, which contacts and activates trigger input **210** of PCBA **120**. Additionally, as discussed previously, top surface **420** may have a concave shape (concavity facing the inside of housing **115**) to accommodate the shape of a finger. It is believed that the design of upper housing member **140** isolates activation of the trigger input **210** from electrodes **350**, thereby minimizing artifact in the data recording.

With continued reference to FIG. 4, lower housing member **145** may be configured to detachably connect with upper housing member **140** in such a way that housing members **140**, **145** may be easily attached and detached for reusability of at least some of the component parts of monitoring device **100**. In some embodiments, a bottom surface **445** (patient facing surface) of lower housing member **145** may include multiple dimples **450** (or “bumps,” “protrusions” or the like), which will contact the patient’s skin during use. Dimples **450** may allow for air flow between bottom surface **445** and the patient’s skin, thus preventing a seal from forming between bottom surface **445** and the skin. It is believed that dimples **450** improve comfort and help prevent a perception in currently available devices in which the

patient feels as if monitoring device **100** is falling off when it housing **115** lifts off the skin and breaks a seal with the skin. In yet another embodiment the bottom surface **445** of lower housing member **450** may include multiple divots (recesses instead of protrusions) to prevent a seal from forming.

Referring now to FIG. 5A, battery holder **150** is shown in greater detail. Battery holder **150** may be made of plastic or other suitable material, is configured to be mounted to PCBA **120** and subsequently attached to rigid housing **115**, and is capable of holding two batteries **160** (FIG. 1B). In alternative embodiments, battery holder **150** may be configured to hold one battery or more than two batteries. A plurality of protrusions **152** provide a stable platform for batteries **160** to be positioned a fixed distance above the surface of PCBA **120**, avoiding unwanted contact with sensitive electronic components yet providing for adequate compression of spring contacts **235** (FIG. 5B). Protrusions **153** lock batteries **160** into position and resist the upward force on the batteries from spring contacts **235**. Battery holder **150** also positions batteries appropriately **160** to provide for adequate compression of spring contacts **236**. Use of battery holder **150** in conjunction with spring contacts **235** and **236** allows for batteries **160** to be electrically connected to PCBA **120** while still having additional electronic components between batteries **160** and PCBA **120** and maintain a very compact assembly. Battery holder **150** may include a flexible hook **510** which engages a corresponding rigid hook **440** of upper housing member **140**. Under normal assembly conditions the flexible hook **510** remains securely mated with rigid hook **440**. For disassembly, flexible hook **510** can be pushed and bent using an appropriate tool passed through top housing **140** causing it to disengage from rigid hook **440** and subsequently allow top housing **140** to be removed.

With reference now to FIGS. 6A and 6B, physiological monitoring device **100** is shown in side view cross-section. As shown in 6A, physiological monitoring device **100** may include flexible body **110** coupled with rigid housing **115**. Flexible body **110** may include top substrate layer **300**, bottom substrate layer **330**, adhesive layer **340** and electrodes **350**. Electrode traces **311**, **312** are also typically part of flexible body **110** and are embedded between top substrate layer **300** and bottom substrate layer **330**, but they are not shown in FIG. 6. Flexible body **110** forms two wings **130**, **131**, extending to either side of housing **115**, and a border **133** surrounding at least part of each wing **130**, **131**. Rigid housing **115** may include an upper housing member **140** coupled with a lower housing member **145** such that it sandwiches a portion of flexible body **110** in between and provides a watertight, sealed compartment for PCBA **120**. Upper housing member **140** may include inner trigger member **430**, and PCBA may include patient trigger member **210**. As discussed previously, lower housing member **145** may include multiple dimples **450** or divots to enhance the comfort of the monitoring device **100**.

It is desirable that PCBA **120** is sufficiently rigid to prevent bending and introducing unwanted artifact into the signal. In certain embodiments, an additional mechanism to reduce and prevent unwanted bending of PCBA **120** may be used. This mechanism is shown in FIG. 6B. Support post **460** is integral to lower housing **145** and is positioned directly under patient trigger input **210**. During patient symptom triggering, upper housing member **140** is depressed, engaging inner trigger mechanism **430** and transmitting a force through patient trigger input **210** into PCBA **120**. The force is further transmitted through PCBA **120** and

into support post **460** without creating a bending moment, thus avoiding unwanted artifact.

Referring to FIG. 7, in some embodiments, physiological monitoring device **100** may include one or more additional, optional features. For example, in one embodiment, monitoring device **100** may include a removable liner **810**, a top label **820**, a device identifier **830** and a bottom label **840**. Liner **810** may be applied over a top surface of flexible member **110** to aid in the application of device **100** to the subject. As is described in further detail below, liner **810** may help support borders **133** of flexible body **110**, as well as wings **130**, **131**, during removal of one or more adhesive covers (not shown) that cover adhesive surface **340** before use. Liner **810** may be relative rigid and/or firm, to help support flexible body **110** during removal of adhesive covers. In various embodiments, for example, liner **810** may be made of cardboard, thick paper, plastic or the like. Liner **810** typically includes an adhesive on one side for adhering to the top surface of wings **130**, **131** of flexible body **110**.

Labels **820**, **840** may be any suitable labels and may include produce name(s), manufacturer name(s), logo(s), design(s) and/or the like. They may be removable or permanently attached upper housing member **140** and/or lower housing member **145**, although typically they will be permanently attached, to avoid unregulated reuse and/or resale of the device by an unregistered user. Device identifier **830** may be a barcode sticker, computer readable chip, RFID, or the like. Device identifier **830** may be permanently or removably attached to PCBA **120**, flexible body **110** or the like. In some embodiments, it may be beneficial to have device identifier **830** stay with PCBA **120**.

Referring now to FIGS. 8A and 8B, physiological monitoring device **100** generally includes hinge portions **132** at or near the juncture of each wing **130**, **131** with rigid housing **115**. Additionally, each wing **130**, **131** is typically adhered to the patient via adhesive layers **340**, while rigid body **115** is not adhered to the patient and is thus free to "float" (i.e., move up and down) over the patient's skin during movement and change of patient position. In other words, when the patient's chest contracts, rigid housing pops up or floats over the skin, thus minimizing stress on device **100**, enhancing comfort, and reducing the tendency of wings **130**, **131** to peel off of the skin. The advantage provided by the combination of the floating rigid body **115** and the adhered wings **130**, **131** is illustrated in FIGS. 8A and 8B. In FIG. 8A, a patient is sleeping, and in FIG. 8B, a patient is playing golf. In both examples, monitoring device **100** is squeezed together by the patient's body, causing rigid housing **115** to float above the skin as wings **130**, **131** move closer together. This advantage of a floating, non-attached portion of a physiological monitoring device is described in further detail in U.S. Pat. No. 8,560,046, which was previously incorporated by reference.

Referring now to FIGS. 9A-9F, one embodiment of a method for applying physiological monitoring device **100** to the skin of a human subject is described. In this embodiment, before the first step shown in FIG. 9A, the patient's skin may be prepared, typically by shaving a small portion of the skin on the left chest where device **100** will be placed and then abrading and/or cleaning the shaved portion. As shown in FIG. 9A, once the patient's skin is prepared, a first step of applying device **100** may include removing one or both of two adhesive covers **600** from adhesive layers **340** on the bottom surface of device **100**, thus exposing adhesive layers **340**. As illustrated in FIG. 9B, the next step may be to apply device **100** to the skin, such that adhesive layer **340** adheres to the skin in a desired location. In some embodiments, one

adhesive cover **600** may be removed, the uncovered adhesive layer **340** may be applied to the skin, and then the second adhesive cover **600** may be removed, and the second adhesive layer **340** may be applied to the skin. Alternatively, both adhesive covers **600** may be removed before applying device **100** to the skin. While adhesive covers **600** are being removed, liner **810** acts as a support for flexible body **110**, provides the physician or other user with something to hold onto, and prevents flexible body **110** and borders **133** of flexible body **110** from folding in on themselves, forming wrinkles, etc. As described above, liner **810** may be made of a relatively stiff, firm material to provide support for flexible body **110** during application of device **100** to the skin. Referring to FIG. 9C, after device **100** has been applied to the skin, pressure may be applied to flexible body **110** to press it down onto the chest to help ensure adherence of device **100** to the skin.

In a next step, referring to FIG. 9D, liner **810** is removed from (peeled off of) the top surface of flexible body **110**. As shown in FIG. 9E, once liner **810** is removed, pressure may again be applied to flexible body **110** to help ensure it is adhered to the skin. Finally, as shown in FIG. 9F, upper housing member **140** may be pressed to turn on physiological monitoring device **140**. This described method is only one embodiment. In alternative embodiments, one or more steps may be skipped and/or one or more additional steps may be added.

When a desired monitoring period has ended, such as about 14-21 days in some cases, a patient (or physician, nurse or the like) may remove physiological monitoring device **100** from the patient's skin, place device **100** in a prepaid mailing pouch, and mail device **100** to a data processing facility. At this facility, device **100** may be partially or completely disassembled, PCBA **120** may be removed, and stored physiological data, such as continuous heart rhythm information, may be downloaded from PCBA **120**. The data may then be analyzed by any suitable method and then provided to a physician in the form of a report. The physician may then discuss the report with the patient. PCBA **120** and/or other portions of device **100**, such as rigid housing **115**, may be reused in the manufacture of subsequent devices for the same or other patients. Because device **100** is built up as a combination of several removably coupled parts, various parts may be reused for the same embodiment or different embodiments of device **100**. For example, PCBA **120** may be used first in an adult cardiac rhythm monitor and then may be used a second time to construct a monitor for sleep apnea. The same PCBA **120** may additionally or alternatively be used with a differently sized flexible body **110** to construct a pediatric cardiac monitor. Thus, at least some of the component parts of device **100** may be interchangeable and reusable.

Advantageously, physiological monitoring device **100** may provide long term adhesion to the skin. The combination of the configuration of flexible and conformal body **110**, the watertight, low profile configuration of rigid housing **115**, and the interface between the two allows device **100** to compensate for stress caused as the skin of the subject stretches and bends. As a result, device **100** may be worn continuously, without removal, on a patient for as many as 14-21 days or more. In some cases, device **100** may be worn for greater or less time, but 14-21 days may often be a desirable amount of time for collecting heart rhythm data and/or other physiological signal data from a patient.

In various alternative embodiments, the shape of a particular physiological monitoring device may vary. The shape, footprint, perimeter or boundary of the device may be

circular, an oval, triangular, a compound curve or the like, for example. In some embodiments, the compound curve may include one or more concave curves and one or more convex curves. The convex shapes may be separated by a concave portion. The concave portion may be between the convex portion on the rigid housing and the convex portion on the electrodes. In some embodiments, the concave portion may correspond at least partially with a hinge, hinge region or area of reduced thickness between the body and a wing.

While described in the context of a heart monitor, the device improvements described herein are not so limited. The improvements described in this application may be applied to any of a wide variety of physiological data monitoring, recording and/or transmitting devices. The improved adhesion design features may also be applied to devices useful in the electronically controlled and/or time released delivery of pharmacological agents or blood testing, such as glucose monitors or other blood testing devices. As such, the description, characteristics and functionality of the components described herein may be modified as needed to include the specific components of a particular application such as electronics, antenna, power supplies or charging connections, data ports or connections for down loading or off loading information from the device, adding or offloading fluids from the device, monitoring or sensing elements such as electrodes, probes or sensors or any other component or components needed in the device specific function. In addition or alternatively, devices described herein may be used to detect, record, or transmit signals or information related to signals generated by a body including but not limited to one or more of ECG, EEG and/or EMG.

While the above embodiments disclose the invention with respect to a data channel for collecting a single physiological signal, it is contemplated that additional data channels can be included to collect additional data, for example, device motion, device flex or bend, heart rate and/or ambient electrical noise.

Various embodiments of a physiological monitoring device and methods for using it have been disclosed above. These various embodiments may be used alone or in combination, and various changes to individual features of the embodiments may be altered, without departing from the scope of the invention. For example, the order of various method steps may in some instances be changed, and/or one or more optional features may be added to or eliminated from a described device. Therefore, the description of the embodiments provided above should not be interpreted as unduly limiting the scope of the invention as it is set forth in the claims.

Various modifications to the implementations described in this disclosure may be made, and the generic principles defined herein may be applied to other implementations without departing from the spirit or scope of this disclosure. Thus, the claims are not intended to be limited to the implementations shown herein, but are to be accorded the widest scope consistent with this disclosure, the principles and the novel features disclosed herein.

Certain features that are described in this specification in the context of separate embodiments also can be implemented in combination in a single embodiment. Conversely, various features that are described in the context of a single embodiment also can be implemented in multiple embodiments separately or in any suitable subcombination. Moreover, although features may be described above as acting in certain combinations and even initially claimed as such, one or more features from a claimed combination can in some

cases be excised from the combination, and the claimed combination may be directed to a subcombination or variation of a subcombination.

Similarly, while operations are depicted in the drawings in a particular order, such operations need not be performed in the particular order shown or in sequential order, or that all illustrated operations be performed, to achieve desirable results. Further, the drawings may schematically depict one more example processes in the form of a flow diagram. However, other operations that are not depicted can be incorporated in the example processes that are schematically illustrated. For example, one or more additional operations can be performed before, after, simultaneously, or between any of the illustrated operations. Moreover, the separation of various system components in the embodiments described above should not be interpreted as requiring such separation in all embodiments. Additionally, other embodiments are within the scope of the following claims. In some cases, the actions recited in the claims can be performed in a different order and still achieve desirable results.

What is claimed is:

1. An electronic device for monitoring physiological signals in a mammal, the device comprising:

a plurality of flexible wings extending laterally from a rigid housing, each flexible wing configured to conform to a surface of the mammal and comprising a lower substrate layer, an upper substrate layer, and a bottom surface comprising a long-term adhesive, the long-term adhesive configured to adhere to the skin of the mammal;

wherein the plurality of flexible wings comprise a first material and the rigid housing comprises a second material, the second material more rigid than the first material;

a hardware processor housed within the rigid housing, the rigid housing configured to prevent deformation of the hardware processor in response to movement of the mammal;

a flexible electrode embedded within each flexible wing, each electrode configured to provide conformal contact with a non-planar surface of the skin of the mammal during movement of the mammal;

an electrode trace positioned between the upper substrate layer and the lower substrate layer, the upper substrate layer comprising a rim extending horizontally outward beyond the lower substrate layer, the rim being thinner in a vertical plane than an adjacent portion of the flexible wing and configured to reduce edge-lift of the flexible wing from the skin of the mammal; and

wherein each electrode trace extends outward from the rigid housing, each electrode trace conforming to an upper surface of a flexible electrode, the electrode traces and the flexible electrodes configured to remain conformal with the skin of the mammal during bending of the skin.

2. The electronic device of claim 1, wherein each electrode trace conforms to the entire upper surface of a flexible electrode.

3. The electronic device of claim 1, wherein the electrode traces comprise a third material and the flexible electrodes comprise a fourth material, the third material different from the fourth material.

4. The electronic device of claim 1, further comprising a plurality of tabs, each tab extending from the housing and positioned over an electrode trace, wherein each tab is configured to provide strain relief to an electrode trace.

5. The electronic device of claim 1, wherein the plurality of electrode traces are not relied upon for mechanical support.

6. The electronic device of claim 1, wherein the rigid housing comprises a first hook, the first hook configured to engage a second hook, the second hook attached to a battery holder, the first hook more rigid than the second hook.

7. The electronic device of claim 1, wherein the rigid housing comprises a patient trigger configured to depress and record an instance of a perceived cardiac event, the patient trigger covering a majority of the top surface of the rigid housing.

8. The electronic device of claim 7, further comprising a support post positioned beneath the patient trigger, the support post configured to remain rigid during depression of the patient trigger.

9. The electronic device of claim 1, wherein the long-term adhesive comprises a pressure-sensitive adhesive.

10. The electronic device of claim 1, wherein each electrode trace is positioned between an upper substrate layer and a lower substrate layer.

11. The electronic device of claim 10, wherein the upper substrate layer extends outward beyond the lower substrate layer.

12. The electronic device of claim 1, wherein each wing comprises a rim, the rim thinner than an adjacent portion of the wing and configured to prevent edge-lift of the flexible wing.

13. An electronic device for monitoring physiological signals in a mammal, the device comprising:

a plurality of flexible wings extending laterally from a rigid housing, each flexible wing configured to conform to a surface of the mammal and comprising a lower substrate layer, an upper substrate layer, and a bottom surface comprising a long-term adhesive, the long-term adhesive configured to adhere to the skin of the mammal;

wherein each wing comprises an upper substrate layer and a lower substrate layer, the upper substrate layer extending outward from the wing beyond the lower substrate layer, the lower substrate layer and the upper substrate layer adhered together by a substrate adhesive positioned between the upper substrate layer and the lower substrate layer; a hardware processor positioned within the housing;

a flexible electrode embedded within each flexible wing, each electrode configured to provide conformal contact with a non-planar surface of the skin of the mammal during movement of the mammal;

an electrode trace positioned between the upper substrate layer and the lower substrate layer, the upper substrate layer comprising a rim extending horizontally outward beyond the lower substrate layer, the rim being thinner in a vertical plane than an adjacent portion of the flexible wing and configured to reduce edge-lift of the flexible wing from the skin of the mammal; and

wherein each electrode trace extends outward from the rigid housing, the electrode traces and the flexible electrodes configured to remain conformal with the skin of the mammal during bending of the skin.

14. The electronic device of claim 13, wherein the housing comprises an upper housing member and a lower housing member, the upper housing member configured to detachably connect to the lower housing member.

15. The electronic device of claim 13, wherein an underside of the housing comprises a plurality of dimples configured to allow airflow between the surface of the mammal and the housing.

16. The electronic device of claim 14, further comprising an upper gasket and a lower gasket positioned between the upper housing member and the lower housing member. 5

17. The electronic device of claim 13, wherein the hardware processor further comprises spring fingers, the spring fingers configured to provide a reusable electrical connection with a detachable power unit. 10

18. The electronic device of claim 13, wherein the long-term adhesive is a hydrocolloid.

19. The electronic device of claim 13, wherein the electrode traces extend into the housing. 15

20. The electronic device of claim 13, wherein the rigid housing comprises a patient trigger configured to depress and record an instance of a perceived cardiac event, the patient trigger covering a majority of the top surface of the rigid housing. 20

\* \* \* \* \*

专利名称(译)	生理监测装置		
公开(公告)号	<a href="#">US10271754</a>	公开(公告)日	2019-04-30
申请号	US16/006719	申请日	2018-06-12
申请(专利权)人(译)	IRHYTHM TECHNOLOGIES , INC.		
当前申请(专利权)人(译)	IRHYTHM TECHNOLOGIES , INC.		
[标]发明人	BAHNEY TIMOTHY J HO HUNG H PARK SHENA H SEPULVEDA GENARO S DAY MARK J TAMURA YURIKO		
发明人	BAHNEY, TIMOTHY J. HO, HUNG H. PARK, SHENA H. SEPULVEDA, GENARO S. DAY, MARK J. TAMURA, YURIKO		
IPC分类号	A61B5/0402 A61B5/00 A61B5/0408		
CPC分类号	A61B5/0408 A61B5/6833 A61B5/721 A61B2562/164 A61B2562/0219 A61B2562/125		
优先权	61/756326 2013-01-24 US		
其他公开文献	US20180289274A1		
外部链接	<a href="#">Espacenet</a>		

摘要(译)

生理监测装置本发明涉及一种生理监测装置。本发明的一些实施例允许长期监测生理信号。进一步的实施例还可以允许监视诸如运动的辅助信号。

