



US 20160128633A1

(19) **United States**

(12) **Patent Application Publication**  
**Silver et al.**

(10) **Pub. No.: US 2016/0128633 A1**

(43) **Pub. Date: May 12, 2016**

(54) **CPR CHEST COMPRESSION MONITOR WITH REFERENCE SENSOR**

**Publication Classification**

(71) Applicant: **ZOLL Medical Corporation**,  
Chelmsford, MA (US)

(51) **Int. Cl.**  
*A61B 5/00* (2006.01)  
*A61B 5/103* (2006.01)

(72) Inventors: **Annemarie E. Silver**, Chelmsford, MA (US); **Ulrich R. Herken**, Chelmsford, MA (US)

(52) **U.S. Cl.**  
CPC ..... *A61B 5/6835* (2013.01); *A61B 5/486* (2013.01); *A61B 5/103* (2013.01); *A61B 5/4836* (2013.01); *A61B 5/6823* (2013.01); *A61B 5/7405* (2013.01); *A61B 5/742* (2013.01); *A61B 2503/04* (2013.01); *A61B 2562/0219* (2013.01)

(73) Assignee: **ZOLL Medical Corporation**,  
Chelmsford, MA (US)

(21) Appl. No.: **14/980,901**

(22) Filed: **Dec. 28, 2015**

(57) **ABSTRACT**

**Related U.S. Application Data**

(63) Continuation of application No. 14/068,649, filed on Oct. 31, 2013, now Pat. No. 9,220,443.

Methods and devices for chest compression depth measurement for CPR.

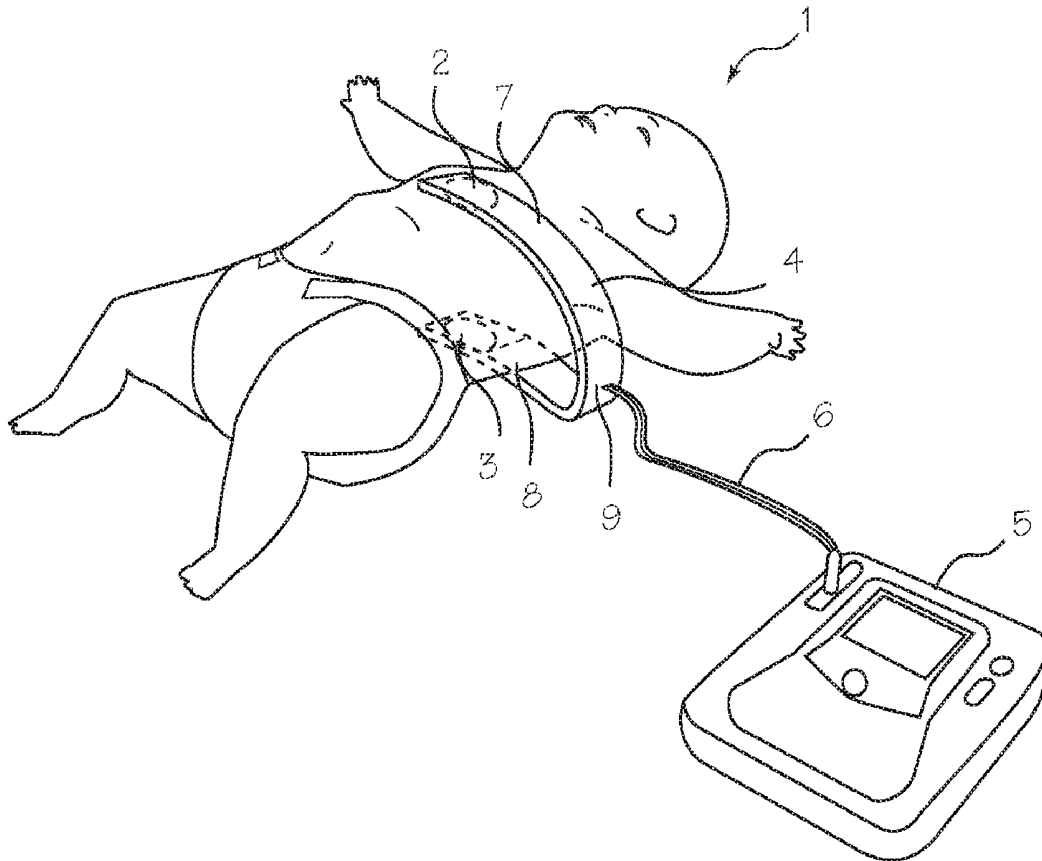

Fig. 1

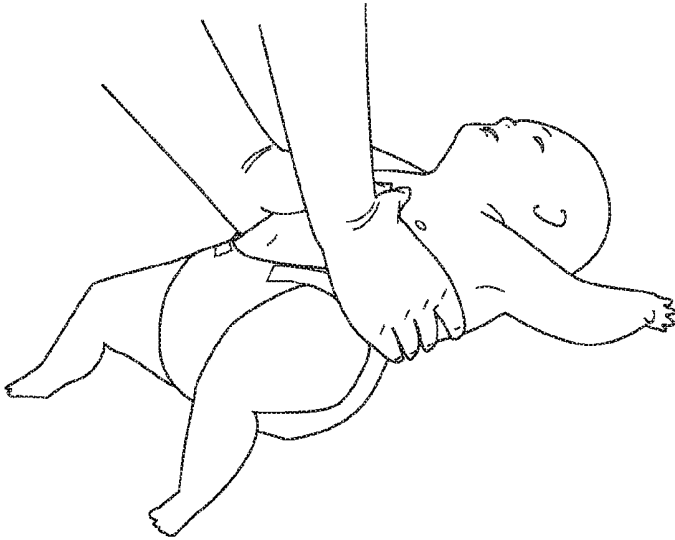

Fig. 2

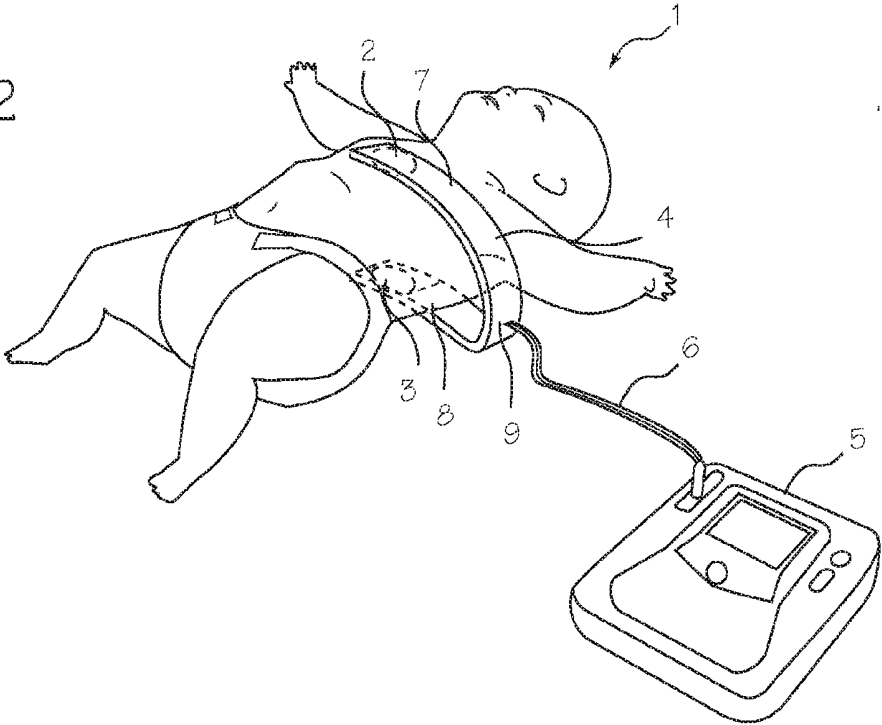

Fig. 3

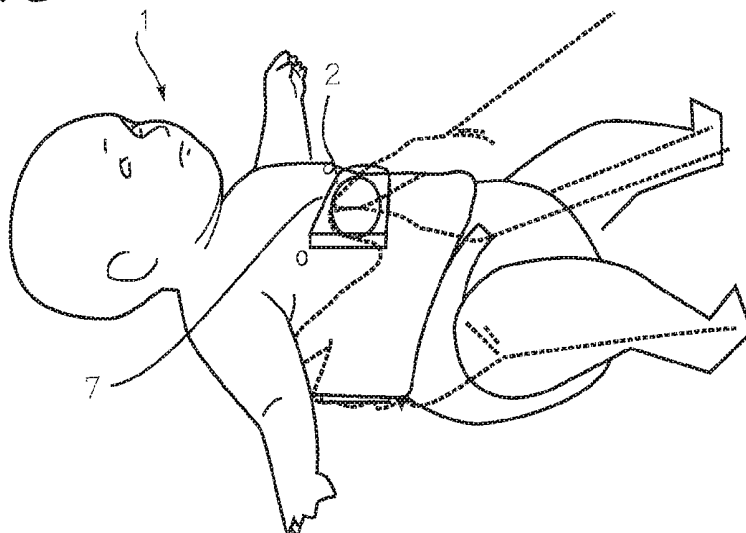

Fig. 4

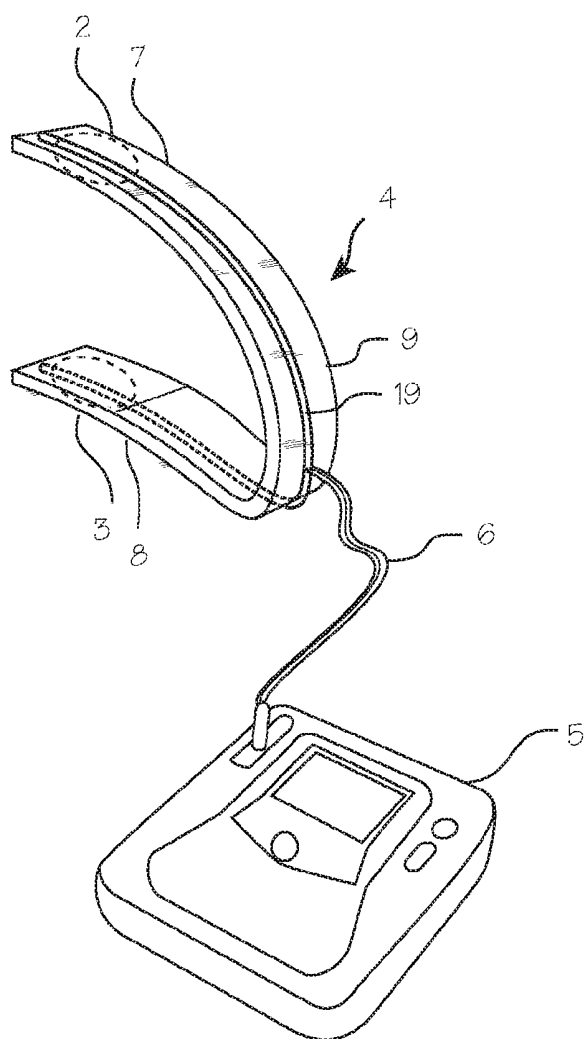

Fig. 5A

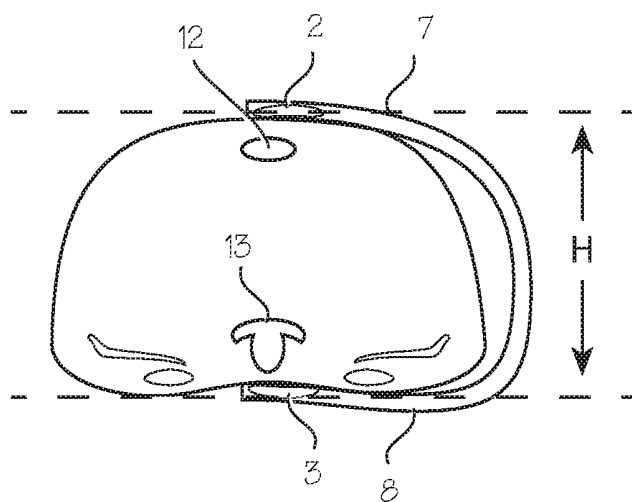

Fig. 5B

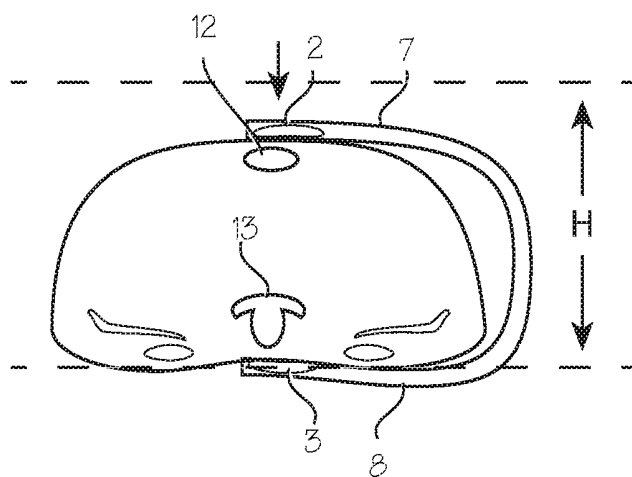

Fig. 5C

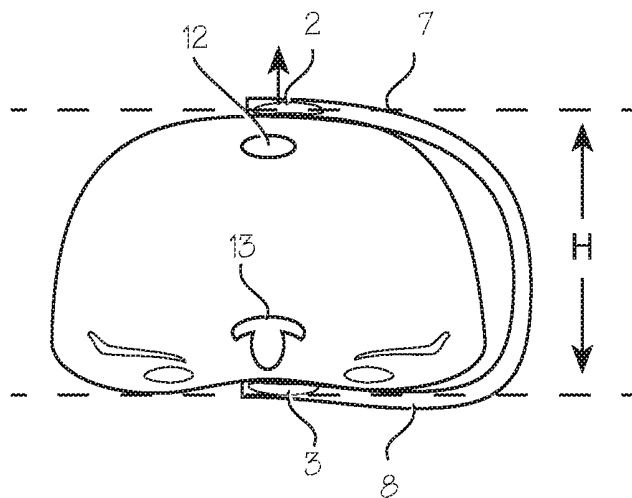



Fig. 8

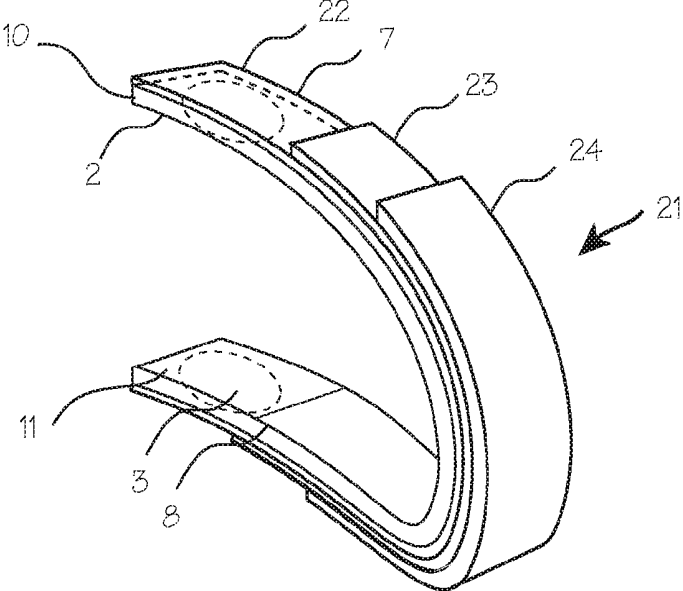
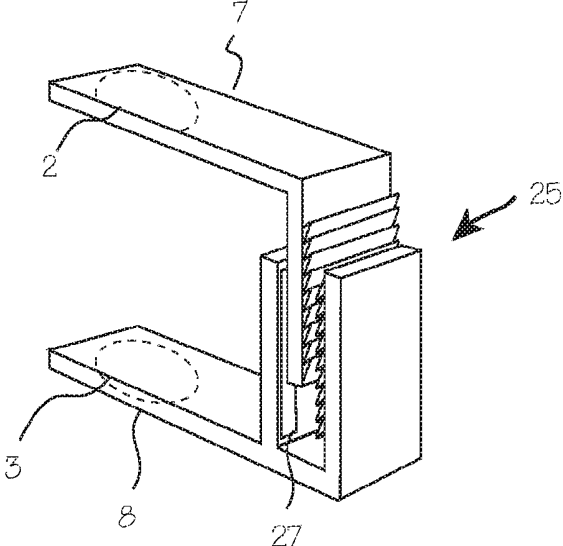

Fig. 9



## CPR CHEST COMPRESSION MONITOR WITH REFERENCE SENSOR

**[0001]** This application is a continuation of U.S. application Ser. No. 14/068,649, filed Oct. 31, 2013, now U.S. Pat. No. 9,220,443.

### FIELD OF THE INVENTIONS

**[0002]** The inventions described below relate the field of CPR.

### BACKGROUND OF THE INVENTIONS

**[0003]** Chest compressions provided as a component of cardiopulmonary resuscitation (CPR) should be accomplished at a consistent depth of about 2 inches, according to the CPR Guidelines 2010. This is difficult to accomplish, especially over a long course of CPR. Chest compression monitors, such as those used in ZOLL Medical Corporation's CPR D padz® and Real CPR chest compression monitor, give real time feedback to a CPR provider, measuring the depth and rate of compressions achieved during CPR and providing immediate reports of achieved chest compression depth to the CPR provider. This helps the CPR provider achieve the desired compression depth and also helps the CPR provider realize when he is too fatigued to provide proper chest compressions. In use, the chest compression monitor is sandwiched between the chest of a cardiac arrest victim and the hands of a CPR provider during compressions. These chest compression monitors are free-floating, and can accurately measure chest compression depth without reference to any external reference or input. This is described in Halperin, et al., *CPR Chest Compression Monitor*, U.S. Pat. No. 6,390,996 (May 21, 2002), as well as Palazzolo, et al., *Method of Determining Depth of Chest Compressions During CPR*, U.S. Pat. No. 7,122,014 (Oct. 17, 2006). Nonetheless, these chest compression monitors can be augmented with reference sensors, to ensure or improve accuracy when chest compressions are performed on a patient that is coincidentally subject to gross vertical movements. For example, Palazzolo, et al., *Method Of Determining Depth Of Chest Compressions During CPR*, U.S. Pat. No. 7,122,014 (Oct. 17, 2006) disclosed a system including a chest compression monitor disposed on the chest of a cardiac arrest victim and a reference sensor disposed elsewhere on the body of the cardiac arrest victim or a gurney supporting the cardiac arrest victim.

**[0004]** For adults, CPR chest compressions are delivered while the patient is supine, supported by a sufficiently rigid surface (a floor, gurney, or hospital bed). For infants, CRP chest compressions are provided with one of two methods. The preferred method is the two-thumb method, and entails grasping the infants thorax with both hands, placing both thumbs over the sternum (with the fingers supporting the back of the infant) and compressing the sternum with the thumbs. Another method, suggested for use by a lone rescuer, is referred to as the two-finger method, and entails compression of the infant's chest with two fingers placed over the inter-mammary line (superior to the xiphoid process). Compressions should be about 1.5 inches (3.8 cm) (one third of the thickness of the thorax of 4.5 inches (11.4 cm), which is rough estimate of infant chest thickness which is of course variable depending on the age of the infant patient). The chest should be released completely after each compression. According to the American Heart Association, the 2-thumb-encircling hands technique is preferred over the 2-finger technique

because it produces higher coronary artery perfusion pressure, results more consistently in appropriate depth or force of compressions, and may generate higher systolic and diastolic pressures.

**[0005]** In another aspect of CPR, active compression-decompression CPR has been suggested as an adjunct to CPR. Active compression-decompression refers to compression techniques which include some mechanism for actively lifting the chest wall between compression down strokes, rather than merely relying on the natural resilience of the chest wall to expand the chest between compressions. Active decompression devices, such as proposed by Steen, *Systems and Procedures for Treating Cardiac Arrest*, U.S. Pat. No. 7,226,427 (Jun. 5, 2007), use a piston to compress the chest. The piston is driven up and down by a motor. A suction cup on the lower face of the piston is intended to pull the chest wall up with the piston. Active decompression is not yet recommended for pediatric use.

### SUMMARY

**[0006]** The devices and methods described below provide for chest compression monitoring during CPR provided to infant cardiac arrest victims, especially where compressions are provided with the two-thumb method. The device includes a chest compression monitor and a reference sensor mounted on the tips of an easily deformable open frame which fits around the infant's thorax. The open frame is placed around the infant's thorax, with one sensor disposed on the compression point and one sensor disposed on the infant's back, and the CPR provider performs the two-thumb compression technique with one sensor trapped between his thumbs and the infant's chest, and the other sensor trapped between the rescuer's fingers and the infant's back. The device used to measure chest compression depth can be augmented to provide active decompression for infant cardiac arrest victims. The frame which holds the device may be resilient, such that it forcefully returns to an open position, and the tips of the frame may be adhesive, such that they adhere to the infants chest and back, such that upon each release by the CPR provider, the frame exerts a gently expansive force on the infant's thorax.

### BRIEF DESCRIPTION OF THE DRAWINGS

**[0007]** FIG. 1 illustrates the two-thumb technique for accomplishing CPR compressions on an infant.

**[0008]** FIG. 2 illustrates placement of the new chest compression depth monitoring system on an infant cardiac arrest victim.

**[0009]** FIG. 3 illustrates the two-thumb technique for accomplishing CPR compressions on an infant while the system of FIG. 2 is installed on the infant.

**[0010]** FIG. 4 illustrates the frame in isolation.

**[0011]** FIGS. 5A, B and C illustrate the compression frame during compressions of the infants thorax.

**[0012]** FIG. 6 illustrates a wrap-around frame which can be fitted on an infant cardiac arrest victim.

**[0013]** FIG. 7 illustrates a variation of the frame, applied to infant cardiac arrest victim over the shoulders of the infant.

**[0014]** FIG. 8 illustrates a frame for use in the system which can be easily modified to adjust the resilience of the frame.

**[0015]** FIG. 9 illustrates a frame for use in the system, which can be adjusted to fit infants of various sizes.

DETAILED DESCRIPTION OF THE  
INVENTIONS

[0016] FIG. 1 illustrates the two-thumb technique for accomplishing CPR compressions on an infant. The infant is shown supine, supported on a surface. A CPR provider has placed his hands around the infant's thorax, placing his thumbs over the infant's sternum with his fingers wrapping over the axillary area under the infant's arms and around the infant's back. In this method, the CPR provider squeezes the infant's thorax, with the thumbs pressing on the sternum, to push the sternum toward the spine. These compression should be accomplished at a rate of 100 compressions per minute and a depth of 1.5 inches (3.8 cm) (or about one-third of the total thickness of the thorax).

[0017] FIG. 2 illustrates placement of the new chest compression depth monitoring system on an infant cardiac arrest victim 1. The system includes a first sensor 2 located over the sternum and a second sensor 3 located on the back. These two sensors are mounted on a frame 4, which, as illustrated, is a U-shaped frame defining an open space which accommodate the infant. The sensors are mounted on the frame such that, with the frame disposed about the infant's thorax, the sensors may be properly located over the sternum and opposite the sternum on the infant's back. The sensors are operably connected to an automatic external defibrillator (AED) 5 through cable 6. The AED box 5 includes a control system, a display and speaker, and a defibrillator. The display and speaker are operable for providing visual or audio feedback to the CPR provider regarding the depth and rate of the compressions provided by the CPR provider, and comprise means for providing feedback to the CPR provider. The AED also includes an input device, such as a keyboard, soft-keys or touchscreen (which may also be used as the display). The control system (a computer) is programmed to interpret the acceleration signals to calculate compression depth and/or velocity (specifically, release velocity), and generate visual displays and/or audio prompts to be displayed or played to guide the CPR provider. (The control system also analyzes ECG signals obtained from ECG electrodes, not shown, to determine if defibrillating shock should be applied, and may prompt the user to apply shock or automatically operate the defibrillator to apply shock to the infant patient.) The control system can also be provided in a stand-alone device, without the defibrillator function. The control system comprises at least one processor and at least one memory including program code with the memory and computer program code configured with the processor to cause the system to perform the functions described throughout this specification.

[0018] FIG. 3 illustrates the two-thumb technique for accomplishing CPR compressions on an infant while the system of FIG. 2 is installed on the infant. As in FIG. 2, the frame 4 is disposed about the thorax of the infant, with the first sensor 2 disposed over the sternum of the infant and the second sensor 3 (see FIG. 2) disposed on or under the back of the infant. The rescuer is shown with his/her thumbs over the first sensor, trapping the first sensor between the rescuer's thumbs and the infant's sternum, and the fingers of both hands wrapped around the infant's thorax, preferably trapping the second sensor between the fingers of the rescuer and the back of the infant.

[0019] FIG. 4 illustrates the frame in isolation. The frame may take on many forms, and is illustrated as a U-shaped frame 4, comprising two laterally extending elements 7 and 8 joined by an arcuate segment 9. The sensors 2 and 3 are

mounted near the tips 10 and 11 of extending elements, so that they can easily be located with the first sensor 2 disposed over the sternum of the infant and the second sensor 3 disposed on or under the back of the infant. The frame construction assures proper placement of the sensors on the anterior and posterior surface of the infant, so that motion signals from each sensor can be used to measure the chest wall motion induced by the CPR compressions accomplished by the CPR provider, taking into account any anterior/superior motions of the infant's entire thorax attendant to the two-thumbs technique. The frame is preferably resilient and biased to an open configuration (as large or larger than the thickness of the infant's thorax), such that after each compression, it resiliently returns to an open position, but may instead be merely flexible such that upon release of the chest by the CPR provider the frame expands due to the natural resilience of the infant's thorax. The frame is illustrated as an open U-shaped frame, but may be most any shape useful to properly locate the sensors above and below the infant's thorax and convenient to dispose about the infant's thorax. So, for example, the frame may be an oval which completely encircles the thorax. The frame may be provided in various sizes, with each size chosen to suit a range of infants and small children of various sizes, or it may be provided in single size suitable for a wide range of patient sizes.

[0020] If the system is intended to impart some expansive force on the chest between compression down strokes, during the release phase or upstroke of a compression, the inner surfaces of the extending segments of a resilient frame, which inner surfaces may include the inner surfaces of the sensor assemblies (or housings, if they are discrete from the extending segments), may be covered or coated with an adhesive layer suitable for adhering the extending segments to the thorax of the infants. The adhesive may be limited to the tips of the extending segments, such that only the tips of the extending segments adhere to the chest wall. With this construction, with each release of compression force, the resilient expansion of the frame will exert expansive force on the chest wall, and provide a degree of active decompression between each compression.

[0021] FIGS. 5A, B and C are cross sections of the frame, illustrating the action of the frame on the thorax of the infant. As shown in FIG. 5A, the frame is slipped over the infant's chest, such that the anterior sensor 2 is disposed directly over the sternum 12, and the posterior sensor 3 is located under the spine 13. The CPR provider squeezes the infant's chest, using the two-thumbs technique, to achieve the compressed state illustrated in FIG. 5B. FIG. 5B represents the compression stroke or compression phase of the compression cycle. Upon release, the infant's chest will expand, as shown in FIG. 5C, to its original thickness H. Where the interior surfaces of the extending segments are adhesive, the resilient expansion of the frame lead to an expansive force applied to the chest, which hastens the expansion of the chest during the release phase of the compression cycle.

[0022] FIG. 6 illustrates a version of the frame which wraps entirely around the infant cardiac arrest victim. In FIG. 6, the frame 4 may be provided in a length exceeding the circumference of the infant, and sufficient to entirely surround the infant's thorax (practically, the wrap around frame will be provided in a single length long enough to surround infants of various sizes). As with the frames of the earlier figures, the frame of FIG. 6 is resiliently biased to open to a circumference larger than the circumference of the infant. The frame

may have an initial configuration which is substantially flat, in which case it is folded up and around the infant's thorax as shown, and adjusted to obtain a close fit with the infant's thorax before compressions are initiated. The frame may instead have an initial configuration which is substantially circular, in which case it is spread open to accommodate the infant's thorax and adjusted to obtain a close fit with the infant's thorax before compressions are initiated. The anterior sensor **2** may be releasably fixed to the frame, with hook and loop fastener or other fastener, so that it can be relocated to the infant's sternum when the frame is adjusted to fit about the infant.

[0023] FIG. 7 illustrates a variation of the frame, applied to infant cardiac arrest victim over the shoulders of the infant. The frame of FIGS. 2 through 4 can of course be fitted over one shoulder of the infant, at the option of the CPR provider. The frame **14** of FIG. 7 comprises a front portion **15** and back portion **16**, with an opening between the two to accommodate the infant's head. From the side or lateral aspect, the frame is U-shaped. As with the frame of FIGS. 2 through 4, this frame may be resilient and biased to an open position, with the distance between the sensors in the open, relaxed configuration being slightly greater than the anterior-posterior thickness of the infant's thorax. The sensors **2** and **3** are mounted on the frame, with the anterior sensor **2** mounted on the front portion and the posterior sensor **3** mounted on the back portion. As illustrated, viewed from the front or anterior aspect, the front portion is V-shaped, with the vertex **17** of the V, where the anterior sensor **2** is located, disposed over the sternum of the infant. The posterior sensor **3** located directly below the anterior sensor, on the back portion and located at the back of the infant. The vertex of the V serves as an easily recognizable landmark for the user when applying the frame to the infant, but the frame may be made in other configurations that permit the frame to be slipped over the infant's head (for example, a bib or pinafore), and provide for locating the anterior sensor over the infant's sternum.

[0024] The frame can be provided in a single size chosen to fit most infants subject to the two-thumb technique, and configured with a resilience and expansive force suitable for applying active compression/decompression for most infants, or the frame can be provided in a variety of sizes, leaving to a CPR provider to select an appropriate size and/or resilience at the point of use, or adjust size and/or resilience of the frame at the point of use when the size of the actual patient is known. Should it be desirable to adjust these properties, the frame can be modified as illustrated in FIGS. 8 and 9. FIG. 8 illustrates a frame for use in the system which can be easily modified to adjust the resilience of the frame. The frame **21** holds the anterior and posterior sensors **2** and **3** at the tips of anterior and posterior extending elements **7** and **8**. The frame **21** is resilient, and manufactured to exert a first level of expansive force when released from compression. The frame comprises one or more additional layers **22**, **23** and **24**, which are also resilient. The additional layers are secured to the underlying layers with adhesive or a mechanical interlock, such that they are releasably secured to underlying layers and may be removed easily by the CPR provider. To adjust the resilience of the frame, one or more releasable layers may be removed, thus weakening the frame and reducing its resilience.

[0025] FIG. 9 illustrates a frame for use in the system, which can be adjusted to fit infants of various sizes. The laterally extending segments **7** and **8** are connected to each other through an expandable ratcheting mechanism **25**. The

ratcheting assembly may be used to expand or collapse the laterally extending segments **7** and **8** to size the device to a particular infant cardiac arrest victim. As with the U-shaped frames illustrated above, the sensors **2** and **3** are disposed within or on the tips of the extending segments.

[0026] The sensors may include any sensor technology suitable for determining compression depth. Accelerometers may be used, as described in Halperin, U.S. Pat. No. 6,390,996 and Palazzolo, U.S. Pat. No. 7,122,014. In this case, the anterior sensor may be an accelerometer-based chest compression monitor as described in Halperin and Palazzolo, and the posterior sensor can be a reference accelerometer or another accelerometer-based chest compression monitor. The accelerometers are capable of producing acceleration signals corresponding to the acceleration of the chest and the acceleration of the back, and the control system is operable to integrate the acceleration signal received from the accelerometers, integrating and combining those signals to determine the depth of chest compression and produce a measured depth signal. The control system is also programmed to report the measured depth to the CPR provider through the display or audio output, or compare the measured depth signal to a desired depth of compression and report to the CPR provider whether the achieved depth of compression meets or fails to meet the desired depth. Velocity sensors may also be used, in which case the control system is programmed to process the velocity signal received from the velocity signals to achieve the same ends. Also, the control system may be programmed to process the acceleration signals to determine the compression velocity, release velocity, and compression rate to produce corresponding signals, and provide reports and feedback to the CPR provider regarding these parameters.

[0027] Magnetic motion sensors, such as those which use an electromagnetic source and sensor, described in Geheb, et al., Method and Apparatus for Enhancement of Compressions During CPR, U.S. Pat. No. 7,220,235 (May 22, 2007) and Centen, et al., *Reference Sensor For CPR Feedback Device*, U.S. Pub. 2012/0083720 (Apr. 5, 2012), may also be used to determine compression depth. In this case, the one sensor is a magnetic field sensor, and the other sensor is replaced by a magnetic field generator (a permanent magnet or an electromagnet), and the control system is operable to receive and process distance information from the electromagnetic sensor to determine compression depth, release velocity, and compression rate. These and any other means for determining compression depth, compression rate, and release velocity may be used.

[0028] The control system is programmed to receive signals corresponding to motion of the chest wall and motion of the thorax (motion of the back, as sensed by the sensor **3**, and determine the depth of compression achieved during CPR based on those signals. (In the magnetic sensing embodiment, the control system is programmed to determine the depth of compression achieved during CPR based signals from the magnetic field sensor.) The control system is programmed to generate a signal corresponding to the determined chest compression depth which may be used to provide a display indicating achieved chest compression, or may be used by other equipment. The control system is further programmed to compare the determined depth of compression with predetermined desired chest compression goals, and provide feedback to a CPR provider regarding the adequacy of chest compression depth, including whether achieved chest compression depth is inadequate, adequate, or excessive as compared to

the predetermined goals. The feedback can include audio or visual prompts to compress more deeply, prompts to compress at a faster or slower rate, and prompts to quickly and completely release the chest of the patient after each compression. The feedback can also include haptic feedback, provided when compression depth is adequate, inadequate, or excessive, through vibrators disposed on the frame.

**[0029]** The system can be adapted to determine an initial measurement of the patient's chest. The sensors mentioned above may be used, or additional sensors may be added to the frame, to measure the patient's chest prior to the start of chest compressions. This information can be used to advise a CPR provider to limit expansive motion of the frame during release (to limit the active decompression) (limiting the expansive motion of the frame during release can be accomplished merely by holding the frame between compressions, and not allowing it to fully expand), and to advise the CPR provider regarding the adequacy of chest compressions based on the size of the patient. The distance between the sensors **2** and **3** can be determined, using signals from the sensors, where applicable. For example, where the sensors are a magnetic field sensor and a magnetic field generator, the position of the magnetic sensor in the magnetic field generated by the magnetic field generator can be determined.

**[0030]** Additional sensors may be used to size the patient. Distance sensors and proximity sensors at the tips of the frame, near sensor **2**, for example, can determine the distance from the frame tip to the patient, and thereby calculate the size of the patient. This system may require operator input, to inform the system when the frame is disposed about the patient such that the bottom frame tip and sensor **3** are in place below the patient, so that the control system can then calculate the patient's chest height based on the known distance between the frame tips and the measured distance between the upper frame tip and the chest wall of the patient. In another system, strain sensors disposed on or within the frame can be used to determine the shape of the frame, and thus the distance between the frame tips. For example, a shape monitoring cable (item **19** in FIG. **4** comprising linear arrays of fiber Bragg gratings may be disposed on or within the frame, and a control system may operate a light source and light sensors to determine the shape of the frame. This system may require operator input, to inform the system when the frame is disposed about the patient such that the bottom frame tips and sensor **2** and sensor **3** are in contact with the patient, so that the control system can then calculate the patient's chest height based on the shape of the frame as determined by the shape monitoring cable. Shape monitoring cables suitable for use in this embodiment may also include piezo-electric strain gauges and other forms of strain gauges.

**[0031]** For the frame of FIG. **9**, an optical, magnetic or capacitive encoder or other position sensor **27** can be used to determine the position of ratcheting segments relative to each other, and from this information the control system can determine the distance between the tips and the chest height of the patient. Again, with operator input informing the system when the frame is disposed about the patient such that the bottom frame tips and sensor **2** and sensor **3** are in contact with the patient, the control system can then calculate the patient's chest height based on the encoder reading. Thus, for the initial determination of the size of the patient, sensors mounted on the frame tips, encoders disposed on an adjustable portion of the frame, a shape monitoring cable disposed on the frame, and any other suitable means of determining the

distance between the frame tips can be used, in conjunction with input from the CPR provider indicating that the frame tips are in close proximity to the patient's thorax.

**[0032]** In each case, the initial measurement of the size of the patient's thorax can be used by the control system to select advisory parameters, such as the amount of compression desired, and the amount of active decompression desired, for the patient based on patient size, and generate advisory prompts to the CPR provider based on patient size. The compression depth targets for infants should be about  $\frac{1}{3}$  of the infant's chest height, and the appropriate chest compression goals can be selected by the control system programmed to calculate the chest compression goals based on the measured size of the patient. Thus, for CPR compressions performed on small children, the control system would be programmed to provide a positive advisory (that compression are adequate) or a negative advisory (that compression are excessive, or active decompression too expansive) for small compressions and active decompressions, and also programmed to provide a positive advisory (that compression are adequate) or a negative advisory (that compression are excessive, or active decompression too expansive) for slightly larger compressions and active decompressions for CPR performed on a larger child.

**[0033]** In use, a CPR provider will place the frame around the thorax of an infant cardiac arrest victim, with one sensor on the victim's chest, over the victim's sternum, and the second sensor under the infant's spine. The CPR provider will then grasp the infant's thorax with both hands, placing his thumbs over the infant's sternum and extending his fingers around the thorax, in the two-thumbs position. The CPR provider will perform CPR compressions, using the two-thumbs technique, pressing down on the chest, keeping the anterior sensor between his thumbs and the victim's chest, so that the sensor moves up and down in fixed relation with the patient's chest, and keeping the posterior sensor between his fingers and the victim's spine, or at least keeping the posterior extending element between his fingers and the patient's back so that the posterior sensor moves up and down in fixed relation with the patient's back. The CPR provider will operate an associated control system, and energize the sensors, to analyze the sensor signals to determine chest compression depth, velocity of the compression monitor (including release velocity), and the rate of compression, compare the determined chest compression depth, release velocity and/or compression rate to the desired values, and operate an output device to provide prompts indicating whether the determined chest compression depth, release velocity and/or compression rate meets or fails to meet the desired values. The control system may also be operated to compare the measured depth of compression to a desired depth of compression and report to the CPR provider whether the achieved depth of compression meets or fails to meet the desired depth. Prior to the start of compressions, the CPR provider may optionally bring the anterior frame and posterior frame into contact with the body, and provide input to the control system that the anterior frame and posterior frame are in contact with the body.

**[0034]** The frame may be used to perform CPR compressions, including active compression/decompression, with or without the compression depth monitoring components of the system. The frame, with an adhesive surface on at least a portion of the interior surface of the anterior segment, can be installed about the thorax of a patient such that the adhesive secures the anterior segment to the patient's chest wall, over

the sternum (that is, the preferred compression point). With the frame installed, CPR compressions are performed. Upon release of each compression, the resilient frame will resiliently expand toward its open configuration, thereby imparting some expansive force on the chest wall. If the patient is prone on a supportive surface, only the anterior segment need be adhesive. If the patient is held up, or prone on a soft surface, the posterior segment interior surface may be adhesive as well. This method may be used on adults and pediatrics as well as infants.

**[0035]** When used to provide CPR compressions with active compression/decompression the method entails providing the frame having an anterior segment and a posterior segment, and sized and dimensioned to fit at least partially around the thorax of the cardiac arrest victim with adhesive on a portion of the anterior segment is adhesive and, optionally, on the posterior segment, and installing the frame about the thorax of a cardiac arrest victim such that the adhesive secures the anterior segment to the cardiac arrest victim's chest wall. After installation, the CPR provider performs CPR chest compressions on the cardiac arrest victim, allowing the frame to expand between compressions to provide active decompression, with the resilience of the frame acting to restore the frame toward its relaxed opened position and thus exert upward pulling force on the thorax.

**[0036]** While the preferred embodiments of the devices and methods have been described in reference to the environment in which they were developed, they are merely illustrative of the principles of the inventions. Though illustrated for use with infants and the two-thumb compression technique, the devices may be used the two-finger technique, and the devices may sized and dimensioned for adult use, and used in otherwise standard CPR compressions. The elements of the various embodiments may be incorporated into each of the other species to obtain the benefits of those elements in combination with such other species, and the various beneficial features may be employed in embodiments alone or in combination with each other. Other embodiments and configurations may be devised without departing from the spirit of the inventions and the scope of the appended claims.

We claim:

1. A device for assisting resuscitation of a victim during CPR chest compressions comprising:

an anterior sensor disposed on an anterior segment, said anterior segment configured to be held adjacent to an anterior surface of the victim and said anterior sensor operable to produce a first signal corresponding to motion of the anterior surface during compressions;

a posterior sensor disposed on a posterior segment, said posterior segment configured to be held adjacent to a posterior surface of the victim and said posterior sensor operable to produce a second signal corresponding to motion of the posterior surface during compressions;

a control system operable to receive the first signal corresponding to motion of the anterior surface and the second signal corresponding to motion of the posterior surface and determine compression depth therefrom; and

a feedback device configured to provide CPR advisory prompts to a rescuer based on the calculated compression depth, velocity or rate; wherein

the anterior segment and posterior segment are configured to provide active decompression between CPR chest compressions.

2. The device of claim 1, wherein the anterior segment is joined to the posterior segment, such that the anterior segment and posterior segment are resiliently biased to open to a configuration larger than a thickness of the victim's chest.

3. The device of claim 1, wherein the anterior segment is joined to the posterior segment, such that the anterior segment and posterior segment are resiliently biased to open to a configuration larger than the circumference of the victim.

4. The device of claim 1 wherein:  
the posterior sensor is operable to detect acceleration of the posterior surface, and the  
the control system operable to determine depth, velocity or rate of CPR chest compressions from acceleration data obtained from the posterior sensor and data from the anterior sensor during CPR chest compressions.

5. The device of claim 1 wherein:  
the anterior sensor is operable to detect acceleration of the anterior surface, and the  
the control system operable to determine depth, velocity or rate of CPR chest compressions from acceleration data obtained from the anterior sensor and data from the posterior sensor during CPR chest compressions.

6. The device of claim 1 wherein:  
the posterior sensor is operable to detect velocity of the posterior surface, and the  
the control system operable to determine depth, velocity or rate of CPR chest compressions from velocity data obtained from the posterior sensor and data from the anterior sensor during CPR chest compressions.

7. The device of claim 1 wherein:  
the anterior sensor is operable to detect velocity of the anterior surface, and the  
the control system operable to determine depth, velocity or rate of CPR chest compressions from velocity data obtained from the anterior sensor and data from the posterior sensor during CPR chest compressions.

8. The device of claim 1, wherein the control system is further operable to compare the measured depth of compression to a desired depth of compression and report to a CPR provider whether the achieved depth of compression meets or fails to meet the desired depth.

9. The device of claim 1 wherein  
the control system is operable to determine the size of the cardiac arrest victim based on the distance between the anterior segment of the frame and the chest wall and provide feedback regarding the performance of chest compressions based on the determined size of the cardiac arrest victim.

10. The device of claim 1 wherein:  
the anterior segment is configured to adhere to the anterior surface of the victim.

11. The device of claim 1 wherein:  
one of the posterior sensor and the anterior sensor is operable to detect a magnetic field and produce a signal corresponding to motion through a magnetic field; and  
the other of the posterior and the anterior sensor is operable to sense the magnetic field; and  
the control system operable to determine depth, velocity or rate of CPR chest compressions from the signal corresponding to motion through the magnetic field during CPR chest compressions.

**12.** A method of administering CPR chest compressions on a cardiac arrest victim, said cardiac arrest victim characterized by a thorax and an anterior chest wall, said method comprising the steps of:

disposing a frame sized and dimensioned to fit at least partially around the thorax of the cardiac arrest victim, said frame having an anterior segment and a posterior segment, an anterior sensor disposed in or on the anterior segment of the frame, said anterior sensor capable of producing a signal corresponding to motion of the chest wall during compressions; a posterior sensor disposed in or on the posterior segment of the frame, said anterior sensor capable of producing a signal corresponding to motion of the thorax during compressions;

performing CPR compressions on the cardiac arrest victim;

operating a control system to receive the signal corresponding to motion of the chest wall and the signal corresponding to motion of the thorax and determine the depth of chest compressions therefrom, and provide audio or visual feedback to a CPR provider.

**13.** The method of claim **12** further comprising the step of: operating the control system to provide prompts to a CPR provider regarding the depth of compression.

**14.** The method of claim **12** further comprising the step of: operating the control system to compare the determined depth of compression to a desired depth of compression and report to a CPR provider whether the determined depth of compression meets or fails to meet the desired depth.

**15.** The method of claim **12** further comprising the step of: bringing the anterior segment and posterior segment into contact with the thorax, and providing input to the control system that the anterior segment and posterior segment are in contact with the thorax.

**16.** The method of claim **12**, wherein the step of performing CPR compressions further comprises the steps of:

trapping the anterior sensor between the CPR provider's hands and the victim's chest wall, and performing CPR compressions with the anterior sensor disposed between the CPR provider's hands and the victim's chest wall.

**17.** The method of claim **12**, wherein the step of performing CPR compressions further comprises the steps of:

grasping the cardiac arrest victim's thorax with both hands of the CPR provider, with the CPR provider's thumbs over the sternum and the CPR provider's fingers extending around the thorax of the victim, trapping the first sensor between the CPR provider's thumbs and the victim's chest wall, and trapping the second sensor between the CPR provider's fingers and the victim's spine, and performing CPR compressions with a two-thumbs technique.

**18.** The method of claim **12**, further comprising the step of: adhering the frame to the cardiac arrest victim's thorax, and allowing the frame to expand between compressions to provide active decompression of the thorax.

**19.** A method of performing CPR compressions, including active compression/decompression, said method comprising:

providing a frame sized and dimensioned to fit at least partially around the thorax of the cardiac arrest victim, said frame having an anterior segment and a posterior segment, wherein at least a portion of the anterior segment is adhesive;

installing the frame about the thorax of a cardiac arrest victim such that the adhesive secures the anterior segment to the cardiac arrest victim's chest wall;

performing CPR chest compressions on the cardiac arrest victim.

\* \* \* \* \*

专利名称(译)	带参考传感器的CPR胸部压缩监测仪		
公开(公告)号	<a href="#">US20160128633A1</a>	公开(公告)日	2016-05-12
申请号	US14/980901	申请日	2015-12-28
[标]申请(专利权)人(译)	卓尔医学产品公司		
申请(专利权)人(译)	ZOLL医疗公司		
当前申请(专利权)人(译)	ZOLL医疗公司		
[标]发明人	SILVER ANNEMARIE E HERKEN ULRICH R		
发明人	SILVER, ANNEMARIE E. HERKEN, ULRICH R.		
IPC分类号	A61B5/00 A61B5/103		
CPC分类号	A61B5/6835 A61B5/486 A61B5/103 A61B5/4836 A61B2562/0219 A61B5/7405 A61B5/742 A61B2503/04 A61B5/6823 A61B5/0053 A61B5/1107 A61B5/1135 A61B5/4848 A61H31/005 A61H2031/002 A61H2201/0192 A61H2201/165 A61H2201/5007 A61H2201/5043 A61H2201/5048 A61H2201/5058 A61H2201/5079 A61H2201/5084 A61H2201/5092 A61H2230/04 A61N1/39044 A61B2562/0223 A61H31/00 A61H31/007 A61H2201/10 A61H2201/5046 A61N1/3993 G01P3/42 G01P15/02		
其他公开文献	US9521977		
外部链接	<a href="#">Espacenet</a> <a href="#">USPTO</a>		

摘要(译)

用于CPR的胸部按压深度测量的方法和装置。

