



US010603105B2

(12) **United States Patent**  
**Cheung et al.**

(10) **Patent No.:** **US 10,603,105 B2**  
(45) **Date of Patent:** **Mar. 31, 2020**

(54) **MEDICAL DEVICES WITH A FLEXIBLE ELECTRODE ASSEMBLY COUPLED TO AN ABLATION TIP**

(58) **Field of Classification Search**  
CPC ..... A61B 2018/1465; A61B 2018/1495  
See application file for complete search history.

(71) Applicant: **Boston Scientific Scimed Inc.**, Maple Grove, MN (US)

(56) **References Cited**

(72) Inventors: **Desmond Cheung**, San Jose, CA (US); **John C. Potosky**, San Jose, CA (US); **Andrew T. Marecki**, Shrewsbury, MA (US); **Isaac J. Kim**, San Jose, CA (US); **Mark D. Mirigian**, San Jose, CA (US)

U.S. PATENT DOCUMENTS

3,773,401 A 11/1973 Douklias et al.  
4,466,443 A 8/1984 Utsugi  
(Continued)

(73) Assignee: **Boston Scientific Scimed Inc**, Maple Grove, MN (US)

FOREIGN PATENT DOCUMENTS

CA 2682055 A1 10/2008  
CA 2847846 A1 3/2013  
(Continued)

(\* ) Notice: Subject to any disclaimer, the term of this patent is extended or adjusted under 35 U.S.C. 154(b) by 759 days.

OTHER PUBLICATIONS

International Preliminary Report on Patentability issued in PCT/US2015/021300 dated Sep. 29, 2016, 7 pages.  
(Continued)

(21) Appl. No.: **14/922,023**

(22) Filed: **Oct. 23, 2015**

*Primary Examiner* — Michael F Peffley

*Assistant Examiner* — Bo Ouyang

(65) **Prior Publication Data**

US 2016/0113712 A1 Apr. 28, 2016

(74) *Attorney, Agent, or Firm* — Faegre Drinker Biddle & Reath LLP

**Related U.S. Application Data**

(60) Provisional application No. 62/068,334, filed on Oct. 24, 2014.

(57) **ABSTRACT**

(51) **Int. Cl.**  
**A61B 18/14** (2006.01)  
**A61B 5/00** (2006.01)  
(Continued)

Medical devices and methods for making and using medical devices are disclosed. An example medical device may include a catheter for use in cardiac mapping and/or ablation. The catheter may include an elongate catheter shaft having a distal ablation electrode region capable of ablating tissue. An electrode assembly may be coupled to the distal ablation electrode region. The electrode assembly may include a flexible circuit having one or more electrodes disposed thereon.

(52) **U.S. Cl.**  
CPC ..... **A61B 18/1492** (2013.01); **A61B 5/0422** (2013.01); **A61B 5/6852** (2013.01);  
(Continued)

**20 Claims, 37 Drawing Sheets**

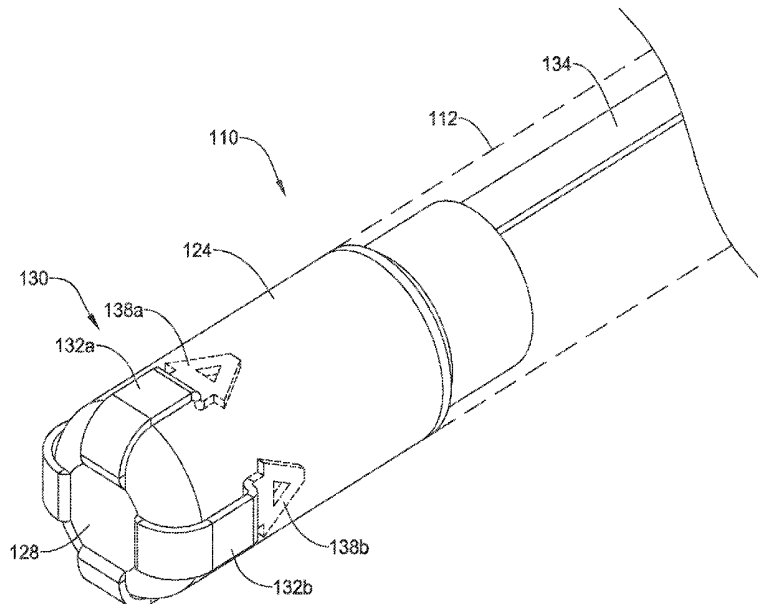

(51)	<b>Int. Cl.</b>		5,913,856 A	6/1999	Chia et al.
	<i>A61B 5/042</i>	(2006.01)	5,916,213 A	6/1999	Haissaguerre et al.
	<i>A61B 18/00</i>	(2006.01)	5,957,850 A	9/1999	Marian et al.
	<i>A61B 17/00</i>	(2006.01)	6,004,269 A	12/1999	Crowley et al.
(52)	<b>U.S. Cl.</b>		6,027,500 A	2/2000	Buckles et al.
	CPC .. <i>A61B 5/6859</i>	(2013.01); <i>A61B 2017/00526</i>	6,050,267 A	4/2000	Nardella et al.
	(2013.01); <i>A61B 2018/00351</i>	(2013.01); <i>A61B</i>	6,050,994 A	4/2000	Sherman
	<i>2018/00577</i>	(2013.01); <i>A61B 2018/00642</i>	6,059,778 A	5/2000	Sherman
	(2013.01); <i>A61B 2018/00839</i>	(2013.01); <i>A61B</i>	6,063,078 A	5/2000	Wittkampf
	<i>2018/1465</i>	(2013.01); <i>A61B 2018/1495</i>	6,064,905 A	5/2000	Webster, Jr. et al.
	(2013.01); <i>A61B 2562/166</i>	(2013.01)	6,068,629 A	5/2000	Haissaguerre et al.
			6,070,094 A	5/2000	Swanson et al.
			6,071,281 A *	6/2000	Burnside ..... A61B 18/1482
					606/37
(56)	<b>References Cited</b>		6,083,170 A	7/2000	Ben-Haim
	<b>U.S. PATENT DOCUMENTS</b>		6,083,222 A	7/2000	Klein et al.
			6,099,524 A	8/2000	Lipson et al.
			6,101,409 A	8/2000	Swanson et al.
			6,116,027 A	9/2000	Smith et al.
			6,120,476 A	9/2000	Fung et al.
			6,165,123 A	12/2000	Thompson
			6,171,305 B1	1/2001	Sherman
			6,200,314 B1	3/2001	Sherman
			6,206,831 B1	3/2001	Suorsa et al.
			6,210,337 B1	4/2001	Dunham et al.
			6,216,027 B1	4/2001	Willis et al.
			6,224,557 B1	5/2001	Ziel et al.
			6,233,491 B1	5/2001	Kordis et al.
			6,241,754 B1	6/2001	Swanson et al.
			6,270,493 B1	8/2001	Lalonde et al.
			6,290,697 B1	9/2001	Tu et al.
			6,352,534 B1	3/2002	Paddock et al.
			6,395,325 B1	5/2002	Hedge et al.
			6,400,981 B1	6/2002	Govari
			6,423,002 B1	7/2002	Hossack
			6,475,213 B1	11/2002	Wayne et al.
			6,488,678 B2	12/2002	Sherman
			6,491,710 B2	12/2002	Satake
			6,500,174 B1	12/2002	Maguire et al.
			6,508,767 B2	1/2003	Burns et al.
			6,508,769 B2	1/2003	Bonnefous
			6,508,803 B1	1/2003	Horikawa et al.
			6,514,249 B1	2/2003	Maguire et al.
			6,516,667 B1	2/2003	Broad et al.
			6,517,533 B1	2/2003	Swaminathan
			6,517,534 B1	2/2003	McGovern et al.
			6,537,271 B1	3/2003	Murray et al.
			6,544,175 B1	4/2003	Newman
			6,546,270 B1	4/2003	Goldin et al.
			6,547,788 B1	4/2003	Maguire et al.
			6,569,160 B1	5/2003	Goldin et al.
			6,572,547 B2	6/2003	Miller et al.
			6,575,966 B2	6/2003	Lane et al.
			6,575,969 B1	6/2003	Rittman et al.
			6,579,278 B1	6/2003	Bencini
			6,582,372 B2	6/2003	Poland
			6,584,345 B2	6/2003	Govari
			6,589,182 B1	7/2003	Loftman et al.
			6,592,525 B2	7/2003	Miller et al.
			6,602,242 B1	8/2003	Fung et al.
			6,620,103 B1	9/2003	Bruce et al.
			6,632,179 B2	10/2003	Wilson et al.
			6,638,222 B2	10/2003	Chandrasekaran et al.
			6,640,120 B1	10/2003	Swanson et al.
			6,647,281 B2	11/2003	Morency
			6,656,174 B1	12/2003	Hegde et al.
			6,658,279 B2	12/2003	Swanson et al.
			6,663,573 B2	12/2003	Goldin
			6,666,862 B2	12/2003	Jain et al.
			6,673,067 B1	1/2004	Peyman
			6,676,606 B2	1/2004	Simpson et al.
			6,692,441 B1	2/2004	Poland et al.
			6,705,992 B2	3/2004	Gatzke
			6,709,396 B2	3/2004	Flesch et al.
			6,711,429 B1	3/2004	Gilboa et al.
			6,719,756 B1	4/2004	Muntermann
			6,723,094 B1	4/2004	Desinger
			6,735,465 B2	5/2004	Panescu
			6,736,814 B2	5/2004	Manna et al.

(56)

## References Cited

## U.S. PATENT DOCUMENTS

6,743,174 B2	6/2004	Ng et al.	7,859,170 B2	12/2010	Knowles et al.
6,773,402 B2	8/2004	Govari et al.	7,862,561 B2	1/2011	Swanson et al.
6,776,758 B2	8/2004	Peszynski et al.	7,862,562 B2	1/2011	Eberl
6,796,979 B2	9/2004	Lentz	7,879,029 B2	2/2011	Jimenez
6,796,980 B2	9/2004	Hall	7,892,228 B2	2/2011	Landis et al.
6,804,545 B2	10/2004	Fuimaono et al.	7,894,871 B2	2/2011	Wittkamp et al.
6,811,550 B2	11/2004	Holland et al.	7,918,850 B2	4/2011	Govari et al.
6,824,517 B2	11/2004	Salgo et al.	7,957,817 B1	6/2011	Gillespie et al.
6,837,884 B2	1/2005	Woloszko	7,996,085 B2	8/2011	Levin
6,845,257 B2	1/2005	Fuimaono et al.	8,016,822 B2	9/2011	Swanson
6,845,264 B1	1/2005	Skladnev et al.	8,048,028 B2	11/2011	Horn et al.
6,917,834 B2	7/2005	Koblish et al.	8,103,327 B2	1/2012	Harlev et al.
6,922,579 B2	7/2005	Taimisto et al.	8,128,617 B2	3/2012	Bencini et al.
6,923,808 B2	8/2005	Taimisto	8,160,690 B2	4/2012	Wilfley et al.
6,932,811 B2	8/2005	Hooven et al.	8,162,935 B2	4/2012	Paul et al.
6,945,938 B2	9/2005	Grunwald	8,265,745 B2	9/2012	Hauck et al.
6,950,689 B1	9/2005	Willis et al.	8,267,926 B2	9/2012	Paul et al.
6,952,615 B2	10/2005	Satake	8,290,578 B2	10/2012	Schneider
6,958,040 B2	10/2005	Oliver et al.	8,317,783 B2	11/2012	Cao et al.
7,001,383 B2	2/2006	Keidar	8,369,922 B2	2/2013	Paul
7,037,264 B2	5/2006	Poland	8,400,164 B2	3/2013	Osadchy et al.
7,047,068 B2	5/2006	Haissaguerre	8,403,925 B2	3/2013	Miller et al.
7,097,643 B2	8/2006	Cornelius et al.	8,406,866 B2	3/2013	Deno et al.
7,099,711 B2	8/2006	Fuimaono et al.	8,414,579 B2	4/2013	Kim et al.
7,105,122 B2	9/2006	Karason	8,449,535 B2	5/2013	Deno et al.
7,112,198 B2	9/2006	Satake	8,454,538 B2	6/2013	Wittkamp et al.
7,115,122 B1	10/2006	Swanson et al.	8,454,589 B2	6/2013	Deno et al.
7,123,951 B2	10/2006	Fuimaono et al.	8,489,184 B2	7/2013	Wilfley et al.
7,131,947 B2	11/2006	Demers	8,579,889 B2	11/2013	Bencini
7,166,075 B2	1/2007	Varghese et al.	8,583,215 B2	11/2013	Lichtenstein
7,181,262 B2	2/2007	Fuimaono et al.	8,603,084 B2	12/2013	Fish et al.
7,220,233 B2	5/2007	Nita et al.	8,603,085 B2	12/2013	Jimenez
7,232,433 B1	6/2007	Schlesinger et al.	8,644,950 B2	2/2014	Hauck
7,247,155 B2	7/2007	Hoey et al.	8,657,814 B2	2/2014	Werneth et al.
7,270,634 B2	9/2007	Scampini et al.	8,672,936 B2	3/2014	Thao et al.
7,288,088 B2	10/2007	Swanson	8,679,109 B2	3/2014	Paul et al.
7,291,142 B2	11/2007	Eberl et al.	8,728,077 B2	5/2014	Paul et al.
7,306,561 B2	12/2007	Sathyannarayana	8,740,900 B2	6/2014	Kim et al.
7,335,052 B2	2/2008	D'Sa	8,755,860 B2	6/2014	Paul et al.
7,347,820 B2	3/2008	Bonnefous	8,771,343 B2	7/2014	Weber et al.
7,347,821 B2	3/2008	Dkyba et al.	8,876,817 B2	11/2014	Avitall et al.
7,347,857 B2	3/2008	Anderson et al.	8,894,643 B2	11/2014	Watson et al.
7,361,144 B2	4/2008	Levrier et al.	8,906,011 B2	12/2014	Gelbart et al.
7,422,591 B2	9/2008	Phan	8,945,015 B2	2/2015	Rankin et al.
7,438,714 B2	10/2008	Phan	8,998,890 B2	4/2015	Paul et al.
7,455,669 B2	11/2008	Swanson	9,089,340 B2	7/2015	Hastings et al.
7,488,289 B2	2/2009	Suorsa et al.	9,125,565 B2	9/2015	Hauck
7,507,205 B2	3/2009	Borovsky et al.	9,125,668 B2	9/2015	Subramaniam et al.
7,519,410 B2	4/2009	Taimisto et al.	9,168,004 B2	10/2015	Gliner et al.
7,529,393 B2	5/2009	Peszynski et al.	9,173,586 B2	11/2015	Deno et al.
7,534,207 B2	5/2009	Shehada et al.	9,211,156 B2	12/2015	Kim et al.
7,544,164 B2	6/2009	Knowles et al.	9,241,687 B2	1/2016	McGee
7,549,988 B2	6/2009	Eberl et al.	9,241,761 B2	1/2016	Rankin et al.
7,569,052 B2	8/2009	Phan et al.	9,254,163 B2	2/2016	Paul et al.
7,578,791 B2	8/2009	Rafter	9,265,434 B2	2/2016	Merschon et al.
7,582,083 B2	9/2009	Swanson	9,271,782 B2	3/2016	Paul et al.
7,585,310 B2	9/2009	Phan et al.	9,283,026 B2	3/2016	Paul et al.
7,610,073 B2	10/2009	Fuimaono et al.	9,370,329 B2	6/2016	Tun et al.
7,648,462 B2	1/2010	Jenkins et al.	9,393,072 B2	7/2016	Kim et al.
7,697,972 B2	4/2010	Verard et al.	9,463,064 B2	10/2016	Subramaniam et al.
7,704,208 B2	4/2010	Thiele	9,603,659 B2	3/2017	Subramaniam et al.
7,720,420 B2	5/2010	Kajita	9,757,191 B2	9/2017	Avitall et al.
7,727,231 B2	6/2010	Swanson	2001/0029371 A1	10/2001	Kordis
7,736,362 B2	6/2010	Eberl et al.	2001/0034518 A1	10/2001	Edwards et al.
7,740,629 B2	6/2010	Anderson et al.	2002/0007180 A1	1/2002	Wittenberger et al.
7,758,508 B1	7/2010	Thiele et al.	2002/0087208 A1	7/2002	Koblish et al.
7,766,833 B2	8/2010	Lee et al.	2002/0165448 A1	11/2002	Ben-Haim et al.
7,776,033 B2	8/2010	Swanson	2002/0183735 A1	12/2002	Edwards et al.
7,785,324 B2	8/2010	Eberl	2002/0198521 A1	12/2002	Maguire
7,794,398 B2	9/2010	Salgo	2003/0004505 A1	1/2003	Bencini et al.
7,796,789 B2	9/2010	Salgo et al.	2003/0004506 A1	1/2003	Messing
7,799,025 B2	9/2010	Wellman	2003/0013958 A1	1/2003	Govari et al.
7,815,572 B2	10/2010	Loupas	2003/0014095 A1	1/2003	Kramer et al.
7,819,863 B2	10/2010	Eggers et al.	2003/0088240 A1	5/2003	Saadat
7,837,624 B1	11/2010	Hossack et al.	2003/0158548 A1	8/2003	Phan et al.
			2003/0158549 A1	8/2003	Swanson
			2003/0229286 A1	12/2003	Lenker
			2004/0006268 A1	1/2004	Gilboa et al.
			2004/0082860 A1	4/2004	Haissaguerre

(56)

## References Cited

## U.S. PATENT DOCUMENTS

2004/0092806 A1	5/2004	Sagon et al.	2009/0005771 A1	1/2009	Lieber et al.	
2004/0116793 A1	6/2004	Taimisto et al.	2009/0030312 A1	1/2009	Hadjicostis	
2004/0147920 A1	7/2004	Keidar	2009/0048591 A1	2/2009	Ibrahim et al.	
2004/0158238 A1	8/2004	Lalonde et al.	2009/0056344 A1	3/2009	Poch	
2004/0162556 A1	8/2004	Swanson	2009/0062790 A1	3/2009	Malchano et al.	
2004/0186467 A1	9/2004	Swanson et al.	2009/0062795 A1	3/2009	Vakharia et al.	
2004/0210136 A1	10/2004	Varghese et al.	2009/0076390 A1	3/2009	Lee et al.	
2004/0215177 A1	10/2004	Swanson	2009/0093810 A1	4/2009	Subramaniam et al.	
2004/0215186 A1	10/2004	Cornelius et al.	2009/0093811 A1	4/2009	Koblish et al.	
2005/0033331 A1	2/2005	Burnett et al.	2009/0099472 A1	4/2009	Remmert et al.	
2005/0059862 A1	3/2005	Phan	2009/0131932 A1	5/2009	Vakharia et al.	
2005/0059962 A1	3/2005	Phan et al.	2009/0163904 A1	6/2009	Miller et al.	
2005/0059963 A1	3/2005	Phan et al.	2009/0171341 A1	7/2009	Pope et al.	
2005/0059965 A1	3/2005	Eberl et al.	2009/0171345 A1	7/2009	Miller et al.	
2005/0065506 A1	3/2005	Phan	2009/0177069 A1	7/2009	Razavi	
2005/0065508 A1	3/2005	Johnson et al.	2009/0177111 A1	7/2009	Miller et al.	
2005/0070894 A1	3/2005	McClurken	2009/0182316 A1	7/2009	Bencini	
2005/0090817 A1	4/2005	Phan	2009/0209950 A1	8/2009	Starksen	
2005/0119545 A1	6/2005	Swanson	2009/0216125 A1	8/2009	Lenker	
2005/0119648 A1	6/2005	Swanson	2009/0240247 A1	9/2009	Rioux et al.	
2005/0119649 A1	6/2005	Swanson	2009/0259274 A1	10/2009	Simon et al.	
2005/0119653 A1	6/2005	Swanson	2009/0275827 A1	11/2009	Aiken et al.	
2005/0119654 A1	6/2005	Swanson et al.	2009/0281541 A1	11/2009	Ibrahim et al.	
2005/0124881 A1	6/2005	Kanai et al.	2009/0287202 A1	11/2009	Ingle et al.	
2005/0165391 A1	7/2005	Maguire et al.	2009/0292209 A1	11/2009	Hadjicostis	
2005/0187544 A1	8/2005	Swanson et al.	2009/0299355 A1	12/2009	Bencini et al.	
2005/0203597 A1	9/2005	Yamazaki et al.	2009/0299360 A1	12/2009	Ormsby	
2005/0228286 A1	10/2005	Messerly et al.	2009/0306643 A1	12/2009	Pappone et al.	
2005/0228504 A1	10/2005	Demarais	2010/0010487 A1	1/2010	Phan et al.	
2005/0273060 A1	12/2005	Levy et al.	2010/0030204 A1	2/2010	Stein et al.	
2005/0288667 A1	12/2005	Thompson et al.	2010/0057072 A1	3/2010	Roman et al.	
2006/0030919 A1	2/2006	Mrva et al.	2010/0076402 A1	3/2010	Mazzone et al.	
2006/0089634 A1	4/2006	Anderson et al.	2010/0076426 A1 *	3/2010	de la Rama .....	A61B 18/1492 606/41
2006/0100522 A1	5/2006	Yuan et al.	2010/0094274 A1	4/2010	Narayan et al.	
2006/0161146 A1	7/2006	Cornelius et al.	2010/0106155 A1	4/2010	Anderson et al.	
2006/0224153 A1	10/2006	Fischell et al.	2010/0113938 A1	5/2010	Park et al.	
2006/0247607 A1	11/2006	Cornelius et al.	2010/0114092 A1	5/2010	Eisele et al.	
2006/0247683 A1	11/2006	Danek et al.	2010/0145221 A1	6/2010	Brunnett et al.	
2006/0253028 A1	11/2006	Lam et al.	2010/0152728 A1	6/2010	Park et al.	
2006/0253116 A1	11/2006	Avitall et al.	2010/0168557 A1	7/2010	Deno et al.	
2007/0003811 A1	1/2007	Zerfass et al.	2010/0168568 A1	7/2010	Sliwa	
2007/0016054 A1	1/2007	Yuan et al.	2010/0168570 A1	7/2010	Sliwa et al.	
2007/0016059 A1	1/2007	Morimoto et al.	2010/0168831 A1	7/2010	Korivi et al.	
2007/0016228 A1	1/2007	Salas	2010/0241117 A1	9/2010	Paul et al.	
2007/0021744 A1	1/2007	Creighton	2010/0249599 A1	9/2010	Hastings et al.	
2007/0049925 A1	3/2007	Phan et al.	2010/0249603 A1	9/2010	Hastings et al.	
2007/0055225 A1	3/2007	Dodd, III et al.	2010/0249604 A1	9/2010	Hastings et al.	
2007/0073135 A1	3/2007	Lee et al.	2010/0268217 A1 *	10/2010	Habib .....	A61B 17/2202 606/33
2007/0088345 A1	4/2007	Larson et al.	2010/0298826 A1	11/2010	Leo et al.	
2007/0165916 A1	7/2007	Cloutier et al.	2010/0331658 A1	12/2010	Kim et al.	
2007/0167813 A1	7/2007	Lee et al.	2011/0028820 A1	2/2011	Lau et al.	
2007/0181139 A1	8/2007	Hauck	2011/0034915 A1	2/2011	Ibrahim et al.	
2007/0225610 A1	9/2007	Mickleley et al.	2011/0071400 A1	3/2011	Hastings et al.	
2007/0238997 A1	10/2007	Camus	2011/0071401 A1	3/2011	Hastings et al.	
2007/0270794 A1	11/2007	Anderson et al.	2011/0112569 A1	5/2011	Friedman et al.	
2008/0009733 A1	1/2008	Saksena	2011/0125143 A1	5/2011	Gross et al.	
2008/0015568 A1	1/2008	Paul et al.	2011/0130648 A1	6/2011	Beeckler et al.	
2008/0025145 A1	1/2008	Peszynski et al.	2011/0137153 A1	6/2011	Govari et al.	
2008/0051841 A1	2/2008	Swerdlow et al.	2011/0144491 A1	6/2011	Sliwa et al.	
2008/0058836 A1	3/2008	Moll et al.	2011/0144524 A1	6/2011	Fish et al.	
2008/0086073 A1	4/2008	McDaniel	2011/0160584 A1	6/2011	Paul et al.	
2008/0091109 A1	4/2008	Abraham	2011/0237933 A1	9/2011	Cohen	
2008/0140065 A1	6/2008	Rioux et al.	2011/0282249 A1	11/2011	Tsoref et al.	
2008/0161705 A1	7/2008	Podmore et al.	2011/0319782 A1	12/2011	Sweeney et al.	
2008/0161795 A1	7/2008	Wang et al.	2012/0004547 A1	1/2012	Harks et al.	
2008/0161796 A1	7/2008	Cao et al.	2012/0029504 A1	2/2012	Afonso et al.	
2008/0195089 A1	8/2008	Thiagalingam et al.	2012/0071870 A1 *	3/2012	Salahieh .....	A61B 5/01 606/33
2008/0228111 A1	9/2008	Nita	2012/0095347 A1	4/2012	Adam et al.	
2008/0243214 A1	10/2008	Koblish	2012/0101398 A1	4/2012	Ramanathan et al.	
2008/0275428 A1	11/2008	Tegg et al.	2012/0116537 A1	5/2012	Liebetanz	
2008/0281322 A1	11/2008	Sherman et al.	2012/0136346 A1	5/2012	Condie et al.	
2008/0287803 A1	11/2008	Li et al.	2012/0136348 A1	5/2012	Condie et al.	
2008/0300454 A1	12/2008	Goto	2012/0136351 A1	5/2012	Weekamp et al.	
2008/0312521 A1	12/2008	Solomon	2012/0172698 A1	7/2012	Hastings et al.	
2008/0312713 A1	12/2008	Wilfley et al.	2012/0172727 A1	7/2012	Hastings et al.	
			2012/0172871 A1	7/2012	Hastings et al.	

(56)

## References Cited

## U.S. PATENT DOCUMENTS

2012/0238897 A1 9/2012 Wilfley et al.  
 2012/0310064 A1 12/2012 McGee  
 2012/0330304 A1 12/2012 Vegesna et al.  
 2013/0023784 A1 1/2013 Schneider et al.  
 2013/0023897 A1 1/2013 Wallace  
 2013/0060245 A1 3/2013 Grunewald et al.  
 2013/0066312 A1 3/2013 Subramaniam et al.  
 2013/0066315 A1 3/2013 Subramaniam et al.  
 2013/0079763 A1 3/2013 Heckel et al.  
 2013/0165926 A1 6/2013 Mathur et al.  
 2013/0172715 A1 7/2013 Just et al.  
 2013/0172742 A1 7/2013 Rankin et al.  
 2013/0172875 A1 7/2013 Govari et al.  
 2013/0184706 A1 7/2013 Gelbart et al.  
 2013/0190747 A1 7/2013 Koblisch et al.  
 2013/0197363 A1 8/2013 Rankin et al.  
 2013/0226169 A1 8/2013 Miller et al.  
 2013/0274582 A1 10/2013 Afonso et al.  
 2013/0331739 A1 12/2013 Gertner  
 2013/0345537 A1 12/2013 Thakur et al.  
 2014/0012251 A1 1/2014 Himmelstein et al.  
 2014/0058375 A1 2/2014 Koblisch  
 2014/0066764 A1 3/2014 Subramaniam et al.  
 2014/0073893 A1 3/2014 Bencini  
 2014/0075753 A1 3/2014 Haarer et al.  
 2014/0081111 A1 3/2014 Tun et al.  
 2014/0081112 A1 3/2014 Kim et al.  
 2014/0081113 A1 3/2014 Cohen et al.  
 2014/0081262 A1 3/2014 Koblisch et al.  
 2014/0100563 A1 4/2014 Govari et al.  
 2014/0107453 A1 4/2014 Maskara et al.  
 2014/0107636 A1 4/2014 Bencini  
 2014/0128757 A1 5/2014 Banet et al.  
 2014/0142393 A1\* 5/2014 Piskun ..... A61M 39/22  
 600/206  
 2014/0194867 A1 7/2014 Fish et al.  
 2014/0200429 A1 7/2014 Spector et al.  
 2014/0200430 A1 7/2014 Spector  
 2014/0214028 A1 7/2014 Gelbart et al.  
 2014/0228713 A1 8/2014 Thao et al.  
 2014/0243917 A1 8/2014 Morley et al.  
 2014/0261985 A1 9/2014 Selkee  
 2014/0275916 A1 9/2014 Nabutovsky et al.  
 2014/0276052 A1 9/2014 Rankin et al.  
 2014/0276811 A1 9/2014 Koblisch et al.  
 2014/0330150 A1 11/2014 Thakur et al.  
 2014/0336518 A1 11/2014 Shuros et al.  
 2014/0358137 A1 12/2014 Hu  
 2014/0364715 A1 12/2014 Hauck  
 2014/0364843 A1 12/2014 Paul et al.  
 2014/0364848 A1 12/2014 Heimbecher et al.  
 2015/0005624 A1 1/2015 Hauck et al.  
 2015/0011995 A1 1/2015 Avitall et al.  
 2015/0018813 A1 1/2015 Gliner  
 2015/0133914 A1 5/2015 Koblisch  
 2015/0133920 A1 5/2015 Rankin et al.  
 2015/0265341 A1 9/2015 Koblisch  
 2015/0265348 A1 9/2015 Avitall et al.  
 2015/0342672 A1 12/2015 Bencini et al.  
 2015/0374252 A1 12/2015 de la Rama et al.  
 2015/0374436 A1 12/2015 Subramaniam et al.  
 2016/0008065 A1 1/2016 Gliner et al.  
 2016/0100884 A1 4/2016 Fay et al.

## FOREIGN PATENT DOCUMENTS

CA 2848053 A1 3/2013  
 CN 1269708 A 10/2000  
 CN 1455655 A 11/2003  
 CN 1674836 A 9/2005  
 CN 1942145 A 4/2007  
 CN 102271607 A 12/2011  
 CN 102573966 A 7/2012  
 CN 103917185 A 7/2014

CN 103987336 A 8/2014  
 CN 104039257 A 9/2014  
 CN 104244810 A 12/2014  
 CN 104254368 A 12/2014  
 CN 104619259 A 5/2015  
 CN 104640513 A 5/2015  
 CN 104661609 A 5/2015  
 EP 1343426 B1 9/2003  
 EP 1343427 B1 9/2003  
 EP 1502542 A1 2/2005  
 EP 1547537 A1 6/2005  
 EP 0985423 B1 4/2006  
 EP 1717601 A2 11/2006  
 EP 1935332 A2 6/2008  
 EP 2755587 A 7/2014  
 EP 2755588 A 7/2014  
 EP 2136702 B1 7/2015  
 EP 2897545 A1 7/2015  
 JP H07100214 A 4/1995  
 JP 2000000242 A 1/2000  
 JP 200083918 A 3/2000  
 JP 2000504242 A 4/2000  
 JP 2002528039 A 8/2002  
 JP 2003504090 A 2/2003  
 JP 2004503335 A 2/2004  
 JP 2006239414 A 9/2006  
 JP 2007163559 A 6/2007  
 JP 2007244857 A 9/2007  
 JP 2009142653 A 12/2008  
 JP 2009518150 A 5/2009  
 JP 2010522623 A 7/2010  
 JP 2011142995 A 7/2011  
 JP 2011525842 A 9/2011  
 JP 2012531967 A 12/2012  
 JP 5336465 B2 11/2013  
 JP 2014012174 A 1/2014  
 JP 2014531244 A 11/2014  
 JP 2015501162 A 1/2015  
 JP 2015509027 A 3/2015  
 KR 20100021401 A 2/2010  
 KR 101490374 B1 2/2015  
 WO WO199221278 A1 12/1992  
 WO WO9413358 A1 6/1994  
 WO WO9604860 A1 2/1996  
 WO WO199725916 A1 7/1997  
 WO WO199725917 A1 7/1997  
 WO WO199736541 A1 10/1997  
 WO 1997045156 A2 12/1997  
 WO WO199858681 A2 12/1998  
 WO 1999009879 A1 3/1999  
 WO WO1999027862 A1 6/1999  
 WO WO9953853 A1 10/1999  
 WO WO2000029062 A2 5/2000  
 WO WO200158372 A1 8/2001  
 WO WO2001064145 A1 9/2001  
 WO WO2001068173 A2 9/2001  
 WO WO0174252 A2 10/2001  
 WO WO0180755 A2 11/2001  
 WO WO0205868 A2 1/2002  
 WO WO2002005868 A2 1/2002  
 WO WO2002009599 A2 2/2002  
 WO WO2002019934 A1 3/2002  
 WO WO200247569 A1 6/2002  
 WO WO2002102234 A2 12/2002  
 WO WO2003039338 A2 5/2003  
 WO WO2007079278 A1 7/2007  
 WO 2008003058 A2 1/2008  
 WO WO2008046031 A2 4/2008  
 WO WO2008118992 A1 10/2008  
 WO WO2009032421 A2 3/2009  
 WO 2009048824 A1 4/2009  
 WO 2009048943 A1 4/2009  
 WO 2010054409 A1 5/2010  
 WO WO2010056771 A1 5/2010  
 WO 2010082146 A1 7/2010  
 WO 2011008444 A1 1/2011  
 WO 2011033421 A1 3/2011  
 WO WO2011024133 A1 3/2011  
 WO WO2011089537 A1 7/2011

(56) **References Cited**

## FOREIGN PATENT DOCUMENTS

WO	2011101778	A1	8/2011
WO	WO2011095937	A1	8/2011
WO	2012001595	A1	1/2012
WO	WO2012001595	A1	1/2012
WO	WO2012049621	A1	4/2012
WO	WO2012066430	A1	5/2012
WO	2012135703	A2	10/2012
WO	2012161880	A1	11/2012
WO	WO2012151301	A1	11/2012
WO	2012166239	A1	12/2012
WO	2013040201	A2	3/2013
WO	2013040297	A1	3/2013
WO	2014036439	A2	3/2014
WO	2014058375	A2	4/2014
WO	2014072879	A2	5/2014
WO	2014152575	A2	9/2014
WO	2015143061	A1	9/2015
WO	2015183635	A1	12/2015

## OTHER PUBLICATIONS

International Search Report and Written Opinion issued in PCT/US2015/066874, dated Apr. 1, 2016, 11 pages.

Extended European Search Report issued in EP Application 16182627.6, dated Nov. 8, 2016, 5 pages.

International Preliminary Report on Patentability issued in PCT/US2015/031591, dated Dec. 6, 2016, 7 pages.

International Search Report and Written Opinion issued in PCT/US2016/028006 dated Jul. 12, 2016, 12 pages.

International Preliminary Report on Patentability issued in PCT/US2015/055173, dated Apr. 27, 2017, 7 pages.

International Preliminary Report on Patentability issued in PCT/US2015/066874, dated Jun. 29, 2017, 7 pages.

Extended European Search Report issued in EP Application No. 15174537.9, dated Mar. 2, 2016, 7 pages.

Goldberg, S. Nahum et al., "Variabiles Affecting Proper System Grounding for Radiofrequency Ablation in an Animal Model", *JVIR*, vol. 11, No. 8, Sep. 2000, pp. 1069-1075.

Haverkamp, W., et. al. Coagulation of Ventricular Myocardium Using Radiofrequency Alternating Current: Bio-Physical Aspects and Experimental Findings. *PACE*, 12:187-195, Jan. 1989, Part II.

International Preliminary Examination Report issued in PCT/US2013/060612, completed Mar. 24, 2015, 10 pages.

International Preliminary Report on Patentability issued in PCT/US2008/058324, dated Sep. 29, 2009, 9 pages.

International Preliminary Report on Patentability issued in PCT/US2012/055155, dated Mar. 18, 2014, 11 pages.

International Preliminary Report on Patentability issued in PCT/US2012/055309, dated Mar. 18, 2014, 8 pages.

International Preliminary Report on Patentability issued in PCT/US2013/056211, completed Feb. 24, 2015, 5 pages.

International Preliminary Report on Patentability issued in PCT/US2013/058105, completed Mar. 10, 2015.

International Preliminary Report on Patentability issued in PCT/US2013/060194, dated Mar. 24, 2015, 6 pages.

International Preliminary Report on Patentability issued in PCT/US2014/027491, dated Sep. 24, 2015, 12 pages.

International Preliminary Report on Patentability issued in PCT/US2013/060183, dated Mar. 24, 2015, 6 pages.

International Search Report and Written Opinion issued in PCT/US2008/058324, dated Aug. 18, 2008, 11 pages.

International Search Report and Written Opinion issued in PCT/US2012/031819, dated Sep. 27, 2012, 16 pages.

International Search Report and Written Opinion issued in PCT/US2012/055155, dated Mar. 11, 2013, 19 pages.

International Search Report and Written Opinion issued in PCT/US2012/055309, dated Nov. 19, 2012, 13 pages.

International Search Report and Written Opinion issued in PCT/US2012/072061, dated Mar. 21, 2013, 9 pages.

International Search Report and Written Opinion issued in PCT/US2013/020503, dated Mar. 20, 2013, 10 pages.

International Search Report and Written Opinion issued in PCT/US2013/021013, dated Apr. 5, 2013, 14 pages.

International Search Report and Written Opinion issued in PCT/US2013/056211, dated Jan. 20, 2014.

International Search Report and Written Opinion issued in PCT/US2013/058105, dated Nov. 22, 2013, 16 pages.

International Search Report and Written Opinion issued in PCT/US2013/060183, dated Jan. 27, 2014, 10 pages.

International Search Report and Written Opinion issued in PCT/US2013/060194, dated Jan. 29, 2014.

International Search Report and Written Opinion issued in PCT/US2013/060194, dated Jan. 29, 2014, 10 pages.

International Search Report and Written Opinion issued in PCT/US2013/060612, dated Feb. 28, 2014, 16 pages.

International Search Report and Written Opinion issued in PCT/US2014/027491, dated Sep. 23, 2014, 17 pages.

International Search Report and Written Opinion issued in PCT/US2015/021300, dated Jun. 9, 2015, 11 pages.

International Search Report and Written Opinion issued in PCT/US2015/055173, dated Jan. 18, 2016, 11 pages.

International Search Report and Written Opinion issued in PCT/US2015/057242, dated Jan. 15, 2016, 11 pages.

International Search Report and Written Opinion issued in PCT/US2015/031591, dated Aug. 17, 2015, 11 pages.

Invitation to Pay Additional Fees and Partial International Search Report issued in PCT/US2014/027491, dated Jul. 28, 2014, 5 pages.

Machi MD, Junji, "Prevention of Dispersive Pad Skin Burns During RFA by a Simple Method", Editorial Comment, *Surg Laparosc Endosc Percutan Tech*, vol. 13, No. 6, Dec. 2003, pp. 372-373.

Neufeld, Gordon R. et al., "Electrical Impedance Properties of the Body and the Problem of Alternate-site Burns During Electrosurgery", *Medical Instrumentation*, vol. 19, No. 2, Mar.-Apr. 1985, pp. 83-87.

Partial International Search Report issued in PCT/US2012/055155, dated Dec. 20, 2012, 7 pages.

Patriciu, A. et al., "Detecting Skin Burns Induced by Surface Electrodes", published in *Engineering in Medicine and Biology Society*, 2001. Proceedings of the 23rd Annual International Conference of the IEEE, vol. 3, pp. 3129-3131.

Piorkowski, Christopher et al., "First in Human Validation of Impedance-Based Catheter Tip-to-Tissue Contact Assessment in the Left Atrium", *Journal of Cardiovascular Electrophysiology*, vol. 20, No. 12, Dec. 1, 2009, pp. 1366-1373.

Pires, L. A., et al. Temperature-guided Radiofrequency Catheter Ablation of Closed-Chest Ventricular Myocardium with a Novel Thermistor-Tipped Catheter. *American Heart Journal*, 127(6):1614-1618, Jun. 1994.

Price, Adam et al., "Novel Ablation Catheter Technology that Improves Mapping Resolution and Monitoring of Lesion Maturation", *The Journal of Innovations in Cardiac Rhythm Management*, vol. 3, 2002, pp. 599-609.

Price, Adam et al., "PO3-39 Pin Electrodes Improve Resolution: Enhanced Monitoring of Radiofrequency Lesions in the Voltage and Frequency Domains", *Heart Rhythm 2010*, 31st Annual Scientific Sessions, May 12-15 in Denver Colorado.

Ring, E. R., et. al. Catheter Ablation of the Ventricular Septum with Radiofrequency Energy. *American Heart Journal*, 117(6):1233-1240, Jun. 1989.

Steinke, Karin et al., "Dispersive Pad Site burns With Modern Radiofrequency Ablation Equipment", *Surg Laparosc Endosc Percutan Tech*, vol. 13, No. 6, Dec. 2003, pp. 366-371.

Zachary, J.M. et al., "PO4-86 Pin Electrodes Provide Enhanced Resolution Enabling Titration of Radiofrequency Duration to Lesion Maturation", *Heart Rhythm 2011*, 32 Annual Scientific Sessions, May 4-7, San Francisco, CA.

International Preliminary Report on Patentability issued in PCT/US2015/057242, dated May 4, 2017, 7 pages.

Partial European Search Report issued in EP Application 18177491.0, dated Jul. 16, 2018, 11 pages.

(56)

**References Cited**

OTHER PUBLICATIONS

Extended European Search Report issued in EP18177491.0, dated Oct. 26, 2018, 10 pages.

\* cited by examiner

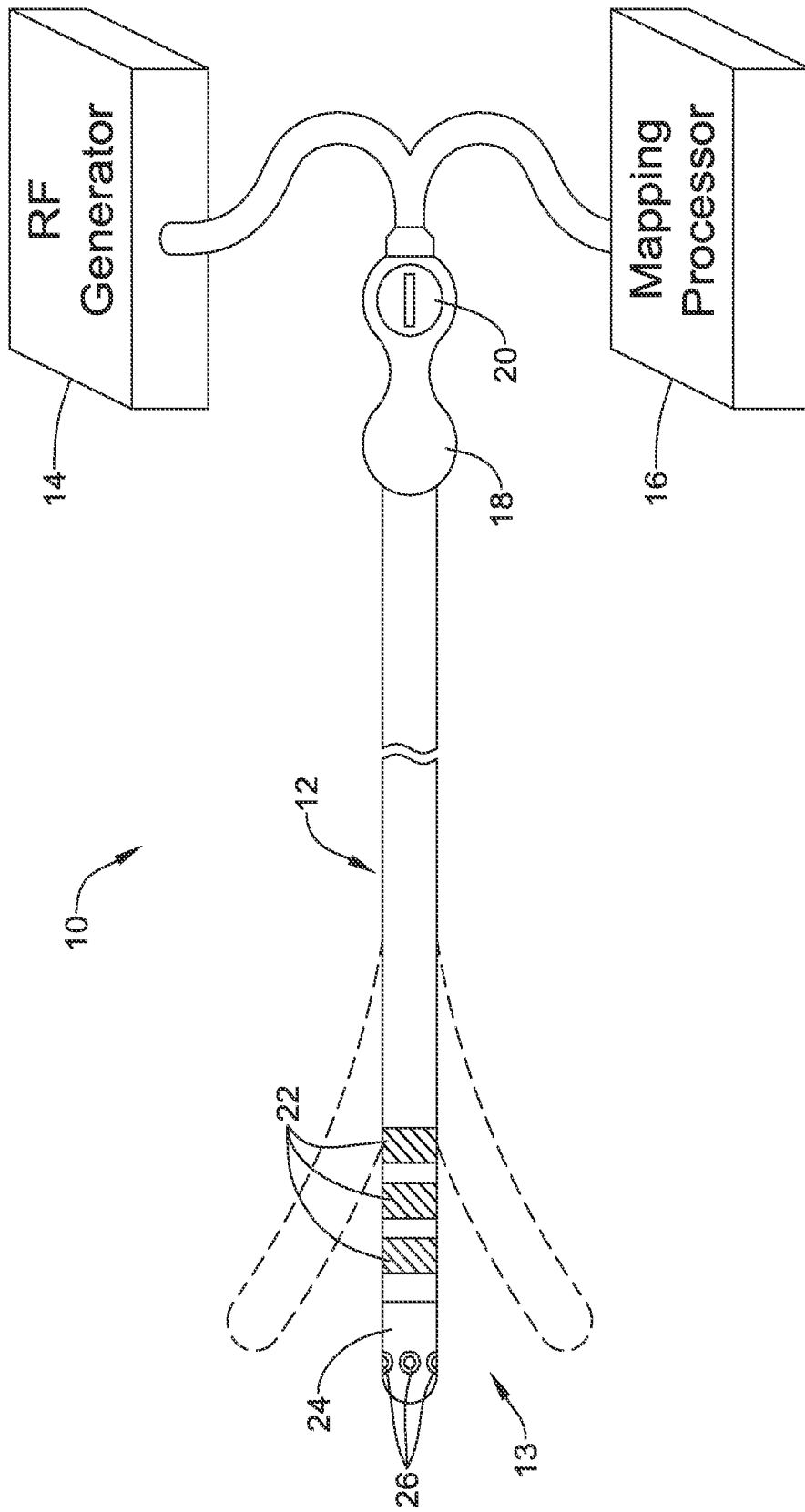

FIG. 1

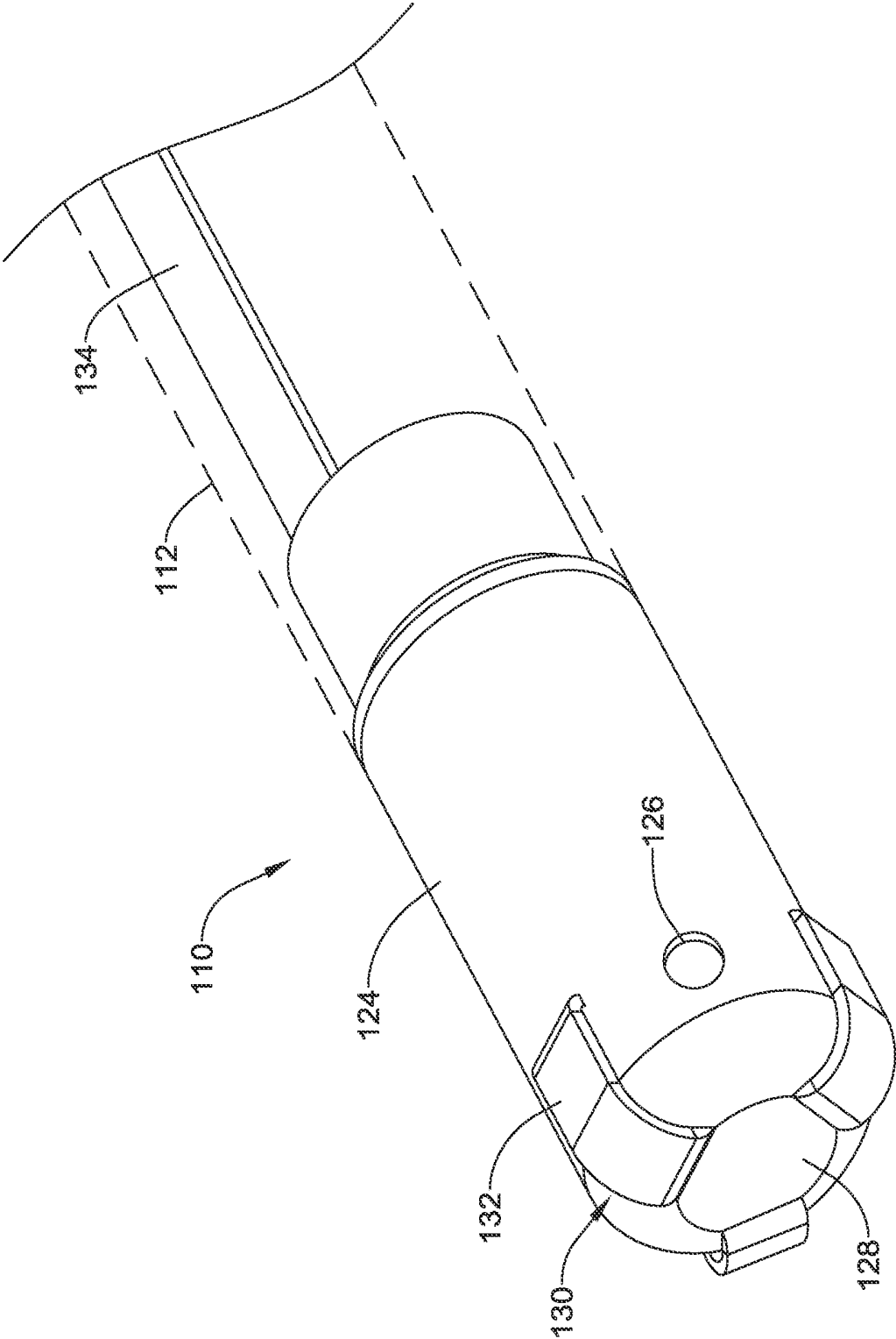

FIG. 2

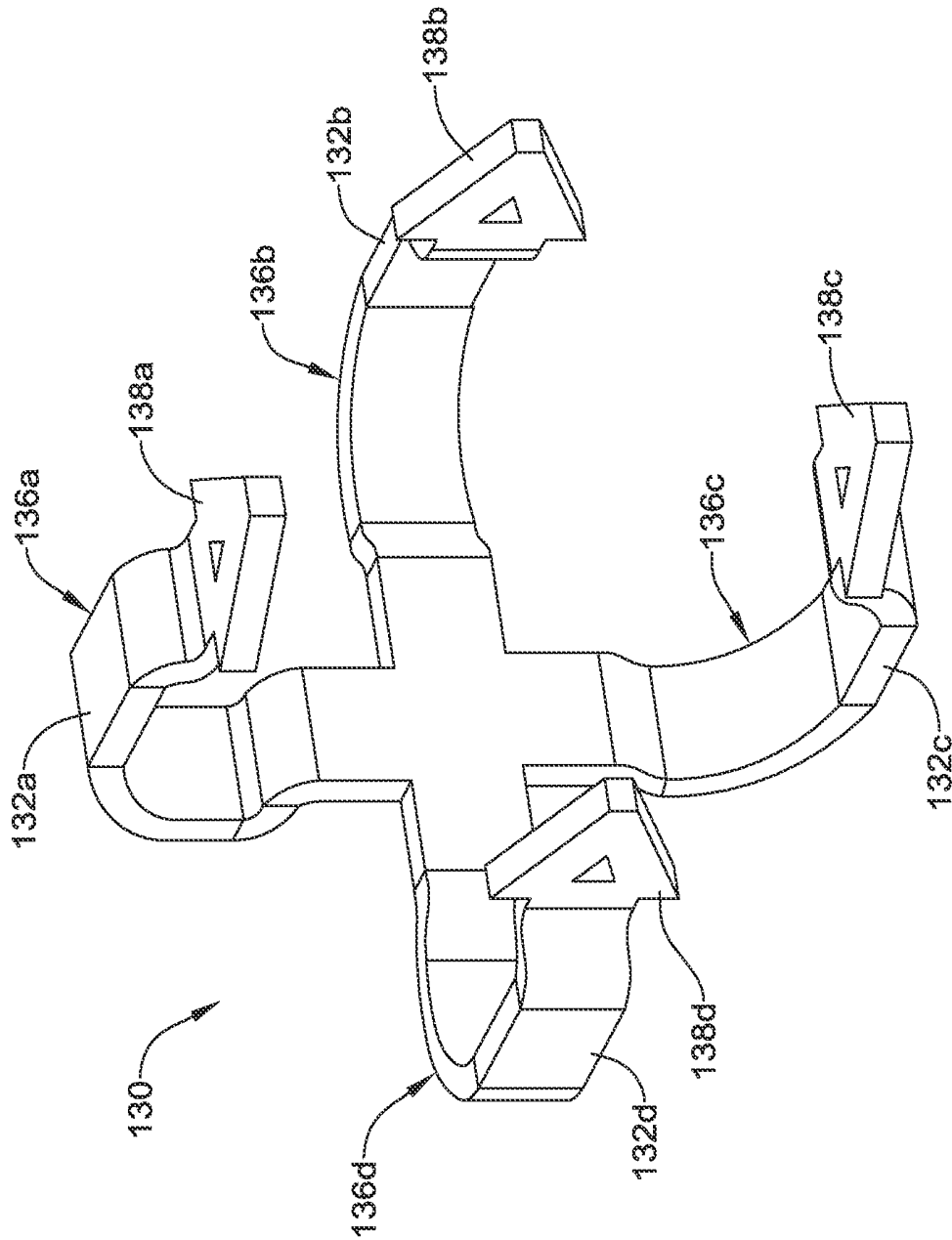

FIG. 3

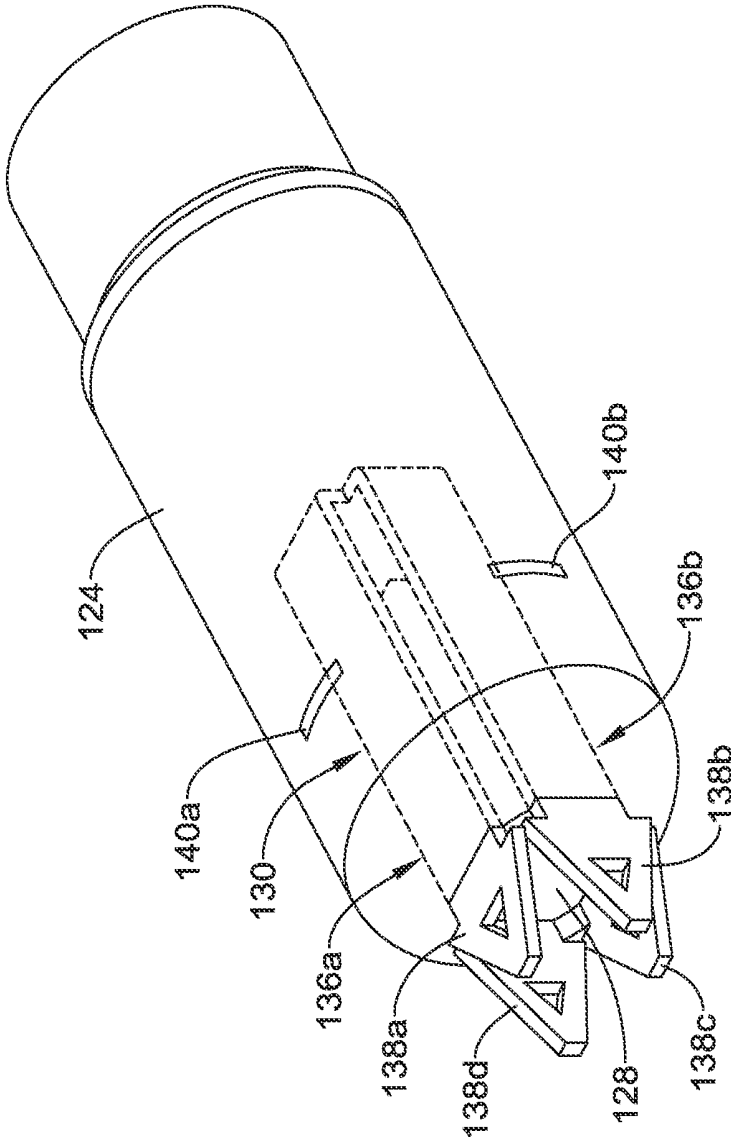

FIG. 4

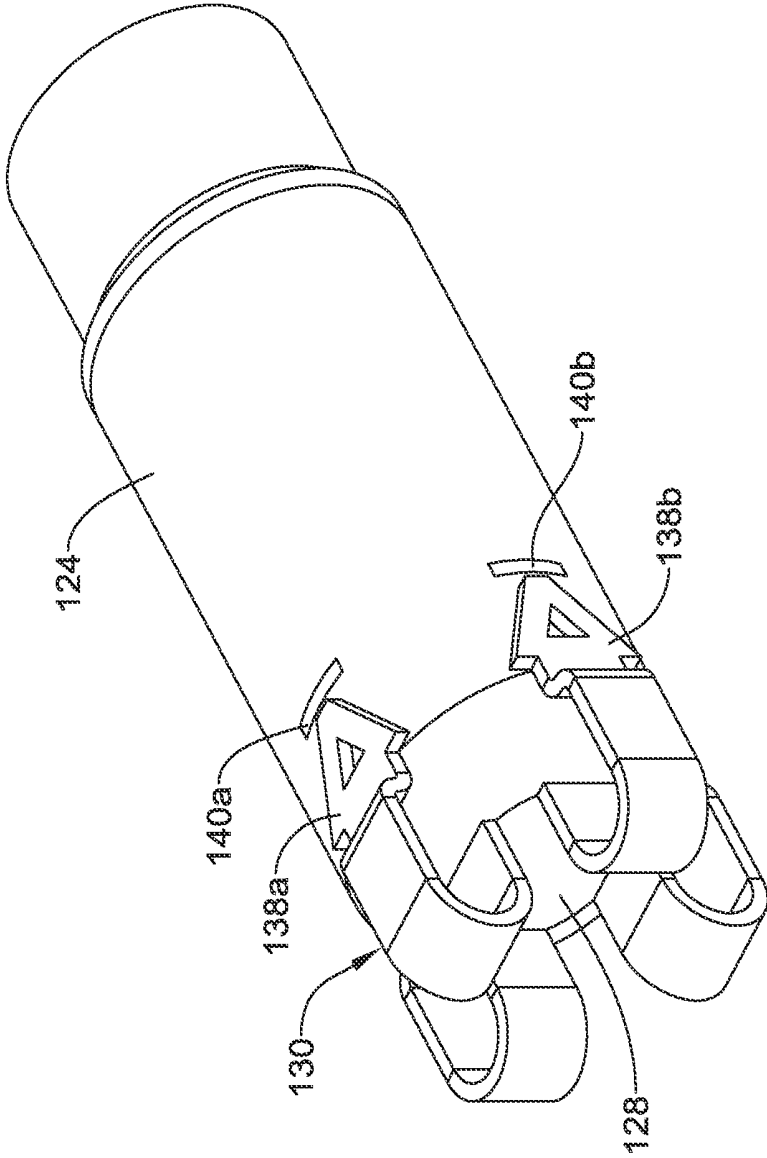

FIG. 5

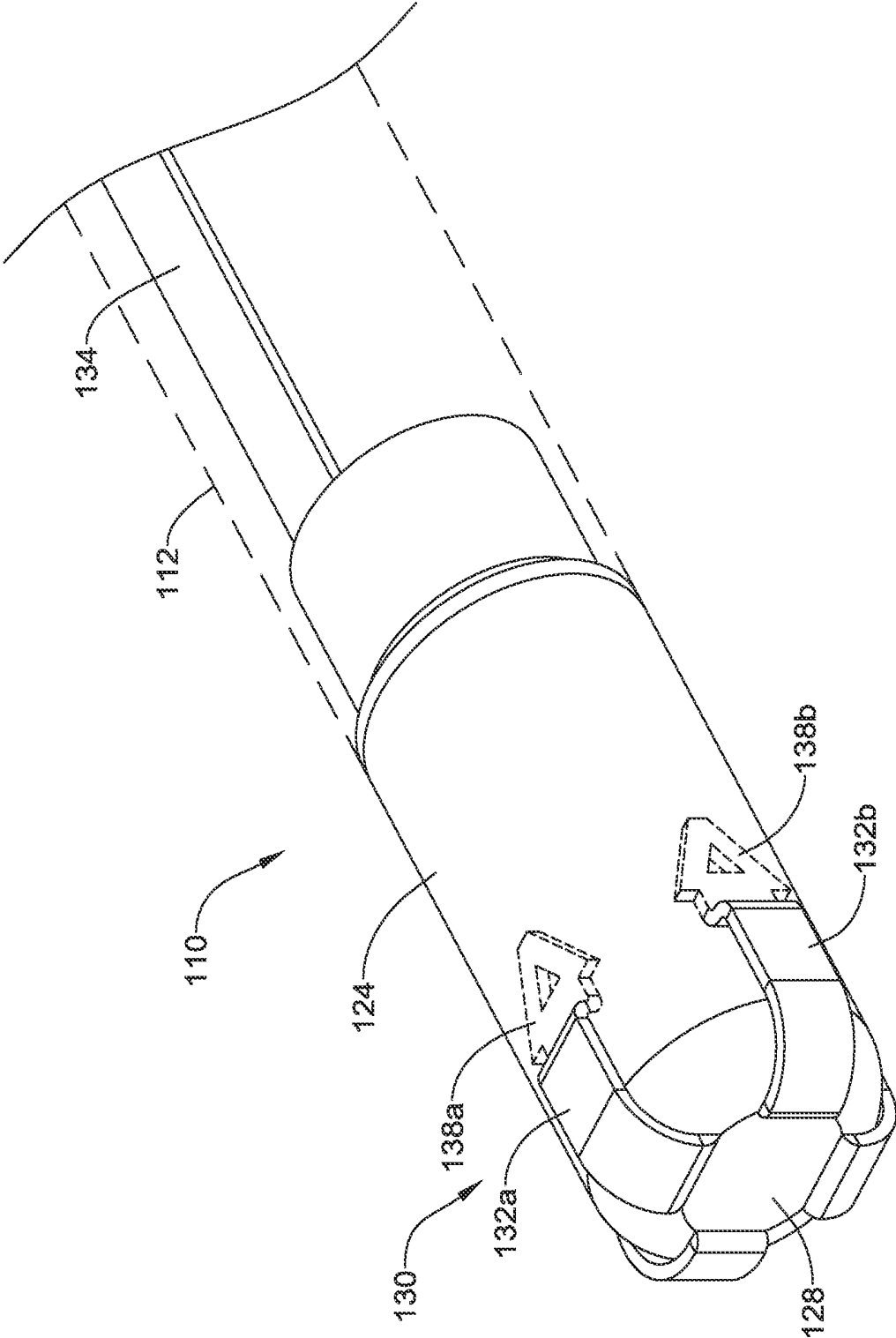

FIG. 6

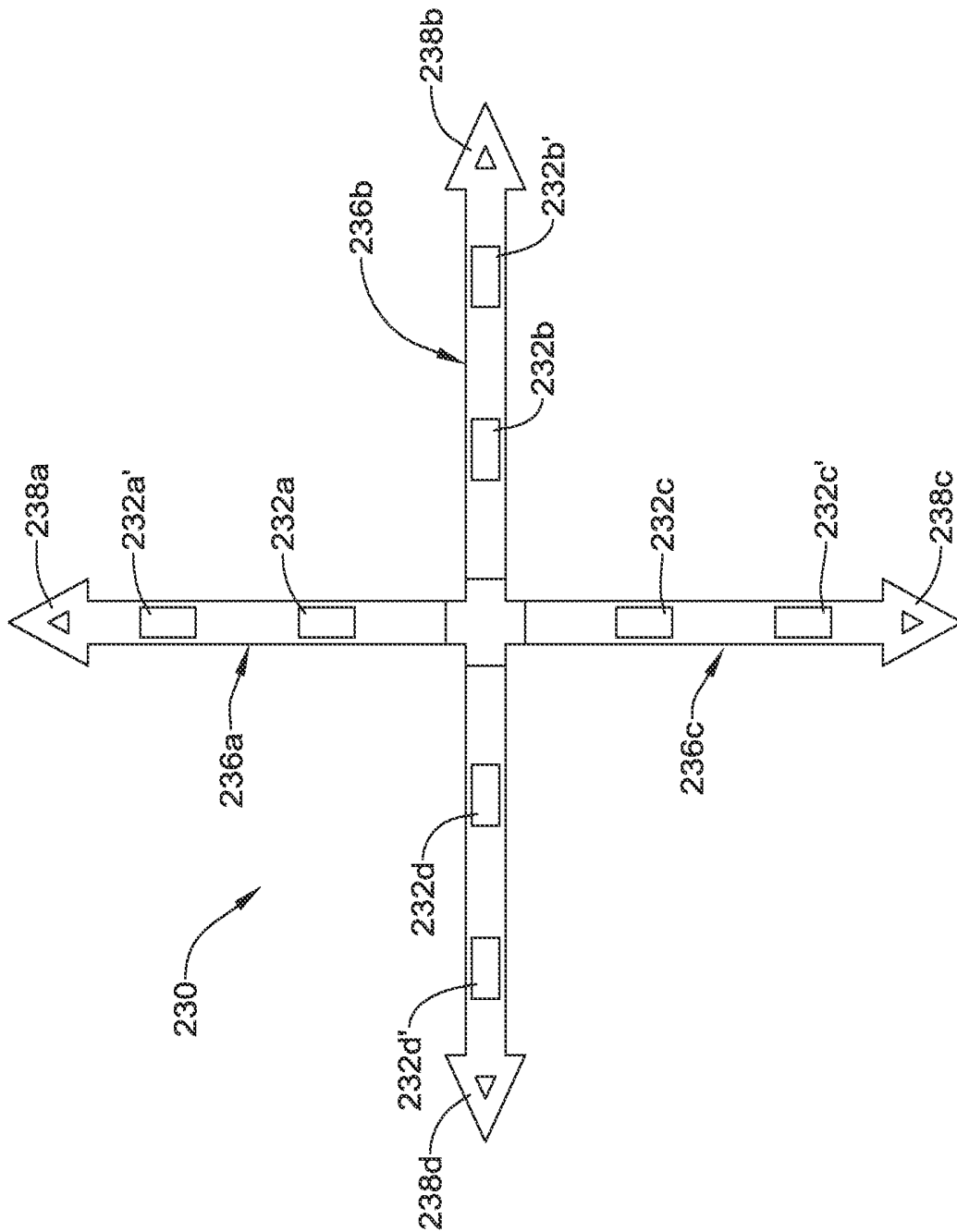

FIG. 7

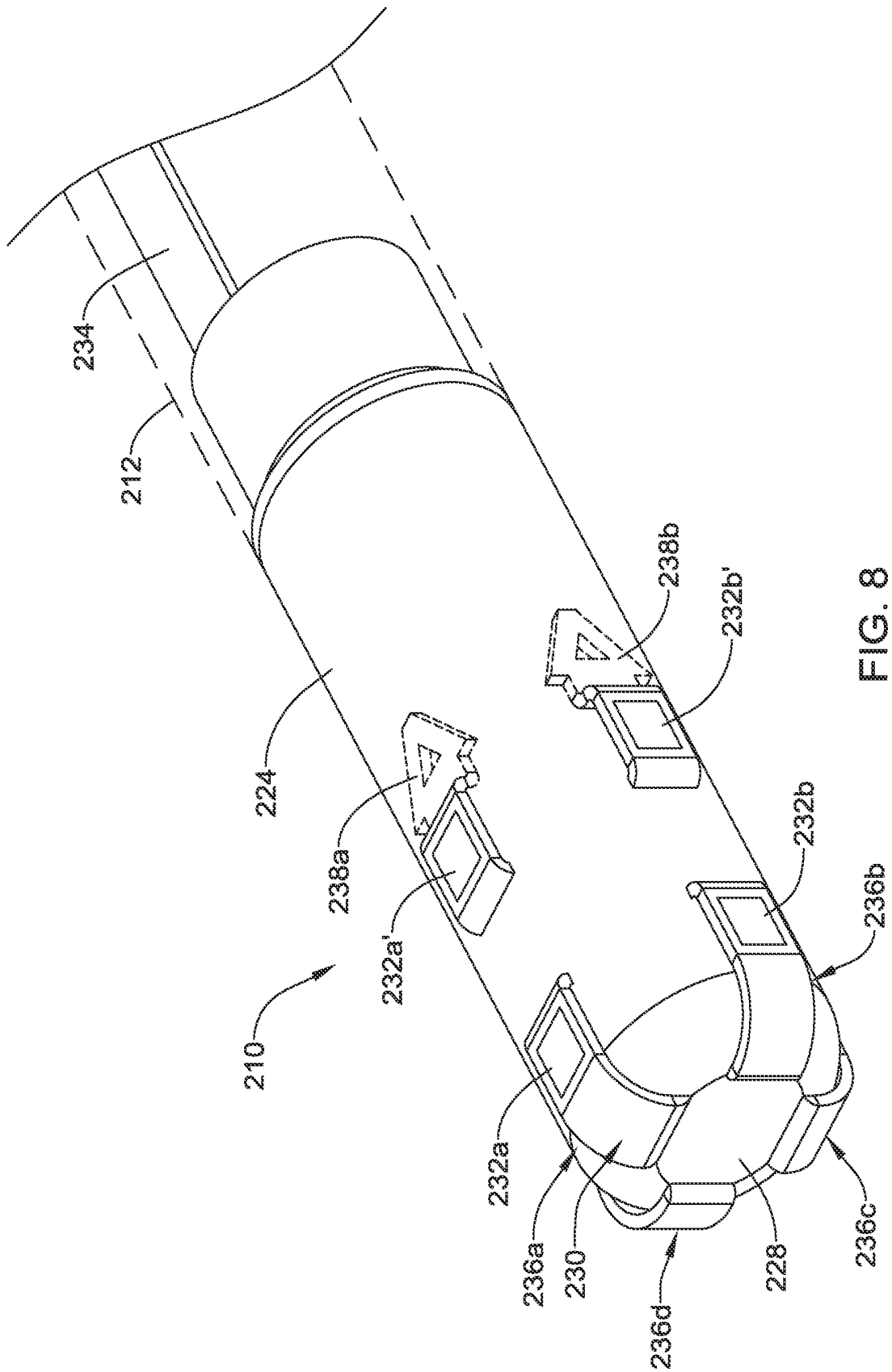

FIG. 8

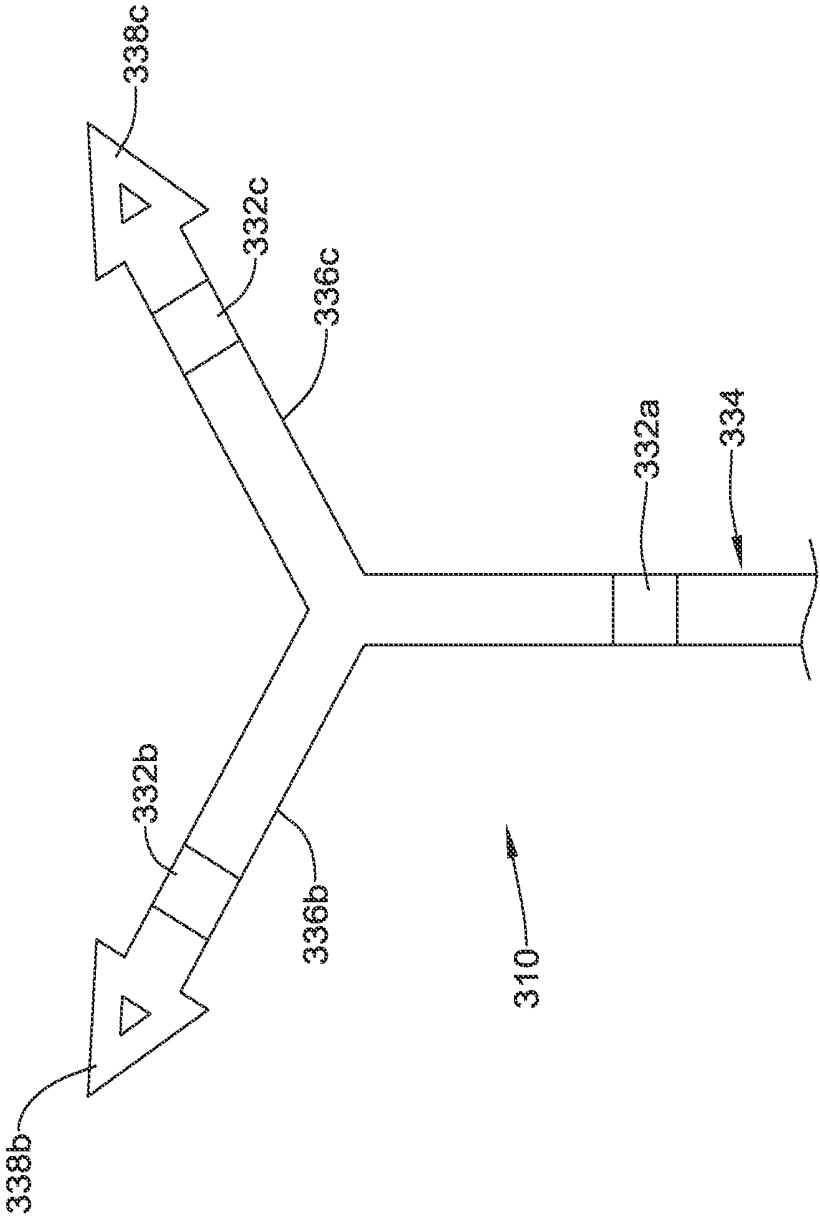

FIG. 9

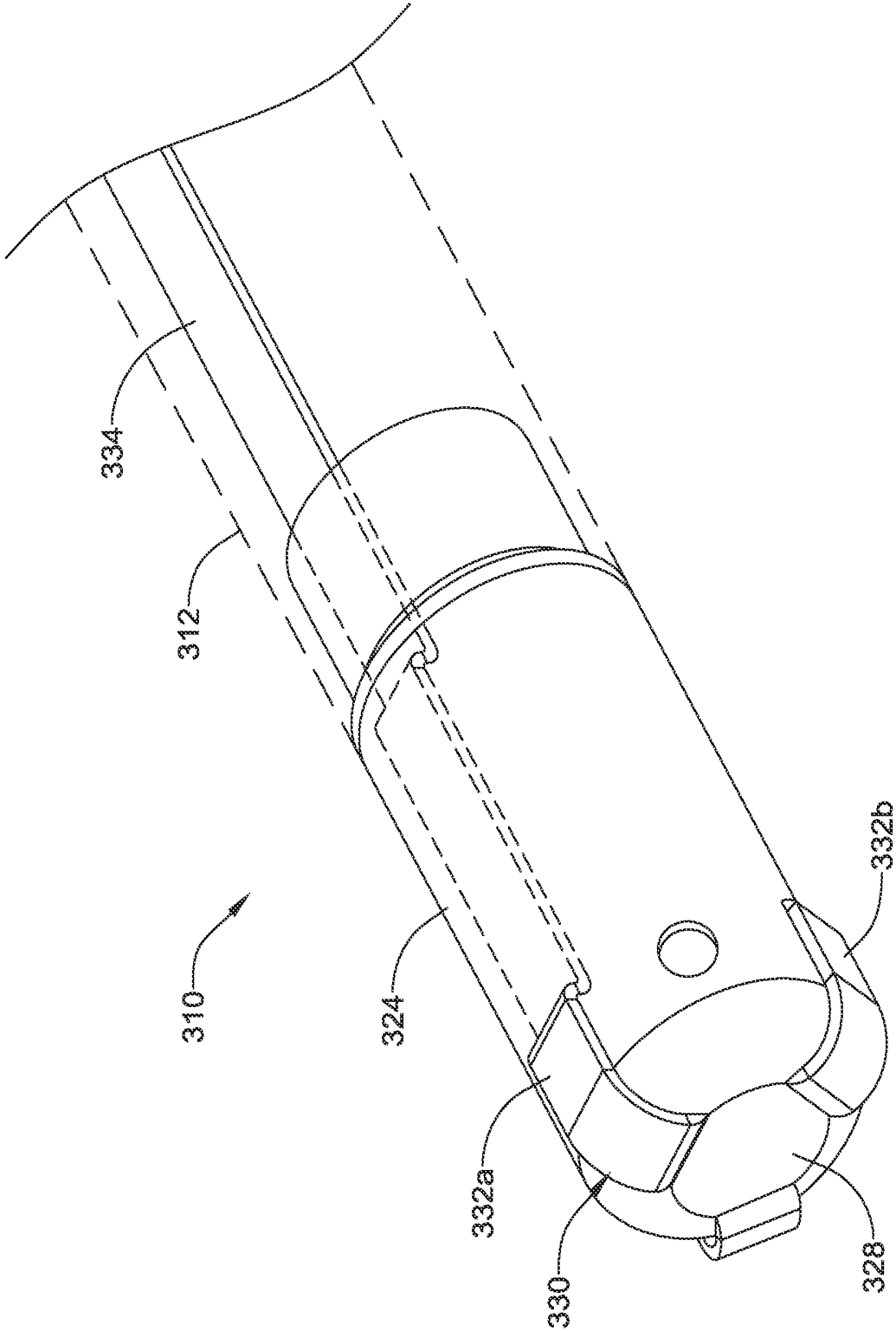

FIG. 10

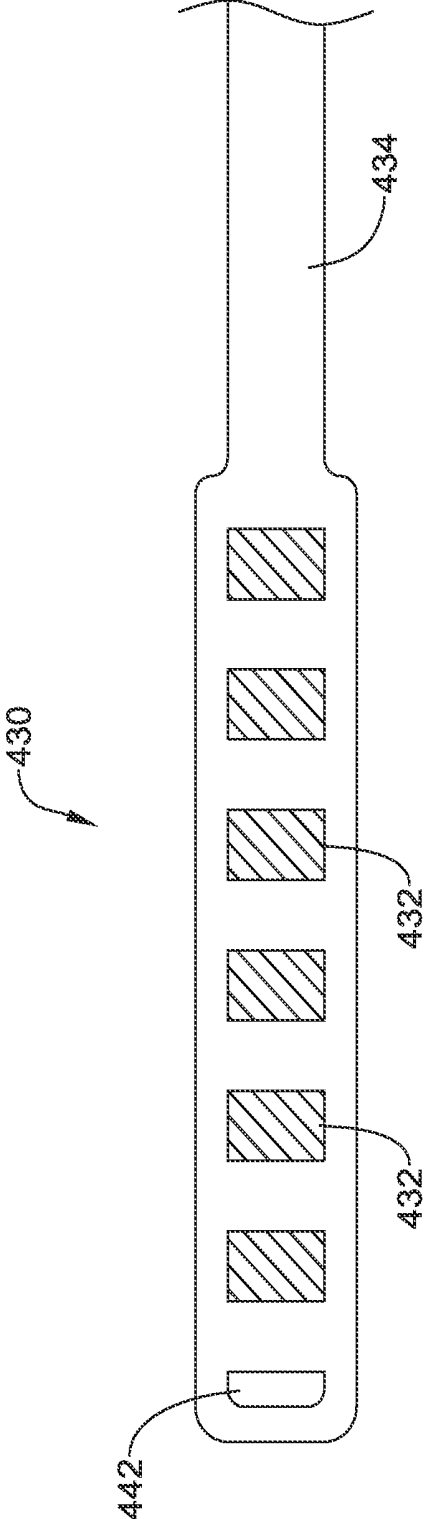

FIG. 11

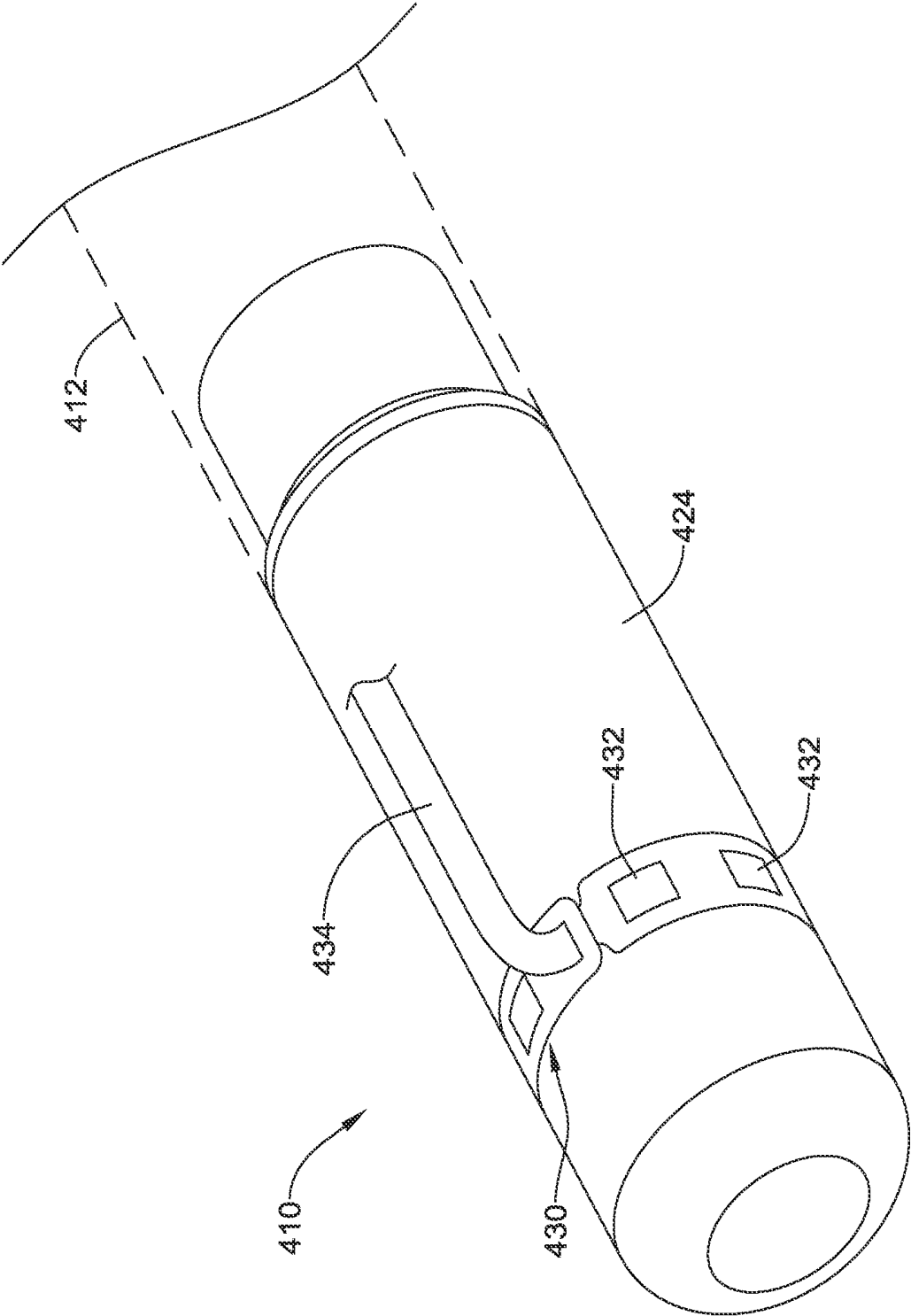

FIG. 12

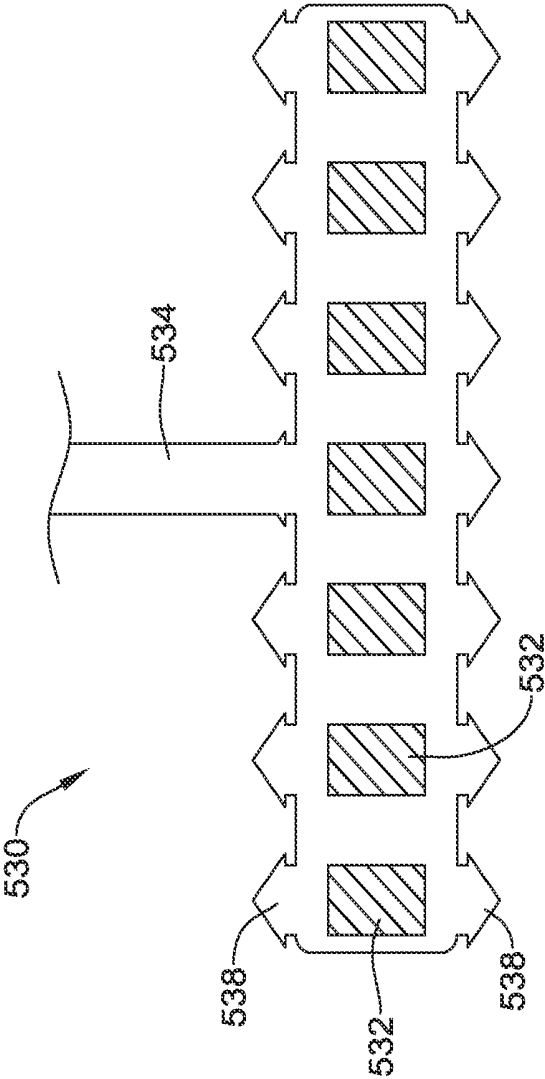

FIG. 13

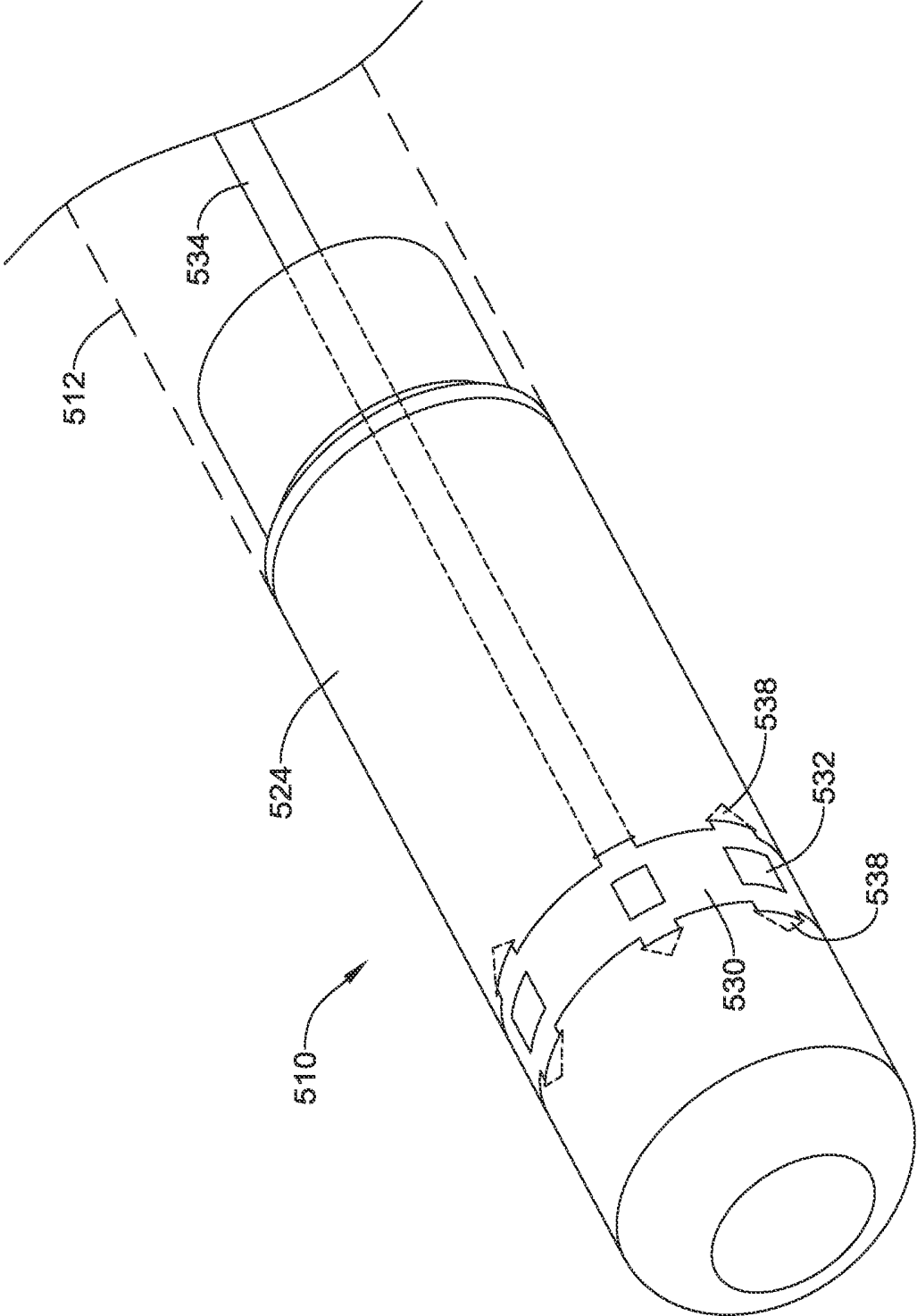

FIG. 14

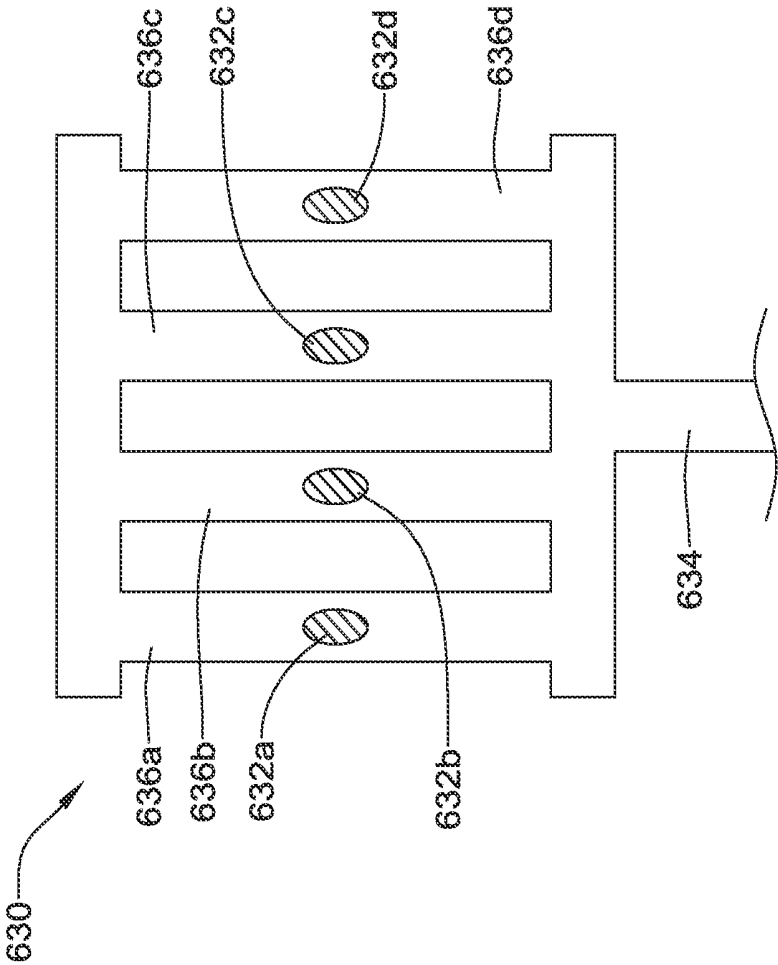

FIG. 15

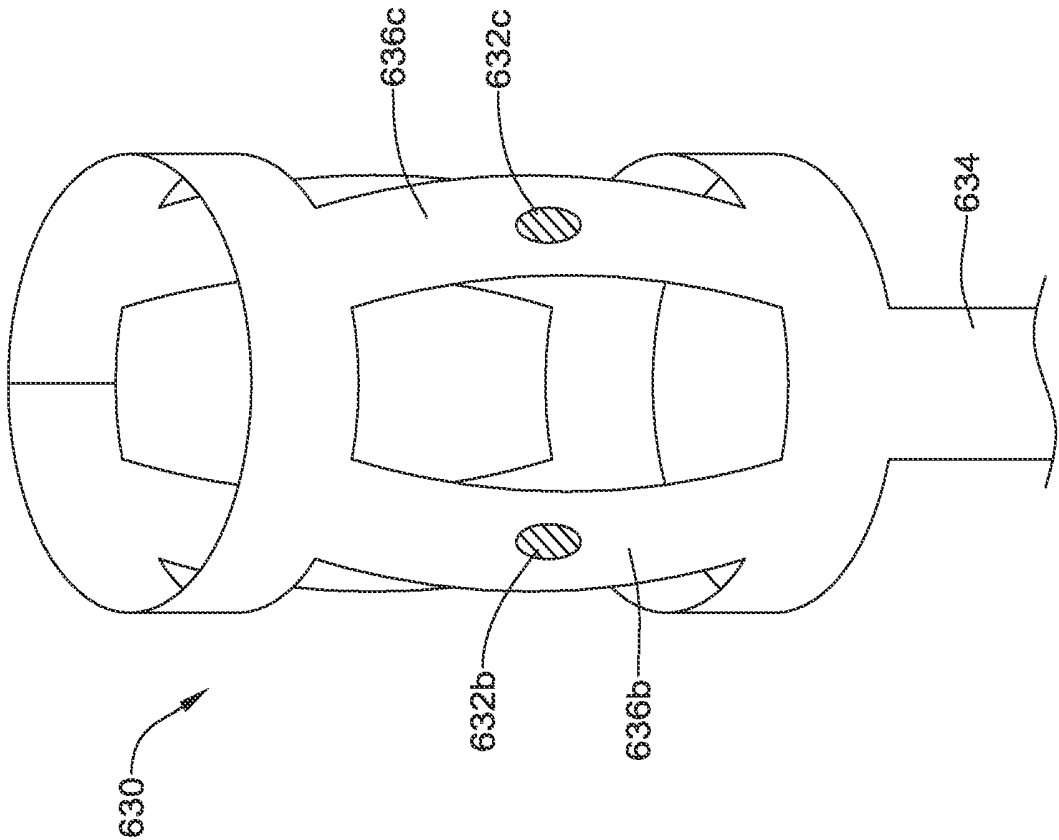

FIG. 16

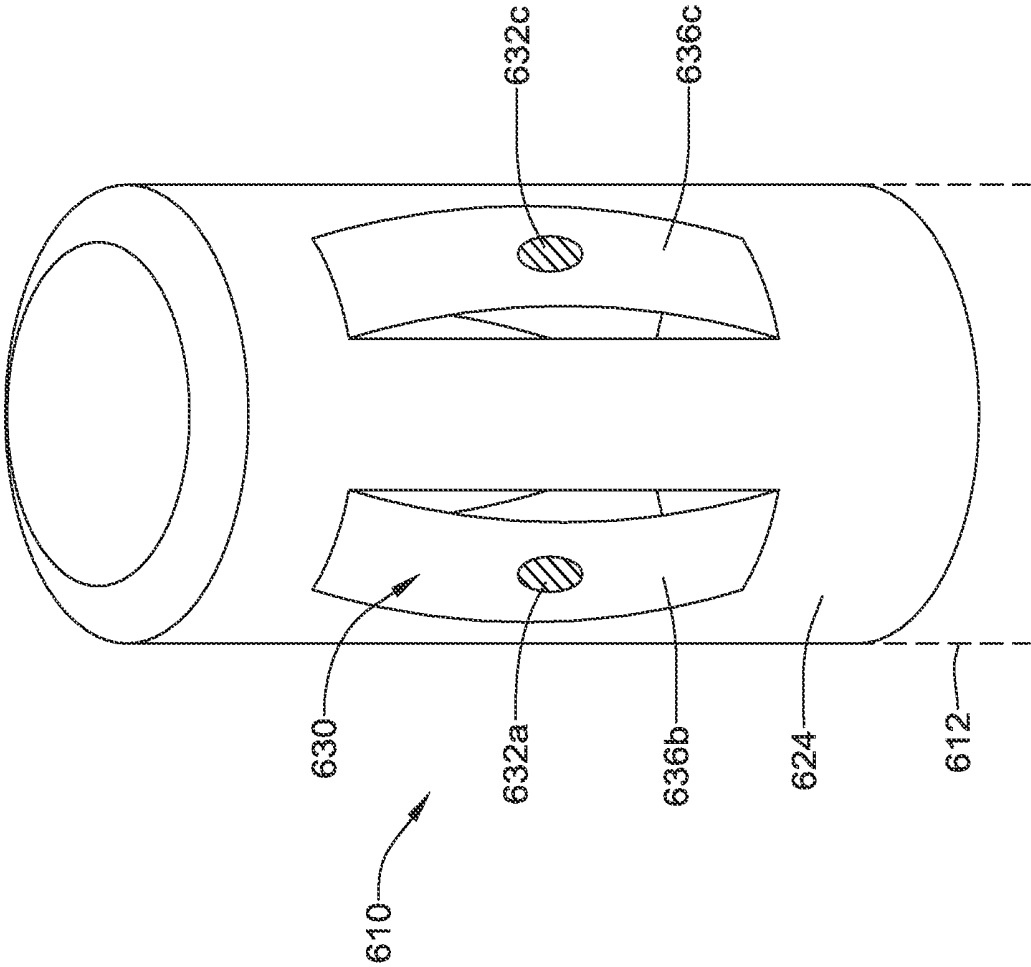

FIG. 17

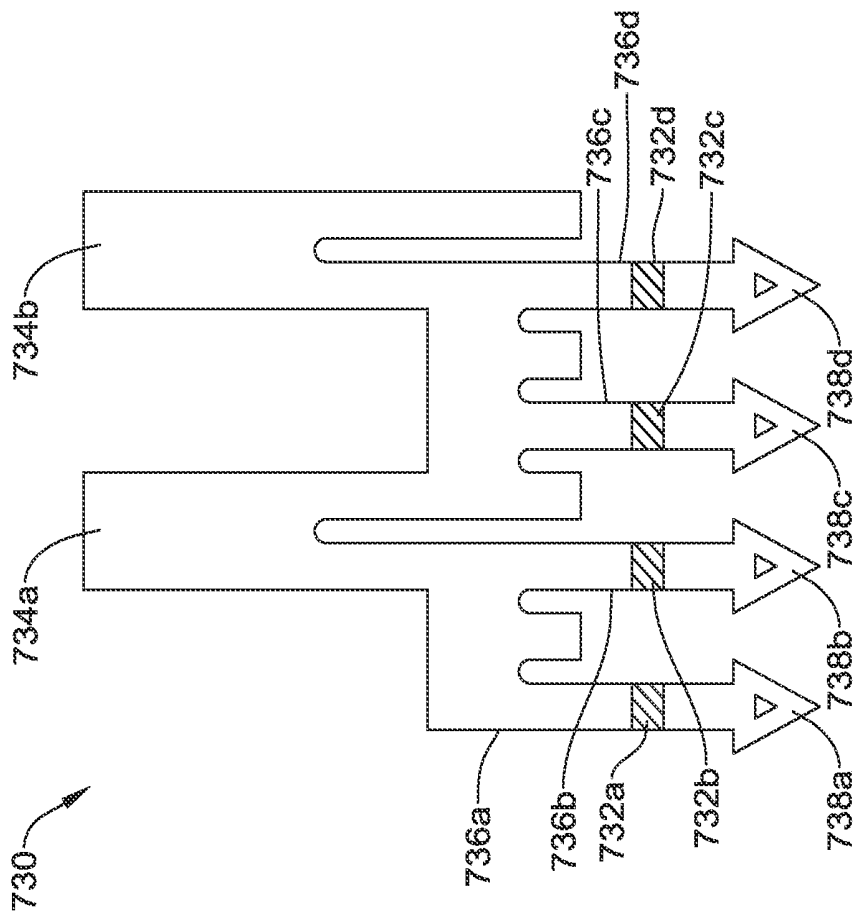

FIG. 18

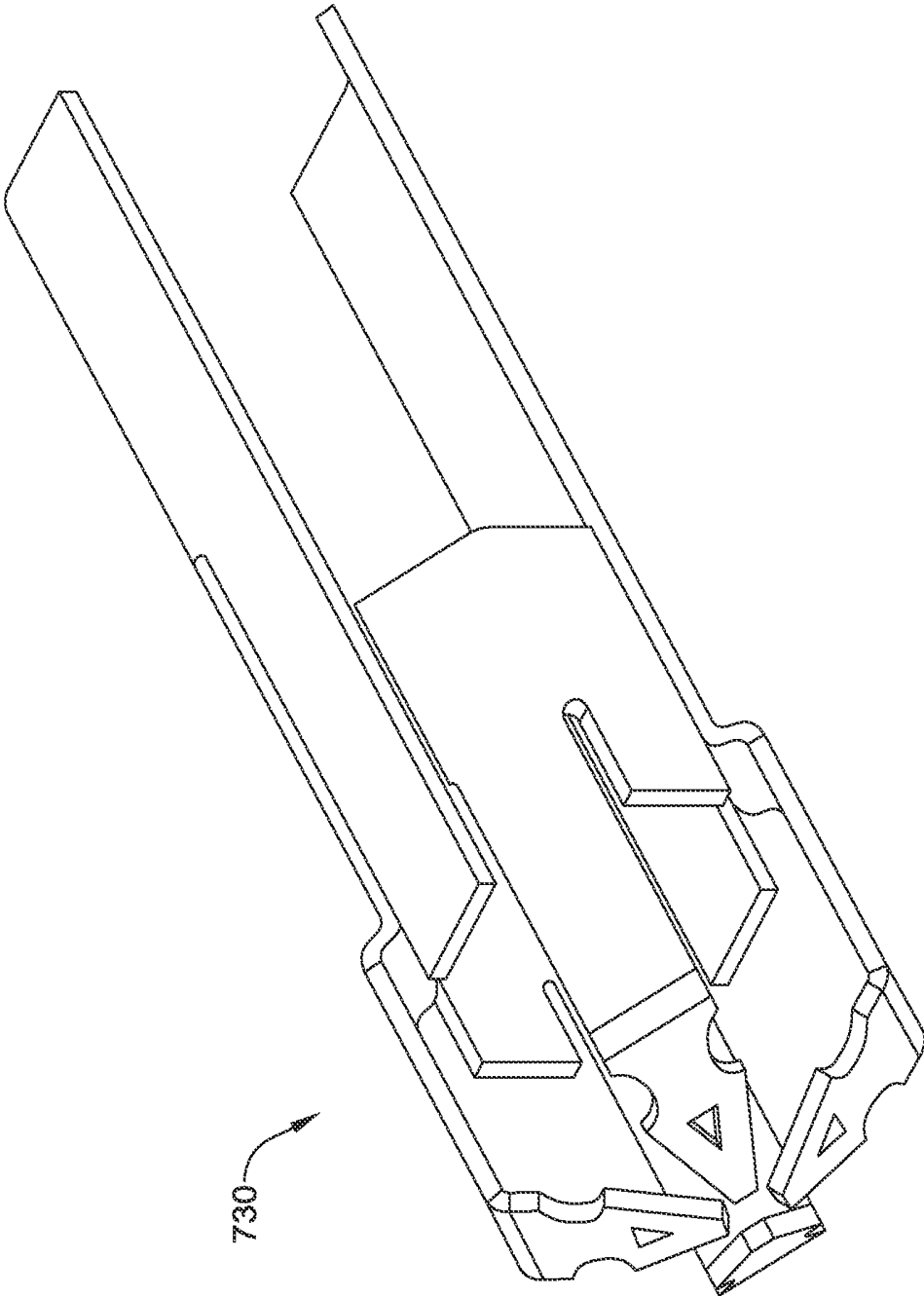

FIG. 19

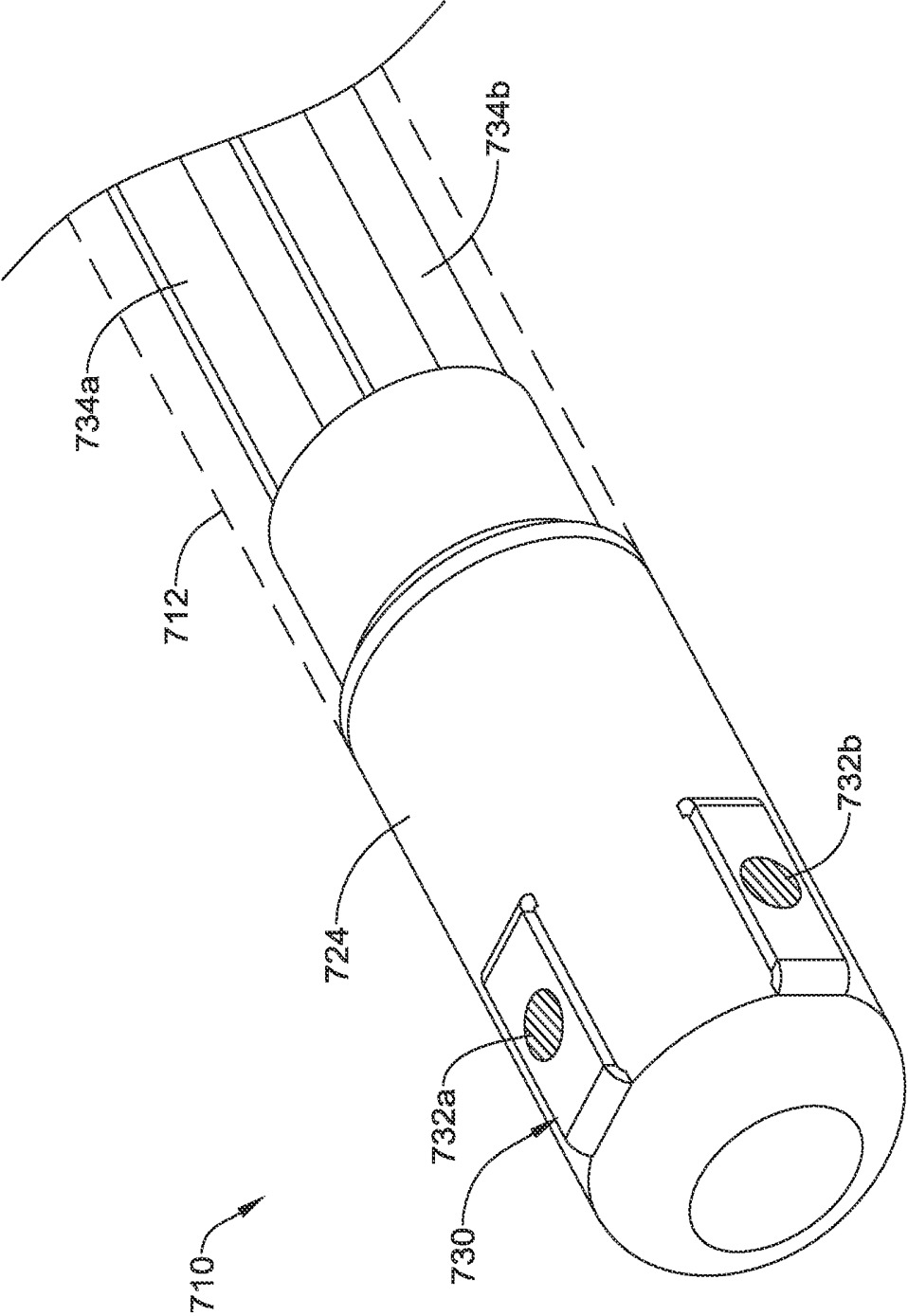

FIG. 20

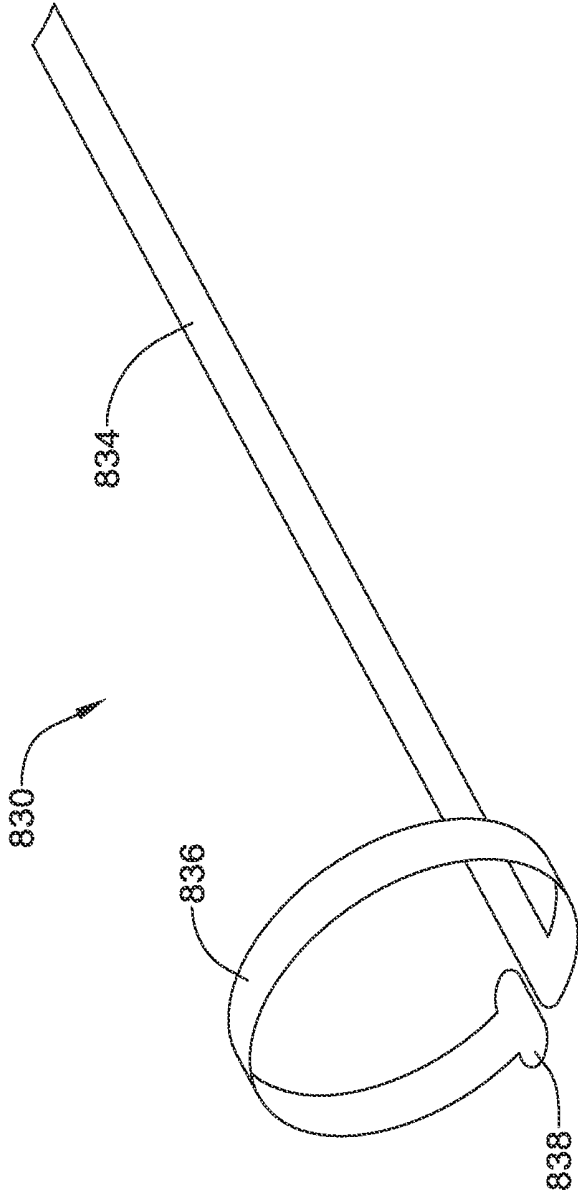

FIG. 21

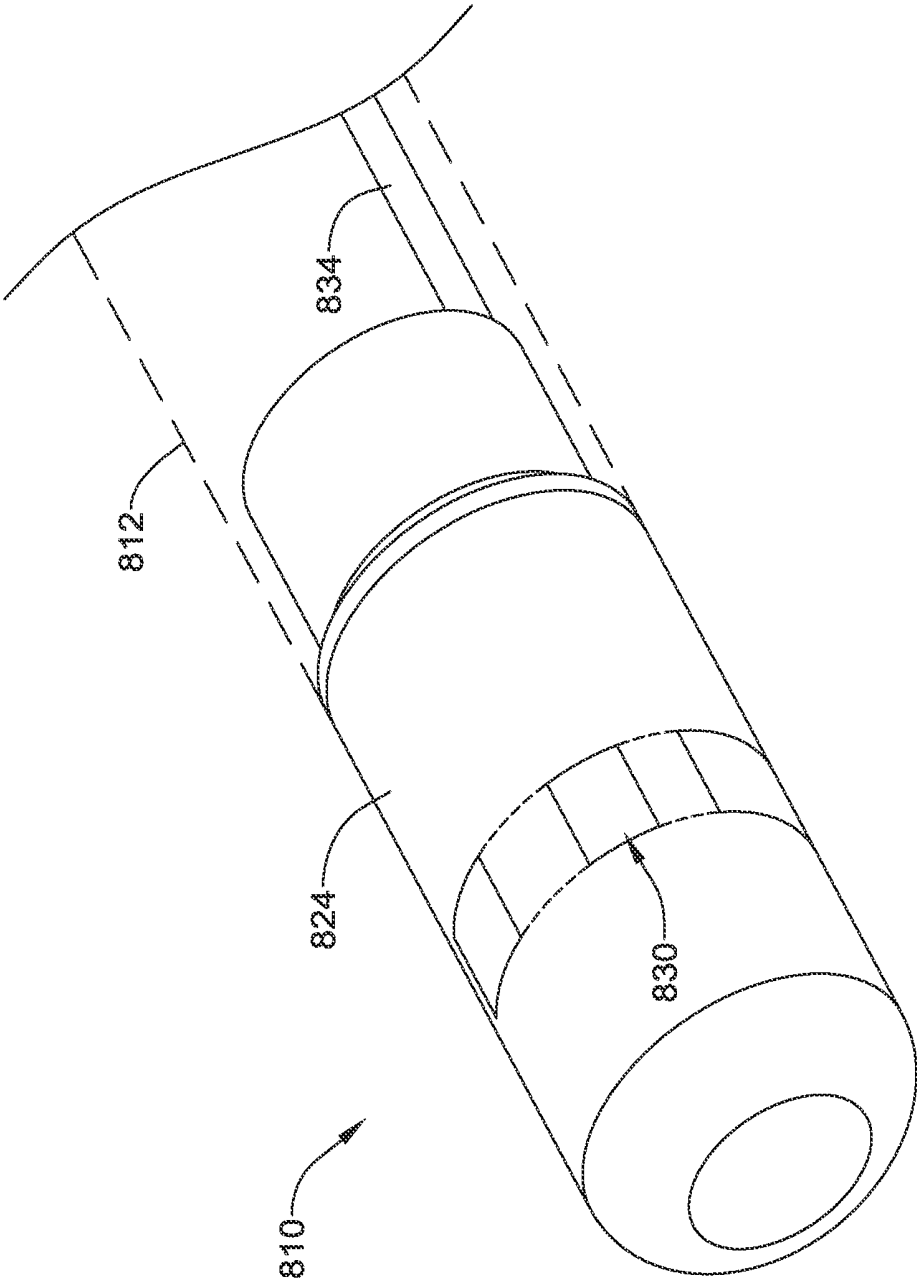

FIG. 22

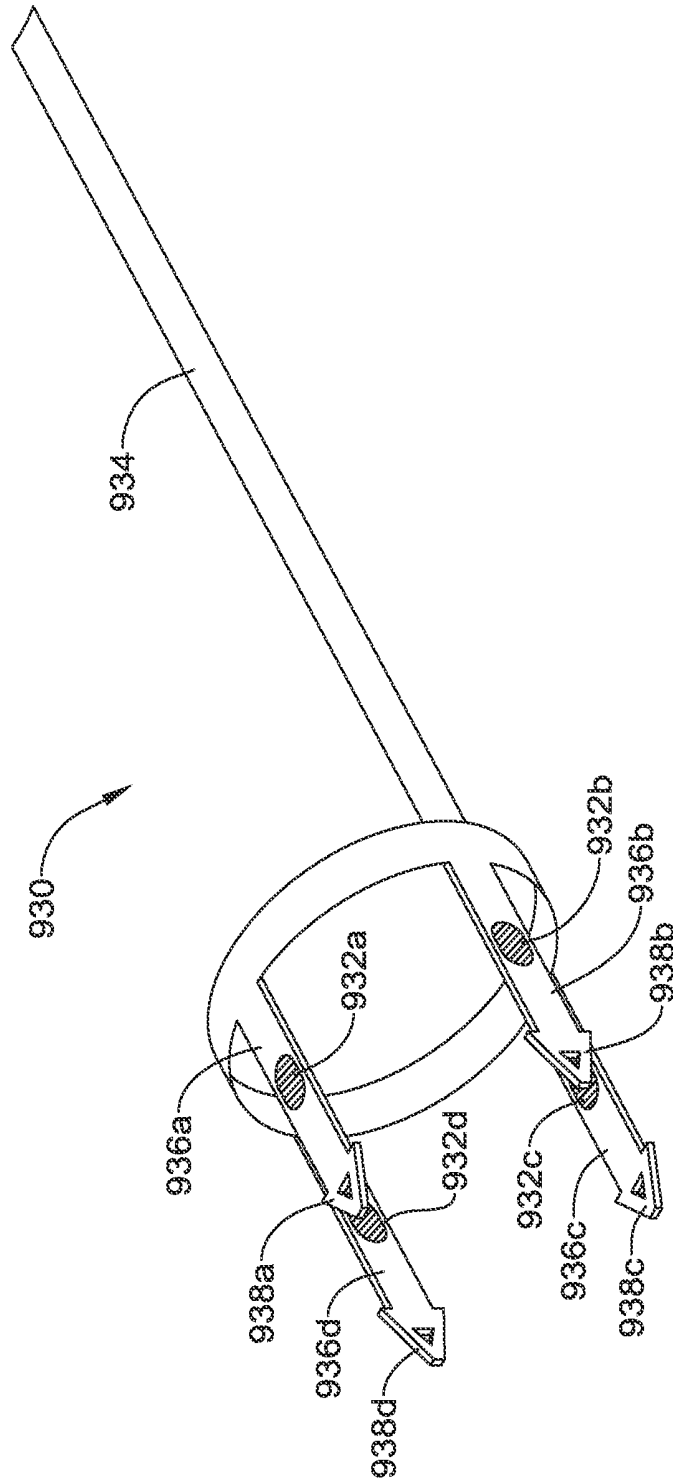

FIG. 23

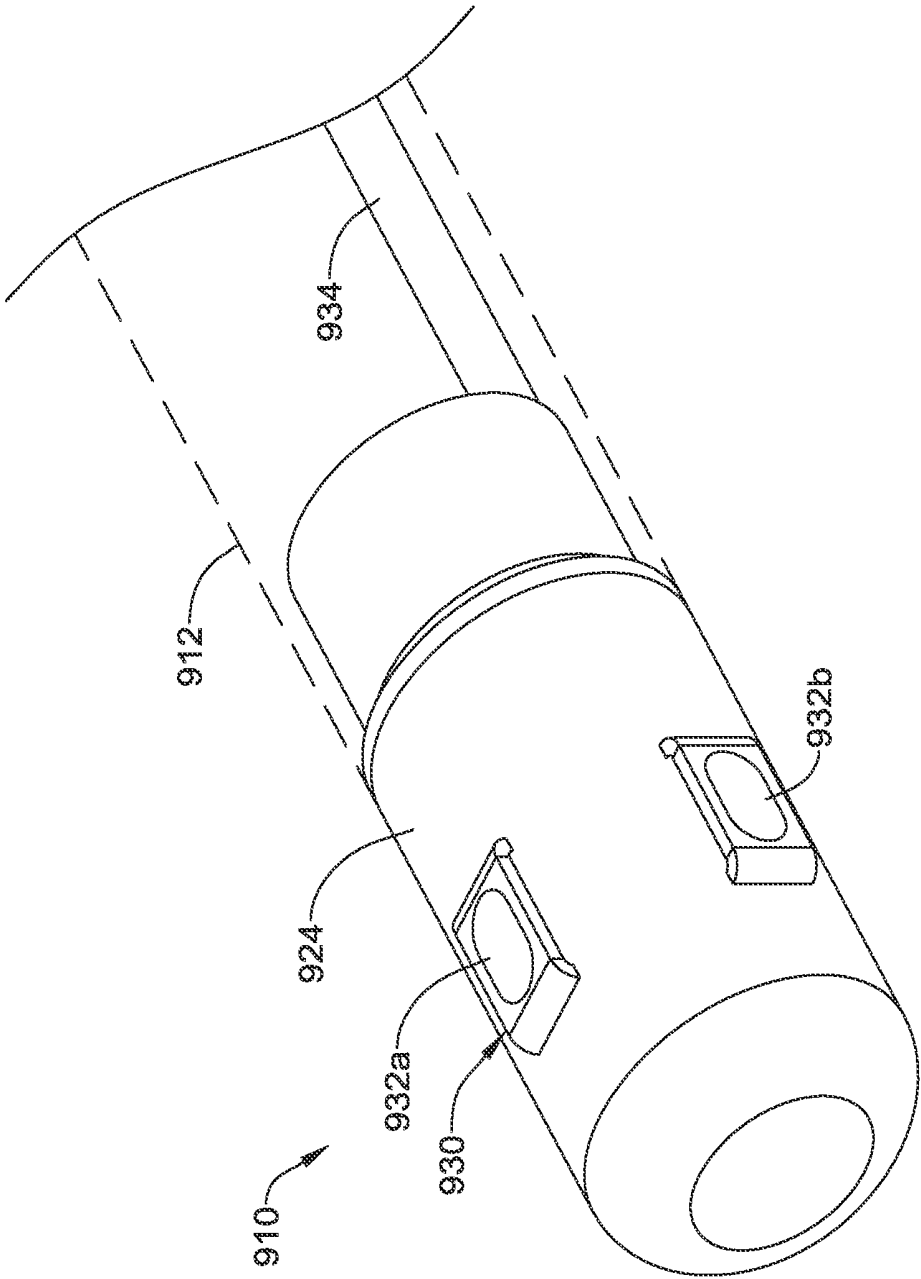

FIG. 24

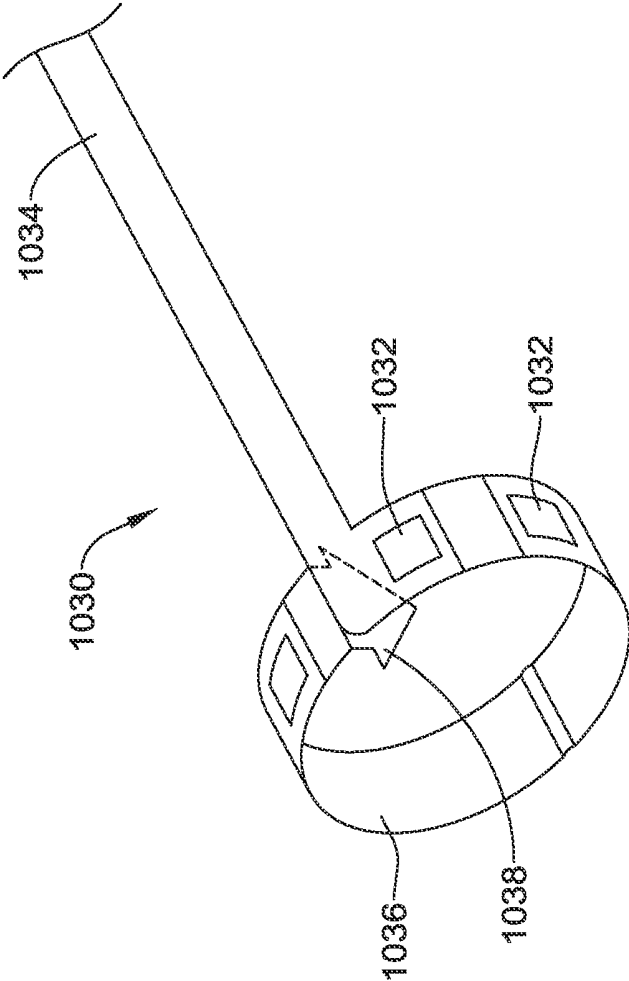

FIG. 25

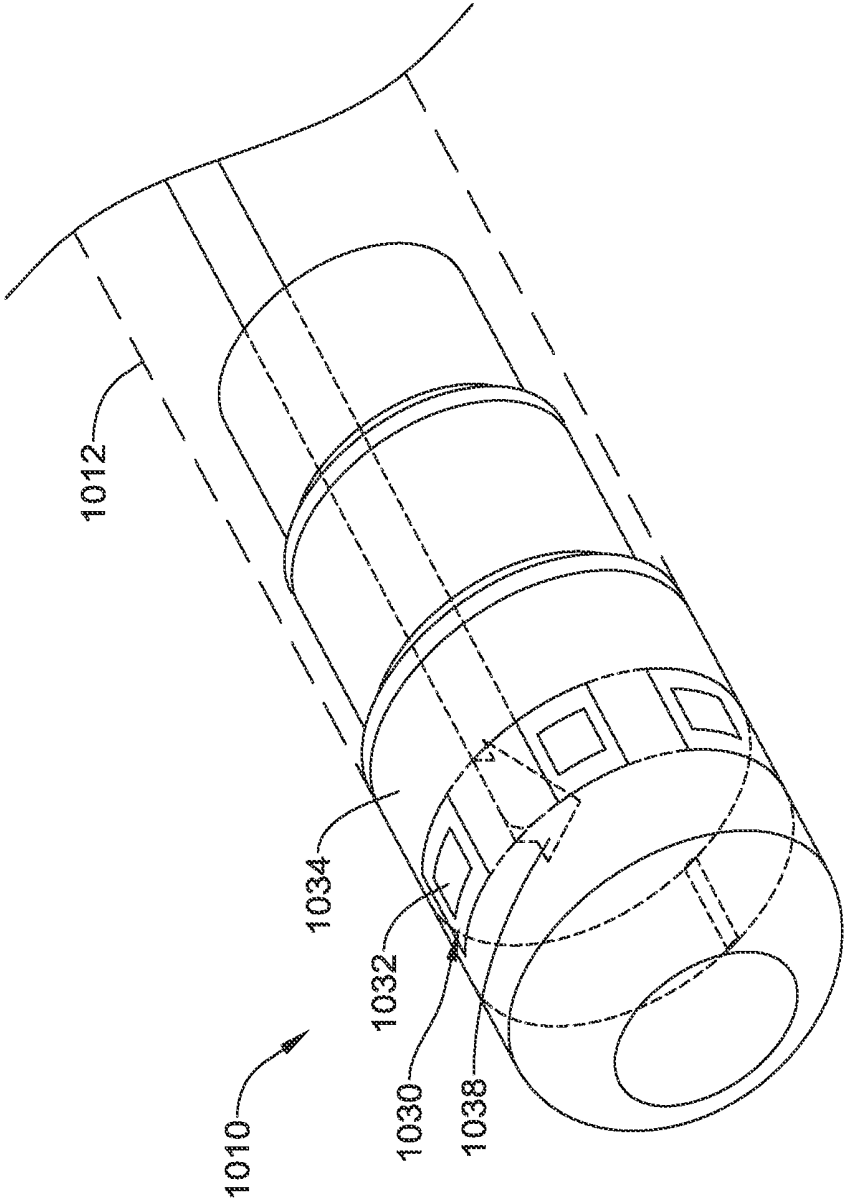

FIG. 26

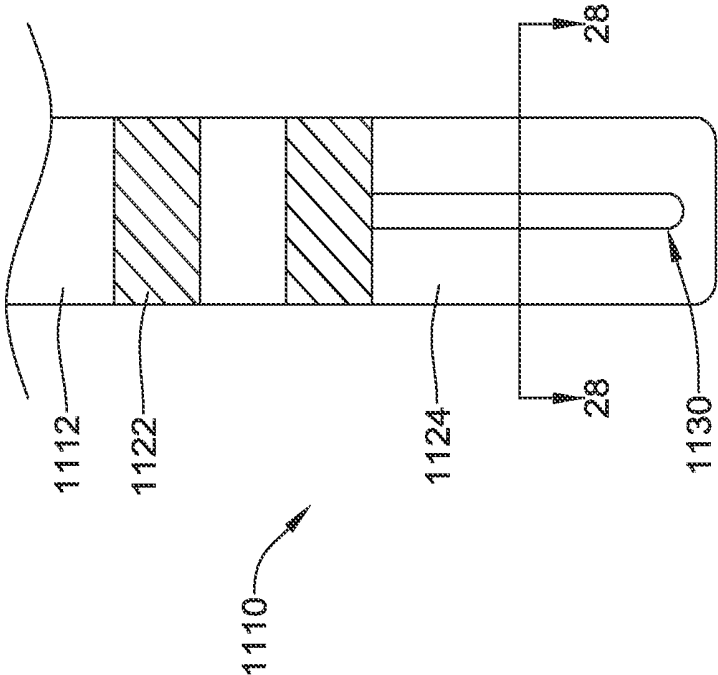

FIG. 27

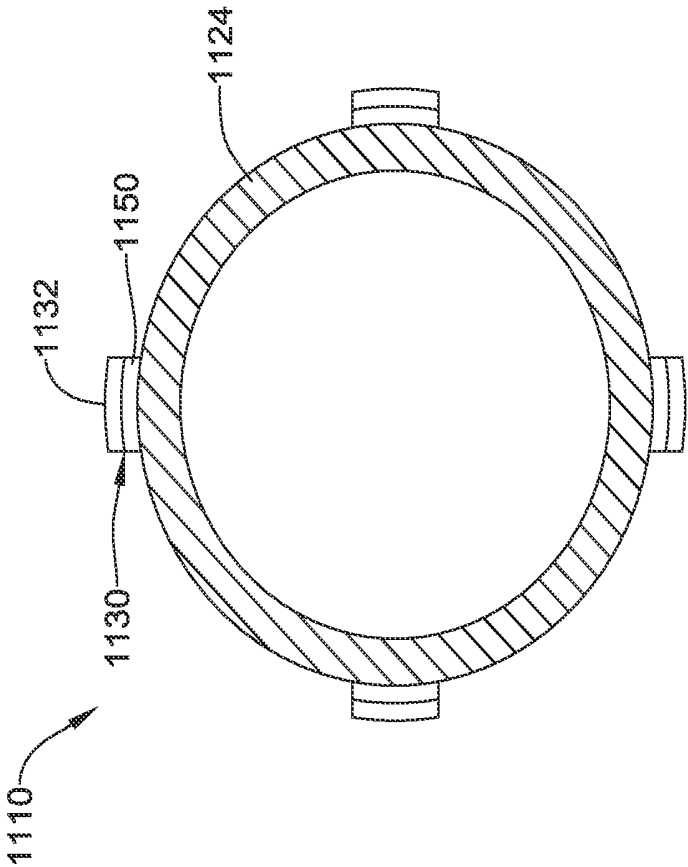

FIG. 28

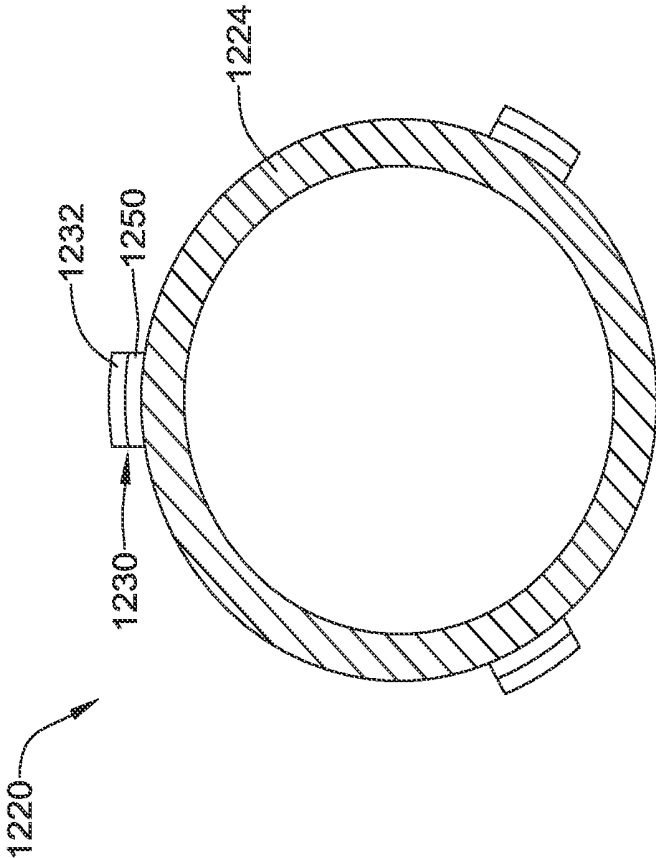

FIG. 29

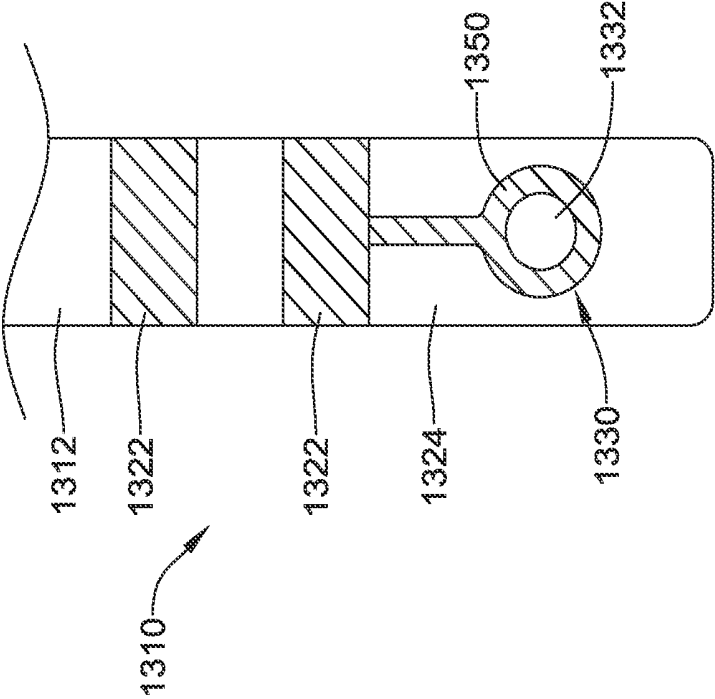

FIG. 30

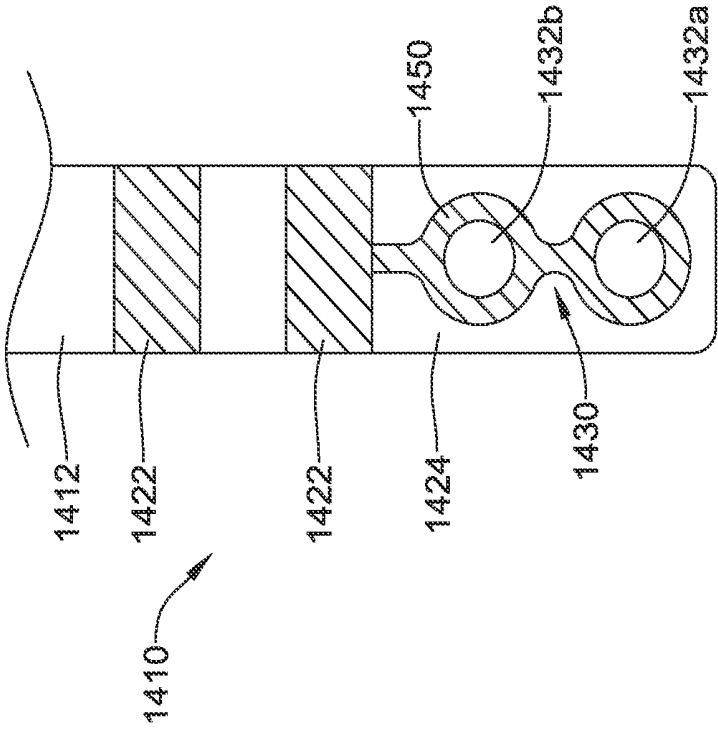

FIG. 31

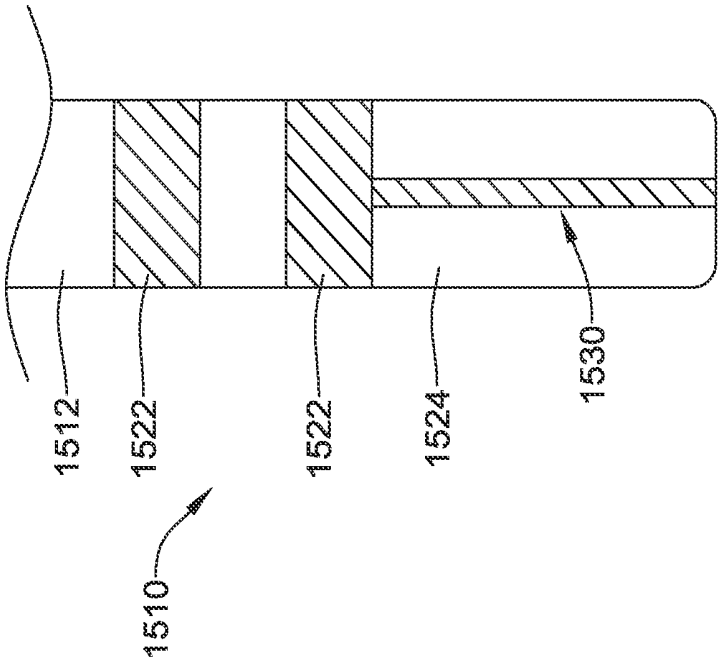

FIG. 32

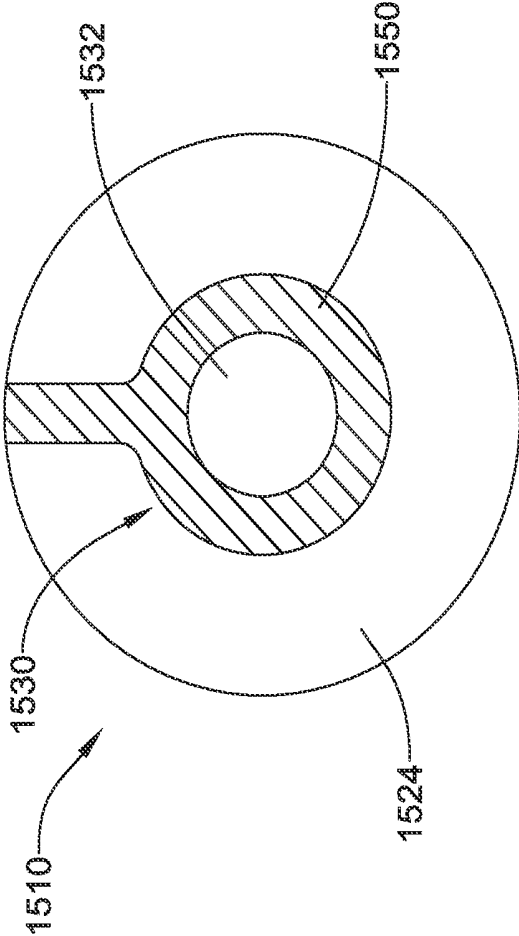

FIG. 33

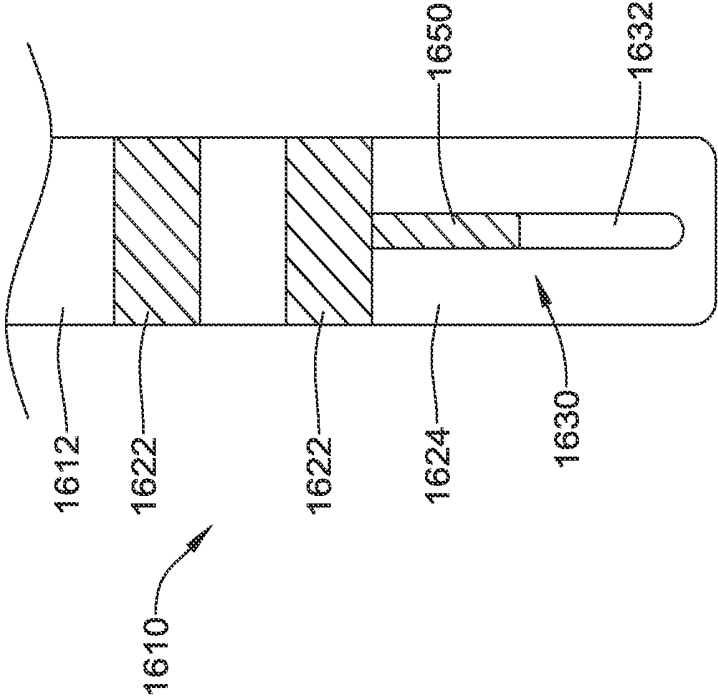

FIG. 34

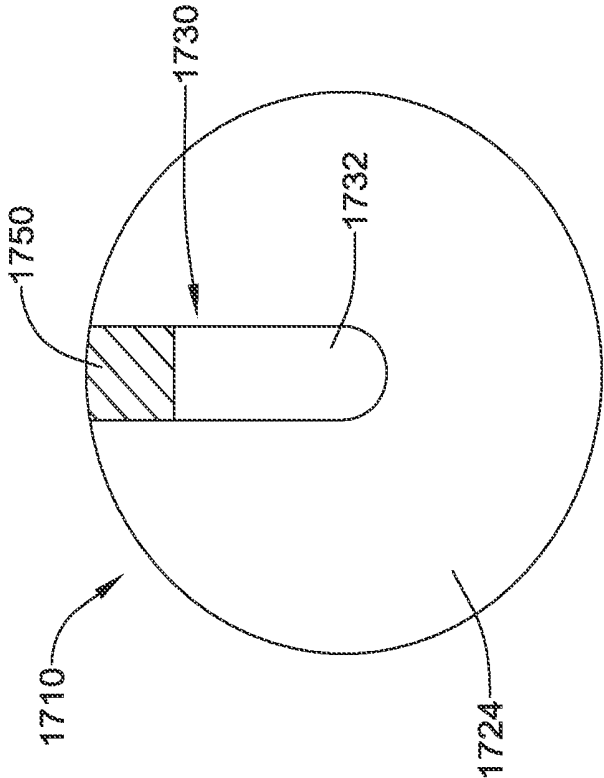

FIG. 35

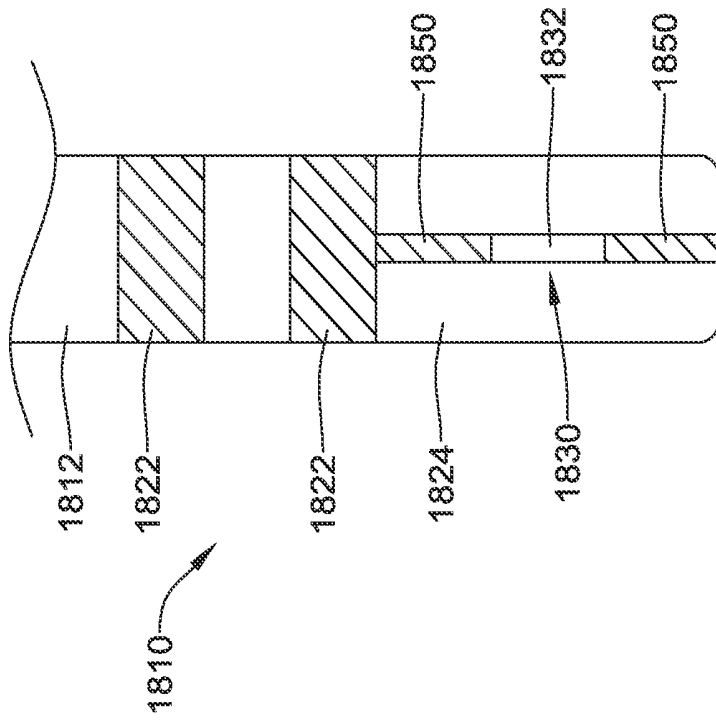

FIG. 36

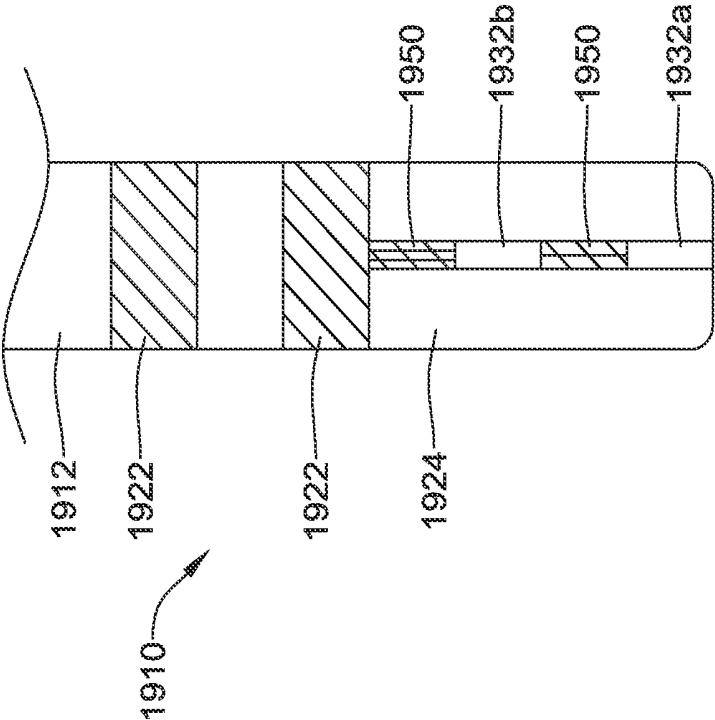

FIG. 37

**MEDICAL DEVICES WITH A FLEXIBLE  
ELECTRODE ASSEMBLY COUPLED TO AN  
ABLATION TIP**

CROSS-REFERENCE TO RELATED  
APPLICATION

This application claims priority to Provisional Application No. 62/068,334, filed Oct. 24, 2014, which is herein incorporated by reference in its entirety.

TECHNICAL FIELD

The present disclosure pertains to medical devices, and methods for manufacturing medical devices. More particularly, the present disclosure pertains to for cardiac mapping and/or ablation.

BACKGROUND

A wide variety of intracorporeal medical devices have been developed for medical use, for example, intravascular use. Some of these devices include guidewires, catheters, and the like. These devices are manufactured by any one of a variety of different manufacturing methods and may be used according to any one of a variety of methods. Of the known medical devices and methods, each has certain advantages and disadvantages. There is an ongoing need to provide alternative medical devices as well as alternative methods for manufacturing and using medical devices.

SUMMARY

This disclosure provides design, material, manufacturing method, and use alternatives for medical devices. An example catheter may include a catheter for use in cardiac mapping and/or ablation. The catheter comprises:

- an elongate catheter shaft having a distal ablation electrode region;
- an electrode assembly coupled to the distal ablation electrode region; and
- wherein the electrode assembly includes a flexible circuit having one or more electrodes disposed thereon.

Alternatively or additionally to any of the embodiments above, the distal ablation electrode region has an opening formed therein and wherein the electrode assembly extends through the opening.

Alternatively or additionally to any of the embodiments above, the electrode assembly includes a region that is disposed along a distal end of the distal ablation electrode region.

Alternatively or additionally to any of the embodiments above, the electrode assembly includes a plurality of arm regions and wherein each of the arm regions includes at least one electrode.

Alternatively or additionally to any of the embodiments above, the electrode assembly includes three or more arm regions.

Alternatively or additionally to any of the embodiments above, the electrode assembly includes four or more arm regions.

Alternatively or additionally to any of the embodiments above, the electrode assembly includes a mechanical locking end region that is capable of mechanically securing the electrode assembly to the distal ablation electrode region.

Alternatively or additionally to any of the embodiments above, the distal ablation electrode region has an opening

formed therein and wherein the mechanical locking end region extends through the opening.

Alternatively or additionally to any of the embodiments above, the catheter shaft includes an inner channel, wherein the distal ablation electrode region includes a first opening and a second opening, and wherein the electrode assembly extends along the inner channel, through the first opening, along an outer surface of the distal ablation electrode region, and through the second opening.

Alternatively or additionally to any of the embodiments above, the electrode assembly is adhesively bonded to the distal ablation electrode region.

Alternatively or additionally to any of the embodiments above, the electrode assembly includes one or more electrode regions and one or more electrically insulated regions.

Alternatively or additionally to any of the embodiments above, the electrode assembly extends circumferentially around the distal ablation electrode region.

Alternatively or additionally to any of the embodiments above, the electrode assembly is designed to bow radially outward from the distal ablation electrode region.

Alternatively or additionally to any of the embodiments above, the distal ablation electrode region includes a platinum ablation tip electrode.

Methods for manufacturing a medical device are also disclosed. The methods may comprise:

- inserting an electrode assembly into a channel formed within a distal ablation tip of a catheter;
- wherein the electrode assembly includes a flexible circuit having one or more electrodes disposed thereon;
- wherein the distal ablation tip includes a first opening and a second opening; and

- extending the electrode assembly through the first opening, along an outer surface of the distal ablation tip, and through the second opening.

Another embodiment of a catheter for use in cardiac mapping and/or ablation may comprise:

- an elongate catheter shaft having an inner channel and a distal end region;
- a distal ablation tip capable of ablating tissue disposed at the distal end region;
- an electrode assembly coupled to the distal ablation tip;

- wherein the electrode assembly includes a flexible circuit having one or more electrodes disposed thereon;
- wherein the distal ablation electrode region includes a first opening and a second opening;

- wherein the electrode assembly extends along the inner channel, through the first opening, along an outer surface of the distal ablation tip, and through the second opening.

Alternatively or additionally to any of the embodiments above, the electrode assembly includes a region that is disposed along a distal end of the distal ablation tip.

Alternatively or additionally to any of the embodiments above, the electrode assembly includes a plurality of arm regions and wherein each of the arm regions includes at least one electrode.

Alternatively or additionally to any of the embodiments above, the electrode assembly includes a mechanical locking end region that is capable of mechanically securing the electrode assembly to the distal ablation tip.

Alternatively or additionally to any of the embodiments above, the mechanical locking end region extends through the first opening, the second opening, or both.

The above summary of some embodiments is not intended to describe each disclosed embodiment or every implemen-

tation of the present disclosure. The Figures, and Detailed Description, which follow, more particularly exemplify these embodiments.

While multiple embodiments are disclosed, still other embodiments of the present invention will become apparent to those skilled in the art from the following detailed description, which shows and describes illustrative embodiments of the invention. Accordingly, the drawings and detailed description are to be regarded as illustrative in nature and not restrictive.

#### BRIEF DESCRIPTION OF THE DRAWINGS

The disclosure may be more completely understood in consideration of the following detailed description in connection with the accompanying drawings, in which:

FIG. 1 is a plan view of an example cardiac mapping and/or ablation system;

FIG. 2 is a partially cutaway perspective view of a portion of an example cardiac mapping and/or ablation system;

FIG. 3 is a perspective view of an example electrode assembly;

FIGS. 4-6 illustrate an example method for securing an electrode assembly to a cardiac mapping and/or ablation system;

FIG. 7 is a side view of an example electrode assembly;

FIG. 8 is a partially cutaway perspective view of a portion of an example cardiac mapping and/or ablation system;

FIG. 9 is a side view of an example electrode assembly;

FIG. 10 is a partially cutaway perspective view of a portion of an example cardiac mapping and/or ablation system;

FIG. 11 is a side view of an example electrode assembly;

FIG. 12 is a partially cutaway perspective view of a portion of an example cardiac mapping and/or ablation system;

FIG. 13 is a side view of an example electrode assembly;

FIG. 14 is a partially cutaway perspective view of a portion of an example cardiac mapping and/or ablation system;

FIG. 15 is a side view of an example electrode assembly;

FIG. 16 is a perspective view of an example electrode assembly in a cylindrical configuration;

FIG. 17 is a side view of a portion of an example cardiac mapping and/or ablation system;

FIG. 18 is a side view of an example electrode assembly;

FIG. 19 is a perspective view of an example electrode assembly in a cylindrical configuration;

FIG. 20 is a side view of a portion of an example cardiac mapping and/or ablation system;

FIG. 21 is a perspective view of an example electrode assembly;

FIG. 22 is a partially cutaway perspective view of a portion of an example cardiac mapping and/or ablation system;

FIG. 23 is a perspective view of an example electrode assembly;

FIG. 24 is a partially cutaway perspective view of a portion of an example cardiac mapping and/or ablation system;

FIG. 25 is a perspective view of an example electrode assembly;

FIG. 26 is a partially cutaway perspective view of a portion of an example cardiac mapping and/or ablation system;

FIG. 27 is a side view of a portion of an example cardiac mapping and/or ablation system;

FIG. 28 is a cross-sectional view taken through line 28-28;

FIG. 29 is an alternative cross-sectional view taken through line 28-28;

FIG. 30 is a side view of a portion of an example cardiac mapping and/or ablation system;

FIG. 31 is a side view of a portion of an example cardiac mapping and/or ablation system;

FIG. 32 is a side view of a portion of an example cardiac mapping and/or ablation system;

FIG. 33 is an end view of the example cardiac mapping and/or ablation system shown in FIG. 32;

FIG. 34 is a side view of a portion of an example cardiac mapping and/or ablation system;

FIG. 35 is an end view of an example cardiac mapping and/or ablation system shown;

FIG. 36 is a side view of a portion of an example cardiac mapping and/or ablation system; and

FIG. 37 is a side view of a portion of an example cardiac mapping and/or ablation system.

While the disclosure is amenable to various modifications and alternative forms, specifics thereof have been shown by way of example in the drawings and will be described in detail. It should be understood, however, that the intention is not to limit the invention to the particular embodiments described. On the contrary, the intention is to cover all modifications, equivalents, and alternatives falling within the spirit and scope of the disclosure.

#### DETAILED DESCRIPTION

For the following defined terms, these definitions shall be applied, unless a different definition is given in the claims or elsewhere in this specification.

All numeric values are herein assumed to be modified by the term “about”, whether or not explicitly indicated. The term “about” generally refers to a range of numbers that one of skill in the art would consider equivalent to the recited value (e.g., having the same function or result). In many instances, the terms “about” may include numbers that are rounded to the nearest significant figure.

The recitation of numerical ranges by endpoints includes all numbers within that range (e.g. 1 to 5 includes 1, 1.5, 2, 2.75, 3, 3.80, 4, and 5).

As used in this specification and the appended claims, the singular forms “a”, “an”, and “the” include plural referents unless the content clearly dictates otherwise. As used in this specification and the appended claims, the term “or” is generally employed in its sense including “and/or” unless the content clearly dictates otherwise.

It is noted that references in the specification to “an embodiment”, “some embodiments”, “other embodiments”, etc., indicate that the embodiment described may include one or more particular features, structures, and/or characteristics. However, such recitations do not necessarily mean that all embodiments include the particular features, structures, and/or characteristics. Additionally, when particular features, structures, and/or characteristics are described in connection with one embodiment, it should be understood that such features, structures, and/or characteristics may also be used connection with other embodiments whether or not explicitly described unless clearly stated to the contrary.

The following detailed description should be read with reference to the drawings in which similar elements in different drawings are numbered the same. The drawings,

which are not necessarily to scale, depict illustrative embodiments and are not intended to limit the scope of the invention.

FIG. 1 illustrates an example cardiac mapping and/or ablation system 10. As shown in FIG. 1, system 10 may include an elongated member or catheter shaft 12, an RF generator 14, and a processor 16 (e.g., a mapping processor, ablation processor, and/or other processor). Illustratively, shaft 12 may be operatively coupled to at least one or more (e.g., one or both) of RF generator 14 and processor 16. Alternatively, or in addition, a device, other than shaft 12, that may be utilized to apply ablation energy to and/or map a target area, may be operatively coupled to at least one or more of RF generator 14 and processor 16. RF generator 14 may be capable of delivering and/or may be configured to deliver ablation energy to shaft 12 in a controlled manner in order to ablate target area sites identified by processor 16. Although the processor 16 and RF generator 14 may be shown as discrete components, these components or features of components may be incorporated into a single device. System 10 may include any of one or more other features, as desired.

In at least some embodiments, shaft 12 may include a handle 18, which may have an actuator 20 (e.g., a control knob or other actuator). The handle 18 (e.g., a proximal handle) may be positioned at a proximal end of shaft 12, for example. Illustratively, shaft 12 may include a flexible body having a distal portion which may include the one or more electrodes. For example, the distal portion of shaft 12 may include one or more of a plurality of ring electrodes 22, a distal ablation tip electrode 24, and a plurality of micro-electrodes or micro-electrode assemblies 26 disposed or otherwise positioned within and/or electrically isolated from distal ablation tip electrode 24.

Shaft 12 may be steerable to facilitate navigating the vasculature of a patient or navigating other lumens. Illustratively, a distal portion 13 of shaft 12 may be deflected by manipulation of actuator 20 to effect steering shaft 12. In some instances, distal portion 13 of shaft 12 may be deflected to position distal ablation tip electrode 24 and/or micro-electrode assemblies 26 adjacent target tissue or to position the distal portion 13 of shaft 12 for another suitable purpose. Additionally, or alternatively, distal portion 13 of shaft 12 may have a pre-formed shape adapted to facilitate positioning distal ablation tip electrode 24 and/or micro-electrode assemblies 26 adjacent a target tissue. Illustratively, the preformed shape of distal portion 13 of shaft 12 may be a radiused shape (e.g., a generally circular shape or a generally semi-circular shape) and/or may be oriented in a plane transverse to a general longitudinal direction of shaft 12. These are just examples.

In some instances, system 10 may be utilized in ablation procedures on a patient. Illustratively, shaft 12 may be configured to be introduced into or through vasculature of a patient and/or into or through any other lumen or cavity. In one example, shaft 12 may be inserted through the vasculature of the patient and into one or more chambers of the patient's heart (e.g., a target area). When in the patient's vasculature or heart, shaft 12 may be used to map and/or ablate myocardial tissue using the ring electrodes 22, micro-electrode assemblies 26, and/or distal ablation tip electrode 24. In some instances, distal ablation tip electrode 24 may be configured to apply ablation energy to myocardial tissue of the heart of a patient.

In some instances, micro-electrode assemblies 26 may be circumferentially distributed about a distal ablation tip electrode 24. In some instances, system 10 may not include

distal ablation tip electrode 24 and, in such embodiments, micro-electrode assemblies 26 may be circumferentially distributed about shaft 12 (e.g., along a distal tip of shaft 12). In general, micro-electrode assemblies 26, as their name suggests, are relatively small in size (e.g., smaller than distal ablation tip electrode 24). Micro-electrode assemblies 26 may be capable of operating, or configured to operate, in unipolar or bipolar sensing modes. In some cases, micro-electrode assemblies 26 may define and/or at least partially form one or more bipolar microelectrode pairs. In an illustrative instance, shaft 12 may have three micro-electrode assemblies 26 distributed about the circumference of distal ablation tip electrode 24, such that the circumferentially spaced microelectrodes may form respective bipolar micro-electrode pairs. Each bipolar microelectrode pair may be capable of generating, or may be configured to generate, an output signal corresponding to a sensed electrical activity (e.g., an electrogram (EGM) reading) of the myocardial tissue proximate thereto. Additionally or alternatively to the circumferentially spaced micro-electrode assemblies 26, shaft 12 may include one or more forward facing micro-electrode assemblies 26 (not shown). The forward facing micro-electrode assemblies 26 may be generally centrally located within distal ablation tip electrode 24 and/or at an end of a tip of shaft 12.

In some examples, micro-electrode assemblies 26 may be operatively coupled to processor 16 and the generated output signals from micro-electrode assemblies 26 may be sent to the processor 16 of ablation system 10 for processing in one or more manners discussed herein and/or for processing in other manners. Illustratively, an EGM reading or signal of an output signal from a bipolar microelectrode pair may at least partially form the basis of a contact assessment, ablation area assessment (e.g., tissue viability assessment), and/or an ablation progress assessment (e.g., a lesion formation/maturation analysis), as discussed below.

Distal ablation tip electrode 24 may be a suitable length and may have a suitable number of micro-electrode assemblies 26 positioned therein and spaced circumferentially and/or longitudinally about distal ablation tip electrode 24. In some instances, distal ablation tip electrode 24 may have a length of between one (1) mm and twenty (20) mm, three (3) mm and seventeen (17) mm, or six (6) mm and fourteen (14) mm. In one illustrative example, distal ablation tip electrode 24 may have an axial length of about eight (8) mm. Distal ablation tip electrode 24 may be formed from other otherwise include platinum and/or other suitable materials. These are just examples.

Processor 16 may be capable of processing or may be configured to process the electrical signals of the output signals from micro-electrode assemblies 26 and/or ring electrodes 22. Based, at least in part, on the processed output signals from micro-electrode assemblies 26 and/or ring electrodes 22, processor 16 may generate an output to a display (not shown) for use by a physician or other user. In instances where an output is generated to a display and/or other instances, processor 16 may be operatively coupled to or otherwise in communication with the display. Illustratively, the display may include various static and/or dynamic information related to the use of system 10. In one example, the display may include one or more of an image of the target area, an image of shaft 12, and information related to EGMs, which may be analyzed by the user and/or by a processor of system 10 to determine the existence and/or location of arrhythmia substrates within the heart, to deter-

mine the location of shaft **12** within the heart, and/or to make other determinations relating to use of shaft **12** and/or other elongated members.

System **10** may include an indicator in communication with processor **16**. The indicator may be capable of providing an indication related to a feature of the output signals received from one or more of the electrodes of shaft **12**. In one example of an indicator, an indication to the clinician about a characteristic of shaft **12** and/or the myocardial tissue interacted with and/or being mapped may be provided on the display. In some cases, the indicator may provide a visual and/or audible indication to provide information concerning the characteristic of shaft **12** and/or the myocardial tissue interacted with and/or being mapped.

FIG. 2 illustrates another example system **110** that may be similar in form and function to other systems disclosed herein. System **110** may include catheter shaft **112**. Distal ablation tip electrode **124** may be disposed at the distal end of catheter shaft **112**. Distal ablation tip electrode **124** may include one or more irrigation ports. For example, distal ablation tip electrode **124** may include one or more circumferential irrigation ports **126**. In some of these and in other instances, distal ablation tip electrode **124** may also include a distal irrigation port **128**. In uses where irrigation is not desired/needed, ports **126/128** may be omitted or sealed, for example with an epoxy.

In some instances, one or more micro-electrode assemblies (e.g., similar to micro-electrode assemblies **26**) may be disposed along distal ablation tip electrode **124**. In some of these and in other embodiments, an electrode assembly **130** may be coupled to distal ablation tip electrode **124**. Electrode assembly **130** may include one or more electrodes or electrode regions **132**. Electrodes **132** may include monopolar electrodes, one or more pairs of bipolar electrodes, or combinations thereof. Electrodes **132** may also take the form of sensors such as impedance and/or contact sensors. A proximal connector **134** may be disposed along (e.g., within) catheter shaft **112**. Proximal connector **134** may be used to connect electrode assembly **130** with a suitable processor/generator.

The use of electrode assembly **130** may be desirable for a number of reasons. For example, electrode assembly **130** may allow for electrodes **132** to be disposed at the front face or distal end of distal ablation tip **124**. This may allow electrodes **132** to be used to sense contact between distal ablation tip **124** and a target tissue. In addition, because it may have a relatively small, compact shape, the use of electrode assembly **130** may free up additional space along and/or within distal ablation tip **124** for other useful structures such as micro-electrodes, force sensors, contact sensors, magnetic sensors, or the like. Moreover, electrode assembly **130** may be wrapped or otherwise disposed along distal ablation tip **124** in a manner that reduces protruding edges that could catch on tissue, other medical devices, etc. Furthermore, by weaving electrode assembly **130** through openings in distal ablation tip **124**, RF edge effects may be reduced or minimized.

Electrode assembly **130** may take the form of a flexible circuit. For example, electrode assembly **130** may include a substrate with one or more electrodes (e.g., electrodes **132**) disposed thereon. The substrate may include a polymeric material (e.g., such as polyimide or other suitable materials including those disclosed herein). Electrode assembly **130** may include a coating such as a parylene coating or other suitable biocompatible coating. Electrodes **132** may be sputtered onto the substrate with iridium oxide. In some of these and in other embodiments, electrodes **132** may be

copper or gold electrodes (or electrodes formed of other suitable materials) disposed along the substrate. In some instances, a temperature or other sensor may be disposed along the substrate. In addition, a magnetic sensing coil, piezoelectric film, MEMS force sensor, or the like may be coupled to assembly **130**. Some example flexible circuits that may be suitable for use as electrode assembly **130** may include or resemble those disclosed in U.S. Patent Application Pub. No. US 2013/0165926, the entire disclosure of which is herein incorporated by reference. The use of a flex circuit may be desirable by allowing for batch processing at relatively high volumes so that manufacturability of system **110** may be increased.

In some instances, electrode assembly **130** may include an inner insulating layer contacts distal ablation tip **124** and electrically insulates electrode assembly **130** from distal ablation tip **124**. Electrodes **132** may be disposed on the insulating layer. Alternatively, electrodes **132** may take the form of a conductive layer or trace disposed along the insulating layer. The conductive layer may extend along essentially the entire length of the insulating layer or along one or more discrete sections thereof. Numerous configurations are contemplated.

FIG. 3 is a perspective view of electrode assembly **130**. Here it can be seen that electrode assembly **130** may include a plurality of arms including arms **136a/136b/136c/136d** each having one or more electrodes **132a/132b/132c/132d**. Each of arms **136a/136b/136c/136d** may include a mechanical interconnecting member **138a/138b/138c/138d**. Mechanical interconnecting members **138a/138b/138c/138d** may be utilized to secure electrode assembly **130** to system **110** (and/or distal ablation tip **124**). In this example, mechanical interconnecting members **138a/138b/138c/138d** take the form of arrow-shaped projections with a tapered edge. Such a shape may allow mechanical interconnecting members **138a/138b/138c/138d** to be passed through an opening and, by interference, being sufficiently captured within the opening. The precise shape of mechanical interconnecting members **138a/138b/138c/138d** may vary and is not intended to be limited to just being arrow-shaped. Mechanical interconnecting members **138a/138b/138c/138d** may have a variety of shapes including rounded shapes, geometric shapes, shapes with relief cutouts (e.g., a "split arrow" shape), shapes with flanges and/or projections, shapes that are deformable or reshapable into two or more shapes, or the like. These are just examples. Other shapes are contemplated.

FIGS. 4-6 illustrate an example method for manufacturing and/or assembling system **110**. For example, in FIG. 4 it can be seen that electrode assembly **130** may be disposed along an interior of distal ablation tip **124**. Arms **136a/136b/136c/136d** may be oriented so that mechanical interconnecting member **138a/138b/138c/138d** extend through distal irrigation port **128**. Arms **136a/136b/136c/136d** may be manipulated so that mechanical interconnecting member **138a/138b/138c/138d** are folded proximally toward openings **140a/140b** as shown in FIG. 5. Openings **140a/140b** may be cuts or slots formed in a suitable manner (e.g., laser cutting with chamfer to reduce/minimize abrasion with assembly **130**). It can be appreciated that in the views of FIGS. 4-6 only two openings **140a/140b** are shown. However, in practice a suitable number of openings may be utilized. For example, four openings may be utilized when electrode assembly **130** includes four arms. Mechanical interconnecting member **138a/138b/138c/138d** may be extended into openings **140a/140b** (and similar openings not shown in this

view) as shown in FIG. 6. This may secure electrode assembly 130 to system 110 (and/or to distal ablation tip 124).

Proximal connector 134 may be coupled to a suitable processor/generator using flying leads, ribbonized cable, or by simply extending proximal connector 134 to the processor/generator. When connecting proximal connector 134 to another suitable device or wire, terminals may be disposed along proximal connector 134. The terminals may be formed by wire bonding, hot bar soldering, anisotropic conductive films, soldering, or the like.

FIG. 7 illustrates another example electrode assembly 230 that may be similar in form and function to other assemblies disclosed herein and may be used, as appropriate, with the systems disclosed herein. Assembly 230 may include arms 236a/236b/236c/236d. Each of arms 236a/236b/236c/236d may include mechanical interconnecting member 138a/138b/138c/138d. In this example, two electrodes are defined along each of arms 236a/236b/236c/236d. For example, arm 236a may include electrodes 232a/232a', arm 236b may include electrodes 232b/232b', arm 236c may include electrodes 232c/232c', and arm 236d may include electrodes 232d/232d'.

FIG. 8 illustrates system 210. System 210 includes catheter shaft 212. Proximal connector 234 may be disposed along shaft 212 and may be coupled to electrode assembly 230. Electrode assembly 230 may be assembled onto distal ablation tip 224 in a manner similar to what is disclosed herein. For example, arms 236a/236b/236c/236d may be passed through port 228 and woven in and out of a pair of openings along distal ablation tip 224 so that electrodes 232a/232a'/232b/232b'/232c/232c'/232d/232d' are disposed along tip 224. Alternatively, each of arms 236a/236b/236c/236d may be passed through port 228, along the outer surface of distal ablation tip 224, and then through a single opening along distal ablation tip 224. In at least some instances, distal ablation tip 224 takes the form of a distal ablation tip electrode 224.

FIG. 9 illustrates another example electrode assembly 330 that may be similar in form and function to other assemblies disclosed herein and may be used, as appropriate, with the systems disclosed herein. In this embodiment, electrode assembly 330 may include three arms. For example, assembly 330 may include arms 336b/336c and a third arm/connector 334. Each of arms 336b/336c may include mechanical interconnecting member 338b/338c. Each of arms 336b/336c may include electrodes 332b/332c. Connector 334 may also include electrode 332a.

FIG. 10 illustrates system 310. System 310 includes catheter shaft 312. Electrode assembly 330 may be assembled onto distal ablation tip 324 in a manner similar to what is disclosed herein. For example, each of arms 336b/236c and connector 334 may be passed through port 328 and passed through an opening along distal ablation tip 324 so that electrodes 332a/332b/332c are disposed along tip 324. Connector 334 may continue along an inner surface (or an outer surface) of shaft 312 to a location where it may be coupled to a suitable processor/generator. In at least some instances, distal ablation tip 324 takes the form of a distal ablation tip electrode 324.

FIG. 11 illustrates another example electrode assembly 430 that may be similar in form and function to other assemblies disclosed herein and may be used, as appropriate, with the systems disclosed herein. Assembly 430 may include a plurality of electrodes 432. Assembly 430 may also include an opening 442 and proximal connector 434.

FIG. 12 illustrates system 410. System 410 includes catheter shaft 412. Electrode assembly 430 may be assembled onto distal ablation tip 424 in a manner similar to what is disclosed herein. For example, electrode assembly 430 may take the form of a strip that is designed to extend circumferentially about distal ablation tip 424. Proximal connector 434 may extend through opening 442 and then proximally along shaft 412. This may include extending proximal connector 434 along the outer surface of shaft 412, along the inner surface of shaft 412, or both. In at least some instances, distal ablation tip 424 takes the form of a distal ablation tip electrode 424.

FIG. 13 illustrates another example electrode assembly 530 that may be similar in form and function to other assemblies disclosed herein and may be used, as appropriate, with the systems disclosed herein. Assembly 530 may include a plurality of electrodes 532. Assembly 530 may also include a plurality of mechanical interconnecting members 538. In this example, a pair of opposing mechanical interconnecting members 538 are positioned on opposite sides of each electrode 532. Assembly 530 may also include proximal connector 534.

FIG. 14 illustrates system 510. System 510 includes catheter shaft 512. Electrode assembly 530 may be assembled onto distal ablation tip 524 in a manner similar to what is disclosed herein. For example, electrode assembly 530 may be disposed about distal ablation tip 524. Mechanical interconnecting members 538 may extend through openings in distal ablation tip 524 to secure electrode assembly 530 to system 510 (and/or distal ablation tip 524). In at least some instances, distal ablation tip 524 takes the form of a distal ablation tip electrode 524.

FIG. 15 illustrates another example electrode assembly 630 that may be similar in form and function to other assemblies disclosed herein and may be used, as appropriate, with the systems disclosed herein. Assembly 630 may include arms 636a/636b/636c/636d and proximal connector 634. Each of arms 636a/636b/636c/636d may include one or more electrodes such as electrodes 632a/632b/632c/632d. Assembly 630 may be rolled into a cylindrical configuration as shown in FIG. 16.

FIG. 17 illustrates system 610. System 610 includes catheter shaft 612. Electrode assembly 630 may be assembled along distal ablation tip 624 in a manner similar to what is disclosed herein. For example, electrode assembly 630 may be disposed within distal ablation tip 624. When assembled, arms 636a/636b/636c/636d extend through openings in distal ablation tip 624 and bow radially outward. This may be due to the application of a compressive force on electrode assembly 630 during the assembly process. Alternatively, an elastomeric gasket may be disposed within electrode assembly 630 in order to bias arms 636a/636b/636c/636d radially outward and/or seal the openings along distal ablation tip 624. The use of a gasket may allow the openings in distal ablation tip 624 to be sealed without the use of an adhesive. In addition, the use of a gasket may also allow for additional structures to be disposed along the interior of distal ablation tip 624. In some instances, the proximal and/or distal ends of assembly 630 may be secured to the inner surface of distal ablation tip 624. Although not expressly shown, system 610 may include one or more irrigation ports, for example along distal ablation tip 624. In at least some instances, distal ablation tip 624 takes the form of a distal ablation tip electrode 624.

The use of electrode assembly 630 may be desirable for a number of reasons. For example, using electrode assembly 630 may allow for assembly of system 610 while reducing/

minimizing the possibility of damaging iridium oxide sputtered electrodes and/or to the parylene coating (e.g., when electrode assembly 630 includes such structures). The length of electrode assembly 630 exposed along the outer surface of system 610 may also be reduced, which may reduce the likelihood of electrode assembly 630 catching during a procedure and also may reduce the amount of surface area along distal ablation tip 624 that may be covered.

While FIGS. 14-16 illustrate arms 636a/636b/636c/636d oriented in an axial direction, electrode assembly 630 may also be arranged so that arms 636a/636b/636c/636d extend circumferentially or otherwise in a direction that is substantially transverse to the longitudinal axis of electrode assembly 630.

FIG. 18 illustrates another example electrode assembly 730 that may be similar in form and function to other assemblies disclosed herein and may be used, as appropriate, with the systems disclosed herein. Assembly 730 may include arms 736a/736b/736c/736d. Each of arms 736a/736b/736c/736d may include one or more electrodes such as electrodes 732a/732b/732c/732d and mechanical interconnecting members 738a/738b/738c/738d. Assembly 730 may also include a pair of proximal connectors 734a/734b. Assembly 730 may be formed into a generally cylindrical configuration as shown in FIG. 19.

FIG. 20 illustrates system 710. System 710 includes catheter shaft 712. Electrode assembly 730 may be assembled along distal ablation tip 724 in a manner similar to what is disclosed herein. For example, mechanical interconnecting members 738a/738b/738c/738d may extend through openings in distal ablation tip 724 to secure assembly 730 to system 710 (and/or to distal ablation tip 724). In at least some instances, distal ablation tip 724 takes the form of a distal ablation tip electrode 724.

FIG. 21 illustrates another example electrode assembly 830 that may be similar in form and function to other assemblies disclosed herein and may be used, as appropriate, with the systems disclosed herein. Assembly 830 may include arm 836, mechanical interconnecting member 838, and proximal connector 834. FIG. 22 illustrates system 810. System 810 includes catheter shaft 812. Electrode assembly 830 may be assembled along distal ablation tip 824 in a manner similar to what is disclosed herein. For example, electrode assembly 830 may be wrapped circumferentially about distal ablation tip 824. Alternatively, electrode assembly 830 may be woven in and out of openings formed in distal ablation tip 824. In at least some instances, distal ablation tip 824 takes the form of a distal ablation tip electrode 824.

FIG. 23 illustrates another example electrode assembly 930 that may be similar in form and function to other assemblies disclosed herein and may be used, as appropriate, with the systems disclosed herein. Assembly 930 may include arms 936a/936b/936c/936d. Each of arms 936a/936b/936c/936d may include one or more electrodes such as electrodes 932a/932b/932c/932d and mechanical interconnecting members 938a/938b/938c/938d. Assembly 930 may also include proximal connector 934.

FIG. 24 illustrates system 910. System 910 includes catheter shaft 912. Electrode assembly 930 may be assembled along distal ablation tip 924 in a manner similar to what is disclosed herein. For example, mechanical interconnecting members 938a/938b/938c/938d may extend through openings in distal ablation tip 924 to secure assembly 930 to system 910 (and/or to distal ablation tip 924). In at least some instances, distal ablation tip 924 takes the form of a distal ablation tip electrode 924.

FIG. 25 illustrates another example electrode assembly 1030 that may be similar in form and function to other assemblies disclosed herein and may be used, as appropriate, with the systems disclosed herein. Assembly 1030 may include arm 1036 arranged in a cylindrical orientation. A plurality of electrodes 1032 may be disposed along arm 1036. Mechanical interconnecting member 1038 may be disposed on an end region of arm 1036. Assembly 1030 may also include proximal connector 1034.

FIG. 26 illustrates system 1010. System 1010 includes catheter shaft 1012. Electrode assembly 1030 may be assembled along distal ablation tip 1024 in a manner similar to what is disclosed herein. For example, mechanical interconnecting member 1038 may extend through openings in distal ablation tip 1024 to secure assembly 1030 to system 1010 (and/or to distal ablation tip 1024). In at least some instances, distal ablation tip 1024 takes the form of a distal ablation tip electrode 1024.

FIG. 27 is a side view of another example system 1110 that may be similar in form and function to other systems disclosed herein. System 1110 includes shaft 1112. One or more ring electrodes 1122 may be disposed along shaft 1112. Distal ablation tip 1124 may be disposed at the distal end of shaft 1112. Electrode assembly 1130 may be disposed along distal ablation tip 1124. For example, electrode assembly 1130 may be attached to distal ablation tip 1124 using an adhesive or other suitable attachment mechanism. In some embodiments, a single electrode assembly 1130 may be disposed along distal ablation tip 1124. In other embodiments, a plurality of electrode assemblies 1130 (e.g., 2-8 or more) may be disposed along distal ablation tip 1124. In at least some instances, distal ablation tip 1124 takes the form of a distal ablation tip electrode 1124. Each electrode assembly 1130 may be formed from a dielectric material disposed along distal ablation tip 1124 with a strip of electrode material (e.g., 300 series stainless steel, gold, platinum, copper, etc.) disposed along the dielectric material. Electrode assembly 1130 may have a width of about 0.01-0.04 inches (e.g., about 0.025 inches) and a length of about 1-5 millimeters (e.g., 3 mm or about 0.118 inches). These are just examples.

FIG. 28 is a cross-sectional view of a portion of system 1110. Here it can be seen that electrode assembly 1130 may include an inner insulating layer 1150 and an outer conductive layer or electrode regions 1132. In some of these and in other embodiments, electrode assembly 1130 may include a flexible circuit as disclosed herein.

While FIG. 28 shows that four electrode assemblies 1130 may be disposed about system 1110, this is not intended to be limiting. For example, FIG. 29 illustrates system 1220 that includes three electrode assemblies 1230 are disposed along distal ablation tip 1224. In at least some instances, distal ablation tip 1224 takes the form of a distal ablation tip electrode 1224. Similarly to electrode assemblies 1130, electrode assemblies 1230 may include inner insulating layer 1250 and outer conductive layer or electrode region 1232.

FIG. 30 is a side view of another example system 1310 that may be similar in form and function to other systems disclosed herein. System 1310 includes shaft 1312. One or more ring electrodes 1322 may be disposed along shaft 1312. Distal ablation tip 1324 may be disposed at the distal end of shaft 1312. Electrode assembly 1330 may be disposed along distal ablation tip 1324. Electrode assembly 1330 may include insulating layer 1350 and electrode region 1332. In this example, electrode region 1332 may take the form of a discrete electrode surrounded by insulating layer 1350. In at

least some instances, distal ablation tip **1324** takes the form of a distal ablation tip electrode **1324**.

FIG. **31** is a side view of another example system **1410** that may be similar in form and function to other systems disclosed herein. System **1410** includes shaft **1412**. One or more ring electrodes **1422** may be disposed along shaft **1412**. Distal ablation tip **1424** may be disposed at the distal end of shaft **1412**. Electrode assembly **1430** may be disposed along distal ablation tip **1424**. Electrode assembly **1430** may include insulating layer **1450** and a plurality of electrode regions **1432a/1432b**. In at least some embodiments, electrode regions **1432a/1432b** may be a pair of bipolar electrodes. In at least some instances, distal ablation tip **1424** takes the form of a distal ablation tip electrode **1424**.

FIGS. **32-33** illustrate another example system **1510** that may be similar in form and function to other systems disclosed herein. System **1510** includes shaft **1512**. One or more ring electrodes **1522** may be disposed along shaft **1512**. Distal ablation tip **1524** may be disposed at the distal end of shaft **1512**. In at least some instances, distal ablation tip **1524** takes the form of a distal ablation tip electrode **1524**.

Electrode assembly **1530** may be disposed along distal ablation tip **1524**. In this example, electrode assembly **1530** may extend to and/or along the distal end of distal ablation tip **1524** as can be seen in FIG. **33**, which is an end view of system **1510**. Here it can be seen that electrode assembly **1530** may include insulating layer **1550** and electrode region **1532**.

FIG. **34** is a side view of another example system **1610** that may be similar in form and function to other systems disclosed herein. System **1610** includes shaft **1612**. One or more ring electrodes **1622** may be disposed along shaft **1612**. Distal ablation tip **1624** may be disposed at the distal end of shaft **1612**. In at least some instances, distal ablation tip **1624** takes the form of a distal ablation tip electrode **1624**.

Electrode assembly **1630** may be disposed along distal ablation tip **1624**. Electrode assembly **1630** may include insulating layer **1650** and electrode region **1632**.

FIG. **35** is an end view of another example system **1710** that may be similar in form and function to other systems disclosed herein. System **1710** includes distal ablation tip **1724**. Electrode assembly **1730** may be disposed along distal ablation tip **1724**. Electrode assembly **1730** may include insulating layer **1750** and electrode region **1732**. In at least some instances, distal ablation tip **1724** takes the form of a distal ablation tip electrode **1724**.

FIG. **36** is a side view of another example system **1810** that may be similar in form and function to other systems disclosed herein. System **1810** includes shaft **1812**. One or more ring electrodes **1822** may be disposed along shaft **1812**. Distal ablation tip **1824** may be disposed at the distal end of shaft **1812**. In at least some instances, distal ablation tip **1824** takes the form of a distal ablation tip electrode **1824**.

Electrode assembly **1830** may be disposed along distal ablation tip **1824**. Electrode assembly **1830** may include a plurality of insulating layers **1850** and electrode region **1832** disposed between insulating layers **1850**.

FIG. **37** is a side view of another example system **1910** that may be similar in form and function to other systems disclosed herein. System **1910** includes shaft **1912**. One or more ring electrodes **1922** may be disposed along shaft **1912**. Distal ablation tip **1924** may be disposed at the distal

end of shaft **1912**. In at least some instances, distal ablation tip **1924** takes the form of a distal ablation tip electrode **1924**.

Electrode assembly **1930** may be disposed along distal ablation tip **1924**. Electrode assembly **1930** may include a plurality of insulating layers **1950** and a plurality of electrode regions **1932a/1932b** disposed between insulating layers **1950**.

The materials that can be used for the various components of system **10** and/or other systems disclosed herein (e.g., shafts, micro-electrodes, distal ablation tip electrodes, flexible circuits, substrates, etc.) may include metals, metal alloys, polymers, metal-polymer composites, ceramics, combinations thereof, and the like, or other suitable material. Some examples of suitable polymers may include polytetrafluoroethylene (PTFE), ethylene tetrafluoroethylene (ETFE), fluorinated ethylene propylene (FEP), polyoxymethylene (POM, for example, DELRIN® available from DuPont), polyether block ester, polyurethane (for example, Polyurethane 85A), polypropylene (PP), polyvinylchloride (PVC), polyether-ester (for example, ARNITEL® available from DSM Engineering Plastics), ether or ester based copolymers (for example, butylene/poly(alkylene ether) phthalate and/or other polyester elastomers such as HYTREL® available from DuPont), polyamide (for example, DURETHAN® available from Bayer or CRISTAMID® available from Elf Atochem), elastomeric polyamides, block polyamide/ethers, polyether block amide (PEBA, for example available under the trade name PEBAX®), ethylene vinyl acetate copolymers (EVA), silicones, polyethylene (PE), Marlex high-density polyethylene, Marlex low-density polyethylene, linear low density polyethylene (for example REXELL®), polyester, polybutylene terephthalate (PBT), polyethylene terephthalate (PET), polytrimethylene terephthalate, polyethylene naphthalate (PEN), polyetheretherketone (PEEK), polyimide (PI), polyetherimide (PEI), polyphenylene sulfide (PPS), polyphenylene oxide (PPO), poly paraphenylene terephthalamide (for example, KEVLAR®), polysulfone, nylon, nylon-12 (such as GRILAMID® available from EMS American Grilon), perfluoro(propyl vinyl ether) (PFA), ethylene vinyl alcohol, polyolefin, polystyrene, epoxy, polyvinylidene chloride (PVdC), poly(styrene-*b*-isobutylene-*b*-styrene) (for example, SIBS and/or SIBS 50A), polycarbonates, ionomers, biocompatible polymers, other suitable materials, or mixtures, combinations, copolymers thereof, polymer/metal composites, and the like.

Some examples of suitable metals and metal alloys include stainless steel, such as 304V, 304L, and 316LV stainless steel; mild steel; nickel-titanium alloy such as linear-elastic and/or super-elastic nitinol; other nickel alloys such as nickel-chromium-molybdenum alloys (e.g., UNS: N06625 such as INCONEL® 625, UNS: N06022 such as HASTELLOY® C-22®, UNS: N10276 such as HASTELLOY® C276®, other HASTELLOY® alloys, and the like), nickel-copper alloys (e.g., UNS: N04400 such as MONEL® 400, NICKELVAC® 400, NICORROS® 400, and the like), nickel-cobalt-chromium-molybdenum alloys (e.g., UNS: R30035 such as MP35-N® and the like), nickel-molybdenum alloys (e.g., UNS: N10665 such as HASTELLOY® ALLOY B2®), other nickel-chromium alloys, other nickel-molybdenum alloys, other nickel-cobalt alloys, other nickel-iron alloys, other nickel-copper alloys, other nickel-tungsten or tungsten alloys, and the like; cobalt-chromium alloys; cobalt-chromium-molybdenum alloys (e.g., UNS: R30003 such as ELGILOY®, PHYNOX®, and the like); platinum

enriched stainless steel; titanium; combinations thereof; and the like; or any other suitable material.

As alluded to herein, within the family of commercially available nickel-titanium or nitinol alloys, is a category designated “linear elastic” or “non-super-elastic” which, although may be similar in chemistry to conventional shape memory and super elastic varieties, may exhibit distinct and useful mechanical properties. Linear elastic and/or non-super-elastic nitinol may be distinguished from super elastic nitinol in that the linear elastic and/or non-super-elastic nitinol does not display a substantial “superelastic plateau” or “flag region” in its stress/strain curve like super elastic nitinol does. Instead, in the linear elastic and/or non-super-elastic nitinol, as recoverable strain increases, the stress continues to increase in a substantially linear, or a somewhat, but not necessarily entirely linear relationship until plastic deformation begins or at least in a relationship that is more linear than the super elastic plateau and/or flag region that may be seen with super elastic nitinol. Thus, for the purposes of this disclosure linear elastic and/or non-super-elastic nitinol may also be termed “substantially” linear elastic and/or non-super-elastic nitinol.

In some cases, linear elastic and/or non-super-elastic nitinol may also be distinguishable from super elastic nitinol in that linear elastic and/or non-super-elastic nitinol may accept up to about 2-5% strain while remaining substantially elastic (e.g., before plastically deforming) whereas super elastic nitinol may accept up to about 8% strain before plastically deforming. Both of these materials can be distinguished from other linear elastic materials such as stainless steel (that can also be distinguished based on its composition), which may accept only about 0.2 to 0.44 percent strain before plastically deforming.

In some embodiments, the linear elastic and/or non-super-elastic nickel-titanium alloy is an alloy that does not show any martensite/austenite phase changes that are detectable by differential scanning calorimetry (DSC) and dynamic metal thermal analysis (DMTA) analysis over a large temperature range. For example, in some embodiments, there may be no martensite/austenite phase changes detectable by DSC and DMTA analysis in the range of about -60 degrees Celsius ( $^{\circ}$  C.) to about 120 $^{\circ}$  C. in the linear elastic and/or non-super-elastic nickel-titanium alloy. The mechanical bending properties of such material may therefore be generally inert to the effect of temperature over this very broad range of temperature. In some embodiments, the mechanical bending properties of the linear elastic and/or non-super-elastic nickel-titanium alloy at ambient or room temperature are substantially the same as the mechanical properties at body temperature, for example, in that they do not display a super-elastic plateau and/or flag region. In other words, across a broad temperature range, the linear elastic and/or non-super-elastic nickel-titanium alloy maintains its linear elastic and/or non-super-elastic characteristics and/or properties.

In some embodiments, the linear elastic and/or non-super-elastic nickel-titanium alloy may be in the range of about 50 to about 60 weight percent nickel, with the remainder being essentially titanium. In some embodiments, the composition is in the range of about 54 to about 57 weight percent nickel. One example of a suitable nickel-titanium alloy is FHP-NT alloy commercially available from Furukawa Techno Material Co. of Kanagawa, Japan. Some examples of nickel titanium alloys are disclosed in U.S. Pat. Nos. 5,238,004 and 6,508,803, which are incorporated herein by reference. Other suitable materials may include ULTANIUM<sup>TM</sup> (available from Neo-Metrics) and GUM METAL<sup>TM</sup> (available

from Toyota). In some other embodiments, a superelastic alloy, for example a superelastic nitinol can be used to achieve desired properties.

In at least some embodiments, components of system 10 may also be doped with, made of, or otherwise include a radiopaque material. Radiopaque materials are understood to be materials capable of producing a relatively bright image on a fluoroscopy screen or another imaging technique during a medical procedure. This relatively bright image aids the user of system 10 in determining its location. Some examples of radiopaque materials can include, but are not limited to, gold, platinum, palladium, tantalum, tungsten alloy, polymer material loaded with a radiopaque filler, and the like. Additionally, other radiopaque marker bands and/or coils may also be incorporated into the design of system 10 to achieve the same result.

In some embodiments, a degree of Magnetic Resonance Imaging (MRI) compatibility is imparted into system 10. For example, components of system 10, or portions thereof, may be made of a material that does not substantially distort the image and create substantial artifacts (e.g., gaps in the image). Certain ferromagnetic materials, for example, may not be suitable because they may create artifacts in an MRI image. Components of system 10, or portions thereof, may also be made from a material that the MRI machine can image. Some materials that exhibit these characteristics include, for example, tungsten, cobalt-chromium-molybdenum alloys (e.g., UNS: R30003 such as ELGILOY<sup>®</sup>, PHYNOX<sup>®</sup>, and the like), nickel-cobalt-chromium-molybdenum alloys (e.g., UNS: R30035 such as MP35-N<sup>®</sup> and the like), nitinol, and the like, and others.

It should be understood that this disclosure is, in many respects, only illustrative. Changes may be made in details, particularly in matters of shape, size, and arrangement of steps without exceeding the scope of the disclosure. This may include, to the extent that it is appropriate, the use of any of the features of one example embodiment being used in other embodiments. The invention’s scope is, of course, defined in the language in which the appended claims are expressed.

Various modifications and additions can be made to the exemplary embodiments discussed without departing from the scope of the present invention. For example, while the embodiments described above refer to particular features, the scope of this invention also includes embodiments having different combinations of features and embodiments that do not include all of the described features. Accordingly, the scope of the present invention is intended to embrace all such alternatives, modifications, and variations as fall within the scope of the claims, together with all equivalents thereof.

We claim:

1. A catheter for use in cardiac mapping and/or ablation, the catheter comprising:

an elongate catheter shaft having a distal ablation electrode configured to contact and provide ablation energy to tissue, wherein the distal ablation electrode comprises a plurality of openings extending through an exterior surface of the distal ablation tip;

an electrode assembly releasably coupled to the distal ablation electrode, wherein the electrode assembly comprises a plurality of members, wherein each member of the plurality of members passes through a respective opening of the plurality of openings to fix the electrode assembly relative to the distal ablation electrode when the electrode assembly is coupled to the distal ablation electrode; and

17

- wherein the electrode assembly includes a flexible circuit having one or more electrodes disposed thereon.
2. The catheter of claim 1, wherein the electrode assembly includes a region that is disposed along a distal end of the distal ablation electrode.
3. The catheter of claim 1, wherein the plurality of members comprises wherein each member of the plurality of members includes at least one electrode.
4. The catheter of claim 3, wherein the electrode assembly includes three or more members.
5. The catheter of claim 3, wherein the electrode assembly includes four or more members.
6. The catheter of claim 1, wherein each member has an arrow shape.
7. The catheter of claim 1, wherein each member has relief cutouts.
8. The catheter of claim 1, wherein the catheter shaft includes an inner channel, wherein the distal ablation electrode region includes a first opening, and wherein the electrode assembly extends along the inner channel, through the first opening.
9. The catheter of claim 1, wherein the electrode assembly is adhesively bonded to the distal ablation electrode.
10. The catheter of claim 1, wherein the electrode assembly includes one or more electrode regions and one or more electrically insulated regions.
11. The catheter of claim 1, wherein the electrode assembly extends circumferentially around the distal ablation electrode.
12. The catheter of claim 1, wherein the electrode assembly is designed to bow radially outward from the distal ablation electrode.
13. The catheter of claim 1, wherein the distal ablation electrode includes a platinum ablation tip electrode.
14. The catheter of claim 1, wherein each member has a rounded shape.
15. A method for manufacturing a medical device, the method comprising:  
 inserting an electrode assembly into a channel formed within a distal ablation tip of a catheter, the distal ablation tip configured to contact and provide ablation energy to tissue;

18

- wherein the electrode assembly includes a flexible circuit having one or more electrodes disposed thereon, wherein the electrode assembly comprises a plurality of members;
- 5 wherein the distal ablation tip includes a first opening and a second opening extending through an exterior surface of the distal ablation tip; and  
 extending electrode assembly through the first opening, along an outer surface of the distal ablation tip, and a member of the plurality of members through the second opening to couple and fix the electrode assembly relative to the distal ablation tip.
16. A catheter for use in cardiac mapping and/or ablation, the catheter comprising:  
 an elongate catheter shaft having an inner channel and a distal end region;  
 a distal ablation tip configured to ablate tissue disposed near the distal end region;  
 an electrode assembly releasably coupled to the distal ablation tip;
- 15 wherein the electrode assembly includes a flexible circuit having a plurality of arm regions, wherein each arm region includes one or more electrodes disposed thereon;  
 wherein the distal ablation electrode region includes a first opening and a second opening extending through an exterior surface of the distal ablation tip;  
 wherein the electrode assembly extends along the inner channel, through the first opening, and wherein an arm region of the plurality of arm regions extends along an outer surface of the distal ablation tip and through the second opening to mechanically secure the electrode assembly to the distal ablation tip.
- 20 17. The catheter of claim 16, wherein the electrode assembly includes a region that is disposed along a distal end of the distal ablation tip.
- 25 18. The catheter of claim 16, wherein each arm region has an arrow shape.
- 30 19. The catheter of claim 16, wherein each arm region has relief cutouts.
- 40 20. The catheter of claim 16, wherein each member has a rounded shape.

\* \* \* \* \*

专利名称(译)	具有连接至消融尖端的柔性电极组件的医疗设备		
公开(公告)号	<a href="#">US10603105</a>	公开(公告)日	2020-03-31
申请号	US14/922023	申请日	2015-10-23
[标]申请(专利权)人(译)	波士顿科学西美德公司		
申请(专利权)人(译)	BOSTON SCIENTIFIC SCIMED INC.		
当前申请(专利权)人(译)	BOSTON SCIENTIFIC SCIMED INC		
[标]发明人	CHEUNG DESMOND POTOSKY JOHN C MARECKI ANDREW T KIM ISAAC J MIRIGIAN MARK D		
发明人	CHEUNG, DESMOND POTOSKY, JOHN C. MARECKI, ANDREW T. KIM, ISAAC J. MIRIGIAN, MARK D.		
IPC分类号	A61B18/14 A61B5/042 A61B5/00 A61B17/00 A61B18/00		
CPC分类号	A61B5/6852 A61B5/6859 A61B18/1492 A61B5/0422 A61B2018/00577 A61B2017/00526 A61B2018/00642 A61B2018/00839 A61B2018/00351 A61B2018/1495 A61B2018/1465 A61B2562/166		
助理审查员(译)	欧阳, BO		
优先权	62/068334 2014-10-24 US		
其他公开文献	US20160113712A1		
外部链接	<a href="#">Espacenet</a>		

摘要(译)

公开了医疗设备以及用于制造和使用医疗设备的方法。示例医疗设备可包括用于心脏标测和/或消融的导管。导管可以包括细长的导管轴，该导管轴具有能够消融组织的远端消融电极区域。电极组件可以联接至远侧消融电极区域。所述电极组件可包括其上布置有一个或多个电极的柔性电路。

