



US 20170188871A1

(19) **United States**

(12) **Patent Application Publication**
Bishay et al.

(10) **Pub. No.: US 2017/0188871 A1**
(43) **Pub. Date: Jul. 6, 2017**

(54) **ELECTROCARDIOGRAPHY PATCH**

(52) **U.S. Cl.**

(71) Applicants: **Jon Mikalson Bishay**, Seattle, WA
(US); **Gust H. Bardy**, Camation, WA
(US); **Jason Felix**, Vashon Island, WA
(US)

CPC **A61B 5/04085** (2013.01); **A61B 5/6823**
(2013.01); **A61B 5/6833** (2013.01); **A61B**
5/02055 (2013.01); **A61B 5/04087** (2013.01);
A61B 2560/0412 (2013.01); **A61B 5/14542**
(2013.01)

(72) Inventors: **Jon Mikalson Bishay**, Seattle, WA
(US); **Gust H. Bardy**, Camation, WA
(US); **Jason Felix**, Vashon Island, WA
(US)

(57)

ABSTRACT

(21) Appl. No.: **15/406,627**

(22) Filed: **Jan. 13, 2017**

Related U.S. Application Data

(63) Continuation of application No. 14/080,717, filed on
Nov. 14, 2013, now Pat. No. 9,545,204.

(60) Provisional application No. 61/882,403, filed on Sep.
25, 2013.

Publication Classification

(51) **Int. Cl.**
A61B 5/0408 (2006.01)
A61B 5/0205 (2006.01)
A61B 5/00 (2006.01)

An electrocardiography patch is provided. A flexible back-
ing is formed of an elongated strip of stretchable material
and a pair of electrodes is respectively affixed on a contact
surface of each end of the elongated strip. A flexible circuit
is affixed on each end of the elongated strip and includes a
pair of circuit traces electrically coupled to each electrode.
A non-conductive receptacle is securely adhered on the one
end of the elongated strip opposite the contact surface and
formed to removably receive an electrocardiography moni-
tor and house a battery. Electrical pads are provided on a
bottom surface of the non-conductive receptacle to interface
with electrical contacts protruding from the electrocardiog-
raphy monitor. A pair of the electrical pads is formed to
electrically couple with the electrodes. A pair of battery
leads is formed on the non-conductive receptacle to electri-
cally interface the battery to another pair of the electrical
pads.

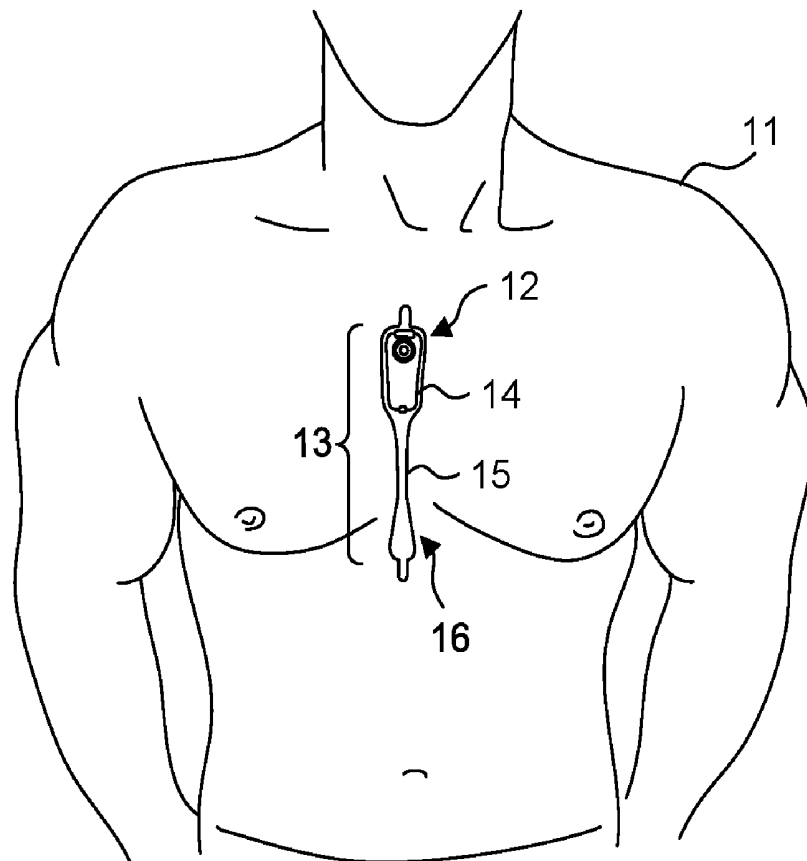

Fig. 1.

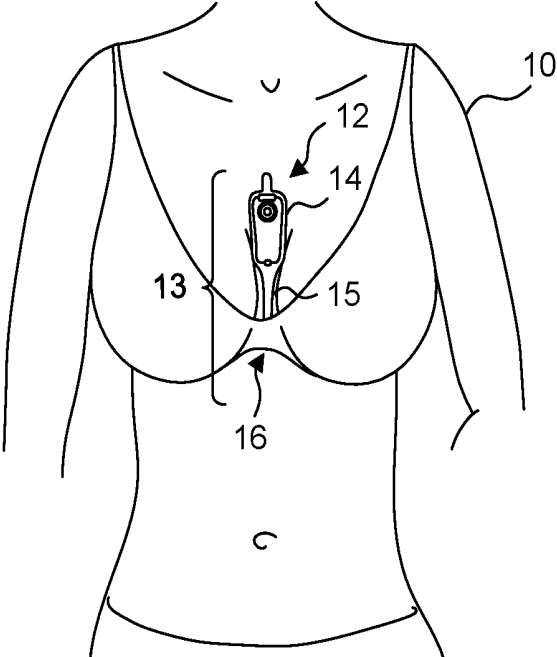

Fig. 2.

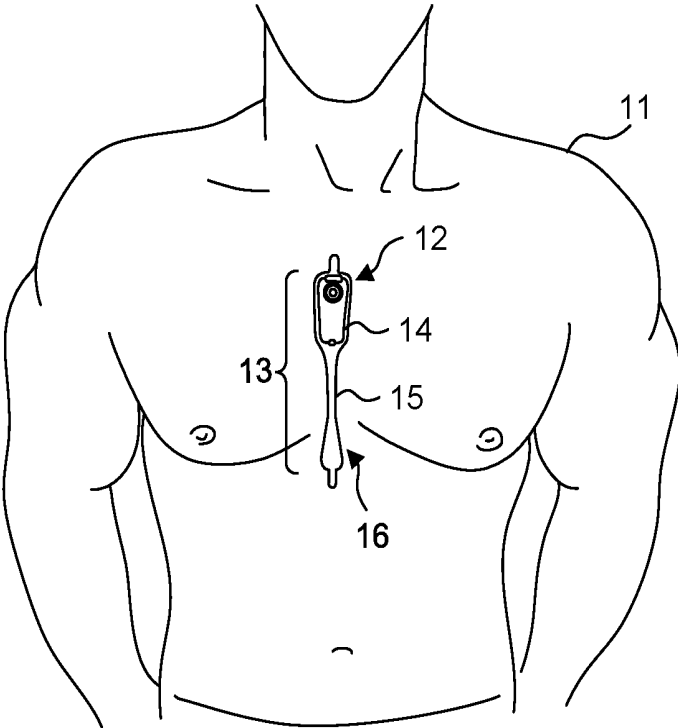

Fig. 3.

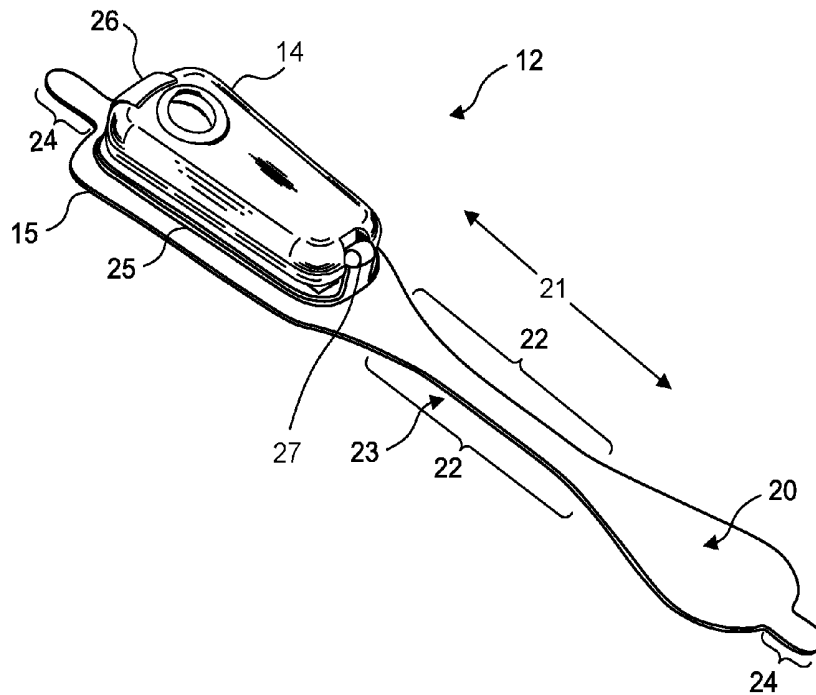

Fig. 4.

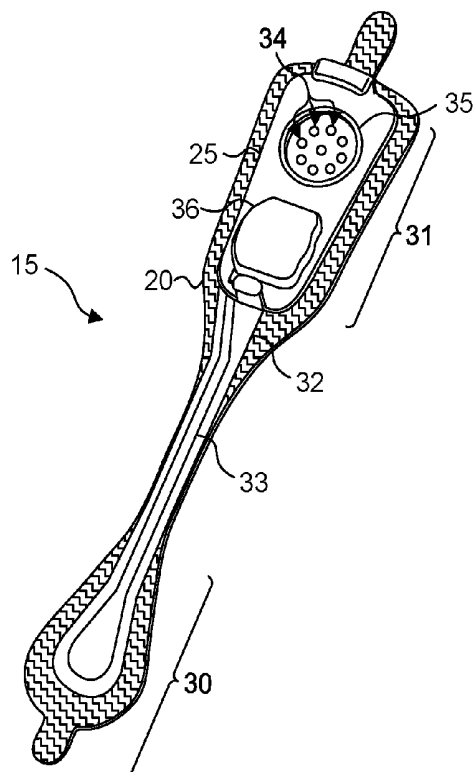

Fig. 5.

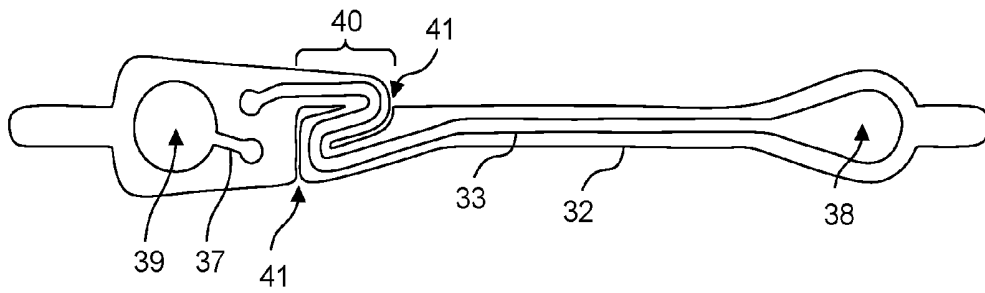

Fig. 6.

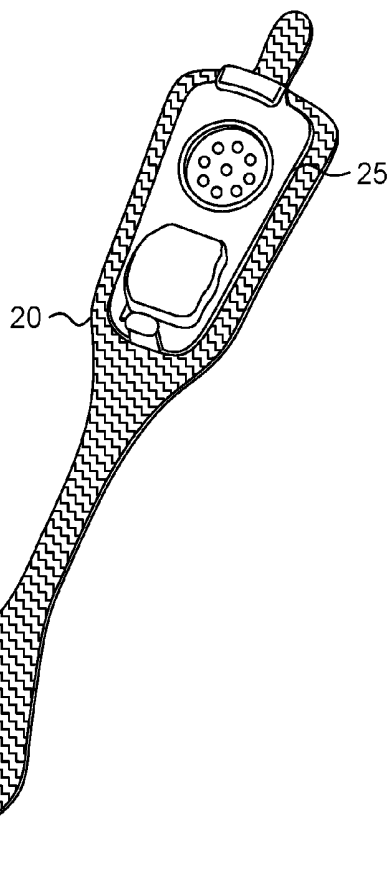

Fig. 7.

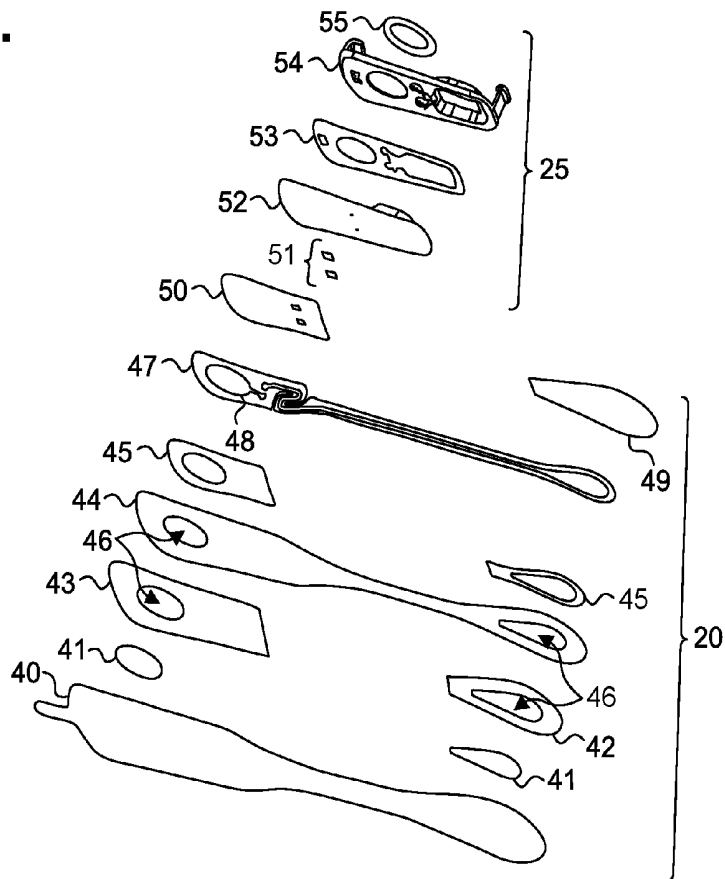
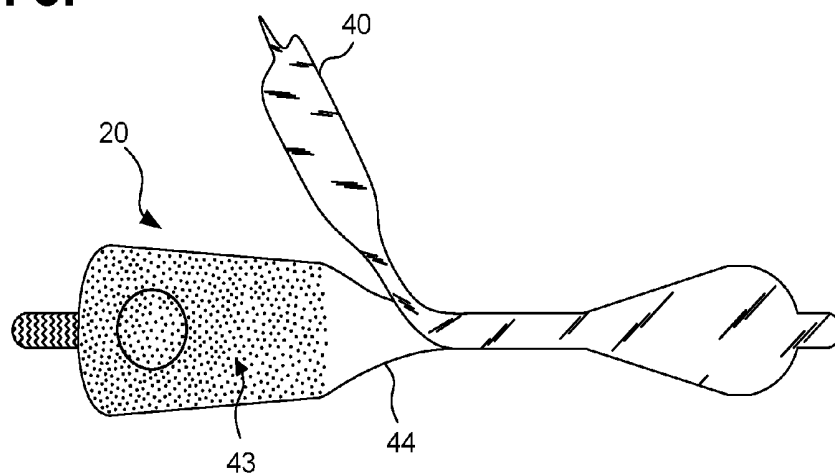

Fig. 8.



ELECTROCARDIOGRAPHY PATCH

CROSS-REFERENCE TO RELATED APPLICATION

[0001] This U.S. patent application is a continuation of U.S. patent application, Ser. No. 14/080,717, filed Nov. 14, 2013, pending, which claims priority under 35 U.S.C. §119 (e) to U.S. Provisional Patent application, Ser. No. 61/882,403, filed Sep. 25, 2013, the disclosure of which is incorporated by reference.

FIELD

[0002] This application relates in general to electrocardiographic monitoring and, in particular, to an electrocardiography patch.

BACKGROUND

[0003] The heart emits electrical signals as a by-product of the propagation of the action potentials that trigger depolarization of heart fibers. An electrocardiogram (ECG) measures and records such electrical potentials to visually depict the electrical activity of the heart over time. Conventionally, a standardized set format 12-lead configuration is used by an ECG machine to record cardiac electrical signals from well-established traditional chest locations. Electrodes at the end of each lead are placed on the skin over the anterior thoracic region of the patient's body to the lower right and to the lower left of the sternum, on the left anterior chest, and on the limbs. Sensed cardiac electrical activity is represented by PQRSTU waveforms that can be interpreted post-ECG recordation to derive heart rate and physiology. The P-wave represents atrial electrical activity. The QRSTU components represent ventricular electrical activity.

[0004] An ECG is a tool used by physicians to diagnose heart problems and other potential health concerns. An ECG is a snapshot of heart function, typically recorded over 12 seconds, that can help diagnose rate and regularity of heartbeats, effect of drugs or cardiac devices, including pacemakers and implantable cardioverter-defibrillators (ICDs), and whether a patient has heart disease. ECGs are used in-clinic during appointments, and, as a result, are limited to recording only those heart-related aspects present at the time of recording. Sporadic conditions that may not show up during a spot ECG recording require other means to diagnose them. These disorders include fainting or syncope; rhythm disorders, such as tachyarrhythmias and bradyarrhythmias; apneic episodes; and other cardiac and related disorders. Thus, an ECG only provides a partial picture and can be insufficient for complete patient diagnosis of many cardiac disorders.

[0005] Diagnostic efficacy can be improved, when appropriate, through the use of long-term extended ECG monitoring. Recording sufficient ECG and related physiology over an extended period is challenging, and often essential to enabling a physician to identify events of potential concern. A 30-day observation day period is considered the "gold standard" of ECG monitoring, yet achieving a 30-day observation day period has proven unworkable because such ECG monitoring systems are arduous to employ, cumbersome to the patient, and excessively costly. Ambulatory monitoring in-clinic is implausible and impracticable. Nevertheless, if a patient's ECG could be recorded in an ambulatory setting, thereby allowing the patient to engage in

activities of daily living, the chances of acquiring meaningful information and capturing an abnormal event while the patient is engaged in normal activities becomes more likely to be achieved.

[0006] For instance, the long-term wear of ECG electrodes is complicated by skin irritation and the inability ECG electrodes to maintain continual skin contact after a day or two. Moreover, time, dirt, moisture, and other environmental contaminants, as well as perspiration, skin oil, and dead skin cells from the patient's body, can get between an ECG electrode, the non-conductive adhesive used to adhere the ECG electrode, and the skin's surface. All of these factors adversely affect electrode adhesion and the quality of cardiac signal recordings. Furthermore, the physical movements of the patient and their clothing impart various compressional, tensile, and torsional forces on the contact point of an ECG electrode, especially over long recording times, and an inflexibly fastened ECG electrode will be prone to becoming dislodged. Moreover, dislodgment may occur unbeknownst to the patient, making the ECG recordings worthless. Further, some patients may have skin that is susceptible to itching or irritation, and the wearing of ECG electrodes can aggravate such skin conditions. Thus, a patient may want or need to periodically remove or replace ECG electrodes during a long-term ECG monitoring period, whether to replace a dislodged electrode, reestablish better adhesion, alleviate itching or irritation, allow for cleansing of the skin, allow for showering and exercise, or for other purpose. Such replacement or slight alteration in electrode location actually facilitates the goal of recording the ECG signal for long periods of time.

[0007] Conventionally, Holter monitors are widely used for long-term extended ECG monitoring. Typically, they are often used for only 24-48 hours. A typical Holter monitor is a wearable and portable version of an ECG that include cables for each electrode placed on the skin and a separate battery-powered ECG recorder. The cable and electrode combination (or leads) are placed in the anterior thoracic region in a manner similar to what is done with an in-clinic standard ECG machine. The duration of a Holter monitoring recording depends on the sensing and storage capabilities of the monitor, as well as battery life. A "looping" Holter (or event) monitor can operate for a longer period of time by overwriting older ECG tracings, thence "recycling" storage in favor of extended operation, yet at the risk of losing event data. Although capable of extended ECG monitoring, Holter monitors are cumbersome, expensive and typically only available by medical prescription, which limits their usability. Further, the skill required to properly place the electrodes on the patient's chest hinders or precludes a patient from replacing or removing the precordial leads and usually involves moving the patient from the physician office to a specialized center within the hospital or clinic.

[0008] The ZIO XT Patch and ZIO Event Card devices, manufactured by iRhythm Tech., Inc., San Francisco, Calif., are wearable stick-on monitoring devices that are typically worn on the upper left pectoral region to respectively provide continuous and looping ECG recording. The location is used to simulate surgically implanted monitors. Both of these devices are prescription-only and for single patient use. The ZIO XT Patch device is limited to a 14-day monitoring period, while the electrodes only of the ZIO Event Card device can be worn for up to 30 days. The ZIO XT Patch device combines both electronic recordation com-

ponents and physical electrodes into a unitary assembly that adheres to the patient's skin. The ZIO XT Patch device uses adhesive sufficiently strong to support the weight of both the monitor and the electrodes over an extended period of time and to resist disadherence from the patient's body, albeit at the cost of disallowing removal or relocation during the monitoring period. The ZIO Event Card device is a form of downsized Holter monitor with a recorder component that must be removed temporarily during baths or other activities that could damage the non-waterproof electronics. Both devices represent compromises between length of wear and quality of ECG monitoring, especially with respect to ease of long term use, female-friendly fit, and quality of atrial (P-wave) signals.

[0009] Therefore, a need remains for an extended wear continuously recording ECG monitor practicably capable of being worn for a long period of time, especially in women where breast anatomy can interfere with signal quality in both men and women and capable of recording atrial signals reliably.

[0010] A further need remains for a device capable of recording signals ideal for arrhythmia discrimination, especially a device designed for atrial activity recording.

SUMMARY

[0011] Physiological monitoring can be provided through a wearable monitor that includes two components, a flexible extended wear electrode patch and a removable reusable monitor recorder. The wearable monitor sits centrally (in the midline) on the patient's chest along the sternum oriented top-to-bottom. The placement of the wearable monitor in a location at the sternal midline (or immediately to either side of the sternum), with its unique narrow "hourglass"-like shape, significantly improves the ability of the wearable monitor to cutaneously sense cardiac electric signals, particularly the P-wave (or atrial activity) and, to a lesser extent, the QRS interval signals in the ECG waveforms indicating ventricular activity. The electrode patch is shaped to fit comfortably and conformal to the contours of the patient's chest approximately centered on the sternal midline. To counter the dislodgment due to compressional and torsional forces, a layer of non-irritating adhesive, such as hydrocolloid, is provided at least partially on the underside, or contact, surface of the electrode patch, but only on the electrode patch's distal and proximal ends. To counter dislodgment due to tensile and torsional forces, a strain relief is defined in the electrode patch's flexible circuit using cutouts partially extending transversely from each opposite side of the flexible circuit and continuing longitudinally towards each other to define in 'S'-shaped pattern. Each of these components are distinctive and allow for comfortable and extended wear, especially by women, where breast mobility would otherwise interfere with monitor use and comfort.

[0012] One embodiment provides an extended wear electrocardiography patch. A flexible backing is formed of an elongated strip of stretchable material with a narrow longitudinal midsection evenly tapering inward from both ends. The elongated strip is adherable only on each end of a contact surface to serve as a crimp relief to facilitate compression of the narrow longitudinal midsection in response to compressional and torsional forces. A pair of electrocardiographic electrodes is respectively affixed to and conductively exposed on the contact surface of each end of

the elongated strip. A flexible circuit is affixed on each end to the elongated strip. The flexible circuit includes a pair of circuit traces both originating within one of the ends of the elongated strip and which are electrically coupled to each electrocardiographic electrode. A laterally-extendable strain relief is defined in the flexible circuit and formed to facilitate extension and rotation of the flexible circuit in response to tensile and torsional forces. A non-conductive receptacle is securely adhered on the one end of the elongated strip opposite the contact surface and is formed to removably receive an electrocardiography monitor. The non-conductive receptacle includes electrode terminals aligned to electrically interface the pair of circuit traces to the electrocardiography monitor.

[0013] A further embodiment provides an electrocardiography patch. A flexible backing is formed of an elongated strip of stretchable material and a pair of electrodes is respectively affixed on a contact surface of each end of the elongated strip. A flexible circuit is affixed on each end of the elongated strip and includes a pair of circuit traces electrically coupled to each electrode. A non-conductive receptacle is securely adhered on the one end of the elongated strip opposite the contact surface and formed to removably receive an electrocardiography monitor and house a battery. Electrical pads are provided on a bottom surface of the non-conductive receptacle to interface with electrical contacts protruding from the electrocardiography monitor. A pair of the electrical pads is formed to electrically couple with the electrodes. A pair of battery leads is formed on the non-conductive receptacle to electrically interface the battery to another pair of the electrical pads.

[0014] The monitoring patch is especially suited to the female anatomy. The narrow longitudinal midsection can fit nicely within the intermammary cleft of the breasts without inducing discomfort, whereas conventional patch electrodes are wide and, if adhered between the breasts, would cause chafing, irritation, frustration, and annoyance, leading to low patient compliance.

[0015] The foregoing aspects enhance ECG monitoring performance and quality facilitating long-term ECG recording, critical to accurate arrhythmia diagnosis.

[0016] In addition, the foregoing aspects enhance comfort in women (and certain men), but not irritation of the breasts, by placing the monitoring patch in the best location possible for optimizing the recording of cardiac signals from the atrium, another feature critical to proper arrhythmia diagnosis.

[0017] Still other embodiments will become readily apparent to those skilled in the art from the following detailed description, wherein are described embodiments by way of illustrating the best mode contemplated. As will be realized, other and different embodiments are possible and the embodiments' several details are capable of modifications in various obvious respects, all without departing from their spirit and the scope. Accordingly, the drawings and detailed description are to be regarded as illustrative in nature and not as restrictive.

BRIEF DESCRIPTION OF THE DRAWINGS

[0018] FIGS. 1 and 2 are diagrams showing, by way of examples, an extended wear electrocardiography monitor, including an extended wear electrode patch in accordance with one embodiment, respectively fitted to the sternal region of a female patient and a male patient.

[0019] FIG. 3 is a perspective view showing an extended wear electrode patch in accordance with one embodiment with a monitor recorder inserted.

[0020] FIG. 4 is a perspective view showing the extended wear electrode patch of FIG. 3 without a monitor recorder inserted.

[0021] FIG. 5 is a top view showing the flexible circuit of the extended wear electrode patch of FIG. 3.

[0022] FIG. 6 is a perspective view showing the extended wear electrode patch in accordance with a further embodiment.

[0023] FIG. 7 is an exploded view showing the component layers of the electrode patch of FIG. 3.

[0024] FIG. 8 is a bottom plan view of the extended wear electrode patch of FIG. 3 with liner partially peeled back.

DETAILED DESCRIPTION

[0025] Physiological monitoring can be provided through a wearable monitor that includes two components, a flexible extended wear electrode patch and a removable reusable monitor recorder. FIGS. 1 and 2 are diagrams showing, by way of examples, an extended wear electrocardiography monitor 12, including an extended wear electrode patch 15 in accordance with one embodiment, respectively fitted to the sternal region of a female patient 10 and a male patient 11. The wearable monitor 12 sits centrally (in the midline) on the patient's chest along the sternum 13 oriented top-to-bottom with the monitor recorder 14 preferably situated towards the patient's head. The electrode patch 15 is shaped to fit comfortably and conformal to the contours of the patient's chest approximately centered on the sternal midline 16 (or immediately to either side of the sternum 13). The distal end of the electrode patch 15 extends towards the Xiphoid process and, depending upon the patient's build, may straddle the region over the Xiphoid process. The proximal end of the electrode patch 15, located under the monitor recorder 14, is below the manubrium and, depending upon patient's build, may straddle the region over the manubrium.

[0026] The placement of the wearable monitor 12 in a location at the sternal midline 16 (or immediately to either side of the sternum 13) significantly improves the ability of the wearable monitor 12 to cutaneously sense cardiac electric signals, particularly the P-wave (or atrial activity) and, to a lesser extent, the QRS interval signals in the ECG waveforms that indicate ventricular activity. The sternum 13 overlies the right atrium of the heart and the placement of the wearable monitor 12 in the region of the sternal midline 13 puts the ECG electrodes of the electrode patch 15 in a location better adapted to sensing and recording P-wave signals than other placement locations, say, the upper left pectoral region. In addition, placing the lower or inferior pole (ECG electrode) of the electrode patch 15 over (or near) the Xiphoid process facilitates sensing of right ventricular activity and provides superior recordation of the QRS interval.

[0027] During use, the electrode patch 15 is first adhered to the skin along the sternal midline 16 (or immediately to either side of the sternum 13). A monitor recorder 14 is then snapped into place on the electrode patch 15 to initiate ECG monitoring. FIG. 3 is a perspective view showing an extended wear electrode patch 15 in accordance with one embodiment with a monitor recorder 14 inserted. The body of the electrode patch 15 is preferably constructed using a

flexible backing 20 formed as an elongated strip 21 of wrap knit or similar stretchable material about 145 mm long and 32 mm at the widest point with a narrow longitudinal mid-section 23 evenly tapering inward from both sides. A pair of cut-outs 22 between the distal and proximal ends of the electrode patch 15 create a narrow longitudinal midsection 23 or "isthmus" and defines an elongated "hourglass"-like shape, when viewed from above, such as described in commonly-assigned U.S. Design Patent application, entitled "Extended Wear Electrode Patch," Ser. No. 29/472,045, filed Nov. 7, 2013, pending, the disclosure of which is incorporated by reference. The upper part of the "hourglass" is sized to allow an electrically non-conductive receptacle 25, sits on top of the outward-facing surface of the electrode patch 15, to be affixed to the electrode patch 15 with an ECG electrode placed underneath on the patient-facing underside, or contact, surface of the electrode patch 15; the upper part of the "hourglass" has a longer and wider profile than the lower part of the "hourglass," which is sized primarily to allow just the placement of an ECG electrode.

[0028] The electrode patch 15 incorporates features that significantly improve wearability, performance, and patient comfort throughout an extended monitoring period. During wear, the electrode patch 15 is susceptible to pushing, pulling, and torquing movements, including compressional and torsional forces when the patient bends forward, and tensile and torsional forces when the patient leans backwards. To counter these stress forces, the electrode patch 15 incorporates crimp and strain reliefs, as further described infra respectively with reference to FIGS. 4 and 5. In addition, the cut-outs 22 and longitudinal midsection 23 help minimize interference with and discomfort to breast tissue, particularly in women (and gynecomastic men). The cut-outs 22 and longitudinal midsection 23 allow better conformity of the electrode patch 15 to sternal bowing and to the narrow isthmus of flat skin that can occur along the bottom of the intermammary cleft between the breasts, especially in buxom women. The cut-outs 22 and longitudinal midsection 23 help the electrode patch 15 fit nicely between a pair of female breasts in the intermammary cleft. In one embodiment, the cut-outs 22 can be graduated to form the longitudinal midsection 23 as a narrow in-between stem or isthmus portion about 7 mm wide. In a still further embodiment, tabs 24 can respectively extend an additional 8 mm to 12 mm beyond the distal and proximal ends of the flexible backing 20 to facilitate purchase when adhering the electrode patch 15 to or removing the electrode patch 15 from the sternum 13. These tabs preferably lack adhesive on the underside, or contact, surface of the electrode patch 15. Still other shapes, cut-outs and conformities to the electrode patch 15 are possible.

[0029] The monitor recorder 14 removably and reusably snaps into an electrically non-conductive receptacle 25 during use. The monitor recorder 14 contains electronic circuitry for recording and storing the patient's electrocardiography as sensed via a pair of ECG electrodes provided on the electrode patch 15, such as described in commonly-assigned U.S. patent application, entitled "Extended Wear Ambulatory Electrocardiography and Physiological Sensor Monitor," Ser. No. 14/080,725, filed Nov. 14, 2013, pending, the disclosure of which is incorporated by reference. The circuitry includes a microcontroller, flash storage, ECG signal processing, analog-to-digital conversion (where applicable), and an external interface for coupling to the

electrode patch **15** and to a download station for stored data download and device programming. The monitor recorder **14** also includes external patient-interfaceable controls, such as a push button to facilitate event marking and a resonance circuit to provide vibratory output. In a further embodiment, the circuitry, with the assistance of the appropriate types of deployed electrodes or sensors, is capable of monitoring other types of physiology, in addition to ECGs. Still other types of monitor recorder components and functionality are possible.

[0030] The non-conductive receptacle **25** is provided on the top surface of the flexible backing **20** with a retention catch **26** and tension clip **27** molded into the non-conductive receptacle **25** to conformably receive and securely hold the monitor recorder **14** in place. The edges of the bottom surface of the non-conductive receptacle **25** are preferably rounded, and the monitor recorder **14** is nestled inside the interior of the non-conductive receptacle **25** to present a rounded (gentle) surface, rather than a sharp edge at the skin-to-device interface.

[0031] The electrode patch **15** is intended to be disposable. The monitor recorder **14**, however, is reusable and can be transferred to successive electrode patches **15** to ensure continuity of monitoring. The placement of the wearable monitor **12** in a location at the sternal midline **16** (or immediately to either side of the sternum **13**) benefits long-term extended wear by removing the requirement that ECG electrodes be continually placed in the same spots on the skin throughout the monitoring period. Instead, the patient is free to place an electrode patch **15** anywhere within the general region of the sternum **13**.

[0032] As a result, at any point during ECG monitoring, the patient's skin is able to recover from the wearing of an electrode patch **15**, which increases patient comfort and satisfaction, while the monitor recorder **14** ensures ECG monitoring continuity with minimal effort. A monitor recorder **14** is merely unsnapped from a worn out electrode patch **15**, the worn out electrode patch **15** is removed from the skin, a new electrode patch **15** is adhered to the skin, possibly in a new spot immediately adjacent to the earlier location, and the same monitor recorder **14** is snapped into the new electrode patch **15** to reinitiate and continue the ECG monitoring.

[0033] During use, the electrode patch **15** is first adhered to the skin in the sternal region. FIG. 4 is a perspective view showing the extended wear electrode patch **15** of FIG. 3 without a monitor recorder **14** inserted. A flexible circuit **32** is adhered to each end of the flexible backing **20**. A distal circuit trace **33** from the distal end **30** of the flexible backing **20** and a proximal circuit trace (not shown) from the proximal end **31** of the flexible backing **20** electrically couple ECG electrodes (not shown) to a pair of electrical pads **34**. The electrical pads **34** are provided within a moisture-resistant seal **35** formed on the bottom surface of the non-conductive receptacle **25**. When the monitor recorder **14** is securely received into the non-conductive receptacle **25**, that is, snapped into place, the electrical pads **34** interface to electrical contacts (not shown) protruding from the bottom surface of the monitor recorder **14**, and the moisture-resistant seal **35** enables the monitor recorder **14** to be worn at all times, even during bathing or other activities that could expose the monitor recorder **14** to moisture.

[0034] In addition, a battery compartment **36** is formed on the bottom surface of the non-conductive receptacle **25**, and

a pair of battery leads (not shown) electrically interface the battery to another pair of the electrical pads **34**. The battery contained within the battery compartment **35** can be replaceable, rechargeable or disposable.

[0035] The monitor recorder **14** draws power externally from the battery provided in the non-conductive receptacle **25**, thereby uniquely obviating the need for the monitor recorder **14** to carry a dedicated power source. The battery contained within the battery compartment **35** can be replaceable, rechargeable or disposable. In a further embodiment, the ECG sensing circuitry of the monitor recorder **14** can be supplemented with additional sensors, including an SpO₂ sensor, a blood pressure sensor, a temperature sensor, respiratory rate sensor, a glucose sensor, an air flow sensor, and a volumetric pressure sensor, which can be incorporated directly into the monitor recorder **14** or onto the non-conductive receptacle **25**.

[0036] The placement of the flexible backing **20** on the sternal midline **16** (or immediately to either side of the sternum **13**) also helps to minimize the side-to-side movement of the wearable monitor **12** in the left- and right-handed directions during wear. However, the wearable monitor **12** is still susceptible to pushing, pulling, and torquing movements, including compressional and torsional forces when the patient bends forward, and tensile and torsional forces when the patient leans backwards. To counter the dislodgment of the flexible backing **20** due to compressional and torsional forces, a layer of non-irritating adhesive, such as hydrocolloid, is provided at least partially on the underside, or contact, surface of the flexible backing **20**, but only on the distal end **30** and the proximal end **31**. As a result, the underside, or contact surface of the longitudinal midsection **23** does not have an adhesive layer and remains free to move relative to the skin. Thus, the longitudinal midsection **23** forms a crimp relief that respectively facilitates compression and twisting of the flexible backing **20** in response to compressional and torsional forces. Other forms of flexible backing crimp reliefs are possible.

[0037] Unlike the flexible backing **20**, the flexible circuit **32** is only able to bend and cannot stretch in a planar direction. FIG. 5 is a top view showing the flexible circuit **32** of the extended wear electrode patch **15** of FIG. 3. A distal ECG electrode **38** and proximal ECG electrode **39** are respectively coupled to the distal and proximal ends of the flexible circuit **32**. The flexible circuit **32** preferably does not extend to the outside edges of the flexible backing **20**, thereby avoiding gouging or discomforting the patient's skin during extended wear, such as when sleeping on the side. During wear, the ECG electrodes **38**, **39** must remain in continual contact with the skin. A strain relief **40** is defined in the flexible circuit **32** at a location that is partially underneath the battery compartment **36** when the flexible circuit **32** is affixed to the flexible backing **20**. The strain relief **40** is laterally extendable to counter dislodgment of the ECG electrodes **38**, **39** due to tensile and torsional forces. A pair of strain relief cutouts **41** partially extend transversely from each opposite side of the flexible circuit **32** and continue longitudinally towards each other to define in 'S'-shaped pattern, when viewed from above. The strain relief respectively facilitates longitudinal extension and twisting of the flexible circuit **32** in response to tensile and torsional forces. Other forms of circuit board strain relief are possible.

[0038] The flexible circuit 32 can be provided either above or below the flexible backing 20. FIG. 6 is a perspective view showing the extended wear electrode patch 15 in accordance with a further embodiment. The flexible circuit (not shown) is provided on the underside, or contact, surface of the flexible backing 20 and is electrically interfaced to the set of electrical pads 34 on the bottom surface of the non-conductive receptacle 25 through electrical contacts (not shown) pierced through the flexible backing 20.

[0039] The electrode patch 15 is intended to be a disposable component, which enables a patient to replace the electrode patch 15 as needed throughout the monitoring period, while maintaining continuity of physiological sensing through reuse of the same monitor recorder 14. FIG. 7 is an exploded view showing the component layers of the electrode patch 15 of FIG. 3. The flexible backing 20 is constructed of a wearable gauze, latex, or similar wrap knit or stretchable and wear-safe material 44, such as a Tricot-type linen with a pressure sensitive adhesive (PSA) on the underside, or contact, surface. The wearable material 44 is coated with a layer 43 of non-irritating adhesive, such as hydrocolloid, to facilitate long-term wear. The hydrocolloid, for instance, is typically made of mineral oil, cellulose and water and lacks any chemical solvents, so should cause little itching or irritation. Moreover, hydrocolloid is thicker and more gel-like than most forms of PSA and provides cushioning between the relatively rigid and unyielding non-conductive receptacle 25 and the patient's skin. In a further embodiment, the layer of non-irritating adhesive can be contoured, such as by forming the adhesive with a concave or convex cross-section; surfaced, such as through stripes or crosshatches of adhesive, or by forming dimples in the adhesive's surface; or applied discontinuously, such as with a formation of discrete dots of adhesive.

[0040] As described supra with reference to FIG. 5, a flexible circuit can be adhered to either the outward facing surface or the underside, or contact, surface of the flexible backing 20. For convenience, a flexible circuit 47 is shown relative to the outward facing surface of the wearable material 44 and is adhered respectively on a distal end by a distal electrode seal 45 and on a proximal end by a proximal electrode seal 45. In a further embodiment, the flexible circuit 47 can be provided on the underside, or contact, surface of the wearable material 44. Through the electrode seals, only the distal and proximal ends of the flexible circuit 47 are attached to the wearable material 44, which enables the strain relief 40 (shown in FIG. 5) to respectively longitudinally extend and twist in response to tensile and torsional forces during wear. Similarly, the layer 43 of non-irritating adhesive is provided on the underside, or contact, surface of the wearable material 44 only on the proximal and distal ends, which enables the longitudinal midsection 23 (shown in FIG. 3) to respectively bow outward and away from the sternum 13 or twist in response to compressional and torsional forces during wear.

[0041] A pair of openings 46 is defined on the distal and proximal ends of the wearable material 44 and layer 43 of non-irritating adhesive for ECG electrodes 38, 39 (shown in FIG. 5). The openings 46 serve as "gel" wells with a layer of hydrogel 41 being used to fill the bottom of each opening 46 as a conductive material that aids electrode signal pick up. The entire underside, or contact, surface of the flexible backing 20 is protected prior to use by a liner layer 40 that is peeled away, as shown in FIG. 8.

[0042] The non-conductive receptacle 25 includes a main body 54 that is molded out of polycarbonate, ABS, or an alloy of those two materials to provide a high surface energy to facilitate adhesion of an adhesive seal 53. The main body 54 is attached to a battery printed circuit board 52 by the adhesive seal 53 and, in turn, the battery printed circuit board 52 is adhered to the flexible circuit 47 with an upper flexible circuit seal 50. A pair of conductive transfer adhesive points 51 or, alternatively, metallic rivets or similar conductive and structurally unifying components, connect the circuit traces 33, 37 (shown in FIG. 5) of the flexible circuit 47 to the battery printed circuit board 52. The main body 54 has a retention catch 26 and tension clip 27 (shown in FIG. 3) that fixably and securely receive a monitor recorder 14 (not shown), and includes a recess within which to circumferentially receive a die cut gasket 55, either rubber, urethane foam, or similar suitable material, to provide a moisture resistant seal to the set of pads 34.

[0043] While the invention has been particularly shown and described as referenced to the embodiments thereof, those skilled in the art will understand that the foregoing and other changes in form and detail may be made therein without departing from the spirit and scope.

What is claimed is:

1. An electrocardiography patch, comprising:
 - a flexible backing formed of an elongated strip of stretchable material;
 - a pair of electrodes respectively affixed to and conductively exposed on a contact surface of each end of the elongated strip;
 - a flexible circuit affixed on each end to the elongated strip and comprising a pair of circuit traces both originating within one of the ends of the elongated strip and electrically coupled to each electrode;
 - a non-conductive receptacle securely adhered on the one end of the elongated strip opposite the contact surface and formed to removably receive an electrocardiography monitor and house a battery;
 - electrical pads provided within a moisture-resistant seal formed on a bottom surface of the non-conductive receptacle to interface with electrical contacts protruding from a bottom surface of the electrocardiography monitor and a pair of the electrical pads formed to electrically couple with the electrodes via the circuit traces; and
 - a pair of battery leads formed on the non-conductive receptacle to electrically interface the battery to another pair of the electrical pads.
2. An electrocardiography patch according to claim 1, further comprising:
 - one of the electrodes being disposed for being adhered to a region overlying the Xiphoid process on a patient's chest; and
 - an other of the electrodes being disposed for being adhered to the region near the manubrium on the patient's chest oriented centrally (in the midline) along the sternum upwards from the one electrode.
3. An electrocardiography patch according to claim 1, further comprising:
 - an upper part of the elongated strip defined on one end of the flexible backing and sized to be affixed to the bottom surface of the non-conductive receptacle, the

- other of the electrodes being affixed to and conductively exposed on the contact surface of the upper part; and
- a lower part of the elongated strip defined on another end of the flexible backing; the one of the electrodes being affixed to and conductively exposed on the contact surface of the lower part,
- wherein the lower part of the elongated strip is provided for being adhered to the region overlying the Xiphoid process on a patient's chest with the narrow longitudinal midsection oriented centrally (in the midline) along the sternum and the upper part of the elongated strip oriented upwards towards the manubrium.
- 4.** An electrocardiography patch according to claim 1, further comprising:
- a non-irritating adhesive dressing at least partially coated on each end of the elongated strip on the contact surface.
- 5.** An electrocardiography patch according to claim 1, further comprising:
- a contoured surface comprised on the non-irritating adhesive dressing on at least one end of the elongated strip.
- 6.** An electrocardiography patch according to claim 1, further comprising:
- a plurality of fasteners comprised on the non-conductive receptacle and oriented to securely receive and to hold captive the electrocardiography monitor into the non-conductive receptacle.
- 7.** An electrocardiography patch according to claim 1, further comprising:
- at least one of an SpO₂ sensor, a blood pressure sensor, a temperature sensor, respiratory rate sensor, a glucose sensor, an air flow sensor, and a volumetric pressure sensor provided to supplement the electrocardiography monitor by one of direct incorporation into the electrocardiography monitor and direct receipt on the non-conductive receptacle.
- 8.** An electrocardiography patch according to claim 1, further comprising:
- a liner shaped to cover the contact surface of the flexible backing.
- 9.** An electrocardiography patch according to claim 1, wherein the flexible circuit is adhered to one of the contact surface of the flexible backing and a surface opposite the contact surface of the flexible backing.
- 10.** An electrocardiography patch according to claim 1, wherein the electrocardiography monitor draws power externally from the battery provided in the non-conductive receptacle.
- 11.** An electrocardiography and physiological sensor monitor, comprising:
- a disposable extended wear electrode patch comprising:
 - a flexible backing formed of an elongated strip of stretchable material;
 - a pair of electrodes respectively affixed to and conductively exposed on a contact surface of each end of the elongated strip;
 - a flexible circuit affixed on each end to the elongated strip and comprising a pair of circuit traces both originating within one of the ends of the elongated strip and electrically coupled to each electrode;
 - a non-conductive receptacle securely adhered on the one end of the elongated strip opposite the contact surface and formed to house a battery;
 - electrical pads provided within a moisture-resistant seal formed on a bottom surface of the non-conductive receptacle and a pair of the electrical pads formed to electrically couple with the electrodes via the circuit traces; and
 - a pair of battery leads formed on the non-conductive receptacle to electrically interface the battery to another pair of the electrical pads; and
- a reusable electrocardiography monitor having a sealed housing adapted to be removably secured into the non-conductive receptacle, wherein the sealed housing comprises a cavity on a bottom surface to accommodate the battery on the extended wear electrode patch and protruding electrical contacts that interface with the electrical pads on the non-conductive receptacle.
- 12.** An electrocardiography and physiological sensor monitor according to claim 11, further comprising:
- one of the electrodes being disposed for being adhered to a region overlying the Xiphoid process on a patient's chest; and
 - an other of the electrodes being disposed for being adhered to the region near the manubrium on the patient's chest oriented centrally (in the midline) along the sternum upwards from the one electrode.
- 13.** An electrocardiography and physiological sensor monitor according to claim 11, further comprising:
- an upper part of the elongated strip defined on one end of the flexible backing and sized to be affixed to the bottom surface of the non-conductive receptacle, the other of the electrodes being affixed to and conductively exposed on the contact surface of the upper part; and
 - a lower part of the elongated strip defined on another end of the flexible backing; the one of the electrodes being affixed to and conductively exposed on the contact surface of the lower part,
 - wherein the lower part of the elongated strip is provided for being adhered to the region overlying the Xiphoid process on a patient's chest with the narrow longitudinal midsection oriented centrally (in the midline) along the sternum and the upper part of the elongated strip oriented upwards towards the manubrium.
- 14.** An electrocardiography and physiological sensor monitor according to claim 11, further comprising:
- a non-irritating adhesive dressing at least partially coated on each end of the elongated strip on the contact surface.
- 15.** An electrocardiography and physiological sensor monitor according to claim 11, further comprising:
- a contoured surface comprised on the non-irritating adhesive dressing on at least one end of the elongated strip.
- 16.** An electrocardiography and physiological sensor monitor according to claim 11, further comprising:
- a plurality of fasteners comprised on the non-conductive receptacle and oriented to securely receive and to hold captive the electrocardiography monitor into the non-conductive receptacle.
- 17.** An electrocardiography and physiological sensor monitor according to claim 11, further comprising:
- at least one of an SpO₂ sensor, a blood pressure sensor, a temperature sensor, respiratory rate sensor, a glucose sensor, an air flow sensor, and a volumetric pressure sensor provided to supplement the electrocardiography

monitor by one of direct incorporation into the electrocardiography monitor and direct receipt on the non-conductive receptacle.

18. An electrocardiography and physiological sensor monitor according to claim **11**, further comprising:

a liner shaped to cover the contact surface of the flexible backing.

19. An electrocardiography and physiological sensor monitor according to claim **11**, wherein the flexible circuit is adhered to one of the contact surface of the flexible backing and a surface opposite the contact surface of the flexible backing.

20. An electrocardiography and physiological sensor monitor according to claim **11**, wherein the electrocardiography monitor draws power externally from the battery provided in the non-conductive receptacle.

* * * * *

专利名称(译)	心电图补丁		
公开(公告)号	US20170188871A1	公开(公告)日	2017-07-06
申请号	US15/406627	申请日	2017-01-13
[标]申请(专利权)人(译)	BISHAY JON MIKALSON BARDY GUST ^ h FELIX JASON		
申请(专利权)人(译)	BISHAY , JON MIKALSON BARDY , GUST H. FELIX , JASON		
当前申请(专利权)人(译)	BISHAY , JON MIKALSON BARDY , GUST H. FELIX , JASON		
[标]发明人	BISHAY JON MIKALSON BARDY GUST H FELIX JASON		
发明人	BISHAY, JON MIKALSON BARDY, GUST H. FELIX, JASON		
IPC分类号	A61B5/0408 A61B5/0205 A61B5/00		
CPC分类号	A61B5/04085 A61B5/6823 A61B5/6833 A61B5/02055 A61B5/04087 A61B2560/0412 A61B2562/164 A61B5/021 A61B5/0816 A61B5/14532 A61B5/087 A61B5/091 A61B5/14542 A61B5/04017 A61B5 /04325 A61B5/1116 A61B5/14551 A61B5/7455 A61B2505/07 A61B2560/0271 A61B2560/045 G01N27 /307 A61B5/0006 A61B5/0022 A61B5/01 A61B5/0452 A61B5/04525 A61B5/1117 A61B5/1118 A61B5 /4809 A61B5/6801 A61B2562/0219		
优先权	61/882403 2013-09-25 US		
其他公开文献	US9901274		
外部链接	Espacenet USPTO		

摘要(译)

提供心电图贴片。柔性背衬由细长的可拉伸材料条形成，并且一对电极分别固定在细长条的每个端部的接触表面上。柔性电路固定在细长条的每一端上，并且包括电耦合到每个电极的一对电路迹线。非导电插座牢固地粘附在与接触表面相对的细长带的一端上并形成可移除地接收心电图监视器并容纳电池。电焊盘设置在非导电插座的底表面上，以与从心电图监视器突出的电触点相接触。一对电焊盘形成为与电极电耦合。一对电池引线形成在非导电插座上，以使电池与另一对电焊盘电接触。

