



US010631748B2

(12) **United States Patent**
Felix et al.

(10) **Patent No.:** **US 10,631,748 B2**
(45) **Date of Patent:** **Apr. 28, 2020**

(54) **EXTENDED WEAR
ELECTROCARDIOGRAPHY PATCH WITH
WIRE INTERCONNECTS**

(71) Applicant: **Bardy Diagnostics, Inc.**, Seattle, WA
(US)

(72) Inventors: **Jason Felix**, Vashon Island, WA (US);
Jon Mikalson Bishay, Lexington, KY
(US); **Gust H. Bardy**, Carnation, WA
(US)

(73) Assignee: **BARDY DIAGNOSTICS, INC.**,
Seattle, WA (US)

(*) Notice: Subject to any disclaimer, the term of this
patent is extended or adjusted under 35
U.S.C. 154(b) by 0 days.

(21) Appl. No.: **16/221,989**

(22) Filed: **Dec. 17, 2018**

(65) **Prior Publication Data**

US 2019/0117107 A1 Apr. 25, 2019

Related U.S. Application Data

(63) Continuation of application No. 15/662,192, filed on
Jul. 27, 2017, now Pat. No. 10,154,793, which is a
(Continued)

(51) **Int. Cl.**
A61B 5/0408 (2006.01)
A61B 5/00 (2006.01)

(52) **U.S. Cl.**
CPC **A61B 5/04085** (2013.01); **A61B 5/0408**
(2013.01); **A61B 5/6823** (2013.01);
(Continued)

(58) **Field of Classification Search**
CPC A61B 5/04085; A61B 5/04087; A61B
5/0408; A61B 5/6823;
(Continued)

(56) **References Cited**

U.S. PATENT DOCUMENTS

3,215,136 A 11/1965 Holter et al.
3,569,852 A 3/1971 Berkovits
3,602,215 A 8/1971 Parnell
3,699,948 A 10/1972 Ota et al.

(Continued)

FOREIGN PATENT DOCUMENTS

DE 19955211 5/2001
EP 1859833 11/2007

(Continued)

OTHER PUBLICATIONS

15 Of The Hottest Wearable Gadgets, Url <<http://thehottestgadgets.com/2008/09/the-15-hottest-wearable-gadgets-001253>> (Web page cached on Sep. 27, 2008).

(Continued)

Primary Examiner — Lee S Cohen

Assistant Examiner — Erin M Cardinal

(74) *Attorney, Agent, or Firm* — Patrick J. S. Inouye;
Leonid Kisselev

(57) **ABSTRACT**

An extended wear electrocardiography patch with wire interconnects is provided. The patch includes a flexible backing formed of an elongated strip of stretchable material with narrow longitudinal midsection evenly tapering inward from a distal end and a proximal end, the elongated strip adherable only at a contact surface defined on each of the ends; a pair of electrocardiographic electrodes interfaced to one or more of a set of electrode pads, each of the electrodes including an electrically conductive surface only exposed on the contact surface; a battery connected to one or more of the pads of the set via at least one flexile wire interconnect, the battery secured in place via a flexile wire; and the set of electrical contact pads included on the flexible backing and formed by a set of further flexile wires, the set configured to interface the electrodes and the battery with an electrocardiography monitor recorder.

18 Claims, 9 Drawing Sheets

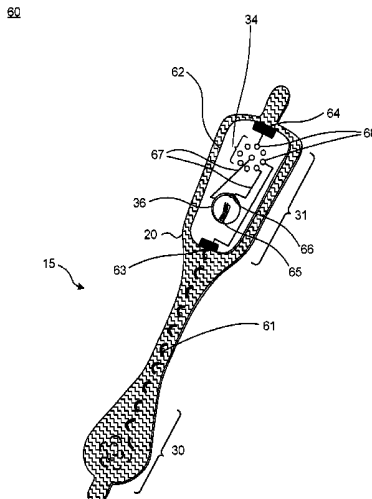

Related U.S. Application Data

- continuation of application No. 14/463,585, filed on Aug. 19, 2014, now Pat. No. 9,717,432, which is a continuation-in-part of application No. 14/080,717, filed on Nov. 14, 2013, now Pat. No. 9,545,204.
- (60) Provisional application No. 61/882,403, filed on Sep. 25, 2013.
- (52) **U.S. Cl.**
 CPC *A61B 5/6833* (2013.01); *A61B 2560/0412* (2013.01); *A61B 2560/0443* (2013.01); *A61B 2560/0456* (2013.01); *A61B 2562/164* (2013.01)
- (58) **Field of Classification Search**
 CPC *A61B 5/6832-6833*; *A61B 2560/0412*; *A61B 2560/0443*; *A61B 2560/0468*; *A61B 2562/0209*; *A61B 2562/164-166*
 See application file for complete search history.

(56) **References Cited**

U.S. PATENT DOCUMENTS

3,718,772 A 2/1973 Sanctuary
 3,893,453 A 7/1975 Goldberg
 4,123,785 A 10/1978 Cherry et al.
 4,151,513 A 4/1979 Menken et al.
 4,328,814 A 5/1982 Arkans
 4,441,500 A 4/1984 Sessions et al.
 4,532,934 A 8/1985 Kelen
 4,546,342 A 10/1985 Weaver et al.
 4,550,502 A 11/1985 Grayzel
 4,580,572 A 4/1986 Granek et al.
 4,635,646 A 1/1987 Gilles et al.
 4,653,022 A 3/1987 Koro
 4,716,903 A 1/1988 Hansen
 4,809,705 A 3/1989 Ascher
 4,915,656 A 4/1990 Alferness
 5,007,429 A 4/1991 Treatch et al.
 5,025,794 A 6/1991 Albert et al.
 5,107,480 A 4/1992 Naus
 5,168,876 A 12/1992 Quedens et al.
 5,215,098 A 6/1993 Steinhaus
 5,231,990 A 8/1993 Gauglitz
 D341,423 S 11/1993 Bible
 5,263,481 A 11/1993 Axelgaard
 5,265,579 A 11/1993 Ferrari
 5,333,615 A 8/1994 Craelius et al.
 5,341,806 A 8/1994 Gadsby et al.
 5,348,008 A 9/1994 Bornn et al.
 5,355,891 A 10/1994 Wateridge et al.
 5,365,934 A 11/1994 Leon et al.
 5,365,935 A 11/1994 Righter et al.
 5,392,784 A 2/1995 Gudaitis
 D357,069 S 4/1995 Plahn et al.
 5,402,780 A 4/1995 Faasse, Jr.
 5,402,884 A 4/1995 Gilman et al.
 5,450,845 A 9/1995 Axelgaard
 5,451,876 A 9/1995 Sendford et al.
 5,458,141 A 10/1995 Neil
 5,473,537 A 12/1995 Glazer et al.
 5,483,969 A 1/1996 Testerman et al.
 5,511,553 A 4/1996 Segalowitz
 5,540,733 A 7/1996 Testerman et al.
 5,546,952 A 8/1996 Erickson
 5,549,655 A 8/1996 Erickson
 5,579,919 A 12/1996 Gilman et al.
 5,582,181 A 12/1996 Ruess
 D377,983 S 2/1997 Sabri et al.
 5,601,089 A 2/1997 Bledsoe et al.
 5,623,935 A 4/1997 Faisandier
 5,682,901 A 11/1997 Kamen
 5,697,955 A 12/1997 Stolte
 5,724,967 A 3/1998 Venkatachalam

5,749,902 A 5/1998 Olsen et al.
 5,788,633 A 8/1998 Mahoney
 5,817,151 A 10/1998 Olsen et al.
 5,819,741 A 10/1998 Karlsson et al.
 5,850,920 A 12/1998 Gilman et al.
 D407,159 S 3/1999 Roberg
 5,876,351 A 3/1999 Rohde
 5,906,583 A 5/1999 Rogel
 5,951,598 A 9/1999 Bishay et al.
 5,957,857 A 9/1999 Hartley
 5,984,102 A 11/1999 Tay
 6,032,064 A 2/2000 Devlin et al.
 6,038,469 A 3/2000 Karlsson et al.
 6,101,413 A 8/2000 Olsen et al.
 6,115,638 A 9/2000 Groenke
 6,117,077 A 9/2000 Del Mar et al.
 6,134,479 A 10/2000 Brewer et al.
 6,148,233 A 11/2000 Owen et al.
 6,149,602 A 11/2000 Arcelus
 6,149,781 A 11/2000 Forand
 6,188,407 B1 2/2001 Smith et al.
 D443,063 S 5/2001 Pisani et al.
 6,245,025 B1 6/2001 Torok et al.
 6,246,330 B1 6/2001 Nielsen
 6,249,696 B1 6/2001 Olson et al.
 D445,507 S 7/2001 Pisani et al.
 6,269,267 B1 7/2001 Bardy et al.
 6,272,385 B1 8/2001 Bishay et al.
 6,298,255 B1 10/2001 Cordero et al.
 6,301,502 B1 10/2001 Owen et al.
 6,304,773 B1 10/2001 Taylor et al.
 6,304,780 B1 10/2001 Owen et al.
 6,304,783 B1 10/2001 Lyster et al.
 6,374,138 B1 4/2002 Owen et al.
 6,381,482 B1 4/2002 Jayaraman et al.
 6,416,471 B1 7/2002 Kumar et al.
 6,418,342 B1 7/2002 Owen et al.
 6,424,860 B1 7/2002 Karlsson et al.
 6,427,083 B1 7/2002 Owen et al.
 6,427,085 B1 7/2002 Boon et al.
 6,454,708 B1 9/2002 Ferguson et al.
 6,456,872 B1 9/2002 Faisandier
 6,463,320 B1 10/2002 Xue et al.
 6,546,285 B1 4/2003 Owen et al.
 6,605,046 B1 8/2003 Del Mar
 6,607,485 B2 8/2003 Bardy
 6,611,705 B2 8/2003 Hopman et al.
 6,671,545 B2 12/2003 Fincke
 6,671,547 B2 12/2003 Lyster et al.
 6,694,186 B2 2/2004 Bardy
 6,704,595 B2 3/2004 Bardy
 6,705,991 B2 3/2004 Bardy
 6,719,701 B2 4/2004 Lade
 6,754,523 B2 6/2004 Toole
 6,782,293 B2 8/2004 Dupelle et al.
 6,856,832 B1 2/2005 Matsumura
 6,860,897 B2 3/2005 Bardy
 6,866,629 B2 3/2005 Bardy
 6,887,201 B2 5/2005 Bardy
 6,893,397 B2 5/2005 Bardy
 6,895,261 B1 5/2005 Palamides
 6,904,312 B2 6/2005 Bardy
 6,908,431 B2 6/2005 Bardy
 6,913,577 B2 7/2005 Bardy
 6,944,498 B2 9/2005 Owen et al.
 6,960,167 B2 11/2005 Bardy
 6,970,731 B1 11/2005 Jayaraman et al.
 6,978,169 B1 12/2005 Guerra
 6,993,377 B2 1/2006 Flick et al.
 7,020,508 B2 3/2006 Stivoric et al.
 7,027,864 B2 4/2006 Snyder et al.
 7,065,401 B2 6/2006 Worden
 7,085,601 B1 8/2006 Bardy et al.
 7,104,955 B2 9/2006 Bardy
 7,134,996 B2 11/2006 Bardy
 7,137,389 B2 11/2006 Berthon-Jones
 7,147,600 B2 12/2006 Bardy
 7,215,991 B2 5/2007 Besson et al.
 7,248,916 B2 7/2007 Bardy

(56)

References Cited

U.S. PATENT DOCUMENTS

7,257,438	B2	8/2007	Kinast	9,603,542	B2	3/2017	Veen et al.
7,277,752	B2	10/2007	Matos	9,700,222	B2	7/2017	Quinlan et al.
7,294,108	B1	11/2007	Bornzin et al.	9,770,182	B2	9/2017	Bly et al.
D558,882	S	1/2008	Brady	10,034,614	B2	7/2018	Edic et al.
7,328,061	B2	2/2008	Rowlandson et al.	10,045,708	B2	8/2018	Dusan
7,412,395	B2	8/2008	Rowlandson et al.	10,049,182	B2	8/2018	Cheffles et al.
7,429,938	B1	9/2008	Corndorf	2002/0013538	A1	1/2002	Teller
7,552,031	B2	6/2009	Vock et al.	2002/0013717	A1	1/2002	Ando et al.
D606,656	S	12/2009	Kobayashi et al.	2002/0016798	A1	2/2002	Sakai
7,706,870	B2	4/2010	Shieh et al.	2002/0103422	A1	8/2002	Harder et al.
7,756,721	B1	7/2010	Falchuk et al.	2002/0109621	A1	8/2002	Khair et al.
7,787,943	B2	8/2010	McDonough	2002/0120310	A1	8/2002	Linden et al.
7,874,993	B2	1/2011	Bardy	2002/0128686	A1	9/2002	Minogue et al.
7,881,785	B2	2/2011	Nassif et al.	2002/0184055	A1	12/2002	Naghavi et al.
D639,437	S	6/2011	Bishay et al.	2002/0193668	A1	12/2002	Munneke
7,959,574	B2	6/2011	Bardy	2003/0004547	A1	1/2003	Owen et al.
8,108,035	B1	1/2012	Bharmi	2003/0028811	A1	2/2003	Walker et al.
8,116,841	B2	2/2012	Bly et al.	2003/0073916	A1	4/2003	Yonce
8,135,459	B2	3/2012	Bardy et al.	2003/0083559	A1	5/2003	Thompson
8,172,761	B1	5/2012	Rulkov et al.	2003/0097078	A1	5/2003	Maeda
8,180,425	B2	5/2012	Selvitelli et al.	2003/0139785	A1	7/2003	Riff et al.
8,200,320	B2	6/2012	Kovacs	2003/0176802	A1	9/2003	Galen et al.
8,231,539	B2	7/2012	Bardy	2003/0211797	A1	11/2003	Hill et al.
8,231,540	B2	7/2012	Bardy	2004/0008123	A1	1/2004	Carrender
8,239,012	B2	8/2012	Felix et al.	2004/0019288	A1	1/2004	Kinast
8,249,686	B2	8/2012	Libbus et al.	2004/0034284	A1	2/2004	Aversano et al.
8,260,414	B2	9/2012	Nassif et al.	2004/0049120	A1	3/2004	Cao et al.
8,266,008	B1	9/2012	Siegal et al.	2004/0049132	A1	3/2004	Barron et al.
8,277,378	B2	10/2012	Bardy	2004/0073127	A1	4/2004	Istvan et al.
8,285,356	B2	10/2012	Bly et al.	2004/0087836	A1	5/2004	Green et al.
8,285,370	B2	10/2012	Felix et al.	2004/0088019	A1	5/2004	Rueter et al.
8,308,650	B2	11/2012	Bardy	2004/0093192	A1	5/2004	Hasson et al.
8,366,629	B2	2/2013	Bardy	2004/0116784	A1	6/2004	Gavish
8,374,688	B2	2/2013	Libbus et al.	2004/0148194	A1	7/2004	Wellons et al.
8,412,317	B2	4/2013	Mazar	2004/0163034	A1	8/2004	Colbath et al.
8,460,189	B2	6/2013	Libbus et al.	2004/0167416	A1	8/2004	Lee
8,473,047	B2	6/2013	Chakravarthy et al.	2004/0207530	A1	10/2004	Nielsen
8,478,418	B2	7/2013	Fahey	2004/0210165	A1	10/2004	Marmaropoulos et al.
8,538,503	B2	9/2013	Kumar et al.	2004/0236202	A1	11/2004	Burton
8,554,311	B2	10/2013	Warner et al.	2004/0243435	A1	12/2004	Williams
8,560,046	B2	10/2013	Kumar et al.	2004/0256453	A1	12/2004	Lammle
8,591,430	B2	11/2013	Amurthur et al.	2004/0260188	A1	12/2004	Syed et al.
8,594,763	B1	11/2013	Bibian et al.	2004/0260192	A1	12/2004	Yamamoto
8,600,486	B2	12/2013	Kaib et al.	2005/0010139	A1	1/2005	Aminian et al.
8,613,708	B2	12/2013	Bishay et al.	2005/0096717	A1	5/2005	Bishay et al.
8,613,709	B2	12/2013	Bishay et al.	2005/0108055	A1	5/2005	Ott et al.
8,620,418	B1	12/2013	Kuppuraj et al.	2005/0151640	A1	7/2005	Hastings
8,626,277	B2	1/2014	Felix et al.	2005/0154267	A1	7/2005	Bardy
8,628,020	B2	1/2014	Beck	2005/0182308	A1	8/2005	Bardy
8,668,653	B2	3/2014	Nagata et al.	2005/0182309	A1	8/2005	Bardy
8,684,925	B2	4/2014	Manicka et al.	2005/0215918	A1	9/2005	Frantz et al.
8,688,190	B2	4/2014	Libbus et al.	2005/0222513	A1	10/2005	Hadley et al.
8,718,752	B2	5/2014	Libbus et al.	2005/0228243	A1	10/2005	Bardy
8,744,561	B2	6/2014	Fahey	2005/0245839	A1	11/2005	Stivoric et al.
8,774,932	B2	7/2014	Fahey	2005/0261564	A1	11/2005	Ryu et al.
8,790,257	B2	7/2014	Libbus et al.	2005/0275416	A1	12/2005	Hervieux et al.
8,790,259	B2	7/2014	Katra et al.	2006/0025696	A1	2/2006	Kurzweil et al.
8,795,174	B2	8/2014	Manicka et al.	2006/0025824	A1	2/2006	Freeman et al.
8,798,729	B2	8/2014	Kaib et al.	2006/0030767	A1	2/2006	Lang et al.
8,798,734	B2	8/2014	Kuppuraj et al.	2006/0030904	A1	2/2006	Quiles
8,818,478	B2	8/2014	Scheffler et al.	2006/0041201	A1	2/2006	Behbehani et al.
8,818,481	B2	8/2014	Bly et al.	2006/0054737	A1	3/2006	Richardson
8,823,490	B2	9/2014	Libbus et al.	2006/0084883	A1	4/2006	Linker
8,938,287	B2	1/2015	Felix et al.	2006/0100530	A1	5/2006	Kliot et al.
8,965,492	B2	2/2015	Baker et al.	2006/0111642	A1	5/2006	Baura et al.
9,066,664	B2	6/2015	Karjalainen	2006/0122469	A1	6/2006	Martel
9,155,484	B2	10/2015	Baker et al.	2006/0124193	A1	6/2006	Orr et al.
9,204,813	B2	12/2015	Kaib et al.	2006/0224072	A1	10/2006	Shennib
9,241,649	B2	1/2016	Kumar et al.	2006/0229522	A1	10/2006	Barr
9,259,154	B2	2/2016	Miller et al.	2006/0235320	A1	10/2006	Tan et al.
9,277,864	B2	3/2016	Yang et al.	2006/0253006	A1	11/2006	Bardy
9,339,202	B2	5/2016	Brockway et al.	2006/0264730	A1	11/2006	Stivoric et al.
9,375,179	B2	6/2016	Schultz et al.	2006/0264767	A1	11/2006	Shennib
9,414,786	B1	8/2016	Brockway et al.	2007/0003115	A1	1/2007	Patton et al.
9,439,566	B2	9/2016	Arne et al.	2007/0038057	A1	2/2007	Nam et al.
				2007/0050209	A1	3/2007	Yered
				2007/0078324	A1	4/2007	Wijisiriwardana
				2007/0078354	A1	4/2007	Holland
				2007/0088406	A1	4/2007	Bennett et al.

(56)		References Cited						
U.S. PATENT DOCUMENTS								
2007/0089800	A1*	4/2007	Sharma	D02G 3/441	2010/0007413	A1	1/2010	Herleikson et al.
				139/388	2010/0022897	A1	1/2010	Parker et al.
2007/0093719	A1	4/2007	Nichols, Jr. et al.		2010/0056881	A1	3/2010	Libbus et al.
2007/0100248	A1	5/2007	Van Dam et al.		2010/0081913	A1	4/2010	Cross et al.
2007/0100667	A1	5/2007	Bardy		2010/0174229	A1	7/2010	Hsu et al.
2007/0123801	A1	5/2007	Goldberger et al.		2010/0177100	A1	7/2010	Carnes et al.
2007/0131595	A1	6/2007	Jansson et al.		2010/0185063	A1	7/2010	Bardy
2007/0136091	A1	6/2007	McTaggart		2010/0185076	A1	7/2010	Jeong et al.
2007/0179357	A1	8/2007	Bardy		2010/0191154	A1	7/2010	Berger et al.
2007/0185390	A1	8/2007	Perkins et al.		2010/0191310	A1	7/2010	Bly
2007/0203415	A1	8/2007	Bardy		2010/0223020	A1	9/2010	Goetz
2007/0203423	A1	8/2007	Bardy		2010/0234715	A1	9/2010	Shin et al.
2007/0208232	A1	9/2007	Kovacs		2010/0234716	A1	9/2010	Engel
2007/0208233	A1	9/2007	Kovacs		2010/0280366	A1	11/2010	Arne et al.
2007/0208266	A1	9/2007	Hadley		2010/0312188	A1	12/2010	Robertson et al.
2007/0225611	A1	9/2007	Kumar et al.		2010/0324384	A1	12/2010	Moon et al.
2007/0244405	A1	10/2007	Xue et al.		2011/0021937	A1	1/2011	Hugh et al.
2007/0249946	A1	10/2007	Kumar et al.		2011/0054286	A1	3/2011	Crosby et al.
2007/0255153	A1	11/2007	Kumar et al.		2011/0060215	A1	3/2011	Tupin et al.
2007/0265510	A1	11/2007	Bardy		2011/0066041	A1	3/2011	Pandia et al.
2007/0270678	A1*	11/2007	Fadem	A61B 5/0006	2011/0077497	A1	3/2011	Oster et al.
				600/372	2011/0105861	A1	5/2011	Derchak et al.
2007/0276270	A1	11/2007	Tran		2011/0144470	A1	6/2011	Mazar et al.
2007/0276275	A1	11/2007	Proctor et al.		2011/0160548	A1	6/2011	Forster
2007/0293738	A1	12/2007	Bardy		2011/0224564	A1	9/2011	Moon et al.
2007/0293739	A1	12/2007	Bardy		2011/0237922	A1	9/2011	Parker, III et al.
2007/0293740	A1	12/2007	Bardy		2011/0237924	A1*	9/2011	McGusty
2007/0293741	A1	12/2007	Bardy					A61B 5/0006
2007/0293772	A1	12/2007	Bardy		2011/0245699	A1	10/2011	Snell et al.
2007/0299325	A1	12/2007	Farrell et al.		2011/0245711	A1	10/2011	Katra et al.
2007/0299617	A1	12/2007	Willis		2011/0288605	A1	11/2011	Kaib et al.
2008/0027339	A1	1/2008	Nagai et al.		2012/0003933	A1	1/2012	Baker et al.
2008/0051668	A1	2/2008	Bardy		2012/0029306	A1	2/2012	Paquet et al.
2008/0058661	A1	3/2008	Bardy		2012/0029315	A1	2/2012	Raptis et al.
2008/0143080	A1	3/2008	Burr		2012/0029316	A1	2/2012	Raptis et al.
2008/0088467	A1	4/2008	Al-Ali et al.		2012/0035432	A1	2/2012	Katra et al.
2008/0091089	A1	4/2008	Guillory et al.		2012/0059668	A1	3/2012	Baldock et al.
2008/0091097	A1	4/2008	Linti et al.		2012/0078127	A1	3/2012	McDonald et al.
2008/0108890	A1	5/2008	Teng et al.		2012/0088998	A1	4/2012	Bardy et al.
2008/0114232	A1	5/2008	Gazit		2012/0088999	A1	4/2012	Bishay et al.
2008/0139953	A1*	6/2008	Baker	A61B 5/0006	2012/0089000	A1	4/2012	Bishay et al.
				600/509	2012/0089001	A1	4/2012	Bishay et al.
2008/0177168	A1	7/2008	Callahan et al.		2012/0089037	A1	4/2012	Bishay et al.
2008/0194927	A1	8/2008	KenKnight et al.		2012/0089412	A1	4/2012	Bishay et al.
2008/0208009	A1	8/2008	Shklarski		2012/0089417	A1	4/2012	Bardy et al.
2008/0208014	A1	8/2008	KenKnight et al.		2012/0095352	A1	4/2012	Tran
2008/0284599	A1	11/2008	Zdeblick et al.		2012/0101358	A1	4/2012	Boettcher et al.
2008/0288026	A1	11/2008	Cross et al.		2012/0101396	A1	4/2012	Solosko et al.
2008/0294024	A1	11/2008	Cosentino et al.		2012/0165645	A1	6/2012	Russel et al.
2008/0306359	A1	12/2008	Zdeblick et al.		2012/0306662	A1	6/2012	Vosch et al.
2008/0312522	A1	12/2008	Rowlandson et al.		2012/0172695	A1	7/2012	Ko et al.
2009/0012412	A1	1/2009	Wesel		2012/0220835	A1	8/2012	Chung
2009/0012979	A1	1/2009	Batani et al.		2012/0232929	A1	9/2012	Experton
2009/0054952	A1*	2/2009	Glukhovskiy	A61N 1/36017	2012/0238910	A1	9/2012	Nordstrom
				607/61	2012/0253847	A1	10/2012	Dell'Anno et al.
2009/0062897	A1	3/2009	Axelgaard		2012/0302906	A1	11/2012	Felix et al.
2009/0069867	A1	3/2009	KenKnight et al.		2012/0330126	A1	12/2012	Hoppe et al.
2009/0073991	A1	3/2009	Landrum et al.		2013/0041272	A1	2/2013	Javier et al.
2009/0076336	A1	3/2009	Mazar et al.		2013/0077263	A1	3/2013	Oleson et al.
2009/0076341	A1	3/2009	James et al.		2013/0079611	A1	3/2013	Besko
2009/0076342	A1	3/2009	Amurthur et al.		2013/0085347	A1	4/2013	Manicka et al.
2009/0076343	A1	3/2009	James et al.		2013/0085403	A1	4/2013	Gunderson et al.
2009/0076346	A1	3/2009	James et al.		2013/0087609	A1	4/2013	Nichol et al.
2009/0076349	A1	3/2009	Libbus et al.		2013/0096395	A1	4/2013	Katra et al.
2009/0076397	A1	3/2009	Libbus et al.		2013/0116533	A1	5/2013	Lian et al.
2009/0076401	A1	3/2009	Mazar et al.		2013/0123651	A1	5/2013	Bardy
2009/0076559	A1	3/2009	Libbus et al.		2013/0158361	A1	6/2013	Bardy
2009/0088652	A1	4/2009	Tremblay		2013/0197380	A1	8/2013	Oral et al.
2009/0112116	A1	4/2009	Lee et al.		2013/0225963	A1	8/2013	Kodandaramaiah et al.
2009/0131759	A1	5/2009	Sims et al.		2013/0225966	A1	8/2013	Barber et al.
2009/0156908	A1	6/2009	Belalcazar et al.		2013/0231947	A1	9/2013	Shusterman
2009/0216132	A1	8/2009	Orbach		2013/0243105	A1	9/2013	Lei et al.
2009/0270708	A1	10/2009	Shen et al.		2013/0274584	A1	10/2013	Finlay et al.
2009/0270747	A1	10/2009	Van Dam et al.		2013/0275158	A1	10/2013	Fahey
2009/0292194	A1	11/2009	Libbus et al.		2013/0324809	A1	12/2013	Lisogurski et al.
					2013/0324855	A1	12/2013	Lisogurski et al.
					2013/0324856	A1	12/2013	Lisogurski et al.
					2013/0325081	A1	12/2013	Karst et al.
					2013/0325359	A1	12/2013	Jarverud et al.

(56)

References Cited

U.S. PATENT DOCUMENTS

2013/0331665	A1	12/2013	Libbus et al.
2013/0338448	A1	12/2013	Libbus et al.
2013/0338472	A1	12/2013	Barber et al.
2014/0012154	A1	1/2014	Mazar et al.
2014/0056452	A1	2/2014	Moss et al.
2014/0088399	A1	3/2014	Lian et al.
2014/0107509	A1	4/2014	Banet et al.
2014/0140359	A1	5/2014	Kalevo et al.
2014/0180027	A1	6/2014	Buller
2014/0189928	A1	7/2014	Oleson et al.
2014/0206977	A1	7/2014	Bahney et al.
2014/0214134	A1	7/2014	Peterson
2014/0215246	A1	7/2014	Lee et al.
2014/0249852	A1	9/2014	Proud
2014/0296651	A1	10/2014	Stone
2014/0343390	A1	11/2014	Berzowska et al.
2014/0358193	A1	12/2014	Lyons et al.
2014/0364756	A1	12/2014	Brockway et al.
2015/0048836	A1	2/2015	Guthrie et al.
2015/0094558	A1*	4/2015	Russell A61B 5/6833 600/391
2015/0164349	A1	6/2015	Gopalakrishnan et al.
2015/0165211	A1	6/2015	Naqvi et al.
2015/0177175	A1	6/2015	Elder et al.
2015/0250422	A1*	9/2015	Bay A61B 5/6833 600/391
2015/0257670	A1	9/2015	Ortega et al.
2015/0305676	A1	11/2015	Shoshani
2015/0359489	A1	12/2015	Baudenbacher et al.
2016/0135746	A1	5/2016	Kumar et al.
2016/0217691	A1	7/2016	Kadobayashi et al.
2019/0021671	A1	1/2019	Kumar et al.

FOREIGN PATENT DOCUMENTS

EP	2438851	4/2012
EP	2438852	4/2012
EP	2465415	6/2012
EP	2589333	5/2013
JP	H06319711	11/1994
JP	H11188015	7/1999
JP	2004129788	4/2004
JP	2007082938	4/2007
JP	2009219554	10/2009
WO	199852463	11/1998
WO	00/78213	12/2000
WO	2003032192	4/2003
WO	2006009767	1/2006
WO	2006014806	2/2006
WO	2007066270	6/2007
WO	2007092543	8/2007
WO	2008010216	1/2008
WO	2008057884	5/2008
WO	2008092098	7/2008
WO	2009036306	3/2009
WO	2009036313	3/2009
WO	2009036327	3/2009
WO	2009112976	9/2009
WO	2009112978	9/2009
WO	2009112979	9/2009
WO	2009142975	11/2009
WO	2010066507	6/2010
WO	2010105045	6/2010
WO	2011047207	4/2011
WO	2012140559	10/2012
WO	2012146957	11/2012

OTHER PUBLICATIONS

Alivecor, URL <<http://www.businesswire.com/news/home/20121203005545/en/AliveCor%E2%80%99s-Heart-Monitor-iPhone-Receives-FDA-Clearance#U7rtq7FVtyF>> (Dec. 3, 2012).

Bharadwaj et al., Techniques for Accurate ECG signal processing, EE Times, URL <www.eetimes.com/document.asp?doc_id=1278571> (Feb. 14, 2011).

Chen et al. "Monitoring Body Temperature of Newborn Infants At Neonatal Intensive Care Units Using Wearable Sensors," BodyNets 2010, Corfu Island, Greece. Sep. 10-12, 1210.

Epstein, Andrew E. et al.; ACC/AHA/HRS 2008 Guidelines for Device-Based Therapy of Cardiac Rhythm Abnormalities. J. Am. Coll. Cardiol. 2008; 51; e1-e62, 66 Pgs.

Fitbit Tracker, URL <<http://www.fitbit.com/>> (Web page cached on Sep. 10, 2008.).

Smith, Jawbone Up, URL <<http://www.businessinsider.com/fitbit-flex-vs-jawbone-up-2013-5?op=1>> (Jun. 1, 2013).

Kligfield, Paul et al., Recommendations for the Standardization and Interpretation of the Electrocardiogram: Part I. J. Am. Coll. Cardiol; 2007; 49; 1109-27, 75 Pgs.

Lauren Gravitz, "When Your Diet Needs a Band-Aid," Technology Review, MIT. (May 1, 2009).

Lieberman, Jonathan, "How Telemedicine Is Aiding Prompt ECG Diagnosis in Primary Care," British Journal of Community Nursing, vol. 13, No. 3, Mar. 1, 2008 (Mar. 1, 2008), pp. 123-126, XP009155082, ISSN: 1462-4753.

McManus et al., "A Novel Application for the Detection of an Irregular Pulse using an iPhone 4S in Patients with Atrial Fibrillation," vol. 10(3), pp. 315-319 (Mar. 2013.).

Nike+ Fuel Band, URL <http://www.nike.com/us/en_us/c/nikeplus-fuelband> (Web page cached on Jan. 11, 2013.).

P. Libby et al., "Braunwald's Heart Disease—A Textbook of Cardiovascular Medicine," Chs. 11, pp. 125-148 and 12, pp. 149-193 (8th ed. 2008), American Heart Association.

Initial hands-on with Polar Loop activity tracker, URL <<http://www.dcrainmaker.com/2013/09/polar-loop-firstlook.html>> (Sep. 17, 2013).

Seifert, Dan, Samsung dives into fitness wearable with the Gear Fit/The Verge, URL <<http://www.theverge.com/2014/2/24/5440310/samsung-dives-into-fitness-wearables-with-the-gear-fit>> (Feb. 24, 2014).

Soper, Taylor, Samsung's new Galaxy S5 flagship phone has fingerprint reader, heart rate monitor, URL <<http://www.geekwire.com/2014/samsung-galaxy-s5-fingerprint>> (Feb. 24, 2014).

Dolcourt, See the Samsung Galaxy S5's Heart rate monitor in action, URL <<http://www.cnet.com/news/see-the-samsung-galaxy-s5s-heart-rate-monitor-in-action>> (Feb. 25, 2014).

Sittig et al., "A Computer-Based Outpatient Clinical Referral System," International Journal of Medical Informatics, Shannon, IR, vol. 55, No. 2, Aug. 1, 1999, pp. 149-158, X0004262434, ISSN: 1386-5056(99)00027-1.

Sleepview, URL <<http://www.clevemed.com/sleepview/overview.shtml>> (Web page cached on Sep. 4, 2011).

Actigraphy/ Circadian Rhythm SOMNOWatch, URL <<http://www.somnomedics.eu/news-events/publications/somnowatchtm.html>> (Web page cached on Jan. 23, 2010).

Zio Event Card, URL <<http://www.irhythmtech.com/zio-solution/zio-event/>> (Web page cached on Mar. 11, 2013.).

Zio Patch System, URL <<http://www.irhythmtech.com/zio-solution/zio-system/index.html>> (Web page cached on Sep. 8, 2011).

Saadi et al. "Heart Rhythm Analysis Using ECG Recorded With a Novel Sternum Based Patch Technology—A Pilot Study." Cardio technix 2013—Proceedings of the International Congress on Cardiovascular Technologies, Sep. 20, 2013.

Anonymous. "Omegawave Launches Consumer App 2.0 in U.S. Endurance Sportswire—Endurance Sportswire." Jul. 11, 2013. URL:<http://endurancesportswire.com/omegawave-launches-consumer-app-2-0-in-u-s/>.

Chan et al. "Wireless Patch Sensor for Remote Monitoring of Heart Rate, Respiration, Activity, and Falls." pp. 6115-6118. 2013 35th Annual International Conference of the IEEE Engineering in Medical and Biology Society.

(56)

References Cited

OTHER PUBLICATIONS

Wei et al. "A Stretchable and Flexible System for Skin-Mounted Measurement of Motion Tracking and Physiological Signals." pp. 5772-5775. 2014 36th Annual International Conference of the IEEE Engineering in Medicine and Biology Society. Aug. 26, 2014.

Daoud et al. "Fall Detection Using Shimmer Technology and Multiresolution Analysis." Aug. 2, 2013. URL: <https://decibel.ni.com/content/docs/DOC-26652>.

Libbus. "Adherent Cardiac Monitor With Wireless Fall Detection for Patients With Unexplained Syncope." Abstracts of the First AMA-IEEE Medical Technology Conference on Individualized Healthcare. May 22, 2010.

Duttweiler et al., "Probability Estimation in Arithmetic and Adaptive-Huffman Entropy Coders," IEEE Transactions on Image Processing, vol. 4, No. 3, Mar. 1, 1995, pp. 237-246.

Gupta et al., "An ECG Compression Technique for Telecardiology Application," India Conference (INDICON), 2011 Annual IEEE, Dec. 16, 2011, pp. 1-4.

Nave et al., "ECG Compression Using Long-Term Prediction," IEEE Transactions on Biomedical Engineering, IEEE Service Center, NY, USA, vol. 40, No. 9, Sep. 1, 1993, pp. 877-885.

Sketting et al., "Improved Huffman Coding Using Recursive Splitting," NORSIG, Jan. 1, 1999.

A Voss et al., "Linear and Nonlinear Methods for Analyses of Cardiovascular Variability in Bipolar Disorders," Bipolar Disorders, vol. 8, No. 5p1, Oct. 1, 2006, pp. 441-452, XP55273826, DK ISSN: 1398-5647, DOI: 10.1111/i.1399-5618.2006.00364.x.

Varicrad-Kardi Software User's Manual Rev. 1.1, Jul. 8, 2009 (Jul. 8, 2009), XP002757888, retrieved from the Internet: URL:<http://www.ehrlich.tv/KARDiVAR-Software.pdf> [retrieved on May 20, 2016].

Vedapulse UK, Jan. 1, 2014 (Jan. 1, 2014), XP002757887, Retrieved from the Internet: URL:<http://www.vedapulseuk.com/diagnostic/> [retrieved on May 19, 2016].

G. G. Ivanov, "HRV Analysis Under the Usage of Different Electrocardiography Systems," Apr. 15, 2008 (Apr. 15, 2008), XP55511209, Retrieved from the Internet: URL:[http://www.drkucera.eu/upload_doc/hrv_analysis_\(methodical_recommendations\).pdf](http://www.drkucera.eu/upload_doc/hrv_analysis_(methodical_recommendations).pdf) [retrieved on Oct. 1, 2018].

<https://web.archive.org/web/20130831204020/http://www.biopac.com/research.asp?CatID=37&Main=Software> (Aug. 2013).

<http://www.gtec.at/Products/Software/g.BSanalyze-Specs-Features> (2014).

Adinstruments:ECG Analysis Module for LabChart & PowerLab, 2008.

Biopac Systems, Inc. #AS148-Automated ECG Analysis, Mar. 24, 2006.

* cited by examiner

Fig. 1

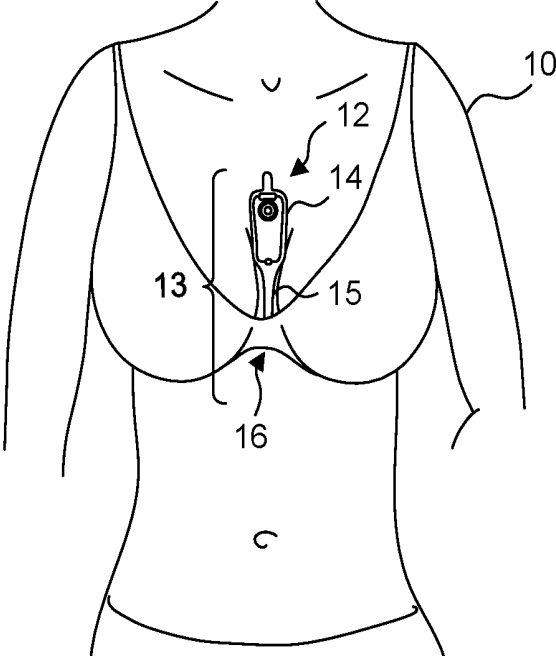

Fig. 2

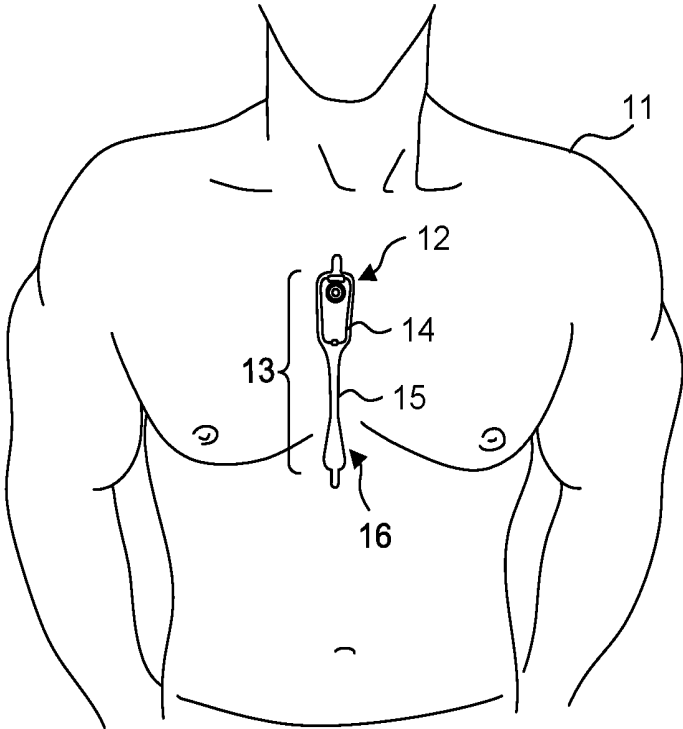

Fig. 3

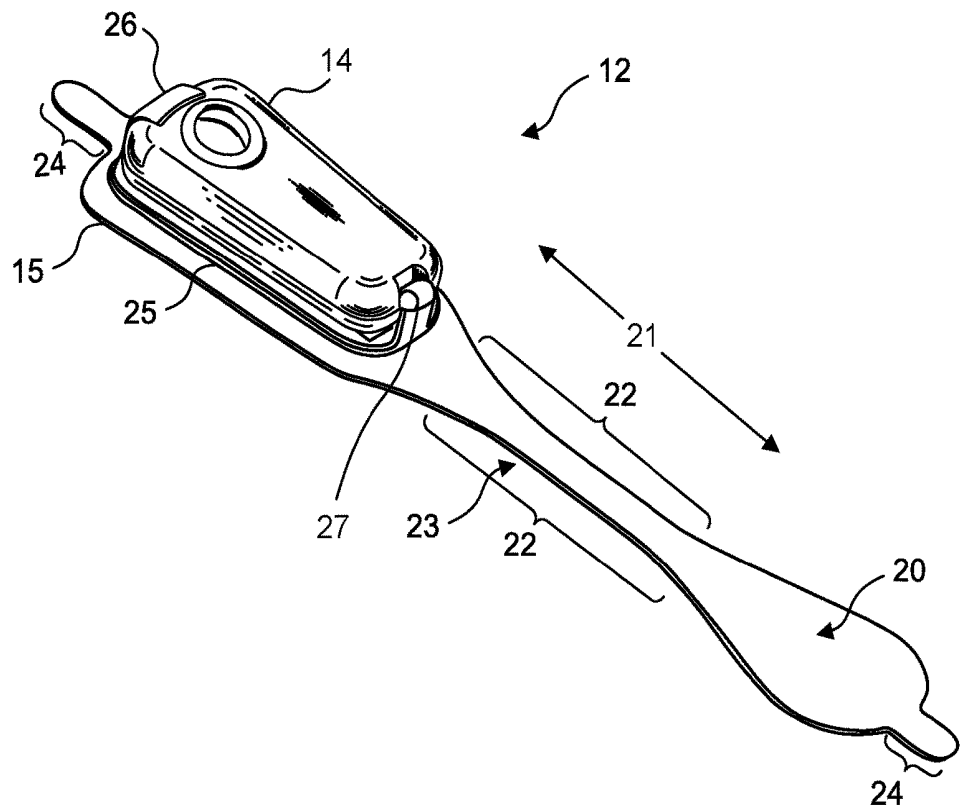

Fig. 4

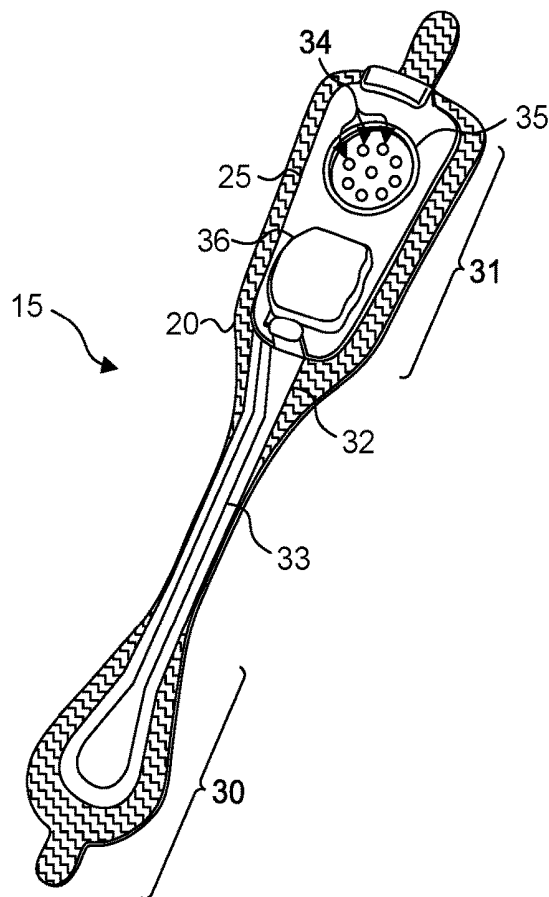

Fig. 5

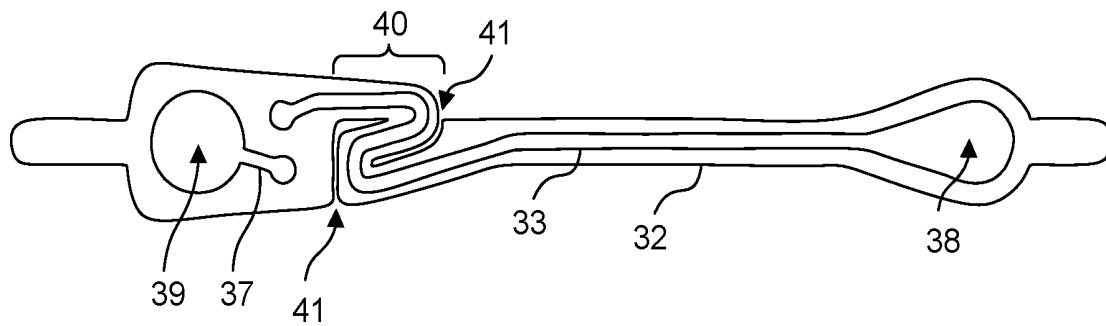

Fig. 6

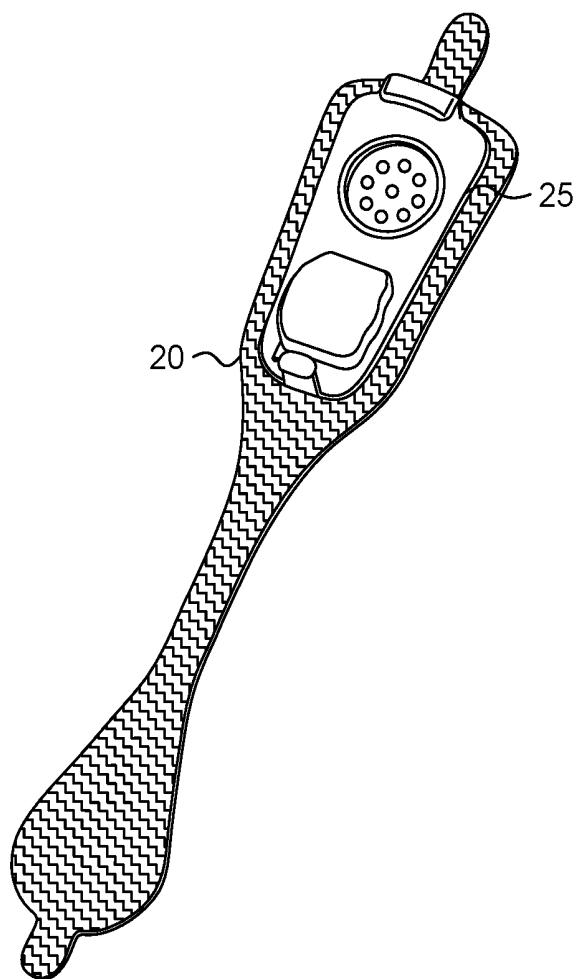

Fig. 7

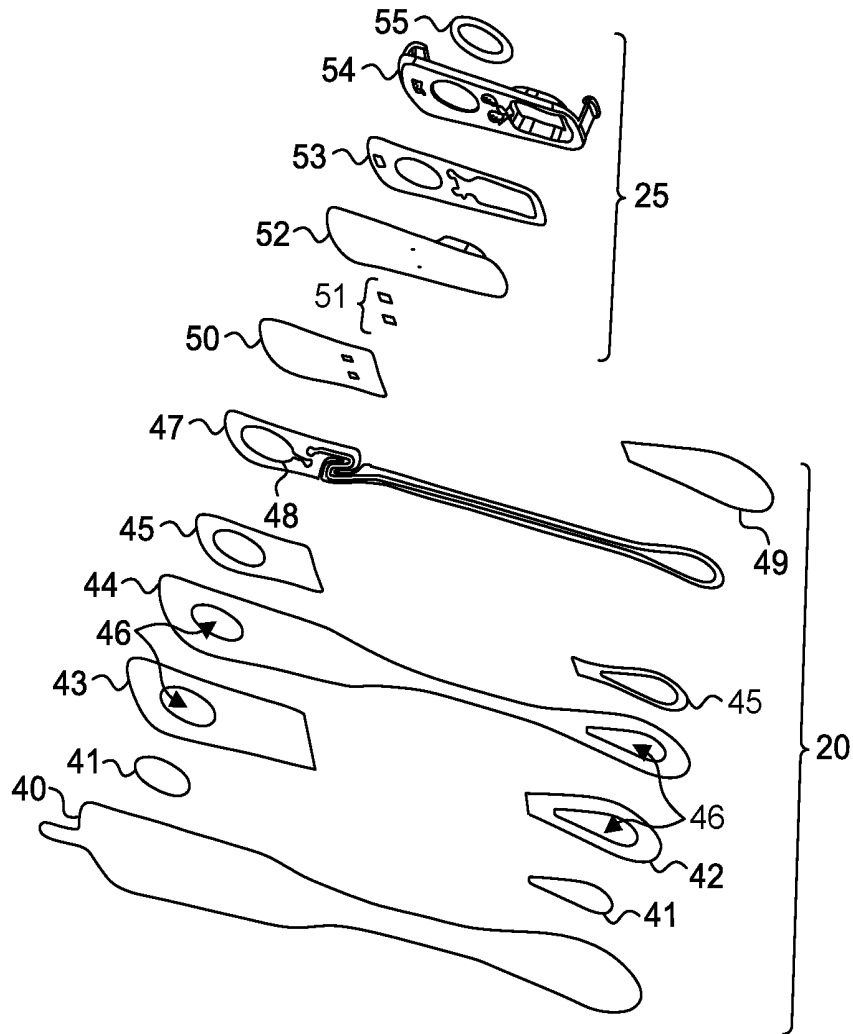

Fig. 8

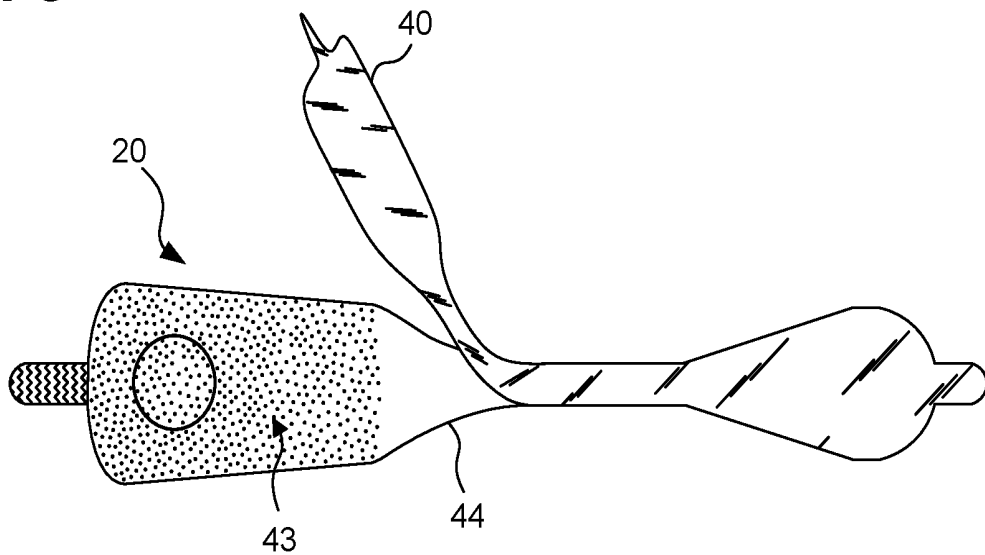

Fig. 9

60

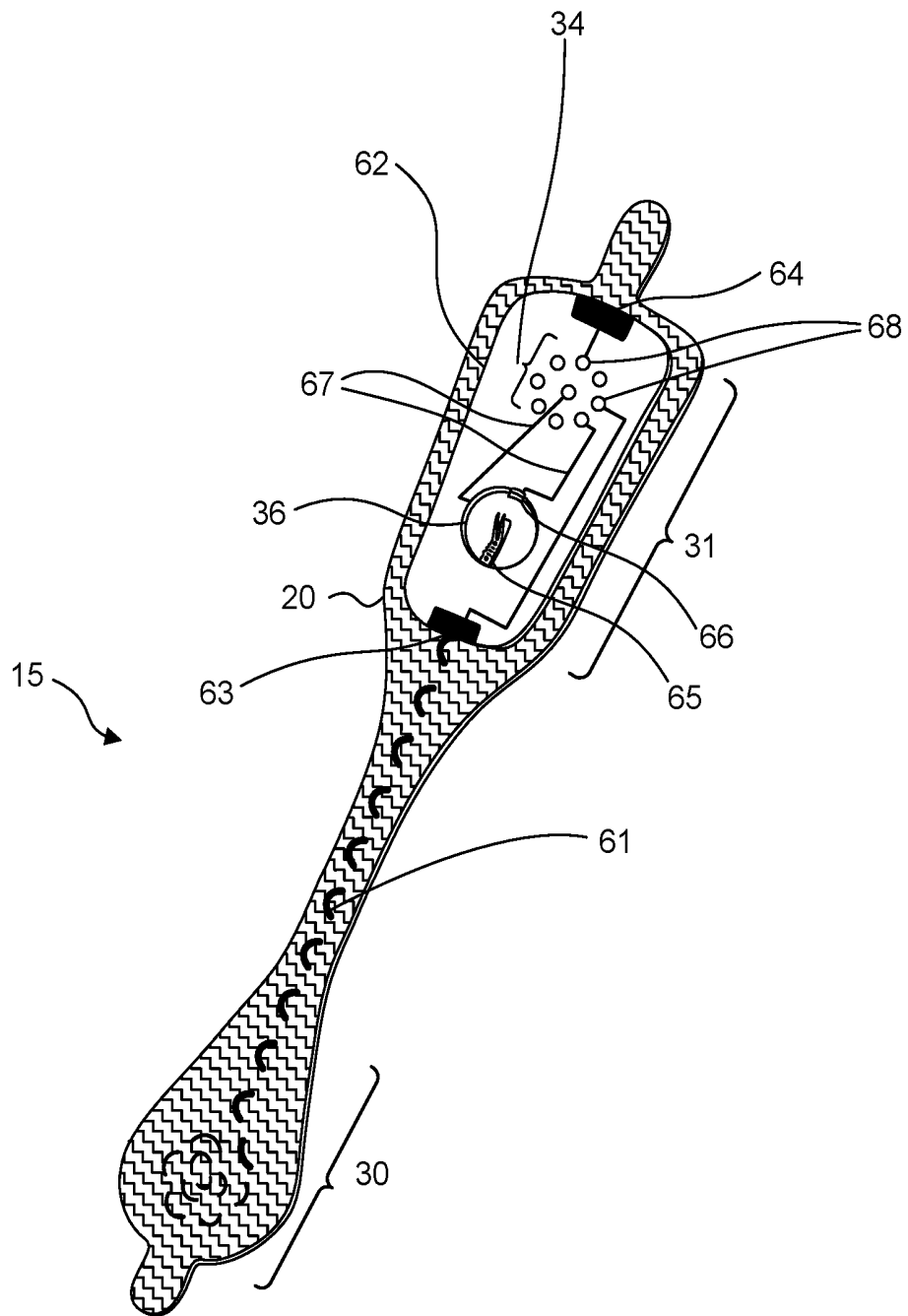

Fig. 10

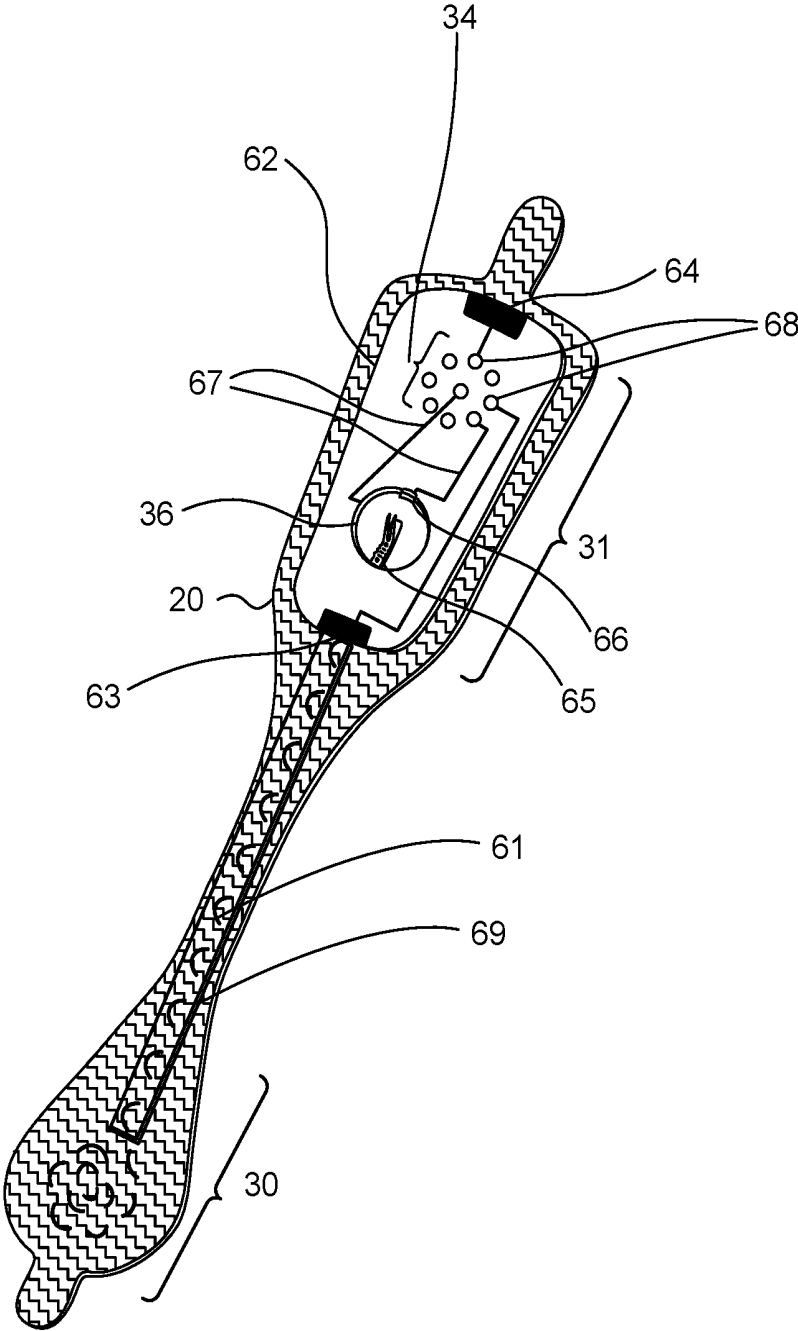

Fig. 11

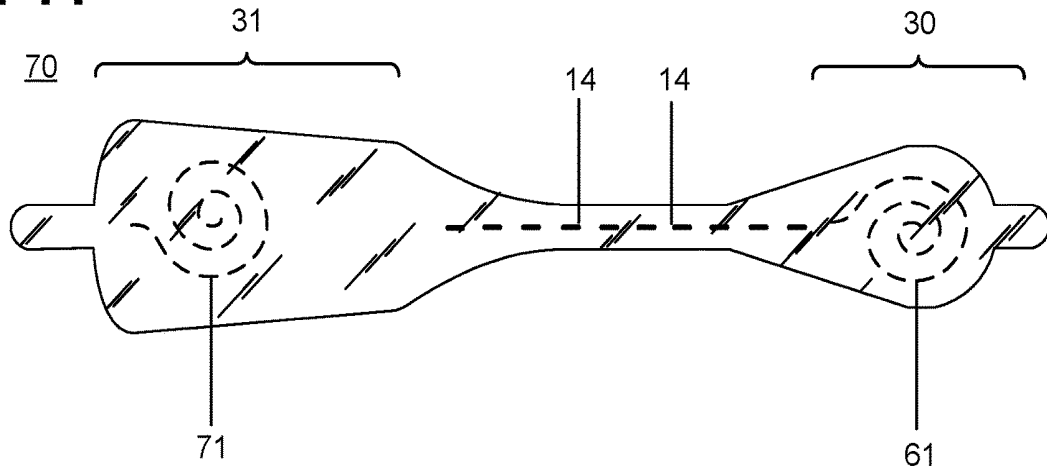

Fig. 12

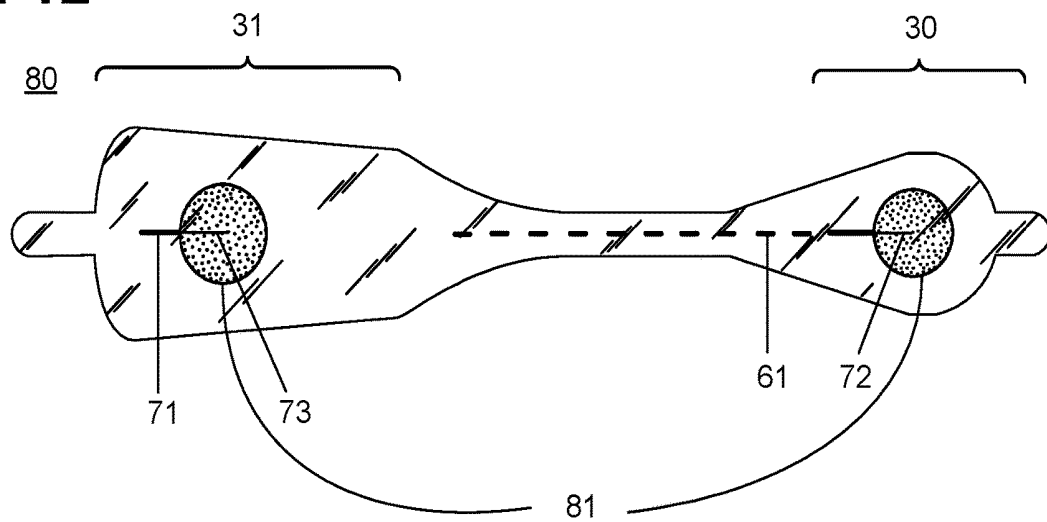

Fig. 13

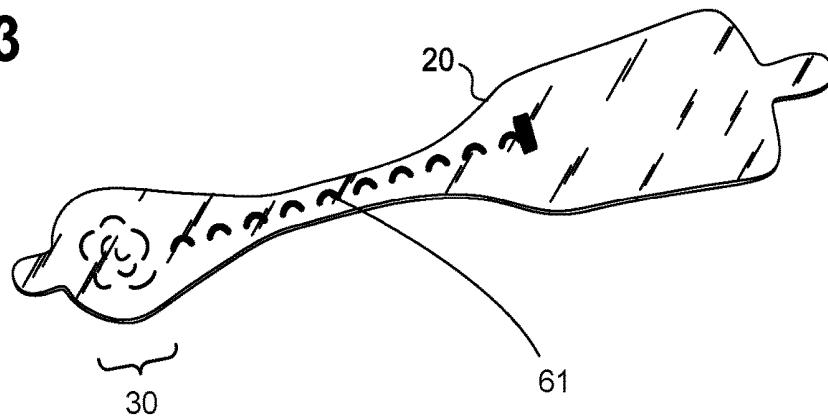

Fig. 14

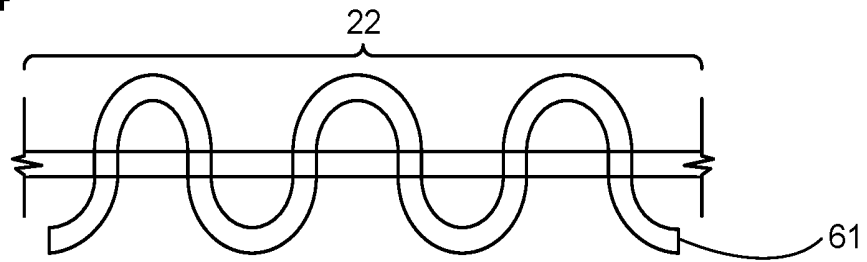

Fig. 15A

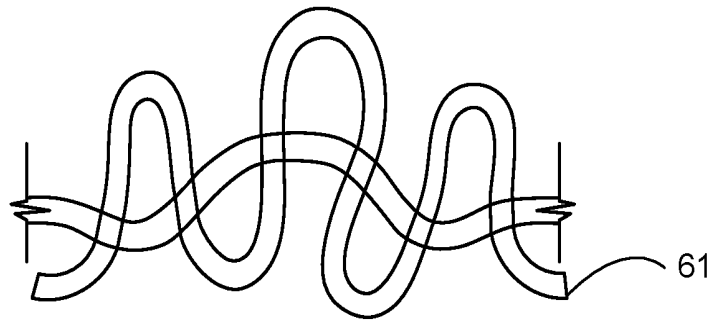

Fig. 15B

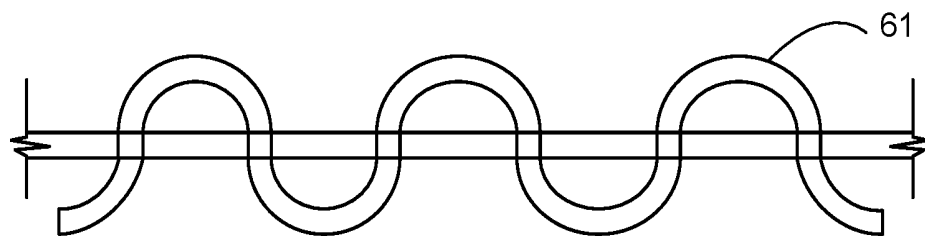

Fig. 15C

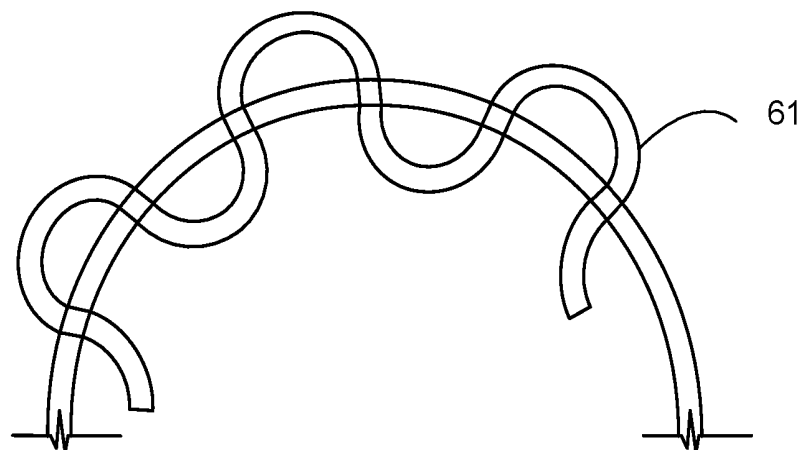
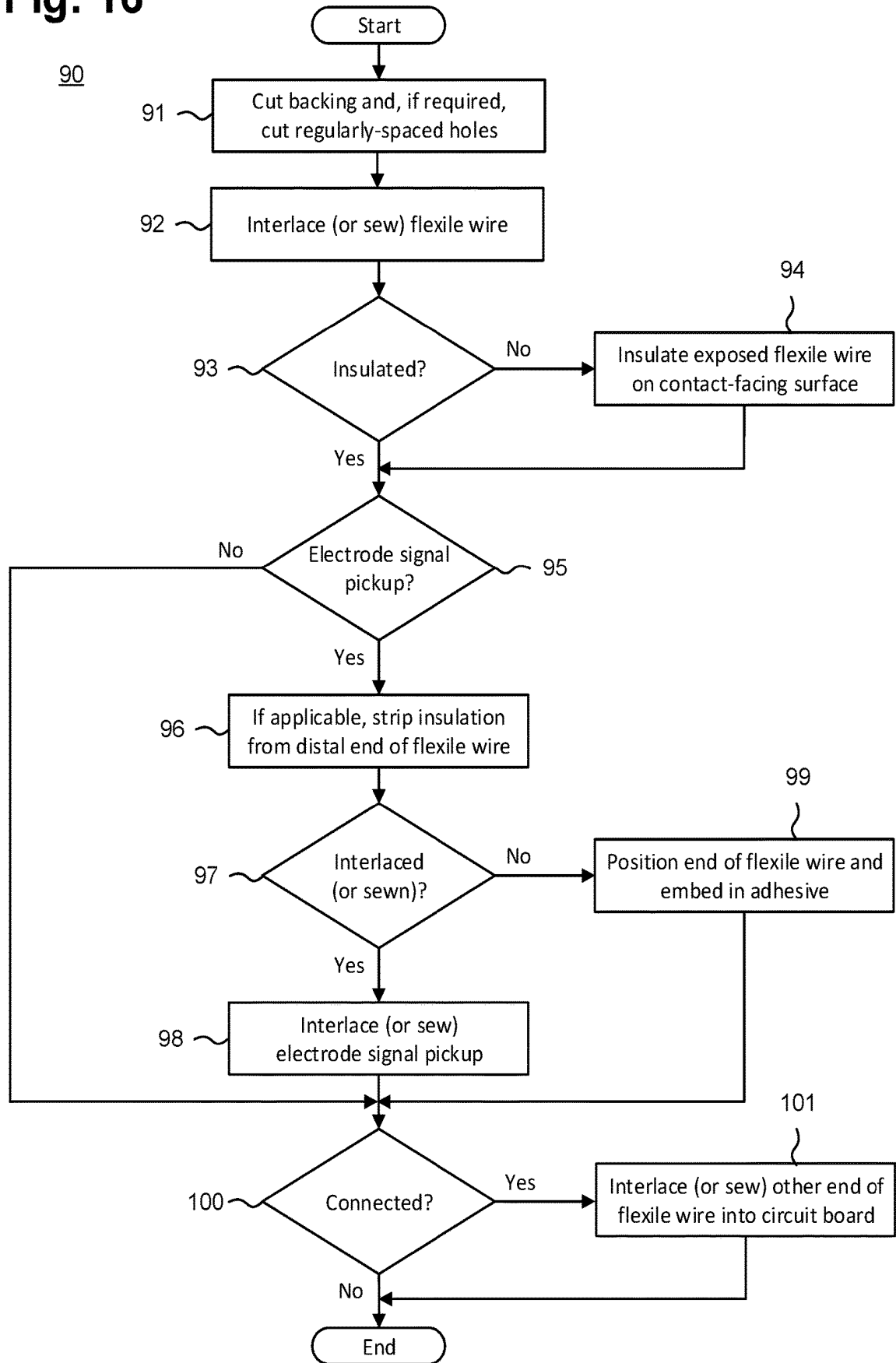

Fig. 16



**EXTENDED WEAR
ELECTROCARDIOGRAPHY PATCH WITH
WIRE INTERCONNECTS**

CROSS-REFERENCE TO RELATED
APPLICATION

This non-provisional patent application is a continuation of U.S. Pat. No. 10,154,793, issued Dec. 18, 2018, which is a continuation of U.S. Pat. No. 9,717,432, issued Aug. 1, 2017, which is a continuation-in-part of U.S. Pat. No. 9,545,204, issued Jan. 17, 2017, and further claims priority under 35 U.S.C. § 119(e) to U.S. Provisional Patent application, Ser. No. 61/882,403, filed Sep. 25, 2013, the disclosures of which are incorporated by reference.

FIELD

This application relates in general to electrocardiographic monitoring and manufacture and, in particular, to an extended wear electrocardiography patch with wire interconnects.

BACKGROUND

An electrocardiogram (ECG) is a tool used by physicians to diagnose heart problems and other potential health concerns. A full 12-lead ECG provides a multi-vector snapshot of heart function, typically recorded over 12 seconds, that can help diagnose rate and regularity of heartbeats, effect of drugs or cardiac devices, including pacemakers and implantable cardioverter-defibrillators (ICDs), and whether a patient has heart disease of any sort. Full 12-lead ECGs are used in-clinics or hospitals and, as a result, are limited to recording only those heart-related aspects present at the time of recording. Sporadic conditions that may not show up during a 12-second ECG recording require other means to diagnose them. These sporadic conditions include fainting or syncope; rhythm disorders, such as tachyarrhythmias and bradyarrhythmias; apneic episodes; and other cardiac and related disorders. Thus, a 12-lead ECG only provides a partial picture and can be insufficient for complete patient diagnosis of many cardiac disorders.

Diagnostic efficacy of problems, like syncope or cardiac arrhythmias, can be improved through the use of long-term extended wear ECG monitoring. Recording sufficient ECG and related physiological data over an extended period of time remains a significant challenge to healthcare providers, despite over a 40-year history of such efforts. Extended period monitoring essentially enables a physician to identify cardiac conditions, specifically, rhythm disorders, and other physiological events of potential concern. A 30-day observation day period is considered the “gold standard” of ECG monitoring, yet achieving a 30-day observation day period has heretofore proven unworkable because such ECG monitoring systems are arduous to employ, cumbersome to the patient, and excessively costly to manufacture and deploy. Nevertheless, if a patient’s ECG could be recorded in an ambulatory setting over prolonged time periods, thereby allowing the patient to engage in activities of daily living, the chances of acquiring meaningful medical information and capturing an abnormal event while the patient is engaged in normal activities becomes more likely to be achieved.

Conventionally, maintaining continual contact between ECG electrodes and the skin after a day or two has been a problem. Time, dirt, moisture, and other environmental

contaminants, as well as perspiration, skin oil, and dead skin cells from the patient’s body, can get between an ECG electrode’s non-conductive adhesive and the skin’s surface. All of these factors adversely affect electrode adhesion and the quality of cardiac signal recordings. Furthermore, the physical movements of the patient and their clothing impart various compressional, tensile, and torsional forces on the contact point of an ECG electrode, especially over long recording times, and an inflexibly fastened ECG electrode will be prone to becoming dislodged. Moreover, dislodgment may occur unbeknownst to the patient, making the ECG recordings worthless. Further, some patients may have skin that is susceptible to itching or irritation, and the wearing of ECG electrodes can aggravate such skin conditions. Thus, a patient may want or need to periodically remove or replace ECG electrodes during a long-term ECG monitoring period, whether to replace a dislodged electrode, reestablish better adhesion, alleviate itching or irritation, allow for cleansing of the skin, allow for showering and exercise, or for other purpose. Such replacement or slight alteration in electrode location actually facilitates the goal of recording the ECG signal for long periods of time.

In addition, the high cost of the patient-wearable components used to provide long-term extended ECG monitoring can negatively influence the availability and use of monitors. Ideally, disposable, single-use components, such as adhesive electrodes, should be low cost, while other components of higher complexity, particularly the electronics hardware that detects and records ECG and related physiology, may be of unavoidably higher cost. To a degree, costs can be balanced by designing higher complexity components to be re-usable, but when the total cost of a full ECG monitoring ensemble remains high, despite the utilization of re-usable parts, the number of monitors available for use by healthcare providers can be inhibited. Cost, then, becomes a barrier to entry, which, in turn, can hinder or prevent healthcare providers from obtaining the means with which to efficaciously identify the physiology underlying sporadic cardiac arrhythmic conditions and can ultimately contribute to a failure to make a proper and timely medical diagnosis.

Conventionally, Holter monitors are widely used for long-term extended ECG monitoring. Typically, they are often used for only 24-48 hours. A typical Holter monitor is a wearable and portable version of an ECG that include cables for each electrode placed on the skin and a separate battery-powered ECG recorder. The cable and electrode combination (or leads) are placed in the anterior thoracic region in a manner similar to what is done with an in-clinic standard ECG machine. The duration of a Holter monitoring recording depends on the sensing and storage capabilities of the monitor, as well as battery life. A “looping” Holter (or event) monitor can operate for a longer period of time by overwriting older ECG tracings, thence “recycling” storage in favor of extended operation, yet at the risk of losing event data. Although capable of extended ECG monitoring, Holter monitors are cumbersome, expensive and typically only available by medical prescription, which limits their usability. Further, the skill required to properly place the electrodes on the patient’s chest hinders or precludes a patient from replacing or removing the precordial leads and usually involves moving the patient from the physician office to a specialized center within the hospital or clinic.

The ZIO XT Patch and ZIO Event Card devices, manufactured by iRhythm Tech., Inc., San Francisco, Calif., are wearable stick-on monitoring devices that are typically worn on the upper left pectoral region to respectively provide continuous and looping ECG recording. The location is used

to simulate surgically implanted monitors. Both of these devices are prescription-only and for single patient use. The ZIO XT Patch device is limited to a 14-day monitoring period, while the electrodes only of the ZIO Event Card device can be worn for up to 30 days. The ZIO XT Patch device combines both electronic recordation components and physical electrodes into a unitary assembly that adheres to the patient's skin. The ZIO XT Patch device uses adhesive sufficiently strong to support the weight of both the monitor and the electrodes over an extended period of time and to resist disadherence from the patient's body, albeit at the cost of disallowing removal or relocation during the monitoring period. The ZIO Event Card device is a form of downsized Holter monitor with a recorder component that must be removed temporarily during baths or other activities that could damage the non-waterproof electronics. Both devices represent compromises between length of wear and quality of ECG monitoring, especially with respect to ease of long term use, female-friendly fit, and quality of cardiac electrical potential signals, especially atrial (P-wave) signals.

Therefore, a need remains for a low cost extended wear continuously recording ECG monitor practicably capable of being worn for a long period of time, especially in patient's whose breast anatomy can interfere with signal quality in both men and women and that is capable of recording atrial action potential signals reliably.

SUMMARY

Physiological monitoring can be provided through a lightweight wearable monitor that includes two components, a flexible extended wear electrode patch and a reusable monitor recorder that removably snaps into a receptacle on the electrode patch. The wearable monitor sits centrally (in the midline) on the patient's chest along the sternum oriented top-to-bottom. The placement of the wearable monitor in a location at the sternal midline (or immediately to either side of the sternum), with its unique narrow "hourglass"-like shape, significantly improves the ability of the wearable monitor to cutaneously sense cardiac electrical potential signals, particularly the P-wave (or atrial activity) and, to a lesser extent, the QRS interval signals indicating ventricular activity in the ECG waveforms.

The electrode patch is shaped to fit comfortably and conformal to the contours of the patient's chest approximately centered on the sternal midline. To counter the dislodgment due to compressional and torsional forces, a layer of non-irritating adhesive, such as hydrocolloid, is provided at least partially on the underside, or contact surface of the electrode patch, but only on the electrode patch's distal and proximal ends, where the electrode signal pickups are located. The unadhesed narrowed midsection rides freely over the skin. To counter dislodgment due to tensile and torsional forces, a flexible backing is reinforced with a flexile wire interlaced longitudinally through the narrowed midsection, with the curvature of the flexile wire providing both structural support and malleability. Each of these components are distinctive and allow for comfortable and extended wear, especially for women, where breast mobility would otherwise interfere with monitor use and wearer comfort.

Moreover, the interlacing of flexile wire simplifies manufacturing and reduces costs. A simple pair of flexile wires are used, instead of custom point-to-point circuit traces, to connect each electrode signal pickup to the receptacle. One end of each flexile wire can be sewn into the receptacle's circuit board, thereby obviating the need for conductive

adhesive, soldered or electromechanical connection, and the other end of each flexile wire, when stripped of insulation, can act as an electrode signal pickup, which lowers component count.

In one embodiment, an extended wear electrocardiography patch with wire interconnects is provided. The patch includes a flexible backing formed of an elongated strip of stretchable material with narrow longitudinal midsection evenly tapering inward from a distal end and a proximal end, the elongated strip adherable only at a contact surface defined on each of the ends; a pair of electrocardiographic electrodes interfaced to one or more of a set of electrode pads, each of the electrodes including an electrically conductive surface only exposed on the contact surface; a battery connected to one or more of the pads of the set via at least one flexile wire interconnect, the battery secured in place via a flexile wire; and the set of electrical contact pads included on the flexible backing and formed by a set of further flexile wires, the set configured to interface the electrodes and the battery with an electrocardiography monitor recorder when the electrocardiography monitor recorder is in contact with the set of the electrical contact pads.

In a further embodiment, an extended wear electrocardiography monitor with wire interconnects is provided. The monitor includes a disposable extended wear electrode patch and an electrocardiography monitor recorder. The extended wear electrode patch includes: a flexible backing formed of an elongated strip of stretchable material with narrow longitudinal midsection evenly tapering inward from a distal end and a proximal end, the elongated strip adherable only at a contact surface defined on each of the ends; a pair of electrocardiographic electrodes interfaced to one or more of a set of electrode pads, each of the electrodes including an electrically conductive surface only exposed on the contact surface; a battery connected to one or more of the pads of the set via at least one flexile wire interconnect, the battery secured in place via a flexile wire; and the set of electrical contact pads provided on the flexible backing and formed by a set of further flexile wires, the set configured to interface the electrodes and the battery with the electrocardiography monitor recorder when the electrocardiography monitor recorder is in contact with the set of the electrical contact pads. The electrocardiography monitor recorder includes a wearable housing; an external interface configured to be removably connected to the set of the electrical contact pads; and electronic circuitry provided within the wearable housing, including: a microcontroller operable to execute over an extended period under micro programmable control as specified in firmware; an electrocardiographic front end circuit under the control of the microcontroller adapted to sense electrocardiographic signals through the electrocardiographic electrodes via the external interface; and a non-volatile memory electrically interfaced with the microcontroller and operable to continuously store samples of the electrocardiographic signals throughout the extended period.

The monitoring patch is especially suited to the female anatomy, although also easily used over the male sternum. The narrow longitudinal midsection can fit nicely within the intermammary cleft of the breasts without inducing discomfort, whereas conventional patch electrodes are wide and, if adhered between the breasts, would cause chafing, irritation, discomfort, and annoyance, leading to low patient compliance.

The foregoing aspects enhance ECG monitoring performance and quality by facilitating long-term ECG recording, which is critical to accurate arrhythmia and cardiac rhythm disorder diagnoses.

In addition, the foregoing aspects enhance comfort in women (and certain men), but not irritation of the breasts, by placing the monitoring patch in the best location possible for optimizing the recording of cardiac signals from the atrium, particularly P-waves, which is another feature critical to proper arrhythmia and cardiac rhythm disorder diagnoses.

Further, the interlaced flexile wires improve the dermal electrode's response to tensile, twisting, compressional, and torsional forces by providing a strain relief and tensile strength, while also diminish the cost and complexity of producing physiological electrode assemblies and other types of electrical circuits, where point-to-point interconnections are needed.

Still other embodiments will become readily apparent to those skilled in the art from the following detailed description, wherein are described embodiments by way of illustrating the best mode contemplated. As will be realized, other and different embodiments are possible and the embodiments' several details are capable of modifications in various obvious respects, all without departing from their spirit and the scope. Accordingly, the drawings and detailed description are to be regarded as illustrative in nature and not as restrictive.

BRIEF DESCRIPTION OF THE DRAWINGS

FIGS. 1 and 2 are diagrams showing, by way of examples, an extended wear electrocardiography monitor, including an extended wear electrode patch in accordance with one embodiment, respectively fitted to the sternal region of a female patient and a male patient.

FIG. 3 is a perspective view showing an extended wear electrode patch in accordance with one embodiment with a monitor recorder inserted.

FIG. 4 is a perspective view showing the extended wear electrode patch of FIG. 3 without a monitor recorder inserted.

FIG. 5 is a top view showing the flexible circuit of the extended wear electrode patch of FIG. 3.

FIG. 6 is a perspective view showing the extended wear electrode patch in accordance with a further embodiment.

FIG. 7 is an exploded view showing the component layers of the electrode patch of FIG. 3.

FIG. 8 is a bottom plan view of the extended wear electrode patch of FIG. 3 with liner partially peeled back.

FIG. 9 is a perspective view of an extended wear electrode patch with a flexile wire electrode assembly in accordance with a still further embodiment.

FIG. 10 is perspective view of the flexile wire electrode assembly from FIG. 9, with a layer of insulating material shielding a bare distal wire around the midsection of the flexible backing.

FIG. 11 is a bottom view of the flexile wire electrode assembly as shown in FIG. 9.

FIG. 12 is a bottom view of a flexile wire electrode assembly in accordance with a still yet further embodiment.

FIG. 13 is a perspective view showing the longitudinal midsection of the flexible backing of the electrode assembly from FIG. 9.

FIG. 14 is a longitudinal cross-sectional view of the midsection of the flexible backing of the electrode assembly of FIG. 11.

FIGS. 15A-C are the electrode assembly from FIG. 14 under compressional, tensile, and bending force, respectively.

FIG. 16 is a flow diagram showing a method for constructing a stress-pliant physiological electrode assembly in accordance with a further embodiment.

DETAILED DESCRIPTION

Physiological monitoring can be provided through a wearable monitor that includes two components, a flexible extended wear electrode patch and a removable reusable monitor recorder. FIGS. 1 and 2 are diagrams showing, by way of examples, an extended wear electrocardiography monitor 12, including an extended wear electrode patch 15 in accordance with one embodiment, respectively fitted to the sternal region of a female patient 10 and a male patient 11. The wearable monitor 12 sits centrally (in the midline) on the patient's chest along the sternum 13 oriented top-to-bottom with the monitor recorder 14 preferably situated towards the patient's head. The electrode patch 15 is shaped to fit comfortably and conformal to the contours of the patient's chest approximately centered on the sternal midline 16 (or immediately to either side of the sternum 13). The distal end of the electrode patch 15 extends towards the Xiphoid process and lower sternum and, depending upon the patient's build, may straddle the region over the Xiphoid process and lower sternum. The proximal end of the electrode patch 15, located under the monitor recorder 14, is below the manubrium and, depending upon patient's build, may straddle the region over the manubrium.

The placement of the wearable monitor 12 in a location at the sternal midline 16 (or immediately to either side of the sternum 13) significantly improves the ability of the wearable monitor 12 to cutaneously sense cardiac electric signals, particularly the P-wave (or atrial activity) and, to a lesser extent, the QRS interval signals in the ECG waveforms that indicate ventricular activity. The sternum 13 overlies the right atrium of the heart and the placement of the wearable monitor 12 in the region of the sternal midline 13 puts the ECG electrodes of the electrode patch 15 in a location better adapted to sensing and recording P-wave signals than other placement locations, say, the upper left pectoral region. In addition, placing the lower or inferior pole (ECG electrode) of the electrode patch 15 over (or near) the Xiphoid process and lower sternum facilitates sensing of right ventricular activity and provides superior recordation of the QRS interval.

During use, the electrode patch 15 is first adhered to the skin along the sternal midline 16 (or immediately to either side of the sternum 13). A monitor recorder 14 is then snapped into place on the electrode patch 15 to initiate ECG monitoring. FIG. 3 is a perspective view showing an extended wear electrode patch 15 in accordance with one embodiment with a monitor recorder 14 inserted. The body of the electrode patch 15 is preferably constructed using a flexible backing 20 formed as an elongated strip 21 of wrap knit or similar stretchable material about 145 mm long and 32 mm at the widest point with a narrow longitudinal mid-section 23 evenly tapering inward from both sides. A pair of cut-outs 22 between the distal and proximal ends of the electrode patch 15 create a narrow longitudinal midsection 23 or "isthmus" and defines an elongated "hourglass"-like shape, when viewed from above, such as described in commonly-assigned U.S. Design Pat. No. D744,659, issued Dec. 1, 2015 the disclosure of which is incorporated by reference. The upper part of the "hourglass" is sized to allow

an electrically non-conductive receptacle **25**, sits on top of the outward-facing surface of the electrode patch **15**, to be affixed to the electrode patch **15** with an ECG electrode placed underneath on the patient-facing underside, or contact, surface of the electrode patch **15**; the upper part of the “hourglass” has a longer and wider profile than the lower part of the “hourglass,” which is sized primarily to allow just the placement of an ECG electrode.

The electrode patch **15** incorporates features that significantly improve wearability, performance, and patient comfort throughout an extended monitoring period. The entire electrode patch **15** is lightweight in construction, which allows the patch to be resilient to disadhering or falling off and, critically, to avoid creating distracting discomfort to the patient, even when the patient is asleep. In contrast, the weight of a heavy ECG monitor impedes patient mobility and will cause the monitor to constantly tug downwards and press on the patient’s body; frequent adjustments by the patient are needed to maintain comfort.

During every day wear, the electrode patch **15** is subjected to pushing, pulling, and torsional movements, including compressional and torsional forces when the patient bends forward, and tensile and torsional forces when the patient leans backwards. To counter these stress forces, the electrode patch **15** incorporates crimp and strain reliefs, as further described infra respectively with reference to FIGS. **4** and **5**. In addition, the cut-outs **22** and longitudinal midsection **23** help minimize interference with and discomfort to breast tissue, particularly in women (and gynecomastic men). The cut-outs **22** and longitudinal midsection **23** allow better conformity of the electrode patch **15** to sternal bowing and to the narrow isthmus of flat skin that can occur along the bottom of the intermammary cleft between the breasts, especially in buxom women. The cut-outs **22** and longitudinal midsection **23** help fit nicely between a pair of female breasts in the intermammary cleft. In one embodiment, the cut-outs **22** can be graduated to form the longitudinal midsection **23** as a narrow in-between stem or isthmus portion about 7 mm wide. In a still further embodiment, tabs **24** can respectively extend an additional 8 mm to 12 mm beyond the distal and proximal ends of the flexible backing **20** to facilitate purchase when adhering the electrode patch **15** to or removing the electrode patch **15** from the sternum **13**. These tabs preferably lack adhesive on the underside, or contact, surface of the electrode patch **15**. Still other shapes, cut-outs and conformities to the electrode patch **15** are possible.

The monitor recorder **14** removably and reusable snaps into an electrically non-conductive receptacle **25** during use. The monitor recorder **14** contains electronic circuitry for recording and storing the patient’s electrocardiography as sensed via a pair of ECG electrodes provided on the electrode patch **15**, such as described in commonly-assigned U.S. Pat. No. 9,730,593, issued Aug. 15, 2017, the disclosure of which is incorporated by reference. The circuitry includes a microcontroller, flash storage, ECG signal processing, analog-to-digital conversion (where applicable), and an external interface for coupling to the electrode patch **15** and to a download station for stored data download and device programming. The monitor recorder **14** also includes external patient-interfaceable controls, such as a push button to facilitate event marking and provide feedback. In a further embodiment, the circuitry, with the assistance of the appropriate types of deployed electrodes or sensors, is capable of monitoring other types of physiology, in addition to ECGs. Still other types of monitor recorder components and functionality are possible.

The non-conductive receptacle **25** is provided on the top surface of the flexible backing **20** with a retention catch **26** and tension clip **27** molded into the non-conductive receptacle **25** to conformably receive and securely hold the monitor recorder **14** in place. The edges of the bottom surface of the non-conductive receptacle **25** are preferably rounded, and the monitor recorder **14** is nestled inside the interior of the non-conductive receptacle **25** to present a rounded (gentle) surface, rather than a sharp edge at the skin-to-device interface.

The electrode patch **15** is intended to be disposable. The monitor recorder **14**, however, is reusable and can be transferred to successive electrode patches **15** to ensure continuity of monitoring. The placement of the wearable monitor **12** in a location at the sternal midline **16** (or immediately to either side of the sternum **13**) benefits long-term extended wear by removing the requirement that ECG electrodes be continually placed in the same spots on the skin throughout the monitoring period. Instead, the patient is free to place an electrode patch **15** anywhere within the general region of the sternum **13**.

As a result, at any point during ECG monitoring, the patient’s skin is able to recover from the wearing of an electrode patch **15**, which increases patient comfort and satisfaction, while the monitor recorder **14** ensures ECG monitoring continuity with minimal effort. A monitor recorder **14** is merely unsnapped from a worn out electrode patch **15**, the worn out electrode patch **15** is removed from the skin, a new electrode patch **15** is adhered to the skin, possibly in a new spot immediately adjacent to the earlier location, and the same monitor recorder **14** is snapped into the new electrode patch **15** to reinitiate and continue the ECG monitoring.

During use, the electrode patch **15** is first adhered to the skin in the sternal region. FIG. **4** is a perspective view showing the extended wear electrode patch **15** of FIG. **3** without a monitor recorder **14** inserted. A flexible circuit **32** is adhered to each end of the flexible backing **20**. A distal circuit trace **33** from the distal end **30** of the flexible backing **20** and a proximal circuit trace (not shown) from the proximal end **31** of the flexible backing **20** electrically couple ECG electrodes (not shown) with a pair of electrical pads **34**. In a further embodiment, the distal and proximal circuit traces are replaced with interlaced or sewn-in flexible wires, as further described infra beginning with reference to FIG. **9**. The electrical pads **34** are provided within a moisture-resistant seal **35** formed on the bottom surface of the non-conductive receptacle **25**. When the monitor recorder **14** is securely received into the non-conductive receptacle **25**, that is, snapped into place, the electrical pads **34** interface to electrical contacts (not shown) protruding from the bottom surface of the monitor recorder **14**. The moisture-resistant seal **35** enables the monitor recorder **14** to be worn at all times, even during bathing or other activities that could expose the monitor recorder **14** to moisture or adverse conditions.

In addition, a battery compartment **36** is formed on the bottom surface of the non-conductive receptacle **25**. A pair of battery leads (not shown) from the battery compartment **36** to another pair of the electrical pads **34** electrically interface the battery to the monitor recorder **14**. The battery contained within the battery compartment **35** can be replaceable, rechargeable or disposable.

The monitor recorder **14** draws power externally from the battery provided in the non-conductive receptacle **25**, thereby uniquely obviating the need for the monitor recorder **14** to carry a dedicated power source. The battery contained

within the battery compartment **36** can be replaceable, rechargeable or disposable. In a further embodiment, the ECG sensing circuitry of the monitor recorder **14** can be supplemented with additional sensors, including an SpO₂ sensor, a blood pressure sensor, a temperature sensor, respiratory rate sensor, a glucose sensor, an air flow sensor, and a volumetric pressure sensor, which can be incorporated directly into the monitor recorder **14** or onto the non-conductive receptacle **25**.

The placement of the flexible backing **20** on the sternal midline **16** (or immediately to either side of the sternum **13**) also helps to minimize the side-to-side movement of the wearable monitor **12** in the left- and right-handed directions during wear. However, the wearable monitor **12** is still susceptible to pushing, pulling, and torquing movements, including compressional and torsional forces when the patient bends forward, and tensile and torsional forces when the patient leans backwards. To counter the dislodgment of the flexible backing **20** due to compressional and torsional forces, a layer of non-irritating adhesive, such as hydrocolloid, is provided at least partially on the underside, or contact, surface of the flexible backing **20**, but only on the distal end **30** and the proximal end **31**. As a result, the underside, or contact surface of the longitudinal midsection **23** does not have an adhesive layer and remains free to move relative to the skin. Thus, the longitudinal midsection **23** forms a crimp relief that respectively facilitates compression and twisting of the flexible backing **20** in response to compressional and torsional forces. Other forms of flexible backing crimp reliefs are possible.

Unlike the flexible backing **20**, the flexible circuit **32** is only able to bend and cannot stretch in a planar direction. FIG. **5** is a top view showing the flexible circuit **32** of the extended wear electrode patch **15** of FIG. **3**. A distal ECG electrode **38** and proximal ECG electrode **39** are respectively coupled to the distal and proximal ends of the flexible circuit **32** to serve as electrode signal pickups. The flexible circuit **32** preferably does not extend to the outside edges of the flexible backing **20**, thereby avoiding gouging or discomforting the patient's skin during extended wear, such as when sleeping on the side. During wear, the ECG electrodes **38**, **39** must remain in continual contact with the skin. A strain relief **40** is defined in the flexible circuit **32** at a location that is partially underneath the battery compartment **36** when the flexible circuit **32** is affixed to the flexible backing **20**. The strain relief **40** is laterally extendable to counter dislodgment of the ECG electrodes **38**, **39** due to tensile and torsional forces. A pair of strain relief cutouts **41** partially extend transversely from each opposite side of the flexible circuit **32** and continue longitudinally towards each other to define in 'S'-shaped pattern, when viewed from above. The strain relief respectively facilitates longitudinal extension and twisting of the flexible circuit **32** in response to tensile and torsional forces. Other forms of circuit board strain relief are possible.

The flexible circuit **32** can be provided either above or below the flexible backing **20**. FIG. **6** is a perspective view showing the extended wear electrode patch **15** in accordance with a further embodiment. The flexible circuit (not shown) is provided on the underside, or contact, surface of the flexible backing **20** and is electrically interfaced to the set of electrical pads **34** on the bottom surface of the non-conductive receptacle **25** through electrical contacts (not shown) pierced through the flexible backing **20**.

The electrode patch **15** is intended to be a disposable component, which enables a patient to replace the electrode patch **15** as needed throughout the monitoring period, while

maintaining continuity of physiological sensing through reuse of the same monitor recorder **14**. FIG. **7** is an exploded view showing the component layers of the electrode patch **15** of FIG. **3**. The flexible backing **20** is constructed of a wearable gauze, latex, woven textile, or similar wrap knit or stretchable and wear-safe material **44**, such as a Tricot-type linen with a pressure sensitive adhesive (PSA) on the underside, or contact, surface. The ends of the wearable material **44** are coated with a layer **43** of non-irritating adhesive, such as hydrocolloid, to facilitate long-term wear, while the unadhesed narrowed midsection rides freely over the skin. The hydrocolloid, for instance, is typically made of mineral oil, cellulose and water and lacks any chemical solvents, so should cause little itching or irritation. Moreover, hydrocolloid can be manufactured into an appropriate thickness and plasticity and provides cushioning between the relatively rigid and unyielding non-conductive receptacle **25** and the patient's skin. In a further embodiment, the layer of non-irritating adhesive can be contoured, such as by forming the adhesive with a concave or convex cross-section; surfaced, such as through stripes or crosshatches of adhesive, or by forming dimples in the adhesive's surface; or applied discontinuously, such as with a formation of discrete dots of adhesive.

As described supra with reference to FIG. **5**, a flexible circuit can be adhered to either the outward facing surface or the underside, or contact, surface of the flexible backing **20**. For convenience, a flexible circuit **47** is shown relative to the outward facing surface of the wearable material **44** and is adhered respectively on a distal end by a distal electrode seal **45** and on a proximal end by a proximal electrode seal **45**. In a further embodiment, the flexible circuit **47** can be provided on the underside, or contact, surface of the wearable material **44**. Through the electrode seals, only the distal and proximal ends of the flexible circuit **47** are attached to the wearable material **44**, which enables the strain relief **40** (shown in FIG. **5**) to respectively longitudinally extend and twist in response to tensile and torsional forces during wear. Similarly, the layer **43** of non-irritating adhesive is provided on the underside, or contact, surface of the wearable material **44** only on the proximal and distal ends, which enables the longitudinal midsection **23** (shown in FIG. **3**) to respectively bow outward and away from the sternum **13** or twist in response to compressional and torsional forces during wear.

A pair of openings **46** is defined on the distal and proximal ends of the wearable material **44** and layer **43** of non-irritating adhesive for ECG electrodes **38**, **39** (shown in FIG. **5**). The openings **46** serve as "gel" wells with a layer of hydrogel **41** being used to fill the bottom of each opening **46** as a conductive material that aids electrode signal capture. The entire underside, or contact, surface of the flexible backing **20** is protected prior to use by a liner layer **40** that is peeled away, as shown in FIG. **8**.

The non-conductive receptacle **25** includes a main body **54** that is molded out of polycarbonate, ABS, or an alloy of those two materials to provide a high surface energy to facilitate adhesion of an adhesive seal **53**. The main body **54** is attached to a battery printed circuit board **52** by the adhesive seal **53** and, in turn, the battery printed circuit board **52** is adhered to the flexible circuit **47** with an upper flexible circuit seal **50**. A pair of conductive transfer adhesive points **51** or, alternatively, soldered connections, or electromechanical connections, including metallic rivets or similar conductive and structurally unifying components, connect the circuit traces **33**, **37** (shown in FIG. **5**) of the flexible circuit **47** to the battery printed circuit board **52**. The main body **54** has a retention catch **26** and tension clip **27**

(shown in FIG. 3) that fixably and securely receive a monitor recorder 14 (not shown), and includes a recess within which to circumferentially receive a die cut gasket 55, either rubber, urethane foam, or similar suitable material, to provide a moisture resistant seal to the set of pads 34. Other types of design, arrangement, and permutation are possible.

In a still further embodiment, the flexible circuit 32 (shown in FIG. 4) and distal ECG electrode 38 and proximal ECG electrode 39 (shown in FIG. 5) are replaced with a pair of interlaced flexile wires. The interlacing of flexile wires through the flexible backing 20 reduces both manufacturing costs and environmental impact, as further described infra. The flexible circuit and ECG electrodes are replaced with a pair of flexile wires that serve as both electrode circuit traces and electrode signal pickups. FIG. 9 is a perspective view of an extended wear electrode patch 15 with a flexile wire electrode assembly in accordance with a still further embodiment. The flexible backing 20 maintains the unique narrow "hourglass"-like shape that aids long term extended wear, particularly in women, as described supra with reference to FIG. 3. For clarity, the non-conductive receptacle 25 is omitted to show the exposed battery printed circuit board 62 that is adhered underneath the non-conductive receptacle 25 to the proximal end 31 of the flexible backing 20. Instead of employing flexible circuits, a pair of flexile wires are separately interlaced or sewn into the flexible backing 20 to serve as circuit connections for an anode electrode lead and for a cathode electrode lead.

To form a distal electrode assembly, a distal wire 61 is interlaced into the distal end 30 of the flexible backing 20, continues along an axial path through the narrow longitudinal midsection of the elongated strip, and electrically connects to the battery printed circuit board 62 on the proximal end 31 of the flexible backing 20. The distal wire 61 is connected to the battery printed circuit board 62 by stripping the distal wire 61 of insulation, if applicable, and interlacing or sewing the uninsulated end of the distal wire 61 directly into an exposed circuit trace 63. The distal wire-to-battery printed circuit board connection can be made, for instance, by back stitching the distal wire 61 back and forth across the edge of the battery printed circuit board 62. Similarly, to form a proximal electrode assembly, a proximal wire (not shown) is interlaced into the proximal end 31 of the flexible backing 20. The proximal wire is connected to the battery printed circuit board 62 by stripping the proximal wire of insulation, if applicable, and interlacing or sewing the uninsulated end of the proximal wire directly into an exposed circuit trace 64. The resulting flexile wire connections both establish electrical connections and help to affix the battery printed circuit board 62 to the flexible backing 20.

The battery printed circuit board 62 is provided with a battery compartment 36. A set of electrical pads 34 are formed on the battery printed circuit board 62. The electrical pads 34 electrically interface the battery printed circuit board 62 with a monitor recorder 14 when fitted into the non-conductive receptacle 25. The battery compartment 36 contains a spring 65 and a clasp 66, or similar assembly, to hold a battery (not shown) in place and electrically interfaces the battery to the electrical pads 34 through a pair of battery leads 67 for powering the electrocardiography monitor 14. Other types of battery compartment are possible. The battery contained within the battery compartment 36 can be replaceable, rechargeable, or disposable.

In a yet further embodiment, the circuit board and non-conductive receptacle 25 are replaced by a combined housing that includes a battery compartment and a plurality of

electrical pads. The housing can be affixed to the proximal end of the elongated strip through the interlacing or sewing of the flexile wires or other wires or threads.

The core of the flexile wires may be made from a solid, stranded, or braided conductive metal or metal compounds. In general, a solid wire will be less flexible than a stranded wire with the same total cross-sectional area, but will provide more mechanical rigidity than the stranded wire. The conductive core may be copper, aluminum, silver, or other material. The pair of the flexile wires may be provided as insulated wire. In one embodiment, the flexile wires are made from a magnet wire from Belden Cable, catalogue number 8051, with a solid core of AWG 22 with bare copper as conductor material and insulated by polyurethane or nylon. Still other types of flexile wires are possible. In a further embodiment, conductive ink or graphene can be used to print electrical connections, either in combination with or in place of the flexile wires.

In a still further embodiment, the flexile wires are uninsulated. FIG. 10 is perspective view of the flexile wire electrode assembly from FIG. 9, with a layer of insulating material 69 shielding a bare uninsulated distal wire 61 around the midsection on the contact side of the flexible backing. On the contact side of the proximal and distal ends of the flexible backing, only the portions of the flexile wires serving as electrode signal pickups are electrically exposed and the rest of the flexile wire on the contact side outside of the proximal and distal ends are shielded from electrical contact. The bare uninsulated distal wire 61 may be insulated using a layer of plastic, rubber-like polymers, or varnish, or by an additional layer of gauze or adhesive (or non-adhesive) gel. The bare uninsulated wire 61 on the non-contact side of the flexible backing may be insulated or can simply be left uninsulated.

Both end portions of the pair of flexile wires are typically placed uninsulated on the contact surface of the flexible backing 20 to form a pair of electrode signal pickups. FIG. 11 is a bottom view of the flexile wire electrode assembly as shown in FIG. 9. When adhered to the skin during use, the uninsulated end portions of the distal wire 61 and the proximal wire 71 enable the monitor recorder 14 to measure dermal electrical potential differentials. At the proximal and distal ends of the flexible backing 20, the uninsulated end portions of the flexile wires may be configured into an appropriate pattern to provide an electrode signal pickup, which would typically be a spiral shape formed by guiding the flexile wire along an inwardly spiraling pattern. The surface area of the electrode pickups can also be variable, such as by selectively removing some or all of the insulation on the contact surface. For example, an electrode signal pickup arranged by sewing insulated flexile wire in a spiral pattern could have a crescent-shaped cutout of uninsulated flexile wire facing towards the signal source.

In a still yet further embodiment, the flexile wires are left freely riding on the contact surfaces on the distal and proximal ends of the flexible backing, rather than being interlaced into the ends of the flexible backing 20. FIG. 12 is a bottom view of a flexile wire electrode assembly in accordance with a still yet further embodiment. The distal wire 61 is interlaced onto the midsection and extends an exposed end portion 72 onto the distal end 30. The proximal wire 71 extends an exposed end portion 73 onto the proximal end 31. The exposed end portions 72 and 73, not shielded with insulation, are further embedded within an electrically conductive adhesive 81. The adhesive 81 makes contact to skin during use and conducts skin electrical potentials to the monitor recorder 14 (not shown) via the flexile wires. The

adhesive **81** can be formed from electrically conductive, non-irritating adhesive, such as hydrocolloid.

The distal wire **61** is interlaced or sewn through the longitudinal midsection of the flexible backing **20** and takes the place of the flexible circuit **32**. FIG. **13** is a perspective view showing the longitudinal midsection of the flexible backing of the electrode assembly from FIG. **9**. Various stitching patterns may be adopted to provide a proper combination of rigidity and flexibility. In simplest form, the distal wire **61** can be manually threaded through a plurality of holes provided at regularly-spaced intervals along an axial path defined between the battery printed circuit board **62** (not shown) and the distal end **30** of the flexible backing **20**. The distal wire **61** can be threaded through the plurality of holes by stitching the flexile wire as a single "thread." Other types of stitching patterns or stitching of multiple "threads" could also be used, as well as using a sewing machine or similar device to machine-stitch the distal wire **61** into place, as further described infra. Further, the path of the distal wire **61** need not be limited to a straight line from the distal to the proximal end of the flexible backing **20**.

The distal wire **61** is flexile yet still retains a degree of rigidity that is influenced by wire gauge, composition, stranding, insulation, and stitching pattern. For example, rigidity decreases with wire gauge; and a solid core wire tends to be more rigid than a stranded core of the same gauge. The combination of the flexibility and the rigidity of the portion of the distal wire **61** located on or close to the midsection contributes to the overall strength and wearability of the patch. FIG. **14** is a longitudinal cross-sectional view of the midsection of the flexible backing **20** of the electrode assembly of FIG. **11**. FIGS. **15A-C** are the electrode assembly from FIG. **14** under compressional, tensile, and bending force, respectively. The relative sizes of the distal wire **61** and flexible backing **20** are not to scale and are exaggerated for purposes of illustration.

The interlacing of the distal wire **61** through the narrow longitudinal midsection **22** of the flexible backing **20** bends the distal wire **61** into a line of rounded stitches that alternate top and bottom, which can be advantageous to long term wearability. First, the tension of the rounded stitches reinforces the planar structure of the narrow longitudinal midsection **22** and spreads a dislodging force impacting on one end of the flexible backing **20** to the other end of the flexible backing **20**. Second, the rounded stitches leave room for stretching, compressing, bending, and twisting, thus increasing the wearability of the patch extended wear electrode patch **15** by facilitating extension, compression, bending, and twisting of the narrow longitudinal midsection **22** in response to tensile, compressional, bending, and torsional forces.

In a further embodiment, the distal wire and the proximal wire may be stitched or sewn into the flexible backing **20**. Depending upon the type of stitching used, the distal or proximal wire may use more than one individual wire. For instance, a conventional sewing machine used to stitch fabrics uses a spool of thread and a bobbin, which are both wound with thread that together allow the creation of various stitching patterns, such as the lockstitch. Other type of stitching patterns are possible. Additionally, where more than one "threads" are used for stitching, the flexile wire may constitute all of the "threads," thereby increasing redundancy of the circuit trace thus formed. Alternatively, just one (or fewer than all) of the threads may be conductive, with the non-conductive threads serving to reinforce the strength of the flexile wire connections and flexible backing **20**. The additional threads can be made from line, threads, or fabrics

of sufficient mechanical strength and do not need to be conductive; alternatively, the same flexile wires can be employed to serve as the additional threads.

Conventionally, flexible circuits, such as the flexible circuit **32** (shown in FIG. **4**) that connects the distal ECG electrode **38** and proximal ECG electrode **39** (shown in FIG. **5**) to the battery printed circuit board **62** (shown in FIG. **9**), are constructed using subtractive processes. In general, a flexible circuit interconnects electronic components with custom point-to-point circuit traces and is typically constructed by forming the conductive circuit traces on a thin film of insulating polymer. A flexible circuit is not an off-the-shelf component; rather, each flexible circuit is designed with a specific purpose in mind. Changes to a flexible circuit's design will generally require fabricating entirely new flexible circuits, as the physical circuit traces on the polymer film cannot be changed.

Manufacturing a flexible circuit typically requires the use of sophisticated and specialized tools, coupled with environmentally unfriendly processes, including depositing copper on a polyamide core, etching away unwanted copper with inline etching or an acid bath to retain only the desired conductive circuit traces, and applying a coverlay to the resulting flexible circuit. Significant amounts of hazardous waste are generated by these subtractive processes during the fabrication of each flexible circuit. Properly posing of such hazardous waste is expensive and adds to the costs of the flexible circuit.

In the still further embodiment described supra beginning with reference to FIG. **9**, the distal and proximal flexile wires replace the flexible circuit **32** and enables the electrode assembly to be constructed using additive processes with off-the-shelf, low cost components. The flexile wires serve the triple functions of an electrode signal pickup, electrical circuit trace, and support for structural integrity and malleability of the electrode assembly.

The general manner of constructing the electrode assembly can be applied to other forms of electronic components in which custom point-to-point circuit traces need to be affixed to a gauze or textile backing, as well as backings made from other materials. The circuit traces are replaced by the interlaced or sewn flexile wires, and the ends of each flexile wire are terminated, as appropriate to the application. The flexile wires may, by example, connect two circuit boards, or connect to an electrical terminal, power source, or electrical component. In addition, flexile wires may be used to replace a printed circuit board entirely, with each flexile wire serving as a form of sewn interconnect between two or more discrete components, including resistors, capacitors, transistors, diodes, operational amplifiers (op amps) and other integrated circuits, and other electronic or electromechanical components.

By way of illustration, the flexile wires will be described as terminated for use in an electrode assembly, specifically, as terminated on one end to form an electrode signal pickup and on the other end to connect into a circuit board. Constructing the electrode assembly entails interlacing, including manually threading, or machine sewing the flexile, conductive wire through the flexible backing **20**. FIG. **16** is a flow diagram showing a method **90** for constructing a stress-pliant physiological electrode assembly in accordance with a further embodiment. The method can be performed by a set of industrial machines, including a gauze cutting machine to cut the flexible backing **20** to form; a hole punch to cut a plurality of holes provided at regularly-spaced intervals; a stitching or sewing machine to interleave or sew the flexile wire through the flexible backing **20**; a wire

stripper or plasma jet to remove insulation from the flexile wire, when applicable; and a glue or adhesive dispenser to embed or coat electrode signal pickup in hydrocolloid gel or equivalent non-irritating adhesive. Other forms or combinations of industrial machines, including a single purpose-built industrial machine, could be used.

As an initial step, a backing is cut to shape and, if required, holes are cut at regularly-spaced intervals along an axial path (step 91) through which the flexile wire will be interlaced. Holes will need to be cut, for instance, if the flexile wire is to be hand-guided through the backing, or where the backing is cut from a material that is difficult to puncture with a threaded needle, such as used by a sewing machine. In one embodiment, the backing is cut from wearable gauze, latex, woven textile, or similar wrap knit or stretchable and wear-safe material, such as a Tricot-type linen; the resulting backing is flexible and yielding. The backing is also cut into an elongated "hourglass"-like shape, when viewed from above, with a pair of cut-outs and a longitudinal midsection that together help minimize interference with and discomfort to breast tissue, particularly in women (and gynecomastic men), such as described supra with reference to FIG. 3. The backing can be cut into other shapes as appropriate to need. In addition, depending upon the application, other materials could be substituted for the backing. For example, neoprene, such as used in wetsuits, could be used where a high degree of elasticity and ruggedness is desired.

The flexile wire is then interlaced or sewn into the backing (step 92). Interlacing can be performed by a machine that guides the flexile wire through the holes previously cut in the material in a crisscrossed, interwoven, or knitted fashion, as well as by hand. The flexile wire can also be guided through the backing without first cutting holes, provided that the weave of the material is sufficiently loose to allow passage of the flexile wire if the flexile wire is otherwise incapable of passing through the backing without the assistance of a needle or other piercing instrument.

Alternatively, the flexile wire could be sewn into the backing by using the flexile wire as "thread" that is stitched into place using a needle or similar implement. If a single flexile wire is employed, the stitching will be a line of rounded stitches that alternate top and bottom, as described supra; however, if more than one flexile wire is used, or the stitching pattern requires the use of more than one thread, other forms of conventional machine-stitching patterns could be employed, such as a lockstitch.

Once completed, the interlacing or sewing of the flexile wire into the backing creates an integrated point-to-point electrical path that takes the place of a custom circuit trace using an additive, rather than subtractive, manufacturing process. The flexile wire can be interlaced or sewn along a straight, curved, or arbitrary path. One flexile wire is required per point-to-point circuit trace. The strength and pliability of the flexile wire reinforces the backing and, in the still further embodiment described supra beginning with reference to FIG. 9, facilitates extension, compression, bending, and twisting of the narrow longitudinal midsection 22 in response to tensile, compressional, bending, and torsional forces. Thus, the path of the flexile wire along the backing can be mapped to take advantage of the strength and reinforcing properties of the flexile wire, which, when interlaced or sewn into the backing, help the backing counter the stresses to which the backing will be subjected when deployed.

The flexile wire itself may be insulated or bare (step 93). When one end of the flexile wire is connected to (or forms)

an electrode, particularly a dermal physiology electrode that senses electrical potentials on the skin's surface, insulated flexile wire will ordinarily be used, with only a portion of the flexile wire incident to the electrode stripped of insulation. However, bare uninsulated flexile wire could alternatively be used throughout, so long as those portions of the uninsulated flexile wire that are exposed on the contact-facing surface of the backing are insulated and shielded from electrical contact (step 94), such as by applying a layer of plastic, rubber-like polymers, or varnish, or by an additional layer of gauze or adhesive (or non-adhesive) gel over the exposed wire. The uninsulated flexile wire exposed on other surfaces of the backing could also be insulated or simply be left bare.

One end of the flexile wire may be terminated as an electrode signal pickup (step 95). If insulated flexile wire is used, a portion of the end of the flexile wire is stripped of insulation (step 96) using, for instance, a wire stripper or plasma jet. The electrode signal pickup could either be formed by interlacing (or sewing) the flexile wire (step 97) into the backing in the shape of the desired electrode (step 98) or positioned over the contact-facing area of the backing designated to serve as an electrode signal pickup and embedded within an electrically conductive adhesive (step 99). In a yet further embodiment, the flexile wire could be terminated as a connection to a discrete electrode, such as by sewing an uninsulated portion of the end of the electrode wire into the discrete electrode to thereby establish an electrical contact and affix the discrete electrode to the backing. The Universal ECG EKG electrode, manufactured by Bio Protech Inc., Tustin, Calif., is one example of a discrete electrode.

Finally, the other end of the flexile wire may be terminated as a connection to a circuit board (step 100). The flexile wire can be interlaced or sewn onto the circuit board, for instance, by back stitching the flexile wire back and forth across the edge of the circuit board to thereby establish an electrical contact and affix the discrete electrode to the backing.

In a further embodiment, flexile wire can be used to replace all or part of a printed circuit board, such as battery printed circuit board 62 used in constructing a stress-pliant physiological electrode assembly, as described supra, or for any other application that requires interconnection of electrical or electro mechanical components on a physical substrate or backing. Flexile wire in place of conductive circuit traces can work especially well with simple circuit board layouts, where ample space between components and relatively uncomplicated layouts are amenable to stitched-in interconnections. In addition, the use of flexile wire can simplify circuit layout design in multilayer circuits, as insulated flexile wires can be run across each other in situations that would otherwise require the use of a multilayer printed circuit board or similar solution.

Through such use of flexile wire, a printed circuit board can be omitted in whole or in part. Interconnects between and connections to the electronic and electro mechanical components formerly placed on the printed circuit board can instead be sewn from flexile wire. For instance, the battery printed circuit board 62 can be replaced by flexile wire interconnects that connect the electrodes to a sewn set of electrical pads formed by over-stitching the flexile wire into electrical contact surfaces of sufficient size to interface with a monitor recorder 14 when fitted into the non-conductive receptacle 25. Likewise, the spring 65 and clasp 66 can be sewn in place using flexile wire to hold a battery in place with flexile wire interconnects connecting the battery to a

sewn set of electrical pads formed by over-stitching the flexile wire into electrical contact surfaces of sufficient size to interface with a monitor recorder **14** when fitted into the non-conductive receptacle **25**. Still other approaches to replacing printed circuit boards with flexile wire interconnects are possible.

The resultant stress-pliant physiological electrode assembly may be electrically coupled to a broad range of physiological monitors not limited to electrocardiographic measurement. The foregoing method of constructing a stress-pliant electrode assembly is adaptable to manufacturing other forms of dermal electrodes, including electrodes for electrocardiography, electroencephalography, and skin conductance measurements. Further, by adjusting the number of electrodes, the distances among the electrode signal pickups, and the thickness of the flexile wire, the method can be adapted to manufacturing at low cost an electrode assembly that is lightweight and resistant to tensile, compressional and torsional forces, thus contributing to long-term wear and versatility.

While the invention has been particularly shown and described as referenced to the embodiments thereof, those skilled in the art will understand that the foregoing and other changes in form and detail may be made therein without departing from the spirit and scope.

What is claimed is:

1. An extended wear electrocardiography patch with wire interconnects, comprising:
 - a flexible backing formed of an elongated strip of stretchable material with narrow longitudinal midsection evenly tapering inward from a distal end and a proximal end, the elongated strip adherable only at a contact surface defined on each of the ends;
 - a pair of electrocardiographic electrodes interfaced to one or more of a set of electrical contact pads, each of the electrodes comprising an electrically conductive surface only exposed on the contact surface;
 - a battery connected to one or more of the electrical contact pads of the set via at least one flexile wire interconnect, the battery secured in place via a flexile wire; and
 - the set of electrical contact pads comprised on the flexible backing and formed by a set of further flexile wires, the set of the further flexile wires configured to interface the electrodes and the battery with an electrocardiography monitor recorder when the electrocardiography monitor recorder is in contact with the set of the electrical contact pads, wherein the flexile wire interconnect, the flexile wire, and the further flexile wires each comprise a plurality of threads.
2. An electrocardiography patch in accordance with claim 1, further comprising:
 - a non-conductive receptacle securely adhered on one of the ends of the elongated strip opposite the contact surface and formed to removably receive the electrocardiography monitor recorder.
3. An electrocardiography patch in accordance with claim 2, further comprising:
 - a battery compartment formed on a bottom surface of the non-conductive receptacle operable to hold the battery, wherein the battery is secured via the flexile wire within the battery compartment.
4. An electrocardiography patch in accordance with claim 1, further comprising:
 - a physiological sensor interfaced to one of the electrical contact pads of the set via a further flexile wire interconnect.

5. An electrocardiography patch in accordance with claim 4, wherein the physiological sensor is selected from the group consisting of an SpO₂ sensor, a blood pressure sensor, a temperature sensor, respiratory rate sensor, a glucose sensor, an air flow sensor, and a volumetric pressure sensor.

6. An electrocardiography patch in accordance with claim 1, wherein at least one of the plurality of threads of the flexile wire interconnect, the flexile wire, and the further flexile wires are electrically conductive threads and at least one of the plurality of threads is electrically non-conductive threads.

7. An electrocardiography patch in accordance with claim 1, wherein all of the threads are electrically conductive threads.

8. An electrocardiography patch in accordance with claim 1, wherein an adhesive is comprised on each of the contact surfaces.

9. An electrocardiography patch in accordance with claim 1, wherein each of the electrocardiographic electrodes is comprised of an additional flexile wire and the additional flexile wires connect the electrodes to two of the electrical contact pads.

10. An extended wear electrocardiography monitor with wire interconnects, comprising:

- a disposable extended wear electrocardiography patch, comprising:
 - a flexible backing formed of an elongated strip of stretchable material with narrow longitudinal midsection evenly tapering inward from a distal end and a proximal end, the elongated strip adherable only at a contact surface defined on each of the ends;
 - a pair of electrocardiographic electrodes interfaced to one or more of a set of electrical contact pads, each of the electrodes comprising an electrically conductive surface only exposed on the contact surface;
 - a battery connected to one or more of the electrical contact pads of the set via at least one flexile wire interconnect, the battery secured in place via a flexile wire; and
 - the set of electrical contact pads comprised on the flexible backing and formed by a set of further flexile wires, the set of the further flexile wires configured to interface the electrodes and the battery with an electrocardiography monitor recorder when the electrocardiography monitor recorder is in contact with the set of the electrical contact pads, wherein the flexile wire interconnect, the flexile wire, and the further flexile wires each comprise a plurality of threads; and
- the electrocardiography monitor recorder, comprising:
 - a wearable housing;
 - an external interface configured to be removably connected to the set of the electrical contact pads; and
 - electronic circuitry provided within the wearable housing comprising:
 - a microcontroller operable to execute over an extended period under micro programmable control as specified in firmware;
 - an electrocardiographic front end circuit under the control of the microcontroller adapted to sense electrocardiographic signals through the electrocardiographic electrodes via the external interface; and
 - a non-volatile memory electrically interfaced with the microcontroller and operable to continuously store samples of the electrocardiographic signals throughout the extended period.

19

11. An extended wear electrocardiography monitor in accordance with claim 10, further comprising:

a non-conductive receptacle securely adhered on one of the ends of the elongated strip opposite the contact surface and formed to removably receive the electrocardiography monitor recorder.

12. An extended wear electrocardiography monitor in accordance with claim 11, further comprising:

a battery compartment formed on a bottom surface of the non-conductive receptacle operable to hold the battery, wherein the battery is secured via the flexile wire within the battery compartment.

13. An extended wear electrocardiography monitor in accordance with claim 10, further comprising:

a physiological sensor interfaced to one of the electrical contact pads of the set via a further flexile wire interconnect.

14. An extended wear electrocardiography monitor in accordance with claim 13, wherein the physiological sensor is selected from the group consisting of an SpO₂ sensor, a

20

blood pressure sensor, a temperature sensor, respiratory rate sensor, a glucose sensor, an air flow sensor, and a volumetric pressure sensor.

15. An extended wear electrocardiography monitor in accordance with claim 10, wherein at least one of the plurality of threads of the flexile wire interconnect, the flexile wire, and the further flexile wires are electrically conductive threads and at least one of the plurality of threads is electrically non-conductive threads.

16. An extended wear electrocardiography monitor in accordance with claim 10, wherein all of the threads are electrically conductive threads.

17. An extended wear electrocardiography monitor in accordance with claim 10, wherein an adhesive is comprised on each of the contact surfaces.

18. An extended wear electrocardiography monitor in accordance with claim 10, wherein each of the electrocardiographic electrodes is comprised of an additional flexile wire and the additional flexile wires connect the electrodes to two of the electrical contact pads.

* * * * *

专利名称(译)	带有导线互连的延长磨损心电图贴片		
公开(公告)号	US10631748	公开(公告)日	2020-04-28
申请号	US16/221989	申请日	2018-12-17
[标]申请(专利权)人(译)	BARDY诊断		
申请(专利权)人(译)	BARDY诊断, INC.		
当前申请(专利权)人(译)	BARDY诊断, INC.		
[标]发明人	FELIX JASON BISHAY JON MIKALSON BARDY GUST H		
发明人	FELIX, JASON BISHAY, JON MIKALSON BARDY, GUST H.		
IPC分类号	A61B5/0408 A61B5/00		
CPC分类号	A61B5/6833 A61B5/0408 A61B5/04085 A61B5/6823 A61B2560/0412 A61B2560/0456 A61B2560/0443 A61B2562/164		
优先权	61/882403 2013-09-25 US		
其他公开文献	US20190117107A1		
外部链接	Espacenet		

摘要(译)

提供了具有导线互连的延长磨损心电图贴片。该贴片包括由可拉伸材料的细长条形成的柔性背衬，该细长条的纵向中部狭窄，从远端和近端向内均匀地逐渐变细，该细长条仅在限定于每个端部上的接触表面处粘附。一对与一组电极垫中的一个或多个电极接口的心电图电极，每个电极包括仅暴露在接触表面上的导电表面；通过至少一根挠性线互连件连接到组中的一个或多个垫的电池，该电池通过挠性线固定在适当位置；所述电接触垫组包括在所述挠性背衬上并且由另一组挠性线形成，所述组电接触垫被配置为使电极和电池与心电图监护仪记录器对接。

60

