

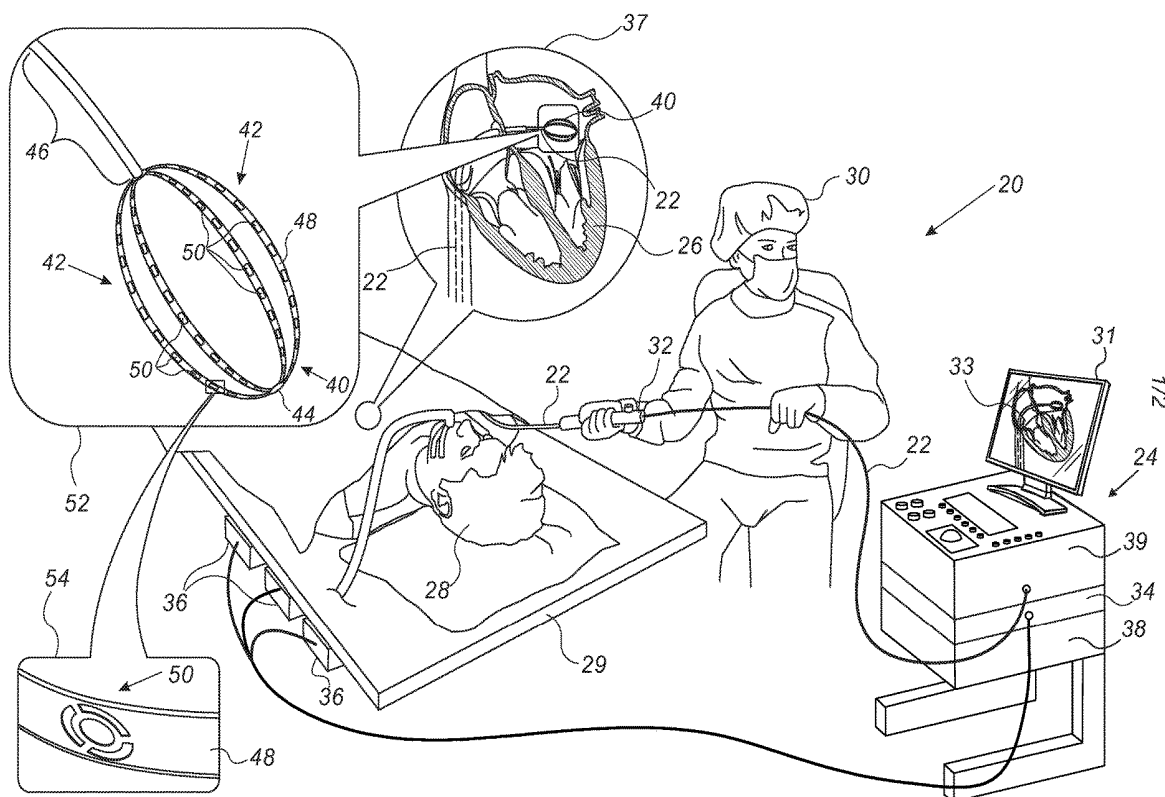

US 20200205689A1

(19) **United States**(12) **Patent Application Publication**
Squires et al.(10) **Pub. No.: US 2020/0205689 A1**(43) **Pub. Date: Jul. 2, 2020**(54) **MAPPING ECG SIGNALS USING A
MULTIPOLE ELECTRODE ASSEMBLY**(52) **U.S. Cl.**
CPC *A61B 5/04011* (2013.01); *A61B 5/0422*
(2013.01); *A61B 2562/125* (2013.01); *A61B*
5/6858 (2013.01); *A61B 2562/046* (2013.01);
A61B 5/0006 (2013.01)(71) Applicant: **Biosense Webster (Israel) Ltd.,**
Yokneam (IL)(72) Inventors: **Alexander David Squires, Duarte, CA**
(US); **Christopher Thomas Beeckler,**
Brea, CA (US)(57) **ABSTRACT**(21) Appl. No.: **16/235,769**(22) Filed: **Dec. 28, 2018****Publication Classification**(51) **Int. Cl.**
A61B 5/04 (2006.01)
A61B 5/042 (2006.01)
A61B 5/00 (2006.01)

A medical probe includes an insertion tube for insertion into a patient body, at least an arm, which is attached to a distal end of the insertion tube, at least a reference electrode coupled to the arm, and multiple electrodes, which are coupled to the arm, surround the reference electrode and are configured to sense electrical signals of body tissues that, when measured relatively to the reference electrode, are indicative of anatomical signals in the patient body.



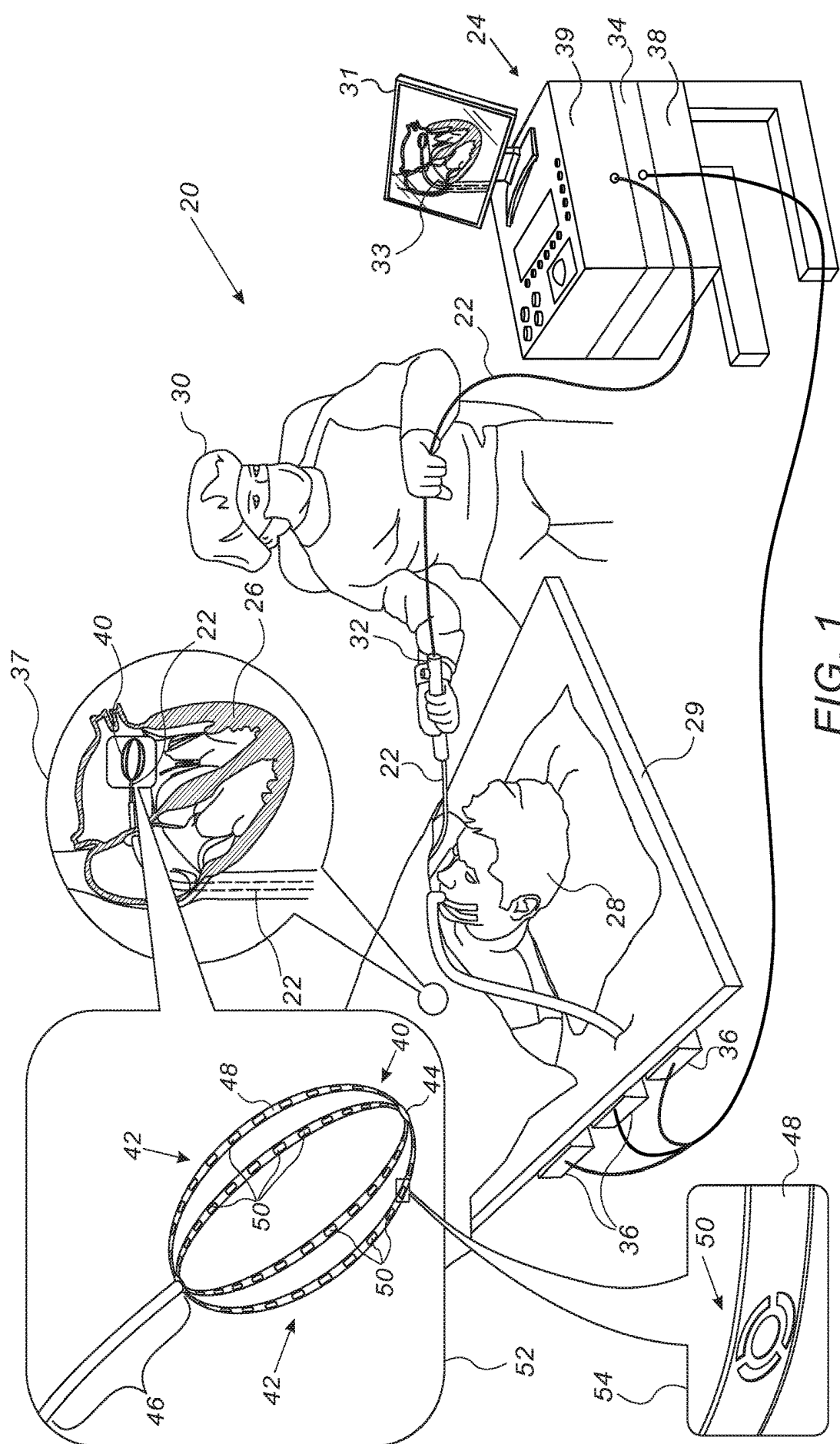

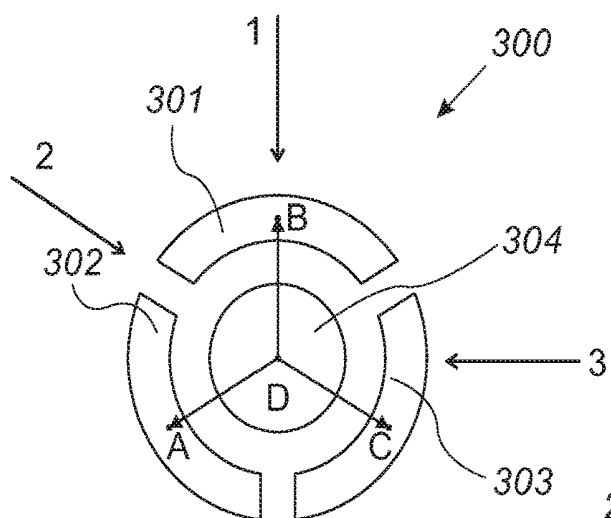

FIG. 2

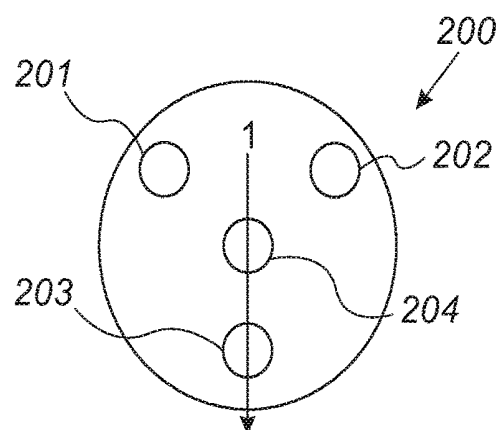

FIG. 3A

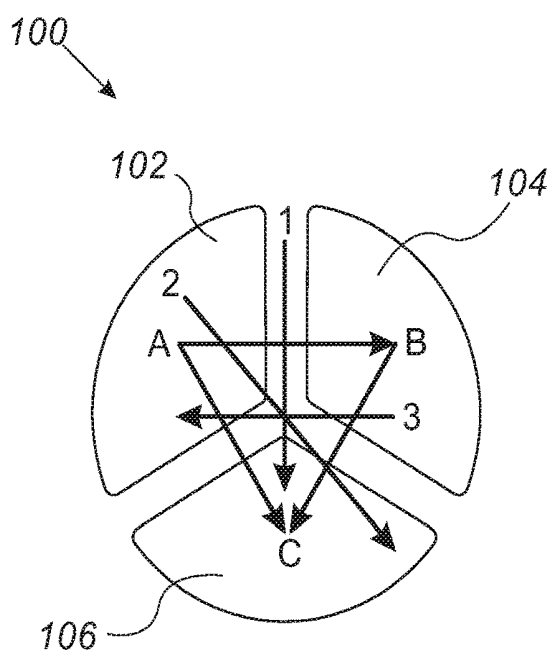

FIG. 3B

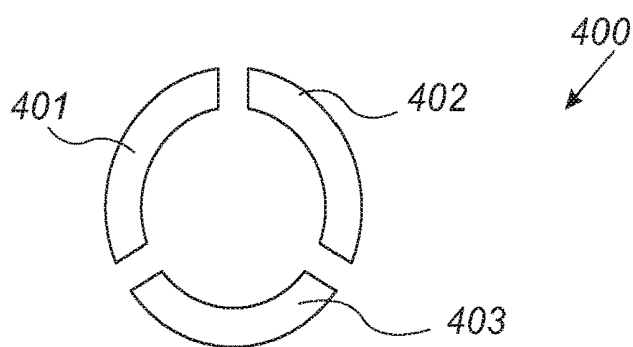

FIG. 3C

MAPPING ECG SIGNALS USING A MULTIPOLE ELECTRODE ASSEMBLY

FIELD OF THE INVENTION

[0001] The present invention relates generally to medical devices, and particularly to methods and systems for mapping anatomical signals in a patient body.

BACKGROUND OF THE INVENTION

[0002] Various methods for measuring anatomical signals, such as electrocardiogram (ECG) signals are known in the art.

[0003] For example, U.S. Patent Application Publication 2009/0221897 describes a sensor for measuring electrical variables at the surface of a human or animal body. The sensor comprising three or more electrodes in a geometrically regular arrangement, and a support member arranged to keep the electrodes together.

[0004] U.S. Patent Application Publication 2010/0010583 describes techniques for posture classification of a patient in a coordinate system of a sensor. A defined vector is obtained from a sensor disposed in a substantially fixed manner relative to the patient, the defined vector is described in a coordinate system of the sensor and without regard to an orientation in which the sensor is disposed in relation to the patient. A detected vector is obtained from the sensor that is described using the coordinate system of the sensor. The detected vector and the defined vector are used to classify the posture state of the patient without regard to the orientation in which the sensor is disposed in relation to the patient.

SUMMARY OF THE INVENTION

[0005] An embodiment of the present invention that is described herein provides a medical probe including an insertion tube for insertion into a patient body, at least an arm, which is attached to a distal end of the insertion tube, at least a reference electrode coupled to the arm, and multiple electrodes, which are coupled to the arm, surround the reference electrode and are configured to sense electrical signals of body tissues that, when measured relatively to the reference electrode, are indicative of anatomical signals in the patient body.

[0006] In some embodiments, the electrodes are arranged in a non-uniform geometry around the reference electrode. In other embodiments, the anatomical signals include electrocardiogram (ECG) signals. In yet other embodiments, the medical probe includes electrical conductors, which are electrically connected to one or more of the electrodes and are configured to transmit the electrical signals to a system external to the patient body.

[0007] In an embodiment, the medical probe includes one or more wireless communication devices, which are electrically connected to one or more of the electrodes and are configured to transmit the electrical signals to a system external to the patient body. In another embodiment, the arm includes a flexible printed circuit board (PCB).

[0008] In some embodiments, the electrical signals are indicative of a direction of the anatomical signals. In other embodiments, the electrical signals are indicative of a propagation speed of the anatomical signals.

[0009] There is additionally provided, in accordance with an embodiment of the present invention, a method that

includes, receiving electrical signals from a medical probe, which includes: (a) at least an arm, which is attached to a distal end of an insertion tube, (b) at least a reference electrode coupled to the arm, and (c) multiple electrodes, which are coupled to the arm, surround the reference electrode, and produce the electrical signals. The electrical signals, when measured relatively to the reference electrode, are indicative of a direction of anatomical signals in the patient body. Based on the electrical signals, at least one of a direction and a propagation speed of the anatomical signals is estimated.

[0010] There is additionally provided, in accordance with an embodiment of the present invention, a method for producing a medical probe, the method includes, attaching, to a distal end of an insertion tube, at least an arm. At least a reference electrode is coupled to the arm. Multiple electrodes arranged in a non-uniform geometry and surrounding the reference electrode are coupled to the arm.

[0011] There is further provided, in accordance with an embodiment of the present invention, a system that includes a reference electrode, a medical probe that includes an insertion tube for insertion into a patient body, at least an arm, which is attached to a distal end of the insertion tube, and multiple electrodes, which are coupled to the arm, and are configured to sense electrical signals of body tissues that, when measured relative to the reference electrode, are indicative of anatomical signals in the patient body. The system further includes a processor, which is configured to estimate, based on the electrical signals, at least one of a direction and a propagation speed of the anatomical signals.

[0012] In some embodiments, the reference electrode includes a body surface electrode coupled to a skin of the patient body. In other embodiments, the reference electrode includes a virtual electrode having a reference signal, and the processor is configured to calculate the reference signal based on additional electrical signals received from at least two body surface electrodes coupled to a skin of the patient body.

[0013] In an embodiment, the reference signal is calculated by averaging the additional electrical signals of at least two of the body surface electrodes. In another embodiment, the reference electrode is coupled to the arm, and the multiple electrodes surround the reference electrode.

[0014] The present invention will be more fully understood from the following detailed description of the embodiments thereof, taken together with the drawings in which:

BRIEF DESCRIPTION OF THE DRAWINGS

[0015] FIG. 1 is a schematic, pictorial illustration of a catheter tracking system, in accordance with an embodiment of the present invention; and

[0016] FIGS. 2 and 3A-3C are schematic, pictorial illustrations of several configurations of electrode assemblies that can be used for measuring a direction and propagation speed of a wavefront of anatomical signals in a patient heart, in accordance with embodiments of the present invention.

DETAILED DESCRIPTION OF EMBODIMENTS

Overview

[0017] Embodiments of the present invention that are described hereinbelow provide improved methods and systems for estimating the direction and propagation speed of

wavefronts caused by anatomical signals, such as electrocardiogram (ECG) signals, in a patient body. In some embodiments, a system for estimating the direction and propagation speed of wavefronts caused by the ECG signals comprises a minimally invasive probe having a distal-end assembly coupled to an insertion tube, and a processor. The distal-end assembly comprises multiple spines, also referred to as arms, wherein each spine comprises a strip made from a flexible printed circuit board (PCB).

[0018] In some embodiments, each spine comprises multiple electrode assemblies coupled to the circuit board side facing the patient tissue, wherein the PCB comprises conductors that provide electrical connectivity between the electrode assemblies and conducting elements, such as traces or wiring running through the probe to a system external to the patient body.

[0019] In some embodiments, each electrode assembly comprises multiple electrodes arranged in a non-uniform geometry. The electrodes are configured to sense electrical signals of body tissues that, when measured relatively to another electrode of the electrode assembly, are indicative of the direction and magnification of the ECG signals in the patient heart.

[0020] In some embodiments, at least one of the electrodes comprises a reference electrode, wherein the other electrodes of the assembly are surrounding the reference electrode and may be arranged in a uniform or non-uniform geometry.

[0021] In some embodiments, the probe is typically inserted into the patient body in a collapsed position (e.g., using a sheath) and is extended upon reaching a target location such as a cavity of the patient heart. In the extended position, the spines are extended to conform to the shape of the cavity so that the electrodes coupled to the spines make contact with the tissue of the inner cavity surface and produce electrical signals indicative of the sensed ECG signals. These electrical signals are provided to the processor.

[0022] In some embodiments, the electrode assembly comprises multiple dipoles formed by the arrangement of the electrodes in a multipole configuration. The multipole arrangement is configured to sense the ECG signals in any direction in the patient heart.

[0023] In some embodiments, the processor is configured to estimate, based on the electrical signals, the direction and propagation speed of the ECG signals. The processor is configured to use various methods, such as calculating vector components of every dipole, and calculating vector addition and/or vector subtraction between the dipoles so as to estimate the direction and speed of a wavefront that carries the electrical field produced by the ECG signals.

[0024] The disclosed techniques improve the accuracy and sensitivity of ECG mapping in patient heart, for diagnosing and treating arrhythmia and other cardiac diseases. Moreover, the disclosed techniques may also be used for accurate mapping of other anatomical signals in patient organs.

System Description

[0025] FIG. 1 is a schematic, pictorial illustration of a catheter tracking system 20, in accordance with an embodiment of the present invention. System 20 comprises a probe, in the present example a cardiac catheter 22, and a control console 24. In the embodiment described herein, catheter 22 may be used for any suitable therapeutic and/or diagnostic

purposes, such as mapping of electro-cardiac signals for the diagnosis of cardiac dysfunctions, such as cardiac arrhythmias, and/or ablation of tissue in a heart 26, e.g., based on the mapping described above.

[0026] Console 24 comprises a processor 39, typically a general-purpose processor of a general-purpose computer, with suitable front end and interface circuits for receiving signals from catheter 22 and for controlling the other components of system 20 described herein. Processor 39 may be programmed in software to carry out the functions that are used by the system, and the processor stores data for the software in a memory 38. The software may be downloaded to console 24 in electronic form, over a network, for example, or it may be provided on non-transitory tangible media, such as optical, magnetic or electronic memory media. Alternatively, some or all of the functions of processor 39 may be carried out by dedicated or programmable digital hardware components.

[0027] An operator 30 (such as an interventional cardiologist) inserts catheter 22 through the vascular system of a patient 28 lying on a table 29. Catheter 22 comprises an insertion tube (not shown), and a distal-end assembly 40 that comprises multiple spines, also referred to herein as “splines” or “arms” (shown in inset 52 and described in detail below). Operator 30 moves assembly 40 of catheter 22 in the vicinity of the target region in heart 26 by manipulating catheter 22 with a manipulator 32 near the proximal end of the catheter as shown in an inset 37 of FIG. 1. The proximal end of catheter 22 is connected to interface circuitry of processor 39 so as to exchange electrical signals therewith.

[0028] The position of the distal-end assembly in the heart cavity is typically measured by magnetic position sensing in catheter tracking system 20. In this case, console 24 comprises a driver circuit 34, which drives magnetic field generators 36 placed at known positions external to patient 28 lying on table 29, e.g., below the patient's torso.

[0029] Distal-end assembly 40 typically comprises multiple spines, each comprising one or more magnetic field sensors and/or one or more ablation or mapping electrodes, and/or other devices (as shown, for example in inset 52 and in FIGS. 2, 3A, 3B and 3C below). When the distal-end assembly is brought into contact with the intracardiac tissue, e.g., the inner heart surface, the mapping electrodes generate potential gradient signals in response to the sensed electrical potentials, also referred to herein as electrical signals.

[0030] In some embodiments, the position sensors generate position signals in response to the sensed external magnetic fields, thereby enabling processor 39 to map the electrical potentials as a function of position within the heart cavity. In some embodiments, the sensed electrical signals are indicative of a direction and propagation speed of wavefronts caused by anatomical signals, such as electrocardiogram (ECG) signals in heart 26, as will be described in detail in FIG. 2 below.

[0031] The multiple magnetic position sensors and mapping electrodes of assembly 40 are connected to interface circuitry of processor 39 at the catheter proximal end. Operator 30 can view the position of assembly 40 in an image 33 of heart 26 on a user display 31.

[0032] This method of position sensing is implemented, for example, in the CARTO™ system, produced by Biosense Webster Inc. (Irvine, Calif.) and is described in detail in U.S. Pat. Nos. 5,391,199, 6,690,963, 6,484,118, 6,239,

724, 6,618,612 and 6,332,089, in PCT Patent Publication WO 96/05768, and in U.S. Patent Application Publications 2002/0065455 A1, 2003/0120150 A1 and 2004/0068178 A1, whose disclosures are all incorporated herein by reference.

[0033] In other embodiments, instead of magnetic position sensors, distal end assembly **40** may comprise one or more impedance position sensors, such as advanced current localization (ACL) sensors, or any other suitable position sensors, and system **20** may comprise a respective position tracking module. In alternative embodiments, system **20** does not comprise any position tracking module, and distal end assembly **40** does not comprise any position tracking sensors.

Basket Catheter for Sensing ECG Signals in Patient Heart

[0034] Reference is now made to inset **52**. In some embodiments, each spine **42** is coupled to a cap **44** located at the distal tip of distal end assembly **40**. In some embodiments, catheter **22** further comprises a shaft **46**, which is used for the transition of assembly **40** between the collapsed and extended positions. For example, after inserting catheter **22** into heart **26**, shaft **46** is configured to extract distal end assembly **40** out of a sheath (not shown) so as to bring assembly **40** to an extended position. Similarly, after concluding the medical procedure, shaft **46** is configured to retract distal end assembly **40** into the sheath to the collapsed position, typically before retracting catheter **22** out of patient body.

[0035] In some embodiments, multiple electrode assemblies **50** are formed on an external surface of a flexible printed circuit board (PCB) **48** so that in the extended position of distal end assembly **40**, electrode assemblies **50** make contact with the tissue of heart **26**. Other components, such as sensors, may be coupled to the spine in a similar manner.

[0036] In some embodiments, electrical circuit traces (not shown) are formed in PCB **48** of spine **42**, each trace is connected to at least one electrode of each electrode assembly **50**. In some embodiments, the electrical circuit traces are connected to suitable wiring or other types of electrical conductors that runs through catheter **22**, for exchanging signals between console **24** and electrode assemblies **50**.

[0037] Reference is now made to an inset **54**. In some embodiments, each electrode assembly **50** comprises at least three electrodes. In the example of inset **54** assembly **50** comprises a reference electrode coupled to spine **52** and three electrodes, which are also coupled to the respective spine, surround the reference electrode and are configured to sense electrical signals of body tissues that, when measured relatively to the reference electrode, are indicative of the aforementioned direction and propagation speed of wavefronts caused by the ECG signals in heart **26**. Additional embodiments related to the structure and operation of electrode assembly **50** are described in detail in FIGS. **2**, **3A**, **3B** and **3C** below. Additionally or alternatively, the electrodes of electrode assembly **50** are configured to sense electrical signals indicative of the direction and speed of any other anatomical signals moving in the patient body.

[0038] In other embodiments, distal end assembly **40** may comprise one or more wireless communication device (not shown), which are electrically connected to one or more of the electrodes of electrode assembly **50**. The one or more

wireless communication devices are configured to transmit the electrical signals to console **24** or to any other system external to the patient body.

Sensing the Speed and Direction of ECG Signals Propagating in Patient Heart

[0039] FIG. **2** is a schematic, pictorial illustration of an electrode assembly **300** configured to measure the direction and propagation speed of a wavefront caused by ECG signals in heart **26**, in accordance with an embodiment of the present invention. Electrode assembly **300** may replace, for example, electrode assembly **50** of FIG. **1** above, and is configured to sense ECG signals or any other signals in the body of patient **28**.

[0040] In some embodiments, electrode assembly **300** comprises three electrodes **301**, **302** and **303** and a reference electrode **304**, which are coupled to or embedded in PCB **48** of spine **42**. Electrodes **301-303** surround reference electrode **304** and may be arranged in a uniform or non-uniform geometry around reference electrode **304**.

[0041] In an embodiment, electrodes **301**, **302**, **303** and **304** whose respective centers of gravity (COGs) are denoted "A," "B," "C" and "D" in the figure, are arranged in three dipoles between reference electrode **304** and each of electrodes **301**, **302** and **303**, and are shown as vectors DA, DB and DC, respectively. In this configuration, vector DA shows the dipole between reference electrode **304** and electrode **302**, vector DB shows the dipole between reference electrode **304** and electrode **301**, and vector DC shows the dipole between reference electrode **304** and electrode **303**.

[0042] Three examples of wavefronts, which are caused by three respective ECG signals of heart **26**, are shown in FIG. **2**, and are referred to herein as wavefronts "1," "2" and "3." It will be understood that the propagation of wavefronts "1," "2" and "3" carry electrical fields along the tissue of heart **26** and typically only one of these example wavefronts exists at a time.

[0043] Note that for a time period, the changes in voltages sensed by the electrodes of a given dipole is indicative of the wavefront propagation speed. Information combined from two or more dipoles, allows for determination of the wavefront propagation direction, which is defined, for example, in a Cartesian coordinate system.

[0044] In the example of FIG. **2**, the COG of reference electrode **304** is aligned with the COG (not shown) of electrode assembly **300**. In addition, electrodes **301-303** share a similar shape that differs from the shape of reference electrode **304**. In some embodiments, the shapes of electrodes **301-303** may be chosen to maximize circumferential coverage around reference electrode **304**, while also matching surface areas so each dipole is comprised of two electrodes of equal surface area.

[0045] In some embodiments, electrodes **301-304** may be arranged in any suitable geometric structure, which may be regular or non-regular. The terms "non-regular" and "irregular" may refer to a structure in which the COGs of electrodes **301**, **302**, **303**, and **304** do not lie on the same geometrical plane. As described above, the non-regular geometrical arrangement allows sensing a wavefront moving in any direction, such as the directions of wavefronts "1," "2" or "3" or any other direction.

[0046] In some embodiments, processor **39** is configured to receive electrical signals produced by electrodes **301-304** (e.g., voltage of each electrode **301-303** relative to reference

electrode 304), which are indicative of the direction and speed of the wavefront caused by the ECG signals in heart 26.

[0047] In some embodiments, in response to wavefront “1,” the dipole represented by vector DB, which is substantially parallel to wavefront “1” and having the inverse direction, will at a first time, t_1 sense the most negative value of voltage among all the dipoles. The dipoles represented by vectors DA and DC will sense, at a second later time, t_2 , a positive value of voltage.

[0048] In an example embodiment, in response to wavefront “2,” the dipole represented by vector DB will sense, at a first time, t_1 , a negative value of voltage. The dipole represented by vector DA will sense at a second later time $t_1 + \delta$ a similar negative value of voltage. Finally, the dipole represented by vector DC, which is substantially parallel to wavefront “2,” will sense, at a third later time, t_2 , a positive value of voltage. The timing difference between when the dipole represented by vector DB and the dipole represented by vector DA first sense voltage changes (δ) can be used to determine the direction of wavefront “2.” For example, a greater value of δ would correspond to a wavefront which was closer to wavefront “1,” a δ of zero would correspond to a wavefront anti-parallel to vector DC, and a negative value of δ would correspond to a wavefront that is closer to being anti-parallel to vector DA.

[0049] In an embodiment, in response to wavefront “3,” the dipole represented by vector DC will sense at a first time t_1 , a negative value of voltage. The dipole represented by vector DB, which is substantially orthogonal to wavefront “3,” will sense, at a second later time, t_2 , a negative value of voltage. Subsequently, at a third time, t_3 , the dipole represented by vector DA will sense a positive value of voltage.

[0050] In some embodiments, based on these electrical signals, processor 39 is configured to estimate the direction and speed of the wavefront caused by the ECG signals in heart 26. The change in the value of the sensed voltage is indicative of the speed of the wavefront and based on a combination of signals from two or more of the aforementioned dipoles, processor 39 may calculate the direction, as well as the speed, of the wavefront caused by the ECG signals of heart 26.

[0051] In other embodiments, electrodes 301, 302, 303, and 304 may have any other suitable type of non-regular geometrical arrangement. For example, at least two of electrodes 301, 302, and 303 may have a unique geometrical shape, and/or size and/or geometrical orientation that differs from one another. Additionally or alternatively, the distances between COGs of the aforementioned dipoles may differ from one another. In the example of FIG. 2, vectors DA and DB may have different respective lengths, for example.

[0052] In other embodiments, electrode assembly 300 may comprise any other suitable number of electrodes arranged in any suitable irregular geometrical structure. In these embodiments, the electrode assembly may have any suitable shape, symmetric or asymmetric. For example, the shape of the electrode assembly may be non-round or even non-circular. Note that at least one of the non-regular arrangements described above may be used to increase the sensitivity of the electrode assembly to sense ECG signals in predefined directions.

[0053] In some embodiments, processor 39 may hold calibration data (e.g., stored in a file) for each electrode

assembly having a non-regular structure as described above. Based on the calibration data, processor 39 is configured to compensate for the shape irregularity in the calculation of the direction and propagation speed of the wavefronts.

[0054] FIG. 3A is a schematic, pictorial illustration of an electrode assembly 200 configured to measure the direction and propagation speed of wavefronts caused by anatomical signals in heart 26, in accordance with another embodiment of the present invention. Electrode assembly 200 may replace, for example, electrode assembly 50 of FIG. 1 above, and is configured to sense wavefronts caused by ECG signals or any other signals in the body of patient 28.

[0055] In some embodiments, electrode assembly 200 comprises three electrodes 201, 202 and 203 and a reference electrode 204, which are coupled to or embedded in PCB 48 of spine 42. Electrodes 201-203 surround reference electrode 204 and may be arranged in a uniform or non-uniform geometry around reference electrode 204. As described in FIG. 2 above, electrodes 201, 202 and 203 and a reference electrode 204 are arranged in three dipoles, a first dipole between reference electrode 204 and electrode 201, a second dipole between reference electrode 204 and electrode 202, and a third dipole between reference electrode 204 and electrode 203. In the example of FIG. 3A, the COG of reference electrode 204 is aligned with the COG of electrode assembly 200 (not shown), and the shape and surface area of electrodes 201-204 is similar.

[0056] In the context of the present invention and in the claims, the terms “non-uniform,” “non-regular” and “non-periodic” are used interchangeably, and refer to any of the geometrical arrangements described in FIG. 2 above, in FIGS. 3A, 3B and 3C, and/or to a geometrical structure in which the COG of reference electrode 204 is not located on a straight line connecting between any pair of electrodes from among electrodes 201-203.

[0057] Moreover, in an example of a round-shaped electrode assembly, but in contrast to the configuration of electrode assembly 200, the COG of the reference electrode may be not aligned with the COG of the electrode assembly.

[0058] Additionally or alternatively, at least one of electrodes 201-204 may have a different size, shape and/or surface area compared to the other electrodes, e.g., electrode 204 may be larger than electrodes 201-203.

[0059] In some embodiments, electrodes 201-203 are configured to sense electrical signals of body tissues that, when measured relatively to reference electrode 204, are indicative of the direction and speed of the wavefront caused by the ECG signals in heart 26, as described in FIG. 2 above.

[0060] In some embodiments, electrodes 201-203 and 204 are electrically connected to processor 39 via the electrical traces and wiring of catheter 22, or via the wireless device, as described in FIGS. 1 and 2 above.

[0061] In some embodiments, processor 39 is configured to receive the electrical signals produced by the aforementioned dipoles of electrode assembly 200, and to estimate, based on the electrical signals, the direction and speed of a wavefront propagating in heart 26.

[0062] In some embodiments, processor 39 compares the voltage measured by each of electrodes 201-203 relative to reference electrode 204. Based on the comparison, processor 39 may estimate the direction and speed of a propagating wavefront caused by the ECG signals. For example, in response to wavefront “1,” which is orthogonal to a virtual line (not shown) connecting between electrodes 201 and

202, the voltage changes would first be sensed by a dipole comprising electrodes **201** and **204** and by a dipole comprising electrodes **202** and **204**, and later by a dipole comprising electrodes **203** and **204**. As described in FIG. 2 above, based on the timing and values of these sensed voltages, processor **39** may estimate the direction and propagation speed of wavefront “1” caused by the ECG signals in heart **26**. Techniques to allow for the estimating or determination of the direction and speed of the wavefront are shown and described at pages 5-10 and specifically page 7 of “TECHNIQUES FOR AUTOMATED LOCAL ACTIVATION TIME ANNOTATION AND CONDUCTION VELOCITY ESTIMATION IN CARDIAC MAPPING” by C. D. Cantwella, C. H. Roney, F. S. Ng, J. H. Siggers, S. J. Sherwina, N. S. Peters, published in *Computers in Biology and Medicine*, April 2015, which article is incorporated by reference with a copy attached hereto in the Appendix.

[0063] FIG. 3B is a schematic, pictorial illustration of an electrode assembly **100**, configured to measure the direction and propagation speed of a wavefront propagating in heart **26**, in accordance with another embodiment of the present invention. Electrode assembly **100** may replace, for example, electrode assembly **50** of FIG. 1 above.

[0064] In some embodiments, electrode assembly **100** comprises three electrodes **102**, **104** and **106**, each of which having a wedge shape and is positioned at a predefined distance from the other two electrodes. In some embodiments, electrodes **102**, **104** and **106** are arranged geometrically such that electrode assembly **100** has a round shape.

[0065] In some embodiments, electrodes **102**, **104** and **106** are coupled to PCB **48** of spine **42** (as shown in FIG. 1) and are electrically connected to processor **39** via the aforementioned electrical traces and wiring, or via the wireless device, as described in FIG. 1 above.

[0066] In some embodiments, electrode assembly **100** comprises three electrodes and, unlike electrode assemblies **300** and **200** of respective FIGS. 2 and 3A above, does not comprise a reference electrode.

[0067] In an embodiment, electrodes **102**, **104** and **106** whose respective COGs are denoted “A,” “B” and “C” in the figure, are arranged in three dipoles between each pair of these electrodes, A-B, A-C and B-C. In some embodiments, in response to any wavefront, such as the aforementioned wavefronts “1,” “2,” or “3,” a vector “AB” is indicative of a voltage sensed by dipole A-B comprising electrodes **102** and **104**. Similarly, a vector “BC” is indicative of a voltage sensed by dipole B-C comprising electrodes **104** and **106**, and a vector “AC” is indicative of a voltage sensed by dipole A-C comprising electrodes **102** and **106**.

[0068] In some embodiments, in response to wavefront “1,” which is orthogonal to vector AB, electrodes **102** and **104** sense about the same signals, thus, the voltage sensed, at a first time, **t1**, by the dipole represented by the vector AB, is about zero. Subsequently, the other two dipoles represented by vectors AC and BC sense, at a later time, **t2**, similar (e.g., positive) values of voltage. In some embodiments, processor **39** is configured to estimate, based on the timing and voltages sensed by dipoles A-B, A-C and B-C, the direction and speed of wavefront “1.”

[0069] In an example embodiment, in response to wavefront “2,” the dipole represented by vector AC, which is almost parallel to wavefront “2” and having the same direction, will at a first time, **t1** sense a positive value of voltage, and the dipole represented by vector BC, which is

almost orthogonal to wavefront “2” will sense a positive value of voltage at a second later time, **t2**.

[0070] In another example embodiment, in response to wavefront “3,” the dipole represented by vector AB, which is substantially parallel to wavefront “3” and having an opposite direction, will sense, at time **t1**, a negative value of voltage. Based on the embodiments and definitions described above, the dipole represented by vector BC will sense a positive value of voltage at time **t1**. Subsequently, at a third later time, **t3**, the dipole represented by vector AC will sense a negative value of voltage.

[0071] In some embodiments, processor **39** is configured to estimate the direction and speed of any wavefronts based on the timing of the sensed voltages received from the three dipoles, as described in FIG. 2 above. Estimating the direction and speed of the wavefront may be carried out using vector addition, vector subtraction or both. Alternatively any other suitable method of calculation for estimating the direction and speed can be used.

[0072] In some embodiments, electrodes **102**, **104** and **106** may be arranged in any suitable geometric structure, which may be regular or non-regular. The terms “non-regular” and “irregular” may refer to a structure in which the COGs of electrodes **102**, **104** and **106** do not lie on the same geometrical plane. As described above, the non-regular geometrical arrangement allows sensing a wavefront moving in any direction, such as the directions of wavefronts “1,” “2,” or “3” or any other direction.

[0073] In other embodiments, electrodes **102**, **104** and **106** may have any other suitable type of non-regular geometrical arrangement. For example, at least two of electrodes **102**, **104** and **106** may have a unique geometrical shape, and/or size and/or geometrical orientation that differs from one another. Additionally or alternatively, the distances between COGs of the aforementioned dipoles may differ from one another. In the example of FIG. 3B, vectors AB and BC may have different respective lengths, for example.

[0074] In the example of FIG. 3B, each of electrodes **102**, **104** and **106** covers an area that comprises almost a third of the total area of the round shape of electrode assembly **100**. In another embodiment, two electrodes (e.g., electrodes **102** and **104**) may each cover, each, almost 40% of the area of electrode assembly **100**, and the third electrode (e.g., electrode **106**) may cover almost 20% of the area of electrode assembly **100**. Note that the terms “almost” are used due to the space between each pair of electrodes from among electrodes **102**, **104** and **106**, which comprises a share of the area of electrode assembly **100**.

[0075] In other embodiments, electrode assembly may comprise any other suitable number of electrodes arranged in any suitable irregular geometrical structure. In these embodiments, the electrode assembly may have any suitable shape, symmetric or asymmetric. For example, the shape of electrode assembly **100** may be non-round or even non-circular. Note that at least one of the non-regular arrangements described above may be used to increase the sensitivity of the electrode assembly to sense ECG signals in predefined directions.

[0076] In some embodiments, processor **39** may hold calibration data (e.g., stored in a file) for each electrode assembly having a non-regular structure as described above. Based on the calibration data, processor **39** is configured to compensate for the shape irregularity in the calculation of

the direction and propagation speed of the wavefronts caused by the ECG signals, or by any other signals of patient 28.

[0077] FIG. 3C is a schematic, pictorial illustration of an electrode assembly 400 configured to measure the direction and propagation speed of wavefronts caused by ECG signals in heart 26, in accordance with an embodiment of the present invention. Electrode assembly 400 may replace, for example, electrode assembly 50 of FIG. 1 above, and is configured to sense the aforementioned ECG signals or any other signals in the body of patient 28.

[0078] In some embodiments, electrode assembly 400 comprises three electrodes 401, 402 and 403, which are coupled to or embedded in PCB 48 of spine 42. Electrodes 401-403 may be arranged in a uniform or non-uniform geometry as described, for example, in FIG. 3B above.

[0079] In some embodiments, processor 39 is configured to receive electrical signals from electrodes 401-403, which are indicative of the direction and propagation speed of wavefronts caused by the ECG signals in heart 26. In some embodiments, the electrical signals may be measured with respect to a reference electrode, also referred to herein as a common electrode, such as a virtual electrode, which is not shown in FIG. 3C.

[0080] In some embodiments, the virtual electrode may be calculated from two or more body surface electrodes, which are coupled to a skin of patient 28 using a patch or any other suitable coupling technique. One such example of a virtual electrode would be a Wilson's central terminal (WCT).

[0081] In alternative embodiments, the dipoles may be formed between two or more physical electrodes, such as any of electrodes 401-403, and a virtual electrode.

[0082] In some embodiments, based on these electrical signals and the techniques described, for example, in FIG. 2 above, processor 39 is configured to estimate the direction and speed of a wavefront (e.g., wavefront "1" of FIG. 2 above) caused by the ECG signals in heart 26.

[0083] In alternative embodiments, electrodes 401-403 may be arranged in three dipoles (not shown), a first dipole between electrodes 401 and 402, a second dipole between electrodes 402 and 403, and a third dipole between electrodes 403 and 401. Each of these dipoles is configured to sense electrical signals of body tissues indicative of the sensed values of voltage using the technique described in FIG. 3B above.

[0084] The configuration of electrode assemblies 50, 100, 200, 300 and 400 are provided by way of example, for demonstrating an example probe or another device in which any of these electrode assemblies may be integrated and used. Alternatively, any other suitable configurations can also be used, for example, using any suitable number of electrodes and/or reference electrodes having any suitable distances therebetween, applying different shape and size of electrode assemblies and of individual electrode or groups of electrodes within the respective electrode assembly. Furthermore, each electrode may be coupled to any suitable type of device, such as processor or controller, using any type coupling technique, and the signals sensed by the electrodes may be transmitted to the device using any suitable communication technique.

[0085] Although the embodiments described herein mainly address sensing the direction and propagation speed of anatomical signals in patient heart, the methods and systems described herein can also be used in other applica-

tions, such as in sensing the direction and propagation speed of anatomical signals in any other organ of the patient or on the patient skin.

[0086] It will thus be appreciated that the embodiments described above are cited by way of example, and that the present invention is not limited to what has been particularly shown and described hereinabove. Rather, the scope of the present invention includes both combinations and sub-combinations of the various features described hereinabove, as well as variations and modifications thereof which would occur to persons skilled in the art upon reading the foregoing description and which are not disclosed in the prior art. Documents incorporated by reference in the present patent application are to be considered an integral part of the application except that to the extent any terms are defined in these incorporated documents in a manner that conflicts with the definitions made explicitly or implicitly in the present specification, only the definitions in the present specification should be considered.

1. A medical probe, comprising:

an insertion tube for insertion into a patient body;

at least an arm, which is attached to a distal end of the insertion tube;

at least a reference electrode coupled to the arm and configured to contact internal tissues; and

multiple electrodes, which are coupled to the arm, surround the reference electrode such that the multiple electrodes sense anatomical signals which, when measured relatively to the reference electrode, are indicative of magnitude and direction of the anatomical signals in the patient body.

2. The probe according to claim 1, wherein the electrodes are arranged in a non-uniform geometry around the reference electrode.

3. The probe according to claim 1, wherein the anatomical signals comprise electrocardiogram (ECG) signals.

4. The probe according to claim 1, and comprising electrical conductors, which are electrically connected to one or more of the electrodes and are configured to transmit the electrical signals to a system external to the patient body.

5. The probe according to claim 1, and comprising one or more wireless communication devices, which are electrically connected to one or more of the electrodes and are configured to transmit the electrical signals to a system external to the patient body.

6. The probe according to claim 1, wherein the arm comprises a flexible printed circuit board (PCB).

7. The probe according to claim 1, wherein the electrical signals are indicative of a direction of the anatomical signals.

8. The probe according to claim 1, wherein the electrical signals are indicative of a propagation speed of the anatomical signals.

9. A method, comprising:

receiving electrical signals from a medical probe, which comprises: (a) at least an arm, which is attached to a distal end of an insertion tube, (b) at least a reference electrode coupled to the arm, and (c) multiple electrodes, which are coupled to the arm and surround the reference electrode to sense anatomical signals in body tissues,

wherein the electrical signals, when measured relatively to the reference electrode, are indicative of a direction of anatomical signals in the body tissues of a patient body; and

estimating, based on the electrical signals, at least one of a direction and a propagation speed of the anatomical signals.

10. The method according to claim **9**, wherein the electrodes are arranged in a non-uniform geometry around the reference electrode.

11. The method according to claim **9**, wherein the anatomical signals comprise electrocardiogram (ECG) signals.

12. A method for producing a medical probe, the method comprising:

attaching, to a distal end of an insertion tube, at least an arm;

coupling to the arm at least a reference electrode; and

coupling to the arm multiple electrodes arranged in a non-uniform geometry and surrounding the reference electrode.

13. The method according to claim **12** and comprising connecting the reference electrode and the multiple electrodes to a system external to the patient body via electrical conductors.

14. The method according to claim **12** and comprising connecting the reference electrode and the multiple electrodes to one or more wireless communication devices coupled to the arm.

15. The method according to claim **12**, wherein the arm comprises a flexible printed circuit board (PCB).

16. A system, comprising:

a reference electrode;

a medical probe, comprising:

an insertion tube for insertion into a patient body;

at least an arm, which is attached to a distal end of the insertion tube; and

multiple electrodes, which are coupled to the arm, and are configured to sense electrical signals in the patient body that, when measured relative to the reference electrode, are indicative of anatomical signals in the patient body; and

a processor, which is configured to estimate, based on the electrical signals, at least one of a direction and a propagation speed of the anatomical signals.

17. The system according to claim **16**, wherein the reference electrode comprises a body surface electrode coupled to a skin of the patient body.

18. The system according to claim **16**, wherein the reference electrode comprises a virtual electrode having a reference signal, and wherein the processor is configured to calculate the reference signal based on additional electrical signals received from at least two body surface electrodes coupled to a skin of the patient body.

19. The system according to claim **18**, wherein the processor is configured to calculate the reference signal by averaging the additional electrical signals of at least two of the body surface electrodes.

20. The system according to claim **16**, wherein the reference electrode is coupled to the arm, and wherein the multiple electrodes surround the reference electrode.

* * * * *

专利名称(译)	使用多极电极组件映射ECG信号		
公开(公告)号	US20200205689A1	公开(公告)日	2020-07-02
申请号	US16/235769	申请日	2018-12-28
[标]申请(专利权)人(译)	韦伯斯特生物官能(以色列)有限公司		
申请(专利权)人(译)	生物传感韦伯斯特 (以色列) LTD.		
当前申请(专利权)人(译)	生物传感韦伯斯特 (以色列) LTD.		
[标]发明人	BEECKLER CHRISTOPHER THOMAS		
发明人	SQUIRES, ALEXANDER DAVID BEECKLER, CHRISTOPHER THOMAS		
IPC分类号	A61B5/04 A61B5/042 A61B5/00		
CPC分类号	A61B5/0422 A61B5/04011 A61B5/6858 A61B2562/125 A61B5/0006 A61B2562/046		
外部链接	USPTO		

摘要(译)

一种医疗探针,包括:用于插入患者体内的插入管,至少一条臂和多个电极,所述至少一条臂附接到所述插入管的远端,所述至少一个参考电极耦接到所述臂,所述多个电极耦接到所述手臂。臂围绕参考电极并且被配置为感测身体组织的电信号,当相对于参考电极进行测量时,该电信号指示患者体内的解剖学信号。

