



US 20150087949A1

(19) **United States**

(12) **Patent Application Publication**

Felix et al.

(10) **Pub. No.: US 2015/0087949 A1**

(43) **Pub. Date: Mar. 26, 2015**

(54) **EXTENDED WEAR AMBULATORY
ELECTROCARDIOGRAPHY AND
PHYSIOLOGICAL SENSOR MONITOR**

(52) **U.S. Cl.**
CPC *A61B 5/04085* (2013.01); *A61B 5/04087*
(2013.01); *A61B 5/0452* (2013.01); *A61B*
5/6801 (2013.01)

(71) Applicant: **Bardy Diagnostics, Inc.**, Vashon, WA
(US)

USPC **600/382; 600/523; 600/391**

(72) Inventors: **Jason Felix**, Vashon Island, WA (US);
Jon Mikalson Bishay, Seattle, WA (US);
Gust H. Bardy, Carnation, WA (US)

(57) **ABSTRACT**

(21) Appl. No.: **14/080,725**

Physiological monitoring can be provided through a wearable monitor that includes two components, a flexible extended wear electrode patch and a removable reusable monitor recorder. The wearable monitor sits centrally (in the midline) on the patient's chest along the sternum oriented top-to-bottom. The placement of the wearable monitor in a location at the sternal midline (or immediately to either side of the sternum) benefits extended wear by removing the requirement that ECG electrodes be continually placed in the same spots on the skin throughout the monitoring period. Instead, the patient can place an electrode patch anywhere within the general region of the sternum. Power is provided through a battery provided on the electrode patch, which avoids having to open the monitor recorder's housing for battery replacement.

(22) Filed: **Nov. 14, 2013**

Related U.S. Application Data

(60) Provisional application No. 61/882,403, filed on Sep. 25, 2013.

Publication Classification

(51) **Int. Cl.**
A61B 5/0408 (2006.01)
A61B 5/00 (2006.01)
A61B 5/0452 (2006.01)

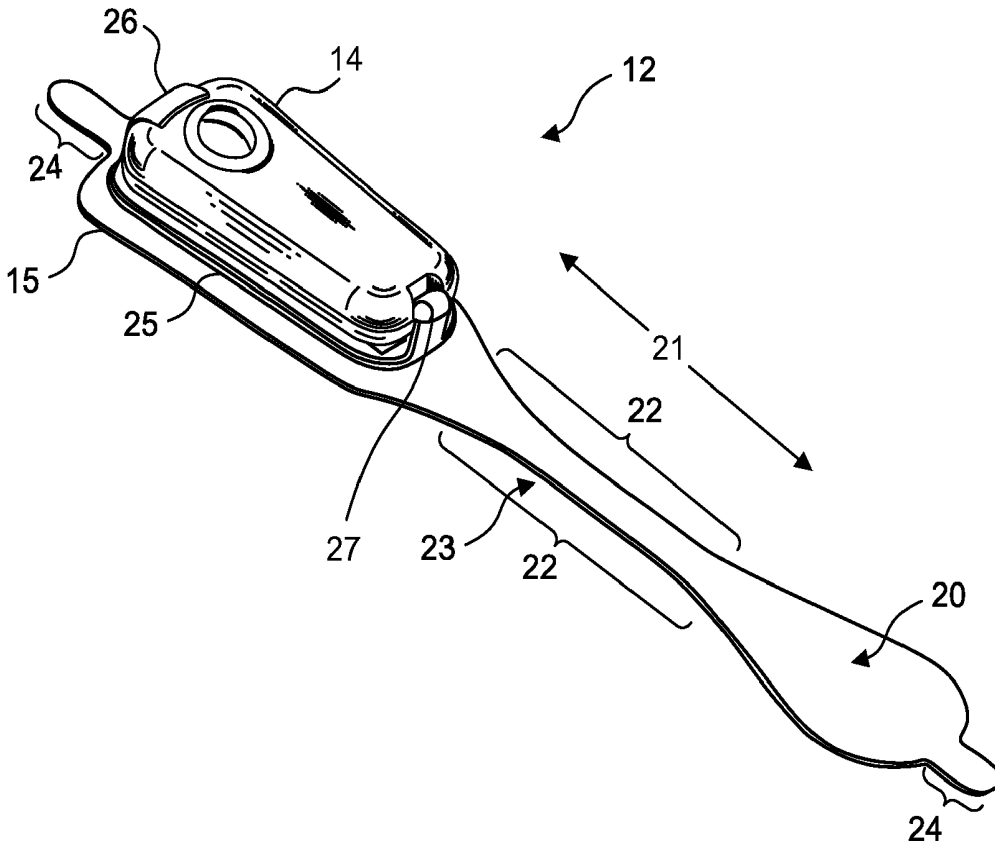

Fig. 1.

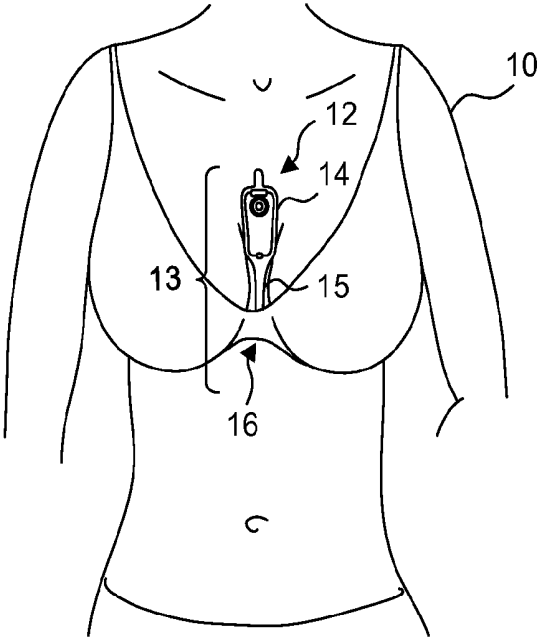

Fig. 2.

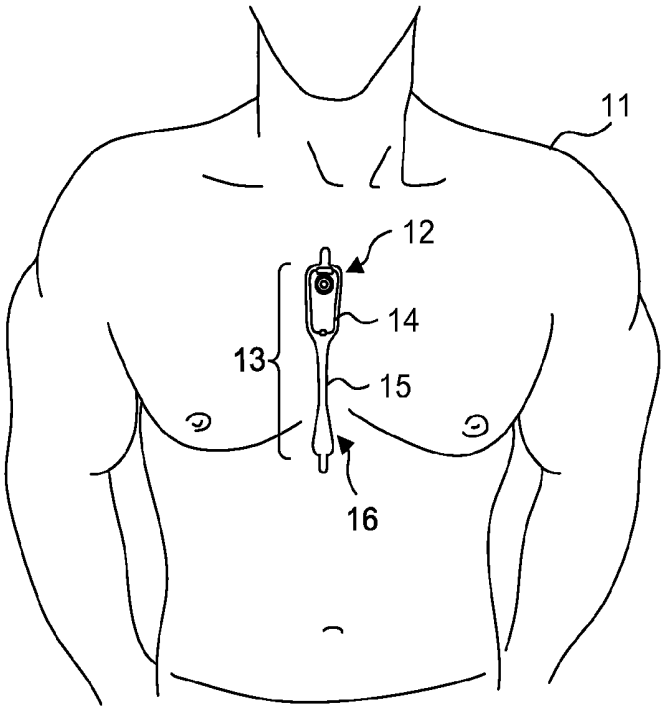

Fig. 3.

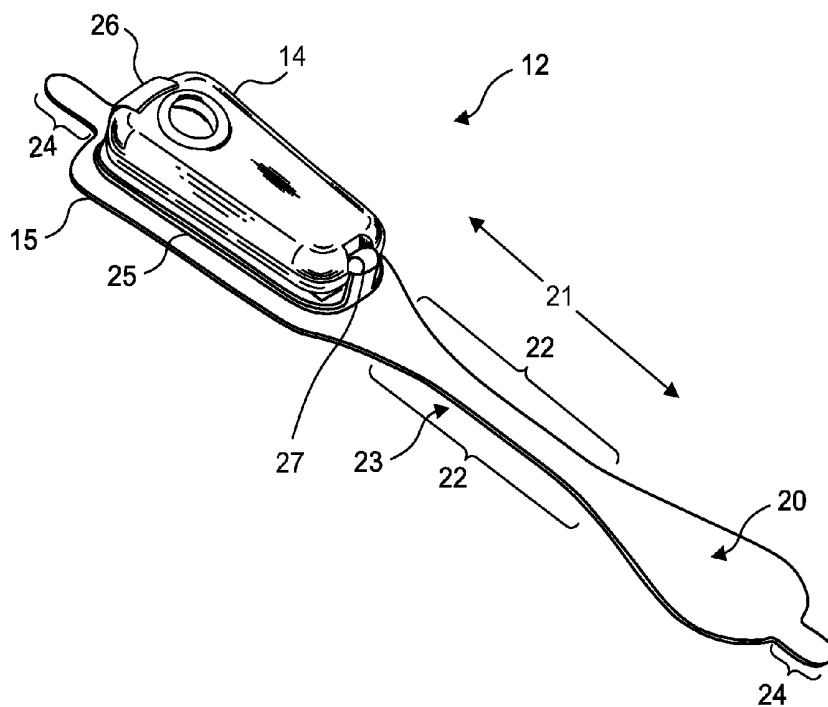

Fig. 4.

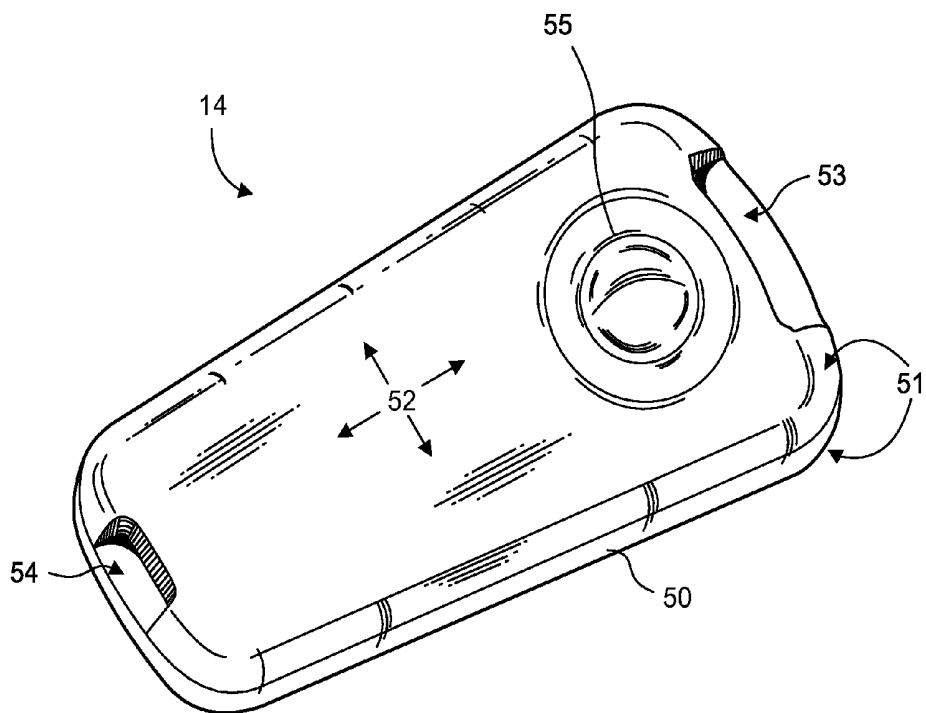

Fig. 5.

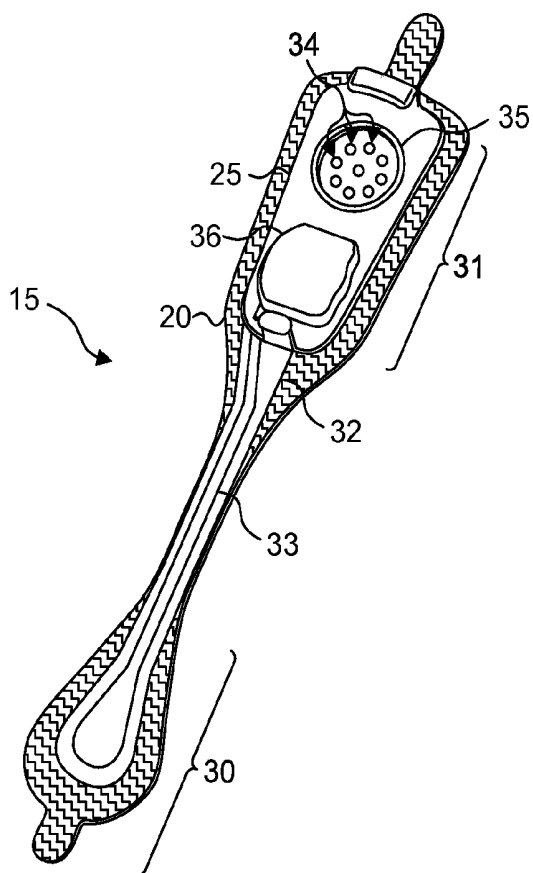

Fig. 6.

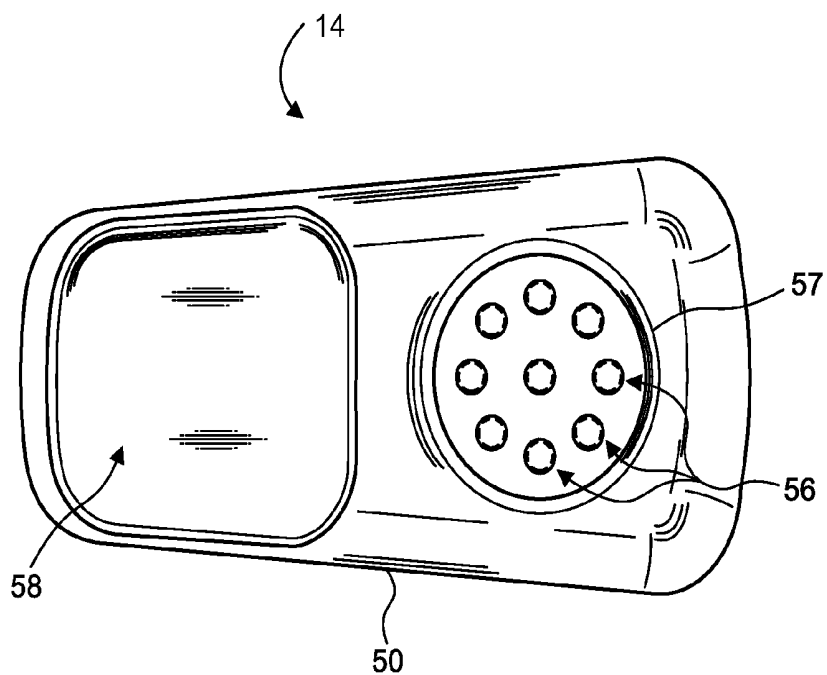

Fig. 7.

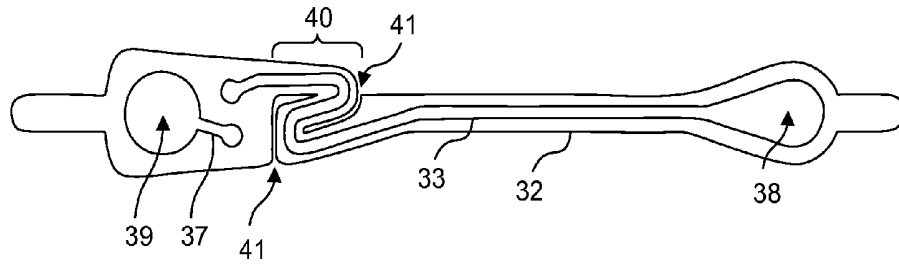

Fig. 8.

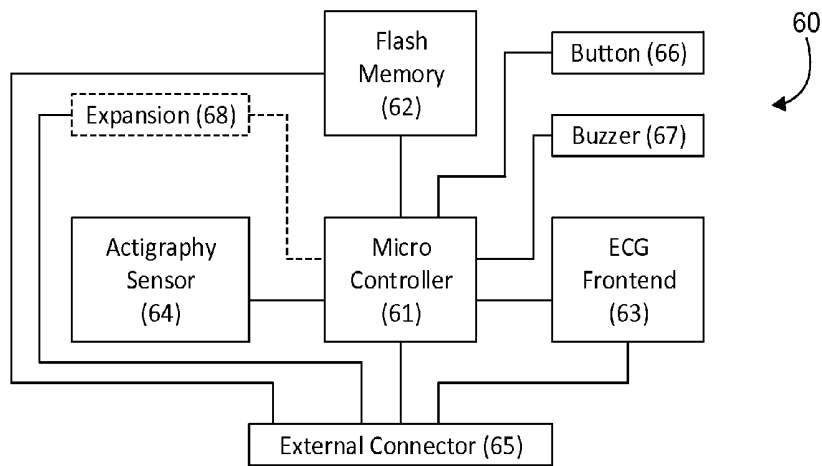

Fig. 9.

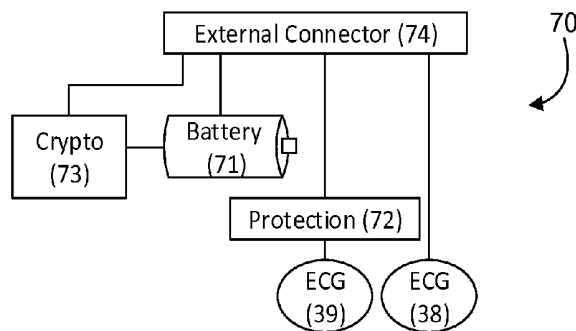

Fig. 10.

100

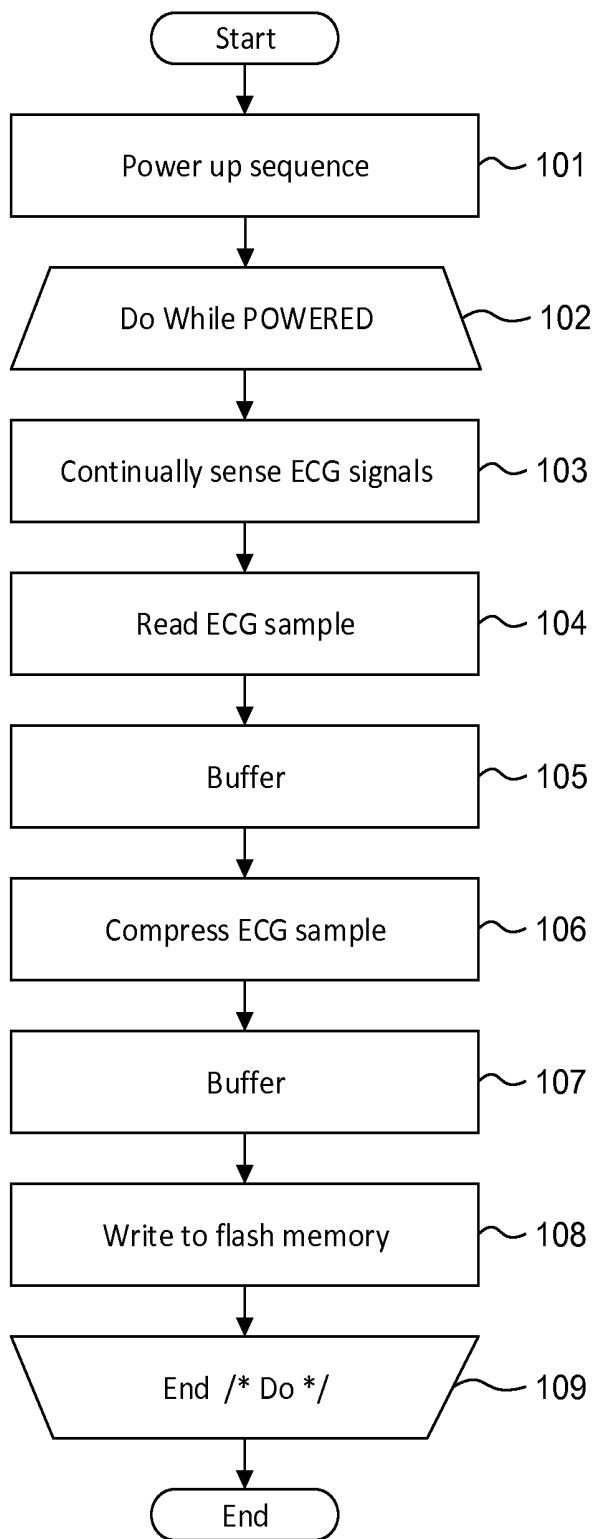
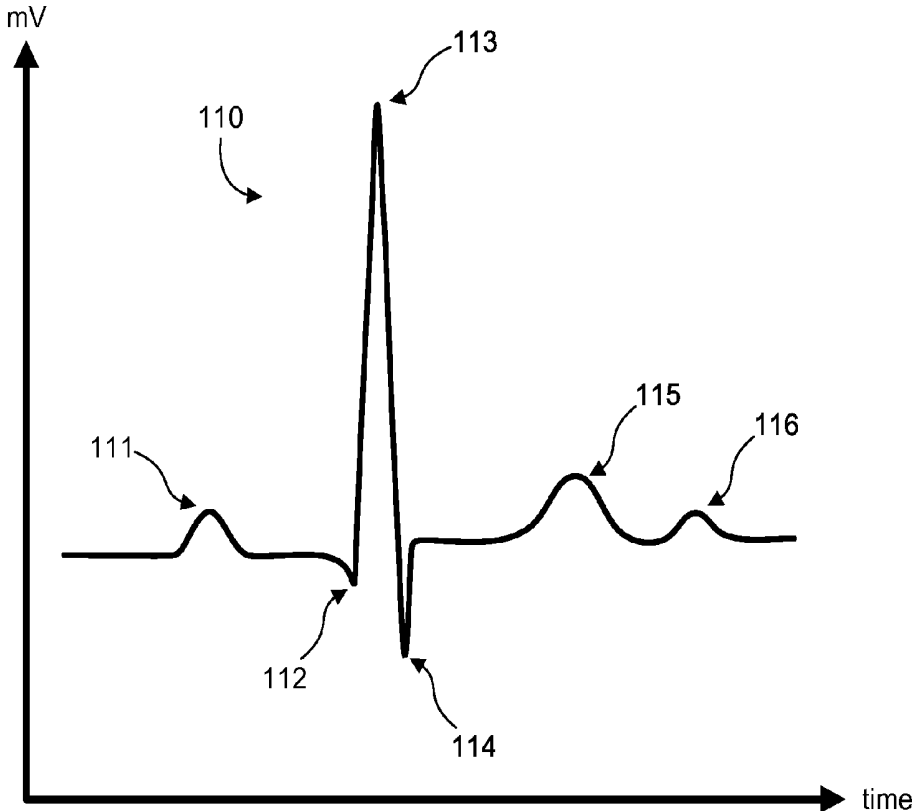

Fig. 11.



**EXTENDED WEAR AMBULATORY
ELECTROCARDIOGRAPHY AND
PHYSIOLOGICAL SENSOR MONITOR**

CROSS-REFERENCE TO RELATED
APPLICATION

[0001] This non-provisional patent application claims priority under 35 U.S.C. §119(e) to U.S. Provisional Patent application, Ser. No. 61/882,403, filed Sep. 25, 2013, the disclosure of which is incorporated by reference.

FIELD

[0002] This application relates in general to electrocardiographic monitoring and, in particular, to an extended wear ambulatory electrocardiography and physiological sensor monitor.

BACKGROUND

[0003] The heart emits electrical signals as a by-product of the propagation of the action potentials that trigger depolarization of heart fibers. An electrocardiogram (ECG) measures and records such electrical potentials to visually depict the electrical activity of the heart over time. Conventionally, a standardized set format 12-lead configuration is used by an ECG machine to record cardiac electrical signals from well-established traditional chest locations. Electrodes at the end of each lead are placed on the skin over the anterior thoracic region of the patient's body to the lower right and to the lower left of the sternum, on the left anterior chest, and on the limbs. Sensed cardiac electrical activity is represented by PQRSTU waveforms that can be interpreted post-ECG recording to derive heart rate and physiology. The P-wave represents atrial electrical activity. The QRSTU components represent ventricular electrical activity.

[0004] An ECG is a tool used by physicians to diagnose heart problems and other potential health concerns. An ECG is a snapshot of heart function, typically recorded over 12 seconds, that can help diagnose rate and regularity of heartbeats, effect of drugs or cardiac devices, including pacemakers and implantable cardioverter-defibrillators (ICDs), and whether a patient has heart disease. ECGs are used in-clinic during appointments, and, as a result, are limited to recording only those heart-related aspects present at the time of recording. Sporadic conditions that may not show up during a spot ECG recording require other means to diagnose them. These disorders include fainting or syncope; rhythm disorders, such as tachyarrhythmias and bradyarrhythmias; apneic episodes; and other cardiac and related disorders. Thus, an ECG only provides a partial picture and can be insufficient for complete patient diagnosis of many cardiac disorders.

[0005] Diagnostic efficacy can be improved, when appropriate, through the use of long-term extended ECG monitoring. Recording sufficient ECG and related physiology over an extended period is challenging, and often essential to enabling a physician to identify events of potential concern. A 30-day observation day period is considered the "gold standard" of ECG monitoring, yet achieving a 30-day observation day period has proven unworkable because such ECG monitoring systems are arduous to employ, cumbersome to the patient, and excessively costly. Ambulatory monitoring in-clinic is implausible and impracticable. Nevertheless, if a patient's ECG could be recorded in an ambulatory setting, thereby allowing the patient to engage in activities of daily

living, the chances of acquiring meaningful information and capturing an abnormal event while the patient is engaged in normal activities becomes more likely to be achieved.

[0006] For instance, the long-term wear of ECG electrodes is complicated by skin irritation and the inability ECG electrodes to maintain continual skin contact after a day or two. Moreover, time, dirt, moisture, and other environmental contaminants, as well as perspiration, skin oil, and dead skin cells from the patient's body, can get between an ECG electrode, the non-conductive adhesive used to adhere the ECG electrode, and the skin's surface. All of these factors adversely affect electrode adhesion and the quality of cardiac signal recordings. Furthermore, the physical movements of the patient and their clothing impart various compressional, tensile, and torsional forces on the contact point of an ECG electrode, especially over long recording times, and an inflexibly fastened ECG electrode will be prone to becoming dislodged. Notwithstanding the cause of electrode dislodgment, depending upon the type of ECG monitor employed, precise re-placement of a dislodged ECG electrode maybe essential to ensuring signal capture at the same fidelity. Moreover, dislodgment may occur unbeknownst to the patient, making the ECG recordings worthless. Further, some patients may have skin that is susceptible to itching or irritation, and the wearing of ECG electrodes can aggravate such skin conditions. Thus, a patient may want or need to periodically remove or replace ECG electrodes during a long-term ECG monitoring period, whether to replace a dislodged electrode, reestablish better adhesion, alleviate itching or irritation, allow for cleansing of the skin, allow for showering and exercise, or for other purpose. Such replacement or slight alteration in electrode location actually facilitates the goal of recording the ECG signal for long periods of time.

[0007] Conventionally, Holter monitors are widely used for long-term extended ECG monitoring. Typically, they are often used for only 24-48 hours. A typical Holter monitor is a wearable and portable version of an ECG that include cables for each electrode placed on the skin and a separate battery-powered ECG recorder. The cable and electrode combination (or leads) are placed in the anterior thoracic region in a manner similar to what is done with an in-clinic standard ECG machine. The duration of a Holter monitoring recording depends on the sensing and storage capabilities of the monitor, as well as battery life. A "looping" Holter monitor (or event) can operate for a longer period of time by overwriting older ECG tracings, thence "recycling" storage in favor of extended operation, yet at the risk of losing event data. Although capable of extended ECG monitoring, Holter monitors are cumbersome, expensive and typically only available by medical prescription, which limits their usability. Further, the skill required to properly place the electrodes on the patient's chest hinders or precludes a patient from replacing or removing the precordial leads and usually involves moving the patient from the physician office to a specialized center within the hospital or clinic.

[0008] The ZIO XT Patch and ZIO Event Card devices, manufactured by iRhythm Tech., Inc., San Francisco, Calif., are wearable stick-on monitoring devices that are typically worn on the upper left pectoral region to respectively provide continuous and looping ECG recording. The location is used to simulate surgically implanted monitors. Both of these devices are prescription-only and for single patient use. The ZIO XT Patch device is limited to a 14-day monitoring period, while the electrodes only of the ZIO Event Card

device can be worn for up to 30 days. The ZIO XT Patch device combines both electronic recordation components, including battery, and physical electrodes into a unitary assembly that adheres to the patient's skin. The ZIO XT Patch device uses adhesive sufficiently strong to support the weight of both the monitor and the electrodes over an extended period of time and to resist disadherence from the patient's body, albeit at the cost of disallowing removal or relocation during the monitoring period. Moreover, throughout monitoring, the battery is continually depleted and battery capacity can potentially limit overall monitoring duration. The ZIO Event Card device is a form of downsized Holter monitor with a recorder component that must be removed temporarily during baths or other activities that could damage the non-waterproof electronics. Both devices represent compromises between length of wear and quality of ECG monitoring, especially with respect to ease of long term use, female-friendly fit, and quality of atrial (P-wave) signals.

[0009] Therefore, a need remains for an extended wear continuously recording ECG monitor practicably capable of being worn for a long period of time in both men and women and capable of recording atrial signals reliably.

[0010] A further need remains for a device capable of recording signals ideal for arrhythmia discrimination, especially a device designed for atrial activity recording.

SUMMARY

[0011] Physiological monitoring can be provided through a wearable monitor that includes two components, a flexible extended wear electrode patch and a removable reusable monitor recorder. The wearable monitor sits centrally (in the midline) on the patient's chest along the sternum oriented top-to-bottom. The placement of the wearable monitor in a location at the sternal midline (or immediately to either side of the sternum), with its unique narrow "hourglass"-like shape, benefits long-term extended wear by removing the requirement that ECG electrodes be continually placed in the same spots on the skin throughout the monitoring period. Instead, the patient is free to place an electrode patch anywhere within the general region of the sternum. In addition, power is provided through a battery provided on the electrode patch, which avoids having to either periodically open the housing of the monitor recorder for the battery replacement, which also creates the potential for moisture intrusion and human error, or to recharge the battery, which can potentially take the monitor recorder off line for hours at a time. In addition, the electrode patch is intended to be disposable, while the monitor recorder is a reusable component. Thus, each time that the electrode patch is replaced, a fresh battery is provided for the use of the monitor recorder.

[0012] One embodiment provides an extended wear electrocardiography and physiological sensor monitor recorder. A sealed housing is adapted to be removably secured into the non-conductive receptacle on a disposable extended wear electrode patch. Electronic circuitry is included within the sealed housing. An externally-powered micro-controller is operable to execute under micro programmable control. An electrocardiographic front end circuit is electrically interfaced to the micro-controller and is operable to sense electrocardiographic signals through electrocardiographic electrodes provided on the disposable extended wear electrode patch. Externally-powered flash memory is electrically interfaced with the micro-controller and is operable to store samples of the electrocardiographic signals.

[0013] A further embodiment provides an extended wear electrocardiography and physiological sensor monitor. A disposable extended wear electrode patch includes a flexible backing formed of an elongated strip of stretchable material with a narrow longitudinal midsection and, on each end. A contact surface is at least partially coated with an adhesive dressing provided as a crimp relief. A pair of electrocardiographic electrodes is conductively exposed on the contact surface of each end of the elongated strip. A non-conductive receptacle is adhered to an outward-facing end of the elongated strip and includes a plurality of electrical pads. A flexible circuit is affixed on each end of the elongated strip as a strain relief and includes a pair of circuit traces electrically coupled to the pair of electrocardiographic electrodes and a pair of the electrical pads. A reusable electrocardiography monitor has a sealed housing adapted to be removably secured into the non-conductive receptacle. A micro-controller is operable to execute under micro programmable control and is electrically interfaced to an electrocardiographic front end circuit that is operable to sense electrocardiographic signals through the electrocardiographic electrodes via the pair of electrical pads. Flash memory is electrically interfaced with the micro-controller and is operable to store samples of the electrocardiographic signals.

[0014] The monitoring patch is especially suited to the female anatomy. The narrow longitudinal midsection can fit nicely within the intermammary cleft of the breasts without inducing discomfort, whereas conventional patch electrodes are wide and, if adhered between the breasts, would cause chafing, irritation, frustration, and annoyance, leading to low patient compliance.

[0015] The foregoing aspects enhance ECG monitoring performance and quality facilitating long-term ECG recording, critical to accurate arrhythmia diagnosis.

[0016] In addition, the foregoing aspects enhance comfort in women (and certain men), but not irritation of the breasts, by placing the monitoring patch in the best location possible for optimizing the recording of cardiac signals from the atrium, another feature critical to proper arrhythmia diagnosis.

[0017] Still other embodiments will become readily apparent to those skilled in the art from the following detailed description, wherein are described embodiments by way of illustrating the best mode contemplated. As will be realized, other and different embodiments are possible and the embodiments' several details are capable of modifications in various obvious respects, all without departing from their spirit and the scope. Accordingly, the drawings and detailed description are to be regarded as illustrative in nature and not as restrictive.

BRIEF DESCRIPTION OF THE DRAWINGS

[0018] FIGS. 1 and 2 are diagrams showing, by way of examples, an extended wear electrocardiography and physiological sensor monitor, including a monitor recorder in accordance with one embodiment, respectively fitted to the sternal region of a female patient and a male patient.

[0019] FIG. 3 is a perspective view showing an extended wear electrode patch with a monitor recorder in accordance with one embodiment inserted.

[0020] FIG. 4 is a perspective view showing the monitor recorder of FIG. 3.

[0021] FIG. 5 is a perspective view showing the extended wear electrode patch of FIG. 3 without a monitor recorder inserted.

[0022] FIG. 6 is a bottom plan view of the monitor recorder of FIG. 3.

[0023] FIG. 7 is a top view showing the flexible circuit of the extended wear electrode patch of FIG. 3 when mounted above the flexible backing

[0024] FIG. 8 is a functional block diagram showing the component architecture of the circuitry of the monitor recorder of FIG. 3.

[0025] FIG. 9 is a functional block diagram showing the circuitry of the extended wear electrode patch of FIG. 3.

[0026] FIG. 10 is a flow diagram showing a monitor recorder-implemented method for monitoring ECG data for use in the monitor recorder of FIG. 3.

[0027] FIG. 11 is a graph showing, by way of example, a typical ECG waveform.

DETAILED DESCRIPTION

[0028] Physiological monitoring can be provided through a wearable monitor that includes two components, a flexible extended wear electrode patch and a removable reusable monitor recorder. FIGS. 1 and 2 are diagrams showing, by way of examples, an extended wear electrocardiography and physiological sensor monitor 12, including a monitor recorder 14 in accordance with one embodiment, respectively fitted to the sternal region of a female patient 10 and a male patient 11. The wearable monitor 12 sits centrally (in the midline) on the patient's chest along the sternum 13 oriented top-to-bottom with the monitor recorder 14 preferably situated towards the patient's head. In a further embodiment, the orientation of the wearable monitor 12 can be corrected post-monitoring, as further described infra. The electrode patch 15 is shaped to fit comfortably and conformal to the contours of the patient's chest approximately centered on the sternal midline 16 (or immediately to either side of the sternum 13). The distal end of the electrode patch 15 extends towards the Xiphoid process and, depending upon the patient's build, may straddle the region over the Xiphoid process. The proximal end of the electrode patch 15, located under the monitor recorder 14, is below the manubrium and, depending upon patient's build, may straddle the region over the manubrium.

[0029] The placement of the wearable monitor 12 in a location at the sternal midline 16 (or immediately to either side of the sternum 13) significantly improves the ability of the wearable monitor 12 to cutaneously sense cardiac electric signals, particularly the P-wave (or atrial activity) and, to a lesser extent, the QRS interval signals in the ECG waveforms that indicate ventricular activity. The sternum 13 overlies the right atrium of the heart and the placement of the wearable monitor 12 in the region of the sternal midline 13 puts the ECG electrodes of the electrode patch 15 in a location better adapted to sensing and recording P-wave signals than other placement locations, say, the upper left pectoral region. In addition, placing the lower or inferior pole (ECG electrode) of the electrode patch 15 over (or near) the Xiphoid process facilitates sensing of right ventricular activity and provides superior recordation of the QRS interval.

[0030] During use, the electrode patch 15 is first adhered to the skin along the sternal midline 16 (or immediately to either side of the sternum 13). A monitor recorder 14 is then snapped into place on the electrode patch 15 to initiate ECG monitoring. FIG. 3 is a perspective view showing an extended wear

electrode patch 15 with a monitor recorder 14 in accordance with one embodiment inserted. The body of the electrode patch 15 is preferably constructed using a flexible backing 20 formed as an elongated strip 21 of wrap knit or similar stretchable material with a narrow longitudinal mid-section 23 evenly tapering inward from both sides. A pair of cut-outs 22 between the distal and proximal ends of the electrode patch 15 create a narrow longitudinal midsection 23 or "isthmus" and defines an elongated "hourglass"-like shape, when viewed from above.

[0031] The electrode patch 15 incorporates features that significantly improve wearability, performance, and patient comfort throughout an extended monitoring period. During wear, the electrode patch 15 is susceptible to pushing, pulling, and torquing movements, including compressional and torsional forces when the patient bends forward, and tensile and torsional forces when the patient leans backwards. To counter these stress forces, the electrode patch 15 incorporates strain and crimp reliefs, such as described in commonly-assigned U.S. patent application, entitled "Extended Wear Electrocardiography Patch," Ser. No. _____, filed _____, pending, the disclosure of which is incorporated by reference. In addition, the cut-outs 22 and longitudinal midsection 23 help minimize interference with and discomfort to breast tissue, particularly in women (and gynecomastic men). The cut-outs 22 and longitudinal midsection 23 further allow better conformity of the electrode patch 15 to sternal bowing and to the narrow isthmus of flat skin that can occur along the bottom of the intermammary cleft between the breasts, especially in buxom women. The cut-outs 22 and longitudinal midsection 23 help the electrode patch 15 fit nicely between a pair of female breasts in the intermammary cleft. Still other shapes, cut-outs and conformities to the electrode patch 15 are possible.

[0032] The monitor recorder 14 removably and reusablely snaps into an electrically non-conductive receptacle 25 during use. The monitor recorder 14 contains electronic circuitry for recording and storing the patient's electrocardiography as sensed via a pair of ECG electrodes provided on the electrode patch 15, as further described infra beginning with reference to FIG. 8. The non-conductive receptacle 25 is provided on the top surface of the flexible backing 20 with a retention catch 26 and tension clip 27 molded into the non-conductive receptacle 25 to conformably receive and securely hold the monitor recorder 14 in place.

[0033] The monitor recorder 14 includes a sealed housing that snaps into place in the non-conductive receptacle 25. FIG. 4 is a perspective view showing the monitor recorder 14 of FIG. 3. The sealed housing 50 of the monitor recorder 14 intentionally has a rounded isosceles trapezoidal-like shape 52, when viewed from above, such as described in commonly-assigned U.S. Design patent application, entitled "Electrocardiography Monitor," Serial No. 29/472,046, filed Nov. 7, 2013, pending, the disclosure of which is incorporated by reference. The edges 51 along the top and bottom surfaces are rounded for patient comfort. The sealed housing 50 is approximately 47 mm long, 23 mm wide at the widest point, and 7 mm high, excluding a patient-operable tactile-feedback button 55. The sealed housing 50 can be molded out of polycarbonate, ABS, or an alloy of those two materials. The button 55 is waterproof and the button's top outer surface is molded silicon rubber or similar soft pliable material. A retention detent 53 and tension detent 54 are molded along the edges of the top surface of the housing 50 to respectively engage the

retention catch 26 and the tension clip 27 molded into non-conductive receptacle 25. Other shapes, features, and conformities of the sealed housing 50 are possible.

[0034] The electrode patch 15 is intended to be disposable. The monitor recorder 14, however, is reusable and can be transferred to successive electrode patches 15 to ensure continuity of monitoring. The placement of the wearable monitor 12 in a location at the sternal midline 16 (or immediately to either side of the sternum 13) benefits long-term extended wear by removing the requirement that ECG electrodes be continually placed in the same spots on the skin throughout the monitoring period. Instead, the patient is free to place an electrode patch 15 anywhere within the general region of the sternum 13.

[0035] As a result, at any point during ECG monitoring, the patient's skin is able to recover from the wearing of an electrode patch 15, which increases patient comfort and satisfaction, while the monitor recorder 14 ensures ECG monitoring continuity with minimal effort. A monitor recorder 14 is merely unsnapped from a worn out electrode patch 15, the worn out electrode patch 15 is removed from the skin, a new electrode patch 15 is adhered to the skin, possibly in a new spot immediately adjacent to the earlier location, and the same monitor recorder 14 is snapped into the new electrode patch 15 to reinitiate and continue the ECG monitoring.

[0036] During use, the electrode patch 15 is first adhered to the skin in the sternal region. FIG. 5 is a perspective view showing the extended wear electrode patch 15 of FIG. 3 without a monitor recorder 14 inserted. A flexible circuit 32 is adhered to each end of the flexible backing 20. A distal circuit trace 33 and a proximal circuit trace (not shown) electrically couple ECG electrodes (not shown) to a pair of electrical pads 34. The electrical pads 34 are provided within a moisture-resistant seal 35 formed on the bottom surface of the non-conductive receptacle 25. When the monitor recorder 14 is securely received into the non-conductive receptacle 25, that is, snapped into place, the electrical pads 34 interface to electrical contacts (not shown) protruding from the bottom surface of the monitor recorder 14, and the moisture-resistant seal 35 enables the monitor recorder 14 to be worn at all times, even during bathing or other activities that could expose the monitor recorder 14 to moisture.

[0037] In addition, a battery compartment 36 is formed on the bottom surface of the non-conductive receptacle 25, and a pair of battery leads (not shown) electrically interface the battery to another pair of the electrical pads 34. The battery contained within the battery compartment 35 can be replaceable, rechargeable or disposable.

[0038] The monitor recorder 14 draws power externally from the battery provided in the non-conductive receptacle 25, thereby uniquely obviating the need for the monitor recorder 14 to carry a dedicated power source. FIG. 6 is a bottom plan view of the monitor recorder 14 of FIG. 3. A cavity 58 is formed on the bottom surface of the sealed housing 50 to accommodate the upward projection of the battery compartment 36 from the bottom surface of the non-conductive receptacle 25, when the monitor recorder 14 is secured in place on the non-conductive receptacle 25. A set of electrical contacts 56 protrude from the bottom surface of the sealed housing 50 and are arranged in alignment with the electrical pads 34 provided on the bottom surface of the non-conductive receptacle 25 to establish electrical connections between the electrode patch 15 and the monitor recorder 14. In addition, a seal coupling 57 circumferentially surrounds the set of elec-

trical contacts 56 and securely mates with the moisture-resistant seal 35 formed on the bottom surface of the non-conductive receptacle 25.

[0039] The placement of the flexible backing 20 on the sternal midline 16 (or immediately to either side of the sternum 13) also helps to minimize the side-to-side movement of the wearable monitor 12 in the left- and right-handed directions during wear. To counter the dislodgment of the flexible backing 20 due to compressional and torsional forces, a layer of non-irritating adhesive, such as hydrocolloid, is provided at least partially on the underside, or contact, surface of the flexible backing 20, but only on the distal end 30 and the proximal end 31. As a result, the underside, or contact surface of the longitudinal midsection 23 does not have an adhesive layer and remains free to move relative to the skin. Thus, the longitudinal midsection 23 forms a crimp relief that respectively facilitates compression and twisting of the flexible backing 20 in response to compressional and torsional forces. Other forms of flexible backing crimp reliefs are possible.

[0040] Unlike the flexible backing 20, the flexible circuit 32 is only able to bend and cannot stretch in a planar direction. The flexible circuit 32 can be provided either above or below the flexible backing 20. FIG. 7 is a top view showing the flexible circuit 32 of the extended wear electrode patch 15 of FIG. 3 when mounted above the flexible backing 20. A distal ECG electrode 38 and proximal ECG electrode 39 are respectively coupled to the distal and proximal ends of the flexible circuit 32. A strain relief 40 is defined in the flexible circuit 32 at a location that is partially underneath the battery compartment 36 when the flexible circuit 32 is affixed to the flexible backing 20. The strain relief 40 is laterally extendable to counter dislodgment of the ECG electrodes 38, 39 due to tensile and torsional forces. A pair of strain relief cutouts 41 partially extend transversely from each opposite side of the flexible circuit 32 and continue longitudinally towards each other to define in 'S'-shaped pattern, when viewed from above. The strain relief respectively facilitates longitudinal extension and twisting of the flexible circuit 32 in response to tensile and torsional forces. Other forms of circuit board strain relief are possible.

[0041] ECG monitoring and other functions performed by the monitor recorder 14 are provided through a micro controlled architecture. FIG. 8 is a functional block diagram showing the component architecture of the circuitry 60 of the monitor recorder 14 of FIG. 3. The circuitry 60 is externally powered through a battery provided in the non-conductive receptacle 25 (shown in FIG. 5). Both power and raw ECG signals, which originate in the pair of ECG electrodes 38, 39 (shown in FIG. 7) on the distal and proximal ends of the electrode patch 15, are received through an external connector 65 that mates with a corresponding physical connector on the electrode patch 15. The external connector 65 includes the set of electrical contacts 56 that protrude from the bottom surface of the sealed housing 50 and which physically and electrically interface with the set of pads 34 provided on the bottom surface of the non-conductive receptacle 25. The external connector includes electrical contacts 56 for data download, microcontroller communications, power, analog inputs, and a peripheral expansion port. The arrangement of the pins on the electrical connector 65 of the monitor recorder 14 and the device into which the monitor recorder 14 is attached, whether an electrode patch 15 or download station (not shown), follow the same electrical pin assignment convention to facilitate interoperability. The external connector

65 also serves as a physical interface to a download station that permits the retrieval of stored ECG monitoring data, communication with the monitor recorder 14, and performance of other functions.

[0042] Operation of the circuitry 60 of the monitor recorder 14 is managed by a microcontroller 61. The micro-controller 61 includes a program memory unit containing internal flash memory that is readable and writeable. The internal flash memory can also be programmed externally. The micro-controller 61 draws power externally from the battery provided on the electrode patch 15 via a pair of the electrical contacts 56. The microcontroller 61 connects to the ECG front end circuit 63 that measures raw cutaneous electrical signals and generates an analog ECG signal representative of the electrical activity of the patient's heart over time.

[0043] The circuitry 60 of the monitor recorder 14 also includes a flash memory 62, which the micro-controller 61 uses for storing ECG monitoring data and other physiology and information. The flash memory 62 also draws power externally from the battery provided on the electrode patch 15 via a pair of the electrical contacts 56. Data is stored in a serial flash memory circuit, which supports read, erase and program operations over a communications bus. The flash memory 62 enables the microcontroller 61 to store digitized ECG data. The communications bus further enables the flash memory 62 to be directly accessed externally over the external connector 65 when the monitor recorder 14 is interfaced to a download station.

[0044] The circuitry 60 of the monitor recorder 14 further includes an actigraphy sensor 64 implemented as a 3-axis accelerometer. The accelerometer may be configured to generate interrupt signals to the microcontroller 61 by independent initial wake up and free fall events, as well as by device position. In addition, the actigraphy provided by the accelerometer can be used during post-monitoring analysis to correct the orientation of the monitor recorder 14 if, for instance, the monitor recorder 14 has been inadvertently installed upside down, that is, with the monitor recorder 14 oriented on the electrode patch 15 towards the patient's feet, as well as for other event occurrence analyses.

[0045] The microcontroller 61 includes an expansion port that also utilizes the communications bus. External devices, separately drawing power externally from the battery provided on the electrode patch 15 or other source, can interface to the microcontroller 61 over the expansion port in half duplex mode. For instance, an external physiology sensor can be provided as part of the circuitry 60 of the monitor recorder 14, or can be provided on the electrode patch 15 with communication with the micro-controller 61 provided over one of the electrical contacts 56. The physiology sensor can include an SpO₂ sensor, blood pressure sensor, temperature sensor, respiratory rate sensor, glucose sensor, airflow sensor, volumetric pressure sensing, or other types of sensor or telemetric input sources. In a further embodiment, a wireless interface for interfacing with other wearable (or implantable) physiology monitors, as well as data offload and programming, can be provided as part of the circuitry 60 of the monitor recorder 14, or can be provided on the electrode patch 15 with communication with the micro-controller 61 provided over one of the electrical contacts 56.

[0046] Finally, the circuitry 60 of the monitor recorder 14 includes patient-interfaceable components, including a tactile feedback button 66, which a patient can press to mark events or to perform other functions, and a buzzer 67, such as

a speaker, magnetic resonator or piezoelectric buzzer. The buzzer 67 can be used by the microcontroller 61 to output feedback to a patient such as to confirm power up and initiation of ECG monitoring. Still other components as part of the circuitry 60 of the monitor recorder 14 are possible.

[0047] While the monitor recorder 14 operates under micro control, most of the electrical components of the electrode patch 15 operate passively. FIG. 9 is a functional block diagram showing the circuitry 70 of the extended wear electrode patch 15 of FIG. 3. The circuitry 70 of the electrode patch 15 is electrically coupled with the circuitry 60 of the monitor recorder 14 through an external connector 74. The external connector 74 is terminated through the set of pads 34 provided on the bottom of the non-conductive receptacle 25, which electrically mate to corresponding electrical contacts 56 protruding from the bottom surface of the sealed housing 50 to electrically interface the monitor recorder 14 to the electrode patch 15.

[0048] The circuitry 70 of the electrode patch 15 performs three primary functions. First, a battery 71 is provided in a battery compartment formed on the bottom surface of the non-conductive receptacle 25. The battery 71 is electrically interfaced to the circuitry 60 of the monitor recorder 14 as a source of external power. The unique provisioning of the battery 71 on the electrode patch 15 provides several advantages. First, the locating of the battery 71 physically on the electrode patch 15 lowers the center of gravity of the overall wearable monitor 12 and thereby helps to minimize shear forces and the effects of movements of the patient and clothing. Moreover, the housing 50 of the monitor recorder 14 is sealed against moisture and providing power externally avoids having to either periodically open the housing 50 for the battery replacement, which also creates the potential for moisture intrusion and human error, or to recharge the battery, which can potentially take the monitor recorder 14 off line for hours at a time. In addition, the electrode patch 15 is intended to be disposable, while the monitor recorder 14 is a reusable component. Each time that the electrode patch 15 is replaced, a fresh battery is provided for the use of the monitor recorder 14, which enhances ECG monitoring performance quality and duration of use. Finally, the architecture of the monitor recorder 14 is open, in that other physiology sensors or components can be added by virtue of the expansion port of the microcontroller 61. Requiring those additional sensors or components to draw power from a source external to the monitor recorder 14 keeps power considerations independent of the monitor recorder 14. Thus, a battery of higher capacity could be introduced when needed to support the additional sensors or components without effecting the monitor recorder circuitry 60.

[0049] Second, the pair of ECG electrodes 38, 39 respectively provided on the distal and proximal ends of the flexible circuit 32 are electrically coupled to the set of pads 34 provided on the bottom of the non-conductive receptacle 25 by way of their respective circuit traces 33, 37. The signal ECG electrode 39 includes a protection circuit 72, which is an inline resistor that protects the patient from excessive leakage current.

[0050] Last, in a further embodiment, the circuitry 70 of the electrode patch 15 includes a cryptographic circuit 73 to authenticate an electrode patch 15 for use with a monitor recorder 14. The cryptographic circuit 73 includes a device capable of secure authentication and validation. The cryptographic device 73 ensures that only genuine, non-expired,

safe, and authenticated electrode patches **15** are permitted to provide monitoring data to a monitor recorder **14**.

[0051] The monitor recorder **14** continuously monitors the patient's heart rate and physiology. FIG. **10** is a flow diagram showing a monitor recorder-implemented method **100** for monitoring ECG data for use in the monitor recorder **14** of FIG. **3**. Initially, upon being connected to the set of pads **34** provided with the non-conductive receptacle **25** when the monitor recorder **14** is snapped into place, the microcontroller **61** executes a power up sequence (step **101**). During the power up sequence, the voltage of the battery **71** is checked, the state of the flash memory **62** is confirmed, both in terms of operability check and available capacity, and microcontroller operation is diagnostically confirmed. In a further embodiment, an authentication procedure between the microcontroller **61** and the electrode patch **15** are also performed.

[0052] Following satisfactory completion of the power up sequence, an iterative processing loop (steps **102-109**) is continually executed by the microcontroller **61**. During each iteration (step **102**) of the processing loop, the ECG front end **63** (shown in FIG. **8**) continually senses the cutaneous ECG electrical signals (step **103**) via the ECG electrodes **38, 29** and is optimized to maintain the integrity of the P-wave. A sample of the ECG signal is read (step **104**) by the microcontroller **61** by sampling the analog ECG signal output front end **63**. FIG. **11** is a graph showing, by way of example, a typical ECG waveform **110**. The x-axis represents time in approximate units of tenths of a second. The y-axis represents cutaneous electrical signal strength in approximate units of millivolts. The P-wave **111** has a smooth, normally upward, that is, positive, waveform that indicates atrial depolarization. The QRS complex usually begins with the downward deflection of a Q wave **112**, followed by a larger upward deflection of an R-wave **113**, and terminated with a downward waveform of the S wave **114**, collectively representative of ventricular depolarization. The T wave **115** is normally a modest upward waveform, representative of ventricular depolarization, while the U wave **116**, often not directly observable, indicates the recovery period of the Purkinje conduction fibers.

[0053] Sampling of the R-to-R interval enables heart rate information derivation. For instance, the R-to-R interval represents the ventricular rate and rhythm, while the P-to-P interval represents the atrial rate and rhythm. Importantly, the PR interval is indicative of atrioventricular (AV) conduction time and abnormalities in the PR interval can reveal underlying heart disorders, thus representing another reason why the P-wave quality achievable by the extended wear ambulatory electrocardiography and physiological sensor monitor described herein is medically unique and important. The long-term observation of these ECG indicia, as provided through extended wear of the wearable monitor **12**, provides valuable insights to the patient's cardiac function and overall well-being.

[0054] Each sampled ECG signal, in quantized and digitized form, is temporarily staged in buffer (step **105**), pending compression preparatory to storage in the flash memory **62** (step **106**). Following compression, the compressed ECG digitized sample is again buffered (step **107**), then written to the flash memory **62** (step **108**) using the communications bus. Processing continues (step **109**), so long as the monitoring recorder **14** remains connected to the electrode patch **15** (and storage space remains available in the flash memory **62**), after which the processing loop is exited and execution terminates. Still other operations and steps are possible.

[0055] While the invention has been particularly shown and described as referenced to the embodiments thereof, those skilled in the art will understand that the foregoing and other changes in form and detail may be made therein without departing from the spirit and scope.

1. An extended wear electrocardiography and physiological sensor monitor recorder, comprising:

a sealed housing adapted to be removably secured into a non-conductive receptacle on a disposable extended wear electrode patch; and

an electronic circuitry comprised within the sealed housing, comprising:

an externally-powered micro-controller operable to execute under micro programmable control through firmware that is stored in a program memory unit of the micro-controller;

an electrocardiographic front end circuit electrically interfaced to the micro-controller and operable to sense electrocardiographic signals through electrocardiographic electrodes provided on the disposable extended wear electrode patch, each of the electrocardiographic electrodes adapted to be positioned axially along the midline of the sternum for capturing action potential propagation; and

an externally-powered flash memory electrically interfaced with the micro-controller and operable to store samples of the electrocardiographic signals.

2. An electrocardiography and physiological sensor monitor recorder according to claim **1**, wherein the electrocardiographic front end circuit is optimized to sense P-wave signals in the electrocardiographic signals.

3. An electrocardiography and physiological sensor monitor recorder according to claim **1**, wherein the disposable extended wear electrode patch is disposed for being adhered to a patient's chest with a narrow longitudinal midsection oriented centrally (in the midline) along the sternum with one of the electrocardiographic electrodes overlying a region of the lower sternum and an other of the electrocardiographic electrodes in a region of the manubrium.

4. An electrocardiography and physiological sensor monitor recorder according to claim **1**, further comprising:

a pair of electrical contacts external to the sealed housing and electrically connected to at least one of the micro-controller and the flash memory;

a battery provided on the disposable extended wear electrode patch; and

a pair of electrical pads external to the disposable extended wear electrode patch and disposed to operatively couple with the pair of the electrical contacts, the electrical pads further electrically interfaced via battery leads to the battery.

5. An electrocardiography and physiological sensor monitor recorder according to claim **4**, wherein the capacity of the battery is selected to support additional electrical components without affecting Operation of either of the micro-controller and the flash memory.

6. An electrocardiography and physiological sensor monitor recorder according to claim **1**, the electrode patch further comprising:

one of the electrocardiographic electrodes on the disposable extended wear electrode patch being disposed for being adhered to a region overlying the lower sternum on a patient's chest; and

an other of the electrocardiographic electrodes on the disposable extended wear electrode patch being disposed for being adhered to a region near the manubrium on the patient's chest oriented centrally (in the midline) along the sternum upwards from the one electrocardiographic electrode.

7. An electrocardiography and physiological sensor monitor recorder according to claim 1, the disposable extended wear electrode patch further comprising:

a flexible backing formed of an elongated strip of stretchable material with a narrow longitudinal midsection and, on each end, a contact surface at least partially coated with an adhesive dressing provided as a crimp relief;

a pair of the electrocardiographic electrodes conductively exposed on the contact surface of each end of the elongated strip;

the non-conductive receptacle adhered to an outward-facing surface of the elongated strip and comprising electrical pads; and

a flexible circuit affixed on each end of the elongated strip as a strain relief and comprising a pair of circuit traces electrically coupled to the pair of the electrocardiographic electrodes and a pair of the electrical pads, at least one of the circuit traces adapted to extend along the narrow longitudinal midsection to serve as the strain relief.

8. An extended wear electrocardiography and physiological sensor monitor, comprising:

a disposable extended wear electrode patch comprising:

a flexible backing formed of an elongated strip of stretchable material with a narrow longitudinal midsection and, on each end, a contact surface at least partially coated with an adhesive dressing provided as a crimp relief;

a pair of electrocardiographic electrodes conductively exposed on the contact surface of each end of the elongated strip, respectively;

a non-conductive receptacle adhered to an outward-facing surface of the elongated strip and comprising a plurality of electrical pads; and

a flexible circuit affixed on each end of the elongated strip as a strain relief and comprising a pair of circuit traces electrically coupled to the pair of the electrocardiographic electrodes and a pair of the electrical pads, at least one of the circuit traces adapted to extend along the narrow longitudinal midsection to serve as the strain relief; and

a reusable electrocardiography monitor having a sealed housing adapted to be removably secured into the non-conductive receptacle and comprising:

a micro-controller operable to execute under micro programmable control through firmware that is stored in a program memory unit of the micro-controller, the micro-controller electrically interfaced to an electrocardiographic front end circuit that is operable to sense electrocardiographic signals through the electrocardiographic electrodes via the pair of the electrical pads; and

a flash memory electrically interfaced with the micro-controller and operable to store samples of the electrocardiographic signals.

9. An electrocardiography and physiological sensor monitor according to claim 8, wherein the electrocardiographic front end circuit is optimized to sense P-wave signals in the electrocardiographic signals.

10. An electrocardiography and physiological sensor monitor according to claim 8, wherein the disposable extended wear electrode patch is disposed for being adhered to a patient's chest with the narrow longitudinal midsection oriented centrally (in the midline) along the sternum with one of the electrocardiographic electrodes overlying a region of the lower sternum and an other of the electrocardiographic electrodes in a region of the manubrium.

11. An electrocardiography and physiological sensor monitor according to claim 8, wherein orientation of the monitor is compensated if installed upside down.

12. An electrocardiography and physiological sensor monitor according to claim 8, further comprising:

a battery comprised on the disposable extended wear electrode patch and electrically interfaced via battery leads to a pair of the electrical pads, and at least one of:

the micro-controller operable to draw power from the battery via the pair of the electrical pads; and

the flash memory operable to draw power from the battery via the pair of the electrical pads.

13. An electrocardiography and physiological sensor monitor according to claim 8, further comprising:

a battery comprised on the disposable extended wear electrode patch and electrically interfaced via battery leads to a pair of the electrical pads, the capacity of the battery being selected to support additional electrical components without affecting operation of the reusable electrocardiography monitor.

14. An electrocardiography and physiological sensor monitor according to claim 8, further comprising:

one of the electrocardiographic electrodes on the disposable extended wear electrode patch being disposed for being adhered to a region overlying the lower sternum on a patient's chest; and

an other of the electrocardiographic electrodes on the disposable extended wear electrode patch being disposed for being adhered to a region near the manubrium on the patient's chest oriented centrally (in the midline) along the sternum upwards from the one electrocardiographic electrode.

15. An electrocardiography and physiological sensor monitor according to claim 8, further comprising:

an expansion bus operatively interconnected to the micro-controller and electrically coupled to at least one of the electrical pads;

a physiology sensor comprised within the disposable extended wear electrode patch and operable to sense physiology and to draw power from the battery via battery leads, the physiology sensor electrically interfaced with the micro-controller over the expansion bus; and

the flash memory further operable through the expansion bus to store samples of the physiology sensed by the physiology sensor.

16. An electrocardiography and physiological sensor monitor according to claim 15, wherein the physiology sensor is selected from the group comprising an SpO₂ sensor, a blood pressure sensor, a temperature sensor, a respiratory rate sensor, a glucose sensor, an air flow sensor, and a volumetric pressure sensor.

17. An electrocardiography and physiological sensor monitor according to claim 8, further comprising:

an expansion bus operatively interconnected to the micro-controller;

a physiology sensor comprised within the reusable electrocardiography monitor and operable to sense physiology and to draw power from a battery via a pair of the electrical pads, the physiology sensor electrically interfaced with the micro-controller over the expansion bus; and

the flash memory further operable through the expansion bus to store samples of the physiology sensed by the physiology sensor.

18. An electrocardiography and physiological sensor monitor according to claim 17, wherein the physiology sensor is selected from the group comprising an SpO₂ sensor, a blood pressure sensor, a temperature sensor, a respiratory rate sensor, a glucose sensor, an air flow sensor, and a volumetric pressure sensor.

19. An electrocardiography and physiological sensor monitor according to claim 8, further comprising:

an actigraphy sensor comprised within the reusable electrocardiography monitor and operable to detect movement, the actigraphy sensor electrically interfaced with the micro-controller; and

the flash memory further operable to store samples of the movement detected by the actigraphy sensor.

20. An electrocardiography and physiological sensor monitor according to claim 8, further comprising at least one of:

a feedback output component comprised in the reusable electrocardiography monitor and electrically interfaced with the micro-controller; and

a feedback input component comprised in the reusable electrocardiography monitor and externally wearer-operable from outside the sealed housing, the feedback input further electrically interfaced with the micro-controller.

21. An electrocardiography and physiological sensor monitor recorder according to claim 4, further comprising:

a power up sequence stored as part of the firmware in the program memory unit, wherein the micro-controller is operable to execute the power up sequence upon the pair of the electrical pads being operatively coupled to the pair of the electrical contacts.

22. An electrocardiography and physiological sensor monitor recorder according to claim 21, further comprising:

a further pair of electrical contacts external to the sealed housing and electrically connected to the micro-controller;

a cryptographic circuit provided on the disposable extended wear electrode patch;

a further pair of electrical pads external to the disposable extended wear electrode patch and disposed to operatively couple with the further pair of the electrical contacts; and

an authentication procedure stored as part of the firmware in the program memory unit, wherein the micro-controller is operable to securely authenticate and validate the disposable extended wear electrode patch through the cryptographic circuit upon the further pair of the electrical pads being operatively coupled to the further pair of the electrical contacts, the micro-controller further operable to cease execution upon failure of the authentication procedure.

23. An electrocardiography and physiological sensor monitor recorder according to claim 21, the power up sequence comprising one or more of a battery voltage checking procedure, a flash memory state checking procedure, and a micro-controller diagnostic procedure.

24. An electrocardiography and physiological sensor monitor according to claim 12, further comprising:

a power up sequence stored as part of the firmware in the program memory unit, wherein the micro-controller is operable to execute the power up sequence upon the pair of the electrical pads being electrically interfaced to the micro-controller.

25. An electrocardiography and physiological sensor monitor according to claim 24, further comprising:

a cryptographic circuit provided on the disposable extended wear electrode patch;

a further pair of electrical pads external to the disposable extended wear electrode patch and disposed to operatively couple with the micro-controller; and

an authentication procedure stored as part of the firmware in the program memory unit, wherein the micro-controller is operable to securely authenticate and validate the disposable extended wear electrode patch through the cryptographic circuit upon the further pair of the electrical pads being electrically interfaced to the micro-controller, the micro-controller further operable to cease execution upon failure of the authentication procedure.

26. An electrocardiography and physiological sensor monitor according to claim 24, the power up sequence comprising one or more of a battery voltage checking procedure, a flash memory state checking procedure, and a micro-controller diagnostic procedure.

* * * * *

专利名称(译)	延长磨损动态心电图和生理传感器监测		
公开(公告)号	US20150087949A1	公开(公告)日	2015-03-26
申请号	US14/080725	申请日	2013-11-14
[标]申请(专利权)人(译)	BARDY诊断		
申请(专利权)人(译)	BARDY诊断, INC.		
当前申请(专利权)人(译)	BARDY诊断, INC.		
[标]发明人	FELIX JASON BISHAY JON MIKALSON BARDY GUST H		
发明人	FELIX, JASON BISHAY, JON MIKALSON BARDY, GUST H.		
IPC分类号	A61B5/0408 A61B5/00 A61B5/0452		
CPC分类号	A61B5/04085 A61B5/6801 A61B5/0452 A61B5/04087 A61B5/02055 A61B5/021 A61B5/04017 A61B5/04325 A61B5/087 A61B5/1116 A61B5/14532 A61B5/14551 A61B5/6823 A61B5/6833 A61B5/7455 A61B2505/07 A61B2560/0271 A61B2560/0412 A61B2560/045 A61B2562/164 G01N27/307 A61B5/0006 A61B5/0022 A61B5/01 A61B5/04525 A61B5/0816 A61B5/091 A61B5/1117 A61B5/1118 A61B5/14542 A61B5/4809 A61B2562/0219		
优先权	61/882403 2013-09-25 US		
其他公开文献	US9730593		
外部链接	Espacenet USPTO		

摘要(译)

可以通过可穿戴式监视器提供生理监测，该监视器包括两个组件，一个灵活的扩展耐磨电极贴片和一个可拆卸的可重复使用的监视器记录器。可穿戴式监视器位于患者胸部的中央（中线），沿着胸骨从上到下。将可穿戴式监视器放置在胸骨中线（或紧邻胸骨的任一侧）的位置，通过消除在整个监视期间将ECG电极连续放置在皮肤上的相同斑点中的要求，有利于延长佩戴。相反，患者可以将电极贴片放置在胸骨的一般区域内的任何位置。通过电极贴片上提供的电池提供电源，这避免了必须打开监视器记录器的外壳以更换电池。

