



(19) **United States**

(12) **Patent Application Publication**
Hickle

(10) **Pub. No.: US 2003/0079746 A1**

(43) **Pub. Date: May 1, 2003**

(54) **APPARATUSES AND METHODS FOR PROVIDING A CONSCIOUS PATIENT RELIEF FROM PAIN AND ANXIETY ASSOCIATED WITH MEDICAL OR SURGICAL PROCEDURES ACCORDING TO APPROPRIATE CLINICAL HEURISTICS**

Publication Classification

(51) **Int. Cl.⁷** **A61M 15/00; A61M 16/00**
(52) **U.S. Cl.** **128/203.12; 128/203.14**

(75) **Inventor: Randall S. Hickle, Lubbock, TX (US)**

(57) **ABSTRACT**

Correspondence Address:
**HOGAN & HARTSON LLP
IP GROUP, COLUMBIA SQUARE
555 THIRTEENTH STREET, N.W.
WASHINGTON, DC 20004 (US)**

A care system and associated methods are provided for alleviating patient pain, anxiety and discomfort associated with medical or surgical procedures. The system comprises: at least one patient health monitor device coupled to a patient and generating a signal reflecting at least one physiological condition of the patient; a drug delivery controller supplying one or more drugs to the patient; a memory device storing a safety data set reflecting parameters of at least one patient physiological condition; and an electronic controller interconnected between the patient health monitor, the drug delivery controller and the safety data set. The electronic controller is capable of effecting a change in the drug supply delivered to the patient and the generation of current signals by the patient health monitor device depending on a comparison between at least one patient physiological condition at its corresponding value reflected in the safety data set.

(73) **Assignee: Scott Laboratories, Inc.**

(21) **Appl. No.: 10/265,639**

(22) **Filed: Oct. 8, 2002**

Related U.S. Application Data

(63) Continuation-in-part of application No. 09/324,759, filed on Jun. 3, 1999.

(60) Provisional application No. 60/087,841, filed on Jun. 3, 1998. Provisional application No. 60/327,313, filed on Oct. 9, 2001.

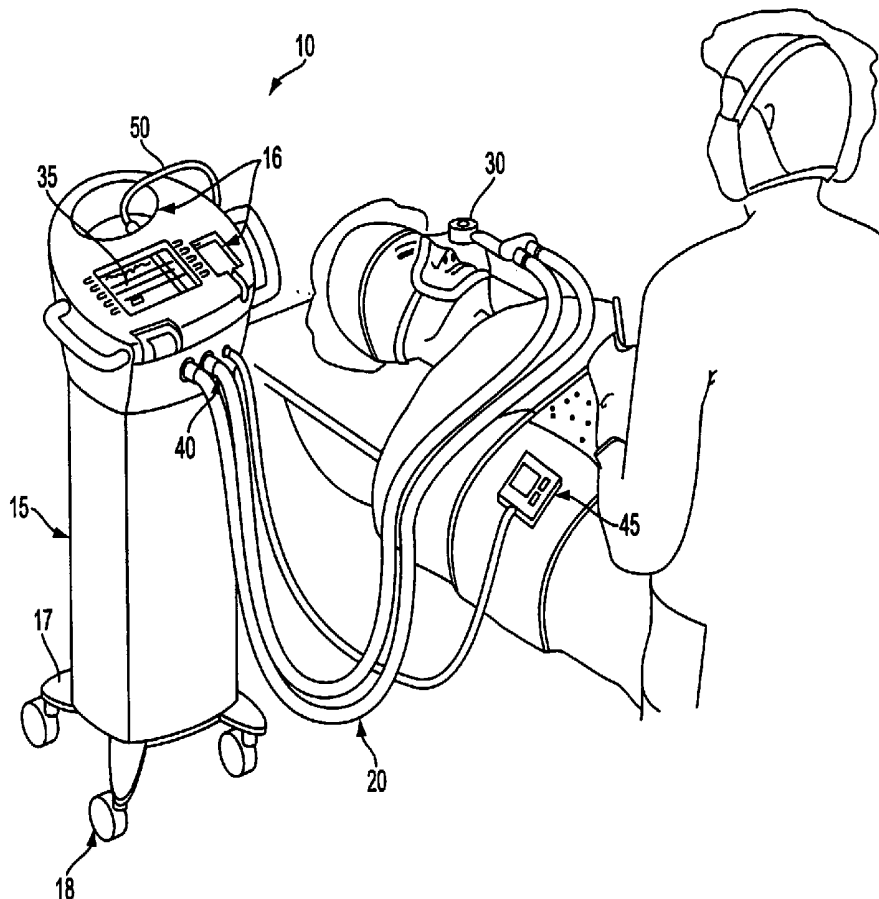

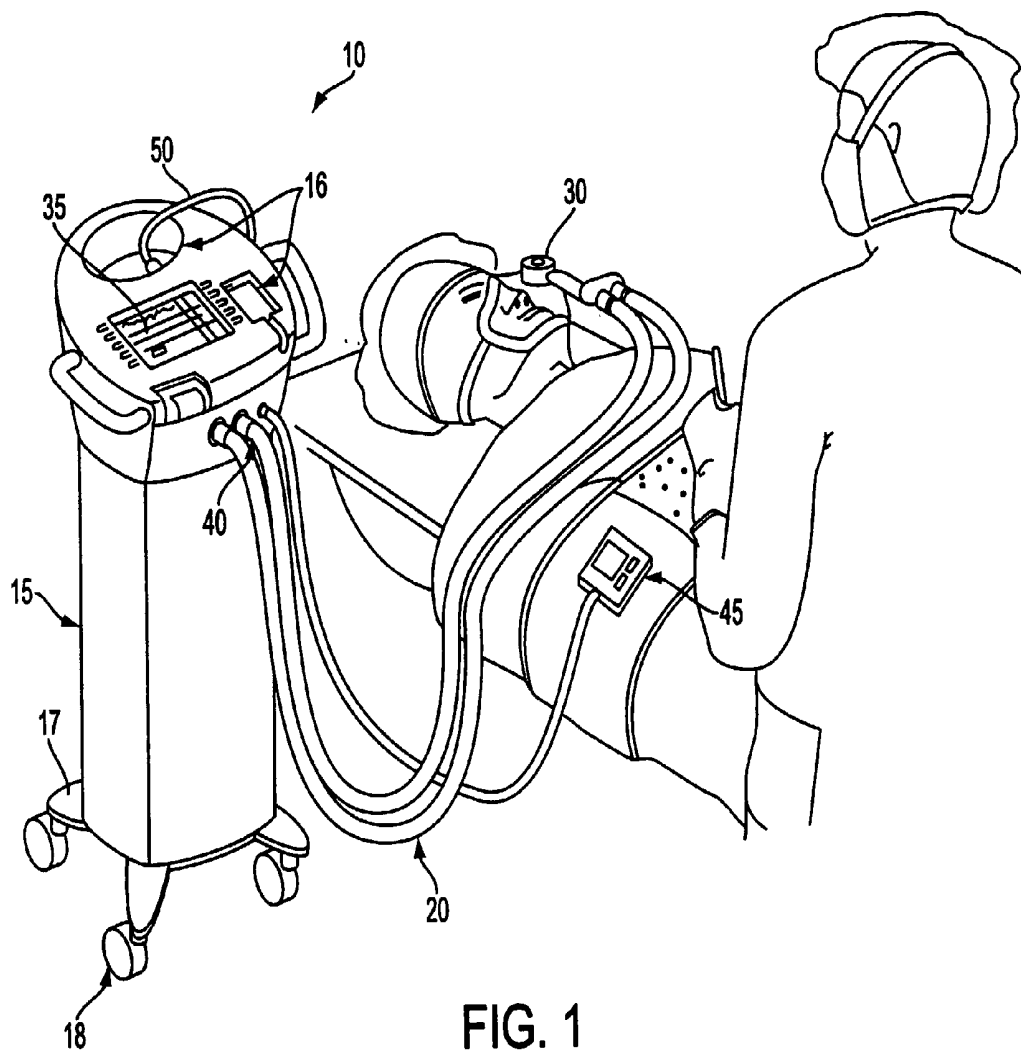

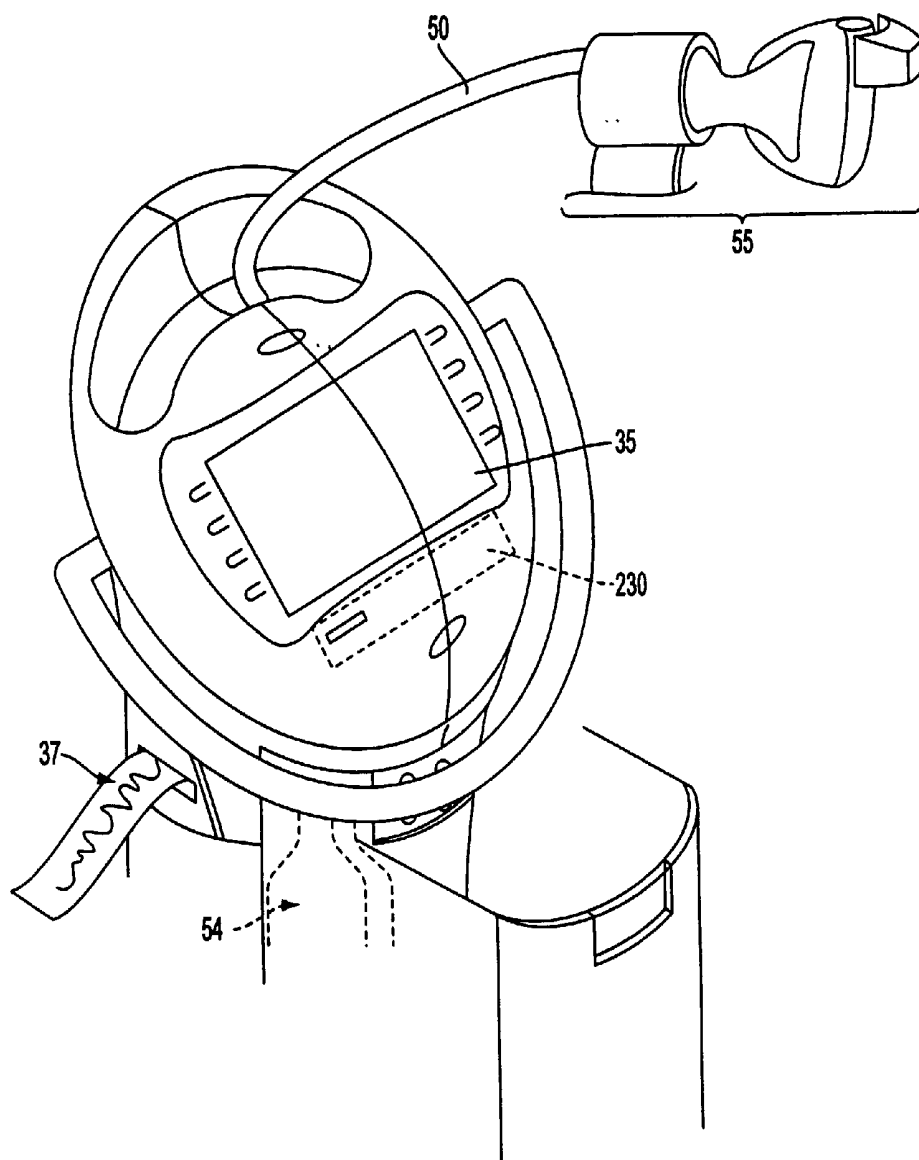

FIG. 2

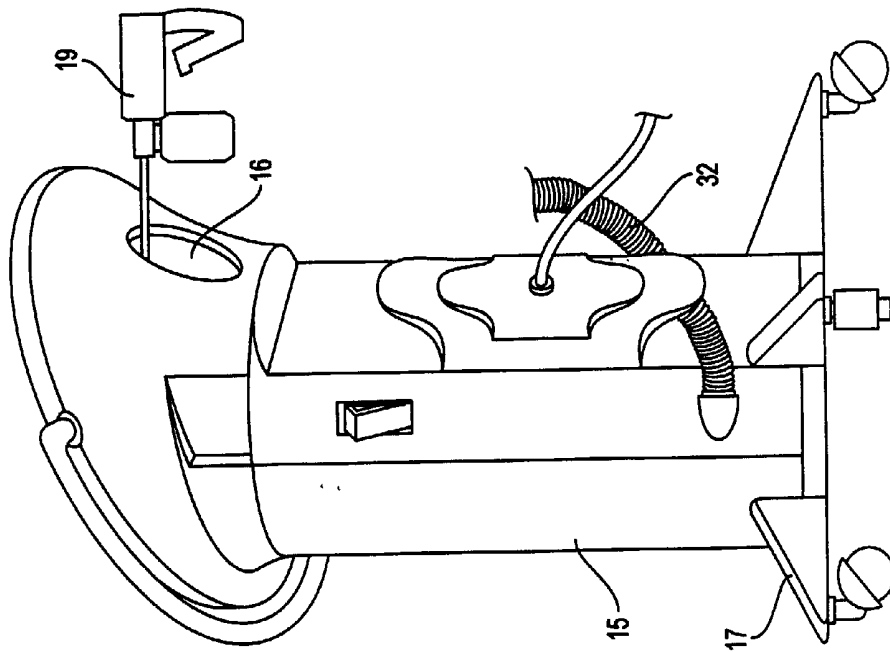

FIG. 3B

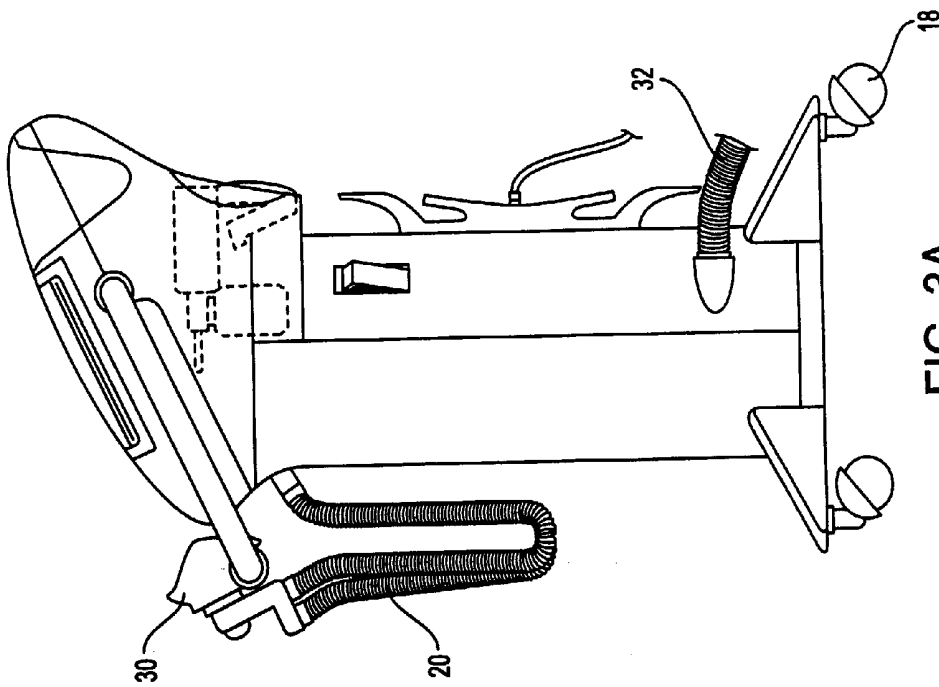

FIG. 3A

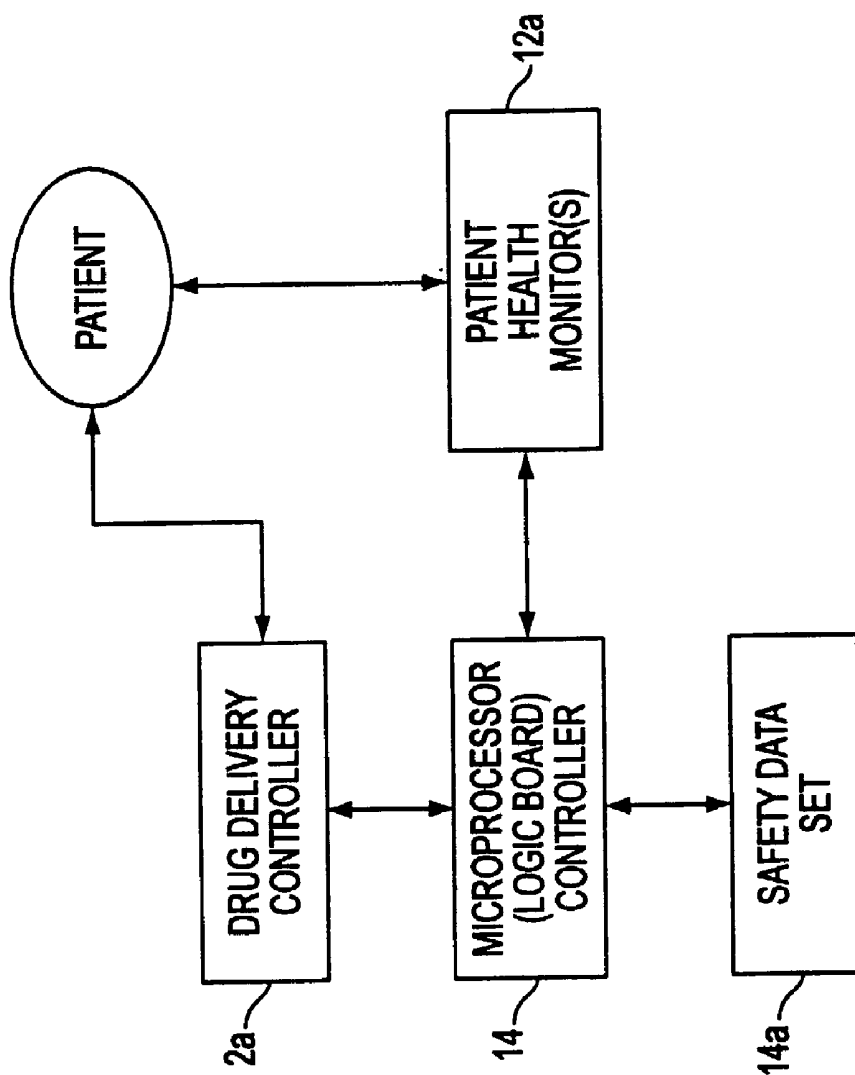

FIG. 4A

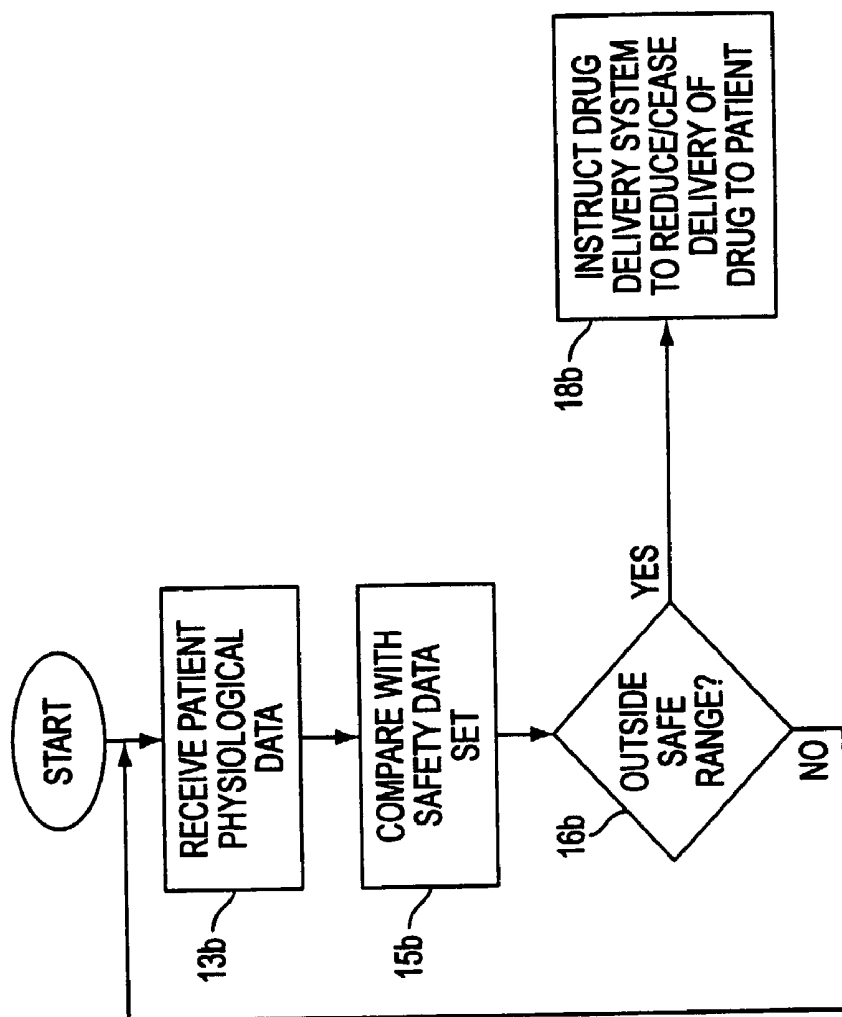

FIG. 4B

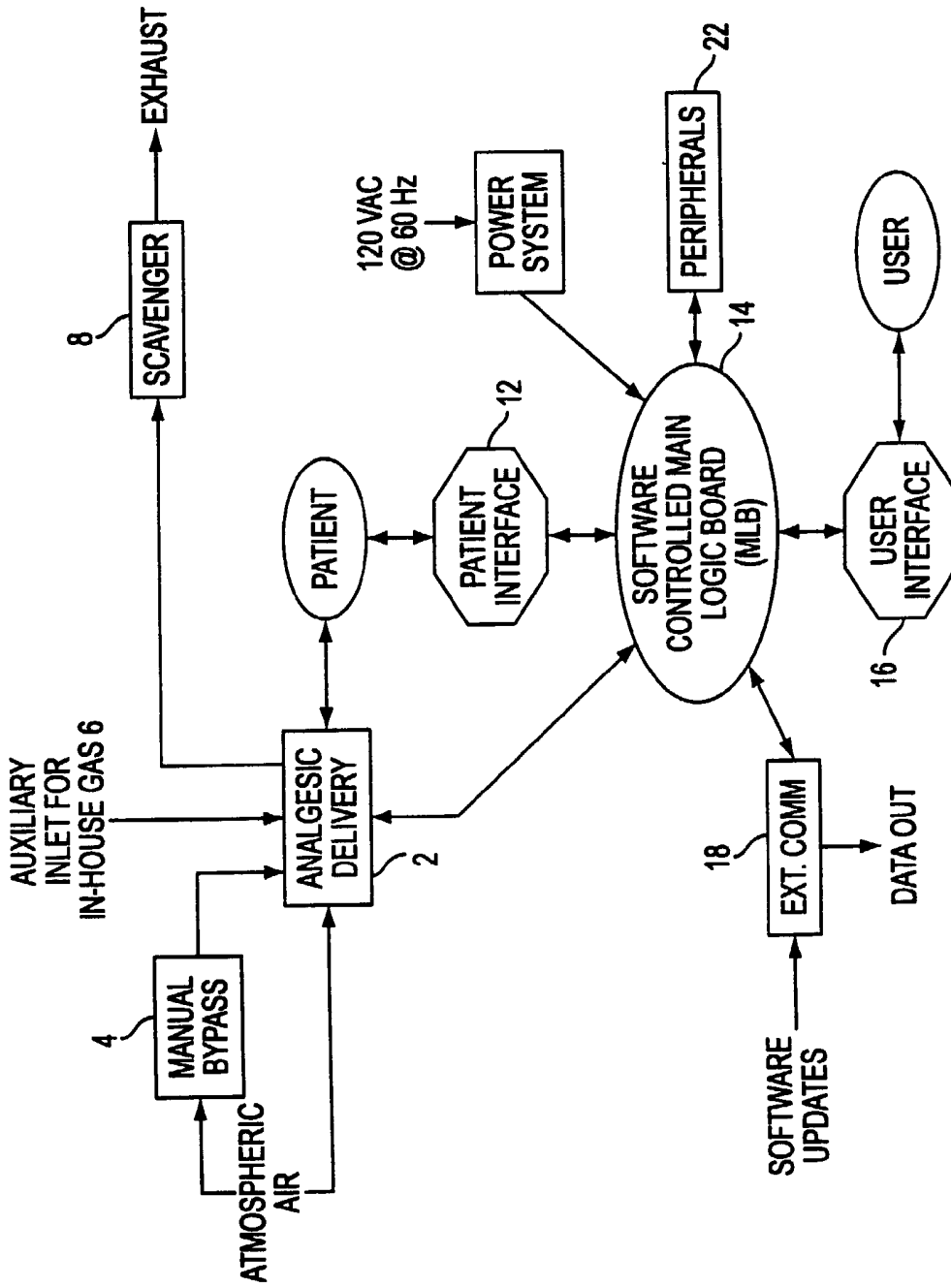

FIG. 5

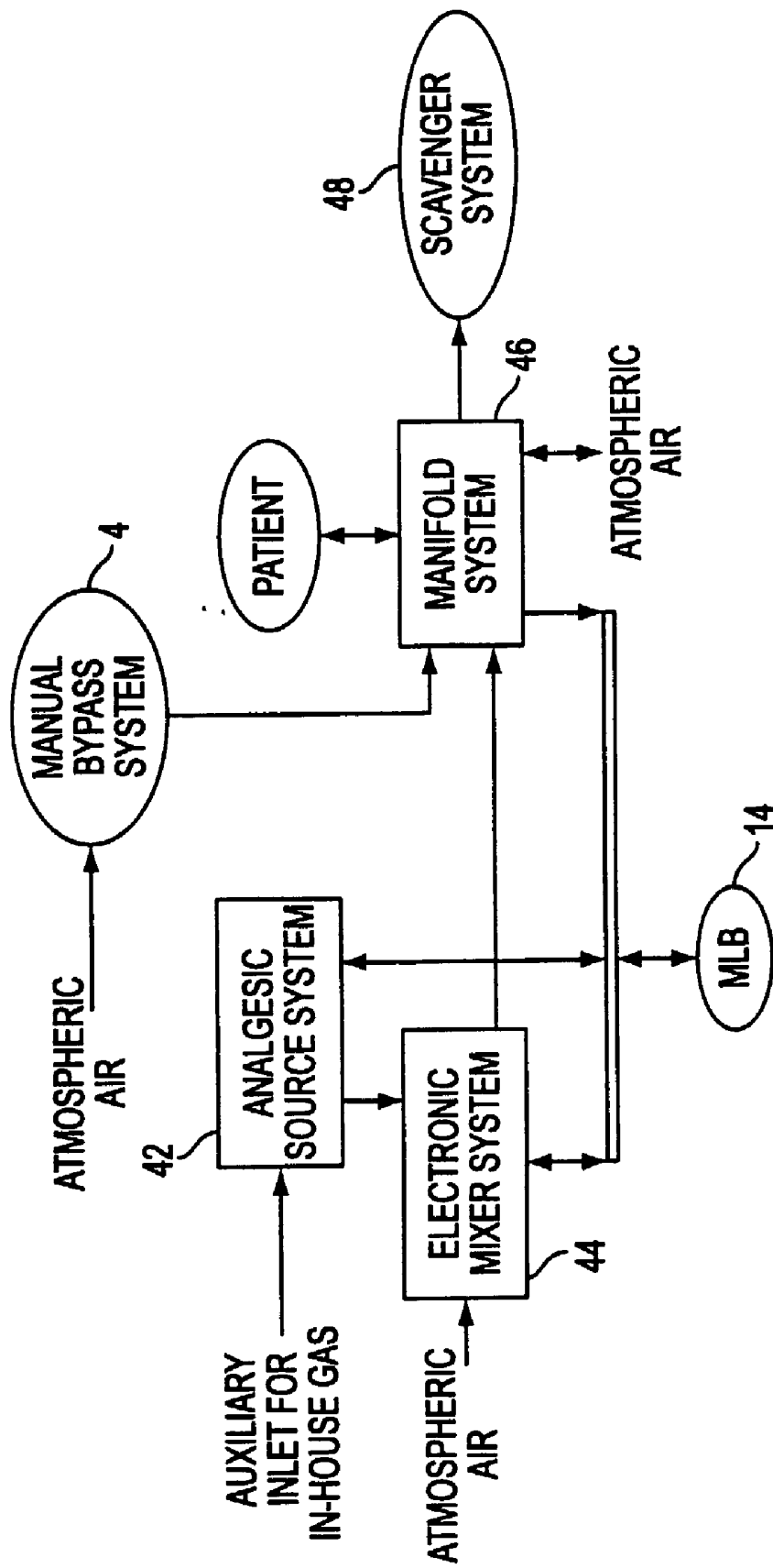

FIG. 6

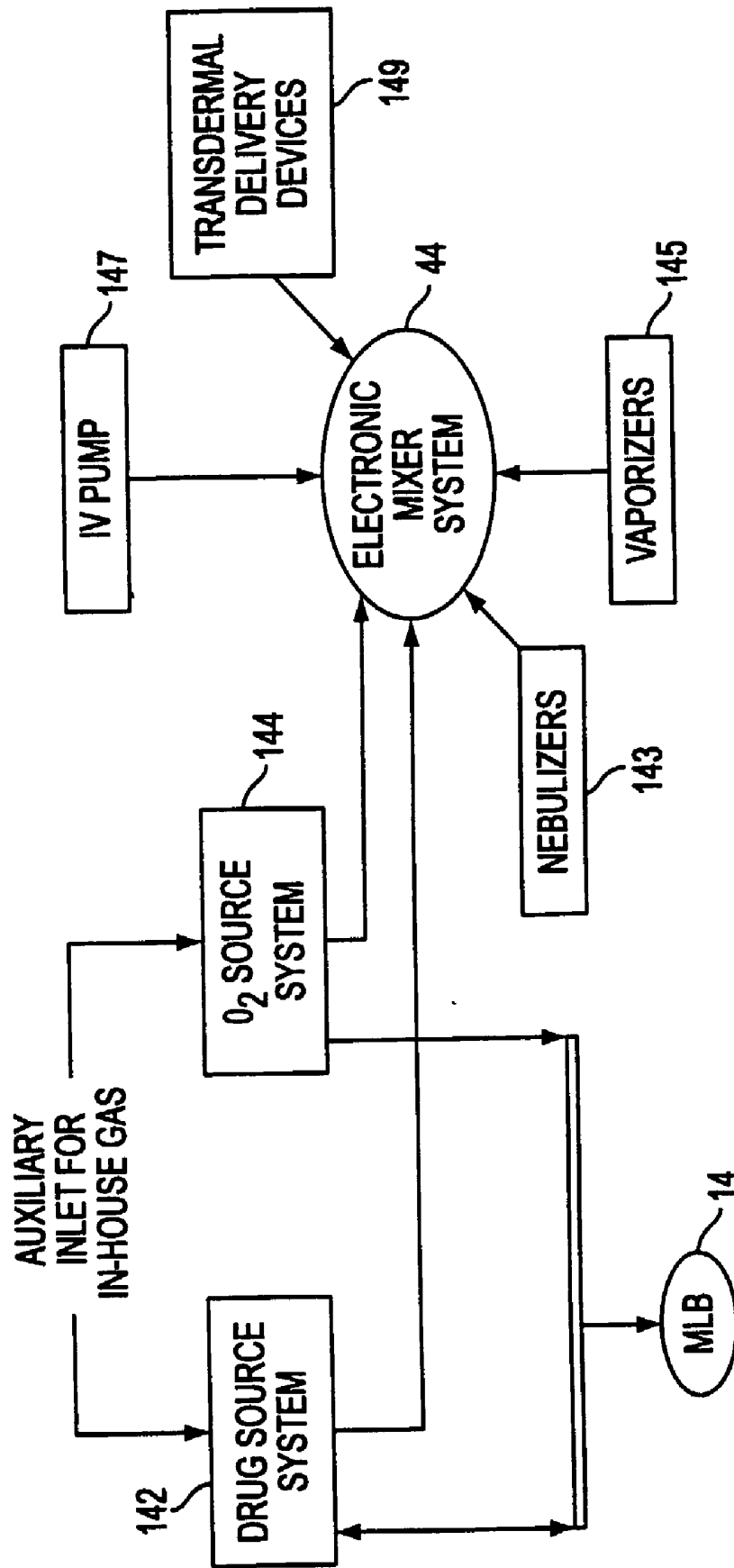

FIG. 7A

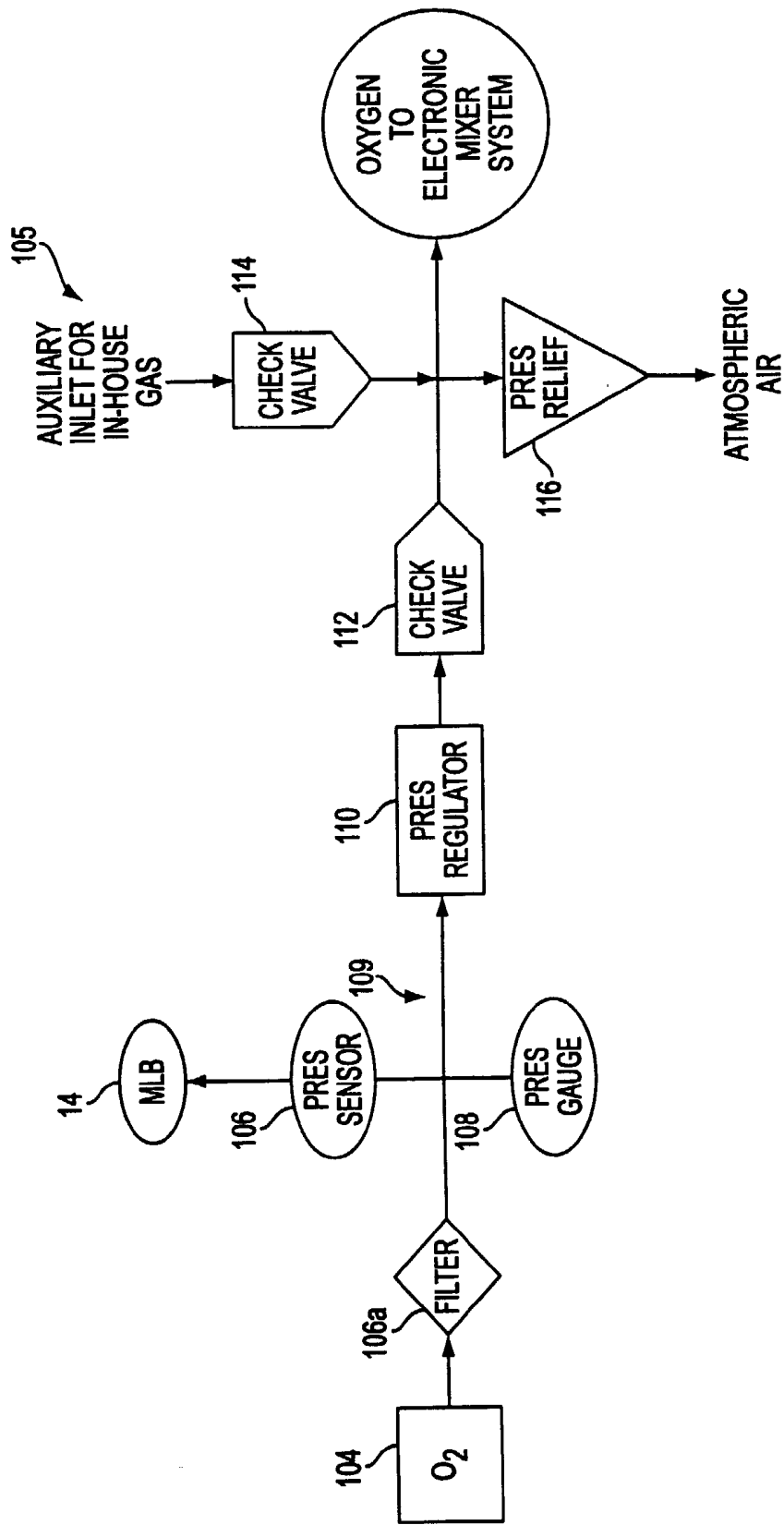

FIG. 7B

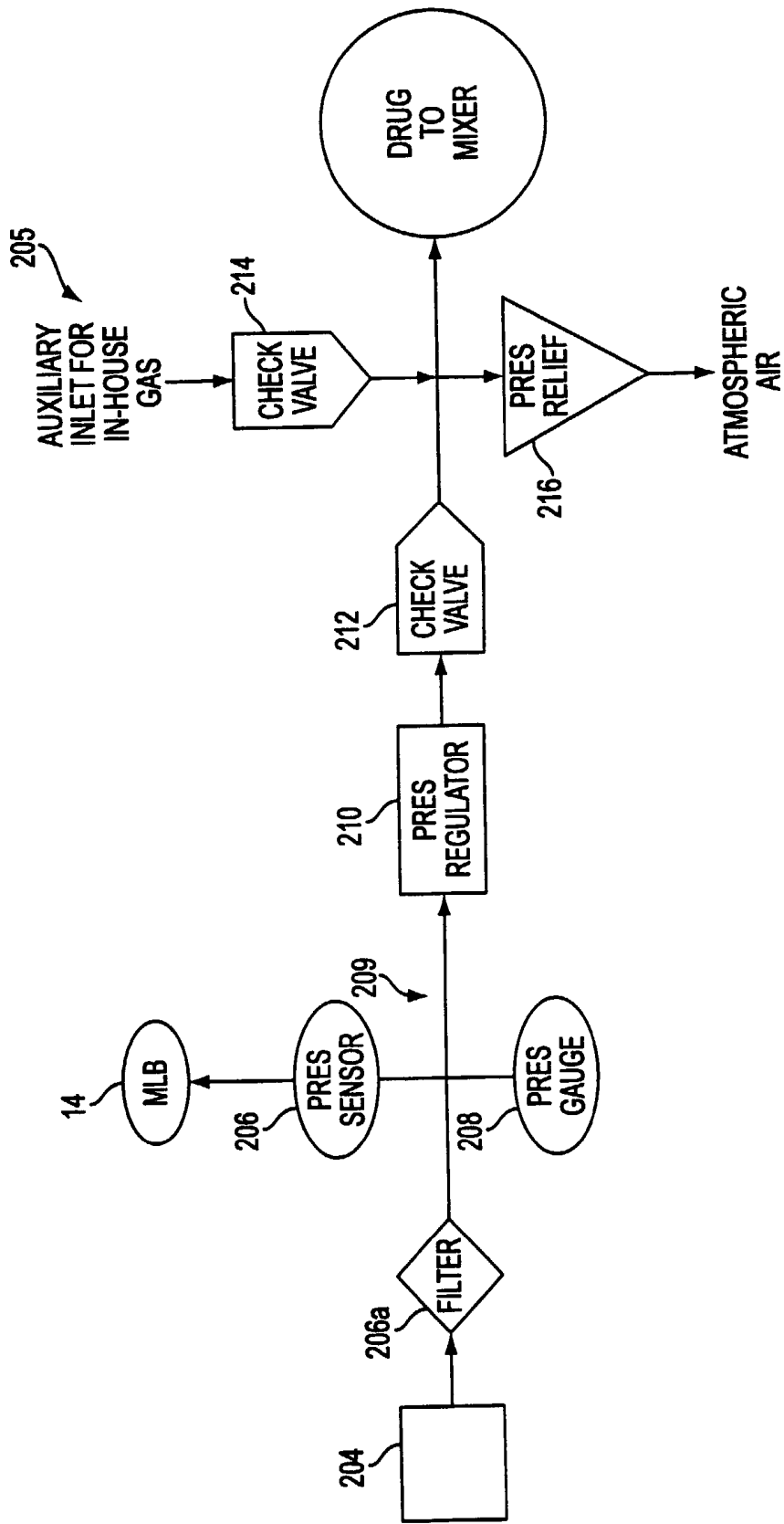

FIG. 7C

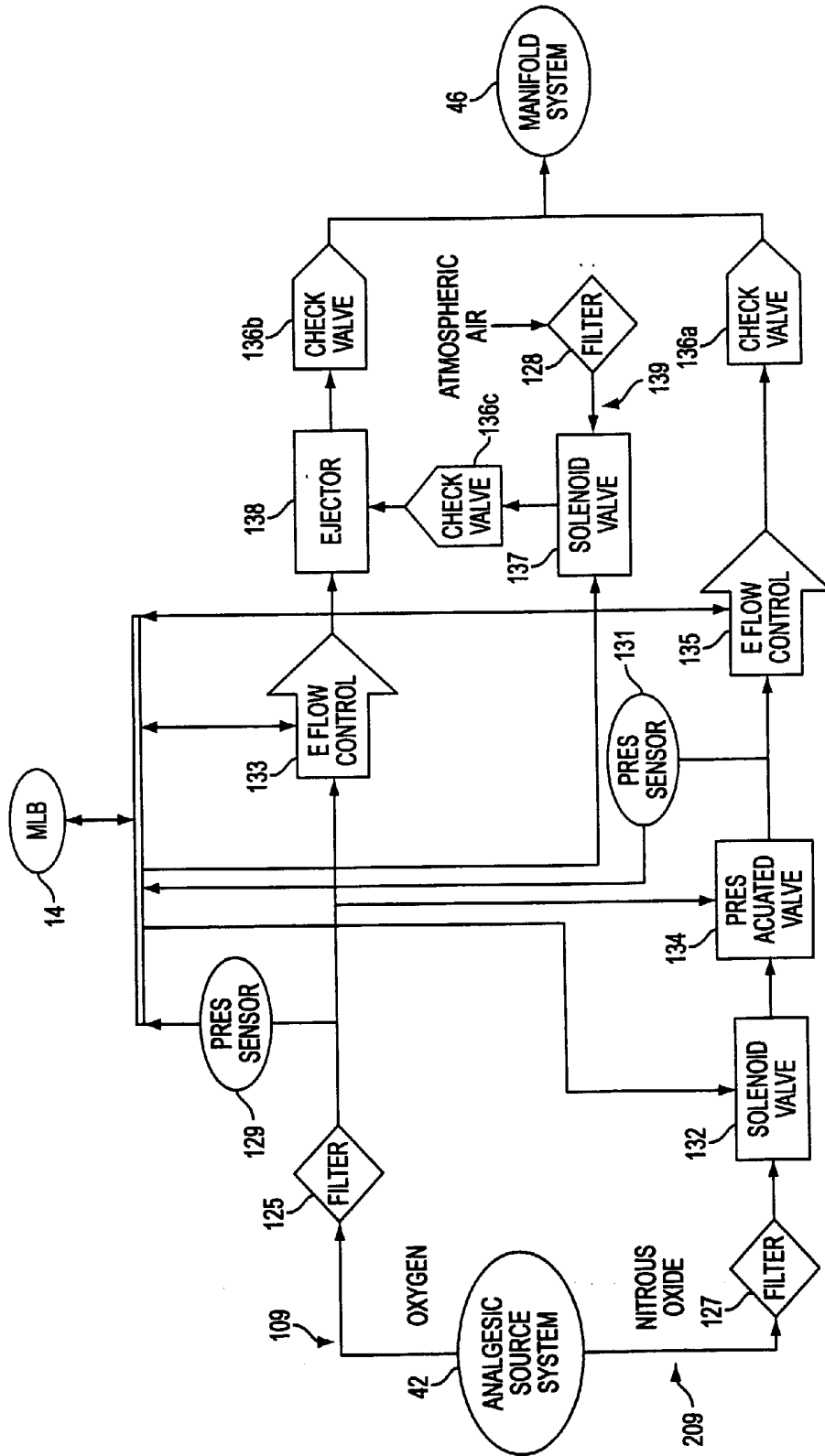

FIG. 8

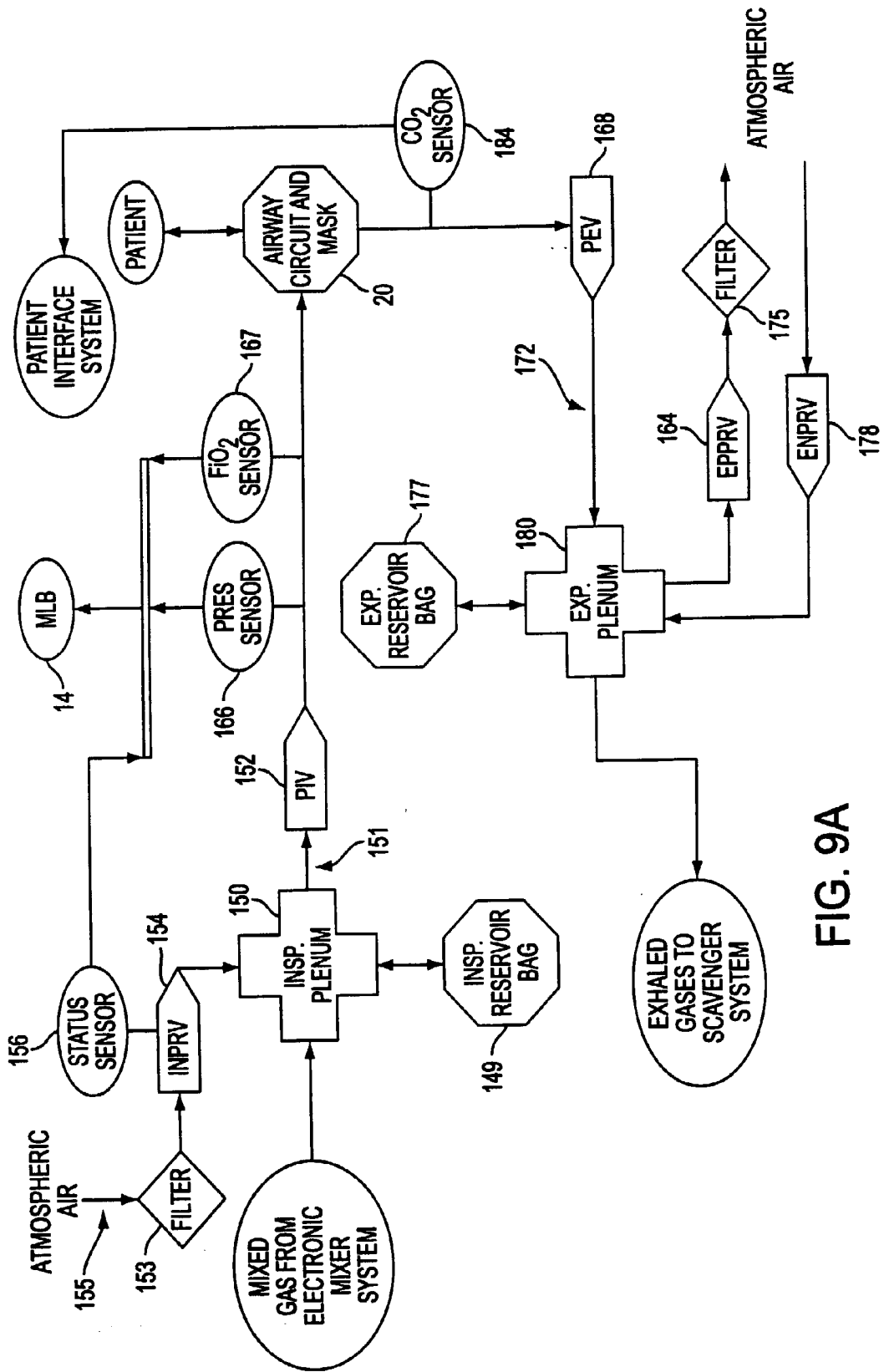

FIG. 9A

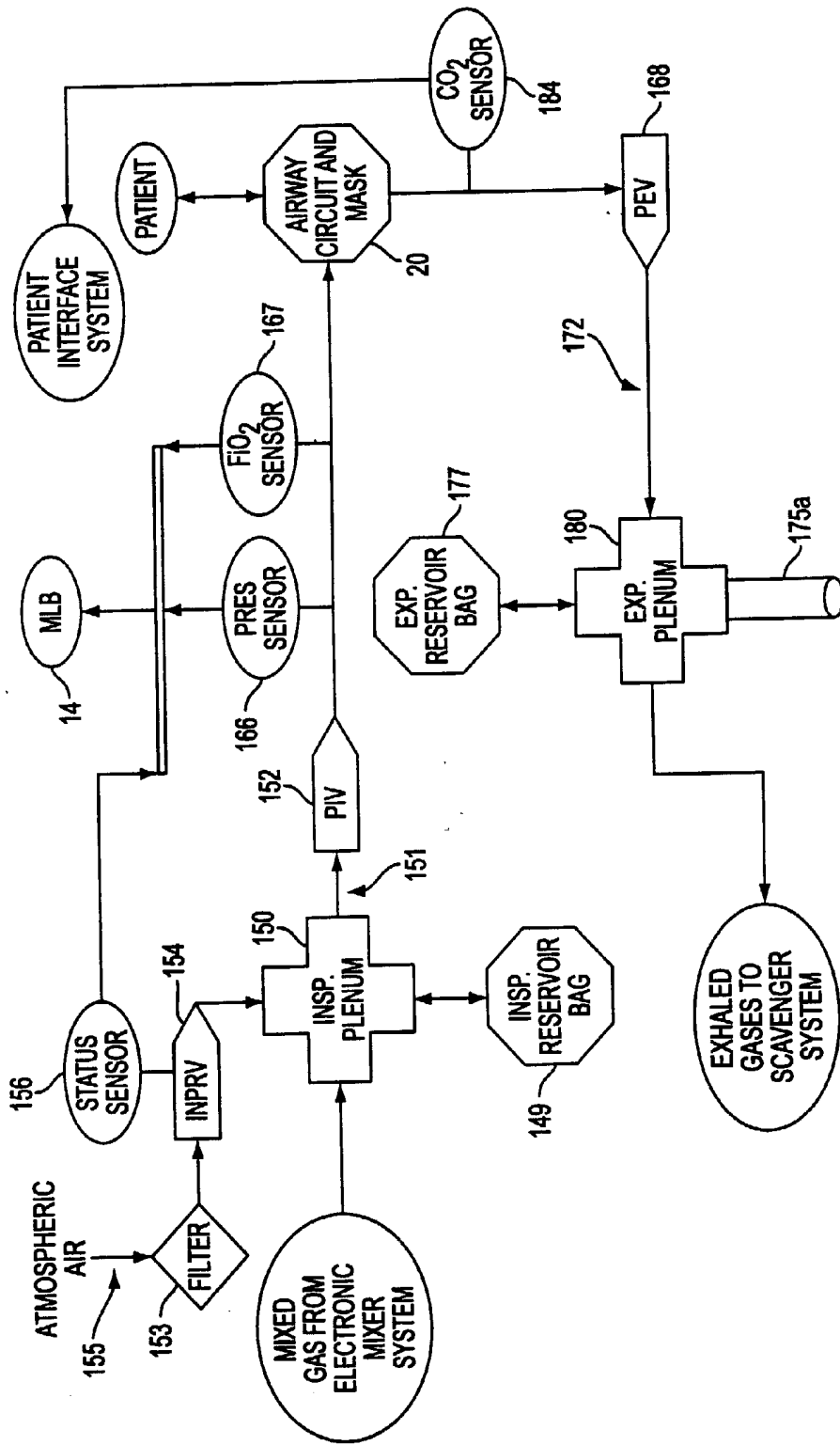

FIG. 9B

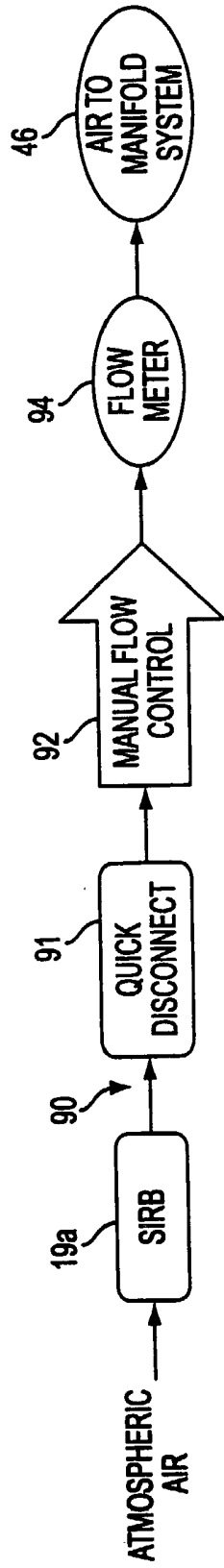

FIG. 10A

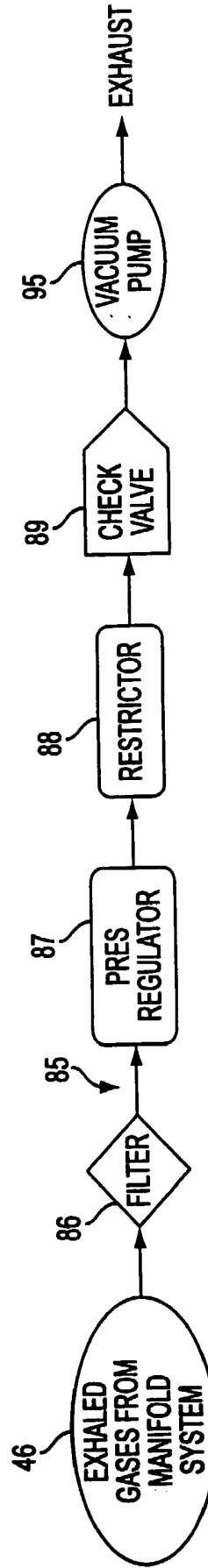

FIG. 10B

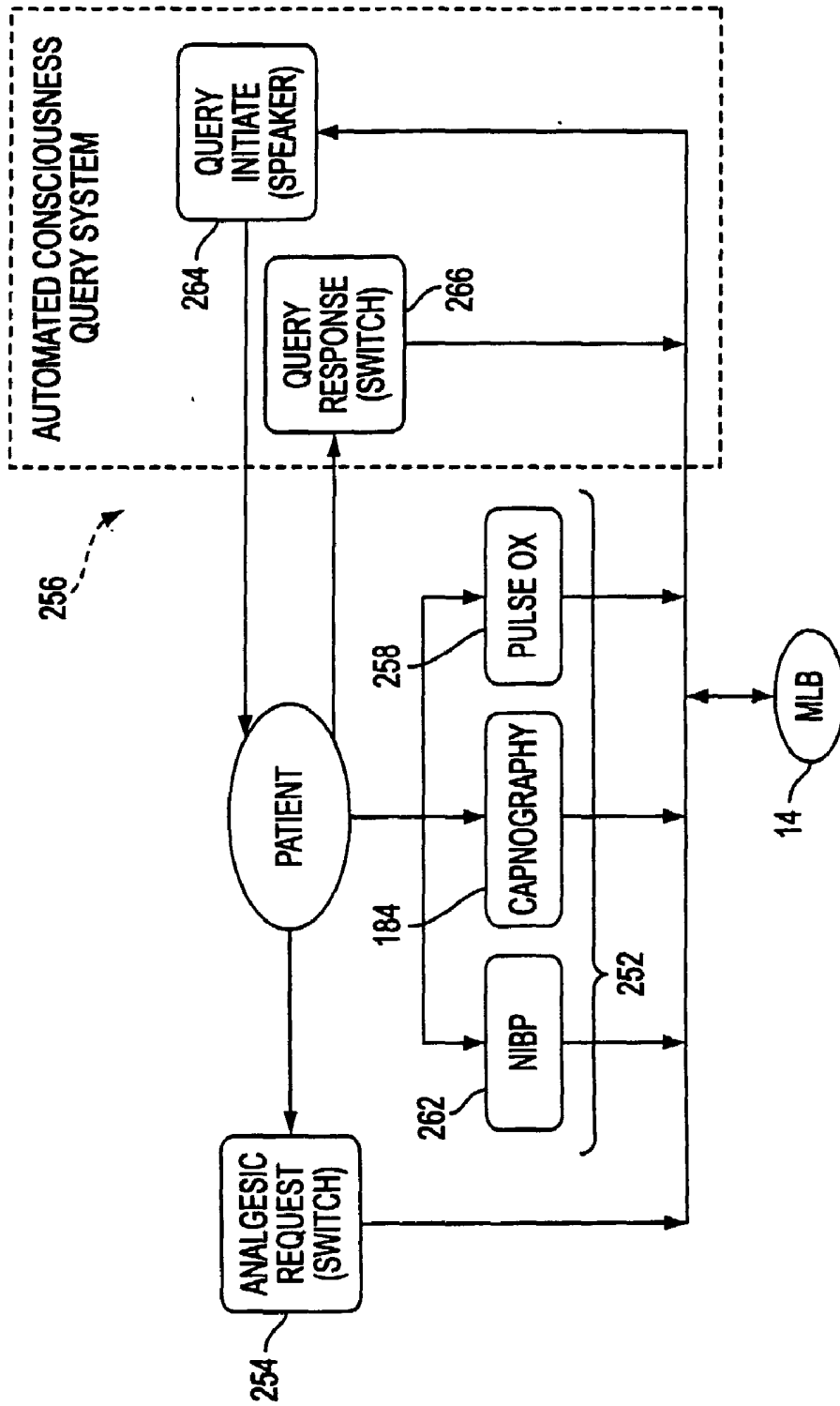

FIG. 11

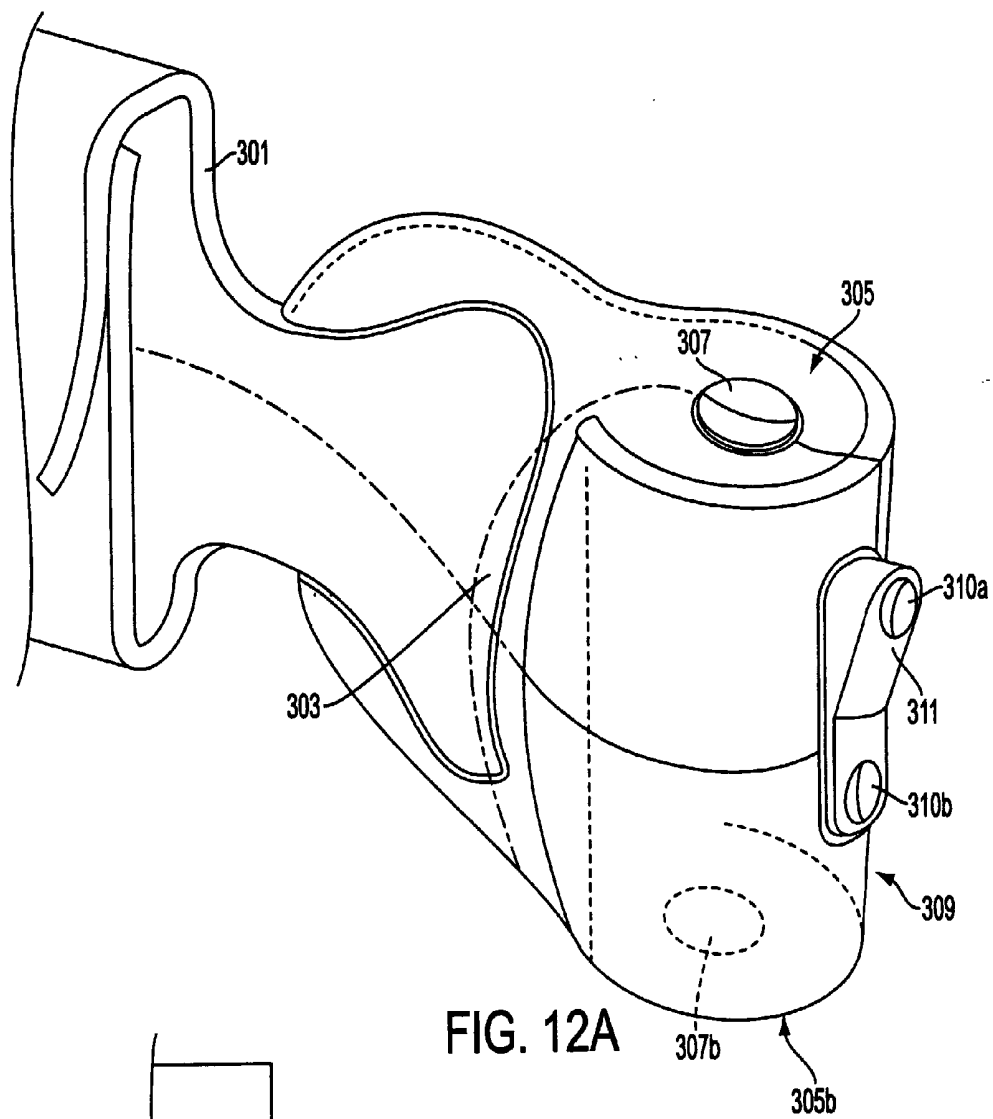

FIG. 12A

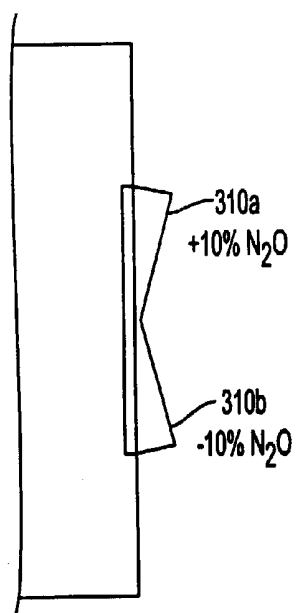

FIG. 12B

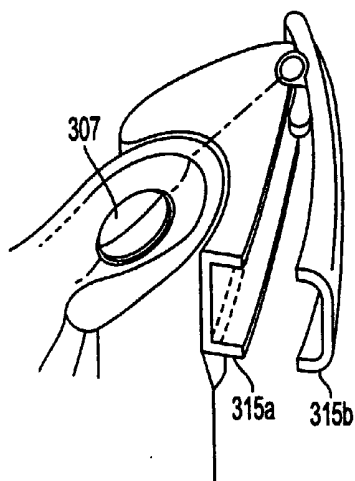

FIG. 13B

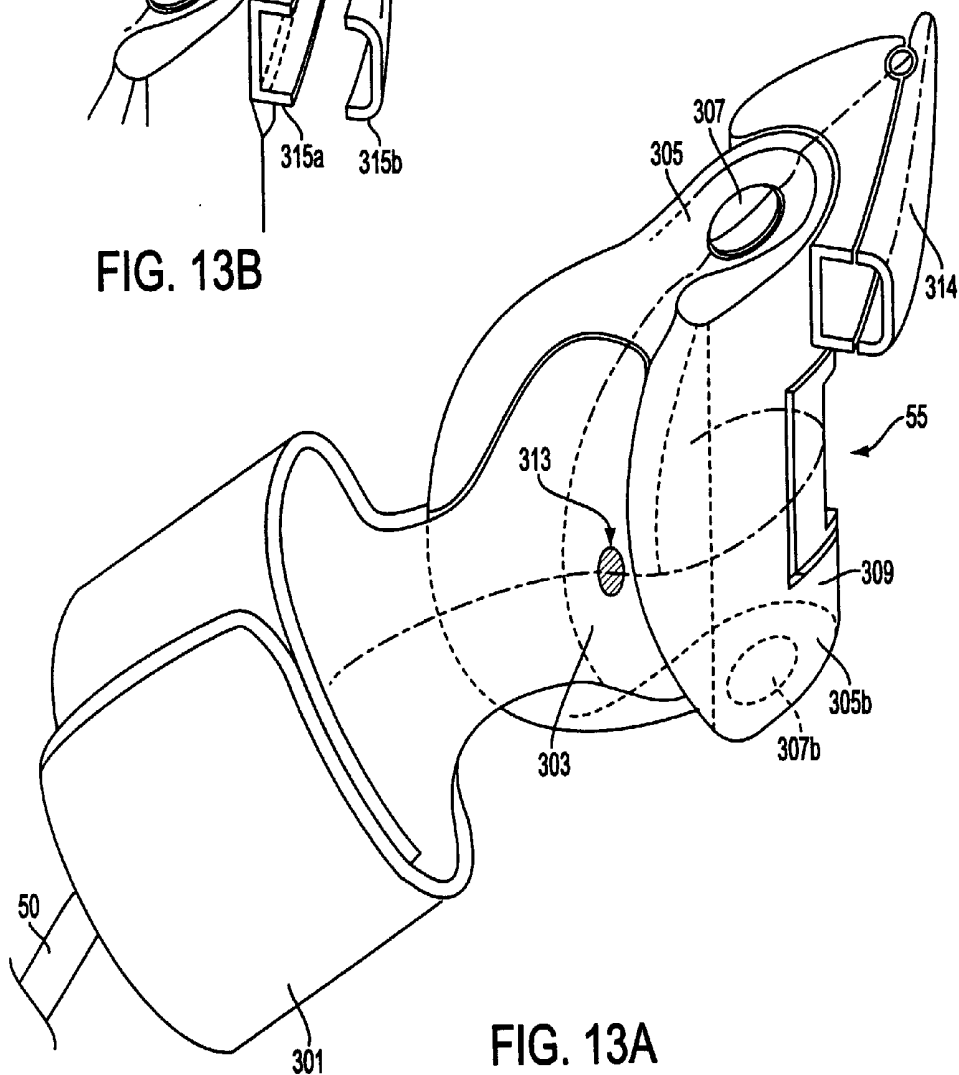

FIG. 13A

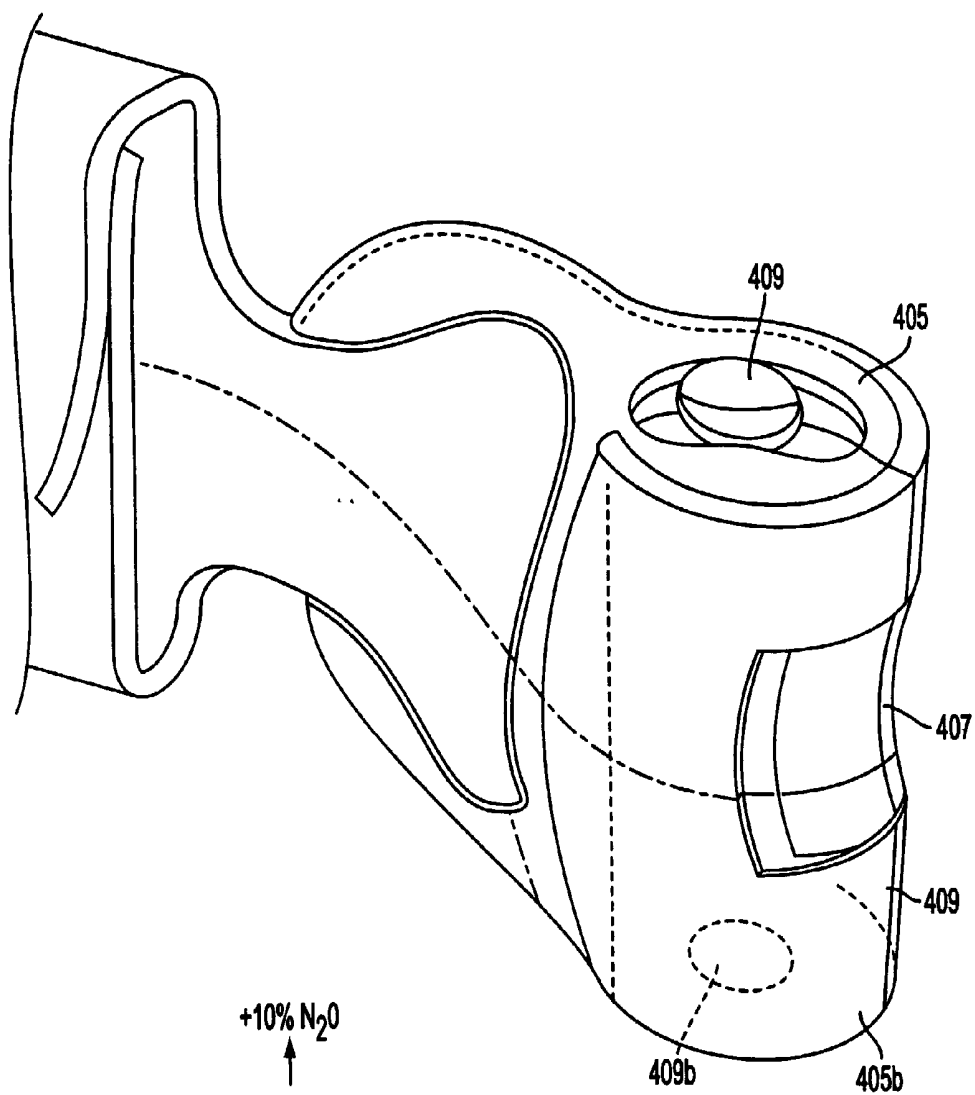

FIG. 14A

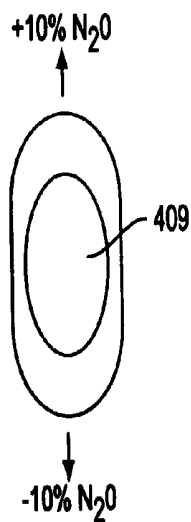

FIG. 14B

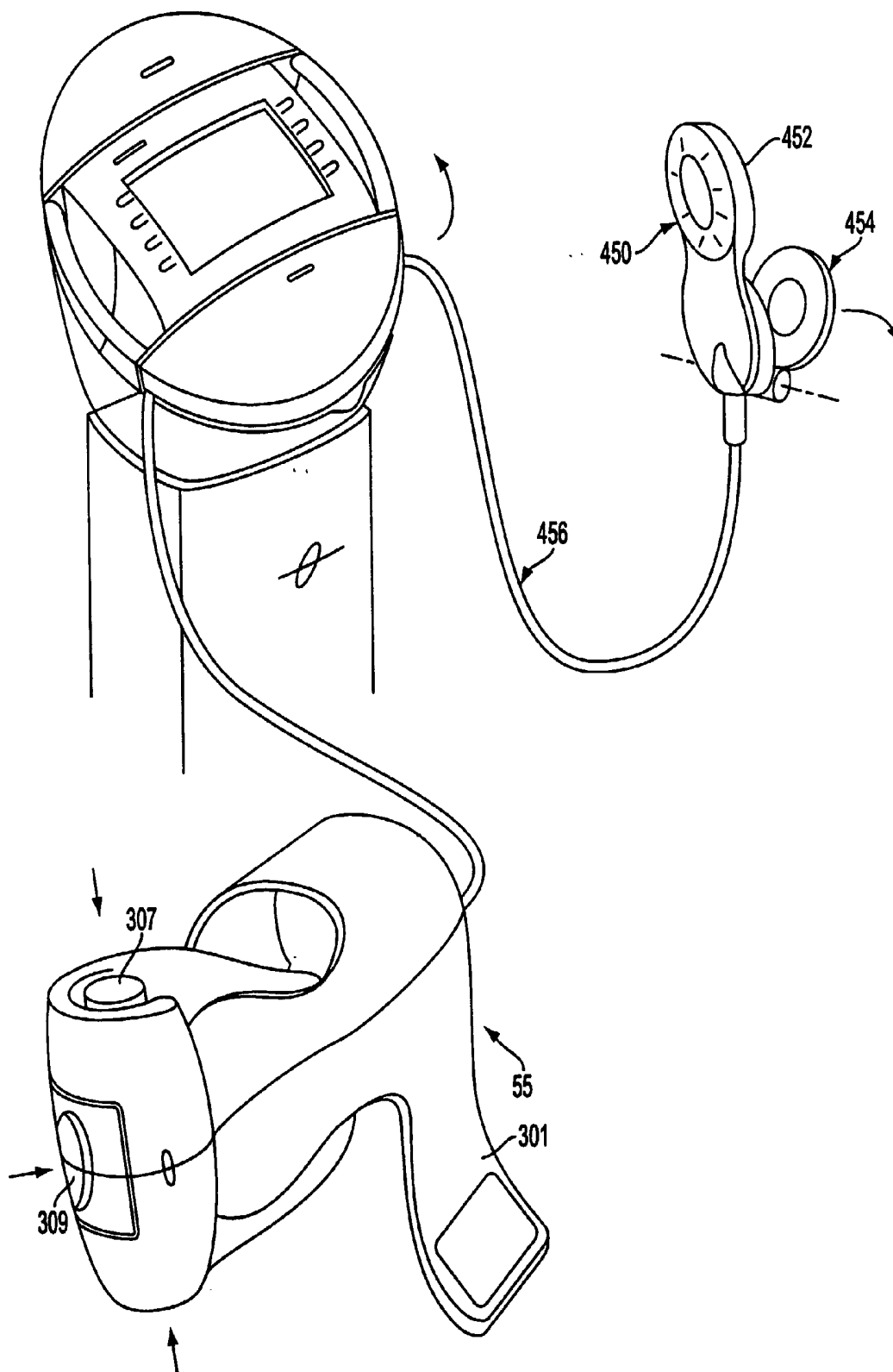

FIG. 15

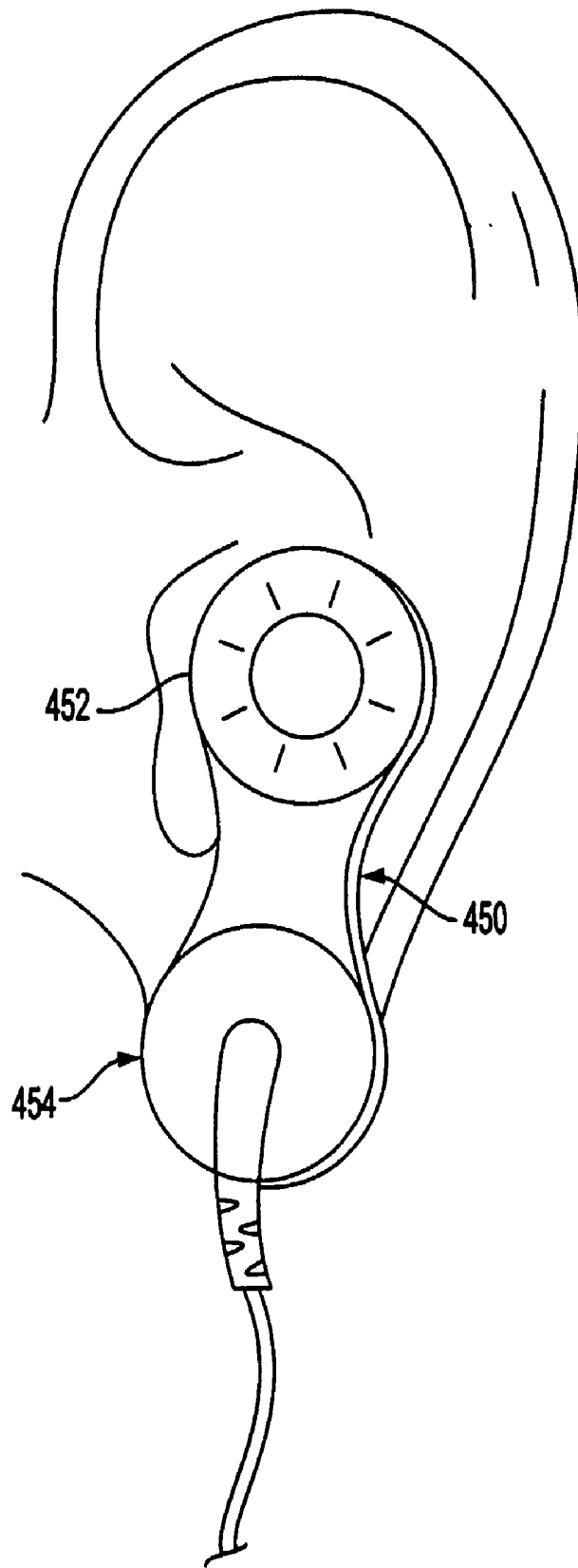

FIG. 16

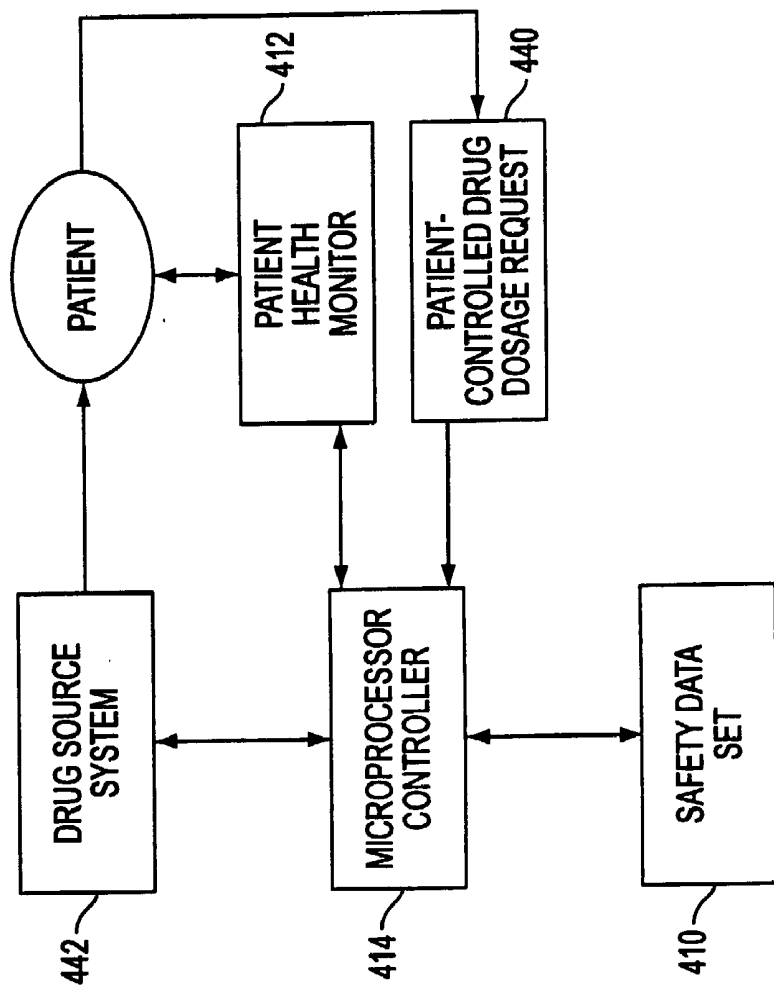

FIG. 17

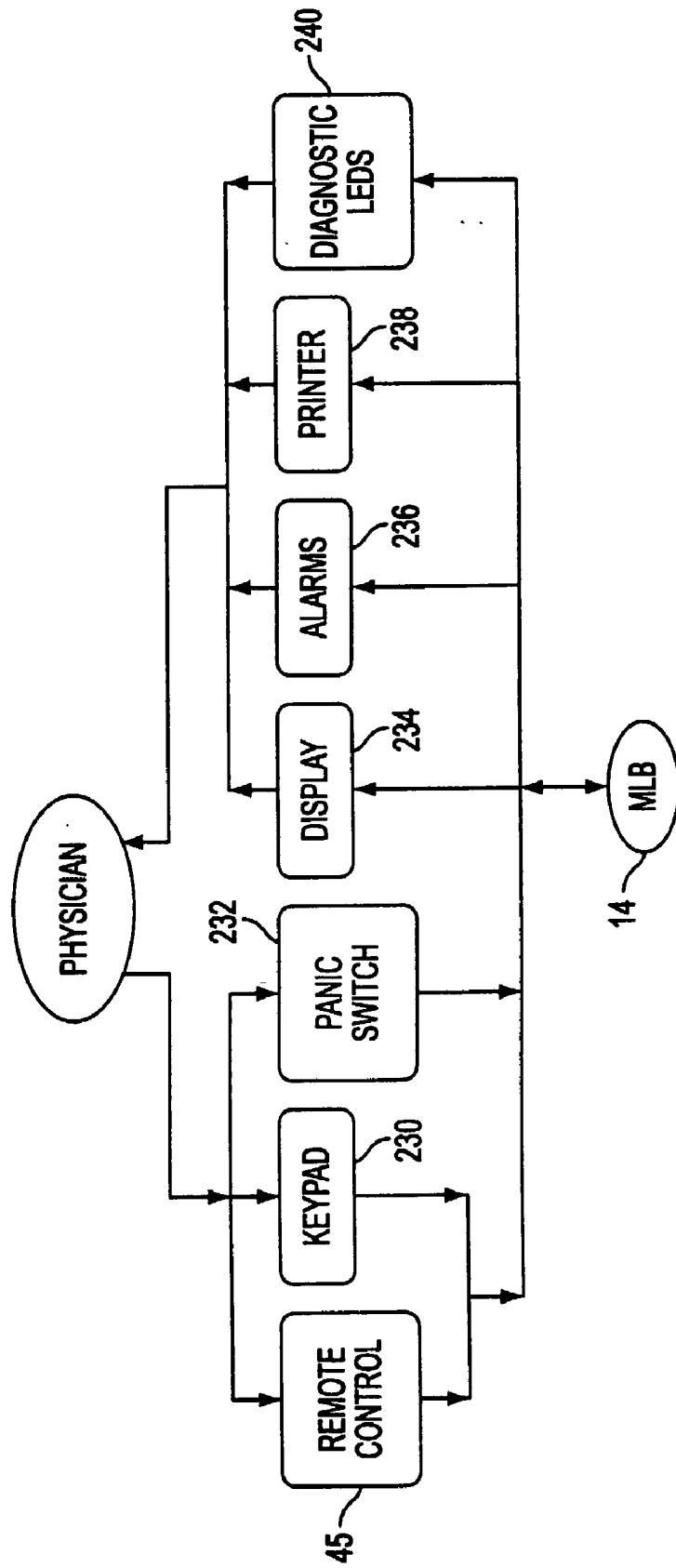

FIG. 18

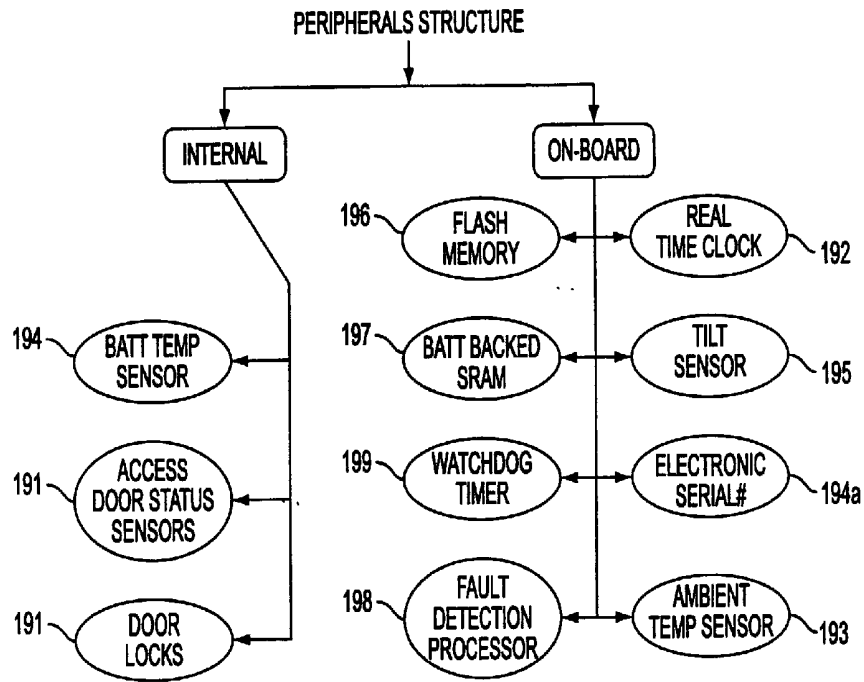

FIG. 19A

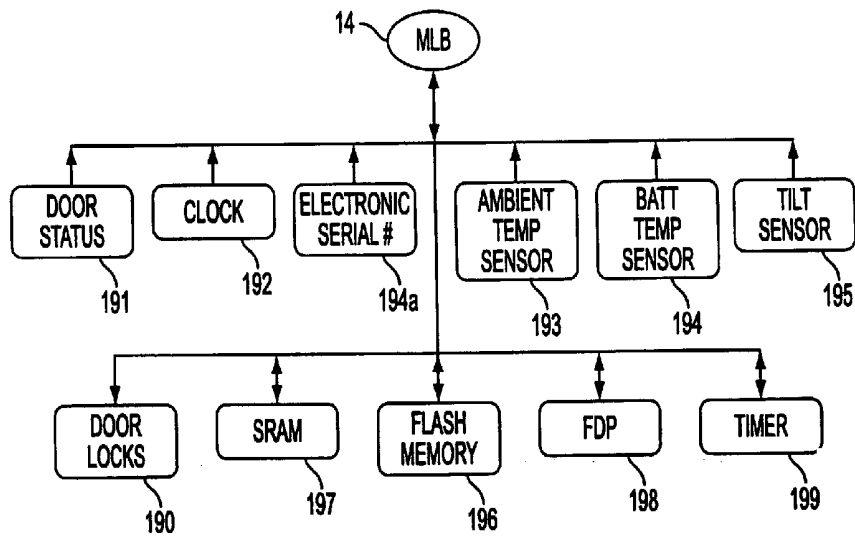

FIG. 19B

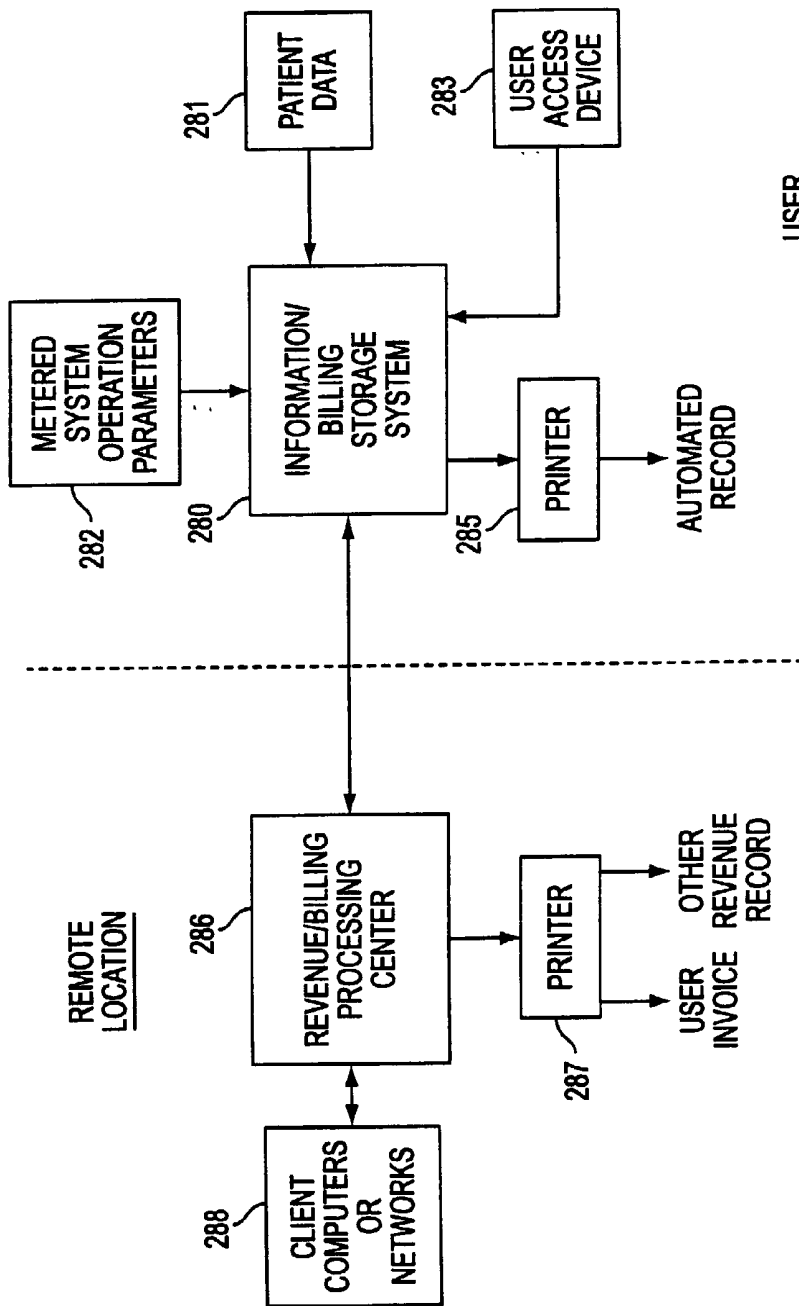

FIG. 20

PATIENT MONITOR	MONITOR READING	ACTION
O ₂ SATURATION	≥ 90%	NONE
	< 90%, ≥ 85%	ALARM 1 SOUNDS FOR 15 S. IF SILENCED MANUALLY, NO FURTHER ACTION IF NOT SILENCED, N ₂ O IS REDUCED TO THE LESSER CONCENTRATION OF 45% OR CURRENT CONCENTRATION - 10%. SIMILAR ALGORITHMS FOR SEVOFLURANE AND IV INFUSIONS TO BE SPECIFIED.
	< 85%, ≥ 80%	ALARM 2 SOUNDS, N ₂ O REDUCED TO THE LESSER CONCENTRATION OF 45% OR CURRENT CONCENTRATION - 10% IMMEDIATELY
	< 80%	ALARM 3 SOUNDS, N ₂ O REDUCED TO 0%
PULSE RATE	≥ 45/min.	NONE
	< 45/min., ≥ 35/min.	ALARM 1 SOUNDS FOR 15 S. IF SILENCED MANUALLY, NO FURTHER ACTION. IF NOT SILENCED, N ₂ O IS REDUCED TO THE LESSER CONCENTRATION OF 45% OR CURRENT CONCENTRATION - 10%
	< 35/min.	ALARM 3 SOUNDS, N ₂ O REDUCED TO 0%
CO ₂ MAXIMUM	≤ 50 mm Hg	NONE
	> 50 mm Hg, ≤ 55 mm Hg	ALARM 1 SOUNDS FOR 15 S. IF SILENCED MANUALLY, NO FURTHER ACTION. IF NOT SILENCED, N ₂ O IS REDUCED TO THE LESSER CONCENTRATION OF 45% OR CURRENT CONCENTRATION - 10%
	> 55 mm Hg, ≤ 60 mm Hg	ALARM 2 SOUNDS, N ₂ O REDUCED TO THE LESSER CONCENTRATION OF 45% OR CURRENT CONCENTRATION - 10% IMMEDIATELY
	< 60 mm Hg	ALARM 3 SOUNDS, N ₂ O REDUCED TO 0%
RESPIRATION RATE	APNEA < 1 min.	NONE
	APNEA ≥ 1 min.	ALARM 2 SOUNDS, N ₂ O REDUCED TO THE LESSER CONCENTRATION OF 45% OR CURRENT CONCENTRATION - 10% IMMEDIATELY
	ALARM 2 AND APNEA ≥ 30 s.	ALARM 3 SOUNDS, N ₂ O REDUCED TO 0%
SYSTOLIC BP	> 70 mm Hg	NONE
	≤ 70 mm Hg, > 65 mm Hg	ALARM 1 SOUNDS FOR 15 S. IF SILENCED MANUALLY, NO FURTHER ACTION. IF NOT SILENCED, N ₂ O IS REDUCED TO THE LESSER CONCENTRATION OF 45% OR CURRENT CONCENTRATION - 10%
	≤ 65 mm Hg, > 60 mm Hg	ALARM 2 SOUNDS, N ₂ O REDUCED TO THE LESSER CONCENTRATION OF 45% OR CURRENT CONCENTRATION - 10% IMMEDIATELY
	≤ 60 mm Hg	ALARM 3 SOUNDS, N ₂ O REDUCED TO 0%
CONSCIOUSNESS MONITOR	PATIENT RESPONDS	NONE
	PATIENT DOES NOT RESPOND	ALARM 1 SOUNDS FOR 15 S. IF SILENCED MANUALLY, NO FURTHER ACTION. IF NOT SILENCED, N ₂ O IS REDUCED TO THE LESSER CONCENTRATION OF 45% OR CURRENT CONCENTRATION - 10%
	ALARM 1 AND PATIENT DOES NOT RESPOND TO STIMULUS 30 s LATER	ALARM 2 SOUNDS, N ₂ O REDUCED TO THE LESSER CONCENTRATION OF 45% OR CURRENT CONCENTRATION - 10% IMMEDIATELY
	ALARM 2 AND PATIENT DOES NOT RESPOND TO STIMULUS 30 s LATER	ALARM 3 SOUNDS, N ₂ O REDUCED TO 0%

FIG. 21A

MONITOR	UNIT	TRANSITION REQUIREMENT	> SETPOINT	< SETPOINT	VALUE
O ₂ TANK PRESSURE	PSI	LOW TANK PRESSURE	> SETPOINT	< SETPOINT	N/A
O ₂ INTERRUPTION FAIL-SAFE	LOGICAL	O ₂ INTERRUPTED	FALSE	N/A	TRUE
TOTAL GAS FLOW	LITERS / MIN	LOW GAS FLOW	> SETPOINT	< SETPOINT	N/A
N ₂ O TANK PRESSURE	PSI	LOW TANK PRESSURE	> SETPOINT	< SETPOINT	N/A
FI _O ₂	%	LOW FI _O ₂	>= 30	N/A	< 30
VACUUM PUMP	LOGICAL	INSUFFICIENT VACUUM PUMP	OK	FAIL	N/A
POWER	LOGICAL	INTERRUPTION IN POWER	OK	N/A	FAIL
		NORMAL	NO CHANGE	START ALARM 1	START ALARM 2 REDUCE N ₂ O TO 0%
		ALARM 1	NORMAL	ALARM 1	ALARM 2
		ALARM 1	STOP ALARM 1	IF DURATION > 15 SEC AND NOT SILENCED THEN REDUCE N ₂ O TO 45% OR CURRENT - 10%	START ALARM 2 REDUCE N ₂ O TO 0%
		ALARM 2	NORMAL	ALARM 1	ALARM 2
		ALARM 2	STOP ALARM 2	GO TO ALARM 1	NO CHANGE
			NORMAL	ALARM 1	ALARM 2

FIG. 21B

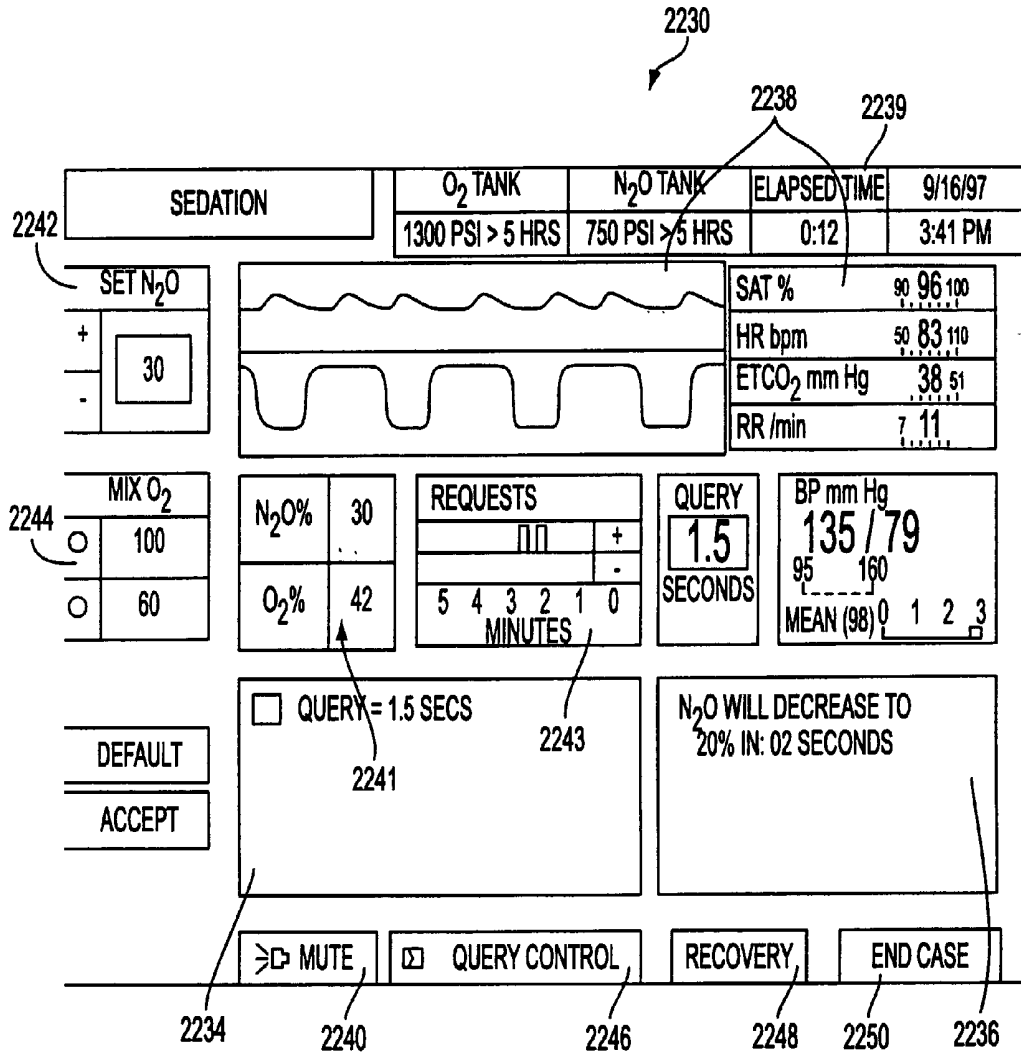

FIG. 22A

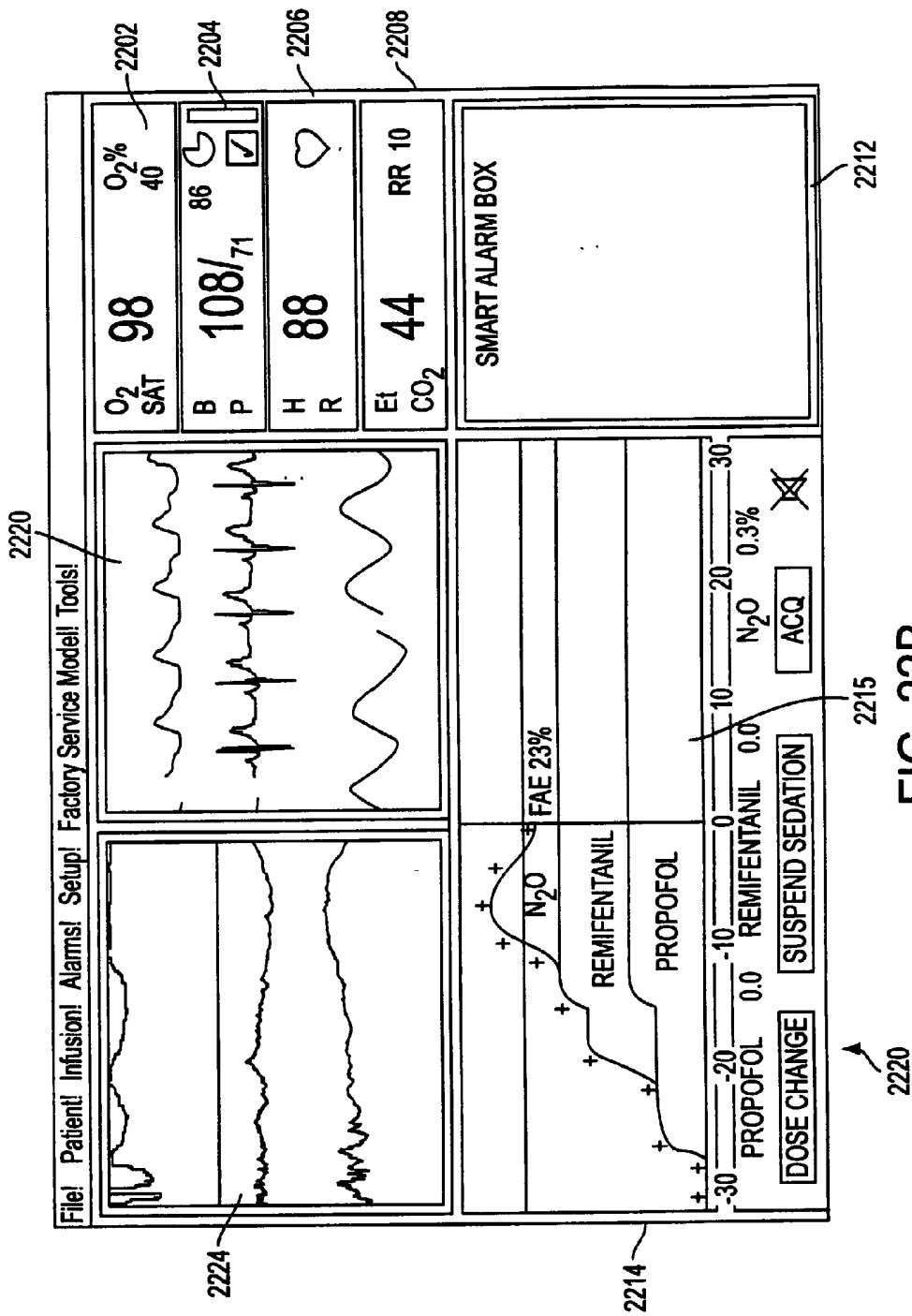

FIG. 22B

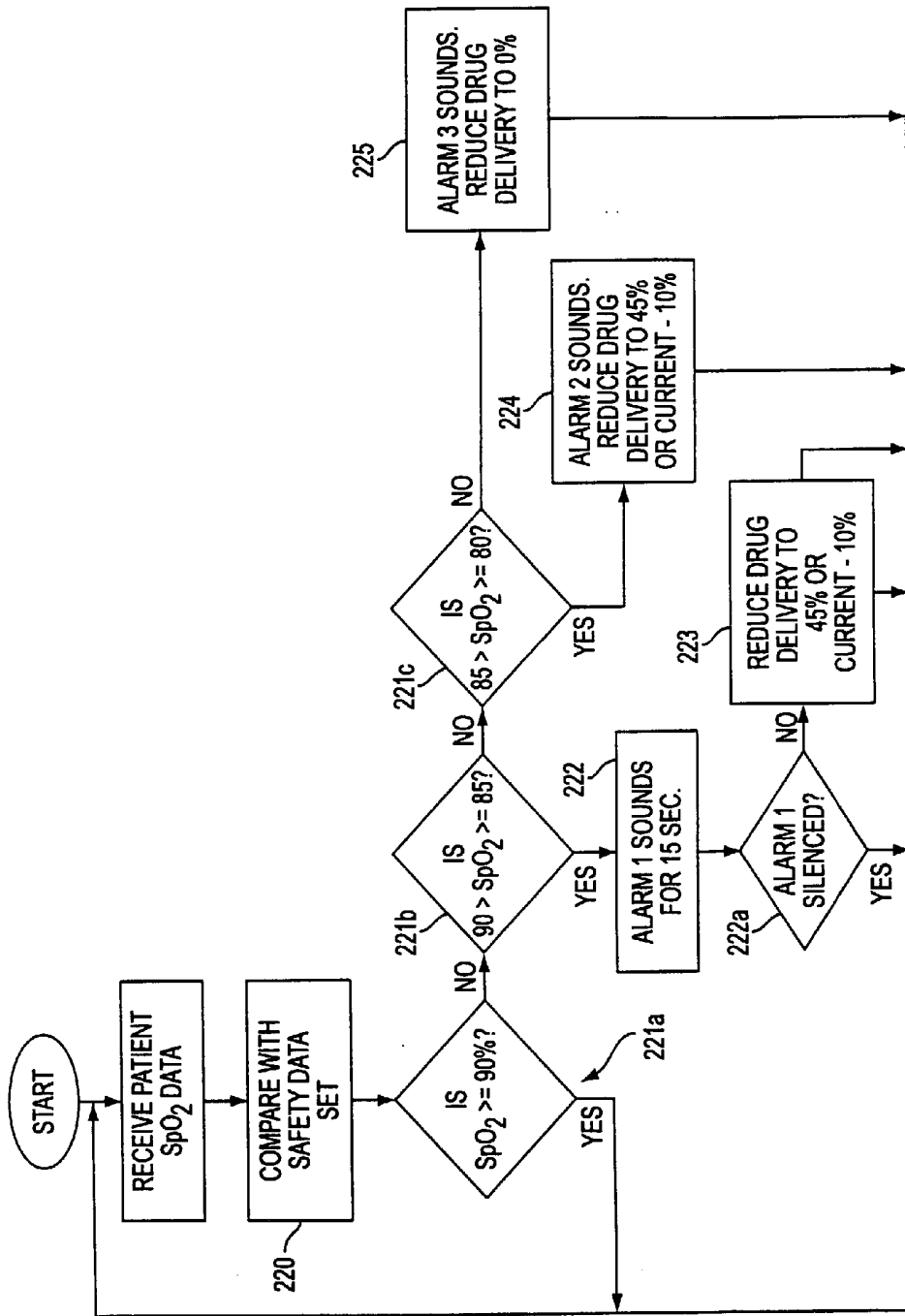

FIG. 23A

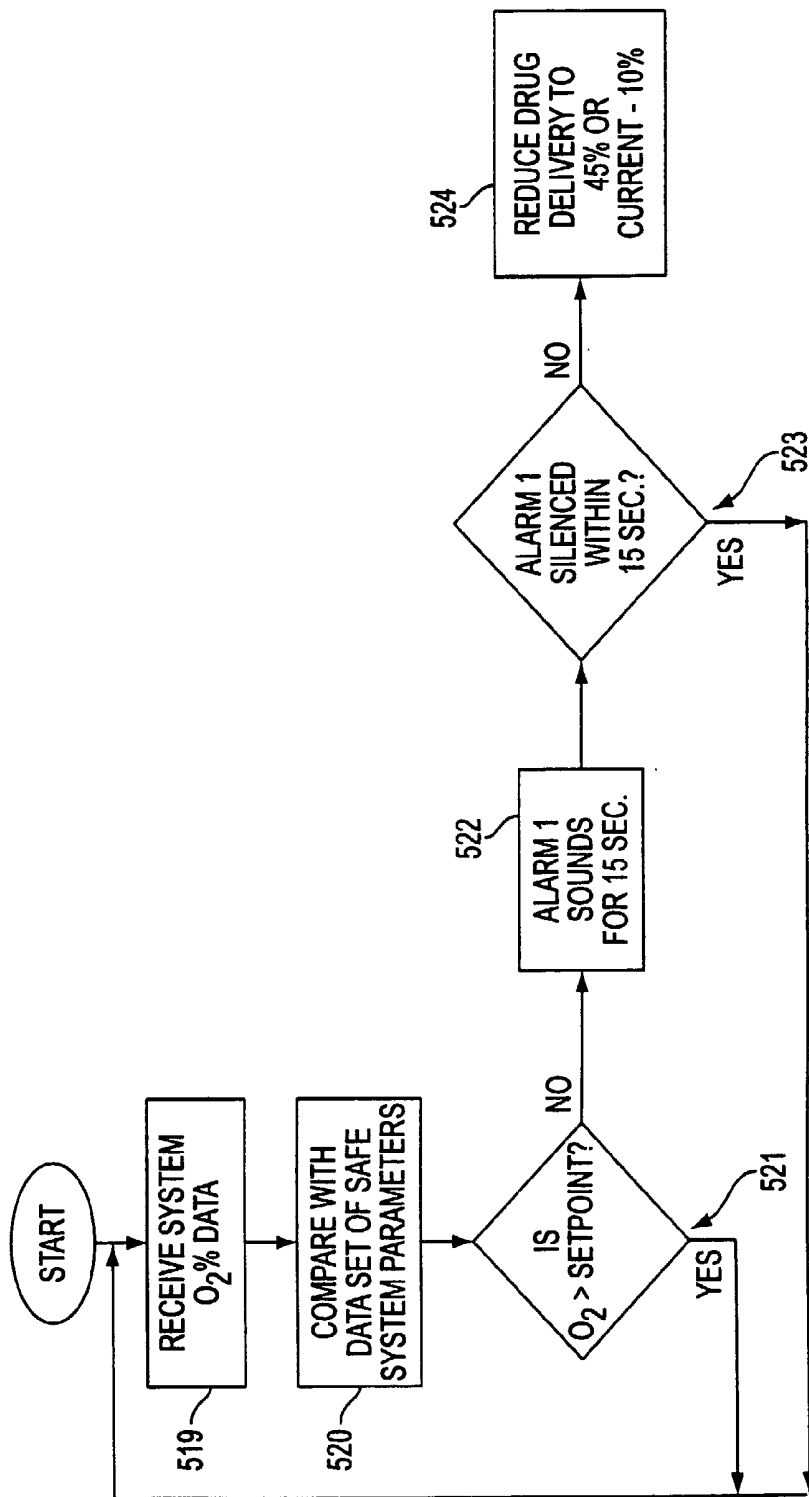
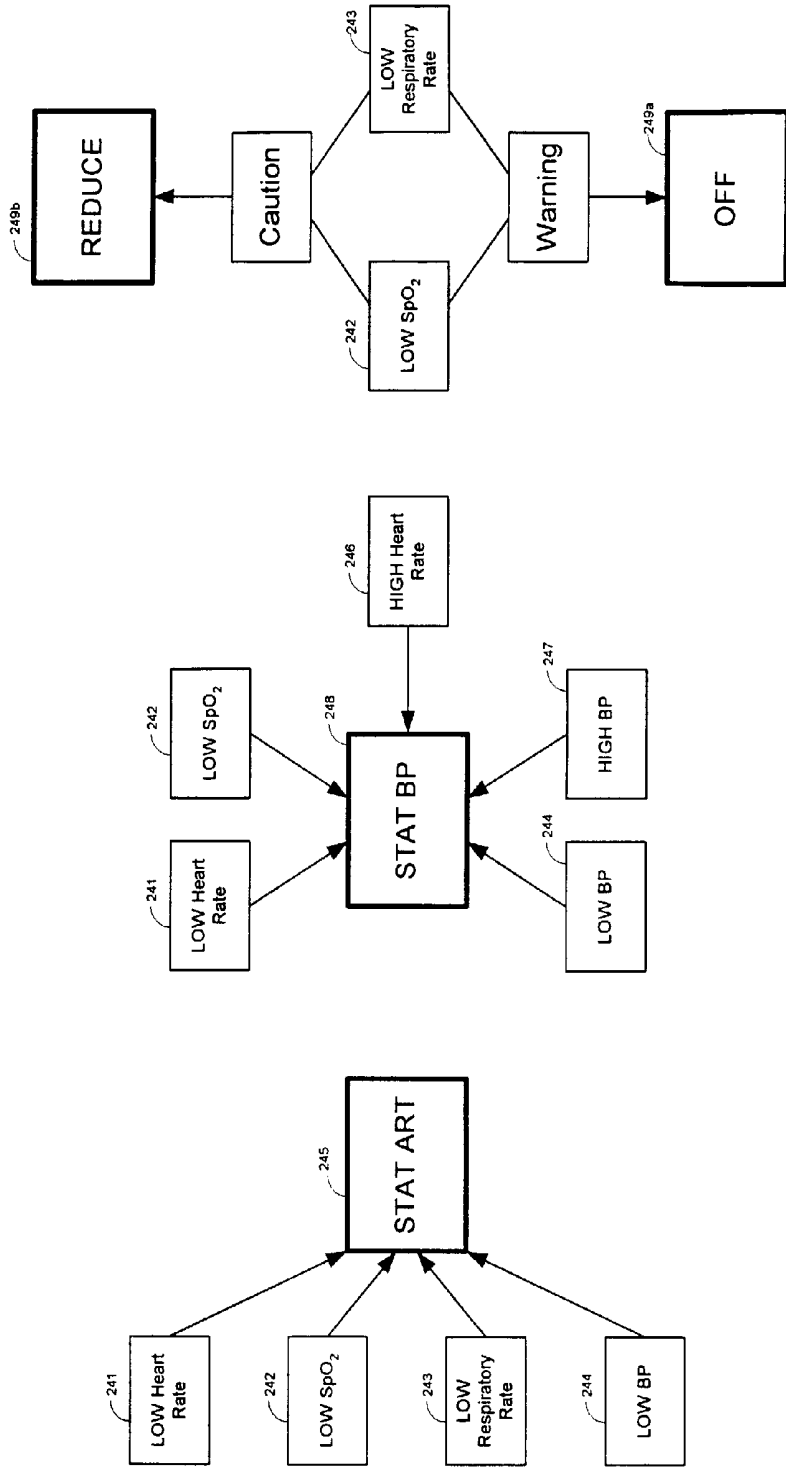

FIG. 23B

FIG. 24



**APPARATUSES AND METHODS FOR PROVIDING
A CONSCIOUS PATIENT RELIEF FROM PAIN
AND ANXIETY ASSOCIATED WITH MEDICAL OR
SURGICAL PROCEDURES ACCORDING TO
APPROPRIATE CLINICAL HEURISTICS**

**CROSS-REFERENCE TO RELATED
APPLICATIONS**

[0001] The present application is a continuation-in-part of U.S. patent application Ser. No. 09/324,759, filed Jun. 3, 1999 which claims priority from U.S. Provisional Patent Application Serial No. 60/087,841 filed Jun. 3, 1998, and is incorporated herein by reference. The present application also claims priority under 35 U.S.C. §119(e) from U.S. Provisional Patent Application Serial No. 60/327,313 filed Oct. 9, 2001

FIELD OF THE INVENTION

[0002] This invention relates generally to an apparatus and method for relieving patient pain and/or anxiety. More particularly, this invention relates to a system and method for providing sedation, analgesia and/or amnesia to a conscious patient undergoing a painful or anxiety-producing medical or surgical procedure, or suffering from post-procedural or other pain or discomfort. The invention electronically integrates through conservative software management the delivery of one or more sedative, analgesic or amnestic drugs with the electronic monitoring of one or more patient physiological conditions. In one form, the invention includes the use of one or more sets of stored data-defining parameters reflecting patient and system states, the parameters being accessed through software to conservatively manage and correlate drug delivery to safe, cost effective, optimized values related to the conscious patient's vital signs and other physiological conditions.

BACKGROUND OF THE INVENTION

[0003] This invention is directed to providing a conscious patient who is undergoing a painful, uncomfortable or otherwise frightening (anxiety-inspiring) medical or surgical procedure, or who is suffering from post-procedural or other pain or discomfort, with safe, effective and cost-effective relief from such pain and/or anxiety. Focuses of the invention include, but are not limited to, enabling the provision of sedation (inducement of a state of calm), analgesia (insensitivity to pain) and/or amnesia to a conscious patient (sometimes referred to collectively as "conscious sedation") by a nonanesthetist practitioner, i.e., a physician or other clinician who is not an anesthesiologist (M.D.A.) or certified nurse PATENT anesthetist (C.R.N.A.), in a manner that is safe, effective and cost-effective; the provision of same to patients in ambulatory settings such as hospital laboratories, ambulatory surgical centers, and physician's offices; and the provision of patient post-operative or other pain relief in remote medical care locations or in home care environments. To those ends, the invention mechanically integrates through physical proximity and incorporation into an overall structural system and electronically integrates through conservative, decision-making software management, the delivery of one or more sedative, analgesic or amnestic drugs to the patient with the electronic monitoring of one or more patient physiological conditions.

[0004] In traditional operating rooms, anesthesiologists provide patients relief from pain, fear and physiological

stress by providing general anesthesia. "Anesthesia" is typically used (and is so used herein) interchangeably with the state of "unconsciousness." Over a billion painful and anxiety-inspiring medical and surgical procedures, however, are performed worldwide each year without anesthesia. Thus, outside the practice of anesthesiology there are currently a large number of patients who, while conscious, undergo medical or surgical procedures that produce considerable pain, profound anxiety, and/or physiological stress. Such medical or surgical procedures are often performed by procedural physicians (nonanesthetists) in hospital laboratories, in physicians' offices, and in ambulatory surgical centers. For example, physician specialists perform painful procedures on conscious patients such as pacemaker placement, colonoscopies, various radiological procedures, microlaparoscopy, fracture reduction, wound dressing changes in burn units, and central and arterial catheter insertion in pediatric patients, in hospital laboratory settings. Primary care physicians perform such procedures as flexible sigmoidoscopies, laceration repairs, bone marrow biopsies and other procedures in physicians' offices. Many surgical specialists perform painful procedures such as anterior segment repairs by ophthalmologists, plastic procedures by cosmetic surgeons, foreign body removal, transurethral procedures, incisions of neck and axilla nodes, and breast biopsies in their offices or in ambulatory surgical centers. The needs of patients for safe and effective pain and anxiety relief during and after such procedures are currently unmet.

[0005] Conscious sedation techniques currently available for use by procedural physicians (nonanesthetists) during medical or surgical procedures such as those described above include sedatives and opioids given orally, rectally or intra-muscularly; sedatives and analgesics administered intravenously; and local anesthetics. Often, however, such techniques are less than satisfactory.

[0006] In the case of oral, rectal or intramuscular administration of sedatives and opioids by procedural physicians during the provision of conscious sedation, there are currently no effective means available to assure that the effects of those drugs can be readily controlled to meet patient need. This is due in part to the variable interval between administration and the onset and dissipation of drug effect. Unreliable sedation and analgesia can result because of mismatches between the dosage administered and the patient's needs which can vary depending on the condition of the patient and the type of procedure performed. Such administration of sedation can also produce an unconscious patient at risk for developing airway obstruction, emesis with pulmonary aspiration or cardiovascular instability. To attempt to avoid these complications, procedural physicians often administer sedatives and analgesics sparingly. This may reduce the risk of major complications, but may also mean that few patients receive adequate relief from pain and/or anxiety during medical and surgical procedures outside the practice of anesthesiology.

[0007] The use of intravenous administration of sedatives and analgesics to conscious patients by procedural physicians in settings such as hospital laboratories, physicians' offices and other ambulatory settings is also less than satisfactory. With respect to intravenous bolus administration, plasma concentrations vary considerably when drugs are injected directly into the blood stream. This can result in initially excessive (potentially toxic) levels followed by

sub-therapeutic concentrations. Although intravenously administered drugs can be titrated to the patient's need, doing so safely and effectively usually requires the full-time attention of a trained care giver, e.g., an anesthesiologist. Costs and scheduling difficulties among other things typically preclude this option.

[0008] Due to the difficulties described above involving administration of sedatives and opioids, many procedural physicians rely on local anesthetics for pain relief. However, local anesthetics alone usually provide inadequate analgesia (insensitivity to pain) for most medical and surgical procedures and the injections themselves are often relatively painful.

[0009] In short, current methods commonly available to procedural physicians for providing effective pain relief to conscious patients outside the practice of anesthesiology typically fall short of the objective. Moreover, there are currently no clear standards of practice for nonanesthetists to guide the relief of pain and anxiety for conscious patients. There is not adequate training for such practitioners in the diagnosis and treatment of complications that may arise or result from the provision of sedation and analgesia to conscious patients. Procedures or mechanisms for ongoing quality management of the care of conscious patients undergoing painful and anxiety-inspiring medical or surgical procedures and the devices and methods employed in that care are inadequate.

[0010] An additional focus of this invention is the electronic monitoring of a conscious patient's physiological condition during drug delivery, and the electronic management of drug delivery by conservative decision-making software that integrates and correlates drug delivery with electronic feedback values representing the patient's physiological condition, thereby ensuring safe, cost-effective, optimized care. Significantly, in many cases involving conscious sedation, the patient's physiological condition is inadequately monitored or not electronically monitored at all during drug delivery and recovery therefrom. That is, there is often no electronic monitoring of basic patient vital signs such as blood pressure, blood oxygen saturation (oximetry) nor of carbon dioxide levels in a patient's inhaled and exhaled gases (capnometry). For example, patients undergoing painful procedures in dentists' offices may receive nitrous oxide (N₂O) gas to relieve pain, but that drug delivery is often not accompanied by electronic monitoring of a patient's physiological condition, and currently there are no devices available to nonanesthetists which safely and effectively integrate electronic patient monitoring with such drug delivery mechanisms.

[0011] In other circumstances involving the provision of conscious sedation and analgesia by the procedural physician, such as a cardiologist's performing a catheterization procedure in a hospital laboratory, electronic patient monitors are sometimes used, but again, there are no devices currently available to the nonanesthetist which safely and effectively integrate both mechanically (through close, physical proximity and incorporation into a structural system), and electronically (through conservative software management), electronic patient monitors with mechanisms for drug delivery.

[0012] One aspect of the invention of this application is directed to the simplification of drug delivery machines for

relieving patient pain and anxiety by eliminating features of those machines that complicate the provision of patient pain and anxiety relief, and by including those features that enable nonanesthetists to provide safe, cost-effective, optimized conscious sedation and analgesia. More specifically, current anesthesia machines used by anesthesiologists to provide general anesthesia and a form of conscious sedation administered by the anesthesiologist known as "monitored anesthesia care" (MAC) include various complex features such as oxygen (O₂) flush valves which are capable of providing large amounts of oxygen to the patient at excessive pressures, and carbon dioxide (CO₂) absorbent material which absorbs CO₂ from a patient's exhaled gases. In addition, anesthesia machines typically deliver halogenated anesthetic gases which can trigger malignant hyperthermia. Malignant hyperthermia is a rare, but highly critical condition requiring the advanced training and skills of an anesthesiologist for rapid diagnosis and therapy. The airway circuit in current anesthesia machines is circular in nature and self-contained in that the patient inhales an oxygen/anesthetic gas mixture, exhales that mixture which is then passed through CO₂ absorbent material, re-inhales the filtered gas mixture (supplemented by additional anesthetic and oxygen), and repeats the process.

[0013] These aspects of anesthesia machines, among others, carry attendant risks for the patient such that anesthesia machines require operation by a professional trained through a multi-year apprenticeship (e.g., an anesthesiologist or C.R.N.A.) in detecting and correcting failure modes in the technology. For example, an oxygen flush valve can cause oxygen to enter a patient's stomach thereby causing vomiting; and carbon dioxide absorbent material can fail in which case the patient could receive too much carbon dioxide if the failure was not promptly detected and corrected. Moreover, the use of the self-contained, circular airway circuit could result in a circumstance whereby if the supply of O₂ suddenly ceased, a patient would only be breathing the finite supply of oxygen with no provision for administration of additional requirements for O₂ or atmospheric air. Such features, among others, make anesthesia machines unusable by nonanesthetists. Therefore, a focal point of this aspect of the invention is the simplification of a drug delivery apparatus by selecting and incorporating the appropriate features to facilitate the rendition of safe and effective conscious sedation by nonanesthetists.

[0014] Certain aspects of this invention also focus on ensuring maintenance of patient consciousness to prevent airway difficulties, including monitoring the level of patient consciousness during the delivery of one or more sedative, analgesic and/or amnestic drugs to a conscious, non-intubated, spontaneously-ventilating patient to prevent airway difficulties. For patients not intubated on a ventilator, monitoring the level of patient consciousness is important to provide information about the likelihood of depressed airway reflexes and respiratory drive to breathe, the ability to maintain a patent airway, and the likelihood of cardiovascular instability. Despite the importance of monitoring and maintaining adequate levels of consciousness in certain medical settings, there is no currently available device for ensuring maintenance of patient consciousness by integrating mechanically and electronically such monitoring of a patient's level of consciousness with a drug delivery system. The invention of this application is directed to this unmet need, as well.

[0015] Further aspects of this invention focus on the electronic monitoring of a patient's physiological conditions during a physician administered medical procedure, the electronic monitoring of the state of the drug delivery system, automated events triggered upon certain states of or changes in the patient's conditions or the states of the system, and automated heuristic responses to such automated events. The purpose of these aspects is to provide, among other things, a means for safe sedation and analgesia, particularly when administered by a physician and nurse team that is multi-tasking during the performance of a medical procedure that may be painful to the patient. The present invention accomplishes this purpose by, first, automatically gathering information about the conditions triggering an event in order to better understand what the event conditions mean and, second, automatically responding to the event conditions based upon clinically appropriate heuristics.

[0016] This invention is also directed to providing conscious patients relief from pain and/or anxiety in a manner that is cost-effective and time efficient. Current solutions for relieving patient pain and anxiety by drug delivery and electronic monitoring of a patient's physiological condition are expensive and require a great deal of time to set-up and take down. Also, the current requirement or desire for the presence of an anesthesiologist during some medical or surgical procedures increases costs, especially if that desire requires in-patient care as opposed to care in an ambulatory setting. To the extent medical procedures are performed on conscious patients without adequate sedation and analgesia due to the current unavailability of appropriate methods and devices for providing such care (e.g., wound dressing changes in burn wards), such procedures may need to be conducted on numerous occasions, but over short periods of time (due to a patient's inability to tolerate the level of pain), as opposed to conducting a fewer number of more definitive procedures. The requirement of multiple sessions of care also typically involves increased costs. This invention addresses such cost-effectiveness concerns and provides solutions to problems such as those described.

[0017] The invention is further directed to the provision of relief from post-operative or other post-procedural pain and discomfort in remote medical care locations and home care type settings. Current devices may permit certain patients in, for example, a home care type setting, to provide themselves with an increased dosage of analgesic through the use of a patient-controlled drug delivery device, e.g., a device that permits a patient to press a button or toggle a switch and receive more analgesic (often intravenously or transdermally). This practice is sometimes called "PCA" or patient-controlled analgesia. Known commercially available PCA-type devices do not electronically integrate and conservatively manage delivery of analgesics in accord with the electronic monitoring of a patient's physiological condition. This invention focuses on this unmet need, as well.

[0018] An additional aspect of this invention is directed to the integration of a billing/information system for use with an apparatus providing sedation, analgesia and/or amnesia to conscious patients in physician's offices, hospital laboratory or other ambulatory settings or remote medical care locations. Current techniques for automated billing and invoice generating provide inadequate and inefficient methods for

tracking recurring revenues derived from repeated use of medical devices such as the apparatus of this invention.

[0019] Other focuses of the invention are apparent from the below detailed description of preferred embodiments.

DESCRIPTION OF RELATED ART

[0020] Known machines or methods administered by the nonanesthetist for providing conscious, non-intubated, spontaneously-ventilating patients with sedation and analgesia are unreliable, not cost-effective or are otherwise unsatisfactory. No commercially available devices reliably provide such patients with safe and cost-effective sedation, analgesia and amnesia to conscious patients by integrating and correlating the delivery of sedative, analgesic and/or amnesic drugs with electronic monitoring of a patient's physiological condition. Available drug delivery systems do not incorporate a safety set of defined data parameters so as to permit drug delivery to be conservatively managed electronically in correlation with the patient's physiological conditions, including vital signs, to effectuate safe, cost-effective and optimized drug delivery to a patient. Available drug delivery systems do not incorporate alarm alerts that safely and reliably free the nonanesthetist practitioner from continued concern of drug delivery effects and dangers to permit the nonanesthetist to focus on the intended medical examination and procedure. Moreover, there are no known patient-controlled analgesia devices that mechanically and electronically integrate and correlate (through conservative software management) patient requests for adjustments to drug dosage and electronic monitoring of patient physiological conditions.

[0021] Known techniques have focused on the delivery of sedation and analgesia to conscious patients with inadequate or no electronic monitoring of patient physiological conditions, including vital signs, and no electronic integration or correlation of such patient monitoring with drug delivery. Other techniques have focused on the provision of anesthesia to unconscious patients with the requirement of an anesthesiologist to operate a complicated, failure-intensive anesthesia machine.

[0022] Presently known nitrous oxide delivery systems such as those manufactured by MatrX Medical, Inc., Accutron, Inc., and others are used primarily in dental offices for providing conscious sedation only. Such devices contain sources of nitrous oxide and oxygen, a gas mixing device and system monitors, but no mechanical or electrical integration of patient physiological condition monitors with drug delivery mechanisms. Similarly, other known drug delivery systems (e.g., intravenous infusion or intramuscular delivery mechanisms) for providing sedatives and analgesics to conscious patients used, for example, in hospital laboratories, do not include mechanical or electronic integration of patient physiological condition monitors with drug delivery mechanisms.

[0023] Anesthesia machines used by anesthesiologists to provide general anesthesia or MAC, such as, by way of example, the NARKOMED line of machines manufactured by North American Drager and EXCEL SE ANESTHESIA SYSTEMS manufactured by Ohmeda Inc., mechanically integrate electronic patient monitors in physical proximity to drug delivery mechanisms. These machines, however, employ features such as O₂ flush valves, malignant hyper-

thermia triggering agents, CO₂ absorbent material, as well as circular airway circuits, among others, thereby requiring operation by an M.D.A. (or C.R.N.A.) to avoid the occurrence of life-threatening incidents. These devices do not provide for the electronic integration or management of drug delivery in correlation with the monitoring of a patient's physiological condition, much less such electronic management through conservative, decision-making software or logic incorporating established safe data-defining parameters.

[0024] U.S. Pat. No. 2,888,922 (Bellville) discloses a servo-controlled drug delivery device for automatic and continuous maintenance of the level of unconsciousness in a patient based on voltages representative of the patient's cortical activity obtained by means of an electroencephalograph (EEG). The device continuously and automatically increases or decreases in robotic fashion the flow of anesthetic gas (or I.V. infusion) in response to selected frequencies of brain potential to maintain a constant level of unconsciousness.

[0025] U.S. Pat. No. 4,681,121 (Kobal) discloses a device for measuring a patient's sensitivity to pain during the provision of anesthesia, by applying a continuous, painful stimulus to the nasal mucosa and regulating the level of anesthesia in response to EEG signals indicating the patient's response to the nasal pain stimulus, with the goal of maintaining a sufficient level of unconsciousness.

[0026] Among other things, none of the above-described known devices manages drug delivery to conscious patients employing conservative decision-making software or logic which correlates the drug delivery to electronic patient feedback signals and an established set of safety data parameters.

[0027] Further, there are no known devices which integrate a clinically appropriate heuristic approach to managing the automated checking of a patient's health parameters with automated drug delivery or patient responsiveness testing. U.S. Pat. Nos. 6,196,974 and 6,421,680 disclose devices that heuristically trigger a blood pressure measurement cycle upon receiving certain pulse wave data. U.S. Pat. Nos. 5,876,348 and 6,083,171 disclose devices which cross-correlate data received from an ECG and a pulse oximeter in order to control a blood pressure measurement cycle. These devices do not, however, heuristically manage either drug delivery or patient responsiveness testing based on the patient health data they receive.

SUMMARY OF THE INVENTION

[0028] The invention provides apparatuses and methods to safely and effectively deliver a sedative, analgesic, amnestic or other pharmaceutical agent (drug) to a conscious, non-intubated, spontaneously-ventilating patient. The invention is directed to apparatuses and methods for alleviating a patient's pain and anxiety before and/or during a medical or surgical procedure and for alleviating a patient's post-operative or other post-procedural pain or discomfort while simultaneously enabling a physician to safely control or manage such pain and/or anxiety. The costs and time loss often associated with traditional operating room settings or other requirements or desires for the presence of anesthetists may thus be avoided.

[0029] A care system in accordance with the invention includes at least one patient health monitor which monitors a patient's physiological condition integrated with a drug delivery controller supplying an analgesic or other drug to the patient. A programmable, microprocessor-based electronic controller compares the electronic feedback signals generated from the patient health monitor and representing the patient's actual physiological condition with a stored safety data set reflecting safe and undesirable parameters of at least one patient physiological condition and manages the application or delivery of the drug to the patient in accord with that comparison. In a preferred embodiment, the management of drug delivery is effected by the electronic controller via conservative, decision-making software accessing the stored safety data set.

[0030] In another aspect the invention also includes at least one system state monitor which monitors at least one operating condition of the care system, the system state monitor being integrated with a drug delivery controller supplying drugs to the patient. In this aspect, an electronic controller receives instruction signals generated from the system monitor and conservatively controls (i.e., curtails or ceases) drug delivery in response thereto. In a preferred embodiment, this is accomplished through software control of the electronic controller whereby the software accesses a stored data set reflecting safe and undesirable parameters of at least one operating condition of the care system, effects a comparison of the signal generated by the system state monitor with the stored data set of parameters and controls drug delivery in accord with same, curtailing or ceasing drug delivery if the monitored system state is outside of a safe range. The electronic controller may also activate attention-commanding devices such as visual or audible alarms in response to the signal generated by the system state monitor to alert the physician to any abnormal or unsafe operating state of the care system apparatus.

[0031] The invention is further directed to an apparatus which includes a drug delivery controller, which delivers drugs to the patient, electronically integrated with an automated consciousness monitoring system which ensures the consciousness of the patient and generates signal values reflecting patient consciousness. An electronic controller is also included which is interconnected to the drug delivery controller and the automated consciousness monitor and manages the delivery of the drugs in accord with the signal values reflecting patient consciousness.

[0032] In another aspect, the invention includes one or more patient health monitors such as a pulse oximeter or capnometer and an automated consciousness monitoring system, wherein the patient health monitors and consciousness monitoring system are integrated with a drug delivery controller supplying an analgesic or other drug to the patient. A microprocessor-based electronic controller compares electronic feedback signals representing the patient's actual physiological condition including level of consciousness, with a stored safety data set of parameters reflecting patient physiological conditions (including consciousness level), and manages the delivery of the drug in accord with that comparison while ensuring the patient's consciousness. In additional aspects of the invention the automated consciousness monitoring system includes a patient stimulus or query device and a patient initiate response device.

[0033] The invention also provides apparatuses and methods for alleviating post-operative or other post-procedural pain or discomfort in a home care-type setting or remote medical care location. Here the care system includes at least one patient health monitor integrated with patient-controlled drug delivery. An electronic controller manages the patient-controlled drug delivery in accord with electronic feedback signals from the patient health monitors. In a preferred embodiment the electronic controller is responsive to software effecting conservative management of drug delivery in accord with a stored safety data set.

DESCRIPTION OF THE DRAWINGS

[0034] Other objects and many of the intended advantages of the invention will be readily appreciated as they become better understood by reference to the following detailed description of preferred embodiments of the invention considered in connection with the accompanying drawings, wherein:

[0035] FIG. 1 is a perspective view of a preferred embodiment of a care system apparatus constructed in accordance with this invention, depicting the provision of sedation, analgesia and/or amnesia to a conscious patient by a nonanesthetist.

[0036] FIG. 2 is a perspective view of a preferred embodiment of a care system apparatus constructed in accordance with this invention depicting user interface and patient interface devices.

[0037] FIGS. 3A and 3B are side-elevation views of a preferred embodiment of an apparatus constructed in accordance with this invention.

[0038] FIG. 4A is a block diagram overview of the invention.

[0039] FIG. 4B is an overview data-flow diagram depicting the drug delivery management aspect of the invention.

[0040] FIG. 5 depicts a preferred embodiment of the invention.

[0041] FIG. 6 depicts a preferred embodiment of a drug delivery system in accordance with the invention.

[0042] FIGS. 7A-7C depict the details of a preferred embodiment of the drug source system in accordance with the invention.

[0043] FIG. 8 depicts a preferred embodiment of an electronic mixer system in accordance with the invention.

[0044] FIG. 9A depicts one embodiment of a manifold system in accordance with the invention.

[0045] FIG. 9B depicts a second embodiment of a manifold system in accordance with the invention.

[0046] FIG. 10A depicts a preferred embodiment of a manual bypass system in accordance with the invention.

[0047] FIG. 10B depicts a preferred embodiment of a scavenger system in accordance with the invention.

[0048] FIG. 11 depicts a preferred embodiment of a patient interface system in accordance with the invention.

[0049] FIGS. 12A and 12B are a front perspective view and a side-elevation view, respectively, of a preferred embodiment of hand cradle device constructed in accordance with the invention.

[0050] FIGS. 13A and 13B are rear perspective views of a preferred embodiment of hand cradle device constructed in accordance with the invention.

[0051] FIGS. 14A and 14B are, respectively, a front perspective view of an alternative embodiment of a hand cradle device constructed in accordance with this invention and a top plan view of a patient drug dosage request device in accordance with the invention.

[0052] FIG. 15 shows a perspective view of a preferred embodiment of the invention, including a hand cradle device and an ear piece combination oximeter/auditory query device.

[0053] FIG. 16 is a side-elevation view of an ear piece placed within a patient's ear containing a pulse oximetry sensor and an auditory query in accordance with the present invention.

[0054] FIG. 17 depicts an alternative preferred embodiment of a care system apparatus constructed in accordance with the invention.

[0055] FIG. 18 depicts a user interface system in accordance with a preferred embodiment of the invention.

[0056] FIGS. 19A and 19B depict the various peripheral devices included in a preferred embodiment of the invention.

[0057] FIG. 20 depicts a preferred embodiment of a patient information/billing system in accordance with the invention.

[0058] FIG. 21A depicts examples of drug delivery management protocols for 3-stage alarm states reflecting monitored patient parameters in accordance with the invention.

[0059] FIG. 21B depicts examples of drug delivery management protocols for 2-stage alarm states reflecting monitored system state parameters in accordance with the invention.

[0060] FIG. 22A depicts a first embodiment of a user interface screen display in accordance with the invention.

[0061] FIG. 22B depicts a second embodiment of a user interface screen display in accordance with the invention.

[0062] FIG. 23A is a data-flow diagram depicting an example of the steps performed by the drug delivery management software or logic responsive to patient health monitors in accordance with the invention.

[0063] FIG. 23B is a data-flow diagram depicting an example of the steps performed by the drug delivery management software or logic responsive to system state monitors in accordance with the invention.

[0064] FIG. 24 is a data-flow diagram depicting examples of clinically appropriate responses that the system can perform depending upon certain patient health parameters.

DETAILED DESCRIPTION OF PREFERRED EMBODIMENTS

[0065] The embodiments illustrated below are not intended to be exhaustive or to limit the invention to the

precise forms disclosed. The embodiments are chosen and described in order to explain the principles of the invention and its applications and uses, and thereby enable others skilled in the art to make and utilize the invention.

[0066] FIG. 1 shows a care system 10 constructed in accordance with this invention, providing sedative, analgesic and/or amnestic drugs to a conscious, non-intubated, spontaneously-ventilating patient undergoing a medical or surgical procedure by a procedural physician. The system 10 has a generally columnar housing 15 with various storage compartments 16 therein for storage of user and patient interface devices, and a base 17 supported on castor wheels 18. A drug delivery system 40 delivers a mixture of one or more gaseous sedative, analgesic or amnestic drugs in combination with oxygen (O₂) gas to a patient, and includes a one-way airway circuit 20 connected at one end to a face mask 30 and at the other end to a manifold valving system contained within housing 15. FIGS. 3A and 3B show from a side-elevation perspective, airway circuit 20, face mask 30, and exhaust hose 32 through which scavenged patient exhaled gases are exhausted to a safe location.

[0067] Referring to FIG. 2, lead 50 connects one or more patient interface devices (e.g., 55) to a microprocessor-based electronic controller or computer (sometimes also referred to herein as main logic board, MLB) located within housing 15. The electronic controller or main logic board may be comprised of combinations of available programmable-type microprocessors and other "chips," memory devices and logic devices on various board(s) such as those manufactured by Texas Instruments (e.g., XK21E) and National Semiconductor (e.g., HKL 72, among others. Patient interface devices 55 can include one or more patient health monitors that monitor a patient's physiological condition, such as known pulse oximeter, capnometer (not shown), non-invasive blood pressure monitors; EKG, EEG, acoustical monitors (not shown), and others; an automated consciousness monitoring system, including query initiate and response devices in accordance with the invention (described below); and patient drug dosage request devices (also described below). The main logic board electronically manages operation of the apparatus 10 by means of conservative, decision-making software that integrates and correlates patient feedback signals received from the one or more patient health monitors with drug delivery.

[0068] Also shown in FIGS. 1 and 2 are various user interface devices, including a display device 35 integrated into the top surface of apparatus 10 which displays patient and system parameters and operation status of the apparatus, a printer 37 which prints, for example, a hard copy of patient parameters indicating the patient's physiological condition and the status of various system alarms with time stamps, and a remote control device 45 which permits a physician to interact with apparatus 10. The various patient and user interface devices are described in more detail below.

[0069] It should be recognized that although certain embodiments of the invention show the analgesic delivery system 40 in a form for delivering one or more sedative, analgesic or amnestic drugs in gaseous form, the invention also specifically includes embodiments where such drugs are delivered intravenously, in nebulized, vaporized or other inhaled form, and/or transdermally such as by using known ion-transfer principles. Drugs that may be delivered by the

care system include, but are not limited to, nitrous oxide, propofol, remifentanyl, dexmedetomidine, epibatidine and sevoflurane. Alternative embodiments are described in more detail herein.

[0070] FIG. 4A is a block diagram overview of a preferred embodiment of the invention. FIG. 4B is an overview data flow diagram depicting the drug delivery management steps performed by the software/logic control of microprocessor controller 14 in a preferred embodiment of the invention. In FIG. 4A, one or more patient health monitors 12a (which may include one or more known patient physiological condition monitors such as pulse oximeters, capnometers, other ventilatory monitors, non-invasive blood pressure monitors, EKG, EEG and others, as well as a patient consciousness monitoring system, are electronically coupled, through suitable A-D converters where appropriate, to electronic controller 14, described above. Patient health monitors 12a generate electronic feedback signals representing actual patient physiological data which are converted to electronic signals and then provided to controller 14. Now referring to FIG. 4B, electronic controller 14, e.g., through appropriate software and/or logic, compares the received electronic patient feedback signals 13b with the safety data set 15b stored in a memory device (such as an EPROM device).

[0071] The stored safety data set 14a (FIG. 4A) contains at least one set of data parameters representing safe and undesirable patient physiological conditions. Based on the comparison of the actual monitored patient physiological data 13b with the safety data set 14a, controller 14 determines whether the monitored patient physiological data is outside of a safe range (FIG. 4B, 16b). If the monitored patient data is outside of a safe range, electronic controller 14 sends instruction commands (signals) to drug delivery controller 2a (FIG. 4A) instructing drug delivery controller 2a to conservatively manage (e.g., reduce or cease) drug delivery (FIG. 4B, 18b). Drug delivery controller 2a may be a standard solenoid valve-type electronic flow controller known to those skilled in the art.

[0072] As is described below, additional embodiments of the invention also contemplate provision of electronic feedback signals representing patient-controlled drug dosage increase or decrease requests to controller 14 and electronic management of drug delivery in consideration of such patient requests vis-a-vis the patient's physiological parameters and/or the state of the care system.

[0073] A block diagram of a preferred embodiment of a care system in accordance with the invention is depicted in FIG. 5. Analgesic delivery system 2 of FIG. 5 delivers a mixture of gaseous sedative, analgesic and/or amnestic drugs (such as nitrous oxide, sevoflurane or nebulized narcotics) and oxygen gas to the patient. Manual bypass circuit 4 (shown in further detail in FIG. 6 and FIG. 10A) is coupled to the manifold system portion of analgesic delivery system 2 and bypasses the source of analgesia enabling the manual control of delivery of atmospheric air to the patient. An auxiliary inlet 6 is provided to analgesic delivery system 2 and enables the provision of in-house supply of gaseous drug or oxygen to the delivery system 2. Scavenger system 8 (shown in detail in FIG. 10B) is coupled to analgesic delivery system 2 and collects exhaled gases from the patient and exhausts them to a safe location through exhaust hose 32 (FIG. 3B).

[0074] Patient interface system **12** includes one or more patient health monitors (these can be known vital sign monitors, such as non-invasive blood pressure monitors, or known pulse oximeters, capnometers, EKGs, etc.); means for monitoring the level of a patient's consciousness; and/or means for the patient to communicate with system **10** (FIG. 1), such as by requesting an increase or decrease in the dosage of drugs. One or more of these patient monitoring and request devices are electronically coupled to and, through A-D converters, provide feedback signals representing the patient's actual physiological condition and drug dosage requests to electronic controller **14**. Controller **14** compares this electronic feedback received with data stored in a memory device, said data representing sets of one or more safe and undesirable patient physiological condition parameters (e.g., safe and undesirable O₂ saturation conditions, end tidal CO₂ levels and/or levels of patient consciousness). These sets of parameters are collectively referred to as a safety data set. Based on the comparison, controller **14** commands conservative application of drug delivery in accord with said parameters at safe, cost-effective optimized values.

[0075] Still referring to FIG. 5, user interface system **16** (described in more detail in FIGS. 18 and 22) displays electronic signal values stored in or provided to electronic controller **14**, such values reflecting the status of one or more of the patient's physiological state, the patient's level of consciousness, and/or the status of various care system parameters. User interface system **16** includes devices that permit the nonanesthetist to interact with the care system via controller **14** (e.g., input patient information, pre-set drug dosages, silence alarms) such as keyboard **230** (FIG. 2) and/or remote control unit **45** (FIG. 1). Patient and care system information is displayed by means of graphical and numeric display devices, e.g., **35** (FIG. 1), LEDs incorporated into housing **15** (FIG. 1) and/or on remote control unit **45**.

[0076] External communication devices **18** (also described in FIGS. 19A and 19B) enable the sending and/or receiving of electronic information signals to and from electronic controller **14** and external computers at remote locations or on local networks. Peripheral devices **22** such as door and temperature sensors, among others, communicate electronically with controller **14** to ensure the proper, safe and secure operation of care system **10**.

[0077] The above systems overviewed in FIG. 5 are now described in more detail.

[0078] FIG. 6 shows in further detail an overview of a preferred drug delivery system **2** (FIG. 5) which provides a mixture of one or more sedative, analgesic and/or amnestic drugs in gaseous form; oxygen; and atmospheric air to a patient, the provision of each being independently adjustable (manually and via electronic controller **14**) by the physician. The drug delivery system is comprised of a drug source system **42**, an electronic mixer system **44** and a manifold system **46**.

[0079] Drug source system **42** contains sources of one or more gaseous drugs and oxygen and is coupled through pneumatic lines to electronic mixer system **42**. Drug source system **42** is also electronically coupled to electronic controller **14**, and as is described below, contains sensors monitoring one or more operating states of drug source

system **42** (e.g., whether the drug is flowing). Such monitored system information is converted to appropriate electronic signals and fed back to electronic controller **14** via the electronic coupling.

[0080] Electronic mixer **44** receives the one or more gaseous drugs, O₂ and atmospheric air through the pneumatic lines and electronically mixes same. Electronic mixer **44** is also electronically coupled to electronic controller **14** and also contains sensors that provide electronic feedback signals reflecting system operation parameters of mixer **44** to electronic controller **14**. Mixer **44** includes electronic flow controllers with solenoid valves which receive flow control instruction signals from controller **14**.

[0081] Manifold system **46** is coupled through pneumatic lines to and receives the one or more gaseous drugs, O₂ and air mixture from electronic mixer **44** and delivers the mixture to the patient via airway circuit **20** (FIG. 1) and face mask **30** (FIG. 1). Manifold system **46** is also electronically coupled to electronic controller **14** and includes sensors that provide electronic feedback signals reflecting manifold system **46** operation parameters to controller **14**. Manifold **46** delivers patient exhaled gases to a scavenging system **48** for exhaust to a safe location via exhaust hose **32** (FIG. 3B).

[0082] Drug source system **42** is shown in further detail in FIGS. 7A-7C. Referring to FIG. 7A, analgesic source system includes drug source system **142** which provides a source of one or more sedative, analgesic and/or amnestic drugs; and an oxygen source system **144** which provides a source of oxygen. In aspects of this invention where the drugs are in gaseous form, the sources of drugs and oxygen provide the gases at low pressure, and can be tanks contained within housing **15** (FIG. 1) such as those shown at numeral **54** in FIG. 2 or an in-house source. The ability to use alternative sources increases the useability of the care system of the invention because the system can function as a source-dependent unit within rooms with access to in-house gas supplies or as a self-contained unit within rooms that do not have in-house gas connections.

[0083] In additional aspects of the invention, drug source system **42** can include one or more of the following: known nebulizers **143** which enable the delivery of aerosolized drugs, such as morphine, meperidine, fentanyl and others; known vaporizers **145** which enable the delivery of halogenated agents, such as sevoflurane; known infusion pump-type drug delivery devices **147** or known transdermal-type drug delivery devices **149** (including ion transfer based devices) to enable the delivery of drugs such as propofol, remifentanyl, and other infusible drugs by continuous or bolus administration.

[0084] FIG. 7B details the oxygen source system and shows an oxygen tank or other source of oxygen **104** and a pneumatic line **109** for delivering oxygen gas to electronic mixer system **44** (FIG. 7A). Filter **106a** in oxygen line **109** removes contaminants within the oxygen stream from oxygen source **104**. Pressure sensor **106** (which may be of a type known and currently available) in oxygen line **109** monitors the pressure in oxygen source **104** generating a signal reflecting same and thereby indirectly measuring the amount of oxygen remaining. Pressure sensor **106** is electronically coupled to electronic controller **14** and forwards signals reflecting the measure of pressure in the oxygen source to controller **14**. In a preferred embodiment, electronic con-

troller 14 receives the signal from pressure sensor 106 and through software accesses data parameters stored in a memory device. The parameters reflect one or more set-points establishing safe and undesirable operating conditions of O₂ operating pressure. Controller 14 compares the actual O₂ pressure to the stored parameter set point data. If the comparison reveals that the O₂ pressure is outside of an established safe range as established by the stored data, an alarm or other attention-commanding device activates and if same is not manually deactivated, electronic controller 14 instructs the flow of drug delivery to reduce to a pre-set safe amount (or cease). The operation of the software control vis-a-vis system state monitors is described in more detail in connection with FIGS. 21B and 23B.

[0085] The signal obtained from oxygen source pressure sensor 106 can be related to the user via display devices (e.g., 35, FIG. 2) in terms of the time remaining under present use so that the user can ascertain if the procedure can be completed. The user is immediately notified if the pressure falls out of the normal operating conditions by an alarm, display device or other suitable attention-commanding device. Pressure gauges 108 visually display to the user the oxygen source pressure obtained by sensor 106. Pressure regulator 110, which may be of a known solenoid type currently available or other suitable regulator, enables the reduction of pressure in oxygen source 104 to a reasonable operating pressure to provide flow of O₂ to the patient. Check valve 112 (check valves may be of a standard one-way type), in oxygen line 109 downstream of regulator 110 prohibits backward flow of the patient's exhalations and ensures that such back-flow does not damage or contaminate regulator 110 and oxygen source 104. In systems where an in-house oxygen source 105 is used, remote check valve 114 ensures that back-flow from the patient's exhalations does not damage or contaminate in-house oxygen source 105. Pressure relief valve 116 exhausts oxygen to the atmosphere if the pressure in oxygen line 109 exceeds safe operating values pre-programmed into electronic controller 14.

[0086] FIG. 7C details the drug source system and in a preferred embodiment includes a tank or other source of drug 204 and a pneumatic line 209 for delivering gaseous drugs to electronic mixer 44. Filter 206a in drug line 209 removes contaminants within the drug stream from drug source 204. Pressure sensor 206 (which may be of a type known and currently available) in drug line 209 monitors the pressure in drug source 204 generating a signal reflecting same and thereby indirectly measuring the amount of drug. Pressure sensor 206 is electronically coupled to electronic controller 14 and forwards signals reflecting the measure of pressure in the drug source to controller 14. As is described above in connection with oxygen source pressure sensor 106 and in FIGS. 21B and 23B, in a preferred embodiment controller 14 receives the signal from sensor 206 and through software accesses stored data parameters reflecting safe and undesirable operating conditions of drug source pressure and conservatively controls drug delivery in accord with said stored parameters.

[0087] The signal obtained from the drug source pressure sensor 206 can be related to the user via display devices (e.g., 35, FIG. 2) in terms of the time remaining under present use so that the user can ascertain if the procedure can be completed. The user is immediately notified via an alarm, display device or other suitable attention-commanding

device if the pressure falls out of the normal operating conditions. Pressure gauges 208 visually display to the user the drug source pressure obtained by sensor 206. Pressure regulator 210, which may be of a known solenoid type currently available, enables the reduction of pressure in drug source 204 to a reasonable operating pressure to provide flow of drug to the patient. Check valve 212 in drug line 209 downstream of regulator 210 prohibits backward flow of the patient's exhalations and ensures that back-flow from the patient's exhalations does not damage or contaminate regulator 210 and drug source 204. In systems where an in-house drug source 205 is used, remote check valve 214 ensures that back-flow from the patient's exhalations does not damage or contaminate in-house drug source 205. Pressure relief valve 216 exhausts the drug to the atmosphere if the pressure in drug line 209 exceeds safe operating values pre-programmed into electronic controller 14.

[0088] To increase safety, the known pin indexed safety system (P.I.S.S.) and/or diameter indexed safety system (D.I.S.S.) may be used for all O₂ source and line fittings where appropriate for tank and/or in-house sources. This ensures, for example, that oxygen source 104 is not mistakenly attached to the drug line 209 and vice versa.

[0089] FIG. 8 details a preferred electronic gas mixer system which electronically mixes gaseous drugs and oxygen so that the precise flow rate of gaseous drug and oxygen is delivered to the patient. The use of the electronic mixer system of this invention increases the operational safety of the apparatus of the invention because, as described below, the volume of drug delivery can be electronically controlled in closed-loop fashion by currently available electronic flow controllers which include solenoid type valves which, in response to command signals from electronic controller 14, halt or reduce the flow of drugs to the patient in the event of an occurrence of unsafe patient or system conditions. Specifically, pneumatic oxygen line 109 and drug line 209 from analgesic source system 42 deliver gaseous drugs and oxygen to filters 125 and 127 in lines 109 and 209, respectively, which filter contaminants from lines 109 and 209. System state monitors, namely, pressure sensors 129, 131, monitor the oxygen and gaseous drug line pressures, respectively, and transmit signals reflecting said pressures to electronic controller 14, which conservatively controls drug delivery in accord with a stored data set containing parameters reflecting one or more safe and undesirable system operation states as described above and in FIGS. 21B. and 23B. Also, if any of the pressures fall out of the norm, electronic controller 14 immediately alerts the user, for example, by means of signaling an alarm device.

[0090] Electronic flow controllers 133, 135, which may be of a known type currently available including solenoid valves, are electronically coupled to and receive instruction signals from electronic controller 14 which has been programmed with and/or calculates a desired flow rate of oxygen and drug. Programmed flow rates may be those input by the physician user employing traditional choices regarding drug administration amounts and rates, including in IV embodiments, target controlled infusion principles, among others. Calculated flow rates may be arrived at through conservative decision-making software protocols including comparison of actual patient physiological condition feedback values with stored data representing safe and undesirable patient physiological conditions. Drug delivery is

effected at the rates calculated in a closed, control-loop fashion (described in more detail below) by flow controllers **133**, **135**. Drug administration may be a combination of one or more physician inputs and/or electronic flow rate calculations based on patient and system state parameters; flow controllers may respond to instruction signals initiated by electronic controller **14** or by the physician.

[0091] Flow controllers **133**, **135** receive instruction signals from controller **14** reflecting the electronic output of both system state monitors (such as pressure sensors **106**, **206** described above) and patient state monitors. Flow controllers **133**, **135**, in response to instruction signals from controller **14**, may curtail or cease flow of drug delivery when system state and/or patient health monitors indicate to controller **14** that failures in the operation of care system **10** have occurred, that system **10** is otherwise operating outside of an established safe state, or that a patient's physiological state (e.g., vital signs or consciousness level) has deteriorated to an unsafe condition.

[0092] As the invention includes both intravenous and gaseous, among other forms of drug delivery, such embodiments may also include known electronic flow controllers coupled to electronic controller **14** and responsive to instruction signals from controller **14** reflecting both patient and system states.

[0093] Referring again to **FIG. 8**, solenoid valve **132** is electronically coupled to electronic controller **14** and must be activated by same before drug will flow through line **209**. In the event of system power failure, drug delivery will be halted due to the fail-closed nature of solenoid valve **132**. This is described, for example, in **FIG. 21B** which shows that if a system state monitor indicates power failure, alarm type "2" sounds to alert the nonanesthetist and drug delivery is halted (i.e., reduced to 0%).

[0094] Moreover, pressure actuated valve **134** in drug line **209** responds to the amount of pressure in O₂ line **109** and permits flow of gaseous drug only if sufficient oxygen flows through oxygen line **109**. Check valve **136a** in drug line **209** ensures that the flow of gaseous drug to manifold system **46** is one-way and that there is no back-flow. Check valve **136b** in oxygen line **109** ensures one-way flow of O₂ to manifold system **46** with no back-flow.

[0095] In atmospheric air line **139**, air inlet solenoid valve **137** is electronically coupled to and activated by electronic controller **14** and if activated permits atmospheric air to be mixed with the oxygen gas by means of air ejector **138**. Air ejector **138** injects a fixed ratio of atmospheric air into oxygen line **109**. Filter **128** removes contaminants from air line **139** and check valve **136c** ensures one-way flow of air from solenoid valve **137** to ejector **138** with no back-flow.

[0096] Referring to **FIG. 9A** which details one embodiment of manifold system **46** (**FIG. 6**), the drug/O₂ gas mixture from electronic mixer system **44** (**FIG. 6**) enters manifold system **46** and flows into inspiratory plenum **150** from which it proceeds through inspiratory line **151** to primary inspiratory valve (PIV) **152** and eventually to airway circuit **20** and mask **30** (**FIG. 1**). Primary inspiratory valve **152** permits one-way flow of said gas mixture and ensures that exhaled gases from the patient do not enter the inspiratory side of manifold system **46** (**FIG. 6**), thereby guarding against possible contamination. Atmospheric air

may be permitted to enter inspiratory line **151** through an inspiratory negative pressure relief valve (INPRV) **154** which allows one-way flow of atmospheric air to reach the patient if a significant negative vacuum is drawn on the inspiratory side of manifold system **46** (e.g., the patient inhales and receives no or insufficient oxygen). INPRV **154** thereby essentially permits air on demand by the patient. INPRV filter **153** removes particulates which may be in air line **155** or present in the atmosphere. INPRV status sensor **156** (which may be of a known pressure, temperature, infra-red or other suitable type) monitors the extent of open/close status of INPRV **154** and generates a signal which is converted to an appropriate electronic (digital) signal and communicates the status of INPRV **154** to electronic controller **14**. During the exhalation phase of the patient's breathing cycle, inspiratory reservoir bag **149** collects the drug/O₂/air mixture which the patient will draw on the next inhalation phase.

[0097] Still referring to **FIG. 9A**, pressure sensor **166** measures pressure in airway circuit **20** (**FIG. 1**) and is used to indicate airway flow, i.e., if the primary inspiratory valve (PIV) **152** or the primary expiratory valve (PEV) **168** is occluded. For example, if sensor **166** reads a high pressure that indicates that PEV **168** is blocked, whereas a low pressure indicates PIV **152** is blocked. Airway circuit **20** (**FIG. 1**) also contains a fraction of inspired oxygen (FIO₂) sensor **167** (which may be of a known type currently available) which measures the oxygen percentage of gas contained in the mixture delivered to the patient, and thus guards against the possibility of delivering a hypoxic mixture to the patient (i.e., a drug/O₂ mixture that does not provide enough O₂ to the patient). INPRV status sensor **156**, pressure/airway flow sensor **166**, and FIO₂ sensor **167** are electronically coupled to and provide electronic feedback signals reflecting system state parameters to electronic controller **14**. As described in **FIGS. 21B and 23B**, controller **14**, through software and/or logic, effects a comparison of the signals generated by these system monitors with a stored data set of system parameters established by setpoints and/or logic-type data reflecting safe and undesirable system operating states, and conservatively controls (e.g., reduces or halts) drug delivery if the comparison determines that care system **10** is operating outside of a safe range.

[0098] Airway circuit and mask (**20**, **FIG. 9**) interface with the patient to provide a closed circuit for the delivery of drug/O₂ gas mixture to the patient. It should be recognized that embodiments of the subject invention in which the drugs are delivered in a form other than compressed gas, such as intravenously or transdermally, may not include face masks, airway circuit features and other aspects associated with delivery of drugs in gaseous form. Where the drug is delivered in gaseous form and an airway circuit and face mask are employed, such face mask and attendant airway circuitry and other features such as the scavenging system maybe in the form of that described in U.S. Pat. No. 5,676,133 issued to Hickie et al. and entitled Expiratory Scavenging Method and Apparatus and Oxygen Control System for Post-Anesthesia Care Patients. (With respect to such embodiments, the specification of Hickie et al. is incorporated herein by reference.)

[0099] In preferred embodiments the mask is disposable and contains means for sampling the CO₂ content of the patient's respiratory airstream and, optionally, means for

also measuring the flow of the patient's airstream and/or means for acoustical monitoring. The sampling of the CO₂ in the patient's airstream may be done by means of a capnometer or a lumen mounted within the mask through a port in the mask, and placed close to the patient's airway. A second lumen similarly mounted within the mask could be used to measure the airflow in the patient's airstream. This airflow measurement could be accomplished by a variety of currently available devices, including for example, devices that measure the pressure drop in the airstream over a known resistance element and thereby calculate the airflow by known formula. The means for acoustical monitoring may be a lumen placed within the mask with a microphone affixed within that lumen. The microphone would permit recording, transducing and playing out through an amplifier the audible sound of the patient's breathing. It is noted that the lumen for acoustical monitoring could be a separate lumen or could be combined with the lumen for calculating the flow of the patient's airstream. It is further noted that it is important to place the lumens, especially the CO₂ sampling lumen, close to the patient's open airway and to ensure such lumens remain close to the patient's airway.

[0100] Referring again to FIG. 9A, primary expiratory valve (PEV) 168 in expiratory line 172 ensures one-way flow of a patient's exhaled gases to scavenger pump system 48, thus, prohibiting any back-flow from gases exhaled to the scavenger system from reaching the patient. Importantly, PEV 168 guards against the re-breathing of exhaled carbon dioxide. As is easily seen, the manifold 46 and airway circuit 20 of a preferred embodiment of this invention permit one-way airway flow only. That is, unlike prior devices that employ circular airway circuits (which require CO₂ absorbent material to permit re-breathing of exhaled air), there is no re-breathing of exhaled gases in this embodiment of the invention.

[0101] In the embodiment of the invention shown in FIG. 9A, expiratory positive pressure relief valve (EPPRV) 164 in expiratory line 172 allows exhaled gases to escape to the atmosphere if sufficient positive pressure develops on the expiratory side of the manifold system. This could happen, for example, if the patient is exhaling, but scavenger system 48 (FIG. 6) is occluded or otherwise not working properly. EPPRV filter 175 downstream of EPPRV 164 filters contaminants from the expiratory stream flowing through EPPRV 164 prior to the stream entering the atmosphere. Expiratory negative pressure relief valve (ENPRV) 178 is a one-way valve that allows atmospheric air to be drawn into expiratory plenum 180 and then on to scavenger system 48 if sufficient vacuum pressure is drawn on the expiratory side of manifold system 46. This could happen, for example, if the vacuum pump of scavenger system 48 is set too high or PEV 168 is blocked. Expiratory reservoir bag 177 collects exhaled gases from the patient during exhalation via expiratory plenum 180. These gases will be exhausted by scavenger system 48 during the next patient inhalation phase. As is described in detail below, patient vital sign monitor, such as a capnometer 184, monitors the amount of CO₂ in the patient's exhaled gases and provides electronic feedback signals reflecting the level of CO₂ in the patient's exhalations to controller 14. Other types of ventilatory monitors such as an airflow measure, IPG device or an acoustical monitor could also be used to provide electronic feedback signals reflecting patient health parameters to controller 14.

[0102] In an alternative preferred embodiment shown in FIG. 9B, ENPRV 164, filter 175 and ENPRV 178 are eliminated. A long pipe or similar conduit 175a, interconnected with reservoir bag 177 and opening to atmospheric air, is substituted therefor. The elimination of the valves 164 and 175 provides for a more cost efficient and simple system, while the substituting of the pipe 175a still ensures that if the scavenger system 48 is occluded, is set too high, is otherwise not working or if PEV 168 is blocked, that there is still access to atmospheric air, and the patient may breath into the room or air may come into the system. A highly compliant reservoir bag 179 also assists in catching excess flow of exhaled air. In this simplified embodiment, there are essentially only three valves, PIV 152, PEV 168 and INPRV 154.

[0103] As is described above, system valves PIV 152 and PEV 168 ensure one-way flow of inspired and expired gases. The patient cannot re-breathe exhaled gases and no contaminants are allowed to enter the source system. The valve system INPRV 154, EPPRV 164, and ENPRV 178 (or the alternate INPRV 154 and pipe) provides a system fail-safe. If analgesic source system 42 (FIG. 6) or scavenging system 48 (FIG. 6) is functioning improperly, the valves will open and allow the patient to breath without significant effort. The system state sensors 156, 166 and 167 monitor system operation such as INPRV valve status, gas pressure and fraction of inspired oxygen, and electronically feed back signals reflecting the operating status of those operations to microprocessor controller 14 to ensure safe operation of the apparatus.

[0104] It is noted that the valves and sensors between INPRV 154 and ENPRV 178 in a preferred embodiment of manifold system 46 can be considered a system state monitoring system because there are no valves controlled by the software of electronic controller 14. At this point in the care system 10, the gas has already been mixed and the volume determined by the flow controllers 133, 135 (FIG. 8). Manifold system 46 (FIG. 6) provides at least two basic services, sensor inputs for FiO₂ and CO₂ (167, 184 of FIG. 9) and flow status derived from flow sensor 166 (FIG. 9).

[0105] The determination of appropriate drug delivery/flow percentages by controller 14 can be accomplished through a variety of methods. Initial drug administration amounts and rates may be selected and input by the physician employing traditional methods. Physicians may also employ pharmacokinetic/pharmacodynamic modeling to predict resulting drug concentrations and their effect based on physician choices, but not permit automatic changes to drug concentrations without instructions from the physician. In intravenous embodiments known target-controlled infusion techniques may be employed where the physician selects a desired (targeted) blood serum or brain effective site concentration based on such patient parameters as height, weight, gender and/or age.

[0106] During operation of the system when an internal or external event occurs, such as the activation of a system or patient health monitor alarm or a physician or patient request for increased drug, electronic controller 14 determines the desired amount of intravenous drug (or fractional amount of O₂, gaseous drug and air in the total gas flow) as the function of such event. The actual IV drug concentrations (or gaseous drug/O₂/air fractions) are then calculated. These actual calculated amounts will not always be the same as those

requested (e.g., by the user, patient or system) because of the often complex relationship between drug or drug and gas mixtures. In sum, drug mix fractions are typically calculated when, for example, an alarm levels change, alarm time-outs occur (e.g., there is no silencing of an initial alarm by the user), a user requests a change, the patient requests a change, when a procedure begins (system resorts to default values) and when a controller clock triggers.

[0107] In a preferred embodiment of the invention delivering gaseous drugs, flow controllers in mixer **44** (detailed in **FIG. 8**) determine the total fresh gas flow (FGF) which is the sum of the volumes of each gas being controlled, namely, the gaseous drug, oxygen and atmospheric air. Solenoid valves are opened proportionally to achieve the desired FGF and fractional amount of each gas. Flow controllers **133**, **135** close the feedback loop on the gas fractions by measuring the FiO_2 and fraction of inspired gaseous drug in the manifold system **46** and adjusting the mixer solenoid valves accordingly.

[0108] In one aspect of the invention, the flow controllers **133**, **135** match the FGF with patient minute ventilation rates. The minute ventilation rate is the volume of breath one inhales and then exhales (e.g., in cubic centimeters or milliliters) in one minute. A patient's respiratory physiology is balanced at this minute ventilation. The care system optimizes FGF rates by matching gas delivery to patient minute ventilation rates. This conserves gas supplies, minimizes the release of anesthesia gases into the operating environment, and helps balance respiratory function. For example, if the FGF is less than the minute ventilation, INPRV **154** will open to supplement the air flow (INPRV **154** being a mechanical system not under electronic control).

[0109] In an additional aspect of the invention, the care system will not only measure and monitor minute ventilation as described above, but also "effective minute ventilation" and thereby improve the quantitative information about patient physiology considered by the system. "Effective minute ventilation" is a term used herein to mean the amount of gas that is actually involved in respiratory gas exchange between the alveolar sacs of the lungs and the capillary blood surrounding those sacs (as opposed to simply the volume of gas one inhales and then exhales, "tidal volume"). This measure may be arrived at by subtracting the volume of anatomical space imposed between the air source (e.g., mouth) and the transfer of gas at the alveolar sacs (estimated from the patient's height and weight), from the tidal volume of gas to arrive at "effective tidal volume." The effective tidal volume is then multiplied by respiratory rate to arrive at "effective minute ventilation."

[0110] **FIG. 10A** details manual bypass system **4** (**FIG. 5**) which is coupled to manifold system **46**. The bypass system **4** includes a self-inflating resuscitation bag (SIRB) **19a** (also shown in **FIG. 3B**) which is a manual pump with which the user can provide air intermittently to the patient through a bypass air line **90**. A quick disconnect type fitting **91** (such as that disclosed in Hickle above) couples SIRB **19a** with manifold system **46** and provides rapid attachment thereto. A manual flow control valve **92** opens or closes bypass air line **90**. When line **90** is open, manual flow control valve **92** can be adjusted to provide the necessary air flow. A flow meter **94** placed in bypass air line **90** provides a visual

display to the user of the status of air flowing through the bypass air line **90**. The above-described manual bypass system **4** provides the patient with manually-controlled flow of air and thus enables air delivery in the case of an oxygen source system **144** (**FIG. 7A**) failure.

[0111] **FIG. 10B** details scavenger pump system **48** (**FIG. 6**) which is integrated into the care system and vacuums exhaled gases from manifold system **46** through a scavenging line **85**. A filter **86** in scavenging line **85** removes contaminants from the gases which have been exhaled from the patient and which are flowing through the scavenger line **85**. Pressure regulator **87** receives the filtered gases and ensures that the vacuum pressure is maintained in vacuum pump **95** downstream at a reasonable working level. Flow restrictor **88** sets the flow rate through the vacuum **95** for a given vacuum pressure. Check valve **89** downstream of flow restrictor **88** provides one-way flow of scavenged gases, and thus ensures that back-flow does not inadvertently flow into scavenger system **48** from the vacuum pump **95** downstream. Vacuum pump **95** provides the vacuum pressure necessary for scavenging of exhaled gases from the patient. The pump may be of an electrical type that can be powered by office standard AC current. As the vacuum pump is integrated into the care system, a wall vacuum source (such as that typically in an OR) is not required. Once the gases are vacuumed off, they are exhausted via exhaust hose **32** (**FIG. 3B**) to an appropriate area. The benefit of scavenging system **48** is at least two-fold in that the system helps assist the patient in the work of breathing and work environment safety is increased.

[0112] In a preferred embodiment, an emesis aspirator **19** (**FIG. 3B**) is integrated into system **10** and may be stored within housing **15**. Emesis aspirator **19** is a manually operated device used to suction a patient's airway in the event of vomiting. Emesis aspirator **19** does not require an external vacuum source (e.g., wall suctioning) or electrical power for operation.

[0113] To enhance the safety of the invention, housing **15** may include structure integrated adjacent or otherwise near where emesis aspirator **19** is stored within housing **15** (**FIG. 3B**) to hold and prominently display containers of drugs capable of reversing the effects of various sedatives/anesthetics. These "reversal drugs," such as naloxone, remazicon and others may be immediately administered to the patient in the event of an overdose of sedative, analgesic and/or amnestic.

[0114] Referring to **FIG. 11**, a preferred embodiment of the invention includes an integrated patient interface system which combines one or more patient health monitors **252** (additional health monitors to those shown are also contemplated by the invention) with additional automated patient feedback devices including a patient drug dosage increase or decrease request device **254** and an automated consciousness query system **256** for monitoring a patient's level of consciousness. These health monitors **252** and automated patient feedback devices **254**, **256** are electronically coupled to electronic controller **14** via leads (e.g., **50**, **FIG. 2**) and provide electronic feedback values (signals) representing the patient's physiological condition to controller **14**. Generally, if any monitored patient parameter falls outside a normal range (which may be preset by the user or otherwise preprogrammed and stored in memory device as described

above), the nonanesthetist is immediately alerted, for example, by an alarm, display or other attention-commanding device. The information obtained from patient health monitors 252 is displayed on a display device 35 (FIG. 2), in, for example, continuous wave form or numerics on LEDs, thus allowing the procedural physician to immediately gain useful information by reviewing the display device. Preferred embodiments of displays contemplated by the invention are described in more detail below.

[0115] A preferred embodiment of one aspect of the invention integrates drug delivery with one or more basic patient monitoring systems. These systems interface with the patient and obtain electronic feedback information regarding the patient's physiological condition. Referring to FIG. 11, a first patient monitoring system includes one or more patient health monitors 252 which monitor a patient's physiological conditions. Such monitors can include a known pulse oximeter 258 (e.g., an Ohmeda 724) which measures a patient's arterial oxygen saturation and heart rate via an infra-red diffusion sensor; a known capnometer 184 (e.g., a Nihon Kohden Sjs12) which measures the carbon dioxide levels in a patient's inhalation/exhalation stream via a carbon dioxide sensor and also measures respiration rate; and a known non-invasive blood pressure monitor 262 (e.g., a Criticon First BP) which measures a patient's systolic, diastolic and mean arterial blood pressure and heart rate by means of an inflatable cuff and air pump. A care system constructed in accordance with this invention may include one or more of such patient health monitors. Additional integrated patient health monitors may also be included, such as, for example, a measure of the flow in a patient's airstream, IPG ventilatory monitoring, a standard electrocardiogram (EKG) which monitors the electrical activity in a patient's cardiac cycle, an electroencephalograph (EEG) which measures the electrical activity of a patient's brain, and an acoustical monitor whose audio signals may be processed and provided to controller 14 and amplified and played audibly.

[0116] A second patient monitoring system monitors a patient's level of consciousness by means of an automated consciousness query (ACQ) system 256 in accordance with the invention. ACQ system 256 comprises a query initiate device 264 and a query response device 266. ACQ system 256 operates by obtaining the patient's attention with query initiate device 264 and commanding the patient to activate query response device 266. Query initiate device 264 may be any type of a stimulus such as a speaker which provides an auditory command to the patient to activate query response device 266 and/or a vibrating mechanism which cues the patient to activate query response device 266. The automated pressurization of the blood pressure cuff employed in the patient health monitoring system may also be used as a stimulus. Query response device 266 can take the form of, for example, a toggle or rocker switch or a depressible button or other moveable member hand held or otherwise accessible to the patient so that the member can be moved or depressed by the patient upon the patient's receiving the auditory or other instruction to respond. In a preferred embodiment, the query system has multiple levels of auditory stimulation and/or vibratory or other sensory stimulation to command the patient to respond to the query. For example, an auditory stimulus would increase in loudness or urgency if a patient does not respond immediately or a vibratory stimulus may be increased in intensity.

[0117] After the query is initiated, ACQ system 256 generates signals to reflect the amount of time it took for the patient to activate response device 266 in response to query initiate device 264 (i.e., this amount of time is sometimes referred to as the "latency period"). ACQ system 256 is electronically coupled to electronic controller 14 and the signals generated by ACQ system 256 are suitably converted (e.g., employing an A-D converter) and thereby provided to controller 14. If the latency period is determined by controller 14, which employs software to compare the actual latency period with stored safety data set parameters reflecting safe and undesirable latency period parameters, to be outside of a safe range, the physician is notified, for example, by means of an alarm or other attention-commanding device. If no action is taken by the physician within a pre-set time period, controller 14 commands the decrease in level of sedation/analgesia/amnesia by control and operation on electronic flow controllers 133, 135 of FIG. 8. The values of the signals reflecting the latency period are displayed on display device 35 (or on LED devices located on housing 15 or on remote control device 45, FIG. 1) and the physician may thus increase or decrease drug delivery based on the latency period.

[0118] The patient interface system of FIG. 11 also includes a drug dosage request device 254 which allows the patient direct control of drug dosage. This is accomplished by the patient activating a switch or button to request electronic controller 14 to command the increase or decrease in the amount of drug he or she is receiving. For example, if a patient experiences increased pain he or she may activate the increase portion of the switch 254, whereas, if a patient begins to feel nauseous, disoriented or otherwise uncomfortable, he or she may request a decrease in drug dosage. In embodiments where drug delivery is intravenous, such delivery can be by continuous infusion or bolus. A feedback signal from analgesic request 254 representing the patient's increase or decrease in drug dosage request is electronically communicated to controller 14 which employs conservative, decision-making software, including comparison of monitored patient conditions with stored safety parameters reflecting patient physiological conditions, to effect safe, optimized drug delivery in response to patient requests. The amount of increase or decrease administered by controller 14 can be pre-set by the physician through user access devices such as keyboard 230, FIG. 2. For example, where the drug being delivered is nitrous oxide, the approved increase or decrease may be in increments of $\pm 10\%$. When not activated by the patient, drug request device 254 remains in a neutral position. The invention thus integrates and correlates patient-controlled drug delivery with electronic monitoring of patient physiological conditions.

[0119] In an alternative embodiment, the physician is notified via user interface system 16 (display device 30 or LEDs remote control device 45), FIG. 1 of the patient request to increase or decrease drug dosage and can approve the requested increase or decrease taking into account the patient's present vital signs and other monitored physiological conditions, including consciousness level status as obtained from the various patient interface system monitors 252, 256 (FIG. 11).

[0120] In a preferred embodiment of the invention, the patient controlled drug dosage request system 254 has lock-out capabilities that prevent patient self-administration

of drugs under certain circumstances. For example, access to self-administration will be prevented by electronic controller **14** under circumstances where patient physiology parameters or machine state parameters are or are predicted to be outside of the stored safety data set parameters. Access to self-administration of drugs could also be inhibited at certain target levels or predicted target levels of drugs or combined levels of drugs. For example, if it were predicted that the combined effect of requested drugs would be too great, drug delivery in response to patient requests would be prohibited. It is noted that such predictive effects of drugs could be determined through the use of various mathematical modeling, expert system type analysis or neural networks, among other applications. In short, the invention is designed to dynamically change drug administration and amount variables as a function of patient physiology, care system state and predictive elements of patient physiology.

[0121] Additionally, it is contemplated that patient self-administration of drugs could be prohibited at times when drug levels are changing rapidly. For example, if a patient is experiencing pain and that is apparent to the physician, the physician may increase the target level of drug while at the same time the patient requests additional drug. The subject invention will sequentially address the physician and patient requests for drug increases and will lock out any patient-requested increases that are beyond programmed parameters.

[0122] In an additional aspect of the invention, a patient may be stimulated or reminded to administer drugs based on electronic feedback from the patient physiology monitoring systems. For example, if there is an underdosing of analgesics and the patient is suffering pain evidenced by a high respiratory rate or high blood pressure reflected in electronic feedbacks to the electronic controller, the controller can prompt the patient to self-administer an increase in drugs. This could be accomplished by, for example, an audio suggestion in the patient's ear. Thus, it is contemplated that the invention will have an anticipatory function where it will anticipate the patient's needs for increased drugs.

[0123] In a preferred embodiment of the invention, one or more patient vital sign monitoring devices **252**, ACQ system devices **256**, and a drug dosage request device **254** are mechanically integrated in a cradle or gauntlet device **55** (FIG. 2) constructed to accommodate and otherwise fit around a patient's hand and wrist. FIG. 2 shows generally hand cradle device **55** electronically coupled by lead **50** to care system **10**. One embodiment of a hand cradle device in accordance with this invention is shown in more detail in FIGS. 12A and 12B.

[0124] FIG. 12A shows blood pressure cuff **301** capable of being wrapped around a patient's wrist and affixed to itself such that it can be held in place. Cuff **301** is affixed to palm support portion **303**. Alternatively, the cuff may be separated from palm support portion **303** and placed on the upper arm at the physician's discretion. A recessed, generally elliptical or rounded portion **305** is supported by the top edge of palm support portion **303** and is capable of receiving and supporting the bottom surface of a patient's thumb. Depressible query response switch **307** is located within thumb support portion **305** such that switch **307** is capable of being depressed by the patient's thumb. The thumb support portion **305** may be constructed so as to have a

housing, frame, raised walls or other guide so that a patient's thumb may more easily be guided to depress or move buttons or switches within portion **305** (here, switch **307**), or so that any significant patient thumb movement toward the switch will activate same. Supporting thumb support portion **305** and abutting palm portion **303** is finger support portion **309** for receiving in a wrapable fashion the patient's fingers. Drug dosage request switch **311** is integrated into finger support portion **309** and is in the form of a rocker switch whereby depressing the top portion **310a** of said switch will effect an increase in the delivery of sedative, analgesic and/or amnestic whereas depressing the bottom portion **310b** of said rocker switch will effect a decrease in drug delivery at an appropriate set percentage (e.g., $\pm 10\%$, FIG. 12B). Rocker switch **311** is constructed so as to remain in a neutral position when not being actuated by the patient.

[0125] FIGS. 13A and 13B show an additional embodiment of the hand cradle device of this invention. Specifically, a pulse oximetry sensor **314** is mechanically affixed to and electronically coupled to hand cradle device **55** abutting the upper end of finger support portion **309**, and being generally planar vis-a-vis the outer edge of thumb support portion **305**. Pulse oximeter **314** is constructed as a clip which can be placed on a patient's finger. The transmitter and receiver portions of sensor **314** are contained in the opposite sides **315a**, **315b** (FIG. 13B) of the finger clip **314** such that when placed on a finger, infra-red radiation travels through the finger; through spectral analysis the percentage of oxygenated hemoglobin molecules is determined. In this embodiment of hand cradle device **55** the query initiate device **313** is in the form of a small vibrator located in palm support portion **303**. Alternatively, to enhance patient attentiveness to the query initiate device and to increase patient accuracy in depressing the response switch, the vibrator may be located adjacent the query response switch **307** or, in the embodiment of FIG. 14A, adjacent response switch **407**.

[0126] In an alternative embodiment of hand cradle device **55**, now referring to FIGS. 14A and 14B, drug dosage request device **409** is located within thumb portion **405** and is in the form of a slidable member **409** wherein sliding member **409** forward effects an increase in analgesic dosage and sliding portion **409** backward effects a decrease in analgesic dosage (FIG. 14B). In this embodiment of the invention, query response device **407** is a depressible portion integrated within finger support portion **409**.

[0127] All embodiments of hand cradle device **55** are constructed so as to be ambidextrous in nature, namely, they accommodate and are workable by a patient's right or left hand. For example, in FIGS. 12A and 13A, a second query response switch **307b** is located within a symmetrically opposed thumb portion **305b** affixed to the opposite end of finger portion **309**. Similarly the device of FIG. 14A is also constructed with a symmetrically opposed thumb portion **405b** and drug dosage request device **409b**. The pulse oximeter clip **314** is affixed to finger support portion **309** so as to be mechanically and electronically quick releasable to permit reversibility when used on the opposite hand. It should also be recognized that the pulse oximeter clip **314** may be tethered to hand cradle device **55** rather than mechanically affixed thereto, or blood pressure cuff **301** and oximeter clip **314** may be mechanically separate from cradle device **55** and electronically coupled to controller **14** with flexible leads.

[0128] Referring to FIG. 15, an additional alternative embodiment of the invention is shown in which hand cradle device 55 includes mechanically integrated blood pressure cuff 301, query response device 307 and analgesic request device 309 similar to that described above. This embodiment, however, includes an ear clip device 450 capable of being clipped to the lobe of a patient's ear and being electronically coupled to electronic controller 14 via lead 456. Referring additionally to FIG. 16, ear clip 450 comprises a query initiate device 452 in the form of a speaker which provides an audible command to patient to activate the response switch. Such speaker may also command a patient to self-administer drugs or play music to a patient during a procedure. Pulse oximeter 454 is a clip capable of being affixed to a patient's ear lobe. One side of the clip being a transmitter and the other side of the clip being a receiver to effect the infra-red spectral analysis of the level of oxygen saturation in the patient's blood.

[0129] In an additional aspect of the invention, the care system's automated monitoring of one or more of the patient's health conditions is synchronized with the monitoring of those one or more conditions and/or the monitoring of one or more other health conditions of the patient. For example, in one embodiment, controller 14 receives parameters such as blood pressure, heart rate, respiratory rate, and blood O₂ saturation from patient health monitors 412 and can automatically inflate the blood pressure cuff and check the patient's blood pressure whenever those parameters exist outside of a desirable range (i.e., outside of the stored safety data set for those parameters.) In a further preferred embodiment, controller 14 immediately initiates ACQ system 256 to query consciousness by triggering an automated responsiveness test (ART) upon receiving certain patient health parameters that are outside of the safety data set.

[0130] If controller 14 receives a value for a patient health parameter that falls outside of the safety data set for that parameter, it will trigger an event. Preferably, the safety data set for each health parameter includes values or a range of values that correspond to high and low event conditions and values or a range of values for each of the high and low event conditions that correspond to warning and caution event conditions. Therefore, some sets of patient health data (e.g. heart rate) may constitute conditions that trigger high warning, high caution, low warning, and low caution events. These sets of patient health data may be dependent on such patient parameters as age or gender. Data within the safety data set for a parameter, i.e., data not triggering one of the four above events, may still trigger an event where the trend of such data over time suggests that it will eventually constitute a condition that would trigger a high warning, a high caution, a low warning, or a low caution event if no clinically appropriate preemptive action is taken.

[0131] Once an event is triggered, notice of it may be displayed to the user via the user interface system. The event may prompt the system to gather more information about the patient health parameters which resulted in the event condition and/or the event may prompt the system to effect a clinically appropriate response to the event condition.

[0132] For example, in one embodiment, controller 14 will call for an immediate blood pressure check (STAT BP) upon its receipt of heart rate or blood O₂ saturation data that falls

within either low warning or low caution event conditions for those parameters. Low blood pressure may be associated with a low heart rate or low blood O₂ saturation, but it may also be caused by too much drug being administered to the patient. Therefore, upon being informed that the patient's heart rate or blood O₂ saturation data falls within the low event conditions for those parameters, the user may want to also have up-to-date blood pressure data for the patient. Therefore, the aforementioned automated response may be clinically appropriate.

[0133] Blood pressure measurements themselves may be in error if the patient flexes a muscle, such as a bicep or tricep, beneath the blood pressure cuff during a measurement cycle. Ordinarily, the care system will only measure the patient's blood pressure intermittently (every five minutes, for example) resulting in blood pressure data that is only infrequently presented to the system's user. Therefore, in a further embodiment, controller 14 triggers an immediate re-check of the blood pressure (STAT BP) whenever it receives blood pressure data that constitutes either high or low alarm conditions in order to provide the user with the most recent blood pressure data between the intermittent blood pressure checks.

[0134] A high heart rate is often associated with a high blood pressure because the same stress hormones (e.g. epinephrine and norepinephrine) cause both conditions. Therefore, when a patient's heart rate constitutes a high event condition, it is probable that the patient's blood pressure is too high as well. Conversely, a high heart rate event may indicate that the patient's blood pressure is low since a high heart rate is occasionally due to arrhythmias which depress blood pressure. So, in another embodiment, when controller 14 receives a heart rate that constitutes a high event condition, it triggers a STAT BP. Therefore, this automated response is clinically appropriate because it automatically provides the care system's user with up-to-date blood pressure data so the user can assess whether a patient's high heart rate is a symptom or a cause of a further condition.

[0135] The above embodiments in which a STAT BP is triggered because of certain events are summarized in Table 1 below:

TABLE 1

Events Which Trigger a STAT BP		
Parameter	Event	
Heart Rate	LOW	WARNING
SpO ₂	LOW	WARNING
Systolic BP	LOW	WARNING
Diastolic BP	LOW	WARNING
Mean BP	LOW	WARNING
Heart Rate	HIGH	WARNING
Systolic BP	HIGH	WARNING
Diastolic BP	HIGH	WARNING
Mean BP	HIGH	WARNING
Heart Rate	LOW	CAUTION
SpO ₂	LOW	CAUTION
Systolic BP	LOW	CAUTION
Diastolic BP	LOW	CAUTION
Mean BP	LOW	CAUTION
Heart Rate	HIGH	CAUTION
Systolic BP	HIGH	CAUTION
Diastolic BP	HIGH	CAUTION
Mean BP	HIGH	CAUTION

[0136] In another example, the electronic checking of blood pressure may be synchronized with the automated responsiveness query because the activation of the cuff may arouse a patient and affect query response times. Thus the invention contemplates an “orthogonal redundancy” among patient health monitors to ensure maximum safety and effectiveness.

[0137] In an additional aspect of the invention, the care system’s automated monitoring of one or more of the patient’s health conditions is synchronized with the automated checking of the patient’s responsiveness by an ART. Low event conditions of certain health parameters, including heart rate, blood O₂ saturation, respiratory rate, and blood pressure, may be caused by a state of drug overdose. If, however, the patient is responsive to the ART, then it is unlikely that any low event conditions of the above health parameters were caused by a sedative drug overdose. Therefore, in a preferred embodiment, whenever the controller 14 receives heart rate, blood O₂ saturation, respiratory rate, and/or blood pressure data that constitute low event conditions for the respective health parameter, it triggers an immediate check of the patient’s responsiveness (STAT ART). The user is thus freed from having to routinely initiate an ART measurement cycle or manually evaluate the patient’s responsiveness each time the above event conditions are present before being able to assess whether those conditions represent possible drug overdose.

[0138] The above embodiment in which a STAT ART is triggered because of certain events is summarized in Table 2 below:

TABLE 2

EVENTS WHICH TRIGGER A STAT ART		
Parameter	Event	
Heart Rate	LOW	WARNING
SpO ₂	LOW	WARNING
Respiratory Rate	LOW	WARNING
Systolic BP	LOW	WARNING
Diastolic BP	LOW	WARNING
Mean BP	LOW	WARNING
Heart Rate	LOW	CAUTION
SpO ₂	LOW	CAUTION
Respiratory Rate	LOW	CAUTION
Systolic BP	LOW	CAUTION
Diastolic BP	LOW	CAUTION
Mean BP	LOW	CAUTION

[0139] As described above, one aspect of a preferred embodiment of the invention includes the electronic management of drug delivery via software/logic controlled electronic controller 14 to integrate and correlate drug delivery with electronic feedback signals from system monitors, one or more patient monitor/interface devices and/or user interface devices. Specifically, electronic signal values are obtained from care system state monitors; from patient monitor/interface devices (which can include one or more vital sign or other patient health monitors 252, ACQ system 256, and/or patient drug dosage request device 254, FIG. 11); and in some instances from one or more user interface devices. All are electronically coupled to, through standard A-D converters where appropriate, electronic controller 14. The controller 14 receives the feedback signal values and, via software and programmed logic, effects a comparison of

these values representing the patient’s monitored physiological conditions with known stored data parameters representing safe and undesirable patient physiological conditions (a safety data set). Controller 14 then generates an instruction in response thereto to maintain or decrease the level of sedation, analgesia, and/or amnesia being provided to the conscious patient thereby managing and correlating drug delivery to safe, cost-effective and optimized values (FIG. 2B). Controller 14 is operatively, electronically coupled to electronic flow controllers 133, 135 (FIG. 8) of electronic mixer 44 which (via solenoid valves) adjust flow of gaseous drug and O₂ in a closed-loop fashion as described above. In intravenous embodiments such flow controllers would adjust the flow of one or more combination of IV drugs. It should be recognized that the electronic values provided to microprocessor controller 14 to effect management and correlation of drug delivery, could include one or more signals representing patient vital signs and other health conditions such as pulse oximetry, without necessarily including signal(s) representing level of patient consciousness, and vice versa.

[0140] For example, in one embodiment, when either the patient’s blood O₂ saturation or respiratory rate data received by controller 14 constitutes low event conditions, as described above, the controller effects management and correlation of drug delivery. Preferably, when the low event conditions for either of the patient’s blood O₂ saturation or respiratory rate data further constitute caution event conditions, controller 14 effects a transition to a reduction in drug (REDUCE) where the drug level being administered to the patient is reduced to achieve a drug level that is a fraction (80%, for example) of the level that was present when the event condition was first detected. Preferably also, when the low event conditions for either of the patient’s blood O₂ saturation or respiratory rate data further constitute warning event conditions, controller 14 effects a transition to a complete halt of drug (OFF) where the drug administration is automatically turned off.

[0141] By automating these responses, the present invention improves the safety of sedation and analgesia by timely gathering information and effecting a clinically appropriate response thereby relieving a multi-tasked physician and nurse team from such routine. By automatically effecting a change of the drug administered, REDUCE for example, the care system prevents mild patient abnormalities, such as a respiratory rate constituting a low caution event condition, from progressing to severe pathophysiology.

[0142] The above embodiments in which REDUCE or OFF is triggered because of certain events is summarized in Table 3 below:

TABLE 3

Events Which Trigger REDUCE or OFF			
Parameter	Event		Effect
SpO ₂	LOW	WARNING	OFF
Respiratory Rate	LOW	WARNING	OFF
SpO ₂	LOW	CAUTION	REDUCE
Respiratory Rate	LOW	CAUTION	REDUCE

[0143] FIG. 24 shows three data-flow diagrams depicting examples of the clinical heuristics that the care system

provides. Event conditions LOW Heart Rate **241**, LOW SpO₂ **242**, LOW Respiratory Rate **243**, and LOW Blood Pressure **244** are shown triggering STAT ART **245**. Event conditions LOW Heart Rate **241**, LOW SpO₂ **242**, and LOW Blood Pressure **244**, HIGH Heart Rate **246**, and HIGH BP **247** are shown triggering STAT BP **248**. Event conditions LOW SPO₂ **242** and LOW Respiratory Rate **243** in Caution and Warning status are shown triggering REDUCE **249a** and OFF **249b**, respectively.

[**0144**] As also indicated above, the software effecting electronic management of drug delivery by controller **14** employs “conservative decision-making” or “negative feedback” principles. This means, for example, that the electronic management of drug delivery essentially only effects an overall maintenance or decrease in drug delivery (and does not increase drugs to achieve overall increased sedation/analgesia). For example, if ACQ system **256** (**FIG. 11**) indicates a latency period outside of an acceptable range, controller **14** may instruct electronic flow controller **133** (**FIG. 8**) to increase the flow of oxygen and/or instruct flow controller **135** to decrease the flow of gaseous drug to manifold system **48**.

[**0145**] In another example of such electronic management of drug delivery by conservative decision-making principles, if ACQ system **256** (**FIG. 11**) indicates a latency period in response to a patient query given every 3 minutes outside of an acceptable range, electronic controller **14** may immediately cease drug delivery, but at the same time, increase the frequency of times that the patient is queried, e.g., to every 15 seconds. When the patient does respond to the query, the drug delivery is reinitiated, but at a lower overall dose such as 20% less than the original concentration of drug that had been provided.

[**0146**] A further example of the invention’s electronic management of drug delivery through conservative, decision-making software instruction employs known target-controlled infusion software routines to calculate an appropriate dosage of IV drug based on patient physical parameters such as age, gender, body weight, height, etc. Here, a practitioner provides the patient physiological parameters through the user interface system, the electronic controller **14** calculates the appropriate drug dosage based on those parameters, and drug delivery begins, for example, as a bolus and is then brought to the pre-calculated target level of infusion. If later there is a significant change in a patient monitored parameter, e.g., pulse oximetry or latency period falls outside of a desired range, controller **14** effects a decrease in overall drug delivery as described above.

[**0147**] One concern that the invention addresses with respect to the target controlled infusion of IV drugs is the nature and speed at which the care system reaches the steady state target level of drug. For example, an important consideration for the physician is, once drug administration begins, when is the patient sufficiently medicated (e.g., sedated or anesthetized), so that the physician can begin the procedure. It is frequently desirable that the patient reach the steady state target level of drug as rapidly as possible so that the procedure can begin as soon as possible. It has been determined that one way of reaching a suitable level of drug effectiveness quickly is to initially overshoot the ultimate steady state target drug level. This shortens the time between the beginning of drug delivery and the onset of clinical drug

effectiveness so that the procedure may begin. Typically, predicted target levels have an error of plus or minus 20%, therefore, one approach of reaching the clinical effectiveness state quickly is to attempt to reach at least 80% of the ultimate target level, but initially overshoot that 80% level by giving a 15% additional increase of drug infusion beyond the 80% target. One method of accomplishing this is to use currently available PDI controllers which employ an error state (here the difference between predicted drug levels in the blood stream and the target level) to arrive at an infusion rate. Other control systems, however, that allow some initial overshoot of the target blood level of the drug to get to a clinical effectiveness level quicker would also be appropriate.

[**0148**] **FIG. 17** is a schematic of an alternative embodiment of an apparatus constructed in accordance with the invention which is particularly suitable for remote medical care locations and home care-type settings for indications such as post-operative or other post-procedural pain and/or discomfort, including, for example, nausea secondary to oncology chemotherapy. In this embodiment, drug source system **442** delivers drugs to the patient (which may be drugs such as propofol, morphine, remifentanyl and others) intravenously by, for example, use of a known syringe pump-type device capable of being worn or otherwise affixed to the patient, or delivers such drugs transdermally by, for example, use of known ion transfer-type devices, among others. The drug delivery may be continuous or by drug bolus and without an integrated supply of O₂. If necessary, oxygen may be supplied to the patient from separate tanks or an in-house, on-site oxygen source. The resulting apparatus is simplified—there is no requirement for an integrated O₂ source, electronic mixer, manifold, or the airway circuit and face mask devices described above.

[**0149**] One or more patient health monitors **412** such as known pulse oximeters, blood pressure cuffs, CO₂ end tidal monitors, EKG, and/or consciousness monitors, or other monitors such as those indicated herein, monitor the patient’s physiological condition. Drug dosage may be pre-set by a physician prior to or during application of drug delivery and/or also patient controlled thereafter by means of a patient drug dosage increase or decrease request devices generally of the type of that described above. It should also be understood that the intravenous delivery of drugs may be by continuous infusion, target-controlled infusion, pure bolus, patient-elected bolus or combinations thereof.

[**0150**] Still referring to **FIG. 17**, electronic management of drug delivery in this embodiment of the invention is provided by electronic controller **414** which may be of a type described above. Controller **414** employs conservative decision-making software and/or logic devices to integrate and correlate drug delivery by drug source system **442** (which may include known solenoid type or other electronic flow controllers) with electronic feedback values from one or more patient health monitors **412**. The values (signals) from patient health monitors **412** represent one or more actual patient monitored physiological conditions. Controller **414**, through software employing comparison protocols such as those described herein, accesses stored safety data set **410** which contains data reflecting safe and undesirable patient physiological conditions, and compares the signals reflecting actual patient monitored conditions with same. As described above, safety data set **410** may be stored in a

memory device such as an EPROM. Based on the result of the comparison, controller 414 either instructs no change in drug delivery or generates a signal instructing the drug flow controllers of drug source system 442 to manage application of the drug to safe, optimized levels.

[0151] In certain aspects of the invention, controller 414 may also access, through software, pre-set parameters stored in a memory device representing initial or target drug dosages and lock-outs of patient drug administration requests as described above. In these circumstances, instruction signals generated by controller 414 would also account for and control drug delivery in accord with these pre-set parameters.

[0152] This embodiment of the invention would also typically include system state monitors, such as electronic sensors which indicate whether power is being supplied to the system or which measure the flow of drugs being delivered. Such system state monitors are electronically coupled to controller 414 and provide feedback signals to same—the control of drug delivery by controller 414 electronically coupled to drug source system 442 in response to said feedback signals is similar to that as described herein with respect to other embodiments.

[0153] In another aspect of the invention, electronic controller 414 is located on a remote computer system and electronically manages on-site drug delivery integrating and correlating same with on-site monitoring of patient physiological conditions and care system states as described above, but here with instructions signals generated from a remote location. It is contemplated that controller 414 may, in some embodiments, effect transmission via modem or electronic pager or cellular-type or other wired or wireless technologies of electronic alarm alerts to remote locations if a monitored patient parameter such as the percentage of oxygen absorbed into the blood (S_pO_2) falls outside of a safe established value or range of values as established by the stored safety data set. Such remote locations could thereby summon an ambulance or other trained caregiver to respond to the alarm alert.

[0154] FIG. 18 details the user interface system of a preferred embodiment of the invention. This system enables the physician to safely and efficaciously deliver one or more of sedation, analgesia or amnesia to a patient while concurrently performing multiple tasks. The user interface permits the physician to interact with the care system and informs the user of the patient's and system's status in passive display devices and a variety of active audio/visual alarms thereby enhancing the safety and enabling immediate response time (including the "conservative" responses, e.g., detailed drug delivery discussed above) to abnormal situations.

[0155] Specifically, a keypad and/or touch screen 230 (FIGS. 2 and 18) allows the physician to interact with electronic controller 14, inputting patient background and setting drug delivery and oxygen levels. A remote control device 45 (FIGS. 1 and 18) provides the physician with remote interaction with the care system 10 allowing him or her to remotely control the functions of the system. Remote control device 45 may be removably integrated into the top surface of housing 15 and capable of being clipped onto material close to the physician and/or patient. In one aspect of the invention, the remote control device 45 itself contains

display devices such as LEDs to advise the physician of patient and system parameters. A panic switch 232 (FIG. 18), which may be on-board housing 15 (FIG. 1) or contained in remote control device 45 and electronically coupled to controller 14 allows the physician to shut down care system 10 and maintains it in a safe state pre-programmed into controller 14.

[0156] Visual display devices 234 (FIG. 2, 35) display actual and predictive or target patient and system parameters and the overall operation status of the care system.

[0157] One version of a preferred embodiment of visual display 234 is shown in FIG. 22A. The display 2230 includes a first portion of the display 2234 which is devoted to displaying to the user the current status of the system operation and monitored patient conditions, including the status of any alarm caused by a change in monitored system or patient condition. For example, if a patient's timed response to a consciousness query (latency period) is outside an established range and an alarm is thus activated, that query latency period is displayed in this first portion 2234 of the visual display, thereby enabling the physician to immediately understand the cause of the alarm.

[0158] The visual display device 2230 of this embodiment also includes a second portion of the display 2236 which is devoted to displaying the actions taken or soon to be taken by the care system. For example, if in response to an alarm indicating a latency period outside of an established safe range the apparatus will decrease the flow of drug to the patient, this second portion 2236 displays the percentage decrease in drug dosage to be effected.

[0159] Visual display 2230 facilitates the physician's interaction with the apparatus by walking the physician through various system operation software subprograms. Such subprograms may include system start-up where a variety of system self-checks are run to ensure that the system is fully functional; and a patient set-up. To begin the procedure, the care system monitors are placed on the patient and the physician activates the system by turning it on and entering a user ID (it is contemplated that such user ID would only be issued to physicians who are trained and credentialed). Next, the visual display would prompt the physician to begin a pre-op assessment, including inputting patient ID information and taking a patient history and/or physical. In the pre-op assessment, the physician poses to the patient a series of questions aimed at determining appropriate drug dosage amounts (such as age, weight, height and gender), including factors indicative of illness or high sensitivity to drugs. The responses to such questions would be inputted into the care system and employed by the system to assist the physician in selecting the appropriate dose amount. For example, the care system may make available to the physician one range of dosage units for a healthy person and a narrower range of dosage units for a sick or older person. The physician would have to make an explicit decision to go above the recommended range.

[0160] In addition to the pre-op assessment performed by the physician described above, it is also contemplated that the care system is capable of performing an automated pre-op assessment of the patient's physiology. For example, with the monitors in place, the care system will assess such parameters as the oxygenation function of the patient's lungs and/or the ventilatory function of the patient's lungs. The

oxygenation function could be determined, for example, by considering the A-a gradient, namely, the alveolar or lung level of oxygen compared to the arteriolar or blood level of oxygen. The ventilatory function of the lungs could be determined from pulmonary function tests (PFTs), among other things, which are measurements of the amount of air and the pressure at which that air is moved in and out of the lungs with each breath or on a minute basis. (It is contemplated that these assessments are performed before the procedure begins and during the procedure as a dynamic intra-operative assessment as well.) Also during the pre-op (or as a continuous intra-operative) assessment, heart function may be assessed by viewing the output of an EKG to determine whether there is evidence of ischemia or arrhythmias. Alternatively, automated algorithms could be applied to the EKG signals to diagnose ischemia or arrhythmias. Additional automated patient health assessments could also be made.

[0161] During patient set-up, current patient and system parameters may also be assessed and displayed, and the consciousness-query system and patient drug increase/decrease system tested and baselined. A set drug subprogram allow for the selection of drugs and/or mixture of drugs (or drug, oxygen and air), allows for picking target levels of drugs, and/or permits enabling of the patient's self-administration of drugs within certain ranges. The invention also contemplates during the pre-op assessment determining a sedation threshold limit for the given patient in the unstimulated state. This could be done as a manual check, i.e., by simply turning up the drug levels and watching the patient manually or the procedure could be automated where the drugs are increased and the safety set parameters such as those for latency (consciousness queries) are tested as the concentration at the drug effect site is increased.

[0162] The system and patient status and system action may be displayed during, for example, a sedation subprogram. Visual display device 2230 may include graphical and numeric representations of patient monitored conditions such as patient respiratory and ventilatory status, consciousness, blood O₂ saturation, heart rate and blood pressure (2238); an indication of elapsed time from the start of drug delivery (2239); drug and/or O₂ concentrations (2241); and indications of patient requests for increases or decreases in drug (2243). The actual fraction of inspired oxygen calculated may also be displayed. Command "buttons" are included to mute alarms (2240), change concentration of drug delivered (2242), turn on or off the mixing of an oxygen stream with atmospheric air (2244), and to turn on or off or make other changes to the automated consciousness query system (2246). Command buttons may also be included to place the apparatus in a "recovery" mode once the procedure is completed (patient parameters are monitored, but drug delivery is disabled) (2248), and to end the case and start a new case (2250) or shut-down the system.

[0163] An alternate version of a preferred embodiment of the visual display portion of the invention is shown in FIG. 22B. Portions 2202, 2204, 2206 and 2208 of display device 2200 show current patient O₂ saturation, blood pressure, heart rate, and end tidal CO₂ levels, respectively. These portions displaying patient physiological state are uniquely color coded. Smart alarm box portion 2212 which may be coded in an attention getting color such as red, displays to the physician the particular alarm that has sounded. For

example, if the patient O₂ blood saturation level falls below safe levels, the O₂ saturation alarm will sound and the O₂ saturation level will appear in smart alarm box portion 2212 where it can be easily seen by the physician. In short, whatever parameter has alarmed is moved to the smart alarm box portion; the specific alarm indicator is moved to the same place every time an alarm sounds. Also, the level of criticality of the alarm which, as described below, in a preferred embodiment may be indicated by either yellow or red color, is displayed in the patient physiological parameter portion of the display. For example, if a red level O₂ saturation alarm sounds, the background portion of the O₂ saturation portion 2202 will appear in red.

[0164] Portion 2214 of display 2200 shows the past, present and predicted levels (2215) of drug administration (the drug levels shown in FIG. 22B are the levels of nitrous oxide remifentanyl and propofol). In a preferred embodiment target controlled infusion past, present and predicted levels are shown graphically beginning with the past thirty minutes and going thirty minutes into the future. The invention also contemplates bracketing a range of accuracy of target controlled infusion levels (not shown).

[0165] Display portions 2220 and 2224 depict graphical representations of patient health parameters such as the A-a gradient (oxygenation function) for the lungs, the results of pulmonary function tests, electrocardiogram, blood O₂ saturation, among others.

[0166] In another aspect of the invention, visual display 35 (FIG. 1) may be removably integrated into the top surface of housing 15 and capable of being removed from housing 15 and affixed to a frame near the patient, such as a gurney rail or examination table. Alternatively, or in addition thereto, a heads-up type visual display device is provided to facilitate a nonanesthetist's involvement in the medical or surgical procedure while simultaneously being able to view the status of system and patient monitored values and the details of alarm states. In this case, the display device is miniaturized and mounted onto a wearable headset or eyeglass-type mount or mounted on an easily viewed wall display.

[0167] Referring again to FIG. 18, in a preferred embodiment, audible alarms 236 alert the physician when patient or system parameters are outside of the normal range. In preferred embodiments, the alarms may be two or three stages with different tones to indicate different levels of concern or criticality. As is described above, when an alarm sounds, the user is able to immediately view the cause of the alarm because the smart alarm box portion 2212 of the visual display 2200 shows the value of the monitored system or patient parameter that caused the alarm to activate.

[0168] FIG. 21 A shows examples of drug delivery management protocols for three-stage alarms responsive to patient monitors, namely, alarms "1," "2" and "3," in accordance with a preferred embodiment of one aspect of the invention. These alarms may have different tones or other indicators to denote different levels of concern or criticality. The dataflow diagram of FIG. 23A depicts one example of the steps performed by the drug delivery managing software or logic for one such protocol, namely, one where electronic controller 14 described above receives an electronic feedback signal from a pulse oximeter monitoring the actual amount of oxygen saturation in a patient's blood (the value

indicated by "SpO₂"). As is shown, the SpO₂ value is compared with stored safety data set 220 containing a parameter value or range of parameters values reflecting safe and undesirable patient blood oxygen saturation conditions. If the SpO₂ value is greater than or equal to stored parameter 90%, no alarm sounds and no adjustment to drug delivery is effected (221a). If the SpO₂ value is less than 90%, but greater than 85% (221b), alarm 1 sounds for 15 seconds (222). If alarm 1 is silenced manually (222a), no further action is taken by the system. If alarm 1 is not silenced, the amount of drug being delivered (in this example gaseous N₂O) is reduced to the lesser of a concentration of 45% or the current concentration minus 10% (223). The software/logic procedure would operate in a similar fashion for intravenous and nebulized forms of drugs and the instructions provided (e.g., as in 223) would be specified for safe dosages of such drugs.

[0169] Further, if the value of oxygen saturation (SpO₂) is less than 85%, but greater than or equal to 80% (221c), alarm 2 sounds and the amount of N₂O being delivered is immediately reduced to the lesser of a concentration of 45% or the current concentration minus 10% (224). If the feedback value SpO₂ from the pulse oximeter indicates that the oxygen saturation in the blood is less than 80%, alarm 3 sounds and the amount of N₂O being delivered would be immediately reduced to 0% (225).

[0170] Similar protocols are described in FIG. 21A for electronic feedback signals from patient health monitors indicating pulse rate, amount of carbon dioxide in a patient's end tidal exhalations, respiration rate, systolic blood pressure, and feedback from the automated consciousness monitoring system constructed in accordance with the invention. These protocols are effected with software (and/or logic) operating in similar fashion to that described in the dataflow diagram of FIG. 23A. That is, the protocol shown in FIG. 23A is one example employing one patient monitored parameter, but the operation of the invention would be similar to effect the remaining protocols of FIG. 21A.

[0171] It should be understood that the system responses to alarms (described above in terms of decreases or cessation of drug concentration) could also include institution and/or increases in administration of oxygen in accord with patient and system state parameters as described above. In circumstances where drugs are halted and pure oxygen (or an O₂ atmospheric mix) is provided, e.g., where feedback signals indicate the patient has a low blood O₂ saturation, a preferred system is designed to operate in a LIFO ("last-in-first-out") manner. This means that when controller 14 receives feedback signaling an adverse patient or machine state and instructs flow controllers to turn on the oxygen, the very next breath the patient takes will be of pure O₂ (and/or atmospheric air) rather than of a drug/air mixture. This may be accomplished, for example, by supplying O₂ for air directly to PIV 152 (FIG. 9A) and bypassing reservoir bag 149.

[0172] FIG. 21B shows examples of drug delivery management protocols for two-stage alarms responsive to system state monitors, namely, alarms "1" and "2," in accordance with a preferred embodiment of one aspect of the invention. The alarms may have different tones or other indicators to note different levels of concern or criticality. The dataflow diagram of FIG. 23B depicts one example of

the steps performed by the drug delivery managing software and/or logic for one such protocol, namely, one where electronic controller 14 (e.g., FIG. 2A) receives an electronic feedback value from an O₂ tank pressure sensor (519) indirectly measuring the amount of oxygen remaining in an on-board oxygen tank (the value indicated by "O₂ remaining"). As is shown, the O₂ remaining value is compared with an established data set of safe system parameters stored in a memory device as described above, said data set containing a "setpoint" reflecting known safe and undesirable oxygen tank pressure conditions (520). If the oxygen pressure is greater than the setpoint, no alarm sounds and no adjustment to drug delivery is effected (521). If the O₂% value is less than the setpoint, alarm "1" sounds (522). If alarm "1" is silenced manually within 15 seconds, no further action is taken by the system (523). If alarm "1" is not silenced within 15 seconds, the amount of drug being delivered (in this example gaseous N₂O) is reduced to the lesser of the concentration of 45% or the current concentration minus 10% (524). The software or logic procedure would operate in a similar fashion for intravenous and nebulized forms of drugs and the instructions provided (e.g., as in 524), would be specified for safe dosages of such drugs.

[0173] In another example of FIG. 21B involving a system state monitor which indicates whether power is being supplied to apparatus 10, a logic operation determines whether power has been interrupted. If the system state monitor for power signals that power has been interrupted, alarm "2" sounds and the delivery of drug is reduced to 0%.

[0174] Similar protocols are described in FIG. 21B for system state monitors indicating O₂ interruption fail safe, total gas flow, drug tank pressure, fraction of inspired oxygen (FIO₂), and operation of the vacuum pump for scavenging system 48 (FIG. 6). These protocols are effected with software (and/or logic) operating in similar fashion to that described in the dataflow diagram of FIG. 23B. That is, the protocol shown in FIG. 23B is one example employing one system state monitor stored parameters, but the operation would be similar to effect the remaining protocols of FIG. 21B.

[0175] In the above examples, involving response to patient physiological state, there is a time lapse between the alarm's sounding and any decrease in drug delivery to the patient. In alternate protocols contemplated by the invention, electronic controller 14 will immediately cease or curtail drug administration upon the sounding of an alarm. For less critical ("yellow") alarms, drug delivery may be decreased to 80% levels upon the sounding of the alarm; for more critical ("red") alarms, drug delivery would cease upon the sounding of the alarm. In either case, the physician will then be given time, for example, thirty seconds, to instruct controller 14 to restart the drug delivery (e.g., the physician will need to override the curtailing of drug delivery). If the physician does override controller 14, drugs are reinitiated, for example, by a bolus amount. This method prevents against a patient's deteriorating while a physician waits to respond to an alarm at current drug levels, and also avoids underdosing by permitting the physician sufficient time to reinitiate drug delivery.

[0176] Referring again to FIGS. 2 and 18, a printer 238 (FIG. 2, 37) provides an on-site hard copy of monitored patient health parameters (e.g., the feedback values from the

one or more patient health monitors), as well as alarm states with time stamps indicating which type of alarms sounded, why and when. Diagnostic LEDs **240** affixed to the exterior of apparatus **10** (e.g., **FIG. 1**) and electronically coupled to controller **14** permit the physician typically involved in the procedure to ascertain system states at a glance; LEDs coupled to microprocessor controller **14** also permit service technicians to assess fault states.

[0177] A preferred embodiment of the invention includes a variety of peripheral electronic devices, one group internal to or integrated within housing **15** of apparatus **10** (e.g., **FIG. 1**) and a second group on-board electronic controller **14**. These electronic devices ensure proper operation of various aspects of system **10**, including providing hardware status feedback through sensors to ensure that the apparatus is operating within its desired parameters. **FIGS. 19A and 19B** describe various peripheral devices in accordance with the invention, such devices may be of a known, off-the-shelf types currently available. Specifically, internal solenoid-type activated door locks **190** restrict access to the interior of apparatus **10**. Door locks **190** are located within housing **15** (**FIG. 1**) and are electronically coupled to and controlled by controller **14** by means of software that includes protocols for password protection. Access to the interior of apparatus **10** is thus restricted to authorized personnel with passwords. This is intended to, among other things, minimize chances of "recreational" abuse of the pharmaceuticals (e.g., N_2O) contained therein. Internal door status sensors **191** located within housing **15** and electronically coupled to controller **14** generate signals indicating if an access door to the interior of apparatus **10** is open or closed. Real-time clock **192** on-board controller **14** enables said controller **14** to provide time stamps for overall system and patient activities and thereby enables creation of an accurate log of the operation of care system **10**. On-board ambient temperature sensor **193** monitors the exterior temperature signaling same to controller **14** which through software comparison type protocols confirms that apparatus **10** is being operated under desired conditions with respect to surrounding temperature. Internal battery temperature sensor **194** located within housing **15** and electronically coupled to controller **14** generates signals to same indicating whether the back-up battery power system is functioning correctly and not overcharging. Tilt sensor **195** located on-board controller **14** signals same if the apparatus **10** is being operated at an angle beyond its designed conditions.

[0178] In a preferred embodiment, the software control processes of electronic controller **14** are stored in a standard flash memory **196** and SRAM type battery-backed memory **197** stores system, patient and other status information in the event of an AC power loss. On-board fault detection processor (FDP) **198** signals failures to controller **14** and is a secondary microprocessor based computing system which relieves controller **14** of its control duties if a fault is detected in operation. On-board watch dog timer **199** indicates to controller **14** that the apparatus **10** is functioning and resets controller **14** if system **10** fails to respond.

[0179] A preferred embodiment of the invention also includes a standard serial port interface, such as an RS-232C serial port, for data transfer to and from electronic controller **14**. The port enables, for example, downloading software upgrades to and transfer of system and patient log data from controller **14**. An interface such as a PC Type III slot is also

provided to enable the addition of computer support devices to system **10**, such as modems or a LAN, to be used, for example, to transfer billing information to a remote site; or to permit diagnosis of problems remotely thereby minimizing the time required for trouble-shooting and accounting.

[0180] It should be understood that the care system of the invention may be modular in nature with its functions divided into separable, portable, plug-in type units. For example, electronic controller **14**, display devices (**FIG. 2, 35**) and one or more patient health monitors would be contained in one module, the pneumatic systems (flow controllers, pressure regulators, manifold) in a second module, and the base (**FIG. 3B, 17**), oxygen and drug tanks (**FIG. 2, 54**), scavenger system and vacuum pump (**FIG. 3B, 32**) in a third module. Additionally, the patient health monitors or drug delivery aspects of the system may each be their own plug-in type modules. The system, for example, may provide for a pluggable ventilator type module. This modularity enables the system not only to be more easily portable, but also enables use of certain features of the system (such as certain patient health monitors), while not requiring use of others.

[0181] **FIG. 20** depicts a preferred embodiment of a patient information and billing system capable of being interfaced with care system **10** (**FIG. 1**) to allow billing or other gathering of patient information to take place locally at the place of use or remotely at a billing office. Specifically, information/billing storage system **280**, which may be of a known type microprocessor-based computing system controlled by software, collects and stores patient data **281** such as the patient's name, address and other account information, as well as metered system operation data **282** generated during operation of apparatus **10** and stored in controller **14** such as start time, time of use, frequency of use, duration of patient monitoring, amount of gases expended, and other such parameters. User access device **283** which may be of a standard keyboard type permits the physician to interact with information/billing storage system **280** to input additional data such as pre-determined treatment or billing parameters or to read the status of same (e.g., to read the status of metered system operation parameters **282**). Preferably, a password is provided to permit access to information/billing system **280**.

[0182] At the termination of a medical or surgical procedure or at some other desired period, information/billing storage system **280** processes the received data and transmits same to revenue/billing processing center **286** at a remote location. Revenue/billing processing center **286** may be of a known, mainframe-type computing system such as that manufactured by International Business Machines (IBM) or a known client-server type computer network system. At the remote location a patient invoice is generated by printer **287** as may be other revenue records used for payment to vendors, etc.

[0183] The invention also contemplates that an automated record of the system operation details will be printed at the user site on printer **285** which is preferably located on-board apparatus **10** (**FIG. 1**). Such system operation details may include, for example, all alarm and actual system operation states, drug flow rates and/or monitored actual patient physiological conditions as supplied by electronic controller **14**. A modem or LAN may be used to send and receive billing

and other information remotely and to communicate with remote client/server or other networks 288 as described above.

I claim:

1. A system for alleviating patient pain, anxiety and discomfort associated with medical or surgical procedures, the system comprising:

one or more patient health monitor devices coupled to a patient and generating at least one first signal reflecting at least one physiological condition of the patient;

a drug delivery controller supplying one or more drugs to the patient based upon the at least one first signal;

a memory device storing a safety data set reflecting safe and undesirable parameters of at least one monitored patient physiological condition; and

an electronic controller interconnected between the patient health monitor, the drug delivery controller and the memory device storing the safety data set; wherein said electronic controller receives the at least one first signal and in response manages the application of the drugs by the drug delivery controller in accord with the safety data set; and the generation of at least one second signal by the one or more patient health monitor devices in accord with the safety data set.

2. The system according to claim 1, wherein the at least one first signal reflects one or more of the following physiological conditions of the patient: heart rate, SpO₂, respiratory rate, blood pressure, and responsiveness.

3. The system according to claim 1, wherein the at least one second signal reflects one or more of the following physiological conditions of the patient: blood pressure and responsiveness.

4. The system according to claim 1, wherein the management of the generation of the at least one second signal includes an assignment of an event condition to the at least one first signal in accord with the safety data set, and wherein the event condition triggers the one or more patient health monitor devices to generate the at least one second signal.

5. The system according to claim 4, wherein the electronic controller assigns an event condition in accord with the safety data set when the at least one first signal reflects a physiological condition of the patient that is outside of predetermined safe levels.

6. The system according to claim 5, wherein the event condition is high when the at least one first signal reflects a physiological condition of the patient that is above predetermined safe levels.

7. The system according to claim 5, wherein the event condition is low when the at least one first signal reflects a physiological condition of the patient that is below predetermined safe levels.

8. The system according to claim 4, wherein the electronic controller assigns an event condition in accord with the safety data set when said at least one first signal reflects a trend in the physiological condition of the patient over time that suggests the condition will be outside of predetermined safe levels within a predetermined time period.

9. The system according to claim 4, the system further comprising a user interface, wherein notice of the event condition is communicated to a user of the system via the user interface.

10. The system according to claim 1, wherein the management of the application of the drugs by the electronic controller includes at least one of reducing or halting the flow of drugs.

11. A method for alleviating pain and anxiety in connection with medical and surgical procedures, the method comprising the steps of:

a) connecting to a patient a drug delivery device having a drug delivery controller supplying one or more drugs, said drug delivery controller being coupled to an electronic controller which controls the delivery of the drugs to the patient;

b) attaching at least one patient health monitor device to a patient, the health monitor devices generating a first value reflecting at least one physiological condition of a patient, the at least one patient health monitor device coupled to the electronic controller;

c) accessing a memory device which stores a safety data set reflecting parameters of at least one patient physiological condition;

d) delivering the drugs to the patient based upon the generated first value and in accord with the safety data set; and

e) generating a second value reflecting the current physiological condition of the patient, the second value generated by the at least one patient health monitor device in accord with the safety data set.

12. The method according to claim 11, wherein said first value reflects at least one of the following physiological conditions of the patient: heart rate, SpO₂, respiratory rate, blood pressure, and responsiveness.

13. The method according to claim 11, wherein the second value reflects at least one of the following physiological conditions of the patient: blood pressure and responsiveness.

14. The method according to claim 11, said method further including the step of assigning an event condition to the first value in accord with the safety data set, wherein the event condition triggers the at least one patient health monitor device to generate the second value.

15. The method according to claim 14, wherein the electronic controller assigns an event condition in accord with the safety data set when said first value reflects a physiological condition of the patient that is outside of predetermined safe levels.

16. The method according to claim 15, wherein the event condition is high when said first value reflects a physiological condition of the patient that is above predetermined safe levels.

17. The method according to claim 15, wherein the event condition is low when said first value reflects a physiological condition of the patient that is below predetermined safe levels.

18. The method according to claim 14, wherein the electronic controller assigns an event condition in accord with the safety data set when said first value reflects a trend in the physiological condition of the patient over time that suggests the condition will be outside of predetermined safe levels within a predetermined time period.

19. The method according to claim 14, said method further comprising the step of communicating an event condition to a user of the system via a user interface.

20. The method according to claim 14, wherein the step of delivering the drugs to the patient comprises at least one of the step of reducing and the step of halting the flow of drugs.

21. A method for alleviating pain and anxiety in connection with medical and surgical procedures, the method comprising the steps of:

- a) measuring at least one physiological condition;
- b) generating a first value based upon the at least one physiological condition;
- c) correlating the generated first value with predetermined safety data;
- d) delivering at least one medication based upon the correlating step; and

e) providing an updated measurement of the at least one physiological condition based upon the correlating step.

22. The method according to claim 21, wherein the at least one physiological condition is at least one of heart rate, SpO₂, respiratory rate, blood pressure, and responsiveness.

23. The method according to claim 21, wherein the physiological condition provided as an updated measurement is one of the same physiological condition used to generate the first value and is a different physiological condition.

24. The method according to claim 21, wherein the physiological condition provided as an updated measurement is one of blood pressure or responsiveness.

* * * * *

专利名称(译)	根据适当的临床启发法提供有意识的患者从医疗或外科手术中减轻疼痛和焦虑的装置和方法		
公开(公告)号	US20030079746A1	公开(公告)日	2003-05-01
申请号	US10/265639	申请日	2002-10-08
[标]申请(专利权)人(译)	斯科特实验室公司		
申请(专利权)人(译)	SCOTT实验室, INC.		
当前申请(专利权)人(译)	SCOTT实验室, INC.		
[标]发明人	HICKLE RANDALL S		
发明人	HICKLE, RANDALL S.		
IPC分类号	A61B5/00 A61B5/02 A61B5/022 A61B5/08 A61B5/083 A61B5/097 A61B5/145 A61B5/16 A61M5/00 A61M15/00 A61M16/00 A61M16/01 A61M16/12 A61M16/20 A61M21/02 G06F19/00		
CPC分类号	A61M16/0051 A61M16/0078 A61M16/009 A61M16/01 A61M16/12 A61M2016/0036 A61M16/202 A61M2209/084 A61M2230/205 A61M2230/432 G06F19/345 G06F19/3468 A61M16/0084 A61M2205/3561 A61M16/0093 A61M16/026 A61M16/1015 A61M16/107 A61M16/203 A61M16/208 A61M16/209 A61M2016/1025 A61M2205/505 A61M2230/43 G16H20/17 G16H50/20		
优先权	60/087841 1998-06-03 US 60/327313 2001-10-09 US		
其他公开文献	US7308894		
外部链接	Espacenet USPTO		

摘要(译)

提供护理系统和相关方法，用于减轻与医疗或外科手术相关的患者疼痛，焦虑和不适。该系统包括：至少一个患者健康监测装置，其耦合到患者并产生反映患者的至少一种生理状况的信号；药物输送控制器向患者提供一种或多种药物；存储装置，存储反映至少一个患者生理状况参数的安全数据集；以及在患者健康监测器，药物输送控制器和安全数据集之间互连的电子控制器。电子控制器能够根据安全数据集中反映的相应值的至少一个患者生理状况之间的比较，实现输送给患者的药物供应的变化以及患者健康监测装置产生的电流信号。

