



(19) **United States**

(12) **Patent Application Publication**
Hauschild et al.

(10) **Pub. No.: US 2003/0073902 A1**

(43) **Pub. Date: Apr. 17, 2003**

(54) **SURGICAL INSTRUMENT AND METHOD**

Publication Classification

(76) Inventors: **Sidney F. Hauschild**, Brooklyn Park, MN (US); **Stephen L. Bolea**, Watertown, MN (US); **Johann J. Neisz**, Coon Rapids, MN (US)

(51) **Int. Cl.⁷** **A61B 5/00**
(52) **U.S. Cl.** **600/431; 604/506; 604/135; 600/437; 600/464**

Correspondence Address:
AMS Research Corporation
10700 Bren Road West
Minnetonka, MN 55343 (US)

(57) **ABSTRACT**

Method and surgical instrument for treating prostate tissue including a surgical instrument having a main body, a needle deployment port, a needle, first and second handles and a lockout release mechanism to limit needle extension. Additionally, a kit includes the surgical instrument, together with a cystoscope, and optionally a syringe and reservoir of ethanol. The method includes needle-less injection and visualizing the ethanol injection by delivering both an echogenic agent and ethanol either by needle or needle-less injection or by providing an ultrasonically visible marker near the tip of the ethanol delivery cannula. The method also includes extending the needle transversely of the instrument housing using a link assembly.

(21) Appl. No.: **10/269,405**

(22) Filed: **Oct. 11, 2002**

Related U.S. Application Data

(60) Provisional application No. 60/329,262, filed on Oct. 12, 2001.

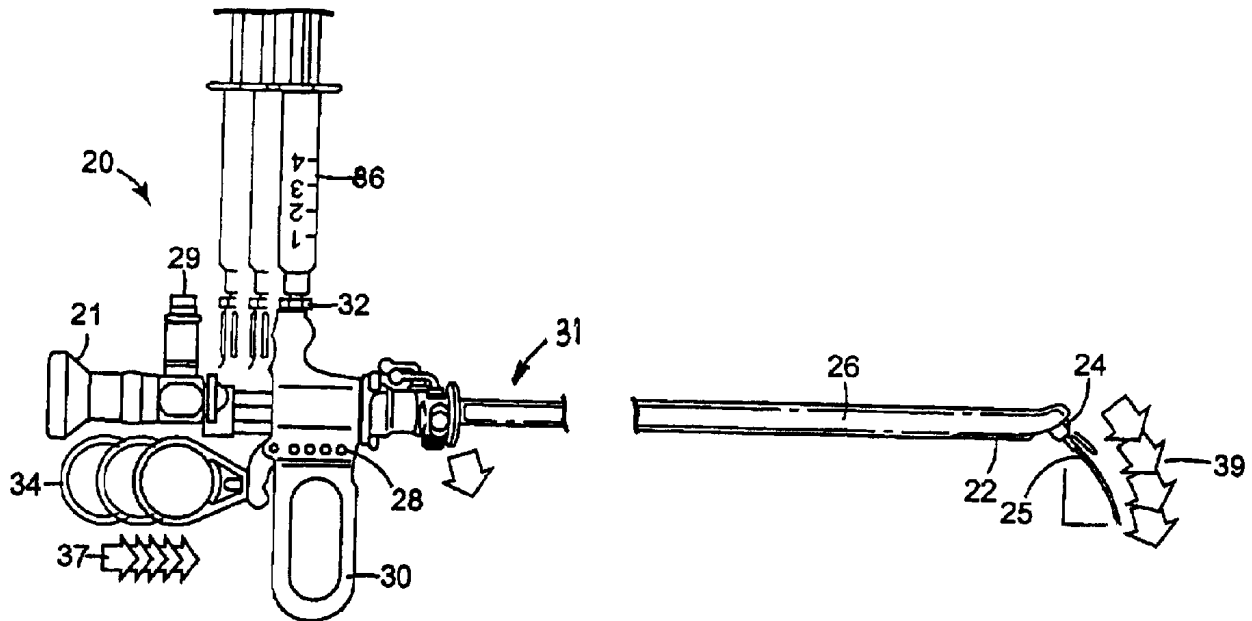

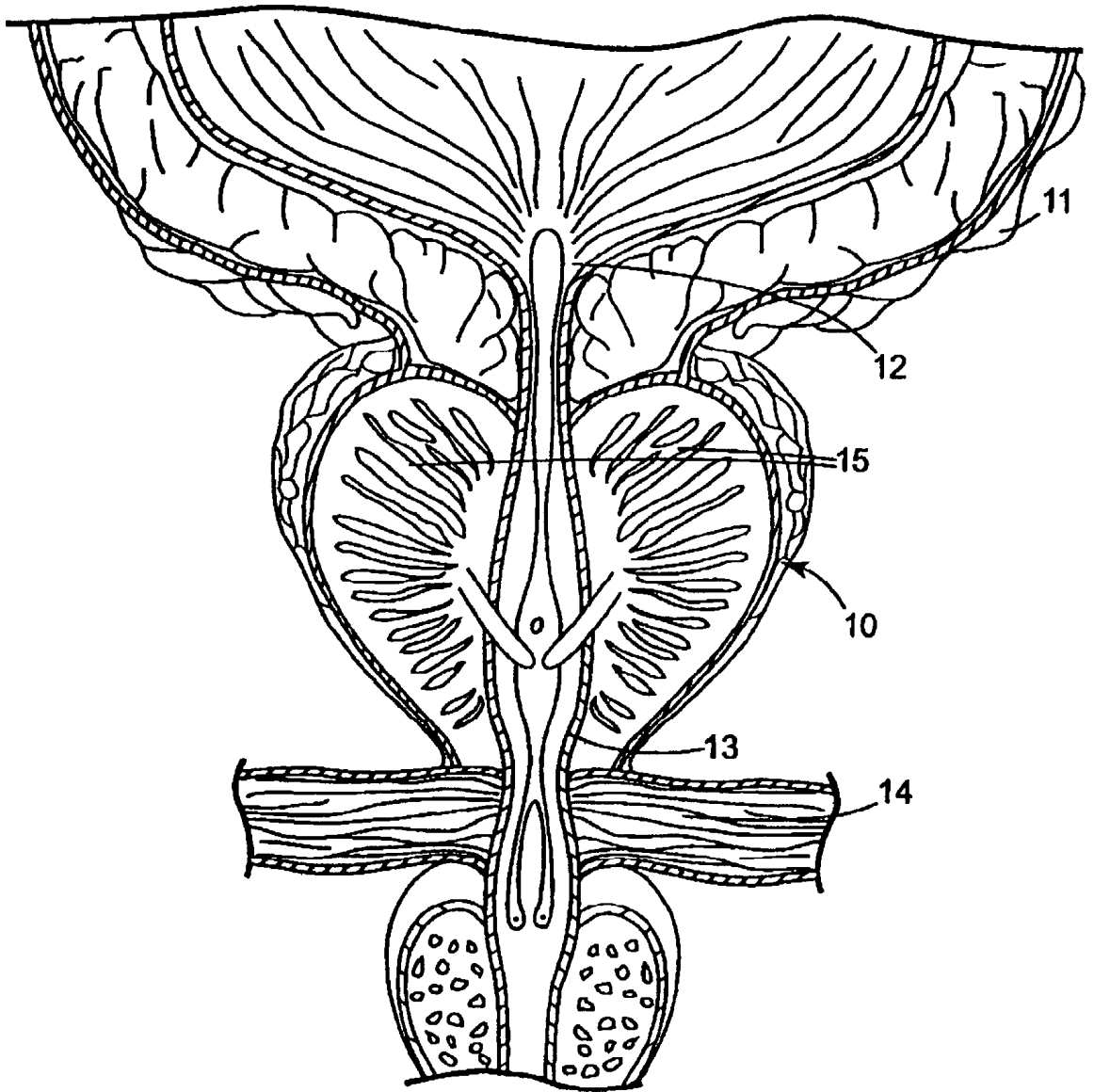

Figure 1

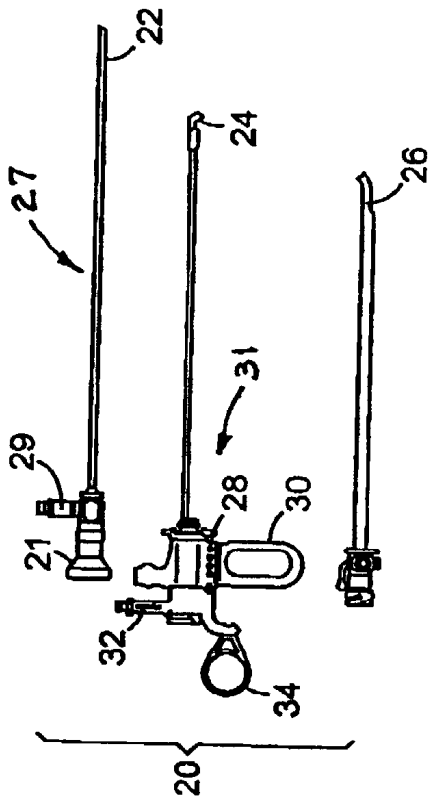

Figure 2

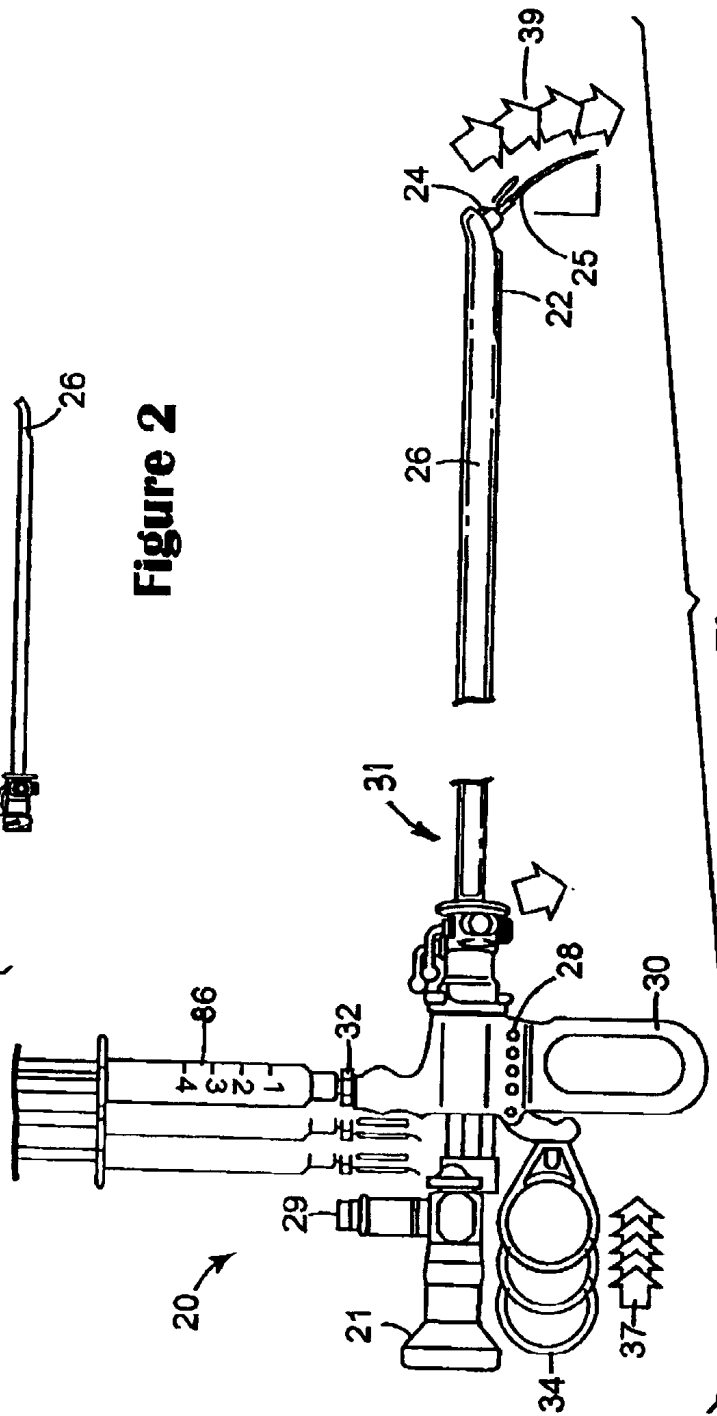

Figure 3

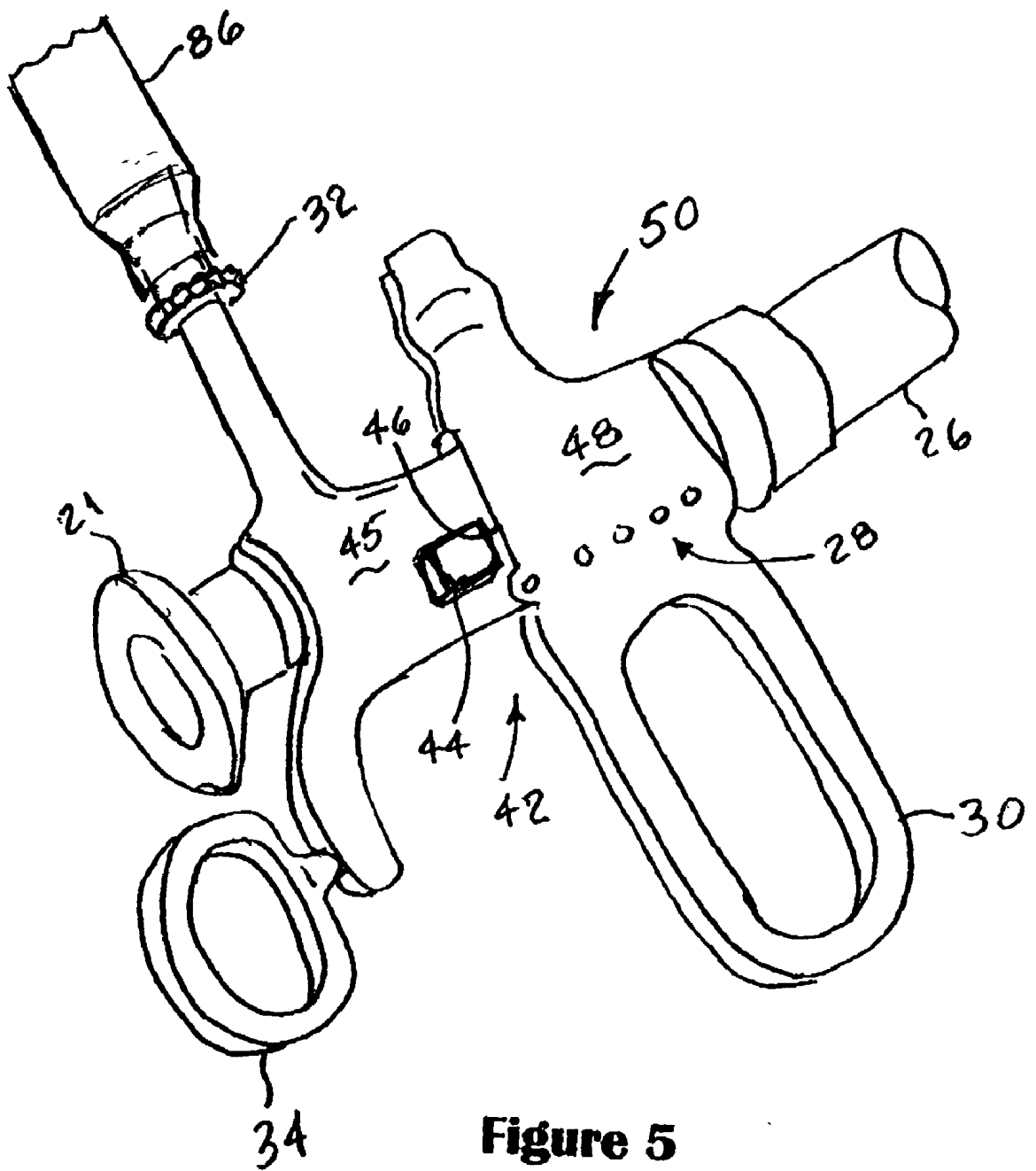

Figure 5

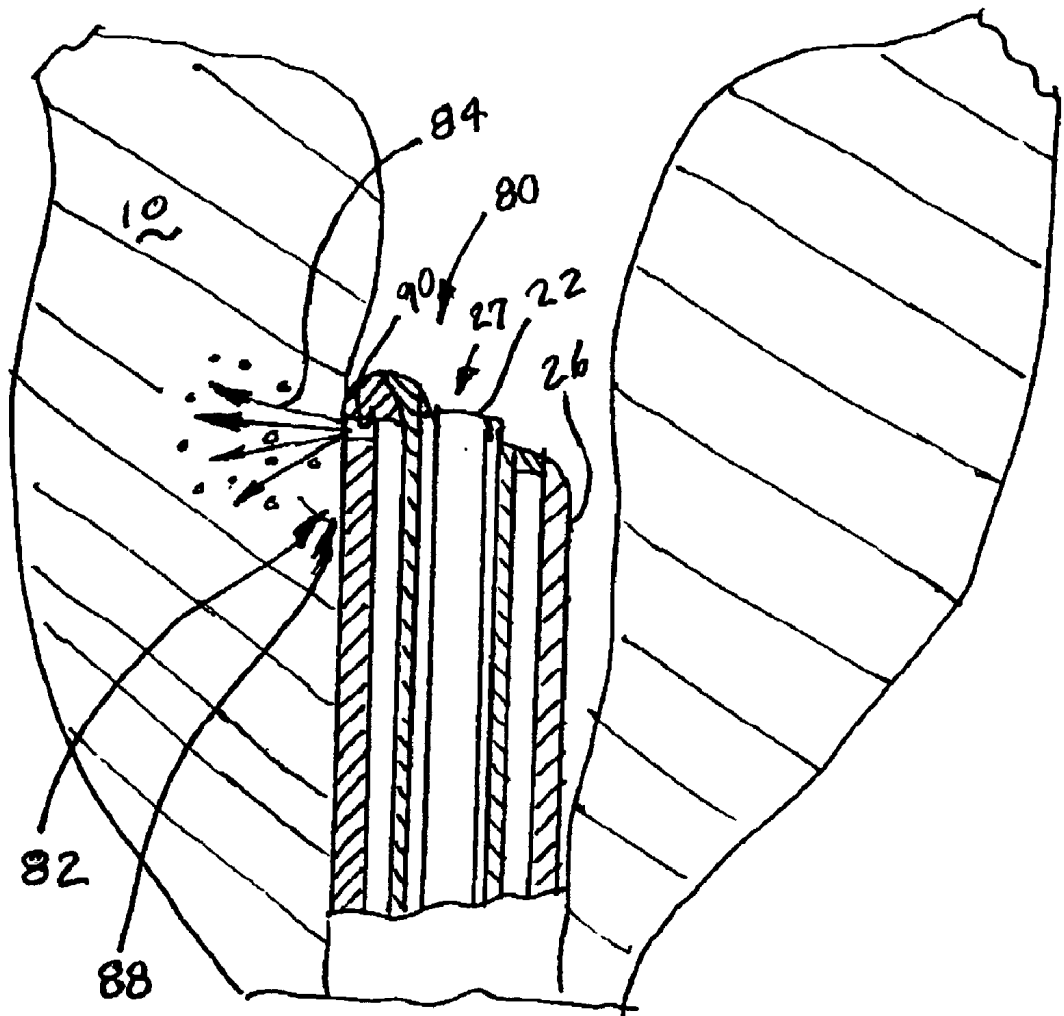

Figure 6

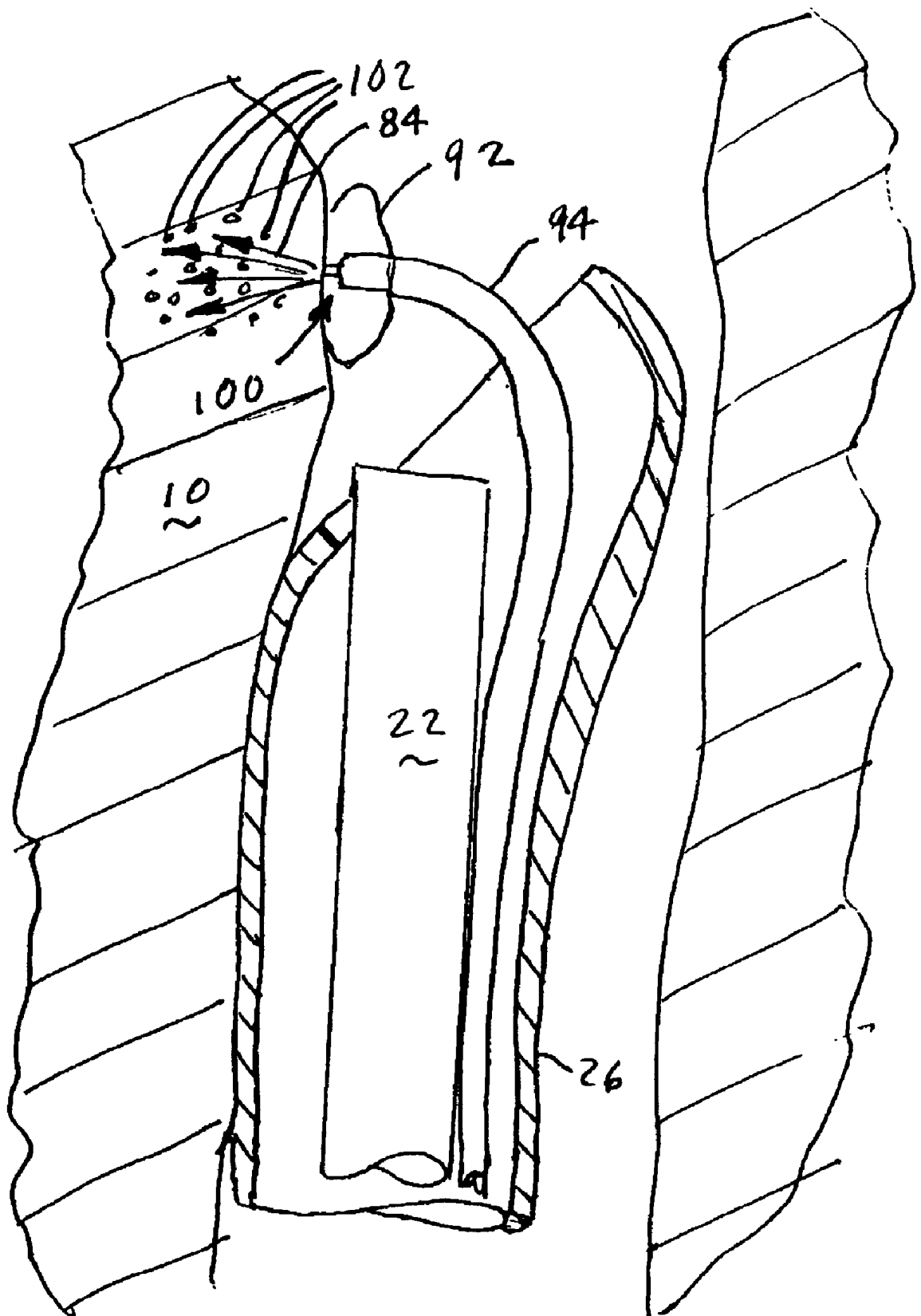

Figure 7

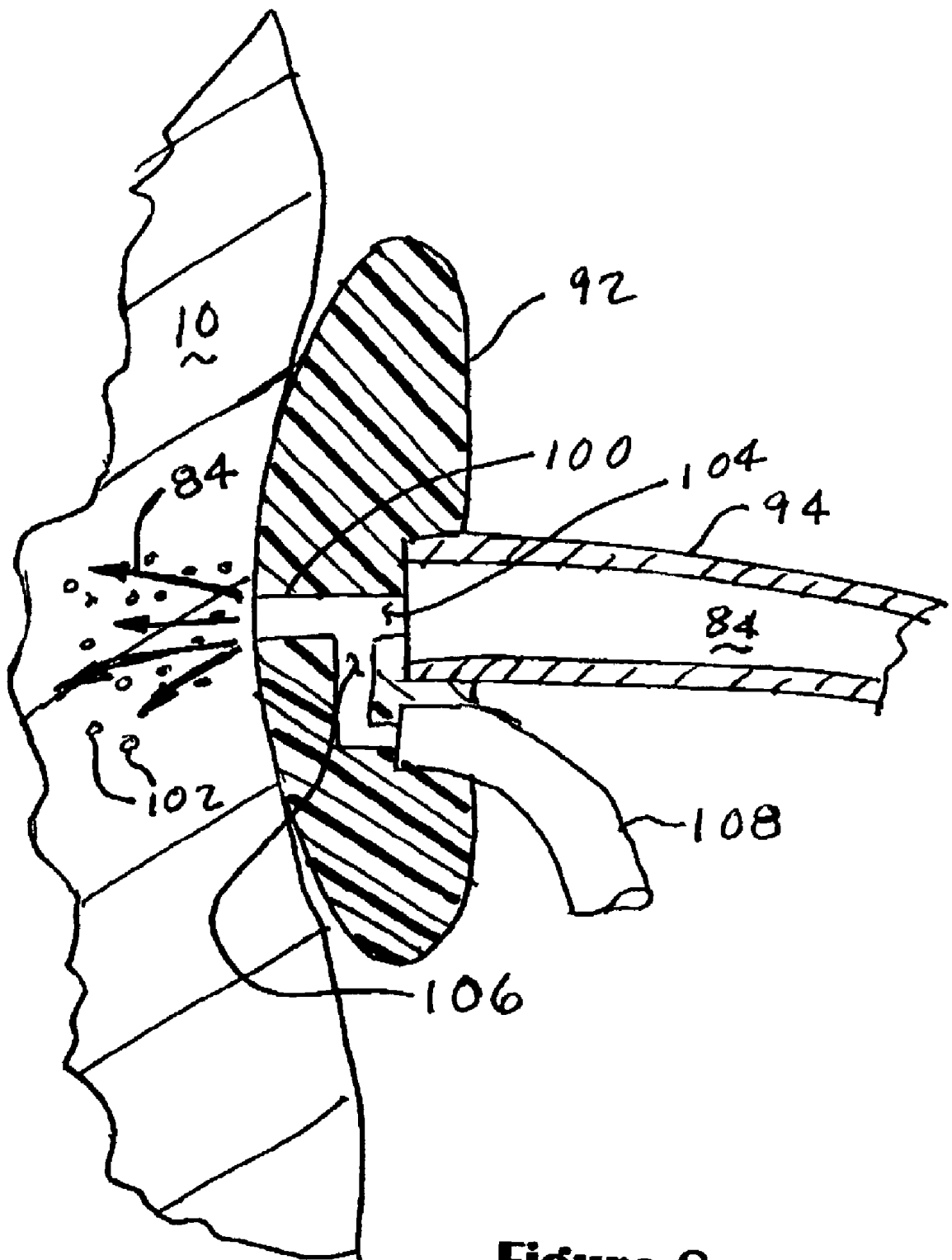

Figure 8

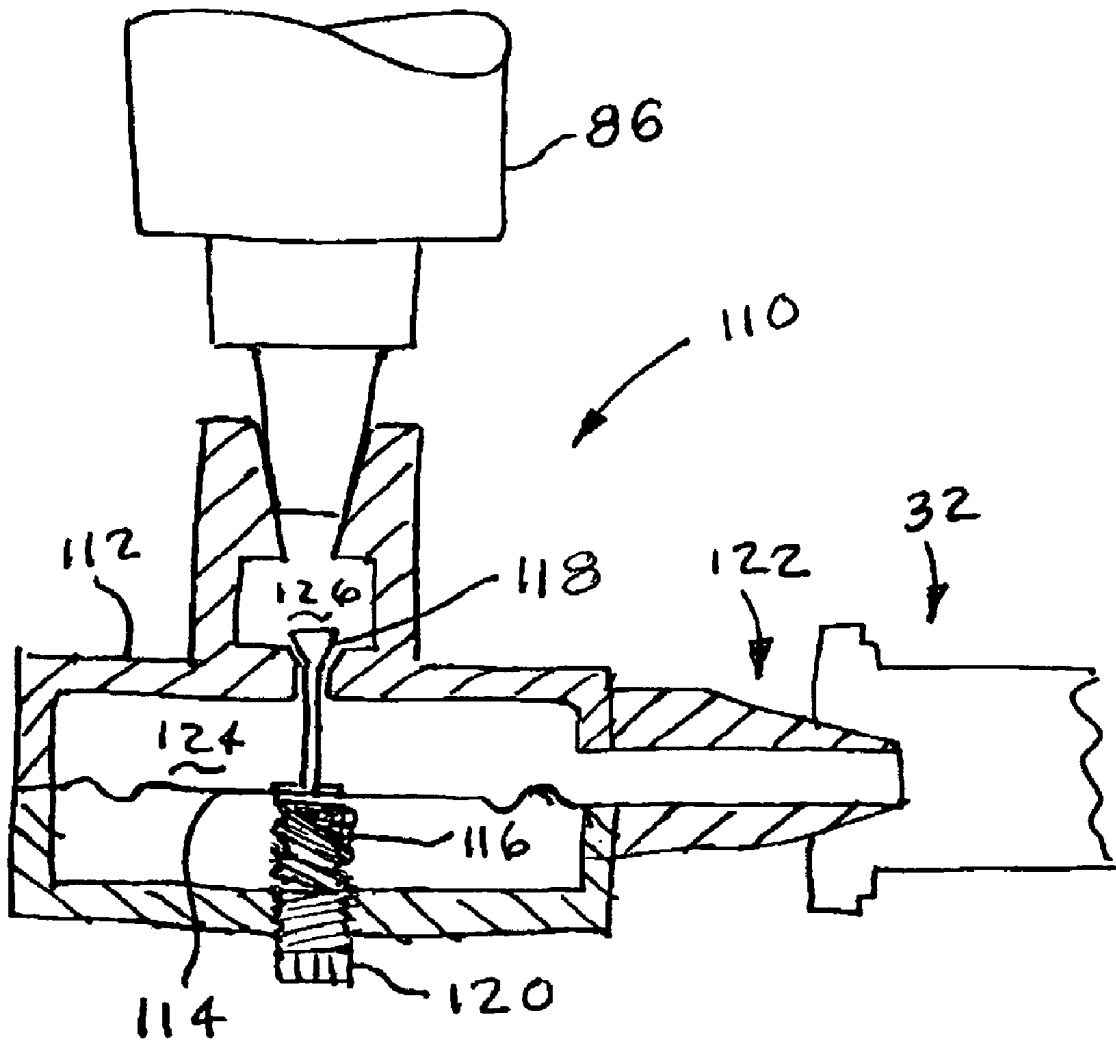

Figure 9

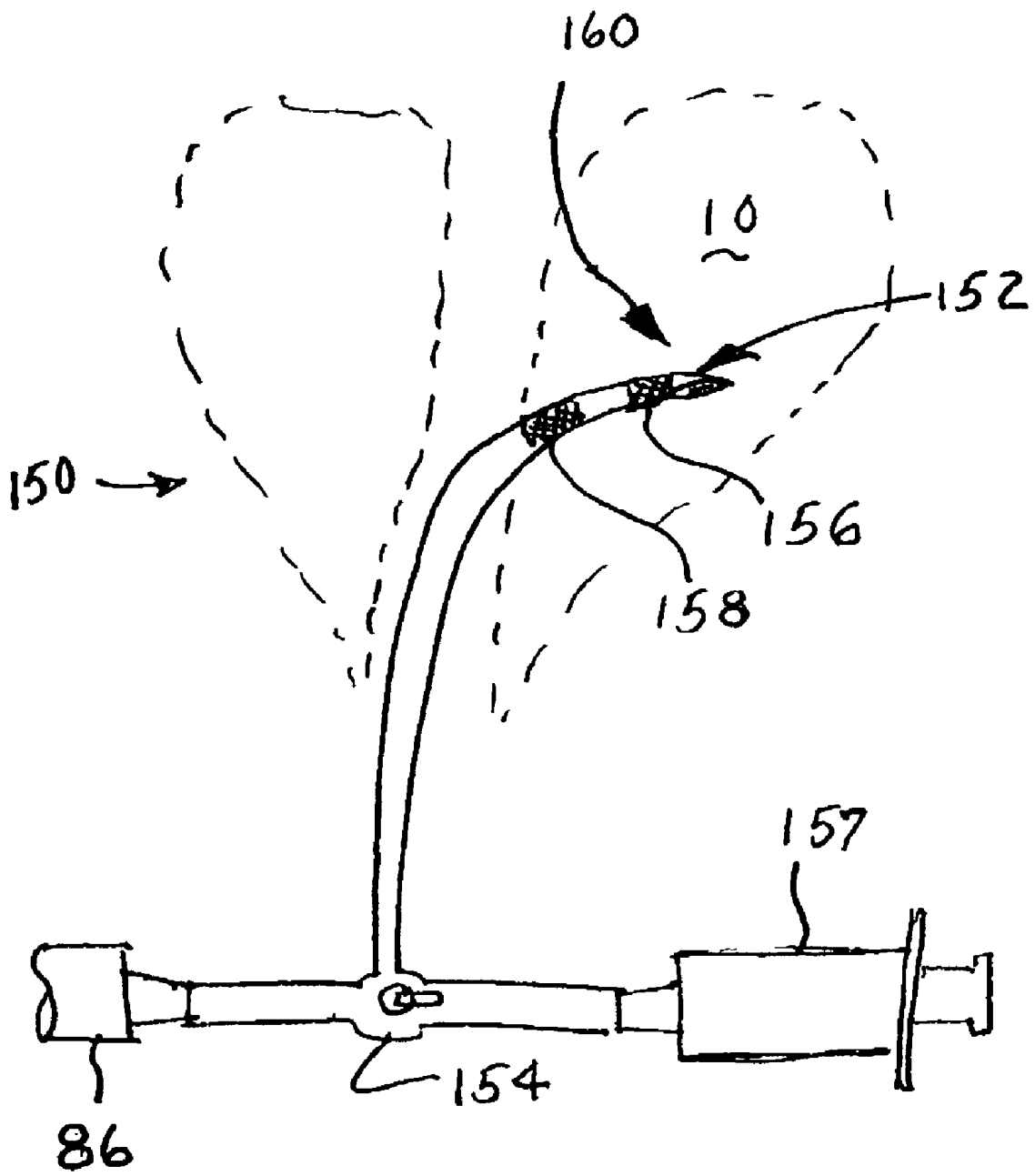
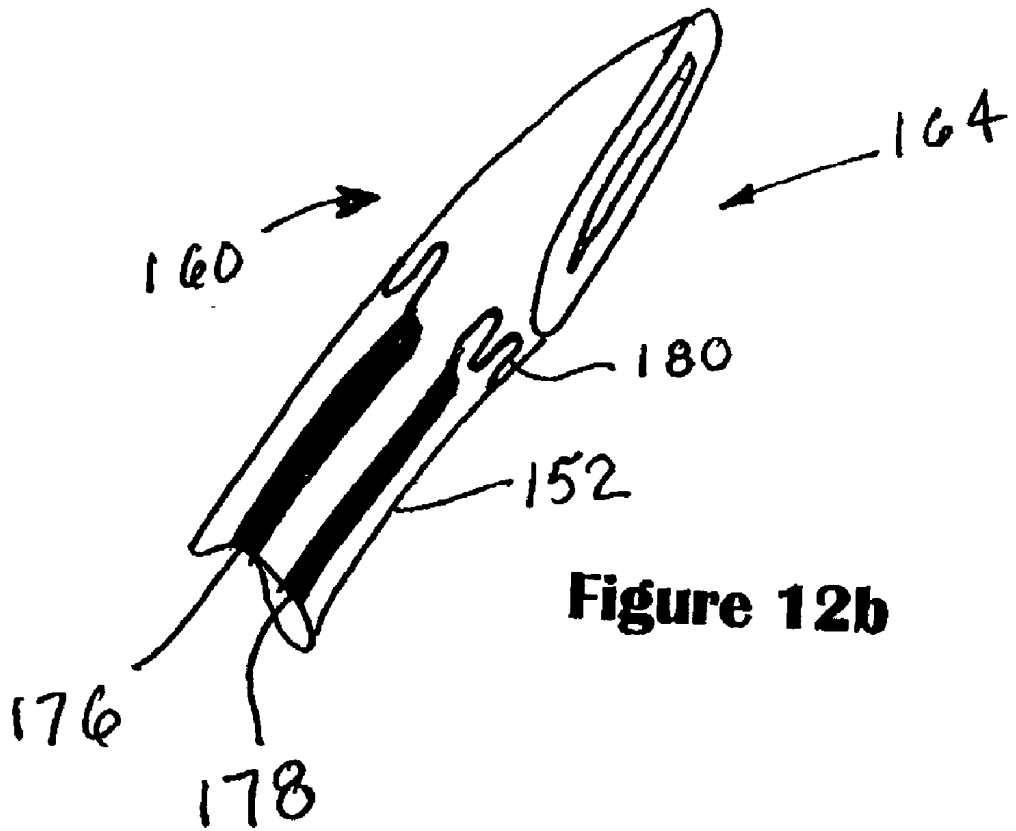
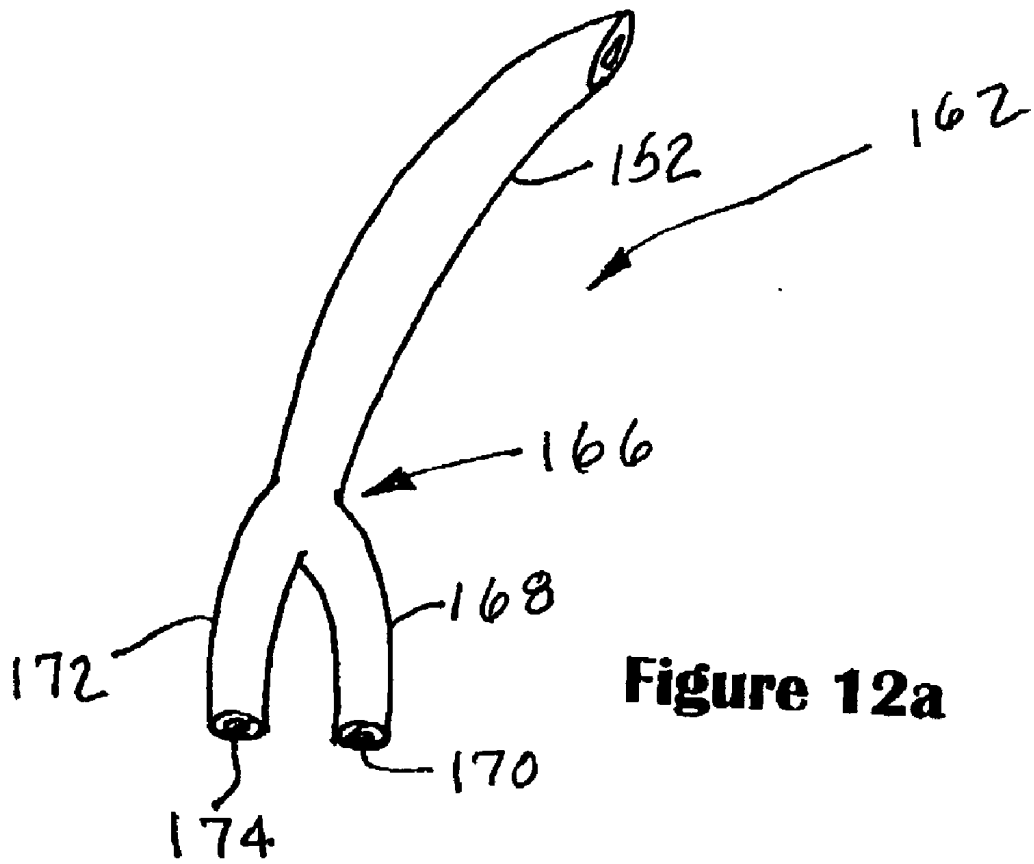
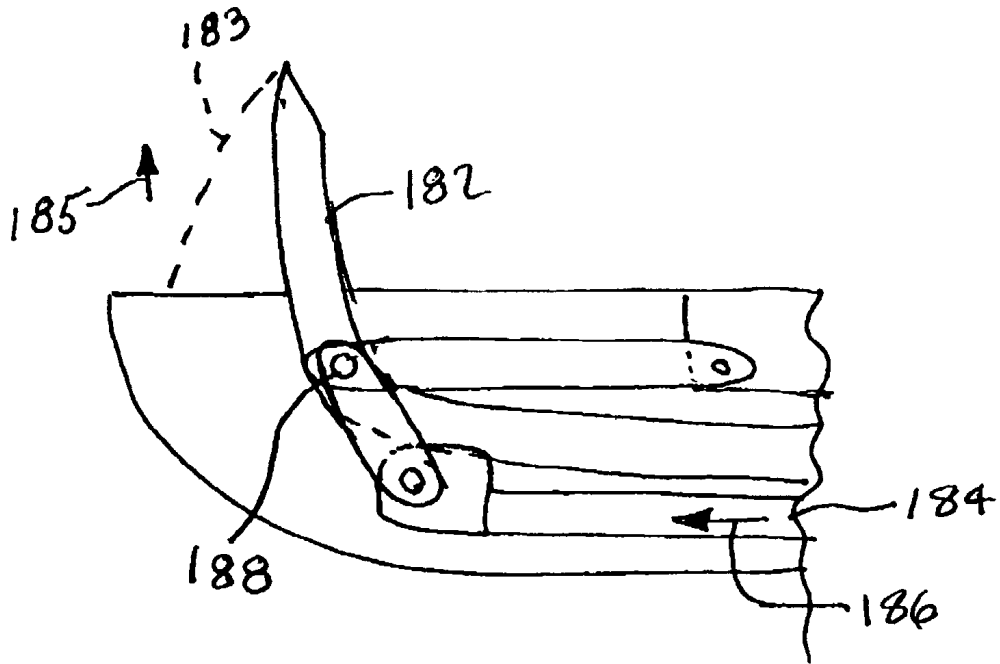
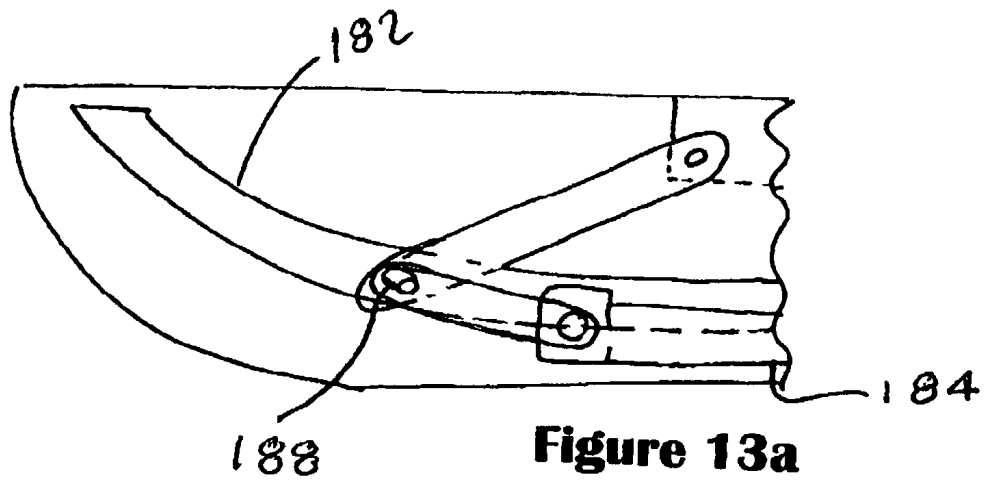

Figure 11





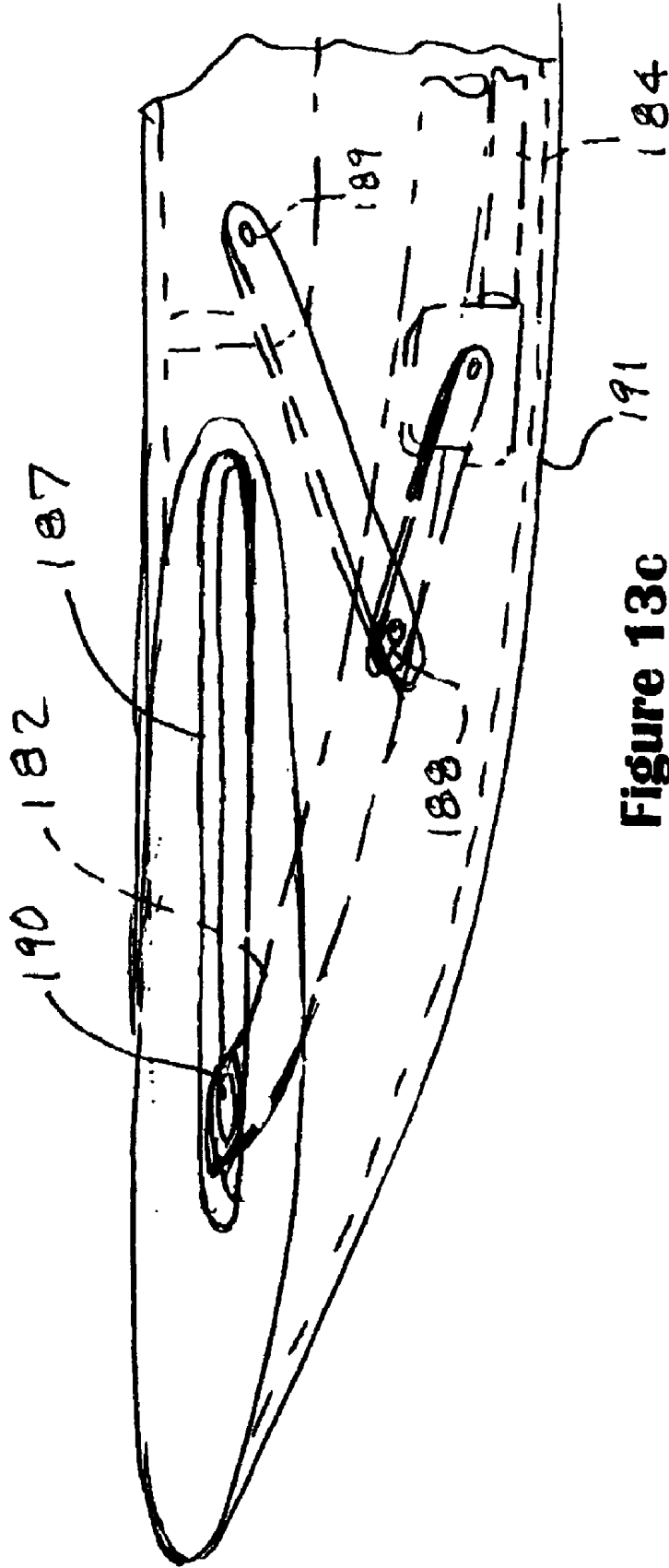

Figure 13C

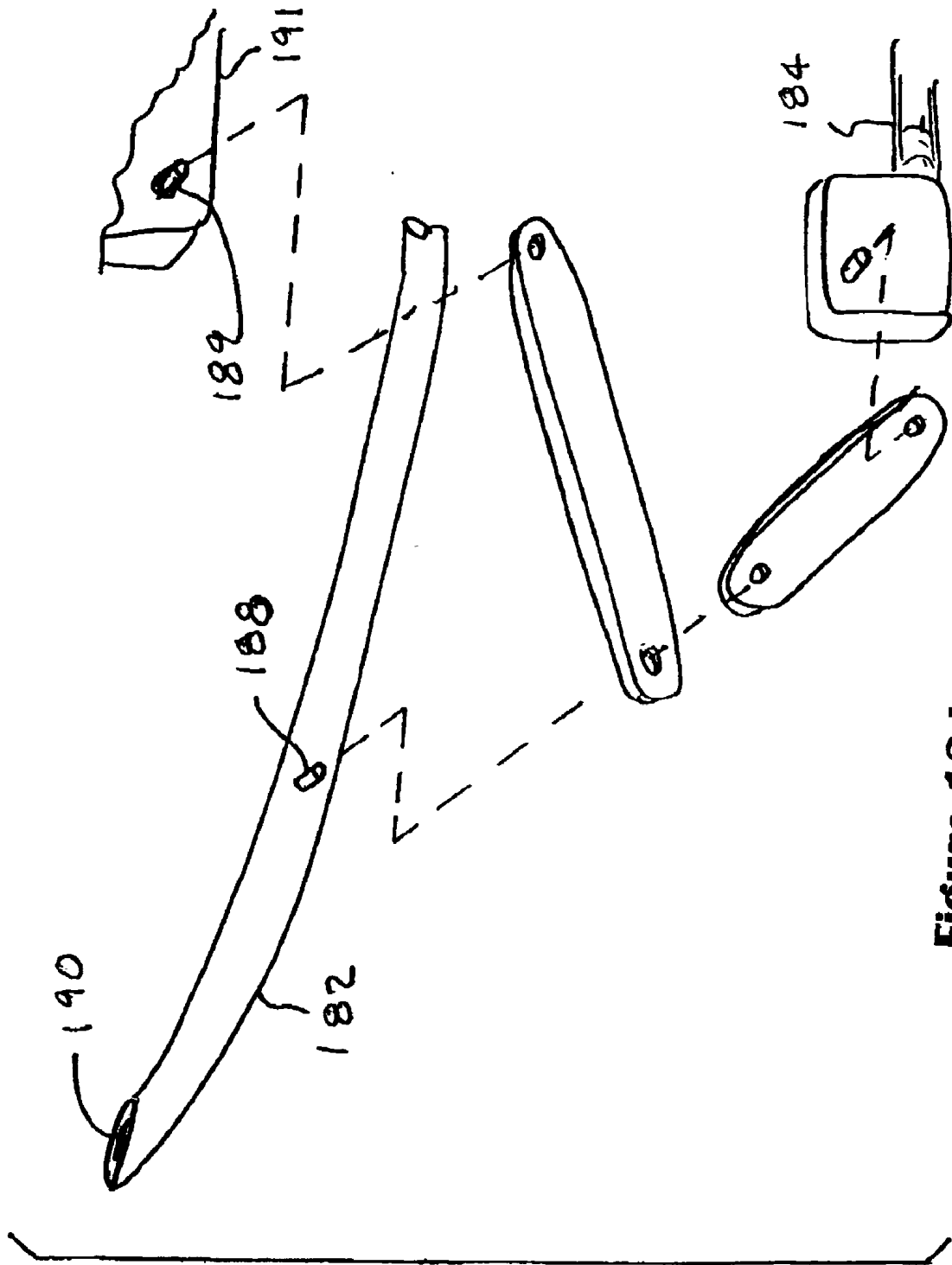

Figure 13d

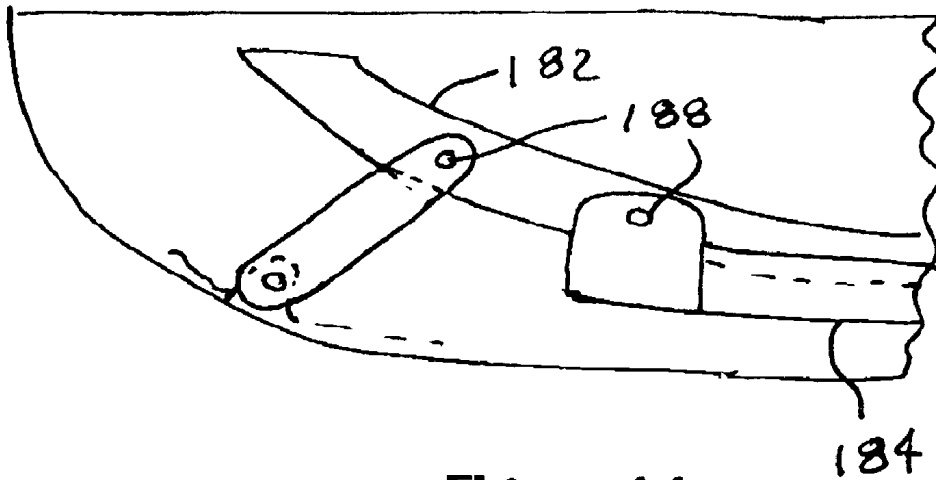

Figure 14a

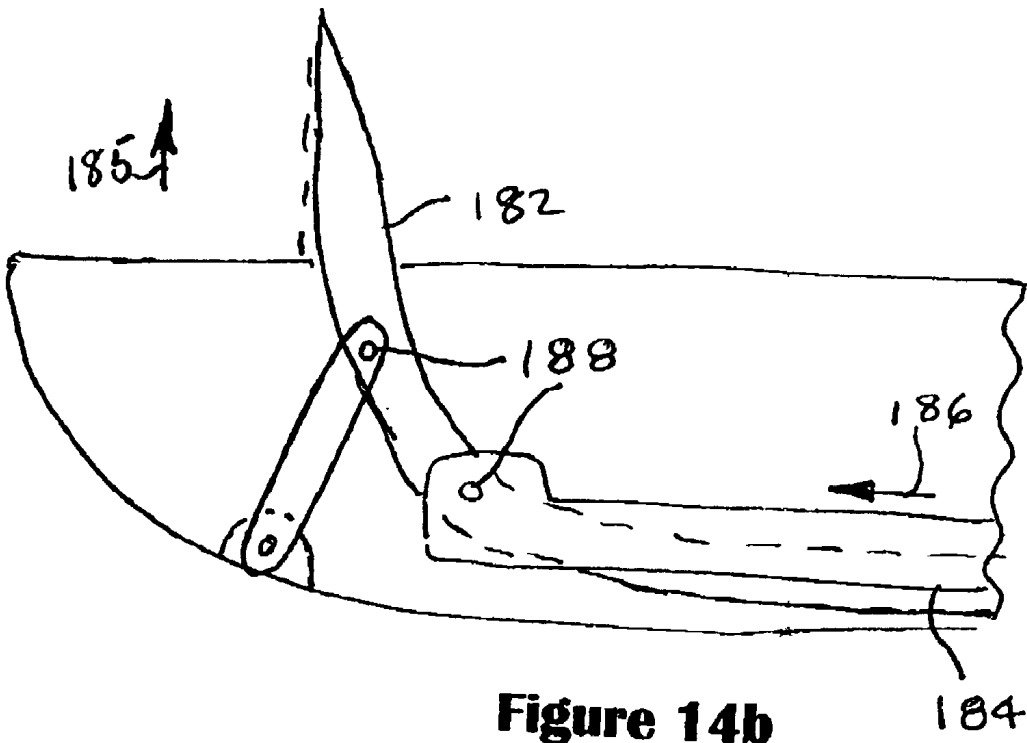
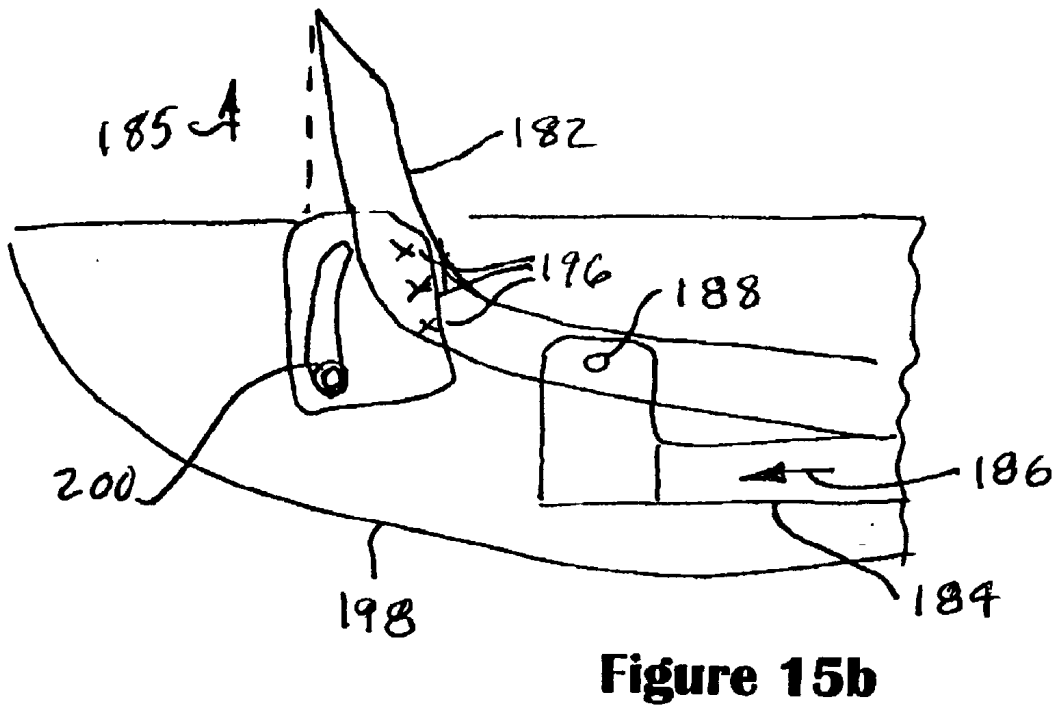
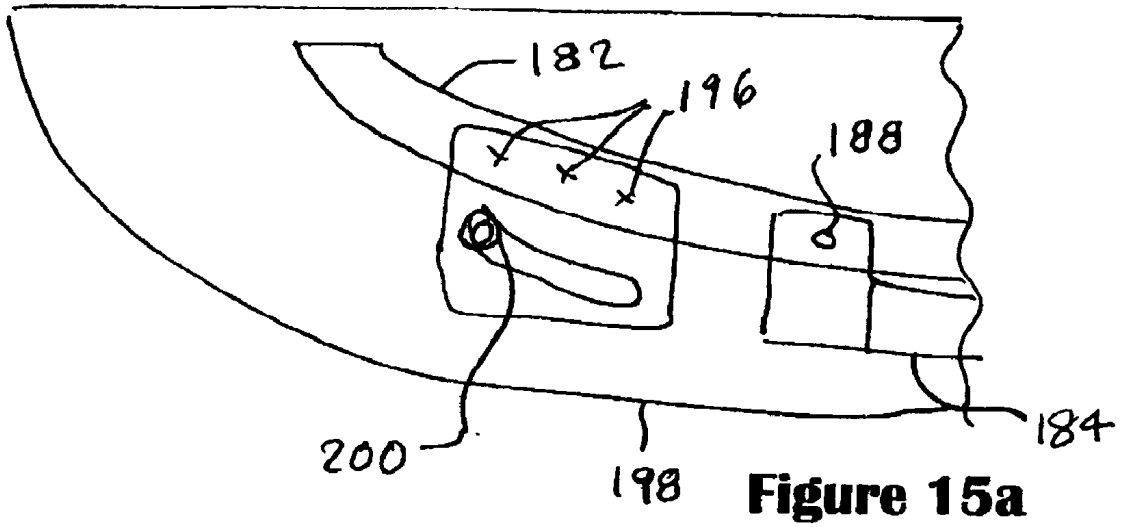
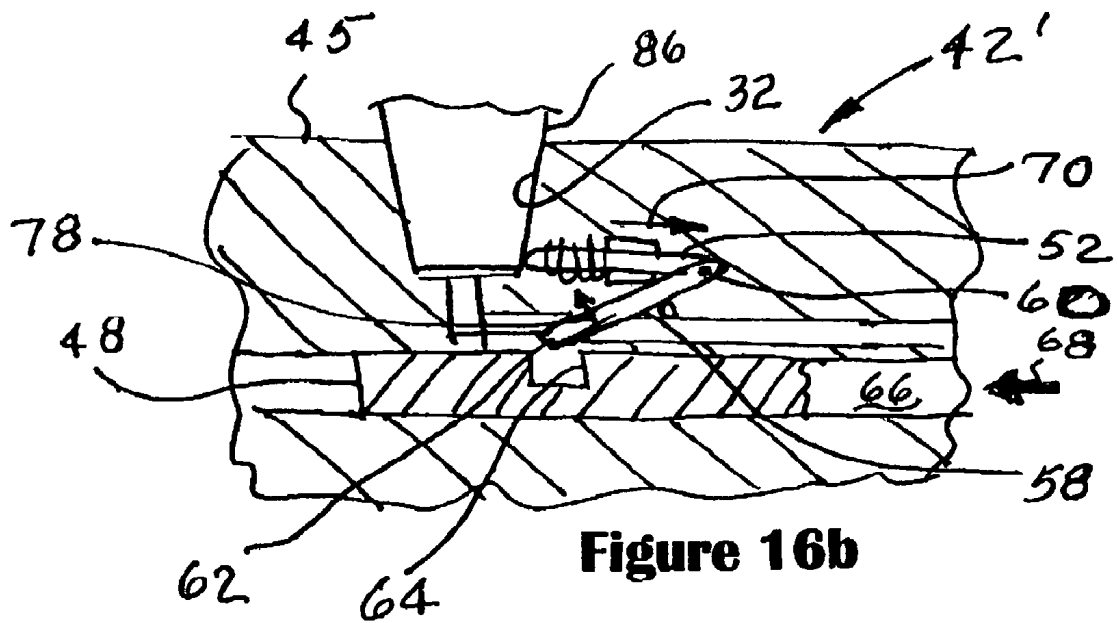
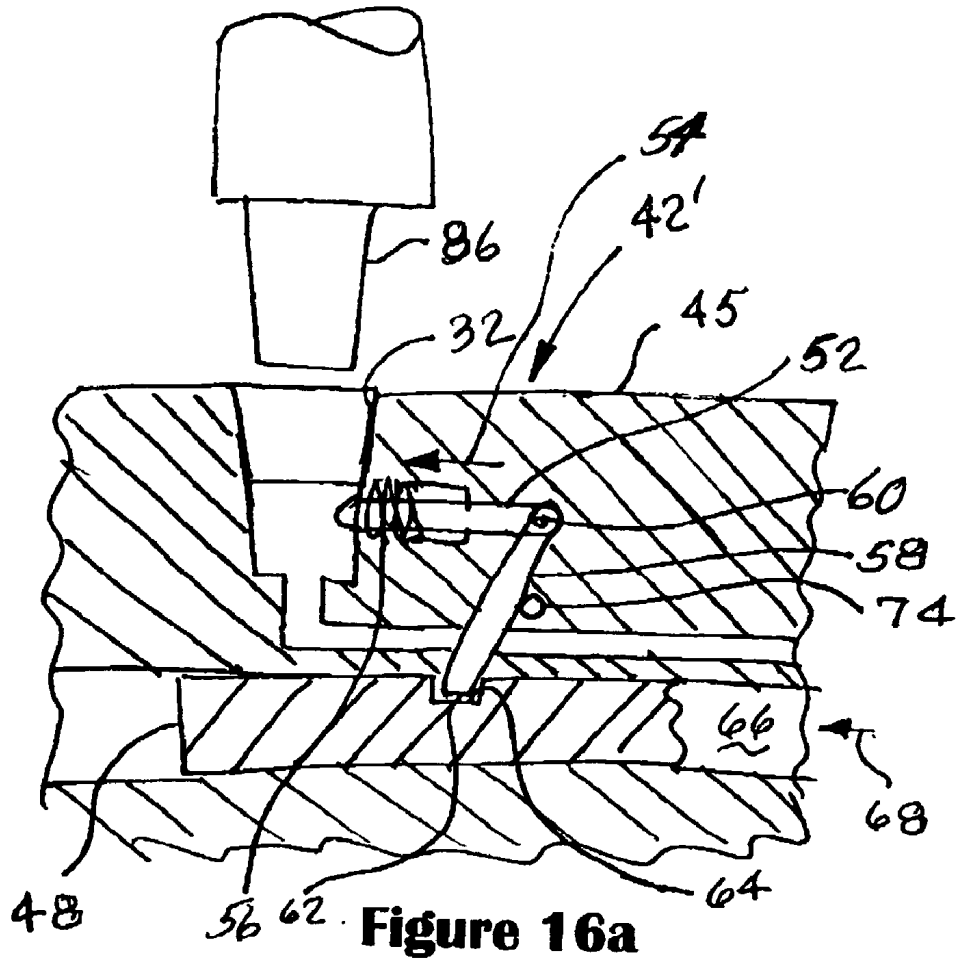

Figure 14b





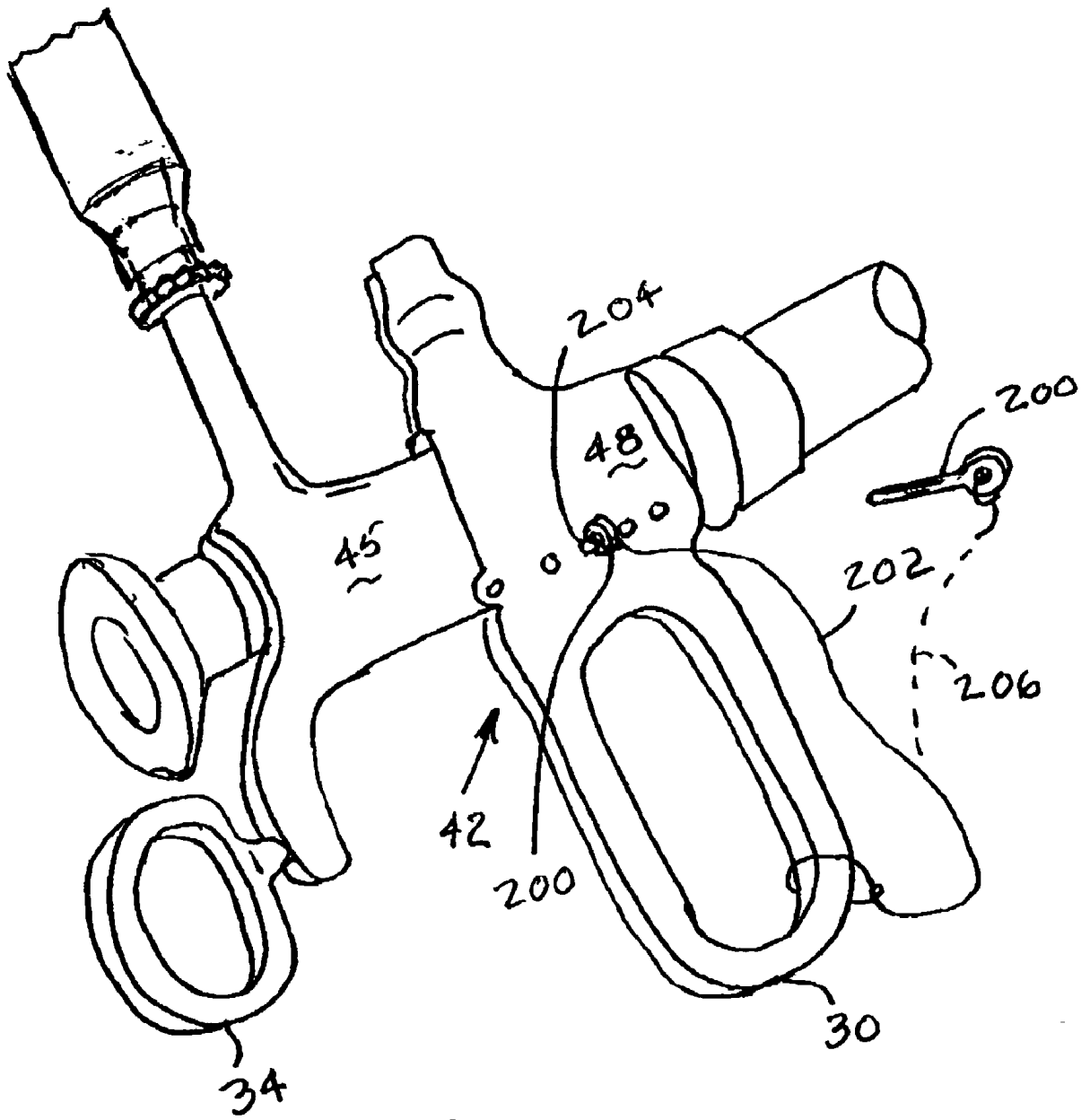

Figure 17

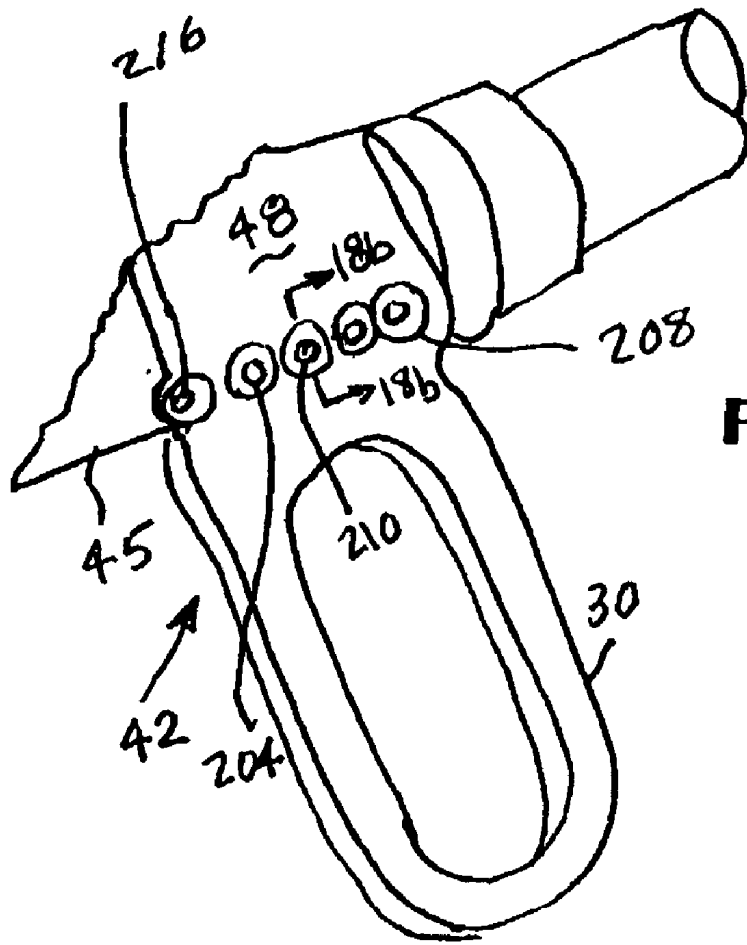

Figure 18a

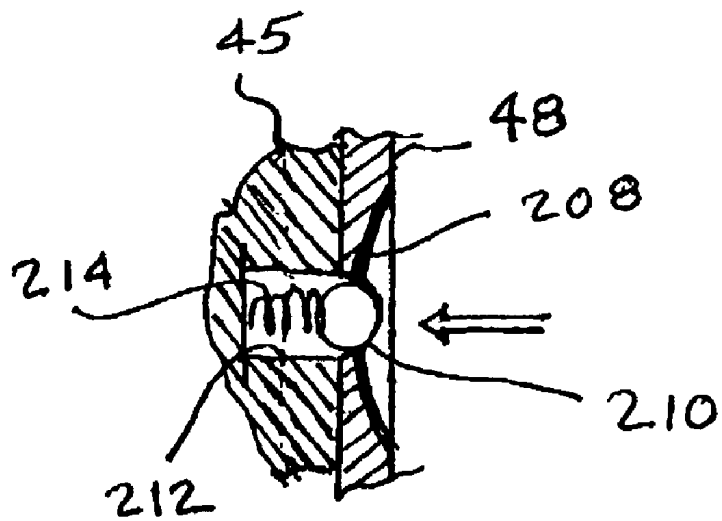

Figure 18b

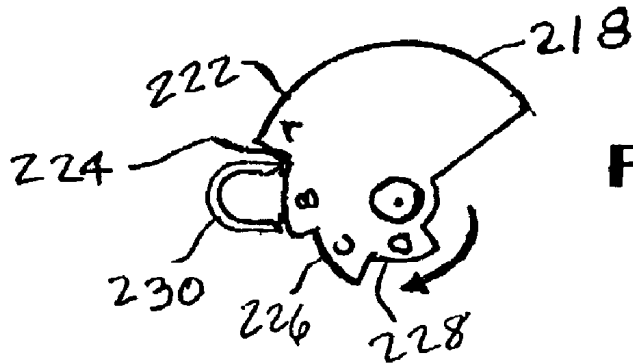

Figure 19b

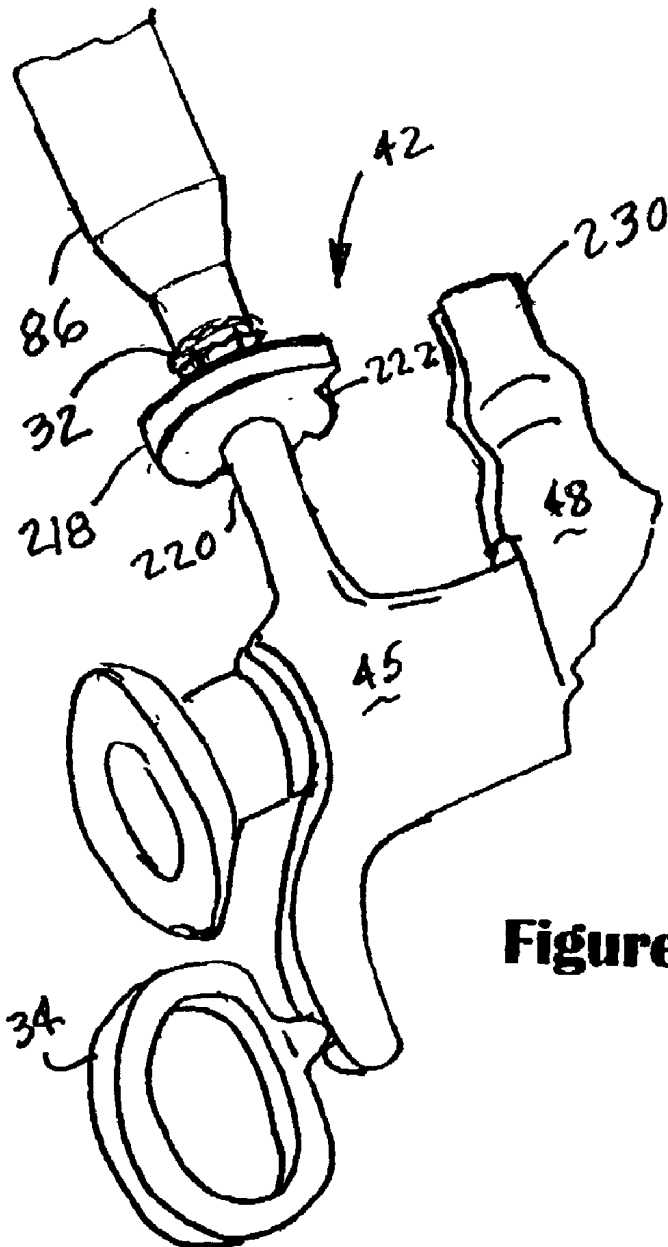

Figure 19a

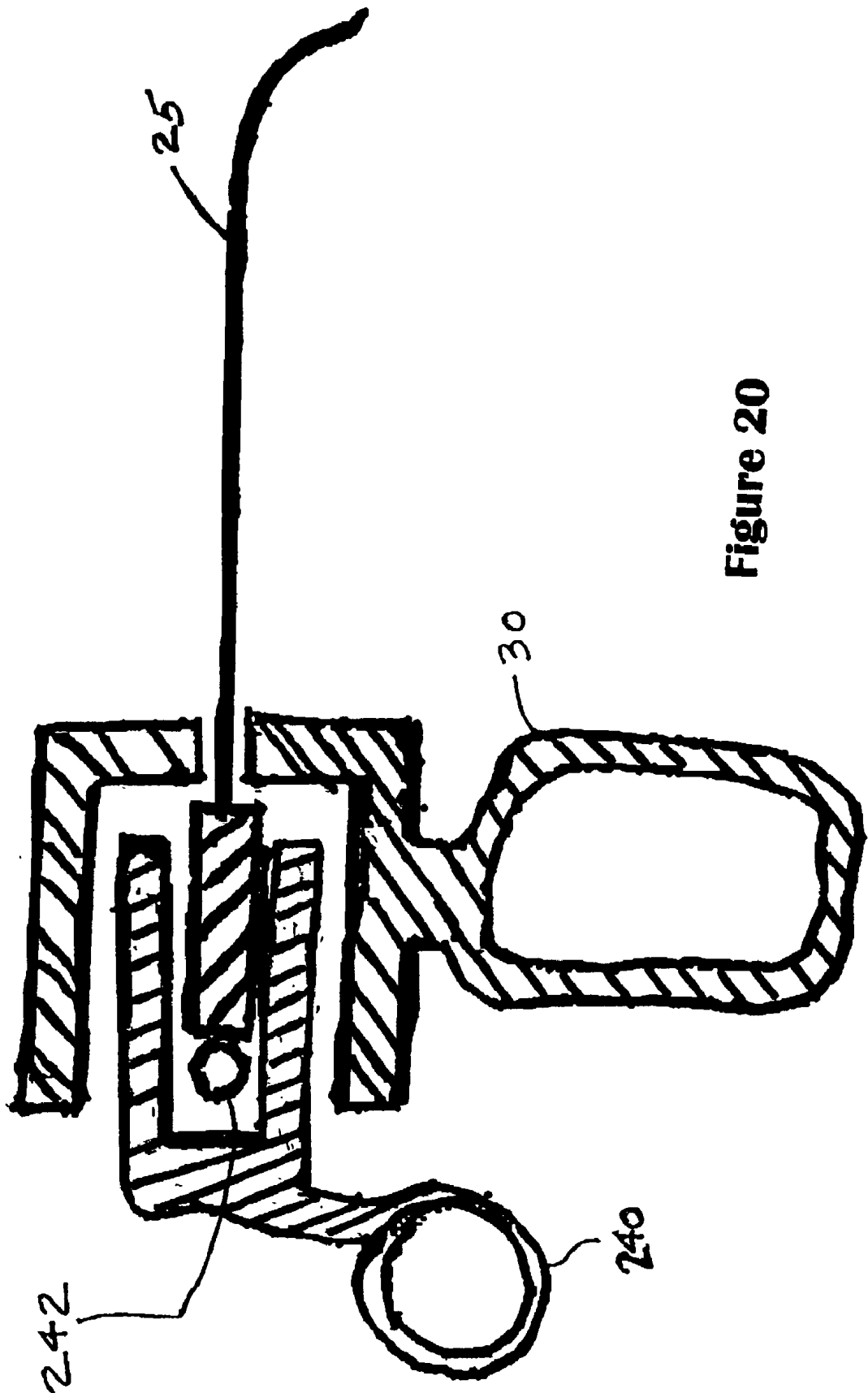

Figure 20

SURGICAL INSTRUMENT AND METHOD

CROSS REFERENCE TO RELATED APPLICATION

[0001] This application claims priority to provisional patent application 60/329,262 filed Oct. 12, 2001, the entire contents of which are expressly incorporated herein by reference.

BACKGROUND OF THE INVENTION

[0002] The present invention relates to surgical instruments and methods, particularly those for treating prostate tissue, and to surgical kits for use in such methods.

[0003] FIG. 1 illustrates the anatomical position of the prostate 10 (including lateral lobes 15) and adjacent tissue including the seminal vesicles 11, bladder neck 12, and pelvic tissues including sphincter muscles 14.

[0004] Prostate disease is a significant health risk for males. Diseases of the prostate include prostatitis, benign prostatic hyperplasia or hypertrophy (BPH) and prostatic carcinoma. Benign prostatic hypertrophy is a very common disorder, affecting an estimated 12 million men in the United States alone. BPH is a chronic condition and is strongly age related; approximately 50% of men over 50, 75% of men over the age of 70 and 90% of men over the age of 80 have BPH.

[0005] BPH is treated with a large number of therapeutic modalities. Transurethral resection of the prostate (TURP) is a preferred method of treating BPH. A typical TURP involves general anesthesia, and the placement of a resectoscope in the urethra to remove multiple small chips of hyperplastic prostatic tissue, thereby relieving the obstruction by removing the adenoma. Complications from TURP include bleeding, incontinence, retrograde ejaculation and impotence.

[0006] Examples of surgical devices for prostate tissue treatment are disclosed in U.S. Pat. Nos. 4,461,283; 5,672,171 and 5,630,794 and PCT International Publication Nos. WO 92/10142 and WO 93/15664 (the entire contents of each of which are herein incorporated by reference). Examples of invasive techniques that surgically damage prostate tissue include laser treatments (including side firing, contact and interstitial laser procedures), and transurethral ethanol ablation of the prostate (TEAP) as described in DiTrollo, J. V., *Transurethral Ablation of the Prostate*, presented at the American Urological Association 94th Annual Meeting, March 1999; and DiTrollo, J. V., *Chemoablation of the Prostate with Dehydrated Ethanol for Treatment of BPH*, 5th International Consultation on BPH, June 2000 in Paris, France (the entire contents of each of which are herein incorporated by reference). Examples of devices and methods for surgically damaging prostate tissue are disclosed in U.S. Pat. Nos. 5,322,503; 5,562,703; 5,861,002; 6,231,591 and 6,461,296.

BRIEF DESCRIPTION OF THE DRAWINGS

[0007] FIG. 1 is a schematic side view showing the anatomical location of prostate tissue.

[0008] FIG. 2 is a side view of a disassembled surgical instrument for use in a preferred embodiment of the present invention.

[0009] FIG. 3 is an enlarged side view of the surgical instrument of FIG. 2 in an assembled condition, that uses arrows to show the motion of elements of the surgical instrument during deployment of a needle.

[0010] FIG. 4 is a side view showing a surgical kit according to another aspect of the present invention.

[0011] FIG. 5 is a view of another variation of the surgical instrument according to the present invention.

[0012] FIG. 6 is a high pressure transurethral drug delivery embodiment of the present invention.

[0013] FIG. 7 is another variation of the embodiment of FIG. 6 to illustrate an additional surgical instrument and method according to the present invention.

[0014] FIG. 8 is an enlarged view of a portion of FIG. 7.

[0015] FIG. 9 is a view of an additional feature of the surgical instrument and method according to the present invention.

[0016] FIG. 10 is a view of still another feature of the surgical instrument and method according to the present invention.

[0017] FIG. 11 is a view of an arrangement to switch between ethanol and an echogenic agent useful in the practice of the present invention.

[0018] FIG. 12a is a perspective view of an alternative embodiment of the surgical instrument and method of the present invention.

[0019] FIG. 12b is an enlarged view of a portion of FIG. 12a.

[0020] FIG. 13a is a view of an alternative embodiment of a surgical instrument in a first position according to the present invention.

[0021] FIG. 13b is a view of the embodiment of FIG. 13a in a second position.

[0022] FIG. 13c is a perspective view corresponding to FIG. 13a.

[0023] FIG. 13d is an exploded view of the embodiment of FIG. 13c.

[0024] FIG. 14a is a view of an alternative embodiment of a surgical instrument in a first position according to the present invention.

[0025] FIG. 14b is a view of the embodiment of FIG. 14a in a second position.

[0026] FIG. 15a is a view of an alternative embodiment of a surgical instrument in a first position according to the present invention.

[0027] FIG. 15b is a view of the embodiment of FIG. 15a in a second position.

[0028] FIG. 16a is a view of a lockout arrangement according to an aspect of the present invention in a first, locked, position.

[0029] FIG. 16b is a view of the lockout arrangement of FIG. 16a in a second, unlocked, position.

[0030] FIG. 17 is a fragmentary view of the surgical instrument showing an alternative embodiment of a locking mechanism useful in the practice of the present invention.

[0031] FIG. 18a is fragmentary view of the surgical instrument showing an alternative embodiment of a locking mechanism useful in the practice of the present invention.

[0032] FIG. 18b is a detailed section view of a portion of FIG. 18a.

[0033] FIG. 19a is a fragmentary view of the surgical instrument showing a still further alternative embodiment of a locking mechanism useful in the practice of the present invention.

[0034] FIG. 19b is a plan view of the locking mechanism of FIG. 19a.

[0035] FIG. 20 is a fragmentary section view of an alternative embodiment of a de-coupling mechanism useful in the practice of the present invention.

DETAILED DESCRIPTION

[0036] FIGS. 2 and 3 show a preferred embodiment of surgical instrument 20 for use in treating prostate tissue by injecting an effective amount of an active ingredient (e.g. ethanol, acetic acid, phenol, Lidocaine, bulking agents, botox, oxybutenin, carboxylic acid). FIG. 2 shows the device 20 in an unassembled condition and FIG. 3 shows the device 20 in an assembled condition.

[0037] The device 20 includes a scope sheath 22 with eye port 21, a sheath 26 and a main body with a needle deployment port 24, handle 30 and thumb ring 34. The main body also includes an ethanol syringe port 32 that is designed to mate with a syringe 86. Preferably the syringe 86 has a threaded-Luer Lok® connector, as opposed to a bayonet syringe or a non-threaded Luer-Lok® connector. (Luer-Lok® is a registered trademark of Becton, Dickinson and Company.) Detents 28 are provided for precise needle advancement through auditory, visual and tactile confirmation of needle-tip position in a lobe of the prostate.

[0038] The surgical device 20 is preferably sized and shaped for transurethral entry under direct vision. Optionally, a conventional cystoscope 27 and sheath 26 for transurethral entry under direct vision may be utilized as a portion of a kit 40. Alternatively, the device may be sized and shaped for transrectal use. It is to be understood that kit 40 preferably includes device 20, syringe 86 and needle 76, and optionally includes a reservoir 72 of ethanol or other therapeutically effective agent.

[0039] The assembled device 20 is advanced into the prostatic urethra. The scope allows visual positioning of the needle port against the urethra adjacent to the lobe of the prostate to be treated. The needle is advanced (as shown in the arrows in FIG. 3) one detent click at a time (e.g. 0.5 cm) to place the needle tip in the adenoma. A small volume (e.g. 3 to 5 ml) of an active ingredient such as anhydrous alcohol (ethanol) is slowly injected into the tissue. The urethral lumen may be continuously irrigated while the ethanol is being administered.

[0040] The needle may then be withdrawn and the device 20 is removed from the sheath. The system may be rotated to target the next transurethral access point. An injection

may be made to each lateral lobe of the prostate and in cases with median lobe enlargement, an injection may be made to the median lobe of the prostate. In cases of longer prostatic urethra, a second plane of injections may optional be administered. For example, a total amount of about 13 ml may be the average amount of ethanol injected per patient.

[0041] The total dosage of ethanol will depend on a variety of factors including, but not limited to the size of the prostate, the shape of the prostate (e.g. length and width), the number of injection sites determined, and the nature and degree of prostate disease. The amount of ethanol could range from one or two mls to about 20 mls or more.

[0042] Optionally, the method may include other steps commensurate with the physician's treatment strategy. Also optionally, other therapeutically effective agents may be used with the surgical devices according to the present invention, including the substances described in U.S. patent application Ser. No. 10/193,716, filed Jul. 9, 2002 with the title REGIMEN FOR TREATING PROSTATE TISSUE AND SURGICAL KIT FOR USE IN THE REGIMEN, the entire contents of which are hereby incorporated by reference.

[0043] In another embodiment, the ethanol may be combined with another agent that enhances delivery and distribution of the ethanol within the prostate tissue. More preferably, the agent may more effectively disperse the ethanol in the vasculature of the prostate tissue. For example, the ethanol may be combined with GELFOAM® Sterile Powder, available from Pharmacia & Upjohn of Kalamazoo, Mich. The GELFOAM powder is believed to enhance the retention of the ethanol within the prostate tissue and to more effectively deliver the ethanol to the capillaries associated with the prostate tissue. Alternatively, the ethanol may be combined with a means for enhancing visualization of the ethanol. For example, the agent may comprise a dye for enhancing visualization of the ethanol. Better visualization of the ethanol may assist some surgeons in more effectively delivering the ethanol to the prostate tissue and avoiding undesirable backflow.

[0044] In a preferred embodiment, the needle deployment port 24 is designed to afford a complete view of the entire needle at all points of deployment.

[0045] In another aspect, the present invention comprises the kit 40 for treating a human male. The kit 40 may comprise a surgical kit. FIG. 4 illustrates one example of a surgical kit 40 according to the present invention. The kit 40 includes a surgical device for damaging, treating or therapeutically affecting prostate tissue according to the present invention.

[0046] The kit 40 includes the surgical device 20 described in conjunction with FIGS. 2 and 3. The device 20 includes a cystoscope 27 having a scope sheath 22 with eye port 21, a sheath 26 and a light cord connector 29. Device 20 also includes main body 31 with a needle deployment port 24, needle 25, handle 30 and thumb ring 34. The main body 31 also includes an ethanol syringe port 32 with a threaded Luer-Lok® feature. Detents 28 are also provided.

[0047] Notably, the present invention is suitable for use in two piece assemblies in contrast to the three piece assembly shown in FIG. 2. For example, the function of the sheath 26 and main body 31 could be combined into a unitary piece

that is designed to operate in conjunction with endoscope 27. Also notably, the assembly may comprise a rigid assembly with, for example, a rigid sheath 26 and scope 27. Alternatively, the present invention includes embodiments that include flexible assemblies, including, for example, flexible scopes 27 and flexible sheaths 26.

[0048] The kit 40 also includes a supply or reservoir 72 of a therapeutically effective substance such as ethanol or a bulking agent. Needle 76 and syringe 86 are provided to load the ethanol into syringe 86 from reservoir 72. The syringe 86 may then be used to deliver ethanol 72 through the needle 25 during a surgical procedure. Preferably, the delivery is transurethral. In operation, thumb ring 34 and handle 30 are manually grasped and drawn together in the direction indicated by arrow 37, causing needle 25 to advance in the direction of arrow 39. It is to be understood that the detents 28 may be used to stop advancement of needle 25 at predetermined distances set by the location of the individual elements of the detents 28. Once the needle 25 is advanced to the desired position within the prostate 10, syringe 86 is operated to deliver ethanol via needle 25 to the prostate 10, as desired. When delivery of ethanol is complete, thumb ring 34 is manually fully retracted away from handle 30 in a direction opposite to arrow 37, causing needle 25 to retract into the needle deployment port 24 in a direction opposite to arrow 39.

[0049] In another embodiment, the thumb ring 34 may be biased toward the position where the needle is fully retracted.

[0050] The elements of the kit may be packaged and sterilized together, or they may be separately packaged and sterilized and assembled into a kit at a later date.

[0051] Referring to FIG. 5, a lockout release 42 can be added to the surgical instrument of FIGS. 2-4 to prevent premature deployment of the needle 25. The lockout release 42 can be a button 44 which is spring loaded and will automatically re-lock when the needle is retracted. When button 44 is in the position shown in FIG. 5, button 44 will prevent advancement of the needle 25 via movement of a slide 45 because of interference with edge 46 of a frame 48 of the handle or finger grip 30 of a modified Prostaject device 50. (Prostaject devices are available from American Medical Systems, Inc. of Minnetonka, Minn., U.S.A.). There are a number of possible ways to implement the concept, all involving the means to prevent or inhibit the relative motion between the handle/cystoscope and the slide/needle. The means to prevent or inhibit this movement can be removed by actuating a button when the physician is ready to advance the needle. The button will re-set when the needle is retracted. Because the force needed to insert the device transurethral is in the same direction as the force needed to advance the needle 25, there is a chance that the needle 25 can be prematurely deployed, causing a hazard to the patient. This device (the lockout release 42) will prevent this from happening. There are a variety of ways of implementing this concept, but all result in a structure that prevents or inhibits movement of the slide 45 relative to the front handle 30 and frame 48.

[0052] In another embodiment, a lockout assembly may be added to ethanol syringe port 32 that prevents or inhibits advancement of the needle (by advancing thumb ring 34) without a syringe 86 inserted in the syringe port 32. FIGS.

16a and 16b schematically illustrate a lockout release or assembly 42" in both the locking and release positions. Although not shown in FIGS. 16a and 16b, it is to be understood that syringe 86 is a Luer-Lok® type syringe. In FIG. 16a, the lockout assembly 42" is shown in a blocking position where a first lockout arm or member 52 is urged in the direction of arrow 54 by a spring 56 acting against slide 45. A second lockout arm or member 58 is connected to the first lockout arm 52 at a pivot 60. A distal end 62 of member 58 engages a blocking topology or notch 64 in an actuation member 66 which is operatively associated with the frame 48 and finger grip 30. In FIG. 16a it may be seen that slide 45 is blocked (i.e., in a blocking condition) from advancing in the direction of arrow 68 by the interengagement of end 62 and notch 64. In FIG. 16b, a release position or condition may be seen in which the syringe 86 urges first member 52 in the direction of arrow 70 acting against spring 56 and causing member 58 to pivot against a fixed point or fulcrum 74 in slide 45, moving in the direction of arrow 78 to move distal end 62 out of engagement with member 66, allowing movement of slide 45 in the direction of arrow 68.

[0053] In another aspect, the present invention comprises a surgical instrument that includes a means to allow for visualization of a drug or the needle used to administer the drug that is injected into target tissue such as the prostate gland. The invention can be divided into categories of ways to make the needle more visible on ultrasound and ways to make the fluid delivered more visible.

[0054] Another aspect of the present invention is shown in FIGS. 6 through 8. In this aspect, the present invention comprises a method with the step of injecting a drug into the prostate using a high-pressure needle-less injection system 80. A novel device 82 forms an aspect of the present invention and can operate independently or with a cystoscope 27 for transurethral delivery of ethanol 84 into the prostate 10. Advantages over a needle delivery system could include better depth of penetration control, containment within the prostate capsule, better volume delivery (minimize extravasation), faster procedure, less pain, and possible bubble formation or bubble injection for visualization in TRUS (transrectal ultrasound). As an alternative, an echogenic substance can be added to the ethanol to enable visualization during the procedure to assess penetration depth.

[0055] In FIG. 6, ethanol 84 is injected into the prostate 10 by high pressure needle-less means 88, preferably in the form of an aperture 90 delivering high pressure ethanol to a site adjacent the prostate transurethral. This would have the advantages mentioned over a needle system and would be expected to further include better depth of ethanol penetration control. Optionally, a balloon may be used to press the means 88 against urethral tissue to ensure suitable contact between the means 88 and the urethral tissue.

[0056] FIG. 7 shows a variation of this approach in which a clear plastic or polymer injection head 92 located adjacent a portion of the prostate 10. A high pressure fluid delivery tube 94 is connected to head 92. Borescope 22 is located within the cystoscope sheath 26 along with tube 94. In operation, head 92 is positioned as desired using the borescope 22 for visual observation while manipulating the sheath 26. A nozzle 100 delivers high pressure ethanol 84, with echogenic bubbles 102, if desired. Optionally, a visu-

ally perceptible marker may be placed on or in the head **92** to indicate its position. A urethral balloon may also be used with this embodiment of the present invention.

[0057] Referring now also to **FIG. 8**, an enlarged view of the injection head **92** may be seen. In this view, it may be seen that the nozzle **100** has a first inlet **104** connected to tube **94** for delivering a chemical agent such as ethanol under high pressure. Nozzle **100** also has a second inlet **106** connected to a gas delivery tube **108** for introducing pressurized gas to form bubbles **102** as an echogenic agent in the prostate tissue **10**.

[0058] **FIGS. 9 and 10** illustrate other aspects of the present invention. These aspects of the surgical instrument **20** include means to either limit injection pressures to predetermined or desired levels during a transurethral ablation of the prostate (TEAP) procedure or features to indicate when unacceptably high pressures are reached.

[0059] **FIG. 9** is a pressure limiter **110** for ethanol injection. A Luer-Lok® type syringe **86** is connected to a housing **112** containing a pressure sensing diaphragm **114**, biased by a spring **116** to hold a shut-off valve **118** in an open position as shown. An (optional) adjustment screw **120** may be used to set the pressure at which valve **118** closes. The output **122** of the pressure limiter **110** is connected to the ethanol syringe port **32** of the Prostaject device **50**. The in-line pressure limiting valve can be used to prevent injection pressures from exceeding acceptable levels during TEAP procedures. If pressures become excessive at the injection site, extravasation can result or rapid flow can occur along tissue planes that allows the ethanol to miss the intended target. In operation, when the force resulting from pressure inside housing **112** in chamber **124** exerted on diaphragm **114** exceeds the force resulting from spring **116**, diaphragm **114** will move towards screw **120**, closing valve **118**. Valve **118** will remain closed for as long as sufficient pressure exists in chamber **126** to cause a force on valve **118** to remain closed against the force of spring **116**. Once the pressure in chamber **126** is reduced, the force from spring **116** will open valve **118**, and allow fluid to flow from chamber **126** to chamber **124** and outlet **122**.

[0060] Referring now to **FIG. 10**, a pressure indicator **130** may be seen. Indicator assembly **130** preferably has an inlet fitting **132** for receiving a Luer Lok® syringe **86** and an outlet fitting **134** for coupling to the Luer Lok® compatible ethanol syringe port **32** on an Prostaject device **50**. It is to be understood that fittings **132** and **134** are shown in simplified form, without Luer Lok® details. Inlet and outlet fittings **132**, **134** are preferably formed integrally with a housing **136** which defines a passage **137** connecting inlet **132** to outlet **134**. Housing **136** further includes a cylinder **138** carrying a piston **140** having an O-ring seal **142** sealing the piston **140** against the cylinder **138**. Piston **140** also has a rod or stem **144** carrying a visually perceptible indicator or flag **146** at a distal end thereof. Indicator housing **136** also contains a spring **148** urging piston **140** to a retracted position, shown in solid lines in **FIG. 10**, in which flag **146** is concealed within housing **136**. In operation, as pressures reach unacceptable levels (e.g., during a TEAP procedure), the moving rod **144** will extend, working against the preset force of spring **148**. The flag **146** will then extend beyond housing **134**, and indicate to the physician that pressures have exceeded acceptable levels. A groove **139** extends part way

along the cylinder **138** in housing **136** to allow fluid to bleed past the piston and O-ring seal **142** in the event a predetermined maximum pressure level is reached. The groove **139** begins at a starting point **141** and extends a distance along the cylinder such that the liquid drug will leak past the piston **140** and O-ring seal **142** via the groove **139** when a predetermined maximum pressure level is reached within the passage **137** causing the piston **140** to move against the spring **148** a distance sufficient to move the piston past the starting point **141** of the groove **139**.

[0061] **FIGS. 11, 12a and 12b** illustrate additional aspects of the surgical instrument and method according to the present invention. These aspects include means for making the needle more visible including the following. 1) The needle can be sandblasted to improve the ability to identify its location via ultrasound. 2) The needle can have a thin film conductor deposited over a dielectric for the purpose of operating a resistor for generating heat or a piezoelectric driver for generating ultrasonic vibration that could be detected via ultrasound imaging. The dielectric capacitance and length of strip create a L-C monopole or bipolar antenna emitting a frequency spectrum to be picked up by external receiver and/or alternatively by ultrasound probe. 3) Echogenic materials could be injected after the needle is inserted into the prostate to verify needle position via TRUS. The ethanol (or other drug) could then be injected. The echogenic materials could include microspheres in a fluid medium, gas bubbles or solid particles suspended in solutions. 4) The echogenic materials could be added to the drug and injected simultaneously either through mixing them before injection or using a double-barreled syringe and having them mix in the needle as seen in **FIG. 11**.

[0062] Notably, the surgical device may optionally include an ultrasonic transducer (e.g. on or near the needle), to enhance the dispersion of the injected substance within the tissue. In another embodiment, the surgical needle may include a coating (e.g. on the needle) of Echo-Coat® material (available from STS Biopolymers Inc.) for better visualization and control.

[0063] **FIG. 11** shows a simplified view of an ethanol injection visualization **150** with a number of parts of the surgical instrument **20** omitted for simplicity. In this visualization, a cannula **152** is connected to a manual device or valve **154** for switching between an echogenic agent and the ethanol. One or more sand blasted surfaces in the form of bands **156**, **158** are located at a distal end **160** of the cannula **152** in order to identify the needle tip and/or the location of injection of ethanol into the prostate **10**. Several means can be employed: 1) The drawing of **FIG. 11** shows a two-syringe system that could inject an agent visible on ultrasound first using the echogenic agent syringe **157**, then inject the ethanol using the ethanol syringe **86** after the position has been identified. The echogenic agent could include microspheres, solid particles in suspension, bubbles, fluids different in density from water, etc. 2) The needle itself can be modified to have better visualization on ultrasound. One way to accomplish this is to roughen the surface of the needle using sandblasting (as shown in **FIG. 11**) or other means, as illustrated in **FIG. 12b**.

[0064] **FIGS. 12a and 12b** show further ethanol injection visualizations **162**, **164**. **FIG. 12a** illustrates a means to inject a drug (ethanol) in combination with an echogenic

marker or radio-opaque marker simultaneously using a Y-connection 166 where the fluids mix, coming from a first tube 168 having a lumen 170 carrying the ethanol and a second tube 172 having a lumen 174 carrying the echogenic agent, both of which are connected via the Y-connection 166 to the cannula 152. FIG. 12b illustrates an alternative embodiment of cannula 152 having first and second thin film conductors 176, 178 connected near the distal end 160 of cannula 152 to a resistor 180 or thin film/MEMS to produce a temperature signal or a piezo oscillator to produce an ultrasonic beacon.

[0065] FIGS. 13a through 15b are views of additional embodiments of surgical instruments and methods according to the present invention. These embodiments have a mechanism for raising the needle 25 in a perpendicular or substantially perpendicular fashion relative to the sides of a needle deployment port. Optionally, an infrared or other light spot may be projected perpendicular to the sheath to the location in the body that would receive the needle. This feature would allow the surgeon to presight or target the specific tissue to be treated.

[0066] FIGS. 13a, 13b, 13c, 13d, 14a, 14b, 15a and 15b show various embodiments of the present invention which have structure for raising the needle in perpendicular or substantially perpendicular direction to the longitudinal axis of the device. Moving the needle in this fashion is believed to provide better control over placement of the needle and thus, the injectable substance. Assemblies for raising a structure in a direction that is perpendicular or substantially perpendicular to the longitudinal axis of a surgical device are described in U.S. Pat. No. 5,306,284 to Agee et al., the contents of which are incorporated herein by reference.

[0067] FIGS. 13a and 13b illustrate an embodiment having needle 182 operated by a pusher 184, which moves in the direction of arrow 186 to raise the needle 182 along path 183 and in the general direction of arrow 185. FIG. 13c is a perspective view corresponding to FIG. 13a, and FIG. 13d is an exploded view of this embodiment. It is to be understood that one or more trunnions 188 project out from needle 182 without blocking or providing a leak path with respect to the lumen 190 interior of needle 182. In FIGS. 13c and 13d it is to be understood that pivot pin 189 is secured to a housing 191 of the assembly. In FIG. 13c the needle 182 is guided by a slot 187 to avoid urethral damage that might otherwise occur due to excessive needle displacement. Furthermore, such a slot guide is expected to reduce the potential for high backflow due to low resistance with an enlarged opening that could reduce the effectiveness of the treatment using the apparatus or method of the present invention. FIGS. 14a and 14b illustrate another embodiment having needle 182 operated by pusher 184, with at least two trunnions 188 on needle 182. Pusher 184 is moved in the direction of arrow 186 to raise needle 182 generally in the direction of arrow 185. FIG. 15a and 15b illustrate still another embodiment having needle 182 operated by pusher 184 via trunnion 188 on needle 182. Pusher 184 is pushed in the direction of arrow 186 to raise needle 182 generally in the direction of arrow 185. In this embodiment, a plate 192 having a curved slot 194 is fastened to needle 182 by conventional means such as welding 196. Slot 194 acts against a roller 196 secured to housing 198 to cause needle 182 to move in response to movement of pusher 184.

[0068] Referring now to FIG. 17, a still further variation of a lockout release 42 may be seen. In this variation, a loose pin 200 (preferably retained by a tether 202) is inserted manually into one of a plurality of pairs of through apertures 204 present for the detents 28 in the Prostaject device 50. Placing the pin 200 in an aligned aperture pair 204 prevents advancement of the slide 45 associated with thumb ring 34 past a desired detent position with respect to frame 48 associated with handle 30, and thus prevents over advancing needle 25 from the needle deployment port 24. It is to be understood that FIG. 17 shows pin 200 in both an installed position in aperture 204, and in a free position, with the tether indicated by dashed line 206 in the free position. It is to be further understood that the apertures corresponding to predetermined distances the needle may be extended correspond to the various detent positions. In operation, the slide will be released to advance until an edge of the structure of the slide contacts the pin in one of the apertures 204, limiting the movement of the slide with respect to the frame, as desired. A further variation of this approach is to provide an aperture which prevents any extension of the needle with the pin received in the aligned aperture pair, with one aperture in the slide and the other aperture in the frame.

[0069] FIG. 18a is a fragmentary view and FIG. 18b is a partial section view (along line 18b-18b of FIG. 18a) of yet another variation of the lockout release 42. In this variation, each detent 28 is surrounded by a generally spherical recess 208. In this variation, a ball 210 of the detent 28 projects sufficiently far out of a recess 212 in slide 45 to block transverse movement of slide 45 with respect to frame 48. When it is desired to permit transverse movement of slide 45 with respect to frame 48 (to advance or retract needle 25) ball 210 is manually depressed into recess 212 by engagement of an operator's finger in the spherical recess 208. A spring 214 urges ball 210 away from recess 212. It is to be understood that the frame 48 of the handle 30 of the Prostaject device 50 currently has the ball 210 that fit into the holes 204 to indicate position and act as detents 28 because the ball 210 only rests partially in one of holes 204. This currently gives slight resistance to movement. If the ball 210 and hole diameter are sized to give a positive lock, that cannot be overcome by just the pressure on the thumb ring 34 pushing the slide 45 forward toward the handle 30. In one form of this variation, only the back hole 216 can be made such that a finger of the operator's hand can push the ball 210 in and release the lock in the hole 216, while the other holes 204 can be sized to give only slight interference.

[0070] Referring now to FIGS. 19a and 19b, a stepped cam version of the lockout release 42 is shown. In this version a stepped cam 218 is located for rotational movement on the projection 220 that carries the ethanol syringe port 32. The stepped cam 218 is in the form of a disk having steps 222, 224, 226, and 228 with different radii and individual indices, represented by the letters "A" "B" "C" and "D." It is to be understood that the projection 220 moves forward to the top finger support 230 where the cam 218 will hold the slide and frame apart by the distance set by the respective radius selected on cam 218 to be positioned between the projection 220 and finger support 230. In operation, when the physician is ready to advance the needle 25 out from port 24, he or she would rotate the disk 218 to a position that allows the needle 25 to be advanced to a predetermined distance. The physician would then advance the thumb ring 34 toward handle 30, moving needle 25

forward until the selected step on disk **218** bottoms out against finger support **230**. It is to be understood that the indices associated with the steps preferably indicate the respective distances of advance for the needle **25**.

[0071] Referring now to **FIG. 20**, a de-coupling mechanism useful in the practice of the present invention may be seen. In this version, a switch **242** provides for de-coupling a handle **240** from the needle **25** to prevent unwanted needle extension instead of blocking relative movement of the two members as described for the embodiment of, e.g., **FIG. 5**. This allows the handle **240** to slide back and forth without movement of the needle until the switch or button **242** is pushed (or other actuation is used) that re-couples the handle **240** to the needle **25** and then allows the needle **25** to be advanced with the handle **240**. Specifically, in **FIG. 20**, the handle **240** (corresponding to thumb ring **34**) is able to move relative to the needle **25** without button **242** being pushed. When button **242** is pushed, the handle **240** is mechanically connected to the needle **25** to advance and retract the needle, by movement of the handle **240** with respect to handle or finger grip **30**. It may thus be seen that the embodiment of **FIG. 20** provides selective coupling apparatus for a surgical instrument of the type having an remotely controllable extendable and retractable needle. The selective coupling apparatus includes a mechanism for selectively engaging and releasing first and second members (such as handles **240** and **30**) from moving with respect to each other. The mechanism provides a mechanical connection between the first and second members when in an operating condition (when button **242** is pushed) and the mechanism provides clearance between the first and second members when in a de-coupled condition (when button **242** is released).

[0072] In describing preferred embodiments of the invention, specific terminology is used for the sake of clarity. The invention, however, is not intended to be limited to the specific terms so selected, and it is to be understood that each term so selected includes all technical equivalents that operate similarly.

[0073] These and other advantages of the invention are more fully shown and described in the drawings and detailed description of this invention, where like reference numerals are used to represent similar parts. It is to be understood, however, that the drawings and description are for the purposes of illustration only and should not be read in a manner that would unduly limit the scope of this invention. This invention may take on various modifications and alterations without departing from the spirit and scope thereof.

What is claimed is:

1. An interlock release apparatus for a surgical instrument of the type having an remotely controllable extendable and retractable needle, the interlock release apparatus comprising a mechanism for selectively blocking and releasing first and second members from moving with respect to each other wherein the mechanism provides interference between the first and second members when in a blocking condition and the mechanism provides clearance between the first and second members when in a release condition.

2. The apparatus of claim 1 wherein the surgical instrument includes first and second manually graspable handles which extend the needle when the handles are moved towards each other, and which retract the needle when the handles are moved away from each other and the mechanism

comprises a depressable button located on the first handle which prevents movement of the first handle towards the second handle in the blocking condition when the button is not depressed, and which permits movement of the first handle towards the second handle in the release condition when the button is depressed.

3. The apparatus of claim 2 wherein the button is resiliently biased towards the blocking condition such that the button returns to the blocking condition when the needle is fully retracted.

4. The apparatus of claim 3 wherein the first handle comprises a thumb ring carried by a slide and the second handle comprises a finger grip carried by a frame and the button is located on the slide and is adjacent an edge of the frame in the blocking condition.

5. The apparatus of claim 4 wherein the slide is free to advance the thumb ring towards the finger grip when the button is depressed to extend the needle to any one of a plurality of predetermined positions.

6. The apparatus of claim 1 wherein the surgical instrument further includes a syringe port for receiving a syringe for delivery of a fluid through the needle and still further includes first and second manually graspable handles which extend the needle when the handles are moved towards each other, and which retract the needle when the handles are moved away from each other and the mechanism comprises a lockout arm assembly having a first end located in the syringe port and engageable with the syringe, which prevents movement of the first handle towards the second handle in the blocking condition when the syringe is not received in the syringe port, and which permits movement of the first handle towards the second handle in the release condition when the syringe is received in the syringe port.

7. The apparatus of claim 6 wherein the lockout arm assembly further comprises a first lockout arm having the first end located in the syringe port, and a second lockout arm connected to the first lockout arm, with the second lockout arm having a distal end engageable with a blocking topology in one of the frame and slide preventing relative movement between the first and second handles in a blocking condition when the syringe is not present in the port and permitting relative movement between the handles in a release condition when the syringe is received in the port such that the needle is prevented from advancing in the absence of the syringe in the port in the blocking condition.

8. The apparatus of claim 7 wherein the lockout arm assembly further comprises a spring urging the lockout arm assembly to the blocking condition.

9. The apparatus of claim 7 wherein the blocking topology comprises a notch in a portion of the frame.

10. The apparatus of claim 1 wherein the mechanism comprises a positive locking ball detent with a manual access for release wherein a ball is resiliently urged out of the slide and towards the frame and rests in a recess in the frame preventing extension of the needle in a blocking condition and wherein the ball is manually displaced via a spherical recess to a release condition wherein the ball is out of positive locking with the frame and permits extension of the needle.

11. The apparatus of claim 1 wherein the mechanism comprises a stepped cam mounted on one of the first and second members and wherein a plurality of steps on the cam are engageable with the other of the first and second members to limit the distance the needle is able to be extended.

12. The apparatus of claim 11 wherein the stepped cam is mounted on a syringe port projection located on the first member and is rotatable thereabout to provide one of a plurality of steps for engagement with a portion of a finger support on the second member.

13. A method of injecting a drug into prostate tissue comprising

- a. positioning a distal end of a surgical instrument adjacent a region of prostate tissue into which it is desired to inject the drug; and
- b. emitting a high pressure stream of the drug from a aperture in the distal end of the surgical instrument using needle-less injection.

14. The method of claim 13 wherein step a further includes positioning an injection head adjacent the prostate, and step b further includes injecting echogenic bubbles along with the drug.

15. The method of claim 14 wherein the injection head has a first inlet connected to a high pressure source of a liquid chemical agent and a second inlet connected to a gas delivery tube.

16. Apparatus for limiting a liquid pressure in a surgical instrument for delivering a liquid drug to a prostate, the apparatus comprising

- a. a housing;
- b. a pressure sensitive diaphragm contained within the housing and having one side responsive to a liquid pressure of in the surgical instrument and another side vented to atmosphere; and
- c. a valve connected to the diaphragm with the valve positioned to selectively block delivery of the liquid when the liquid pressure exceeds a predetermined level.

17. The apparatus of claim 16 wherein the diaphragm is biased to a predetermined pressure by a spring.

18. The apparatus of claim 17 wherein the predetermined pressure is adjustable.

19. A pressure indicator for indicating when a predetermined pressure is exceeded in a surgical instrument for delivering a liquid drug to a prostate, the apparatus comprising:

- a. a housing;
- b. a passage in the housing for the liquid drug;
- c. a piston responsive to pressure in the passage;
- d. a spring acting between the piston and the housing; and
- e. a visually perceptible indicator connected to the piston and extendable out of the housing when the pressure in the passage exceeds a predetermined level set by the spring such that the appearance of the indicator corresponds to a pressure in excess of the predetermined level.

20. The pressure indicator of claim 19 wherein the housing further comprises a cylinder receiving the piston and wherein the cylinder has a groove beginning at a starting point and extending a distance along the cylinder such that the liquid drug will leak past the piston via the groove when a predetermined maximum pressure level is reached within

the passage causing the piston to move against the spring a distance sufficient to move the piston past the starting point of the groove.

21. A method of visualizing ethanol injection into a prostate comprising:

- a. transurethrally inserting a surgical instrument to inject ethanol into a prostate; and
- b. delivering both an echogenic agent and ethanol as the medium delivered to the prostate by the surgical instrument.

22. The method of claim 21 wherein step b further comprises switching between the echogenic agent and ethanol.

23. The method of claim 21 wherein step b further comprises simultaneously delivering the echogenic agent and the ethanol via a Y-connection.

24. A method of visualizing ethanol injection into a prostate comprising:

- a. providing an ultrasonically visible marker near the tip of a delivery cannula for delivering ethanol to the prostate; and
- b. observing the marker using ultrasound to position the cannula for delivery of ethanol to a desired location with respect to the prostate.

25. The method of claim 24 wherein step a comprises providing at least one roughened band at the distal end of the cannula.

26. The method of claim 24 wherein step a comprises providing a resistor located at the distal end of the cannula to provide a temperature signal indicative of the position of the distal end of the cannula.

27. The method of claim 24 wherein step a comprises providing a piezo oscillator to produce an ultrasonic beacon at the distal end of the cannula.

28. A method of extending a needle from a surgical instrument for injecting a liquid drug into a prostate, the method comprising:

- a. providing a link assembly at a distal end of the surgical instrument with the link assembly connected to a needle and to a housing carrying the needle; and
- b. extending the needle generally transversely to the housing using a pusher moving longitudinally in the housing acting through the link assembly.

29. The method of claim 28 wherein step b further comprises pivoting the link assembly about a pivot connected to the housing.

30. The method of claim 28 wherein step b further comprises pivoting the needle using at least one link arm pivotally connected to the housing.

31. The method of claim 28 wherein step b further comprises moving the needle using a slot moving along a pin connected to the housing.

32. The method of claim 28 wherein step b further comprises guiding the needle through a slot in the housing.

33. A kit for injecting a liquid drug into a prostate, the kit comprising:

- a. a cystoscope and scope sheath; and
- b. a surgical instrument having a main body, a needle deployment port, a needle, first and second handles,

and a lockout release mechanism to limit the distance the needle is extendable beyond the needle deployment port.

34. The kit of claim 33 further comprising:

c. a syringe for delivering the liquid drug to the prostate.

35. The kit of claim 34 further comprising:

d. a reservoir of ethanol; and

e. a syringe needle for drawing the ethanol from the reservoir into the syringe.

36. A method of visualizing placement of a therapeutically effective substance that is substantially invisible to ultrasound in the treatment of prostate tissue comprising adding an echogenic substance to the therapeutically effective substance to enable visualization during the procedure to assess penetration depth.

37. Apparatus for visualizing a polymer injection head which is formed of a clear polymer in the treatment of prostate tissue comprising a visually perceptible marker located on the head to indicate its position.

38. A selective coupling apparatus for a surgical instrument of the type having a remotely controllable extendable and retractable needle, the selective coupling apparatus comprising a mechanism for selectively engaging and releasing first and second members from moving with respect to each other wherein the mechanism provides a mechanical connection between the first and second members when in an operating condition and the mechanism provides clearance between the first and second members when in a de-coupled condition.

* * * * *

专利名称(译)	手术器械和方法		
公开(公告)号	US20030073902A1	公开(公告)日	2003-04-17
申请号	US10/269405	申请日	2002-10-11
[标]申请(专利权)人(译)	HAUSCHILD SIDNEY F BOLEA STEPHEN L NEISZ JOHANN J		
申请(专利权)人(译)	HAUSCHILD西德尼F. BOLEA斯蒂芬L. NEISZ JOHANN J.		
当前申请(专利权)人(译)	HAUSCHILD西德尼F. BOLEA斯蒂芬L. NEISZ JOHANN J.		
[标]发明人	HAUSCHILD SIDNEY F BOLEA STEPHEN L NEISZ JOHANN J		
发明人	HAUSCHILD, SIDNEY F. BOLEA, STEPHEN L. NEISZ, JOHANN J.		
IPC分类号	A61B17/00 A61B17/22 A61B17/28 A61B17/34 A61B19/00 A61M5/48 A61B5/00		
CPC分类号	A61B17/32037 A61B17/3403 A61B17/3478 A61B2017/00274 A61B2017/003 A61B2017/22082 A61M5/3287 A61B2018/00547 A61B2019/305 A61B2019/4805 A61M5/486 A61M5/488 A61M5/3007 A61B2017/2946 A61B2090/035 A61B2090/0801		
优先权	60/329262 2001-10-12 US		
其他公开文献	US6905475		
外部链接	Espacenet USPTO		

摘要(译)

用于治疗前列腺组织的方法和手术器械包括具有主体，针部署口，针，第一和第二手柄以及限制针延伸的锁定释放机构的手术器械。另外，套件包括手术器械，膀胱镜，以及任选的注射器和乙醇储器。该方法包括无针注射和通过针或无针注射或通过在乙醇递送套管的尖端附近提供超声可见标记来递送回声剂和乙醇来可视化乙醇注射。该方法还包括使用连杆组件使针横向于器械壳体延伸。

