



US 20050234398A1

(19) **United States**

(12) **Patent Application Publication**
Wood, JR.

(10) **Pub. No.: US 2005/0234398 A1**

(43) **Pub. Date: Oct. 20, 2005**

(54) **SYSTEM WITH A RESERVOIR FOR
PERFUSION MANAGEMENT**

(21) Appl. No.: **10/827,572**

(22) Filed: **Apr. 19, 2004**

(75) Inventor: **Lowell L. Wood JR., Livermore, CA
(US)**

Publication Classification

Correspondence Address:
**INTELLECTUAL VENTURES, LLC
1756 - 114TH AVE., S.E.
SUITE 110
BELLEVUE, WA 98004 (US)**

(51) Int. Cl.⁷ **A61M 31/00**

(52) U.S. Cl. **604/65**

(57) **ABSTRACT**

(73) Assignee: **Searete LLC, alimited liability corpo-
ration of the State of Delaware**

A system for perfusion management that monitors, main-
tains, diagnoses, or treats perfusion deficiencies.

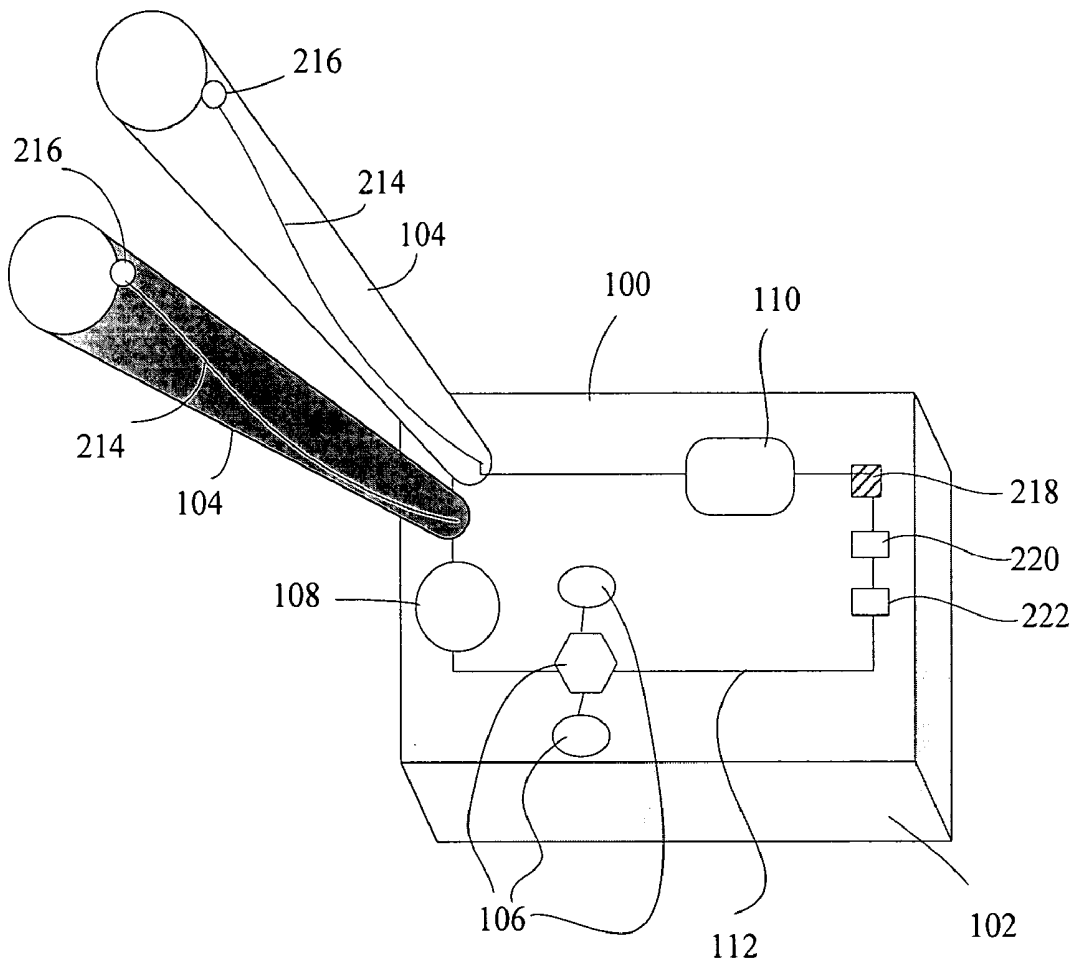

Fig 1

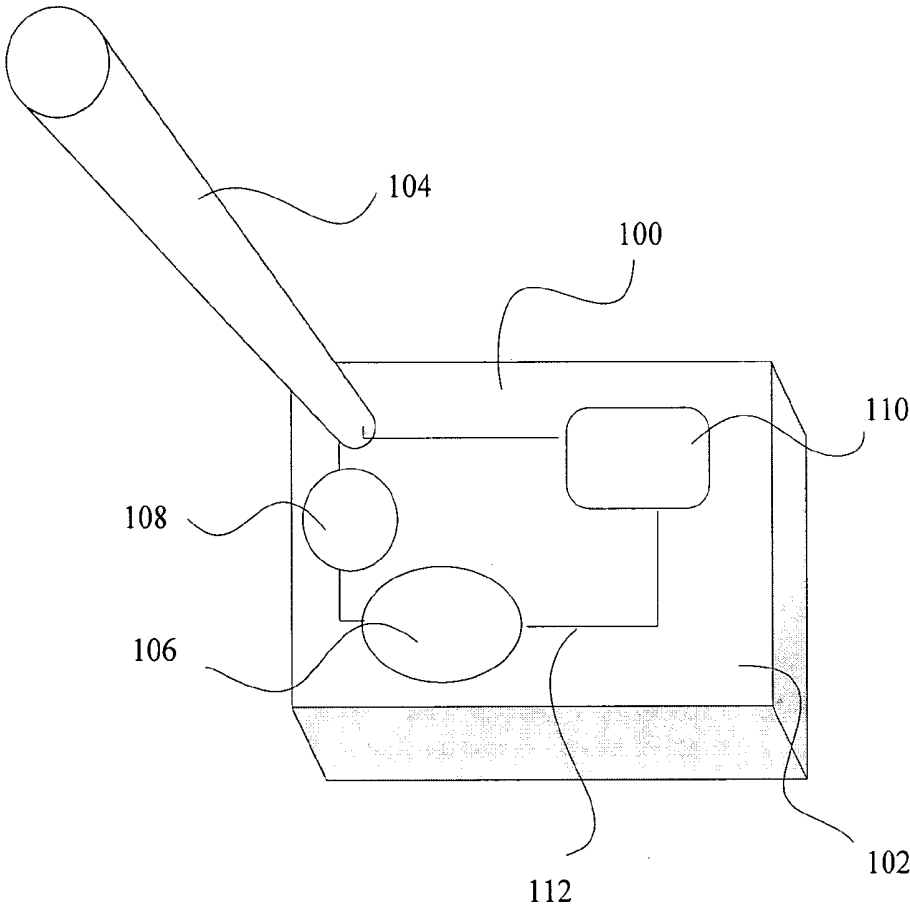

Fig 2

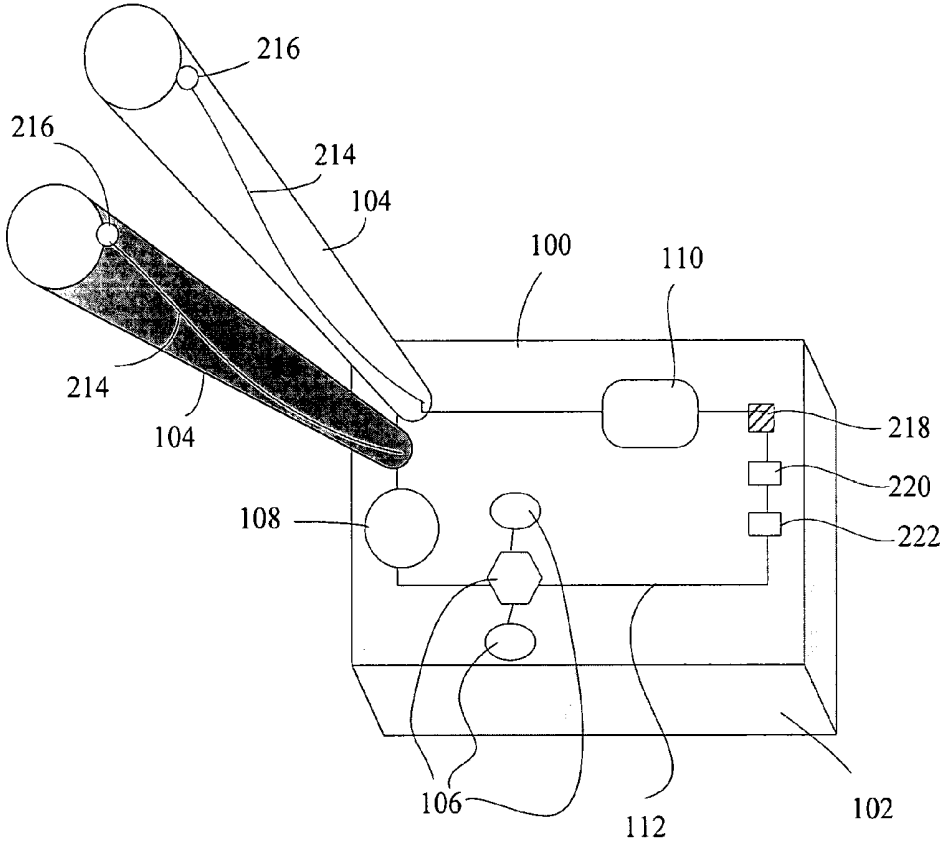

Fig 3

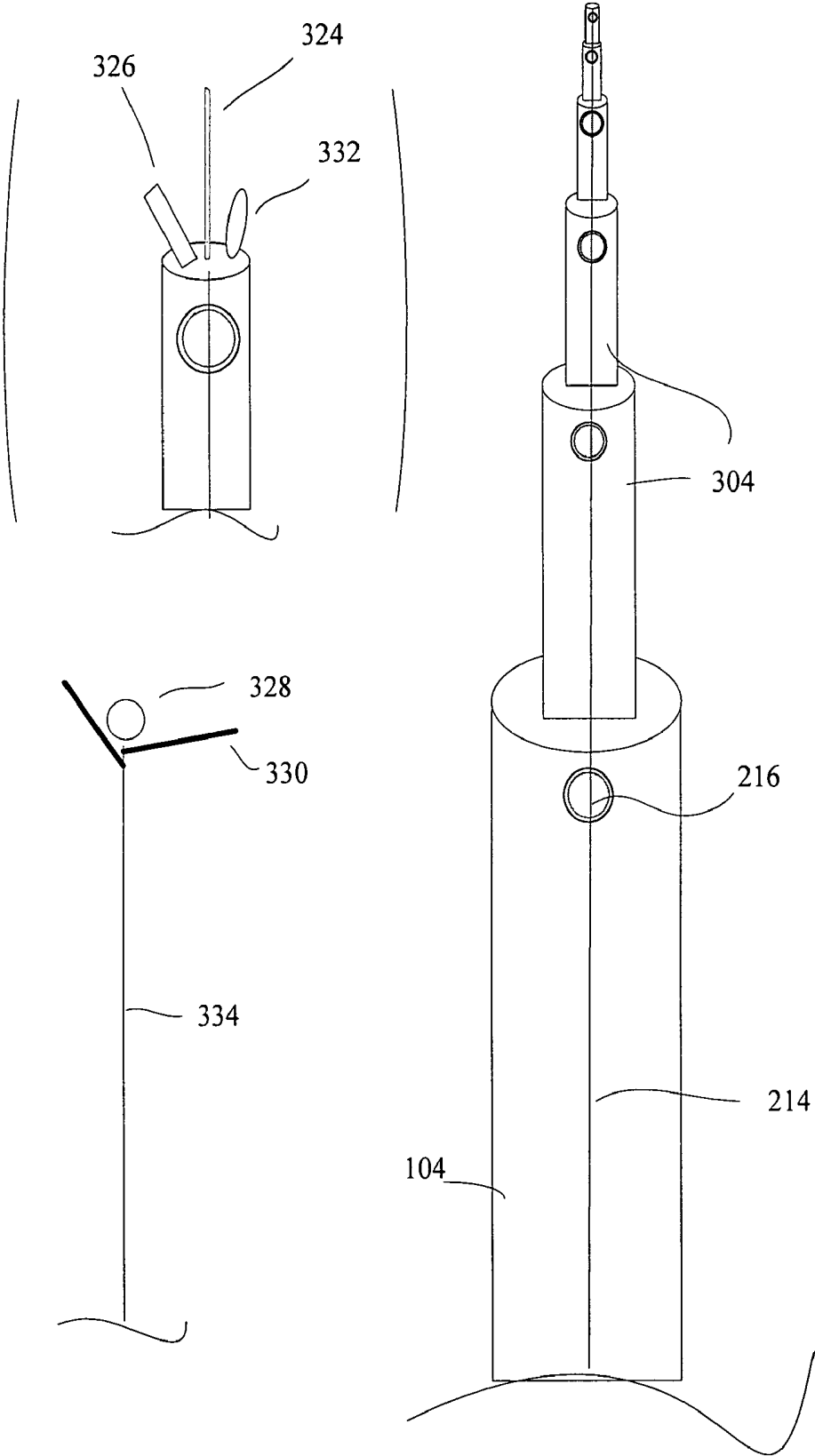

Fig 4

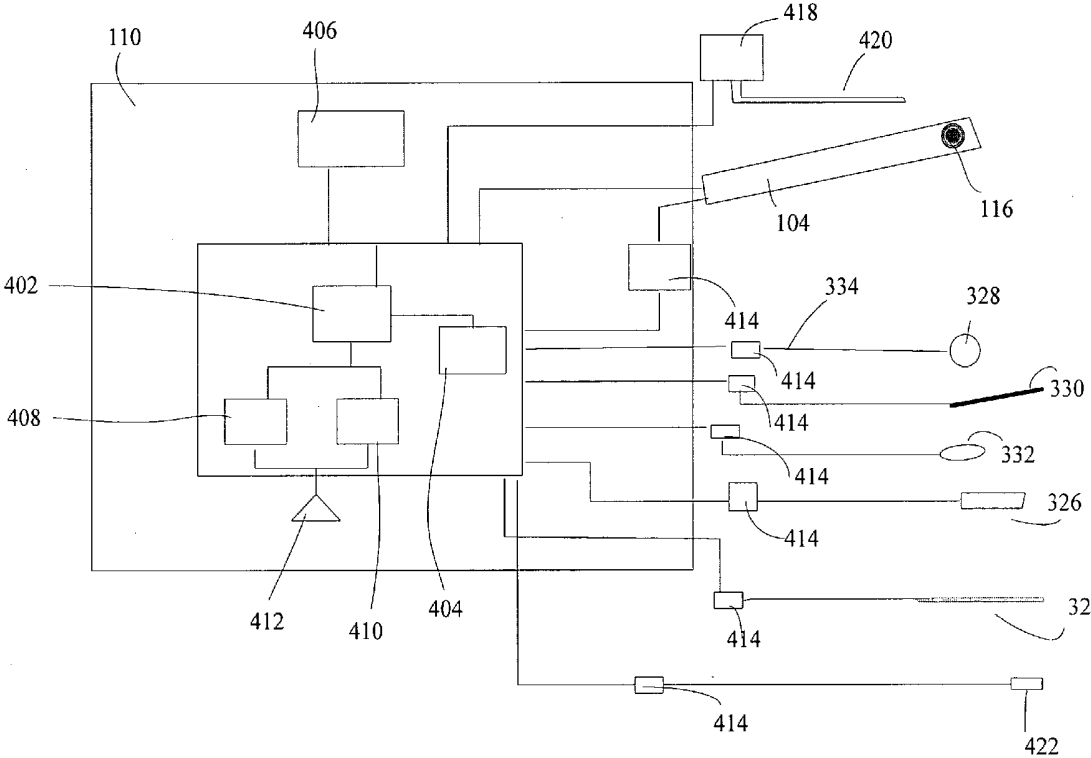
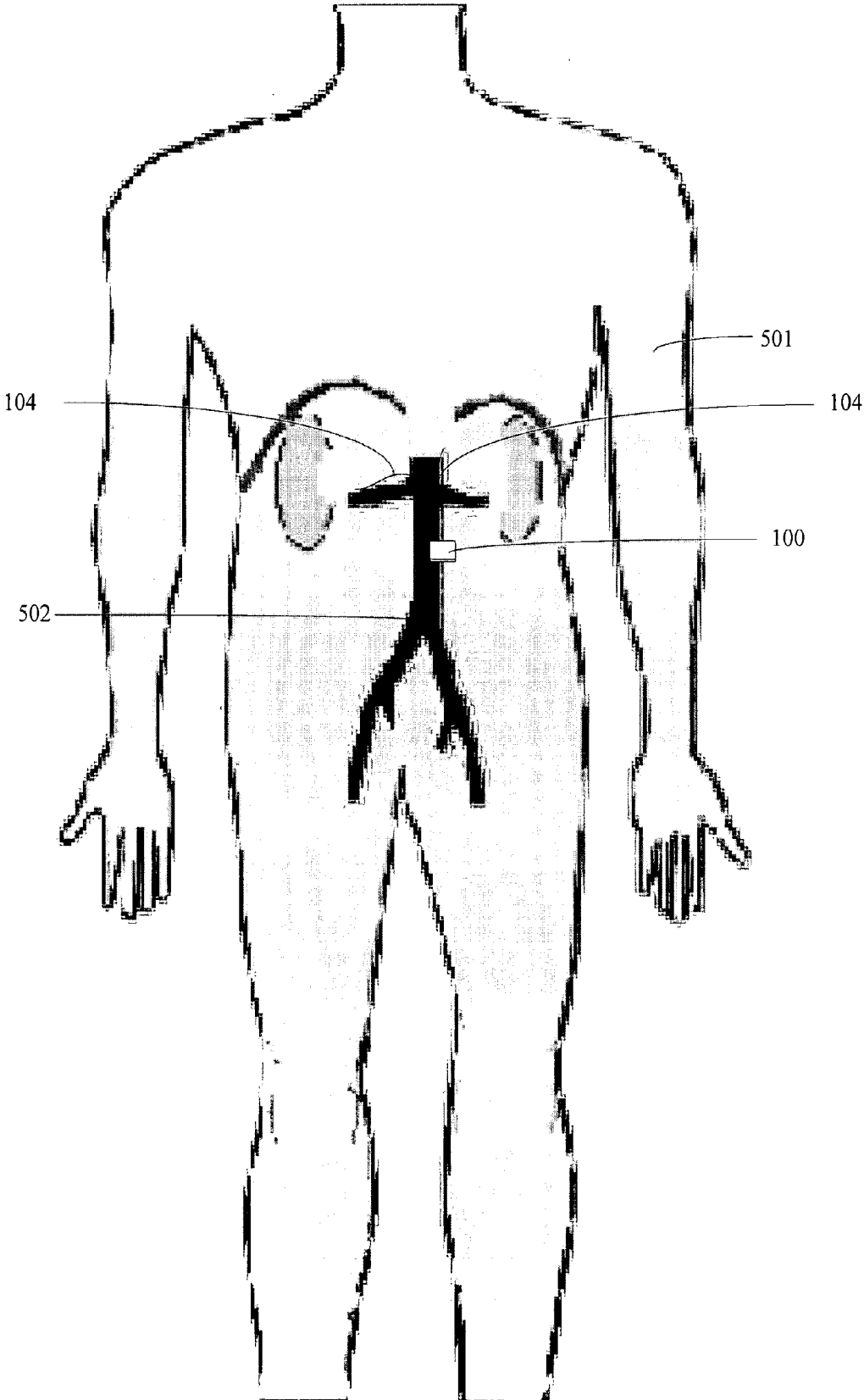

Fig 5



SYSTEM WITH A RESERVOIR FOR PERFUSION MANAGEMENT

CROSS-REFERENCE TO RELATED APPLICATIONS

[0001] The present application is related to, claims the earliest available effective filing date(s) from (e.g., claims earliest available priority dates for other than provisional patent applications; claims benefits under 35 USC § 119(e) for provisional patent applications), and incorporates by reference in its entirety all subject matter of the following listed applications; the present application also claims the earliest available effective filing date(s) from, and also incorporates by reference in its entirety all subject matter of any and all parent, grandparent, great-grandparent, etc. applications of the following listed applications:

[0002] 1. United States patent application entitled A SYSTEM FOR PERFUSION MANAGEMENT, naming Lowell L. Wood Jr. as inventor, filed substantially contemporaneously and commonly assigned herewith.

[0003] 2. United States patent application entitled A SYSTEM WITH A SENSOR FOR PERFUSION MANAGEMENT, naming Lowell L. Wood Jr. as inventor, filed substantially contemporaneously and commonly assigned herewith.

[0004] 3. United States patent application entitled A TELESCOPING PERFUSION MANAGEMENT SYSTEM, naming Lowell L. Wood, Jr. as inventor, filed substantially contemporaneously and commonly assigned herewith.

TECHNICAL FIELD

[0005] The present application relates, in general, to detection and/or treatment.

SUMMARY

[0006] In one aspect, a system includes but is not limited to: a body portion; at least one extensible finger coupled to said body portion; at least one reservoir in communication with said extensible finger; and a control circuitry coupled to said extensible finger, or said body portion. In addition to the foregoing, other system aspects are described in the claims, drawings, and text forming a part of the present application.

[0007] In one aspect, a method includes but is not limited to: fabricating a device by forming a cavity for storing a receivable; coupling a flexible conduit to said cavity, the conduit being configured to extend from said cavity to a target location in an animal's body; and coupling said flexible conduit and said cavity to a monitoring system, said monitoring system including logic or software configured for directing said receivable from said cavity to said target location. In addition to the foregoing, other method aspects are described in the claims, drawings, and text forming a part of the present application.

[0008] In another aspect, a method includes but is not limited to: storing a receivable in an implanted storage medium; extending a flexible conduit between said storage medium and a target location; and transmitting said receivable from said storage medium to said target location. In

addition to the foregoing, other method aspects are described in the claims, drawings, and text forming a part of the present application.

[0009] In one or more various aspects, related systems include but are not limited to circuitry and/or programming for effecting the herein-referenced method aspects; the circuitry and/or programming can be virtually any combination of hardware, software, and/or firmware configured to effect the herein—referenced method aspects depending upon the design choices of the system designer.

[0010] In addition to the foregoing, various other method and or system aspects are set forth and described in the text (e.g., claims and/or detailed description) and/or drawings of the present application.

[0011] The foregoing is a summary and thus contains, by necessity; simplifications, generalizations and omissions of detail; consequently, those skilled in the art will appreciate that the summary is illustrative only and is NOT intended to be in any way limiting. Other aspects, inventive features, and advantages of the devices and/or processes described herein, as defined solely by the claims, will become apparent in the non-limiting detailed description set forth herein.

BRIEF DESCRIPTION OF THE FIGURES

[0012] FIG. 1 is a front-plan view of a device for perfusion management 100.

[0013] FIG. 2 is a front-plan view of another aspect of the device for perfusion management 100.

[0014] FIG. 3 is an exploded view of an extensible finger 104.

[0015] FIG. 4 is a schematic view of the control circuit 110 and devices in communication with the control circuit 110.

[0016] FIG. 5 illustrates an example wherein the device for perfusion management 100 is placed in a selected location in a human body 501.

[0017] The use of the same symbols in different drawings typically indicates similar or identical items.

DETAILED DESCRIPTION

[0018] The present application uses formal outline headings for clarity of presentation. However, it is to be understood that the outline headings are for presentation purposes, and that different types of subject matter may be discussed throughout the application (e.g., device(s)/structure(s) may be described under the process(es)/operations heading(s) and/or process(es)/operations may be discussed under structure(s)/process(es) headings). Hence, the use of the formal outline headings is not intended to be in any way limiting.

[0019] 1. Perfusion Management Device(s) and/or Process(es).

[0020] With reference now to FIG. 1, shown is a front plan view illustrative of various exemplary perfusion management device(s) and/or process(es). Accordingly, the present application first describes certain specific exemplary structures of FIG. 1; thereafter, the present application illustrates certain specific exemplary processes. Those having skill in the art will appreciate that the specific devices

and processes described herein are intended as merely illustrative of their more general counterparts.

[0021] A. Structure(s) and or Device(s)

[0022] With reference to the figures, and with reference now to FIG. 1, shown is a front-plan view of a device for perfusion management 100. The device for perfusion management 100 includes a body portion 102 from which at least one extensible finger 104 projects. At least one reservoir 106 within the body portion 102 contains a fluid, for example, a fluid for treatment. A controllable valve 108 provides a path through which the fluid may travel to the at least one extensible finger 104. A control circuit 110 provides a control signal that may open or close the control valve 108.

[0023] Referring now to FIG. 2, depicted is an aspect of the device for perfusion management 100 which includes a body portion 102 from which a set of extensible fingers projects. In one aspect, at least one of the extensible finger 104 of the set of extensible fingers has a sensor 216 at the distal end of the at least one of the extensible finger 104. Additionally, a sense line 214 connects the control circuit 110 to the sensor 216 at the distal end of the extensible finger 104. The control circuit 110 may be connected to a sense line 214 that allows it to monitor the fluid levels within the at least one reservoir 106.

[0024] Continuing to refer to FIG. 2, in one aspect, each of the extensible finger 104 of the set of extensible fingers is in fluid communication with at least one of a respective reservoir 106 filled with a different fluid for delivery. In another approach, the at least one reservoir 106 may be coupled to a mixing chamber where the fluid contents of the at least one reservoir 106 are present for mixing and the mixed contents enter the extensible finger 104 for delivery to a selected location. The choice of the fluid in the at least one reservoir 106 may depend, for example, on the purpose of the device, for example, treatment of colon cancer, treatment of breast cancer, or treatment of an arterial disease. The choice of fluid in the reservoir 106 includes, but is not limited to, for example, a chemical, a chemical compound, a protein, a lipoprotein, a glycoprotein, a sugar, a lipid, an antigen, an antibody, a cytokine, a peptide, a neurotransmitter, a hormone, an ion, a messenger a molecule, a nucleic acid, an engineered nucleic acid, a nucleic acid vector, a drug, a cell, a cell fragment, a cell organelle, a liposome, a pharmaceutical agent, a biological material, or a biological fraction. The reservoir 106 may also be utilized for storage and disposal of operational fluids. Also, although the exemplary embodiment described herein focuses primarily on fluid delivery, one skilled in the art will understand that fluid-like substances, such as gels, and fluidizable substances or non-fluid type substances, such as small solid particles, may be delivered in accordance with the invention. It will also be appreciated by those having skill in the art that the nature of the fluid in the reservoir 206 includes, for example, and is not limited to, a liquid, a solution, a mixture, a gel, a colloid, a colloid of a suitable viscosity, a suspension, an emulsion, or any material of low shear-strength for delivery to a site.

[0025] In one aspect one or more fluids are delivered to one or more of selected locations by the device for perfusion management 100. The selected location may be, for example, in proximity to or within a tumor, a circulatory system, an aorta, a vena cava, a site of therapy, or a site of investigation in an animal.

[0026] Continuing to refer to FIG. 2, a pump 218 provides fluid at a controlled flow rate for delivery to a site from the reservoir 106. It will be appreciated by those skilled in the art that the type of pump is not critical to the invention and may include, for example, a mechanical pump, a piezoelectric pump, an osmotic pump, a source of pressure, or a device for maintaining a positive flow of fluid through the device. Additionally, fluid flow may be further modulated with micro valves and self-pressurizing fluidic reservoirs. Moreover, in some applications, the fluid may be delivered without a pump. For example, fluid delivery may be controlled using a pressurized bladder, controlled dissolution or dilution of a material, a drip or gravity type of approach, or any other suitable approach to deliver the appropriate amount or an appropriate delivery-rate of the fluid.

[0027] With reference now to FIG. 3, depicted is an exploded view of the extensible finger 104 showing a plurality of telescoping segments 304 with the sensor 216 at the distal end of each of the telescoping segments 304. In one aspect of the invention, the sensor 216 is an array of sensors, deployed from one or more portholes, at the distal end of each of the telescoping segments 304. In one approach, the portholes are sized and shaped to provide access through which the sensors 216 may be deployed. The portholes may include seals, stress relief or other features appropriate for proper mechanical deployment. In one approach, one or more of the portholes can be controllably opened or closed to provide communication exterior to the extensible finger or main body. The sensor 216 may be retracted within the port hole and deployed through the porthole. Where the porthole can be opened and closed, the porthole can close to limit communication and can be opened for deployment. The array of sensors may include, but is not limited to, for example, sensors for detecting pressure, temperature, chemical, gas, electrolyte, flow, volume, composition, or concentration. In an alternate aspect of the invention, microelectrodes, such as, for example, solid-state microelectrodes are sensitized with an agent for detecting a relevant interactor. Examples of the agent include, but are not limited to, for example, agonists of angiogenesis. The choice of sensor 216 depends on the physiological variable being monitored, treated, or controlled. The term "physiological variable" refers to any and all measurements relating to the functioning of a living organism under normal, sub-normal, or abnormal states.

[0028] Continuing to refer to FIG. 3 and referring now to FIG. 4, an operative tool 324 is coupled to the distal most telescoping segment 304, or deployed from the porthole, or carried by the extensible finger 104, further including a carrying line 334 in communication with the control circuit 110. The operative tool 324 includes, but is not limited to, for example, one or more of a combination of, a tool positioner, an ablation device, a laser, a vacuum, a siphon 326, an evacuation device, a fluid dispenser 328, a cauterizer 330, a stent 332, a tissue-liquefying device, or a source of an electric or an electromagnetic charge 422. The vacuum or the siphon is employed for removing a cell, a mass of cells, a tissue, a fluid, a gel, a sample, a debris, a contaminant, or other material for which removal is desired or appropriate. The ablation device operates for perturbing or reducing the structural integrity or viability of a cell, a mass of cells, an assembly of biological materials exhibiting shear strength, or a tissue. The assembly of biological materials includes, for example, blood clots, cartilage, or bone. The source of an

electric or electromagnetic charge **422** includes, but is not limited to, for example, steady state electric currents, time-varying electric currents, alternating electric currents, radio waves, microwaves, ultraviolet rays, infra-red rays, optical rays, terahertz beams, and the like.

[0029] Continuing to refer to **FIG. 3**, it will be appreciated by those having skill in the art that the operative tool **324** may include a set of devices having general or “multi-purpose” utility. The operative tool **324** may include, but is not limited to, for example, a combination of the fluid dispenser **328**, the siphon **326**, and the ablation device. In this example the operative tool combination, for example, delivers the fluid or gel, ablates cells, and removes debris.

[0030] Continuing to refer to **FIG. 3**, the plurality of telescoping segments **304** may themselves be hollow forming a conduit for delivery of the fluid to a site, or for housing a circuitry coupling the control circuit **110** to the operative tool **324**, or for housing a mechanism that guides the arm **104** or the plurality of telescoping segments **304**.

[0031] With reference now to **FIG. 4**, illustrated is a schematic view of the control circuit **110** and devices in communication with the control circuit **110**. The device for perfusion management **100** shows a data transmitter **410**, and a data receiver **408** coupled to the control circuit **110**. An antenna **412** may be used for transmitting data to the exterior wirelessly. The antenna **412** is shown diagrammatically, but may be a structure, such as a strip antenna, that may be integrated in a manner that does not impair or significantly perturb system performance. The control circuit **110** is depicted as having a processor **402** coupled to a memory **404** that provides data storage and retrieval capability, and a power source **406**. Feedback circuitry or logic circuitry provides communication between the control circuit **110** and devices in communication with it. In some applications, a software program providing instructions may be stored in the memory **404** to control operation of the control circuitry or to store data gathered under control of the control circuitry. Additionally, the control circuit **110** may have components for system integrated digital data gathering, processing, storage, compression and transmission. These can provide data control capabilities and operation control capabilities. For example, the transmission components may communicate through the antenna **412** to a person, system, computer, or device exterior to the body. This communication can allow data gathered by the sensors to be displayed, stored or otherwise processed in the external environment. Additionally, this communication may allow for the processed data or a plurality of new data to be received from the exterior by the device for perfusion management **100**. Data compression can allow the control circuitry to store data representing larger amounts of data to be stored in the memory **404** or to be transmitted to the exterior environment in a more efficient manner.

[0032] Continuing to refer to **FIG. 4**, one or more of the operative tools **324** are mounted on an actuator **414** which allows for the independent movement of each tool. Alternatively, one or more operative tools **324** may be mounted as a unit on one actuator **414** and moved as a group, for example, forming an aspirating-dispensing unit. For example, the fluid dispenser **328** and the siphon **326** may be mounted together as a group. The actuator **414** may be a motor, a piezo electrically driven actuator, a micromechanical or electrical effector, or the like.

[0033] Continuing to refer to **FIG. 4**, the extensible finger **104** may include an imaging device deployed from the porthole or from the distal end of the extensible finger **104** or carried by a carrying line **334**. The term “imaging device” being used herein to designate in general those components, circuits, assemblies and sub-assemblies comprising electrical, optical, or opto-electronic components. In one aspect, the control circuit **110** is coupled to the imaging device that includes a laser **418**, or a source of light or scene-illuminating radiation, coupled to an optical feed line **420** to illuminate an area. A charge coupled device is positioned to capture data from the illuminated area and provides an electronic signal indicative of the area imaged. Conventional circuitry then produces a digital representation that may be displayed, stored in the memory **404**, or otherwise processed. The displayed image may serve, for example, for guiding the extensible finger **104** to the selected location or for determining the efficacy of a treatment or a procedure. One skilled in the art will recognize that the imaging device described herein is exemplary of imaging devices and that other imaging devices, including for example, raster and line-scanning imagers, nonvisible spectral imagers, and fluorescence imagers, may be included.

[0034] With reference now to **FIG. 5**, the device for perfusion management **100** is depicted implanted in an aorta **502** with the extensible finger **104** traveling a blood vessel in a human body **501**. Additionally, the device for perfusion management **100** is configured for full or partial placement in the human body **501**. The configuration may incorporate a combination of the following criteria, including but not limited to, dimensions, composition, shape, power dissipation level, or texture. In one aspect, the body portion **102** is sized for implantation in proximity to the aorta **502** or the vena cava and the extensible finger **104** is sized for traveling a blood vessel in an animal, for example, the human body **501**. In this aspect, if the vasculature decreases two-fold, each of the telescoping segments **304** has about a two-fold decrease in diameter. The length of the extensible finger **104**, for example, depends upon the distance between the selected location and the location of the body portion **102**, and the route traveled by the extensible finger **104** to arrive at the selected location. It will be appreciated by those having skill in the art that the extensible finger **104** including the one or more of the operative tools **324** is of a size, dimension or shape operable for traveling one or more blood vessel of decreasing or increasing luminal diameter. It will also be appreciated by those having skill in the art that the extensible finger **104** and the one or more operative tool **324** may pass through the wall of the lumen, or trans-luminally, to the surrounding tissue for detecting, delivery of a treatment, or for sampling. It will also be appreciated by those having skill in the art that the trans-luminal mode described is not limited to blood vessels and includes the space or cavity of an organ or structure.

[0035] It will also be appreciated by those having skill in the art that the device for perfusion management **100** and its components, such as, for example, the extensible finger **104**, the plurality of telescoping segments **304**, or one or more operative tools **324**, has a size, dimension, shape, material, and properties of flexion, retraction, and extension to allow for the steering, guiding, or positioning of the components of the device for perfusion management **100**. For example, the extensible finger **104** may need to be steered around an occlusion or a fork in the vasculature. In this example, the

extensible finger **104** may need to be retracted, repositioned and then extended in a new direction. Extending, retracting or repositioning of the extensible finger **104** may be accomplished by techniques known in the art, for example, by using a guide wire or a by employing a shape polymer. In another aspect, the extensible finger may be retracted and then “punched through” an occlusion to dislodge it. In this example, lasers, shears, or a drug may be employed to degrade the occlusion. In this example, subsequent to the dislodgement and degradation of the occlusion, the siphon **326** or an evacuation device is employed to evacuate any debris, before the extensible finger **104** continues traveling the circulatory system. It will also be appreciated by those skilled in the art that the device for perfusion management **100** is not restricted to traveling the circulatory system but may be implanted in any tissue, such as, for example, nerve, epithelial, dermal, sub-dermal, connective, or muscle tissue. Additionally, the device for perfusion management **100** may be implanted in inter-tissue spaces, or inter-organ spaces, for example, those found within a body cavity.

[0036] In one aspect the device for perfusion management **100** includes an array of sensors **116** positioned across the plurality of telescoping segments **304** for monitoring, tracking, or mapping a gradient of temperature, pressure, flow, or material concentration in one or more locations. The one or more location may be, for example, a tissue, an artery, or a vein. In another aspect the device for perfusion management **100** has an auto-correct feature for correcting a sub-normal or abnormal gradient of temperature, pressure, flow concentration, or material concentration

[0037] The device for perfusion management **100** may be composed of materials known in the art, for example, a metal, a ceramic, a glass, a plastic, a polymer, a biologically compatible material, or a combination. For example, the device for perfusion management **100** may be made of helically-coiled stainless steel wire and coated with a polymer, such as, Teflon™. In another example, the device for perfusion management **100** may be made of helically-coiled stainless steel wire and coated with a polymer and impregnated with one or more of a biological material, for example, including but not limited to, anti coagulants, or inhibitors.

[0038] B. Operation(s) and/or Process(es)

[0039] Those having skill in the art will appreciate that some or all of the components of the device for perfusion management **100** may be present ex-vivo. In one implementation, the device for perfusion management **100** is placed in proximity to the location on the animal, for example, the human body **501**, and the extensible finger **104** directed to the selected location and an effective agent delivered in proximity to the selected location. The extensible finger **104** may be retracted after such a delivery, leaving the device for perfusion management **100** in place at the location, until time for a future delivery of the effective agent or another operation. In this implementation, the majority of the device for perfusion management **100** is ex vivo while the extensible finger **104** alternates between ex vivo and in vivo states.

[0040] In another aspect, some or all the components of the device for perfusion management **100** are present in vivo. In one implementation, the device for perfusion management **100** is placed in proximity to the location within the animal, for example, the human body **501**, and the extensible

finger **104** directed to a selected location and an effective agent delivered in proximity to the selected location. The extensible finger **104** may be retracted after such a delivery, leaving the device for perfusion management **100** in place at the location, until time for a future delivery or another operation. In this implementation, the majority of the device for perfusion management **100** is in-vivo while the extensible finger **104** alternates between retracted, partially retracted or unretracted states.

[0041] In one implementation, the device for perfusion management **100** is operable by a person. The person monitors, guides, positions, and performs other actions/operations or manages a response consistent with the device for perfusion management **100** being managed by the person. In such an implementation a separate display device can present imagery to aid the person. The imagery may be captured as described above with reference to FIG. 4, may be computer generated or may be captured by a separate imaging device internal to or external to the animal, for example, the human body **501**. Actions may be performed under control of the person who may be on site or may be linked from a remote location, or the device for perfusion management **100** may be programmed to perform some or all functions automatically. For example, the device for perfusion management **100** may be programmed to perform functions, such as, lumen clearance, lumen maintenance, monitoring of concentrations, sending of alerts, delivery of one or more of the effective agent at timed intervals or locations, self-check, and self-diagnosis. It will be appreciated by those of skill in the art that the device for perfusion management **100** may be programmed for complete automatic operation of one or more functions.

[0042] C. Variation(s), and/or Implementation(s)

[0043] Those having skill in the art will recognize that the present application teaches modifications of the devices, structures, and/or processes within the spirit of the teaching herein. For example, the device for perfusion management **100** need not be limited to managing perfusion. The device provides a mechanism for exploring one or more regions and/or reaching a location within an animal, obtaining information, communicating this information, performing operations, performing procedures, and providing treatment. In another example, the device for perfusion management **100** may find utility in the management of physiological functions, the detection or elimination of pathological functions or conditions, and/or treatment of diseases of non-human animals. Other modifications of the subject matter herein will be appreciated by one of skill in the art in light of the teachings herein.

[0044] The foregoing described aspects depict different components contained within, or connected with, different other components. It is to be understood that such depicted architectures are merely exemplary, and that in fact many other architectures can be implemented which achieve the same functionality. In a conceptual sense, any arrangement of components to achieve the same functionality is effectively “associated” such that the desired functionality is achieved. Hence, any two components herein combined to achieve a particular functionality can be seen as “associated with” each other such that the desired functionality is achieved, irrespective of architectures or intermedial components. Likewise, any two components so associated can

also be viewed as being “operably connected”, or “operably coupled”, to each other to achieve the desired functionality.

[0045] While particular aspects of the present subject matter described herein have been shown and described, it will be obvious to those skilled in the art that, based upon the teachings herein, changes and modifications may be made without departing from this subject matter described herein and its broader aspects and, therefore, the appended claims are to encompass within their scope all such changes and modifications as are within the true spirit and scope of this subject matter described herein. Furthermore, it is to be understood that the invention is defined solely by the appended claims. It will be understood by those within the art that, in general, terms used herein, and especially in the appended claims (e.g., bodies of the appended claims) are generally intended as “open” terms (e.g., the term “including” should be interpreted as “including but not limited to,” the term “having” should be interpreted as “having at least,” the term “includes” should be interpreted as “includes but is not limited to,” etc.). It will be further understood by those within the art that if a specific number of an introduced claim recitation is intended, such an intent will be explicitly recited in the claim, and in the absence of such recitation no such intent is present. For example, as an aid to understanding, the following appended claims may contain usage of the introductory phrases “at least one” and “one or more” to introduce claim recitations. However, the use of such phrases should not be construed to imply that the introduction of a claim recitation by the indefinite articles “a” or “an” limits any particular claim containing such introduced claim recitation to inventions containing only one such recitation, even when the same claim includes the introductory phrases “one or more” or “at least one” and indefinite articles such as “a” or “an” (e.g., “a” and/or “an” should typically be interpreted to mean “at least one” or “one or more”); the same holds true for the use of definite articles used to introduce claim recitations. In addition, even if a specific number of an introduced claim recitation is explicitly recited, those skilled in the art will recognize that such recitation should typically be interpreted to mean at least the recited number (e.g., the bare recitation of “two recitations,” without other modifiers, typically means at least two recitations, or two or more recitations), etc.

What is claimed is:

1. A device for perfusion management, comprising:
 - a body portion;
 - at least one extensible finger coupled to said body portion;
 - at least one reservoir in communication with said extensible finger; and
 - a control circuitry coupled to said extensible finger, or said body portion.
2. The device for perfusion management according to claim 1, further comprising a device for data gathering, data processing, data storage, or data transmission.
3. The device for perfusion management according to claim 1, further comprising an imager, a pressure sensor, a temperature sensor, a chemical sensor, a gas sensor, an electrolyte sensor, a composition sensor, a concentration sensor, or a flow sensor coupled to said extensible finger.

4. The device for perfusion management according to claim 1, further comprising a pump, or a source of pressure coupled to said extensible finger.

5. The device for perfusion management according to claim 1, further comprising a motor or an actuator coupled to said extensible finger.

6. The device for perfusion management according to claim 1, further comprising a wireless data transmitter, coupled to said extensible finger or said control circuitry.

7. The device for perfusion management according to claim 1, further comprising a wireless data receiver, or a wireless data controller coupled to said extensible finger or said control circuit.

8. The device according to claim 1, wherein said at least one extensible finger is coupled to a source of a chemical, a chemical compound, a protein, a lipoprotein, a glycoprotein, a sugar, a lipid, an antigen, an antibody, a cytokine, a peptide, a neurotransmitter, a hormone, an ion, a messenger molecule, a nucleic acid, an engineered nucleic acid, a nucleic acid vector, a drug, a cell, a cell fragment, a cell organelle, a liposome, a pharmaceutical agent, a biological material, or a biological fraction internal or external to said reservoir.

9. The device according to claim 1, wherein said at least one extensible finger is coupled to a source of two or more of a chemical, a chemical compound, a protein, a lipoprotein, a glycoprotein, a sugar, a lipid, an antigen, an antibody, a cytokine, a peptide, a neurotransmitter, a hormone, an ion, a messenger molecule, a nucleic acid, an engineered nucleic acid, a nucleic acid vector, a drug, a cell, a cell fragment, a cell organelle, a liposome, a pharmaceutical agent, a biological material, or a biological fraction internal or external to said reservoir.

10. The device for perfusion management according to claim 1, further comprising an operative tool in communication with said extensible finger.

11. The device for perfusion management according to claim 10, wherein said operative tool comprises a tool positioner.

12. The device for perfusion management according to claim 10, wherein said operative tool comprises a device for ablating, or a device for degrading or liquefying a cell, a mass of cells, a tissue, or an assembly of biological materials exhibiting shear strength.

13. The device for perfusion management according to claim 10, wherein said control circuitry is operative to guide said operative tool.

14. The device for perfusion management according to claim 1, wherein said extensible finger includes a source of an electric charge or electromagnetic radiation coupled or carried by said extensible finger.

15. The device for perfusion management according to claim 1, wherein said extensible finger includes a plurality of telescoping segments.

16. The device for perfusion management according to claim 15, wherein said plurality of telescoping segments is hollow.

17. The device for perfusion management according to claim 1, wherein said extensible finger further comprises a device for fully or partially blocking or shunting a liquid flow.

18. The device for perfusion management according to claim 1, further comprising a device for evacuating a target coupled to said extensible finger.

19. The device for perfusion management according to claim 1, further comprising a device for cauterizing or sealing a cell, a mass of cells, a tissue, or an assembly of biological materials exhibiting shear strength carried by said extensible finger.

20. The device for perfusion management according to claim 1, further comprising a fluid dispenser operative to provide a fluid at a controlled rate.

21. The device for perfusion management according to claim 20, wherein said fluid dispenser is carried by said extensible finger.

22. The device for perfusion management according to claim 1, wherein said extensible finger comprises a stent.

23. The device for perfusion management according to claim 1, wherein said control circuitry is coupled to control said extensible finger.

24. The device for perfusion management according to claim 1, wherein said control circuitry is operative to guide said extensible finger.

25. The device for perfusion management according to claim 1, wherein said control circuitry comprises a processor, a feedback circuit, or a logic circuit.

26. The device for perfusion management according to claim 1, wherein said control circuitry is a processor further comprising a stored software or firmware program cooperative with said processor.

27. The device according to claim 1, wherein said device is of a size, a composition, a power dissipation level, or a shape configured for full or partial placement in vivo.

28. The device for perfusion management according to claim 1, wherein said device is configured for implantation in an animal.

29. The device for perfusion management according to claim 28, wherein said animal is human.

30. The device for perfusion management according to claim 29, wherein said device is configured for placement in a selected location in said human corresponding to at least one physiological variable to be monitored or treated.

31. The device for perfusion management according to claim 30, wherein said selected location is in a circulatory system, an aorta or a vena cava.

32. The device for perfusion management according to claim 1, wherein said device is operative to provide or monitor a treatment or a response in a patient.

33. The device for perfusion management according to claim 32, wherein said treatment comprises delivering a medicinal agent, a pharmaceutical agent, a therapeutic device or assembly to a location in said patient.

34. The device for perfusion management according to claim 1, wherein said device communicates exterior to said patient.

35. A method of fabricating a perfusion management device, comprising: forming a cavity for storing a receivable;

coupling a flexible conduit to said cavity, the conduit being configured to extend from said cavity to a target location in an animal's body; and

coupling said flexible conduit and said cavity to a monitoring system, said monitoring system including logic or software configured for directing said receivable from said cavity to said target location.

36. The method as in claim 35, comprising the step of configuring said device for implantation in proximity to said target location.

37. The method as in claim 35, comprising the step of configuring said device for providing or monitoring a treatment or a response in a patient.

38. The method for perfusion management according to claim 35, including coupling an imager, a pressure sensor, a temperature sensor, a chemical sensor, a gas sensor, an electrolyte sensor, a flow sensor, a concentration sensor, a composition sensor, or a flow regulator to said monitoring system.

39. The method for perfusion management according to claim 35, further including coupling a pump, a motor, a vacuum, a siphon, or an evacuation device to said monitoring system.

40. The method for perfusion management according to claim 35, further including coupling an actuator, a tool positioner, an ablator, a cauterizer, or a sealer to said monitoring system.

41. The method for perfusion management according to claim 35, comprising the step of placing a source of a chemical, a chemical compound, a protein, a lipoprotein, a glycoprotein, a sugar, a lipid, an antigen, an antibody, a cytokine, a peptide, a neurotransmitter, a hormone, an ion, a messenger molecule, a nucleic acid, an engineered nucleic acid, a nucleic acid vector, a drug, a cell, a cell fragment, a cell organelle, a liposome, a pharmaceutical agent, a biological material, or a biological fraction internal or external to said cavity.

42. The method for perfusion management according to claim 35, comprising the step of placing a source of two or more of a chemical, a chemical compound, a protein, a lipoprotein, a glycoprotein, a sugar, a lipid, an antigen, an antibody, a cytokine, a peptide, a neurotransmitter, a hormone, an ion, a messenger molecule, a nucleic acid, an engineered nucleic acid, a nucleic acid vector, a drug, a cell, a cell fragment, a cell organelle, a liposome, a pharmaceutical agent, a biological material, or a biological fraction internal or external to said cavity.

43. The method for perfusion management according to claim 35, comprising the step of coupling or carrying a source of an electrical charge or electromagnetic radiation to said flexible conduit.

44. The method for perfusion management according to claim 35, wherein said monitoring system comprises a processor, a feedback circuit, or a logic circuit.

45. The method for perfusion management according to claim 35, wherein said monitoring system is a processor further comprising a stored software program cooperative with said processor.

46. The method for perfusion management according to claim 35, wherein said monitoring system communicates wirelessly.

47. A method for perfusion management, comprising:

storing a receivable in an implanted storage medium;

extending a flexible conduit between said storage medium and a target location; and

transmitting said receivable from said storage medium to said target location.

48. The method for perfusion management according to claim 47, comprising the step of gathering, processing, storing or transmitting data.

49. The method for perfusion management according to claim 47, further comprising the step of imaging, or detecting a level of pressure, temperature, chemical, gas, electrolyte, composition, concentration, or flow.

50. The method for perfusion management according to claim 47, comprising the step of delivering chemicals, chemical compounds, proteins, lipoproteins, glycoproteins, sugars, lipids, antigens, antibodies, cytokines, peptides, neurotransmitters, hormones, ions, messenger molecules, nucleic acids, engineered nucleic acids, nucleic acid vectors, drugs, cells, cell fragments, cell organelles, liposomes, pharmaceutical agents, biological materials, or biological fractions internal or external to said storage medium.

51. The method for perfusion management according to claim 47, comprising the step of performing one or more operations or actions.

52. The method for perfusion management according to claim 47, comprising the step of positioning tools.

53. The method for perfusion management according to claim 47, comprising the step of fully or partially blocking or shunting a liquid flow.

54. The method for perfusion management according to claim 47, comprising the step of ablating, degrading, or liquefying a cell, a mass of cells, a tissue, or an assembly of biological materials exhibiting shear strength.

55. The method for perfusion management according to claim 47, comprising the step of capturing a cell, a tissue, a fluid, a gel, a sample, a colloid, and emulsion, a debris, a contaminant, or a biological material.

56. The method for perfusion management according to claim 47, comprising the step of sampling a cell, a mass of cells, a tissue, or an assembly of biological materials exhibiting shear strength.

57. The method for perfusion management according to claim 47, comprising the step of cauterizing or sealing a cell, a mass of cells, a tissue, or an assembly of biological materials exhibiting shear strength.

58. The method for perfusion management according to claim 47, comprising the step of dispensing a fluid at a controlled rate.

59. The method for perfusion management according to claim 47, comprising the step of controlling or guiding said extensible finger.

60. The method for perfusion management according to claim 47, further comprising the step of placing said device fully or partially in vivo.

61. The method for perfusion management according to claim 47, comprising configuring said device for implantation in an animal.

62. The method for perfusion management according to claim 61, wherein said animal is human.

63. The method for perfusion management according to claim 62, further comprising configuring said device for placement in a selected location in said human.

64. The method for perfusion management according to claim 63, wherein said selected location is in a circulatory system, an aorta or in a vena cava.

65. The method for perfusion management according to claim 47, comprising the step of releasing an electric current or an electromagnetic radiation in proximity to a cell, a tissue, or an assembly of biological materials exhibiting shear strength.

* * * * *

专利名称(译)	具有用于灌注管理的储液器的系统		
公开(公告)号	US20050234398A1	公开(公告)日	2005-10-20
申请号	US10/827572	申请日	2004-04-19
[标]申请(专利权)人(译)	SEARETE LLC ALIMITED责任特拉华州		
申请(专利权)人(译)	SEARETE有限责任公司，特拉华州的ALIMITED责任公司		
当前申请(专利权)人(译)	齿轮箱有限责任公司		
[标]发明人	WOOD LOWELL L JR		
发明人	WOOD, LOWELL L. JR.		
IPC分类号	A61B5/00 A61B5/07 A61B18/14 A61B18/18 A61B18/24 A61F2/02 A61K31/19 A61M1/00 A61M3/00 A61M29/00 A61M31/00		
CPC分类号	A61B1/00016 Y10T29/49826 A61B5/0031 A61B5/076 A61B5/145 A61B5/14546 A61B5/4839 A61B5/6876 A61B5/7232 A61B18/1492 A61B18/18 A61B18/24 A61B2562/028 A61F2250/002 A61M1/0058 A61M2205/3561 A61M2205/3592 A61M2209/084 A61B1/041		
其他公开文献	US7850676		
外部链接	Espacenet USPTO		

摘要(译)

用于灌注管理的系统，其监测，维持，诊断或治疗灌注缺陷。

