



US008317697B2

(12) **United States Patent**
Hawthorne et al.

(10) **Patent No.:** **US 8,317,697 B2**
(45) **Date of Patent:** **Nov. 27, 2012**

(54) **METHOD AND APPARATUS FOR REMOTE
BLOOD ALCOHOL MONITORING**

(75) Inventors: **Jeffrey Scott Hawthorne**, Bennett, CO (US); **Brian Kirby Phillips**, Lakewood, CO (US); **Michael Leonard Iiams**, Littleton, CO (US); **William James Roushey, III**, Littleton, CO (US); **Nolan James Farmer, Jr.**, Jamestown, CO (US)

(73) Assignee: **Alcohol Monitoring Systems, Inc.**, Littleton, CO (US)

(*) Notice: Subject to any disclaimer, the term of this patent is extended or adjusted under 35 U.S.C. 154(b) by 1211 days.

(21) Appl. No.: **11/411,694**

(22) Filed: **Apr. 25, 2006**

(65) **Prior Publication Data**

US 2006/0202838 A1 Sep. 14, 2006

Related U.S. Application Data

(62) Division of application No. 10/441,940, filed on May 19, 2003, now Pat. No. 7,462,149.

(51) **Int. Cl.**
A61B 5/00 (2006.01)

(52) **U.S. Cl.** **600/300; 600/301; 128/920**

(58) **Field of Classification Search** **600/300-301, 600/309, 353, 364, 583; 436/68, 132; 422/84; 128/920**

See application file for complete search history.

(56) **References Cited**

U.S. PATENT DOCUMENTS

2,845,226 A 7/1958 Cummings et al.
3,439,596 A 4/1969 Pickering et al.
4,173,971 A 11/1979 Karz

4,749,553 A 6/1988 Lopez et al.
4,868,545 A 9/1989 Jones
4,885,571 A 12/1989 Pauley et al.
4,916,435 A 4/1990 Fuller
4,999,613 A * 3/1991 Williamson et al. 340/573.4
5,033,293 A 7/1991 Honma et al.

(Continued)

FOREIGN PATENT DOCUMENTS

WO WO 02/12883 A1 2/2002

OTHER PUBLICATIONS

"Medtronic Begins Worldwide Rollout of Innovative Medtronic CareLink Programmer to Enhance Cardiac Care," Business Wire, Mar. 18, 2002, 3 pgs., 2002 Business Wire HealthWire, Minneapolis.

(Continued)

Primary Examiner — Rene Towa

(74) *Attorney, Agent, or Firm* — Stanley J. Gradisar; Sheridan Ross PC

(57) **ABSTRACT**

A tamper proof transdermal alcohol content monitoring device is made up of analog and digital sides which are securely attached to the human subject to be monitored. The analog side has a sampling circuit which draws a measured insensible skin perspiration sample from the skin of the subject and measured with an electrochemical fuel cell. A distance measurement of the device from the skin of the subject and temperature of the sample are monitored along with the transdermal alcohol content, and converted to digital signals which are transmitted to a modem when the monitor is in proximity to the modem. The signals are stored in the modem and uploaded to a central monitoring station. Automatic alerts may be sent from the central monitoring station to a supervising agency. The supervising agency may also access the information through secured dedicated websites via the Internet.

25 Claims, 12 Drawing Sheets

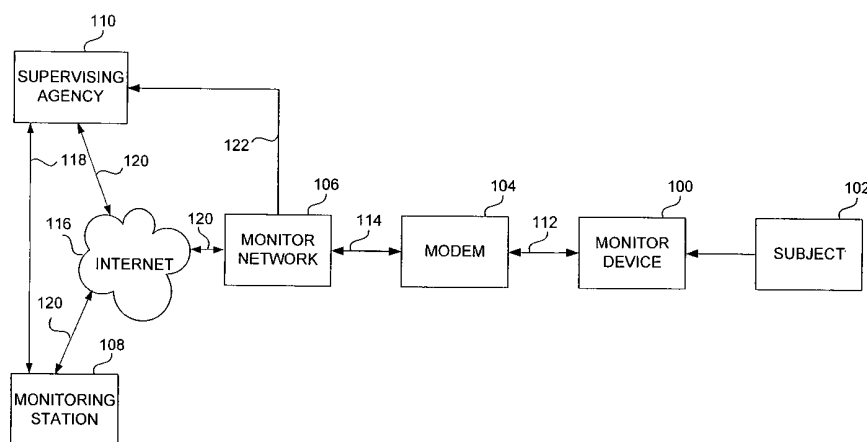

U.S. PATENT DOCUMENTS

5,115,223	A	5/1992	Moody	
5,220,919	A *	6/1993	Phillips et al.	600/345
5,303,575	A	4/1994	Brown et al.	
5,408,520	A	4/1995	Clark et al.	379/93.07
5,543,780	A	8/1996	McAuley et al.	
5,627,520	A	5/1997	Grubbs et al.	
5,678,562	A *	10/1997	Sellers	600/523
5,724,025	A	3/1998	Tavori	
5,823,409	A	10/1998	Kennedy	
5,836,993	A	11/1998	Cole	
5,944,661	A	8/1999	Swette et al.	
6,024,699	A	2/2000	Surwit et al.	
6,093,146	A *	7/2000	Filangeri	600/300
6,168,563	B1	1/2001	Brown	600/301
6,364,834	B1	4/2002	Reuss et al.	600/300
6,409,675	B1	6/2002	Turcott	
6,443,890	B1	9/2002	Schulze et al.	
6,497,655	B1	12/2002	Linberg et al.	600/300
6,524,239	B1	2/2003	Reed et al.	
6,726,636	B2	4/2004	Der Ghazarian et al.	
6,801,137	B2	10/2004	Eggers	
6,805,667	B2	10/2004	Christopherson et al.	600/300
RE38,838	E	10/2005	Taylor, Jr.	
6,957,107	B2	10/2005	Rogers et al.	
7,044,911	B2	5/2006	Drinan et al.	
7,051,120	B2	5/2006	Greene et al.	
7,285,090	B2	10/2007	Stivoric et al.	
7,311,665	B2	12/2007	Hawthorne et al.	
7,462,149	B2	12/2008	Hawthorne et al.	
7,611,461	B2	11/2009	Hawthorne et al.	
7,641,611	B2	1/2010	Hawthorne et al.	
2002/0156650	A1	10/2002	Klein et al.	
2003/0114735	A1 *	6/2003	Silver et al.	600/300
2003/0126593	A1	7/2003	Mault	
2003/0172940	A1 *	9/2003	Rogers et al.	128/899
2004/0019503	A1 *	1/2004	Berenguer	705/2
2004/0122486	A1	6/2004	Stahmann et al.	607/60
2005/0177615	A1	8/2005	Hawthorne et al.	
2007/0100666	A1	5/2007	Stivoric et al.	

OTHER PUBLICATIONS

"Medtronic CareLink Network extends cardiac patient monitoring beyond clinic walls," Virtual Medical Worlds, Monthly Newsletter, Mar. 18, 2002, Atlanta, 3 pgs.

"Medtronic Completes Phase One of Its Medtronic CareLink Patient Management Network Rollout; American College of Cardiology Meeting 2002," Mar. 18, 2002, <http://www.businesswire.com>, LexisNexis Healthwire Business Wire Headline, 2 pgs., 2002 Business Wire, Inc., Minneapolis.

U.S. Appl. No. 10/441,960, filed May 19, 2003, (n/k/a 7,311,665, Issued Dec. 25, 2007) Non-Final Office Action dated Oct. 4, 2004, 9 pages.

U.S. Appl. No. 10/441,960, filed May 19, 2003, (n/k/a 7,311,665, Issued Dec. 25, 2007) Non-Final Office Action dated Jun. 30, 2005, 9 pages.

U.S. Appl. No. 10/441,960, filed May 19, 2003, (n/k/a 7,311,665, Issued Dec. 25, 2007) Final Office Action dated Jan. 24, 2006, 10 pages.

U.S. Appl. No. 10/441,960, filed May 19, 2003, (n/k/a 7,311,665, Issued Dec. 25, 2007) Non-Final Office Action dated Sep. 11, 2006, 7 pages.

U.S. Appl. No. 10/441,960, filed May 19, 2003, (n/k/a 7,311,665, Issued Dec. 25, 2007) Notice of Allowance dated Apr. 23, 2007, 6 pages.

U.S. Appl. No. 10/441,960, filed May 19, 2003, (n/k/a 7,311,665, Issued Dec. 25, 2007) Notice of Allowance dated Aug. 9, 2007, 5 pages.

U.S. Appl. No. 10/441,960, filed May 19, 2003, (n/k/a 7,311,665, Issued Dec. 25, 2007) Notice of Allowance dated Oct. 1, 2007, 2 pages.

U.S. Appl. No. 11/086,192, filed Mar. 22, 2005, Final Office Action dated Jan. 20, 2010, 17 pages.

U.S. Appl. No. 10/441,940, filed May 19, 2003, (n/k/a 7,462,149, Issued Dec. 9, 2008) Non-Final Office Action dated Jul. 11, 2006, 18 pages.

U.S. Appl. No. 10/441,940, filed May 19, 2003, (n/k/a 7,462,149, Issued Dec. 9, 2008) Final Office Action dated Nov. 29, 2006, 18 pages.

U.S. Appl. No. 10/441,940, filed May 19, 2003, (n/k/a 7,462,149, Issued Dec. 9, 2008) Advisory Action dated Jan. 30, 2007, 4 pages.

U.S. Appl. No. 10/441,940, filed May 19, 2003, (n/k/a 7,462,149, Issued Dec. 9, 2008) Non-Final Office Action dated May 10, 2007, 30 pages.

U.S. Appl. No. 10/441,940, filed May 19, 2003, (n/k/a 7,462,149, Issued Dec. 9, 2008) Non-Final Office Action dated Dec. 28, 2007, 19 pages.

U.S. Appl. No. 10/441,940, filed May 19, 2003, (n/k/a 7,462,149, Issued Dec. 9, 2008) Notice of Allowance dated Oct. 8, 2008, 7 pages.

U.S. Appl. No. 11/411,692, filed Apr. 25, 2006, (n/k/a 7,611,461, Issued Nov. 3, 2009,) Non-Final Office Action dated Jan. 9, 2009, 14 pages.

U.S. Appl. No. 11/411,692, filed Apr. 25, 2006, (n/k/a 7,611,461, Issued Nov. 3, 2009) Notice of Allowance dated Jul. 17, 2009, 9 pages.

U.S. Appl. No. 11/411,686, filed Apr. 25, 2006 (n/k/a 7,641,611, Issued Jan. 5, 2010) Non-Final Office Action dated Oct. 30, 2008, 9 pages.

U.S. Appl. No. 11/411,686, filed Apr. 25, 2006 (n/k/a 7,641,611, Issued Jan. 5, 2010) Final Office Action dated Apr. 16, 2009, 10 pages.

U.S. Appl. No. 11/411,686, filed Apr. 25, 2006 (n/k/a 7,641,611, Issued Jan. 5, 2010) Advisory Action dated Jun. 26, 2009, 3 pages.

U.S. Appl. No. 11/411,686, filed Apr. 25, 2006 (n/k/a 7,641,611, Issued Jan. 5, 2010) Notice of Allowance dated Oct. 20, 2009, 8 pages.

Kristine K. Rapillo, Office Action, Jul. 7, 2009, U.S. Appl. No. 11/086,192 Titled "Bio-Information Sensor Monitoring System and Method" filed Mar. 22, 2005.

Kristine K. Rapillo, Office Action, Jul. 13, 2009, U.S. Appl. No. 11/104,810 Titled "Bio-Information Sensor Monitoring System and Method" filed Apr. 13, 2005.

Kristine K. Rapillo, Office Action, Dec. 20, 2010, U.S. Appl. No. 11/104,810 Titled "Bio-Information Sensor Monitoring System and Method" filed Apr. 13, 2005.

Kristine K. Rapillo, Office Action (Non-Final), Jun. 28, 2011, U.S. Appl. No. 11/086,192 Titled "Bio-Information Sensor Monitoring System and Method" filed Mar. 22, 2005.

Kristine K. Rapillo, Office Action (Final), Jun. 28, 2011, U.S. Appl. No. 11/104,810 Titled "Bio-Information Sensor Monitoring System and Method" filed Apr. 13, 2005.

Michael C. Astorino, Interview Summary, Jan. 3, 2007, U.S. Appl. No. 10/441,960 Titled "Bio-Information Sensor Monitoring System and Method" filed May 19, 2003, 3 pages.

Rene T. Towa, Final Office Action, Apr. 16, 2009, U.S. Appl. No. 11/411,686 Titled "Method and Apparatus for Remote Blood Alcohol Monitoring" filed Apr. 25, 2006, 10 pages.

Rene T. Towa, Advisory Action, Jun. 26, 2009, U.S. Appl. No. 11/411,686 Titled "Method and Apparatus for Remote Blood Alcohol Monitoring" filed Apr. 25, 2006, 3 pages.

Rene T. Towa, Office Action, Oct. 30, 2008, U.S. Appl. No. 11/411,686 Titled "Method and Apparatus for Remote Blood Alcohol Monitoring" filed Apr. 25, 2006, 9 pages.

Alcohol Monitoring Systems, Inc. v. BI Inc., No. 11-cv-00301-DME-CBS, Complaint, Doc. #1 (D. Colo. Feb. 4, 2011), 90 pages.

Alcohol Monitoring Systems, Inc. v. BI Inc., No. 11-cv-00301-DME-CBS, Answer, Doc. #10 (D. Colo. Mar. 21, 2011), 33 pages.

Alcohol Monitoring Systems, Inc. v. BI Inc., No. 11-cv-00301-DME-CBS, Answer to Counterclaim and Counterclaim, Doc. #11 (D. Colo. Apr. 11, 2011), 8 pages.

Alcohol Monitoring Systems, Inc. v. BI Inc., No. 11-cv-00301-DME-CBS, Motion for Stay, Doc. #17 (D. Colo. Apr. 27, 2011), 194 pages.

Alcohol Monitoring Systems, Inc. v. BI Inc., No. 11-cv-00301-DME-CBS, Motion to Dismiss, Doc. #21 (D. Colo. May 2, 2011), 5 pages.

Alcohol Monitoring Systems, Inc. v. BI Inc., No. 11-cv-00301-DME-CBS, Answer to Counterclaims, Doc. #22 (D. Colo. May 2, 2011), 6 pages.

Alcohol Monitoring Systems, Inc. v. 81 Inc., No. 11-cv-00301-DME-CBS, Opposition to Motion for Stay, Doc. #26 (D. Colo. May 18, 2011), 29 pages.

Alcohol Monitoring Systems, Inc. v. BI Inc., No. 11-cv-00301-DME-CBS, Order Denying Stay, Doc. #27 (D. Colo. May 19, 2011), 2 pages.

Alcohol Monitoring Systems, Inc. v. BI Inc., No. 11-cv-00301-DME-CBS, Renewed Motion for Stay, Doc. #32 (D. Colo. May 27, 2011), 74 pages.

Alcohol Monitoring Systems, Inc. v. BI Inc., No. 11-cv-00301-DME-CBS, Motion for Leave to File 1st Amended Complaint, Doc. #38 (D. Colo. Jun. 10, 2011), 169 pages.

Alcohol Monitoring Systems, Inc. v. BI Inc., No. 11-cv-00301-DME-CBS, Opposition to Renewed Motion for Stay, Doc. #41 (D. Colo. Jun. 17, 2011), 14 pages.

Alcohol Monitoring Systems, Inc. v. BI Inc., No. 11-cv-00301-DME-CBS, Order Denying Renewed Motion for Stay, Doc. #42 (D. Colo. Jun. 24, 2011), 2 pages.

Kristine K. Rapillo, Office Action, Mar. 21, 2012, U.S. Appl. No. 11/086,192 Titled "Bio-Information Sensor Monitoring System and Method" filed Mar. 22, 2005, 18 pages.

Request for Inter Partes Reexamination, Filed Apr. 21, 2011, US Patent No. 7,462,149 Titled "Method and Apparatus for Remote Blood Alcohol Monitoring," Issued on Dec. 9, 2008 U.S. Appl. No. 10/441,940, filed May 19, 2003, 83 pages.

Order Granting Request for Inter Partes Reexamination, Mailed on May 20, 2011, U.S. Appl. No. 95/001,609 Titled "Method and Apparatus for Remote Blood Alcohol Monitoring," filed Apr. 21, 2011, 12 pages.

Jeffrey L. Gellner, Office Action, May 20, 2011, U.S. Appl. No. 95/001,609 Titled "Method and Apparatus for Remote Blood Alcohol Monitoring," filed Apr. 21, 2011, 39 pages.

Response to Office Action, Filed Jul. 20, 2011, U.S. Appl. No. 95/001,609, filed Apr. 21, 2011, 39 pages.

Information Disclosure Statement, Filed Jul. 20, 2011, U.S. Appl. No. 95/001,609, filed Apr. 21, 2011, 10 pages.

Kristine K. Rapillo, Office Action (Non-Final), Dec. 23, 2011, U.S. Appl. No. 11/104,810 Titled "Bio-Information Sensor Monitoring System and Method" filed Apr. 13, 2005.

* cited by examiner

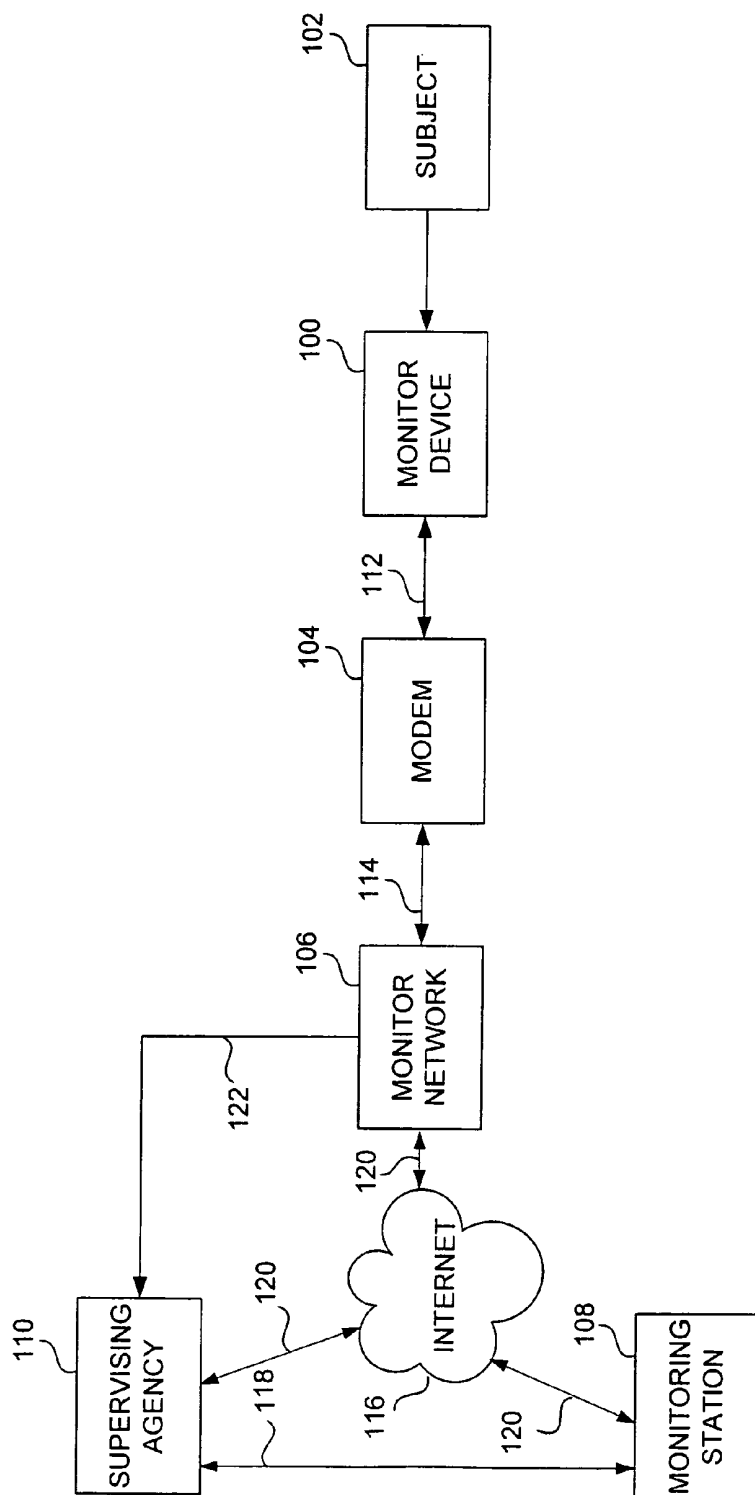
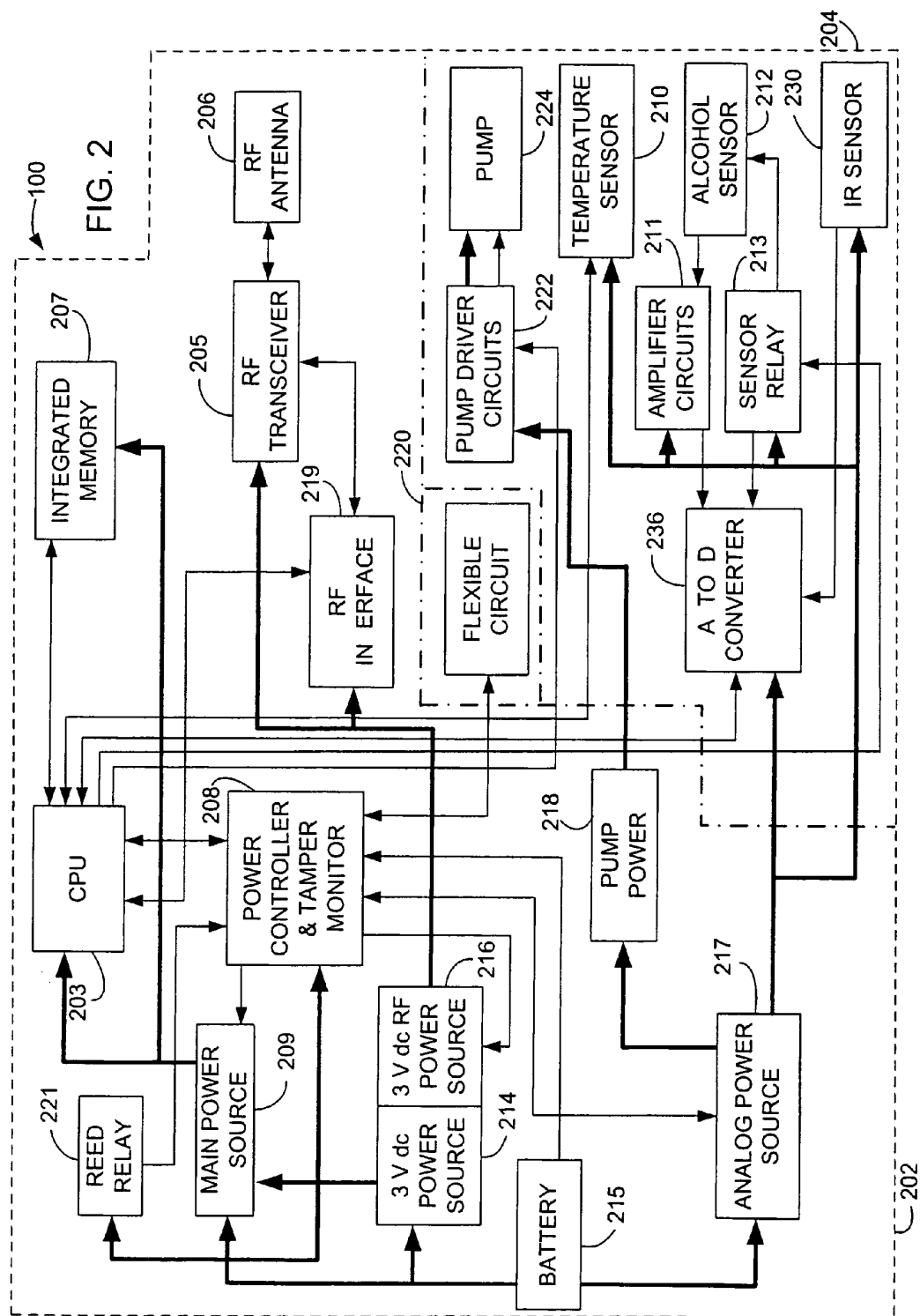
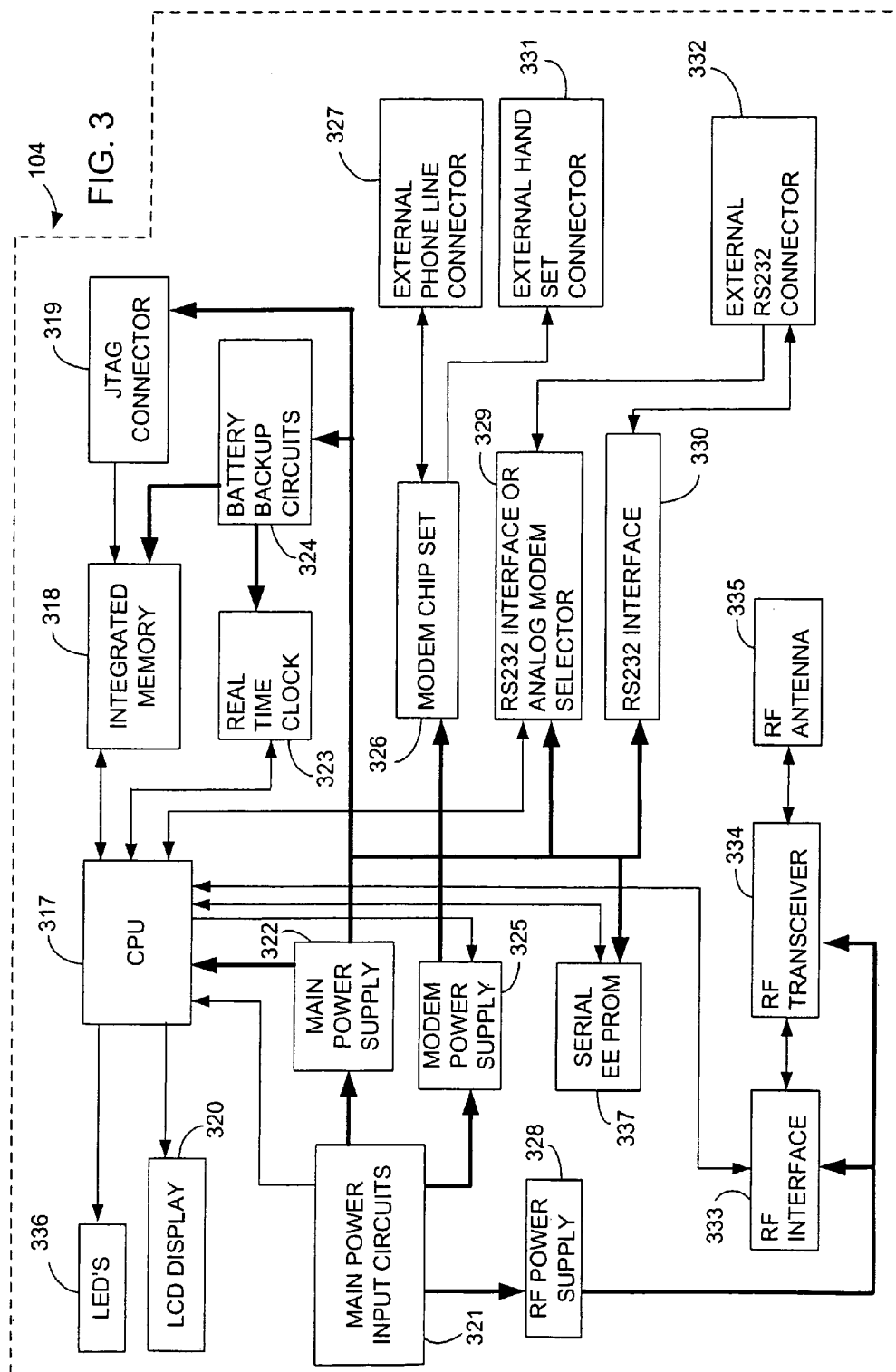

FIG. 1





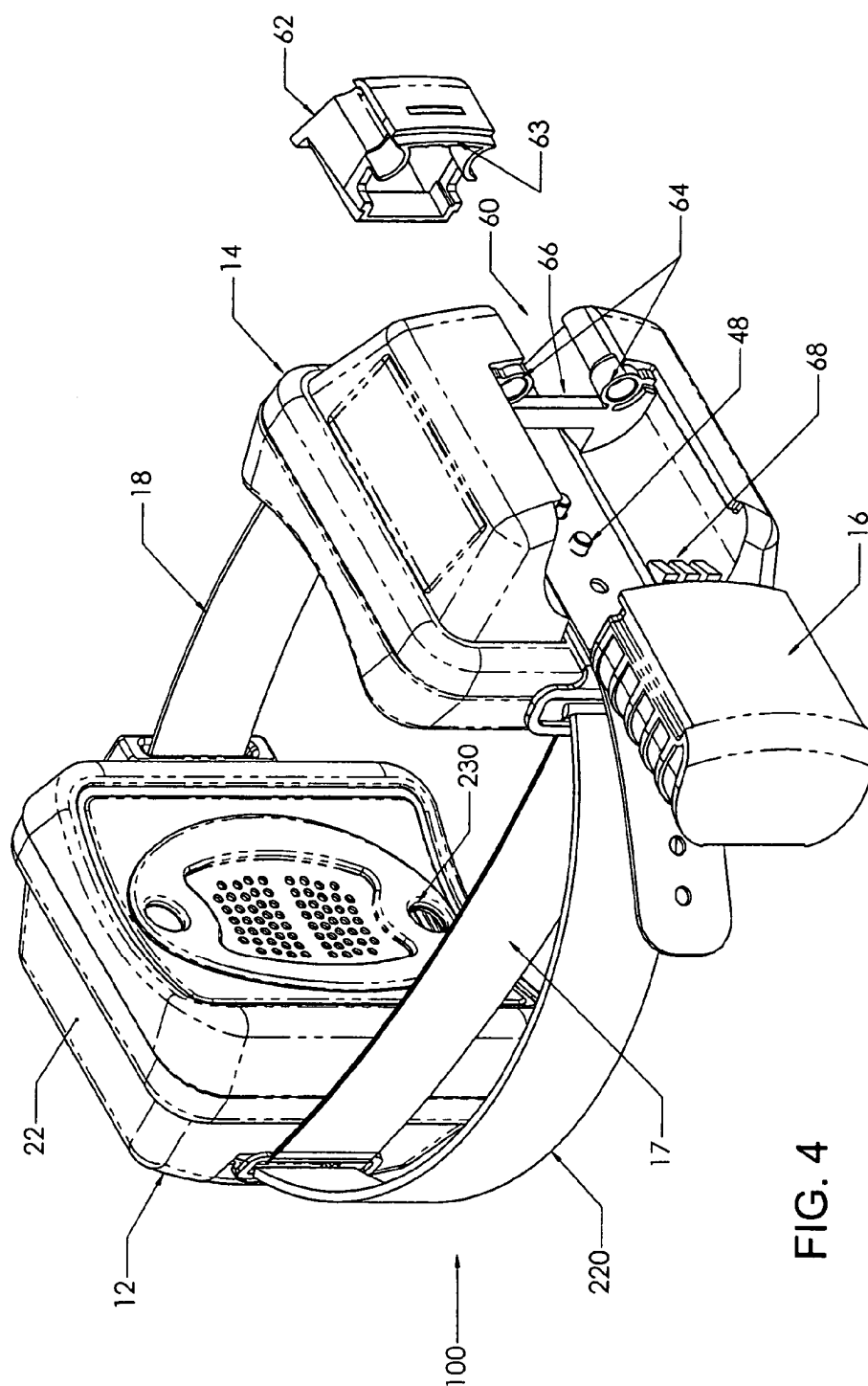

FIG. 4

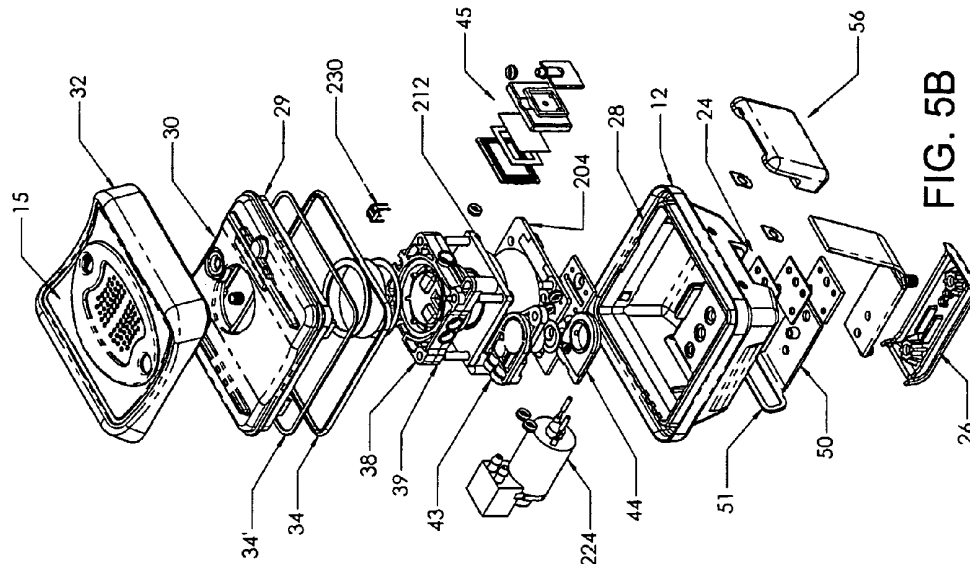

FIG. 5B

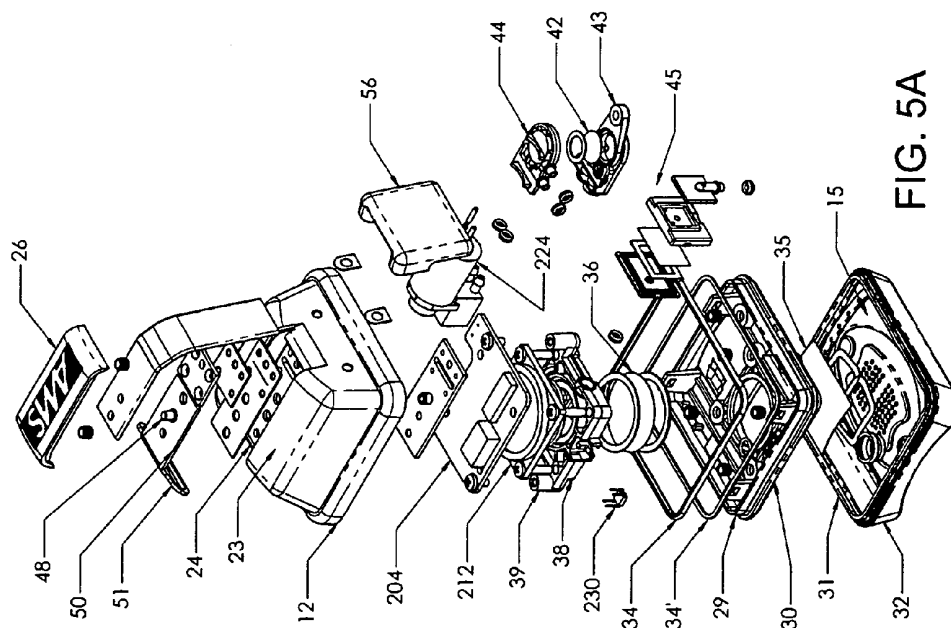

FIG. 5A

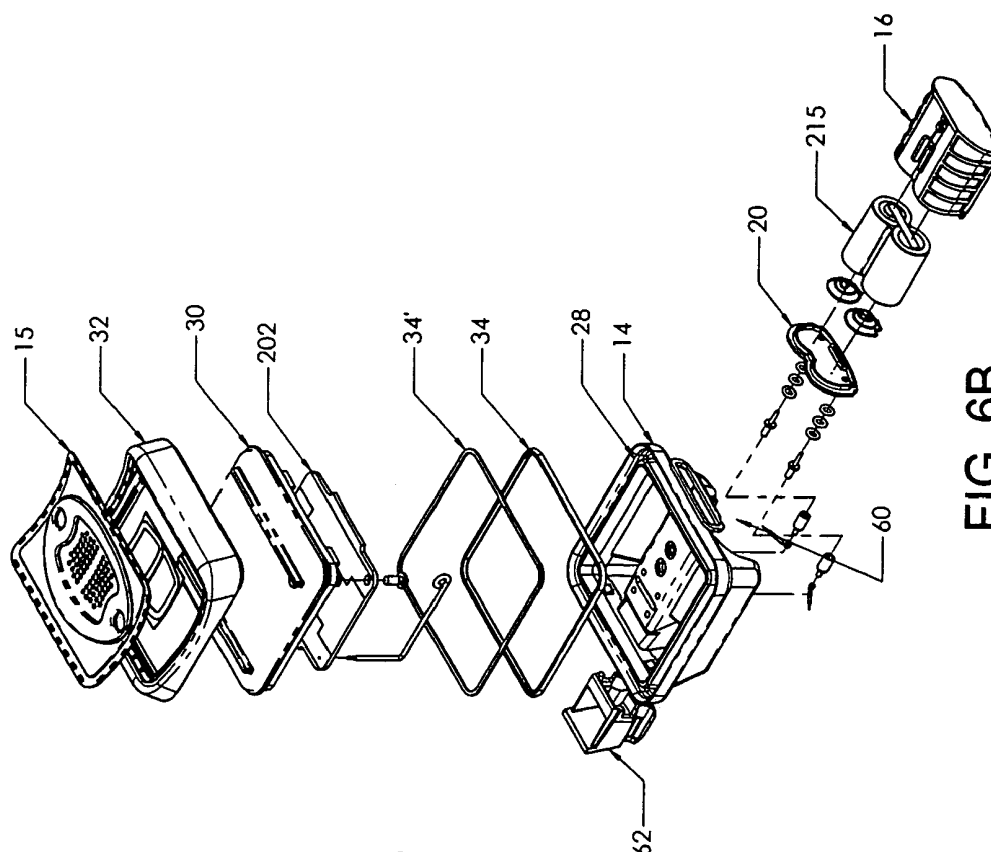

FIG. 6B

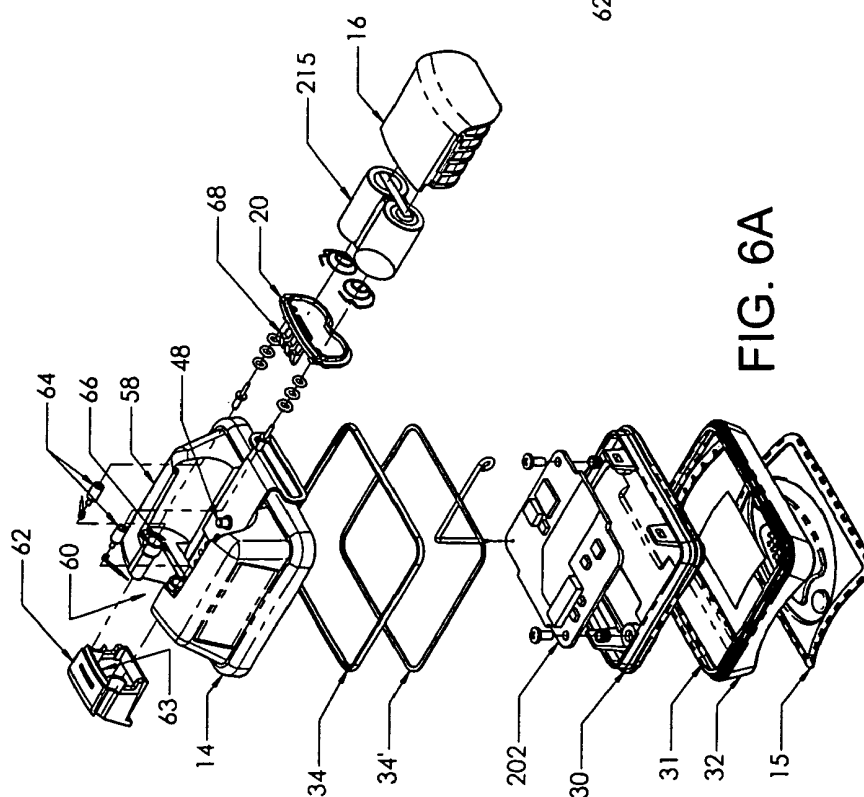
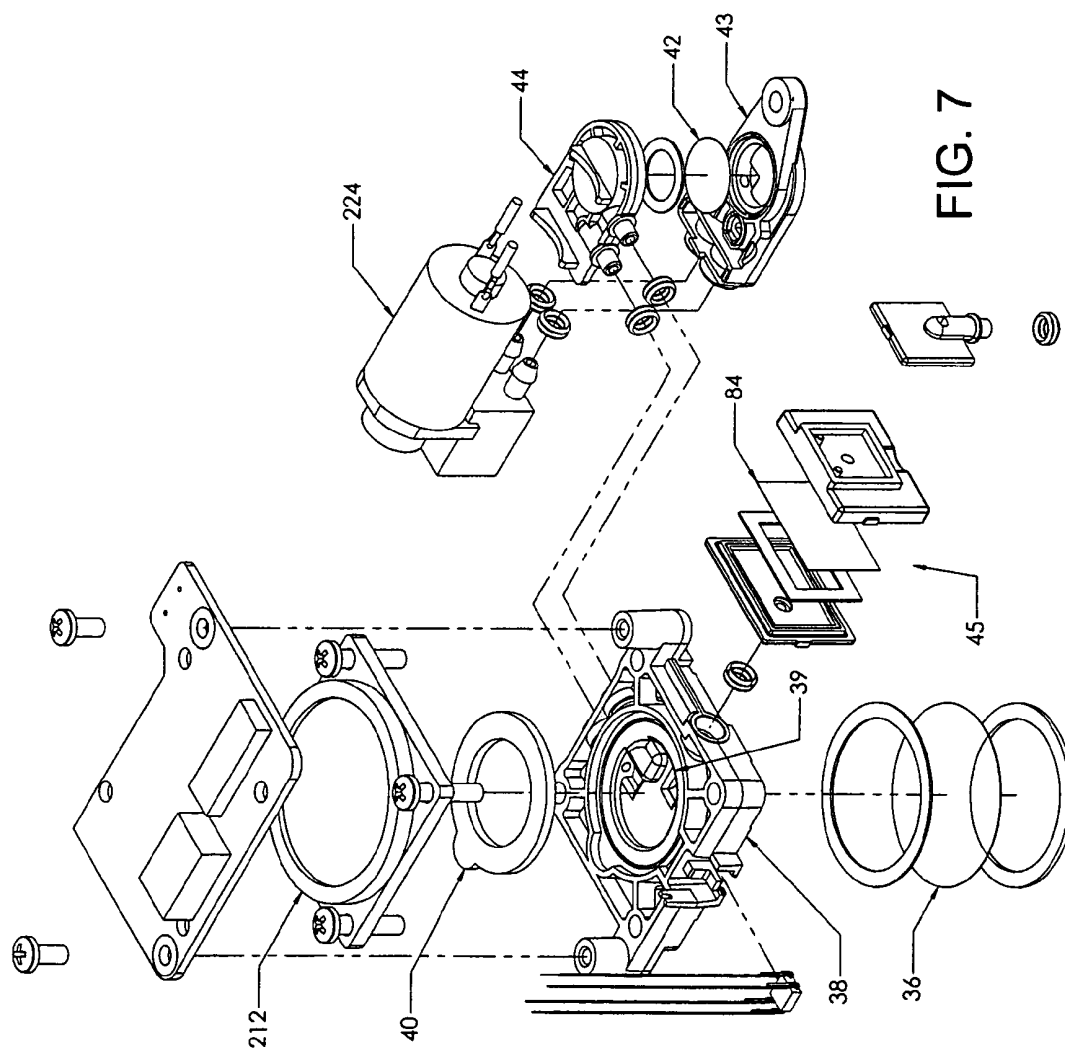

FIG. 6A



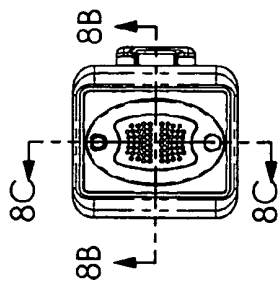

FIG. 8A

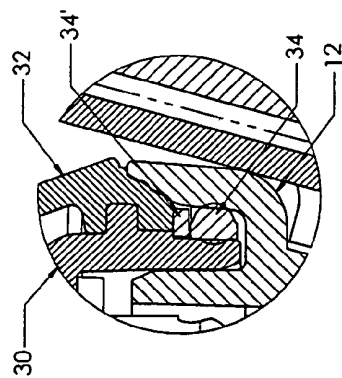

FIG. 8D

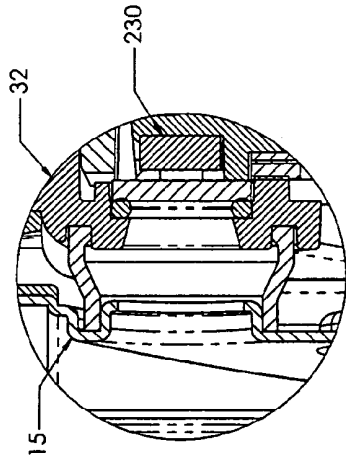

FIG. 8E

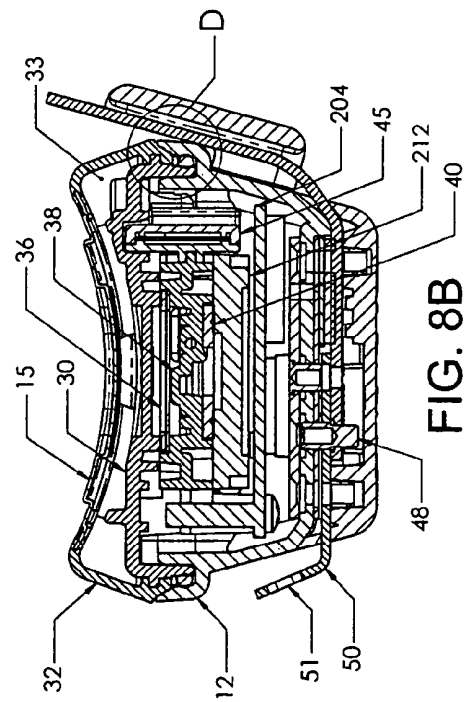

FIG. 8B

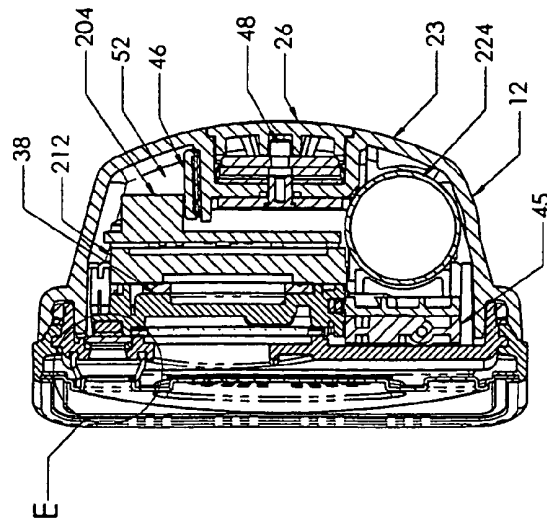

FIG. 8C

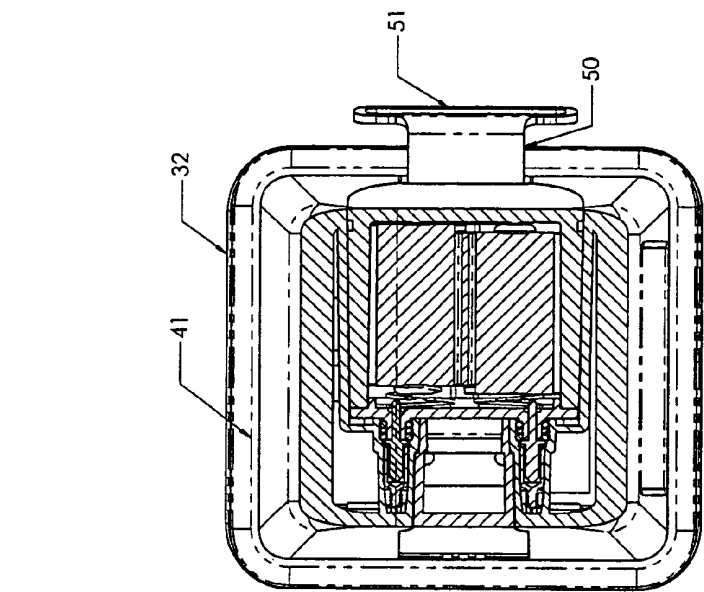

FIG. 9A

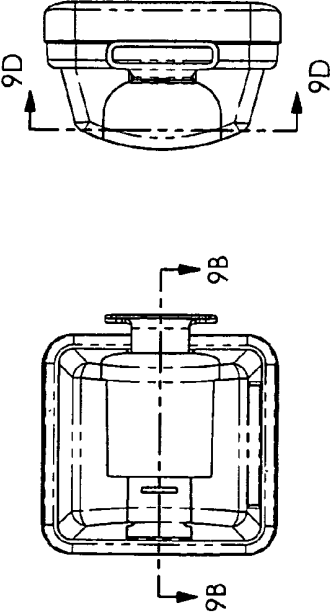

FIG. 9C

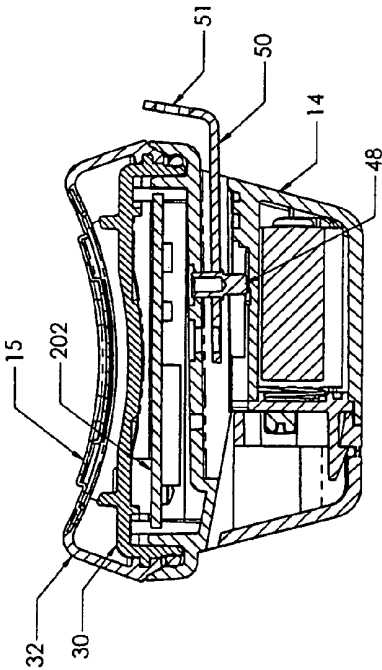

FIG. 9B

FIG. 9D

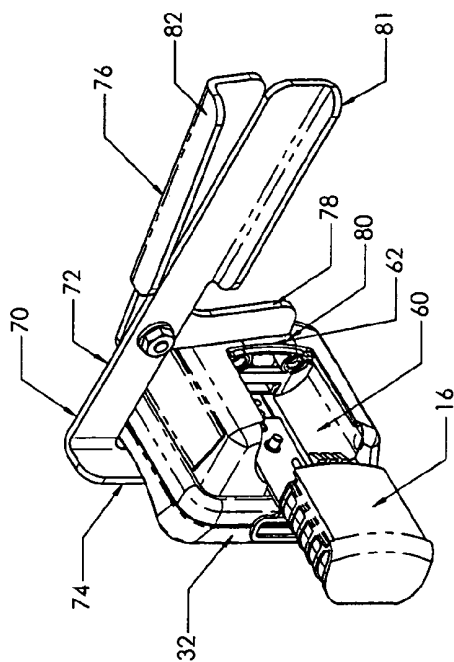

FIG. 12

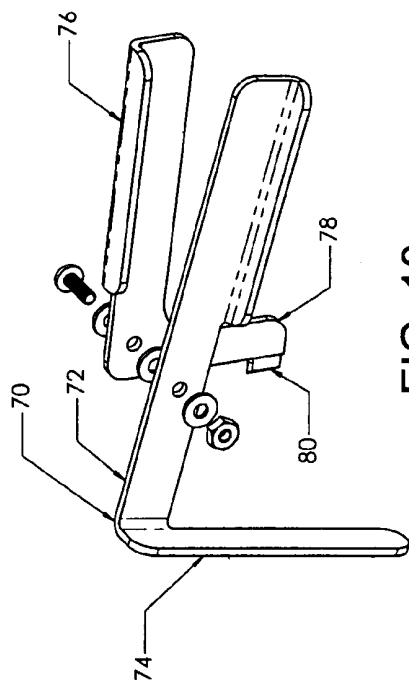

FIG. 10

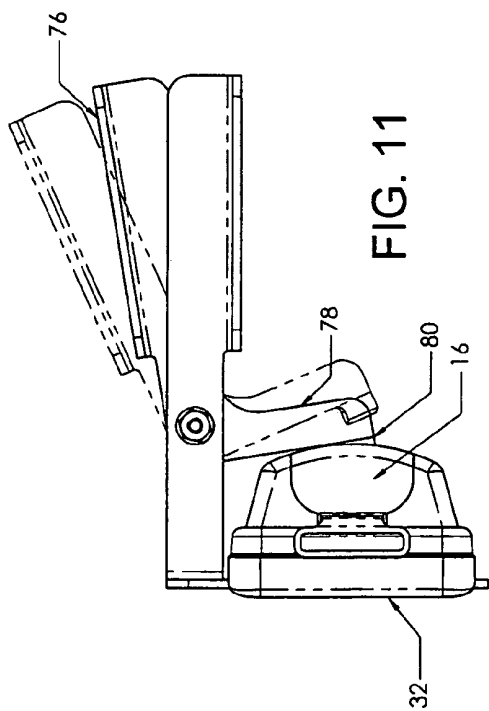

FIG. 11

FIG. 13A

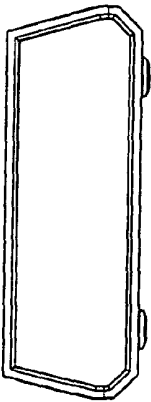
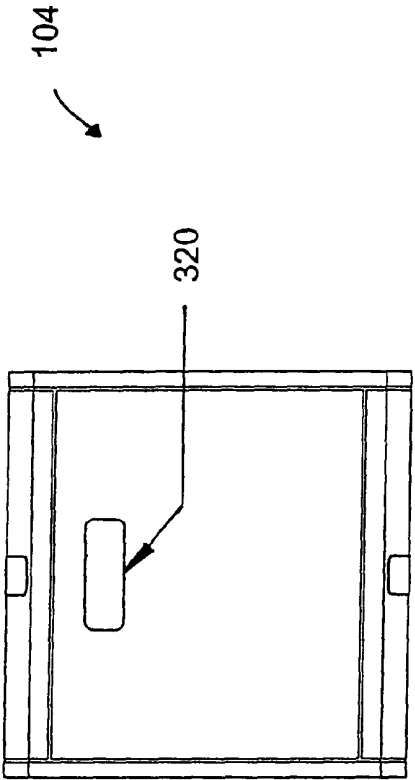

FIG. 13B

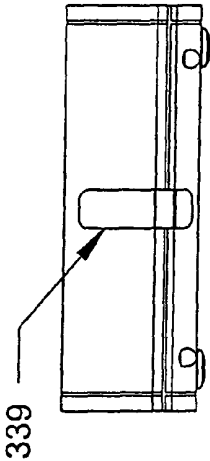

FIG. 13C

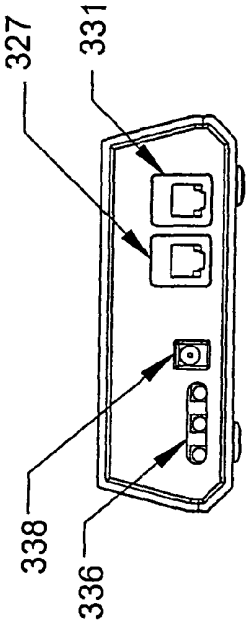

FIG. 13D

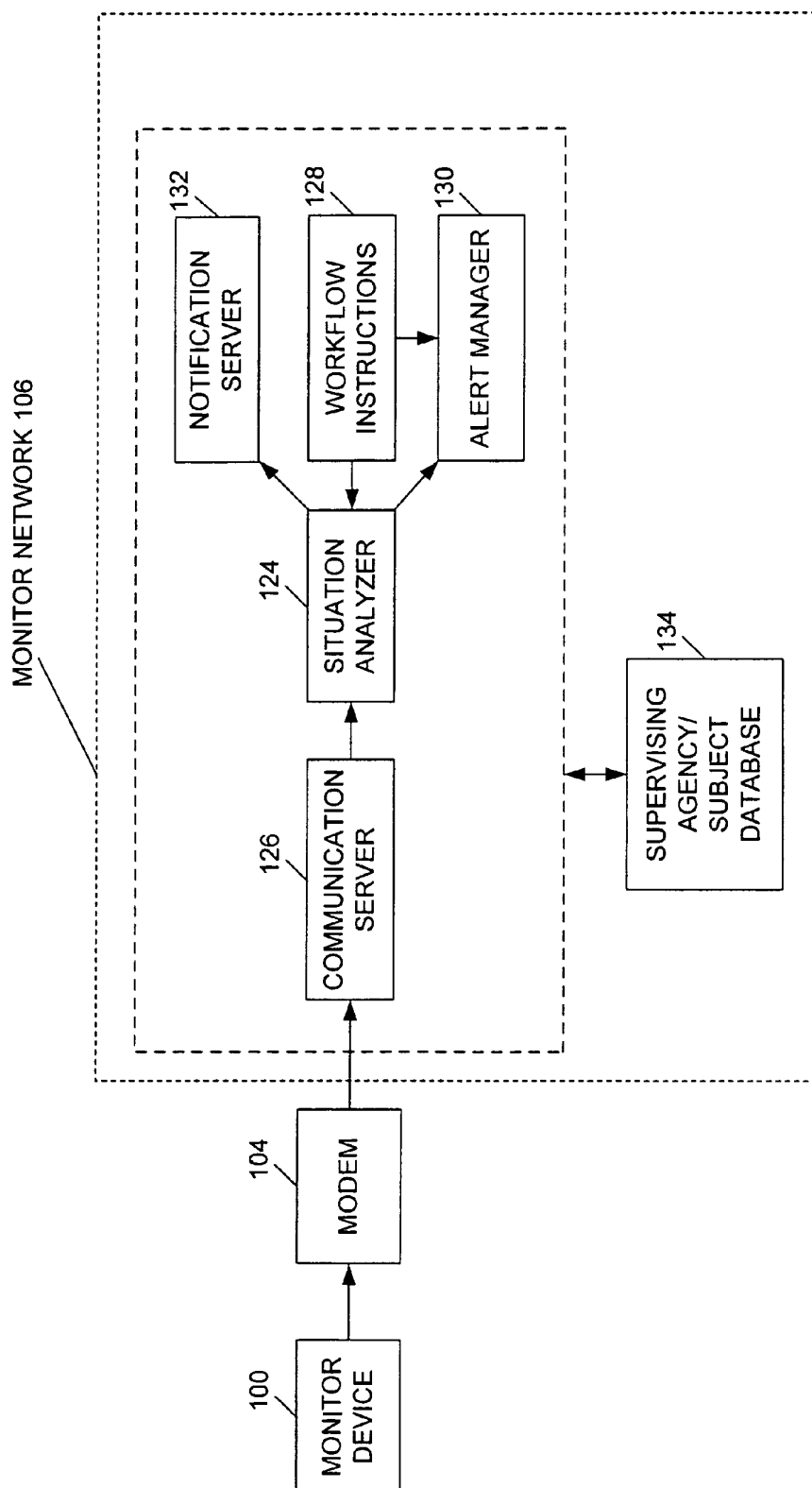

FIG. 14

METHOD AND APPARATUS FOR REMOTE BLOOD ALCOHOL MONITORING

CROSS REFERENCE TO RELATED APPLICATION

This application is a divisional application of application Ser. No. 10/441,940, filed on May 19, 2005 now U.S. Pat. No. 7,462,149, titled "Method And Apparatus For Remote Blood Alcohol Monitoring" which is incorporated herein by reference in its entirety, and this application is related to a co-pending patent application Ser. No. 10/441,960, filed on May 19, 2005, by Hawthorne et al. titled "BIO-INFORMATION SENSOR MONITORING SYSTEM AND METHOD" which is owned by the same assignee of this invention.

FIELD OF THE INVENTION

This invention relates to a blood alcohol monitoring system, and more particularly, relates to an improved non-invasive method and apparatus for transdermal monitoring of blood alcohol levels.

BACKGROUND OF THE INVENTION

Reference is made to U.S. Pat. No. 5,220,919 titled "BLOOD ALCOHOL MONITOR" and European Patent No. EPO 623001B1 titled "BLOOD ALCOHOL MONITOR," both owned by the assignee of this invention and both are hereby incorporated herein by reference.

Individuals on probation, parole, or in alcohol treatment programs may be prohibited from consuming alcohol, and many federal, state, and local law enforcement agencies require testing to ensure participants in court ordered programs remain alcohol free. In general, present-generation remote alcohol monitoring devices used in probation, parole, and treatment settings are fixed-location breath-testing devices that utilize voice or video identification of the participant. If a subject tests positive for alcohol, the monitoring device then sends a message alerting the monitoring center of a violation by the subject, and the monitoring center then sends an alert message to the subject's supervising agency or dedicated administrator.

As alcohol is ingested orally, it is absorbed into the body's blood and distributed throughout the body via the circulatory system. Alcohol is eliminated from the body by two mechanisms: metabolism and excretion. Metabolism accounts for the removal of greater than 90% of the alcohol consumed, removing it from the body via oxidation of the ethyl alcohol molecule to carbon dioxide and water primarily in the liver. The remaining alcohol is excreted unchanged wherever water is removed from the body—breath, urine, perspiration, and saliva. Although excretion accounts for less than 10% of the eliminated alcohol, it is significant because unaltered alcohol excretion permits an accurate measurement of alcohol concentration in the body by way of both breath analysis and insensible skin perspiration. Insensible skin perspiration is the vapor that escapes through the skin through sweating. The average person will emit approximately one liter of insensible skin perspiration each day. This perspiration can be used to obtain a transdermal measurement of blood alcohol concentration, referred to as Transdermal Alcohol Concentration ("TAC").

Transdermal monitoring of blood alcohol levels is accomplished by taking percentage measurements of alcohol contained in the air vapor that is expelled through human skin. A monitoring device is attached to the skin to capture the air and

measure the alcohol. There are numerous advantages to transdermal monitoring, as opposed to breath alcohol testing, including, but not limited to, the ability to take readings at any time without the knowledge of the subject, consistent and continuous testing (unlike breath alcohol testing where a subject breathing incorrectly into the testing device can cause inaccurate results), and the ability to convert such readings into electrical signals that can be transmitted to a central monitoring station.

However, there is a continuing need for a remote alcohol monitoring system which can be conveniently placed on the subject that can carry out TAC measurements at selected time intervals as well as at random times. There is also a need for a remote alcohol monitoring system that will compensate for the effects of temperature changes on TAC readings, is tamper-proof, and virtually impossible for the subject to remove without triggering an alarm. Still further, there is also a need to be able to download the TAC measurements to a monitoring station without requiring any actions on the part of the subject being monitored, eliminating the need for the subject to personally report to a central monitoring station or probation officer, or connect the monitoring device to a telephone line to download and transmit data to a monitoring station. The present invention meets these and other needs in the art.

BRIEF DESCRIPTION OF THE DRAWINGS

FIG. 1 shows a block diagram of a preferred form of monitoring system in an embodiment of the present invention.

FIG. 2 shows a block diagram of the sensing circuit of the monitor device in an embodiment of the monitoring system of the present invention.

FIG. 3 shows a block diagram of the modem in an embodiment of the monitoring system of the present invention.

FIG. 4 shows a perspective view of a monitor device assembly in an embodiment of the monitoring system of the present invention.

FIG. 5A shows an exploded perspective view of the analog side of the monitor device shown in FIG. 4 in an embodiment of the present invention.

FIG. 5B shows another exploded perspective view of the analog side of the monitor device reversed 180° with respect to FIG. 5A in an embodiment of the present invention.

FIG. 6A shows an exploded perspective view of the digital side of the monitor device shown in FIG. 4 in an embodiment of the present invention.

FIG. 6B shows another exploded perspective view of the digital side of the monitor device shown in FIG. 4 but reversed 180° with respect to that shown in FIG. 6A in an embodiment of the present invention.

FIG. 7 shows an exploded perspective view of the sampling system in the analog side of the monitor device shown in FIGS. 5A and 5B in an embodiment of the present invention.

FIG. 8A shows a front view in elevation of the analog side of the monitor device shown in FIG. 4 in an embodiment of the present invention.

FIG. 8B shows a cross-sectional view taken about line 8B of FIG. 8A in an embodiment of the present invention.

FIG. 8C shows a cross-sectional view taken about line 8C of FIG. 8A in an embodiment of the present invention.

FIG. 8D shows a detailed view taken at D of FIG. 8B in an embodiment of the present invention.

FIG. 8E shows another detailed view taken at E of FIG. 8C in an embodiment of the present invention.

FIG. 9A shows a front view in elevation, of the digital side of the monitor device shown in FIG. 4 in an embodiment of the present invention.

FIG. 9B shows a cross-sectional view taken about line 9B of FIG. 9A in an embodiment of the present invention.

FIG. 9C shows a side view in elevation of the digital side of the monitor device shown in FIG. 4 in an embodiment of the present invention.

FIG. 9D shows a cross-sectional view taken about line 9D of FIG. 9C in an embodiment of the present invention.

FIG. 10 shows an exploded, perspective view of the release tool in an embodiment of the present invention.

FIG. 11 shows a side view in elevation of the digital side of the monitor device shown in FIG. 4 and the release tool shown in FIG. 10 engaging the battery housing of the digital side for removal and replacement in an embodiment of the present invention.

FIG. 12 shows a perspective view of the assembly shown in FIG. 11 after the battery housing has been released by the release tool in an embodiment of the present invention.

FIGS. 13A-13D show a top view and three elevation views of the modem in an embodiment of the present invention.

FIG. 14 shows a block diagram of the monitor network in an embodiment of the present invention.

DETAILED DESCRIPTION OF THE INVENTION

Referring now to the Figures, in which like reference numerals refer to structurally and/or functionally similar elements thereof, FIG. 1 shows by way of illustrative example a system block diagram of the method and apparatus for remote blood alcohol monitoring between a human Subject 102 and a Monitoring Station 108. The preferred form of Monitor Device 100 weighs about eight ounces, is waterproof, and designed to handle the stress of everyday activity, and can be worn under any conditions, including bathing and swimming. Monitor Device 100 is attached to the Subject 102 being monitored in a manner to be described. Once Monitor Device 100 is in place, it cannot be removed without triggering a tamper alarm, which is recorded in Monitor Device 100. In addition, there are a number of anti-tamper features designed into Monitor Device 100 to ensure that the TAC readings taken are from Subject 102, and accurately represent the blood alcohol level of Subject 102 and not some other person. Though this discussion focuses on one Subject 102, one skilled in the art will recognize that many Monitor Devices 100 may be attached to many Subjects 102 at the same time over a broad geographic area, and all may be monitored by Monitoring Station 108, which is the intended purpose of the invention. Likewise, there may be multiple Monitor Networks 106 and Monitoring Stations 108 that manage additional Subjects 102 in diverse geographic locations.

Monitor Device 100 will take TAC readings that are time stamped at predetermined or random intervals twenty-four hours a day, seven days a week, 365 days a year, without active participation by Subject 102. Testing schedules may range from as frequent as every 30 minutes or as infrequent as once per day. Monitor Device 100 collects TAC data from Subject 102 regardless of the location or activity of Subject 102. While commuting, at work, at home, during recreation, in the shower, or sleeping, Subject 102 is passively monitored, allowing for continual, effective monitoring while Subject 102 maintains a normal routine. Subject 102 typically does not know when the sampling will occur. Typical existing alcohol monitoring programs that have used other means of testing subjects for alcohol will likely see an increase in the number of program positives utilizing the present invention.

This is a result of the continuous monitoring, rather than the pre-arranged, specific testing times typical of current monitoring programs. Continuous monitoring eliminates the ability for subjects to manipulate their drinking patterns to avoid detection.

TAC readings are taken as scheduled without the participation of Subject 102, with the data uploaded at scheduled time intervals to Modem 104, or immediately if a positive drinking event or a tamper is detected and Modem 104 is in range. Typically, Modem 104 would be placed at the residence of Subject 102, and Subject 102 is merely required to periodically be in proximity to Modem 104 for the purpose of allowing automatic transmission of TAC measurements taken by Monitor Device 100 over a period of time. Subject 102 comes within range of Modem 104, typically within about ten to twenty feet, on a periodic basis, such as once per day, to allow the automatic transmission to take place. Different hardware components may increase or decrease the range at which the automatic transmission will take place. Subject 102 may rise and leave for work, return home, and remain at home until the next day when it is time to leave for work again. When Monitor Device 100 is in range and the timer indicates that it is time to communicate with Modem 104, Monitor Device 100 will transfer to Modem 104 through radio frequency ("RF") signals through bi-directional RF Communication Link 112 all the TAC readings, tamper indicators, error indicators, diagnostic data, and any other data stored in Monitor Device 100 regarding Subject 102. Modem 104 also can transmit operational information, such as monitoring schedules and reporting schedules in the form of RF signals back to Monitor Device 100 over bi-directional RF Communication Link 112.

Modem 104 stores the data contained in the RF signals received from Monitor Device 100 for transmission to Monitor Network 106. After receiving all of the information from Monitor Device 100, Modem 104 will check the stored data for any TAC readings, tampers, errors, or diagnostic data. Any one of these, or a trigger from a predetermined time interval, will cause Modem 104 to establish a connection over Communication Link 114 with Monitor Network 106. Once a connection is established, Monitor Network 106 validates the identity of Modem 104 and authenticates the data before it is stored. Once validated, Modem 104 will transfer all of the TAC readings, tampers, errors, diagnostic data, and any other data stored to a web-hosted database server at Monitor Network 106 where all data is permanently stored. Monitor Network 106 then analyzes the data received and separates and groups the data into a number of separate categories for reporting to monitoring personnel at Monitoring Station 108. The data can then be accessed by the monitoring personnel through the use of secured dedicated websites through the Internet 116 and Internet Connection 120 to Monitor Network 106. When Monitor Network 106 analyzes the data received, an automatic alert, based upon a rules-based database, may be sent directly from Monitor Network 106 to a call center at Supervising Agency 110 over Communication Link 122, or to an individual previously designated by Supervising Agency 110, when a specific alert, or combination of alerts, are received. The alert may be an e-mail, a fax, or a page to a previously provided number. Communication Link 122 may be a wire or wireless connection.

Monitor Network 106 may be located at Monitoring Station 108, or in a separate location. Monitoring personnel at Monitoring Station 108 have access to all of the data gathered on all of the Subjects 102. Supervising personnel at the call

center of Supervising Agency 110, however, only have access to those Subjects 102 that are associated with Supervising Agency 110.

Monitoring Station 108 may automatically or periodically transmit data received from Modem 104 via Monitor Network 106 to one or more persons at Supervising Agency 110 who are assigned to monitor Subject 102, such as a parole officer, probation officer, case worker, or other designated person or persons in charge of enrolling Subject 102 and monitoring the data being collected on Subject 102. Only one Supervising Agency 110 is shown for simplicity, but one skilled in the art will recognize that many Supervising Agencies 110 may be accessing Monitor Network 106 at any given time. A connection is established with Supervising Agency 110 through Communication Link 118. Typically this connection is accomplished via the telephone system through a wire or wireless link, and may connect to a pager or cellular phone of the designated person. Designated personnel at Supervising Agency 110 may also access Monitor Network 106 through the use of secured dedicated websites through the Internet 116 and Internet Connection 120 to Monitor Network 106. Monitor Network 106 web software allows Supervising Agency 110 the ability to track Subject 102 compliance in a manner most feasible to them, and can be defined to fit the needs of both small and large programs. Each Supervising Agency 110 may customize the frequency of monitoring and the method of notification for alerts that they want to receive from Monitor Network 106. Alerts may be categorized by the type and severity of alert, allowing each Supervising Agency 110 to prioritize and better categorize a response (i.e., a low battery warning versus a possible alcohol violation).

Each Supervising Agency 110 has its own separate data storage area on the database server at Monitor Network 106 so that representatives from each Supervising Agency 110 can retrieve the secure data they need when they need it. The method and system of the present invention will work in conjunction with existing monitoring agencies that are experienced at managing alcohol offenders.

The method and apparatus for remote blood alcohol monitoring of the present invention has many advantages and benefits over existing methods and apparatus, including, but not limited to, no collection of body fluids (blood, breath, urine) that require special gathering, handling, or disposal considerations; no waiting for laboratory test results; there is no need for the subject to travel to a test center; continuous 24/7/365 monitoring and data collection from any location; no subject, agency official, or laboratory intervention--only passive participation on the part of the subject; the monitoring device is light weight and can be hidden from normal view; tamper-resistant technology ensures accurate readings representative of the subject being monitored; advanced technology utilizing microprocessors, encrypted data links, and secure data storage and retrieval; the ability for monitored subjects to maintain normal daily routines, including work, counseling, community service, family obligations, and recreation; and easy, web-based, secure access for the monitoring agency to each subject's data.

FIG. 2 shows a block diagram of an embodiment of Monitor Device 100. Referring now to FIG. 2, thicker arrows represent power circuits, and thinner arrows represent signal circuits. Monitor Device 100 is made up of two separate circuit boards referred to as Digital Board 202 and Analog Board 204 that are connected together by a Flexible Circuit 220 which also serves as a tamper strap.

Digital Board 202 contains a micro-controller that functions as a Power Controller And Tamper Monitor 208. Power

Controller And Tamper Monitor 208 controls all of the power in Monitor Device 100. When Battery 215 is inserted into Monitor Device 100, Power Controller And Tamper Monitor 208 is activated by the 3 V dc Power Source 214, and Monitor Device 100 operates at a 3 volt level. Once Power Controller And Tamper Monitor 208 is initialized and running it will turn on the main power to Monitor Device 100 by activating the Main Power Source 209. Power Controller And Tamper Monitor 208 will now operate at a 5 volt level with the rest of the circuits.

Another function of Power Controller And Tamper Monitor 208 is to monitor the output power level of Battery 215 that operates Monitor Device 100. This is accomplished by running the raw battery voltage through a resistive voltage divider and then connecting it directly to Power Controller And Tamper Monitor 208. Power Controller And Tamper Monitor 208 also power controls the power to Analog Board 204 through the Analog Power Source 217. Analog Power Source 217 in turn provides power to Pump Power 218 which powers the pump circuits, so that the pump circuits are not powered up unless Analog Board 204 is turned on.

Another function of Power Controller And Tamper Monitor 208 is to provide a real time clock that may set the increments of time that Monitor Device 100 is turned off before turning back on. The time and date are downloaded to Central Processing Unit ("CPU") 203 from Modem 104 and are then communicated to Power Controller And Tamper Monitor 208, which will then keep track of the time and date and automatically turn on Main Power Source 209 at scheduled times, which can be programmed by CPU 203. Power Controller And Tamper Monitor 208 allows Monitor Device 100 to turn itself on and off to conserve battery life, and allows external stimulus events to turn on power to Monitor Device 100.

The tamper control portion of Power Controller And Tamper Monitor 208 monitors all of the inputs that can cause Monitor Device 100 to wake up due to some kind of a tamper condition. The first condition occurs if a magnet is passed near Reed Relay 221. Passing a magnet near Reed Relay 221 is a method that monitoring personnel employ to wake up Monitor Device 100 in order to take a TAC reading at an unscheduled time. However, Subject 102 may attempt to repeatedly pass a magnet near Reed Relay 221 in order to wear the battery down. Therefore, even when activated by monitoring personnel, any such activation of Monitor Device 100 is still processed as a tamper. Monitoring personnel can note in the records that the tamper event recorded as a result of their actions was a manual turn on, and not a tamper, and prevent any notifications from being sent to Supervising Agency 110.

Passing a magnet near Reed Relay 221 will cause it to open and close, creating a pulsing effect at the tamper monitoring input. When Power Controller And Tamper Monitor 208 detects this pulsing input it will immediately turn on Main Power Source 209 and activate Monitor Device 100. A tamper event record is recorded, and the procedure to take a TAC reading is initiated. A temperature reading and a distance reading are also taken. Monitor Device 100 then checks to see if it is within range of Modem 104. If so, then the communication and transmission procedure is initiated.

The tamper control portion of Power Controller And Tamper Monitor 208 also monitors a continuous signal that is being passed through Flexible Circuit 220 and Analog Board 204 and back to the tamper control portion. If this signal is interrupted, then Power Controller And Tamper Monitor 208 will immediately activate Main Power Source 209 and Monitor Device 100 will proceed as outlined above.

As mentioned above, Digital Board **202** also contains CPU **203** which is a stand alone processor which typically has no internal memory component. In another embodiment of the invention, CPU **203** and Integrated Memory **207** may be combined together in the same chip. CPU **203** retrieves all of its instructions and data from Integrated Memory **207**, which is used for both program memory and data storage memory. Integrated Memory **207** is divided internally into several different memory segments. There is a small segment of the memory dedicated to the boot strap program. The boot strap program is used to initialize Monitor Device **100** when power is first applied. The boot strap program is a very basic program that will initialize CPU **203** and then check the validity of the main operating program that is stored in a larger section of Integrated Memory **207**. The boot strap program also has the capability of establishing communications through RF Communication Link **112** if the main program is not valid.

The RF link between Monitor Device **100** and Modem **104** is established through the use of a serial to RF Transceiver **205** and RF Antenna **206**. CPU **203** will command Power Controller And Tamper Monitor **208** to turn on 3 V dc RF Power Source **216**. Power Controller And Tamper Monitor **208** will then activate 3 V dc RF Power Source **216** and supply all the RF components with 3 volts. CPU **203** is connected to RF Transceiver **205** through RF Interface **219** which allows the 5 volt serial signal from CPU **203** to be converted to the proper voltage (3 volts) for the RF transceiver circuits. By establishing RF Communication Link **112** the main program can then be downloaded into Monitor Device **100** by Modem **104** if required. Once the boot strap program has verified that the main program is valid, it will then switch operation to the main program segment stored in Integrated Memory **207** instead of establishing RF Communication Link **112**.

Analog Board **204** contains a serial programmable chip Analog to Digital ("A to D") Converter **236**. This is a programmable chip in that it allows for amplifier gain to be applied to the signals that are being monitored thorough the use of internal Amplifier Circuits **211** and software stored in Integrated Memory **207**, instead of using external hardware to amplify the signals. CPU **203** can then use the software to change the gain of all the A to D channels at any time. A to D Converter **236** is used to convert data created by Alcohol Sensor **212**, Infrared ("IR") Sensor **230**, and Sensor Relay **213** into digital data. These signals are input to A to D Converter **236** in analog form and are then converted to a digital signal and communicated through a serial link to CPU **203**. Alcohol Sensor **212** is a passive electrochemical fuel cell. The output of Alcohol Sensor **212** is an electrical current which is proportional to the amount of alcohol present in the vapor sample. IR Sensor **230** measures the distance between Monitor Device **100** and the skin of Subject **102** to confirm that Monitor Device **100** has not been removed, or that a barrier has not been placed between the skin of Subject **102** and Monitor Device **100**, such as plastic wrap, tape, paper, aluminum foil, playing cards, and the like. Sensor Relay **213** keeps Alcohol Sensor **212** shorted, and only opens it when a reading is being taken.

Analog Board **204** also contains serial Temperature Sensor **210**. Temperature Sensor **210** measures temperature in degrees Celsius and transmits temperature readings through a serial link to CPU **203**. A low temperature reading may indicate that Monitor Device **100** has been removed from the limb of Subject **102**. Normally, the skin temperature of Subject **102** will constantly fluctuate up and down over time. A period of fairly constant temperature readings may be an indication that a barrier has been placed between the skin and Monitor Device **100**. Temperature readings from Temperature Sensor

210 combined with distance readings from IR Sensor **230** are evaluated together to determine a tamper condition. Temperature readings are also used to adjust the TAC readings as discussed immediately below.

The last items on Analog Board **204** are Pump Driver Circuits **222** and Pump **224**. CPU **203** will activate Pump **224** in the process of taking a reading. Pump **224** draws a consistent and predetermined amount of air across Alcohol Sensor **212**, which measures the amount of alcohol present in the air sample. The amount of time that Pump **224** is activated is strictly controlled by CPU **203** in order to control the consistency of each sample taken. When the predetermined amount of time has expired, CPU **203** will turn off Pump **224**. CPU **203** will then monitor Alcohol Sensor **212**. Once the peak voltage from the alcohol sensor has been recorded, CPU **203** will then calculate the approximate TAC reading for the peak voltage recorded and store that information in Integrated Memory **207** for later retrieval by Modem **104**.

Each Monitor Device **100** must be calibrated through a characterization process before it can be used to monitor a Subject **102**. The characterization process takes several hours. In a controlled environment, air samples of known alcohol concentrations are introduced into the sample chambers of each Monitor Device **100** at six different temperatures. The voltage generated by Alcohol Sensor **212** is then recorded. Alcohol concentrations of 0.00%, 0.02%, 0.05%, and 0.08% are used in the characterization process. Thus, a table is created for each Monitor Device **100** having 24 separate values. An example of a characterization data table for a particular Monitor Device **100** is shown below. No two Monitor Devices **100** will have the same characterization table due to the variances of all of the assembled components. In the table below, the temperatures are listed across the top row of the table and the alcohol concentrations supplied are shown in the far left column. The resulting voltages from the Monitor Device **100** being characterized are shown in the table matrix corresponding to each sample and temperature.

The gain shown is the software gain that CPU **203** will use for each reading when Monitor Device **100** is operating on Subject **102**. The gain is determined for each Monitor Device **100** during the characterization process, and will also vary from device to device. The first step in the characterization process is to heat Monitor Device **100** to the maximum temperature and allow it to settle in at that temperature. The gain is then set to a default value of 8. The maximum allowable sample (0.08%) is then introduced to Monitor Device **100**. The resulting Alcohol Sensor **212** voltage is measured, and this voltage must be less than the maximum allowable voltage for Monitor Device **100**. If it is, then the gain is increased and the test is repeated until the maximum allowable voltage is exceeded. Once the maximum allowable voltage has been exceeded, the gain is set back one level to ensure that the maximum allowable voltage will not be exceeded.

Characterization Table						
%/Celsius	15	21	27	33	39	45
0.00	0.18	0.36	0.34	0.36	0.40	0.52
0.02	0.54	0.82	1.08	1.04	1.14	1.24
0.05	1.10	1.98	2.14	2.20	2.26	2.32
0.08	2.12	3.22	3.46	3.54	3.56	3.70

Gain = 8

The characterization table for each Monitor Device **100** is stored in Integrated Memory **207**, and CPU **203** will extrapolate

late the TAC reading based upon the temperature reading and the voltage reading and the gain applied.

After Monitor Device 100 has completed the reading, it will then activate the RF circuits and wait to see if an RF signal is received from Modem 104. If a signal is received from Modem 104, Modem 104 will then retrieve all of the information stored in Integrated Memory 207 and transmit it to Modem 104. If no signal is received, then Modem 104 will turn off.

FIG. 3 shows a block diagram of an embodiment of Modem 104 where thicker arrows represent power circuits, and thinner arrows represent signal circuits. FIGS. 13A-13D show a top and three elevation views of an embodiment of Modem 104. Referring now to FIG. 3 and FIGS. 13A-13D, Modem 104 is powered by an external dc power supply (not shown in FIG. 3 or FIGS. 13A-13D). The dc power supply can be configured to plug into either an 115V AC supply or an international type power outlet. The dc power supply is plugged into an external power source and then plugged into the back of Modem 104 at Main Power Input 338. Main Power Input 338 is connected to Main Power Input Circuits 321. These circuits filter the power and make sure that the polarity of the power is correct and then distribute the power to Main Power Supply 322, Modem Power Supply 325, and RF Power Supply 328. Main Power Input Circuits 321 also monitor the power for AC power failures. This is accomplished by running the DC power input through a resistive divider and then into CPU 317.

Main Power Supply 322 supplies the power to CPU 317, RS232Interface or Analog Modem Selector 329, RS232 Interface 330, Serial EE Prom 337, Battery Backup Circuits 324 and JTAG Connector 319. Battery Backup Circuits 324 supply the power to Integrated Memory 318 and Real Time Clock 323. The main power is applied as soon as Modem 104 is plugged in. The fact that Modem 104 is on is reflected by at least one LED that is illuminated in LED's 336. LCD Display 320 will also display various status messages regarding the current status of Modem 104. Tamper Tape Strip 339 is applied to a side of Modem 104 where the top half and bottom half come together as a tamper indicator. Any attempt by Subject 102 to gain access to the internal portion of Modem 104 will be evident from the altered state of Tamper Tape Strip 339.

Integrated Memory 318 is divided internally into several different memory segments. There is a small segment of the memory dedicated to the boot strap program. The boot strap program is used to initialize Modem 104 when power is first applied. The boot strap is a very basic program that will initialize CPU 317 and then check the validity of the main operating program that is stored in a larger section of Integrated Memory 318. There is also an additional RAM component that supplies extra data storage capabilities. Serial EE Prom 337 is used to store all of the critical information for Modem 104 such as the serial number, device identification information and the phone numbers that should be called to connect to Monitor Network 106. Modem 104 will retrieve and validate all of the critical information and will then validate the main operational program. If the main operational program is valid, Modem 104 will switch operation from the bootstrap program to the main operational program. Once the switch is made Modem 104 will contact Monitor Network 106 and report the latest power fail. If Subject 102 unplugs Modem 104 and moves it to a different location, or if the electricity is cut off for any reason, such as a power outage, a power fail event is recorded. If the main operational program is not valid then Modem 104 will try to contact Monitor Network 106 and get the main operational program down-

loaded to itself. The JTAG Connector 319 also provides a means of programming both the modem boot strap program and the main operational program into Integrated Memory 318.

To connect to Monitor Network 106, Modem 104 will check the input from the RS232 Interface or Analog Modem Selector 329 and see if there is a serial cable attached to Modem 104 at External RS232 Connector 332, which is accessible by opening up the cover of Modem 104. If there is, then Modem 104 will go into slave mode waiting for serial communications to come in through RS232 Interface 330. This mode provides a means of manually issuing commands and loading programs and or data to Modem 104. If there is no serial cable attached to Modem 104, then CPU 317 will turn on Modem Power Supply 325. After allowing Modem Chip Set 326 to power up and stabilize, CPU 317 will check for a dial tone. If no dial tone is identified, then CPU 317 will hang up and generate an alarm to indicate that the phone line is not connected at External Phone Line Connector 327. Modem 104 will then try again after a predefined delay period. External Hand Set Connector 331 receives the telephone wire that comes from the telephone hand set.

Once a dial tone has been established, CPU 317 will dial the phone number for Monitor Network 106. CPU 317 will then monitor Modem Chip Set 326 for an indication that a connection has been established with Monitor Network 106. If CPU 317 determines that the phone line is busy, or that there is no answer, then CPU 317 will hang up and log an alarm indicating that a connection could not be established. Modem 104 will then wait a predefined delay period and try to make the connection again. Once the connection is established, Monitor Network 106 becomes the master and Modem 104 becomes the slave. Monitor Network 106 will then extract all of the pertinent information that it needs to validate Modem 104 and to update its status. It will then update Real Time Clock 323 so that Modem 104 is set to the proper time for the time zone where Modem 104 is currently located. Monitor Network 106 will then upload all data that has been stored in Modem 104 since the last upload. Monitor Network 106 then has the ability to download any number of specific monitoring instructions that need to be sent to Monitor Device 100, along with all of the schedule information for Modem 104 and Monitor Device 100. Monitor Network 106 will then tell Modem 104 to hang up and start operations.

CPU 317 will hang up and turn off the power to Modem Chip Set 326. CPU 317 will then activate the RF circuits and try to establish an RF link. The RF link is established through the use of a serial to RF Transceiver 334 and the RF antenna 335. CPU 317 is connected to RF transceiver 334 through RF Interface 333 which allows the serial signal from CPU 317 to be converted to the proper voltage for the RF transceiver circuits. CPU 317 will start sending a standard message out over the RF link. This message is addressed to Monitor Device 100, so if Monitor Device 100 is within range of Modem 104 and Monitor Device 100 is active, then Monitor Device 100 will answer the message with a status message indicating that Monitor Device 100 is active and operating. Modem 104 will then become the master and Monitor Device 100 will become the slave. Modem 104 will extract all of the status information from Monitor Device 100 and will validate the operating program and any pertinent operating data needed by Monitor Device 100. Modem 104 will then update the real time clock in Monitor Device 100 so that Monitor Device 100 and Modem 104 are on the same time. Modem 104 will then extract any TAC reading information as well as any tamper or error information from Monitor Device 100. Modem 104 will then turn off the RF signal. When the RF

signal is turned off, Monitor Device 100 will turn itself off and return to normal monitoring mode.

CPU 317 will then scan through the data just received and determine if any of the data needs to be sent immediately to Monitor Network 106. If not, then CPU 317 will wait a predefined delay period and then start the polling sequence again. If there is data that needs to be transmitted to Monitor Network 106 immediately, or if the time clock indicates that it is a scheduled time to call Monitor Network 106, then Modem 104 will go through the connection process and connect to Monitor Network 106.

FIG. 14 shows a more detailed block diagram of Monitor Network 106. Alert/tamper information is constantly being generated and monitored by the system components of the present invention. The following description will describe how and why the information is generated and how the information is handled and processed once it is generated.

Passive identification of Subject 102 is achieved by securely attaching Monitor Device 100 to Subject 102 in such a manner that it cannot be removed without physically damaging Monitor Device 100 and leaving evidence that Monitor Device 100 has been removed. Once Conductive Strap 18 has been adjusted and secured over Securing Pins 48, Battery Housing 16 and Battery Clip 62 are inserted into Enlarged Channel 60 securing Monitor Device 100 to Subject 102. The only way Monitor Device 100 can now be removed from Subject 102 is by cutting Conductive Strap 18 or Flexible Circuit 220, or by breaking or cutting one of Housing 12, Housing 14, Battery Housing 16, or Battery Clip 62.

When Battery 215 makes electrical contact upon being inserted in Monitor Device 100, an alert is generated indicating that power has been applied to Monitor Device 100 and the last known time and date are logged with the alert so that the duration Monitor Device 100 went without power can be determined. Normal occurrences of these alerts are generated each time Monitor Device 100 is attached to Subject 102, or each time that Battery 215 is changed in Monitor Device 100. There should never be an alert of this type generated when Monitor Device 100 is in normal operation on Subject 102. Another type of removal alarm is generated if Flexible Circuit 220 or Conductive Strap 18 are cut or disconnected at any time after Battery 215 is secured in Monitor Device 100. Monitor Device 100 will generate a Strap Alert, along with the time and date the Strap Alert was generated.

Monitor Device 100 monitors the data from Alcohol Sensor 212 and Infrared Sensor 230 combined with Temperature Sensor 210, which are mounted on Analog Board 204, to determine if there has been some type of obstruction placed between Monitor Device 100 and the skin of Subject 102. If the output of these three sensors indicates that there is an obstruction, Monitor Device 100 will log the alert along with the time and date that the alert occurred. This alert will be generated as long as the sensor data indicates that the condition is present.

All of the alerts described previously will cause Monitor Device 100 to attempt to communicate with Modem 104 as soon as possible, overriding the normal scheduled communication programmed into Modem 104 and Monitor Device 100. The system of the present invention uses the scheduled communication times to ensure that all equipment is operational under normal conditions. During normal operation there should be no reason for the equipment to override the schedules, and it will only communicate when scheduled. If no schedules were used, there would be no communication and no validation that readings were being taken and stored by Monitor Device 100. If Monitor Device 100 does not communicate at a scheduled communication time, Modem

104 will generate an alert that Monitor Device 100 failed to communicate on schedule, along with the present time and date. This alert will be labeled as a Communication Alert by Situation Analyzer 124. If Monitor Device 100 does not communicate with Modem 104 for a period of 24 hours, Modem 104 will generate a No Monitor Communication Alert, along with the present time and date. This will also be labeled as a Communication Alert by Situation Analyzer 124. Thus, the normal flow of communication between Monitor Device 100 and Modem 104 must exist or there will be alerts generated to inform the monitoring personnel that something is wrong with the system.

Modem 104 communicates with the Monitor Network 106 through Communication Server 126. The normal communication between these two devices is controlled by schedules programmed into the particular Modem 104 that is assigned to a particular Monitor Device 100. Monitor Network 106 also monitors these schedules. If Modem 104 fails to communicate when scheduled, Monitor Network 106 will generate a Communication Alert indicating that Modem 104 failed to communicate when scheduled. Thus if the normal communications cycle between Modem 104 and Communication Server 126 is broken, then alerts will be generated to inform the monitoring personnel that something is wrong with the system. This type of system architecture provides the means for equipment at each level of the communication chain to generate alarms. This guarantees that if a piece of equipment anywhere in the chain of communication fails, there will be an alarm to report it.

Data input and data management are handled by Supervising Agency/Subject Database 134. Supervising Agency/Subject Database 134 is actually a combination of databases that support all of the processes of Monitor Network 106. Supervising Agency/Subject Database 134 includes input and management of the call center data, the Supervising Agency/Subject data, and any specific information relating to a treatment center associated with the Supervising Agency 110, and the offender or patient data for all Subjects 102, including their individual monitoring and communication schedules and the device information for Modems 104 and Monitor Devices 100 assigned to them. Supervising Agency/Subject Database 134 stores all of the readings and tampers/alerts information that is received from all Modems 104 and Monitor Devices 100, as well as any device information that needs to be stored and monitored. Supervising Agency/Subject Database 134 provides a complete historical record of all readings and tampers/alerts for all Subjects 102 being monitored in the system.

Situation Analyzer 124 is used to parse the data and apply a known set of rules and instructions for handling the raw data and parsing it into a limited number of categories. These categories can be broken down as follows:

Positive TAC: Includes all positive readings and any type of positive readings that involve an interferant. An interferant is defined as a reading indicating a positive TAC, where the positive TAC is caused by some sort of topical ethanol applied to the skin or spilled/poured onto the Monitoring Device 100, but not ingested into the body by drinking.

Equipment Tamper: Includes Obstruction alarms received from Monitor Device 100. Power up alarms received from Monitor Device 100, and distance and temperature alarms that are received from Monitor Device 100. Also included are Equipment Failures.

Communication Alerts: Includes No Modem Communication, No Monitor Device Communication, Modem

missed scheduled call-in time alerts, and Monitor Device missed scheduled call-in time alerts.

Equipment Maintenance: Includes alerts for scheduled maintenance, non-scheduled maintenance, and software downloads.

Equipment Assignment: Includes alerts for equipment now assigned to a client and equipment removed from a client.

Situation Analyzer 124 will make inquiries to Workflow Instructions 128 to get direction on what is the default or specific action that should be applied to the message that was just received. Situation Analyzer 124 will then use those instructions and any historical data relating to similar messages to make a decision as to what to do with the message just received. Situation Analyzer 124 can also monitor historical data and escalate the severity of alert messages if there is a pattern emerging in the data that would require more immediate attention. Once Situation Analyzer 124 has made its decision, it will pass the message to Alert Manager 130. Alert Manager 130 will inquire to Workflow Instructions 128 for direction on what should be done with this message. Alert Manager 130 will then present the alert information to the monitoring personnel upon request and prompt them for some type of action required to address the alert. The main categories of alert management can be broken down as:

Review/Report the information.

Take Action: By monitoring personnel or some other person in a monitoring role.

Snooze the alert.

Log all action that is required for the alert.

Change the Status of the Alert: By taking the appropriate action the alert can now be resolved. Once resolved, the database will reflect this status and remove the Alert from the new information screens.

Situation Analyzer 124 will then check to see if the message that is being dealt with requires any type of immediate notification of a monitoring person. If it does, then Situation Analyzer 124 will send the message to Notification Server 132. Notification Server 132 will then inquire to Supervising Agency/Subject Database 134 to see what method of notification is preferred by the monitoring person, and then execute the notification method, such as sending an e-mail, sending a fax, or sending a page to the appropriate person.

Thus, the method and system of the present invention offers multiple levels of alert ranging from alerts generated by Monitor Device 100, from Modem 104, and from Monitor Network 106. The flexible and changeable scheduling at the Subject 102 level allows for more timely intervention for all of the Subjects 102 being monitored who are demonstrating problems.

Referring now to FIGS. 4, 5A, and 5B, a preferred form of Monitor Device 100 is illustrated for attachment to a human Subject 102, the Monitor Device 100 being in the form of a bracelet broadly comprised of an analog side having Housing 12, digital side having Housing 14 and Battery Housing 16, and Elastic Strap 17 with Flexible Circuit 220 connected to Conductive Strap 18 between the Housing 12 and Housing 14, all of which enable the bracelet to encircle the limb of a human Subject 102, such as an arm or a leg. Flexible Circuit 220 contains the circuit connections between Analog Board 204 in Housing 12 and Digital Board 202 in Housing 14. One end of Conductive Strap 18 is connected to Flexible Circuit 220, and the other end of Conductive Strap 18 has a series of holes punched there through which are designed to fit in cooperation with Securing Pins 48 in Enlarged Channel 60 in Housing 14 so that Monitor Device 100 may be adjustably tightened to fit securely to the limb of Subject 102. Strap

Securing Bracket 56 attaches to Housing 12 and channels Conductive Strap 18 towards Housing 14. Strap Securing Bracket 56 prevents Subject 102 from being able to manipulate and rotate Housing 12 and Housing 14 inside out so that Cover Plates 15 are facing outward from the skin of Subject 102. The extra rigidity provided by Strap Securing Bracket 56 along its length over a portion of Conductive Strap 18 prevents Subject 102 from being able to turn the bracelet inside out after being secured to a limb.

Housing 12 is preferably a rigid casing generally rectangular in cross-section with a concave-shaped open interior with Side Walls 22 and Back Wall 23 having a Channel 24 for mounting Elastic Strap 17, Conductive Strap 18, and Flexible Circuit 220 in a manner to be described. Cover Plate 26 is attached to Back Wall 23 so as to hold the straps permanently in place. Housing 12 is open opposite Back Wall 23 and has an outer continuous peripheral edge having Groove 28 for insertion of a Surrounding Edge 29 of an analog Base Plate 30 together with Surrounding Edge 31 of a Flexible Boot 32 in outer spaced relation to Base Plate 30. Flexible Boot 32 is of generally concave configuration, as best seen from FIG. 5B, and the same is true of a rigid metal Cover Plate 15 which is mounted centrally of Flexible Boot 32. Cover Plate 15 is curved to conform to the curvature of the leg or arm of human Subject 102 to which it is attached, and is perforated to permit the passage of air into the interior of Housing 12. Cover Plate 15 is made from surgical stainless steel so as not to cause skin irritation to Subject 102 during the duration of time of continuous wear. A D-Ring 34 and D-ring Retainer 34' are inserted into Groove 28 along with the Surrounding Edge 29 of Base Plate 30 to establish a press fit, waterproof engagement between Flexible Boot 32, Base Plate 30, and the peripheral edge of Housing 12. In this way, the assembled Base Plate 30 and Flexible Boot 32 define a Collection Chamber 33 (see FIG. 8B) for retention of each air sample recovered from the skin of Subject 102. By virtue of the flexing of Flexible Boot 32 in relation to the skin of the limb of Subject 102, a suction/vacuum created thereby helps induce the drawing of insensible skin perspiration into Collection Chamber 33 through Cover Plate 15. In this relation, a Boot Filter 35 underlies Cover Plate 15 to selectively remove any moisture from each sample as it is drawn into Collection Chamber 33. Material for Boot Filter 35 is selected to allow air to pass through but trap moisture to maintain the waterproof requirement, but allow enough air to pass through to work effectively with Pump 224.

Referring now to FIGS. 7 and 8, a Sample Chamber Filter 36 is mounted in the bottom of a First Sample Chamber 38 which is divided from a Second Sample Chamber 39 and is located directly in the path of air sample flow from Collection Chamber 33 through Base Plate 30. A Gasket 40 is mounted between Second Sample Chamber 39 and Alcohol Sensor 212. Pump 224 causes the air sample to flow from First Sample Chamber 38 through a manifold having Manifold Lower Half 43 and Manifold Upper Half 44 separated by a Moisture Filter 42, into Second Sample Chamber 39. A Check Valve Assembly 45 permits the air sample to be exhausted from Second Sample Chamber 39 into Space 52 in Housing 12. Analog Board 204 is mounted on top of Alcohol Sensor 212 and forms the bottom of Space 52. The top of Space 52 is bounded by Vent Cover 46 and Back Wall 23 in which Restraining Bracket 50 is mounted (See FIG. 5A) which has a Looped End 51 (See FIG. 5A) and Securing Pins 48. Looped End 51 has affixed to it a looped end of Elastic Strap 17. Flexible Circuit 220 is affixed to Securing Pins 48, and then extends through Restraining Bracket 50, Back Wall

23 and is electrically connected to Analog Board 204. Conductive Strap 18 is also affixed to Securing Pins 48 and then secured by Cover Plate 26.

In order to reliably measure blood alcohol content, the insensible skin perspiration which is emitted from the body in the form of vapors will migrate away from the skin and through Boot Filter 35 located on Cover Plate 15 of the analog side of Monitor Device 100. These vapors collect in Collection Chamber 33 between the Cover Plate 15 and the Base Plate 30. As this space fills with vapors from the body of Subject 102, the vapors will start to migrate through the Sample Chamber Filter 36 and collect in First Sample Chamber 38 in Housing 12. Pump 224 is activated to draw the sample from Collection Chamber 33 as well as First Sample Chamber 38 to exit into Manifold Upper Half 44 and pass through Moisture Filter 42 into Manifold Lower Half 43 and Pump 224. The sample is then forced out of Pump 224 into Manifold Lower Half 43 where it passes back into Manifold Upper Half 44 and the upper portion of Second Sample Chamber 39 and passes across Alcohol Sensor 212 where the sample will of course displace any existing air from the upper portion of Second Sample Chamber 39 through Check Valve Assembly 45. In exiting through Check Valve Assembly 45 the air is forced through another Moisture Filter 84 into Space 52 in the interior area between Second Sample Chamber 39 and Back Wall 23 of Housing 12. The sample discharged into Space 52 will in turn cause any existing air in Space 52 to migrate through Vent Cover 46 in Back Wall 23 and escape into the atmosphere.

In order to avoid false readings, it is important that the sampling system not only be waterproof to prevent the entry of moisture from the atmosphere but that any moisture in the sample itself be removed including any condensation resulting from temperature changes between the point where the sample is collected and the measuring area. From the foregoing, the filters referred to in the preceding paragraph and specifically in relation to the analog side of Monitor Device 100 are hydrophobic filters which will remove moisture from each sample while permitting the gas and entrained alcohol to pass through the air flow path as described. Thus, any moisture contained within the vapors migrating through Flexible Boot 32 will be removed by Boot Filter 35. However, as the sample undergoes cooling as it is advanced from Collection Chamber 33 through First Sample Chamber 38, Manifold Upper Half 44, and Pump 224, there will be additional condensation of moisture which must be removed in order to obtain the most accurate readings at Alcohol Sensor 212. It is equally important that Housing 12 itself be water-tight to prevent the entry of any moisture through the juncture of Flexible Boot 32 with Housing 12 as well as through the interface between Flexible Circuit 220 and Back Wall 23, and particularly from the flex circuit connection into Analog Board 204 located in the region of Vent Cover 46.

Referring now to FIGS. 6A, 6B, 9A and 9B, the digital Housing 14 is constructed in a manner closely similar to the analog Housing 12, and like parts are correspondingly enumerated. However, the interior of the housing essentially contains only a digital printed circuit, Digital Board 202, which receives the output signals of A to D Converter 236. Reed Relay 221 on Digital Board 202 can be magnetically activated to awaken the analog circuit for taking a measurement. Back Wall 58 of digital Housing 14 includes Enlarged Channel 60 for insertion of Battery Housing 16 through one end of Enlarged Channel 60 into secure engagement with Battery Clip 62, which is mounted in the opposite end of Enlarged Channel 60 between a pair of Battery Contact Sockets 64. A Cross-Member 66 is permanently mounted in

Enlarged Channel 60 between Battery Contact Sockets 64 to support Housing 14. Battery Housing 16 and Battery Clip 62 are hollow and of generally rectangular configuration and correspondingly sized so that projecting catches on the ends of Tangs 68 on Battery Cover 20 will move into engagement with a molded breakaway on an off-set portion of Lip 63, on an outer end wall of Battery Clip 62 when Battery Housing 16 and Battery Clip 62 are inserted into opposite ends of Enlarged Channel 60.

In the preferred form, the Battery Housing 16 is designed to be permanently affixed in the Back Wall 58 of Housing 14. When thus fixed in place, it is impossible to remove Monitor Device 100 from the limb of Subject 102 without cutting Flexible Circuit 220 or Conductive Strap 18, or otherwise breaking Housing 12, Housing 14, or Battery Clip 62. Nevertheless, when it does become necessary to replace Battery 215, or simply to remove Monitor Device 100 from Subject 102, Battery Housing 16 must be removed. To this end a Release Tool 70 is provided as illustrated in FIGS. 10-12. Release Tool 70 is made up of an Elongated Handle 72 having a Stationary Arm 74 extending from one end of said arm and at right angles thereto. A tang-engaging Lever Arm 76 is pivotally connected to an intermediate portion of Elongated Handle 72 and has a Blade Member 78 with a Blade Edge 80 at its free end. Lever Arm 76 is pivotally connected to Elongated Handle 72 at a location such that when Stationary Arm 74 bears against Flexible Boot 32, Blade Edge 80 is pivoted into engagement with the molded breakaway portion of Battery Clip 62. Blade Edge 80 is movable to bear against Tangs 68 so as to release them from engagement from Battery Clip 62 and allow removal of Battery Housing 16 and enclosed Battery 215 from Housing 14 for replacement of Battery 215. It is necessary to break the breakaway portion of Battery Clip 62 in order to release Tangs 68. Battery Clip 62 must be replaced to permit reattachment of Battery Housing 16 with a new Battery 215.

In order to facilitate manual gripping of Release Tool 70, Elongated Handle 72 is provided with a Rounded Portion 81 along one edge, and Lever Arm 76 is provided with a Rounded Portion 82 along one edge which will move into engagement with an edge of Elongated Handle 72 when Lever Arm 76 is squeezed to force Blade Edge 80 into engagement with the breakaway portion of Battery Clip 62.

Having described the present invention, it will be understood by those skilled in the art that many changes in construction and circuitry and widely differing embodiments and applications of the invention will suggest themselves without departing from the scope of the present invention.

What is claimed is:

1. A modem for use with but independent from a continuous remote blood alcohol monitoring device adapted to be attached to a human subject, and for use with but independent from a monitor network, the modem comprising:

a radio frequency transceiver for communicating bi-directional radio frequency signals with the continuous remote blood alcohol monitoring device when the continuous remote blood alcohol monitoring device comes within range of the modem according to a first schedule stored in the continuous remote blood alcohol monitoring device, and without the human subject actively initiating the communicating of the radio frequency signals between the continuous remote blood alcohol monitoring device and the modem, wherein the radio frequency signals contain a plurality of data regarding the human subject and are communicated from the continuous remote blood alcohol monitoring device to the modem according to the first schedule on a non real time basis;

a central processing unit in communication with the radio frequency transceiver, wherein the central processing unit processes the plurality of data to determine if at least one predefined trigger condition exists, and if not, the plurality of data is stored in a memory in the modem for communication to the monitor network according to a second schedule stored in the memory in the modem; and

a modem chip set in communication with the central processing unit, wherein when the at least one predefined trigger condition exists, a communication link is established by the central processing unit through the modem chip set to the monitor network, and further wherein the central processing unit communicates an alert over the communication link to the monitor network while no communication link exists between the modem and the continuous remote blood alcohol monitoring device; wherein when a positive drinking event has been detected by the continuous remote blood alcohol monitoring device and the continuous remote blood alcohol monitoring device is within range of the modem, the first schedule stored in the continuous remote blood alcohol monitoring device is bypassed and the radio frequency signals containing the plurality of data is communicated immediately from the continuous remote blood alcohol monitoring device to the modem, and further wherein communication of the plurality of data stored in the memory in the modem to the monitor network according to the second schedule only occurs when the plurality of data does not include the at least one predefined trigger condition.

2. The modem according to claim 1 wherein said central processing unit controls a plurality of processes, said plurality of processes comprising:

- a schedule process that controls a plurality of communication events between the continuous remote blood alcohol monitoring device and the modem, and between the modem and the monitor network;
- a monitoring process that monitors said bi-directional radio frequency signals, containing said plurality of data, between the continuous remote blood alcohol monitoring device and the modem; and
- an analysis process for analyzing said plurality of data for said at least one predefined trigger condition.

3. The modem according to claim 1 wherein said plurality of data further comprises:

- a set of operating instructions;
- an operating data;
- a time and date synchronization information for the continuous remote blood alcohol monitoring device; and
- a plurality of monitoring data received from the continuous remote blood alcohol monitoring device.

4. The modem according to claim 3 wherein said central processing unit communicates through said modem chip set to the monitor network over said communication link at least a one of:

- said plurality of monitoring data;
- a continuous remote blood alcohol monitoring device tamper alert;
- a modem tamper alert;
- a time and date synchronization information;
- a schedule information;
- an operating data for the continuous remote blood alcohol monitoring device;
- a modem operating program information; and
- a continuous remote blood alcohol monitoring device operating program.

5. The modem according to claim 3 wherein said plurality of monitoring data further comprises:

- a plurality of transdermal alcohol concentration readings taken of the human subject;
- a plurality of distance readings taken between the remote blood alcohol monitor device and a portion of skin of the human subject, wherein said plurality of distance readings are used to detect an obstruction there between, or to detect removal of the remote blood alcohol monitor device from the human subject;
- a plurality of temperature readings taken of a plurality of consistent and predetermined samples of insensible skin perspiration from the human subject;
- a plurality of diagnostic data; and
- when a predefined error condition has been detected by the continuous remote blood alcohol monitoring device, an error condition data.

6. The modem according to claim 1 wherein when said central processing unit communicates said alert to the monitor network, said monitor network analyzes said alert according to a rules-based database, and based on said analysis, said monitor network may send an automatic alert to a supervising agency or to a designated individual over a new communication link.

7. The modem according to claim 1 further comprising:

- an LCD display connectable to said central processing unit for displaying a plurality of status messages regarding the modem, wherein said plurality of status messages are instructions to the human subject that the continuous remote blood alcohol monitoring device needs to communicate with the modem or perform a type of operation.

8. The modem according to claim 1 further comprising:

- an integrated memory connectable to said central processing unit;
- a main operating program stored in said integrated memory; and
- a main power input circuits for receiving power from an external source, wherein when said power is first received, said main power input circuits provide power to said central processing unit, wherein said central processing unit checks a validity of said main operating program, wherein if said main operating program is invalid, said modem chip set attempts to establish a communication link to a monitor network to download a valid version of said main operating program.

9. The modem according to claim 8 further comprising:

- a real time clock connectable to said central processing unit, wherein said real time clock is updated when said communication link is established with said monitor network, and further wherein said monitor network uploads said data from the modem.

10. The modem according to claim 8 further comprising:

- a phone line connected to the modem for establishing said communication link.

11. The modem according to claim 1 wherein the continuous remote blood alcohol monitoring of a human subject may be done twenty-four hours a day, seven days a week, 365 days a year.

12. A method for using a modem to process data received from a continuous remote blood alcohol monitoring device adapted to be attached to a human subject, and for use with a monitor network, the modem being independent from both the continuous remote blood alcohol monitoring device and the monitor network, the method comprising the steps of:

- (a) when a positive drinking event has been detected by the continuous remote blood alcohol monitoring device,

- determining if the continuous remote blood alcohol monitoring device is within range of the modem;
- (b) when it has been determined that the continuous remote blood alcohol monitoring device is within range of the modem, bypassing a first schedule stored in the continuous remote blood alcohol monitoring device for communicating the data to the modem; and
- (c) communicating immediately the radio frequency signals containing the data from the continuous remote blood alcohol monitoring device to a radio frequency transceiver in the modem;
- (d) in the absence of the positive drinking event being detected in step (a) or when it has been determined in step (b) that the continuous remote blood alcohol monitoring device is not within range of the modem, communicating bi-directionally with the radio frequency transceiver in the modem radio frequency signals with the continuous remote blood alcohol monitoring device when the continuous remote blood alcohol monitoring device comes within range of the modem and according to the first schedule stored in the continuous remote blood alcohol monitoring device without the human subject actively initiating the communicating of the radio frequency signals between the continuous remote blood alcohol monitoring device and the modem, wherein the radio frequency signals containing the data are communicated from the continuous remote blood alcohol monitoring device to the modem on a non real time basis;
- (e) processing the data by a central processing unit in the modem in communication with the radio frequency transceiver to determine if at least one predefined trigger condition exists, and if not, storing the data in a memory in the modem for communication to the monitor network according to a second schedule stored in the memory in the modem;
- (f) when the at least one predefined trigger condition exists, establishing a communication link by the central processing unit through the modem chip set to a monitor network; and
- (g) communicating by the central processing unit an alert over the communication link to the monitor network while no communication link exists between the modem and the continuous remote blood alcohol monitoring device, and further the communicating of the plurality of data stored in the memory in the modem to the monitor network according to the second schedule only occurs when the data does not include the at least one predefined trigger condition.
- 13.** The method according to claim **12** further comprising the steps of:
- controlling by said central processing unit a schedule process for scheduling a plurality of communication events between the continuous remote blood alcohol monitoring device and the modem, and between the modem and said monitor network;
- controlling by said central processing unit a monitoring process that monitors said radio frequency signals, containing the data, between the continuous remote blood alcohol monitoring device and the modem; and
- controlling by said central processing unit an analysis process for analyzing the data for said at least one predefined trigger condition.
- 14.** The method according to claim **12** wherein the data further comprises:
- a set of operating instructions;
- an operating data;

- a time and date synchronization information for the continuous remote blood alcohol monitoring device; and
- a plurality of monitoring data received from the continuous remote blood alcohol monitoring device.
- 15.** The method according to claim **14** further comprising the steps of:
- communicating by said central processing unit through said modem chip set to said monitor network over said communication link at least a one of said plurality of monitoring data, a continuous remote blood alcohol monitoring device tamper alert, a modem tamper alert, a time and date synchronization information, a schedule information, an operating data for the continuous remote blood alcohol monitoring device, a modem operating program information, and a continuous remote blood alcohol monitoring device operating program.
- 16.** The method according to claim **14** wherein said plurality of monitoring data further comprises:
- a plurality of transdermal alcohol concentration readings taken of the human subject;
- a plurality of distance readings taken between the remote blood alcohol monitor device and a portion of skin of the human subject, wherein said plurality of distance readings are used to detect an obstruction there between, or to detect removal of the remote blood alcohol monitor device from the human subject;
- a plurality of temperature readings taken of a plurality of consistent and predetermined samples of insensible skin perspiration from the human subject;
- a plurality of diagnostic data; and
- when a predefined error condition has been detected by the continuous remote blood alcohol monitoring device, an error condition data.
- 17.** The method according to claim **12** further comprising the steps of:
- analyzing by said monitor network said alert according to a rules-based database; and
- based on said analysis, sending an automatic alert to a supervising agency or to a designated individual over a new communication link.
- 18.** The method according to claim **12** further comprising the step of:
- displaying on an LCD display of the modem a plurality of status messages regarding the modem, wherein said plurality of status messages are instructions to the human subject that the continuous remote blood alcohol monitoring device needs to communicate with the modem or perform a type of operation.
- 19.** The method according to claim **12** further comprising the steps of:
- connecting the modem to a power source;
- receiving power in said central processing unit;
- checking by said central processing unit a validity of a modem main operating program for the modem stored in an integrated memory;
- checking by said central processing unit a validity of a monitoring main operating program for the continuous remote blood alcohol monitoring device stored in said integrated memory;
- when at least a one of said modem main operating program and said monitoring main operating program is invalid, establishing a communication link by said modem chip set to the monitor network;
- downloading to the modem from said monitor network a valid version of at least a one of said modem main operating program and said monitoring main operating program;

21

storing at least a one of said modem main operating program and said monitoring main operating program in said integrated memory;
 updating a real time clock of the modem; and
 uploading by said monitor network the data from the modem.

20. The method according to claim 19 wherein said establishing step further comprises the steps of:

- (1) checking by said central processing unit for a dial tone of a phone line connected to the modem;
- (2) if no dial tone is detected, generating a no phone line connected alarm by said central processing unit;
- (3) waiting by said central processing unit a predefined period of time; and
- (4) repeating steps (1) through (3) until a dial tone is detected.

21. The method according to claim 20 further comprising the steps of:

- (5) when a dial tone is detected by said central processing unit, dialing a phone number for said monitor network;
- (6) monitoring by said modem chip set if said communication link is established to said monitor network;
- (7) if at least a one of a busy signal and a no answer is detected, generating a no connection alarm by said central processing unit;
- (8) waiting by said central processing unit a predefined period of time; and
- (9) repeating steps (5) through (8) until said communication link is established.

22. The method according to claim 12 further comprising the step of:

once said communication link is established, downloading a monitoring instructions, a schedule information, and a characterization table for later delivery to the continuous remote blood alcohol monitoring device;
 downloading a schedule information for the modem; and
 downloading a hang up instruction to the modem.

23. The method according to claim 22 further comprising the steps of:

once said hang up instruction is downloaded, hanging up by said central processing unit and powering off said modem chip set;

22

activating said radio frequency transceiver;
 communicating a standard message over said radio frequency signals to the continuous remote blood alcohol monitoring device;

when the continuous remote blood alcohol monitoring device is within a range of the modem, receiving an answer message over said radio frequency signals sent from the continuous remote blood alcohol monitoring device;

extracting by the modem said data from the continuous remote blood alcohol monitoring device;

validating by the modem an operating program of the continuous remote blood alcohol monitoring device;

validating by the modem a characterization table of the continuous remote blood alcohol monitoring device;

updating by the modem a real time clock of the continuous remote blood alcohol monitoring device;

terminating said radio frequency signals sent from the modem to the continuous remote blood alcohol monitoring device;

when the continuous remote blood alcohol monitoring device is not within said range of the modem, terminating said radio frequency signals; and

waiting a predefined period of time before recommunicating said standard message over said radio frequency signals to the continuous remote blood alcohol monitoring device.

24. The method according to claim 23 further comprising the steps of:

scanning by said central processing unit said data to determine if an immediate alert needs to be communicated to said monitor network;

when said immediate alert needs to be communicated, establishing a communication link to said monitor network; and

when there is no said immediate alert to be communicated, waiting a predefined period of time before activating said radio frequency transceiver again.

25. The method according to claim 12 wherein steps (a) through (d) may be performed twenty-four hours a day, seven days a week, 365 days a year.

* * * * *

专利名称(译)	用于远程血液酒精监测的方法和设备		
公开(公告)号	US8317697	公开(公告)日	2012-11-27
申请号	US11/411694	申请日	2006-04-25
[标]申请(专利权)人(译)	酒精监测SYST		
申请(专利权)人(译)	酒精监控系统，LLC		
当前申请(专利权)人(译)	酒精监控系统，INC.		
[标]发明人	HAWTHORNE JEFFREY SCOTT PHILLIPS BRIAN KIRBY IIAMS MICHAEL LEONARD ROUSHEY III WILLIAM JAMES FARMER JR NOLAN JAMES		
发明人	HAWTHORNE, JEFFREY SCOTT PHILLIPS, BRIAN KIRBY IIAMS, MICHAEL LEONARD ROUSHEY, III, WILLIAM JAMES FARMER, JR., NOLAN JAMES		
IPC分类号	A61B5/00 G01N33/497		
CPC分类号	A61B5/145 A61B5/14546 G01N33/4972 A61B5/0022 A61B5/0008 A61B2560/0406 Y10S128/92 G16H40/67		
其他公开文献	US20060202838A1		
外部链接	Espacenet USPTO		

摘要(译)

防篡改透皮酒精含量监测装置由模拟和数字侧面组成，其牢固地附着于待监测的人体。模拟侧具有采样电路，其从受试者的皮肤吸取测量的不敏感皮肤出汗样品并用电化学燃料电池测量。从受试者皮肤和样品温度的装置的距离测量与透皮酒精含量一起被监测，并且被转换成数字信号，当监视器接近调制解调器时，该数字信号被发送到调制解调器。信号存储在调制解调器中并上传到中央监控站。可以从中央监控站向监管机构发送自动警报。监管机构还可以通过互联网通过安全的专用网站访问信息。

