



US008679011B2

(12) **United States Patent**
Islam

(10) **Patent No.:** **US 8,679,011 B2**
(45) **Date of Patent:** **Mar. 25, 2014**

(54) **SYSTEM AND METHOD FOR VOICE CONTROL OF MEDICAL DEVICES**

(75) Inventor: **Mohammed N. Islam**, Ann Arbor, MI (US)

(73) Assignee: **Omni MedSci, Inc.**, Ann Arbor, MI (US)

(*) Notice: Subject to any disclaimer, the term of this patent is extended or adjusted under 35 U.S.C. 154(b) by 0 days.

(21) Appl. No.: **13/531,853**

(22) Filed: **Jun. 25, 2012**

(65) **Prior Publication Data**

US 2012/0296181 A1 Nov. 22, 2012

Related U.S. Application Data

(60) Continuation of application No. 13/349,244, filed on Jan. 12, 2012, now Pat. No. 8,472,108, which is a continuation of application No. 13/078,547, filed on Apr. 1, 2011, which is a division of application No. 12/625,253, filed on Nov. 24, 2009, now Pat. No. 8,098,423, which is a division of application No. 12/206,432, filed on Sep. 8, 2008, now Pat. No. 7,633,673, which is a division of application No. 10/812,608, filed on Mar. 30, 2004, now Pat. No. 7,433,116, which is a continuation of application No. 10/757,341, filed on Jan. 13, 2004, now Pat. No. 7,259,906, which is a continuation of application No. 10/652,276, filed on Aug. 29, 2003, now abandoned.

(60) Provisional application No. 60/408,025, filed on Sep. 3, 2002.

(51) **Int. Cl.**
A61B 5/00 (2006.01)

(52) **U.S. Cl.**
USPC **600/300; 379/106.2**

(58) **Field of Classification Search**

USPC 600/300; 129/920, 903, 904; 705/4; 379/106.2; 709/200

See application file for complete search history.

(56) **References Cited**

U.S. PATENT DOCUMENTS

4,063,106 A 12/1977 Ashkin et al.
4,158,750 A 6/1979 Sakoe et al.

(Continued)

FOREIGN PATENT DOCUMENTS

EP 1 148 666 A2 10/2001
WO WO 97/15240 5/1997

(Continued)

OTHER PUBLICATIONS

G.S. Edwards et al., "Free-electron-laser-based biophysical and biomedical instrumentation," American Institute of Physics, vol. 74, No. 7, pp. 3207-3245, Jul. 2003.

(Continued)

Primary Examiner — Mark Hellner

(74) *Attorney, Agent, or Firm* — Brooks Kushman P.C.

(57) **ABSTRACT**

A medical diagnostic system and method include a software application capable of generating medical data representing patient physiological information based on input signals received directly from one or more sensors. The application is capable of operating on a controller adapted to receive, store, and process the physiological information and may include a touch-screen, one or more auxiliary input devices, circuitry for obtaining position information from a location sensor, and a wireless transceiver to transmit data that may include patient physiological information over a wireless link. The controller may be capable of receiving voice input signals and manually entered input signals. A host may include a digital file for receiving and storing the wireless data, control logic to process the wireless data to generate a medical status of the patient, and a memory storage device for recording the medical status.

20 Claims, 7 Drawing Sheets

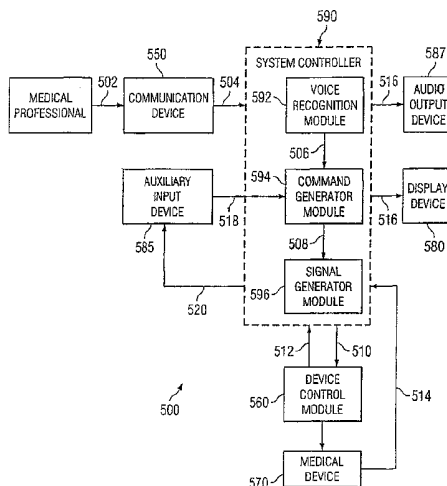

(56)

References Cited

U.S. PATENT DOCUMENTS

4,221,997	A	9/1980	Flemming	6,381,391	B1	4/2002	Islam et al.
4,275,266	A	6/1981	Lasar	6,402,691	B1	6/2002	Peddicord et al.
4,374,618	A	2/1983	Howard	6,407,853	B1	6/2002	Samson et al.
4,403,605	A	9/1983	Tanikawa	6,416,471	B1	7/2002	Kumar et al.
4,462,080	A	7/1984	Johnstone et al.	6,436,107	B1	8/2002	Wang et al.
4,516,207	A	5/1985	Moriyama et al.	6,441,747	B1	8/2002	Khair et al.
4,523,884	A	6/1985	Clement et al.	6,442,430	B1	8/2002	Ferek-Petric
4,605,080	A	8/1986	Lemelson	6,443,890	B1	9/2002	Schulze et al.
4,641,292	A	2/1987	Tunnell et al.	6,450,172	B1	9/2002	Hartlaub et al.
4,704,696	A	11/1987	Reimer et al.	6,453,201	B1	9/2002	Daum et al.
4,728,974	A	3/1988	Nio et al.	6,454,705	B1	9/2002	Cosentino et al.
4,762,455	A	8/1988	Coughlan et al.	6,458,120	B1	10/2002	Shen et al.
4,776,016	A	10/1988	Hansen	6,462,500	B1	10/2002	L'Hegarar et al.
4,958,910	A	9/1990	Taylor et al.	6,463,361	B1	10/2002	Wang et al.
4,989,253	A	1/1991	Liang et al.	6,480,656	B1	11/2002	Islam et al.
5,078,140	A	1/1992	Kwoh	6,549,702	B2	4/2003	Islam et al.
5,084,880	A	1/1992	Esterowitz et al.	6,567,431	B2	5/2003	Tabirian et al.
5,086,401	A	2/1992	Glassman et al.	6,603,910	B2	8/2003	Islam et al.
5,134,620	A	7/1992	Huber	6,605,080	B1	8/2003	Altshuler et al.
5,142,930	A	9/1992	Allen et al.	6,625,180	B2	9/2003	Bufetov et al.
5,180,378	A	1/1993	Kung et al.	6,631,025	B2	10/2003	Islam et al.
5,191,628	A	3/1993	Byron	6,659,947	B1*	12/2003	Carter et al. 600/300
5,218,655	A	6/1993	Mizrahi	6,659,999	B1	12/2003	Anderson et al.
5,230,023	A	7/1993	Nakano	6,705,990	B1	3/2004	Gallant et al.
5,267,256	A	11/1993	Saruwatari et al.	6,760,148	B2	7/2004	Islam
5,267,323	A	11/1993	Kimura	6,790,178	B1	9/2004	Mault et al.
5,300,097	A	4/1994	Lerner et al.	6,802,811	B1*	10/2004	Slepian 600/309
5,303,148	A	4/1994	Mattson et al.	6,885,498	B2	4/2005	Islam
5,305,427	A	4/1994	Nagata	6,885,683	B1	4/2005	Fermann et al.
5,313,306	A	5/1994	Kuban et al.	6,943,936	B2	9/2005	Islam et al.
5,323,404	A	6/1994	Grubb	7,027,467	B2	4/2006	Baev et al.
5,345,538	A	9/1994	Narayannan et al.	7,060,061	B2	6/2006	Altshuler et al.
5,400,165	A	3/1995	Gnauck et al.	7,098,992	B2	8/2006	Ohtsuki et al.
5,408,409	A	4/1995	Glassman et al.	7,167,300	B2	1/2007	Fermann et al.
5,458,122	A	10/1995	Hethuin	7,209,657	B1	4/2007	Islam
5,544,654	A	8/1996	Murphy et al.	7,259,906	B1	8/2007	Islam
5,558,638	A	9/1996	Evers et al.	7,263,288	B1	8/2007	Islam
5,572,999	A	11/1996	Funda et al.	7,294,105	B1*	11/2007	Islam 600/300
5,617,871	A	4/1997	Burrows	7,433,116	B1	10/2008	Islam
5,631,758	A	5/1997	Knox et al.	7,519,253	B2	4/2009	Islam
5,687,734	A	11/1997	Dempsey et al.	2001/0000526	A1	4/2001	Gopinathan et al.
5,695,493	A	12/1997	Nakajima et al.	2001/0007053	A1	7/2001	Bardy
5,696,778	A	12/1997	McPherson	2001/0029322	A1	10/2001	Iliff
5,704,351	A	1/1998	Mortara et al.	2001/0041831	A1	11/2001	Starkweather et al.
5,718,234	A	2/1998	Warden et al.	2001/0047125	A1	11/2001	Quy
5,748,103	A	5/1998	Flach et al.	2001/0051819	A1	12/2001	Fischell et al.
5,792,204	A	8/1998	Snell	2001/0056229	A1	12/2001	Cosentino et al.
5,812,978	A	9/1998	Nolan	2002/0002326	A1	1/2002	Causey et al.
5,855,550	A	1/1999	Lai et al.	2002/0007105	A1	1/2002	Prabhu et al.
5,862,803	A	1/1999	Besson et al.	2002/0013518	A1	1/2002	West et al.
5,867,305	A	2/1999	Waarts et al.	2002/0014951	A1	2/2002	Kramer et al.
5,912,749	A	6/1999	Harstead et al.	2002/0019584	A1	2/2002	Schulze et al.
5,944,659	A	8/1999	Flach et al.	2002/0023654	A1	2/2002	Webb
5,950,629	A	9/1999	Taylor et al.	2002/0032468	A1	3/2002	Hill et al.
5,957,854	A	9/1999	Besson et al.	2002/0058861	A1*	5/2002	Drew 600/300
5,970,457	A	10/1999	Brant et al.	2002/0082612	A1	6/2002	Moll et al.
6,014,249	A	1/2000	Fermann et al.	2002/0109621	A1*	8/2002	Khair et al. 341/174
6,043,927	A	3/2000	Islam	2002/0115914	A1	8/2002	Russ
6,185,535	B1	2/2001	Hedin et al.	2002/0118112	A1	8/2002	Lang
6,200,309	B1	3/2001	Rice et al.	2002/0128804	A1	9/2002	Geva
6,224,542	B1	5/2001	Chang et al.	2002/0128846	A1	9/2002	Miller
6,246,707	B1	6/2001	Yin et al.	2002/0143263	A1	10/2002	Shusterman
6,273,858	B1	8/2001	Fox et al.	2002/0151771	A1	10/2002	Braun et al.
6,278,975	B1	8/2001	Brant et al.	2002/0178003	A1	11/2002	Gehrke et al.
6,281,471	B1	8/2001	Smart	2003/0023146	A1	1/2003	Shusterman
6,289,238	B1	9/2001	Besson et al.	2003/0045815	A1	3/2003	Ombrellaro
6,301,271	B1	10/2001	Sanders et al.	2003/0069752	A1	4/2003	LeDain et al.
6,301,273	B1	10/2001	Sanders et al.	2003/0101078	A1	5/2003	Voegeli et al.
6,333,803	B1	12/2001	Kurotori et al.	2003/0107487	A1	6/2003	Korman et al.
6,337,462	B1	1/2002	Smart	2003/0130567	A1	7/2003	Mault et al.
6,340,806	B1	1/2002	Smart et al.	2003/0149593	A1	8/2003	Mok et al.
6,350,261	B1	2/2002	Domankevitz et al.	2003/0212579	A1	11/2003	Brown et al.
6,358,202	B1	3/2002	Arent	2004/0078219	A1	4/2004	Kaylor et al.
6,364,834	B1	4/2002	Reuss et al.	2004/0100376	A1	5/2004	Lye et al.
6,374,006	B1	4/2002	Islam et al.	2004/0111296	A1	6/2004	Rosenfeld et al.
				2004/0117207	A1	6/2004	Brown
				2004/0120557	A1	6/2004	Sabol et al.
				2004/0122787	A1	6/2004	Avinash et al.
				2004/0152956	A1	8/2004	Korman

(56)

References Cited

U.S. PATENT DOCUMENTS

2004/0162035	A1	8/2004	Petersen et al.
2004/0174914	A1	9/2004	Fukatsu
2004/0186357	A1	9/2004	Soderberg et al.
2004/0240037	A1	12/2004	Harter
2005/0038326	A1	2/2005	Mathur
2005/0043894	A1	2/2005	Fernandez
2005/0054941	A1	3/2005	Ting et al.
2005/0060198	A1	3/2005	Bayne
2005/0075542	A1	4/2005	Goldreich
2005/0111500	A1	5/2005	Harter et al.
2006/0004611	A1	1/2006	Brown
2006/0013270	A1	1/2006	Yumoto et al.
2006/0036134	A1	2/2006	Tarassenko et al.
2006/0234202	A1	10/2006	Brown
2006/0245461	A1	11/2006	Islam
2006/0268393	A1	11/2006	Islam
2007/0020181	A1	1/2007	Workman et al.
2007/0078348	A1	4/2007	Holman
2007/0088521	A1	4/2007	Shmueli et al.
2008/0105665	A1	5/2008	Kondo
2009/0028193	A1	1/2009	Islam
2009/0204110	A1	8/2009	Islam
2010/0046067	A1	2/2010	Fermann et al.
2013/0070044	A1	3/2013	Naidoo et al.

FOREIGN PATENT DOCUMENTS

WO	WO 97/49340	12/1997
WO	WO 01/50959 A1	7/2001
WO	WO 01/89362 A2	11/2001
WO	WO0182789	11/2001
WO	WO 02/27640 A2	4/2002
WO	WO 02/28123 A2	4/2002
WO	WO03043494	5/2003

OTHER PUBLICATIONS

Computer Motion, Inc., "501(k) Summary—ZEUS® MicroWrist™ Surgical System and Accessories," 6 pages, Sep. 24, 2002.

Computer Motion, Inc. "HERMEST™ O.R. Control Center—510(k) Summary of Safety and Effectiveness," 5 pages, Oct. 11, 2002.

K.M. Joos, et al. "Optic Nerve Sheath Fenestration with a Novel Wavelength Produced by the Free Electron Laser (FEL)," *Lasers in Surgery and Medicine*, 27:191-205, 2000.

J. Sanghera, I. Aggarwal, "IR Fiber Optics at NRL," 10 pages, undated.

J. Sanghera, L.B. Shaw, I.D. Aggarwal, "Applications of chalcogenide glass optical fibers," *Academic of Science*, pp. 1-11, 2003.

B. Rigas, P.T.T. Wong, "Human Colon Adenocarcinoma Cell Lines Display Infrared Spectroscopic Features," *Cancer Research*, pp. 84-88, Jan. 1, 1992.

G. Edwards, et al., "Comparison of OPA and Mark-III FEL for Tissue Ablation at 6.45 Microns," Department of Physics and Free Electron Laser Laboratory, Duke University, 7 pages, 2002.

Glenn Edwards, "Biomedical and potential clinical applications for pulsed lasers operating near 6.45 μm ," Society of Photo-Optical Instrumentation Engineers, 2 pages, 1995.

Passat, "Solid-State Lasers and Optical Components," 5 pages, Jul. 14, 2003.

P.A. Thielen and L.B. Shaw, et al., "Small-core As-Se fiber for Raman amplification," *Optics Letters*, vol. 28, No. 16, 3 pages, Aug. 15, 2003.

R.Rox Anderson, et al., "Selective Photothermolysis: Precise Microsurgery by Selective Absorption of Pulsed Radiation," Department of Dermatology, Harvard Medical School, Science, vol. 220, 4 pages, Apr. 29, 1983.

U.S. Appl. No. 10/652,276, "System and Method for Voice Control of Medical devices," by Mohammed N. Islam, abandoned, filed Aug. 29, 2003.

U.S. Appl. No. 10/757,341, "System and Method for Voice Control of Medical devices," by Mohammed N. Islam, issued, filed Jan. 13, 2004.

U.S. Appl. No. 12/206,432, "System and Method for Voice Control of Medical Devices," by Mohammed N. Islam, pending, filed Sep. 8, 2008.

U.S. Patent and Trademark Office, Office Action for U.S. Appl. No. 12/206,432, filed Sep. 8, 2008, Mohammed N. Islam, filed Mar. 12, 2009.

U.S. Patent and Trademark Office, Notice of Allowance and Fee(s) Due for U.S. Appl. No. 12/206,432, filed Sep. 8, 2008, Mohammed N. Islam, filed Aug. 28, 2009.

Istepanian, Robert H., "The Comparative Performance of Mobile Telemedical Systems based on the IS-54 and GSM Cellular Telephone Standards"; *Journal of Telemedicine and Telecare* 1999; pp. 97-104.

Aris, Ishak Bin, "An Internet-Based Blood Pressure Monitoring System for Patients"; *Journal of Telemedicine and Telecare* 2001; pp. 51-53.

Islam, M. N., et al., "Broad bandwidths from frequency-shifting solitons in fibers", *Optics Letters*, vol. 14, No. 7, pp. 370-372, Apr. 1, 1989.

Islam, M. N., et al., "Femtosecond distributed soliton spectrum in fibers", *J. Opt. Soc. Am. B*, vol. 6, No. 6, pp. 1149-1158, Jun. 1989.

Busse, Lynda E., et al., "Design Parameters for Fluoride Multimode Fibers", *Journal of Lightwave Technology*, vol. 9, No. 7, pp. 828-831, Jul. 1991.

Wüthrich, Stefan, et al., "Optical damage thresholds at 2.94 μm in fluoride glass fibers", *Applied Optics*, vol. 31, No. 27, pp. 5833-5837, Sep. 20, 1992.

Inoue, H., et al., "Computer simulation of the vibrational spectra and properties of fluoride glasses based on ZrF_4 ", *Journal of Non-Crystalline Solids*, vol. 161, pp. 118-122, 1993.

Mizunami, Toru, et al., "Gain saturation characteristics of Raman amplification in silica and fluoride glass optical fibers", *Optics Communications* 97, pp. 74-78, 1993.

Desthieux, B., et al., "111 kW (0.5 mJ) pulse amplification at 1.5 μm using a gated cascade of three erbium-doped fiber amplifiers," *Appl. Phys. Lett.* vol. 63, pp. 586-588, Aug. 2, 1993.

Edwards, Glenn, et al., "Tissue ablation by a free-electron laser tuned to the amide II band", *Nature*, vol. 371, pp. 416-419, Sep. 29, 1994.

Borrelli, N. F., et al., "Resonant and non-resonant effects in photonic glasses", *Journal of Non-Crystalline Solids* 185, pp. 109-122, 1995.

Asobe, Masaki, et al., "Third-order nonlinear spectroscopy in As_2S_3 chalcogenide glass fibers", *J. Appl. Phys.* 77 (11), pp. 5518-5523, Jun. 1, 1995.

Jarman, Richard H., "Novel optical fiber lasers", *Current Opinion in Solid State and Materials Science* 1996, pp. 199-203, 1996.

Iatridis, James C., et al., "Is the Nucleus Pulposus a Solid or a Fluid? Mechanical Behaviors of the Nucleus Pulposus of the Human Intervertebral Disc", *Spine*, vol. 21(10), pp. 1174-1184, May 15, 1996.

Asobe, Masaki, "Nonlinear Optical Properties of Chalcogenide Glass Fibers and Their Application to All-Optical Switching", *Optical Fiber Technology*, vol. 3, Article No. OF970214, pp. 142-148, 1997.

Smektala, F., et al., "Chalcogenide glasses with large non-linear refractive indices", *Journal of Non-Crystalline Solids* 239, pp. 139-142, 1998.

Hamilton, James D., et al., "High Frequency Ultrasound Imaging with Optical Arrays", *IEEE Transactions on Ultrasonics, Ferroelectrics, and Frequency Control*, vol. 45, No. 1, pp. 216-235, Jan. 1998.

Hamilton, James D., et al., "High Frequency Ultrasound Imaging Using an Active Optical Detector", *IEEE Transactions on Ultrasonics, Ferroelectrics, and Frequency Control*, vol. 45, No. 3, pp. 719-727, May 1998.

Nowak, G. A., et al., "Low-power high-efficiency wavelength conversion based on modulational instability in high-nonlinearity fiber," *Optics Letters*, vol. 23, No. 12, pp. 936-938, Jun. 15, 1998.

Cardinal, T., et al., "Non-linear optical properties of chalcogenide glasses in the system As-S-Se ", *Journal of Non-Crystalline Solids* 256 & 257, pp. 353-360, 1999.

(56) References Cited

OTHER PUBLICATIONS

- Lucas, Jacques, "Infrared glasses", *Current Opinion in Solid State & Materials Science* 4, pp. 181-187, 1999.
- Sanghera, J. S., et al., "Active and passive chalcogenide glass optical fibers for IR applications: a review", *Journal of Non-Crystalline Solids* 256 & 257, pp. 6-16, 1999.
- Nishida, Yoshiki, et al., "Reliability of Fluoride Fiber Module for Optical Amplifier Use", *IEEE Photonics Technology Letters*, vol. 11, No. 12, pp. 1596-1598, Dec. 1999.
- Nowak, George A., et al., "Stable supercontinuum generation in short lengths of conventional dispersion-shifted fiber", *Applied Optics*, vol. 38, No. 36, pp. 7364-7369, Dec. 20, 1999.
- Urban, J. P. G., et al., "The Nucleus of the Intervertebral Disc from Development to Degeneration", *Amer. Zool.*, vol. 40, pp. 53-61, 2000.
- Hamilton, James D., et al., "High Frequency Optoacoustic Arrays Using Etalon Detection", *IEEE Transactions on Ultrasonics, Ferroelectrics, and Frequency Control*, vol. 47, No. 1, pp. 160-169, Jan. 2000.
- Ranka, Jinendra K., et al., "Visible continuum generation in air-silica microstructure optical fibers with anomalous dispersion at 800 nm", *Optics Letters*, vol. 25, No. 1, pp. 25-27, Jan. 1, 2000.
- Boult, Maggi, et al., "Systematic Review of Percutaneous Endoscopic Laser Discectomy: Update and Re-appraisal", *Australian Safety and Efficacy Register of New Interventional Procedures—Surgical Report No. 5*, 49 pages, Feb. 2000.
- Boult, Maggi, et al., "Percutaneous Endoscopic Laser Discectomy", *Systematic Review*, *Aust. N.Z. J. Surg.*, vol. 70, pp. 475-479, Apr. 7, 2000.
- Camacho, Nancy P., et al., "FTIR Microscopic imaging of Collagen and Proteoglycan in Bovine Cartilage," *Biopolymers Biospectroscopy*, vol. 62, pp. 1-8, 2001.
- Choi, Joon Y., et al., "Thermal, Mechanical, Optical, and Morphologic Changes in Bovine Nucleus Pulposus Induced by Nd:YAG ($\lambda = 1.32 \mu\text{m}$) Laser Irradiation", *Lasers in Surgery and Medicine*, vol. 28, pp. 248-254, 2001.
- Hafez, M.I., et al., "The Effect of Irrigation on Peak Temperatures in Nerve Root, Dura, and Intervertebral Disc During Laser-Assisted Foraminoplasty", *Lasers in Surgery and Medicine*, vol. 29, pp. 33-37, 2001.
- Jackson, Stuart D., et al., "Theory and numerical simulation of nth-order cascaded Raman fiber lasers", *J. Opt. Soc. Am. B*, vol. 18, No. 9, pp. 1297-1306, Sep. 2001.
- Werle, Peter, et al., "Near- and mid-infrared laser-optical sensors for gas analysis", *Optics and Lasers in Engineering* 37, pp. 101-114, 2002.
- Beck, Matthias, et al., "Continuous Wave Operation of a Mid-Infrared Semiconductor Laser at Room Temperature," *Science*, vol. 295, www.sciencemag.org, pp. 301-305, Jan. 11, 2002.
- Harbold, J. M., et al., "Highly nonlinear As-S-Se glasses for all-optical switching", *Optics Letters*, vol. 27, No. 2, pp. 119-121, Jan. 15, 2002.
- Coen, Stéphane, et al., "Supercontinuum generation by stimulated Raman scattering and parametric four-wave mixing in photonic crystal fibers", *J. Opt. Soc. Am. B*, vol. 19, No. 4, pp. 753-764, Apr. 2002.
- Dudley, John M., et al., "Supercontinuum generation in air-silica microstructured fibers with nanosecond and femtosecond pulse pumping", *J. Opt. Soc. Am. B*, vol. 19, No. 4, pp. 765-771, Apr. 2002.
- Harbold, Jeffrey M., et al., "Highly Nonlinear Ge-As-Se and Ge-As-S-Se Glasses for All-Optical Switching", *IEEE Photonics Technology Letters*, vol. 14, No. 6, pp. 822-824, Jun. 2002.
- Husakou, Anton V., et al., "Supercontinuum generation, four-wave mixing, and fission of higher-order solitons in photonic-crystal fibers", *J. Opt. Soc. Am. B*, vol. 19, No. 9, pp. 2171-2182, 2002, Sep. 2002.
- Wadsworth, William J., et al., "Supercontinuum generation in photonic crystal fibers and optical fiber tapers: a novel light source", *J. Opt. Soc. Am. B*, vol. 19, No. 9, pp. 2148-2155, Sep. 2002.
- Kumar, V.V. Ravi Kanth, et al., "Extruded soft glass photonic crystal fiber for ultrabroad supercontinuum generation", *Optics Express*, vol. 10, No. 25, pp. 1520-1525, Dec. 16, 2002.
- Edwards, Glenn S., et al., "Advantage of the Mark-III FEL for bio-physical research and biomedical applications", *J. Synchrotron Rad.* vol. 10, pp. 354-357, 2003.
- Nicholson, J. W., et al., "Pulsed and continuous-wave supercontinuum generation in highly nonlinear, dispersion-shifted fibers", *Applied Physics B* 77, pp. 211-218, 2003.
- Sobol, Emil, et al., "Time-resolved, light scattering measurements of cartilage and cornea denaturation due to free electron laser radiation", *Journal of Biomedical Optics*, vol. 8, No. 2, pp. 216-222, Apr. 2003.
- Nicholson, J. W., et al., "All-fiber, octave-spanning supercontinuum", *Optics Letters*, vol. 28, No. 8, pp. 643-645, Apr. 15, 2003.
- Faralli, S., et al., "Impact of Double Rayleigh Scattering Noise in Distributed Higher Order Raman Pumping Schemes", *IEEE Photonics Technology Letters*, vol. 15, No. 6, pp. 804-806, Jun. 2003.
- "New and Emerging Techniques—Surgical, Rapid Review, Laser Discectomy", *Australian Safety and Efficacy Register of New Interventional Procedures—Surgical*, 12 pages, Jun. 2003.
- Avdokhin, A. V., et al., "Continuous-wave, high-power, Raman continuum generation in holey fibers", *Optics Letters*, vol. 28, No. 15, pp. 1353-1355, Aug. 1, 2003.
- Mussot, Arnaud, et al., "Generation of a broadband single-mode supercontinuum in a conventional dispersion-shifted fiber by use of a subnanosecond microchip laser", *Optics Letters*, vol. 28, No. 19, pp. 1820-1822, Oct. 1, 2003.
- Slusher, Richard, et al., "Highly nonlinear composite chalcogenide/polymer fibers", *OSA* 2004, 1 page, 2004.
- Thongtrangan, Issada, et al., "Minimally invasive spinal surgery: a historical perspective", *Neurosurg. Focus*, vol. 16, Article 13, pp. 1-10, Jan. 2004.
- Hori, Takashi, et al., "Flatly broadened, wideband and low noise supercontinuum generation in highly nonlinear hybrid fiber", *Optics Express*, vol. 12, No. 2, pp. 317-324, Jan. 26, 2004.
- Wadsworth, W. J., et al., "Supercontinuum and four-wave mixing with Q-switched in endlessly single-mode photonic crystal fibres", *Optics Express*, vol. 12, No. 2, pp. 299-309, Jan. 26, 2004.
- Hilligsoe, Karen Marie, et al., "Supercontinuum generation in a photonic crystal fiber with two zero dispersion wavelengths", *Optics Express*, vol. 12, No. 6, pp. 1045-1054, Mar. 22, 2004.
- Venugopalan, V., "Optical Society of America BIOMED Topical Meeting Tutorial on Tissue Optics", pp. 1-32, Apr. 27, 2004.
- Slusher, Richard E., et al., "Large Raman gain and nonlinear phase shifts in high-purity As₂Se₃ chalcogenide fibers", *J. Opt. Soc. Am. B*, vol. 21, No. 6, pp. 1146-1155, Jun. 2004.
- Leon-Saval, S. G., et al., "Supercontinuum generation in submicron fibre waveguides", *Optics Express*, vol. 12, No. 13, pp. 2864-2869, Jun. 28, 2004.
- Nicholson, J. W., et al., "High power, single mode, all-fiber source of femtosecond pulses at 1550 nm and its use in supercontinuum generation", *Optics Express*, vol. 12, No. 13, pp. 3025-3034, Jun. 28, 2004.
- Genty, G., et al., "Enhanced bandwidth of supercontinuum generated in microstructured fibers", *Optics Express*, vol. 12, No. 15, pp. 3471-3480, Jul. 26, 2004.
- Champert, Pierre-Alain, et al., "White-light supercontinuum generation in normally dispersive optical fiber using original multi-wavelength pumping system", *Optics Express*, vol. 12, No. 19, pp. 4366-4371, Sep. 20, 2004.
- Nicholson, J. W., "Supercontinuum generation in ultraviolet-irradiated fibers", *Optics Letters*, vol. 29, No. 20, pp. 2363-2365, Oct. 15, 2004.
- Hori, Takashi, et al., "Experimental and numerical analysis of widely broadened supercontinuum generation in highly nonlinear dispersion-shifted fiber with a femtosecond pulse", *J. Opt. Soc. Am. B*, vol. 21, No. 11, pp. 1969-1980, Nov. 2004.
- Demircan, Ayhan, et al., "Supercontinuum generation by the modulation instability", *Optics Communications* 244, pp. 181-185, 2005.
- Papernyi, S. B., et al., "Sixth-Order Cascaded Raman Amplification", *OFC/NFOEC*, 3 pages, 2005.

(56)

References Cited

OTHER PUBLICATIONS

- Tanaka, Keiji, "Optical nonlinearity in photonic glasses", *Journal of Materials Science: Materials in Electronics* 16, pp. 633-643, 2005.
- Westbrook, Paul S., "Improved Supercontinuum Generation Through UV Processing of Highly Nonlinear Fibers", *Journal of Lightwave Technology*, vol. 23, No. 1, pp. 13-18, Jan. 2005.
- Abeeluck, Akheesh K., et al., "Continuous-wave pumping in the anomalous- and normal-dispersion regimes of nonlinear fibers for supercontinuum generation", *Optics Letters*, vol. 30, No. 1, pp. 61-63, Jan. 1, 2005.
- Kutz, J. Nathan, et al., "Enhanced Supercontinuum Generation through Dispersion-Management", *Optics Express*, vol. 13, No. 11, pp. 3989-3998, May 30, 2005.
- Lee, Ju Han, et al., "Experimental performance comparison for various continuous-wave supercontinuum schemes: ring cavity and single pass structures", *Optics Express*, vol. 13, No. 13, pp. 4848-4853, Jun. 27, 2005.
- Salimnia, A., et al., "Ultra-broad and coherent white light generation in silica glass by focused femtosecond pulses at 1.5 μm ", *Optics Express*, vol. 13, No. 15, pp. 5731-5738, Jul. 25, 2005.
- Takushima, Yuichi, "High average power, depolarized supercontinuum generation at 1.55- μm ASE noise source", *Optics Express*, vol. 13, No. 15, pp. 5871-5877, Jul. 25, 2005.
- Travers, J. C., et al., "Extended continuous-wave supercontinuum generation in a low-water-loss holey fiber", *Optics Letters*, vol. 30, No. 15, pp. 1938-1940, Aug. 1, 2005.
- Kobtsev, Serguei M., et al., "Modelling of high-power supercontinuum generation in highly shifted fibers at CW pump", *Optics Express*, vol. 13, No. 18, pp. 6912-6918, Sep. 5, 2005.
- Falk, Peter, et al., "Supercontinuum generation in a photonic crystal fiber with two zero-dispersion wavelengths tapered to normal dispersion at all wavelengths", *Optics Express*, vol. 13, No. 19, pp. 7535-7540, Sep. 19, 2005.
- Tombelaine, Vincent, et al., "Ultra wide band supercontinuum generation in air-silica holey fibers by SHG-induced modulation instabilities", *Optics Express*, vol. 13, No. 19, pp. 7399-7404, Sep. 19, 2005.
- Lee, Ju Han, et al., "Continuous-wave supercontinuum laser based on an erbium-doped fiber ring cavity incorporating a highly nonlinear optical fiber", *Optics Letters*, vol. 30, No. 19, pp. 2599-2601, Oct. 1, 2005.
- Genty, G., et al., "Supercontinuum generation in large mode-area microstructured fibers", *Optics Express*, vol. 13, No. 21, pp. 8625-8633, Oct. 17, 2005.
- Schreiber, T., et al., "Supercontinuum generation by femtosecond single and dual wavelength pumping in photonic crystal fibers with two zero dispersion wavelengths", *Optics Express*, vol. 13, No. 23, pp. 9556-9569, Nov. 14, 2005.
- Travers, J. C., et al., "Extended blue supercontinuum generation in cascaded holey fibers", *Optics Letters*, vol. 30, No. 23, pp. 3132-3134, Dec. 1, 2005.
- Hagen, C. L., et al., "Generation of a Continuum Extending to the Midinfrared by Pumping ZBLAN Fiber With an Ultrafast 1550-nm Source", *IEEE Photonics Technology Letters*, vol. 18, No. 1, pp. 91-93, Jan. 1, 2006.
- Moon, Suhei, et al., "Generation of octave-spanning supercontinuum with 1550-nm amplified diode-laser pulses and a dispersion-shifted fiber", *Optics Express*, vol. 14, No. 1, pp. 270-278, Jan. 9, 2006.
- Fedotova, O., et al., "Supercontinuum generation in planar rib waveguides enabled by anomalous dispersion", *Optics Express*, vol. 14, No. 4, pp. 1512-1517, Feb. 20, 2006.
- Harrington, James A., "Infrared Fiber Optics", *OSA Handbook*, vol. III, white paper, to be published by McGraw Hill, 13 pages, Undated.
- Aaviksoo, J., et al., "Observation of optical precursors at pulse propagation in GaAs", *Physical Review A*, vol. 44, No. 9, pp. R5353-R5356, Nov. 1, 1991.
- Boppart, Stephen A., et al., "Imaging developing neural morphology using optical coherence tomography", *Journal of Neuroscience Methods* 70, pp. 65-72, 1996.
- Boppart, Stephen A., et al., "Noninvasive assessment of the developing *Xenopus* cardiovascular system using optical coherence tomography", *Proc. Natl. Acad. Sci. USA*, vol. 94, pp. 4256-4261, Apr. 1997.
- Tearney, Guillermo J., et al., "In vivo Endoscopic Optical Biopsy with Optical Coherence Tomography", *Science, New Series*, vol. 276, pp. 2037-2039, Jun. 27, 1997.
- de Boer, Johannes F., et al., "Imaging thermally damaged tissue by polarization sensitive optical coherence tomography", *Optics Express* 212, vol. 3, No. 6, pp. 212-218, Sep. 14, 1998.
- Roggan, André, et al., "Optical Properties of Circulating Human Blood in the Wavelength Range 400-2500 NM", *Journal of Biomedical Optics*, vol. 4, No. 1, pp. 36-46, Jan. 1999.
- de Boer, Johannes F., et al., "Determination of the depth-resolved Stokes parameters of light backscattered from turbid media by use of polarization-sensitive optical coherence tomography", *Optics Letters*, vol. 24, No. 5, pp. 300-302, Mar. 1, 1999.
- Rollins, Andrew M., et al., "Real-time in vivo imaging of human gastrointestinal ultrastructure by use of endoscopic optical coherence tomography with a novel efficient interferometer design", *Optics Letters*, vol. 24, No. 19, pp. 1358-1360, Oct. 1, 1999.
- D'Amico, Anthony V., et al., "Optical Coherence Tomography as a Method for Identifying Benign and Malignant Microscopic Structures in the Prostate Gland", *Basic Science, Urology* 55 (5), pp. 783-787, 2000.
- Li, Xingde, et al., "Imaging needle for optical coherence tomography", *Optics Letters*, vol. 25, No. 20, pp. 1520-1522, Oct. 15, 2000.
- Oughstun, Kurt E., "Influence of precursor fields on ultrashort pulse autocorrelation measurements and pulse width evolution", *Optics Express*, vol. 8, No. 8, pp. 481-491, Apr. 9, 2001.
- Kowalewicz, Andrew M., et al., "Ultrahigh resolution optical coherence tomography using a superluminescent light source", *Optics Express* 349, vol. 10, No. 7, pp. 349-353, Apr. 8, 2002.
- Povazay, B., et al., "Submicrometer axial resolution optical coherence tomography", *Optics Letters*, vol. 27, No. 20, pp. 1800-1802, Oct. 15, 2002.
- Xie, T.-Q., et al., "Detection of tumorigenesis in urinary bladder with optical coherence tomography: optical characterization of morphological changes", *Optics Express*, vol. 10, No. 24, pp. 1431-1443, Dec. 2, 2002.
- Seefeldt, Michael, et al., "Compact white-light source with an average output power of 2.4 W and 900 nm spectral bandwidth", *Optics Communications* 216, pp. 199-202, 2003.
- Wang, Yimin, et al., "Ultrahigh-resolution optical coherence tomography by broadband continuum generation from a photonic crystal fiber", *Optics Letters*, vol. 28, No. 3, pp. 182-184, Feb. 1, 2003.
- Bizheva, K., et al., "Compact, broad-bandwidth fiber laser for sub-2- μm axial resolution optical coherence tomography in the 1300-nm wavelength region", *Optics Letters*, vol. 28, No. 9, pp. 707-709, May 1, 2003.
- Pan, Yingtian, et al., "Hand-held arthroscopic optical coherence tomography for in vivo high-resolution imaging of articular cartilage", *Journal of Biomedical Optics* 8(4), pp. 648-654, Oct. 2003.
- Xie, Tuqiang, et al., "Endoscopic optical coherence tomography with a modified microelectromechanical systems mirror for detection of bladder cancers", *Applied Optics*, vol. 42, No. 31, pp. 6422-6426, Nov. 1, 2003.
- Dubois, A., et al., "Three-dimensional cellular-level imaging using full-field optical coherence tomography", *Physics in Medicine and Biology*, *Phys. Med. Biol.* 49, pp. 1227-1234, 2004.
- Park, Jesung, et al., "Analysis of birefringent image in the retinal nerve fiber layer by polarization sensitive optical coherence tomography", *Ophthalmic Technologies XIV, Proceedings of SPIE*, vol. 5314, pp. 188-194, 2004.
- Unterhuber, A., et al., "Advances in broad bandwidth light sources for ultrahigh resolution optical coherence tomography", *Physics in Medicine and Biology*, *Phys. Med. Biol.* 49, pp. 1235-1246, 2004.

(56)

References Cited

OTHER PUBLICATIONS

Drexler, Wolfgang, "Ultra-high-resolution optical coherence tomography", *Journal of Biomedical Optics*, vol. 9, No. 1, pp. 47-74, Jan./Feb. 2004.

Schmitt, Joseph, et al., "Intravascular Optical Coherence Tomography Opens a Window Onto Coronary Artery Disease", *Optics & Photonics News*, pp. 20-25, Feb. 2004.

Nassif, N. A., et al., "In vivo high-resolution video-rate spectral-domain optical coherence tomography of the human retina and optic nerve", *Optics Express*, vol. 12, No. 3, pp. 367-376, Feb. 9, 2004.

Choi, Seung-Ho, et al., "Observation of Optical Precursors in Water", *Physical Review Letters*, vol. 92, No. 19, pp. 193903-1-193903-3, May 14, 2004.

Pierce, Mark C., et al., "Advances in Optical Coherence Tomography Imaging for Dermatology", *Optical Coherence Tomography Advances, The Journal of Investigative Dermatology*, pp. 458-463, Sep. 3, 2004.

"State-Specific Trends in Chronic Kidney Failure—United States, 1990-2001", *Morbidity and Mortality Weekly Report*, Department of Health and Human Services Centers for Disease Control and Prevention, vol. 53, No. 39, internet: file:///C:/Documents and Settings/eturlo/Desktop/State-Specific Trends in Chronic Kidney ... 2/12/10, pp. 918-920. Dated: Oct. 8, 2004.

I.B. Aris, A.A.E. Wagie, N. B. Mariun, A.B.E. Jammal, "An Internet-based blood pressure monitoring system for patients," *Journal of Telemedicine and Telecare*, pp. 51-53, 2001.

R.H. Istepanian, B. Woodward, P.A. Balos, S. Chen, B. Luk, "The comparative performance of mobile telemedical systems based on the IS-54 and GSM cellular telephone standards," *Journal of Telemedicine and Telecare*, pp. 97-104, 1999.

Shaw, et al., *IR Supercontinuum Generation in As-Se Photonic Crystal Fiber*, Optical Society of America, 3 pages, © 2005.

PCT/US06/44451, Notification of Transmittal of the International Search Report and the Written Opinion of the International Searching Authority, or the Declaration, 12 pages, Date Mailed Nov. 29, 2007.

* cited by examiner

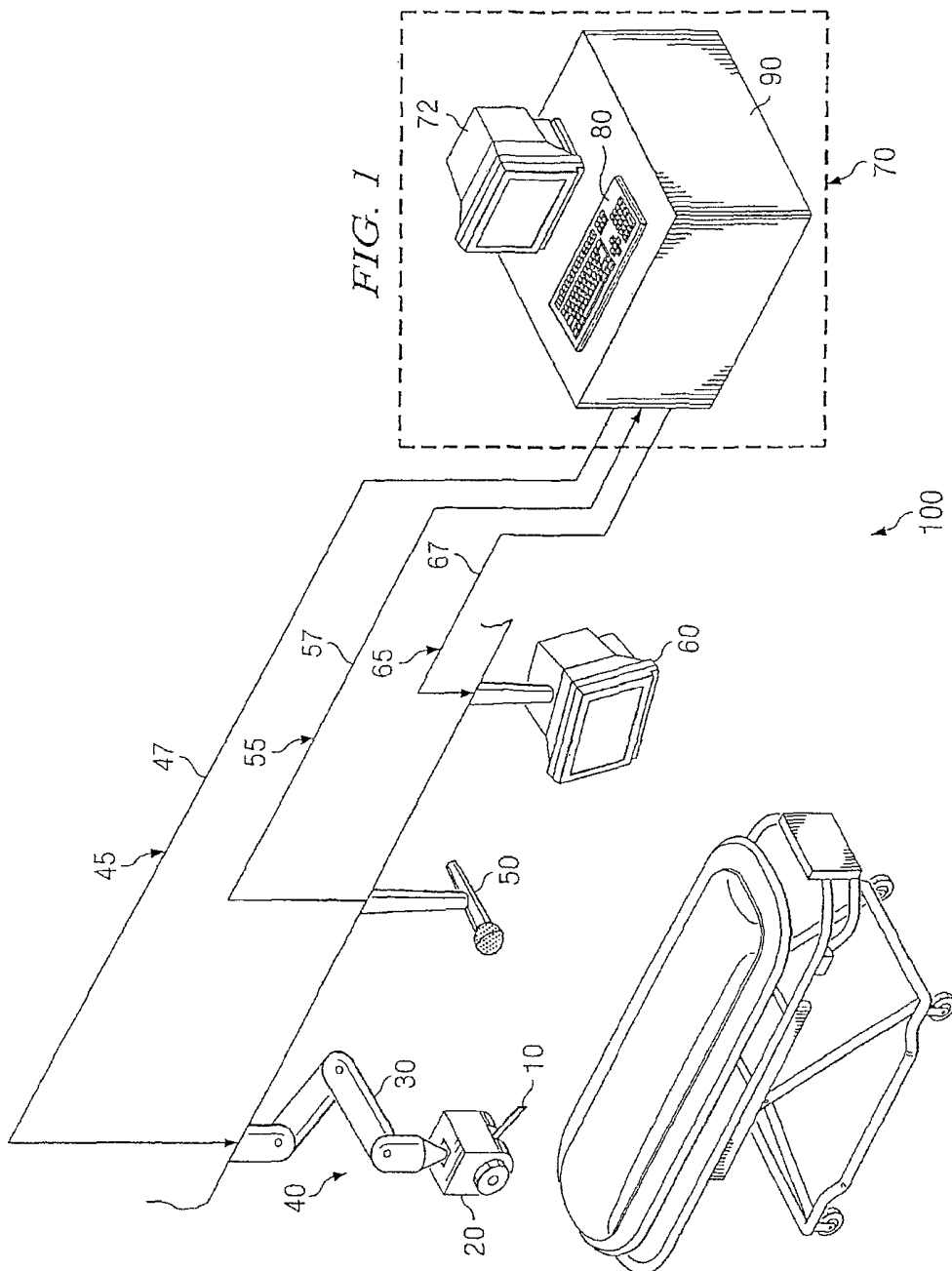

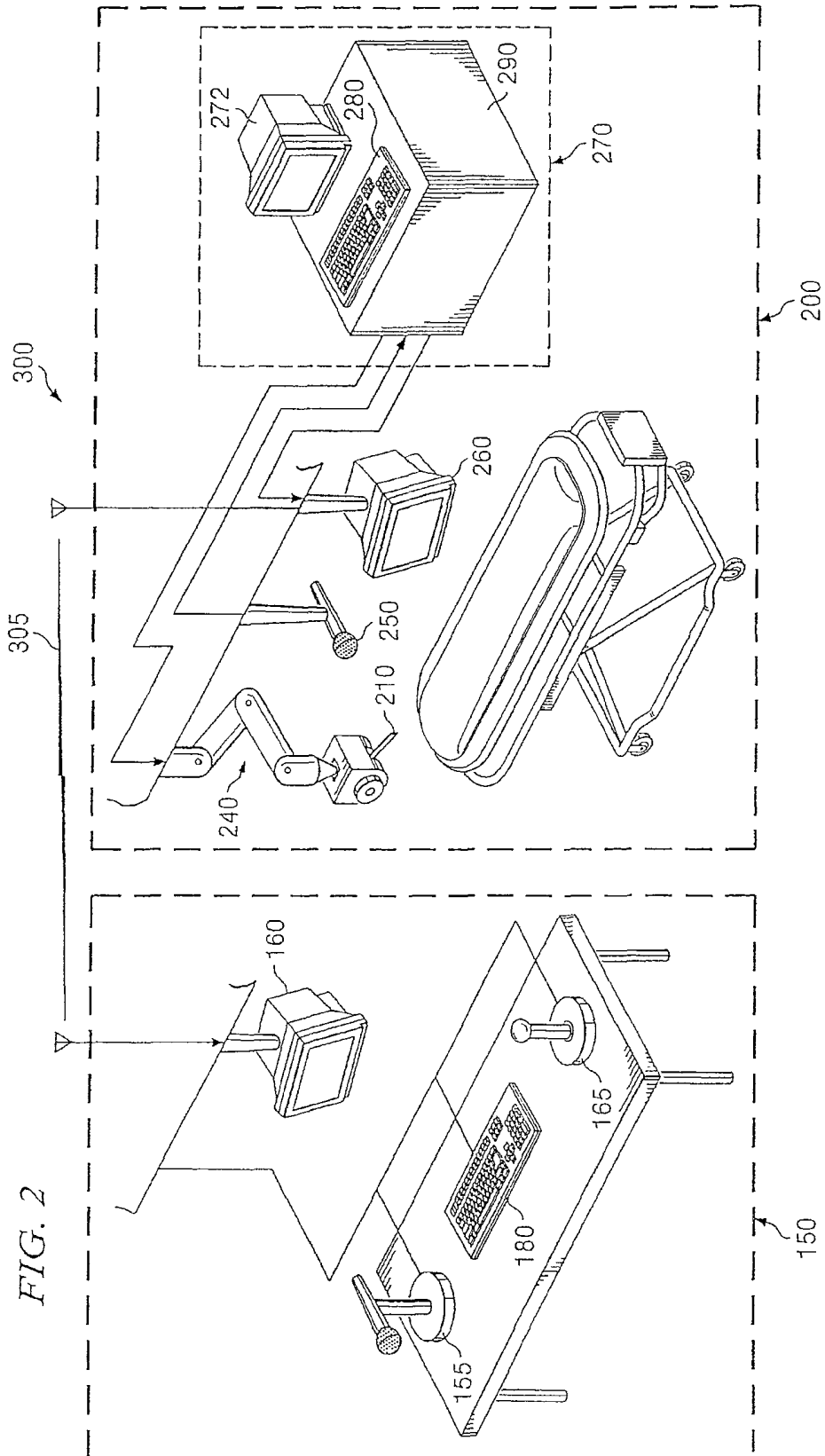

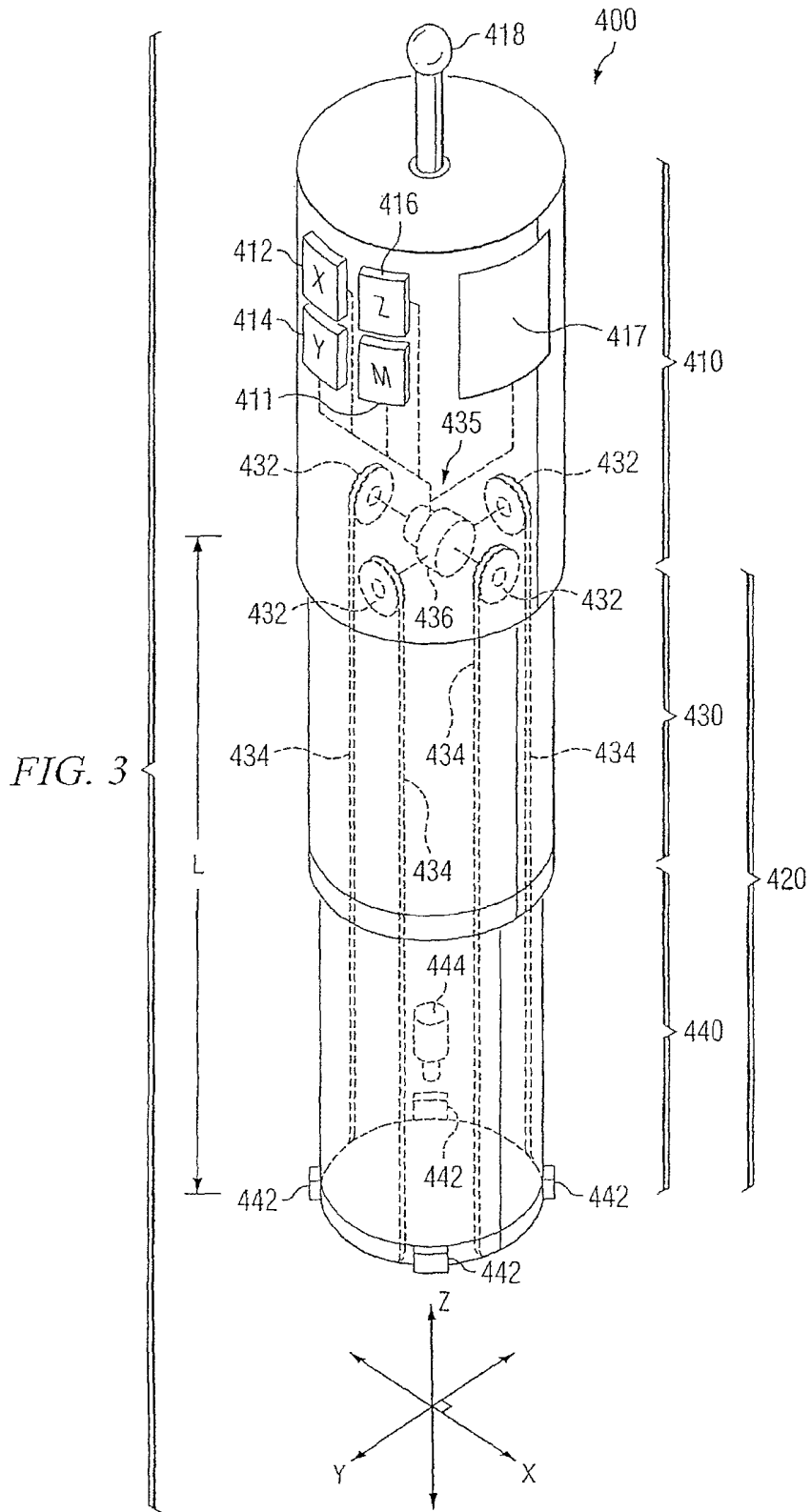

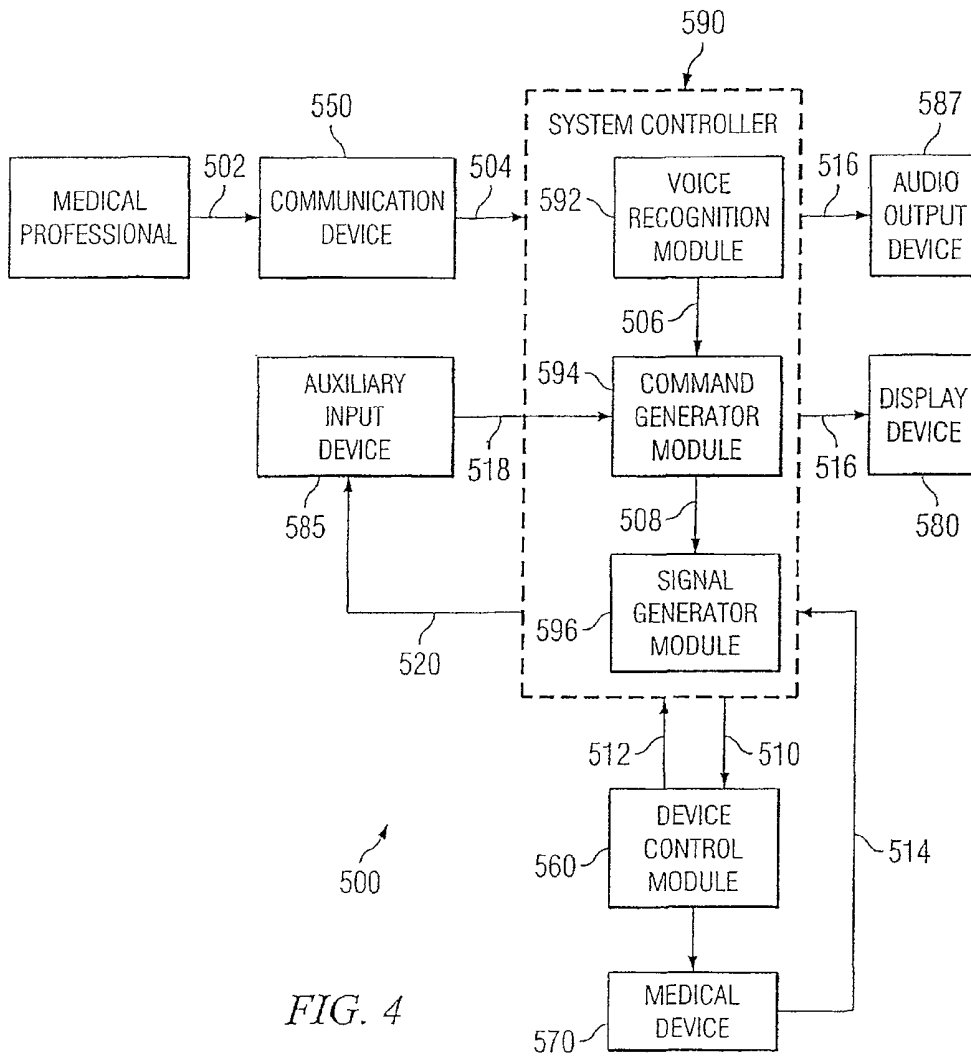

FIG. 4

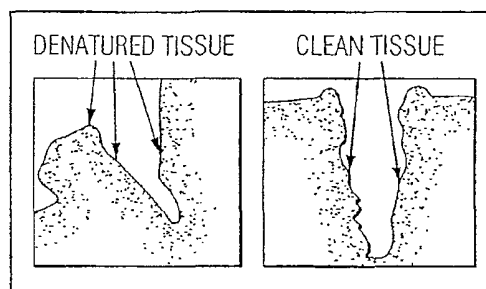

FIG. 6A

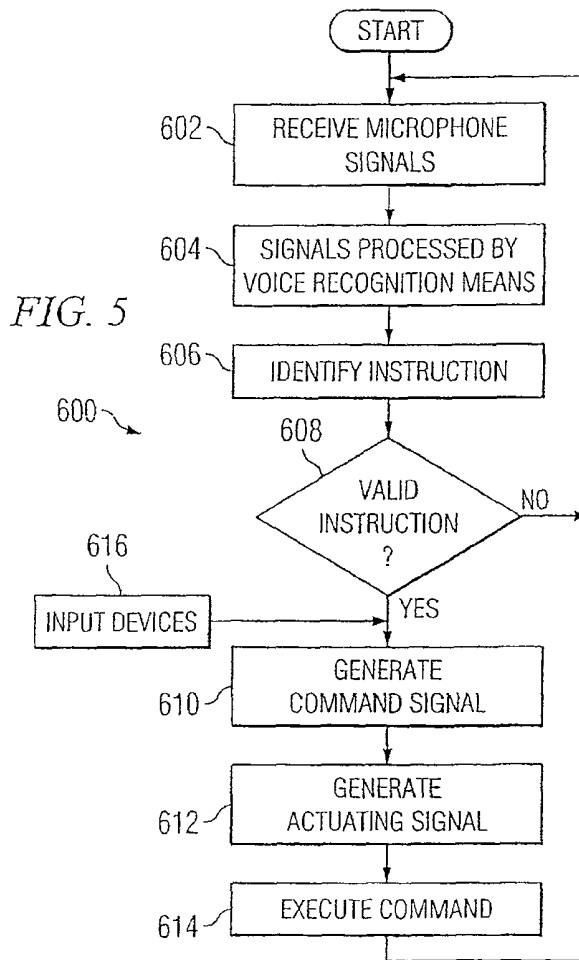
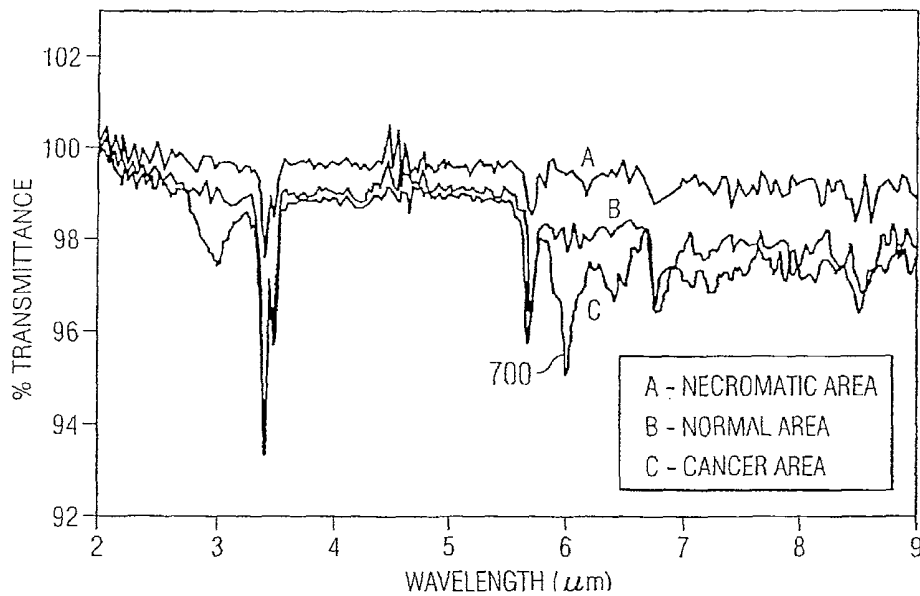
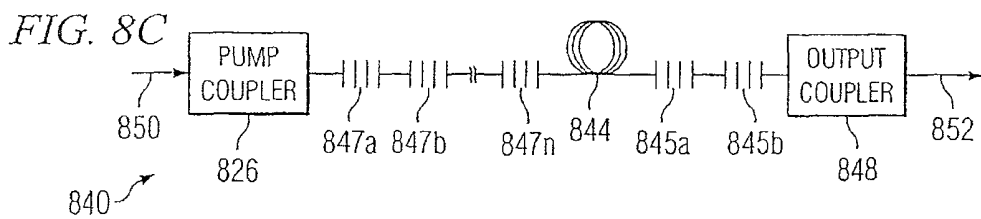
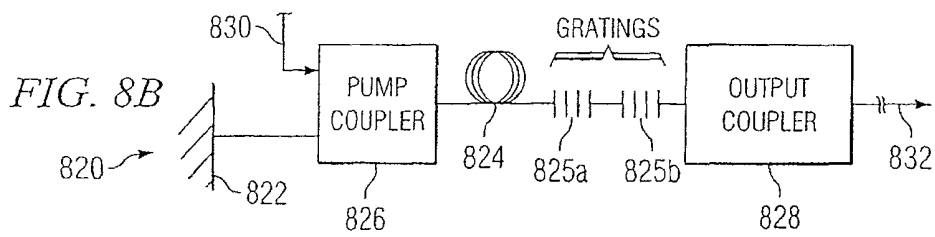
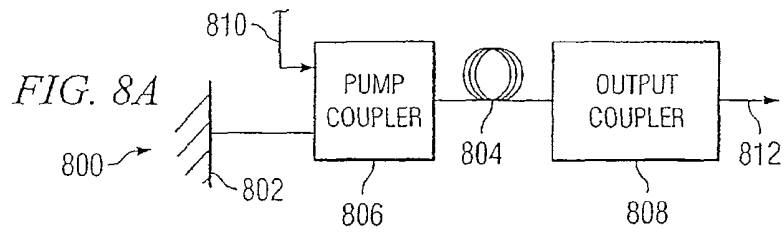
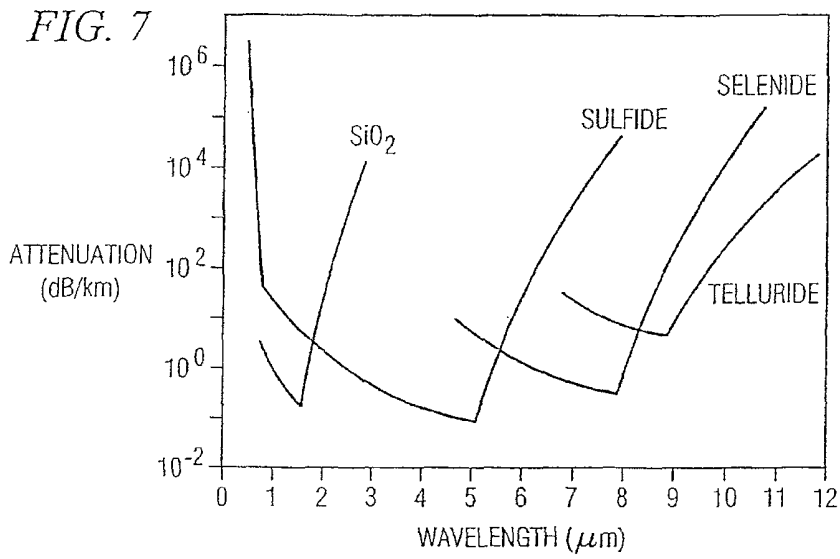

FIG. 6B





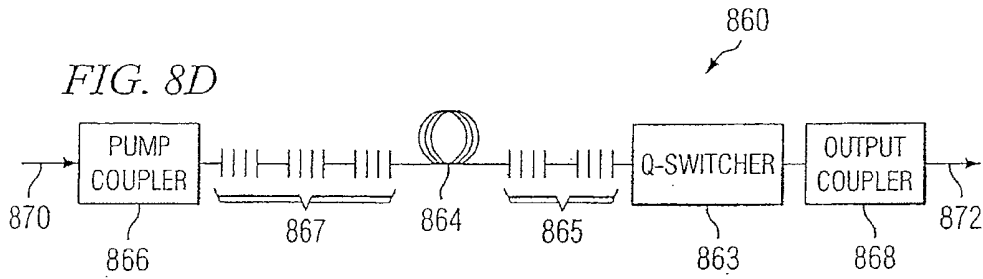

FIG. 9A

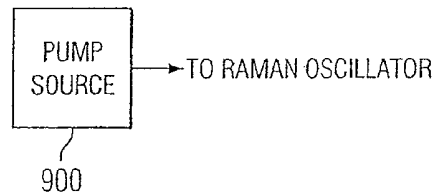
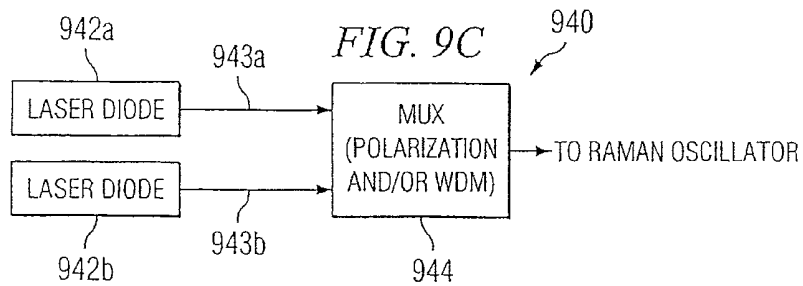
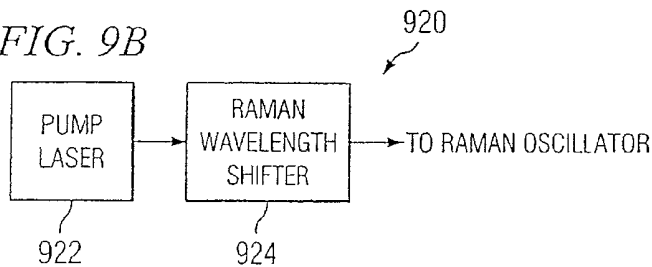

FIG. 9B



SYSTEM AND METHOD FOR VOICE CONTROL OF MEDICAL DEVICES

RELATED APPLICATIONS

This application is a continuation of U.S. application Ser. No. 13/349,244 entitled "System and Method for Voice Control of Medical Devices" filed Jan. 12, 2012, currently pending, which is a continuation of U.S. application Ser. No. 13/078,547 entitled "System and Method for Voice Control of Medical Devices", filed Apr. 1, 2011, currently pending, which is a divisional of U.S. application Ser. No. 12/625,253, now U.S. Pat. No. 8,098,423, entitled "System and Method for Voice Control of Medical Devices" filed Nov. 24, 2009, issued Jan. 17, 2012, which is a divisional of U.S. patent application Ser. No. 12/206,432, entitled "System and Method for Voice Control of Medical Devices" filed Sep. 8, 2008, now U.S. Pat. No. 7,633,673, issued Dec. 15, 2009 which is a divisional of U.S. patent application Ser. No. 10/812,608, entitled "System and Method for Voice Control of Medical Devices" filed Mar. 30, 2004, now U.S. Pat. No. 7,433,116, issued Oct. 7, 2008, which is a continuation of U.S. patent application Ser. No. 10/757,341, entitled "System and Method for Voice Control of Medical Devices" filed Jan. 13, 2004, now U.S. Pat. No. 7,259,906, issued Aug. 21, 2007, which is a continuation of U.S. patent application Ser. No. 10/652,276 entitled "System and Method for Voice Control of Medical Devices" filed Aug. 29, 2003, abandoned. application Ser. No. 10/652,276 claims the benefit under 35 U.S.C. §119(e) to U.S. Provisional Patent Application No. 60/408,025 entitled "Voice Control of Medical Instruments and Devices" filed Sep. 3, 2002.

TECHNICAL FIELD OF INVENTION

This invention relates generally to medical devices and more particularly to a system and method for voice control of medical devices.

OVERVIEW

Medical procedures typically use medical instruments or devices that tend to require a high level of manual dexterity on the part of medical professionals. To achieve this high level of dexterity, medical professionals require years of training and practice. This high level of dexterity and the strain imposed on the medical professional when using those instruments can cause the medical professional to become fatigued during medical procedures. For example, certain medical instruments require the medical professional to use both hands and to stand next to the patient, sometimes in an awkward position through the entire procedure. This can create fatigue, thereby limiting the number of procedures that the medical professional is able to perform in a given period. In addition, the high level of fatigue may lead to unnecessary and dangerous errors occurring during medical procedures.

SUMMARY OF EXAMPLE EMBODIMENTS

In one embodiment, a medical diagnostic system includes a software application capable of generating medical data based at least in part on input signals received directly from one or more sensors, wherein the medical data represents at least in part physiological information associated with a patient. The software application is capable of operating on a controller adapted to receive, store, and process at least a portion of the physiological information. The controller may

include a touch-screen, one or more auxiliary input devices, circuitry for obtaining position information from a location sensor, and a wireless transceiver to transmit data over a wireless link. The wireless data may include at least a portion of the physiological information, wherein the controller is further capable of receiving voice input signals and manually entered input signals. A host may include a digital file for receiving and storing at least a portion of the wireless data, and control logic at the host to process at least the portion of the wireless data to generate a medical status of the patient. The host may also include a memory storage device for recording the medical status. The system may also include an output for communicating at least a portion of the medical status over a communication link to one or more display output devices, wherein the one or more display output devices are located remotely from the host.

Various embodiments may include a method of processing medical data including providing a software application to a control module, the software application capable of generating medical data based at least in part on input signals received directly from one or more sensors, wherein the medical data represents at least in part a motion or change in position of one or more of the sensors associated with a patient. The method may also include receiving at least a portion of the medical data at a medical data processing system over a communication link from the control module, wherein at least a part of the communication link is wireless, storing the received medical data in a digital file at the medical data processing system, processing the medical data in the digital file using control logic at the medical data processing system to generate a medical status of the patient, recording the medical status within a memory storage device of the medical data processing system, and transmitting at least a portion of the medical status to one or more display output devices, wherein the one or more display output devices are located remotely from the medical data processing system.

In one embodiment, a method of processing medical data includes providing a software application to a control module, the software application capable of generating medical data based at least in part on input signals received directly from one or more sensors, wherein the medical data represents at least in part physiological parameters associated with a patient, wherein the one or more sensors further provide positioning information, and wherein the medical data further comprises voice input signals and the software application further comprises voice recognition software. The method may also include receiving at least a portion of the medical data at a medical data processing system over a communication link from the control module, wherein at least a part of the communication link is wireless, storing the received medical data in a digital file at the medical data processing system, and processing the medical data in the digital file using control logic at the medical data processing system to generate a medical status of the patient, wherein the medical data processing system further comprises a voice recognition module. The method may also include recording the medical status within a memory storage device of the medical data processing system, and transmitting at least a portion of the medical status to one or more display output devices, wherein the one or more display output devices are located remotely from the medical data processing system, and wherein the medical data processing system is adapted to permit access of the medical status from two or more different locations remote from the medical data processing system.

In one embodiment, a medical device comprises an insertable portion capable of being inserted into an orifice associated with a body of a patient. The insertable portion compris-

ing an automated head unit capable of being manipulated in at least two axes of motion based at least in part on one or more control signals. The medical device further comprises one or more controllers coupled to the automated head unit. In one particular embodiment, the one or more controllers generate the one or more control signals based at least in part on an input signal.

In another embodiment, a medical device capable of minimizing tissue damage comprises an insertable portion capable of being inserted into an orifice associated with a body of a patient. The medical device further comprises one or more sensors coupled to the insertable portion. The one or more sensors capable of generating a feedback signal capable of being used to substantially minimize damage to tissue associated with the patient.

In yet another embodiment, a medical device capable of being used in a medical procedure comprises a pump laser capable of generating a pump signal. The medical device further comprises a Raman wavelength shifter coupled to the pump laser, at least a portion of the wavelength shifter comprising a waveguide structure. In one particular embodiment, the Raman wavelength shifter generates an output optical signal comprising a wavelength of approximately 1.7 microns or more.

In still another embodiment, a medical device capable of being used in a medical procedure comprises a Raman wavelength shifter operable to generate an optical signal comprising a mid-infrared wavelength. At least a portion of the Raman wavelength shifter comprises a chalcogenide waveguide.

In another embodiment, a system for controlling a medical device includes a monitor capable of communicating medical information associated with a patient and a communication device capable of receiving one or more input signals from a user. In one particular embodiment, the one or more input signals are based at least in part on the medical information displayed on the monitor. The system further includes one or more processors coupled to the communicated device and operable to convert the one or more input signals into one or more control signals capable of being used to manipulate a medical device.

Depending on the specific features implemented, particular embodiments may exhibit some, none, or all of the following technical advantages. Various embodiments may be capable of reducing medical professional fatigue through the implementation of a control system capable of manipulating a medical device through voice commands. Some embodiments may be capable of controlling a medical device from a remote location. Other embodiments may be capable of reducing the level of dexterity required of a medical professional when performing a medical procedure.

Other technical advantages will be readily apparent to one skilled in the art from the following figures, description, and claims. Moreover, while specific advantages have been enumerated, various embodiments may include all, some, or none of the enumerated advantages.

BRIEF DESCRIPTION OF THE DRAWINGS

To provide a more complete understanding of the present invention and certain features and advantages, thereof, reference is made to the following description taken in conjunction with the accompanying drawings, in which:

FIG. 1 illustrates one example embodiment of medical device control system;

FIG. 2 illustrates another example embodiment of a medical device control system;

FIG. 3 illustrates an example medical device capable of being inserted into a patient's body during a medical procedure;

FIG. 4 is a block diagram illustrating a flow of command signals from a medical professional to a medical device in a medical device control system;

FIG. 5 is a flow chart illustrating an exemplary method for processing a voice control signal and/or a command signal received by a medical device control system;

FIG. 6A compares a surgical incision made using a 2.94 micron optical signal wavelength to a surgical incision made using a 6.45 micron optical signal wavelength;

FIG. 6B illustrates example evanescent spectra in different cell-type regions;

FIG. 7 illustrates example attenuation characteristics of several optical fibers based on wavelength;

FIGS. 8A through 8D are block diagrams illustrating example embodiments of Raman wavelength shifters and/or Raman oscillators capable of shifting a pump signal to an output signal wavelength of 1.7 microns or more; and

FIGS. 9A through 9C are block diagrams illustrating example embodiments of pump sources that are capable of generating a pump signal for use in a Raman wavelength shifter.

DESCRIPTION OF EXAMPLE EMBODIMENTS

FIG. 1 illustrates one example embodiment of a medical device control system **100**. In this example, system **100** includes a medical device **10**, a manipulator **40**, a microphone **50**, a display device **60**, and a host **70**. In various embodiments, system **100** may be capable of receiving voice commands associated with the manipulation of medical device **10** from a medical professional, such as a nurse, a medical assistant, a medical technician, and/or a doctor. In some cases, system **100** is capable of assisting a medical professional during a medical procedure by processing data signals associated with one or more voice commands and manipulating medical device **10** in response to those commands.

Medical device **10** may comprise any device or instrument that a medical professional needs to perform a medical procedure. Medical device **10** can comprise, for example, a surgical scalpel, a scope, a laser, an imaging device, a microscope, or a combination of these or any other suitable device. As used throughout this document, the term "scope" refers to any medical device capable of entering a patient's body, such as endoscopes, colonoscopes, gastroscopes, enteroscopes, bronchoscopes, laryngoscopes, choledochoscopes, sigmoidoscopes, duodenoscopes, arthroscopes, cystoscopes, hysteroscopes, laparoscopes, or a combination of these or any other suitable device.

In one particular embodiment, medical device **10** comprises an endoscope. In those cases, the endoscope may comprise an insertable portion capable of being inserted through an orifice associated with a patient. In other embodiments, the insertable portion may be capable of being guided through the patient's orifice, and capable of collecting biological samples from the patient for investigation. The orifice associated with the patient may comprise, for example, a throat, a mouth, a nasal passage, an orifice created by the medical professional, and/or any other suitable orifice. In some embodiments, medical device **10** may include a fiber-optic cable with a lens system at the end that is capable of sending images to a camera and/or a display device, such as display device **60**.

In other embodiments, medical device **10** may comprise one or more sensors coupled to feedback control circuitry that is capable of minimizing collateral tissue damage during a

medical procedure. In various embodiments, the one or more sensors and the control circuitry may be capable of providing positioning information to a medical professional and/or a controller, such as system controller **90**. In other embodiments, the one or more sensors and the control circuitry may be capable of providing data associated with one or more physiological parameters associated with the patient to a medical professional and/or a controller. In some cases, the one or more sensors may be capable of detecting and/or alerting a medical professional or a controller when medical device **10** is in close proximity to and/or in contact with tissue. In other cases, the one or more sensors and the control circuitry may be capable of detecting when medical device **10** is in contact with tissue and capable of overriding control signals received by medical device **10**.

In this example, manipulator **40** includes an actuation unit **20** and a supporting structure **30**. Actuation unit **20** may house one or more control systems capable of receiving control signals and manipulating medical device **10** in response to those control signals. The one or more control systems may comprise, for example, a mechanical control system, an electrical control system, or a combination of these or any other control system. As used throughout this document, the phrase “mechanical control system” refers to a control system that at least partially includes mechanical components. In various embodiments, actuation unit **20** can implement a mechanical control system, such as a hydraulic system, pneumatic system, or a pulley guide-wire system.

Supporting structure **30** may comprise a robotic arm, one or more pivoted links, multiple links connected together to move in a “scissor-like” manner, or any other structure capable of supporting and manipulating medical device **10**. Although this example depicts manipulator **40** and medical device **10** as separate devices, manipulator **40** and medical device **10** can comprise a unitary medical apparatus capable of performing the desired functionalities without departing from the scope of the present disclosure. For example, manipulator **40** and medical device **10** can be combined to form a unitary medical apparatus, such as an endoscope, have an automated portion.

In some embodiments, a freedom of motion associated with manipulator **40** can have a resolution that substantially replicates the manual dexterity of a medical professional and/or a manual medical device used by the medical professional. In some cases, manipulator **40** may have a step size and/or angle of rotation step size that is substantially similar to the manual dexterity of a medical professional and/or a manual medical device used by the medical professional. For example, the number of degrees of manipulation freedom associated with medical device **10** can match the number of degrees of manipulation freedom currently available on manual devices. That is, if a conventional manual device that has four degrees of freedom in the x-y plane, then the range of motion associated with manipulator **40** can include at least four degrees of freedom in the x-y plane. In some embodiments, manipulator **40** may include manual override controls that allow a medical professional to exercise manual control of medical device **10**.

Manipulator **40** is coupled to host **70** through a first communication link **45**. As used throughout this document, the term “couple” and/or “coupled” refers to any direct or indirect communication between two or more elements, whether or not those elements are in physical contact with one another. In this example, first communication link **45** is operable to facilitate the communication of command/data signals **47** between manipulator **40** and host **70**. Command/data signals **47** may comprise, for example, video signals from a video

device coupled to medical device **10**, data obtained by sensors coupled to medical device **10**, or manipulation commands generated in response to voice commands, auxiliary input commands, and/or automated commands.

In this example, host **70** is capable of performing a desired communicating and/or computing functionality. For example, host **70** may be capable of at least partially contributing to the manipulation of medical device **10**. In other embodiments, host **70** may be capable of collecting, entering, processing, storing, retrieving, amending, and/or dispatching medical data during a medical procedure. In operation, host **70** may execute with any of the well-known MS-DOS, PC-DOS, OS-2, MAC-OS, WINDOWS™, UNIX, or other appropriate operating systems. In some embodiments, host **70** may include a graphical user interface (GUI) **72** that enables a medical professional to display medical data and/or medical video associated with medical device **10**. Host **70** may comprise, for example, a desktop computer, a laptop computer, a server computer, a personal digital assistant, and/or any other computing or communicating device or combination of devices.

In this example, host **70** includes system controller **90** capable of processing, collecting, storing, retrieving, and/or amending medical data and/or video during a medical procedure. System controller **90** may comprise one or more computers, an embedded microprocessor, or any other appropriate device or combination of devices capable of processing and/or generating voice command signals **47** and/or **57**. In operation, system controller **90** may execute with any of the well-known MS-DOS, PC-DOS, OS-2, MAC-OS, WINDOWS™, UNIX, or other appropriate operating systems. In this embodiment, system controller **90** may implement voice recognition software operable to process voice command signals **57**. For example, system controller **90** may implement one or more voice recognition software programs, such as ViaVoice or Dragon Speech Recognition software, or any appropriate proprietary or non-proprietary voice recognition software. In certain embodiments, the voice recognition software may be programmed to recognize the medical professional’s voice and commands may be customized to the medical professional’s preferences. In addition, the voice recognition software may be capable of filtering out background noise.

System controller **90** is operable to process voice command signals **57**, generate command/data signals **47** in response to the voice command, and communicate the command/data signals **47** to manipulator **40**. System controller **90** may also be used to collect and record data using a memory storage device. System controller **90** may be operable to provide data associated with a patient’s medical status during a medical procedure to the medical professional using display device **60** and/or GUI **72**, or any other appropriate devices.

In this embodiment, host **70** also includes an auxiliary input device **80** coupled to system controller **90**. Although a keyboard is depicted in this example, any other device capable of inputting commands and/or data may be used without departing from the scope of this disclosure. In this example, auxiliary device **80** is operable to facilitate manual entry of manipulation commands to supplement and/or replace voice commands. In addition, the medical professional may use auxiliary device **80** to input data into system controller **90**, such as the patient’s physiological parameters, for example, blood pressure, heart rate, blood oxygen level, or to retrieve data stored in a memory device associated with host **70**.

In this example, system **100** also includes display device **60** and a graphical user interface (GIU) **72**, each capable of

displaying medical information, such as medical data and/or medical video. Display device 60 and GUI 72 may comprise, for example, a monitor, a LED, a heads-up display, virtual reality goggles, a closed-circuit television, a CAVE environment, or any other device or combination of devices capable of displaying. In some cases, display device 60 and GUI 72 may display a live video image from a video device associated with medical device 10, information about a patient's medical status, such as the current state of any number of the patient's physiological parameters, information about the particular medical device 10 being used, or any other information that may assist a medical professional during a medical procedure. In this example, display device 60 is coupled to host 70 through a third communication link 65, which is operable to facilitate the communication of data signals 67 to and/or from host 70.

In this example, system 100 also includes communication device 50 that enables a medical professional to communicate with host 70. Communication device 50 can comprise any device that enables a medical professional to communicate with host 70. Communication device 50 may comprise, for example, a telephone, a wireless device, a voice-over-IP device, a unidirectional microphone attached to a headset worn by a medical professional, a bi-directional microphone, or any other suitable communicating device or combination of devices. Communication device 50 may be selectively attached to and/or placed near the medical professional for ease of use. Attaching communication device 50 to the medical professional can, in some cases, advantageously minimize background noise. Although system 100 includes one communication device 50 in this example, any other number of communication devices may be used without departing from the scope of the present disclosure. Communication device 50 is coupled to host 70 through a second communication link 55, which is operable to facilitate the communication of voice command signals 57 between communication device 50 and host 70.

In the illustrated embodiment, system 100 includes at least a first communications link 45 a second communications link 55, and a third communications link 65 each operable to facilitate the communication of data to and/or from host 70. Communications links 45, 55, and 65 may include any hardware, software, firmware, or combination thereof. In various embodiments, communications link 45, 55, and 65 may comprise any communications medium capable of assisting in the communication of analog and/or digital signals. Communications links 45, 55, and 65 may, for example, comprise a twisted-pair copper telephone line, a fiber optic line, a Digital Subscriber Line (DSL), a wireless link, a USB bus, a PCI bus, an Ethernet interface, or any other suitable interface operable to assist in the communication of information to and/or from network 104.

In conventional medical procedures involving a scope, a medical professional manually manipulates the medical device based on feedback from the medical device. The medical professional typically uses one hand to hold the medical device and guide it into and through a patient's body. The medical professional's other hand is used to manipulate the manual controls of the medical device. Thus, conventional systems typically require significant manual dexterity, which can result in a significant amount of strain on the medical professional.

Unlike conventional procedures, system 100 comprises a communication device 50 that enables a medical professional to manipulate medical device 10 using voice commands, auxiliary input commands, and/or automated commands. Allowing a medical professional to use voice commands and/

or automated commands can significantly reduce the manual dexterity, and the resulting strain, imposed on the medical professional during a medical procedure.

In operation, a medical professional can speak voice commands into communication device 50 for communication to host 70. Host 70 receives voice command signals 57 from communication device 50 and processes those signals using a voice recognition module associated with host 70. Host 70 converts the voice command signals into command/data signals 47 and communicates signals 47 to manipulator 40. Manipulator 40 responds by causing medical device 10 to perform its desired function. Voice commands may comprise, for example, a voice to take a photograph of a portion of the patient's body, a voice command to change an image size by zooming in or out, or any other suitable voice command capable of causing medical device 10 to perform its functionality. In other embodiments, host 70 is capable of automatically generating command/data signals 47 based at least in part on data received from medical device 10 through communication link 47.

FIG. 2 illustrates another example embodiment of a medical device control system 300. System 300 includes system 150 for remote manipulation of a medical device 210 and system 200 for voice control of medical device 210. In this example, system 150 is capable of controlling at least a portion of system 200 from a remote location. For example, a medical professional may use system 150 to remotely control system 200 in the case where the medical professional is not located near system 200. The remote location may comprise, for example, a different location in the hospital that includes system 200, a location in a different hospital, or any other location.

System 150 can include a communication device 155, a display device 160, a first auxiliary input device 165, and a second auxiliary input device 180. The structure and function of communication device 155, display device 160, and second auxiliary input device 180 can be substantially similar to the structure and function of communication device 50, display device 60, and auxiliary input device 80, respectively, of FIG. 1. First auxiliary input device 165 may comprise, for example, a joystick, a computer mouse, a rollerball, knobs, levers, buttons, touchpads, touchscreens, or any other appropriate control device capable of being used to control manipulator 240. In this example, a medical professional can use first auxiliary input device 165 to control manipulator 240 from the remote location.

In this embodiment, system 200 includes a medical device 210, a manipulator 240, a communication device 250, and a display device 260. System 200 also includes a host 270 comprising GUI 272, a third auxiliary input device 280, and a system controller 290. Although host 270 resides within system 200 in this example, host 270 could reside within system 150 or could reside in any location accessible to system 300 without departing from the scope of the present disclosure. The structure and function of medical device 210, manipulator 240, communication device 250, display device 260, host 270, GUI 272, third auxiliary input device 280, and system controller 290 can be substantially similar to the structure and function of medical device 10, manipulator 40, communication device 50, display device 60, host 70, GUI 72, auxiliary input device 80, and system controller 90, respectively, of FIG. 1.

System 150 communicates with system 200 over communication link 305. Although communication link 305 comprises a single communication link in this example, any other number of communication links may be used without departing from the scope of the present disclosure. Communications

link **305** may include any hardware, software, firmware, or combination thereof. In various embodiments, communications link **305** may comprise a communications medium capable of assisting in the communication of analog and/or digital signals. Communications link **305** may, for example, comprise a twisted-pair copper telephone line, a fiber optic line, a Digital Subscriber Line (DSL), a wireless link, a USB bus, a PCI bus, an Ethernet interface, or a combination of these or other elements.

In some embodiments, a first medical professional can manually insert medical device **210** into a patient. In those cases, system **200** can communicate data to a second medical professional using remote system **150** through communication link **305**. The second medical professional, while monitoring display device **160**, can remotely manipulate medical device **210** using voice instructions communicated through communication device **155** coupled to communication link **305** to host **270**. In this manner, the medical professional using system **150** can substantially emulate a medical professional's manual control of medical device **210**. In other embodiments, the medical professional can remotely manipulate medical device **210** using auxiliary devices **165** and/or **180**. In an alternative embodiment, a medical professional can insert medical device **210** into a patient using system **200** locally or using system **150** remotely.

In addition to voice command control and/or auxiliary input device control, other methods of medical device control may be implemented. In some cases, system **150** and/or system **200** can implement a heads-up-display (HUD) capable of controlling and/or manipulating medical device **210** and/or manipulator **240**. The HUD may be capable of projecting images onto or near the eyes of a medical professional and capable of sending command signals using a virtual control device attached to the medical professional. In another example, the medical professional may wear a helmet capable of manipulating medical device **210** and/or manipulator **240** based at least in part on command signals generated in response to a motion associated with the head of the medical professional. For example, rotation of the head to the right may indicate that the operator wants the medical device to move to the right.

FIG. 3 illustrates an example medical device **400**. In various embodiments, at least a portion of medical device **400** may be inserted into a patient's body through an orifice during a medical procedure. The orifice may comprise, for example, the patient's throat or mouth, the patient's nasal passages, an incision made during surgery, or any other suitable orifice. In this particular example, medical device **400** comprises a scope. The scope may comprise, for example, an endoscope, a colonoscope, a gastroscope, an enteroscope, a bronchoscope; a laryngoscope, a choledochoscope, a sigmoidoscope, a duodenoscope, an arthroscope, a cystoscope, a hysteroscope, a laparoscope, or a combination of these or any other suitable device. In various embodiments, medical device **400** can be controlled through, for example, voice commands, auxiliary input command, automated commands, and/or manual commands. In some cases, medical device **400** can be coupled to a medical device control system, such as system **100** or system **300** of FIG. 1 and FIG. 2, respectively.

Medical device **400** includes a base portion **410** capable of controlling and/or at least partially contributing to the manipulation of an insertable portion **420**. In this example, base portion **410** includes control system **435** capable of at least partially contributing to the control and/or the manipulation of insertable portion **420**. Control system **435** may be capable of receiving, processing, executing, and/or communicating one or more signals associated with the manipulation

of insertable portion **420**. In various embodiments, these signals received by base portion **410** may comprise, for example, voice commands, auxiliary input commands, automated commands, physiological parameters, video data, positioning data, or a combination of these or other signal types.

In various embodiments, control system **435** may reside in a location outside of base portion **410** and/or may be partially or wholly included within base portion **410**. Control systems **435** may comprise, for example, a mechanical control system, an electrical control system, an electro-mechanical control system, or a combination of these or any other suitable control system. The phrase "mechanical control system" refers to a control system that at least partially includes mechanical components. Mechanical control systems can include, for example, hydraulic components, pneumatic components, pulleys, guidewires, gears, actuators, pushrods, sprocket/chain mechanisms, feedback control circuitry, or any other suitable components.

In this particular embodiment, control system **435** includes a manual override control module **411**, an x-axis control module **412**, a y-axis control module **414**, and a z-axis control module **416**. Control modules **411**, **412**, **414**, and **416** may include any hardware, software, firmware, or combination thereof. In some embodiments, control modules **411**, **412**, **414**, and **416** may comprise buttons, knobs, dials, control circuitry, or any other suitable control input device. In this particular embodiment, control modules **412**, **414**, and **416** operate to receive and process input signals from a medical professional. In addition, control modules **412**, **414**, and **416** operate to at least partially contribute to the manipulation of insertable portion **420**. The input signals may comprise, for example, voice commands, auxiliary input commands, and/or manual input commands. In other embodiments, control modules **412**, **414**, and **416** operate to receive and process input signals from a host and/or system controller. For example, a medical professional can use control modules **412**, **414**, and **416** to individually control medical device **400** in the x-, y-, and z-axes, respectively. In various embodiments, override control module **411** may be capable of enabling the medical professional to override the automatic operation of medical device **400** as necessary during a medical procedure.

Control system **435** may also include touch-screen **417** and controller **418**. Controller **418** operates to combine the individual control functions of control modules **412**, **414**, and **416** into a single controller. For example, a medical professional can use controller **418** and/or touch-screen **417** to manually control medical device **400** in the x-, y-, and z-axes, respectively. Controller **418** can comprise any device capable of controlling the manipulation of insertable portion **420**. Controller can comprise, for example, a joystick, a rollerball, knobs, levers, buttons, or any other appropriate control device.

Control system **435** further includes motors **436**, pulleys **432**, and guidewires **434**. Although motors, pulleys, and guidewires are used in this example, control system **435** can include any other components capable of contributing to the manipulation of insertable portion **420** without departing from the scope of the present disclosure. In this example, motors **436** operate to control the positioning of insertable portion **420** based at least in part on control signals received from modules **411**, **412**, **414**, and **416**, and/or controller **418**. Motors **436** operate to manipulate guidewires **434** coupled to one end of insertable portion **420**. In other embodiments, base unit **410** includes actuators, pushrods, sprocket/chain mechanisms, feedback control circuitry, or any other control mechanism appropriate to control insertable portion **420**.

In this example, pulleys **432** and motors **436** operate to control the tension in guide wires **434**. In some embodiments, each guidewire **434** may comprise two or more segments, each segment comprising a different radial stiffness. For example, a first segment of guidewire **434** may be coupled to pulley **432**, and a second segment of guidewire **434** may be coupled to an end of insertable portion **420**. In that example, the second segment of guidewire segment may have a radial stiffness that is less than a radial stiffness associated with the first segment guidewire. In various embodiments, the force exerted by guidewires **434** can cause insertable portion **430** to move in a corresponding manner.

Medical device **400** may also include insertable portion **420** connected to base portion **410** and capable of being inserted into an orifice or incision in a patient's body during a medical procedure. In this particular embodiment, a medical profession can, using base portion **410**, manipulate insertable portion **420** in the patient's body to perform a medical procedure. In various embodiments, a medical professional can control insertable portion **420** using voice commands, auxiliary input commands, automated commands, and/or manually.

In this example, insertable portion **420** includes a flexible portion **430** and an automated head unit **440**. In this particular embodiment, one end of each guidewire **434** is connected to one end of automated head unit **440**, while the other end of each guidewire **434** is connected to one of pulleys **432**. Although pulleys and guide wires are used to manipulate automated head unit **440**, any other appropriate control mechanism may be used without departing from the scope of the present disclosure. In this example, control system **435** operates to create tension in guide wires **434**. The tension in guidewires **434** operates to exert a force on automated head unit **440**, which causes automated head unit **440** to move in a corresponding manner. For example, control system **435** may operate to apply tension to one or more guidewires **434** creating a force in the x-plane, which causes automated head unit **440** to move in the x-plane. Any suitable movement of automated head unit **440** in the x-y plane tends to impart a corresponding movement to flexible portion **430** in the x-y plane.

In this example, four guide wires **434** are used to manipulate automated head unit **440** with two guidewires **434** connected along the x-axis and two guidewires **434** connected along the y-axis. In an alternative embodiment, six or more guidewires **434** may be positioned around the periphery of the insertable portion **420**, which can allow a medical professional more precise control of medical device **400**. In some cases, the movement of automated head unit **440** may be controlled independently of the movement of flexible portion **430**. In some embodiments, flexible portion **430** and automated head unit **440** may operate as "telescoping" tubes, where automated head unit **440** may retract into and extend from flexible portion **430** to adjust a length (L) of insertable portion **420**. Such a telescoping motion may be controlled through the positioning of pulleys **432** and guidewires **434**.

In this particular embodiment, control modules **412**, **414**, and/or **416** receive and process command signals corresponding to a desired manipulation of insertable portion **420**. Control module **412** and control module **414** are operable to control the motion of automated head unit **440** and the entire insertable portion **420** in the x-axis and y-axis, respectively. In some embodiments, control module **416** is operable to adjust the distance that automated head unit **440** moves relative to flexible portion **430**. In those cases, control module **416** is operable to cause motor **436** to position the pulleys **432** and guidewires **434** so as to extend and retract automated head unit **440** relative to flexible portion **430**. Control module **412**

and control module **414** are operable to independently control the motion of automated head unit **440** regardless of length L, enabling insertable portion **420** to have independent motion in the x-, y-, and z-axes.

Insertable portion **420** may also include sensors **442** and a camera **444**. Although this example depicts sensors **442** as being connected to automated head unit **440**, sensors may be connected to any portion of medical device **400** without departing from the scope of the present disclosure. Injury may occur when a medical professional accidentally or mistakenly causes insertable portion **420** to contact tissue associated with the patient, which can cause bruising or damage to the tissue. Sensors **442** can comprise any device capable of providing data and/or a signal to a medical professional. Sensors **442** may be capable of generating and transmitting, for example, positioning information associated with insertable portion **420**, physiological information associated with the patient, control signals, a signal indicating the presence or absence of blood, or any other data. In one particular embodiment, sensors **442** are capable of generating and transmitting data associated with insertable portion's **420** proximity to tissue of the patient.

In other embodiments, sensors **442** may be capable of detecting a collision with tissue. In those cases, sensors **442** are capable of generating and transmitting a feedback signal to control modules **412**, **414**, **416**, a host coupled to medical device **400**, or a system controller coupled to medical device **400**. For example, sensors **442** may communicate data indicating that wall tissue of a patient's orifice has been encountered and that device **400** may need to be directed away from that wall to prevent injury to the patient's tissue. In some embodiments, sensors **442** operate to generate alarms associated with medical device **400**. For example, one or more sensors **442** may monitor the presence of blood in the orifice, so that the medical professional may be alerted to unexpected or excessive bleeding.

In operation, medical device **400** may be inserted into the patient by inserting insertable portion **420** into the appropriate orifice or incision. In some embodiments, a medical professional can insert medical device **400** into the patient. In other embodiments, the insertion of medical device **400** into the patient may be performed using a medical device control system implementing a manipulator, such as system **100** and manipulator **40** of FIG. **1** or system **300** and manipulator **240** of FIG. **2**.

In this particular embodiment, medical device **400** is capable of being manipulated in at least three axes of motion. That is, medical device **400** is capable of being manipulate in the x-axis, y-axis, and z-axis. In other embodiments, medical device **400** is capable of being manipulated in at least two axes of motion. In some embodiments, medical device **400** may be capable of manipulating insertable portion **420** one axis at a time. In other embodiments, medical device **400** may be capable of manipulating insertable portion **420** one axis at a time and manipulating insertable portion **420** along multiple axes substantially simultaneously. In this example, medical device **400** is capable of manipulating insertable portion **420** along multiple axes substantially simultaneously. As used throughout this document, the phrase "substantially simultaneously" refers to the manipulation of insertable portion **420** and/or automated head unit **440** in multiple axes in response to an input command before responding to a subsequent input command. For example, medical device **400** can manipulate insertable portion **420** along the z-axis and, during that manipulation, medical device **400** can also manipulate insertable portion **420** along the x-axis. In various embodiments,

medical device **400** can manipulate automated head unit **440** independently of the movement of flexible portion **430**.

FIG. **4** is a block diagram illustrating a flow of command signals from a medical professional to a medical device in a medical device control system **500**. In various embodiments, medical device control system **500** can be substantially similar to control system **100** of FIG. **1** or control system **300** of FIG. **2**. In this example, a communication device **550** receives a voice command **502** from a medical professional. In various embodiments, the structure and function of communication device **550** can be substantially similar to the structure and function of communication device **50** of FIG. **1**. Communication device **550** operates to convert voice command **502** into an electrical voice command signal **504** and to communicate electrical voice command signal **504** to a system controller **590**. In various embodiments, the structure and function of system controller **590** can be substantially similar to the structure and function of system controller **90** of FIG. **1**.

In this particular embodiment, system controller **590** comprises a voice recognition module **592** capable of at least partially contributing to one or more functions of system controller **590**. That is, voice control module **592** is not required to be capable of performing the desired functionality of system controller **590** alone, but may contribute to the performance of the function as part of a larger routine. In this example, voice recognition module **592** at least partially contributes to the conversion of voice command signal **504** to a control signal **506**. Voice recognition module **592** may include any hardware, software, firmware, or any combination thereof that is capable of converting voice command signal **504** into control signal **506**.

System controller **590** also includes a command generator module **594** capable of at least partially contributing to one or more functions of system controller **590**. In this example, command generator module **594** operates to receive control signal **506** communicated from voice recognition module **592** and at least partially contributes to the conversion of control signal **506** into a command signal **508**. Command generator module **594** may comprise any hardware, software, firmware, or any combination thereof that is capable of converting control signal **506** into command signal **508**. In this example, command generator module **594** communicates command signal **508** to a signal generator module **596** capable of at least partially contributing to one or more functions of system controller **590**. In this example, signal generator module **596** at least partially contributes to the conversion of command signal **508** into an actuation signal **510**. Signal generator module **596** may comprise any hardware, software, firmware, or any combination thereof that is capable of converting command signal **508** into actuation signal **510**.

In this example, system controller **590** communicates actuation signal **510** to a device control module **560** capable of manipulating a medical device **570**. In various embodiments, the structure and function of device control module **560** can be substantially similar to the structure and function of actuation unit **20** of FIG. **1** or base portion **410** of FIG. **3**. In various embodiments, the structure and function of medical device **570** can also be substantially similar to the structure and function of medical device **10** of FIG. **1** or medical device **400** of FIG. **3**.

In various embodiments, device control module **560** may be capable of generating a feedback signal **512** and communicating feedback signal **512** to system controller **590**. Feedback signal **512** may comprise, for example, positioning data associated with medical device **570**, a video feed, a physiological parameter associated with a patient, or any other information associated with medical device **570**, device con-

trol module **560**, and/or a patient undergoing a medical procedure. In some embodiments, medical device **570** can communicate data **514** to system controller **590**. Data **514** may comprise, for example, positioning data, one or more physiological parameters associated with a patient, a live video feed associated with a camera coupled to medical device **570**, or any other data capable of being collected by medical device **570**.

In various embodiments, system controller **590** may be capable of generating commands on its own based at least in part on data **514** and/or feedback signal **512** communicated from medical device **570** and/or device control module **560**. For example, if medical device **570** comprises a scope with blood sensors, system controller **590** may stop the movement of the scope within a patient's body if data **514** is received from medical device **570** indicating that the patient is bleeding excessively.

In this example, system **500** also includes a display device **580** capable of displaying data associated with medical device **570** and/or a patient. The structure and functional of display device **580** can be substantially similar to the structure and function of display device **60** or GUI **72** of FIG. **1**. Although system **500** includes a single display device in this example, any other number of display devices may be used without departing from the scope of the present disclosure. In some embodiments, system controller **590** can communicate an output signal **516** containing data associated with medical device **570** and/or a patient to display device **580**.

In some embodiments, system **500** may also include an audio output device **587** capable of communicating data associated with medical device **570** and/or a patient. Audio output device **587** can comprise any device capable of providing an audio output signal, such as a speaker, headphones, an audio alarm device, or any other suitable audio output device. Although system **500** includes a single audio output device in this example, any other number of audio output devices may be used without departing from the scope of the present disclosure. In some embodiments, system controller **590** may communicate an audio output signal **516** to output device **587** so that the medical professional may receive the data associated with output signal **516** in audio format.

Although, in most cases, voice command **502** represents the primary control input into system **500**, system **500** also includes an auxiliary input device **585** capable of generating a control signal **518**. Control signal **518** can comprise data that is substantially similar to data contained within control signal **506**. In various embodiments, the structure and function of auxiliary input device **585** can be substantially similar to the structure and function of auxiliary input devices **165** or **180** of FIG. **2**. Although system **500** includes a single auxiliary input device in this example, any other number of auxiliary input devices may be used without departing from the scope of the present disclosure. In this particular embodiment, auxiliary input device **585** is coupled directly to command generator **594**. In some embodiments, auxiliary input device **585** may also receive data signals **520** from system controller **590**. For example, in a case where auxiliary input device **585** comprises a "force-feedback" joystick, signals **520** may comprise the feedback signal representing the force being exerted on medical device **570** by the patient's body.

FIG. **5** is a flow chart illustrating an exemplary method **600** for processing a voice control signal and/or a command signal received by a medical device control system. In, one particular embodiment, voice control signals and/or command signals are received from system **100** of FIG. **1**. Although system **100** is used in this example, any other system, such as systems

300 and 500 of FIGS. 2 and 4, respectively, may be used without departing from the scope of the present disclosure.

In this example, method 600 begins at step 602 where communication device 50 receives a voice command from a medical professional. Communication device 50 operates to convert the voice command into voice command signal 57 and communicates voice command signal 57 to host 70. In this particular example, host 70 includes a voice recognition module that processes voice command signal 57 at step 604 by converting voice command signal 57 into a control signal. In various embodiments, the structure and function of the voice recognition module can be substantially, similar to voice recognition module 592 of FIG. 4. In this example, the voice recognition module further operates to identify the specific voice command represented by the control signal at step 606. In some embodiments, identifying the specific voice command may be accomplished by comparing the received control signal with a list of pre-programmed commands stored in a memory device associated with host 70.

The voice recognition module validates the control signal at step 608. If the voice command is not recognized as a pre-programmed command, the invalid voice command is ignored and the method loops back to step 602. If the voice command is valid, the voice recognition module communicates the control signal to a command generator. In this example, the command generator operates to convert the control signal into a command signal representing the voice command at step 610. In various embodiments, the structure and function of the command generator can be substantially similar to the structure and function of command generator module 594 of FIG. 4.

In an alternate embodiment, auxiliary control signals capable of manipulating a medical device may be generated by an auxiliary input device at step 616. In various embodiments, the auxiliary input device may comprise, for example, auxiliary input devices 165 and/or 180 of FIG. 2. The auxiliary input device communicates the auxiliary control signal to the command generator, which converts the auxiliary control signal into a command signal at step 610. The command generator also operates to communicate the command signal to a signal generator.

In this example, the signal generator operates to convert the command signal into an actuation signal 47 representing the voice command of the medical professional at step 612. In various embodiments, the structure and function of the signal generator can be substantially similar to the structure and function of signal generator module 596 of FIG. 4. In this example, manipulator 40 and/or medical device 10 operates to receive and execute actuation signal 47 at step 614.

Medical devices, such as a scope, that are adapted to be inserted into the patient's body typically permit the introduction of a waveguide structure or other wired device through the patient's orifice. The waveguide structure can comprise, for example, an optical fiber, a hollow tube waveguide, an air core waveguide, a planar waveguide, or a combination of these or other devices. Examples of such additional devices include, for example, surgical knives, sample collectors, and/or cauterizing heads. In some cases, inserting a waveguide structure may enable, for example, the early detection of cancerous cells and may contribute to the removal of the cancerous cells. In various embodiments, the waveguide structure may communicate an optical signal wavelength of 1.7 microns or more.

In some embodiments, a waveguide structure may be implemented in a medical device that uses an optical signal wavelength in the mid-infrared (mid-IR) wavelength range to perform surgery and/or spectroscopy on a patient. In various

embodiments, a wavelength in the mid-IR range comprises a wavelength between approximately two (2) microns and approximately ten (10) microns. In other embodiments, a wavelength in the mid-IR range comprises a wavelength between approximately five (5) and seven (7) microns. For light-based surgery and spectroscopy, it can be particularly advantageous to use an optical signal wavelength in the range between approximately 5 microns to approximately 7 microns to minimize tissue damage or collateral damage. In a particular embodiment, an optical signal having a wavelength of approximately 6.45 microns may be advantageously used for light-based surgery and/or spectroscopy.

In some embodiments, a Raman wavelength shifter coupled to a pump laser is capable of generating an optical signal wavelength in the mid-IR range. As used in this document, the phrase "Raman wavelength shifter" refers to any device that uses the Raman effect to shift a shorter optical signal wavelength to a longer optical signal wavelength. The Raman wavelength shifters may comprise, for example, one or more reflectors, one or more gratings, an optical fiber, or a combination of these or other elements. In various embodiments, the Raman wavelength shifter may comprise, for example, a chalcogenide glass fiber that is capable of shifting the shorter pump laser wavelength to a longer wavelength, such as a wavelength in the mid-IR region. The chalcogenide fiber may comprise, for example, a ZBLAN fiber, a sulphide fiber, a selenides fiber, or a telluride fiber, or a combination of these or other fiber types.

In other embodiments, a first wavelength shifter coupled to a pump laser may be capable of shifting an optical signal wavelength to approximately 2 microns. The first wavelength shifter may comprise, for example, a fused silica optical fiber capable of shifting the shorter pump laser wavelength to approximately two (2) microns. In that example, a second Raman wavelength shifter is coupled to the first Raman wavelength shifter and is capable of shifting the two (2) micron signal to a wavelength in the five (5) to seven (7) micron range. In that example, the second Raman wavelength shifter comprises a chalcogenide glass fiber.

FIG. 6A compares a surgical incision made using a 2.94 micron optical signal wavelength to a surgical incision made using a 6.45 micron optical signal wavelength. This figure illustrates that tissue damage, such as denatured tissue, can result when a medical device implements a 2.94 micron optical signal wavelength. This tissue damage tends to result from the protein temperatures in the tissue do not uniformly exceed the water temperature in the aqueous components of the tissue.

Compared to the incision performed using the 2.94 micron optical signal wavelength, the incision made using the 6.45 micron optical signal has little or no denatured tissue. This reduction in collateral tissue damage is based at least in part on the tissue's ability to absorb differential energy. For example, when using an optical signal wavelength at approximately 6.45 microns to create an incision, the protein temperatures in the tissue uniformly exceed the water temperature in the tissue and the protein begins to transform into brittle denatured protein. The brittle fracture of the proteins at the onset of explosive vaporization leads to the confinement of collateral damage. Therefore, the use of a 6.45 micron optical signal wavelength as a tissue cutting implement may minimize collateral tissue damage during laser-based surgery. By using an optical signal wavelength of 6.45 microns with a medical scope-type device, "clean" surgery may be performed for many medical procedures, such as removing

cancerous polyps. Similar results can be obtained using an optical signal wavelength in the five (5) to seven (7) micron range.

FIG. 6B illustrates example evanescent spectra in different cell-type regions (using a mouse as the biological sample). This figure illustrates that cancerous cells tend to show a distinct reduction **700** in transmission at an optical signal wavelength of approximately 6.1 microns. Medical professionals can exploit this spectral signature in various medical procedures, such as a procedure for the early detection of cancer. Thus, an optical signal wavelength in the mid-IR range may be used to perform a medical procedure for the early detection of tissue abnormalities such as cancer cells. In other embodiments, an optical signal wavelength in the mid-IR range can be used in a diagnostic procedure, such as spectroscopy. Diagnostic techniques capable of using the mid-IR optical signal wavelength include, for example, transmission, reflection, fluorescence, and near field microscopy. Although specific examples of spectroscopy are discussed, any other appropriate form of spectroscopy may be used without departing from the scope of this disclosure.

To improve the signal-to-noise ratio of a spectroscopic measurement such as in FIG. 6B, several methodologies may be used. First, a differential measurement may be taken between a known cancer-free area and the suspect area, for example, differential spectroscopy rather than absolute spectroscopy. In addition, measurements may be taken at several wavelengths and compared to each other. For example, measuring the differential transmission of the tissue at two or more wavelengths, such as 5 microns and 6.1 microns, may improve the signal-to-noise ratio of the cancer cell signature.

FIG. 7 illustrates example attenuation characteristics of several optical fibers based on wavelength. This example shows that fused silica (SiO₂) fibers become lossy above approximately 2 microns in wavelength, while mid-IR optical fibers remain relatively loss-less above 2 microns. A mid-IR fiber may comprise any optical fiber capable of at least partially transmitting for at least a portion of the mid-IR range. For example, a mid-IR fiber may comprise a chalcogenide fiber, such as a Sulfide fiber, a Selenide fiber, or a Telluride fiber. Therefore, in some cases, a pump source coupled to a medical device, such as medical device **400** of FIG. 3, may comprise a high powered pump source coupled to a Raman wavelength shifter comprising a mid-IR fiber. In a particular embodiment, such a pump source may operate in a pulsed mode or in a continuous wave mode. The power levels required depend on the particular application. For example, spectroscopy may require a relatively low power level, while surgery may require a relatively high power level.

Conventional surgical devices capable of using a 5.0 to 6.5 micron optical signal wavelength typically implement a Free Electron Laser (FEL) pump source. However, a FEL pump source is a large and very expensive facility that tends to be impractical for surgical applications. Unlike conventional surgical devices, a medical device, such as device **400** of FIG. 3, can include a pump laser coupled to one or more Raman wavelength shifters capable of shifting a shorter signal wavelength to a longer signal wavelength. In that example, at least a portion of the Raman wavelength shifter can be implemented in a waveguide structure. In various embodiments, the longer signal wavelength can comprise, for example, an optical signal wavelength in the mid-IR wavelength range. Coupling a pump laser to one or more Raman wavelength shifters can result in a commercially and economically viable optical cutting implement for use in a medical device. In addition, coupling a pump laser to one or more Raman wavelength

shifters can result in a significantly smaller footprint area than a FEL pump source and can significantly reduce the cost.

Conventional wavelength shifters or oscillators are typically implemented in fused silica fiber. The loss associated with fused silica fiber tends to increase rapidly for optical signal wavelengths greater than about 2 or 2.3 microns. Unlike conventional wavelength shifters, a medical device, such as device **400** of FIG. 3, can include a Raman wavelength shifter or oscillator that is capable of transmitting in the mid-IR wavelength range, such as chalcogenide optical fibers.

FIGS. 8A through 8D are block diagrams illustrating example embodiments of Raman wavelength shifters and/or Raman oscillators capable of shifting a shorter pump signal wavelength to a longer output signal wavelength. Although particular examples of wavelength shifters are described in FIGS. 8A through 8D, any other Raman wavelength shifter can be implemented without departing from the scope of the present disclosure.

FIG. 8A is a block diagram illustrating one example of a Raman wavelength shifter **800** capable of shifting a shorter pump signal **810** wavelength to a longer output signal wavelength **812**. In this example, Raman wavelength shifter **800** operates to generate an optical signal wavelength **812** of 1.7 microns or more. In various embodiments, Raman wavelength shifter **800** can operate to generate an optical signal wavelength **812** in the mid-IR wavelength range. In other embodiments, Raman wavelength shifter **800** can operate to generate an optical signal wavelength **812** a wavelength in the five (5) to seven (7) micron range. In various embodiments, pump signal **810** can comprise, for example, a 1310 nanometer (nm) wavelength, 1390 nm wavelength, 1510 nm wavelength, or other optical signal wavelength.

Raman wavelength shifter includes a gain fiber **804** operable to facilitate shifting pump signal **810** to a desired wavelength. Gain fiber **804** may comprise any waveguide structure capable of wavelength shifting pump signal **810** to a longer wavelength or a different Raman cascade order. In this particular embodiment, gain fiber **804** comprises an optical fiber. The optical fiber used as gain fiber **804** may comprise, for example, a dispersion compensating fiber, a dispersion shifter fiber, a single mode fiber, a chalcogenide fiber, a fused silica optical fiber, or a combination of these or other fiber types. Raman wavelength shifter **800** also includes a broadband reflector **802** operable to substantially reflect all optical signal wavelengths contained within Raman wavelength shifter **800** and a pump signal coupler **806**. Reflector **802** may comprise any device capable of reflecting a wide range of wavelength signals, such as a mirror. Pump signal coupler **806** may comprise any device capable of coupling pump signal **810** to Raman wavelength shifter **800**, such as a wavelength division multiplexer or a power coupler.

In this example, Raman wavelength shifter **800** further includes a wavelength separator **808** capable of transmitting at least a portion of the desired wavelength from Raman wavelength shifter **800**. In addition, wavelength separator **808** operates to at least partially reflect a desired wavelength to gain medium **804** to continue lasing at the desired wavelength or wavelengths. In this particular embodiment, a cavity is formed between reflector **802** and wavelength separator **808**. Separator **808** could comprise, for example, a demultiplexer, one or more partially transmissive gratings, one or more partially transmitting mirrors, one or more Fabry Perot filters, one or more dielectric gratings, or any combination of these or other devices.

FIG. 8B is a block diagram illustrating one example of a Raman wavelength shifter **820** capable of shifting a shorter

pump signal **830** wavelength to a longer output signal wavelength **832**. In this example, Raman wavelength shifter **820** operates to generate an optical signal wavelength **832** of 1.7 microns or more. In various embodiments, Raman wavelength shifter **820** operates to generate an optical signal wavelength **832** in the mid-IR wavelength range. In other embodiments, Raman wavelength shifter **820** operates to generate an optical signal wavelength **832** a wavelength in the five (5) to seven (7) micron range. In various embodiments, pump signal **830** can comprise, for example, a 1310 nanometer (nm) wavelength, 1390 nm wavelength, 1510 nm wavelength, or other optical signal wavelength.

In this example, Raman wavelength shifter **820** includes a reflector **822**, a gain fiber **824**, a pump input coupler **826**, and a wavelength separator **828**. In various embodiments, the structure and function of reflector **822**, gain fiber **824**, coupler **826**, and separator **828** can be substantially similar to reflector **802**, gain fiber **804**, coupler **806**, and separator **808** of FIG. **8A**, respectively. In this particular embodiment, at least a portion of gain fiber **824** can comprise a chalcogenide fiber.

Raman wavelength shifter **820** may also include at least a first selecting element **825a** and a second selecting element **825b**. Although this example may also include two selecting elements **825a** and **825b**, any number of selecting elements can be used without departing from the scope of the present disclosure. Selecting elements **825a** and **825b** can comprise any device, such as a dielectric grating or one or more Fabry Perot filters. Each selecting element operates to transmit a portion of a desired wavelength to be output from Raman wavelength shifter **820**. In addition, each selecting element **825a** and **825b** operates to at least partially reflect a desired wavelength to gain medium **824** to allow wavelength shifter **820** to continue lasing at the desired wavelength or wavelengths. In this particular embodiment, an optical cavity is formed between reflector **822** and selecting element **825a** and/or selecting element **825b**.

FIG. **8C** is a block diagram illustrating one example of a Raman wavelength shifter **840** capable of shifting a shorter pump signal **850** wavelength to a longer output signal wavelength **852**. In this example, Raman wavelength shifter **840** operates to generate an optical signal wavelength **852** of 1.7 microns or more. In various embodiments, Raman wavelength shifter **840** operates to generate an optical signal wavelength **852** in the mid-IR wavelength range. In other embodiments, Raman wavelength shifter **840** operates to generate an optical signal wavelength **852** a wavelength in the five (5) to seven (7) micron range. In various embodiments, pump signal **850** can comprise, for example, a 980 nanometer (nm) wavelength, a 1060 nm wavelength, a 1310 nm wavelength, a 1390 nm wavelength, a 1510 nm wavelength, or other optical signal wavelength.

In this example, Raman wavelength shifter **840** includes a gain fiber **844**, a pump input coupler **846**, and selecting elements **845**. In various embodiments, the structure and function of gain fiber **844**, coupler **826**, selecting elements **845**, and output coupler **848** can be substantially similar to gain fiber **824**, coupler **826**, selecting elements **825**, and coupler **828** of FIG. **8B**, respectively. In this particular embodiment, at least a portion of gain fiber **824** can comprise a chalcogenide fiber.

The example illustrated in FIG. **8C** differs from the example illustrated in FIG. **8B** in that wavelength shifter **840** implements a plurality of reflective gratings **847a-847n** each centered on a different wavelength of a reflection band. Although this example includes three gratings, any number of gratings can be used without departing from the scope of the present disclosure. Gratings **847a-847n** can comprise any

device, such as a high-reflectivity dielectric grating. In this particular example, each grating **847a-847n** comprises a grating with a reflectivity between ninety-five (95) to one hundred (100) percent at the center wavelength. Gratings **847a-847n** operate to facilitate cascading of pump signal **850** to a desired output wavelength. In this particular embodiment, an optical cavity is formed between selecting elements **845** are gratings **847**.

FIG. **8D** is a block diagram illustrating one example of a Raman wavelength shifter **860** capable of shifting a shorter pump signal **870** wavelength to a longer output signal wavelength **872**. In this example, Raman wavelength shifter **860** operates to generate an optical signal wavelength **872** of 1.7 microns or more. In various embodiments, Raman wavelength shifter **860** operates to generate an optical signal wavelength **872** in the mid-IR wavelength range. In other embodiments, Raman wavelength shifter **860** operates to generate an optical signal wavelength **872** a wavelength in the five (5) to seven (7) micron range. In various embodiments, pump signal **870** can comprise, for example, a 980 nm wavelength, a 1060 nm wavelength, a 1310 nm wavelength, a 1390 nm wavelength, a 1510 nm wavelength, or other optical signal wavelength.

In this example, Raman wavelength shifter **860** includes a gain fiber **864**, a pump input coupler **866**, selecting elements **864**, reflective gratings **867**, and an output coupler **868**. In various embodiments, the structure and function of gain fiber **864**, input coupler **866**, elements **864**, gratings **867**, and output coupler **868** can be substantially similar to gain fiber **844**, coupler **846**, elements **845**, gratings **847**, and coupler **848** of FIG. **8C**, respectively. Although example elements are illustrated, Raman wavelength shifter **860** may include some, none, or all of these elements. For example, in some embodiments, pump input coupler **866** and/or output coupler **868** may be optional.

The example illustrated in FIG. **8D** differs from the example illustrated in FIG. **8C** in that wavelength shifter **860** implements a Q-switcher **863** capable of transitioning from a reflective state to a transmissive state. Q-switcher **863** can comprise a device or combination of devices having a variable loss. For example, Q-switcher may comprise one or more moving mirrors, electro-optic switches, saturable absorbers, or a combination of these or other optical devices. In some cases, Q-switcher **863** can initially operate as a reflective mirror so that optical signal energy may build-up within the laser cavity. After the laser cavity contains a sufficient amount of optical energy, Q-switcher **863** can operate to substantially transmit the desired optical signal wavelength in the form of a relatively large pulse or burst. In various embodiments, Q-switcher **863** may be capable of providing an output signal having a pulse width in the range of two (2) nanoseconds to one hundred (100) milliseconds. In other embodiments, Q-switcher **863** may be capable of providing an output signal having a pulse repetition rate in the range of two (2) hertz to one hundred (100) megahertz.

FIGS. **9A** through **9C** are block diagrams illustrating example embodiments of pump sources that are capable of generating a pump signal for use in a Raman wavelength shifter. Although particular examples of pump sources are described in FIGS. **9A** through **9C**, any other pump source can be implemented without departing from the scope of the present disclosure.

FIG. **9A** is a block diagram illustrating one example embodiment of a pump source **900** capable of being coupled to a Raman wavelength shifter and/or a Raman oscillator. Pump source **900** can comprise any device capable of generating an optical signal at a desired wavelength and power. For

example, pump source **900** can comprise a solid state laser, such as Nd:YAG or Nd:YLF laser, a semiconductor laser, a laser diode, a cladding pump fiber laser, or any combination of these or other light sources. In this example, pump source **900** comprises a high powered laser **902** coupled to a Raman oscillator or a Raman wavelength shifter, such as Raman wavelength shifters **800**, **820**, **840**, or **860** of FIGS. **8A** through **8D**.

FIG. **9B** is a block diagram illustrating one example embodiment of a pump source **920** capable of being coupled to a Raman wavelength shifter and/or a Raman oscillator. In this example, pump source **920** includes a pump laser **922** and an intermediate stage **924** capable of shifting the optical signal wavelength generated by pump laser **922** to a longer wavelength. The structure and function of laser **922** may be substantially similar to the structure and function of pump source **900** of FIG. **9A**. In this particular example, intermediate stage **924** comprises a first Raman wavelength shifter **924**. In some embodiments, intermediate wavelength shifter **924** may advantageously be implemented using fused silica optical fiber.

In some embodiments, pump sources **900** and **920** may comprise a cladding-pumped fiber laser, capable of emitting a pump signal wavelength of approximately 1 micron. In those examples, pump sources **900** and **920** can be coupled to a first or auxiliary cascaded Raman oscillator or Raman wavelength shifter. In some cases, the auxiliary Raman oscillator or Raman wavelength shifter may comprise, for example, Raman wavelength shifters **800**, **820**, **840**, or **860** of FIGS. **8A** through **8D** implementing a fused silica optical fiber. Such an arrangement may be used to shift the 1 micron optical signal to approximately 2 to 2.3 microns. The 2-2.3 micron signal output from the auxiliary Raman wavelength shifter can then be shifted to a mid-IR wavelength by another cascaded Raman oscillator or Raman wavelength shifter that implements in mid-IR fiber.

FIG. **9C** is a block diagram illustrating one example embodiment of a pump source **940** capable of being coupled to a Raman wavelength shifter and/or a Raman oscillator. In this example, pump source **940** includes a pump laser **942** and a multiplexer **944** capable of combining a plurality of pump signals into a pump output signal. In this particular example, pump source **900** comprises a first laser diode **942a** and a second laser diode **942b** each centered at a desired wavelength and capable of generating pump signals **943a** and **943b**. Although this example includes two laser diodes, any number of laser diodes may be used without departing from the scope of the present disclosure. In various embodiments, laser diodes **942a** and **942b** can be centered on substantially the same wavelength, such as 980 nm, 1310 nm, 1390 nm, 14xx nm, or 1510 nm. In this particular, pump signals **943a** and **943b** are combined by multiplexer **944**. Multiplexer **944** can comprise any device capable of combining pump signals **943**, such as a wavelength division multiplexer. In various embodiments, multiplexer **944** can be capable of polarization and/or wavelength multiplexing pump signals **943a** and **943b** to form a pump output signal.

In some embodiments, a Raman wavelength shifter, such as those illustrated in FIGS. **8A** through **8D**, may be used to deliver an optical signal wavelength directly to the patient. In other embodiments, a second mid-IR waveguide structure, that at least partially transmits in at least a portion of the mid-IR wavelength range, may be coupled to the output of the Raman wavelength shifter to deliver the optical signal wavelength to the patient. Coupling a second mid-IR waveguide structure to the Raman wavelength shifter can advantageously allow the delivery waveguide structure to be disposed

after use within the patient. In addition, coupling a second mid-IR waveguide structure can substantially reduce the chance of breaking a fiber associated with a Raman wavelength shifter. Furthermore, it may be desirable to couple a tapered end or lens on the delivery fiber for improved focusing of optical signal on the patient.

In various embodiments, an optical signal wavelength is capable of being delivered to a medical device inserted into a patient using a waveguide structure having a relatively low coupling loss. In some cases, the waveguide structure maintain the coupling loss to, for example, 5 dB or less, 3 dB or less, or even less than 1 dB.

Although the present invention has been described with several embodiments, a multitude of changes, substitutions, variations, alterations, and modifications may be suggested to one skilled in the art, and it is intended that the invention encompass all such changes, substitutions, variations, alterations, and modifications as fall within the spirit and scope of the appended claims.

What is claimed is:

1. A medical diagnostic system comprising:

a software application capable of generating medical data based at least in part on input signals received directly from one or more sensors, wherein the medical data represents at least in part physiological information associated with a patient;

the software application capable of operating on a controller adapted to receive, store and process at least a portion of the physiological information, the controller having a touch-screen, one or more auxiliary input devices, circuitry for obtaining position information from a location sensor, and a wireless transceiver to transmit data over a wireless link, the wireless data comprising at least a portion of the physiological information, wherein the controller is further capable of receiving voice input signals and manually entered input signals; and

a host comprising:

a digital file for receiving and storing at least a portion of the wireless data;

control logic at the host to process at least the portion of the wireless data to generate a medical status of the patient; a memory storage device for recording the medical status; and

an output for communicating at least a portion of the medical status over a communication link to one or more display output devices, wherein the one or more display output devices are located remotely from the host.

2. The medical diagnostic system of claim 1, wherein the one or more control logic include a voice recognition software to process at least a portion of the voice input signals, and wherein the controller further comprises a voice recognition module.

3. The medical diagnostic system of claim 1, wherein at least some of the one or more sensors are adapted to be inserted into a body associated with the patient.

4. The medical diagnostic system of claim 1, wherein the controller is further capable of generating an alarm based at least in part on the information received from the one or more sensors.

5. The medical diagnostic system of claim 1, wherein the physiological information is blood pressure, heart rate, blood oxygen level, bleeding or proximity to a tissue associated with the patient.

6. The medical diagnostic system of claim 1, wherein the one or more sensors are further coupled to a camera.

7. The medical diagnostic system of claim 1, wherein the communication link is the wireless link, another wireless link, a fiber-optic line, a twisted-pair copper telephone line, or an Ethernet interface.

8. A method of processing medical data, the method comprising the steps of:

- providing a software application to a control module, the software application capable of generating medical data based at least in part on input signals received directly from one or more sensors, wherein the medical data represents at least in part a motion or change in position of one or more of the sensors associated with a patient;
- receiving at least a portion of the medical data at a medical data processing system over a communication link from the control module, wherein at least a part of the communication link is wireless;
- storing the received medical data in a digital file at the medical data processing system;
- processing the medical data in the digital file using control logic at the medical data processing system to generate a medical status of the patient;
- recording the medical status within a memory storage device of the medical data processing system; and
- transmitting at least a portion of the medical status to one or more display output devices, wherein the one or more display output devices are located remotely from the medical data processing system.

9. The method of claim 8, further comprising generating an alarm based at least in part on the medical data.

10. The method of claim 8, wherein the medical data processing system is adapted to permit access of the medical status stored on the medical data processing system from two or more different locations remote from the medical data processing system.

11. The method of claim 8, wherein the one or more sensors further provide at least in part physiological parameters associated with the patient.

12. The method of claim 8, where the one or more sensors are further coupled to a camera.

13. The method of claim 8, wherein the one or more sensors are adapted to be inserted into a body associated with the patient.

14. The method of claim 8, wherein the medical data further comprises voice input signals, and wherein the medical data processing system further comprises a voice recognition module.

15. The method of claim 11, wherein the physiological parameters are selected from the group consisting of blood

pressure, heart rate, blood oxygen level, bleeding and proximity to a tissue associated with the patient.

16. The method of claim 8, wherein at least a portion of the medical data is generated by a communication device in response to one or more commands selected from the group consisting of voice commands, auxiliary input commands, and automated commands.

17. A method of processing medical data, the method comprising:

- providing a software application to a control module, the software application capable of generating medical data based at least in part on input signals received directly from one or more sensors, wherein the medical data represents at least in part physiological parameters associated with a patient, wherein the one or more sensors further provide positioning information, and wherein the medical data further comprises voice input signals and the software application further comprises voice recognition software;
- receiving at least a portion of the medical data at a medical data processing system over a communication link from the control module, wherein at least a part of the communication link is wireless;
- storing the received medical data in a digital file at the medical data processing system;
- processing the medical data in the digital file using control logic at the medical data processing system to generate a medical status of the patient, wherein the medical data processing system further comprises a voice recognition module;
- recording the medical status within a memory storage device of the medical data processing system; and
- transmitting at least a portion of the medical status to one or more display output devices, wherein the one or more display output devices are located remotely from the medical data processing system, and wherein the medical data processing system is adapted to permit access of the medical status from two or more different locations remote from the medical data processing system.

18. The method of claim 17, wherein transmitting comprises transmitting at least the portion of the medical status to at least two different devices.

19. The method of claim 17, wherein the control module further comprises a touch-screen and one or more auxiliary input devices.

20. The method of claim 17, further comprising generating an alarm based at least in part on the medical data.

* * * * *

专利名称(译)	用于医疗设备的语音控制的系统和方法		
公开(公告)号	US8679011	公开(公告)日	2014-03-25
申请号	US13/531853	申请日	2012-06-25
[标]申请(专利权)人(译)	CHEETAH OMNI		
申请(专利权)人(译)	CHEETAH OMNI , LLC		
当前申请(专利权)人(译)	OMNI MEDSCI INC.		
[标]发明人	ISLAM MOHAMMED N		
发明人	ISLAM, MOHAMMED, N.		
IPC分类号	A61B5/00		
CPC分类号	H01S3/302 A61B5/1455 A61B5/7264 A61B5/024 A61B5/742 A61B5/0075 A61B5/021 A61B5/0022 A61B5/7445 A61B5/02042 A61B5/749 A61B5/0013 A61B5/14551 A61B1/00039 A61B5/0084 A61B5/06 A61B5/7435 A61B34/70 A61B2505/05 G06F19/00		
优先权	60/408025 2002-09-03 US		
其他公开文献	US20120296181A1		
外部链接	Espacenet USPTO		

摘要(译)

医学诊断系统和方法包括能够基于直接从一个或多个传感器接收的输入信号生成表示患者生理信息的医学数据的软件应用程序。该应用程序能够在适于接收，存储和处理生理信息的控制器上操作，并且可以包括触摸屏，一个或多个辅助输入设备，用于从位置传感器获得位置信息的电路，以及无线收发器。通过无线链路发送可包括患者生理信息的数据。控制器可以能够接收语音输入信号和手动输入的输入信号。主机可以包括用于接收和存储无线数据的数字文件，用于处理无线数据以生成患者的医疗状态的控制逻辑，以及用于记录医疗状态的存储器存储设备。

