



US 20080221930A1

(19) **United States**

(12) **Patent Application Publication**  
**Wekell et al.**

(10) **Pub. No.: US 2008/0221930 A1**

(43) **Pub. Date: Sep. 11, 2008**

(54) **HEALTH DATA COLLECTION TOOL**

**Publication Classification**

(75) Inventors: **William Wekell**, Bellevue, WA (US); **Robert Boyer Koenig**, Redmond, WA (US); **Joseph C. Basta**, Duvall, WA (US)

(51) **Int. Cl.**  
**A61B 5/00** (2006.01)  
(52) **U.S. Cl.** ..... **705/3**

(57) **ABSTRACT**

A portable health data tool permits a health care provider to assimilate and display a plurality of health care data from a patient and to associate the data with patient identifying information all stored in a memory contained in the tool. The tool includes a code reader for reading patient information into the tool from a bar code or other coded tag. The tool is associated with a plurality of different data assimilation devices stored with the tool's housing, including but not limited to, instruments for measuring, temperature, blood pressure, two-finger or lead wire ECG data, pulse oximetry data, sound data and picture data obtained from an optional digital camera integrated within the housing. The tool further includes data receiver and/or transmitter ports, which may be wireless or cable ports, for transferring data between the health data tool and a separate computer system that stores patient records.

Correspondence Address:  
**DORSEY & WHITNEY LLP**  
**INTELLECTUAL PROPERTY DEPARTMENT**  
**SUITE 3400, 1420 FIFTH AVENUE**  
**SEATTLE, WA 98101 (US)**

(73) Assignee: **Spacelabs Medical, Inc.**, Issaquah, WA (US)

(21) Appl. No.: **11/716,513**

(22) Filed: **Mar. 9, 2007**

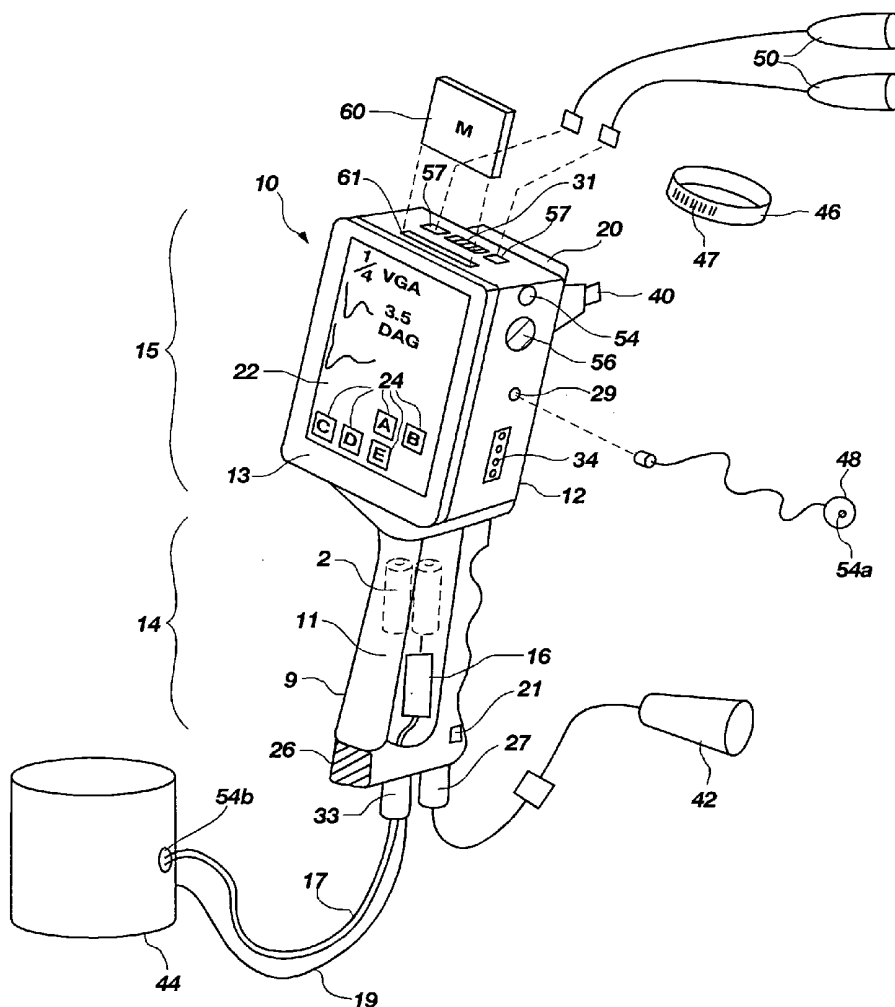

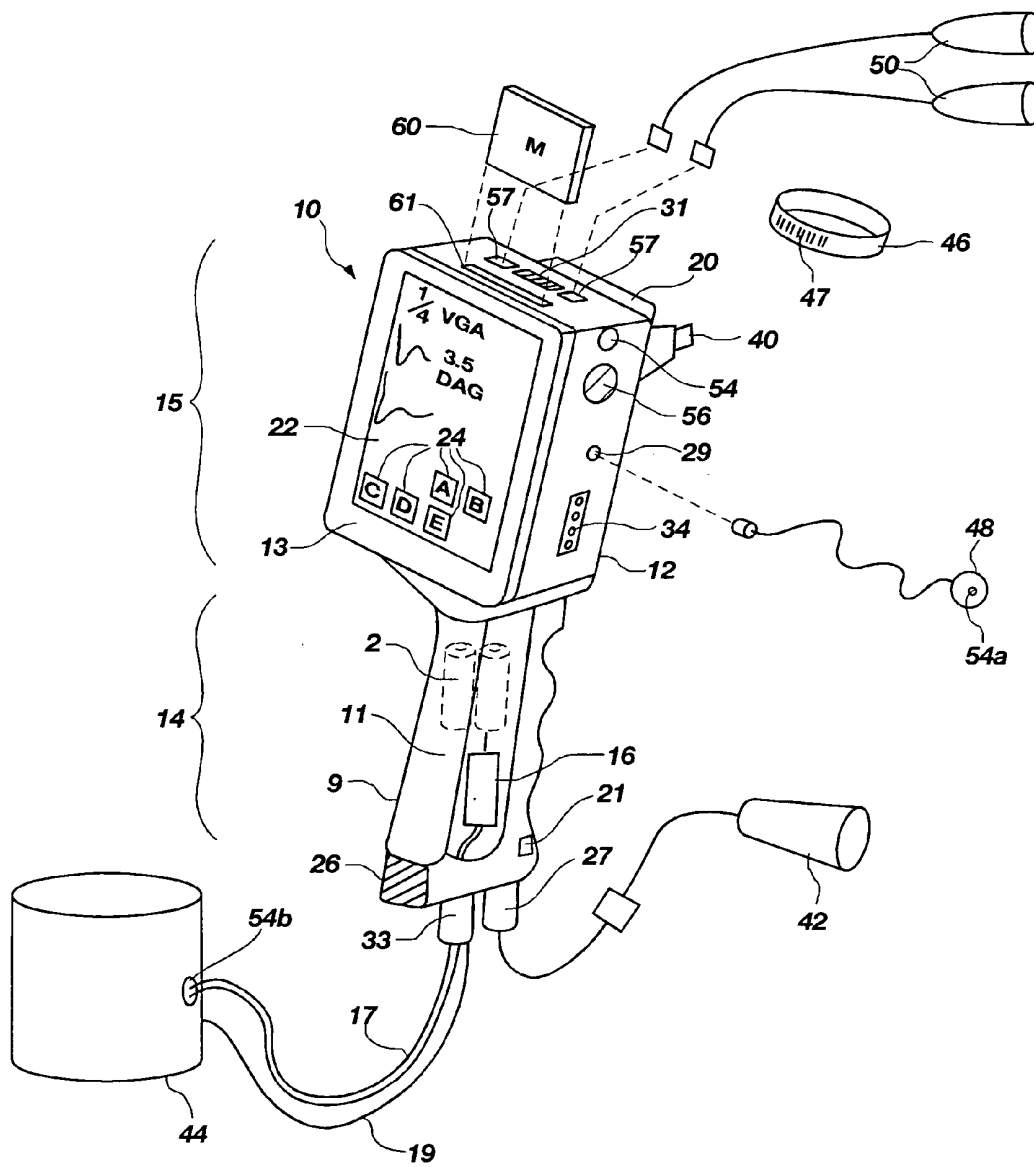

FIG. 1

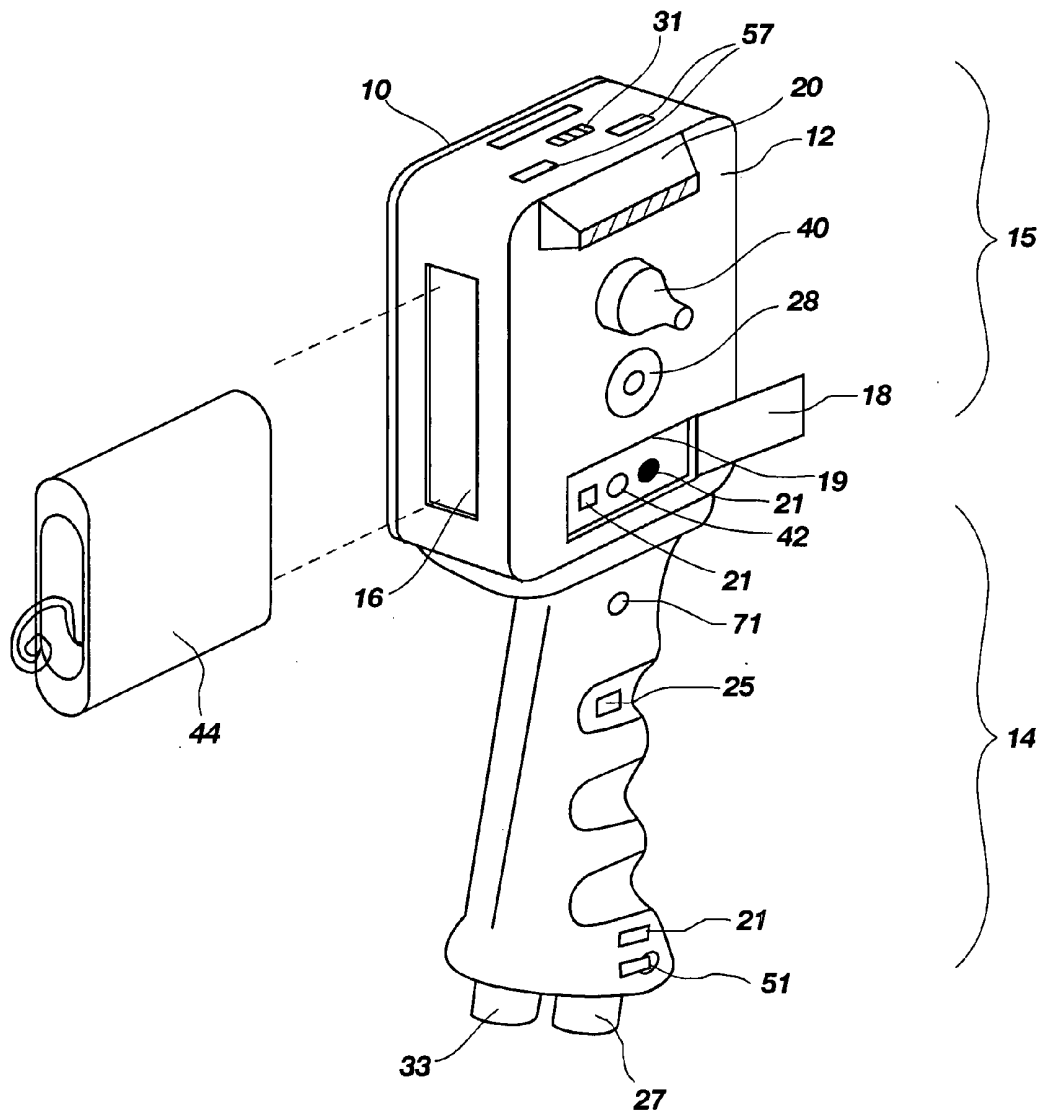
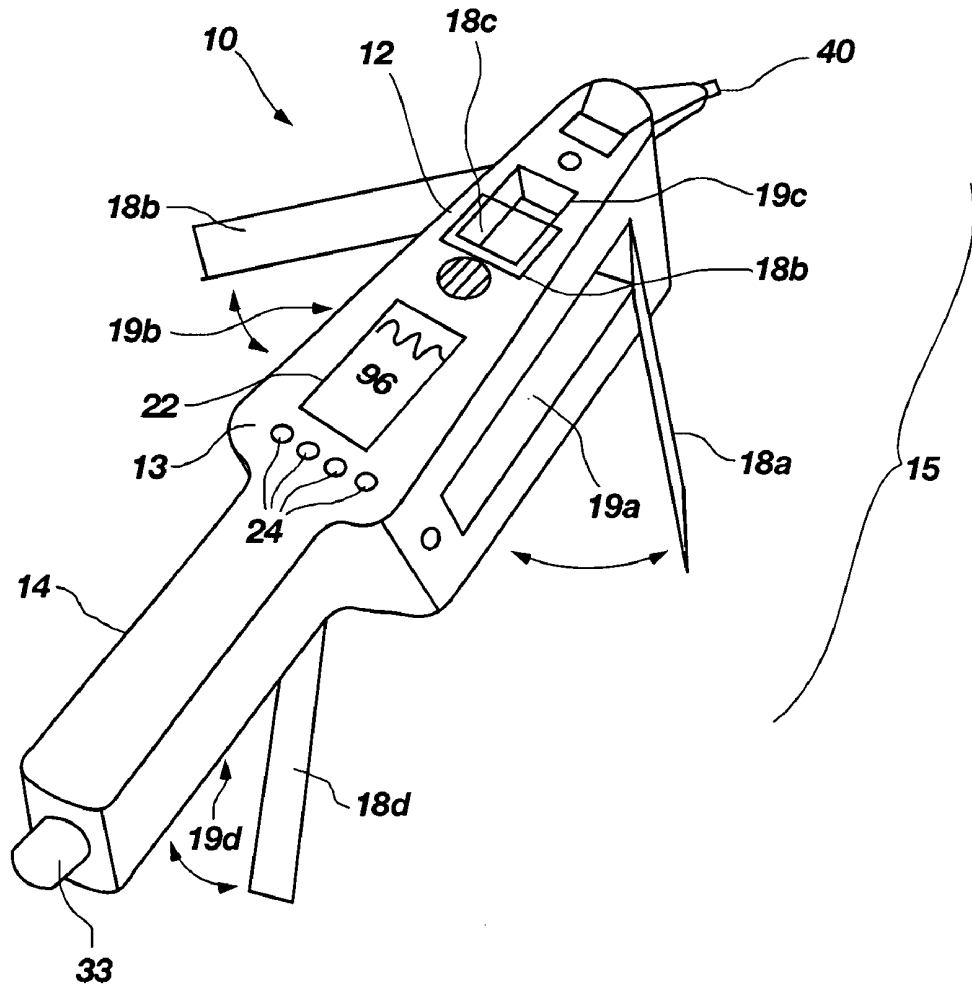
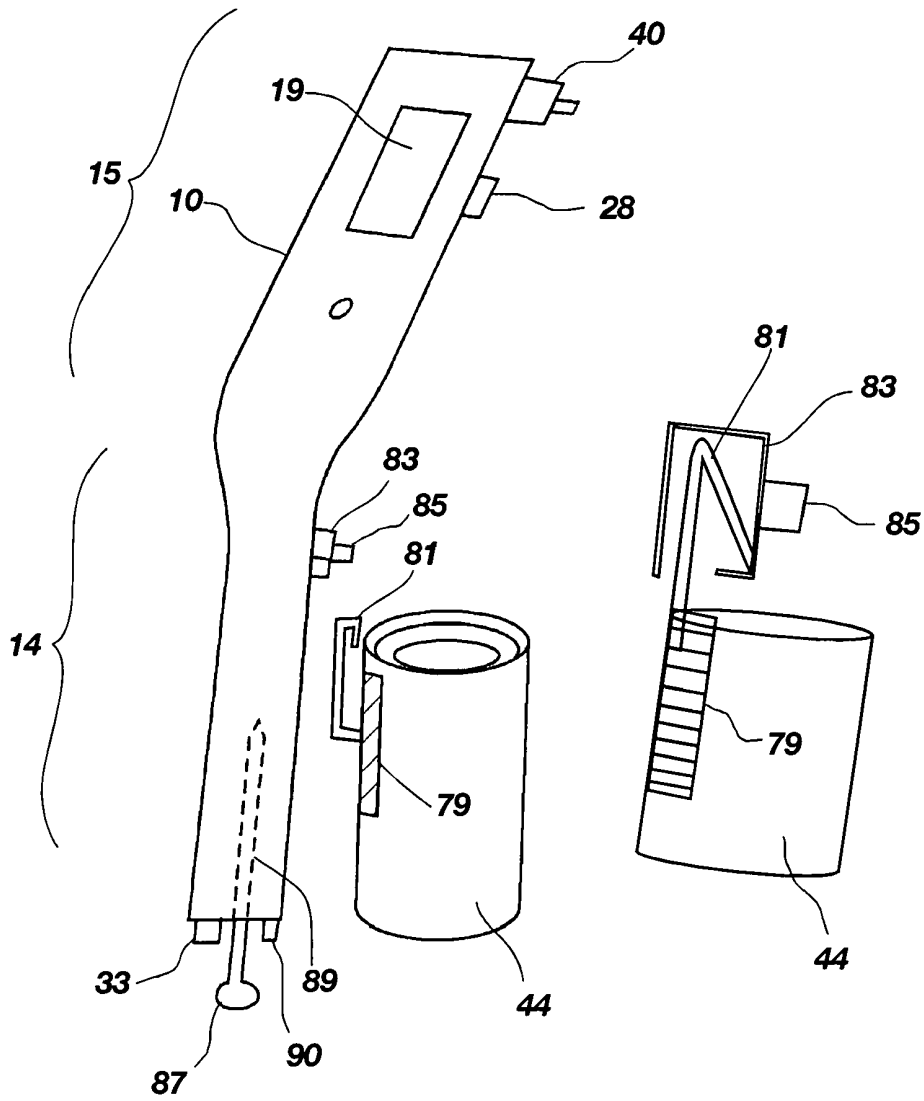

FIG. 2



**FIG. 3**



**FIG. 4**

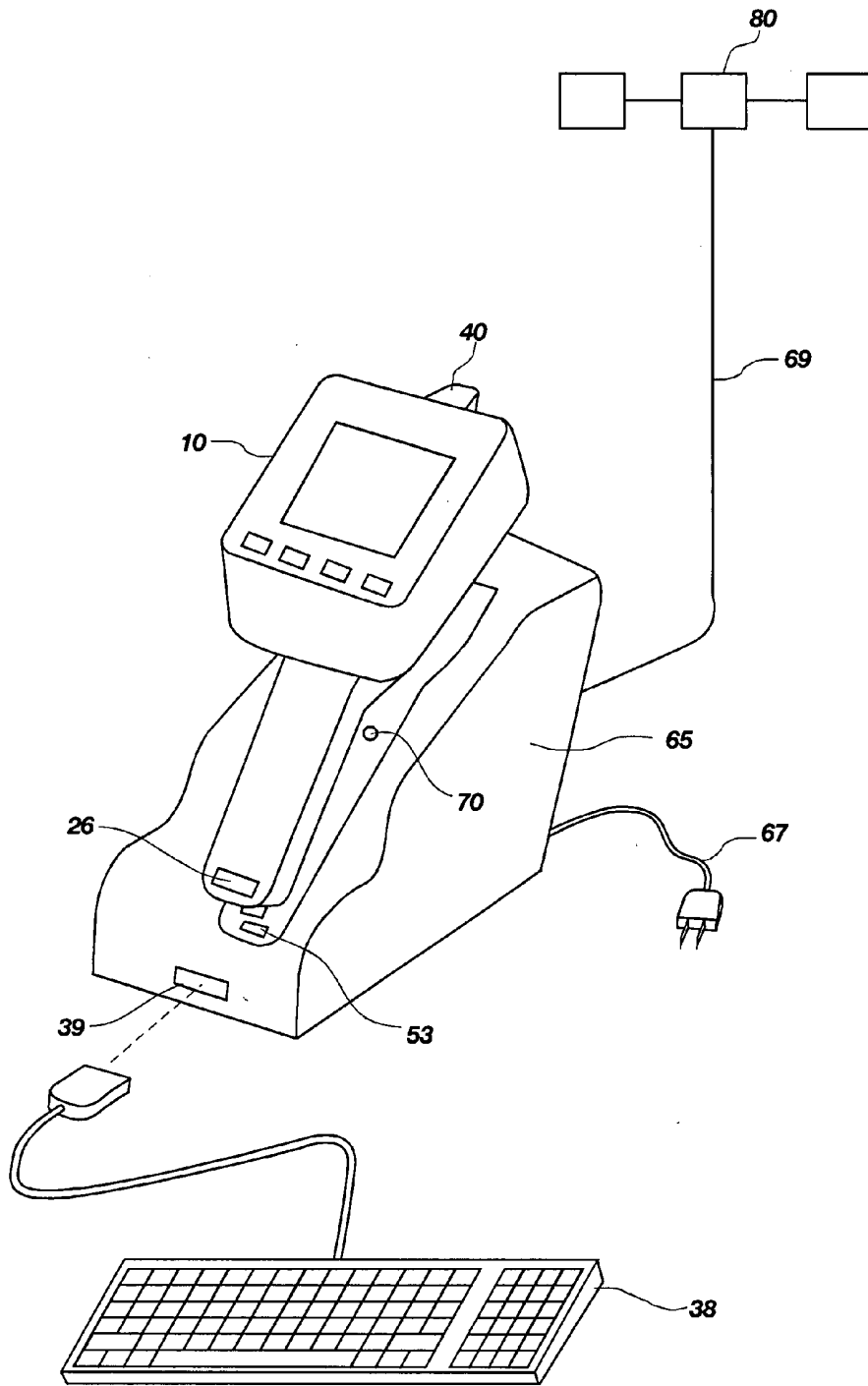
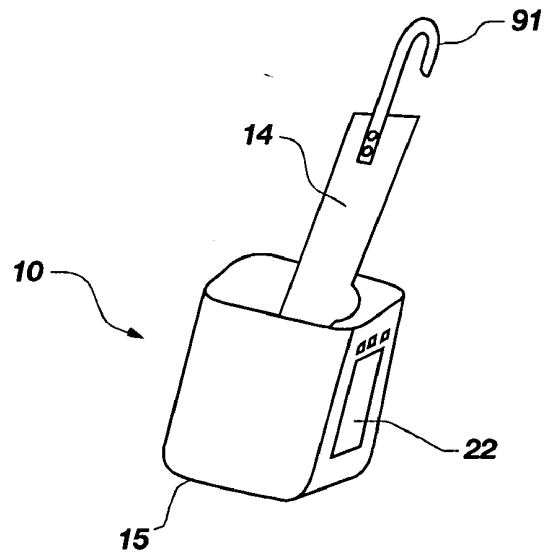
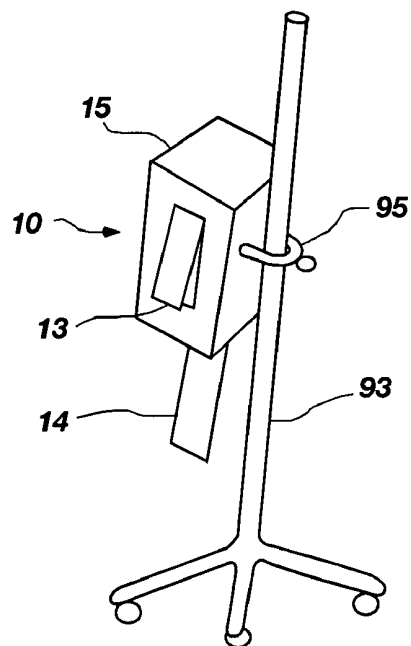

FIG 5



**FIG. 6A**



**FIG. 6B**

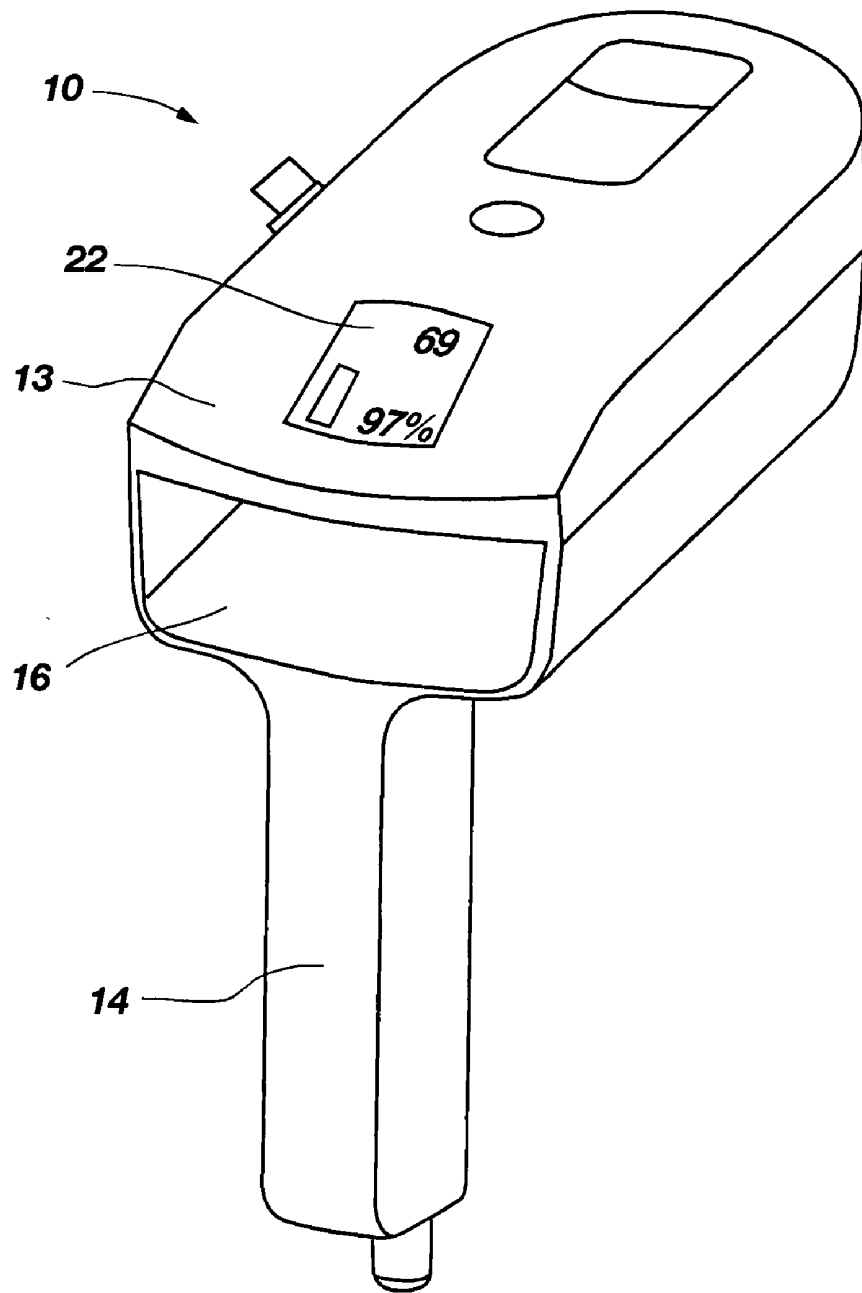

**FIG. 7**

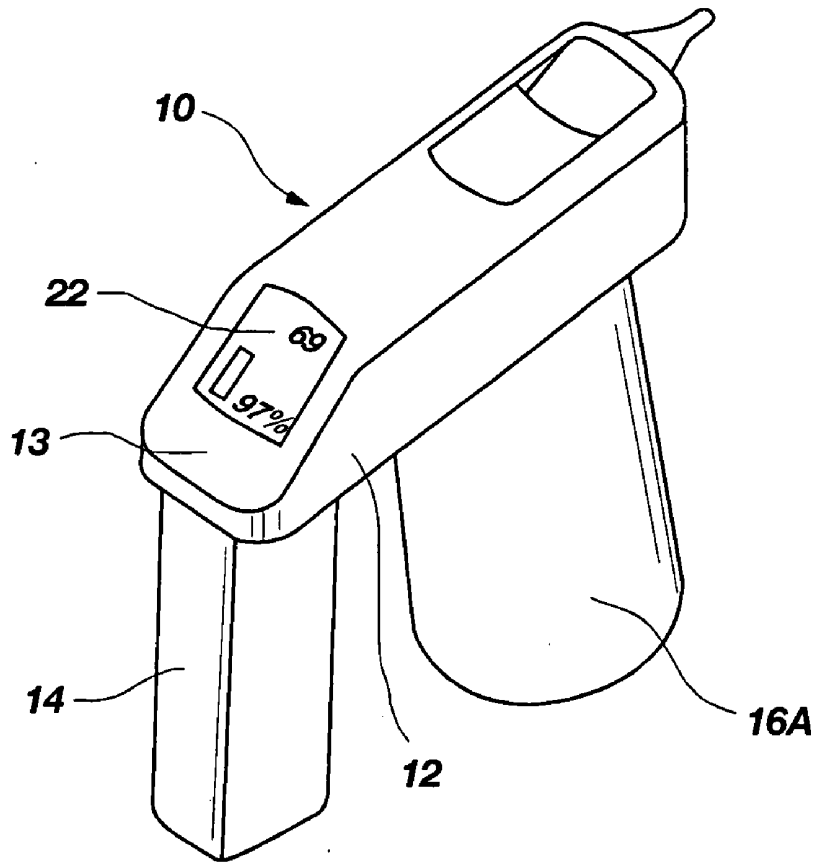

**FIG. 8**

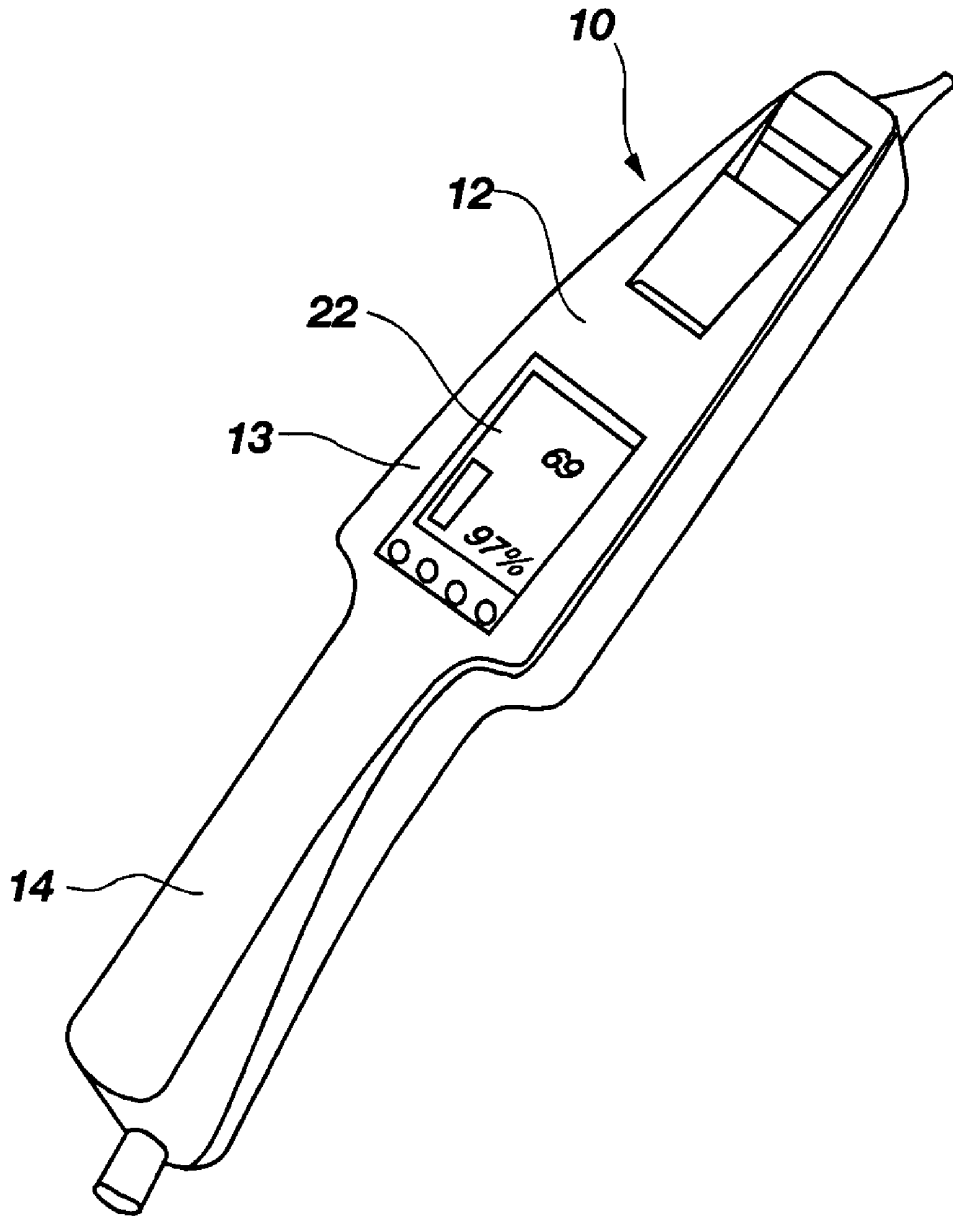

**FIG. 9**

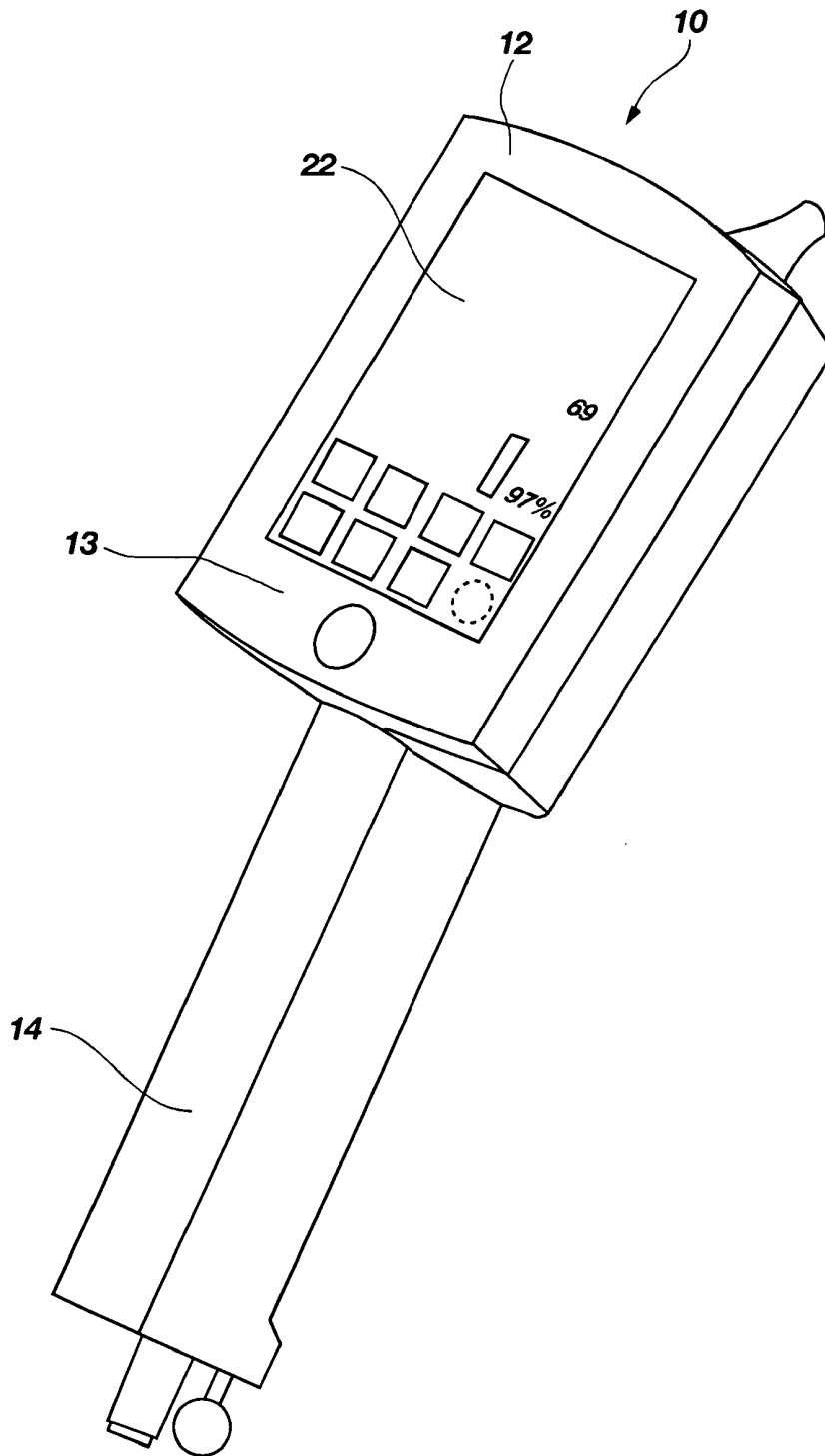

**FIG. 10**

## HEALTH DATA COLLECTION TOOL

### TECHNICAL FIELD

**[0001]** This invention relates to the field of health care devices for gathering, displaying and transmitting health care data concerning the vital signs of a patient, particularly to portable nursing devices for gathering such data, and still more particularly to portable devices that provide for assimilating a plurality of different types of health care data, including patient identity, using a single integrated device.

### BACKGROUND OF THE INVENTION

**[0002]** In a medical facility such as a hospital, clinic or doctor's office, the creation and maintenance of patient files is critical to recording vital data and history of a patient's treatment. Patient files include patient identifying information as well as a variety of health care data associated with the patient. Identifying information is routinely taken at intake of a patient and typically includes, for example, name, age, sex and insurance information, which is used to establish the base file for the patient. In addition, routine health care data such as temperature, pulse, blood pressure and the like are typically hand recorded at or near intake and included in a hard-copy paper file. The file is typically physically transferred to a patient examination room where further health care data and notes may be entered by a health care provider and manually recorded into the file.

**[0003]** If the patient is to be admitted to a hospital, an identification bracelet is typically created to be worn on the patient's wrist for follow-up care, and the patient's file is transferred to the patient's bedside. At the bedside, the file is manually updated upon periodic visits by a physician or nurse who manually records notes and other health care data into the file. Prescription and diagnosis information is also recorded in the file. In instances before or after a significant medical procedure such as birth or surgery, basic vital signs such as temperature, pulse, blood pressure, respiratory rate, oximetry, electrocardiogram (ECG) or other data pertaining to the patient's body may be continuously monitored during the patient's stay. Specialized semi-portable monitoring instruments for obtaining and monitoring this type of health care data are part of a hospital's inventory of equipment that is assigned to individual patients on an as-needed basis and rolled into a patient's room on carts or roller stands. A large variety of semi-portable monitors are commercially provided by numerous manufacturers and distributors.

**[0004]** Fully portable devices that do not require a cart or stand are also commercially available. One example of a fully portable data health care data device provided by WelchAllyn is the SPOT VITAL SIGNS™ device that allows a health care provider to take non-invasive blood pressure, pulse, oximetry, and arterial pressure data, and which may be configured with a printer for recording the data. On routine visits, or "rounds," hard copy recordings of health care data obtained from such devices may be periodically printed and included in the files to create a vital signs history. Alternatively, the health care provider may manually record such data in the file with time and date information.

**[0005]** In the past, day-to-day patient intake and monitoring information was exclusively hand recorded in a paper file by a variety of health care provider personnel. Today, health care institutions are increasingly moving toward recording health care information in electronic patient files rather than

in hard-copy files. In typical electronic file systems, patient files are maintained on a centralized computer system and patient information and health care data are entered from a variety of distributed smart terminals positioned in intake rooms, examination rooms and hospital rooms. The smart terminals serve as a substitute for the hard copy files, permitting the variety of health care providers to enter and display a variety of health care information from a variety of locations without need for physically transferring the hard copy file.

**[0006]** Another improvement in recent years is that monitoring devices have been equipped with telemetry equipment to wirelessly upload health care data through a network of receivers that are positioned remotely from the monitors. In certain situations, such as with ambulatory patients requiring continuous monitoring of specific vital signs, or with ambulance patients being transported to a hospital under emergency situations, small, portable monitors with self-contained power and data telemetry units are used to continuously record and transmit health care data to a centralized computer system. Commercially available examples of such portable monitors are exemplified by the Micropaq™ and Propaq™ monitors provided by WelchAllyn. These monitors display ECG waveforms, heart rate, invasive or non-invasive blood pressure, temperature, pulse oximetry and respiratory data. In certain optional configurations, these devices can wirelessly transmit such data over a local area wireless radio frequency network (FlexNet™). In other optional configurations, data assimilated by the monitors may be transmitted via infrared data transmission.

**[0007]** While the provision of centralized electronic patient record files and portable health care data monitors equipped with telemetry options has improved the ease and efficiency of collecting, transmitting and storing health care data, there remains a need in the art to equip a health care provider with options for integrating the collected data with patient identification information, and for providing for additional types of data that can be collected using an inexpensive and fully portable device.

### SUMMARY OF THE INVENTION

**[0008]** The invention provides a portable, multifunctional health data tool for use by a healthcare provider. The health data tool includes a housing configured to be of a shape, size and weight to permit the housing to be held in a hand of a healthcare provider. It further contains a code reader associated with the housing configured to read coded information, such as information pertaining to the patient's identity or information pertaining to a drug or device used by the patient. The tool further includes multiple input ports for different data assimilation devices associated with the housing for inputting different health care data obtained from a patient into the health data tool. A display screen configured to display the health care data obtained from the data assimilation devices is also provided. Finally, the tool includes a data transmitter and a data receiver port to permit the health care data and other information to be transferred between the health data tool and a remote device that is separate from the tool.

**[0009]** In one aspect, the code reader is a bar code scanner that reads bar code information. In another aspect, the code reader is a radio receiver that receives a radio signal encoding the information. In another embodiment, the code reader is an optical character recognition device that reads

character information. In yet another embodiment, the code reader recognizes a pattern of dots encoding the information.

[0010] In another aspect, the housing comprises an upper portion that houses the display screen and a lower portion downwardly extending from the upper portion that defines a handle dimensioned to fit within the hand of the health care provider. The housing may include a plurality of storage compartments to store the plurality of data assimilation devices associated with the housing. A plurality of doors providing access to the storage compartments may also be provided to enclose the associated data assimilation devices within the health data tool. In most embodiments, at least one of the storage compartments should include a compartment for holding a blood pressure cuff. The blood pressure cuff storage compartment may, for example, be configured as a slot within the housing. In other embodiments, at least one of the data assimilation devices, such as the blood pressure cuff, is removably attachable to the housing by a spring actuated latch. The housing may be configured to store an air compressor for operating the blood pressure cuff, or the blood pressure cuff may be manually operated by a hand pump.

[0011] The health data tool further includes an electronic memory associated with the housing to store the health care data. The electronic memory may be configured to store health care data for a plurality of patients, typically in a database format.

[0012] In the following detailed description of exemplary embodiments of the invention, reference is made to the accompanying drawings, which form a part hereof, and in which are shown, by way of illustration, specific exemplary embodiments in which the invention may be practiced. In the drawings, like numerals describe substantially similar components throughout the several views. These embodiments are described in sufficient detail to enable those skilled in the art to practice the invention. Other embodiments may be utilized and structural, logical, electrical, and other changes may be made without departing from the spirit or scope of the present invention. The following detailed description is, therefore, not to be taken in a limiting sense, and the scope of the present invention is defined only by the appended claims.

#### BRIEF DESCRIPTION OF THE DRAWINGS

[0013] FIG. 1 is a front isometric view of an exemplary embodiment of the health data tool of the invention including exemplary data assimilation devices associated therewith.

[0014] FIG. 2 is a rear isometric view of an exemplary embodiment of the health data tool of the invention.

[0015] FIG. 3 is a front isometric view of another exemplary embodiment of a health data tool of the invention illustrating storage compartments incorporated into the health data tool.

[0016] FIG. 4 is a side elevational view of an exemplary embodiment depicting device attachment clips.

[0017] FIG. 5 is a front isometric view of an exemplary embodiment of a health data tool of the invention and a docking station for use therewith.

[0018] FIGS. 6A and 6B are isometric views of a belt attachment hook and a pole mount, respectively, associated with one embodiment of the health data tool of the invention.

[0019] FIG. 7 is a front isometric view of another exemplary embodiment of a health data tool of the invention.

[0020] FIG. 8 is a front isometric view of another exemplary embodiment of a health data tool of the invention.

[0021] FIG. 9 is a front isometric view of another exemplary embodiment of a health data tool of the invention.

[0022] FIG. 10 is a front isometric view of another exemplary embodiment of a health data tool of the invention.

#### DETAILED DESCRIPTION OF PREFERRED EMBODIMENTS

[0023] As used herein, "health care data" is the meaningful form of data, including at least in-part, data commonly known as "vital signs" that pertain to the health of a patient. Typical types of health care data include, but are not limited to, temperature, pulse, blood O<sub>2</sub> level, electro cardiogram data, blood pressure, respiratory rate, appearance (such as may be recorded by a camera), sound information (such as obtained by a stethoscope) and the like.

[0024] The term "patient identifying data" refers to data that can be used to identify a patient. Typical types of patient identifying data includes name, age, sex, and insurance information.

[0025] The term "signal data" refers to the raw signal that is received from a health care data assimilation device before the raw signal is converted into meaningful health care data by the action of a microprocessor. Typically, signal data is in the form of an amplitude or a frequency of a voltage, a current, or optical analogues of the same, which has been transduced from a detector that detects changes in pressure, light, sound, temperature or other measurable attribute.

[0026] The term "associated with" as used with respect to a component part of the health data tool (described in more detail hereafter) means that the component part is physically stored in, attached, or coupled or connected to the health data tool. The attachment or connection may be fixed or removable.

[0027] FIGS. 1 and 2, illustrate front and rear isometric views, respectively, of one embodiment of a health data tool 10 of the invention. The health data tool 10 includes a housing 12 that houses a plurality of data assimilation devices 40, 42, 44, 48, 50, 57 associated with health data tool 10. The housing 12 includes a lower handle 14 portion, which in advantageous embodiments, extends longitudinally downward with respect to a front display surface 13 of the housing 12. The housing 12 is configured to be of shape, size and weight to permit the health data tool 10 to be held in one hand of health care provider. In typical embodiments, the housing 12 is made of a plastic material and occupies less than about 2 or less than about 1 cubic feet of space and weighs less than about 10 pounds, less than about 5 pounds or less than about 3 pounds. The downwardly extending handle 14 and overall configuration of the health data tool 10 permits a health care provider to hold the health data tool 10 in one hand while manipulating data assimilation devices with the other hand and simultaneously observing data that is displayed on a display screen 22 located in an upper portion 15 of the housing 12. The data assimilation devices 40, 42, 44, 48, 50, 57 and the display screen 22 are described in more detail hereafter.

[0028] In certain embodiments, the downwardly extending handle 14 is configured with an access door 9 that provides access to a hollow compartment 11. The hollow compartment 11 may be used to store one or more of the data assimilation devices. In the embodiment depicted in FIG. 1, the hollow compartment 11 in the handle 14 encloses batteries 13 used to power the health data tool 10 and, optionally, one or more of the data assimilation devices associated therewith. As depicted in FIG. 1, the hollow compartment 11 also houses a

small air compressor **16** used to supply air through an air line **17** for automatic operation of a non-invasive blood pressure cuff **44**. Of course, the batteries or air compressor **16** may be located elsewhere in the housing **12** so long as suitable electrical connections or tubing is provided to power the health data tool **10** and channel air flow to the air line **17**. The air compressor **16** is not needed when the blood pressure cuff **44** is configured for manual inflation using a bulb.

**[0029]** The health data tool **10** includes a code reader **20** associated with the housing **12** to read information pertaining to the patient. In advantageous embodiments, the code reader **20** is integrated into the housing **12**, although in other embodiments the code reader **20** may detachably coupled to the housing **12**. The function of the code reader **20** is to read coded information associated with or pertaining to the patient. The coded information typically includes personal information that identifies the patient and may also include information pertaining to drugs or devices that are to be administered or otherwise used in treating or monitoring the patient.

**[0030]** In one exemplary embodiment, the code reader **20** is a standard bar code reader. Typically, during an intake procedure at a health care facility a patient to be treated or admitted is supplied with an identity tag **46**, usually in the form of wrist bracelet, that includes the name of the patient, the date of admission, the administering health care provider or other information such as insurance provider and the like. Some or all of this information may be encoded in a bar code **47** on the identity tag **46**. The bar code reader **20** permits this identifying information to be rapidly and accurately entered into the health data tool **10**.

**[0031]** The patient may also be prescribed a drug therapy that includes a name for the prescribed drug, a dosage and frequency of administration. In certain cases the patient may bring a drug container to a health care provider upon admission to a health care facility to assist in diagnosis or treatment, while in other cases the health care provider at the facility may prescribe a drug treatment to the patient. Such prescription information, or parts thereof, may also be encoded in a bar code associated with the container that contains the drug. The bar code reader **20** permits the health care provider to enter the relevant drug information into the health data tool **10**. Similarly, an admitted patient may be assigned usage of various medical devices from an inventory of devices provided by the health care facility. These medical devices often include a bar code to identify the particular device for tracking, performance monitoring and inventory purposes. The bar code reader **20** allows the health care provider to associate a given medical device with a given patient identification in a memory record to facilitate these purposes.

**[0032]** While the bar code reader **20** may be the most universally adopted form of a code reader **20**, it is understood that that many other embodiments of the code reader **20** may be associated with the health data tool **10** to provide the same or similar functions. Another embodiment of the code reader **20**, for example, is a "dot" reader that scans a pattern of dots that encode information. Another embodiment is an optical character recognition scanner that scans an image in bit form and then converts the scanned image into alphanumeric characters. Another embodiment is a magnetic strip reader that extracts information magnetically encoded on a data strip. Yet another embodiment is a radio frequency (RF) receiver that receives electromagnetic waves transmitted from an RF identification tag in which information regarding the subject is

encoded. Still another embodiment of the code reader **20** is a hologram reader that detects spectral or diffraction patterns emitted by an illuminated hologram and extracts information encoded therein from the pattern of spectral or diffraction patterns detected. Accordingly, the skilled person will understand that the code reader **20** can be embodied in many forms and with many variations, as long as the code reader **20** permits information to be extracted from a tag, card or other identifying device associated with a subject patient (or thing).

**[0033]** Turning now to the data assimilation devices **40**, **42**, **44**, **48**, **50**, and **57**, in various embodiments, the data assimilation devices associated with the health data tool **10** include at least two different instruments for measuring health care data from a patient. Example data assimilation devices include, but are not limited to, a pulse oximeter (SPO2 meter) **42** for measuring pulse rate and oxygen saturation of the blood, a thermometer such as tympanic thermometer **40** for measuring a patient's temperature, a non-invasive blood pressure device **44** that includes a blood pressure cuff for measuring blood pressure, an electronic stethoscope **48** for detecting interior sounds from the patient's body, and a "two finger" electrocardiogram device **57** or an ECG lead wire set **50** for recording cardiac activity through finger electrodes. In some advantageous embodiments, the health data tool **10** also includes a digital camera **28** as a data assimilation device integrated within the housing **12** for recording digital pictures of the patient.

**[0034]** The housing **12** of the health data tool **10** also includes one or more device input ports **27**, **29**, **31**, **33**, and **34** configured to receive data output from the data assimilation devices **40**, **42**, **44**, **48**, **50**, and **57**. In certain examples, the input ports **29**, **31** and **33** are particularly configured to receive output from the data communication lines of particular data assimilation devices such as the stethoscope **48**, the ECG **50** and the blood pressure cuff **44**, respectively. Blood pressure input port **33** may be further configured for delivering air pressure to the blood pressure cuff **44** through air flow line **17** and to receive data from the blood pressure cuff **44** through data input line **19**. The input ports **34** may also be configured to receive data output from the ECG lead wire set **50**. The input port **27** is a standard two-way input/output computer interface port that receives a standard computer data communication cable, such as for example, a USB cable. Various commercially available data assimilation devices, exemplified by the SPO2 oximeter **42** depicted in FIG. 1, may be pre-configured or adapted to output data over such standard computer cables. One advantage of the two-way input/output port **27** is that it can be used to receive data from the data assimilation devices in one operational mode of the health data tool **10**, and used as a data transmitter or receiver port in another operational mode where the health care data is uploaded or downloaded into a remote computer system as will be described in more detail hereafter.

**[0035]** As illustrated in FIG. 2, the housing **12** also includes one or more storage compartments **16** and **19** for storing the data assimilation devices associated with health data tool **10**. The storage compartment **16** is an open slot configured for storing the blood pressure cuff **44** folded or rolled into a size that slips into the slot **16**. The storage compartment **19** is configured to store one or more smaller data assimilation devices, exemplified in FIG. 1 by SPO2 pulse oximeter **42**. The interior of storage compartments **16** or **19** may optionally be equipped with clamps, hooks, Velcro™ or other latching mechanism **21** for securely holding the data assimilation

device within the storage compartment 16 or 19. In addition, or alternatively, the storage compartment 19 may be configured with a door 18 for enclosing the interior of the compartment 19 with the stored data assimilation device. The door 18 in various embodiments, may be sliding door, a swinging door, or a removable door.

[0036] FIG. 3 illustrates another configuration of the health data tool 10 and depicting other locations of various storage compartments 19a and 19b with corresponding access doors 18a and 18b, which are located on side edges of the upper portion 15 of the housing 12. Storage compartment 19c with sliding door 18c is located on the upper surface 13 of the health data tool along with the display screen 22. Storage compartment 19d with corresponding access door 18d is located on the back side of downwardly extending handle 14. Accordingly, the storage compartments 16 and 19 may be located anywhere in the housing 12 where there is room to accommodate a compartment without making the overall dimensions of the health data tool 10 too large to be comfortably handled by a health care provider.

[0037] The storage compartments 16 and 19 represent one example embodiment of means to associate the data assimilation devices with the health data tool 10 of the invention. Other means are also available. For example FIG. 4 is a side view of an alternative means for associating data assimilation devices 44 and 87 with the health data tool 10. In this embodiment, a thermistor type temperature probe 87 that is separate from the tympanic thermometer 40 is releasably inserted into a receptacle 89 situated in the handle 14 of the housing 12. The temperature probe 87 is secured within, and released from, the receptacle 89 by means of closing and opening a latch mechanism 90 provided on the bottom of the handle 14. Also in this embodiment, instead of using a slot 16 or compartment 18 to store the blood pressure cuff 44, the cuff 44 is rolled and banded with an elastic or Velcro™ band 79. The band 79 is attached to a flat spring clip 81 configured to be inserted into a spring receptacle 83 that securely holds the blood pressure cuff 44 in place on the handle 14 of the health data tool 10 by the tension of the spring clip 81 against the wall and ledge of the spring receptacle 83. The blood pressure cuff 44 is released from the spring receptacle 83 by operation of spring release mechanism 85, which compresses the flat spring clip 81 thereby releasing the tension of the spring from the walls and ledge of the receptacle.

[0038] Referring again to FIG. 1, in some advantageous embodiments, the health data tool 10 optionally includes a microphone 54 for collecting sound information. The sound information may include for example, oral notes made by a health care provider or patient or sounds emitted from the patients body, such as the sound of a heartbeat, organ function or flow of blood. Specialized microphones 54a or 54b may be configured with the stethoscope 48 or the blood pressure device 44 to amplify the sound of the patient's heartbeat, organ function or blood flow. A speaker 56 and associated amplifier (not shown) may optionally be associated with the health data tool to audibly emit the sounds received from the microphones 54, 54a or 54b.

[0039] The front surface 13 of the health data tool 10 also includes input keys 24 for selecting various functions to be executed by the health data tool 10. The input keys 24 may be touch-screen type input keys as depicted in FIG. 1 or conventional toggle input keys 24 integrated into the housing 12 separately from the display screen 22, as depicted in FIGS. 3-6. The display screen 22 is configured to display a plurality

of different types of health care data obtained by the data assimilation devices and to display commands or status information selected by the input keys 24. In various embodiments the display screen 22 displays wave form data, alpha numeric data and/or image data.

[0040] In an example use, input key 24a is depressed to select a particular data assimilation device to acquire health care data. A name or other designation of the selected device is initially displayed on the display screen 22 to verify the selection. Toggling of the input key 24A sequentially displays the name of different input devices. The selected device is activated by the health care provider and the health data tool 10 is set to acquire and display the selected type of data by depressing enter key 24B. Alternatively, the input ports 27, 29, 31 and 33 may be configured with a plug-and-play type of switch to automatically set the health data tool for acquiring data from a particular data assimilation device when that device is plugged into the appropriate input port. The health care provider then withdraws the necessary data assimilation device from its storage location in the housing 12 and, in the case of data assimilation devices such as the blood pressure cuffs 44, the SPO2 pulse oximeter 42 or finger ECG electrodes 57, dons the instrument on the patient. Alternatively, in the case of data assimilation devices such as the stethoscope 48, thermometer 40, or camera 28, the health care provider situates the instrument in the appropriate location to acquire the health care data.

[0041] Once donned or situated, the health care provider presses input button 24c to begin acquiring the health care data. In the case of a camera 28, the selection of that device activates trigger 25 to function as a shutter release so that when the trigger 25 is depressed, the camera takes a photo. In any case, the acquired data is displayed on display screen 22 in the appropriate form for the selected device. For example, if the selected data assimilation device is the two-finger ECG 57 or ECG lead wire set 50, then the wave form of the electrocardiogram signal is displayed on the display screen 22. If the selected data assimilation device is a blood pressure device 44, then the systolic and diastolic readings are displayed in alphanumeric form on the display screen 22. Similarly, if the selected data assimilation device is a thermometer 40, then an alphanumeric representation of temperature is displayed as it is being collected. If the selected device is the camera 28, then the recorded digital image is displayed on the display screen.

[0042] The health data tool 10 is optionally equipped with a speaker 56 associated with the housing 12. If the selected data assimilation device is a stethoscope 48, then the sound detected through the stethoscope microphone 54a is amplified and emitted through the speaker 56 to permit the health care provider to listen to the sound and readjust the position of the stethoscope as needed. Optionally, when the stethoscope 48 is selected, depressing input key 24c activates trigger 25 to cause the health data tool 10 to operate in record mode so that if a recording is desired, depressing the trigger 25 a first time begins the process of taking a digital sound recording and depressing the trigger 25 a second time ends the recording. Similarly, if the selected data assimilation device is a voice record, then depressing input key 24c activates microphone 54 to receive voice information and activates trigger 25 to function in record mode. Depressing the trigger 25 a first time begins the process of taking a digital voice recording and depressing the trigger 25 a second time ends the voice recording. In certain embodiments, the health data tool may also

include a microprocessor programmed with voice recognition software to translate the sound recording into alphanumeric text.

**[0043]** When the data is a sound recording, ECG output, or other time-dependent data, such data is digitally recorded for a time period that in one embodiment, is selected by the health care provider. When such time dependent data assimilation devices are selected, input key 24E may be used to select the time period of the recording to store. In an alternative embodiment, the time period of the recording is the same as the time period that results from depressing the input trigger 25 on and off as described above. Alternatively, the health data tool 10 may be pre-programmed to record and/or store particular types of health care data for a predetermined increment of time. For example, the health data tool 10 may be pre-programmed to record and store ECG data for a period of 60 seconds and to record and store stethoscope data for a period of 10 seconds.

**[0044]** The operation of the various input keys 24A-24E and trigger 25 described above is for exemplary purposes only. One of ordinary skill in the art will recognize that the input keys 24 can be programmed to perform the functions of the health data tool 10 in a variety of configurations. For example, even a single input key 24 can be configured with programming to select functions from a menu of options displayed on the display screen 22. Similarly, the functions of the trigger 25 can be accomplished using an input key 24. Accordingly, any arrangement of input keys 24 that allows the health care provider to operate the health data tool 10 to perform any of the functions described herein is suitable for the invention.

**[0045]** Furthermore, the embodiments of the health data tool 10 are described above as functioning in a sequential data assimilation mode, whereby one type of data assimilation device is activated at a time. In other advantageous embodiments, multiple data assimilation devices can be selected to simultaneously acquire different types of health care data, in which case the health data tool 10 functions as a multimeter, simultaneously acquiring and displaying a plurality of different data. In such embodiments, multiple devices are selected by sequentially depressing select input key 24a and enter key 24b. The display screen 22 initially displays each selected device in a list when entered. In one embodiment illustrated in FIG. 2, when acquire input key 24c is depressed, the display screen 22 is activated to display the different types of data on divided portions of the same display screen 22. Alternatively, multiple screens 22 are used to display different data on different types of screens. In such embodiments, simple alphanumeric data may be displayed on simple low resolution LED display screens, while more information intensive data such as wave form data or image data is displayed on a field emission, plasma, or other type of high resolution display screen.

**[0046]** In advantageous embodiments, the health data tool 10 is also equipped with an electronic memory 60 to store patient information and the health care data assimilated through the various data assimilation devices associated with the health data tool 10. As depicted in FIG. 1, the memory 60 is shown as a removable memory card, such as a flash memory card, that is inserted into memory slot 61. However, it is understood that the health data tool 10 may be configured with another type of memory such as conventional electronic memory 60 integrated within the housing 12. In an example operation, depressing store data input key 24d functions to

store the health care data in the memory 60. Alternatively, the health data tool 10 may be programmed to automatically store the data in memory 60 when acquisition is complete. In an advantageous embodiment, the data is stored in a record structure associated with the patient identification information acquired using code reader 20. In certain embodiments, date and time information is automatically provided in the record, and time information is supplied from a clock (not shown) associated with the health data tool 10.

**[0047]** In further advantageous embodiments, the memory 60 stores a plurality of health care data records for a plurality of patients in a database structure. In such embodiments, the health care provider can acquire multiple records from multiple patients, or for the same patient, over the course of a shift and later upload the recorded information into a centralized database on a remote computer 80, as depicted in FIG. 5, that stores patient records as will be described more fully hereafter.

**[0048]** In certain advantageous embodiments, the health data tool 10 is also equipped with one or more data transmission devices 21 and/or data receiver devices 26. In one embodiment, the data transmitter 21 or receiver 26 device is a wireless data transmission device. Example wireless data transmission and receiver devices suitable for the invention include, but are not limited to, infrared and radio frequency transmitters and receivers. The data transmitter 21 is used to upload data stored in the memory 60 of the health data tool 10 into the remote computer system 80 via transmission of the data to remote infrared data or RF receiver. The data receiver 26 is used to receive an input of data into the health care tool 10 from a remote wireless data transmitter. Such remote transmitters and receivers are typically situated in individual rooms where the patient is located, in which case the data can be transmitted or received simultaneously in a given patient's room. Alternatively, these remote transmitters and receivers may be located in a central location where multiple data records for multiple patients may be uploaded or downloaded in a single session. Data transmission or reception is accomplished either automatically or by selecting a transmit or receive function from one of the input keys 24, which in certain embodiments, activates trigger 25 to function to initiate data transfer.

**[0049]** Another embodiment of a data transmission and receiver device is the computer input/output port 27. An appropriate data communication cable is attached to the input/output port 27 and to an input/output port for the central computer system. An advantage of using a standard computer interface cable is that is adaptable for use with any modifications, upgrades or other changes that are made to the health data tool 10 or the remote computer system 80.

**[0050]** Data transfer to the remote computer 80 may also be accomplished using docking port 51. The docking port 51 is specifically configured to plug the health data tool 10 into a data transfer port 53 situated in a docking station 65 as depicted in FIG. 5. The docking station 65 has a power supply cord 67 and outputs to a data transmission line 69 for transferring data between the remote computer system 80 and the data tool 10. In addition, the docking station 65 may include a battery recharging port 70 adapted to fit into recharging receptacle 71 in the health data tool 10 for recharging the batteries 13 housed therein. The docking station 65 may also include a keyboard data receiver port 39, which may be an infrared data port or cable type of port. Textual data may then be entered and stored into memory in the health data tool 10

via keyboard **38** that transmits the data either through the wireless receiver **21** associated with the health data tool **10** or through the data receiver port **39** associated with the docking station **65**. In an exemplary practice, input key **24e** is toggled to select a patient record stored into memory **60**. Input select key **24a** is toggled to select "text" data. The health data tool **10** is then activated to receive data entered from the keyboard **38**, which is displayed in text format on screen **22** and ultimately transmitted to the remote computer system **80** with the other patient record data stored in the memory **60** of the health data tool **10**.

**[0051]** The electronics required to operate the health data tool **10** are located within the housing **12**. The electronics include a microprocessor that is programmed to perform the various functions described above for the health data tool **10**. The operating electronics contains conventional busses, clocks, and logic necessary for communication between the microprocessor, the various data assimilation devices and the memory. The operating electronics also include the required circuitry for operating the display screen **22** responsively to the data output.

**[0052]** In certain embodiments, the data assimilation devices associated with the health data tool **10** contain separate microprocessors for converting the raw signal detected by transducers in the data assimilation devices into meaningful health care data. In these embodiments, only the converted health care data is input into the health data tool **10**, thereby simplifying the electronics and lowering the cost of manufacturing the health data tool **10**. These embodiments are adaptable for a wide variety of data assimilation devices now in existence or yet to be devised. In other embodiments, one or more microprocessors housed within the health data tool **10** are configured to perform the signal to data conversion functions of the data assimilation devices. In these embodiments, all or at least a portion of the electronics needed to perform the functions of the various data assimilation devices is also contained within the health data tool. Each of the example data assimilation devices described herein are well known to those of ordinary skill in the art, as is the circuitry required to perform the signal to data conversion functions of the devices.

**[0053]** The health data tool **10** of the invention is a versatile tool that is primarily meant to be used for portable applications, such as in taking patient data during rounds. However, the health data tool **10** may also be used for longer term monitoring. To facilitate both portability and long term usage, the health data tool may optionally be configured with a belt hook **91** and/or a pole mount **95** illustrated in FIG. 6. The belt hook **91** may be advantageously located in the handle **14** of the health data tool **10** and is used to conveniently attach the health data tool **10** to a belt worn by the health care provider. For long term monitoring, the pole mount **95** allows the health data tool to be securely mounted on a standard medical device pole **93** positioned by the patients bed.

**[0054]** The overall structural configuration of the health data tool **10** can be implemented in numerous other forms as exemplified in FIGS. 7-10. FIG. 7 illustrates an "L" shaped configuration where the downwardly extending handle **14** is positioned at one end of the upper portion of the housing and perpendicular to the front surface **13** of the health data tool **10**. The slot **16** for storing the blood pressure cuff **44** is positioned beneath the front surface **13** of the housing between the display **22** and the downwardly extending handle **14**. FIG. 8 illustrates a variation on the "L" shaped configuration where a cylindrical blood pressure cuff compartment **16A** is

attached to a back surface opposite the front surface **13** of the housing **12**. FIG. 9 and FIG. 3 illustrate "spearhead" configurations where the downwardly extending handle **14** has an upper surface that is continuous with the front surface **13** of the housing and upper surface of the housing containing the display **22** is flared at a medial position to define a junction between the handle **14** and the upper portion of the housing **12**. FIG. 10 illustrates a "bent-T" shaped configuration where the downwardly extending handle **14** extends downwardly at an acute angle relative to the upper surface **13** of the health data tool **10**.

**[0055]** From the foregoing it will be appreciated that, although specific embodiments of the invention have been described herein for purposes of illustration, various modifications may be made without deviating from the spirit and scope of the invention. Accordingly, the invention is not limited except as by the following claims.

What is claimed is:

1. A health data tool for use by a healthcare provider, comprising,
  - a housing configured to be of a shape, size and weight to permit the housing to be held in a hand of a human healthcare provider;
  - a code reader associated with the housing configured to read at least one of information pertaining to the patient's identity and information pertaining to at least one of a drug or device used by the patient;
  - a plurality of input ports for different data assimilation devices associated with the housing for inputting different health care data obtained from a patient into the health data tool;
  - a display screen configured to display the health care data obtained from the data assimilation devices; and
  - at least one of a data transmitter and a data receiver port configured to at least one of transmit and receive, respectively, the health care data between the health data tool and a remote device separate from the health data tool.
2. The device of claim 1 wherein the code reader is a bar code scanner that reads bar code information.
3. The device of claim 1 wherein the code reader is a radio receiver that that receives a radio signal encoding the information.
4. The device of claim 1 wherein the code reader is an optical character recognition device that reads character information.
5. The device of claim 1 wherein the code reader recognizes a pattern of dots encoding the information.
6. The device of claim 1 wherein the housing comprises an upper portion that houses the display screen and a lower portion downwardly extending from the upper portion that defines a handle dimensioned to fit within the hand of the health care provider.
7. The device of claim 1 wherein the housing includes a plurality of storage compartments to store the plurality of data assimilation devices associated with the housing.
8. The device of claim 7 wherein the housing includes a plurality of doors providing access to the storage compartments.
9. The device of claim 7 wherein at least one of the storage compartments includes a compartment for holding a blood pressure sleeve.
10. The device of claim 9 wherein the blood pressure sleeve storage compartment is configured as a slot within the housing.

11. The device of claim 1 wherein at least one data assimilation devices is removably attachable to the housing by a spring actuated latch.

12. The device of claim 1 further comprising an electronic memory associated with the housing to store the health care data.

13. The device of claim 12 wherein the electronic memory stores health care data for a plurality of patients.

14. The device of claim 1 wherein at least one of the data transmitter port and the data receiver port is an infrared data port.

15. The device of claim 1 wherein at least one of the data transmitter port and the data receiver port is a radio frequency data port.

16. The device of claim 1 wherein at least one of the data transmitter port and the data receiver port a computer cable port.

17. The device of claim 1 wherein the remote device is a computer.

18. The device of claim 1 wherein the remote device is a keyboard and the data receiver port receives data transmitted from the keyboard.

19. The device of claim 1 wherein at least one of the data assimilation devices includes a self contained microprocessor to convert signal data obtained from the data assimilation devices into the health care data.

20. The device of claim 1 wherein the health data tool includes a microprocessor associated with the tool separate from the data assimilation device that is configured to convert signal data obtained from the data assimilation devices into the health care data.

21. The device of claim 1 wherein the plurality of data assimilation devices includes at least two devices selected from the group consisting of a thermometer, a pulse meter, an oximeter, a blood pressure measurement device, a stethoscope, a finger electrocardiogram unit, a lead wire electrocardiogram wire set, a digital camera, and a microphone.

22. The device of claim 21 wherein the thermometer is a tympanic temperature type thermometer.

23. The device of claim 21 wherein the thermometer is a thermistor type thermometer.

24. The device of claim 1 further including a plurality of input keys associated with health data tool, the input keys configured to at least one of: input patient identity informa-

tion obtained from the code reader, select a type of health care data to be obtained, review a type of health care data obtained, display a type of health care data obtained, receive a transmission of data from a remote transmitter, transmit data to a remote receiver, upload information from remote computer and download information to a remote computer.

25. The device of claim 1 wherein the health data tool includes a camera associated with the housing and configured to record a digital photograph.

26. The device of claim 1 wherein the display is configured to display a picture stored in a digital picture file.

27. The device of claim 1 wherein the display screen is configured to display a wave form.

28. The device of claim 27 wherein the wave form depicts at least one of an electrical cardiogram and a pulse.

29. The device of claim 1 wherein the health data tool includes a microphone associated with the housing and configured to record digital sound information.

30. The device of claim 29 wherein the health data tool includes a speaker associated therewith configured to emit an audible sound from at least one of: sound received by the microphone or sound digitally recorded in a sound file.

31. The device of claim 1 wherein the housing stores an air compressor configured for operating a blood pressure cuff.

32. The device of claim 1 wherein the housing stores a hand pump configured for operating a blood pressure cuff.

33. The device of claim 1 wherein the health data tool is powered by a rechargeable battery and the housing further includes a power port associated therewith configured to pass a charge from a battery charger to the rechargeable battery.

34. A docking station configured to dock the device of claim 32 comprising a charging port for charging the battery and optionally including a data port for transferring data between the health data tool and the remote device.

35. The device of claim 1 wherein the health data tool further includes an attachment device associated with the housing to attach the health data tool to a storage location.

36. The device of claim 1 wherein the attachment device includes a hook configured to hang the health data tool on a belt.

37. The device of claim 1 wherein the attachment device includes a clamp configured to mount the health data tool on at least one of a pole or rail.

\* \* \* \* \*

专利名称(译)	健康数据收集工具		
公开(公告)号	<a href="#">US20080221930A1</a>	公开(公告)日	2008-09-11
申请号	US11/716513	申请日	2007-03-09
申请(专利权)人(译)	SPACELABS MEDICAL, INC.		
当前申请(专利权)人(译)	SPACELABS MEDICAL, INC.		
[标]发明人	WEKELL WILLIAM KOENIG ROBERT BOYER BASTA JOSEPH C		
发明人	WEKELL, WILLIAM KOENIG, ROBERT BOYER BASTA, JOSEPH C.		
IPC分类号	A61B5/00 G16H10/60		
CPC分类号	A61B5/02055 H02J7/0044 A61B5/02438 A61B5/0404 A61B5/145 A61B5/6826 A61B5/6838 A61B7/04 A61B2560/0295 A61B2560/0431 A61B2560/0456 A61B2560/0475 G06Q50/24 A61B2560/0406 A61B5 /002 G06F19/323 A61B5/022 G06F19/36 G16H10/60 G16H10/65		
外部链接	<a href="#">Espacenet</a>	<a href="#">USPTO</a>	

摘要(译)

便携式健康数据工具允许健康护理提供者从患者同化和显示多个健康保障数据，并将数据与全部存储在工具中包含的存储器中的患者识别信息相关联。该工具包括代码阅读器，用于从条形码或其他编码标签将患者信息读入工具。该工具与存储在工具外壳中的多个不同数据同化装置相关联，包括但不限于用于测量的仪器，温度，血压，双指或引线ECG数据，脉搏血氧测定数据，声音数据和图片从集成在外壳内的可选数码相机获得的数据。该工具还包括数据接收器和/或发送器端口，其可以是无线或电缆端口，用于在健康数据工具和存储患者记录的单独计算机系统之间传输数据。

