

(19)



(11)

**EP 1 732 646 B1**

(12)

**EUROPEAN PATENT SPECIFICATION**

(45) Date of publication and mention of the grant of the patent:  
**07.09.2011 Bulletin 2011/36**

(51) Int Cl.:  
**A61B 1/04** <sup>(2006.01)</sup>      **A61B 1/06** <sup>(2006.01)</sup>  
**A61B 1/12** <sup>(2006.01)</sup>      **A61B 5/00** <sup>(2006.01)</sup>  
**A61B 18/18** <sup>(2006.01)</sup>      **A61N 5/06** <sup>(2006.01)</sup>

(21) Application number: **05711335.9**

(86) International application number:  
**PCT/US2005/000756**

(22) Date of filing: **10.01.2005**

(87) International publication number:  
**WO 2005/070129 (04.08.2005 Gazette 2005/31)**

**(54) ILLUMINATION DEVICE AND RELATED METHODS**

BELEUCHTUNGSVORRICHTUNG UND VERWANDTE VERFAHREN

DISPOSITIF D'ECLAIRAGE ET METHODES ASSOCIEES

(84) Designated Contracting States:  
**AT BE BG CH CY CZ DE DK EE ES FI FR GB GR HU IE IS IT LI LT LU MC NL PL PT RO SE SI SK TR**

(74) Representative: **Baker, Colin John**  
**Potter Clarkson LLP**  
**Park View House**  
**58 The Ropewalk**  
**Nottingham**  
**NG1 5DD (GB)**

(30) Priority: **08.01.2004 US 535183 P**

(43) Date of publication of application:  
**20.12.2006 Bulletin 2006/51**

(56) References cited:  
**US-A- 5 267 856**      **US-A- 5 402 770**  
**US-A- 5 836 941**      **US-A- 5 836 941**  
**US-A- 6 118 521**      **US-A1- 2003 045 780**  
**US-A1- 2003 045 780**      **US-A1- 2003 167 066**  
**US-A1- 2003 167 066**      **US-B1- 6 254 597**

(73) Proprietor: **BioLase Technology, Inc.**  
**San Clemente,**  
**California 92673 (US)**

(72) Inventor: **BOUTOUSSOV, Dmitri**  
**Dana Point, CA 92629 (US)**

**EP 1 732 646 B1**

Note: Within nine months of the publication of the mention of the grant of the European patent in the European Patent Bulletin, any person may give notice to the European Patent Office of opposition to that patent, in accordance with the Implementing Regulations. Notice of opposition shall not be deemed to have been filed until the opposition fee has been paid. (Art. 99(1) European Patent Convention).

## Description

### BACKGROUND OF THE INTENTION

#### 1. Field of the Invention

**[0001]** The present invention relates to illumination devices, and more particularly to illumination devices used in connection with medical and dental settings. More specifically, the present invention relates to an illumination device including a plurality of fibers that transmit and emit electromagnetic energy, such as light, toward a target surface. The fibers of the device are configured to deliver cutting energy, light for illumination of an operational area, light for excitation of the target surface and/or curing energy to the target surface, and to transmit light from the target surface back to one or more analyzers.

#### 2. Description of Related Art

**[0002]** Optical cutters are well-known in medical, dental, and industrial settings. Generally, optical cutters employ a source of electromagnetic energy, such as a laser source, and an optical fiber system connected to the laser source and configured to direct the laser through one or more optical fibers to a surface to be cut. The optical fiber system may include one or more optical fibers contained within an optical fiber tube. The optical fiber tube may have a device at its end (the distal end) for controlling the delivery of the laser to the surface to be cut. The other end (the proximal end) of the optical fiber tube is connected or coupled to the laser source.

**[0003]** US 2003/0045780 discloses a probe which includes a plurality of first optical fibers and a plurality of second optical fibers that are tied as a composite bundle at a distal end side with forming a centre channel through which a treatment instrument can be drawn.

**[0004]** US 2003/0167066 discloses a penetration apparatus for use during a surgical procedure, comprising:

a first end and a second end which has detailing that combines a plurality of small diameter optical fibers. The optical fibers are parted at an intermediate position along their length to allow the introduction of penetration apparatus.

**[0005]** US 5,836,941 discloses a laser probe including an optical fiber for guiding a laser beam, a holder fixed at an end portion of the optical fiber, and a reflection tip detachably attached to the holder and having a reflection surface for reflecting the laser beam emitted from the optical fiber.

**[0006]** US 6,188,521 discloses an optical characteristic measuring systems and methods such as for determining the colour or other optical characteristics of teeth. Perimeter receiver fiber optics preferably are spaced apart from a source fiber optic and receive light from the surface of the object/tooth being measured.

**[0007]** The present invention herein disclosed relates to an illumination device having a plurality of optical fibers which transmit electromagnetic energy toward a target surface for medical and dental procedures. An illumination device in accordance with the invention herein disclosed includes an elongate body that has a distal end and a proximal end, and a hollow interior. Two or more optical fibers, or other light transmitters, are located in the hollow interior of the elongate body.

**[0008]** In one embodiment, the illumination device includes an elongate body with at least two proximal end members, each proximal end member having a hollow interior sized to accommodate at least one light transmitter, and in communication with a hollow interior of the elongate body so that the at least one light transmitter extends from the proximal end to the distal end of the elongate body. In the illustrated embodiment, the illumination device includes four proximal end members. Three of the proximal end members may have equally sized inner diameters, and a fourth proximal end member may have a diameter that is less than the diameter of the other three members.

**[0009]** In another embodiment, an illumination device includes a distal portion and a proximal portion. The distal portion of the elongate body includes a unitary distal portion tube which includes a lumen extending therethrough. The proximal portion includes a plurality of proximal portion tubes, each proximal portion tube having a lumen in communication with the lumen of the distal portion of the elongate body. In the illustrated embodiments, the distal portion and proximal portion of the elongate body are integrally formed. The illumination device is illustrated as having four proximal portion tubes, where three of the four proximal portion tubes have similar diameters.

**[0010]** In certain embodiments of the foregoing device, the first, second and third proximal portion tubes each contain three optical fibers disposed in the lumens of the proximal portion tubes, and the fourth proximal portion tube contains one optical fiber disposed in the fourth proximal portion tube lumen. The optical fibers may be fused or separate from each other. At least a portion of the elongate body is flexible, such as a major portion of the elongate body. In certain embodiments, the distal portion of the elongate body includes a region that is rigid, straight and axially symmetrical relative to the proximal portion of the elongate body.

**[0011]** The illumination device of the present invention includes a light emitting output end, and it may also include at least one mirror or other reflector distally located to the light emitting output end. In one embodiment, the illumination device includes two mirrors near the output end, one mirror being constructed to reflect electromagnetic energy provided by an erbium cutting laser, and a second mirror constructed to reflect visible light. The device may include a hand piece sized to be held by a user's hand. The hand piece is typically coupled to the distal end of the elongate body of the illumination device, and may include the reflectors, as discussed herein.

**[0012]** Any feature or combination of features described herein are included within the scope of the present invention provided that the features included in any such combination are not mutually inconsistent as will be apparent from the context, this specification, and the knowledge of one of ordinary skill in the art.

**[0013]** Additional advantages and aspects of the present invention are apparent in the following detailed description and claims.

#### BRIEF DESCRIPTION OF THE DRAWINGS

##### **[0014]**

FIG. 1 is a side elevation view of a illumination device of the invention.

FIG. 1A is a sectional view along line 1A-1A of FIG. 1.

FIG. 1B is a sectional view along line 1B-1B of FIG. 1.

FIG. 2 is a sectional view of the illumination device of FIG. 1.

FIG. 3 is a side elevation view of an illumination device similar to the illumination device of FIG. 1.

FIG. 3A is a sectional view along line 3A-3A of FIG. 3.

FIG. 3B is a sectional view along line 3B-3B of FIG. 3.

FIG. 4 is a sectional view of the illumination device of FIG. 3.

#### DETAILED DESCRIPTION OF THE PRESENTLY PREFERRED EMBODIMENT

**[0015]** The present invention disclosed herein relates to illumination devices which utilize optical fibers to transmit electromagnetic energy toward a target surface. As used herein, "optical fiber" refers to any light transmitting fiber that is able to transmit light from one end of the fiber to another end of the fiber. The light transmission may be passive or it may include one or more light altering elements to influence the way light is emitted from the optical fiber. Optical fibers can be used to transmit any type of light, including, visible light, infrared light, blue light, laser light, and the like. Optical fibers may be hollow or solid, and may include one or more reflectors within the fiber bodies to control transmission and emission of light from the optical fibers.

**[0016]** An illumination device in accordance with the present invention includes a unitary distal end (output end) and a split proximal end (input end). As used herein, "distal end" refers to the end of an illumination device that is closest to a target surface, and "proximal end" refers to the end of an illumination device that is closest to a power source, or other source of electromagnetic

energy. The illumination device can include a plurality of different sized optical fibers depending on the particular application for which the illumination device is utilized. In the illustrated embodiment, and as disclosed herein, the proximal end of the illumination device includes four proximal end members configured to accommodate four sets of optical fibers.

**[0017]** Another illumination device in accordance with the present invention includes a plurality of optical fibers configured to emit electromagnetic energy from the distal end of the illumination device toward a target surface, and at least one optical fiber configured to receive electromagnetic energy from the target surface and transmit it to the proximal end of the illumination device. The electromagnetic energy that is transmitted to the proximal end of the illumination device can be used as a signal for further analysis.

**[0018]** In another embodiment of the present invention, an illumination device includes a hand piece having a reflector. The reflector is constructed to reflect both laser energy, such as light provided by an erbium laser, and visible light, including blue light, toward a target surface. It also reflects light from target surface towards proximal end of illumination device. In the illustrated embodiment, as disclosed herein, the reflector includes a plurality of mirrors to provide enhanced control of the emission of electromagnetic energy from the optical fibers toward a target surface and back.

**[0019]** Reference will now be made in detail to the presently preferred embodiments of the invention, examples of which are illustrated in the accompanying drawings. Wherever possible, the same or similar reference numbers are used in the drawings and the description to refer to the same or like parts. It should be noted that the drawings are in simplified form and are not to precise scale. In reference to the disclosure herein, for purposes of convenience and clarity only, directional terms, such as, top, bottom, left, right, up, down, over, above, below, beneath, rear, front, distal, and proximal are used with respect to the accompanying drawings. Such directional terms should not be construed to limit the scope of the invention in any manner.

**[0020]** Although the disclosure herein refers to certain illustrated embodiments, it is to be understood that these embodiments are presented by way of example and not by way of limitation. The intent of the following detailed description, although discussing exemplary embodiments, is to be construed to cover all modifications, alternatives, and equivalents of the embodiments as may fall within the spirit and scope of the invention as defined by the appended claims. The present invention may be utilized in conjunction with various medical and/or dental procedures that are conventionally used in the art.

**[0021]** Referring to the figures, and specifically FIG. 1, an illumination device 10 is illustrated. Illumination device 10 includes an elongate body 12 having a generally tube-like structure that is structured to contain a plurality of light transmitters, such as optical fibers and the like,

which are used to transmit light toward or from a hand piece. In the illustrated embodiment, illumination device 10 includes an elongate body 12 surrounding a hollow interior 14 (see FIG. 1B). Illumination device 10 has a distal end D and a proximal end P, the distal end being the end closest to the end being held by a user. Referring to the illustrated embodiment, a distal portion 24 of illumination device 10 includes distal end D, and a proximal portion 26 includes proximal end P. Elongate body 12 is a hollow structure having a portion that is flexible, and a portion that may be substantially inflexible. Referring to the apparatus of FIG. 1, a fraction of distal portion 24 is substantially inflexible, or is generally rigid and straight, and a fraction of elongate body, including proximal portion 26 is flexible. In additional embodiments, both distal portion 24 and proximal portion 26 are flexible. Elongate body 12 can be made from any suitable material or materials, such as stainless steel, metal coil or plastic. In addition, apparatus 10 is illustrated as having a generally cylindrical cross-section, but it could also include one or more portions with different cross-sectional shapes including oval, rectangular, or triangular, and the like.

**[0022]** Illumination device 10 is illustrated having a plurality of proximal members 22A, 22B, 22C and 22D. Each proximal member 22A, 22B, 22C and 22D has a hollow interior configured to accommodate one or more light transmitters or other tubular or elongate structures that have cross-sectional areas less than the cross-sectional area of the hollow interior. Proximal members 22A, 22B, 22C and 22D are arranged such that the hollow interiors of each of the proximal members is in communication with hollow interior 14 of elongate body 12. This arrangement provides for a substantially continuous path for the light transmitters to extend from proximal end P to distal end D of elongate body 12. Although the illustrated embodiment is provided with four proximal members, additional embodiments could be provided with two, or three or more proximal members, depending on for example the number of light transmitters being used in the apparatus. In addition, the illustrated embodiment of illumination device 10 includes two proximal members 22A, and 22B that have substantially equal diameters, and one proximal member 22C that may have a diameter that is different than either of the diameters of the other two proximal members. Other diameter distributions among the four proximal members may be implemented in modified embodiments. According to the example embodiment illustrated in FIG. 1, proximal member 22D has a fiber 20 for transmitting cutting laser energy.

**[0023]** Illumination device 10 is illustrated as being configured to be held by a user. In a preferred embodiment, illumination device 10 is configured to direct electromagnetic energy from a hand piece and/or receive, energy that may be generated in proximity to the hand piece. The illumination device can be used in medical, industrial, dental, and other applications. In one embodiment, the illumination device is a device for emitting electromagnetic energy in dental applications. The electro-

magnetic energy preferably includes light, such as visible light, laser light, and the like. The device can be used in dental hygiene procedures as well.

**[0024]** Illumination device 10 is typically connected to at least one external electromagnetic energy source, such as a laser, a light emitting diode (LED), and/or a lamp, so that the electromagnetic energy that is generated by the source can be transmitted through illumination device 10 and directed from a hand piece. In modified embodiments, the electromagnetic energy source and/or delivery system may comprise parts or substantially all of that described in U.S. Patent No. 5,741,247 to the extent compatible; or, in other embodiments, structures described in the referenced patent may be modified to be compatible with the device 10.

**[0025]** In a further embodiment of the invention, and as illustrated in FIG. 1, the illumination device includes an elongate body 12 having a distal portion 24 and a proximal portion 26. Distal portion 24 is illustrated as being a unitary structure having an inner lumen to form a distal portion tube, and proximal portion 26 includes a plurality of proximal portion tubes 22A, 22B, 22C and 22D, each proximal portion tube having a lumen in communication with lumen 14 of distal portion 24.

**[0026]** Referring to elongate body 12 of FIG. 1, proximal members 22A, 22B, and 22C are integrally formed with distal portion 24 of the elongate body, and proximal member 22D is a separate element that is connected to elongate body 12, so that the proximal member lumens are in communication with the hollow interior or lumen 14 of distal portion 24. In additional embodiments, fewer (e.g., none) or greater numbers of separate elements can be joined or connected to elongate body 12.

**[0027]** In the illustrated embodiment of elongate body 12, distal end D includes an electromagnetic energy emitting output end, and proximal end P includes an electromagnetic energy input end. Referring to proximal members 22A, 22B, 22C and 22D of FIG. 1, each proximal member includes a lumen dimensioned to accommodate one or more light transmitters or other tube- or fiber-like structures. In the illustrated embodiment, proximal members 22A, 22B and 22C each contain three energy emitting fibers, such as optical fibers, and proximal member 22D contains one energy emitting fiber, such as an optical fiber. In modified embodiments, proximal member 22C may have a different cross-sectional area relative to, for example, one or both of the proximal members 22A and 22B. As shown in the illustrated embodiment of FIG. 1A, which is a sectional view along the line 1A-1A of FIG. 1, the three optical fibers 16, which are in each of the proximal members 22A and 22B, are bundled together. In other embodiments, the three optical fibers 16 within one or more of the proximal members can be substantially fused together or joined by other means to define a unitary light emitting assembly or waveguide.

**[0028]** In the illustrated example, proximal member 22C also includes three fibers 18, which are depicted in the sectional view of FIG. 1B that is taken along the line

1B-1B near distal end D of elongate body 12. Fibers 18, also indicated with parentheses in FIG. 1A as having a similar form and orientation as fibers 16, are in the illustrated embodiment equally separated from each other. In other embodiments, two or more of the fibers 18 can be positioned asymmetrically and/or fused or otherwise joined together. One or more of the fibers 18 may also be of different diameter than, for example, one or more of the fibers 16. Fibers 16 and 18 can be manufactured from plastic using conventional techniques, such as extrusion and the like.

**[0029]** Optical fiber 20 is illustrated as part of proximal member 22D passing between proximal members 22A and 22B near the input end of elongate body 12, and centrally disposed relative to fibers 16 and 18 near the output end of elongate body 12 (as shown in FIG. 1B). Optical fiber 20 is illustrated as a power erbium fiber that is structured to fit inside elongate body 12 but may comprise other structures in modified embodiments. At the output end, the fibers 16 and 18 are arranged in a plane. Preferably, the fibers are cut and polished in the same plane, and the fibers are arranged to be maintained in a substantially fixed position relative to one another and the hand piece. Fiber 20 may be polished and inserted separately, but mounted in a fixed position as well. For example, tubing, such as metal tubing, can be used both at the inside of elongate body 12 and outside of elongate body 12 to keep part, and preferably all, of the fibers 16, 18, and 20 in a fixed, straight position.

**[0030]** At the input end, or proximal end P, as illustrated in FIG. 1, fibers 16 of proximal members 22A and 22B are configured to receive and transmit light from for example a laser, an LED, or a lamp. As presently embodied, white light 70, for example white light generated by one or more white light LEDs is input. In the illustrated embodiment, two ultra-bright white light LEDs are used as a source of illumination light for transmission through fibers 16, with each LED generating, for example, electromagnetic energy at a power level of about 200 mW in either continuous wave (CW) or pulsed mode. In other embodiments, one or both white light LEDs can be substituted with different LEDs having different properties such as different colors (e.g., blue). Blue light can be particularly useful in curing dental composites, tooth whitening, and caries detection, among other things, when the device is used for dental care and hygiene. In this case, each proximal member 22A and 22B may include an optional shutter mechanism or filter (not shown) to influence the transmission of blue light from the LEDs. The shutter mechanism or filter might be structured to convert blue light into white, or any other visible light. This may be accomplished by using or placing phosphoric filters in front of each of the proximal members 22A and 22B.

**[0031]** Proximal member 22C is configured to accommodate the three fibers 18, as discussed above. In the illustrated embodiment, optical fibers 18 are configured to collect or receive reflected and scattered light from the

output end of apparatus 10 and guide that light back toward the input end. The reflected and/or scattered light can be used as a feedback signal, which can be passed to a sensor or other suitable device for analysis as indicated by 66 in FIG. 1. The feedback signal can detect damage of an optical surface (e.g., aiming red light beam will scatter and reflect back), fluorescence of dental material (e.g., caries, bacteria, demineralization, and the like) among other things. An optical fiber for erbium radiation (at about a 3 micron wavelength range), or fibers for transmission of other laser radiation, 20 can be inserted into elongate body 12 such that the distal end of fiber 20 is parallel with fibers 16 and 18 at distal end D of apparatus 10. In the illustrated embodiment, fiber 20 is centrally disposed along a central longitudinal axis of elongate body 12, as shown in FIG. 1B. In the illustrated configuration, fibers 16 and 18 are perimetrically disposed around fiber 20, at least at the distal end D of apparatus 10. The concentric configuration of fibers 16, 18, and 20 can be maintained for any desired distance of elongate body 12, and in the illustrated embodiment, the concentric configuration is maintained until a region where proximal members 22A, 22B, and 22C split from elongate body 12.

**[0032]** At the output end of elongate body 12, light is emitted from and collected into illumination device 10. In the illustrated embodiment, light or other electromagnetic radiation is emitted from fibers 16, and light is collected by a transparent tip or other type of waveguides 38. In addition, light or other electromagnetic radiation from a laser, a LED, or a lamp can be emitted from fiber 20.

**[0033]** In an illustrated embodiment, electromagnetic radiation 68 is derived from an erbium, chromium, yttrium scandium gallium garnet (Er, Cr:YSGG) solid state laser, which generates electromagnetic energy having a wavelength of approximately 2.78 microns at an average power of up to 8 Watts, a repetition rate of about 10 to 50 Hz, and a pulse width of about 150 to 700 microseconds. Moreover, electromagnetic radiation 68 may further comprise an aiming beam, such as light having a wavelength of about 655 nm and an average power of about 1 mW (CW or pulsed mode). In one embodiment, blue or/and white light are emitted from one or more fibers 16, reflected light or stimulated fluorescent light is collected by fibers 18, and erbium laser light is emitted from fiber 20. The emitted light is directed toward a working surface, such as a tissue surface, including a surface of a tooth, to perform one or more light sensitive procedures.

**[0034]** Although in certain embodiments of the invention, apparatus 10 may be useable in a person's hand or other suitable holding device to direct light toward a target surface, in the illustrated embodiment, illumination device 10 is configured to be coupled to a hand piece 100 (see FIG. 2). Hand piece 100 is structured to be held in a user's hand. Hand piece 100 is illustrated as having a contra-angle design configuration, including a hand piece output end 102 oriented at an angle to the output end of illumination device 10. In the illustrated embodi-

ment, hand piece output end 102 is oriented at an approximately ninety degree angle to the output end of illumination device 10. To direct the emitted light from fibers 16 and 20 toward hand piece output end 102, a reflector 30 is provided with hand piece 100. Reflector 30 is illustrated as including a plurality of mirrors 32 and 34. In additional embodiments, fewer or more mirrors may be provided. Mirror 32 is illustrated as being configured to alter the light emitted from fiber 20. In other words, mirror 32 is configured to direct for example a beam generated by an erbium laser source from the output end of illumination device 10 to hand piece output end 102. Mirror 34 is illustrated as being configured to alter the path of light emitted from one or more fibers 16. In other words, mirror 34 is configured to direct one or more beams of light, such as blue light or white light, from the output end of illumination device 10 to hand piece output end 102. In addition, mirror 34 is configured to direct light 64 that is reflected back from the target surface toward fibers 18 to provide a signal that can be used for analysis, as discussed above.

**[0035]** Hand piece 100 is also illustrated as including a tip 40 to direct light emitted from fiber 20 toward a target surface as indicated by reference number 62. In addition, a sleeve 38 may be provided with hand piece 100 substantially surrounding tip 40. Sleeve 38 is illustrated as being made of a material that is substantially transparent to permit light emitted from fibers 16, such as white light, to be directed to a target surface, as indicated by reference number 60. Tip sleeve 38, as illustrated in FIG. 2, is mounted into the ferrule 39, which has multiple openings for optical waveguides to transmit light 60. In other embodiments the tip sleeve 38 may be constructed of transparent material such as sapphire or clear plastic. Light 60 may be used for example to illuminate the target surface. The illumination of the target surface may occur continuously during the procedure being performed, or the illumination may be interrupted. In addition, the illumination may be automatically or manually controlled. Mirrors 32 and 34 may also be constructed to focus one or more of the light beams into tip 40. In the illustrated embodiment, mirror 32 is constructed to focus the erbium laser beam emitted from fiber 20 into tip 40, and mirror 34 is constructed to focus the light emitted from fibers 16, such as blue light, white light, or other light, into ferrule 39 or sleeve 38.

**[0036]** Hand piece 100 may also include another tip structure 36, such as a curing tip, as illustrated in FIG. 1. Tip structure 36 can be used instead of tip 40, or in conjunction with tip 40. When tip structure 36 is a curing tip, the curing tip is positioned in hand piece 100 and configured to receive or collect blue light emitted from fibers 16 to direct the blue light toward a target surface to obtain a desired effect, such as curing of dental composites. To increase the amount of blue light that is collected by tip structure 36, a diameter can be chosen for tip structure 36 to maximize the amount of blue light collected. Tip 40 and tip structure 36 are preferably made

of a sapphire or glass materials, including plastic materials, that is/are optically transparent to permit the light to be effectively transmitted therethrough to a target surface.

**[0037]** One particular, non-limiting embodiment of the invention is illustrated in FIGS. 3 and 4. In the embodiment shown in FIGS. 3 and 4, like parts are reflected by like numbers, and parts that are similar to the elements identified in the embodiment of FIGS. 1 and 2 have been identified by an apostrophe after the reference number. In the embodiment of FIGS. 3 and 4, the total length of illumination device 10' is between about 1 and about 2 meters. In one particular embodiment, illumination device 10' is about 1.6 meters long. Each proximal member 22A' and 22B' has a diameter between about 2 mm and about 3 mm, and preferably about 2.5 mm. Proximal members 22A', 22B', and 22C' meet to define a unitary tubular structure having an outer diameter between about 3 mm and about 5 mm, for example about 4 mm. Proximal members 22A', 22B', and 22C' are arranged so that the fibers contained therein define a central lumen having a diameter ranging from about 1 mm to about 2 mm, for example, about 1.5 mm (or about 1/16 of an inch). This central lumen is structured to accommodate the power erbium laser fiber, such as fiber 20', which is similar to fiber 20 discussed above. In the embodiment illustrated in FIG. 3, proximal members 22A', 22B', and 22C' come together to form a unitary structure at a distance of approximately 5 cm from the proximal end of elongate body 12'. As shown in FIG. 3B, power erbium fiber 20' has a diameter of approximately 0.5 mm, fibers 16' have a diameter of about 1 mm, and fibers 18' have a diameter also of about 1mm. The output end of illumination device 10' includes a substantially rigid, straight portion that is approximately 2 centimeters in length. Illumination device 10' includes six larger diameter fibers 16' concentrically arranged about a central lumen, and three fibers 18' concentrically arranged about a central lumen and equally spaced of elongate body 12', as shown in FIG. 3B. The numerical apertures of fibers 16' and 18' are about 0.51.

**[0038]** Similar to the embodiment shown in FIG. 1 and FIG. 2, light provided by two high power white LEDs is directed into proximal members 22A' and 22B' of FIG. 3. The white light may be used to illuminate the operational area. Each white light LED has a power of approximately 1/2 watt. One suitable example of a high-power white LED is a Luxeon Emitter, 5 W (Model No. LXHL-PW03). An erbium laser fiber is placed inside a central lumen created by the fibers in proximal members 22A', 22B', and 22C', as discussed above.

**[0039]** By way of the disclosure herein, an illumination device has been described that utilizes electromagnetic energy to affect a target surface. In the case of dental procedures, the illumination device includes an optical fiber for transmitting laser energy to a target surface for treating, e.g., ablating, a dental structure, such as a tooth, a plurality of optical fibers for transmitting for example

white light to a tooth to provide illumination of the target surface, a plurality of optical fibers for transmitting blue light for illumination curing, whitening, and/or diagnostics of a tooth, and a plurality of optical fibers for transmitting light from the target surface back to a sensor for analysis. In the illustrated embodiment, the optical fibers that transmit white light also may transmit blue light. In accordance with one aspect of the invention herein disclosed, an illumination device comprises an illumination tube having a feedback signal end and a double mirror hand piece.

**[0040]** In certain embodiments, the methods and apparatuses of the above embodiments can be configured and implemented for use, to the extent compatible and/or not mutually exclusive, with existing technologies including any of the above-referenced apparatuses and methods and including those disclosed in any of the following patents: U.S. Patent No. 5,741,247; U.S. Patent No. 5,785,521; U.S. Patent No. 5,968,037; U.S. Patent No. 6,086,367; U.S. Patent No. 6,231,567; U.S. Patent No. 6,254,597; U.S. Patent No. 6, 288,499; U.S. Patent No. 6,350,123; U.S. Patent No. 6,389,193; and U.S. Patent No. 6,544,256,

**[0041]** While this invention has been described with respect to various specific examples and embodiments, it is to be understood that the invention is not limited thereto and that it can be variously practiced with the scope of the following claims. Multiple variations and modification to the disclosed embodiments will occur, to the extent not mutually exclusive, to those skilled in the art upon consideration of the foregoing description. Additionally, other combinations, omissions, substitutions and modifications will be apparent to the skilled artisan in view of the disclosure herein. Accordingly, the present invention is not intended to be limited by the disclosed embodiments, but is to be defined by reference to the appended claims.

## Claims

1. A handpiece (100) coupled to the distal end of the elongated body of an illumination device comprising an illumination device (10) comprising an elongate body (12) having a distal portion (24) and a proximal portion (26), the distal portion (24) comprising a unitary distal portion tube (24) having a lumen (14), and the proximal portion (26) including a plurality of proximal portion tubes (22), each proximal portion tube (22) having a lumen in communication with the lumen (14) of the distal portion tube (24) of the elongate body (12);  
a power optical fiber (20) having a first transmitting interior wherein the interior in for transmitting cutting laser energy a proximal end in communication with a first one of the proximal portion tubes (22) and, a distal end in communication with the lumen and the distal portion (24) tube;  
an illumination optical fiber (16) having a second transmitting interior that differs from the first transmitting interior, a proximal end in communication with a second one of the proximal portion tubes (22), and a distal end in communication with the lumen (14) and the distal portion;  
a reflector positioned to intercept laser light from the power optical fiber (20) and to direct the laser light in a direction toward a handpiece (100) output end, the reflector (30) further being positioned to intercept illumination light from the illumination optical fiber (16) and to direct the illumination light in a direction toward the handpiece (100) output end;  
a first output tip waveguide (40) having a laser-transmitting interior and configured to receive laser light from the power optical fiber (20) and to direct the laser light away from the handpiece (100) output end; and  
a second output tip waveguide (38) having an illumination transmitting interior, which is not the same as the laser transmitting interior, and configured to receive visible light from the illumination optical fiber (16) and to direct the visible light away from the handpiece (100) output end.
2. The handpiece as set forth in claim 1, wherein the plurality of proximal portion tubes (22) comprises three optical fibers (16).
3. The handpiece as set forth in claim 1, wherein at the distal portion (24) the at least two proximal portion tubes (22) form the lumen (14) dimensioned to accommodate at least one optical fiber (16, 20).
4. The handpiece as set forth in claim 1, wherein:
  - the plurality of proximal portion tubes (22) comprises a first proximal portion tube, the second proximal portion tube, and a third proximal portion tube; each having an equal inner diameter; and
  - the proximal portion (26) of the elongate body (12) further includes a fourth proximal portion tube having an inner diameter smaller than the inner diameter of the first proximal portion tube and the second proximal portion tube.
5. The handpiece as set forth in claim 1, wherein;
  - the elongate body comprises a central longitudinal axis; and
  - the reflector (30) is positioned at the central axis and the distal portion (24), the optical element (30) being configured to direct laser light from the power optical fiber (20) into the first output tip waveguide (40) and to direct visible light from the illumination optical fiber (16) into the second output tip waveguide (38).
6. The handpiece as set forth in claim 1, wherein the distal portion (24) and proximal portion (26) of the

- elongate body (12) are integrally formed.
7. The handpiece as set forth in claim 1, and further comprising a first, a second, and a third, and a fourth proximal portion tube (22A, 22B, 22C, 22D).
  8. The handpiece as set forth in claim 7, wherein three of the four proximal portion tubes (22) have similar diameters.
  9. The handpiece as set forth in claim 7, wherein the first proximal portion tube, second and the third proximal portion tubes (22) each contain three optical fibers disposed in the lumen of the respective proximal portion tubes (22), and the fourth proximal portion tube contains one optical fibers disposed in the lumen of the fourth proximal portion tube.
  10. The handpiece as set forth in claim 9, wherein each of the first and second proximal portion tubes contains a plurality of optical fibers fused together.
  11. The handpiece as set forth in claim 1, wherein the elongate body (12) is about 1.5 meters in length and the proximal portion (26) of the elongate body is about 5 centimeter in length.
  12. The handpiece as set forth in claim 1, wherein the distal portion (24) and the proximal portion (26) are made of a flexible material.
  13. The handpiece as set forth in claim 1, wherein the distal portion (24) includes a region that is rigid and straight relative to the proximal portion (26) of the elongate body.
  14. The handpiece as set forth in claim 1, wherein the distal portion (24) includes a light emitting output end, and the device further comprises at least one mirror (30) distally located to the light emitting output end.
  15. The handpiece as set forth in claim 14, comprising a first mirror (32) constructed to reflect electromagnetic energy provided by an erbium laser, and a second mirror (34) constructed to reflect visible light.
  16. The handpiece as set forth in claim 14, wherein the hand piece (100) comprises a tip structure which includes the first output tip waveguide (40) and the second output tip waveguide (38) and which is coupled to the distal end (24) of the elongate body (12) to direct electromagnetic energy from the hand piece (100).
  17. The handpiece as set forth in any of claims 1-16, wherein the device further comprises a fluid output for directing fluid toward a target surface when elec-

tromagnetic energy is directed from the hand piece (100).

18. The handpiece as set forth in claim 17, wherein: the device generates and outputs a laser beam; the fluid comprises atomized fluid particles emitted from the fluid output above the target surface so that in use portions of the atomized fluid particles intersect the laser beam above the target surface.
19. The handpiece as set forth in claim 18, wherein the target surface comprises one of bone, teeth, cartilage and soft tissue and the atomized fluid particles comprise water.
20. The handpiece as set forth in claim 18, wherein the laser beam is configured to impart relatively large amounts of energy into the atomized fluid particles in the volume above the target surface to thereby expand the atomized fluid particles and impart disruptive forces onto the target surface.
21. The handpiece as set forth in claim 20, wherein: the fluid output is configured to place water into the volume; and the device comprises one of an Er: YAG, an Er: YSGG, an Er, Cr: YSGG and a CTE: YAG laser.

### 30 Patentansprüche

1. Griffelement (100), das mit dem entfernten Ende eines länglichen Körpers einer Beleuchtungsvorrichtung verbunden ist, mit:
  - einer Beleuchtungsvorrichtung (10) mit einem länglichen Körper (12) mit einem entfernten Abschnitt (24) und einem nahen Abschnitt (26), wobei der entfernte Abschnitt (24) ein einheitliches entferntes Abschnittsrohr (24) mit einem Lumen (14) aufweist, wobei das nahe Ende (26) eine Mehrzahl von nahen Abschnittsrohren (22) aufweist, wobei jedes nahe Abschnittsrohr (22) ein Lumen in Kommunikation mit dem Lumen (14) des entfernten Abschnittsrohrs (24) des länglichen Körpers (12) aufweist;
  - einer optischen Leistungsfaser (20) mit einem ersten übertragenden Inneren, wobei das Innere für die Übertragung einer Schneidlaserenergie vorgesehen ist, mit einem nahen Ende in Kommunikation mit einem der nahen Abschnittsrohre (22) und mit einem entfernten Ende in Kommunikation mit dem Lumen und dem entfernten Abschnittsrohr (24);
  - einer optischen Beleuchtungsfaser (18) mit einem zweiten Inneren, das sich von dem ersten übertragenden Innern unterscheidet, und mit einem nahen Ende in Kommunikation mit einem

- zweiten der nahen Abschnittsrohre (22) und einem entfernten Ende in Kommunikation mit dem Lumen (14) und dem entfernten Abschnitt; einem Reflektor, der angeordnet ist, um das Laserlicht der optischen Leistungsfaser (20) zu abzufangen und das Laserlicht in eine Richtung hin zu einem Ausgabeende des Griffteils (100) zu lenken, wobei der Reflektor (20) desweiteren angeordnet ist, um das Beleuchtungslicht von der optischen Beleuchtungsfaser (60) abzufangen und das Beleuchtungslicht in eine Richtung hin zu dem Ausgabeende des Griffelement (100) zu lenken;
- einer ersten Ausgabewellenleiterspitze (40) mit einem laserübertragenen Inneren und ausgestaltet zum Empfang von Laserlicht von der optischen Leistungsfaser (20) und zum Richten des Laserlichts weg von dem Ausgabeende des Griffelements (100) Ausgabeende; und einer zweiten Ausgabewellenleiterspitze (38) mit einem Lichtübertragenden Inneren, das nicht dasselbe wie das Laserübertragende Innere ist, und ausgestaltet zum Empfang von sichtbarem Licht von der optischen Beleuchtungsfaser (16) und zum Richten des sichtbaren Lichts weg von dem Ausgabeende des Griffelement (100).
2. Griffelement nach Anspruch 1, bei dem die Mehrzahl von nahen Abschnittsrohren (22) drei optische Fasern (16) umfasst.
  3. Griffelement nach Anspruch 1, bei dem an dem entfernten Abschnitt (24) zumindest zwei entfernte Abschnittsrohre (22) das Lumen (14) bilden, die ausgestaltet sind, um zumindest eine optische Faser (16,20) aufzunehmen.
  4. Griffelement nach Anspruch 1, bei dem:
    - die Mehrzahl naher Abschnittsrohre (22) ein erstes nahes Abschnittsrohr, ein zweites nahes Abschnittsrohr und ein drittes nahes Abschnittsrohr umfassen, jedes mit einem gleichen Innendurchmesser; und
    - wobei der nahe Abschnitt (26) des länglichen Körpers (12) des Weiteren ein viertes nahes Abschnittsrohr aufweist, mit einem Innendurchmesser, der kleiner als der Innendurchmesser des ersten nahen Abschnittsrohres und des zweiten nahen Abschnittsrohres ist.
  5. Griffelement nach Anspruch 1, bei dem:
    - der längliche Körper eine mittlere Längsachse aufweist; und
    - wobei der Reflektor (30) an der mittleren Achse und dem entfernten Abschnitt (24) angeordnet
- ist, wobei das optische Element (30) ausgestaltet ist, um das Laserlicht von der optischen Leistungsfaser (20) in die Ausgabewellenleiterspitze (40) zu lenken, und um das sichtbare Licht von der optischen Beleuchtungsfaser (16) in die zweite Ausgabewellenleiterspitze (38) zu lenken.
6. Griffelement nach Anspruch 1, bei dem der entfernte Abschnitt (24) und der nahe Abschnitt (26) des länglichen Körpers einstückig ausgebildet sind.
  7. Griffelement nach Anspruch 1, des Weiteren mit einem ersten, einem zweiten, und einem dritten und einem vierten nahen Abschnittsrohr (22A,22B,22C, 22D).
  8. Griffelement nach Anspruch 7, bei dem drei der vier nahen Abschnittsrohre (22) ähnliche Durchmesser haben.
  9. Griffelement nach Anspruch 7, bei dem das erste nahe Abschnittsrohr, das zweite und das dritte nahe Abschnittsrohr (22) jeweils drei optische Fasern enthalten, die in dem Lumen der jeweiligen nahen Abschnittsrohre (22) enthalten sind, und wobei das vierte nahe Abschnittsrohr eine optische Faser aufweist, die in dem Lumen des vierten nahen Abschnittsrohres enthalten ist.
  10. Griffelement nach Anspruch 9, bei dem jedes der ersten und zweiten nahen Abschnittsrohre eine Mehrzahl von optischen Fasern enthält, die miteinander verschweisst sind.
  11. Griffelement nach Anspruch 1, bei dem der längliche Körper (12) etwa eine 1,5 m in der Länge ist, wobei der nahe Abschnitt (26) des länglichen Körpers etwa 5 cm lang ist.
  12. Griffelement nach Anspruch 1, bei dem der entfernte Abschnitt (24) und der nahe Abschnitt (26) aus einem flexiblen Material gebildet sind.
  13. Griffelement nach Anspruch 1, bei dem der entfernte Abschnitt (24) einen Bereich umfasst, der steif, und relativ zu dem nahen Abschnitt (26) des länglichen Körpers gerade ist.
  14. Griffelement nach Anspruch 1, bei dem der entfernte Abschnitt (24) ein lichtemittierendes Ausgabeende aufweist, und wobei die Vorrichtung des Weiteren zumindest einen Spiegel (30) aufweist, der entfernt von dem lichtemittierenden Ausgabeende ist.
  15. Griffelement nach Anspruch 14, mit einem ersten Spiegel (32), der ausgestaltet ist, um elektromagnetische Energie zu reflektieren, die durch einen Erbi-

um-Laser bereitgestellt wird, und mit einem zweiten Spiegel (34), der ausgestaltet ist, um sichtbares Licht zu reflektieren.

16. Griffelement nach Anspruch 14, bei dem das Griff-  
element (100) eine Spitzenstruktur aufweist, die eine  
erste Wellenleiterspitze (40) und den zweiten Wel-  
lenleiterausgabespitze (38) aufweist, und die mit  
dem entfernten Ende (24) des länglichen Körpers  
(12) gekoppelt ist, um die elektromagnetische Ener-  
gie von dem Handelement (100) zu lenken. 5
17. Griffelement nach einem der Ansprüche 1 bis 16, bei  
dem die Vorrichtung des Weiteren eine Fluidausgabe  
aufweist, um ein Fluid hin zu einer Zieloberfläche  
zu lenken, wenn elektromagnetische Energie von  
dem Griffelement (100) gerichtet wird. 10
18. Griffelement nach Anspruch 17, bei dem die Vorrich-  
tung einen Laserstrahl erzeugt und ausgibt, wobei  
das Fluid atomisierte Fluidpartikel aufweist, die von  
dem Fluidauslass, oberhalb der Zieloberfläche,  
emittiert werden so dass der benutzte Anteil der ato-  
misierten Fluidpartikel mit dem Laserstrahl oberhalb  
der Zieloberfläche schneidet. 20
19. Griffelement nach Anspruch 18, bei dem die Ziel-  
oberfläche Knochen, Zähnen, Knorpel und/oder  
Weichgewebe umfasst, und wobei die atomisierten  
Fluidpartikel Wasser umfassen. 25
20. Griffelement nach Anspruch 18, bei dem der Laser-  
strahl ausgestaltet ist, um relativ große Mengen von  
Energie an die atomisierten Fluidpartikel in den Vo-  
lumen oberhalb der Zielfläche zu übertragen, um da-  
durch die atomisierten Fluidpartikel auszudehnen,  
und eine disruptive Kraft auf die Zieloberfläche aus-  
zuüben. 30
21. Griffelement nach Anspruch 20, bei dem die Fluid-  
ausgabe ausgestaltet ist, um Wasser in das Volu-  
men einzubringen, und wobei die Vorrichtung eine  
ER:YAG, ER:YSGG, ER,CR:YSGG und/oder CTE:  
YAG-Laser umfasst. 35

## Revendications

1. Pièce à main (100) couplée à l'extrémité distale du  
corps allongé d'un dispositif d'éclairage,  
comprenant : 50
- un dispositif d'éclairage (10) comprenant un  
corps allongé (12) ayant une portion distale (24)  
et une portion proximale (26), la portion distale  
(24) comprenant un tube de portion distale uni-  
taire (24) ayant une lumière (14), et la portion  
proximale (26) incluant une pluralité de tubes de

portion proximale (22), chaque tube de portion  
proximale (22) ayant une lumière en communi-  
cation avec la lumière (14) du tube de portion  
distale (24) du corps allongé (12) ;  
une fibre optique de puissance (20) ayant un  
premier intérieur de transmission, l'intérieur  
étant destiné à transmettre de l'énergie laser de  
coupe, une extrémité proximale en communi-  
cation avec un premier tube des tubes de portion  
proximale (22), et une extrémité distale en com-  
munication avec la lumière du tube de portion  
distale (24) ;  
une fibre optique d'éclairage (16) ayant un  
deuxième intérieur de transmission qui diffère  
du premier intérieur de transmission, une extré-  
mité proximale en communication avec un  
deuxième tube des tubes de portion proximale  
(22), et une extrémité distale en communication  
avec la lumière (14) et la portion distale ;  
un réflecteur positionné pour intercepter la lu-  
mière laser provenant de la fibre optique de puis-  
sance (20) et pour diriger la lumière laser dans  
une direction vers une extrémité de sortie de  
pièce à main (100), le réflecteur (30) étant en  
outre positionné pour intercepter la lumière  
d'éclairage provenant de la fibre optique d'éclairage  
(16) et pour diriger la lumière d'éclairage  
dans une direction vers l'extrémité de sortie de  
pièce à main (100) ;  
un premier guide d'onde de pointe de sortie (40)  
ayant un intérieur de transmission de laser et  
configuré pour recevoir la lumière laser de la  
fibre optique de puissance (20) et pour diriger  
la lumière laser en éloignement de l'extrémité  
de sortie de pièce à main (100) ; et  
un deuxième guide d'onde de pointe de sortie  
(38) ayant un intérieur de transmission d'éclairage  
qui n'est pas le même que l'intérieur de  
transmission de laser, et configuré pour recevoir  
la lumière visible provenant de la fibre optique  
d'éclairage (16) et pour diriger la lumière visible  
en éloignement de l'extrémité de sortie de pièce  
à main (100).

2. Pièce à main selon la revendication 1, dans laquelle  
la pluralité de tubes de portion proximale (22) com-  
prend trois fibres optiques (16). 45
3. Pièce à main selon la revendication 1, dans laquelle,  
au niveau de la portion distale (24), les au moins  
deux tubes de portion proximale (22) forment la lu-  
mière (14) dimensionnée pour recevoir au moins une  
fibre optique (16, 20). 50
4. Pièce à main selon la revendication 1, dans laquelle :  
la pluralité de tubes de portion proximale (22)  
comprend un premier tube de portion proximale,

- le deuxième tube de portion proximale, et un troisième tube de portion proximale ; chacun ayant un diamètre interne égal ; et la portion proximale (26) du corps allongé (12) inclut en outre un quatrième tube de portion proximale ayant un diamètre interne plus petit que le diamètre interne du premier tube de portion proximale et du deuxième tube de portion proximale.
5. Pièce à main selon la revendication 1, dans laquelle :
- le corps allongé comprend un axe longitudinal central ; et le réflecteur (30) est positionné au niveau de l'axe central et de la portion distale (24), l'élément optique (30) étant configuré pour diriger la lumière de laser provenant de la fibre optique de puissance (20) dans le premier guide d'onde de pointe de sortie (40) et pour diriger la lumière visible provenant de la fibre optique d'éclairage (16) dans le deuxième guide d'onde de pointe de sortie (38).
6. Pièce à main selon la revendication 1, dans laquelle la portion distale (24) et la portion proximale (26) du corps allongé (12) sont formées solidairement.
7. Pièce à main selon la revendication 1, comprenant en outre un premier tube, un deuxième tube, un troisième tube et un quatrième tube de portion proximale (22A, 22B, 22C, 22D).
8. Pièce à main selon la revendication 7, dans laquelle trois des quatre tubes de portion proximale (22) ont des diamètres similaires.
9. Pièce à main selon la revendication 7, dans laquelle le premier tube de portion proximale, les deuxième et troisième tubes de portion proximale (22) contiennent chacun trois fibres optiques disposées dans la lumière des tubes de portion proximale respectifs (22), et le quatrième tube de portion proximale contient une fibre optique disposée dans la lumière du quatrième tube de portion proximale.
10. Pièce à main selon la revendication 9, dans laquelle chacun des premier et deuxième tubes de portion proximale contient une pluralité de fibres optiques regroupées ensemble.
11. Pièce à main selon la revendication 1, dans laquelle le corps allongé (12) a une longueur d'environ 1,5 mètre et la portion proximale (26) du corps allongé a une longueur d'environ 5 centimètres.
12. Pièce à main selon la revendication 1, dans laquelle la portion distale (24) et la portion proximale (26) sont constituées d'un matériau flexible.
13. Pièce à main selon la revendication 1, dans laquelle la portion distale (24) inclut une région qui est rigide et droite par rapport à la portion proximale (26) du corps allongé.
14. Pièce à main selon la revendication 1, dans laquelle la portion distale (24) inclut une extrémité de sortie émettant de la lumière, et le dispositif comprend en outre au moins un miroir (30) situé distalement par rapport à l'extrémité de sortie émettant de la lumière.
15. Pièce à main selon la revendication 14, comprenant un premier miroir (32) élaboré pour réfléchir l'énergie électromagnétique fournie par un laser à l'erbium, et un deuxième miroir (34) élaboré pour réfléchir la lumière visible.
16. Pièce à main selon la revendication 14, dans laquelle la pièce à main (100) comprend une structure de pointe qui inclut le premier guide d'onde de pointe de sortie (40) et le deuxième guide d'onde de pointe de sortie (38) et qui est couplée à l'extrémité distale (24) du corps allongé (12) pour diriger l'énergie électromagnétique provenant de la pièce à main (100).
17. Pièce à main selon l'une quelconque des revendications 1 à 16, dans laquelle le dispositif comprend en outre une sortie de fluide pour diriger le fluide vers une surface cible lorsque de l'énergie électromagnétique est dirigée en provenance de la pièce à main (100).
18. Pièce à main selon la revendication 17, dans laquelle : le dispositif génère et produit en sortie un faisceau laser ; le fluide comprend des particules de fluide atomisées émises depuis la sortie de fluide au-dessus de la surface cible de sorte qu'en utilisation, des portions des particules de fluide atomisées coupent le faisceau laser au-dessus de la surface cible.
19. Pièce à main selon la revendication 18, dans laquelle la surface cible comprend un élément parmi l'os, les dents, le cartilage et le tissu mou et les particules de fluide atomisées comprennent de l'eau.
20. Pièce à main selon la revendication 18, dans laquelle le faisceau laser est configuré pour conférer des quantités relativement importantes d'énergie dans les particules de fluide atomisées dans le volume situé au-dessus de la surface cible pour ainsi dilater les particules de fluide atomisées et conférer des forces de perturbation sur la surface cible.
21. Pièce à main selon la revendication 20, dans laquelle : la sortie de fluide est configurée pour pla-

cer de l'eau dans le volume ; et le dispositif comprend un élément parmi un laser Er:YAG, un laser Er:YSGG, un laser Er,Cr:YSGG et un laser CTE:YAG.

5

10

15

20

25

30

35

40

45

50

55

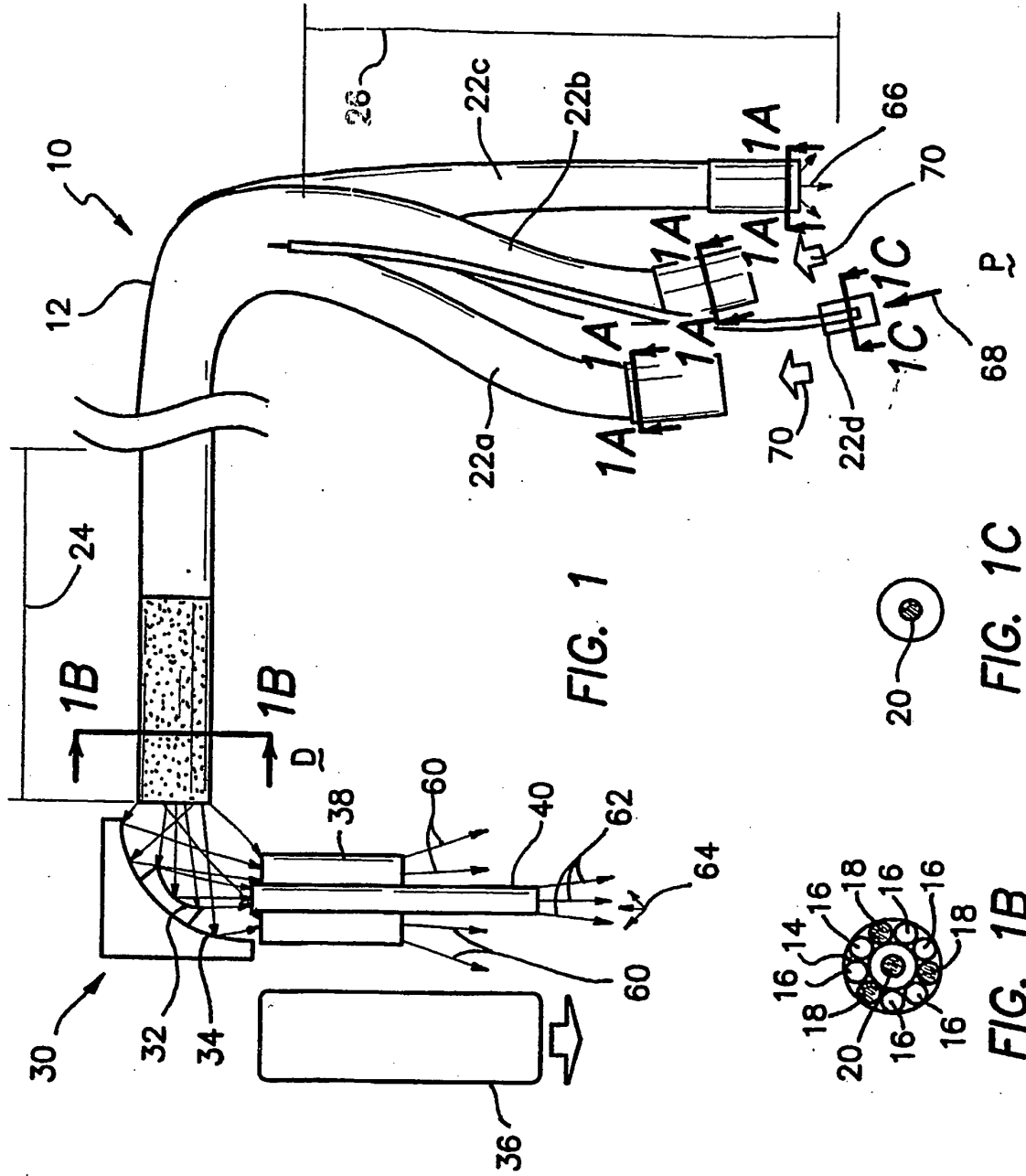

FIG. 1

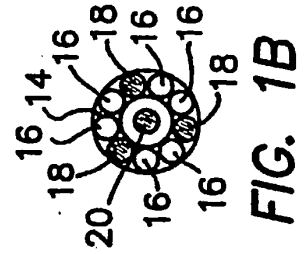

FIG. 1A

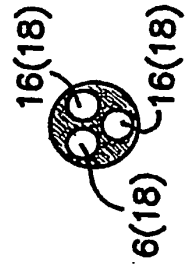

FIG. 1B



FIG. 1C

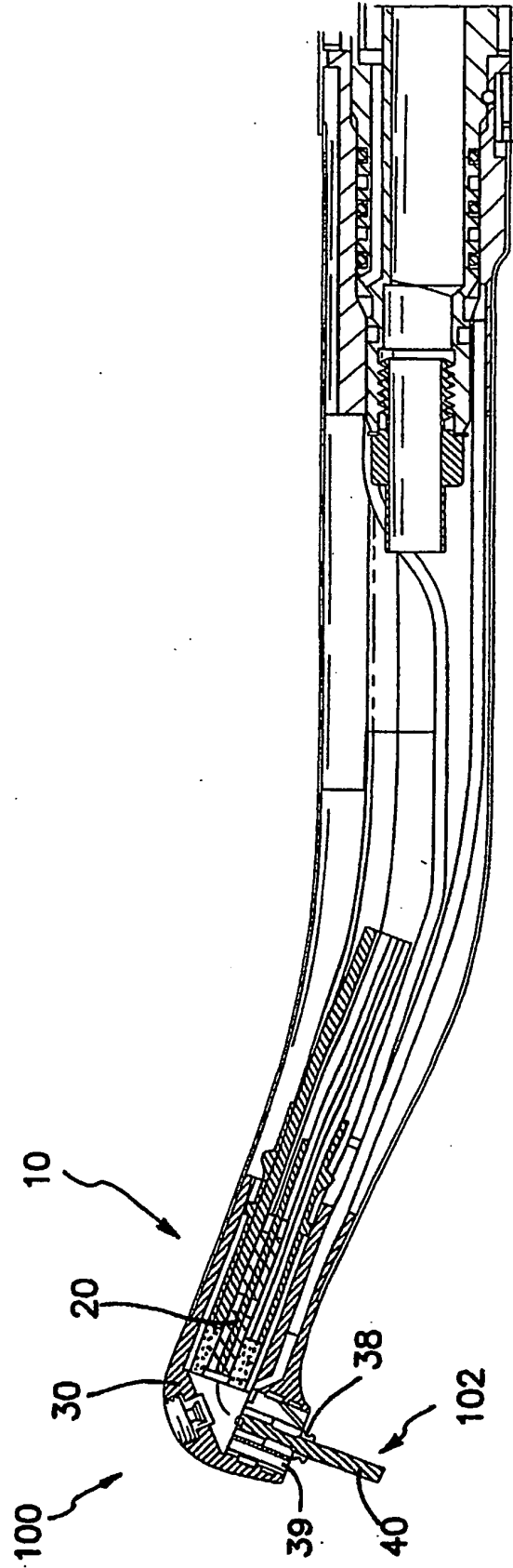

FIG. 2

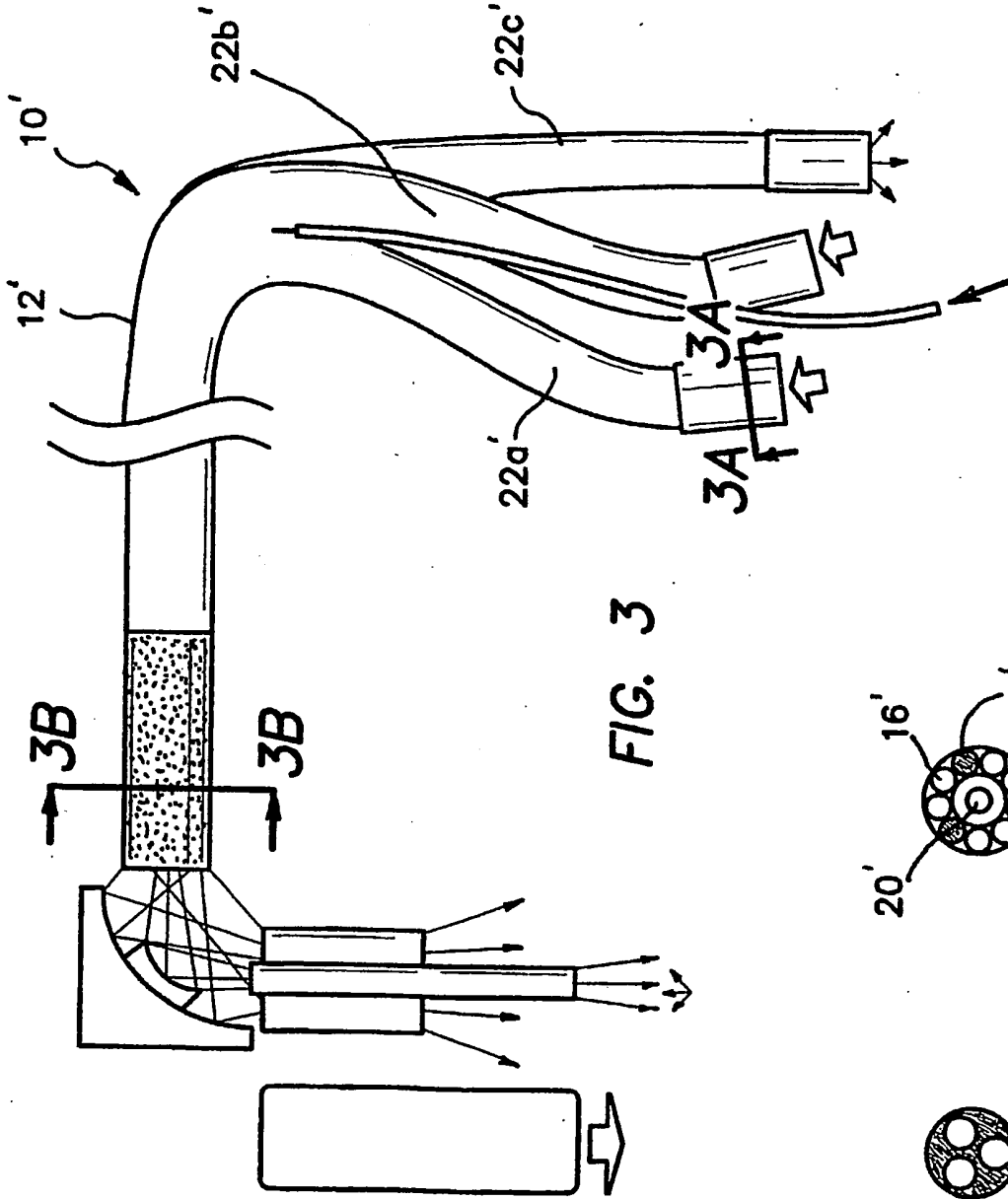
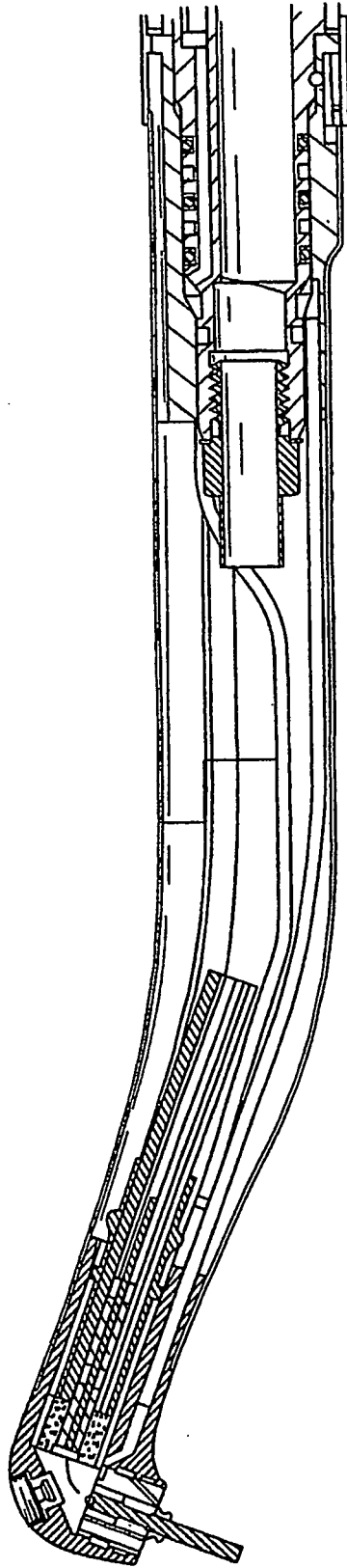

FIG. 3

FIG. 3B

FIG. 3A



**FIG. 4**

**REFERENCES CITED IN THE DESCRIPTION**

*This list of references cited by the applicant is for the reader's convenience only. It does not form part of the European patent document. Even though great care has been taken in compiling the references, errors or omissions cannot be excluded and the EPO disclaims all liability in this regard.*

**Patent documents cited in the description**

- US 20030045780 A [0003]
- US 20030167066 A [0004]
- US 5836941 A [0005]
- US 6188521 B [0006]
- US 5741247 A [0024] [0040]
- US 5785521 A [0040]
- US 5968037 A [0040]
- US 6086367 A [0040]
- US 6231567 B [0040]
- US 6254597 B [0040]
- US 6288499 B [0040]
- US 6350123 B [0040]
- US 6389193 B [0040]
- US 6544256 B [0040]

专利名称(译)	照明装置和相关方法		
公开(公告)号	<a href="#">EP1732646A4</a>	公开(公告)日	2008-06-11
申请号	EP2005711335	申请日	2005-01-10
[标]申请(专利权)人(译)	生物雷射科技股份有限公司		
申请(专利权)人(译)	BIOLASE TECHNOLOGY, INC.		
当前申请(专利权)人(译)	BIOLASE TECHNOLOGY, INC.		
[标]发明人	BOUTOUSSOV DMITRI		
发明人	BOUTOUSSOV, DMITRI		
IPC分类号	A61N5/00 A61B1/04 A61B1/06 A61B1/12 A61B5/00 A61B18/18 A61B18/20 A61B18/22 A61B19/00 A61C1/00 A61C1/08 A61N5/06		
CPC分类号	A61B18/22 A61B90/30 A61B2090/306 A61C1/0046 A61C1/088		
优先权	60/535183 2004-01-08 US		
其他公开文献	EP1732646B1 EP1732646A2		
外部链接	<a href="#">Espacenet</a>		

摘要(译)

描述了一种用于医疗和牙科手术的照明装置。该照明装置包括细长主体，该细长主体被配置为包含两个或更多个光纤，以将来自电源的电磁能量传输到目标表面。照明装置的远端示出为整体结构，并且近端示出为具有多个近端构件。该照明装置包括两个或更多个用于向远端传输能量的光纤，以及至少一个用于将能量从远端朝向装置的近端传输的光纤。

