



(11) **EP 3 408 650 B1**

(12) **EUROPEAN PATENT SPECIFICATION**

(45) Date of publication and mention of the grant of the patent:
27.11.2019 Bulletin 2019/48

(51) Int Cl.:
G01N 21/47 (2006.01) A61B 5/00 (2006.01)

(21) Application number: **16705993.0**

(86) International application number:
PCT/IB2016/050375

(22) Date of filing: **26.01.2016**

(87) International publication number:
WO 2017/130020 (03.08.2017 Gazette 2017/31)

(54) **PORTABLE OPTICAL APPARATUS FOR DIFFUSE REFLECTANCE SPECTROSCOPY**

TRAGBARE OPTISCHE VORRICHTUNG FÜR DIFFUSE REFLEXIONSSPEKTROSKOPIE

APPAREIL OPTIQUE PORTABLE POUR SPECTROSCOPIE DE RÉFLECTANCE DIFFUSE

(84) Designated Contracting States:
AL AT BE BG CH CY CZ DE DK EE ES FI FR GB GR HR HU IE IS IT LI LT LU LV MC MK MT NL NO PL PT RO RS SE SI SK SM TR

- **ULUDAG , Yildiz**
41470 Kocaeli (TR)
- **BEKTAS , Gökhan**
41470 Kocaeli (TR)
- **CANSU, Veysi**
41470 Kocaeli (TR)
- **RIZA, Dadas**
41470 Kocaeli (TR)

(43) Date of publication of application:
05.12.2018 Bulletin 2018/49

(73) Proprietor: **Tubitak**
06100 Ankara (TR)

(56) References cited:
GB-A- 2 115 175 US-A- 4 223 680
US-A1- 2007 265 513 US-A1- 2009 022 463
US-A1- 2015 015 888

(72) Inventors:

- **KARAMAVUS , Yunus**
41470 Kocaeli (TR)
- **ÇELEBI , Hasan Basri**
41470 Kocaeli (TR)

EP 3 408 650 B1

Note: Within nine months of the publication of the mention of the grant of the European patent in the European Patent Bulletin, any person may give notice to the European Patent Office of opposition to that patent, in accordance with the Implementing Regulations. Notice of opposition shall not be deemed to have been filed until the opposition fee has been paid. (Art. 99(1) European Patent Convention).

Description

Technical Field

[0001] The present invention relates to an optical apparatus for portable diffuse reflectance spectroscopy; and more particularly, relates to an optical probe that is made of Poly(methyl methacrylate) (PMMA) material for the spectroscopic measurement or analysis of biological attributes of tissue.

Background Art

[0002] Obtaining optical properties of skin leads to useful information about the skin physiology, morphology, and composition. These can be obtained in a non-invasive manner and in real time using an optical method of analysis. One such optical method is reflectance spectroscopy consists of two components: specular reflectance and diffuse reflectance. The specular reflectance of a skin sample is the light which does not propagate into the sample, but rather reflects from the front surface of the sample. This component contains information about the biological sample at the surface. In order to gather information from the deeper section of the biological tissues, diffuse reflectance spectroscopy can be applied.

[0003] Diffuse reflectance spectra are obtained from the light that has traveled within the tissue. As the beam penetrates the biological tissue, the direction of propagation changes randomly due to the refractive index variations in the layers beneath. The light is attenuated on its pathway due to the absorption and scattering events. After numerous scattering events, some of the light emerges from the surface. The intensity of this reflected light carries information regarding the absorption and scattering of light through the medium which can be correlated with the morphology to determine the pathological state of the tissue and/or the concentration of a biochemical/analyte in the tissue. Diffuse Reflectance Spectroscopy has been widely used for non-invasive analysis and the characterization of the biological tissues. This technique provides rapid quantitative measurements of pigments within the tissue. Non-invasive measurements via reflectance spectroscopy are desirable because they are painless, do not require fluid drawn from the body, carries little risk of contamination or infection, and do not generate any hazardous waste and enables rapid measurement. Accurate, non-invasive determination of bilirubin, as an example, could reduce many of the complications associated with the newborn jaundice. Similarly, accurate, non-invasive determination of various disease states could allow faster, more convenient screening and diagnosis, allowing more effective treatment. Biomedical applications of reflectance spectroscopy include study on colon, esophagus, stomach, bladder, cervix, ovaries, breast, brain, liver, pancreas, heart, oral tissues, and skin [1].

[0004] A typical measurement setup for reflectance spectroscopy consists of a light source for illumination of skin, a detector for evaluation of reflected light, and an optical probe for delivery and collection of the reflected light. A light source can be a halogen lamp, a tungsten lamp, a light emitting diode (LED) etc. A detector can be a photo detector or a spectrometer. Generally, fiber optic cables are being used as an optic probe for light transmission [2-3-4]. Optic probes consist of two separate light paths, one for the delivery of light to the targeted biological tissue and one for the collection of light coming from the targeted biological tissue.

Disclosure of Invention

Technical Problem

[0005] Designing of a portable diffuse reflectance spectroscopy is a challenge due to the difficulties faced to miniaturize the device and the manufacturing of the optical apparatus, which leads to a high cost. Furthermore, collecting the returning light from deep within the tissue is challenging due to the specular component of the reflected light. Longer integration time is another problem of reflectance spectroscopy.

[0006] Traditionally, the accessory used to measure diffuse reflectance is an integrating sphere [5]. Because of the geometry of the integrating sphere, it has the ability to collect most of the reflected light, it can remove any directional preferences, and present an integrated signal to the detector. However, for a portable skin measuring device, application of diffuse reflectance spectroscopy necessitates being compact, lightweight, small sized and user friendly optical apparatus. Integrating sphere structure does not allow miniaturization and hence not suitable to be used in a portable device.

[0007] Currently, fiber optic probes with varying diameters and fiber cable arrangements are in use for the optical probes. For example, a construction of a probe with a linear alignment of fibers, and placing the detection fibers in different places is a design currently in use. An alternative design is, a circular fiber arrangement with a source fiber in the middle of all other fibers. Also, it is possible to face a micro machined fiber optical sensor with different number of source fibers and numerous collection fibers. The source fibers are placed obliquely with the angle 45°. In another fiber optic probe, 5 fibers are used which are cast in-line in an aluminum probe. The first fiber is used for the illumination and others are used for the source detection (source-detector distances are 0.6 mm, 1.2 mm, 1.8 mm, and 2.4 mm). Despite the wide use of fiber optic probes, their manufacturing process is rather complex. Especially, while designing a custom designed probe, one can need to cut the fibers which are not an easy process. Cutting the fibers needs special cutter devices and after the cutting process fibers' endings need to be polished which is another difficult and time consuming process. Furthermore, arranging fibers

in a desired alignment as making fiber bundle, is not easy because of small diameters. Another important drawback of using fiber is the dead area between fibers in a fiber bundle. This dead area is unfavorable because of not allowing light transportation.

[0008] The main components of the reflected light include specular reflectance and diffuse reflectance. The diffuse component of the reflected light is desirable, and even essential, if the reflectance spectroscopy is used for examining the subcutaneous tissue, since specular reflectance component only contains information about the surface of the skin. The information about the presence or concentration of a chromophore in the subcutaneous tissue, such as hemoglobin and bilirubin, is carried by diffusely reflected light from the human tissue. The epidermis layer has very little or no blood and thus corresponding diffusely reflected light component from epidermis layer has little or no information about the biological information. Consequently, it is critical to collect only diffusely reflected light returning from the subcutaneous tissue.

[0009] Diffuse reflectance spectrum carries the information about the concentration of the biological chromophores deep inside the human skin. It is critical to acquire the sufficient reflected light intensity to calculate the concentration of those chromophores. In order to have this sufficient intensity, integration time or efficiency of the system can be increased. However, in some applications, such as transcutaneous bilirubinometry, fast integration time is required to decrease the environmental noise effects such as motion blur. Thus, achieving shorter integration time is one of the most vital issues in diffuse reflectance spectroscopy. Increasing the light transmission efficiency is a mean to shorten the integration time. For better light transmission efficiency, light delivery path should be coupled to the light source effectively and so should light collection path with detector.

[0010] Document US 2007/0265513 A1 teaches an optical apparatus for obtaining a reflectance spectrum, wherein a means for transferring light to and receiving light from a substrate is an optic probe comprising concentric fibre bundles for transferring light to and receiving light from the substrate respectively.

Technical Solution

[0011] The present invention comprises a new optical probe design for diffuse reflectance spectroscopy measurements; more particularly, a novel optical apparatus design in which an optical probe made of Poly(methyl methacrylate) (PMMA) is used to transfer and receive light for the spectroscopic measurements. Here, a novel device is presented with a new optical apparatus that provides smaller size, easy manufacturing process and lower cost. Also, optical apparatus is designed in such a way that only diffusely reflected light can be collected by the detector. Shorter integration time is another superiority of this novel optical apparatus. While designing a

portable diffuse reflectance spectroscopy instrument, a compact, lightweight, small sized and user friendly design should be taken into account. Obtaining such an optical apparatus, using PMMA rods for light transmission is a solid solution. Besides using PMMA material in the designed optical probe, the present invention has novelty in optical apparatus components (detector, source, and probe) placement. A micro spectrometer is used as a detector and placed on top of the optical apparatus coupling to the light collection path. Below the spectrometer, light source is placed that is coupled to the light delivery path. This placement creates a compact structure for the designed optical apparatus.

[0012] Using PMMA material in the optical probe has several advantages. First of all, it enables an easy manufacturing process compared to fiber optic cable based systems. Also, PMMA optical probe does not need advanced cleaving devices, polishing materials or a bundling process as required by optical fiber cables. Only one piece of a PMMA rod with couple of mm core size has capability to carry sufficient light intensity to either transfer or collect light. Eventually, PMMA probe is much easier to manufacture, more compact and more affordable than the conventional optical fiber probes. These attributes results in a superior optical probe for any spectroscopic analysis.

[0013] Another important aspect of this novel optical apparatus is, it provides maximum light transmission efficiency by minimizing the dead zone. The present invention provides an optical probe consisted of two nested PMMA rods with 4 mm and 8 mm core sizes. The outer rod is used to expose the skin surface with a white light produced by a LED. And the reflected light emerging from the various layers of the tissue is collected by the inner rod, which is coupled to a spectrometer. Because of the tightly nested structure of two cylindrical PMMA rods, there is no dead zones as seen in fiber optic cable bundles.

[0014] The proposed optical apparatus includes a pressure-sensitive probe that is activated when pressed on human skin. This illuminates the skin with a bright strobe light generated by a LED light source. This bright light travels for a short distance through the skin where the pressure-sensitive probe is applied and brightens the underlying subcutaneous tissue. The scattered light is then channeled through the inner PMMA rod that is isolated from the outer PMMA rod. The specular component of the reflectance spectrum cannot follow the inner path because of this isolation between the two rods. Thus, only diffusely reflected light reaches the spectrometer module.

[0015] Shorter integration time is another advantage of the proposed optical apparatus. Higher light transmission efficiency is the main reason of achieving shorter integration time. Although, the attenuation coefficient of PMMA material is not smaller than the fiber optic cable, the dissipation is negligible because of the short illumination channels. In addition, because of the larger con-

tact area of the probe to the skin surface, higher light intensity is received than the fiber optic cable can permit.

[0016] With these and other solutions in view, which will become apparent to one who is expert in the art, this invention resides in the novel construction, original placement of components, and increased light transmission efficiency of optical apparatus for diffuse reflectance spectroscopy. More particularly a new approach is offered by the use of PMMA material in the optical probe design that makes this invention novel.

Advantageous Effects

[0017] This invention is advantageous because it is compact, lightweight, small sized and user friendly.

[0018] Another advantage of this invention is to provide a novel placement of detector, source, and optic probe.

[0019] It is another advantage of this invention is to use a white LED with a flat spectrum in visible range.

[0020] It is yet another advantage of this invention is, use of PMMA material in the optical probe design. Using this material makes this invention manufacturing process easy and affordable.

[0021] It is another advantage of this invention is the minimization of dead zone that prevents the light transmission.

[0022] It is still another advantage of this invention is to provide maximum light transmission efficiency.

[0023] It is still another advantage of this invention is to provide shorter integration time.

[0024] It is still another advantage of this invention is to provide a pressure-sensitive probe, which is invoked when pressed on the human skin.

[0025] It is still another advantage of this invention is that it provides collection of diffusely reflected light.

Description of Drawings

[0026] The accompanying drawings illustrate a complete embodiment of the invention according to the best mode so far devised for the practical application of the principles thereof, and in which:

FIG. 1 is a schematic and block diagram of the diffuse reflectance measurement system

FIG. 2 is a schematic representation of the incident light on a skin tissue

FIG. 3 shows the expanded figure of optical apparatus

FIG. 4 shows the cross sectional view of optical apparatus

FIG. 5 shows the top view of optical apparatus

[0027] In FIG. 1, it is shown that the light that is pro-

duced by a white LED is directed to the skin surface. The light penetrates into the skin tissue by randomized propagation. After numerous scattering events, some of the light emerges from the skin surface. This reflected light is collected by a spectrometer to obtain the reflectance spectra. From this spectra, it is possible to determine the concentration of the target chromophore in the subcutaneous tissue by the appropriate data analyses.

[0028] FIG. 2 illustrates the skin surface 1 illumination by an incident light coming from the outer PMMA rod 12. As depicted in the simplified representation, the skin includes three layers, the upper layer or epidermis 2, a middle layer or dermis 3, and subcutaneous tissue 4. Incident light 5 illuminates the skin surface and penetrates into the subcutaneous tissue. A portion of the light energy may be reflected specularly 6 which cannot not reach the light collection path. Instead, a tissue sample may absorb a portion of the light energy, resulting in absorbed light energy 7. A third phenomena includes transmitted energy 8 into the deeper tissue. Lastly, a portion of the light can be diffusely reflected 9. As shown in FIG. 1 diffusely reflected portion of light ray change the direction several times and then this portion 10 is collected by the inner PMMA rod 13. To prevent the light transmission from one rod to the other, the rods are isolated from each other by a semi mirrored isolator 14. In this way only diffusely reflected light is analyzed. Also, the semi-mirrored isolator increases the light transmission efficiency. The outer isolation is provided by the optical probe holder 11, which holds the other components of the optical apparatus.

[0029] The expanded schematic view of the optical apparatus is shown in FIG. 3. Two cylindrical PMMA rods 12, 13 are placed in a nested structure and isolated from each other with an isolator material 14. Optic probe holder 11 contains a spring 16 with a spring holder 15 allowing pressure-sensitive activation mechanism. This mechanism allows the appropriate pressure on the skin surface, and thus helps providing correct measurement results. Illumination of the target skin surface is achieved by the LEDs, placed on the LED circuit card 17. After a sufficient illumination of the skin, the diffusely reflected light that is typically reflected by various depths within the tissue is collected by the inner PMMA rod and carried to the spectrometer 18. This spectrometer is placed on a circuit card 19.

[0030] Referring now to FIG. 4, there is shown a cross sectional view of optical apparatus. In FIG. 4 the placement of the optical apparatus components is seen. From the top side to the bottom, spectrometer circuit card 19 is in the first place that is fixed with two screws 20. The collected light enters the spectrometer 18 through its slit 21. Collection PMMA rod 13 is directly coupled to this slit. Below the spectrometer, LED circuit card 17 is placed and fixed by two screws 24. On this card, there are two white LEDs 23 with wide flat spectrums (for example from 350 nm to 750 nm wavelengths). These LEDs are positioned adjacent the top surface of the source PMMA rod

12. Light travels through this path and reaches the skin surface.

[0031] FIG. 5 shows the top view of the optical apparatus. This is a moving part inside the measurement device. When this apparatus applied on to the skin surface with a sufficient pressure, it moves inside the device and touches to a switch by a switch contact point 22. This contact activates the system and initiates the measurement.

References

[0032]

1. Zonios, G., & Dimou, A. (2006). Modeling diffuse reflectance from semi-infinite turbid media: application to the study of skin optical properties. *Optix Express*, 14 (9).
2. Nichols, M. G., Hull, E. L., & Foster, T. H. (1997). Design and testing of a white-light, steady-state diffuse reflectance spectrometer for determination of optical properties of highly scattering system. *Appl. Optics*, 36 (1), 93-104.
3. Bosschaart, N., Mentink, R., Kok, J. H., van Leeuwen, T. G., & Aalders, M. C. (2011, September). Optical properties of neonatal skin measured in vivo as a function of age and skin pigmentation, „, Sep. 2011. *Journal of Biomedical Optics* .
4. Bhadri, P. R. (2007). Spectrometric Quantification of Bilirubin in Hemorrhagic Spinal Fluid using an Innovative Algorithm,. *Medical Chemistry*, 3, 21-27.
5. Saidi, I. S. (1992). Transcutaneous Optical measurements of hyperbilirubinemia in neonates. Rice University

Claims

1. An optical apparatus for obtaining a reflectance spectrum for obtaining information about a chromophore concentration in a substrate, the apparatus comprising:
 - a) means for generating a probe light
 - b) means for transferring said probe light to and receiving reflected light from a substrate, wherein said means is an optic probe made of PMMA material having: exactly two compact coaxial PMMA rods (12, 13), one being nested within the other, respectively for collection of reflected light and illumination with probe light, the inner rod (13) for receiving said reflected light being longer than the outer rod (12) for illumination of the substrate with the probe light, the inner rod being optically isolated from the outer rod with a semi-mirrored isolator layer (14);
 - c) means for collecting the reflected light that is reflected from deep within the substrate and re-

ceived by the inner rod (13) wherein the semi-mirrored isolator layer is configured to prevent specular reflected light from entering the inner rod.

2. An optical apparatus according to claim 1, wherein means for generating the said probe light is two white LEDs (23) with wide flat spectrums preferably from 350 nm to 750 nm wavelengths
3. An optical apparatus according to claim 1, comprising a micro-spectrometer for detecting the spectrum of the diffusely reflected probe light passed through the inner rod (13).
4. An optical apparatus according to claim 1 for obtaining a reflectance spectrum wherein the placement of the components of the optical apparatus is done accordingly to provide a compact structure comprising:
 - a) Micro spectrometer is placed uppermost of the optical apparatus,
 - b) LED light source is placed below the micro spectrometer directed to the optic probe wherein
 - c) the optic probe is coupled to LED and micro spectrometer.

Patentansprüche

1. Optisches Gerät zum Erhalten eines Reflexionspektrums zum Erhalten von Informationen über eine Chromophorkonzentration in einem Substrat, wobei die Vorrichtung folgendes umfaßt:
 - a) Mittel zum Erzeugen eines Sondenlichts
 - b) Mittel zum Übertragen des Sondenlichts auf ein Substrat und zur Aufnahme von reflektiertem Licht von einem Substrat; wobei das Mittel eine optische Sonde, aus PMMA-Material ist: Genau zwei kompakte koaxiale PMMA-Stäbe (12, 13), von denen eines im anderen verschachtelt ist, zum Sammeln von reflektiertem Licht und zum Beleuchten mit Sondenlicht; wobei der innere Stab (13) zur Aufnahme des reflektierten Lichts länger ist als der äußere Stab (12) und der innere Stab vom äußeren Stab durch eine halbverspiegelte Isolatorschicht optisch isoliert ist (14)
 - c) Mittel zum Sammeln des reflektierten Lichts, das aus der Tiefe des Substrats reflektiert und von der inneren Stab (13) empfangen wird, wobei die halbspiegelnde Isolierschicht konfiguriert ist, um zu verhindern, dass das spiegelreflektierte Licht in den inneren Stab eintritt.
2. Optisches Gerät gemäß Anspruch 1, wobei das Mit-

tel zum Erzeugen des Sondenlichts zwei weiße LEDs (23) mit breiten flachen Spektren, vorzugsweise für Wellenlängen von 350 bis 750 nm sind.

3. Optisches Gerät gemäß Anspruch 1, die ein Mikrospektrometer zum Erfassen des Spektrums von diffus reflektiertem Sondenlicht umfasst, das durch den inneren Stab (13) geleitet wird.

4. Optisches Gerät gemäß Anspruch 1, zum Erhalten eines Reflexionsspektrums, wobei die Platzierung der Komponenten des optischen Gerätes durchgeführt wird, um eine kompakte Struktur bereitzustellen, die folgendes umfasst:

- a) Das Mikrospektrometer befindet sich ganz oben auf der optischen Vorrichtung,
- b) Die LED-Lichtquelle befindet sich unter dem Mikrospektrometer, das auf die optische Sonde gerichtet ist, wobei
- c) Die optische Sonde mit LED und dem Mikrospektrometer gekoppelt ist.

Revendications

1. Appareil optique pour obtenir un spectre de réflectance afin d'obtenir des informations sur une concentration de chromophore dans un substrat, l'appareil comprenant:

- a) des moyens pour générer une lumière de sonde
- b) des moyens pour transférer ladite lumière de sonde sur un substrat et recevoir de la lumière réfléchie par un substrat, ledit moyen étant une sonde optique faite d'un matériau à base de PMMA ayant: exactement deux tiges PMMA coaxiales compacts (12, 13), l'un imbriqué dans l'autre, respectivement pour la collecte de la lumière réfléchie et l'éclairage avec une lumière de sonde, la tige interne (13) destinée à recevoir ladite lumière réfléchie étant plus longue que la tige externe (12) pour l'éclairage du substrat avec la lumière de sonde, la tige interne étant isolée optiquement de la tige externe avec une couche isolante semi-réfléchissante (14);
- c) des moyens pour collecter la lumière réfléchie qui est réfléchie de manière profonde dans le substrat et reçue par la tige interne (13), la couche isolante semi-miroir étant configurée pour empêcher la lumière spéculaire réfléchie d'entrer dans la tige interne.

2. Appareil optique selon la revendication 1, dans lequel les moyens pour générer ladite lumière de sonde sont deux LED blanches (23) à large spectre plat,

de préférence de 350 nm à 750 nm de longueur d'onde.

3. Appareil optique selon la revendication 1, comprenant un micro-spectromètre pour détecter le spectre de la lumière de sonde réfléchie de manière diffuse et passée à travers la tige interne (13).

4. Appareil optique selon la revendication 1 pour obtenir un spectre de réflectance, dans lequel le placement des composants de l'appareil optique est effectué en conséquence pour fournir une structure compacte comprenant:

- a) Un micro spectromètre est placé en haut de l'appareil optique,
- b) La source de lumière LED est placée sous le micro spectromètre dirigé vers la sonde optique, dans laquelle
- c) la sonde optique est couplée à une LED et à un micro spectromètre.

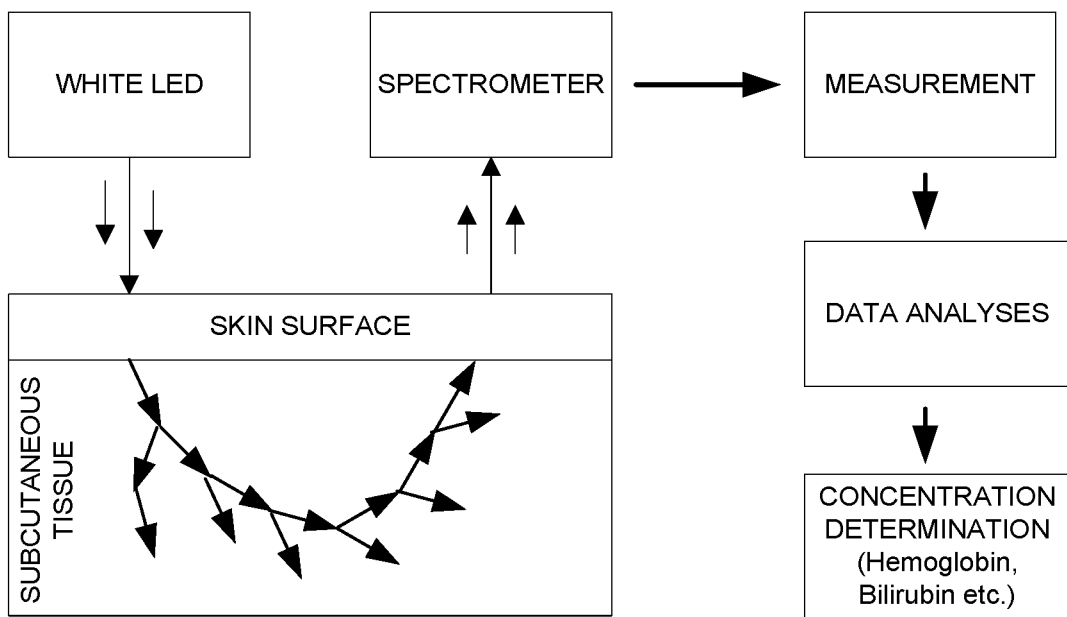

FIG. 1

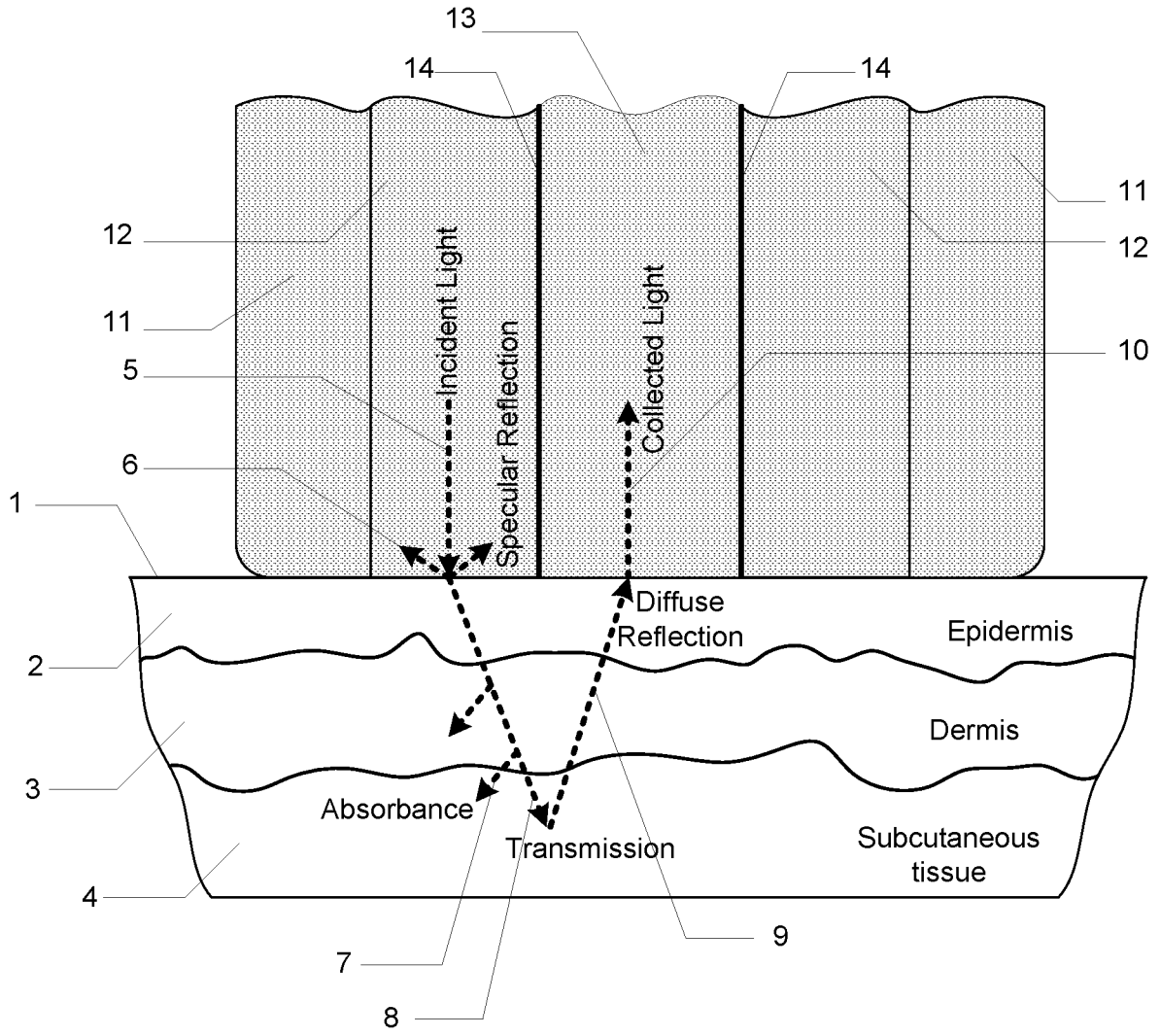

FIG. 2

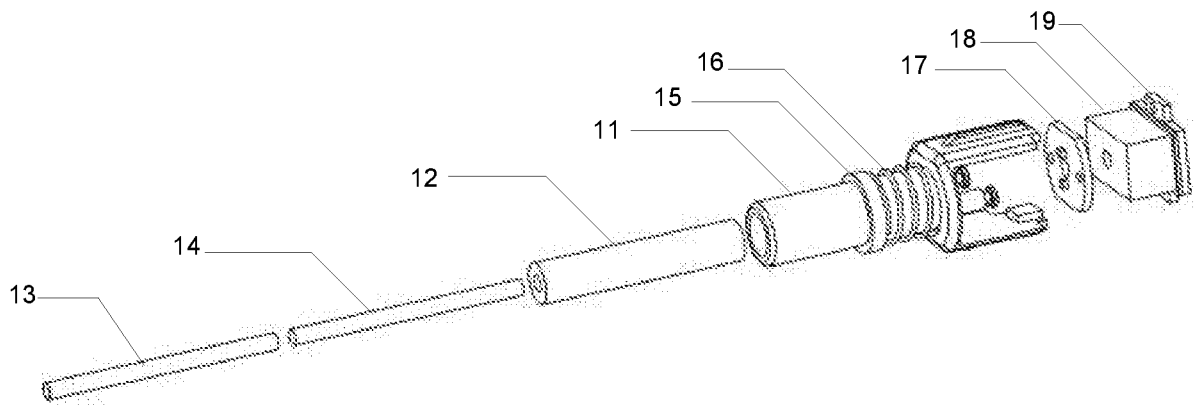

FIG. 3

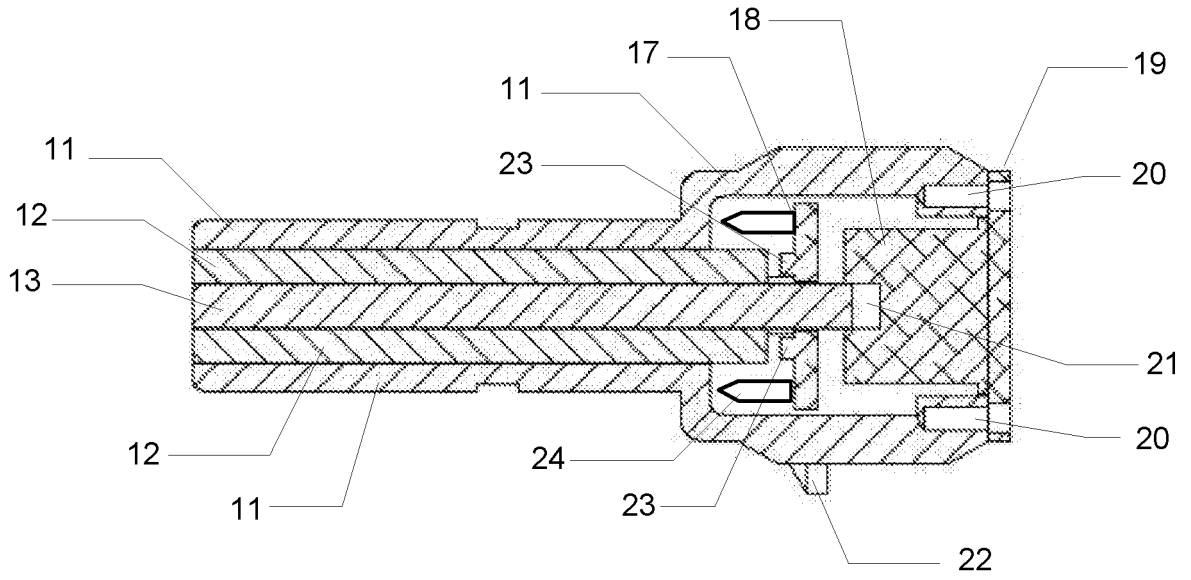

FIG. 4

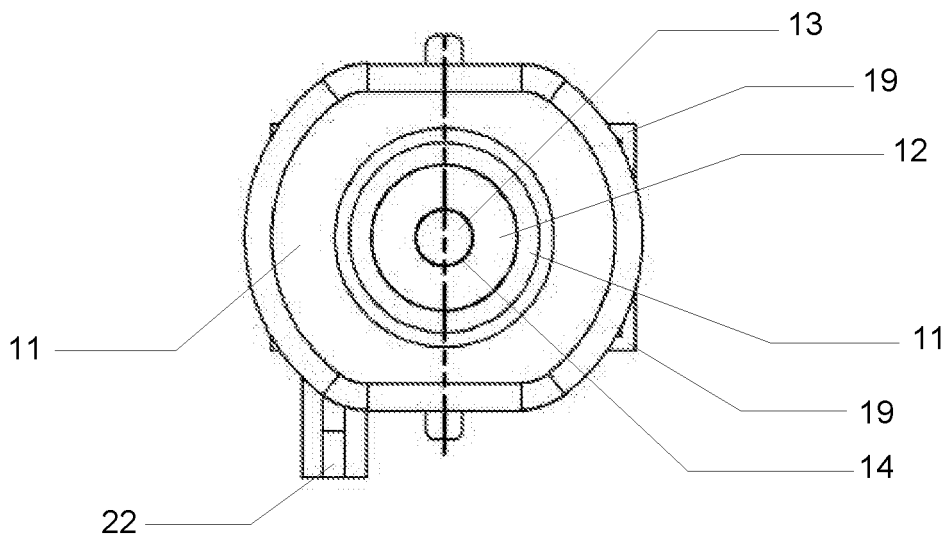

FIG. 5

REFERENCES CITED IN THE DESCRIPTION

This list of references cited by the applicant is for the reader's convenience only. It does not form part of the European patent document. Even though great care has been taken in compiling the references, errors or omissions cannot be excluded and the EPO disclaims all liability in this regard.

Patent documents cited in the description

- US 20070265513 A1 [0010]

Non-patent literature cited in the description

- **ZONIOS, G. ; DIMOU, A.** Modeling diffuse reflectance from semi-infinite turbid media: application to the study of skin optical properties. *Optix Express*, 2006, vol. 14 (9) [0032]
- **NICHOLS, M. G. ; HULL, E. L. ; FOSTER, T. H.** Design and testing of a white-light, steady-state diffuse reflectance spectrometer for determination of optical properties of highly scattering system. *Appl. Optics*, 1997, vol. 36 (1), 93-104 [0032]
- **BOSSCHAART, N. ; MENTINK, R. ; KOK, J. H. ; VAN LEEUWEN, T. G. ; AALDERS, M. C.** Optical properties of neonatal skin measured in vivo as a function of age and skin pigmentation. *Journal of Biomedical Optics*, September 2011 [0032]
- **BHADRI, P. R.** Spectrometric Quantification of Bilirubin in Hemorrhagic Spinal Fluid using an Innovative Algorithm. *Medical Chemistry*, 2007, vol. 3, 21-27 [0032]
- **SAIDI, I. S.** Transcutaneous Optical measurements of hyperbilirubinemia in neonates. Rice University, 1992 [0032]

| | | | |
|----------------|--|---------|------------|
| 专利名称(译) | 用于差分反射光谱的便携式光学装置 | | |
| 公开(公告)号 | EP3408650B1 | 公开(公告)日 | 2019-11-27 |
| 申请号 | EP2016705993 | 申请日 | 2016-01-26 |
| [标]申请(专利权)人(译) | 土耳其科学技术研究理事会 | | |
| 申请(专利权)人(译) | 国家研究理事会 | | |
| 当前申请(专利权)人(译) | 国家研究理事会 | | |
| [标]发明人 | KARAMAVUS YUNUS CELEBI HASAN BASRI ULUDAG YILDIZ BEKTAS GOKHAN CANSU VEYSI RIZA DADAS | | |
| 发明人 | KARAMAVUS , YUNUS ÇELEBI , HASAN BASRI ULUDAG , YILDIZ BEKTAS , GÖKHAN CANSU , VEYSI RIZA , DADAS | | |
| IPC分类号 | G01N21/47 A61B5/00 | | |
| CPC分类号 | A61B5/0075 A61B5/441 G01N21/474 G01N2021/4752 G01N2021/4759 G01N21/47 G01J3/02 G01N2021/4742 | | |
| 其他公开文献 | EP3408650A1 | | |
| 外部链接 | Espacenet | | |

摘要(译)

用于获得反射光谱的光学设备包括：第一装置，用于产生光；第二装置，用于在基板上传输和接收光；第三装置，用于收集漫反射的光；以及第四装置，用于分离漫反射的光。从镜面反射光中获得信息，以获得有关基质中发色团浓度的信息。第二种装置是由聚甲基丙烯酸甲酯（PMMA）材料制成的光学探头，包括一个内杆和一个外杆，该内杆嵌套在该外杆内用于收集和照明，该内杆和外杆是同轴，内杆比外杆长，内杆通过半镜隔离器与外杆隔离，反射光被内杆从基板深处反射。

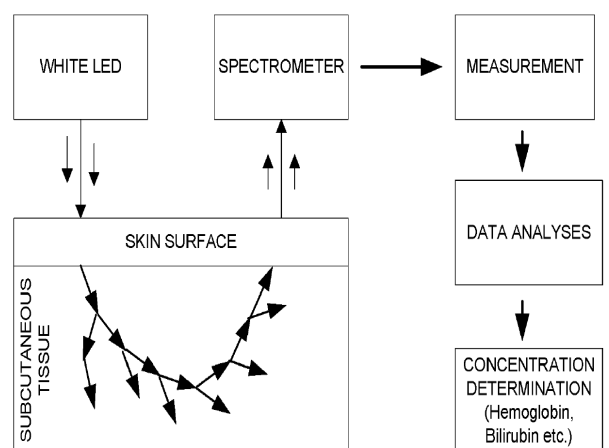

FIG. 1