



(12) **EUROPEAN PATENT APPLICATION**

(43) Date of publication:
22.05.2019 Bulletin 2019/21

(51) Int Cl.:
A61M 15/00 (2006.01) **A61B 5/00 (2006.01)**
A61B 5/087 (2006.01) **A61M 16/00 (2006.01)**

(21) Application number: **17202620.5**

(22) Date of filing: **20.11.2017**

(84) Designated Contracting States:
AL AT BE BG CH CY CZ DE DK EE ES FI FR GB GR HR HU IE IS IT LI LT LU LV MC MK MT NL NO PL PT RO RS SE SI SK SM TR
 Designated Extension States:
BA ME
 Designated Validation States:
MA MD

(72) Inventors:
 • **Jung, Benjamin**
50674 Köln (DE)
 • **Sarda, Arun**
Preston, Lancashire PR5 4TY (GB)

(74) Representative: **Uexküll & Stolberg**
Partnerschaft von
Patent- und Rechtsanwälten mbB
Beselerstraße 4
22607 Hamburg (DE)

(71) Applicant: **Presspart GmbH & Co. KG**
34431 Marsberg (DE)

(54) **INHALATION SYSTEM**

(57) An inhalation system comprising a metered dose inhaler (2) for dispensing an aerosol dose during use and a separate computing device for computing signals received from the metered dose inhaler. The metered dose inhaler (2) comprises a flow rate sensor (16) for detecting an inhalation flow through the actuator housing (4) during use of the metered dose inhaler (2) upon inhalation by a patient and a transmitting unit (20) for transmitting a signal of the at least first switch (10a) as well as of the flow rate sensor (16) to the computing device (3). The computing device (3) is configured to generate visual and/or acoustic messages independently of

the signals of the at least one switch (10a) and the flow rate sensor (16) in order to guide the patient through multiple steps of the use of the metered dose inhaler (2). The computing device is further configured to evaluate the use of the metered dose inhaler (2) by comparing the transmitted signals of the at least first switch (10a) and of the flow rate sensor (16) with the visual and/or acoustic messages. The transmitting unit (20) is configured to transmit the signals of the at least first switch (10a) and the flow rate sensor (15a) to the computing device (3) after the use of the metered dose inhaler (2).

Fig. 1

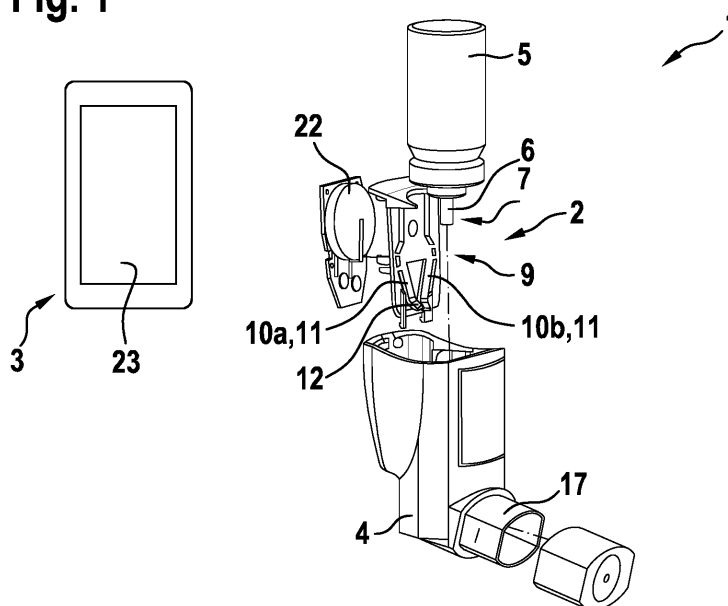

Description

TECHNICAL FIELD

[0001] The present invention relates to an inhalation system comprising a metered dose inhaler for dispensing an aerosol dose during use and a separate computing device for computing signals received from the metered dose inhaler. The metered dose inhaler comprises an actuator housing in which an aerosol container with an activation valve is inserted. The container is configured to move in a longitudinal direction from a rest position to an activation position in which the valve is depressed against a bottom of the actuator housing such that an aerosol dose is released. A triggering unit comprises at least a first trigger member which is configured to interact with the container moving in the longitudinal direction. The at least first trigger member triggers at least a first switch of an electronic unit when the container reaches a first longitudinal position during its movement from the rest position to the activation position.

BACKGROUND OF THE INVENTION

[0002] Metered dose inhalers (MDIs) are medication delivery devices which deliver a pharmaceutical formulation including one or more pharmaceutical active compounds to a human or another mammalian patient. Typically, the pharmaceutical formulation is delivered by the MDIs in unit doses in the form of an aerosol. Each actuation of the MDIs delivers one unit dose. The unit dose is expelled by the MDIs and is taken into the body of the patient on inhalation, via the nose or mouth. The pharmaceutical formulation is delivered to or via the respiratory track, notably to the lungs, of the patient on inhalation. Metered dose inhalers are typically used for the treatment of respiratory infections and disorders including respiratory track infections, obstructive lung disease, inflammatory lung disease and chronic obstructive pulmonary disease. Asthma treatment is a particularly common use of MDIs.

[0003] Metered dose inhalers typically comprise a dose counter. Dose counters allow counting of the doses which are released from the container such that the patient inhaling the doses is always aware of the doses being left in the container. These dose counters may operate either mechanically or electromechanically.

[0004] There has been a recent development towards use of electronic dose counters, as they allow the implementation of additional functions such as monitoring functions or evaluation functions. Based on these additional functions a physician or the patient may for example monitor the frequency of dispensed doses and the point of time when these doses have been dispensed.

[0005] WO 2016/030844 A1 describes a metered dose inhaler with an actuator housing in which two separate trigger members are actuated by the container in two different positions of the container. The first trigger mem-

ber is actuated upon displacement of the container from the rest position to a first position, thereby indicating that the user intends to dispense a dose of the aerosol. The container is then moved from the first position to a second position in which the valve is opened and the aerosol is dispensed. When the aerosol is dispensed, the second trigger member is actuated. Upon actuation the first and second trigger members trigger first and second switches of a circuit assembly. A counting circuit receives signals from the first and second switches when being triggered and counts the number of dispensed doses.

[0006] Co-pending European Patent Application No. 17156995.7 also discloses a metered dose inhaler with an actuator housing and an electronic dose counter. Upon movement of a container from a rest position to an activation position in which an aerosol dose is released, a single trigger member is actuated. Upon actuation the trigger member interacts with a switch generating an electrical signal that is transmitted to a processing unit. The metered dose inhaler further comprises a transmitting unit for wirelessly transmitting results processed by the processing unit. The results may be transmitted to a user's smartphone or any other electronic device.

[0007] Studies have shown that the effect of an inhaled pharmaceutical formulation is heavily dependent on, amongst others, the ability of the patient to inhale the right amount of the pharmaceutical formulation. It has been found that a lot of patients living with asthma do not use their inhaler adequately and thus do not receive the correct amount of medication upon inhalation. In particular, a lack of hand-breath coordination (press and breathe), an incorrect speed and/or depth of inhalation, an incorrect actuation of the canister and a missing breath-hold after inhalation of the dose of medicament are the most frequent errors when using an MDI. Thus, there is a need to implement guiding functions in the metered dose inhaler in order to help patients to adequately use their inhaler.

[0008] WO 2015/109259 A1 discloses a system comprising a pulmonary medication device and a separate computing device such as a smartphone. The pulmonary medication dosing device comprises a flow rate sensor to sense an inhalation flow of a patient. Moreover, the pulmonary medication device comprises an actuation sensor configured to detect actuation of a medication canister by which a dose of medicament is dispensed. Based on a signal of the flow rate sensor indicative of the sensed inhalation flow, the computing device generates an alert that instructs a user to actuate the medication canister. This requires a stable connection between the flow rate sensor and the smartphone in order to transmit data of the flow rate sensor to the smartphone and generate the alert within a predefined time interval after start of the inhalation. In case of connection problems between the flow rate sensor and the computing device, the alert may be generated too late or not at all. In either case the ideal point of time to actuate the canister may be missed.

[0009] It is an object of the present invention to provide a cost-effective and highly reliable inhalation system which simplifies the correct use of a metered dose inhaler.

SUMMARY OF THE INVENTION

[0010] This object is achieved by an inhalation system comprising the features of claim 1. Preferred embodiments are set out in the dependent claims.

[0011] According to the present invention, the metered dose inhaler comprises a flow rate sensor for detecting an inhalation flow through the actuator housing during use of the metered dose inhaler upon inhalation by a patient. The metered dose inhaler further comprises a transmitting unit for transmitting a signal of the at least first switch indicating a first time when the first switch is triggered by the first trigger member and a signal of the flow rate sensor to the computing device. The computing device is configured to generate visual and/or acoustic messages independently of the signals of the at least first switch and the flow rate sensor in order to guide the patient through multiple steps of the use of the metered dose inhaler. The computing device is further configured to evaluate the use of the metered dose inhaler by comparing transmitted signals of the at least first switch and of the flow rate sensor with the visual and/or acoustic messages and/or with predefined data which corresponds to an ideal use of the metered dose inhaler. Moreover, the transmitting unit is configured to transmit the signals of the at least first switch and the flow rate sensor to the computing device during and/or after the use of the metered dose inhaler.

[0012] The transmitting unit may be configured to directly transmit the signals of the at least first switch and the flow rate sensor to the computing device. However, the transmitting unit may also be configured to transmit the signals of the at least first switch and the flow rate sensor to a cloud-based server system, e.g. via NB-IoT (NarrowBand - Internet of things), which then transmits said signals to the computing device. Alternatively the computing device may also request transmittal of said signals from the cloud-based server system.

[0013] The general function of the triggering unit comprising two trigger members is disclosed in International Patent Application WO 2016/030844 A1 which is herewith incorporated by reference in its entirety. Moreover, the general function of the triggering unit comprising one single trigger member is disclosed in European Patent Application No. 17156995.7 which is herewith incorporated by reference in its entirety, also. The triggering unit together with the electronic unit has proven to provide reliable detection of actuation of the medicament container and, thus, reliable counting of the released aerosol doses. In particular, it is advantageous to install the triggering unit in the interior of the actuator housing, as this avoids unintended dose counts, for example when the metered dose inhaler is dropped on the floor.

[0014] In connection with the present invention the term "use of the metered dose inhaler" has to be understood as the process applied by a patient in order to deliver an aerosol dose dispensed by a metered dose inhaler to or via the respiratory track, notably to the lungs, of the patient. This process may include multiple steps such as the inhalation of an inhalation flow, the actuation of the canister and/or the holding of breath after inhalation. Optionally, the process does not include the step of holding breath after inhalation. Moreover, the process may also include one or more steps of preparing the metered dose inhaler for dispensing an aerosol dose, such as shaking of the inhaler and/or priming. However, the term "use of the metered dose inhaler" refers to a single use of the metered dose inhaler during which in general one single aerosol dose is dispensed and inhaled.

[0015] Based on the visual and/or acoustic messages generated by the computing device, the patient receives instructions how to use the metered dose inhaler in a correct way. Following the instructions increases the effectiveness of the use of the metered dose inhaler which means that the correct amount of pharmaceutical formulation as dispensed by the canister is inhaled and the dispensed aerosol dose is allowed to fully impact on the patient's body. As the instructions are given independently of any signals of the metered dose inhaler, the instructions are not subjected to any delays caused by connection problems between the metered dose inhaler and the computing device. The signals of the switch and the flow rate sensor may be transmitted to the computing device during and/or subsequent to the use of the metered dose inhaler or at a later point of time.

[0016] According to an embodiment of the present invention, the transmission unit is configured to check during and/or subsequent to the use of the metered dose inhaler whether a connection is established between the transmitting unit and the computing device and, given that a connection is established, to transmit the signals of the at least first switch and of the flow rate sensor to the computing device. Preferably, the transmission unit is configured to check whether a connection is established once during and/or subsequent to the use of the metered dose inhaler. In case a connection is established, the signals of the at least first switch of the flow rate sensors are transmitted subsequently. Further attempts to check a connection between the metered dose inhaler and the computing device may be omitted in order to save energy.

[0017] Optionally, the computing device or the metered dose inhaler is configured to establish a connection to the respective other one upon an input by the user. The user may manually establish a connection between the metered dose inhaler and the computing device and thus a transmittance of the signals several hours or days after using the metered dose inhaler. In order to provide this time-shifted transmittance of the signals to the computing device, the electronic unit may comprise a storage device in order to save the signals of the at least one switch as

well as of the flow rate sensor.

[0018] In a further embodiment of the present invention, the computing device is configured to generate visual and/or acoustic messages independently of the signals of the at least one switch and the flow rate sensor in order to guide the patient through the steps of starting inhalation, moving the canister from the rest position into the activation position and holding breath for a predefined period of time subsequent to inhalation. By receiving the messages from the computing device, the patient learns the timely sequence of the single steps of use of the metered dose inhaler. In addition, the patient gets used to the time intervals inbetween the single steps of use and thus to their timing.

[0019] According to another embodiment of the present invention, the computing device is configured to generate visual and/or acoustic messages independently of the signals of the at least one switch and the flow rate sensor in order to guide the patient through the steps of shaking and/or priming of the metered dose inhaler prior to inhalation. Shaking and/or priming of the metered dose inhaler prior to inhalation ensures that the components contained in the canister are properly mixed and uniformly spread in the canister. Thus, the steps of shaking and/or priming of the metered dose inhaler ensure that the dispensed aerosol dose upon actuation of the canister contains the intended dose of medicament.

[0020] Preferably, the computing device is configured to evaluate the use of the metered dose inhaler by comparing the timing of the transmitted signals of the at least first switch and of the flow rate sensor with the timing of the visual and/or acoustic messages. Optionally, the computing device is configured to evaluate the use of the metered dose inhaler by comparing the time differences between the transmitted signals with the time differences of the visual and/or acoustic messages. In order to determine the effectiveness of the use of the metered dose inhaler, the time difference between the start of inhalation and the actuation of the canister as well as optionally the duration of breath hold subsequent to inhalation is of particular relevance. In case the time difference between inhalation and actuation of the canister as well as optionally the period of breath hold correlate to predefined time intervals, the use of the metered dose inhaler may be identified as an effective use. Preferably, the computing device (3) is configured to evaluate the use of the metered dose inhaler (2) by analyzing the amount of the inhalation flow and preferably its run measured by the flow rate sensor. The computing device may for example be configured to compare the amount and/or the run of the inhalation flow to predefined data which corresponds to an ideal use of the metered dose inhaler. Those data may relate to the total amount but also to the constancy of the inhalation flow. Optionally, the computing device is configured to evaluate the use of the metered dose inhaler by comparing the timing of the transmitted signals of the at least first switch and of the flow rate sensor with predefined data which corresponds to an ideal use of the

metered dose inhaler. Preferably, the computing device is further configured to generate additional visual and/or acoustic messages relating to the effectiveness of the use of the metered dose inhaler subsequent to evaluation of the corresponding use. The computing device may be configured to generate visual and/or acoustic messages stating whether the use of the metered dose inhaler was effective or ineffective or to generate a number stating how effective the use of the metered dose inhaler was.

[0021] Also preferred is an embodiment of the present invention according to which the computing device comprises a display, wherein the visual and/or acoustic messages are contained in a video clip which is shown on the display of the computing device. Optionally, the video clip contains several written messages when to start the multiple steps of the use of the metered dose inhaler. Alternatively, the video clip may show the application of the metered dose inhaler in pictures.

[0022] According to a further embodiment, the first trigger member is designed as flexible tongue having an end portion configured to interact with the container moving from the rest position to the activation position. Preferably, the container laterally bends the trigger member upon movement of the container in a longitudinal direction from the rest position to the activation position.

[0023] According to another embodiment, the triggering unit comprises a second trigger member and the electronic unit has a substrate with a second switch thereon, the second switch being configured to interact with the second trigger member when the container moves from the rest position to the activation position such that the second trigger member triggers the second switch when the container reaches a second longitudinal position that is different from the first longitudinal position during movement of the container from the rest position to the activation position. Using two trigger members instead of one single trigger member allows a more precise detection of the movement of the container from the rest position to the activation position. In particular, the use of two trigger members allows detection of a speed of the container moving from the rest position to the activation position. In case the time interval inbetween the triggering of the first and second trigger members is below and/or above a predefined threshold indicating that the canister is travelling at a sufficient speed, actuation of the canister and thus release of an aerosol dose is to be expected. Preferably, the transmitting unit is configured to also transmit a signal of the second switch indicating a second time when the second switch is triggered by the second trigger member to the computing device.

[0024] Preferably, the first and second trigger members are designed as flexible tongues, each having an end portion configured to interact with the container moving from the rest position to the activation position. Preferably, the first and second trigger members extend from a backside of the actuator housing diagonally to a mouthpiece located on a front side of the actuator housing opposite the back side. The trigger members are configured

to be bent laterally to the longitudinal direction of the container being moved from the rest position to the actuation position upon movement of the container. Accordingly, the electronic unit comprising the first and second switches is positioned at the backside of the actuator housing. However, it is also possible to position the electronic unit at the front side of the actuator housing. Accordingly, the trigger members extend diagonally from the front side to the backside of the actuator housing.

[0025] According to another embodiment of the invention, the flow rate sensor is configured to be brought from a sleep mode into an active mode by triggering the first switch when the container reaches the first longitudinal position during movement of the container from the rest position to the activation position or by the computing device when generating a visual and/or acoustic message, wherein in the sleep mode the flow rate sensor is deactivated and wherein in the active mode the flow rate sensor is capable of sensing an inhalation flow. Preferably, the electronic unit as well as the flow rate sensor connected thereto are powered by a power source such as a battery. Thus, there is a need to reduce the energy consumption of the inhalation system in order to increase the lifetime of the battery. By configuring the flow rate sensor such that the sensor may be brought into a sleep mode during non-use of the inhalation system, the power consumption of the inhalation system is decreased.

Also preferred is an embodiment according to which the flow rate sensor is configured to be brought from a sleep mode into an active mode by the computing device when generating a visual and/or acoustic message, wherein in the sleep mode the flow rate sensor is deactivated and wherein in the active mode the flow rate sensor is capable of sensing an inhalation flow. Bringing the flow rate sensor into an active mode upon generating a visual and/or acoustic message allows the activation of the flow rate sensor independently of one or more trigger members. Preferably, the flow rate sensor is brought into an active mode at the same time or prior to the point of time when the computing device instructs the patient to start inhalation.

[0026] In an embodiment of the present invention the metered dose inhaler and/or the computing device comprise one or several sensors for measuring temperature and/or humidity and/or one or several sensors for taking a reading of amount and size of dust particles in ambient air, and/or hazardous gases like smoke, carbon dioxide, cigarette smoke, smog, nitrogen compounds, ammonia or alcohol. Additional sensors which, for example, sense ambient air of the metered dose inhaler allow better understanding of when a patient uses the metered dose inhaler. Thus, additional sensors help physicians to diagnose and manage asthma to prevent severe attacks. Moreover, the metered dose inhaler and/or the computing device may comprise a Global Positioning System sensor (GPS sensor) for sensing and tracking the position of the inhaler. Preferably, the computing device is configured to combine data of different sensors and/or

data of different sensors with data stored for example on a cloud based server system and/or data of different sensors with data which is entered by the patient and/or data of different sensors with data captured by other devices used by the patient. Combining such data may for example be useful when evaluating the use of the metered dose inhaler or to evaluate compliance of the patient with a medication plan.

[0027] Preferably, the flow rate sensor is a differential pressure sensor. In order to sense a flow rate along a flow path, sensation of a pressure difference along the flow path is of advantage. The differential pressure sensor is capable of measuring such a pressure difference, wherein each pressure is connected to opposite sides of the sensor. Thus, compared to the use of two separate pressure sensors, the differential pressure sensor needs a smaller installation space and reduces the cabling effort for connecting the sensor to the electronic unit.

[0028] Preferably, the flow rate sensor is positioned in the actuator housing, preferably in proximity to a mouthpiece of the metered dose inhaler. Optionally, the flow rate sensor is fixed to an inner side of the housing in proximity to a mouthpiece. As the inhalation flow containing inhaled air as well as the dispensed aerosol dose entrained in the inhaled air exits the metered dose inhaler through the mouthpiece, positioning of the flow rate sensor in proximity thereto allows measurement of the inhalation flow in total and not only the measurement of components (air flow or aerosol dose) thereof. Alternatively, the flow rate sensor may be positioned on the substrate of the electronic unit. This is a cost effective way to position the flow rate sensor as wiring between the electronic unit and the flow rate sensor is omitted.

[0029] The invention will now be described in connection with one exemplary embodiment shown in the figures in which:

Fig. 1 shows a perspective view of an inhalation system according to the present invention and

Fig. 2 shows a cross-sectional view of the metered dose inhaler of Fig. 1.

[0030] Figs. 1 and 2 show an inhalation system 1 comprising a metered dose inhaler 2 for dispensing an aerosol dose during use and a computing device formed as a smartphone 3. The smartphone 3 is adapted to compute signals received from the metered dose inhaler 2 and is formed separately from the metered dose inhaler 2.

[0031] The metered dose inhaler 2 comprises an actuator housing 4 adapted to receive an aerosol container 5 with an activation valve 6 at a valve end 7 of the container 5. The container 5 is configured to move in a longitudinal direction A from a rest position to an activation position in which the valve 6 is depressed against a bottom portion 8 of the actuator housing 4 such that an aerosol dose is released.

[0032] The metered dose inhaler 2 further comprises

a triggering unit 9 comprising first and second trigger members 10a, 10b, each being configured to interact with the container 5 when the container 5 moves in the longitudinal direction A from the rest position to the activation position. The first and second trigger members 10a, 10b are designed as flexible tongues 11, each having an end portion 12 configured to interact with the container 5 moving from the rest position to the activation position.

[0033] The metered dose inhaler 2 further comprises an electronic unit 13 having a substrate 14 with first and second switches 15a, 15b thereon. The first switch 15a is configured to interact with the first trigger member 10a when the container 5 moves from the rest position to the activation position such that the first trigger 10a triggers the first switch 15a when the container 5 reaches a first longitudinal position during movement of the container 5 from the rest position to the activation position. The second switch 10b is also configured to interact with the second trigger member 15b when the container 5 moves from the rest position to the activation position such that the second trigger member 10b triggers the second switch 15b when the container 5 reaches a second longitudinal position that is different from the first longitudinal position during movement of the container 5 from the rest position to the activation position. The detailed function of a metered dose inhaler as described above, is disclosed in WO 2016/030844 A1 which is herewith incorporated by reference in its entirety.

[0034] The metered dose inhaler 2 further comprises a flow rate sensor which is a differential pressure sensor 16 for detecting an inhalation flow through the actuator housing 4. The differential pressure sensor 16 is positioned in the actuator housing 4 in proximity to a mouthpiece 17 of the metered dose inhaler 2. The mouthpiece 17 is located at a front side 18 of the actuator housing 4 opposite a back side 19 of the actuator housing 4.

[0035] The differential pressure sensor 16 is configured to be brought from a sleep mode into an active mode by triggering the first switch 15a when the container 5 reaches the first longitudinal position during movement of the container 5 from the rest position to the activation position. In sleep mode the differential pressure sensor 16 is deactivated, whereas in the active mode the differential pressure sensor 16 is capable of sensing an inhalation flow.

[0036] Moreover, the metered dose inhaler 2 comprises a transmitting unit 20 for transmitting a signal of the first and second switches 10a, 10b as well as of the differential pressure sensor 16 to the smartphone 3. The signals of the first and second switches 15a, 15b indicate a first and second time when the first and second switches 15a, 15b are triggered by the first and second trigger members 10a, 10b, respectively. The signal of the differential pressure sensor 16 indicates a presence and/or a flow rate of the inhalation flow through the actuator housing 4 of the metered dose inhaler 2.

[0037] The transmitting unit 20 is part of the electronic unit 13 which additionally comprises a storage unit 21 for

storing the signals received from the first and second switches 15a, 15b as well as from the differential pressure sensor 16. The storage unit 21 may be designed as a hard disk, a flash memory or any other memory for electronic data known in the prior art.

[0038] The storage unit may optionally be part of the transmitting unit such as e.g. a Bluetooth transmitting unit.

[0039] Additionally, the electronic unit 13 comprises a power source formed as a battery 22 for providing the electronic unit and any other electronic components of the metered dose inhaler 2 with power.

[0040] The transmitting unit 20 is configured to transmit the signals of the first and second switches 15a, 15b and the differential pressure sensor 16 to the smartphone 3 after the use of the metered dose inhaler 2. In other words: The transmitting unit is configured to transmit the signals of the first and second switches 15a, 15b and the differential pressure sensor 16 after a patient has stopped inhaling the aerosol dose dispensed by the metered dose inhaler 2 and after the patient held its breath for a predetermined duration of time.

[0041] The transmitting unit 20 is further configured to check during and/or subsequent to the use of the metered dose inhaler whether a connection is established between the transmitting unit 20 and the smartphone 3. Given that a connection is established, the transmitting unit 20 is configured to transmit the signals of the first and second switches 15a, 15b and of the differential pressure sensor to the smartphone 3. However, the smartphone 3 may also be configured to establish a connection between the metered dose inhaler 2 and the smartphone 3 upon a manual actuation by a user and thus to request transmittance of signals by the transmitting unit 20 several minutes, hours or days after using the metered dose inhaler 2.

[0042] The smartphone 3 is configured to generate visual and/or acoustic messages independently of the signals of the first and second switches 15a, 15b and the differential pressure sensor 16 in order to guide the patient through multiple steps of the use of the metered dose inhaler 2. These multiple steps may include the steps of shaking and/or priming of the metered dose inhaler 2 prior to inhalation and/or the steps of starting inhalation by the patient, moving the container 5 from the rest position into the activation position and holding breath for a predefined period of time subsequent to inhalation.

[0043] The smartphone 3 comprises a display 23, wherein the visual and/or acoustic messages are contained in a video clip which is shown on the display 23.

[0044] The smartphone 3 is further configured to evaluate the use of the metered dose inhaler 2 by comparing the transmitted signal of the first and second switches 15a, 15b and of the differential pressure sensor 16 with the visual and/or acoustic messages. In other words: The computing device is configured to evaluate the use of the metered dose inhaler 2 after the metered dose inhaler 2

has been used by the patient for dispensing and inhaling an aerosol dose.

[0045] The smartphone 3 is further configured to evaluate the use of the metered dose inhaler 2 by comparing the timing, in particular the time difference of the transmitted signals of the first and second switches 15a, 15b and of the differential pressure sensor 16 with the timing, in particular the time differences of the visual and/or acoustic messages. For example, a first time difference between the signal of the differential pressure sensor 16 indicating the presence of an inhalation flow through the actuator housing 4 and the signal of the second switch 15b indicating, for example, that the container was moved to the activation position such that an aerosol dose is released, is compared to a second time difference between the corresponding visual and/or acoustic messages instructing the patient to start inhalation and to move the container from the rest position into the activation position. If the first time difference is identical or lies in a band of tolerance compared to the second time difference the use of the metered dose inhaler 2 is determined an "effective" use. The smartphone 3 may be configured to display a corresponding message determining the use of the metered dose inhaler 2 as an "effective" use on the display 23.

[0046] Accordingly, when the evaluated time difference between the signal of the differential pressure sensor 16 and the signal of the second switch 15b is much bigger than the difference between the corresponding visual and/or acoustic messages such that a predefined threshold is exceeded, the smartphone 3 determines the use of the metered dose inhaler 2 as an "ineffective" use and may display a corresponding message on the display 23.

[0047] The smartphone 3 is also configured to bring the differential pressure sensor 16 from a sleep mode into an active mode when generating a visual and/or acoustic message. For example, the visual and/or acoustic messages may be started by a patient intending to use the metered dose inhaler 2, wherein the computing device is configured to send a corresponding signal to the differential pressure sensor 16 upon start of the visual and/or acoustic messages in order to bring the differential pressure sensor 16 into an active mode.

[0048] Moreover, the metered dose inhaler 2 and/or the smartphone 3 may comprise a sensor for measuring temperature and humidity and/or a sensor for taking a reading of amount and size of dust particles in ambient air as well as hazardous gases like smoke, carbon dioxide, cigarette smoke, smog, nitrogen compounds, ammonia or alcohol. Alternatively, the metered dose inhaler 2 and/or the smartphone 3 may be connected to a further device such as a watch which comprises such sensors. The watch (not shown) is configured to transmit the corresponding sensor data to the metered dose inhaler 2 and/or the smartphone 3.

Reference numerals

[0049]

5	1	inhalation system
	2	metered dose inhaler
	3	smartphone (computing device)
	4	actuator housing
	5	aerosol container
10	6	activation device
	7	valve end
	A	longitudinal direction
	8	bottom portion
	9	triggering unit
15	10a/b	first/second trigger members
	11	flexible tongues
	12	end portion
	13	electronic unit
	14	substrate
20	15a/b	first/second switches
	16	differential pressure sensor (flow rate sensor)
	17	mouthpiece
	18	front side
	19	back side
25	20	transmitting unit
	21	storage unit
	22	battery
	23	display

30

Claims

1. Inhalation system comprising:

35 a metered dose inhaler (2) for dispensing an aerosol dose during use and
 a separate computing device (3) for computing signals received from the metered dose inhaler (2),
 40 the metered dose inhaler (2) comprising:

- an actuator housing (4) adapted to receive an aerosol container (5) with an activation valve (6) at a valve end (7) of the container (5), the container (5) being configured to move in a longitudinal direction (A) from a rest position to an activation position in which the valve (6) is depressed against a bottom portion (8) of the actuator housing (4) such that an aerosol dose is released,
 - a triggering unit (9) comprising at least a first trigger member (10a) configured to interact with the container (5) when the container (5) moves in the longitudinal direction (A) from the rest position to the activation position and
 - an electronic unit (13) having a substrate (14) with at least a first switch (15a) thereon,

the first switch (15a) being configured to interact with the first trigger member (10a) when the container (5) moves from the rest position to the activation position such that the first trigger member (10a) triggers the first switch (15a) when the container (5) reaches a first longitudinal position during movement of the container (5) from the rest position to the activation position,

characterized in

that the metered dose inhaler further comprises

- a flow rate sensor (16) for detecting an inhalation flow through the actuator housing (4) during use of the metered dose inhaler (2) upon inhalation by a patient and
 - a transmitting unit (20) for transmitting a signal of the at least first switch (10a) as well as of the flow rate sensor (16) to the computing device (3),
- wherein the signal of the first switch (10a) indicates a first time when the first switch (10a) is triggered by the first trigger member (15a) and,
- wherein the signal of the flow rate sensor (16) indicates a presence and/or a flow rate of the inhalation flow and,

that the computing device (3) for computing signals received from the metered dose inhaler (2) is configured

- to generate visual and/or acoustic messages independently of the signals of the at least first switch (10a) and the flow rate sensor (16) in order to guide the patient through multiple steps of the use of the metered dose inhaler (2), and
- to evaluate the use of the metered dose inhaler (2) by comparing the transmitted signals of the at least first switch (10a) and of the flow rate sensor (16) with the visual and/or acoustic messages and/or with predefined data,

wherein the transmitting unit (20) is configured to transmit the signals of the at least first switch (10a) and the flow rate sensor (15a) to the computing device (3) during and/or after the use of the metered dose inhaler (2).

2. Inhalation system according to claim 1 **characterized in that** the transmission unit (20) is configured to check during and/or subsequently to the use of the metered dose inhaler (2) whether a connection is established between the transmitting unit (20) and the computing device (3) and, given that a connection

is established, to transmit the signals of the at least first switch (10a) and of the flow rate sensor (16) to the computing device (3).

5 3. Inhalation system according to any of the preceding claims **characterized in that** the computing device (3) is configured to generate visual and/or acoustic messages independently of the signals of the at least one switch (10a) and the flow rate sensor (16) in order to guide the patient through the steps of starting inhalation, moving the container (5) from the rest position into the activation position and holding breath for a predefined period of time subsequent to inhalation.

10 4. Inhalation system according to any of the preceding claims, **characterized in that** the computing device (3) is configured to generate visual and/or acoustic messages independently of the signals of the at least first switch (10a) and the flow rate sensor (16) in order to guide the patient through the steps of shaking and/or priming of the metered dose inhaler prior to inhalation.

15 5. Inhalation system according to any of the preceding claims, **characterized in that** the computing device (3) is configured to evaluate the use of the metered dose inhaler (2) by comparing the timing of the transmitted signals of the at least first switch (10a) and of the flow rate sensor (16) with the timing of the visual and/or acoustic messages and/or with predefined data such as predefined time intervals.

20 6. Inhalation system according to any of the preceding claims, **characterized in that** the computing device (3) is configured to evaluate the use of the metered dose inhaler (2) by analyzing the amount of the inhalation flow and/or preferably its run measured by the flow rate sensor.

25 7. Inhalation system according to any of the preceding claims, **characterized in that** the computing device (3) comprises a display (23), wherein the visual and/or acoustic messages are contained in a video clip which is shown on the display (23) of the computing device (3).

30 8. Inhalation system according to any of the preceding claims **characterized in that** the first trigger member (15a) is designed as a flexible tongue (11) having an end portion (12) configured to interact with the container (5) moving from the rest position to the activation position.

35 9. Inhalation system according to any of the preceding claims **characterized in that** the triggering unit (9) comprises a second trigger member (10b) and, that the electronic unit (13) has a substrate (14) with a

second switch (15b) thereon, the second switch (15b) being configured to interact with the second trigger (10b) member when the container (5) moves from the rest position to the activation position such that the second trigger member (10b) triggers the second switch (15b) when the container (5) reaches a second longitudinal position that is different from the first longitudinal position during movement of the container (5) from the rest position to the activation position.

10. Inhalation system according to claim 8 **characterized in that** the first and the second trigger member (10a, 10b) are designed as flexible tongues (11) each having an end portion (12) configured to interact with the container (5) moving from the rest position to the activation position.

11. Inhalation system according to claim 8 **characterized in that** the flow rate sensor (16) is configured to be brought from a sleep mode into an active mode by triggering the first switch (15a) when the container (5) reaches the first longitudinal position during movement of the container (5) from the rest position to the activation position or by the computing device (3) when generating a visual and/or acoustic message, wherein in the sleep mode the flow rate sensor (16) is deactivated and, wherein in the active mode the flow rate sensor (16) is capable of sensing an inhalation flow.

12. Inhalation system according to any of the preceding claims **characterized in that** the flow rate sensor (16) is configured to be brought from a sleep mode into an active mode by the computing device (3) when generating a visual and/or acoustic message wherein in the sleep mode the flow rate sensor (16) is deactivated and, wherein in the active mode the flow rate sensor (16) is capable of sensing an inhalation flow.

13. Inhalation system according to any of the preceding claims **characterized in that** the metered dose inhaler (2) and/or the computing device (3) comprise a sensor for measuring temperature and/or humidity and/or a sensor for taking a reading of amount and size of dust particles in ambient air, and/or hazardous gases like smoke, carbon dioxide, cigarette smoke, smog, nitrogen compounds, ammonia or alcohol.

14. Inhalation system according to any of the preceding claims **characterized in that** the flow rate sensor (16) is a differential pressure sensor.

15. Inhalation system according to any of the preceding claims **characterized in that** the flow rate sensor (16) is positioned in the actuator housing (4), pref-

erably in proximity to a mouthpiece (17) of the metered dose inhaler (2) or further preferably on the substrate (14) of the electronic unit (13).

5 16. Inhalation system according to any of the preceding claims **characterized in that** the computing device (3) is configured to combine data of different sensors (16) and/or data of different sensors (16) with data stored for example on a cloud based server system and/or data of different sensors (16) with data which is entered by a patient and/or data of different sensors (16) with data captured by other devices used by the patient in order to evaluate the use of the metered dose inhaler (2) or to evaluate compliance of the patient with a medication plan.

Fig. 1

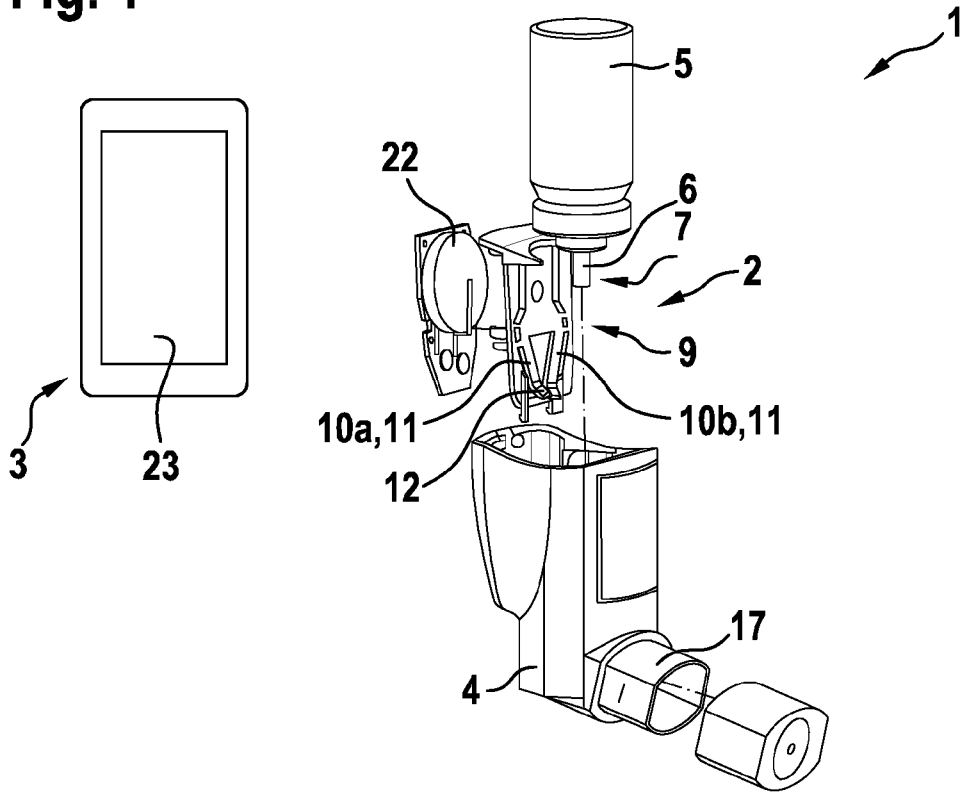
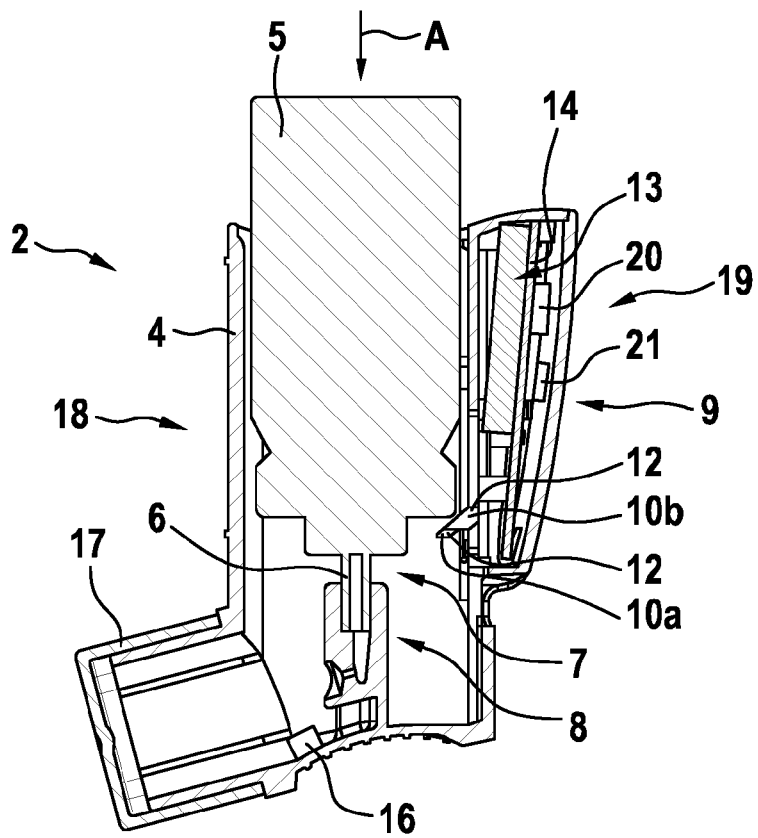

Fig. 2





EUROPEAN SEARCH REPORT

Application Number
EP 17 20 2620

5

10

15

20

25

30

35

40

45

50

55

DOCUMENTS CONSIDERED TO BE RELEVANT			
Category	Citation of document with indication, where appropriate, of relevant passages	Relevant to claim	CLASSIFICATION OF THE APPLICATION (IPC)
X,D Y	WO 2015/109259 A1 (FOCUSSTART RESPIRATORY LLC [US]) 23 July 2015 (2015-07-23) * figures 1A-4 * * paragraph [0062] - paragraph [0171] *	1-7, 11-16 8-10	INV. A61M15/00 A61B5/00 A61B5/087
X	US 2016/144142 A1 (BAKER JEFF [US] ET AL) 26 May 2016 (2016-05-26) * figure 4 and 5 * * paragraph [0010] - paragraph [0075] *	1-16	ADD. A61M16/00
Y,D	WO 2016/030844 A1 (PRESSPART GMBH & CO KG [DE]; SHEARS DANA; FERENC KEVIN; FALENDYSZ GREG) 3 March 2016 (2016-03-03) * the whole document *	8-10	
A	WO 2016/033421 A1 (MICRODOSE THERAPEUTX INC [US]; NORTON WATERFORD LTD [IE]) 3 March 2016 (2016-03-03) * the whole document *	1-16	
A	WO 2016/030521 A1 (NORTON WATERFORD LTD [IE]; TEVA PHARMACEUTICALS EUROP B V [NL]) 3 March 2016 (2016-03-03) * the whole document *	1-16	TECHNICAL FIELDS SEARCHED (IPC) A61M A61B
A	DE 20 2017 101591 U1 (PRESSPART GMBH & CO KG [DE]) 11 May 2017 (2017-05-11) * the whole document *	1-16	
The present search report has been drawn up for all claims			
Place of search Munich		Date of completion of the search 18 April 2018	Examiner Cecchini, Stefano
CATEGORY OF CITED DOCUMENTS X : particularly relevant if taken alone Y : particularly relevant if combined with another document of the same category A : technological background O : non-written disclosure P : intermediate document		T : theory or principle underlying the invention E : earlier patent document, but published on, or after the filing date D : document cited in the application L : document cited for other reasons & : member of the same patent family, corresponding document	

EPO FORM 1503 03/02 (P04C01)

ANNEX TO THE EUROPEAN SEARCH REPORT
ON EUROPEAN PATENT APPLICATION NO.

EP 17 20 2620

5 This annex lists the patent family members relating to the patent documents cited in the above-mentioned European search report.
The members are as contained in the European Patent Office EDP file on
The European Patent Office is in no way liable for these particulars which are merely given for the purpose of information.

18-04-2018

Patent document cited in search report	Publication date	Patent family member(s)	Publication date
WO 2015109259 A1	23-07-2015	US 2016325058 A1 WO 2015109259 A1	10-11-2016 23-07-2015
US 2016144142 A1	26-05-2016	US 2016144142 A1 WO 2016085988 A2	26-05-2016 02-06-2016
WO 2016030844 A1	03-03-2016	EP 3125980 A1 ES 2645292 T3 US 2017087312 A1 WO 2016030844 A1	08-02-2017 04-12-2017 30-03-2017 03-03-2016
WO 2016033421 A1	03-03-2016	AR 101720 A1 CA 2958883 A1 EP 3185752 A1 JP 2017526445 A TW 201620569 A US 2017290527 A1 WO 2016033421 A1	11-01-2017 03-03-2016 05-07-2017 14-09-2017 16-06-2016 12-10-2017 03-03-2016
WO 2016030521 A1	03-03-2016	AR 102055 A1 AR 102057 A1 AU 2015308424 A1 AU 2015308748 A1 CA 2958849 A1 CA 2958894 A1 CN 106714880 A CN 106999681 A EP 3057637 A1 EP 3097937 A1 EP 3185938 A1 HK 1222815 A1 JP 2017525511 A JP 2017525512 A KR 20170048483 A KR 20170048484 A TW 201611855 A TW 201617102 A US 2016325057 A1 US 2016339190 A1 US 2017274163 A1 US 2017340844 A1 WO 2016030521 A1 WO 2016033419 A1	01-02-2017 01-02-2017 13-04-2017 23-03-2017 03-03-2016 03-03-2016 24-05-2017 01-08-2017 24-08-2016 30-11-2016 05-07-2017 14-07-2017 07-09-2017 07-09-2017 08-05-2017 08-05-2017 01-04-2016 16-05-2016 10-11-2016 24-11-2016 28-09-2017 30-11-2017 03-03-2016 03-03-2016
DE 202017101591 U1	11-05-2017	DE 202017101591 U1 EP 3300753 A1	11-05-2017 04-04-2018

EPO FORM P0459

For more details about this annex : see Official Journal of the European Patent Office, No. 12/82

55

**ANNEX TO THE EUROPEAN SEARCH REPORT
ON EUROPEAN PATENT APPLICATION NO.**

EP 17 20 2620

5

This annex lists the patent family members relating to the patent documents cited in the above-mentioned European search report. The members are as contained in the European Patent Office EDP file on The European Patent Office is in no way liable for these particulars which are merely given for the purpose of information.

18-04-2018

10

Patent document cited in search report	Publication date	Patent family member(s)	Publication date
US 2018093053 A1			05-04-2018
<hr style="border-top: 1px dashed black;"/>			

15

20

25

30

35

40

45

50

EPO FORM P0459

55

For more details about this annex : see Official Journal of the European Patent Office, No. 12/82

REFERENCES CITED IN THE DESCRIPTION

This list of references cited by the applicant is for the reader's convenience only. It does not form part of the European patent document. Even though great care has been taken in compiling the references, errors or omissions cannot be excluded and the EPO disclaims all liability in this regard.

Patent documents cited in the description

- WO 2016030844 A1 [0005] [0013] [0033]
- EP 17156995 A [0006] [0013]
- WO 2015109259 A1 [0008]

专利名称(译)	吸入系统		
公开(公告)号	EP3485930A1	公开(公告)日	2019-05-22
申请号	EP2017202620	申请日	2017-11-20
申请(专利权)人(译)	PRESSPART GMBH & CO.KG		
当前申请(专利权)人(译)	PRESSPART GMBH & CO.KG		
[标]发明人	JUNG BENJAMIN		
发明人	JUNG, BENJAMIN SARDA, ARUN		
IPC分类号	A61M15/00 A61B5/00 A61B5/087 A61M16/00		
代理机构(译)	UEXKÜLL & STOLBERG		
审查员(译)	切基尼, STEFANO		
外部链接	Espacenet		

摘要(译)

一种吸入系统，包括用于在使用期间分配气溶胶剂量的计量剂量吸入器 (2) 和用于计算从计量剂量吸入器接收的信号的计算装置。定量吸入器 (2) 包括流速传感器 (16)，用于在患者和发射单元 (20) 吸入时在计量剂量吸入器 (2) 的使用期间检测通过致动器壳体 (4) 的吸入流量。将至少第一开关 (10a) 以及流速传感器 (16) 的信号传输到计算设备 (3)。计算设备 (3) 被配置为独立于至少一个开关 (10a) 和流速传感器 (16) 的信号生成视觉和/或声学消息，以便引导患者通过使用的多个步骤。计量吸入器 (2)。计算设备还被配置为通过将至少第一开关 (10a) 和流速传感器 (16) 的发送信号与视觉和/或声学消息进行比较来评估计量剂量吸入器 (2) 的使用。发送单元 (20) 被配置为在使用计量剂量吸入器 (2) 之后将至少第一开关 (10a) 和流速传感器 (15a) 的信号发送到计算装置 (3)。

Fig. 1

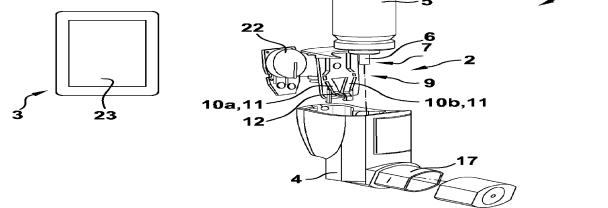

Fig. 2

