



(11) **EP 1 691 190 B1**

(12) **EUROPEAN PATENT SPECIFICATION**

(45) Date of publication and mention of the grant of the patent:
10.08.2011 Bulletin 2011/32

(51) Int Cl.:
G01N 21/35^(2006.01) A61B 5/00^(2006.01)

(21) Application number: **06002664.8**

(22) Date of filing: **09.02.2006**

(54) **Near infrared spectroscopy device with reusable portion**

Nahinfrarotspektroskopievorrichtung mit wiederverwendbarem Teil

Dispositif de spectroscopie en proche infrarouge avec partie réutilisable

(84) Designated Contracting States:
DE FR GB IT

(30) Priority: **10.02.2005 US 651886 P**

(43) Date of publication of application:
16.08.2006 Bulletin 2006/33

(73) Proprietor: **Terumo Cardiovascular Systems Corporation**
Ann Arbor MI (US)

(72) Inventors:
• **Hacker, Thomas G.**
Anaheim, CA 92807 (US)
• **Brent, Allen W.**
Rancho Santa Margarita, CA 92688 (US)

(74) Representative: **Vossius & Partner**
Siebertstrasse 4
81675 München (DE)

(56) References cited:
US-A- 6 014 576 US-A1- 2002 016 536

EP 1 691 190 B1

Note: Within nine months of the publication of the mention of the grant of the European patent in the European Patent Bulletin, any person may give notice to the European Patent Office of opposition to that patent, in accordance with the Implementing Regulations. Notice of opposition shall not be deemed to have been filed until the opposition fee has been paid. (Art. 99(1) European Patent Convention).

Description

[0001] The present invention relates in general to measurement of oxygenation-related parameters of a patient during surgery, and, more specifically, to a near infrared spectroscopy sensor device having reusable and disposable portions and specially adapted for monitoring hemoglobin level and/or oxygen carrying capacity of blood in the brain during cardiac surgery.

[0002] During cardiac surgery, it is very useful for surgeons to monitor oxygenation-related parameters within the brain. Major causes of neurological damage during cardiac surgery include decreased cerebral blood flow, insufficient oxygenation, insufficient hemoglobin concentration, and cerebral embolism. When the brain experiences low oxygen levels during surgery, there is increased risk of neurological problems after surgery which often results in a greater need for critical care and longer hospital stays. Use of brain monitoring devices can help members of the surgical team monitor changes in the oxygen level and/or hemoglobin concentration of the brain and take action before brain damage occurs.

[0003] Some previous methods of monitoring the brain were invasive and created other medical risks. Near infrared spectroscopy (NIRS) has been developed as a noninvasive method of monitoring the oxygen level and hemoglobin concentration of blood perfusing the brain employing light emitters and sensors attached to a patient's forehead. Known systems have had unresolved problems in that current sensors are large and bulky and can be affected by exterior light sources. The sensors also have difficulty staying attached to the forehead. Smaller sensors are needed that not only stay firmly attached to the forehead, but leave room on the forehead for other monitors, such as a BIS monitor for anesthesia monitoring. Thus, there is a need in the art for a small NIRS sensor device that stays firmly attached to the patient's forehead and is less affected by outside light.

[0004] There exist further unmet needs to ensure safe, hygienic use of NIRS sensors from the standpoint of the patient and to improve efficiency, ease of use, and ease of integration with other surgical/monitoring systems from the standpoint of the medical practitioner.

[0005] US 2002/0016536 A1 describes a laser diode transducer assembly for non-invasive spectrophotometric blood oxygenation monitoring. The assembly comprises a disposable part having transparent windows or open apertures to allow light from the transducer to pass to the patient's skin and having adhesive properties to attach the transducer to a patient's skin.

[0006] US 6,014,576 describes a two-piece photoplethysmographic sensor having a universal probe end and an interconnect cable segment providing for use of the universal probe end with a variety of different photoplethysmographic devices.

[0007] The present invention is an improved NIRS sensor device for brain monitoring that is small in size, provides reliable attachment to a patient, blocks ambient

light, is easy to use, is hygienic, and supports data integration with surgical and monitoring systems. The sensor device is coupled to a remote near infrared light source via a hybrid cable. Since the light source is remotely located, a source adapted for providing high energy, short pulses can easily be used so that there is less chance of interference by superficial non-brain tissues and less interference from ambient light. In addition, the remote location avoids changes in output of local light sources experienced in the prior art during hypothermia procedures (e.g., bandwidth shifts in LEDs as a result of lowered temperature). The higher energy may be achieved by the use of laser diodes as opposed to locally-mounted LEDs typically used in the prior art. The sensor device is a two-piece design comprising a reusable portion containing the of photodetectors. A disposable coupler portion comprises a flexible housing fixedly mounting a light channel member adapted to be selectively coupled to the termination of the ferrule member for directing the near infrared light toward the body surface. The flexible housing further comprises an adhesive layer for temporarily attaching the disposable coupler portion to the body surface. The flexible housing includes a window disposed in alignment with the pair of infrared detectors for admitting reflected near infrared light from the patient when the disposable coupler portion is releasably connected with the reusable probe portion.

[0008] Preferred embodiments of the present invention are exemplified in the following Figures.

[0009] Figure 1 is an isometric view of a fully assembled NIRS sensor including a reusable portion mated with a disposable portion.

[0010] Figure 2 is an isometric view of the reusable and disposable portions prior to mating.

[0011] Figure 3 is an isometric view showing the rear side of the disposable portion.

[0012] Figure 4 is an isometric view showing the bottom, patient contacting side of the disposable portion.

[0013] Figure 5 is a bottom perspective view of one embodiment of a light channel member and electronic memory of the disposable portion.

[0014] Figure 6 is an exploded perspective view of another embodiment of the light channel member.

[0015] Figure 7 is an exploded perspective view of the embodiment of Figure 6.

[0016] Figure 8 is a partially broken-away view showing the flexible housing overmolded on the light channel member.

[0017] Figure 9 is a perspective, cross-sectional view of the disposable portion.

[0018] Figure 10 is yet another view of the light channel member.

[0019] Figure 11 is a perspective view of the reusable portion with its overmold removed.

[0020] Figure 12 is an exploded, perspective view of the reusable portion of Figure 11.

[0021] Figure 13 is a perspective view of photodetectors mounted to a flexible circuit board of the reusable

portion.

[0022] Figure 14 shows a ferrule member mounted to the hybrid cable.

[0023] Figures 15 and 16 show the interconnection of the flexible circuit board with the ferrule member.

[0024] Figures 17-21 show an EMI shield and plastic housing for containing the photodetectors.

[0025] Figure 22 is a bottom, isometric view of the assembled NIRS sensor device.

[0026] Figure 23 shows a pair of NIRS sensors attached to a patient.

[0027] Figure 24 shows a monitoring system including a monitor controller.

[0028] Referring now to Figures 1 and 2, a NIRS sensor device 10 comprises a disposable coupler portion 12 and a reusable probe portion 14. A hybrid (optical/electrical) cable 16 integrated into reusable portion 14 provides optical and electrical connection to a monitor controller (not shown). Reusable portion 14 can be releasably inserted within a receiving slot 18 of disposable portion 12. Locking features 15 and 17 interlock when the two portions are mated to help keep them together. Feature 15 is part of a soft rubber overmold and is easily compressed within feature 17. Moreover, it can be selectively released when it is desired to unmate the two portions.

[0029] As shown in Figure 3, a light channel member 20 including an indicator lens 21 and pin members 22 is embedded in an overmold 23 that defines receiving slot 18 and a window 24 that receives the photodetector end of reusable probe portion 14. Lens 21 is centrally located in feature 15 so that it is visible after the mating of portions 12 and 14.

[0030] Figure 4 shows a bottom, patient-contacting surface 25 of disposable coupler portion 12 which includes an adhesive layer for attaching the device to a patient's forehead. Overmold 23 is pliable so that it can accommodate the contours of the forehead or other attachment site. Any conventional biocompatible adhesive may be used as is known in the art. Light channel member 20 includes an input coupler 26 for receiving near infrared light from reusable portion 14 and an exit 27 for directing the near infrared light perpendicularly toward the body (e.g., skin) surface of the patient.

[0031] The bottom side of channel member 20 is shown in greater detail in Figure 5. Light channel 30 extends between input coupler 26 and exit 27 and has a keying slot 31 for receiving a corresponding tab on the hybrid cable. A flange 32 includes holes for receiving tubular pin members 22 which may be swaged in place. Connecting pins 33 of an electronic memory device 34 are electrically mounted (e.g., by press fit) within pin members 22 for external connection. Light channel member 20 further includes a light guide 35 for receiving visible light from a device within reusable probe portion 14 and providing it to indicator lens 21.

[0032] A top perspective view of a slightly modified embodiment of channel member 20 is shown in Figures 6 and 7. This embodiment differs in that flange 32 extends

from both sides of channel 30. In this view, the coupling of visible light through light guide 35 toward indicator lens 21 can be seen. An angled, reflective surface 36 below lens 21 helps direct the indicating light upward for easy viewing by a user. An angled, reflective surface 37 is also formed within channel 30 to bend the near infrared light by 90° to enter the patient perpendicularly while allowing the cable providing the near infrared light to lie parallel to body surface of the patient. Figure 8 shows light channel member 20 including electronic memory 34 encapsulated within the soft rubber overmold 23. Figure 9 shows a cross section of the encapsulated parts. Figure 10 shows how connection pins 33 may be press fit into tubular pin members 22 prior to encapsulation.

[0033] Turning now to the detailed construction of the preferred embodiment for reusable probe portion 14, Figure 11 shows a flexible printed circuit board 40 connected to a ferrule member 41 which is mounted near the end of hybrid cable 16. An optical guide 42 delivers near infrared light from a remote source (e.g., located at a monitor controller or device bay). Electrical conductors within cable 16 are broken out and routed through ferrule member 41 to a plurality of connection points 43 on flexible circuit board 40. A rigid circuit board 44 is mounted to an end face of ferrule member 41 and is also connected to electrical conductors from cable 16. Board 44 includes a light generator 45 (preferably and LED) for providing visible light to light guide 35 in the light channel member of the disposable coupler portion when power is received via cable 16. Receptacles 46 receive pin members 22 when the two device portions are mated so that circuits within the monitor controller can communicate with electronic memory 34.

[0034] Flexible circuit board 40 includes two elongated finger sections 50 and 51 extending to a distal end 52 where board 40 connects to a photodetector assembly 53. As shown in exploded view in Figure 12, distal end 52 may have interface circuit components mounted thereon. A photodetector integrated circuit device 55 is connected to distal board end 52, e.g., by soldering. An insulating foam piece 56 overlies the components on distal board end 52 and insulates them from an EMI cover or shield 57. A plastic housing having a lower cup 58 and a lid 59 is attached to seal photodetector assembly 53.

[0035] Figures 13-21 illustrate several representative steps in a preferred fabrication process for the reusable probe portion. In Figure 13, all components including the photodetector unit 55 are soldered to flexible board 40. In Figure 14, ferrule member 41 is installed onto the end of hybrid cable 16 which has been prepared by stripping the electrically conductive wires and exposing the optical guide. The wires may be routed through passages within ferrule member 41 for soldering to the circuit boards. A keying feature 60 is shown integral with ferrule member 41 for mating with keying slot 31 of the light channel member. Ferrule 41 may preferably be adhesively bonded onto cable 16. Figures 15 and 16 show the assembly of flexible board 40 to ferrule member 41 in greater detail.

Conductive wires from cable 16 are soldered to holes 61 in board 40. Signals are then able to be conducted via traces 62 to and from the photodetector assembly.

[0036] As shown in Figures 17-21, insulator 56 is placed over distal end 52 of board 40. In Figure 18, the photodetector assembly is inserted into the lower cup 58. As shown in Figure 19, the bottom of cup 58 includes apertures 63 and 64 corresponding to the locations of a pair of photodetector elements as used in known NIRS sensing. A silicon sealer is preferably injected within cup 58 around the photodetector assembly and around apertures 63 and 64 to make the reusable probe portion watertight. In Figure 20, the insulator and EMI cover have been inserted into cup 58. Figure 21 shows the photodetector assembly after lid 59 is attached to cup 58.

[0037] The central section of flexible board 40 is covered by a further plastic housing or an overmold to protect the circuit traces and to provide durability.

[0038] Figure 22 shows a bottom perspective view of the two portions in a mated condition. After mating, the photodetectors are in alignment with window 24 in disposable portion 12. Furthermore, the two photodetectors which receive reflected light from the patient through apertures 63 and 64 are spaced at predetermined distances from exit 27 of light channel 30 in accordance with the known operation of NIRS sensors.

[0039] As seen in Figure 23, NIRS device 10 is mounted to forehead 70 of a patient 71 during monitoring. For different types of monitoring, attachment to other skin surfaces in other areas of the patient's body may be employed. Device 10 is sufficiently compact that other sensors for monitoring other parameters such as a sensor 71 may also be mounted to the forehead.

[0040] Figure 24 shows an overall monitoring system wherein device 10 is connected to a monitor controller or device bay 75 which preferably includes programmable computing elements. A monitor 76 displays the measured oxygenation-related parameters for viewing by the medical practitioners.

Claims

1. A near infrared spectroscopy system for monitoring an oxygenation-related parameter beneath a body surface of a patient, **characterized by** comprising:

a reusable probe portion (14) comprising a ferrule member (41) mounted to a hybrid cable (16) for conveying near infrared light from a remote source, said reusable probe portion (14) further comprising a pair of photodetectors, said ferrule member (41) having a termination spaced from said pair of photodetectors; and
a disposable coupler portion (12) comprising a flexible housing fixedly mounting a light channel member (20) adapted to be selectively coupled to said termination of said ferrule member (41)

for directing said near infrared light toward said body surface, wherein said flexible housing further comprises an adhesive layer for temporarily attaching said disposable coupler portion (12) to said body surface, and wherein said flexible housing includes a window (24) disposed in alignment with said pair of infrared detectors for admitting reflected near infrared light from said patient when said disposable coupler portion is releasably connected with said reusable probe portion (14).

2. The system of claim 1 wherein said light channel member (20) comprises a light bender having a reflective surface (37) for directing said near infrared light in a direction substantially perpendicular to said body surface.

3. The system of claim 2 wherein said flexible housing comprises a substantially opaque overmold (23) including soft rubber.

4. The system of claim 1 wherein said disposable coupler portion (12) further comprises an electronic memory (34) for storing information associated with a patient, wherein said near infrared spectroscopy system is adapted to be coupled to a monitor controller via said hybrid cable (16), and wherein said reusable probe portion (14) includes a data circuit for coupling with said electronic memory (34) to make said patient information accessible to said monitor controller via said hybrid cable (16).

5. The system of claim 4 wherein said electronic memory (34) comprises an integrated circuit having connection pins (33) and wherein said disposable coupler portion (12) further comprises pin members (22) mounted to said light channel member (20) for receiving said connection pins at one end thereof and for projecting from said disposable coupler portion (12) at the other end thereof to join with said hybrid cable (16).

6. The system of claim 1 further comprising:

a light generator (45) mounted to said ferrule member (41) for generating a visible emission when receiving electrical power from said hybrid cable; and
a lens (21) included in said disposable coupler portion (12) receiving said visible emission and radiating said visible emission outside said disposable coupler portion (12) to indicate that said electrical power is being received.

7. The system of claim 1 wherein said reusable probe portion (14) further comprises:

an elongated flexible printed circuit board (40) mounted to said ferrule member (41) at a first end and connected to said pair of photodetectors (53) at a second end (52) wherein said flexible printed circuit board (40) includes conductive traces (62) for interconnecting said photodetectors to said hybrid cable (16).

8. The system of claim 7 further comprising:

an EMI cover (57) mounted at said second end (52);
a rigid housing (58,59) containing said photodetectors and said EMI cover (57); and an overmolded body covering said flexible printed circuit board (40).

9. The system of claim 8 wherein said overmolded body of said reusable probe portion (14) and said flexible housing of said disposable coupler portion (12) include respective locking features (15,17) for positively retaining said disposable coupler portion and said reusable probe portion when connected for use.

10. The system of claim 9 wherein said photodetectors (53) are respectively spaced at predetermined distances from said light channel member (20) when connected for use.

11. A method of measuring an oxygenation-related parameter during surgery of a patient using a monitoring system having a near infrared light source and a controller and using a near infrared spectroscopy system according to claim 1 having a reusable portion (14) and a disposable portion (12) said method comprising the steps of:

mating said reusable portion (14) and said disposable portion (12) to conduct near infrared light from said source through said mated portions and projecting out of an exit (27) from said disposable portion, wherein as a result of said mating a photodetector (53) in said reusable portion is disposed in a window formed in said disposable portion at a predetermined distance from said exit;
attaching said disposable portion (12) to a skin surface of said patient over an area of interest; illuminating said area of interest with said near infrared light;
detecting reflected light with said photodetector (53) as a measure of said oxygenation-related parameter;
removing said disposable portion from said skin surface after completion of said surgery;
unmating said reusable portion from said disposable portion; and
mating said reusable portion to a second dis-

posable portion to measure an oxygenation-related parameter of a second patient during a second surgery.

Patentansprüche

1. Nahinfrarotspektroskopiesystem zur Überwachung eines oxygenierungsabhängigen Parameters unter einer Körperoberfläche eines Patienten, **dadurch gekennzeichnet, dass** das System aufweist:

einen wiederverwendbaren Sondenteil (14) mit einem Hülsenelement (41), das an einem Hybridkabel (16) für die Zuführung von Nahinfrarotlicht von einer entfernten Quelle montiert ist, wobei der wiederverwendbare Sondenteil (14) ferner ein Photodetektorpaar aufweist, wobei das Hülsenelement (41) einen von dem Photodetektorpaar beabstandeten Abschluss aufweist; und

einen Einmalgebrauchs-Kopplerteil (12) mit einem flexiblen Gehäuse, in dem ein Lichtkanalelement (20) fest montiert ist, das an eine selektive Kopplung an den Abschluss des Hülsenelements (41) angepasst ist, um das Nahinfrarotlicht zur Körperoberfläche zu lenken, wobei das flexible Gehäuse ferner eine Klebstoffschicht zum vorübergehenden Befestigen des Einmalgebrauchs-Kopplerteils (12) an der Körperoberfläche aufweist, und wobei das flexible Gehäuse ein Fenster (24) enthält, das auf das Infrarotdetektorpaar ausgerichtet ist, um vom Patienten reflektiertes Nahinfrarotlicht durchzulassen, wenn der Einmalgebrauchs-Kopplerteil lösbar mit dem wiederverwendbaren Sondenteil (14) verbunden ist.

2. System nach Anspruch 1, wobei das Lichtkanalelement (20) einen Lichtablenker mit einer reflektierenden Oberfläche (37) aufweist, um das Nahinfrarotlicht in eine Richtung zu lenken, die im Wesentlichen senkrecht zur Körperoberfläche ist.

3. System nach Anspruch 2, wobei das flexible Gehäuse eine im Wesentlichen lichtundurchlässige Umspritzung (23) aufweist, die Weichgummi enthält.

4. System nach Anspruch 1, wobei der Einmalgebrauchs-Kopplerteil (12) ferner einen elektronischen Speicher (34) zum Speichern von patientenbezogenen Informationen aufweist, wobei das Nahinfrarotspektroskopiesystem so angepasst ist, dass es über das Hybridkabel (16) an ein Monitorsteuergerät angekoppelt wird, und wobei der wiederverwendbare Sondenteil (14) eine Datenleitung zur Kopplung mit dem elektronischen Speicher (34) enthält, um die Patienteninformationen über das Hybridkabel (18)

für das Monitorsteuergerät zugänglich zu machen.

5. System nach Anspruch 4, wobei der elektronische Speicher (34) einen integrierten Schaltkreis mit Anschlussstiften (33) aufweist, und wobei der Einmalgebrauchs-Kopplerteil (12) ferner an dem Lichtkanalelement (20) montierte Stiftelemente (22) aufweist, um an einem Ende des Lichtkanalelements die Anschlussstifte aufzunehmen und an seinem anderen Ende aus dem Einmalgebrauchs-Kopplerteil (12) für die Verbindung mit dem Hybridkabel (16) vorzustehen.

6. System nach Anspruch 1, das ferner aufweist:

einen an dem Hülsenelement (41) montierten Lichterzeuger (45) zur Erzeugung einer Emission von sichtbarem Licht bei Aufnahme elektrischer Leistung aus dem Hybridkabel; und eine in dem Einmalgebrauchs-Kopplerteil (12) enthaltene Linse (21), die das emittierte sichtbare Licht von dem Einmalgebrauchs-Kopplerteil (12) nach außen strahlt, um den Empfang der elektrischen Leistung anzuzeigen.

7. System nach Anspruch 1, wobei der wiederverwendbare Sondenteil (14) ferner aufweist:

eine langgestreckte flexible Leiterplatte (40), die an einem ersten Ende an dem Hülsenelement (41) montiert ist und an einem zweiten Ende (52) mit dem Photodetektorpaar (53) verbunden ist, wobei die flexible Leiterplatte (40) Leiterbahnen (62) für den Anschluss der Photodetektoren an das Hybridkabel (16) enthält.

8. System nach Anspruch 7, das ferner aufweist:

eine an dem zweiten Ende (52) montierte elektromagnetische (EMI-) Störschutzhaube (57); ein starres Gehäuse (58, 59), das die Photodetektoren und die EMI-Störschutzhaube (57) enthält; und einen umspritzten Körper, der die flexible Leiterplatte (40) abdeckt.

9. System nach Anspruch 8, wobei der umspritzte Körper des wiederverwendbaren Sondenteils (14) und das flexible Gehäuse des Einmalgebrauchs-Kopplerteils (12) Arretierungen (15, 17) zum zwangsläufigen Sichern des Einmalgebrauchs-Kopplerteils bzw. des wiederverwendbaren Sondenteils aufweisen, wenn diese zum Gebrauch angeschlossen sind.

10. System nach Anspruch 9, wobei die Photodetektoren (53) jeweils in vorgegebenen Abständen von dem Lichtkanalelement (20) angeordnet sind, wenn

sie zum Gebrauch angeschlossen sind.

11. Verfahren zur Messung eines oxygenierungsabhängigen Parameters während der Operation eines Patienten unter Verwendung eines Überwachungssystems mit einer Nahinfrarotlichtquelle und einem Steuergerät und unter Verwendung eines Nahinfrarotspektroskopiesystems nach Anspruch 1 mit einem wiederverwendbaren Teil (14) und einem Einmalgebrauchsteil (12), wobei das Verfahren die folgenden Schritte aufweist:

Zusammenfügen des wiederverwendbaren Teils (14) und des Einmalgebrauchsteils (12), um Nahinfrarotlicht von der Quelle durch die zusammengefügte Teile zu leiten und aus einer Austrittsöffnung (27) des Einmalgebrauchsteils zu projizieren, wobei als Ergebnis des Zusammenfügens ein Photodetektor (53) in dem wiederverwendbaren Teil in einem Fenster angeordnet ist, das in dem Einmalgebrauchsteil in einem vorgegebenen Abstand von der Austrittsöffnung ausgebildet ist;

Befestigen des wiederverwendbaren Teils (12) an einer Hautoberfläche des Patienten über einem interessierenden Bereich;

Beleuchten des interessierenden Bereichs mit Nahinfrarotlicht;

Nachweis von reflektiertem Licht mit dem Photodetektor (53) als Maß für den oxygenierungsabhängigen Parameter;

Entfernen des Einmalgebrauchsteils von der Hautoberfläche nach Abschluss der Operation; Lösen des wiederverwendbaren Teils von dem Einmalgebrauchsteil; und

Zusammenfügen des wiederverwendbaren Teils mit einem zweiten Einmalgebrauchsteil, um einen oxygenierungsabhängigen Parameter eines zweiten Patienten während einer zweiten Operation zu messen.

Revendications

1. Système de spectroscopie proche infrarouge pour surveiller un paramètre relatif à l'oxygénation au-dessous d'une surface corporelle d'un patient **caractérisé en ce qu'il comprend** :

une partie de sonde réutilisable (14) comprenant un élément de ferrule (41) monté sur un câble hybride (16) pour acheminer la lumière proche infrarouge depuis une source distante, ladite partie de sonde réutilisable (14) comprenant en outre une paire de photodétecteurs, ledit élément de ferrule (41) ayant une terminaison espacée de ladite paire de photodétecteurs ; et une partie de coupleur jetable (12) comprenant

- un logement flexible logeant de façon fixe un élément de canal de lumière (20) conçu pour être couplé sélectivement à ladite terminaison dudit élément de ferrule (41) afin de diriger ladite lumière proche infrarouge vers ladite surface corporelle, ledit logement flexible comprenant en outre une couche adhésive pour fixer provisoirement ladite partie de coupleur jetable (12) à ladite surface corporelle, et ledit logement flexible comprenant une fenêtre (24) disposée en alignement avec ladite paire de détecteurs infrarouges destinée à admettre la lumière proche infrarouge réfléchie depuis ledit patient lorsque ladite partie de coupleur jetable est reliée de manière amovible à ladite partie de sonde réutilisable (14).
2. Système selon la revendication 1, dans lequel ledit élément de canal de lumière (20) comprend un fléchisseur de lumière ayant une surface réfléchissante (37) permettant de diriger ladite lumière proche infrarouge dans une direction sensiblement perpendiculaire à ladite surface corporelle.
 3. Système selon la revendication 2, dans lequel ledit logement flexible comprend un surmoule sensiblement opaque (23) constitué de caoutchouc souple.
 4. Système selon la revendication 1, dans lequel ladite partie de coupleur jetable (12) comprend en outre une mémoire électronique (34) permettant de stocker les informations associées à un patient, dans lequel ledit système de spectroscopie proche infrarouge est conçu pour être couplé à une unité de commande de moniteur via ledit câble hybride (16), et dans lequel ladite partie de sonde réutilisable (14) comprend un circuit de données destiné à être couplé avec ladite mémoire électronique (34) pour rendre lesdites informations relatives au patient accessibles à ladite unité de commande de moniteur via ledit câble hybride (16).
 5. Système selon la revendication 4, dans lequel ladite mémoire électronique (34) comprend un circuit intégré ayant des broches de connexion (33) et dans lequel ladite partie de coupleur jetable (12) comprend en outre des éléments formant broches (22) montés sur ledit élément de canal de lumière (20) destinés à recevoir lesdites broches de connexion à une extrémité de celui-ci et à se projeter depuis ladite partie de coupleur jetable (12) à l'autre extrémité de celui-ci pour être joints audit câble hybride (16).
 6. Système selon la revendication 1, comprenant en outre :
 - un générateur de lumière (45) monté sur ledit élément de ferrule (41) pour générer une émission visible lors de la réception d'énergie électrique depuis ledit câble hybride ; et
 - une lentille (21) comprise dans ladite partie de coupleur jetable (12) recevant ladite émission visible et faisant rayonner ladite émission visible à l'extérieur de ladite partie de coupleur jetable (12) pour indiquer que ladite énergie électrique est reçue.
 7. Système selon la revendication 1, dans lequel ladite partie de sonde réutilisable (14) comprend en outre :
 - une carte de circuit imprimé flexible allongée (40) montée sur ledit élément de ferrule (41) à une première extrémité et connectée à ladite paire de photodétecteurs (53) à une seconde extrémité (52), ladite carte de circuit imprimé flexible (40) comprenant des traces conductrices (62) pour interconnecter lesdits photodétecteurs audit câble hybride (16).
 8. Système selon la revendication 7, comprenant en outre :
 - un cache contre les perturbations électromagnétiques (57) monté au niveau de ladite seconde extrémité (52) ;
 - un logement rigide (58, 59) contenant lesdits photodétecteurs et ledit cache (57) ; et un corps surmoulé couvrant ladite carte de circuit imprimé flexible (40).
 9. Système selon la revendication 8, dans lequel ledit corps surmoulé de ladite partie de sonde réutilisable (14) et ledit logement flexible de ladite partie de coupleur jetable (12) comprennent des éléments de verrouillage respectifs (15, 17) destinés à retenir positivement ladite partie de coupleur jetable et ladite partie de sonde réutilisable lorsqu'ils sont connectés pour utilisation.
 10. Système selon la revendication 9, dans lequel lesdits photodétecteurs (53) sont respectivement espacés à des distances prédéterminées dudit élément de canal de lumière (20) lorsqu'ils sont connectés pour utilisation.
 11. Procédé de mesure d'un paramètre relatif à l'oxygénation pendant une intervention chirurgicale sur un patient au moyen d'un système de surveillance ayant une source de lumière proche infrarouge et un contrôleur et au moyen d'un système de spectroscopie proche infrarouge selon la revendication 1 ayant une partie réutilisable (14) et une partie jetable (12), ledit procédé comprenant les étapes consistant à :
 - accoupler ladite partie réutilisable (14) et ladite partie jetable (12) pour acheminer la lumière

proche infrarouge de ladite source à travers les-
dites parties accouplées et la projeter hors d'une
sortie (27) depuis ladite partie jetable, un pho-
todétecteur (53) dans ladite partie réutilisable
étant disposé, suite audit accouplement, dans 5
une fenêtre formée dans ladite partie jetable à
une distance prédéterminée de ladite sortie ;
fixer ladite partie jetable (12) à une surface cu-
tanée dudit patient sur une zone d'intérêt ;
éclairer ladite zone d'intérêt avec ladite lumière 10
proche infrarouge ;
détecter la lumière réfléchiée avec ledit photodé-
tecteur (53) en tant que mesure dudit paramètre
relatif à l'oxygénation ;
retirer ladite partie jetable de ladite surface cu- 15
tanée après réalisation de ladite intervention
chirurgicale ;
désaccoupler ladite partie réutilisable de ladite
partie jetable ; et accoupler ladite partie réutili- 20
sable à une seconde partie jetable pour mesurer
un paramètre relatif à l'oxygénation d'un second
patient au cours d'une seconde intervention chi-
rurgicale.

25

30

35

40

45

50

55

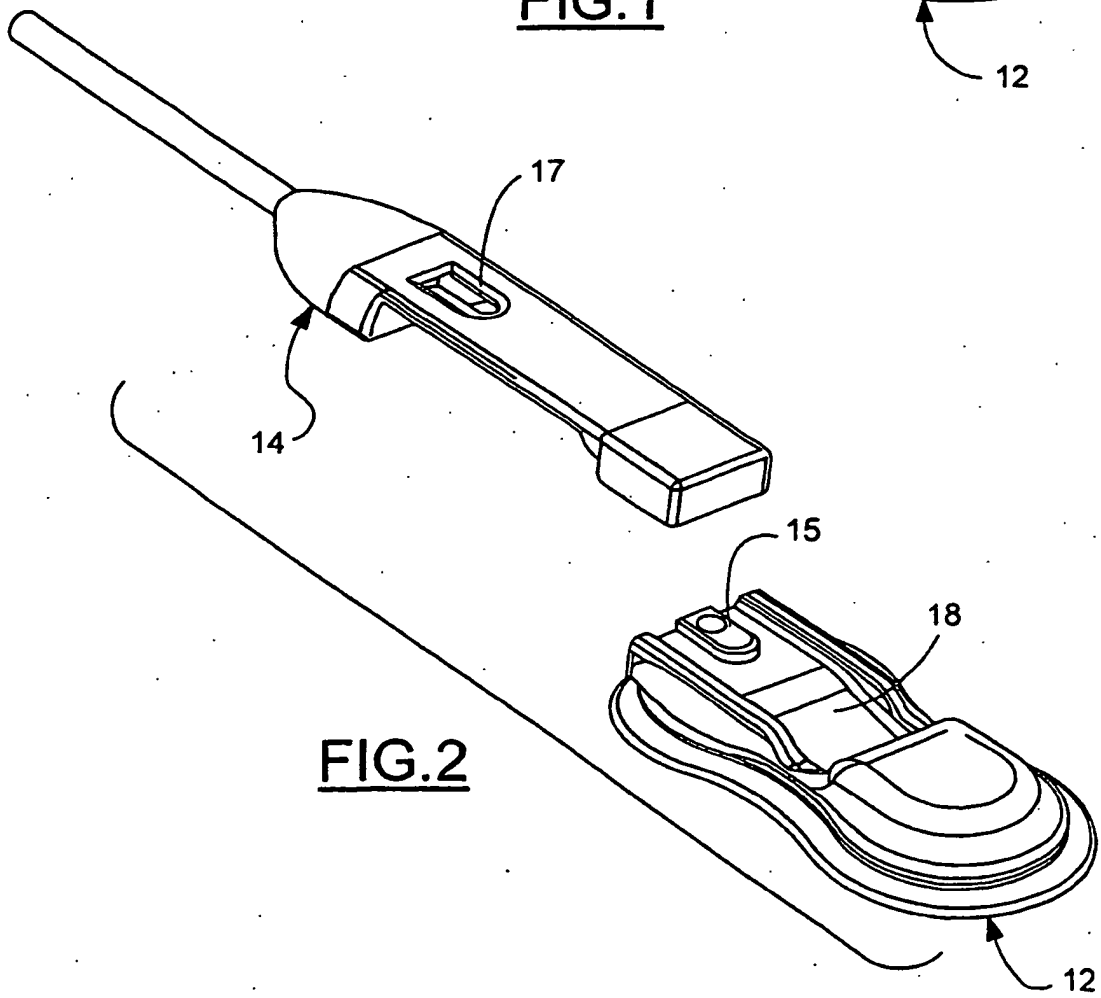
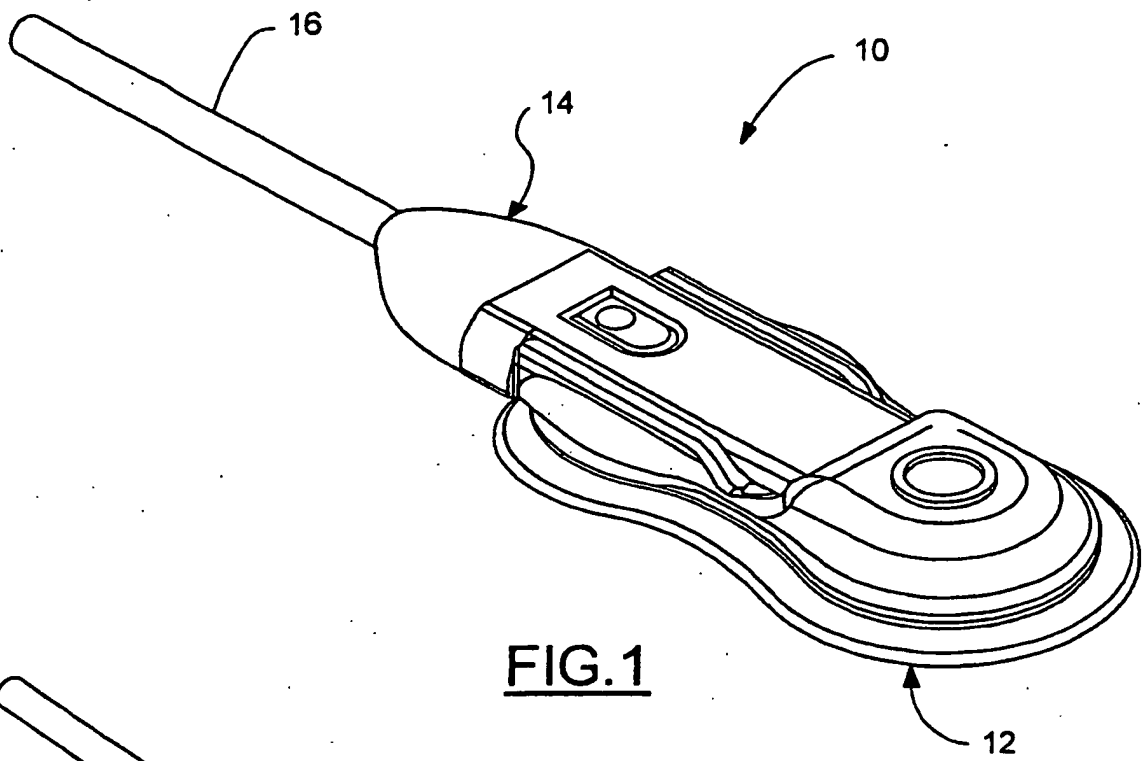

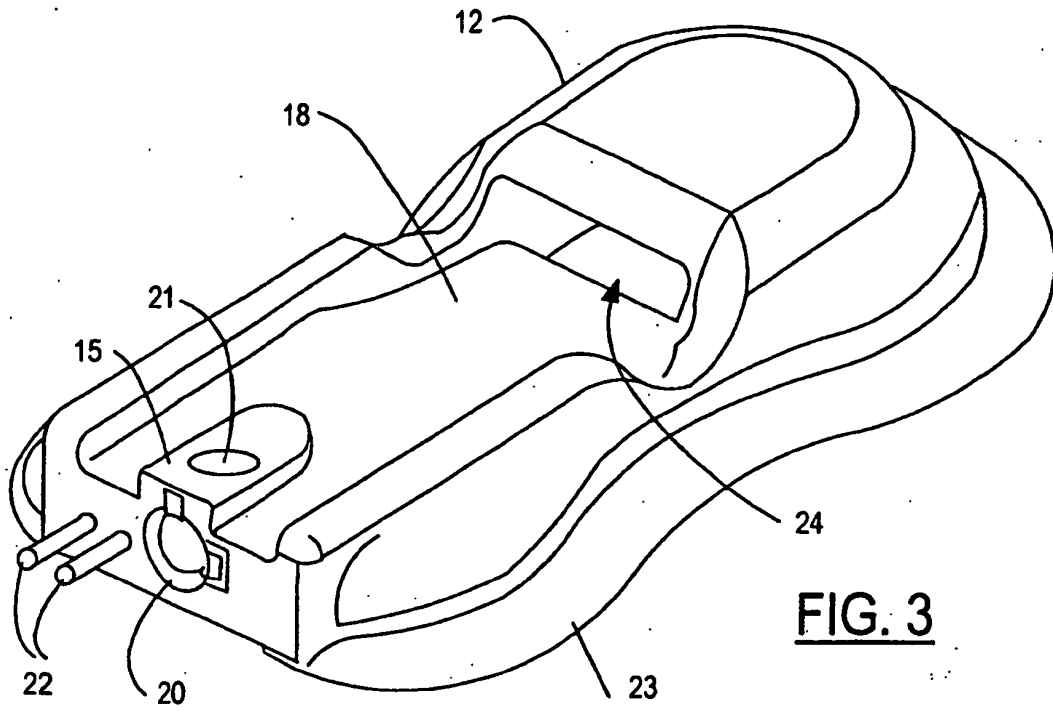

FIG. 3

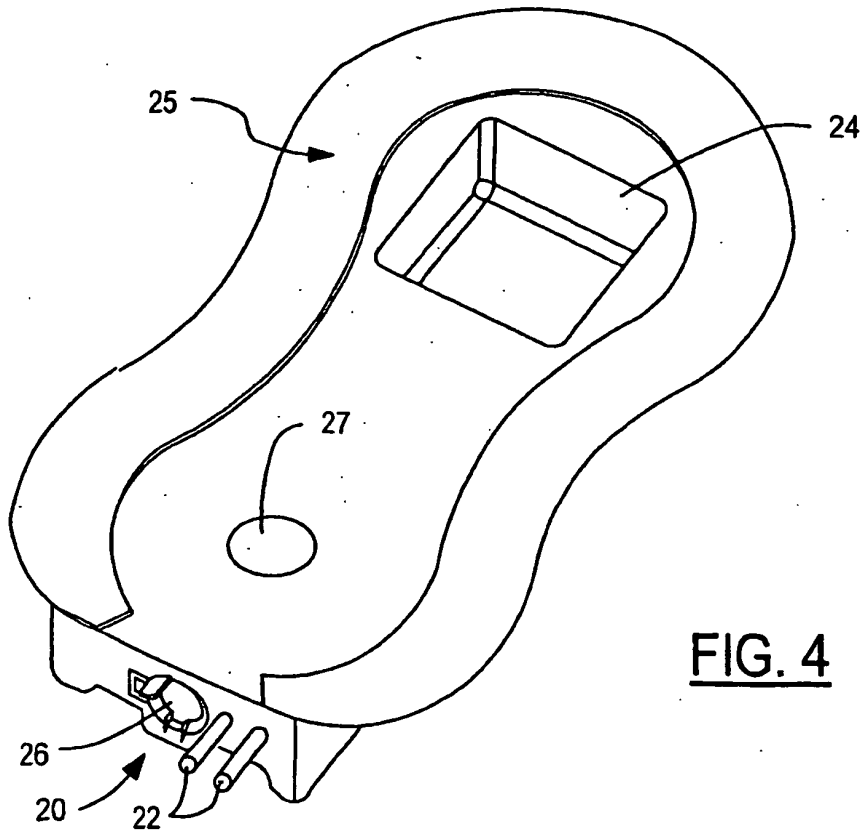

FIG. 4

FIG.5

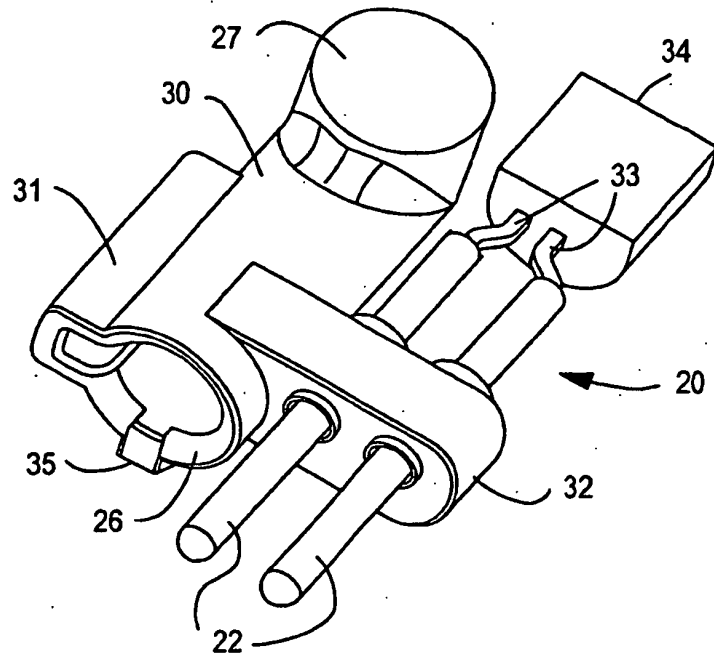

FIG.6

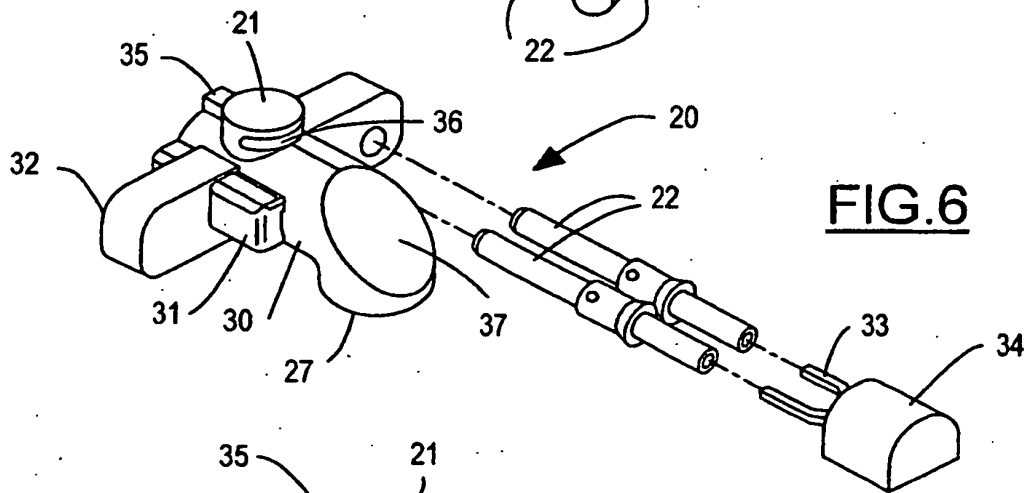
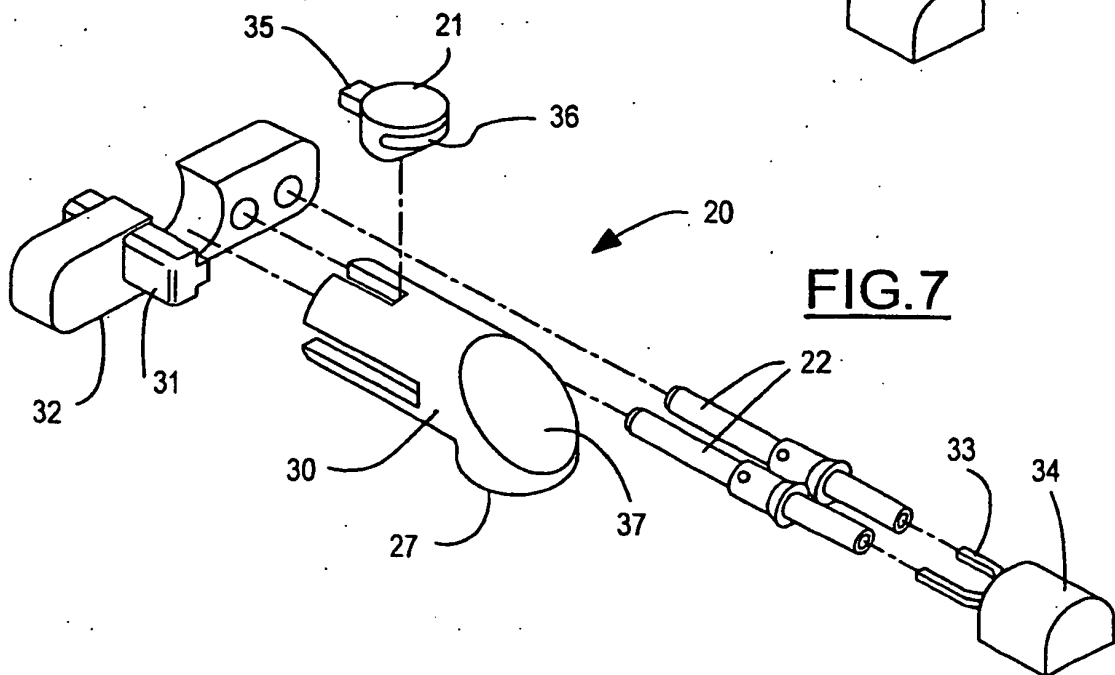
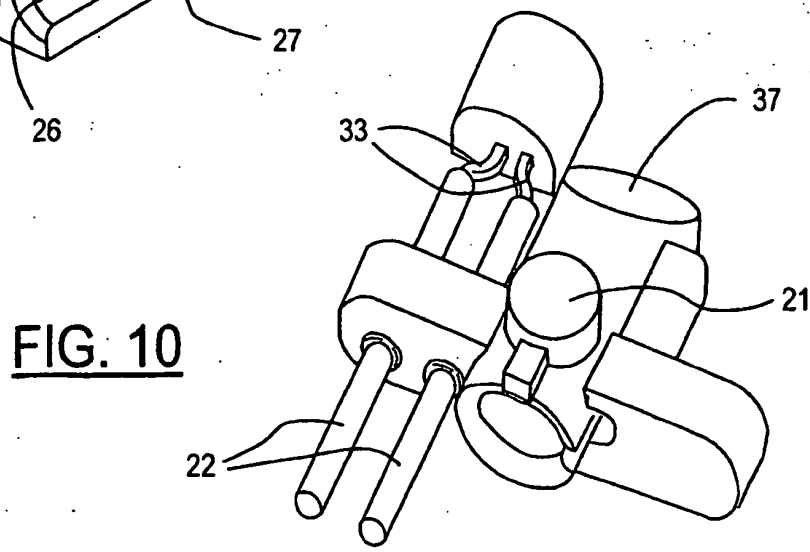
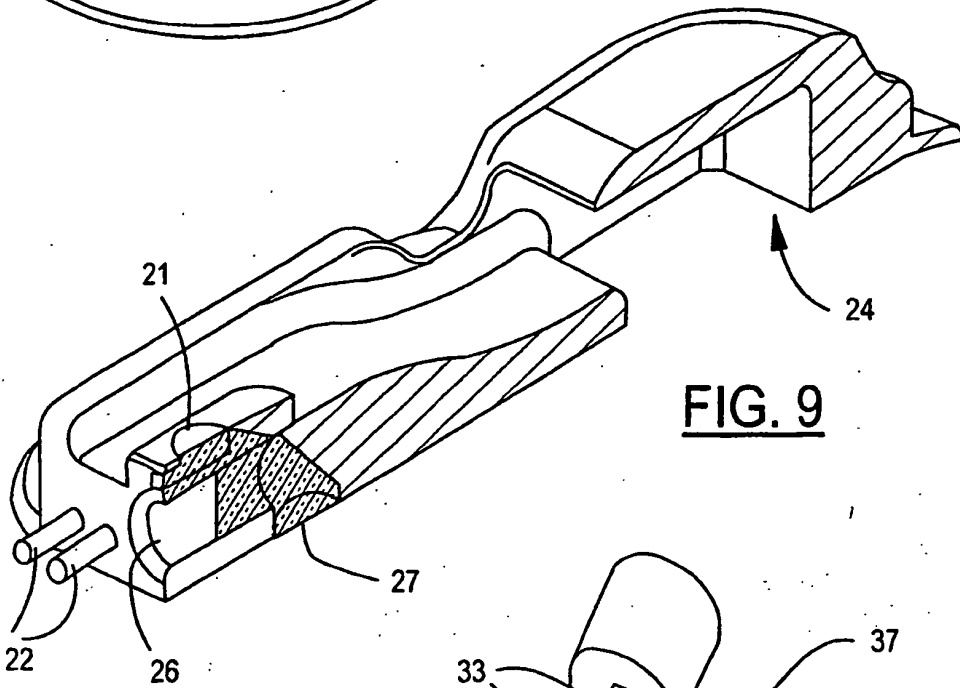
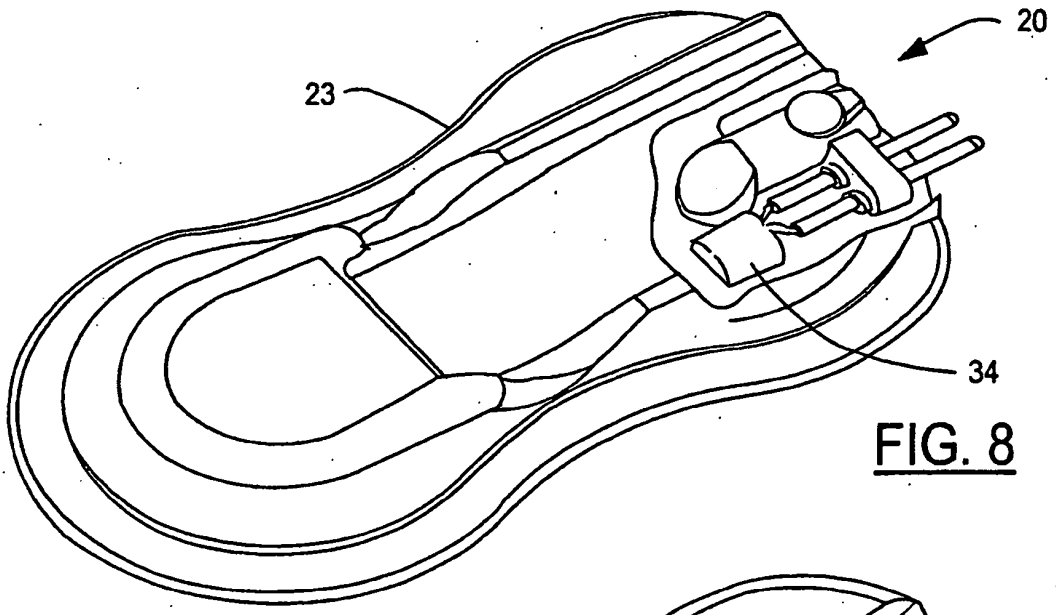

FIG.7





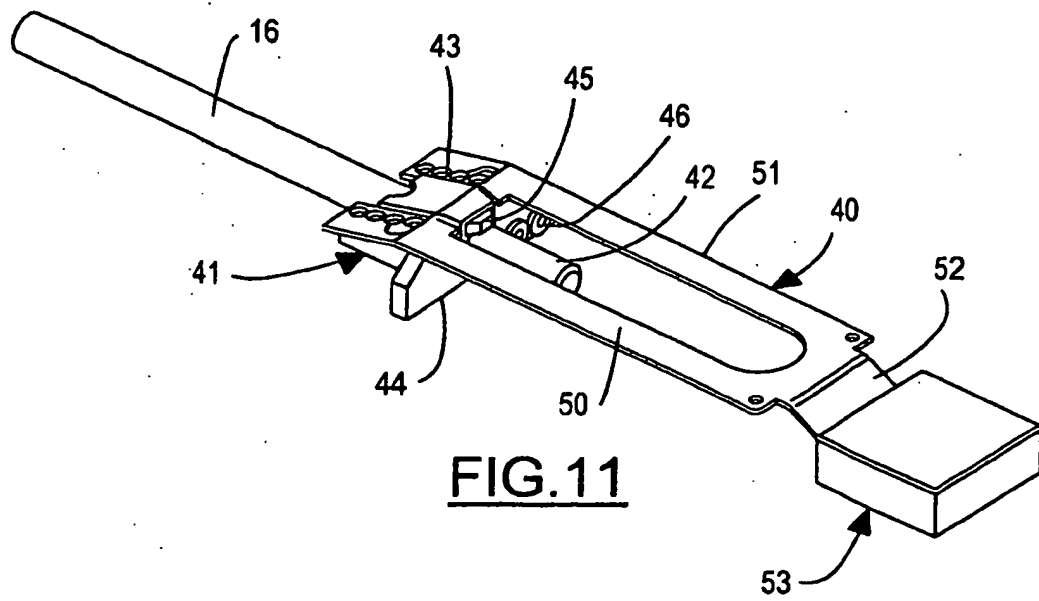

FIG. 11

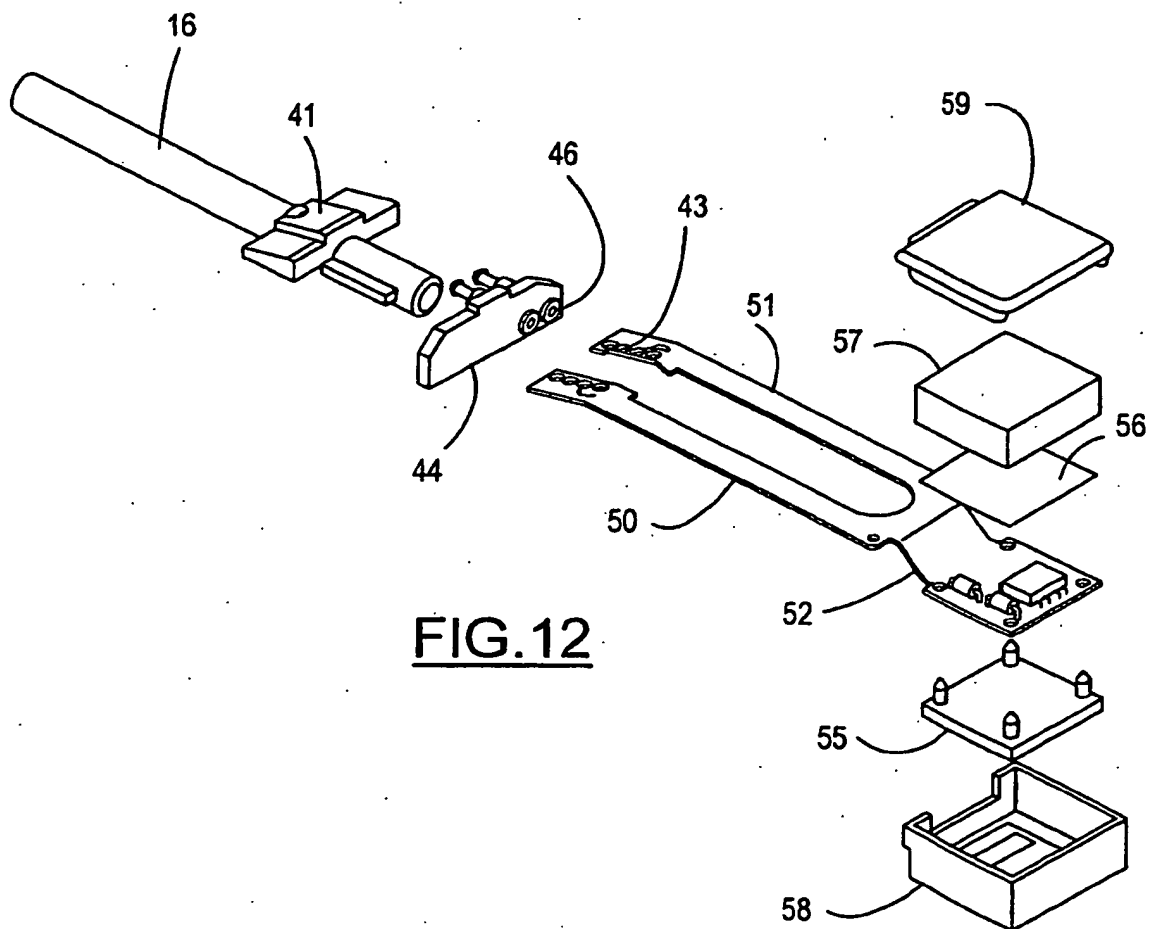

FIG. 12

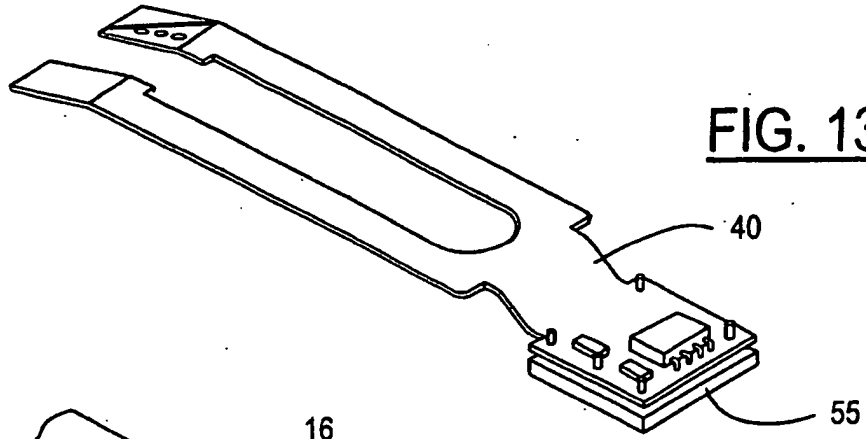

FIG. 13

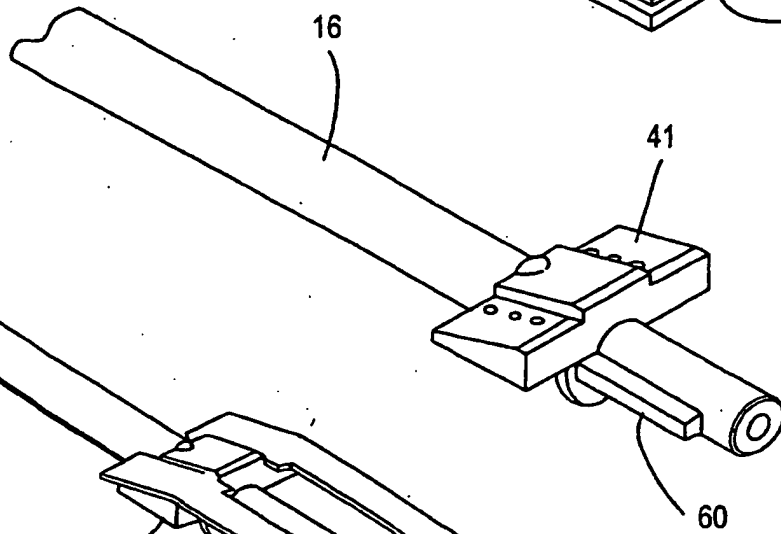

FIG. 14

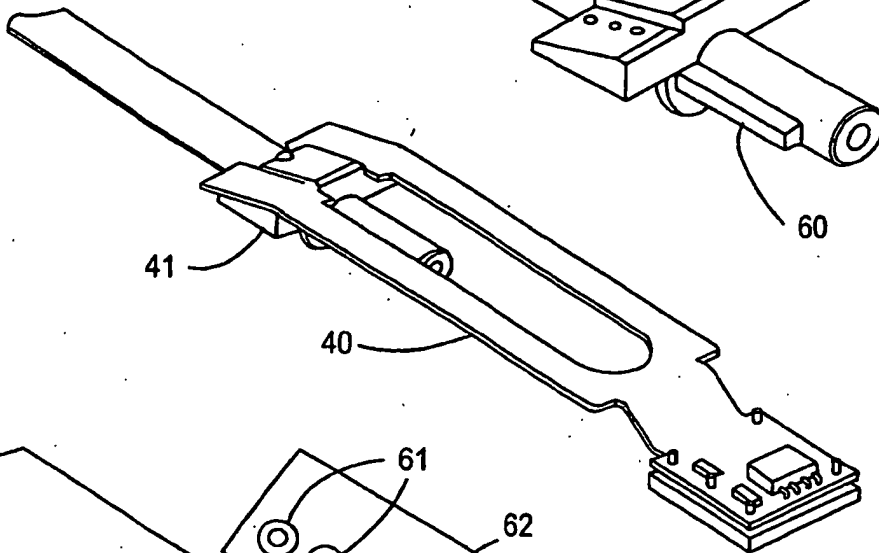

FIG. 15

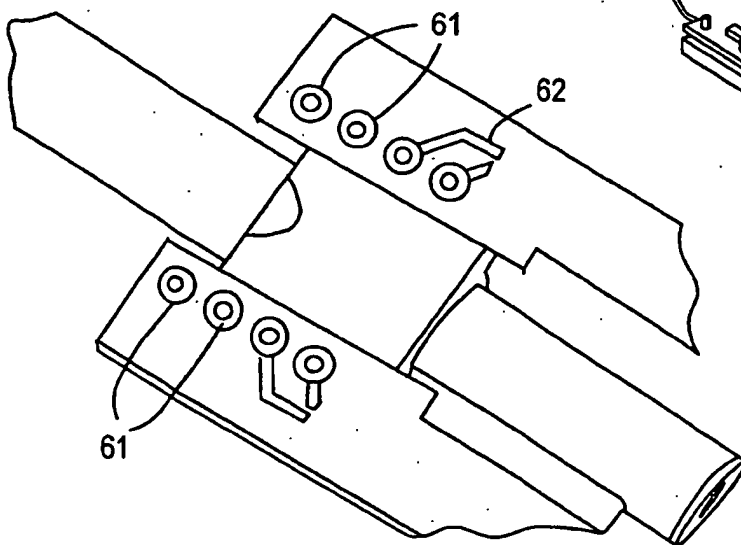

FIG. 16

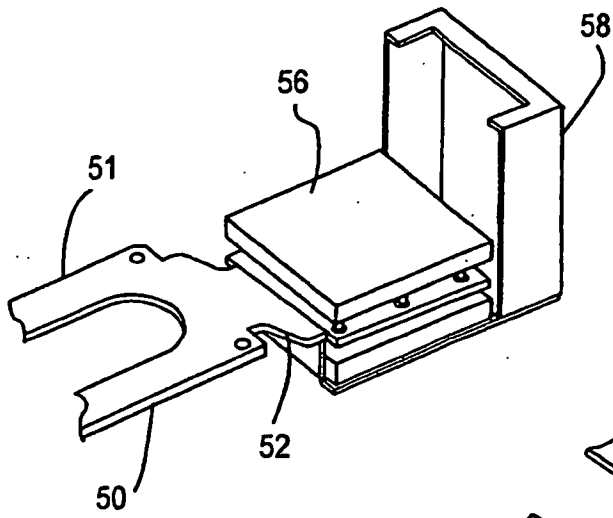

FIG. 17

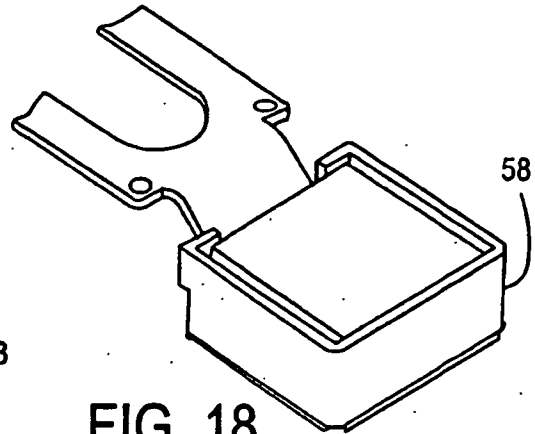

FIG. 18

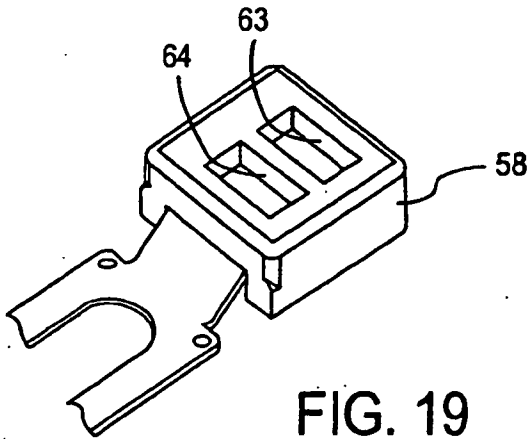

FIG. 19

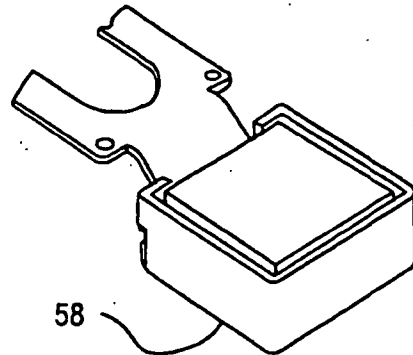

FIG. 20

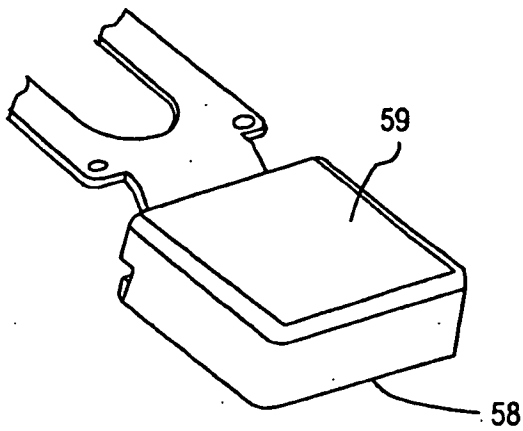

FIG. 21

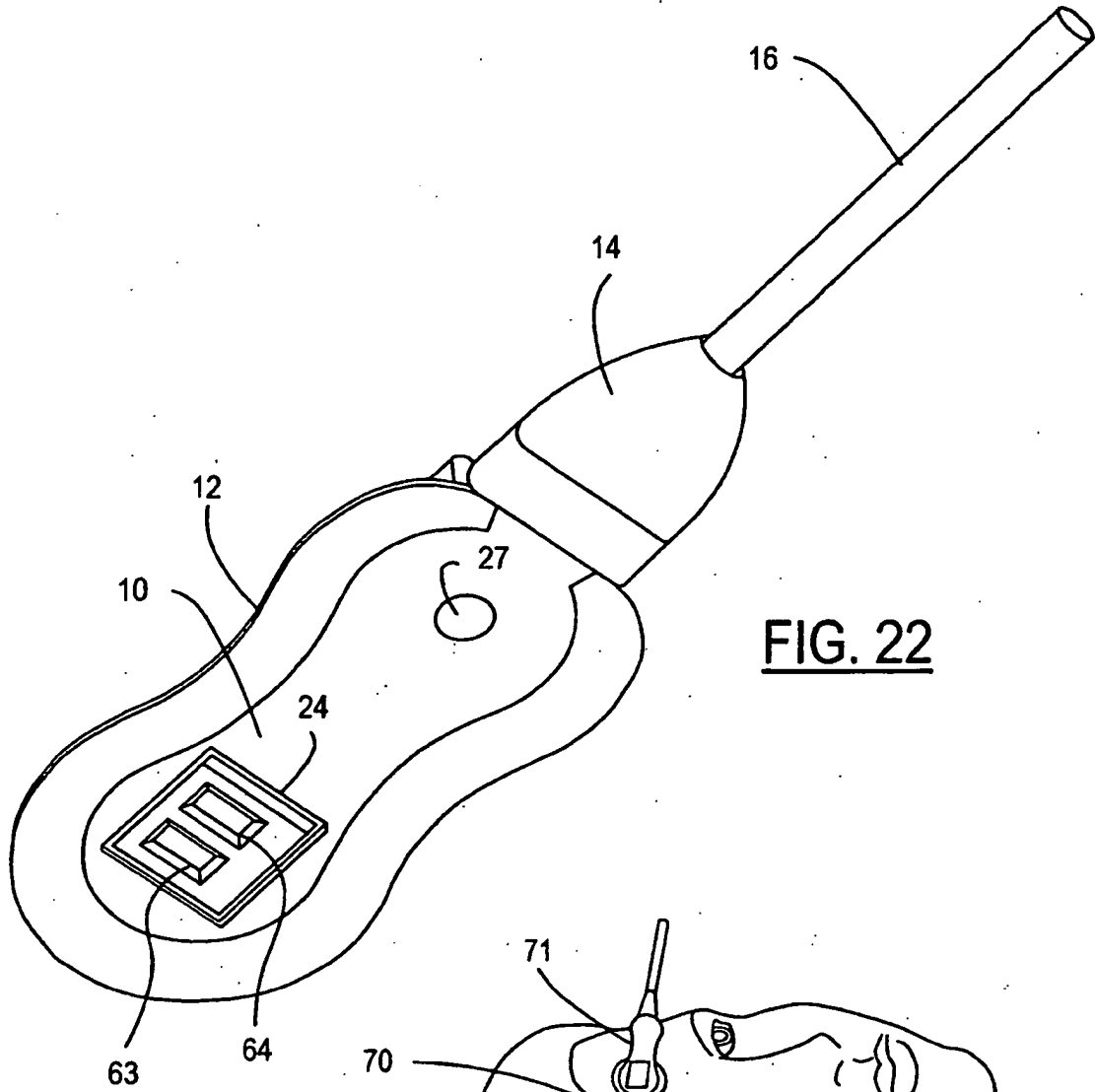

FIG. 22

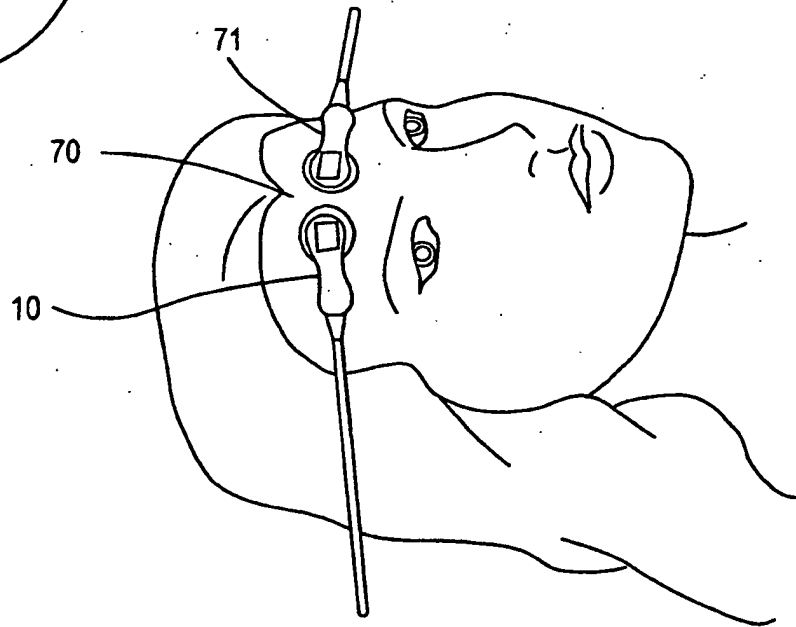

FIG. 23

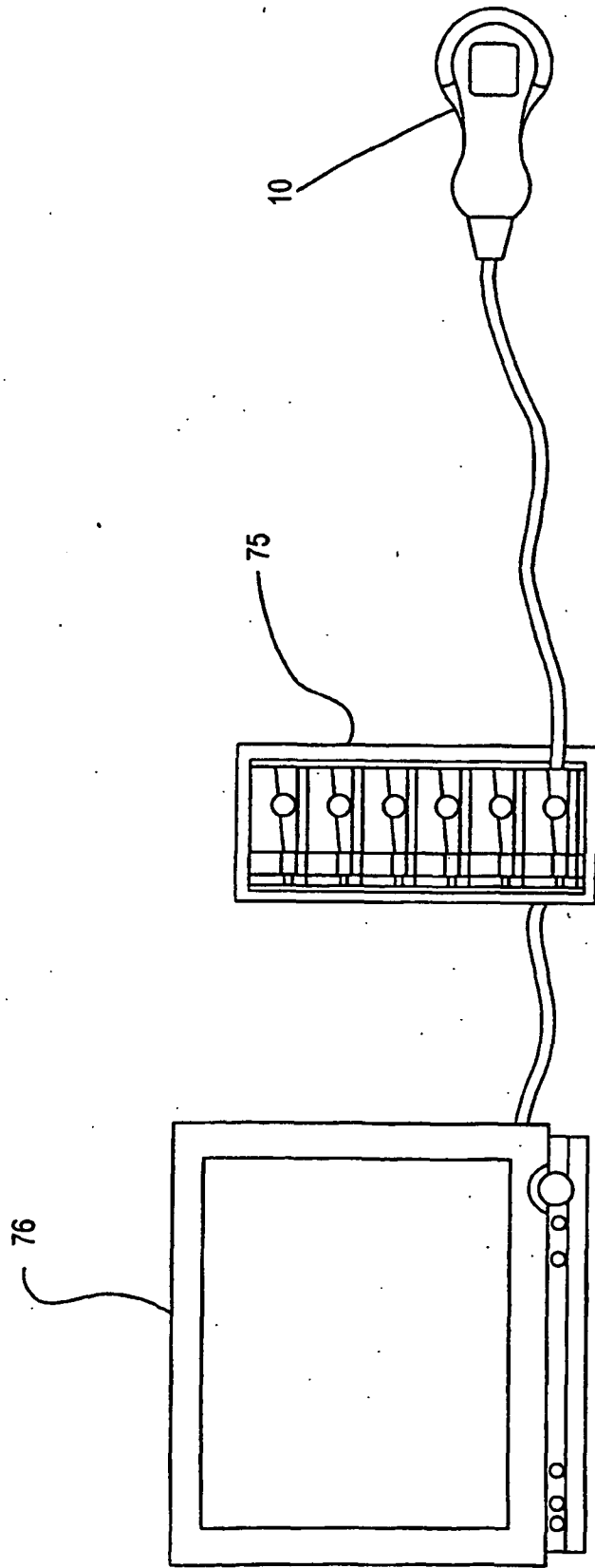

FIG. 24

REFERENCES CITED IN THE DESCRIPTION

This list of references cited by the applicant is for the reader's convenience only. It does not form part of the European patent document. Even though great care has been taken in compiling the references, errors or omissions cannot be excluded and the EPO disclaims all liability in this regard.

Patent documents cited in the description

- US 20020016536 A1 [0005]
- US 6014576 A [0006]

专利名称(译)	具有可重复使用部分的近红外光谱装置		
公开(公告)号	EP1691190B1	公开(公告)日	2011-08-10
申请号	EP2006002664	申请日	2006-02-09
[标]申请(专利权)人(译)	心血管系统股份有限公司		
申请(专利权)人(译)	泰尔茂心血管系统股份有限公司		
当前申请(专利权)人(译)	泰尔茂心血管系统股份有限公司		
[标]发明人	HACKER THOMAS G		
发明人	HACKER, THOMAS G. BRENT, ALLEN W.		
IPC分类号	G01N21/35 A61B5/00		
CPC分类号	A61B5/6814 A61B5/14552 A61B5/14553 A61B2562/222 A61B2562/223 G01N21/359 G01N21/4738		
代理机构(译)	法思博事务所		
优先权	60/651886 2005-02-10 US		
其他公开文献	EP1691190A1		
外部链接	Espacenet		

摘要(译)

用于脑监测的NIRS传感器装置(10)尺寸小,为患者提供可靠的附着,阻挡环境光,易于使用,卫生,并且支持与外科手术和监测系统的数据集成。传感器装置通过混合电缆(16)耦合到远程近红外光源。由于光源位于远处,因此可以容易地使用适于提供高能量短脉冲的源,使得表面非脑组织干扰的机会较少,并且环境光的干扰较小。另外,远程位置避免了在低温过程期间(例如,由于降低的温度导致的LED中的带宽偏移)在现有技术中经历的本地光源的输出的变化。与通常在现有技术中使用的局部安装的LED相比,可以通过使用激光二极管来实现更高的能量。传感器装置(10)是两件式设计,包括包含光电探测器的可重复使用部分(14)和接收来自可再用部分的光并使其弯曲以将光引导到大脑中的一次性部分(12)。。

