



(19)

Europäisches Patentamt
European Patent Office
Office européen des brevets



(11)

EP 1 168 960 B1

(12)

EUROPEAN PATENT SPECIFICATION

(45) Date of publication and mention
of the grant of the patent:

06.10.2004 Bulletin 2004/41

(21) Application number: **01906960.8**

(22) Date of filing: **02.02.2001**

(51) Int Cl.⁷: **A61B 5/00**

(86) International application number:
PCT/US2001/003589

(87) International publication number:
WO 2001/056467 (09.08.2001 Gazette 2001/32)

(54) INFORMATION REMOTE MONITOR (IRM) MEDICAL DEVICE

GERÄT ZUR INFORMATIONSBEOBACHTUNG AUF ABSTAND FÜR MEDIZINISCHE
VORRICHTUNG

DISPOSITIF MEDICAL AVEC MONITEUR D'INFORMATIONS A DISTANCE (IRM)

(84) Designated Contracting States:
DE FR

(30) Priority: **04.02.2000 US 180285 P**

(43) Date of publication of application:
09.01.2002 Bulletin 2002/02

(73) Proprietor: **Medtronic, Inc.**
Minneapolis, Minnesota 55432-5604 (US)

(72) Inventors:
• **CHRISTOPHERSON, Mark, A.**
Shoreview, MN 55126 (US)
• **TAPP, Gary, A.**
Plymouth, MN 55446 (US)

- **MALEWICZ, Andrzej, M.**
Minneapolis, MN 55409 (US)
- **SCHMALZ, Brian, P.**
Minneapolis, MN 55412 (US)
- **KOPISCHKE, Troy, D.**
Hamel, MN 55340 (US)

(74) Representative: **Hughes, Andrea Michelle**
Frank B. Dehn & Co.,
European Patent Attorneys,
179 Queen Victoria Street
London EC4V 4EL (GB)

(56) References cited:
US-A- 5 467 773 **US-A- 5 720 770**
US-A- 5 810 735 **US-A- 5 904 708**

EP 1 168 960 B1

Note: Within nine months from the publication of the mention of the grant of the European patent, any person may give notice to the European Patent Office of opposition to the European patent granted. Notice of opposition shall be filed in a written reasoned statement. It shall not be deemed to have been filed until the opposition fee has been paid. (Art. 99(1) European Patent Convention).

Description

Field of the Invention

[0001] The present invention generally relates to medical devices. Specifically, the invention relates to an interface device implemented to telemetrically and wirelessly transmit physiologic and cardiac data obtained from one or more implantable medical devices (IMDs). More specifically, the invention relates to an information remote monitor (IRM) medical device, having data communications with the IMDs and a remote computer/server that is accessible by Medtronic, Inc. and other care providers to seamlessly and continuously transfer data and enable remote monitoring and management of patients with chronic disease. Preferably, the IRM is placed in the patient's home/room to access the IMD and transmit stored data via various data transmission schemes to a remote server or other expert centers.

Background of the Invention

[0002] The present invention relates generally to telemetry systems for uplink and downlink telemetry transmission between at least one implantable medical device and an IRM. The IRM is implemented to overcome the problems encountered in providing patient services that are generally limited to in-hospital operations.

[0003] Prior art methods of reviewing patient data and conducting clinical follow-ups on patients with one or more IMDs, requires a patient to go to a clinic or hospital. Further, if the medical condition of a patient with an IMD warrants a continuous monitoring or adjustment of the device, the patient would have to stay in a hospital indefinitely. Such a continued treatment plan poses both economic and social problems. Under the exemplary scenario, as a segment of the population with IMDs increases, many more hospitals/clinics, including service personnel will be needed to provide in-hospital service for the patients, thus escalating the cost of health care. Additionally, the patients would be unduly restricted and inconvenienced by the need to either stay in the hospital or make very frequent visits to a clinic.

[0004] Yet another condition of the prior art practice requires that a patient visit a clinic center for occasional retrieval of data from the IMD to assess the operation of the device and gather patient history for both clinical and research purposes. Further, if a patient with IMDs is taking a drug, it is often clinically prudent to monitor the dose and its impact on the performance of the IMD. Furthermore, the IMD may be adapted to monitor the patient's drug intake, compliance and effectiveness by directly measuring the dose of the drug in the patient. Normally, such data is acquired by having the patient in a hospital/clinic to download the stored data from the IMD or by direct examination, such as, for example, a blood test. Depending on the frequency of data collection, this procedure of assessing a chronic condition of a patient

with IMDs may pose serious difficulty and inconvenience for patients who live in rural areas or have limited mobility.

[0005] Current practice in the art involves the use of an external programming unit for non-invasive communication with IMDs via uplink and downlink communication channels associated with the programmers. In accordance with conventional medical device programming systems, a programming head is used for facilitating two-way communication between IMDs and the programmer. In many known implanted IMD systems, a programming head is positioned on the patient's body over the IMD side such that one or more antennae within the head can send RF signals to, and receive RF signals from, an antenna disposed within the hermetic enclosure of the IMD or disposed within the connector block of the IMD in accordance with common practice in the art. As was indicated hereinabove, procedures that require downlink and uplink using programmers require that the patient be present at the hospital or clinic. A programmer of this type is described in more detail in U.S. Patent No. 5,345,362 issued to Thomas J. Winkler, entitled PORTABLE COMPUTER APPARATUS WITH ARTICULATING DISPLAY PANEL.

[0006] In the context of the present invention, programmers are complicated and expensive units to deploy in patients' homes to implement a highly distributive chronic patient monitoring and management. Notwithstanding, more recently, it has been proposed to provide communication systems for IMDs in which the programming head is eliminated and communication occurs directly between the IMDs and the programmer located some distance from the patient. Such programmers still require the patient to be within telemetry range and therefore are not compatible with a remote patient management. Such systems are disclosed in U.S. Patent No. 5,404,877 to Nolan et al, and U.S. Patent No. 5,113,869 to Nappholz. In the Nappholz patent, in particular, broadcasting RF signals from an IMD to a programmer that may be located some feet away from the patient, is suggested. Such a communication system is also disclosed in U.S. Patent Application SN 09/303,178 for A TELEMETRY SYSTEM FOR IMPLANTABLE MEDICAL DEVICES, filed April 30, 1999 by Villaseca et al.

[0007] In the context of remote communication relating to IMD data transfer and exchange, for example, U.S. Patent No. 3,769,965 issued to Raddi et al, discloses a monitor apparatus for implanted pulse generator. Specifically, a monitor apparatus is disclosed for monitoring electrical stimulation signals due to either natural or artificial electrical stimulation of a body part via a communication link such that the repetition rate of the electrical stimulation signals can be determined. The monitor apparatus comprises the subsystems: a transducer; a communication link or network; and a receiver. The transducer is adapted to sense the electrical stimulation signals generated either naturally or by an electronic or-

gan stimulator, such as an implanted cardiac pacer, and to convert the electrical stimulation signals to audible signals such as tone bursts. These audible tone bursts are then transmitted over a communication link such as the standard telephone network to the receiver located at a remote telephone station, typically a cardiologist's office. The receiver is adapted to measure the time interval between received tone bursts. The receiver is further adapted to display or indicate to an observer the time interval between received tone burst. If desired, the receiver can be adapted to indicate directly the repetition rate of the stimulation signals. The information is then utilized by an observer for diagnostic purposes. The monitor apparatus also includes a test means for testing the integrity of the apparatus including the transducer, the communication link and the receiver.

[0008] Further, U.S. Patent No. 3,885,552 issued to Kennedy discloses a diagnostic method and system for the detection and transmission of data from a remote location to a central location.

[0009] U.S. Patent No. 4,142,533 issued to Brownlee et al, discloses a monitoring system for cardiac pacers. It discloses a complete system for telemetering and monitoring the functioning of an implanted pacemaker as well as controlling the testing of the functions from a remotely located central facility is disclosed specifically comprising the provision of capabilities for directly and simultaneously transmitting from the pacer, electrical signals indicative of multiple pacer functions, such as, pacer rate, cell voltage, refractory period, heart rate with pacer inhibited, R-wave level and sensing margin, sensing circuit and other component failure, cardiac electrode lead break, and hermetic integrity. The indicative signals are picked up at the patient's location for local analysis and/or telephonically communicated to a remote central monitoring station. The central station may control testing of the pacemaker functions by transmitting command signals back telephonically for coupling through cooperating external and implanted inductances or magnetically controlled switches to the implanted pacer circuitry.

[0010] U.S. Patent No. 5,467,773 issued to Bergelson et al, discloses cardiac pacing remote monitoring system. Remote monitoring of cardiac electrical activity and/or pacemaker function under extensive control by personnel at a central station over the operation of a monitoring instrument at the patient's home, to thereby reduce reliance on active participation by the patient and to enhance useful information and suppress undesirable information in the signals transmitted between the home monitoring unit and the central station.

[0011] U.S. Patent No. 5,626,630 to Markowitz et al, discloses a medical telemetry system using an implanted passive transponder. The telemetry system includes a remote monitoring station, a repeater worn externally by a patient and a quasipassive transponder attached to a device implanted in the patient. The remote monitoring station communicates to the repeater to initiate

an interrogation routine between the repeater and the transponder to extract patient condition information from the implanted device. When the repeater receives the condition information, it relays it to the remote monitoring station. The transponder is specially designed to operate with an extremely low level of power, less than 1 nW/ baud, and to be compatible for attachment to existing implanted devices. The transponder can operate at a very high data rate, including a rate of about 100 kbps.

[0012] U.S. Patent No. 5,720,770 to Nappholz et al, discloses a cardiac stimulation system with enhanced communication and control capability. Specifically, a cardiac stimulation system is provided which delivers long term cardiac therapy without a personal supervision by a physician. The system includes a cardiac stimulation device implanted in a patient and an external device in constant or periodic communication with the cardiac device. The external device is used to control the pacemaker operation. The external device receives updates of the condition of the patient and the operation of the cardiac device and the therapy provided by the cardiac device. This information is transmitted by the external device over a standard telephone network which may consist of hardwired network, a cellular network, or a combination thereof to a remote control device operating near the physician and/or a monitoring station used for monitoring and data logging information from a plurality of patients. The cardiac device, through the external device can also communicate directly and exchange information with the patient over an RF channel. Finally, the external device may be provided with ground position indication system for locating the patient geographically in an emergency.

[0013] U.S. Patent No. 5,944,659 to Flach et al, relates to architecture for TDMA medical telemetry system. A medical telemetry system is provided for collecting the real-time physiologic data of patients (including ambulatory patients) of a medical facility, and for transferring the data via RF to a real-time data distribution network for monitoring and display. The system includes battery-powered remote telemeters which attach to respective patients, and which collect and transmit (in data packets) the physiologic data of the patients. The remote telemeters communicate bi-directionally with a number of ceiling-mounted RF transceivers, referred to as "VCELLs," using a wireless TDMA protocol. The VCELLs, which are hardwire-connected to a LAN, forward the data packets received from the telemeters to patient monitoring stations on the LAN. The VCELLs are distributed throughout the medical facility such that different VCELLs provide coverage for different patient areas. As part of the wireless TDMA protocol, the remote telemeters continuously assess the quality of the RF links offered by different nearby VCELLs (by scanning the frequencies on which different VCELLs operate), and connect to those VCELLs which offer the best link conditions. To provide a high degree of protection against multi-path interference, each remote telemeter

maintains connections with two different VCELLs at-a-time, and transmits all data packets (on different frequencies and during different timeslots) to both VCELLs; the system thereby provides space, time and frequency diversity on wireless data packet transfers from the telemeters. The telemeters and VCELLs also implement a patient location protocol for enabling the monitoring of the locations of individual patients. The architecture can accommodate a large number of patients (e.g., 500 or more) while operating within the transmission power limits of the VHF medical telemetry band.

[0014] U.S. Patent No. 6,073,046 issued to Pattel et al, discloses a heart monitor system to enable a medical facility, after discharge of a cardiovascular patient, to remain in contact with the patient. The patient is provided with a multiple lead EKG terminal spread placed on the body, and the signals therefrom are collected and transmitted. They are transmitted to a remote central location. At the central location, the transmitted EKG data is analyzed. It is compared with normal EKG signals and signals captured in time from the same patient as part of the patient history. The evaluation is done through a neural network which forms an output signal automatically or through intervention of a cardiologist sending an alarm condition signal to the patient instructing the patient to get immediate treatment at the patient's location or to otherwise go to a specific medical facility. Signal preparation includes providing EKG signals through a multiplexer, conversion into a digital data, removal of bias signals, stabilization of this EKG base line, compression and data transmission through a modulator. The receive signal is reconstructed to provide an EKG signal of the patient which is then evaluated in the neural network. As appropriate, transmitter/receiver repeater stations and synchronous satellites are used to convey these signals.

[0015] U.S. Patent No. 6,162,180 issued to Miesel et al discloses a non-invasive cardiac monitoring system and method with communications interface. Specifically, a system and method for determining a patient's cardiac output in a non-invasive manner and transmitting cardiac output data to a remote host processor, a communications system, or a local output device is disclosed. A noninvasive cardiac monitoring approach utilizes an implantable medical device coupled to an oxygen sensor. The oxygen sensor provides venous oxygen saturation data to the implantable medical device. An oxygen consumption unit produces oxygen consumption data using air exhaled by a patient. A processing unit calculates a cardiac output result in real-time using the venous oxygen saturation data, the oxygen consumption data, and arterial oxygen saturation data assumed to be about 100% or acquired using a sensor external to the patient. The implantable medical device may transmit the venous oxygen saturation data to the processing unit using electromagnetic signals or acoustic signals. The implantable medical device may be a pacemaker, a pacemaker, cardioverter, defibrillator

(PCD), an oxygen sensing device, or an implantable hemodynamic monitor. The processing unit may store the cardiac output data/result for a period of time and/or communicate the

5 cardiac output result to the remote host processor substantially in real-time via a communications interface. The interface may include a modem, a computer interface, a network interface, or a communications system interface, for example. The processing unit may communicate the cardiac output result to the remote host processor in an analog, digital or optical form.

[0016] Use of the systems of the prior art may not be conducive for patients to stay in their home while receiving a high quality continuous monitoring and clinical service. In sharp contrast, the IRM of the present invention is intended to provide means for a patient to transmit data from their residence to a health care provider and/or remote server. As will be discussed in the preferred embodiments herein, the design is focused on making the process very easy and automated for the patient. The complete system of the IRM in conjunction with a server, a web browser and a remote communication system, allows the patient to stay in their home, thus reducing patient visits to the physician or the hospital, while increasing the level of care at a reduced cost.

Summary of the Invention

[0017] The present invention relates to a communications system between one or more implanted devices (IMDs) in a patient and an associated information remote monitor (IRM) located at a distance from the IMDs to enable the transmission of physiologic and cardiac data from at least one of the IMDs.

[0018] In a preferred embodiment the IRM includes software adapted to communicate with Chronicle[□] which is an implantable hemodynamic monitor. The Chronicle[□] without limitation, stores trend data in a large buffer in RAM with resolution ranges from a few seconds to several minutes, depending on storage time interval.

[0019] The IRM is implemented to collect patient/medical device data in a patient's home for transmission to a remote server or clinician to enable remote and chronic patient monitoring and management. In the preferred embodiment the IRM is adapted to download data from an external pressure reference (EPR) simultaneous with downloading data from the Chronicle[□] using a wireless telemetry data transfer.

[0020] The IRM is adapted for connection to a PC to use the PC for data transfer. In the alternate, the PC may be used to control the IRM and program the implanted device thereby implementing the IRM as a programmer. In the context of the present invention, the IRM could transfer EPR and Chronicle[□] (IMD) data through the PC to a server or a remote clinical/physician center. The IRM may also, via a modem and other wireless communications media, transfer the data to a serv-

er or the remote center. In one embodiment, the IRM utilizes an integral modem to dial a server and transfer data via FTP, PPP and TC/PIP protocols.

[0021] The IRM includes various structures to promote ease of use in the home environment. Specifically, ergonomic structures in combination with user interface instructions, displays and audible communication make the IRM a user friendly device for application in the home environment.

Brief Description of the Drawings

[0022]

Figure 1 shows a diagram illustrating a program and the IRM to the present invention, communicating with one or more implantable medical devices (IMDs) in a patient.

Figure 2 represents the IRM of the present invention in telemetry communications with an IMD such as the Chronicle□ and a data transmission scheme.

Figure 3A is a perspective view of the IRM including a telemetry antenna.

Figure 3B is a perspective view of the IRM depicting the various front and back structures of the device.

Figure 4A is a perspective view representing the back side of the IRM with the antenna in a stored position.

Figure 4B is a front elevation view of the connection panel located behind the back panel of the IRM.

Figure 5A is a representation of the engagement between the IRM and the external pressure reference (EPR).

Figure 5B represents the engagement of the EPR with the IRM.

Figure 6 is a block diagram representing the major components of the IRM and the EPR.

Figure 7 is a simplified block/circuit diagram in accord with the preferred embodiment of the invention.

Detailed Description of the Preferred Embodiments of the Invention

[0023] The present invention relates to the transmission of physiologic and cardiac data obtained from preferably a Chronicle□ implantable heart monitor to a remote computer or server that is accessible by Medtronic and other care providers. The data transmitted from a patient's home or room via transmission methods such as cellular phone links, LANS, RF links, regular phone lines, cable modems and the like. The IRM is ergonomically designed for home use and includes a highly simplified but effective user interface to enable the patient to use the device without assistance from others.

[0024] Although the IRM includes software that is adaptable to communicate with various types of IMDs, including but not limited to neural implants, drug delivery

systems and other medical devices, for the purposes of this disclosure, the Chronicle□ is considered the IMD with which data communication and transmission are effected. Chronicle□ is a hemodynamic monitor and includes circuitry for data storage, recovering and processing of pressure, electrogram, heart rate, core temperature, and activity data. Triggered events cause high resolution data collection that is beat to beat for approximately 18 minutes before and after 6 minutes post event. There are three types of triggers, including bradycardia trigger, tachycardia trigger, and patient activated trigger. The bradycardia trigger and tachycardia trigger are automatic, and the patient activated trigger requires the application of the antenna by placing it at the IMD's position in the patient's body. In the alternate, a wireless communication may be implemented using, for example, various types of RF signals blue tooth or equivalent.

[0025] Generally, a communication between the IMD and the IRM could be via direct antenna placement or telemetrically within a range of a few feet. The IMD may employ, for example, an elongated antenna which projects outward from the housing of the IMD as described in the cited Villaseca et al application, or may employ a coil antenna located external the housing.

[0026] Figure 1 is a simplified schematic diagram representation of a functional uplink and downlink bi-directional communication in accordance with the present invention. Specifically, one or more IMDs such as IMD 10, 10' and 10" may be implanted in patient 12. It may also be possible for the IMDs to have internal communications, B, B' and B". The IMDs may consist of cardiac device 10, drug delivery device 10', neurological drug device 10" and many others as may be needed to provide the necessary therapy, diagnosis and clinical care to patient 12.

[0027] IMD 10 is also shown to have wireless communication with programmer 11 via wireless telemetry line 18". As was discussed hereinabove, any downlink and uplink operations that implement programmer 11 would require the patient to go to the hospital or clinic. This is particularly because programmer 11 is rather robust. Programmer 11 is also expensive and technically complicated to operate, and is not easily adaptable for in-home use by patients.

[0028] However, the present invention provides tailored services that parallel some of the operations of programmer 11 at reduced cost and in user friendly settings. For example, programmer 11, after an uplink or downlink could communicate via communication lines 15 with PC 17 or with a Medtronic server 21 via link 19. Communication lines 15 and 19 represent, without limitation, a modem, an ISDN line, cable, RF, telephone line and may also represent a secure intranet, internet, extranet or World-Wide Web environments to enable data transmission between programmer 11, PC 17 and server/computer 21.

Further, using similar data transmission systems, PC 17

which is in bi-directional data communication with server 21 would enable access to stored data and can transfer information between them. One aspect of the uplink and downlink operation, using programmer 11, requires either a physician or a technician to be able to operate programmer 11. External pressure reference EPR13 measures and records barometric pressure which is necessary for correlation to atmospheric pressure. The Chronicle□ is generally used in patients with chronic CHF, undergoing serial clinical management. It is generally used to complement existing CHF therapies and disease management regimens in order to provide precise therapy management, early intervention by remote monitoring of impending decompensation and to improve quality of life. In this regard, the use of programmer 11 outside the hospital or clinic environment becomes highly impractical.

[0029] Referring now to the left side of Figure 1, IRM 20 is shown in data communications with IMD 10. IMD 10 is implanted in patient 12 beneath the patient's skin or muscle, and is electrically coupled to heart 16 of patient 12 through pace/sense electrodes and lead conductors, or at least one cardiac pacing lead 14 in a manner known in the art. IMD 10 may represent Chronicle□ which contains an operating system that may employ a microcomputer or a digital state machine for timing, sensing, data storage, recovery and processing of pressure, electrogram, heart rate and other related data, to thereby monitor the hemodynamic environment.

[0030] IRM 20 includes telemetry hardware and software which implement an automatic gain control, for instance AGC algorithm to a low, easier positioning of antenna 18 by patient 12. In an alternate embodiment, a wireless communication line 18' could also be implemented. For the purposes of the present invention, the placement of antenna 18 by the patient on IMD 10, without limitation, is considered the preferred procedure to trigger data transfer or uplink.

[0031] IRM 20 includes ergonomic features that make it highly compatible for in-home use by a patient. For example, the upright shape of IRM 20 enables the unit to sit on a counter or on a nightstand. Further, the user interface, including a start button, are located in positions which make them highly accessible to the patient. As will be discussed hereinbelow, various aspects of the design of IRM 20 make it highly adaptable for home use. Further, IRM 20 and EPR 24 are adapted to transfer time stamped long term barometric pressure data to enable correction of cardiac pressure readings due to barometric pressure uplinked from Chronicle□, (IMD 10) to IRM 20.

[0032] EPR 24 is generally carried by patient 12 or a belt implement 32 or is kept in close proximity to patient 12. EPR 24 is used to derive reference pressure data for use in combination with absolute pressure derived from Chronicle□ (IMD 10). Various embodiments of this device are disclosed in U.S. Patent No. 6,152,885 issued to Taepke. Similarly, U.S. Patent No. 5,810,735 to

Halperin et al, discloses external patient reference sensors of internal sensors.

[0033] Referring to Figure 2, IRM 20 is shown in telemetry communication with Chronicle□ IMD 10. Generally, cardiac data is transmitted to IMD 10 via lead 14 as described hereinabove. During an uplink or a downlink session, telemetry communication is established between IMD 10 and IRM 20. Communication could be via antenna 18 or wireless communication such as RF signals 18' as is discussed hereinbelow. Patient 12 triggers an uplink session by installing EPR 24 in a designated slot and push the start button. The microcontroller in IRM 20 will look for EPR 24 and if it confirms the existence of EPR 24 it will start downloading barometer data into IRM 20. Thereafter, telemetry is enabled and data will start being transmitted from IMD 10. When all the data from IMD 10 is telemetered down, then IRM 20 will try to transmit the data out via transmission line 26 which may include a phone line, a cable modem, an ISD line, a cable or equivalent wireless data transmission system to transfer the data to server 30.

[0034] Referring now to Figure 3A, a perspective view of IRM 20 is shown with antenna 18, which antenna should be placed at the implant position to enable telemetry link in accordance with one embodiment of the present invention.

[0035] Figure 3B is a perspective drawing representing the various structures of IRM 20. Specifically, IRM 20 includes back panel 40 with support cradles attached externally thereof. Support cradles 50 enable to securely stow antenna 18 when not in use. Further, aperture 52 is designed to allow easy movement and access for cords and wires to connect to a panel behind back panel 40. Support structure 42 separates back panel 40 and front structure 44. In addition to providing stability to IRM 20, support structure 42 may be used to store the cord of antenna 18. Structure 44 represents the side panels that connect the back panels via support structure 42 to the front panel which includes panel 46 and interface panel 48. Top structure of IRM 20 includes slot 54 fitted for installing EPR 24 in position to download information into IRM 20. Button 56 is a push down start button that a patient or an operator needs to push in order to initiate the operations of IRM 20.

[0036] Referring now to Figures 4A and 4B, IRM 20 shown with antenna 18 in stowed position in support cradle 50. The power cord for antenna 18 is shown pulled through aperture 52 and disposed frontally at panel 40. Figure 4B shows power panel 60 which is disposed behind panel 40. Power panel 60 includes power plug 62 to which a power cord could be attached to supply power to the IRM. Serial port 64 is implemented to connect the IRM 20 to PC 27, for example (See Figure 1 or Figure 2). Telephone connections 66 may be used to connect to a telephone jack and optionally a caller ID box in communication with an answering machine and a telephone. Dialing sequence switch 68 is placed in either a standard position which is up, or to dial a special number,

down.

[0037] Figure 5A shows EPR 24 poised on top of slot 54 which it must engage to enable download of barometric pressure used for correlation to atmospheric pressure from EPR 24 to IRM 20.

[0038] Figure 5B shows EPR 24 positioned/engaged in slot 54 to download barometric data into IRM 20.

[0039] Figure 6 is a block diagram representing the various components in accordance with the present invention. Specifically, main microcontroller 72 is in operable electrical communication with EPR interface 74. EPR interface 74 is located in slots 54 to enable engagement between EPR 24 and IRM 20. Further, telemetry board 70 is in electrical communication with main microcontroller 72. In addition, telemetry board 70 is connected to flexible antenna 18. As discussed hereinabove, when antenna 18 is placed on implantable medical device such as Chronicle□, telemetry communication is established. Through this communication, data contained in IMD 10 is transferred to IRM 20. Further, main microcontroller 72 is connected to a power supply and modem 78 or equivalent. User interface LED buttons 48 operate via main microcontroller logic as will be discussed hereinbelow.

[0040] Reviewing microcontroller 72 in more detail in Figure 7, EPR serial, interface 74 is in operable data communication with microcontroller 72 and EPR connector 80. It should be noted that EPR connector 80 is disposed in slots 54 (See Figure 5A) to engage EPR 24. Microprocessor 81 is connected to telemetry circuit 82 which in turn is connected to antenna 18. Clocks 86 and 88 run various functions of microcontroller 81. Further, internal LED are represented by block 84. Microcontroller 72 is in operable electrical and data communication with microcontroller 81 and clock 88. Further, microcontroller 72 is in data and operable electrical communication with modem 78 which in turn is connected to phone jacks 66. Power supply for microcontroller 72 includes voltage regulator 83 that regulates modem, memory and the user interface, and voltage regulator 85 which regulates telemetry and related circuits. The system is adapted to use a twelve volt DC as a power supply. User interface 90 includes front panel LEDs, buttons, speakers and beepers, in addition to LCDs. The LCD could provide a graphic LCD display and actual text. The LCD may also have multilingual programmable text, including help instructions. Data bus 98 sends data out to memory 94. Similarly, data is sent out to EEPROM 96 via data bus 98. Clock 92 runs microcontroller 72.

[0041] Functionally, IRM 20 of the present invention could be used as an interface to transfer medical device information via the known wireless communication systems, patient data to remote location for review in chronic monitoring. IRM 20 operates in conjunction with EPR 24. EPR 24 is generally worn by the patient or kept in close proximity to monitor environment of biometric pressure.

[0042] In the preferred embodiment, IRM 20 is con-

nected to a power outlet via connection 62. IRM 20 may also be connected to a telephone line via telephone connection 66, but this connection is not necessary for the IRM to work properly.

[0043] Assuming that IRM 20 is connected to a telephone line, a dialing sequence switch should be placed in the right setting. Most homes would use a standard sequence with switch 68 in an up position. When IRM 20 is connected to a power outlet, a green power light on interface panel 48 will come on. This green light is an indication that IRM 20 is on. EPR 24 is placed in slot 54 on top of IRM 20. The patient would then place antenna 18 over IMD 10. While holding antenna 18 over IMD 10, the patient would push start button 56 on top of IRM 20. Thereafter, a green LED will blink indicating that IRM 20 is gathering information from EPR 24 and IMD 10. When data transmission is complete the light will stop blinking and a second green light will come on. The second green light will start to blink when IRM 20 is transferring data to the remote station. Subsequently, when IRM 20 is done sending information, the second light will turn off and two or more beeps will sound. The patient then will remove EPR 24 from IRM 20 and wear it as a pager or keep it in the vicinity until it is time to use IRM 20 again.

[0044] The preceding specific embodiments are illustrative of the practice of the invention. It is to be understood, therefore, that other expedients known to those of skill in the art or disclosed herein may be employed without departing from the invention or the scope of the appended claims. It is therefore to be understood that within the scope of the appended claims, the invention may be practiced otherwise than as specifically described, without actually departing from the scope of the present invention.

Claims

1. A remote medical data transfer system in which data from one or more implanted medical devices (10, 10', 10'') in a patient is transferred to a remote server or physician, the data transfer system comprising:
 - an information remote monitor (20) in wireless communication with the one or more implanted medical devices (10, 10', 10'');
 - an external pressure reference (24) containing long term barometric pressure data; and
 - a data transfer medium in operable communications with the information remote monitor (20);
- said information remote monitor (20) having engagement means to download said barometric data from the external pressure reference (24) and further implementing the wireless communication to

uplink the one or more implanted medical devices (10, 10', 10'') to transfer patient data in real time and to thereby integrate the patient data and the external pressure reference (24) for transmission to the remote server or physician via said data transfer medium.

2. The data transfer system of claim 1 wherein said information remote monitor (20) includes telemetry hardware and software and promotes ease of use by the patient.
3. The data transfer system of claim 1 wherein said information remote monitor (20) includes an integral modem to dial a server and transfer medical/patient data via FTP, PPP and TC/PIP protocols.
4. The data transfer system of claim 1 wherein said external pressure reference (24) engages said information remote monitor (20) via a docking port to allow data from the external pressure reference (24) to be downloaded.
5. The data transfer system of claim 4 wherein said docking port is adapted to accept and cradle said external pressure reference (24) for ease of use by the patient.
6. The data transfer system of claim 1 wherein said information remote monitor (20) includes ergonomic structures.
7. The data transfer system of claim 1 wherein said information remote monitor (20) includes a user interface system including visual displays, tones and correlated graphics.

Patentansprüche

1. Datenfernübertragungssystem für medizinische Daten, bei dem Daten von einer oder mehreren implantierten medizinischen Vorrichtung(en) (10, 10', 10'') in einem Patienten an einen entfernten Server oder Arzt übertragen werden, wobei das Datenübertragungssystem aufweist:

ein Ferninformationsüberwachungsgerät bzw. einen Ferninformationsmonitor (20), der in kabelloser Verbindung steht mit der einen oder den mehreren implantierten medizinischen Vorrichtung(en) (10, 10', 10'');
eine externe Druckreferenz (24), die langfristige barometrische Druckdaten enthält;
und ein Datenübertragungsmedium, das in betriebsbereiter Kommunikation mit dem Ferninformationsmonitor (20) steht;

wobei der Ferninformationsmonitor (20) Eingriffsmittel aufweist, um die barometrischen Daten von der externen Druckreferenz (24) herunterzuladen und ferner die kabellose Kommunikation auszuführen, um die eine oder mehreren implantierte(n) medizinische(n) Vorrichtung(en) (10, 10', 10'') anzusprechen bzw. zu verbinden, um Patientendaten in Echtzeit zu übertragen und um dabei die Patientendaten und die externe Druckreferenz (24) zur Übermittlung zum entfernten Server oder Arzt über das Datenübertragungsmedium zusammenzufassen.

2. Datenübertragungssystem nach Anspruch 1, bei dem der Ferninformationsmonitor (20) Telemetrie-Hardware und -Software aufweist und eine leichte Benutzung durch den Patienten fördert.
3. Datenübertragungssystem nach Anspruch 1, bei dem der Ferninformationsmonitor (20) ein integriertes Modem aufweist, um einen Server anzuwählen und medizinische Daten/Patientendaten über FTP-, PPP- und TCP/IP-Protokolle zu übertragen.
4. Datenübertragungssystem nach Anspruch 1, bei dem die externe Druckreferenz (24) in den Ferninformationsmonitor (20) über eine Anschlussstelle eingreift, um das Herunterladen von Daten von der externen Druckreferenz (24) zu erlauben.
5. Datenübertragungssystem nach Anspruch 4, bei dem die Anschlussstelle ausgebildet ist, um die externe Druckreferenz (24) zur leichten Benutzung durch den Patienten aufzunehmen und festzuhalten.
6. Datenübertragungssystem nach Anspruch 1, bei dem der Ferninformationsmonitor (20) ergonomische Strukturen aufweist.
7. Datenübertragungssystem nach Anspruch 1, bei dem der Ferninformationsmonitor (20) ein Benutzerschnittstellensystem mit sichtbaren Anzeigen, Tönen und korrelierten Grafiken, aufweist.

Revendications

1. Un système de transfert de données médicales à distance, dans lequel des données en provenance d'un ou plusieurs dispositifs médicaux implantés (10, 10', 10'') chez un patient sont transférées à un serveur ou à un médecin installé à distance, le système de transfert de données comprenant :

un dispositif de contrôle des informations à distance (20) en communication sans fil avec le un ou les plusieurs dispositifs médicaux im-

plantés (10, 10', 10") ;
 une source de référence de pression externe (24) contenant des données de pression barométriques à long terme ; et
 un moyen de transfert de données en communication opérationnelle avec le dispositif de contrôle des informations à distance (20) ;
 ledit dispositif de contrôle des informations à distance (20) étant pourvu de moyens de branchement pour télécharger lesdites données barométriques à partir de la source de référence de pression externe (24) et mettant en oeuvre la communication sans fil afin de relier en liaison montante le un ou les plusieurs dispositifs médicaux implantés (10, 10', 10") afin de transférer les données relatives au patient en temps réel et afin d'intégrer de ce fait les données relatives au patient et la source de référence de pression externe (24) pour les transmettre au serveur ou au médecin à distance par le biais dudit moyen de transfert de données.

des informations à distance (20) comprend un système d'interface utilisateur comprenant des affichages visuels, des couleurs et des graphiques corrélés.

2. Le système de transfert de données selon la revendication 1, dans lequel ledit dispositif de contrôle des informations à distance (20) comprend un appareil et un logiciel de télémétrie et favorise la facilité d'utilisation de la part du patient 25
3. Le système de transfert de données selon la revendication 1, dans lequel ledit dispositif de contrôle des informations à distance (20) comprend un modem intégré pour établir la communication avec un serveur et transférer des données médicales / relatives au patient par le biais d'un protocole FTP, PPP et TC/PIP. 30 35
4. Le système de transfert de données selon la revendication 1, dans lequel ladite source de référence de pression externe (24) se met en relation avec ledit dispositif de contrôle des informations à distance (20) par le biais d'un port de connexion afin de permettre aux données en provenance de la source de référence de pression externe (24) d'être téléchargées. 40 45
5. Le système de transfert de données selon la revendication 4, dans lequel ledit port de connexion est adapté pour accepter et pour synchroniser ladite source de référence de pression externe (24) pour faciliter l'utilisation de la part du patient. 50
6. Le système de transfert de données selon la revendication 1, dans lequel ledit dispositif de contrôle des informations à distance (20) comprend des structures ergonomiques. 55
7. Le système de transfert de données selon la revendication 1, dans lequel ledit dispositif de contrôle

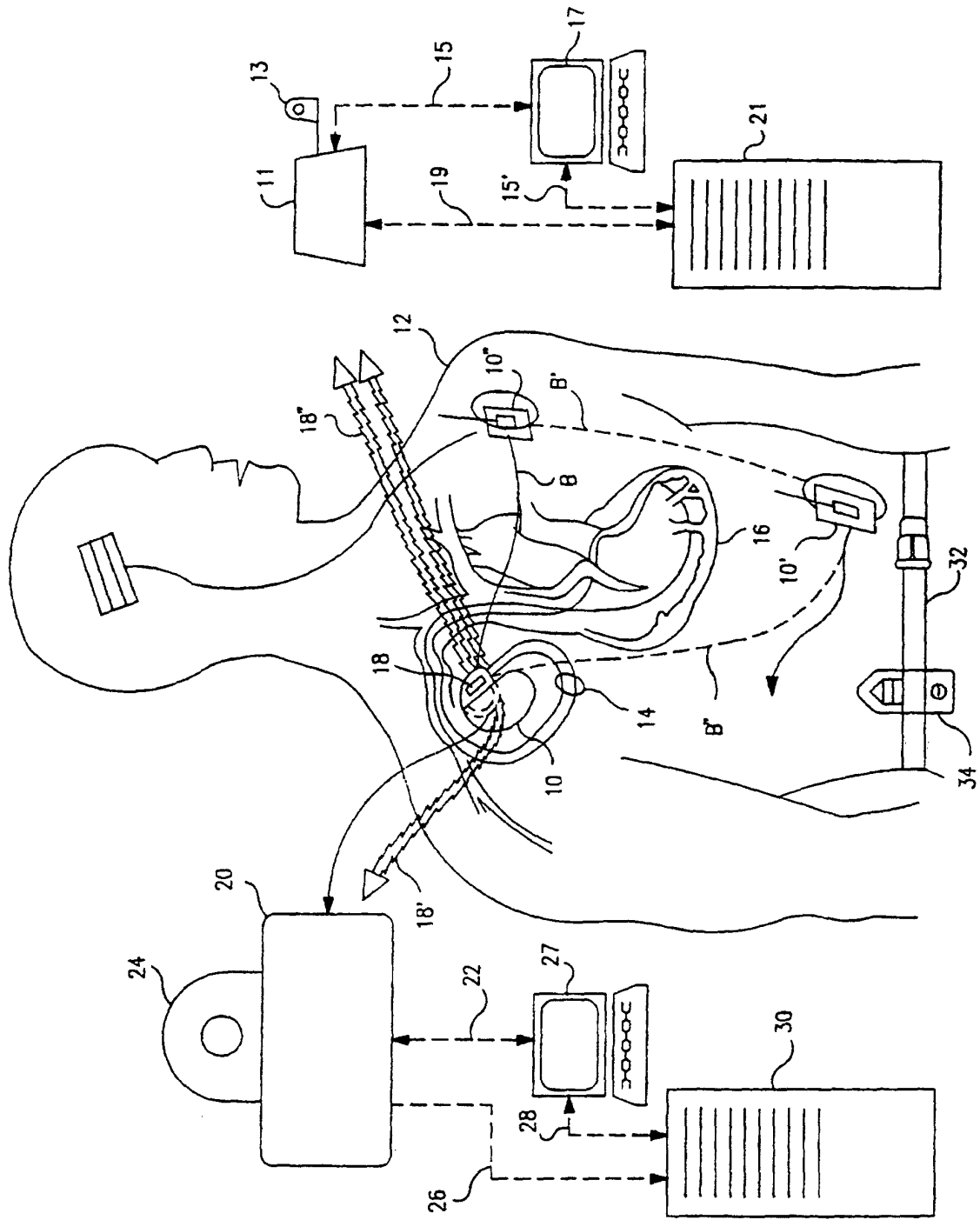

FIG. 1

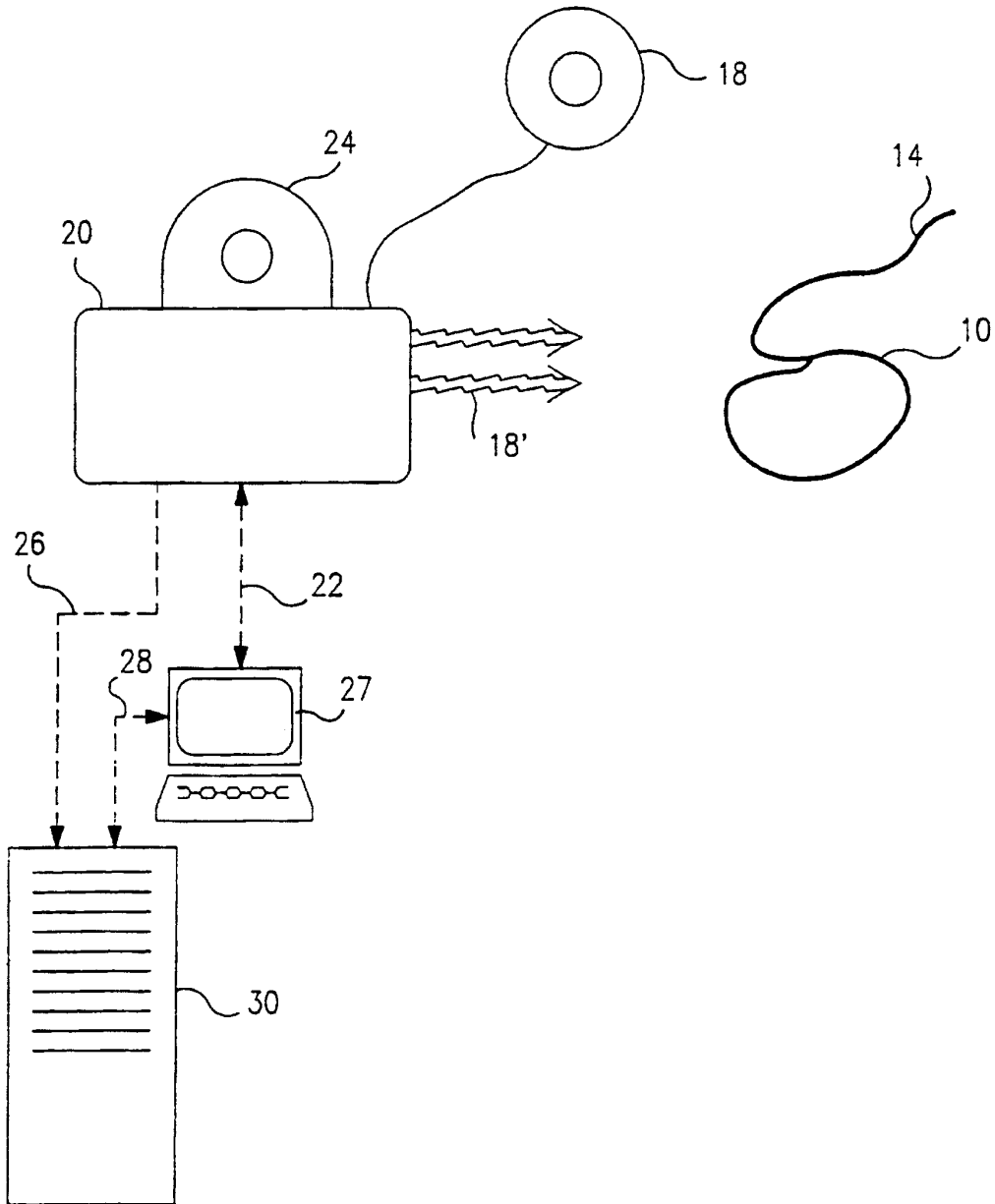

FIG. 2

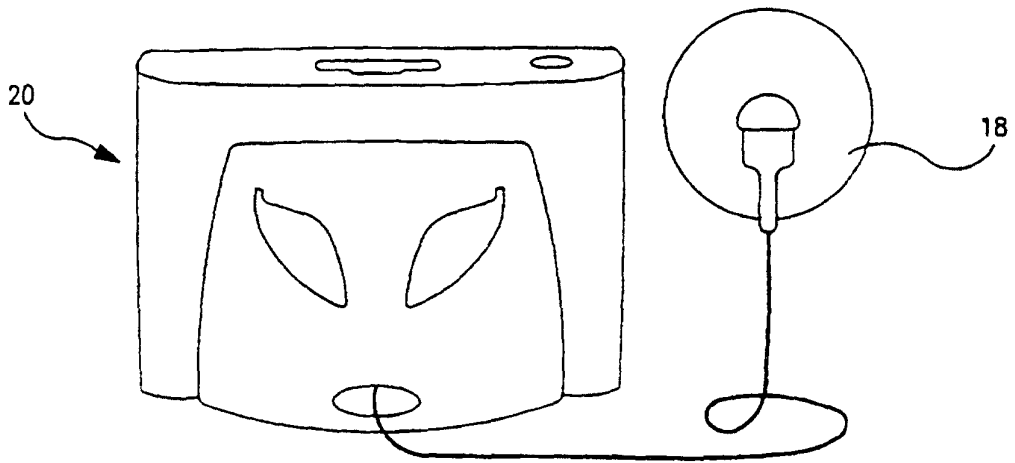

FIG. 3A

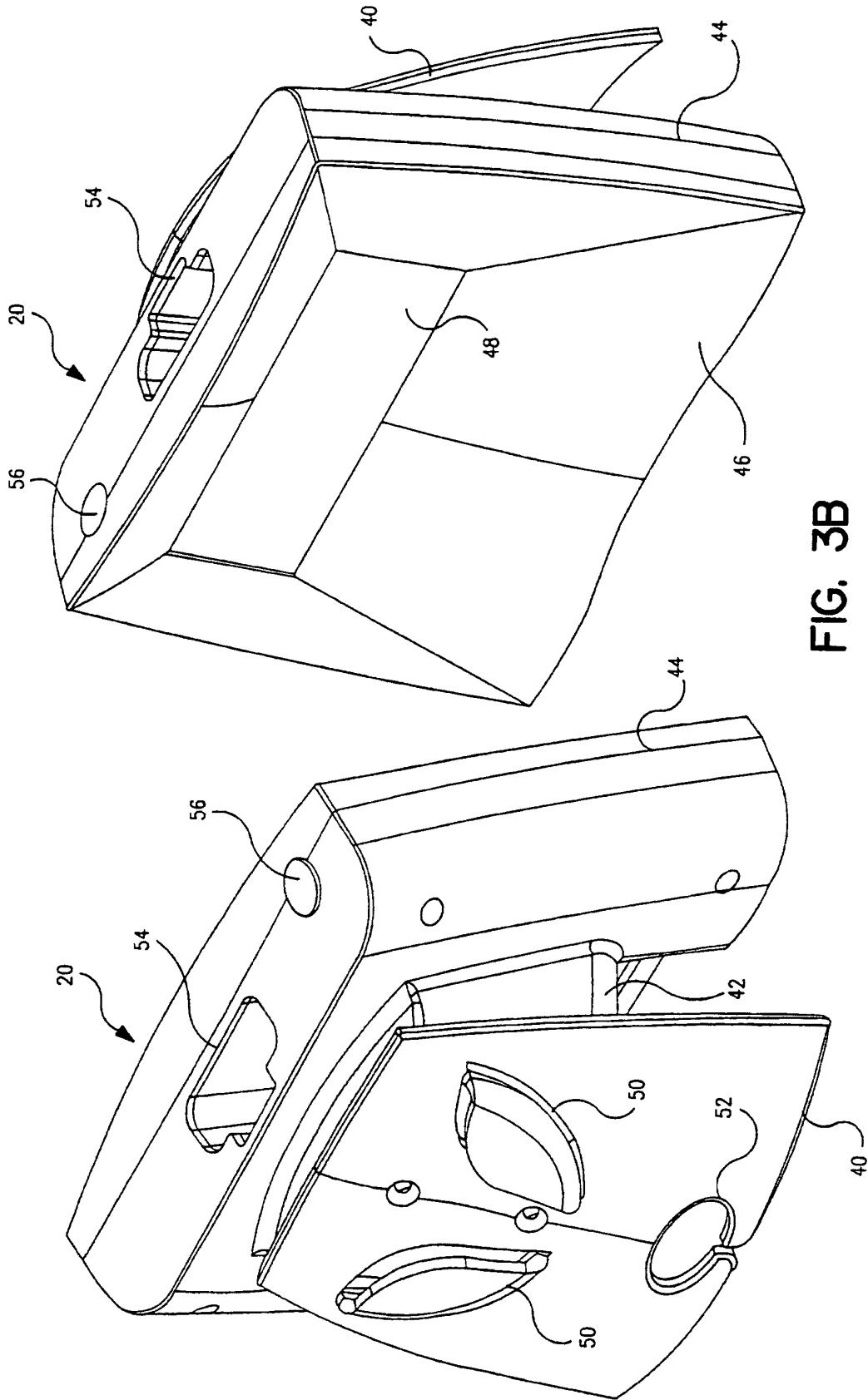

FIG. 3B

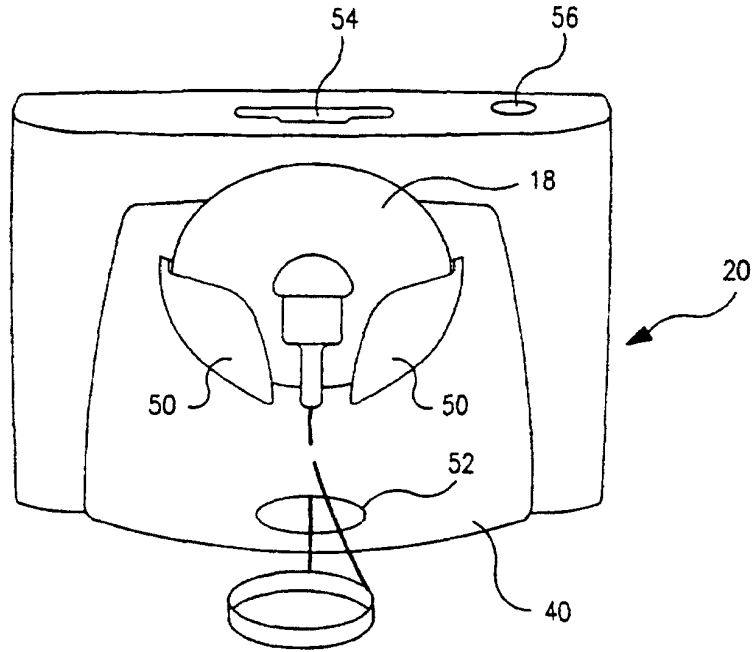

FIG. 4A

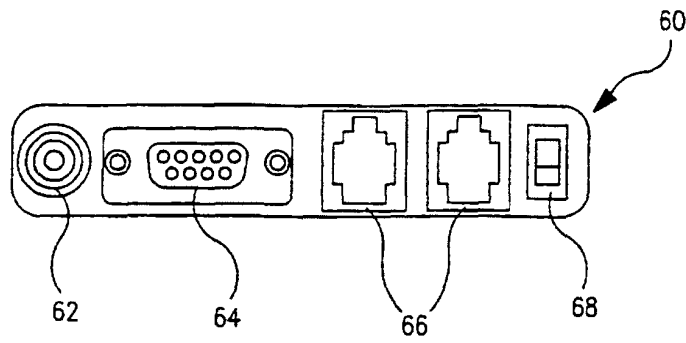

FIG. 4B

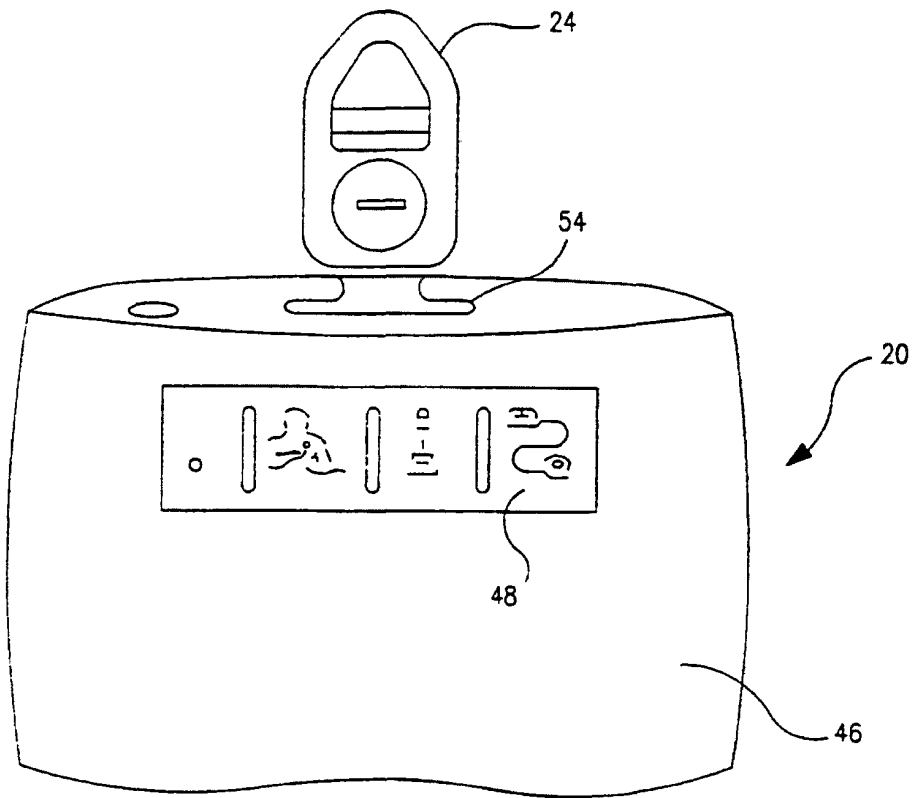

FIG. 5A

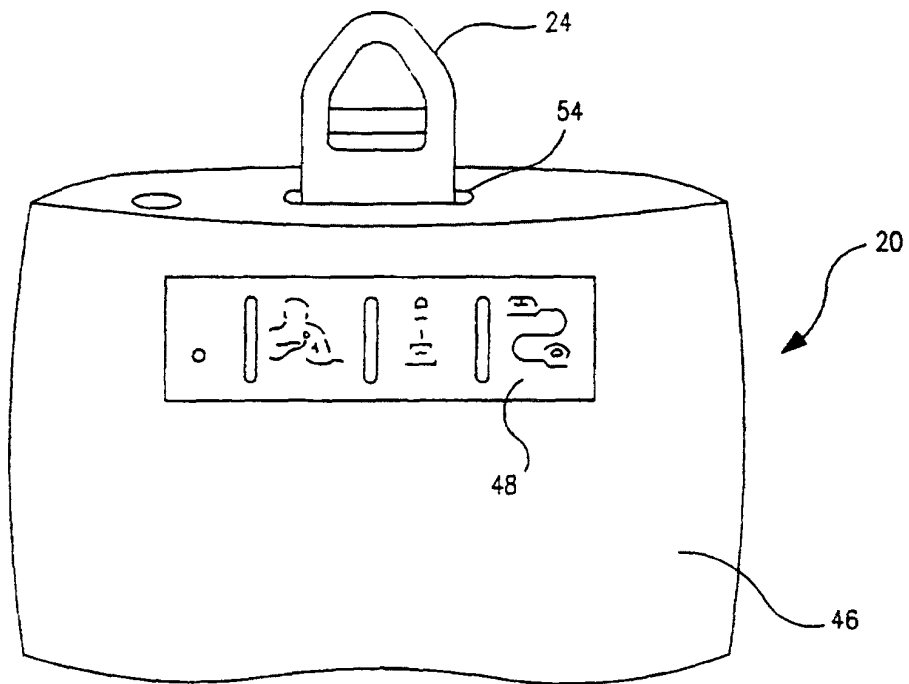

FIG. 5B

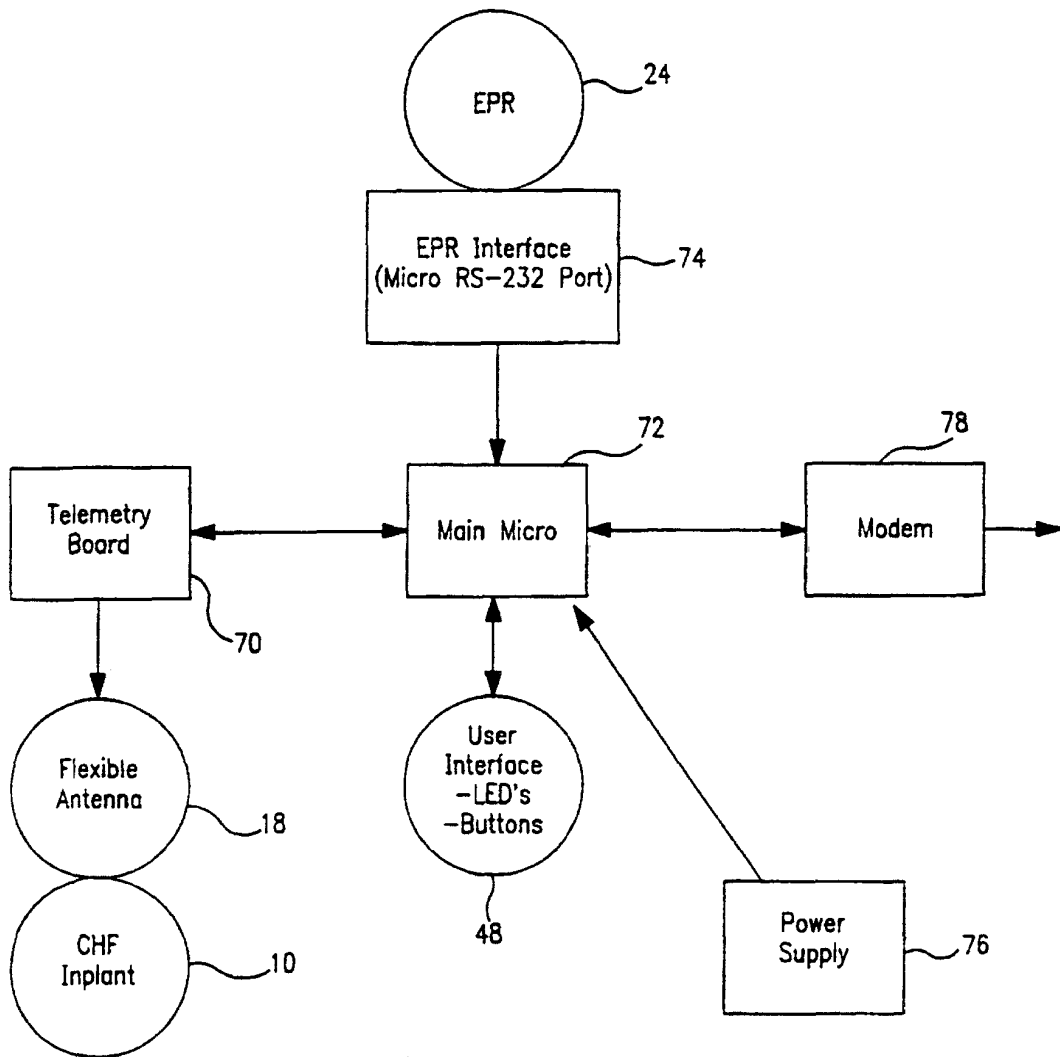

FIG. 6

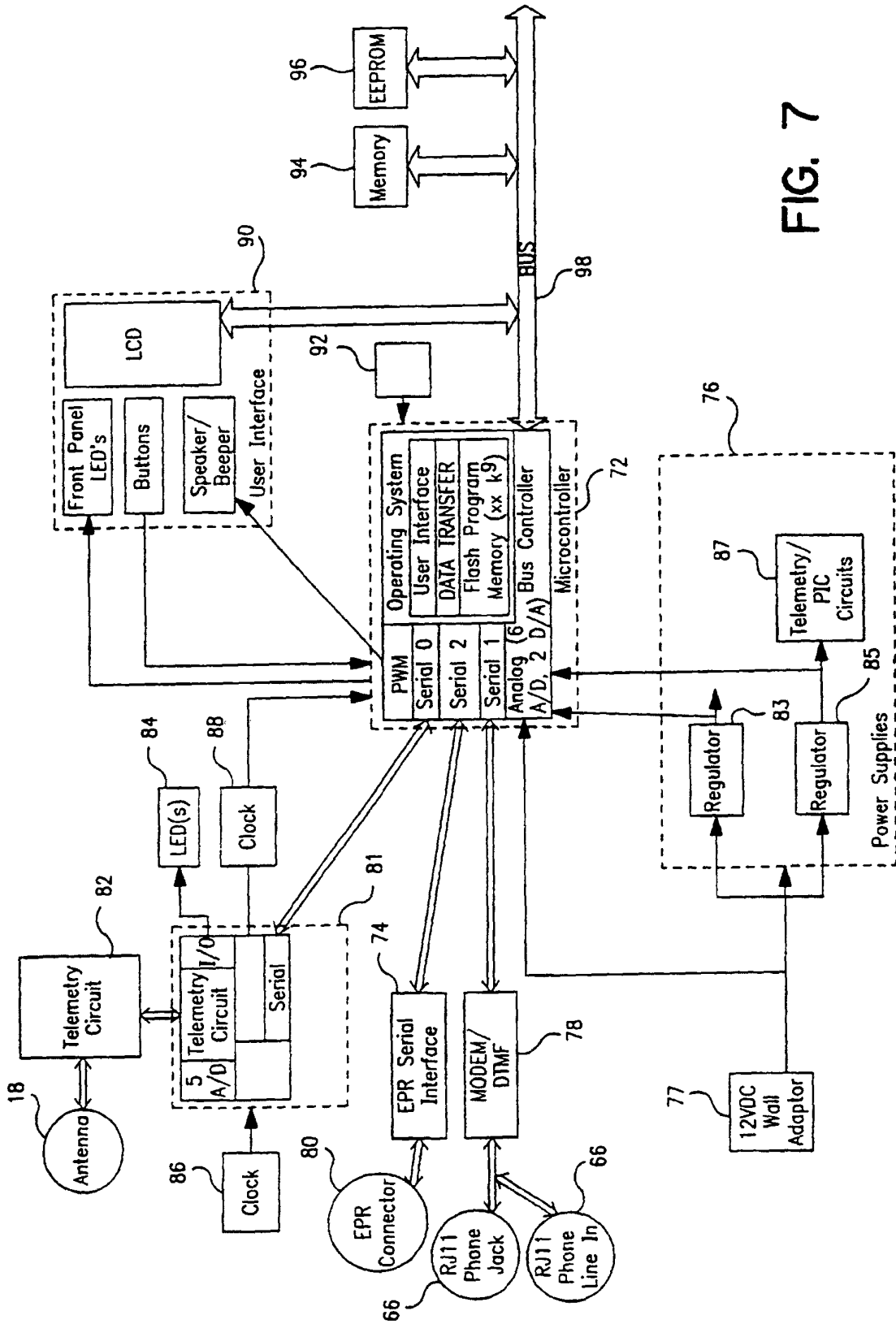

FIG. 7

专利名称(译)	信息远程监控 (IRM) 医疗设备		
公开(公告)号	EP1168960B1	公开(公告)日	2004-10-06
申请号	EP2001906960	申请日	2001-02-02
[标]申请(专利权)人(译)	美敦力公司		
申请(专利权)人(译)	美敦力公司, INC.		
当前申请(专利权)人(译)	美敦力公司, INC.		
[标]发明人	CHRISTOPHERSON MARK A TAPP GARY A MALEWICZ ANDRZEJ M SCHMALZ BRIAN P KOPISCHKE TROY D		
发明人	CHRISTOPHERSON, MARK, A. TAPP, GARY, A. MALEWICZ, ANDRZEJ, M. SCHMALZ, BRIAN, P. KOPISCHKE, TROY, D.		
IPC分类号	A61B5/00		
CPC分类号	A61B5/0002 A61B2560/0257 Y10S128/903 Y10S128/904		
优先权	60/180285 2000-02-04 US		
其他公开文献	EP1168960A1		
外部链接	Espacenet		

摘要(译)

实现信息远程监视器 (IRM) 以在患者家中本地收集医疗设备数据以便传输到远程位置。具体而言, IRM集成来自外部压力参考 (EPR) 和植入式医疗设备 (IMD) (优选为Chroniclec) 的数据, 用于远程传输至服务器或临床中心以进行后续, 监测和评估。IRM利用无线遥测技术下行至IMD并直接与EPR接合以下载气压数据以校正来自Chroniclec或IMD的心脏压力读数。IRM可以串行连接到PC, 并且PC可以控制IRM的功能。在替代方案中, PC可用于将数据从IRM, 通过支持Web的网络系统传输到服务器或远程位置。IRM利用集成调制解调器拨打服务器并通过FTP, PPP和TC / PIP协议传输患者数据。IRM包括适合家庭使用的符合人体工程学的形状和特征, 包括高度简化和说明性的用户界面, 使患者能够轻松操作设备以根据需要成功传输医疗数据。

